



US011662028B2

(12) **United States Patent**
Lee

(10) **Patent No.:** **US 11,662,028 B2**
(45) **Date of Patent:** **May 30, 2023**

(54) **BUTTERFLY VALVE AND METHOD OF MANUFACTURING THE SAME**

(71) Applicant: **Sang Seon Lee**, Wonju-si (KR)

(72) Inventor: **Sang Seon Lee**, Wonju-si (KR)

(*) Notice: Subject to any disclaimer, the term of this patent is extended or adjusted under 35 U.S.C. 154(b) by 0 days.

(21) Appl. No.: **17/488,483**

(22) Filed: **Sep. 29, 2021**

(65) **Prior Publication Data**

US 2022/0018448 A1 Jan. 20, 2022

Related U.S. Application Data

(63) Continuation of application No. 16/659,489, filed on Oct. 21, 2019, now Pat. No. 11,199,266, which is a continuation of application No. PCT/KR2019/000975, filed on Jan. 23, 2019.

(30) **Foreign Application Priority Data**

Apr. 25, 2018	(KR)	10-2018-0048160
Dec. 21, 2018	(KR)	10-2018-0167205
Dec. 21, 2018	(KR)	10-2018-0167458
Dec. 21, 2018	(KR)	10-2018-0167459
Dec. 21, 2018	(KR)	10-2018-0167460
Dec. 21, 2018	(KR)	10-2018-0167461

(51) **Int. Cl.**

F16K 1/22	(2006.01)
B23P 15/00	(2006.01)
B29C 70/68	(2006.01)
B29K 705/00	(2006.01)
B29L 31/00	(2006.01)

(52) **U.S. Cl.**

CPC **F16K 1/222** (2013.01); **B23P 15/001** (2013.01); **B29C 70/68** (2013.01); **B29K 2705/00** (2013.01); **B29L 2031/7506** (2013.01)

(58) **Field of Classification Search**

CPC **F16K 1/222**; **F16K 25/005**; **F16K 27/0218**; **B23P 15/001**; **B29C 70/68**; **B29K 2705/00**; **B29L 2031/7506**
See application file for complete search history.

(56) **References Cited**

U.S. PATENT DOCUMENTS

3,425,439	A *	2/1969	Duffey	F16K 1/2265	251/308
3,670,071	A	6/1972	Walchle		
4,510,965	A *	4/1985	Peroux	F16K 27/0272	251/305
5,150,731	A *	9/1992	Jiro	F16K 1/2265	137/375
5,360,030	A	11/1994	Sisk		
9,222,592	B2	12/2015	Tsai		
11,199,266	B2 *	12/2021	Lee	F16K 25/005	

(Continued)

FOREIGN PATENT DOCUMENTS

JP	2005114140	A	4/2005
JP	2007192374	A	8/2007

(Continued)

Primary Examiner — Michael R Reid

(57) **ABSTRACT**

A body covering a disk in a butterfly valve comprises: an upper body; and a lower body, wherein an inserting space is formed by combining the upper body with the lower body, the disk is inserted into the inserting space, and at least one of the upper body and the lower body includes a framework formed of a metal and a plastic layer formed on the framework.

3 Claims, 5 Drawing Sheets

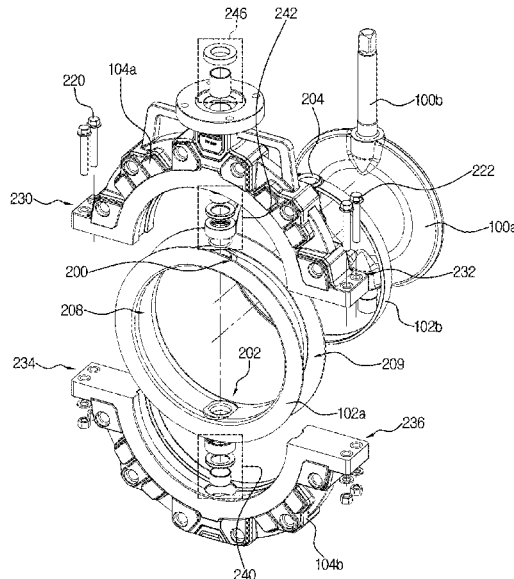

(56)

References Cited

U.S. PATENT DOCUMENTS

2008/0173841 A1 7/2008 Sisk
2010/0065763 A1* 3/2010 Suetome B29C 45/1459
251/366
2016/0178067 A1* 6/2016 Abouelleil F16K 1/2265
251/308

FOREIGN PATENT DOCUMENTS

JP 2008002512 A 1/2008
JP 2017032062 A 2/2017
JP 2017223323 A 12/2017
KR 1020110118081 A 10/2011
KR 10-1241998 B1 3/2013
KR 10-1749350 B1 6/2017

* cited by examiner

FIG. 1

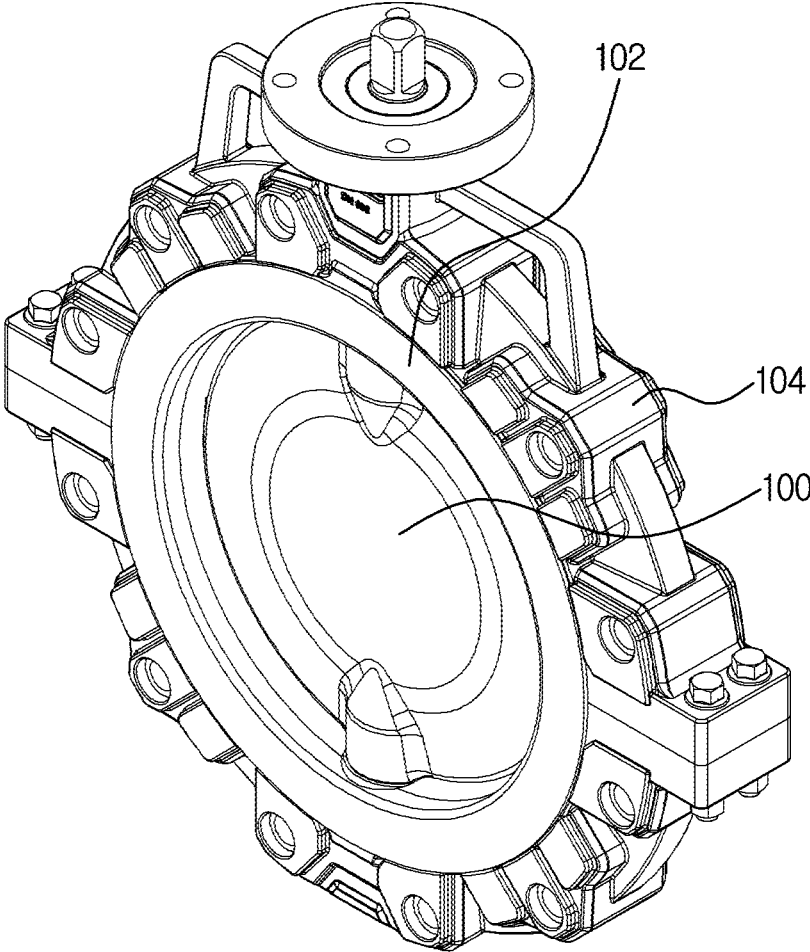

FIG. 2

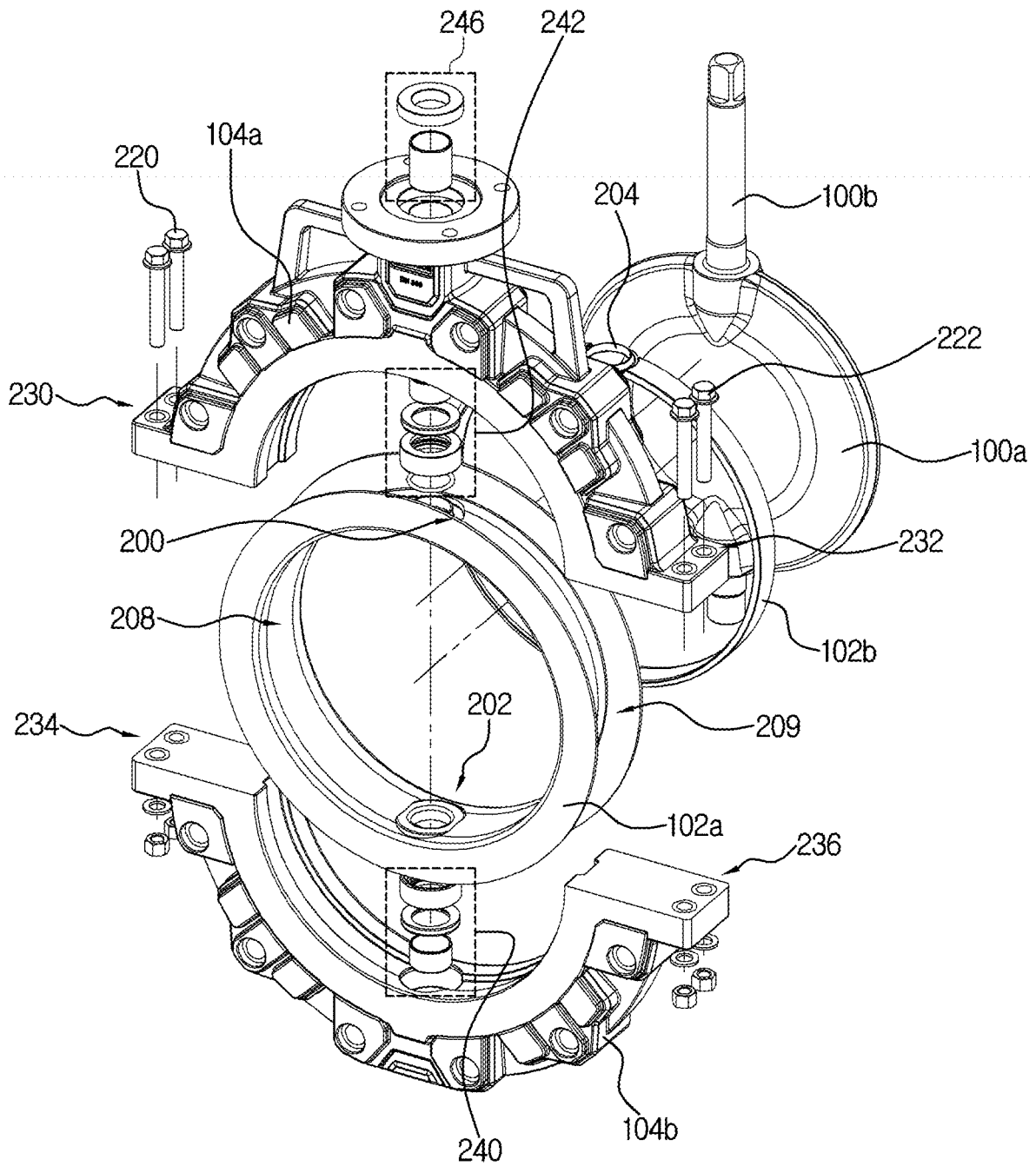

FIG. 3

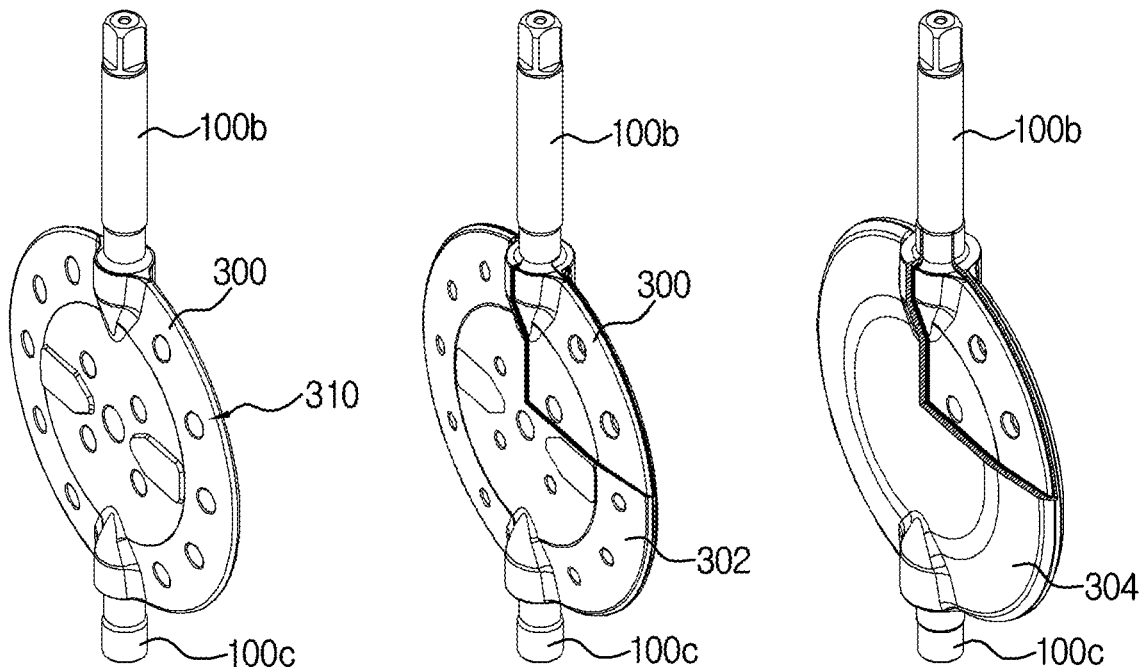

FIG. 4

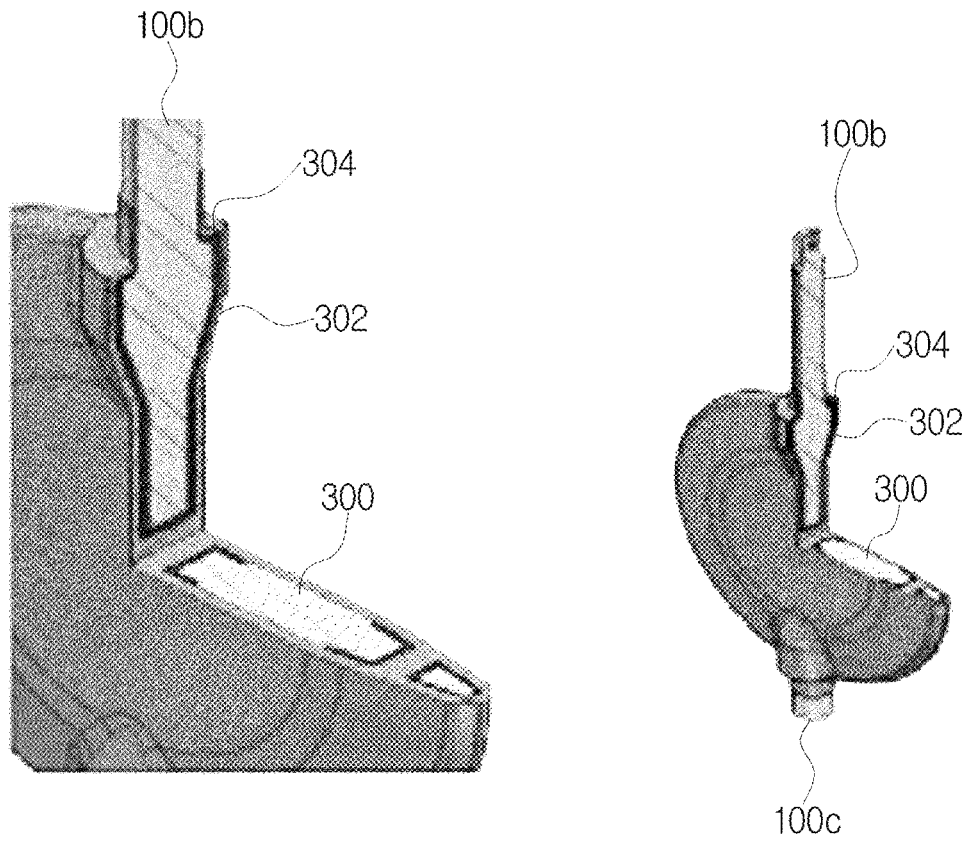

FIG. 5

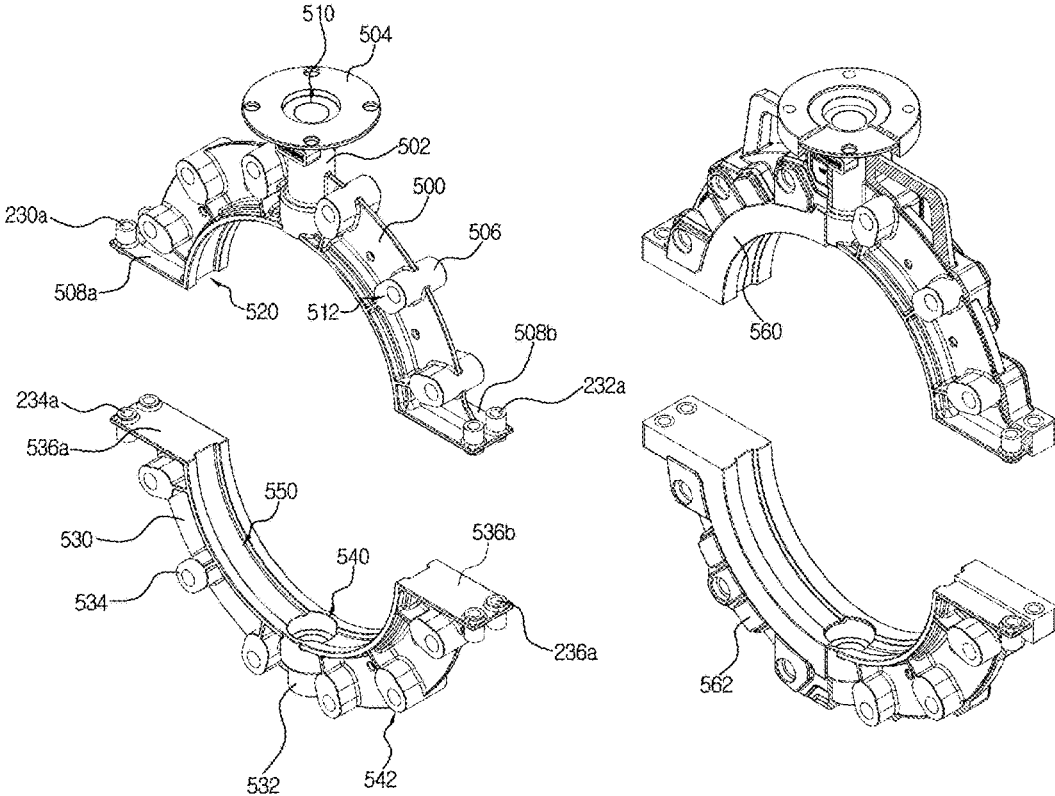
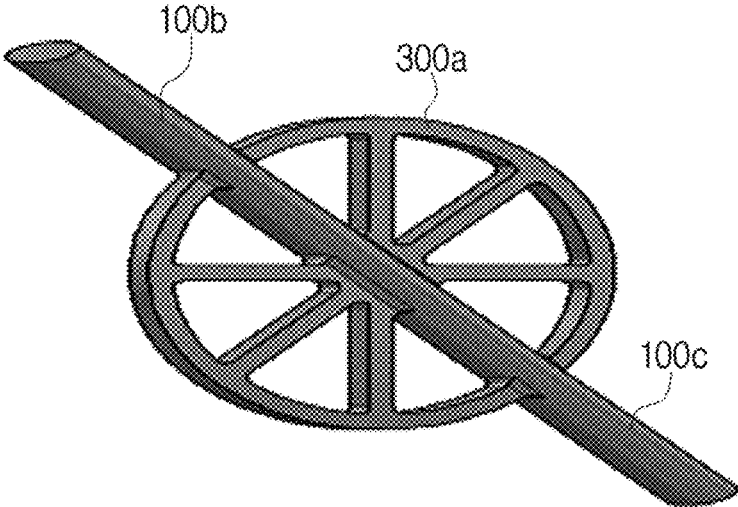

FIG. 6



**BUTTERFLY VALVE AND METHOD OF
MANUFACTURING THE SAME****CROSS-REFERENCE TO RELATED
APPLICATIONS**

This application is a continuation application of U.S. application Ser. No. 16/659,489, which was filed on Oct. 21, 2019, and which is a continuation application of U.S. application Ser. No. 16/659,489, which was filed on Oct. 21, 2019, and which is a continuation application of PCT application filed on Jan. 23, 2019 and assigned Serial No. PCT/KR2019/000975, and which claims priority from Korean Patent Application No. 10-2018-0048160 filed with the Korean Intellectual Property Office on Apr. 25, 2018, Korean Patent Application No. 10-2018-0167205 filed with the Korean Intellectual Property Office on Dec. 21, 2018, Korean Patent Application No. 10-2018-0167458 filed with the Korean Intellectual Property Office on Dec. 21, 2018, Korean Patent Application No. 10-2018-0167460 filed with the Korean Intellectual Property Office on Dec. 21, 2018, Korean Patent Application No. 10-2018-0167461 filed with the Korean Intellectual Property Office on Dec. 21, 2018, and Korean Patent Application No. 10-2018-0167459 filed with the Korean Intellectual Property Office on Dec. 21, 2018. The entire disclosures of above patent applications are incorporated herein by reference.

TECHNICAL FIELD

The present disclosure relates to a butterfly valve and method of manufacturing the same.

BACKGROUND

Conventional butterfly valve is formed of only steel, and thus its strength is high, but it is easy to be corroded, its weight is heavy and its manufacture cost has increased. Specially, the butterfly valve should be precisely processed, but it is difficult to process precisely the butterfly valve because the butterfly valve is formed of the steel. Accordingly, it is impossible to achieve mass production.

SUMMARY

To solve problem of the convention technique, the present disclosure is to provide a butterfly valve which may enhance corrosion resistance or acid resistance with keeping its strength, have light weight and realize mass production, and method of manufacturing the same.

A butterfly valve according to an embodiment of the present disclosure comprises a body in which an inserting space is formed; and a disk inserted into the inserting space of the body. Here, fluid flow is opened or closed in response to rotation of the disk. The disk includes: a disk body formed of a metal; a first plastic layer formed of a first plastic on the disk body; and a second plastic layer formed of a second plastic on the first plastic layer, wherein a melting point of the first plastic layer is higher than a melting point of the second plastic layer.

A disk used in a butterfly valve according to an embodiment of the present disclosure comprises a disk body formed of a metal; a first plastic layer formed on the disk body and formed of a first plastic; and a second plastic layer formed on the first plastic layer and formed of a second plastic. Here, wherein a melting point of the first plastic is different from a melting point of the second plastic.

A body covering a disk in a butterfly valve according to an embodiment of the present disclosure comprises: an upper body; and a lower body. Here, an inserting space is formed by combining the upper body with the lower body, the disk is inserted into the inserting space, and at least one of the upper body and the lower body includes a framework formed of a metal and a plastic layer formed on the framework.

A fluid contacting member contacted with a fluid in a valve according to an embodiment of the present disclosure comprises: a body formed of a metal and manufactured by using a mechanical processing; a first plastic layer formed on the body and formed of a first plastic; and a second plastic layer formed on the first plastic layer and formed of a second plastic. Here, the plastic layers are formed through an insert molding, and a melting point of the first plastic is different from a melting point of the second plastic.

A method of manufacturing a disk used in a butterfly valve according to an embodiment of the present disclosure comprises: forming a first plastic layer on a disk body formed of a metal through an insert molding; and forming a second plastic layer on the first plastic layer through an insert molding. Here, a melting point of a first plastic of the first plastic layer is different from a melting point of a second plastic of the second plastic layer.

Butterfly valve and method of manufacturing the same according to the present disclosure use a disk including a disk body formed of a metal and plastic layers formed on the disk body through an insert molding, thus the butterfly valve may have enhanced corrosion resistance or acid resistance with keeping similar strength to a butterfly valve formed of only steel.

Additionally, a weight of the butterfly valve has reduced, it is easy to mold the butterfly valve and so it is possible to achieve mass production. Of course, it is possible to manufacture precisely the butterfly valve.

BRIEF DESCRIPTION OF DRAWINGS

Example embodiments of the present disclosure will become more apparent by describing in detail example embodiments of the present disclosure with reference to the accompanying drawings, in which:

FIG. 1 is a perspective view illustrating a butterfly valve according to an embodiment of the present disclosure;

FIG. 2 is a view illustrating a disassemble structure of the butterfly valve according to an embodiment of the present disclosure;

FIG. 3 is a view illustrating a disk according to an embodiment of the present disclosure;

FIG. 4 is a view illustrating partial section of the disk according to an embodiment of the present disclosure;

FIG. 5 is a view illustrating an upper body and a lower body according to an embodiment of the present disclosure; and

FIG. 6 is a view illustrating a disk body according to an embodiment of the present disclosure.

DETAILED DESCRIPTION

In the present specification, an expression used in the singular encompasses the expression of the plural, unless it has a clearly different meaning in the context. In the present specification, terms such as "comprising" or "including," etc., should not be interpreted as meaning that all of the elements or operations are necessarily included. That is, some of the elements or operations may not be included,

while other additional elements or operations may be further included. Also, terms such as “unit,” “module,” etc., as used in the present specification may refer to a part for processing at least one function or action and may be implemented as hardware, software, or a combination of hardware and software.

Embodiments of the present disclosure relate to a valve, particularly a butterfly valve. The butterfly valve may have enhanced lifetime and corrosion resistance, etc. with keeping similar strength and precision to a butterfly valve formed of only steel. Furthermore, manufacture cost of the butterfly valve may be considerably reduced, productivity of the butterfly valve may be highly enhanced and it is possible to realize mass production.

Conventional butterfly valve is formed of only steel, and thus its strength is high, but it is difficult to process precisely the butterfly valve and so productivity of the butterfly valve has lowered and manufacturing cost of the butterfly valve is high. Moreover, the butterfly valve has been easily corroded when it is used in a ship, a water treatment apparatus (a seawater desalination apparatus, a wastewater treatment apparatus) and so on, and thus it can't use the butterfly valve more than one year.

The butterfly valve of the present disclosure may enhance corrosion resistance, lifetime (more than 10 years), reduce manufacturing cost and reduce weight by molding plastic on a metal, e.g. a light metal such as aluminum.

Of course, the present technique is not limited to the butterfly valve, and it is applicable to any valves as described below.

Hereinafter, various embodiments of the disclosure will be described in detail with reference to accompanying drawings.

FIG. 1 is a perspective view illustrating a butterfly valve according to an embodiment of the disclosure, FIG. 2 is a view illustrating a disassemble structure of the butterfly valve according to an embodiment of the disclosure, and FIG. 3 is a view illustrating a disk according to an embodiment of the disclosure. FIG. 4 is a view illustrating partial section of the disk according to an embodiment of the disclosure, FIG. 5 is a view illustrating an upper body and a lower body according to an embodiment of the disclosure, and FIG. 6 is a view illustrating a disk body according to an embodiment of the disclosure.

In FIG. 1, the butterfly valve of the present embodiment includes a disk 100, a disk supporting member 102 and a body 104. In another embodiment, the butterfly valve may include only the disk 100 and the body 104 without the disk supporting member 102.

The disk 100 may be manufactured by forming plastics on a metal, e.g. a light metal such as aluminum through two consecutive molding as described below, and opens or closes flow of a fluid. The disk 100 is opened according as it rotates by for example 90° when the fluid flows through the butterfly valve, and the disk 100 is closed as shown in FIG. 1 when the flowing of the fluid is blocked.

The disk supporting member 102 supports stably the disk 100, and it may be formed of a fluorine resin, for example a Polytetrafluoroethylene, PTFE, a Perfluoroalkoxy alkane PFA or a Polyvinylidene fluoride PVDF, etc. The fluorine resin means every resin including fluorine in a molecule, and has excellent heat resistance, excellent chemical resistance, excellent electric insulation, small friction coefficient, and does not have adhesion.

The body 104 covers the disk supporting member 102, and may be formed by mixing a glass fiber with for example a Polyvinyl Chloride PVC, a polypropylene PP, a Poly

Phenylene sulfide PPS, a Polyphthalamide PPA, a Polyamide PA6, a Polyamide PA66, a Polyketone POK or a Polyethylene PE. As a result, strength, impact resistance and mechanical feature of the body 104 may be enhanced. This will be described in detail below.

In another embodiment, the body 104 may be formed by mixing a glass fiber and a carbon fiber with for example, a PVC, a PP, a PPS, a PPA, a PA6, a PA66, a POK or a PE. Accordingly, strength, impact resistance and mechanical feature of the body 104 may be enhanced.

In still another embodiment, the body 104 may be formed by mixing a glass fiber, a carbon fiber and a graphite fiber with for example, a PVC, a PP, a PPS, a PPA, a PA6, a PA66, a POK or a PE. As a result, strength, impact resistance and mechanical feature of the body 104 may be enhanced.

Hereinafter, structure and combination of elements in the butterfly valve of the disclosure will be described in detail.

In FIG. 2 to FIG. 5, a disk 100 may include an opening-closing member 100a, a manipulation member 100b and a fixing member 100c.

The opening-closing member 100a opens or closes flow of a fluid, and may have for example a circular shape. A structure of the opening-closing member 100a will be described below.

The manipulation member 100b is connected to an upper part of the opening-closing member 100a, and it is projected in an upward direction. The manipulation member 100b is projected in an upward direction of an upper body 104a through a hole 510 formed at a central part of the upper body 104a, as shown in FIG. 1. The manipulation member 100b is combined with a control unit (not shown), and rotates in response to control of the control unit. As a result, the opening-closing member 100a is rotated, and thus an opening-closing operation is performed.

The fixing member 100c is inserted into a hole 540 formed at a central part of a lower body 104b, and so the disk 100 may be stably fixed to the body 104. The fixing member 100c is not projected outside when it is inserted, and it may have smaller length than the manipulation member 100b.

The disk supporting member 102 may include a first supporting member 102a and a second supporting member 102b.

The first supporting member 102a may have the same shape as the opening-closing member 100a, e.g. circular shape, and it may have a size higher than the opening-closing member 100a.

In an embodiment, a space (hole) 208 may be formed through a front surface and a rear surface of the first supporting member 102a, and a hole 209 may be formed along general circumference of the first supporting member 102a.

In an embodiment, the hole 200 into which the manipulation member 100b is inserted is formed at a top central part of the first supporting member 102a, and a hole 202 into which the fixing member 100c is inserted may be formed at a lower central part of the first supporting member 102a.

The second supporting member 102b may have the same shape, e.g. circular shape as the opening-closing member 100a, an opening member 204 may be formed at a top central part of the second supporting member 102b, an opening member may be formed at a lower central part of the second supporting member 102b, and holes may be respectively formed on the opening member 204 and the opening member. Here, a hole of the opening member 204 corresponds to the hole 200 formed on the top of the first supporting member 102a, and a hole of the opening member

formed at the lower central part corresponds to the hole **202** formed on the lower part of the first supporting member **102a**.

In an embodiment, the second supporting member **102b** may be formed of an Ethylene Propylene Diene Monomer EPDM, a Fluoro Elastomers FKM or a silicon, etc.

The opening-closing member **100a** of the disk **100** may be inserted into the space **208** of the first supporting member **102a**, and the second supporting member **102b** may be combined on a home **209** formed at the top of the first supporting member **102a**. That is, the second supporting member **102b** fixes stably the opening-closing member **100a** by applying a pressure to the opening-closing member **100a** of the disk **100** inserted in the space **208** of the first supporting member **102a**.

In an embodiment, the opening-closing member **100a** of the disk **100** has a little higher size than the space **208** of the first supporting member **102a**. An outermost part of the opening-closing member **100a** is made up of a plastic to have elasticity, and thus the opening-closing member **100a** may be inserted into the space **208** of the first supporting member **102a**.

The manipulation member **100b** may be exposed outside through a hole **510** formed to a top central part of the upper body **104a**, and the fixing member **100c** may be inserted into a hole **540** formed to a lower central part of the lower body **104b**.

Here, the manipulation member **100b** may be stably fixed to the supporting members **102a** and **102b** and the upper body **104a** by using fastening members **242** and **246**, and the fixing member **100c** may be stably fixed to the lower body **104b** by using a fastening member **240**.

A structure for fixing the disk **100** and controlling rotation for opening/closing is not limited to the above structure and may be variously modified.

Referring to FIG. 5, the upper body **104a** may include an upper base formed of a metal, e.g. a light metal such as an aluminum, etc. and an upper plastic layer **560** formed by mixing a glass fiber with a PVC, a PP, a PPS, a PPA, a PA6, a PA66, a POK or a PE, etc.

The upper base may include an upper framework **500**, a reception member **502**, a head **504**, pipe combination members **506** and bottom members **508a** and **508b** in both sides.

Top and bottom of the upper framework **500** may have semi-circular shape, and the upper framework **500** may be formed of a metal, especially a light metal. Here, the upper framework **500** and a lower framework **530** may form a space into which the disk supporting member **102** for supporting the disk **100** can be inserted. To fix stably the disk supporting member **102**, a home **520** may be formed at a lower outer surface of the upper framework **500**, and a home **550** may be formed at an inner surface of the lower framework **530**.

The reception member **502** may be longitudinal-extended at a central part of the upper framework **500** in a direction crossing over the upper framework **500**, preferably a direction vertical to the upper framework **500**, and it may be formed of a metal.

A hole **510** may be formed at the reception member **502**, and the manipulation member **100b** of the disk **100** may be exposed outside via the hole **510**.

The head **504** may be connected to an end part of the reception member **502**, be made up of a metal, and have a size higher than the reception member **502**. Here, the manipulation member **100b** may be projected over the head **504**.

The pipe combination member **506** is used for connecting pipes, for example may be a rib projected from the upper framework **500**, and may be formed of a metal.

In an embodiment, a hole **512** may be formed on the pipe combination member **506**. The butterfly valve may be combined with pipes by passing a fixing member such as a bolt, etc. through the pipes and the butterfly valve after the pipes locate at both sides of the butterfly valve. Here, the bolt may pass through the pipe combination member **506** of the butterfly valve. That is, the pipe combination member **506** may be used for combining the butterfly valve with the pipes.

The bottom members **508a** and **508b** are formed at both ends of the upper framework **500**, respectively. These bottom members **508a** and **508b** may be used for combination with the lower body **104b**, and it may be formed of a metal. For example, a bolt inserting members **230a** and **232a** may be formed on each of the bottom members **508a** and **508b**.

The upper plastic layer **560** is formed on the upper base, for example may be formed on the upper base through an insert molding.

In an embodiment, the upper plastic layer **560** may be formed by mixing a glass fiber with a PVC, a PP, a PPS, a PPA, a PA6, a PA66, a POK or a PE.

In another embodiment, the upper plastic layer **560** may be formed by mixing a glass fiber and a carbon fiber with a PVC, a PP, a PPS, a PPA, a PA6, a PA66, a POK or a PE, or by mixing a glass fiber, a carbon fiber and a graphite fiber with a PVC, a PP, a PPS, a PPA, a PA6, a PA66, a POK or a PE.

In still another embodiment, the upper plastic layer **560** may be formed by mixing a carbon fiber with a PVC, a PP, a PPS, a PPA, a PA6, a PA66, a POK or a PE, or by mixing a carbon fiber and a graphite fiber with a PVC, a PP, a PPS, a PPA, a PA6, a PA66, a POK or a PE. As a result, strength, impact resistance or mechanical feature of the upper base may be enhanced.

That is, the upper body **104a** may have similar strength to an upper body formed of only steel with including thin thickness of the upper framework **500** made up of a steel by forming the upper plastic layer **560** in which the glass fiber, etc. is mixed. As a result, the upper body **104a** may maintain the strength with light weight.

Referring to FIG. 5, the lower body **104b** may include a lower base and a lower plastic layer **562**. Here, the lower base may have a lower framework **530**, a reception member **532**, a pipe combination member **534** and bottom members **536a** and **536b**.

The lower framework **530** may have a shape corresponding to the upper framework **500**, for example a semi-circular shape, and it may be made up of a light metal such as an aluminum, etc.

The reception member **532** receives the fixing member **100c** of the disk **100** and may be formed of a metal. A hole **540** in which the fixing member **100c** is inserted is formed on the reception member **532**.

The pipe combination member **534** may perform the same function as the pipe combination member **506**, be projected from the lower framework **530** and be formed of a metal. A hole **542** may be formed on the pipe combination member **534**.

The bottom members **536a** and **536b** are formed at both ends of the lower framework **530**, respectively. These bottom members **536a** and **536b** may be used for combination with the upper **104a**, and it may be formed of a metal. For example, a bolt inserting members **234a** and **236a** may be formed on each of the bottom members **536a** and **536b**. The

upper body **104a** and the lower body **104b** may be combined according as the bolts **220** are inserted into the bolt inserting members **230a**, **232a**, **234a** and **236a** as shown in FIG. 2.

The lower plastic layer **562** is formed on the lower base, for example may be formed on the lower base through an insert molding.

In an embodiment, the lower plastic layer **562** may be formed by mixing a glass fiber with a PVC, a PP, a PPS, a PPA, a PA6, a PA66, a POK or a PE.

In another embodiment, the lower plastic layer **562** may be formed by mixing a glass fiber and a carbon fiber with a PVC, a PP, a PPS, a PPA, a PA6, a PA66, a POK or a PE, or by mixing a glass fiber, a carbon fiber and a graphite fiber with a PVC, a PP, a PPS, a PPA, a PA6, a PA66, a POK or a PE.

In still another embodiment, the lower plastic layer **562** may be formed by mixing a carbon fiber with a PVC, a PP, a PPS, a PPA, a PA6, a PA66, a POK or a PE, or by mixing a carbon fiber and a graphite fiber with a PVC, a PP, a PPS, a PPA, a PA6, a PA66, a POK or a PE.

As a result, strength, impact resistance or mechanical feature of the lower body **104b** may be enhanced.

That is, the lower body **104b** may have similar strength to a lower body formed of only steel with including thin thickness of the lower framework **530** made up of a steel by forming the lower plastic layer **562** in which the glass fiber, etc. is mixed. As a result, the lower body **104b** may maintain the strength with light weight.

Hereinafter, structure of the disk **100** will be described in detail.

In FIG. 3 and FIG. 4, the opening-closing member **100a** of the disk **100** may include a disk body **300**, a first plastic layer **302** and a second plastic layer **304**. Two plastic layers **302** and **304** are shown in drawings, but the opening-closing member **100a** may include three or more plastic layers.

The disk body **300** is a base framework of the disk **100**, and it may be formed of a metal, for example a light metal such as an aluminum, etc.

In an embodiment, the disk body **300** may have a circular shape as shown in FIG. 3, and at least one hole **310** may be formed thereon. On the other hand, the disk body **300** is not limited as a structure in FIG. 3, and it may have a framework structure **300a** which has a circular shape and many spaces in the circular shape as shown in FIG. 6.

The first plastic layer **302** may be formed on the disk body **300** through an insert molding. Here, the first plastic layer **302** may cover the whole of the disk body **300**.

In an embodiment, the first plastic layer **302** may be formed of high strength plastic, e.g. an engineering plastic or a super engineering plastic. For example, the first plastic layer **302** may be made up of a polyphenylene ethers resin composition including a polyphenylene ethers resin and a polystyrene resin, or a polyimide, a polysulfone, a polyphenylene sulfide, a polyamide imide, a polyacrylate, a polyether sulfone, a polyether ether ketone, a polyether imide, a liquid crystal polyester, a polyether ketone, etc. and their combination.

The second plastic layer **304** may be formed on the first plastic layer **302** through an insert molding. Here, the second plastic layer **304** may cover the whole of the first plastic layer **302** and fill holes on the disk body **300** and the first plastic layer **302**.

In an embodiment, the second plastic layer **304** may be formed of a fluorine resin, e.g. a polytetrafluoroethylene PTFE, a Perfluoroalkoxy alkane PFA or a polyvinylidene fluoride PVDF, etc.

In another embodiment, the second plastic layer **304** may be formed of a plastic having a melting point smaller than the first plastic layer **302**. For example, the second plastic layer **304** may be formed of the PTFE.

The first plastic layer **302** and the second plastic layer **304** may be formed of plastics having different melting point.

In an embodiment, corrosion resistance or acid resistance of a second plastic of the second plastic layer **304** is excellent than that of a first plastic of the first plastic layer **302**, and strength of the first plastic may be better than that of the second plastic. That is, the first plastic may increase the strength of the disk **100**, and the second plastic may prevent corrosion or oxidation due to fluid.

Briefly, the opening-closing member **100a** of the disk **100** may include the disk body **300**, the first plastic layer **302** and the second plastic layer **304** disposed in sequence.

The whole of conventional disk is formed of a steel, and thus it should be manufactured by using a mechanical processing. However, it is difficult to process precisely the steel to have desired shape, and so productivity of the disk gets much lower. As a result, it is impossible to achieve mass production. Of course, since the whole of the disk is formed of steel, the strength of the disk is high, but weight and manufacture cost of the disk are great and the disk is easy to be corroded.

In the disk **100** of the present disclosure, only the disk body **300** as the base framework is formed of the metal, and the plastic layers **302** and **304** are formed on the disk body **300** through two insert moldings.

The disk body **300** is considerably thin compared with the conventional disk, and thus it is easy to process precisely the disk body **300** to have desired shape though mechanical processing is performed. Specially, since precise shape of the disk **100** may be realized through the first plastic layer **302**, it is not necessary to process precisely the disk body **300**. Hence, it is possible to produce the disk **100** in large quantities.

Corrosion resistance and acid resistance of the disk **100** may be considerably enhanced and the disk **100** may have excellent strength characteristics, due to the plastic layers **302** and **304**. Particularly, since the first plastic layer **302** is formed of the engineering plastic or the super engineering plastic, the disk **100** may have very small weight with keeping the strength similar to the conventional disk. For example, when the conventional butterfly valve formed of only steel has weight 1kg, the butterfly valve of the present disclosure may have weight 350g with keeping the strength similar to the conventional butterfly valve. That is, super lightweight may be achieved.

On the other hand, the second plastic layer **304** formed of PTFE is directly formed on the disk body **300** formed of the steel without the first plastic layer **302**. In this case, the problem exists in that thickness of the PTFE formed on the steel is not constant or uniform (flat). That is, it is difficult to process the disk to have precise shape.

Accordingly, the method of manufacturing the valve of the present disclosure uses high strength plastic (for example, engineering plastic or super engineering plastic) which is practicable easily precise-processing on the metal. That is, the method may produce the disk **100** with precise shape by forming the first plastic layer **302** formed of high strength plastic on the disk body **300** formed of the metal.

Subsequently, the method may form the second plastic layer **304** formed of the PTFE on the first plastic layer **302** formed of the high strength plastic. Here, the PTFE may be formed of constant thickness on the high strength plastic.

Shortly, the opening-closing member **100a** of the disk **100** may have enhanced productivity and reduced weight and manufacture cost with maintaining the same precise shape and processing as the conventional disk. Additionally, it is possible to achieve mass production of the butterfly valve.

Only the disk **100** is mentioned in above description. However, the structure of the disk **100** is applicable to every fluid contacting member of valves other than the butterfly valve, wherein the fluid contacting member should have excellent corrosion resistance because it contacts with fluid. That is, the fluid contacting member may include a body formed of a metal, a first plastic layer formed of high strength plastic on the body, and a second plastic layer formed of fluorine resin on the first plastic layer.

Hereinafter, plastic layers **560** and **562** of the body **104** will be described in detail. Since the plastic layers **560** and **562** have the same component, only the plastic layer **560** will be described.

In an embodiment, the plastic layer **560** may be formed by mixing a PP with a glass fiber. Preferably, the glass fiber has 0 weight percent to 40 weight percent, and the PP has a weight percent higher than 60 weight percent. Experimental result is shown in following table 1.

TABLE 1

embodiment	glass fiber weight percent	Tensile strength (Mpa@23° C.) [ASTM D638]
comparison	0	25
1	10	54
2	15	59
3	20	78
4	30	83
5	40	94

It is verified through the above table 1 that tensile strength of the plastic layer **560** when the plastic layer **560** is formed by mixing the PP with the glass fiber is very greater than that of a plastic layer formed of only the PP. That is, mechanical property and chemical property may be enhanced. However, it is difficult to manufacture the plastic layer **560** to have desired shape because an insert molding feature for manufacturing the plastic layer **560** is deteriorated when the glass fiber has a weight percent higher than 40 weight percent.

In another embodiment, the plastic layer **560** may be formed by mixing a PPS with a glass fiber. Preferably, the glass fiber has 0 weight percent to 40 weight percent, and the PPS has a weight percent higher than 60 weight percent. Experimental result is shown in following table 2.

TABLE 2

embodiment	glass fiber weight percent	Tensile strength (Mpa@23° C.) [ASTM D638]
comparison	0	70
1	30	140
2	40	200

It is verified through the above table 2 that tensile strength of the plastic layer **560** when the plastic layer **560** is formed by mixing the PPS with the glass fiber is greater than that of a plastic layer formed of only the PPS. That is, mechanical property and chemical property may be enhanced, and thus light and strong plastic layer **560** may be formed. However, it is difficult to manufacture the plastic layer **560** to have desired shape because an insert molding feature for manu-

facturing the plastic layer **560** is deteriorated when the glass fiber has a weight percent higher than 40 weight percent.

In still another embodiment, the plastic layer **560** may be formed by mixing a PPA with a glass fiber. Preferably, the glass fiber has 0 weight percent to 55 weight percent, and the PPA has a weight percent higher than 45 weight percent. Experimental result is shown in following table 3.

TABLE 3

embodiment	glass fiber weight percent	Tensile strength (Mpa@23° C.) [ASTM D638]
comparison	0	105
1	25	170
2	35	210
3	45	250
4	55	270

It is verified through the above table 3 that tensile strength of the plastic layer **560** when the plastic layer **560** is formed by mixing the PPA with the glass fiber is greater than that of a plastic layer formed of only the PPA. That is, mechanical property and chemical property may be enhanced, and thus light and strong plastic layer **560** may be formed. However, it is difficult to manufacture the plastic layer **560** to have desired shape because an insert molding feature for manufacturing the plastic layer **560** is deteriorated when the glass fiber has a weight percent higher than 55 weight percent.

In still another embodiment, the plastic layer **560** may be formed by mixing a PA6 with a glass fiber. Preferably, the glass fiber has 0 weight percent to 50 weight percent, and the PA6 has a weight percent higher than 50 weight percent. Experimental result is shown in following table 4.

TABLE 4

embodiment	glass fiber weight percent	Tensile strength (Mpa@23° C.) [ASTM D638]
comparison	0	70
1	15	125
2	20	145
3	30	170
4	33	180
5	35	185
6	40	192
7	45	200
8	50	220

It is verified through the above table 4 that tensile strength of the plastic layer **560** when the plastic layer **560** is formed by mixing the PA6 with the glass fiber is very greater than that of a plastic layer formed of only the PA6. That is, mechanical property and chemical property may be enhanced, and thus light and strong plastic layer **560** may be formed. However, it is difficult to manufacture the plastic layer **560** to have desired shape because an insert molding feature for manufacturing the plastic layer **560** is deteriorated when the glass fiber has a weight percent higher than 50 weight percent.

In still another embodiment, the plastic layer **560** may be formed by mixing a PA66 with a glass fiber. Preferably, the glass fiber has 0 weight percent to 50 weight percent, and the PA66 has a weight percent higher than 50 weight percent. Experimental result is shown in following table 5.

TABLE 5

embodiment	glass fiber weight percent	Tensile strength (Mpa@23° C.) [ASTM D638]
comparison	0	80
1	25	165
2	30	186
3	33	196
4	35	200
5	50	245

It is verified through the above table 5 that tensile strength of the plastic layer 560 when the plastic layer 560 is formed by mixing the PA66 with the glass fiber is very greater than that of a plastic layer formed of only the PA66. That is, mechanical property and chemical property may be enhanced, and thus light and strong plastic layer 560 may be formed. However, it is difficult to manufacture the plastic layer 560 to have desired shape because an insert molding feature for manufacturing the plastic layer 560 is deteriorated when the glass fiber has a weight percent higher than 50 weight percent.

In still another embodiment, the plastic layer 560 may be formed by mixing a POK with a glass fiber. Preferably, the glass fiber has 0 weight percent to 40 weight percent, and the POK has a weight percent higher than 60 weight percent. Experimental result is shown in following table 6.

TABLE 6

embodiment	glass fiber weight percent	Tensile strength (Mpa@23° C.) [ASTM D638]
comparison	0	60
1	15	100
2	20	125
3	30	140
4	40	165

It is verified through the above table 6 that tensile strength of the plastic layer 560 when the plastic layer 560 is formed by mixing the POK with the glass fiber is very greater than that of a plastic layer formed of only the POK. That is, mechanical property and chemical property may be enhanced, and thus light and strong plastic layer 560 may be formed. However, it is difficult to manufacture the plastic layer 560 to have desired shape because an insert molding feature for manufacturing the plastic layer 560 is deteriorated when the glass fiber has a weight percent higher than 40 weight percent.

The embodiments of the present disclosure described above are disclosed only for illustrative purposes. A person having ordinary skill in the art would be able to make various modifications, alterations, and additions without departing from the spirit and scope of the disclosure, but it is to be appreciated that such modifications, alterations, and additions are encompassed by the scope of claims set forth below.

What is claimed is:

1. A body covering a disk in a butterfly valve, the body comprising:

an upper body; and
a lower body,

wherein an inserting space is formed by combining the upper body with the lower body,

the disk is inserted into the inserting space, at least one of the upper body and the lower body includes a framework formed of a metal and a plastic layer formed on the framework,

a pipe combination member, on which a hole for combining the butterfly valve with a pipe is formed, is projected from the framework, and the butterfly valve is combined with the pipe by inserting a fixing member into the hole of the framework and a hole of the pipe, a disk supporting member formed of a fluorine resin for supporting the disk,

wherein a home is formed at a surface of the framework to fix the disk supporting member,

wherein the disk supporting member includes a first supporting member and a second supporting member.

2. The body of claim 1,

wherein the framework of the upper body is included in the plastic layer of the upper body, the framework of the lower body is included in the plastic layer of the lower body,

the framework of the upper body is separable from the framework of the lower body,

bottom members are respectively formed at an end part of the framework of the upper body and an end part of the framework of the lower body, and the framework of the upper body and the framework of the lower body are combined through the bottom members.

3. The body of claim 2, wherein the framework of the upper body and the framework of the lower body have a semi-circular shape.

* * * * *