



- (51) International Patent Classification:  
*B60N 2/28* (2006.01)      *B60N 2/26* (2006.01)
- (21) International Application Number:  
PCT/US2012/058918
- (22) International Filing Date:  
5 October 2012 (05.10.2012)
- (25) Filing Language: English
- (26) Publication Language: English
- (30) Priority Data:
 

61/543,938	6 October 2011 (06.10.2011)	US
61/559,949	15 November 2011 (15.11.2011)	US
13/315,900	9 December 2011 (09.12.2011)	US
13/315,867	9 December 2011 (09.12.2011)	US

(74) Agents: BALDAUF, Kent, E., Jr. et al.; The Webb Law Firm, One Gateway Center, 420 Ft. Duquesne Blvd., Suite 1200, Pittsburgh, Pennsylvania 15222 (US).

(81) Designated States (unless otherwise indicated, for every kind of national protection available): AE, AG, AL, AM, AO, AT, AU, AZ, BA, BB, BG, BH, BN, BR, BW, BY, BZ, CA, CH, CL, CN, CO, CR, CU, CZ, DE, DK, DM, DO, DZ, EC, EE, EG, ES, FI, GB, GD, GE, GH, GM, GT, HN, HR, HU, ID, IL, IN, IS, JP, KE, KG, KM, KN, KP, KR, KZ, LA, LC, LK, LR, LS, LT, LU, LY, MA, MD, ME, MG, MK, MN, MW, MX, MY, MZ, NA, NG, NI, NO, NZ, OM, PA, PE, PG, PH, PL, PT, QA, RO, RS, RU, RW, SC, SD, SE, SG, SK, SL, SM, ST, SV, SY, TH, TJ, TM, TN, TR, TT, TZ, UA, UG, US, UZ, VC, VN, ZA, ZM, ZW.

(71) Applicant: THORLEY INDUSTRIES, LLC [US/US]; 40 24th Street, Third Floor, Pittsburgh, Pennsylvania 15222 (US).

(84) Designated States (unless otherwise indicated, for every kind of regional protection available): ARIPO (BW, GH, GM, KE, LR, LS, MW, MZ, NA, RW, SD, SL, SZ, TZ, UG, ZM, ZW), Eurasian (AM, AZ, BY, KG, KZ, RU, TJ, TM), European (AL, AT, BE, BG, CH, CY, CZ, DE, DK, EE, ES, FI, FR, GB, GR, HR, HU, IE, IS, IT, LT, LU, LV, MC, MK, MT, NL, NO, PL, PT, RO, RS, SE, SI, SK, SM, TR), OAPI (BF, BJ, CF, CG, CI, CM, GA, GN, GQ, GW, ML, MR, NE, SN, TD, TG).

(72) Inventors: SZAKELYHIDI, Dave; 4419 Green Cove Street, Olympia, Washington 98502 (US). WALKER, John, J.; 45 Oregon Trail, Pittsburgh, Pennsylvania 15205 (US). THORNE, Henry, F.; 145 Hidden Valley Drive, West View, Pennsylvania 15237 (US). HOPKE, Frederick, K.; 2506 Sapling Street, Glenshaw, Pennsylvania 15116 (US). DALEY, Robert, D.; 134 Hoodridge Drive, Pittsburgh, Pennsylvania 15228 (US).

Published:  
— with international search report (Art. 21(3))

[Continued on next page]

(54) Title: CHILD RESTRAINT SYSTEM WITH AUTOMATED INSTALLATION

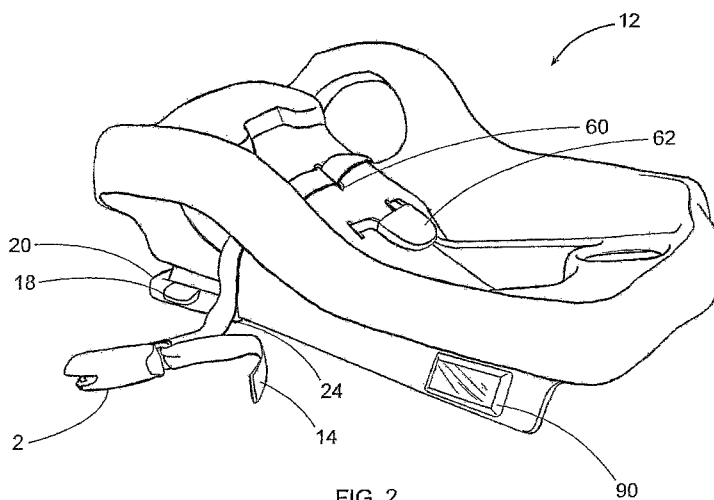

FIG. 2

(57) Abstract: Provided is a child restraint system (CRS) with automated installation that provides automated feedback and control of seat installation angle, belt latching and tightening, and confirmation of correct install. The CRS utilizes sensors to monitor CRS base angle relative to level, confirm correct latching of the CRS to its base and then to the vehicle seat, and confirm tightening of the belts to the required tension to be crashworthy. The stepwise operation and confirmation of the installation procedure may be operated via button(s) or other tactical input, and relayed to the user via electronic visual display and/or audible means. All operations will be overseen and processed by an integrated control system, affording minimal user decision or interface. An intelligent latching device which can be adapted for use with an existing CRS is also provided.



- *before the expiration of the time limit for amending the claims and to be republished in the event of receipt of amendments (Rule 48.2(h))*

## CHILD RESTRAINT SYSTEM WITH AUTOMATED INSTALLATION

## CROSS REFERENCE TO RELATED APPLICATIONS

[0001] This application claims priority to United States Provisional Application Nos. 61/543,938, filed October 6, 2011 and 61/559,949, filed November 15, 2011 and United States Patent Application Nos. 13/315,867, filed December 9, 2011 and 13/315,900, filed December 9, 2011, which are all incorporated herein by reference in their entirety.

## BACKGROUND OF THE INVENTION

Field of the Invention

[0002] The present invention is generally directed to a child car seat or child restraint system (CRS) for use in an automobile and, more particularly, to self-adjusting and automatically installing a CRS.

Description of Related Art

[0003] Numerous industry and government guidance documents and standards recommend proper constraints for CRS installation. Aside from CRS manufacturer datasheets, pertinent information regarding standards and guidance can be found in three National Highway Traffic Safety Administration (NHTSA) reports, entitled, "Driver mistakes when installing child seats", "Misuse of Child Restraints", and "Child Restraint Use Survey: LATCH Use and Misuse". Also, FMVSS213 and 225 standards include testing and crashworthiness requirements for a CRS.

[0004] In addition, Federal Motor Vehicle Safety Standards state that after the CRS undergoes crash impact testing, the angle between the CRS's back support surface for the child and the vertical should not exceed 70 degrees. In order to minimize this angle of travel after crash impact and to prevent separation of the child from the CRS, manufacturers state that when installing a CRS in the rear-facing position, the child seat should be reclined at least 30 degrees from vertical and up to 45 degrees from vertical when the car is parked on a level surface. Because vehicle seats are at varying angles, it has become standard for most child restraint manufacturers to provide a means to level the child restraint seat in relation to the vehicle seat angle, in order to achieve this optimal CRS seat back angle range. Existing devices for leveling include mechanical legs, screw mechanisms, levers, spacers, platforms, and other non-automated means. All of these devices are hand actuated. There have also been a few limited attempts at a motorized CRS recliner. In relating the angle of the seat to the user, there are numerous mechanical devices currently in use, including bubble floats,

rolling balls, and other sight windows or pendulum indicators. Some electro-mechanical based angle feedback indicators are also currently in existence.

[0005] Modern child restraint systems can be connected to the vehicle by the vehicle seat belt or by the Lower Anchors and Tethers for CHildren (LATCH) system, which is integrated with the CRS, having specialized connectors and belts. It is required that either the LATCH system belt or the vehicle seat belt connect the CRS tight enough that it cannot move more than one inch side to side and front to back in relation to the vehicle seat to which it is attached. Many manufacturers use a simple belt cinch, while others rely on cranks and lever arms, or other mechanical means to assist a user in tightening. There are even a few devices that use motor actuated mechanisms to tighten the belt. As for determination of torque, there have been mechanical devices described, but only a few electro-mechanical means of feedback.

[0006] Feedback of the CRS infant carrier seat to its base and then to the vehicle have also been disclosed, however, the manner in which this connection has been determined has not been in the CRS latches themselves, but in the vehicle or infant carrier seat housing and also in the vehicle seat belt or latch anchor points.

[0007] A 2009 NHTSA study entitled Drivers' Mistakes When Installing Child Seats (DOT HS 811 234) mentioned that approximately 73% of child restraints were installed incorrectly. It also states that in 72% of these installs, the user assumed that they had correctly installed the CRS, while in fact it was wrong.

[0008] Accordingly, a need exists for a CRS installation system that can be more effectively achieved by automation, with less user error/inconvenience and greater safety.

#### SUMMARY OF THE INVENTION

[0009] Provided is a CRS with automated installation that provides automated feedback and control of seat installation angle, belt latching and tightening, and confirmation of correct install. More specifically, the CRS disclosed herein utilizes sensors to monitor CRS base angle relative to level, confirm correct latching of the CRS to its base and then to the vehicle seat, and confirm tightening of the belts to the required tension to be crashworthy. The stepwise operation and confirmation of the installation procedure will be operated via button(s) or other tactical input, and relayed to the user via electronic visual display and/or audible means. All operations will be overseen and processed by an integrated control system, affording minimal user decision or interface.

[0010] More specifically, provided is a child seat configured to be secured to a seat of a vehicle. The child seat includes: a seat base secured to the seat of the vehicle; a child receiving portion supported by the seat base; a belt tensioning system incorporated into the seat base for receiving a belt that couples the seat base to the seat of the vehicle; a leveling system incorporated into the seat base for leveling the seat base relative to the seat of the vehicle; and a controller operatively coupled to the belt tensioning system and the leveling system. The controller activates the belt tensioning system and the leveling system such that the belt tensioning system tensions the belt to a predetermined tension and the leveling system levels the seat base to a predetermined angle relative to the seat of the vehicle.

[0011] The controller may be configured to activate the belt tensioning system and the leveling system iteratively, simultaneously, or sequentially. The belt received by the belt tensioning system may be a seat belt of the vehicle or a belt of a LATCH system. The child seat may be selected from the group comprising: rear-facing infant carriers; forward-facing and rear-facing convertible child seats; and booster seats with harnesses.

[0012] The child seat may further include: at least one sensor for determining tension of the belt received by the belt tensioning system; and at least one sensor for determining the angle of the seat base relative to the seat of the vehicle. The at least one sensor for determining tension and the at least one sensor for determining the angle may be operatively coupled to the controller. The controller may activate the belt tensioning system and the leveling system such that the belt tensioning system tensions the belt to a predetermined tension and the leveling system levels the seat base to a predetermined angle relative to the seat of the vehicle based on feedback from the at least one sensor for determining tension and the at least one sensor for determining the angle.

[0013] A user interface may be positioned on at least one of the seat base or the child receiving portion to allow a user to initiate the belt tensioning system and the leveling system. Alternatively, the user interface may be an individual electronic module communicating with a controller of the child seat via a wire or wirelessly. The user interface may provide feedback to the user of a status of the child seat. The leveling system may be configured to raise and lower a foot connected to a bottom surface of the seat base.

[0014] In addition, provided is a child seat configured to be secured to a seat of a vehicle. The child seat includes: a seat base secured to the seat of the vehicle; a child receiving portion supported by the seat base; a leveling system incorporated into the seat base for leveling the seat base relative to the seat of the vehicle; and a controller operatively coupled to the belt tensioning system and the leveling system. The controller receives feedback from

at least one sensor associated with the child seat of an angle of the seat base relative to the seat of the vehicle and provides an indication to a user of the angle of the seat base relative to the seat of the vehicle.

[0015] The indication may be a visual indication provided on a display connected to at least one of the seat base or the child receiving portion. Alternatively, the indication may be at least one of a visual or audible indication that the seat base is positioned relative to the seat of the vehicle at an acceptable angle. The acceptable angle may be determined by the controller by comparing the angle of the seat base relative to the seat of the vehicle determined by the at least one sensor with a predetermined angle. The predetermined angle may be at least one of a factory set angle or an angle determined by calibrating the car seat relative to either a surface on which the vehicle is resting or a surface of the vehicle. The leveling system may be manually activated to level the seat base to a predetermined angle. Alternatively, the leveling system may be activated by the controller to level the seat base to a predetermined angle based on feedback from the at least one sensor.

[0016] The child seat may further include a belt tensioning system incorporated into the seat base for receiving a belt that couples the seat base to the seat of the vehicle. The controller may be configured to receive feedback from at least one sensor associated with the belt that couples the seat base to the seat of the vehicle and provide an indication to a user of the tension on the belt. The belt received by the belt tensioning system may be at least one of a seat belt of the vehicle or a belt of a LATCH system. The belt tensioning system may be manually activated to tension the belt to a predetermined tension. The belt tensioning system may be activated by the controller to tension the belt to a predetermined tension based on feedback from the at least one sensor associated with the belt.

[0017] Also provided is a child car seat that includes: a seat base secured to a seat of a vehicle; an infant carrier removably connected to the seat base; a belt tensioning system incorporated into the seat base for receiving a belt that couples the seat base to the seat of the vehicle; a leveling system incorporated into the seat base for leveling the seat base relative to the seat of the vehicle; and a controller operatively coupled to the belt tensioning system and the leveling system. The controller activates the belt tensioning system and the leveling system such that the belt tensioning system tensions the belt to a predetermined tension and the leveling system levels the seat base to a predetermined angle relative to the seat of the vehicle.

[0018] Additionally, provided is a child car seat that includes: a seat base secured to a seat of a vehicle; an infant carrier removably connected to the seat base; and an interface device

coupled to at least one of the seat base or the infant carrier and configured to provide an indication to a user that the seat base is properly secured to the seat of the vehicle.

[0019] The interface device may be configured to provide the indication to the user when the infant carrier is connected to the seat base. The interface device may include a display providing a visual indication to the user that the seat base is properly secured to the seat. The child car seat may further include a plurality of sensors associated with at least one of the seat base and the infant carrier and configured to determine whether the seat base is at a proper level, a belt securing the seat base to the seat of the vehicle is at a proper tension, a handle of the infant carrier is at a correct position, the belts securing the seat base to the seat of the vehicle are not twisted, a harness securing a child within the infant carrier is at a proper tension and a proper height, or any combination thereof. The car seat may also include a controller operably coupled with the plurality of sensors and configured to output to the interface device the indication that the seat base is properly secured to the seat of the vehicle. The indication that the seat base is properly secured to the seat of the vehicle may include an indication that the seat base is at a proper level, that a belt securing the seat base to the seat of the vehicle is at a proper tension, that a handle of the infant carrier is at a correct position, that the belts securing the seat base to the seat of the vehicle are not twisted, that a harness securing a child within the infant carrier is at a proper tension and a proper height, or any combination thereof.

[0020] The child car seat may further include a belt tensioning system incorporated into the seat base for receiving a belt that couples the seat base to the seat of the vehicle; a leveling system incorporated into the seat base for leveling the seat base relative to the seat of the vehicle; and a controller operatively coupled to the belt tensioning system and the leveling system. The controller may be configured to activate the belt tensioning system and the leveling system such that the belt tensioning system tensions the belt to a predetermined tension and the leveling system levels the seat base to a predetermined angle relative to the seat of the vehicle. The belt received by the belt tensioning system may be at least one of a seat belt of the vehicle or a belt of a LATCH system.

[0021] The child car seat may further include: at least one sensor for determining tension of the belt received by the belt tensioning system; and at least one sensor for determining the angle of the seat base relative to the seat of the vehicle. The at least one sensor for determining tension and the at least one sensor for determining the angle may be operatively coupled to the controller. The controller may activate the belt tensioning system and the leveling system such that the belt tensioning system tensions the belt to a predetermined

tension and the leveling system levels the seat base to a predetermined angle relative to the seat of the vehicle based on feedback from the at least one sensor for determining tension and the at least one sensor for determining the angle.

[0022] Also provided is a child car seat that includes: a seat base secured to a seat of a vehicle; a child receiving portion coupled to the seat base; at least one sensor associated with at least one of the child receiving portion or the seat base configured to determine the presence of an object within the child receiving portion; and an interface device coupled to at least one of the seat base or the child receiving portion and configured to provide an indication to a user that the seat base is properly secured to the seat of the vehicle when the at least one sensor provides an indication that an object is present within the child receiving portion.

[0023] The child receiving portion may be removably coupled to the seat base. The at least one sensor associated with at least one of the child receiving portion or the seat base may be configured to determine at least one of the height and the weight of the object within the child receiving portion. If the at least one sensor determines that at least one of the height and weight of the object are below a predetermined value, an indication may be provided on the user interface that the child car seat should be installed in a rear-facing orientation.

[0024] In addition, provided is a child car seat that includes: a seat body coupled to a seat of a vehicle; a plurality of sensors associated with the seat body; and an interface device connected to the seat body and configured to provide an indication to a user that the seat body is properly secured to the seat of the vehicle based on feedback from the plurality of sensors.

[0025] The plurality of sensors associated with the seat body may be configured to determine whether the seat base is at a proper level, a belt securing the seat base to the seat of the vehicle is at a proper tension, a handle of the infant carrier is at a correct position, the belts securing the seat base to the seat of the vehicle are not twisted, a harness securing a child within the infant carrier is at a proper tension and a proper height, or any combination thereof. The child car seat may further include a controller operably coupled with the plurality of sensors and configured to output to the interface device the indication that the seat base is properly secured to the seat of the vehicle. The indication that the seat base is properly secured to the seat of the vehicle may include an indication that the seat base is at a proper level, that a belt securing the seat base to the seat of the vehicle is at a proper tension, that a handle of the infant carrier is at a correct position, that the belts securing the seat base to the seat of the vehicle are not twisted, that a harness securing a child within the infant carrier is at a proper tension and a proper height, or any combination thereof.



[0026] These and other features and characteristics of the present invention, as well as the methods of operation and functions of the related elements of structures and the combination of parts and economies of manufacture, will become more apparent upon consideration of the following description and the appended claims with reference to the accompanying drawings, all of which form a part of this specification, wherein like reference numerals designate corresponding parts in the various figures. It is to be expressly understood, however, that the drawings are for the purpose of illustration and description only and are not intended as a definition of the limits of the invention. As used in the specification and the claims, the singular form of “a”, “an”, and “the” include plural referents unless the context clearly dictates otherwise.

#### BRIEF DESCRIPTION OF THE DRAWINGS

[0027] For the purpose of facilitating understanding of the invention, the accompanying drawings and description illustrate preferred embodiments thereof, from which the invention, various embodiments of its structures, construction and method of operation, and many advantages may be understood and appreciated.

[0028] **FIGS. 1A-1C** provide several views of a LATCH device that incorporates a system for the confirmation of belt latching in accordance with the present invention;

[0029] **FIG. 2** is a perspective view of a carrier base and LATCH device embodying various features of a CRS according to the present invention;

[0030] **FIG. 3** is a side view of the carrier base of **FIG. 2** with an elevating foot which rotates around a central pivot point in the extended position;

[0031] **FIG. 4** is a side view of the carrier base with the elevating foot in the extended position of **FIG. 3** installed in a vehicle seat;

[0032] **FIG. 5** is a bottom-side perspective view of a leveling mechanism for use with the CRS in accordance with the present invention with a motor and cam assembly for driving the elevating foot to an extended position;

[0033] **FIG. 6** is a perspective view of a leveling foot with a linear motion mechanism according to another embodiment of the present invention having a scissor mechanism for providing automated leveling and angle feedback;

[0034] **FIG. 7** is a side view of a linear motion leveling mechanism with a foot extending from the carrier base installed in a vehicle seat;

[0035] FIG. 8 is a side view of the carrier base of FIG. 2 installed in a vehicle seat having a roller attached to the foot and a lip extension that fits between the vehicle seat cushion and back for easier installation;

[0036] FIG. 9 is a perspective view of the carrier base of FIG. 2 with a belt for attaching the base to a vehicle seat and a tension detection sensor for measuring the tension on the belt;

[0037] FIG. 10 is a top-side perspective view of a tensioning mechanism according to the present invention for automatically increasing the tension on a belt;

[0038] FIG. 11 is a bottom-side perspective view of the tensioning mechanism of FIG. 10 showing the belt wound around a belt tightening spindle and a latching mechanism consisting of a pawl and ratchet for preventing “backdriving” of the belt;

[0039] FIG. 12 is a side view of the pawl and ratchet mechanism of FIG. 11;

[0040] FIG. 13 is a perspective view of the bottom of the carrier base of FIG. 2 with a foot of the leveling mechanism in the open position, so that the tensioning mechanism is accessible;

[0041] FIG. 14 is a perspective view of another embodiment of a carrier base with a belt in an improved routing configuration;

[0042] FIG. 15A is a block diagram of the electronic components of the CRS showing the relationship between the components and the microcontroller;

[0043] FIG. 15B is a flow chart describing the algorithm for calibrating a CRS according to the present invention;

[0044] FIG. 15C is a flow chart describing the installation, leveling, and tensioning algorithm as used by a CRS according to the present invention;

[0045] FIG. 16 is a perspective view of the carrier base of FIG. 2 with a battery and a self-generating power mechanism exposed;

[0046] FIG. 17 is a side view of the carrier base of FIG. 2 with a control center of a user interface shown in an enlarged manner;

[0047] FIG. 18 is a perspective view of the base and carrier according to the present invention with a power connection socket for transferring power and data between the base and carrier;

[0048] FIG. 19 is a side view of the carrier base of FIG. 2 connected to an infant carrier with an enlarged view of the latch mechanism for connecting the base to the carrier;

[0049] FIGS. 20A and 20B provide side and perspective views, respectively, illustrating the sensor configuration for connecting the CRS to a base in accordance with the present invention;

[0050] FIG. 21 is a front view of an infant carrier according to the present invention with a motorized mechanism to tighten/loosen a harness and harness tension sensors;

[0051] FIG. 22 is a perspective view of the back portion of the carrier of FIG. 21 with a motor mechanism for adjusting the height of a harness;

[0052] FIG. 23 is a perspective view of an intelligent latching device having a latch and tensioner mechanism and connectors for attachment to a LATCH system;

[0053] FIG. 24 is a perspective view of the latch and tensioner mechanism of FIG. 23;

[0054] FIG. 25 is a bottom view of the latch and tensioner mechanism of FIG. 23;

[0055] FIG. 26 is a cross sectional view of the latch and tensioner mechanism of FIG. 23 in which a motor, gear train, and spindle are visible;

[0056] FIG. 27 is an exploded view of the latch and tensioner mechanism of FIG. 23; and

[0057] FIG. 28 is a flow chart depicting the process for increasing the tension of a belt for use with the intelligent latching device of FIG. 23.

#### DETAILED DESCRIPTION OF THE PREFERRED EMBODIMENTS

[0058] For purposes of the description hereinafter, the terms “upper”, “lower”, “right”, “left”, “vertical”, “horizontal”, “top”, “bottom”, “lateral”, “longitudinal”, and derivatives thereof shall relate to the invention as it is oriented in the drawing figures. However, it is to be understood that the invention may assume alternative variations and step sequences, except where expressly specified to the contrary. It is also to be understood that the specific devices and processes illustrated in the attached drawings, and described in the following specification, are simply exemplary embodiments of the invention. Hence, specific dimensions and other physical characteristics related to the embodiments disclosed herein are not to be considered as limiting.

[0059] A CRS with automated installation embodying various aspects of the present invention is shown in FIGS. 1 through 23. It will be readily apparent to those skilled in the art, however, that the CRS of FIGS. 1 through 23 represents but one of a wide variety of structures, configurations and modes of operation of child restraints which fall within the scope of the present invention. For instance, the aspects of the present invention discussed herein may be incorporated into rear-facing infant carriers, forward-facing and rear-facing convertible child carriers, and booster seats with harnesses and for use with lap/shoulder belts.

[0060] The CRS, according to the present invention, is firmly attached to a vehicle seat by a belt. In one embodiment, the CRS is configured for use with the Lower Anchors and

Tethers for Children (LATCH) system, which has a European equivalent in the ISOFIX system. With reference to **FIGS. 1A-1C**, connectors **2** adapted for use with a LATCH device are illustrated. The connectors **2** incorporate a sensor **4** to detect the presence of the connection point, always a metal bar **6**, within the engagement “jaws” **8** of the connectors **2**. The sensor **4** may be an optical interrupt switch, contact switch, miniaturized metal detecting circuit, or other similar device. A wire lead **10** transmits a signal from the sensors **4** to a controller (not shown) provided on the CRS indicating that the connector **2** is attached to the bar **6** of the LATCH system. Alternatively, the CRS could be attached to the vehicle seat through other standardized CRS vehicle connection points such as a seat belt.

[0061] With reference to **FIGS. 2** through **17**, an infant carrier base of a CRS with automated installation is illustrated. The base of the CRS is adapted to firmly attach to a vehicle interior seat. The base **12** comprises a cradle shaped structure adapted to receive and hold an infant carrier (not shown), a belt **14** for anchoring the base to the vehicle seat, and a leveling mechanism **20** which levels the base **12** relative to the vehicle seat thereby ensuring that the infant carrier is held at a level orientation.

[0062] As shown in **FIG. 2**, the belt **14** extends from the connectors **2** located on either side of the CRS through holes located on the side of the base structure, and to a tensioning mechanism **60**. The leveling mechanism **20** extends from the lower portion of the base **12** to counteract the slope (theta) of a vehicle seat. A foot **24** is located at the base of the leveling mechanism **20**. A height adjust manual release **18** extends from the base of the foot allowing a user to adjust the height manually. Optionally, the tensioning mechanism **60** is a motorized tensioning device for automatically adjusting the tension of the belt **14**. In the case of an automated tensioning mechanism, the base **12** may further comprise a manual release **62** extending from the base **12** allowing a user to release the belt **14** from the automated mechanism and to adjust tension manually using overdrive crank **78**. The base **12** further comprises a user interface having a control center **90** such as a visual display for displaying visual data for a user. Relevant data includes, for example, an indicator light informing the user of whether the seat is level, whether the base is securely anchored to the vehicle seat by the connectors, and whether a harness securing the child to the infant carrier is securely in place. The control center may also include input devices allowing a user to input data regarding the child to be secured to the CRS.

[0063] With reference to **FIGS. 3** through **8**, as described above, a CRS of the present invention includes a system for automatically leveling the CRS and providing angle feedback to a user. According to one embodiment of the automated leveling system, shown in **FIGS. 3**

through **5**, the leveling mechanism **20** comprises a foot **24** extending from the carrier base **12**. The foot **24** extends in a downward direction rotating around a rotational joint **22**. The advantage of the rotational joint **22** is that there is the ability to achieve a greater amount of motion of the foot **24** with a smaller amount of motion of a drive mechanism. In this way, the challenge of extending the foot beyond the height of the seat base is effectively mitigated.

[0064] As depicted in **FIG. 3**, the foot **24** extends from the lower portion of the infant carrier base **12** in a telescoping arrangement in which a plurality of elevating sections **26** are nested within one another when the foot **24** is in a closed position. As the foot extends downward, rotating around the rotation joint **22**, the nested sections **26** disengage from one another. **FIG. 4** depicts the base **12** with the foot **24** in the extended position installed in a vehicle seat **16**. Optionally, as shown in **FIG. 5**, the leveling mechanism **20** includes a motor **28** for driving the expansion of the telescoping foot **24**. The leveling mechanism including the motor is housed in the interior of the carrier base **12**.

[0065] **FIG. 5** depicts one embodiment of the leveling mechanism having a motor for automated leveling. The mechanism comprises the motor **28** engaged with a cam **30** by a Hirth coupling **32**. The motor **28** used to power the cam **30** may be electrical or any other type, such as hydraulic. A Hirth coupling is a mechanical connection used to connect two pieces of a shaft together and characterized by teeth that mesh together on the end faces of each half of the shaft. As the motor **28** drives the cam **30**, the cam **30** rotates thereby exerting force on the telescoping foot **24** causing the foot **24** to extend and the nested sections **26** of the foot to disengage. In addition to the cam mechanism, a screw jack mechanism, rack and pinion mechanism, scissor lift mechanism, or other type of linear motion mechanism may also be used to provide means of leveling the height via a rotational joint with a motor. In addition, rotary motion mechanisms to adjust height could also be used. Rotary motion mechanisms include a gearing mechanism, sprocket and chain mechanism, pulley and belt mechanism, or direct drive with a rotary motor.

[0066] It is desirable that the height of the infant carrier base be adjustable without a motor as well, in case the user is unable or unwilling to use the automated system. Manual release is accomplished by a release knob which disengages the cam from the motor. As shown in **FIG. 5**, the leveling mechanism **20** further comprises a manual release knob **34** and manual overdrive knob **36**. The manual release knob **34** allows a user to disengage the motor **28** from the cam **30** thereby preventing the motor from supporting the cam **30**, causing the foot **24** to return to the retracted position. Once the motor **28** is disengaged, a user can rotate the manual overdrive knob **36** to manually manipulate the height of the foot **24**. Height may also

be adjusted through other mechanical mechanisms such as, for example, a turn crank that actuates a spindle comprising part of a drive train or with a slip clutch mechanism.

[0067] It is desirable that the height adjustment system is not backdriveable so that, in the event of a crash, the forces are not transferred through the drive train of the actuating mechanism. In view of this concern, the leveling mechanism **20** further comprises a locking mechanism **38** with a ratchet and pawl for securing the cam **30** in place once the desired height is reached.

[0068] Alternatively, as shown in **FIGS. 6** and **7**, the CRS may include a liner extension mechanism **200** to adjust the height of the base **12**. A liner extension mechanism relies on motorized leg(s), which can be raised or lowered to achieve the required optimal angle. As with the rotational adjustment mechanism, the extendable foot is driven by a motor. The motor used to power the legs may be of any type, electrical or other, such as hydraulic. The motorized legs may extend and contract by means of a screw jack mechanism, scissor jack, cable and pulley, chain, hydraulic/pneumatic piston, or other type of mechanical mechanism. As illustrated in **FIG. 6**, in one embodiment of the automated leveling system with linear extension mechanism, a scissor jack mechanism is utilized. The scissor jack comprises scissor legs **202**, a motor and screw **204** for driving the movement of the legs **202**, a stabilization bridge **206** extending between corresponding scissor legs **202**, and a screw collar **208** engaged with the motor. The internal base of the CRS is mounted to the scissor legs **202** by mounting rails **210**. **FIG. 7** is a perspective view of the base **12** installed in a vehicle seat **216**. The foot **224** is in the extended position. The CRS is attached to the vehicle seat **216** by connectors **211** attached to a connector belt **214**.

[0069] For either the linear motion or rotational leveling mechanisms, it is desirable for the range of adjustment to exceed the height of the base. In this case, a telescoping or nesting covering is necessary to cover the mechanics throughout the entire range of extension. Furthermore, the rotational joint and linear elevation devices described above should not be construed as limiting the present invention as other mechanisms may be utilized to elevate and level the CRS.

[0070] The interaction between the CRS foot and base and the vehicle seat is very important. In order to prevent the CRS leg or base from becoming jammed during the installation process, the portion of the CRS that interfaces with the seat may be shaped in a way to facilitate sliding the CRS into the correct position. According to one embodiment, as shown in **FIG. 8**, this is accomplished with wheels **44** for rolling the base to the desired location on the vehicle seat **16**. A lip extension mechanism **46** extends from the foot **24**.

When the base **12** is installed, the lip extension mechanism **46** fits between the vehicle seat cushion and the back of the vehicle seat. A sensor **48** on the lip extension mechanism **46** records whether the CRS is in the proper position. Alternatively, a ski like plastic contour on the bottom of the CRS would be effective for sliding the CRS to the desired position.

[0071] In addition to use with the fully integrated CRS system described herein, the automated leveling system and tensioning mechanism are applicable to various formats of child restraint systems. These formats include, but are not limited to, rear-facing infant carriers, forward-facing and rear-facing convertible child seats, booster seats with harnesses and those for use with vehicle lap/shoulder belts. These child restraint systems may or may not contain a separate base component.

[0072] The automated CRS of the present invention also includes an integrated mechanism for automatic tightening of the connector belt. **FIGS. 9** through **14** depict this tensioning mechanism **60** for the CRS. The belt **14** extends from the connectors **2** to the CRS. The belt **14** is wound through and secured in place by the tensioning mechanism **60**.

[0073] As shown in **FIG. 9**, the tensioning mechanism **60** includes one or more tension detection sensors **64** located on the exterior of the carrier base **12** for measuring the tension of the belt **14** against the base **12** to ensure that the base is firmly attached to the vehicle seat. The belt **14** enters the tensioning mechanism **60** through a slot **72** located on the exterior of the carrier base **12**. The manual release **62** is also located on the top of the base **12**. A tension detection sensor is an electro-mechanical device for determining belt tension feedback. For instance, it is possible to mount strain gauge(s) or other load cell(s) to various support members of the CRS in order to measure forces which can be directly related to the tension of the connection belts. These gauges or load cells can be mounted to the support structures of the belt tightening mechanism, such that strains or loads on these members might be correlated to the tension of the belts as shown in **FIG. 9**. Alternatively, the gauges or load cells may also be mounted on the shaft of the belt tightening motor to relate torque deformation to belt tension. Alternatively, the gauges or load cells may also be mounted in the "legs" or other load bearing areas of the heightening mechanism or support structures, in order to determine forces related back to belt tension. The feedback from these torque and/or tension sensors is used to indicate to the CRS controller when the belt tightening motor/mechanism should be stopped due to reaching desired tension. Any combination of these measurement techniques can be used in concert to more accurately or robustly provide belt tension feedback.

[0074] FIGS. 10 and 11 are top-side view and bottom-side perspective views of the tensioning mechanism. The mechanism is located inside the carrier base 12. The tensioning mechanism 60 comprises a motor 66 which rotates a belt tightening spindle 68. The motor 66 is engagingly connected to the tightening spindle 68 by a Hirth coupling 70. In use, the belt 14 enters the tensioning mechanism 60 through a slot 72 in the base 12 located above the tensioning mechanism. Where the motor is controlled by a driver interfaced with the automatic control system of the CRS, the motor control is configured to monitor electrical current draw. The measurement can be used to determine the torque on the motor which is directly related to tension on the belt. Additionally, the measurement can be used to detect increase in current draw, indicating obstructions to the associated motor mechanism. Alternatively, the tension sensors 64 are used to monitor the tension of the belt 14.

[0075] One challenge in designing the belt tightening mechanism is that ideally the tightening mechanism should not be required to withstand crash forces to achieve appropriate safety standards. Having to account for crash forces would add significant cost and complexity to the design of the drive system. Instead, configuring the drive system as a non-backdriveable system satisfies necessary safety levels without the added complexity of needing to configure the mechanism to withstand crash forces. Although there are many such non-backdrivable drive mechanisms, the preferred embodiment according to the present invention uses a motor 66 to operate a locking mechanism 74 comprising a ratchet 75 and pawl 76. Alternatively, a motor could pull a friction-based mechanism similar to existing belt tensioning mechanisms that are common in the art. As shown in FIG. 11, the locking mechanism 74 is located between the spindle 68 and a manual overdrive crank 78. FIG. 12 depicts a more detailed view of the ratchet and pawl mechanism in which the belt tightening ratchet 75 is contacted by the spring loaded pawl 76. The pawl 76 prevents the ratchet 75 from rotating in a backwards direction.

[0076] When the drive mechanism is non-backdriveable, the system must be designed to allow for release of tension in some other manner so that the CRS may be removed from the vehicle seat. The belt tightening mechanism in FIGS. 10 and 11 can be manually disengaged in order to allow the user to uninstall the CRS. Although this could be automated by allowing the drive system to be reversible, for safety reasons, a manual approach is preferable. In this embodiment, a manual belt release latch 62 is located on one end of the tightening mechanism 60. Once the release latch 62 is engaged, a user can manually adjust tension using a manual overdrive crank 78 located on the other end of the tightening mechanism.



[0077] As shown in FIG. 13, the motorized belt tightening mechanism 60 is located in the interior of the infant carrier base 12. The tightening mechanism is accessible when the foot 24 of the leveling mechanism 20 is in the open position.

[0078] FIG. 14 depicts an alternate embodiment of the base and belt in which the belt 314 is held in a "routing orientation." The routing design allows the belt 314 to exert forces in both the downward and backward directions thereby more firmly attaching the base 312 to the vehicle seat. As shown in FIG. 14, the belt is attached to the carrier base by four loop holders 320 causing the belt to form a U-shaped curve.

[0079] A further challenge in the design of the drive mechanism is that the LATCH restraints connect on both the left and right sides of the CRS. Driving a single spindle fixedly attached to the CRS, for example, does not guarantee equal tension in both sides for all vehicle seat geometries. This may be acceptable for some cases, particularly if the attachment anchor points are well defined such as in the ISOFIX standard. In another embodiment, each side is motorized and tightened separately. This embodiment works particularly well for CRS systems that can be mounted forward or rear-facing which often are designed with independently adjustable tethers. A third embodiment uses a single drive system that is not fixedly attached to the CRS. Instead, the drive system is mounted in such a way that it freely slides laterally between a set of end points or pivots in such a way that tension between the sides is equalized. The slideable mechanism is preferred due to the limited space available for the drive system. The drive system should be configured so as not to change the location of the child's center of gravity, nor to infringe on the child's space.

[0080] The functions of the leveling mechanism and tensioning mechanisms are directed according to an automated installation process. The automated installation process is controlled by a CRS controller comprising a microprocessor and associated electronics. The controller may be integrated into the CRS or self-contained and attachable to the CRS externally. The CRS controller may be wired or wirelessly interfaced with the various sensors disclosed. Some, or the entire control algorithm, may also be realized with discrete analog components in lieu of a digital microcontroller where possible.

[0081] FIG. 15A is a block diagram of the microcontroller, sensors, and additional electronic components of a CRS according one embodiment of the present invention. As depicted in FIG. 15A, the microcontroller 500 receives input from latch sensors 502, level sensors 504, and tension sensors 506. Additional data may also be received from child sensors 508 located on the infant carrier including a child restraint sensor 510 and other environmental sensors 510 located throughout the CRS. The controller 500 receives power

from a power system 514 such as a battery 516. Optionally, the controller 500 also receives power from a generator 518 responsive to the motion of the vehicle or from the vehicle itself through a power adapter connected to the vehicle's power outlet 520. The controller 500 may manage how power is stored and distributed to the electronic components of the CRS. Similarly the microcontroller 500 may reduce power consumption by turning sensors and motors on and off at appropriate times. The controller 500 is also in connection with the user interface 522. The controller 500 receives input from a user, such as the weight and age of the child, via the user interface 522. Based on the input data, the installation and monitoring functions of the CRS may be adapted to better correspond to the size and age of the child to be secured. The CRS may also rely on input data to signal to the user how the CRS should be positioned and secured (e.g. front facing or backwards facing, secured using the LATCH system or a seat belt). Similarly, the controller 500 manages when and how data is displayed to a user on the user interface 522. The microcontroller 500 also manages when the leveling and tensioning motors 28, 66 are turned on and off according to an installation algorithm described in greater detail below.

[0082] In a NHTSA study and manufacturer literature, it is recommended that a vehicle be parked on level ground before installing a CRS. The automated leveling mechanism of the present invention approximates being parked on level ground by determining the slope of the vehicle. This angle is in reference to a known "level" ground, which would be a plane perpendicular to gravity. Since this reference point can be determined, it is unnecessary for the vehicle to be parked on a level surface during installation, as the control algorithm will compensate for an un-level ground surface by incorporating the degrees from actual level during leveling control. Feedback of the CRS angle is achieved by a single or multiple axis accelerometer(s), or other like sensor, with the ability to indicate its angle with respect to Earth's gravity, providing a graduated electrical analog or digital signal. This signal has sufficient resolution in order to make informed control decisions related to feedback of CRS angle. Ideally, a seat back angle between 30 and 45 degrees in respect to level ground should be achieved when the CRS is placed in a rear-facing position.

[0083] The installation process begins with a calibration cycle. **FIG. 15B** is a flow chart depicting a calibration cycle as adapted for use with one embodiment of the CRS carrier. First, the user is instructed to place the CRS on the ground in a specific orientation parallel to the major axis of the vehicle. The angle of the ground relative to gravity is measured by the accelerometer.

[0084] A second option for determining the base angle is to have a reference puck that is independently moveable from the CRS but able to communicate via wires or wireless communication. This puck can be placed on a level surface such as the ground or the vehicle floor during the installation calibration portion. The puck should be designed in such a way that the intended orientation of the puck during this calibration process is readily evident.

[0085] A third related option to the puck is to have a foot extending from the CRS adapted to engage with the vehicle floor. The vehicle floor can be assumed to be level as a calibration surface. The relative angle between the foot at the base can be used to determine the reference angle. The leveling and tightening algorithms disclosed here could also be applied to a system without the calibration mechanism by instructing the user to first drive the car to a level pad similar to existing installation instructions.

[0086] Once the base angle ( $\Theta_B$ ) is determined, the CRS compares  $\Theta_B$  to a maximum angle ( $\Theta_{Max}$ ). The maximum angle is a preset value which represents the maximum slope on which a vehicle can be parked before it is unsafe to install the CRS. If the maximum angle is too great, the CRS instructs the user to move to more level ground before installing the CRS. If the slope is not greater than the maximum value ( $\Theta_B < \Theta_{Max}$ ), the base angle ( $\Theta_B$ ) is recorded for use during installation. Then the user is alerted that the device is ready for install. At that point, the user places the carrier base on the vehicle seat, secures the connection belt to the LATCH system or other attachment mechanism such as a seat belt system, and begins the installation process by pressing an activation button located on the user interface.

[0087] One embodiment of the installation algorithm, as shown schematically in **FIG. 15C**, utilizes an iterative process in which foot elevation and tension are modified in small increments to arrive at a desired angle and belt tension level. **FIG. 15C** is a flow chart depicting this iterative process.

[0088] As described above, before the installation process is started, the CRS must be calibrated to determine the angle ( $\Theta_B$ ) of the ground on which the vehicle is parked. After calibration, a plurality of system sensors are read to ensure that the CRS is safe for use. This unique feature in the automated install process allows the system to prevent installation of a CRS that may not be safe. For example, since materials degrade (e.g., polymer hysteresis) over time, each CRS is given an expiration date at the time of manufacture. If the current date exceeds the expiration date, the CRS controller can either warn the user or prevent installation according to a predefined set of rules. Similarly, after a CRS is in a crash, even if there is no externally visible damage, internal damage may mean the seat is unsafe. By either monitoring an accelerometer in the X-Y plane or by use of a mechanical fuse that

permanently deforms when subjected to a force in excess of a predetermined amount, the CRS controller can determine when the seat should no longer be used. In this case, the CRS system either warns the user or prevents installation entirely. Similarly, the CRS may alert the user that the vehicle is parked on such a steep grade (beyond 22 degrees) that it would be unsafe to install the CRS.

[0089] Optionally, at this point, the CRS control system can simplify the installation process by soliciting metadata from the user such as the child's age, height, or weight, or the vehicle in which the seat is being installed in order to recommend that the seat be installed forward-facing or rear-facing, where the shoulder straps need to be positioned, or the safest place to install the seat in this model of vehicle. Alternatively, the height or the weight of the child may be determined by sensors associated with the car seat.

[0090] If sensors indicate that the device is safe ( $S_n$ =yes) then the automated system moves forward to the next installation step. At this point, a sensor reads the angle  $\Theta$ .  $\Theta$  is the angle of the device in relation to actual level (e.g., a level perpendicular to gravitational force). The sensor is preferably a three axis accelerometer capable of measuring this orientation.

[0091] If  $\Theta$  is less than a calculated level, and the leveling motor is not already engaged, a signal is sent to the motor to turn on. Turning on the motor increases the height of the foot thereby increasing  $\Theta$ . The calculated level is equal to the calibration angle  $\Theta_B$  plus a predetermined overshoot value. The overshoot value means that the motor will continue to run elevating the base beyond the level position. Once  $\Theta$  equals the calculated level, the level motor is turned off.

[0092] After the level motor is turned off, the tension of the belt ( $F_T$ ) is read by the tension sensor. Possible tension sensors include a strain gauge, a pressure gauge, or other mechanical sensor. In a similar feedback loop to the process for the leveling motor, if  $F_T$  is less than the desired tension, the motor will continue to run until the desired tension is reached. Since the tension mechanism is non-backdrivable, if  $F_T$  exceeds the desired tension, the installation fails and must be started again. In an iterative process, once the tension motor is turned off, the leveling angle  $\Theta$  is once again measured. If  $\Theta$  is within range (preferably defined as within 5 degrees of  $\Theta_B$ ), and  $F_T$  has not exceeded the desired tension, the system will alert the user that installation was successful. If  $\Theta$  is above range, the level motor is turned on to decrease  $\Theta$  slightly. Once the level motor is turned off, the tension motor is turned on to increase the tension on the belts to the desired level. If, however,  $\Theta$  is below the desired range, the system will alert the user that installation was unsuccessful.

[0093] The iterative leveling algorithm described above is but one of many algorithms in which the leveling sensors and mechanism may be used alone or in combination with the tensioning sensors and mechanism to effectively automatically level the CRS. For example, the leveling mechanism and sensor may independently level the CRS. In this case, a simpler leveling algorithm would be employed in which the height of the elevating foot would be increased until the desired predetermined angle is achieved. The predetermined angle could either be based on a factory set value or an angle determined using the calibration procedure described above and depicted in FIG. 15B. In the case of a factory preset value, it would be necessary for the vehicle to be parked on relatively level ground. As described above, the calibration procedure can be used to install the seat base even when the ground is not level.

[0094] Alternatively, the leveling sensor could be used in combination solely with a tensioning mechanism whereby the tension on the belt is continually increased until the leveling sensors determine that the CRS has reached the correct angle. Similarly, the leveling mechanism could continue to increase the elevation of the foot until a predetermined belt tension as measured by the tension sensor is achieved. In that instance, the leveling mechanism is adjusted solely in response to input from the tensioning sensor. It is understood that the present invention could be used with any of these leveling algorithms.

[0095] Another possible automatic installation algorithm modifies level and tension independently to place the CRS in the desired orientation. Specifically, an installation process which modifies elevation of the foot and tension either simultaneously or sequentially may be useful in certain situations. For example, CRSs for use with the ISOFIX system, can be designed with the rotational angle adjustment system on top of a fixed frame so that the device can be first tightened and then leveled independently. In this case, the position of the rotational frame has no impact on the tension in the restraint system. Therefore, a simpler installation algorithm of tightening and then adjusting the angle is sufficient. It is preferable to design the LATCH restraints and supporting hardware in such a way as to direct forces both down towards the seat cushion and back toward the seat back.

[0096] The threshold values for angle ( $\Theta$ ) and belt tension ( $F_T$ ) are based on the recommended NHTSA CRS installation criteria or the recommendation of other scientific boards. For example, NHTSA recommends that the tension in each LATCH belt be 53.5-67 N (12-15 lbf). A controller implemented with a microcontroller may be reprogrammable and thus updateable when the criteria are updated. In addition, the algorithm can be updated by the user based on the user's experience with the CRS. The controller may also be configured to store usage data, with the ability to download and analyze data offline by the manufacturer.

[0097] Another common CRS installation failure is when users incorrectly twist the LATCH restraint's webbing while fastening them to the tethers. When the CRS controller detects this state, it can warn the user and prevent installation. One option for detecting that the restraint is twisted is to embed wires in the webbing fabric such as piezo-elements. Because of the cost and complexity of this solution, the preferred embodiment is a combination of mechanical guides that inhibit twisting of the LATCH restraint's webbing and sensors that determine when the LATCH restraints are oriented correctly into the attachment anchor points of the vehicle.

[0098] It is further envisioned that the CRS control system be able to determine whether a child is present in the seat. Sensors capable of detecting the child include one or more of a weight sensor in the infant carrier, a sensor for determining whether the harness is buckled, or a heat sensor, visual sensor, or strain gauge, for directly measuring the child. Accordingly, every time the system detects that a child is in the seat, the interface could provide feedback to the caregiver on the readiness and safety of the CRS. Such feedback may include, but is not limited, to confirmation that the seat is at the proper level, that the vehicle based restraint system is at the proper tension, that the infant carrier handle is at the correct position, that the LATCH restraints are not twisted, that the child restraints are at the proper tension, or that the child restraints are at the proper height. If any input is deemed unsafe by the system, the system can alert the caregiver or optionally make adjustments. Additionally the control system may provide feedback on the conditions of the vehicle such as the temperature, and optionally alert if the conditions are deemed unsafe. This process may occur on a rear-facing infant carrier whenever it is detected that the infant carrier has been connected to the base.

[0099] It is important that this check be conducted every time a child is placed in the seat since even conditions that were checked during the installation process may change over time. For example, it is very common for a CRS that is installed with the passenger seat belt system to become accidentally detached when the seat belt is unbuckled. The automatic CRS can be configured with a seat belt tension sensor located on the CRS base to warn the user when the seat belt is unbuckled. When installed correctly, the seat belt passes over the seat belt tension sensor and exerts force against the CRS base. When the belt is too loose or unbuckled entirely the tension against the CRS base is decreased. In this case, the CRS warns the user that the CRS is unsafe for use and must be installed again. The arrangement of the seat belt tension sensor is similar to the arrangement of automatic tensioning mechanisms as depicted in FIG. 9.

[00100] Another common problem is that the hysteresis of the vehicle seat foam changes over time causing the tension in the LATCH straps and the angle of the CRS to change as well. In this case, the CRS controller could either alert the user or engage one or more of the tension or leveling drive systems to fix the issue.

[00101] When the check is conducted when a child is detected, the CRS control system can make recommendations to the user based on metadata, namely predefined rules. For example, if the child is detected to be below a certain weight or certain height, the system can recommend that the seat be installed in a rear-facing orientation. If the total weight exceeds the recommended weight limit for LATCH, the CRS controller can recommend using the vehicle seat belt. If the current date exceeds the expiration date programmed at the factory, a warning can be issued. If the system has detected forces consistent with a crash that may have damaged the CRS, the caregiver can be alerted so that the child is not put in an unsafe seat.

[00102] The CRS interface may gather information on the height and weight of the child present. Optical sensors or contact sensors at varying heights can determine the height of a child's shoulders, which can be used to convey feedback to the caregiver on the proper use of the CRS. Optionally, the height of the restraints can be adjusted automatically or by the caregiver with the assistance of a motorized mechanism. Since the recommended height of the system depends not only on the height of the child, but the orientation of the CRS, the CRS can be equipped with sensors including, but not limited to, one or more pressure sensors in the base or an accelerometer to determine whether it is installed forward-facing or rear-facing.

[00103] One challenge in designing a commercially viable seat with electronics is reducing the burden on the caregiver of maintaining a sufficient battery level. The power providing elements of the CRS are depicted in FIG. 16. In the simplest configuration, the CRS includes a battery 98 for providing power to the motors and plurality of sensors. The battery 98 is located in the interior of the carrier base 12. The battery may be removable from the base and rechargeable. In addition, the CRS could be configured to receive power from the vehicle's power outlet (*e.g.*, a cigarette lighter outlet). In that case, the CRS base would include a socket for receiving the power adapter. Power from the adapter could power the CRS during installation or recharge the battery. According to the embodiment of the CRS depicted in FIG. 16, the CRS base further comprises a self generating power production mechanism 96 connected to the battery 98 and plurality of CRS sensors. Since the CRS is mounted on a mobile platform (*e.g.*, a motor vehicle), the power production mechanism is

subject to forces as the vehicle is driven around. A linear generator is a very simple option for generating electric energy from the motion of the vehicle. A magnet internal to the CRS base can pass through a coil which will generate electricity that can be stored in a battery. Alternatively, other known mechanisms for generating power, such as a pendulum or piezoelectric element, could be used.

[00104] The CRS may be configured with a two level system for power consumption. One system is used only for monitoring the system parameters and controlling the user interface. This system is designed to be very low power. The second power system is used to drive the motors in the installation process and, therefore, uses higher amounts of energy. The power source for the first system is preferred to be a battery. The power supply for the second system may be a separate battery or may be an input from the vehicle's power jack. This secondary or backup system guarantees that power is preserved for the user interface.

[00105] In one embodiment, the CRS controller further includes a user interface to receive user input to trigger the setup and installation procedures. As depicted in **FIG. 17**, the user interface components are assembled in a discrete package, representing a "control center." The control center **90** is located on the side of the infant carrier base **12**. According to one embodiment, the user interface is a visual display including installation control buttons **92** for activating and directing the installation process. Optionally, the interface also includes a keypad, touch screen, voice recognition, remote control, or other inputs. The other inputs allow a user to enter metadata about the child to tailor installation for the characteristics of the specific child (*e.g.*, height, weight, age). The CRS controller may interface, either through a wired connection or wirelessly, with mobile media devices (such as smartphones, laptops, tablet PCs, etc.) for control and feedback.

[00106] One unique feature of the CRS system is the ability to continually monitor the CRS and to provide information regarding the safety of the CRS to the user in real time. To accomplish this purpose, the control center **90** further includes safety indicators **94**. The indicators provide feedback to the user as to the state of the CRS installation and general safety of the CRS. This data is relayed to the CRS controller and control center from the plurality of sensors located throughout the CRS. The information relayed may include confirmation that connectors are correctly locked to the LATCH system on the vehicle seat, information about the tension on the belt, CRS leveling, and/or conformation that the carrier is correctly attached to the base. According to one embodiment, the feedback is visual, having any form of LEDs. User interface components may also be distributed throughout the CRS at strategic locations (*i.e.*, LEDs indicating proper belt latching placed nearby the



latching locations). Alternative feedback indicators include an LCD display, or audible and/or tactile feedback devices.

[00107] The CRS controller may also direct reinstallation of the CRS base if monitoring sensors indicate that the installation is no longer correct (e.g., the base is no longer level or the belts have loosened). According to a monitoring and reinstallation algorithm, data is obtained from the level sensor. If the CRS is not level, the elevation of the foot and the tension of the belt are adjusted according to the iterative process described above.

[00108] In addition to the control center, the CRS controller may optionally communicate to a user through a wired connection or wirelessly with the vehicle's on board computer in order to integrate the data from the user interface into the vehicle control system or provide it to an external system such as OnStar.

[00109] According to another embodiment of the CRS control center, the control center is situated on the removable infant carrier rather than on the base for increased convenience for the user. In this case, power and communication may be passed from the base to the carrier by means of a common blind mate connector such as a fork and blade connector or set of contact plates. With such a connection, information on the position of the carrier handlebar can be sensed and included in the interface so that the user can be warned if it is not in the manufacturer's recommended use position or transmitted down to the base for additional processing by the control system there. One embodiment of the power connection is depicted in **FIG. 18**.

[00110] The CRS further comprises the infant carrier adapted to connect to the carrier base. **FIGS. 19, 20A, and 20B** are schematic drawings of the latching mechanism for connecting the carrier **100** to the base **12**. The latching mechanism comprises a base connector tooth **102** on the base **12** adapted to surround and hold a bar **104** of the carrier **100**. **FIG. 19** is a schematic drawing of the carrier attached to the base with a partial section view of the latching mechanism. **FIGS. 20A and 20B** are schematic drawings of the latching mechanism detached from the carrier and base. As shown in each figure, the latch further comprises a metal detector sensor **106** for identifying the presence of the bar from the CRS connector. Based on data from the latch sensor, the control center **90** alerts the user when the carrier **100** and base **12** are correctly connected together. Optionally, the carrier and base are also connected by a power connection. As shown in **FIG. 18**, the base **12** includes a power socket **110** which connects to a power connector **112** on the infant carrier **100**. The connection provides power to sensors and allows data from sensors located on the carrier to pass to the CRS controller and user interface. In the embodiment of the CRS depicted in

**FIG. 18**, the control center **120** is located on the carrier **100**. Alternatively, the control center may be an individual electronic module communicating with a controller of the child seat via a wire or wirelessly.

[00111] With reference to **FIG. 21**, another accessory optionally included in the CRS is a restraint accessory comprising a motorized tensioner **130** for the infant harness **132**. Harness webbing **132** is wound through a motorized tensioner **130** mechanism to tighten or loosen the harness **132**. The harness **132** secures a child within the infant carrier **100**. Included on the harness are harness tension sensors **134** to measure the tension against the child. Sensors which can be used for this purpose include strain gauges, pressure gauges, or other types of mechanical sensors.

[00112] Another feature optionally included with the infant carrier is an automated height adjustment mechanism. **FIG. 22** is a schematic drawing of the back of the infant carrier **100** with a height adjustment mechanism for adjusting the height of the harness **132** based on the size of the child. The carrier comprises a harness height adjust screw **140** attached to a motor mechanism **142** for height adjustment. The harness **132** is wound through the harness guide attached to the screw **140**, which is coupled to the motor mechanism **142**. The screw **140** is used to adjust the height of the harness by raising or lowering the harness guide and harness **132**. A sensor **144** for determining the correct harness position for the child is included on the carrier **100** to measure the height of the child and to determine the correct level for the harness based on that measurement.

[00113] With reference to **FIGS. 23** through **28**, a variation to the full intelligent and automated CRS system is an intelligent latching device which can be adapted for use with an existing CRS **400**. The intelligent restraint system could either replace the existing LATCH connectors included with the child car seat or could be designed to go between the existing CRS LATCH connectors and the vehicle attachment anchor points. In either case, much of the same technology described above still applies. The preferred embodiment for the tensioning drive is a ratchet and pawl system with a manual override for releasing tension on the webbing (*see FIG. 14*). The system comprises a belt **402** forming a loop for attachment to the CRS **400**. A motorized latch and tensioner attachment **404** increases tension on the belt to hold the CRS in place.

[00114] More specifically, and with reference to **FIGS. 24** through **27**, one embodiment of the latch and tensioner attachment **404** includes a spindle **414** turned by a gear train **418** and driven by a motor **420**. The motor **420**, gear train **418**, and spindle **414** are located within the attachment **404** and are encased within a motor/spindle cover **412** and gear train cover **419**

respectively. The belt 402 is wound around the spindle 414. Webbing guides 408 located on exterior sides of the motor/spindle cover 412 direct the belt 402 to and from the spindle 414 through slots 410 in the motor/spindle cover 412. The tension on the belt 402 increases as the spindle 414 is wound. The motor 420 may be electrical or of any other suitable type such as hydraulic. A spindle end 416 extends beyond the motor/spindle cover 412 and can be turned manually by a user to adjust the tension of the belt 402.

[00115] As shown in FIG. 23, a connector 406 is connected to the motorized latch and tensioner attachment 404. The connector 406 is adapted for attachment to the CRS LATCH system. Sensors such as strain gauges could determine when connectors located on each side of the CRS are tightened to the correct tension. The left and right sides should preferably be coupled together electronically so that they can be synchronized during the installation process. There may be optionally a user interface to provide feedback including that the latches are engaged with the vehicle anchors, that tension in the belts is correct, battery level, etc. The user interface may also optionally guide the user through the installation process by soliciting metadata and providing audio or visual instructions. As with the power mechanism for the full CRS described above, the latching device could be self-powered by a generator powered by the motion of the vehicle.

[00116] FIG. 28 is a flow chart depicting the steps followed by the intelligent latching device for increasing the tension of the belt 402. As in other algorithms used with the CRS, data from the plurality of sensors is acquired to determine whether the CRS can be safely installed (*e.g.*, vehicle is within an acceptable range of level, CRS is structurally sound, and connectors are latched to LATCH system or a seat belt). If the CRS is safe ( $S_N = \text{yes}$ ) a reading from the tension sensor on the belt is obtained. If the tension ( $F_T$ ) is less than the desired tension ( $F_{SP}$ ) then the tension motor is turned. The motor remains on until  $F_T$  is equal to (or within an acceptable range) of  $F_{SP}$ . At that point, the tension motor is turned off. The user is alerted that the belt tension is correct.

[00117] Although the invention has been described in detail for the purpose of illustration based on what is currently considered to be the most practical and preferred embodiments, it is to be understood that such detail is solely for that purpose and that the invention is not limited to the disclosed embodiments, but, on the contrary, is intended to cover modifications and equivalent arrangements. For example, it is to be understood that the present invention contemplates that, to the extent possible, one or more features of any embodiment can be combined with one or more features of any other embodiment.

## THE INVENTION CLAIMED IS

1. A child seat configured to be secured to a seat of a vehicle, comprising:  
a seat base secured to the seat of the vehicle;  
a child receiving portion supported by the seat base;  
a belt tensioning system incorporated into the seat base for receiving a belt that couples the seat base to the seat of the vehicle;  
a leveling system incorporated into the seat base for leveling the seat base relative to the seat of the vehicle; and  
a controller operatively coupled to the belt tensioning system and the leveling system,  
wherein the controller activates the belt tensioning system and the leveling system such that the belt tensioning system tensions the belt to a predetermined tension and the leveling system levels the seat base to a predetermined angle relative to the seat of the vehicle.
2. The child seat of claim 1, wherein the controller activates the belt tensioning system and the leveling system iteratively.
3. The child seat of claim 1, wherein the controller activates the belt tensioning system and the leveling system simultaneously.
4. The child seat of claim 1, wherein the controller activates the belt tensioning system and the leveling system sequentially.
5. The child seat of claim 1, wherein the belt received by the belt tensioning system is at least one of a seat belt of the vehicle or a belt of a LATCH system.
6. The child seat of claim 1, wherein the child seat is selected from the group comprising: rear-facing infant carriers; forward-facing and rear-facing convertible child seats; and booster seats with harnesses.

7. The child seat of claim 1, further comprising:  
at least one sensor for determining tension of the belt received by the belt tensioning system; and

at least one sensor for determining the angle of the seat base relative to the seat of the vehicle.

8. The child seat of claim 7, wherein the at least one sensor for determining tension and the at least one sensor for determining the angle are operatively coupled to the controller.

9. The child seat of claim 8, wherein the controller activates the belt tensioning system and the leveling system such that the belt tensioning system tensions the belt to a predetermined tension and the leveling system levels the seat base to a predetermined angle relative to the seat of the vehicle based on feedback from the at least one sensor for determining tension and the at least one sensor for determining the angle.

10. The child seat of claim 1, further comprising a user interface positioned on at least one of the seat base or the child receiving portion to allow a user to initiate the belt tensioning system and the leveling system.

11. The child seat of claim 10, wherein the user interface provides feedback to the user of a status of the child seat.

12. The child seat of claim 1, wherein the leveling system is configured to raise and lower a foot connected to a bottom surface of the seat base.

13. A child seat configured to be secured to a seat of a vehicle, comprising:  
a seat base secured to the seat of the vehicle;  
a child receiving portion supported by the seat base;  
a leveling system incorporated into the seat base for leveling the seat base relative to the seat of the vehicle; and  
a controller operatively coupled to the belt tensioning system and the leveling system,

wherein the controller receives feedback from at least one sensor associated with the child seat of an angle of the seat base relative to the seat of the vehicle and provides an indication to a user of the angle of the seat base relative to the seat of the vehicle.

14. The child seat of claim 13, wherein the indication is a visual indication provided on a display connected to at least one of the seat base or the child receiving portion.

15. The child seat of claim 13, wherein the indication is at least one of a visual or audible indication that the seat base is positioned relative to the seat of the vehicle at an acceptable angle.

16. The child seat of claim 15, wherein the acceptable angle is determined by the controller by comparing the angle of the seat base relative to the seat of the vehicle determined by the at least one sensor with a predetermined angle.

17. The child seat of claim 16, wherein the predetermined angle is at least one of a factory set angle, an angle determined by calibrating the car seat relative to a surface on which the vehicle is resting, or an angle determined by calibrating the car seat relative to a surface of the vehicle.

18. The child seat of claim 13, wherein the leveling system is manually activated to level the seat base to a predetermined angle.

19. The child seat of claim 13, wherein the leveling system is activated by the controller to level the seat base based on feedback from the at least one sensor.

20. The child seat of claim 13, further comprising:  
a belt tensioning system incorporated into the seat base for receiving a belt that couples the seat base to the seat of the vehicle.

21. The child seat of claim 20, wherein the controller receives feedback from at least one sensor associated with the belt that couples the seat base to the seat of the vehicle and provides an indication to a user of the tension on the belt.

22. The child seat of claim 21, wherein the belt received by the belt tensioning system is at least one of a seat belt of the vehicle or a belt of a LATCH system.

23. The child seat of claim 20, wherein the belt tensioning system is manually activated to tension the belt to a predetermined tension.

24. The child seat of claim 21, wherein the belt tensioning system is activated by the controller to tension the belt based on feedback from the at least one sensor.

25. A child car seat comprising:  
a seat base secured to a seat of a vehicle;  
an infant carrier removably connected to the seat base;  
a belt tensioning system incorporated into the seat base for receiving a belt that couples the seat base to the seat of the vehicle;  
a leveling system incorporated into the seat base for leveling the seat base relative to the seat of the vehicle; and  
a controller operatively coupled to the belt tensioning system and the leveling system,  
wherein the controller activates the belt tensioning system and the leveling system such that the belt tensioning system tensions the belt to a predetermined tension and the leveling system levels the seat base to a predetermined angle relative to the seat of the vehicle.

26. A child car seat comprising:  
a seat base secured to a seat of a vehicle;  
an infant carrier removably connected to the seat base; and  
an interface device coupled to at least one of the seat base or the infant carrier and configured to provide an indication to a user that the seat base is properly secured to the seat of the vehicle.

27. The child car seat of claim 26, wherein the interface device provides the indication to the user when the infant carrier is connected to the seat base.

28. The child car seat of claim 26, wherein the interface device comprises a display providing a visual indication to the user that the seat base is properly secured to the seat.

29. The child car seat of claim 26, further comprising:  
a plurality of sensors associated with at least one of the seat base and the infant carrier and configured to determine whether the seat base is at a proper level, a belt securing the seat base to the seat of the vehicle is at a proper tension, a handle of the infant carrier is at a correct position, the belts securing the seat base to the seat of the vehicle are not twisted, a harness securing a child within the infant carrier is at a proper tension and a proper height, or any combination thereof.

30. The child car seat of claim 29, further comprising:  
a controller operably coupled with the plurality of sensors and configured to output to the interface device the indication that the seat base is properly secured to the seat of the vehicle.

31. The child car seat of claim 30, wherein the indication that the seat base is properly secured to the seat of the vehicle comprises an indication that the seat base is at a proper level, that a belt securing the seat base to the seat of the vehicle is at a proper tension, that a handle of the infant carrier is at a correct position, that the belts securing the seat base to the seat of the vehicle are not twisted, that a harness securing a child within the infant carrier is at a proper tension and a proper height, or any combination thereof.

32. The child car seat of claim 26, further comprising:  
a belt tensioning system incorporated into the seat base for receiving a belt that couples the seat base to the seat of the vehicle; and  
a leveling system incorporated into the seat base for leveling the seat base relative to the seat of the vehicle.

33. The child car seat of claim 32, further comprising:  
a controller operatively coupled to the belt tensioning system and the leveling system,



wherein the controller activates the belt tensioning system and the leveling system such that the belt tensioning system tensions the belt to a predetermined tension and the leveling system levels the seat base to a predetermined angle relative to the seat of the vehicle.

34. The child car seat of claim 32, wherein the belt received by the belt tensioning system is at least one of a seat belt of the vehicle or a belt of a LATCH system.

35. The child car seat of claim 33, further comprising:  
at least one sensor for determining tension of the belt received by the belt tensioning system; and

at least one sensor for determining the angle of the seat base relative to the seat of the vehicle.

36. The child car seat of claim 35, wherein the at least one sensor for determining tension and the at least one sensor for determining the angle are operatively coupled to the controller.

37. The child car seat of claim 36, wherein the controller activates the belt tensioning system and the leveling system such that the belt tensioning system tensions the belt to a predetermined tension and the leveling system levels the seat base to a predetermined angle relative to the seat of the vehicle based on feedback from the at least one sensor for determining tension and the at least one sensor for determining the angle.

38. A child car seat comprising:  
a seat base secured to a seat of a vehicle;  
a child receiving portion coupled to the seat base;  
at least one sensor associated with at least one of the child receiving portion or the seat base configured to determine the presence of an object within the child receiving portion; and

an interface device coupled to at least one of the seat base or the child receiving portion and configured to provide an indication to a user that the seat base is properly secured to the seat of the vehicle when the at least one sensor provides an indication that an object is present within the child receiving portion.

39. The child car seat of claim 38, wherein the child receiving portion is removably coupled to the seat base.

40. The child car seat of claim 38, wherein the at least one sensor associated with at least one of the child receiving portion or the seat base is configured to determine at least one of the height and the weight of the object within the child receiving portion.

41. The child car seat of claim 40, wherein if the at least one sensor determines that at least one of the height and weight of the object are below a predetermined value, an indication is provided on the user interface that the child car seat should be installed in a rear-facing orientation.

42. A child car seat comprising:  
a seat body coupled to a seat of a vehicle;  
a plurality of sensors associated with the seat body; and  
an interface device connected to the seat body and configured to provide an indication to a user that the seat body is properly secured to the seat of the vehicle based on feedback from the plurality of sensors.

43. The child car seat of claim 42, wherein the plurality of sensors associated with the seat body are configured to determine whether the seat base is at a proper level, a belt securing the seat base to the seat of the vehicle is at a proper tension, a handle of the infant carrier is at a correct position, the belts securing the seat base to the seat of the vehicle are not twisted, a harness securing a child within the infant carrier is at a proper tension and a proper height, or any combination thereof.

44. The child car seat of claim 43, further comprising:  
a controller operably coupled with the plurality of sensors and configured to output to the interface device the indication that the seat base is properly secured to the seat of the vehicle.

45. The child car seat of claim 44, wherein the indication that the seat base is properly secured to the seat of the vehicle comprises an indication that the seat base is at a

proper level, that a belt securing the seat base to the seat of the vehicle is at a proper tension, that a handle of the infant carrier is at a correct position, that the belts securing the seat base to the seat of the vehicle are not twisted, that a harness securing a child within the infant carrier is at a proper tension and a proper height, or any combination thereof.

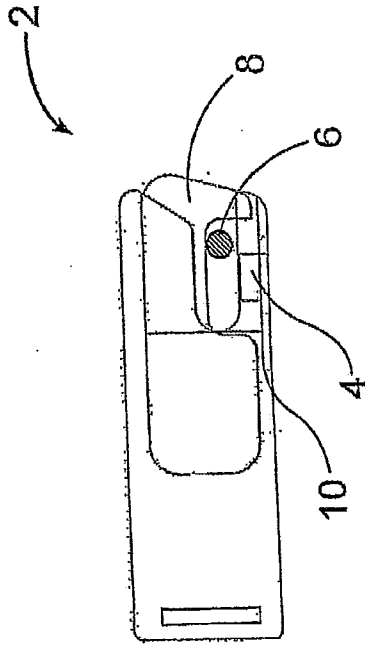

FIG. 1A

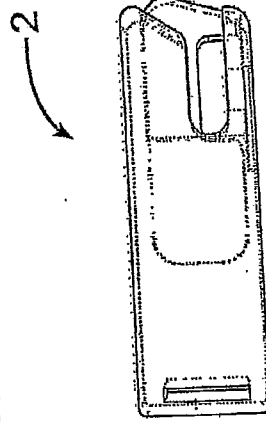

FIG. 1C

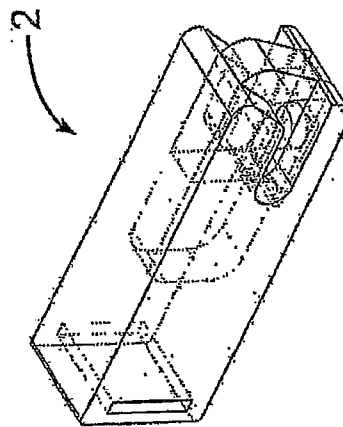

FIG. 1B

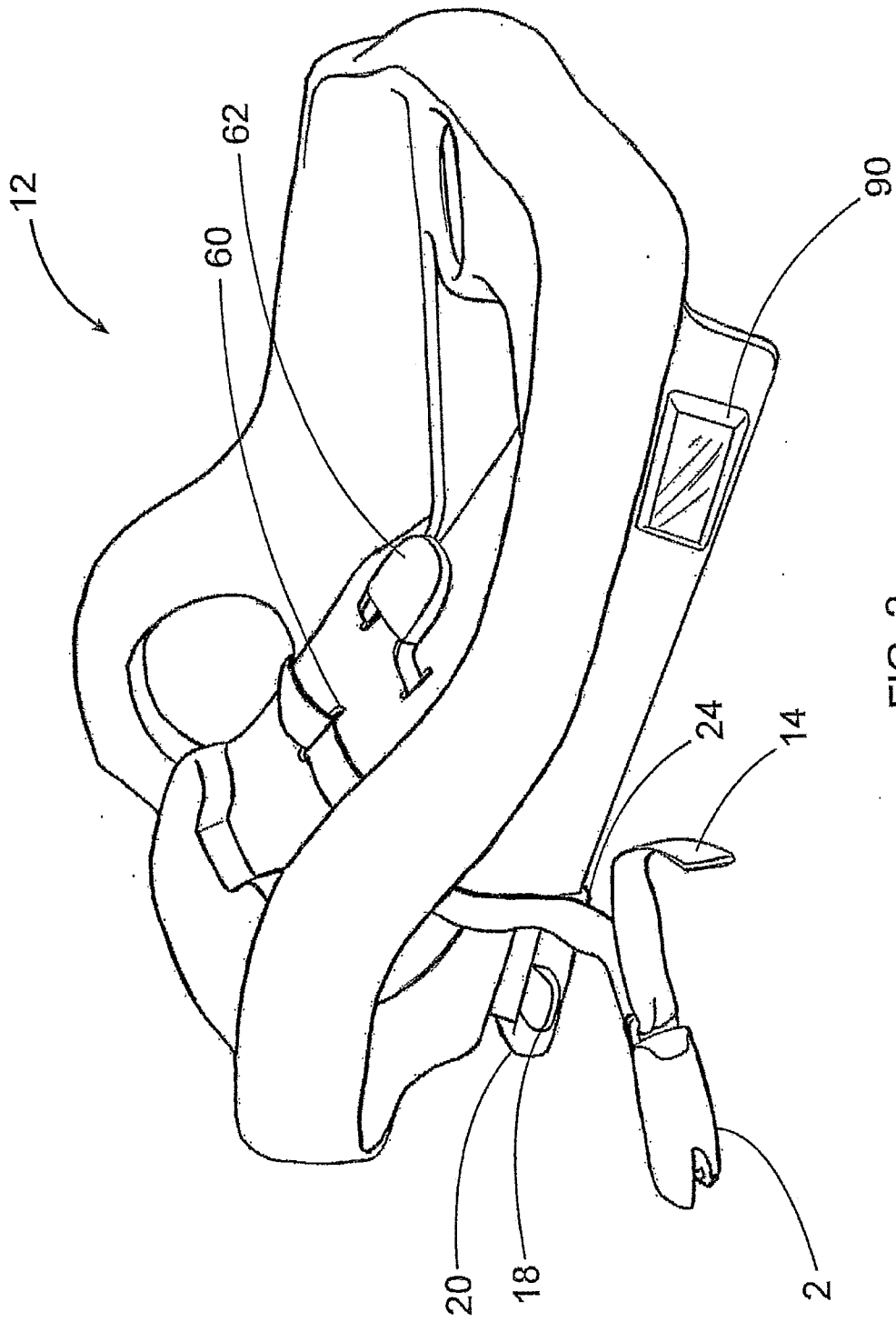

FIG. 2

3/29

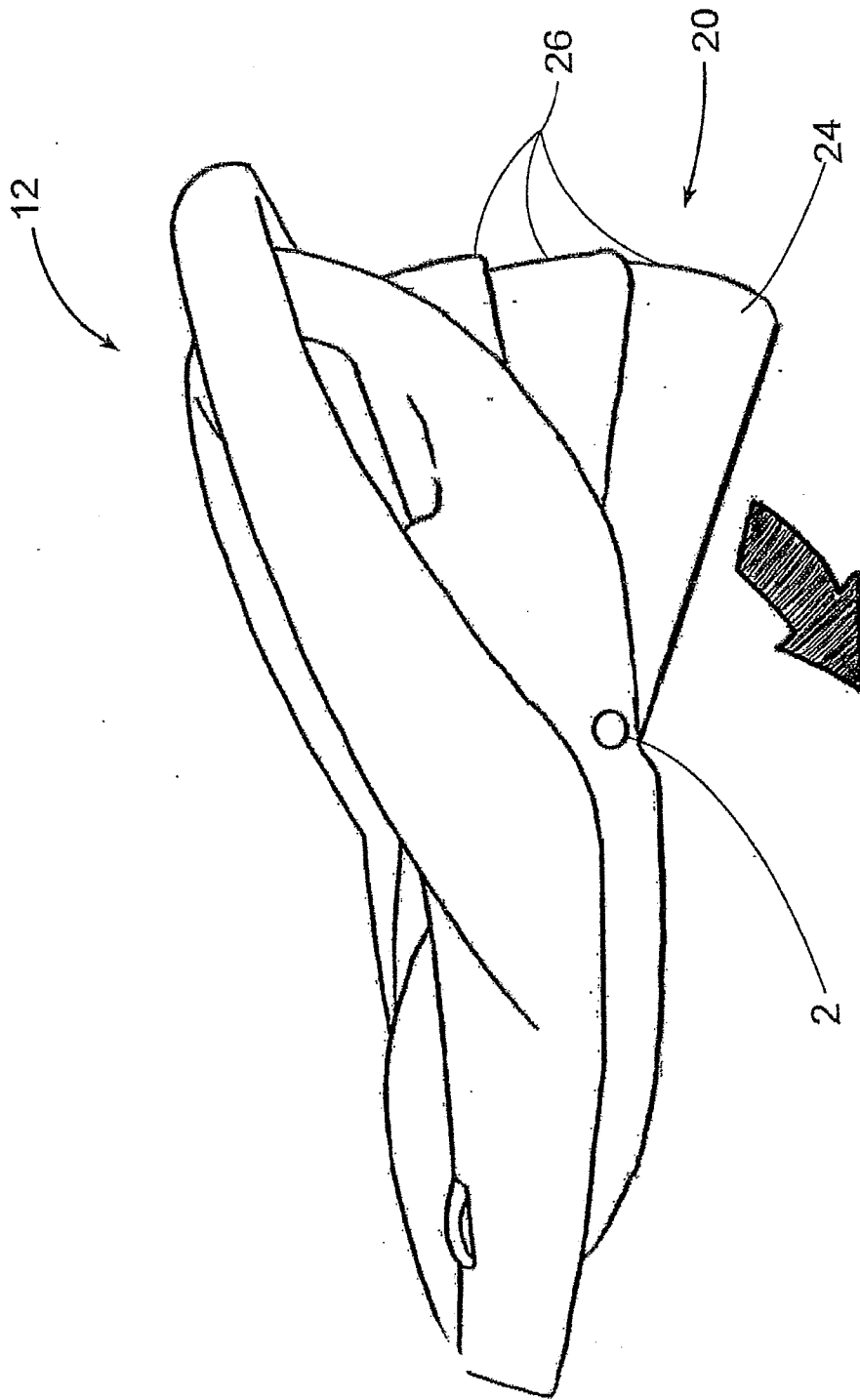

FIG. 3

4/29

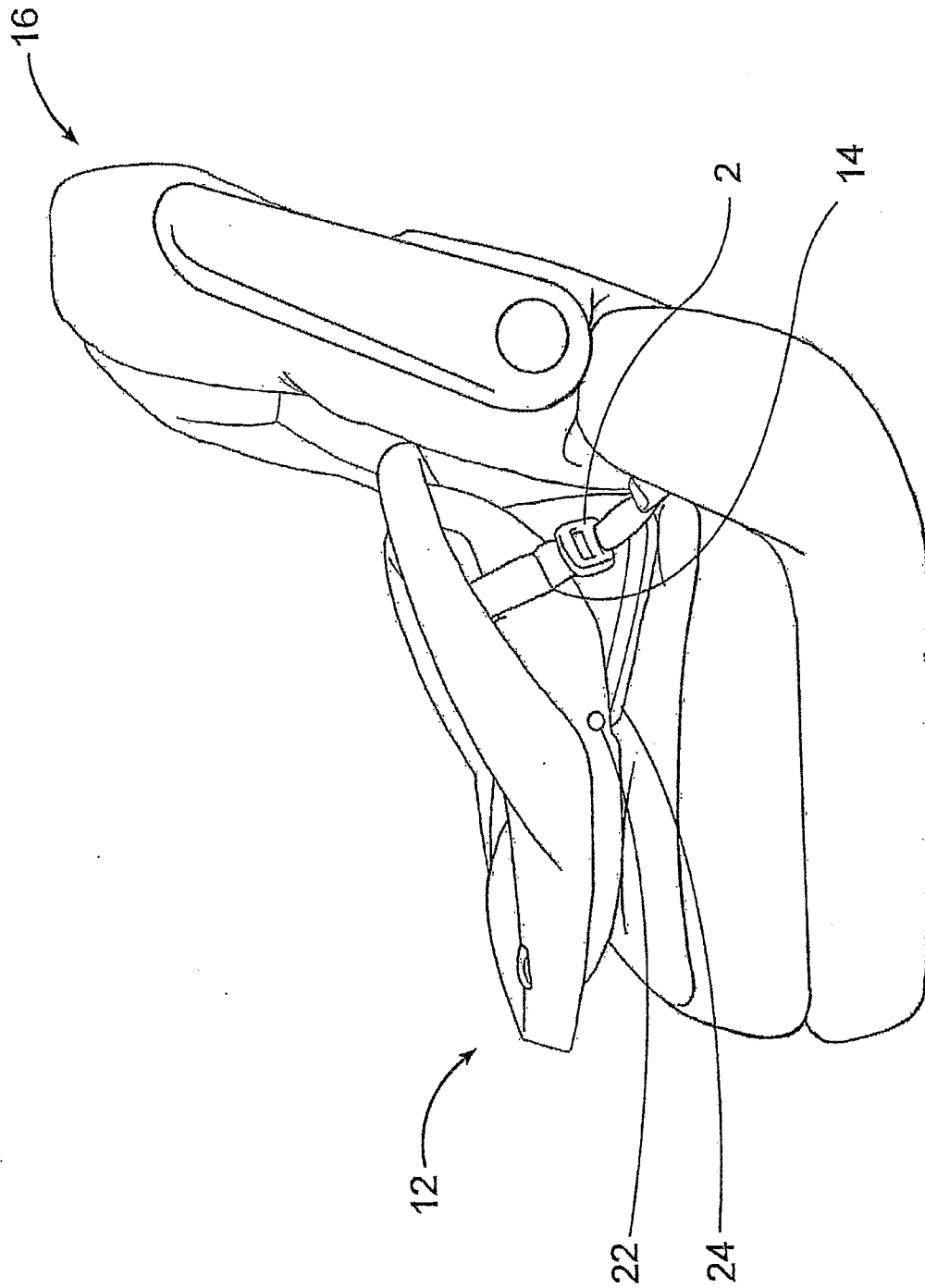

FIG. 4

5/29

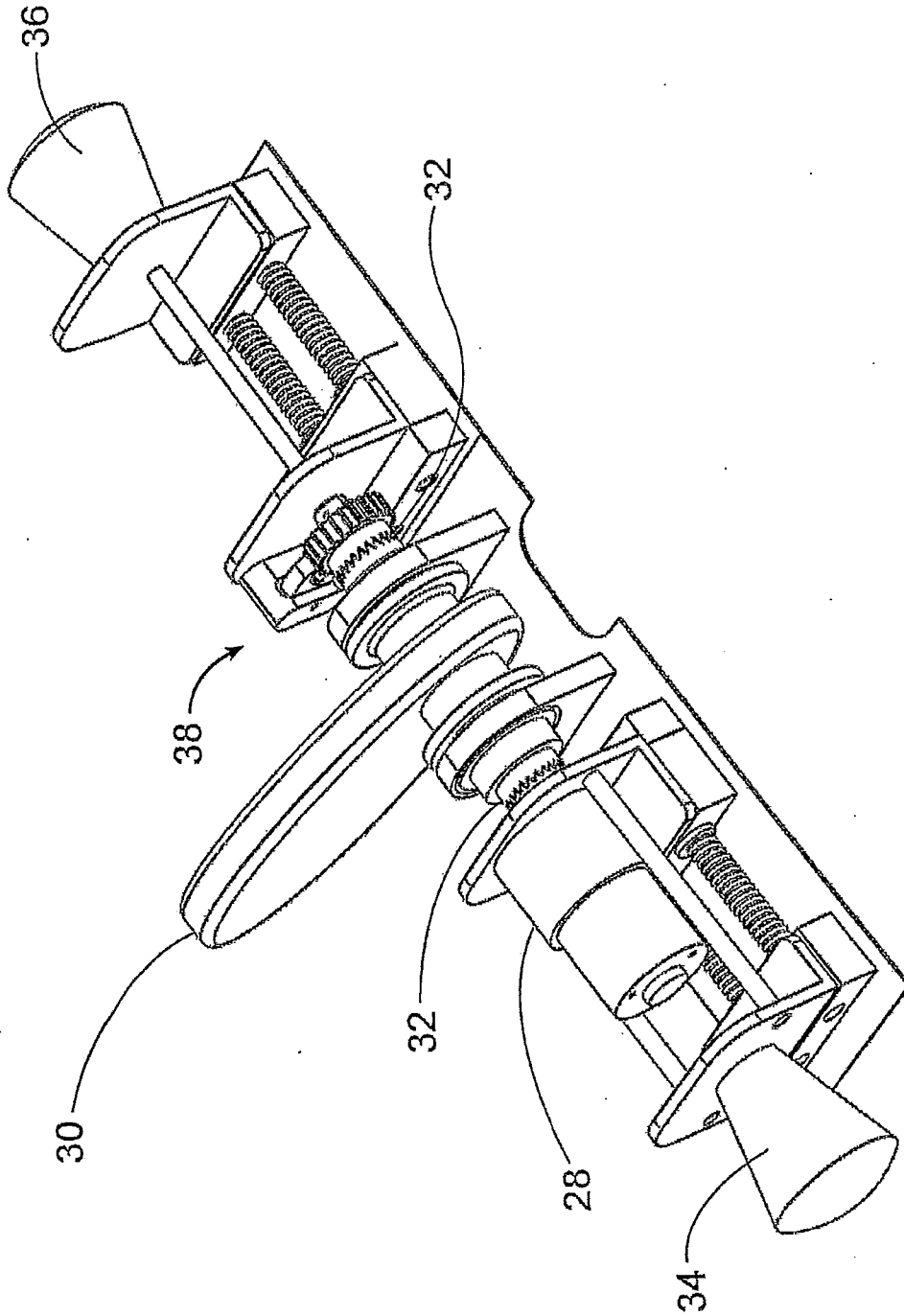

FIG. 5



6/29

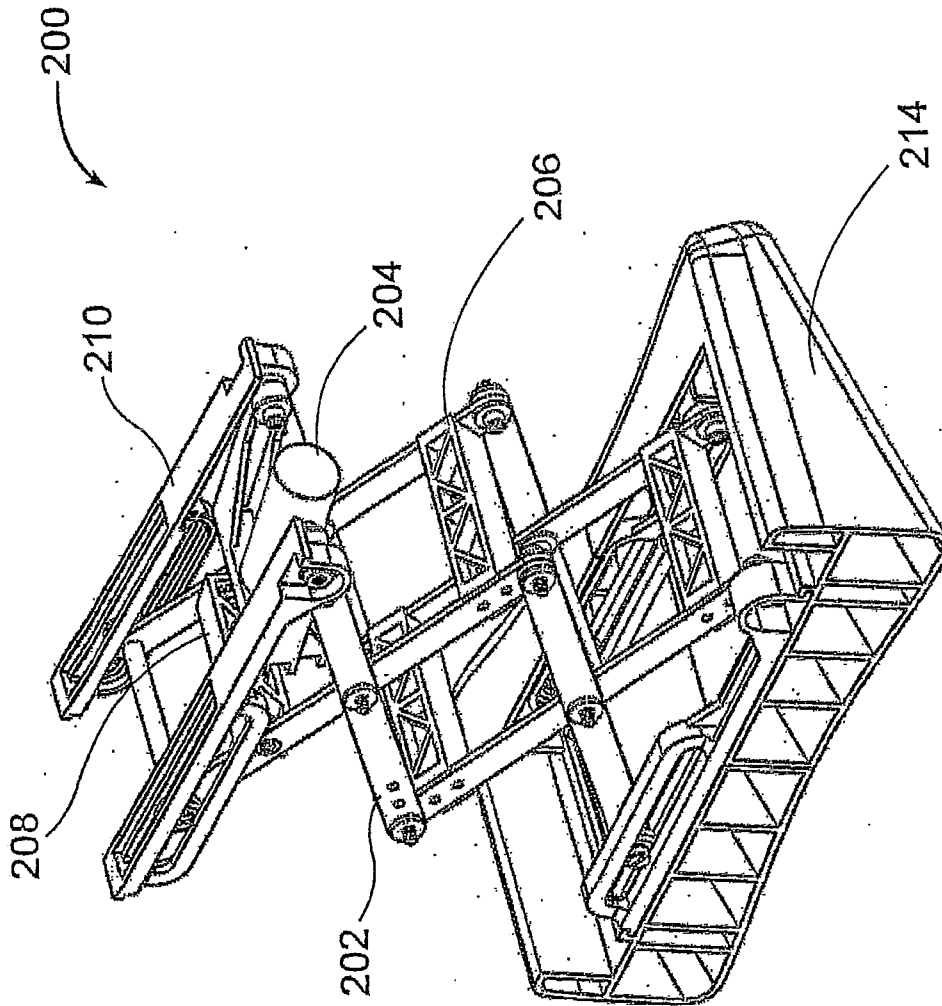

FIG. 6

7/29

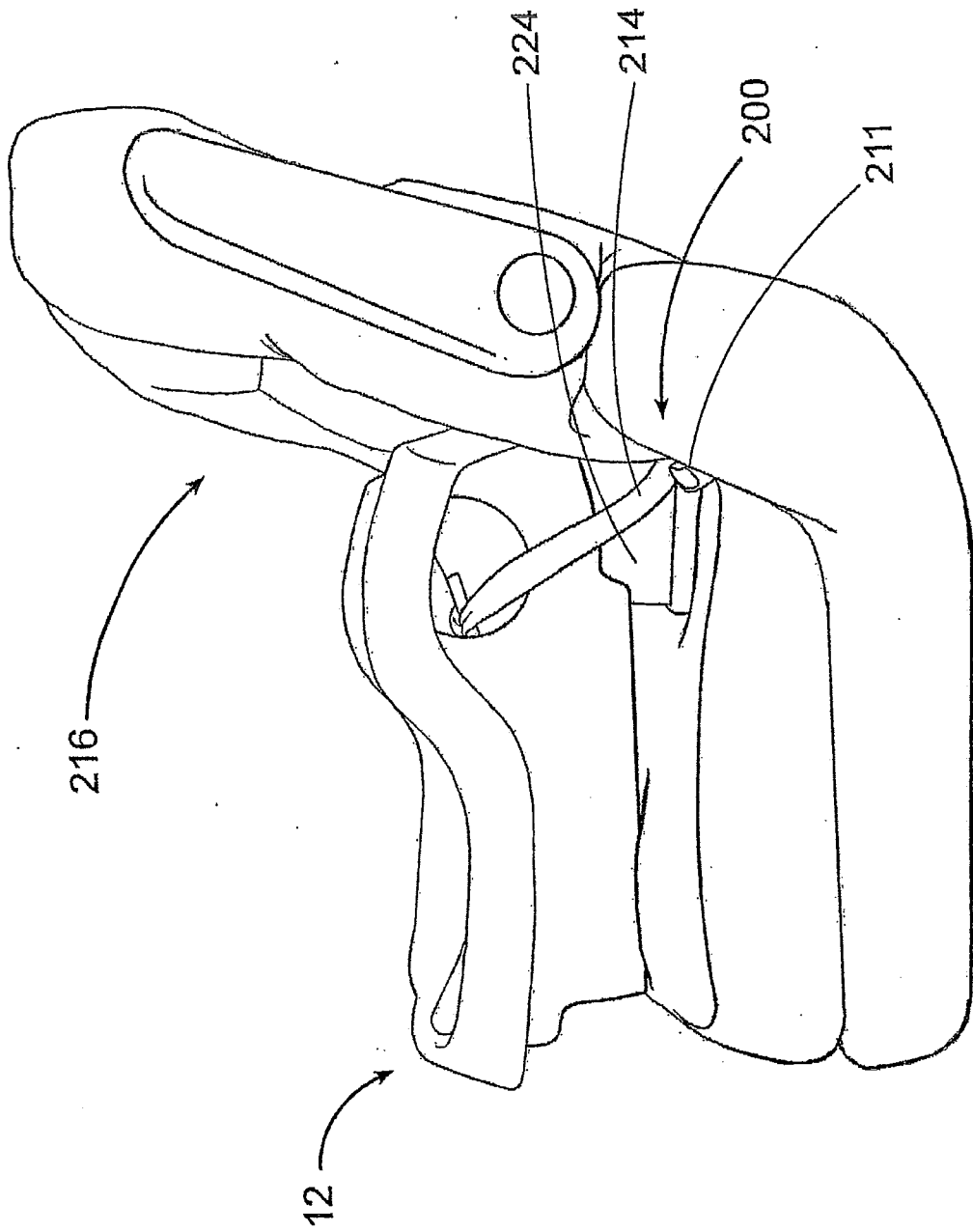

FIG. 7

8/29

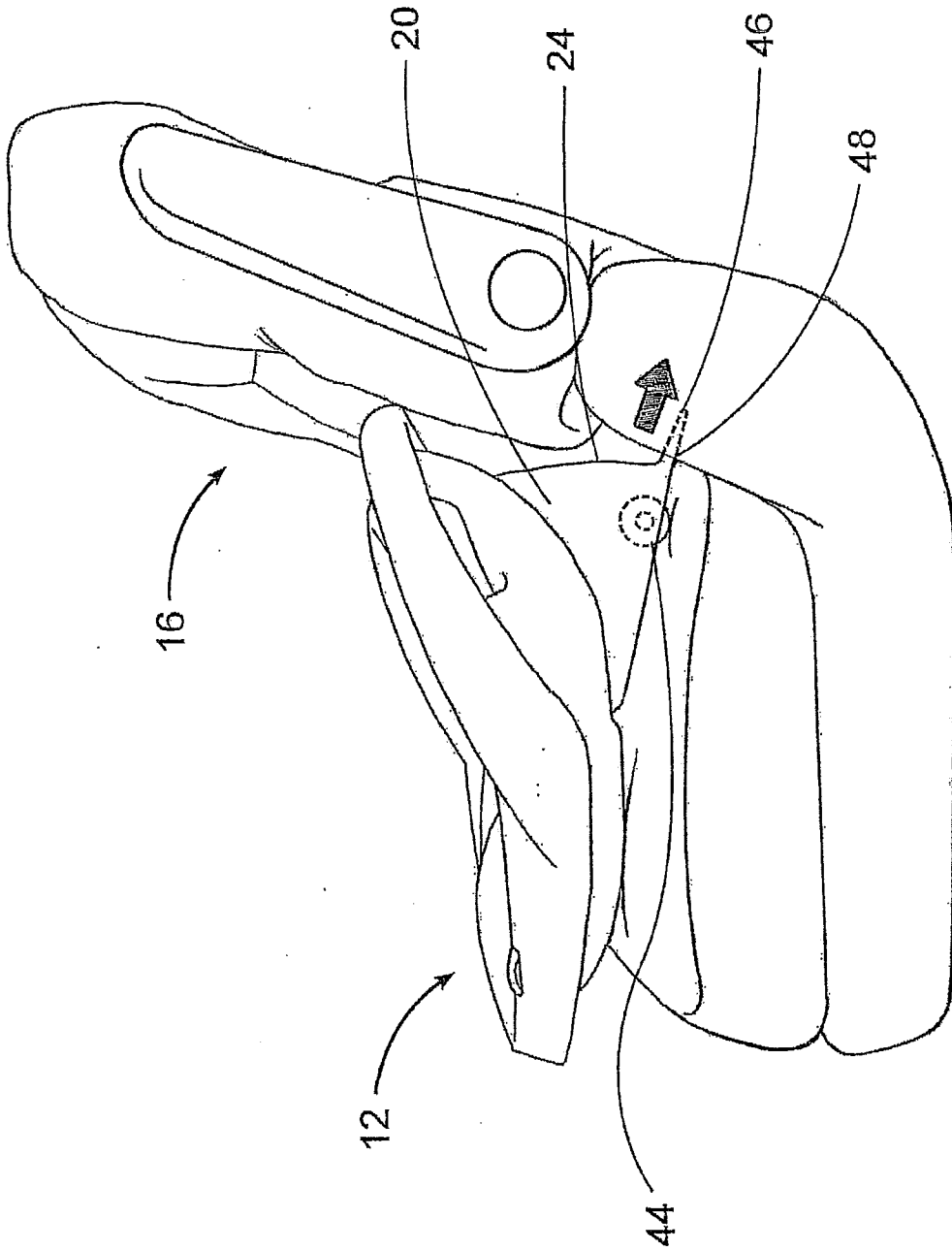

FIG. 8

9/29

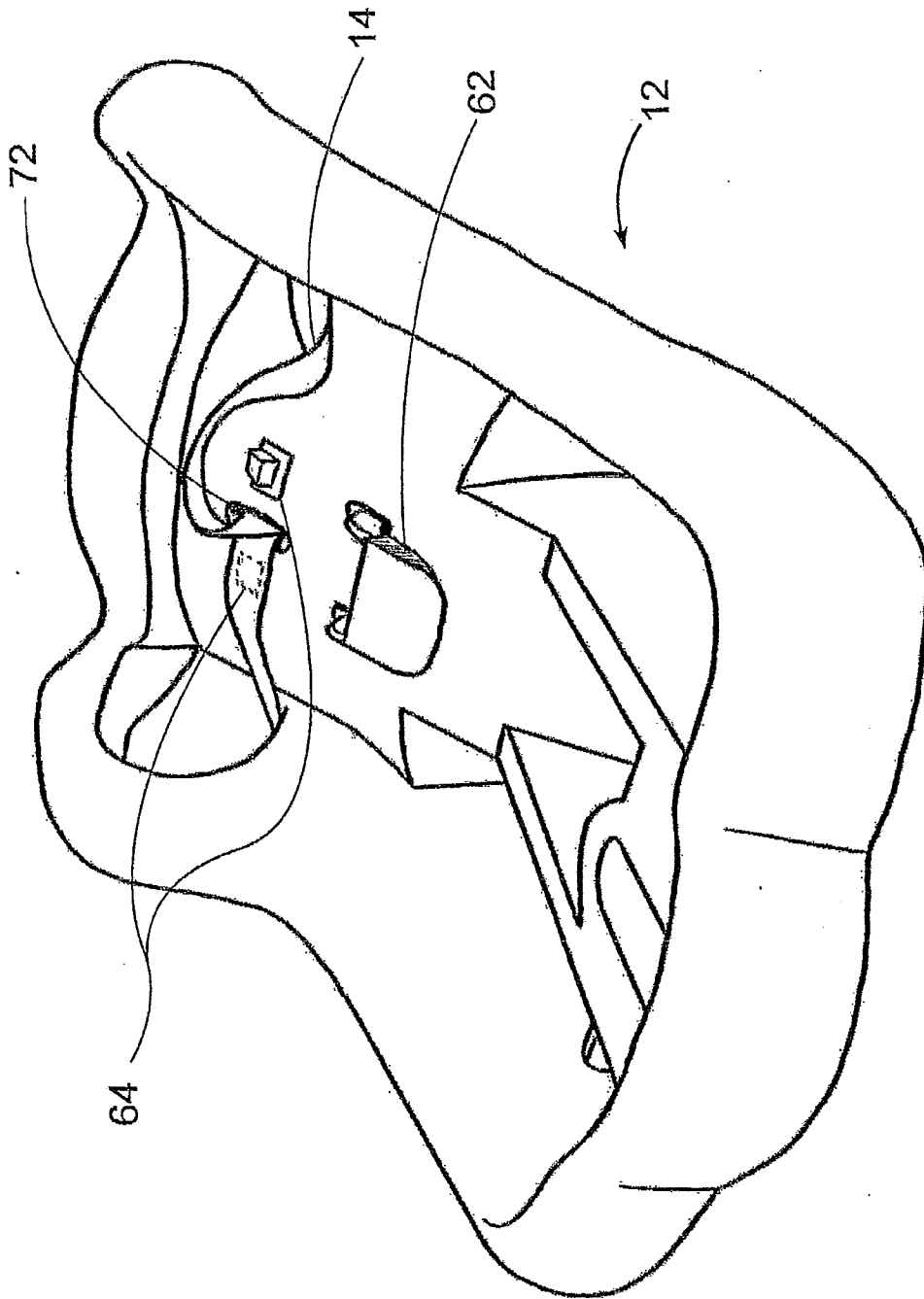

FIG. 9

10/29

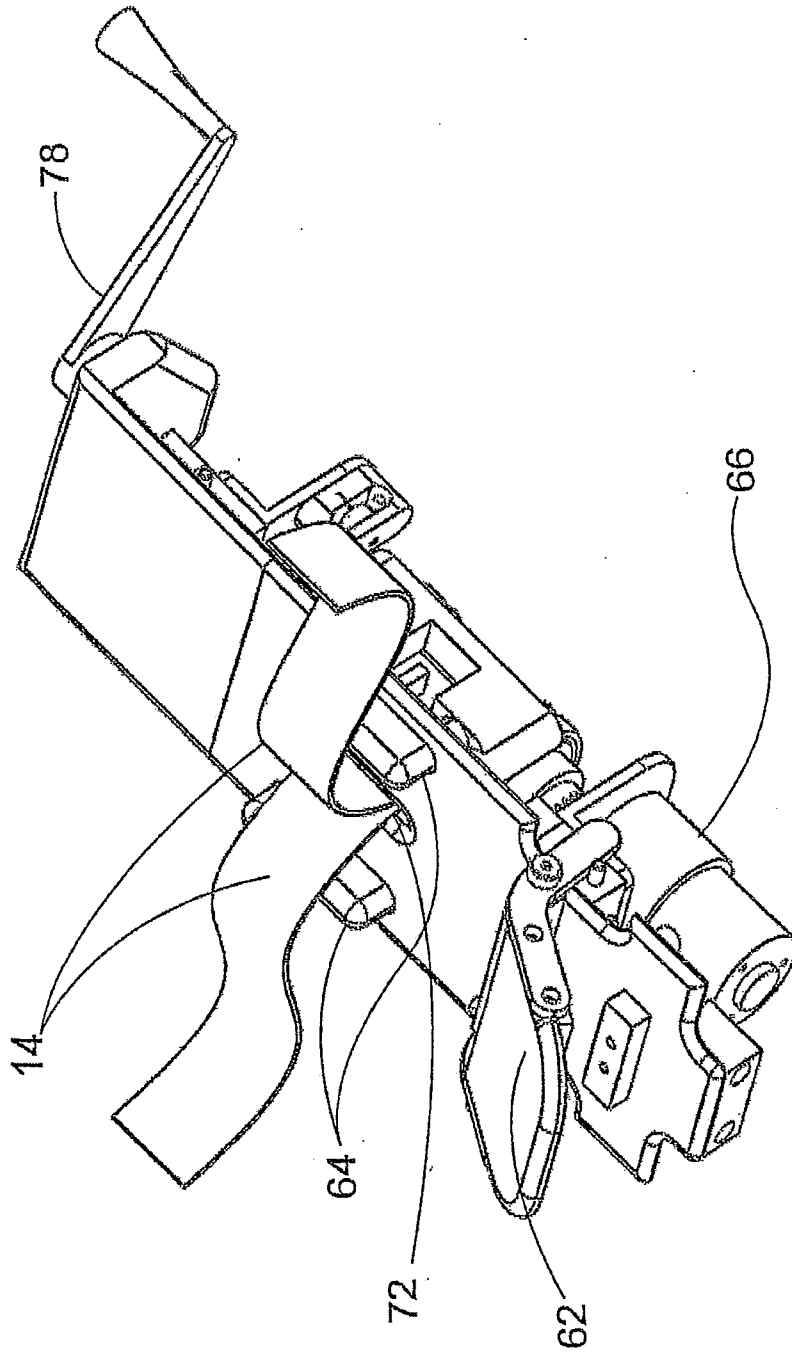

FIG. 10

11/29

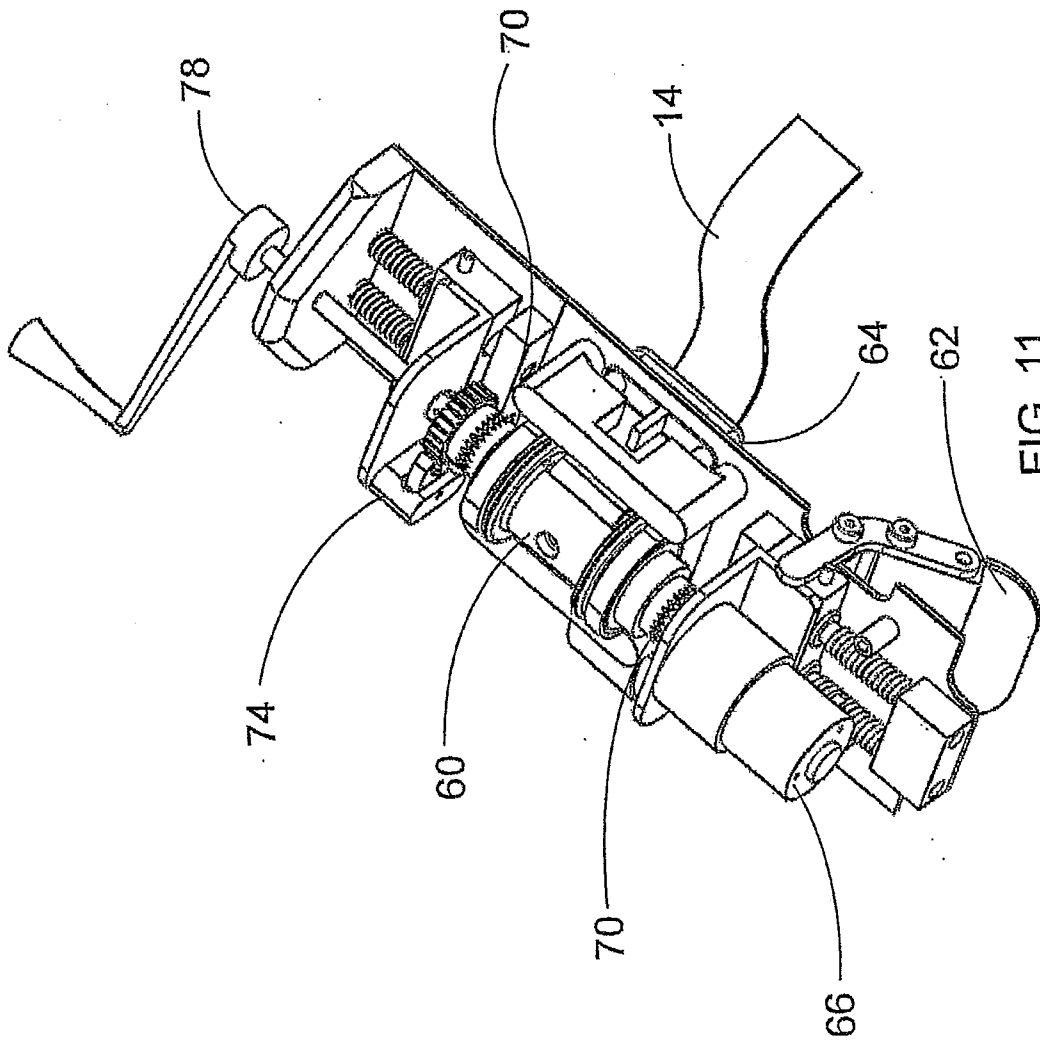

FIG. 11

12/29

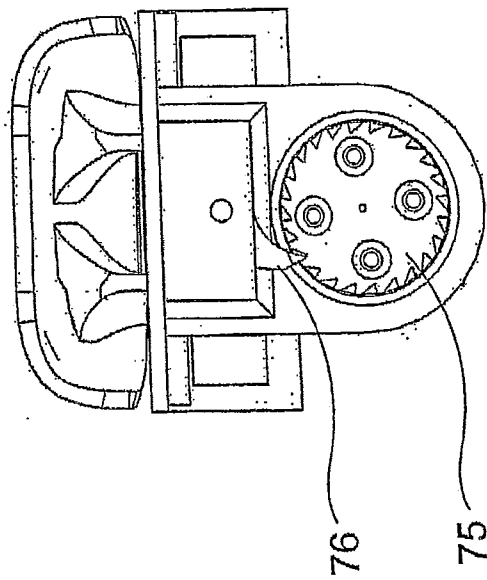

FIG. 12

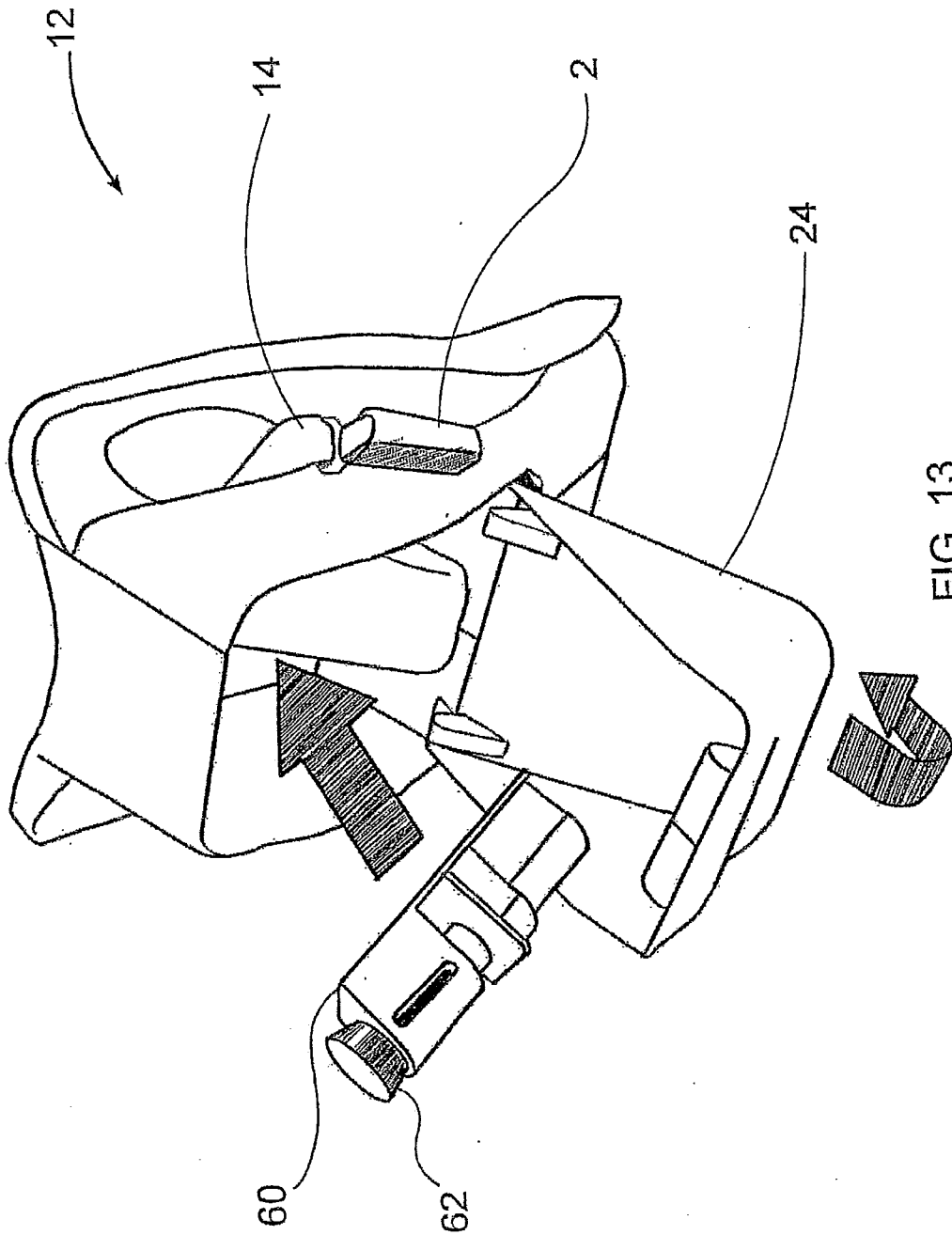

FIG. 13



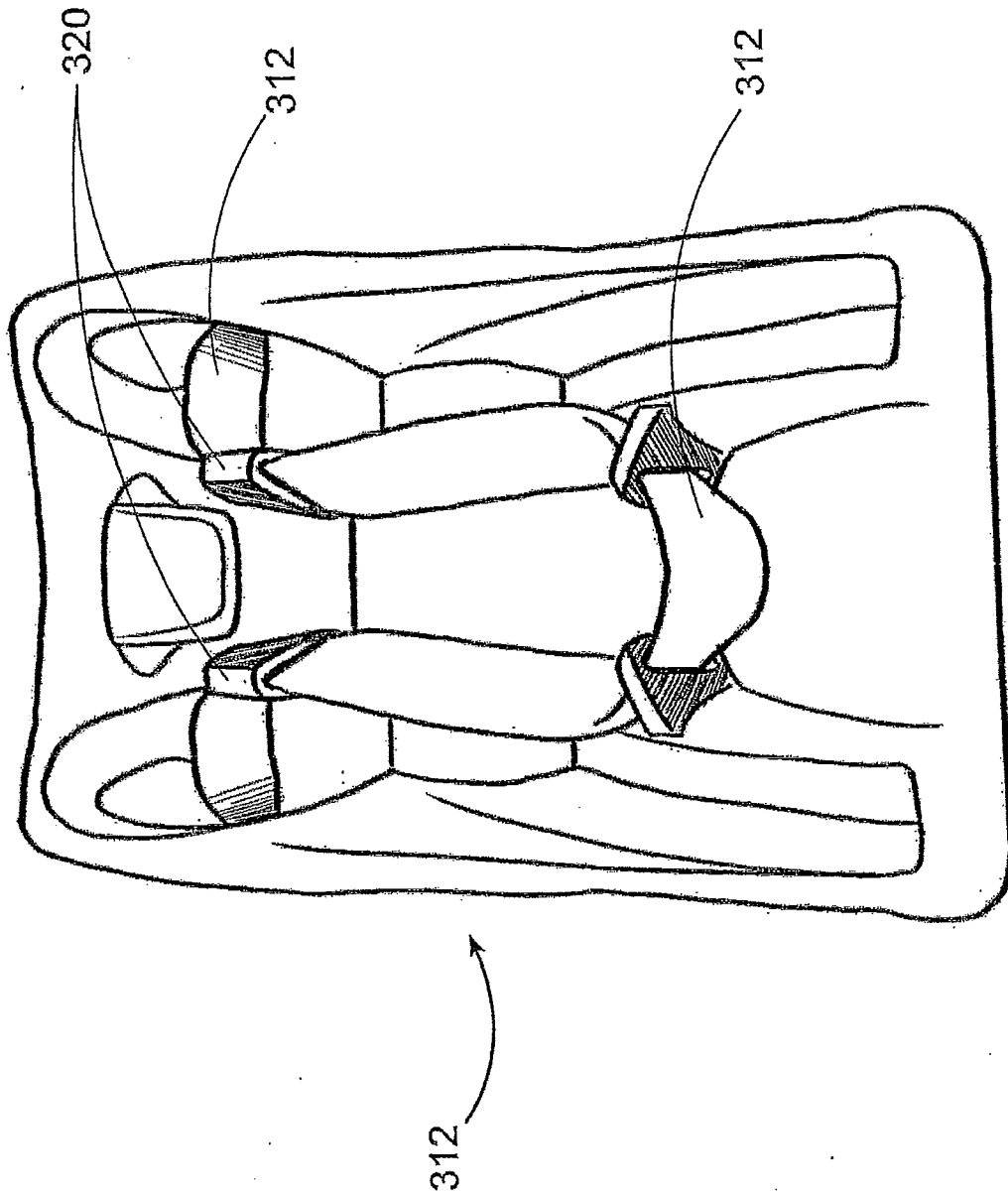

FIG. 14

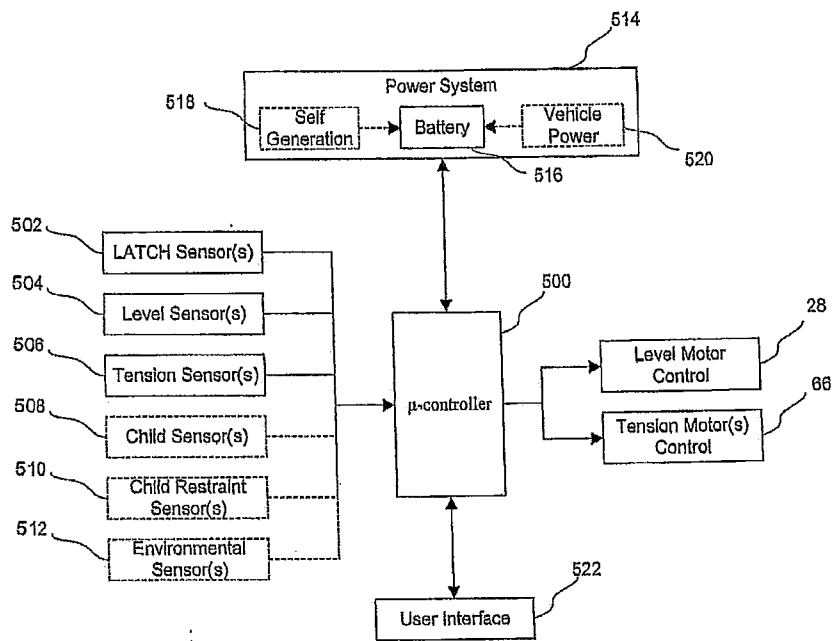

FIG. 15A

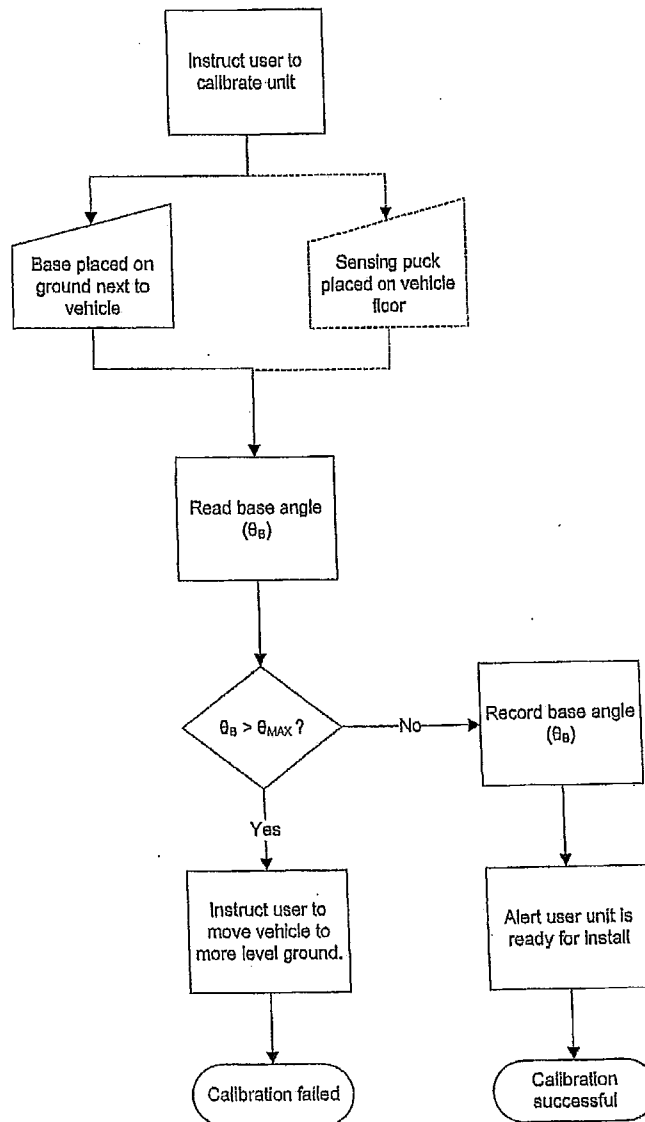

FIG. 15B

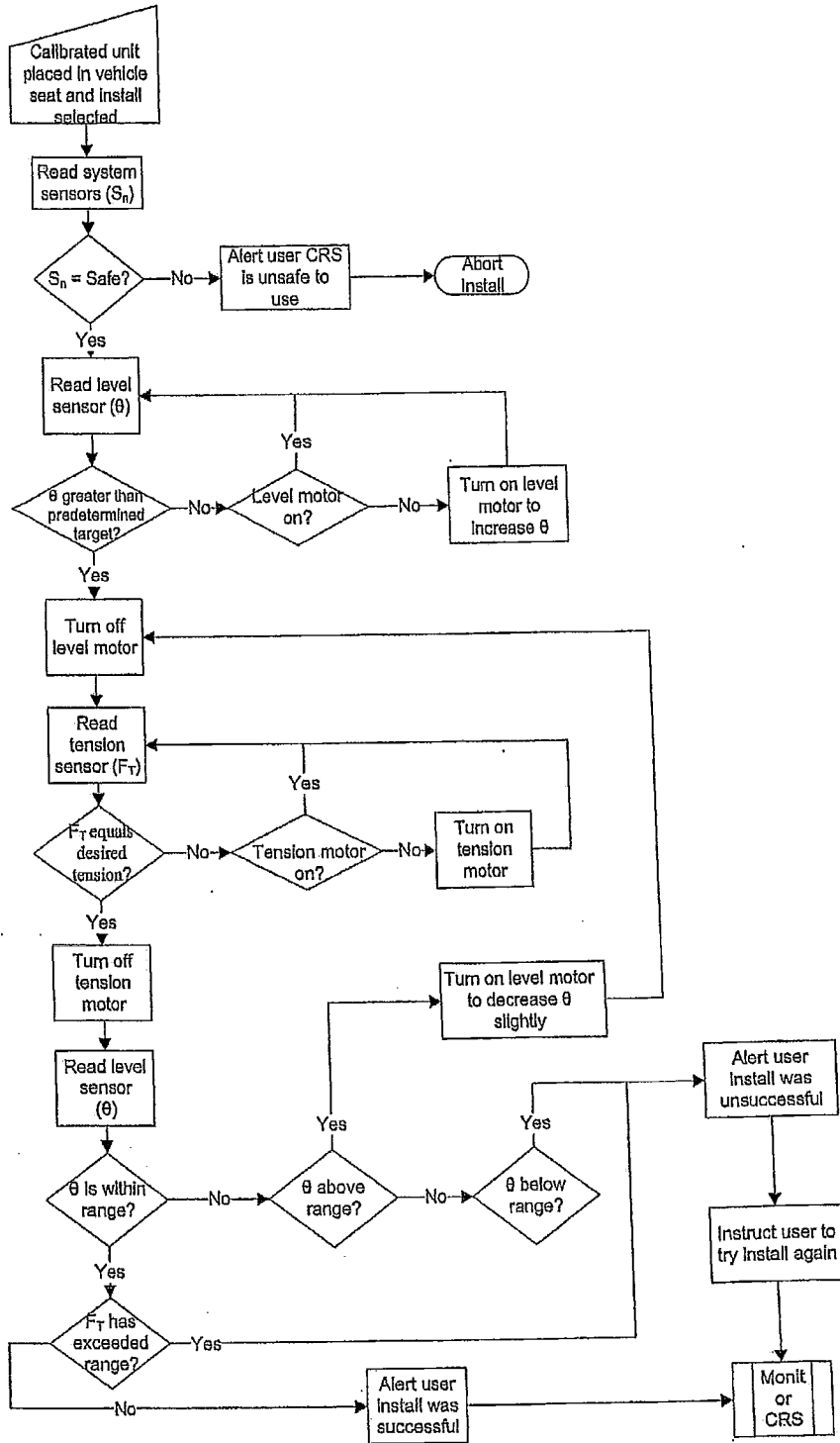

FIG. 15C

18/29

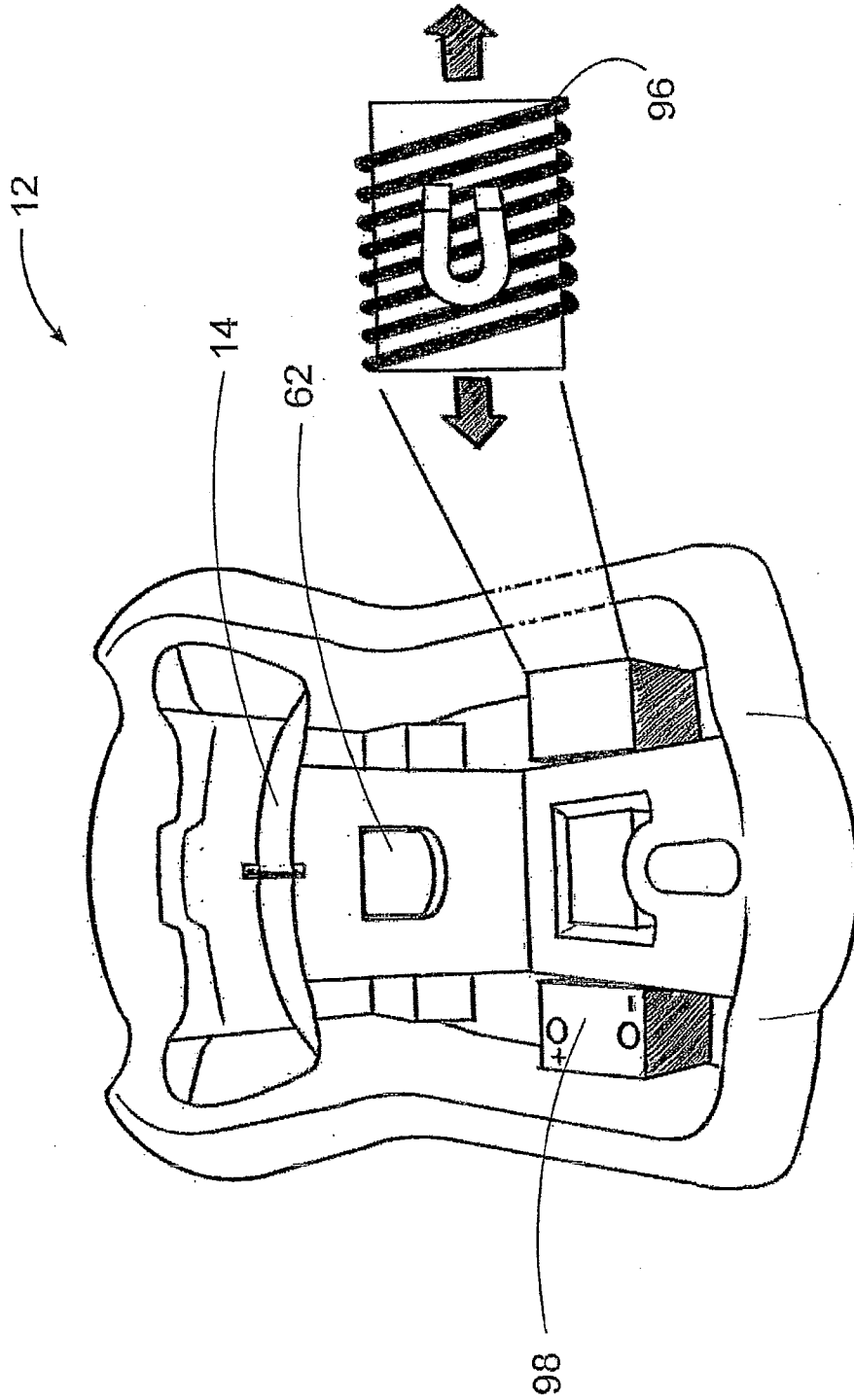

FIG. 16

19/29

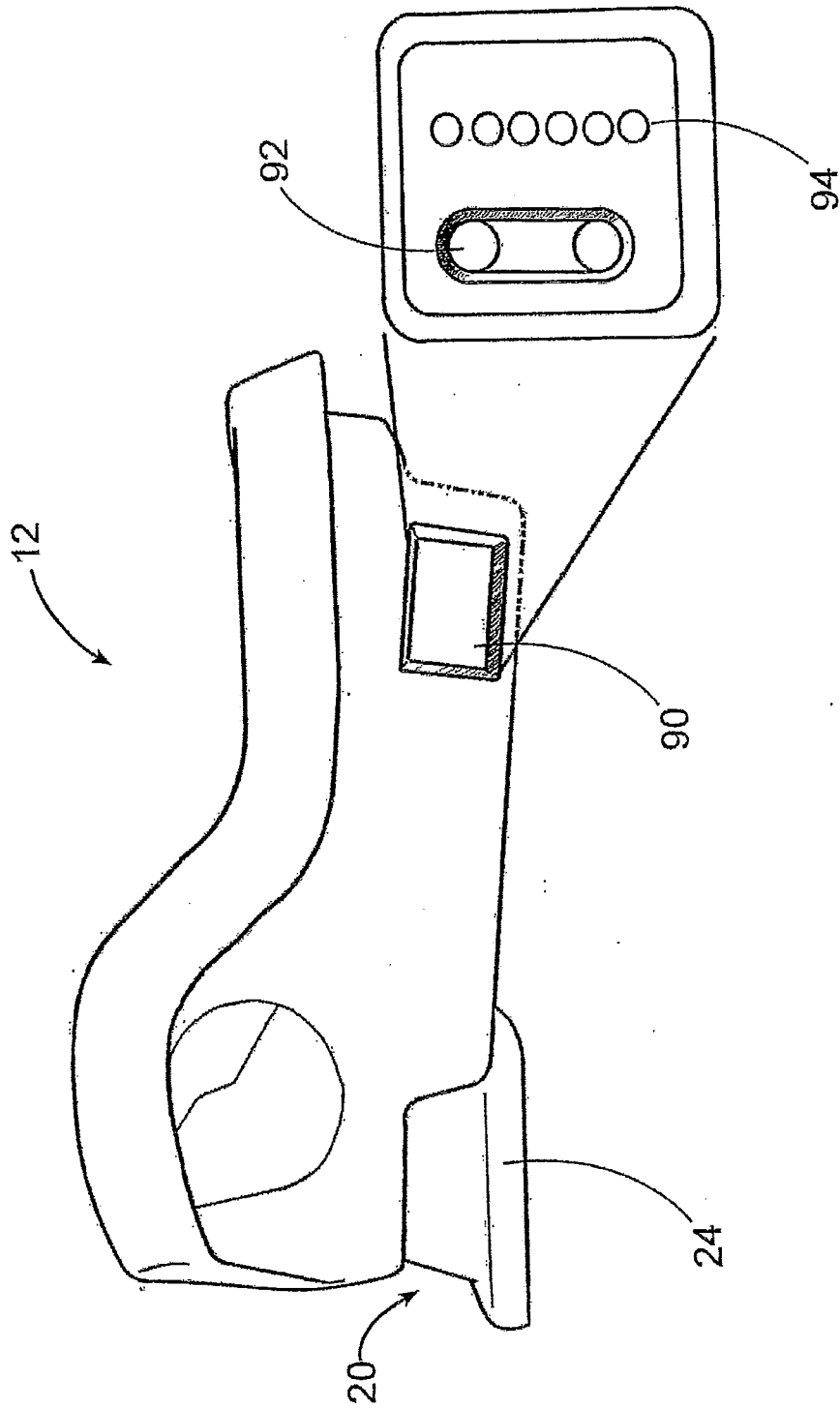

FIG. 17

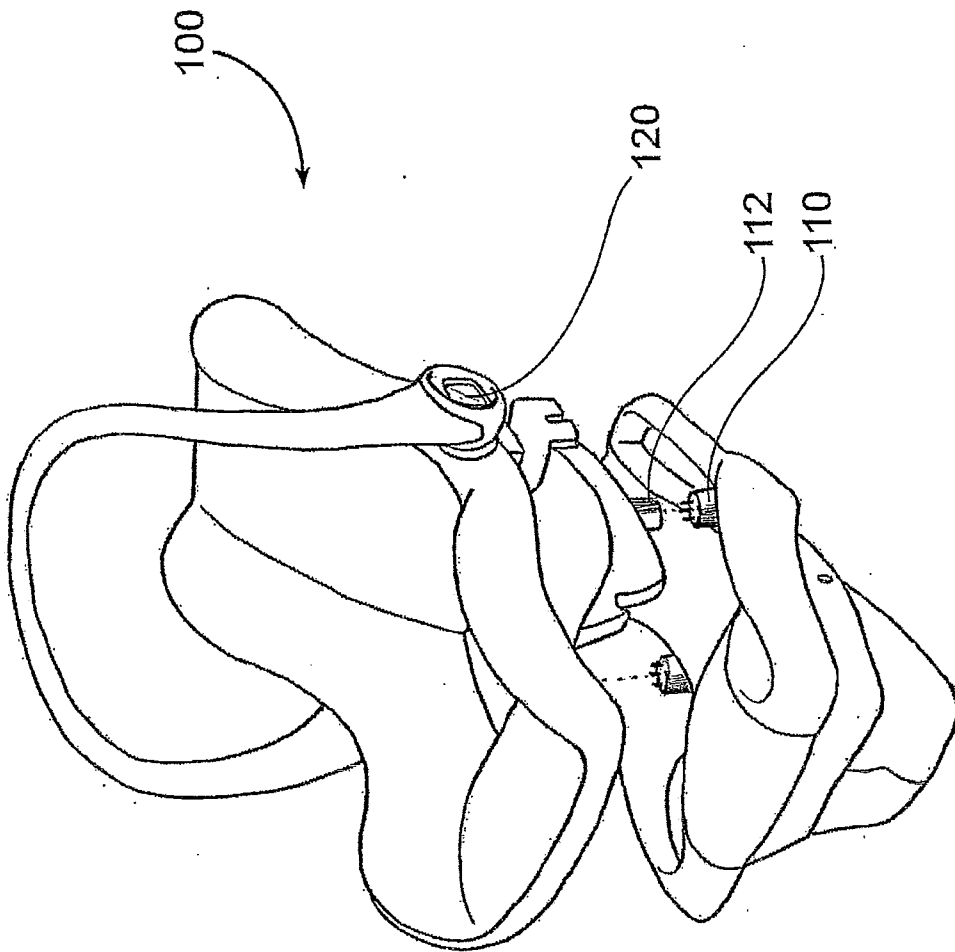

FIG. 18

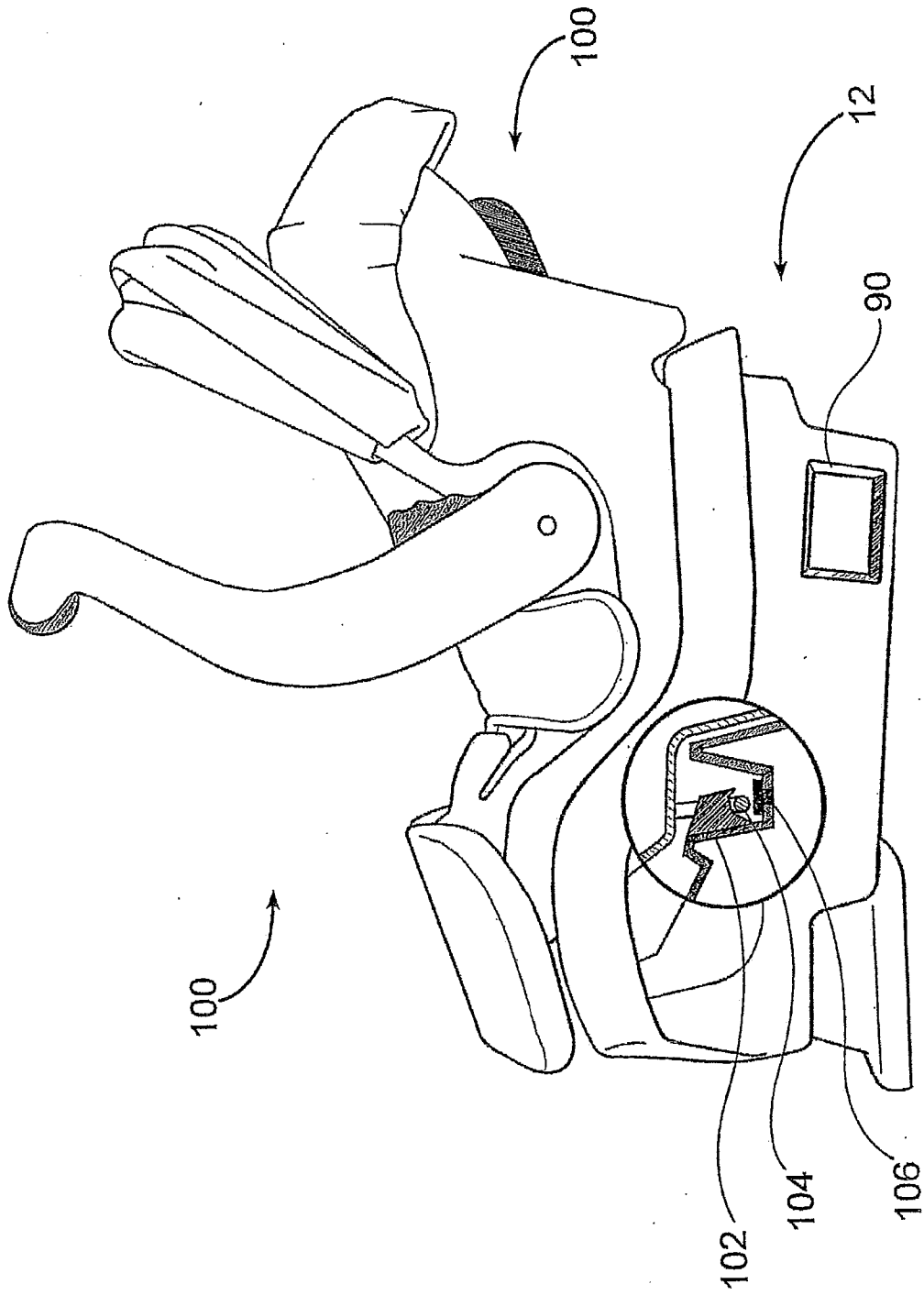

FIG. 19



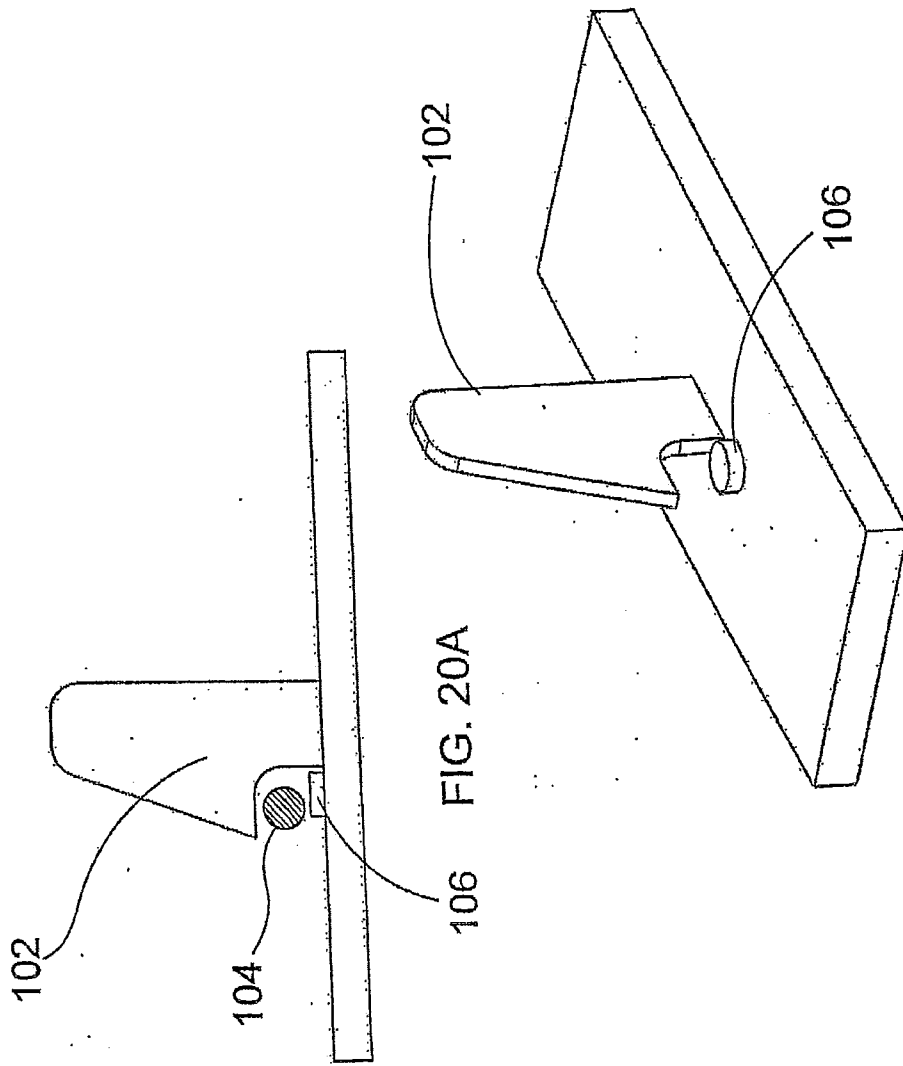

FIG. 20B

FIG. 20A

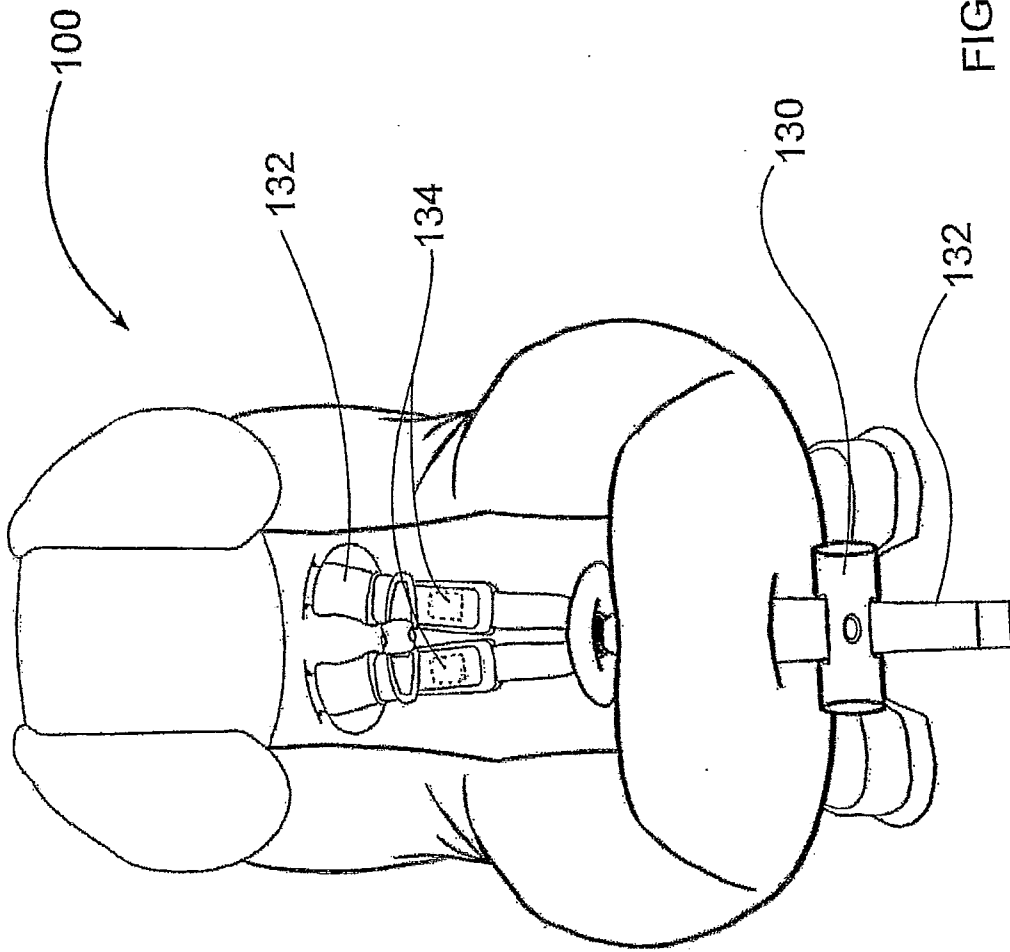

FIG. 21

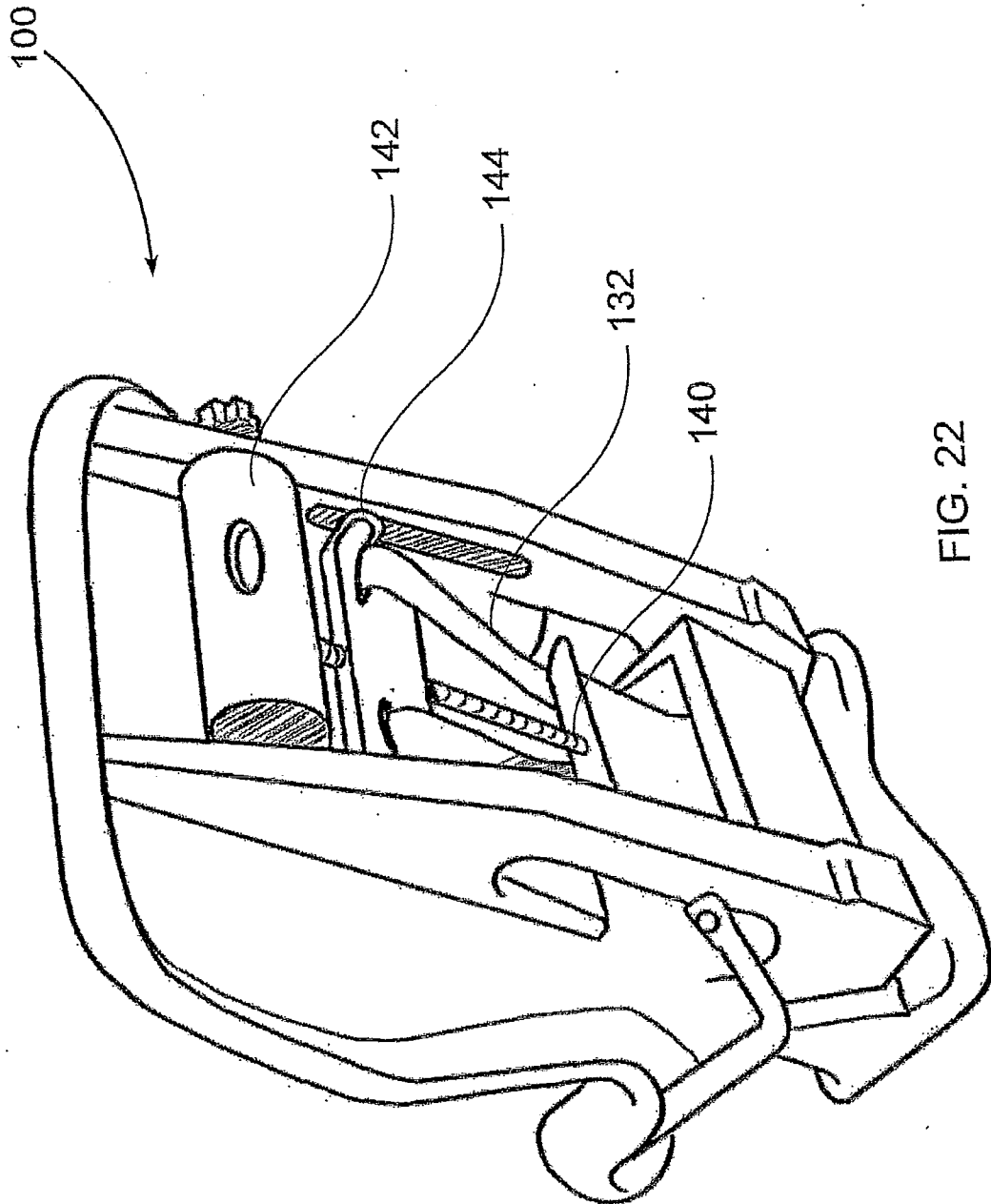

FIG. 22

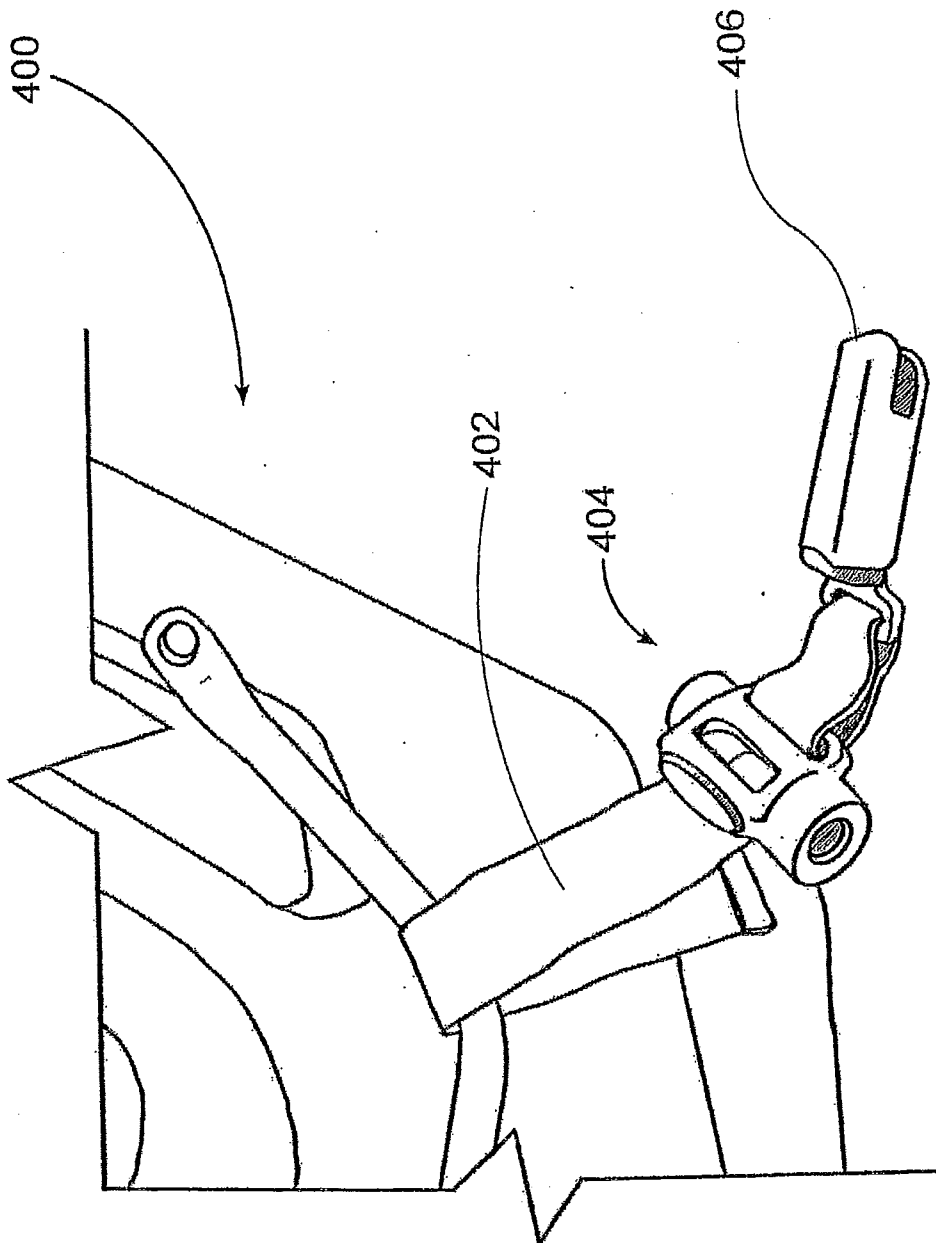

FIG. 23

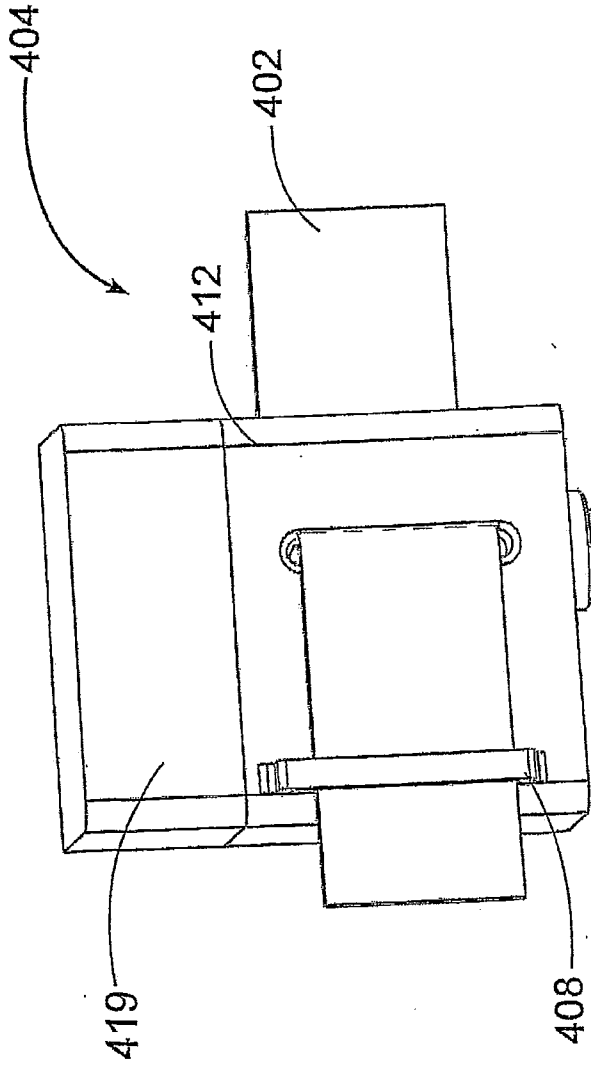

FIG. 24

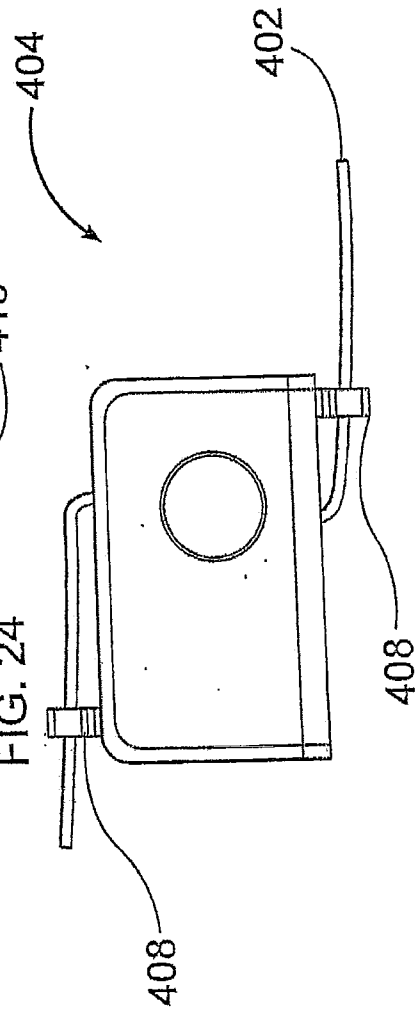

FIG. 25

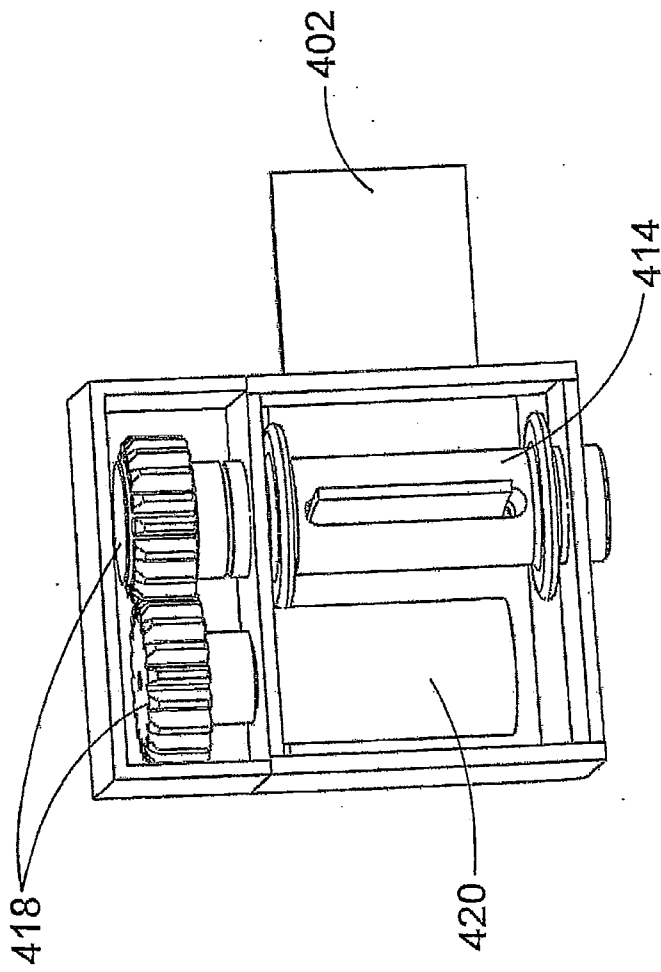

FIG. 26

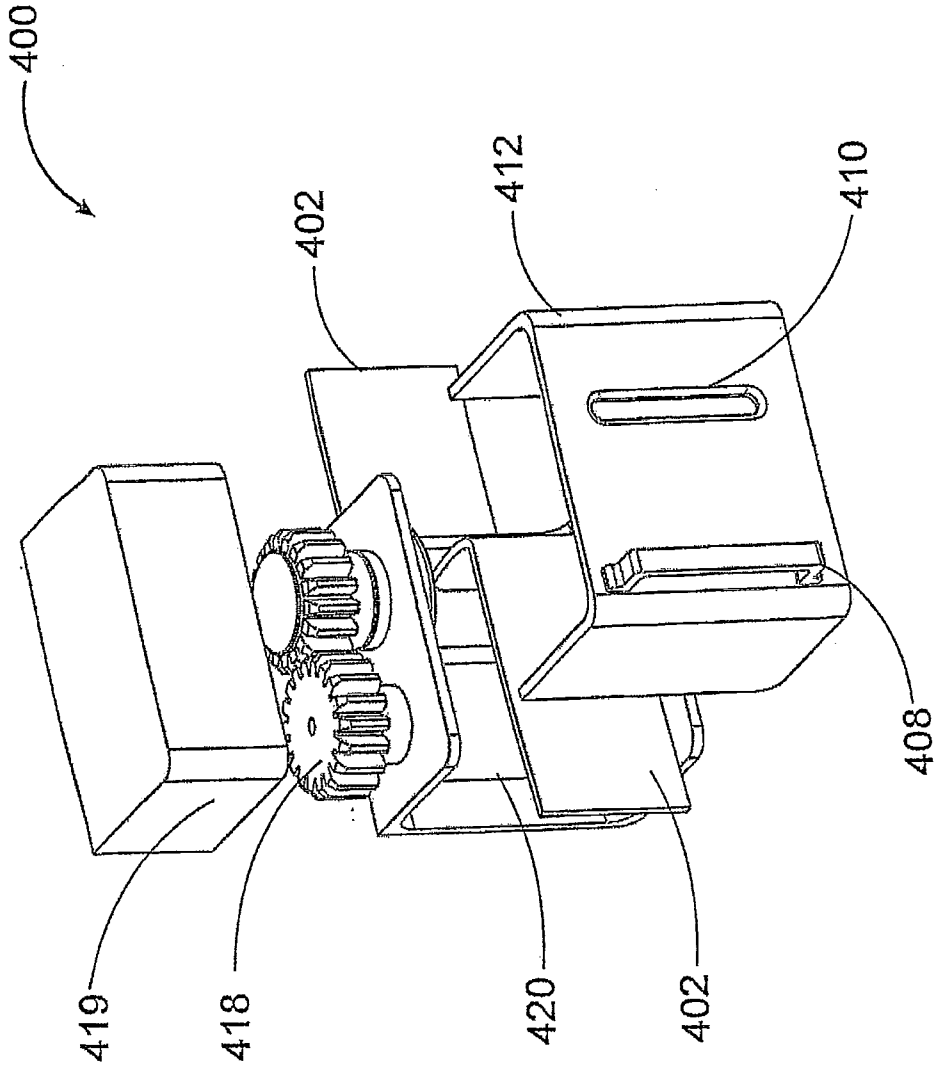

FIG. 27

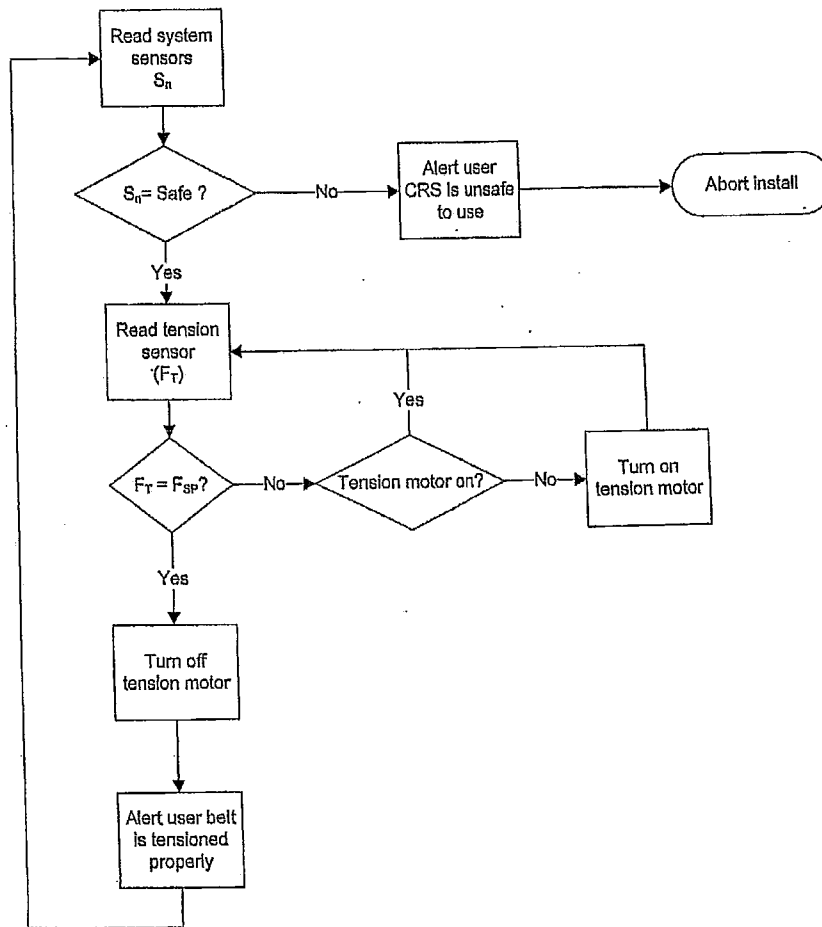

FIG. 28



## INTERNATIONAL SEARCH REPORT

International application No.  
**PCT/US2012/058918****A. CLASSIFICATION OF SUBJECT MATTER*****B60N 2/28(2006.01)i, B60N 2/26(2006.01)i***

According to International Patent Classification (IPC) or to both national classification and IPC

**B. FIELDS SEARCHED**

Minimum documentation searched (classification system followed by classification symbols)

IPC: B60N 2/28; B60N 2/44; B60N 2/26; B60Q 1/00; B60N 2/42; A47D 1/10

Documentation searched other than minimum documentation to the extent that such documents are included in the fields searched

Korean utility models and applications for utility models  
Japanese utility models and applications for utility models

Electronic data base consulted during the international search (name of data base and, where practicable, search terms used)

eKOMPASS(KIPO internal) &amp; Keywords: level, angle, tension, control, sensor, interface, adjust and automate

**C. DOCUMENTS CONSIDERED TO BE RELEVANT**

Category*	Citation of document, with indication, where appropriate, of the relevant passages	Relevant to claim No.
X	US 2011-0089726 A1 (GIBREE, STEVEN) 21 April 2011	13-24
Y	See abstract, paragraphs [0027],[0029],[0030],[0036];	1-12,25-37
A	claims 1-3,7,8,10-12 and figures 1,5,7.	38-45
X	US 2010-0253498 A1 (RORK et al.) 07 October 2010	38-45
Y	See abstract, paragraphs [0018]-[0028],[0032]-[0034],[0038],[0048],	1-12,25-37
A	[0051]-[0062]; claims 1,7 and figures 2,3,5,6.	13-24
A	US 7,658,446 B2 (MEEKER et al.) 09 February 2010	1-45
	See abstract, column 7 lines 29-37, column 12 lines 21-33; claims 1,2 and figures 1,14-14c.	
A	WO 2006-009619 A2 (DELPHI TECHNOLOGIES, INC) 26 January 2006	1-45
	See abstract, paragraphs [0026]-[0028]; claims 1,7,13 and figures 1,5.	
A	KR 10-0320662 B1 (AMPAFRANCE) 08 March 2002	1-45
	See abstract, claim 1 and figures 1,3.	

 Further documents are listed in the continuation of Box C. See patent family annex.

\* Special categories of cited documents:

"A" document defining the general state of the art which is not considered to be of particular relevance

"E" earlier application or patent but published on or after the international filing date

"L" document which may throw doubts on priority claim(s) or which is cited to establish the publication date of citation or other special reason (as specified)

"O" document referring to an oral disclosure, use, exhibition or other means

"P" document published prior to the international filing date but later than the priority date claimed

"T" later document published after the international filing date or priority date and not in conflict with the application but cited to understand the principle or theory underlying the invention

"X" document of particular relevance; the claimed invention cannot be considered novel or cannot be considered to involve an inventive step when the document is taken alone

"Y" document of particular relevance; the claimed invention cannot be considered to involve an inventive step when the document is combined with one or more other such documents, such combination being obvious to a person skilled in the art

"&amp;" document member of the same patent family

Date of the actual completion of the international search

19 MARCH 2013 (19.03.2013)

Date of mailing of the international search report

**20 MARCH 2013 (20.03.2013)**

Name and mailing address of the ISA/KR

Korean Intellectual Property Office  
189 Cheongsu-ro, Seo-gu, Daejeon Metropolitan  
City, 302-701, Republic of Korea

Facsimile No. 82-42-472-7140

Authorized officer

HAN, Joong Sub

Telephone No. 82-42-481-5606

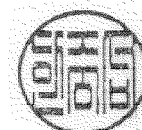

**INTERNATIONAL SEARCH REPORT**

Information on patent family members

International application No.

**PCT/US2012/058918**

Patent document cited in search report	Publication date	Patent family member(s)	Publication date
US 2011-0089726 A1	21.04.2011	US 2011-0089729 A1 US 2011-0089731 A1	21.04.2011 21.04.2011
US 2010-0253498 A1	07.10.2010	None	
US 7658446 B2	09.02.2010	CA 2554667 A1 CA 2554667 C CN 101124104 A0 CN 101124104 B CN 101863237 A EP 1732782 A2 US 2005-0110318 A1 WO 2005-079239 A2	01.09.2005 20.07.2010 13.02.2008 01.09.2010 20.10.2010 20.12.2006 26.05.2005 01.09.2005
WO 2006-009619 A2	26.01.2006	EP 1755424 A2 EP 1755424 A4 EP 1755914 A2 EP 1755914 A4 EP 1755915 A2 EP 1755915 A4 EP 1755916 A2 EP 1755916 A4 EP 1755917 A2 EP 1755917 A4 EP 1778520 A2 EP 1791718 A2 EP 1791720 A2 EP 1794025 A2 EP 1794025 A4 EP 1794026 A2 EP 1831473 A2 EP 1831473 A4 US 2005-275258 A1 US 2005-275260 A1 US 2005-275554 A1 US 7188898 B2 US 7385520 B2 US 7478875 B2 WO 2005-120888 A2 WO 2005-120888 A3 WO 2005-120889 A2 WO 2005-120889 A3 WO 2005-120890 A2 WO 2005-120890 A3 WO 2005-120891 A2 WO 2005-120891 A3 WO 2005-120892 A2 WO 2005-120892 A3 WO 2005-120893 A2	28.02.2007 01.02.2012 28.02.2007 06.10.2010 28.02.2007 27.07.2011 28.02.2007 13.10.2010 28.02.2007 01.02.2012 02.05.2007 06.06.2007 06.06.2007 13.06.2007 06.10.2010 13.06.2007 12.09.2007 01.02.2012 15.12.2005 15.12.2005 15.12.2005 13.03.2007 10.06.2008 20.01.2009 22.12.2005 25.01.2007 22.12.2005 16.04.2009 22.12.2005 23.08.2007 22.12.2005 25.01.2007 22.12.2005 07.12.2006 22.12.2005

**INTERNATIONAL SEARCH REPORT**

Information on patent family members

International application No.

**PCT/US2012/058918**

Patent document cited in search report	Publication date	Patent family member(s)	Publication date
		WO 2006-020604 A2	23.02.2006
		WO 2006-029218 A2	16.03.2006
		WO 2006-029325 A2	16.03.2006
		WO 2006-029328 A2	16.03.2006
KR 10-0320662 B1	08.03.2002	EP 0816160 A1	07.01.1998
		JP 10-059037 A	03.03.1998
		US 5810436 A	22.09.1998