



(12) **EUROPEAN PATENT APPLICATION**

(88) Date of publication A3:
15.02.2006 Bulletin 2006/07

(51) Int Cl.:
B05B 7/24 (2006.01)

(43) Date of publication A2:
24.08.2005 Bulletin 2005/34

(21) Application number: **04009716.4**

(22) Date of filing: **23.04.2004**

(84) Designated Contracting States:
**AT BE BG CH CY CZ DE DK EE ES FI FR GB GR
HU IE IT LI LU MC NL PL PT RO SE SI SK TR**
Designated Extension States:
AL HR LT LV MK

(72) Inventor: **Vicentini, Marco G.**
10125 Torino (IT)

(74) Representative: **Buzzi, Franco**
Buzzi, Notaro & Antonielli d'Oulx S.r.l.
Via Maria Vittoria 18
10123 Torino (IT)

(30) Priority: **05.12.2003 IT to20030981**

(71) Applicant: **Anest Iwata Europe Srl**
10155 Torino (IT)

(54) **A manual spray gun and associated cup**

(57) A cup (6; 28) for spray guns, having an outflow union (22) to be coupled with an inflow union (5) of the gun body (1) by removable connection means comprising a bayonet coupling (27, 11) with associated safety device (27, 14) for its positive locking in the coupled condition.

FIG. 1

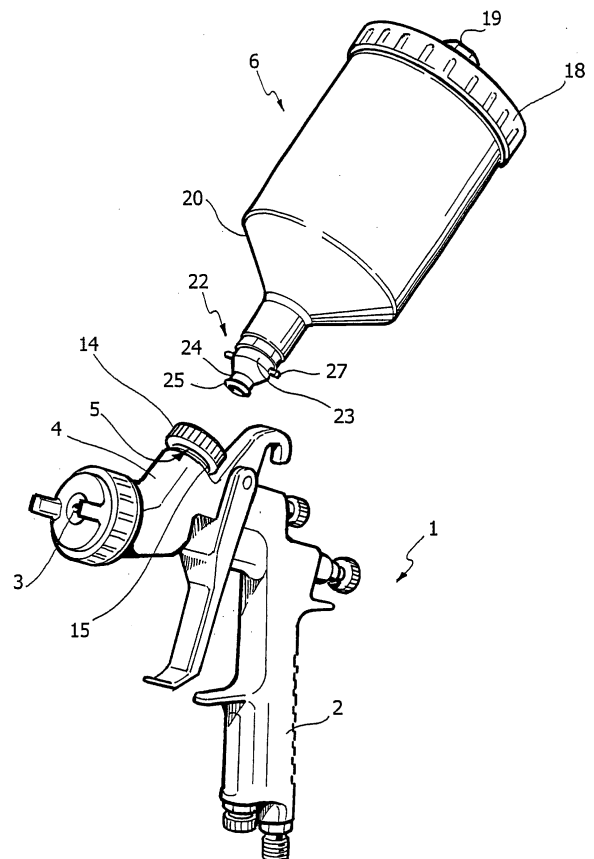



DOCUMENTS CONSIDERED TO BE RELEVANT			
Category	Citation of document with indication, where appropriate, of relevant passages	Relevant to claim	CLASSIFICATION OF THE APPLICATION (IPC)
X	US 5 035 339 A (MEYERSBURG ET AL) 30 July 1991 (1991-07-30) * column 2, lines 42-68 * * column 3, lines 1-8; figures 1-7 * -----	1,2,10, 11	B05B7/24
X	US 3 236 459 A (MCRITCHIE THOMAS P) 22 February 1966 (1966-02-22) * column 5, lines 5-38; figures 1-11 * -----	12-22	
X	WO 98/43894 A (SOUDAL; SCHRAVEN, JOHN) 8 October 1998 (1998-10-08) * page 6 - page 9; figures 1,2a,2b,3a,3b,3c,3d * -----	1,10,11	
X	US 3 381 845 A (MACDONALD RODERICK B) 7 May 1968 (1968-05-07) * column 2, lines 21-48; figure 4 * -----	1,10,11	
			TECHNICAL FIELDS SEARCHED (IPC)
			B05B B65D
The present search report has been drawn up for all claims			
Place of search Munich		Date of completion of the search 16 December 2005	Examiner Flori, M
CATEGORY OF CITED DOCUMENTS X : particularly relevant if taken alone Y : particularly relevant if combined with another document of the same category A : technological background O : non-written disclosure P : intermediate document		T : theory or principle underlying the invention E : earlier patent document, but published on, or after the filing date D : document cited in the application L : document cited for other reasons & : member of the same patent family, corresponding document	

1
EPO FORM 1503 03.82 (P04C01)

**ANNEX TO THE EUROPEAN SEARCH REPORT
ON EUROPEAN PATENT APPLICATION NO.**

EP 04 00 9716

This annex lists the patent family members relating to the patent documents cited in the above-mentioned European search report. The members are as contained in the European Patent Office EDP file on
The European Patent Office is in no way liable for these particulars which are merely given for the purpose of information.

16-12-2005

Patent document cited in search report		Publication date	Patent family member(s)	Publication date
US 5035339	A	30-07-1991	NONE	

US 3236459	A	22-02-1966	NONE	

WO 9843894	A	08-10-1998	AU 4106897 A	22-10-1998
			CZ 9903410 A3	15-11-2000
			DE 69731772 D1	30-12-2004
			EE 9900432 A	17-04-2000
			EP 0975533 A1	02-02-2000
			ES 2234027 T3	16-06-2005
			PL 335973 A1	05-06-2000
			PL 188358 B1	31-01-2005

US 3381845	A	07-05-1968	NONE	

EPO FORM P0459

For more details about this annex : see Official Journal of the European Patent Office, No. 12/82