



US 20110270160A1

(19) **United States**(12) **Patent Application Publication**  
**Mernoe**(10) **Pub. No.: US 2011/0270160 A1**(43) **Pub. Date: Nov. 3, 2011**(54) **MEDICINE DISPENSING DEVICE**(75) Inventor: **Morten Mernoe**, Charlottenlund  
(DK)(73) Assignee: **Asante Solutions, Inc.**, Sunnyvale,  
CA (US)(21) Appl. No.: **13/182,107**(22) Filed: **Jul. 13, 2011**(30) **Foreign Application Priority Data**

Apr. 6, 2005	(DK)	PA200500483
Apr. 14, 2005	(DK)	PA200500542
Jun. 3, 2005	(DK)	PA200500817
Apr. 6, 2006	(WO)	PCTDK2006000195

**Publication Classification**

(51) **Int. Cl.**  
**A61M 5/145** (2006.01)  
**A61M 5/168** (2006.01)

(52) **U.S. Cl.** ..... **604/67; 604/154**

(57) **ABSTRACT**

Some embodiments of a wearable, disposable medicine dispensing device may include a piston rod that is advanced to dispense medicine from the device. A rotational motor may be coupled to a drive mechanism so as to carry out a certain number of revolutions and thereby displace the piston rod by a desired distance. Such a device can be used in a method of dispensing liquid medicine.

**Related U.S. Application Data**

(63) Continuation of application No. 12/767,570, filed on Apr. 26, 2010, now Pat. No. 7,998,116, which is a continuation of application No. 10/591,190, filed on Aug. 31, 2006, now Pat. No. 7,713,238.

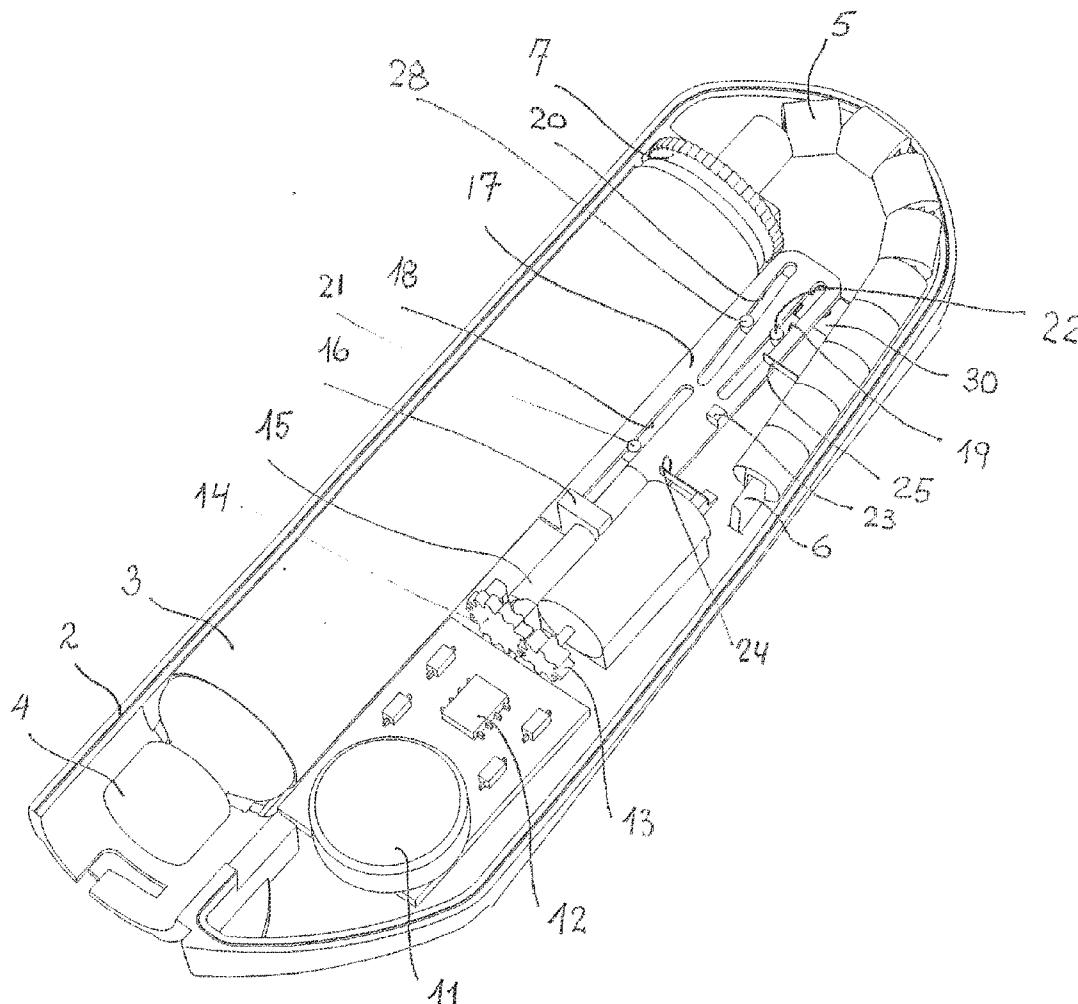

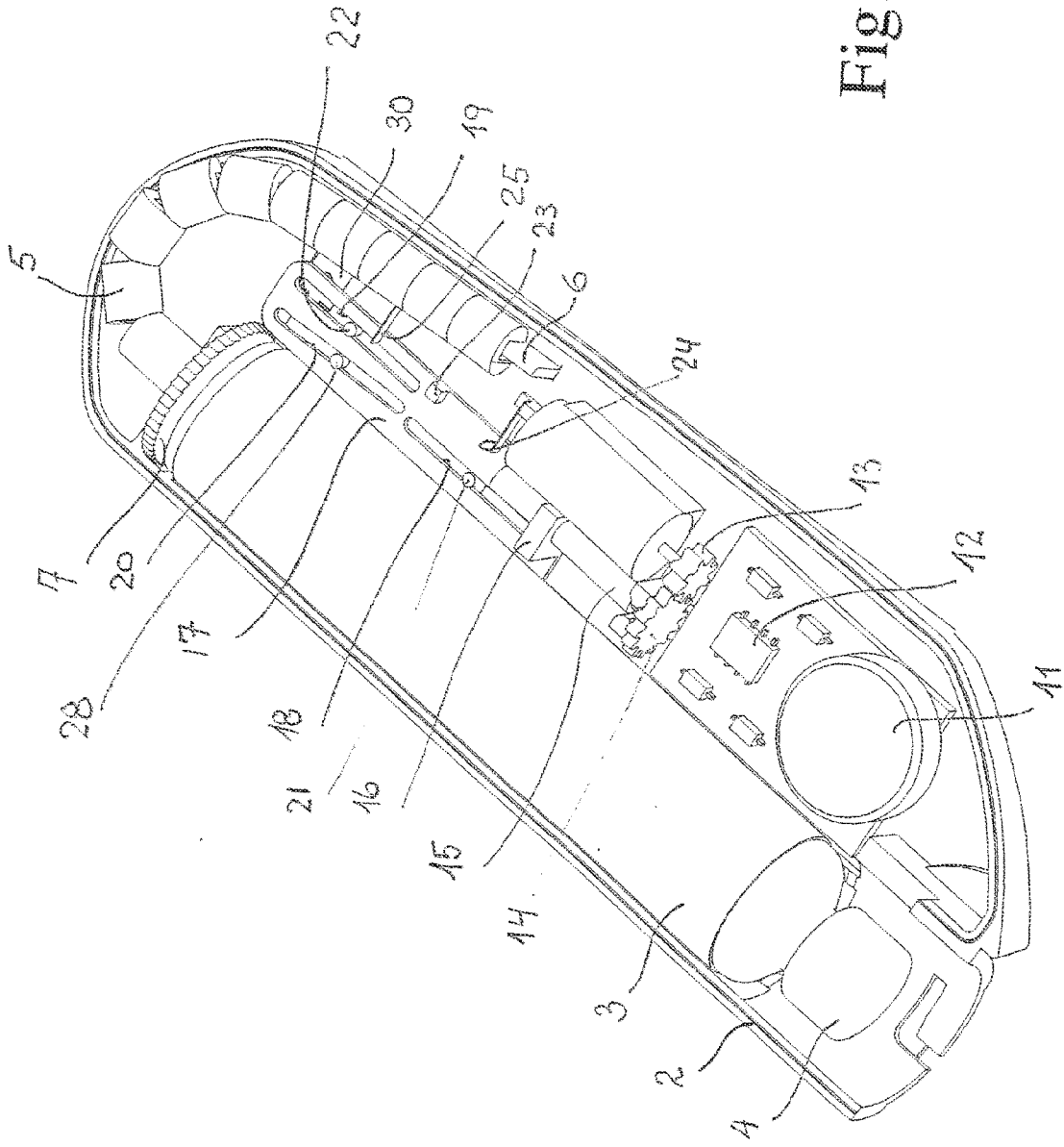
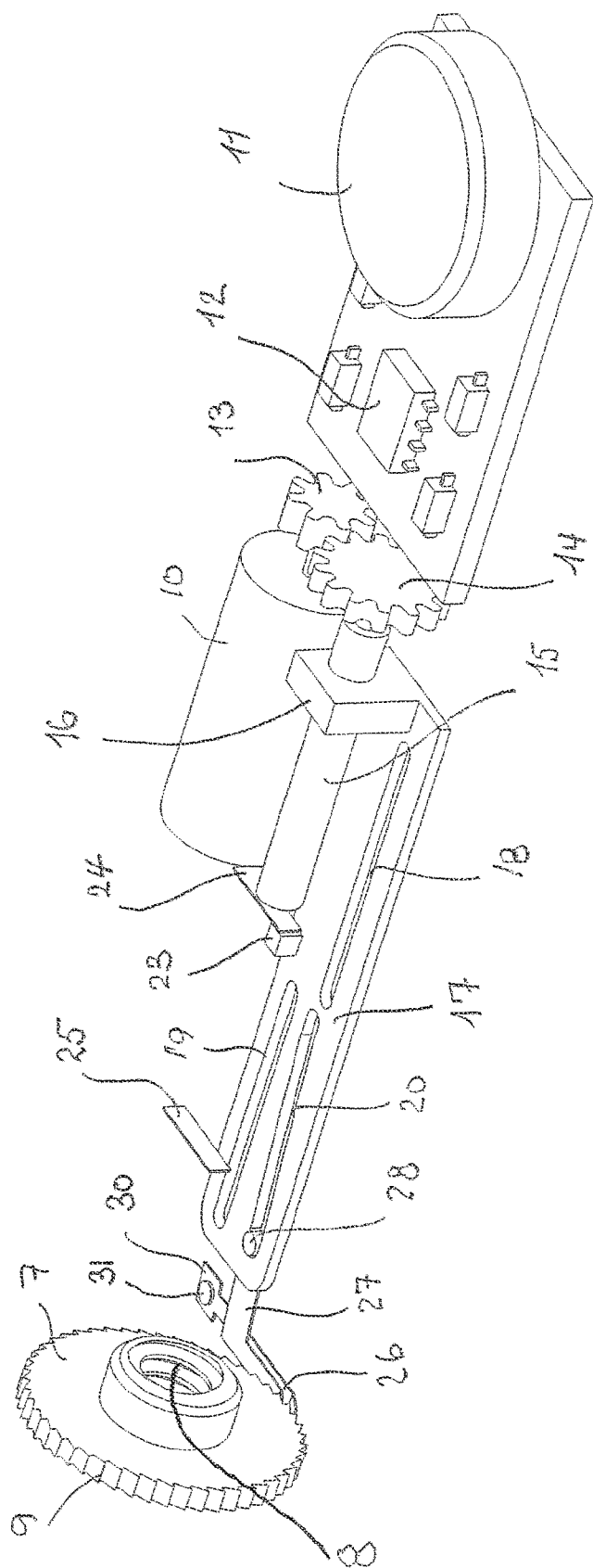

Fig. 1

2  
Li<sup>2+</sup>

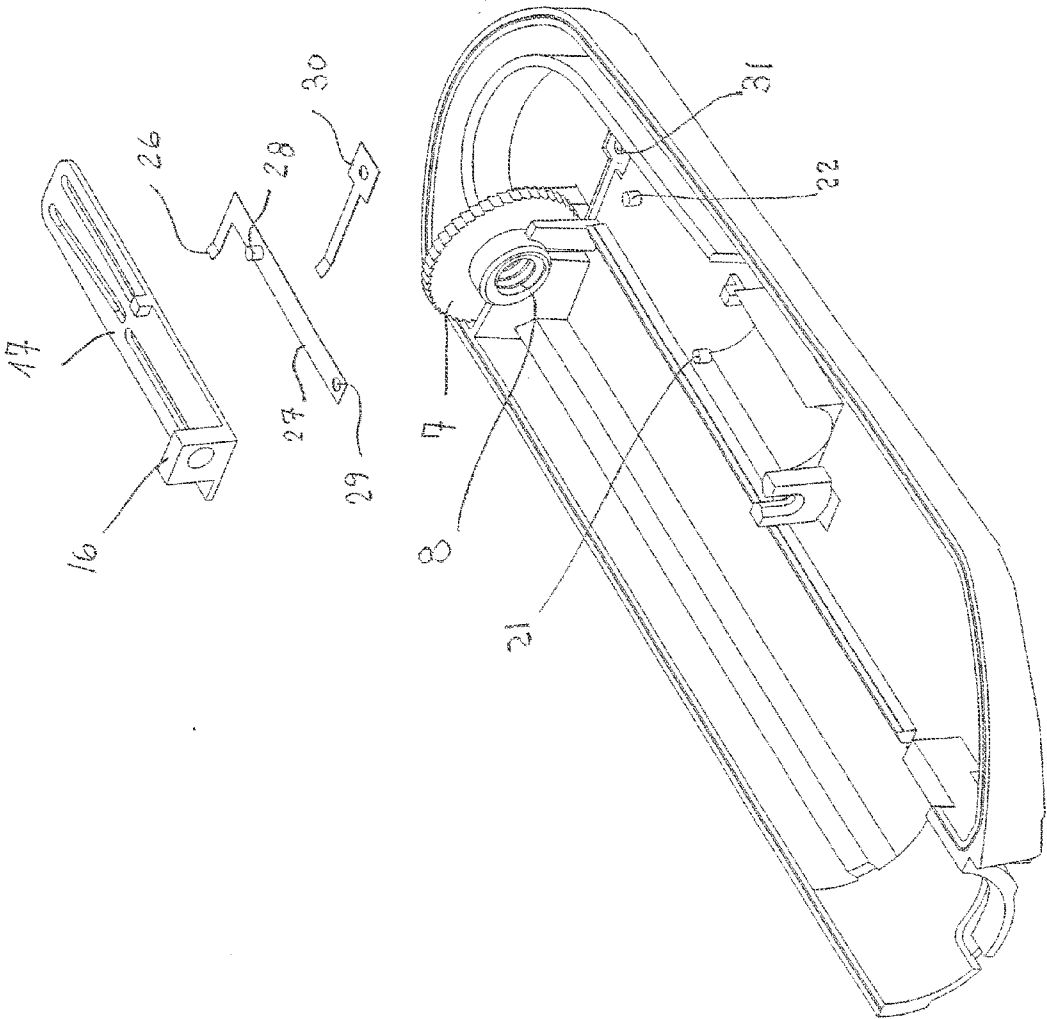

Fig. 3

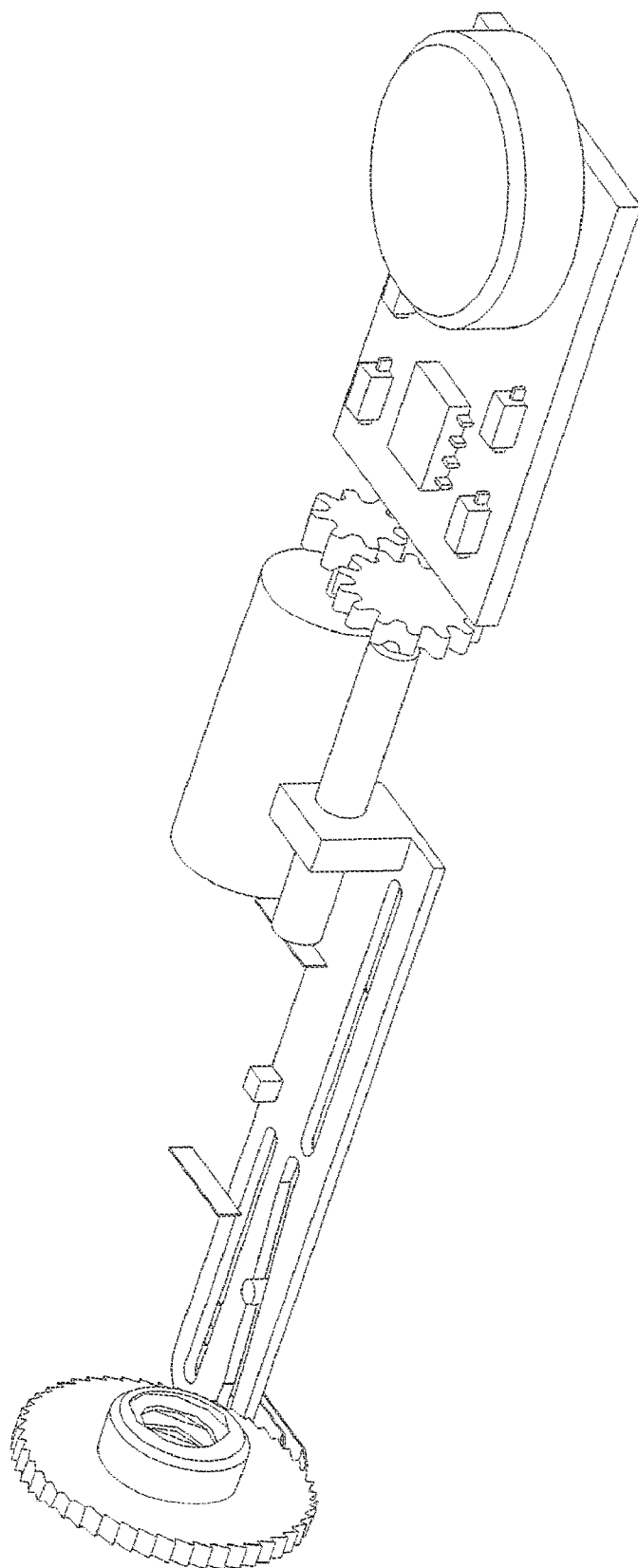

Fig. 4

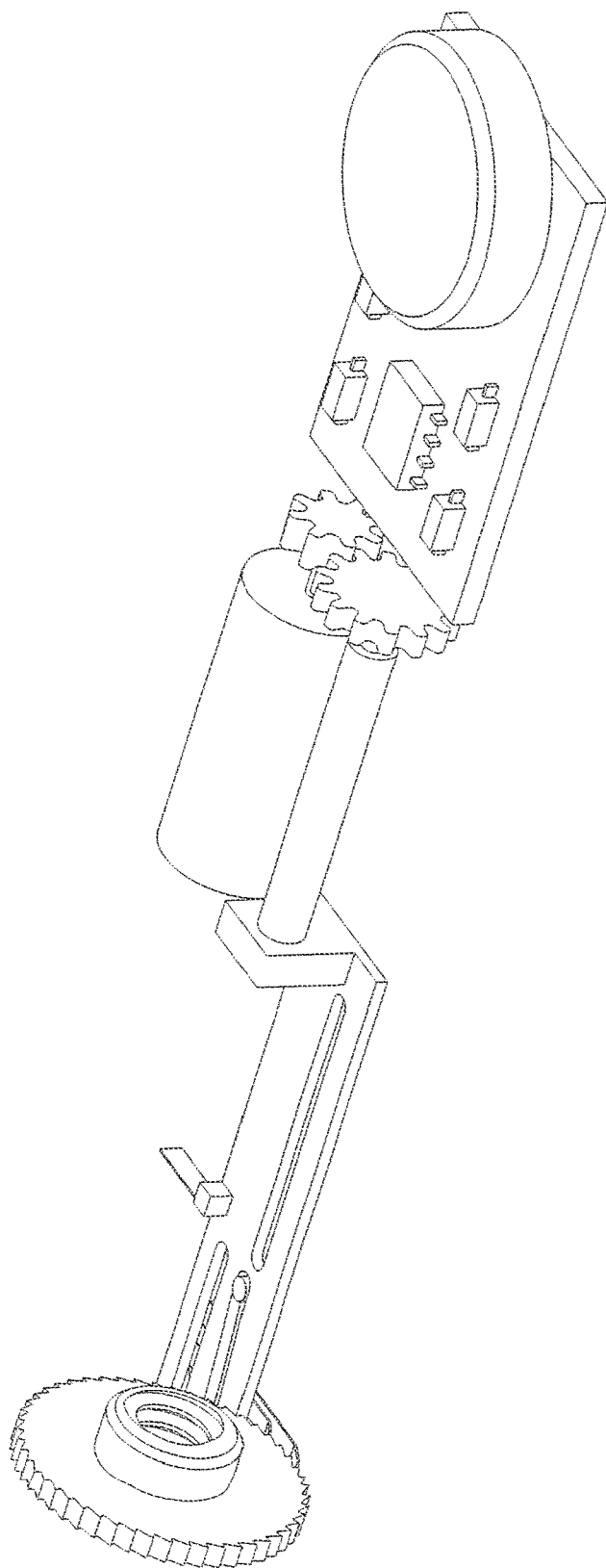

Fig. 5

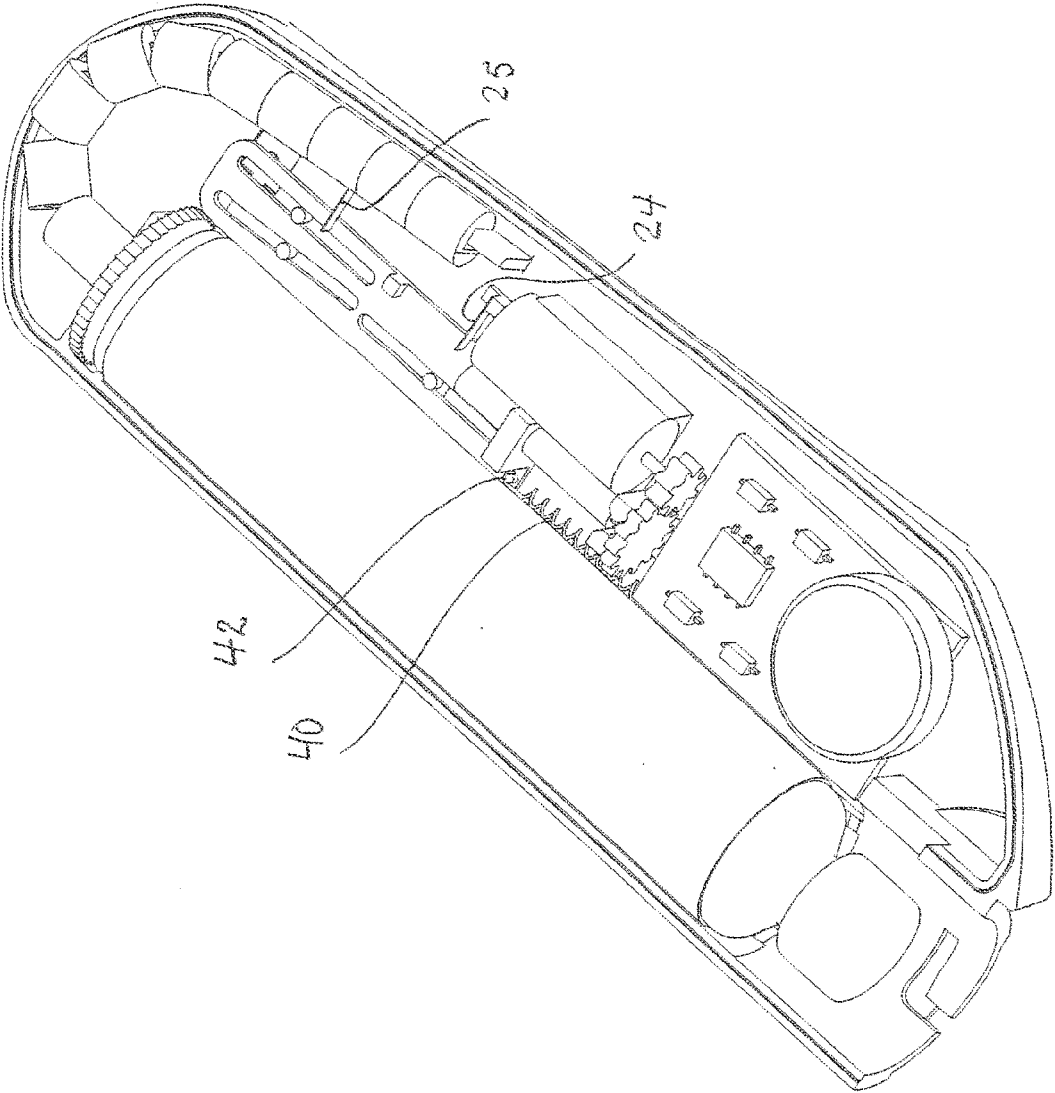

Fig. 6

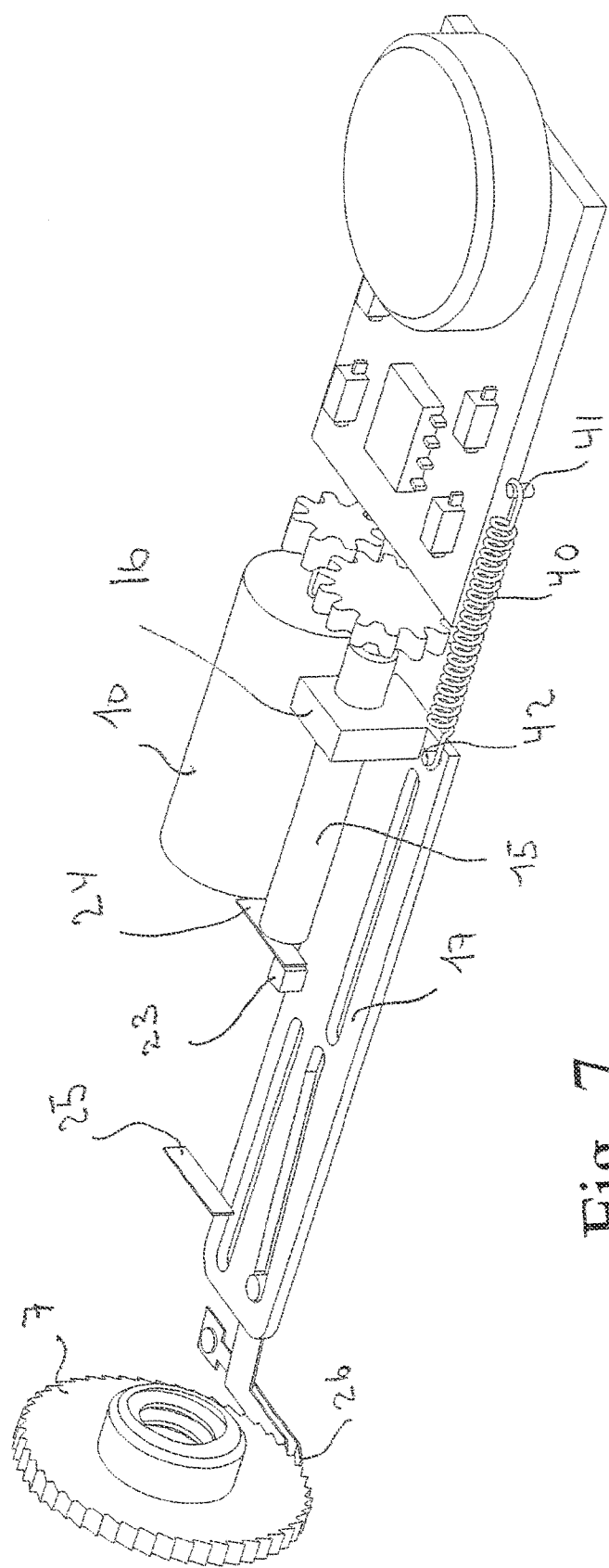

Fig. 7



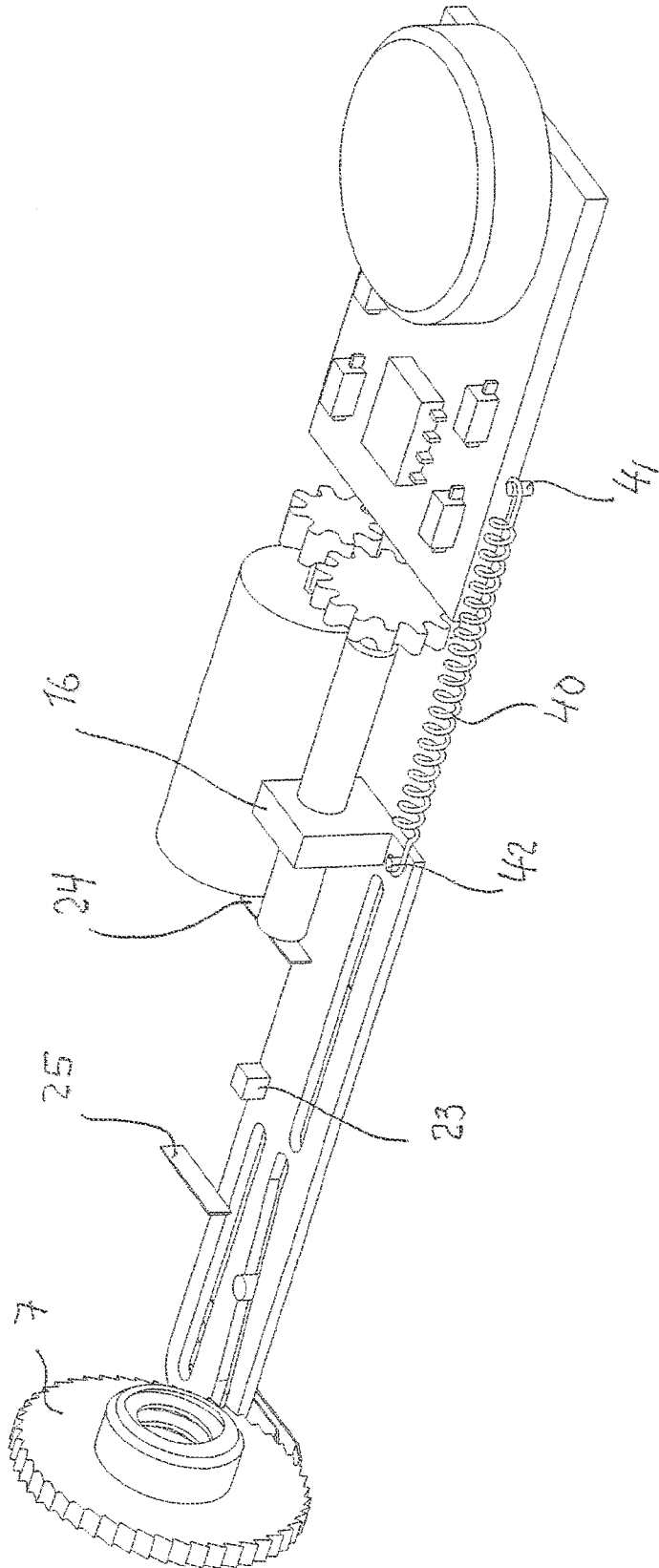

Fig. 8

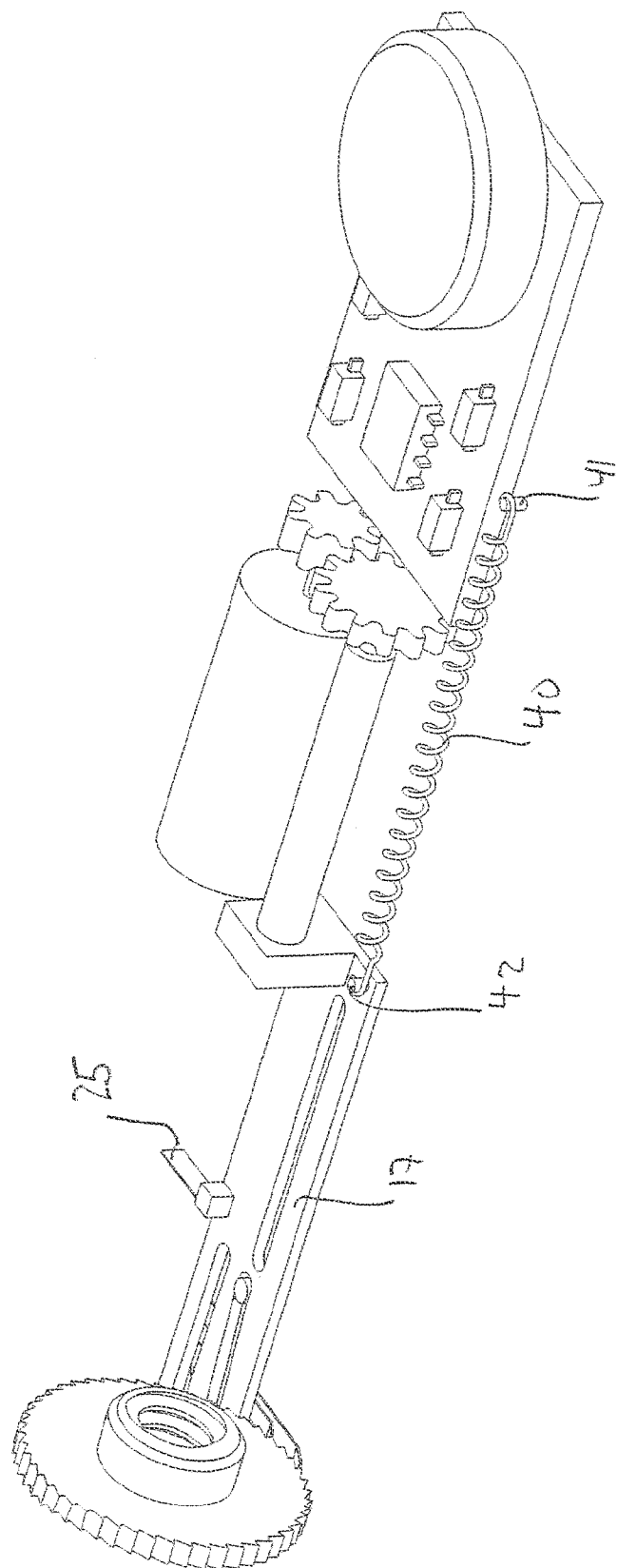
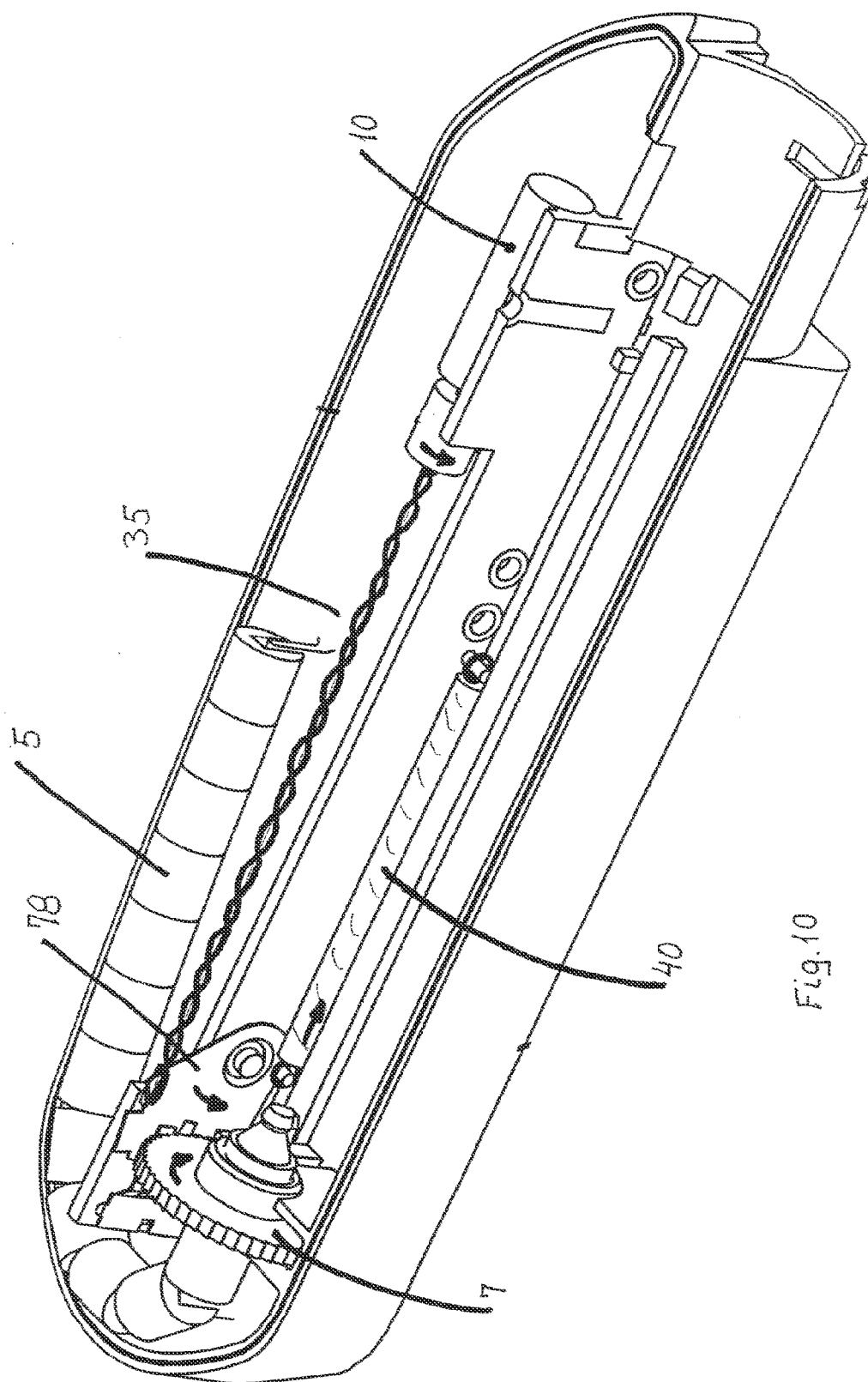
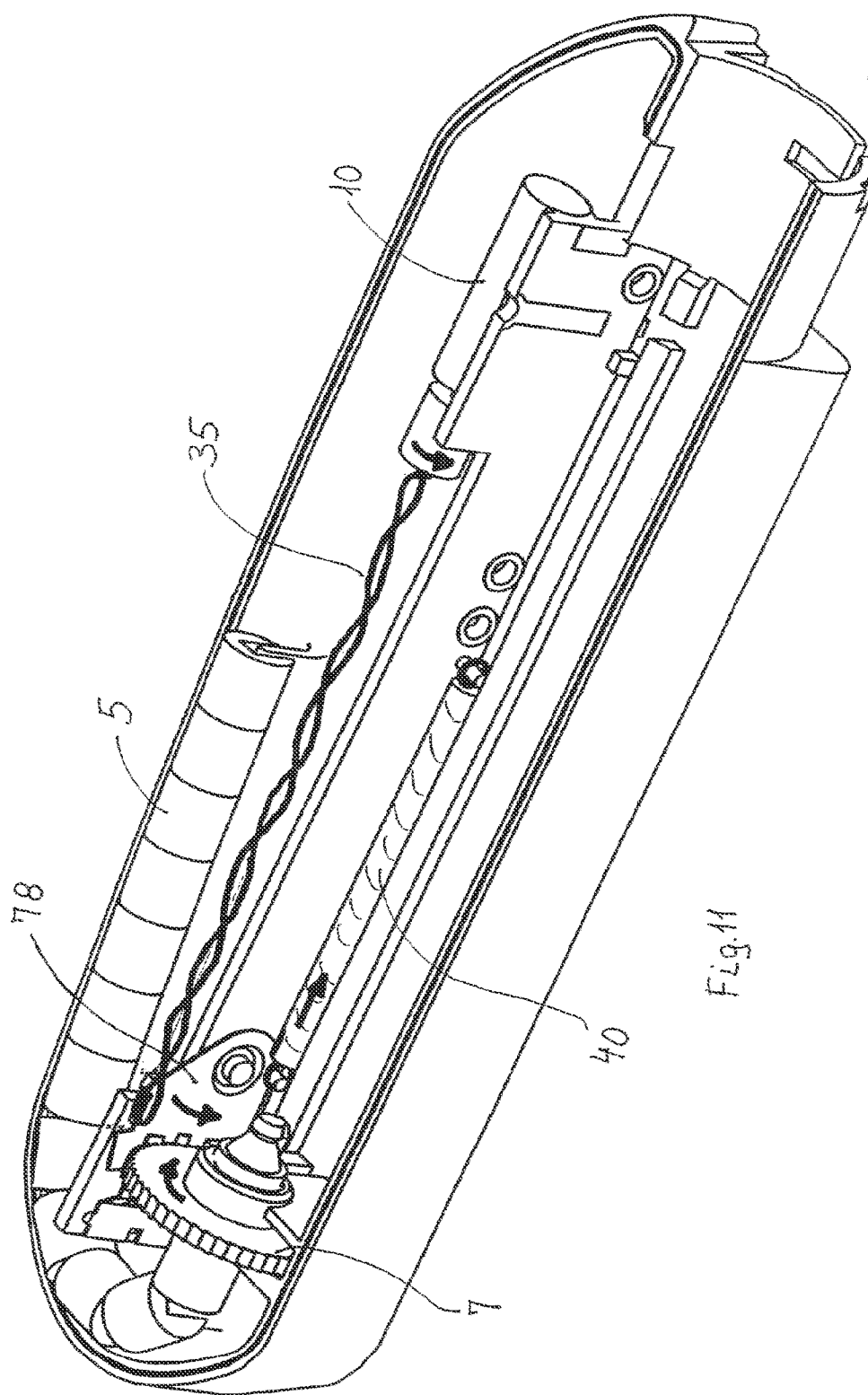
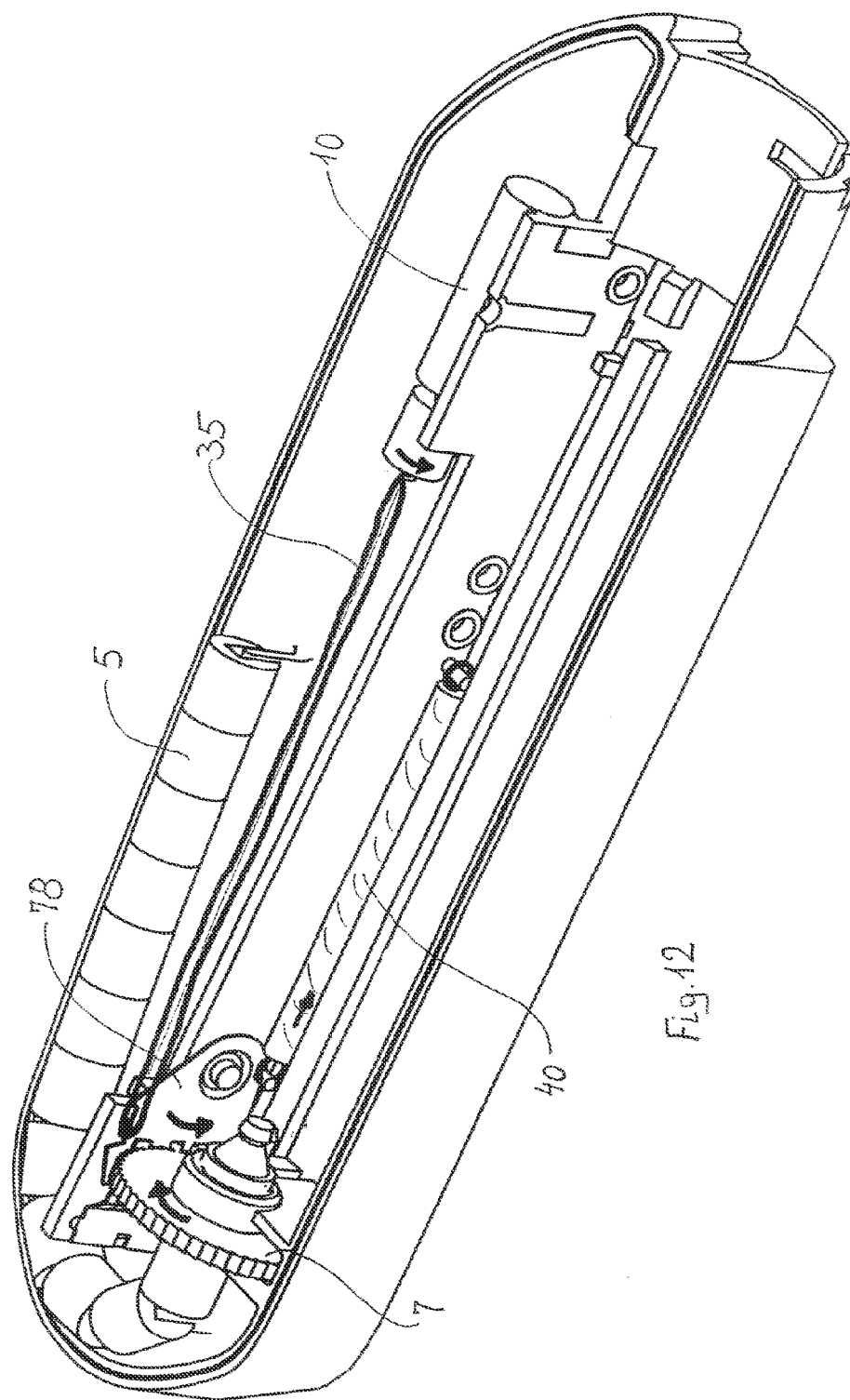
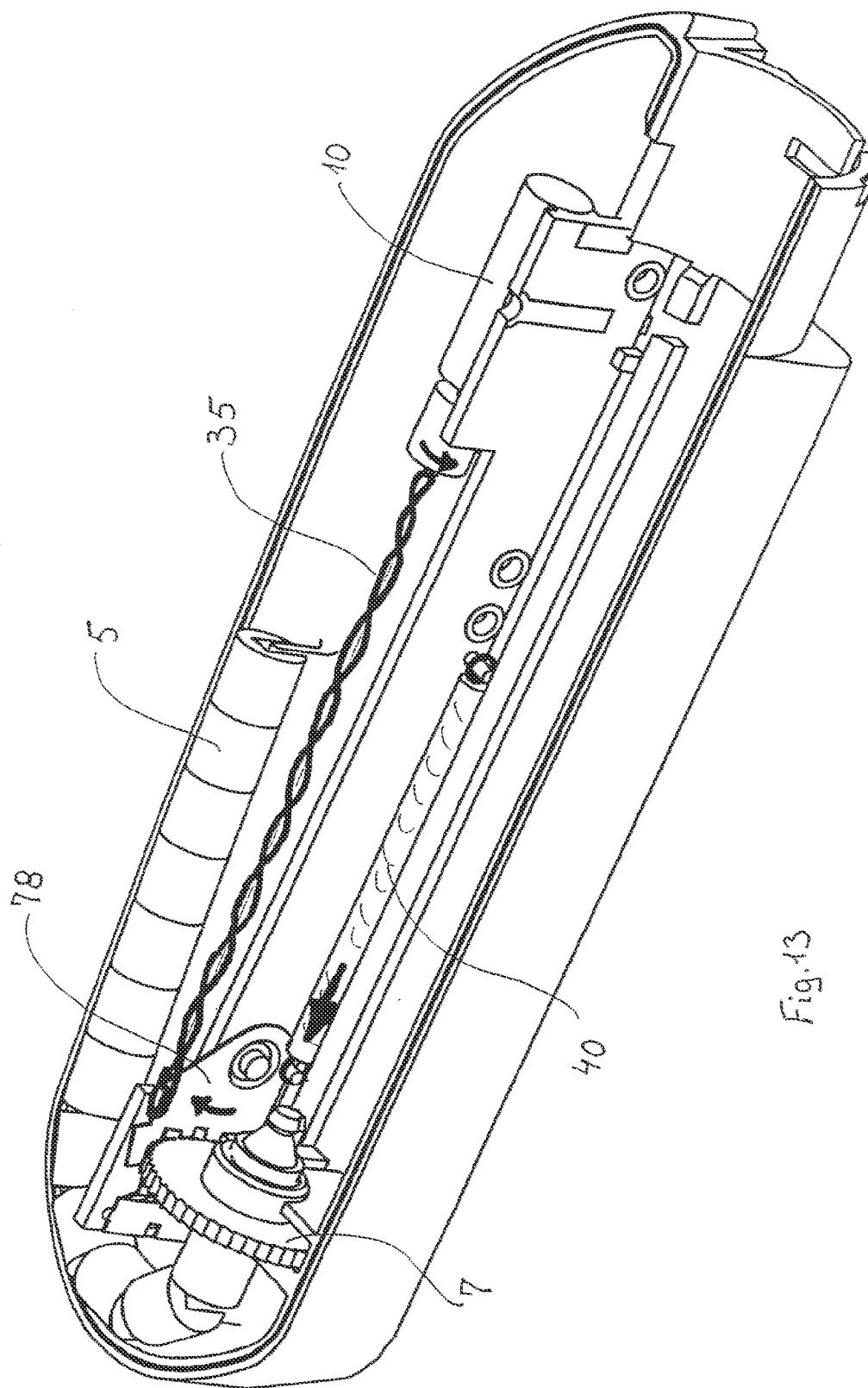

Fig. 9









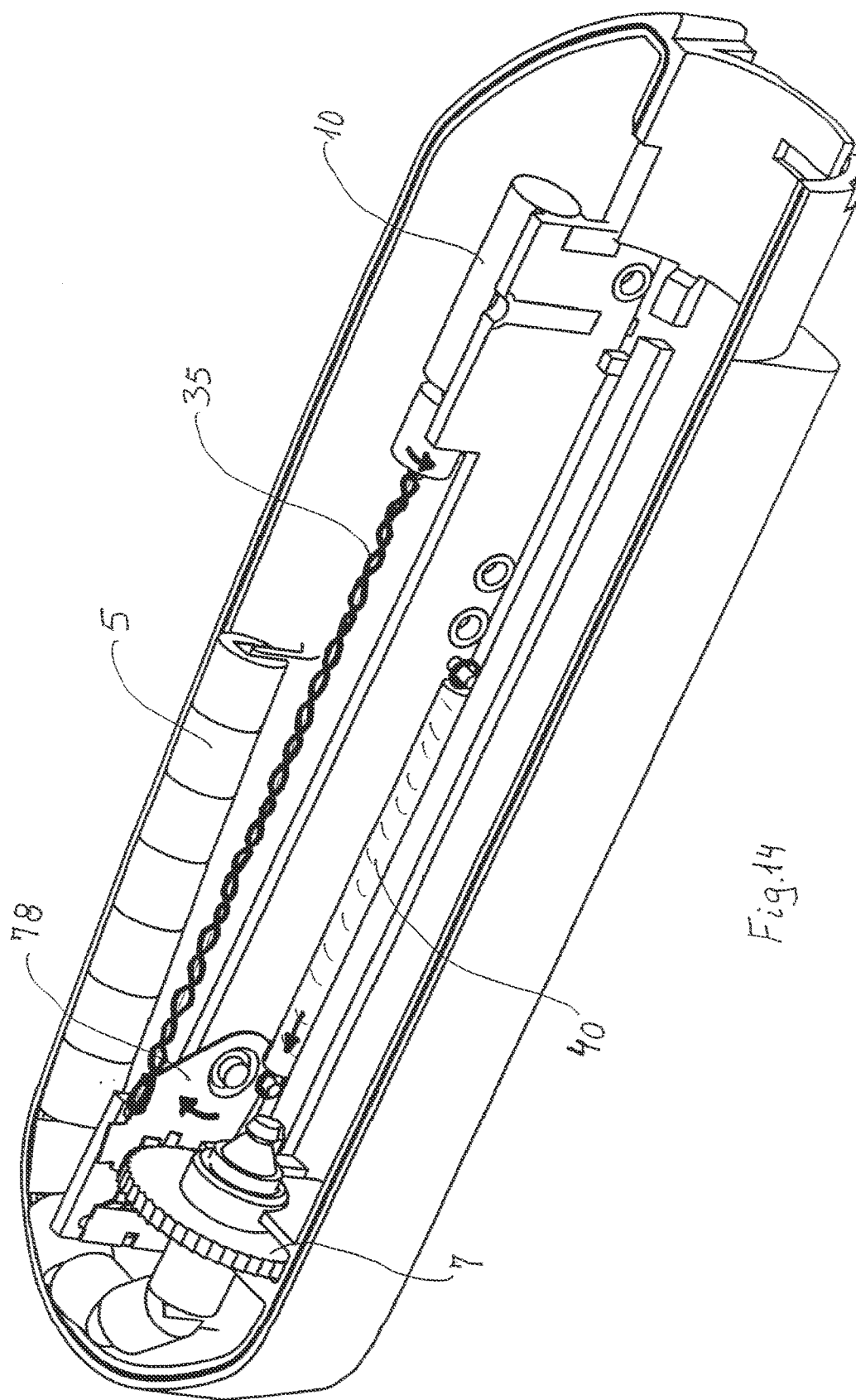

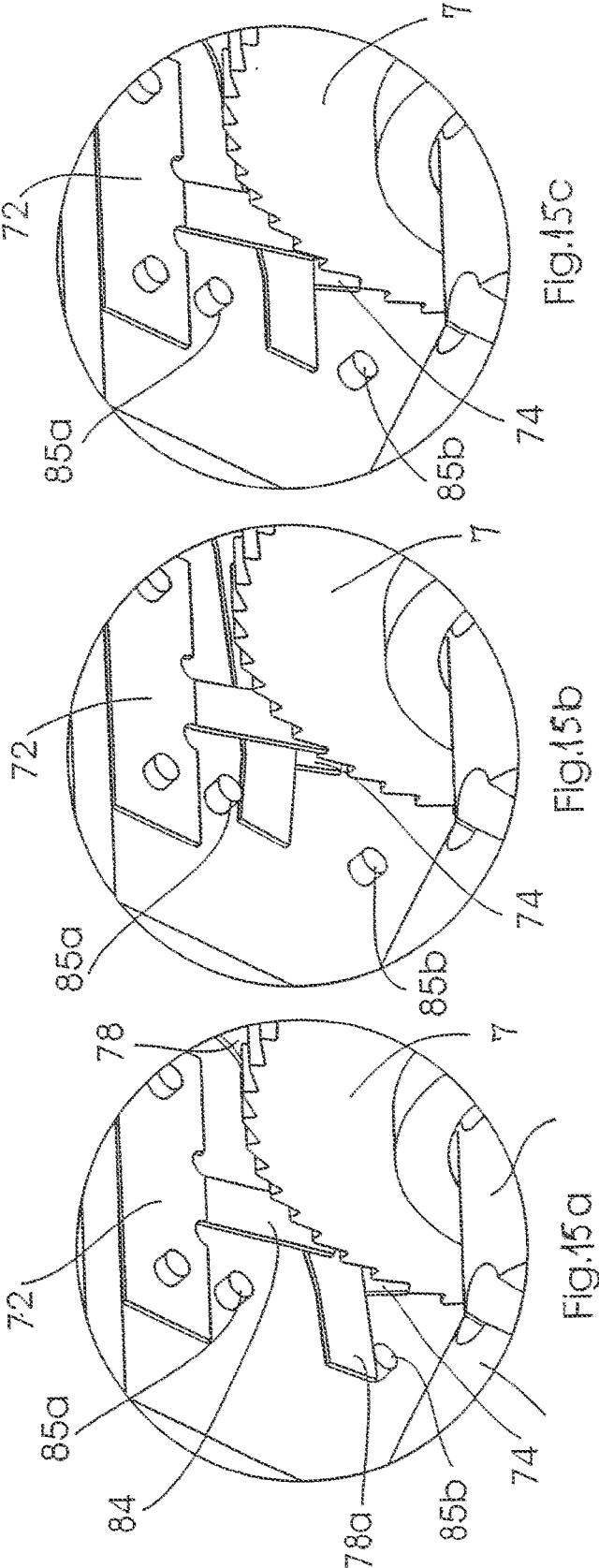



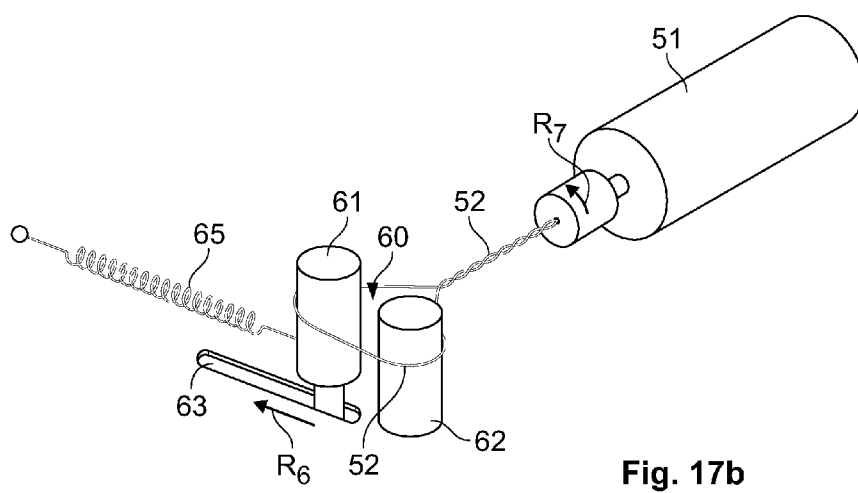
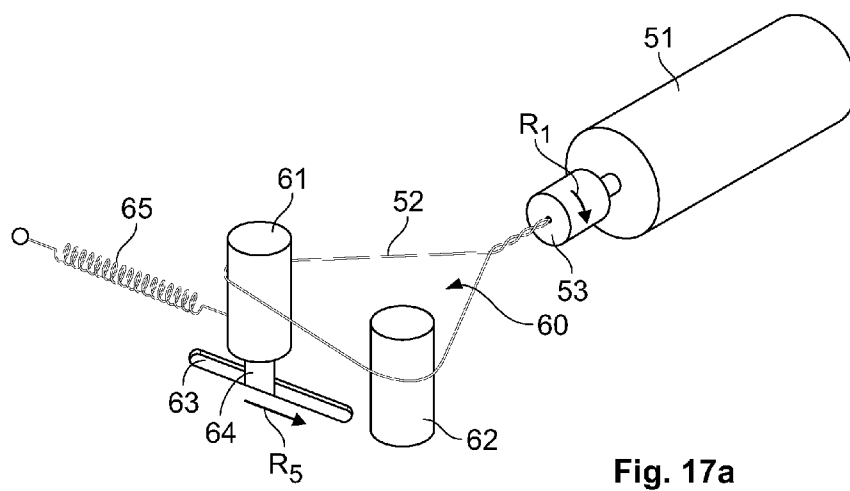
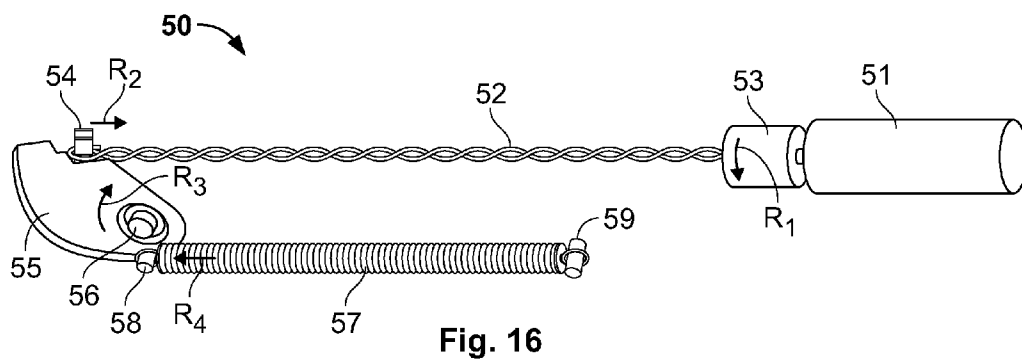

## MEDICINE DISPENSING DEVICE

### CROSS-REFERENCE TO RELATED APPLICATIONS

[0001] This application is a continuation of U.S. patent application Ser. No. 12/767,570 filed on Apr. 26, 2010, which is a continuation of U.S. patent application Ser. No. 10/591,190 filed on Aug. 31, 2006, which is a national stage application under 35 U.S.C. § 371 that claims the benefit of PCT/DK2006/000195 (published as WO2006/105794) filed on Apr. 6, 2006, which claims priority to the following Denmark patent applications: serial no. PA 2005 00483 filed on Apr. 6, 2005, serial no. PA 2005 00542 filed on Apr. 14, 2005, and serial no. PA 2005 00817 filed on Jun. 3, 2005. The entire contents of these prior applications are incorporated herein by reference.

### SUMMARY

[0002] The present invention relates to a method of dispensing liquid medicine comprising the steps of providing a wearable, disposable dispensing device comprising a syringe having a cylinder and a plunger displaceable in said syringe cylinder for pressing medicine out of said syringe cylinder and a drive mechanism connected to said plunger for displacing said plunger in said cylinder, and an electrical motor connected to a battery and to said drive mechanism for providing a rotary force to said driving mechanism for displacing said plunger, displacing said plunger a certain distance in connection with a cycle of said driving mechanism.

[0003] Methods of this type are known, wherein the electrical motor is controlled by a control means so as to carry out a certain number of revolutions for each cycle corresponding to the desired distance of displacement of the plunger.

[0004] In connection with such methods it is important that no more than the predetermined amount of medicine be dispensed per cycle as otherwise life threatening dosages may be dispensed.

[0005] When utilizing an electrical motor, a short circuit can entail that the motor does not stop after the predetermined number of revolutions or that the motor starts by itself.

[0006] Security means have been suggested to ensure that the predetermined dosage is not exceeded, for instance monitoring the amount of liquid dispensed per cycle or monitoring the displacement distance of the plunger or the amount of revolutions of the motor per cycle with interruption means being activated if the monitored elements exceed a certain value.

[0007] There exists a need for a simple and fail-safe method to avoid over-dosage of medicine. One main object of the invention is to meet this need.

[0008] According to the invention this object is achieved by the cycle comprising rotating said electrical motor in a first direction of rotation and subsequently rotating said electrical motor in the opposite direction of rotation.

[0009] Hereby, any short-circuit of the motor will not entail continued rotation of the motor in one direction with ensuing continued dispensing of medicine.

[0010] The invention furthermore relates to a wearable, disposable medicine dispensing device comprising:

[0011] a syringe having cylinder and a plunger displaceable in the syringe cylinder for pressing medicine out of said syringe cylinder,

[0012] a drive mechanism connected to said plunger for displacing said plunger in said cylinder, and

[0013] an electrical motor connected to a battery and to said drive mechanism for providing a rotary force to said driving mechanism for displacing said plunger, and

[0014] control means adapted for repeatedly reversing the direction of rotation of said electrical motor.

[0015] In a further aspect, the present invention relates to an actuator comprising:

[0016] a rotational motor.

[0017] one or more elongate, flexible elements such as a string, a filament, a strip, a ribbon and combinations thereof, said one or more elements being attached to said motor for rotation thereby and to a displaceable body, such that rotation of said motor twists said one or more elements and shortens the overall length thereof so that said displaceable body is displaced by the shortened element or elements.

[0018] Such an actuator according to the invention may be used in connection with medicine dispensing devices, but also in any application where a rotational force or movement is to be utilized to displace a body.

### DESCRIPTION OF DRAWINGS

[0019] In the following the invention will be described more in detail in connection with two embodiments shown, solely by way of example, in the accompanying drawings, where

[0020] FIG. 1 shows a first embodiment of a device according to the invention seen in perspective and with the top part of the housing removed,

[0021] FIG. 2 shows a perspective view of the drive mechanism of the device according to the invention in FIG. 1,

[0022] FIG. 3 is an exploded view of some of the drive mechanism elements of the device in FIG. 1, and

[0023] FIGS. 4 and 5 are views corresponding to FIG. 2 with the drive mechanism in other positions, and

[0024] FIGS. 6-9 are views of a second embodiment of the device according to the invention corresponding to FIGS. 1, 2, 4 and 5, respectively.

[0025] FIGS. 10-14 show a perspective view of a third embodiment of the device according to the invention in different sequential states during a first half cycle during rotation of the electrical motor in a first direction of rotation,

[0026] FIGS. 15a, b and c are views of some of the drive mechanism elements of the device in FIGS. 10-14 in different states during the cycle.

[0027] FIG. 16 is a schematic perspective view of a first embodiment of an actuator according to the invention, and

[0028] FIGS. 17a-b very schematically show a second embodiment of an actuator according to the invention at two different phases of an actuation cycle.

### DETAILED DESCRIPTION

[0029] Referring now to FIGS. 1-5, a wearable disposable dispensing device for medicine referred to generally by the numeral 1 and of the type described in WO 2004/041330 and WO 2004/056412, the disclosure of which is hereby incorporated herein by reference, comprises a housing 2, where only the bottom half is shown for the sake of clarity, a cylindrical medicine container or carpule 3 having at one end a silicone body for receiving a catheter for dispensing medicine from the interior of the carpule to a human body and being

open at the opposite end to receive a flexible piston rod 5 for displacing an internal not shown plunger or piston in the carpule 3 for forcing medicine out through a catheter needle assembly connected to the silicone body 4.

[0030] The flexible piston 5 is composed of segments hinged together and outwardly threaded guided by a rail 6 received in recesses in each of the segments of the rod 5. The not shown outward threads of the segments of the flexible piston rod 5 engage in a thread 8 of ratchet wheel 7 having teeth 9 along the periphery thereof. An electrical motor 10 electrically connected to a battery 11 and control means 12 is provided with a gear 13 meshing with a gear 14 attached to an outwardly threaded spindle or shaft 15 received in an inwardly threaded nut 16 attached a plate 17 provided with two slits 18 and 19, extending parallel to the axis of said spindle 15 and a third slit 20, extending at an angle to said axis. Two fixedly arranged pins 21 and 22 are received in the slits 18 and 19, respectively such that the pins serve as guides to the to and fro displacement of the plate 17 by means of the spindle 15 when the electrical motor 10 rotates first in one directional rotation and thereafter in the opposite directional rotation.

[0031] A protuberance 23 is arranged on the plate 17 to co-operate with two end stop contacts 24 and 25 electrically connected to the control means 12 for reversing the direction of rotation of the electrical motor when the protuberance 23 contacts one of the end stop contacts 24 or 25. A pawl 26 is attached to a pivotable elongated body 27 having a pin 28 for being received in the oblique slit 20 and a hole 29 for receiving the pin 21 such that the body 27 is pivotable around the pin 21. A ratchet 30 is fixedly attached to the housing 2 by means of a pin 31 and is located so as to engage the teeth 9 of the ratchet wheel 7. The pawl 26 is displaceable from a retracted position where it does not engage the teeth 9 of the ratchet wheel 7 and in an engaged position in which it engages the teeth of the ratchet wheel and rotates the ratchet wheel in a clockwise direction.

[0032] The displacement of the pawl 26 between the two positions indicated above takes place by the linear displacement of the plate 17. When the plate 17 is displaced in the direction from the end stop contact 24 to the end stop contact 25, the oblique slit 20 urges the pin 28 of the elongated body 27 in a direction 10 away from the carpule 3 such that the elongated body 27 pivots around the pin 21 in a clockwise direction, whereby the pawl 26 is moved in towards its retracted position relative to the ratchet wheel 7. When the protuberance 23 on the plate 17 contacts the end stop contact 25, the directional rotation of the motor 10 is reversed and the plate 17 is displaced in the direction from the end stop contact 25 towards the end stop contact 24, whereby the oblique slit 20 forces the pin 28 towards the carpule 3, whereby the elongated body 27 is forced to rotate in a counterclockwise direction whereby the pawl 26 is brought into contact with one of the teeth 9 of the ratchet wheel and rotates the ratchet wheel in a clockwise direction, while the ratchet rides over one of the other teeth 9 for locking the ratchet wheel against rotation in the counterclockwise direction.

[0033] Thus, during one cycle of rotation in one direction and the opposite direction of the electrical motor 10, the ratchet wheel 7 will be advanced by one tooth corresponding to one displacement of the pawl 26 from the retracted position thereof to the engaged position thereof.

[0034] Referring now to FIGS. 6-9, in this embodiment a coil spring 40 is attached to a pin 41 fixedly attached to the housing 2 and a pin 42 fixedly attached to the plate 17.

[0035] When the plate 17 is moved in the direction from end contact 24 towards the end contact 25, the spring 40 is in tension, and when the plate 17 moves back in a direction from the end stop contact 25 towards the end stop contact 24 after reversion of the direction of rotation of the motor 10, the spring 40 will be relaxed and exert a force in the same direction as the motor 10 on the plate 17 and thus reinforcing the force available to rotate the ratchet wheel 7.

[0036] Referring now to FIGS. 10-15, the electrical motor 10 is electrically connected to a battery and control means and the axle of the motor is connected to a pair of twisted strings 35 or a band or similar device, which reduces its length when twisted and increases its length when untwisted, said length variation being provided by the rotation of the motor, i.e. the device is connected to the rotating axle of the motor at one end and connected to a pivotable body 78 at the opposite end. The pivotable body is provided with an extension 78a comprising a pawl 74 arranged to engage the teeth 9 on the ratchet wheel 7, as indicated in FIGS. 15a, 15b, 15c, whereby the pivoting of the pivotable body 78 provides a rotation of the ratchet wheel 7. A second pawl mechanism 72, 84 is provided to prevent rotation of the ratchet wheel 7 in the opposite direction, again as shown in FIGS. 15a-15c.

[0037] The displacement of the pawl 74 between the two positions indicated in FIGS. 15a and 15b is provided by the reduction of the length of the twisted strings 35 by rotation of the motor and the displacement in the opposite direction is provided by the spring 40 during extension of the twisted strings 35 provided by rotation of the motor in the opposite direction, whereafter further rotation in this direction again reduces the length of the twisted strings 35, whereby a complete cycle of rotation in one direction of the motor provides a movement of the pivotable body from the position shown in FIG. 15a to the position shown in FIG. 15b and back to the position shown in FIG. 15a, this movement being provided by the twisted strings 35 being untwisted and twisted in the opposite direction during rotation of the motor in one direction. Thus, the rotation of the motor in one direction of rotation provides a full stroke for the pivotable body and thus the pawl mechanism moving the ratchet wheel one step forward and the following rotation of the motor in an opposite direction of rotation provides a further full stroke of the pivotable body and the pawl mechanism.

[0038] Thus, during one cycle of rotation in one direction and the opposite direction of the electrical motor 10, the ratchet wheel 7 will be advanced by two teeth corresponding to two displacements of the pawl 74. The pivotable body 78 comprises a protuberance 78a which co-operates with two end stop contacts 85a and 85b electrically connected to the control means for controlling the reversal of the direction of rotation of the electrical motor when the protuberance 78a contacts the end stop contact 85a. Due to the fact that the twisted strings 35 can only provide a pulling force on the pivotable body 78, a spring 40 is connected to the pivotable body to provide the movement in the direction shown by the arrow in FIG. 10.

[0039] In the embodiment shown in the figures spring 40 is a coil spring, however, other types of springs, such as a rod spring could be provided for this purpose.

[0040] Referring now to FIG. 16, an actuator according to the invention is referred to generally by the numeral 50 and is

identical to the actuator shown in FIGS. 10-14. This actuator may be employed for any use requiring transformation of a rotation to a linear movement or a rotational force to a linear force.

**[0041]** A rotation motor **51** is attached to a pair of elongate, flexible elements such as strings or filaments **52** by means of a rotational body **53** that may or may not function as a fly wheel. The elements **52** are attached to a pin **54** on a pivotable plate. Rotation of the motor in the direction **R1** will twist the strings **52** such that the length thereof is shortened until the pin **54** is displaced linearly in the direction **R2** whereby the plate **55** is rotated around pivot **56** in the direction **R3**. A tension spring **57** is attached to plate **55** at pin **58** and to a not shown frame at pin **59**.

**[0042]** Rotation of the plate **55** will expand the spring **57** in the direction **R4** against the spring force thereof.

**[0043]** Rotation of the motor **51** in the direction opposite **R1** will at first untwist the elements **52** whereby the length thereof becomes larger with the consequence that the spring **57** rotates the plate **55** in the direction opposite **R3**.

**[0044]** Further rotation of the motor **51** in the direction opposite **R1** will twist the elements **52** again and eventually exert a force on said pin **54** in direction **R2** again, the direction of rotation being subsequently reversed again and the cycle starts anew.

**[0045]** In case, a smaller interval is desired between each turn of the plate **55** in the direction **R3**, the motor **51** may reverse direction of rotation as soon the elements **52** have become untwisted to an extent that the spring **57** has pivoted the plate a certain distance in the direction opposite **R3**.

**[0046]** Reference is now made to FIGS. 17a-17b, where a motor **51** is attached to both opposed ends of an elongate, flexible element such as a string or filament **52** by means of a rotational body **53** that may or may not function as a fly wheel. The element **52** forms a loop **60** within which are located two bodies **61** and **62**.

**[0047]** The body **61** is displaceable along a groove **63** in which a pin **64** of the body is slideably received. A spring **65** is attached to the displaceable body **61** such that displacement of said body **61** in the direction **R5** takes place against the biasing force exerted by the spring **65**.

**[0048]** The other body **62** is fixedly arranged such that when twisting of the element **52** by rotation of the motor **51** takes place the loop **60** is reduced in size as seen in FIG. 17b and the displaceable body **61** is forced towards the fixed body **62** along the groove **63** and against the spring force of the spring **65**.

**[0049]** When the rotational direction of the motor is reversed so that it rotates in the direction **R7**, the element **52** will be untwisted, the loop **60** will enlarge and the spring **65** will displace the body in the direction **R6**.

**[0050]** Although the groove is shown extending substantially linearly, it may obviously be curved and extend at different angles to the axis of the motor.

**[0051]** The body **61** may be attached to a multitude of different driving or transmission mechanisms, for example the ratchet and pawl mechanisms shown in FIGS. 1-9.

**[0052]** A displaceable body should be taken to mean any body that can change position either by linear motion, curved motion, rotative motion, etc. and any combination thereof under the influence of a force applied to a point on or in said body.

**[0053]** Displacement should likewise be taken to mean any change in position resulting from linear motion, curved motion, rotative motion, etc. and any combination thereof.

What is claimed is:

1. A wearable medicine dispensing device, comprising:
  - a portable housing that defines a space to receive a medicine for incremental dispensation to a user;
  - a piston rod being arranged in the portable housing and being movable in individual forward increments toward the medicine when the medicine is received in the space;
  - a drive mechanism arranged in the portable housing and coupled to the piston rod so as to longitudinally advance the piston rod in each of the individual forward increments for medicine dispensation when the medicine is received in the space;
  - a battery-powered, reversible motor arranged in the portable housing and coupled to the drive mechanism such that rotation of the reversible motor urges the drive mechanism to advance piston rod in each of the individual forward increments; and
 wherein the drive mechanism is configured to longitudinally advance the piston rod in one of the individual forward increments in response to each motor rotation cycle including one or more full rotations of the reversible motor in a first rotational direction and one or more full rotations of the reversible motor in a second reverse rotational direction.
2. The wearable medicine dispensing device of claim 1, wherein the drive mechanism comprises a pawl and a ratchet wheel, the pawl positioned to engage at least one of the teeth of the ratchet wheel, wherein the pawl reciprocates between a first position and a second position to incrementally rotate the ratchet wheel, wherein rotation of the ratchet wheel in a drive direction causes longitudinal advancement of the piston rod.
3. The wearable medicine dispensing device of claim 2, further comprising at least two gears coupled between the reversible motor and the pawl.
4. The wearable medicine dispensing device of claim 3, further comprising a rigid plate member coupled between the at least two gears and the pawl.
5. The wearable medicine dispensing device of claim 3, wherein one or more full rotations of the rotational motor causes the pawl to pivot about an axis.
6. The wearable medicine dispensing device of claim 1, further comprising a control circuit device that communicates signals to cause the reversible motor to repeatedly reverse the direction of rotation between the first rotational direction and the second reverse rotational direction.
7. The wearable medicine dispensing device of claim 6, further comprises a sensor that communicates with the control circuit device to cause the rotation of the motor to be reversed from the first rotational direction to the second reverse rotational direction.
8. The wearable medicine dispensing device of claim 1, wherein the drive mechanism comprises a drive wheel to mate with a portion of the piston rod, wherein the drive wheel is locked from rotation in a direction opposite to a forward rotation drive direction of the drive wheel.
9. The wearable medicine dispensing device of claim 8, wherein the drive wheel comprises an internal thread configuration that engages with an outer thread configuration of the piston rod.
10. The wearable medicine dispensing device of claim 1, wherein the piston rod comprises a flexible piston rod having

rod segments hinged together and outwardly threaded, wherein at least a portion of the flexible piston rod extends longitudinally in a curved configuration inside the housing.

**11.** The wearable medicine dispensing device of claim **1**, wherein the drive mechanism prevents over-dispensation of the medicine in the event of continuous rotation of the reversible motor in any of the first rotational direction and the second reverse rotational direction.

**12.** The wearable medicine dispensing device of claim **11**, wherein the drive mechanism prevents over-dispensation of the medicine in the event of continuous rotation of the reversible motor so as to provide a fail-safe protection against over-dosage of medicine.

**13.** The wearable medicine dispensing device of claim **1**, wherein the drive mechanism further comprises a linearly displaceable plate coupled to the reversible motor.

**14.** The wearable medicine dispenser device of claim **13**, wherein one or more full rotations of the reversible motor causes the linearly displaceable plate to act upon a pawl of the drive mechanism.

**15.** The wearable medicine dispensing device of claim **1**, further comprising a battery in electrical connection with the reversible motor so as to provide power to rotate the reversible motor in a first direction and in a second reverse direction, the battery being positioned inside the portable housing.

\* \* \* \* \*