



- (51) International Patent Classification:
A61M 29/02 (2006.01) *A61M 25/10* (2013.01)
- (21) International Application Number:
PCT/US2013/033845
- (22) International Filing Date:
26 March 2013 (26.03.2013)
- (25) Filing Language: English
- (26) Publication Language: English
- (30) Priority Data:
61/616,790 28 March 2012 (28.03.2012) US
- (71) Applicant: **BOARD OF REGENTS, THE UNIVERSITY OF TEXAS SYSTEM** [US/US]; 201 West 7th Street, Austin, TX 78701 (US).
- (72) Inventor: **NOWAK, Brent, M.**; 8403 Floyd Curl Drive, Mail Code 7746, San Antonio, TX 78229-3904 (US).
- (74) Agent: **MEYERTONS, Eric, B.**; Meyertons, Hood, Kivlin, Kowert & Goetzel, P.C., P.O. Box 398, Austin, TX 78767-0398 (US).
- (81) Designated States (unless otherwise indicated, for every kind of national protection available): AE, AG, AL, AM, AO, AT, AU, AZ, BA, BB, BG, BH, BN, BR, BW, BY,

BZ, CA, CH, CL, CN, CO, CR, CU, CZ, DE, DK, DM, DO, DZ, EC, EE, EG, ES, FI, GB, GD, GE, GH, GM, GT, HN, HR, HU, ID, IL, IN, IS, JP, KE, KG, KM, KN, KP, KR, KZ, LA, LC, LK, LR, LS, LT, LU, LY, MA, MD, ME, MG, MK, MN, MW, MX, MY, MZ, NA, NG, NI, NO, NZ, OM, PA, PE, PG, PH, PL, PT, QA, RO, RS, RU, RW, SC, SD, SE, SG, SK, SL, SM, ST, SV, SY, TH, TJ, TM, TN, TR, TT, TZ, UA, UG, US, UZ, VC, VN, ZA, ZM, ZW.

- (84) Designated States (unless otherwise indicated, for every kind of regional protection available): ARIPO (BW, GH, GM, KE, LR, LS, MW, MZ, NA, RW, SD, SL, SZ, TZ, UG, ZM, ZW), Eurasian (AM, AZ, BY, KG, KZ, RU, TJ, TM), European (AL, AT, BE, BG, CH, CY, CZ, DE, DK, EE, ES, FI, FR, GB, GR, HR, HU, IE, IS, IT, LT, LU, LV, MC, MK, MT, NL, NO, PL, PT, RO, RS, SE, SI, SK, SM, TR), OAPI (BF, BJ, CF, CG, CI, CM, GA, GN, GQ, GW, ML, MR, NE, SN, TD, TG).

Published:

- with international search report (Art. 21(3))
- before the expiration of the time limit for amending the claims and to be republished in the event of receipt of amendments (Rule 48.2(h))

(54) Title: ADVANCED CERVICAL RIPENING SYSTEM

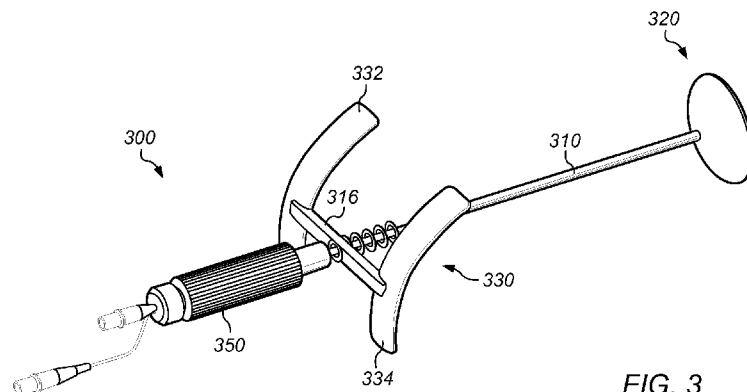

FIG. 3

(57) Abstract: Traditional and existing methods of cervical ripening employ a Foley Bulb designed for and typically used in bladder procedures. Consequently, the application to the cervix is sub-optimal. The described device resolves this and related limitations. The device includes a balloon that has been designed to accommodate the cervix geometry, and which can adapt to normal differences in the individual. Further improvements are attained by the use of a supporting device which couples the cervix ripening device to the individual.



TITLE: ADVANCED CERVICAL RIPENING SYSTEMBACKGROUND OF THE INVENTION5 1. Field of the Invention

The invention generally relates to cervical ripening devices and methods.

2. Description of the Relevant Art

10 Cervical ripening refers to the effacement or thinning of the cervix followed by dilation in preparation for the birthing process. Critical factors in the initiation of the ripening process include release of enzymes, hormonal factors, and local pressure on the internal os of the cervix as a result of the fetus' head following decent. When the progression of cervical ripening is slow or is not naturally initiated, stimulation by insertion and inflation of a balloon catheter to apply additional local has been shown to be effective.

15 Current methodology utilizes a Foley urinary catheter that is inserted into the cervical os and inflated to 50 to 80 ml with saline solution. The resulting spherical balloon is 5 to 6cm in diameter. The area in contact with the internal os is roughly 30 to 45 cm² with the locally applied pressure a function of the cosine of the angle between the axis of the cervical channel and the point of contact by the balloon. The addition of approximately 1 Kg to the distal end of the Foley catheter has improved the ripening process substantially.

20 Several problems with the Foley catheter approach to cervical ripening are evident. Since the balloon is spherical, local pressure is not uniform over the internal os. This presents the potentiality that local release of hormonal and enzymatic factors are not uniformly induced in the cervix, thus, sub-optimally facilitating cervical ripening. Only the lower hemisphere of the balloon that is prescribed by the bisection of the catheter balloon by a plane perpendicular to the catheter axis is in contact with the internal os. The upper hemisphere protrudes in to the uterus potentially applying elevated pressure to the head of the fetus. The tip of the Foley catheter presents addition protrusion in to the uterus potentially injuring the fetus. The added kilogram of weight is generally a liter bag of saline solution which is allowed to hang over the side of the bed. Significant discomforts to the patient and the potential of injury from inadvertent snagging
30 of the bag are added complications with this method.

SUMMARY OF THE INVENTION

A cervical ripening device includes an elongated tube comprising a first end and a second end; a balloon coupled to the second end of the elongated tube; wherein the balloon has a shape and size that matches the shape of the internal os of the cervix of a subject having a fetus present
35 in the subject's uterus; and a support device coupled to the elongated tube, wherein the support

device is couplable to a portion of the subject. In one embodiment, the elongated tube comprises an outer tube and an inner tube, wherein fluid used to fill the balloon is passed through the inner tube into the balloon during use.

5 In one embodiment, the balloon is substantially disk shaped. The portion of the balloon in contact with the cervix may have a curvature that substantially matches the curvature of the internal os of the cervix when a fetus is present in the uterus. In one embodiment, the balloon comprises a first disk and a second disk coupled to the first disk at the outer edge, wherein the first disk includes a reinforced material and the second disk comprises a membrane that is inflatable during use.

10 The support device, in one embodiment, may include a band couplable to the subject's leg. The elongated tube may be variably positionable with respect to the support device to alter the pressure placed on the internal os of the subject's cervix. In one embodiment, the support device is in the form of a pubic saddle that includes a first support member and a second support member coupled to each other. The first support member and the second support member couple
15 to the pubic bone region of the subject and provide an outward force against the balloon during use. In an embodiment, the outward force applied on the balloon is altered by adjusting the position of the elongated tube with respect to the support device. The outward force applied to the balloon may be altered by adjusting a threaded collar engaged to threading on the elongated tube to adjust the position of the elongated tube with respect to the cervix.

20 In an embodiment, a method of inducing dilation of the cervix of a subject includes placing at least a portion of a cervical ripening device into the cervix of the subject, coupling the support device to the subject; inflating the balloon, wherein the balloon is positioned against the internal os of the cervix when inflated; and applying pressure to the cervix by moving the elongated tube away from the cervix.

25 In an embodiment, the cervical ripening device may be positioned by placing an insertion device into the cervix of the subject, and inserting at least a portion of the cervical ripening device through the insertion device into the cervix of the subject.

In an embodiment, applying pressure to the cervix includes adjusting a threaded collar engaged to threading on the elongated tube to adjust the position of the elongated tube with
30 respect to the cervix.

A kit for of inducing dilation of the cervix of a subject may includes a cervical ripening device, an inserter for use in placing the cervical ripening device into the cervix of the subject; and one or more syringes for injecting a fluid into the balloon during use.

BRIEF DESCRIPTION OF THE DRAWINGS

Advantages of the present invention will become apparent to those skilled in the art with the benefit of the following detailed description of embodiments and upon reference to the accompanying drawings in which:

- 5 FIG. 1 depicts a projection view of an embodiment of an elongated tube of a cervical ripening device;
- FIG. 2 depicts a projection view of an embodiment of a cervical ripening device having a support device;
- FIG. 3 depicts a projection view of an alternate embodiment of a cervical ripening device
- 10 having a support device;
- FIG. 4 depicts a projection view of an insertion device; and
- FIG. 5 depicts a cervical ripening kit.

While the invention may be susceptible to various modifications and alternative forms, specific embodiments thereof are shown by way of example in the drawings and will herein be

15 described in detail. The drawings may not be to scale. It should be understood, however, that the drawings and detailed description thereto are not intended to limit the invention to the particular form disclosed, but to the contrary, the intention is to cover all modifications, equivalents, and alternatives falling within the spirit and scope of the present invention as defined by the appended claims.

20 DETAILED DESCRIPTION OF THE PREFERRED EMBODIMENTS

It is to be understood the present invention is not limited to particular devices or methods, which may, of course, vary. It is also to be understood that the terminology used herein is for the purpose of describing particular embodiments only, and is not intended to be limiting. As used

25 in this specification and the appended claims, the singular forms “a”, “an”, and “the” include singular and plural referents unless the content clearly dictates otherwise. Furthermore, the word “may” is used throughout this application in a permissive sense (i.e., having the potential to, being able to), not in a mandatory sense (i.e., must). The term “include,” and derivations thereof, mean “including, but not limited to.” The term “coupled” means directly or indirectly connected.

To remedy at least some of the problems associated with using a traditional Foley

30 catheter to induce cervical dilation, the following parameters were identified. A cervical ripening device should:

1. have an inflatable balloon having a conformation similar to that of the cervix internal os;

2. apply a uniform distribution of force over the contact area of the cervix internal os;
3. incorporate an internal channel for infusion of sterile saline;
4. be capable of deployment of the catheter through an insertion device; and
5. utilize the elasticity of the catheter in combination with a support device to apply and fix traction onto the cervix internal os in a measurable and consistent fashion.

The curvature of the cervix internal os surface, however, is not uniform but varies to approximate the curvature of the fetal head. In the frontal or coronal plane the radius of curvature is approximately 4.5 cm, with the lateral or sagittal plane curvature average of 5.6 cm (5.0 cm radius posterior to the ear and 5.8 anterior to the ear). The average radius of curvature of the cervix internal os is roughly 5 cm.

In the current usage of the Foley catheter for initiation of cervical ripening, a balloon is inflated with 60 to 80 ml of sterile saline. The infused volume produces a spherical balloon having a diameter between 5 and 6 cm. As noted above, however, the balloon is spherical and local pressure is not uniform over the cervix internal os due to the differences in curvature.

To remedy the non-uniform shape of the cervix internal os, a balloon was designed to better match the known curvature of the internal os when a fetus is present. In one embodiment, a balloon is formed from two silicone disks as shown in FIG. 1.. A cervical ripening device **100** includes an elongated tube **110** and a balloon **120** that is formed from two silicone disks **122** and **124**. The balloon **120** includes, in one embodiment, two 5.5 cm diameter concave silicone disks **122** and **124** having a radius of curvature of 5 cm. The disks may generally have a diameter ranging from about 1 cm to about 10 cm and a radius of curvature of between about 1 cm to about 10 cm.

Upper disk **122** may be fiber reinforced silicone. The fiber may limit expansion of the upper disk, helping to define the shape and size of the balloon. Lower disk **124** is composed of a silicone membrane that may be expand when a fluid is introduced into the balloon. During use lower disk **124** contacts the cervix internal os of the patient. The fluid in the balloon helps the lower disk to conform with the shape of the subjects cervix. The disks may be bonded at the outer edge to form an inflatable cavity having a volume of approximately 2-4 ml. Openings **125** on the central axis of the disks couple the balloon to the elongated tube **110**. The disks are bonded to elongated tube **110** such that the upper disk **122** is coplanar with the tip of the elongated tube and the lower (membrane) disk **124** is bonded 1 to 2 mm below the upper disk.

The area of the cervix internal os in contact with the inflated disk balloon **120** varies from about 15 cm² to about 40 cm² depending on the size and radius of curvature of the disks. In an

embodiment, when the disks have a diameter of 5.5 cm and a radius of curvature of 5 cm, the area of internal os contact is about 23.5 cm². An advantage of the above described balloon, is that the balloon can adapt and/or form to match both the specific shape of the internal os and/or the infant's head.

5 Elongated tube **110** may be formed from a flexible material that has a stiffness suitable for easy insertion, a low resistance internal channel for saline injection, and sufficient wall thickness for incorporation of a balloon inflation channel. In one embodiment, a 0.25in outside diameter silicone tube with .063in wall thickness was selected as the elongated tube **110** for the cervical ripening device. Elongated tube **110** may have a length of about 20 cm to about 50 cm
10 long. The tube should have a length sufficient to allow the tube to extend from the subjects cervix to a position proximate to the legs of the patient.

In one embodiment, elongated tube **110** is composed of an outer tube **112** and an inner tube **114**. Inner tube **114** is used for inflation of balloon **120**. Inner tube **114** is used to inject a fluid into the balloon, is of low resistance and allows easy infusion of aqueous fluids. In one
15 embodiment, saline is injected into the balloon to inflate the balloon during use. Outer tube may be used for injection of an amniotic saline infusion.

A support device may be coupled to the elongated tube. The support device is coupleable to a portion of the subject to secure the catheter to the subject. The support device also is configured to allow the forces applied to the balloon to be varied by adjusting the position of the
20 elongated tube with respect to the support device.

An embodiment of a cervical ripening device having a support device is depicted in FIG. 2. Cervical ripening device **200** includes an elongated tube **210** and a balloon **220** coupled to the elongated tube **210**. A support device **230** is coupled to elongated tube **210**. Support device **230** is, in one embodiment, includes a band **234** coupleable to the subject's leg. A coupling **232**
25 couples band **234** to elongated tube **210**.

Support device **230** inhibits dislodgment of the cervical ripening device from the subject. Support device also provides a stable anchor from which tension can be applied to the balloon. In the embodiment depicted in FIG. 2, a threaded collar **250** is coupled to external threading (not shown, depicted in FIG.1 as elements **150** and **152**) of elongated member **210**. Turning threaded
30 collar **250** in a predetermined direction causes elongated tube **210** to move in a direction away from coupling **232**. Movement of elongated tube **210** away from the coupling **232** creates tension on balloon **210** during use. In one example, it was determined that the application of 9.8N (1 Kg x 9.8 m/sec²) of tension to the cervical ripening device tube results in a calculated uniform pressure distribution of around 0.41 N/cm² to the cervix internal os. In one embodiment,

calibration marks may be formed on the elongated tube to allow the user to estimate the pressure applied to the cervix by the device.

In an alternate embodiment, a support device **320** may include a pubic saddle that is used as a support device **330**, as depicted in FIG. 3. Pubic saddle includes a first support member **332** and a second support member **334** coupled to each other through coupling support **336**. First support member **332** and second support member **334** have a shape which is complementary with the general shape and size of the pubic bone region. During use, first support member **332** and second support member **334** are coupled to the pubic bone region of the subject and balloon **320** is inserted into the cervix. Elongated tube **310** is fixedly coupled to coupling support **336**. During use, pressure may be increased on the cervix by moving the elongated tube away from the coupling support. Coupling support may engage elongated tube using a threaded collar **350** coupled to threads on the elongated tube. Calibrations on the collar specify may be used to estimate the tension on the cervix. The pubic saddle design for the support device allows easy access to the vaginal canal.

FIG. 4 depicts an insertion device **400** used to properly position the cervical ripening device in the proper position. In one embodiment, insert is formed from a polymeric tube with end designs that will provide easy insertion while minimizing potential injury. In one embodiment, insertion device **400** is composed of a polypropylene material, similar to the material that is used to facilitate tampon insertion. Insertion device **400** may include an insertion tube **410** and receiving tube **420**. During use, insertion device **400** is placed in the cervix of the subject such that end **412** of insertion tube **410** enters the uterus of the subject. A cervical dilator device, such as the devices described herein, may be positioned in the receiving tube **420** of the inserter and passed through insertion tube **410**, such that the balloon of the cervical dilator device is positioned in the uterus. The use of an inserter allows easy insertion and positioning of the cervical dilator device. In some embodiments, marking on the insertion device may correspond to markings on the cervical dilator device to allow the user to determine how far the device has been inserted into the subject.

In an embodiment, dilation of the cervix of a subject may be accomplished by placing the devices described herein through the cervix of the subject such that the balloon is in the uterus of the subject. An insertion device may be used to assist positioning of the cervical ripening device in the subject. Once positioned, a support device of the cervix dilator device may be coupled to the subject. The balloon is then inflated by passing fluid through the elongated tube. The inflated balloon is thus positioned against the internal os of the cervix. To improve dilation of the cervix, the elongated tube is moved in a direction away from the cervix. This “pulls” the

balloon against the cervix, creating an environment that encourages dilation of the cervix. In one embodiment, the cervical ripening device includes a threaded collar which is coupled to threading on the elongated tube. Adjustment of the threaded collar alters the position of the elongated tube with respect to the support and therefore with respect to the cervix. In this manner, the amount of pressure placed against the cervix by the balloon may be altered.

In one embodiment, the device may be placed into the cervix with speculum or by digital exam. The catheter may be placed with the speculum or by digital guidance into the cervical os and advancing the catheter until it is in the cervix about 2 cms. After the catheter is in place, the guide is removed and the catheter is held in position. Using a syringe with sterile water, water is placed into the appropriate tube while the catheter is held in place. Once the balloon is inflated and determined to be at the internal os, the catheter is then attached to the supporting device and the desired traction is created.

FIG. 5 depicts a kit that includes components that are used to induce dilation of the cervix of a subject. Kit **500** includes a cervical ripening device **510**, a support device **520**, and one or more syringes **530** used to inject fluids into the balloon. An inserter (not shown) may also be included with the kit.

While the primary use of the device is for cervical ripening, the device may also be used for other *in utero* procedures. For example, the device may be used to withdraw body fluids from within the womb, through the same aperture that is used to inject the amniotic saline infusion. Furthermore, along with amniotic saline infusion, medications may also be injected into the uterus through the same tube. In some embodiments, the device may include two or more inlet/outlet ports that extend into the uterus when the device is positioned in the subject.

Further modifications and alternative embodiments of various aspects of the invention will be apparent to those skilled in the art in view of this description. Accordingly, this description is to be construed as illustrative only and is for the purpose of teaching those skilled in the art the general manner of carrying out the invention. It is to be understood that the forms of the invention shown and described herein are to be taken as examples of embodiments. Elements and materials may be substituted for those illustrated and described herein, parts and processes may be reversed, and certain features of the invention may be utilized independently, all as would be apparent to one skilled in the art after having the benefit of this description of the invention. Changes may be made in the elements described herein without departing from the spirit and scope of the invention as described in the following claims.

WHAT IS CLAIMED IS:

1. A cervical ripening device comprising:
 - 5 an elongated tube comprising a first end and a second end;

a balloon coupled to the second end of the elongated tube; wherein the balloon has a shape and size that matches the shape of the internal os of the cervix of a subject having a fetus present in the subject's uterus;
 - 10 a support device coupled to the elongated tube, wherein the support device is couplable to a portion of the subject.
2. The device of claim 1, wherein the elongated tube comprises an outer tube and an inner
15 tube, wherein fluid used to fill the balloon is passed through the inner tube into the balloon during use.
3. The device of claim 1 or 2, wherein the balloon is substantially disk shaped.
- 20 4. The device of any one of claims 1-3, wherein the portion of the balloon in contact with the cervix has a curvature that substantially matches the curvature of the internal os of the cervix when a fetus is present in the uterus.
- 25 5. The device of any one of claims 1-4, wherein the balloon comprises a first disk and a second disk coupled to the first disk at the outer edge, wherein the first disk comprises a reinforced material and the second disk comprises a membrane that is inflatable during use.
6. The device of any one of claims 1-5, wherein the support device comprises a band
30 couplable to the subject's leg.
7. The device of any one of claims 1-6, wherein the elongated tube is variably positionable with respect to the support device to alter the pressure placed on the internal os of the subject's cervix.

8. The device of any one of claims 1-7, wherein the support device comprises a first support member and a second support member coupled to each other, wherein the first support member and the second support member couple to the pubic bone region of the subject and provide an outward force against the balloon during use.
9. The device of claim 8, wherein the outward force applied on the balloon is altered by adjusting the position of the elongated tube with respect to the support device.
10. 10. The device of claim 8, wherein the outward force applied to the balloon is altered by adjusting a threaded collar engaged to threading on the elongated tube to adjust the position of the elongated tube with respect to the cervix.
11. A method of inducing dilation of the cervix of a subject comprising:
- placing at least a portion of a cervical ripening device as described in any one of claims 1-10 into the cervix of the subject,
- coupling the support device to the subject;
- inflating the balloon, wherein the balloon is positioned against the internal os of the cervix when inflated;
- applying pressure to the cervix by moving the elongated tube away from the cervix.
12. The method of claim 11, further comprising placing an insertion device into the cervix of the subject, and inserting at least a portion of the cervical ripening device through the insertion device into the cervix of the subject.
13. The method of claim 11 or 12, wherein the balloon is inflated with a saline solution.
14. The method of any one of claims 11-13, wherein applying pressure comprises adjusting a threaded collar engaged to threading on the elongated tube to adjust the position of the elongated tube with respect to the cervix.

15. A kit for inducing dilation of the cervix of a subject comprising:

5 a cervical ripening device as described in any one of claims 1-10;

an inserter for use in placing the cervical ripening device into the cervix of the subject;

one or more syringes for injecting a fluid into the balloon during use.

10 16. A cervical ripening device comprising:

an elongated tube comprising a first end and a second end;

15 a balloon coupled to the second end of the elongated tube;

a support device coupled to the elongated tube.

1 / 5

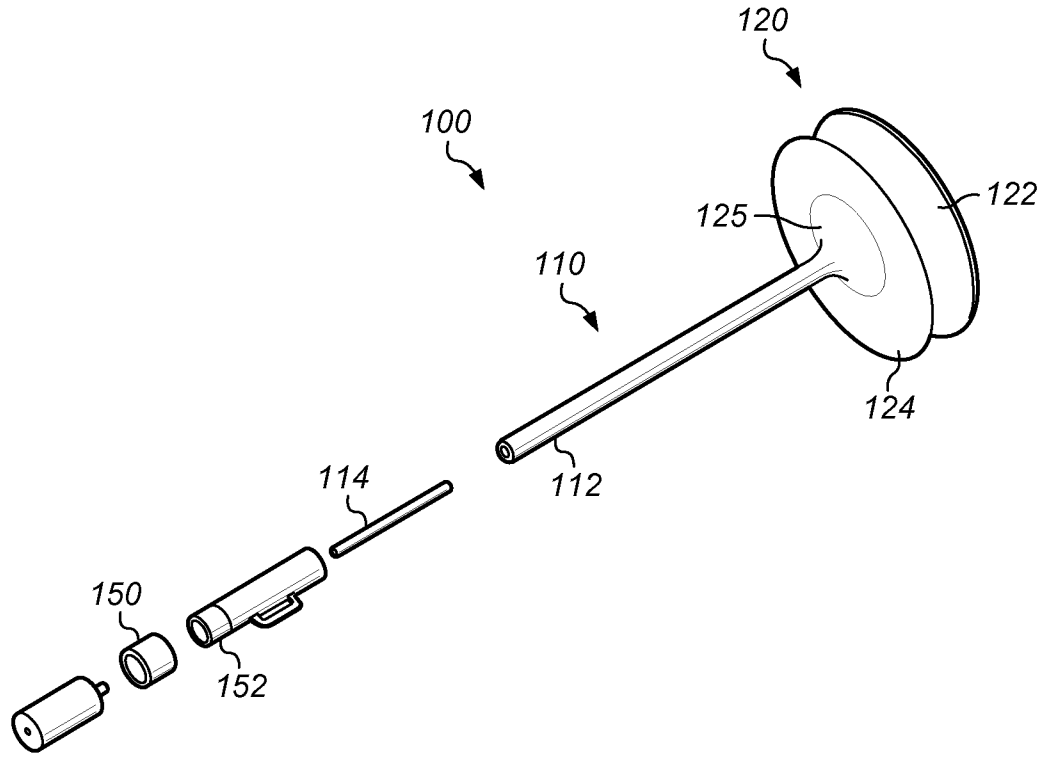

FIG. 1

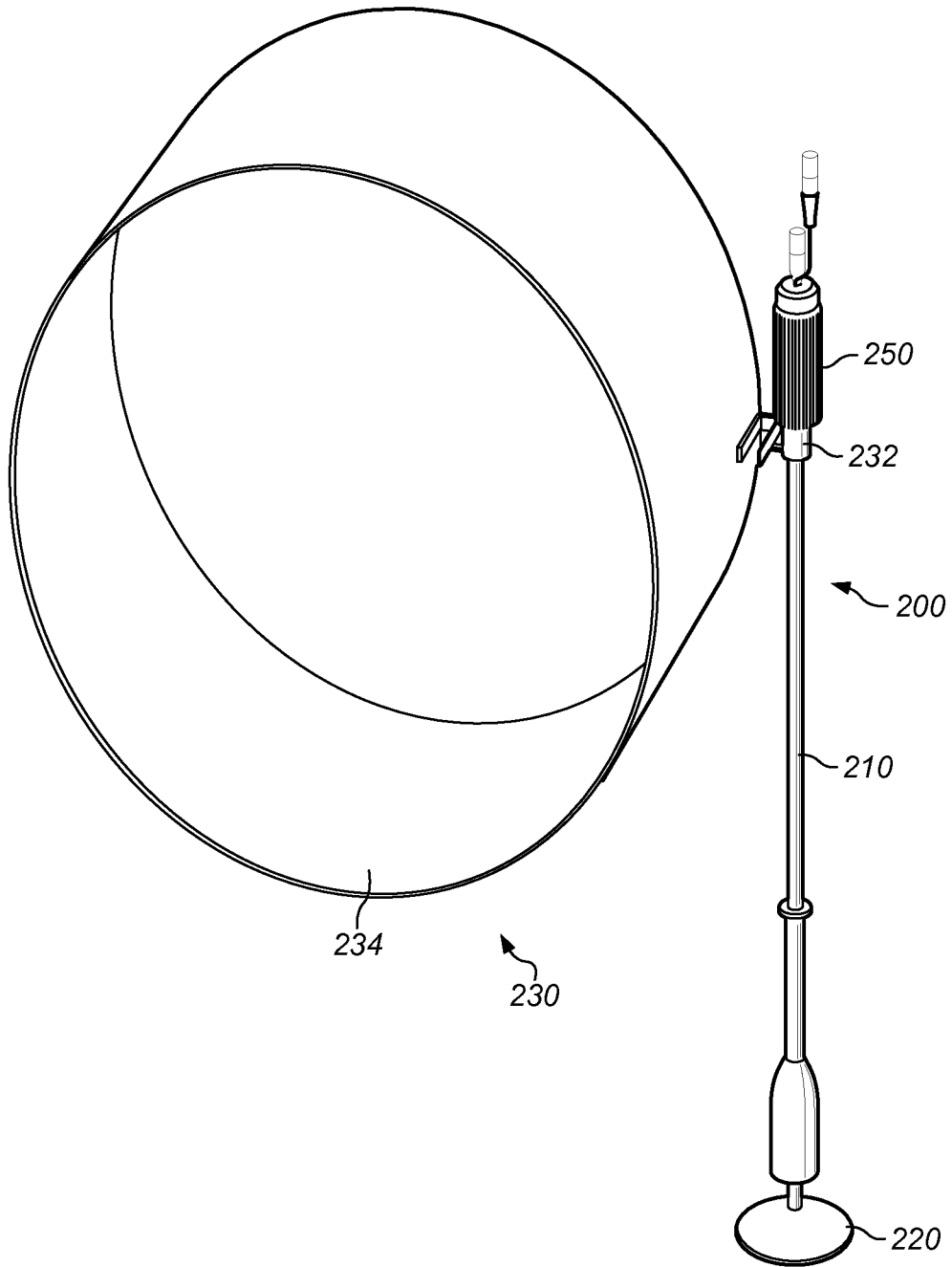

FIG. 2

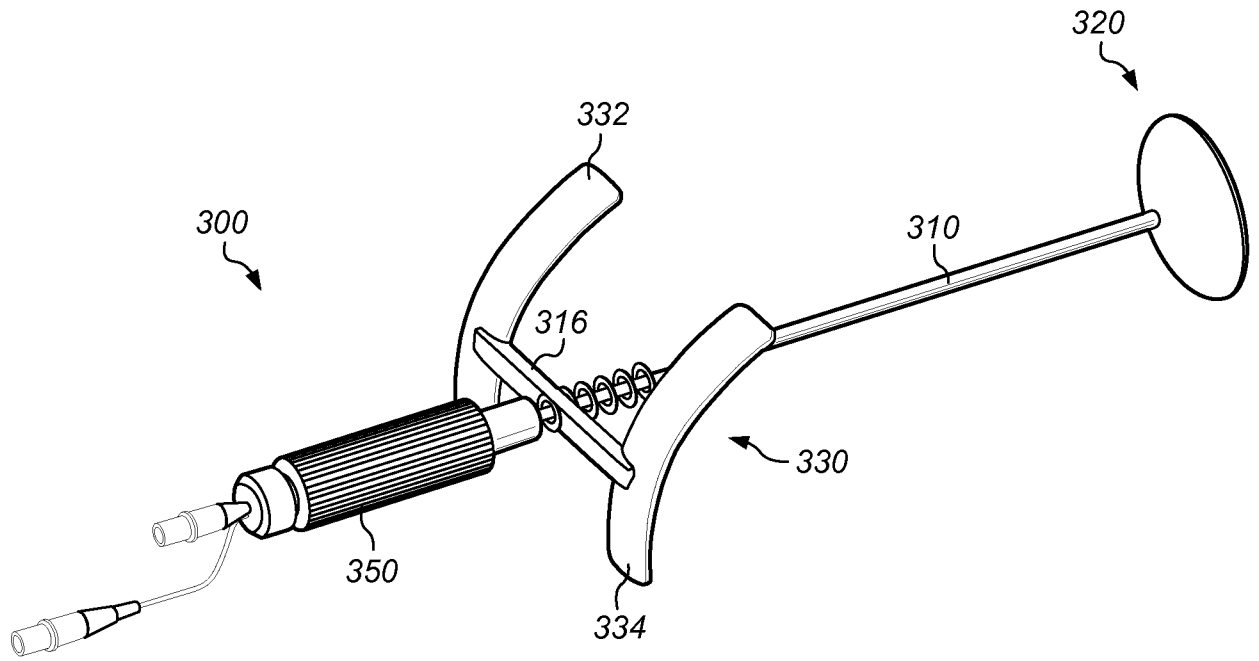

FIG. 3

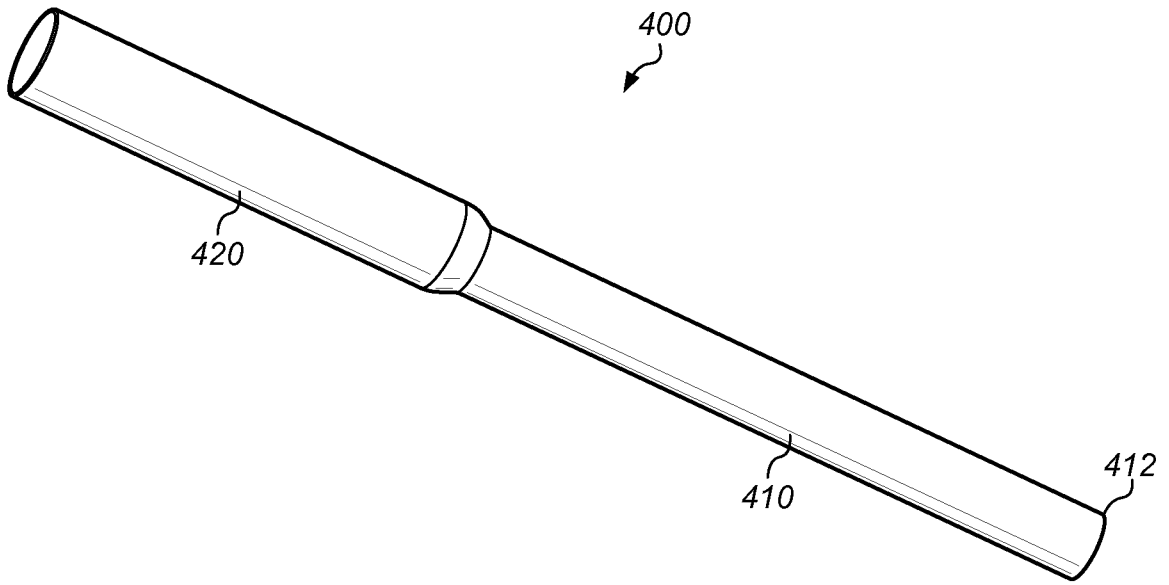

FIG. 4

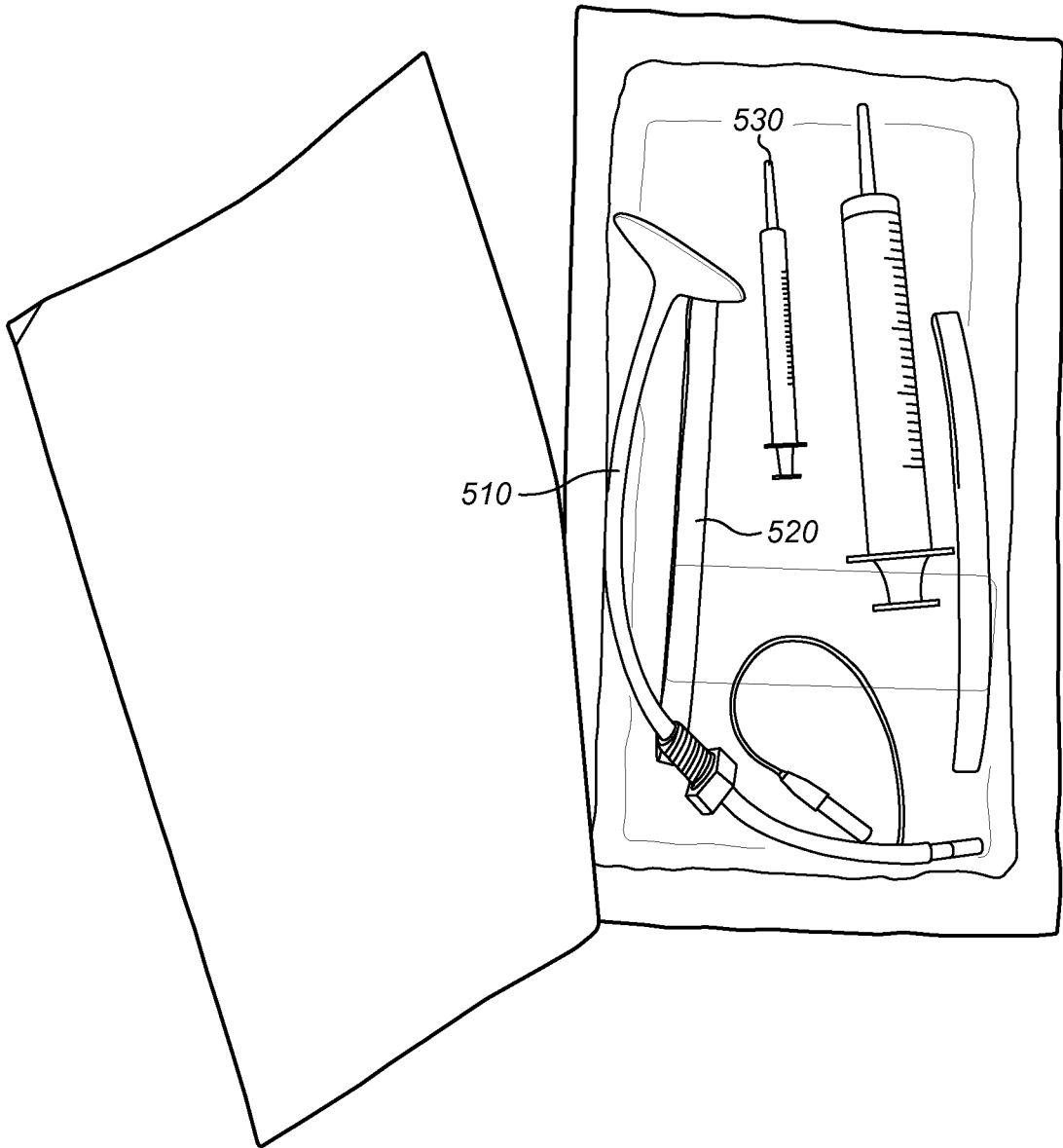

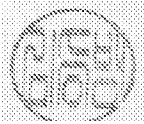

FIG. 5

INTERNATIONAL SEARCH REPORT

International application No.
PCT/US2013/033845

A. CLASSIFICATION OF SUBJECT MATTER A61M 29/02(2006.01)i, A61M 25/10(2006.01)i		
According to International Patent Classification (IPC) or to both national classification and IPC		
B. FIELDS SEARCHED		
Minimum documentation searched (classification system followed by classification symbols) A61M 29/02; A61M 29/00; A61M 25/00; A61M 1/00; A61B 5/103; A61M 25/10		
Documentation searched other than minimum documentation to the extent that such documents are included in the fields searched Korean utility models and applications for utility models Japanese utility models and applications for utility models		
Electronic data base consulted during the international search (name of data base and, where practicable, search terms used) eKOMPASS(KIPO internal) & Keywords: cervix, ripening		
C. DOCUMENTS CONSIDERED TO BE RELEVANT		
Category*	Citation of document, with indication, where appropriate, of the relevant passages	Relevant to claim No.
Y	US 2006-0058831 A1 (ATAD) 16 March 2006 See paragraphs [0101], [0103], [0112]; claim 3; and figure 3A.	1-3, 16
Y	US 2007-0156067 A1 (DUBEY et al.) 5 July 2007 See paragraphs [0021], [0027]; and figure 1.	1-3, 16
A	US 5209754 A (AHLUWALIA) 11 May 1993 See claims and figure 1.	1-3, 16
A	US 4693704 A (OGITA) 15 September 1987 See claims and figure 1.	1-3, 16
A	US 2001-0018577 A1 (FITZPATRICK et al.) 30 August 2001 See paragraphs [0018]-[0034]; and figure 1.	1-3, 16
A	US 2004-0153116 A1 (NOBLES et al.) 5 August 2004 See paragraphs [0055]-[0057]; and figure 1.	1-3, 16
<input type="checkbox"/> Further documents are listed in the continuation of Box C. <input checked="" type="checkbox"/> See patent family annex.		
* Special categories of cited documents: "A" document defining the general state of the art which is not considered to be of particular relevance "E" earlier application or patent but published on or after the international filing date "L" document which may throw doubts on priority claim(s) or which is cited to establish the publication date of citation or other special reason (as specified) "O" document referring to an oral disclosure, use, exhibition or other means "P" document published prior to the international filing date but later than the priority date claimed "T" later document published after the international filing date or priority date and not in conflict with the application but cited to understand the principle or theory underlying the invention "X" document of particular relevance; the claimed invention cannot be considered novel or cannot be considered to involve an inventive step when the document is taken alone "Y" document of particular relevance; the claimed invention cannot be considered to involve an inventive step when the document is combined with one or more other such documents, such combination being obvious to a person skilled in the art "&" document member of the same patent family		
Date of the actual completion of the international search 19 August 2013 (19.08.2013)		Date of mailing of the international search report 19 August 2013 (19.08.2013)
Name and mailing address of the ISA/KR  Korean Intellectual Property Office 189 Cheongsa-ro, Seo-gu, Daejeon Metropolitan City, 302-701, Republic of Korea Facsimile No. +82-42-472-7140		Authorized officer KIM Seung Beom Telephone No. +82-42-481-3371 

INTERNATIONAL SEARCH REPORT

International application No.
PCT/US2013/033845**Box No. II Observations where certain claims were found unsearchable (Continuation of item 2 of first sheet)**

This international search report has not been established in respect of certain claims under Article 17(2)(a) for the following reasons:

1. Claims Nos.: 11-14
because they relate to subject matter not required to be searched by this Authority, namely:
Claims 11 to 14 pertain to methods for treatment of the human body by surgery and thus relate to a subject matter which this International Searching Authority is not required to search, under Article 17(2)(a)(i) of the PCT and Rule 39.1(iv) of the Regulations under the PCT.
2. Claims Nos.: 9,10
because they relate to parts of the international application that do not comply with the prescribed requirements to such an extent that no meaningful international search can be carried out, specifically:
Claims 9 and 10 are unclear because they refer to multiple dependent claim 8 which does not comply with PCT Rule 6.4(a).
3. Claims Nos.: 4-8,14,15
because they are dependent claims and are not drafted in accordance with the second and third sentences of Rule 6.4(a).

Box No. III Observations where unity of invention is lacking (Continuation of item 3 of first sheet)

This International Searching Authority found multiple inventions in this international application, as follows:

1. As all required additional search fees were timely paid by the applicant, this international search report covers all searchable claims.
2. As all searchable claims could be searched without effort justifying an additional fee, this Authority did not invite payment of any additional fee.
3. As only some of the required additional search fees were timely paid by the applicant, this international search report covers only those claims for which fees were paid, specifically claims Nos.:

4. No required additional search fees were timely paid by the applicant. Consequently, this international search report is restricted to the invention first mentioned in the claims; it is covered by claims Nos.:

- Remark on Protest**
- The additional search fees were accompanied by the applicant's protest and, where applicable, the payment of a protest fee.
 - The additional search fees were accompanied by the applicant's protest but the applicable protest fee was not paid within the time limit specified in the invitation.
 - No protest accompanied the payment of additional search fees.

INTERNATIONAL SEARCH REPORT

Information on patent family members

International application No.

PCT/US2013/033845

Patent document cited in search report	Publication date	Patent family member(s)	Publication date
US 2006-0058831 A1	16/03/2006	None	
US 2007-0156067 A1	05/07/2007	CA 2635383 A1 CA 2635383 C CA 2635561 A1 CA 2635561 C CA 2635712 A1 CA 2635712 C EP 1968445 A2 EP 1968446 A1 EP 1976432 A2 US 2007-0156068 A1 US 2007-0239197 A1 US 2007-0255185 A1 US 2008-0114268 A1 US 2008-0188774 A1 US 7527601 B2 US 7654970 B2 US 7713216 B2 US 7749176 B2 US 7811239 B2 WO 2007-078448 A2 WO 2007-078448 A3 WO 2007-078449 A1 WO 2007-089319 A2 WO 2007-089319 A3	12/07/2007 20/09/2011 12/07/2007 24/01/2012 09/08/2007 15/05/2012 17/09/2008 17/09/2008 08/10/2008 05/07/2007 11/10/2007 01/11/2007 15/05/2008 07/08/2008 05/05/2009 02/02/2010 11/05/2010 06/07/2010 12/10/2010 12/07/2007 04/10/2007 12/07/2007 09/08/2007 06/12/2007
US 05209754 A	11/05/1993	EP 0636038 A1 EP 0636038 A4 JP 08-500745 A WO 93-19801 A1	02/05/1997 28/06/1995 30/01/1996 14/10/1993
US 04693704 A	15/09/1987	EP 0121571 A1 EP 0121571 B1 JP 1415105 C JP 59-067969 A JP 62-020828 B WO 84-01514 A1	17/10/1984 04/04/1990 10/12/1987 17/04/1984 08/05/1987 26/04/1984
US 2001-0018577 A1	30/08/2001	AR 024596 A1 AU 2000-51277 A1 WO 01-00113 A1	16/10/2002 31/01/2001 04/01/2001
US 2004-0153116 A1	05/08/2004	AU 3309801 A US 2002-0013601 A1 US 2007-0225744 A1 WO 01-54568 A1	07/08/2001 31/01/2002 27/09/2007 02/08/2001