



(11) **EP 3 381 318 A1**

(12) **EUROPEAN PATENT APPLICATION**
published in accordance with Art. 153(4) EPC

(43) Date of publication:
03.10.2018 Bulletin 2018/40

(51) Int Cl.:
A45D 33/34 (2006.01) B65D 83/00 (2006.01)
B65D 77/04 (2006.01)

(21) Application number: **15909347.5**

(86) International application number:
PCT/KR2015/012814

(22) Date of filing: **27.11.2015**

(87) International publication number:
WO 2017/090798 (01.06.2017 Gazette 2017/22)

(84) Designated Contracting States:
AL AT BE BG CH CY CZ DE DK EE ES FI FR GB GR HR HU IE IS IT LI LT LU LV MC MK MT NL NO PL PT RO RS SE SI SK SM TR
Designated Extension States:
BA ME
Designated Validation States:
MA MD

(72) Inventor: **LEE, Do Hoon**
Incheon 403-030 (KR)

(74) Representative: **Eder, Michael**
df-mp Dörries Frank-Molnia & Pohlman
Patentanwälte Rechtsanwälte PartG mbB
Theatinerstrasse 16
80333 München (DE)

(71) Applicant: **Pum-Tech Korea Co., Ltd**
Bupyeong-gu
Incheon 403-030 (KR)

(54) **FOUNDATION CONTAINER CAPABLE OF FIRMLY FIXING RUBBER PAD**

(57) The present invention relates to a foundation container capable of firmly fixing a rubber pad and, more specifically, to a foundation container capable of firmly fixing a rubber pad, and comprising: a container cover hinge-coupled to a cosmetic container so as to be opened and closed; a contents accommodation container placed inside the cosmetic container; a support frame coupled to the outer periphery of the contents accommodation container and having a support protrusion on the upper part thereof; a rubber pad placed on the upper part of the support frame and having a plurality of outlets and a fixing groove on the outer periphery thereof; and a fixing frame coupled to the outer periphery of the support frame, and having a plurality of locking hooks, wherein the plurality of locking hooks are formed in a bent state on the outer periphery of the fixing frame, and when the support frame, the fixing frame, and the rubber pad are coupled to the contents accommodation container and then, are inserted and coupled into the cosmetic container, the bent locking hooks are inwardly bent by the inner periphery of the cosmetic container and firmly fix the fixing groove of the rubber pad by pressing the same, such that the rubber pad is firmly fixed even if the rubber pad is strongly pressed with a puff when the residual quantity of the contents accommodated in the contents accommodation container is used, thereby enabling the contents to be effectively used without any leftover.

[Fig. 4]

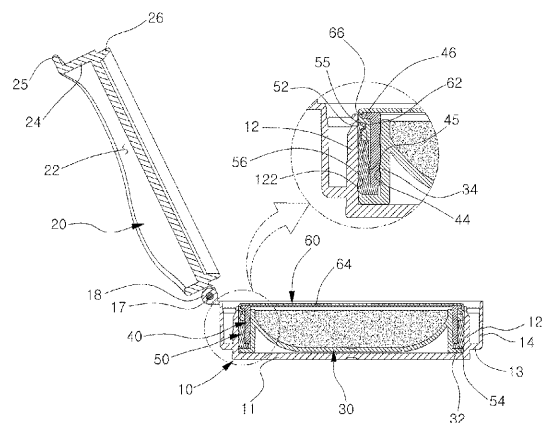

Description

[Technical Field]

5 **[0001]** The present invention relates to a foundation container capable of firmly fixing a rubber pad and, more specifically, to a foundation container capable of firmly fixing a rubber pad, and comprising: a container cover hinge-coupled to a cosmetic container so as to be opened and closed; a contents accommodation container placed inside the cosmetic container; a support frame coupled to the outer periphery of the contents accommodation container and having a support protrusion on the upper part thereof; a rubber pad placed on the upper part of the support frame and having a plurality of outlets and a fixing groove on the outer periphery thereof; and a fixing frame coupled to the outer periphery of the support frame, and having a plurality of locking hooks, wherein the plurality of locking hooks are formed in a bent state on the outer periphery of the fixing frame, and when the support frame, the fixing frame, and the rubber pad are coupled to the contents accommodation container and then, are inserted and coupled into the cosmetic container, the bent locking hooks are inwardly bent by the inner periphery of the cosmetic container and firmly fix the fixing groove of the rubber pad by pressing the same, such that the rubber pad is firmly fixed even if the rubber pad is strongly pressed with a puff when the residual quantity of the contents accommodated in the contents accommodation container is used, thereby enabling the contents to be effectively used without any leftover.

[Background Art]

20 **[0002]** Color cosmetics, which are used to beautifully adorn the skin of a user by making the appearance beautiful, are classified into a base makeup used for making a skin color uniform and covering a defect and a point makeup used for partially enhancing a three-dimensional effect of lips, eyes, or nails. The base makeup includes a makeup base, a foundation and a powder, and the point makeup includes a lipstick, an eye liner, and a mascara.

25 **[0003]** The foundation is classified into solid type foundation, liquid type foundation and gel type foundation according to a type of cosmetic contents. In case of the solid type foundation, although the solid-type foundation has a good cover effect, the makeup is united when the makeup is refreshed. In case of the liquid type foundation, although the liquid type foundation gives a good close contact feel, the persistency is weak. Thus, in recent years, the number of customers who prefer the gel type foundation, which has a considerable persistency and provides a good feeling when it is applied to the skin, has been increased.

30 **[0004]** Therefore, there is a need to develop a container for gel type foundation. Generally, the gel type foundation, which is filled into a glass container or a tube container, is used in such a manner that the user takes some foundation on user's hands for use or squeezes the foundation from the container and then, applies the foundation on the user's skin by using a puff or user's hands.

35 **[0005]** However, according to the related art, since the user gets cosmetics on user's hand whenever using the cosmetics, it is inconvenient to wash hands every time after use. In addition, as the hands coated with cosmetics are washed, the cosmetics are wasted.

40 **[0006]** To solve the above mentioned problems, as shown in FIG. 1, Korean Patent Publication No. 10-2015-0087772 has been disclosed. The rubber ejection pad formed therein with a plurality of outlets is coupled to the container body, the rubber ejection pads is coupled to the tension cap formed therein with a tension protrusion, such that the tension protrusion presses a periphery of the rubber ejection pad to allow the rubber ejection pad to be tight, and the tension cap tightly couples the rubber ejection pad to a container body, thereby preventing the rubber ejection pad from being separated from the container body when a puff presses the rubber ejection pad, and allowing the rubber ejection pad to be pressed down to the bottom of the container body by the elasticity of the rubber ejection pad, such that the contents accommodated in the container body can be used without remaining.

45 **[0007]** However, the related art has a structure in which a rubber ejection pad is placed on an upper portion of the container body and a tension cap is fitted to an upper end of the rubber ejection pad. Accordingly, when the remaining contents accommodated in a lower portion of the container body, the rubber ejection pad is separated from the tension cap if the rubber ejection pad is strongly pressed, and the user has to combine the separated rubber ejection pads again.

[Disclosure]

[Technical Problem]

55 **[0008]** To solve the problems described above, the object of the present invention is to provide a foundation container capable of firmly fixing a rubber pad, which includes: a container cover hinge-coupled to a cosmetic container so as to be opened and closed; a contents accommodation container placed inside the cosmetic container; a support frame coupled to the outer periphery of the contents accommodation container and having a support protrusion on the upper

part thereof; a rubber pad placed on the upper part of the support frame, having a plurality of outlets, and having a fixing groove on the outer periphery thereof; a fixing frame coupled to the outer periphery of the support frame, and having a plurality of locking hooks, wherein the plurality of locking hooks are formed in a bent state on the outer periphery of the fixing frame, and when the support frame, the fixing frame, and the rubber pad are coupled to the contents accommodation container and then inserted and coupled into the cosmetic container, the bent locking hooks are inwardly bent by the inner periphery of the cosmetic container and firmly fix the fixing groove of the rubber pad by pressing the same, such that when the residual quantity of the contents accommodated in the contents accommodation container is used, the rubber pad is firmly fixed even if the rubber pad is strongly pressed with a puff, thereby enabling the contents to be effectively used without any leftover.

[Technical Solution]

[0009] According to the present invention, in a foundation container including a cosmetic container (10) and a container cover (20) hinge-coupled to one side of the cosmetic container (10) so as to be opened and closed, the foundation container provides a foundation container capable of firmly fixing a rubber pad, which includes:

a contents accommodation container (30) mounted inside the cosmetic container (10) for accommodating contents; a support frame (40) coupled to an outer periphery of the contents accommodation container (30); a fixing frame (50) coupled between an outer periphery of the support frame (40) and the cosmetic container (10); and a rubber pad (60) fitted in an upper portion of the support frame (40), formed therein with a plurality of outlets (64), and formed on an outer periphery thereof with a fixing groove (62), wherein a plurality of locking hooks (52) are formed on an upper portion of the fixed frame (50) so that the locking hooks are bent inward by an inner periphery of the cosmetic container (10) and fitted into the fixing groove (62) of the rubber pad (60).

[0010] In addition, a fixing frame mount part (32) extends outward from a lower outer periphery of the contents accommodation container (30).

[0011] In addition, a support protrusion (46) extends outward from an upper portion of the support frame (40), and a support protrusion insertion groove (66) is formed on an inner side of the rubber pad (60) so that the support protrusion (46) is inserted into the support protrusion insertion groove (66).

[0012] In addition, the locking hook (52) of the fixing frame (50) is slanting outward so as to be pushed inward by the inner periphery of the cosmetic container (10).

[Advantageous Effects]

[0013] A foundation container capable of firmly fixing a rubber pad according to the present invention includes: a container cover hinge-coupled to a cosmetic container so as to be opened and closed; a contents accommodation container placed inside the cosmetic container; a support frame coupled to the outer periphery of the contents accommodation container and having a support protrusion on the upper part thereof; a rubber pad placed on the upper part of the support frame, having a plurality of outlets, and having a fixing groove on the outer periphery thereof; and a fixing frame coupled to the outer periphery of the support frame, and having a plurality of locking hooks, wherein the plurality of locking hooks are formed in a bent state on the outer periphery of the fixing frame, and when the support frame, the fixing frame, and the rubber pad are coupled to the contents accommodation container and then inserted and coupled into the cosmetic container, the bent locking hooks are inwardly bent by the inner periphery of the cosmetic container and firmly fix the fixing groove of the rubber pad by pressing the same, such that when the residual quantity of the contents accommodated in the contents accommodation container is used, the rubber pad is firmly fixed even if the rubber pad is strongly pressed with a puff, so that the contents can be effectively used without any leftover.

[Description of Drawings]

[0014]

FIG. 1 is a conventional cosmetic container having a rubber ejection pad.

FIG. 2 is a perspective view of a foundation container capable of firmly fixing a rubber pad according to the present invention.

FIG. 3 is an exploded perspective view of a foundation container capable of firmly fixing a rubber pad according to the present invention.

FIG. 4 is a sectional view of a foundation container capable of firmly fixing a rubber pad according to the present

invention.

FIG. 5 is a sectional view showing a combination of the support frame, a fixing frame, and a rubber pad with each other in a foundation container capable of firmly fixing a rubber pad according to the present invention.

FIG. 6 is a sectional view showing that a support frame, a fixing frame and a rubber pad are coupled between a contents accommodation container and a cosmetic container in a foundation container capable of firmly fixing a rubber pad according to the present invention.

FIG. 7 is a sectional view showing that a locking hook ring is bent inward by an inner periphery of a cosmetic container in a foundation container capable of firmly fixing a rubber pad according to the present invention.

FIG. 8 is a sectional view showing that a puff presses a rubber pad in a foundation container capable of firmly fixing a rubber pad according to the present invention.

FIG. 9 is a sectional view of a foundation container capable of firmly fixing a rubber pad according to another embodiment of the present invention.

[Best Mode]

[Mode for Invention]

[0015] An embodiment of a foundation container capable of firmly fixing a rubber pad according to the present invention will be described in detail with reference to the accompanying drawings.

[0016] FIG. 2 is a perspective view of a foundation container capable of firmly fixing a rubber pad according to the present invention. FIG. 3 is an exploded perspective view of a foundation container capable of firmly fixing a rubber pad according to the present invention. FIG. 4 is a sectional view of a foundation container capable of firmly fixing a rubber pad according to the present invention. FIG. 5 is a sectional view showing a combination of the support frame, a fixing frame, and a rubber pad with each other in a foundation container capable of firmly fixing a rubber pad according to the present invention. FIG. 6 is a sectional view showing that a support frame, a fixing frame and a rubber pad are coupled between a contents accommodation container and a cosmetic container in a foundation container capable of firmly fixing a rubber pad according to the present invention. FIG. 7 is a sectional view showing that a locking hook ring is bent inward by an inner periphery of a cosmetic container in a foundation container capable of firmly fixing a rubber pad according to the present invention. FIG. 8 is a sectional view showing that a puff presses a rubber pad in a foundation container capable of firmly fixing a rubber pad according to the present invention. FIG. 9 is a sectional view of a foundation container capable of firmly fixing a rubber pad according to another embodiment of the present invention.

[0017] According to the present invention, in a foundation container including a cosmetic container (10) and a container cover (20) hinge-coupled to one side of the cosmetic container (10) so as to be opened and closed, the foundation container includes: a contents accommodation container (30) mounted inside the cosmetic container (10) for accommodating contents; a support frame (40) coupled to an outer periphery of the contents accommodation container (30); a fixing frame (50) coupled between an outer periphery of the support frame (40) and the cosmetic container (10); and a rubber pad (60) fitted in an upper portion of the support frame (40), formed therein with a plurality of outlets (64), and formed on an outer periphery thereof with a fixing groove (62), wherein a plurality of locking hooks (52) are formed on an upper portion of the fixed frame (50), so that the locking hooks are bent inward by an inner periphery of the cosmetic container (10) and fitted into the fixing groove (62) of the rubber pad (60).

[0018] An upper portion of the cosmetic container (10) is opened, and the contents accommodation container (30) is accommodated therein.

[0019] The cosmetic container (10) includes a bottom surface (11), an inner wall (12) extending upward from the bottom surface (11), a horizontal extension piece (13) extending outward from the inner wall (12), and an outer wall (14) extending upward from the horizontal extension piece (13).

[0020] A coupling groove (122) is formed in an inner periphery of the inner wall (12) of the cosmetic container (10), and coupled to the fixing frame (50).

[0021] The cosmetic container (10) is provided at one side of the outer wall (14) thereof with a container hinge part (18) hinge-coupled to the container cap (20).

[0022] The container cap (20) is hinge-coupled to one side of the cosmetic container (10), thereby sealing the cosmetic container (10).

[0023] A puff accommodation space (22) is formed at an upper portion of the container cap (20), a press protrusion (24) extends upward from an outer side of the puff accommodation space (22), and a knob (25) is formed on one side of the press protrusion (24).

[0024] A sealing protrusion (26) for sealing the inside of the cosmetic container (10) extends downward from the lower portion of the container cap (20), in which the sealing protrusion (26) comes into close contact with the inner periphery of the outer wall (14) of the cosmetic container (10).

[0025] A cap hinge part (28) is formed on one side of the outer periphery of the container cap (20), and coupled to a

container hinge part (18) of the cosmetic container (10) by using a hinge pin (17).

[0026] The contents accommodation container (30) is mounted inside the cosmetic container (10), and contents are accommodated therein.

5 **[0027]** A fixing frame mount part (32) extends outward from the lower outer periphery of the contents accommodation container (30), in which a lower surface of the fixing frame mount part (32) comes into close contact with a bottom surface (11) of the cosmetic container (10), and a lower end of the fixing frame (50) is mounted on the top surface of the fixing frame mount part (32).

[0028] The coupling protrusion (34) protrudes from the outer periphery of the contents accommodation container (30) and is coupled to the support frame (40).

10 **[0029]** The support frame (40) is formed in a cylindrical shape having upper and lower openings, and coupled to the outer periphery of the contents accommodation container (30), thereby preventing the rubber pad (60) from being separated to the outside together with the fixing frame (50).

[0030] A support protrusion (46) extends outward from the upper portion of the support frame (40), and the rubber pad (60) is fitted to the support protrusion (46).

15 **[0031]** The support frame (40) is formed on an inner periphery thereof with a coupling groove (44), and formed on an outer periphery thereof with a first mount protrusion (45), so that the coupling protrusion (34) of the contents accommodation container (30) is coupled to the coupling groove (44).

20 **[0032]** The fixing frame (50) is formed in a cylindrical shape having upper and lower openings, and coupled between the outer periphery of the support frame (40) and the inner wall (12) of the cosmetic container (10), thereby preventing the rubber pad (60) from being separated to the outside together with the support frame (40).

[0033] The contents accommodation container mount part (54) extends inward from the lower end of the fixing frame (50), in which the lower end of the support frame (40) is mounted on the upper surface of the contents accommodation container mount part (54), and the lower surface of the contents accommodation container mount part (54) is mounted on the upper surface of the fixing frame mount part (32) of the contents accommodation container (30).

25 **[0034]** A second mount protrusion (55) is formed on the inner periphery of the fixing frame (50), and undercut-coupled to the first mount protrusion (45) of the support frame (40).

[0035] In addition, a fastening protrusion (56) is formed on the outer periphery of the fixing frame (50), and coupled to a fastening groove (122) of the cosmetic container (10).

30 **[0036]** A plurality of locking hooks (52) are formed on the upper portion of the fixing frame (50), in which the locking hooks (52) are slanting outward, such that when the fixing frame (50) is coupled to the inside of the cosmetic container (10) so as to be pushed toward the inside of the cosmetic container (10) by the inner periphery of the cosmetic container (10).

35 **[0037]** When the locking hook (52) is coupled between the cosmetic container (10) and the contents accommodation container (30) in a state that the locking hook (52) is slanting outward of the fixing frame (50), the locking hook (52) is bent inward by the inner periphery of the cosmetic container (10), and then fitted in the fixing groove (62) of the rubber pad (60).

40 **[0038]** In other words, the contents accommodation container (30) is fitted inside a cosmetic container (10), the rubber pad (60) covers an upper portion of the support frame (40), and the fixing frame (50) is assembled to the outer periphery of the support frame (40) from the lower side of the support frame (40). Then, when the assembly of the support frame (40) the rubber pad (60) and the fixing frame (50) assembled in the above manner is pushed between the inner wall (12) of the cosmetic container (10) and the outer periphery of the contents accommodation container (30), the upper end of the inner wall (12) of the cosmetic container (10) pushes the outer peripheral surface of the locking hook (52) slanting outward, so that the locking hook (52) is bent inward. Accordingly, the locking hook (52) is fitted into the fixing groove (62) of the rubber pad (60), thereby firmly fixing the rubber pad (60).

45 **[0039]** Preferably, the locking hook (52) may have a sectional shape corresponding to that of the fixing groove (62) of the rubber pad (60) in order to firmly fix the rubber pad (60).

[0040] The rubber pad (60) covers the upper portion of the support frame (40) and fixed by the fixing frame (50), and formed therein with a plurality of outlets (64).

50 **[0041]** The rubber pad (60) serves to discharge the contents accommodated in the content accommodation container (30) to the outlets (64) upon pressure.

[0042] The rubber pad (60) is formed therein with a support protrusion insertion groove (66) into which the support protrusion (46) of the support frame (40) is inserted.

[0043] The rubber pad (60) is formed on the outer periphery thereof with a fixing groove (62) into which the locking hook (52) of the fixing frame (50) is inserted.

55 **[0044]** In other words, the inner periphery of the rubber pad (60) covers the upper part of the support frame (40), and the outer periphery thereof is pressed by the locking hook (52) of the fixing frame (50), so that the rubber pad (60) is firmly fixed by the support frame (40) and the fixing frame (50).

[0045] The rubber pad (60) is formed of rubber, and preferably formed of at least one of natural rubber, urethane

rubber, nitrile-butadiene rubber NBR, and silicone.

[0046] In addition, an auxiliary support protrusion (48) is formed on a lower side of the support protrusion (46) of the support frame (40), and an auxiliary protrusion insertion groove (68) is formed on a lower side of support protrusion insertion groove (66) of the rubber pad (60), so that the auxiliary support protrusion (48) may be inserted thereto.

[0047] The assembling of a foundation container capable of firmly fixing a rubber pad configured in the above manner will be described as follows.

[0048] To assemble the foundation container capable of firmly fixing a rubber pad according to the present invention, at first, the contents accommodation container (30) is mounted inside the cosmetic container (10) hinge-coupled to the container cap (20), and the contents are filled in the contents accommodation container (30).

[0049] Next, as shown in FIG. 5, the rubber pad (60) is coupled to the upper portion of the support frame (40), and the fixing frame (50) is coupled to the lower portion of the support frame (40), in which the support protrusion (46) of the support frame (40) is fitted into the support protrusion insertion groove (66) of the rubber pad (60), and the first mount protrusion (45) of the support frame (40) is undercut-coupled to the second mount protrusion (55) of the fixing frame (50).

[0050] Herein, the locking hook (52) of the fixing frame (50) is open outward.

[0051] Next, as shown in FIG. 6, the assembly of the support frame (40), the fixing frame (50), and the rubber pad (60) assembled in the above manner is inserted between the inner wall (12) of the cosmetic container (10) and the outer periphery of the contents accommodation container (30).

[0052] Then, as shown in FIG. 7, the assembly of the support frame (40), the fixing frame (50), and the rubber pad (60) is continuously inserted between the inner wall (12) of the cosmetic container (10) and the outer periphery of the contents accommodation container (30), such that the upper end of the inner wall (12) of the cosmetic container (10) pushes the outer peripheral surface of the locking hook (52), and thus the locking hook (52) is bent inward. Accordingly, the locking hook (52) is fitted into the fixing groove (62) of the rubber pad (60) and applies the pressure, thereby firmly fixing the rubber pad (60).

[0053] Finally, the assembly of the support frame (40), the fixing frame (50), and the rubber pad (60) is inserted into and coupled to the fixing frame mount part (32) of the contents accommodation container (30), in which the contents accommodation container mount part (54) of the fixing frame (50) is mounted on the fixing frame mount part (32) of the content accommodation container (30), the coupling protrusion (34) of the contents accommodation container (30) is coupled to the coupling groove (44) of the support frame (40), and the fastening protrusion (56) of the fixing frame (50) is coupled to the fastening groove (122) of the cosmetic container (10). Herein, the assembly of the foundation container capable of firmly fixing a rubber pad according to the present invention is finished.

[0054] The method of using the foundation container capable of firmly fixing a rubber pad assembled in the above manner will be described as follows.

[0055] In order to use the foundation container capable of firmly fixing a rubber pad according to the present invention, at first, the handle (25) of the container cap (20) is held and rotated to open the container cap (20) from the cosmetic container (10).

[0056] Then, as shown in FIG. 8, when the upper surface of the rubber pad (60) is pressed using the puff (P) accommodated in the puff accommodation space (22) of the container cap (20), the rubber pad (60) is pushed downward, thereby discharging the contents accommodated inside the contents accommodation container (30) to the outlets (64) of the rubber pad (60), so that the contents are put on the puff (P).

[0057] Herein, since the inner periphery of the rubber pad (60) is fitted in the support protrusion (46) of the support frame (40), and the outer periphery thereof is pressed by the locking hook (52) of the fixing frame (50) so as to be firmly fixed to the support frame (40) and the fixing frame (50), the rubber pad (60) is prevented from being easily separated.

[0058] Finally, the user applies the contents of the cosmetic while tapping or rubbing the puff P, which is smeared with the contents of the cosmetic in the above manner, on the skin.

[0059] The above description of the present invention is merely an embodiment for carrying out a foundation container capable of firmly fixing a rubber pad, and the present invention is not limited to the embodiment. It will be apparent to those skilled in the art that various substitutions, deformations and modifications are construed to be available within the scope without departing from the invention.

[Description of Reference Numerals]

10: cosmetic container	20: container cap
30: contents accommodation container	32: fixing frame mount part
40: support frame	46: support protrusion
48: auxiliary support protrusion	50: fixing frame
52: locking hook	
54: contents accommodation container mount part	
60: rubber pad	62: fixing groove

(continued)

66: support protrusion insertion groove 68: auxiliary protrusion groove
P: puff

5

Claims

10

1. A foundation container capable of firmly fixing a rubber pad and including a cosmetic container (10) and a container cover (20) hinge-coupled to one side of the cosmetic container (10) so as to be opened and closed, the foundation container comprising:

15

a contents accommodation container (30) mounted inside the cosmetic container (10) to accommodate contents therein;

a support frame (40) coupled to an outer periphery of the contents accommodation container (30);

a fixing frame (50) coupled between an outer periphery of the support frame (40) and the cosmetic container (10); and

20

a rubber pad (60) fitted to an upper portion of the support frame (40), formed therein with a plurality of outlets (64), and formed on an outer periphery thereof with a fixing groove (62), wherein

a plurality of locking hooks (52) are formed on an upper portion of the fixed frame (50), so that the locking hooks are bent inward by an inner periphery of the cosmetic container (10) and fitted into the fixing groove (62) of the rubber pad (60).

25

2. A foundation container capable of firmly fixing a rubber pad, wherein a contents accommodation container (30) is fitted inside a cosmetic container (10), an upper portion of a support frame (40) is covered with a rubber pad (60), a fixing frame (50) is coupled to a lower outer periphery of the support frame (40), and an assembly of the support frame (40), the rubber pad (60) and the fixing frame (50) is coupled between an inner wall (12) of the cosmetic container (10) and an outer periphery of the contents accommodation container (30), in which

30

an upper end of the inner wall (12) of the cosmetic container (10) pushes the outer peripheral surface of the locking hook 52 slanting outward to allow the locking hook (52) to be bent inward, so that the locking hook (52) is fixedly fitted in a fixing groove (62) of the rubber pad (60).

35

3. The foundation container of claim 1 or 2, wherein a fixing frame mount part (32) extends outward from a lower outer periphery of the contents accommodation container (30).

40

4. The foundation container of claim 1 or 2, wherein a support protrusion (46) extends outward from an upper portion of the support frame (40), and a support protrusion insertion groove (66) is formed on an inner side of the rubber pad (60), so that the support protrusion (46) is inserted into the support protrusion insertion groove (66).

45

5. The foundation container of claim 1, further comprising an auxiliary support protrusion (48) formed on a lower side of the support protrusion (46) of the support frame (40), wherein an auxiliary protrusion insertion groove (68) is formed on a lower side of support protrusion insertion groove (66) of the rubber pad (60), so that the auxiliary support protrusion (48) is inserted into the auxiliary protrusion insertion groove (68).

50

55

[Fig. 1]

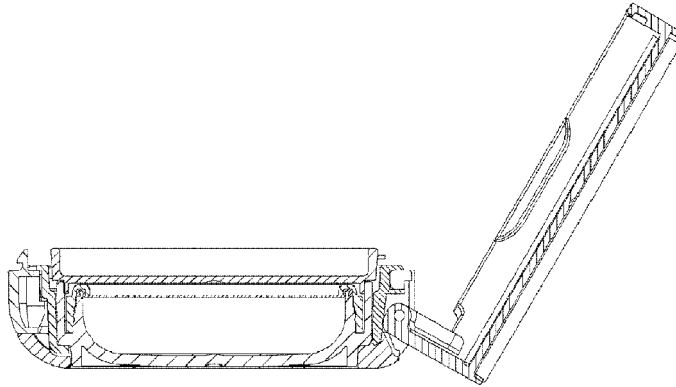

[Fig. 2]

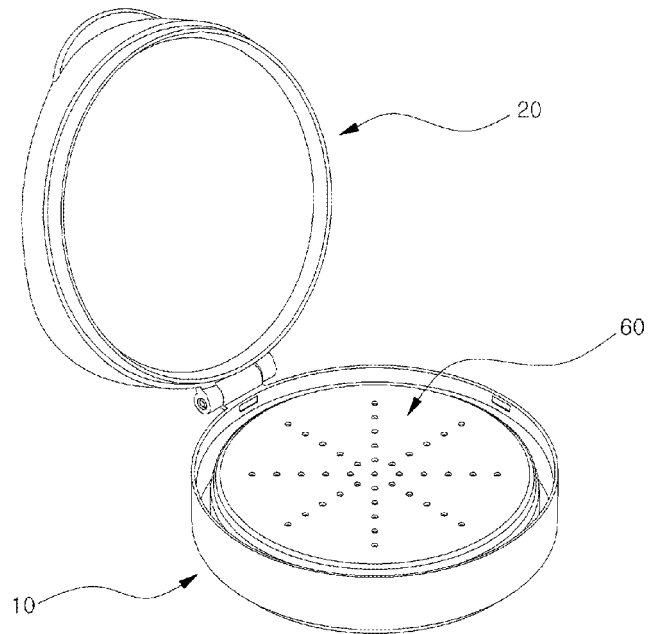

[Fig. 3]

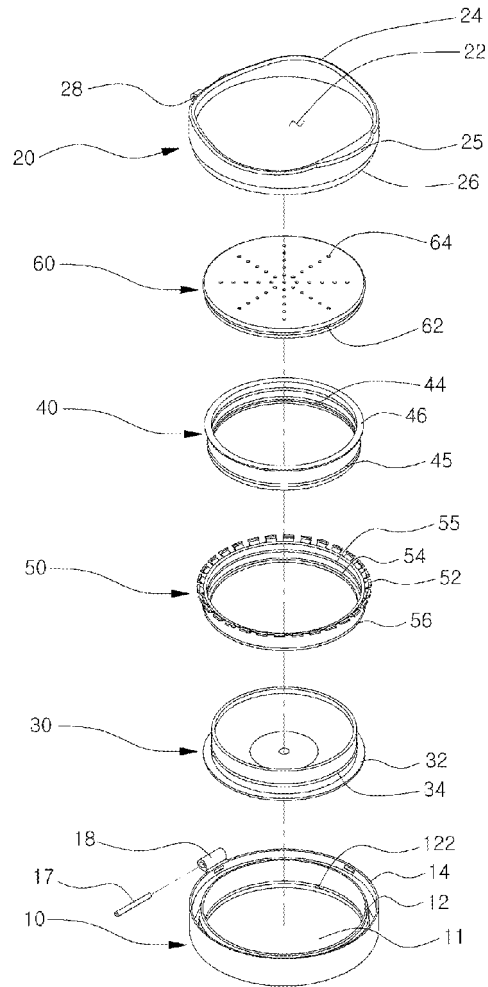

[Fig. 4]

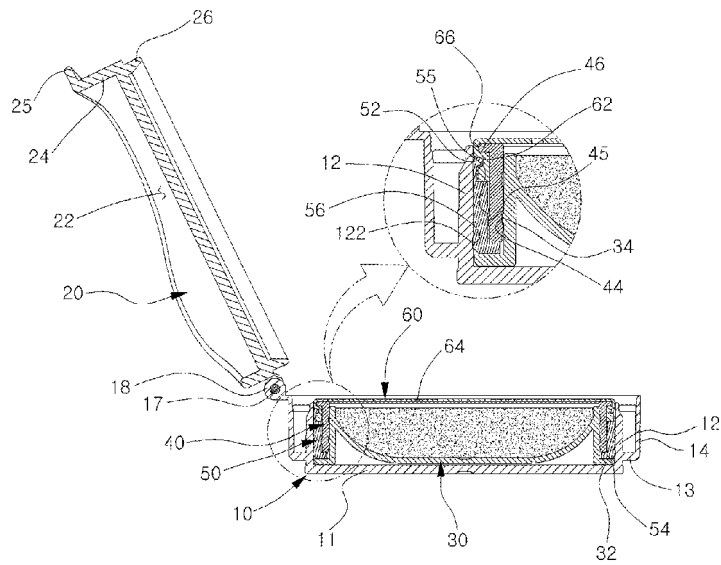

[Fig. 5]

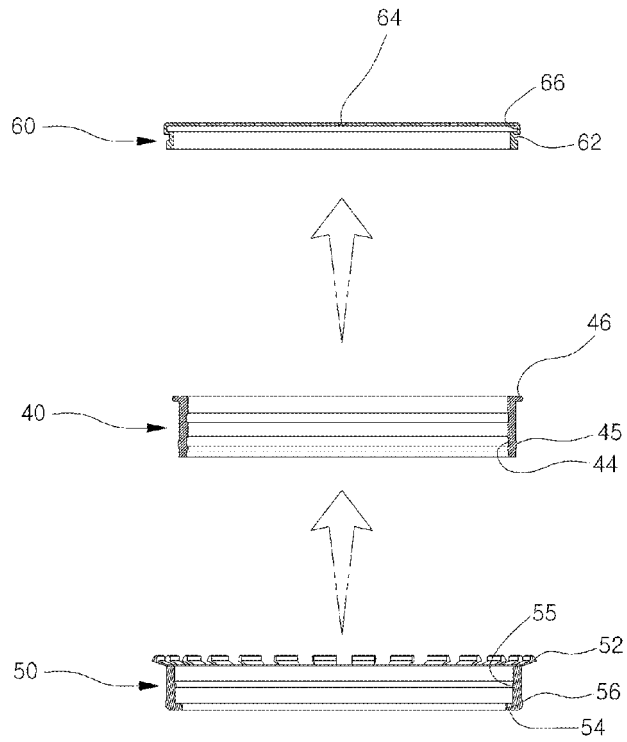

[Fig. 6]

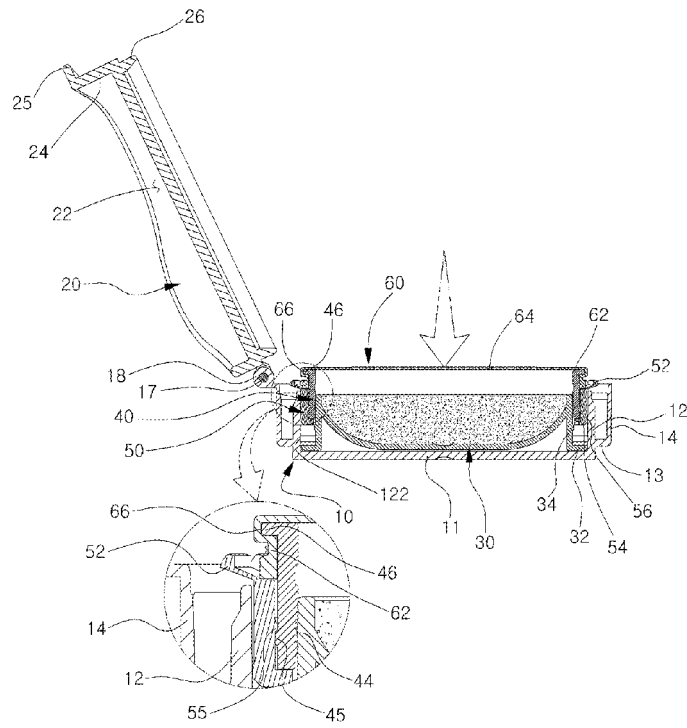

[Fig. 7]

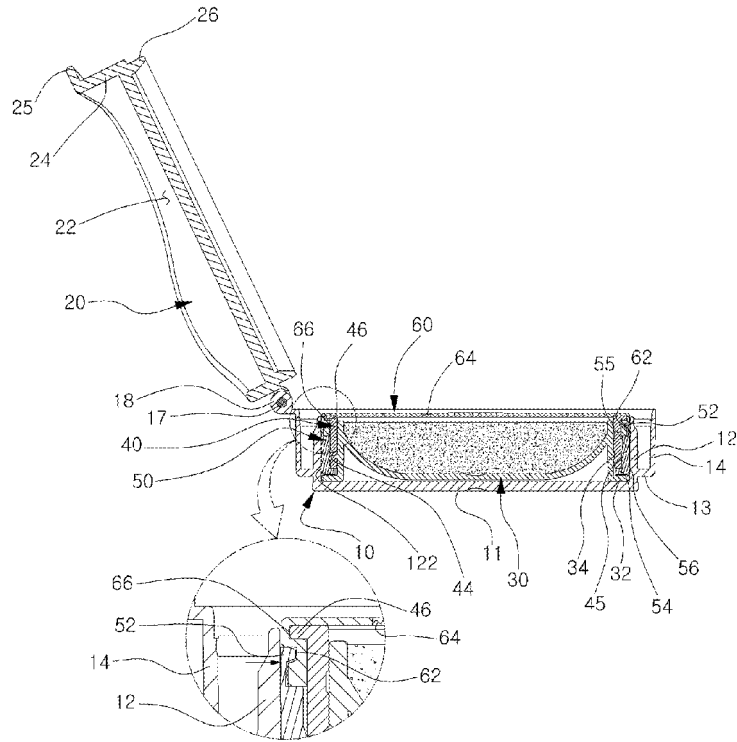

[Fig. 8]

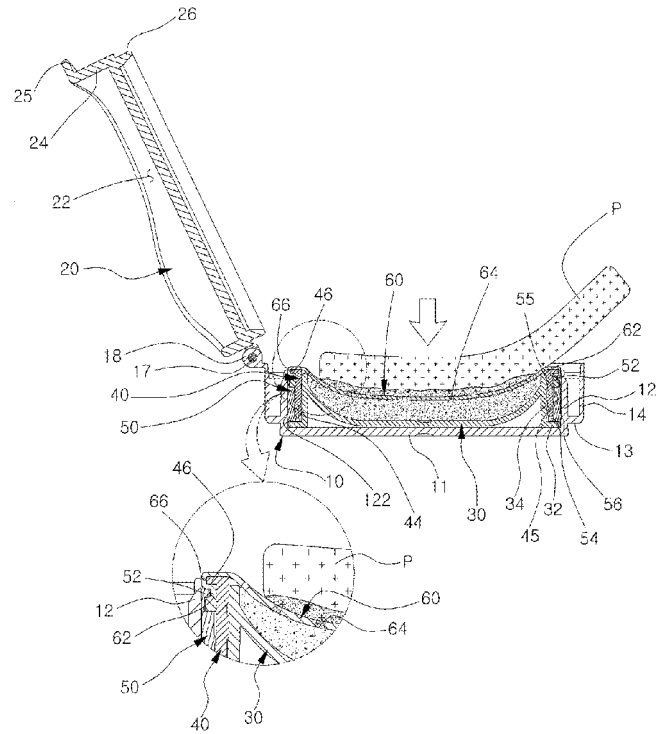

[Fig. 9]

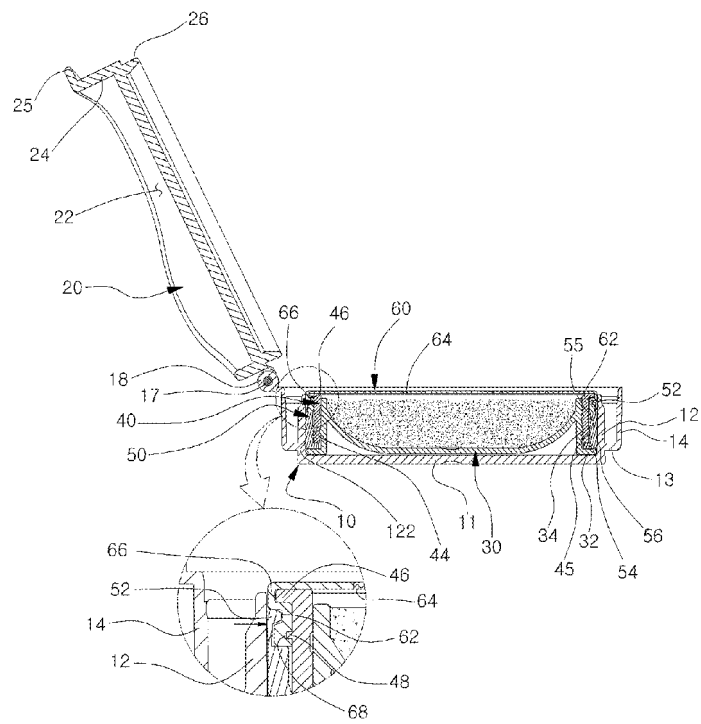

INTERNATIONAL SEARCH REPORT

International application No.

PCT/KR2015/012814

5

A. CLASSIFICATION OF SUBJECT MATTER
A45D 33/34(2006.01)i, B65D 83/00(2006.01)i, B65D 77/04(2006.01)i
 According to International Patent Classification (IPC) or to both national classification and IPC

10

B. FIELDS SEARCHED
 Minimum documentation searched (classification system followed by classification symbols)
 A45D 33/34; A45D 33/00; A45D 34/00; A45D 34/04; A45D 40/00; A45D 33/24; B65D 83/00; B65D 77/04
 Documentation searched other than minimum documentation to the extent that such documents are included in the fields searched
 Korean Utility models and applications for Utility models: IPC as above
 Japanese Utility models and applications for Utility models: IPC as above

15

Electronic data base consulted during the international search (name of data base and, where practicable, search terms used)
 eKOMPASS (KIPO internal) & Keywords: container, rubber, pad, lock, hook, fixing, inner side, bending, discharging

20

C. DOCUMENTS CONSIDERED TO BE RELEVANT

25

30

35

Category*	Citation of document, with indication, where appropriate, of the relevant passages	Relevant to claim No.
A	KR 10-2015-0087772 A (AMOREPACIFIC CORPORATION) 30 July 2015 See paragraphs [0038]-[0093]; claims 1-12; figures 1-8c.	1-5
A	KR 10-2015-0132062 A (LG HOUSEHOLD & HEALTH CARE LTD.) 25 November 2015 See paragraphs [0030]-[0057]; claims 1-10; figures 1a-13.	1-5
A	KR 10-2014-0147706 A (KR CO., LTD. et al.) 30 December 2014 See paragraphs [0112]-[0126]; figures 2, 3.	1-5
A	KR 10-1380587 B1 (HANCOOK PUFF & PACK MANUFACTURING CO., LTD.) 01 April 2014 See the entire document.	1-5
A	KR 10-1248345 B1 (JEONG, Kyu Sun) 03 April 2013 See the entire document.	1-5

40

Further documents are listed in the continuation of Box C. See patent family annex.

45

* Special categories of cited documents:
 "A" document defining the general state of the art which is not considered to be of particular relevance
 "E" earlier application or patent but published on or after the international filing date
 "L" document which may throw doubts on priority claim(s) or which is cited to establish the publication date of another citation or other special reason (as specified)
 "O" document referring to an oral disclosure, use, exhibition or other means
 "P" document published prior to the international filing date but later than the priority date claimed
 "T" later document published after the international filing date or priority date and not in conflict with the application but cited to understand the principle or theory underlying the invention
 "X" document of particular relevance; the claimed invention cannot be considered novel or cannot be considered to involve an inventive step when the document is taken alone
 "Y" document of particular relevance; the claimed invention cannot be considered to involve an inventive step when the document is combined with one or more other such documents, such combination being obvious to a person skilled in the art
 "&" document member of the same patent family

50

Date of the actual completion of the international search 08 AUGUST 2016 (08.08.2016)	Date of mailing of the international search report 08 AUGUST 2016 (08.08.2016)
--	--

55

Name and mailing address of the ISA/KR  Korean Intellectual Property Office Government Complex-Daejeon, 189 Seonsa-ro, Daejeon 302-701, Republic of Korea Facsimile No. 82-42-472-7140	Authorized officer Telephone No.
---	---

INTERNATIONAL SEARCH REPORT
Information on patent family members

International application No.

PCT/KR2015/012814

5

10

15

20

25

30

35

40

45

50

55

Patent document cited in search report	Publication date	Patent family member	Publication date
KR 10-2015-0087772 A	30/07/2015	WO 2015-141937 A1	24/09/2015
KR 10-2015-0132062 A	25/11/2015	KR 10-1471339 B1	10/12/2014
		KR 10-1566114 B1	05/11/2015
		KR 10-1566115 B1	05/11/2015
		KR 10-1566119 B1	05/11/2015
		KR 10-1599676 B1	03/03/2016
		KR 10-2015-0096358 A	24/08/2015
		KR 10-2015-0096359 A	24/08/2015
		KR 10-2015-0096601 A	25/08/2015
		KR 10-2015-0096602 A	25/08/2015
		KR 10-2015-0096603 A	25/08/2015
		KR 10-2015-0096604 A	25/08/2015
		KR 10-2015-0096605 A	25/08/2015
		KR 10-2015-0096606 A	25/08/2015
		KR 10-2015-0096607 A	25/08/2015
		KR 10-2015-0096608 A	25/08/2015
		KR 10-2015-0096609 A	25/08/2015
		KR 10-2015-0096610 A	25/08/2015
		KR 10-2015-0096611 A	25/08/2015
		KR 10-2015-0096616 A	25/08/2015
		KR 10-2015-0096617 A	25/08/2015
		KR 10-2015-0096618 A	25/08/2015
		KR 10-2015-0096620 A	25/08/2015
		KR 10-2015-0096621 A	25/08/2015
		US 2016-0015149 A1	21/01/2016
		WO 2015-122584 A1	20/08/2015
		WO 2015-122643 A1	20/08/2015
KR 10-2014-0147706 A	30/12/2014	NONE	
KR 10-1380587 B1	01/04/2014	NONE	
KR 10-1248345 B1	03/04/2013	NONE	

REFERENCES CITED IN THE DESCRIPTION

This list of references cited by the applicant is for the reader's convenience only. It does not form part of the European patent document. Even though great care has been taken in compiling the references, errors or omissions cannot be excluded and the EPO disclaims all liability in this regard.

Patent documents cited in the description

- KR 1020150087772 [0006]