



- (51) **International Patent Classification:** Not classified
- (21) **International Application Number:**
PCT/US2011/037201
- (22) **International Filing Date:**
19 May 2011 (19.05.2011)
- (25) **Filing Language:** English
- (26) **Publication Language:** English
- (30) **Priority Data:**
61/346,390 19 May 2010 (19.05.2010) US
61/411,862 9 November 2010 (09.11.2010) US
- (71) **Applicant (for all designated States except US):** **DIRECT FLOW MEDICAL, INC.** [US/US]; 451 Aviation Blvd., Suite 107A, Santa Rosa, CA 95403 (US).
- (72) **Inventors; and**
- (75) **Inventors/Applicants (for US only):** **ROBIN, Kevin** [—/US]; 1088 Civic Center Dr., Rohnert Park, CA 94928 (US). **UONG, Do** [US/US]; 2149 Waltzer Road, Santa Rosa, CA 95403 (US). **BISHOP, Gordon** [US/US]; 2487 Murdock Drive, Santa Rosa, CA 95404 (US).
- (74) **Agent:** **DELANEY, Karoline, A.**; Knobbe, Martens, Olson & Bear, LLP, 2040 Main Street, 14th Floor, Irvine, CA 92614 (US).
- (81) **Designated States (unless otherwise indicated, for every kind of national protection available):** AE, AG, AL, AM,

AO, AT, AU, AZ, BA, BB, BG, BH, BR, BW, BY, BZ, CA, CH, CL, CN, CO, CR, CU, CZ, DE, DK, DM, DO, DZ, EC, EE, EG, ES, FI, GB, GD, GE, GH, GM, GT, HN, HR, HU, ID, IL, IN, IS, JP, KE, KG, KM, KN, KP, KR, KZ, LA, LC, LK, LR, LS, LT, LU, LY, MA, MD, ME, MG, MK, MN, MW, MX, MY, MZ, NA, NG, NI, NO, NZ, OM, PE, PG, PH, PL, PT, RO, RS, RU, SC, SD, SE, SG, SK, SL, SM, ST, SV, SY, TH, TJ, TM, TN, TR, TT, TZ, UA, UG, US, UZ, VC, VN, ZA, ZM, ZW.

- (84) **Designated States (unless otherwise indicated, for every kind of regional protection available):** ARIPO (BW, GH, GM, KE, LR, LS, MW, MZ, NA, SD, SL, SZ, TZ, UG, ZM, ZW), Eurasian (AM, AZ, BY, KG, KZ, MD, RU, TJ, TM), European (AL, AT, BE, BG, CH, CY, CZ, DE, DK, EE, ES, FI, FR, GB, GR, HR, HU, IE, IS, IT, LT, LU, LV, MC, MK, MT, NL, NO, PL, PT, RO, RS, SE, SI, SK, SM, TR), OAPI (BF, BJ, CF, CG, CI, CM, GA, GN, GQ, GW, ML, MR, NE, SN, TD, TG).

Declarations under Rule 4.17:

- as to applicant's entitlement to apply for and be granted a patent (Rule 4.17(ii))

Published:

- without international search report and to be republished upon receipt of that report (Rule 48.2(g))

(54) **Title:** LOW CROSSING PROFILE DELIVERY CATHETER FOR CARDIOVASCULAR PROSTHETIC IMPLANT

FIG. 3A

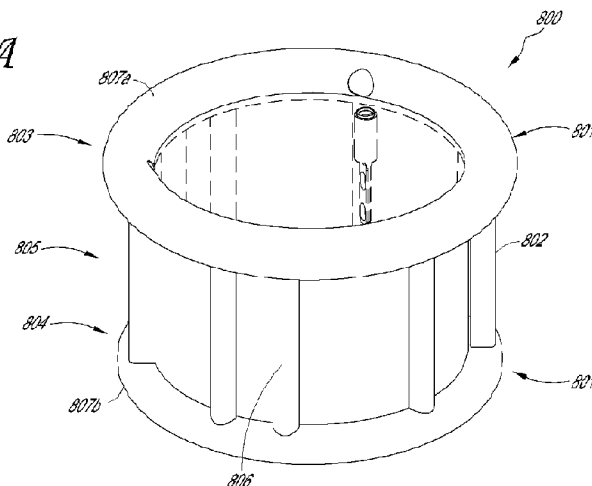

(57) **Abstract:** A delivery catheter and a method for deploying a cardiovascular prosthetic implant using a minimally invasive procedure are disclosed. The delivery catheter comprises an elongate, flexible catheter body having a proximal end and a distal end, wherein the distal end has an outer diameter of 18 French or less, a cardiovascular prosthetic implant at the distal end of the catheter body, wherein the cardiovascular prosthetic implant comprises an inflatable cuff and a tissue valve coupled to the inflatable cuff, and at least one link between the catheter body and the cardiovascular prosthetic implant.

LOW CROSSING PROFILE DELIVERY CATHETER FOR CARDIOVASCULAR PROSTHETIC IMPLANT

CROSS-REFERENCE TO RELATED APPLICATIONS

[0001] This application claims the priority benefit to U.S. Provisional No. 61/346,390 filed May 19, 2010 and U.S. Provisional No. 61/411,862 filed November 9, 2010, the entireties of which are hereby incorporated by reference herein.

BACKGROUND OF THE INVENTION

Field of the Invention

[0002] The present invention relates to medical methods and devices, and, in particular, to a low crossing profile delivery catheter for percutaneously implanting a cardiovascular implant having a formed-in-place support structure.

Description of the Related Art

[0003] According to recent estimates, more than 79,000 patients are diagnosed with aortic and mitral valve disease in U.S. hospitals each year. More than 49,000 mitral valve or aortic valve replacement procedures are performed annually in the U.S., along with a significant number of heart valve repair procedures.

[0004] The circulatory system is a closed loop bed of arterial and venous vessels supplying oxygen and nutrients to the body extremities through capillary beds. The driver of the system is the heart providing correct pressures to the circulatory system and regulating flow volumes as the body demands. Deoxygenated blood enters heart first through the right atrium and is allowed to the right ventricle through the tricuspid valve. Once in the right ventricle, the heart delivers this blood through the pulmonary valve and to the lungs for a gaseous exchange of oxygen. The circulatory pressures carry this blood back to the heart via the pulmonary veins and into the left atrium. Filling of the left atrium occurs as the mitral valve opens allowing blood to be drawn into the left ventricle for expulsion through the aortic valve and on to the body extremities. When the heart fails to continuously produce normal flow and pressures, a disease commonly referred to as heart failure occurs.

[0005] Heart failure simply defined is the inability for the heart to produce output sufficient to demand. Mechanical complications of heart failure include free-wall

rupture, septal-rupture, papillary rupture or dysfunction aortic insufficiency and tamponade. Mitral, aortic or pulmonary valve disorders lead to a host of other conditions and complications exacerbating heart failure further. Other disorders include coronary disease, hypertension, and a diverse group of muscle diseases referred to as cardiomyopathies. Because of this syndrome establishes a number of cycles, heart failure begets more heart failure.

[0006] Heart failure as defined by the New York Heart Association in a functional classification.

- I. Patients with cardiac disease but without resulting limitations of physical activity. Ordinary physical activity does not cause undue fatigue, palpitation, dyspnea, or anginal pain.
- II. Patient with cardiac disease resulting in slight limitation of physical activity. These patients are comfortable at rest. Ordinary physical activity results in fatigue, palpitation, dyspnea, or anginal pain.
- III. Patients with cardiac disease resulting in marked limitation of physical activity. These patients are comfortable at rest. Less than ordinary physical activity causes fatigue palpitation, dyspnea, or anginal pain.
- IV. Patients with cardiac disease resulting in inability to carry on any physical activity without discomfort. Symptoms of cardiac insufficiency or of the anginal syndrome may be present even at rest.
If any physical activity is undertaken, discomfort is increased.

[0007] There are many styles of mechanical valves that utilize both polymer and metallic materials. These include single leaflet, double leaflet, ball and cage style, slit-type and emulated polymer tricuspid valves. Though many forms of valves exist, the function of the valve is to control flow through a conduit or chamber. Each style will be best suited to the application or location in the body it was designed for.

[0008] Bioprosthetic heart valves comprise valve leaflets formed of flexible biological material. Bioprosthetic valves or components from human donors are referred to as homografts and xenografts are from non-human animal donors. These valves as a group are known as tissue valves. This tissue may include donor valve leaflets or other biological materials such as bovine pericardium. The leaflets are sewn into place and to

each other to create a new valve structure. This structure may be attached to a second structure such as a stent or cage or other prosthesis for implantation to the body conduit.

[0009] Implantation of valves into the body has been accomplished by a surgical procedure and has been attempted via percutaneous method such as a catheterization or delivery mechanism utilizing the vasculature pathways. Surgical implantation of valves to replace or repair existing valves structures include the four major heart valves (tricuspid, pulmonary, mitral, aortic) and some venous valves in the lower extremities for the treatment of chronic venous insufficiency. Implantation includes the sewing of a new valve to the existing tissue structure for securement. Access to these sites generally include a thoracotomy or a sternotomy for the patient and include a great deal of recovery time. An open-heart procedure can include placing the patient on heart bypass to continue blood flow to vital organs such as the brain during the surgery. The bypass pump will continue to oxygenate and pump blood to the body's extremities while the heart is stopped and the valve is replaced. The valve may replace in whole or repair defects in the patient's current native valve. The device may be implanted in a conduit or other structure such as the heart proper or supporting tissue surrounding the heart. Attachments methods may include suturing, hooks or barbs, interference mechanical methods or an adhesion median between the implant and tissue.

[0010] Although valve repair and replacement can successfully treat many patients with valvular insufficiency, techniques currently in use are attended by significant morbidity and mortality. Most valve repair and replacement procedures require a thoracotomy, usually in the form of a median sternotomy, to gain access into the patient's thoracic cavity. A saw or other cutting instrument is used to cut the sternum longitudinally, allowing the two opposing halves of the anterior or ventral portion of the rib cage to be spread apart. A large opening into the thoracic cavity is thus created, through which the surgical team may directly visualize and operate upon the heart and other thoracic contents. Alternatively, a thoracotomy may be performed on a lateral side of the chest, wherein a large incision is made generally parallel to the ribs, and the ribs are spread apart and/or removed in the region of the incision to create a large enough opening to facilitate the surgery.

[0011] Surgical intervention within the heart generally requires isolation of the heart and coronary blood vessels from the remainder of the arterial system, and arrest of cardiac function. Usually, the heart is isolated from the arterial system by introducing an

external aortic cross-clamp through a sternotomy and applying it to the aorta to occlude the aortic lumen between the brachiocephalic artery and the coronary ostia. Cardioplegic fluid is then injected into the coronary arteries, either directly into the coronary ostia or through a puncture in the ascending aorta, to arrest cardiac function. The patient is placed on extracorporeal cardiopulmonary bypass to maintain peripheral circulation of oxygenated blood.

[0012] Since surgical techniques are highly invasive and in the instance of a heart valve, the patient must be put on bypass during the operation, the need for a less invasive method of heart valve replacement has long been recognized. At least as early as 1972, the basic concept of suturing a tissue aortic valve to an expandable cylindrical "fixation sleeve" or stent was disclosed. See U.S. Patent No. 3,657,744 to Ersek. Other early efforts were disclosed in U.S. Patent No. 3,671,979 to Mouloupoulos and 4,056,854 to Boretos, relating to prosthetic valves carried by an expandable valve support delivered via catheter for remote placement. More recent iterations of the same basic concept were disclosed, for example, in patents such as 5,411,552, 5,957,949, 6,168,614, and 6,582,462 to Anderson, et al., which relate generally to tissue valves carried by expandable metallic stent support structures which are crimped to a delivery balloon for later expansion at the implantation site.

[0013] In each of the foregoing systems, the tissue or artificial valve is first attached to a preassembled, complete support structure (some form of a stent) and then translumenally advanced along with the support structure to an implantation site. The support structure is then forceably enlarged or allowed to self expand without any change in its rigidity or composition, thereby securing the valve at the site.

[0014] Despite the many years of effort, and enormous investment of entrepreneurial talent and money, no stent based heart valve system has yet received regulatory approval, and a variety of difficulties remain. For example, stent based systems have a fixed rigidity even in the collapsed configuration, and have inherent difficulties relating to partial deployment, temporary deployment, removal and navigation.

[0015] Thus, a need remains for improvements over the basic concept of a stent based prosthetic valve. As disclosed herein a variety of significant advantages may be achieved by eliminating the stent and advancing the valve to the site without a support structure. Only later, the support structure is created *in situ* such as by inflating one or

more inflatable chambers to impart rigidity to an otherwise highly flexible and functionless subcomponent.

SUMMARY OF THE INVENTION

[0016] One aspect of the present invention comprises a delivery catheter for deploying a cardiovascular prosthetic implant using a minimally invasive procedure. The delivery catheter comprises an elongate, flexible catheter body having a proximal end and a distal end. The distal portion of the catheter has an outer diameter of 18 French or less. A cardiovascular prosthetic implant is positioned at the distal end of the catheter body. The cardiovascular prosthetic implant comprises an inflatable cuff and a tissue valve having a thickness of at least about .011 inches coupled to the inflatable cuff. At least one link is provided between the catheter body and the cardiovascular prosthetic implant

[0017] Another aspect of the present invention comprises a method of deploying a cardiovascular prosthetic implant. The method includes translumenally advancing a catheter having a distal portion with a diameter of 18 French and carrying a cardiovascular prosthetic implant with a tissue valve having a thickness of at least about .011 inches to a position proximate a native valve of a patient. The cardiovascular prosthetic implant comprises an inflatable cuff, a tissue valve coupled to the inflatable cuff. The inflatable cuff is inflated fully with a hardenable inflation media. The catheter is removed from the patient, leaving the hardenable inflation media in the cardiovascular prosthetic implant within the patient.

[0018] Another aspect of the present invention comprises a delivery catheter for deploying a cardiovascular prosthetic implant using a minimally invasive procedure. The delivery catheter comprises an elongate, flexible catheter body having a proximal end and a distal end, wherein the distal end has an outer diameter of 18 French or less. A cardiovascular prosthetic implant is positioned at the distal end of the catheter body. The cardiovascular prosthetic implant comprises a support structure and a tissue valve having a thickness of at least about .011 inches coupled to the support structure

[0019] Another aspect of the present invention comprises a method of deploying a cardiovascular prosthetic implant. The method comprises translumenally advancing a catheter having a distal portion with a diameter of 18 French and carrying a cardiovascular prosthetic implant with a tissue valve having a thickness of at least about .011 inches to a position proximate a native valve of a patient. The cardiovascular

prosthetic implant is deployed within the patient and the catheter is removed from the patient.

BRIEF DESCRIPTION OF THE DRAWINGS

[0020] Figure 1 is a cross-sectional schematic view of a heart and its major blood vessels.

[0021] Figure 2A is a partial cut-away view a left ventricle and aortic with an prosthetic aortic valve implant according to one embodiment of the present invention positioned therein.

[0022] Figure 2B is a side view of the implant of Figure 2A positioned across a native aortic valve.

[0023] Figure 3A is a front perspective view of the implant of Figure 2B.

[0024] Figure 3B is a front perspective view of an inflatable support structure of the implant of Figure 3A.

[0025] Figure 3C is a cross-sectional side view of the implant of Figure 3A.

[0026] Figure 3D is an enlarged cross-sectional view of an upper portion of Figure 3C.

[0027] Figure 4 is a cross-sectional view of the connection port and the inflation valve in the implant of Figure 3B.

[0028] Figure 5A is a side perspective view of a deployment catheter with retracted implant.

[0029] Figure 5B is a side perspective view of the deployment catheter of Figure 5A with the implant outside of the outer sheath jacket.

[0030] Figure 5C is a side perspective view of the position-and-fill lumen (PFL), which is a component of the deployment catheter of Figures 5A and 5B.

[0031] Figure 6 is a cross-sectional view taken through line A-A of Figure 5B.

[0032] Figure 7 is a side perspective view of a loading tool base.

[0033] Figures 8A-C illustrate time sequence steps of partially deploying and positioning an artificial valve implant.

[0034] Figures 9A-E illustrates time sequence steps of deploying, testing and repositioning an artificial valve implant.

[0035] Figures 10A-C illustrates time sequence steps of deploying and withdrawing an artificial valve implant.

[0036] Figure 11 is a side perspective view of an embodiment of recovery catheter for retrieving the implant in the patient.

[0037] Figure 12 is a side perspective view of a method of compressing the implant of Figures 3A-B.

DETAILED DESCRIPTION OF THE EMBODIMENTS

[0038] Figure 1 is a schematic cross-sectional illustration of the anatomical structure and major blood vessels of a heart 10. Deoxygenated blood is delivered to the right atrium 12 of the heart 10 by the superior and inferior vena cava 14, 16. Blood in the right atrium 12 is allowed into the right ventricle 18 through the tricuspid valve 20. Once in the right ventricle 18, the heart 10 delivers this blood through the pulmonary valve 22 to the pulmonary arteries 24 and to the lungs for a gaseous exchange of oxygen. The circulatory pressures carry this blood back to the heart via the pulmonary veins 26 and into the left atrium 28. Filling of the left atrium 28 occurs as the mitral valve 30 opens allowing blood to be drawn into the left ventricle 32 for expulsion through the aortic valve 34 and on to the body extremities through the aorta 36. When the heart 10 fails to continuously produce normal flow and pressures, a disease commonly referred to as heart failure occurs.

[0039] One cause of heart failure is failure or malfunction of one or more of the valves of the heart 10. For example, the aortic valve 34 can malfunction for several reasons. For example, the aortic valve 34 may be abnormal from birth (e.g., bicuspid, calcification, congenital aortic valve disease), or it could become diseased with age (e.g., acquired aortic valve disease). In such situations, it can be desirable to replace the abnormal or diseased valve 34.

[0040] Figure 2 is a schematic illustration of the left ventricle 32, which delivers blood to the aorta 36 through the aortic valve 34. The aorta 36 comprises (i) the ascending aorta 38, which arises from the left ventricle 32 of the heart 10, (ii) the aortic arch 40, which arches from the ascending aorta 38 and (iii) the descending aorta 42 which descends from the aortic arch 40 towards the abdominal aorta (not shown). Also shown are the principal branches of the aorta 14, which include the innominate artery 44 that immediately divides into the right carotid artery (not shown) and the right subclavian artery (not shown), the left carotid 46 and the subclavian artery 48.

Inflatable prosthetic aortic valve implant

[0041] With continued reference to Figure 2A, a cardiovascular prosthetic implant **800** in accordance with an embodiment of the present invention is shown spanning the native abnormal or diseased aortic valve **34**. The implant **800** and various modified embodiments thereof will be described in detail below. As will be explained in more detail below, the implant **800** is preferably delivered minimally invasively using an intravascular delivery catheter **900** or trans apical approach with a trocar.

[0042] In the description below, the present invention will be described primarily in the context of replacing or repairing an abnormal or diseased aortic valve **34**. However, various features and aspects of methods and structures disclosed herein are applicable to replacing or repairing the mitral **30**, pulmonary **22** and/or tricuspid **20** valves of the heart **10** as those of skill in the art will appreciate in light of the disclosure herein. In addition, those of skill in the art will also recognize that various features and aspects of the methods and structures disclosed herein can be used in other parts of the body that include valves or can benefit from the addition of a valve, such as, for example, the esophagus, stomach, ureter and/or vesice, biliary ducts, the lymphatic system and in the intestines.

[0043] In addition, various components of the implant and its delivery system will be described with reference to coordinate system comprising “distal” and “proximal” directions. In this application, distal and proximal directions refer to the deployment system **900**, which is used to deliver the implant **800** and advanced through the aorta **36** in a direction opposite to the normal direction of blood through the aorta **36**. Thus, in general, distal means closer to the heart while proximal means further from the heart with respect to the circulatory system.

[0044] In some embodiments, the implant **800** may be a prosthetic aortic valve implant. With reference to Figure 2B in the illustrated embodiment, the implant **800** has a shape that can be viewed as a tubular member or hyperboloid shape where a waist **805** excludes the native valve **34** or vessel and proximally the proximal end **803** forms a hoop or ring to seal blood flow from re-entering the left ventricle **32**. Distally, the distal end **804** also forms a hoop or ring to seal blood from forward flow through the outflow track. Between the two ends **803** and **804**, the valve **104** is mounted to the cuff or body **802** such that when inflated the implant **800** excludes the native valve **34** or extends over the former location of the native valve **34** and replaces its function. The distal end **804**

should have an appropriate size and shape so that it does not interfere with the proper function of the mitral valve, but still secures the valve adequately. For example, there may be a notch, recess or cut out in the distal end **804** of the device to prevent mitral valve interference. The proximal end **803** is designed to sit in the aortic root. It is preferably shaped in such a way that it maintains good apposition with the wall of the aortic root. This prevents the device from migrating back into the ventricle **32**. In some embodiments, the implant **800** is configured such that it does not extend so high that it interferes with the coronary arteries.

[0045] Any number of additional inflatable rings or struts may be disposed between the proximal end **803** and distal end **804**. The distal end **804** of the implant **800** is preferably positioned within the left ventricle **34** and can utilize the aortic root for axial stabilization as it may have a larger diameter than the aortic lumen. This may lessen the need for hooks, barbs or an interference fit to the vessel wall. Since the implant **800** may be placed without the aid of a dilatation balloon for radial expansion, the aortic valve **34** and vessel may not have any duration of obstruction and would provide the patient with more comfort and the physician more time to properly place the device accurately. Since the implant **800** is not utilizing a support member with a single placement option as a plastically deformable or shaped memory metal stent does, the implant **800** may be movable and or removable if desired. This could be performed multiple times until the implant **800** is permanently disconnected from the delivery catheter **900** as will be explained in more detail below. In addition, the implant **800** can include features, which allow the implant **800** to be tested for proper function, sealing and sizing, before the catheter **900** is disconnected.

[0046] With reference to Figure 3A, the implant **800** of the illustrated embodiment generally comprises an inflatable cuff or body **802**, which is configured to support a valve **104** (see Figure 2A) that is coupled to the cuff **802**. In some embodiments, the valve **104** is a tissue valve. In some embodiments, the tissue valve has a thickness equal to or greater than about 0.011 inches. In another embodiment, the tissue valve has a thickness equal to or greater than about .018 inches. As will be explained in more detail below, the valve **104** is configured to move in response to the hemodynamic movement of the blood pumped by the heart **10** between an “open” configuration where blood can throw the implant **800** in a first direction (labeled A in Figure 2B) and a

“closed” configuration whereby blood is prevented from back flowing through the valve 104 in a second direction B (labeled B in Figure 2B).

[0047] In the illustrated embodiment, the cuff 802 comprises a thin flexible tubular material such as a flexible fabric or thin membrane with little dimensional integrity. As will be explained in more detail below, the cuff 802 can be changed preferably, *in situ*, to a support structure to which other components (e.g., the valve 104) of the implant 800 can be secured and where tissue ingrowth can occur. Uninflated, the cuff 802 is preferably incapable of providing support. In one embodiment, the cuff 802 comprises Dacron, PTFE, ePTFE, TFE or polyester fabric as seen in conventional devices such as surgical stented or stent less valves and annuloplasty rings. The fabric thickness may range from about 0.002 inches to about 0.020 inches depending upon material selection and weave. Weave density may also be adjusted from a very tight weave to prevent blood from penetrating through the fabric to a looser weave to allow tissue to grow and surround the fabric completely. In preferred embodiments, the fabric may have a linear mass density about 20 denier or lower.

[0048] With reference to Figures 3B-3D, in the illustrated embodiment, the implant 800 includes an inflatable structure 813 that is formed by one or more inflation channels 808. The inflatable channels 808 are formed by a pair of distinct balloon rings or toroids (807a and 807b) and struts 806. In the illustrated embodiment, the implant 800 comprises a proximal toroid 807a at the proximal end 803 of the cuff 802 and a distal toroid 807b at the distal end 804 of the cuff 802. The toroids 807 can be secured to the cuff 802 in any of a variety of manners. With reference to Figures 3C and 3D, in the illustrated embodiment, the toroids 807 are secured within folds 801 formed at the proximal end 803 and the distal end 804 of the cuff 802. The folds 801, in turn, are secured by sutures or stitches 812. When inflated, the implant 800 is supported in part by series of struts 806 surrounding the cuff 802. In some embodiments, the struts 806 are configured so that the portions on the cuff run substantially perpendicular to the toroids. In some embodiments, the struts are sewn onto the cuff 802 or are enclosed in lumens made from the cuff material and sewn onto the cuff 802. The toroids 807 and the struts 806 together form one or more inflatable channels 808 that can be inflated by air, liquid or inflation media.

[0049] With reference to Figure 3B, the inflation channels are configured so that the cross-sectional profile of the implant **800** is reduced when it is compressed or in the retracted state. The inflation channels **808** are arranged in a step-function pattern. The inflation channels **808** have three connection ports **809** for coupling to the delivery catheter **900** via position and fill lumen tubing (PFL) tubing **916** (see Figures 5A-5C). In some embodiments, at least two of the connection ports **809** also function as inflation ports, and inflation media, air or liquid can be introduced into the inflation channel **808** through these ports. The PFL tubing **916** can be connected to the connection ports **809** via suitable connection mechanisms. In one embodiment, the connection between the PFL tubing **916** and the connection port **809** is a screw connection. In some embodiments, an inflation valve **810** is present in the connection port **809** and can stop the inflation media, air or liquid from escaping the inflation channels **808** after the PFL tubing is disconnected. In some embodiments, the distal toroid **807b** and the proximal toroid **807a** may be inflated independently. In some embodiments, the distal toroid **807b** can be inflated separately from the struts **806** and the proximal toroid **807a**. The separate inflation is useful during the positioning of the implant at the implantation site. With reference to Figures 3C and 3D, in some embodiments, the portion of struts **806** that runs parallel to the toroids **807** is encapsulated within the folds **801** of the implant **800**. This may also aid in reducing the cross-sectional profile when the implant is compressed or folded.

[0050] As mentioned above, the inflatable rings or toroids **807** and struts **806** form the inflatable structure **813**, which, in turn, defines the inflation channels **808**. The inflation channels **808** receive inflation media to generally inflate the inflatable structure **813**. When inflated, the inflatable rings **807** and struts **806** can provide structural support to the inflatable implant **800** and/or help to secure the implant **800** thin the heart **10**. Uninflated, the implant **800** is a generally thin, flexible shapeless assembly that is preferably incapable of support and is advantageously able to take a small, reduced profile form in which it can be percutaneously inserted into the body. As will be explained in more detail below, in modified embodiments, the inflatable structure **813** may comprise any of a variety of configurations of inflation channels **808** that can be formed from other inflatable members in addition to or in the alternative to the inflatable rings **807** and struts **806** shown in Figures 3A and 3B. In one embodiment, the valve has

an expanded diameter that is greater than or equal to 22 millimeters and a maximum compressed diameter that is less than or equal to 6 millimeters (18F).

[0051] With particular reference to Figure 3B, in the illustrated embodiment, the distal ring **807b** and struts **806** are joined such that the inflation channel **808** of the distal ring **807b** is in fluid communication with the inflation channel **808** of some of the struts **806**. The inflation channel **808** of the proximal ring **807a** is also in communication with the inflation channels **808** of the proximal ring **807a** and a few of the struts **806**. In this manner, the inflation channels of the (i) proximal ring **807a** and a few struts **806** can be inflated independently from the (ii) distal ring **807b** and some struts. In some embodiments, the inflation channel of the proximal ring **807a** is in communication with the inflation channel of the struts **806**, while the inflation channel of the distal ring **807b** is not in communication with the inflation channel of the struts. As will be explained in more detail below, the two groups of inflation channels **808** are preferably connected to independent PFL tubing **916** to facilitate the independent inflation. It should be appreciated that in modified embodiments the inflatable structure can include less (i.e., one common inflation channel) or more independent inflation channels. For example, in one embodiment, the inflation channels of the proximal ring **807a**, struts **806** and distal ring **807b** can all be in fluid communication with each other such that they can be inflated from a single inflation device. In another embodiment, the inflation channels of the proximal ring **807a**, struts **806** and distal ring **807b** can all be separated and therefore utilize three inflation devices.

[0052] With reference to Figure 3B, in the illustrated embodiment, each of the proximal ring **807a** and the distal ring **807b** has a cross-sectional diameter of about 0.090 inches. The struts have a cross-sectional diameter of about 0.060 inches. In some embodiments, within the inflation channels **808** are also housed valve systems that allow for pressurization without leakage or passage of fluid in a single direction. In the illustrated embodiment shown in Figure 3B, two end valves or inflation valves **810** reside at each end section of the inflation channels **808** adjacent to the connection ports **809**. These end valves **810** are utilized to fill and exchange fluids such as saline, contrast agent and inflation media. The length of this inflation channel **808** may vary depending upon the size of the implant **800** and the complexity of the geometry. The inflation channel material may be blown using heat and pressure from materials such as nylon,

polyethylene, Pebax, polypropylene or other common materials that will maintain pressurization. The fluids that are introduced are used to create the support structure, where without them, the implant **800** is an undefined fabric and tissue assembly. In one embodiment the inflation channels **808** are first filled with saline and contrast agent for radiopaque visualization under fluoroscopy. This can make positioning the implant **800** at the implantation site easier. This fluid is introduced from the proximal end of the catheter **900** with the aid of an inflation device such as an endoflator or other means to pressurize fluid in a controlled manner. This fluid is transferred from the proximal end of the catheter **900** through the PFL tubes **916** which are connected to the implant **800** at the end of each inflation channel **808** at the connection port **809**.

[0053] With reference to Figure 3B, in the illustrated embodiment, the inflation channel **808** can have an end valve **810** (i.e., inflation valve) at each end whereby they can be separated from the PFL tubes **916** thus disconnecting the catheter from the implant. This connection can be a screw or threaded connection, a colletting system, an interference fit or other means of reliable securement between the two components (i.e., the end valve **810** and the PFL tubes **916**). In between the ends of the inflation channel **808** is an additional directional valve **811** to allow fluid to pass in a single direction. This allows for the filling of each end of the inflation channel **808** and displacement of fluid in a single direction. Once the implant **808** is placed at the desired position while inflated with saline and contrast agent, this fluid can be displaced by an inflation media that can solidify or harden. As the inflation media is introduced from the proximal end of the catheter **900**, the fluid containing saline and contrast agent is pushed out from one end of the inflation channel **808**. Once the inflation media completely displaces the first fluid, the PFL tubes are then disconnected from the implant **800** while the implant **800** remains inflated and pressurized. The pressure is maintained in the implant **800** by the integral valve (i.e., end valve **810**) at each end of the inflation channel **808**. In the illustrated embodiment, this end valve **810** has a ball **303** and seat to allow for fluid to pass when connected and seal when disconnected. In some case the implant **800** has three or more connection ports **809**, but only two have inflation valves **810** attached. The connection port without the end valve **810** may use the same attachment means such as a screw or threaded element. Since this connection port is not used for communication with the support structure **813** and its filling, no inflation valve **810** is necessary. In other

embodiments, all three connection ports **809** may have inflation valves **810** for introducing fluids or inflation media.

[0054] With reference to Figure 4, the end valve system **810** comprises a tubular section **312** with a soft seal **304** and spherical ball **303** to create a sealing mechanism **313**. The tubular section **312** in one embodiment is about 0.5 cm to about 2 cm in length and has an outer diameter of about 0.010 inches to about 0.090 inches with a wall thickness of about 0.005 inches to about 0.040 inches. The material may include a host of polymers such as nylon, polyethylene, Pebax, polypropylene or other common materials such as stainless steel, Nitinol or other metallic materials used in medical devices. The soft seal material may be introduced as a liquid silicone or other material where a curing occurs thus allowing for a through hole to be constructed by coring or blanking a central lumen through the seal material. The soft seal **304** is adhered to the inner diameter of the wall of the tubular member **312** with a through hole for fluid flow. The spherical ball **303** is allowed to move within the inner diameter of the tubular member **312** where it seats at one end sealing pressure within the inflation channels and is moved the other direction with the introduction of the PFL tube **916** but not allowed to migrate too far as a stop ring or ball stopper **305** retains the spherical ball **303** from moving into the inflation channel **808**. As the PFL tube **916** is screwed into the connection port **809**, the spherical ball **303** is moved into an open position to allow for fluid communication between the inflation channel **808** and the PFL tube **916**. When disconnected, the ball **303** is allowed to move against the soft seal **304** and halt any fluid communication external to the inflation channel **808** leaving the implant **800** pressurized. Additional embodiments may utilize a spring mechanism to return the ball to a sealed position and other shapes of sealing devices may be used rather than a spherical ball. A duck-bill style sealing mechanism or flap valve would additionally suffice to halt fluid leakage and provide a closed system to the implant. Additional end valve systems have been described in U.S. Patent Publication No. 2009/0088836 to Bishop et al., which is thereby incorporated by reference herein.

[0055] The implant **800** allows the physician to deliver a prosthetic valve via catheterization in a lower profile and a safer manner than currently available. When the implant **800** is delivered to the site via a delivery catheter **900**, the implant **800** is a thin, generally shapeless assembly in need of structure and definition. At the implantation site,

the inflation media (e.g., a fluid or gas) may be added via PFL tubes of the delivery catheter **900** to the inflation channels **808** providing structure and definition to the implant **800**. The inflation media therefore comprises part of the support structure for implant **800** after it is inflated. The inflation media that is inserted into the inflation channels **808** can be pressurized and/or can solidify in situ to provide structure to the implant **800**. Additional details and embodiments of the implant **800**, can be found in U.S. Patent No. 5,554,185 to Block and U.S. Patent Publication No. 2006/0088836 to Bishop et al., the disclosures of which are expressly incorporated by reference in their entirety herein.

[0056] The cuff **802** may be made from many different materials such as Dacron, TFE, PTFE, ePTFE, woven metal fabrics, braided structures, or other generally accepted implantable materials. These materials may also be cast, extruded, or seamed together using heat, direct or indirect, sintering techniques, laser energy sources, ultrasound techniques, molding or thermoforming technologies. Since the inflation channels **808** generally surrounds the cuff **802**, and the inflation channels **808** can be formed by separate members (e.g., balloons and struts), the attachment or encapsulation of these inflation channels **808** can be in intimate contact with the cuff material. In some embodiments, the inflation channels **808** are encapsulated in the folds **801** or lumens made from the cuff material sewn to the cuff **802**. These inflation channels **808** can also be formed by sealing the cuff material to create an integral lumen from the cuff **802** itself. For example, by adding a material such as a silicone layer to a porous material such as Dacron, the fabric can resist fluid penetration or hold pressures if sealed. Materials may also be added to the sheet or cylinder material to create a fluid-tight barrier.

[0057] Various shapes of the cuff **802** may be manufactured to best fit anatomical variations from person to person. As described above, these may include a simple cylinder, a hyperboloid, a device with a larger diameter in its mid portion and a smaller diameter at one or both ends, a funnel type configuration or other conforming shape to native anatomies. The shape of the implant **800** is preferably contoured to engage a feature of the native anatomy in such a way as to prevent the migration of the device in a proximal or distal direction. In one embodiment the feature that the device engages is the aortic root or aortic bulb **34** (see e.g., Figure 2A), or the sinuses of the coronary arteries. In another embodiment the feature that the device engages is the native valve annulus, the native valve or a portion of the native valve. In certain embodiments, the feature that the implant **800** engages to prevent migration has a diametral difference

between 1% and 10%. In another embodiment, the feature that the implant **800** engages to prevent migration the diameter difference is between 5% and 40%. In certain embodiments the diameter difference is defined by the free shape of the implant **800**. In another embodiment the diameter difference prevents migration in only one direction. In another embodiment, the diameter difference prevents migration in two directions, for example proximal and distal or retrograde and antigrade. Similar to surgical valves, the implant **800** will vary in diameter ranging from about 14 mm to about 30 mm and have a height ranging from about 10 mm to about 30 mm in the portion of the implant **800** where the leaflets of the valve **104** are mounted. Portions of the implant **800** intended for placement in the aortic root may have larger diameters preferably ranging from about 20 mm to about 45 mm. In some embodiment, the implant **800** has an outside diameter greater than about 22 mm when fully inflated.

[0058] In certain embodiments, the cuffs, inflated structure can conform (at least partially) to the anatomy of the patient as the implant **800** is inflated. Such an arrangement may provide a better seal between the patient's anatomy and the implant **800**.

[0059] Different diameters of prosthetic valves will be needed to replace native valves of various sizes. For different locations in the anatomy, different lengths of prosthetic valves or anchoring devices will also be required. For example a valve designed to replace the native aortic valve needs to have a relatively short length because of the location of the coronary artery ostium (left and right arteries). A valve designed to replace or supplement a pulmonary valve could have significantly greater length because the anatomy of the pulmonary artery allows for additional length. Different anchoring mechanisms that may be useful for anchoring the implant **800** have been described in U.S. Patent Publication No. 2009/0088836 to Bishop et al.

[0060] In the embodiments described herein, the inflation channels **808** may be configured such that they are of round, oval, square, rectangular or parabolic shape in cross section. Round cross sections may vary from about 0.020 – about 0.100 inches in diameter with wall thicknesses ranging from about 0.0005 – about 0.010 inches. Oval cross sections may have an aspect ratio of two or three to one depending upon the desired cuff thickness and strength desired. In embodiments in which the inflation channels **808** are formed by balloons, these channels **808** can be constructed from conventional balloon materials such as nylon, polyethylene, PEEK, silicone or other generally accepted medical device material

[0061] In some embodiments, portions of the cuff or body **802** can be radio-opaque to aid in visualizing the position and orientation of the implant **800**. Markers made from platinum gold or tantalum or other appropriate materials may be used. These may be used to identify critical areas of the valve that must be positioned appropriately, for example the valve commissures may need to be positioned appropriately relative to the coronary arteries for an aortic valve. Additionally during the procedure it may be advantageous to catheterize the coronary arteries using radio-opaque tipped guide catheters so that the ostia can be visualized. Special catheters could be developed with increased radio-opacity or larger than standard perfusion holes. The catheters could also have a reduced diameter in their proximal section allowing them to be introduced with the valve deployment catheter.

[0062] As mentioned above, during delivery, the body **802** is limp and flexible providing a compact shape to fit inside a delivery sheath. The body **802** is therefore preferably made from a thin, flexible material that is biocompatible and may aid in tissue growth at the interface with the native tissue. A few examples of material may be Dacron, ePTFE, PTFE, TFE, woven material such as stainless steel, platinum, MP35N, polyester or other implantable metal or polymer. As mentioned above with reference to Figure 2A, the body **802** may have a tubular or hyperboloid shape to allow for the native valve to be excluded beneath the wall of the cuff **802**. Within this cuff **802** the inflation channels **808** can be connected to a catheter lumen for the delivery of an inflation media to define and add structure to the implant **800**. The valve **104**, which is configured such that a fluid, such as blood, may be allowed to flow in a single direction or limit flow in one or both directions, is positioned within the cuff **802**. The attachment method of the valve **104** to the cuff **802** can be by conventional sewing, gluing, welding, interference or other means generally accepted by industry.

[0063] In one embodiment, the cuff **802** would have a diameter of between about 15 mm and about 30 mm and a length of between about 6 mm and about 70 mm. The wall thickness would have an ideal range from about 0.01 mm to about 2 mm. As described above, the cuff **802** may gain longitudinal support *in situ* from members formed by inflation channels or formed by polymer or solid structural elements providing axial separation. The inner diameter of the cuff **802** may have a fixed dimension providing a constant size for valve attachment and a predictable valve open and closure function.

Portions of the outer surface of the cuff **802** may optionally be compliant and allow the implant **800** to achieve interference fit with the native anatomy.

[0064] The implant **800** can have various overall shapes (e.g., an hourglass shape to hold the device in position around the valve annulus, or the device may have a different shape to hold the device in position in another portion of the native anatomy, such as the aortic root). Regardless of the overall shape of the implant **800**, the inflatable channels **808** can be located near the proximal and distal ends **803**, **804** of the implant **800**, preferably forming a configuration that approximates a ring or toroid **807**. These channels may be connected by intermediate channels designed to serve any combination of three functions: (i) provide support to the tissue excluded by the implant **800**, (ii) provide axial and radial strength and stiffness to the **800**, and/or (iii) to provide support for the valve **104**. The specific design characteristics or orientation of the inflatable structure **813** can be optimized to better serve each function. For example if an inflatable channel **808** were designed to add axial strength to the relevant section of the device, the channels **808** would ideally be oriented in a substantially axial direction.

[0065] The cuff **802** and inflation channels **808** of the implant **800** can be manufactured in a variety of ways. In one embodiment the cuff **802** is manufactured from a fabric, similar to those fabrics typically used in endovascular grafts or for the cuffs of surgically implanted prosthetic heart valves. The fabric is preferably woven into a tubular shape for some portions of the cuff **802**. The fabric may also be woven into sheets. In one embodiment, the yarn used to manufacture the fabric is preferably a twisted yarn, but monofilament or braided yarns may also be used. The useful range of yarn diameters is from approximately 0.0005 of an inch in diameter to approximately 0.005 of an inch in diameter. Depending on how tight the weave is made. Preferably, the fabric is woven with between about 50 and about 500 yarns per inch. In one embodiment, a fabric tube is woven with a 18mm diameter with 200 yarns per inch or picks per inch. Each yarn is made of 20 filaments of a PET material. The final thickness of this woven fabric tube is 0.005 inches for the single wall of the tube. Depending on the desired profile of the implant **800** and the desired permeability of the fabric to blood or other fluids different weaves may be used. Any biocompatible material may be used to make the yarn, some embodiments include nylon and PET. Other materials or other combinations of materials are possible, including Teflon, fluoropolymers, polyimide, metals such as stainless steel, titanium, Nitinol, other shape memory alloys, alloys comprised primarily of a

combinations of cobalt, chromium, nickel, and molybdenum. Fibers may be added to the yarn to increase strength or radiopacity, or to deliver a pharmaceutical agent. The fabric tube may also be manufactured by a braiding process.

[0066] The fabric can be stitched, sutured, sealed, melted, glued or bonded together to form the desired shape of the implant **800**. The preferred method for attaching portions of the fabric together is stitching. The preferred embodiment uses a polypropylene monofilament suture material, with a diameter of approximately 0.005 of an inch. The suture material may range from about 0.001 to about 0.010 inches in diameter. Larger suture materials may be used at higher stress locations such as where the valve commissures attach to the cuff. The suture material may be of any acceptable implant grade material. Preferably a biocompatible suture material is used such as polypropylene. Nylon and polyethylene are also commonly used suture materials. Other materials or other combinations of materials are possible, including Teflon, fluoropolymers, polyimides, metals such as stainless steel, titanium, Kevlar, Nitinol, other shape memory alloys, alloys comprised primarily of a combinations of cobalt, chromium, nickel, and molybdenum such as MP35N. Preferably the sutures are a monofilament design. Multi strand braided or twisted suture materials also may be used. Many suture and stitching patterns are possible and have been described in various texts. The preferred stitching method is using some type of lock stitch, of a design such that if the suture breaks in a portion of its length the entire running length of the suture will resist unraveling. And the suture will still generally perform its function of holding the layers of fabric together.

[0067] In some embodiments, the implant **800** is not provided with separate balloons, instead the fabric of the cuff **802** itself can form the inflation channels **808**. For example, in one embodiment two fabric tubes of a diameter similar to the desired final diameter of the implant **800** are placed coaxial to each other. The two fabric tubes are stitched, fused, glued or otherwise coupled together in a pattern of channels **808** that is suitable for creating the geometry of the inflatable structure **813**. In some embodiments, the fabric tubes are sewn together in a pattern so that the proximal and distal ends of the fabric tubes form an annular ring or toroid **807**. In some embodiments, the middle section of the implant **800** contains one or more inflation channels shaped in a step-function pattern. In some embodiments, the fabric tubes are sewn together at the middle section of the implant to form inflation channels **808** that are perpendicular to the toroids **807** at the

end sections of the implant **800**. Methods for fabricating the implant **800** have been described in U.S. Patent Publication No. 2006/0088836 to Bishop et al.

[0068] In the illustrated embodiment of Figures 3A and 3B, the struts **806** are arranged such that there is no radial overlap with the distal and proximal rings **807a**, **807b**. That is, in the illustrated embodiment, the struts **808** do not increase the radial thickness of the inflation structure because there is no radial overlap between the distal and proximal rings and the channels so that the channels lie within the radial thickness envelop defined by the distal and proximal rings **807a**, **807b**. In another embodiment, the struts **808** can be wider in the radial direction than the distal and proximal rings **807a**, **807b** such that the distal and proximal rings **807a**, **807b** lie within a radial thickness envelop defined by the struts **806**.

[0069] In one embodiment, the valve **800** can be delivered through a deployment catheter with an 18 F or smaller outer diameter and when fully inflated has an effective orifice area of at least about 1.0 square cm; and in another embodiment at least about 1.3 square cm and in another embodiment about 1.5 square cm. In one embodiment, the valve **800** has a minimum cross-sectional flow area of at least about 1.75 square cm.

Leaflet Subassembly

[0070] With reference back to the embodiments of Figure 2A, the valve **104** preferably is a tissue-type heart valve that includes a dimensionally stable, pre-aligned tissue leaflet subassembly. Pursuant to this construction, an exemplary tissue valve **104** includes a plurality of tissue leaflets that are templated and attached together at their tips to form a dimensionally stable and dimensionally consistent coapting leaflet subassembly. Then, in what can be a single process, each of the leaflets of the subassembly is aligned with and individually sewn to the cuff **802**, from the tip of one commissure uniformly, around the leaflet cusp perimeter, to the tip of an adjacent commissure. As a result, the sewed sutures act like similarly aligned staples, all of which equally take the loading force acting along the entire cusp of each of the pre-aligned, coapting leaflets. Once inflated, the cuff **802** supports the commissures with the inflation media and its respective pressure which will solidify and create a system similar to a stent structure. The resulting implant **800** thereby formed can reduce stress and potential fatigue at the leaflet suture interface by distributing stress evenly over the entire leaflet cusp from commissure to commissure. In

some embodiments, the tissue valve is coupled to the inflatable cuff **802** by attaching to the fabric of the cuff only.

[0071] In one embodiment, the tissue leaflets are not coupled to each other but are instead individually attached to the cuff **802**.

[0072] A number of additional advantages result from the use of the implant **800** and the cuff **802** construction utilized therein. For example, for each key area of the cuff **802**, the flexibility can be optimized or customized. If desired, the coapting tissue leaflet commissures can be made more or less flexible to allow for more or less deflection to relieve stresses on the tissue at closing or to fine tune the operation of the valve. Similarly, the base radial stiffness of the overall implant structure can be increased or decreased by pressure or inflation media to preserve the roundness and shape of the implant **800**.

[0073] Attachment of the valve **104** to the cuff **802** can be completed in any number of conventional methods including sewing, ring or sleeve attachments, gluing, welding, interference fits, bonding through mechanical means such as pinching between members. An example of these methods are described in Published Applications from Huynh et al (06/102944) or Lafrance et al (2003/0027332) or U.S. Patent Number 6,409,759 to Peredo, which are hereby incorporated by reference herein. These methods are generally known and accepted in the valve device industry. The valve, whether it is tissue, engineered tissue, mechanical or polymer, may be attached before packaging or in the hospital just before implantation. Some tissue valves are native valves such as pig, horse, cow or native human valves. Most of which are suspended in a fixing solution such as Glutaraldehyde.

[0074] In some embodiments, heart valve prostheses can be constructed with flexible tissue leaflets or polymer leaflets. Prosthetic tissue heart valves can be derived from, for example, porcine heart valves or manufactured from other biological material, such as bovine or equine pericardium. Biological materials in prosthetic heart valves generally have profile and surface characteristics that provide laminar, nonturbulent blood flow. Therefore, intravascular clotting is less likely to occur than with mechanical heart valve prostheses.

[0075] Natural tissue valves can be derived from an animal species, typically mammalian, such as human, bovine, porcine canine, seal or kangaroo. These tissues can be obtained from, for example, heart valves, aortic roots, aortic walls, aortic leaflets,

pericardial tissue such as pericardial patches, bypass grafts, blood vessels, human umbilical tissue and the like. These natural tissues are typically soft tissues, and generally include collagen containing material. The tissue can be living tissue, decellularized tissue or recellularized tissue. Tissue can be fixed by crosslinking. Fixation provides mechanical stabilization, for example by preventing enzymatic degradation of the tissue. Glutaraldehyde or formaldehyde is typically used for fixation, but other fixatives can be used, such as other difunctional aldehydes, epoxides, genipin and derivatives thereof. Tissue can be used in either crosslinked or uncrosslinked form, depending on the type of tissue, use and other factors. Generally, if xenograft tissue is used, the tissue is crosslinked and/or decellularized. Additional description of tissue valves can be found in U.S. Patent Publication No. 2009/008836 to Bishop et al.

Inflation Media

[0076] The inflatable structure **813** can be inflated using any of a variety of inflation media, depending upon the desired performance. In general, the inflation media can include a liquid such water or an aqueous based solution, a gas such as CO₂, or a hardenable media which may be introduced into the inflation channels **808** at a first, relatively low viscosity and converted to a second, relatively high viscosity. Viscosity enhancement may be accomplished through any of a variety of known UV initiated or catalyst initiated polymerization reactions, or other chemical systems known in the art. The end point of the viscosity enhancing process may result in a hardness anywhere from a gel to a rigid structure, depending upon the desired performance and durability.

[0077] Useful inflation media generally include those formed by the mixing of multiple components and that have a cure time ranging from a tens of minutes to about one hour, preferably from about twenty minutes to about one hour. Such a material may be biocompatible, exhibit long-term stability (preferably on the order of at least ten years *in vivo*), pose as little an embolic risk as possible, and exhibit adequate mechanical properties, both pre and post-cure, suitable for service in the cuff of the present invention *in vivo*. For instance, such a material should have a relatively low viscosity before solidification or curing to facilitate the cuff and channel fill process. A desirable post-cure elastic modulus of such an inflation medium is from about 50 to about 400 psi--balancing the need for the filled body to form an adequate seal *in vivo* while maintaining clinically relevant kink resistance of the cuff. The inflation media ideally should be radiopaque, both acute and chronic, although this is not absolutely necessary.

[0078] One preferred family of hardenable inflation media are two part epoxies. The first part is an epoxy resin blend comprising a first aromatic diepoxy compound and a second aliphatic diepoxy compound. The first aromatic diepoxy compound provides good mechanical and chemical stability in an aqueous environment while being soluble in aqueous solution when combined with suitable aliphatic epoxies. In some embodiments, the first aromatic diepoxy compound comprises at least one N,N-diglycidylaniline group or segment. In some embodiments, the first aromatic diepoxy compound are optionally substituted N,N-diglycidylaniline. The substituent may be glycidyloxy or N,N-diglycidylaniliny-methyl. Non-limiting examples of the first aromatic diepoxy compound are N,N-diglycidylaniline, N,N-diglycidyl-4-glycidyloxyaniline (DGO) and 4,4'-methylene-bis(N,N-diglycidylaniline) (MBD), etc.

[0079] The second aliphatic diepoxy compound provides low viscosity and good solubility in an aqueous solution. In some embodiments, the second aliphatic diepoxy compound may be 1,3-butadiene diepoxide, glycidyl ether or C₁₋₅ alkane diols of glycidyl ether. Non-limiting examples of the second aliphatic diepoxy compounds are 1,3-butadiene diepoxide, butanediol diglycidyl ether (BDGE), 1,2-ethanediol diglycidyl ether, glycidyl ether, etc.

[0080] In some embodiments, additional third compound may be added to the first part epoxy resin blend for improving mechanical properties and chemical resistance. In some embodiments, the additional third compound may be an aromatic epoxy other than the one containing N,N-diglycidylaniline. However, the solubility of the epoxy resin blend can also decrease and the viscosity can increase as the concentration of the additional aromatic epoxies increases. The preferred third compound may be tris(4-hydroxyphenyl)methane triglycidyl ether (THTGE), bisphenol A diglycidyl ether (BADGE), bisphenol F diglycidyl ether (BFDGE), or resorcinol diglycidyl ether (RDGE).

[0081] In some embodiments, the additional third compound may be a cycloaliphatic epoxy compound, preferably more soluble than the first aromatic diepoxy compound. It can increase the mechanical properties and chemical resistance to a lesser extent than the aromatic epoxy described above, but it will not decrease the solubility as much. Non-limiting examples of such cycloaliphatic epoxy are 1,4-cyclohexanedimethanol diglycidyl ether and cyclohexene oxide diglycidyl 1,2-cyclohexanedicarboxylate. Similarly, in some embodiments, aliphatic epoxy with 3 or more glycidyl ether groups, such as polyglycidyl ether, may be added as the additional

third compound for the same reason. Polyglycidyl ether may increase cross linking and thus enhance the mechanical properties.

[0082] In general, the solubility of the epoxy resin blend decreases and the viscosity increases as the concentration of the first aromatic diepoxy compound increases. In addition, the mechanical properties and chemical resistance may be reduced as the concentration of the aliphatic diepoxy compound goes up in the epoxy resin blend. By adjusting the ratio of the first aromatic diepoxy compound and the second aliphatic diepoxy compound, a person skilled in the art can control the desired properties of the epoxy resin blend and the hardened media. Adding the third compound in some embodiments may allow further tailoring of the epoxy resin properties.

[0083] The second part of the hardenable inflation media comprises a hardener comprising at least one cycloaliphatic amine. It provides good combination of reactivity, mechanical properties and chemical resistance. The cycloaliphatic amine may include, but not limited to, isophorone diamine (IPDA), 1,3-bisaminocyclohexane (1,3-BAC), diamino cyclohexane (DACH), n-aminoethylpiperazine (AEP) or n-aminopropylpiperazine (APP).

[0084] In some embodiments, an aliphatic amine may be added into the second part to increase reaction rate, but may decrease mechanical properties and chemical resistance. The preferred aliphatic amine has the structural formula (I):

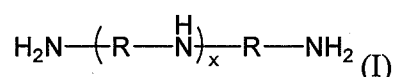

wherein each R is independently selected from branched or linear chains of C₂₋₅ alkyl, preferably C₂ alkyl. The term “alkyl” as used herein refers to a radical of a fully saturated hydrocarbon, including, but not limited to, methyl, ethyl, n-propyl, isopropyl (or i-propyl), n-butyl, isobutyl, tert-butyl (or t-butyl), n-hexyl, and the like. For example, the term “alkyl” as used herein includes radicals of fully saturated hydrocarbons defined by the following general formula C_nH_{2n+2}. In some embodiments, the aliphatic amine may include, but not limited to, tetraethylenepentamine (TEPA), diethylene triamine and triethylene tetraamine. In some embodiments, the hardener may further comprise at least one radio-opaque compound, such as iodo benzoic acids.

[0085] Additional details of hardenable inflation media are described in co-pending application titled “Inflation Media Formulation,” hereby incorporated herein by reference. Other suitable inflation media are also described in U.S. patent application Ser.

No. 09/496,231 to Hubbell et al., filed Feb. 1, 2000, entitled "Biomaterials Formed by Nucleophilic Addition Reaction to Conjugated Unsaturated Groups" and U.S. Patent No. 6,958,212 to Hubbell et al. The entireties of each of these patents are hereby incorporated herein by reference.

[0085] Below is listed one particular two-component medium. This medium comprises:

First Part – epoxy resin blend

[0086] (1) N,N-Diglycidyl-4-glycidyoxyaniline (DGO), present in a proportion ranging from about 10 to about 70 weight percent; specifically in a proportion of about 50 weight percent,

[0087] (2) Butanediol diglycidyl ether (BDGE) present in a proportion ranging from about 30 to about 75 weight percent; specifically in a proportion of about 50 weight percent, and optionally

[0088] (3) 1,4-Cyclohexanedimethanol diglycidyl ether, present in a proportion ranging from about 0 to about 50 weight percent.

Second Part – amine hardener

[0089] (1) Isophorone diamine (IPDA), present in a proportion ranging from about 75 to about 100 weight percent, and optionally

[0090] (2) Diethylene triamine (DETA), present in a proportion ranging from about 0 to about 25 weight percent.

[0091] The mixed uncured inflation media preferably has a viscosity less than 2000cps. In one embodiment the epoxy based inflation media has a viscosity of 100-200cps. In another embodiment the inflation media has a viscosity less than 1000cps. In some embodiments, the epoxy mixture has an initial viscosity of less than about 50 cps, or less than about 30 cps after mixing. In some embodiments, the average viscosity during the first 10 minutes following mixing the two components of the inflation media is about 50 cps to about 60 cps. The low viscosity ensures that the inflation media can be delivered through the inflation lumen of a deployment catheter with small diameter, such as an 18 French catheter

[0092] In some embodiments, the balloon or inflation channel may be connected to the catheter on both ends. This allows the balloon to be pre-inflated with a non-solidifying material such as a gas or liquid. If a gas is chosen, CO₂ or helium are the likely choices; these gasses are used to inflate intraortic balloon pumps. Preferably the pre-inflation media is radio-opaque so that the balloon position can be determined by

angiography. Contrast media typically used in interventional cardiology could be used to add sufficient radio-opacity to most liquid pre-inflation media. When it is desired to make the implant permanent and exchange the pre-inflation media for the permanent inflation media, the permanent inflation media is injected into the inflation channel through a first catheter connection. In some embodiments, the permanent inflation media is capable of solidifying into a semi-solid, gel or solid state. As the permanent inflation media is introduced into the inflatable structure, the pre-inflation media is expelled out from a second catheter connection. The catheter connections are positioned in such a way that substantially all of the pre-inflation media is expelled as the permanent inflation media is introduced. In one embodiment an intermediate inflation media is used to prevent entrapment of pre-inflation media in the permanent inflation media. In one embodiment the intermediate inflation media is a gas and the pre-inflation media is a liquid. In another embodiment the intermediate inflation media or pre-inflation media functions as a primer to aid the permanent inflation media to bond to the inner surface of the inflation channel. In another embodiment the pre-inflation media or the intermediate inflation media serves as a release agent to prevent the permanent inflation media from bonding to the inner surface of the inflation channel.

[0093] The permanent inflation media may have a different radiopacity than the preinflation media. A device that is excessively radiopaque tends to obscure other nearby features under angiography. During the preinflation step it may be desirable to visualize the inflation channel clearly, so a very radiopaque inflation media may be chosen. After the device is inflated with the permanent inflation media a less radiopaque inflation media may be preferred. The feature of lesser radiopacity is beneficial for visualization of proper valve function as contrast media is injected into the ventricle or the aorta.

[0094] Another embodiment of the inflation media is disclosed in co-pending application filed on the same day as this application under Attorney Docket: DFMED.034A, entitled INFLATION MEDIA FOR IMPLANTS, and U.S. Provisional Patent Application No. 61/346,419 filed May 19, 2011, the entirety of these applications are hereby incorporated by reference herein.

Low Crossing Profile Delivery System

[0095] Figures 5A-5B illustrate an exemplary embodiment of a low crossing profile delivery catheter 900 that can be used to deliver the implant 800. In general, the

delivery system comprises a delivery catheter **900**, and the delivery catheter **900** comprises an elongate, flexible catheter body having a proximal end and a distal end. In some embodiments, the catheter body has an outer diameter of about 18 French or less particularly at the distal portion of the catheter body (i.e. the deployment portion). In some embodiments, the delivery catheter also comprises a cardiovascular prosthetic implant **800** at the distal end of the catheter body. As described herein, certain features of the implant **800** and delivery catheter **900** are particularly advantageous for facilitating delivering of cardiovascular prosthetic implant **800** an within a catheter body having outer diameter of about 18 French or less while still maintaining a tissue valve thickness equal to or greater than about .011 inches and/or having an effective orifice area equal to or greater than about 1 cm squared, or in another embodiment, 1.3 cm squared or in another embodiment 1.5 cm squared. In such embodiments, the implant **800** may also have an expanded maximum diameter that is greater than or equal to about 22 mm. In some embodiments, at least one link exists between the catheter body and the implant **800**. In some embodiments, the at least one link is the PFL tubing. In one embodiment, the delivery system is compatible with 0.035" or 0.038" guidewire.

[0096] In general, the delivery catheter **900** can be constructed with extruded tubing using well known techniques in the industry. In some embodiments, the catheter **900** can incorporate braided or coiled wires and or ribbons into the tubing for providing stiffness and rotational torqueability. Stiffening wires may number between 1 and 64. In some embodiments, a braided configuration is used that comprises between 8 and 32 wires or ribbon. If wires are used in other embodiments, the diameter can range from about 0.0005 inches to about 0.0070 inches. If a ribbon is used, the thickness is preferably less than the width, and ribbon thicknesses may range from about 0.0005 inches to about 0.0070 inches while the widths may range from about 0.0010 inches to about 0.0100 inches. In another embodiment, a coil is used as a stiffening member. The coil can comprise between 1 and 8 wires or ribbons that are wrapped around the circumference of the tube and embedded into the tube. The wires may be wound so that they are parallel to one another and in the curved plane of the surface of the tube, or multiple wires may be wrapped in opposing directions in separate layers. The dimensions of the wires or ribbons used for a coil can be similar to the dimensions used for a braid.

[0097] With reference to Figures 5A and 5B, the catheter **900** comprises an outer tubular member **801** having a proximal end **902** and a distal end **903**, and an inner

tubular member 904 also having a proximal end 905 and a distal end 906. The inner tubular member 904 extends generally through the outer tubular member 901, such that the proximal and distal ends 902, 903 of the inner tubular member 904 extend generally past the proximal end 902 and distal end 903 of the outer tubular member 901. The distal end 903 of the outer tubular member 901 comprises a sheath jacket 912. In some embodiments, the sheath jacket 912 may comprise KYNAR tubing. The sheath jacket 912 can house the implant 800 in a retracted state for delivery to the implantation site. In some embodiments, the sheath jacket 912 is capable of transmitting at least a portion of light in the visible spectrum. This allows the orientation of the implant 800 to be visualized within the catheter 900. In some embodiments, an outer sheath marking band 913 may be located at the distal end 903 of the outer tubular member 901. The proximal end 905 of the inner tubular member 904 is connected to a handle 907 for grasping and moving the inner tubular member 904 with respect to the outer tubular member 901. The proximal end 902 of the outer tubular member 901 is connected to an outer sheath handle 908 for grasping and holding the outer tubular member 901 stationary with respect to the inner tubular member 904. A hemostasis seal 909 is preferably provided between the inner and outer tubular members 901, 904, and the hemostasis seal 909 is disposed in outer sheath handle 908. In some embodiments, the outer sheath handle 908 comprises a sideport valve 921, and the fluid can be passed into the outer tubular member through it.

[0098] In general, the inner tubular member 904 comprises a multilumen hypotube (see Figure 6). In some embodiments, a neck section 910 is located at the proximal end 905 of the inner tubular member 904. The neck section 910 may be made from stainless steel, Nitinol or another suitable material which can serve to provide additional strength for moving the inner tubular member 904 within the outer tubular member 901. In some embodiments, a multilumen marker band 911 is present at the distal end 906 of the inner tubular member 904. The multilumen hypotube has a wall thickness between about 0.004 in and about 0.006 in. In a preferred embodiment, the wall thickness is about 0.0055 in, which provides sufficient column strength and increases the bending load required to kink the hypotube. With reference to Figure 6, the inner tubular member 904 (i.e., multilumen hypotube) comprises at least four lumens. One of the lumens accommodates the guidewire tubing 914, and each of the other lumens accommodates a positioning-and-fill lumen (PFL) tubing 916. The guidewire tubing 914 is configured to

receive a guidewire. The PFL tubing **916** is configured to function both as a control wire for positioning the implant **800** at the implantation site, and as an inflation tube for delivering a liquid, gas or inflation media to the implant **800**. In particular, the tubing **916** can allow angular adjustment of the implant **800**. That is, the plane of the valve (defined generally perpendicular to the longitudinal axis of the implant **800**) can be adjusted with the tubing **916**.

[0099] With reference to Figures 5A and 5B, in general, the guidewire tubing **914** is longer than and extends throughout the length of the delivery catheter **900**. The proximal end of the guidewire tubing **914** passes through the inner sheath handle **907** for operator's control; the distal end of the guidewire tubing **914** extends past the distal end **903** of the outer tubular member **901**, and is coupled to a guidewire tip **915**. The guidewire tip **915** can close the distal end **903** of the outer tubular member **901** (or the receptacle) and protect the retracted implant **800**, for example, during the advancement of the delivery catheter. The guidewire tip **915** can be distanced from the outer tubular member **901** by proximally retracting the outer tubular member **901** while holding the guidewire tubing **914** stationary. Alternatively, the guidewire tubing **914** can be advanced while holding the outer tubular member **901** stationary. The guidewire tubing **914** may have an inner diameter of about 0.035 inches to about 0.042 inches, so the catheter system is compatible with common 0.035" or 0.038" guidewires. In some embodiments, the guidewire tubing **914** may have an inner diameter of about 0.014 inches to about 0.017 inches, so the catheter system is compatible with a 0.014" diameter guidewire. The guidewire tubing **914** may be made from a lubricious material such as Teflon, polypropylene or a polymer impregnated with Teflon. It may also be coated with a lubricous or hydrophilic coating.

[0100] The guidewire tip **915** may be cone shaped, bullet shaped or hemispherical on the front end. The largest diameter of the guidewire tip **915** is preferably approximately the same as the distal portion **903** of the outer tubular member **901**. The guidewire tip **915** preferably steps down to a diameter slightly smaller than the inside diameter of the outer sheath jacket **912**, so that the tip can engage the outer sheath jacket **912** and provide a smooth transition. In the illustrated embodiment, the guidewire tip **915** is connected to the guidewire tube **914**, and the guidewire lumen passes through a portion of the guidewire tip **915**. The proximal side of the guidewire tip **915** also has a

cone, bullet or hemispherical shape, so that the guidewire tip **915** can easily be retraced back across the deployed implant **800**, and into the deployment catheter **900**. The guidewire tip **915** can be manufactured from a rigid polymer such as polycarbonate, or from a lower durometer material that allows flexibility, such as silicone. Alternatively, the guidewire tip **915** may be made from multiple materials with different durometers. For example, the portion of the guidewire tip **915** that engages the distal portion **903** of the outer tubular member **901** can be manufactured from a rigid material, while the distal and or proximal ends of the guidewire tip **915** are manufactured from a lower durometer material.

[0101] Each PFL tubing **916** also extends throughout the length of the delivery catheter **900**. The proximal end of the PFL tubing **916** passes through the handle **907**, and has a luer lock **917** for connecting to fluid, gas or inflation media source. The distal end of the PFL tubing **916** extends past the distal end **906** of the inner tubular member **904** through the hypotube lumen. With reference to Figure 5C, in some embodiments, the PFL tubing **916** comprises a strain relief section **918** at the proximal end where the tubing **916** is connected to the luer lock **917**, and the strain relief section **918** serves to relieve the strain on the PFL tubing **916** while being maneuvered by the operator. The distal end of the PFL tubing **916** comprises a tip or needle **919** for connecting to the implant **800**. In some embodiments, the tip **919** may have a threaded section toward the end of the needle **919** (see Figure 5C). In some embodiments, the PFL tubing **916** may have PFL marker(s) **920** at the distal end and/or proximal end of the tubing **916** for identification.

[0102] The PFL tubing **916** is designed to accommodate for the ease of rotation in a tortuous anatomy. The tubing **916** may be constructed using polyimide braided tube, Nitinol hypotube, or stainless steel hypotube. In a preferred embodiment, the PFL tubing **916** is made from braided polyimide, which is made of polyimide liner braided with flat wires, encapsulated by another polyimide layer and jacketed with prebax and nylon outer layer. In some embodiments, a Nitinol sleeve may be added to the proximal end of the PFL tubing **916** to improve torque transmission, kinks resistance and pushability. In some embodiments, the outside surface of the PFL tubing **916** and/or the inside surface of the lumens in the multilumen hypotube can also be coated with a lubricious silicone coating to reduce friction. In some embodiments, an inner lining material such as Teflon may be used on the inside surface of the lumens in the multilumen

hypotube to reduce friction and improve performance in tortuous curves. Additionally, slippery coatings such as DOW 360, MDX silicone or a hydrophilic coating from BSI Corporation may be added to provide another form of friction reducing elements. This can provide a precision control of the PFL tubings **916** during positioning of the implant **800**. In some embodiments, the outside surface of the PFL tubing **916** can be jacketed and reflowed with an additional nylon 12 or Relsan AESNO layer to ensure a smooth finished surface. In some embodiments, anti-thrombus coating can also be put on the outside surface of the PFL tubing **916** to reduce the risk of thrombus formation on the tubing.

[0103] In some embodiments, the outer diameter of the catheter **900** measures generally about 0.030 inches to about 0.200 inches with a wall thickness of the outer tubular member **901** being about 0.005 inches to about 0.060 inches. In preferred embodiments, the outer diameter of the outer tubular member **901** is between about 0.215 and about 0.219 inches. In this embodiment, the wall thickness of the outer tubular member **901** is between about 0.005 inches and about 0.030 inches. The overall length of the catheter **900** ranges from about 80 centimeters to about 320 centimeters. In preferred embodiments, the working length of the outer tubular member **901** (from the distal end of the sheath jacket **912** to the location where the tubular member **901** is connected to the outer sheath handle **908**) is about 100 cm to about 120 cm. In some embodiments, the inner diameter of the sheath jacket **912** is greater than or equal to about 0.218 inches, and the outer diameter of the sheath jacket **912** is less than or equal to about 0.241 inches. In a preferred embodiment, the outer diameter of the sheath jacket portion **912** is less than or equal to about 0.236 inches or 18 French. In some embodiments, the outer diameter of the PFL tubing **916** is less than or equal to about 0.0435 inches, and the length is about 140 cm to about 160 cm.

[0104] In the embodiments that employ a low crossing profile outer tubular member, a low profile inflatable implant in a retracted state is preferable for fitting into the sheath jacket **912**. The low crossing profile outer tubular member may comprise an outer sheath with a sheath jacket **912** having an outer diameter of 18 French or less. In some embodiments, the implant **800** comprises a tissue valve **104** with an expanded outer diameter greater than or equal to about 22 mm and a tissue thickness of greater than or equal to about 0.011 inches. The compressed diameter of the implant **800** may be less

than or equal to about 6 mm or 18 French. The retracted implant **800** is generally loaded between the distal portion **903** of the outer tubular member **901** and the distal portion **906** of the inner tubular member **904**. The distal portion **903** of the outer tubular member **901** therefore forms a receptacle for the implant **800**. The implant **800** may be exposed or pushed out of the receptacle by holding the implant **800** stationary as the outer tubular member **901** is retracted. Alternatively, the outer tubular member **901** can be held stationary while the inner tubular member **904** is advanced and thereby pushing the implant **800** out of the receptacle.

[0105] The delivery system also includes a loading tool base **925** that is configured to connect to the PFL tubing **916**. In some embodiments, the PFL tubing **916** can connect to the loading tool base **921** via a luer connection. With reference to Figure 7, one end of the loading tool base **921** may be configured to have step edge **923s**. In some embodiments, the distal end of the loading tool base has three step edges **923**, each step edge **923** has a luer connector **924** for connecting the PFL tubing **916**. In some embodiments, the loading tool base **921** may also comprise at least two additional connectors **922** (e.g. additional luer connectors), each in fluid communication with one of the luer connector **924** on the stepped edges **923**, which would allow the introduction of fluid, gas or air into the implant **800** for testing purposes. For example, in the exemplified embodiment, once the PFL tubings **916** are connected to the loading tool base **921**, a liquid or air source can be connected to the loading tool base **921** via the additional connectors **922**. The liquid or air can then be introduced into the implant **800** through the loading tool base **921** and the PFL tubings **916**.

[0106] The step edges **923** on the loading tool base **921** allows the implant **800** to be collapsed or folded up tightly so it can be loaded into the sheath jacket **912** at the distal end of the outer tubular member **901**. When the proximal end of the PFL tubings **916** are connected to the loading tool base **921** and the distal end connected to the connection ports **809** of the implant **800**, the step edge connections pull the PFL tubings **916** in a way that creates an offset of the inflation valves **810** and/or the connection ports **809** in the inflation channels **808** when the implant **800** is folded or collapsed. By staggering the connection ports/inflation valves, the collapsed implant **800** can have a reduced cross-sectional profile. In some embodiments, the check valve **814** in the inflation channel is also staggered with the connection ports/inflation valves in the

collapsed state. Accordingly, in one embodiment, the inflation valves **810** and/or the connection ports **809** are axially aligned when the valve is positioned within the deployment catheter in a collapsed configuration. That is, the inflation valves **810** and/or the connection ports **809** and/or check valve **814** are positioned such that they do not overlap with each other but are instead aligned generally with respect to the longitudinal axis of the deployment catheter. In this manner, the implant **800** can be collapsed into a smaller diameter as opposed to a configuration in which with the inflation valves **810** and/or the connection ports **809** and/or check valve **814** overlap each other in a radial direction, which can increase the diameter of the compressed implant **800**. In a similar manner, the channels **806** can be arranged positioned such that they also do not overlap with each other as shown in Figure 12. As shown in Figure 12, the loading tool base **925** can be used to pull one end of the distal and proximal rings **807a**, **807b** in a proximal direction so as to align the inflation valves **810** and/or the connection ports **809** and/or check valve **814** axially as described above and/or align the channels so as to reduce the overlap between multiple channels **806**.

Method of Deployment

[0107] The implant **800** may be deployed in the aortic position using the low crossing profile delivery system and a minimally invasive procedure. In some embodiments, the method generally comprises gaining access to the aorta, most often through the femoral artery. The vascular access site is prepared according to standard practice, and the guidewire is inserted into the left ventricle through the vascular access. In some embodiments, an introducer is placed in the access vessel. A balloon valvuloplasty may optionally be performed in the case of aortic stenosis.

[0108] The catheter **900** carrying the cardiovascular prosthetic implant is translumenally advanced to a position proximate a native valve. After the delivery sheath or catheter **900** is inserted over the guidewire and advanced over the aortic arch and past the aortic valve, the implant **800** may be revealed or exposed by retracting the outer tubular member **901** partially or completely while holding the inner tubular member **904** stationary and allowing proper placement at or beneath the native valve. In some embodiments, the implant may also be revealed by pushing the inner tubular member **904** distally while holding the outer tubular member **901** stationary. Once the implant **800** is unsheathed, it may be moved proximally or distally, and the fluid or inflation media may

be introduced to the cuff **802** providing shape and structural integrity. In some embodiments, the distal toroid of the inflatable cuff or inflatable structure is inflated first with a first liquid, and the implant **800** is positioned at the implantation site using the links between the implant **800** and the catheter **900**. In some embodiments, no more than three links are present. In some embodiments, the links are PFL tubes **916**, which can be used to both control the implant **800** and to fill the inflatable cuff.

[0109] The deployment of the implant **800** can be controlled by the PFL tubes **916** that are detachably coupled to the implant **800**. The PFL tubes **916** are attached to the cuff **802** of the implant **800** so that the implant **800** can be controlled and positioned after it is removed from the sheath or delivery catheter **900**. Preferably, three PFL tubes **916** are used, which can provide precise control of the implant **800** PFL tubes **916** during deployment and positioning. The PFL tubes **916** can be used to move the implant **800** proximally and distally, or to tilt the implant **800** and change its angle relative to the native anatomy.

[0110] In some embodiments, the implant **800** contains multiple inflation valves **810** to allow the operator to inflate specific areas of the implant **800** with different amounts of a first fluid or a first gas. With reference to Figures 8A-C, in some embodiments, the implant **800** is initially deployed partially in the ventricle **32** (Figure 8A). The inflation channel **808** is filled partially, allowing the distal portion of the implant **800** to open to approximately its full diameter. The implant is then pulled back into position at or near the native valve **34** annulus (Figure 8B). In some embodiments, the distal toroid **807b** is at least partially inflated first, and the cardiovascular prosthetic implant **800** is then retracted proximally for positioning the cuff across the native valve **34**. The distal ring **807b** seats on the ventricular side of the aortic annulus, and the implant **800** itself is placed just above the native valve **34** annulus in the aortic root. At this time, the PFL tubes **916** may act to help separate fused commissures by the same mechanism a cutting balloon can crack fibrous or calcified lesions. Additional inflation fluid or gas may be added to inflate the implant **800** fully, such that the implant **800** extends across the native valve annulus extending slightly to either side (See Figure 8C). The PFL tubes **916** provide a mechanism for force transmission between the handle of the deployment catheter **900** and the implant **800**. By moving all of the PFL tubes **916** together or the inner tubular member **904**, the implant **800** can be advanced or retracted in

a proximal or distal direction. By advancing only a portion of the PFL tubes **916** relative to the other PFL tubes **916**, the angle or orientation of the implant **800** can be adjusted relative to the native anatomy. Radiopaque markers on the implant **800** or on the PFL tubes **916**, or the radio-opacity of the PFL tubes **916** themselves, can help to indicate the orientation of the implant **800** as the operator positions and orients the implant **800**.

[0111] In some embodiments, the implant **800** has two inflation valves **810** at each end of the inflation channel **808** and a check valve **811** in the inflation channel **808**. The check valve **811** is positioned so the fluid or gas can flow in the direction from the proximal toroid **807a** to the distal toroid **807b**. In some embodiments, the implant **800** is fully inflated by pressurizing the endoflator attached to the first PFL tube **916** that is in communication with the first inflation valve **810** that leads to the proximal toroid **807a**, while the endoflator attached to the second inflation valve **810** that is in communication with the distal toroid **807b** is closed. The fluid or gas can flow into the distal toroid **807b** through the one-way check valve. The proximal toroid **807a** is then deflated by depressurizing the endoflator attached to the second inflation valve. The distal toroid **807b** will remain inflated because the fluid or gas cannot escape through the check valve **811**. The implant **800** can then be positioned across the native annulus. Once in the satisfactory placement, the proximal toroid **807a** can then be inflated again.

[0112] In some embodiments, the implant **800** may only have one inflation valve. When the inflation channel **808** is inflated with the first fluid or gas, the proximal portion of the implant **800** may be slightly restricted by the spacing among the PFL tubes **916** while the distal portion expands more fully. In general, the amount that the PFL tubes **916** restricts the diameter of the proximal end of the implant **800** depends on the length of the PFL tubes **916** extend past the outer tubular member **901**, which can be adjusted by the operator. In other embodiments, burst discs or flow restricters are used to control the inflation of the proximal portion of the implant **800**.

[0113] The implant **800** can also be deflated or partially deflated for further adjustment after the initial deployment. As shown in Figure 9A, the implant **800** is partially deployed and the PFL tubes **916** used to seat the implant **800** against the native aortic valve **34**. The implant **800** can then be fully deployed as in shown in Figure 9B and then tested as shown in Figure 9C. If justified by the test, the implant **800** can be deflated

and moved as shown in Figure 9D to a more optimum position. The implant **800** can then be fully deployed and released from the control wires as shown in Figure 9E.

[0114] As discussed above, in some embodiments, the first inflation fluid or gas can be displaced by an inflation media that can harden to form a more permanent support structure in vivo. Once the operator is satisfied with the position of the implant **800**, the PFL tubes **916** are then disconnected, and the catheter is withdrawn leaving the implant **800** behind (see Figure 8C), along with the hardenable inflation media. The inflation media is allowed to solidify within the inflatable cuff. The disconnection method may include cutting the attachments, rotating screws, withdrawing or shearing pins, mechanically decoupling interlocked components, electrically separating a fuse joint, removing a trapped cylinder from a tube, fracturing an engineered zone, removing a collecting mechanism to expose a mechanical joint or many other techniques known in the industry. In modified embodiments, these steps may be reversed or their order modified if desired.

[0115] The above-described method generally describes an embodiment for the replacement of the aortic valve. However, similar methods could be used to replace the pulmonary valve or the mitral or tricuspid valves. For example, the pulmonary valve could be accessed through the venous system, either through the femoral vein or the jugular vein. The mitral valve could be accessed through the venous system as described above and then trans-septally accessing the left atrium from the right atrium. Alternatively, the mitral valve could be accessed through the arterial system as described for the aortic valve, additionally the catheter can be used to pass through the aortic valve and then back up to the mitral valve. Additional description of mitral valve and pulmonary valve replacement can be found in U.S. Patent Publication No. 2009/0088836 to Bishop et al.

Implant Recovery

[0116] Current valve systems are often deployed through a stent-based mechanism where the valve is sewn to the support structure. In the inflated embodiments described herein, the structure is added to the implant secondarily via the inflation fluid. This allows the user to inflate or pressurize the implant **800** with any number of media including one that will solidify. As such, if the operator desires, the implant **800** can be moved before the inflation media is solidified or depressurization can allow for movement of the implant within the body. Since catheter based devices tend to be small in diameter

to reduce trauma to the vessel and allow for easier access to entry, it is often difficult to remove devices such as stents once they have been exposed or introduced into the vasculature. However, as will be explained below, a device described herein enables a percutaneous prosthetic aortic valve to be recovered from the body and reintroduced retrograde to the introducer.

[0117] With reference to Figures 10A-C, the deployment control device also provides a method for retracting the implant **800** back into the introducer if the result is not satisfactory, or if the sizing of the implant could be optimized. Thus, after the implant **800** is fully or partially deployed (Figure 10A), in addition to providing a mechanism to transmit axial force to the implant **800**, the PFL tubes **916** described above provide a guide or ramp to pull the implant **800** back into the introducer as it is retracted as shown in Figures 10B and 10C. In some embodiments, the outer tubular member **901** is retracted out of the vessel while leaving the inner tubular member **904** still attached to the implant **800** prior to introducing the recovery catheter **930**.

[0118] To recapture an inflatable implant **800**, the implant is first deflated (Figure 10B). In some embodiment, the implant **800** may be retracted to the tip of the inner tubular member **904** by pulling the PFL tubing **916** proximally, and the implant **800** and the delivery catheter **900** are then retracted to the tip of the introducer. The inner sheath handle **907** may be removed by unthreading the distal portion and sliding off at the proximal end of the delivery catheter **900**. In some embodiments, the luer connections **917** on the proximal end of the PFL tubing **916** may be cut off for the removal of the inner sheath handle **907**. Optionally a pushing tube can be loaded over the guidewire and PFL tubing until adjacent to the proximal end of the inner tubular member **904**. The outer tubular member **901** can then be removed from the delivery catheter system, while keeping the implant **800** stationary.

[0119] The recovery catheter **930** can then be advanced over the guidewire and the inner tubular member **904**. Once the recovery catheter **930** is proximate to the implant, the recovery sheath **931** is retracted to expose the basket section **933**. The implant **800** can then be retracted into the basket section **933** (Figure 10C). Once the implant **800** is completely inside the basket section **933**, in some embodiments, the PFL tubes **916** are adjusted to offset the end valves **810** in the implant **800** to allow more

compact fold. The recovery system **930** is then slowly pulled back through the introducer and out of the patient.

[0120] Figure 11 illustrates one embodiment of a recovery catheter **930** for recapturing an implant **800**. As shown, the recovery catheter **930** comprises an outer recovery sheath **931**. The outer recovery sheath **931** is inserted over the inner shaft **932**. The inner shaft **932** comprises a basket structure **933**, which is coupled to the distal end of the inner shaft **932** and is configured to capture the implant into the outer recovery sheath **931** without harm to the patient. Relative movement of the inner shaft **932** with respect to the outer recovery sheath **931** would expose the basket **933** when introduced into the body. By pulling the implant **800** into the basket section **933** it may be safely reintroduced into the introducer or outer recovery sheath **931**. The basket **933** allows the implant to be guided into an introducer without harm or worry of the implant being tethered or compiled to a larger diameter where it may not fit into the inner diameter of a sheath.

[0121] The outer recovery sheath **931** is attached to the outer recovery handle or hub **935** at the proximal end, while the inner shaft **932** is attached to the inner recovery handle or hub **934** at the proximal end. A hemostasis valve (not shown) is preferably disposed in each of the inner and outer recovery handles **934** and **935**. Also on the inner recovery handle **934**, a flush port **936** and stop-cock can be provided for fluid introduction. In one embodiment, the inner shaft **932** would have a length of about 40 to 60 centimeters and a diameter of about 2 to about 10 millimeters. In a preferred embodiment, the outer diameter of the inner shaft **932** is less than or equal to 0.207". The basket section **933** may be constructed with materials such as polymeric strands or Nitinol, stainless steel or MP35N wire and attached by glue or thermal bonding techniques know in the industry. This wire, strand or ribbon may have a diameter or dimension of about 0.002 to 0.020 of an inch. The set or expanded shape would be about 1.00 to 1.50 inches and the length of the basket section **933** would measure about 6 to 9 inches in length. In another embodiment, the basket section **933** is made out of a fabric, where the fabric basket may contain a feature such as a preshaped wire or a balloon to facilitate its opening.

[0122] The basket section **933** can be formed by heat setting or other manners into a cone shape with a free diameter slightly larger than the patients aorta. In another

embodiment, the braided basket is manufactured from loops of wire so that the cut ends of the wire are all located at the proximal end of the basket. The wires used to manufacture the basket 933 preferably have a diameter from 0.002in to 0.020 in. The wires may also be replaced by ribbons having a thickness between 0.002in and 0.020in and a width between 0.003in and 0.030in. The diameter of the small end of the basket is preferably between 0.007in and 0.3in the basket is preferably be capable of collapsing to a diameter small enough to pass through the desired introducer size. The large end of the basket section preferably expands to a diameter similar to or slightly larger than the typical human aorta, or 0.75in to 1.50in.

[0123] The various methods and techniques described above provide a number of ways to carry out the invention. Of course, it is to be understood that not necessarily all objectives or advantages described may be achieved in accordance with any particular embodiment described herein. Thus, for example, those skilled in the art will recognize that the methods may be performed in a manner that achieves or optimizes one advantage or group of advantages as taught herein without necessarily achieving other objectives or advantages as may be taught or suggested herein.

[0124] Furthermore, the skilled artisan will recognize the interchangeability of various features from different embodiments disclosed herein. Similarly, the various features and steps discussed above, as well as other known equivalents for each such feature or step, can be mixed and matched by one of ordinary skill in this art to perform methods in accordance with principles described herein. Additionally, the methods which is described and illustrated herein is not limited to the exact sequence of acts described, nor is it necessarily limited to the practice of all of the acts set forth. Other sequences of events or acts, or less than all of the events, or simultaneous occurrence of the events, may be utilized in practicing the embodiments of the invention.

[0125] Although the invention has been disclosed in the context of certain embodiments and examples, it will be understood by those skilled in the art that the invention extends beyond the specifically disclosed embodiments to other alternative embodiments and/or uses and obvious modifications and equivalents thereof. Accordingly, the invention is not intended to be limited by the specific disclosures of preferred embodiments herein

WHAT IS CLAIMED IS:

1. A delivery catheter for deploying a cardiovascular prosthetic implant using a minimally invasive procedure, wherein the delivery catheter comprises:
 - an elongate, flexible catheter body having a proximal end and a distal end, wherein the distal end has an outer diameter of 18 French or less;
 - a cardiovascular prosthetic implant at the distal end of the catheter body, wherein the cardiovascular prosthetic implant comprises an inflatable cuff and a tissue valve having a thickness of at least about .011 inches coupled to the inflatable cuff; and
 - at least one link between the catheter body and the cardiovascular prosthetic implant.
2. The delivery catheter of Claim 1, further comprising an outer tubular member in which the cardiovascular prosthetic implant is stored in a collapsed state for delivery.
3. The delivery catheter of Claim 1, wherein the at least one link is a position-and-fill lumen configured for positioning the implant and for filling the inflatable cuff.
4. The delivery catheter of any one of Claims 1, wherein the inflatable cuff comprises at least one inflatable channel that forms, at least in part, a distal toroid, a proximal toroid and at least two struts between the distal toroid and the proximal toroid.
5. The delivery catheter of Claim 4, wherein the struts are substantially perpendicular to the distal and the proximal toroids.
6. The delivery catheter of Claims 4, wherein the cardiovascular prosthetic implant further comprises at least two inflation valves disposed in the two end sections of the at least one inflatable channel.
7. The delivery catheter of Claim 6, wherein each of the inflation valves comprises a sealing mechanism.
8. The delivery catheter of Claim 6, further comprising a directional valve between the two end sections of the at least one inflation channel.
9. The delivery catheter of Claim 6, wherein the cardiovascular prosthetic implant further comprises at least two links, and the at least two links are coupled to the at least two inflation valves.

10. The delivery catheter of Claim 6, wherein the cardiovascular prosthetic implant further comprises a connection port coupled to a third link between the catheter body and the cardiovascular prosthetic implant.

11. The delivery catheter of Claim 10, wherein the inflation valves and the connection port are staggered when the cardiovascular prosthetic implant is in a collapsed state.

12. The delivery catheter of any one of Claims 1, wherein the cardiovascular prosthetic implant has an outside diameter of greater than about 22 millimeters when fully inflated.

13. The delivery catheter of Claim 12, wherein the tissue valve is attached to the cuff.

14. The delivery catheter of Claim 12, wherein the tissue valve comprises three individual leaflets that are individually attached to the cuff.

15. A method of deploying a cardiovascular prosthetic implant, the method comprising the steps of:

translumenally advancing a catheter having a distal portion with a diameter of 18 French and carrying a cardiovascular prosthetic implant with a tissue valve having a thickness of at least about .011 inches to a position proximate a native valve of a patient, wherein the cardiovascular prosthetic implant comprises an inflatable cuff, a tissue valve coupled to the inflatable cuff;

inflating the inflatable cuff fully with a hardenable inflation media; and
removing the catheter from the patient, leaving the hardenable inflation media in the cardiovascular prosthetic implant within the patient

16. The method of Claim 15 further comprising before inflating the inflating the inflatable cuff fully with a first media, innflating a distal toroid of the inflatable cuff with a first liquid and positioning the cardiovascular prosthetic implant using the links.

17. The method of Claim 16 displacing the first liquid in the inflatable cuff with a hardenable inflation media; and

18. The method of Claim 16, wherein inflating the distal toroid and inflating the inflatable cuff are done using the links.

19. The method of Claim 16, further comprising allowing the inflation media to solidify within the inflatable cuff.

20. The method of Claim 16, further comprising proximally retracting the cardiovascular prosthetic implant after the distal toroid is at least partially inflated.

21. A delivery catheter for deploying a cardiovascular prosthetic implant using a minimally invasive procedure, wherein the delivery catheter comprises:

an elongate, flexible catheter body having a proximal end and a distal end, wherein the distal end has an outer diameter of 18 French or less; and

a cardiovascular prosthetic implant at the distal end of the catheter body, wherein the cardiovascular prosthetic implant comprises a support structure and a tissue valve having a thickness of at least about .011 inches coupled to the support structure

22. A method of deploying a cardiovascular prosthetic implant, the method comprising the steps of:

translumenally advancing a catheter having a distal portion with a diameter of 18 French and carrying a cardiovascular prosthetic implant with a tissue valve having a thickness of at least about .011 inches to a position proximate a native valve of a patient; and

deploying the cardiovascular prosthetic implant within the patient; and
removing the catheter from the patient.

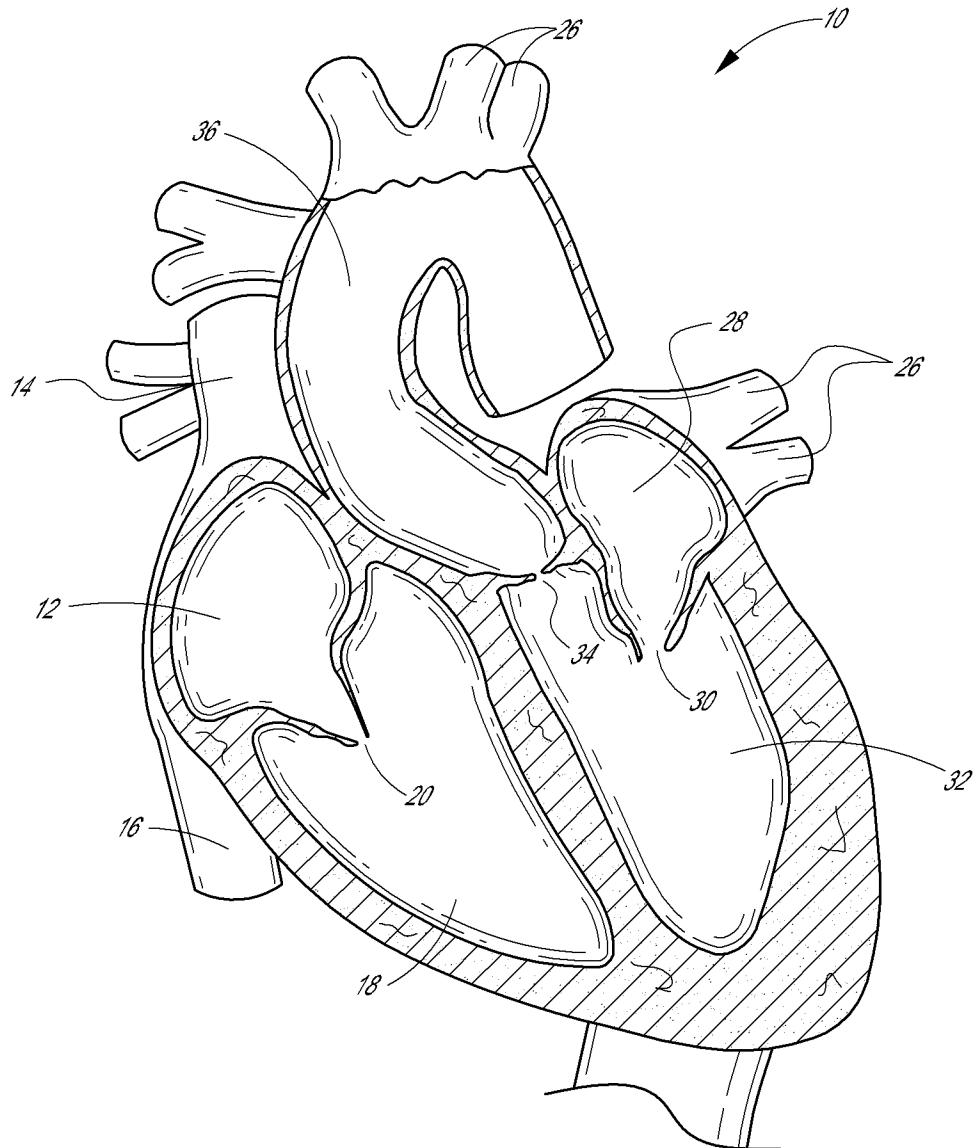

FIG. 1

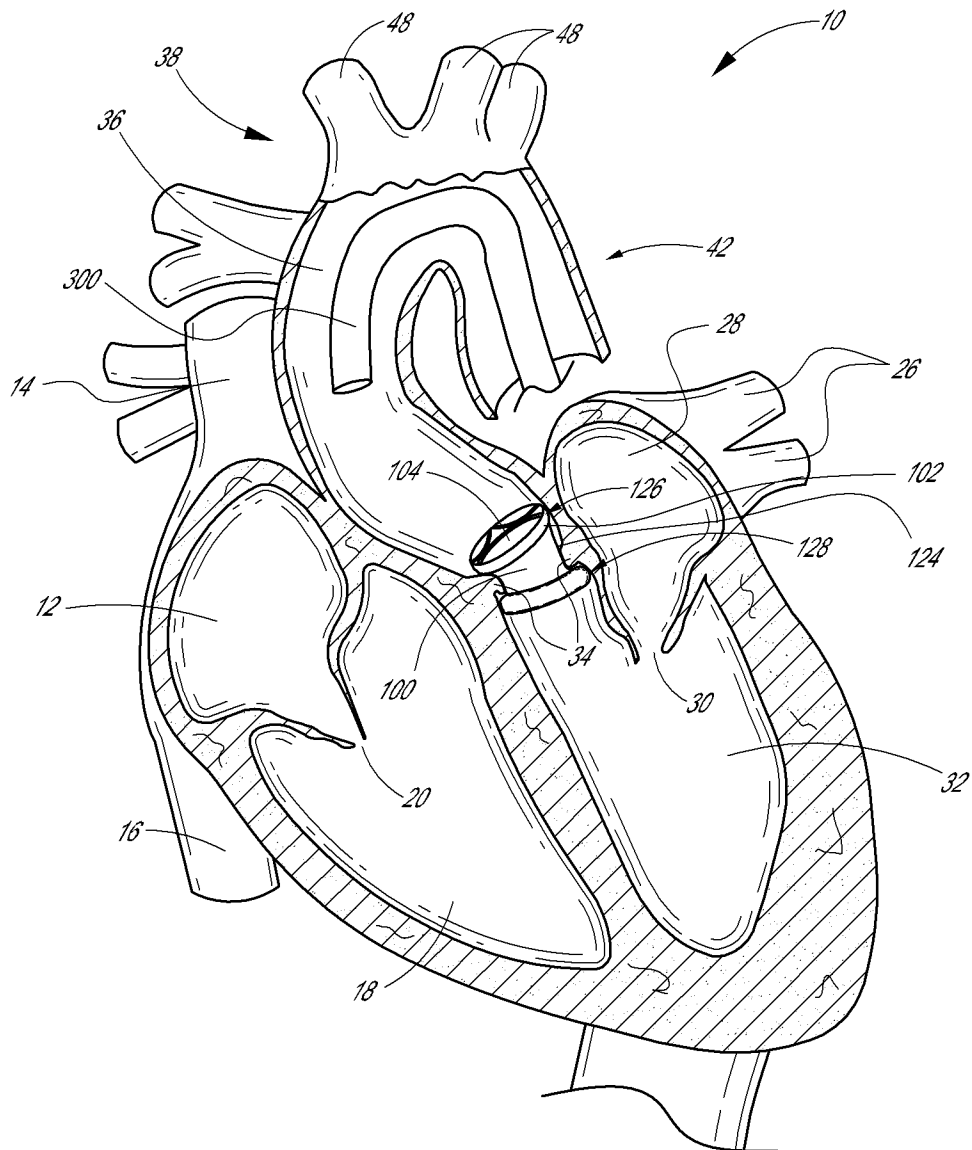

FIG. 2A

3/14

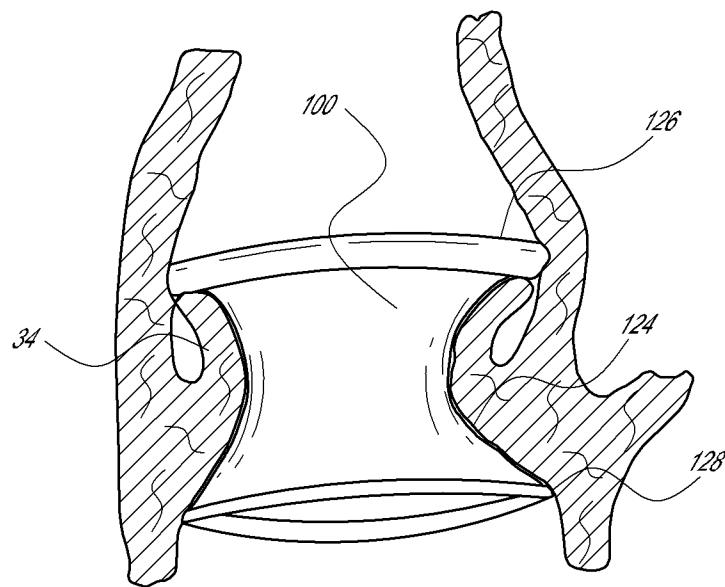

FIG. 2B

4/14

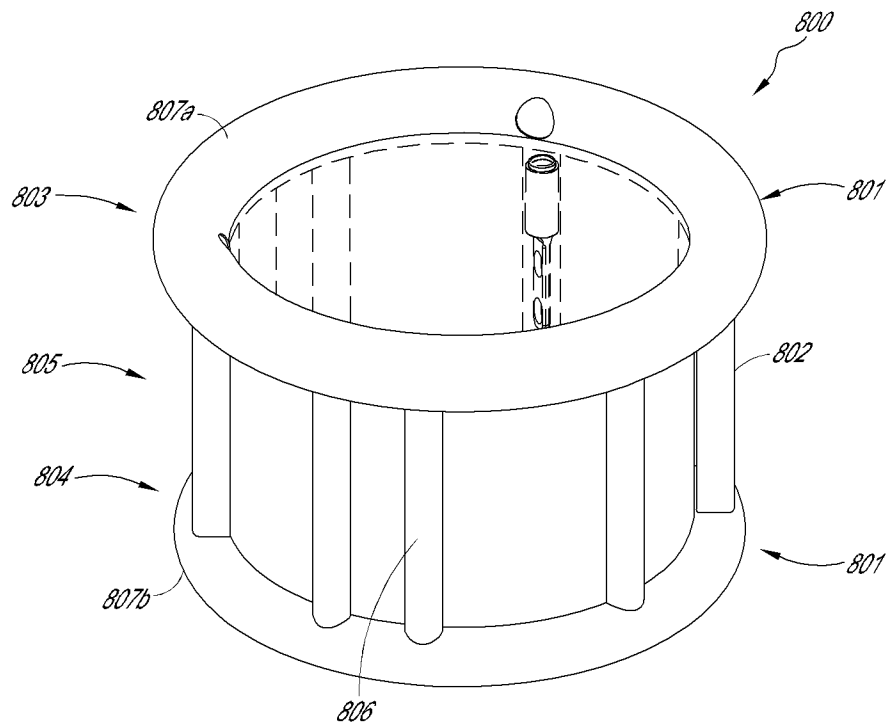

FIG. 3A

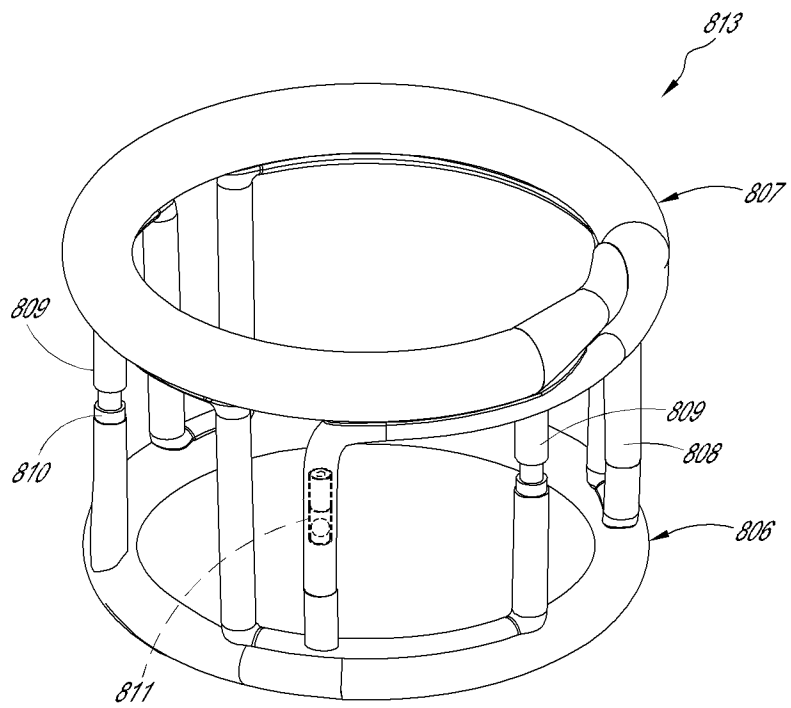

FIG. 3B

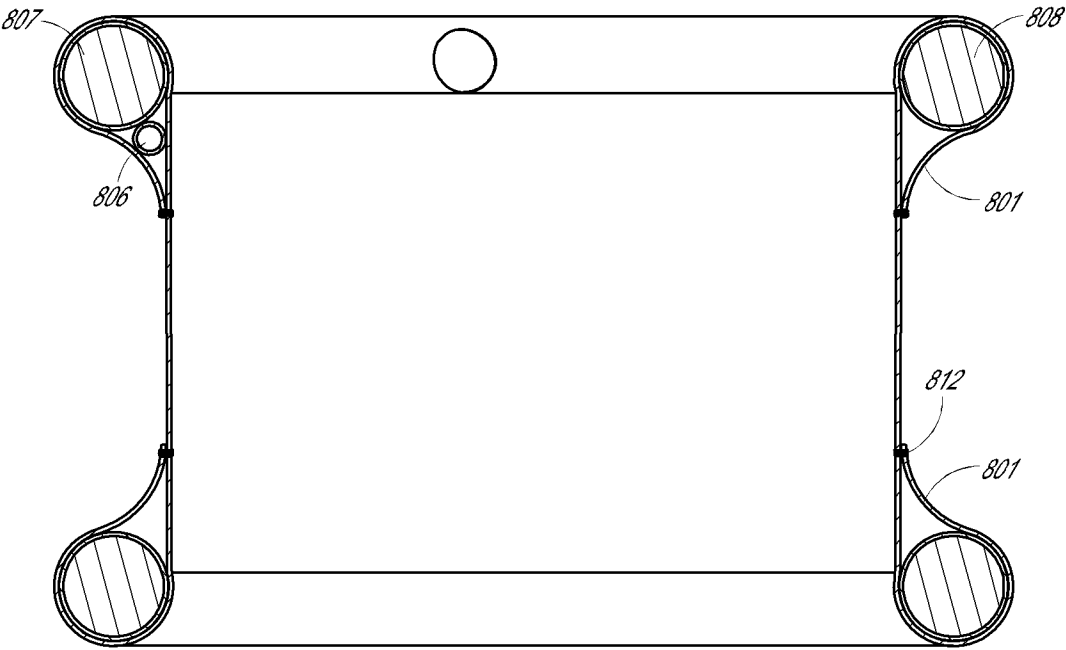

FIG. 3C

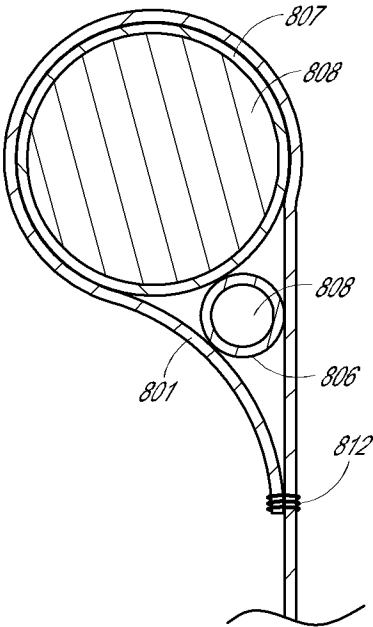

FIG 3D

6/14

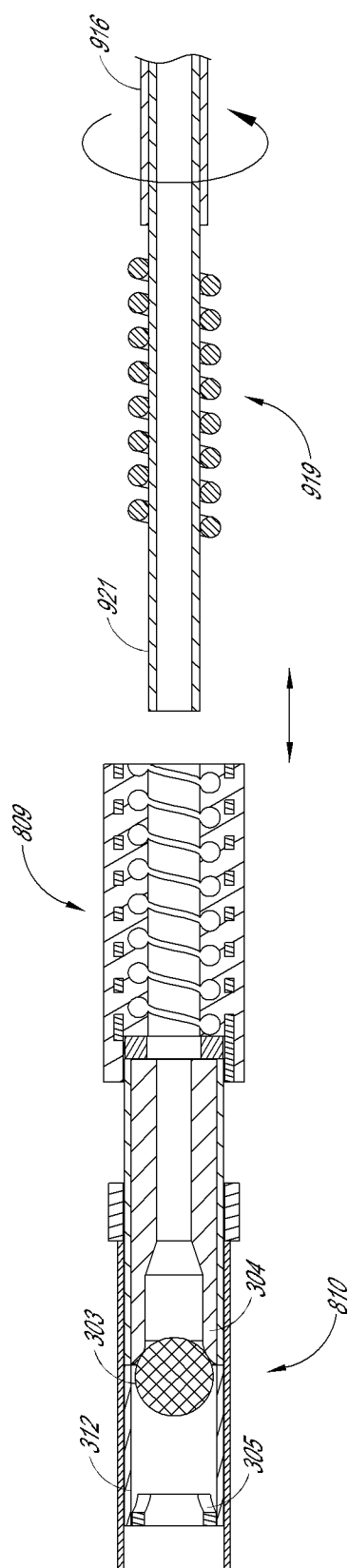

FIG. 4

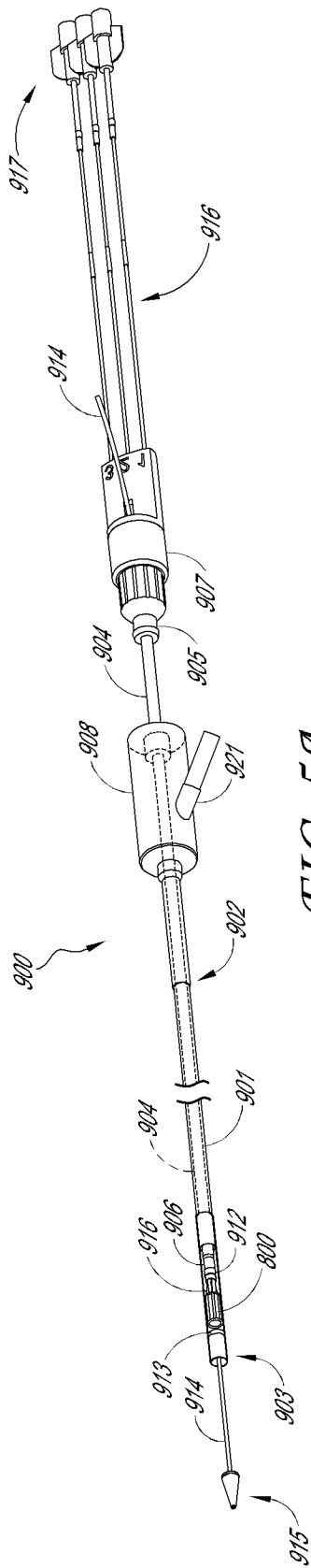

FIG. 5A

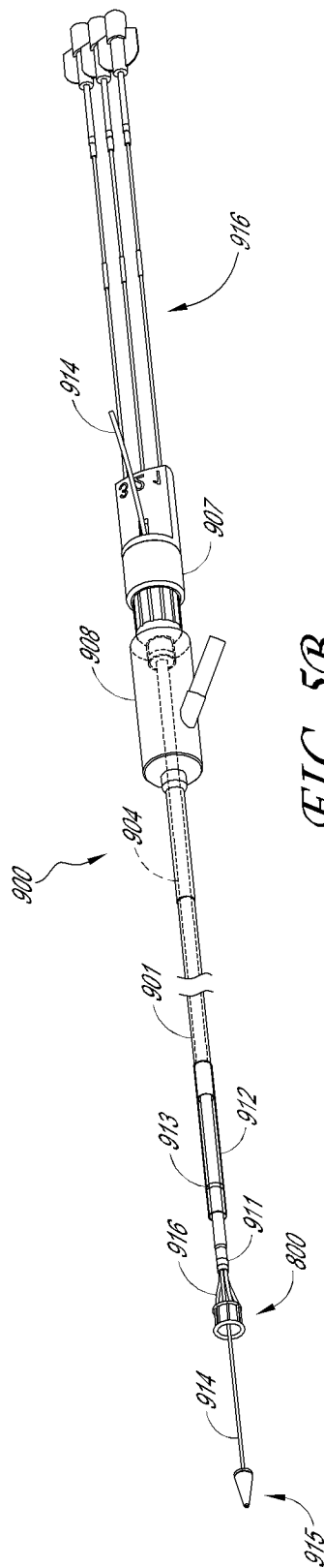

FIG. 5B

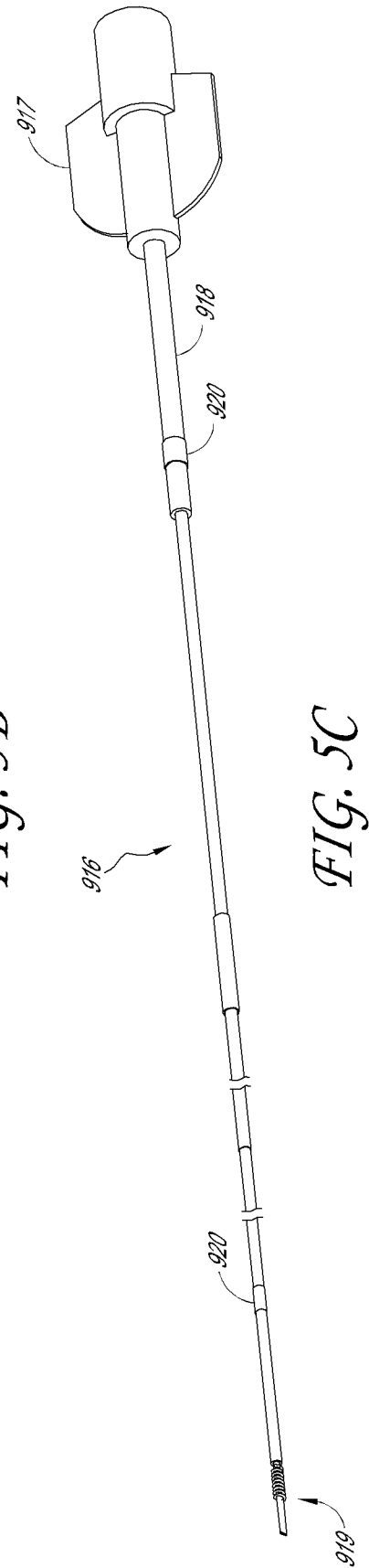

FIG. 5C

8/14

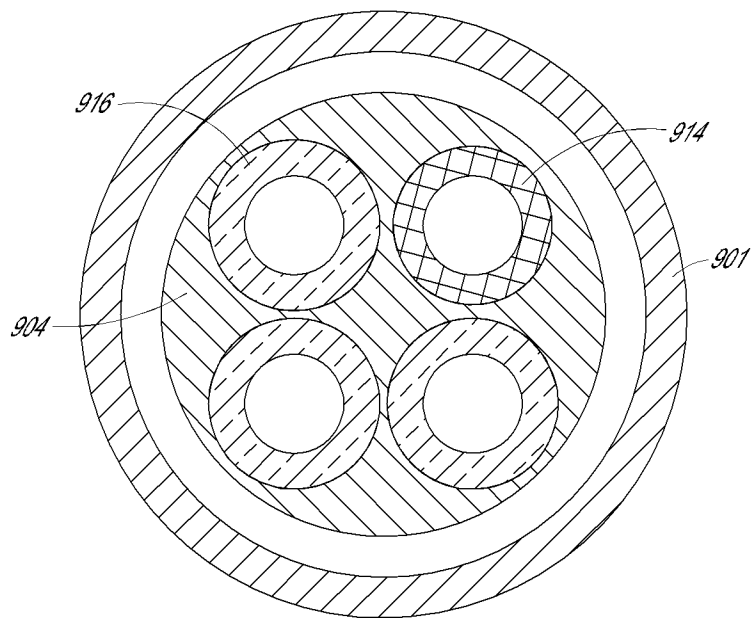

FIG. 6

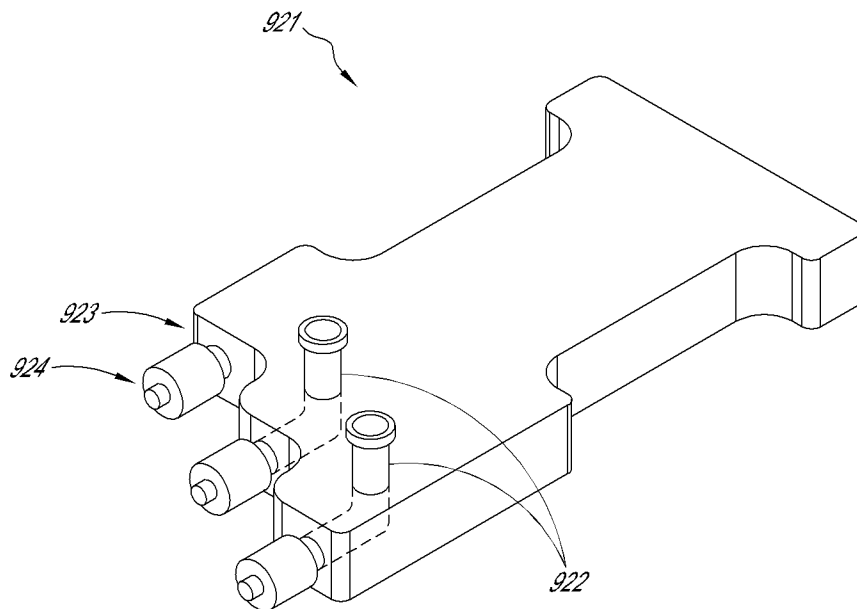

FIG. 7

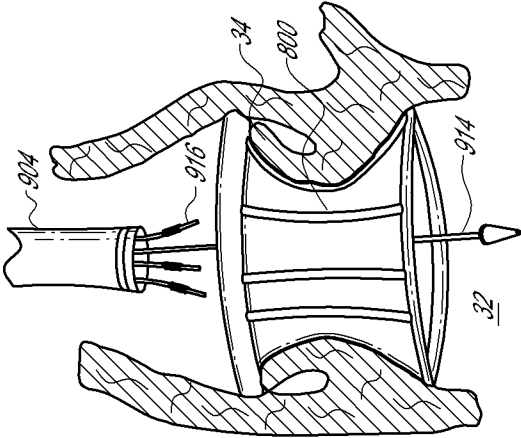

FIG. 8A

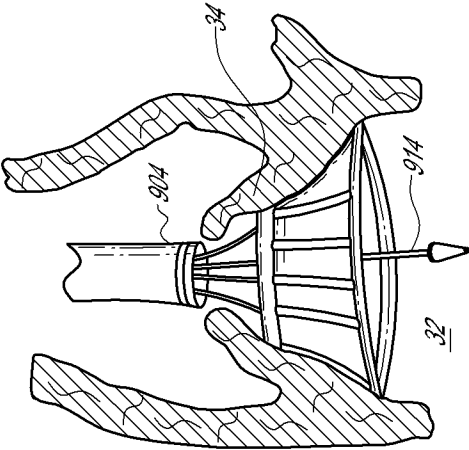

FIG. 8B

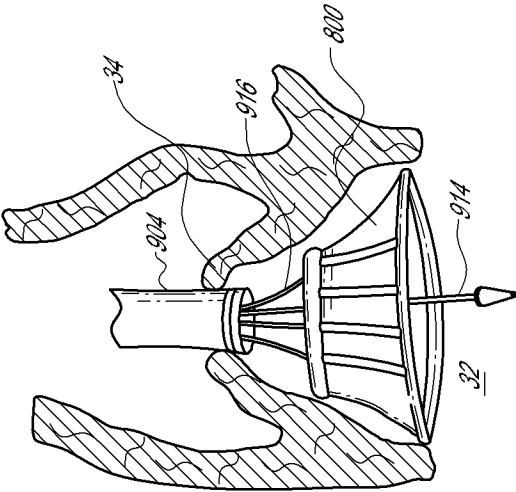

FIG. 8C

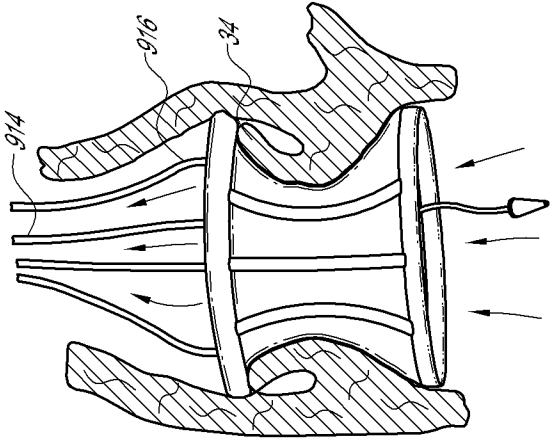

FIG. 9C

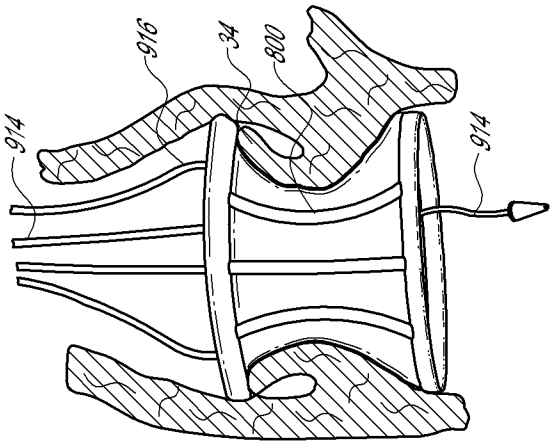

FIG. 9B

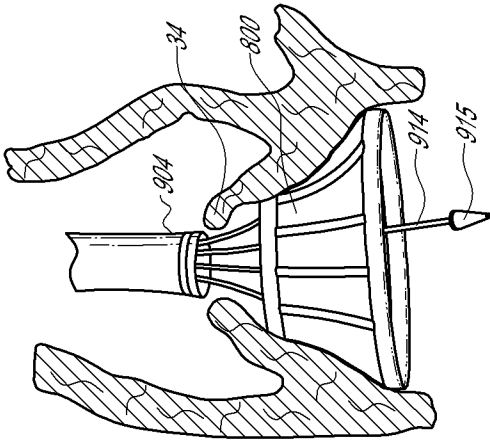

FIG. 9A

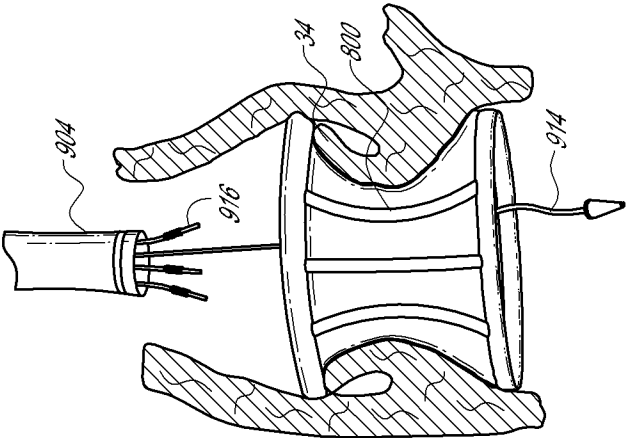

FIG. 9E

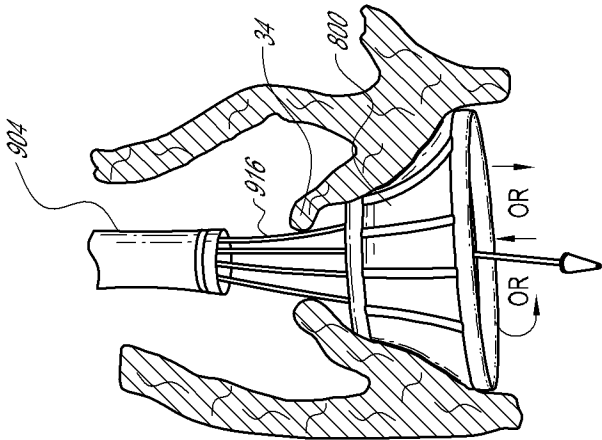

FIG. 9D

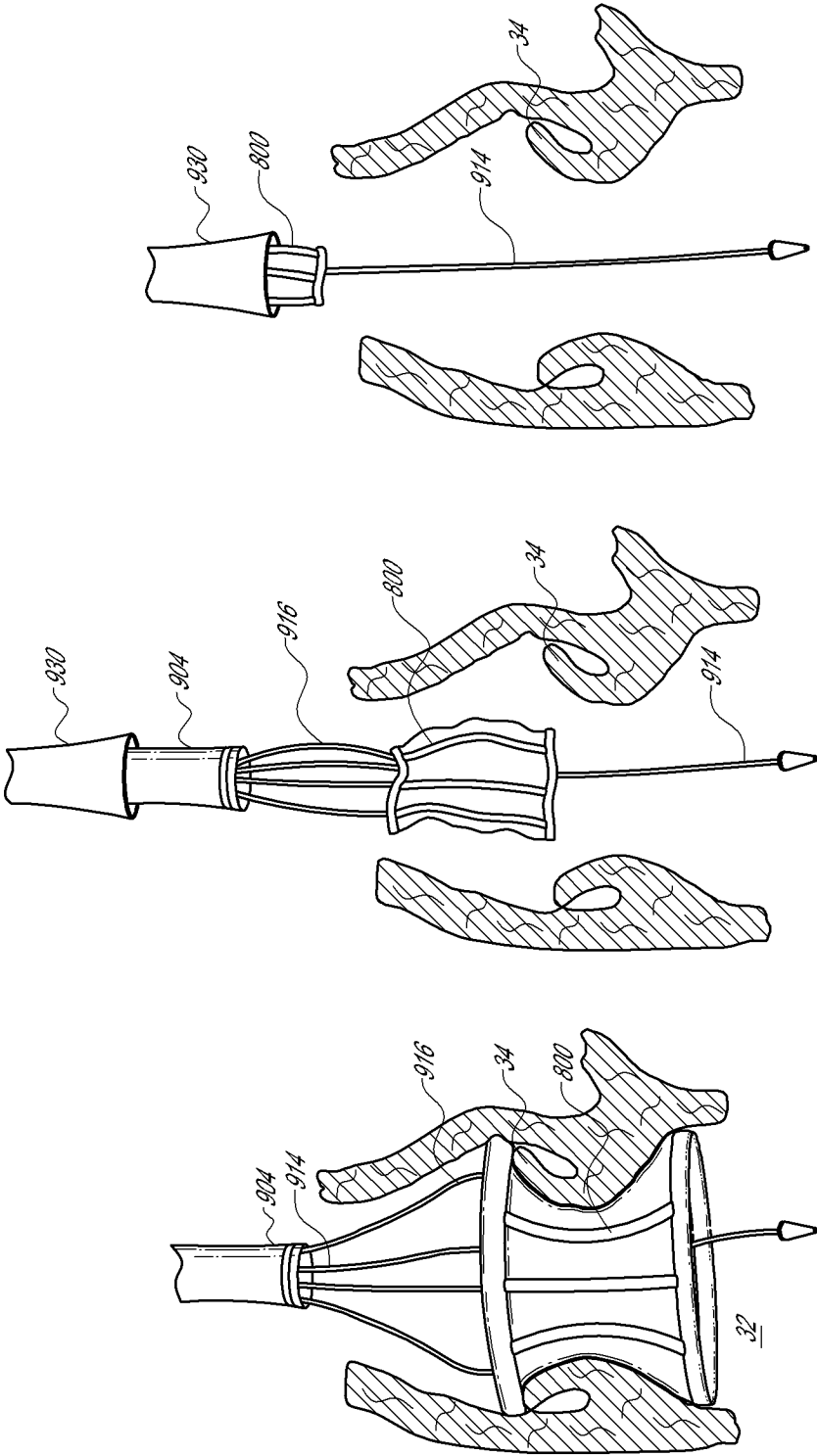

FIG. 10C

FIG. 10B

FIG. 10A

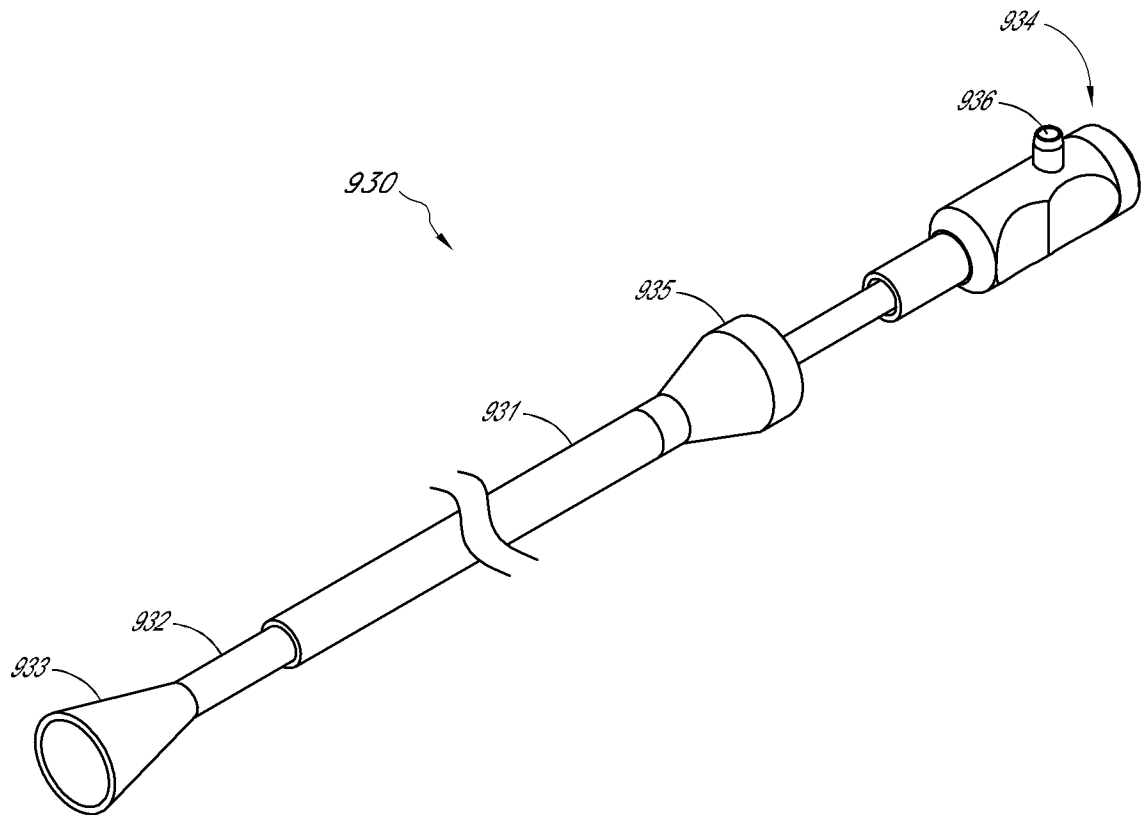

FIG. 11

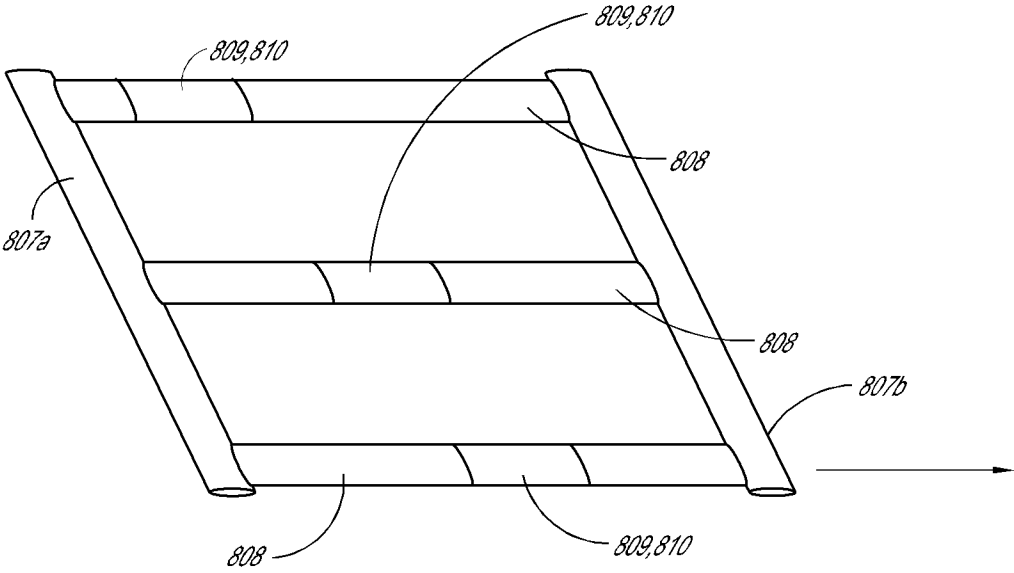

FIG. 12