

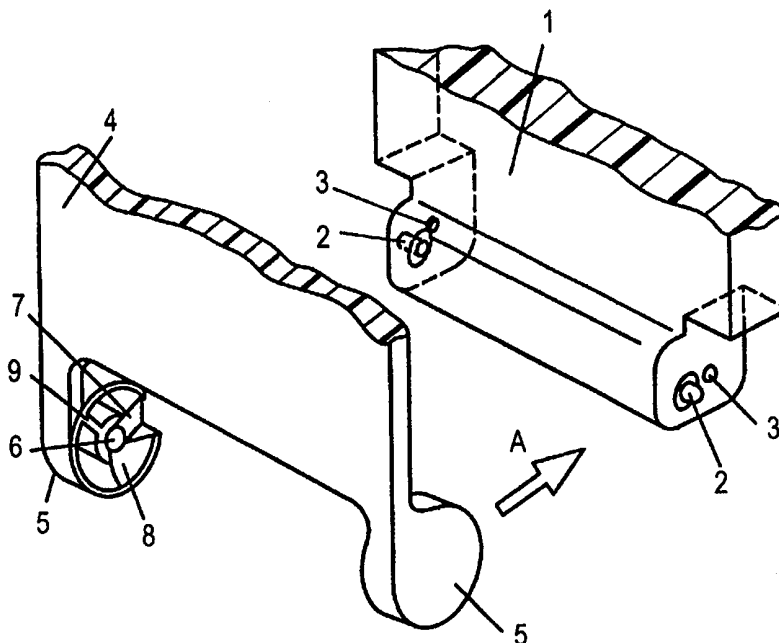

INTERNATIONAL APPLICATION PUBLISHED UNDER THE PATENT COOPERATION TREATY (PCT)

<p>(51) International Patent Classification ⁶ : H04M 1/02, E05D 11/10, H05K 7/16</p>	<p>A1</p>	<p>(11) International Publication Number: WO 99/21342</p> <p>(43) International Publication Date: 29 April 1999 (29.04.99)</p>
<p>(21) International Application Number: PCT/JP98/01293</p> <p>(22) International Filing Date: 24 March 1998 (24.03.98)</p> <p>(30) Priority Data: 9/289395 22 October 1997 (22.10.97) JP</p> <p>(71) Applicant (for all designated States except US): MATSUSHITA ELECTRIC INDUSTRIAL CO., LTD. [JP/JP]; 1006, Oaza Kadoma, Kadoma-shi, Osaka 571-8501 (JP).</p> <p>(72) Inventors; and (75) Inventors/Applicants (for US only): CHIBA, Kazuya [JP/JP]; 19-B-606, Mihogaoka, Ibaraki-shi, Osaka 567-0047 (JP). SHIMIZU, Kaoru [JP/JP]; 4-1, Shimizu 2-chome, Asahi-ku, Osaka-shi, Osaka 535-0021 (JP).</p> <p>(74) Agents: TAKIMOTO, Tomoyuki et al.; Matsushita Electric Industrial Co., Ltd., 1006, Oaza Kadoma, Kadoma-shi, Osaka 571-8501 (JP).</p>		<p>(81) Designated States: BR, CN, CZ, KR, US, European patent (AT, BE, CH, DE, DK, ES, FI, FR, GB, GR, IE, IT, LU, MC, NL, PT, SE).</p> <p>Published With international search report.</p>

(54) Title: HOUSING DEVICE WITH COVER



(57) Abstract

A pair of spindles (2) are formed on both sides of an end of a housing body (1), and a pair of extended parts (5) facing each other, are formed on an end of a cover (4). On each opposite face of the extended parts (5), a hole (6) rotatively engaging with the spindle (2), a slope (7) guiding the spindle (2) to the hole (6) in mounting the cover to the housing body (1), and another slope (8) guiding the spindle (2) out from the extended part (5) in detaching the cover (4) from the housing body (1), are formed. Those elements enable the cover (4) to be mounted/detached to/from the housing body (1) with ease as well as free from damage.

FOR THE PURPOSES OF INFORMATION ONLY

Codes used to identify States party to the PCT on the front pages of pamphlets publishing international applications under the PCT.

AL	Albania	ES	Spain	LS	Lesotho	SI	Slovenia
AM	Armenia	FI	Finland	LT	Lithuania	SK	Slovakia
AT	Austria	FR	France	LU	Luxembourg	SN	Senegal
AU	Australia	GA	Gabon	LV	Latvia	SZ	Swaziland
AZ	Azerbaijan	GB	United Kingdom	MC	Monaco	TD	Chad
BA	Bosnia and Herzegovina	GE	Georgia	MD	Republic of Moldova	TG	Togo
BB	Barbados	GH	Ghana	MG	Madagascar	TJ	Tajikistan
BE	Belgium	GN	Guinea	MK	The former Yugoslav Republic of Macedonia	TM	Turkmenistan
BF	Burkina Faso	GR	Greece	ML	Mali	TR	Turkey
BG	Bulgaria	HU	Hungary	MN	Mongolia	TT	Trinidad and Tobago
BJ	Benin	IE	Ireland	MR	Mauritania	UA	Ukraine
BR	Brazil	IL	Israel	MW	Malawi	UG	Uganda
BY	Belarus	IS	Iceland	MX	Mexico	US	United States of America
CA	Canada	IT	Italy	NE	Niger	UZ	Uzbekistan
CF	Central African Republic	JP	Japan	NL	Netherlands	VN	Viet Nam
CG	Congo	KE	Kenya	NO	Norway	YU	Yugoslavia
CH	Switzerland	KG	Kyrgyzstan	NZ	New Zealand	ZW	Zimbabwe
CI	Côte d'Ivoire	KP	Democratic People's Republic of Korea	PL	Poland		
CM	Cameroon	KR	Republic of Korea	PT	Portugal		
CN	China	KZ	Kazakistan	RO	Romania		
CU	Cuba	LC	Saint Lucia	RU	Russian Federation		
CZ	Czech Republic	LI	Liechtenstein	SD	Sudan		
DE	Germany	LK	Sri Lanka	SE	Sweden		
DK	Denmark	LR	Liberia	SG	Singapore		
EE	Estonia						

DESCRIPTION

Housing Device with Cover

Technical Field

5 The present invention relates to a housing device with a cover, i.e. a lid, or a door which covers an opening of a case, a cabinet, or a control panel of an electric apparatus, and a housing including the case or the cabinet, to which the lid or the door is mounted or detached with ease.

10 Background Art

 An electric apparatus, e.g. a television receiver has a control panel on its front side having a cover mounted thereto with a hinge. A lid of a remote control is also hinged to the remote control, a door of a cabinet which houses an electric apparatus is also hinged to the cabinet, and double doors of a box
15 on which an electric apparatus is placed are also hinged to the box. Those are the conventional structure of a housing device having a cover, therefore, in general, it is not easy to mount/detach the lid, door, or double doors to/from the case, or box.

 On the other hand, a mounting method of a cover to a remote control as
20 shown in Figs. 5 and 6 is also available. Fig. 5 is a perspective view of the remote control when its cover is opened, and Fig. 6 is a perspective view of an essential part of the remote control and its cover before the cover is mounted to the body.

 In Fig. 6, the body 21 of the remote control has a pair of spindles 22 on
25 both sides on its first end. (One spindle 22 is shown, but another spindle 22 is not shown.) The cover 23 has a pair of elastic extended parts 24 shaped in a cantilever on both sides of its first end, and the pair of elastic extended parts 24 face each other.

 On a facing side of the pair of the elastic extended parts 24, a hole 25 to
30 be rotatively engaged with the spindle 22 is disposed. (A hole 25 on one side is

shown, and the counterpart hole 25 is not shown.) When the cover 23 is mounted to the body 21, the elastic extended parts 24 are opened outside using the elasticity, and the spindles 22 of the body 21 are fit into the holes 25. Therefore, when the cover 23 is detached from the body 21, the elastic extended parts 24 are opened outside forcibly. This structure always accompanies a cumbersome work for mounting/detaching the cover 23 to/from the body 21 such as opening the extended parts 24 outside forcibly. In this cumbersome work, if an extra force is applied to the extended parts 24, bending stress is applied to a base of the extended part 24, which is sometimes permanently deformed, or cracked. The cover 23 cracked or having a permanent set cannot be reused. This mounting/detaching work is done by manual and difficult done by machines. In Fig. 5, a denote 26 represents a bottom disposed on the remote control, and 27 represents a hole punched on the cover 23 corresponding to the bottom 26. Through the hole 27, the bottom 26 is protruded.

The present invention addresses the above problems, and aims to provide a housing device having a cover, with which a mounting/detaching of the cover to/from the housing body can be done with ease, while no crack and no permanent set occur on the cover, further, a rate of reuse or recycle of the housing device having the cover increases.

Disclosure of the Invention

The present invention relates particularly to a housing device with a cover, comprising a housing body and a cover for covering switches of the remote control. A structure of the housing device with a cover is outlined as follows:

The housing body has a pair of spindles on both sides of its first end. The cover has a pair of extended parts on both sides of its first end, and the pair of extended parts face each other. On a facing side of the pair of the extended parts, the following three elements are formed, i.e. (1) a pair of holes

to be rotatively engaged with the pair of spindles, (2) a pair of first slopes guiding the pair of spindles to the pair of holes when the cover is mounted to the housing body, and (3) a pair of second slopes guiding the pair of the spindles outside the pair of holes are formed. Thanks to these three elements,
5 the cover can be easily mounted/detached to/from the housing body without damaging the cover per se.

The above structure is more specifically detailed as follows:

(1) The housing device with a cover according to the present invention comprises the following elements;

- 10 (a) a housing body having a spindle on both sides thereof,
(b) a cover having a hole rotatively engaging with the spindle, and a slope guiding the spindle to the hole so that the spindle engages with the hole when the cover is mounted to the housing body, where a height of the slope increases gradually from an edge of the cover to the hole.

15 (2) The housing device with a cover according to the present invention comprises the following elements:

- (a) a housing body having a spindle on both sides thereof,
(b) a cover having a hole rotatively engaging with the spindle, and a slope guiding the spindle outside the hole so that the spindle detaches from
20 the hole when the cover is detached from the housing body, where a height of the slope increases gradually from the hole to an edge of the cover.

(3) The housing device with a cover according to the present invention comprises the following elements:

- (a) a housing body having a spindle on both sides thereof,
25 (b) a cover having the following three elements: (b-1) a hole rotatively engaging with the spindle, (b-2) a first slope guiding the spindle to the hole so that the spindle engages with the hole when the cover is mounted to the housing body, where a height of the first slope increases gradually from an edge of the cover to the hole, and (b-3) a second slope guiding the spindle
30 outside the hole so that the spindle detaches from the hole when the cover is

detached from the housing body, where a height of the second slope increases gradually from the hole to an edge of the cover.

Any one of the above structure (1), (2) and (3) can realize an easy mounting/detaching of the cover to/from the housing body, and thus the work efficiency is increased. A rate of reuse or recycle of the cover also increases, thereby contributing to environmental protection as well as saving resources.

Brief Description of the Drawings

Fig. 1 is a perspective view of an essential part of a housing device according to the present invention before the device is assembled.

Fig. 2a is a front view of an extended part viewed inside, of the cover of the housing device according to the present invention.

Fig. 2b is a cross section taken on line Y-Y of Fig. 2a.

Fig. 2c is a cross section taken on line X-X of Fig. 2a.

Fig. 3 is a perspective view of an essential part of the housing device with the cover when the cover is opened by 180°.

Fig. 4a through Fig. 4d depicts steps how to detach the cover from the housing body.

Fig. 5 is a perspective view of a remote control as a conventional housing device with a cover.

Fig. 6 is a perspective view of an essential part of the remote control in Fig. 5 before it is assembled.

Detailed Description of the Preferred Embodiments of the Invention

Preferred embodiments according to the present invention are described hereinafter by referring to Fig. 1 through Fig. 4d.

(Embodiment 1)

In Fig. 1 through Fig. 2c, a housing device with a cover comprises the following elements:

(a) a housing body 1 comprises the following sub-elements;

(a-1) a pair of spindles 2 disposed at both sides on a first end of the housing body 1,

(a-2) a pair of protrusions 3 having a spherically shaped head disposed at both sides on a first end of the housing body 1, where the protrusions 3 are located at a predetermined distance from the spindles 2,

(b) a cover 4 comprises the a pair of elastic and extended parts 5 facing each other, being shaped in a cantilever, and disposed at both sides on a first end of the cover 4, and the extended parts 5 comprise the following sub-elements;

10 (b-1) a pair of holes 6 having bottoms disposed on the facing sides of the extended parts 5, i.e. on the inside faces thereof, so that the spindles 2 are engaged with the holes (one hole 6 is shown in the Figs., however; another hole 6 is not shown.)

15 (b-2) a pair of mounting guide faces 7 (the first slope) utilized for guiding the spindles 2 to be engaged with the holes 6, when the cover 4 is mounted to the housing body 1 (one guide face 7 is shown in the Figs., but the other guide face 7 is not shown.)

20 (b-3) a pair of detaching guide faces 8 (the second slope) utilized for guiding the spindles 2 to be detached from the holes 2, when the cover 4 is detached from the housing body 1 (one guide face 8 is shown in the Figs., but the other guide face 8 is not shown.)

25 (b-4) a pair of ribs 9 disposed near the holes 6, and utilized as a bar against a rotation of the extended parts 5 through being hit by the protrusions 3 disposed on the housing body 1 (one rib 9 is shown in the Figs., but the other rib 9 is not shown.)

The height of the mounting guide face 7 increases gradually from an outer edge of the cover 4 (actually, the outer edge of the extended part 5) to the hole 6, and the height of the detaching guide face 8 increases gradually from the hole 6 to the outer edge of the cover 4 (actually, the outer edge of the extended part 5.)

30

Now, how to mount the cover 4 to the housing body 1 is described by referring to Fig. 1.

(1) Place the cover 4 upon the housing body 1 along the arrow mark A so that the mounting guide face 7 substantially meets the spindle 2.

5 (2) Press the pair of the extended part 5 toward the housing body 1 along the arrow mark A, then the spindle 2 touches the mounting guide face 7 and the pair of extended parts 5 start opening outside (in the case of the housing body of a remote control, the extended parts open along its width direction.)

10 (3) Further press and push the extended parts 5 by touching the mounting guide face 7 to the spindle 2 until those two elements are engaged with each other, which produces a click sound.

The mounting guide face 7, as described above, helps identifying the mounting point between the housing body 1 and the cover 4, and avoids
15 slippage of the cover 4 when the spindle 2 is engaged with the hole 6.

Further, the mounting guide face 7 regulates elastic deformation of the extended part 5 to a minimum quantity, and also prevents the root of the extended part 5 from being cracked.

Next, how to detach the cover 4 from the housing body 1 is described by
20 referring to Fig. 4a - Fig. 4d and Fig. 3.

(1) Rotate the cover 4 by 180° to open the housing device as shown in Fig. 4a and Fig. 4b. Fig. 3 shows an essential part of the cover 4 being opened. When the cover 4 is opened by 180°, the rib 9 hits the protrusion 3, and the cover 4 stops being opened.

25 (2) Push down the cover 4 further, then the rib 9 leans on the spherical head of the protrusion 3, and the extended part 5 start opening due to elastic deformation along a direction of detaching from the spindle 2.

(3) Further push down the cover 4, then the rib 9 arrives at the top of spherical head of the protrusion 3, and then the hole 6 detaches and slips off
30 from the spindle 2 by a predetermined distance, whereby the spindle 2

relatively is moved to a dint (starting point of the slope) of the detaching guide face 8. Fig. 4c shows this status, where "d" represents slippage quantity.

(4) Press the cover further until it rotates by about 270° in total, then the spindle 2 relatively moves along the detaching guide face 8, and the extended part 5 is further deformed elastically until the terminal of the detaching guide face 8 comes off the spindle 2. Namely, the cover 4 is detached from the spindle 2 completely and separated from the housing body 1. Fig. 4d depicts this status.

As described above, the cover 4 is opened by 180° using the spindle 2 as a fulcrum of a lever, and the cover 4 is further pushed down by its end to be rotated until the cover is detached. It requires only a little press power to detach the cover 4. Further, this structure can regulate the elastic deformation to a minimum quantity to prevent the root of the extended part 5 from being deformed or cracked.

15

(Embodiment 2)

A modification of Embodiment 1 is described here as Embodiment 2.

1. When the pair of extended parts 5 are not provided on the cover 4, the pair of holes 6, the pair of slopes 7 and 8, and the pair of ribs 9 are provided on the cover 4.

2. When at least one of a pair of slopes 7 and 8 are provided on the cover 4 anyhow, the pair of extended parts 5, the pair of ribs 9 and remained pair of slopes 7 or 8 can be entirely or partially omitted. Although they are omitted, a housing device having substantially the same functions described in Embodiment 1 can be produced. In this case, the pair of protrusions 3 also can be omitted.

The preferred embodiment and the modification described above are just the exemplary embodiments, thus the scope of the present invention is not limited by those embodiments, but is indicated by the claims described

30

hereunder. Modifications and changes within an equivalent scope to the scope of the claims are covered by the present invention.

5

Industrial Applicability

According to the present invention, a cover can be mounted/detached to/from a housing body with ease, and an excessive elastic deformation is not applied to a cantilever-shaped extended part provided on the cover, whereby a permanent set and a crack can be prevented. The housing device of the present invention can bear repeated mounting/detaching. Because of easy mounting/detaching, the rate of reuse or recycle of the housing device can be increased, thereby contributing to environmental protection as well as saving resources.

The present invention can be applied to a housing of remote control, a control panel disposed on the front of a television receiver, a box on which a television receiver is placed, etc. The present invention is particularly effective to such electronics apparatus as described above.

Claims

1. A housing device comprising:

(a) a housing body having a spindle on both sides thereof,

(b) a cover comprising:

5 (b-1) a hole with which said spindle engages,

(b-2) a slope guiding said spindle to said hole in mounting said cover to said housing body.

2. The housing device of Claim 1, wherein a height of said slope
10 increases gradually from an edge of said cover to said hole.

3. A housing device comprising:

(a) a housing body having a spindle on both sides thereof,

(b) a cover comprising a pair of cantilever-shaped extended parts
15 provided on an end thereof, wherein each of opposite faces of said extended parts has a hole rotatively engaging with said spindle, and a slope guiding said spindle to said holes in mounting said cover to said housing body.

4. The housing device of Claim 3, wherein a height of the slope gradually increases from an edge of the cover to the hole.

20 5. A housing device comprising:

(a) a housing body having a spindle on both sides thereof,

(b) a cover comprising:

(b-1) a hole engaging to said spindle,

(b-2) a slope guiding said spindle to come off said hole in
25 detaching said cover from said housing body.

6. The housing device of Claim 5, wherein a height of said slope increases gradually from the hole to an edge of the cover.

30 7. A housing device comprising;

(a) a housing body having a spindle and a protrusion with a predetermined distance therebetween on both sides of said housing body,

(b) a cover having a pair of cantilever-shaped elastic parts extended from an end of said cover, wherein said elastic parts comprising:

5 (b-1) a pair of opposite faces having a hole rotatively engaging with said spindle,

(b-2) a pair of slopes guiding said spindle to come off said holes in detaching the cover from the housing body,

10 (b-3) a pair of bars stopping rotation of said cantilever-shaped elastic parts by hitting said protrusions.

8. The housing device of Claim 7, wherein a height of said slope increases from said hole to an edge of said cover.

9. A housing device comprising:

15 (a) a housing body having a spindle on both sides thereof,

(b) a cover comprising;

(b-1) a hole rotatively engaging with said spindle,

(b-2) a first slope guiding said spindle to said hole in mounting said cover to said housing body,

20 (b-3) a second slope guiding said spindle to come off said hole in detaching said case from said housing body.

10. The housing device of Claim 9, wherein a height of said first slope increases gradually from an edge of said cover to said hole, and a height of said second slope increases gradually from said hole to the edge of said cover.

11. A housing device comprising:

(a) a housing body having a spindle and a protrusion with a predetermined distance therebetween on both sides of said housing body,

30 (b) a cover having a pair of cantilever-shaped elastic parts

extended from an end of said cover, wherein of said elastic parts comprising:

(b-1) a pair of opposite faces having a hole rotatively engaging with said spindle,

(b-2) a pair of first slopes guiding said spindle to said hole in mounting said cover to said housing body,

(b-3) a pair of second slopes guiding said spindle to come off said holes in detaching the cover from the housing body,

(b-3) a pair of bars stopping rotation of said cantilever-shaped elastic parts by hitting said protrusions on said housing body.

10

12. The housing device of Claim 11, wherein a height of said first slope increases gradually from an edge of said cover to said hole, and a height of said second slope increases gradually from said hole to the edge of said cover.

15

13. A housing device comprising:

(a) a housing body having a spindle and a protrusion on both side thereof,

(b) a cover engaging with said spindle for covering said housing body, wherein said cover is come off said spindle with said protrusion by opening said cover from closed status by more than 180°.

20

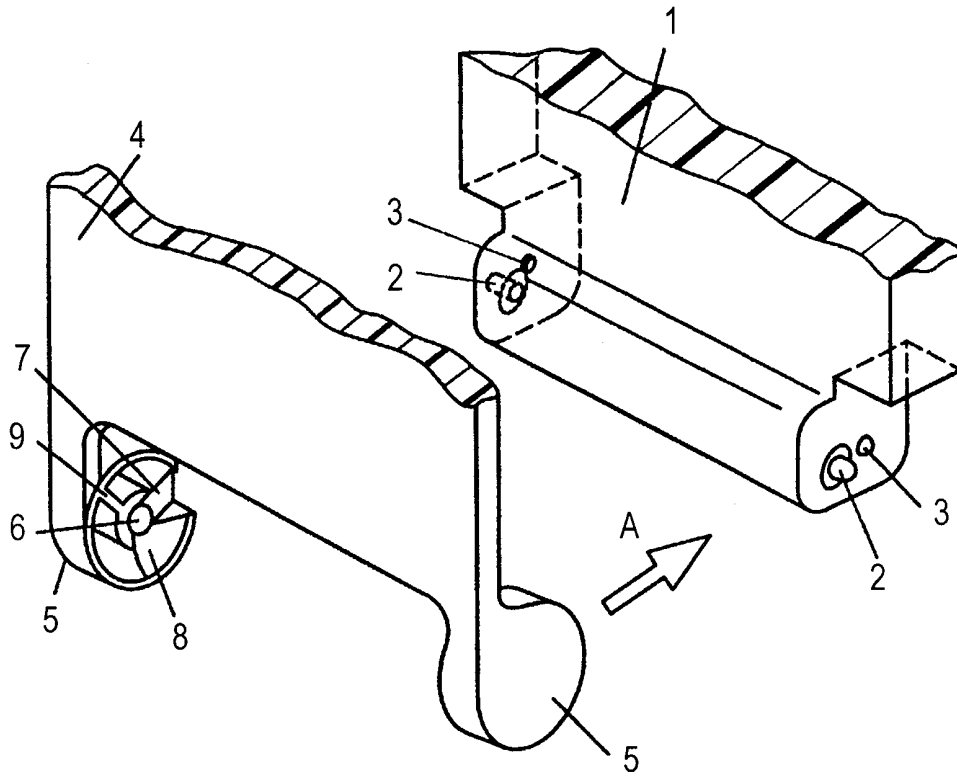

FIG. 1

FIG. 2a

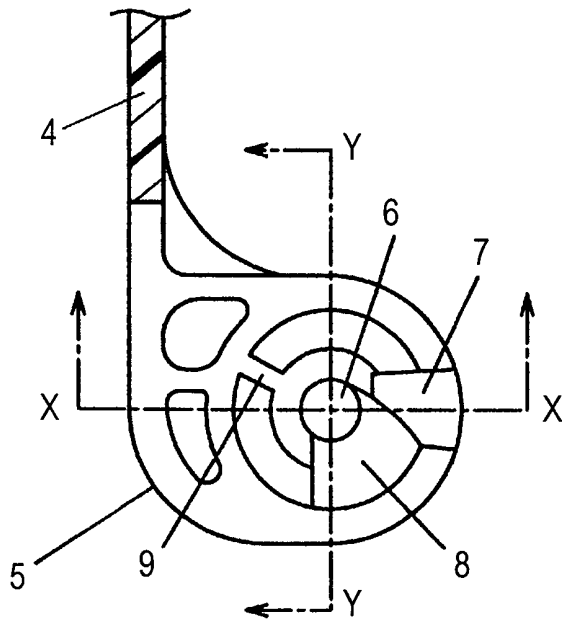

FIG. 2b

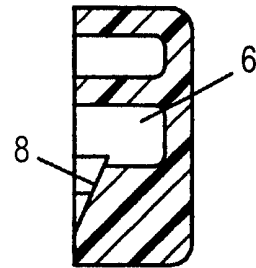
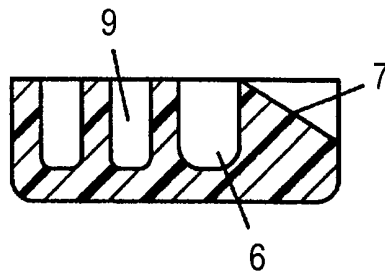

FIG. 2c



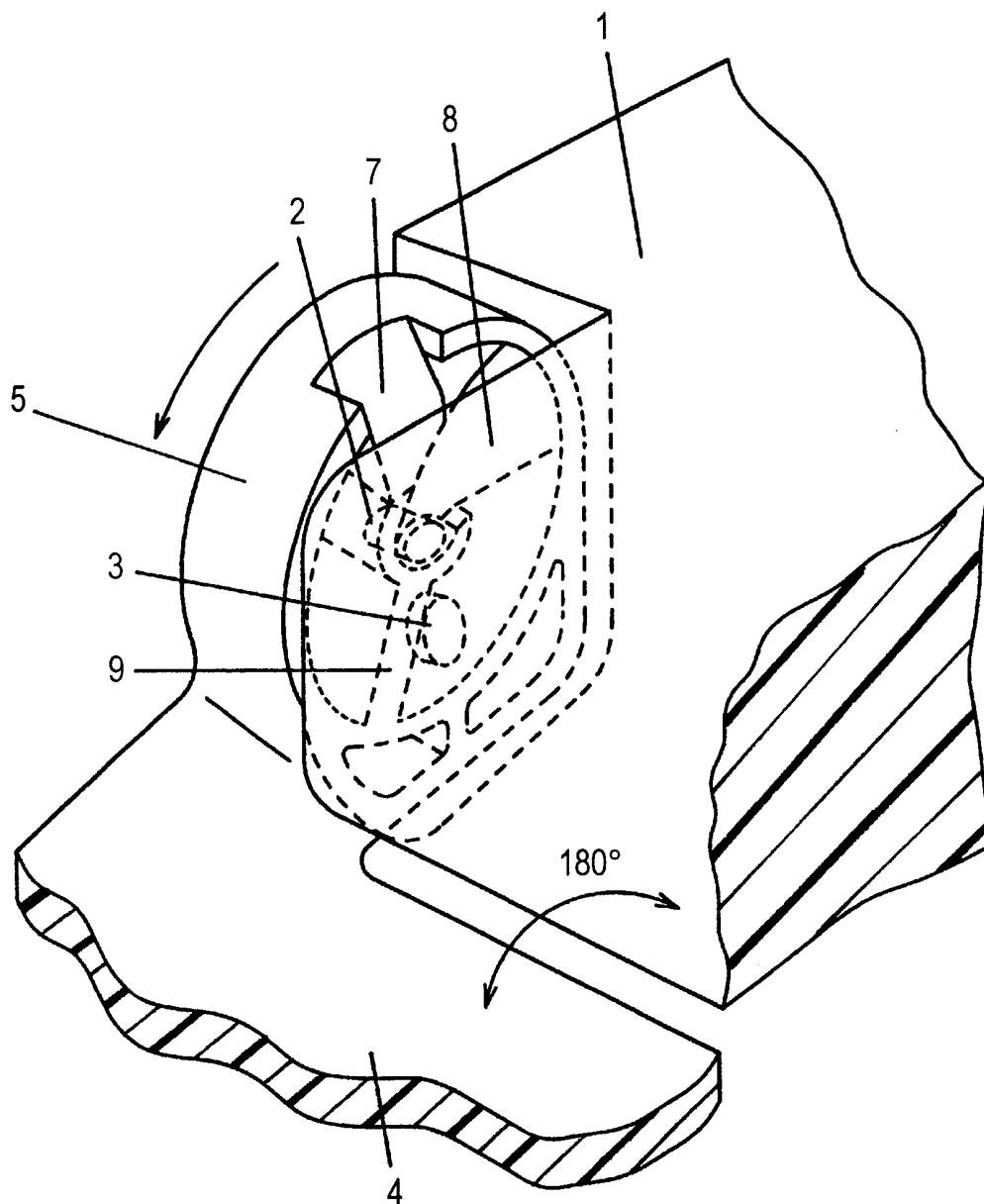

FIG.3

FIG. 4a

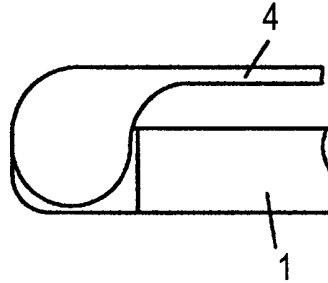

FIG. 4b

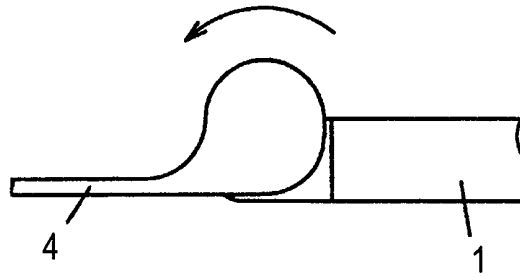

FIG. 4c

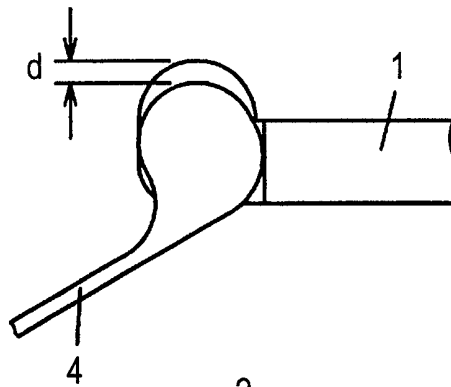
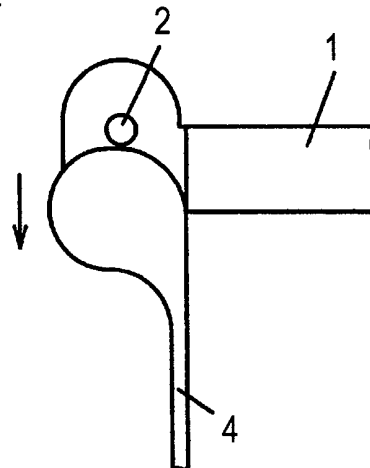

FIG. 4d



5/7

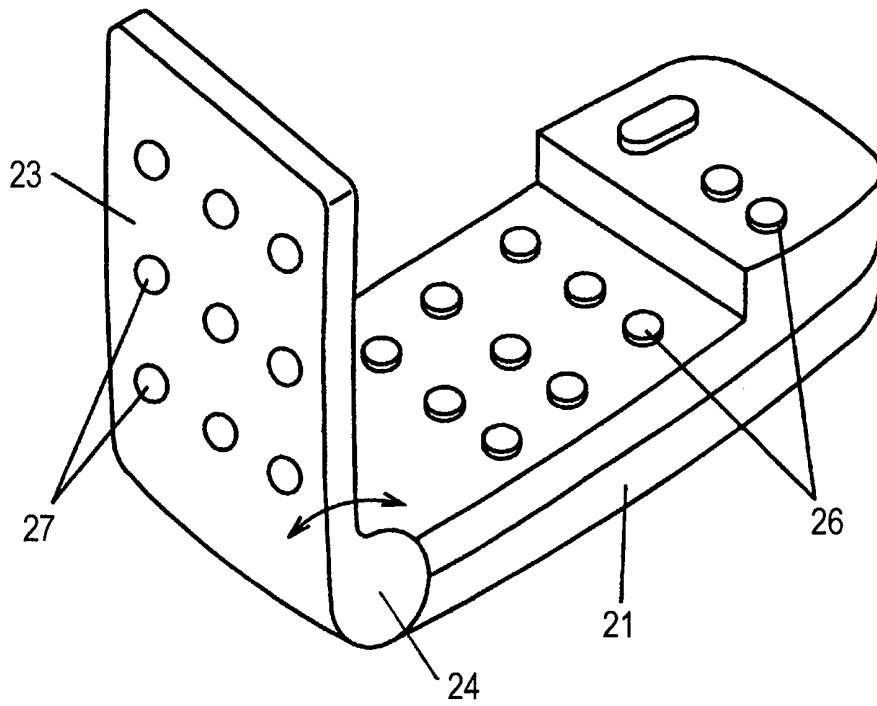

FIG. 5

6/7

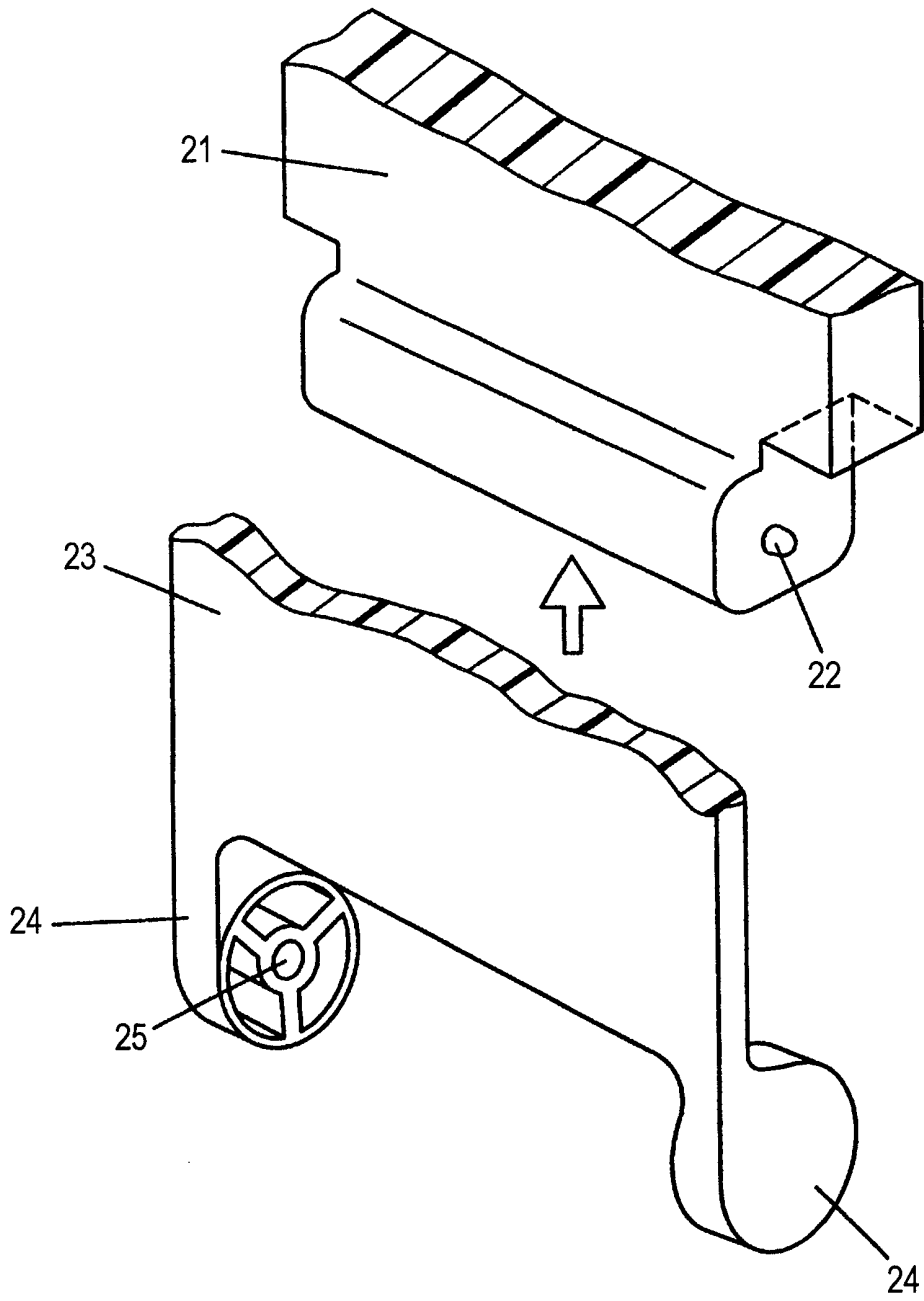

FIG. 6

Reference No. list of the drawings

- 1 case (housing body)
- 2 spindle
- 3 protrusion
- 4 cover
- 5 extended part
- 6 hole
- 7 mounting guide face (first slope)
- 8 detaching guide face (second slope)
- 9 rib (blocking rib against rotation)
- 21 body of remote control (case)
- 22 spindle
- 23 cover
- 24 extended part
- 25 hole
- 26 button
- 27 through hole

INTERNATIONAL SEARCH REPORT

International Application No

PCT/JP 98/01293

A. CLASSIFICATION OF SUBJECT MATTER
 IPC 6 H04M1/02 E05D11/10 H05K7/16

According to International Patent Classification (IPC) or to both national classification and IPC

B. FIELDS SEARCHED

Minimum documentation searched (classification system followed by classification symbols)
 IPC 6 H04M H04B H04Q E05D E05F H05K

Documentation searched other than minimum documentation to the extent that such documents are included in the fields searched

Electronic data base consulted during the international search (name of data base and, where practical, search terms used)

C. DOCUMENTS CONSIDERED TO BE RELEVANT

Category °	Citation of document, with indication, where appropriate, of the relevant passages	Relevant to claim No.
X A	GB 2 256 424 A (PILZ TECHNOLOGIE GMBH) 9 December 1992 see page 7, line 14-37 see page 11, line 5-14 see figures 1,2,4,4A ---	1-3,7,8, 11,12 4-6,9, 10,13
X A	PATENT ABSTRACTS OF JAPAN vol. 098, no. 001, 30 January 1998 & JP 09 246744 A (NIPPON DENKI IDO TSUSHIN KK), 19 September 1997, see abstract ---	1,13 2-12
A	EP 0 272 042 A (SHAPE INC) 22 June 1988 see column 5, line 24 - column 6, line 3; figures 1,2,11 ---	1-13
	-/--	

Further documents are listed in the continuation of box C.

Patent family members are listed in annex.

° Special categories of cited documents :

- "A" document defining the general state of the art which is not considered to be of particular relevance
- "E" earlier document but published on or after the international filing date
- "L" document which may throw doubts on priority claim(s) or which is cited to establish the publication date of another citation or other special reason (as specified)
- "O" document referring to an oral disclosure, use, exhibition or other means
- "P" document published prior to the international filing date but later than the priority date claimed

- "T" later document published after the international filing date or priority date and not in conflict with the application but cited to understand the principle or theory underlying the invention
- "X" document of particular relevance; the claimed invention cannot be considered novel or cannot be considered to involve an inventive step when the document is taken alone
- "Y" document of particular relevance; the claimed invention cannot be considered to involve an inventive step when the document is combined with one or more other such documents, such combination being obvious to a person skilled in the art.
- "&" document member of the same patent family

Date of the actual completion of the international search

16 July 1998

Date of mailing of the international search report

22/07/1998

Name and mailing address of the ISA

European Patent Office, P.B. 5818 Patentlaan 2
 NL - 2280 HV Rijswijk
 Tel. (+31-70) 340-2040, Tx. 31 651 epo nl,
 Fax: (+31-70) 340-3016

Authorized officer

Golzio, D

INTERNATIONAL SEARCH REPORT

International Application No
PCT/JP 98/01293

C.(Continuation) DOCUMENTS CONSIDERED TO BE RELEVANT

Category	Citation of document, with indication, where appropriate, of the relevant passages	Relevant to claim No.
A	EP 0 765 063 A (SAMSUNG ELECTRONICS CO LTD) 26 March 1997 see abstract; figure 4 ----	1-13
A	DE 196 08 473 A (AEG MOBILE COMMUNICATION) 11 September 1997 see column 1, line 45-47 see column 2, line 40 - column 3, line 43; figures 1,3-6,11,12 ----	1-13
A	WO 96 21988 A (ERICSSON GE MOBILE INC) 18 July 1996 see abstract; figures 1,4-6 ----	1-13
A	US 5 507 013 A (WEADON MARK W ET AL) 9 April 1996 see column 2, line 42 - column 3, line 19 see column 4, line 8-47 see column 5, line 1 - column 7, line 38 see figures 1,3-9 -----	1-13

INTERNATIONAL SEARCH REPORT

information on patent family members

International Application No

PCT/JP 98/01293

Patent document cited in search report	Publication date	Patent family member(s)	Publication date
GB 2256424 A	09-12-1992	DE 4118769 A	10-12-1992
		CN 1067762 A,B	06-01-1993
		WO 9222065 A	10-12-1992
		WO 9222066 A	10-12-1992
		FR 2677480 A	11-12-1992
EP 0272042 A	22-06-1988	US 4793480 A	27-12-1988
		AU 606906 B	21-02-1991
		AU 8252887 A	16-06-1988
		CA 1301711 A	26-05-1992
		DE 3787081 A	23-09-1993
		DE 3787081 T	11-05-1994
		JP 63161577 A	05-07-1988
		MX 168449 B	25-05-1993
		EP 0765063 A	26-03-1997
DE 19608473 A	11-09-1997	NONE	
WO 9621988 A	18-07-1996	US 5732331 A	24-03-1998
		AU 4972696 A	31-07-1996
		DE 19681139 T	05-02-1998
US 5507013 A	09-04-1996	NONE	