

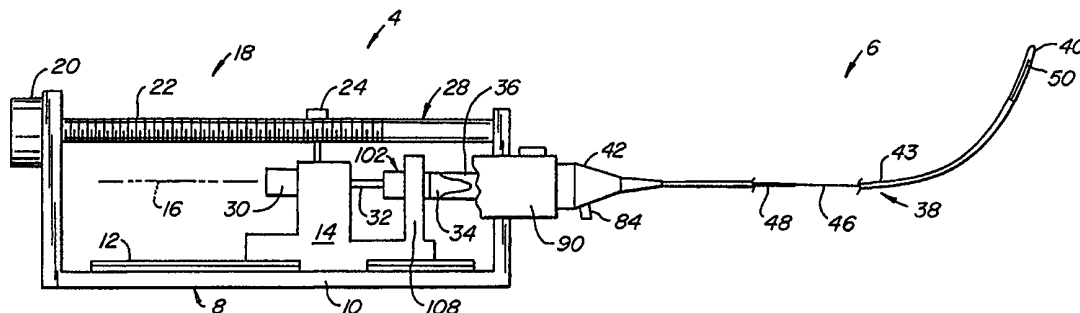

## INTERNATIONAL APPLICATION PUBLISHED UNDER THE PATENT COOPERATION TREATY (PCT)

<p>(51) International Patent Classification <sup>7</sup> : <b>A61B 8/12</b></p>	<p><b>A1</b></p>	<p>(11) International Publication Number: <b>WO 00/07500</b></p> <p>(43) International Publication Date: 17 February 2000 (17.02.00)</p>
<p>(21) International Application Number: PCT/IB99/01363</p> <p>(22) International Filing Date: 30 July 1999 (30.07.99)</p> <p>(30) Priority Data: 09/130,198      5 August 1998 (05.08.98)      US</p> <p>(71) Applicant: BOSTON SCIENTIFIC LIMITED [IE/BB]; The Financial Services Centre, P.O. Box 111, Bishop's Court Hill, St. Michael, Barbados (BB).</p> <p>(72) Inventor: MANSOURI-RUIZ, Idriss; 1872 Market Street, 1, Santa Clara, CA 95050 (US).</p> <p>(74) Agents: EVENS, Paul, Jonathan et al.; Maguire Boss, 5 Crown Street, St. Ives, Cambridgeshire PE17 4EB (GB).</p>		<p>(81) Designated States: CA, JP, European patent (AT, BE, CH, CY, DE, DK, ES, FI, FR, GB, GR, IE, IT, LU, MC, NL, PT, SE).</p> <p><b>Published</b> <i>With international search report.</i></p>

(54) Title: AUTOMATIC/MANUAL LONGITUDINAL POSITION TRANSLATOR AND ROTARY DRIVE SYSTEM FOR CATHETERS



## (57) Abstract

An automatic pullback catheter system (2) includes a disposable catheter assembly (6) mountable to a drive assembly (4). The drive assembly includes a body (8) to which a drive chassis (14) is mounted for movement along a longitudinal path (16) by a motor (20) which rotates a longitudinal drive screw (22) selectively coupled to the drive chassis by a threaded clamp (24). A rotary drive motor (30), mounted to the drive chassis, rotates a first combined connector (34). The catheter assembly includes a hollow sheath (38) housing a rotatable and axially movable cable assembly (44). The sheath includes a proximal hub (42) mountable to the body. The cable assembly includes an elongate imaging cable (46) with a second combined connector (36) at its proximal end. The first and second combined connectors are blind matable connectors and provide for the longitudinal movement coupling, the rotary movement coupling and the data/information connection of the two connectors.

**FOR THE PURPOSES OF INFORMATION ONLY**

Codes used to identify States party to the PCT on the front pages of pamphlets publishing international applications under the PCT.

AL	Albania	ES	Spain	LS	Lesotho	SI	Slovenia
AM	Armenia	FI	Finland	LT	Lithuania	SK	Slovakia
AT	Austria	FR	France	LU	Luxembourg	SN	Senegal
AU	Australia	GA	Gabon	LV	Latvia	SZ	Swaziland
AZ	Azerbaijan	GB	United Kingdom	MC	Monaco	TD	Chad
BA	Bosnia and Herzegovina	GE	Georgia	MD	Republic of Moldova	TG	Togo
BB	Barbados	GH	Ghana	MG	Madagascar	TJ	Tajikistan
BE	Belgium	GN	Guinea	MK	The former Yugoslav Republic of Macedonia	TM	Turkmenistan
BF	Burkina Faso	GR	Greece	ML	Mali	TR	Turkey
BG	Bulgaria	HU	Hungary	MN	Mongolia	TT	Trinidad and Tobago
BJ	Benin	IE	Ireland	MR	Mauritania	UA	Ukraine
BR	Brazil	IL	Israel	MW	Malawi	UG	Uganda
BY	Belarus	IS	Iceland	MX	Mexico	US	United States of America
CA	Canada	IT	Italy	NE	Niger	UZ	Uzbekistan
CF	Central African Republic	JP	Japan	NL	Netherlands	VN	Viet Nam
CG	Congo	KE	Kenya	NO	Norway	YU	Yugoslavia
CH	Switzerland	KG	Kyrgyzstan	NZ	New Zealand	ZW	Zimbabwe
CI	Côte d'Ivoire	KP	Democratic People's Republic of Korea	PL	Poland		
CM	Cameroon	KR	Republic of Korea	PT	Portugal		
CN	China	KZ	Kazakstan	RO	Romania		
CU	Cuba	LC	Saint Lucia	RU	Russian Federation		
CZ	Czech Republic	LI	Liechtenstein	SD	Sudan		
DE	Germany	LK	Sri Lanka	SE	Sweden		
DK	Denmark	LR	Liberia	SG	Singapore		
EE	Estonia						



Numerous approaches for reducing and removing such vascular deposits have been proposed, including balloon angioplasty where a balloon-tipped catheter is used to dilate a region of atheroma, and other devices that are pushed or pulled along or through a deposit, such as atherectomy where a blade or cutting bit is used to sever and remove the atheroma, spark gap reduction in which an electrical spark burns through the plaque, laser angioplasty where laser energy is used to ablate at least a portion of the atheroma, and opening of vessels through the use of stents.

Two major difficulties in using such devices are maintaining a constant translational rate for the device and obtaining images of and information on the region of the blood vessel to be treated. Several imaging techniques have been proposed. Catheters incorporating mechanical rotation of ultrasonic transducers for imaging are disclosed in U.S. Patent Nos. 4,794,931; 5,000,185; 5,049,130; and 5,024,234. These catheters scan in a plane normal to the catheter axis. Catheters employing phased array imaging systems are disclosed in U.S. Patent Nos. 4,841,977 and 4,917,097. Catheters employing fiber optic imaging components are also known.

Generally deposits extend some longitudinal distance along the length of a vessel. To view different portions of the deposit a physician typically moves a handle attached to a proximal end of the imaging catheter along the vessel, for example, by pushing or pulling the catheter.

Imaging using computer-assisted reconstruction algorithms enables physicians to view a representation of the patient's interior intravascular structures in two or three dimensions (i.e., so-called three-dimensional or longitudinal view reconstruction). In this connection, image reconstruction algorithms typically employ data-averaging techniques which assume that the intravascular structure between an adjacent pair of data samples will simply be an average of each such data sample. Thus, the algorithms use graphical "fill in" techniques to depict a selected section of a patient's vascular system under investigation. Of course, if data samples are not sufficiently closely spaced, then

lesions and/or other vessel abnormalities may in fact remain undetected (i.e., since they might lie between a pair of data samples and thereby be "masked" by the image reconstruction algorithms mentioned previously).

5 Even with the most skilled physician, it is practically impossible to manually exercise sufficiently slow constant rate longitudinal translation of the ultrasound imaging device (which thereby provides for a precisely known separation distance between adjacent data samples). In  
10 addition, with manual translation, the physician must manipulate the translation device while observing the conventional two-dimensional sectional images. This division of the physician's attention and difficulty in providing a sufficiently slow constant translation rate can result in some  
15 diagnostic information being missed. To minimize the risk that diagnostic information is missed, it is necessary to lengthen the imaging scan time which may be stressful to the patient. Similarly, it is difficult for physicians to manually control the translational rate of atherectomy  
20 catheters and other interventional devices that are longitudinally advanced and retracted through blood vessel and other body lumens.

U.S. Patent No. 5,485,486 discloses an ultrasound imaging transducer which is capable of being translated  
25 longitudinally within a section of a patient's vascular system at a precise constant rate through the use of a longitudinal translation assembly. The longitudinal translation assembly moves the entire rotary drive assembly to provide the desired longitudinal movement of the transducer. Such an ability  
30 enables a series of precisely separated data samples to be obtained thereby minimizing (if not eliminating) distorted and/or inaccurate reconstructions of the ultrasonically scanned vessel section (i.e., since a greater number of more closely spaced data samples can reliably be obtained). Also,  
35 such an assembly can be operated in a "hands-off" manner which allows the physician to devote his or her attention entirely to the real-time images with the assurance that all sections of the vessel are displayed. While such a longitudinal

translation assembly can work well, it is relatively large, bulky and heavy; it is expensive; and it is cumbersome to set up, in part because the rotary drive and longitudinal translation assemblies are wrapped in separate sterile drapes (plastic bags) for sterility.

One drawback with conventional catheter imaging systems is the cost of replacing the disposable catheter assembly. The catheter assembly is mounted to a draped pullback assembly for use, used and then discarded after use. However, the catheter assembly includes the electronics necessary to send, receive and filter signals. These electronic components are disposed of with the rest of the catheter assembly which raises the cost of the procedure.

#### SUMMARY OF THE INVENTION

The present invention provides an automatic pullback catheter system in which costly electronic signal processing components can be removed from the disposable catheter assembly and incorporated into the drive assembly. This helps reduce the cost of each use. With the present invention, the catheter assembly need only include the sheath, the elongate operative element within the sheath, the drive connector, and the data/information connector, typically a coaxial electrical connector. The drive and data/information connectors are preferably combined into a combined connector. The resulting structure is compact, simple to use, and reduces the cost of the disposable catheter assembly.

The drive assembly includes a body to which a drive chassis is mounted for movement along a longitudinal path by a longitudinal driver. The longitudinal driver typically includes a motor which rotates a longitudinal drive screw selectively coupled to the drive chassis by a threaded clamp or clutch. The drive assembly also includes a rotary driver mounted to the drive chassis and movable with the drive chassis along the longitudinal path. The rotary driver includes a rotary drive motor and a first combined connector rotatable by the rotary drive motor.

The catheter assembly includes a hollow sheath housing an elongate operative element, typically a rotatable imaging core or cable having an imaging element at its distal end. The sheath includes a proximal portion removably mounted to the body. The catheter assembly also includes a rotatable and axially movable second combined connector connected to the proximal end of the cable or other operative element. The second combined connector is preferably housed within the proximal portion of the sheath.

The first and second combined connectors are preferably blind matable connectors to facilitate mounting the catheter assembly to and dismounting the catheter assembly from the drive assembly. The combined connectors provide for the transfer of information/data from the operative element to the drive assembly as well as for both the longitudinal movement coupling of the two combined connectors and the rotary movement coupling of the two combined connectors. Therefore, rotating the first combined connector by the rotary drive motor mounted to the drive chassis rotates the second combined connector thereby rotating the elongate operative element. Likewise, actuating the longitudinal driver drives the drive chassis along the longitudinal path which causes the longitudinal movement of the operative element within the sheath.

The drive chassis is preferably mounted to the body along a linear bearing. Using a linear bearing helps to ensure that the longitudinal movement of the drive chassis is smooth, encounters little friction and is very stable. Using a manually actuated threaded clamp to selectively secure the drive chassis to the longitudinal drive screw permits the user to decouple the drive chassis from the longitudinal drive shaft when desired and manually move the drive chassis, and thus the imaging element at the distal end of the imaging core, to the desired longitudinal position.

Another advantage of the invention results when the connection between the first and second combined connectors is a blind matable connection. That is, the connectors need only be properly aligned so pushing the two connectors together

causes them to properly mate. Preferably, the data/information connection is made using coaxial plug and socket connectors which not only provide the desired electrical, optical or other type of connection, but also provides sufficient frictional engagement between the first and second combined connectors to permit the longitudinal movement of the elongate operative element (e.g. cable) within the sheath. While the frictional engagement between the two data/information connectors may be enough to provide an acceptable rotary drive interface, it is preferred that the first and second combined connectors include first and second rotary drive connectors including rotary drive surfaces. These rotary drive surfaces are preferably arranged to guide the two connectors into proper rotary alignment when engaged.

The proximal portion of the cable is preferably much stiffer than the remainder of the cable. This helps to ensure a fluid-tight seal can be provided between the cable and the proximal portion of the sheath. This is important when a fluid or flush port is provided distally of such seal; the seal helps to prevent the fluid from entering into the drive assembly. In addition, this stiff, proximal portion can be made sufficiently long so that when the rotary driver is in the longitudinally pulled-back or proximal position, only the stiff proximal portion of the cable is exterior of the sheath and inside the drive assembly. The stiff portion of the cable is stiff enough to be self-supporting and does not droop within the drive assembly. Pushing the cable distally is also facilitated by the use of a cable with a stiff proximal portion.

Other features and advantages will appear from the following description in which the preferred embodiment has been set forth in detail in conjunction with the accompanying drawings.

#### BRIEF DESCRIPTION OF THE DRAWINGS

Fig. 1 is a simplified schematic view of a catheter system made according to the invention;

Fig. 2 is a perspective view of a prototype of the drive assembly and the proximal portion of the catheter assembly of Fig. 1 with the drive assembly in a distal, extended position and with the sides of the body of the drive assembly removed for convenient access;

Fig. 2A is similar to Fig. 2 with the drive assembly in a proximal, pulled-back or retracted position;

Fig. 3 is a partial cross-sectional view of the catheter assembly of Figs. 1 and 2 with the cable assembly in a distal position, the bellows collapsed and the imaging element at the tip of the sheath;

Fig. 3A is a view similar to Fig. 3 with the cable assembly in the proximal position of Fig. 2A, the bellows expanded and the imaging element pulled back away from the tip of the sheath;

Fig. 4 is an isometric view of the cable assembly of Fig. 3;

Fig. 5 is an exploded isometric view of the cable assembly of Fig. 4;

Fig. 6 is an isometric view of the first combined connector and bearing assembly of Fig. 1; and

Fig. 7 is an exploded isometric view of the first combined connector and bearing assembly of Fig. 6.

#### DESCRIPTION OF THE PREFERRED EMBODIMENT

Fig. 1 illustrates, in schematic form, a catheter system 2 including a drive assembly 4 to which a typically disposable catheter assembly 6 is removably mounted. Referring now also to Figs. 2 and 2A, drive assembly 4 includes a body 8 having a base 10 supporting a linear bearing track 12. A drive chassis 14 is mounted for linear movement along a longitudinal path 16 by a longitudinal driver 18. Longitudinal driver 18 includes a longitudinal drive motor 20 which rotates a longitudinal drive screw 22 rotatably supported at each end by body 8. Driver 18 also includes a threaded clamp 24 having threads which match the threads on drive screw 22. Clamp 24 is mounted to and moves with drive chassis 14. Clamp 24 is normally biased into engagement with

drive screw 22, but can be moved out of engagement with drive shaft 22 by the user moving a drive clamp handle 26; doing so disengages clamp 24 from drive screw 22 and permits the user to move drive chassis 14 along longitudinal path 16.

5 Releasing drive clamp handle 26 allows clamp 24 to again engage drive screw 22; this secures drive chassis 14 in position along longitudinal path 16, subject to any subsequent rotation of drive screw 22.

10 Drive assembly 4 also includes a rotary driver 28 mounted to and carried by drive chassis 14. Rotary driver 28 includes a rotary drive motor 30, mounted to drive chassis 14, which rotates a drive shaft 32. As will be discussed in more detail below, drive shaft 32 rotates a first combined connector 34. First combined connector 34 moves with drive  
15 chassis 14 along longitudinal path 16. First combined connector 34 operably engages a second combined connector 36, also discussed below, the second combined connector being a part of catheter assembly 6.

20 Turning now to Figs. 3-5, catheter assembly 6 will be described in more detail. Catheter assembly 6 includes a hollow sheath 38 extending between a tip 40 at its distal end and a hub 42 at its proximal end with a main portion 43 in between. Sheath 38 houses a cable assembly 44, see Figs. 4 and 5. Cable assembly 44 includes second combined  
25 connector 36 from which a cable 46 (the elongate operative element) extends. Cable 46 includes a stiff initial section 48 extending from second combined connector 36 and an image element 50 at the distal end of cable 46. Stiff initial section 48 is typically made by securing a length of hypotube (a thin-walled stainless steel tube) over the proximal end of  
30 the cable. Cable assembly 44 can be used for ultrasonic imaging, laser imaging or other imaging purposes. Also, cable assembly 44 could be used for purposes other than imaging such as ablation, photodynamic therapy, delivery of therapeutic or diagnostic fluids, delivery of devices such as stents, and for  
35 other purposes. In the preferred embodiment, tip 40 is open to permit fluid to be flushed through the interior of sheath 44; in some situations tip 40 may be sealed. In some

cases image element 50 may be positioned past tip 40 and external of sheath 38.

5 Second combined connector 36 includes a second rotary drive connector 52 and a second electrical connector or plug 54 (a data/information connector). A drive joint 56 has three spring fingers 58 which engage recesses 60 formed in drive connector 52 to secure plug 54 in place. Plug 54 has spring finger electrical contacts 62 surrounding a center pin 64. Initial section 48 of cable 46 is secured to the interior of a rotary shaft coupler 6, coupler 66 being affixed to a hub 10 portion 68 of drive joint 56. Appropriate electrical connections between drive cable 46 and plug 54 are made in a conventional manner.

15 Hub 42 of sheath 38 includes a main cavity 70 which houses second combined connector 36. Catheter assembly 6 also includes a bearing washer 74 mounted between second combined connector 36 and the proximal end of main cavity 70. Bellows 78, typically made of polyester shrink (?) or PTFE, is fastened at its proximal edge 80 to drive joint 56 and its 20 distal edge 82 to hub 42. Bellows 78 is used to help prevent contamination of the interior of sheath 38. Bearing washer 74, used to secure the distal end of a bellows 78 to hub 42, is made of a low friction polymer.

25 Hub 42 also includes a fluid or flush port 84 coupled to the interior of sheath 38 to permit the sheath interior to be flushed with a saline solution or other suitable fluid. An O-ring fluid seal 86 is used between hub 42 and coupler 66 (in position of Fig. 2) or stiff initial section 48 (in position of Fig. 2A) to prevent the flow of 30 fluid from flush port 84 back into cavity 70 and thus into the interior of drive assembly 4.

35 Catheter assembly 6 is quickly and easily mounted to drive assembly 4. To do so, the proximal end of hub 42 is inserted into a through-hole 88 formed in a proximal portion mount 90 of body 8 of drive assembly 4 until latched into place. This occurs by the engagement of an upwardly-extending, spring-biased latch pin, not shown, engaging a recess 94 formed in hub 42; the latch pin can be removed from

recess 94 by the user pressing on a release button 92. Mounting catheter assembly 6 to drive assembly 4 preferably occurs when rotary driver 28 is in the distal-most or fully-extended position of Figs. 1 and 2. Upon mounting  
5 hub 42 into proximal portion member 90, second combined connector 36 automatically blind matably connects with first combined connector 34 to provide for longitudinal and rotational driving connection and for electrical connection.

Turning now to Figs. 6 and 7, first combined  
10 connector assembly 34 will be discussed. First combined connector assembly 34 includes a first rotary drive connector 96 configured for complementary mating engagement with second rotary drive connector 52. Assembly 34 also includes a first electrical connector or socket 98 secured  
15 between connector 96 and a second drive joint 100. Socket 98 and plug 54 are configured to mate with one another in a coaxial mating arrangement in a manner similar to connector 22, electrical connector 54 and drive joint 56 of Fig. 5. First combined connector 34 is coupled to a bearing  
20 assembly 102. Bearing assembly 102 includes first and second housing portions 104, 106 which house drive shaft 32. Electrical wires 107 extend from socket 98, through housing portion 104, and through a cut-out 109 in housing portion 106 for connection to appropriate circuitry, not shown. Bearing  
25 assembly 102 is supported by the front end 108 of drive chassis 14 engaging housing portion 104. Drive shaft 32 is supported within housing portions 104, 106 by a pair of bearings 110, 112. Drive shaft 32 passes freely through a non-rotating ferrite 114 which is fixed within distal housing  
30 portion 104, typically through a light press fit or through the use of an adhesive. Non-rotating ferrite 114 is positioned at a necked down portion 116 of drive shaft 108. A rotating ferrite 118 is mounted to drive shaft 32 to be positioned adjacent to non-rotating ferrite 114. Rotating  
35 ferrite 118 is secured to drive shaft 32, such as through a light press fit, and rotates with the drive shaft. Rotating and non-rotating ferrites 118, 114 are used to monitor the rotation of drive shaft 32 and, thus, of cable assembly 44.

The hub portion 120 of drive joint 100 is housed within the distal end of distal housing portion 104. The distal end 122 of drive shaft 32 is keyed or otherwise fixed to hub portion 120 so that rotating drive shaft 32 causes first rotary drive connector 96 to rotate, thus rotating cable assembly 44. The proximal end 124 of drive shaft 32 extends beyond housing portion 106 and into driven engagement with rotary drive motor 30. Thus, rotary motion of rotary drive motor 30 causes drive shaft 32 to rotate, thus rotating cable assembly 44. Longitudinal movement of drive chassis 14 through the engagement of clamp 24 with drive screw 22 causes rotary driver 28 to move along longitudinal path 16. However, the frictional connection between plug 54 and socket 98 causes cable assembly 44, see Fig. 4, to be pulled along longitudinal path 16 with the longitudinal movement of rotary driver 28. The use of stiffened section 48 as the initial portion of cable 46 provides the necessary support for the cable during this longitudinal movement.

In use, an appropriate catheter assembly 6 is selected to be used during a procedure. If rotary driver 28 is not in its distal-most position of Figs. 1 and 2, the user will place rotary driver 28 at its distal-most position, typically by grasping drive clamp handle 26, temporarily disengaging clamp 24 from drive screw 22, and then manually moving the rotary driver in the distal direction to its distal-most position. Once in position, drive clamp handle 26 is released, permitting the reengagement of threaded clamp 24 with drive screw 22, thus securing rotary driver 28 in place. Spring biased release button 92 is then depressed and the proximal end of hub 42 is inserted into through-hole 88 formed in proximal portion mount 90. Once hub 42 is partially inserted, release button 92 is released and hub 42 is continued to be inserted into mount 90 until the locking pin attached to release button 92 engages recess 94 formed in hub 42. When this occurs, hub 42 becomes properly secured to drive assembly 4.

During this insertion, first and second combined connectors 34, 36 blind matably connect to one another. First

and second rotary drive connectors 96, 52 have alignment/drive surfaces 126, 128 which extend both circumferentially and longitudinally so to provide the proper rotary orientation upon engagement of the connectors. In addition, plug 54 and socket 98 are axially aligned during this movement and become electrically coupled to one another as the first and second rotary drive connectors 96, 52 mate.

Tip 40 of catheter assembly 6 is then transluminally positioned to the target area within the patient. With rotary driver 28 in its distal-most position, which causes imaging element 50 to be in its distal-most position, rotary drive motor 30 and longitudinal drive motor 20 can be simultaneously or sequentially actuated to permit 360° images to be obtained along a length of vessel or other cavity within a patient. Excessive proximal movement is prevented when drive chassis 14 engages a limit switch 130 mounted to body 8.

The movements of imaging element 50 are controlled in a very stable manner through the use of motors 20, 30 to provide superior imaging than could otherwise be obtained. If desired, rotary driver 28 can be manually longitudinally positioned through the disengagement of clamp 24, the manual movement of rotary actuator 28 along longitudinal path 16 and the reengagement of clamp 24 with drive screw 22. In the preferred embodiment, the length of longitudinal travel will be about 10 cm. Drive assembly 4 can be made to accommodate other lengths of longitudinal travel as well.

Modification and variation can be made to the disclosed embodiment without departing from the subject of the invention as defined in the following claims. For example, other types of rotary and longitudinal drivers could be used, such as a longitudinal chain or belt drive in lieu of the longitudinal drive screw 22. It is desirable that combined connectors 34, 36 be engagable and disengagable by straight longitudinal movement of the connectors into and out of engagement. However, in appropriate circumstances, a type of twist-lock blind matable connector may be used as well. Alignment/drive surfaces 126, 128 are basically dual V-shaped surfaces so that cable assembly 44 ends up at one of two

different rotary orientations, 180° apart, relative to the rotary orientation of first combined connector 34. It may be desirable in some circumstances to ensure only a single relative rotary orientation of connectors 34, 36. This could be achieved by having a single angled surface for guiding the connectors into the proper rotary orientation and separate rotary drive surfaces for a rotary driving engagement between the two connectors. Body 8 is shown in a very simple form. In a commercial embodiment, body 8 would preferably have a more ergonomic shape, and may have fixed or extendable legs to allow drive assembly to rest comfortably but securely on, for example, the patient's leg or chest. While it is expected that drive assembly 4 will be connected to remote power and control assemblies, it may be desirable to include a controller, input panel, and a battery pack as a part of drive assembly 4 to make the drive assembly substantially self-contained. Data from catheter system 2 could be then provided to an external recorder and/or monitor through hardware or telemetry, such as by using radio frequency transmitters and receivers. While the invention is particularly adapted for imaging of vascular regions, the invention is suitable types of diagnostic and therapeutic procedures in vascular and other body structures. Instead of bellows 78, other structures, such as telescoping tubing, can be used to help prevent contamination of the interior of sheath 38; the bellows or tubing could have round, rectangular or other cross-sectioned shapes.

Any and all patents, applications and publications referred to above are incorporated by reference.

WHAT IS CLAIMED IS:

- 1           1. A catheter assembly comprising:  
2           a hollow sheath having a proximal portion and a tip;  
3           an elongate operative element slidably and rotatably  
4 housed within the sheath, the operative element comprising a  
5 distal end and a proximal end;  
6           the elongate operative element comprising a  
7 relatively stiff, self-supporting initial section at the  
8 proximal end thereof; and  
9           a combined connector secured to the proximal end of  
10 the operative element, said combined connector comprising a  
11 data/information connector and a mechanical connector.
- 1           2. The catheter assembly according to claim 1  
2 wherein said data/information connector comprises an  
3 electrical connector.
- 1           3. The catheter assembly according to claim 1  
2 wherein said mechanical connector comprises a rotary drive  
3 connector.
- 1           4. The catheter assembly according to claim 3  
2 wherein said rotary drive connector comprises an axially- and  
3 circumferentially-extending drive surface.
- 1           5. The catheter assembly according to claim 1  
2 wherein said combined connector comprises a rotary alignment  
3 surface.
- 1           6. The catheter assembly according to claim 1  
2 wherein said elongate operative element comprises an imaging  
3 cable having an image element at said distal end thereof.
- 1           7. The catheter assembly according to claim 1  
2 wherein said initial section comprises a metal tube.

1           8. The catheter assembly according to claim 1  
2 further comprising a fluid seal between said proximal portion  
3 of said sheath and the initial section of the elongate  
4 operative element.

1           9. The catheter system according to claim 1  
2 wherein said elongate operative element comprises a flexible  
3 imaging core and a relatively stiff tube at the proximal end  
4 thereof to create a relatively stiff, self-supporting initial  
5 section of the elongate operative element at the proximal end  
6 thereof.

1           10. A combined connector assembly, for use with a  
2 catheter system of the type including a rotary and  
3 longitudinal driver and a catheter assembly having an outer  
4 sheath and an inner catheter rotatably and slidably housed  
5 within the outer sheath, the combined connector assembly  
6 comprising:

7           a first combined connector connected to and movable  
8 with the driver and a second combined connector connected to  
9 and movable with the inner catheter; and

10           said first and second combined connectors being  
11 blind matable connectors constructed to (1) provide a  
12 data/information connection between the driver and the inner  
13 catheter when connected, and (2) cause the second combined  
14 connector and inner catheter therewith to rotate and move  
15 longitudinally according to the rotation and longitudinal  
16 movement of the driver.

1           11. The connector assembly according to claim 10  
2 wherein the first and second combined connectors comprise:  
3           socket and plug electrical connectors; and  
4           first and second rotary drive connectors  
5           with axially- and circumferentially-extending drive surfaces.

1           12. The connector assembly according to claim 11  
2 wherein said socket and plug electrical connectors are located  
3 coaxial with said first and second rotary drive connectors.

1           13. The connector assembly according to claim 10  
2 wherein said first and second combined connectors comprise  
3 rotary alignment surfaces which engage when said connectors  
4 are connected so to ensure proper rotary alignment of said  
5 connectors when connected.

1           14. A catheter system comprising:  
2 a drive assembly comprising:  
3           a body including a proximal portion mount;  
4           a drive chassis movably mounted to the body for  
5 movement along a longitudinal path;  
6           a longitudinal mover operably coupling the  
7 drive chassis and the body for selective movement of the drive  
8 chassis along the longitudinal path; and  
9           a rotary driver mounted to the drive chassis  
10 and moveable therewith along the longitudinal path, the rotary  
11 driver comprising a rotary drive motor and a first combined  
12 connector rotatable by the rotary drive motor and movable  
13 along the longitudinal path between first and second  
14 positions; and  
15           a catheter assembly comprising:  
16           a hollow sheath having a proximal portion and a  
17 tip, said proximal portion of the sheath being removably  
18 secured to the proximal portion mount of the body;  
19           an elongate operative element slidably and  
20 rotatably housed within the sheath, the operative element  
21 comprising a distal end and a proximal end; and  
22           a second combined connector secured to the proximal  
23 end of the operative element; and  
24           said first and second combined connectors being  
25 blind matable connectors constructed to (1) provide a  
26 data/information connection between the operative element and  
27 the rotary driver when connected, and (2) cause the second  
28 combined connector and operative element therewith to rotate  
29 and move longitudinally according to the rotation and  
30 longitudinal movement of the first combined connector.

1           15. The catheter system according to claim 14  
2 wherein the body and the drive chassis comprise a linear  
3 bearing, the linear bearing comprising a linear bearing track  
4 mounted to the body, the linear bearing track lying parallel  
5 to said longitudinal path.

1           16. The catheter system according to claim 14  
2 wherein the longitudinal mover comprises:  
3           a drive screw rotatably mounted to the body;  
4           a drive screw motor mounted to the body and  
5 drivingly coupled to the drive screw; and  
6           a drive screw clamp mounted to the drive chassis for  
7 movement between drive screw engaged and disengaged positions  
8 so that said chassis is moved along the longitudinal path when  
9 the drive screw clamp is in the drive screw engaged position  
10 and the drive screw motor is rotating the drive screw.

1           17. The catheter system according to claim 16  
2 wherein the drive screw is housed within the body.

1           18. The catheter system according to claim 16  
2 wherein the drive screw clamp is a manually-operated clamp.

1           19. The catheter system according to claim 14  
2 wherein the first and second combined connectors comprise:  
3           socket and plug electrical connectors; and  
4           first and second rotary drive connectors  
5 with axially- and circumferentially-extending drive surfaces.

1           20. The catheter system according to claim 19  
2 wherein said socket and plug electrical connectors are located  
3 coaxial with said first and second rotary drive connectors.

1           21. The catheter system according to claim 14  
2 wherein said first and second combined connectors comprise  
3 rotary alignment surfaces which engage when said connectors  
4 are connected so to ensure proper rotary alignment of said  
5 connectors when connected.

1           22. The catheter system according to claim 14  
2 wherein said proximal portion of said sheath comprises a fluid  
3 port.

1           23. The catheter system according to claim 14  
2 wherein the elongate operative element comprises a relatively  
3 stiff, self-supporting initial section at the proximal end  
4 thereof.

1           24. A method for operating a catheter system  
2 comprising:

3           selecting a catheter assembly, said catheter  
4 assembly comprising:

5           a hollow sheath having a proximal portion and a  
6 tip;

7           an elongate operative element slidably and  
8 rotatably housed within the sheath, the operative element  
9 comprising a distal end and a proximal end; and

10          a second combined connector secured to the  
11 proximal end of the operative element;

12          mounting said catheter assembly to a drive assembly,  
13 the drive assembly comprising a rotatable and translatable  
14 first combined connector;

15          connecting the second combined connector of the  
16 catheter assembly to the first combined connector;

17          securing the proximal portion of the sheath to a  
18 proximal portion mount of the drive assembly;

19          selectively rotating the first combined connector  
20 which in turn rotates the second combined connector which in  
21 turn rotates the elongate operative element within the sheath;  
22 and

23          selectively longitudinally translating the operative  
24 element within the sheath by moving the first combined  
25 connector along a longitudinal path between an extended  
26 position and a retracted position.

1           25. The method according to claim 24 wherein the  
2 catheter assembly mounting step is carried out by positioning  
3 the first combined connector at the extended position, the  
4 first and second combined connectors being connected to one  
5 another while the proximal portion of the sheath and the  
6 proximal portion mount are being secured to one another.

1           26. The method according to claim 24 wherein the  
2 connecting step is carried out by moving the proximal end of  
3 the catheter assembly in a straight line causing the  
4 frictional coupling of the first and second combined  
5 connectors.

1           27. The method according to claim 26 wherein the  
2 proximal end moving step causes the first and second combined  
3 connectors to be frictionally coupled.

1           28. The method according to claim 24 wherein the  
2 selectively rotating step is carried out using a motor.

1           29. The method according to claim 24 wherein the  
2 selectively longitudinally translating step is carried out  
3 using a motor.

1           30. The method according to claim 24 wherein the  
2 selectively longitudinally translating step can be carried out  
3 manually or using a motor.

1           31. The method according to claim 30 wherein when  
2 the selectively longitudinally translating step is carried out  
3 manually, a user manually disengages a drive chassis of the  
4 drive assembly from a drive screw of the drive assembly to  
5 permit said drive chassis, and the first combined connector  
6 therewith, to be freely manually translated along a  
7 longitudinal path.

1           32. The method according to claim 24 wherein said  
2 positioning step is carried out manually, a user manually  
3 disengages a drive chassis of the drive assembly from a drive  
4 screw of the drive assembly to permit said drive chassis, and  
5 the first combined connector therewith, to be freely manually  
6 translated along a longitudinal path.

1           33. A method for preparing a catheter system for  
2 use, comprising the following steps:

3           selecting a catheter assembly, said catheter  
4 assembly comprising:

5                   a hollow sheath having a proximal portion and a  
6 tip;

7                   an elongate operative element slidably and  
8 rotatably housed within the sheath, the operative element  
9 comprising a distal end and a proximal end; and

10                  a second combined connector secured to the  
11 proximal end of the operative element; and

12                  mounting said catheter assembly to a drive assembly  
13 by:

14                   positioning a rotatable and translatable first  
15 combined connector at an extended position; and

16                   connecting the second combined connector of the  
17 catheter assembly to the first combined connector while  
18 securing the proximal portion of the sheath to a proximal  
19 portion mount of the drive assembly so that rotating the first  
20 combined connector rotates the second combined connector which  
21 in turn rotates the elongate operative element within the  
22 sheath, and moving the first combined connector along a  
23 longitudinal path between said extended position and a  
24 retracted position translates the second combined connector  
25 which in turn translates the operative element within the  
26 sheath.

2

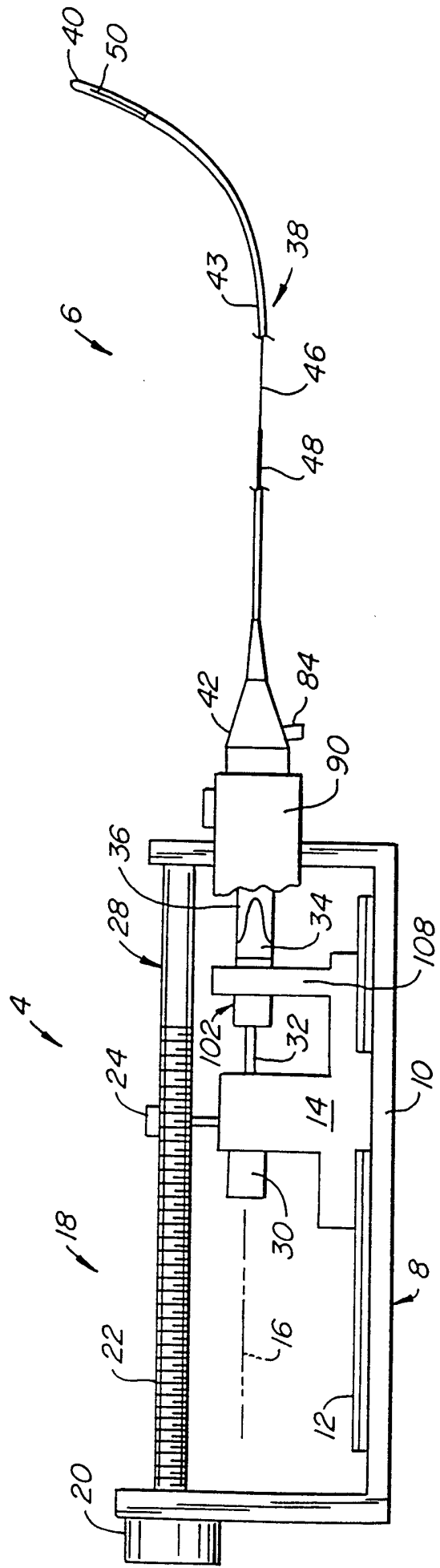

FIG. 1.

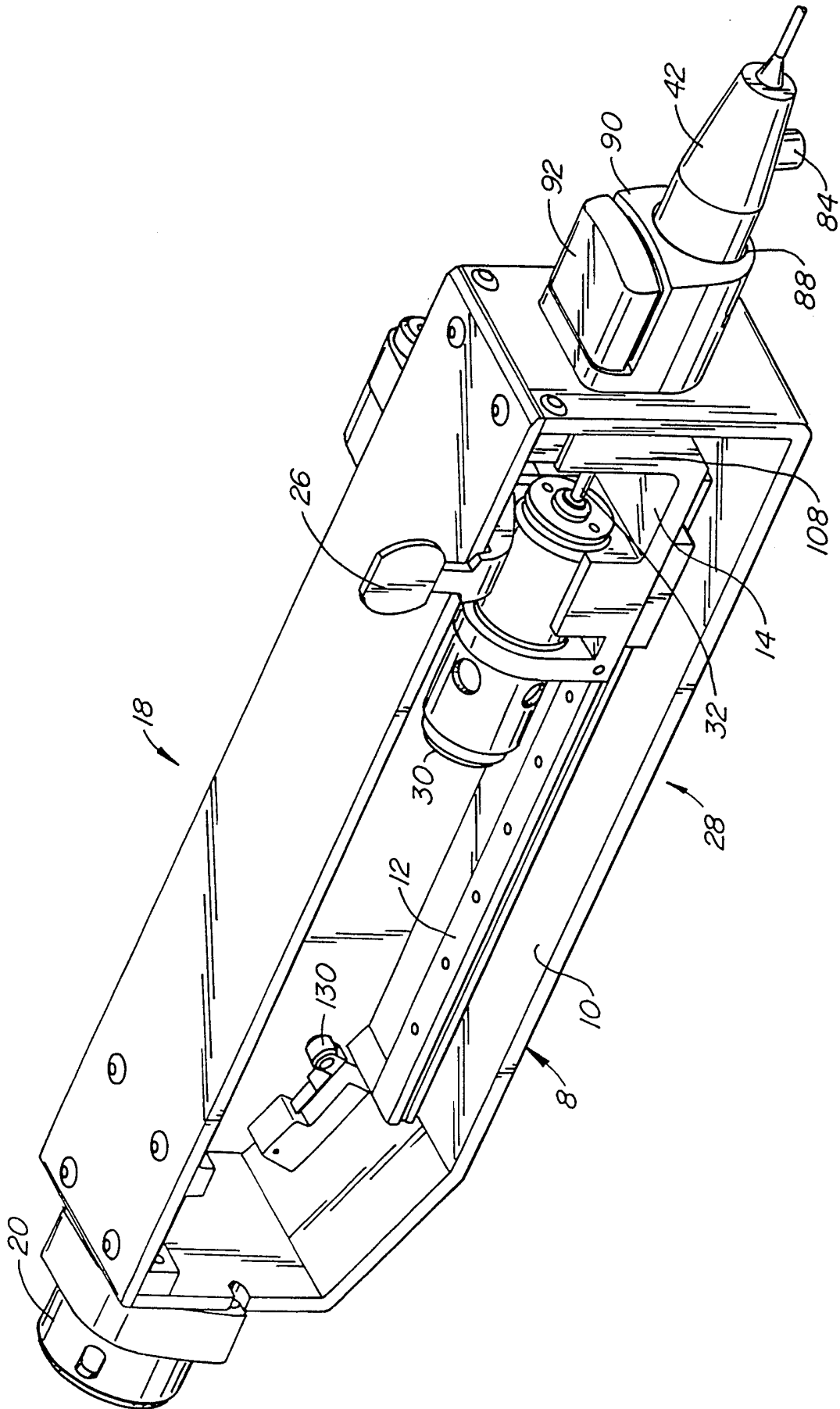

FIG. 2.

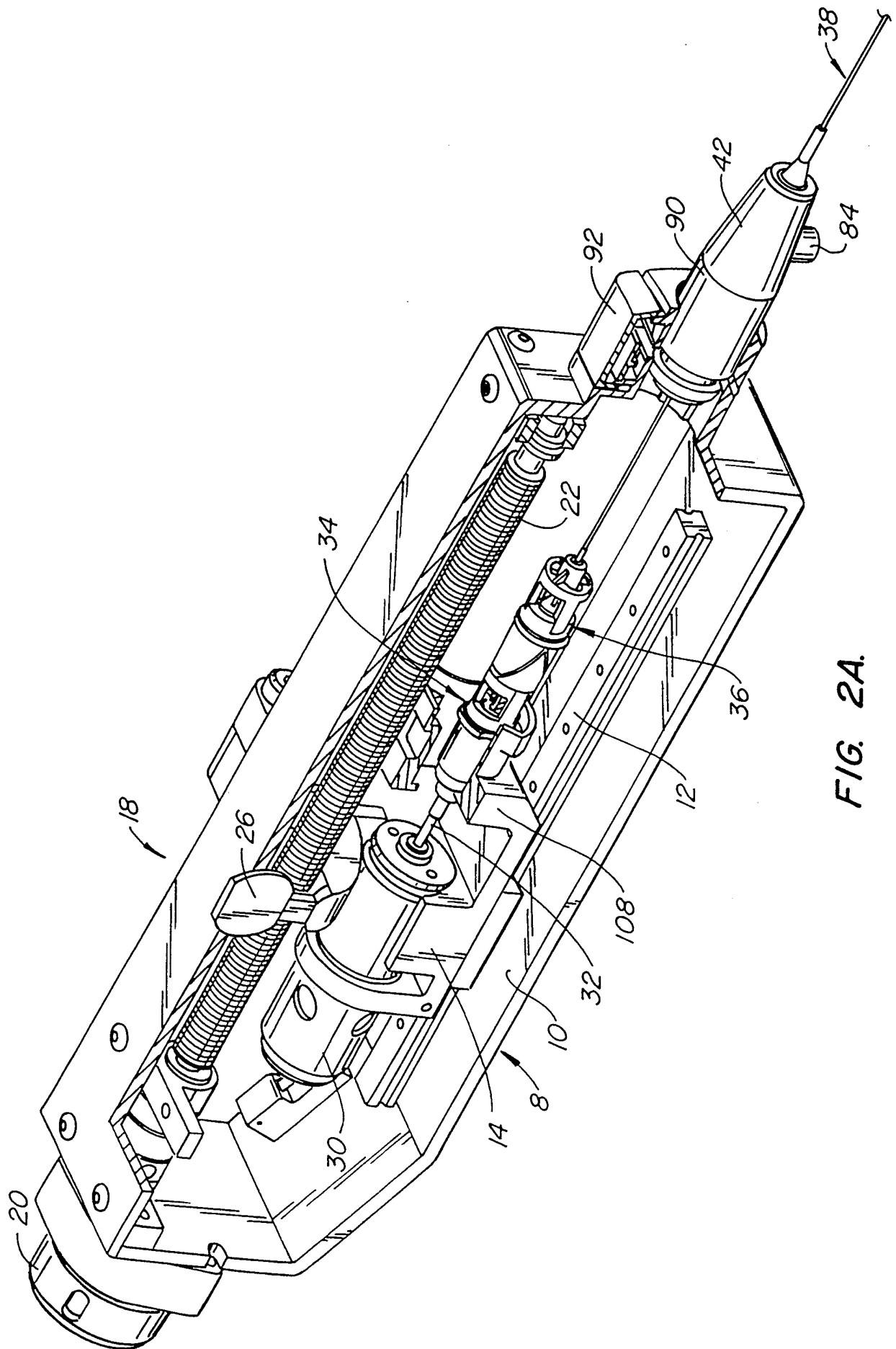

FIG. 2A.

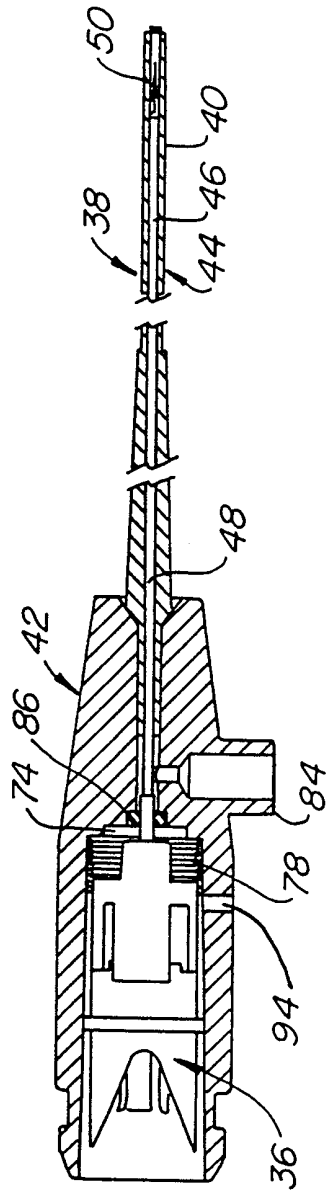

FIG. 3.

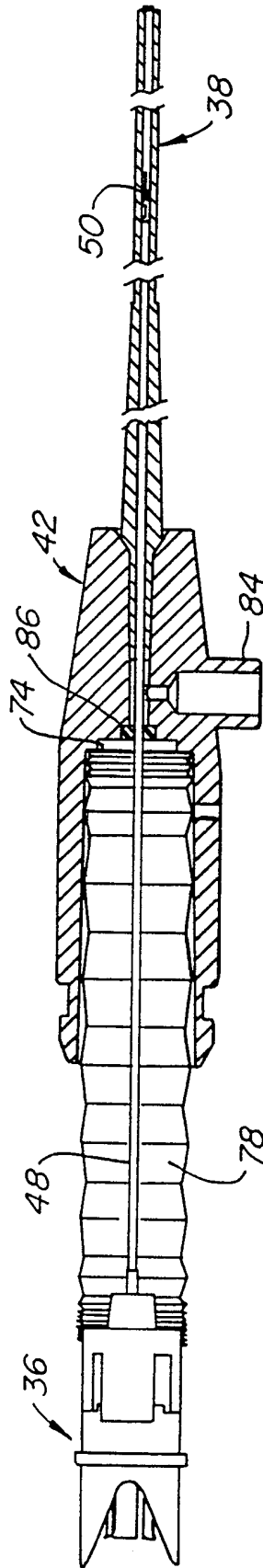

FIG. 3A.

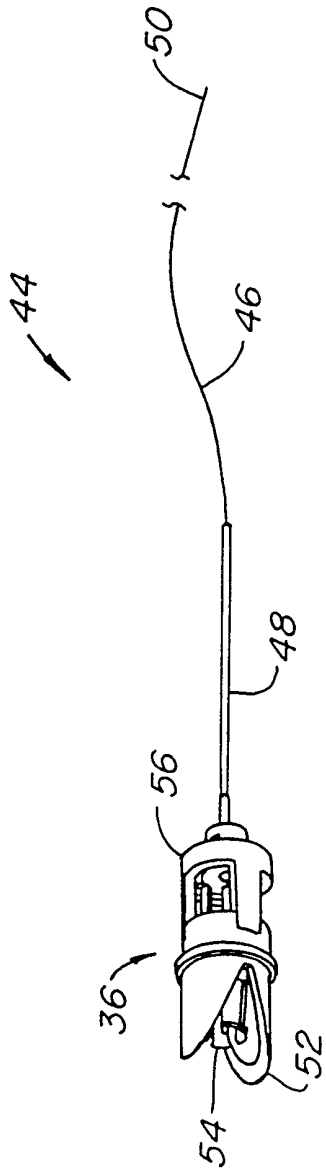

FIG. 4.

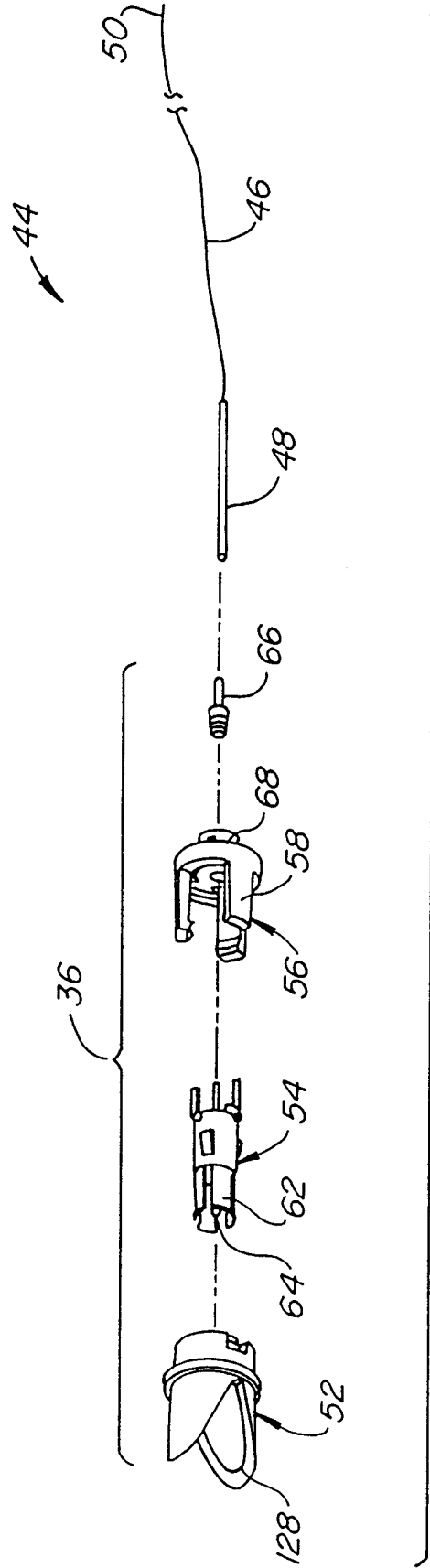

FIG. 5.

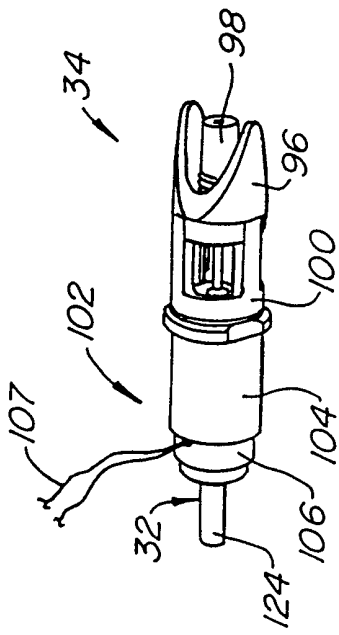

FIG. 6.

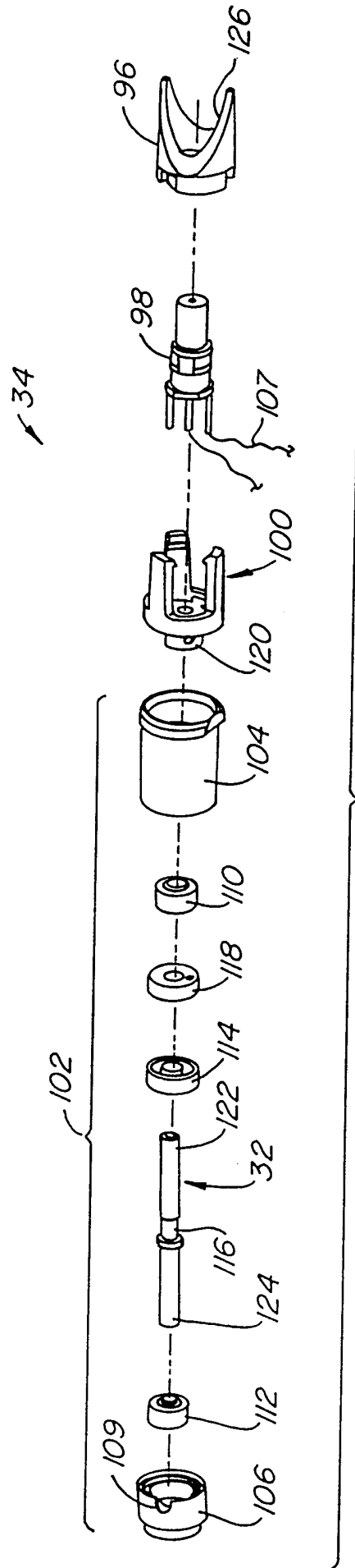

FIG. 7.

# INTERNATIONAL SEARCH REPORT

International Application No

PCT/IB 99/01363

**A. CLASSIFICATION OF SUBJECT MATTER**

IPC 7 A61B8/12

According to International Patent Classification (IPC) or to both national classification and IPC

**B. FIELDS SEARCHED**

Minimum documentation searched (classification system followed by classification symbols)

IPC 7 A61B

Documentation searched other than minimum documentation to the extent that such documents are included in the fields searched

Electronic data base consulted during the international search (name of data base and, where practical, search terms used)

**C. DOCUMENTS CONSIDERED TO BE RELEVANT**

Category °	Citation of document, with indication, where appropriate, of the relevant passages	Relevant to claim No.
X A	WO 92 03095 A (BOSTON SCIENTIFIC) 5 March 1992 (1992-03-05) page 19, line 19 -page 24, line 14  page 47, line 19 - line 21 -----	1-3, 6-10, 12 4, 11, 14, 19, 20, 22-24, 26-28, 30-33
A	US 5 546 947 A (YAGAMI & AL) 20 August 1996 (1996-08-20)  column 9, line 64 -column 10, line 40 -----	1-3, 5, 10, 12-14, 21

Further documents are listed in the continuation of box C.

Patent family members are listed in annex.

° Special categories of cited documents :

"A" document defining the general state of the art which is not considered to be of particular relevance

"E" earlier document but published on or after the international filing date

"L" document which may throw doubts on priority claim(s) or which is cited to establish the publication date of another citation or other special reason (as specified)

"O" document referring to an oral disclosure, use, exhibition or other means

"P" document published prior to the international filing date but later than the priority date claimed

"T" later document published after the international filing date or priority date and not in conflict with the application but cited to understand the principle or theory underlying the invention

"X" document of particular relevance; the claimed invention cannot be considered novel or cannot be considered to involve an inventive step when the document is taken alone

"Y" document of particular relevance; the claimed invention cannot be considered to involve an inventive step when the document is combined with one or more other such documents, such combination being obvious to a person skilled in the art.

"&" document member of the same patent family

Date of the actual completion of the international search

11 November 1999

Date of mailing of the international search report

18/11/1999

Name and mailing address of the ISA

European Patent Office, P.B. 5818 Patentlaan 2  
 NL - 2280 HV Rijswijk  
 Tel. (+31-70) 340-2040, Tx. 31 651 epo nl,  
 Fax: (+31-70) 340-3016

Authorized officer

Lemercier, D

# INTERNATIONAL SEARCH REPORT

Information on patent family members

International Application No

Pct/IB 99/01363

Patent document cited in search report	Publication date	Patent family member(s)	Publication date
WO 9203095    A	05-03-1992	CA 2089656 A	22-02-1992
		EP 0544820 A	09-06-1993
		JP 6500248 T	13-01-1994
		US 5421338 A	06-06-1995
		US 5546948 A	20-08-1996
		US 5524630 A	11-06-1996
		US 5588432 A	31-12-1996
		US 5715825 A	10-02-1998
		US 5368035 A	29-11-1994
		US 5372138 A	13-12-1994
US 5546947    A	20-08-1996	JP 7095980 A	11-04-1995
		JP 7155327 A	20-06-1995
		JP 7255726 A	09-10-1995
		JP 7265310 A	17-10-1995