



(11) **EP 3 064 676 A3**

(12) **EUROPEAN PATENT APPLICATION**

(88) Date of publication A3:
21.12.2016 Bulletin 2016/51

(51) Int Cl.:
E04H 15/38 ^(2006.01) **E04H 15/48** ^(2006.01)
E04H 15/32 ^(2006.01)

(43) Date of publication A2:
07.09.2016 Bulletin 2016/36

(21) Application number: **16020043.2**

(22) Date of filing: **12.02.2016**

(84) Designated Contracting States:
AL AT BE BG CH CY CZ DE DK EE ES FI FR GB GR HR HU IE IS IT LI LT LU LV MC MK MT NL NO PL PT RO RS SE SI SK SM TR
Designated Extension States:
BA ME
Designated Validation States:
MA MD

(71) Applicant: **Fox International Group Limited**
Hainault,
Essex IG6 3UT (GB)

(72) Inventor: **Taylor, Adam Richard Ellis**
Loughton, Essex IG10 2QH (GB)

(74) Representative: **Crouch, David John et al**
Bromhead Johnson
Sovereign House
212-224 Shaftesbury Avenue
London WC2H 8HQ (GB)

(30) Priority: **13.02.2015 GB 201502466**

(54) **A TENT FRAME AND CORRESPONDING TENT**

(57) A tent frame (10) comprising a hub (12) from which extend a plurality of limbs (14,15), respective ends of some of which are secured to the hub (12) by way of respective pivots (16), constituting a first set of pivots, having respective pivot axes which are generally parallel to one another. Respective ends of at least two (15) of the said plurality of limbs (14,15) are secured to the hub (12) by way of respective pivots (24), constituting a second set of pivots, enabling the said at least two (15) of

the said plurality of limbs (14,15) to be pivoted about axes which are generally transverse of the pivot axes of the said first set of pivots (16). The pivots (16,24) of the first and second set of pivots are fixed in position relative to one another even when the limbs (14,15) are pivoted about their respective pivots (16,24) whilst the frame (10) is unfolded into an erect condition and whilst it is folded for stowage.

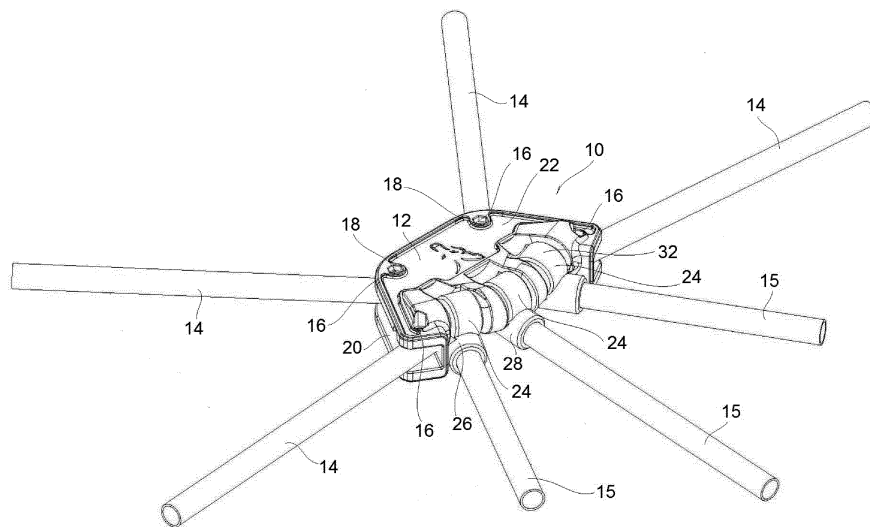

Fig. 1

EP 3 064 676 A3



EUROPEAN SEARCH REPORT

Application Number
EP 16 02 0043

5

10

15

20

25

30

35

40

45

50

55

DOCUMENTS CONSIDERED TO BE RELEVANT			
Category	Citation of document with indication, where appropriate, of relevant passages	Relevant to claim	CLASSIFICATION OF THE APPLICATION (IPC)
X	WO 2009/071026 A1 (XIAMEN INNOVATION METAL PROD [CN]; CHOI KWANJUN [KR]) 11 June 2009 (2009-06-11) * figures 1-7 *	1-3,8,14	INV. E04H15/38 E04H15/48 E04H15/32
A	----- * figures 1-7 *	4-7	
X	AU 523 506 B2 (ORIBIN EDWIN HENRY; ORIBIN J I) 29 July 1982 (1982-07-29) * figures 1-3 *	1-3,8,14	
A	----- * figures 1-3 *	4-7	
X	EP 0 417 919 A1 (QUAKER OATS CO [US]) 20 March 1991 (1991-03-20) * figures 1-7 *	1-3,8,14	
A	----- * figures 1-7 *	4-7	
A,D	EP 1 445 400 A1 (MANIFOLD CHRISTOPHER DAVID [GB]) 11 August 2004 (2004-08-11) * figures 1-15 *	1-8,14	

----- -The present search report has been drawn up for all claims			
Place of search Munich		Date of completion of the search 26 July 2016	Examiner Decker, Robert
CATEGORY OF CITED DOCUMENTS X : particularly relevant if taken alone Y : particularly relevant if combined with another document of the same category A : technological background O : non-written disclosure P : intermediate document T : theory or principle underlying the invention E : earlier patent document, but published on, or after the filing date D : document cited in the application L : document cited for other reasons & : member of the same patent family, corresponding document			

EPO FORM 1503 03/02 (P04C01)



Application Number

EP 16 02 0043

5

CLAIMS INCURRING FEES

The present European patent application comprised at the time of filing claims for which payment was due.

10

Only part of the claims have been paid within the prescribed time limit. The present European search report has been drawn up for those claims for which no payment was due and for those claims for which claims fees have been paid, namely claim(s):

15

No claims fees have been paid within the prescribed time limit. The present European search report has been drawn up for those claims for which no payment was due.

20

LACK OF UNITY OF INVENTION

The Search Division considers that the present European patent application does not comply with the requirements of unity of invention and relates to several inventions or groups of inventions, namely:

25

see sheet B

30

All further search fees have been paid within the fixed time limit. The present European search report has been drawn up for all claims.

35

As all searchable claims could be searched without effort justifying an additional fee, the Search Division did not invite payment of any additional fee.

40

Only part of the further search fees have been paid within the fixed time limit. The present European search report has been drawn up for those parts of the European patent application which relate to the inventions in respect of which search fees have been paid, namely claims:

45

None of the further search fees have been paid within the fixed time limit. The present European search report has been drawn up for those parts of the European patent application which relate to the invention first mentioned in the claims, namely claims:

50

1-8(completely); 14(partially)

55

The present supplementary European search report has been drawn up for those parts of the European patent application which relate to the invention first mentioned in the claims (Rule 164 (1) EPC).



**LACK OF UNITY OF INVENTION
SHEET B**

Application Number
EP 16 02 0043

5

The Search Division considers that the present European patent application does not comply with the requirements of unity of invention and relates to several inventions or groups of inventions, namely:

10

1. claims: 1-8(completely); 14(partially)

A first tent frame and corresponding tent

15

2. claims: 9, 10(completely); 13, 14(partially)

A second tent frame and corresponding tent

20

3. claims: 11, 12(completely); 13, 14(partially)

Third tent frame and corresponding tent

25

30

35

40

45

50

55

ANNEX TO THE EUROPEAN SEARCH REPORT
ON EUROPEAN PATENT APPLICATION NO.

EP 16 02 0043

5 This annex lists the patent family members relating to the patent documents cited in the above-mentioned European search report.
The members are as contained in the European Patent Office EDP file on
The European Patent Office is in no way liable for these particulars which are merely given for the purpose of information.

26-07-2016

Patent document cited in search report	Publication date	Patent family member(s)	Publication date
WO 2009071026 A1	11-06-2009	CN 201129060 Y	08-10-2008
		KR 20100007878 A	22-01-2010
		US 2011073147 A1	31-03-2011
		US 2013233367 A1	12-09-2013
		US 2014109947 A1	24-04-2014
		WO 2009071026 A1	11-06-2009

AU 523506 B2	29-07-1982	AU 523506 B2	29-07-1982
		AU 4937779 A	21-02-1980

EP 0417919 A1	20-03-1991	CA 2022870 A1	15-03-1991
		EP 0417919 A1	20-03-1991
		US 4966178 A	30-10-1990

EP 1445400 A1	11-08-2004	AT 299218 T	15-07-2005
		DE 60300978 D1	11-08-2005
		DE 60300978 T2	01-12-2005
		EP 1445400 A1	11-08-2004
