

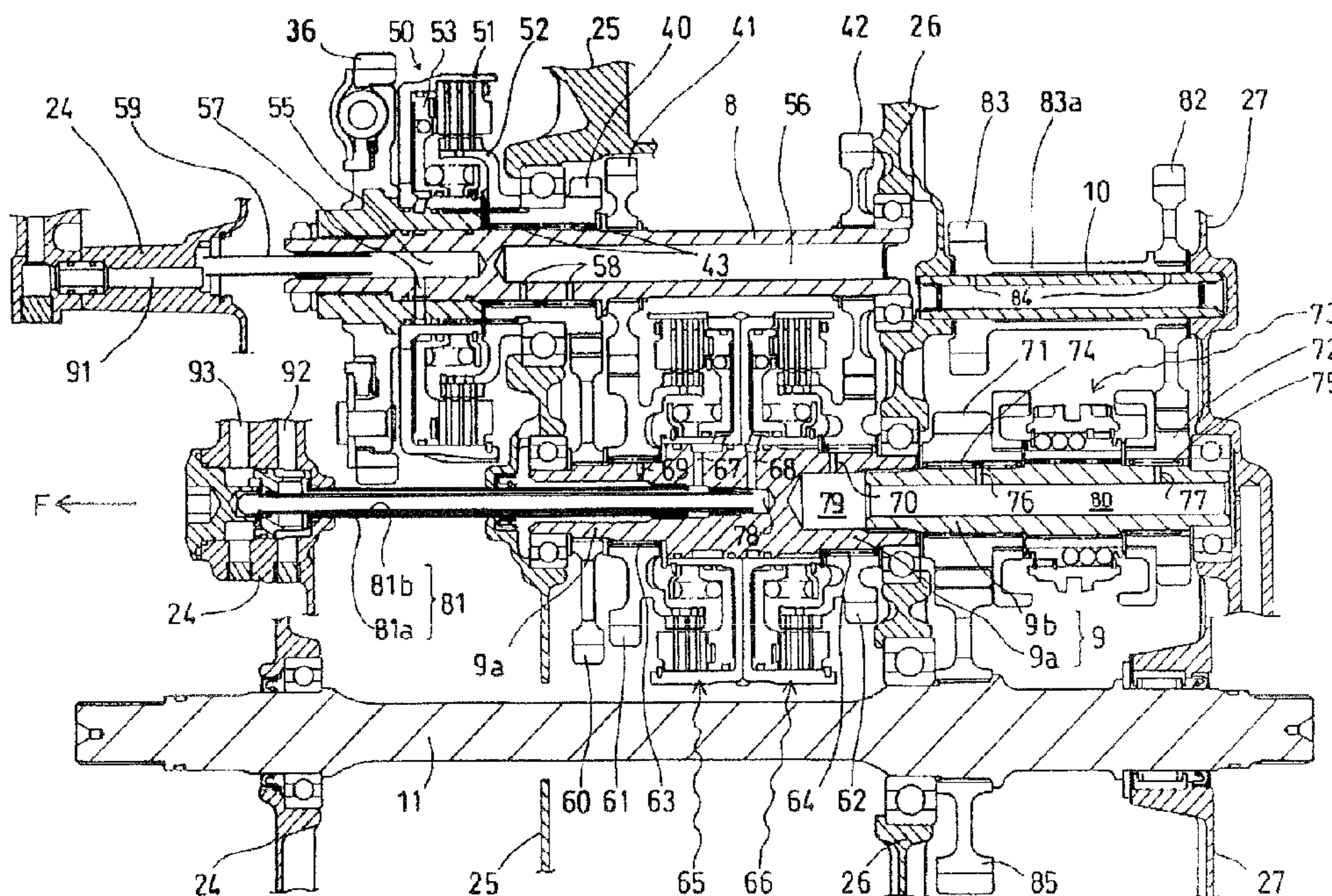

(22) Date de dépôt/Filing Date: 2003/06/26  
(41) Mise à la disp. pub./Open to Public Insp.: 2004/01/05  
(30) Priorité/Priority: 2002/07/05 (2002-197503) JP

(51) Cl.Int.<sup>7</sup>/Int.Cl.<sup>7</sup> F16H 1/20  
(71) Demandeur/Applicant:  
HONDA GIKEN KOGYO KABUSHIKI KAISHA, JP  
(72) Inventeurs/Inventors:  
HORI, YOSHIKI, JP;  
HAMAOKA, SEIJI, JP  
(74) Agent: DENNISON ASSOCIATES

(54) Titre : TRANSMISSION  
(54) Title: TRANSMISSION



(57) Abrégé/Abstract:

In the related art transmission, two larger-diameter gears are mounted on a final shaft, causing an increase in weight of the transmission. It is an object of the present invention to reduce the weight of the transmission by mounting only one larger-diameter gear on the final shaft. The transmission of the present invention includes an output shaft; a counter shaft extending parallel to the output shaft; an intermediate shaft extending parallel to the output shaft; a forward drive gear relatively rotatably supported to the counter shaft; a reverse drive gear relatively rotatably supported to the counter shaft; a first intermediate gear relatively rotatably supported to the intermediate shaft, the first intermediate gear being normally in mesh with the reverse drive gear; a second intermediate gear relatively rotatably supported to the intermediate shaft, the second intermediate gear being interlocked with the first intermediate gear to rotate therewith; an output shaft driven gear fixed to the output shaft, the output shaft driven gear being normally in mesh with the forward drive gear and the second intermediate gear; and gear selecting and fixing means axially movably mounted on the counter shaft for selectively fixing the forward drive gear and the reverse drive gear to the counter shaft.

## ABSTRACT OF THE DISCLOSURE

In the related art transmission, two larger-diameter gears are mounted on a final shaft, causing an increase in weight of the transmission. It is an object of the present invention to reduce the weight of the transmission by mounting only one larger-diameter gear on the final shaft. The transmission of the present invention includes an output shaft; a counter shaft extending parallel to the output shaft; an intermediate shaft extending parallel to the output shaft; a forward drive gear relatively rotatably supported to the counter shaft; a reverse drive gear relatively rotatably supported to the counter shaft; a first intermediate gear relatively rotatably supported to the intermediate shaft, the first intermediate gear being normally in mesh with the reverse drive gear; a second intermediate gear relatively rotatably supported to the intermediate shaft, the second intermediate gear being interlocked with the first intermediate gear to rotate therewith; an output shaft driven gear fixed to the output shaft, the output shaft driven gear being normally in mesh with the forward drive gear and the second intermediate gear; and gear selecting and fixing means axially movably mounted on the counter shaft for selectively fixing the forward drive gear and the reverse drive gear to the counter shaft.

## TRANSMISSION

### FIELD OF THE INVENTION

5 The present invention relates to a transmission for a saddle type vehicle (buggy) for rough terrain running.

### BACKGROUND OF THE INVENTION

10 A conventional transmission is described in Japanese Patent Publication No. 63-61212. This transmission includes a primary shaft, a main shaft, and a counter shaft. Power is transmitted in this order, and the counter shaft is a final shaft in this transmission. In general, gears having diameters larger than the diameters of gears mounted on front-stage shafts are mounted on rear-stage shafts, so as to sequentially reduce a rotational  
15 speed during transmission of the power. Also in the above conventional transmission described above, larger-diameter gears are mounted on the final shaft.

20 More specifically, two larger-diameter gears having different diameters are fixed to the final shaft (the counter shaft in the above publication). Two smaller-diameter gears normally meshing with the two larger-diameter gears are relatively rotatably supported to the shaft (the main shaft in the above publication) provided on the directly front stage of the final shaft. Further, gear selecting and fixing means (a gear selecting mechanism in  
25 the above publication) is provided between these smaller-diameter gears. Either of these smaller-diameter gears is selected and fixed to the support shaft by the gear selecting and fixing means, thereby allowing the selection of any one of different operational conditions.

As mentioned above, the two larger-diameter gears are mounted on the final shaft of the transmission in the related art, causing an increase in weight of the transmission. It is accordingly an object of the present invention to reduce the weight of the transmission by mounting only one  
5 larger-diameter gear on the final shaft.

### **SUMMARY OF THE INVENTION**

In accordance with the present invention, there is provided a transmission including an output shaft; a counter shaft extending parallel  
10 to said output shaft; an intermediate shaft extending parallel to said output shaft; a forward drive gear relatively rotatably supported to said counter shaft; a reverse drive gear relatively rotatably supported to said counter shaft; a first intermediate gear relatively rotatably supported to  
15 said intermediate shaft, said first intermediate gear being normally in mesh with said reverse drive gear; a second intermediate gear relatively rotatably supported to said intermediate shaft, said second intermediate gear being interlocked with said first intermediate gear to rotate therewith; an output shaft driven gear fixed to said output shaft, said output shaft  
20 driven gear being normally in mesh with said forward drive gear and said second intermediate gear; and gear selecting and fixing means axially movably mounted on said counter shaft for selectively fixing said forward drive gear and said reverse drive gear to said counter shaft.

With this configuration, only one larger-diameter gear is mounted on the  
25 final shaft of the transmission as the output shaft driven gear, thereby allowing a reduction in weight of the transmission.

### **BRIEF DESCRIPTION OF THE DRAWINGS**

30 Preferred embodiments of the invention are shown in the drawings, wherein:

FIG. 1 is a side view of a four-wheel buggy (saddle type vehicle for rough  
35 terrain running) having a transmission according to a preferred embodiment of the present invention.

FIG. 2 is an elevational view of a power unit in the vehicle shown in FIG. 1.

FIG. 3 is a rear elevation of a rear crankcase.

5

FIG. 4 is a longitudinal sectional view of an internal structure of a crankcase, showing the relation between a crankshaft and a main shaft.

10 FIG. 5 is a longitudinal sectional view of the internal structure of the crankcase, showing the relation between the main shaft, a counter shaft, an intermediate shaft, and an output shaft.

FIG. 6 is a longitudinal sectional view showing a driving mechanism for a dog clutch for forward/reverse selection.

15

#### **DETAILED DESCRIPTION OF THE PREFERRED EMBODIMENTS**

FIG. 1 is a side view of a four-wheel buggy (saddle type vehicle for rough terrain running) having a transmission according to a preferred embodiment of the present invention. This buggy includes a body frame 1, a pair of right and left front wheels 2 provided at a front portion of the body frame 1, and a pair of right and left rear wheels 3 provided at a rear portion of the body frame 1. A power unit 6 configured by integrating an internal combustion engine 4 and a transmission 5 is supported to a central portion of the body frame 1. The power unit 6 is arranged so that a crankshaft 7 extends in the longitudinal direction of the vehicle. As will be hereinafter described in detail, the rotation of the crankshaft 7 is transmitted through a main shaft 8, a counter shaft 9, and an intermediate shaft 10 (each being shown in FIG. 3) to an output shaft 11 in the transmission 5. These shafts 8, 9, 10, and 11 extend parallel to the crankshaft 7 in the longitudinal direction of the vehicle. The front wheels 2 are driven by a front drive shaft 12 connected to the front end of the output shaft 11, and the rear wheels 3 are driven by a rear drive shaft 13 connected to the rear end of the output shaft 11. A steering handle 14, a fuel tank 15, and a saddle seat 16 are arranged in this order from the front side of the vehicle on an upper portion of the body frame 1.

20

25

30

35

FIG. 2 is an elevational view of the power unit 6 as viewed from the front side of the power unit 6. The power unit 6 is generally composed of a cylinder head cover 20, a cylinder head 21, a cylinder block 22, and a crankcase 23 arranged in this order from the upper side of the power unit 6. The crankcase 23 is divided into four parts along planes perpendicular to the crankshaft 7. That is, as partially shown in FIGS. 4 and 5 to be referred later, the crankcase 23 is composed of a front crankcase cover 24, a front crankcase 25, a rear crankcase 26, and a rear crankcase cover 27 arranged in this order from the front side of the power unit 6. In FIG. 2, the front crankcase cover 24 is generally viewed and the front crankcase 25 is slightly viewed around the front crankcase cover 24. Various devices and pipes are mounted on the front surface of the front crankcase cover 24.

FIG. 3 is a rear elevation of the rear crankcase 26, showing the positions of the crankshaft 7, the main shaft 8, the counter shaft 9, the intermediate shaft 10, and the output shaft 11. FIGS. 4 and 5 are longitudinal sectional views showing an internal structure of the crankcase 23 along these shafts 7 to 11. More specifically, FIG. 4 shows the relation between the crankshaft 7 and the main shaft 8, and FIG. 5 shows the relation between the main shaft 8, the counter shaft 9, the intermediate shaft 10, and the output shaft 11. In FIGS. 4 and 5, the arrow F indicates the front side of the crankcase 23.

FIG. 4 shows a power transmitting mechanism related to the crankshaft 7 and the main shaft 8. The crankshaft 7 is rotatably supported through bearings to the front and rear crankcases 25 and 26. An extended front end of the crankshaft 7 is supported through a bearing to the front crankcase cover 24. The crankshaft 7 is divided into front and rear sections in the longitudinal direction. The front and rear sections of the crankshaft 7 are connected at their crank webs 7a by a crankpin 7b. An alternator 28 for producing alternating current by the rotation of the crankshaft 7 is mounted on a rear end portion of the crankshaft 7 (the rear section). Reference numeral 29 denotes an oil filter provided on the front crankcase cover 24 for cleaning a clutch operating oil.

A torque converter 30 is mounted on a front portion of the crankshaft 7 (the front section), and a primary drive gear 31 is mounted adjacent to the

torque converter 30. The primary drive gear 31 is relatively rotatably supported through a needle bearing 32 to the crankshaft 7. The torque converter 30 includes a pump impeller 33 fixed to the crankshaft 7, a turbine runner 34 opposed to the pump impeller 33, and a stator 35. The primary drive gear 31 rotatable relative to the crankshaft 7 is connected to the turbine runner 34, and power from the crankshaft 7 is hydraulically transmitted through the torque converter 30 to the primary drive gear 31. A primary driven gear 36 normally meshing with the primary drive gear 31 is fixed to a front end portion of the main shaft 8. The rotation of the crankshaft 7 is transmitted through the torque converter, the primary drive gear 31, and the primary driven gear 36 to the main shaft 8 with a primary speed reduction obtained by the gears 31 and 36.

FIG. 5 shows a power transmitting mechanism related to the main shaft 8, the counter shaft 9, the intermediate shaft 10, and the output shaft 11. The main shaft 8 is rotatably supported through bearings to the front and rear crankcases 25 and 26. A first-speed drive gear 40, a second-speed drive gear 41, and a third-speed drive gear 42 different in the number of teeth according to gear ratios are mounted on the main shaft 8. The second-speed drive gear 41 and the third-speed drive gear 42 are fixed to the main shaft 8, and the first-speed drive gear 40 is relatively rotatably supported through needle bearings 43 to the main shaft 8. In the following description, a gear relatively rotatably supported through a needle bearing to a rotating shaft will be referred to generally as an idle gear. A first-speed hydraulic multiplate clutch 50 is interposed between the main shaft 8 and the first-speed drive gear 40. The first-speed hydraulic multiplate clutch 50 has an outer member 51 fixed to the main shaft 8 and an inner member 52 connected to the first-speed drive gear 40. A pressure plate 53 is axially movably engaged in the outer member 51. The main shaft 8 has a front center hole 55 axially extending from the front end of the main shaft 8 to an intermediate portion and a rear center hole 56 axially extending from the rear end of the main shaft 8 to the intermediate portion. The rear center hole 56 is slightly larger in diameter than the front center hole 55. Thus, the front center hole 55 and the rear center hole 56 of the main shaft 8 are not in communication with each other at this intermediate portion. The main shaft 8 further has an operating oil supply hole 57 communicating with the front center hole 55 and the first-speed hydraulic

multiplate clutch 50, and has lubricating oil supply holes 58 communicating with the rear center hole 56 and the needle bearings 43.

As shown in FIG. 5, an operating oil for the first-speed hydraulic  
5 multiplate clutch 50 is supplied from the front crankcase cover 24 side through an operating oil supply pipe 59 into the front center hole 55, and is further supplied through the operating oil supply hole 57 into the clutch 50. The operating oil supplied to the clutch 50 is introduced into a space between the outer member 51 and the pressure plate 53. When the  
10 pressure plate 53 is moved by this oil pressure to engage the clutch 50, the first-speed drive gear 40 is fixed to the main shaft 8, so that the rotation of the main shaft 8 is transmitted to the first-speed drive gear 40. A lubricating oil to the needle bearings 43 for supporting the first-speed drive gear 40 is supplied from the rear center hole 56 through the lubricating oil  
15 supply holes 58.

The counter shaft 9 is composed of a front counter shaft 9a and a rear counter shaft 9b integrally connected with each other. The counter shaft 9 is rotatably supported through bearings to the front crankcase 25, the rear  
20 crankcase 26, and the rear crankcase cover 27. A first-speed driven gear 60, a second-speed driven gear 61, and a third-speed driven gear 62 respectively normally meshing with the first-speed drive gear 40, the second-speed drive gear 41, and the third-speed drive gear 42 supported to the main shaft 8 are mounted on the front counter shaft 9a. The first-  
25 speed driven gear 60 is fixed to the front counter shaft 9a. The second-speed driven gear 61 and the third-speed driven gear 62 are idle gears, which are relatively rotatably supported through needle bearings 63 and 64 to the front counter shaft 9a, respectively. A second-speed hydraulic multiplate clutch 65 is interposed between the front counter shaft 9a and  
30 the second-speed driven gear 61. A third-speed hydraulic multiplate clutch 66 is interposed between the front counter shaft 9a and the third-speed driven gear 62. The second-speed hydraulic multiplate clutch 65 has an outer member fixed to the front counter shaft 9a and an inner member connected to the idle gear 61, and the third-speed hydraulic multiplate  
35 clutch 66 has an outer member fixed to the front counter shaft 9a and an inner member connected to the idle gear 62. These clutches 65 and 66 are similar in configuration and operation to the first-speed hydraulic

multiplate clutch 50 mentioned above. An operating oil for these clutches 65 and 66 is supplied through operating oil supply holes 67 and 68 formed in the front counter shaft 9a, respectively, thereby stopping idle rotation of the idle gears 61 and 62 to permit power transmission and effect a second-speed or third-speed reduction. A lubricating oil to the needle bearings 63 and 64 for respectively supporting the second-speed driven gear 61 and the third-speed driven gear 62 is supplied through lubricating oil supply holes 69 and 70 formed in the front counter shaft 9a.

10 The front counter shaft 9a has a front center hole 78 axially extending from the front end of the shaft 9a to an intermediate portion and a rear center hole 79 axially extending from the rear end of the shaft 9a to the intermediate portion. The front center hole 78 has a stepwise diameter, and the rear center hole 79 is larger in diameter than the front center hole 15 78. Thus, the front center hole 78 and the rear center hole 79 of the front counter shaft 9a are not in communication with each other at this intermediate portion. On the other hand, the rear counter shaft 9b has a through center hole 80 axially extending between the opposite ends of the shaft 9b. The front end of the rear counter shaft 9b is engaged with the rear 20 center hole 79 of the front counter shaft 9a, thus making an integral rotation of the front and rear counter shafts 9a and 9b. The rear center hole 79 of the front counter shaft 9a is in communication with the through center hole 80 of the rear counter shaft 9b.

25 The supply of the operating oil to the second-speed and third-speed hydraulic multiplate clutches 65 and 66 is performed through a double pipe 81 inserted in the front center hole 78 of the counter shaft 9 from the front crankcase cover 24 side. The double pipe 81 is composed of an outer pipe 81a and an inner pipe 81b inserted in the outer pipe 81a. The 30 operating oil to the second-speed hydraulic multiplate clutch 65 is supplied through an oil passage defined between the outer pipe 81a and the inner pipe 81b and through the operating oil supply hole 67. The operating oil to the third-speed hydraulic multiplate clutch 66 is supplied through an oil passage defined inside the inner pipe 81b and through the 35 operating oil supply hole 68. The lubricating oil to the needle bearing 63 for supporting the second-speed driven gear 61 is supplied from the front crankcase 25 side through an oil passage defined between the front counter

shaft 9a and the outer pipe 81a and through the lubricating oil supply hole 69. The lubricating oil to the needle bearing 64 for supporting the third-speed driven gear 62 is supplied from the rear crankcase cover 27 side through the through center hole 80, the rear center hole 79, and the  
5 lubricating oil supply hole 70.

A forward drive gear 71 and a reverse drive gear 72 are mounted on the rear counter shaft 9b. These gears 71 and 72 are idle gears. A manually operated dog clutch 73 (gear selecting and fixing means defined in claim 1)  
10 is interposed between these gears 71 and 72 so that the dog clutch 73 is engageable with either the gear 71 or 72. Accordingly, either the gear 71 or 72 engaged with the dog clutch 73 is selectively fixed to the rear counter shaft 9b, thereby allowing power transmission. The rear counter shaft 9b is formed with lubricating oil supply holes 76 and 77 for respectively  
15 supplying the lubricating oil to needle bearings 74 and 75 for respectively supporting the forward drive gear 71 and the reverse drive gear 72. The lubricating oil to the needle bearings 74 and 75 is supplied from the rear crankcase cover 27 side through the through center hole 80 and the lubricating oil supply holes 76 and 77 of the rear counter shaft 9b.

20 The intermediate shaft 10 is supported to the rear crankcase 26 and the rear crankcase cover 27. A first intermediate gear 82 normally meshing with the reverse drive gear 72 and a second intermediate gear 83 having a long sleeve portion 83a connected to the first intermediate gear 82 are relatively  
25 rotatably supported to the intermediate shaft 10. These gears 82 and 83 are idle gears. The lubricating oil to sliding portions of the intermediate shaft 10 for sliding the first and second intermediate gears 82 and 83 is supplied from the rear crankcase 26 side through a center hole of the intermediate shaft 10 and lubricating oil supply holes 84 of the intermediate shaft 10.

30 The output shaft 11 is rotatably supported through bearings to the front crankcase cover 24, the rear crankcase 26, and the rear crankcase cover 27. The output shaft 11 extends through the front crankcase 25 in noncontact relationship therewith. An output shaft driven gear 85 normally meshing  
35 with the forward drive gear 71 and the second intermediate gear 83 is fixed to the output shaft 11. The output shaft driven gear 85 is driven in a forward direction or a reverse direction through either the gear 71 or 72

engaged with the dog clutch 73, thereby rotating the output shaft 11 in a direction adapted to the forward running or reverse running of the vehicle. The reverse driving of the output shaft driven gear 85 is effected only when the counter shaft 9 is being rotated at the first speed.

5

All of the gears in this transmission are constant-mesh type gears, and what gear ratio is to be selected is determined by what of the hydraulic multiplate clutches 50, 65, and 66 is to be engaged. The hydraulic control for these clutches 50, 65, and 66 is performed by a valve body 90 (see FIG. 2) assembled as a hydraulic control unit including a solenoid valve and a pressure switching valve. As shown in FIG. 2, the valve body 90 is mounted on the front surface of the front crankcase cover 24.

10

As shown in FIG. 5, the operating oil to the first-speed hydraulic multiplate clutch 50 is supplied from the valve body 90 through an oil passage 91 formed in the front crankcase cover 24 and the operating oil supply pipe 59 inserted in the front center hole 55 of the main shaft 8 into the front center hole 55, and is further supplied through the operating oil supply hole 57 to the first-speed hydraulic multiplate clutch 50.

15

The operating oil to the second-speed hydraulic multiplate clutch 65 or the third-speed hydraulic multiplate clutch 66 is supplied from the valve body 90 through an oil passage 92 or 93 formed in the front crankcase cover 24 and the outer passage or the inner passage of the double pipe 81 inserted in the front center hole 78 of the counter shaft 9 into the front center hole 78, and is further supplied through the operating oil supply hole 67 or 68 to the second-speed hydraulic multiplate clutch 65 or the third-speed hydraulic multiplate clutch 66.

20

A driving mechanism for the dog clutch 73 for selecting the forward running or the reverse running of the vehicle is shown in FIGS. 6 and 3. Referring to FIG. 6, the outer surface of the dog clutch 73 is formed with a circumferential groove 73a, and a shift fork 100 is engaged at its forked portion with the circumferential groove 73a of the dog clutch 73. The shift fork 100 is axially slidably engaged with a guide shaft 101. The guide shaft 101 is a fixed shaft supported to the rear crankcase 26 and the rear crankcase cover 27. The shift fork 100 is integrally formed with a shifter

25

30

35

pin 102 opposite to the forked portion. The head of the shifter pin 102 is slidably engaged with a helical groove 103a formed on a shift drum 103.

5 The helical groove 103a of the shift drum 103 is a short groove extending along a substantially half portion of the outer circumference of the shift drum 103. Accordingly, an unnecessary portion of the shift drum 103 is cut away for the purpose of weight reduction. The shift drum 103 is supported to a drum shaft 104. A drum driven gear 105 and a shift cam 106 are also mounted on the drum shaft 104. The shift drum 103, the  
10 drum driven gear 105, and the shift cam 106 are joined together by an interlocking pin 107 to restrain their relative rotation, so that these members 103, 105, and 106 are rotated together.

A shift spindle 108 is rotatably supported to the rear crankcase 26 and the  
15 rear crankcase cover 27. A sector gear 109 meshing with the drum driven gear 105 is fixed to the shift spindle 108. When the shift spindle 108 is rotated, the drum driven gear 105, the shift drum 103, and the shift cam 106 are rotated together by the sector gear 109. The shift spindle 108 is connected through an operating cable (not shown) to a shift lever (not  
20 shown) provided on the steering handle 14 of the vehicle, and is rotated by manually operating the shift lever.

As shown in FIG. 3, the shift cam 106 is a star plate member, and a roller  
25 111 supported at the upper end of a shift drum stopper 110 is in contact with the outer circumference of the shift cam 106. The shift drum stopper 110 is pivotably supported to a pin 112, and a spring 113 is engaged with the shift drum stopper 110 to normally bias the roller 111 against the outer circumference of the shift cam 106. This mechanism constitutes a  
30 rotational position holding device for the shift drum 103 such that the rotational position of the shift drum 103 becomes stable when the roller 111 comes into contact with any one of the valleys formed on the outer circumference of the shift cam 106. There are three stable positions of the shift drum 103 corresponding to forward, neutral, and reverse conditions.

35 When the shift lever provided on the steering handle 14 of the vehicle is rotationally operated from a neutral position to a forward position or a reverse position, the shift spindle 108 and the sector gear 109 are rotated

together, thereby rotating the drum driven gear 105 to a stable position given by the shift cam 106. At the same time, the shift drum 103 is rotated about the drum shaft 104 together with the drum driven gear 105 by the operation of the interlocking pin 107, so that the shifter pin 102 is pushed  
5 by the inner edge of the helical groove 103a formed on the outer circumference of the shift drum 103. As a result, the shift fork 100 supported to the guide shaft 101 is axially slid, and the dog clutch 73 is accordingly moved in the axial direction of the counter shaft 9 through the circumferential groove 73a of the dog clutch 73. At this time, one of the  
10 projections formed at the opposite ends of the dog clutch 73 comes into engagement with either the forward drive gear 71 or the reverse drive gear 72 to fix the gear 71 or 72 to the counter shaft 9, thus allowing power transmission and effecting forward or reverse running of the vehicle.

15 According to this preferred embodiment as described above in detail, the counter shaft and the intermediate shaft are provided parallel to the output shaft. The forward drive gear and the reverse drive gear are relatively rotatably supported to the counter shaft. The first intermediate gear and the second intermediate gear are relatively rotatably supported to  
20 the intermediate shaft. The first intermediate gear is normally in mesh with the reverse drive gear, and the second intermediate gear is rotatable together with the first intermediate gear. The single output shaft driven gear normally meshing with the forward drive gear and the second intermediate gear is fixed to the output shaft as a final shaft. Further, the  
25 dog clutch as the gear selecting and fixing means is provided to selectively fix the forward drive gear and the reverse drive gear to the counter shaft, thereby selecting different operational conditions of the vehicle. Thus, only one larger-diameter gear is mounted on the final shaft of the transmission as the output shaft driven gear, thereby allowing a reduction  
30 in weight of the transmission.

Although various preferred embodiments of the present invention have been described herein in detail, it will be appreciated by those skilled in the  
35 art, that variations may be made thereto without departing from the spirit of the invention or the scope of the appended claims.

**THE EMBODIMENTS OF THE INVENTION IN WHICH AN EXCLUSIVE PROPERTY OR PRIVILEGE IS CLAIMED ARE DEFINED AS FOLLOWS:**

1. A transmission comprising an output shaft; a counter shaft  
5 extending parallel to said output shaft; an intermediate shaft extending parallel to said output shaft; a forward drive gear relatively rotatably supported to said counter shaft; a reverse drive gear relatively rotatably supported to said counter shaft; a first intermediate gear relatively rotatably supported to said intermediate shaft, said first intermediate gear  
10 being normally in mesh with said reverse drive gear; a second intermediate gear relatively rotatably supported to said intermediate shaft, said second intermediate gear being interlocked with said first intermediate gear to rotate therewith; an output shaft driven gear fixed to said output shaft, said output shaft driven gear being normally in mesh  
15 with said forward drive gear and said second intermediate gear; and gear selecting and fixing means axially movably mounted on said counter shaft for selectively fixing said forward drive gear and said reverse drive gear to said counter shaft.

20

[FIG. 1]

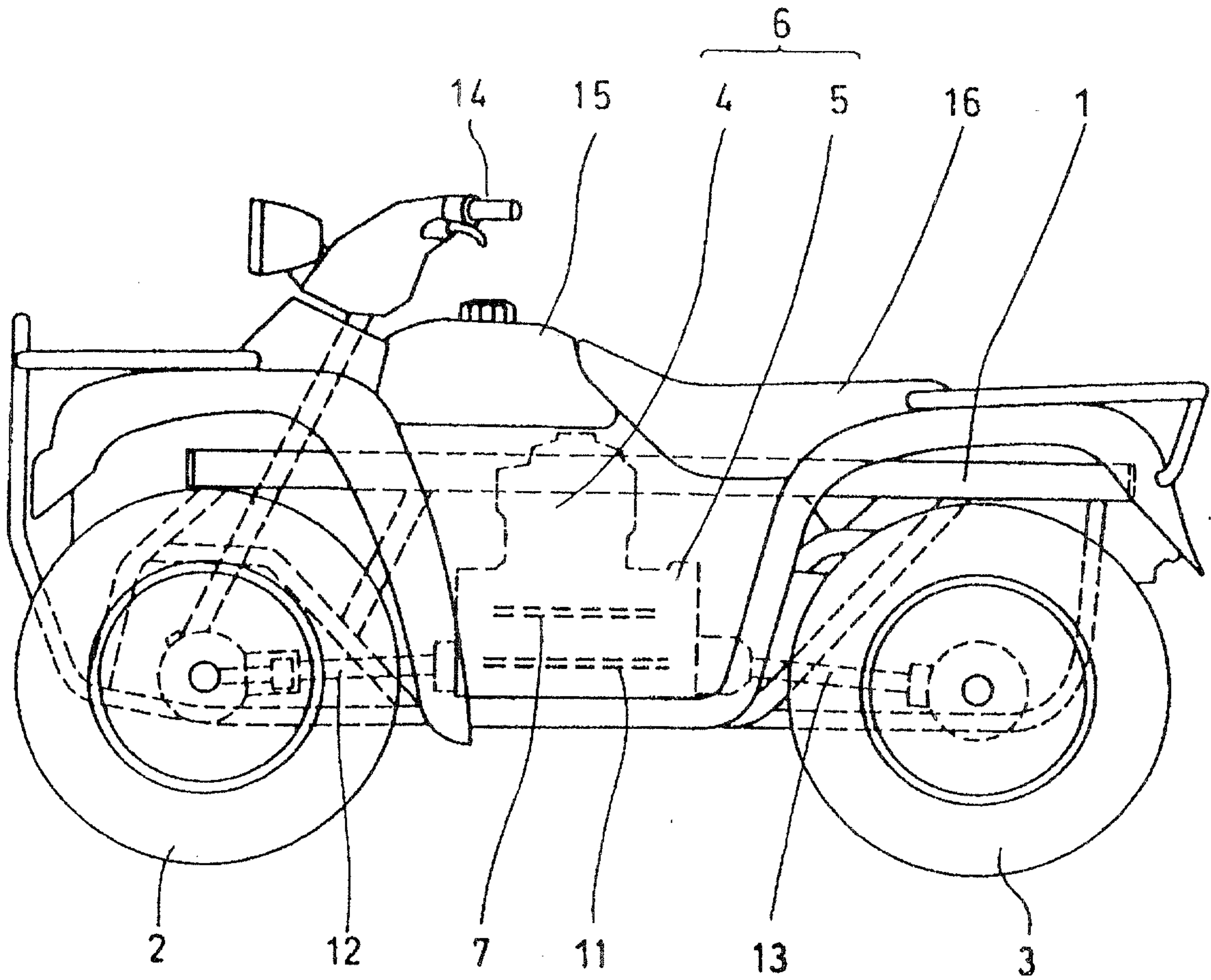

[FIG. 2]

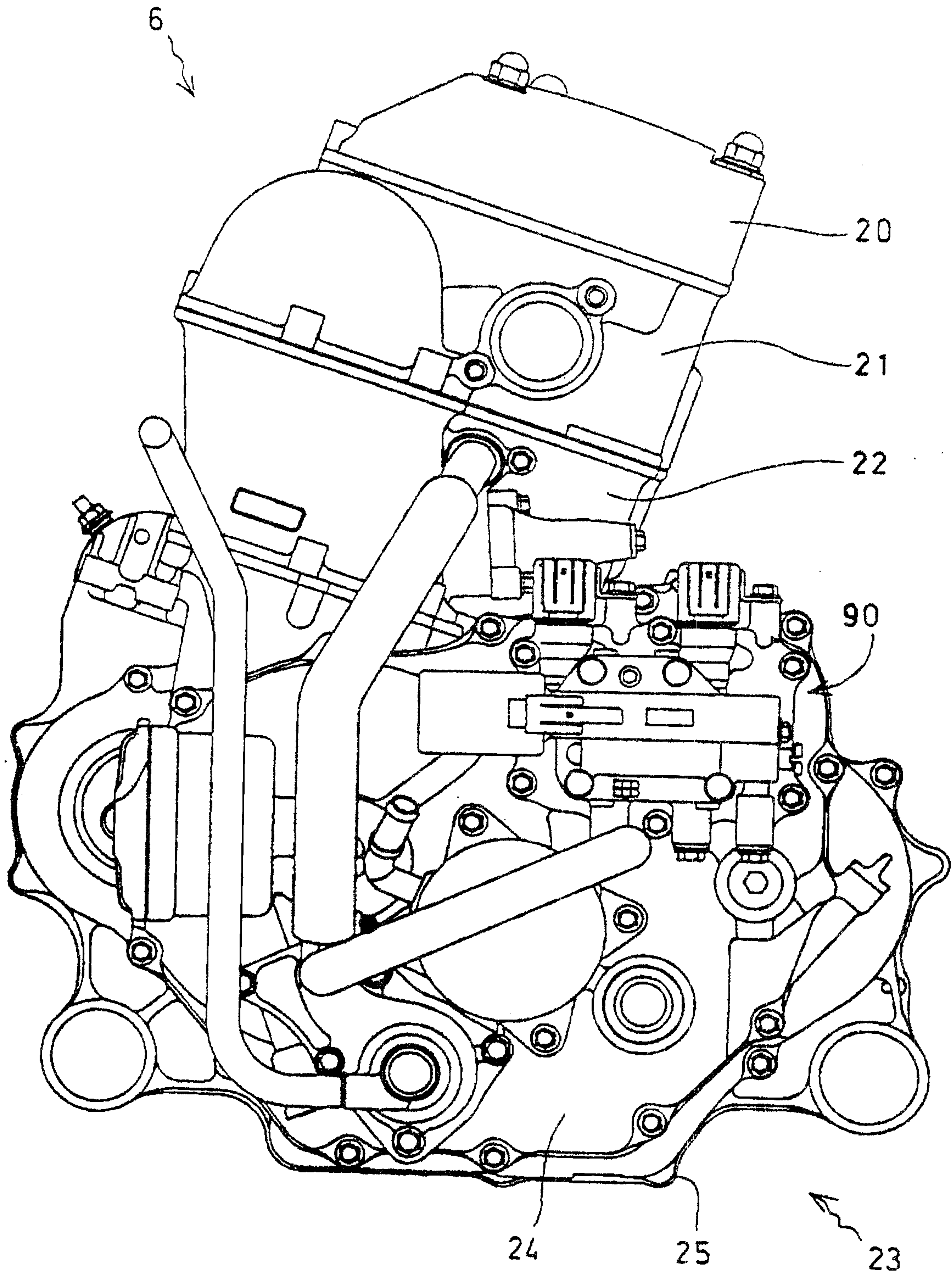

[FIG. 3]

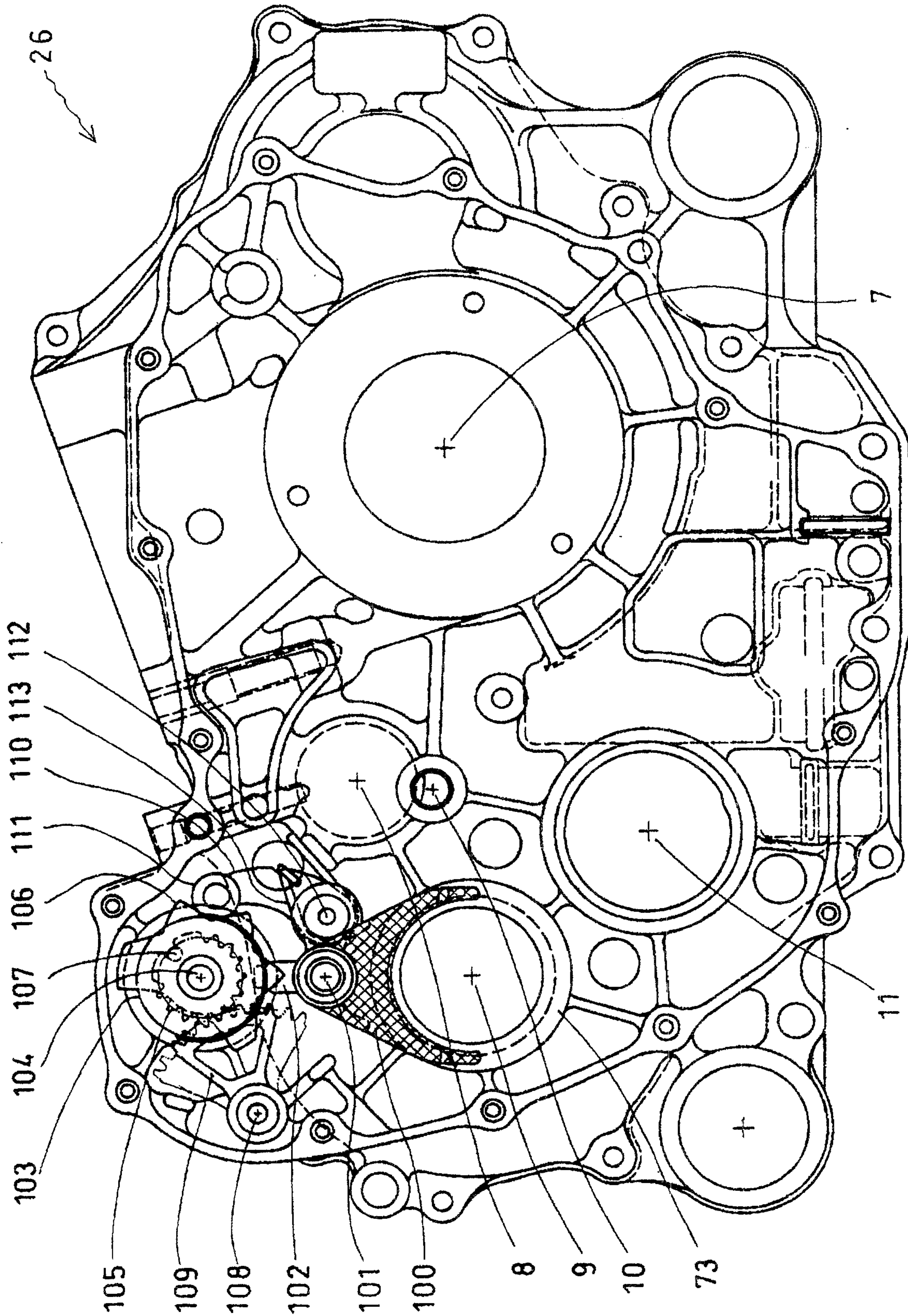

[FIG. 4]

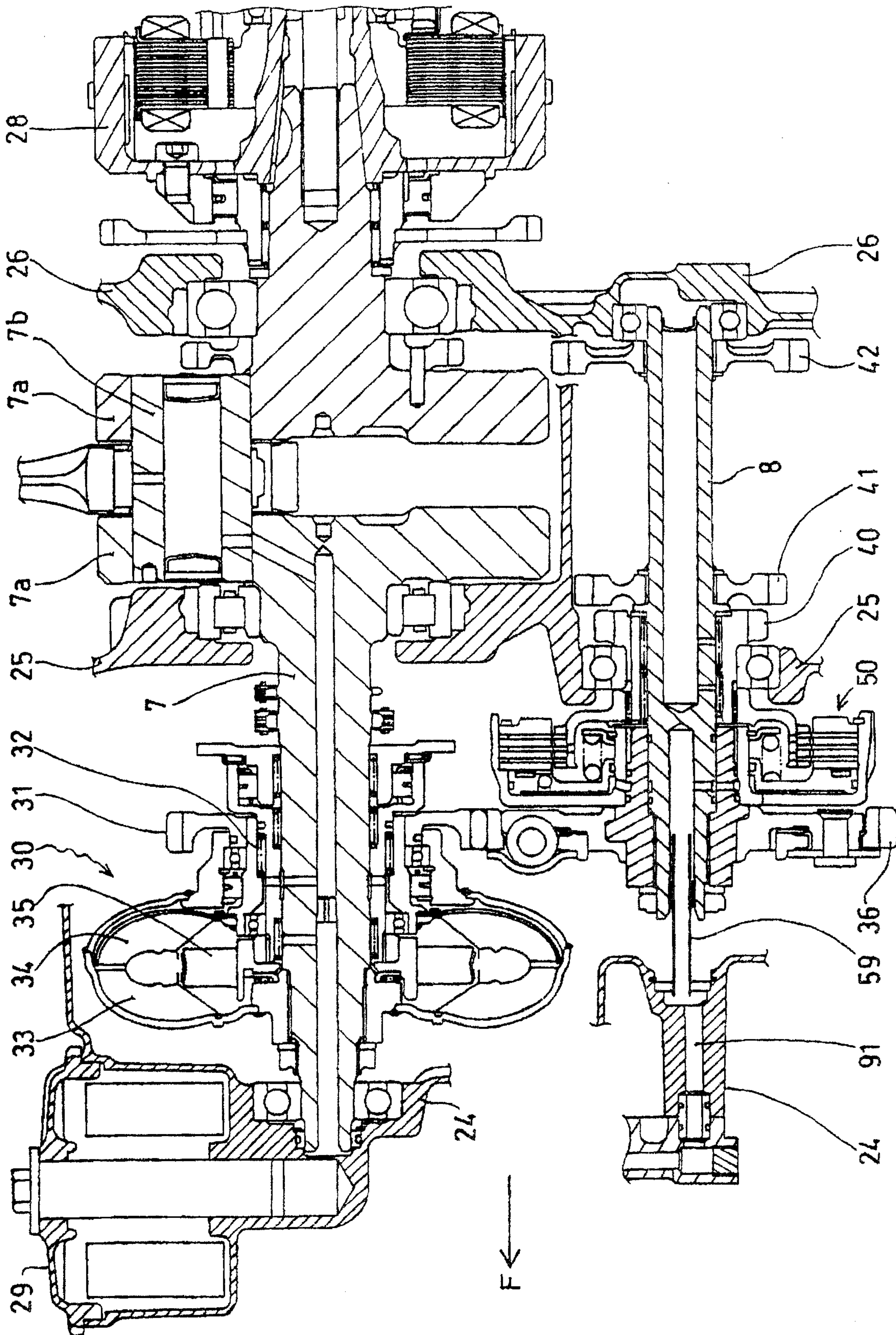



[FIG. 6]

