



(22) Date de dépôt/Filing Date: 2012/05/10

(41) Mise à la disp. pub./Open to Public Insp.: 2012/11/12

(45) Date de délivrance/Issue Date: 2014/10/07

(30) Priorité/Priority: 2011/05/12 (US13/106168)

(51) Cl.Int./Int.Cl. *B65G 15/44* (2006.01),
B65G 15/08 (2006.01)

(72) Inventeurs/Inventors:
NEUFELD, JUAN, US;
THIESSEN, BERNIE, US

(73) Propriétaire/Owner:
MERIDIAN MANUFACTURING GROUP, US

(74) Agent: PERRY + CURRIER

(54) Titre : TRANSPORTEUR A COURROIE AVEC CRAMPONS CROISES POUR CONVOYEUR TUBULAIRE

(54) Title: CROSS CLEATED CONVEYOR BELT FOR A TUBULAR CONVEYOR

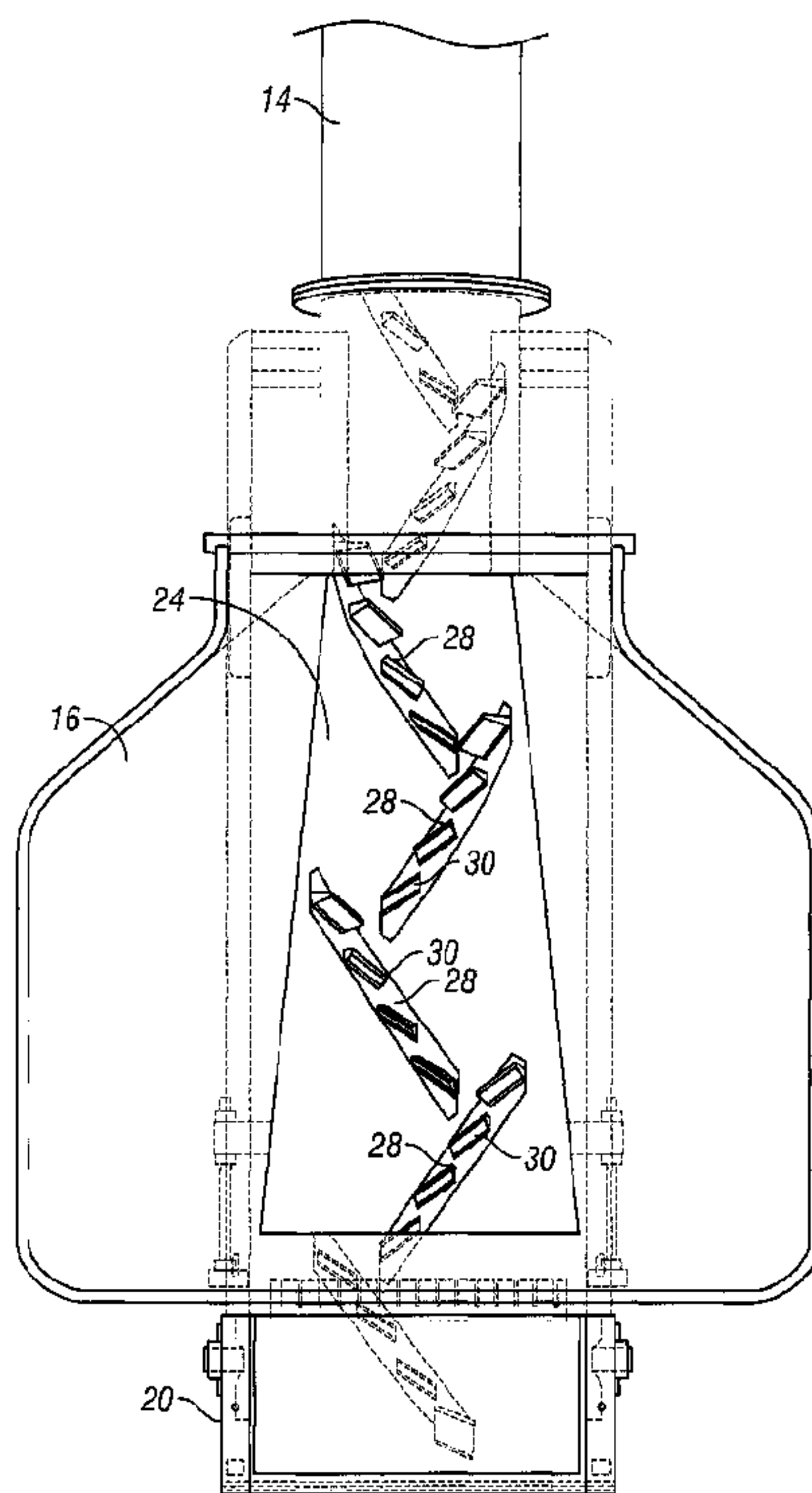

(57) Abrégé/Abstract:

An improved conveyor belt is provided for use in a tubular conveyor. The belt includes a plurality of cleat sets extending at a non-perpendicular angle across the axis of the belt. Adjacent cleat sets are offset with respect to one another, such that the axis of adjacent cleat sets are non-parallel. Each cleat set includes a plurality of spaced apart, upstanding cleat members. The orientation of the cleat sets helps maintain material toward the center of the belt, while the orientation of the cleat members eliminates vacuum behind the cleat members.



ABSTRACT

An improved conveyor belt is provided for use in a tubular conveyor. The belt includes a plurality of cleat sets extending at a non-perpendicular angle across the axis of the belt. Adjacent cleat sets are offset with respect to one another, such that the axis of adjacent cleat sets are non-parallel. Each cleat set includes a plurality of spaced apart, upstanding cleat members. The orientation of the cleat sets helps maintain material toward the center of the belt, while the orientation of the cleat members eliminates vacuum behind the cleat members.

CROSS CLEATED CONVEYOR BELT FOR A TUBULAR CONVEYOR

5 BACKGROUND OF THE INVENTION

Cleated conveyor belts are well-known for use in transporting materials such as grain, seeds, and other dry or particulate material. The conveyor belt extends around a pair of spaced apart pulleys and is rotated to transport the material from an inlet adjacent one end of the belt to an outlet at the opposite end of the belt. Often, the conveyor system is inclined, such that gravity and operational vibrations causes the material to slide down the belt while being carried upwardly. The cleats, which normally extend across the belt in an arrangement perpendicular to the longitudinal axis of the belt, help minimize undesirable product migration or slide.

It is also well-known to use cleated belts in a tubular conveyor, which precludes or minimizes loss of material from blowing air, particularly in inclined applications. However, since the belt must curve across its width to pass through the tubular conduit or channel, the cleats must be segmented to accommodate the change in belt shape from a flat configuration adjacent the pulleys to a curved configuration of the tubular channel.

Also, with prior art conveyors having cleats perpendicular to the conveyor axis, there tends to be a vacuum formed behind the cleat at the discharge end of the conveyor. This vacuum causes material to be sucked into the belt guard, and thus not discharged as desired at the outlet end of the belt.

Accordingly, a primary objective of the present invention is the provision of an improved cleated conveyor belt for use in tubular conveyor assemblies.

Another objective of the present invention is the provision of a conveyor system having a cross cleated conveyor belt.

A further objective of the present invention is the provision of a conveyor belt having a plurality of cleat sets arranged on the belt with non-parallel axes.

Still another objective of the present invention is the provision of a cross cleated conveyor belt with multiple sets of cleats, with each set including a plurality of spaced cleat members.

A further objective of the present invention is the provision of an improved conveyor belt for use in a tubular conveyor wherein the cleat arrangement and configuration eliminates or minimizes any vacuum behind the cleats at the discharge end of the conveyor.

5 Yet another objective of the present invention is a conveyor belt having a plurality of sets of cleats, with each set crossing the longitudinal axis of the belt at a non-perpendicular angle.

Another objective of the present invention is the provision of an improved conveyor belt with cleats which is economical to manufacture and safe and durable in use.

10 These and other objectives will become apparent from the following description of the invention.

SUMMARY OF THE INVENTION

15 The conveyor assembly of the present invention includes a pair of spaced apart pulleys with a tubular channel or conduit extending between the pulleys. An endless loop belt is trained about the pulleys for rotation about the pulleys. The belt extends through the tubular channel. The belt is substantially flat when passing around the pulleys and curved substantially in accordance with the lower wall of the tubular channel when passing through the channel.

20 The belt includes a plurality of cleat sets, with each set having a longitudinal axis which is non-perpendicular to the longitudinal axis of the belt. The cleat sets are alternately offset with respect to one another, such that the axes of adjacent sets are non-parallel to one another. Each cleat set includes a plurality of cleat members which are also oriented in a non-perpendicular relation to the belt axis.

25

BRIEF DESCRIPTION OF THE DRAWINGS

Figure 1 is a perspective view of a conveyor according to the present invention.

Figure 2 is a perspective view of the inlet end of the conveyor.

Figure 3 is an elevation view of the inlet end of the conveyor.

30 Figure 4 is a top plan view of the inlet end of the conveyor.

Figure 5 is a perspective view of the outlet end of the conveyor with a portion of the housing broken away to show the cleated belt according to the present invention.

Figure 6 is a perspective view of the cleated belt in a flat condition.

Figure 7 is a plan view of the cleated belt in a flat condition.

5 Figure 8 is a side elevation view of the cleated belt in a flat condition.

Figure 9 is an enlarged view taken along lines 9-9 of Figure 7.

Figure 10 is a sectional view taken along lines 10-10 of Figure 7.

Figure 11 is a front elevation view of one of the cleat members of the cleated belt.

Figure 12 is an end view of one of the cleat members.

10 Figure 13 is a top plan view of one of the cleat members.

DETAILED DESCRIPTION OF THE PREFERRED EMBODIMENTS

A tubular style conveyor according to the present invention is generally designated by the reference numeral 10 in the drawings. The conveyor 10 includes a wheeled frame
 15 12 for supporting a tubular conduit or channel 14 at various angles. The frame 12 is adjustable, in manners known in the art, so that the inclination of the tube 14 can be set as desired. The conveyor 10 includes an inlet hopper 16 and an outlet discharge chute 18 at opposite ends. Pulleys 20, 22 are rotatably mounted at the opposite ends of the conveyor 10 adjacent the inlet hopper 16 and the discharge chute 18, respectively. Preferably, one of
 20 the pulleys 20, 22 is driven and the other pulley is an idler. As seen in Figure 5, in a preferred embodiment, a motor 19 drives the pulley 22. The components 12-22 of the conveyor 10 may have various dimensions and construction, without departing from the scope of the invention.

The conveyor 10 also includes an elongated endless loop belt 24 trained about the
 25 pulleys 20, 22 for rotation with the pulleys. The belt 24 has a constant width and a central, longitudinal axis 26. The belt 24 also has a plurality of cleat sets 28 on the outer surface of the belt and which are staggered along the full length of the belt 24. Each of the cleat sets 28 has a longitudinal axis which is non-perpendicular to the belt axis 26. In a preferred
 30 embodiment, the cleat sets 28 are set at an angle of approximately 35° relative to the opposite edges of the belt. The longitudinal axis of the cleat sets 28 can be varied without departing from the scope of the invention.

Adjacent cleat sets 28 are angularly offset with respect to one another, such that the axis of one cleat set is non-parallel to the axis of an adjacent cleat set. Each cleat set 28 has forward and rearward ends, and each cleat set 28 crosses the belt axis in a non-perpendicular angle. Thus, the front end of one cleat set is on the same side of the belt axis 5 26 as the rear end of an adjacent cleat set. The front end of each cleat set is defined as the end closest to the outlet pulley 22, while the rear end of each cleat set is defined as the end closest to the inlet pulley 20.

Each cleat set includes a plurality of upstanding cleat members 30. Each cleat member 30 may be independently secured to the outer surface of the belt 24, or 10 alternatively, the cleat members 30 in each cleat set 28 can be interconnected with a base 32 which in turn is mounted on the outer surface of the belt 24. The mounting of the cleat sets 28 and cleat members 30 on the belt 24 is by any convenient means. The cleat members 30 in each cleat set 28 are spaced apart and have parallel longitudinal axes. As seen in Figure 9, the longitudinal axis of the individual cleat members 30 is offset with 15 respect to the longitudinal axis of the cleat sets 28. In a preferred embodiment, the cleat members are oriented at approximately 55° relative to a side edge of the belt 24. It is understood that this angle may be varied without departing from the scope of the invention. The dimensions of the cleat members 30 may be the same or different from one another, and may vary depending on the width of the belt 24. Also, the spacing between the cleat 20 members 30 may be equal or non-equal.

In use, the belt 24 is substantially flat across its width as it passes around each pulley 20, 22. As the belt 24 enters the downstream end of the tube 14, the belt 24 curves across its width to a radius substantially similar to the curvature of the tube 14. As the belt 24 exits the tube 14, the belt 24 flattens out for passage around the outlet pulley 22. As 25 seen in Figure 5, the angular orientation of the cleat sets 28 and the separate configuration of the cleat members 30 in each cleat set 28 allows the cleat members 30 to sequentially pass around each pulley 20, 22 without undue stress or detrimental force.

The alternating angular orientation of the adjacent cleat sets tends to maintain the material or product on the belt 24 toward the center of the belt 24. The angle and distance 30 between the cleat sets 28 results in less drag adjacent the outlet pulley 22 as material passes over the pulley 22. Also, the angular orientation of the cleat sets 28 eliminates or

minimizes any vacuum forming behind the cleat members 30, and thus avoids material being sucked into the belt guard. The cleat sets 28 also extend substantially across the width of the belt 24, thereby decreasing or minimizing material rollback down the belt 24 as the belt 24 is moving through the inclined tube 14.

5 The overall structure and orientation of the cleat sets 28 and cleat members 30 produce more efficient, gentler and faster transportation of the material by the conveyor 10. Thus, the improved cleated belt of the present invention yields time and energy savings.

10 Even when the conveyor 10 is inclined at relatively steep angles, the cleat sets 28 minimize or eliminate downward product slide or tumble, thereby reducing product damage during conveyance. The stepper incline of the conveyor 10 which is possible with the cleated belt 24 also reduces the footprint of the conveyor.

 The scope of the claims should not be limited by the preferred embodiments set forth in the examples, but should be given the broadest interpretation consistent with the description as a whole.

CLAIMS

1. An improved conveyor belt for use in a tubular conveyor, comprising:
an endless loop belt having an outer surface, opposite left and right edges, and a
5 longitudinal axis;
a first set of cleats on the belt extending across the longitudinal axis at a non-
perpendicular angle from left to right;
a second set of cleats on the belt extending across the longitudinal axis at a non-
perpendicular angle from right to left;
10 each set of cleats including a plurality of upstanding cleat members; and
each set of cleats having a longitudinal axis and each cleat member having a
longitudinal axis, with the axes of cleat members in a set being offset from the
longitudinal axis of the set.
- 15 2. The improved conveyor belt of claim 1 wherein each of the first and second sets of
cleats have forward and rearward ends, with the forward ends being on opposite sides
of the belt axis and the rearward ends being on opposite sides of the belt axis.
3. The improved conveyor belt of claim 1 wherein each of the first and second sets of
20 cleats have forward and rearward ends, with the rearward end of the first set and the
forward end of the second set being on the same side of the longitudinal axis.
4. The improved conveyor belt of claim 1 further comprising a plurality of the first and
second sets of cleats alternately arranged on the belt.
- 25 5. The improved conveyor belt of claim 1 wherein each cleat member has a primary
horizontal axis which is non-perpendicular to the longitudinal axis of the belt.
6. The improved conveyor belt of claim 1 wherein the cleat members in each set are
30 mounted on a base.

7. The improved conveyor belt of claim 1 wherein the cleat members in each set are interconnected.
8. The improved conveyor belt of claim 1 wherein each cleat member has a longitudinal axis extending approximately 55° relative to the belt's longitudinal axis.
9. The improved conveyor belt of claim 1 wherein each cleat set has a longitudinal axis extending approximately 35° relative to the belt's longitudinal axis.
10. A conveyor assembly, comprising:
 - a pair of spaced apart pulleys;
 - a tubular channel between the pulleys;
 - an endless loop belt trained about the pulleys for rotation about the pulleys and the belt having a longitudinal axis;
 - the belt being substantially flat from side to side while passing over the pulleys and being curved from side to side while passing through the channel;
 - a plurality of alternating first and second cleat sets;
 - the first and second cleat sets having non-parallel longitudinal axes;
 - each cleat set including a plurality of upstanding cleat members; and
 - each set having a longitudinal axis extending approximately 35° from the belt's longitudinal axis and each cleat member having a longitudinal axis extending approximately 55° relative to the belt's longitudinal axis.
11. The conveyor assembly of claim 10 wherein the longitudinal axes of the cleat sets are non-perpendicular to the belt longitudinal axis.
12. The conveyor assembly of claim 10 wherein the first and second cleat sets each have forward and rearward ends on opposite sides of the belt axis.

13. The conveyor assembly of claim 10 wherein each cleat set has a forward end and a rearward end, with the forward end of each cleat set extending forwardly beyond the rearward end of each adjacent cleat set.
- 5 14. The conveyor assembly of claim 10 wherein each cleat set has forward and rearward ends residing on opposite sides of the belt axis.
15. The conveyor assembly of claim 10 wherein each cleat member has a primary horizontal axis which is non-perpendicular to the longitudinal axis of the belt.
- 10 16. The conveyor assembly of claim 10 wherein the cleat members in each set are interconnected.

1/7

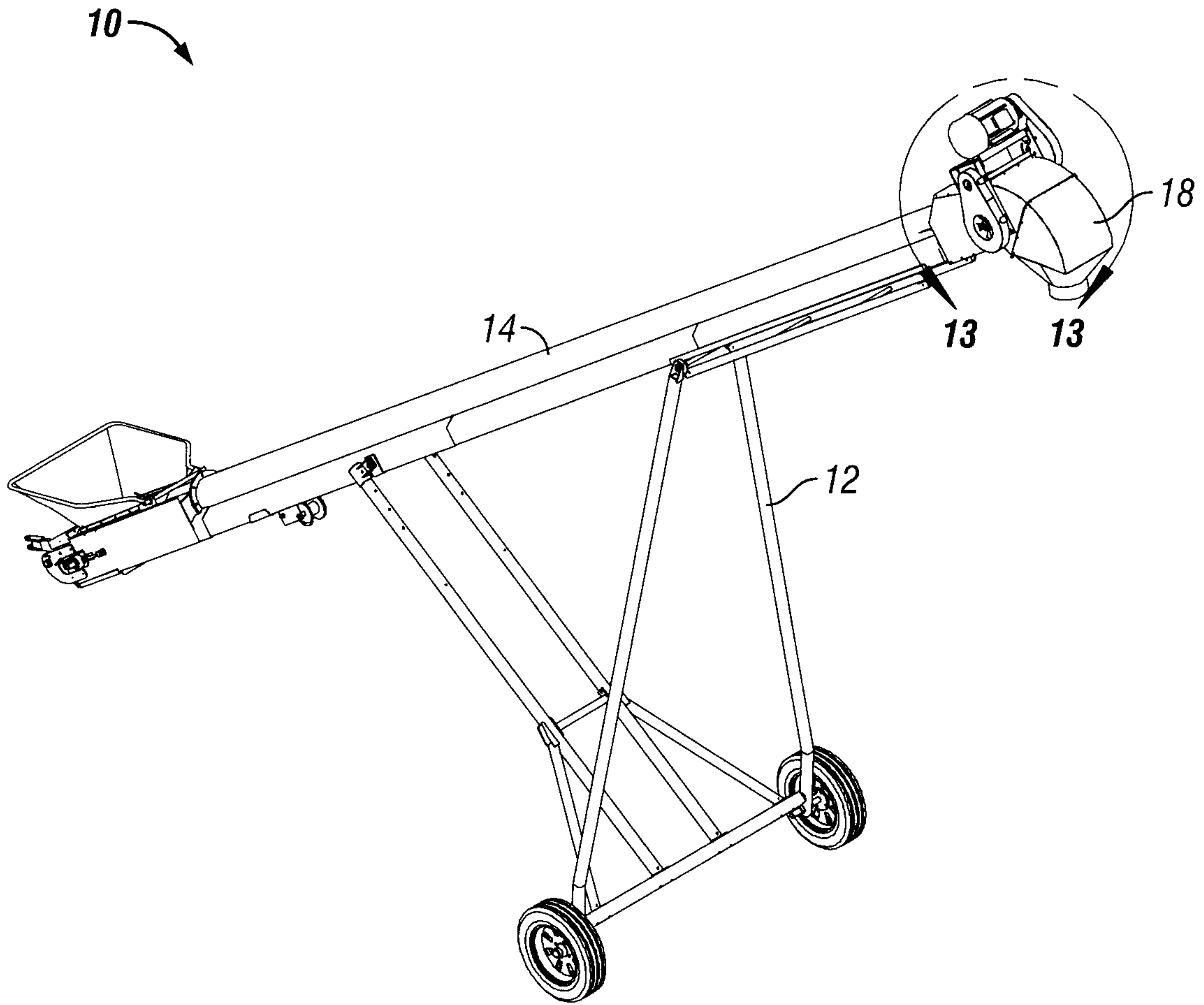

FIG. 1

2/7

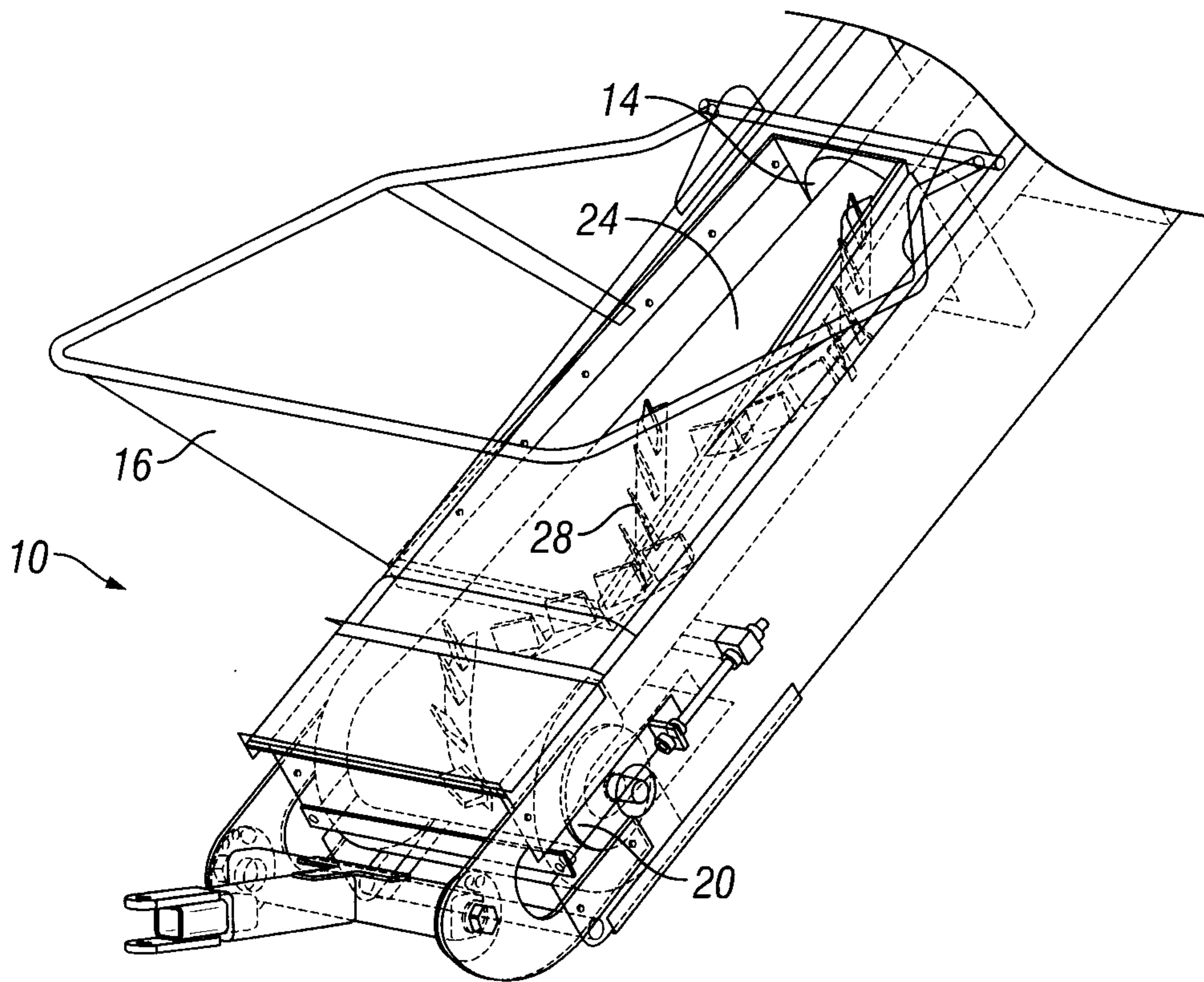

FIG. 2

3/7

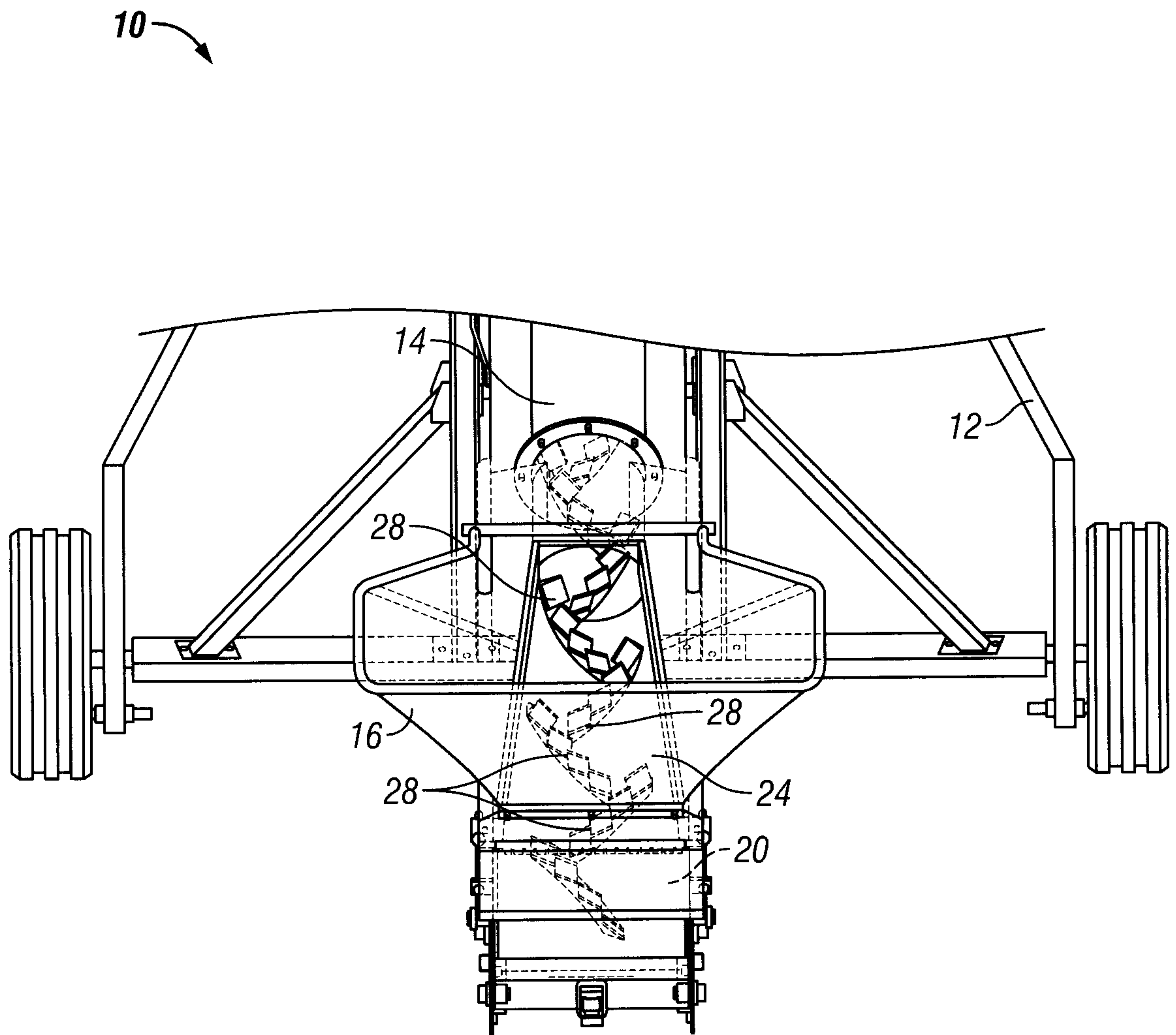

FIG. 3

4/7

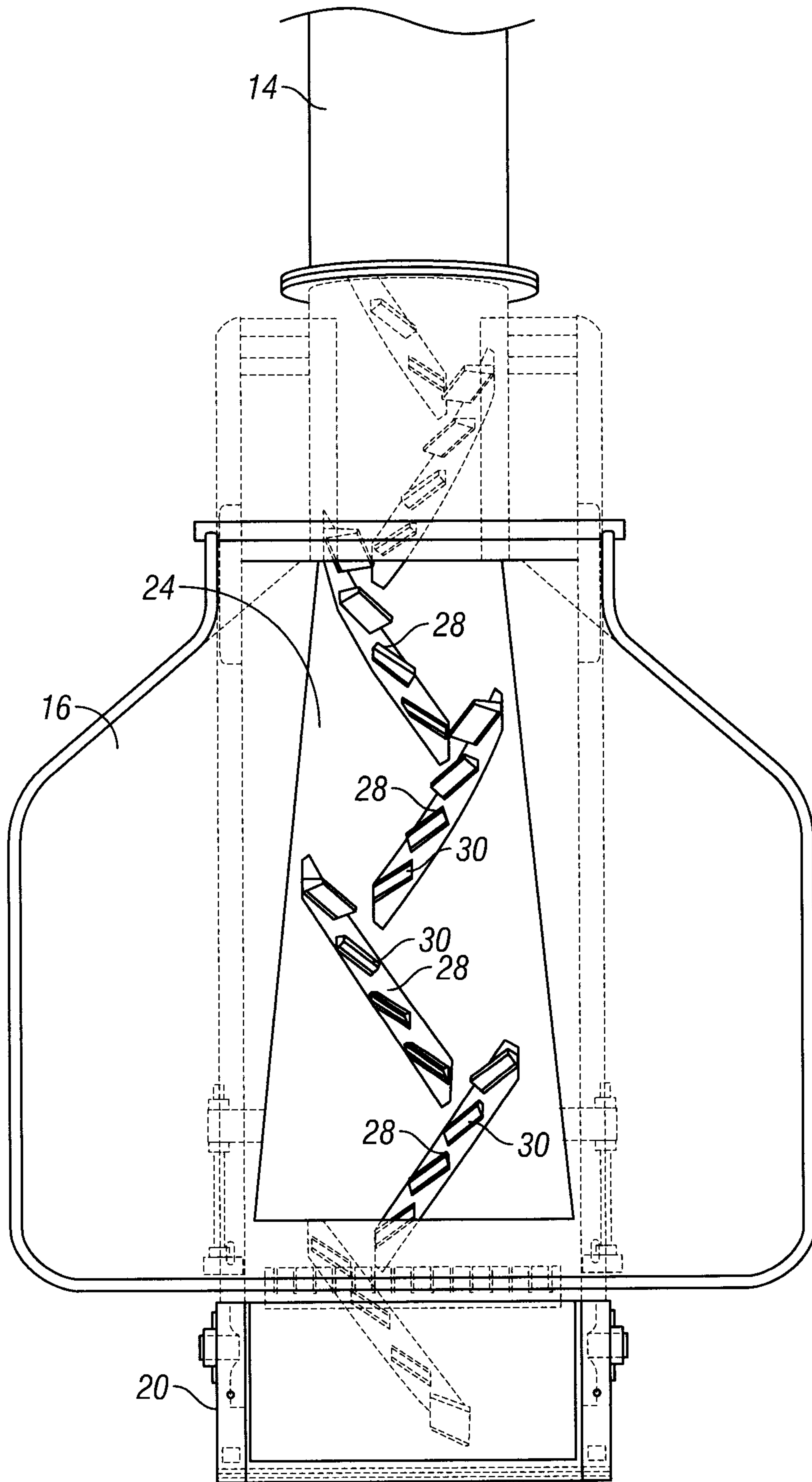

FIG. 4

5/7

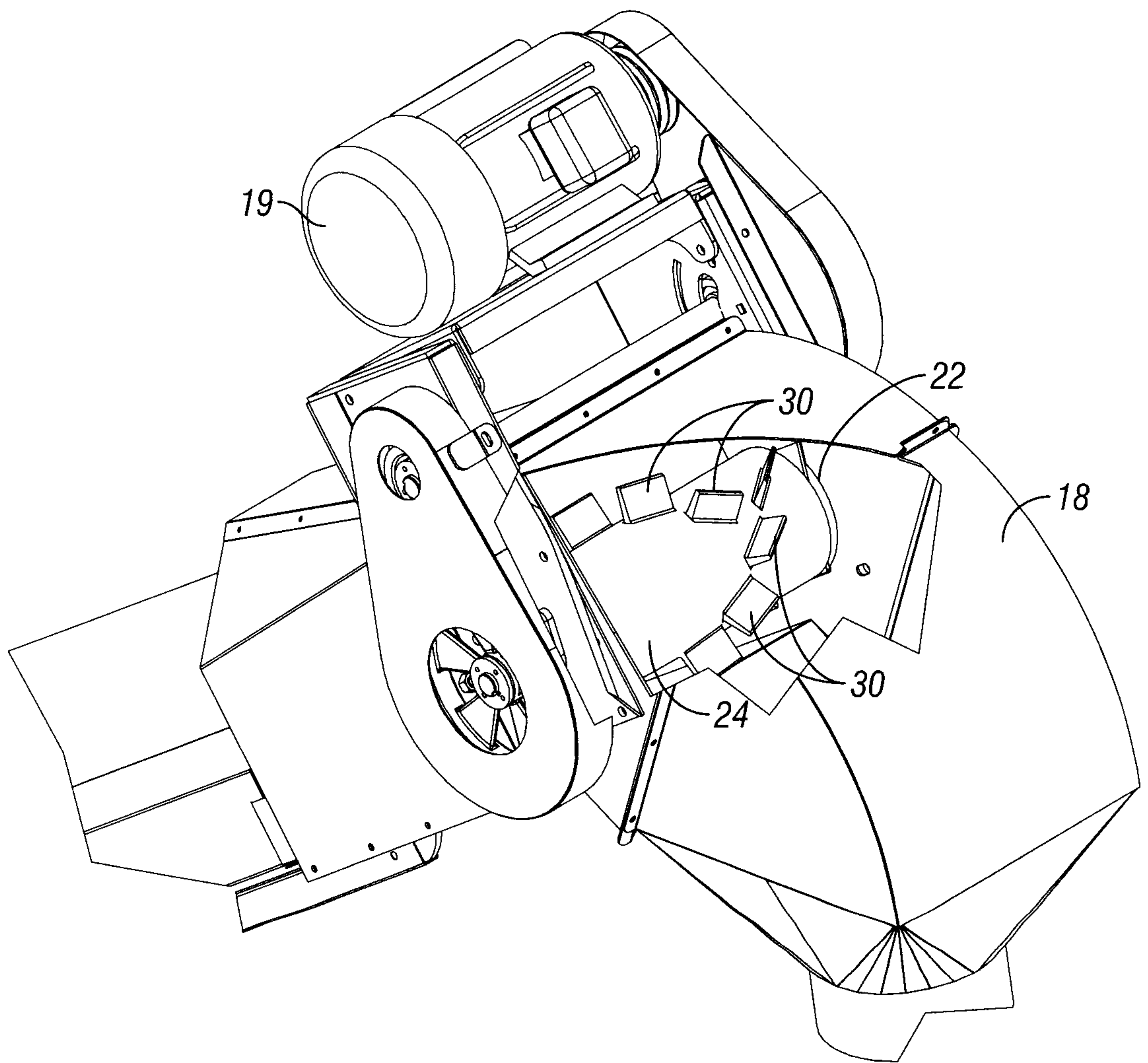

FIG. 5

6/7

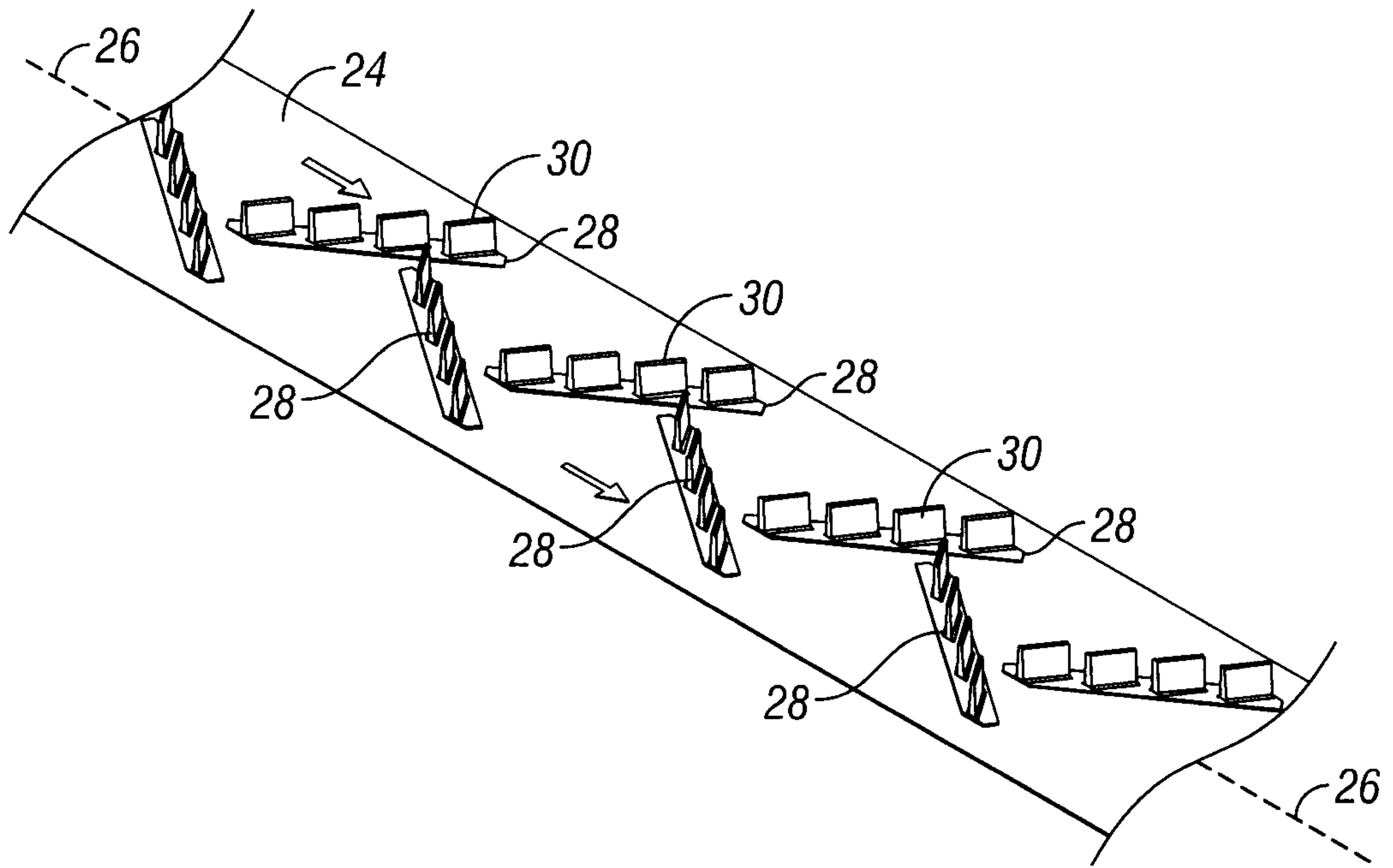

FIG. 6

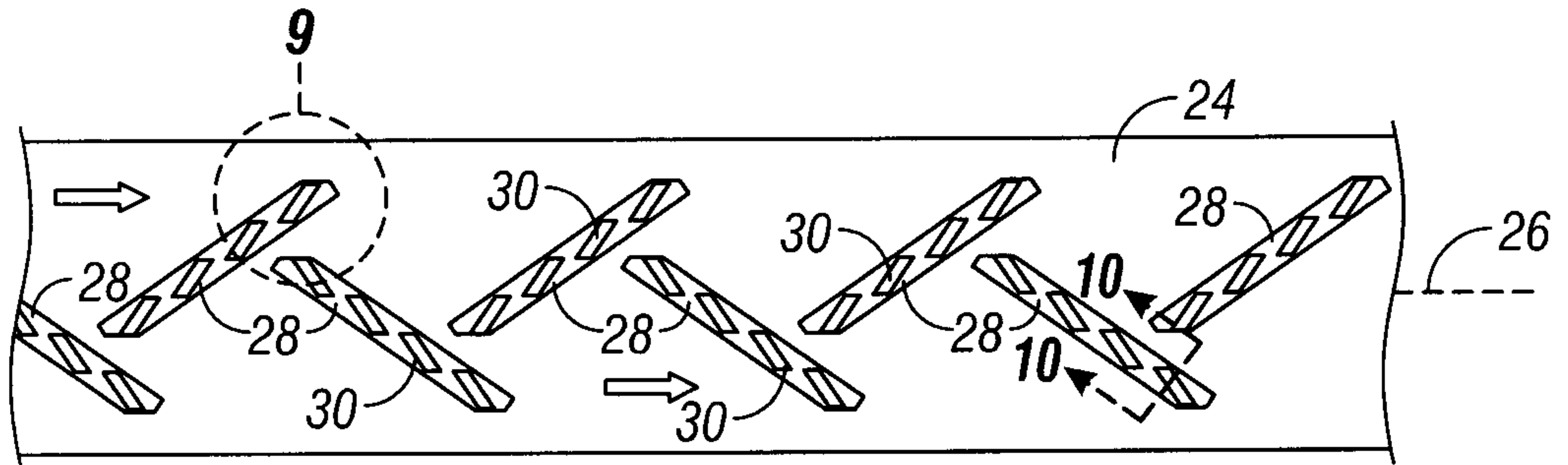

FIG. 7



FIG. 8

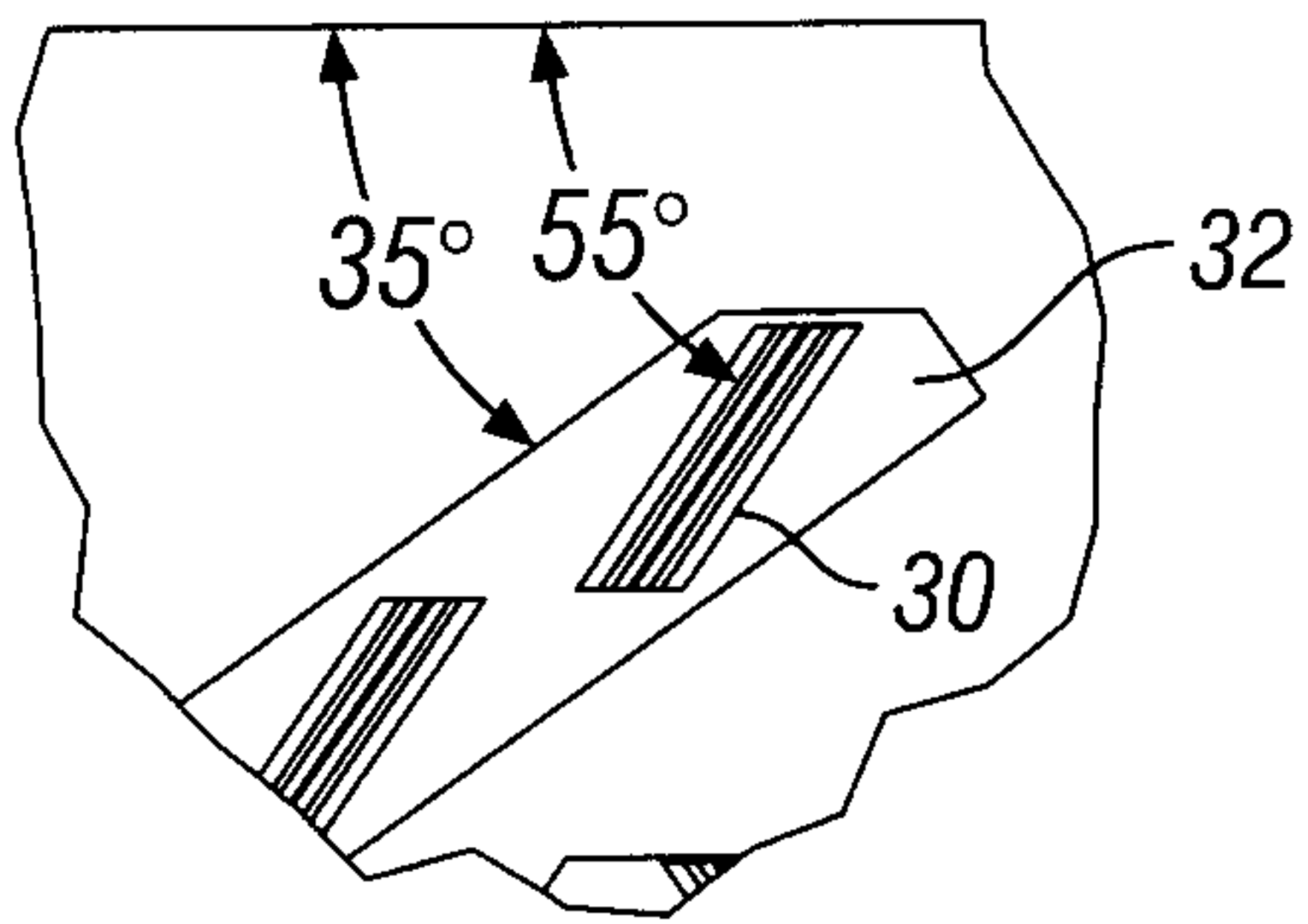

FIG. 9

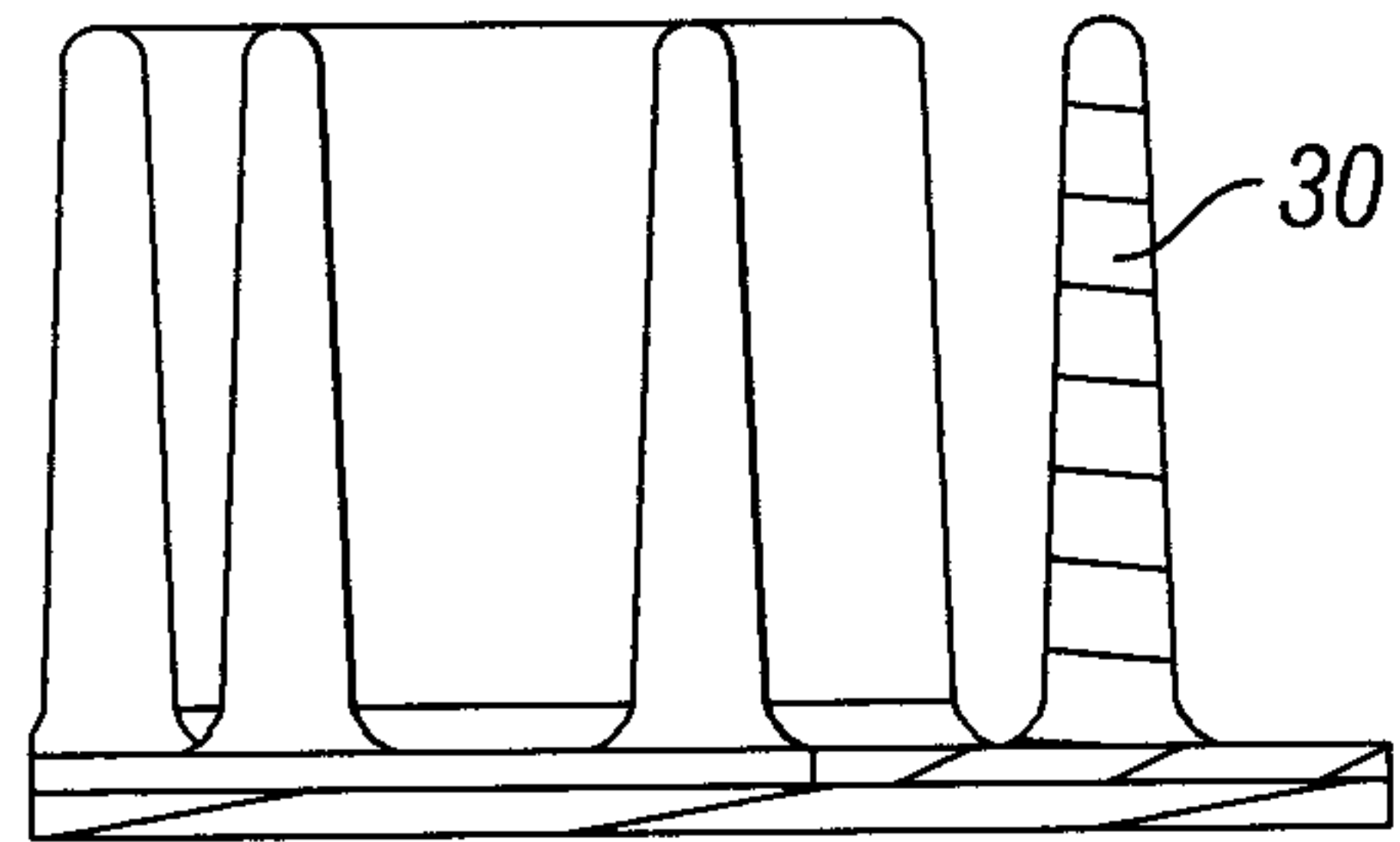

FIG. 10

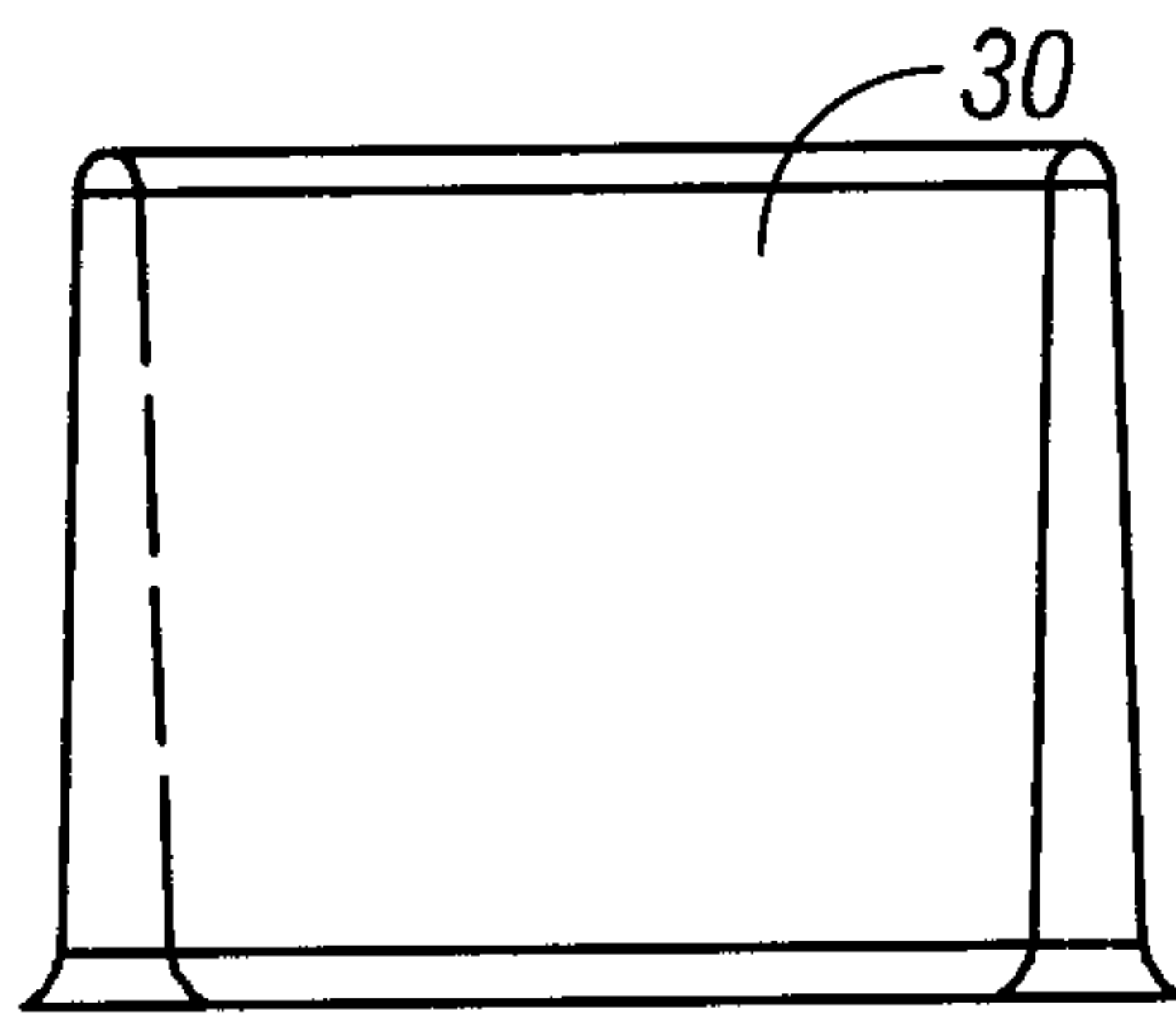

FIG. 11

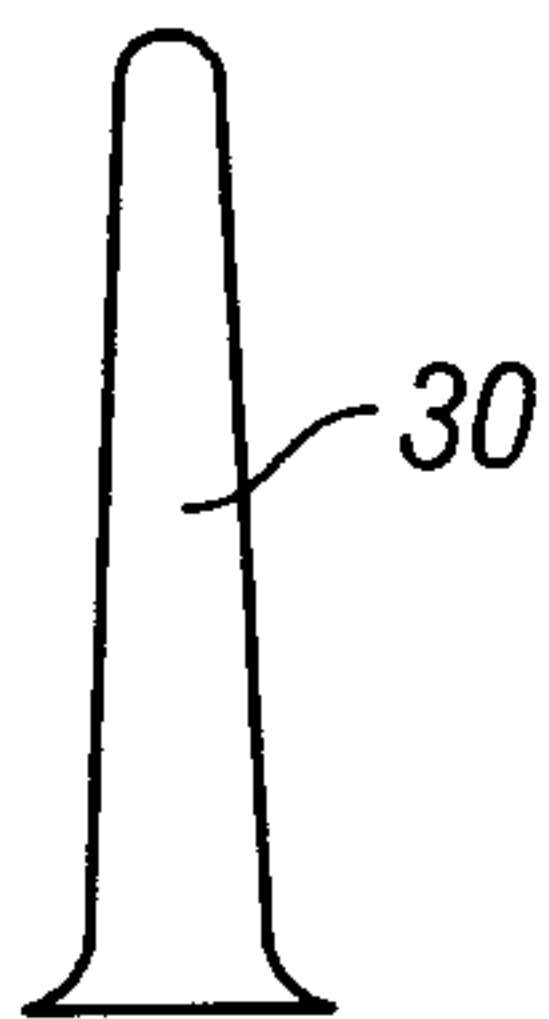

FIG. 12

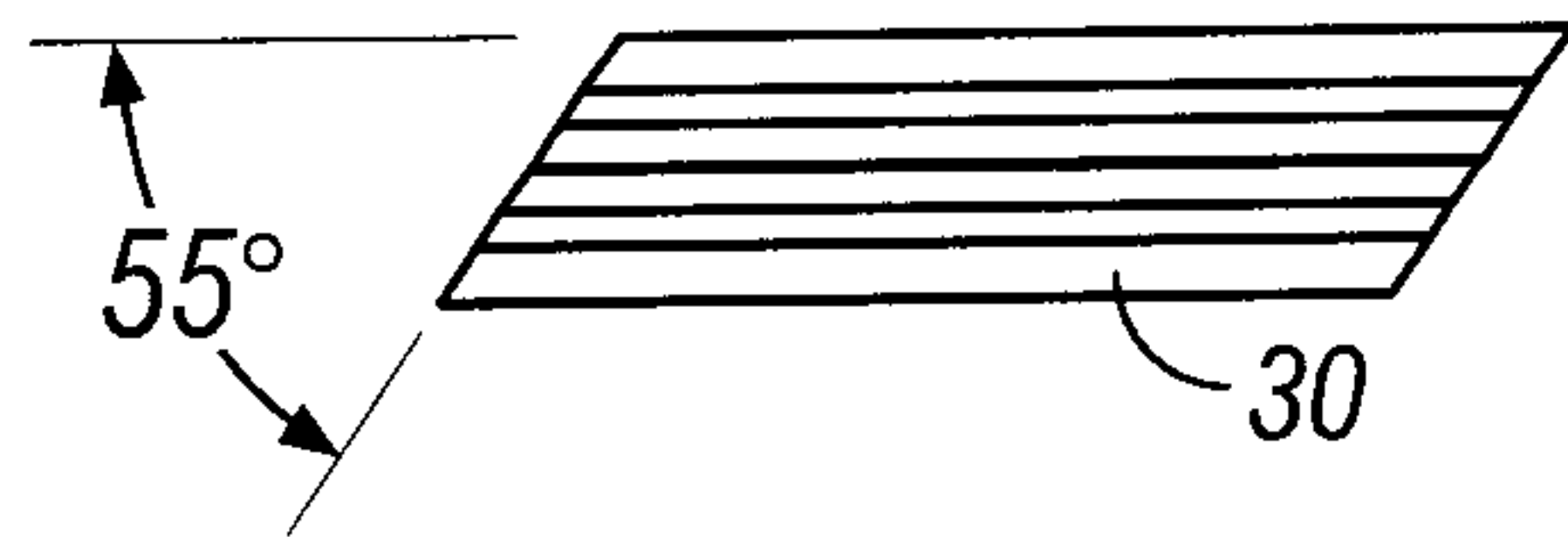

FIG. 13

