



- (51) **International Patent Classification:**
A61B 6/04 (2006.01) *A61B 6/00* (2006.01)
- (21) **International Application Number:** PCT/FI2014/050930
- (22) **International Filing Date:** 1 December 2014 (01.12.2014)
- (25) **Filing Language:** Finnish
- (26) **Publication Language:** English
- (30) **Priority Data:**
20130361 29 November 2013 (29.11.2013) FI
20136259 13 December 2013 (13.12.2013) FI
- (71) **Applicant:** PLANMED OY [FI/FI]; Sorvaajankatu 7, FI-00880 Helsinki (FI).
- (72) **Inventors:** LAUKKANEN, Tapio; Planmed Oy, Sorvaajankatu 7, FI-00880 Helsinki (FI). ASPELUND, Leo; Planmed Oy, Sorvaajankatu 7, FI-00880 Helsinki (FI).
- (74) **Agent:** TAWAST, Juha; Planmeca Oy, Asentajankatu 6, FI-00880 Helsinki (FI).
- (81) **Designated States** (*unless otherwise indicated, for every kind of national protection available*): AE, AG, AL, AM, AO, AT, AU, AZ, BA, BB, BG, BH, BN, BR, BW, BY, BZ, CA, CH, CL, CN, CO, CR, CU, CZ, DE, DK, DM, DO, DZ, EC, EE, EG, ES, FI, GB, GD, GE, GH, GM, GT, HN, HR, HU, ID, IL, IN, IR, IS, JP, KE, KG, KN, KP, KR, KZ, LA, LC, LK, LR, LS, LU, LY, MA, MD, ME, MG, MK, MN, MW, MX, MY, MZ, NA, NG, NI, NO, NZ, OM, PA, PE, PG, PH, PL, PT, QA, RO, RS, RU, RW, SA, SC, SD, SE, SG, SK, SL, SM, ST, SV, SY, TH, TJ, TM, TN, TR, TT, TZ, UA, UG, US, UZ, VC, VN, ZA, ZM, ZW.
- (84) **Designated States** (*unless otherwise indicated, for every kind of regional protection available*): ARIPO (BW, GH, GM, KE, LR, LS, MW, MZ, NA, RW, SD, SL, ST, SZ, TZ, UG, ZM, ZW), Eurasian (AM, AZ, BY, KG, KZ, RU, TJ, TM), European (AL, AT, BE, BG, CH, CY, CZ, DE, DK, EE, ES, FI, FR, GB, GR, HR, HU, IE, IS, IT, LT, LU, LV, MC, MK, MT, NL, NO, PL, PT, RO, RS, SE, SI, SK,

[Continued on next page]

(54) **Title:** IMPROVEMENT FOR MAMMOGRAPHY EXAMINATIONS

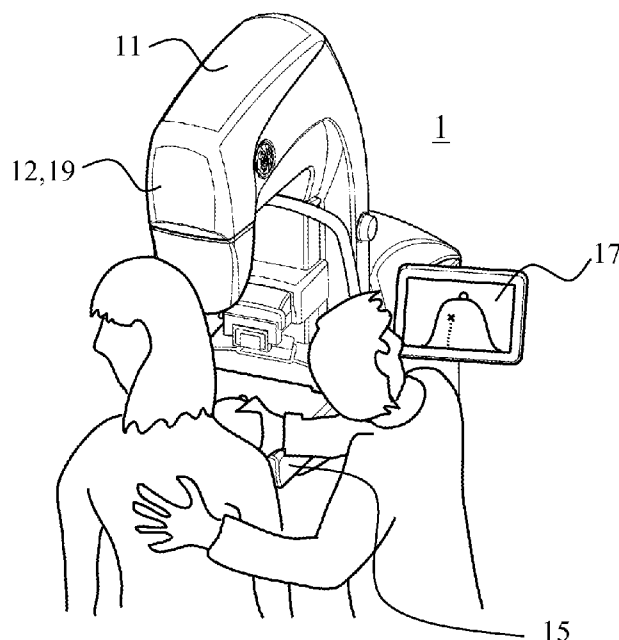

Fig. 2

(57) **Abstract:** The invention relates to an arrangement in connection with a mammography apparatus, in the invention, a screen (17) or a user interface with a screen (17) is attached to the mammography apparatus, which attachment is realized such that the screen (17) or the user interface with a screen (17) is aligned or can be aligned at least partly towards a lower tray structure (15) of the mammography apparatus. Such screen (17) or a user interface with a screen (17) can be arranged in a functional connection with an information system and patient images recorded earlier in the information system can be displayed on the screen (17) or the user interface with a screen (17).



SM, TR), OAPI (BF, BJ, CF, CG, CI, CM, GA, GN, GQ, GW, KM, ML, MR, NE, SN, TD, TG). **Published:**

Declarations under Rule 4.17:

- *as to applicant's entitlement to apply for and be granted a patent (Rule 4.17(ii))*
- *of inventorship (Rule 4.17(iv))*

- *with international search report (Art. 21(3))*
- *before the expiration of the time limit for amending the claims and to be republished in the event of receipt of amendments (Rule 48.2(h))*

IMPROVEMENT FOR MAMMOGRAPHY EXAMINATIONS

FIELD OF THE INVENTION

- 5 The present invention relates to an arrangement and method to facilitate mammography examinations.

DESCRIPTION OF PRIOR ART

- 10 Breast cancer is the most common type of cancer in women. According to investigations, about one in every ten women contracts breast cancer at some point in their lives. When breast cancer is detected on the basis of symptoms, the illness often has already developed to a stage where the prognosis for recovery is relatively poor. Some of the cases are detected
15 in screening programs arranged in many countries for women over the age of 40. Screening often reveals a cancer at a very early stage, so its treatment can be started in time and recovery is thus more likely.

- Mammography is a widely used method in breast cancer screening as a clinical investigation method and also in follow-up diagnosis. Mammography is
20 an X-ray imaging method wherein an apparatus specifically designed for this purpose is used. In screening studies, mammography has been reported to have a sensitivity of 90 - 93 % and a specificity of 90 - 97 %. This indicates that screening studies are useful and that early detection of
25 breast cancer by screening can save human lives. It has been established that mammography reduces breast cancer mortality by 35 percent among women over 50 and by 25 - 35 percent among women at the age of 40 - 50 years.

- 30 The mammography images are examined to detect various anomalies in the breast, such as calcifications, i.e. small deposits of calcium in the soft breast tissue. A calcification generally cannot be detected by feeling the breast, but it is visible in the x-ray image. Large calcifications are generally not associated with cancer, but clusters of small
35 calcium deposits, i.e. so-called micro-calcifications, are an indication

of extra breast cell activity, which may be associated with breast cancer. Other features to be detected by mammography include cysts and fibroadenomas, which, however, are generally not associated with cancer.

5 In conventional screening mammography, the breast gland is typically compressed between two compression plates and exposed to radiation at least twice, from above and from an oblique direction. If necessary, an additional third image is taken squarely from the side. As in such imaging the tissue layers lie on top of each other in the direction of the x-ray
10 beam, these irradiations produce two-dimensional images in which strongly absorbing structures may hinder the detection of structures lying beneath them.

Continual improvement in mammography has led to novel type of mammography
15 methods and devices that produce tomographic images of a patient's breast. In these solutions, several projections of the breast at different angles are produced and an image is generated by using an applicable reconstruction algorithm. From the image information, i.e. from the individual images, typically several images are constructed which represent
20 layers of the breast oriented in parallel with the surface of the x-ray detector, thus making possible to detect tissue structures laying on top of each other.

A typical digital mammography apparatus comprises a frame part and a C-
25 arm or a corresponding structure rotatably connected to the frame part. At the first end of the C-arm, there is arranged an x-ray source and at the second end, a radiation detector. A term imaging means is often used for these devices. Disposed substantially in the region between said x-ray source and detector, typically at a close proximity to the detector,
30 a compression structure is arranged which is designed to position a breast as compressed for the duration of an exposure.

Mammography patients often experience varying degrees of anxiety that may be related not only to the general fear regarding a possible disease the
35 examination may discover as such but also, for example, to the fear of

physical pain the compressing of a breast for the imaging process or the injecting of a biopsy needle into the breast tissue causes. As the patient's anxiety may affect the patient's behavior, and thus the success of the imaging or sampling, all means by which the patient's fears can be alleviated are welcomed.

User interfaces of the mammography apparatus are traditionally fixed structures and as the name suggests, specifically designed to be used by the user of the apparatus. Traditionally, mammography apparatus have not been arranged with means for presenting information to a patient.

In mammography, it is known to use images taken of the patient earlier or during the ongoing operation as a source of information for taking new images, or for biopsy. It is known to use information one can get from such images to facilitate patient positioning, when the same object is being imaged anew, or when one is about to initiate a biopsy, or during it. According to the prior art, such images taken earlier have been studied at a workstation, which typically has not been arranged immediately next to the mammography apparatus. This means that the information relevant for positioning, established at the workstation, just has to be remembered and figured out correctly after having returned to the mammography apparatus from the workstation.

SUMMARY OF THE INVENTION

The object of the present invention and its preferable embodiments is to accomplish a new kind of mammography apparatus including integrated solutions thanks to which the biopsy operation or the positioning of the breast for the imaging may be facilitated. On the other hand, preferable embodiments of the invention can alleviate the patient's fear relating to an upcoming operation or during it.

The object of the invention is achieved by a solution of the accompanying independent claims. Some preferable embodiments of the invention have been presented in the accompanying dependent claims. It is essential to

the invention to implement an arrangement integrated to the mammography apparatus which enables presenting images taken of the patient on a screen, which is arranged to the mammography apparatus in the immediate vicinity of its imaging station.

5

Thus, a mammography apparatus according to the invention is arranged with a screen (17) or a user interface with a screen (17), which is brought into a functional connection with an information system in which images taken of a patient are recorded. A memory of this information system can comprise a memory arranged in connection with the mammography apparatus or a memory separate to that, or both. When images taken of a patient earlier are studied, according to the prior art, at some separate workstation, the present invention provides an opportunity to bring such images to the immediate vicinity of a place where information one can get from the earlier images can be directly utilized to facilitate positioning. Preferably, the arrangement includes a possibility to present the images taken of the patient earlier in the same orientation in which the breast is being positioned to the imaging apparatus.

On the other hand, preferable embodiments of the invention provide a new way to guide and calm the patient and to provide information to the patient prior to or during an imaging or biopsy procedures. Thanks to embodiments of the invention, the patient can be provided information on when exactly an exposure will begin and the patient should be still, for example, or how long the operation will still last.

DETAILED DESCRIPTION OF THE INVENTION

In the following, some embodiments of the invention and their benefits will be described in more detail, also with help of the attached figures, of which figures

- Fig. 1 shows a basic structure of one mammography apparatus according to the invention,

35

- Fig. 2 shows a solution in which information which facilitates patient positioning is being presented on a screen connected to a mammography apparatus,

5 - Figs. 3a, 3b and 3c show a mammography apparatus according to Fig. 1 in an oblique imaging position and as viewed from above, and

- Fig. 4 is a diagrammatic presentation of an arrangement for presenting information in connection with a mammography imaging apparatus.

10

DETAILED DESCRIPTION OF THE INVENTION

A mammography apparatus (1) presented in Fig. 1 consists of a substantially vertically standing frame part (10) and an arm structure (11) connected to it. An X-ray source (12) is arranged to the upper part of the arm structure (11), within its cover, the x-ray source (12) being arranged to generate a beam which goes through an upper compression plate (14) of the mammography apparatus (when such upper compression plate is connected to the apparatus) and towards a detector (18) placed in a detector housing (13). The detector housing (13) or a corresponding structure is typically arranged inside a lower tray structure (15). The lower tray structure (15) can be a structure fixed to the apparatus or it can be arranged as removably connected. When the upper surface of the lower tray structure (15) typically functions as a platform on which a breast is positioned for imaging, this structure is often also referred to as a lower compression plate. Also, in connection with the arm structure (11), such as in the vicinity of the radiation source (12), a camera or a video camera aligned at the lower tray structure (15) may have been arranged, to be utilized in patient positioning. In the solution according to Fig. 1, attaching means (16) is arranged to the lower tray structure (15) to enable its releasable connection to the mammography apparatus (1). In addition, a screen (17) or a user interface with a screen (17), to be described in more detail below, is arranged to the apparatus according to Fig. 1.

35

Figs. 3a-3c show the apparatus according to Fig. 1 as viewed from above and in an oblique imaging position. Two screens (17), which may be touch screens, are arranged to the frame part (10) of the apparatus, on the opposite sides of the frame part (10). Attachment of the screen (17) to the frame part (10) of the apparatus may be articulated such that it can be turned to both a first position in which it is aligned away from the lower tray structure (15) of the apparatus (Fig. 3a), in connection with which structure the patient is positioned for imaging or operations, and to a second position (Fig. 3b) in which it is at least partly aligned towards the lower tray structure (15), i.e. in which it is in such position that the patient has a line of sight to the screen (17).

A position is presented in Fig. 3 intermediate to the previous positions which is applicable for consultation, for example, in which position both the operator of the apparatus and the patient have a good view at the screen (17).

The screen (17) may be just a screen but preferably it is a true traditional touch screen and it may also be some other user interface comprising a screen. Then the first position of the touch screen (17) according to Fig. 3a can be used when operations of the apparatus are controlled or when information is presented on the touch screen which one does not want the patient to see or which the patient needs no to see. Also the position according to Fig. 3b, and especially according to Fig. 3c can be used when controlling operation of the apparatus, but those positions of the screen (17) are especially designed to be used for delivering information to the patient.

In reference to Fig. 4, according to one preferable embodiment of the invention, the touch screen (17) is arranged in functional connection with the control system of the apparatus to display imaging parameter values, for example, or the time remaining in the imaging process. Preferably, though, a functional connection like this is arranged e.g. to a patient data base, whereby one preferable embodiment according to the invention includes a solution in which a touch screen (17) is arranged in a func-

tional connection with an information system in which images of a patient taken earlier have been recorded. It is known as such to use information achievable from such images to facilitate patient positioning when the same object is being re-imaged or when a biopsy is to be started or is
5 going on, which information may include measurement markings or other made to the images relating to findings which have been detected. According to prior art, though, such images taken earlier have been studied at some separate workstation, but the present invention makes it possible to bring the images to the immediate vicinity of the place where that infor-
10 mation is needed. Then, the arrangement preferably includes a possibility to present images of a patient's breast taken earlier, especially in the same orientation in which the breast is being positioned to the imaging apparatus and in which images, as said, measurement markings or other may have been made relating to findings which have been detected. Fig. 2 demonstrates a situation like this.
15

Especially the bringing of the touch screen in connection with the imaging station of a mammography apparatus makes it possible to alter characteristics of an earlier image of the breast as well as putting down measurement markings as mentioned above on an image in connection with repositioning.
20

The screen or the user interface with a screen connected to a mammography apparatus as presented above can be utilized in patient positioning also
25 if the mammography apparatus is equipped with a camera or a video camera (19) aligned at the imaging station of the apparatus. A picture of a breast positioned for imaging may have been taken by such camera (19) in connection with an earlier imaging event (which camera may have in principle been located at some other corresponding apparatus), which picture
30 can then be shown in real time in connection with a new positioning, at the immediate vicinity of the imaging station of the apparatus. On the other hand, also taking a real time photograph of the imaging area may be useful in positioning, when the operator of the apparatus can have a look at the screen to review the positioning situation, instead of following

the situation in a possibly cramped space outlined by the mammography apparatus and the patient.

When information one can acquire from images of the patient taken earlier
5 is directly available in connection with patient positioning, such as information of location of a finding detectable from earlier images, the present invention provides a possibility for smooth and precise positioning for re-imaging or biopsy. Further, the possibility to guide and inform the patient of various stages of the imaging or biopsy event can
10 help in achieving a successful procedure, by e.g. helping the patient to be still throughout an operation which may take quite a while.

The invention can also be realized by the patient herself controlling operation of the mammography apparatus from the user interface brought in
15 connection with the imaging station when the patient's breast is being compressed for imaging. Such solution is prone to lessen the fears of the patient relating to compressing a breast, taking in consideration that there are studies according to which a patient may allow the mammography apparatus to compress a breast even more when she can control the compressing process herself. The solution according to the invention may
20 thus offer the possibility to bring a touch screen (17) arranged to control operation of the mammography apparatus so close to the lower tray structure (15) of the apparatus that the patient can herself control via it e.g. movements of the upper compression plate (14) of the apparatus
25 according to Fig. 1.

In one embodiment of the invention the articulation of the screen (17) or the user interface with a screen (17) is realized as motorized. Then, at least one operation mode can be arranged to the control system of the apparatus according to which the screen (17) automatically turns into a position which has been designated for it in that operation mode. The position of the screen (17) can thus be arranged to be changed according to which procedure that operation mode relates to, or according to what the control system displays on the screen. The screen (17) can be arranged
35 e.g. to turn towards the patient when the time remaining in the image

process is displayed on the screen. On the other hand, also in the case of an articulation being implemented to be turned manually, one or more views may be defined in the control system which are automatically displayed on the screen when it is turned into a position in which it comes
5 to the field of view of the patient, i.e. into a position as aligned towards the lower tray structure (15).

Solutions according to the invention and its preferable embodiments may thus include a mammography apparatus which includes a substantially vertically standing frame part (10) or a frame part (10) attachable to a
10 wall or a ceiling, an arm structure (11) connecting to this frame part (10) and pivotable in relation to a horizontal rotation axis, at a substantially first end of the opposite ends of the arm structure (11) is placed an X-ray source (12), and substantially at a second end an image
15 data receiving means (18), and in connection with said second end of the arm structure (11) is additionally arranged a lower tray structure (15) positioned substantially on top of the image data receiving means (18), a control system and in connection with it a user interface arrangement and at least one screen (17) or user interface with a screen (17). Said
20 screen (17) or user interface with a screen (17) is connected to the mammography apparatus (1) and the connection is realized such that the screen (17) or user interface with a screen (17) is aligned or can be aligned at least partly towards the lower tray structure (15). Further, a means is arranged to the mammography apparatus (1) to bring said screen
25 (17) or user interface with a screen (17) into a functional connection with an external information system such that patient images recorded earlier in said information system can be displayed on said screen (17) or user interface with a screen (17) connected to structures of the mammography apparatus. Preferably the arrangement includes a means for showing
30 images on the screen (17) in an orientation corresponding to an orientation in which a breast is positioned on top of said lower tray structure (15).

As patient positioning in mammography typically includes procedures performed on both sides of the lower tray structure, the invention gets ef-
35

fectively utilized when said screens (17) or user interfaces with a screen (17) are arranged to the mammography apparatus (1) at least one on both of its sides, as viewed from said lower tray structure (15). The user interface arrangement may include at least one screen (17) or
5 user interface with a screen (17) which is

- attached as articulated to the frame part (10) or
- implemented with a technology by which a direction in which information on the screen is visible is adjustable

so that a view generated by said at least one screen (17) or a user in-
10 terface with a screen (17) can be aligned at least at a first direction in which it is aligned away from said lower tray structure (15) and at a second direction in which it is at least partially aligned towards said lower tray structure (15).

15 The at least at least one screen (17) or user interface with a screen (17) is attached to the frame part (10) as articulated. The articulation can be realized as motorized and said control system to comprise at least one operation mode according to which a view generated by the screen au-
20 tomatically turns into a position determined for it by said operation mode, as dependent on the operation to which the operation mode relates to or on what the control system shows on the screen (17). The articulation can also include a structure which enables bringing the screen (17) or the user interface with a screen into a substantial vicinity of the lower tray structure (15), especially within an arm's length or closer.

25 One or several views can be defined in the control system to be automatically presented on the screen (17) or a user interface with a screen (17), when it is turned into its said second position.

30 The invention also concerns a method for positioning a breast into a mammography apparatus, in which method an image taken of the breast is used as an aid for positioning the breast, which image is a patient image recorded earlier in an information system external to the mammography apparatus and said image is presented on a screen (17) or a user interface
35 with a screen (17) attached to the structures of the mammography appa-

ratus. This image can be presented in a direction at which there is a line of sight from an imaging station of the mammography apparatus, especially in an orientation corresponding to the orientation in which the breast is being positioned for mammography imaging or for biopsy, in relation to the imaging station of the mammography apparatus.

5

CLAIMS

1. A mammography imaging arrangement, which includes a mammography apparatus (1), which includes

- 5 - a substantially vertically standing frame part (10) or a frame part (10) attachable to a wall or a ceiling,
 - an arm structure (11) connecting to said frame part (10) and pivotable in relation to a horizontal rotation axis,
 - wherein at a substantially first end of the opposite ends of the arm structure (11) is placed an X-ray source (12) and substantially
 - 10 at a second end an image data receiving means (18) and
 - wherein in connection with said second end of the arm structure (11) is additionally arranged a lower tray structure (15), positioned substantially on top of the image data receiving means (18)
 - 15 and
 - a control system and in connection with it a user interface arrangement,
 - at least one screen (17) or user interface with a screen (17),
- characterized in that said at least one screen (17) or
- 20 user interface with a screen (17) is connected to structures of the mammography apparatus (1), the connection being realized such that said screen (17) or user interface with a screen (17) is aligned or can be aligned at least partly at said lower tray structure (15), and in that a means is arranged to the mammography apparatus (1) to bring said screen
 - 25 (17) or user interface with a screen (17) into a functional connection with an external information system such that patient images recorded earlier in said information system can be displayed on said screen (17) or user interface with a screen (17) connected to the structures of the mammography apparatus.

30 2. The arrangement according to claim 1, characterized in that the arrangement includes a means for showing images on said screen (17) in an orientation corresponding to an orientation in which a breast is positioned on top of said lower tray structure (15).

3. The arrangement according to claim 1 or 2, characterized in that said screens (17) or user interfaces with a screen (17) are arranged to the mammography apparatus (1) at least one on both of its sides, as viewed from said lower tray structure (15).

4. The arrangement according to any of the claims 1 - 3, characterized in that said user interface arrangement comprises at least one screen (17) or a user interface with a screen (17) which is

- attached as articulated to the frame part (10) or

- implemented with a technology by which a direction in which information on the screen is visible is adjustable

so that a view generated by said at least one screen (17) or a user interface with a screen (17) can be aligned at least at a first direction in which it is aligned away from said lower tray structure (15) and at a second direction in which it is at least partially aligned towards said lower tray structure (15).

5. The arrangement according to claim 4, characterized in that said at least one screen (17) or user interface with a screen (17) is attached to the frame part (10) as articulated, the articulation being realized as motorized, and said control system comprises at least one operation mode according to which a view generated by the screen automatically turns into a position determined for it by said operation mode, as dependent on the operation to which the operation mode relates to or on what the control system shows on the screen (17).

6. The arrangement according to claim 4 or 5, characterized in that said at least one screen (17) or user interface with a screen (17) is attached to the frame part (10) as articulated, the articulation being implemented so that the screen (17) can be brought into a substantial vicinity of the lower tray structure (15), especially within an arm's length or closer.

7. The arrangement according to any one of claims 4 - 6, characterized in that one or several views have been defined in the

control system to be automatically presented on the screen (17) or a user interface with a screen (17) when it is turned into its said second position.

5 8. The arrangement according to any one of claims 1 - 7, characterized in that said screen (17) or a user interface with a screen (17) is a touch screen (17).

9. The arrangement according to any one of claims 1 - 8, characterized in that a camera or a video camera (19) aligned at
10 said lower tray structure (15) is arranged in connection with the arm structure (11) of the mammography apparatus.

10. A method for positioning a breast to a mammography apparatus, in
15 which method an image taken of the breast is used as an aid for positioning the breast, characterized in that said image of the breast is a patient image recorded earlier in an information system external to the mammography apparatus, which image is presented on a screen (17) or a user interface with a screen (17) attached to the structures of
20 the mammography apparatus.

11. The method according to claim 10, characterized in that said image is presented in a direction at which there is a line of sight from an imaging station of the mammography apparatus.

25 12. The method according to claim 10, characterized in that said image is presented in the direction of said imaging station in an orientation corresponding to the orientation in which the breast is being positioned to the mammography apparatus.

30

1/4

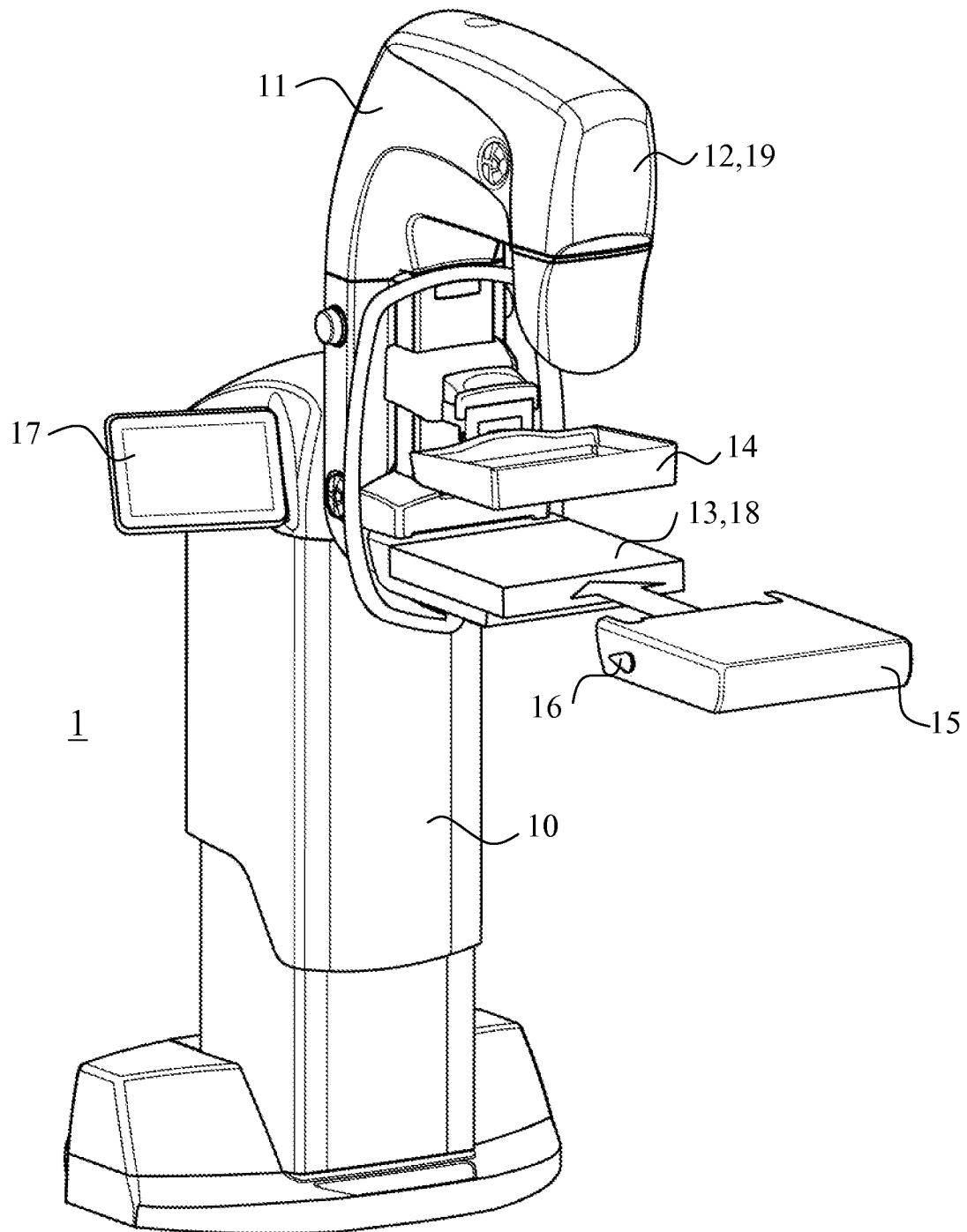

Fig. 1

2/4

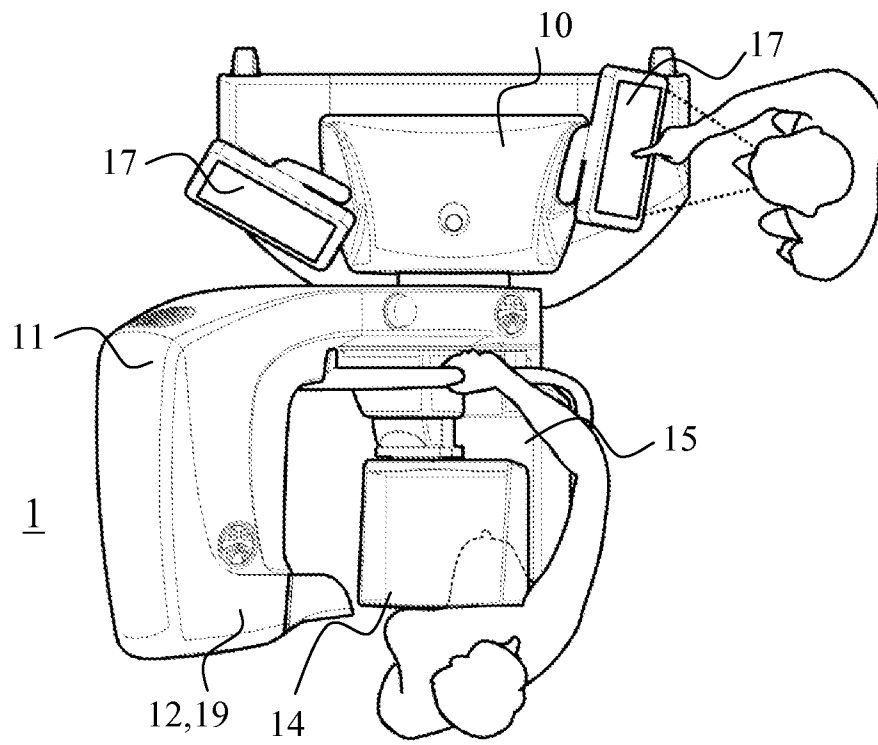

Fig. 3a

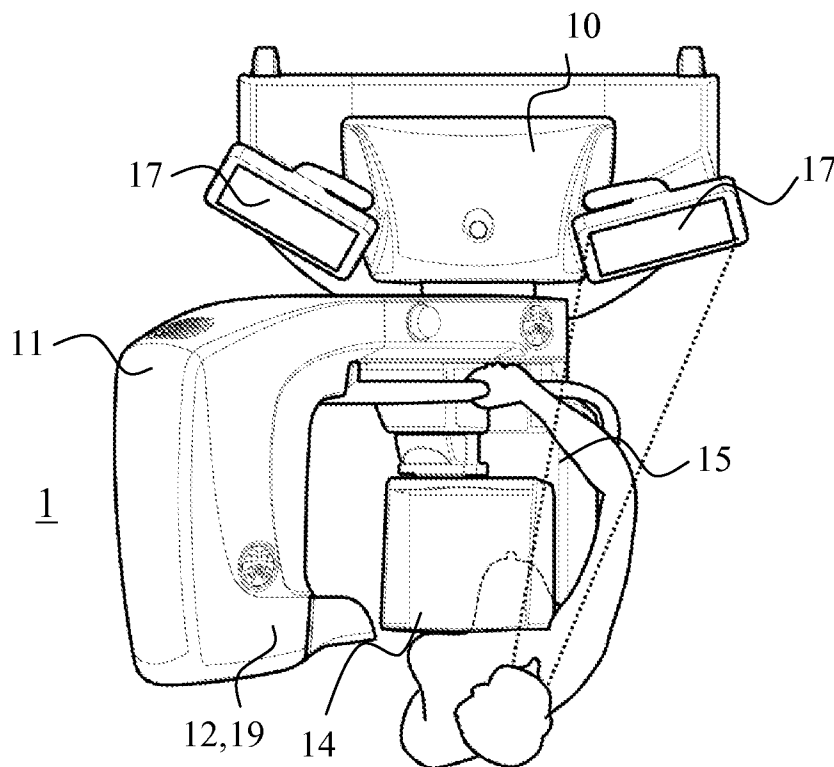

Fig. 3b

3/4

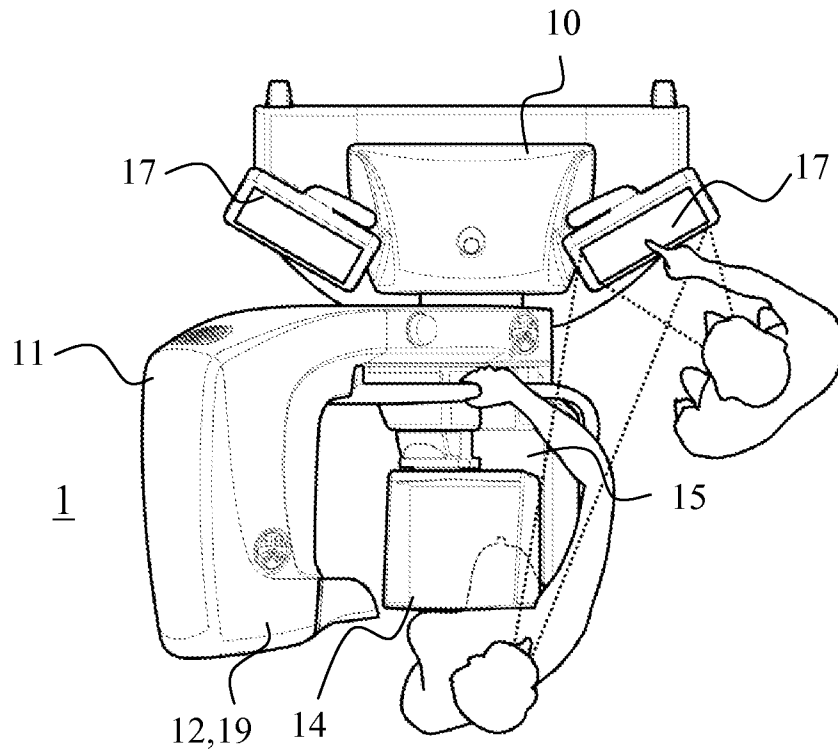

Fig. 3c

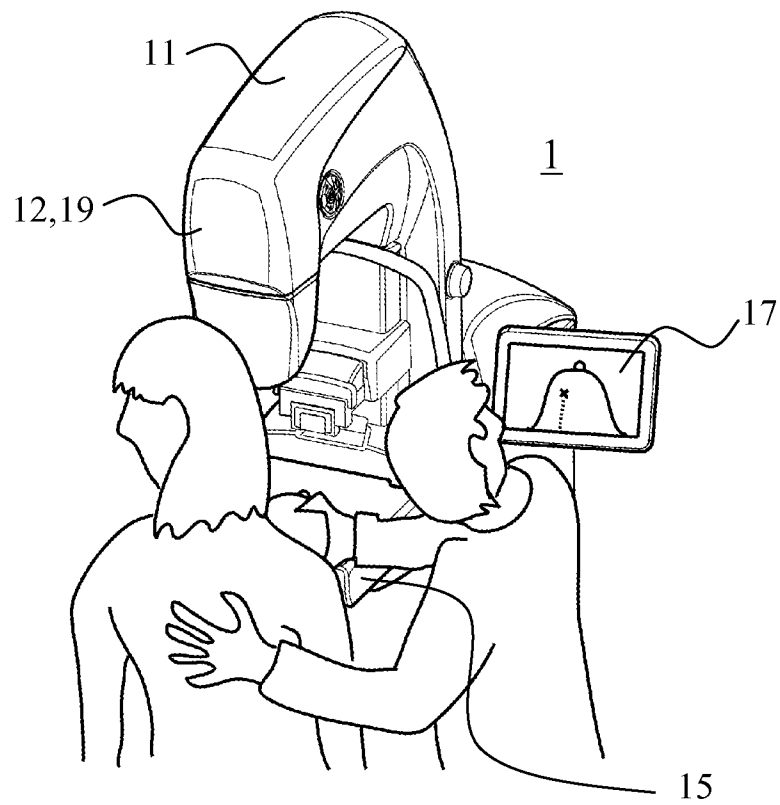

Fig. 2

4/4

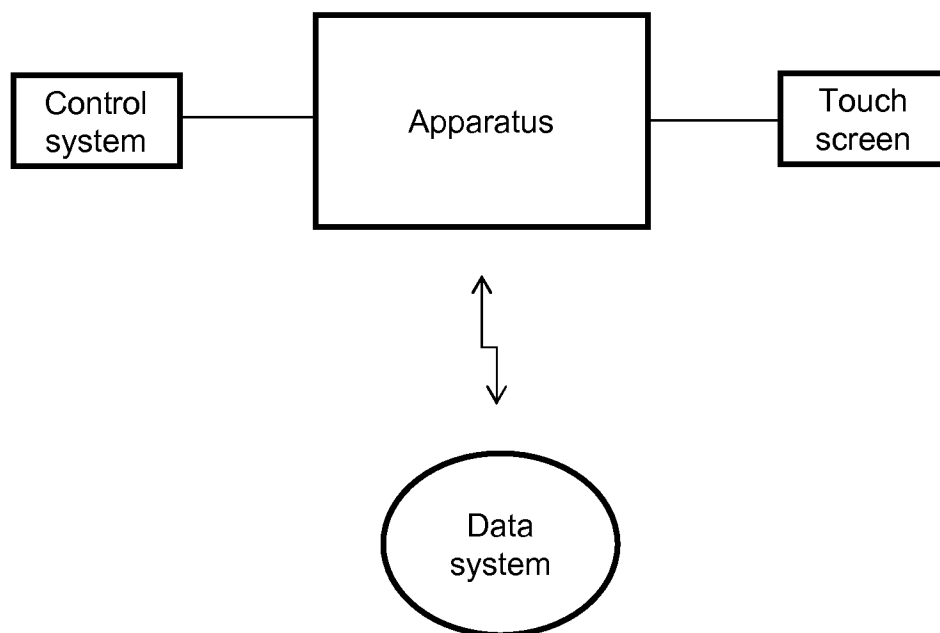

Fig. 4

INTERNATIONAL SEARCH REPORT

International application No.

PCT/FI2014/050930

A. CLASSIFICATION OF SUBJECT MATTER

See extra sheet

According to International Patent Classification (IPC) or to both national classification and IPC

B. FIELDS SEARCHED

Minimum documentation searched (classification system followed by classification symbols)

IPC: A61B

Documentation searched other than minimum documentation to the extent that such documents are included in the fields searched
FI, SE, NO, DK

Electronic data base consulted during the international search (name of data base, and, where practicable, search terms used)

EPO-Internal, WPI, BIOSIS, COMPDX, EMBASE, INSPEC, MEDLINE, NPL, TDB, XP3GPP, XPAIP, XPESP, XPETSI, XPI3E, XPIEE, XPIETF, XPIOP, XPIPCOM, XPJPEG, XPMISC, XPOAC, XPRD, XPTK

C. DOCUMENTS CONSIDERED TO BE RELEVANT

Category*	Citation of document, with indication, where appropriate, of the relevant passages	Relevant to claim No.
X	JP 2007236805 A (TOSHIBA CORP [JP]) 20 September 2007 (20.09.2007) figures 1, 8 & PAJ abstract; JPO-INPIT machine translation, paragraphs [0013] - [0014], [0024] - [0028], [0039], [0046] - [0050]	1 - 2, 4, 6, 10 - 12
Y	ibid.	5, 7 - 8
X	JP 2009285345 A (FUJIFILM CORP [JP]) 10 December 2009 (10.12.2009) figures 2, 6 & PAJ abstract; JPO-INPIT machine translation, paragraphs [0018] - [0020], [0034], [0041]	1 - 2, 4, 6, 8, 10 - 12
Y	ibid.	5, 7

☒ Further documents are listed in the continuation of Box C.☒ See patent family annex.

* Special categories of cited documents:	"T" later document published after the international filing date or priority date and not in conflict with the application but cited to understand the principle or theory underlying the invention
"A" document defining the general state of the art which is not considered to be of particular relevance	"X" document of particular relevance; the claimed invention cannot be considered novel or cannot be considered to involve an inventive step when the document is taken alone
"E" earlier application or patent but published on or after the international filing date	"Y" document of particular relevance; the claimed invention cannot be considered to involve an inventive step when the document is combined with one or more other such documents, such combination being obvious to a person skilled in the art
"L" document which may throw doubts on priority claim(s) or which is cited to establish the publication date of another citation or other special reason (as specified)	"&" document member of the same patent family
"O" document referring to an oral disclosure, use, exhibition or other means	
"P" document published prior to the international filing date but later than the priority date claimed	

Date of the actual completion of the international search

23 March 2015 (23.03.2015)

Date of mailing of the international search report

25 March 2015 (25.03.2015)

Name and mailing address of the ISA/FI
Finnish Patent and Registration Office
P.O. Box 1160, FI-00101 HELSINKI, Finland
Facsimile No. +358 9 6939 5328

Authorized officer
Antti Salmela
Telephone No. +358 9 6939 500

INTERNATIONAL SEARCH REPORT

International application No.

PCT/FI2014/050930

C (Continuation). DOCUMENTS CONSIDERED TO BE RELEVANT

Category*	Citation of document, with indication, where appropriate, of the relevant passages	Relevant to claim No.
X	US 2012053455 A1 (OKADA NAOYUKI [JP]) 01 March 2012 (01.03.2012) abstract; figures 1, 10; paragraphs [0051] - [0052], [0072], [0081], [0090] - [0092], [0099], [0114], [0117]	1 - 2, 4, 6, 8, 10 - 12
Y	ibid.	5, 7
X	US 2008087830 A1 (KASHIWAGI NOBUHIKO [JP]) 17 April 2008 (17.04.2008) abstract; figure 7; paragraphs [0054], [0107] - [0115], [0119] - [0120], [0140] - [0146]	1 - 2, 9 - 12
Y	ibid.	4 - 8
X	US 2011087132 A1 (DEFREITAS KENNETH [US] et al.) 14 April 2011 (14.04.2011) abstract; figures 1 - 3, 5, 10 - 11; paragraphs [0024] - [0028], [0037] - [0039], [0043]	1 - 2, 4, 6, 8
X	JP 2010167134 A (FUJIFILM CORP [JP]) 05 August 2010 (05.08.2010) figures 1, 8, 11 & PAJ abstract; JPO-INPIT machine translation, paragraphs [0016] - [0018], [0025], [0032], [0039], [0043], [0058] - [0061], [0065], [0072], [0076] - [0077]	1 - 2, 4, 6, 8 - 9
Y	ibid.	5, 7
X	JP 2008119457 A (TOSHIBA CORP [JP]) 29 May 2008 (29.05.2008) figure 1 & PAJ abstract; JPO-INPIT machine translation, paragraphs [0001] - [0002], [0014] - [0015], [0028]	1 - 2, 4, 6
Y	ibid.	5, 7 - 8
Y	EP 2407108 A1 (GENERAL ELECTRIC COMPANY [US]) 18 January 2012 (18.01.2012) abstract; paragraphs [0003], [0009], [0012], [0020] - [0022], [0029] - [0036], [0038] - [0044], [0050]; figures 2 - 3	4 - 6
Y	DE 102007052650 A1 (SIEMENS AG [DE]) 14 May 2009 (14.05.2009) abstract; paragraphs [0001] - [0002], [0004], [0015] - [0018], [0023], [0030] - [0034], [0038] - [0039], [0046] - [0049]; figures 2 - 4	4, 6 - 8
A	ibid.	3
A	US 6891920 B1 (MINYARD THOMAS J [US] et al.) 10 May 2005 (10.05.2005) figures 2 - 4; column 9, line 58 - column 11, line 13	
L	WO 2015008117 A1 (GENERAL ELECTRIC COMPANY [US]) 22 January 2015 (22.01.2015) later document for the applicant's information, abstract; page 5, lines 17 - 32; page 8, lines 15 - 25; page 9, line 14 - page 10, line 18; figure 2	

INTERNATIONAL SEARCH REPORT
Information on Patent Family Members

International application No.
PCT/FI2014/050930

Patent document cited in search report	Publication date	Patent family members(s)	Publication date
JP 2007236805 A	20/09/2007	None	
JP 2009285345 A	10/12/2009	JP 5456988 B2	02/04/2014
US 2012053455 A1	01/03/2012	US 8825135 B2 CN 102429678 A JP 2012045221 A JP 5650467 B2	02/09/2014 02/05/2012 08/03/2012 07/01/2015
US 2008087830 A1	17/04/2008	US 7732775 B2 JP 2008086389 A JP 4833785 B2	08/06/2010 17/04/2008 07/12/2011
US 2011087132 A1	14/04/2011	CN 102481146 A EP 2485651 A1 JP 2013507175 A WO 2011043838 A1	30/05/2012 15/08/2012 04/03/2013 14/04/2011
JP 2010167134 A	05/08/2010	None	
JP 2008119457 A	29/05/2008	JP 5283882 B2 US 2008095420 A1 US 8311305 B2	04/09/2013 24/04/2008 13/11/2012
EP 2407108 A1	18/01/2012	FR 2962638 A1 FR 2962638 B1 US 2012016222 A1 US 8849370 B2	20/01/2012 15/03/2013 19/01/2012 30/09/2014
DE 102007052650 A1	14/05/2009	None	
US 6891920 B1	10/05/2005	AU 2003297582 A1 EP 1571997 A2 US 2004114714 A1 US 7406150 B2	23/06/2004 14/09/2005 17/06/2004 29/07/2008

INTERNATIONAL SEARCH REPORT
Information on Patent Family Members

International application No.
PCT/FI2014/050930

Patent document cited in search report	Publication date	Patent family members(s)	Publication date
		US 2008279439 A1	13/11/2008
		US 7639780 B2	29/12/2009
		WO 2004049908 A2	17/06/2004
.....			
WO 2015008117 A1	22/01/2015	None	
.....			

INTERNATIONAL SEARCH REPORT

International application No.
PCT/FI2014/050930

CLASSIFICATION OF SUBJECT MATTER

IPC
A61B 6/04 (2006.01)
A61B 6/00 (2006.01)