



(51) International Patent Classification:

A61B 6/04 (2006.01) A61N 5/10 (2006.01)  
A61F 5/37 (2006.01)

(21) International Application Number:

PCT/EP2013/059644

(22) International Filing Date:

8 May 2013 (08.05.2013)

(25) Filing Language:

English

(26) Publication Language:

English

(30) Priority Data:

NL1039586 8 May 2012 (08.05.2012) NL

(71) Applicant: **DYNAMIC SYSTEMS HOLDING BV**  
[NL/NL]; Zuidbaan 578, NL-2841 MD Moordrecht (NL).

(72) Inventor: **DE MOOLJ, Leendert Gerrit**; Calle Orenga 34,  
E-03700 Denia, Alicante (ES).

(74) Agent: **BRANTS, Johan Philippe Emile**; Brantsandpat-  
ents BVBA, Guldensporenpark 75, B-9820 Merelbeke  
(BE).

(81) Designated States (unless otherwise indicated, for every  
kind of national protection available): AE, AG, AL, AM,

AO, AT, AU, AZ, BA, BB, BG, BH, BN, BR, BW, BY,  
BZ, CA, CH, CL, CN, CO, CR, CU, CZ, DE, DK, DM,  
DO, DZ, EC, EE, EG, ES, FI, GB, GD, GE, GH, GM, GT,  
HN, HR, HU, ID, IL, IN, IS, JP, KE, KG, KM, KN, KP,  
KR, KZ, LA, LC, LK, LR, LS, LT, LU, LY, MA, MD,  
ME, MG, MK, MN, MW, MX, MY, MZ, NA, NG, NI,  
NO, NZ, OM, PA, PE, PG, PH, PL, PT, QA, RO, RS, RU,  
RW, SC, SD, SE, SG, SK, SL, SM, ST, SV, SY, TH, TJ,  
TM, TN, TR, TT, TZ, UA, UG, US, UZ, VC, VN, ZA,  
ZM, ZW.

(84) Designated States (unless otherwise indicated, for every  
kind of regional protection available): ARIPO (BW, GH,  
GM, KE, LR, LS, MW, MZ, NA, RW, SD, SL, SZ, TZ,  
UG, ZM, ZW), Eurasian (AM, AZ, BY, KG, KZ, RU, TJ,  
TM), European (AL, AT, BE, BG, CH, CY, CZ, DE, DK,  
EE, ES, FI, FR, GB, GR, HR, HU, IE, IS, IT, LT, LU, LV,  
MC, MK, MT, NL, NO, PL, PT, RO, RS, SE, SI, SK, SM,  
TR), OAPI (BF, BJ, CF, CG, CI, CM, GA, GN, GQ, GW,  
ML, MR, NE, SN, TD, TG).

Declarations under Rule 4.17:

— of inventorship (Rule 4.17(iv))

Published:

— with international search report (Art. 21(3))

(54) Title: DEVICE, SYSTEM AND METHOD FOR IMMOBILIZATION OF A HUMAN'S BODY PART

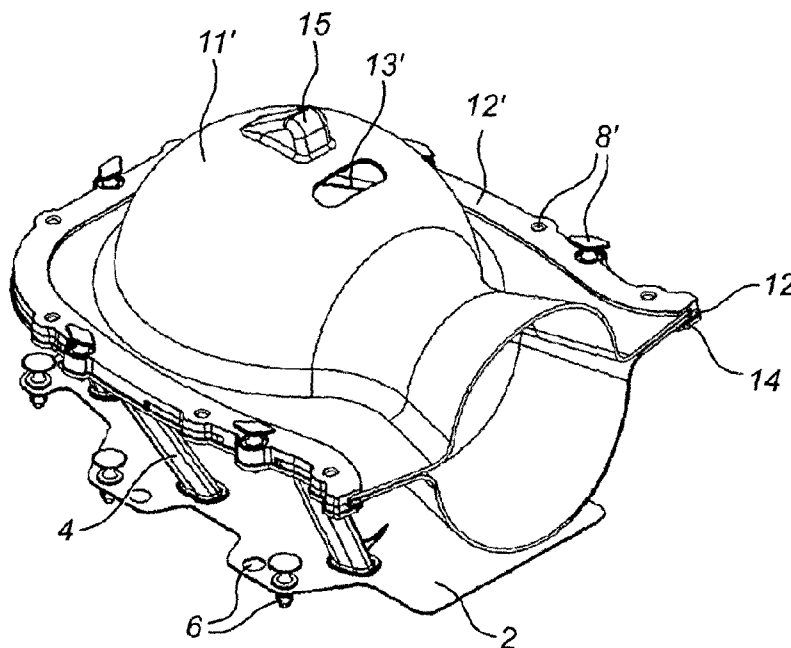

Fig. 12

(57) Abstract: The present invention provides a system for immobilization of a patient body part for radiotherapy applications comprising: a device comprising at least one flanged support member which is suitable to be mounted to a fixation surface and is adapted to receive and retain at least two sheets; a first sheet for covering the anatomical contours of a first area of said body part, and a second sheet for covering the anatomical contours of a second area of said body part which is not covered by the first sheet; whereby the system is adapted for supporting the immobilized body part free from the fixation surface by the two sheets and the device.



**Device, system and method for immobilization of a human's body part****Field of the invention**

5

The present invention pertains to a device, a system and a method for immobilizing at least part of a human's body part for receiving radiation treatment. The invention is suitable for use in the medical field, particularly for immobilization purposes in radiotherapy and cancer treatment.

10

**Background**

The treatment of patients having cancer frequently makes use of radiation therapy wherein radiation is directed to particular sites in the patient's body. These treatments require high precision, reliable and accurate patient set-up to position and immobilize the relevant portion of the patient's body undergoing the radiation. Various devices and equipment are available for effecting such action. For example, patient couches or tables are commonly provided at the radiation machine, e.g., linear accelerator, CT machine, MRI, etc., to support the patient in a prone or supine position while the relevant portion of the patient's body is held in a fixed or immobilized condition. To that end the immobilization of the relevant portion of the patient's body is commonly achieved by various types of devices mounted on the patient couch/treatment table.

A commonly used body part (i.e. the head) restraint device is a mask that is placed over the face of the patient to hold the patient's head stationary. Such masks may be molded to conform to the contours of the patient's face to ensure maximum immobilization. The back of the patient's head and contiguous portion of the patient's neck may be supported by a cushion which itself can be pre-contoured for a specific shape or can be conformed, e.g., molded, to the shape of the back of the patient's head. The mask itself can be pre-formed to a shape that will generally conform to the contours of the patient's face, or may be molded on the patient's face to closely conform to those contours. The molding of the mask is typically conducted preceding the first treatment. After this the mask can be mounted on the head of the patient and subsequently will be fixed to the patient support table. However, the patient's head and neck will still have to be supported, such as by cushions filled with granular material, for example, or by preformed cushions. Here, too, deviations in the position of the head in relation to the preceding treatment can easily occur.

US 5 702 406 discloses a reference system for noninvasive, stereotactic immobilization of a human head in reproducible position. The reference system comprises a head ring having a pair of support legs adapted to be positioned at opposite sides of the head of a specific patient. The reference system also comprises a mask containing a plurality of separate

40

parts capable of assuming a given conformation. A first part is adapted to be conformed to and to cover the anatomical contours of a first area of the specific patient's head. A second part is adapted to be conformed to and to cover the anatomical contours of a second area of the specific patient's head which is not covered by the first part. The reference system further comprises means for connecting the mask parts with one another, said connection means also connecting the connected mask parts to the reference system. Another part of the reference system is a detachable support, made of plastic and used for supporting the back of the head of the patient. One of the disadvantages of this system is that the obtained mask has an open area on the cranial side and does not fully cover the head of a patient.

US 2008/078410 discloses a support assembly for the head and neck of a patient. The assembly includes a concave shaped, conformable (e.g., a resilient foamed plastic) cushion, a holder for the cushion and a conformable, curable (e.g., thermoplastic) cover sheet. The cover sheet is heated to soften it, whereupon it can be disposed over the cushion so that the patient's head and neck can be impressed into it to conform to the contour of the head and neck. The cover sheet is then cured to permanently retain its shape. A conventional conformable mask can be used to conform it to the face of the patient whose head and neck is supported on the support assembly, thereby resulting in a combination that immobilizes the head and neck.

The main disadvantage of the above described systems resides in the use of a head support such as a support cushion. The use of said support to shape a mask adapted to a patient's head for instance, results in a mask which is adapted to the pre-shaped form of the support cushion. The obtained mask is hence not fully adapted to the anatomical contours of the body part that needs to be immobilized. In addition, the rotation of said body part will be adapted to the support cushion shape and material. This provides the patient with a very low comfort level especially if the treatment time is long.

Another disadvantage related to the use of a support cushion is the incapacity of the practitioner to be in touch with the body part surface which is supported by the support cushion. Hence, the practitioner will have a limited access to the body part surface supported by the support cushion which leads to a mask which is not fully conform to the anatomical contours of the mentioned body part. In case the practitioner has access to the body part surface which is normally supported by the support cushion of the prior art, he can ensure a perfect conformity of the mask to the anatomical contours and boney reference structures of the body part that needs to be immobilized. Moreover, the contact of the practitioner with the body part of interest will provide the patient with a security and a comfort feeling.

40

Still another disadvantage of the immobilization systems described in the prior art is that they comprise several devices that needs to be assembled which, on one hand, represents a high workload for the practitioner and on the other hand, prolongs the time required for the making of the immobilization mask thereby providing the patient with an uncomfortable feeling. The immobilization systems described in the prior art are also very bulky and a high amount of material is required for their manufacture which leads to a non-homogeneous dose delivery and high attenuation of the radiation beam.

The aim of the present invention is to provide a solution to overcome at least part of the above mentioned disadvantages. The invention thereto aims to provide a method, a device and a system which are highly effective and easy to use and apply for the immobilization of a patient body part.

### SUMMARY

The present invention provides a system for immobilization of a patient body part for radiotherapy applications comprising: - a device comprising at least one flanged support member which is suitable to be mounted to a fixation surface and is adapted to receive and retain at least two sheets, - a first sheet for covering the anatomical contours of a first area of said body part, and - a second sheet for covering the anatomical contours of a second area of said body part which is not covered by the first sheet; whereby the system is adapted for supporting the immobilized body part free from the fixation surface by the two sheets and the device.

In a preferred embodiment, the present invention provides a system for immobilization of a patient body part for radiotherapy applications comprising: - a device comprising at least one flanged support member which is suitable to be mounted to a fixation surface and is adapted to receive and retain at least two moldable thermoplastic sheets, - a first moldable thermoplastic sheet for covering the anatomical contours of a first area of said body part; and - a second moldable thermoplastic sheet for covering the anatomical contours of a second area of said body part which is not covered by the first moldable thermoplastic sheet, whereby the system is adapted for supporting the immobilized body part free from the fixation surface by the two sheets and the device.

In a preferred embodiment, the first sheet is designed to conform the anatomical contours of the first area of the body part and the second sheet is designed to conform the anatomical contours of the second area of the body part thereby forming a double shell mask enclosing said body part.

In a preferred embodiment, the system comprises at least one flanged support member fixation means for mounting the flanged support member of the device to the fixation

surface at a distance from said fixation surface, thereby mounting the flanged support member substantially parallel to the fixation surface. The flanged support member can also be mounted at a distance from said fixation surface and at a desired "pre-set" angle from said surface.

5

In a preferred embodiment, the flanged support member is provided with a plurality of attachment means adapted to receive and retain the sheets. In a preferred embodiment, the flanged support member is provided with a plurality of attachment means adapted to receive and retain the moldable thermoplastic sheets.

10

In a preferred embodiment, the first and the second sheet comprise each a circumferential rim provided with a number of connection means for mounting said sheets to the flanged support member.

15

In a preferred embodiment, the circumferential rims of the first sheet and of the second sheet are designed to be superimposable.

20

In a preferred embodiment, the connection means of the circumferential rim of the sheet are positioned such as to correspond to the connection means of the circumferential rim of the second sheet and/or to the attachment means of the flanged support member of the device.

25

In a preferred embodiment, the system comprises at least one stabilization means suitable to be dismountably fixed to the flanged support member for optimizing the immobilization of said body part.

30

In a preferred embodiment, the connection means of the circumferential rim of the first thermoplastic sheet are positioned such as to correspond to the connection means of the circumferential rim of the second thermoplastic sheet and/or to the attachment means of the flanged support member of the device when the first and the second thermoplastic sheets are simultaneously attached to the flanged support member.

35

The present invention further provides a device for immobilization of a patient body part for radiotherapy applications comprising at least one flanged support member suitable to receive and retain two sheets, said flanged support member is suitable to be mounted to a fixation surface using support member fixation means, such as said flanged support member is mounted and at a distance from said fixation surface.

40

In a preferred embodiment, the flanged support member is mounted substantially parallel to the fixation surface. The flanged support member can also be mounted at a distance from said fixation surface and at a desired "pre-set" angle from said surface.

The present invention further provides a method for immobilization of a patient body part for radiotherapy applications comprising the steps of: - mounting a device comprising a flanged support member to a fixation surface; said flanged support member is adapted to receive and retain at least two sheets; - mounting a first sheet to the flanged support member; - placing the patient body part to be immobilized on said first sheet thereby covering the anatomical contours of a first area of said body part; and - mounting a second sheet to the flanged support member thereby covering the anatomical contours of a second area of said body part which is not covered by the first sheet; Wherein the method is adapted for supporting the immobilized body part free from the fixation surface by the two sheets and the device.

In a preferred embodiment, the first and the second sheets are suitable to be formed on the patient body part such as to conform the anatomical contours of said patient body part.

In a preferred embodiment, the first and the second sheets are pre-formed sheets which are conform to the anatomical contours of the patient body part.

In a preferred embodiment, the method comprises the step of scanning the body part for pre-forming the first and the second sheets.

The present invention further provides at least two moldable thermoplastic sheets for immobilization of a patient body part for radiotherapy applications, said sheets are suitable to be connected and retained by a device comprising at least one flanged support member which is suitable to be mounted to a fixation surface, whereby the sheets and the device are adapted for supporting the immobilized body part free from the fixation surface and wherein the sheets have different physical properties. Wherein large body parts are immobilized, there will be a minimal and a very small area of contact between the patient's body and the fixation surface.

In a preferred embodiment, the said sheets are suitable to be directly molded on the patient body part thereby obtaining molded sheets. In a preferred embodiment, a first molded sheet is designed to conform the anatomical contours of a first area of the body part and a second molded sheet is designed to conform the anatomical contours of a second area of the body part thereby forming a double shell mask enclosing said body part.

In a preferred embodiment, the sheets have different elasticity. In a preferred embodiment, the elasticity ratio of the sheet with the highest elasticity to the sheet with the lowest elasticity is at least 5. In a further preferred embodiment, the elasticity of the less elastic sheet is at least 50%, preferably at least 60% and is at most 80%, preferably at most 100%.

In a preferred embodiment, the thickness of the less elastic sheet is of 1.5 to 1.8 mm, preferably about 1.7 mm. The thickness of the more elastic sheet is of 1.5 to 2.5, preferably 2 to 2.4 mm, preferably about 2.3 mm. In a preferred embodiment, at least one  
5 sheet is provided with perforations.

In a preferred embodiment, the melt temperature  $T_m$  of the sheets is in the range of from 50 to 85°C, preferably from 65 to 75°C. In a preferred embodiment, the crystallization temperature  $T_c$  of the sheets is in the range of from 19 to 25°C.  
10

The present invention provides several improvements and advantages compared to the systems and devices of the prior art. The invention does not require using a cushion or a support for the body part to be immobilized. Hence, the immobilized body part will be supported by the sheet and the device having a flanged support member. Consequently,  
15 the sheet will be exactly adapted and conform to the anatomical contours of the immobilized body part. Wherein, moldable thermoplastic sheets are used, said sheet will deform according to only and solely the patient's body part shape and anatomical contours.

The invention also provides a full freedom of anatomical contours and rotation and position  
20 of the patient's body part. This is important to avoid the critical organs (example: glandula parotis, gladula submandibularis, glandula sublingualis nervus opticus, chiasma, truncus encephali) during treatment and will also limit the materials used in the radiation beam (skin dose, attenuation and risk on damage to skin and critical non-effected organs).

The invention does not make use of a material or a support on which the immobilized body  
25 part rests, such as cushions, as described in the systems of the prior art. Consequently, the immobilized body part of the patient is, up to 360°, accessible to the practitioner and/or for radiation application. This means that the practitioner can touch and/or apply radiation to any area of the immobilized body part. This is not offered by the systems of the prior art  
30 wherein the area of the immobilized body part resting on a cushion is neither accessible to the practitioner nor to the application of radiation.

The thermoplastic sheets according to an embodiment of the present invention provide for  
35 the above described immobilization of the body part, i.e. without use of a material or a support on which the immobilized body part rests. The thermoplastic sheets further allow the immobilization of the body part without the use of reinforcement strips. Said sheets have sufficient rigidity so that additional reinforcement strips are unnecessary. In addition, the total material thickness of the thermoplastic sheets used in the present invention is relatively low, which has a positive effect on the dosimetry. The "double shell" mask  
40 obtained by the invention fully covers and encompasses the patient's body part to be immobilized. For instance, for the head, the double shell mask covers the areas

corresponding to and including the frontal bone, the parietal bone and the occipital bone while in the prior art system the area corresponding to these bones is only partially covered or is not covered.

- 5 Another advantage of the present invention is the freedom of rotation of the patient's head in the XZ and the YZ plane with respect to the areas to be treated and critical organs to be kept away from the applied radiation.

10 Another advantage provided by the present invention relates to the amount and type of material used for the immobilization of body part. The devices and systems of the prior art are bulky, comprise several devices which have a negative impact on the dosimetric properties and which leads to a long mounting time and discomfort for the patient. The present invention provides a system, device and a method wherein a limited amount of material and devices are used. The method, system and device according to the invention  
15 are simple to use which reduces the time and/or effort required for the production of the immobilisation device (or the double shell mask).

#### DESCRIPTION OF THE FIGURES

20 The invention will be further described in detail with reference to the exemplary embodiments represented by the accompanying figures, in which

**FIG. 1** shows the device according to the present invention.

**FIG. 2** shows the device and the circumferential rims of the thermoplastic sheets according to the present invention.

25 **FIG. 3** shows the support fixation surface, the device and the circumferential rims of the thermoplastic sheets according to the present invention.

**FIG. 4** shows two different moldable thermoplastic sheets designed to be super imposable according to the present invention.

30 **FIG. 4A** shows another embodiment of two different moldable thermoplastic sheets designed to be super imposable according to the present invention.

**FIG. 5** shows a moldable thermoplastic sheet in initial state according to the present invention.

**FIG. 6** shows the thermoplastic sheet of **Fig. 5** in final state, after molding on a patient's body part and curing.

35 **FIG. 6A** shows a thermoplastic sheet in final state, after molding and curing. The sheet is devoid of circumferential rim.

**FIG. 7** shows another moldable thermoplastic sheet in initial state according to the present invention.

40 **FIG. 7A** shows an embodiment of the moldable thermoplastic sheet of **Fig. 7** which is devoid of opening.

**FIG. 8** shows the thermoplastic sheet of **Fig. 7** in final state, after molding and curing.

**FIG. 8A** shows the thermoplastic sheet of in final state, after molding and curing. The sheet is devoid of circumferential rim.

**FIG. 9** shows both thermoplastic sheets, as represented in **Fig. 6** and **Fig. 8**, in final state, after molding on a patient's body part and curing.

5 **FIG. 10** shows both thermoplastic sheets, as represented in **Fig. 6** and **Fig. 8**, in final state, after molding on a patient's body part and curing. The sheets are superimposed.

**FIG. 11** shows the device and both thermoplastic sheets, as represented in **Fig. 6** and **Fig. 8**, in final state, after molding on a patient's body part and curing.

10 **FIG. 12** shows the device and both thermoplastic sheets. The sheets are as represented in **Fig. 6** and **Fig. 8**, in final state, after molding on a patient's body part and curing. The device and the sheets are superimposed.

**FIG. 13** shows a side view of the superimposed device and both thermoplastic sheets. **FIG. 13** is a side view of the devices represented in **FIG. 12**.

15 **FIG. 14** shows an exploded view of one exemplary embodiment of an assembly comprising a support fixation surface, a device and two thermoplastic sheets constructed according to the present invention. The sheets are as represented in **Fig. 6** and **Fig. 8**, in final state, after molding on a patient's body part and curing.

20 **FIG. 15** shows a view of one exemplary embodiment of an assembly comprising a support fixation surface, a device and two thermoplastic sheets constructed according to the present invention. The sheets are as represented in **Fig. 6** and **Fig. 8**, in final state, after molding on a patient's body part and curing. The support fixation surface, the device and both thermoplastic sheets are connected and fixed to each other.

25 **FIG. 16** shows a side view of the exemplary embodiment as shown in **FIG. 15**. The support fixation surface, the device and both thermoplastic sheets are connected and fixed to each other.

30 **FIG. 17** shows a view of one exemplary embodiment of an assembly comprising a support fixation surface, a device and two thermoplastic sheets constructed according to the present invention. The support fixation surface, the device and both thermoplastic sheets are connected and fixed to each other and are used for the immobilization of a patient's head while the patient is in prone position.

**FIG. 18** shows an embodiment of a thermoplastic sheet designed for immobilizing a head, a neck and at least part of a patient's trunk.

**FIG. 19** shows the thermoplastic sheet of **Fig. 18** provided with circumferential rim and attachment edges.

35 **FIG. 20** shows the thermoplastic sheet of **Fig. 18** in final state, after molding on a patient's body part and curing.

40 **FIG. 21** shows an exploded view of an embodiment of the double shell mask for immobilizing a head, a neck and at least part of a patient's trunk. The mask comprises the molded thermoplastic sheets wherein one sheet is provided with attachment edges and the circumferential rims of the sheets.

**FIG. 22** shows an exploded side view of the double shell mask for immobilizing a head, a neck and at least part of a patient's trunk. The mask comprises the molded thermoplastic sheets wherein one sheet is provided with attachment edges and the circumferential rims of the sheets.

5 **FIG. 23** shows an exploded view of the support fixation surface, the device, the moldable thermoplastic sheets and their respective circumferential rims for immobilizing a head, a neck and at least part of a patient's trunk according to an embodiment of the invention.

**FIG. 24** shows an exploded side view of the support fixation surface, the device, the moldable thermoplastic sheets and their respective circumferential rims for immobilizing a head, a neck and at least part of a patient's trunk according to an embodiment of the invention.

10

**FIG. 25** shows an exploded view of the fixation surface, the device and the double shell mask for immobilizing a head, a neck and at least part of a patient's trunk according to an embodiment of the invention.

15 **FIG. 26** shows an exploded side view of the fixation surface, the device and the double shell mask for immobilizing a head, a neck and at least part of a patient's trunk according to an embodiment of the invention.

**FIG. 27** shows a perspective of an embodiment of the device to which the double shell mask is fixed. The device and the mask are fixed to a fixation surface.

20 **FIG. 28** shows a side view of an embodiment of the device to which the double shell mask is fixed. The device and the mask are fixed to a support fixation surface.

**FIG. 28A** shows a side view of an embodiment of the device to which the double shell mask is fixed. The device and the mask are fixed to a support fixation surface. The double shell mask is covering the head, the neck and at least part of the patient's trunk.

25 **FIG. 29** shows a perspective view of the device and the thermoplastic sheets to which stabilization means is attached and fixed.

**FIG. 30** shows an exploded view of the device, the thermoplastic sheets and the stabilization means of **Fig. 29**.

**FIG. 31** shows an exploded view of the stabilization means support.

30 **FIG. 32** shows a perspective view of the first stabilization device.

**FIG. 33** shows an exploded view of the first stabilization device.

**FIG. 34** shows a perspective view of the second stabilization device.

**FIG. 35** shows an exploded view of the second stabilization device.

**FIG. 36** shows an embodiment of the invention wherein the body part is scanned for forming the sheets.

35

**FIG. 37** shows a side view of the embodiment of **Fig. 36**.

**FIG. 38** shows the embodiment of **Fig. 36** and an embodiment of controlling the formation of the sheets.

**FIG. 39A** shows an embodiment of the formed sheets designed for immobilizing the trunk of a patient.

40

**FIG. 39B** shows side view of **Fig. 39A**.

**FIG. 39B** shows side view of **Fig. 39A**.

**FIG. 40** shows a flow chart of an embodiment of a method for making pre-formed sheets according to present invention.

**FIG. 41** shows a top view of an immobilized trunk of a patient.

5 **FIG. 42** shows a side view of the immobilized trunk of a patient shown in **Fig. 42**.

#### **DETAILED DESCRIPTION OF THE INVENTION**

10 The present invention relates to a method, a device and a system for the immobilization of a patient body part. The present invention can be used for the immobilization of any single body part of a human being. The present invention can also be used for the immobilization of more than one body part of a human being, such as the head, the neck and the shoulders and optionally part of the trunk. The present invention is preferably used for the immobilization of a body part for radiotherapy applications. The body part can be the part  
15 enclosing any organ of the patient such as the liver, the lungs or the kidneys, such as to deliver radiation to said organ.

Unless otherwise defined, all terms used in disclosing the invention, including technical and scientific terms, have the meaning as commonly understood by one of ordinary skill in the  
20 art to which this invention belongs. By means of further guidance, term definitions are included to better appreciate the teaching of the present invention.

As used herein, the following terms have the following meanings:

25 "A", "an", and "the" as used herein refers to both singular and plural referents unless the context clearly dictates otherwise. By way of example, "a compartment" refers to one or more than one compartment.

30 "About" as used herein referring to a measurable value such as a parameter, an amount, a temporal duration, and the like, is meant to encompass variations of +/-20% or less, preferably +/-10% or less, more preferably +/-5% or less, even more preferably +/-1% or less, and still more preferably +/-0.1% or less of and from the specified value, in so far such variations are appropriate to perform in the disclosed invention. However, it is to be understood that the value to which the modifier "about" refers is itself also specifically  
35 disclosed.

"Comprise," "comprising," and "comprises" and "comprised of" as used herein are synonymous with "include", "including", "includes" or "contain", "containing", "contains" and are inclusive or open-ended terms that specifies the presence of what follows e.g.  
40 component and do not exclude or preclude the presence of additional, non-recited components, features, element, members, steps, known in the art or disclosed therein.

The recitation of numerical ranges by endpoints includes all numbers and fractions subsumed within that range, as well as the recited endpoints.

- 5 The expression "% by weight" (weight percent), here and throughout the description unless otherwise defined, refers to the relative weight of the respective component based on the overall weight of the formulation.

10 The term "initial state" of a thermoplastic sheet used herein refers to a thermoplastic sheet which is still flat and not yet deformed. The term "final state" of a thermoplastic sheet used herein refers to a thermoplastic sheet which has been deformed to conform the anatomical contours of a body portion and cured thereby having a rigid molded thermoplastic sheet.

15 The term "cured" used herein refers to a thermoplastic sheet that was heated, deformed according to a patient's body part anatomical contours and cooled to ambient temperature such as to rigidify.

The terms "support fixation surface" and "fixation surface" are used herein as synonyms and refer to a surface to which the device according to the present invention is suitable to be mounted and/or fixed. Said fixation surface might be a radiation table for instance.

In a first aspect, the present invention provides a method for non-invasive stereotactic immobilization of a patient body part for radiotherapy applications comprising the steps of:

- mounting a device comprising a flanged support member to a fixation surface; said flanged support member is adapted to receive and retain at least two sheets;
- mounting a first sheet to the flanged support member;
- placing the patient body part to be immobilized on said first sheet thereby covering the anatomical contours of a first area of said body part; and
- mounting a second sheet to the flanged support member thereby covering the anatomical contours of a second area of said body part which is not covered by the first sheet.

The method is adapted for supporting the immobilized body part free from the fixation surface by the two sheets and the device. This means that the immobilized body part is not in contact with the fixation surface but is separated from said surface by a distance **d**.

- 35 In a preferred embodiment, the first and the second sheets are suitable to be formed on the patient body part such as to conform the anatomical contours of said patient body part.

In another preferred embodiment, the first and the second sheets are pre-formed sheets which are conform to the anatomical contours of the patient body part. The method according to an embodiment of the invention can further comprise the step of scanning the

body part for pre-forming the first and the second sheets. This embodiment will be further detailed later.

Wherein the first and the second sheets are suitable to be formed on the patient body part, moldable thermoplastic sheets might be used. In this embodiment, the method comprises the following subsequent steps:

- mounting a device **1**, **FIG. 1** to a support fixation surface **7**, **FIG. 3** such as a table for radiation therapy. As shown in **FIG. 1**, the device **1** comprises a bottom plate **2** having fixation means **6** for mounting said bottom plate **2** to the support fixation surface; a flanged support member **3** having a plurality of attachment means **5** adapted to receive at least two moldable thermoplastic sheets; said bottom plate **2** is connected to said flanged support member **3** by an open structure which preferably comprises a plurality of upstanding circumferential support legs **4**,
- Heating and mounting a first moldable thermoplastic sheet to the flanged support member **3** of the device **1**,
- Placing the patient body part to be immobilized on said first heated moldable thermoplastic sheet such as to deform the first moldable thermoplastic sheet into a shape which is conform to the anatomical contours of a first area of the patient body part and in an optimized position for the radiation dose delivery with respect to the critical organs and which covers said first area. If the head of the patient is to be immobilized, the patient lays the back of his head (parietal and occipital bone) into the first heated thermoplastic sheet. The first thermoplastic sheet will conform to the anatomical contours of the back of the patient's head and the desired position and rotation in the XZ and YZ plane,
- Cooling the first moldable thermoplastic sheet to ambient temperature to rigidify the deformed first moldable thermoplastic sheet. The cured thermoplastic sheet will have the same shape as the back or the front head of the patient,
- Heating and mounting a second moldable thermoplastic sheet to the flanged support member **3** of the device **1** such as to deform said second moldable thermoplastic sheet into a shape which is conform and covers the anatomical contours of a second area of the patient body part which is not covered by the first area. If the first thermoplastic sheet was used to conform to the anatomical contours of the back of the head, than the second thermoplastic sheet will be used to conform to the front of the head (the patient's face),
- Cooling the second moldable thermoplastic sheet to ambient temperature to rigidify the deformed second moldable thermoplastic sheet. The patient remains in the same position during the production of the double shell mask. This means that, for mounting the second thermoplastic sheet, the patient is maintained in the same position as for mounting the first thermoplastic sheet.

In a preferred embodiment, when the patient body part to be immobilized is placed on the first heated moldable thermoplastic sheet, a pressure is applied on said body part. The pressure is applied such as to conform the first elastic sheet to the anatomical contours of a

first area of the patient body part. Said pressure should be applied with care as it should high enough to conform the sheet to the body part and simultaneously, it should not be too high to avoid bringing the patient body part in contact with the fixation surface. This is due to the low elasticity of the first thermoplastic sheet which will be further detailed.

5

In a preferred embodiment, the second heated moldable thermoplastic sheet is only brought in contact with the patient's body part without pressing it against said body part. The second sheet is provided with high elasticity such as it conforms the patient's body part anatomical contours without pressure requirement. In some cases and wherein the face is covered by the second sheet, it might be required to apply a pressure on the bone of the nose to conform the sheet to the nose of the patient.

The cured first and second thermoplastic sheets form an immobilization double shell mask covering the entire head of the patient. The double shell mask is personalized to the patient's head anatomy. In a preferred embodiment of the method, for mounting the second thermoplastic sheet, the patient is maintained in the same position as for mounting the first thermoplastic sheet. This is advantageous as a high level of stability is ensured during the production of the immobilization double shell mask, thereby providing a better fit of the mask to the anatomical contours of the patient's head.

20

In a preferred embodiment, when mounted on the device **1**, the first moldable thermoplastic sheet **11** is not supported in its central region but is only circumferentially supported by the flanged support member. This is achievable as the first thermoplastic sheet **11** has a rigidity that allows providing a sufficient force to support the rear or the front head and simultaneously providing a sufficient elasticity such as to deform the sheet according to the anatomical contours of the rear or the front head. After cooling, the cured first thermoplastic sheet will be separated from the bottom plate **2** by an open accessible space. Said open accessible space is created underneath the cured first thermoplastic sheet. The device of the present invention is designed such as the cured first thermoplastic sheet will not be in contact with the bottom plate **2**. This is advantageous as the thermoplastic sheet will deform according to only and solely the patient's head shape. In addition, the practitioner will have access and will be able to touch, support and shape the thermoplastic sheet when the patient's head is placed on the other surface of the sheet. The practitioner can then make sure that the sheet is perfectly matching the anatomical contours of the head.

35

In a preferred embodiment, when mounted on the device **1**, the first moldable thermoplastic sheet **11** is not supported in its central region by a cushion for instance but is only circumferentially supported by the flanged support member. The first thermoplastic sheet **11** can have a single contact point with the bottom plate. This is achievable as the first thermoplastic sheet **11** has a rigidity that allows providing a sufficient force to support

40

the rear or the front head and simultaneously providing a sufficient elasticity such as to deform the sheet according to the anatomical contours of the rear or the front head. This is advantageous as the thermoplastic sheet will deform according to only and solely the patient's head shape.

5

In a preferred embodiment, taking as reference the bottom plate of the device, the closest point of the first cured thermoplastic sheet is separated from the bottom plate by a free empty distance **d** (not shown). Said distance is measured perpendicular to the plane of the bottom plate. In a preferred embodiment, the distance **d** is comprised between 0.2 and 25  
10 cm, preferably between 0.5 and 12 cm, more preferably between 1 and 18 cm, even more preferably between 2 and 6 cm, most preferably between 1 and 4 cm.

In a preferred embodiment, the first and/or the second thermoplastic sheet might be provided with one or more openings. For instance an opening can be provided in the sheet  
15 covering the face of the patient. Said opening will be positioned such as to be at the level of the nose and/or the mouth such as to permit the patient to breathe.

In a preferred embodiment, the first and the second moldable thermoplastic sheets are heated at a temperature comprised between 70 and 90°C, preferably between 65 and  
20 85°C. The sheets may be softened by warming them to a temperature above their glass transition temperature, for instance by immersion in warm water, at which temperature they becomes shapeable. In a preferred embodiment, the sheets are warmed by immersion in an aqueous liquid having a temperature comprised between 70-90 °C. As described  
25 above, the sheets are allowed to cool below their glass transition temperature, preferably to ambient temperature of 20°C to 30°C. The sheets will rigidify and provide a form-fitting double shell mask.

Although warming of the thermoplastic sheets **11, 11'** above their glass transition temperature will cause the sheets to become stretchable and deformable, they can be  
30 transported without damage by taking hold of the circumferential rims **12, 12'** of the sheets and displacing them on the flanged support member **3** of the device **1**. Said circumferential rims **12, 12'** can be permanently fixed to the moldable thermoplastic sheets or can be dismountably fixed to said sheets. The latter configuration is advantageous as it allows optimizing the cleaning of the sheets both in their initial and final state. Furthermore,  
35 dismountable circumferential rims can be easily changed by new rims if required, for instance if the rim is damaged.

In a second aspect, the present invention provides a device for immobilization of a patient body part for radiotherapy applications. The device comprises at least one flanged support  
40 member **3** suitable to receive and retain two sheets. The sheets can be moldable

thermoplastic sheets or pre-formed sheets or any other sheets suitable to be used in the context of the present invention and known to the person skilled in the art.

5 Preferably, the flanged support member is suitable to be mounted on a fixation surface using support member fixation means, such as said flanged support member is mounted and at a distance **d** from said fixation surface. In a preferred embodiment, the flanged support member is mounted substantially parallel to the fixation surface. Preferably, the flanged support member is mounted such as to be contained in a plane which is substantially parallel to the plane of the fixation surface.

10

In a preferred embodiment, the flanged support member fixation means are selected from the group comprising upstanding circumferential support legs, upstanding walls provided with openings, upstanding pyramids, inverted pyramids or any other flanged support member fixation means known to the person skilled in the art. Said flanged support member fixation means can be of any shape. The height of said flanged support member fixation means should be selected such as a free space between the fixation surface and the sheet when the body part is immobilized. For example, referring to **Fig. 16**, the height of the flanged support member fixation means, i.e. upstanding circumferential support legs **4**, is higher than the distance separating the rim **12** of the sheet **11** from the point which is most distal to said rim **12**. The distance is measured perpendicularly to the rim **12**. It is to be understood that said distance is measured differently according to the immobilized body part and/or according to the position in which said body part is immobilized.

15

In a preferred embodiment, the device comprises a bottom plate. Preferably said bottom plate is permanently or dismountably connected to said flanged support member by the flanged support member fixation means. The bottom plate is provided with fixation means for mounting said bottom plate to a fixation surface.

25

In a preferred embodiment, the device comprises at least one flanged support member **3** having a plurality of attachment means **5** adapted to receive at least two sheets or two moldable thermoplastic sheets. The plane of the bottom plate and the plane of the flanged support member are substantially parallel to each other or form 2 angled planes to preposition the patient's body part depending on the treatment. The device might comprise a bottom plate **2** which is connected to said flanged support member **3** by an open structure which preferably comprises a plurality of upstanding circumferential support legs **4** (**FIG. 1**).

30

In a preferred embodiment, the open structure preferably comprising a plurality of upstanding circumferential support legs **4** or the flanged support member fixation means separates the plane of the bottom plate or the plane of the fixation surface from the plane of the flanged support member by a distance **d** comprised between 5 and 100 cm,

40

preferably between 10 and 90 cm, more preferably between 15 and 80 cm, even more preferably between 20 and 70 cm, most preferably between 25 and 60 cm, even most preferably between 30 and 50 cm.

5 In a preferred embodiment, the upstanding circumferential support legs **4** are separated from each other by a distance comprised between 8 and 30 cm, preferably between 10 and 20 cm. In a preferred embodiment, the device is provided with 2 to 20, preferably 3 to 15, more preferably 4 to 10 upstanding circumferential support legs. In a preferred embodiment, the device comprises at least 6 upstanding circumferential support legs. The support legs consist of a Uni Directional carbon fiber tube with a wall thickness of 0.2-10 2.0mm and a weight between 150 and 250gr/m<sup>2</sup>. For optimal dosimetric properties, the wall thickness is between 0.2 and 0.5mm. The support legs might be glued to the flanged support member and/or to the bottom plate. In the gluing areas the tubes are filled with low density foam, e.g. Rohacell 51 or 71, with a maximum length of 10-15mm.

15 In a preferred embodiment, the upstanding circumferential support legs are substantially perpendicular to the bottom plate **2** and/or to the flanged support member and are separated from each other, at the level of the bottom plate **2**, by a distance **D** comprised between 8 and 30 cm, preferably between 10 and 20 cm.

20 In a more preferred embodiment, the upstanding circumferential support legs form an angle  $\alpha$  (shown in **FIG. 1** and **FIG. 16**) with the bottom plate **2** such as  $\alpha$  is at least 90° and is comprised between 90° and 150°, preferably between 100° and 140° More preferably between 110° and 135°. In this embodiment, the upstanding circumferential support legs are also separated from each other, at the level of the bottom plate **2**, by a 25 distance **D** comprised between 8 and 30 cm, preferably between 10 and 20 cm.

In a preferred embodiment, the flanged support member **3** of the device has preferably a flat shape (**FIG. 1**). The flanged support member **3** is adapted to receive at least two sheets or two moldable thermoplastic sheets having each a circumferential rim (will be 30 detailed further). In a preferred embodiment, the circumferential rims of both sheets or thermoplastic sheets and the flanged support member are, at least partially, superimposable (as shown in **FIG. 2**).

In a preferred embodiment, the device of the present invention has a shape which is open 35 at one end; said shape is preferably a U shape. In a preferred embodiment, the flanged support member **3** and the circumferential rims **12, 12'** presented in the figures have a U shape as said figures show a device adapted for immobilizing a human head. It is to be understood that the flanged support member **3** and the circumferential rims **12, 12'** can have any other shape adapted to immobilize any other part of a human body. For instance 40 the device might comprise two flanged support members having a shape which is parallel to the contours of the trunk of a patient. The two flanged support members might be linear

members whereby one member is placed at the right and the other member is placed at the left of the body part to be immobilized.

5 In a preferred embodiment, the flanged support member is provided with attachment means **5**. Preferably, the attachment means **5** of the flanged support member are selected from the group comprising: snap fit means connections and openings for receiving rivets, screws or bolts (**FIG. 1**). In a preferred embodiment, the flanged support member is provided with 5 to 30, preferably 10 to 25, more preferably 12 to 22 attachment means.

10 In a preferred embodiment, the bottom plate **2** is provided with fixation means **6** for mounting the bottom plate **2**, and hence mounting the device, to a support fixation surface **7** such as table for radiation therapy (**FIG. 3**). The support fixation surface **7** is also provided with support surface fixation means **9** which correspond to the bottom plate fixation means **6** (**FIG. 3**). The fixation means of the bottom plate and the corresponding  
15 fixation means of the support fixation surface are selected from the group comprising: rivets, screws, bolts and nuts, and snap fit means connections and foam or plastic pads or parts that will fit in recesses in the support fixation surface or baseplate. Preferably, the fixation means **6** of the bottom plate **2** comprise snap fit connections and rivets. More preferably said provided snap fit connections **6'** and rivets **6''** are provided in an  
20 intermittent pattern (**FIG. 3**). In a preferred embodiment, the bottom plate is provided with 3 to 30, preferably 5 to 25, more preferably 10 to 20 fixation means. Wherein the flanged support member is mounted on the fixation surface using flanged support member fixation means, the fixation surface is adapted to receive and fix said fixation means.

25 The bottom plate of the device according to an embodiment of the invention can have different shapes. Each shape will be adapted to fit to a specific position of the head including the positions wherein the chin is in the air, the position wherein the chin is on the chest and the prone position. This variation accomplishes and secures the most desired position of the head to avoid critical organs in the radiation field. The shape might also be  
30 adapted and fitted for any other part of the body. The bottom plate of the device according to an embodiment of the present invention can also have different shapes. Each shape will be adapted to fit to different support fixation surfaces or baseplates.

In a preferred embodiment, the device is manufactured from a material having a low  
35 density. In a further preferred embodiment, the device is manufactured from a carbon composite material, more preferably from a carbon composite polymer, most preferably from carbon fiber reinforced plastics. This is advantageous as the device will have a low specific weight while having the necessary strength for holding the patient's head during the production of the double shell mask. In a preferred embodiment, the weight of the  
40 device is comprised between 50 and 1000g, preferably between 100 and 900 g, more preferably between 150 and 800g.

In a third aspect, the present invention provides a system for immobilization of a patient body part for radiotherapy applications comprising a device comprising at least one flanged support member which is suitable to be mounted to a fixation surface and is adapted to receive and retain at least two sheets; a first sheet for covering the anatomical contours of a first area of said body part, and a second sheet for covering the anatomical contours of a second area of said body part which is not covered by the first sheet. The system is adapted for supporting the immobilized body part free from the fixation surface by the two sheets and the device. Free from the fixation surface refers to the fact that the immobilized body part is not in contact with the fixation surface but is separated from said surface by a free space.

In a preferred embodiment, the system for immobilization of a patient body part comprises: a device **1** comprising a bottom plate **2** and a flanged support member **3** adapted to receive at least two moldable thermoplastic sheets, said bottom plate **2** and flanged support member are connected by an open structure, preferably comprising a plurality of upstanding circumferential support legs **4** (**FIG. 1**); a first moldable thermoplastic sheet (**11**, **FIG. 4** and **5**); and a second moldable thermoplastic sheet (**11'**, **FIG. 4** and **7**). In a preferred embodiment, the first and the second moldable thermoplastic sheets **11**, **11'** are designed to be superimposable (**FIG. 4**).

In a preferred embodiment, the first sheet is designed and/or molded to conform the anatomical contours of the first area of the body part and the second sheet is designed and/or molded to conform the anatomical contours of the second area of the body part thereby forming a double shell mask enclosing said body part.

In a preferred embodiment, the flanged support member is provided with a plurality of attachment means adapted to receive and retain the sheets. In a preferred embodiment, the system comprises at least one flanged support member fixation means for mounting the flanged support member of the device to the fixation surface at a distance from said fixation surface, thereby mounting the flanged support member substantially parallel to the fixation surface.

In a preferred embodiment, the first sheet and the second sheet comprise each a circumferential rim having a number of connection means for mounting said sheets to the flanged support member. In a preferred embodiment, the first and the second sheets or moldable thermoplastic sheets (**11**, **11'**) comprise each a circumferential rim **12**, **12'** having a number of connection means **8**, **8'**. In a further preferred embodiment, the circumferential rims **12**, **12'** of the first and the second sheets or moldable thermoplastic sheets **11**, **11'** are designed to be superimposable (**FIG. 4**). In a preferred embodiment, at least one of said sheets or thermoplastic sheets **11'** is provided with at least one opening

**13'** for the patient's mouth as shown in **Fig. 4**. In another embodiment, both sheets are devoid of openings as shown in **Fig. 4A**.

5 The connection means **8, 8'** of the circumferential rims **12, 12'** of the sheets or the thermoplastic sheets are selected from the group comprising: rivets, screws, bolts and nuts, and snap fit means connections or any other type of connections means known to the person skilled in the art. The connection means **8, 8'** can also be simply openings wherein a fastening means such as rivets or bolts can be introduced and used. In a preferred  
10 embodiment, each circumferential rim is provided with 3 to 30, preferably 5 to 25, more preferably 10 to 20 connection means.

In a preferred embodiment, the connection means **8** of the circumferential rim **12** of the first sheet or first thermoplastic sheet **11** are positioned such as to correspond to all or to a part the connection means **8'** of the circumferential rim **12'** of the second sheet or second  
15 thermoplastic sheet and/or to all or to a part of the attachment means **5** of the flanged support member **3** of the device **1** when the first and the second sheets or thermoplastic sheets are simultaneously attached to the flanged support member **3**.

In a preferred embodiment, the connection means **8'** of the circumferential rim **12'** of the  
20 second sheet or second thermoplastic sheet **11'** are positioned such as to correspond to all or to a part of the connection means **8** of the circumferential rim **12** of the first sheet or first thermoplastic sheet and/or to all or to a part of the attachment means **5** of the flanged support member **3** of the device **1** when the first and the second thermoplastic sheets are simultaneously attached to the flanged support member **3**.

25 In a preferred embodiment, the connection means **8, 8'** are positioned on the circumferential rims **12, 12'** such as to correspond intermittently with all or with a part of the attachment means **5** of the flanged support member **3**. For instance, each attachment means **5** of the flanged support member **3** corresponding with a connection means **8** of the  
30 first sheet or thermoplastic sheet **11** will have a left and right neighboring attachment means that correspond with two connection means **8'** of the second sheet or second thermoplastic sheet **11'**. Similarly, each attachment means **5** of the flanged support member **3** corresponding with a connection means **8'** of the second sheet or second thermoplastic sheet **11'** will have a left and right neighboring attachment means that  
35 correspond with two connection means **8** of the first sheet or first thermoplastic sheet **11**.

In a preferred embodiment, the first sheet or first moldable thermoplastic sheet has a shear modulus - or rigidity - which is higher than the shear modulus of the second sheet or second moldable thermoplastic sheet. In a preferred embodiment, the ratio = shear  
40 modulus of the first moldable thermoplastic sheet/shear modulus of the second moldable thermoplastic sheet is at least 1.05, preferably at least 1.1, more preferably at least 1.2,

even more preferably at least 1.3, most preferably at least 1.4, even most preferably at least 1.5. Said ratio is at most 5, preferably at most 4, more preferably at most 3, even more preferably at most 2.5, most preferably at most 2, even most preferably at most 1.8.

5 In use, the device **1** is fixed to the support fixation surface **7** using the fixation means **6** and the support surface fixation means **9**. Then, the first thermoplastic sheet **11**, **FIG. 5** is heated and fixed, via the connection means **8** of its circumferential rim **12**, to the flanged support member **3** attachment means **5**. In addition, the recess **14** of the first thermoplastic sheet **11** can be used for fixing said sheet on an edge of the flanged support member **3**. The patient is then placed with his rear head or his front head, on the heated first moldable thermoplastic sheet such as to deform the sheet according to the anatomical contours of the rear or the front head. The first thermoplastic sheet **11** is then allowed to cool down such as to obtain a cured first thermoplastic sheet **11** as shown in **FIG. 6**.

15 Afterwards, the second thermoplastic sheet **11'**, **FIG. 7** is heated and fixed, via the connection means **8'** of its circumferential rim **12'**, to the flanged support member **3** attachment means **5**. In addition, the recess **14'** of the first thermoplastic sheet **11'** can be used for fixing said sheet on an edge of the flanged support member **3**. The second thermoplastic sheet will then cover the part of the head (rear or front head) which was not covered by the first thermoplastic sheet **11**. The heated second thermoplastic sheet **11'** will deform according to the anatomical contours of the rear or the front head. The second thermoplastic sheet **11'** is then allowed to cool down such as to obtain a cured second thermoplastic sheet **11'** as shown in **FIG. 8**. The cured second thermoplastic sheet **11'** shown in **FIG. 8** presents a protrusion **15** corresponding to the nose of the patient and is provided with an opening corresponding to the mouth of the patient. It is to be understood that the cured second thermoplastic sheet can be provided with at least two openings wherein the nose protrudes through one opening and the mouth protrudes through the other opening.

30 Alternatively, when pre-formed sheets are used, the flanged support member is fixed to the fixation surface using the flanged support member fixation means. Then, the first sheet is fixed, via the connection means of its circumferential rim, to the flanged support member attachment means. In addition, the recess of the first sheet can be used for fixing said sheet on an edge of the flanged support member. The patient is then placed with his rear head or his front head, on the first sheet such as to cover a first area of the head. Afterwards, the second sheet is fixed, via the connection means of its circumferential rim, to the flanged support member attachment means. In addition, the recess of the first sheet can be used for fixing said sheet on an edge of the flanged support member. The second sheet will then cover the part of the head which was not covered by the first sheet.

40

**FIG. 9** and **FIG. 10** respectively show the nonattached and the attached cured first and second thermoplastic sheets **11, 11'**. The circumferential rims **12, 12'** of said cured sheet are adapted and/or designed to be superimposable.

5 **FIG. 11** and **FIG. 12** respectively show the nonattached and the attached cured thermoplastic sheets **11, 11'** to the device **1**. The superimposable circumferential rims **12, 12'** of the cured thermoplastic sheets **11** and **11'** are also, at least partially, superimposable and fixable to the flanged support member **3** of the device **1**.

10 **FIG. 13** shows a side view of the assembly comprising the device **1** and the cured thermoplastic sheets **11, 11'**. The entire head is covered by the double shell mask of the present invention.

**FIG. 14** and **FIG. 15** respectively show the nonattached and the attached cured thermoplastic sheets **11, 11'** to the device **1** and to the support fixation surface **7**. The fixation means **6** of the bottom plate **2** of the device **1** are corresponding to the support surface fixation means **9**.

**FIG. 16** shows a side view of the assembly comprising the support fixation surface **7**, the device **1** and the cured thermoplastic sheets **11, 11'**. The entire head is covered by the double shell mask of the present invention.

It is to be understood that the first thermoplastic sheet can be also molded to conform to the front of the patient's head (so to the patient's face). The first thermoplastic sheet will conform to the anatomical contours of the front of the patient's head. The immobilization of the head, according to the present invention, can be achieved while the patient is the supine position or in the prone position. This example is illustrated in **FIG. 17** wherein a side view of the assembly comprising the support fixation surface **7**, the device **1** and the cured thermoplastic sheets **11, 11'** is shown. The entire head of the patient in prone position is covered by the double shell mask of the present invention.

For treatment of the patient's head in the prone position, it is also possible to mold the first thermoplastic sheet to conform the back of patient's head while the second sheet is used to conform the front of the patient's head, so the patient's face. After obtaining the sheets in their final state, the patient is placed in the prone position and the sheets are mounted and fixed to the flanged support member such as to conform said prone position of the patient.

In some case, for treatment of a patient in prone position, the device and system of the present invention can be used such as to first mold and cure a thermoplastic sheet on the patient's front head while the patient is in supine position. Afterwards, the cured first

thermoplastic sheet is then used to position the patient in the prone position. A second thermoplastic sheet is then molded and cured on the patient's rear head.

5 In another preferred embodiment, the system, the device and the method of the invention are suitable for immobilizing the head and the neck and the trunk of a patient. In a preferred embodiment, the trunk is at least partially immobilized by the present invention. The system of this embodiment comprises a first moldable thermoplastic sheet, a second moldable thermoplastic sheet and a flanged support member suitable to be mounted to a fixation surface at a distance (d, not shown) from said fixation surface and adapted to  
10 receive and retain said first and second moldable thermoplastic sheets. This embodiment is illustrated by **Fig. 18** to **Fig. 28** which are hereunder described in details.

In this embodiment, a device is also provided. Said device might be similar to the first sheet described above for the previous embodiment and might be provided with all the  
15 features of the first sheet shown in **Fig. 1** to **Fig. 17**. In a preferred embodiment, the device comprises a bottom plate **122** and a flanged support member **123** adapted to receive and retain at least two moldable thermoplastic sheets. Preferably flanged support member **123** is provided with attachment means **125** for receiving and retaining said thermoplastic sheets. Said bottom plate **122** and flanged support member **123** are  
20 connected by an open structure, preferably comprising a plurality of upstanding circumferential support legs **124** (**FIG. 26**). In a preferred embodiment, the device is suitable to receive and retain a first moldable thermoplastic sheet **100**; and a second moldable thermoplastic sheet **100'**. In a preferred embodiment, the first and the second moldable thermoplastic sheets **100, 100'** are designed to be superimposable.

25 In a preferred embodiment, the first and the second moldable thermoplastic sheets **11, 11'** comprise each a circumferential rim **112, 112'** having a number of connection means **108, 108'**. In a further preferred embodiment, the circumferential rims **112, 112'** of the first and the second moldable thermoplastic sheets **100, 100'** are designed to be superimposable (**FIG. 4**). In a preferred embodiment, at least one of said thermoplastic sheets is provided with at least one opening **101** for the patient's mouth as shown in **Fig. 18**. In another embodiment, both sheets are devoid of openings.

**Fig. 18** shows the second moldable thermoplastic sheet **100** comprising an area **HN**  
35 designed to be molded and to cover a first area of the head and the neck of a patient and an area **T** designed to be molded and to cover a first area of the trunk of a patient. Said sheet is provided with apertures **102** for mounting attachment edges **113** to the sheet **100**. Preferably said apertures **102** are provided at the area **T** designed to be molded and to cover a first area of the trunk of a patient of the sheet **100**. Preferably said apertures  
40 **102** are provided on either side, i.e. on the left and on the right, of the longitudinal central axis **A-A'** of the sheet (**Fig. 18**). The sheet might be provided with one or more openings **101** which might correspond to the mouth or the nose of the patient.

In a preferred embodiment, the area **HN**, designed to be molded and to cover a first area of the head and the neck of a patient, is connectable to a circumferential rim **112** (**Fig. 19**). The area **T**, designed to be molded and to cover a first area of the trunk of a patient, is connectable to attachment edges **113** via the aperture **102** (**Fig. 19**). In a preferred embodiment, the circumferential rim **112** and/or the attachment edges **113** of the moldable thermoplastic sheet **100** are provided with a number of connection means **108**.

The second moldable sheet **100** of **Fig. 19** is heated and molded on a patient's body part comprising the face, the neck and at least partially the trunk. The sheet will conform and cover the anatomical contours of the patient's body part. After curing, a molded sheet is obtained as shown in **Fig. 20**. The sheet shows a protrusion **109** corresponding to the nose of the patient and an opening **101** for the mouth of said patient. It is to be understood that the sheet can be also designed to cover the side of the patient comprising the rear head, the rear neck and the back of the patient. The sheet can also be of any other shape and can be designed to cover any body part of a patient.

The present invention also provides a first moldable thermoplastic sheet designed to be molded and to cover an area of the head and the neck of a patient which is not covered by the second moldable thermoplastic sheet. Said first moldable thermoplastic sheet might be similar to the first sheet described above for the previous embodiment and might be provided with all the features of the first sheet shown in **Fig. 1** to **Fig. 17**.

In a preferred embodiment, the first moldable thermoplastic sheet is provided with a circumferential rim **112'**. Said circumferential rim **112'** can be permanently fixed to the moldable thermoplastic sheets or can be dismountably fixed to said sheet. The latter configuration is advantageous as it allows optimizing the cleaning of the sheets both in their initial and final state. Furthermore, dismountable circumferential rims can be easily changed by new rims if required, for instance if the rim is damaged.

In a preferred embodiment, the circumferential rims **112**, **112'** of the first and the second moldable thermoplastic sheets **100**, **100'** are each provided with a number of connection means **108**, **108'**. In a further preferred embodiment, the circumferential rims **112**, **112'** of the first and the second moldable thermoplastic sheets **100**, **100'** are designed to be superimposable.

In a preferred embodiment, the connection means **108**, **108'** of thermoplastic sheets circumferential rims **112**, **112'** are selected from the group comprising: rivets, screws, bolts and nuts, and snap fit means connections or any other type of connections means known to the person skilled in the art. The connection means **108**, **108'** can also be simply openings wherein a fastening means such as rivets or bolts can be introduced and used. In

a preferred embodiment, each circumferential rim is provided with 3 to 30, preferably 5 to 25, more preferably 10 to 20 connection means.

5 In a preferred embodiment, the connection means **108** of the circumferential rim **112** of the first thermoplastic sheet **100** are positioned such as to correspond to all or to a part the connection means **108'** of the circumferential rim **112'** of the second thermoplastic sheet **100'** and/or to all or to a part of the attachment means **125** of the flanged support member **123** of the device when the first and the second thermoplastic sheets are simultaneously attached to the flanged support member **123**.

10

In a preferred embodiment, the connection means **108'** of the circumferential rim **112'** of the second thermoplastic sheet **100'** are positioned such as to correspond to all or to a part of the connection means **108** of the circumferential rim **112** of the first thermoplastic sheet **100'** and/or to all or to a part of the attachment means **125** of the flanged support member **123** of the device when the first and the second thermoplastic sheets are simultaneously attached to the flanged support member **123**.

15

In a preferred embodiment, the connection means **108**, **108'** are positioned on the circumferential rims **112**, **112'** such as to correspond intermittently with all or with a part of the attachment means **125** of the flanged support member **123**. For instance, each attachment means **125** of the flanged support member **123** corresponding with a connection means **108** of the first thermoplastic sheet **100** will have a left and right neighboring attachment means that correspond with two connection means **108'** of the second thermoplastic sheet **100'**. Similarly, each attachment means **125** of the flanged support member **123** corresponding with a connection means **108'** of the second thermoplastic sheet **100'** will have a left and right neighboring attachment means that correspond with two connection means **108** of the first thermoplastic sheet **100**.

20

25

**Fig. 21** shows an exploded view of the double shell mask according to an embodiment of the invention. Said double shell mask comprises the first and the second thermoplastic sheets **100**, **100'** in a molded state. The figure also shows the respective rims **112**, **112'** and the connection means **108**, **108'**. The first molded thermoplastic sheet **100** is designed to cover and to conform the anatomical contours of the face, the neck and at least partially the trunk of a patient. **Fig. 22** shows an exploded side view of the double shell mask according to an embodiment of the invention and presented in **Fig. 21**.

30

35

**Fig. 23** and **Fig. 24** show respectively an exploded view and a side exploded view of the double shell mask, the device and the fixation surface according to an embodiment of the invention. The device is suitable to be mounted to the fixation surface **127** using support surface fixation means **129** which correspond to fixation means **126** provided on the bottom plate of the device (**FIG. 3**). In a preferred embodiment, the attachment edges **113**

40

of the second moldable sheet **100** are also provided with fixation means **126** for fixing the sheet **100** area **T**, designed to be molded and to cover a first area of the trunk of a patient, to the fixation surface **127**.

- 5 Preferably, the support surface fixation means **129** of the fixation surface **7** correspond to fixation means **126** of the bottom plate. The fixation means of the bottom plate and the corresponding fixation means of the support fixation surface are selected from the group comprising: rivets, screws, bolts and nuts, and snap fit means connections and foam or plastic pads or parts that will fit in recesses in the support fixation surface or baseplate.
- 10 Preferably, the fixation means **126** of the bottom plate **122** comprise snap fit connections and rivets. More preferably, said provided snap fit connections and rivets are provided in an intermittent pattern. In a preferred embodiment, the bottom plate is provided with 3 to 30, preferably 5 to 25, more preferably 10 to 20 fixation means.

15 **Fig. 25** shows the double shell mask comprising the molded thermoplastic sheets **100**, **100'** and the rims **112**, **122'** fixed to each other. Said mask is suitable to be attached to the flanged support member **123** of the device via the rims **122**, **122'** using the connection means **108**, **108'**. Said device is suitable to be fixed to the fixation surface **127**, **Fig. 24** shows a side view of the mask, the device and the fixation surface shown in **Fig. 26**.

20

**Fig. 27** shows the double shell mask comprising the molded thermoplastic sheets **100**, **100'** and the rims **112**, **122'** fixed to each other. Said mask is attached to the flanged support member **123** of the device via the rims **122**, **122'** using the connection means **108**, **108'**. The device is itself fixed to the fixation surface **127** using the support surface fixation means **129** of the fixation surface **127** and the fixation means **126** of the bottom plate of the device. The attachment edges **113** of the second moldable sheet **100** are also fixed to the fixation surface using the fixation means **126** of said attachment edges **113**, thereby fixing the sheet area **T**, designed to be molded and to cover a first area of the trunk of a patient, to the fixation surface **127**. In a preferred embodiment, the fixation surface

25

30 **127** is provided with fixation means **129** positioned such as to correspond to different body and more in particular to different trunk widths including the left and the right arms of the patient. **Fig. 28** shows a side view of the mask, the device and the fixation surface shown in **Fig. 27**.

35 **Fig. 23** to **Fig. 28** show that the rims **112**, **112'** are superimposable and that said rims are also at least partially superimposable with the flanged support member **123**. The mentioned figures shows the different steps for immobilizing patient body part using the system, the devices and the method of the invention. Although a patient is not shown in the figures, it is to be understood that for a first use, the moldable sheets are in their initial

40 state. The first sheet is fixed to the flanged support member via its rim. Said flanged support member is already mounted on the fixation surface. Said first sheet is heated

before or after fixing it on to the flanged support member. The patient body part to be immobilized is placed on the first sheet which will deform and conform the anatomical contours of the body part thereby covering a first area of said body part. The second sheet is then heated and fixed to the flanged support member via its rim. The second sheet will then deform and conform the anatomical contours of the body part thereby covering a second area of the body part which is not covered by the first sheet. After treatment, the molded sheets can be dismantled from the flanged support member and stored for a personalized future use.

The patient's body part immobilized using the system, method and/or device according to any embodiment of the present invention is immobilized in a free floating manner. This refers to the fact that said body part is only supported by the thermoplastic sheet and the flanged support member. The body part is immobilized in a way which is devoid of any support cushion or support material. A free space is hence available between the immobilized body part and the fixation surface of the device thereby providing a 360° free access of the practitioner to the immobilized body part.

In a preferred embodiment, the system according to the present invention further comprises stabilization means for optimizing the immobilization of the patient's body part. For treatments comprising the application of radiations to a specific zone of the immobilized body part, it is highly recommended to avoid any movement of said body part during the treatment. Also for repetitive treatments comprising the application of radiations to a specific zone of the immobilized body part, it is crucial to exactly reproduce the immobilization position of said body part during each application of the radiations. This leads to an enhancement of the efficacy of the treatment and avoids application of radiations to zones of the immobilized body part surrounding the specific zone to be treated. Such treatments can be spread over a long time which can be from few weeks to few months. It is often the case that the positioning of the immobilized body part is not reproduced with exactitude. This might be due, for instance, to slight modifications of the orientation of the body part to be immobilized during each treatment and/or to small weight loss of the patient. The stabilization means provided by the present invention are advantageous as they allow the exact reproduction of the immobilization position during repetitive treatment of the immobilized body part. The stabilization means further improve said immobilization and serve as marks to exactly reproduce the immobilization position during repetitive treatment.

In a preferred embodiment, the stabilization means are dismountably fixed to the flanged support member and/or to at least one of the rims of the thermoplastic sheets for optimizing the immobilization of said body part. Preferably, said stabilization means comprise at least one stabilization means support and at least one stabilization device. Preferably, the stabilization means are suitable to be dismountably fixed to the flanged

support member and/or to at least one of the rims of the thermoplastic sheets via said stabilization means support.

**Fig. 29** and **Fig. 30** show respectively a perspective view and an exploded view of the device to which two thermoplastic sheets **300, 300'** in their initial state are fixed. The device shown in **Fig. 29** and **Fig. 30** comprises a bottom plate **302** provided with fixation means **306** for fixing said device to a fixation surface; a flanged support member **303** provided with attachment means **305** for attaching the sheets to the device; and a plurality of upstanding circumferential support legs **304**. It is to be understood that the device might comprise the flanged support member **303** and is suitable to be mounted to a fixation surface using support member fixation means, such as said flanged support member is fixed and at a distance **d** from said fixation surface.

The thermoplastic sheets **300, 300'** are each dismountably connected to a rim **312, 312'** wherein each rim is provided with connection means **308, 308'** for attaching the sheets to the flanged support member **303** of the device (**Fig. 29** and **Fig. 30**). In a preferred embodiment, the connection means **308, 308'** of thermoplastic sheets circumferential rims **312, 312'** are selected and/or positioned as described above for the embodiments represented by **Fig. 1** to **Fig. 17** and by **Fig. 19** to **Fig. 28**.

Stabilization means, comprising at least one stabilization means support and at least one stabilization device **M, N**, is suitable to be fixed and mounted to the flanged support member **303** and/or to at least one of the rims **312, 312'** of the thermoplastic sheets **300, 300'** (**Fig. 29** and **Fig. 30**). The stabilization means support comprises at least one frame **321** for dismountably holding and fixing at least one stabilization device; said frame **321** is connected to at least one upstanding member **320**, preferably to a plurality of upstanding members **320**. The upstanding members are releasably connectable to the flanged support member **303** and/or to at least one of the rims **312, 312'** of the thermoplastic sheets **300, 300'**.

The frame **321** of the stabilization means can be of any shape provided it is suitable to dismountably hold and fix at least one stabilization device. Said frame can have a shape selected from the group comprising square, circular, triangular shape or any other shape. Preferably said frame has a rectangular shape (**Fig. 29, Fig. 30** and **Fig. 31**).

In a preferred embodiment, the frame **321** is provided with a plurality of serrations **322** for fixing the stabilization devices **M, N** to said frame. Preferably said serrations **322** are provided on at least two parallel opposite sides of the frame **321**. The serrations are preferably provided over the full length of said frame sides. This allows fixation of the stabilization devices to the frame at different positions thereby adapting the position of the stabilization devices to the immobilized body part. In the embodiment shown in **Fig. 29** and

**Fig. 30**, the device, the sheets and the stabilization means are provided for immobilizing the head of a patient. In this embodiment, two stabilization devices are provided wherein one stabilization device **M** is designed for the mouth of the patient and the other stabilization device **N** is designed for the nose of the patient. It is to be understood that the immobilization device can be adapted and designed to immobilize any other body part. Also the stabilization device can be adapted and designed to stabilize any other body part.

A preferred embodiment of the stabilization means support is shown in **Fig. 31**. The support comprises frame **321** provided with serrations **322** and comprises a plurality of upstanding member **320** for fixing the stabilization means support at a distance **d** from the flanged support member **303** and/or at least one of the rims **312, 312'** of the thermoplastic sheets **300**. The upstanding members are, at one end, permanently or dismountably attached to the frame **321**. The distance **d** is determined by the length of the upstanding members **320**. Said upstanding member can be provided with a fixed length or a variable length. By variable length, we refer to the possibility of shortening or making longer the upstanding members.

In a preferred embodiment, the end of the upstanding member **320** which is not attached to the frame **321** is suitable to receive coupling means **323, 324, 235** (**Fig. 31**) for dismountably fixing the stabilization means support to the flanged support member **303** and/or to at least one of the rims **312, 312'** of the thermoplastic sheets **300, 300'**. Said coupling means are selected from the group comprising screws, blind, rivets, tacks, nails, nuts, pins, bolts, rivets, clamps, actuated lever clamps or any combination thereof. Preferably said coupling means are actuated lever clamps which are movable between a locked position and unlocked position.

In a preferred embodiment, the stabilization device is dismountably fixed on the frame **321** of the stabilization means support. Said stabilization device comprises at least one fastening means for fastening the stabilization means to the frame **321**; at least one positioning means suitable to be in contact with an area of the immobilized patient body part; and adjustment means for changing the position of the positioning means.

In a preferred embodiment, the stabilization device **M** designed for the mouth is dismountably fixed on the frame **321** of the stabilization means support. Said stabilization device **M** comprises fastening means **341, 342, 343** for fastening the stabilization means to the frame **321**. In a preferred embodiment, the stabilization device **M** comprises at least one positioning means **327** suitable to be in contact with an area of the immobilized patient body part and adjustment means **340** for changing the position of the positioning means **327**, thereby adapting its position to the targeted area of the immobilized body part.

In the embodiment shown in **Fig. 32** and **Fig. 33**, the positioning means **327** is suitable to be in contact with the mouth of the patient and/or to be bitten by the patient. Consequently, optimized and/or complete immobilization of the patient's head during treatment is ensured. The positioning means **327** can be made of silicone, rubber or any other suitable material. The positioning means **327** can be dismountably connected to a covering body **328** and is suitable to be replaced by a new positioning means when required. It is to be understood that the positioning means can be of any other shape and/or any other material.

10 In a preferred embodiment, the fastening means are components of an actuated lever clamp comprising a lever **341** and at least two clamping jaws **342, 343**. The lever **341** is movable between a locked position and an unlocked position. In the locked position, the clamping jaws **342, 343** are at least partially surrounding the edges of the frame **321** and are clamped around said edges thereby fixing the stabilization device to the stabilization  
15 means support. In the unlocked position, the clamping jaws **342, 343** are not surrounding the edges of the frame **321** thereby removing the stabilization device from the stabilization means support. Preferably, said clamping jaws **342, 343** are designed to form-fit the serrations **322** of the frame **321**. Hence, the user controls the position of the stabilization device **M** on the frame and thereby the position of the stabilization device with respect to  
20 the immobilized body part.

In a preferred embodiment, the positioning means **327** is dismountably connectable to the adjustment means **340** which comprises a plurality of hook like attachment means **351** suitable for receiving and/or fixing the positioning means and/or the fastening means. The  
25 adjustment means **340** further comprises openings **350** for receiving and/or fixing the positioning means and/or the fastening means. The positioning means **327** and/or the covering body **328** is provided with a connection plate **329** comprising at least one opening **330** for connecting said positioning means to the adjustment means (**Fig. 32** and **Fig. 33**).

30 The exploded view of the stabilization device **M** provided in **Fig. 33** shows the different components of the fastening means, i.e. the lever **341** the clamping jaws **342, 343**. The same figure further shows the positioning means **327**, the adjustment means **340** and the different means **344, 345, 346, 347, 348, 349** used for assembling said components. Said means are selected from the group comprising screws, blind, rivets, tacks, nails, nuts,  
35 pins, bolts, rivets or any combination thereof. When assembled as shown in **Fig. 32**, the user can easily dismount the adjustment means **340** from the stabilization device **M**. The user can then select the position of the positioning means **327** with respect to the adjustment means **340** by selecting one hook like attachment means **351** for attaching the adjustment means **340** to the stabilization device **M**. Preferably, the hook like attachment  
40 means **351** are positioned on the adjustment means **340** such as to define a translation direction **T-T** of the positioning means **327** (**Fig. 33**).

For attaching the stabilization device **M** to the frame **321** of the stabilization means support as shown in **Fig. 29**, the user or practitioner controls the position of the stabilization device **M** with respect to the frame by choosing the serrations of the frame to which said device  
5 will be attached. By consequence, the user controls and selects the area of the immobilized body part which will be stabilized by the stabilization means **M**. Said area corresponds to the projection, on the immobilized body part, of the positioning means **327** in the translation direction **T-T**. The user also controls the position of the positioning means **327** with respect to the adjustment means **340** by choosing one hook like attachment means  
10 **351** for attaching the adjustment means **340** to the stabilization device **M**. Consequently, the user ensures that the positioning means **327** will be in contact with the selected area of the immobilized body part and/or bitten by the mouth of the patient if the head is immobilized.

15 In a preferred embodiment, the stabilization device **N** designed for the nose is dismountably fixed on the frame **321** of the stabilization means support. Said stabilization device **N** comprises fastening means **363, 355, 356** for fastening the stabilization means to said frame **321**. In a preferred embodiment, the stabilization device **N** comprises at least one  
20 positioning means **360** suitable to be in contact with an area of the immobilized patient body part and adjustment means **362, 364** for changing the position of the positioning means **360**, thereby adapting its position to the targeted area of the immobilized body part.

In the embodiment shown in **Fig. 32** and **Fig. 33**, the positioning means **360** is suitable to  
25 be in contact with the nose of the patient. Preferably said positioning means is suitable to be in contact with the nose bone of the patient. Consequently, optimized and/or complete immobilization of the patient's head during treatment is ensured. The positioning means **360** can be made of silicone, rubber, polypropylene or any other suitable material. The positioning means **360** is suitable to be replaced by a new positioning means when  
30 required. It is to be understood that the positioning means can be of any other shape and/or any other material.

In a preferred embodiment, the fastening means are components of an actuated lever clamp comprising a lever **363** and at least two clamping jaws **355, 356**. The lever **363** is  
35 movable between a locked position and an unlocked position. In the locked position, the clamping jaws **355, 356** are at least partially surrounding the edges of the frame **321** and are clamped around said edges thereby fixing the stabilization device to the stabilization means support. In the unlocked position, the clamping jaws **355, 356** are not surrounding  
40 the edges of the frame **321** thereby removing the stabilization device from the stabilization means support. Preferably, said clamping jaws **355, 356** are designed to form-fit the serrations **322** of the frame **321**. Hence, the user controls the position of the stabilization

device **N** on the frame and thereby the position of the stabilization device with respect to the immobilized body part.

5 In a preferred embodiment, the positioning means **360** is slidably connected to an adjustment means **364** via at least one blocking means **362**. The positioning means **360** is slidable with respect to the adjustment means **364** along a translation axis **T'-T'** (**Fig. 34**). Said blocking means is movable between an unblocked position in which the positioning means **360** is slidable with respect to the adjustment means **364** and a blocked position in which the positioning means **360** is not slidable with respect to the adjustment means **364**.  
10 Consequently user controls the position of the positioning means **360** with respect to the adjustment means **364** (**Fig. 34** and **Fig. 35**).

The exploded view of the stabilization device **N** provided in **Fig. 35** shows the different components of the fastening means, i.e. the lever **363** the clamping jaws **355, 356**. The same figure further shows the positioning means **360**, the adjustment means **364**, the blocking means **362** and the different means **357, 358, 359, 361, 361** used for assembling said components. Said means are selected from the group comprising screws, blind, rivets, tacks, nails, nuts, pins, bolts, rivets or any combination thereof. When assembled as shown in **Fig. 34**, the user can easily select the position of the positioning means **360** with respect to the adjustment means **364** by moving blocking means **362** from the blocked position to the unblocked position and sliding the positioning means **360** with respect to the adjustment means **364** along the translation axis **T'-T'**.  
15  
20

For attaching the stabilization device **N** to the frame **321** of the stabilization means support as shown in **Fig. 29**, the user or practitioner controls the position of the stabilization device **N** with respect to the frame by choosing the serrations of the frame to which said device will be attached. By consequence, the user controls and selects the area of the immobilized body part which will be stabilized by the stabilization device **N**. Said area corresponds to the projection, on the immobilized body part, of the positioning means **360** in the translation direction **T'-T'**. The user also controls the position of the positioning means **360** with respect to the adjustment means **364** by choosing the position of the stabilization device **N**. Consequently, the user ensures that the positioning means **360** will be in contact with the selected area of the immobilized body part which can be the nose bone if the head is immobilized.  
25  
30

35 In a fourth aspect, the present invention provides a moldable thermoplastic sheet comprising a circumferential rim **12, 12'** which is provided with connection means **8, 8'** such as said connection means are corresponding to all or to some attachment means of the device according to an embodiment of the invention. In a preferred embodiment, the connection means **8, 8'** are regularly distributed on the circumferential rim **12, 12'**.  
40

In a preferred embodiment, the circumferential rim **12**, **12'** are manufactured from a material having high temperature tolerance. In a further preferred embodiment, the circumferential rim **12**, **12'** are manufactured from a carbon composite material having low density, more preferably from a carbon composite polymer, most preferably from carbon fiber or carbon fiber reinforced plastics. This is advantageous as the thermoplastic sheets will have a low weight facilitating their used and manipulation by the practitioner.

**FIG. 5** shows an embodiment of a moldable thermoplastic sheet according to the present invention. The moldable thermoplastic sheet is in its initial state and comprises a circumferential rim **12** provided with attachment means **8** and the thermoplastic sheet itself **11**. **Fig. 6** shows the moldable thermoplastic sheet of **Fig. 5** in a final state, i.e. after being heated and molded to conform and cover the anatomical contours of a patient's body portion. Said sheet in its final state might be disconnected from the circumferential rim (**Fig. 6A**) which for instance allows optimization of the cleaning of the molded sheet thereby optimizing the hygiene of the mask.

**FIG. 7** shows another moldable thermoplastic sheet **11'** according to an embodiment of the present invention. The moldable thermoplastic sheet is in its initial state and comprises a circumferential rim **12'** provided with attachment means **8'** and the thermoplastic sheet itself **11'**. The moldable thermoplastic sheet **11'** comprises an opening **13'** which can correspond to the nose or to the mouth of the patient's when the sheet is cured. The thermoplastic sheet may be provided with more than one opening. **FIG. 7A** shows another embodiment of the moldable thermoplastic sheet **11'** wherein the sheet is devoid of any opening.

In a preferred embodiment, the thermoplastic sheet **11**, **11'** and the circumferential rim **12**, **12'** are physically (i.e. heat bonding), mechanically (i.e. clamping) or chemically bonded (i.e. glued). In another preferred embodiment, the thermoplastic sheet **11**, **11'** and the circumferential rim **12**, **12'** are dismountably fixed to each other, via snap-fit system for instance.

In a preferred embodiment, the circumferential rim **12**, **12'** comprises at least one recess **14**, **14'** in **FIG. 2** provided over at least a part of the circumferential rim, said recess **14**, **14'** is adapted for matingly fixing the circumferential rim to a flanged support member **3** of the device of the present invention described above. In a preferred embodiment, the flanged support member **3** of the device according to the present invention is adapted to snap fit into the recess **14**, **14'** of the circumferential rim **12**, **12'** of the moldable thermoplastic sheet **11**, **11'**.

In a further preferred embodiment, for fixing two moldable thermoplastic sheets **11** and **11'** to a flanged support member **3** of the device according to the present invention, the

recesses **14** and **14'** of the circumferential rims **12** and **12'** can be provided such as each recess snap fits an edge (**10** or **10'** in **FIG. 1**) of the flanged support member **3**.

5 In a preferred embodiment, the sheets have different elasticity. Preferably, the elasticity ratio of the sheet with the highest elasticity to the sheet with the lowest elasticity is at least 5. In a further preferred embodiment, the elasticity of the less elastic sheet is at least 50%, preferably at least 60%, more preferably at least 65%, most preferably at least 70%. The elasticity of the less elastic sheet is at most 150%, preferably at most 120%, more preferably at most 100%, most preferably at most 80%. Preferably the less elastic sheet is  
10 the first sheet, i.e. used for covering a first area of the body part to be immobilized.

The moldable thermoplastic sheets of the invention can be of any composition known to the person skilled in the art and/or described in the prior art and/or available on the market. The thermoplastic sheet can be a single sheet or a laminate which is perforated or non-  
15 perforated. The laminate can comprise one or more core thermoplastic layers bound to a support which comprises a mesh and/or a layer of cotton and/or a layer of elastic cotton and/or open cell foam and/or silicone and/or any other soft fabric for providing a comfortable feeling to the patient. The perforations diameter is comprised between 0.1 mm and 3 mm and preferably between 0.5 and 2 mm, more preferably between 1 to 1.3 mm.  
20 Said perforations may be positioned in rows separated by 1 mm to 5 mm. The perforations may represent 10% to 90%, preferably 20% to 80%, more preferably 30% to 70% of the sheet surface. The perforations allow the skin of the patient to breathe even after application of the thermoplastic sheets.

25 In a preferred embodiment, the thickness of the less elastic sheet in its initial state is of from 1.5 to 1.8 mm, preferably about 1.7 mm. The thickness sheet with the highest elasticity, in its initial state, is of from 2 to 2.5 mm, preferably about 2.3 mm. The thickness of the sheet in its initial state is also called pre-molding thickness. The thickness of the sheet in its final state is also called post-molding thickness.  
30

In a preferred embodiment, in their final state, so after being molded and cured, the thickness of the less elastic and the thickness of the sheet having the highest elasticity are very close to each other and preferably equal to each other. The post molding thickness is of from 1.4 to 1.9 mm, preferably of from 1.5 to 1.8 mm. The equal post molding thickness  
35 of the sheets is advantageous as it provides for a uniform radiation level independently from the position at which said radiations are applied. This means that the inhibition of the radiation by the sheets will be uniform through the double shell mask.

In a preferred embodiment, the thermoplastic sheet shows reduced draping when warmed.  
40 Gamma irradiation can be applied or can be not applied to the thermoplastic sheet of the

invention. The thermoplastic sheet can be coated or non-coated. A polyurethane polymer coating can be applied on the thermoplastic sheet.

5 In a preferred embodiment, the thermoplastic sheet is optically transparent. The optical transparency permits using positioning markers on one or both of the immobilization device and the body part to facilitate re-positioning. This renders the thermoplastic sheet suitable for use in radiation therapy and diagnostic imaging and any other applications where an accurate re-positioning of the immobilization device is of high importance.

10 In another preferred embodiment, the thermoplastic sheet of the present invention has a softening temperature of less than 60°C, preferably of less than 65°C and comprises a thermoplastic copolymer of a lactone and a lactide in a weight ratio of from 96:4 to 87:13, respectively, wherein the copolymer has a melt temperature  $T_m$  in the range of from 47 to 58°C.

15 In a preferred embodiment, said copolymer of the thermoplastic sheet has a melt temperature  $T_m$  in the range of from 50 to 85°C, preferably from 65 to 75°C and a crystallisation temperature  $T_c$  in the range of from 19 to 25°C.

20 In a preferred embodiment, the copolymer of the thermoplastic sheet has a molecular weight of at least 30000, and preferably from 40000 to 100000.

In another preferred embodiment, the copolymer of the thermoplastic sheet is obtained from a lactone and lactide in a weight ratio of from 93:7 to 91:9.

25 In another preferred embodiment, the thermoplastic sheet of the present invention comprises a core layer having an upper surface and lower surface. The core layer has a thermoplastic composition comprising polycaprolactone and polyurethane. The thermoplastic sheet comprises also a first outer layer disposed over the upper surface of the core layer and a second outer layer disposed over the lower surface of the core layer. In a preferred embodiment, the first outer layer comprises a material formed from a yarn comprising polyamide and elastane. In a preferred embodiment, the second outer layer comprises open cell foam. The first and the second outer layers are bonded to the core layer so as to form a single sheet.

35 In a preferred embodiment, the core layer comprises 20 % to 40 %, polyurethane, and 60% to 80% (w/w) polycaprolactone.

40 In a preferred embodiment, the core layer further comprises between 1 to 40 % (w/w) of non-metallic, heat-accumulating microspheres.

In a preferred embodiment, the yarn of the first outer layer comprises between 80% to 95 % polyamide, and between 5 % and 15 % elastane. The thickness of the first outer layer is between 0.05 and 1.5 mm. The fabric weight of the first outer layer is between 210 g/m<sup>2</sup> and 230 g/m<sup>2</sup>.

5

In a preferred embodiment, the second outer layer is made from polyurethane, polyester polyurethane or polyether open-cell foam.

10 In a preferred embodiment, the thermoplastic sheet comprises an intervening layer disposed between the core layer and the first outer layer, and/or disposed between the core layer and the second outer layer, made from the same material as the core and with higher polycaprolactone content.

15 In a preferred embodiment, the thermoplastic sheet has a maximum total thickness of 1.5 to 1.7 mm.

In another preferred embodiment, the thermoplastic sheet of the present invention is as described in JP 2 527 348 and comprises a mixture of a polycaprolactone resin with a styrene/acrylonitrile copolymer resin. Preferably, the caprolactone monomer is reacted at 20 100-230°C in the presence of a catalyst by using water in the monomer as an initiator to obtain a polycaprolactone resin (A) of a relative viscosity (measured with a capillary viscometer) of 1.50-2.80. Separately, a styrene monomer is copolymerized with 20-35wt% acrylonitrile monomer to obtain a styrene/acrylonitrile copolymer resin (B). Component A is mixed with component B at a weight ratio of 50-95/50-5, and the resulting mixture is 25 optionally mixed with a metal salt of a higher fatty acid (e.g., calcium stearate).

In a preferred embodiment, when cured, the thermoplastic sheet of the invention shows limited shrinking and is soft such as to provide comfort to the patient.

30 In a preferred embodiment, the thermoplastic sheet is directly moldable on the human body and presents the advantage that it is unbreakable in case of hard handling or after falling. Moreover, the thermoplastic sheet is optically transparent which gives the possibility to observe whether or not it has been properly molded to the body part. The thermoplastic sheet can also be semi-transparent or opaque.

35

In another preferred embodiment, the invention provides for the immobilization of a body part wherein the sheets are pre-formed. A pre-formed sheet is herein called cast. Preferably, casts are 3D printed casts that conform and cover the body part to be immobilized. The casts are suitable to be connected and retained by a device comprising at 40 least one flanged support member which is suitable to be mounted to a fixation surface. Preferably, two casts are provided wherein a first cast is designed to conform the

anatomical contours of a first area of the body part and a second cast is designed to conform the anatomical contours of a second area of the body part thereby forming a double shell mask enclosing said body part. The body part is thereby immobilized free from the fixation surface by the casts and the device.

5

In a preferred embodiment, the casts are produced using any tool or system known to the person skilled in the art. Preferably said casts are printed according to the patient's body part to be immobilized.

10 **Fig. 36** and **Fig. 37** show an embodiment of the system of the invention wherein the body part to be immobilized is scanned and the casts printed using a 3D printer. The system comprises a frame **400** mounted on a wall or another fixed structure defines a pair of rails **402** with which a motorised drive mechanism **403** engages to drive an arm **407** linearly back and forth in a first, axial direction of movement. Said axial direction is preferably  
15 parallel to the longitudinal direction of a table **409** on which a patient **408** is placed for scanning the body part to be immobilized. Said axial direction corresponds preferably to the direction of scanning in use. The drive mechanism **403** further comprises a housing **401** in which the arm **407** is movable by the drive mechanism **403** thereby allowing a 3D imaging and/or scanning apparatus **404** of the system to rotate about an axis parallel with the axial scanning direction. This rotation allows the imaging and/or scanning of the patient's body  
20 part over 360°.

The 3D imaging or scanning apparatus **404** for obtaining a 3D image or scan of said patient's **408** body part is preferably provided on a head **405** connected to the housing  
25 **401** and/or the arm **407**. The head **405** and thereby the 3D imaging or scanning apparatus **404** are movable by the movement of the arm **407**. The 3D imaging or scanning apparatus may also comprise a scanning unit or detector for visualising internal structures such as bone structures, such as e.g. a seismographic 3D scanner. The system might be further provided with a detector unit **406**. Preferably said unit **406** and the head **405** are  
30 supported at opposite ends of the curved arm **407**. The detector unit **406** transmits the data acquired by said 3D imaging apparatus to an acquisition unit **411**, such as a computer, for acquiring the data collected by the 3D imaging or scanning apparatus **404** and for processing said obtained data to obtain a model for two 3D casts **611** (**Fig. 38**). Preferably, said acquisition unit **411** is operated by a qualified operator. After processing  
35 the data collected by the 3D imaging or scanning apparatus **404** in the acquisition unit **411**, instruction is send to the 3D printing device **413** (**Fig. 38**) for printing the casts which are conforming the anatomical contours of the scanned body part.

The collected data comprises parameters selected by the operator. Said parameters  
40 comprise the length, the width, the muscle content, the fat content of the body part to be immobilized or any combination thereof. After processing the data in the acquisition unit,

the operator can choose the material of the casts which is most appropriate for the immobilization of the body part. Said casts can be made from a material selected from the group comprising rigid-elastic material, plastics, polyethylene, polypropylene, polyvinylchloride, polystyrene, polyethylene terephthalate, polycarbonate or any combination thereof.

**Fig. 39A** provides a schematic view of two 3D casts **611, 611'** used for enclosing the trunk of a patient. Preferably, each 3D printed cast is provided with a side rim **512, 512'** suitable to be connected and fixed to a flanged support member as described above. Each rim is preferably provided with a plurality of connection means **505, 505'**. **Fig. 39B** provides a side view of the 3D printed casts of **Fig. 39A**. By connecting the 3D printed casts **611, 611'** to a flanged support member as described above and according to the invention, said casts will conform the anatomical contours of the patient's body part. The rim **512, 512'** can also be 3D printed thereby perfectly matching the connection means of the rim to the attachment means of the flanged support member **503**.

The present invention hence provides a system for immobilization of a patient body part, comprising: - a device comprising a flanged support member as described above and adapted to receive at least two casts; - a first casts **611**; and - a second casts **611'** whereby the system is adapted for supporting the immobilized body part free from the fixation surface by the two casts and the device.

The current invention further provides a method for producing pre-formed sheets, also called, casts for immobilization of a patient's body part comprising the steps of:

- scanning said patient's body part with a 3D scanner, thereby obtaining scan data of said body part;
- collecting said scan data of said body part;
- processing the collected scan data of said body part thereby obtaining a model which is fitting and personalized to the scanned body part;
- producing casts which are suitable to be attached and fixed to a flanged support member thereby supporting the immobilized body part free from the fixation surface by the two casts and the device. Preferably, the casts are produced by 3D printing said model in two 3D printed casts that, when attached and fixed to the flanged support member are conform to the anatomical contours of said patient's body part.

**Fig. 40** provides a flow chart of a method for making said casts. The method comprises the steps of (i) scanning the body parts of interest; (ii) determining body part characteristics for instance by the acquisition unit; (iii) sending instructions to a 3D printer; and (iv) obtaining said pre-formed 3D printed casts.

The further provides a method for immobilization of a patient body part for radiotherapy applications comprising the steps of:

- scanning said patient's body part with a 3D scanner, thereby obtaining scan data of said body part;
  - 5 - collecting said scan data of said body part;
  - processing the collected scan data of said body part thereby obtaining a model which is fitting and personalized to the scanned body part;
  - producing at least two casts,
  - mounting a device comprising a flanged support member to a fixation surface; said  
10 flanged support member is adapted to receive and retain at least the two casts;
  - mounting a first cast to the flanged support member;
  - placing the patient body part to be immobilized on said first cast thereby covering the anatomical contours of a first area of said body part; and
  - mounting a second cast to the flanged support member thereby covering the anatomical  
15 contours of a second area of said body part which is not covered by the first cast,
- wherein the method is adapted for supporting the immobilized body part free from the fixation surface by the two casts and the device.

**Fig. 41** and **Fig. 42** show the pre-formed 3D printed casts in use for immobilization of the  
20 patient's trunk, whereby said trunk is enclosed in two 3D printed casts. Said 3D printed casts are mounted on a flanged support member **503** which is mounted and fixed to a fixation surface **507** using a plurality of upstanding circumferential support legs **504**. The fixation surface in this embodiment might be a carbon fiber surface or any surface made from any suitable material. The remaining body part of the patient might be supported with  
25 any other material for providing comfort to the patient during treatment. For instance, in **Fig. 42**, further support means **508** are used for positioning other body parts of the patient, in order to provide comfort to said patient and to further improve an accurate positioning of the various organs. It is to be understood that any other support means known to the person skilled in the art might be used.

30 The system and the method according to an embodiment of the invention wherein the body part to be immobilized is scanned for producing casts are advantageous. Said system and method provide for personalized casts which might be adapted to any variation of the body part – weight gain or loss. Furthermore, the casts material is selected according to the  
35 patient's specific body composition – fat, muscles. In addition the immobilized part is free from the fixation surface and is only supported by the device and the casts thereby presenting the advantages as described above.

40 Preferably, the sheet according to any embodiment of the invention – moldable thermoplastic sheet or any other pre-formed sheet or cast – is treated with an antibacterial product before being used. In a further preferred embodiment, said sheet comprises at

least one antibacterial compound or a mixture of antibacterial compounds. Further, the sheet is not susceptible to any crimping during use or storage.

5 The device according to any embodiment of the present invention is suitable to be used in the system according to any embodiment of the present invention. Further, in the method according to any embodiment of the present invention, the system and/or the device as provided by the invention are suitable to be used.

10 It is to be understood that the features described for an embodiment of the present invention are suitable to be applied to any other described embodiment of the invention without departing from the scope of this invention which is defined by the appended claims.

15 Although the present invention has been described with reference to preferred embodiments thereof, many modifications and alternations may be made by a person having ordinary skill in the art without departing from the scope of this invention which is defined by the appended claims.

**Claims**

1. A system for immobilization of a patient body part for radiotherapy applications comprising:
  - a device comprising at least one flanged support member which is suitable to be mounted to a fixation surface and is adapted to receive and retain at least two sheets,
  - a first sheet for covering the anatomical contours of a first area of said body part, and
  - a second sheet for covering the anatomical contours of a second area of said body part which is not covered by the first sheet,whereby the system is adapted for supporting the immobilized body part free from the fixation surface by the two sheets and the device.
2. The system according to claim 1, wherein the first sheet is designed to conform the anatomical contours of the first area of the body part and the second sheet is designed to conform the anatomical contours of the second area of the body part thereby forming a double shell mask enclosing said body part.
3. The system according to any of claims 1-2, comprising at least one support member fixation means for mounting the flanged support member of the device to the fixation surface at a distance from said fixation surface, thereby mounting the flanged support member substantially parallel to the fixation surface.
4. The system according to any of the preceding claims, wherein the flanged support member is provided with a plurality of attachment means adapted to receive and retain the sheets.
5. The system according to any of the preceding claims, wherein the first and the second sheet comprise each a circumferential rim provided with a number of connection means for mounting said sheets to the flanged support member.
6. The system according to any of any of the preceding claims, wherein the circumferential rims of the first sheet and of the second sheet are designed to be superimposable.
7. The system according to any of the preceding claims, wherein the connection means of the circumferential rim of the sheet are positioned such as to correspond to the connection means of the circumferential rim of the second sheet and/or to the attachment means of the flanged support member of the device.
8. The system according to any of the preceding claims, comprising at least one stabilization means suitable to be dismountably fixed to the flanged support member for optimizing the immobilization of said body part.
9. A device for immobilization of a patient body part for radiotherapy applications comprising at least one flanged support member suitable to receive and retain two sheets, said flanged support member is suitable to be mounted to a fixation surface

using support member fixation means, such as said flanged support member is mounted and at a distance from said fixation surface.

10. A device according to claim 9, wherein the flanged support member is mounted substantially parallel to the fixation surface.
11. A method for immobilization of a patient body part for radiotherapy applications comprising the steps of:
  - mounting a device comprising a flanged support member to a fixation surface; said flanged support member is adapted to receive and retain at least two sheets;
  - mounting a first sheet to the flanged support member;
  - placing the patient body part to be immobilized on said first sheet thereby covering the anatomical contours of a first area of said body part; and
  - mounting a second sheet to the flanged support member thereby covering the anatomical contours of a second area of said body part which is not covered by the first sheet,wherein the method is adapted for supporting the immobilized body part free from the fixation surface by the two sheets and the device.
12. The method according to claim 11, wherein the first and the second sheets are suitable to be formed on the patient body part such as to conform the anatomical contours of said patient body part.
13. The method according to any of claims 11-12, wherein the first and the second sheets are pre-formed sheets which are conform to the anatomical contours of the patient body part.
14. The method according to any of claims 11-13, comprising the step of scanning the body part for pre-forming the first and the second sheets.

1/36

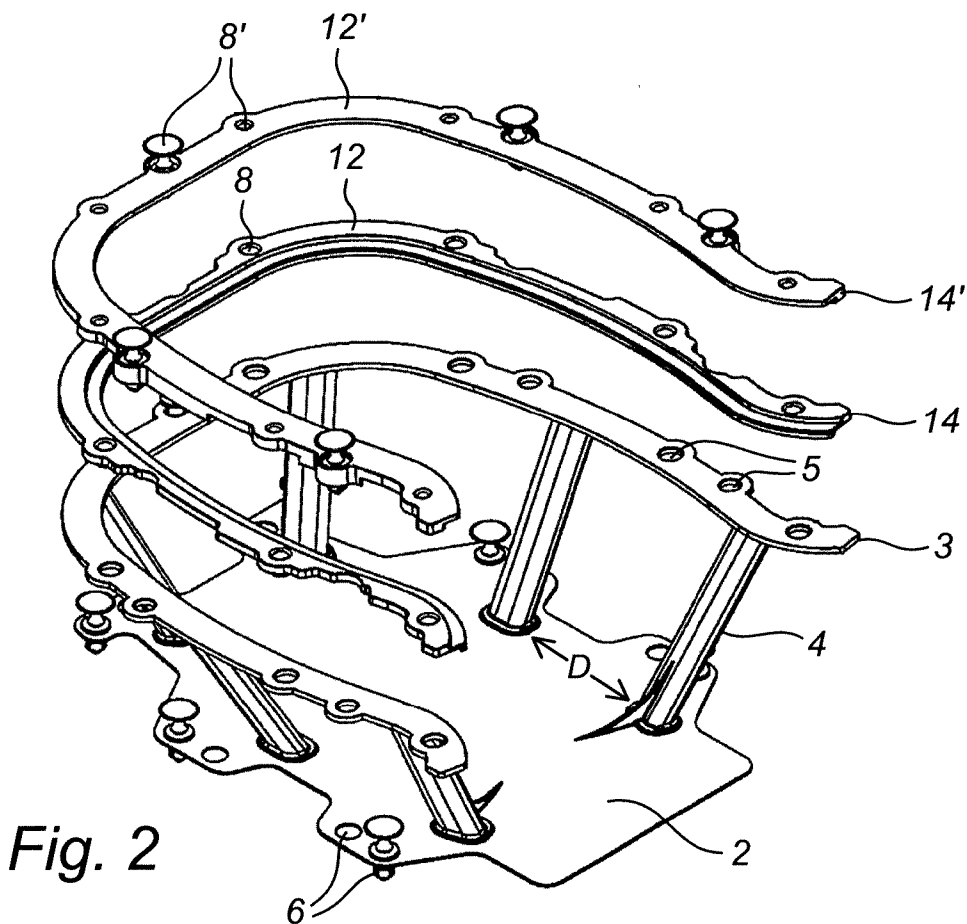
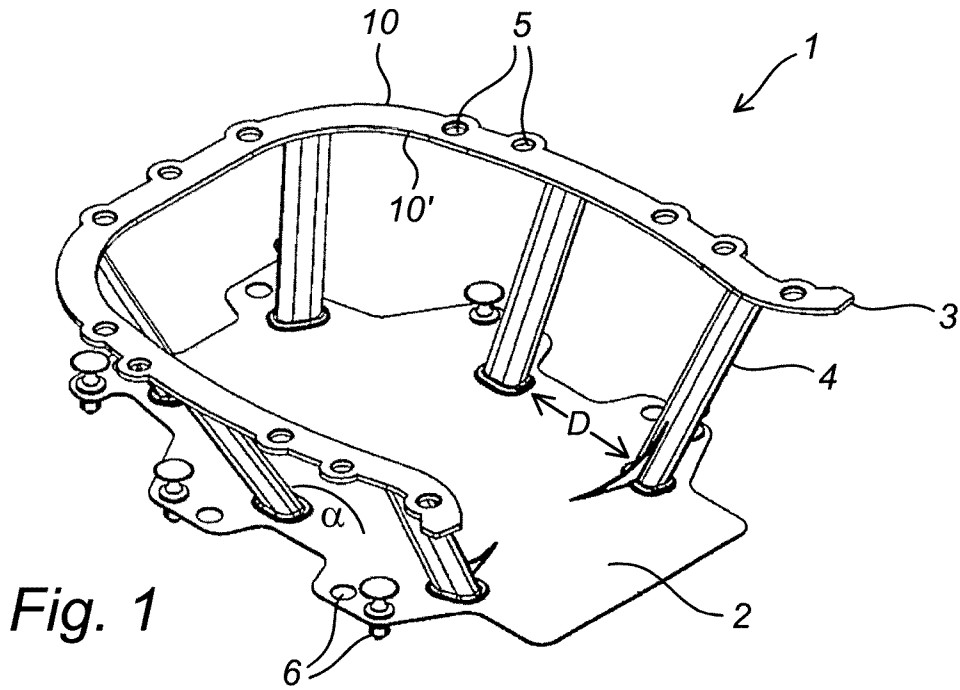

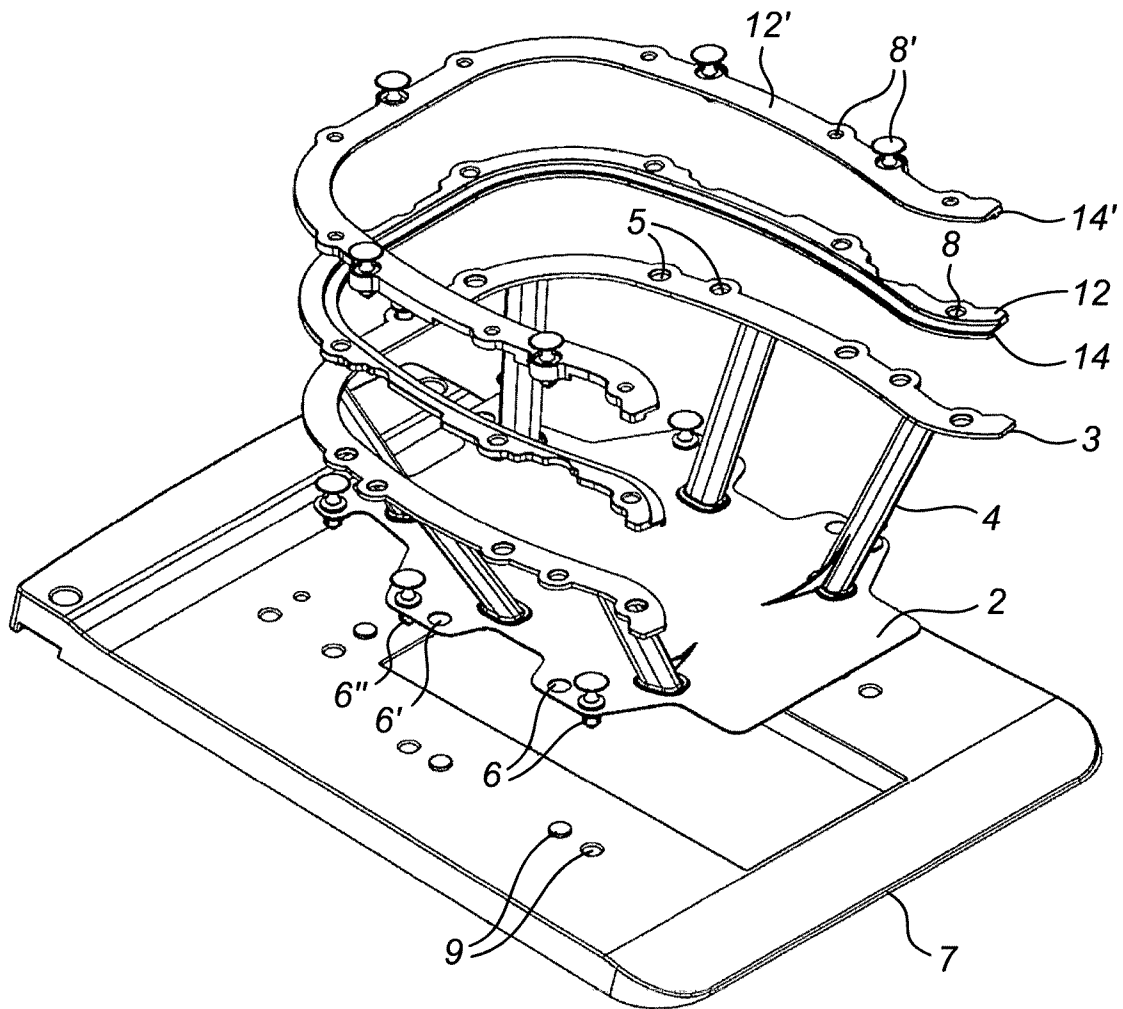

Fig. 3

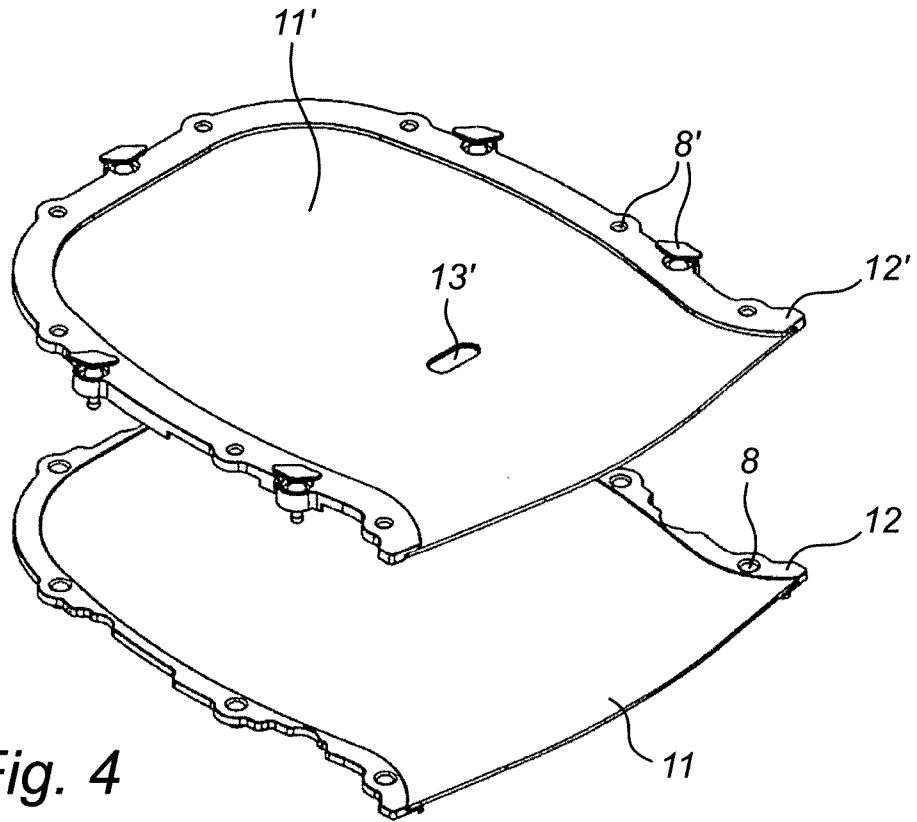

Fig. 4

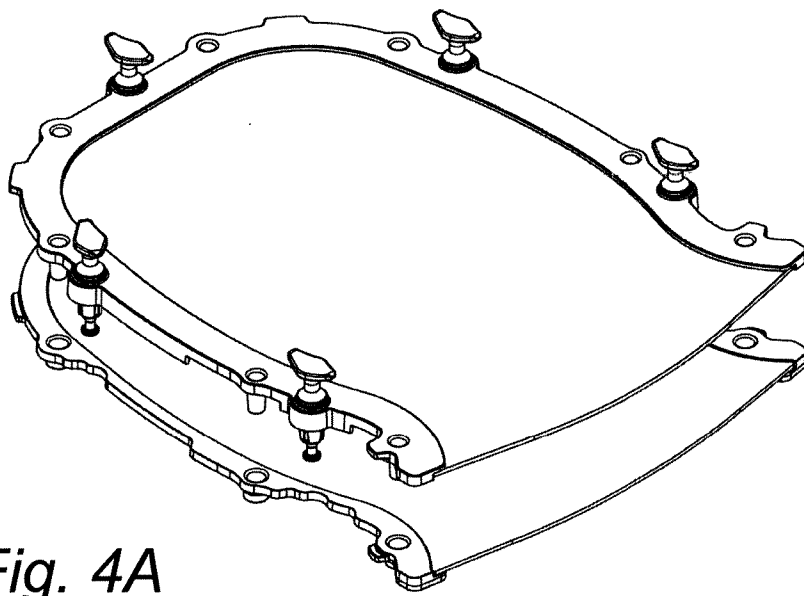
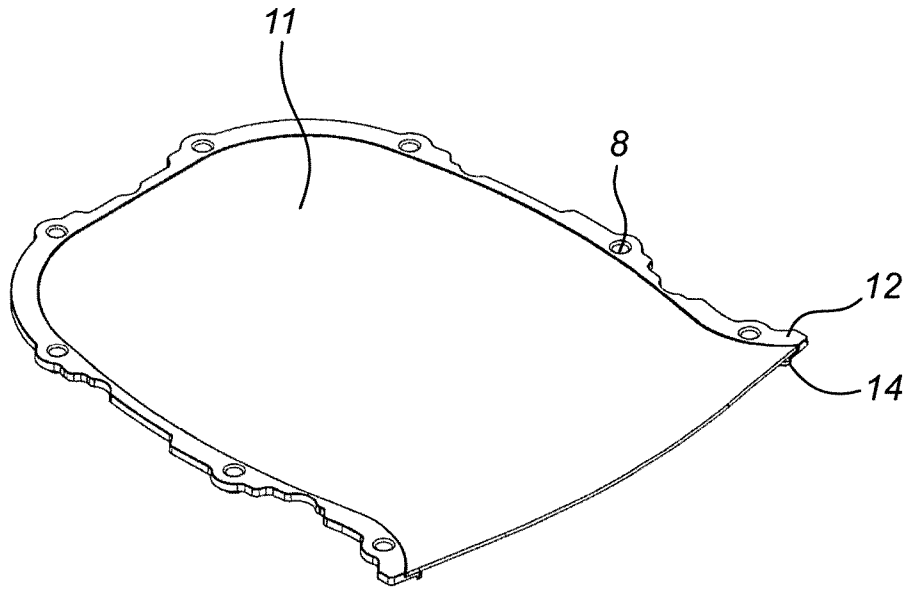

Fig. 4A

4/36



*Fig. 5*

5/36

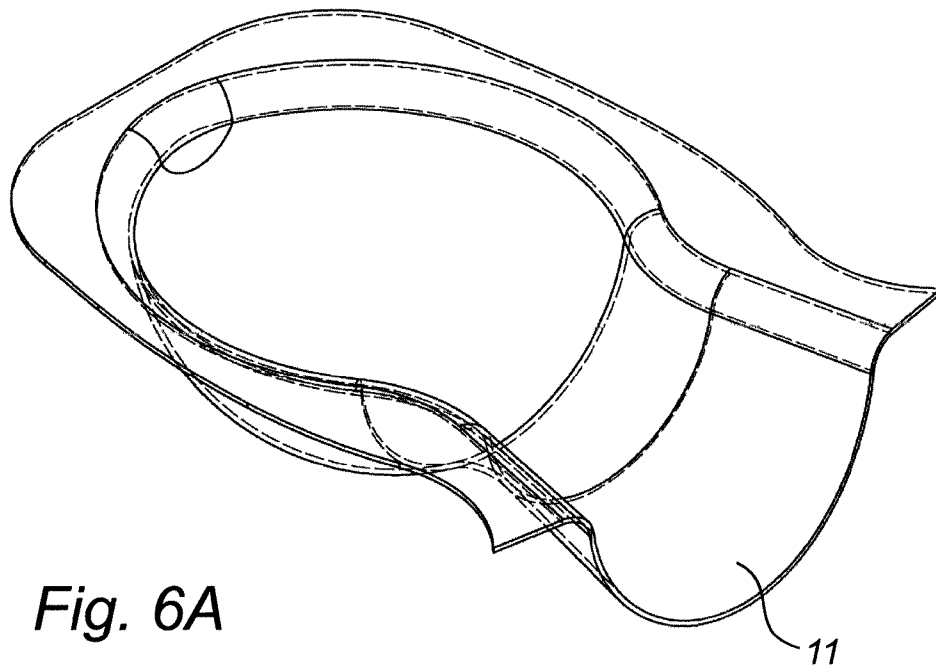
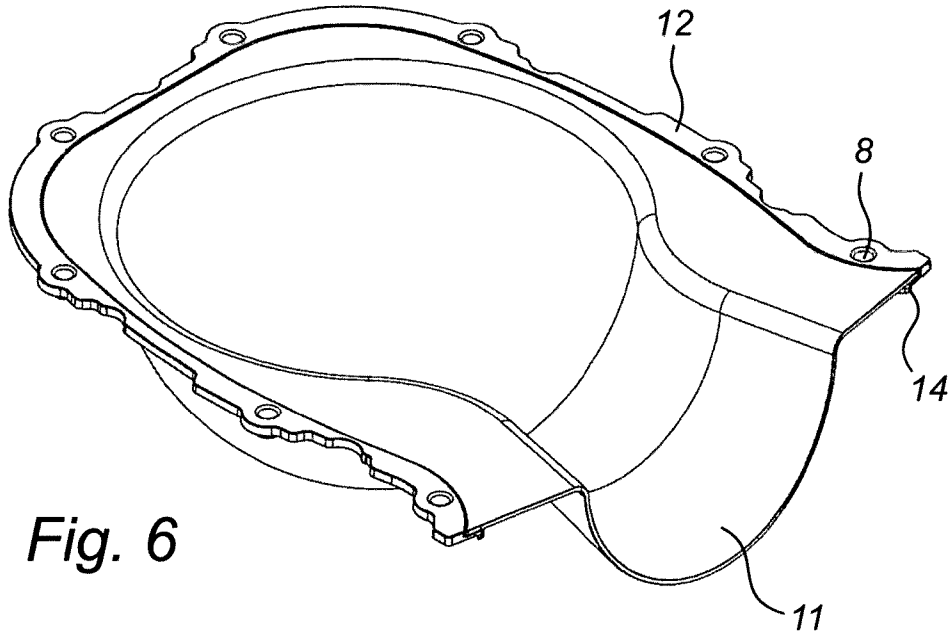

6/36

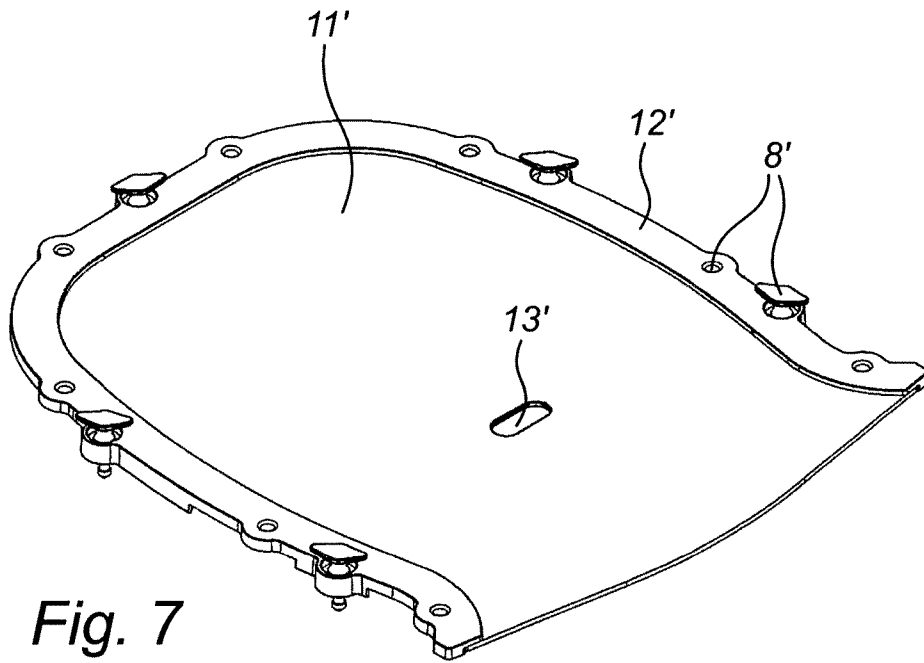

Fig. 7

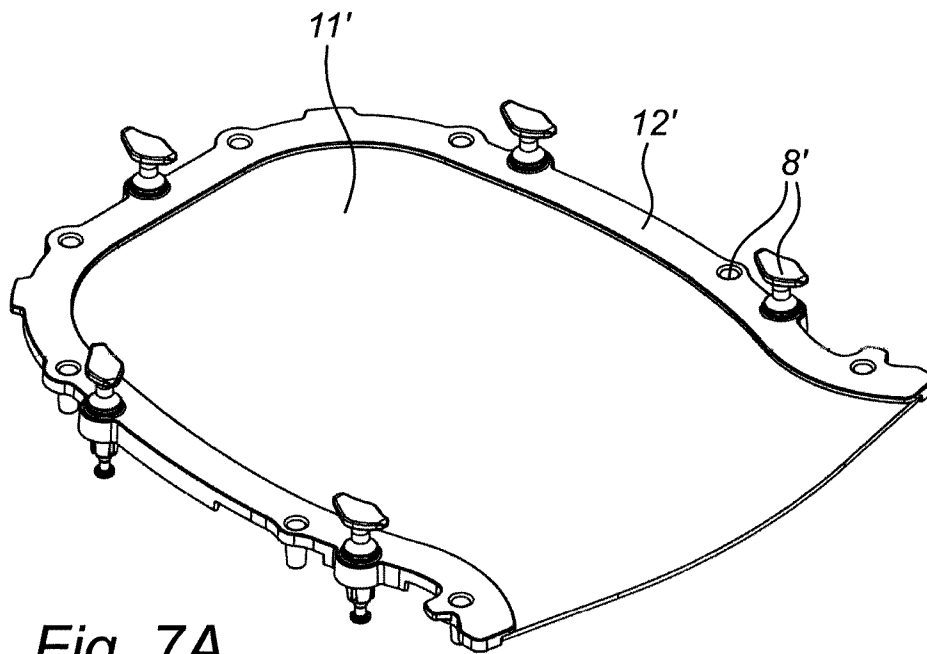
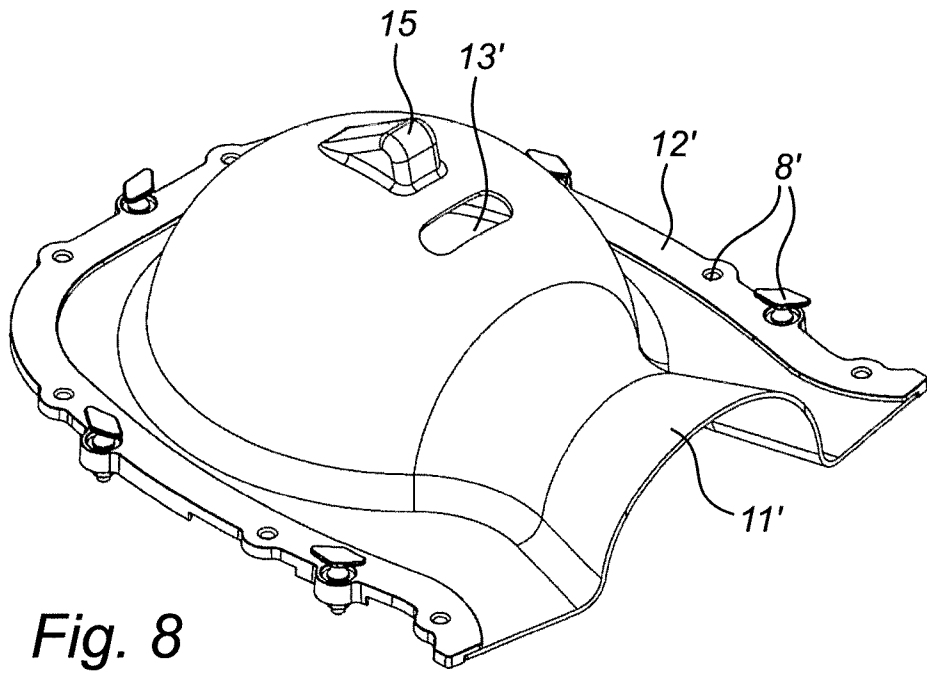
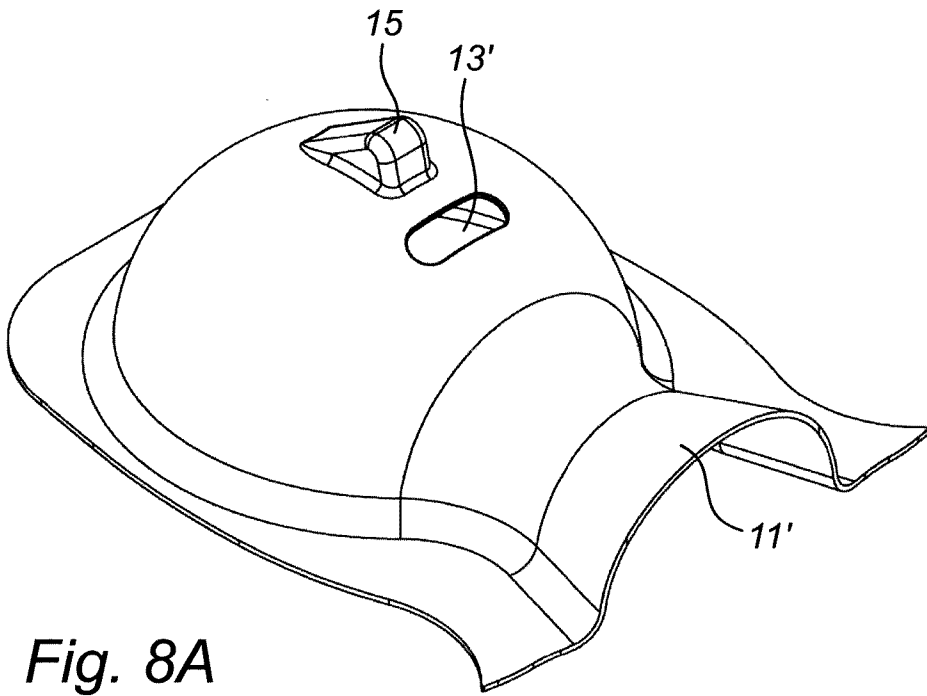

Fig. 7A

7/36



*Fig. 8*



*Fig. 8A*

8/36

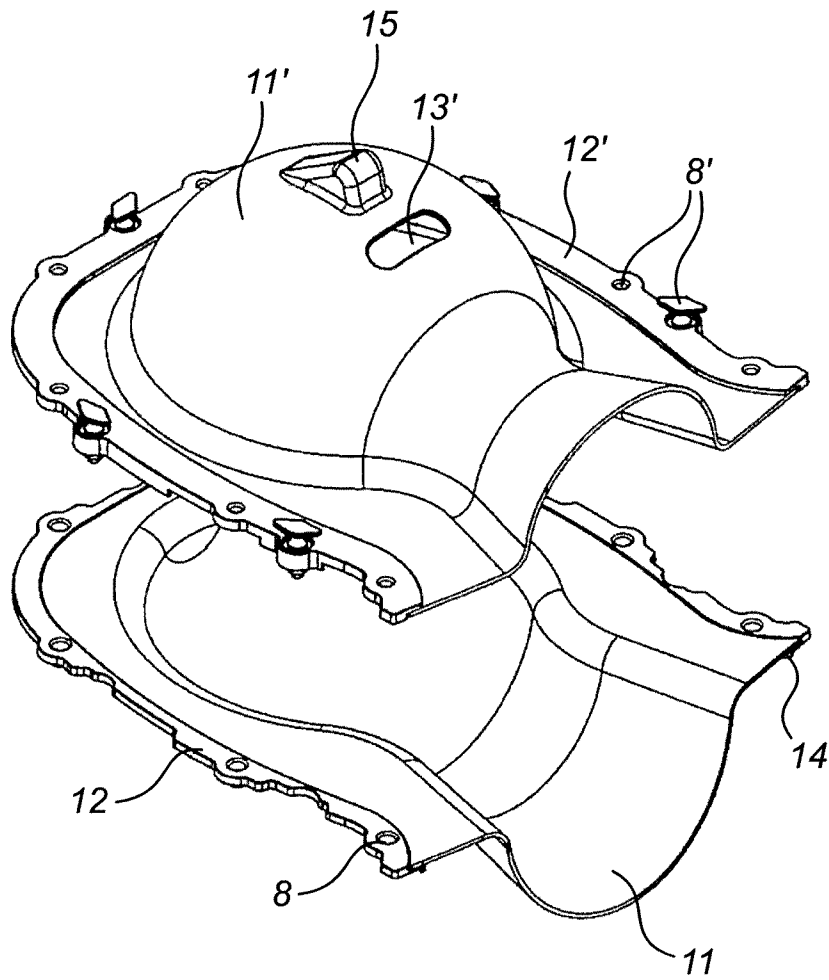

Fig. 9

9/36

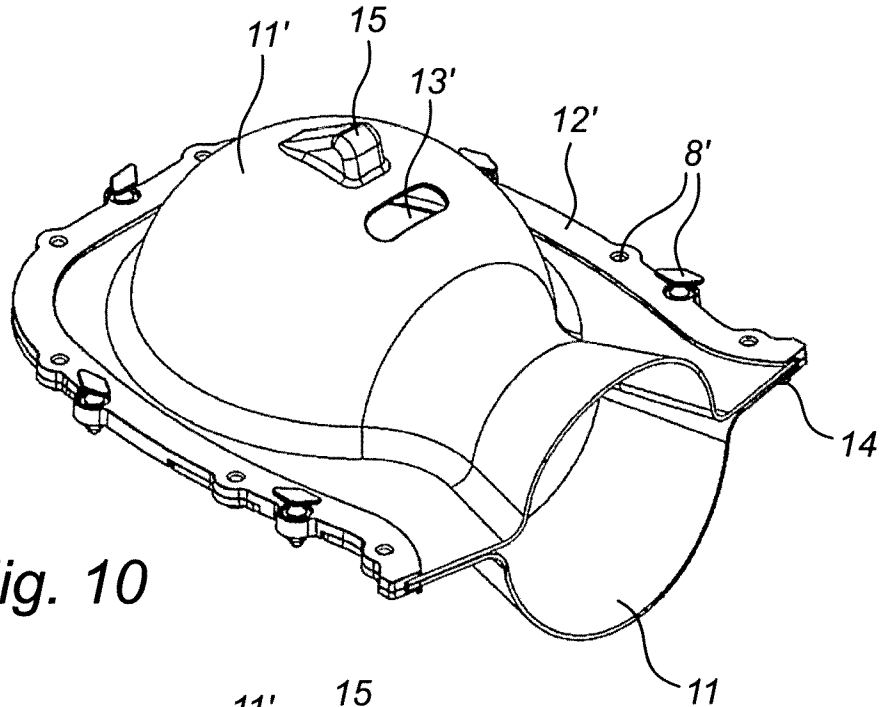

Fig. 10

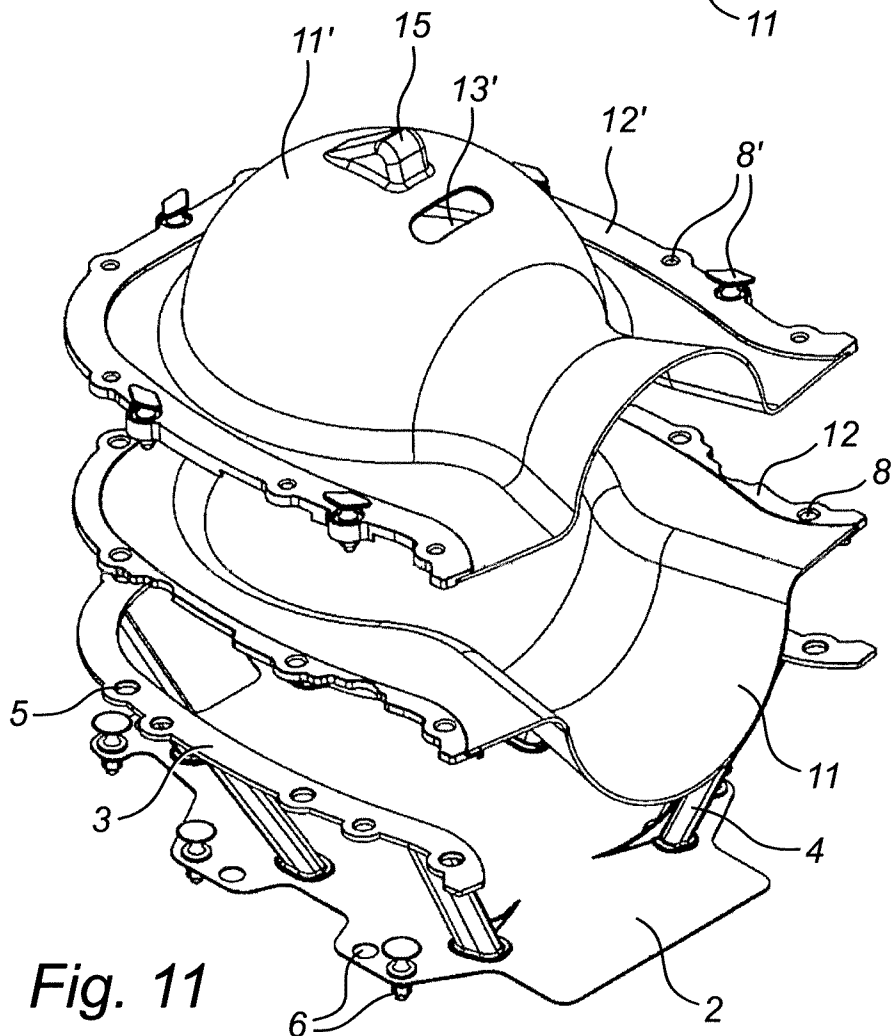

Fig. 11

10/36

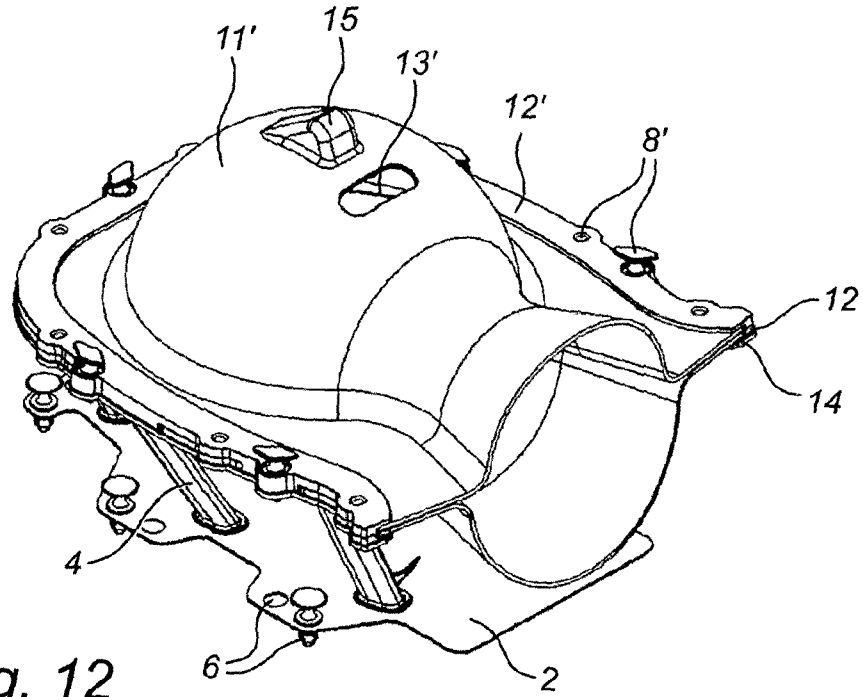

Fig. 12

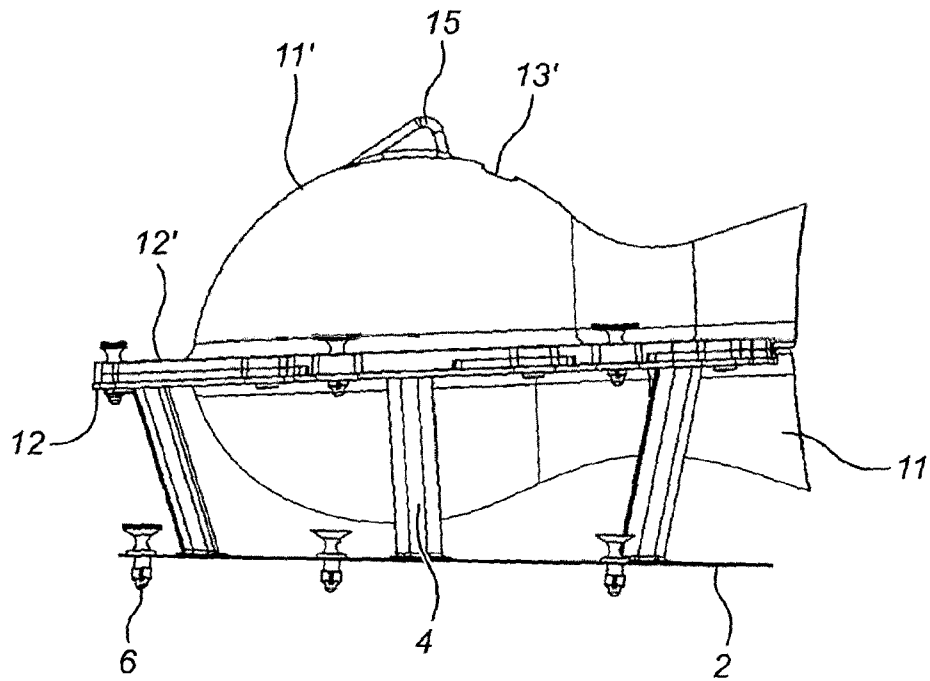

Fig. 13

11/36

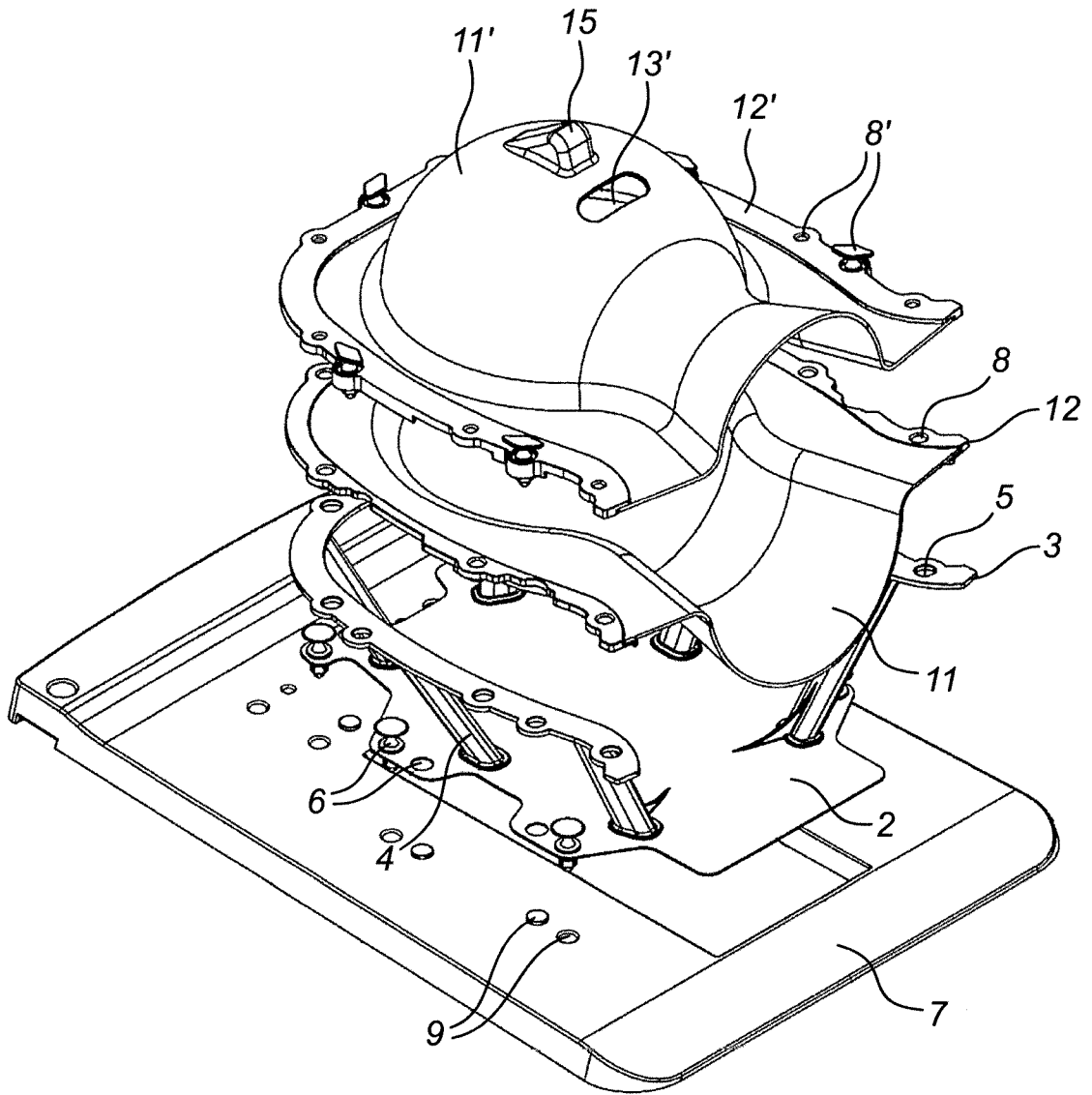

Fig. 14

12/36

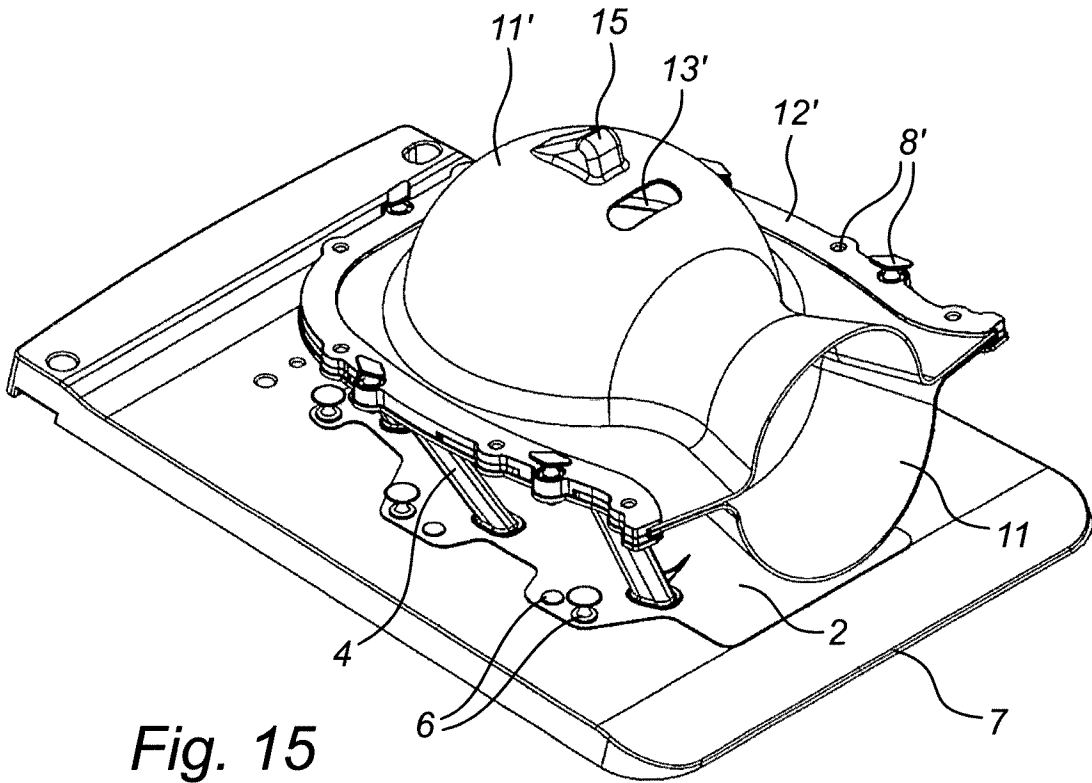

Fig. 15

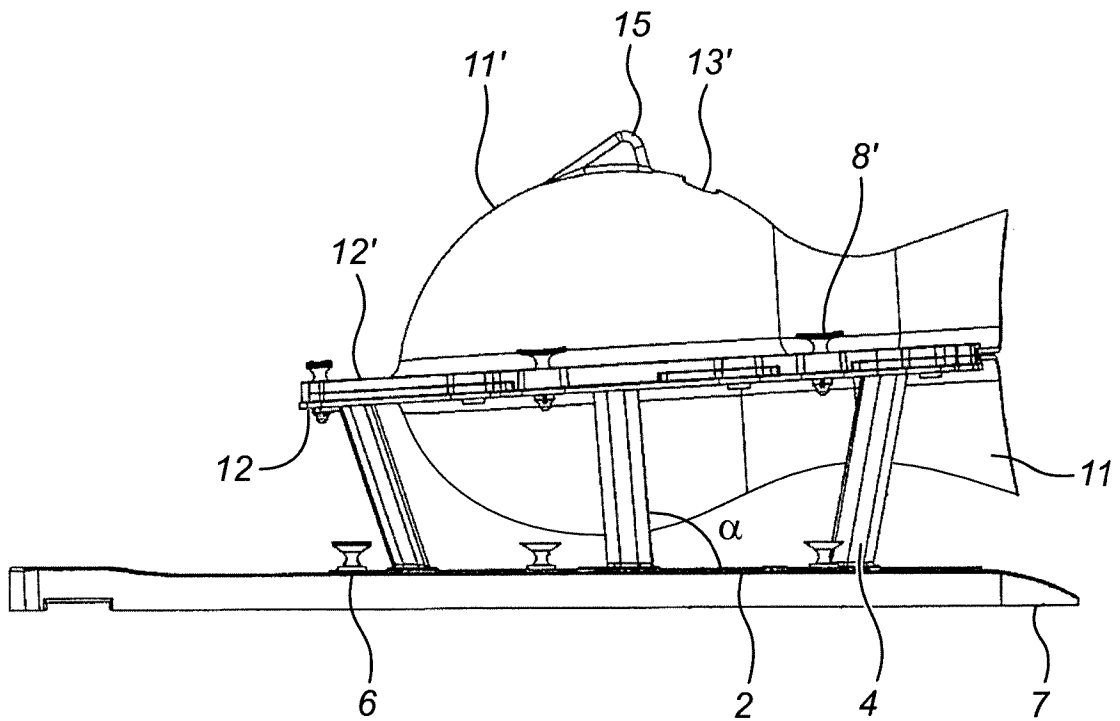

Fig. 16

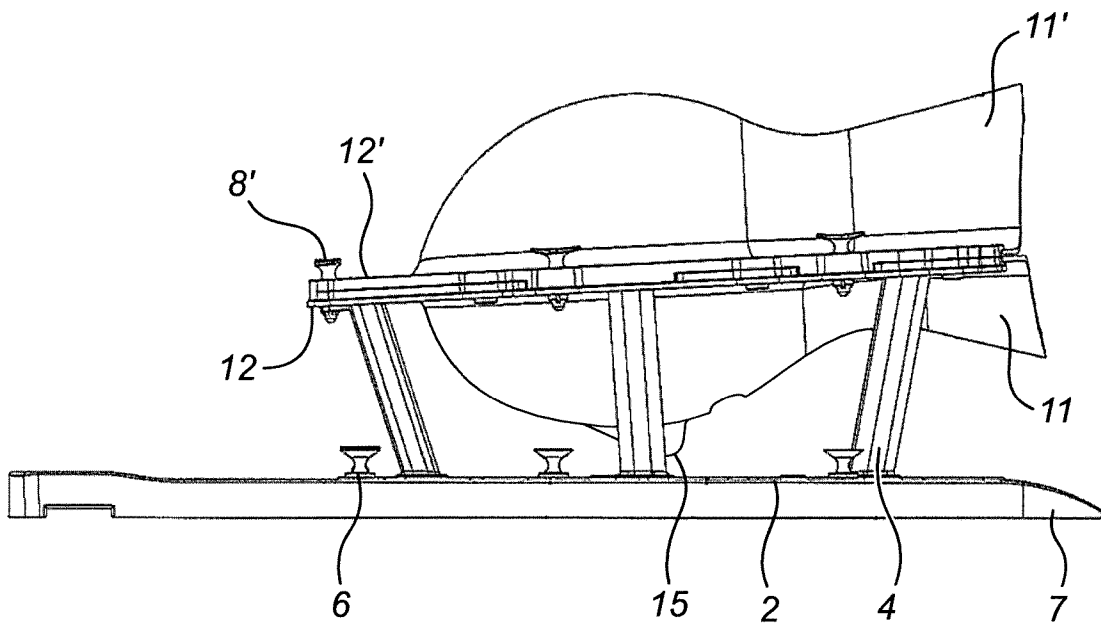
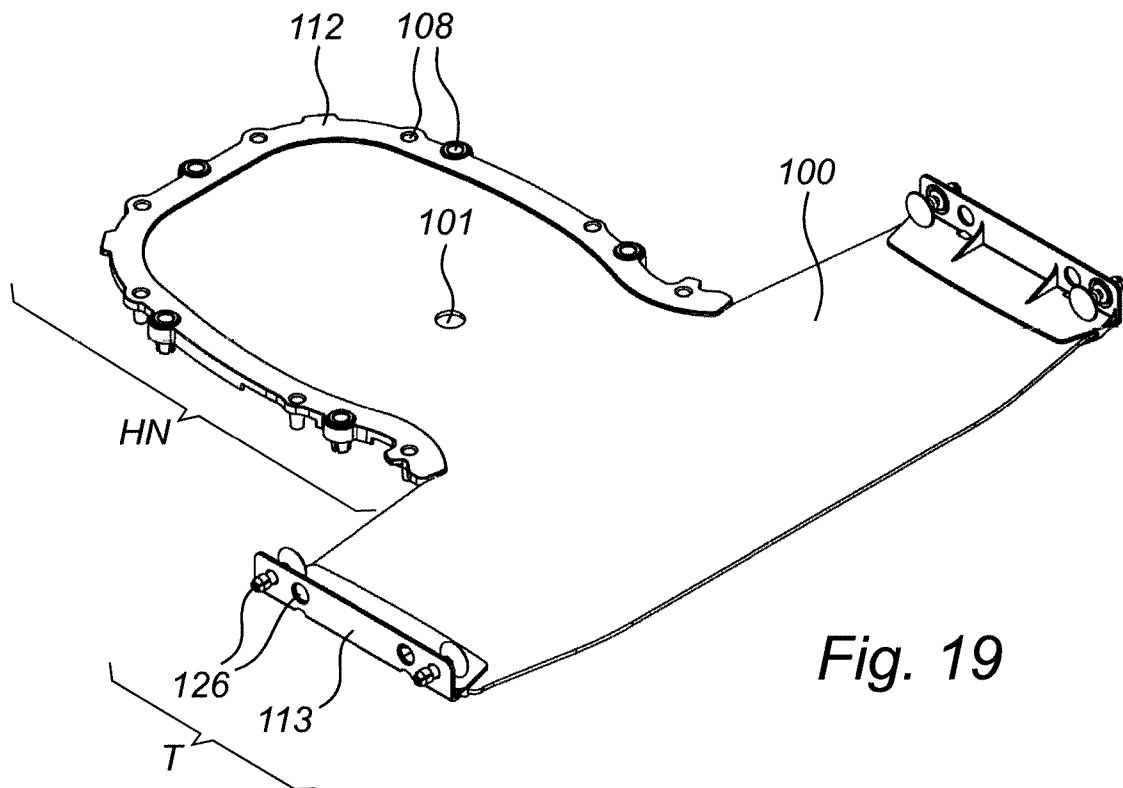
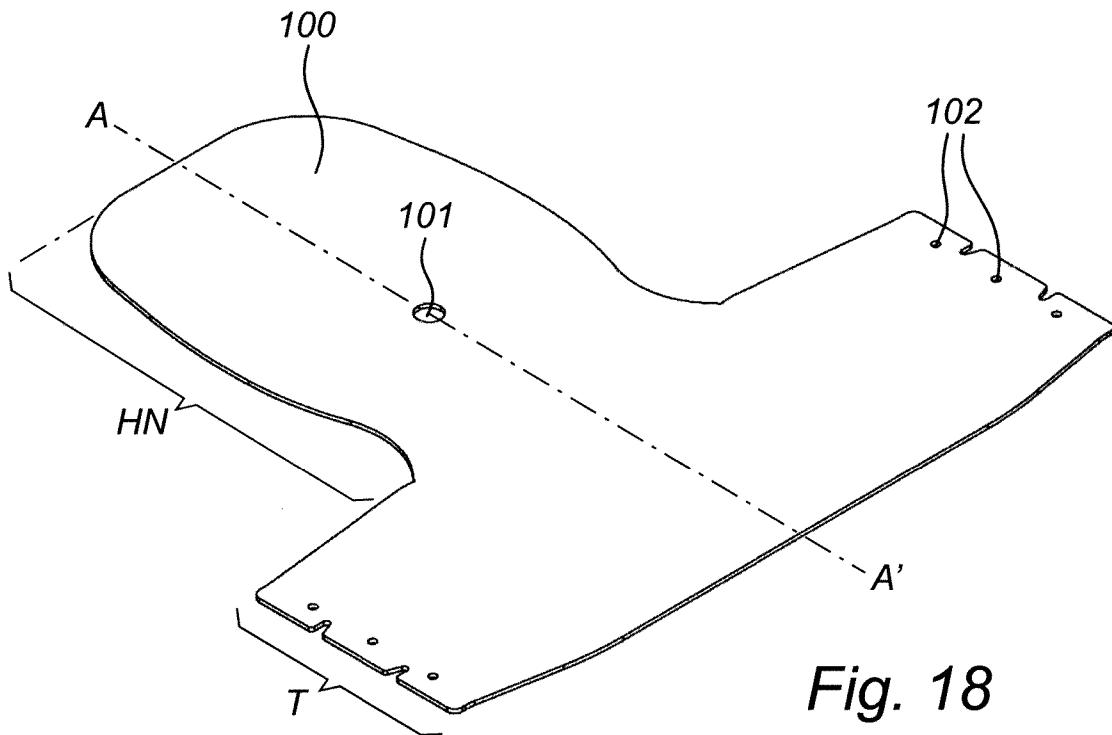

Fig. 17



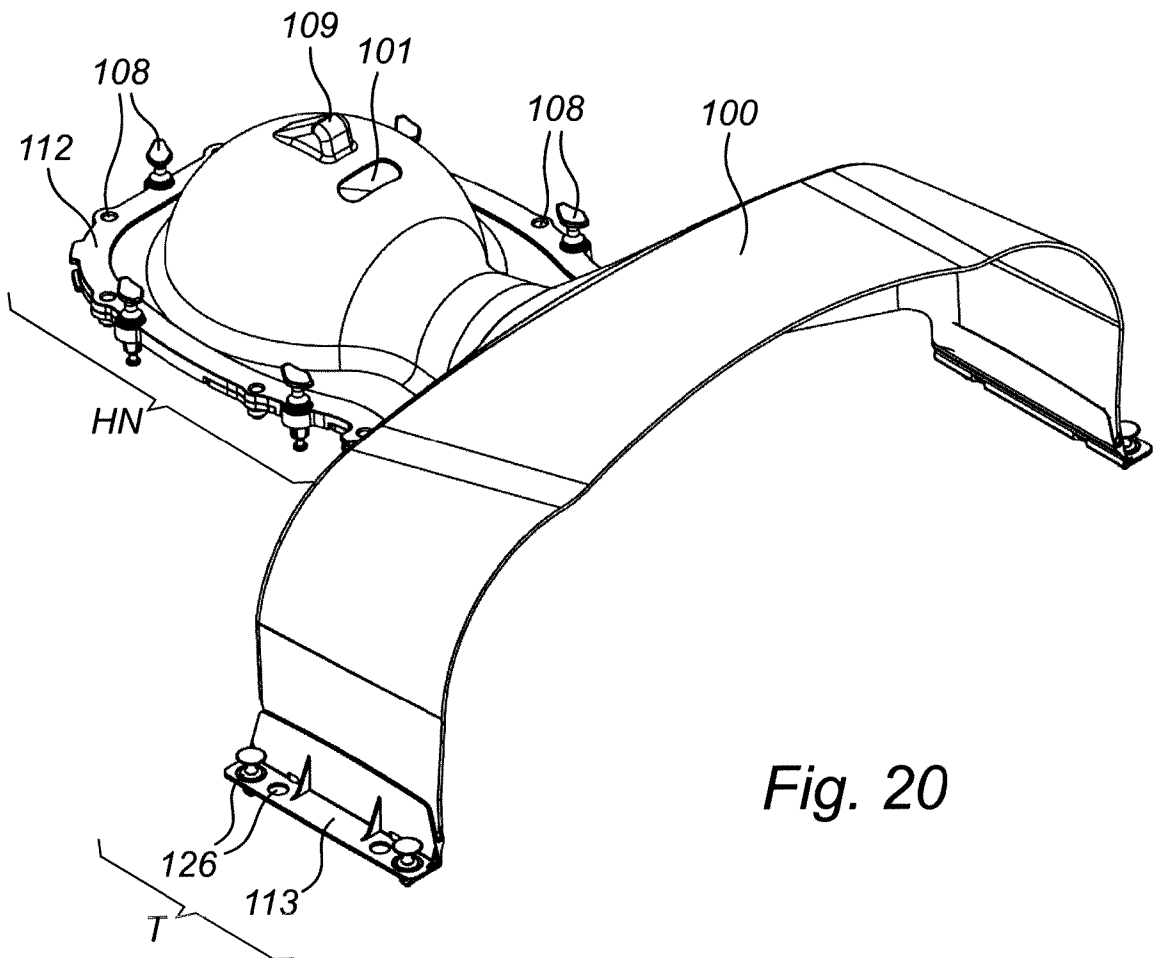

Fig. 20

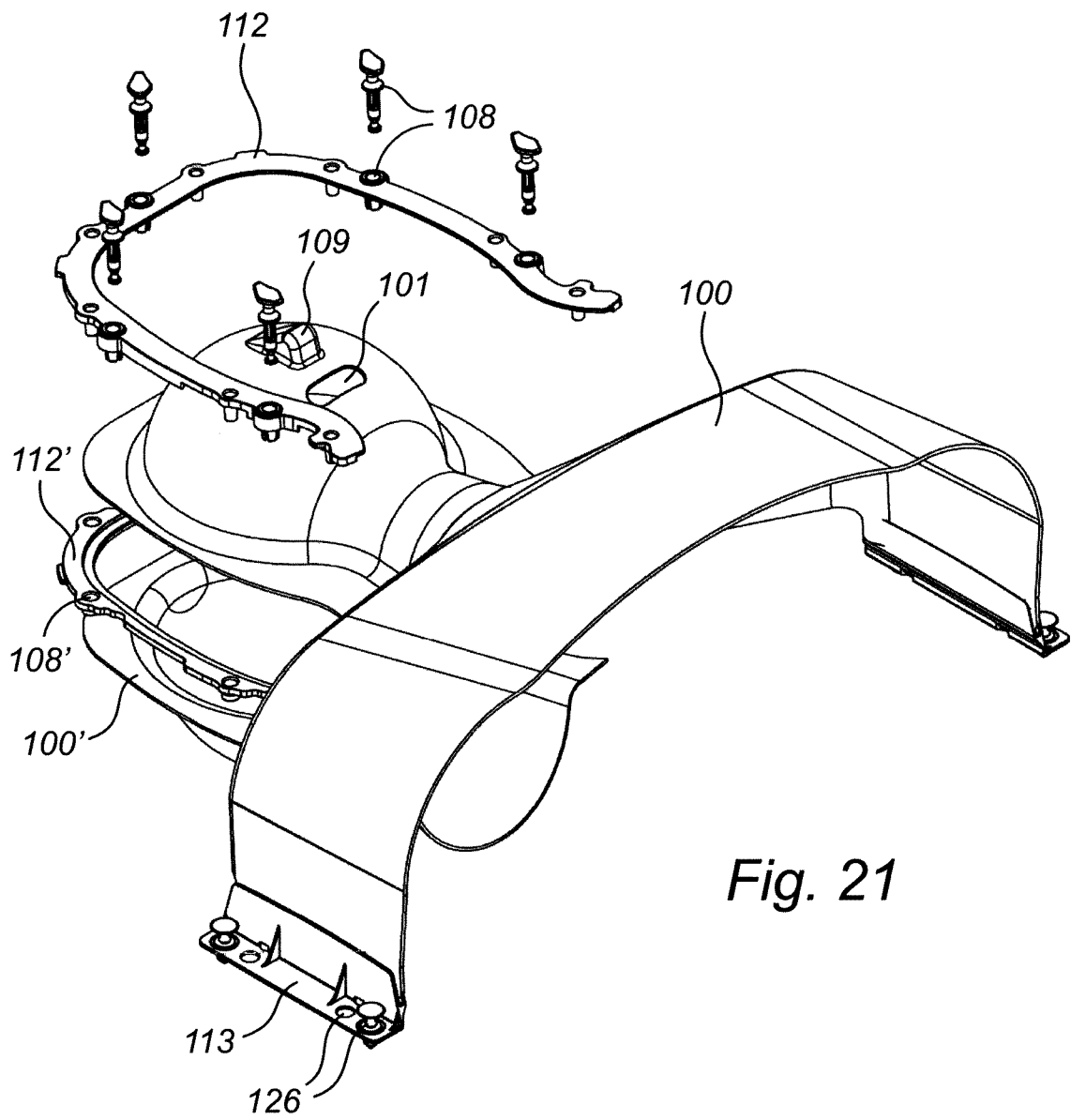

Fig. 21

17/36

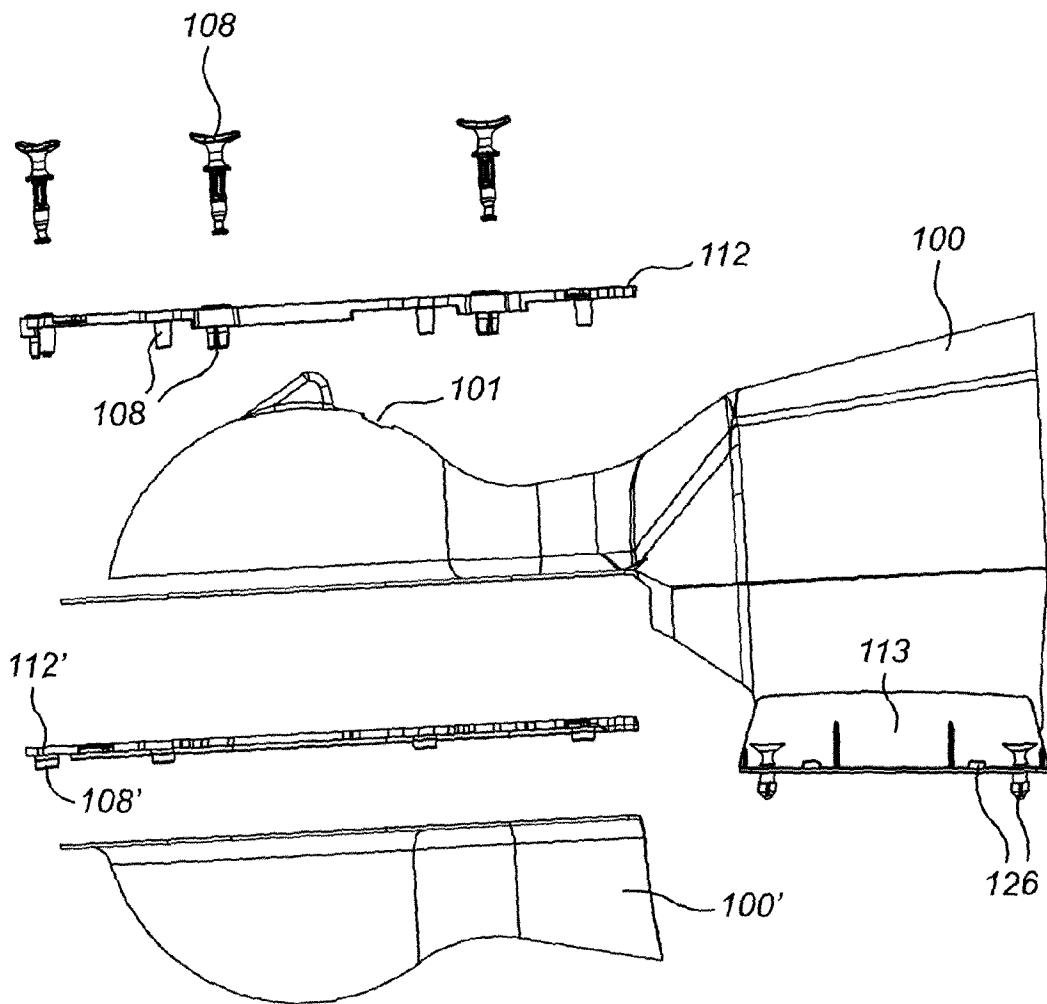

Fig. 22

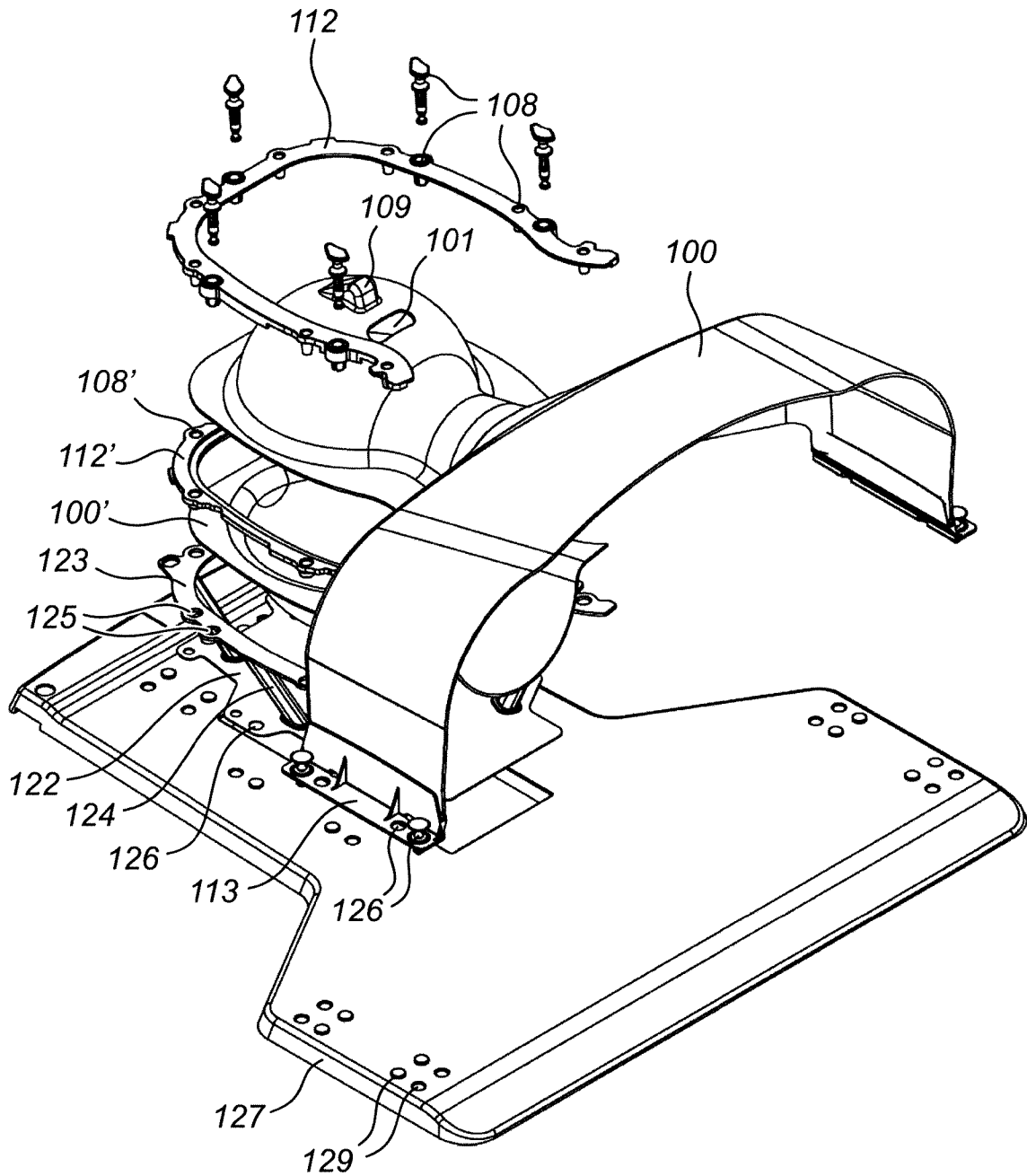

Fig. 23

19/36

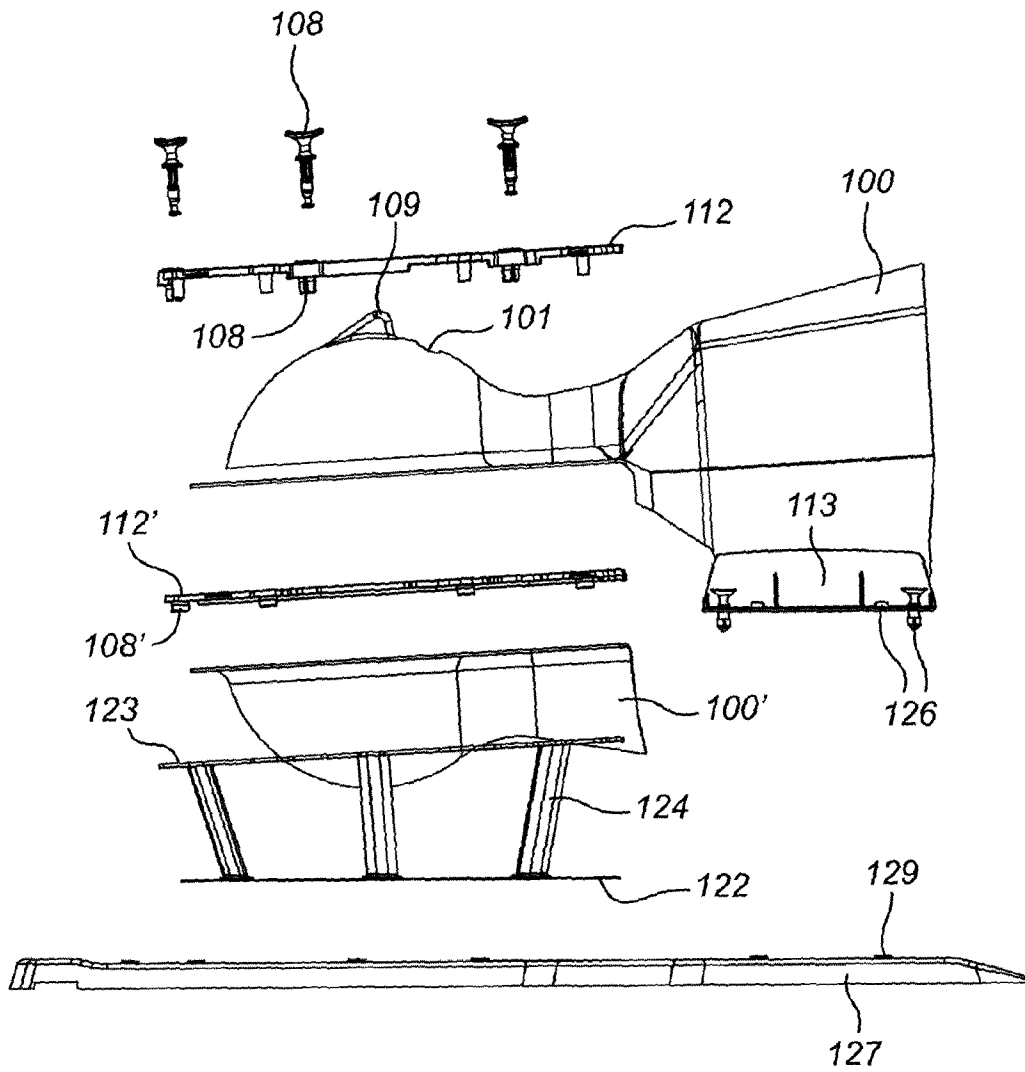

Fig. 24

20/36

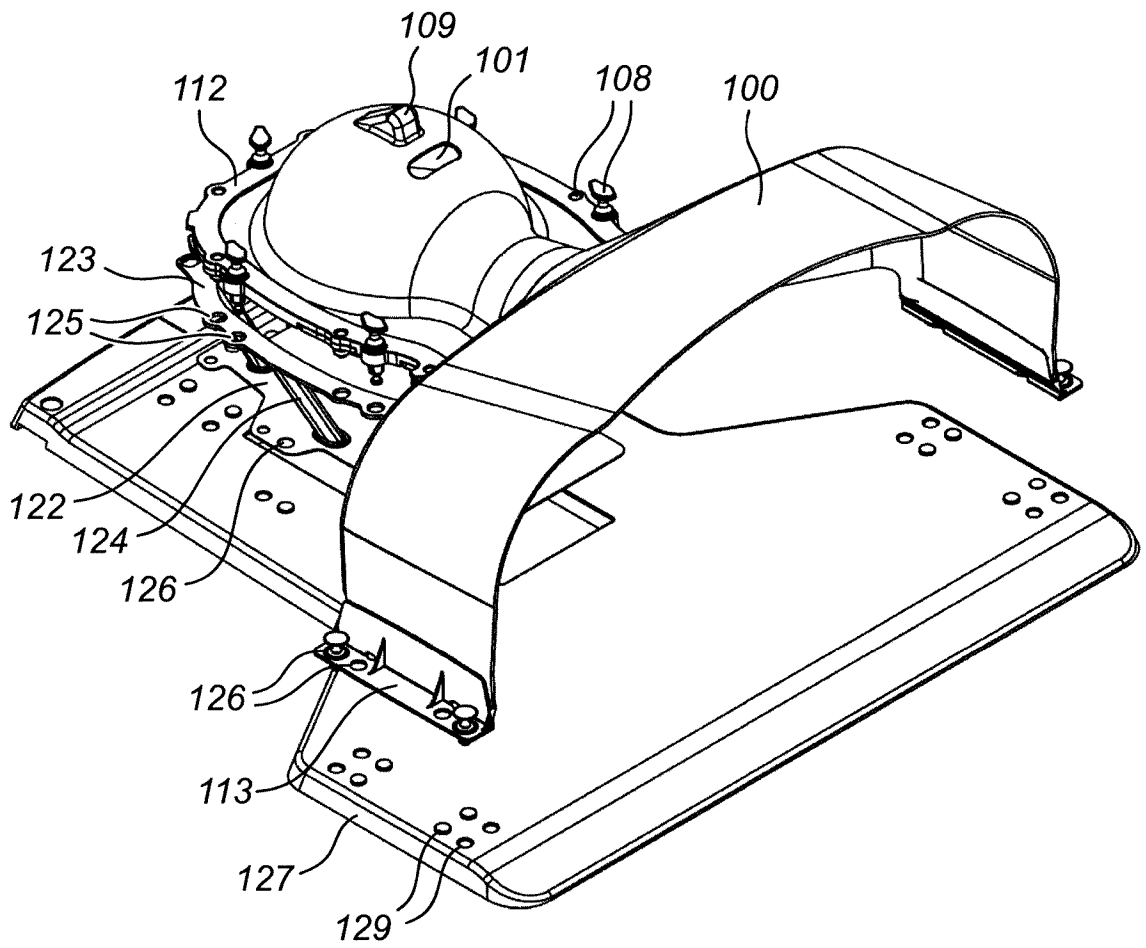

Fig. 25

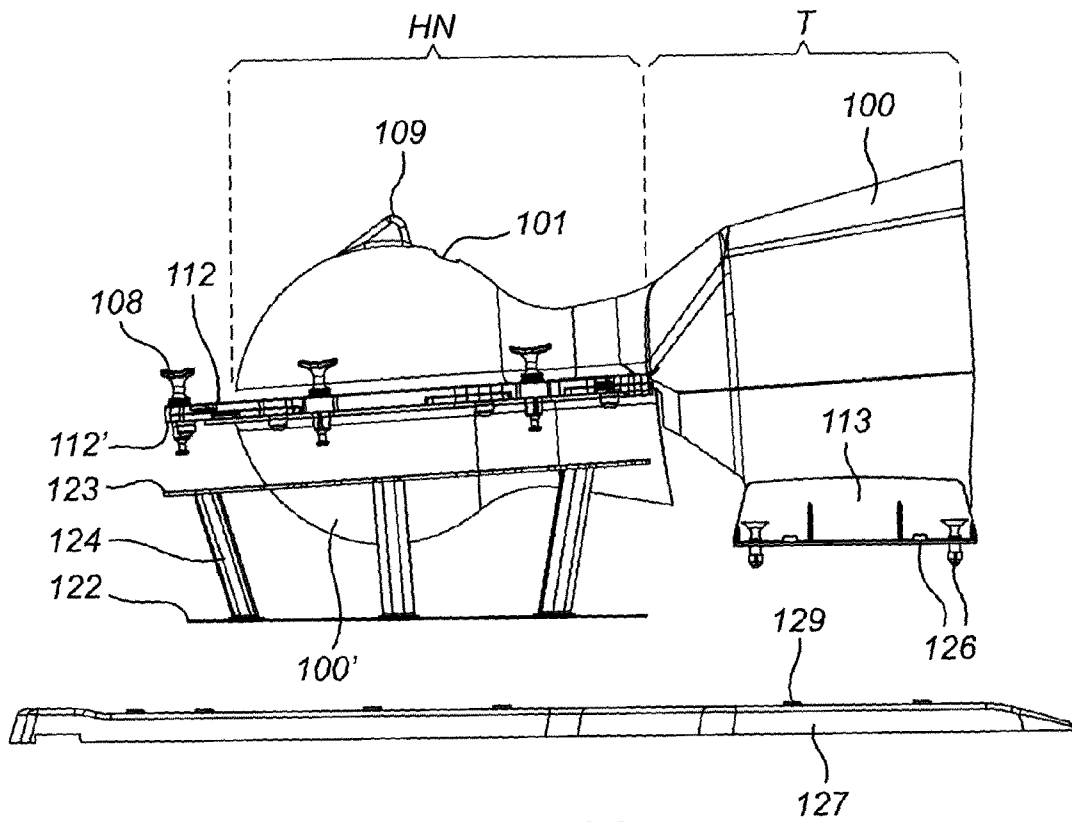

Fig. 26

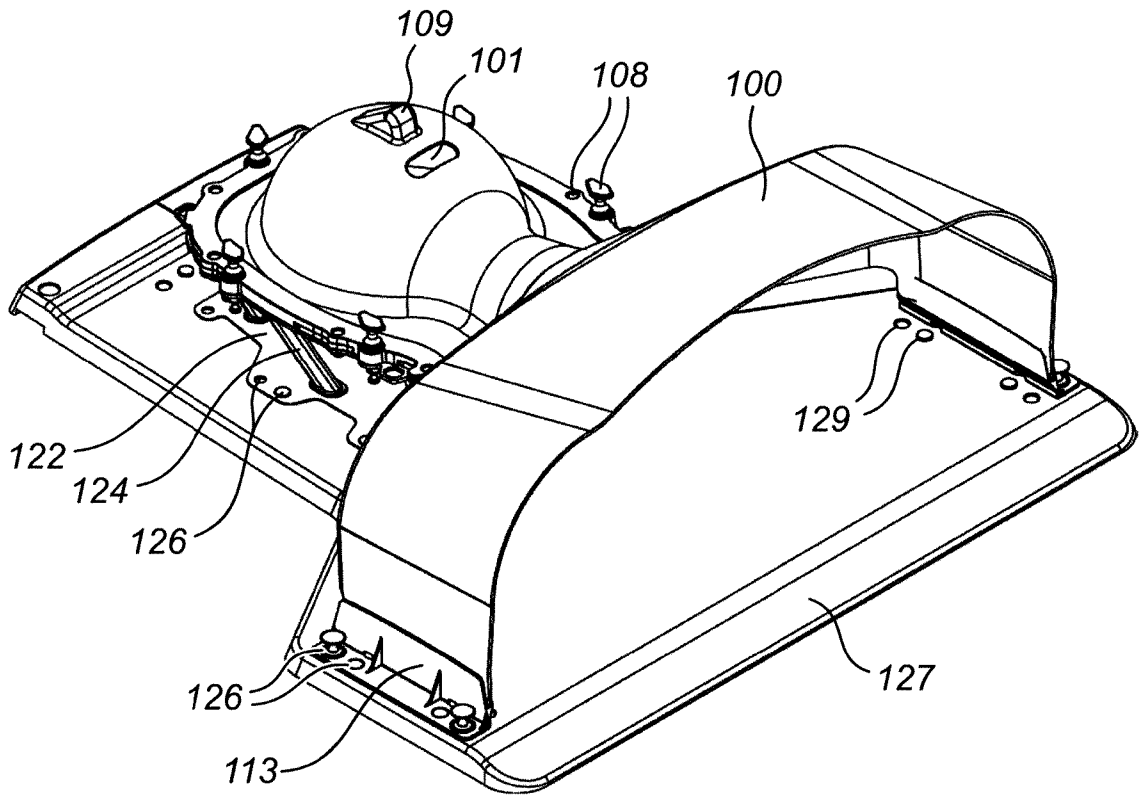

Fig. 27

23/36

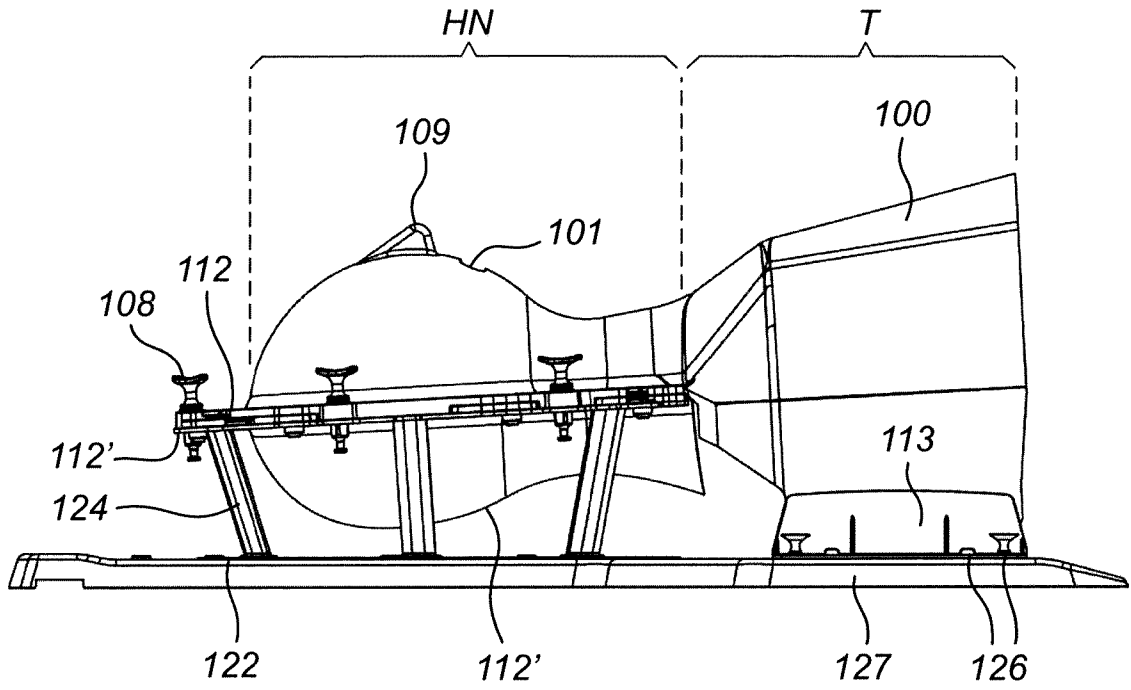

Fig. 28

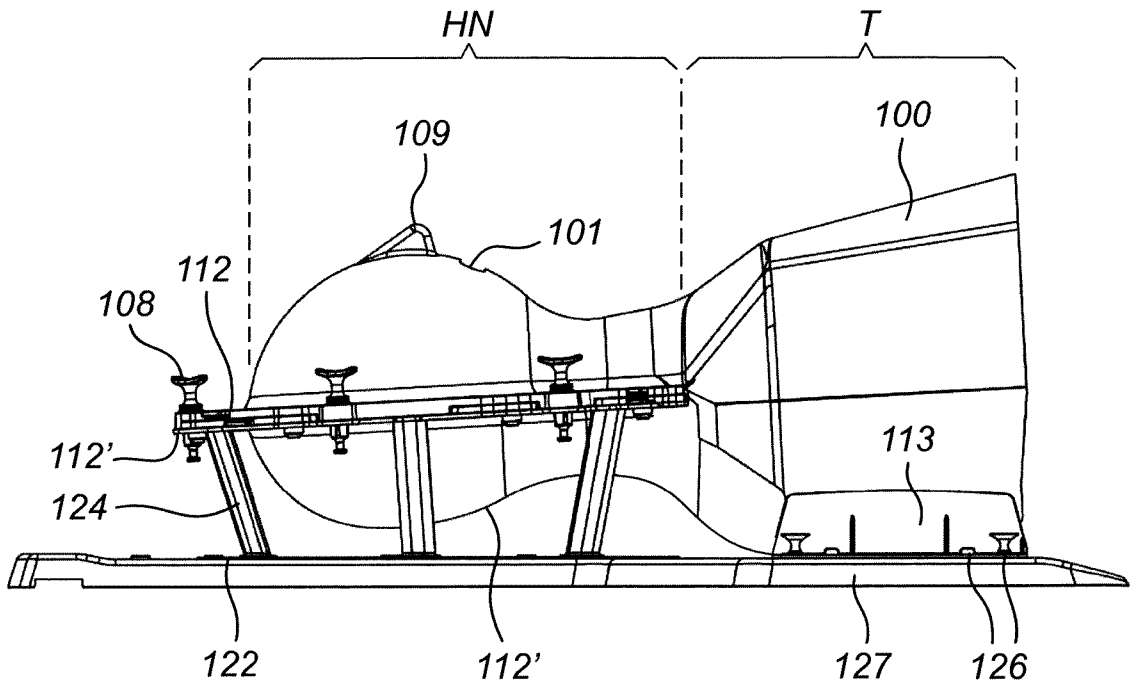

Fig. 28A

24/36

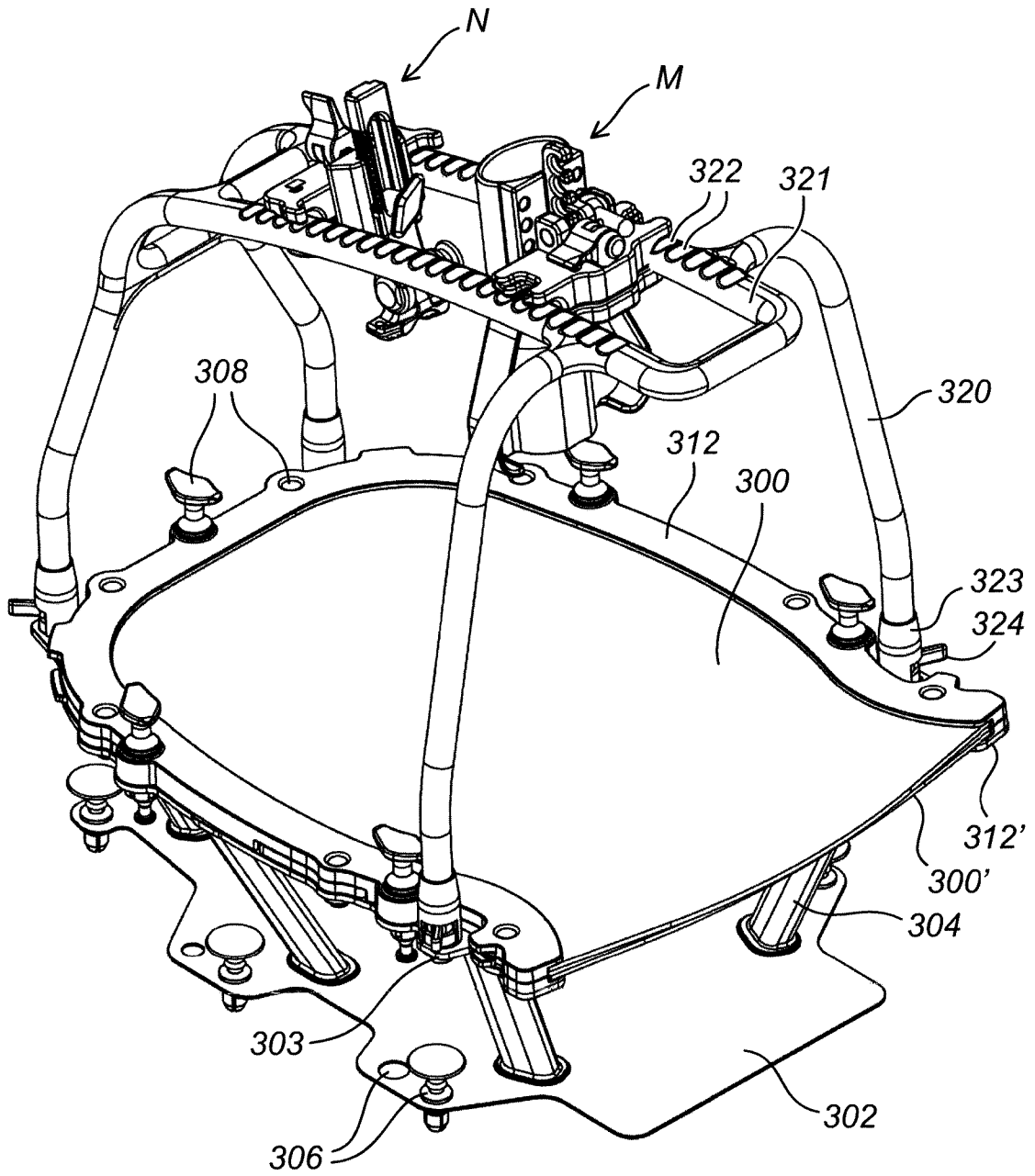

Fig. 29

25/36

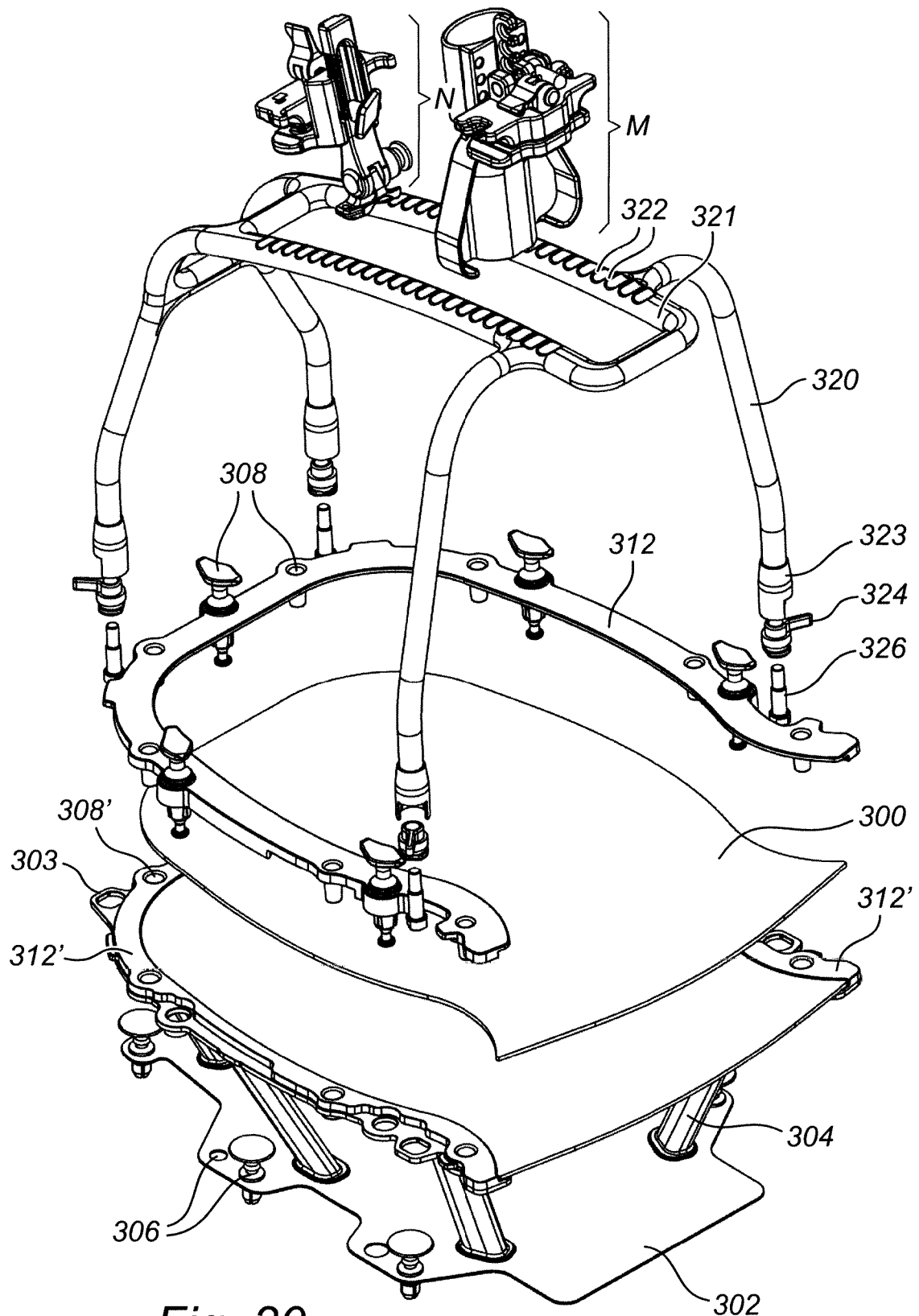

Fig. 30

26/36

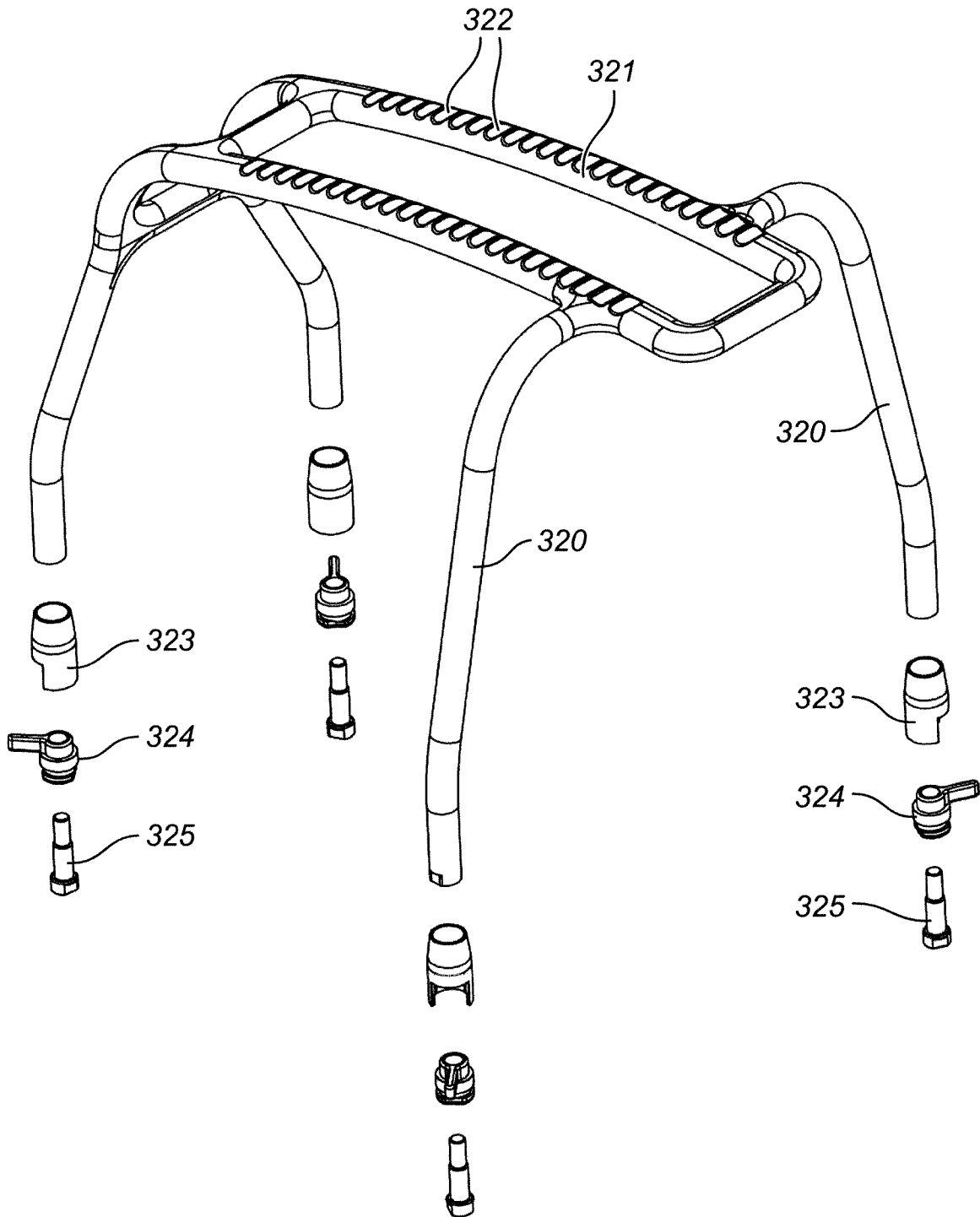

Fig. 31

27/36

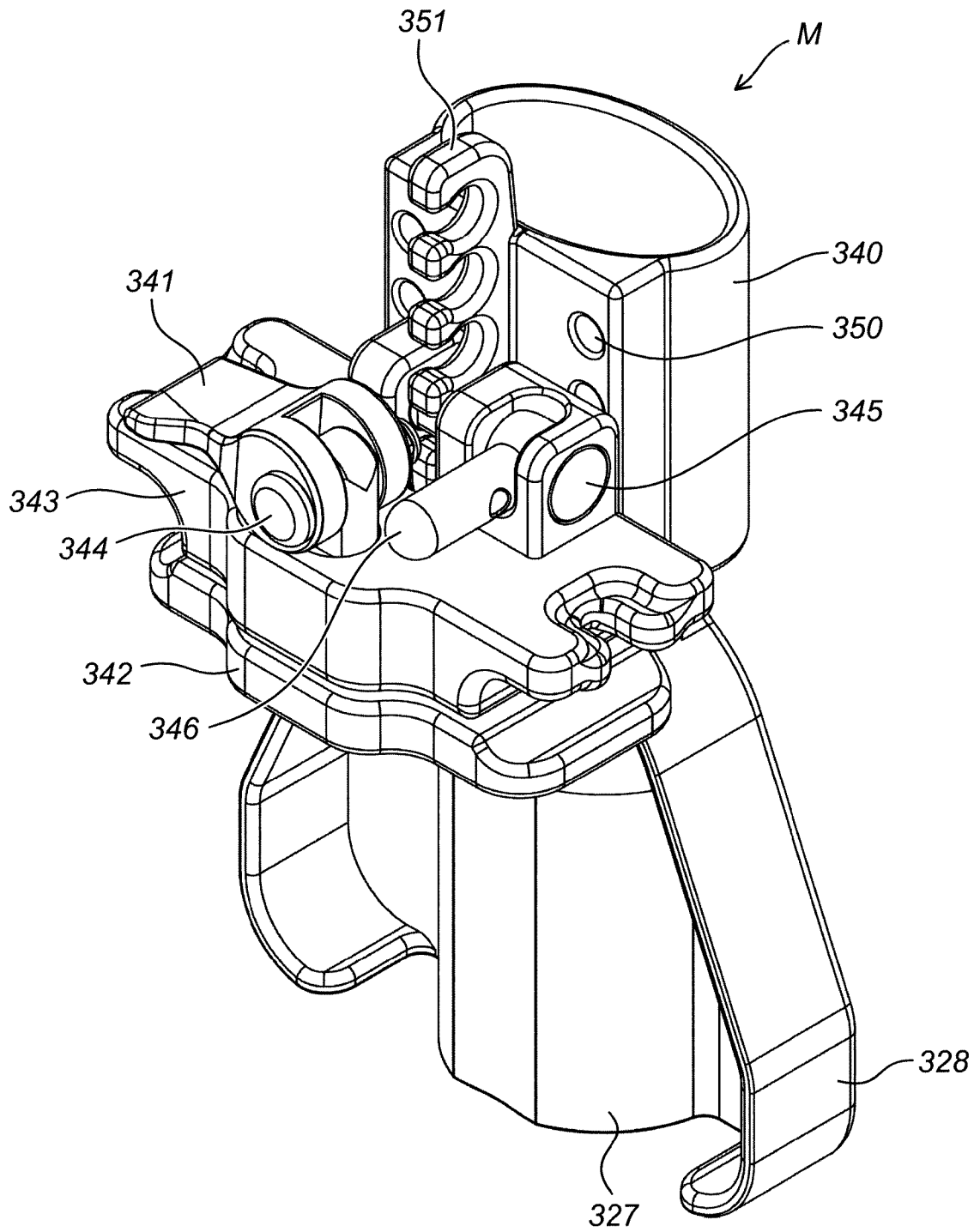

Fig. 32

28/36

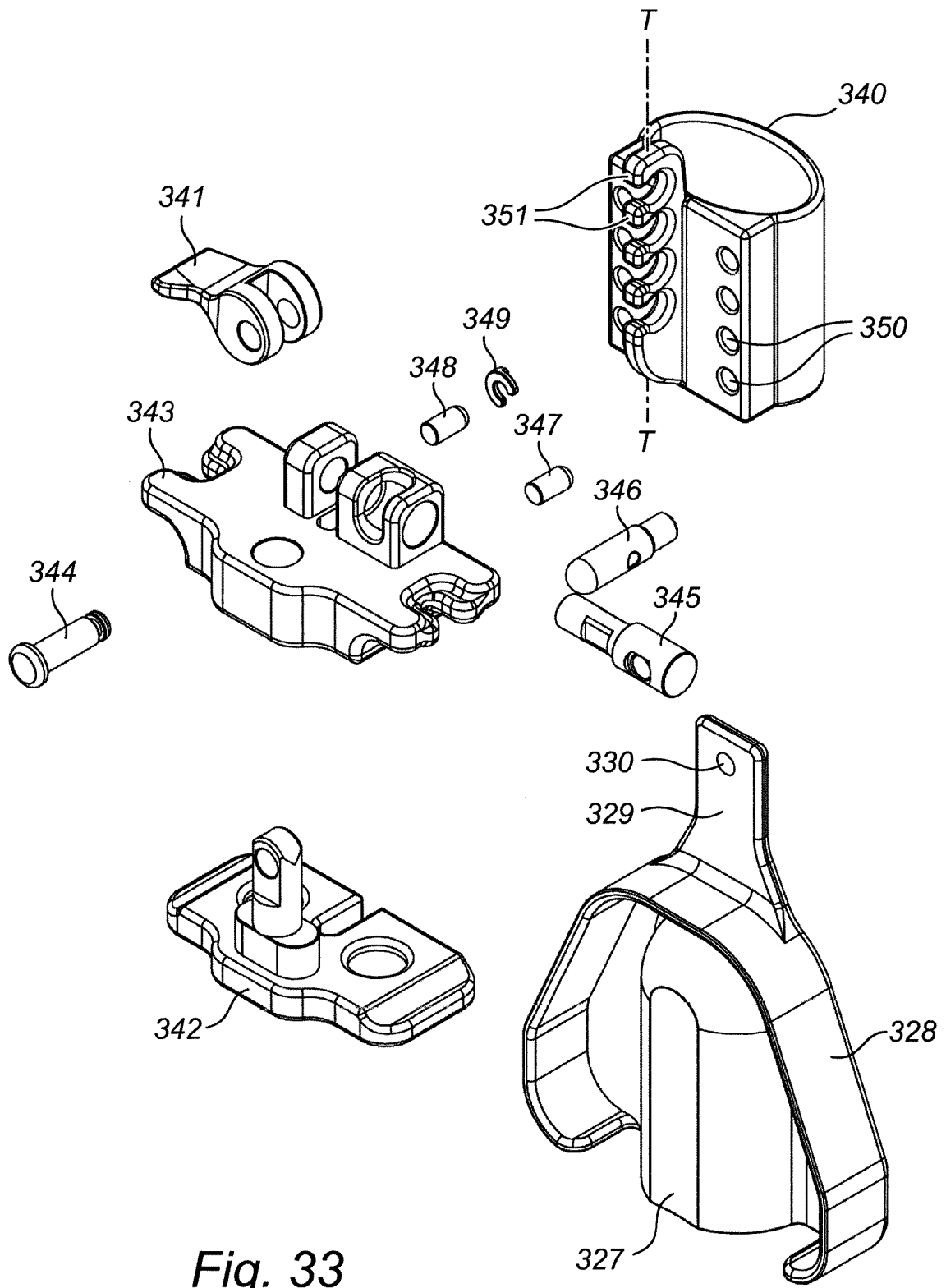

Fig. 33

29/36

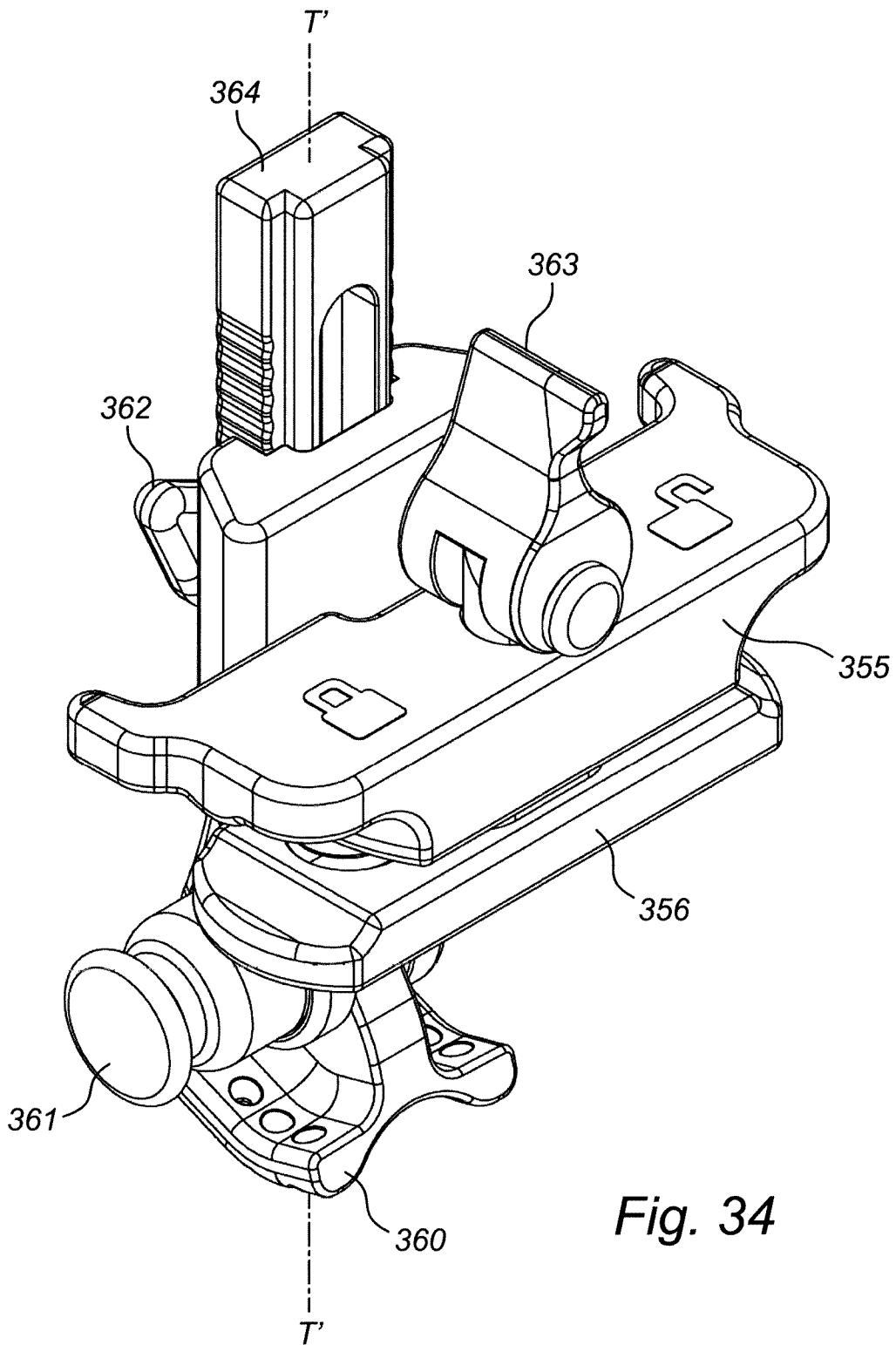

Fig. 34

30/36

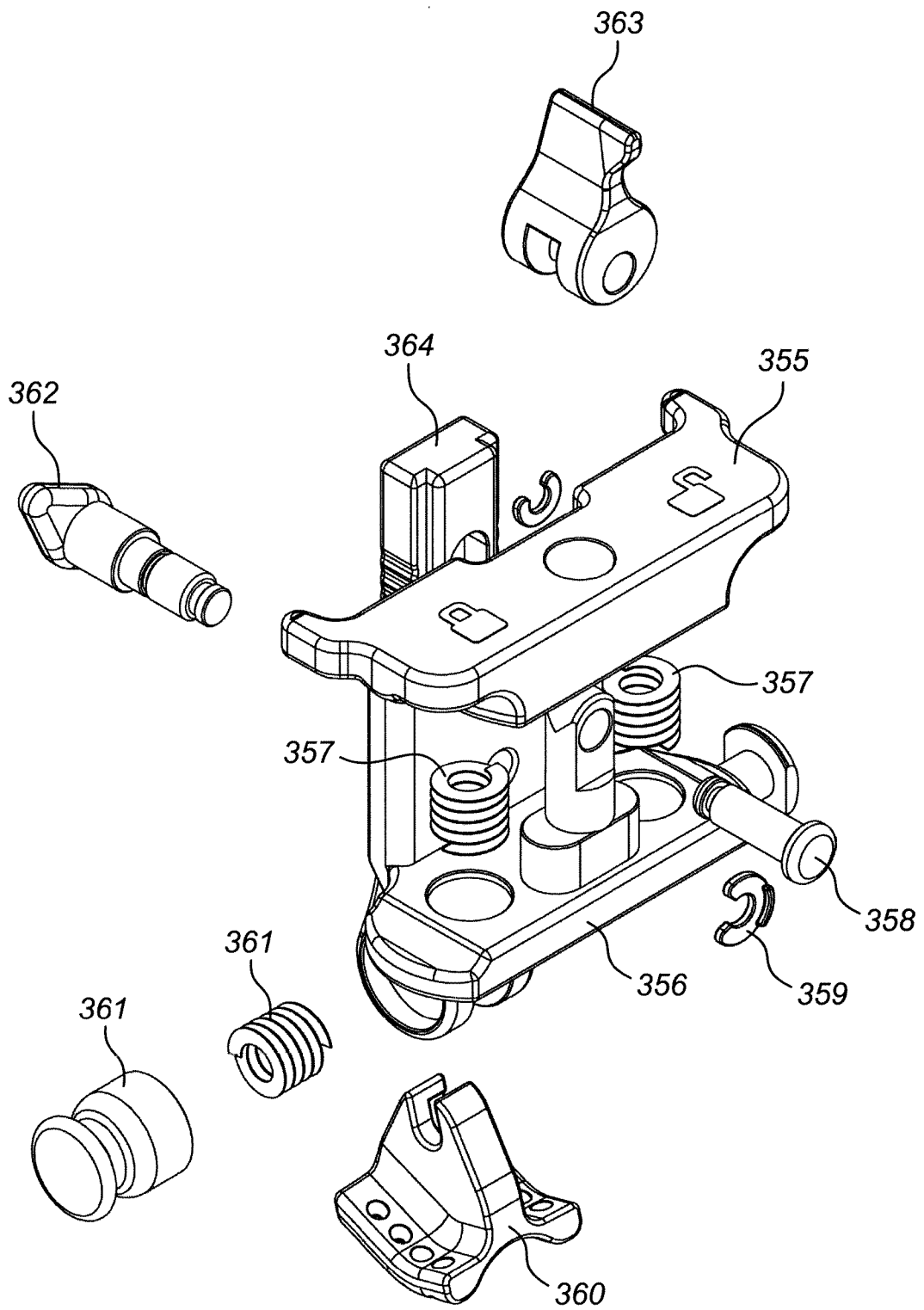

Fig. 35

31/36

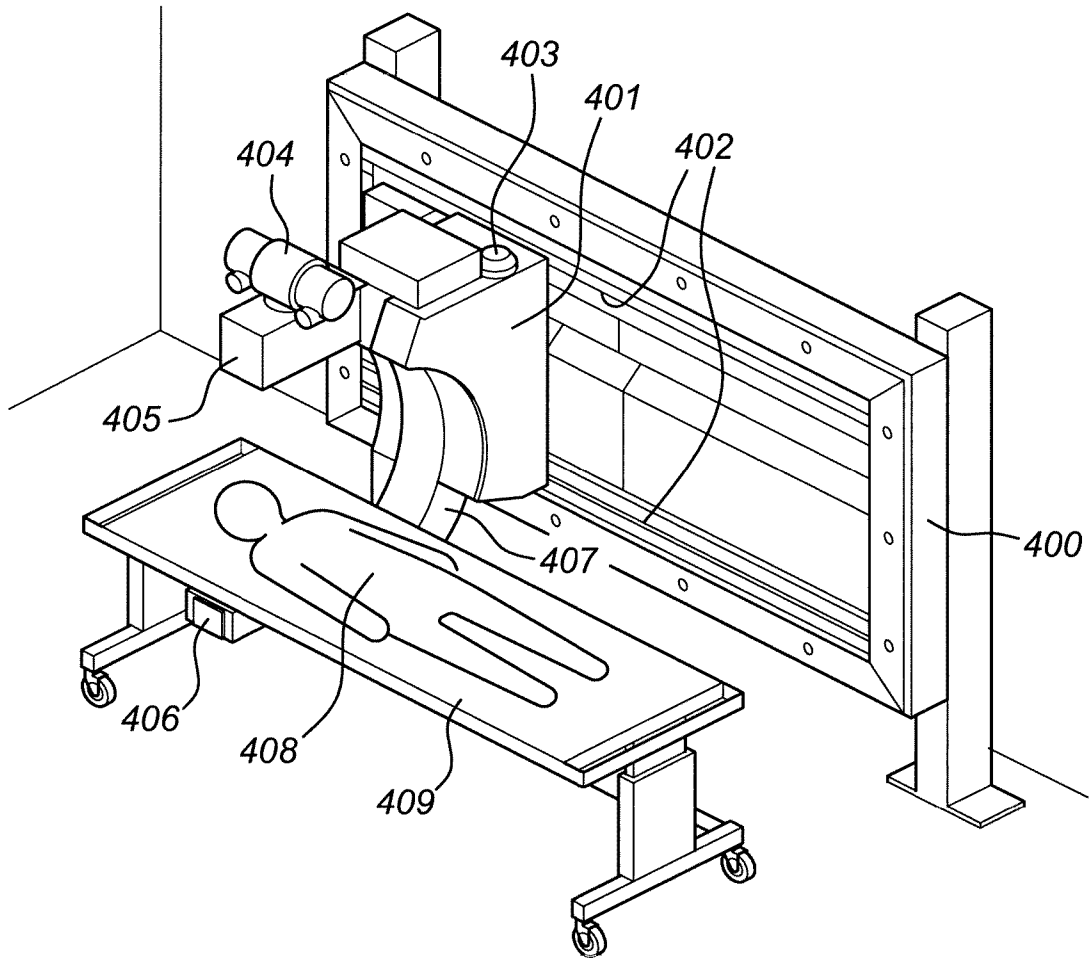
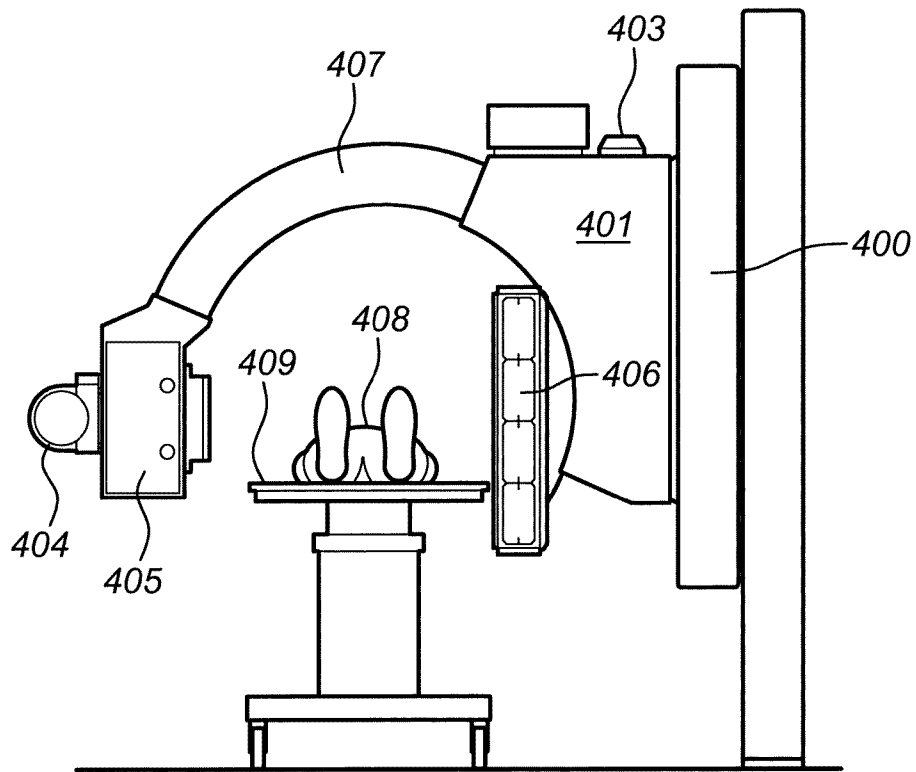

Fig. 36



*Fig. 37*

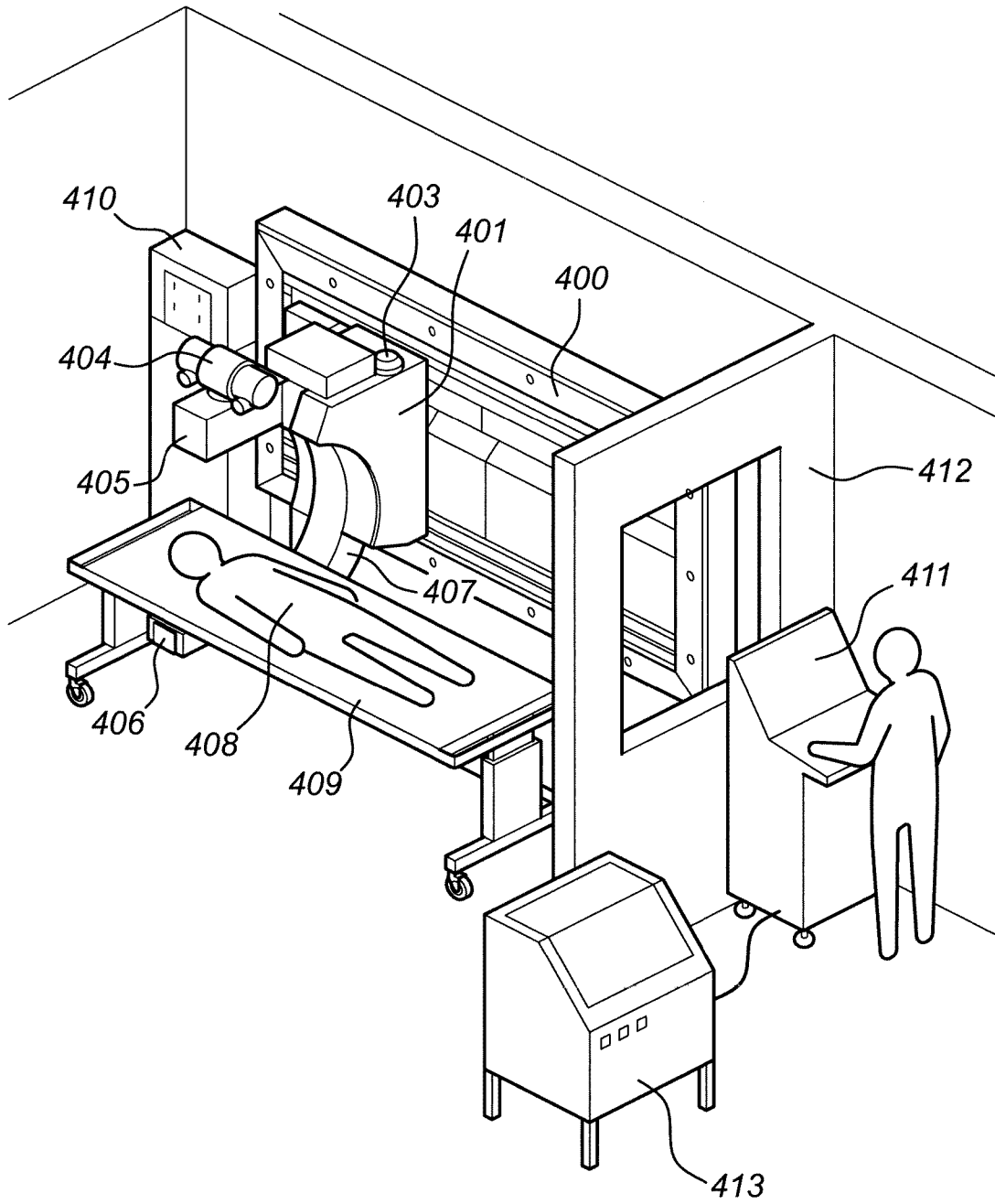

Fig. 38

34/36

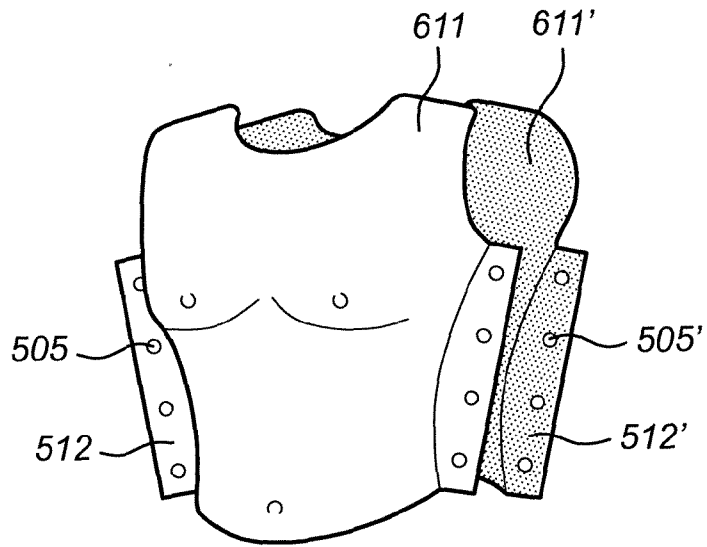

Fig. 39A

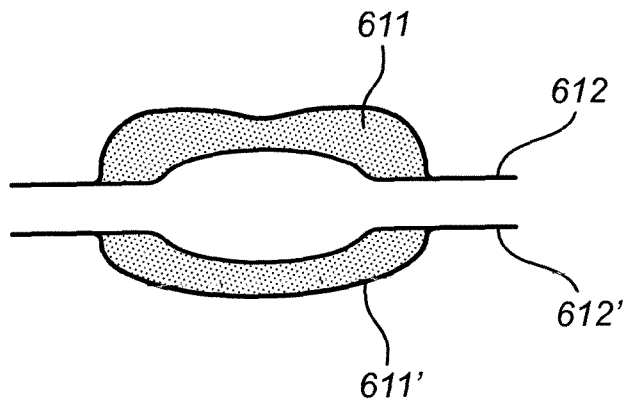
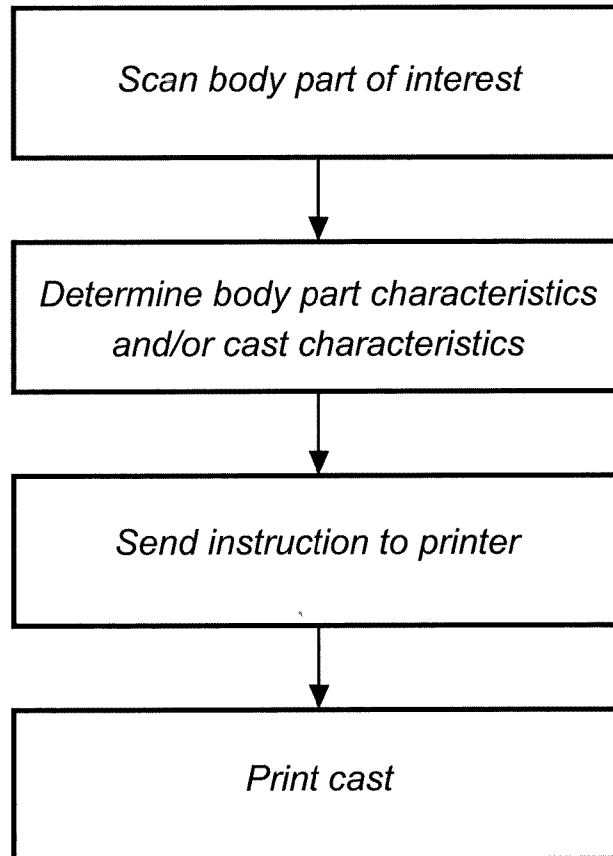
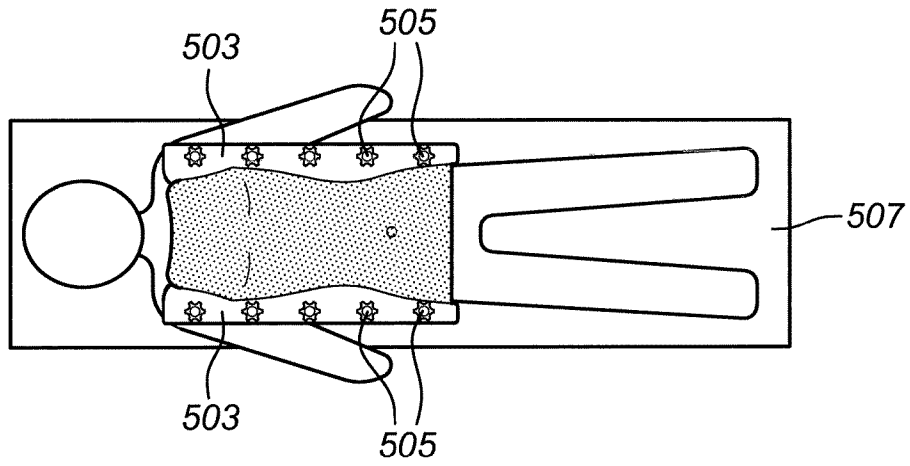

Fig. 39B

35/36



*Fig. 40*



*Fig. 41*

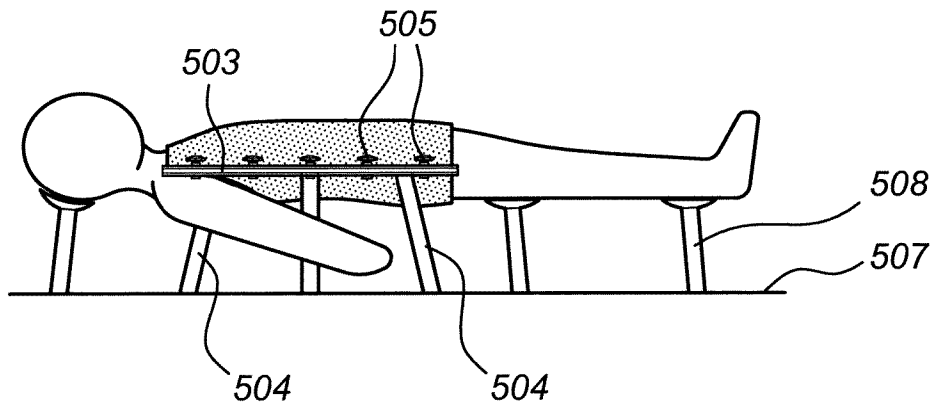

*Fig. 42*

**INTERNATIONAL SEARCH REPORT**

International application No  
PCT/EP2013/059644

**A. CLASSIFICATION OF SUBJECT MATTER**  
 INV. A61B6/04 A61F5/37  
 ADD. A61N5/10

According to International Patent Classification (IPC) or to both national classification and IPC

**B. FIELDS SEARCHED**  
 Minimum documentation searched (classification system followed by classification symbols)  
 A61B A61F A61N

Documentation searched other than minimum documentation to the extent that such documents are included in the fields searched

Electronic data base consulted during the international search (name of data base and, where practicable, search terms used)  
 EPO-Internal, WPI Data

**C. DOCUMENTS CONSIDERED TO BE RELEVANT**

Category*	Citation of document, with indication, where appropriate, of the relevant passages	Relevant to claim No.
X	US 5 702 406 A (VILSMEIER STEFAN [DE] ET AL) 30 December 1997 (1997-12-30) abstract column 1, line 34 - line 36 column 4, line 20 - line 23 column 5, line 64 - column 9, line 17 figures 1-8	1-14
X	US 5 566 681 A (MANWARING KIM H [US] ET AL) 22 October 1996 (1996-10-22) abstract column 3, line 5 - column 5, line 32 figures 1-6	1-14
A	US 5 730 745 A (SCHULTE REINHARD W [US] ET AL) 24 March 1998 (1998-03-24) column 4, line 7 - column 4, line 36 column 12, line 35 - line 40 figures 1,11	8

Further documents are listed in the continuation of Box C.

See patent family annex.

\* Special categories of cited documents :

- "A" document defining the general state of the art which is not considered to be of particular relevance
- "E" earlier application or patent but published on or after the international filing date
- "L" document which may throw doubts on priority claim(s) or which is cited to establish the publication date of another citation or other special reason (as specified)
- "O" document referring to an oral disclosure, use, exhibition or other means
- "P" document published prior to the international filing date but later than the priority date claimed

- "T" later document published after the international filing date or priority date and not in conflict with the application but cited to understand the principle or theory underlying the invention
- "X" document of particular relevance; the claimed invention cannot be considered novel or cannot be considered to involve an inventive step when the document is taken alone
- "Y" document of particular relevance; the claimed invention cannot be considered to involve an inventive step when the document is combined with one or more other such documents, such combination being obvious to a person skilled in the art
- "&" document member of the same patent family

Date of the actual completion of the international search  
 28 June 2013

Date of mailing of the international search report  
 08/07/2013

Name and mailing address of the ISA/  
 European Patent Office, P.B. 5818 Patentlaan 2  
 NL - 2280 HV Rijswijk  
 Tel. (+31-70) 340-2040,  
 Fax: (+31-70) 340-3016

Authorized officer  
 Marteau, Frédéric

# INTERNATIONAL SEARCH REPORT

Information on patent family members

International application No

PCT/EP2013/059644

Patent document cited in search report		Publication date		Patent family member(s)		Publication date
US 5702406	A	30-12-1997	DE	4432891 A1		21-03-1996
			US	5702406 A		30-12-1997
-----						
US 5566681	A	22-10-1996	NONE			
-----						
US 5730745	A	24-03-1998	US	5464411 A		07-11-1995
			US	5730745 A		24-03-1998
-----						