

**PCT**WORLD INTELLECTUAL PR  
Internation:

INTERNATIONAL APPLICATION PUBLISHED UNI

WO 9605632A1

(51) International Patent Classification<sup>6</sup>:

H01R 9/07

A1

(11) International Publication Number:

WO 96/05632

(43) International Publication Date: 22 February 1996 (22.02.96)

(21) International Application Number: PCT/US95/06360

(22) International Filing Date: 19 May 1995 (19.05.95)

(30) Priority Data:

08/290,325

12 August 1994 (12.08.94)

US

(71) Applicant: THE WHITAKER CORPORATION [US/US];  
Suite 450, 4550 New Linden Hill Road, Wilmington, DE  
19808 (US).(72) Inventors: WEIDLER, Charles, Harry; 926 First Street, Lan-  
caster, PA 17603 (US). MOLL, Hurley, Chester, Jr.; 2434  
Duke Street, Harrisburg, PA 17104 (US). GRIESMERER,  
David, Alan; 667 Frances Drive, Harrisburg, PA 17109  
(US). WHITEMAN, Robert, Neil, Jr.; 1031 Plane Street,  
Middletown, PA 17057 (US). LONG, Michael, David; 4200  
N. Progress Avenue, Harrisburg, PA 17110 (US).(74) Agents: KITA, Gerald, K. et al.; The Whitaker Corporation,  
Suite 450, 4500 New Linden Hill Road, Wilmington, DE  
19808 (DE).(81) Designated States: BR, CA, CN, CZ, HU, JP, KR, PL,  
European patent (AT, BE, CH, DE, DK, ES, FR, GB, GR,  
IE, IT, LU, MC, NL, PT, SE).**Published***With international search report.*

(54) Title: CONNECTOR FOR AN ELECTRICAL CABLE

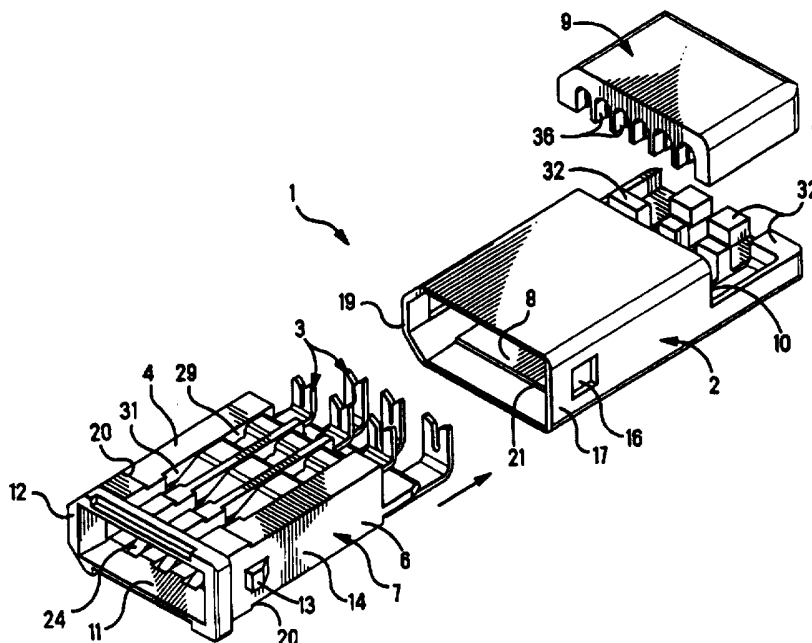

## (57) Abstract

An electrical connector (1) comprises, electrical contacts (3) arranged in two contact rows on opposite sides of an insulator (6), with the contacts (3) in each row being spaced apart laterally one from one another, the contacts (3) being arranged in pairs with the insulator (6) being between the contacts (3) of each pair, mating contact portions (24) on each pair of the contacts (3) overlying each other in opposed spaced relationship, and electrical terminals (26) on each pair of the contacts (3) being offset from each other in lateral directions, and being offset from each other front to rear.

**FOR THE PURPOSES OF INFORMATION ONLY**

Codes used to identify States party to the PCT on the front pages of pamphlets publishing international applications under the PCT.

AT	Austria	GB	United Kingdom	MR	Mauritania
AU	Australia	GE	Georgia	MW	Malawi
BB	Barbados	GN	Guinea	NE	Niger
BE	Belgium	GR	Greece	NL	Netherlands
BF	Burkina Faso	HU	Hungary	NO	Norway
BG	Bulgaria	IE	Ireland	NZ	New Zealand
BJ	Benin	IT	Italy	PL	Poland
BR	Brazil	JP	Japan	PT	Portugal
BY	Belarus	KE	Kenya	RO	Romania
CA	Canada	KG	Kyrgyzstan	RU	Russian Federation
CF	Central African Republic	KP	Democratic People's Republic of Korea	SD	Sudan
CG	Congo	KR	Republic of Korea	SE	Sweden
CH	Switzerland	KZ	Kazakhstan	SI	Slovenia
CI	Côte d'Ivoire	LI	Liechtenstein	SK	Slovakia
CM	Cameroon	LK	Sri Lanka	SN	Senegal
CN	China	LU	Luxembourg	TD	Chad
CS	Czechoslovakia	LV	Latvia	TG	Togo
CZ	Czech Republic	MC	Monaco	TJ	Tajikistan
DE	Germany	MD	Republic of Moldova	TT	Trinidad and Tobago
DK	Denmark	MG	Madagascar	UA	Ukraine
ES	Spain	ML	Mali	US	United States of America
FI	Finland	MN	Mongolia	UZ	Uzbekistan
FR	France			VN	Viet Nam
GA	Gabon				

**CONNECTOR FOR AN ELECTRICAL CABLE**

The invention relates to an electrical connector for connection to an electrical cable, and, more particularly, to an electrical connector with electrical terminals for connection to conductors of an electrical cable.

An electrical connector is known from U.S. Patent 5,129,840 and comprises, two rows of electrical contacts on opposite sides of an insulator. The contacts pass are close together, and pass by one another on crossing paths. The contacts are thinner where they pass by one another to avoid intersecting engagement with one another.

Another known connector comprises, three identical rows of electrical contacts with offset electrical terminals, with each row being moved over or being inverted to move the contacts of one row to staggered positions relative to the contacts in the other rows.

According to the invention, an electrical connector comprises, two rows of electrical contacts with different shapes on opposite sides of an insulator adapted for assembly as a unit into an insulating housing, the contacts being arranged in pairs, with the contacts of each pair opposing each other across the insulator.

An advantage of the invention resides in a unit adapted for assembly in an insulating housing, comprising, an insulator and multiple contacts having different shapes, which avoids a need for a housing manufactured with passages of different shapes to receive contacts having different shapes.

According to an embodiment of the invention, electrical terminals on respective pairs of electrical contacts are offset from each other in a lateral direction and are offset from each other in a direction front to rear. An advantage resides in terminals that

are close together to be connected to conductors of a cable that are side by side and close together.

According to another embodiment of the invention, the terminals on some of the contacts cross over the insulator and are together with the terminals on the remaining contacts to connect with conductors of an electrical cable that are side by side and close together. An advantage resides in a unit constructed with an insulator and contacts on both sides of the insulator, and terminals on the contacts that cross over the insulator to be grouped together to connect with conductors of a cable.

An embodiment of the invention will now be described, by way of example, with reference to the accompanying drawings, according to which;

FIGURE 1 is an isometric view of an electrical connector with component parts separated to depict details of construction;

FIGURE 2 is an isometric view of the structure shown in Fig. 1, with the structure inverted;

FIGURE 3 is a section view of the electrical connector shown in Fig. 1, with the component parts assembled together and connected to an electrical cable;

FIGURE 4 is an elevation view or side view of a pair of electrical terminals in positions as they would appear in the electrical connector as shown in Figs. 1-4;

FIGURE 5 is a schematic view of multiple electrical conductors of an electrical cable assembled in a cover;

FIGURE 6 is an isometric view of an insulator and electrical contacts of the electrical connector shown in Fig. 1, with parts cut away and with parts separated to illustrate details of construction;

FIGURE 7 is a plan view of a first row of electrical contacts in blank form and prior to being formed to shape for use in the electrical connector shown in Fig. 1;

FIGURE 8 is a plan view of a second row of electrical contacts in blank form and prior to being formed to shape for use in the electrical connector shown in Fig. 1; and

5       FIGURE 9 is an isometric view of the first and second rows of contacts as shown in Fig. 8, with the contacts being formed to shape.

With reference to Figs. 1 and 2, an electrical connector 1 comprises, an insulating housing 2, and multiple electrical contacts 3 arranged in two rows that are on opposite sides 4, 5 of an insulator 6 adapted to be assembled as a unit 7 into a unit receiving, cavity 8 in the housing 2, and an insulating cover 9 adapted to cover an open side 10 of the housing 2. The cavity 8 communicates with the open side 10. The contacts 3 in each row are of different shapes, and are offset laterally one from another. A mating connector receiving, deep mouth 11 on a front mating end of the insulator 6 is for mating connection with another mating connector, not shown.

A bezel 12 with a nonsymmetrical circumference encircles the mouth 11. The bezel 12 projects outwardly from a front exterior circumference on the deep mouth 11. Both the bezel 12 and the unit receiving cavity 8 of the housing 2 have a nonsymmetrical circumference to provide polarization for mating with a nonsymmetrical mating connector, not shown. A portion of the mating connector fits along the nonsymmetrical circumference. Another portion of the mating connector fits inside the deep mouth 11. With reference to Fig. 6, the unit 7 comprises, the contacts 3 on the insulator 6, adapted to be assembled with the housing 2. With reference to Figs. 1, 2 and 3, the unit 7 is adapted to be inserted through the mouth 11 to registers in the cavity 8. Rear tapering latches 13 on exterior sides 14, 15 on the insulator 6 and rearward of the bezel 12 wedge along the interior of the mouth 11 until they project into latch

receiving openings 16 through sides 17, 18 of the housing 2. The projecting bezel 12 impinges against a front 19 of the housing 2 to resist movement of the unit 7 relative to the housing 2. Each of the sides 4, 5 on the insulator 6 is provided with an exterior, rear facing step 20 that is received against an interior, front facing step 21 on respective interior sides on the housing 2 to resist movement of the unit 7 relative to the housing 2. The unit 7 locks with the housing 2. The latches 13 lock in the openings 16 and prevent withdrawal of the insulator 6 in a forward direction relative to the housing 2. The bezel 12 prevents further movement of the insulator 6 in a rearward direction relative to the housing 2.

With reference to Figs. 4, 6, 7, 8 and 9, each of the contacts 3 is of unitary construction, stamped and formed from a blank of metal having a plane of thickness that becomes the plane of thickness of each of the contacts 3. The contacts 3 are manufactured as being connected together by a carrier strip 22, as shown in Figs. 7 and 8. Subsequently, the individual contacts 3 are separated from one another and from the carrier strip 22. Each contact 3 is manufactured with a forward facing mating contact portion 23, an outwardly flared front tip 24, projecting barbs 25 along opposite lateral sides of the contact 3, and an electrical terminal 26 on a rear end, with a conductor connecting slot 27 along the terminal 26. Each of the terminals 26 is bent at ninety degrees to project toward the open side 10 of the housing 2. The barbs 25 are located along a deeply bowed portion 28 of the contact 3.

With reference to Figs. 1, 2, 3 and 6, individual contacts 3 are assembled along individual channels 29 in the opposite sides 4, 5 of the insulator 3. The contacts 3 are located along the channels 29 by the deeply bowed portions 28 in registration with deep portions 30 of the channels 29. The barbs 25 impinge

and wedge against opposite sides of the channels 29 to retain the contacts 3 along the channels 29. The channels 29 each open into respective slotted openings 31 through the opposite sides 4, 5 and through an interior of the deep mouth 11, as depicted in Figs. 3 and 6. The mating contact portions 23 on the contacts 3 comprise resilient spring fingers extending through the slotted openings 31 and into the interior of the deep mouth 11 for mating connection with electrical contacts, not shown, of a mating electrical connector, not shown, received in the deep mouth 11. The front tips 24 of the contacts 3 are outwardly flared to prevent stubbing abruptly against the mating electrical connector, not shown.

With reference to Figs. 1, 2 and 3, the terminals 26 face away from the insulator 6, and toward the open side 10 of the housing 2, such that the slots 27 extend toward the open side 10 of the housing 2. Shorter electrical terminals 26 are on the contacts 3 on the side 4 of the insulator 6. Longer electrical terminals 26 are on the contacts 3 on the second side 5 of the insulator. The longer terminals 26 cross over the insulator 6, Fig. 3, and face in the same direction as the shorter terminals 26. The shorter terminals 26 are in one row of terminals 26. The longer terminals 26 are in another row of terminals 26 rearward of the first row of the terminals 26. The terminals 26 move rearwardly into positions beside projecting, terminal supporting columns 32 that are unitary with a side 33 of the housing 2. The columns 32 are in two rows and are spaced apart to align with the spaced apart terminals 26 in the two rows of terminals 26.

With reference to Figs. 3 and 5, insulated conductors 34 of an electrical cable are laid side by side and close together along grooved, conductor receiving passages 35 in an interior of the cover 9. The conductors 34 are side by side and close together.

The spacing between central axes of the side by side conductors 34 is known as the pitch spacing of the conductors 34. The spacing of and between the passages 36 corresponds with the pitch spacing of the conductors 34. The terminals 26 are spaced apart on pitch spacings that correspond with the pitch spacings of the conductors 34. The cover 9 and the conductors 34 are moved toward the slots 27 that face the open side 10 of the housing 2. The terminals 26 intercept the passages 35. The shorter terminals 26 project across an imaginary plane to intersect alternate conductors 34 extending along said plane. The longer terminals 26 project across said imaginary plane to intersect different alternate conductors 34 extending along said plane. The cover 9 urges the conductors 34 along the slots 27 to terminate the conductors 34 with the connector 1. Projecting wedge shaped latches 36, Fig. 2, along the passages 36 in the cover 9 latch to the housing 2. The cover 9 remains impinged against the conductors 34 while the conductors 34 are fully inserted in the slots 27. The slot 27 in each contact 3 has an open end to receive one of the insulated conductors 34. Opposite sides along the slot 27 slice through insulation on the conductor 34, and grip the conductor 34 to establish an electrical connection. Different widths of the slots 27 accommodate different widths or different diameters of the conductors 34. The terminals 26 that connect to larger conductors 34 have larger sizes for strength. The insulator 6 supports the shorter terminals 26 to resist forces occurring during insertion of the conductors 34. The side 33 of the housing 2 opposite the open side 10 supports the longer terminals 26 to resist forces occurring during insertion of the conductors 34. The columns 32 keep the terminals 26 upright and prevent the terminals 26 from bending over.



With reference to Figs. 3, 4 and 6, the contacts 3 are arranged in pairs, with the contact portions 23 on each pair opposing and overlying each other across the insulator 6. The insulator 6 is between the contacts 3 of each pair. One of the pairs is shown in Figs. 3 and 4. In Fig. 6 one of the pairs is separated from the insulator 6 to show details of construction. The terminals 26 on the pairs of contacts 3 will now be described with reference to Figs. 7, 8 and 9, taken in conjunction with Figs. 1 and 2. A first contact 37 and a second contact 38 comprise a first pair of the contacts 3. A first terminal 26 on the first contact 37 is offset laterally by an offset portion 39 a full pitch spacing with respect to a second terminal 26 on the second contact 38. The second terminal 26 on the second contact 38 is aligned straight with the mating contact portion 23 on the second contact 38.

A third contact 40 and a fourth contact 41 comprise a second pair of the contacts 3. Third and fourth terminals 26 on the third contact 40 and the fourth contact 41 are offset laterally by offset portions 42, 43 in opposite directions one-half of a full pitch spacing.

A fifth contact 44 and a sixth contact 45 comprise a third pair of the contacts 3. A fifth terminal 26 on the fifth contact 44 is aligned straight with the mating contact portion 23 on the fifth contact 44. A sixth terminal 26 on the sixth contact 45 is offset laterally by an offset portion 46 a full pitch spacing with respect to the fifth terminal 26 on the fifth contact 44. The first and the sixth terminals 26 are offset laterally in opposite directions. The terminals 26 in different rows of the terminals 26 are offset from each other in a direction from front to rear. The terminals 26 are offset by different amounts in directions laterally of the connector 1.

An advantage of the invention resides in a unit adapted for assembly in an insulating housing, comprising, an insulator and multiple contacts having different shapes, which avoids a need for a housing  
5 manufactured with passages of different shapes to receive contacts having different shapes.

CLAIMS:

1. An electrical connector comprising; a housing,  
an insulator, electrical contacts on opposite sides of  
the insulator, the electrical contacts and the insulator  
5 being in the housing, mating contact portions on the  
electrical contacts, shorter electrical terminals on  
respective electrical contacts on one side of the  
insulator, longer electrical terminals on respective  
electrical contacts on the other side of the insulator,  
10 characterised in that; the longer electrical terminals  
and the shorter electrical terminals extend in the same  
direction, the insulator supports the shorter terminals,  
and the housing supports the longer terminals.

2. An electrical connector as recited in claim 1,  
15 further characterised by; an open side of the housing,  
the shorter terminals extending toward the open side,  
and the longer electrical terminals crossing over the  
insulator to extend toward the open side.

3. An electrical connector as recited in claim 1,  
20 further characterised by; terminal supporting columns on  
a side of the housing facing the open side, and the  
columns being beside corresponding terminals.

4. An electrical connector as recited in claim 1,  
wherein; third and fourth contacts comprise a second  
25 pair of the contacts, and third and fourth of said  
terminals on the third and fourth contacts are offset  
laterally in opposite directions one-half of a full  
pitch spacing.

5. An electrical connector as recited in claim 4,  
30 wherein; fifth and sixth contacts comprise a third pair  
of the contacts, a sixth of said terminals on the sixth  
contact is laterally offset by a full pitch spacing with  
respect to a corresponding mating contact portion on the  
sixth contact, a fifth of said terminals on the fifth  
35 contact is aligned on the same pitch spacing with  
respect to a corresponding mating contact portion on the  
fifth contact, and the fifth and sixth of said terminals

are laterally offset from each other by a full pitch spacing.

6. An electrical connector as recited in claim 1,  
further characterised by; conductor connecting slots in  
5 the terminals, the slots extending toward the open side.

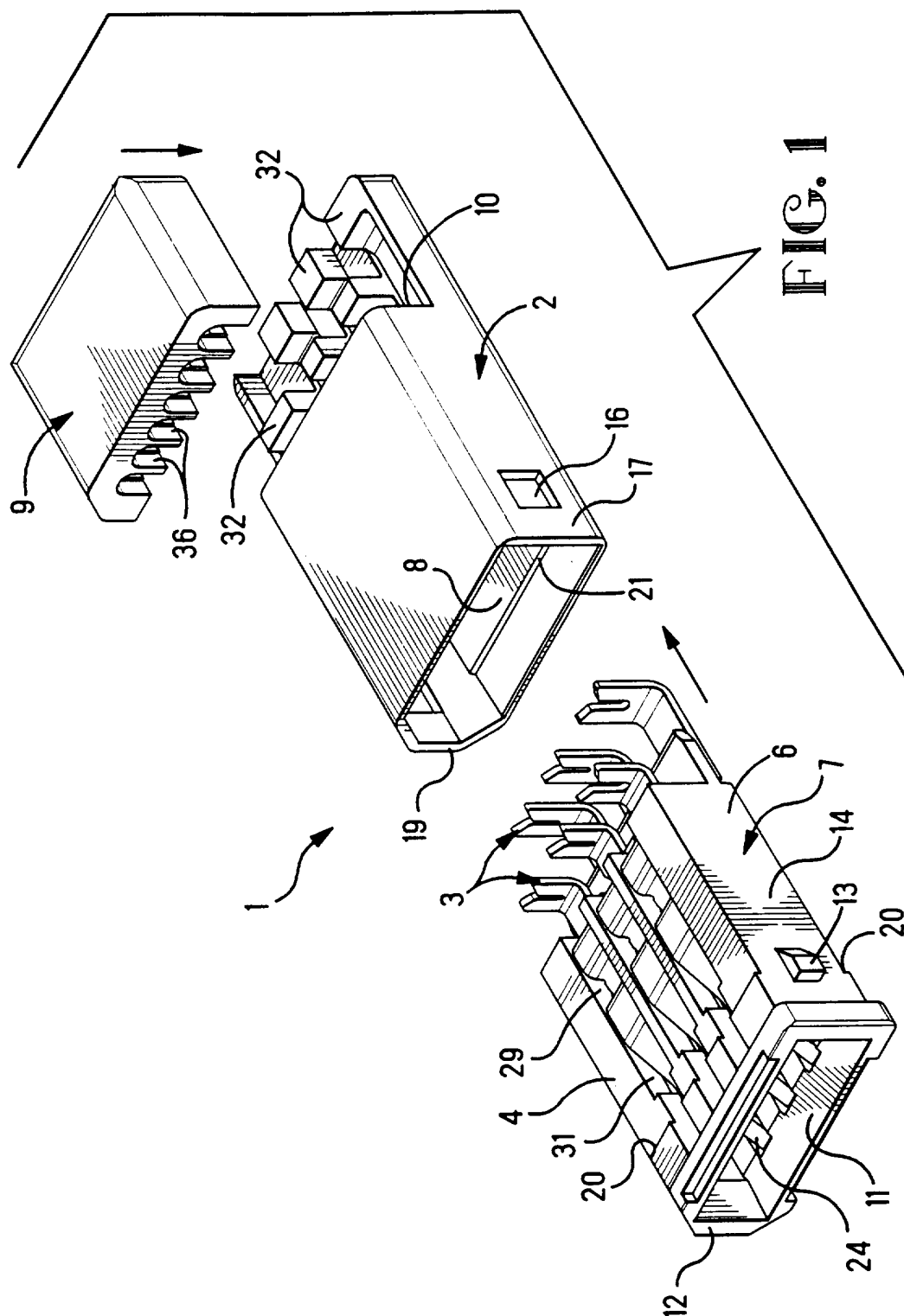

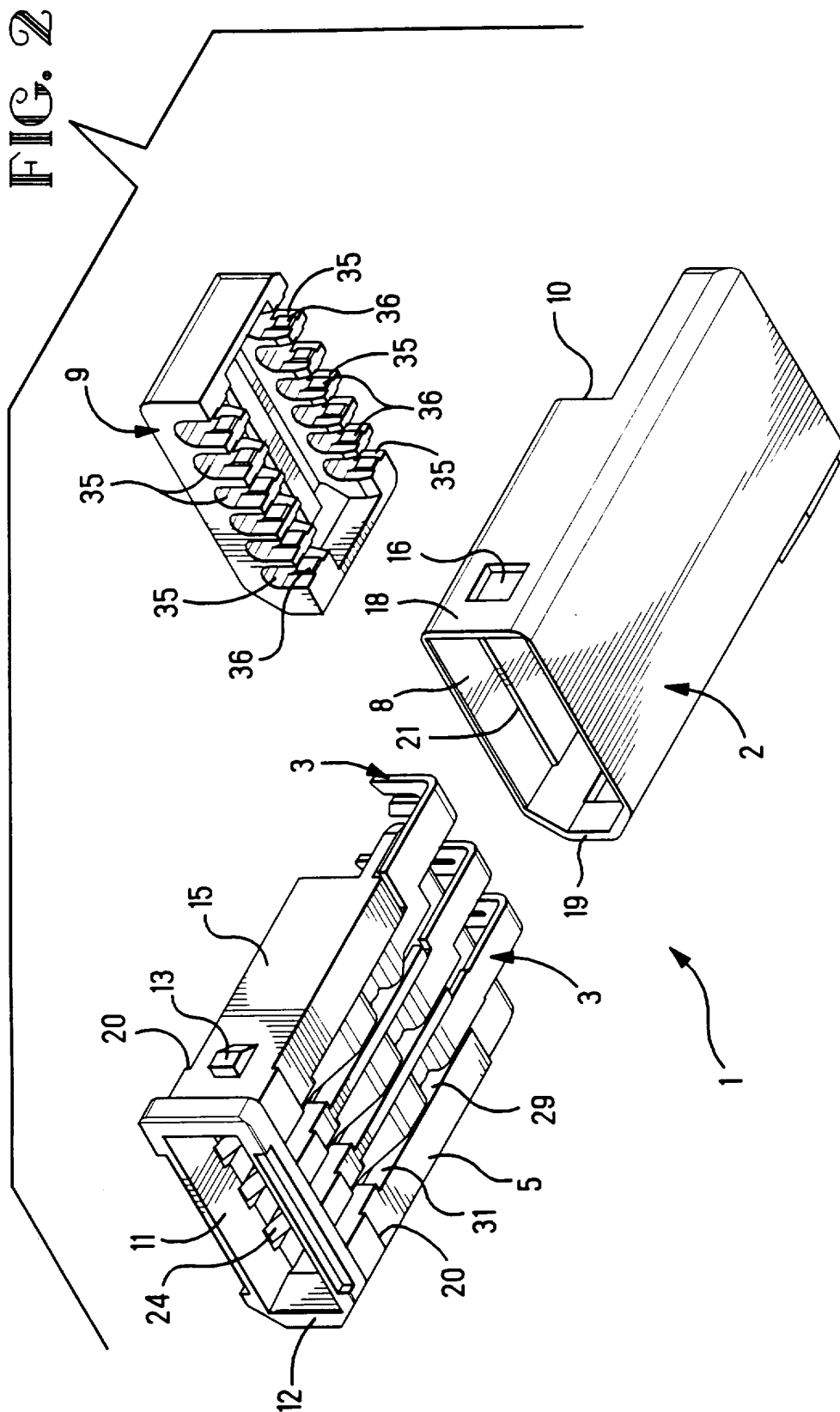

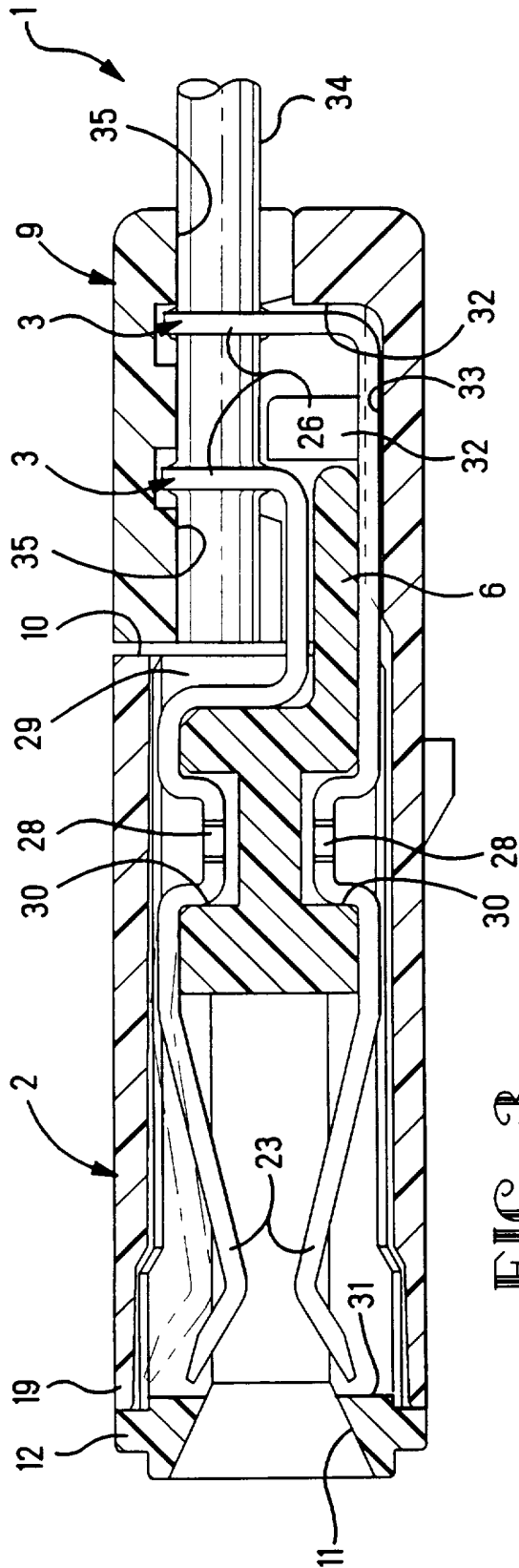

FIG. 3

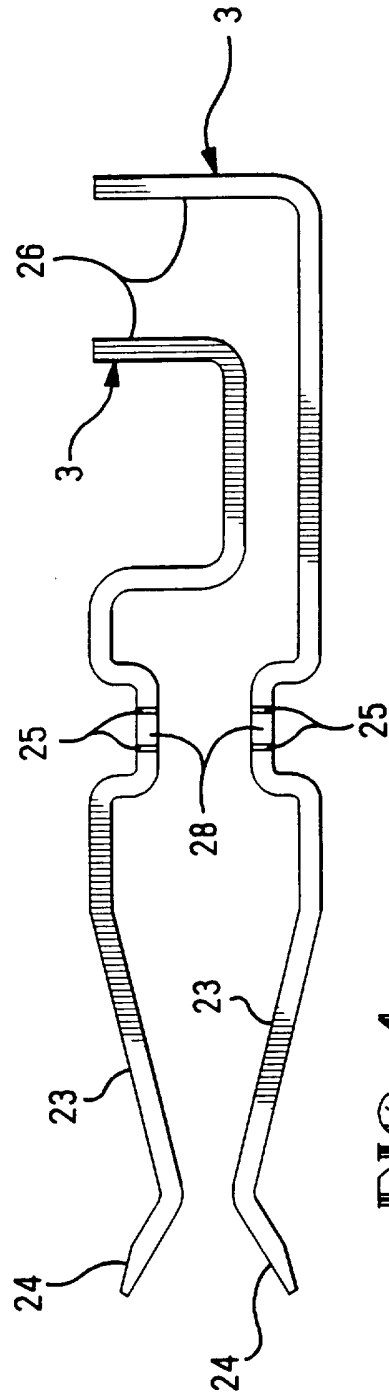

FIG. 4

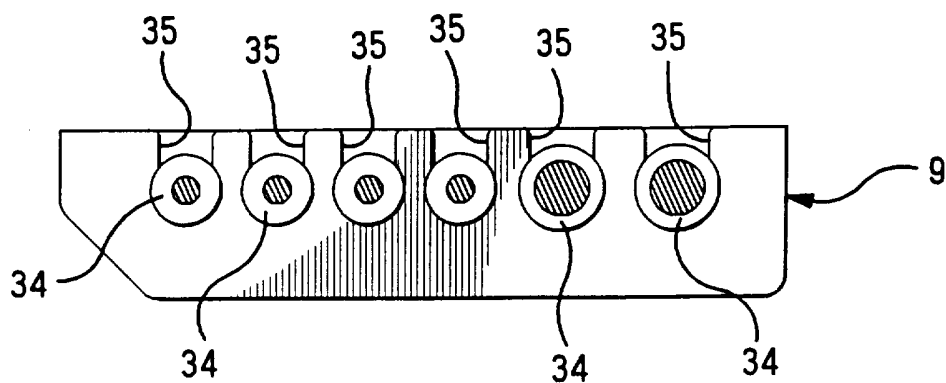

FIG. 5

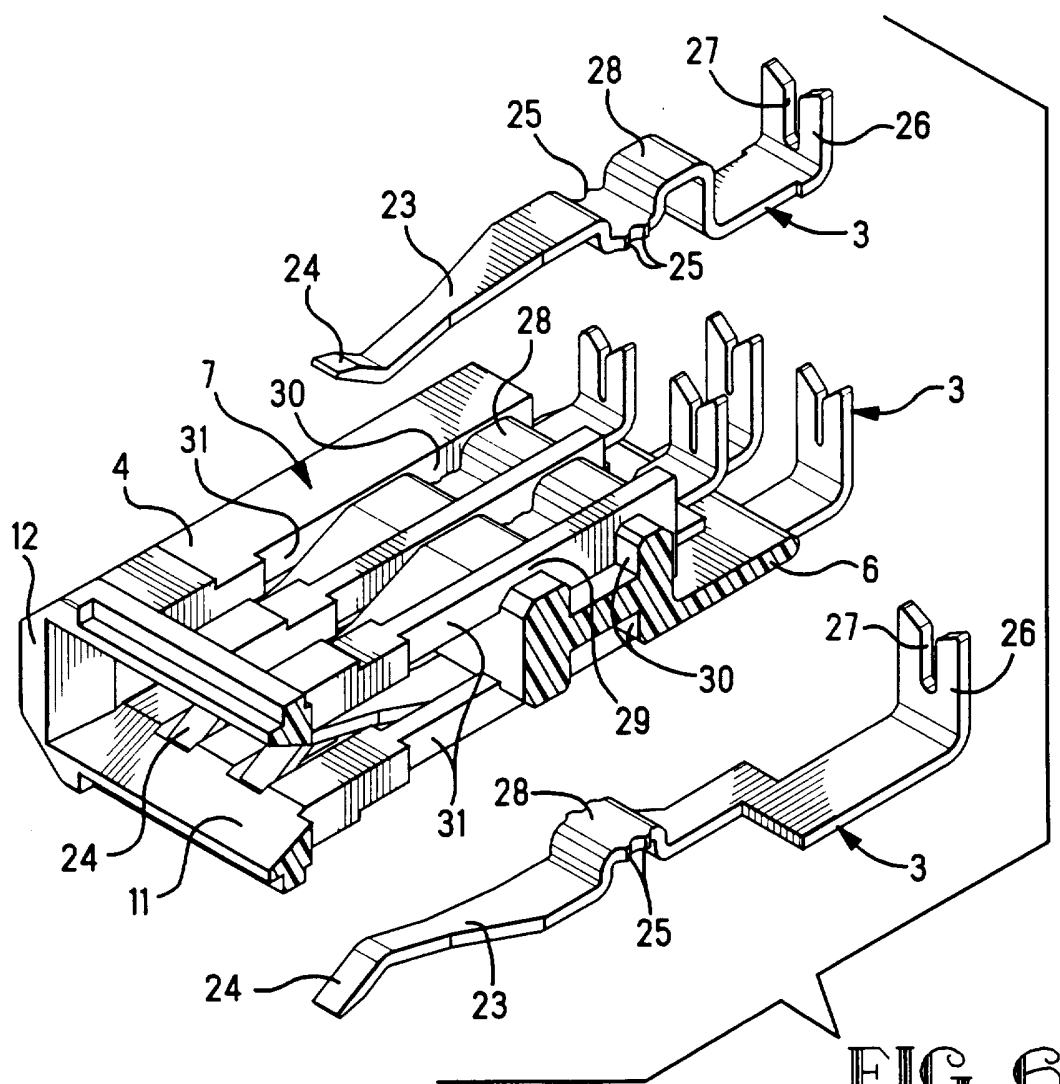
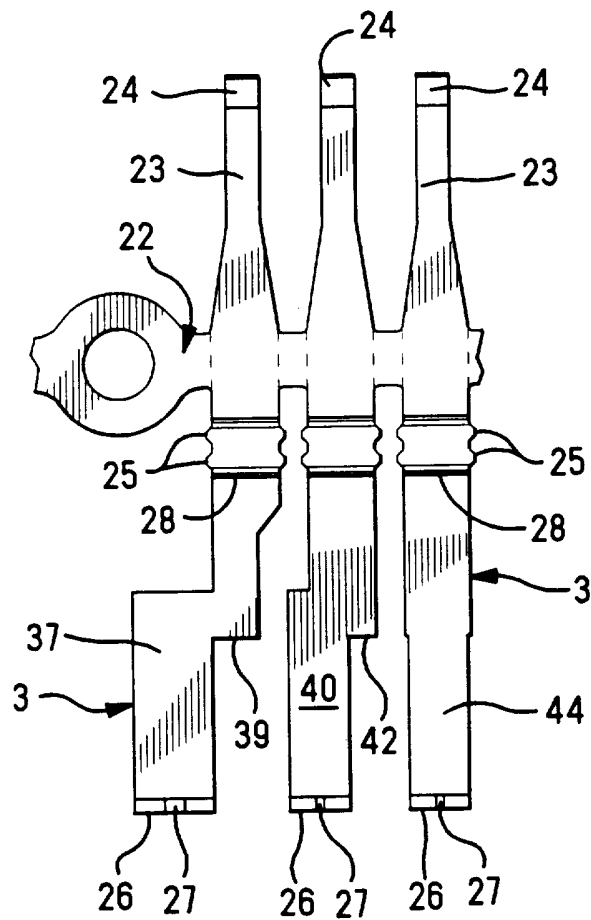
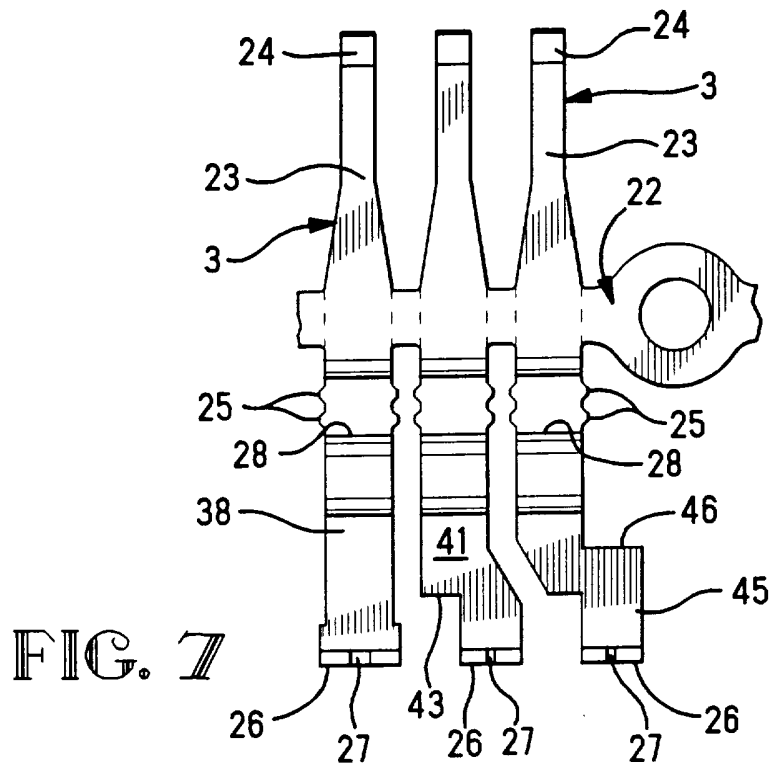

FIG. 6





**FIG. 8**

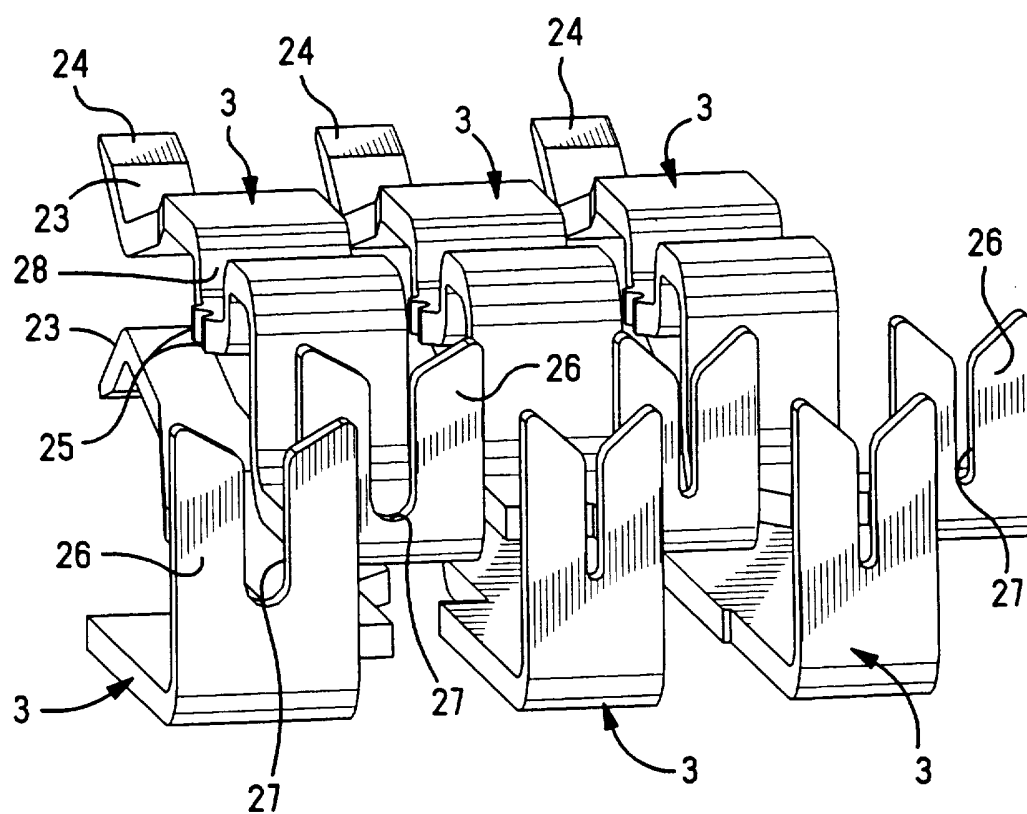

FIG. 9

## INTERNATIONAL SEARCH REPORT

Intern al Application No  
PCT/US 95/06360

A. CLASSIFICATION OF SUBJECT MATTER  
IPC 6 H01R9/07

According to International Patent Classification (IPC) or to both national classification and IPC

## B. FIELDS SEARCHED

Minimum documentation searched (classification system followed by classification symbols)  
IPC 6 H01R

Documentation searched other than minimum documentation to the extent that such documents are included in the fields searched

Electronic data base consulted during the international search (name of data base and, where practical, search terms used)

## C. DOCUMENTS CONSIDERED TO BE RELEVANT

Category *	Citation of document, with indication, where appropriate, of the relevant passages	Relevant to claim No.
X	FR,A,2 361 759 (AMP INC) 10 March 1978 see page 3, line 27 - page 5, line 24; figures 2-4 ---	1-4,6
A	EP,A,0 203 793 (DU PONT) 3 December 1986 see page 9, line 15 - page 10, line 9; figures 5,6 ---	1-6
A	EP,A,0 456 340 (ITT) 13 November 1991 see page 3, column 4, line 27 - page 4, column 5, line 10; figures 1,3 -----	1-6

☐ Further documents are listed in the continuation of box C.

☒ Patent family members are listed in annex.

## \* Special categories of cited documents :

- "A" document defining the general state of the art which is not considered to be of particular relevance
- "E" earlier document but published on or after the international filing date
- "L" document which may throw doubts on priority claim(s) or which is cited to establish the publication date of another citation or other special reason (as specified)
- "O" document referring to an oral disclosure, use, exhibition or other means
- "P" document published prior to the international filing date but later than the priority date claimed

- "T" later document published after the international filing date or priority date and not in conflict with the application but cited to understand the principle or theory underlying the invention
- "X" document of particular relevance; the claimed invention cannot be considered novel or cannot be considered to involve an inventive step when the document is taken alone
- "Y" document of particular relevance; the claimed invention cannot be considered to involve an inventive step when the document is combined with one or more other such documents, such combination being obvious to a person skilled in the art.
- "&" document member of the same patent family

Date of the actual completion of the international search

24 August 1995

Date of mailing of the international search report

06.09.95

Name and mailing address of the ISA

European Patent Office, P.B. 5818 Patentlaan 2  
NL - 2280 HV Rijswijk  
Tel. (+31-70) 340-2040, Tx. 31 651 epo nl,  
Fax (+31-70) 340-3016

Authorized officer

Criqui, J-J

# INTERNATIONAL SEARCH REPORT

information on patent family members

Intern: Application No  
PCT/US 95/06360

Patent document cited in search report	Publication date	Patent family member(s)	Publication date
FR-A-2361759	10-03-78	US-A- 4085994	25-04-78
		US-A- 4083615	11-04-78
		AU-B- 507948	06-03-80
		AU-A- 2700477	18-01-79
		BE-A- 857561	06-02-78
		CA-A- 1065031	23-10-79
		DE-A- 2735838	16-02-78
		GB-A- 1527329	04-10-78
		JP-C- 1308500	26-03-86
		JP-A- 53021792	28-02-78
		JP-B- 60028109	03-07-85
		NL-A- 7707851	14-02-78
EP-A-0203793	03-12-86	SE-C- 427599	28-07-83
		SE-A- 7709154	13-02-78
		US-A- 4632486	30-12-86
		AU-B- 581389	16-02-89
		AU-A- 5795886	04-12-86
		CA-A- 1235205	12-04-88
EP-A-0456340	13-11-91	JP-A- 61273881	04-12-86
		US-A- 4697862	06-10-87
		US-A- 4995828	26-02-91
		JP-A- 4230968	19-08-92