

(19) World Intellectual Property
Organization
International Bureau



(43) International Publication Date
4 November 2004 (04.11.2004)

PCT

(10) International Publication Number
WO 2004/093719 A3

- (51) International Patent Classification⁷: **A61C 17/34**, 17/22, A61H 13/00
- (74) Common Representative: **THE PROCTER & GAMBLE COMPANY**; c/o T. David Reed, 6110 Center Hill Road, Cincinnati, OH 45224 (US).
- (21) International Application Number: PCT/US2004/011803
- (81) Designated States (unless otherwise indicated, for every kind of national protection available): AE, AG, AL, AM, AT, AU, AZ, BA, BB, BG, BR, BW, BY, BZ, CA, CH, CN, CO, CR, CU, CZ, DE, DK, DM, DZ, EC, EE, EG, ES, FI, GB, GD, GE, GH, GM, HR, HU, ID, IL, IN, IS, JP, KE, KG, KP, KR, KZ, LC, LK, LR, LS, LT, LU, LV, MA, MD, MG, MK, MN, MW, MX, MZ, NA, NI, NO, NZ, OM, PG, PH, PL, PT, RO, RU, SC, SD, SE, SG, SK, SL, SY, TJ, TM, TN, TR, TT, TZ, UA, UG, US, UZ, VC, VN, YU, ZA, ZM, ZW.
- (22) International Filing Date: 16 April 2004 (16.04.2004)
- (25) Filing Language: English
- (26) Publication Language: English
- (30) Priority Data: 60/464,787 23 April 2003 (23.04.2003) US
- (71) Applicant (for all designated States except US): **THE PROCTER & GAMBLE COMPANY** [US/US]; One Procter & Gamble Plaza, Cincinnati, OH 45202 (US).
- (72) Inventors; and
- (75) Inventors/Applicants (for US only): **CHAN, John, Geoffrey** [US/US]; 3641 Nantucket Drive, Apt. B, Loveland, OH 45140 (US). **GALL, Douglas, A.** [US/US]; 14591 Mill Hollow Lane, Strongsville, OH 44136 (US).
- (84) Designated States (unless otherwise indicated, for every kind of regional protection available): ARIPO (BW, GH, GM, KE, LS, MW, MZ, SD, SL, SZ, TZ, UG, ZM, ZW), Eurasian (AM, AZ, BY, KG, KZ, MD, RU, TJ, TM), European (AT, BE, BG, CH, CY, CZ, DE, DK, EE, ES, FI, FR, GB, GR, HU, IE, IT, LU, MC, NL, PL, PT, RO, SE, SI, SK, TR), OAPI (BF, BJ, CF, CG, CI, CM, GA, GN, GQ, GW, ML, MR, NE, SN, TD, TG).

[Continued on next page]

(54) Title: ELECTRIC TOOTHBRUSHES

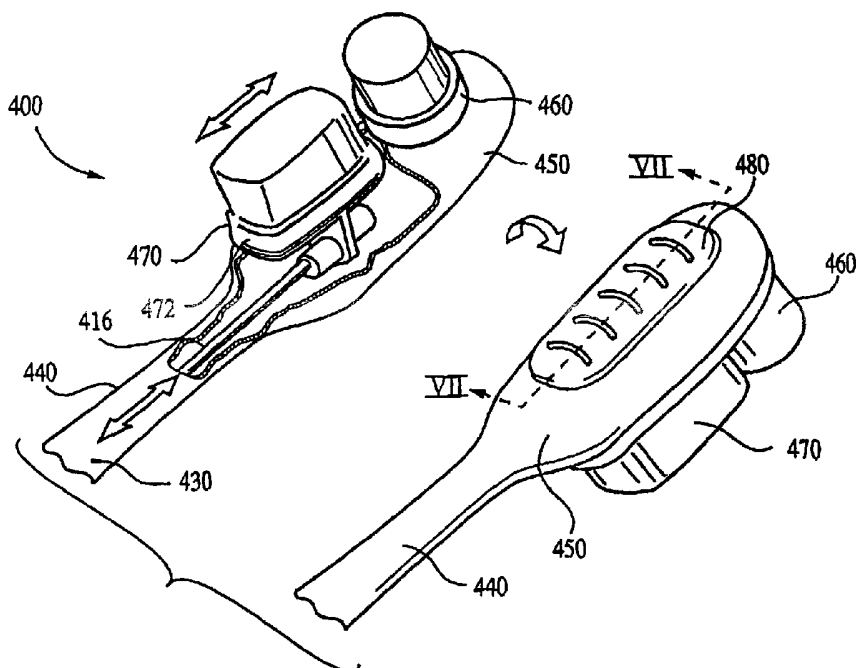

(57) Abstract: An electric toothbrush is provided. The electric toothbrush has an elongated body, a head comprising a movable massaging plate and a movable bristle carrier disposed opposite the massaging plate, and a neck extending between the body and the head. An electric motor is operatively connected to a shaft, wherein operation of the electric motor moves the shaft in a reciprocating motion and wherein the shaft is operatively connected to the massaging plate and bristle carriers.

**Declarations under Rule 4.17:**

- *as to applicant's entitlement to apply for and be granted a patent (Rule 4.17(ii)) for the following designations AE, AG, AL, AM, AT, AU, AZ, BA, BB, BG, BR, BW, BY, BZ, CA, CH, CN, CO, CR, CU, CZ, DE, DK, DM, DZ, EC, EE, EG, ES, FI, GB, GD, GE, GH, GM, HR, HU, ID, IL, IN, IS, JP, KE, KG, KP, KR, KZ, LC, LK, LR, LS, LT, LU, LV, MA, MD, MG, MK, MN, MW, MX, MZ, NA, NI, NO, NZ, OM, PG, PH, PL, PT, RO, RU, SC, SD, SE, SG, SK, SL, SY, TJ, TM, TN, TR, TT, TZ, UA, UG, UZ, VC, VN, YU, ZA, ZM, ZW, ARIPO patent (BW, GH, GM, KE, LS, MW, MZ, SD, SL, SZ, TZ, UG, ZM, ZW), Eurasian patent (AM, AZ, BY, KG, KZ, MD, RU, TJ, TM), European patent (AT, BE, BG, CH, CY, CZ, DE, DK, EE, ES, FI, FR, GB, GR, HU, IE, IT, LU, MC, NL, PL, PT, RO, SE, SI, SK, TR), OAPI patent (BF, BJ, CF, CG, CI, CM, GA, GN, GQ, GW, ML, MR, NE, SN, TD, TG)*

- *as to the applicant's entitlement to claim the priority of the earlier application (Rule 4.17(iii)) for all designations*

Published:

- *with international search report*
— *before the expiration of the time limit for amending the claims and to be republished in the event of receipt of amendments*

(88) Date of publication of the international search report:

31 March 2005

For two-letter codes and other abbreviations, refer to the "Guidance Notes on Codes and Abbreviations" appearing at the beginning of each regular issue of the PCT Gazette.

INTERNATIONAL SEARCH REPORT

International Application No
PCT/US2004/011803

A. CLASSIFICATION OF SUBJECT MATTER

IPC 7 A61C17/34 A61C17/22 A61H13/00

According to International Patent Classification (IPC) or to both national classification and IPC

B. FIELDS SEARCHED

Minimum documentation searched (classification system followed by classification symbols)

IPC 7 A61C A61H

Documentation searched other than minimum documentation to the extent that such documents are included in the fields searched

Electronic data base consulted during the international search (name of data base and, where practical, search terms used)

EP0-Internal, WPI Data, PAJ

C. DOCUMENTS CONSIDERED TO BE RELEVANT

Category °	Citation of document, with indication, where appropriate, of the relevant passages	Relevant to claim No.
A	US 4 827 551 A (MASER ET AL) 9 May 1989 (1989-05-09) column 2, line 48 - line 56 claim 9; figure 4	1
A	US 6 371 294 B1 (BLAUSTEIN ET AL) 16 April 2002 (2002-04-16) column 10, line 41 - column 11, line 22 figures 13-16	1

☐ Further documents are listed in the continuation of box C.

☒ Patent family members are listed in annex.

° Special categories of cited documents :

"A" document defining the general state of the art which is not considered to be of particular relevance

"E" earlier document but published on or after the international filing date

"L" document which may throw doubts on priority claim(s) or which is cited to establish the publication date of another citation or other special reason (as specified)

"O" document referring to an oral disclosure, use, exhibition or other means

"P" document published prior to the international filing date but later than the priority date claimed

"T" later document published after the international filing date or priority date and not in conflict with the application but cited to understand the principle or theory underlying the invention

"X" document of particular relevance; the claimed invention cannot be considered novel or cannot be considered to involve an inventive step when the document is taken alone

"Y" document of particular relevance; the claimed invention cannot be considered to involve an inventive step when the document is combined with one or more other such documents, such combination being obvious to a person skilled in the art.

"&" document member of the same patent family

Date of the actual completion of the international search

16 September 2004

Date of mailing of the international search report

15 FEB 2005

Name and mailing address of the ISA

European Patent Office, P.B. 5818 Patentlaan 2
NL - 2280 HV Rijswijk
Tel. (+31-70) 340-2040, Tx. 31 651 epo nl,
Fax: (+31-70) 340-3016

Authorized officer

Raybould, B

INTERNATIONAL SEARCH REPORT

International application No.
PCT/US2004/011803

Box II Observations where certain claims were found unsearchable (Continuation of item 2 of first sheet)

This International Search Report has not been established in respect of certain claims under Article 17(2)(a) for the following reasons:

1. ☐ Claims Nos.:
because they relate to subject matter not required to be searched by this Authority, namely:
2. ☐ Claims Nos.:
because they relate to parts of the International Application that do not comply with the prescribed requirements to such an extent that no meaningful International Search can be carried out, specifically:
3. ☐ Claims Nos.:
because they are dependent claims and are not drafted in accordance with the second and third sentences of Rule 6.4(a).

Box III Observations where unity of invention is lacking (Continuation of item 3 of first sheet)

This International Searching Authority found multiple inventions in this international application, as follows:

see additional sheet

1. ☐ As all required additional search fees were timely paid by the applicant, this International Search Report covers all searchable claims.
2. ☐ As all searchable claims could be searched without effort justifying an additional fee, this Authority did not invite payment of any additional fee.
3. ☐ As only some of the required additional search fees were timely paid by the applicant, this International Search Report covers only those claims for which fees were paid, specifically claims Nos.:
4. ☒ No required additional search fees were timely paid by the applicant. Consequently, this International Search Report is restricted to the invention first mentioned in the claims; it is covered by claims Nos.:

1-7

Remark on Protest

- ☐ The additional search fees were accompanied by the applicant's protest.
- ☐ No protest accompanied the payment of additional search fees.

FURTHER INFORMATION CONTINUED FROM PCT/ISA/ 210

This International Searching Authority found multiple (groups of) inventions in this international application, as follows:

1. claims: 1-7

An electric toothbrush comprising a handle, a head with movable massage plate and movable bristle carrier, a neck and a shaft.

2. claims: 8,9

An electric toothbrush comprising a handle, a head with transversely movable bristle carriers, a neck and a shaft.

3. claim: 10

An electric toothbrush comprising a handle, a head with longitudinally movable bristle carriers, a neck and a shaft.

INTERNATIONAL SEARCH REPORT

Information on patent family members

International Application No

PCT/US2004/011803

Patent document cited in search report	Publication date	Patent family member(s)	Publication date
US 4827551	A	09-05-1989	DE 3620295 A1 17-12-1987
		AT 70428 T 15-01-1992	
		DE 3775354 D1 30-01-1992	
		WO 8707500 A1 17-12-1987	
		EP 0269702 A1 08-06-1988	
		JP 1500490 T 23-02-1989	
US 6371294	B1	16-04-2002	US 6178579 B1 30-01-2001
			US 6189693 B1 20-02-2001
			US 6000083 A 14-12-1999
			CA 2465716 A1 06-03-2003
			EP 1383443 A2 28-01-2004
			WO 03017861 A2 06-03-2003
			JP 2004520929 T 15-07-2004
			TW 495359 B 21-07-2002
			US 2002152564 A1 24-10-2002
			US 2004088807 A1 13-05-2004
			US 2001022277 A1 20-09-2001
			US 2001054561 A1 27-12-2001
			US 2002020645 A1 21-02-2002
			US 2002017474 A1 14-02-2002
			US 2002029988 A1 14-03-2002
			AU 2296401 A 17-04-2001
			CA 2364232 A1 22-03-2001
			CN 1423545 T 11-06-2003
			EP 1143875 A2 17-10-2001
			JP 2004507273 T 11-03-2004
			TR 200101408 T1 21-08-2002
			TW 474803 B 01-02-2002
			WO 0119281 A2 22-03-2001
			US 2002078514 A1 27-06-2002
			US 2004074026 A1 22-04-2004
			US 2001004781 A1 28-06-2001
			US 2002032941 A1 21-03-2002
			AU 748925 B2 13-06-2002
			AU 4882999 A 06-04-2000
			BR 9908667 A 10-10-2000
			CA 2282957 A1 30-03-2000
			CN 1252248 A ,C 10-05-2000
			DE 29924223 U1 06-06-2002
			EP 0990424 A1 05-04-2000
			JP 3566150 B2 15-09-2004
			JP 2000210307 A 02-08-2000
			JP 2004223276 A 12-08-2004
			KR 2000023525 A 25-04-2000
			NZ 337972 A 25-05-2001
			RU 2234287 C2 20-08-2004
			SG 79283 A1 20-03-2001
			TR 9902394 A2 21-04-2000
			TW 490297 B 11-06-2002