



US 20060194631A1

(19) **United States**

(12) **Patent Application Publication**
Rowe et al.

(10) **Pub. No.: US 2006/0194631 A1**

(43) **Pub. Date: Aug. 31, 2006**

(54) **METHOD AND SYSTEM FOR ISSUING
GAMING MACHINE RECEIPTS**

Publication Classification

(75) Inventors: **Rick Rowe**, Henderson, NV (US);
Ward Chilton, Reno, NV (US)

(51) **Int. Cl.**
A63F 9/24 (2006.01)
(52) **U.S. Cl.** **463/25**

Correspondence Address:
BEYER WEAVER & THOMAS, LLP
P.O. BOX 70250
OAKLAND, CA 94612-0250 (US)

(57) **ABSTRACT**

The invention comprises a gaming system including at least one gaming machine arranged to accept and print receipts. In one embodiment of a method, a player playing a gaming machine is issued a receipt which represents credit or value belonging to the player, and includes secondary information. The secondary information may comprise promotional award information, such as a matching bet for use in playing another game or a prize, or information unrelated to the games, such as a horoscope. In another embodiment of the invention, a method comprises issuing a first receipt at a first location, such as a parking garage, accepting the first receipt at a gaming machine, issuing a second receipt at the gaming machine and then accepting the second receipt at another location, such as a parking garage exit. In this method, the gaming machine serves as a validation mechanism to a player activity or event.

(73) Assignee: **IGT**

(21) Appl. No.: **11/336,398**

(22) Filed: **Jan. 19, 2006**

Related U.S. Application Data

(63) Continuation of application No. 10/224,167, filed on Aug. 19, 2002, now Pat. No. 7,008,321, which is a continuation-in-part of application No. 09/903,089, filed on Jul. 10, 2001, now Pat. No. 7,008,320.

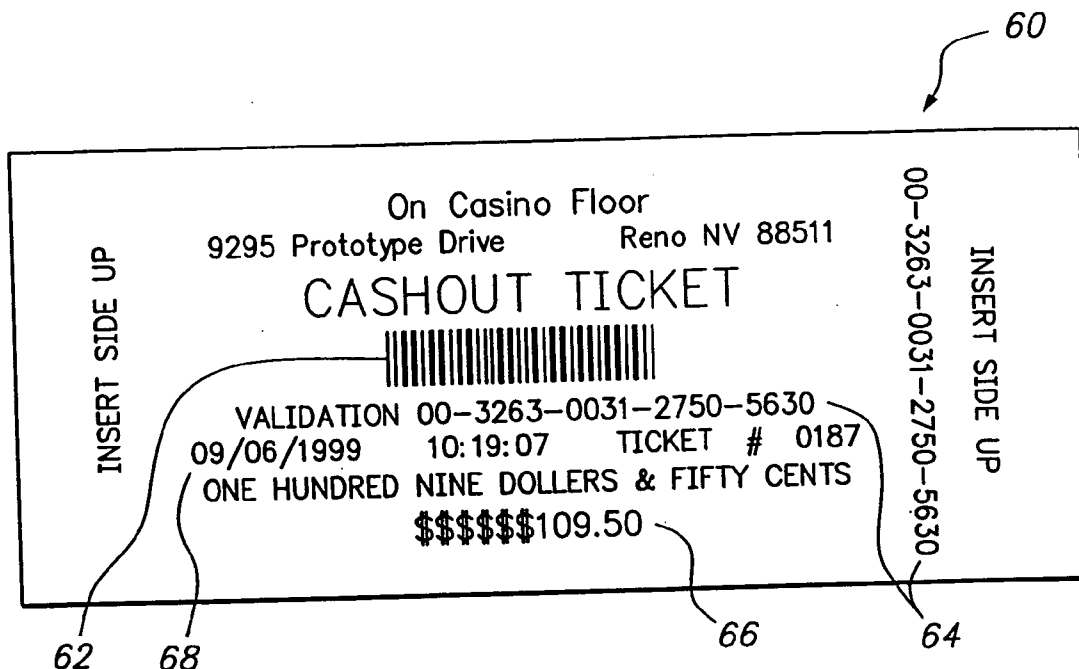

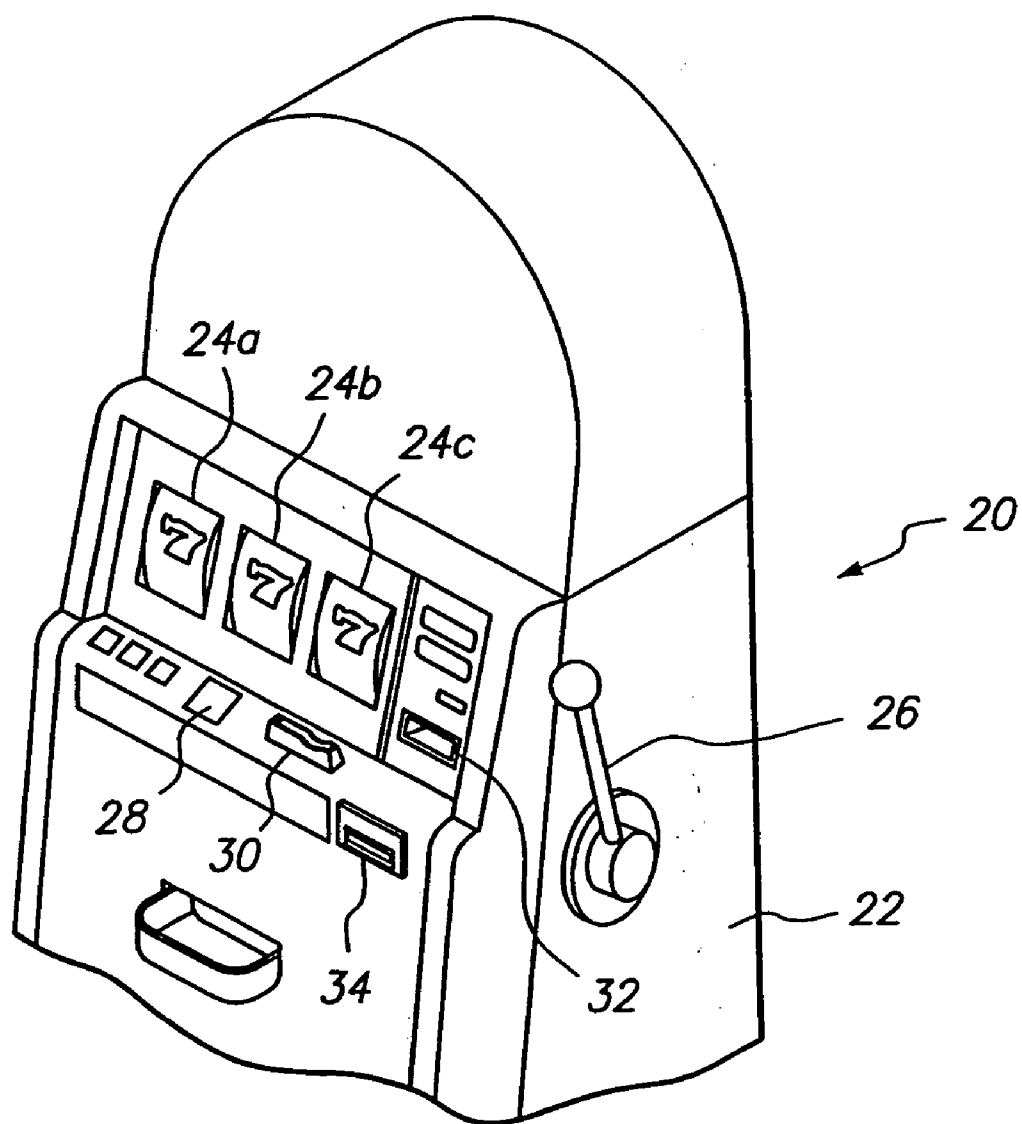

FIG. 1

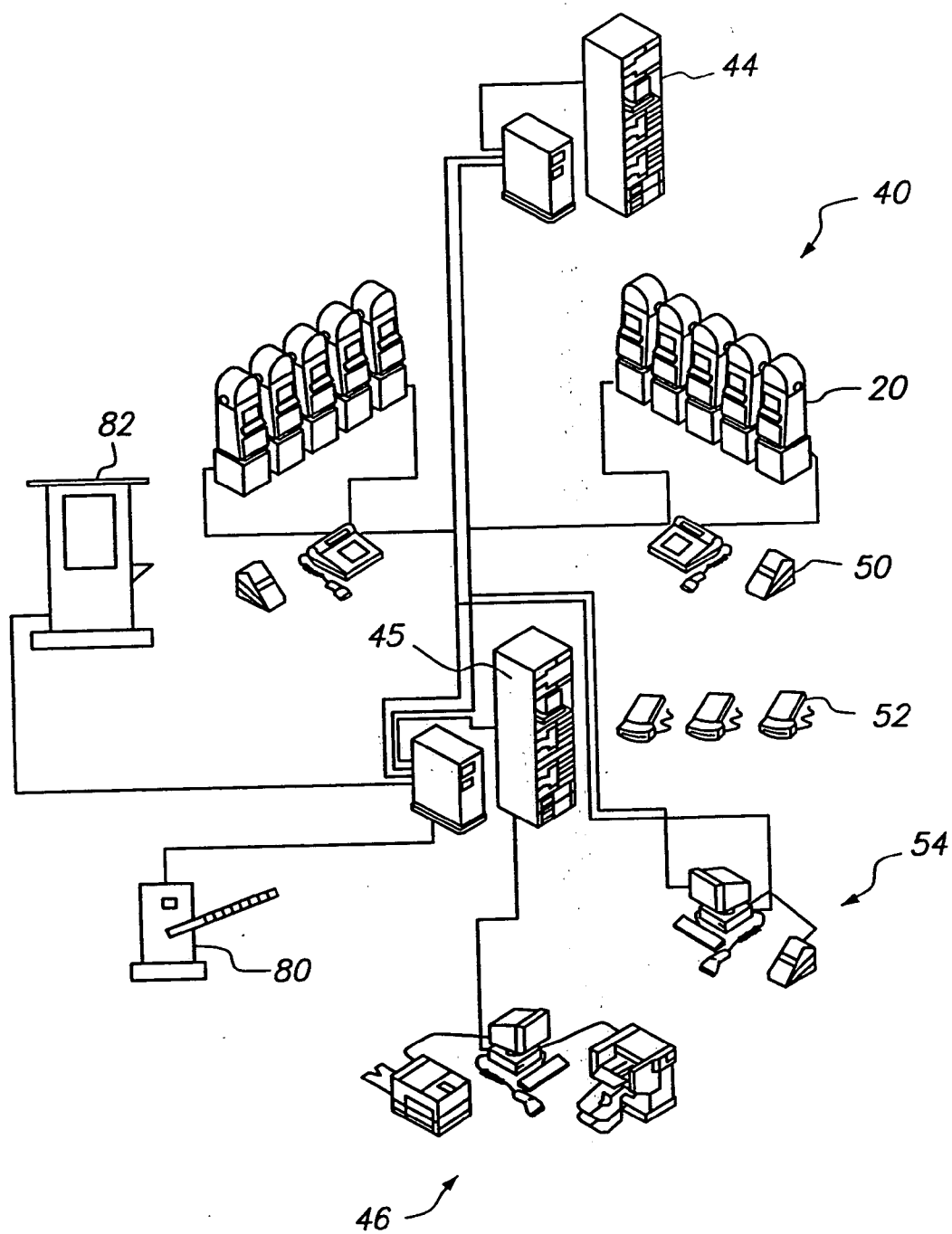

FIG. 2

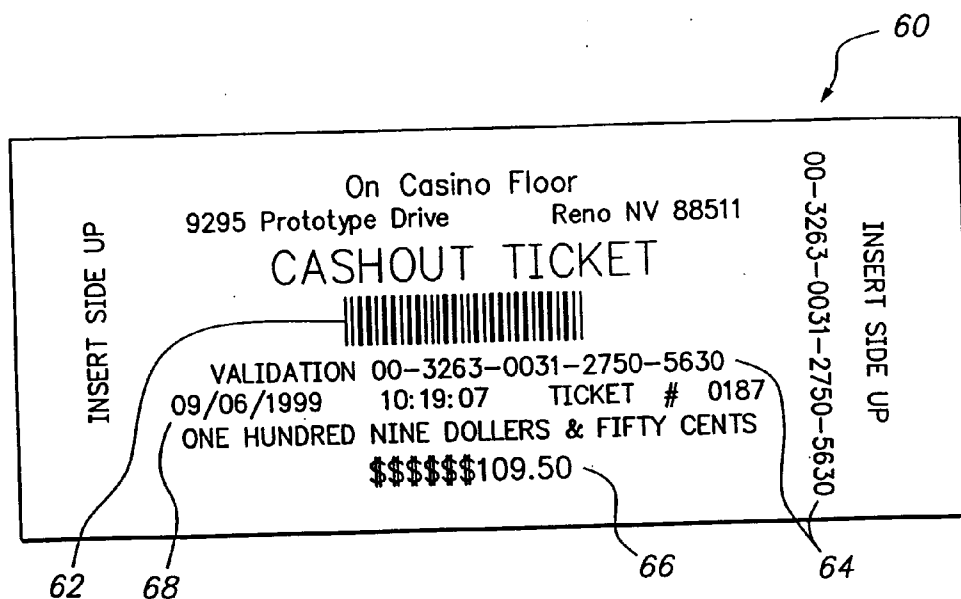

FIG. 3A

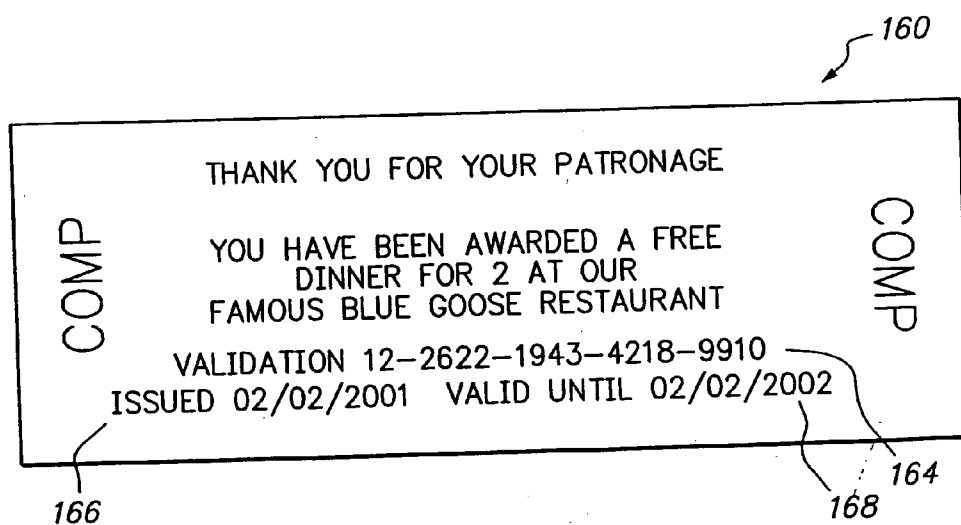

FIG. 3B

METHOD AND SYSTEM FOR ISSUING GAMING MACHINE RECEIPTS

RELATED APPLICATIONS

[0001] This application is a continuation of U.S. application Ser. No. 10/224,167, filed on Aug. 19, 2002 and now pending, which in turn is a continuation-in-part of U.S. application Ser. No. 09/903,089 filed on Jul. 10, 2001 and now pending, each of which are incorporated by reference in their entirety.

FIELD OF THE INVENTION

[0002] The present invention relates to gaming machines, and more particularly, a gaming machine capable of issuing a receipt or ticket.

BACKGROUND OF THE INVENTION

[0003] Currently, a variety of tasks related to the operation of a gaming machine including associated systems and a variety of the services offered to game players, are disjunctive. For example, a gaming machine may be arranged to accept credit cards, coins or cash as a payment form from a player for entitlement to place a bet and play a game. To facilitate these functions, gaming machines may be linked to a first network which is arranged to carry out a credit card authorization function.

[0004] A gaming machine may also include a card reader for reading information from a player tracking card and for tracking player play and rewarding awards for play. For this purpose, gaming machines may be linked to a second, entirely different player tracking network. This network may be arranged to monitor a player's play and award the player "comps" in the event the player's play reaches one or more predetermined levels, as generally reflected by points which are awarded for play. In the event a player receives sufficient points, the player may proceed to a player reward station and "cash in" their points for the comp, such as free games, a free dinner or show. Generally, this requires that a player take their player tracking card to the reward booth after they have stopped playing a gaming machine, provide their player tracking card as identification, and then be awarded a "comp."

[0005] The machine may also be provided with a jack into which may be plugged diagnostic equipment for receiving information from a gaming controller of the machine. In order to receive information regarding the operation of the gaming machine, however, a technician must travel to the machine with the necessary diagnostic equipment. Diagnosis information may be viewed on a screen of the diagnostic equipment.

[0006] It is desirable to reduce the complexity of the gaming machine, as such both reduces its cost of manufacture and cost of operation. At the same time, it is desirable to make the gaming machine more versatile, offering the player a greater number of services.

SUMMARY OF THE INVENTION

[0007] The present invention comprises a gaming system and a method of using and issuing receipts.

[0008] In one embodiment, the gaming system includes at least one gaming machine. The gaming machine is adapted

to accept credit from a player, present a game for play to a player, and pay a winning in the event a winning event is achieved by play of the game. The gaming machine is arranged to print receipts.

[0009] In one embodiment of a method, the receipt issued by the gaming machine is representative of value issued belonging to the player, such as credits provided to and won on the gaming machine. In addition, the receipt includes secondary information. The secondary information in one embodiment comprises information regarding a promotional award. In accordance with the method, the receipt is presented and the award issued. In one embodiment, the award is for a prize, and the prize is issued. In another embodiment, the award is for credit, such as a matching bet or a free game, such as at a table game. In another embodiment, the secondary information is unrelated to game play and comprises horoscope, lucky number or other information.

[0010] In another embodiment of the invention, the gaming system includes at least one first location at which a first receipt may be issued. The first receipt may be accepted by a gaming machine. The gaming machine may then issue a second receipt, the second receipt usable at a second location. In one embodiment of a method, a first receipt is issued at a parking garage entrance or similar location. A player presents the first receipt at a gaming machine. In response, the gaming machine issues a second receipt. The player may utilize the second receipt at a second location for free or reduced cost goods or services, such as free parking when presented at the exit booth at the parking garage.

[0011] In one embodiment, the gaming system includes at least one host. The host generates first receipt information and stores this information. The first receipt information is transmitted to the first location, such as the ticket issuing device at the parking garage entrance, for use in printing the first receipt. The gaming machine reads information from the first receipt and transmits it to the host for verification. If the first receipt was properly issued and has not expired or otherwise become invalid, the host generates second receipt information and transmits it to the gaming machine. The gaming machine uses the second receipt information to generate the second receipt and issue it to the player. Upon presentation of the second receipt at the second location, second receipt information may be transmitted to the host for validation.

[0012] In accordance with this method of the invention, the gaming machine is utilized to validate an activity. In one embodiment, validation may only occur if the player participates in a game at the gaming machine.

[0013] Further objects, features, and advantages of the present invention over the prior art will become apparent from the detailed description of the drawings which follows, when considered with the attached figures.

DESCRIPTION OF THE DRAWINGS

[0014] FIG. 1 illustrates a gaming machine adapted to print a receipt in accordance with the present invention;

[0015] FIG. 2 illustrates a gaming network including a plurality of gaming machines in accordance with the present invention;

[0016] FIG. 3(a) illustrates a "value" type receipt which may be issued/generated with a gaming machine in accor-

dance with the invention and be accepted by a gaming machine as value for bets; and

[0017] **FIG. 3(b)** illustrates a “comp” type receipt which may be issued/generated with a gaming machine in accordance with the invention and redeemed for an award or prize.

DETAILED DESCRIPTION OF THE INVENTION

[0018] The invention is a gaming machine arranged to generate receipts, a gaming system including one or more of the gaming machines, and one or more methods of generating and redeeming receipts. In the following description, numerous specific details are set forth in order to provide a more thorough description of the present invention. It will be apparent, however, to one skilled in the art, that the present invention may be practiced without these specific details. In other instances, well-known features have not been described in detail so as not to obscure the invention.

[0019] **FIG. 1** illustrates a gaming machine or device **20** in accordance with an embodiment of the invention. In general, the gaming machine **20** is adapted to present at least one game for play to a player. As illustrated, the gaming machine **20** includes a housing **22** which supports and/or houses the various components of the gaming machine **20**. In the embodiment illustrated, the gaming machine **20** is adapted to present a game of “slots,” and includes three rotating reels **24a,b,c**. A handle **26** or spin button **28** may be used to effectuate rotation of the reels **24a,b,c**.

[0020] In this well known game, a player may be declared the winner of the game and be awarded an award if the result of the rotation of the reels **24a,b,c** is a predetermined combination of symbols. It should be understood that the gaming machine **20** may be adapted to present one or more of a wide variety of games. Depending upon the game presented, the configuration of the machine may vary. For example, in the event the gaming machine **20** is adapted to present the game of video poker, then the gaming machine **20** may include a video display.

[0021] In one or more embodiments of the invention, the gaming machine **20** is adapted to present a wager-type game. In this arrangement, a player is required to place a bet or wager in order to participate in the game. In the event the outcome of the game is a winning outcome, then the player may be provided with an award. In one arrangement, the award may be winnings in proportion to the amount wagered or bet by the player. The winnings may comprise coins or paper currency, or credit redeemable for coins, paper currency or prizes.

[0022] In order to accept a wager, the gaming machine **20** may include a coin acceptor **30** for accepting coins. The gaming machine **20** may also include a bill acceptor or validator **32** for accepting paper currency. The gaming machine **20** may be provided with other means for accepting or verifying value, such as a credit card reader.

[0023] Preferably, in accordance with one embodiment of the present invention, the gaming machine **20** includes at least one means for generating a receipt. In one embodiment, this means comprises a receipt printer **34**. The receipt printer **34** may comprise a variety of now known or later-developed devices. In general, the receipt printer **34** comprises a device

for generating a receipt having information associated therewith. In one embodiment, the receipt is generated by printing, such as with ink, information onto an element. It is contemplated, however, that the information need not be printed, but may be generated and associated with the receipt in other manners. For example, electronic data may be generated and then “written” to a magnetic stripe of the receipt.

[0024] In a preferred embodiment, the receipt is constructed from paper or a similar material. The receipt may comprise a wide variety of other elements or members, however, such as cards or the like. While the term “receipt” is used herein, it will be appreciated that these elements may be referred to as vouchers, tickets or the like.

[0025] Though not illustrated in detail, the gaming machine **20** includes appropriate elements for generating the receipts. The gaming machine **20** may include, for example, a receipt storage device for storing blank or unprinted receipts. In one or more embodiments, a controller is provided for controlling the operation of the receipt printer **34**. As is well known, the gaming machine **20** may include a master gaming controller (not illustrated) for controlling the operation of many of the peripheral devices of the gaming machine **20**, such as lights, input buttons, coin and bill acceptors and the like. The gaming controller may include a bus with which a printer controller is associated. In this manner, the gaming controller may provide instructions, such as print instructions, to the printer for printing receipts.

[0026] In a preferred embodiment, the gaming controller of the gaming machine **20** is associated with other devices, such as through a wired or wireless network, which will be described in more detail below. **FIG. 2** illustrates one particular environment/application of the method and apparatus of the invention. As described in more detail below, this preferred environment/application comprises a gaming system **40**. The method and apparatus of the present invention may be applied to a number of different environments, including but not limited to food service, entertainment shows, promotional game play, or generally to events or activities where receipts may be issued and redeemed or used.

[0027] In general, the system **40** includes at least one gaming machine **20**. As illustrated, in a preferred embodiment, the system **40** includes a plurality of gaming machines **20**. Each gaming machine **20** is arranged to present one or more games to a player. The game presented at each machine may be the same or different.

[0028] In a preferred embodiment, the gaming machines **20** are associated with a player tracking or reward system host **44**. One or more appropriate communications links, whether wired or wireless, permit information to be transferred to and from each gaming machine **20** and the player tracking host **44**. The player tracking host **44** may comprise a single computer or a group of computers associated with one another via one or more communication links forming a network.

[0029] In one embodiment, the player tracking host **44** is associated with a player tracking/reward or “comp” function. The player tracking host **44** may thus be adapted to aggregate game play data regarding the players playing the gaming machines **20**. This data may include information

such as the length of time of game play, amounts bet, amounts awarded, and a wide variety of other information. The player tracking host **44** may also store information regarding receipts which are issued for "comps," as described in more detail below. In general, each gaming machine **20** is adapted to transmit the player tracking data over the communications link(s) to the player tracking host **44**.

[0030] In one embodiment, the player tracking host **44** includes at least one data storage element for storing the player information. The data storage element may comprise a hard drive, RAM, tape drive, CD or other memory or data storage member or element. The player tracking host **44** also includes necessary communications equipment, such as network cards or the like for receiving and sending information.

[0031] In a preferred embodiment, the gaming machines **20** are also associated with a payment host **45**. The payment host **45** may be similar to the player tracking host **44**, and comprise a computer or group of computers and include memory or other data storage devices. In one embodiment, the payment host **45** is adapted to store information regarding payment information and receipt or ticket information when a receipt or ticket has associated value.

[0032] The gaming system **40** may include a wide variety of other hosts or be associated with other networks, such as a security monitoring network or the like. As illustrated, in one or more embodiments, a variety of sub-systems or devices are associated with the gaming system **40**. In one embodiment, a soft count system **46** is associated with the gaming system **40**. The soft count system **46** is for use in a soft count process of reconciling the amounts received and paid by the gaming machines **20** with bills or receipts which have been accepted by the gaming machine **20** and removed therefrom.

[0033] One or more receipt validation mechanisms **50**, wireless receipt terminals **52** and cashier cage systems **54** may be associated with the gaming system **40**. The manner by which information from these mechanisms, terminals and systems is transmitted to and from other mechanisms, terminals and systems may vary. For example, as illustrated, the wireless receipt terminals **52** may comprise handheld devices adapted to transmit and receive information from the payment host **45** via a wireless communications link. The other systems, including the soft count system **46**, receipt validation mechanisms **50** and cashier cage systems **54** are illustrated as being hard wired to the player tracking host **44** and payment host **45**.

[0034] The receipt validation mechanisms **50**, wireless receipt terminals **52** and cashier cage systems **54** may be arranged to include a variety of apparatus, including both hardware and software, for performing a variety of functions. In one or more embodiments, these mechanisms, terminals and systems may include receipt generation/printing devices and receipt scanning or reading devices. In this manner gaming personnel may issue receipts to players and players may cash-in receipts after play at a variety of locations.

[0035] The receipts which are generated/printed by the gaming machines **20** (and optionally by other devices such as the receipt validation mechanisms **50**, wireless receipt terminals **52** and cashier cage systems **54**) may have a

variety of information associated therewith and may be used for a variety of purposes. In one embodiment, the receipts may be representative of value. As an example, in the event the player is declared a winner of a game played on a gaming machine **20**, the player may be paid an award. As noted above, the award may be in the form of coins. In one embodiment of the invention, however, the award may be associated with or represented by a receipt. For example, in the event the player wins **100** dollars and the player wishes to discontinue playing the gaming machine **20**, the gaming machine **20** may print a receipt representing this winning amount. As detailed below, data regarding the ticket and the winning amount is preferably transmitted to the payment central host **45**. Such a receipt may be referred to as a "value" receipt.

[0036] In one or more embodiments, the gaming machine **20** may be arranged to accept such a (value) receipt, thus forming a basis by which the player may provide credit to play the game. As illustrated in **FIG. 1**, the gaming machine **20** includes a validating mechanism **32** and a storage device for the bill monies and receipts. The validating mechanism is arranged to verify the authenticity of the bill money or a receipt which is supplied by the player, thus establishing the right of the player to play the game. For example, the validating mechanism is arranged to reject a counterfeit paper item which a player attempts to pass as a treasury bill. The operation of these mechanisms are well known. Additional details regarding the validation of a value type receipt are disclosed below.

[0037] Receipts of different types or for different purposes may have a variety of different forms. Referring to **FIG. 3(a)**, there is illustrated a receipt **60** which may be representative of cash value or currency. In one or more embodiments, the information associated with the receipt **60** includes machine readable information. As illustrated, this information comprises a UPC type bar-code **62**. In one or more embodiments, the bar-code **62** may represent encoded information such as the value of the receipt **62** and other information. In a preferred embodiment, the bar code **62** represents the validation code or other unique identifier **64**. Information such as a value **66** of the receipt **60** is obtainable utilizing the validation code or number **64** this information capable of being located or stored remote from the receipt **60** itself, as described in detail below. The receipt **60** may include other information, such as a date of issuance **68**.

[0038] As noted above, the receipt **60** may have a variety of forms. For example, the bar coding may be accomplished with different colors of material comprising the receipt **60**, such as by exposing thermoplastic to high heat or the like to generate the spaced bars. The magnetic stripes or chips or similar information storage elements may be associated with the receipt **60** for use in storing the information. Information may be coded in the form of punch holes or other patterns of material or voids of material.

[0039] In accordance with the present invention, the gaming machine **20** is preferably adapted to generate or print receipts of other types or associated with functions/purposes other than for use in replacement of currency or value as described above. In one or more embodiments, the gaming machine **20** is arranged to print receipts which represent "comps," gratuities or other awards. It is common for frequent players to be rewarded for their play. In an embodi-

ment of the invention, a player's play is rewarded with a receipt which may be redeemed for a prize or award. For example, the receipt may be redeemable for a free dinner at a restaurant, a free night or nights stay in a hotel room, airline miles, travel, luggage or a wide range of other goods or services. Receipts may also be awarded or issued which simply provide information, such as hotel room charges, hotel room check-out information or receipts, show or restaurant times, restaurant menus and prices, and a wide range of other information.

[0040] Such "comp" or award receipts may be generated in a number of manners. In one embodiment, a player's play of any gaming machine associated with the gaming system 40 is tracked. Data regarding the player's play is stored at the player tracking host 44. The player tracking host 44 is also preferably arranged to monitor the play data such that, if the player reaches predetermined levels of play or other criteria of play exist, the player is awarded a "comp." In another embodiment, the play of a particular gaming machine 20 may trigger a "comp" award. As is known, the tracking of the play of a particular player may be initiated by the player identifying themselves, such as by swiping a magnetic stripe of a player tracking/identification card through a card reader associated with the gaming machine 20.

[0041] The criteria for awarding a "comp" or "complimentary" reward may vary. In a preferred embodiment of the invention, the player is rewarded a comp based upon criteria independent of the direct outcome of a game played at the gaming machine. In this regard, the award may be referred to as a bonus, as the award is above and beyond any award provided to the player based in the above outcome of a player's game, and does not require further or additional consideration (such as an additional bet) by the player. As noted, the comp may be awarded based upon frequency or time of play, actual losses, theoretical win or a wide variety of criteria other than the direct win or loss of a game.

[0042] A "comp" receipt may also be awarded to a player at the discretion of the game operator or casino. For example, regardless of the length of time a player has been playing, the operator may instruct the machine 20 to issue a receipt for a prize or award. The operator may also cause receipts representing awards independent of game play to be issued at several gaming machines, such as a promotion.

[0043] Once a player is entitled to a "comp," the player tracking host 44 is adapted to send a signal to the gaming machine 20 to cause the gaming machine to issue a "comp" receipt. In one embodiment, the player may be provided with an opportunity to select the "comp" or award which is given. For example, for reaching a predetermined level of play, a player may be permitted to select one prize from a list of prizes. This list may be transmitted from the player tracking host 44 for display by the gaming machine 20 to the player. The player may then input their selection. The gaming machine 20 is then arranged to print the receipt representative of the "comp." Information regarding the comp which has been awarded is stored at the player tracking host 44 and printed on the receipt.

[0044] FIG. 3(b) illustrates an embodiment of a "comp" or award receipt 160 in accordance with the invention. As illustrated, the receipt 160 includes text indicating that the receipt 160 has been awarded as a result of the player's play. The nature of the comp is indicated, such as the fact that the

receipt represents a free dinner award. A receipt identifier 164 is printed on the receipt 160. In addition, an issue date 166 and expiration date 168 are printed on the receipt. The "comp" type of receipt 160 may have other forms than that illustrated. For example, the receipt 160 may be similar to the receipt 60 illustrated in FIG. 3(a), and include a readable bar code.

[0045] In one embodiment, the comp receipt 160 may be similar to a value receipt in that it may be presented to a gaming machine 20 or other location for redemption or other use. In one embodiment, the comp receipt 160 may, as just indicated, include a readable bar code or other machine readable information.

[0046] In one embodiment, the comp receipt 160 may be issued at a gaming machine 20 or other location, such as at the front desk of the hotel/casino to new patrons or at a station when a player joins a player tracking/rewards club of the casino. The comp receipt 160 may be presented as a value receipt to a gaming machine 20 or at another location. For example, the comp receipt 160 may entitle a player to \$5 of free game play, a matching bet amount at the gaming machine 20, or free or discounted merchandise. In one embodiment, the receipt 160 may be issued by the gaming machine 20. For example, upon reaching a predetermined level of play, such as an amount bet or time of play, the gaming machine 20 may be configured to print the comp receipt 160 entitling the player to free game play, a value credit or the like.

[0047] In one embodiment, the gaming machine 20 may be configured to print the receipt based on tracked play or, as indicated above, the player tracking host 44 or other device may track play and then send a signal to the gaming machine 20 causing the gaming machine to print the receipt.

[0048] In another embodiment, the gaming machine 20 may be configured to print an informational receipt. The informational receipt may include a variety of information, such as a daily horoscope, a lucky set of numbers, advertising for products and/or services, or information regarding show or other event times and prices. Of course, the variety of information which may be provided on the receipt is limitless and not limited to the information detailed here.

[0049] In one embodiment, the gaming machine 20 is arranged to print a receipt which is representative of value belonging to a player, such as credits or value deposited by the player and accrued while playing games on the gaming machine 20, along with secondary information. In one embodiment, the secondary information may include information such as a horoscope or the like as described above. In another embodiment, the secondary information may be information entitling the player to a "comp," such as a free credit or game play.

[0050] In another embodiment of the invention, the gaming machine 20 is adapted to print a receipt which includes game accounting, security or diagnosis information. In one embodiment, a technician may open the machine 20 and cause the gaming controller to perform a diagnostic function (such as by simply pressing a button or providing other input). The gaming controller is then arranged to print out the results of the diagnostic on a receipt with the receipt printer 34. It will be appreciated that the variety of information which may be printed depends substantially upon the

nature of the diagnostic which is performed. Such diagnostic functions are well known, and may be programmed into the gaming controller. It will also be appreciated that the manner by which the diagnostic is initiated may vary. For example, in one embodiment, a simple key switch may be located on the exterior of the gaming machine 20. When the technician turns the key switch with the appropriate key, the controller may be caused to perform a diagnosis and print the results.

[0051] In accordance with the present invention, the receipt printer 34 of the gaming machine 20 may be adapted to print a wide range of other information. For example, a gaming representative may cause the gaming machine 20 to print audit information, such as information relating to the amounts bet and awarded as a result of play of the machine 20. An audit receipt may be printed as needed or automatically at specified intervals. The audit receipt may include information such as, but not limited to, coins paid in and coins paid out, currency in, and the time that a cash box was removed. The gaming machine 20 may be adapted to print a receipt having information regarding a wide variety of functions, such as a coin hopper fill status, meter/counter data and the like.

[0052] In one or more embodiments of the invention, the gaming machine 20 may be instructed to print a receipt (such as a diagnosis or audit receipt) from a remote location. For example, a gaming representative may send a diagnosis signal to the gaming machine 20 via a network link. In one embodiment, a gaming representative may use a wireless control device, such as one of the hand-held units 52, to send a command to cause the gaming machine 20 to print a receipt with desired information.

[0053] Regardless of the receipt's type, a variety of limitations may be imposed on the use of a receipt. For example, as illustrated in FIG. 3(b), the receipt 160 may be deemed to expire after a certain period of time if not used. Preferably, the expiration data 168 is stored at the player tracking host 44 such that if a person attempts to redeem the receipt 160 (as described below) after its expiration period, that receipt 160 is rejected. A receipt may also be redeemable at one or more specific locations or at specific times.

[0054] As detailed below, in accordance with one or more embodiments of the invention, there are provided methods and devices for validating a receipt. As used herein, the terms of validation or entitlement generally mean establishing the right of the player to use the receipt, such as to redeem the receipt for an award or "comp," or to use the value associated with the receipt, as in placing wagers or bets. Thus, one aspect of the invention is validating the "value" type receipt 60 to establish a player's right to use the value associated with the receipt. Similarly, one aspect of the invention is the validating of the "comp" type receipt 160 to establish the right of a player to the award or comp associated therewith.

[0055] In one or more embodiments, the receipt 60,160 may be redeemed for value in coins or currency or a specific award or prize. If the receipt 60,160 has little associated value or is associated with a minimal award, then the receipt may be redeemed after simple inspection by a gaming representative or other authorized personnel. For example, if the receipt entitles a person to a free dinner, the hostess at the restaurant may visually inspect the receipt to determine that it is still valid and is to be redeemed for a free dinner at that particular restaurant.

[0056] In one or more embodiments, validation of the receipt 60,160 may include confirmation that the party redeeming it is the rightful owner. For example, in the case of the "comp" receipt 160, the receipt 160 may include a player tracking number or other identifier printed thereon (or stored at the player tracking host 44). At the time of redemption, the player may be required to provide identification verifying that they are the same party that was issued the receipt 160.

[0057] In a preferred embodiment, the receipt 60,160 is verified using data stored at the appropriate database, such as at the tracking host 44 or the player host 45. As stated above, when a receipt 60,160 is generated, a corresponding data file or other record is also generated. In one embodiment, the receipt 60,160 record is stored in one or more locations, such as the player tracking host 44 or payment host 45.

[0058] Preferably, when the receipt 60,160 is redeemed, the authenticity of the receipt 60,160 is confirmed, and the status of the receipt 60,160 and related information is updated. The receipt 60,160 may be presented or redeemed in a variety of manners. As noted above, a player having a value receipt 60 may travel to a gaming machine 20 which is arranged to accept receipts and utilize the receipt to provide the necessary credit to entitle the player to play the game. In one or more embodiments, the player is not limited to presenting the receipt 60 to the same gaming machine 20 which issued it, but may present it to any gaming machine 20 associated with the system 40. A player may also be permitted to redeem the value receipt 60 at a remote location, such as the receipt validation mechanism 50, cashier station 54 or other location. Such a station may be located at a cashier cage, or a moving cart or other locations.

[0059] A player may be permitted to redeem an award or "comp" receipt 160 at a variety of locations. One location may be the specific location providing the good or service which the receipt represents. For example, if the receipt 160 is for a dinner or show, then the player may redeem the receipt at the dinner or show, just as if the player had cash or a ticket. In another embodiment, the player may be required to redeem the receipt 160 at one or more specified locations, such as a central station. For example, a player may be required to redeem their receipt 160 for a free show at the ticket or box office for the show for exchange of the receipt for an actual ticket to the show.

[0060] Regardless, in one embodiment, the receipt 60,160 is validated using a validating mechanism discussed below. The validating mechanism is arranged to verify the authenticity of the receipt 60,160 which is supplied.

[0061] In one embodiment, the gaming machine 20 includes a validating mechanism (such as reader 32) for reading the bar code 62 and sending the validation code 64 or other identifying information for a value receipt 60 represented by the bar code 62 to the payment host 45. The payment host 45 may then confirm whether the receipt 60 is valid and the value 66 which it represents. If the payment host 45 indicates that the receipt 60 is valid, then the gaming machine 20 is arranged to credit the player the value 66 of that receipt 60. Further, a transaction record associated with the gaming machine 20 is updated, which record makes it possible to determine the total value of all bill monies and receipts accepted by that particular gaming machine.

[0062] As provided above, the payment host 45 may verify the authenticity or validity of a particular receipt 60 by comparison to a voucher record. In one or more embodiments, the verification includes matching the code 64 read from the receipt 60 against the records to determine that a receipt 60 having the particular code was authorized and issued. Next, the verification includes determining that the receipt 60 is indicated as outstanding and not already paid. The verification may also include confirming the value 66 of the receipt 60.

[0063] In one or more embodiments, once the receipt 60 is accepted, verified and its value credited, the receipt record is updated. In one embodiment, the voucher record may be updated to reflect that the receipt 60 has been paid and is no longer outstanding. In this manner, if the receipt 60 is thereafter stolen and re-presented, during the verification step the receipt 60 will be identified as previously presented and will not be paid again. In this method, the step of updating may comprise the writing or rewriting of the voucher record stored at the payment host 45.

[0064] In one embodiment, when a player attempts to redeem a "comp" receipt 160, information associated with the receipt 160 is preferably verified with the stored receipt data. In one embodiment, a receipt reader is located at each redemption point. For example, a receipt redemption station 50 may be located at each restaurant, ticket office, or other prize redemption location. In the preferred embodiment, information associated with the receipt 160 is inputted, such as by key input of the code 164, or by optical reading the information or the like. This information is then transmitted to the player host 44 for confirmation/comparison. If the receipt 160 is valid, an instruction is returned to the station 50 that the redemption is allowable. If the receipt 160 is invalid, such as if it is expired or is counterfeit, then such an indication is provided. If the receipt 160 is redeemed, then the data regarding that receipt 160 is preferably updated, such as by indicating that the receipt 160 has been redeemed and is no longer valid.

[0065] As described above, the receipt 60, 160 issued by the gaming machine 20 may be used to obtain goods or services. In one embodiment of the invention, the gaming machine 20 validates an activity or receipt. In one method, a first receipt is used at a first location, and the first receipt is accepted at the gaming machine 20. The gaming machine 20 validates the first receipt, and in one embodiment issues a second receipt. The second receipt is used by a player to obtain free or reduced cost goods or services.

[0066] In one specific embodiment of the invention, the receipt 60, 160 may be used to obtain free parking or a similar service. As illustrated in FIG. 2, in one embodiment, a parking garage ticket issuing device 80 may be arranged to print a receipt 60 which is readable or usable at a gaming machine 20. In one embodiment, a casino patron may be issued such a receipt 60 when they park their car at a parking lot or structure associated with the casino. Receipt information may be generated at the payment host 45 or another location and then transmitted to the parking garage ticket issuing device 80 for printing. Preferably, the receipt 60 information is stored at the host 45 or at an associated device.

[0067] The player may utilize the receipt 60 at a gaming machine 20 in the casino. In one embodiment, the player

may utilize the receipt 60 to obtain free game play or credits, in like manner to the comp receipt 160 having value described above. In another embodiment, the receipt 60 may simply be accepted for acknowledgment by the gaming machine 20.

[0068] When a player participates in game play at the gaming machine 20, the gaming machine 20 may send a signal to the payment host 45 indicating that the player has entered their receipt 60 or has otherwise engaged in play. In one embodiment, the gaming machine 20 reads information from the receipt 60 and transmits this information to the payment host 45 for verification against the stored information. This step may be used, for example, to verify that the receipt 60 is valid. For example, the receipt may be deemed invalid if it has been used before, or is beyond an assigned time frame or the like.

[0069] The gaming machine 20 may then be caused to issue another receipt 60 to the player. This receipt 60 may be utilized by the player to exit the parking structure without payment for parking. In other words, the gaming machine 20 issued receipt is valid for free or reduced goods or services upon redemption, those services comprising in this embodiment parking.

[0070] The player may present the gaming machine 20 issued receipt 60 to a parking attendant or a device for verifying entitlement to exit the parking area 82 as illustrated in FIG. 2. In one embodiment, the receipt 60 may have information printed thereon, such as a bar code or text, which is used to verify that the player is entitled to free or reduced cost parking services. In one embodiment, a bar code on the receipt 60 may be read and the information transmitted to the payment host 45 for verification against stored receipt information.

[0071] This embodiment is illustrative of the many types of receipts which the gaming machine 20 may both utilize and issue. It will also be appreciated that the methods may be applied in other than casino environments. For example, the above-described method may be applied at an airport where there is a parking area and one or more gaming machines are located in the airport. Parties picking up or delivering passengers may be entitled to free parking upon entering the airport and playing a game or games.

[0072] A variety of alternate embodiments to the methods described above are contemplated. For example, instead of utilizing a first receipt and then issuing a second receipt, the first receipt may simply be validated and then utilized at the second location. For example, information regarding the first receipt may be updated at the host, such that when the first receipt is presented at the second location, the host indicates that the first receipt is valid for free or reduced cost goods or services.

[0073] In one embodiment, validation of the receipt occurs only if a player engages in the play of a game. In another embodiment, the validation may occur if a player only presents the receipt to a gaming machine. For example, in one embodiment the first receipt may permit a player to participate in one free game on the gaming machine. Upon doing so, the receipt may be validated or the second receipt issued to the player.

[0074] The methods and devices of the present invention have numerous advantages. First, a gaming machine 20 is

adapted to generate, such as by configuring data and printing, a receipt. This receipt may be representative of a value or award, be used for direct redemption of a good or service, provide general information, such as diagnostic or accounting data, or otherwise be used for a wide variety of purposes. In this manner, the gaming machine 20 is capable of carrying out a plurality of functions which were previously not permitted.

[0075] As one aspect of the invention, a player may be awarded a “comp” directly by a gaming machine while playing the gaming machine. The player is no longer always required to travel to a remote player reward station to determine if they are entitled to a “comp” and be provided that comp. For example, a player may be rewarded a free dinner for their play. A receipt may be immediately issued to the player when the comp is achieved, and the player may then travel directly to the restaurant to obtain their reward.

[0076] As another aspect of the invention, gaming machine diagnostic, accounting and similar information may be obtained from a receipt printed by the gaming machine. This avoids the need for additional diagnostic equipment and the like. A technician or gaming representative may simply instruct the gaming machine 20 to provide the requested information which is then printed on the spot. A technician or gaming representative may travel from gaming machine to gaming machine and quickly obtain information for a variety of purposes, including comparison to other machines.

[0077] As another aspect of the invention, the gaming machine is adapted to print an information receipt providing information to the player/user of the gaming machine. In one or more embodiments, other servers or computers may be in communication with the gaming machine. These servers may provide data representing a wide variety of information, such as restaurant menu information, show times and rates and the like. In one embodiment, the gaming machine may be arranged to be in communication with a hotel reservation/accounting system permitting a player/user of the gaming machine to check out or obtain information such as room charge information.

[0078] In one or more embodiments, the gaming machine may be adapted to display and print menu information to a player. The player may use the menu to select particular information or activities to be associated with the receipt. For example, the gaming machine may include a “menu” button causing a menu to be displayed. The menu may

include “access room account” as a selection which the player/user may select in order to obtain their room charge information, which information is then printed out and dispensed to the player.

[0079] In accordance with the invention, a variety of methods are provided for verifying information, such as for the redemption of a receipt. The receipt may be verified with receipt data stored at a remote location.

[0080] It will be understood that the above described arrangements of apparatus and the method therefrom are merely illustrative of applications of the principles of this invention and many other embodiments and modifications may be made without departing from the spirit and scope of the invention as defined in the claims.

We claim:

1. A method of issuing and utilizing receipts in a gaming system comprising:

- issuing a first receipt to a player at a first location;
- accepting said first receipt at a gaming machine arranged to present at least one game for play by a player;
- verifying said first receipt;
- issuing a second receipt at said gaming machine to said player; and
- accepting said second receipt at a second location;

wherein said second receipt requires redemption at said second location where said second location is selected from the group consisting of a parking garage exit, a ticket office and a restaurant.

2. The method in accordance with claim 1 further including providing goods or services to said player upon acceptance of said second receipt at said second location.

3. The method in accordance with claim 1 wherein said verifying said first receipt comprises comparing information associated with said receipt with information utilized to generate said receipt.

4. The method in accordance with claim 1 wherein said verifying game play by said player at said gaming machine and issuing said second receipt upon verification of said game play.

5. The method in accordance with claim 1 wherein said issuing a first receipt is in response to a positive action performed by said player at the first location.

* * * * *