

(12) STANDARD PATENT
(19) AUSTRALIAN PATENT OFFICE

(11) Application No. **AU 2017200730 B2**

(54) Title
Water purifying apparatus and filter structure

(51) International Patent Classification(s)
B01D 35/30 (2006.01) **B01D 35/12** (2006.01)
B01D 29/13 (2006.01) **B01D 35/147** (2006.01)

(21) Application No: **2017200730** (22) Date of Filing: **2017.02.03**

(30) Priority Data

(31) Number	(32) Date	(33) Country
10-2016-0034309	2016.03.22	KP

(43) Publication Date: **2017.10.12**

(43) Publication Journal Date: **2017.10.12**

(44) Accepted Journal Date: **2018.06.21**

(71) Applicant(s)
LG Electronics Inc.

(72) Inventor(s)
YOU, Jimin;AN, Siyeon;HWANG, Uison;KIM, Youngjae;KWEON, Gyeonghwan

(74) Agent / Attorney
Watermark Intellectual Property Pty Ltd, Level 1 109 Burwood Road, Hawthorn, VIC, 3122, AU

(56) Related Art
WO 2008007823 A1

ABSTRACT

A water purifying apparatus includes a head on having a water inlet portion and a water outlet portion; a shaft provided in the head and rotatably mounted between the water inlet portion and the water outlet portion; a bypass flow path passing through a circumference of the shaft, and communicating the water inlet portion with the water outlet portion according to rotation of the shaft; a filter detachably mounted to the head, and having a filter inserting portion in which the shaft is inserted when being mounted on the head; and a filtering flow path in which an inlet port and an outlet port are formed on the circumference of the shaft in a direction intersecting the bypass flow path, and communicated between the filter, the water inlet portion and the water outlet portion with each other according to the rotation of the shaft.

Fig.4

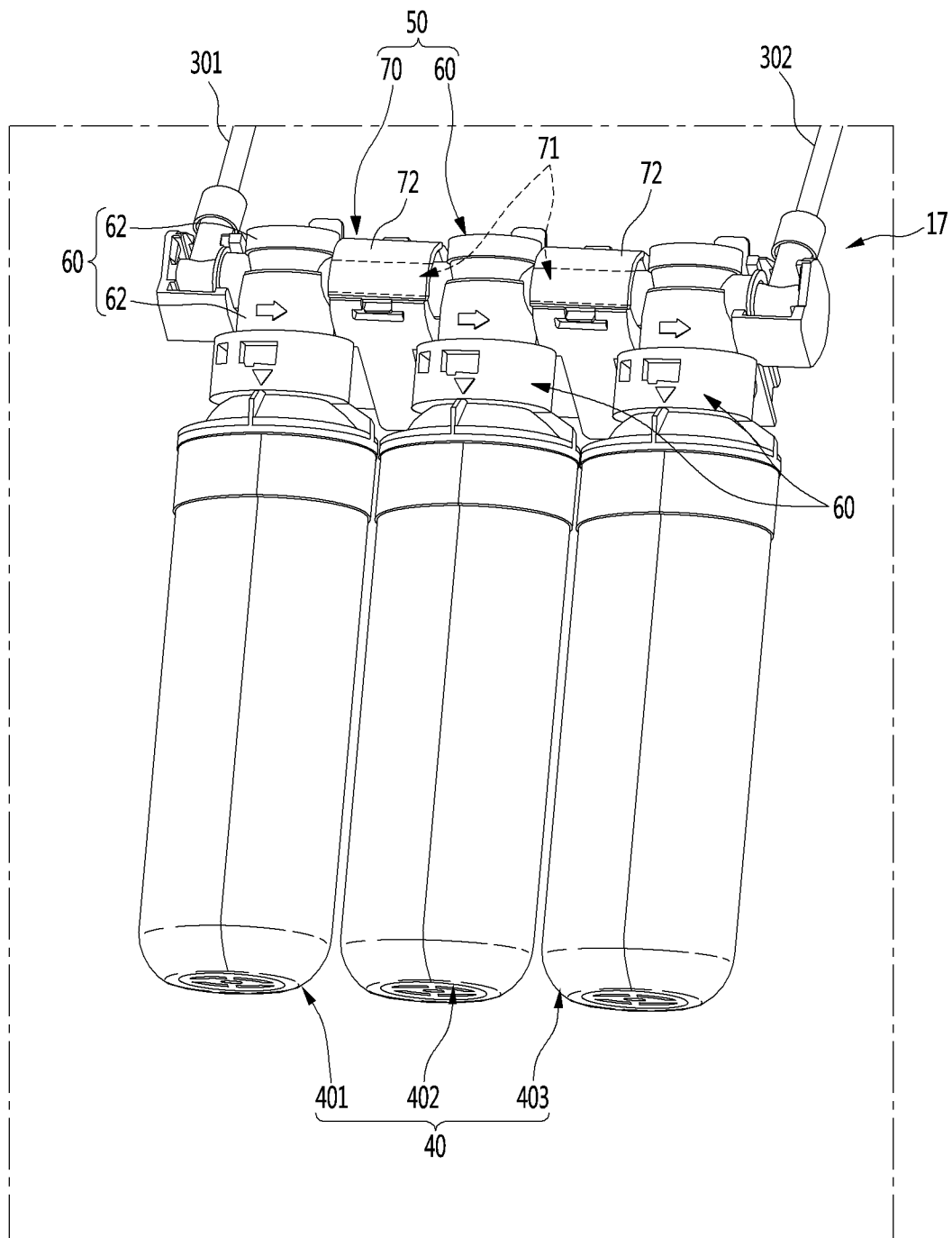

WATER PURIFYING APPARATUS AND FILTER STRUCTURE

BACKGROUND

[0001] In general, a water purifying apparatus is used to purify supplied water using a filter or filtering material, and includes an apparatus that purifies water from a water pipe or tank to be fit to drink.

[0002] A representative example of the water purifying apparatus that supplies drinkable water is a water purifier. Recently, the entire or a portion of such a water purifying apparatus has been provided even in a refrigerator to be supplied with purified water through the refrigerator or make ice using the purified water.

[0003] In a refrigerator including the water purifying apparatus, a filter constituting the water purifying apparatus is required to be replaced or inspected as necessary. Accordingly, the filter is detachably installed for this purpose. The water purifying apparatus is configured to have a bypass flow path which is capable of supplying water even in a state where the filter is separated and then a user can take out water even during replacement or inspection of the filter.

[0004] Korean Patent Laid-Open Publication No. 10-2015-0135021 (published on December 2, 2015) discloses a head for a water purifying filter having a bypass structure.

[0005] However, the head of the related art has a complicated structure so that the flow path is capable of being opened and closed by a flow path switching plunger which is supported by an elastic member at the time of attachment and detachment of the filter. Therefore, there is a problem of poor productivity and assembling workability.

[0006] In addition, there is a problem that the bypass path of the flow path is complicated due to the structure of the flow path switching plunger which is slid, thereby deteriorating the flow performance of water.

[0007] In addition, there may arise a problem that the flow path is not capable of being switched when the performance of the elastic member is deteriorated or the elastic member is abnormal.

SUMMARY

[0008] In one aspect of the invention, there is provided a water purifying apparatus including: a head on which a water inlet portion and a water outlet portion are formed to face each other in a straight line; a mounting member on which a rotation supporting portion is formed to surround the water inlet portion and the water outlet portion of the head; a water inlet pipe and a water outlet pipe which are connected to the mounting member; a shaft provided in the head and rotatably mounted between the water inlet portion and the water outlet portion; a bypass flow path formed to pass through a circumference of the shaft, having a flow path projecting portion on a penetrated flow path, and communicating the water inlet portion with the water outlet portion according to rotation of the shaft; a filter detachably mounted to the head, and having a filter inserting portion in which the shaft is inserted when being mounted on the head; and a filtering flow path in which an inlet port and an outlet port are formed on the circumference of the shaft in a direction intersecting the bypass flow path, and which communicates between the filter, the water inlet portion and the water outlet portion with each other according to the rotation of the shaft.

[0009] In another aspect of the invention, there is provided a water purifying apparatus including: a head on which a water inlet portion and a water outlet portion are formed; a shaft provided in the head and rotatably mounted between the water inlet portion and the water outlet portion; a bypass flow path formed to pass through a circumference of the shaft and communicating the water inlet portion with the water outlet portion according to rotation of the shaft; a filtering flow path formed in the shaft in a direction intersecting the bypass flow path; an inner pipe formed to extend downward from the shaft and having a pipe cutout portion on an end thereof; a filter detachably mounted to the head and having a filter inserting portion in which the shaft is inserted when being mounted on the head; and a first connecting portion formed on a supporter extending portion which extends in a direction of the shaft in the filter insertion portion, to rotate the shaft upon rotatably coupling of the filter by coupling with the pipe cutout portion.

[0010] In still another aspect of the invention, there is provided a water purifying apparatus, comprising: a head on which a water inlet portion and a water outlet portion are formed; a shaft provided in the head, and rotatably mounted between the water inlet portion and the water outlet portion; a bypass flow path formed to pass through a circumference of the shaft and communicating the water inlet portion with the water outlet portion according to rotation of the shaft; a filtering flow path formed in the shaft to be separated from the bypass flow path; an inner pipe formed to extend downward from the shaft and having a pipe cutout portion on an end thereof and connected to the filtering flow path; a filter detachably mounted to the head and having a filter inserting portion in which the shaft is inserted when being mounted on the head; a supporter extending

portion forming a first filter inlet flow path which is connected to the inner pipe and provided in the filter; and a first connecting portion formed on an upper portion of the supporter extending portion to rotate the shaft upon rotatably coupling of the filter by coupling with the pipe cutout portion.

[0011] In still another aspect of the invention, there is provided a filter structure, comprising: a housing body formed in a cylindrical shape to have a first accommodating space and having an upper opening portion; a housing cap coupled to the upper opening portion of the housing body by a portion thereof being formed in a cylindrical shape to have a second accommodating space, wherein a coupling projection and an upper opening portion are formed on an outer circumferential surface thereof, and a housing fastening portion is formed on an inner circumferential surface thereof; a filtering member having a cylindrical shape accommodated in the first accommodating space; and an upper supporter coupled to an upper portion of the filtering member and an inner surface of the housing cap respectively, and accommodated in the second accommodating space.

[0012] The upper supporter includes a supporter accommodating portion coupled to the upper portion of the filtering member; a supporter stepped portion integrally formed on an upper portion of the supporter accommodating portion and in which a second filter inlet flow path is formed on the outer circumferential surface thereof so that water is supplied in a space between the outer circumferential surface of the filtering member and the housing body; a supporter extending portion which extends upward from the supporter stepped portion, in which a first filter inlet flow path which communicates with a second filter inlet flow path is formed on a center portion thereof, in which a pair of projecting portions

are formed to be extend on the upper portion of the first filter inlet flow path and in which a filter outlet flow path is formed on an outside of the first filter inlet flow path; and a supporter fastening portion which prevents a rotation of the upper supporter in the housing cap by being coupled to the housing fastening portion.

[0013] In an embodiment, the water purifying apparatus may be capable of continuously supplying water by a bypass flow path being switched according to attachment and detachment of a filter.

[0014] In an embodiment, the water purifying apparatus may advantageously have a simple bypass flow path switching structure which improves productivity and assembling workability.

[0015] In an embodiment, the water purifying apparatus may have a bypass flow path capable of being switched by rotation mounting of a filter.

[0016] In an embodiment, the water purifying apparatus may provide easy attachment and detachment of the filter.

[0017] In an embodiment of the water purifying apparatus, the flow of water is advantageously capable of being smoothly performed when the bypass flow path is converted by the attachment and the detachment of the filter.

[0017a] "Comprises/comprising" when used in this specification is taken to specify the presence of stated features, integers, steps or components but does not preclude the presence or addition of one or more other features, integers, steps, components or groups thereof.

BRIEF DESCRIPTION OF THE DRAWINGS

[0018] Fig. 1 is a front view illustrating a refrigerator according to an embodiment.

5a

[0019] Fig. 2 is a front view illustrating a state where a door of the refrigerator is opened.

[0020] Fig. 3 is a view schematically illustrating a disposition structure of a water supplying flow path of the refrigerator.

[continued on page 6]

[0021] Fig. 4 is a perspective view illustrating the structure of the water purifying apparatus.

[0022] Fig. 5 is a perspective view illustrating a structure of a water purifying apparatus according to another embodiment.

[0023] Fig. 6 is an exploded perspective view illustrating a state where a filter and a head of the water purifying apparatus are separated.

[0024] Fig. 7 is an exploded view illustrating the structure of the filter.

[0025] Fig. 8 is a longitudinal sectional view of Fig. 7.

[0026] Fig. 9 is a sectional view taken along line 9-9 'of Fig. 7.

[0027] Fig. 10 is a sectional view taken along line 10-10 'of Fig. 6.

[0028] Fig. 11 is a partially cutaway perspective view illustrating an upper supporter of the filter.

[0029] Fig. 12 is a side view illustrating the head.

[0030] Fig. 13 is an exploded perspective view illustrating a coupling structure of the head viewed from a side.

[0031] Fig. 14 is an exploded perspective view illustrating the coupling structure of the head viewed from the other side.

[0032] Fig. 15 is a cutaway exploded perspective view illustrating an internal structure of the head viewed from one side.

[0033] Fig. 16 is a cutaway exploded perspective view illustrating the internal structure of the head viewed from the other side.

[0034] Fig. 17 is a perspective view illustrating the head viewed from the lower side.

[0035] Fig. 18 is a partially cutaway perspective view illustrating the head.

[0036] Fig. 19 is a cutaway perspective view illustrating a state where the filter and the head are separated from each other.

[0037] Fig. 20 is an enlarged view of portion A of Fig. 19.

[0038] Fig. 21 is a view illustrating a shaft position in a state where the filter and the head are separated from each other.

[0039] Fig. 22 is a view illustrating a state where the filter is inserted into an inside of the head.

[0040] Fig. 23 is a view illustrating a state where the filter is fully inserted into the inside of the head.

[0041] Fig. 24 is a view illustrating a state where the filter is rotated for coupling in a state where the filter is fully inserted into the inside of the head.

[0042] Fig. 25 is an enlarged view of portion B in Fig. 24.

[0043] Fig. 26 is a view illustrating a shaft position in a state where the filter is coupled to the head.

DETAILED DESCRIPTION OF THE EMBODIMENTS

[0044] Hereinafter, specific embodiments of the present invention will be described in detail with reference to the drawings. However, the present invention is not limited to the embodiment in which the concept of the present invention is presented and other embodiments which are included in the scope of spirit of another degenerate invention or the present invention is capable of being easily suggested by another component being added, changed, deleted, or the like.

[0045] Fig. 1 is a front view illustrating a refrigerator according to an embodiment and Fig. 2 is a front view illustrating a state where a door of the refrigerator is opened.

[0046] With reference to Fig. 1 and Fig. 2, an outer appearance of a refrigerator 1 which includes a water purifying apparatus according to an embodiment may be formed by a cabinet 10 that forms a storage space, and a door 10 that opens and closes the storage space of the cabinet 10.

[0047] The cabinet 10 may include an outer case 11 made of a metal material forming the outer surface and an inner case 12 made of a resin material which is coupled with the outer case 11 and forming a storage space in an inside portion of the refrigerator 1. Insulation material is filled between the outer case 11 and the inner case 12 to insulate the space in the inside of the refrigerator 1.

[0048] The storage space is divided in a vertical direction based on a barrier 13, and may be configured by an upper refrigerating compartment 14 and a lower freezing compartment 15. The freezing compartment 15 may be further divided in a lateral direction. It will be apparent that the storage space may be divided into left and right compartments based on the barrier 13.

[0049] The door 20 may include a refrigerating compartment door 21 and a freezing compartment door 22, which independently open and close the refrigerating compartment 14 and the freezing compartment 15, respectively.

[0050] Both of the refrigerating compartment door 21 and the freezing compartment door 22 may open and close the refrigerating compartment 14 and the freezing compartment 15 by rotation thereof. For this, both the refrigerating compartment door 21 and the freezing compartment door 22 may be rotatably

connected to the cabinet 10 by a hinge device 26 (see FIG. 3). In addition, the refrigerating compartment door 21 may be configured as a French type door configured such that a pair of doors independently rotate at both left and right sides.

[0051] A dispenser 23 and an ice maker 24 may be provided at one of the pair of refrigerating compartment doors 21.

[0052] The dispenser 23 is provided at a front surface of the refrigerating compartment door 21, and enables a user to take out water or ice by manipulating the dispenser 23 from the outside. An ice making compartment 25 is provided above the dispenser 23. The ice making compartment 25 is a heat insulating space in which ice is made and stored, and the ice maker 24 is accommodated in an inside portion of the ice making compartment and is capable of being opened and closed by a separate door. Although not shown in the drawings, the ice making compartment 25 may communicate with the freezing compartment 15 by a cool air duct in a state in which the refrigerating compartment door 21 is closed, and may receive cool air necessary for the ice making from a freezing compartment evaporator (not shown).

[0053] Meanwhile, a plurality of shelves and drawers for storing foods may be provided in the refrigerating compartment 14. Particularly, a drawer assembly 16 may be provided on a bottom surface of the refrigerating compartment 14. The drawer assembly 16 may include a drawer 161 provided to be slidable and a table 162 that shields a top surface of the drawer 161.

[0054] The drawer assembly 16 may be configured such that the inside thereof can be seen therethrough, and a main water tank 34 (see FIG. 3) provided at a rear side of the refrigerating compartment 14 may be shielded by the drawer 161.

[0055] A water purifying apparatus 17 may be provided at the side of the drawer assembly 16 for purifying water to be supplied and then supplying the purified water to the dispenser 23 and the ice maker 24. The water purifying apparatus 17 may be disposed between the accommodating space and the wall surface of the drawer 161 and may be shielded by a front surface of the drawer 161. Therefore, in a state where the drawer 161 is closed, the water purifying apparatus 17 is not exposed to the outside, and in a state where the drawer 161 is withdrawn, the water purifying apparatus is exposed to the outside and thus access to the water purifying apparatus 17 is capable of being performed. Of course, the mounting position of the water purifying apparatus 17 is not limited to one side of the drawer 161 and may be provided in the region of the refrigerating compartment 14 including the refrigerating compartment 14 or the refrigerating compartment door 21.

[0056] A plurality of shelves having a cantilever structure may be detachably provided above the drawer assembly 16 such that their heights are adjustable. A main duct 18 is provided on a rear surface of the refrigerating compartment 14 and cool air generated from an evaporator (not shown) may be supplied to the inside portion of the refrigerating compartment 14 through a plurality of discharging ports which are formed in a main duct 18.

[0057] Fig. 3 is a view schematically illustrating a disposition structure of a water supplying flow path of the refrigerator.

[0058] With reference to Fig. 3, the refrigerator 1 may include a water supplying flow path 30 that purifies or cools water supplied from an external water supply source and then takes out water from the dispenser 23, or supplies the purified water to the dispenser 23 or the icemaker 24.

[0059] The water supplying flow path 30 may be directly connected to a water supply source 2 such as a water supply pipe at the outside of the refrigerator, and be introduced into a space of the refrigerator through a tube guide 19 mounted in the cabinet 10 to be connected to an inlet portion of the water purifying apparatus in the refrigerator.

[0060] The water supplying flow path 30 may include a water supply valve 31 and a flow rate sensor 32. The flow rate sensor 32 may be integrally formed with the water supply valve 31, if necessary.

[0061] The water supplying flow path 30 may connect the water purifying apparatus 17 and a first branch pipe 33 with each other and the water supplying flow path 30 branched from the first branch pipe 33 may be connected to the main water tank 34 and a first branch valve 35, respectively.

[0062] The water supplying flow path 30 which is connected to an outlet portion of the first branch valve 35 extends along an upper surface after extending along a side wall of the inside of the cabinet 10 or a rear wall surface of the outside of the cabinet 10 through the tube guide 19 and may be introduced into the refrigerating compartment door 21 via the hinge device 26.

[0063] The water supplying flow path of the refrigerating compartment door 21 may be branched by a second branch pipe 36 and connected to an inlet portion of a sub water tank 37 and a second branch valve 38. The sub water tank 37 is connected to the dispenser 23 so that cooled water is capable of being taken out through the dispenser 23.

[0064] An outlet portion of the second branch valve 38 is respectively connected to the dispenser 23 and the ice maker 24 by the water supplying flow path

30 to be capable of supplying purified water to the dispenser 23 and the ice maker 24.

[0065] The water purified through the water purifying apparatus 17 may be cooled and then supplied to the dispenser 23 or may be supplied to the dispenser 23 or the ice maker 24 in a state of being purified without being cooled.

[0066] The water purifying apparatus 17 may include a plurality of filters 40 for purifying supplied water and a head unit 50 to which the plurality of filters 40 are coupled and which is connected a flow path through which water flows. The water purifying apparatus 17 may further include a case 171 in which the filters 40 and the head unit 50 are accommodated.

[0067] Fig. 4 is a perspective view illustrating the structure of the water purifying apparatus.

[0068] With reference to Fig. 4, the water purifying apparatus 17 may include the plurality of filters 40 and the head unit 50.

[0069] The plurality of filters 40 may include a first filter 401 which is connected to a water inlet side of the head unit 50, a third filter 403 which is connected to a water outlet side of the head unit 50, and a second filter 402 disposed between the first filter 401 and the third filter 403 and thus is capable of purifying water. However, it is not limited to this.

[0070] The first filter 401 may be a pre-carbon filter, the second filter 402 may be a membrane filter, and the third filter 403 may be a post-carbon filter. Of course, the present invention is not limited to the number and types of the filters 40, and the number which is capable of being accommodated in the inside of the water

purifying apparatus 17 and different types of functional filters from each other for effectively purifying water may be applied.

[0071] The head unit 50 may include a plurality of heads 60 to which each filters 40 is coupled and a mounting member 70 on which the head 60 is rotatably seated.

[0072] A water inlet pipe 301 for introducing original water is capable of being connected to one end of the mounting member 70, and a water outlet pipe 302 for discharging purified water is capable of being connected to the other end thereof.

[0073] The plurality of heads 60 may be independently rotated in a state where the plurality of heads 60 are mounted on the mounting member 70. The flow paths of the plurality of heads 60 are capable of being connected to each other by connecting pipes 71 and the original water which flows in through the water inlet pipe 301 is purified after passing through each of the filters 40 and then may be flows out from the water outlet pipe 302.

[0074] Each of the connecting pipes 71 is mounted on the mounting member 70 and is provided between adjacent two heads 60 to each other to allow water to flow between the heads 60. A cover 72 may be mounted on one side of the mounting member 70 which corresponds to the connecting pipe 71 to shield the connecting pipe 71.

[0075] The head 60 may include a head body 61 to which an upper end of the filter 40 is inserted and then fixed, and a shaft (90 in Fig. 6) connected to the upper end of the filter 40 in the inside portion of the head body 61 and thus forms a flow path through which water flows. The head 50 may further include a head cap

62 for shielding an upper surface of the head body 61 into which the shaft 90 is inserted.

[0076] The filter 40 may be fixedly mounted to the head 60 in a rotating manner and the shaft 90 may be connected to the filter 40 to form a flow path in a process of the filter 40 being mounted and when the filter 40 is rotated, the shaft 90 is rotated along with the filter 40 so that the flow path of the shaft 90 is capable of being switched.

[0077] In other words, in a case where the filter 40 is mounted, the flow path is switched to the filter 40 side by the shaft 90 so that the water is capable of being purified through the filter 40. In a case where the filter 40 is separated, the supplying water is capable of being bypassed without passing through the filter 40, and thus the flow path is capable of being switched so that water passes through the head 60. The switching and detailed structure of the flow path will be described in more detail in the following other embodiments.

[0078] The case 171 may have various structures which can accommodate the filter 40 and the head unit 50. The case 171 is capable of fully accommodating the filter 40 and the head unit 50. Alternatively, the case 171 may accommodate at least a portion of the filter 40 and the head unit 50.

[0079] The case 171 may have a structure which is capable of being fixedly mounted on one side of the inside portion of the refrigerating compartment 14. Of course, the case 171 may not be provided if necessary, and the mounting member 70 may be directly mounted on a side of the inner portion of the refrigerating compartment 14.

[0080] On the other hand, only one filter 40 may be provided according to the function of the water purifying apparatus 17, and in a case where only one filter 40 is provided, one head unit 50 and one mounting member 70 may be also provided. The structure of the head 60 may have the same structure irrespective of one head 60 or the plurality of the heads 60. Hereinafter, a water purifying apparatus having one filter 40 and one head 60 will be described.

[0081] Fig. 5 is a perspective view illustrating a structure of a water purifying apparatus according to another embodiment. Fig. 6 is an exploded perspective view illustrating a state where a filter and a head of the water purifying apparatus are separated.

[0082] With reference to Fig. 5 and Fig. 6, a water purifying apparatus 17 according to another embodiment may include a filter 40 and a head 60. The water purifying apparatus 17 may further include a mounting member 70 on which the head 60 is mounted.

[0083] The filter 40 has a cylindrical shape, and the outer shape thereof is capable of being formed by the housing 41. The housing 41 may include a housing body 42 which accommodates a filtering member (44 in Fig. 7) in an inside portion thereof, and a housing cap 43 which is coupled to an upper end of the housing body 42 to form an upper portion of the housing 41.

[0084] The housing body 42 may have a cylindrical shape to define a first accommodating space for accommodating the filtering member 44. The housing body 42 may have an upper opening portion.

[0085] The housing cap 43 may be coupled to the upper opening portion of the housing body 42. The housing cap 43 may define a second accommodating

space for accommodating a portion of the filtering member 44. For this, a portion of the housing cap 42 may have a cylindrical shape. The housing cap 43 has an upper opening portion. A portion of the shaft 90 to be described below is capable of being inserted through the upper opening portion of the housing cap 43.

[0086] The housing cap 43 may be inserted into an opened lower surface of the head 60. A pair of O-rings 432 may be provided at an upper end of the housing cap 43. The O-rings 432 may be hermetically sealed with the inner surface of the head 60 to prevent leakage.

[0087] A coupling projection 433 may be further provided on an outer circumferential surface of the upper portion of the housing cap 43. The coupling projection 433 is capable of being moved along a coupling groove 631 which is formed on an inner surface of the head 60 when the upper portion of the filter 40 is inserted into the inside of the head 60.

[0088] At this time, the coupling projection 433 and the coupling groove 631 may be formed in a direction intersecting a direction into which the filter 40 is inserted. Accordingly, the filter 40 is rotated in a state of being inserted into the inside of the head 60 and may have a structure in which the coupling projection 433 and the coupling groove 631 are coupled to each other by rotation of the filter 40. In a state where the filter 40 and the head 60 are fully coupled to each other, the supplying water is capable of flowing into the inside portion of the filter 40 by the filter 40 and the flow path of the head 60 being connected to each other in the inside portion thereof.

[0089] The mounting member 70 may include a base 73 which is mounted on one side wall surface of the refrigerator 1 or the case 171 and rotating support

portions 74 which project from both sides of the base 73 and rotatably support both sides of the head 60.

[0090] End portions of the water inlet pipe 301 and the water outlet pipe 302 are disposed on the rotating support portion 74 and the water inlet pipe 301 and the water outlet pipe 302 may be connected to a water inlet portion 611 and a water outlet portion 612 of the head 60 at the rotating support portion 74.

[0091] The head 60 may be rotatably mounted on the mounting member 70 by the rotating support portion 74. Therefore, a space for attachment and detachment of the filter 40 can be secured by operating rotation or tilting of the head 60 at the time of attachment and detachment of the filter 40 and thus the operation for the attachment and detachment of the filter 40 is capable of being easily performed.

[0092] The head 60 may be formed in a cylindrical shape having an opened lower surface. The head 60 may include a head body 61 to which the filter 40 is inserted and fixed and a shaft 90 which is accommodated in the inside of the head body 61. In addition, the head 60 may further include a head cap 62 which shields an opened upper surface of the head body 61.

[0093] An insertion indicating portion 613 for indicating an insertion position of the coupling projection 433 may be formed on the outer surface of the head body 61. The insertion indicating portion 613 may be formed by printing, molding or machining. The user can recognize the position of the coupling groove 631 by the insertion indicating portion 613, and may easily perform alignment between the coupling projection 433 and the coupling groove 631.

[0094] In addition, a rotation indicating portion 614 for indicating the rotational direction of the filter 40 may be formed on the outer surface of the head body 61. The rotation indicating portion 614 may also be formed by printing, molding or machining. The engagement projection 433 may be moved along and coupled to the inside of the coupling groove 631 by the user operating rotation of the filter 40 in a correct direction by the rotation indicating portion 614.

[0095] An opening portion 632 for checking the engaging restraint state of the coupling projection 433 may be further formed on the outer surface of the head body 61. The opening portion 632 may be formed at a position which corresponds to the position of the coupling groove 631 or may include at least a portion of the coupling groove 631.

[0096] Fig. 7 is an exploded view illustrating the structure of the filter. Fig. 8 is a longitudinal sectional view of Fig. 7. Fig. 9 is a cross-sectional view taken along line 9-9' of Fig. 7. Fig. 10 is a cross-sectional view taken along line 10-10' of Fig. 6.

[0097] With reference to the drawings, in a case where the structure of the filter 40 describes in more detail, the filter 40 may include a filter housing 41 which forms an outer shape, a filtering member 44 provided in the filter housing 41, and an upper supporter 80 for supporting the filtering member 44.

[0098] In addition, the filter 40 may further include a lower supporter 45 for supporting the filtering member 44 in the filter housing 41.

[0099] The filter housing 41 is formed in a cylindrical shape, and may be formed by the housing body 42 and the housing cap 43 being coupled to each other. A filter inserting portion 431 is formed on the upper end of the housing cap 43. A plurality of O-rings 432 may be vertically arranged in the filter inserting portion 431.

[00100] The coupling projection 433 may be formed on a lower side of the plurality of O-rings 432 on the outside of the filter inserting portion 431. A pair of coupling projections 433 may be formed at positions which are opposite to each other, and may be formed to have a size that is capable of being inserted into the coupling groove 631.

[00101] The coupling projection 433 may include a projection guide portion 433a. The projection guide portion 433a may be formed to have a slope or a predetermined curvature on the upper surface of the coupling projection 433. The coupling projection 433 is in contact with a groove guide portion (633 in Fig. 15) for guiding the coupling projection 433 to the entrance of the coupling groove 631 so as to guide rotation of the coupling projection 433 in one direction.

[00102] A restraining projection 433b which projects to a lower side may be further formed on one side of the lower surface of the coupling projection 433. The restraining projection 433b may be engaged with the inside of the coupling groove 631 to be restrained. Accordingly, the filter 40 is capable of being fixed to the inside of the head 60 in a state where the coupling projection 433 is fully inserted into the inside of the coupling groove 631.

[00103] On the other hand, the inside portion of the filter inserting portion 431 is formed in a hollow shape and a housing fastening portion 434 for being coupled with the upper supporter 80 may be protruded from the inner side of the filter inserting portion 431. In other words, the upper supporter 80 is capable of being accommodated in the second accommodating space in which the housing cap 43 is defined. The upper supporter 80 may be coupled to the upper portion of the filtering member 44 and the inner surface of the housing cap 43, respectively.

[00104] The upper surface 434a of the housing fastening portion 434 may be formed to be inclined. As an example, a pair of housing fastening portions 434 may be formed at positions facing each other, and may be formed so that inclined directions thereof are opposed to each other.

[00105] A supporter fastening portion 81 may be formed on the upper supporter 80 which corresponds to the housing coupling portion 434. As an example, the supporter fastening portion 81 may be formed on the second extending portion 87. A hook portion 811 is formed at one end of the supporter fastening portion 81.

[00106] In a case where the upper end of the upper supporter 80 may be rotated in one direction in a state of being inserted into the filter inserting portion 431, the hook portion 811 of the supporter fastening portion 81 is moved along the inclined surface of the upper surface of the housing fastening portion 434 to be restrained. In a state where the upper supporter 80 is fully rotated, the hook portion 811 of the supporter fastening portion 81 is engaged to the end portion of the housing fastening portion 434 and thus the upper supporter 80 is capable of being coupled to the housing cap 43.

[00107] The supporter fastening portion 81 and the housing fastening portion 434 may have various structures which are mutually combined with each other and the filter housing 41 and the upper supporter 80 in the inside portion of the filter housing 41 may be integrated with each other by the supporter fastening portion 81 and the housing fastening portion 434 being coupled to each other. Therefore, when the filter 40 is rotated at the time of the filter 40 being mounted, the upper supporter 80 may be also rotated along with the filter 40.

[00108] On the other hand, the filtering member 44 may be accommodated in the inside of the filter housing 41. The filtering member 44 allows the incoming water to pass through and thus be purified. For example, the filtering member 44 may be a commonly used carbon filter or a membrane filter, and various types of filters may be used depending on the required purifying performance in addition to this.

[00109] The filtering member 44 may be formed in a cylindrical shape having a hollow 441 formed at the center thereof in the vertical direction and the upper supporter 80 and the lower supporter 45 are coupled to the upper end and the lower end of the filtering member 44 so that the filtering member 44 is capable of being fixedly mounted on the inside of the filter housing 41.

[00110] An outer diameter of the filtering member 44 is formed to be smaller than the inner diameter of the filter housing 41 and a space for flowing water between the filter housing 41 and the outer surface of the filtering member 44 may be formed.

[00111] The upper supporter 80 is disposed at the upper end of the filtering member 44 and may extend in the upper direction to form a passage connecting the inlet portion of the filter inserting portion 431 and the hollow 441 to each other. Accordingly, water supplied from the head 60 is capable of flowing into the filtering member 44 through the filter inserting portion 431 and water purified in the filtering member 44 flows out to the head 60.

[00112] The upper supporter 80 may include a supporter accommodating portion 82 for accommodating the upper end of the filtering member 44.

[00113] The upper supporter 80 may further include a supporter inserting portion 83 which extends from a central portion of the supporter accommodating portion 82 in the lower direction and is inserted into the hollow 441 of the filtering member 44.

[00114] The upper supporter 80 may further include a supporter stepped portion 84 which projects from the upper surface of the supporter inserting portion 83 in the upper direction.

[00115] The upper supporter 80 may further include a supporter extending portion 85 extending from the center of the upper surface of the supporter stepped portion 84 toward the inside of the filter inserting portion 431.

[00116] Fig. 11 is a partially cutaway perspective view illustrating an upper supporter of the filter.

[00117] With reference to Fig. 8 to Fig. 11, the upper supporter 80 will be described in more detail.

[00118] When the upper supporter 80 and the filtering member 44 are coupled to each other, the supporter accommodating portion 82 may surround the upper surface and a circumference of the filtering member 44. The supporter inserting portion 83 is inserted into the hollow 441 and is in contact with an inner surface of the filtering member 44 so that the upper supporter 80 is capable of being fixedly mounted on the upper surface of the filtering member 44.

[00119] The inside portion of the supporter inserting portion 83 is formed to be hollow and is capable of communicating with a filter outlet flow path 861 formed on the supporter extending portion 85. Accordingly, the purified water flowing into the hollow 441 of the filtering member 44 may pass through the supporter inserting

portion 83, the filter outlet flow path 861 and a filter outlet port 862 of the end portion of the filter outlet flow path 861 in this order and may be discharged through the opening of the filter inserting portion 431.

[00120] The supporter stepped portion 84 protrudes from the upper surface of the supporter accommodating portion 82 and may be formed to have a smaller diameter than the supporter accommodating portion 82. The circumference of the supporter stepped portion 84 and the supporter accommodating portion 84 may be spaced apart from the inner surface of the housing cap 43 when the housing cap 43 and the upper supporter 80 are coupled to each other.

[00121] The supporter extending portion 85 may extend from the center of the supporter step portion 84 in the upper direction. The supporter extending portion 85 is located in the filter inserting portion 431 when the housing cap 43 and the upper supporter 80 are coupled to each other. A filter inlet flow path 871 and a filter outlet flow path 861 may be formed in the inside of the supporter extending portion 85. Therefore, water supply into the inside portion of the filter 40 and discharge of the purified water from the filter 40 is capable of being performed through the supporter extending portion 85.

[00122] Specifically, a first filter inlet flow path 872 extending in a lower direction is formed on the opened upper surface of the supporter extending portion 85. The supporter stepped portion 84 may include a second filter inlet flow path 873 passing across the supporter stepped portion 84.

[00123] The second filter inlet flow path 873 may have an opening formed in a circumferential surface of the supporter stepped portion 84 and extend toward the center of the supporter stepped portion 84. The first filter inlet flow path 872 and

the second filter inlet flow path 873 may be connected to each other at a lower end of the supporter extending portion 85, that is, at the inside of the supporter stepped portion 84.

[00124] Accordingly, the water which flows into through the filter inserting portion 431 flows into through the first filter inlet flow path 872 of the supporter extending portion 85 and then be moved along the second filter inlet flow path 873 which is branched into both sides at the lower end of the first filter inlet flow path 872 to the outside and thus is capable of being discharged through an opening of the circumference of the supporter stepped portion 84.

[00125] The water which is discharged through the filter inlet flow path 871 flows along the space between the filter housing 41 and the filtering member 44. The water which flows into the outside of the filtering member 44 may be purified in the process of coming in the hollow 441 through the filtering member 44.

[00126] On the other hand, the supporter extending portion 85 may include a first extending portion 86 which extends from the upper surface of the supporter stepped portion 84 and a second extending portion 87 which extends from the first extending portion 86 in the upper direction. The first extending portion 86 may be formed to have an outer diameter which is larger than that of the second extending portion 87 and the filter outlet port 862 may be formed on the upper side portion of the first extending portion 86.

[00127] A guide surface 874 which is recessed in the inside direction is formed on the outer surface of the second extending portion 87 of the upper side of the filter outlet port 862. The guide surface 874 may be formed to be inclined and may be spaced apart from the filter outlet port 862 in the upper direction.

Therefore, when the purified water which is discharged to the filter outlet port 862 flows in the upper direction, the water is guided to the outside of the second extending portion 87 by the guide surface 874 so that the water can flow more effectively.

[00128] A portion of the second extending portion 87 may extend toward the inside of the first extending portion 86 at the lower end of the guide surface 874. At this time, the filter outlet flow path 861 may be defined in a space between an inner surface of the first extending portion 86 and an outer surface of the second extending portion 87. The first filter inlet flow path 872 may extend from the opened upper surface of the second extending portion 87 to the lower end thereof.

[00129] On the other hand, the outer diameter of the first extending portion 86 is formed to be somewhat smaller than the inner diameter of the filter inserting portion 431 and the purified water which is discharged through the filter outlet port 862 is capable of being discharged through a space between the first extending portion 56 and the filter inserting portion 431.

[00130] An outlet port groove 875 may be formed in the lower end of the guide surface 874 of the upper side of the filter outlet port 862. The outlet port groove 875 may be formed to be recessed along the circumference of the second extending portion 87. Accordingly, the water which is discharged from the filter outlet ports 862 which are disposed on both sides is capable of flowing along the outlet port groove 875 and is capable of being discharged along the water outlet guide portion 965b formed on the outer surface of the shaft 90.

[00131] The outer diameter of the second extending portion 87 may be formed to correspond to the inner diameter of the shaft 90 which is located in the

inside of the filter inserting portion 431. Therefore, in a case where the second extending portion 87 and the shaft 90 are coupled to communicate with each other, water supplied through the inside of the shaft 90 is capable of coming in the inside of the second extending portion 87.

[00132] A first extending portion O-ring 863 may be provided on the outside of the first extended portion 86 and a second extending portion O-ring 876 may be provided on the outside of the second extending portion 87. The first extending portion O-ring 863 hermetically seals between the inside of the filter inserting portion 431 and the first extending portion 86. The second extending portion O-ring 876 is in close contact with the inner surface of the shaft 90 to hermetically seal between the second extending portion 87 and the shaft 90.

[00133] Therefore, the purifying water which flows into the inside of the supporter extending portion 85 and the purified water which is discharged to the outside of the supporter extending portion 85 may flow through independent flow paths respectively without leakage or mixing with each other.

[00134] On the other hand, a first connecting portion 851 may be formed on the upper end of the supporter extending portion 85. The first connecting portion 851 is formed to be recessed toward the inside from the upper end of the supporter extending portion 85 and may be formed to be symmetrical to both the left side and the right side thereof. The first connecting portion 851 may be formed in a corresponding shape to that of the second connecting portion 972 of the shaft 90 to be described below so as to be engaged each other in a case where the second connecting portion 972 is inserted into the first connecting portion 851. The shaft

90 and the filter 40 may be rotated together in a state where the first connecting portion 851 and the second connecting portions 972 are coupled to each other.

[00135] The first connecting portion 851 may be formed to be symmetrical with respect to a projecting portion 852 projecting from a position which is opposite to the inner surface of the supporter extending portion 85 while being recessed in a predetermined depth. A first inclined surface 853 may be formed on both side ends of the first connecting portion 851, that is, on both side surfaces of the projecting portion 852. The first inclined surface 853 may be formed in a shape that the width of the first connecting portion 851 gradually increases and the width of the projecting portion 852 gradually decreases from the lower side to the upper side of the first inclined surface. In other words, the first connecting portion 851 may be formed so that the width thereof is gradually narrowed toward the depth direction to be recessed.

[00136] In addition, the first inclined surface 853 may be inclined in a direction crossing a lengthwise vertical direction of the first inclined surface 853, that is, in a direction of rotation of the filter 40. Accordingly, the projecting portion 852 may be formed so that the width thereof is gradually widen from the inner surface of the supporter extending portion 85 toward the center of the inner diameter of the supporter extending portion 85.

[00137] Due to such a structure, the first connecting portion 851 and the second connecting portion 972 are capable of being easily assembled. In addition, in a case where the torsion moment is applied in a state where the first connecting portion 851 and the second connecting portion 972 are in contact with each other,

the first connecting portion 851 and the second connecting portion 972 are slid so that the filter 40 is capable of being easily separated from the shaft 90.

[00138] Fig. 12 is a side view illustrating the head, Fig. 13 is an exploded perspective view illustrating a coupling structure of the head viewed from a side, and Fig. 14 is an exploded perspective view illustrating the coupling structure of the head viewed from the other side.

[00139] With reference to the drawings, when the structure of the head 60 will be described in more detail, the shaft 90 is inserted through the opened upper surface of the head body 61 and the head cap 62 is capable of shielding the opened upper surface of the head body 61.

[00140] The head body 61 may include a lower body 63 and an upper body 64.

[00141] The lower body 63 is a portion into which the filter inserting portion 431 is inserted and to which the filter inserting portion 43 is coupled and the lower surface of the lower body 63 is opened so that the filter 40 is capable of being accommodated. The coupling groove 631 for inserting the coupling projection 433 may be formed on the lower body 63.

[00142] An opening portion 632 for forming the coupling groove 631 may be formed on the lower body 63 and the insertion state of the coupling projection 433 may be confirmed through the opening portion 632. A plurality of supporting ribs 634 for supporting the outer side of the filter inserting portion 431 may be formed on the circumference of the inner surface of the lower body 63 in order to prevent the filter 40 from sagging in a state where the filter inserting portion 431 is inserted into the lower body 63.

[00143] The upper body 64 may be formed at an upper end of the lower body 63 and may be formed to have a smaller diameter than that of the lower body 63. The shaft 90 may be mounted on the inside of the upper body 64 and the shaft 90 is inserted through the opened upper surface of the upper body 64 and thus may be mounted on the inside of the upper body 64.

[00144] The upper end of the filter inserting portion 431, the upper end of the supporter extending portion 85 and the lower end of the shaft 90 may be disposed on the inside of the upper body 64 and a flow path through which purified water through the filter 40 is capable of flowing is formed by coupling portions which is configured as described above with each other.

[00145] A water inlet portion 611 and a water outlet portion 612 are formed to project to the outside in the upper body 64. The water inlet portion 611 and the water outlet portion 612 may communicate with a water inlet pipe 301 and a water outlet pipe 302, respectively. At this time, the water inlet portion 611 and the water outlet portion 612 are capable of selectively communicating with the flow path formed in the shaft 90. The water inlet portion 611 and the water outlet portion 612 may be disposed on in a straight line so as to face each other in the head.

[00146] The head cap 62 may shield the upper surface of the upper body 64. The head cap 62 presses the upper surface of the shaft 90 so that the shaft 90 is capable of maintaining a state of being fixedly mounted on the inside of the upper body 64. To this end, a cap support portion 621 extending to the upper surface of the shaft 90 may be further formed on a lower surface of the head cap 62.

[00147] The shaft 90 is capable of selectively switching the flow path of water flowing in the inside of the head 60 and is capable of being rotatably seated on the

upper body 64. A filtering flow path 96 and a bypass flow path 95 are formed in the shaft 90. The flow paths may be selectively connected to the water inlet portion 611 and the water outlet portion 612 by the rotation of the shaft 90.

[00148] The shaft 90 may include an upper part 91 and a lower part 92. The upper part 91 may be formed to have a larger diameter than that of the lower part 92 and have an outer diameter corresponding to the inner diameter of the upper body 64.

[00149] A shaft O-ring 93 may be provided at the upper end and the lower end of the upper part 91, respectively. The shaft O-ring 93 hermetically seals between the shaft 90 and the inner surface of the upper body 64 to prevent leakage of water flowing through the head 60.

[00150] A shaft inlet port 961 and a shaft outlet port 962 are formed on the circumference of the upper part 91 between the plurality of shaft O-rings 93, respectively. The shaft inlet port 961 and the shaft outlet port 962 may be formed at positions facing each other and at positions corresponding to the water inlet portion 611 and the water outlet portion 612. Therefore, water which passes through the water inlet portion 611 is capable of coming in the shaft inlet port 961, and water which passes through the shaft outlet port 962 is capable of being discharged through the water outlet portion 612.

[00151] On the other hand, the shaft inlet port 961 and the shaft outlet port 962 may be formed in a rectangular shape; however it is not limited to this. A sealing member mounting portion 911 on which a sealing member 94 is mounted may be formed on the circumference of the shaft inlet port 961 and the shaft outlet port 962. The sealing member mounting portion 911 and the sealing member 94

may be formed in a rectangular shape corresponding to the shaft inlet port 961 and the shaft outlet port 962.

[00152] At this time, the sealing member 94 may include a pressing portion 941 which is pressed into and mounted on the inside of the sealing member mounting portion 911 and a sealing portion 942 which projects along the circumference of the pressing portion 941. The sealing portion 942 is in contact with the inner surface of the upper body 64 when the shaft 90 is mounted. Accordingly, when the shaft inlet port 961 and the shaft outlet port 962 are connected to the water inlet portion 611 and the water outlet portion 612 by the rotation of the shaft 90, the water which flows into and flows out is prevented from leaking between the shaft 90 and the head 60. In particular, the shape of the sealing member 94 may be formed to be lengthened in a direction in which the shaft 90 is rotated so that the removal of the sealing member 94 from the shaft 90 or interference of the sealing member 94 with the shaft 90 is minimized during the rotation of the shaft 90.

[00153] A sealing rib 613 may be formed in a water inlet port 611a and a water outlet port 612a which are formed in the water inlet portion 611 and the water outlet portion 612, respectively. The sealing ribs 613 prevent the sealing member 94 from being separated or damaged and may be formed to cross the water inlet port 611a and the water outlet port 612a of the inner surface of the upper body 64. The sealing ribs 613 may extend laterally and a plurality of sealing ribs 613 may be disposed in a direction intersecting each other, if necessary.

[00154] Therefore, the sealing member 94 which is passed by the water inlet port 611a and the water outlet port 612a which are formed in the water inlet portion

611 and the water outlet portion 612 is hooked into the water inlet port 611a and the water outlet port 612a in a process of the rotation of the shaft 90 and thus the sealing member 94 is capable of being prevented from being separated from the sealing member mounting portion 911. In other words, since a state where the sealing ribs 613 press the outer surface of the sealing member 94 in the process of the rotation of the shaft 90 is maintained, the sealing member 94 is capable of being prevented from being separated from the sealing member mounting portion 911.

[00155] A bypass inlet port 951 and a bypass outlet port 952 may be formed between the shaft inlet port 961 and the shaft outlet port 962 of the outer surface of the upper part 91, respectively. The bypass inlet port 951 and the bypass outlet port 952 may also be disposed at positions facing each other. Accordingly, in a case where the bypass inlet port 951 and the bypass outlet port 952 are aligned with the water inlet portion 611 and the water outlet portion 612 by the rotation of the shaft 90, the water supplied to the water inlet portion 611 is capable of being discharged directly to the water outlet portion 612 through the bypass flow path 95.

[00156] The bypass inlet port 951 and the bypass outlet port 952 may be formed at positions which are the same height as the shaft inlet port 961 and the shaft outlet port 962, respectively and which are rotated by 90 degrees to each other. Therefore, in order to connect the filtering flow path 96 or the bypass flow path 95 to the water inlet portion 611 and the water outlet portion 612, the shaft 90 should be rotated by 90 degrees.

[00157] A portion which forms the upper end of the filtering flow path 96 is capable of projecting from the bypass flow path 95 in the inside of the upper part 91. Accordingly, it is possible to realize the filtration flow path 96 and the bypass flow

path 95 at the same time in a state where the height of the shaft 90 is minimized. Through this, the head 60 and the water purifying apparatus 17 is capable of being configured more compactly.

[00158] A rotating projection 921 may be provided on the lower surface of the upper part 91. A pair of rotating projections may be formed and one rotating projection may be formed at a position corresponding to the shaft inlet port 961 and the shaft outlet port 962, respectively. In other words, the pair of rotating projections 921 may be formed at positions which are rotated by 90 degrees with respect to each other.

[00159] On the other hand, the lower part 92 extends from the center of the upper part 91 in the lower direction. The lower part 92 may be formed to be smaller than the inner diameter of the seating portion 65 and extend through the seating portion 65 in the lower direction. The lower part 92 may extend to a length such that the shaft 90 and the upper supporter 80 are capable of being engaged with each other when the filter 40 is coupled to the head 60.

[00160] A water outlet guide portion 965b may be formed on one side surface of the lower part 92. The water outlet guide portion 965b may extend vertically from the lower side of the shaft outlet port 962. The water outlet guide portion 965b may be formed by cutting a portion of the outer surface of the lower part 92 having a cylindrical shape into a planar shape, for example.

[00161] Therefore, in a state where the shaft 90 is mounted on the head 60, the water outlet guide portion 965b of the shaft 90 is spaced apart from the inner surface of the head 60 and thus the shaft water outflow path 965 which is a flow path of water is formed. Since the lower end of the water outlet guide portion 965b is

located on the upper side of the filter outlet port 862, the water discharged from the filter outlet port 862 is moved along the water outlet guide portion 965b in the upper direction, and then passes by the shaft outlet port 962 and the water outlet portion 612 in this order and flows to the water outlet pipe 302.

[00162] Fig. 15 is a cutaway exploded perspective view illustrating an internal structure of the head viewed from one side, and Fig. 16 is a cutaway exploded perspective view illustrating the internal structure of the head viewed from the other side.

[00163] Fig. 15 illustrates a longitudinal section in a state where the bypass flow path 95 is switched to be connected to the water inlet portion 611 and the water outlet portion 612. As illustrated in the drawing, a bypass flow path 95 passing through the center of the upper part 91 is formed on the upper part 91 and the bypass inlet port 951 and the bypass outlet port 952 are formed on both sides of the circumference of the upper part 91, respectively.

[00164] The bypass inlet port 951 and the bypass outlet port 952 may be formed to be larger than the sizes of the water inlet port 611a and the water outlet port 612a and may be positioned between a pair of shaft O-rings which are vertically disposed. Therefore, the water passing through the bypass flow path 95 in a state where the bypass flow path 95 is aligned with the water inlet portion 611 and the water outlet portion 612 does not leak to the outside and is passed across the head 60.

[00165] In other words, water introducing into the head 60 passes through the head 60 without passing through the filter 40, and even in a state where the filter 40

is separated, water does not leak from a side on which the filter 40 is mounted and is capable of being continuously supplied to the water supplying flow path 30.

[00166] On the other hand, a flow path projecting portion 963 which projects for forming the filtering flow path 96 to be described below is formed on the inner surface of the bypass flow path 95. The flow path projecting portion 963 may be formed at the center of the inside portion of the shaft 90 and project from the bottom of the bypass flow path 95 but may be formed not to shield the bypass flow path 95.

[00167] Both ends of the flow path projecting portion 963 are formed to be inclined or rounded so that decrease in the flow velocity caused by the flow path projecting portion 963 is capable of being minimized when water flows through the bypass flow path 95.

[00168] Fig. 16 illustrates a longitudinal section in a state where the filtering flow path is shifted to be connected with the water inlet portion and the water outlet portion.

[00169] As illustrated in the drawings, the filtering flow path 96 may be connected to the water inlet portion 611 and the water outlet portion 612 according to the rotation of the shaft 90.

[00170] At this time, the shaft inlet port 961 and the shaft outlet port 962 are in contact with the water inlet port 611a and the water outlet port 612a, respectively and the outsides of the shaft inlet port 961 and the shaft outlet port 962 and the outsides of the water inlet port 611a and the water outlet port 612a are capable of being fully sealed by the sealing member 94. An inner pipe 97 is formed on the inside of the lower part 92 and the inner pipe 97 is capable of being connected to the supporter extending portion 85.

[00171] Accordingly, the water which flows into through the shaft 90 is capable of being supplied to the inside portion of the filter 40 through the upper supporter 80 and discharged to the shaft 90 through the upper supporter 80 after the water is purified by the filtering member 44. In other words, the water which flows into the head 60 is capable of being purified through the filter 40 and then discharged through the head 60.

[00172] On the other hand, the filtering flow path 96 may include a shaft water inlet flow path 964 and a shaft water outlet flow path 965.

[00173] The shaft water inlet flow path 964 includes a horizontal portion 964a which extends from the shaft inlet port 961 to the center of the shaft 90 and a vertical portion 964b which extends from an end portion of the vertical portion 964a in the lower direction. The vertical portion 964b may be formed by the inner pipe 97.

[00174] The outer surface of the inner pipe 97 is disposed to be spaced apart from the inner surface of the lower part 92 to form a spacing space 971. The distance of the spacing space 971 may be formed to correspond to the thickness of the supporter extending portion 85. Therefore, when the filter 40 is mounted, the upper end of the supporter extending portion 85 is capable of being inserted into an inside of the spacing space 971.

[00175] The length of the inner pipe 97 in the vertical direction is formed to be shorter than that of the outer surface of the lower part 92 in the vertical direction. The inner pipe 97 and the supporter extending portion 85 may be connected to each other on the inner surface of the lower part 92. To this end, a second connecting portion 972 may be formed on the lower end of the inner pipe 97.

[00176] The second connecting portion 972 may be formed in a shape corresponding to the first connecting portion 851. The second connecting portion 972 is inserted into the first connecting portion 851 so that the shaft 90 and the upper supporter 80 are capable of being rotated together.

[00177] The shaft water inlet flow path 964 is capable of communicating with the filter inlet flow path 871 and the water for purification is capable of being supplied to the filtering member 44 by the coupling between the inner pipe 97 and the supporter extending portion 85 with each other.

[00178] The shaft water outlet flow path 965 may include an water outlet guide portion 965b which is formed on an outer surface of the lower part 92 and an water outlet connecting portion 965a which is formed on the upper part 91.

[00179] The upper end of the water outlet guide portion 965b passes through the lower surface of the upper part 91 and then communicates with the water outlet connecting portion 965a. The water outlet connecting portion 965a connects the water outlet guide portion 965b and the shaft outlet port 962 at the inside of the upper part 91.

[00180] Accordingly, the purified water which is discharged from the filter outlet port 862 is capable of being moved along the water guide portion 965b in the upper direction and discharged to the shaft outlet port 962 through the water outlet connecting portion 965a. The purified water which is discharged to the shaft outlet port 962 may be discharged through the water outlet portion 612.

[00181] Accordingly, as illustrated in Fig. 16, in a state where the filtering flow path 96 is connected to the water inlet portion 611 and the water outlet portion 612, the water which flows into the head 60 through the water inlet pipe 301 is supplied

into the inside portion of the filter 40 and then is capable of being purified, and may flows again from the filter 40 to the head 60 and may be discharged to the water outlet pipe 302.

[00182] On the other hand, the body seating portion 65 may be formed on the inner circumferential surface of the upper body 64. The lower surface of the upper part 91 is seated on the body seating portion 65 when the shaft 90 is mounted.

[00183] Fig. 17 is a perspective view illustrating the head viewed from below. Fig. 18 is a partially cutaway perspective view illustrating the head.

[00184] With reference to Fig. 15 to Fig. 18, a rotating guide 651 is formed on the body seating portion 65 by being cut. At this time, the rotating projection 921 is positioned on an inside of the rotating guide 651. The rotating guide 651 may be cut by an angle of 180 degrees with respect to the center of the head body 61. However, it is limited thereto.

[00185] Since a pair of rotating projections 921 are disposed at an angle of 90 degrees, in a case where the shaft 90 may be rotated by the angle of 90 degrees, the rotating projections 921 is capable of being stopped by stoppers 652 which are formed on both ends of the rotating guide 651.

[00186] The water inlet portion 611 and the water outlet portion 612 may be selectively connected to the filtering flow path 96 or the bypass flow path 95 at a position which is stopped by the stopper 652. Therefore, when the user rotates the filter 40 to a point where the filter 40 is no longer rotated in one direction even without rotating the filter 40 while measuring an accurate angle, the flow path is capable of being selected and accurately connected.

[00187] A flow path cutout portion 653 may be formed on one side of the body seating portion 65. The flow path cutout portion 653 may be formed on the seating portion 65 in a position facing the rotating guide 651 and may be formed on the lower side of the water outlet port 612a in the vertical direction.

[00188] Therefore, the flow path cutout portion 653 is positioned on a position which is the same as that of the water outlet guide portion 965b in a state where the shaft 90 is rotated so that the filtering flow path 96 is connected to the water inlet portion 611 and the water outlet portion 612. The flow path cutout portion 653 may be formed to have the same width as the water outlet guide portion 965b. Therefore, the water outlet guide portion 965b and the flow path cutout portion 653 are capable of being in contact with each other to form a flow path through which the purified water is capable of flowing in the upper direction.

[00189] On the other hand, a pair of the coupling grooves 631 and a plurality of the supporting ribs 634 may be formed on the inner surface of the lower body 63. When the filter 40 is mounted on the head 60 and then rotated so that the filtering flow path 96 is connected to the water inlet portion 611 and the water outlet portion 612, the coupling projection 433 is capable of being inserted into the coupling groove 631.

[00190] The coupling groove 631 may be exposed to the outside portion through the opening portion 632 and the coupling state of the restraining projection 433b and the restraining groove 631a is capable of being checked through the opening portion 632. The position of the restraining groove 631a may be formed at a position in which the restraining projection 433b and the restraining groove 631a may be engaged to be restrained with each other in a state where the coupling

projection 433 is fully rotated. Therefore, in a state where the filter 40 is inserted into the inside of the head 60 and then fully rotated, the coupling projection 433 is capable of being restrained in the inside of the coupling groove 631 and thus random separation of the filter is capable of being prevented.

[00191] On the other hand, the coupling groove 631 may be formed by a first guide projecting portion 635 which projects from the inner surface of the lower body 63. The restraining groove 631a may be formed on the upper surface of the first guide projecting portion 635. The first guide projecting portion 635 may be formed from the opened end of the lower body 63 to the coupling groove 631 and provides a surface on which the coupling projection 433 is capable of being seated.

[00192] Therefore, when the filter 40 is inserted into the head 60, the coupling projection 433 is not capable of being inserted into some sections of the opening of the lower surface of the head 60 due to the interference of the first guide projecting portion 635. The coupling projection 433 is capable of being inserted through the section which is not interfered with the first guide projecting portion 635, so that the filter 40 is capable of being prevented from being erroneously mounted.

[00193] A first groove guide portion 633a for guiding the coupling projection 433 to the entrance of the adjacent coupling groove 631 may be formed on one side surface of the first guide projecting portion 635. The first groove guide portion 633a may be formed to have a predetermined inclination and is in contact with the projection guide portion 433a of the coupling projection 433 and thus guides the rotational movement of the coupling projection 433 in one direction when the coupling projection 433 is inserted.

[00194] A second guide projecting portion 636 may be formed on one side which is spaced apart from the end portion of the first groove guide portion 633a along the inner surface of the lower body 63 by a predetermined distance. A second groove guide portion 633b is formed to be inclined on the second guide projecting portion 636 so that the coupling projection 433 which passes by the first groove guide portion 633a rotates moves along the second groove guide portion 633b so as to be guided and to be moved the entrance of the coupling groove 631. The second groove guide portion 633b may extend from one side away from the first groove guide portion 633a to the entrance of the coupling groove 631.

[00195] Therefore, when the filter 40 is inserted into the opened lower surface of the lower body 63 after the coupling projection 433 is positioned at a position corresponding to the inserting display portion 613 when the filter 40 is mounted, the projection guide portion 433a slides along the first groove guide portion 633a and then is slid along the second groove guide portion 633b and inserted into the inside of the coupling groove 631.

[00196] In a case where the user inserts the coupling projection 433 of the filter 40 by aligning the coupling projection 433 in a process of the filter 40 being inserted into the inside of the head 60, the filter 40 is capable of being coupled while being smoothly rotated by the first groove guide portion 633a and the second groove guide portion 633b.

[00197] The shaft 90 and the upper supporter 80 are integrally coupled with each other in a state where the filter 40 is fully inserted and then the coupling projection 433 is positioned at the entrance of the coupling groove 631. When the filter 40 is further rotated so that the coupling projection 433 is fully inserted into the

inside of the coupling groove 631, the shaft 90 is rotated together with the filter 40 and the filtering flow path 96 is rotated to be connected to the water inlet portion 611 and the water outlet portion 612.

[00198] To this end, a second connecting portion 972 may be formed at the lower end of the shaft 90, that is, at the lower end of the inner pipe 97. A pair of second connecting portions 972 may be formed in the same shape at a position which faces each other, and both sides of the lower end of the inner pipe 97 are formed by being cut. However, it is not limited to thereto.

[00199] Specifically, the lower end of the inner pipe 97 may include the pair of second connecting portions 972 and a pair of pipe cutout portions 973 formed between the second connecting portions 972. The pair of second connecting portions 972 may have a width which is gradually narrowed in the lower direction.

[00200] A second inclined surface 974 may be formed at both side ends of the pair of second connecting portions 972 and the second inclined surface 974 may be formed to have an inclination corresponding to the first inclined surface 853.

[00201] The second inclined surface 974 is inserted along the first inclined surface 853 in a process of the filter 40 being rotatably inserted into the head 60. When the filter 40 is fully inserted into the head 60, the second connecting portion 972 is matched with the first connecting portion 851 and the projecting portion 852 is matched with the pipe cutoff portion 973. Therefore, the first inclined surface 853 and the second inclined surface 974 are capable of being in close fully contact with each other.

[00202] In addition, the second inclined surface 974 may be also formed to be inclined in the direction of rotation of the filter 40 as the first inclined surface 853.

Therefore, when the filter 40 is further rotated in a state where the rotation of the shaft 90 is restricted by the stopper 652, the force in the rotating direction is acted to the second inclined surface 974 and the first inclined surface 853 and the first inclined surface 853 moves along the second inclined surface 974 so that the filter 40 is capable of being easily separated.

[00203] On the other hand, a plurality of the supporting ribs 634 are formed on the inner surface of the lower body 63 and the outer surface of the filter inserting portion 431 is capable of being supported by the supporting ribs 634.

[00204] Hereinafter, the operation of the water purifying apparatus according to the embodiment of the present invention having the structure described above will be described.

[00205] Fig. 19 is a cutaway perspective view illustrating a state where of the filter and the head are separated from each other, Fig. 20 is an enlarged view of portion A of Fig. 19, and Fig. 21 is a view illustrating a shaft position in a state where the filter and the head are separated from each other.

[00206] As illustrated in the drawings, the bypass flow path 95 is connected to the water inlet portion 611 and the water outlet portion 612 in a state where the filter 40 is not coupled to the head 60.

[00207] Therefore, the water which flows into through the water inlet portion 611 flows into the bypass inlet port 951 through the water inlet port 611a and flows along the bypass flow path 95. The water is discharged to the water outlet portion 612 through the bypass outlet port 952 and the water outlet port 612a. In other words, the water which flows into the water inlet portion 611 passes through the

head 60 without being subjected to a purification process, and is supplied directly to the ice maker 24 or the dispenser 23 through the water supplying flow path 30.

[00208] Such a state may correspond to a state where the filter 40 is separated for replacement of the filter 40, or may correspond to a case where the service which is related to the cleaning of a pipeline or other maintenance is performed. In addition, even in a case where at least a portion of the plurality of filters 40 are not used, or even in a case where purification of water is not required, it is capable of corresponding to such a state. Even in a case where the filter 40 is separated, no problem occurs in use of the refrigerator 1.

[00209] On the other hand, with reference to Fig. 21, when the disposition of the shaft 90 is described in a state where the filter 40 is not mounted, the first rotating projection 921a of the pair of rotating projections 921 is in a state of being in contact with the stopper 652 of one side of the rotating guide 651. In this state, the water outlet guide portion 965b and the flow path cutout portion 653 are maintained a state of being shifted by an angle of about 90 degrees with each other.

[00210] Fig. 22 is a view illustrating a state where the filter is inserted into an inside of the head, and Fig. 23 is a view illustrating a state where the filter is fully inserted into the inside of the head.

[00211] As illustrated in the drawings, the filter inserting portion 431 is inserted into the opening of the lower surface of the head 60 to mount the filter 40. At this time, the position of the coupling projection 433 is capable of being aligned and inserted by referring to the inserting display portion 613 formed on the outside of the head 60.

[00212] The coupling projection 433 slides along the first groove guide 633a and the second groove guide 633b in a process of the insertion of the filter 40. Accordingly, the filter 40 is capable of being smoothly rotated along with insertion.

[00213] When the filter 40 is inserted by a predetermined depth, the insertion of the second connecting portion 972 into the inside of the first connecting portion 851 proceeds, as illustrated in Fig. 21. At this time, the second connecting portion 972 and the first connecting portion 851 are capable of being slid while the second inclined surface 974 and the first inclined surface 853 are in contact with each other, respectively. Accordingly, the second connecting portion 972 may be guided to the inside of the first connecting portion 851.

[00214] In other words, when the filter 40 is inserted and mounted, the filter 40 is smoothly rotated in the process of inserting the filter 40 into the head 60 by the first groove guide 633a and the second groove guide 633b. The shaft 90 and the supporter extending portion 85 is capable of being fully matched by sliding the second inclined surface 974 and the first inclined surface 853 in the process of rotation, as illustrated in Fig. 23.

[00215] As illustrated in Fig. 23, the coupling projections 433 are located on the inner side or the entrance side of the coupling grooves 631 in a case where the shaft 90 and the supporter extending portion 85 are fully matched with each other. In other words, the filter 40 corresponds to a state where the filter 40 is simply inserted before the filter 40 is fully coupled with the head. In this state, the shaft 90 is not rotated, and the bypass flow path 95 is in a state of being connected to the water inlet portion 611 and the water outlet portion 612.

[00216] In a state of being illustrated in Fig. 23, the user is capable of further rotating the filter 40 in the rotation advancing direction and is rotated by about 90 degrees so that the coupling projection 433 is fully inserted into the inside of the coupling groove 631.

[00217] Fig. 24 is a view illustrating a state where the filter is rotated for coupling in a state where the filter is fully inserted into the inside of the head, Fig. 25 is an enlarged view of portion B in Fig. 24, and Fig. 26 is a view illustrating a shaft position in a state where the filter is coupled to the head.

[00218] In a state of being illustrated in Fig. 23, when the filter 40 is further rotated by an angle of 90 degrees so that the coupling projection 433 and the coupling groove 631 are rotated to be fully coupled with each other, the shaft 90 is also rotated along with the rotation of the filter and thus is in a state of being illustrated in Fig. 26.

[00219] Specifically, when the filter 40 is rotated in a state where the second connecting portion 972 is inserted into the first connecting portion 851 and thus fully coupled with each other, the shaft 90 rotates along with the filter 40.

[00220] The shaft 90 may be further rotated by an angle of about 90 degrees until the second rotating projection 921b reaches the position of the stopper 652. When the shaft 90 is fully rotated, the filtering flow path 96 is connected to the water inlet portion 611 and the water outlet portion 612 with each other. Of course, the inner pipe 97 and the supporter extending portion 85 maintains a connected state with each other and thus the original water and the purified water is capable of flowing in and out between the head 60 and the filter 40. In addition, the coupling projection 433 is in a state of being fully inserted into and thus is coupled with the

coupling groove 631 and the filter 40 is operated to be rotated in a direction which is opposite to the coupling direction by the user and thus the filter 40 is maintained in a state of coupling with the head 40 until the filter 40 is separated from the head 60.

[00221] In a state of being illustrated in Fig. 24, the water flowing in through the water inlet portion 611 flows along the shaft water inlet flow path 964 through the water inlet port 611a and the shaft inlet port 961. In other words, water flowing along the horizontal portion 964a and the vertical portion 964b passes by the inner pipe 97, flows into the inside of the supporter extending portion 85 and flows along the first filter inlet flow path 872 in the lower direction. Then, water is branched by the second filter inlet flow path 873 and flows into the space between the inner surface of the housing 41 and the filtering member 44.

[00222] The water flowing into the hollow 441 of the inside of the filtering member 44 from the outside of the filtering member 44 may be purified in the process of passing through the filtering member 44. The purified water of the inside of the filtering member 44 flows along the inside of the first extending portion 86 in the upper direction and is discharged from the filter outlet port 862 which is disposed on both sides of the upper end of the first extending portion 86 in the upper direction.

[00223] At this time, a space in which water purified by the outer surface of the first extending portion 86 and the lower part 92 inserted into the inside of the filter inserting portion 431 flows to the head 60 side is formed in the inside of the filter inserting portion 431. On the other hand, as illustrated in Fig. 24, in a state where the filtering flow path 96 is connected to the water inlet portion 611 and the water outlet portion 612, the water outlet guide portion 965b and the flow path cutout

portion 653 are positioned at the same position with each other and thus the purified water is capable of flowing to the upper part 91 side.

[00224] Accordingly, the purified water flows along the water outlet guide portion 965b formed in the lower part 92 in the upper direction and flows into the inside of the upper part 91 and thus passes through the shaft outlet port 962 and the water outlet portion 612 in this order, and then is discharged to the water outlet portion 612. The water outlet pipe 302 of the water outlet portion 612 forms a portion of the water supplying flow path 30 to supply the purified water to the dispenser 23 and the ice maker 24.

[00225] In a state of being illustrated in Fig. 23, in a state where the filter 40 should be removed because of reach of period of replacement of the filter 40 or other maintenance, the filter 40 is first rotated in a direction which is opposite to the coupling direction.

[00226] The coupling projection 433 is moved in a direction away from the coupling groove 631 according to the rotation of the filter 40 and the supporter extending portion 85 rotates the shaft 90. As illustrated in Fig. 20, when the filtering flow path 96 is closed by the shaft 90 being rotated by 90 degrees and then the bypass flow path 95 is connected, the rotating projection 921 is in contact with the stopper 652 and thus is restricted the rotation of the shaft 90.

[00227] In this state, when a force is applied to further rotate the filter 40, the shaft 90 is not capable of being further rotated by the stopper 652. Accordingly, a torsion moment is applied to the first inclined surface 853 and the second inclined surface 974 so that the second inclined surface 974 is smoothly separated along the first inclined surface 853 while being slid. Further, the coupling projection 433

which is escaped from the coupling groove 631 passes by the second groove guide portion 633b and the first groove guide portion 633a in this order to allow the filter 40 to be separated from the head 60.

[00228] On the other hand, in the embodiment of the present invention, as an example, the water purifying apparatus 17 is mounted on the refrigerator 1 in order to facilitate the understanding and the explanation. However, the water purifying apparatus 17 is capable of being applied to the water purifier which is generally used and the entire device which is capable of purifying water by a filter exchanging manner.

[00229] The water purifying apparatus according to the proposed embodiment and the refrigerator including the water purifying apparatus are capable of being expected the following effects.

[00230] According to the embodiment of the present invention, in a case where the filter is separated from the head for replacement or maintenance of the filter, the bypass flow path connects to the water inlet portion and the water outlet portion so that the flow path is capable of being connected without generating leakage. Since the water supplying flow path is capable of being maintained in a connected state by the bypass flow path, continuous supply of water to the dispenser or the ice maker becomes possible, and service work such as the cleaning of the flow path becomes possible. Therefore, convenience of use of the water purifying apparatus is capable of being improved.

[00231] In addition, in the embodiment of the present invention, the filtration flow path is connected to the water inlet portion and the water outlet portion during the rotation operation for mounting the filter, so that purified water is capable of being

supplied. When rotation for the separation of the filter is operated, the bypass flow path is connected to the water inlet portion and the water outlet portion so that water is capable of being continuously supplied even at the removal of the filter. In other words, it is possible to switch the flow path without additional operation by the rotation operation of mounting and separating the filter, and thus the convenience of use is capable of being further improved.

[00232] In addition, in the embodiment of the present invention, the exact position is capable of being displayed on the head into which the filter is inserted so that the filter is capable of being mounted accurately. In addition, since a groove guide which is in contact with the coupling projection is formed at the inside of the head so as to be inclined, the filter is capable of being smoothly rotated and thus inserted into the coupling groove only by inserting the filter at an exact position. In addition, since the flow paths of the head and the filter are capable of being connected at the same time by the coupling of the coupling projections with the coupling grooves, convenience of use is capable of being further improved.

[00233] In addition, in the embodiment of the present invention, the first connecting portion and the second connecting portion which are formed at the ends of the shaft and the upper supporter have a structure which are matched with each other and have an inclination in the axial direction and thus when the filter is inserted into the head, since the inclinations are in contact with each other, the filter is guided to be inserted in the exact position. In addition, when the filter is rotated to separate the filter, the inclined surfaces of the first connecting portion and the second connecting portion are capable of being easily separated from each other in a

section in which the rotation of the shaft is restricted, and thus convenience of use is capable of being further improved.

[00234] In addition, in the embodiment of the present invention, since the flow path is capable of switching by only the rotation of the shaft without a separate valve structure and an elastic member for switching the flow path, the configuration of the product is capable of being simplified and thus the productivity is improved and manufacturing cost is capable of being reduced.

[00235] In addition, malfunction is capable of being prevented due to a simple operation structure, a reliable operation is capable of being assured, and the durability of the product is capable of being improved.

[00236] In addition, in the embodiment of the present invention, since a portion of the filtering flow path projects to the inside of the bypass flow path, so that the structure of the shaft is capable of being made compact. This makes it possible to minimize the capacity loss of the refrigerator when the water purifying apparatus is installed in the refrigerator by the size of the head on which the shaft is mounted and further the structure of the entire water purifying apparatus being made compact.

[00237] The foregoing description is merely illustrative of the technical idea of the present invention and various changes and modifications may be made without departing from the essential characteristics of the present invention by those having ordinary skill in the art to which the present invention belongs. Therefore, the embodiments disclosed in the present invention are intended to illustrate rather than limit the scope of the present invention, and the scope of the technical idea of the present invention is not limited by these embodiments.

What is claimed is:

1. A water purifying apparatus, comprising:
 - a head on which a water inlet portion and a water outlet portion are formed to face each other in a straight line;
 - a mounting member on which a rotation supporting portion is formed to surround the water inlet portion and the water outlet portion of the head;
 - a water inlet pipe and a water outlet pipe which are connected to the mounting member;
 - a shaft provided in the head and rotatably mounted between the water inlet portion and the water outlet portion;
 - a bypass flow path formed to pass through a circumference of the shaft, having a flow path projecting portion on a penetrated flow path, and communicating the water inlet portion with the water outlet portion according to rotation of the shaft;
 - a filter detachably mounted to the head, and having a filter inserting portion in which the shaft is inserted when being mounted on the head; and
 - a filtering flow path in which an inlet port and an outlet port are formed on the circumference of the shaft in a direction intersecting the bypass flow path, and which communicates between the filter, the water inlet portion and the water outlet portion with each other according to the rotation of the shaft.

2. The water purifying apparatus of claim 1, wherein the flow path projecting portion projects upward from a bottom of the bypass flow path.

3. The water purifying apparatus of claim 1, wherein both ends of the flow path projecting portion are formed to be inclined or rounded.

4. The water purifying apparatus of claim 1, wherein the head includes a head body having an opened upper surface,

wherein the shaft is accommodated in the head body through the opened upper surface, and

wherein the opened upper surface is covered by a head cap.

5. The water purifying apparatus of claim 4, wherein a body seating portion on which the shaft is seated in a state where a portion of the shaft is passed through is provided in an inner circumferential surface of the head body.

6. The water purifying apparatus of claim 5, wherein a rotating guide is formed on the seating portion, and

wherein the rotating guide is cut at a predetermined angle so that a rotating projection of the shaft is accommodated and the rotation of the shaft is capable of being guided.

7. The water purifying apparatus of claim 1, wherein the shaft includes an inner pipe which communicates with the filtering flow path and is connected with the

filter inserting portion.

8. The water purifying apparatus of claim 1, wherein the flow path projecting portion forms the filtering flow path.

9. The water purifying apparatus of claim 1, wherein the inlet port and the outlet port of the filtering flow path and the inlet port and the outlet port of the bypass flow path are disposed along the circumference of the shaft at an angle of 90 degrees.

10. A water purifying apparatus, comprising:
a head on which a water inlet portion and a water outlet portion are formed;
a shaft provided in the head and rotatably mounted between the water inlet portion and the water outlet portion;

a bypass flow path formed to pass through a circumference of the shaft and communicating the water inlet portion with the water outlet portion according to rotation of the shaft;

a filtering flow path formed in the shaft in a direction intersecting the bypass flow path;

an inner pipe formed to extend downward from the shaft and having a pipe cutout portion on an end thereof;

a filter detachably mounted to the head and having a filter inserting portion in

which the shaft is inserted when being mounted on the head; and

a first connecting portion formed on a supporter extending portion which extends in a direction of the shaft in the filter insertion portion, to rotate the shaft upon rotatably coupling of the filter by coupling with the pipe cutout portion.

11. The water purifying apparatus of claim 10, wherein the shaft includes a flow path projecting portion which projects upward from a bottom of the bypass flow path to form the filtering flow path.

12. The water purifying apparatus of claim 10, wherein the inlet port and the outlet port of the filtering flow path and the inlet port and the outlet port of the bypass flow path are disposed along the circumference of the shaft at an angle of 90 degrees at the same height.

13. The water purifying apparatus of claim 10, wherein the inner pipe forms the filtering flow path.

14. The water purifying apparatus of claim 10, wherein the shaft includes an upper part and a lower part, and the inner pipe is formed in the lower part and is spaced apart from an inner circumferential surface of the lower part.

15. The water purifying apparatus of claim 10, wherein the filter includes

a housing body having an upper opening portion,
a filtering member accommodated in the housing body,
a housing cap coupled to the upper opening portion of the housing body and provided with the filter inserting portion, and
an upper supporter coupled to an upper surface of the filtering member and an inner surface of the housing cap, respectively.

16. The water purifying apparatus of claim 15, wherein the supporter extending portion is provided on the upper supporter.

17. The water purifying apparatus of claim 15, wherein a housing fastening portion is formed on a side of an inner circumferential surface of the filter inserting portion, and

wherein the upper supporter includes a supporter fastening portion coupled to the housing fastening portion.

18. The water purifying apparatus of claim 15, wherein the shaft is inserted into the housing body and the supporter extending portion is inserted into the shaft and then is connected to the inner pipe, in a process of the filter being coupled to the head.

19. The water purifying apparatus of claim 10, wherein the inner pipe

includes a pair of second connecting portions,

wherein the pipe cutout portion is positioned between the pair of second connecting portions, and

wherein a first inclined surface is formed on the first connecting portion and a second inclined surface which is in contact with the first inclined surface is formed on each second connecting portion.

20. A water purifying apparatus, comprising:

a head on which a water inlet portion and a water outlet portion are formed;

a shaft provided in the head, and rotatably mounted between the water inlet portion and the water outlet portion;

a bypass flow path formed to pass through a circumference of the shaft and communicating the water inlet portion with the water outlet portion according to rotation of the shaft;

a filtering flow path formed in the shaft to be separated from the bypass flow path;

an inner pipe formed to extend downward from the shaft and having a pipe cutout portion on an end thereof and connected to the filtering flow path;

a filter detachably mounted to the head and having a filter inserting portion in which the shaft is inserted when being mounted on the head;

a supporter extending portion forming a first filter inlet flow path which is connected to the inner pipe and provided in the filter; and

a first connecting portion formed on an upper portion of the supporter extending portion to rotate the shaft upon rotatably coupling of the filter by coupling with the pipe cutout portion.

21. The water purifying apparatus of claim 20, wherein the shaft includes an upper part and a lower part, and

wherein the inner pipe is formed in the lower part and is spaced apart from an inner circumferential surface of the lower part.

22. The water purifying apparatus of claim 21, wherein the filter includes
a housing body having an upper opening portion,
a filtering member accommodated in the housing body,
a housing cap coupled to the upper opening portion of the housing body and provided with the filter inserting portion, and
an upper supporter coupled to the upper portion of the filtering member and an inner surface of the housing cap, respectively.

23. The water purifying apparatus of claim 22, wherein the supporter extending portion is provided on the upper supporter.

24. The water purifying apparatus of claim 21, wherein the first filter inlet flow path extends downward from a center of the supporter extending portion.

25. The water purifying apparatus of claim 24, wherein a second filter inlet flow path which extends from a lower end of the first filter inlet flow path in the lateral direction is provided in the supporter extending portion.

26. The water purifying apparatus of claim 25, wherein the supporter extending portion further includes a filter outlet flow path disposed on an outside of the first filter inlet flow path.

27. The water purifying apparatus of claim 26, wherein an outlet port groove for discharging water which flows along the filter outlet flow path is formed in a circumference of the supporter extending portion.

28. The water purifying apparatus of claim 24, wherein the filtering flow path includes a shaft water inlet flow path, and

wherein the shaft water inlet flow path includes a horizontal portion which extends from an inlet port of the shaft to a center of the shaft and a vertical portion which extends downward from an end portion of the horizontal portion.

29. The water purifying apparatus of claim 28, wherein the vertical portion is formed by the inner pipe.

30. The water purifying apparatus of claim 28, wherein the filtering flow path further includes a shaft water outlet flow path, and

wherein the shaft water outlet flow path includes

a water outlet guide portion formed on an outer surface of the lower part, and

a water outlet connecting portion which passes through a lower surface of the upper part and thus is connected to the water outlet guide portion.

31. The water purifying apparatus of claim 22, wherein a housing fastening portion is formed on a side of the inner circumferential surface of the filter inserting portion, and

wherein the upper supporter includes a supporter fastening portion coupled to the housing fastening portion.

32. The water purifying apparatus of claim 22, wherein the shaft is inserted into the housing body and the supporter extending portion is inserted into the shaft and then is connected with the inner pipe, in a process of the filter being coupled to the head.

33. A filter structure, comprising:

a housing body formed in a cylindrical shape to have a first accommodating space and having an upper opening portion;

a housing cap coupled to the upper opening portion of the housing body by a

portion thereof being formed in a cylindrical shape to have a second accommodating space, wherein a coupling projection and an upper opening portion are formed on an outer circumferential surface thereof, and a housing fastening portion is formed on an inner circumferential surface thereof;

a filtering member having a cylindrical shape accommodated in the first accommodating space; and

an upper supporter coupled to an upper portion of the filtering member and an inner surface of the housing cap respectively, and accommodated in the second accommodating space,

wherein the upper supporter includes

a supporter accommodating portion coupled to the upper portion of the filtering member,

a supporter stepped portion integrally formed on an upper portion of the supporter accommodating portion and in which a second filter inlet flow path is formed on the outer circumferential surface thereof so that water is supplied in a space between the outer circumferential surface of the filtering member and the housing body,

a supporter extending portion which extends upward from the supporter stepped portion, in which a first filter inlet flow path which communicates with the second filter inlet flow path is formed on a center portion thereof, in which a pair of projecting portions are formed to extend on the upper portion of the first filter inlet flow path and in which a filter outlet flow path is formed on an outside of the first filter

inlet flow path, and

a supporter fastening portion which prevents a rotation of the upper supporter in the housing cap by being coupled to the housing fastening portion.

34. The filter structure of claim 33,

wherein the supporter extending portion includes a first extending portion which extends upward from the center of the supporter stepped portion, and

a second extending portion which extends upward from the first extending portion and formed to have a cross-sectional area which is smaller than that of the first extending portion, and

wherein the filter outlet flow path extends from the inside portion of the filtering member to the upper end of the first extending portion.

35. The filter structure of claim 34,

wherein a first extending portion O-ring is provided in the first extending portion, and

wherein a second extending portion O-ring is provided in the second extending portion.

Fig.1

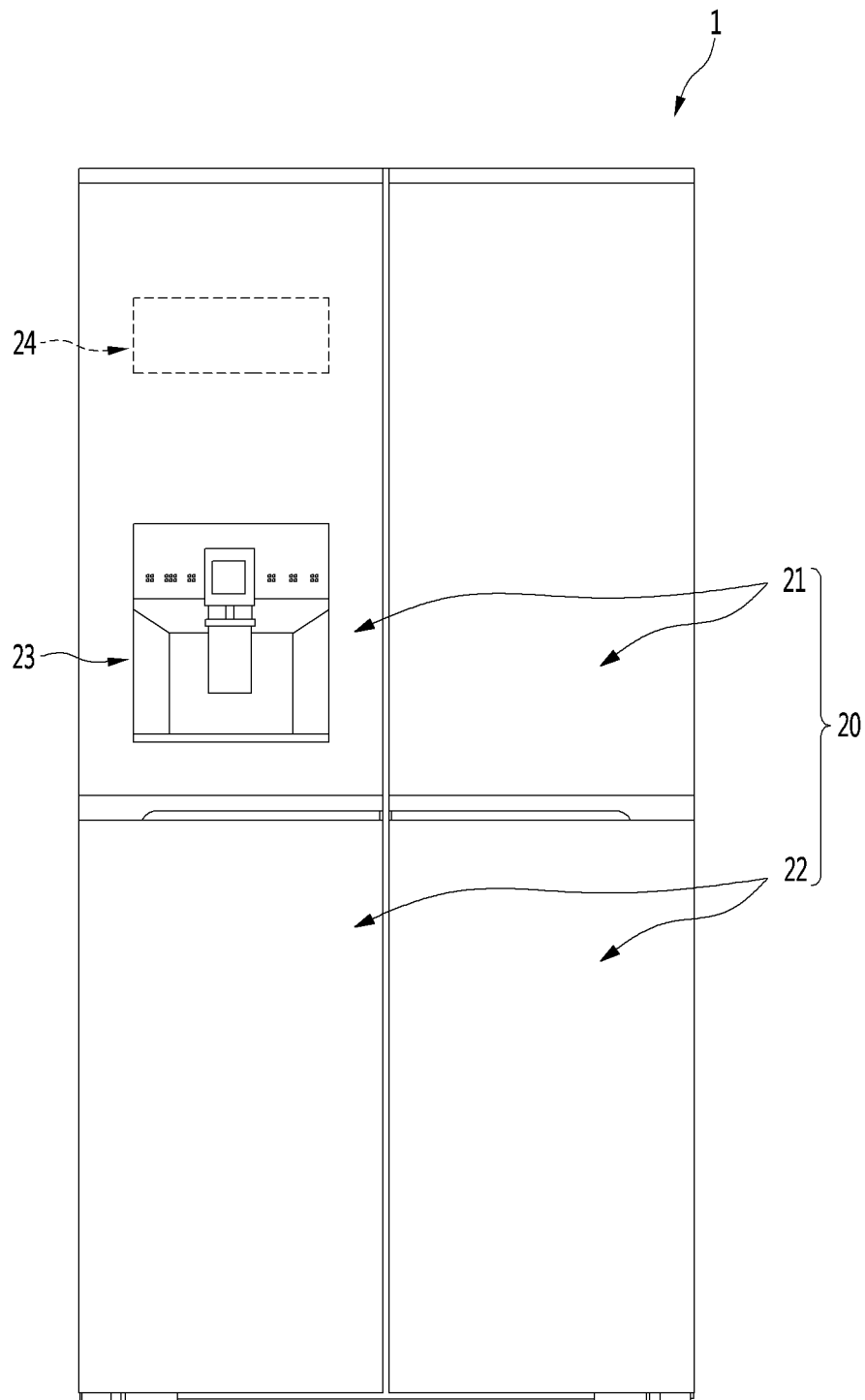

Fig.2

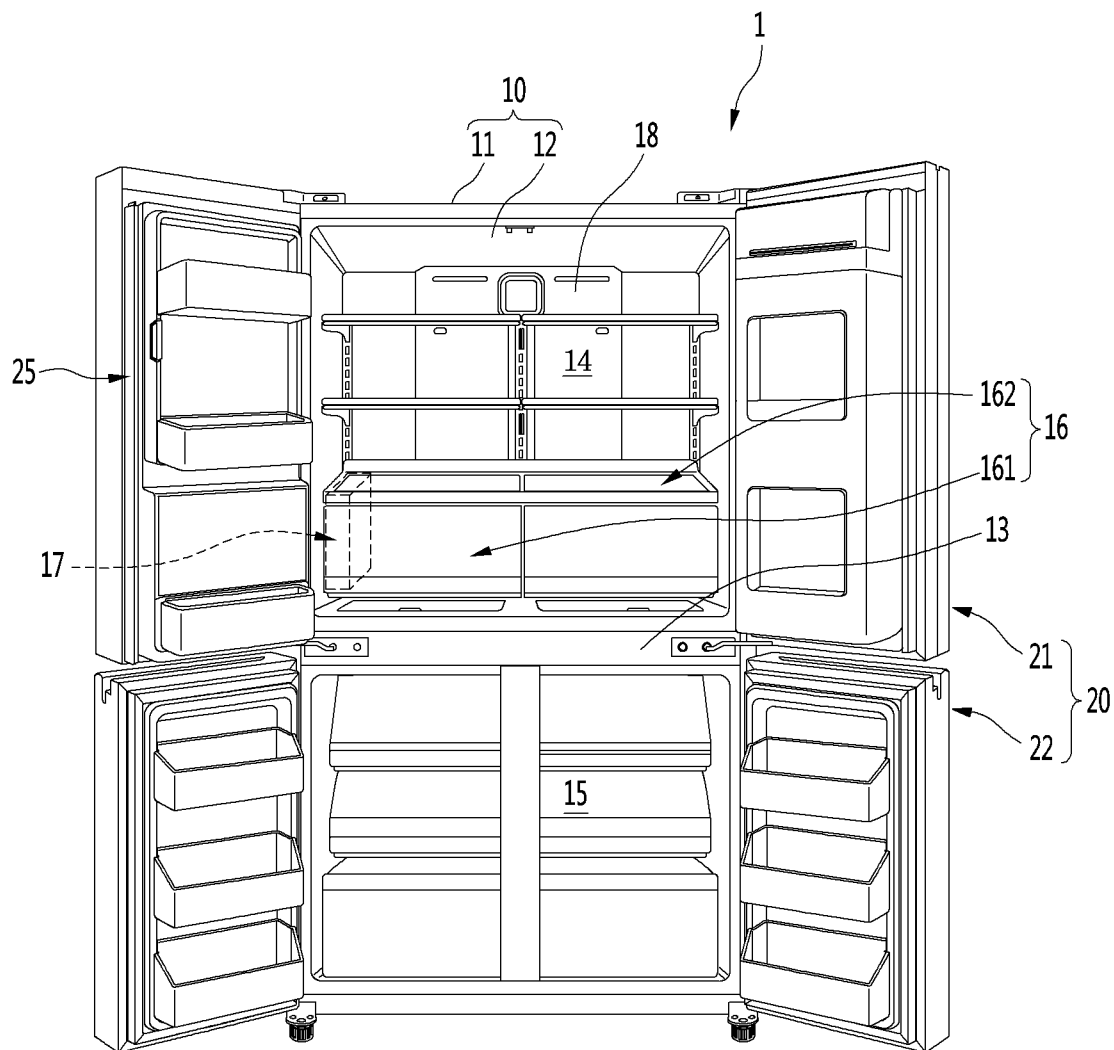
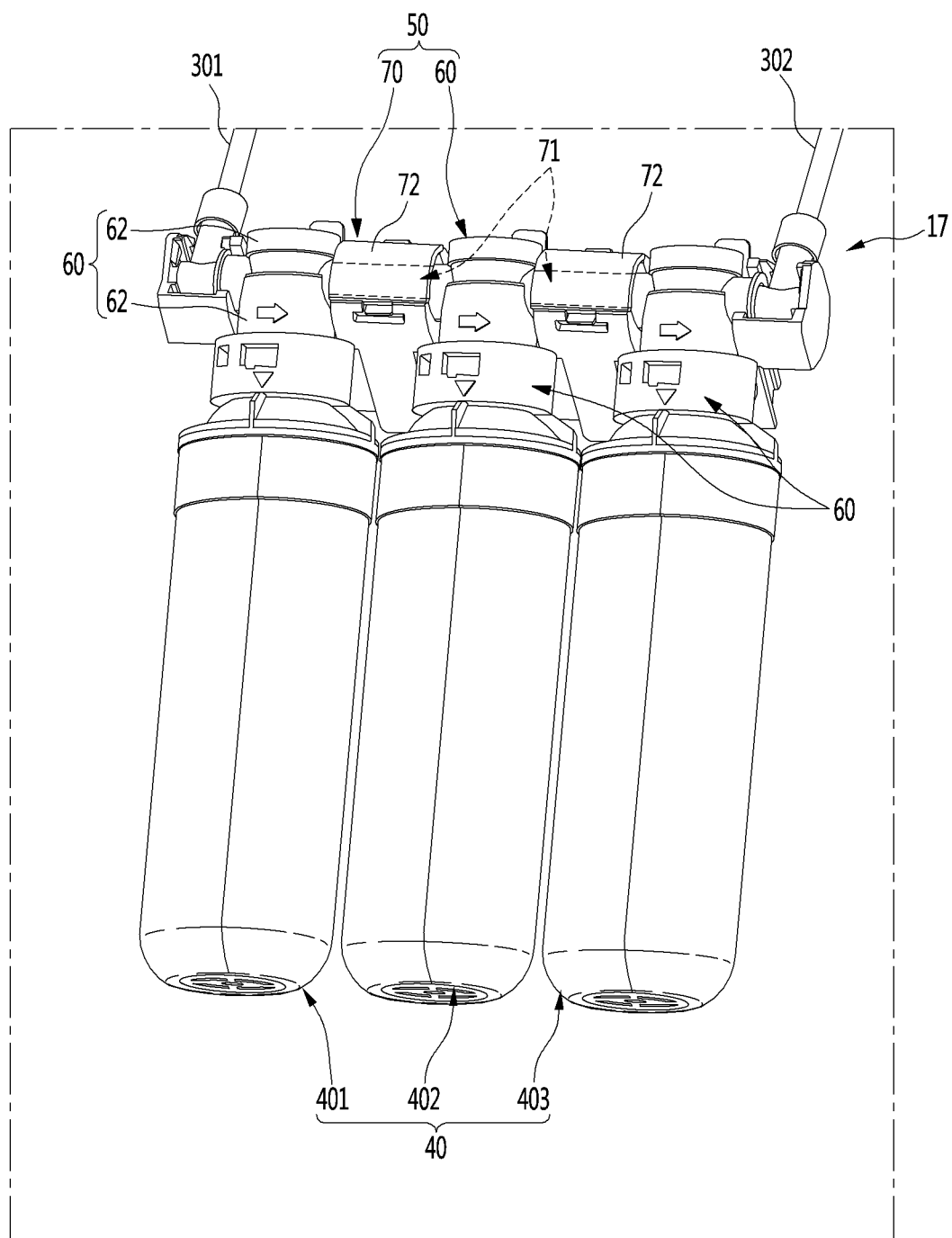

Fig.4



2017200730 03 Feb 2017

Fig.5

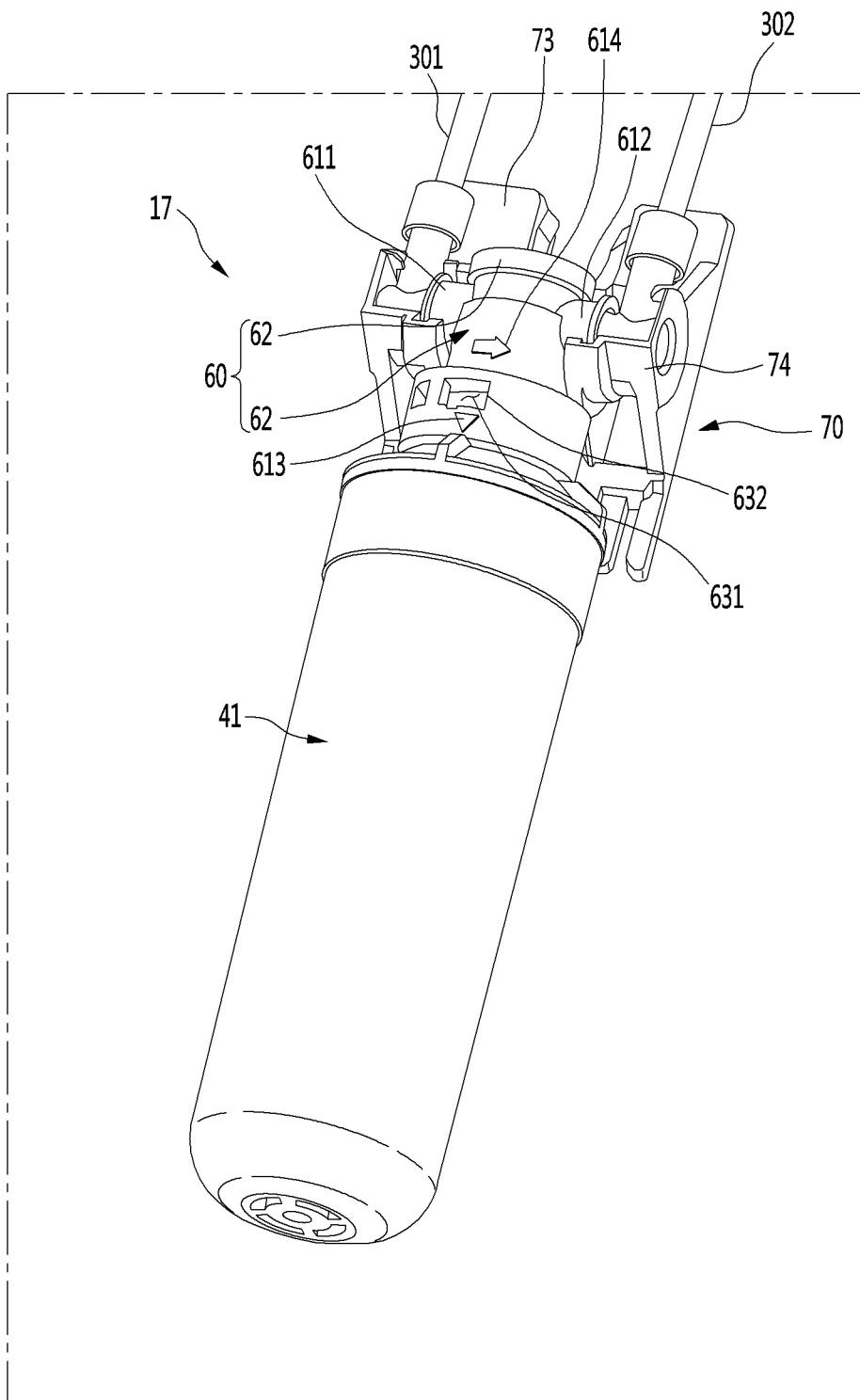

Fig.6

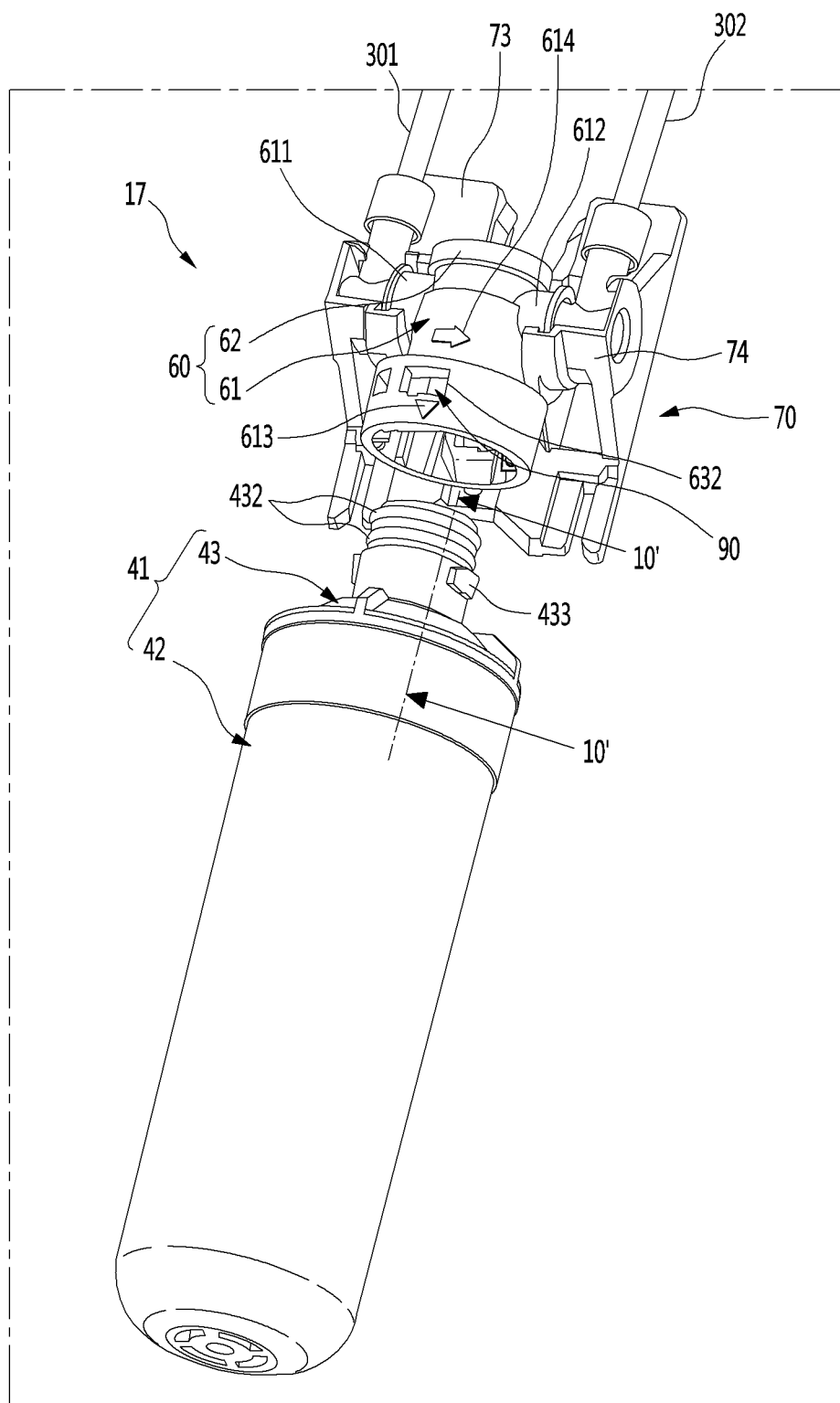

Fig.7

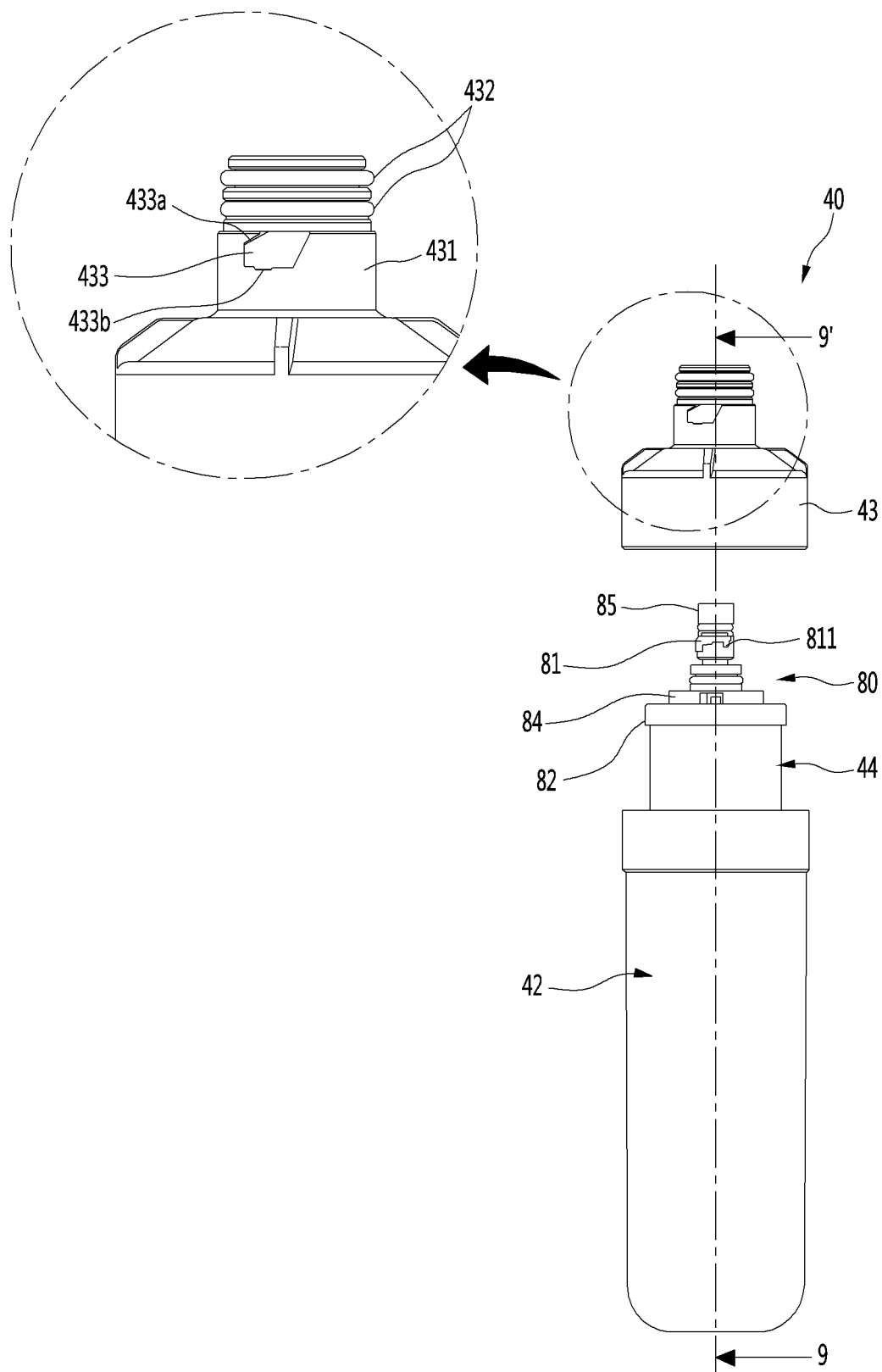

Fig.8

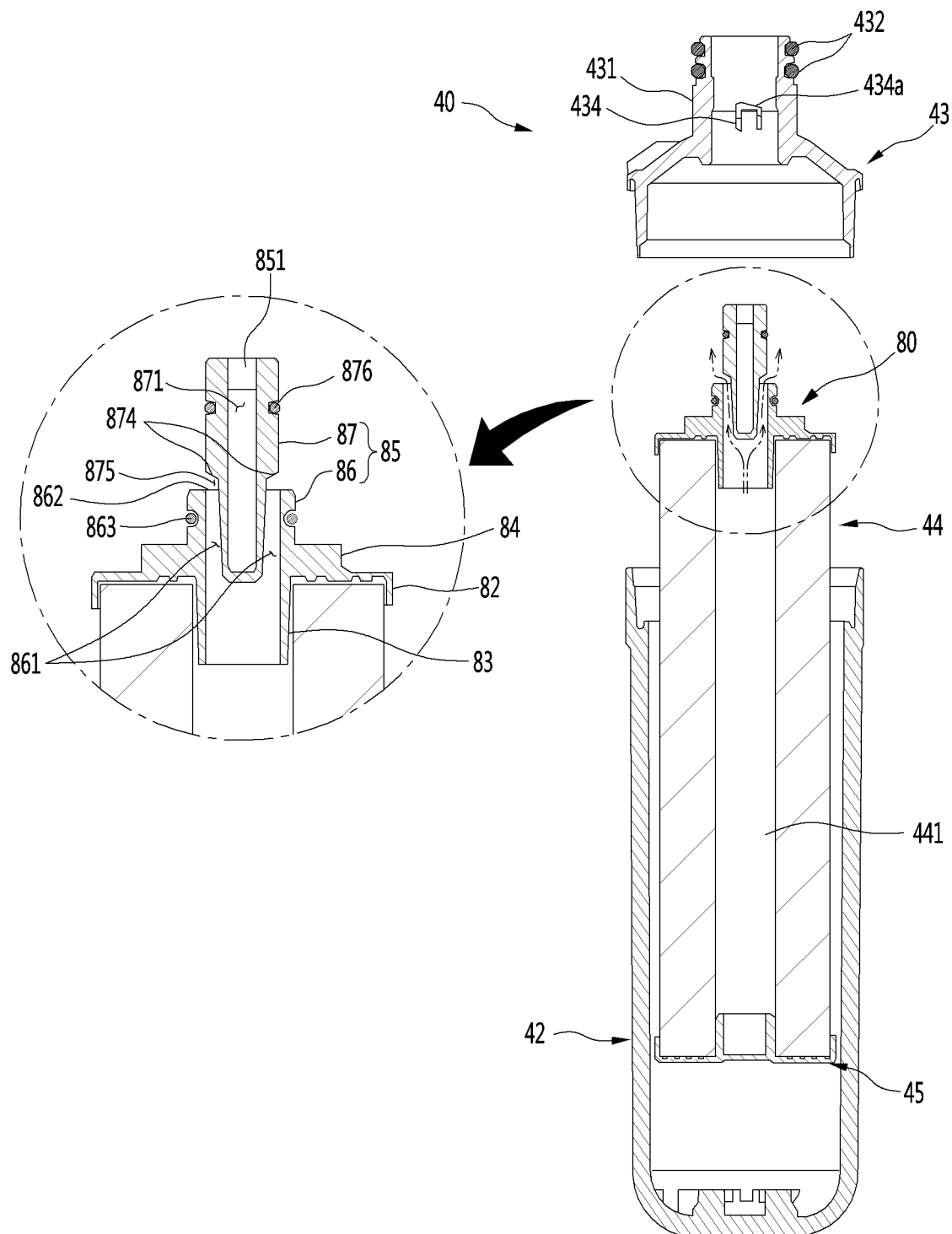

Fig.9

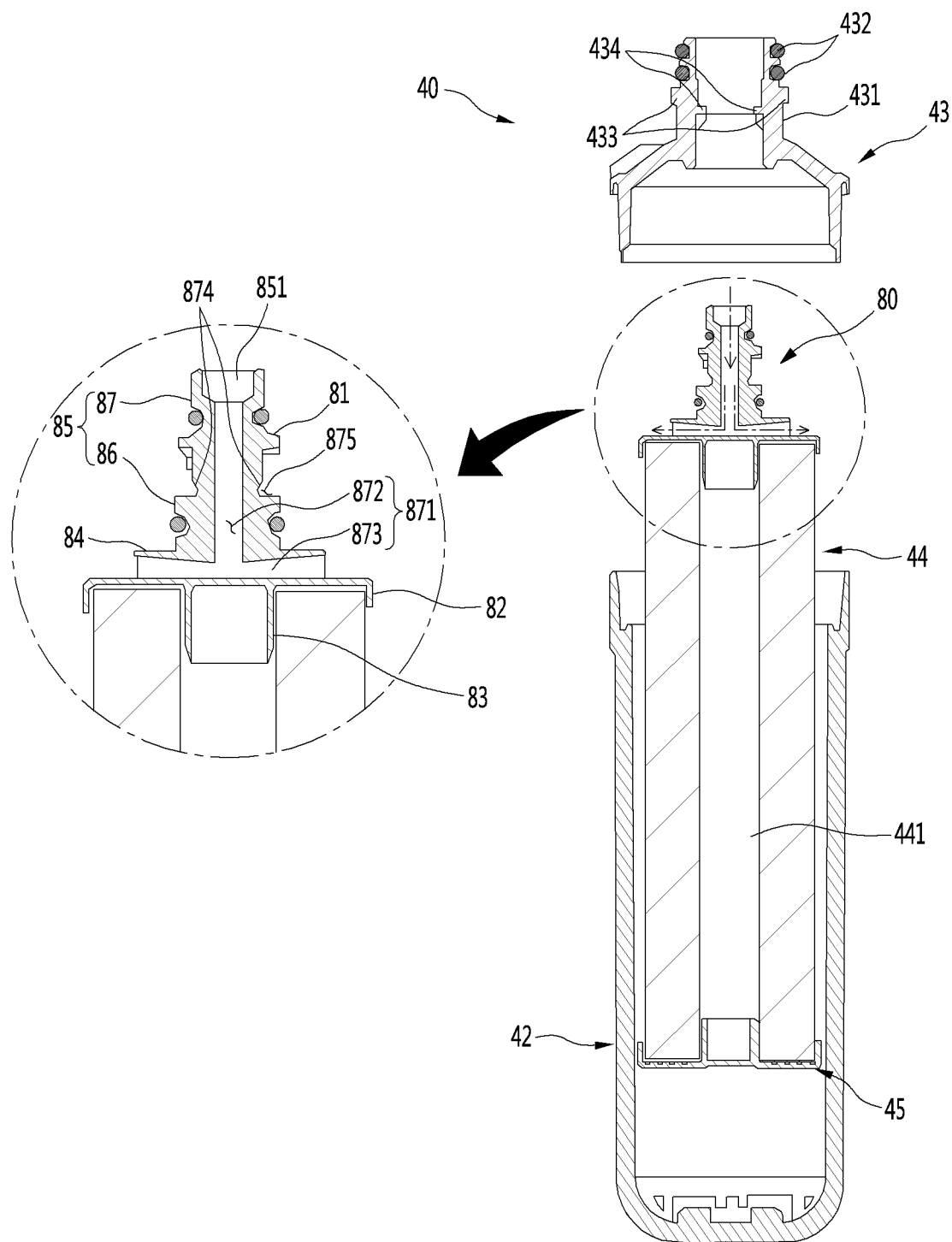

Fig.10

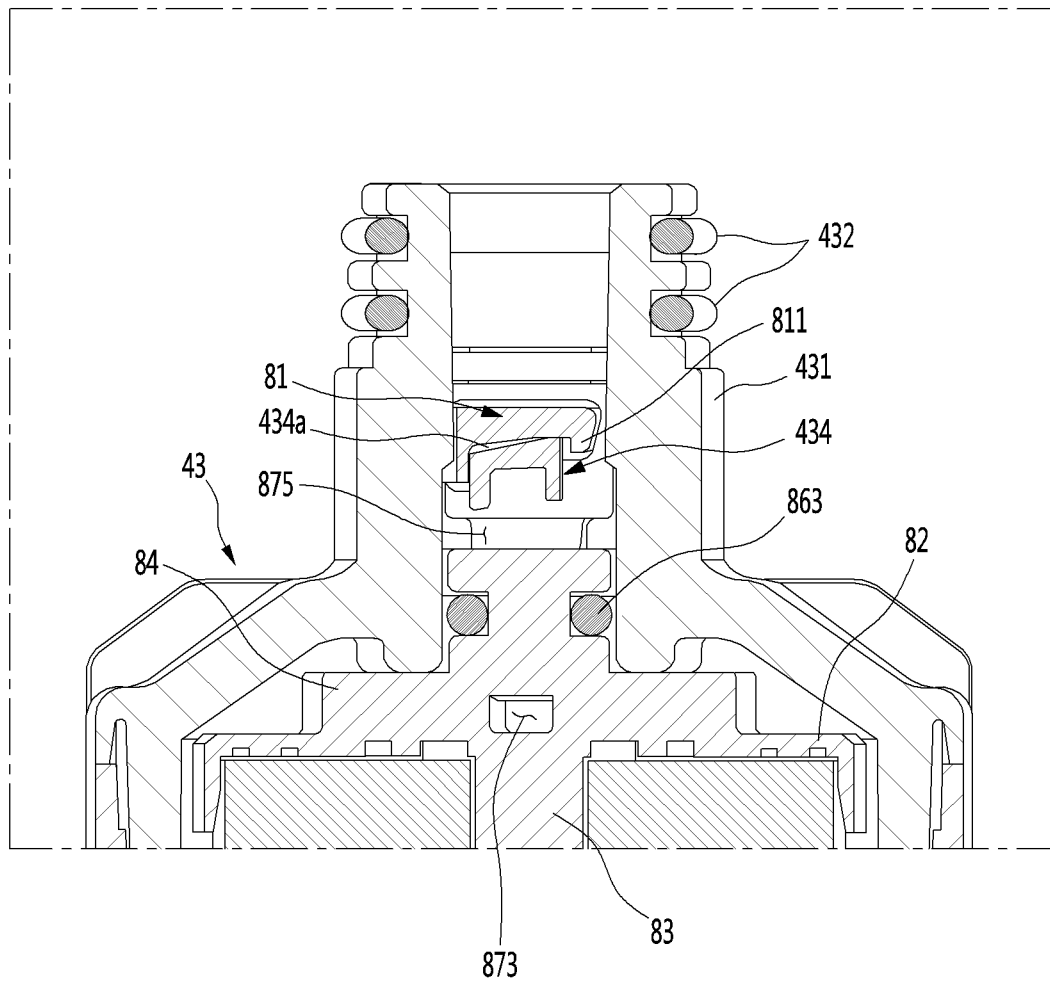

Fig.11

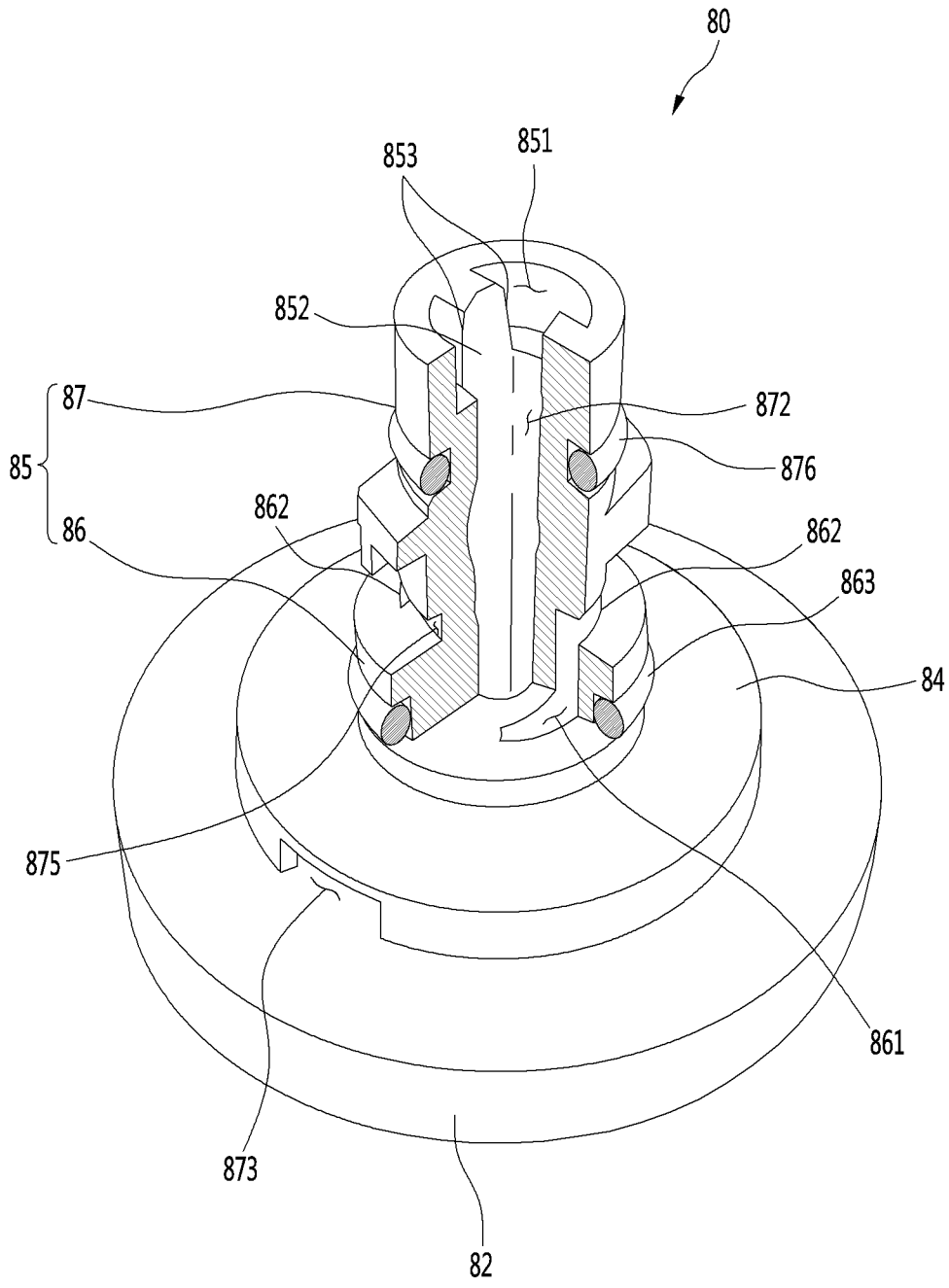

Fig.12

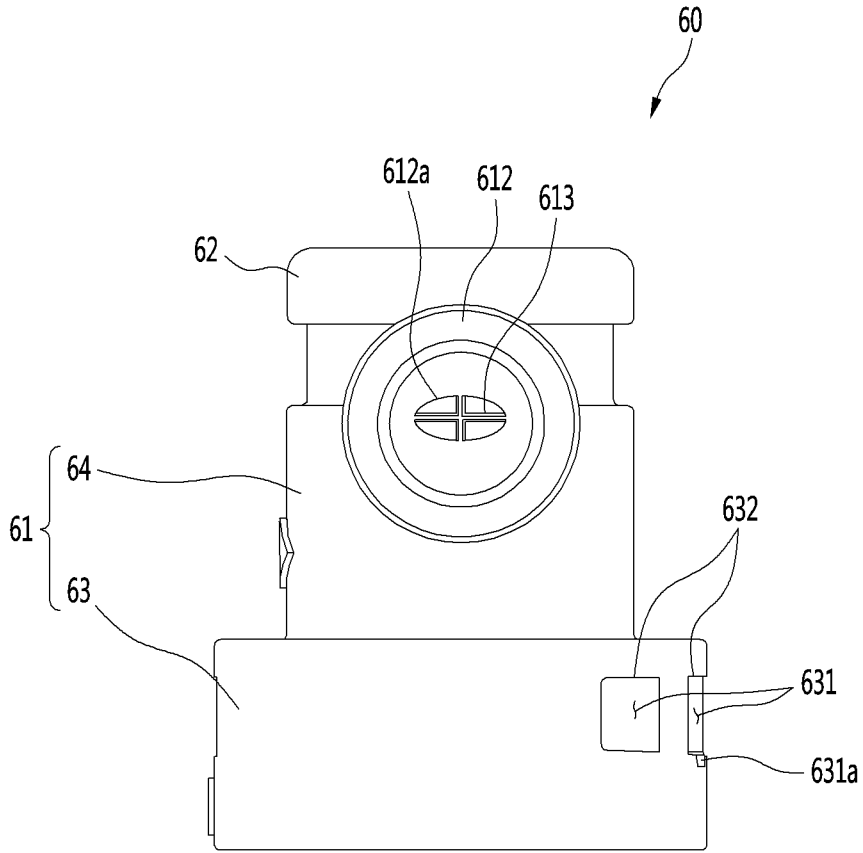
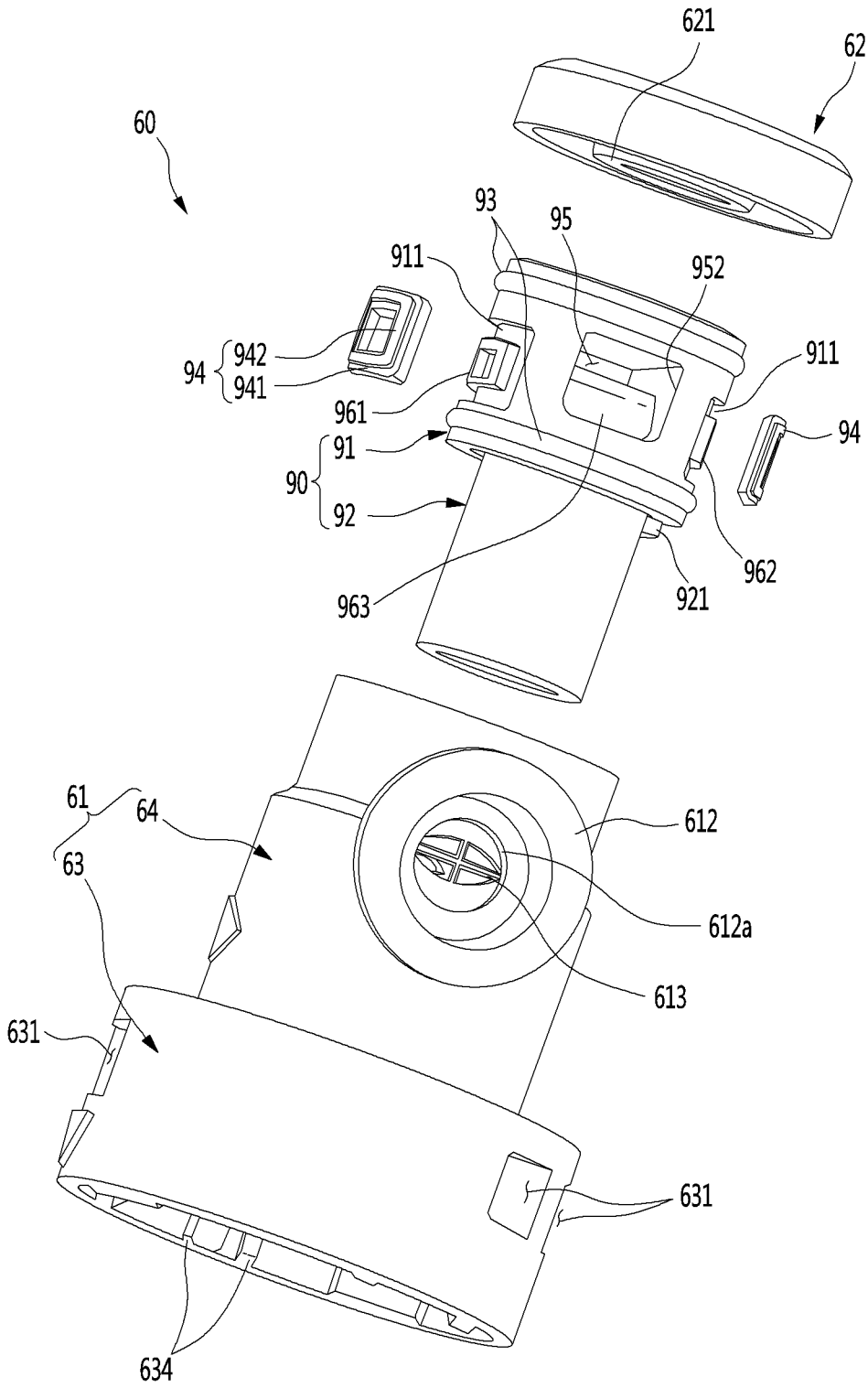
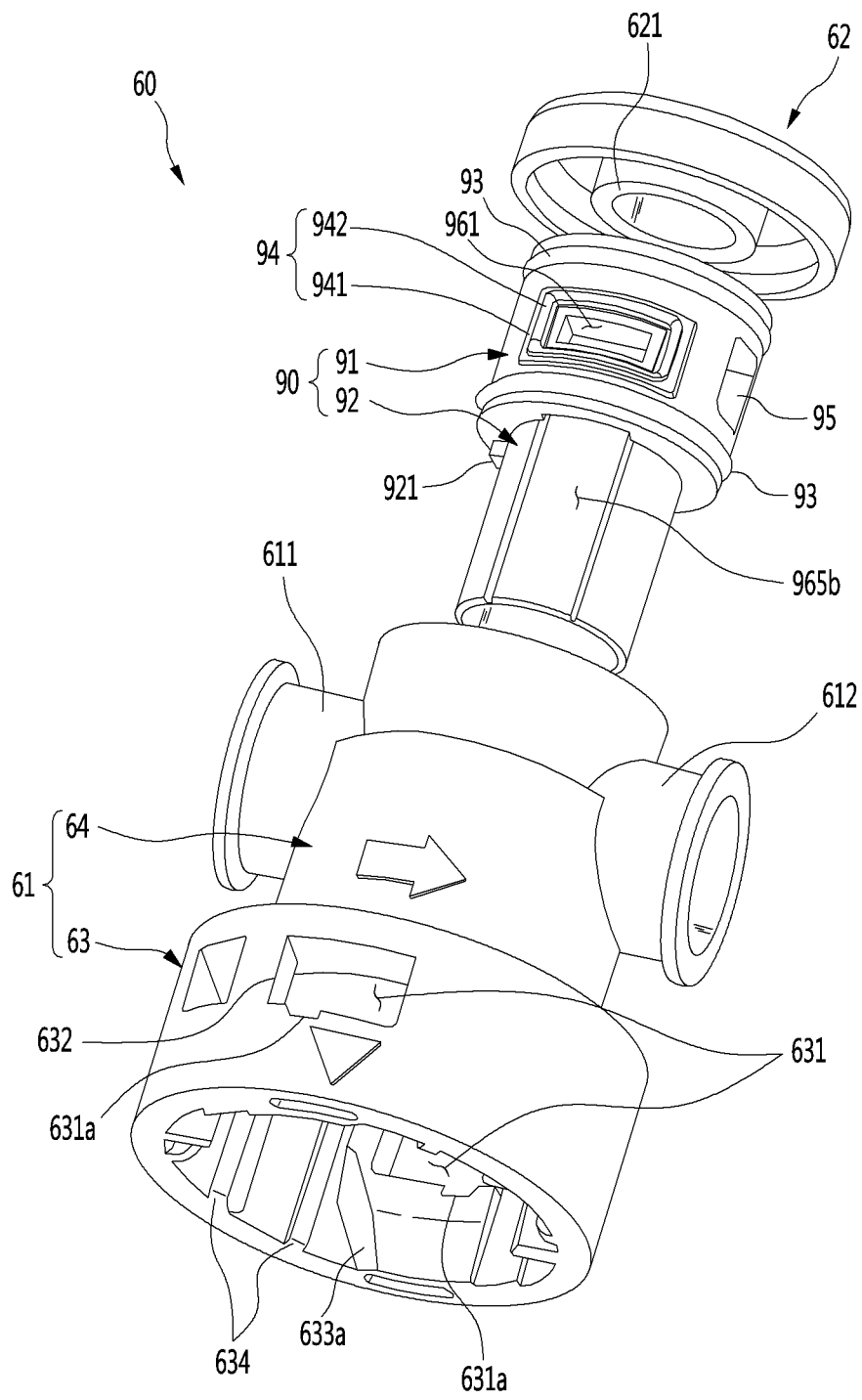

Fig.13



2017200730 03 Feb 2017

Fig.14



2017200730 03 Feb 2017

Fig.15

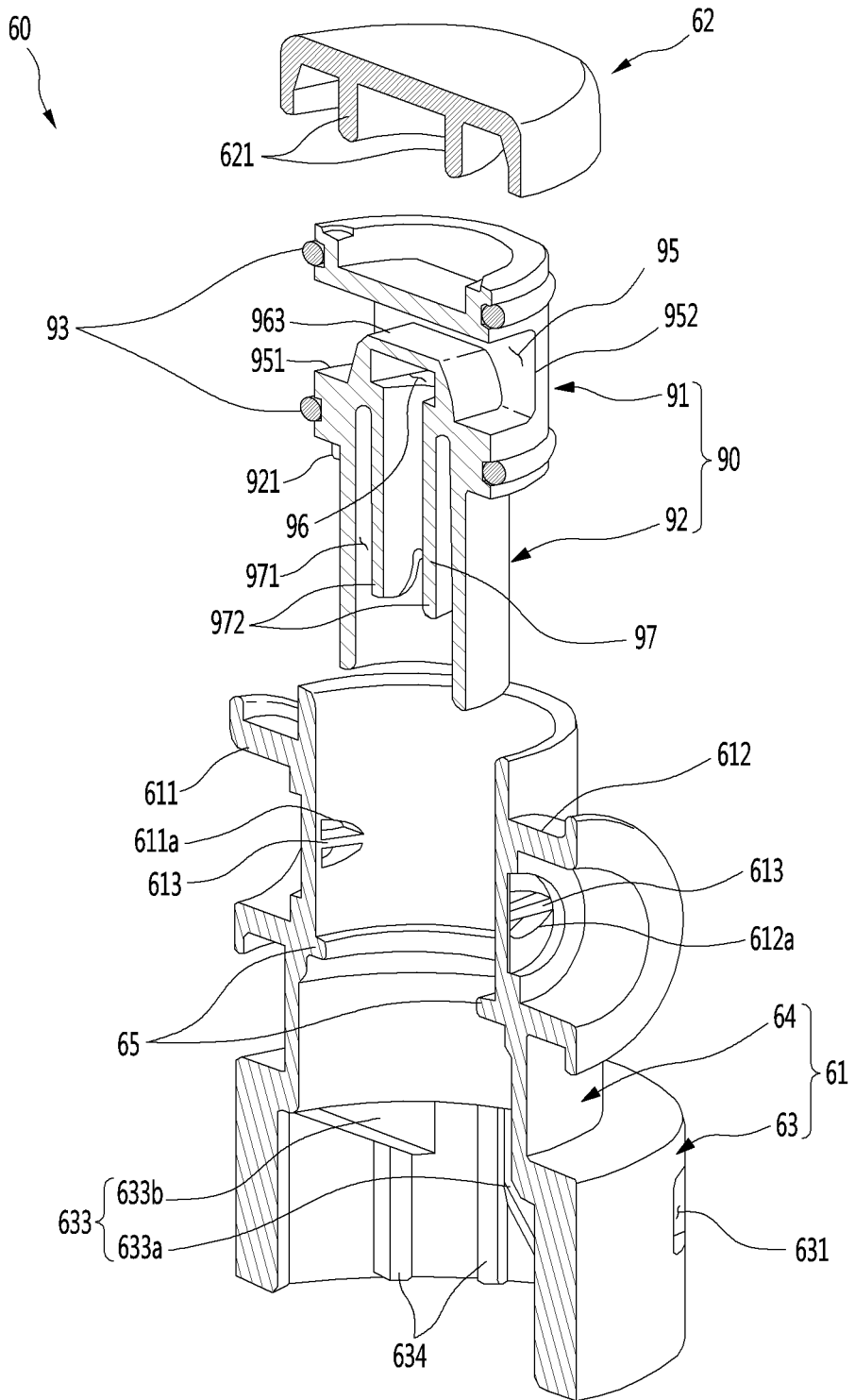

2017200730 03 Feb 2017

Fig.16

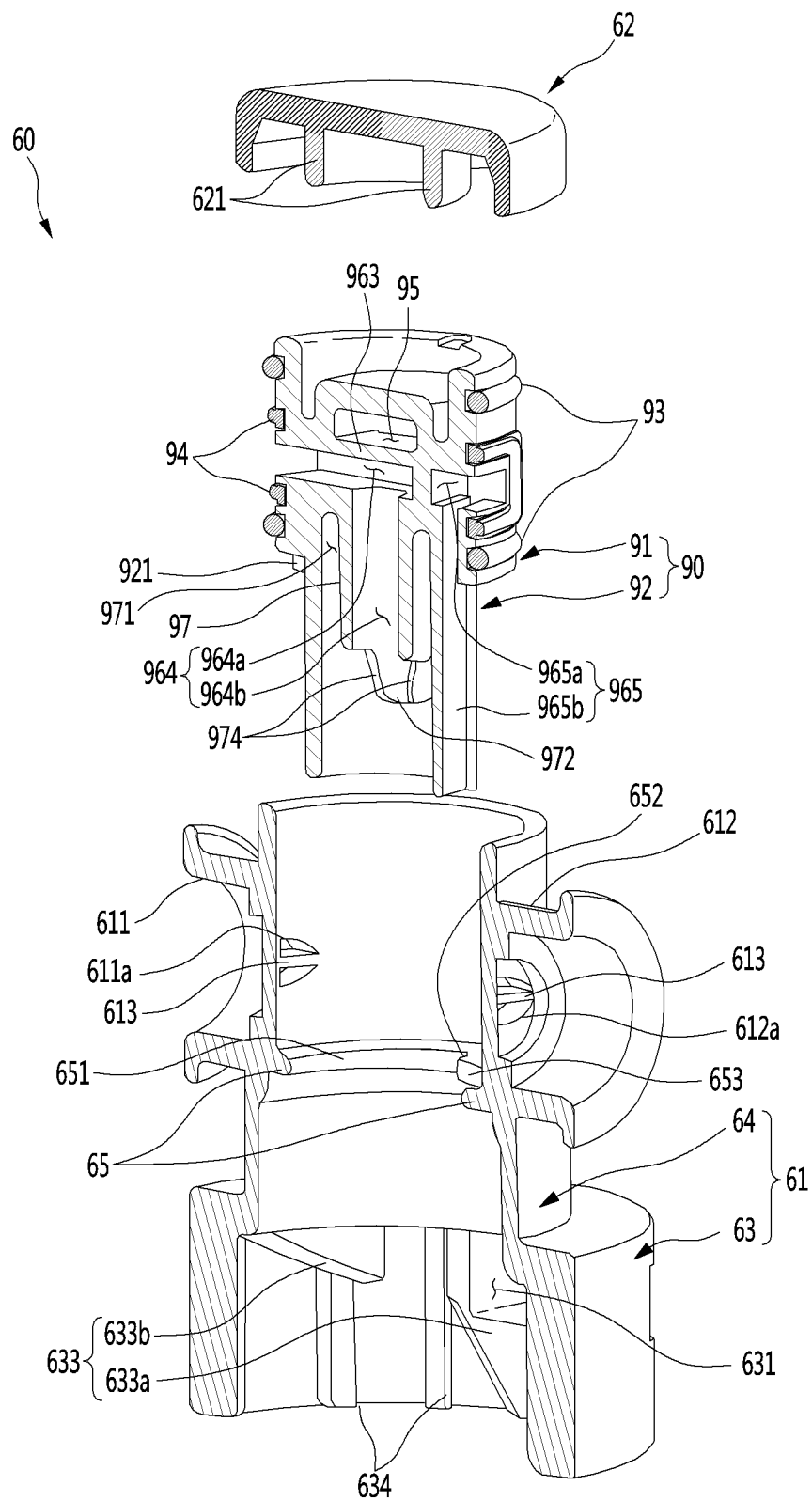

2017200730 03 Feb 2017

Fig.18

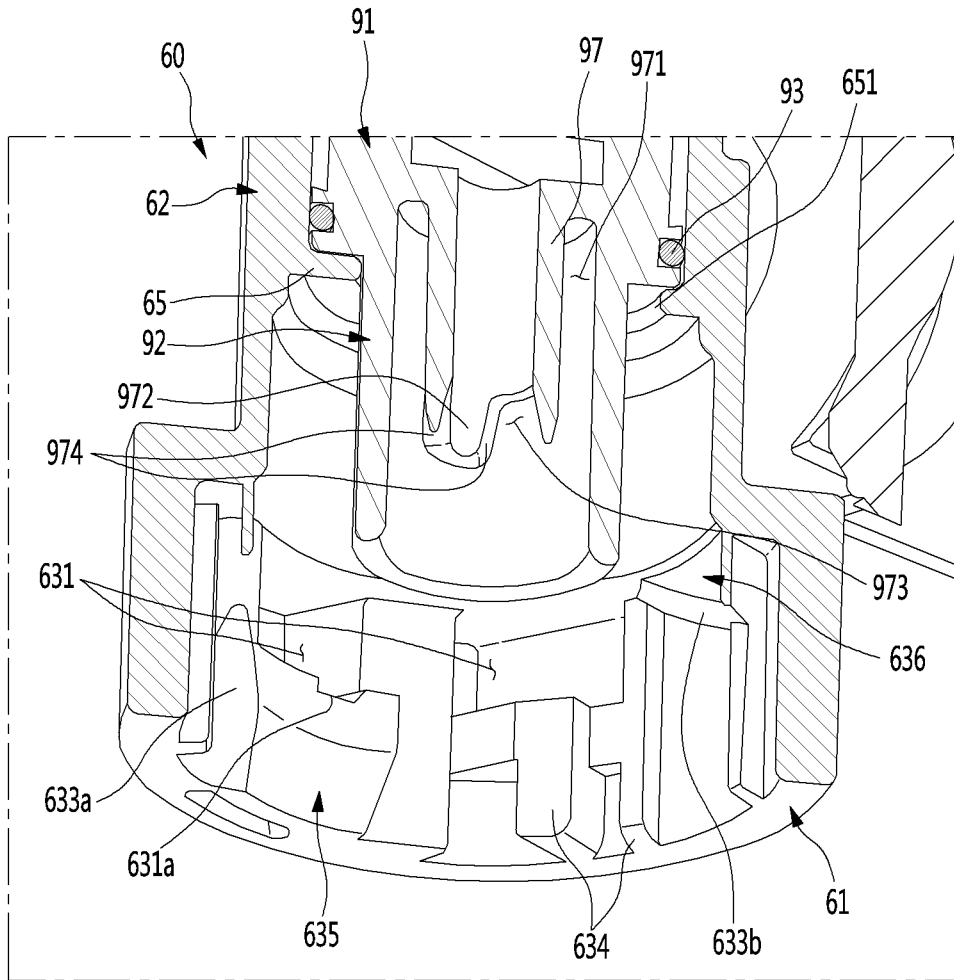

2017200730 03 Feb 2017

Fig.20

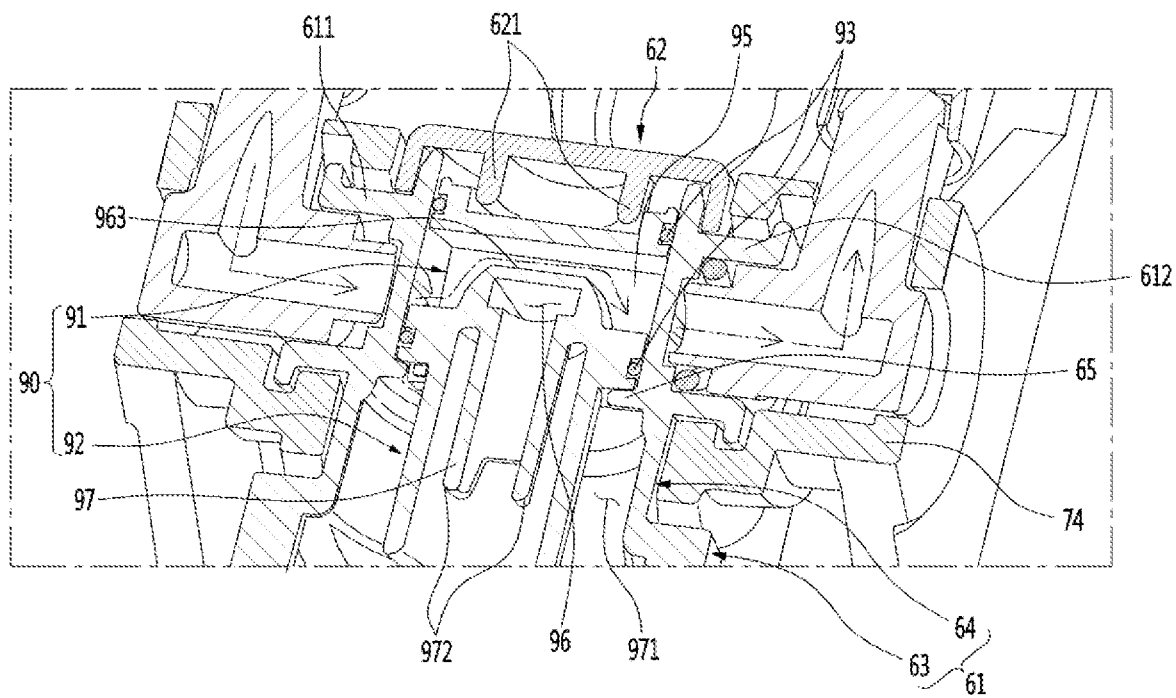

2017200730 03 Feb 2017

Fig.21

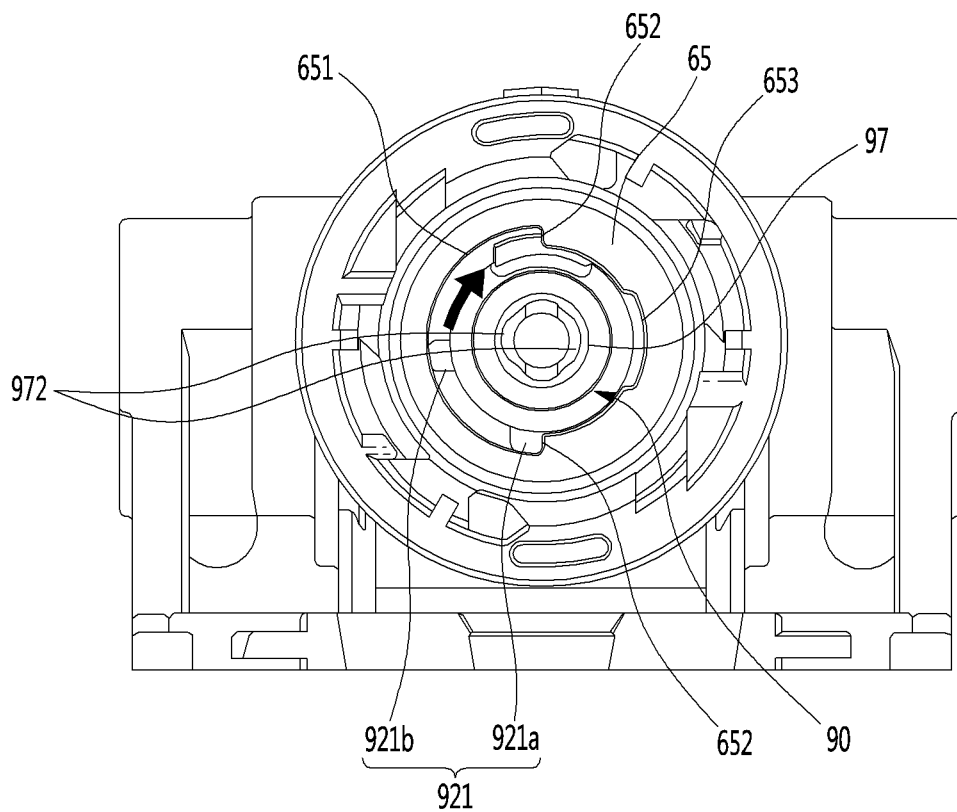
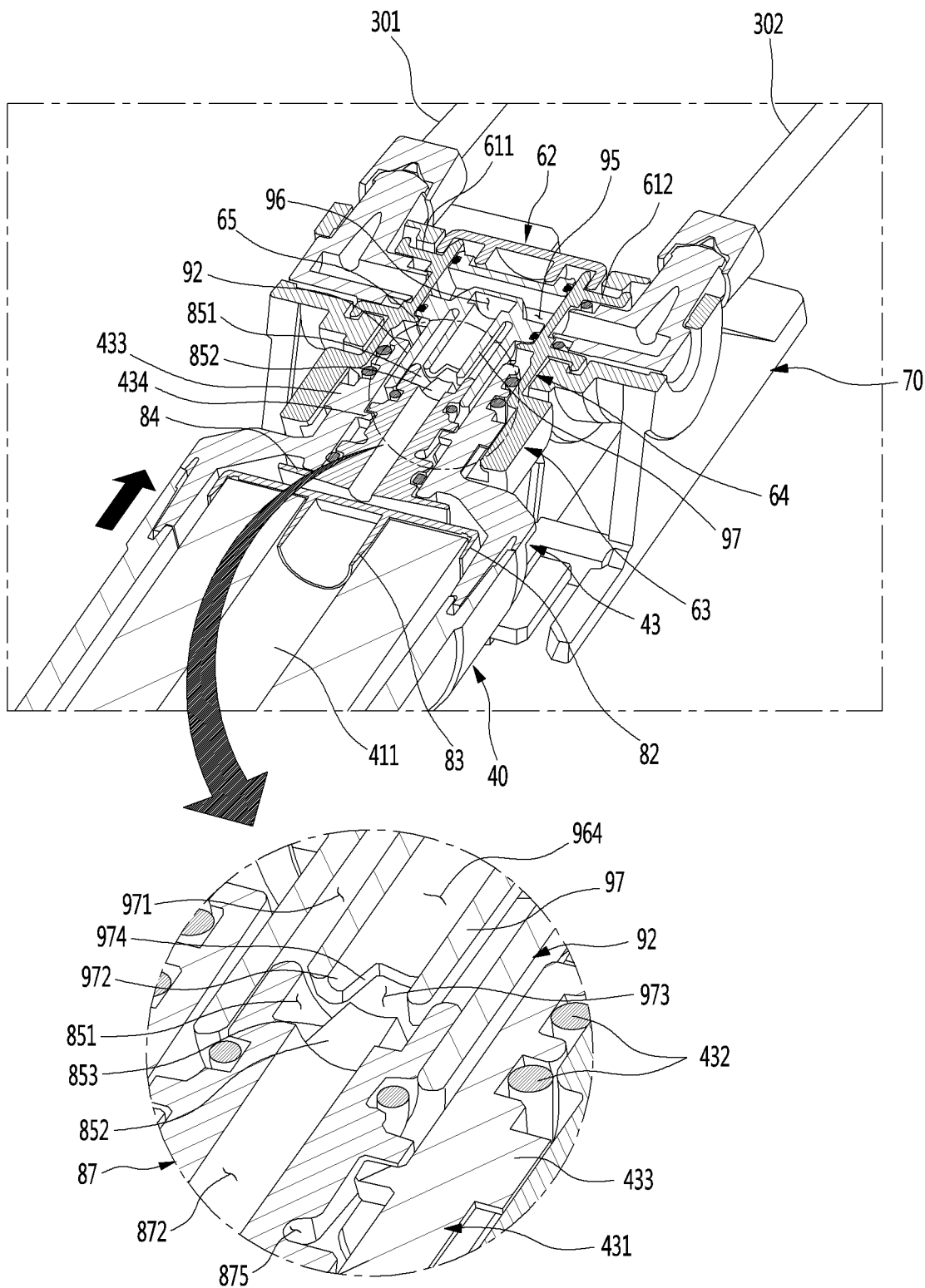
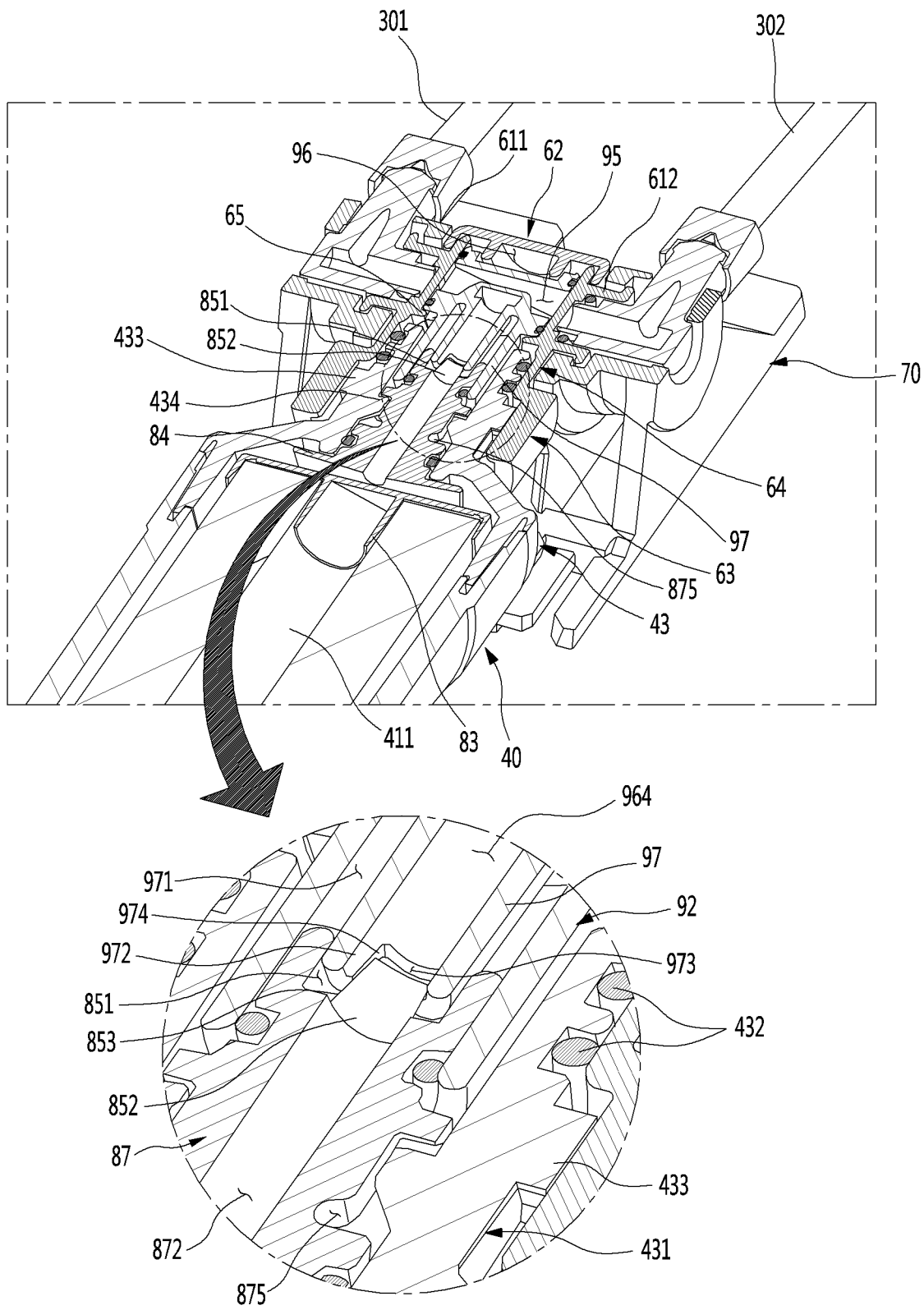

Fig.22



2017200730 03 Feb 2017

Fig.23



2017200730 03 Feb 2017

Fig.24

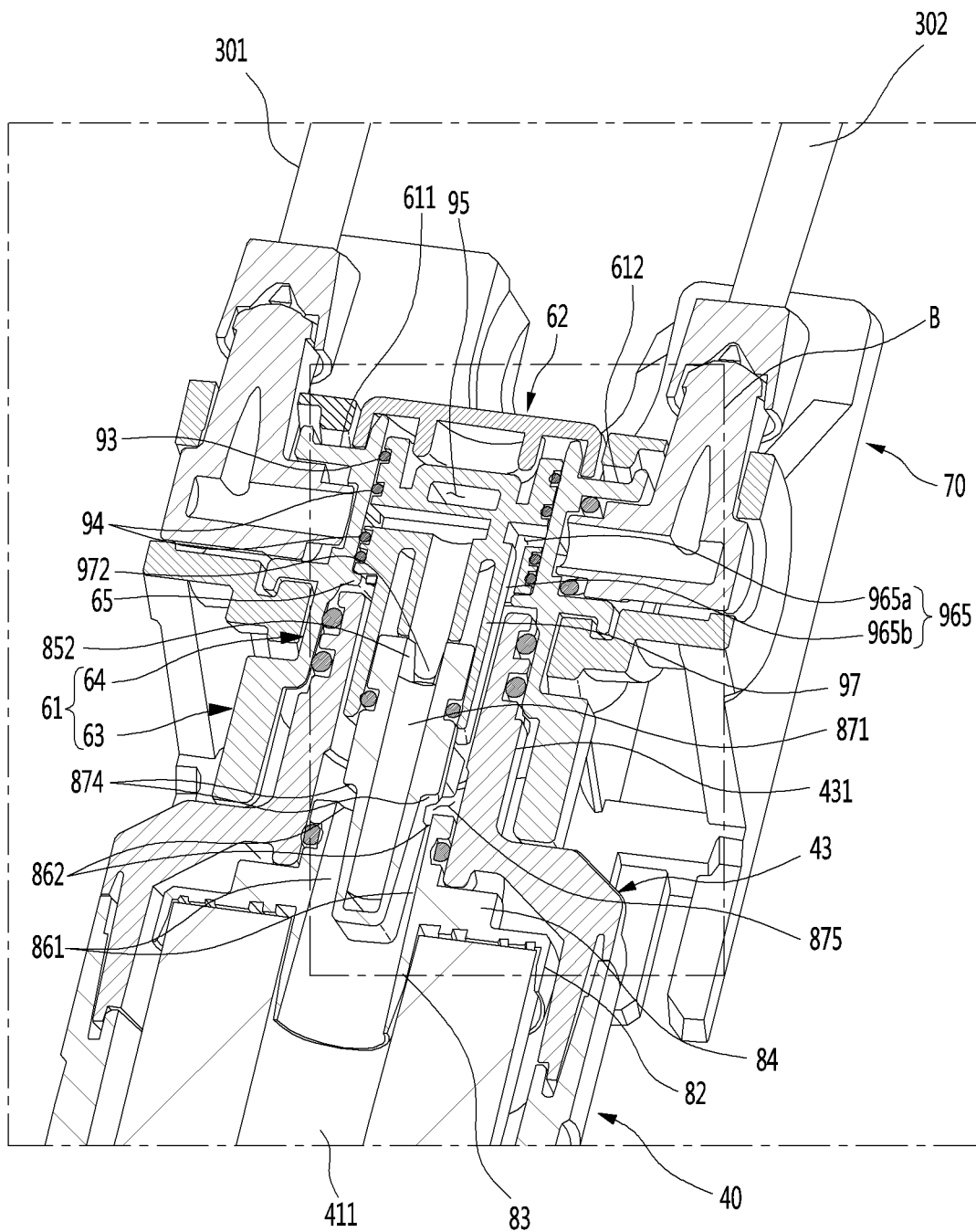

Fig.25

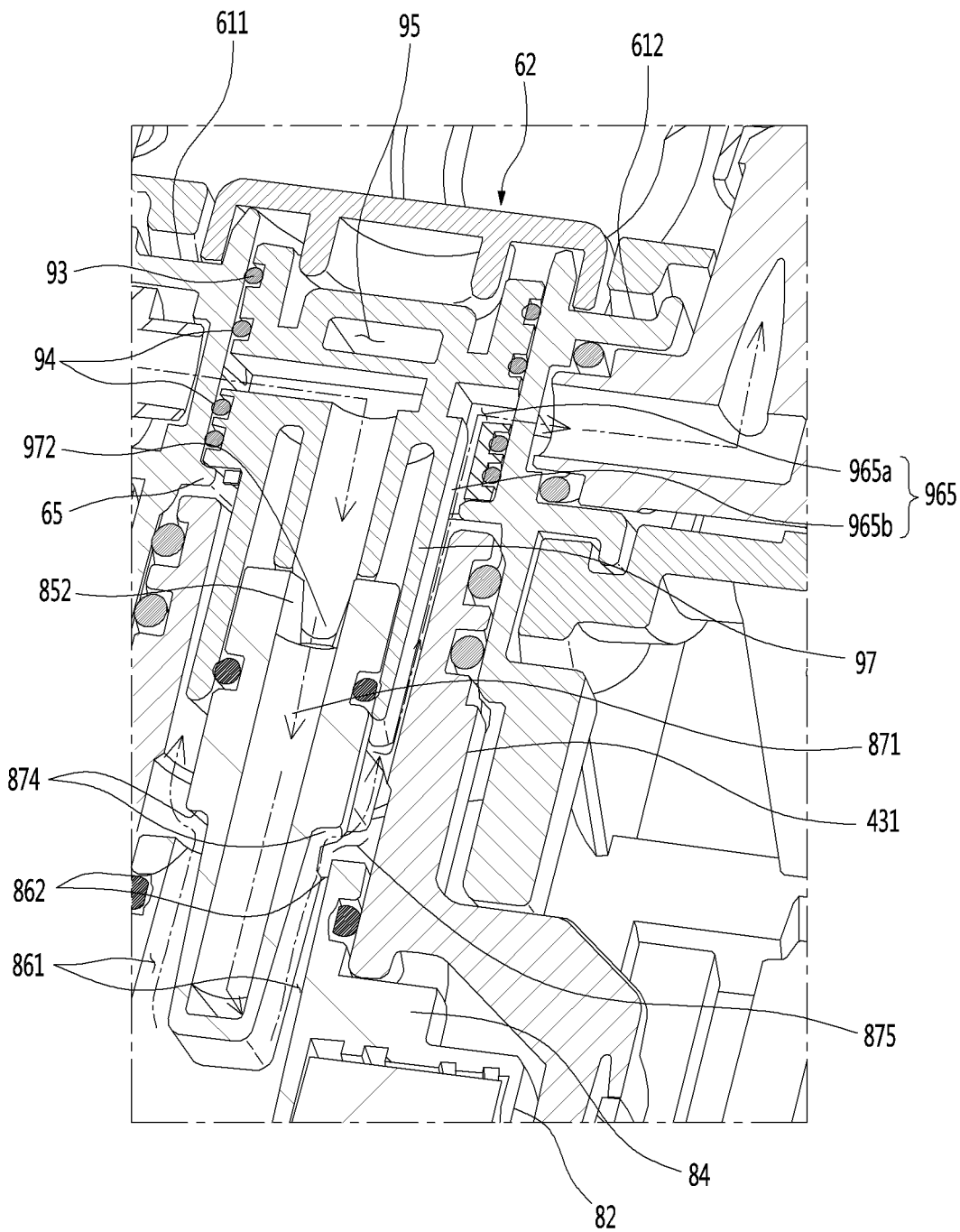

Fig.26

