



(51) International Patent Classification:

B60G 15/06 (2006.01) *F16F 13/00* (2006.01)
B60G 17/02 (2006.01) *F16F 9/56* (2006.01)
B62K 25/04 (2006.01) *F16F 9/58* (2006.01)

(21) International Application Number:

PCT/IB2014/058857

(22) International Filing Date:

7 February 2014 (07.02.2014)

(25) Filing Language:

Italian

(26) Publication Language:

English

(30) Priority Data:

PD2013A000030 12 February 2013 (12.02.2013) IT

(71) Applicant: **PIAGGIO & C. S.p.A.** [IT/IT]; V.le Rinaldo Piaggio, 25, I-56025 Pontedera, Pisa (IT).

(72) Inventors: **BARTOLOZZI, Stefano**; c/o Piaggio & C. S.p.A., V.le Rinaldo Piaggio, 25, I-56025 Pontedera, Pisa (IT). **BERTELLI, Michele**; c/o Piaggio & C. S.p.A., V.le Rinaldo Piaggio, 25, I-56025 Pontedera, Pisa (IT). **DALL'IGNA, Luigi**; c/o Piaggio & C. S.p.A., V.le Rinaldo Piaggio, 25, I-56025 Pontedera, Pisa (IT). **SAVIN, Riccardo**; c/o Piaggio & C. S.p.A., V.le Rinaldo Piaggio, 25, I-56025 Pontedera, Pisa (IT).

(74) Agents: **MITOLA, Marco** et al.; c/o Jacobacci & Partners S.p.A., Via Berchet, 9, I-35131 Padova (IT).

(81) Designated States (unless otherwise indicated, for every kind of national protection available): AE, AG, AL, AM, AO, AT, AU, AZ, BA, BB, BG, BH, BN, BR, BW, BY, BZ, CA, CH, CL, CN, CO, CR, CU, CZ, DE, DK, DM, DO, DZ, EC, EE, EG, ES, FI, GB, GD, GE, GH, GM, GT, HN, HR, HU, ID, IL, IN, IR, IS, JP, KE, KG, KN, KP, KR, KZ, LA, LC, LK, LR, LS, LT, LU, LY, MA, MD, ME, MG, MK, MN, MW, MX, MY, MZ, NA, NG, NI, NO, NZ, OM, PA, PE, PG, PH, PL, PT, QA, RO, RS, RU, RW, SA, SC, SD, SE, SG, SK, SL, SM, ST, SV, SY, TH, TJ, TM, TN, TR, TT, TZ, UA, UG, US, UZ, VC, VN, ZA, ZM, ZW.

(84) Designated States (unless otherwise indicated, for every kind of regional protection available): ARIPO (BW, GH, GM, KE, LR, LS, MW, MZ, NA, RW, SD, SL, SZ, TZ, UG, ZM, ZW), Eurasian (AM, AZ, BY, KG, KZ, RU, TJ, TM), European (AL, AT, BE, BG, CH, CY, CZ, DE, DK, EE, ES, FI, FR, GB, GR, HR, HU, IE, IS, IT, LT, LU, LV, MC, MK, MT, NL, NO, PL, PT, QA, RO, RS, SE, SI, SK, SM, TR), OAPI (BF, BJ, CF, CG, CI, CM, GA, GN, GQ, GW, KM, ML, MR, NE, SN, TD, TG).

Declarations under Rule 4.17:

— as to applicant's entitlement to apply for and be granted a patent (Rule 4.17(ii))

[Continued on next page]

(54) Title: SUSPENSION GROUP IN PARTICULAR FOR MOTORISED VEHICLES

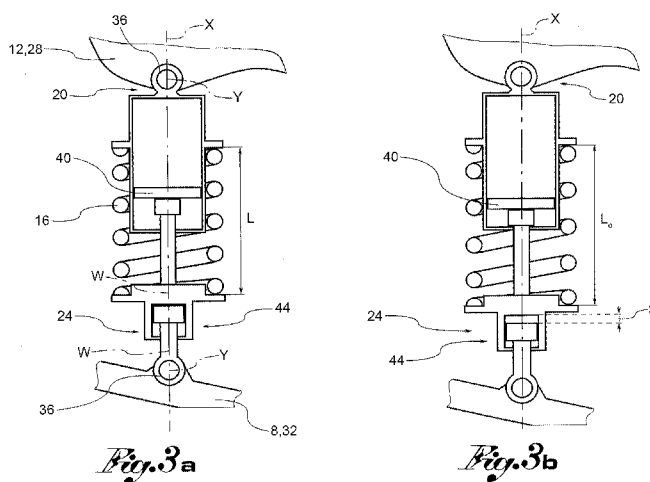

(57) Abstract: Suspension group (4) for motorised vehicles comprising a main spring (16) which extends between a first and a second end (20, 24) of the group (4), a main damper (40) connected in parallel to said main spring (16) said main spring (16) being pre-loaded by pre-loading means which together press the spring (16) in compression and impose a rest length thereon (L_0), namely the length assumed by the spring (16) when there are no further external loads on the first and/or on the second end (20, 24) of the group (4) except for the pre-load caused by the pre-loading means, wherein the first and second end (20, 24) are connected kinematically to a first and a second mass (28, 32) of the motor vehicle respectively. Between at least one of said first and second ends (20, 24) and the respective suspended/non-suspended mass (28, 32) at least one kinematism (44) is placed, in series with the main spring (16) which permits a supplementary stroke (S) between the end (20, 24) to which it is attached and the relative adjacent suspended/non-suspended mass (28, 32), said supplementary stroke (S) increasing the distance between the suspended and non-suspended mass (28, 32) imposed by the extension of the main spring (16), providing a supplementary stroke (S), after the main spring (16) has extended reaching its rest length (L_0).



— *of inventorship (Rule 4.17(iv))*

Published:

— *with international search report (Art. 21(3))*

DESCRIPTION**"Suspension group in particular for motorised vehicles"**Field of application

[0001] The present invention relates to a suspension group,
5 in particular for motorised vehicles.

State of the art

[0002] As is known, in motorised land vehicles making use
of wheels, the lack of contact of one or more wheels with
the ground causes serious problems of driveability and of
10 traction. The cause of the phenomenon may reside in the
conformation of the terrain or in the dynamics of the
vehicle. Known examples of this phenomenon are:

[0003] - in a four-wheeled vehicle which takes a curve at
high speed such as for example a racing car, one or both
15 wheels on the inside of the curve may lose contact with
the ground as a result of the roll of the vehicle,

[0004] - in an off-road vehicle travelling over uneven
terrain, such as for example a rally car, a wheel may
lose contact with the ground as a result of a hole which
20 is too deep for the maximum admissible wheel stroke.

[0005] - in a vehicle which travels over the brow of a hill
or an obstacle at high speed, such as for example a
racing car, the lifting motion resulting from the
suspended mass may lead to a loss of contact of one or
25 more wheels with the ground, giving rise to problems of

directionality and traction

[0006] - in two-wheeled vehicles, such as for example a racing bike , the back wheel may lose contact with the ground upon braking, or the front wheel may lose contact
5 with the ground upon accelerating.

[0007] In most of these cases the loss of contact with the ground is caused by reaching the maximum extension of the suspension. In many suspension systems the function of generating the elastic force is attributed to a single
10 subsystem (with linear or rotary excursion) which is connected to the remaining parts of the suspension system and to the suspended mass of the vehicle at its two ends.

[0008] For these vehicles frequently the condition of maximum extension of the suspension and thus of
15 detachment from the ground of the relative wheel occurs when said sub-system reaches its limit stop position at maximum extension. In many vehicles said elastic sub-system exercises a thrust force (which thus tends to make the ends thereof move away from each other) until it
20 reaches its limit stop position at maximum extension , but in some solutions close to this condition the force exercised by the elastic sub-system becomes a traction force, it thus becoming necessary to exercise a traction force on the subsystem from the outside to extend it
25 completely. In such latter case it will be the weight of

the non-suspended mass which exercises this traction force on the subsystem near the condition of maximum extension of the suspension, that is near the condition of detachment of the wheel from the ground, and it may happen that the detachment of the wheel from the ground occurs before effectively reaching the limit stop condition in extension, simply because the weight of the non-suspended mass is not sufficient to completely extend the elastic subsystem. For the purposes of the invention in question, the condition of maximum extension is equal to the so called rest length of the spring, that is the length or extension which the spring assumes when it is free to extend inasmuch as subjected solely to the pre-load but not to the weight deriving from the suspended mass. In other words, when the wheel tends to lift off the ground, the spring is no longer compressed by the weight deriving from the suspended mass but is free to extend as a function merely of the compression pre-load and of the weight of the non-suspended mass. Consequently, the length assumed by the spring in detached conditions of the wheel is due to its rigidity and the pre-load imposed on it; such length may be defined as rest length, that is, in unloaded conditions of the spring except for its possible pre-load.

25 Presentation of the invention

[0009] To resolve the aforesaid problems, as of today some solutions have been used in the prior art. For example, in the current state of the art two types of solution are used able to reduce the aforesaid phenomena of detachment
5 of a wheel from the ground, that is, the so-called counter-spring and the so-called "helper-spring".

[0010] The so-called "counter-spring" or contractor" spring (fig.1a-1b), that is a spring located inside the body of the shock absorber is such as to be completely compressed
10 when the elastic sub-system is completely extended: the effect is to substantially reduce the elastic force near the entirely extended position of the elastic subsystem, opposing the force of the main spring , which is usually pre-loaded even in the position of maximum extension of
15 the elastic sub-system. To such purpose see the graph in figure 1b, showing the force-excursion diagram of the elastic subsystem: the effect of the counter spring is to modify the force curve so as to make it pass from the section ED to the section FD (without counter spring).
20 The graph in figure 1b shows the condition in which by effect of the counter spring being mounted, the elastic subsystem in its position of equilibrium (point 0.0 of the graph, null force at the ends) is not in its position of maximum extension (coinciding with the point F).

25 [0011] Such solution (counter spring) significantly reduces

the forces which tend to completely extend the suspension in a very short section of excursion, close to the fully extended position, but, as may be seen from the graph in figure 1b, significantly increases the rigidity of the elastic subsystem in such section: in the case in which the counter spring permits a further extension after the force has been annulled (section from 0,0 to point F); in any case with little excursion, it will develop a high traction force and will rapidly be able to lift the wheel from the ground.

[0012] As regards the 'helper spring' (or "assist-spring" or "tender-spring", fig. 2a-2b), this is a spring installed in series with the main spring of the elastic subsystem, of much lower rigidity, so as to generate a force-excursion diagram of the elastic sub-system of the bilinear type, such that in the first part of stroke from its position of maximum extension the elastic subsystem has a much lesser rigidity. To such purpose see the graph in figure 2b, the section interested by the "helper-spring" is the section ED. This type of solution is used when upon full extension of the suspension (usually determined by the full extension of the shock absorber) the main spring is mounted with clearance in its direction of movement, that is to say, housed in a bigger space than its free length: the function of the "helper-

spring" is, as the name would suggest, to keep the main spring in its seat without letting it jerk.

[0013] Such second solution instead maintains a very low rigidity in the first section, but cannot be used in conjunction with the counter-spring and requires the use of shock absorbers with a lot of excursion which are thus longer and occupy more space, and thus heavier and not always possible to install. In addition, for the entire section which goes from point A to point E of the graph it is not possible to brusquely lower the force of the suspension as in the case of the counter-spring.

[0014] The need is therefore felt to resolve the drawbacks and limitations mentioned above with reference to the prior art.

[0015] Such purpose is achieved by a suspension group according to claim 1.

Description of the drawings

[0016] Further characteristics and advantages of the present invention will be more clearly comprehensible from the description given below of its preferred and non-limiting embodiments, wherein:

[0017] figures 1a-1b respectively represent an assembly diagram of a suspension with counter-spring and the relative force-excursion diagram according to a solution of the prior art;

[0018] figures 2a-2b respectively represent an assembly diagram of a suspension with helper-spring and the relative force-excursion diagram according to a further solution of the prior art;

5 [0019] figure 3a,3b - 8a, 8b show variants of suspension groups according to the present invention , in which each suspension group is shown both in the compressed configuration (figures "a") and in the fully extended configuration (figures "b");

10 [0020] figure 9a,9b - 14a, 14b show variants of the suspension groups in figures 3a,3b - 8a,8b, in which each suspension group is shown both in the compressed configuration (figures "a") and in the fully extended configuration (figures "b");

15 [0021] figures 15a-15c show the force-excursion diagrams relative to the construction solutions illustrated in figures 3a,3b - 8a, 8b;

[0022] figures 16a-16c show the force-excursion diagrams relative to the construction solutions illustrated in
20 figures 9a,9b - 14a,14b;

[0023] figures 17-20 show variants of components of suspension groups according to the present invention.

[0024] The elements or parts of elements common to the embodiments described below will be indicated using the
25 same reference numerals.

Detailed description

[0025] With reference to the aforementioned figures, reference numeral 4 globally denotes an overall schematic view of suspension group for motorised vehicles according to the present invention.

[0026] For the purposes of the present invention it must be specified that the term motorised vehicle must be considered in a broad sense, comprising any motorcycle having at least two wheels, that is a front wheel and a back wheel. Such definition thus encompasses motor cycles having three wheels, of which for example two paired and steering wheels on the front axle and one drive wheel, on the rear axle, but also motorcycles which comprise a single steering wheel on the front axle and two drive wheels on the rear axle. Lastly, such definition also comprises so-called quad bikes having two wheels on the front axle and two wheels on the rear axle.

[0027] Preferably, the term suspension group 4 is understood to mean preferably but not exclusively, a rear suspension, that is placed between the rear axle or swingarm 8, having one or more wheels, and the frame 12 operatively connected to said suspension.

[0028] The frame 12 may be in one piece or in several parts: generally the portion of frame 12 interfacing with the swingarm 8 supports the saddle for the rider and/or

passenger. The swingarm 8 is hinged to said portion of frame 12 of the motorcycle in relation to at least one hinge pin, not shown. It is to be specified that, the connection between the swingarm 8 and the frame 12 may be
5 direct, by means of direct hinging, or may also be made by the interposition of linkages and/or intermediate subframes.

[0029] Both the rear swingarm 8 and the frame 12 may be of any shape or dimension and may for example be of the
10 trellis type, box type, die-cast and so forth.

[0030] In any case the present invention is also applicable to a front suspension in which the suspension group is placed between the front wheel and a front portion of the frame; in such application the suspension group may for
15 example be incorporated on the stems of the front fork or even at the steering tube so as to damp the front wheel group in relation to said tube or to an adjacent portion of the front frame of the motor vehicle.

[0031] The suspension group 4 for motor vehicles comprises
20 a main spring 16 which extends between a first and a second end 20, 24 of the group, influencing them elastically along a working axis X-X.

[0032] The main spring 16 may be for example a cylindrical and/or conical spring with a constant or variable pitch;
25 in addition the spring may be made of metal and/or

polymer material. The main spring 16 may consist of any other elastic means suitable to apply an elastic force between the components it connects; so the main spring may also be a pneumatic and/or hydraulic spring.

5 [0033] The first and the second ends 20, 24 are kinematically connected to a first and second mass 28, 32 of the motorised vehicle respectively.

[0034] Such connection may be direct or provide for the interposition of linkages according to various solutions
10 in use in the prior art. Such linkages are for example used to modify the usually linear behaviour of the spring depending on its effective length, both in extension and in compression.

[0035] Such kinematic connection is realised for example by
15 means of the interposition of hinges 36 having hinge axes Y-Y parallel to each other and perpendicular to the working axis X-X. Preferably, said hinges 36 are directed along transversal hinge axes Y-Y, that is directed perpendicular to the direction of movement of the
20 motorised vehicle. The presence of the hinges enables the suspension group to work mechanically adapting to the rotations of the swingarm and/or fork during the movement of the vehicle. In other words, the swingarm group acts as a connecting rod which suspends and dampens the
25 relative movements between the first and the second mass

28, 32.

[0036] The first mass 28 is a mass suspended by the suspension group 4 and the second mass 32 is a non-suspended mass.

5 [0037] The suspended mass 28 usually comprises a portion of saddle and of frame of the motor vehicle, which in fact weighs on the suspension group. In the case of the rider and/or passenger being on board the vehicle, such additional masses constitute suspended masses. The
10 definition of suspended mass applies both in the case of a front suspension group and in the case of a rear suspension group.

[0038] The non-suspended mass 32 is commonly called ground mass, in that it is a mass which discharges its weight on
15 the ground through the tyre; typically the non-suspended mass 32 comprises the wheel or a portion of connection/support to a wheel of the motor vehicle. In addition, the non-suspended mass 32 comprises the swingarm or support fork of the wheel and any further
20 accessories such as for example the braking devices directly connected to said wheel.

[0039] According to one embodiment, the main spring 16 is pre-loaded by pre-loading means (not shown) which together influence the spring 16 in compression and
25 impose a rest length thereon L_0 , namely the length

assumed by the spring 16 when there are no further external loads on the first and/or on the second end 20, 24 of the group except for the pre-load caused by said pre-loading means.

5 [0040] In other words, the main spring 16 of the suspension group 4 is pre-loaded in compression by the pre-loading means which may for example comprise a mechanical ring-nut in the known manner. Such pre-loading means impose a rest length L_0 on the main spring 16 which is that
10 assumed by the spring in the absence of further external loads such as for example the loads deriving from the suspended and/or non-suspended mass. For example, such rest length L_0 is that which the spring assumes when it is subjected solely to pre-loading compression and not to
15 the weight force deriving from the suspended and/or non-suspended mass.

[0041] According to one embodiment, the suspension group further comprises a main damper 40 connected in parallel to said main spring 16 so as to exercise a damping action
20 of the relative movement between said first and second ends 20,24, induced and/or countered by the main spring 16.

[0042] The main damper 40 is thus mechanically connected to said first and second end 20, 24.

25 [0043] Connection in parallel is taken to mean that both

the main spring 16 and the main damper 40 are connected to the same ends 20, 24 so as to act mechanically on the same strokes and speed of movement between said ends 20, 24.

5 [0044] According to one embodiment, the main damper 40 is positioned coaxially in relation to the main spring 16 and is thus directed parallel to said working axis X-X.

[0045] Advantageously, between at least one of said first and second ends 20, 24 and the respective suspended/non-suspended mass 28, 32 at least one kinematism 44 is placed, in series with the main spring 16 which permits a supplementary stroke S between the end 20, 24 to which it is attached and the relative adjacent suspended/non-suspended mass 28, 32, said supplementary stroke S increasing the distance between the suspended and non-suspended mass 28, 32 imposed by the extension of the main spring 16.

[0046] The kinematism 44 is influenced by the load of the suspended mass 28, so as to prove retracted, namely not to provide any supplementary stroke S, until the length of the main spring 16 is less than or equal to the rest length L_0 , and so as to extend under the effect of the non-suspended mass 32, providing a supplementary stroke S, after the main spring 16 has extended reaching its rest length L_0 .

[0047] The passage of the kinematism 44 from the retracted condition to the elongated or extraction condition may also occur before the main spring 16 has exactly reached its rest length L_0 , for example as a result of the presence of a counter-spring 68 or even merely by effect of vibrations or inertia of the suspended and non-suspended masses subject to oscillations.

[0048] It is clear that the kinematism 44 is able to freely and thus completely extend only when the main spring 16 is extended, reaching its rest length L_0 , that is when the non-suspended mass 32 tends to detach itself from the ground; despite which tolerances of the extended condition of the kinematism 44 are admitted which may therefore also occur when the length of the main spring is approximately 3% less than the nominal value of the rest length L_0 .

[0049] In other words, when the suspended mass and/or any additional masses (due for example to the rider and passenger) weigh on the main spring 16, this is compressed assuming an effective length less than that of the rest length L_0 .

[0050] In such condition, the kinematism 44 is retracted in its closed condition; consequently it does not provide any supplementary stroke compared to the action and to the distance between the masses imposed by the main

spring 16. The retraction of the kinematism 44 is caused by the action of the weight due to the suspended mass which closes it completely

[0051] When the main spring 16 extends, reaching its rest length L_0 , the kinematism is free to extend providing the supplementary stroke S. The extended condition of the main spring 16 until it reaches the rest length L_0 occurs when, on account of the jumps caused by the asperities of the terrain or on account of the dynamic transfers of the load, the non-suspended mass tends to lose contact with the ground: in such condition, the main spring 16 is subject only to its pre-load and can thus extend to reach its rest length L_0 . In such condition the kinematism is no longer flattened by the suspended mass 28 and is thus in turn free to extend, providing the supplementary stroke S which enables the wheel to maintain contact with the ground.

[0052] It is evident that such contact is ensured as long as the lifting of the wheel is less than or equal to the supplementary stroke S provided by the kinematism 44.

[0053] The kinematism 44 also extends merely thanks to the thrust action of the non-suspended mass 32 to which it is kinematically connected. If the kinematism 44 is applied to the second end 24, such non-suspended mass 32 comprises for example the wheel and its support; if the

kinematism 44 is applied to the first end 20, such non-suspended mass 32 also comprises the mass of the main spring 16 and of the main damper 40.

[0054] Preferably, the main spring 16 guarantees a main stroke equal to at least 2.5 times the supplementary stroke S due to the kinematism 44; in particular, the main stroke is defined by the difference between the length at rest L_0 of the main spring 16 and the minimum length of the main spring 16 achieved in conditions of maximum admissible load in compression.

[0055] According to one embodiment, the kinematism 44 comprises at least one secondary spring 48 which influences the kinematism 44 in extension so as to pass from the retracted configuration to the extracted configuration, said secondary spring 48 extending the kinematism 44 after the main spring has extended reaching its rest length L_0 .

[0056] Preferably, the rigidity of the main spring 16 is at least 8 times the rigidity of the secondary spring 48.

[0057] Rigidity of the main spring is taken to mean the overall rigidity of the elastic system comprising the main spring 16 plus a possible counter-spring 68 further described below.

[0058] According to one embodiment, said kinematism 44 comprises at least one secondary damper 52 suitable for

damping the compression and extension movement of the kinematism.

[0059] The secondary damper 52 may for example be of the pneumatic, hydraulic or even friction type.

5 [0060] Preferably, the secondary damper 52 influences the kinematism 44 mainly in compression so as to damp the reclosing stroke of said kinematism. In other words, the behaviour of the damper of the kinematism is highly asymmetric given that it is minimum in extension of the
10 kinematism and is maximum in compression of said kinematism. This way, the extension of the kinematism in the lifting step of the non suspended mass 32 is facilitated and the support of the wheel resting on the ground is also facilitated, once said kinematism is
15 extended.

[0061] Various implementations of solutions of kinematisms fitted with a secondary spring 48 and/or secondary damper 52 are possible, using as secondary springs 48, mechanical springs of various types such as helical
20 traction springs (fig.18b), compression (fig. 17a, b and c, fig. 18 a) or torsion (fig. 18 c) , spring washers or pneumatic springs (fig.17d). The arrangement of said secondary springs 48 may be such as to tend to make the aforesaid kinematism remain at a degree of freedom in its
25 position of maximum extension or in its closed position,

or in equilibrium in an intermediate position:

[0062] • should it tend to keep the kinematism in the closed position, the rigidity is chosen in such a way that said kinematism 44 extends completely or almost
5 under the action of the non suspended mass 32 (or of the relative wheel and all the elements of the suspension connected between the wheel and said kinematism) when the vehicle is lifted so that the wheels detach from the ground.

10 [0063] • should it instead tend to keep the kinematism 44 in the completely extended or intermediate position, the rigidity must be chosen in such a way that the main elastic subsystem of the suspension proves compressed by a practically negligible entity when the force needed to
15 bring it into a closed position is applied to the kinematism.

[0064] As regards the secondary damping this may be realised by means of friction inside the kinematism 44 along its direction of permitted movement or with the
20 usual means for realising hydraulic or pneumatic dampers. that is, making two fluid chambers separated by a mobile piston (fig.19a,b and c) and interconnected by means of valves or passages of a greatly reduced size, in such a way that during its movement the kinematism forces the
25 piston to move inside the aforesaid chambers, forcing the

fluid to circulate from one to the other. The fluid, passing through the aforesaid valves or passages, undergoes a pressure variation, so that the difference in pressure of the fluid of the two chambers exercises a thrust resulting on the mobile piston in a direction such as to oppose the movement thereof.

[0065] With these means it is possible to realise one-way dampers, that is which provide much more damping in one direction than in another (fig. 19 c). It is preferable in such case to provide a greater damping in the direction from the position of maximum extension of the kinematism 44 to the closed position, to reduce the effect of the sudden reclosing the kinematism 44 which invokes the elastic subsystem with an impulsive stress when the vehicle resumes loading the weight on the wheel.

[0066] In a particular application (fig. 20 a, b and c) the fluid used is the atmospheric air and the kinematism consists of a prismatic torque made at one end of the elastic subsystem in the form of a cylindrical body separated into two chambers by a piston, to which a stem is connected which at the other end is connected to the remaining components of the suspension system. The device aspirates air in the upper chamber through a check valve when the kinematism extends and then expels it through a calibrated discharge hole when the

kinematism returns towards the closed position. At most the realisation of the calibrated discharge hole may be omitted, should the system seep air on account of an imperfect seal of the chamber or of the check valve.

5 [0067] Limit stop pads in elastomeric material may be provided for, so that when the kinematism reaches its closed position or its maximum extension no violent impacts between metal parts are triggered, which could cause damage to the system or unpleasant sensations for
10 the driving of the vehicle.

[0068] According to one embodiment, the kinematism 44 comprises a prismatic guide 56 which permits a reciprocating rectilinear movement along a kinematism axis W-W parallel to said working axis X-X of the main
15 spring 16.

[0069] For example, said prismatic guide 56 comprises a stem 58 sliding inside a lining 60.

[0070] The secondary spring 48 and/or the secondary damper 52, if provided for, are housed inside said lining.

20 [0071] According to a further embodiment, the kinematism 44 comprises a connecting rod 64 which connects the relative end 20, 24 with the suspended/non-suspended mass 28, 32.

[0072] The kinematism 44 may comprise a secondary spring 48 having one end connected to the rod 64 and one end
25 connected to the relative suspended/non-suspended mass

28, 32 so as to influence the kinematism 44 in extension, that is, to open.

[0073] The suspension group 4 according to the present invention may also comprise two kinematisms 44', 44" positioned in series between each of said first and second ends 20, 24 and the respective suspended/non-suspended mass (28, 32); this way each kinematism permits a supplementary stroke S', S" between the ends 20, 24 to which it is applied and the relative adjacent suspended/non-suspended mass 28, 32. In particular, each kinematism 44', 44'' is influenced by the load of the suspended mass 28, so as to prove retracted, namely not to provide any supplementary stroke S', S", until the length of the main spring 16 has reached its rest length L_0 , and so as to extend under the thrust of the non-suspended mass 32, providing said supplementary stroke S', S" after the main spring 16 has reached its rest length L_0 .

[0074] According to a possible embodiment, the pre-loading means comprise a counter-spring 68 which acts so as to influence the main spring 16 in extension, that is which opposes the elastic action of the main spring 16 (figures 9a 14b).

[0075] As described above, the pre-loading means together influence the spring 16 in compression and impose a

specific rest length thereon L_0 . Consequently the counter spring 68, while pre-loading in extension, does not modify the overall pre-load of the main spring 16 which is in any case an overall pre-load of compression.

5 [0076] According to a possible embodiment, the counter-spring 68 is housed inside the main damper 40.

[0077] The functioning and thus the regulation of a suspension group for motor cycles according to the present invention will now be described.

10 [0078] In particular, in conditions of normal use, namely when the motorised vehicle has the non suspended mass in contact with the ground, the kinematism is in the closed position. Consequently, the kinematism does not provide any supplementary stroke over the stroke or distance
15 imposed by the main spring to the suspended and non-suspended masses.

[0079] Such functioning condition is, for example illustrated in figures 3a-14a. As may be seen in such figures 3a-14a, the kinematism is always closed under the
20 load of the suspended mass, that is does not provide any supplementary stroke S , while the main spring 16 is at least partially compressed compared to its rest condition; in other words, the main spring has a length L less than its rest length L_0 .

25 [0080] In such condition the kinematism does not influence

the behaviour of the suspension and thus the rigidity and overall damping of the suspension group, In such condition the length of the main spring is less than the rest length L_0 given that the load of the suspended mass which is usually greater than the pre-load imposed by the pre-loading means, weighs on such main spring.

[0081] When for example due to a sudden transfer of load (for example upon braking) the rear suspension group tends to unload, the main spring being relieved of the load deriving from the suspended mass, tends to extend until it reaches its rest length L_0 , that is the length deriving solely from the pre-load imposed. In this condition, as shown for example in figures 3b- 14b, the non-suspended mass, namely the rear wheel would tend to lose contact with the ground, putting the dynamics of the motorised vehicle in a critical situation.

[0082] As may be seen in such figures 3b-14b, the kinematism 44 is open, that is, extended under the load of the non-suspended mass, namely, provides the supplementary stroke S, while the main spring 16 is extended as far as to reach its rest condition; in other words, the main spring has a length equal to its rest length L_0 .

[0083] In such condition, as soon as the spring reaches its rest length L_0 , that is as soon as the spring extends

concurrently with the detachment of the wheel from the ground (which coincides with the loss of the load due to the suspended mass), the kinematism extends permitting the rear wheel to recover contact with the ground and
5 thereby improve the dynamics of the motorised vehicle. It is evident that the kinematism extends thanks to the action of the load deriving from the non-suspended mass which always tends to extend it, as well as thanks to the action of the possible secondary spring.

10 [0084] This way, the winding motion and loss of adherence for example of the rear wheel is significantly limited when, on account of a sudden transfer of load, for example when braking or on account of an uneven road surface, such wheel would tend to detach from the ground.
15 The kinematism is thus able to ensure contact with the ground as long as the lifting of the rear wheel is less than or equal to the supplementary stroke supplied by said kinematism.

[0085] The functioning of the suspension group according to
20 the present invention can also be seen in schematic form in the force-excursion diagrams shown in figures 15 and 16.

[0086] For example, figures 15a-15c show force-excursion diagrams of suspension groups according to the present
25 invention, but without a counter-spring.

[0087] It is to be specified that, the y-axis shows the elastic force exercised between said ends 20,24 and thus the suspended mass and the non-suspended mass 28,32 (without the interposition between said ends 20,24 and the masses 28,32 of linkages, as used in the prior art).

[0088] The x-axis shows the excursion of the main spring 16 compared to its rest length L_0 , corresponding to point 0,0. Consequently a positive excursion (in relation to the diagram) corresponds to a compression of the main spring 16 in relation to its rest length L_0 ; in the same way, a negative excursion, that is the negative x-axis of the graph, corresponds to a lengthening or extension of the kinematism 44.

[0089] The points A,B,C on the graphs represent design parameters, that is values which are pre-set depending on the type of motorised vehicle; point A for example represents the load condition due to the weight of the vehicle, that is the design suspended mass.

[0090] The graph in figure 15b shows the behaviour of the suspension group 4 wherein the kinematism 44 is lacking any secondary spring (the graphs show static conditions there is therefore no point in speaking of the effect of a possible secondary damper).

[0091] As may be seen, the absence of any secondary spring makes the force decline nominally to zero, at the moment

in which the main spring reaches its rest length L_0 (corresponding to point 0 on the x-axis). In this condition, the kinematism 44 extends under the thrust of the non-suspended mass.

5 [0092] The presence of a secondary spring 48 slightly modifies the graph. For example, the graph in figure 15a shows the suspension group of figure 15b also comprising a secondary spring 48 acting in traction, that is tending to counter the extension of the kinematism 44. Such
10 condition determines the section G0 along which the spring 48 applies a force which tends to lift the non-suspended mass from the ground, said force gradually increasing as the excursion S increases. The force of contact on the ground of the corresponding wheel will
15 thus gradually fall to zero. Such condition is in any case preferable to the brusque annulment of the load which occurs in the solutions of the prior art, that is which do not use the kinematism 44. Instead, the graph in figure 15c shows the suspension group of figure 15b
20 also comprising a secondary spring 48 acting in compression, that is tending to facilitate the extension of the kinematism 44. Such condition determines the section E'F which has a positive effect on the behaviour of the suspension given that it tends to counter the
25 detachment of the wheel from the ground, as may be seen

by the fact that the force, once reaching the point 0,0 does not invert direction: the wheel is thus pushed against the ground. The stroke corresponding to the section OF is equal to the supplementary stroke S given
5 by said kinematism.

[0093] The graphs in figures 16a-16c correspond to the same functioning conditions as the graphs in figures 15a-15c except for the fact that the suspension group is fitted with a counter-spring 68.

10 [0094] As may be seen, the effect of such counter spring 68 may be seen in the section which goes from the origin 0,0 as far as point D. Such section prevents sudden drops in force given that the main spring tends to extend as far as its rest length L_0 . This way, the behaviour of the
15 spring is much more progressive and counters any brusque transfers of load. The condition of figure 16b provides for the absence of any secondary spring 48; figure 16a provides for a secondary spring 48 acting in traction (as in figure 15a) and figure 16c provides for a secondary
20 spring 48 acting in compression (as in figure 15c).

[0095] The suspension group described may also be applied to a front wheel of a vehicle. In such case the detachment phenomena of the wheel from the ground may be due for example to an uneven road surface or for example
25 to sudden transfers of load due to sudden accelerations.

In both situations, the kinematism is able to ensure the contact of the wheel with the ground making it possible to achieve the directionality of the vehicle as long as the lifting stroke does not exceed the supplementary
5 stroke provided by said kinematism.

[0096] As may be seen from the description, the suspension according to the invention makes it possible to overcome the drawbacks of the prior art presented.

[0097] In particular, the solution according to the present
10 invention makes it possible to ensure the contact of the wheel with the ground even in conditions of elevated transfers of load due to energetic braking and/or to jumping of the wheel due to an uneven road surface.

[0098] The kinematism does not influence or modify the
15 functioning parameters of the suspension as long as it remains in the retracted or closed condition; this way the kinematism does not prove invasive and does not influence the design parameters of the suspension

[0099] At the same time, the kinematism automatically
20 intervenes in the functioning of the suspension only in critical conditions, that is to say when the wheel begins to jump due for example to transfers of load when braking and/or to an uneven road surface. The intervention of the kinematism considerably improves the stability of the
25 motorised vehicle given that it always guarantees a

margin of traction and/or of directionality of the wheel thanks to the recovery of contact with the road surface thereof.

[00100] In any case, upon cessation of the
5 jumping/detachment phenomenon of the wheel the kinematism automatically returns to its closed condition so as not to interfere with the functioning parameters of the suspension group.

[00101] The kinematism is of such dimensions and weight
10 as to be substantially negligible compared to the dimensions and weight of the spring and of the main damper.

[00102] The kinematism significantly improves the stability and thus the safety of the motorised vehicle in
15 all conditions of potential detachment of the wheel from the ground.

[00103] The kinematism allows for greater design freedom in the choice of the main parameters of the suspension group, that is, of the spring and of the main
20 damper.

[00104] In fact, in the absence of the kinematism the extension of the main spring due to the load of the non-suspended mass would be extremely limited if not null on account of the fact that such spring must normally be
25 extremely rigid. Such elevated rigidity in fact prevents

the lengthening of the spring beyond its rest length L_0 .

[00105] The addition of the kinematism in fact makes it possible not to modify the rigidity of the main spring and at the same time to permit a recovery of the lifting
5 stroke of the wheel thanks to the supplementary stroke provided by said kinematism.

[00106] A person skilled in the art may make numerous modifications and variations to the suspension groups described above so as to satisfy contingent and specific
10 requirements, while remaining within the sphere of protection of the invention as defined by the following claims.

Claims

1. Suspension group (4) for motor vehicles comprising
- a main spring (16) which extends between a first and a second end (20,24) of the group (4), influencing them
 - 5 elastically along a working axis (X-X),
 - a main damper (40) connected in parallel to said main spring (16) so as to exercise a damping action of the relative movement between said first and second ends (20,24), induced and/or countered by the main spring
 - 10 (16),
 - said main spring (16) being pre-loaded by pre-loading means which together influence the spring (16) in compression and impose a rest length thereon (L_0), namely the length assumed by the spring (16) when there are no
 - 15 further external loads on the first and/or on the second end (20, 24) of the group (4) except for the pre-load caused by the pre-loading means,
 - in which the first and second end (20, 24) are connected kinematically to a first and a second mass
 - 20 (28,32) of the motor vehicle respectively, the first mass (28) being a mass suspended by the suspension group (4) and the second mass (32) being a non-suspended mass and comprising a wheel or a portion of connection/support to a wheel of the motor vehicle,
 - 25 characterised in that

- between at least one of said first and second ends (20,24) and the respective suspended/non-suspended mass (28,32) at least one kinematism (44) is placed, in series with the main spring (16) which permits a supplementary stroke (S) between the end (20,24) to which it is attached and the relative adjacent suspended/non-suspended mass (28,32), said supplementary stroke (S) increasing the distance between the suspended and non-suspended mass (28,32) imposed by the extension of the main spring (16),

- wherein the kinematism (44) is influenced by the load of the suspended mass (28), so as to prove retracted, namely not to provide any supplementary stroke, until the length of the main spring (16) is less than or equal to the rest length (L_0), and so as to extend under the effect of the non-suspended mass (32), providing a supplementary stroke (S), after the main spring (16) has extended reaching its rest length (L_0).

2. Suspension group (4) according to claim 1, wherein the kinematism (44) comprises at least one secondary spring (48) which influences the kinematism (44) in extension so as to pass from the retracted configuration to the extracted configuration, said secondary spring (48) extending the kinematism (44) after the main spring (16) has extended reaching its rest length (L_0).

3. Suspension group (4) according to claim 1, wherein the kinematism (44) comprises at least one secondary spring (48) which influences the kinematism (44) in traction so as to pass from the extracted configuration to the retracted configuration.

4. Suspension group (4) according to claim 1, 2 or 3, wherein said kinematism (44) comprises at least one secondary damper (52) suitable for damping the compression and extension movement of the kinematism (44).

5. Suspension group (4) according to any of the previous claims wherein the kinematism (44) comprises a prismatic guide (56) which permits a reciprocating rectilinear movement along a kinematism axis (W-W) parallel to said working axis (X-) of the main spring (16).

6. Suspension group (4) according to claim 5, when dependent on claim 2, 3, or 4, wherein said prismatic guide (56) comprises a stem (58) sliding inside a lining (60), wherein the secondary spring (48) and/or the secondary damper (52) are housed inside said lining (60).

7. Suspension group (4) according to any of the previous claims, wherein the kinematism (44) comprises a connecting rod (64) which connects the relative end (20,24) to which the suspended/ non-suspended mass

(28,32) is applied.

8. Suspension group (4) according to claim 7, wherein the kinematism (44) comprises a secondary spring (48) having one end connected to the rod (64) and one end
5 connected to the relative suspended /non-suspended mass (28, 32) so as to influence the kinematism (44) in extension.

9. Suspension group (4) according to any of the previous claims, wherein said pre-loading means comprise
10 a counter-spring (68) which acts so as to influence the main spring (16) in extension, that is which opposes the elastic action of the main spring (16).

10. Suspension group (4) according to claim 9, wherein said counter-spring (68) is housed inside the main damper
15 (40).

11. Suspension group (4) according to any of the previous claims, wherein the main damper (40) is mechanically connected to said first and second ends (20,
24).

20 12. Suspension group (4) according to any of the previous claims, wherein the main damper (40) is positioned coaxially in relation to the main spring (16).

13. Suspension group (4) according to any of the previous claims, wherein between each of said first and
25 second ends (20, 24) and the respective suspended/ non-

suspended mass (28, 32) a kinematism (44', 44'') is placed, in series, which permits a supplementary stroke (S) between the ends (20, 24) to which it is applied and the relative adjacent suspended/ non-suspended mass (28, 32),
5 each kinematism (44', 44'') being influenced by the load of the suspended mass (28), so as to prove retracted, namely not to provide any supplementary stroke, until the length of the main spring (16) is less than or equal to the rest length (L_0), and so as to extend under the
10 effect of the non-suspended mass (32), providing a supplementary stroke (S), after the main spring (16) has extended reaching its rest length (L_0).

14. Suspension group (4) according to any of the previous claims, wherein the first and the second end
15 (20, 24) are kinematically connected to the first and to the second mass (28, 32) of the motor vehicle respectively by means of hinges (36) having hinge axes (Y-Y) parallel to each other and perpendicular to the working axis (X-X).

20 15. Suspension group (4) according to any of the previous claims, wherein the kinematism (44) comprises at least one secondary spring (48) which influences the kinematism (44) in extension, and wherein the rigidity of the main spring (16), if applicable also comprising the
25 rigidity of any counter-spring (68) is at least 8 times

the rigidity of the secondary spring (48).

16. Suspension group (4) according to any of the previous claims, wherein the main spring (16) guarantees a main stroke equal to at least 2.5 times the
5 supplementary stroke (S) due to the kinematism (44), the main stroke being defined by the difference between the length at rest (L_0) of the main spring (16) and the minimum length of the main spring (16) achieved in conditions of maximum admissible load in compression.
- 10 17. Suspension group (4) according to any of the previous claims, wherein the kinematism (44) comprises at least one secondary damper (52) which influences the kinematism (44) in compression to damp the reclosing stroke of the kinematism (44).
- 15 18. Suspension group (4) according to any of the previous claims, wherein the non-suspended mass (32) comprises a rear wheel of the motor vehicle and part of the fork supporting said rear wheel and wherein the suspended mass (28) comprises or is mechanically attached
20 to the support frame of the saddle of the motor vehicle.
19. Motor vehicle comprising a suspension group (4) according to any of the previous claims,

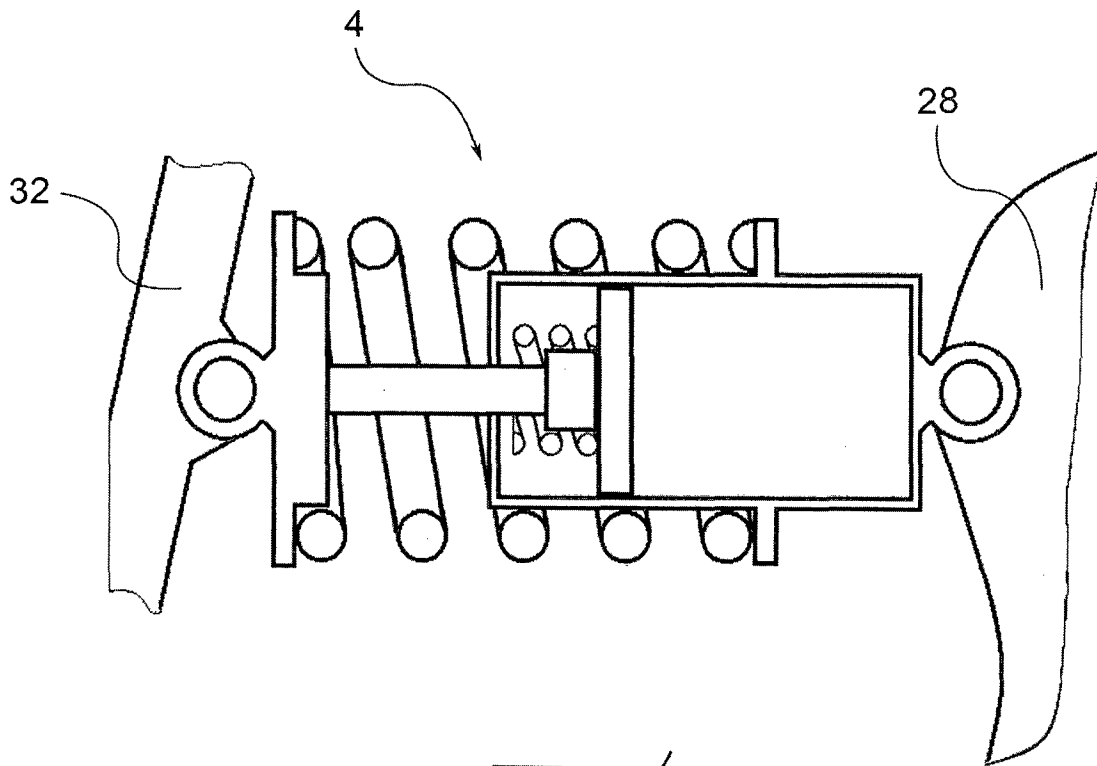

Fig. 1 a

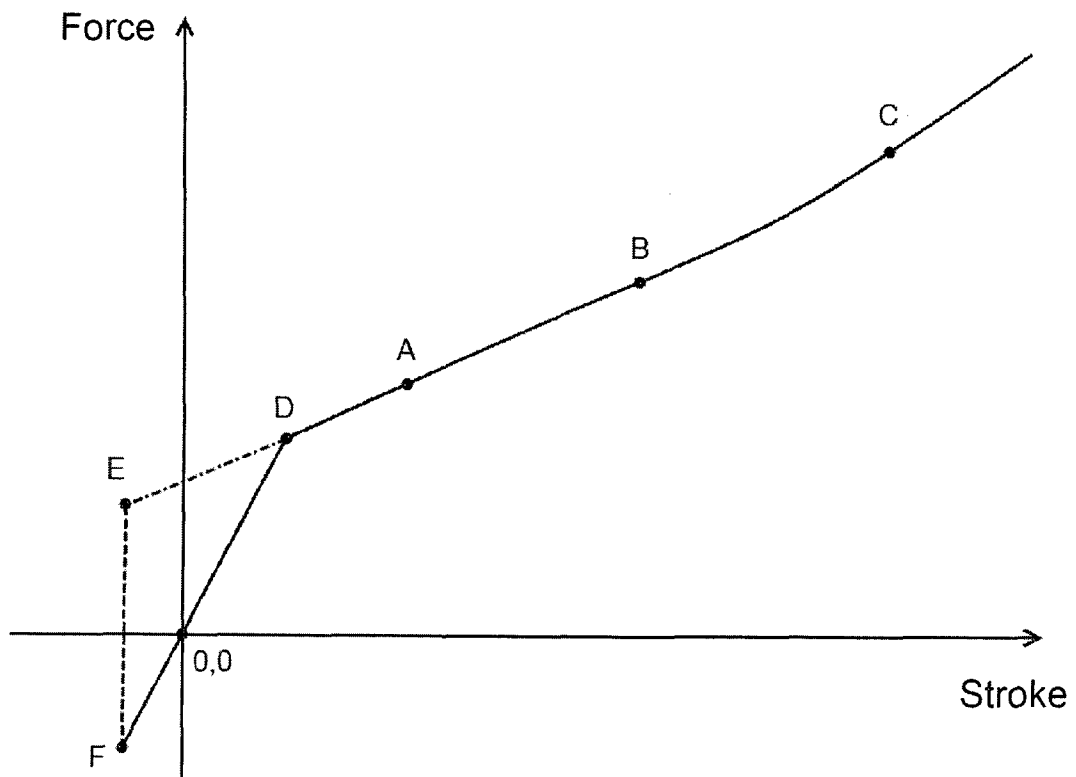

Fig. 1 b

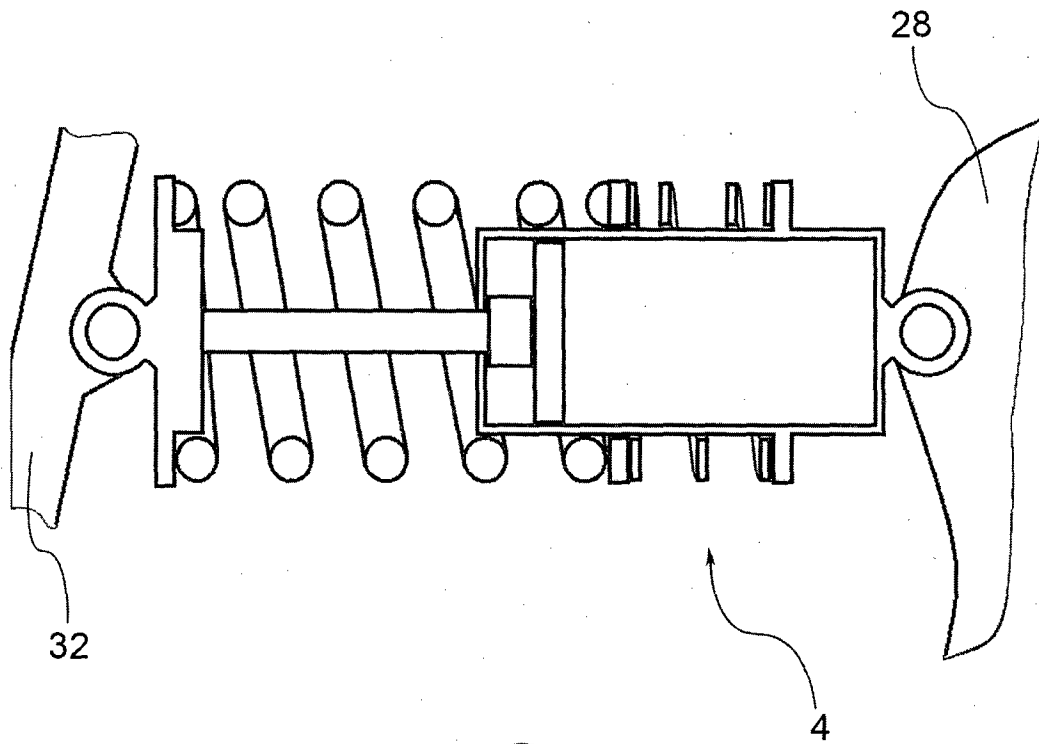

Fig. 2a

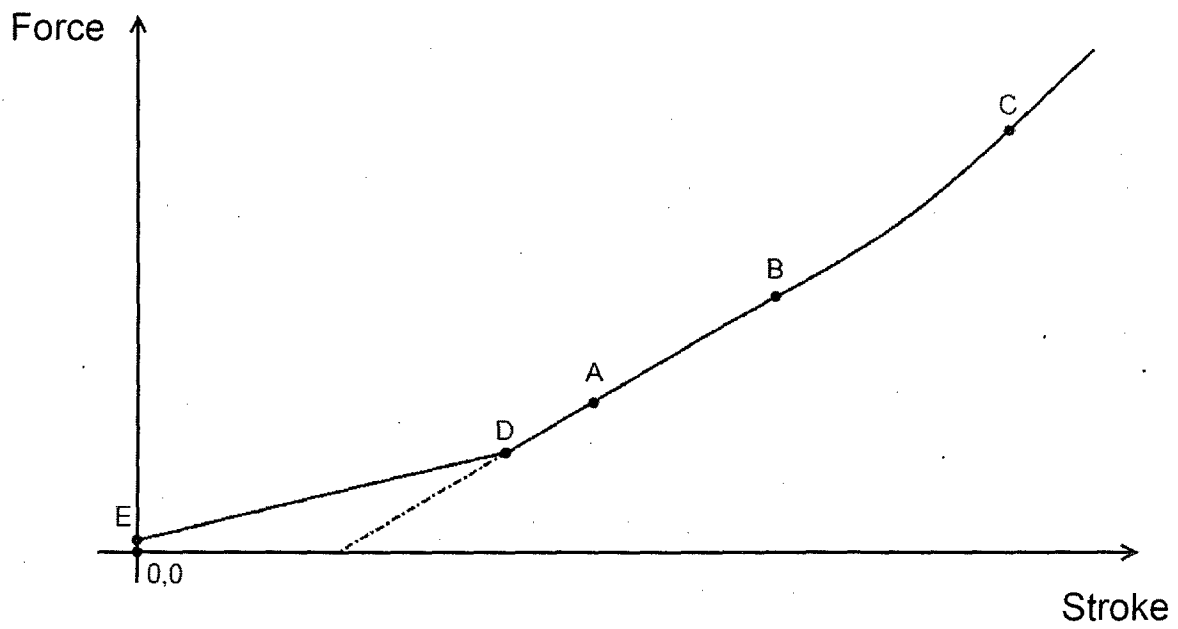

Fig. 2b

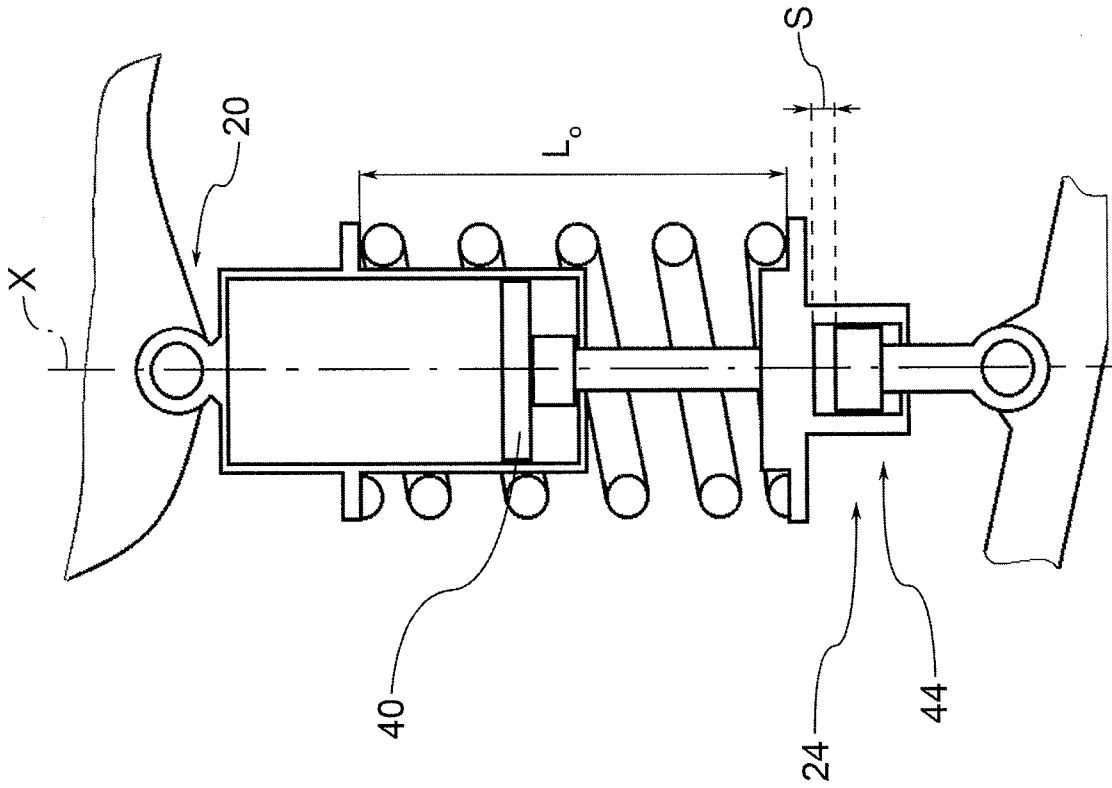

Fig. 3b

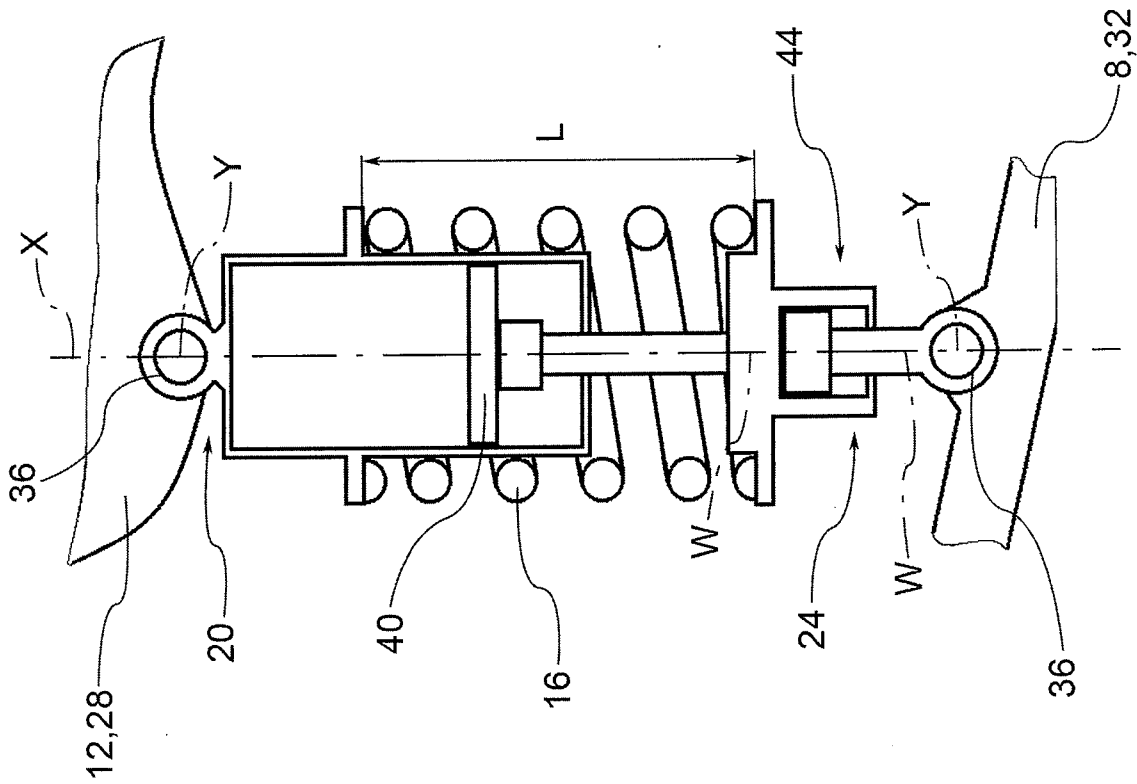
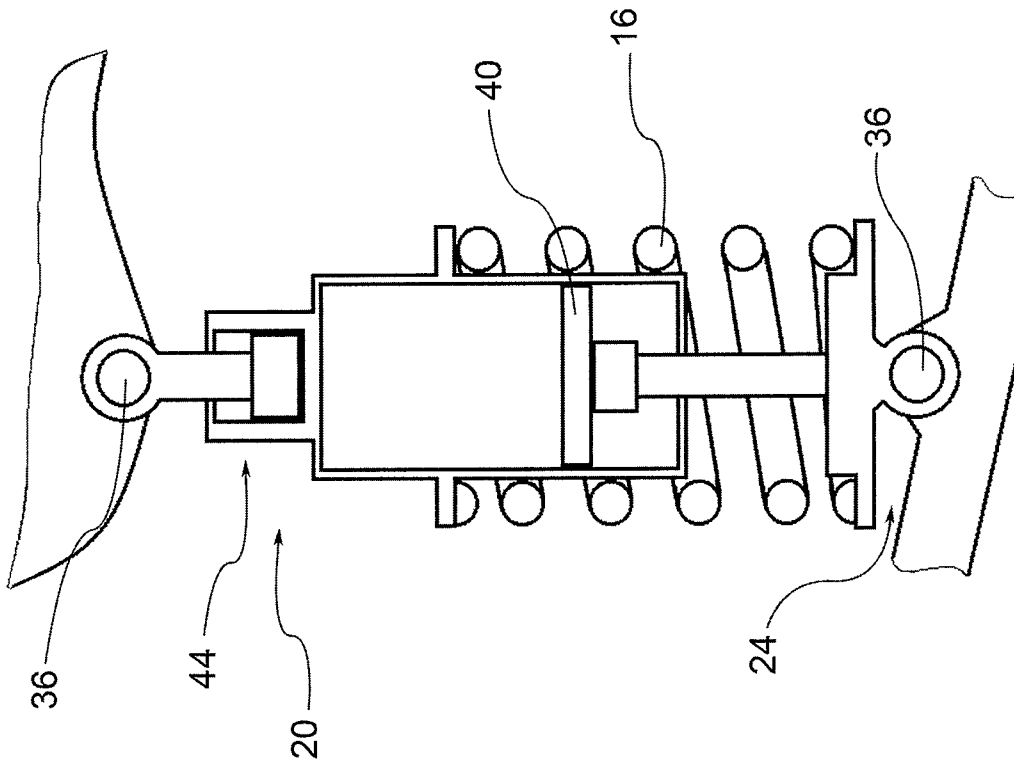
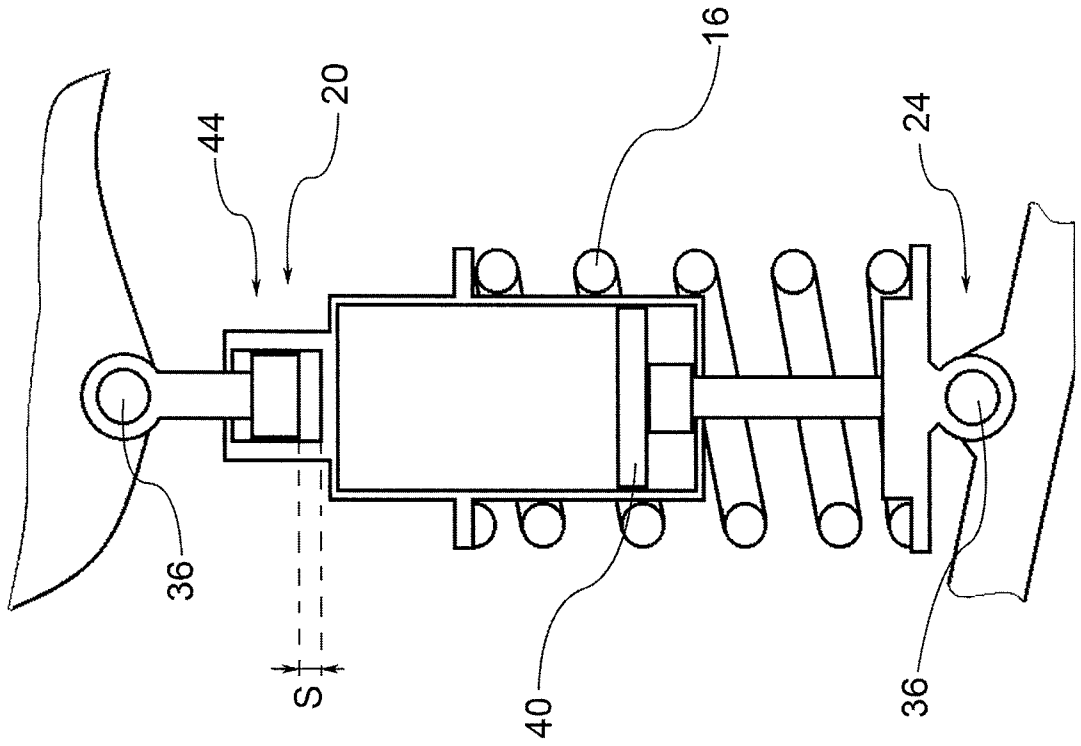

Fig. 3a



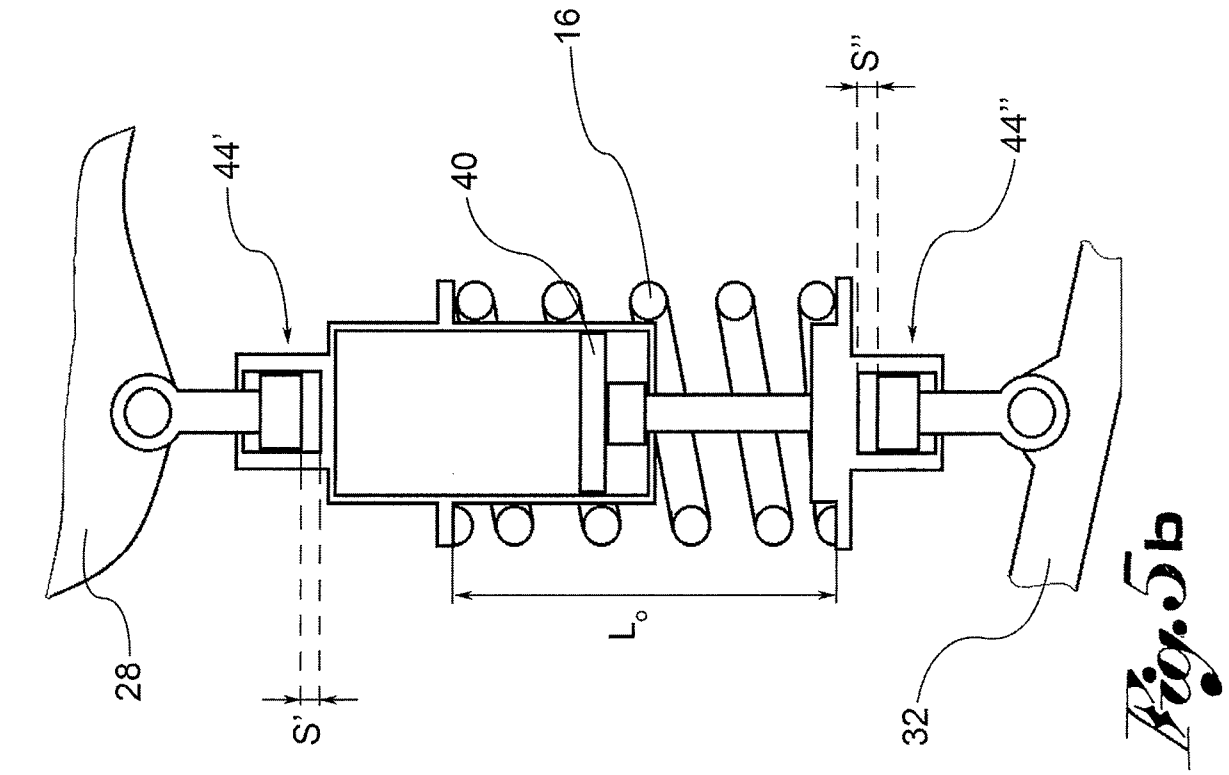

Fig. 5a

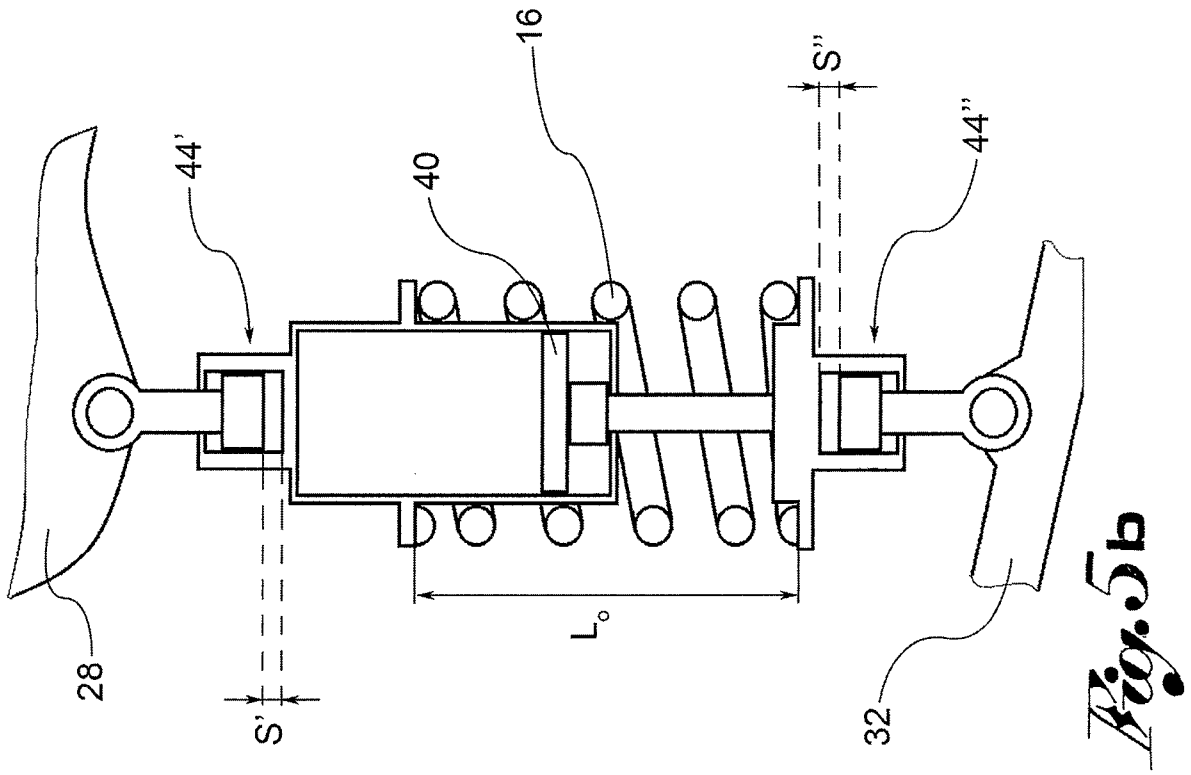

Fig. 5b

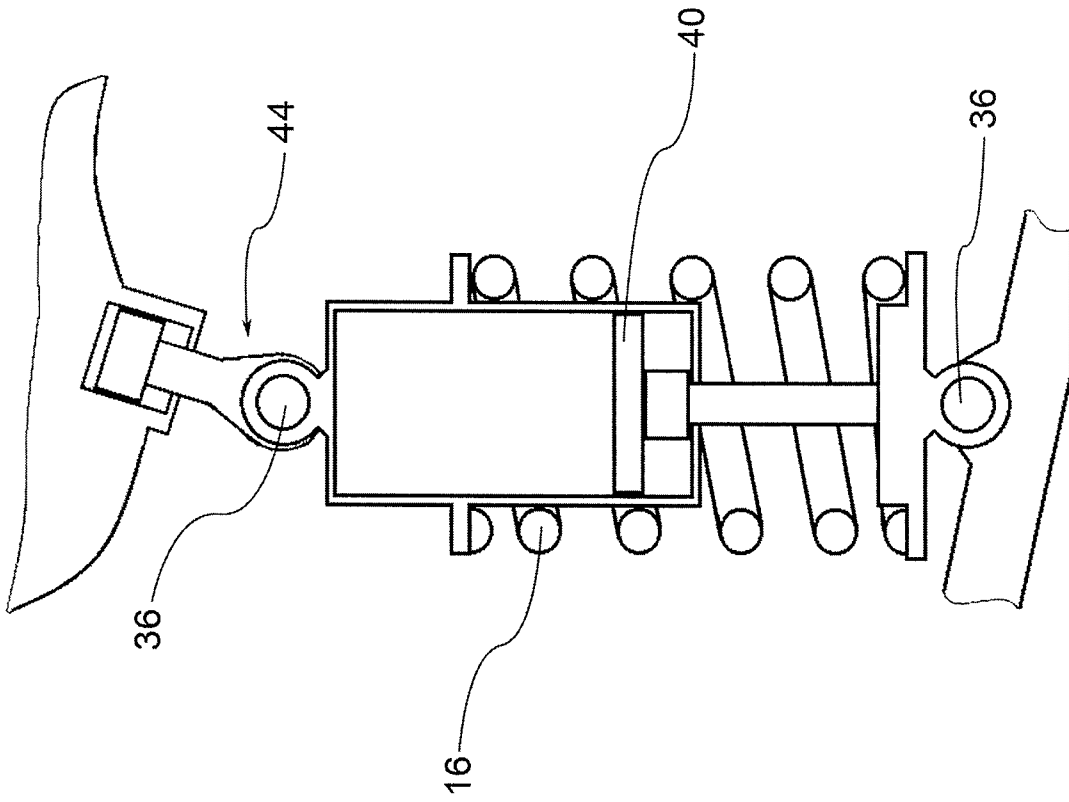

Fig. 6b

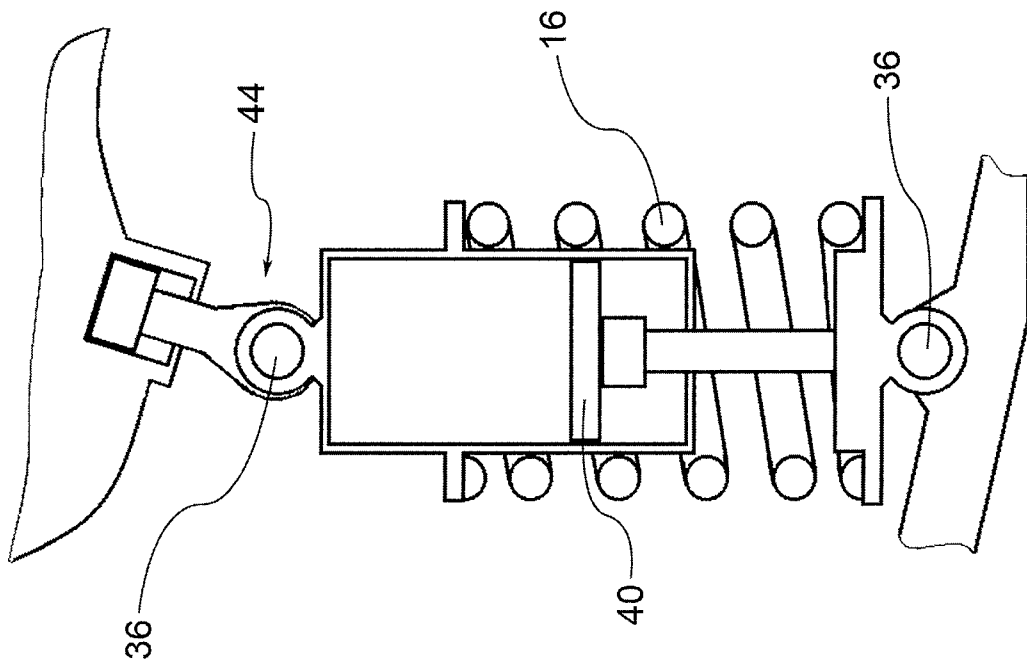

Fig. 6a

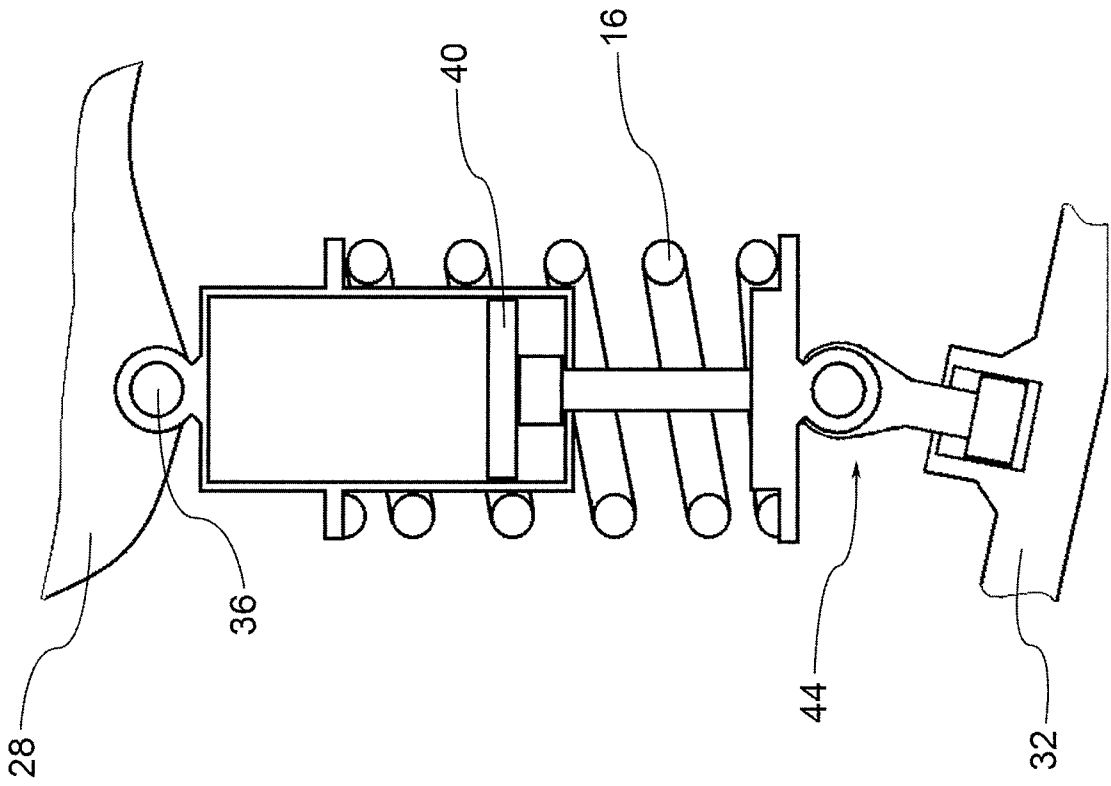

Fig. 7b

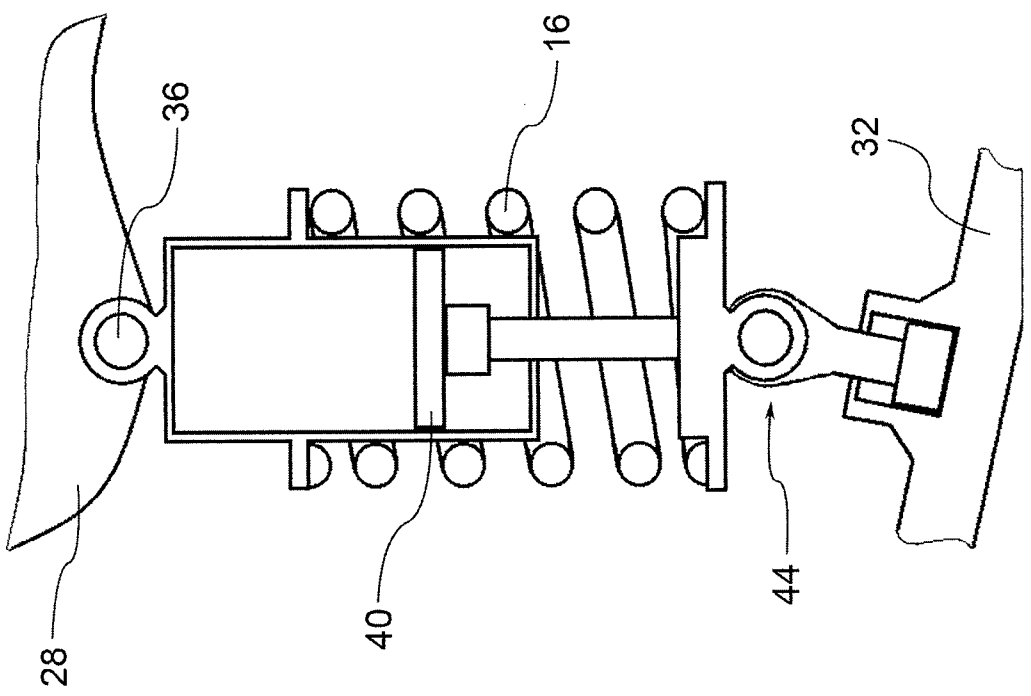

Fig. 7a

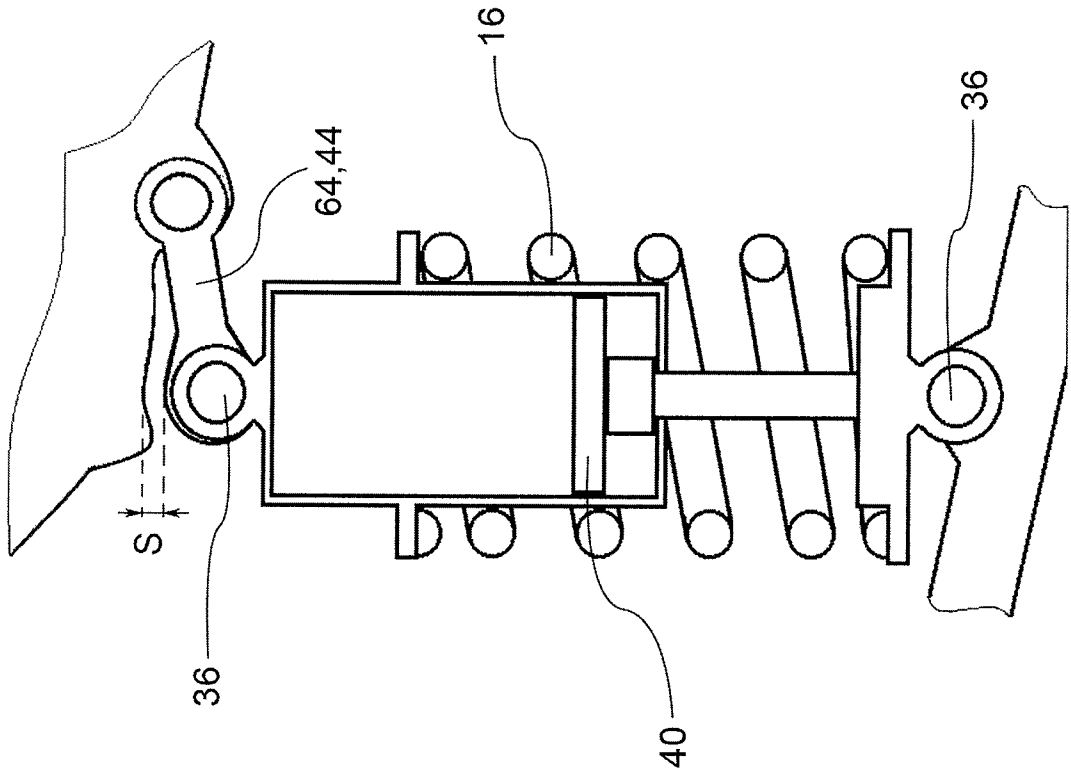

Fig. 8b

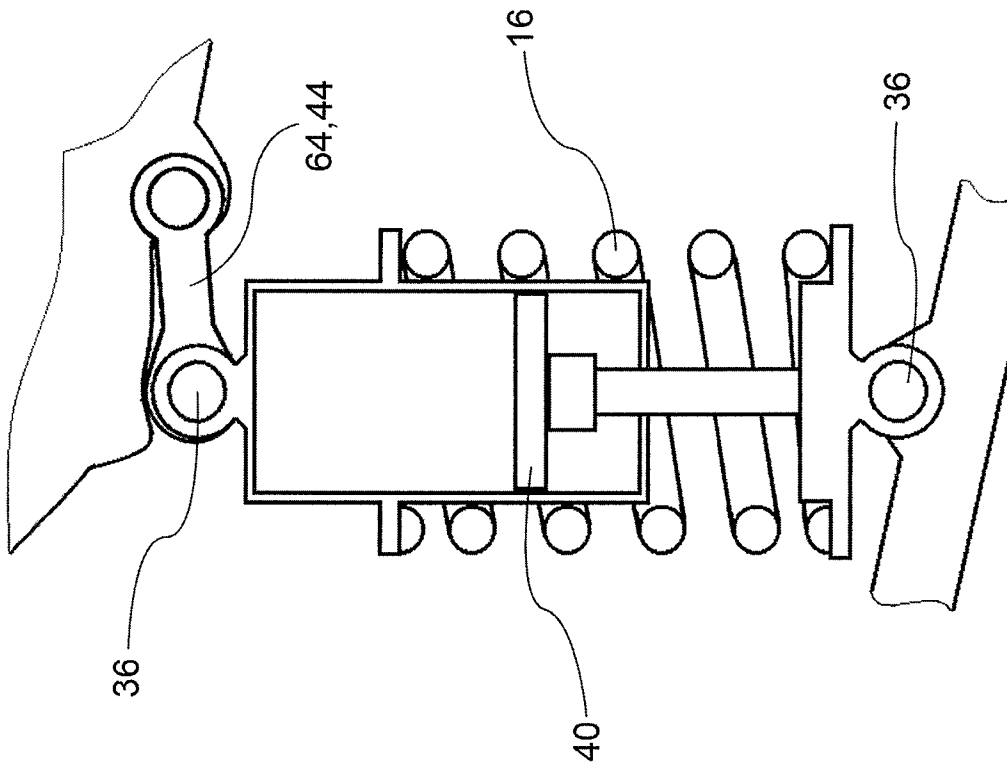

Fig. 8a

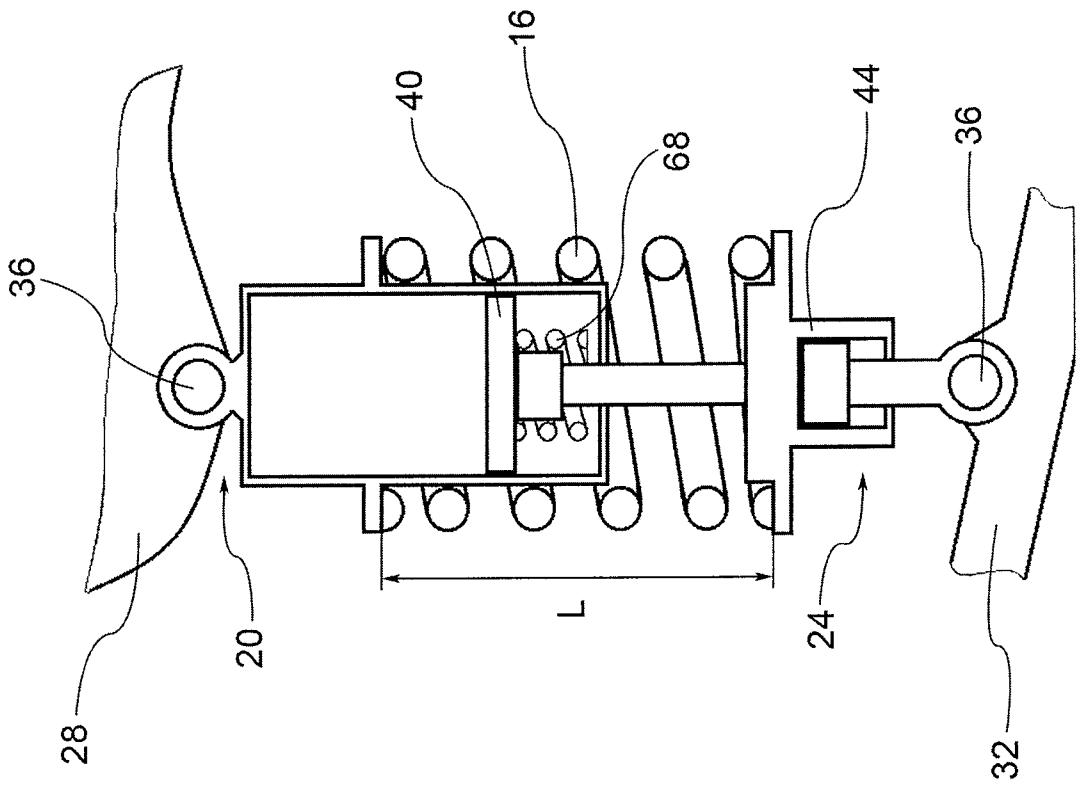

Fig. 9a

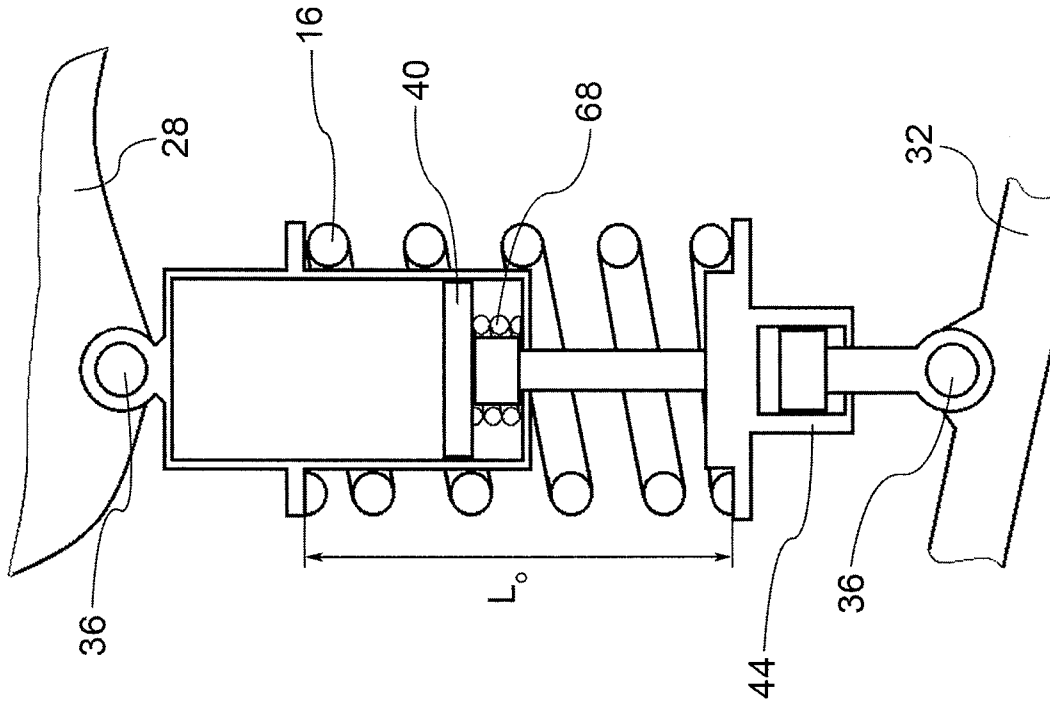

Fig. 9b

10/22

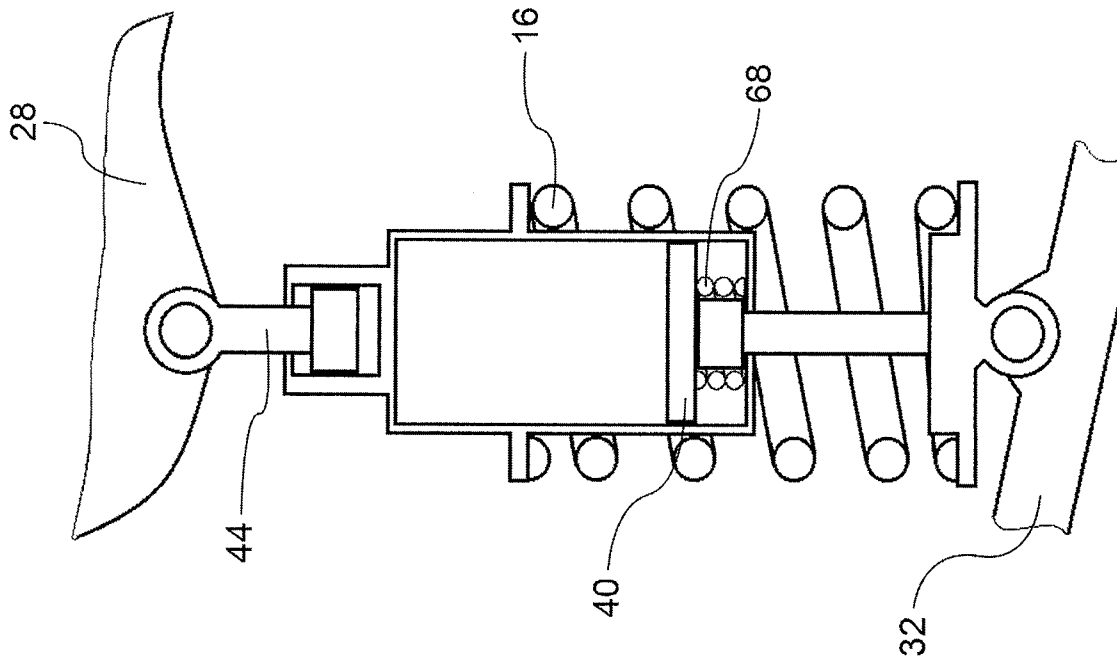

Fig. 10b

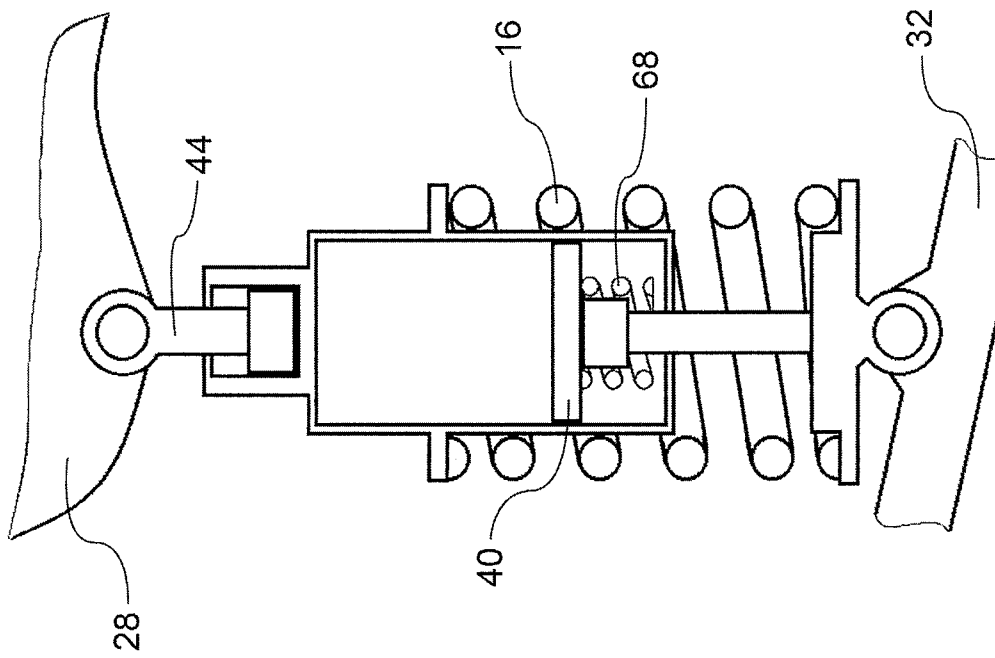
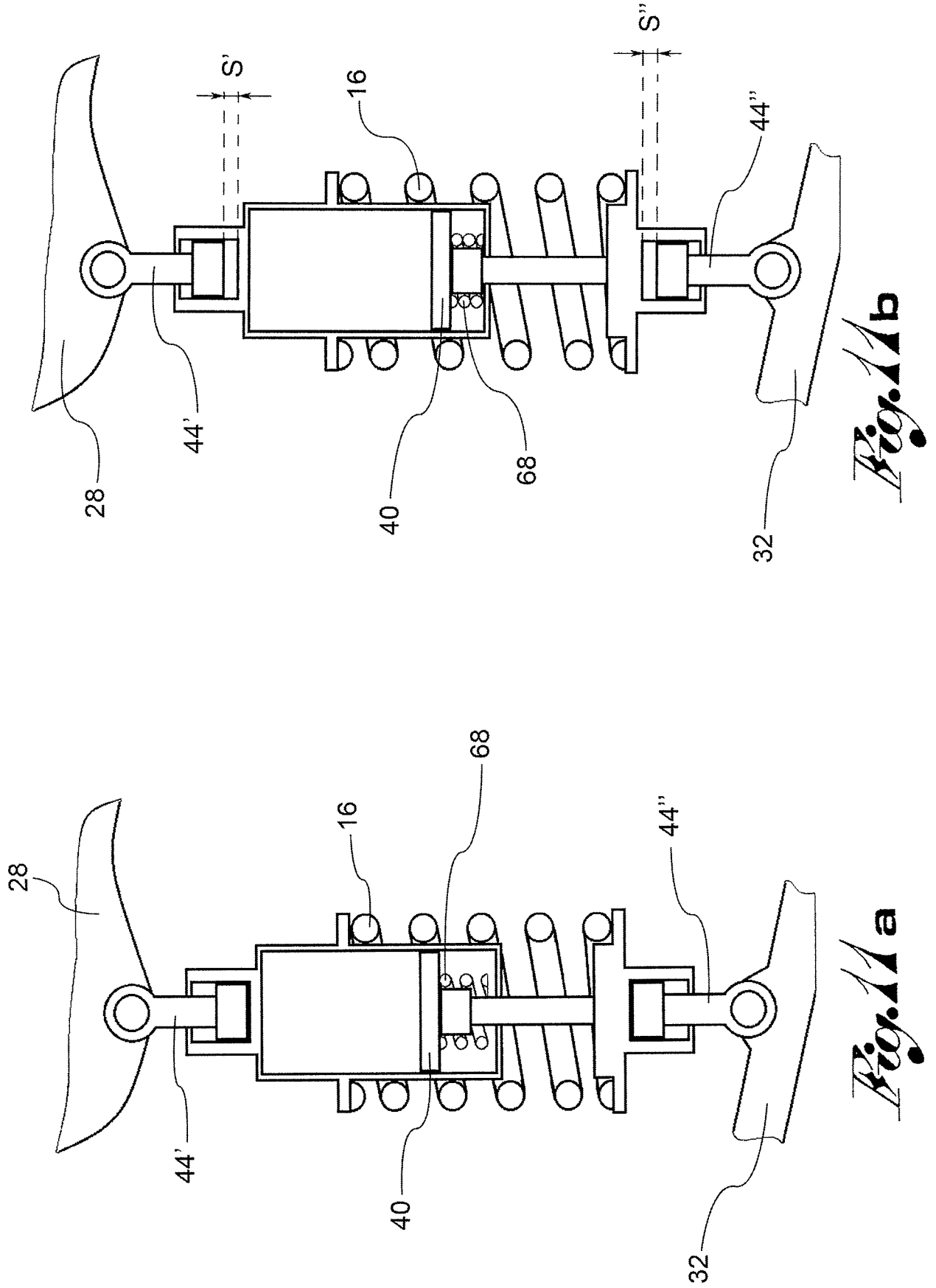

Fig. 10a



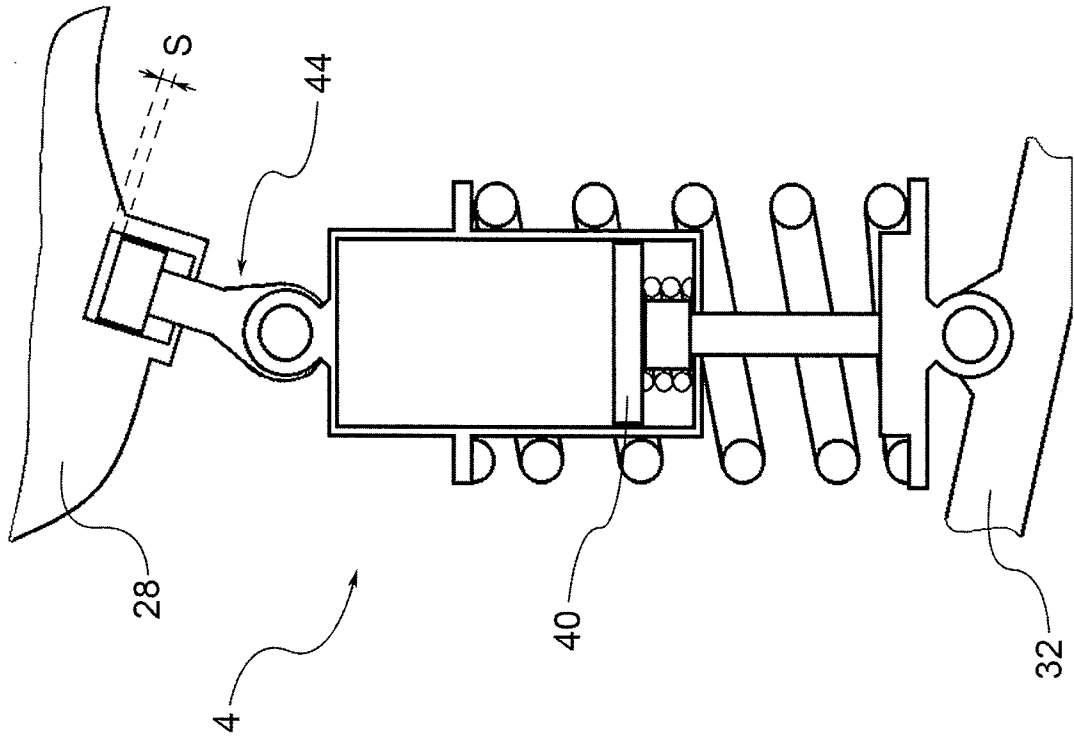

Fig. 12b

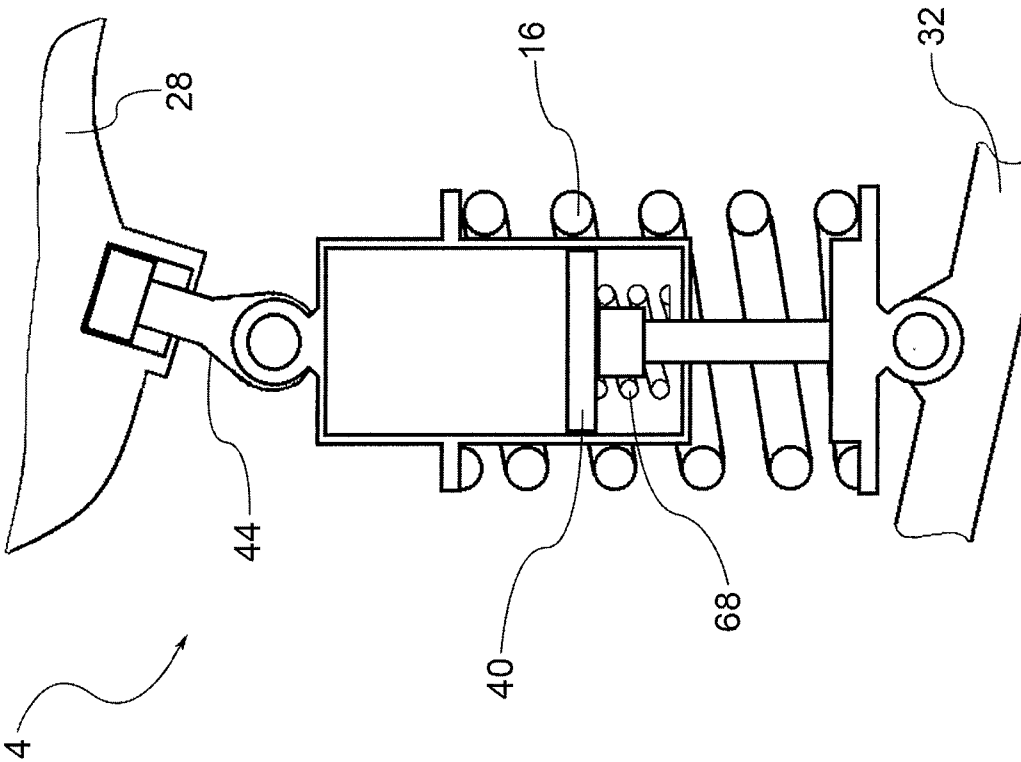

Fig. 12a

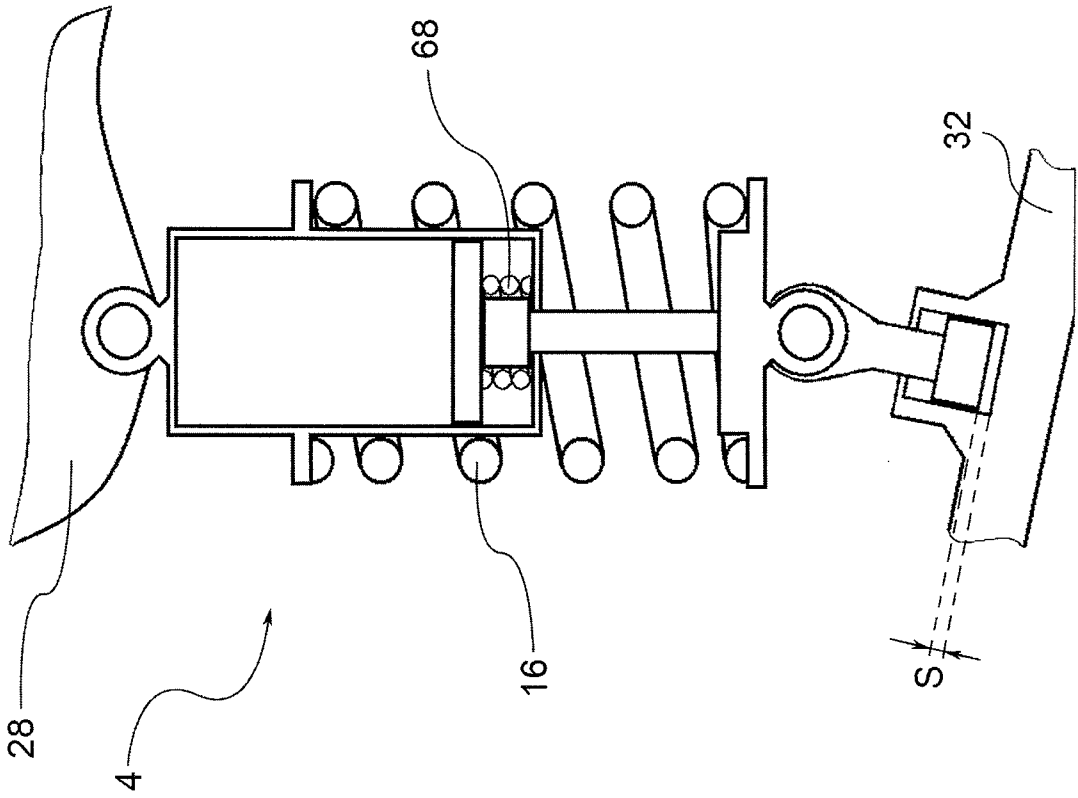

Fig. 13b

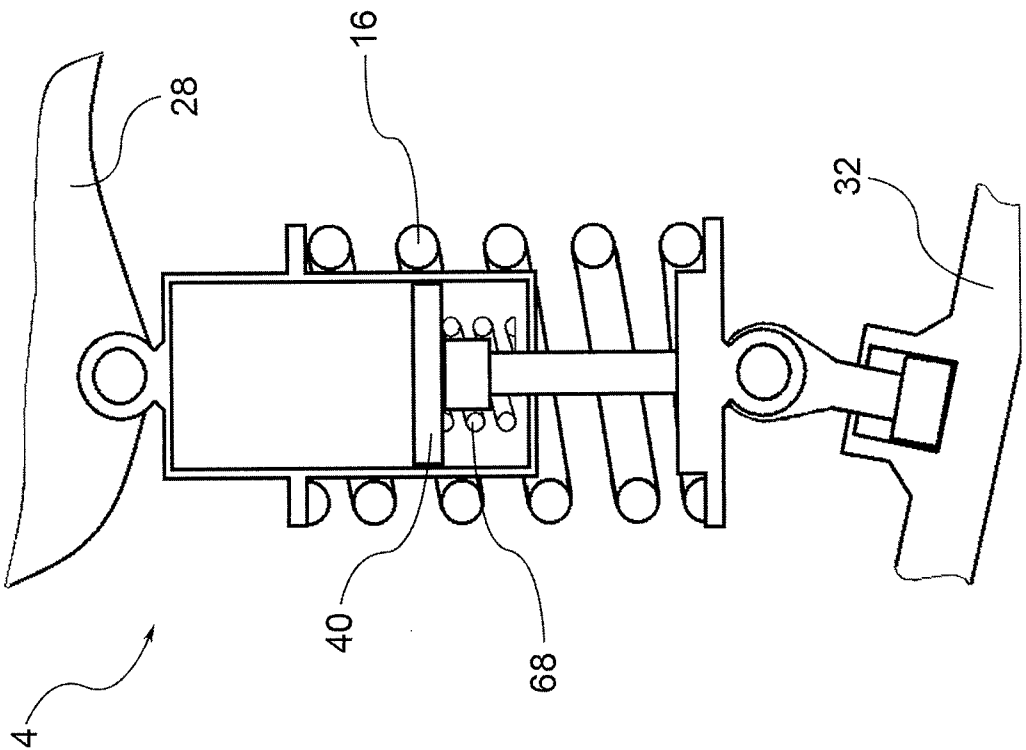

Fig. 13a

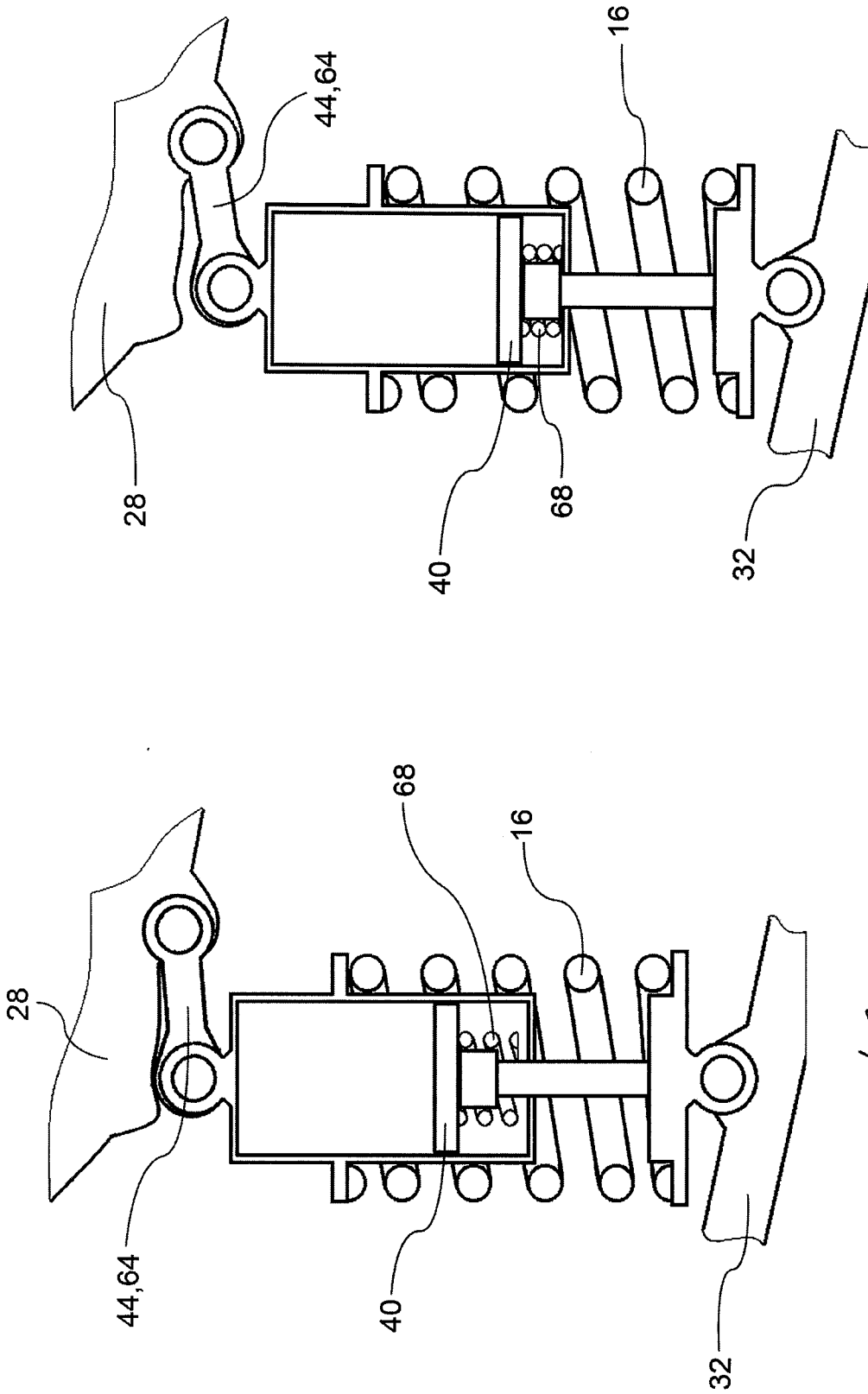

Fig. 14b

Fig. 14a

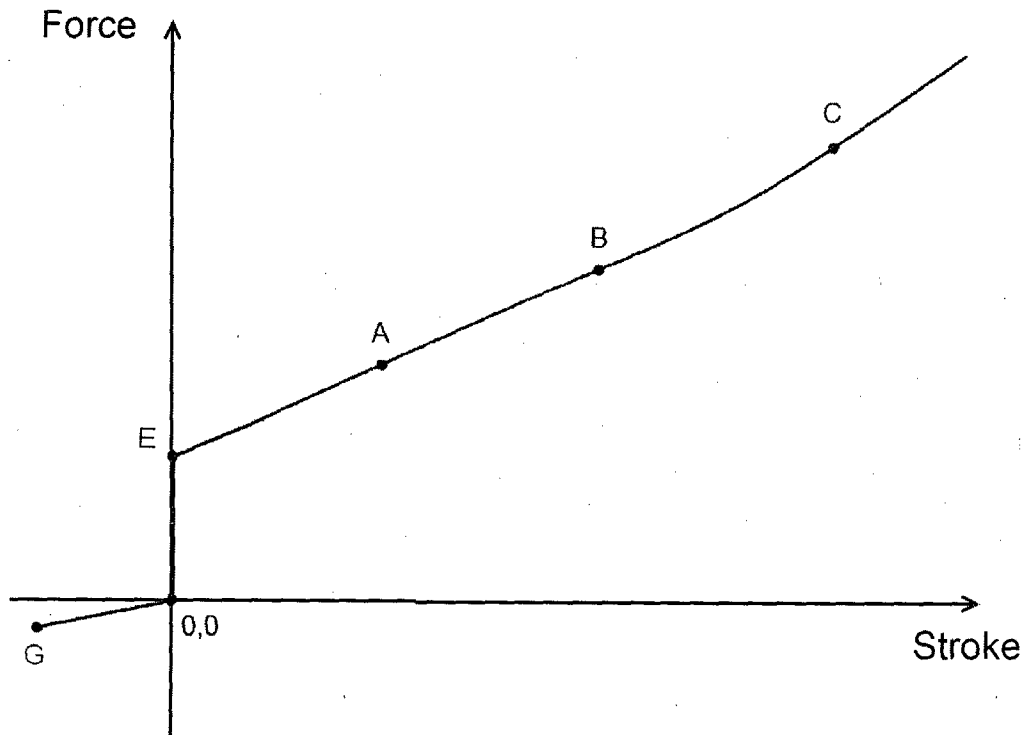

Fig. 15a

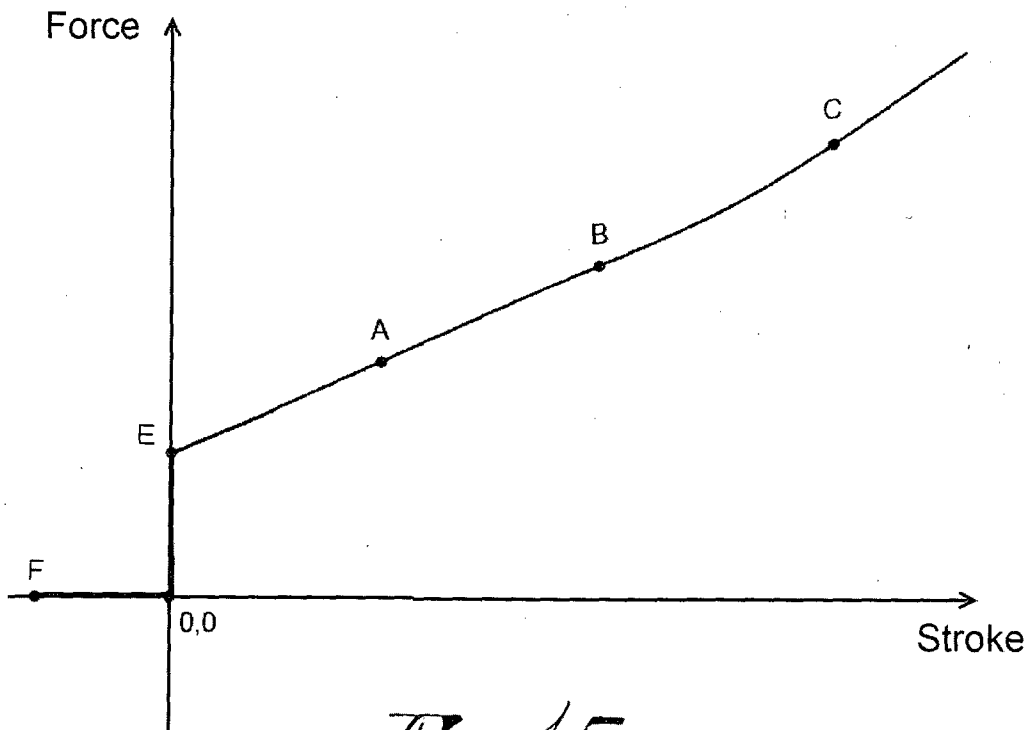

Fig. 15b

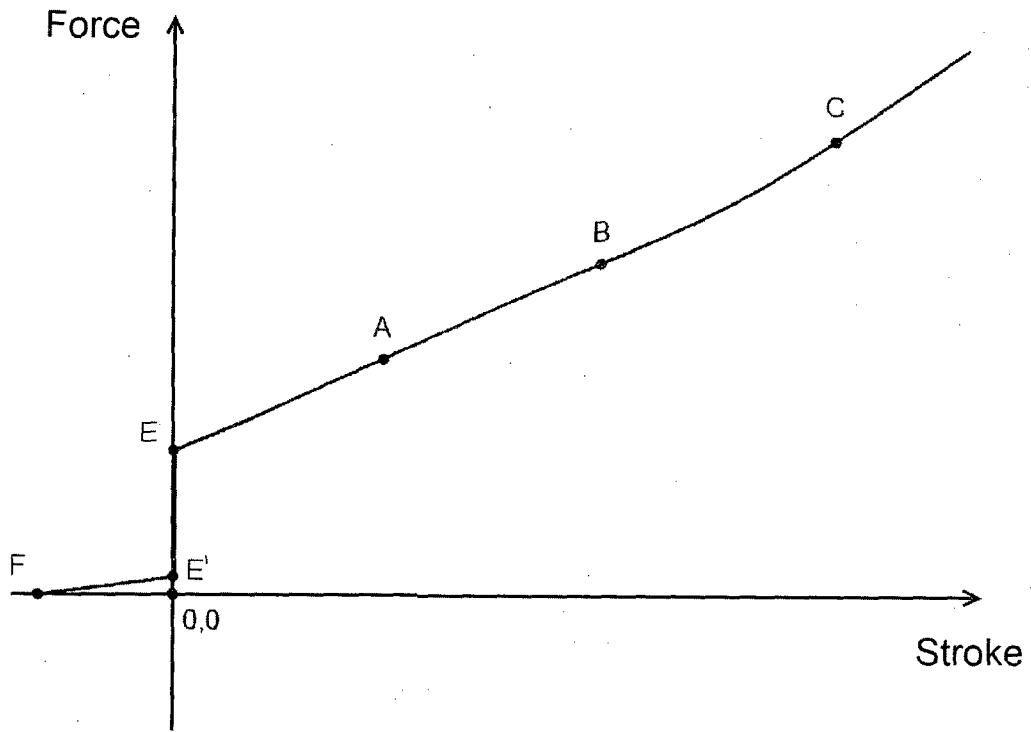

Fig. 15c

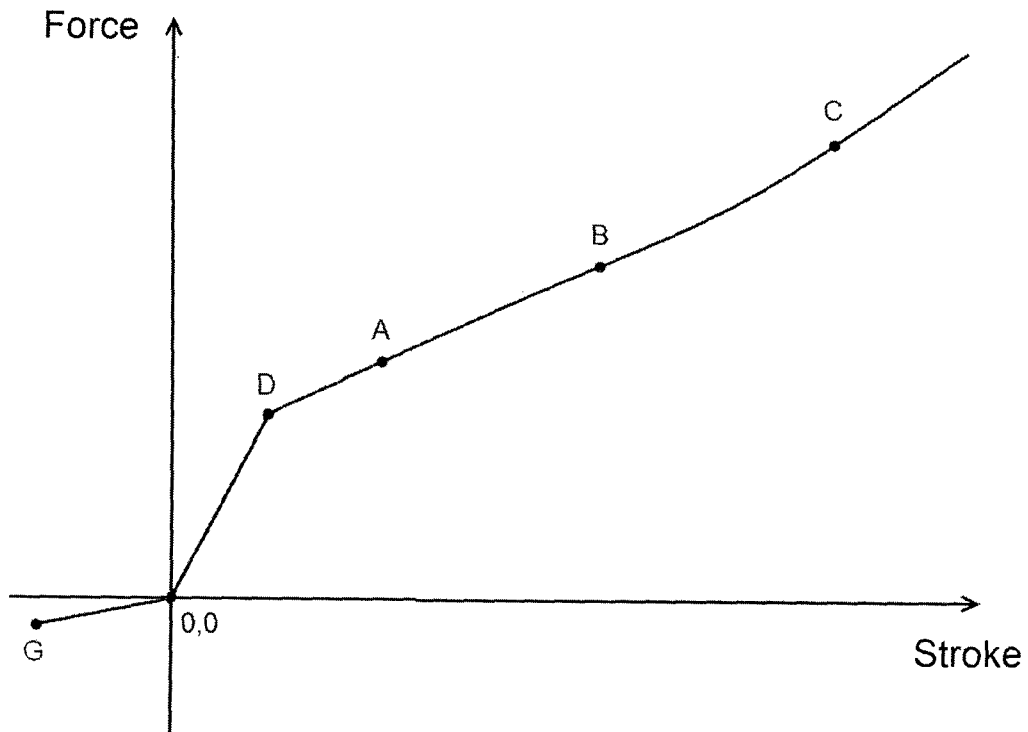

Fig. 16a

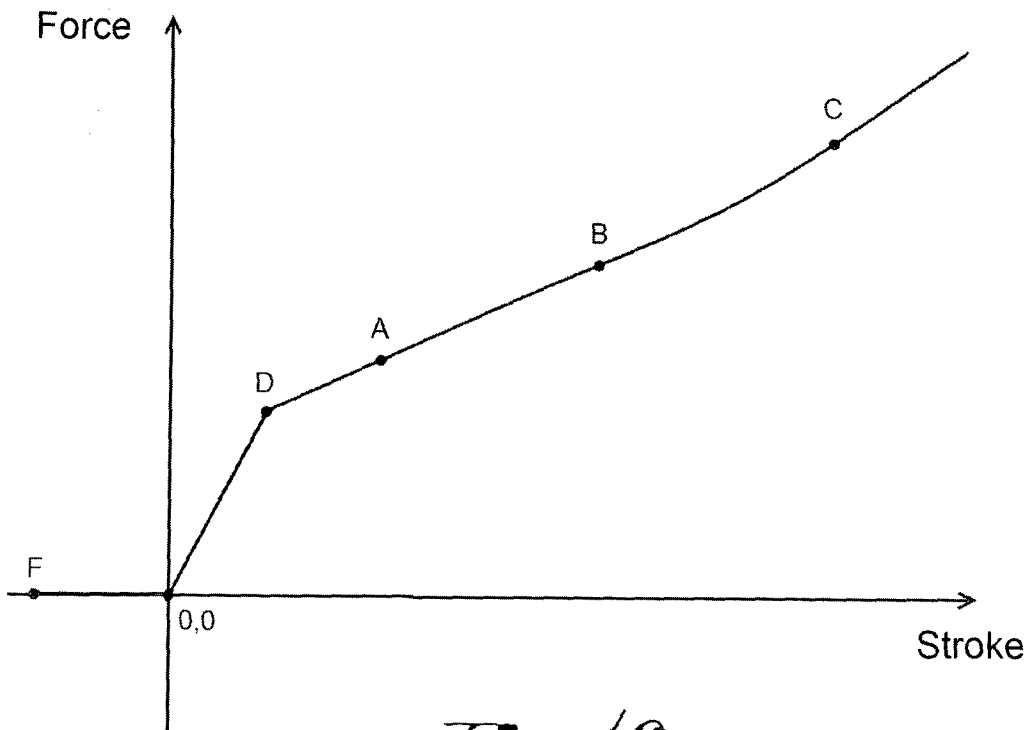

Fig. 16b

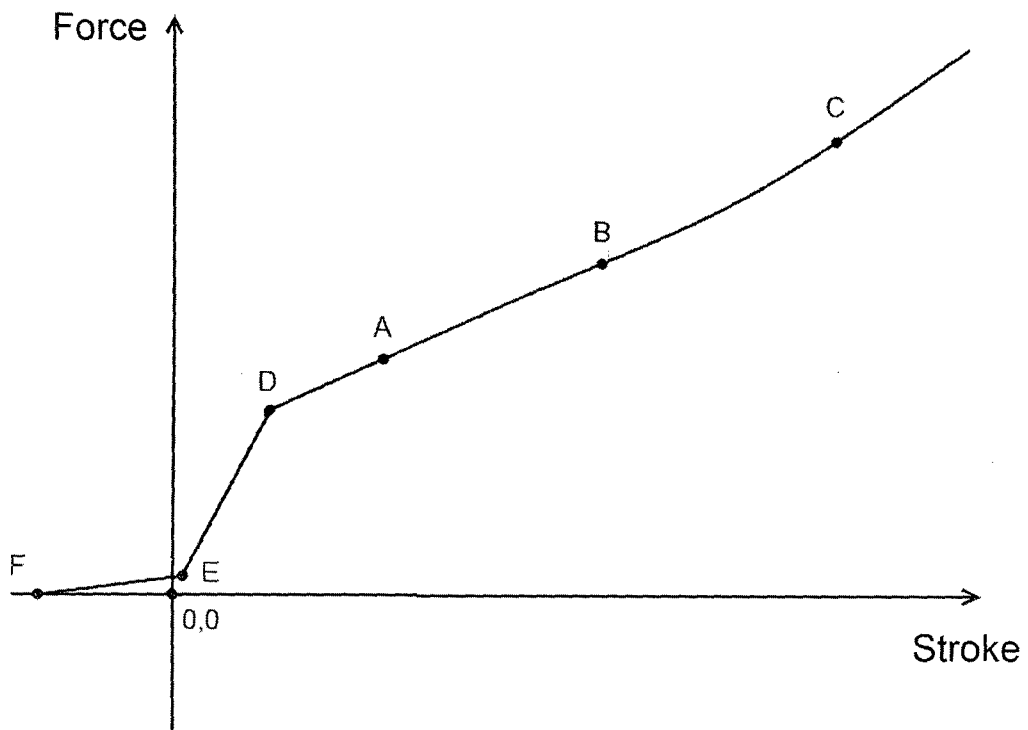

Fig. 16c

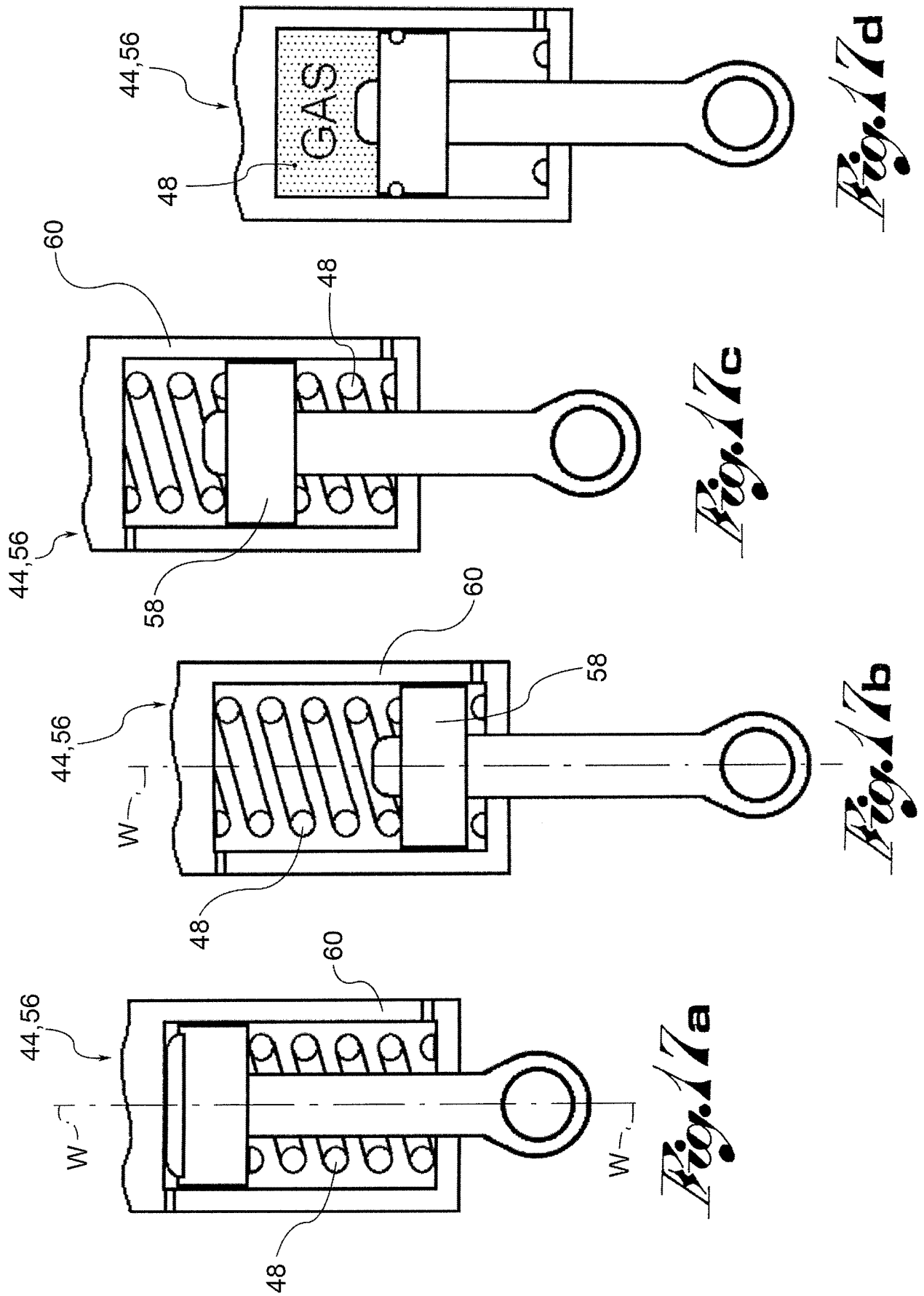

Fig. 17d

Fig. 17c

Fig. 17b

Fig. 17a

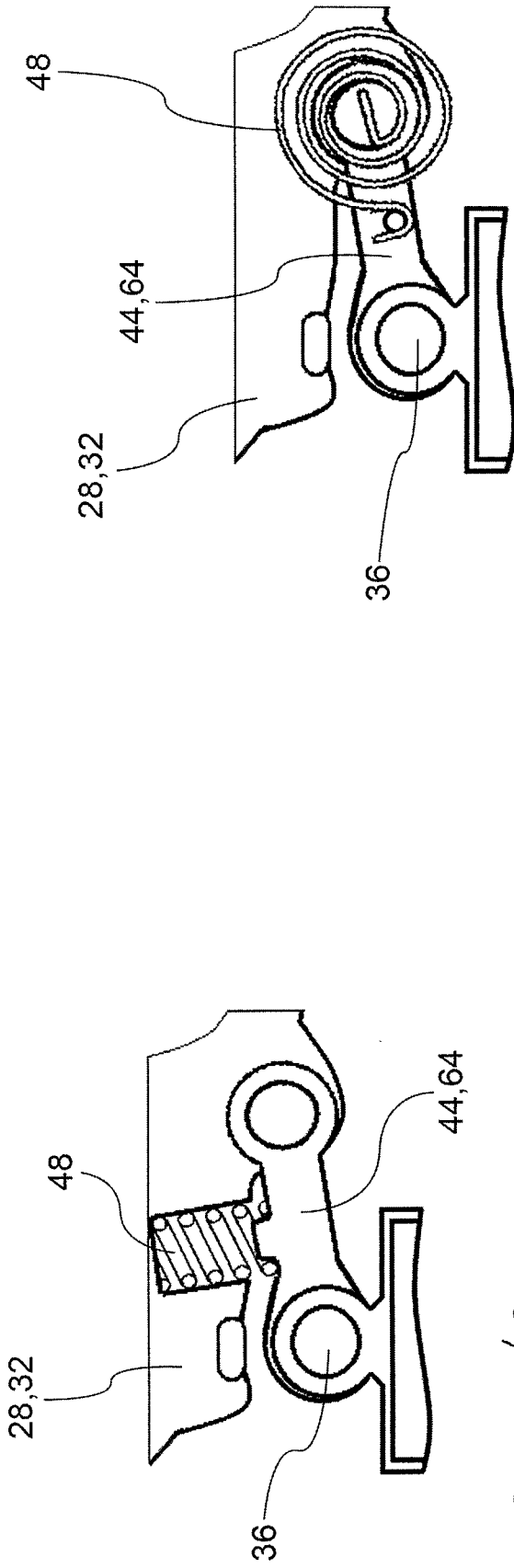

Fig. 18a

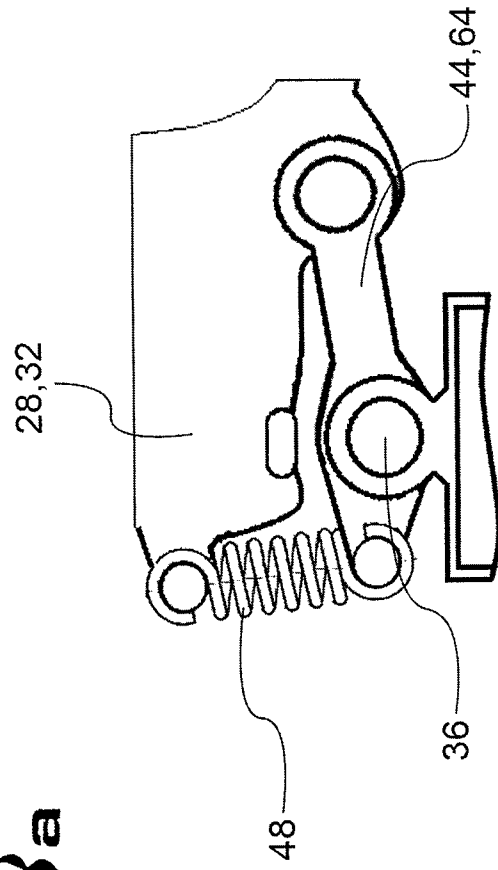

Fig. 18b

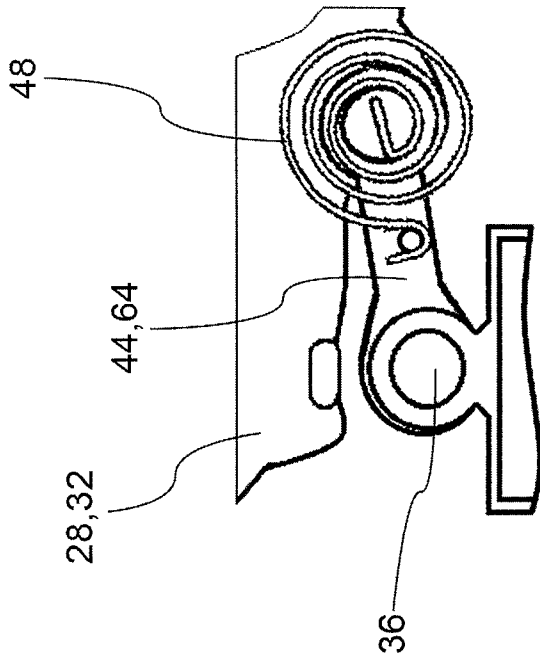

Fig. 18c

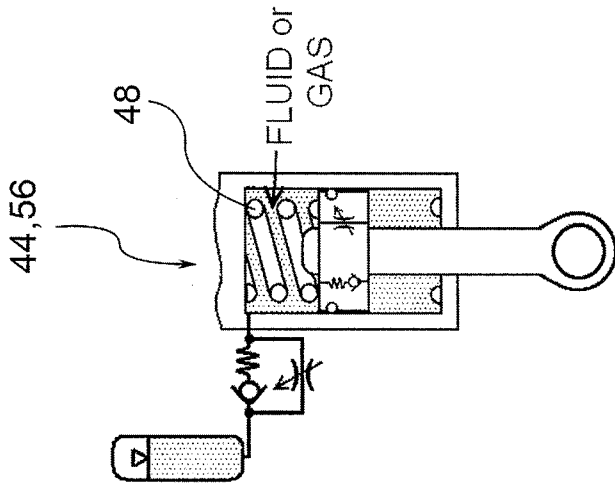

Fig. 19c

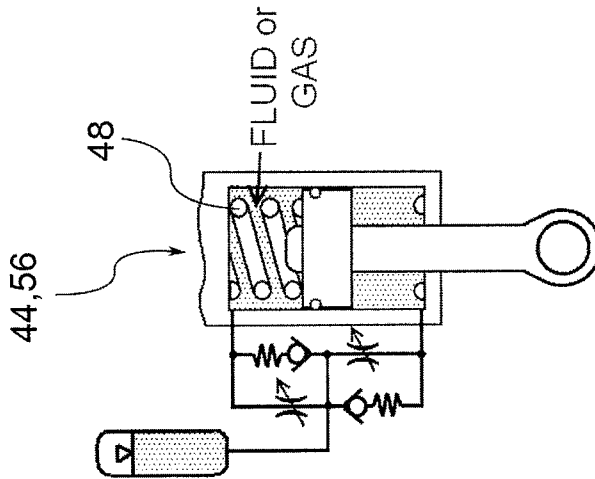

Fig. 19b

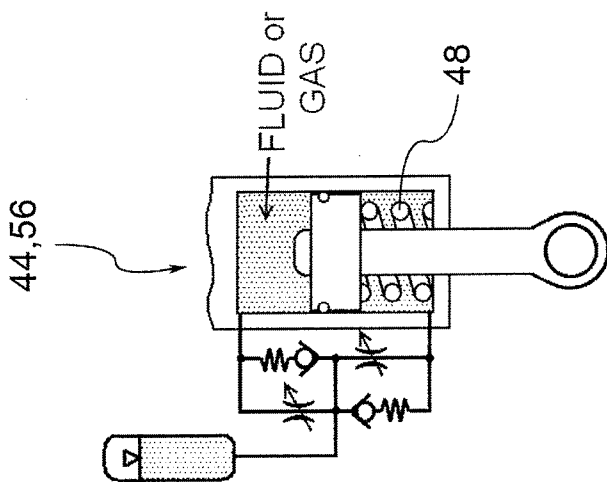

Fig. 19a

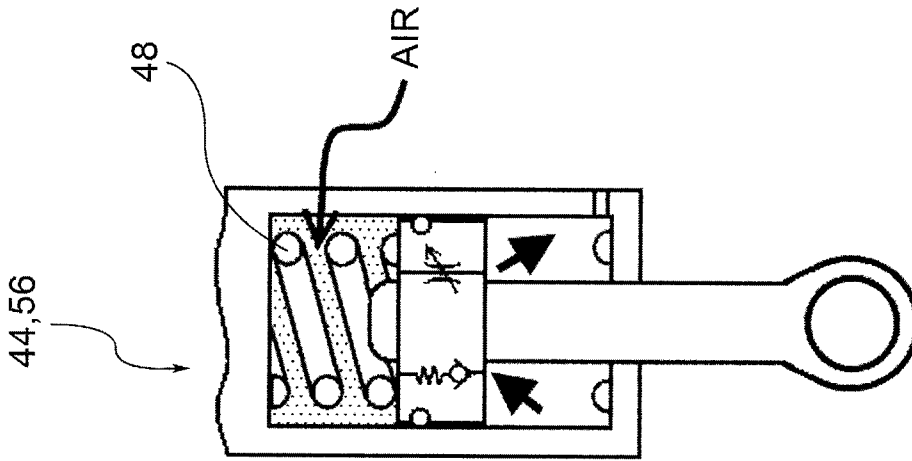

Fig. 20c

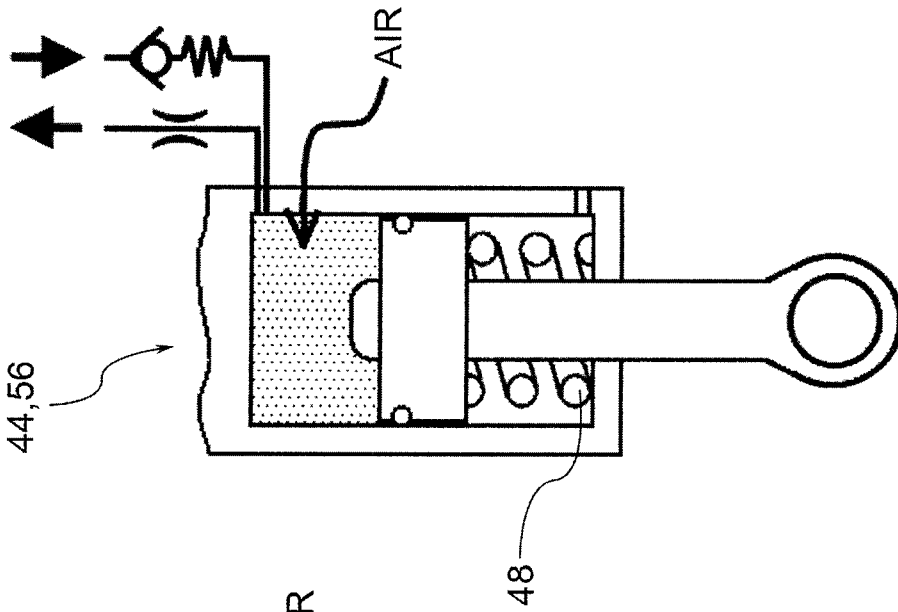

Fig. 20b

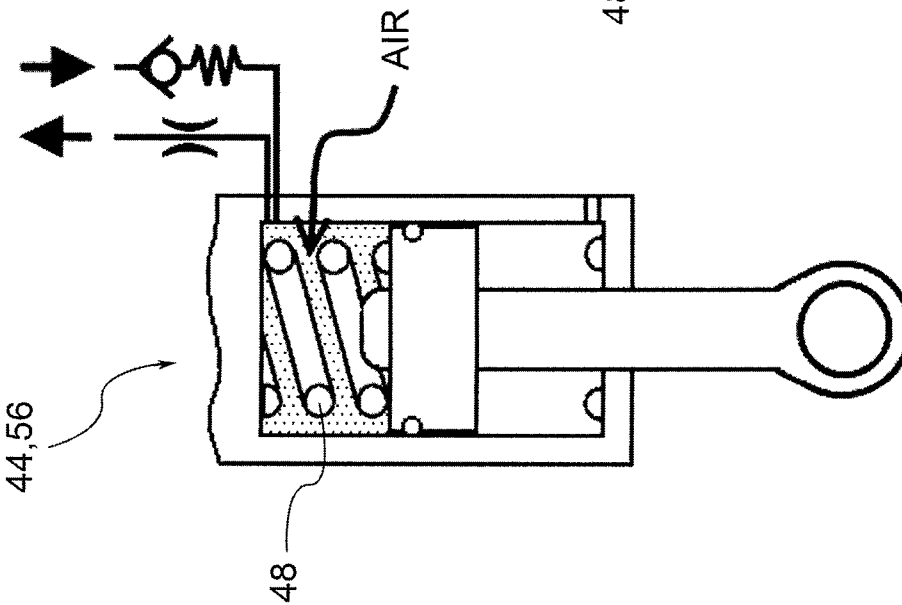

Fig. 20a

INTERNATIONAL SEARCH REPORT

International application No PCT/IB2014/058857

A. CLASSIFICATION OF SUBJECT MATTER
 INV. B60G15/06 B60G17/02 B62K25/04 F16F13/00 F16F9/56
 F16F9/58
 ADD.
 According to International Patent Classification (IPC) or to both national classification and IPC

B. FIELDS SEARCHED
 Minimum documentation searched (classification system followed by classification symbols)
 B60G F16F B62K

Documentation searched other than minimum documentation to the extent that such documents are included in the fields searched

Electronic data base consulted during the international search (name of data base and, where practicable, search terms used)
 EPO-Internal, WPI Data

C. DOCUMENTS CONSIDERED TO BE RELEVANT

Category*	Citation of document, with indication, where appropriate, of the relevant passages	Relevant to claim No.
X	DE 199 42 890 A1 (VOLKSWAGEN AG [DE]) 15 March 2001 (2001-03-15) abstract; claims; figures 1,3a,3b -----	1,19
X	JP H05 16627 A (NISSAN MOTOR) 26 January 1993 (1993-01-26) abstract; figures -----	1-3,7,8, 19
X	FR 2 689 062 A1 (PEUGEOT [FR]; CITROEN SA PEUGEOT [FR]; CITROEN SA [FR]) 1 October 1993 (1993-10-01) abstract; claims; figure 1 -----	1-5,19
X	US 3 417 986 A (ALFRED FUKE WILLIAM) 24 December 1968 (1968-12-24) figure 1 ----- -/--	1-3,19

Further documents are listed in the continuation of Box C. See patent family annex.

* Special categories of cited documents :

"A" document defining the general state of the art which is not considered to be of particular relevance	"T" later document published after the international filing date or priority date and not in conflict with the application but cited to understand the principle or theory underlying the invention
"E" earlier application or patent but published on or after the international filing date	"X" document of particular relevance; the claimed invention cannot be considered novel or cannot be considered to involve an inventive step when the document is taken alone
"L" document which may throw doubts on priority claim(s) or which is cited to establish the publication date of another citation or other special reason (as specified)	"Y" document of particular relevance; the claimed invention cannot be considered to involve an inventive step when the document is combined with one or more other such documents, such combination being obvious to a person skilled in the art
"O" document referring to an oral disclosure, use, exhibition or other means	"&" document member of the same patent family
"P" document published prior to the international filing date but later than the priority date claimed	

Date of the actual completion of the international search 12 March 2014	Date of mailing of the international search report 21/03/2014
--	--

Name and mailing address of the ISA/ European Patent Office, P.B. 5818 Patentlaan 2 NL - 2280 HV Rijswijk Tel. (+31-70) 340-2040, Fax: (+31-70) 340-3016	Authorized officer Tsitsilonis, Lucas
--	--

INTERNATIONAL SEARCH REPORT

International application No
PCT/IB2014/058857

C(Continuation). DOCUMENTS CONSIDERED TO BE RELEVANT		
Category*	Citation of document, with indication, where appropriate, of the relevant passages	Relevant to claim No.
X	US 2001/005065 A1 (BECK HUBERT [DE] ET AL) 28 June 2001 (2001-06-28) the whole document	1,19
X	JP H02 120106 A (MAZDA MOTOR) 8 May 1990 (1990-05-08) abstract; figures	1,4-6, 9-12,17, 19
X	JP H04 244406 A (SUZUKI MOTOR CO) 1 September 1992 (1992-09-01) abstract; figures	1,19
X	JP H02 120103 A (MAZDA MOTOR) 8 May 1990 (1990-05-08) abstract; figures	1,19
X	JP S58 85704 A (KAYABA INDUSTRY CO LTD) 23 May 1983 (1983-05-23) abstract; figures 3-7	1,19
X	JP S56 86807 A (HONDA MOTOR CO LTD; SHOWA MFG) 15 July 1981 (1981-07-15) abstract; figures	1,19
A	JP S58 136506 A (SHOWA MFG) 13 August 1983 (1983-08-13) abstract; figures	1-19
A	JP 2006 248326 A (YOKOHAMA RUBBER CO LTD) 21 September 2006 (2006-09-21) abstract; figures	1-19
A	EP 1 535 828 A2 (SHOWA CORP [JP]) 1 June 2005 (2005-06-01) the whole document	1-19
A	DE 10 2006 012640 A1 (HONDA MOTOR CO LTD [JP]) 5 October 2006 (2006-10-05) the whole document	1-19
A	EP 0 466 628 A1 (BIANCHI MAURO SA [FR]) 15 January 1992 (1992-01-15) the whole document	1-19
A	WO 91/04876 A1 (BIANCHI MAURO SA [FR]) 18 April 1991 (1991-04-18) abstract; claims; figures 1-9,14-17	1-19
A	WO 2004/028883 A1 (DAIMLER CHRYSLER AG [DE]; BERGHUS JUERGEN [DE]; ENDER ALEXANDER [DE];) 8 April 2004 (2004-04-08) abstract; figures 5,10	1,19
	-/--	

INTERNATIONAL SEARCH REPORT

International application No
PCT/IB2014/058857

C(Continuation). DOCUMENTS CONSIDERED TO BE RELEVANT

Category*	Citation of document, with indication, where appropriate, of the relevant passages	Relevant to claim No.
A	DE 103 52 212 A1 (VOLKSWAGEN AG [DE]) 3 February 2005 (2005-02-03) abstract; figures 4,5 -----	1,19
A	JP 2006 131066 A (NISSAN MOTOR) 25 May 2006 (2006-05-25) figures -----	1-19
A	US 2007/200311 A1 (BECK HUBERT [DE]) 30 August 2007 (2007-08-30) figures 2,3,4 -----	1,19

INTERNATIONAL SEARCH REPORT

Information on patent family members

International application No PCT/IB2014/058857

Patent document cited in search report	Publication date	Patent family member(s)	Publication date
DE 19942890	A1	15-03-2001	NONE

JP H0516627	A	26-01-1993	NONE

FR 2689062	A1	01-10-1993	DE 4310548 A1 07-10-1993 FR 2689062 A1 01-10-1993

US 3417986	A	24-12-1968	GB 1081709 A 31-08-1967 US 3417986 A 24-12-1968

US 2001005065	A1	28-06-2001	DE 19959197 A1 28-06-2001 US 2001005065 A1 28-06-2001

JP H02120106	A	08-05-1990	NONE

JP H04244406	A	01-09-1992	NONE

JP H02120103	A	08-05-1990	NONE

JP S5885704	A	23-05-1983	JP H035322 B2 25-01-1991 JP S5885704 A 23-05-1983

JP S5686807	A	15-07-1981	JP S623004 B2 22-01-1987 JP S5686807 A 15-07-1981

JP S58136506	A	13-08-1983	JP S629044 B2 26-02-1987 JP S58136506 A 13-08-1983

JP 2006248326	A	21-09-2006	JP 4577049 B2 10-11-2010 JP 2006248326 A 21-09-2006

EP 1535828	A2	01-06-2005	EP 1535828 A2 01-06-2005 JP 2005153807 A 16-06-2005 US 2005116437 A1 02-06-2005

DE 102006012640	A1	05-10-2006	DE 102006012640 A1 05-10-2006 JP 4648738 B2 09-03-2011 JP 2006264459 A 05-10-2006 US 2007102218 A1 10-05-2007

EP 0466628	A1	15-01-1992	AT 116219 T 15-01-1995 DE 69106250 D1 09-02-1995 DE 69106250 T2 03-08-1995 DK 0466628 T3 15-05-1995 EP 0466628 A1 15-01-1992 ES 2068552 T3 16-04-1995 FR 2664210 A1 10-01-1992 GR 3015280 T3 30-06-1995 JP 3182657 B2 03-07-2001 JP H06129471 A 10-05-1994 US 5183285 A 02-02-1993

WO 9104876	A1	18-04-1991	AT 91464 T 15-07-1993 AU 6543090 A 28-04-1991 BR 9006962 A 08-10-1991 CA 2044275 A1 06-04-1991 DE 69002227 D1 19-08-1993 DE 69002227 T2 17-02-1994

INTERNATIONAL SEARCH REPORT

Information on patent family members

International application No PCT/IB2014/058857

Patent document cited in search report	Publication date	Patent family member(s)	Publication date
		DK 0446338 T3	22-11-1993
		EP 0446338 A1	18-09-1991
		ES 2045949 T3	16-01-1994
		FR 2652783 A1	12-04-1991
		HU 211405 B	28-11-1995
		JP 3268454 B2	25-03-2002
		JP H04504239 A	30-07-1992
		RO 113960 B1	30-12-1998
		RU 2065820 C1	27-08-1996
		US 5244190 A	14-09-1993
		WO 9104876 A1	18-04-1991
WO 2004028883	A1	08-04-2004	
		DE 10244361 A1	01-04-2004
		EP 1542896 A1	22-06-2005
		JP 2006500271 A	05-01-2006
		US 2005189735 A1	01-09-2005
		WO 2004028883 A1	08-04-2004
DE 10352212	A1	03-02-2005	NONE
JP 2006131066	A	25-05-2006	NONE
US 2007200311	A1	30-08-2007	
		DE 102006008608 A1	06-09-2007
		US 2007200311 A1	30-08-2007