

(19) World Intellectual Property Organization
International Bureau



(43) International Publication Date
10 May 2001 (10.05.2001)

PCT

(10) International Publication Number
WO 01/32244 A1

(51) International Patent Classification⁷: A61M 5/32

Kaysville, UT 84037 (US). WILSON, Michael; 663 East 600 South, Salem, UT 84653 (US). FERGUSON, Mark; 1595 East Treeview Drive, Salt Lake City, UT 84124 (US).

(21) International Application Number: PCT/US00/29971

(22) International Filing Date: 31 October 2000 (31.10.2000)

(81) Designated States (national): AE, AG, AL, AM, AT, AU, AZ, BA, BB, BG, BR, BY, BZ, CA, CH, CN, CR, CU, CZ, DE, DK, DM, DZ, EE, ES, FI, GB, GD, GE, GH, GM, HR, HU, ID, IL, IN, IS, JP, KE, KG, KP, KR, KZ, LC, LK, LR, LS, LT, LU, LV, MA, MD, MG, MK, MN, MW, MX, MZ, NO, NZ, PL, PT, RO, RU, SD, SE, SG, SI, SK, SL, TJ, TM, TR, TT, TZ, UA, UG, UZ, VN, YU, ZA, ZW.

(25) Filing Language: English

(26) Publication Language: English

(30) Priority Data:
09/434,036 4 November 1999 (04.11.1999) US

(84) Designated States (regional): ARIPO patent (GH, GM, KE, LS, MW, MZ, SD, SL, SZ, TZ, UG, ZW), Eurasian patent (AM, AZ, BY, KG, KZ, MD, RU, TJ, TM), European patent (AT, BE, CH, CY, DE, DK, ES, FI, FR, GB, GR, IE, IT, LU, MC, NL, PT, SE), OAPI patent (BF, BJ, CF, CG, CI, CM, GA, GN, GW, ML, MR, NE, SN, TD, TG).

(71) Applicant: SPECIALIZED HEALTH PRODUCTS, INC. [US/US]; 585 West 500 South, Bountiful, UT 84010 (US).

(72) Inventors: THORNE, Gale; 1056 Millcrest Circle, Bountiful, UT 84010 (US). THORNE, Gale, Jr.; 1898 So. Chokecherry Drive, Bountiful, UT 84010 (US). NELSON, Mark; 7759 Keswick Rd., Sandy, UT 84093 (US). THORNE, Kendall; 942 West 60 North, Layton, UT 84041 (US). THORNE, David; 1759 South 450 East,

Published:
— With international search report.
— Before the expiration of the time limit for amending the claims and to be republished in the event of receipt of amendments.

[Continued on next page]

(54) Title: REACCESSIBLE MEDICAL NEEDLE SAFETY DEVICES AND METHODS

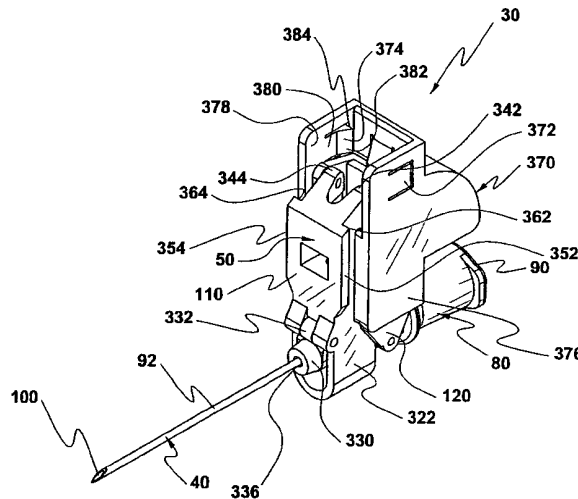

(57) Abstract: A retractable and extendable medical needle protective shield (50, 560, 707) which provides opportunity for accessing and reaccessing medical needle (40) and associated sharpened needle tip (100) and recovering the needle (40) and tip (100) for safety between accesses. The shield (50, 560, 707) includes a needle guide (330, 600, 600') which assures the needle tip (100) is untouched by any part of the shield (50, 560, 707) as the shield (50, 560, 707) is displaced to cover and uncover the needle (40). A releasible latch (372, 374, 656, 660, 810, 812) is provided to guard against inadvertent removal of the protective shield between accesses. An unreleasible latch (410, 648) is also provided to secure the shield (50, 560, 707) relative to the latch (410, 648) preparatory to final disposal. In combination with the protective shield (50, 560, 707), a plurality of adapters are disclosed which provide examples of passively operated, protected access to membrane pierceable fluid sources such as a "Y" connection site (950) of an IV set line (952), a drug vial (900), a vacuum sample tube (902'), an umbilical cord holder (960) and a hypodermic sit (930).



WO 01/32244 A1



For two-letter codes and other abbreviations, refer to the "Guidance Notes on Codes and Abbreviations" appearing at the beginning of each regular issue of the PCT Gazette.

REACCESSIBLE MEDICAL NEEDLE SAFETY DEVICES AND METHODS**FIELD OF THE INVENTION**

5 This invention relates generally to safety devices for hollow bore medical needles and particularly to syringe needle devices which employ protective needle shields or sheaths for securely shielding sharp needle tips, both before and after being used in a medical procedure. This invention more particularly relates to medical needle shields, sheaths or shrouds which may be used as a removable and replaceable protective needle cover. This invention also relates to connectors or adapters which may be used to further shield and protect a needle during use and which may be keyed for selective release of
10 an associated medical needle shield from a needle tip end of a device.

BACKGROUND OF THE INVENTION

Problems associated with inadvertent needle sticks are well known in the art of blood sampling, percutaneous medication injection and other medical procedures involving use of medical needles. Ever increasing attention is being paid to needle stick
15 problems due to the contemporary sensitivity of exposure to AIDS, Hepatitis and other serious blood-borne diseases.

Procedures involving removing a needle from a patient commonly require a technician to use one hand to place pressure at the wound site where the needle is being withdrawn, while removing the needle apparatus with the other hand. It is common
20 practice for an attending technician to give higher priority to care for the wound than is given to disposal of a needle. In the case of common non-safety devices, such priority either requires the convenience of an available sharps container within ready reach or another means for safe disposal without leaving the patient's side. Providing adequate care, with accompanying safety procedures, is often compounded by the patient's
25 physical condition and mental state (e.g., in burn units and psychiatric wards). Under such conditions it is often difficult, if not impossible, to take the appropriate action to properly dispose of a used, exposed needle while caring for a patient. The common practice of filling syringes with medication in one area and then transporting an uncapped needle to a patient area provides a significant opportunity for accidental needle
30 sticks. Recapping a needle is currently discouraged in U.S. medical practice due to the dangers of accidental needle sticks associated with recapping.

The widespread knowledge and history associated with needle care and disposal problems have resulted in the numerous devices for preventing accidental needle sticks. Current devices for shielding syringe needles often require two hands, and with some devices the safety status of needle shields are not readily apparent.

5 There is often a need to use syringe needles a plurality of times. When an intramuscular injection is made, it is common practice to draw the contents from a drug vial into a syringe and then inject the contents into a patient. It is desirable to use the same needle for penetrating a membrane on the drug vial and then for injecting the patient. However, the site where contents are drawn from the drug vial may be some
10 distance from a site where the patient is to be injected. Such situations may result in a technician's recapping the needle for transport to the patient. Equally as concerning is another practice of carrying the needle unprotected. Some currently available safety devices permit covering and reaccessing a needle. However, factors such as those disclosed above have limited acceptance of these safety devices.

15 The acknowledgment of the need for safety, even in situations where a needle is entering a relatively sterile field (such as through a "Y" connection in an IV set), has resulted in successful design and marketing of a class of medical devices commonly known as "needleless systems". However, even these systems do not totally eliminate the use of needles, as the procedure for filling a vial still requires the use of a sharp
20 needle to fill a syringe. Once the syringe has been filled, it is common practice for the used needle to be removed and discarded and replaced with a blunt cannula or connected to a needleless connector, while the needle is still exposed and dangerous during the syringe filling procedure.

25 There remains a need to provide a more satisfactory solution to a needle safety device which is reaccessible for multiple uses.

SUMMARY OF THE INVENTION

In brief summary, the novel invention disclosed herein dramatically diminishes known major problems resulting from injury-related needle sticks which occur when needle tips are bared as medical needles are withdrawn from a patient at the end of a
30 needle insertion procedure. The present invention permits access to a medical needle in

several steps in medical procedure, while being able to return the needle to the safety of a covering enclosure between the steps.

The present invention employs a protective needle shield which is displaceable to cover and protect a needle tip and which is further displaceable to bare the needle and tip a plurality of times for use throughout a medical procedure. Moreover, the needle tip is untouched by the shield in addition to being protectively covered.

In the present invention, a shield is disposed about a needle and tip to provide protection. A temporary, releasible latch is provided which may be disengaged to permit the shield to refold and, thereby, permit reaccess to the needle for a subsequent medical procedure. Once each procedure is complete, the shield is again extended and latched to provide a safety cover. A selectively activated unreleasible lock is also provided for the protective shield to assure secured needle tip protection at the end of use.

In one embodiment, the shield includes a needle guide proximally disposed relative to the tip of a needle, which protects the tip from damage through contact with the shield as the protective shield is displaced to cover and shield the needle and as the shield is removed to bare the needle for use. The needle guide is disposed and constrained to travel in alignment with the long axis of the needle and also constrained to facilitate movement of the shield about the needle without contact with the needle tip.

Generally, the device may be configured into at least two temporary or releasible but stable states. In one stable state the shield is constrained to be disposed "out-of-the-way" when the needle is bared for use. In a second releasible stable state, the shield is constrained to be protectively disposed about the needle and needle tip. Further, the device and shield, in combination, include the permanent lock which is securely and unreleasibly affixed to prevent further use of the device when use is complete. Preferably, latches are used to constrain the shield in each of the stable states.

Other important factors in safety needle devices involve whether the device can be effectively used by a single hand and the number of times a needle may be accessed while being maintained in a needle-safe condition between uses. Particularly in the case of hypodermic syringe needle devices, the ability to access a medical needle from a safety state a plurality of times is very important as it is common practice to prefill a syringe using a needle to access a medical fluid containing vial and then deliver the contents of the syringe to a patient using the same needle.

The invention generally provides for single-handed operation and for access to a medical needle a plurality of times while protecting a user from inadvertent injury from the needle, and while protecting the needle and its fragile tip from damage when the device is moved to, displaced from or simply disposed within the safety of the shield.

5 However efficacious a needle shield may be, the needle is still prone to cause inadvertent needle sticks when being used in standard needle bared procedures, such as that which occurs in hypodermic applications. Needleless systems have gained popularity for this reason. One embodiment of the present invention involves combining the needle shield with special connectors (or adapters) to provide functional access to the
10 needle, while retaining the needle under continual protective cover.

 In such embodiments, each extended shield has a distally disposed latch which locks the extended shield in place as a prevention against inadvertent folding, to protect against inadvertent baring of the needle and its tip. Each connector or adapter has an actuator and a key by which the latch is unlocked by the act of connecting the connector
15 or adapter to the shield and thereby permitting the shield to be removed (folded away) from the needle while keeping continuous protective cover about the needle tip. Cooperatively, as the shield is removed, the motion of the connector or adapter toward the tip of the needle is in a linear path (which is in line with the long axis of the needle) toward and into the connector adapter. In this manner, there is practically no tendency
20 to bend a needle during use of the connector. The needle tip is continuously protected by the shield until it is within the connector or adapter. As the needle tip is constrained to be covered and protected continually, needle safety is assured for all purposes in which a shield is used with a connector or adapter.

 Such purposes are generally fulfilled by the same number and type of steps as
25 would be required when performing the same function without using a connector or adapter. For this reason, most operations using these connectors cooperatively with shields are considered passive operations (i.e., they require no steps in addition to those of standard procedures without shields and connectors). Passive operation is further realized by the interaction between the connector and shield to return the shield
30 automatically to an extended needle protecting state as the needle is withdrawn from the connector. As in the case of connecting and folding the shield, the needle tip is continuously covered as the needle is extracted from the connector. The shield is thus

assured to fully protect the needle before the connector is disconnected, thereby assuring safety before, during and after needle use.

5 Within the scope of the invention, there are many applications where such connectors may be safely and efficaciously employed. For example, though not restricted to the following, connectors may be placed upon vials, "Y" connector sites on intravenous (IV) tubing sets and vacuum sampling tubes.

10 Briefly summarized, the foregoing objects are achieved by a medical needle safety system which can be used for repeatably accessing a medical needle from a needle tip protecting shield for in seriatim use of the needle, the safety system comprising a medical needle assembly comprising an elongated medical needle and a needle hub, the medical needle being securely affixed in the hub and having a distally disposed sharpened tip and a long axis which is medially disposed along a line from the hub to the tip, a safety shield assembly hingeably associated with the hub and comprising a shield comprising a plurality of foldable segments each segment of which is hingeably affixed
15 to at least one other segment, at least one of said segments being articulated to pivot about the long axis of the needle, and the shield assembly further comprising at least one releasible latching part which, when the shield is extended about the needle, latches to affix the shield for the purpose of providing a needle independent, substantially rigid structure protectively disposed about the needle and the needle tip and still further
20 comprising an actuator by which the latch is released to permit the shield to be foldably retracted to bare the needle and needle tip for use and later reextended about the needle and its tip.

BRIEF DESCRIPTION OF THE DRAWINGS

25 Figure 1 is an embodiment of a medical needle shield assembly with a needle cover and a needle shield which permits reaccessing a medical needle, maintaining a protective cover over the needle between procedures requiring access to the needle and securely and permanently locking the shield to provide permanent needle protection once all desired procedures are complete.

30 Figure 2 is a perspective view of the embodiment illustrated in Figure 1 with the cover removed.

Figure 3 is a perspective view which is similar to the Figure 2 with a variation of having a needle with two sharpened ends and a threadable needle hub, such as those medical needles used in phlebotomy.

5 Figure 4 is a perspective view of the device shown in Figure 1, with the shield partially displaced.

Figure 5 is a perspective view of the device shown in Figures 2 and 4 with the shield fully displaced to provide protective needle coverage, but disposed such that the shield may be retractively displaced to provide repeated needle access.

10 Figure 6 is a perspective view of the device shown in Figure 5, but with a part of the shield displaced to unreleasibly lock the shield to prevent needle reaccess.

Figure 7 is a perspective view of an inferior view of a needleless folding portion of the shield shown in Figures 1-6.

Figure 8 is a perspective view of a slider portion of the needle shield.

15 Figure 9 is a perspective view of yet another embodiment of the instant invention showing a shield protectively disposed about a medical needle, with releasible and unreleasible catches which are selectively engageable when the shield is protectively disposed about the needle.

Figure 10 is a perspective view of the device shown in Figure 9 wherein the shield is partially displaced to bare a sharpened tip of the medical needle.

20 Figure 11 is a perspective view of the device shown in Figure 9 wherein the shield is displaced more than the displacement shown in Figure 10 to bare more of the sharpened tip of the medical needle than the embodiment shown in Figure 10.

Figure 12 is a perspective view of the device shown in Figure 9 wherein the shield is fully folded to altogether bare the needle and needle tip.

25 Figure 13 is a perspective view of the device shown in Figure 9 with the shield disposed in an unreleasible state.

Figure 14 is a perspective view of a portion of the shield of the device shown in Figure 9 disposed in an "as molded" state.

Figure 15 is a perspective view of a slider part associated with the shield.

30 Figure 16 is a perspective view of a needle guide associated with the shield.

Figure 17 is a perspective view of another embodiment of a needle shield assembly which is affixed to a syringe.

Figure 18 is a perspective view of a disconnected needle shield assembly of the embodiment seen in Figure 17.

Figure 19 is a perspective view of the embodiment of Figure 17 with the needle shield assembly partially folded.

5 Figure 20 is a cross-section view of the needle shield assembly shown in Figure 18 with the assembly folded for access to an associated medical needle.

Figure 21 is a perspective view of a needle shield without the associated medical needle.

10 Figure 22 is a perspective view of a slider portion of the needle shield assembly of Figure 18.

Figure 23 is a perspective view of a needle guide associated with a distal segment of the needle shield.

Figure 24 is a perspective view of the embodiment of Figure 17 and a drug vial having a connector adapter affixed thereto.

15 Figure 25 is a cross-section view of the perspective shown in Figure 24.

Figure 26 is a perspective view of a connector adapter associated with the needle shield assembly and shown in Figure 24.

20 Figure 27 is a perspective view of the vial and connector adapter of Figure 24 disposed in communication with the needle shield assembly and resulting flexure (folding) of the needle shield assembly.

Figure 28 is a cross-section view of the interconnected vial, connector adapter and needle shield assembly.

25 Figure 29 is a perspective view of the connector adapter engaging and folding the needle shield assembly.

Figure 30 is a cross-section view of the connector and needle shield assembly shown in Figure 29 with the vial removed for clarity of presentation.

Figure 31 is a perspective view of an adapter for use in hypodermic applications.

Figure 32 is a perspective view of a connector affixed to a vacuum sampling tube.

Figure 33 is a perspective view of a connector affixed to a "Y" injection site.

30 Figure 34 is a perspective view of an open umbilical cord container with an adapter affixed thereto.

Figure 35 is a perspective view of the cord container of Figure 34 closed for viewing an adapter affixed thereto.

DETAILED DESCRIPTION OF THE INVENTION

In this description, the term proximal is generally used to indicate relative nearness of a referenced item to a prospective user of a device, unless otherwise specified. The term distal is similarly used to indicate relative remoteness. Reference is now made to the embodiments illustrated in Figures 1-35 wherein like numerals are used to designate like parts throughout. In those cases where parts have similar, but not identical, form and function, numerals with primes may be used for ease in interpretative cross referencing.

A first embodiment of a needle shielding safety device, according to the invention, is shown in Figure 1 as device 10. Device 10 has a needle cover 20 and a needle-hub-shield assembly 30.

Needle-hub-shield assembly 30 is better seen in Figure 2, where cover 20 is removed to expose a medical needle 40 and otherwise concealed distal portions of a foldable needle shield 50 to view. As is apparent from differences between Figures 1 and 2, needle cover 20 has an elongated hollow frustoconical distal part 60, similar in form and function to needle covers commonly used for protecting needles prior to use. Cover 20 also has a laterally and proximally disposed guard 70. Guard 70 acts as a keeper against inadvertent shield 50 actuation, before removal of cover 20 for use of needle 40. Similar to commonly currently available needle covers, needle cover 20 may be formed (e.g., injection molded) from polypropylene, other synthetic resinous material, or equivalents thereof.

In addition to needle 40 and shield 50, assembly 30 has a needle hub 80 to which needle 40 is securely affixed and to which shield 50 is hingeably affixed. In this embodiment, hub 80 is seen to comprise a female luer (lock) fitting 90, though other flow through hub fittings and connections may be used within the scope of the instant invention. Needle 40 is generally formed having an elongated shank 92 and a sharpened tip 100.

It is important to note that for devices which permit reaccessing a medical needle, a cover such as cover 20 may not be necessary. When a shield is securely, but releasibly

latched, a device, such as assembly 30 may be deployed in a safe state with a needle 40 being protectively covered by a shield, such as shield 50, as shown in Figure 5. The device, so deployed, may then be packaged and shipped in an antiseptic protective wrap, such as a "bubble pack" without a cover 20. Such deployment and elimination of a cover
5 reduces both the cost of the basic device and the cost of discarding ancillary parts.

Shield 50 is primary to the inventive novelty of this embodiment. As shown in Figure 4, shield 50 is formed as two segments, a distal segment 110 and a proximal segment 120. However, more than two segments may be used within the scope of the invention.

10 Distal segment 110 is made of a pair of juxtaposed elongated side pieces 322 and 324 and a closed end 326 which is formed to be contiguous with side pieces 322 and 324 forming a hollow needle tip 100 guard recess 328. As shield 50 unfolds to protect needle 40 and, needle tip 100, tip 100 should make no contact with any parts of distal
15 segment 110. Such contact could jeopardize the structural integrity of tip 100, and therefore, similarly jeopardize continuing use of needle 40. To assure that needle tip 100 is guided in and out of distal segment 110 in both cases where shield 50 is unfolded to become a shroud and refolded to bare needle tip 100 for further use, a needle bearing and guide 330 is affixed to side members 322 and 324 by a hinge 332. Needle bearing and
20 guide 330 rotates relative to distal segment 110 via hinge 332 in a manner which displaces closed end 326 away from needle tip 100. Needle bearing and guide 330 comprises a needle bearing surface 336, best seen in Figures 2 and 7, by which needle 40 is constrained to assure needle tip 100 does not contact distal shield 50 as distal segment 110 rotates about needle 40 during folding and unfolding.

25 Distal segment 110 has a pair of proximally disposed connective hinges 342 and 344 (see Figure 2) by which segment 110 is hingedly affixed to segment 120. All or part of the hinges of assembly 30 may be formed as living hinges by injection molding all, or any combination, of parts of molding hub 80, proximal section 120 and distal section 110, if an appropriate material such as polypropylene or equivalents thereof are used.

30 Located superiorly and proximally upon segment 110 are a pair of laterally extending wings 352 and 354 (see Figure 2). Each wing 352 and 354 is displaced away from respective sides 322 and 324 (see Figure 4) to provide a ledge, respectively numbered as 362 and 364, which acts as a catch for a releasible latch. Operation of such a catch and latch combination is disclosed in detail hereafter.

An important element of assembly 30 is a slideable latch part 370, shown in Figures 2, 4-6 and 8. Latch part 370 is slideably affixed to proximal segment 120 and comprises latches for both releasible and unreleasible connections to segment 110 when shield 50 is variably, selectively extended to protect needle tip 100. As shown in Figure 2, latch part 370 has two latches 372 and 374, each disposed in a respective side wall 376 and 378 of part 370. Latch 374 is formed integral with side wall 378 having a connecting riser 380, an inwardly sloping surface 382 and a bearing surface 384. Latch 372 is formed as a juxtaposed mirror image of latch 374. The details of latch 372 are not shown in the figures, but its riser, inwardly sloping surface and bearing surface are similar to connecting riser 380, inwardly sloping surface 382 and a bearing surface 384 of latch 374 and are numbered for reference in this text as 380', 382' and 384', respectively. Bending of risers 380 and 380' as sloped surfaces 382 and 382' meet wings 352 and 354, respectively, permits part 370 to be "snapped" onto segment 110 during an assembly process.

Reference is now made to Figure 7 where detailed structure of proximal segment 120 is more clearly shown. As well as being connected to distal segment 110 by hinges 342 and 344, proximal segment 120 is also connected to needle hub 80 by a pair of hinges 386 and 388. As previously indicated, hinges such as hinges 342, 344, 386 and 388 may be molded as living hinges should any combination of distal segment 110, proximal segment 120 and/or needle hub 80 be molded as integral parts. In such a case, parts may be molded from polypropylene or equivalents thereof. Proximal segment 120 is preferably formed as a unitary structure having a planar top joining layer 390 and two side members 392 and 394 orthogonally affixed thereto. Each side member forms a linear rail, respectively numbered 396 and 398, disposed away from layer 390.

As best seen in Figure 8, latch part 370 has a button part 400 formed on a generally superiorly disposed side of latch part 370. On each side, button 400 is integral with side walls 376 and 378. Button 400 further comprises a raised surface 402 which provides a digitary interface that permits latch part 370 to be slid proximally to release latches 372 and 374 from contact with wings 352 and 354, respectively, to permit folding of distal segment 110 against proximal segment 120 to bare needle 40 for use. Contact with the same raised surface 402 permits button 400 to be used as an actuator to unfold distal segment 110 and proximal segment 120 about needle 40 to provide a protective cover for needle tip 100. Distally displacing part 370 slideably affixes surfaces 384 and

384' (as earlier cited 384' is not found in the figures) against wing surfaces 364 and 362, respectively, to provide a releasible, but secure fastening of part 370 about hinges 342 and 344 thereby assuring a stable, substantially rigid structure.

5 Part 370 should remain slideably affixed to proximal segment 120. For this purpose, part 370 comprises a substantially planar understructure 404 generally disposed inferior to button 400. Understructure 404 is sized to accommodate layer 390 such that part 370 slides facily thereupon. Side walls 376 and 378 are integral with understructure 404 as well as button 400. Opposite understructure 404 each side wall, 376 and 378, terminates in a ledge, numbered 406 and 408, respectively. Side walls 376
10 and 378 and ledges 406 and 408 are sized and disposed such that part 370 slides upon layer 390 and rails 396 and 398. In this manner, part 370 is proximally displaced to free latch connections formed by latches 372 and 374 and wings 352 and 354 and distally displaced to engage those latch connections.

15 Another latch 410 is formed in understructure 404 (see Figure 8). A catch 412 for latch 110 is formed as a rectangular slot 414 in a superior portion 416 of distal segment 110 between wings 352 and 354, as seen in Figure 5. Latch 410 is disposed to be urged outwardly and then reactively snap into slot 414 as part 370 is fully displaced distally to achieve any unreleasible coupling thereby securely affixing a protective shield about needle tip 100.

20 Shield 50, therefore, provides a means for reaccessing a medical needle from a shrouded state within a releasible shield and for recovering the needle to the releasibly latched shrouded state a plurality of times to improve safety in medical procedures involving multiple separate uses of the needle. Once the total medical procedure is completed, the medical needle can be unreleasibly locked within the shield. In Figure
25 5, shield 50 is releasibly disposed about needle 40 (not seen in Figure 5). In Figure 4, shield 50 is partially displaced. In Figure 2, shield 50 is fully displaced to bare needle 40 and needle tip 100. In a similar manner, shield 50 may be displaced from the state seen in Figure 2 through the state seen in Figure 4 to the safety needle covering state seen in Figure 5. This sequence may be repeated as desired throughout a medical procedure.
30 Finally, distal displacement of part 370, as seen in Figure 6, engages latch 410 in slot 414 (seen in Figure 5) and thereby securely and unreleasibly locks shield 50 about needle 40.

In another embodiment 30', shield 50 may be employed with a needle 40' having two sharpened ends, 100 and 100', as seen in Figure 3. In this case, a hub 80' has a

threaded connection 418 which may be used with a phlebotomy barrel for the purpose of drawing fluid samples into a vacuum sampling tube.

Device 510, which is yet another embodiment of the present invention, is seen in Figure 9. Device 510 includes a shield assembly 530 which is hingedly affixed to a hub assembly 540. Shield assembly 530 is generally fabricated from two parts, a slider 550 and a needle shield 560. Hub assembly 540 includes a medical needle, such as needle 40 (earlier enumerated), securely affixed to a hub part 570. Hub part 570 is shown to comprise a proximal female locking luer connection 572 (similar to luer fitting 90) for connecting device 510 to a syringe, although other hub connections can be used within the scope of the invention.

Associated with hub part 570 is a pair of juxtaposed slider guides 574 and 576, which are aligned with the long axis of needle 40. Each guide 574 and 576 has a guide track 578 and 580, respectively, the purpose of which is described in detail hereafter.

Shield 560 is formed having a pair of hinged, substantially rigid arms 582 and 584, which are better seen in Figure 10. Arm 582 is affixed to arm 584 by hinges 586 and 588. Hinges 586 and 588 may be living hinges interconnecting arms 582 and 584 when integrally formed in the same mold cavity with arms 582 and 584. With the exception of needle 40 and any adhesives used to affix needle 40 to hub part 570, all other parts may be made from synthetic resinous material, such as polypropylene or equivalents thereof. Though other materials may be used, it is preferred that a material be selected which has sufficient rigidity to shield needle 40 and flexibility to form living hinges.

Arm 582 has a pair of superiorly disposed laterally extending wings 590 and 592 which form catches for slider 550, as described in detail hereafter. Distal from wings 590 and 592, a needle guide 600 is affixed to a distal portion of arm 582 by a hinge 602. Distal from guide 600, arm 582 has a closed end 596 to protectively cover a tip 100 of needle 40 when shield 560 is extended about needle 40. In the same manner that hinges 586 and 588 may be integrally molded as part of shield 560, hinge 602 and associated needle guide 600 may be molded as an integral part of arm 560 and shield assembly 530.

Needle guide 600 is shown in Figure 16 as a separate part for clarity of presentation. Guide 600 has a proximally disposed guide ring 604 which has a medially disposed through hole 606, sized for facile passage of needle 40 (not shown in Figure 16). Ring 604 should be disposed geometrically to constrain and guide needle 40, as

shield 560 is folded to bare needle 40, in such a manner that tip 100 does not touch any part of shield 560, particularly arm 582. In this manner, tip 100 is guided to move past end 596 without being touched. Needle guide 600 also has a distally disposed shroud 608, having a cover part 610 and a pair of side protectors 612 and 614. Cover part 610
5 in combination with side protectors 612 and 614 define an opening 616 through which needle 40 glides as shield 560 is folded and unfolded. Needle guide 600, when formed as a separate part, has a transverse through hole 618 disposed for use in hinge 602.

Arm 584 is best seen in Figure 14, where shield assembly 530 is shown in a bottom view without needle 40 to portray a potential "as molded" orientation. Arm 584
10 has a substantially planar, medially disposed top portion 620 with a pair of inferiorly distending sides 622 and 624. Side 622 has a substantially planar bottom surface 626 disposed between a pair of inferior extensions 628 and 630. Similarly, side 624 has a substantially planar bottom surface 632 and a pair of inferiorly oriented extensions 634 and 636.

A pair of hinges 638 and 639 (see Figure 14) hingedly affix arm 584 to hub 570. As disposed in Figure 14, shield 560 and hub 570 may be injection molded as a single, integrally molded part. Hub 570 also has a medially disposed through hole 640 wherein
15 needle 40 is affixed.

Reference is now made to Figure 15 wherein slider 550 is shown as a separate
20 part. Slider 550 is used as an actuator in folding, in unfolding, in temporarily latching and unreleasibly locking shield assembly 530. As disposed for use on shield assembly 530, slider 550 has a superiorly extending button 640 which acts as an actuator for shield assembly 530. Button 640 should be configured for facile distal and proximal application of force to displace shield 560 to a folded state from an unfolded state and
25 to an unfolded state from a folded state. Such configurations are well known in the actuator manufacturing art. Button 640 is an integral part of a top section 642 of slider 550, which has a distal top section 644 and a proximal top section 646.

Distal top section 644 has a medially disposed latch leg 648 which has an inferiorly disposed latching face 650. Distending inferiorly on each side of top section
30 644 are a pair of latching legs 652 and 654. Latching leg 652 has a medially directed latch 656 with a superior latch face 658. Latching leg 654 similarly has a medially directed latch 660 and a superior latch face 662.

Proximal top section 646 is integrally connected to two parallel sides 664 and 666 which distend inferiorly therefrom. Side 664 abruptly ends inferiorly in a medially extending slide rail 668 which extends medially from an inferior face 670 of side 664. Side 666 has a similar, but mirror image slide rail 672. In addition, side 664 has an outwardly extending guide knob 674 disposed proximally and inferiorly relative to button 640. Side 666 has a similarly positioned guide knob 676.

Referring to Figure 9, slider 550 is assembled as a part of shield assembly 530 by snapping slider sides 664 and 666 (see Figure 15) about respective inferiorly distending sides 622 and 624 (seen in Figure 14), respectively, until respective surfaces 626 and 632 are juxtaposed slide rails 668 and 672. In this manner, slider 550 is constrained to slide along arm 584 with slide rails 668 and 672 travel limited by extensions 626 and 630 and 634 and 636 (see Figure 14), respectively. In similar fashion, as shown in Figure 9, latching leg 652 is latched upon a catch formed by wing 590 and latching leg 654 is latched upon a catch formed by wing 592. A slot 678 is medially disposed in the top surface of arm 582 in line with latch leg 648. The function of slot 678 relative to latch leg 648 is described hereafter.

Figure 9 displays a state of device 510 which may be used in transport and storage of device 510 before use. In this state, needle 40 and needle tip 100 are safely covered and protected by shield 560 which is constrained to be a substantially rigid member by the combination of guide 600, shield 560 and slider 550 disposed and securely latched about hinges 586 and 588 by interaction of wings 590 and 592, latching legs 652 and 654, distending sides 622 and 624 and slide rails 668 and 672, as previously disclosed. At this point of rotation, part 610 provides a protective superiorly disposed cover for needle tip 100. In this state, device 510 may be packaged in a "bubble pack" or the like package to protect cleanliness and sterility of needle 40 during transport and storage.

After removal of device 510 from protective packaging and affixing needle 40 to a syringe or the like for use, slider 550 may be displaced toward luer connection 572, preferably by applying a proximally directed force against button 640, until latching legs 652 and 654 are freed from catches formed by wings 590 and 592, respectively, as seen in Figure 10. Continuing displacement of slider 550 causes knobs 674 and 676 to enter and follow tracks 578 and 580, respectively. Tracks 578 and 580 are formed to urge slider 550 and affixed arm 584 to rotate about hinges 638 and 639 (see Figure 14) and

thereby cause shield 560 to fold about needle 40. Attention should be paid to a recess 680 disposed in distal end 596 of arm 582. Recess 680, while blocked by cover part 610 when shield 560 is unfolded, provides a clear pathway for needle tip 100 to exit shield 560 without contacting any portion of the shield. Guide ring 604 (see Figure 14) is positioned to be continuously proximally disposed relative to tip 100 during all phases of transport and storage and is displaced proximally away from tip 100 during unfolding to assure tip 100 has no contact with any portion of shield 560.

Continued rotational displacement of button 640 with knobs 674 and 676 following tracks 578 and 580 continues to pivot arm 584 and further fold arm 582 as shown in Figure 11. Ultimately, shield 560 is completely folded to bare needle 40 for use as seen in Figure 12. It is preferred to provide releasible latching tabs (not shown) which may be affixed to react between fixed elements of device 510 and folding parts (e.g., guide 574 and slider 550) to retain shield 560 in a state of relative stability while folded.

From the state shown in Figure 12, shield 560 may be unfolded to protectively cover needle 40 and particularly needle tip 100 by applying a distally directed force against button 640. In this manner, shield 560 unfolds sequentially through states seen in seriatim in Figure 11 then Figure 10 until completely disposed in a releasibly latched state in Figure 9. Needle 40 may be reaccessed and then recovered a plurality of times by following the steps outlined above to uncover and recover needle 100.

Once a medical procedure is finished and it is determined that device 510 should be disposed of, a firm distal force may be applied against button 640 to displace latch leg 648 to be permanently latched in a catch provided by slot 678 as seen in Figure 13.

Another device 700, shown in Figure 17 affixed to a syringe barrel 702, also may be used to reaccess a medical needle without undue jeopardy of an inadvertent needle stick. Further, device 700 may be used with a connector or adapter (as disclosed in detail hereafter) to access fluid containment vessels, such as drug vials, vacuum sampling tubes, cord containers and "Y" injection sites, without accessibly exposing a needle tip (such as needle tip 100).

Device 700 is assembled from a distal section 704, a proximal section 706, a needle hub assembly 540' and a slider assembly 708. In combination, distal section 704 and proximal section 706 form a safety shield 707. A magnified representation of device 700 is shown in Figure 18, wherein hub assembly 540' is shown to have a proximally

disposed female luer lock fitting 572. Affixed to hub assembly 540' are two guides 574' and 576', which are similar in form and function to guides 574 and 576. Similar to guides 574 and 576, guides 574' and 576' have guide tracks 578' and 580'. A hollow medical needle 40 is securely affixed in hub assembly 540' by processes well understood in the art of syringe needle manufacture.

Similar to slider 550, slider assembly 708 has a pair of laterally affixed, juxtaposed knobs 674' and 676' (see Figure 22) which are sized and disposed to be constrained to travel along guide tracks 578' and 580' as slider assembly 708 is proximally displaced. In contrast to slider 550, slider assembly 708 has a distal section 710 as well as a proximal section 712.

Proximal section 712 has a button 640', similar in form and function to button 640 (see Figures 9-12). Similar to an earlier disclosed button, button 640' may be used to displace slider assembly 708 proximally to fold distal segment 704 against proximal segment 706, to bare needle 40 for use, and to displace slider assembly 708 distally to unfold segments 704 and 706, and to protectively enclose needle 40.

A pair of hinges 714 and 716 (see Figure 22 where slider assembly 708 is shown as a separate part) hingeably join proximal segment 712 to distal segment 710. Hinges 714 and 716 may be living hinges when slider assembly 708 is injection molded. Slider assembly 708 may be injection molded using polypropylene or equivalent thereof, as may hub assembly 540', distal segment 704 and proximal segment 706. Similar to slider assembly 708, moldable portions of hub assembly 540', distal segment 704 and proximal segment 706 may each be injection molded as a single part interconnected by living hinges for intersegment and hub to segment hinges which are disclosed in detail hereafter.

Proximal section 712 further comprises parallel exterior of sides 718 and 720 which extend, generally inferiorly, from a superiorly disposed button 640 to a pair of respective inwardly protruding slide rails 722 and 724, respectively. Distal from button 640, proximal segment 712 has a planar top piece 726.

Distal section 710 has a transverse, planar top piece 728 which lies in substantially the same plane as planar top piece 726 when distal section 710 and proximal section 712 are unfolded and aligned. Disposed at right angles to planar top piece 728 are a pair of juxtaposed sides 730 and 732, which extend from planar top piece 728 to form a respective pair of inwardly directed, bottom rails 734 and 736. Section 710

also has an arcuate opening 738, partially closed by a pair of inwardly disposed tongues 740 and 742. An inward surface 744 of opening 738 has a centrally disposed arcuate notch 746. Referring again to Figure 18, distal section 710 has an upwardly protruding knob 748 with a large diameter superior portion 750 and an inferiorly disposed smaller diameter portion 752.

An "as may be molded" rendition of a combined hub assembly 540' (without luer lock fitting 572), distal segment 704 and proximal segment 706 is seen in Figure 21. Proximal segment 706 is hingedly affixed to each guide 574' and 576' by a respective hinge 754 and 756, which permits proximal segment 706 to rotate to an orthogonal state relative to hub assembly 540' as shown in Figure 21, and to an extended state along the long axis of needle 40 as seen in Figure 18. Similarly, distal section 704 is hingedly affixed to section 706 by respective hinges 758 and 760, permitting section 704 to be aligned with section 706 as seen in Figures 18 and 21 and to be folded to bare needle 40 as seen in Figure 20.

Proximal segment 706 has a substantially planar top surface 762, as may be seen on each side in Figures 18 and 21. Distending downward orthogonally from top surface 762 are a pair of substantially parallel sides 764 and 766, best shown in Figure 21. At the bottom of each side 764 and 766 is a linear indentation 768 and 770, respectively. Indentation 768 is bounded by a distal stop 772 and a proximal stop 774. Similarly, indentation 770 is bounded by a distal stop 776 and a proximal stop 778. The purpose and function of stops 772, 774, 776 and 778 is disclosed in detail hereafter.

Distal segment 704 also has a substantially planar top 780 and a pair of juxtaposed wings which extend laterally outward, one wing 782 is shown in Figure 21. The other wing, referenced herein as 782', is not shown but is a mirror image of wing 782. Distal segment 704 has a pair of juxtaposed side members 784 and 786 orthogonally connected to top 780. Each side member has a plurality of downwardly distending ribs which are separated to form a channel 788 for a needle 40. Similarly, sides 764 and 766 are likewise separated to provide a similar channel 790 which is continuous with channel 788 when segment 704 is aligned with segment 706.

At a distal site 792, segment 704 has a closed end 794. Closed end 794 may have a notch 796 which provides a clear pathway whereby a needle tip 100 being constrained outward from site 792 may clear and not touch any part of segment 704. Also, disposed proximal to closed end 794 are a pair of juxtaposed substantially rectangular members

800 and 802, the purpose and function of which is disclosed in detail hereafter. Superiorly disposed on top 780 is a stem 804 (see Figure 18) which culminates in a bulbous knob 806. Center points of stem 804 and portion 752 lie in a line which is aligned with the long axis of needle 40.

5 Similar to guide 600 of arm 582 earlier disclosed, segment 704 has a needle guide 600' affixed thereto as shown in Figure 18. Needle guide 600' is seen in Figure 23 as a separate part for clarity of presentation. However, it is preferred that guide 600' be integrally molded with distal segment 704. Guide 600' has a proximally disposed guide ring 604' which has a medially disposed through hole 606' which is sized for facile
10 passage of a needle 40 (not shown in Figure 23). Ring 604' should be disposed geometrically to constrain and guide needle 40, as segments 704 and 706 are folded to bare needle 40, in such a manner that tip 100 does not touch any part of segment 704, particularly closed end 794. In this manner, tip 100 is guided to move past end 794 without being damaged or contaminated. Needle guide 600' also has a distally disposed
15 shroud 608', with a cover part 610' and a pair of side protectors 612' and 614'. Side protectors 612' and 614' and cover part 610' define an inner surface 615' and an opening 616' through which needle 40 glides as segments 704 and 706 are folded and unfolded. Needle guide 600', when formed as a separate part, has a transverse through hole 618' disposed for use in hinge 602', as shown in Figures 25, 28 and 30. Care should be taken
20 in defining the position for hinge 602'. As will become evident from the disclosure provided hereafter, it is critical that hinge 602' be situated to permit rotation of segment 704 about needle 40 in such a manner that as segment 704 is folded, members 800 and 802 (seen in Figure 24) are in continuous alignment with the long axis of needle 40.

 Referring to Figure 18, residing about stem 804 and portion 752 of knob 748 is
25 an energy storing elastic ring 808 used to store energy as slider assembly 708 is displaced proximally relative to shield 707. However, as shown in Figure 18, ring 808 is unstressed and remains so until slider assembly 708 is displaced proximally in the process of baring needle tip 100. Ring 808 should be made from an elastic which has sufficient resiliency to displace slider assembly 708 distally to engage temporary latches as disclosed hereafter. Ring 808 is constrained to remain affixed to stem 804 and portion
30 752 by top 780 and knobs 748 and 806. Any energy storing member such as a metal or plastic spring or other element which would be stressed as slider assembly 708 is displaced proximally and which would have sufficient resiliency to return slider

assembly 708 to the state seen in Figure 18 may be used within the scope of the invention.

As shown in seriatim in Figures 17, 19 and 20, displacing slider assembly 707 proximally causes slider assembly 708 and distal segment 704 and proximal segment 706 to fold from an extended state seen in Figure 17, through an intermediate state depicted in Figure 19, to a folded state seen in Figure 20. When in the extended state of Figure 17, shield 707 is securely, but releasibly, latched for safety.

Reference is again made to Figure 22 where releasible latching members are shown. Along a line in the same plane as bottom rail 736 is a more proximal rail 810 disposed along side 720 of proximal section 712. A similar rail 812 (hidden in Figure 22) is similarly disposed along side 718 of proximal section 712. During assembly, bottom rails 734 and 736 of slider assembly 708 are slideably engaged about wings 782 and 782', respectively. Each wing (such as wing 782 seen in Figure 21) forms a catch for a latch formed by one rail of rails 810 and 812.

Further, when slider assembly 708 is slideably joined to shield 707, sides 718 and 720 are disposed about sides 764 and 766 of proximal segment 712 such that rails 722 and 724 slide upon linear indentations 768 and 770, respectively. So joining of slider assembly 708 to proximal segment 712 is facilitated by using a flexible resilient material such as polypropylene or equivalents thereof for slider assembly 708 and by providing beveled edges 814 and 816 for rails 722 and 724, respectively, this permits slider assembly 708 to "snap" into engagement with proximal segment 712. So engaged, rails 722 and 724 are constrained to slide proximally and distally between stops 774 and 778 and 768 and 776, respectively, and are so limited by the stops.

When shield 707 and slider assembly 708 are disposed as shown in Figure 17, rails 810 and 812 are engaged with wings 782' and 782, respectively. This engagement deters action of all hinges 758, 760, 714 or 716. It is not until slider assembly 708 is displaced proximally, such as under forces placed upon button 640, that such latches are disengaged from the catches and hinges 758, 760, 714 and 716 are free to rotate. By this same action, elastic ring 808 is stressed and energy is resultingly stored therein. At this point hinges 758 and 714 and 760 and 716 should be transversely aligned relative to the long axis of needle 40. Also, concurrent with release of the hinges, latches and catches, stems of knobs 674' and 676' are displaced into tracks 578' and 580', respectively to urge hinges 758, 760, 714 and 716 to lift upward from needle 40 and thereby fold shield 707

along with slider assembly 708, as seen in Figures 19 and 20. Slider assembly 708 and shield 707 are shown in cross-section, magnified and without connection to a syringe for clarity of detail in Figure 20.

Reversing forces upon button 640 unfolds shield 707 and slider assembly 708 about needle 40. Once shield 707 and slider assembly 708 are unfolded, retraction of elastic ring 808 reengages rails 810 and 812 against the wings. Shield 707 and slider assembly 708 are again releasibly latched. A permanent latch may be achieved in the manner disclosed in Figures 9-13, as one skilled in the art of plastics design would understand.

By the capability of efficaciously covering and reaccessing a medical needle, a plurality of medical procedures, separated by time and distance, may be performed using the same needle with safety not possible when a single use safety needle is employed. However, there are a number of common medical procedures which require a needle insertion which too often provide an opportunity for an inadvertent needle stick. Such is the case when a syringe has been used to draw blood from a patient and the blood is transferred to a vacuum sample tube for analysis. In this case, a needle often contaminated after removal from a patient is driven through a stopper of the vacuum sample tube without the benefit of any safety mechanism.

Similarly, when syringes are filled from drug vials, a needle is bared to pierce a membrane on the vial before using the contents of the syringe in a medical procedure. Since it is against standard precautions to recap a needle, the needle may be transported to a patient site uncovered.

Another example of a case where accidental needle sticks are of concern is at "Y" connectors on intravenous (IV) injection sites. For purposes such as this, "needleless systems" have in many instances replaced needles. However, this has not been achieved without cost. History has shown these alternative needleless systems to be much more expensive than needles alone.

Of course, direct percutaneous entry into a patient is likely the most significant opportunity for inadvertent sticks by a contaminated needle. Every time a needle is bared for use in a medical procedure there is opportunity for contamination which endangers either a health care worker or patient. These needs have motivated the broadened use and applications of device 700 as disclosed hereafter.

Reference is now made to Figures 24-34 wherein methods and apparatus related to passively activating safety connectors or adapters for syringes are disclosed. In Figure 24 device 700 affixed to a syringe 702 is seen in association with a vial 900 and vial adapter 902. Vial 900 may be any general vial from which fluids are drawn into a syringe or where syringe contents are injected from a syringe into a vial (e.g., blood culture bottles). Vial 900 is most often considered to be a vial from which drugs are drawn for hypodermic delivery to a patient.

Adapter 902 is a connector between vial 900 and device 700 which provides an interface to a keying actuator by which a latch is released to be permitted to fold, and, a tool by which shield 707 is selectively folded away from needle tip 100. As shown in Figure 26, adapter 902 has a snap or attachment ring 904 by which adapter 902 is securely affixed to vial 900, and a substantially planar face 906 which is disposed over a pierceable access membrane through which fluids are commonly drawn into a syringe via a syringe needle 40.

Jutting outward from face 906 are a pair of connecting members 908 and 910. Each connecting member 908 and 910 has a pair of outwardly projecting prongs 912 and 914 which define a hollow cavity 916. Though other geometries may be used within the scope of the invention, each cavity 916 is substantially circular in cross section. Disposed between prongs 912 and 914 is a vial access orifice 918 through which a needle tip 100 and needle 40 passes to pierce a pierceable membrane of vial 902. Each prong 912 and 914 ends abruptly with a flat surface 920, the purpose for which is disclosed in detail hereafter. Adapters such as adapter 902 may be made from polypropylene or equivalents thereof with sufficient rigidity to act as a connector that may be used interactively with shield 707 and that have sufficient resiliency for use as a plastic connector.

Each prong pair 912 and 914 has an inwardly disposed pair of curved surfaces 912' and 914', respectively, which are separated by a predetermined distance. Referring to Figure 18, member 802 has a predetermined cross sectional width delineated by arrows 922 and 922'. Member 800 has a similar predetermined cross sectional width. As may be seen in combination in Figures 24 and 27, to selectively acquire protected access to needle tip 100 through the use of adapter 902, prong pairs 912 and 914 (see Figure 26) are displaced until members 800 and 802 completely pass by associated prong curved surfaces 912' and 914'. The minimum predetermined distance separating each

curved surface 912' and 914' should be somewhat less than the cross sectional widths of members 800 and 802. Even so, the resiliency of prong pairs must be sufficient to allow each member 800 and 802 to pass into an associated cavity 916 without undue force.

Referring to Figure 22, it may be noted that each tongue 740 and 742 has a flat distally disposed surface 924, which is sized and positioned to impact a surface 920 as adapter 902 is connected about members 800 and 802. The act of making such a connection displaces tongues 740 and 742 and resultingly proximally displaces slider 708. In this manner, each set of prongs 912 and 914 act as keys which displace tongues 740 and 742 (which are protected from displacement by members 800 and 802, respectively), thereby effecting a selective release of the latching interface between slider 708 and shield 707. Just as proximally displacing button 640 causes slider 708 to release latches from catches and permits shield 707 to fold from a needle protecting state to a needle 40 access state, connection adapter 902 to members 800 and 802 results in the same action through tongues 740 and 742.

One of the critical factors of delivering needle 40 into a membrane via an adapter or connector such as adapter 902 is that no undue stress resulting from forces which are not in line with the long axis of needle 40 should be placed upon needle 40 when needle travel is either distal or proximal. To accomplish this, members 800 and 802 must be disposed along a transverse line of rotation of distal segment 704 of shield 707 about the long axis of needle 40. This line of rotation is determined, in combination, by axis of rotation of hinge 602' and deployment of hole 606' of needle guide 600' (see Figure 28). Proper deployment assures that no undue torquing or bending force is placed upon needle 40. This is especially critical when small diameter needles are used.

Passive operation is defined to be operation which requires no additional steps other than those usually employed to operate a device. Needle access is provided with shield 707 and adapter 902 operating jointly to provide access by needle 40 into vial 900 without additional steps. As shown in Figure 24, adapter 902, previously affixed to vial 900, is displaced toward needle tip 100 (hidden in Figure 24, but clearly seen with needle tip 100 untouched by needle guide 600' in Figure 25) in a manner similar to displacement of a standard vial toward any needle tip affixed to a syringe. Displacement of prongs 912 and 914 about members 800 and 802 causes displacement of slider 708 and ultimate rotation of shield 707, see Figure 27. In Figure 27, the rotation of shield 707 causes similar rotation of members 800 and 802 relative to prongs 912 and 914, thereby

resulting in the capture of each member 800 and 802 (not seen in Figure 27) within an associated cavity 916. Members 800 and 802 are affixed and so captured until shield 707 is once more completely unfolded (extended to a needle protected state).

Proximal displacement of adapter 902 toward needle hub assembly 540 causes
5 needle guide 600' to urge needle tip 100 and needle 40 away from shield 707, as shown in Figure 28. Continued displacement directs needle tip 100 through access orifice 918 and into vial 900 as seen in Figure 29. A fully folded shield 707, with adapter 902 in place, is seen in Figure 30.

As earlier mentioned, there are many opportunities to protect a needle where it
10 is currently common practice to use a bare needle. The most common opportunity may be found in hypodermic applications. By applying a connective element, similar to adapter 900, to a flat plate device, such as device 930 shown in Figure 31, passive needle protection can be provided in hypodermic procedures as well. Device 930 has a flat plate 932 designed to provide an interface with skin. Similar to adapter 902, plate 932 has a
15 pair of outwardly jutting connecting members 908 and 910. Rather than a attachment ring 904 of adapter 902, device 930 has a pair of wings 934 and 936 used to hold device 930 against skin as needle 40 is withdrawn at the end of a hypodermic procedure. As is the case of adapter 902, device 930 may be made from polypropylene or equivalents thereof, preferably by injection molding.

20 Connectors or adapters, similar to adapter 902, may be used for various other needle protecting applications. Examples of such applications are shown in Figures 32-35.

Figure 32 shows a connecting adapter 902' affixed to a vacuum sampling tube 940. Adapter 902' has a pair of outwardly jutting connecting members 908' and 910'
25 which are similar in form and function to connecting members 908 and 910 (see Figure 26). An access orifice 918' (similar to orifice 918) provides a passageway for needle tip 100 and needle 40 to traverse to pierce a stopper of vacuum sampling tube 940. Prongs 942 and 944 provide an interface to device 700 which is equivalent to the interface provided by prongs 912 and 914 (see Figures 24-30).

30 Figure 33 shows a connecting adapter 902" affixed to a "Y" injection site 950 of an IV set 952. Adapter 902" has a pair of outwardly jutting connecting members 908' and 910' which are similar in form and function to connecting members 908 and 910 (see Figure 26). An access orifice 918" (similar to orifice 918') provides a passageway for

needle tip 100 and needle 40 to traverse to pierce a membrane of "Y" injection site 950. As is the case in the apparatus shown in Figure 32, prongs 942 and 944 provide an interface to device 700 which is equivalent to the interface provided by prongs 912 and 914 (see Figures 24-30).

5 Figures 34 and 35 depict a container 960 for an umbilical cord (not shown) from which blood samples are drawn. Container 960 has a connector 962 affixed to an outside surface 964 which is formed to provide needle tip 100 protected access through an orifice 966 to the umbilical cord. Connector 962 has a pair of outwardly jutting connecting members 970 and 972 which are similar in form and function to connecting members 10 908 and 910 (see Figure 26). However, in the case of connector 962, connecting members have prongs 974 and 976 disposed to facilitate oblique entry through orifice 966 and into the umbilical cord. Container 960 is preferably injection molded from polypropylene, as is the case for adapters 902' and 902". The state of container 960 in Figure 34 is the preferred "as molded configuration". As such, container 960 comprises 15 a living hinge 980 connectively hinging two halves, 982 and 984, of container 960. Half 982 has a series of latches, each latch numbered 986, formed along an outside edge 988. Half 984 has a plurality of slots 990 along an outside edge 992 which is juxtaposed to associated respective latches 986 and edge 988 when container 960 is closed about an umbilical cord for use. Each half 982 and 984 has at least one elongated indentation 994 20 which forms half of a cord clamp when container 960 is closed.

The invention may be embodied in other specific forms without departing from the spirit or essential characteristics thereof. The present embodiment is therefore to be considered in all respects as illustrative and not restrictive, the scope of the invention being indicated by the appended claims rather than by the foregoing description, and all 25 changes which come within the meaning and range of equivalency of the claims are therefore intended to be embraced therein.

What is claimed and desired to be secured by Letters Patent is:

CLAIMS

1. A medical needle safety system which can be used for repeatably accessing a medical needle from a needle tip protecting shield for in seriatim use of the needle, said safety system comprising:

5 a medical needle assembly comprising an elongated medical needle and a needle hub, said medical needle being securely affixed in the hub and having a distally disposed sharpened tip and a long axis which is medially disposed along a line from the hub to the tip;

10 a safety shield assembly hingeably associated with the hub and comprising a shield comprising a plurality of foldable segments each segment of which is hingeably affixed to at least one other segment, at least one of said segments being articulated to pivot about the long axis of the needle; and

15 said shield assembly further comprising at least one releasible latching part which, when the shield is extended about the needle, latches to affix the shield for the purpose of providing a needle independent, substantially rigid structure protectively disposed about the needle and the needle tip and still further comprising an actuator by which the latch is released to permit the shield to be foldably retracted to bare the needle and needle tip for use and later reextended about the needle and its tip.

20 2. The medical needle safety system according to claim 1, wherein said shield assembly further comprises a needle guide and a hinge for affixing the guide to a distal segment of the shield to, thereby, permit the guide to rotate relative to the distal segment of the shield to linearly slide distally and proximally along the long axis of said needle as the shield is extended to cover the needle tip and foldably retracted to bare the needle and tip for use, respectively, said guide interacting with said needle to displace
25 the needle tip into and out of the shield in such a manner that the needle tip is untouched by any part of the shield assembly.

3. The medical needle safety system according to claim 1, wherein said safety shield assembly comprises at least one distally disposed part for communicating with said actuator to provide a releasing trigger on a distal end of said assembly.

4. The medical needle safety system according to Claim 3, wherein a most distal segment of the shield comprises at least one member for connecting to a needle protecting connecting adapter which interfaces with needle pierceable targets to protect against inadvertent needle sticks, said member being juxtaposed a center of rotation of said needle guide such that no undue torque is placed upon the needle as said shield folds and unfolds while the needle is engaged with one of the pierceable targets.

5. The medical needle safety system according to Claim 4, wherein said connecting member provides a guard against inadvertent displacement of said elongated trigger releasing part.

6. The medical needle safety system according to claim 4, wherein said connecting member comprises an elongated structure, comprising a longer dimension orthogonal to a shorter dimension, the longer dimension being substantially in line with the long axis of the needle when the shield is disposed to cover the needle and being angularly displaced by rotation of the shield about the needle as the needle is bared for use such that the longer dimension is substantially out-of-line with the long axis of the needle.

7. The medical needle safety system according to Claim 4, further comprising the needle protecting adapter to which said at least one member interfaces.

8. The medical needle safety system according to Claim 7, wherein said at least one member and needle protecting adapter, in combination, comprise a releasible interface whereby the releasible latching part is released to permit shield displacement.

9. The medical needle safety system according to Claim 8, wherein said releasible interface comprises a connecting linkage which connects each adapter to the most distal segment and which can only be selectively separated when the shield is extended.

10. The medical needle safety system according to Claim 7, wherein said at least one member and needle protecting adapter together comprise elements of a lock and

key combination which comprises a releasible interface in which one element of said combination acts as a lock and the other element acts as a key to assure integrity of the releasible latch against inadvertent release.

5 11. The medical needle safety system according to Claim 7, wherein said adapter comprises a connection to a vacuum sampling tube.

 12. The medical needle safety system according to Claim 7, wherein said adapter comprises a connection to an umbilical cord sampling apparatus.

 13. The medical needle safety system according to Claim 7, wherein said adapter comprises a vial connecting element.

10 14. The medical needle safety system according to Claim 7, wherein said adapter comprises a connector for attachment to a "Y" injection site.

 15. The medical needle safety system according to Claim 1, further comprising a syringe affixed to said needle hub.

15 16. The medical needle safety system according to Claim 1, further comprising a locking part associated with the latching part, said locking part acting in combination with a catch disposed in said shield to deny further access to the needle and needle tip.

20 17. The medical needle safety system according to Claim 1, further comprising an adapter which communicates with the actuator to unlatch and relatch the shield and which provides an interface between a target fluid space and the medical needle assembly, said adapter further providing a protected passageway for the needle tip and a portion of the needle while the needle is displaced from the protective shield.

25 18. The medical needle safety system according to Claim 17, wherein said tip protecting shield and adapter cooperatively comprise connective parts which, when joined, urge the shield to retract from protectively shielding the needle and needle tip

thereby delivering the needle tip outwardly through the adapter passageway and which are releasible only when the protective sheath is extended to protect the needle and needle tip, thereby assuring continuous protection of the needle and needle tip when exposed from the shield.

5 19. The medical needle safety system according to Claim 18, wherein said connective parts comprise a selectively disposed hinge which is articulated in a manner which retracts the shield without placing undue transverse forces upon the needle.

 20. A method for using a medical needle safety system which can be employed for repeatably accessing a medical needle from a needle tip protecting shield for in seriatim use of the needle, comprising the following steps:

10 (a) providing a medical needle assembly comprising an elongated medical needle and needle hub in which said medical needle is securely affixed, said medical needle having a distally disposed sharpened tip and a long axis which is medially disposed along a line from the hub to the tip;

15 (b) further providing a safety shield hingeably associated with the hub and comprising a plurality of foldable segments each of which is hingeably affixed to at least one other segment, at least one of such segments being articulated to pivot about the long axis of the needle, at least one releasible latch which affixes the shield relative to the needle to provide a substantially rigid apparatus independent of the needle and a secure safety cover for the needle tip when the shield is extended about the needle, an actuator by which the latch is released to permit the shield to be foldably retracted to bare the needle and needle tip for use;

20 (c) when the shield is extended, applying a force against the actuator to release the latch;

25 (d) folding the shield to bare the needle associated needle tip;

 (e) using the needle in a portion of a predetermined procedure;

 (f) extending the shield to provide a safety cover for the needle; and

 (g) repeating steps (d) through (f) until all portions of the predetermined procedure have been completed.

21. The method for using a medical needle safety system according to Claim 20, further comprising the step of providing a needle guide, affixed to a distal segment of the shield, which is disposed to slide distally and proximally upon said needle as the shield is extended to cover the needle tip and foldably retracted to bare the needle and tip for use, respectively, said guide interacting with said needle to displace the needle tip into and out of the shield in such a manner that the tip is untouched by any part of the shield.

22. The method for using a medical needle safety system according to Claim 21, adding to step (d) a step of guiding the needle tip from the distal section without causing the needle to touch the distal section as the needle and needle tip are displaced from protective cover of the shield.

23. The method for using a medical needle safety system according to Claim 21, adding to step (f) a step of guiding the needle tip into protective cover of the distal section without allowing the needle to touch the distal section as the needle and needle tip are displaced to protective cover of the shield.

24. The method for using a medical needle safety system according to Claim 20, wherein the safety shield providing step comprises providing a lock which securely and unreleasibly affixes the shield about the needle and needle tip.

25. The method for using a medical needle safety system according to Claim 24, comprising the additional step of:

(h) engaging the lock.

26. The method for using a medical needle safety system according to Claim 20, wherein the safety shield providing step comprises providing a connective interface affixed to the most distal segment of the shield, said connective interface being disposed at a center of rotation about and along the needle by the distal segment as the segment pivots while the shield folds and unfolds.

27. The method for using a medical needle safety system according to Claim 26, further comprising a step for providing an adapter associated with a vessel having a portal accessible via a needle pierceable membrane, said adapter comprising a part which links to the connective interface and which communicates with the actuator to provide a distally disposed release of said releasible latch and further comprising a needle shielding pathway between said sheath and the pierceable membrane.

28. The method for using a medical needle safety system according to Claim 27, wherein step (c) comprises applying the force against the actuator via the adapter.

29. The method for using a medical needle safety system according to Claim 28, wherein step (d) comprises folding the sheath without placing undue transverse forces on the needle.

30. The method for using a medical needle safety system according to Claim 29, wherein step (e) comprises using the needle to pierce the membrane.

31. The method for using a medical needle safety system according to Claim 27, wherein said adapter comprises an interface to one membrane target site selected from a group of such sites comprising drug vials, vacuum sampling tubes, umbilical cord containers, IV sets, hypodermic applications and blood vessels.

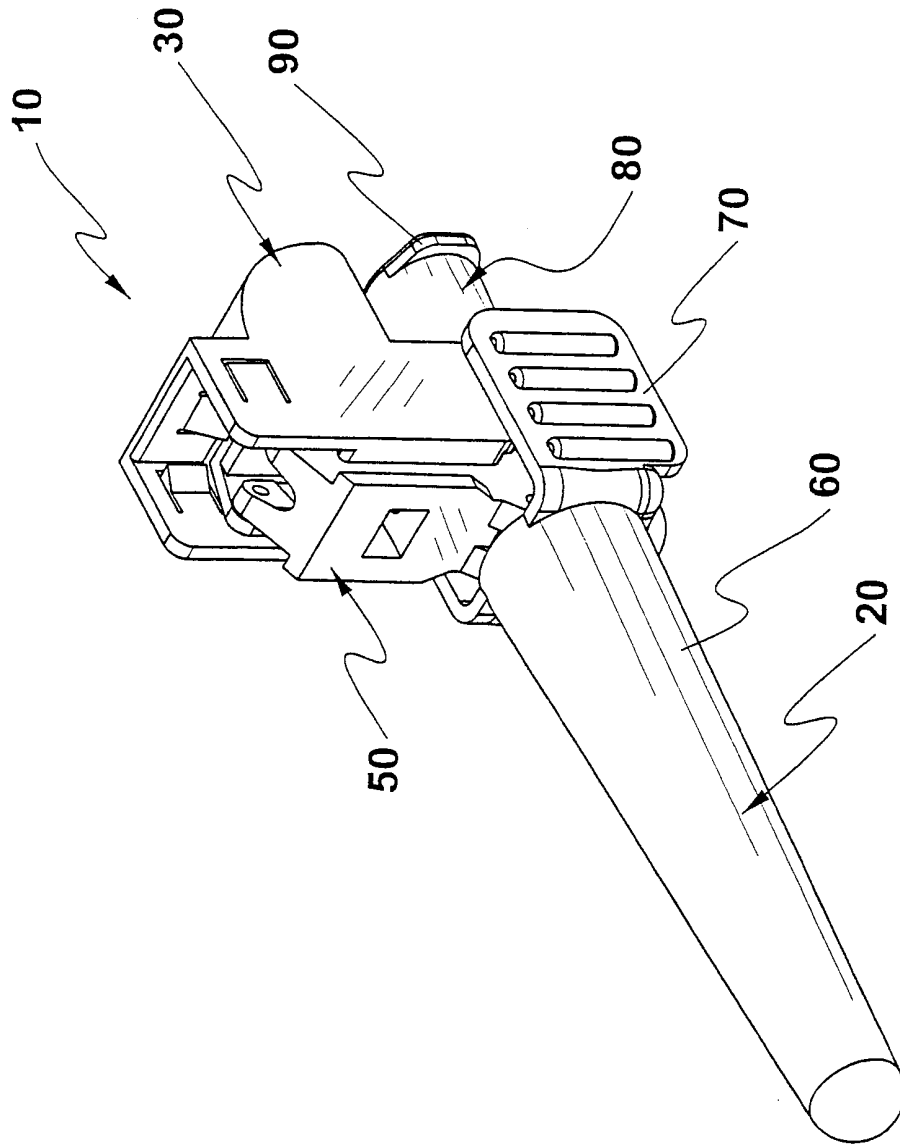

FIGURE 1

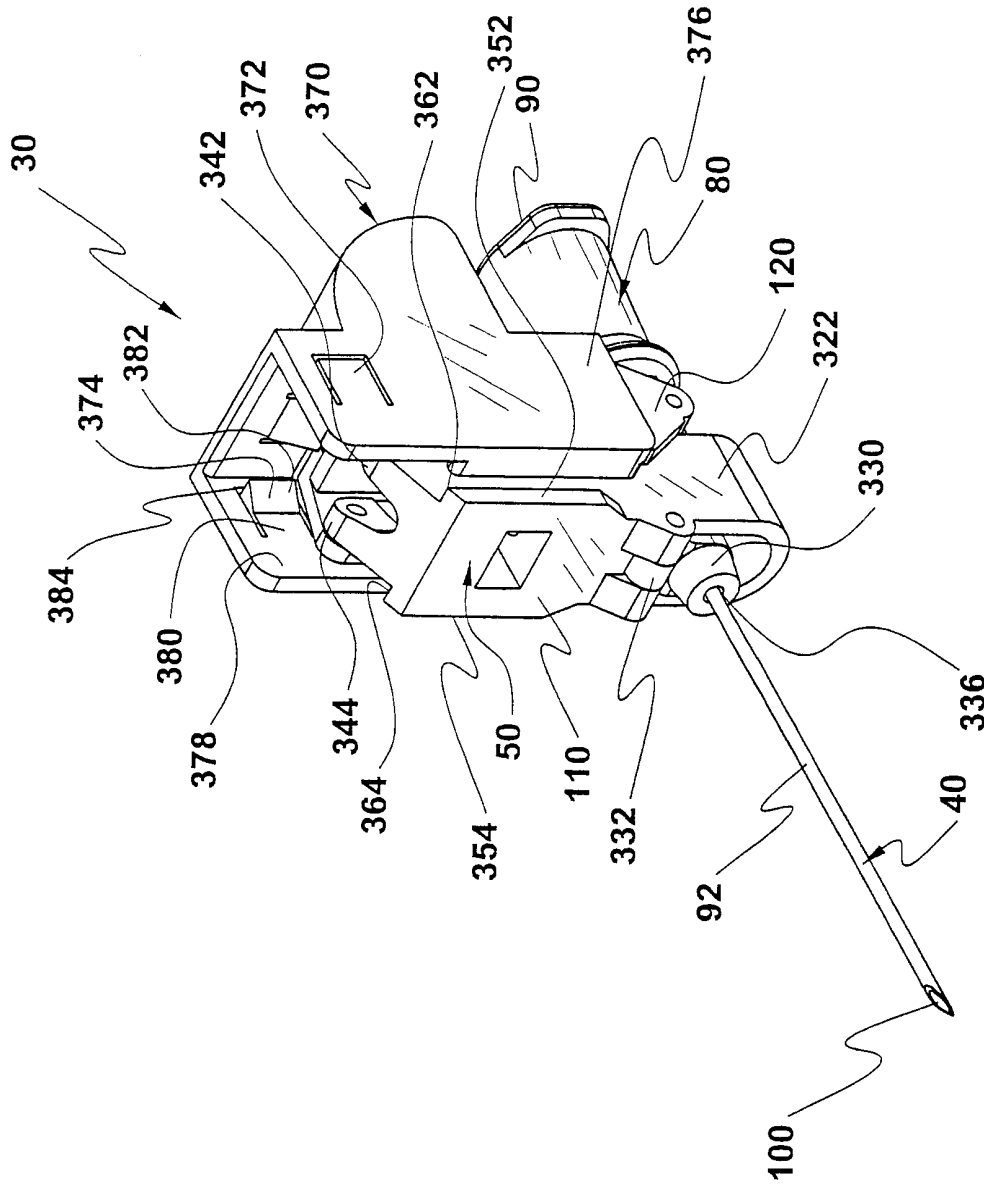

FIGURE 2

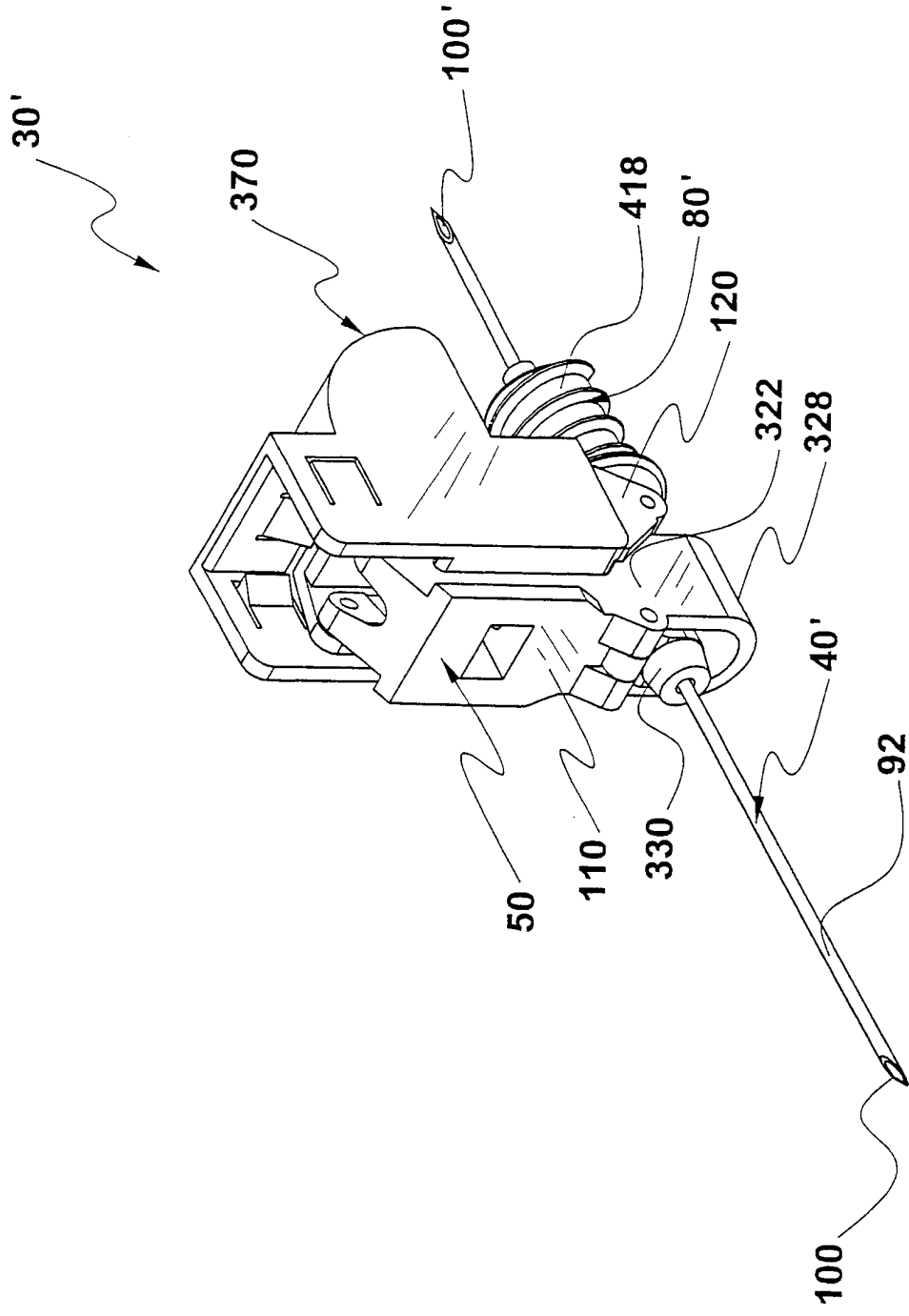

FIGURE 3

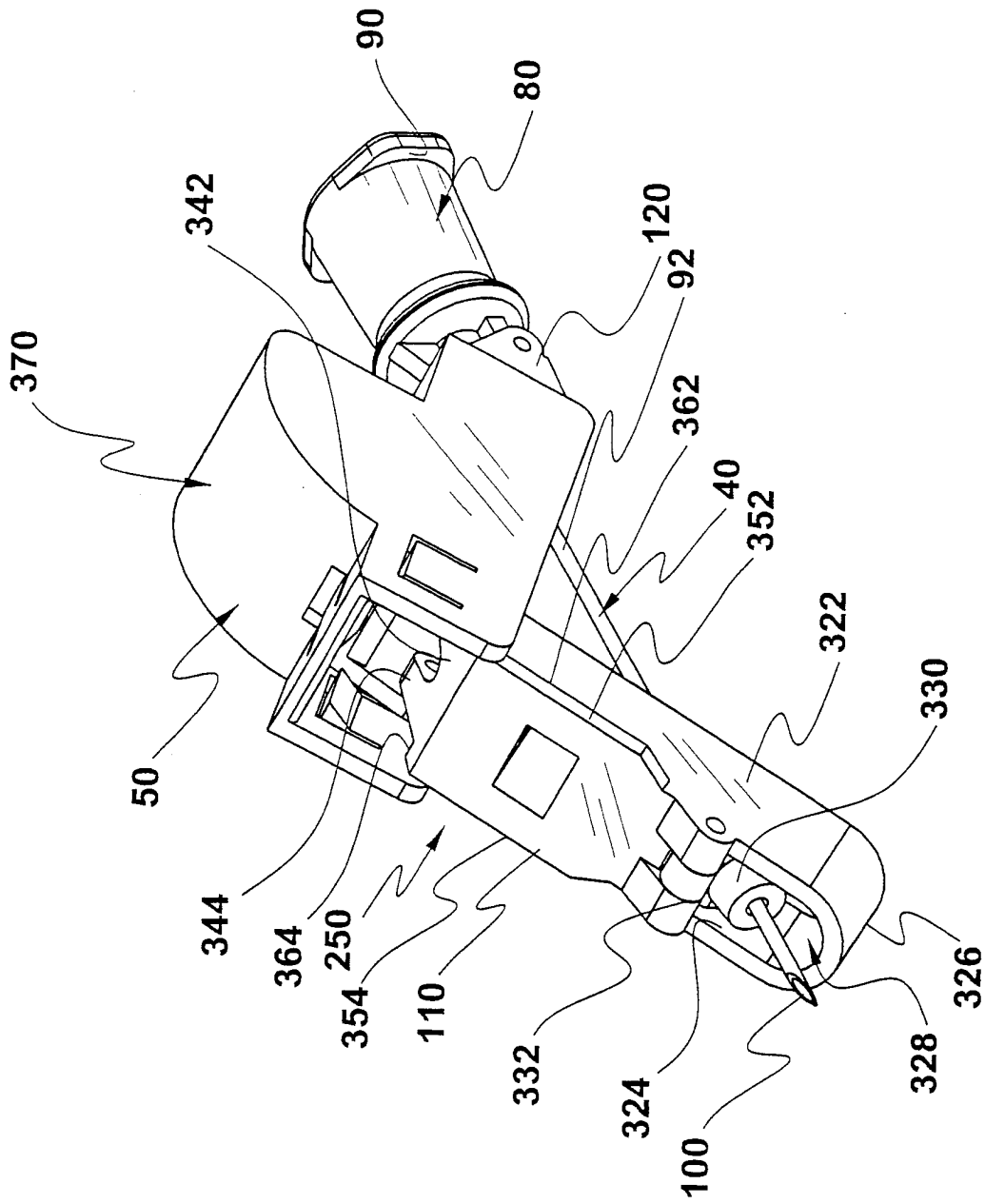

FIGURE 4

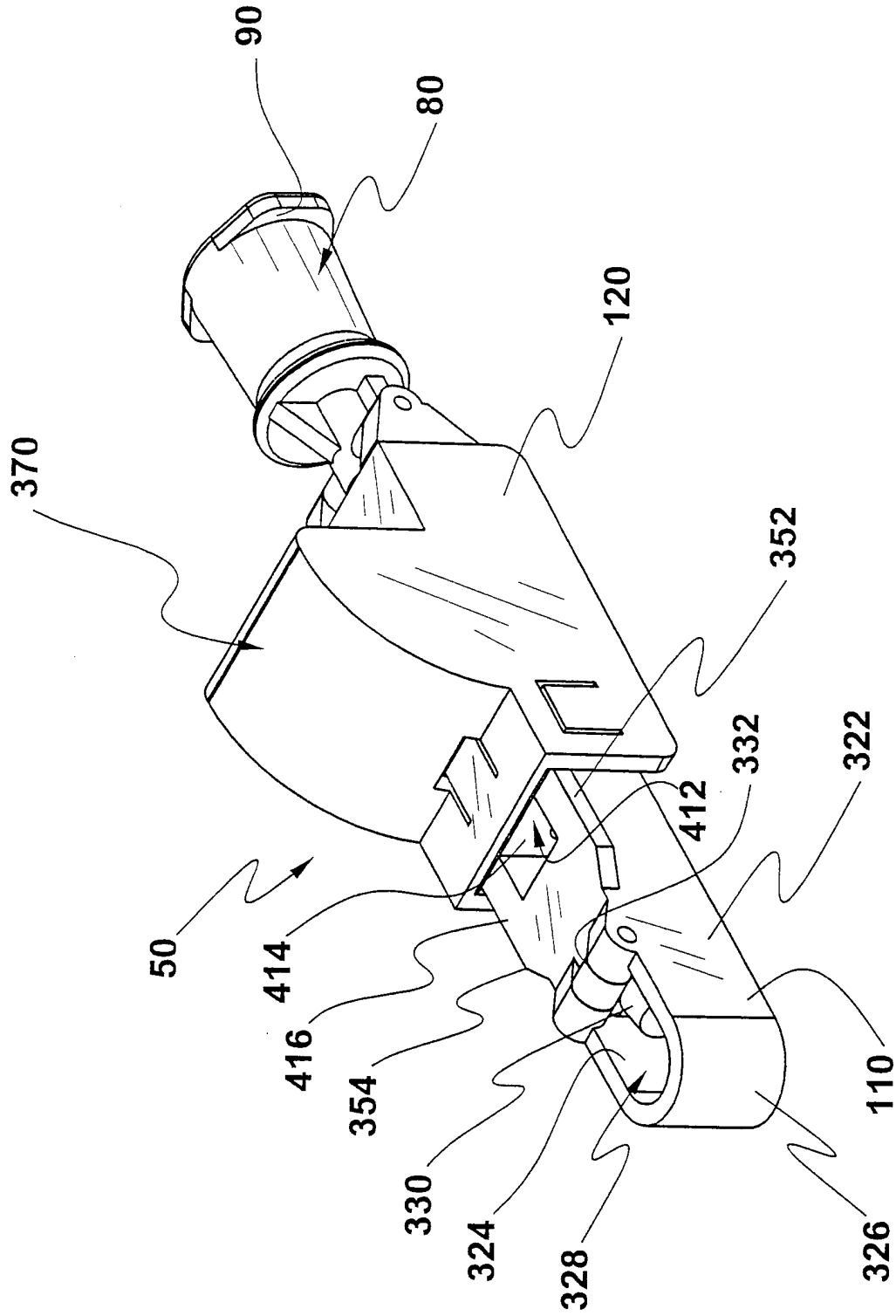

FIGURE 5

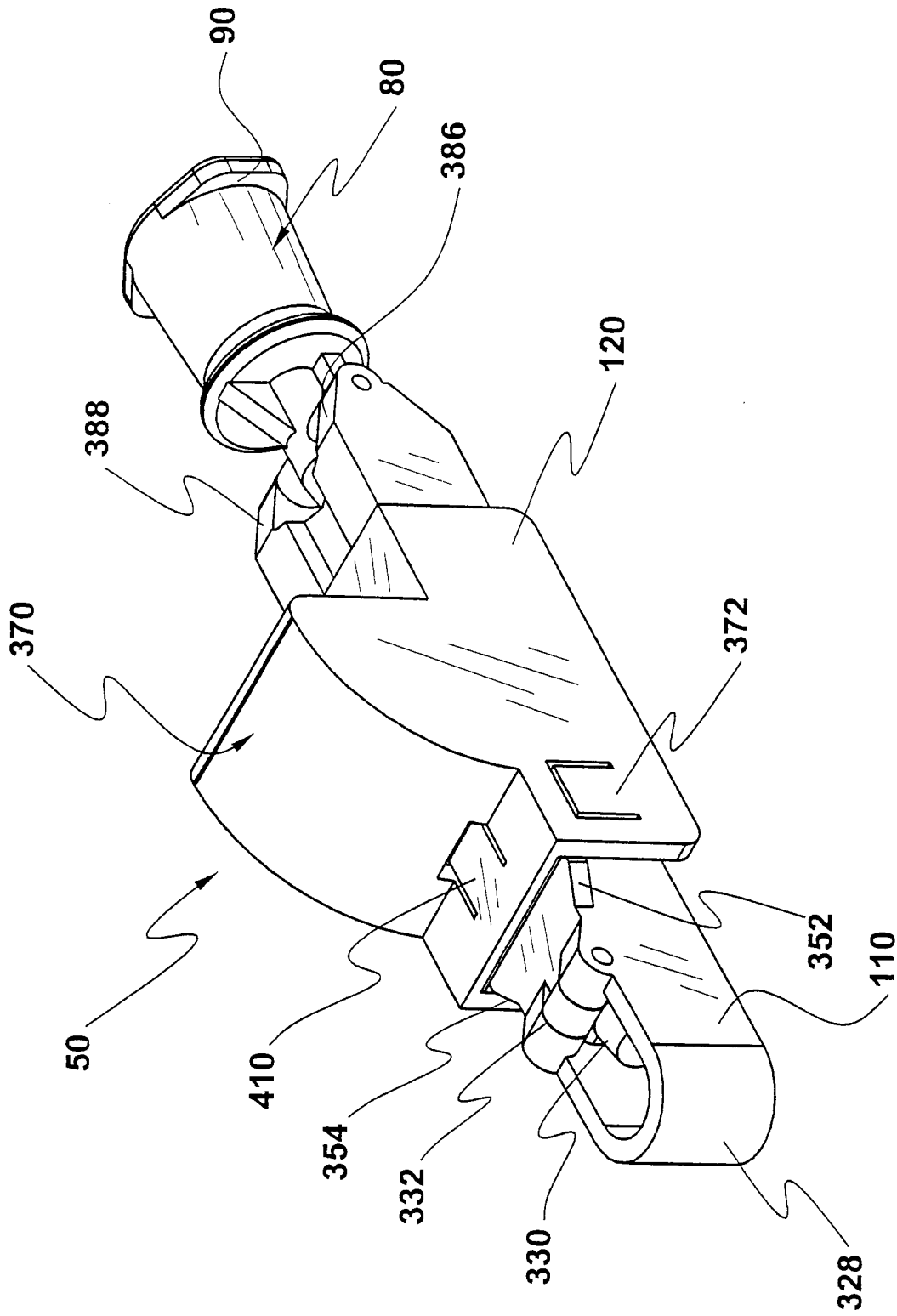

FIGURE 6

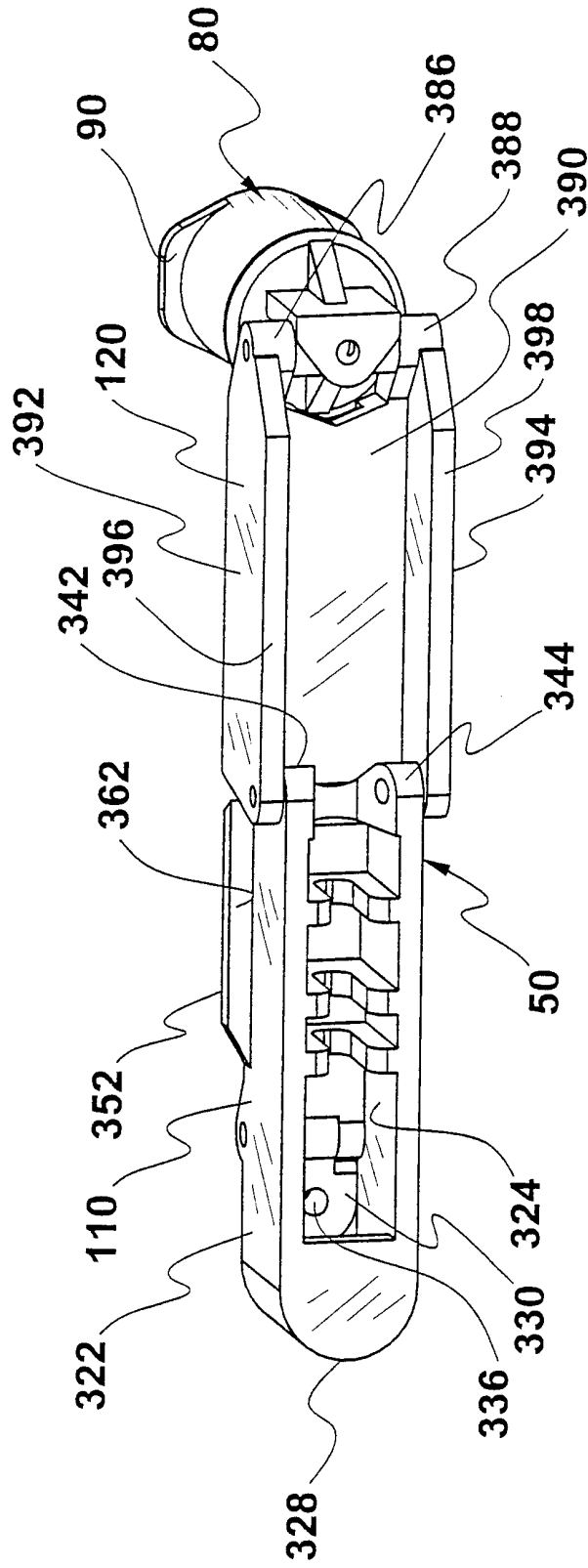

FIGURE 7

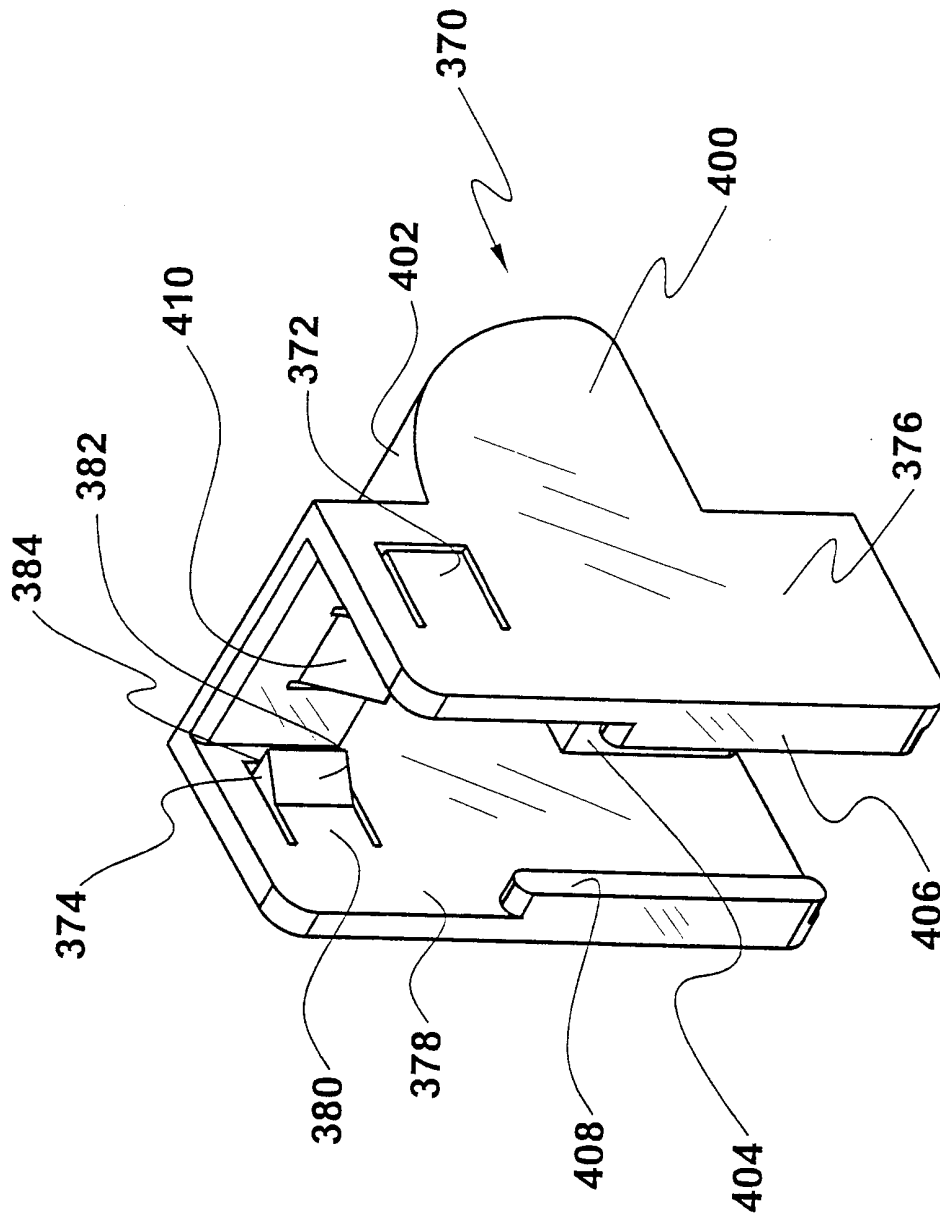

FIGURE 8

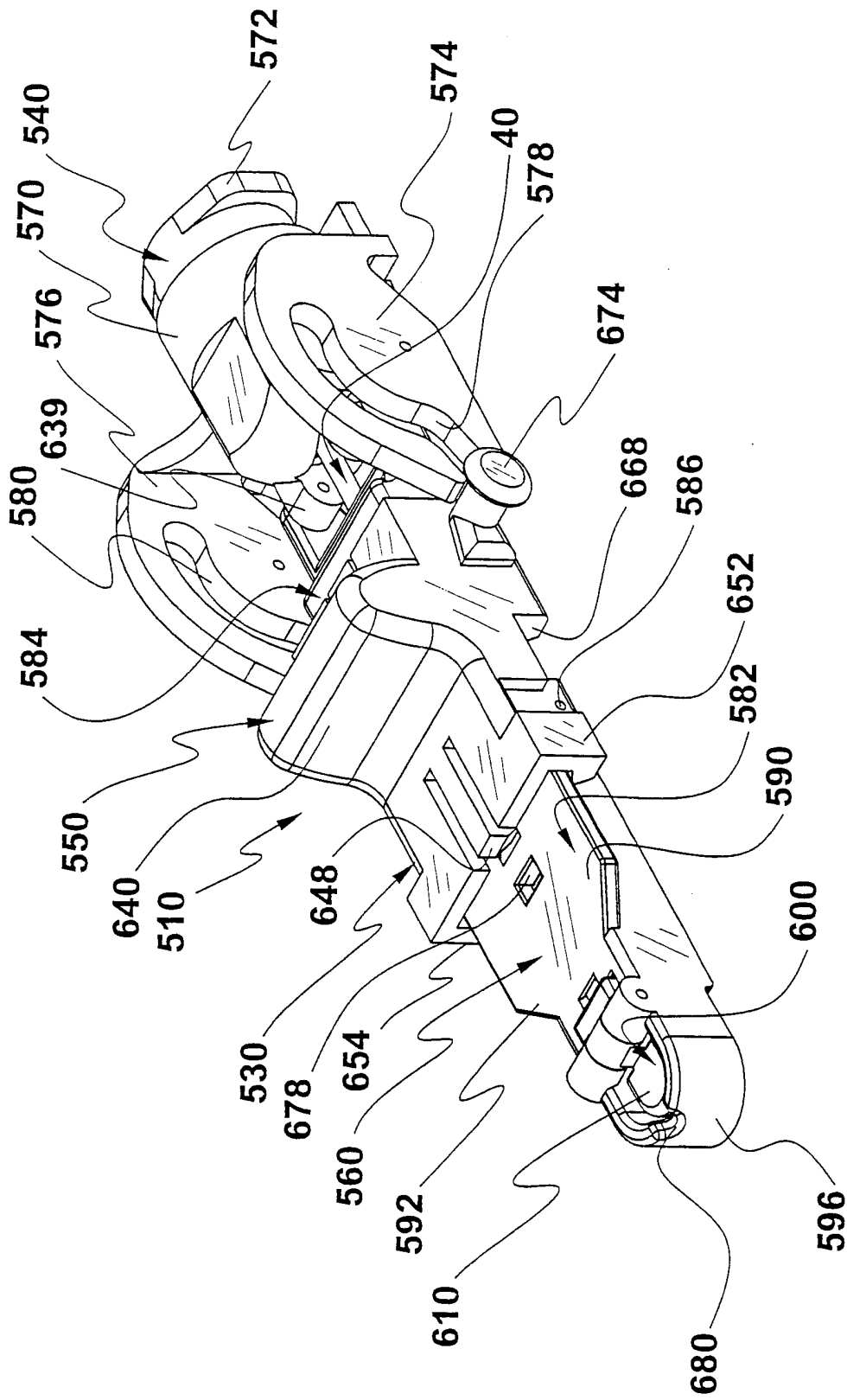

FIGURE 9

10/35

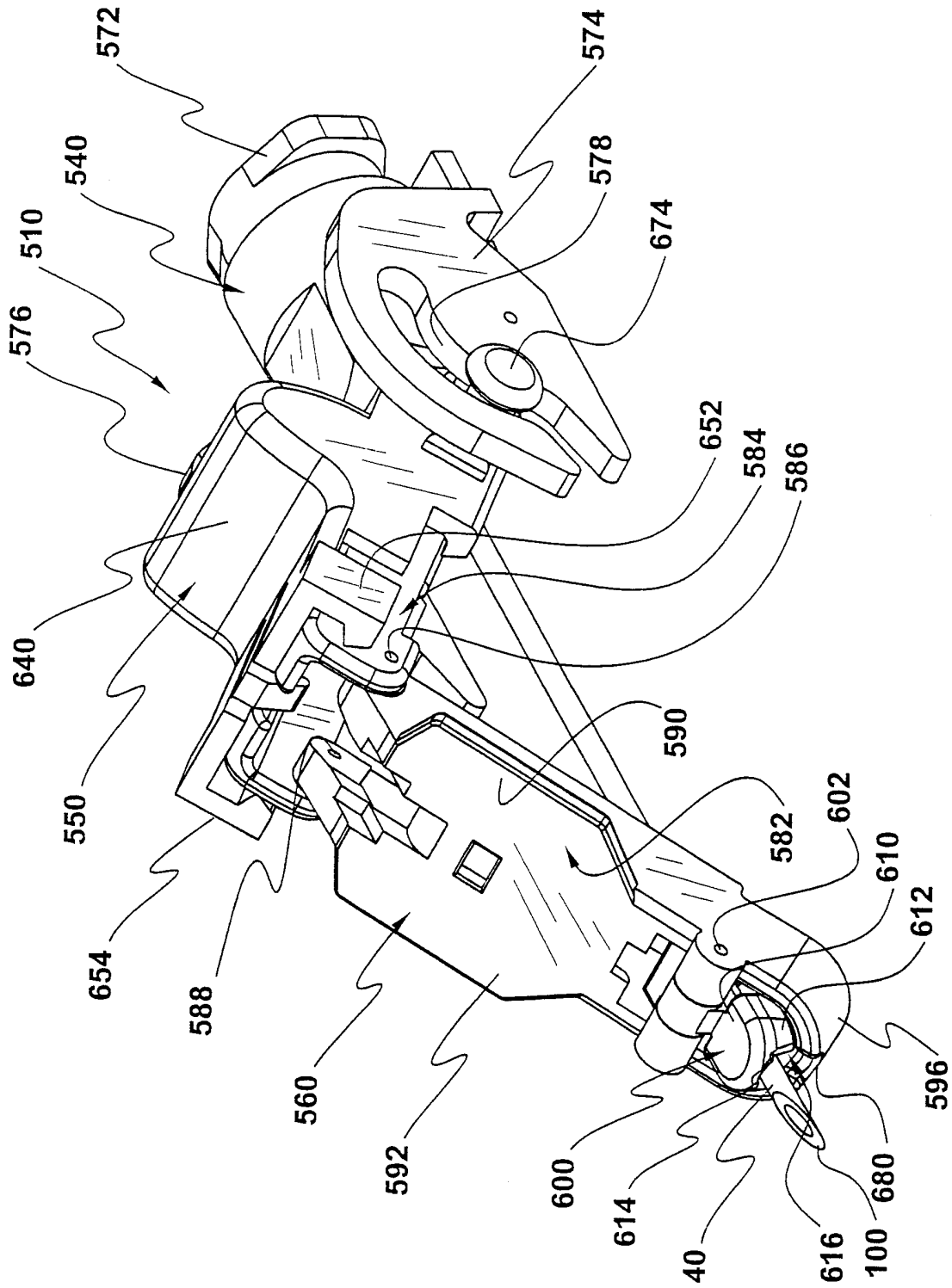

FIGURE 10

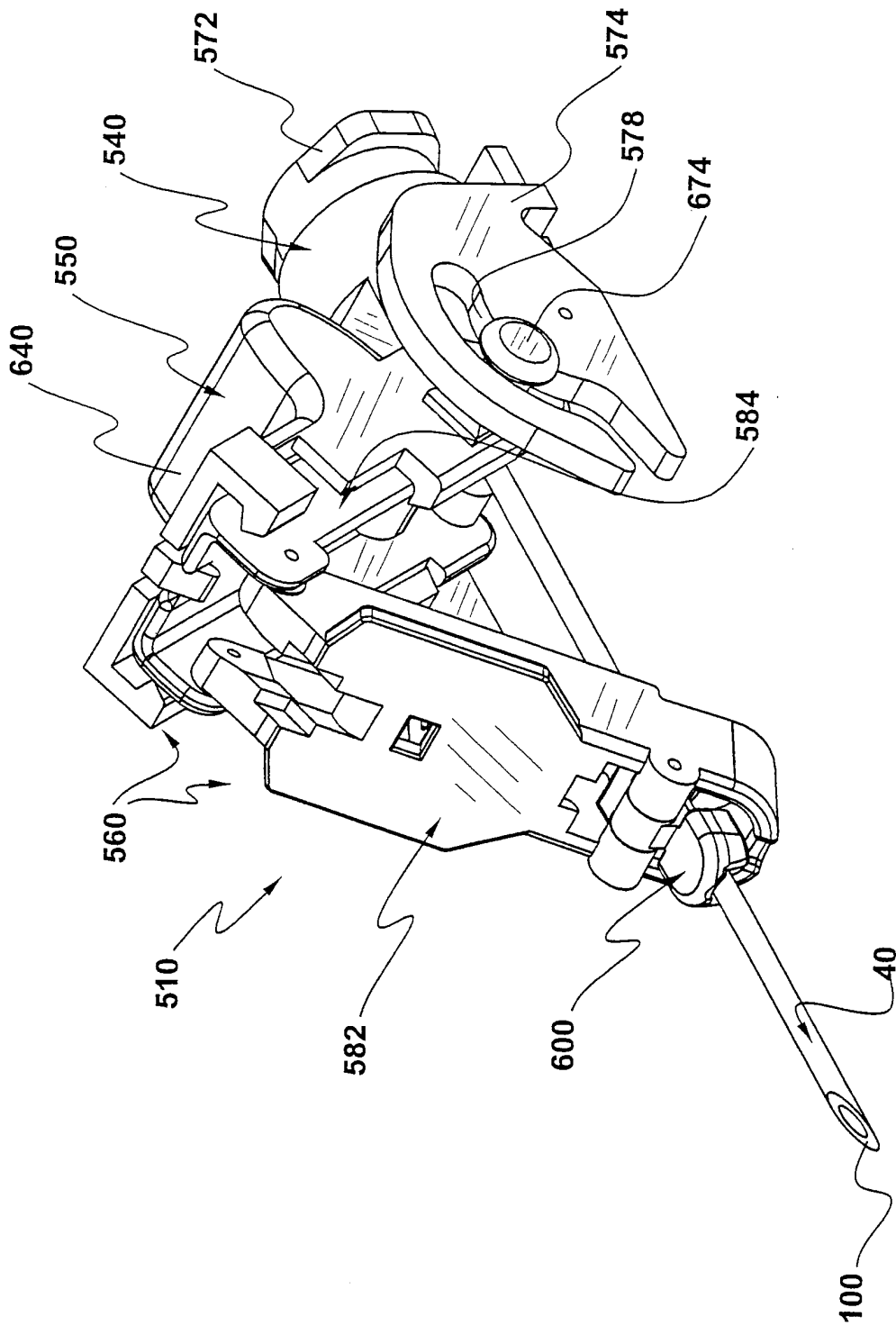

FIGURE 11

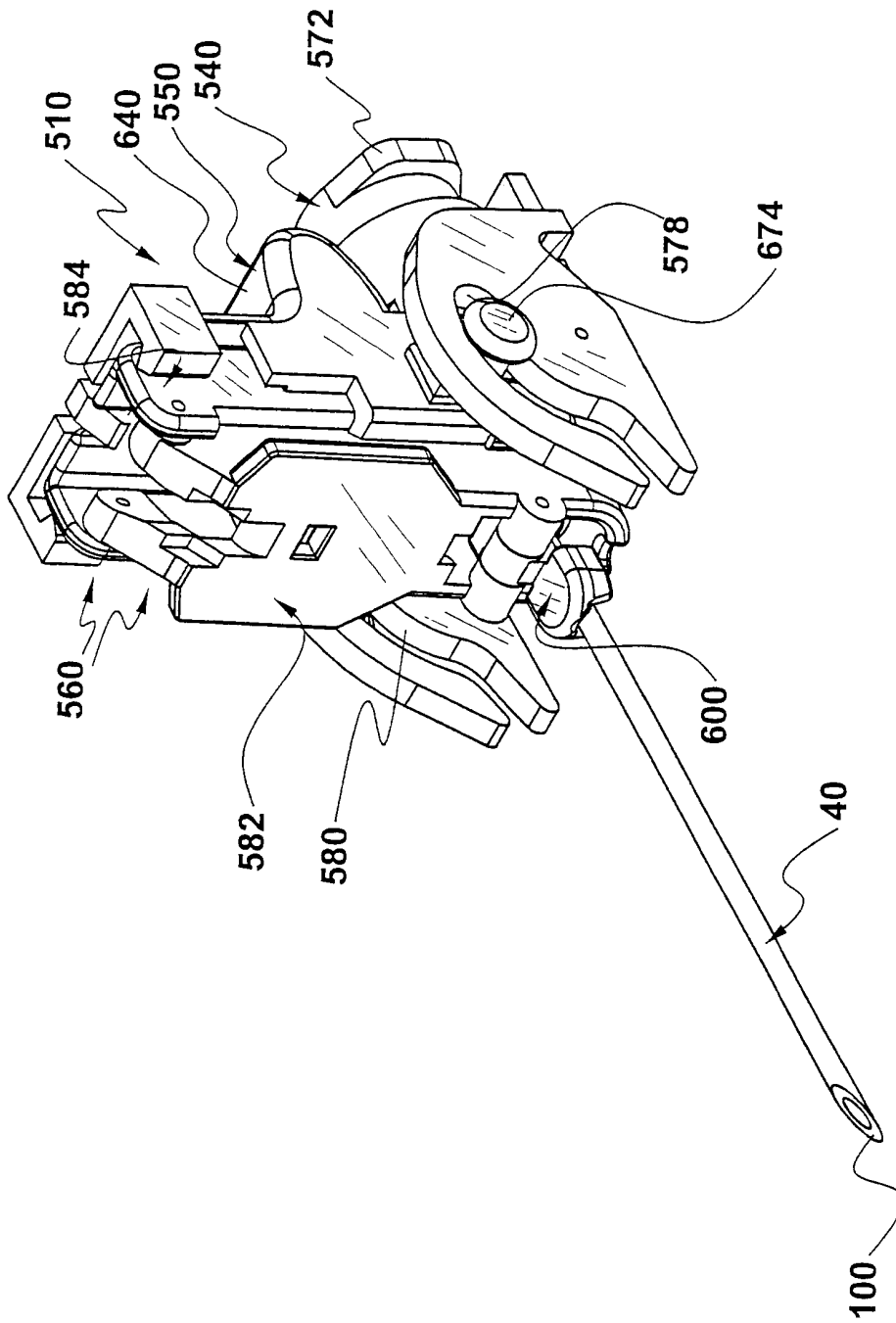

FIGURE 12

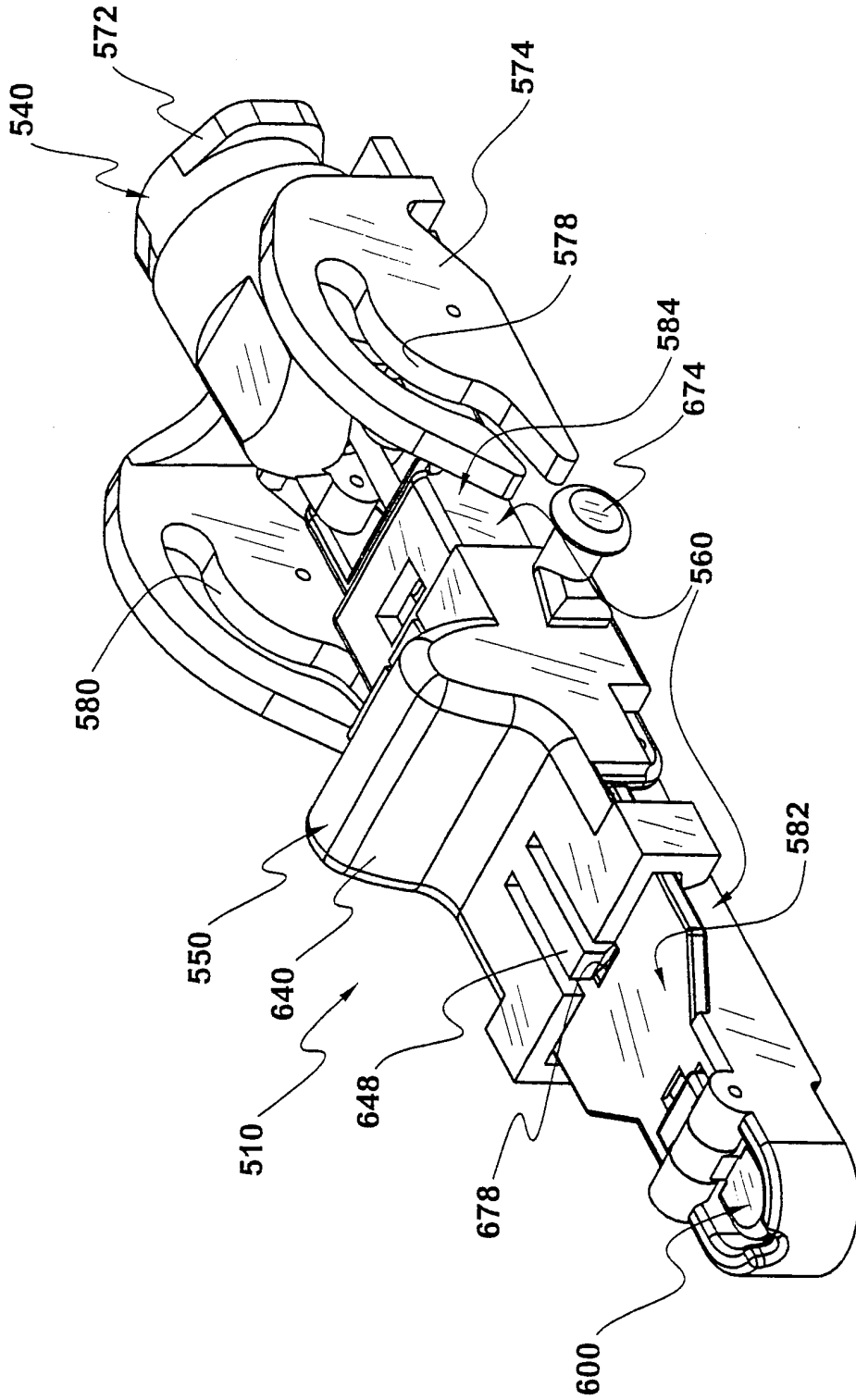

FIGURE 13

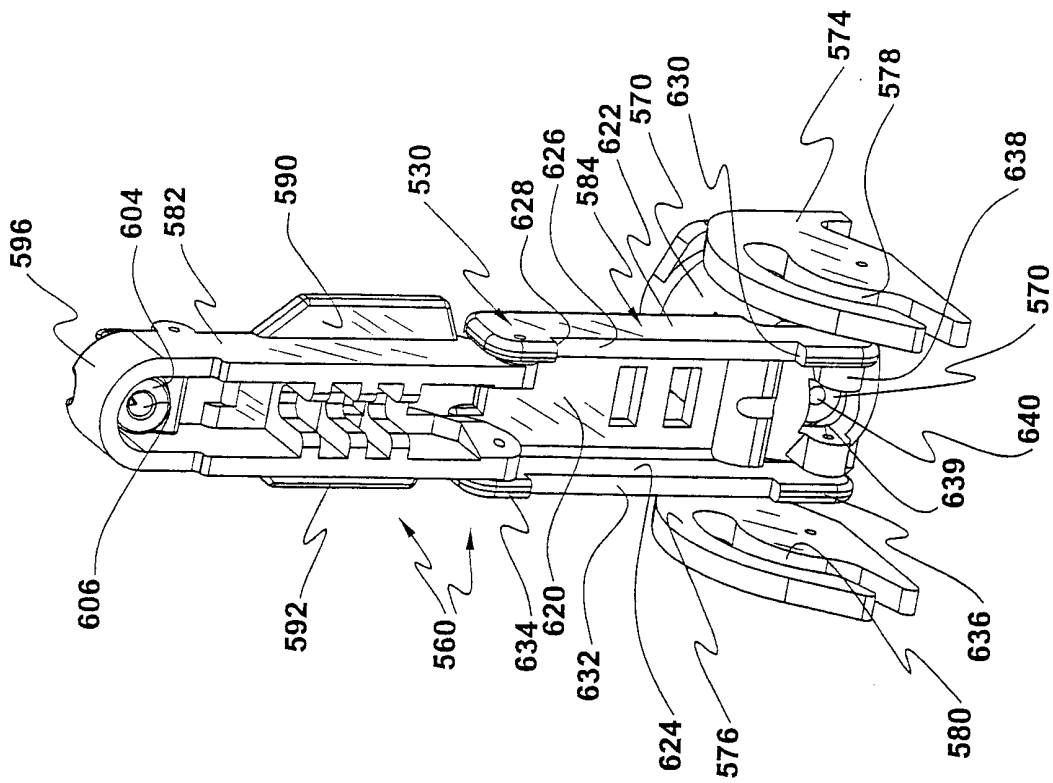

FIGURE 14

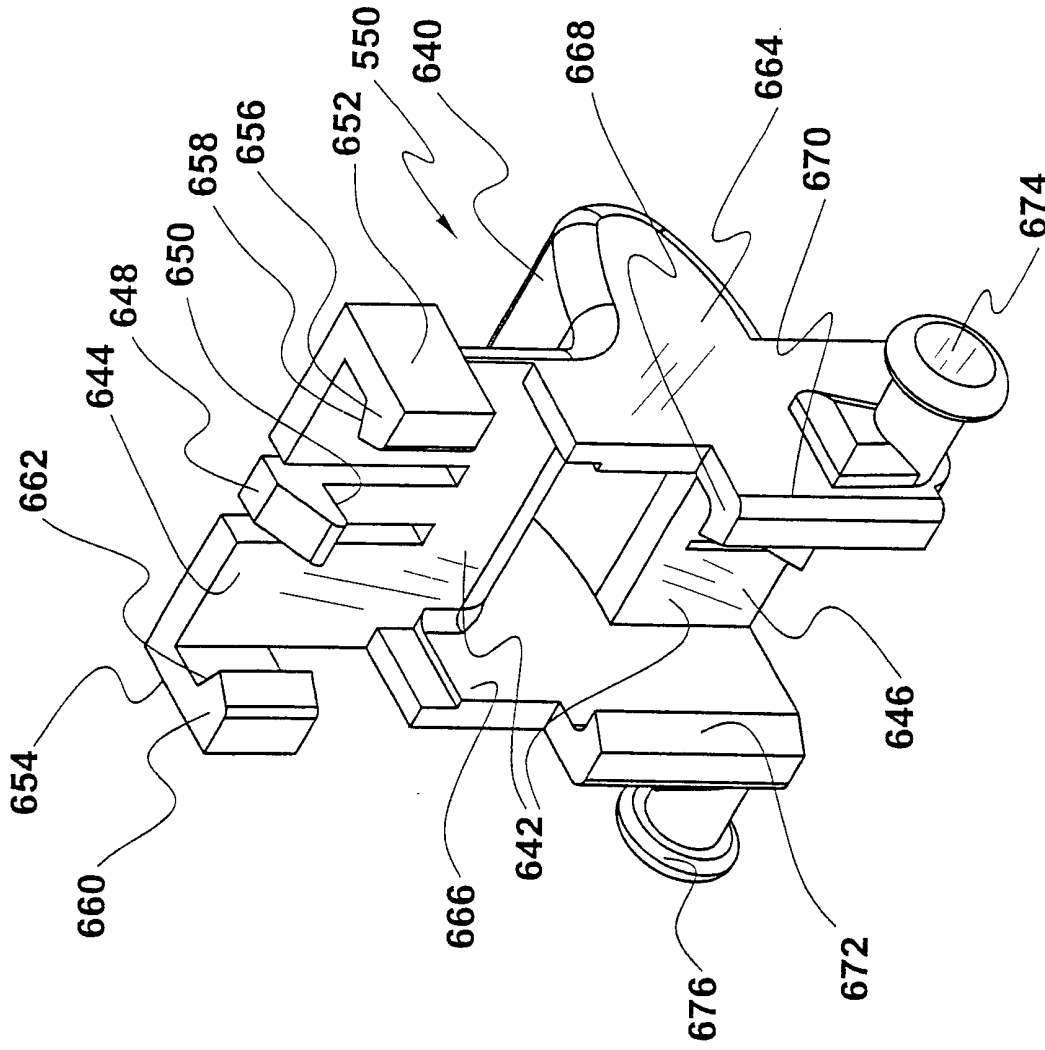

FIGURE 15

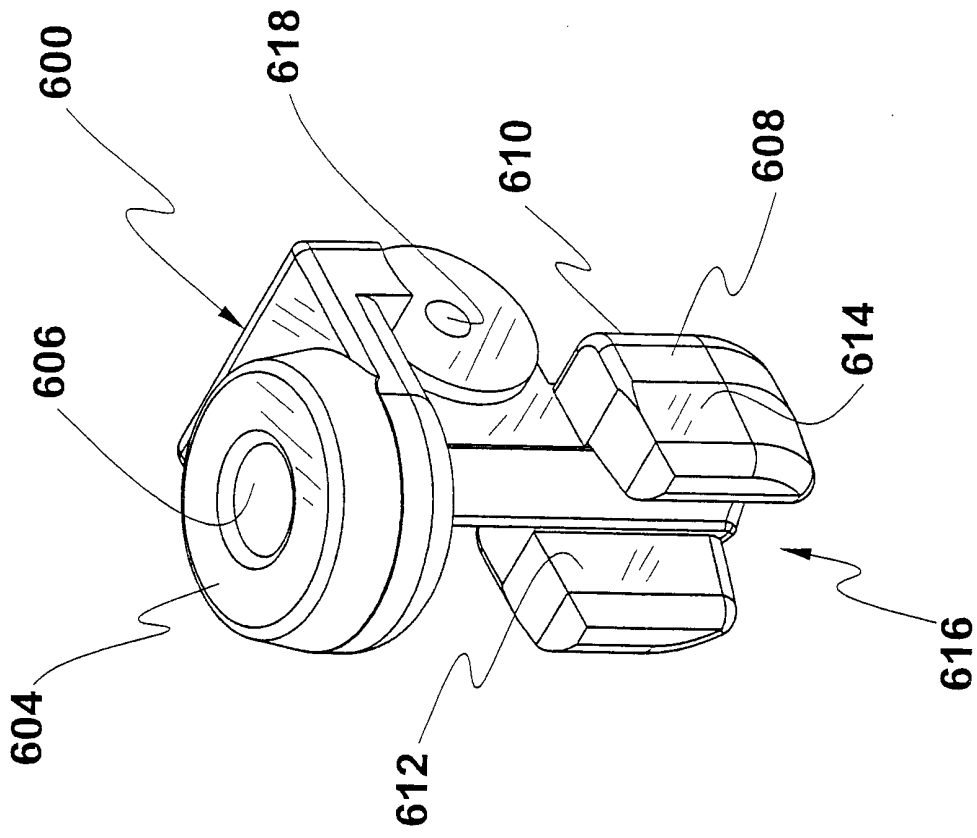

FIGURE 16

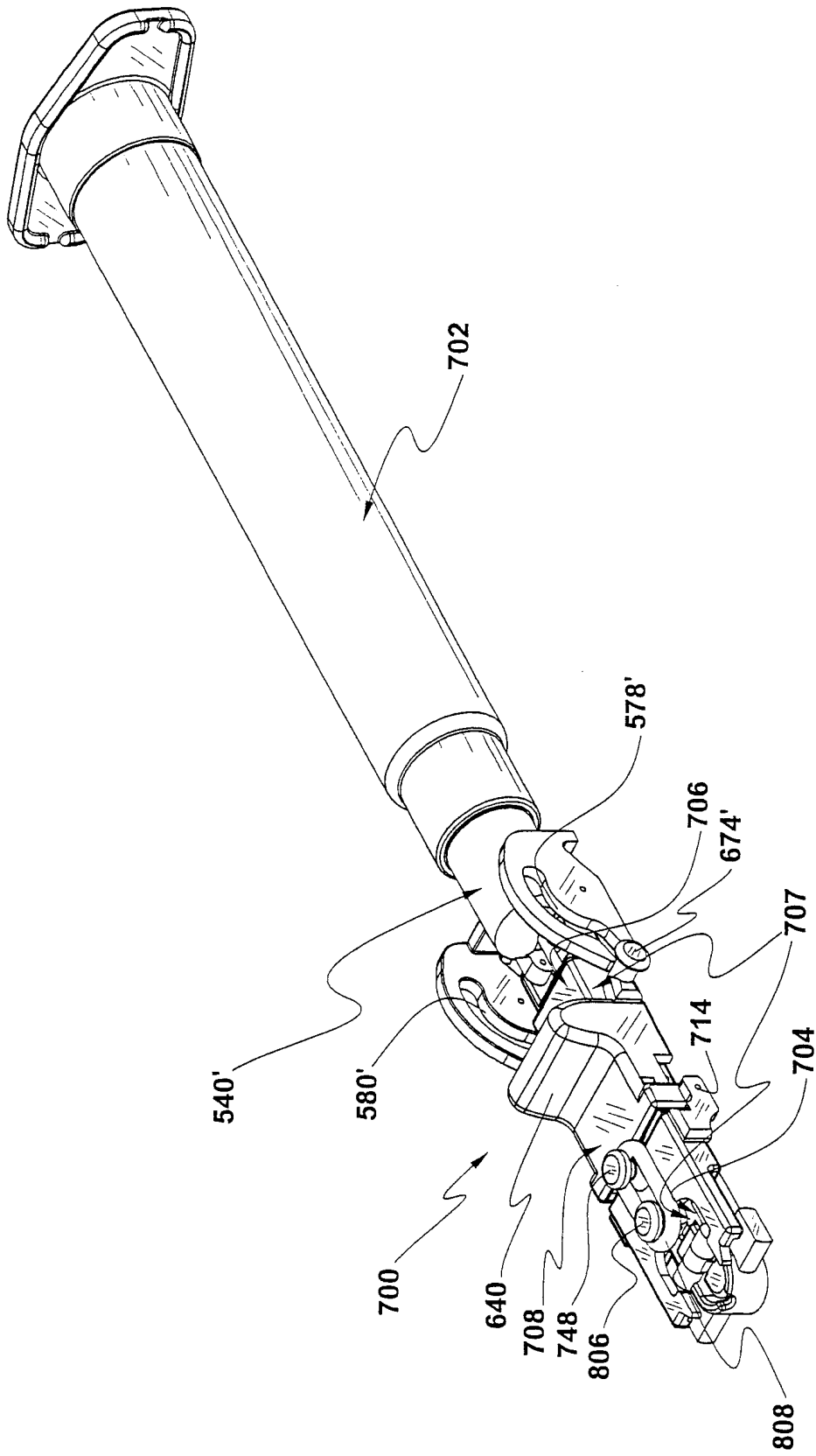

FIGURE 17

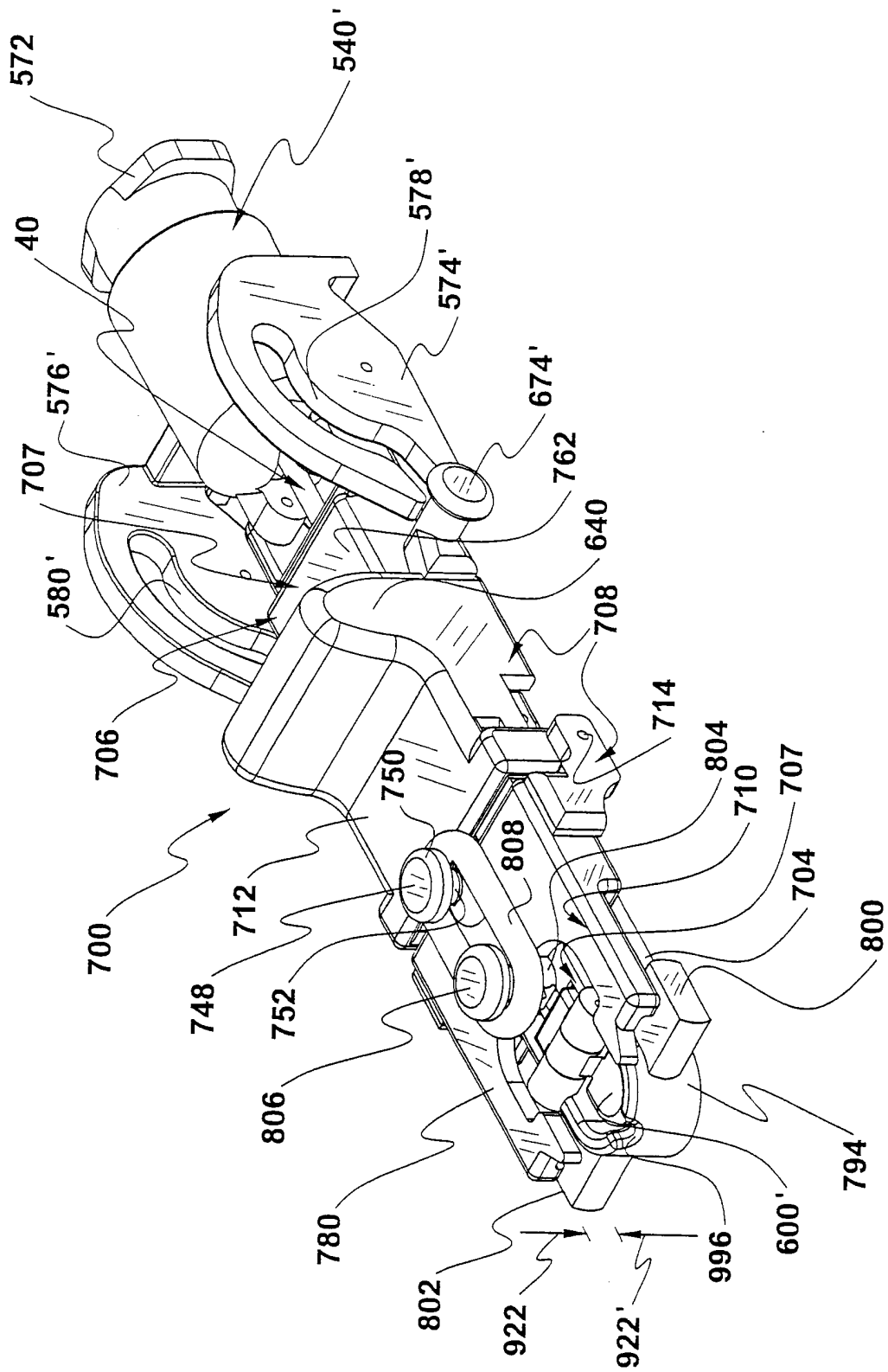

FIGURE 18

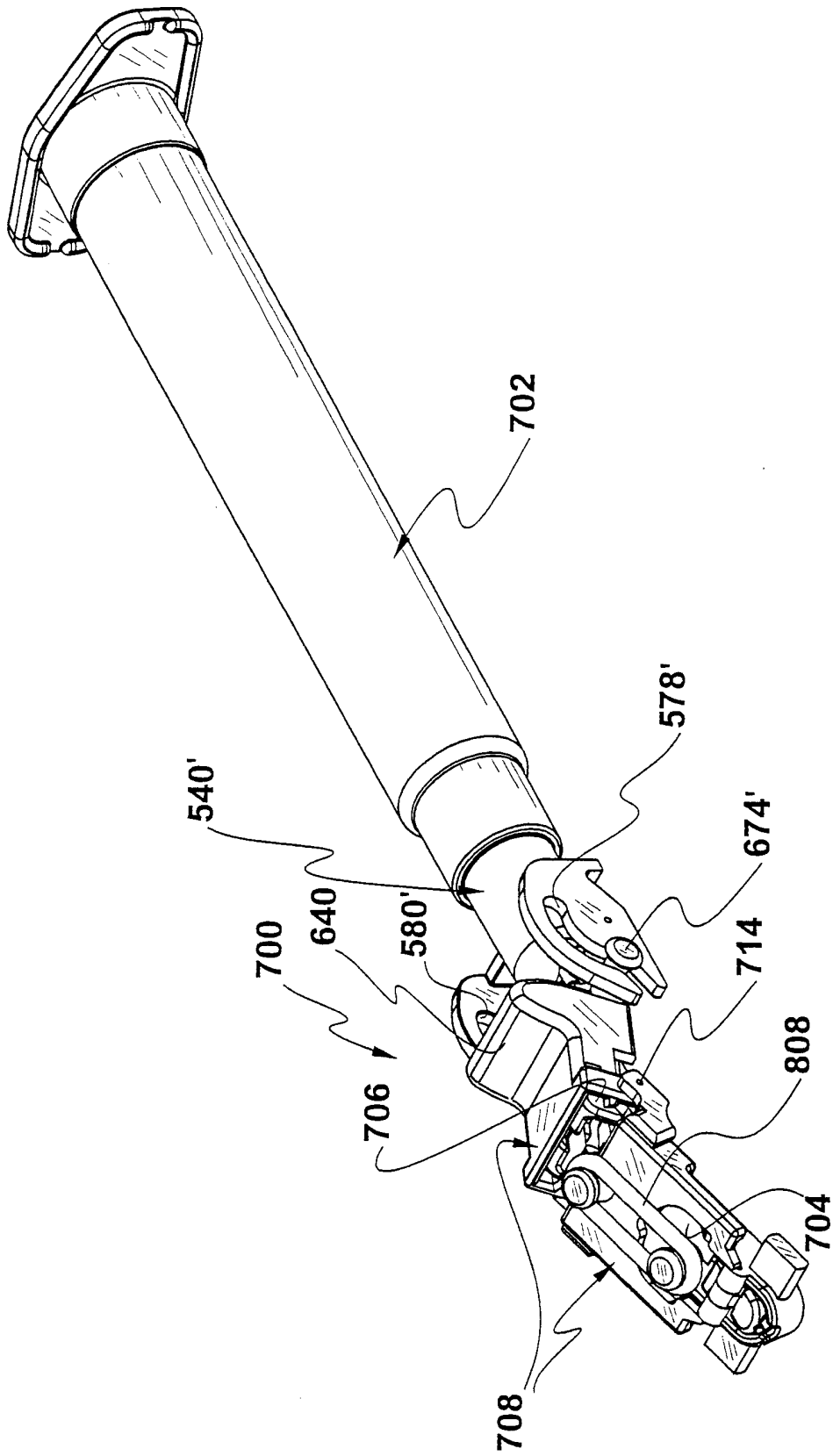

FIGURE 19

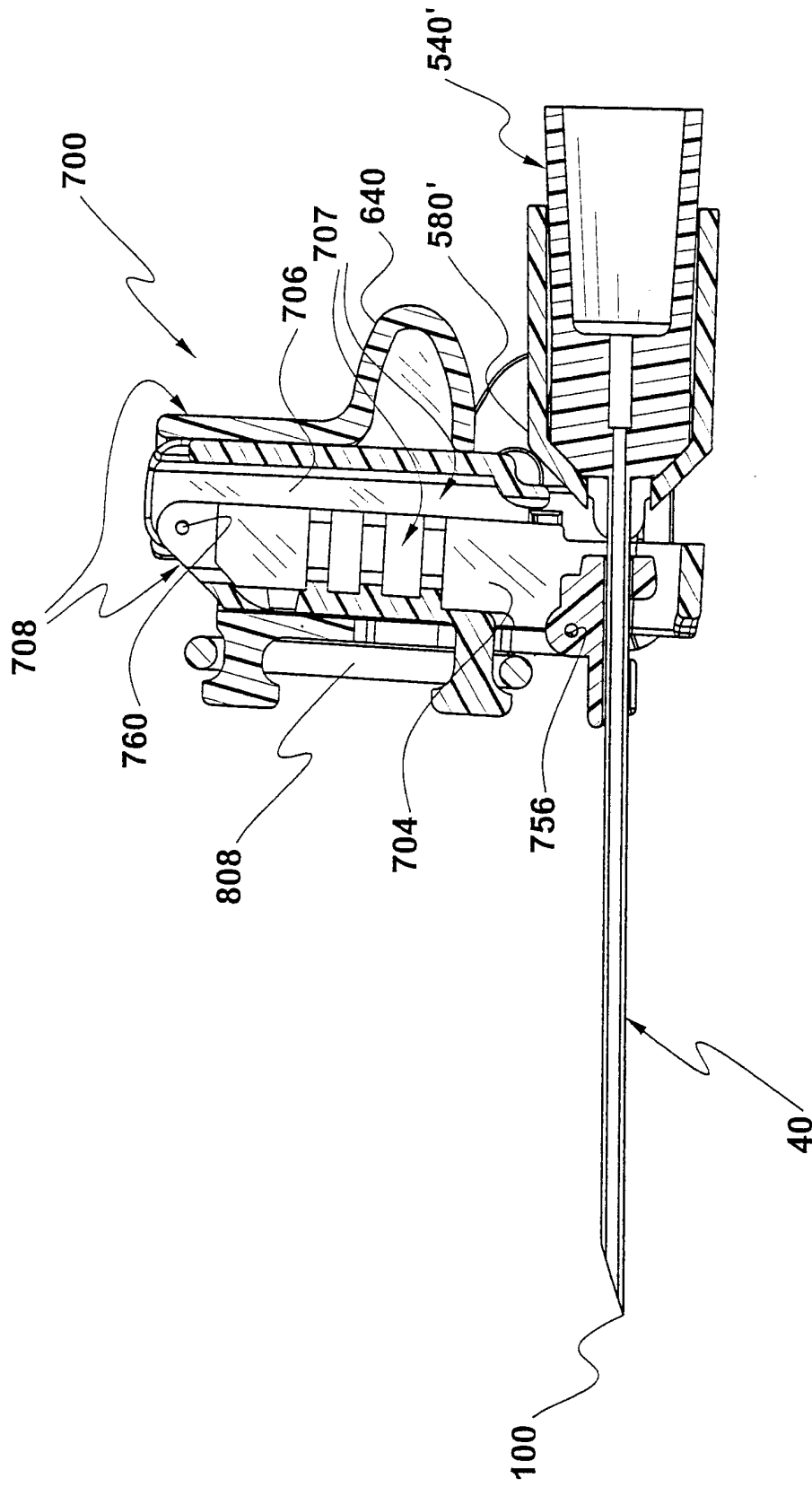

FIGURE 20

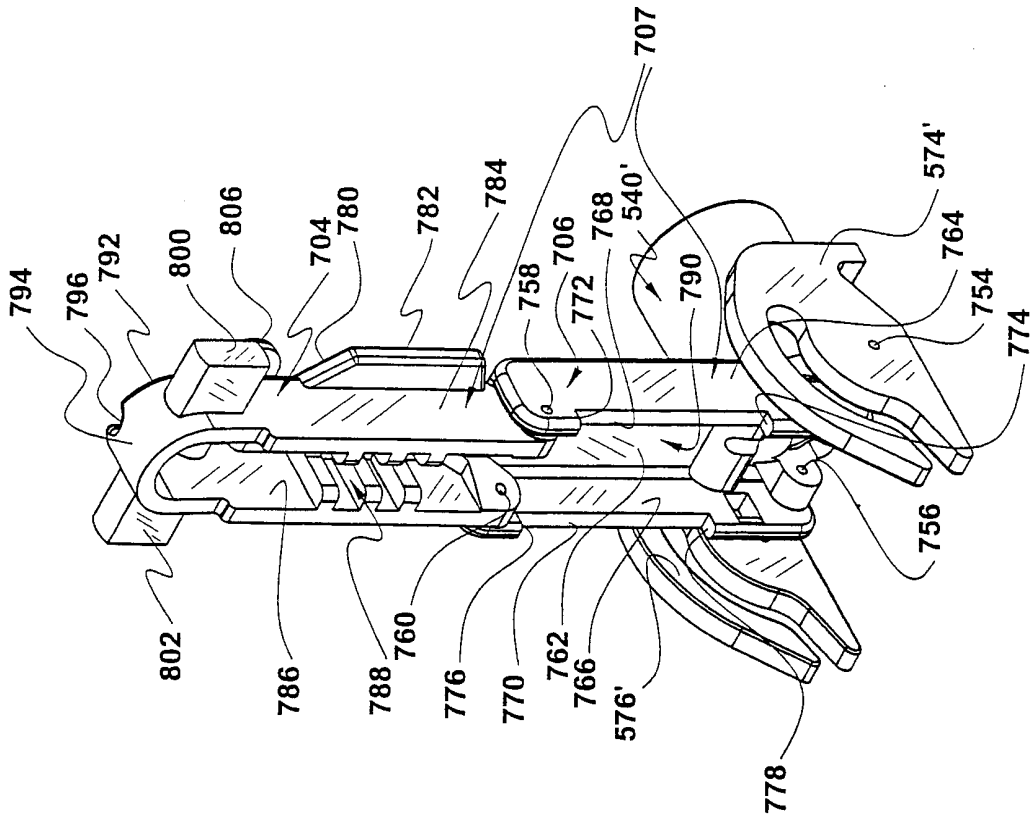

FIGURE 21

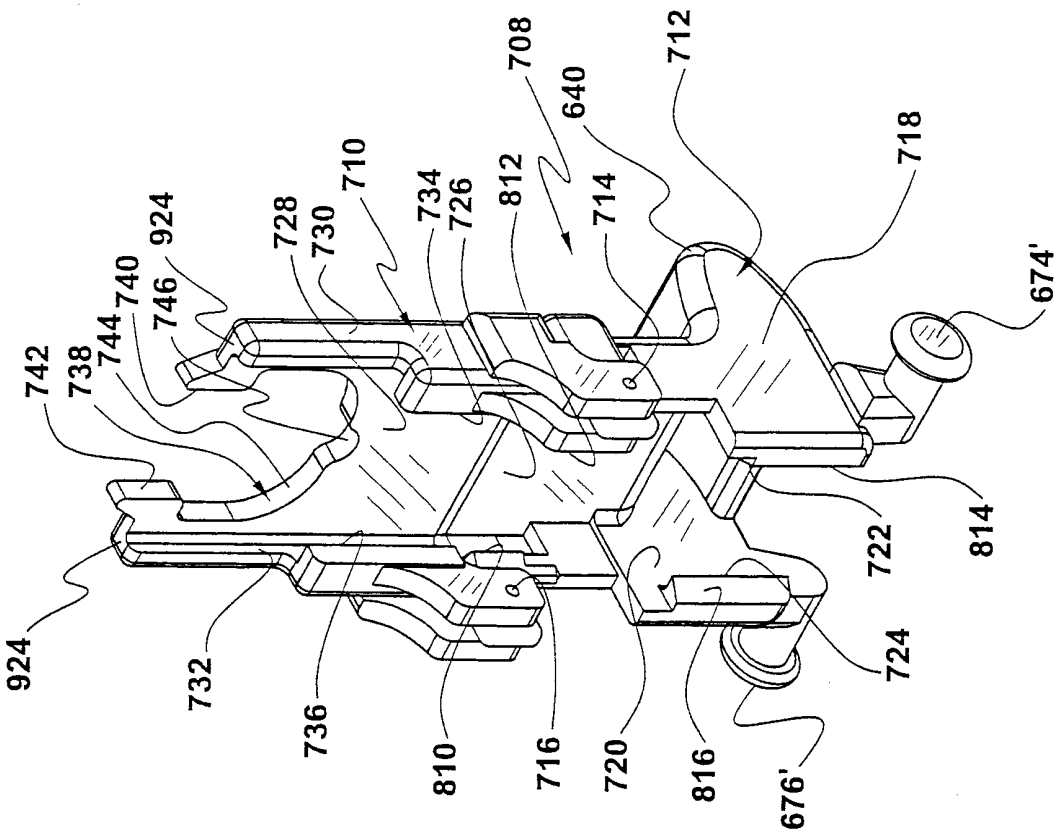

FIGURE 22

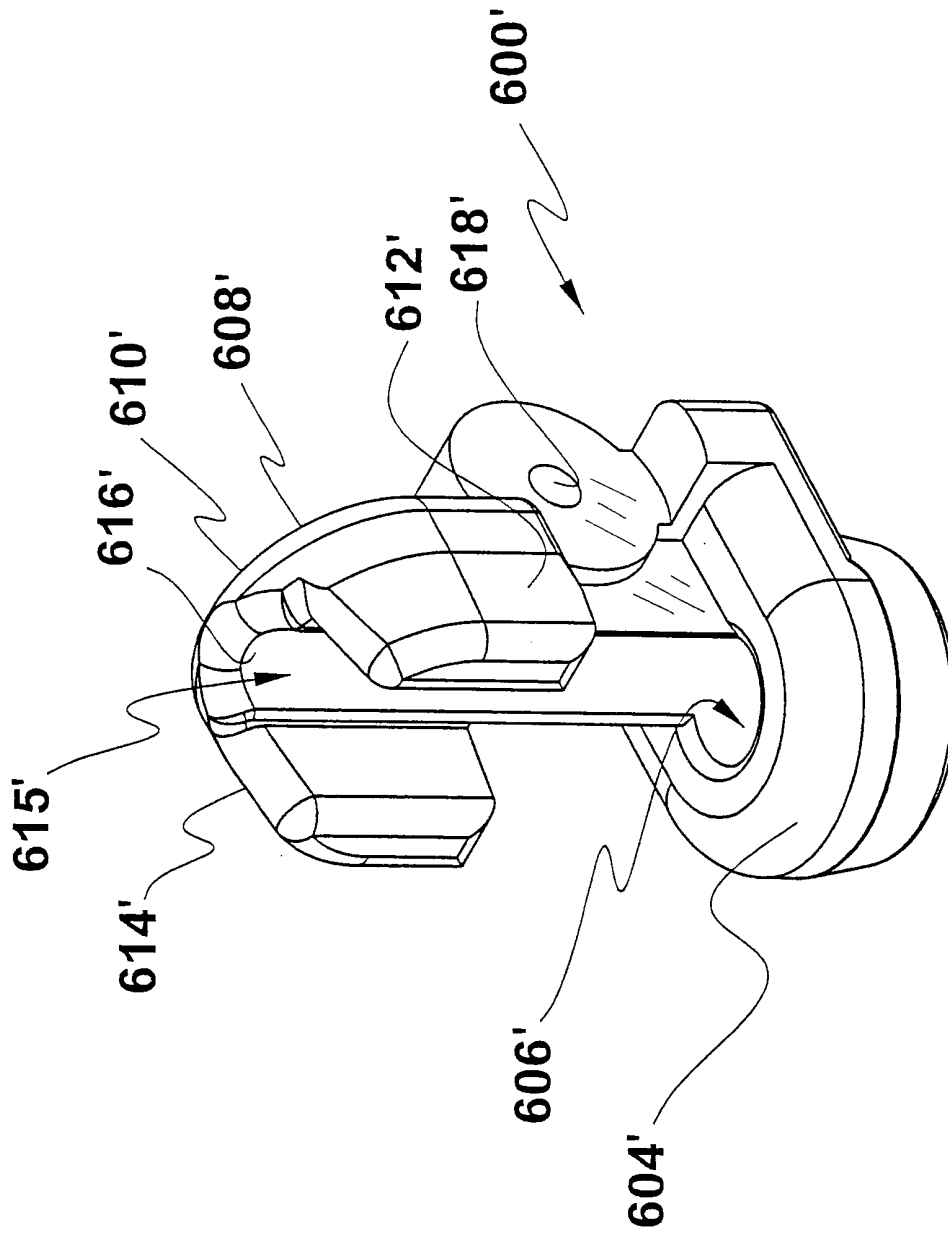

FIGURE 23

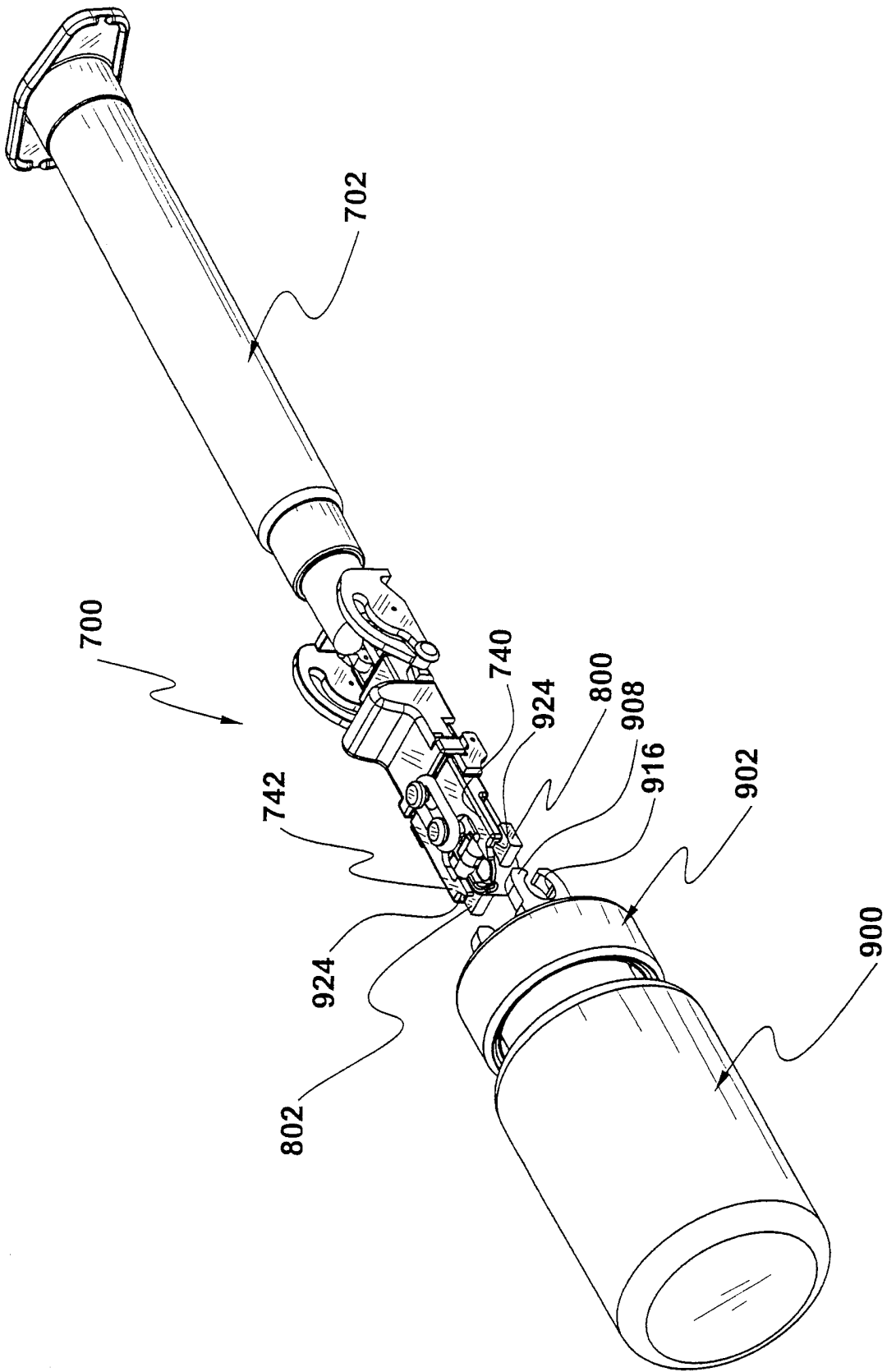

FIGURE 24

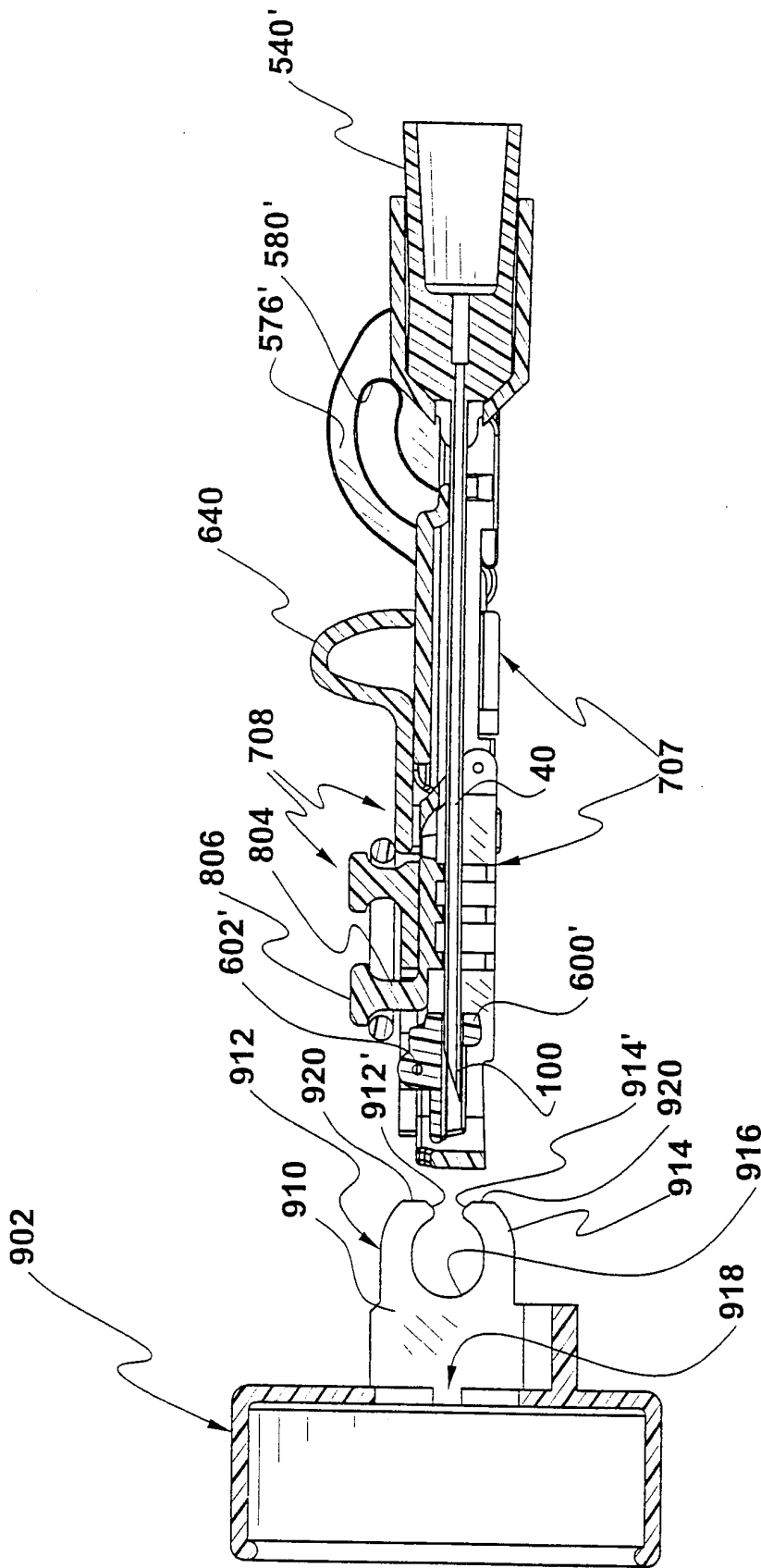

FIGURE 25

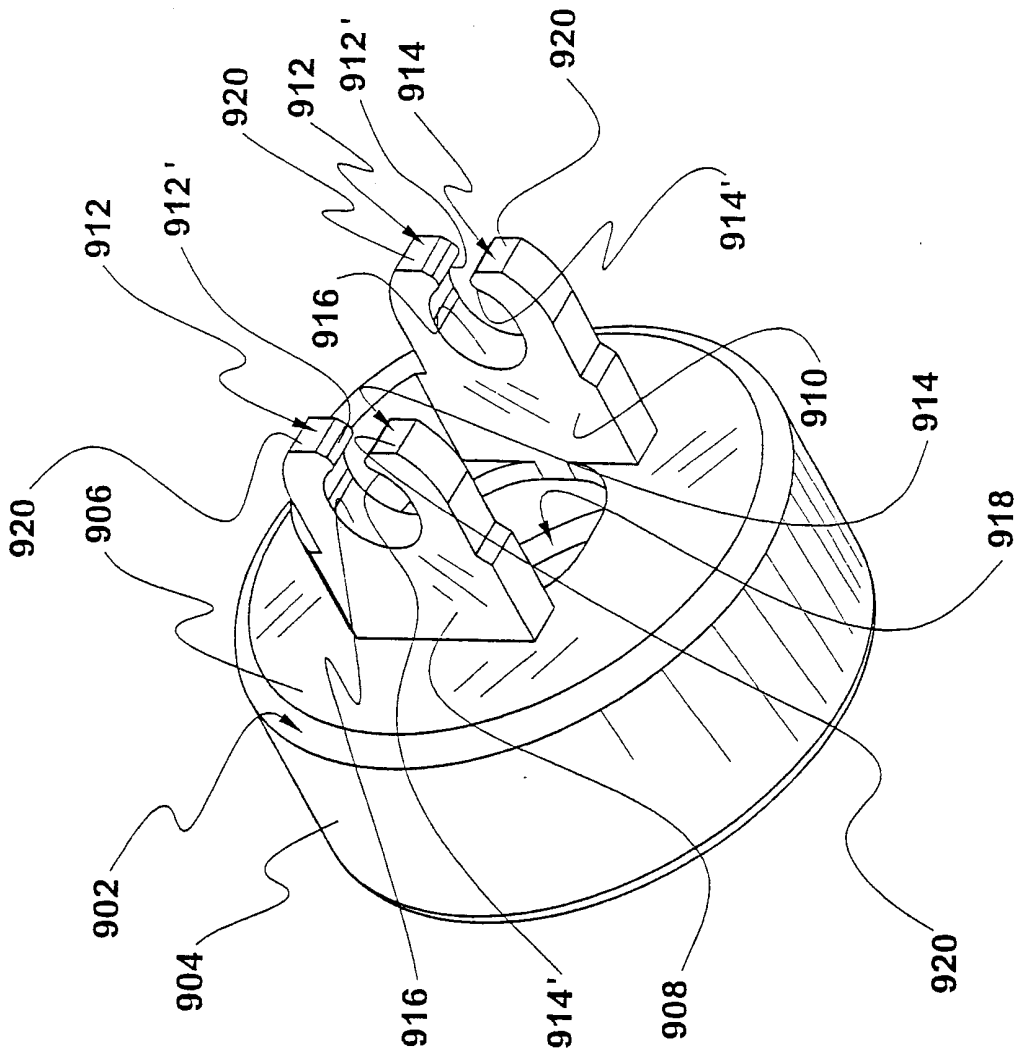

FIGURE 26

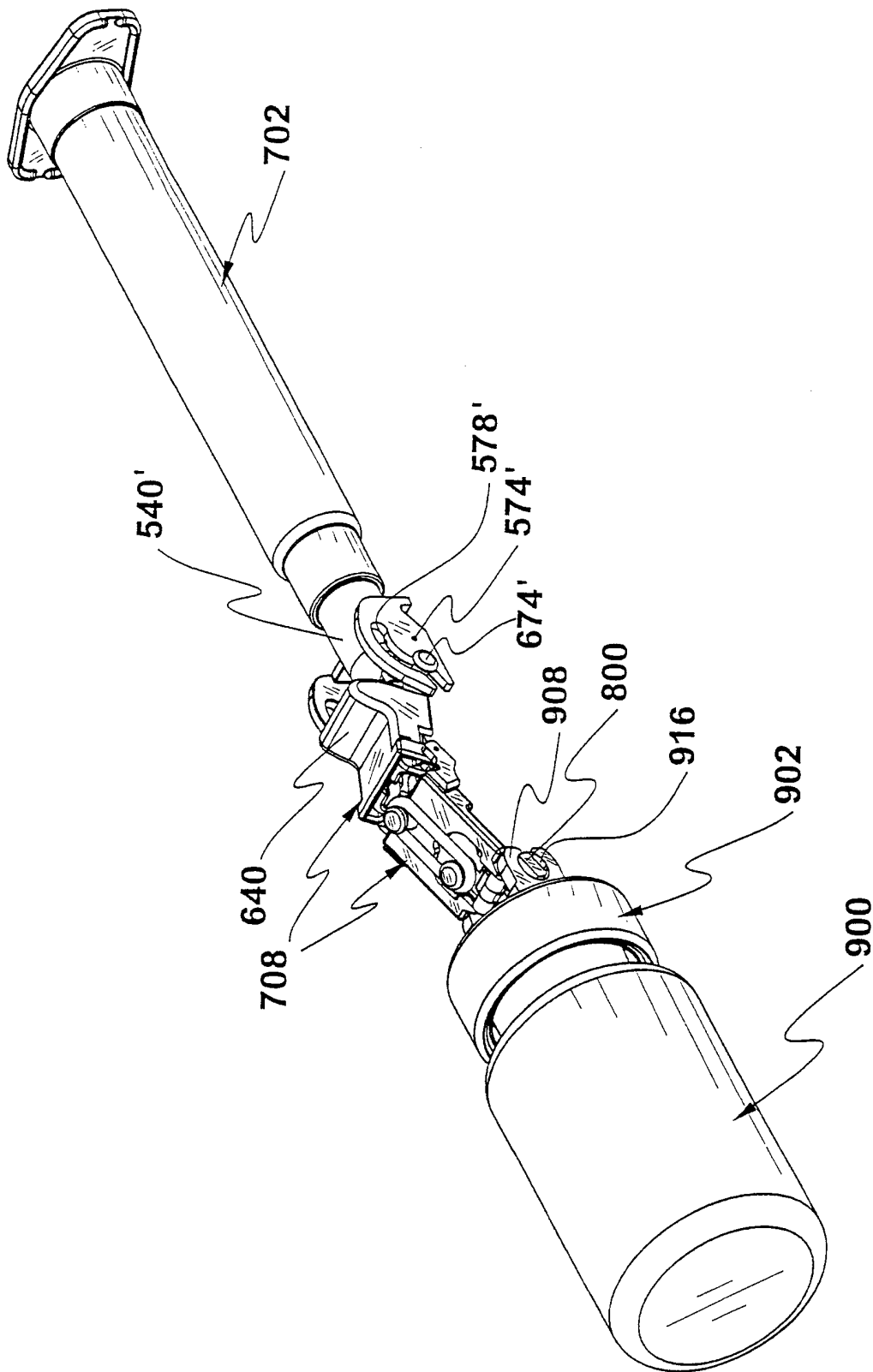

FIGURE 27

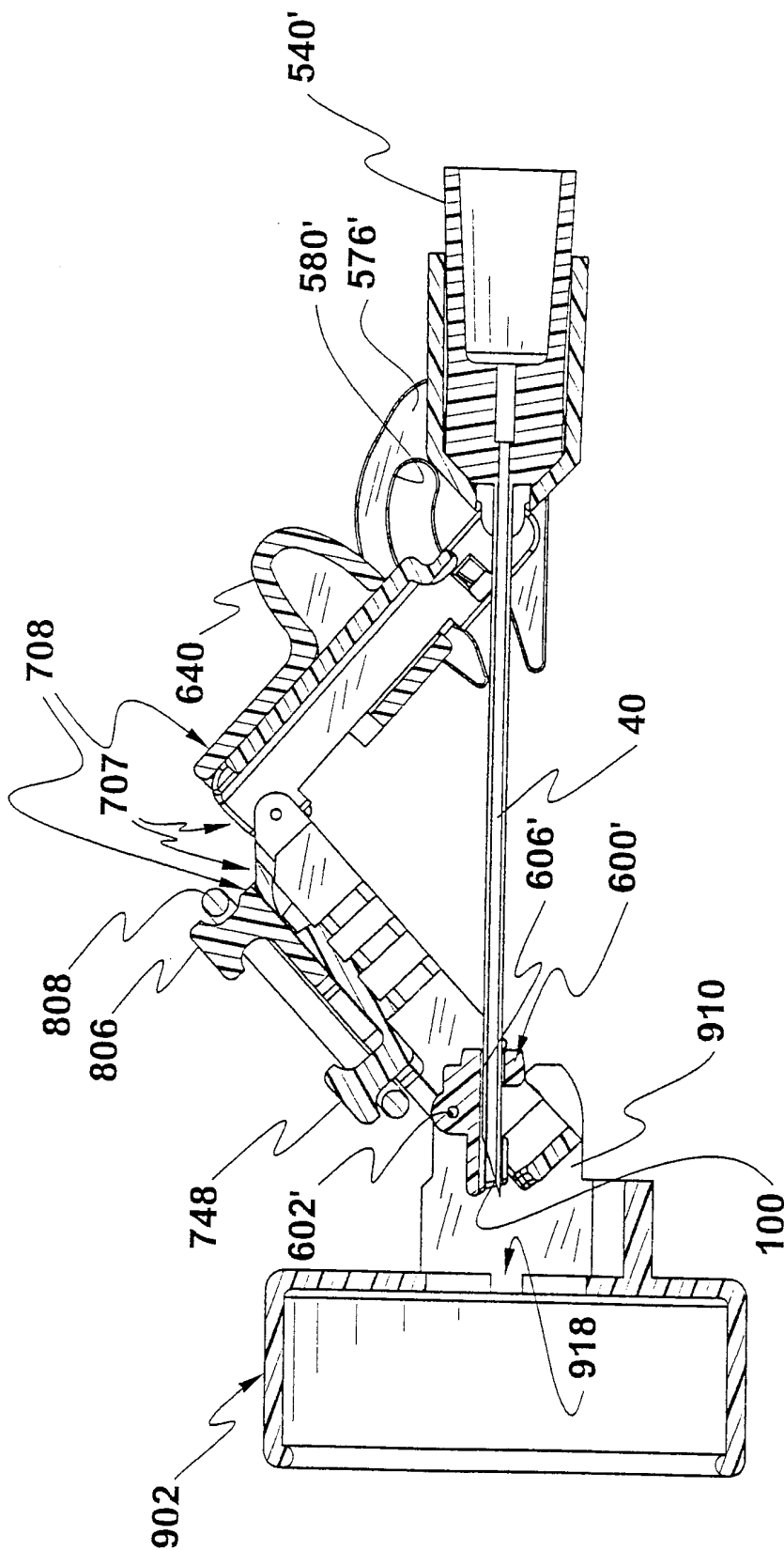

FIGURE 28

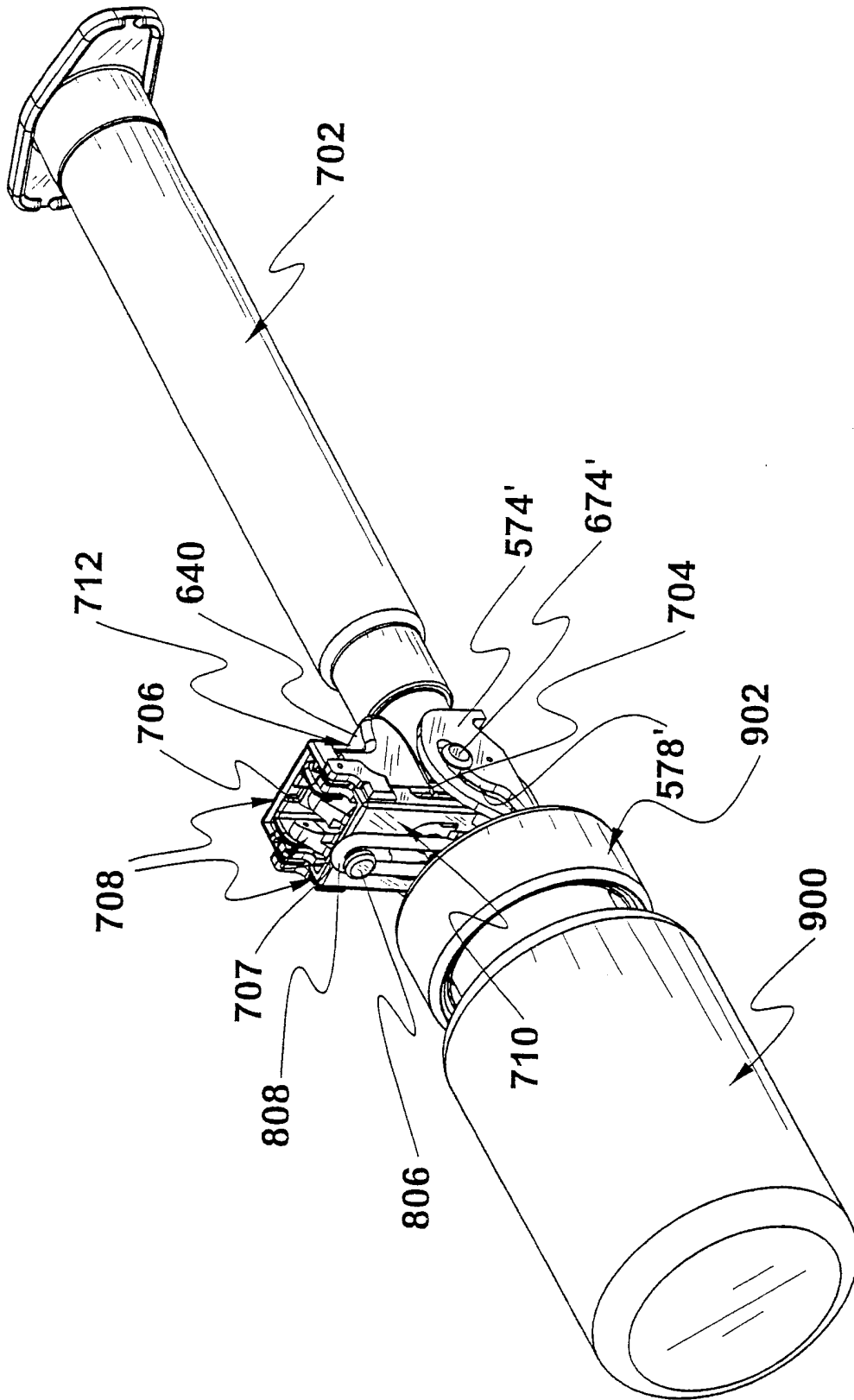

FIGURE 29

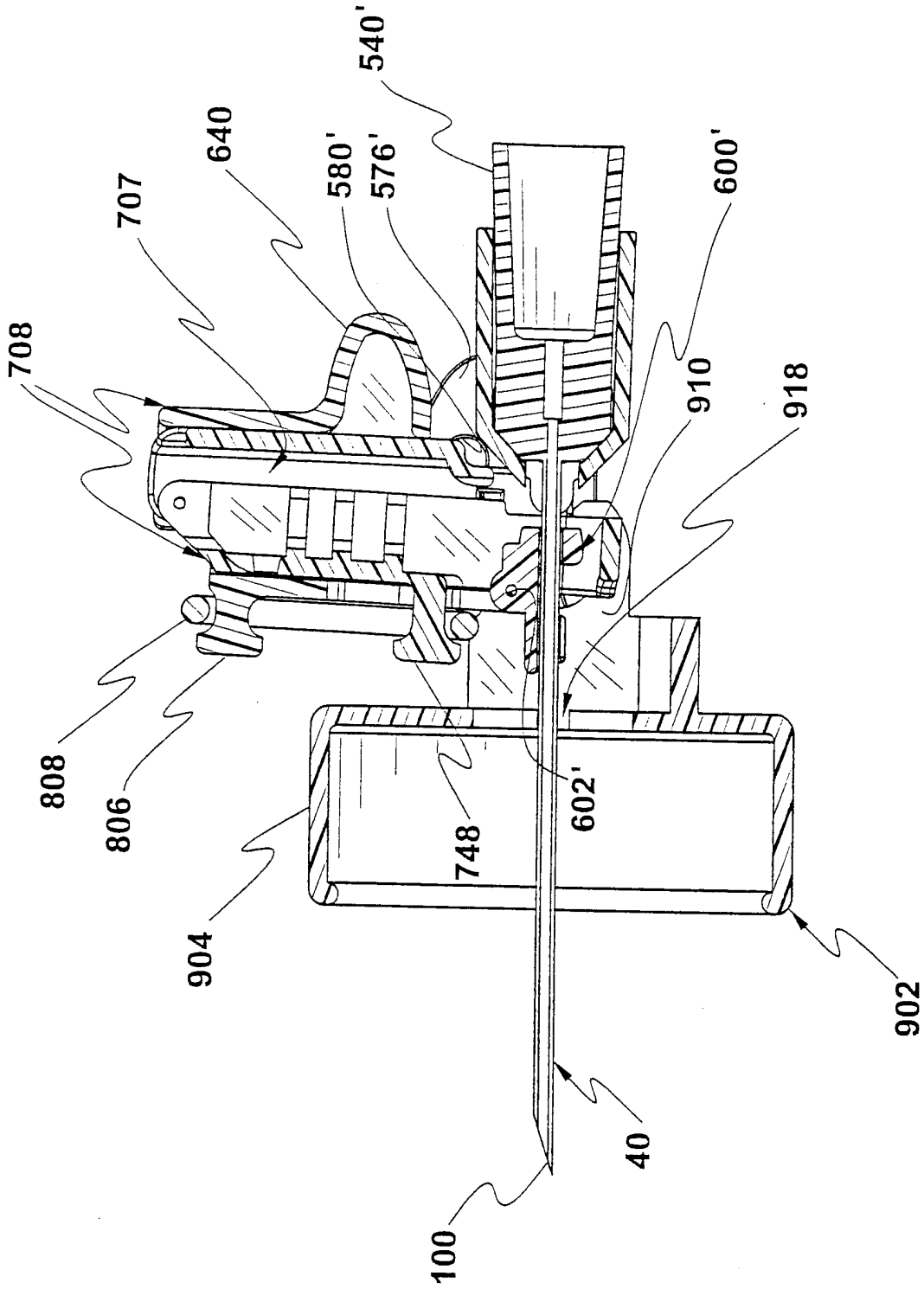

FIGURE 30

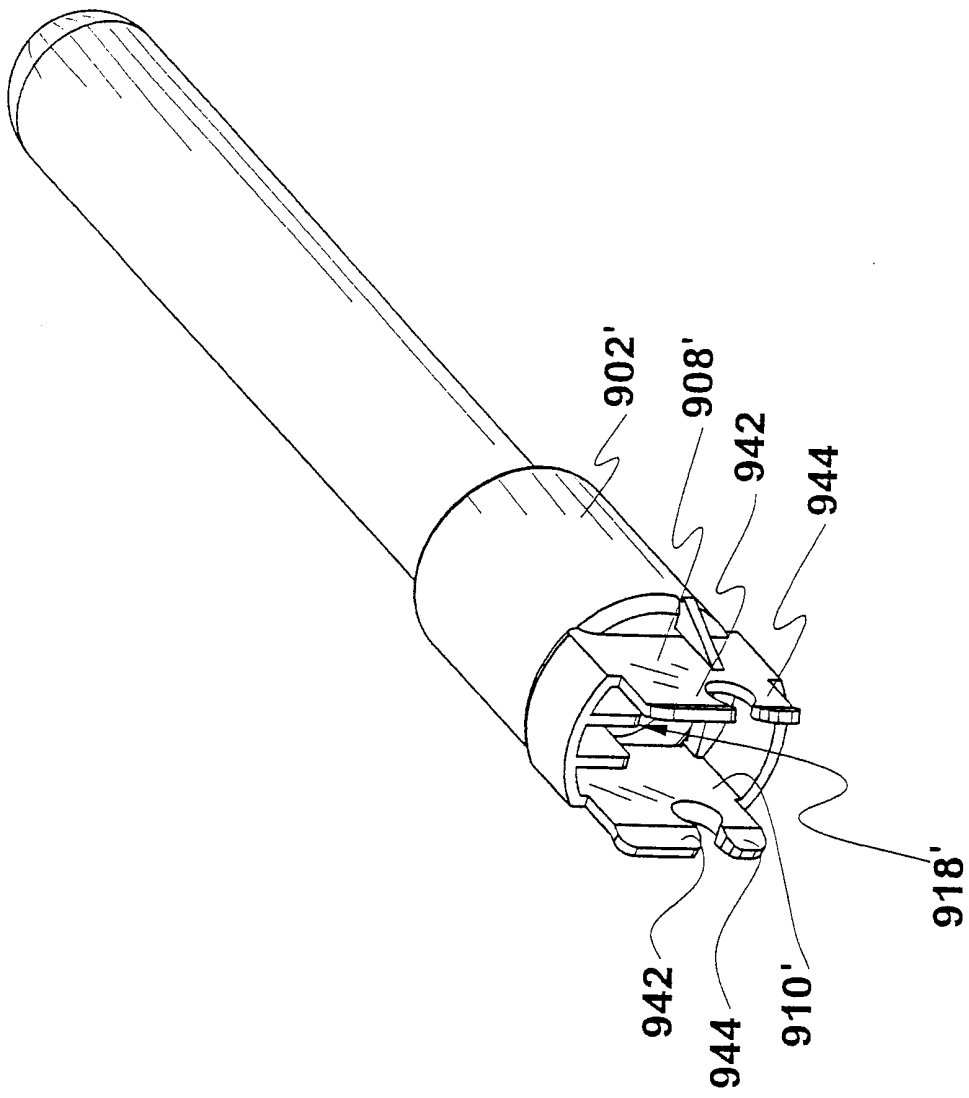

FIGURE 32

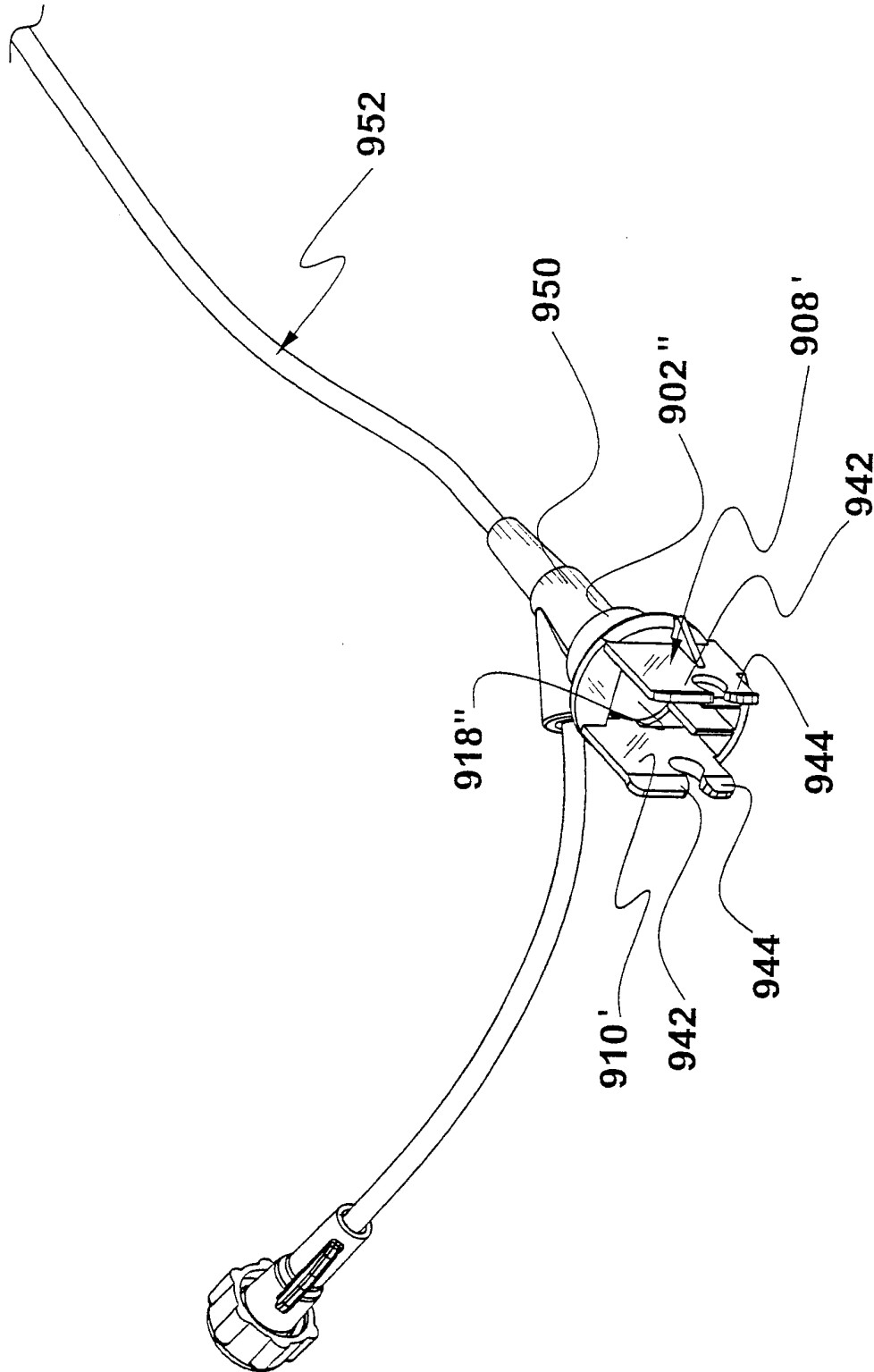

FIGURE 33

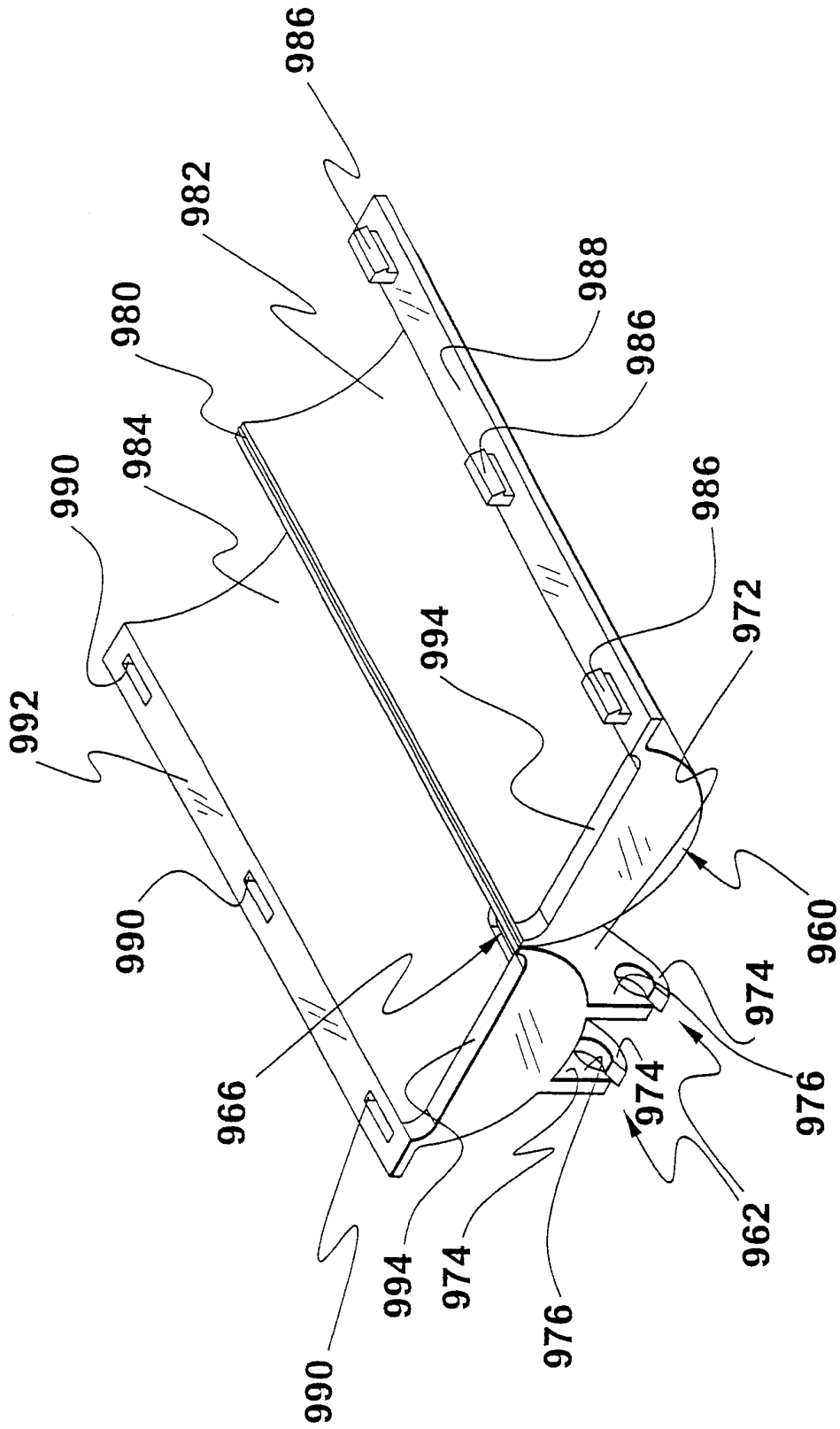

FIGURE 34

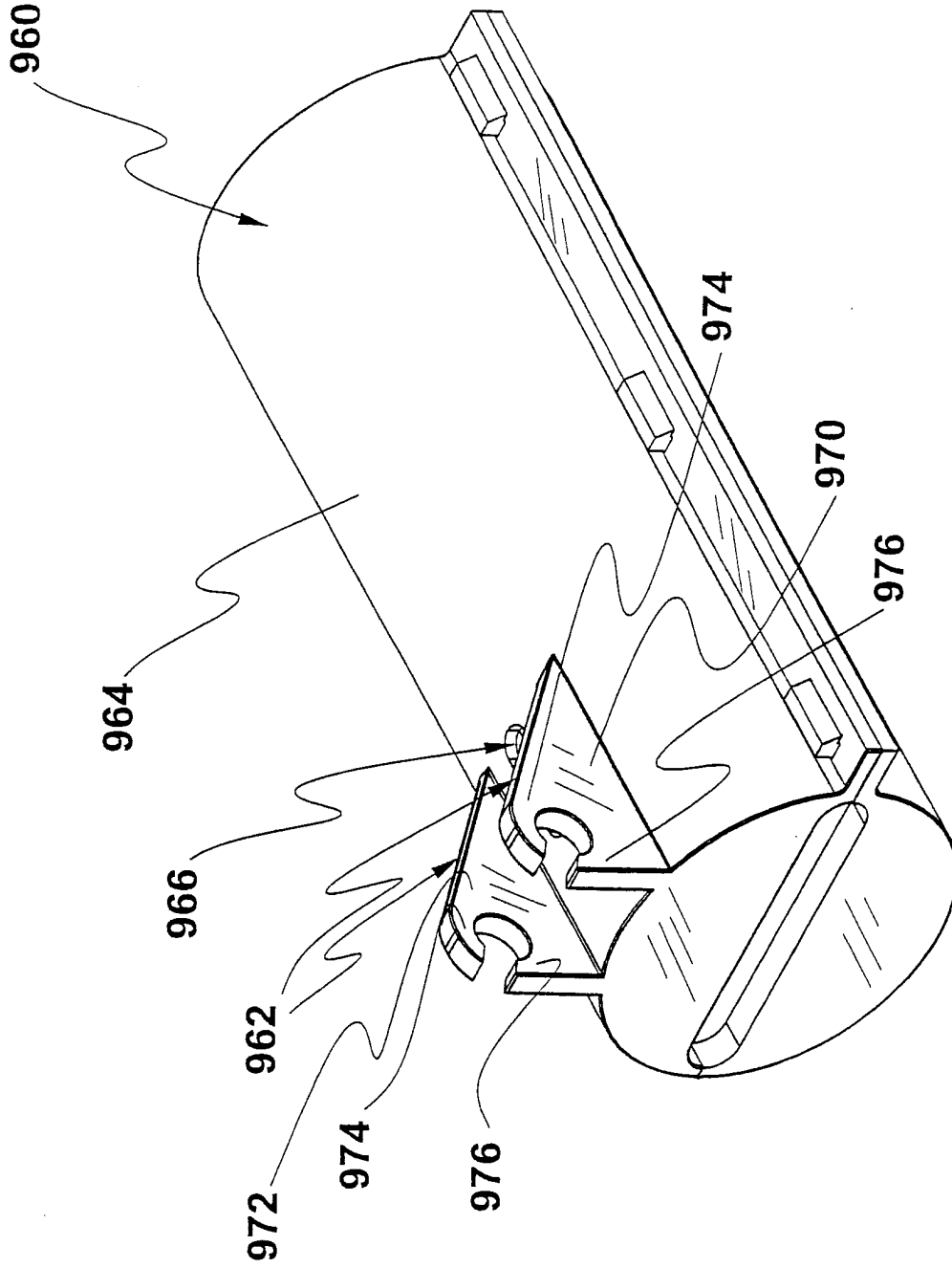

FIGURE 35

INTERNATIONAL SEARCH REPORT

International application No.
PCT/US00/29971

A. CLASSIFICATION OF SUBJECT MATTER
 IPC(7) :A61M 5/32
 US CL :604/198
 According to International Patent Classification (IPC) or to both national classification and IPC

B. FIELDS SEARCHED
 Minimum documentation searched (classification system followed by classification symbols)
 U.S. : 604/198, 192, 196, 197, 110, 263, 240, 273; 128/ 912, 919

Documentation searched other than minimum documentation to the extent that such documents are included in the fields searched

Electronic data base consulted during the international search (name of data base and, where practicable, search terms used)

C. DOCUMENTS CONSIDERED TO BE RELEVANT

Category*	Citation of document, with indication, where appropriate, of the relevant passages	Relevant to claim No.
A	US 5,348,544 A (SWEENEY et al.) 20 September 1994, Figures 2 & 4.	1 & 20.
A	US 5,814,018 A (ELSON et al.) 29 September 1998, Figures 5 & 8.	1 & 20.
A	US 5,746,726 A (SWEENEY et al) 05 May 1998, Figures 2-4 & 7-10.	1, 20.
A	US 5,738,665 A (CAIZZA et al.) 14 April 1998, Figures 2 & 4.	1 & 20.

Further documents are listed in the continuation of Box C. See patent family annex.

* Special categories of cited documents:	*T* later document published after the international filing date or priority date and not in conflict with the application but cited to understand the principle or theory underlying the invention
A document defining the general state of the art which is not considered to be of particular relevance	*X* document of particular relevance; the claimed invention cannot be considered novel or cannot be considered to involve an inventive step when the document is taken alone
E earlier document published on or after the international filing date	*Y* document of particular relevance; the claimed invention cannot be considered to involve an inventive step when the document is combined with one or more other such documents, such combination being obvious to a person skilled in the art
L document which may throw doubts on priority claim(s) or which is cited to establish the publication date of another citation or other special reason (as specified)	* & * document member of the same patent family
O document referring to an oral disclosure, use, exhibition or other means	
P document published prior to the international filing date but later than the priority date claimed	

Date of the actual completion of the international search 02 FEBRUARY 2001	Date of mailing of the international search report 09 APR 2001
Name and mailing address of the ISA/US Commissioner of Patents and Trademarks Box PCT Washington, D.C. 20231 Facsimile No. (703) 305-3230	Authorized officer <i>A. T. NGUYEN</i> A. T. NGUYEN Telephone No. (703) 308-2154