



(51) International Patent Classification:  
A61B 17/00 (2006.01)

(21) International Application Number:  
PCT/US2010/039354

(22) International Filing Date:  
21 June 2010 (21.06.2010)

(25) Filing Language: English

(26) Publication Language: English

(30) Priority Data:  
61/219,120 22 June 2009 (22.06.2009) US  
12/498,586 7 July 2009 (07.07.2009) US

(71) Applicant (for all designated States except US): GORE ENTERPRISE HOLDINGS, INC. [US/US]; 551 Paper Mill Road, P.O. Box 9206, Newark, DE 19714-9206 (US).

(72) Inventors; and

(75) Inventors/Applicants (for US only): AURILIA, Brad, A. [US/US]; 1110 Hawk Hill Drive, Friendswood, TX 77546 (US). MASTERS, Steven, J. [US/US]; 5070 East Dean Avenue, Flagstaff, AZ 86004 (US).

(74) Agents: CARLETON, Katherine, L. et al.; W.I. Gore & Associates, Inc., 551 Paper Mill Road, P.O. Box 9206, Newark, DE 19714-9206 (US).

(81) Designated States (unless otherwise indicated, for every kind of national protection available): AE, AG, AL, AM, AO, AT, AU, AZ, BA, BB, BG, BH, BR, BW, BY, BZ, CA, CH, CL, CN, CO, CR, CU, CZ, DE, DK, DM, DO, DZ, EC, EE, EG, ES, FI, GB, GD, GE, GH, GM, GT, HN, HR, HU, ID, IL, IN, IS, JP, KE, KG, KM, KN, KP, KR, KZ, LA, LC, LK, LR, LS, LT, LU, LY, MA, MD, ME, MG, MK, MN, MW, MX, MY, MZ, NA, NG, NI, NO, NZ, OM, PE, PG, PH, PL, PT, RO, RS, RU, SC, SD, SE, SG, SK, SL, SM, ST, SV, SY, TH, TJ, TM, TN, TR, TT, TZ, UA, UG, US, UZ, VC, VN, ZA, ZM, ZW.

(84) Designated States (unless otherwise indicated, for every kind of regional protection available): ARIPO (BW, GH, GM, KE, LR, LS, MW, MZ, NA, SD, SL, SZ, TZ, UG, ZM, ZW), Eurasian (AM, AZ, BY, KG, KZ, MD, RU, TJ, TM), European (AL, AT, BE, BG, CH, CY, CZ, DE, DK, EE, ES, FI, FR, GB, GR, HR, HU, IE, IS, IT, LT, LU, LV, MC, MK, MT, NL, NO, PL, PT, RO, SE, SI, SK, SM, TR), OAPI (BF, BJ, CF, CG, CI, CM, GA, GN, GQ, GW, ML, MR, NE, SN, TD, TG).

Published:

— with international search report (Art. 21(3))

(54) Title: SEALING DEVICE AND DELIVERY SYSTEM

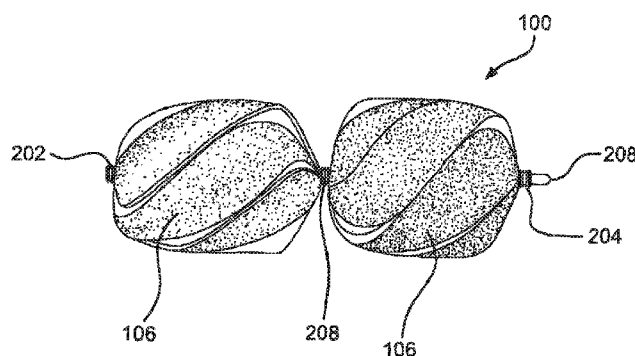

FIG. 5A

(57) Abstract: The invention relates to a sealing device for repair of cardiac and vascular defects or tissue opening such as a patent foramen ovale (PFO) or shunt in the heart, the vascular system, etc. and particularly provides an occluder device and transcatheter occluder delivery system. The sealing device would have improved conformity to heart anatomy and be easily deployed, repositioned, and retrieved at the opening site. The sealing device comprises an expandable frame (200) consisting of 5 nitinol wires extending from a proximal end to a distal end of the frame (200) wherein nitinol comprises 10 % by weight platinum and is drawn filled nitinol. The wires form a proximal eyelet (202), an intermediate eyelet (203) and a distal eyelet (204). The sealing device further comprises a sealing member (508) at least partially encapsulating the expandable wire frame. The sealing member is thin material of ePTFE adhered to the frame by the FEP adhesive.



MP/292

**TITLE OF THE INVENTION**

SEALING DEVICE AND DELIVERY SYSTEM

5       **CROSS REFERENCE TO RELATED APPLICATIONS**

This application claims priority to provisional application USSN 61/219,120, filed June 22, 2009.

10       **BACKGROUND OF THE INVENTION****Field of the Invention**

The invention relates to a sealing device for repair of cardiac and vascular defects or tissue opening such as a patent foramen ovale (PFO) or shunt in the heart, the vascular system, etc. and particularly provides an occluder device and trans-catheter occluder delivery system.

**Discussion of the Related Art**

Sealing devices may be utilized for the occlusion of many types of tissue openings, such as septal defects, PFO, and the like.

Tissue openings have traditionally been corrected by open heart surgery. In order to avoid the trauma and complications associated with open-heart surgery, a variety of trans-catheter closure techniques have been implemented. In such techniques, an occluding device is delivered through a catheter to the site of the opening or defect. A device is placed into the defect and permanently deployed.

A variety of trans-catheter delivered devices are known. These include devices that require assembly at the site of the tissue opening or require threading or "buttoning" of the discrete device elements. Other devices include self-expanding devices. These self-expanding devices tend to be difficult to visualize, cumbersome to load, difficult to position at the site of a tissue opening, and reposition. Most self-expanding devices do not conform to heart anatomy leading to tissue erosion.

An example of a self-expanding device includes an occlusion bag, a third tube, a guide catheter, a super elastic wire, a release mechanism and a delivery sheath. The super elastic wire is attached to the release mechanism and the wire, release mechanism, occlusion bag, guide

MP/292

catheter and third tube are inserted into a delivery sheath for transport to the aperture. After delivery, the occlusion bag is placed within the aperture and the wire is deployed within the bag. The bag and wire are repositioned if necessary, and the release mechanism is activated to release the wire.

Another example of a self-expanding device includes a shape set tubular metal fabric device and optionally, an occluding fiber included in the hollow portions of the device. The metal fabric defines a medical device shaped like a bell, which can be collapsed for passage through a catheter for deployment in a channel of a patient's body.

While these and other self-expanding devices are designed for trans-catheter delivery, they require assembly either prior to use or during use. They are also difficult to reposition or retrieve once deployed and provide poor conformity to heart anatomy. For these reasons, it would be desirable to provide an improved sealing device for use in trans-catheter techniques. Such sealing devices would preferably have improved conformity to heart anatomy and be easily deployed, repositioned, and retrieved at the opening site.

Trans-catheter self-expanding sealing devices may be delivered and deployed by a variety of means. Most trans-catheter delivery devices choose one of two basic systems for deploying the device: pulling back an outer catheter to release the device or pushing the device free of the catheter with a push rod. Each of these systems utilizes a handle to actuate the mechanism used to deploy the device. An example of such a system includes a flexible urging member for urging the sealing device through a catheter and a remotely located control means for advancing the urging member. In this example, the control means includes a threaded, tubular shaft connected to the urging member and a manually rotatable threaded rotor mounted on the shaft. The threads on the rotor mate with the threads on the shaft so that the rotation of the rotor through a known angle will advance the shaft and the urging member a known distance.

An example of a system that utilizes a pull back outer shaft or catheter includes a handle that may selectively hold the delivery system components at any configuration during deployment and positioning of the device. The outer catheter of such a system would be pulled back to

MP/292

release the device by actuating a sliding lever and a rotating finger ring on the delivery system handle.

While these and other device delivery systems are designed for trans-catheter device deployment, they require the use of a threaded  
5 rotor, which can become difficult to rotate or they require large forces to pull back the outer catheter to expose the entire length of the constrained device. Most deployment systems are either not reversible or very difficult to reverse once the deployment procedure has taken place. For these reasons, it would be desirable to provide an improved delivery  
10 system for a sealing device. Such delivery system would preferably have a handle able to be operated simply with a single hand and would be able to execute multiple manipulations with minimal force or hand movement.

15 **SUMMARY OF THE INVENTION**

A first embodiment provides a sealing device having an expandable frame formed from a plurality of wires extending from a proximal end to a distal end of the frame with the wires forming a  
20 proximal and distal eyelet with a sealing member at least partially encapsulating the expandable wire frame.

A further embodiment provides a handle for deploying a sealing device having a housing having a slot and a length with a linear actuator located within the slot and the linear actuator capable of independently  
25 advancing and retracting at least three separate components by advancing and retracting the actuator along the slot length.

An additional embodiment provides an apparatus comprising a handle having a housing having a slot with a length and a linear actuator located within the slot the linear actuator capable of independently  
30 advancing and retracting at least three separate components by advancing and retracting the actuator along the slot length. The apparatus also comprising a sealing device having an expandable frame formed from a plurality of wires extending from a proximal end to a distal end of the frame with the wires forming a proximal and distal eyelet with  
35 a sealing member at least partially encapsulating the expandable wire frame.

MP/292

Additional features and advantages of the invention will be set forth in the description or may be learned by practice of the invention. These features and other advantages of the invention will be realized and attained by the structure particularly pointed out in the written  
5 description and claims hereof as well as the appended drawings.

It is to be understood that both the foregoing general description and the following detailed description are exemplary and explanatory and are intended to provide further explanation of the invention as claimed.

10 **BRIEF DESCRIPTION OF THE DRAWINGS**

The accompanying drawings are included to provide a further understanding of the invention and are incorporated in and constitute a part of this specification, illustrate embodiments of the invention, and  
15 together with the description serve to explain the principles of the invention.

In the drawings:

FIG. 1 is a perspective view of a deployed sealing device attached to the distal end of a delivery system.

20 FIG. 2A is a view of an expanded frame of a sealing device.

FIG. 2B is an end on view of an eyelet of a sealing device.

FIG. 2C is a end on view of a frame of a sealing device.

FIGS. 3A-B are views of components of a winding jig.

FIG. 4A is a side view of a winding jig.

25 FIG. 4B is a top view of a winding jig.

FIG. 5A is a side view of an expanded covered sealing device.

FIG. 5B is a side view of an expanded partially covered sealing device.

30 FIG. 6 is a side view of a self-centering embodiment of a sealing device.

FIG. 7 is a side view of a deployed sealing device.

FIG. 8 is a perspective view of a delivery system including a deployment handle and attached sealing device.

35 FIG. 9A-D are flow charts describing the operation of the delivery system.

FIG. 10 is a perspective view of a sealing device deployment handle.

MP/292

FIG. 11 is a perspective view of an assembly of a sealing device deployment handle.

FIG. 12A is a top down view of an embodiment of a first linear actuator.

5        FIG. 12B is a side view of an embodiment of a first linear actuator.

FIG. 12C is a side view of an embodiment of a first linear actuator.

FIG. 12D is a side view of an embodiment of a first linear actuator.

FIG. 13A is a perspective view of an embodiment of a lock release actuator.

10        FIG. 13B is a perspective view of an embodiment of a lock release actuator in the activated position.

FIG. 14A is a perspective view of an embodiment of a spring.

FIG. 14B is an end on view of an embodiment of a first linear actuator.

15        FIG. 15 is an end on view of an embodiment of a first linear actuator with molded spring component.

FIG. 16 is a perspective view of a spring component.

#### **DETAILED DESCRIPTION OF THE ILLUSTRATED EMBODIMENTS**

20

A first embodiment provides a sealing device having an expandable frame formed from a plurality of wires extending from a proximal end to a distal end of the frame with the wires forming a proximal and distal eyelet with a sealing member at least partially encapsulating the expandable wire frame.

25

Figure 1 shows one embodiment of sealing device 100. Sealing device 100 will be discussed in detail in a later section. Sealing device 100 may be housed within third tube 104. Third tube 104 contains sealing device 100, first tube 102, second tube 108, retrieval cord 110 and locking loop 111. Third tube 104 may be manufactured of Pebax® or any other material with suitable biocompatible and mechanical properties. A material choice with radiopacity may also be an option. The third tube 104 may be manufactured with or without a reinforcing braid to provide appropriate kink resistance and strength for the chosen application. Third tube 104 may also be designed with or without a radiopaque marker band. The design and materials of third tube 104 may be chosen for other properties such as torqueability, steerability and

30

35

MP/292

vascular trauma reduction. One of skill in the art can readily appreciate that there are a wide variety of potential materials that may be used to facilitate the present invention. The third tube 104 may be of any size but is preferably 10fr. with an inner diameter of about 0.048 mm and an  
5 outer diameter of about 0.33 mm. Third tube 104 may be used with or without a guidewire and may include a rapid exchange port 103. The tip of first tube 104 is preferably curved to aid in navigation and delivery of sealing device 100 from the access site to the defect with or without a guidewire.

10 Also shown in Figure 1 is first tube 102. As previously stated, first tube 102 may be housed within third tube 104. The first tube 102 may be of any outer diameter size but is preferably sized to fit within the lumen of the third tube 104. First tube 102 may be manufactured of  
15 Pebax® or any other material with suitable biocompatible and mechanical properties. First tube 102 is preferably a triple lumen catheter. The lumens may be of any geometric shape but are preferably round or oval or a combination of both. First tube 102 may be used to position and aid in the deployment of sealing device 100. First tube 102 may be utilized in conjunction with second tube 108 to cause sealing  
20 device 100 to protrude from the distal tip of third tube 104 once sealing device 100 has reached the defect site. The first tube 102 may also have the function of retaining sealing device 100 onto the delivery system until final device deployment. First tube 102 has an opening 109 in the distal most end to allow the locking loop 111 to protrude during  
25 device deployment. The opening 109 and protruding locking loop 111 provide attachment to the device delivery system. Locking loop 111 is shown in its extended position prior to retaining its pre-set shape. The first tube 102 may be surface treated or coated to enhance the material's biocompatibility or alter or enhance the surface friction.

30 First tube 102 may house the second tube 108. The second tube 108 is essentially tubular with an oval cross section and can have an outer diameter suitable to fit inside first tube 102. A preferred outer diameter range would be from about 1.27 x 0.68 mm and would be flared at the distal end. The second tube 108 may be fabricated from any  
35 suitable biocompatible material including polymers or metals. A preferable material would be PEEK (polyetheretherketone). Second tube 108 can be used to aid in the delivery and deployment of sealing device

MP/292

100 to a defect site. Second tube 108 is threaded through the eyelets of sealing device 100 to hold sealing device 100 on the delivery system and to provide stability while deploying the sealing device 100. Sealing device eyelets will be discussed further.

5 Retrieval cord 110 is looped through two of the smaller lumens of the first tube 102 and through the proximal eyelet of the sealing device 100 to provide attachment to the delivery system and a method of retrieval once the sealing device has been deployed. Retrieval cord 110 extends through the length of first tube 102 with the ends terminating at  
10 the handle used for deploying sealing device 100. Retrieval cord 110 may be manufactured of any biocompatible material of sufficient strength and size. A preferable material is ePTFE (expanded polytetrafluoroethylene).

As shown in Figure 2A sealing device 100 is formed of a wire  
15 frame 200. When situated for delivery, wire frame 200 is at an extended position on second tube 108 and within third tube 104. Wire frame 200 may be of any size appropriate for an application but is preferably sized with finished outer diameters of 15, 20, 25, or 30 mm. The wire frame 200 is formed of continuous wires. Any number of wires may be used to  
20 construct the wire frame 200. A preferable number of wires is five. The wire frame 200 can be constructed of wires that have elastic properties that allow for wire frame 200 to be collapsed for catheter based delivery or thoracoscopic delivery, and self-expand to a "memory" induced configuration once positioned in a defect. The elastic wire may be a  
25 spring wire, or a shape memory NiTi (nitinol) alloy wire or a super-elastic NiTi alloy wire. The elastic wire may also be of a drawn-filled type of NiTi containing a different metal at the core. Preferably, wire frame 200 would be constructed of a drawn-filled type of NiTi wire containing a radiopaque metal at the center. Upon deployment, the wire structure  
30 resumes its deployed shape without permanent deformation.

Wire frame 200 and other wire frames shown are formed from elastic wire materials that have outer diameters between 0.12 and 0.4 mm. In a preferable embodiment, wire outer diameter size would be about 0.3 mm. When formed, wire frame 200 comprises a distal bumper  
35 208, distal eyelet 204, locking loop 206, an optional center eyelet 203, and proximal eyelet 202. Figure 2B shows the position of elastic wires during the formation of eyelets 202, 203 and 204 of wire frame 200.



MP/292

Figure 2C shows a disk formed when wire frame 200 is deployed. The elastic wires that form wire frame 200 form petals 212 during deployment. The pre-set elastic wire configuration of wire frame 200 allows the frame to twist during deployment. This twist forms petals 212. Deployed petals 212 form the outer diameter 214 of the wire frame 200. Deployed petals 212, when covered with sealing member 106, form proximal and distal disks, to be discussed further. Petals 212 are optimally formed to have overlapping zones 216 to improve sealing qualities. The radius of petals 212 may be maximized to minimize sharp bend angles in the elastic wire and to minimize unsupported sections of petals 212 that improve sealing qualities of the device, reduce bending fatigue in the wire and aid in reducing device loading forces. Deployed petals 212 form a disk on either side of the center eyelet 203. The deployed configuration will be discussed further.

Construction of wire frame 200 may be accomplished by a variety of means including machine winding with automatic wire tensioning or by hand winding with weights suspended from each wire during construction. Shown in Figures 3A-C are keyed center pin 300 and button 304, which may be used to aid in the construction of wire frame 200. One commonly skilled in the art would recognize that there are many materials suitable for use as a manufacturing aid or tooling. A preferable material for use in forming a center pin 300 would be cobalt high strength steel. A preferable material for use in forming a button 304 and winding jig would be corrosion resistant tool steel. The winding jig will be discussed further. Shown in detail in Figure 3A, keyed center pin 300 may have groove 302, which can be used to secure an elastic wire during device construction. Keyed center pin 300 can be used to guide an elastic wire through opening 306 in button 304, the features of which are illustrated in Figures 3B-C. Button 304 is preferably formed with an indentation 308 in the bottom to fit securely in a winding jig. An elastic wire held in groove 302 and inserted through opening 306 in button 304 can form a bumper 208 and locking loop 206. Keyed center pin 300 is also used in the formation of eyelets 202, 203 and 204. During device construction, after the formation of bumper 208, elastic wires can be wound around keyed center pin 300 to form a distal eyelet 202. Other eyelets, 203 and 204 can be formed in a similar manner. Once keyed

MP/292

center pin 300 is inserted in button 304 an elastic wire may be inserted into grooves in a winding jig.

A winding jig may be used to secure and form the elastic wires during construction and processing of the sealing device 100. A typical winding jig may be constructed as commonly known in the arts. Materials used for construction of such a winding jig have been discussed previously. A preferable winding jig is shown in Figures 4A and 4B. Figure 4A illustrates a side view of the winding jig 400. Figure 4B shows a view of the top of a preferable winding jig 400. Winding jig 400 contains an aperture 402 that may be shaped and sized to hold keyed center pin 300 and button 304 during device construction. Grooves 404 in the jig surface are used to secure and form the elastic wires into petals 212. Grooves 404 may be of any diameter but are preferably sized to accommodate an outer diameter of elastic wire. In one embodiment shown in Figure 5A, the winding jig assembly may be used to form a center eyelet 203, a petal assembly and proximal eyelet 204. The shaped wire may be constrained in the winding jig assembly, heated and processed to shape set as commonly known in the arts.

Figure 5A shows an embodiment of sealing device 100 which is a composite assembly of wire frame 200 and sealing member 106. Sealing member 106 may be attached to wire frame 200 by a bonding agent. Wire frame 200 may be coated with a bonding agent, for example fluorinated ethylene propylene (FEP) or other suitable adhesive. The adhesive may be applied through contact coating, powder coating, dip coating, spray coating, or any other appropriate means. In a preferred embodiment, the FEP adhesive is applied by electrostatic powder coating. Sealing member 106 may be constructed of a variety of materials, such as DACRON®, polyester, polyethylene, polypropylene, fluoropolymers, polyurethane, foamed films, silicone, nylon, silk, thin sheets of super-elastic materials, woven materials, polyethylene terephthalate (PET), collagen, pericardium tissue or any other biocompatible material. In one embodiment, sealing member 106 can be formed of a thin porous ePTFE (expanded polytetrafluoroethylene) substrate. Sealing member 106 is designed to enhance the defect closure characteristics of sealing device 100 by providing defect blockage and a medium for cellular in growth.

MP/292

Also shown in Figure 5A are proximal, distal and center eyelets (202, 203 and 204) respectively covered with sealing member 106 and wrapped with a film. The eyelets 202, 203 and 204 may be wrapped with a film to encourage adhesion of sealing member 106 to the device. The film used to wrap eyelets 202, 203, and 204 may be any biocompatible thin material but is a material preferably comprised of multiple layers of thin porous ePTFE that may be laminated with one or more layers of non-porous FEP.

Figure 5B illustrates an embodiment of sealing device 100 that includes a sealing member 508 that partially covers wire frame 200. A partially covered device may have either the distal or proximal bulb covered in part or in entirely with a sealing member 508.

Another embodiment of the device is a self centering device 600. Shown in Figure 6, self centering device 600 comprises a wire frame 602 similar to that of wire frame 200. Self centering device 600 is a composite assembly of wire frame 602 and sealing member 604. Wire frame 602 may be constructed with the same techniques and a material as wire frame 200 but has no center eyelet. Wire frame 602 comprises distal bumper 606, covered distal eyelet 608, covered proximal eyelet 610, and locking loop 612. The pre-set elastic wire configuration of wire frame 602 allows the frame to twist upon deployment and create a centering region 614 of the device 600 during deployment. During deployment, region 614 may center itself in the defect forming a disk comprised of petals on either side of region 614 and the defect.

Figure 7 shows a sealing device 100 fully deployed. During deployment, the constraint of the third tube 104 is removed from device 100 and the device returns to its pre-set shape. During deployment and locking, lock loop 111 is released from the constraint of first tube 102 and returns to its pre-set shape, curling from the proximal eyelet 202. In this manner, the device is locked in a deployed state. Figure 7 also illustrates the position of the proximal and distal disks, elements 702 and 704, in relation to the proximal, center, and distal eyelets 202, 203, and 204 respectively.

Figure 8 shows a perspective view of sealing device 100 attached to a delivery system including first tube 102, third tube 104, and a handle for deploying a sealing device 100. Figure 8 further illustrates a fist linear actuator 802, a flushing port 804, the second linear actuator 806,

MP/292

lock release actuator 808, a housing 810 and a slot with a length in the housing 812. First linear actuator 802 may have a variety of configurations which will be discussed further.

Figures 9A-D are flow charts which describe the movements of the various components of the delivery system and attached sealing device 100 during use. Loading sealing device 100 into the delivery system prior to use is described in Figure 9A. Components of the delivery system handle are shown in Figures 8, 10 and 11. A clinician may flush the delivery system by attaching a syringe or other suitable implement onto flushing port 804 and filling the system with saline or any other appropriate flushing material. The first linear actuator 802 may then be moved in slot 812 in housing 810 against a spring 1100. Spring 1100 may be configured as shown or may be formed as a leaf spring, stepped spring or any form commonly known in the arts. This action rotates the mandrel control lever 1000, shown in Figure 11, about a slider rod 1102 to the side of housing 810. This same motion moves the first linear actuator 802 free of distal notch 1104 in the sizing insert 1103 and prevents the second tube 108 from translating either proximally or distally. Sizing insert 1103 may be of any material with suitable mechanical properties.

Typical handles, handle components, tools or catheters used to deliver medical devices can comprise commonly known materials such as Amorphous Commodity Thermoplastics that include Polymethyl Methacrylate (PMMA or Acrylic), Polystyrene (PS), Acrylonitrile Butadiene Styrene (ABS), Polyvinyl Chloride (PVC), Modified Polyethylene Terephthalate Glycol (PETG), Cellulose Acetate Butyrate (CAB); Semi-Crystalline Commodity Plastics that include Polyethylene (PE), High Density Polyethylene (HDPE), Low Density Polyethylene (LDPE or LLDPE), Polypropylene (PP), Polymethylpentene (PMP); Amorphous Engineering Thermoplastics that include Polycarbonate (PC), Polyphenylene Oxide (PPO), Modified Polyphenylene Oxide (Mod PPO), Polyphenylene Ether (PPE), Modified Polyphenylene Ether (Mod PPE), Thermoplastic Polyurethane (TPU); Semi-Crystalline Engineering Thermoplastics that include Polyamide (PA or Nylon), Polyoxymethylene (POM or Acetal), Polyethylene Terephthalate (PET, Thermoplastic Polyester), Polybutylene Terephthalate (PBT, Thermoplastic Polyester), Ultra High Molecular Weight Polyethylene (UHMW-PE); High

MP/292

Performance Thermoplastics that include Polyimide (PI, Imidized Plastic), Polyamide Imide (PAI, Imidized Plastic), Polybenzimidazole (PBI, Imidized Plastic); Amorphous High Performance Thermoplastics that include Polysulfone (PSU), Polyetherimide (PEI), Polyether Sulfone (PES), Polyaryl Sulfone (PAS); Semi-Crystalline High Performance Thermoplastics that include Polyphenylene Sulfide (PPS), Polyetheretherketone (PEEK); and Semi-Crystalline High Performance Thermoplastics, Fluoropolymers that include Fluorinated Ethylene Propylene (FEP), Ethylene Chlorotrifluoroethylene (ECTFE), Ethylene, Ethylene Tetrafluoroethylene (ETFE), Polychlorotrifluoroethylene (PCTFE), Polytetrafluoroethylene (PTFE), Polyvinylidene Fluoride (PVDF), Perfluoroalkoxy (PFA). Other commonly known medical grade materials include elastomeric organosilicon polymers, polyether block amide or thermoplastic copolyether (PEBAX) and metals such as stainless steel and nickel/titanium alloys.

A distal notch 1104 and proximal notch 1106 in sizing insert 1103 may be used to aid in the positioning of the first linear actuator 802 in housing slot 812. The distance between the two notches, 1104 and 1106 respectively, may be the length of sealing device 100 when it is elongated over second tube 108 prior to loading onto the delivery system. Sizing insert 1103 may be sized to accommodate a variety of device lengths and is preferably from about 22.28 cm long with a distance between the proximal end of distal notch 1104 and proximal end of proximal notch 1106 from about 6.25-13.32 cm. Notches 1104 and 1106 may be of any shape but are preferably rectangular.

The first linear actuator 802 is then moved to a mid point in slot 812 toward the proximal end of the housing 810. This action causes the first tube 102 to move proximally and the sealing device 100 proximal end to move proximally, thus elongating sealing device 100. First linear actuator 802 may be any shape (lever, ball) but is preferably shaped to accommodate a clinician's thumb. First linear actuator 802 may be constructed of any material with suitable mechanical properties but is preferably a material similar to that of sizing insert 1103. A feature of the first linear actuator 802 are recessed teeth formed in the top portion of the first linear actuator 802 for securing retrieval cord 110. This feature is preferred but optional. The teeth could be made into any tortuous path or have any shape desired to create resistance for retrieval cord 110

MP/292

during loading, deployment, or retrieval of sealing device 100.

Corresponding protruding teeth (not shown) may be formed in the bottom surface of retrieval cord lock 803. These teeth may fit together and hold the retrieval cord firmly. Other methods commonly known in the art for  
5 securing a small diameter cord may also be used and will be discussed in detail in a following section.

The first linear actuator 802 is then moved further proximally until the device is loaded in third tube 104. During this action, spring 1100 pushes the first linear actuator 802 and the mandrel control lever 1000 to  
10 the left of slot 812 and into the proximal notch 1106 in sizing insert 1103. The second tube 108 is free to move proximally with sealing device 100 and first tube 102. As the first linear actuator 802 is moved proximally, the second tube 108, sealing device 100 and first tube 102 slide or translate into the third tube 104. After the first linear actuator 802 is in its  
15 proximal most position, the system may again be flushed with saline in the manner described above.

Alternate embodiments of first linear actuator 802 are shown in Figures 12A-D. Figure 12A shows a perspective view of the alternate linear actuator 1108 in the locked retrieval cord position. Linear actuator  
20 1108 is similar in construction to linear actuator 802 but features a retrieval cord locking ring 1110 and retrieval cord groove 1112. Figure 12B depicts alternate embodiment 1114, which is configured with a thumb wheel 1116 that extends beyond the sides of the linear actuator to facilitate easy manipulation. Thumb wheel 1116 is screwed onto a  
25 threaded post 1118 around which the retrieval cord is wound. Embodiment 1114 also contains a retrieval cord groove 1120 through which the retrieval cord is guided prior to securing it around threaded post 1118. Figure 12C illustrates yet another embodiment 1122 that utilizes a side fitted threaded thumb wheel 1124 around which the  
30 retrieval cord is wound and secured to the actuator 1122 by the act of inserting the threaded post 1124 into a threaded aperture (not shown) in the side of the actuator 1122. Prior to threading the retrieval cord around the threaded post 1124, the retrieval cord is inserted through the retrieval cord groove 1126. Yet another embodiment 1128 is shown in Figure  
35 12D. Embodiment 1128 shows a linear actuator with molded thumb wheel 1130. The thumb wheel 1130 extends slightly beyond the edges of the linear actuator facilitating manipulation of the linear actuator. The

MP/292

retrieval cord is inserted through cord groove 1132 and wound around a threaded post (not shown). The molded thumb wheel 1130 is then secured on the threaded post securing the retrieval cord.

Deploying sealing device 100 into a defect is described in Figure 9B. The first linear actuator 802 is moved distally until a stop is reached. This movement causes the first tube 102 and second tube 108 to move distally within the third tube 104. The linear actuator 802 must then be moved to the right in slot 812, against spring 1100. When the linear actuator 802 is moved to the right, mandrel control lever 1000 rotates on slider rod 1102. This action causes the linear actuator 802 to be free of the proximal notch 1106 in sizing insert 1103. After this action, the linear actuator 802 is further translated distally. This causes the first tube 102 and proximal eyelet 202 of sealing device 100 to move distally. Also affected by this action is the distal end of sealing device 100 which is prevented from moving. The first tube 102 guides the device out of the third tube 104 to deploy the device in a defect. Moving linear actuator 802 distally to the end of slot 812 results in the entire sealing device being deployed. One skilled in the art would recognize that the steps described above could be halted and reversed at certain points to allow optimal positioning of sealing device 100.

Locking the device is described in the flowchart illustrated in Figure 9C. The retrieval cord lock 803 would be unsnapped from the first linear actuator 802. A clinician would grasp the second linear actuator 806 by gripping attached lock release actuator 808 and press it toward the middle of housing 810. The second linear actuator 806 may be of any size or shape but is preferably sized to fit within a slot 1002 in the longitudinal surface of housing 810. Linear actuator 806 is fitted with lock release actuator 808 by means of a snap fitting. Any means of attachment would suffice to fasten lock release actuator 808 to linear actuator 806 such as glue or construction as a molded part. Materials appropriate for both the second linear actuator 806 and lock release actuator 808 may be any material of suitable mechanical properties but are preferably similar to that of the previously mentioned handle components. Lock release actuator 808 is designed to enable a user to grip the device securely. Gripping may be aided by protrusions on the lateral sides of the lock release actuator 808. These protrusions may be made of a similar material as that of the lock release actuator 808 or may

MP/292

be made of a material with a high coefficient of friction or of a material more compliant than that of lock release actuator 808. These protrusions may also be made with grating, a roughening, a raised design, or striations in the surface in conjunction with the material listed  
5 above to further aid in the gripping of the device. These features on the surface of lock release actuator 808 may also be used to aid in gripping without the use of gripping protrusions and may be applied directly to the lateral surface of the second linear actuator 806. Slot 1002 may be configured to have a stop to hold the second linear actuator 806 in a  
10 distal most position until lock release of the sealing device. A preferred stop is shown in Figures 10 and 11 in the form of a corrugated area but may also be any manner of mechanical stop. Slot 1002 may be of any length but preferably has a length sufficient to translate motion proximally about the width of the second linear actuator 806 plus about 3.18 cm.  
15 Slot 1002 may be any shape that would accommodate the second linear actuator 806.

An alternate embodiment of second linear actuator 806 is shown in Figures 13A and 13B. Instead of gripping lock release actuator 808 and activating second linear actuator 806 a rotatable lock release  
20 actuator 1300 is gripped and rotated to affect lock release. The rotatable lock release actuator 1300 may contain a window 1302 which would prevent forward movement of the first linear actuator 802. When rotated, lock release actuator 1300 allows the same actions as lock release actuator 806 shown in Figure 10.

25 Once the second linear actuator 808 is gripped, a clinician may move the second linear actuator 806 proximally. This action results in proximal movement of third tube 104, mandrel control lever 1000, sizing insert 1103 and second tube 108. Second tube 108 moves proximally from between eyelets of the device. An alternate method of achieving  
30 this action would be to provide a twist mechanism to the distal end of the handle instead of a second linear actuator 806. This twist mechanism would be provided with a slot that allows for the same movement of the third tube 104, mandrel control lever 1000, sizing insert 1103 nad second tube 108 as the second linear actuator 806.

35 Once lock release has been achieved, the retrieval cord lock 803 is then twisted to remove it from the first linear actuator 802 and pulled until the retrieval cord 110 is free of the delivery system. Retrieval cord



MP/292

110 is attached to the retrieval cord lock 803 at one end. Retrieval cord 110 may be constructed of any material with suitable mechanical properties such as Kevlar®, flexible metal wire, polymers and the like. A preferably material for retrieval cord 110 is an ePTFE fiber. Retrieval  
5 cord lock 803 may be configured in a variety of shapes and sizes. Possible retrieval cord locks may be designed to provide a slot in the linear actuator 802 through which the retrieval passes. In one configuration, the retrieval cord is secured by passing the cord through a slot or hole in the axis of the thumb wheel disposed in the linear actuator  
10 802 and tightened by twisting the thumb wheel. An alternate configuration would provide a slide lock that binds the retrieval cord between the lock and the linear actuator 802 using friction. A preferred design would be to secure the retrieval cord between teeth formed in the retrieval cord lock as shown in Figure 11.

15 Materials suitable for constructing retrieval cord lock 803 are similar to that used to construct housing 810 and other handle components. As mentioned previously, retrieval cord lock 803 preferably has teeth or protrusions that correspond to indentations in linear actuator 802 for the purpose of gripping retrieval cord 110. Retrieval cord lock  
20 803 may be configured in a variety of shapes to enable retrieval cord 110 to be secured. A preferred configuration would include apertures through the retrieval cord lock 803 to allow retrieval cord 110 to be threaded therethrough and knotted. After twisting the retrieval cord lock 803, it is pulled until the retrieval cord 110 is removed from the delivery  
25 system.

Prior to the step four described in Figure 9C, the sealing device 100 may be retrieved as described in the flowchart illustrated in Figure 9D. The retrieval cord lock 803 may be snapped into the first linear actuator 802. This serves to lock the retrieval cord 110 in place. The  
30 clinician then moves the first linear actuator 802 to the right edge of slot 812. The first linear actuator 802 moves in slot 812 to the right pressing on spring 1100 while the mandrel control lever 1000 rotates on the slider rod 1102 to the right of the handle. Slider rod 1102 is preferably of a round cross-section but one skilled in the art would recognize that a  
35 variety of cross-sectional shapes (e.g. square or triangular) would be acceptable. Slider rod 1102 could also be configured in the shape of a crown spring 1400 as shown in Figures 14A and B. The spring could be

MP/292

inserted in a slot 1402 through the linear actuator to allow fore and aft translation of the linear actuator. An alternate embodiment of spring 1100 may be a spring molded as an integral part 1500 of first linear actuator 802 as illustrated by Figure 15. Another embodiment of spring 1100 is shown in Figure 16. In this configuration, a spring 1600 is attached to housing 810 and pushes on the first linear actuator 802 in key positions. As stated above, one skilled in the art would recognize the appropriate materials for use as a spring or molded part. The first linear actuator 802 is free of distal notch 1104 and the second tube 108 is prevented from moving. The first linear actuator is moved proximally by the clinician causing first tube 102 to move proximally. This motion translates the proximal end of sealing device 100 proximally elongating the device 100 and allowing it to be pulled into the third tube 104.

**EXAMPLES:**

Without intending to limit the scope of the invention, the following examples illustrate how various embodiments of the invention may be made and/or used.

**Example 1:**

A sealing device similar to Figure 1 was manufactured using the following components and assembly process.

An expanded polytetrafluoroethylene material was obtained with the following properties:

- Methanol bubble point of 1 psi
- Mass/area of 2.2 grams/square meter
- Longitudinal maximum load of 1.6 kg/inch
- Thickness of 0.0003 inch
- Longitudinal matrix tensile strength of 92000 psi

The following test methods and equipment were used to determine the above-mentioned properties: Methanol bubble point was measured using a custom built machine with a 1 inch diameter foot, a ramp rate of 0.2 psi/second and a liquid media of methanol. Length and width of the material were measured using a metal ruler. Mass/area was measured using a balance (Model GF-400 Top Loader Balance, ANG, San Jose CA.) with a 36 x 5 inch sample. Longitudinal maximum load was measured using a materials test machine (Model 5564, Instron,

MP/292

Grove City, PA ) equipped with a 10 kg load cell. The gauge length was 1 inch and the cross head speed was 25mm/minute. Sample width was 1 inch. Longitudinal tensile test measurements were taken in the length direction of the material. Thickness was measured using a thickness gauge (Mitutoyo Digital Indicator 547-400) with a foot diameter of ¼ inch. The longitudinal matrix tensile strengths (MTS) were calculated using the following equation: Density was calculated using the formula, density = mass/volume.

$$\text{Matrix Tensile Strength} = \frac{(\sigma_{\text{sample}}) * (\rho_{\text{PTFE}})}{(\rho_{\text{sample}})}$$

where:  $\rho_{\text{PTFE}} = 2.2 \text{ grams/cc}$

$\sigma_{\text{sample}} = (\text{Maximum Load/Width})/\text{Thickness}$

$\rho_{\text{sample}} = (\text{Mass/Area})/\text{Thickness}$

An expanded polytetrafluoroethylene with a thin layer of FEP (fluorinated ethylene propylene) material was obtained with the following properties:

- Mass/area of 36.1 grams/square meter
- Maximum Load, Longitudinal of 12.6 kg/inch
- Maximum Load, Transverse of 0.3 kg/inch
- Thickness of 0.0012 inch

The following test methods and equipment were used to determine the above-mentioned properties: Material was weighed using a precision analytical balance (Model GF-400 Top Loader Balance, ANG, San Jose CA.) with a sample area of 36 x 1 inch sample. Length and width of the material were measured using a metal ruler. Material thickness was measured using a digital thickness gauge (Mitutoyo Digital Indicator 547-400) with a foot diameter of ¼ inch. Maximum transverse load was measured using a materials test machine (Model 5564, Instron, Grove City, PA ) equipped with a 10kg load cell. The sample width was 1 inch, the gauge length was 1 inch and the cross head speed was 25mm/minute. Maximum longitudinal load was measured using a materials test machine (Model 5564, Instron, Grove City, PA ) equipped with a 200kg load cell. The sample width was 1 inch, the gauge length was 1 inch and the cross head speed was 25mm/minute. Longitudinal

MP/292

tensile test measurements were taken in the length direction of the material and transverse tensile test measurements were taken in the direction orthogonal to the length direction.

5 A distal eyelet was formed by first obtaining a length of 10% platinum drawn filled nitinol wire (Fort Wayne Metals, Fort Wayne, IN.) with a diameter of about 0.23 mm. This wire was labeled "first wire". A free end of the first wire was doubled on itself to create an open-ended loop and the open-ended loop was inserted into the button. The button was then inserted onto the keyed center pin. The button was shaped to  
10 have an opening through the center to accommodate the keyed center pin and to have features that allow it to rest securely in the winding jig. The keyed center pin (major axis of about 0.51 mm and minor axis of about 0.25 mm and length of about 10.16 mm) was then inserted in the center of a winding jig. The keyed center pin was fabricated from high  
15 strength steel (Super Cobalt HSS Tool Bit, MSC#56424278, Seco Fagersta). The steel was tempered per manufacture's instructions at 1475°F for one hour. The winding jig and button were fabricated in house from corrosion resistant tool steel.

A second length of the same type of drawn filled nitinol wire was  
20 obtained and labeled "fifth wire". The first, fifth and an additional three wires were tensioned by attaching weights to the wire ends. The first wire and the fifth wire were then wound around the free end of the first wire one full revolution. The three additional wires were introduced to the winding jig and all five wires were wound around the free end of the  
25 first wire to a height of about 1.98 mm.

A distal disk was then formed by separating the five wires and securing them in radial grooves around the circumferential edge of the winding jig. A radius was formed with the dimensions of 15 mm. Each wire formed one petal of the distal disk. The radius on the curvature of  
30 the petals was maximized in order to minimize sharp bend angles in the wire.

A center eyelet was formed by grouping the wires together and winding them around the free end of the first wire and the keyed center pin to a height of about 1.98 mm. The wires were then separated and  
35 secured in radial grooves around the circumferential edge of the winding jib creating a proximal disk with a radius of 15 mm.

MP/292

A proximal eyelet was formed by again grouping the five wires and winding them around the free end of the first wire and the keyed center pin to a height of about 1.98 mm. The five wires were then separated and secured by placing a stainless steel plate on top of the  
5 wires and locking down the plate with screws. The free end of the first wire was then wound one revolution around a stainless steel pin with a diameter of about 3.18 mm and secured similarly to the other five wires.

The jig with sealing device was then removed from the stabilizing fixture and placed in an oven (BlueM SPX Electric Forced Air Convection  
10 Oven) and the wires were thermally shape set as commonly known in the arts. The device and jig were then water quenched. The secured wires were released from the securing plate and the device was chilled and removed from the jig and keyed center pin. The device was then placed on a piece of flattened PEEK (polyetherether ketone) and  
15 trimmed by hand to the outer diameter of the distal eyelet. The lock loop was trimmed by hand to a point just beyond one complete revolution and pulled through the proximal and center eyelets.

The device was pushed from the PEEK mandrel onto a keyed stainless steel process mandrel with an oval cross section. The mandrel  
20 was produced from flattened stainless steel wire (Ft. Wayne Metals, Fort Wayne, IN) with an oval cross-section to have a 45° clockwise twist between the proximal eyelet and the center eyelet and a second 45° clockwise twist between the center eyelet and the distal eyelet.

The process mandrel and device were then placed in a stabilizing  
25 fixture which was placed in a FEP powder coating machine (C-30, Electrostatic Technology, Inc., Bradford, CN) and processed until coated completely. Excess FEP powder was removed from the device. The FEP was vacuumed from the lock loop, process mandrel and bumper. The process mandrel and device were removed from the stabilizing  
30 fixture, placed into an oven and baked to set the FEP coating as commonly known in the arts.

A hollow core film mandrel (35.99 mm O.D. 76.2 cm long stainless steel) was obtained. Expanded polytetrafluoroethylene material with a slit width of 22.22 mm was obtained and loaded onto a spiral wrapping  
35 machine. The machine was manufactured in house to wrap PTFE (polytetrafluoroethylene) material at any desired angle, tension and rate. The mandrel was loaded onto the wrapping machine and the material

MP/292

was wrapped three times around the circumference of the hollow core mandrel. The material was then wrapped around the mandrel at an angle of about 8° for the length of the mandrel. The direction of wrapping was reversed and the material over wrapped at the same angle. The third and fourth layers were wrapped in the same manner with the seams offset. The mandrel was removed from the wrapping machine, inserted in an oven and baked at 370° C for 45 minutes. The wrapped mandrel was removed from the oven and allowed to cool to room temperature. The resulting PTFE tube was removed from the mandrel.

The PTFE tube was then cut to about 140 mm and hand stretched to a desired length 155 mm. The PTFE tube was then pulled over the frame. The PTFE tube was then crimped onto the center eyelet and then crimped onto the distal and proximal eyelets.

An expanded polytetrafluoroethylene with a thin layer of FEP (fluorinated ethylene propylene) material was then wrapped four times around the eyelets starting with the center eyelet. The wrapped eyelets were tacked into place a soldering iron. The PTFE tube was then heat set for 3 minutes at 320° C and trimmed to the outer most points of the proximal and distal eyelets. The device was removed from the mandrel.

#### **Example 2:**

A sealing device similar to Figure 6 was manufactured using the following components and assembly process.

Expanded polytetrafluoroethylene and expanded polytetrafluoroethylene with a thin layer of FEP (fluorinated ethylene propylene) materials similar to that described in Example 1 were obtained.

A distal eyelet was formed by first obtaining a length of 10% platinum drawn filled nitinol wire (Fort Wayne Metals, Fort Wayne, IN.) with a diameter of about 0.23 mm. This wire was labeled "first wire". A free end of the first wire was doubled on itself to create an open-ended loop and the open-ended loop was inserted into the button. The button was then inserted onto the keyed center pin. The button was shaped to have an opening through the center to accommodate the keyed center pin and to have features that allow it to rest securely in the winding jig. The keyed center pin (major axis of about 5.79 mm and minor axis of about 0.25 mm and length of about 10.16 mm) was inserted in the center

MP/292

of a winding jig. The keyed center pin was fabricated from high strength steel (Super Cobalt HSS Tool Bit, MSC#56424278, Seco Fagersta). The winding jig and button were fabricated in house from corrosion resistant tool steel.

5           A second length of the same type of drawn filled nitinol wire was obtained and labeled "fifth wire". The first, fifth and an additional three wires were tensioned by attaching weights to the wire ends. The first wire and the fifth wire were then wound around the free end of the first wire one full revolution. The three additional wires were introduced to  
10       the winding jig and all five wires were wound around the free end of the first wire to a height of about 1.98 mm.

          A device was then formed by separating the five wires and securing them in radial grooves around the circumferential edge of the winding jig. A radius was formed with the dimensions of 15 mm. Each  
15       wire made an entire revolution around the winding jig.

          A proximal eyelet was formed by grouping the five wires and winding them around the free end of the first wire and the keyed center pin to a height of about 1.981 mm. The five wires were then separated and secured by placing a stainless steel plate on top of the wires and  
20       locking down the plate with screws. The free end of the first wire was then wound one revolution around a stainless steel pin with a diameter of about 3.18 mm and secured similarly to the other five wires.

          The jig with sealing device was removed from the stabilizing fixture and placed in an oven (Blue M SPX Electric Forced Air  
25       Convection Oven) where the wires were partially thermally shape set as commonly known in the arts. The device and jig were then water quenched. The secured wires were released from the securing plate and then the device was chilled and removed from the jig and keyed center pin. The lock loop was trimmed by hand to a point just beyond one  
30       complete revolution and pulled through the proximal and center eyelets.

          The device was pushed from the PEEK mandrel onto a keyed stainless steel transfer mandrel with an oval cross section. The mandrel was produced from flattened stainless steel wire (Ft. Wayne Metals, Fort Wayne, IN) with an oval cross-section. The device was then partially  
35       removed from one end of the transfer mandrel. The removed device end was twisted approximately 180° clockwise and repositioned on the transfer mandrel. The device and transfer mandrel were placed in an

MP/292

oven (Blue M SPX Electric Forced Air Convection Oven) where the wires were thermally shape set as commonly known in the arts.

The transfer mandrel and device were then placed in a stabilizing fixture which was placed in a FEP powder coating machine (C-30, Electrostatic Technology, Inc., Bradford, CN) and processed until coated completely. Excess FEP powder was removed. FEP powder was vacuumed from the lock loop, process mandrel and bumper. The transfer mandrel and device were then removed from the stabilizing fixture, placed into an oven and baked to set the FEP coating as commonly known in the arts.

A hollow core film mandrel (35.99 mm O.D. 76.2 cm long stainless steel) was obtained. An ePTFE material with a slit width of 22.24 mm was obtained and loaded onto a spiral wrapping machine. The machine was manufactured in house to wrap ptfe film at any desired angle, tension and rate. The mandrel was loaded onto the wrapping machine and the film was wrapped three times around the circumference of the hollow core mandrel. The ePTFE material was then wrapped around the mandrel at an angle of about 8° for the length of the mandrel. The direction of wrapping was reversed and the material over wrapped at the same angle. The third and fourth layers were wrapped in the same manner with the seams offset. The mandrel was removed from the wrapping machine, inserted in an oven and baked at 370° C for 45 minutes. The wrapped mandrel was removed from the oven and allowed to cool to room temperature. The resulting ePTFE tube was removed from the mandrel.

The ePTFE tube was then cut to about 140 mm and hand stretched to a desired length 155 mm. The ePTFE tube was then pulled over the frame. The ePTFE tube was then crimped onto the distal and proximal eyelets. An ePTFE with a thin layer of FEP (fluorinated ethylene propylene) material was then wrapped four times around the eyelets. The wrapped eyelets were tacked into place a soldering iron. The ePTFE tube was then heat set for 3 minutes at 320° C and trimmed to the outer most points of the proximal and distal eyelets. The device was then removed from the mandrel.

35

**Example 3:**



MP/292

An handle assembly similar to Figure 8 was manufactured using the following components and assembly process.

Components for the handle assembly were fabricated using an injection molding process. The parts were fabricated by Contour Plastics (Baldwin, WI) using Lustran® 348. This material was suitable for use in medical devices and has an advertised tensile strength of 48.2 MPa and a tensile modulus of 2.62 GPa. Nine parts were fabricated using this injection process and Lustran® 348. The parts included the second linear actuator, flushing gasket retainer, a first linear actuator, retrieval cord lock, mandrel control lever, left body housing, sizing insert, right body housing, and a lock release actuator.

Other materials required for the assembly of the handle were purchased items. A catheter tube formed with a layup process commonly known in the arts was ordered (Teleflex Medical, Jaffrey, NH) with an I.D. of 0.048 mm and an O.D. of 0.33 mm and a platinum iridium marker band placed near the end of the distal tip. The main body of the catheter tube was Pebax® 7233 tube with PTFE liner and stainless steel braid (65 PPI) and the distal most 20.32 mm of the catheter tube was comprised of 6333 Pebax® (0.027 mm I.D. and an 0.033 mm O.D.) and a curve in the distal end (39.98 mm radius). A guidewire port formed by a laser was placed in the catheter tube proximal of the marker band. A flushing gasket or u-cup type gasket made of silicone (22.99 mm depth, I.D. tapered from 2.89 mm to 1.85 mm I.D. tapered from 6.71 mm to 7.75 mm) was procured from Apple Rubber of Lancaster, NY. A flushing port (Merit Medical, South Jordan, UT) having an about six inch flexible pvc (polyvinyl chloride) tube with a 3.18 mm O.D. female luer connector was obtained. A quick set cyanoacrylate adhesive was supplied from in-house stock. Stainless steel hypotubes were ordered from Small Parts, Inc. (1.45 mm O.D., 1.30 mm I.D., length of 30.48 cm.). Slider rods (PTFE coated stainless steel hypotubes, 3.18 mm O.D., 1.65 mm I.D., length of 33.02 cm) were procured from Applied Plastics. Control springs (PTFE-coated stainless steel leaf springs, thickness 0.10 mm, minor flange length 5.33 mm, major flange length 10.11 mm, overall length 15.88 mm) were ordered from Incodema of Ithaca, NY.

The remainder of the components were supplied from in house stock or manufactured in house. All triple lumen tubes were manufactured of Pebax® 7233 with 20% barium sulfate. Both triple

MP/292

lumen tubes had an O.D. (outer diameter) of 0.25 mm. One triple lumen tube had round lumens with two I.D.s (inner diameters) of 0.035 mm and one I.D. of 0.15 mm. One triple lumen tube had one lumen with an oval cross-section with two I.D.s of 0.036 mm and one I.D of 0.127 x 0.07 mm. Stainless steel PTFE coated (polytetrafluoroethylene) process mandrels were manufactured in house. One process mandrel had a cross-sectional shape that transitioned from round (O.D. of 0.16 mm) to oval (O.D. of 0.14 x 0.07 mm). PTFE covered stainless steel wire was procured from in house stock (O.D. 0.03 mm). Standard luer fittings were obtained from in house stock. A PEEK (polyetheretherketone) second tube extrusion was obtained from in house stock with an oval cross-section of 1.27 x 0.69 mm O.D.

A first tube was made in the following manner. One triple lumen extruded tube with round lumens was obtained. Another triple lumen extruded tube was obtained with one lumen having an oval cross-section. A stainless steel processing mandrel was also obtained having a cross-sectional shape, which transitions from round (O.D. of 1.52 mm), to oval (O.D. of 1.39 x 0.81 mm). Both extruded tubes were loaded onto the mandrel with the mandrel being inserted through the larger lumen on both tubes. Two small PTFE covered stainless steel wires were inserted through the smaller lumens of both extruded tubes. The mandrel and tubes were inserted into a RF (radio frequency) die (2.51 mm I.D., 4.45 mm length, fabricated from D2 tool steel). The junction of the two catheters was positioned in the center of the RF die. The RF die and mandrel was placed in the middle of an RF coil on an RF welding machine (Hot Shot I, Ameritherm Inc., Scottsville, NY) and welded as commonly known in the art. When the components had reflowed, pressure was applied to each end of the extruded tubes to meld the junction of the tubes. The die was then sprayed with compressed air to cool the die and to set the Pebax®. The extruded tube and die were removed from the RF machine and the extruded tube was removed from the die. The process mandrel and wires were removed from the lumens of the extruded tube.

A lubricious coating may be applied to the second tube. A silicone mold release spray (Nix Stix X-9032A, Dwight Products, Inc., Lyndhurst NJ) may be sprayed onto about the distal 30 cm of the second tube and allowed to dry at ambient temperature under a fume hood.

MP/292

A third tube sub-assembly was made in the following manner. A catheter tube was bisected with a straight razor at approximately 6.35 cm from the proximal end of the catheter tube. A male and female in-line luer connector (Qosina, Edgewood, NY) was obtained and drilled to an I.D. of 3.45 mm. U.V. (ultra-violet) cured adhesive (Loctite 3041) was applied to the bisected ends of the catheter tube and the drilled luer fittings were attached. The adhesive was cured per manufacture's instructions and the luer fittings were screwed together.

A the second linear actuator sub-assembly was made in the following manner. A the second linear actuator, flushing port, flushing gasket retainer and silicone flushing gasket were obtained. The flushing gasket was inserted into the back of the second linear actuator with the u portion of the flushing gasket facing distally. The flushing gasket retainer was fitted over the top inside the second linear actuator. Cyanoacrylate glue was applied around the gasket retainer to hold the gasket retainer in place. The flushing port was placed into an aperture in the second linear actuator and an U.V. cure adhesive was applied and cured according to manufactures instructions.

A first tube was obtained and cyanoacrylate was applied to the outside surface of the round I.D. section of the catheter in a 2.54 cm band from the end. The catheter was then inserted into the distal end of the control shuttle until the catheter became flush with the back of the control shuttle. The catheter was oriented so that the two small lumens were horizontal and on the top portion of the round lumen. The retrieval cord lock was snapped onto the control shuttle.

The second tube sub-assembly was manufactured in the following manner. A four inch piece of 0.033 mm diameter nitinol wire was inserted into the second tube extrusion. The second tube extrusion with wire insert was inserted into a hypotube. The distal end of the hypotube was crimped by hand three times.

The distal end of the first tube was threaded through the top of the mandrel control lever and through the top aperture on the distal end of the mandrel control lever. The distal end of the second tube was threaded into the proximal end of the control catheter. The second tube was pushed into the first tube until about 4 in. of hypotube were protruding from the end of the control catheter. A cyanoacrylate adhesive was applied to the proximal end of the hypotube over about a

MP/292

12.7 mm section. This section was inserted into the top aperture in the proximal end of the mandrel control lever until flush with the back of the mandrel control lever. The distal end of the first tube was then threaded into the proximal end of the second linear actuator. The second linear  
5 actuator was moved to the back most position on the control catheter.

A sizing insert was then fitted into a left body shell. The sizing insert was oriented so that the groove in the sizing insert fit over the ridge in the left shell. The catheter sub assembly was placed into the left body shell so that the mandrel control lever fit into the sizing insert and  
10 the second linear actuator fit into the slot in the distal end of the left body shell. A slider rod was inserted through the openings in the sizing insert, mandrel control lever, control shuttle and the second linear actuator. The slider rod was made to rest on two supports in the left body shell. The control spring was inserted into the right body shell so that it fit into  
15 the opposing teeth. The right body shell was then placed onto the left body shell and the two were snapped together. Two screws (#4-24 x 1/2 in. thread-forming Pan Head) were inserted into the available apertures on the left body shell and tightened. The lock release actuator was snapped into place on the right tab of the second linear actuator with a  
20 drop of cyanoacrylate adhesive to ensure that it remained attached.

The second linear actuator, control shuttle, and the mandrel control lever were moved to their forward most positions. The second linear actuator was pulled back and then returned to its forward position. The distal end of the first tube was trimmed by hand with a razor blade to  
25 1.27 mm measured from the tip of the third tube. The sizing insert was pushed forward. The second tube was trimmed by hand using a razor blade to a length of about 0.76 mm measured from the distal most end of the control catheter. An about 4 inch long piece of nitinol wire (0.30 mm diameter) was obtained. A cyanoacrylate adhesive was applied into the  
30 tip of the second tube with an elongated applicator tip. The nitinol wire was inserted into the tip of the locking and another piece of wire was used to insert the nitinol wire about 2 mm into the second tube. The cyanoacrylate adhesive was allowed to cure.

The second linear actuator was pulled back and a slot was  
35 punched out of the control catheter. The slot had a width that was about the same width as the small axis of the oval lumen of the catheter. A razor was used to skive the slot to a final length of about 19.05 mm. The

MP/292

second linear actuator and the sizing insert were then moved to a forward position.

A retrieval cord approximately 3.05 m long (PTFE fiber with a 0.25 mm O.D.) and a 1.52 m (0.15 mm O.D.) nitinol wire were obtained. The  
5 nitinol wire was inserted into one of the 0.04 mm lumens in the first tube and pushed through until it came out into the handle. Tweezers were used to grasp the wire and pull it out of the slot in the handle. About 76.2 mm of wire were made to protrude from the distal end of the control catheter. A loop was formed in the wire by inserting the loose end into  
10 the same lumen at the distal end of the control catheter. About 76.2 mm of retrieval cord was then threaded through the resulting loop. The nitinol wire was pulled through the catheter until the retrieval cord protruded into the handle.

A sealing device was obtained. A needle of a type commonly  
15 used for sewing was threaded with the retrieval cord and the needle was inserted through the PTFE bag opposite the lock loop and through the lumen of the proximal eyelet of the sealing device. The nitinol wire was then threaded through the remaining unoccupied 0.04 mm lumen in the first tube with the loop end of the wire pointing distally. The needle was  
20 removed from the retrieval cord and the cord was threaded through the loop on the nitinol wire. The retrieval cord was then pulled through the catheter in the manner described previously.

The control shuttle was retracted approximately 12.7 mm. The second tube was then threaded through the eyelets of the device.  
25 Tweezers were used to grasp the retrieval cord and pull in to the outside of the handle. A loop was formed in a portion of small diameter nitinol wire. The loop was inserted through an aperture in the distal portion of the top of the control shuttle. The retrieval cord was threaded through this loop and pulled through the aperture in the distal portion of the  
30 control shuttle. The retrieval cord lock was removed from the control shuttle and one free end of the retrieval cord was inserted through the aperture in the retrieval cord lock from the bottom. Four over hand knots were tied in the cord. Excess cord was trimmed by hand and the retrieval cord lock was returned to the control shuttle.

35 The remaining free retrieval cord was pulled until all slack was gone. The remaining free end of the retrieval cord was inserted into an aperture in the front of the top of the control shuttle. The retrieval cord

MP/292

was pulled until taught and the retrieval cord lock was snapped closed.  
The cord was trimmed by hand to about 20.32 cm.

5 The second tube was flared by obtaining a soldering iron with a sharp tip and heating it to about 500° F. The tip of the iron was inserted into the second tube until a flare was created that was approximately 1.39 mm in diameter. The locking loop on the device was chilled.

MP/292

**WHAT IS CLAIMED IS:**

1. A sealing device comprising:  
an expandable frame formed from a plurality of wires  
5 extending from a proximal end to a distal end of the frame;  
the wires forming a proximal eyelet and a distal eyelet; and  
sealing member at least partially encapsulating the  
expandable wire frame.
- 10 2. The sealing device of claim 1, wherein the sealing device is self-centering when deployed.
3. The sealing device of claim 1, wherein the expandable frame  
further comprises an intermediate eyelet formed from the plurality  
15 of wires.
4. The sealing device of claim 3, wherein the sealing member  
substantially completely encapsulates the expandable frame.
- 20 5. The sealing device of claim 1, wherein the expandable wire frame  
consists of 5 wires.
6. The sealing device of claim 1, wherein the sealing member  
comprises a material selected from the group consisting of  
25 polyester, polyethylene, polypropylene, fluoropolymer,  
polyurethane, silicone, nylon, and silk.
7. The sealing device of claim 6, wherein the fluoropolymer comprises  
polytetrafluoroethylene.
- 30 8. The sealing device of claim 7, wherein the polytetrafluoroethylene  
comprises expanded polytetrafluoroethylene.
9. The sealing device of claim 1, wherein the plurality of wires  
35 comprise nitinol.

MP/292

10. The sealing device of claim 1, wherein the sealing member comprises an inner surface at least a portion of which is attached to the plurality of wires.
- 5 11. The sealing device of claim 1, further comprising a distal bumper located distal to the distal eyelet.
12. The sealing device of claim 11, further comprising a device lock loop.
- 10 13. The sealing device of claim 1, wherein the plurality of wires extend helically from the proximal end to the distal end.
14. The sealing device of claim 1, wherein at least one of the eyelets  
15 are formed into a non-circular shape.
15. The sealing device of claim 10, wherein the inner surface of the sealing member is attached to the plurality of wires by an adhesive.
- 20 16. The sealing device of claim 15, wherein the adhesive comprises FEP.
17. The sealing device of claim 9, wherein the nitinol comprises 10%  
by weight platinum.
- 25 18. The sealing device of claim 17, wherein the nitinol is drawn filled nitinol.



1/17

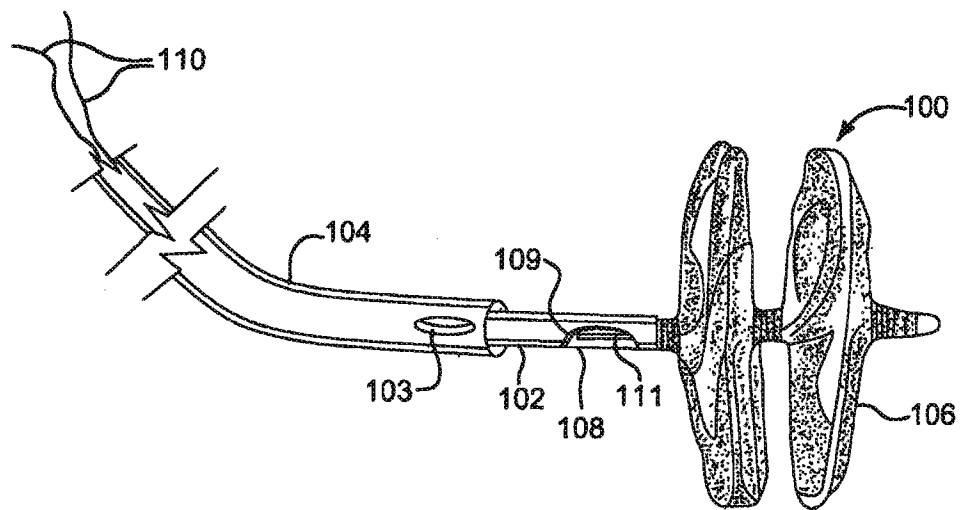

FIG. 1

2/17

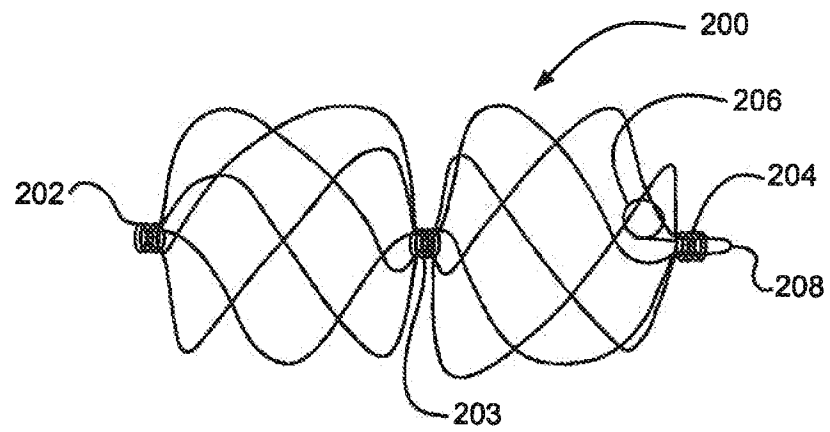

FIG. 2A

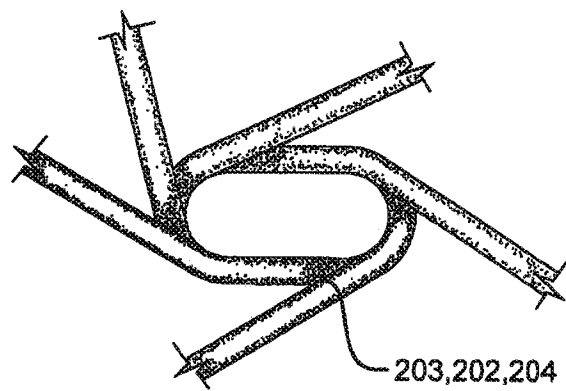

FIG. 2B

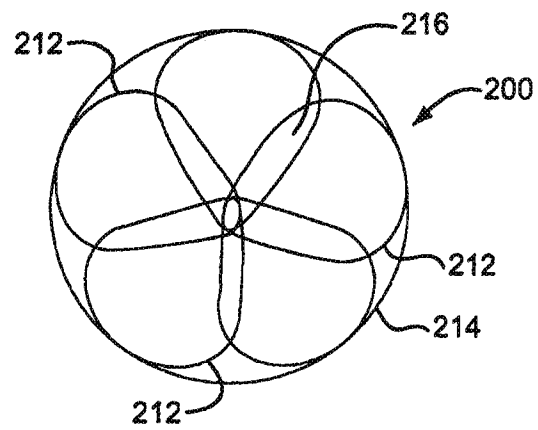

FIG. 2C

3/17

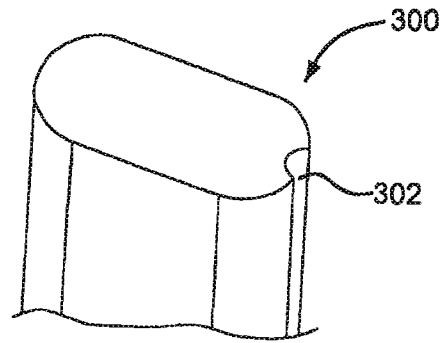

FIG. 3A

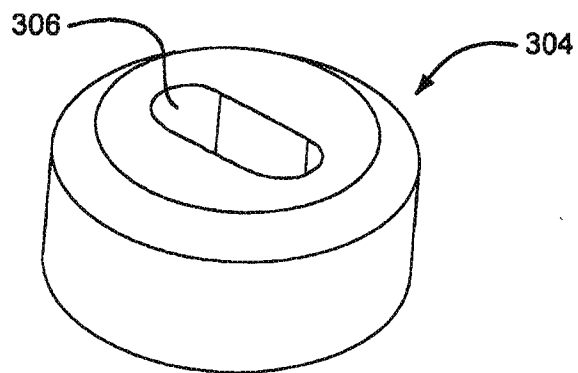

FIG. 3B

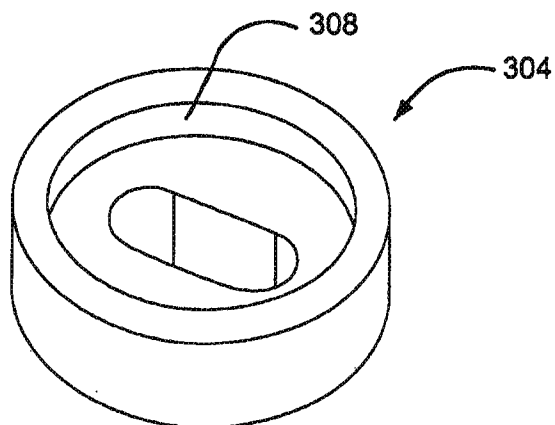

FIG. 3C

4/17

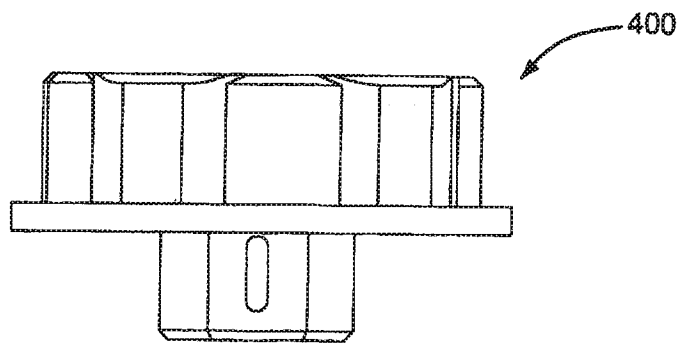

FIG. 4A

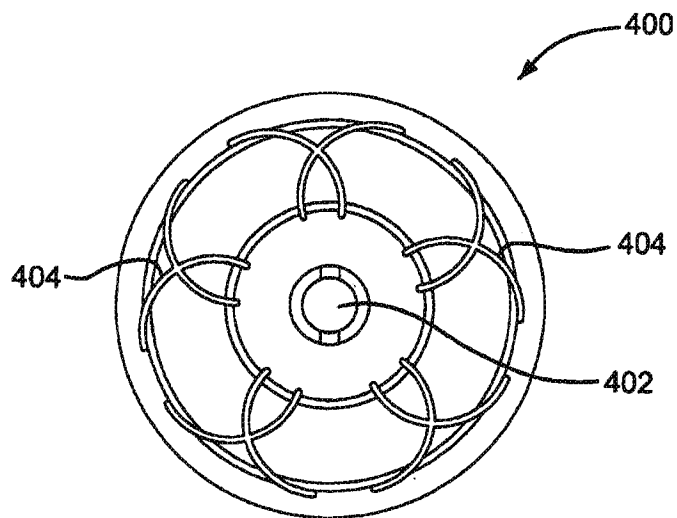

FIG. 4B

5/17

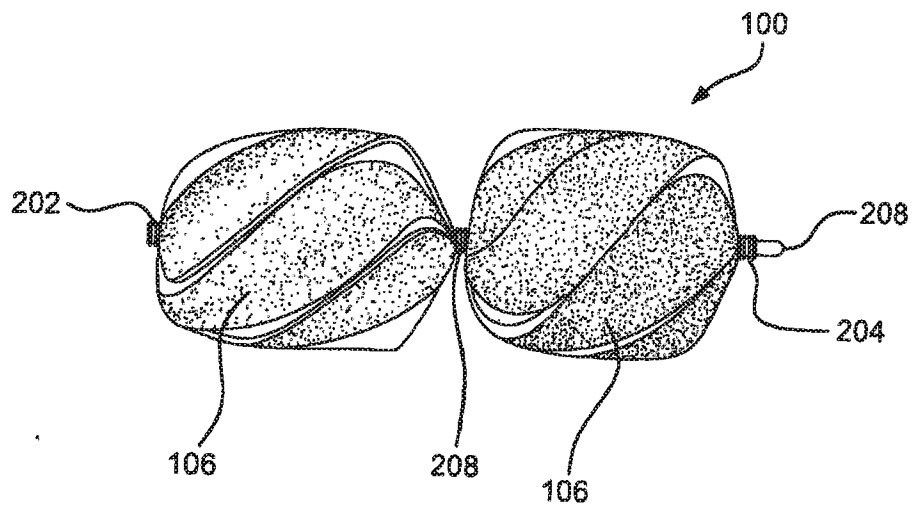

FIG. 5A

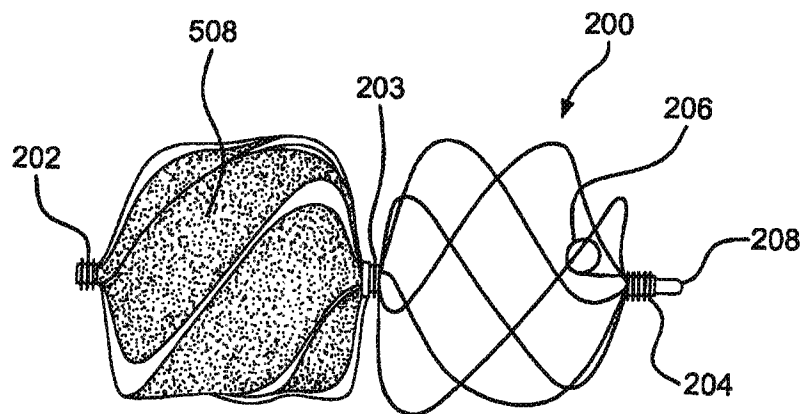

FIG. 5B

6/17

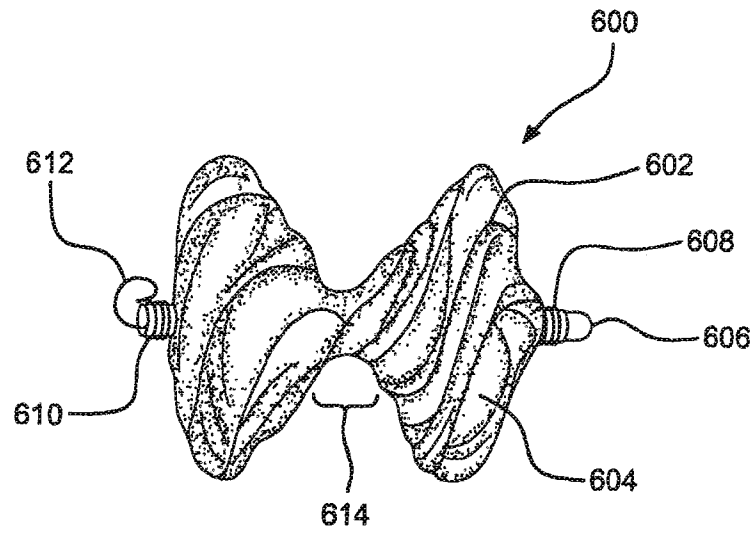

FIG. 6

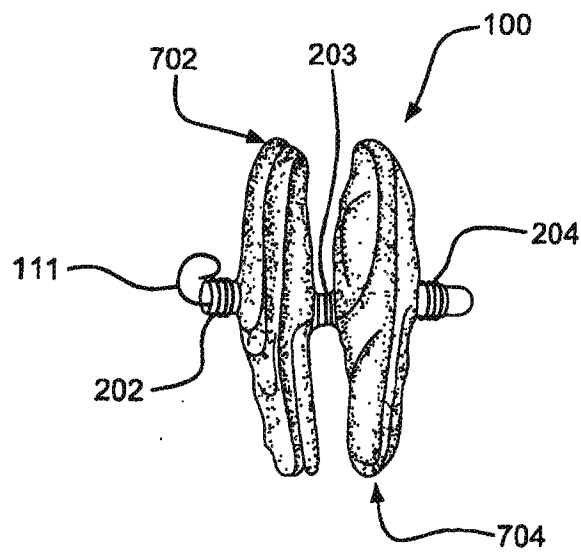

FIG. 7

7/17

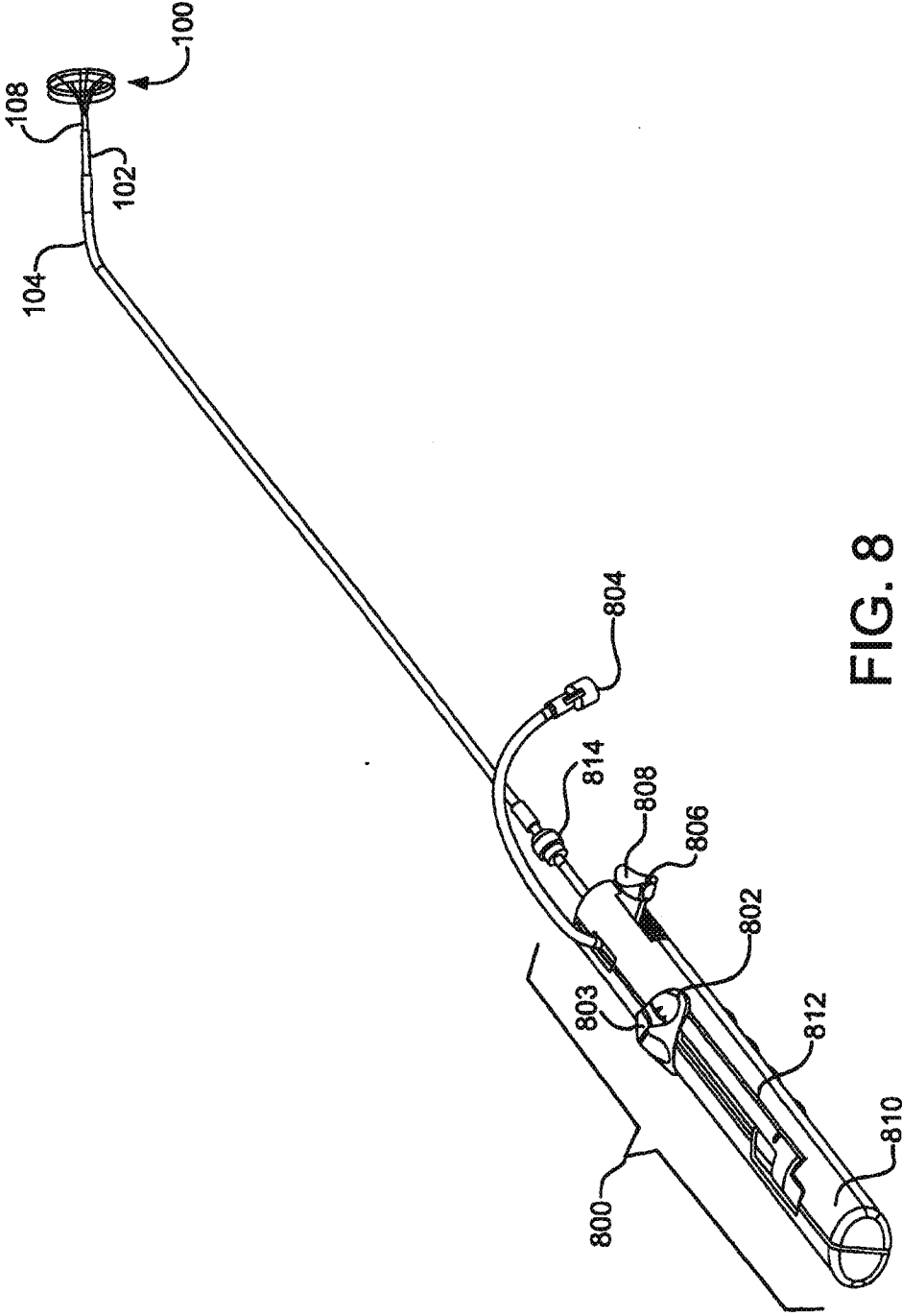

FIG. 8

8/17

## Load the Device

	Clinician movement	Component movement
Step 1	Flush the delivery system with saline	Attach a saline filled syringe to the flushing port and push in saline until it comes out the distal end of the delivery system
Step 2	Move the first linear actuator to the right edge of the slot	The first linear actuator moves in slot to the right pressing on the spring The mandrel control lever rotates on slider rod to the right A first linear actuator is free of the distal notch in the sizing insert The second tube is prevented from moving
Step 3	Move the first linear actuator proximally	The first tube moves proximally The device proximal end moves proximally elongating the device
Step 4	Move the first linear actuator proximally until device is loaded in delivery catheter	The spring pushes the first linear actuator and mandrel control lever to the left into the proximal notch in the sizing insert The second tube is now free to move proximally with the device and the first tube The second tube, device and first tube slide into delivery catheter
Step 5	Flush the delivery system with saline	Attach a saline filled syringe to the flushing port and push in saline until it comes out the distal end of the delivery system

FIG. 9A

## Deploy Device

	Clinician movement	Component movement
Step 1	Move the first linear actuator distally until it stops	The first tube and second tube move distally in the third tube
Step 2	Move the first linear actuator to the right	The first linear actuator moves in the slot to the right, pressing on the spring The mandrel control lever rotates on the slider rod to the right The first linear actuator is free of the proximal notch in the sizing insert
Step 3	Move the first linear actuator distally	The first tube moves distally The proximal eyelet of the device moves distally The distal end of device is stopped in place The first tube guides the device out of the third tube to deploy
Step 4	Move the first linear actuator to the distal most point in slot	The device is free of the third tube The first linear actuator is at a distal most point in slot The mandrel control lever is pushed to the left of the slot by the spring The first linear actuator is in the forward notch in the sizing insert

FIG. 9B



9/17

## Lock the device

	Clinician movement	Component movement
Step 1	Flip up the retrieval cord lock in the first linear actuator	The retrieval cord lock flips up
Step 2	Grasp the second linear actuator and press it	The second linear actuator becomes free of the corrugations in slot The third tube is attached to the second linear actuator
Step 3	Move the second linear actuator proximally	The third tube moves proximally The mandrel control lever moves proximally The sizing insert moves proximally The second tube moves proximally from between the eyelets of the device
Step 4	Twist the retrieval cord lock then pull on the retrieval cord lock until the retrieval cord comes out of the handle	The retrieval cord is attached to the retrieval cord lock at one end  Pulling removes the cord from the device through a lumen of the first tube The device is permanently deployed

FIG. 9C

## Device Retrieval

	Clinician movement	Component movement
Step 1	Flip the retrieval lock lever down	The retrieval cord is locked
Step 3	Unscrew the retrieval luer	The delivery catheter is separated from the handle
Step 4	Hold the delivery catheter and pull the entire handle assembly proximally	The handle, first tube and second tube move proximally The device proximal end moves proximally elongating the device  The device is withdrawn proximally into the delivery catheter

FIG. 9D

10/17

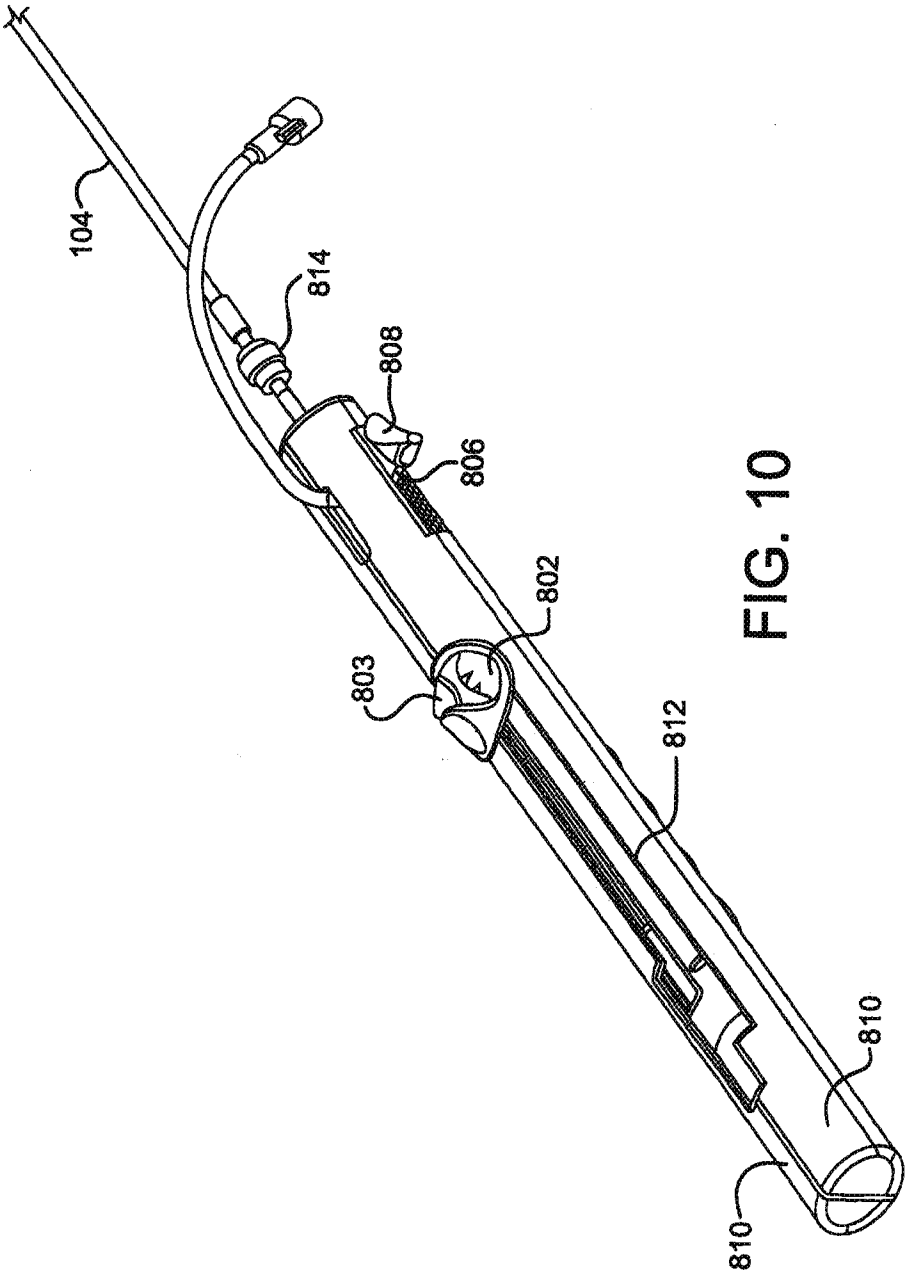

FIG. 10

11/17

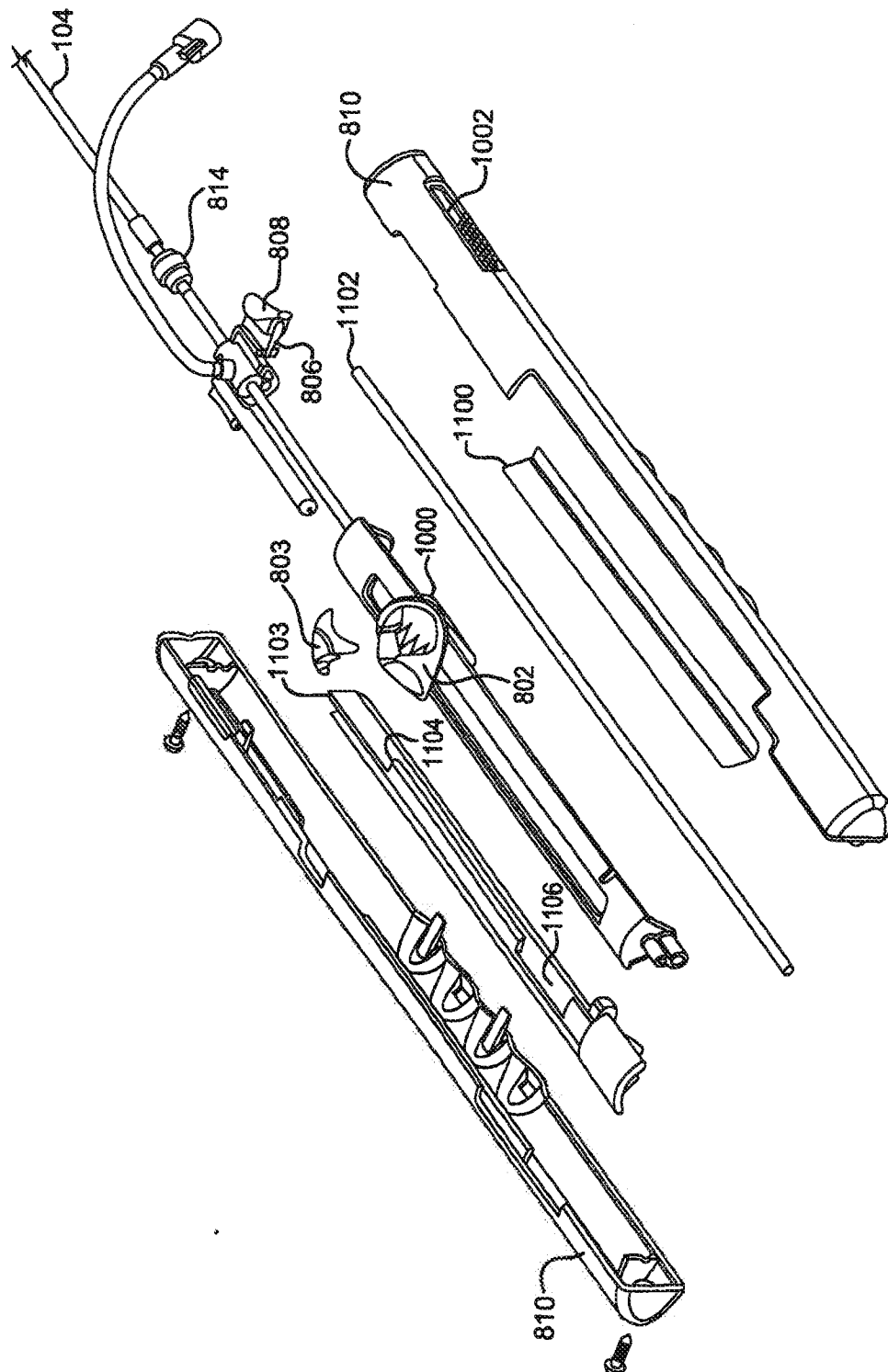

FIG. 11

12/17

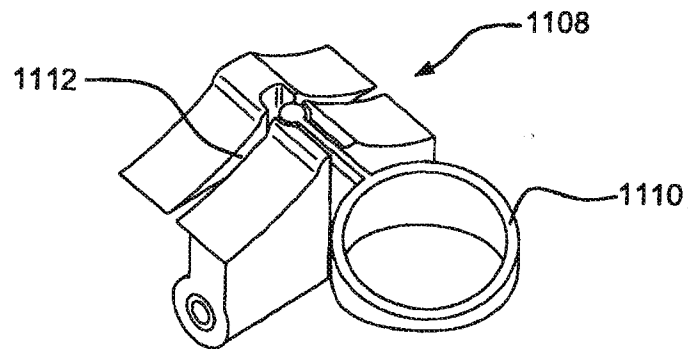

FIG. 12A

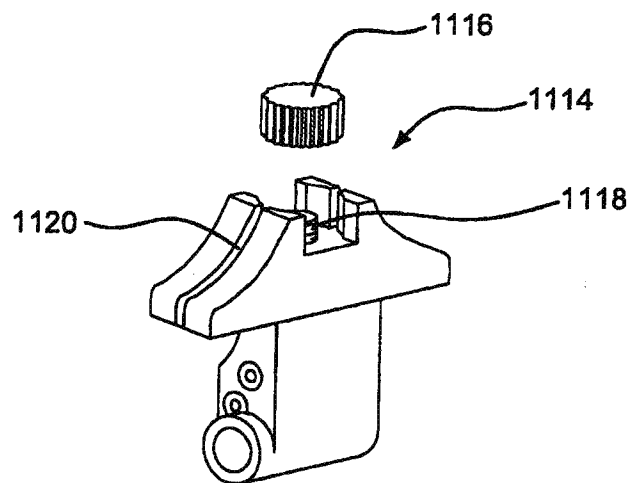

FIG. 12B

13/17

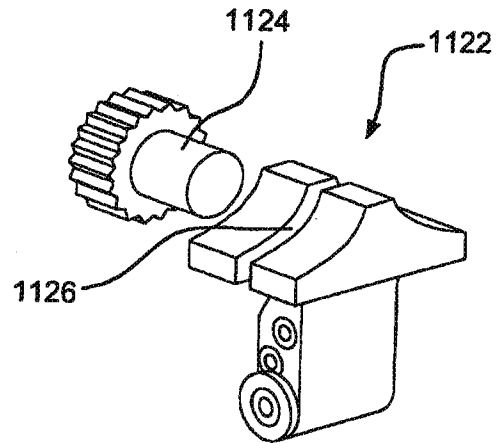

FIG. 12C

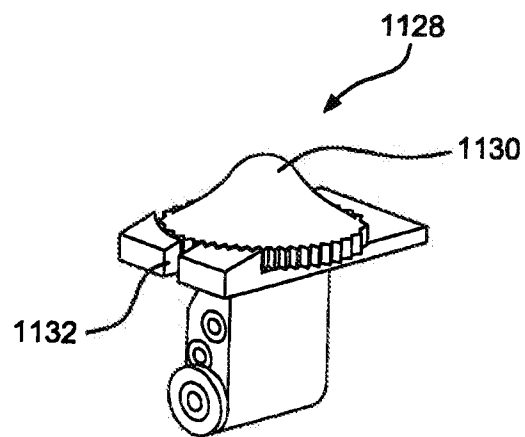

FIG. 12D

14/17

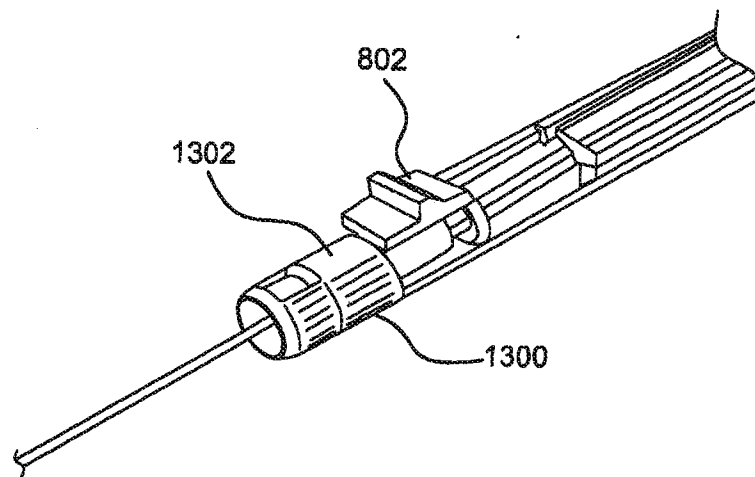

FIG. 13A

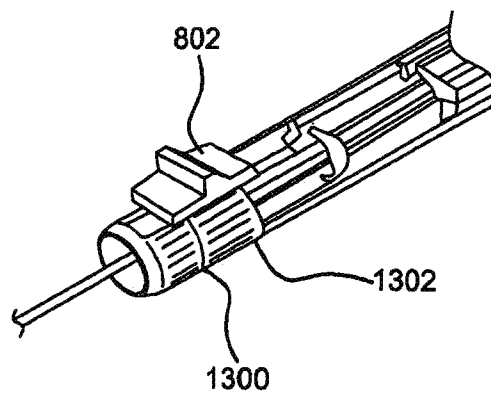

FIG. 13B

15/17

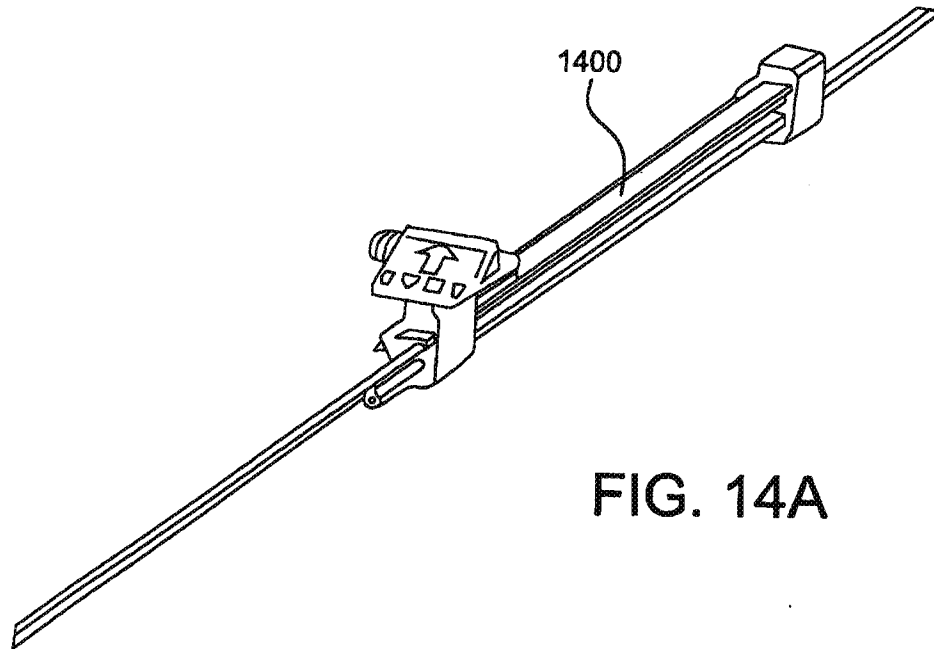

FIG. 14A

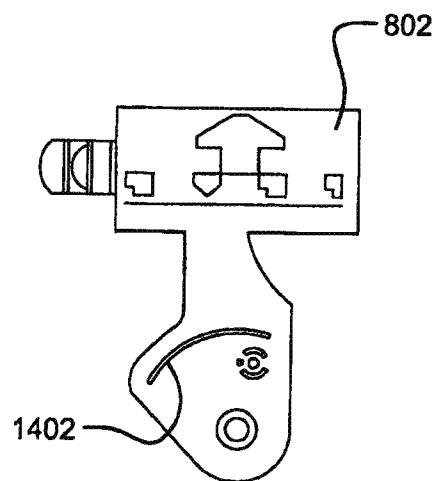

FIG. 14B

16/17

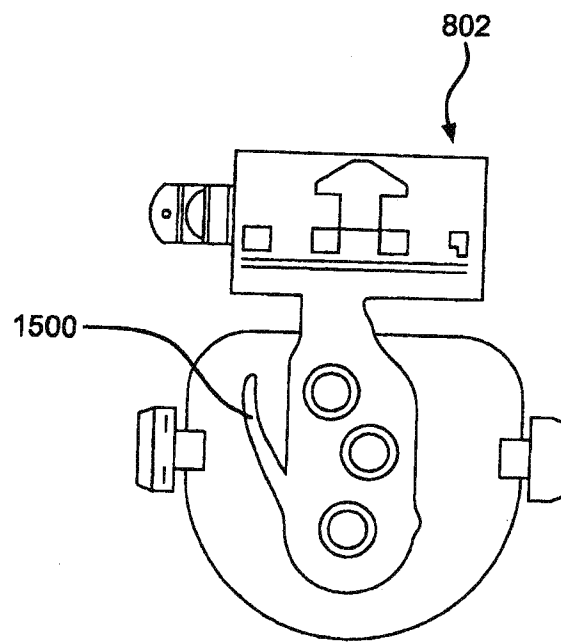

FIG. 15



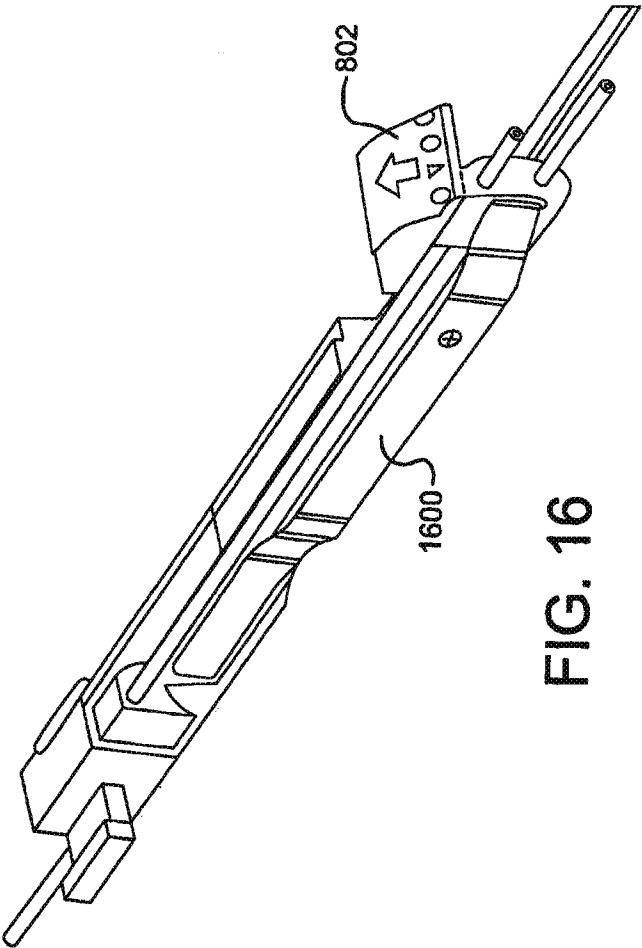

FIG. 16

## INTERNATIONAL SEARCH REPORT

International application No

PCT/US2010/039354

## A. CLASSIFICATION OF SUBJECT MATTER

INV. A61B17/00

ADD.

According to International Patent Classification (IPC) or to both national classification and IPC

## B. FIELDS SEARCHED

Minimum documentation searched (classification system followed by classification symbols)

A61B

Documentation searched other than minimum documentation to the extent that such documents are included in the fields searched

Electronic data base consulted during the international search (name of data base and, where practical, search terms used)

EPO-Internal

## C. DOCUMENTS CONSIDERED TO BE RELEVANT

Category*	Citation of document, with indication, where appropriate, of the relevant passages	Relevant to claim No.
X	US 2003/195555 A1 (KHAIRKHAHAN ALEXANDER K [US] ET AL) 16 October 2003 (2003-10-16)	1-12, 14-18
Y	paragraphs [0007], [0008]; figures 1-6,13-17A,17B paragraph [0044] - paragraph [0068] paragraph [0080] - paragraph [0086]	11-13
X	US 2008/077180 A1 (KLADAKIS STEPHANIE M [US] ET AL) 27 March 2008 (2008-03-27)	1-10, 13-18
Y	paragraph [0045] - paragraph [0068]; figures 2A-2R,8-19 paragraphs [0074], [0092] - paragraph [0098]	11-13
X	WO 00/51500 A1 (UNIV TEXAS [US]; KONYA ANDRAS [US]; WALLACE SIDNEY [US]; WRIGHT KENNET) 8 September 2000 (2000-09-08)	1,4-10, 12,14, 17,18
Y	the whole document	11,13
	----- -/-	



Further documents are listed in the continuation of Box C.



See patent family annex.

## \* Special categories of cited documents:

"A" document defining the general state of the art which is not considered to be of particular relevance

"E" earlier document but published on or after the international filing date

"L" document which may throw doubts on priority claim(s) or which is cited to establish the publication date of another citation or other special reason (as specified)

"O" document referring to an oral disclosure, use, exhibition or other means

"P" document published prior to the international filing date but later than the priority date claimed

"T" later document published after the international filing date or priority date and not in conflict with the application but cited to understand the principle or theory underlying the invention

"X" document of particular relevance; the claimed invention cannot be considered novel or cannot be considered to involve an inventive step when the document is taken alone

"Y" document of particular relevance; the claimed invention cannot be considered to involve an inventive step when the document is combined with one or more other such documents, such combination being obvious to a person skilled in the art.

"&amp;" document member of the same patent family

Date of the actual completion of the international search

3 September 2010

Date of mailing of the international search report

15/09/2010

Name and mailing address of the ISA/

European Patent Office, P.B. 5818 Patentlaan 2  
NL - 2280 HV Rijswijk  
Tel. (+31-70) 340-2040,  
Fax: (+31-70) 340-3016

Authorized officer

Strazdauskas, Gedas

## INTERNATIONAL SEARCH REPORT

International application No

PCT/US2010/039354

C(Continuation). DOCUMENTS CONSIDERED TO BE RELEVANT

Category*	Citation of document, with indication, where appropriate, of the relevant passages	Relevant to claim No.
X	US 6 214 029 B1 (THILL GARY A [US] ET AL) 10 April 2001 (2001-04-10)  the whole document -----	1-7, 9, 10, 12, 14-18

# INTERNATIONAL SEARCH REPORT

Information on patent family members

International application No

PCT/US2010/039354

Patent document cited in search report	Publication date	Patent family member(s)	Publication date
US 2003195555 A1	16-10-2003	US 2006206148 A1 US 2003204203 A1 US 2003212432 A1	14-09-2006 30-10-2003 13-11-2003
US 2008077180 A1	27-03-2008	NONE	
WO 0051500 A1	08-09-2000	AU 3865900 A EP 1161186 A1 US 2002156499 A1 US 6368338 B1	21-09-2000 12-12-2001 24-10-2002 09-04-2002
US 6214029 B1	10-04-2001	CA 2344987 A1 EP 1149561 A1 JP 3712630 B2 JP 2002119516 A	26-10-2001 31-10-2001 02-11-2005 23-04-2002