

(19) World Intellectual Property Organization  
International Bureau



(43) International Publication Date  
27 March 2003 (27.03.2003)

PCT

(10) International Publication Number  
**WO 03/024510 A1**

(51) International Patent Classification<sup>7</sup>: **A61M 1/02**,  
5/148

US  
Filed on  
Unknown (CON)  
28 August 2002 (28.08.2002)

(21) International Application Number: PCT/US02/27696

(71) Applicant (for all designated States except US):  
**ZYMEQUEST, INC.** [US/US]; 100 Cummings Center,  
Beverly, MA 01915 (US).

(22) International Filing Date: 29 August 2002 (29.08.2002)

(25) Filing Language: English

(72) Inventor; and

(75) Inventor/Applicant (for US only): **ROSIELLO, Keith**  
[US/US]; 32 Deerfield Road, Shrewsbury, MA 01545 (US).

(26) Publication Language: English

(30) Priority Data:  
60/322,387 14 September 2001 (14.09.2001) US  
Unknown 28 August 2002 (28.08.2002) US

(74) Agent: **ELRIFI, Ivor, R.**; Mintz, Levin, Cohn, Ferris,  
Glovski and Popeo PC, One Financial Center, Boston, MA  
02111 (US).

(63) Related by continuation (CON) or continuation-in-part  
(CIP) to earlier applications:  
US 60/322,389 (CON)  
Filed on 14 September 2001 (14.09.2001)

(81) Designated States (national): AE, AG, AL, AM, AT, AU,  
AZ, BA, BB, BG, BR, BY, BZ, CA, CH, CN, CO, CR, CU,  
CZ, DE, DK, DM, DZ, EC, EE, ES, FI, GB, GD, GE, GH,  
GM, HR, HU, ID, IL, IN, IS, JP, KE, KG, KP, KR, KZ, LC,  
LK, LR, LS, LT, LU, LV, MA, MD, MG, MK, MN, MW,

[Continued on next page]

(54) Title: BLOOD PRODUCT TRANSFER SYSTEM

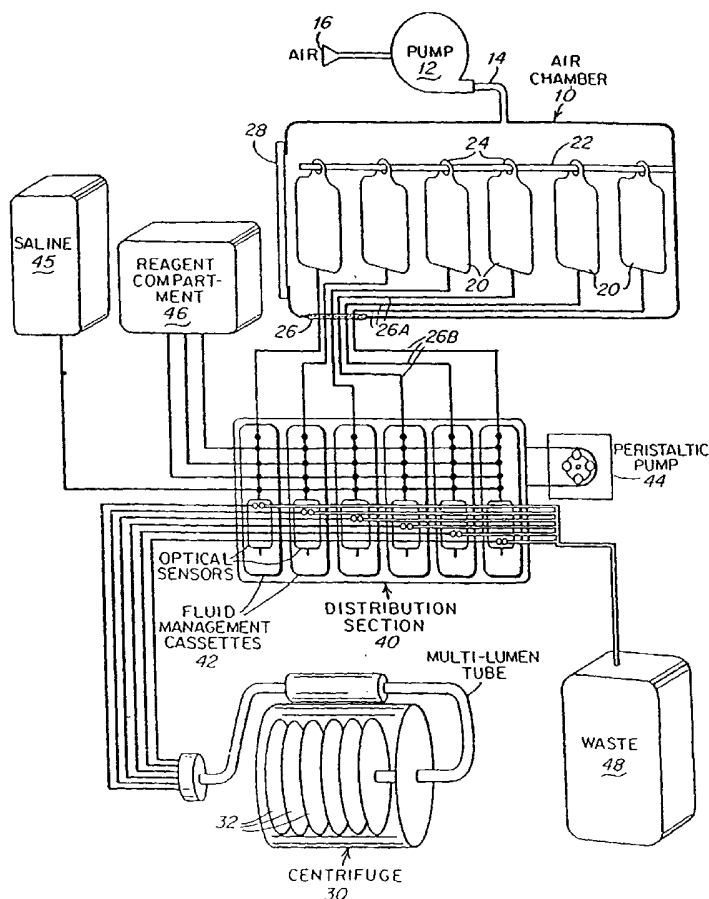

(57) Abstract: A system for transferring blood product between a blood storage bag (20) and a processing bag (32). The system includes an airtight containment chamber (10) for supporting therein one or more blood storage bags (20). A door (28) is provided for access to the chamber (10) and there is included an airtight fixture (26) that allows tubing from the blood storage bag (20) to exit the chamber (10). A fluid pump (12) is coupled to the containment chamber (10) for establishing either pressure or vacuum within the containment chamber (10). A controller (50) controls the air pump (12) to, in turn, control the transfer of a blood product.

WO 03/024510 A1



MX, MZ, NO, NZ, OM, PH, PL, PT, RO, RU, SD, SE, SG,  
SI, SK, SL, TJ, TM, TN, TR, TT, TZ, UA, UG, US, UZ,  
VN, YU, ZA, ZM, ZW.

TR), OAPI patent (BF, BJ, CF, CG, CI, CM, GA, GN, GQ,  
GW, ML, MR, NE, SN, TD, TG).

**(84) Designated States (regional):** ARIPO patent (GH, GM,  
KE, LS, MW, MZ, SD, SL, SZ, TZ, UG, ZM, ZW),  
Eurasian patent (AM, AZ, BY, KG, KZ, MD, RU, TJ, TM),  
European patent (AT, BE, BG, CH, CY, CZ, DE, DK, EE,  
ES, FI, FR, GB, GR, IE, IT, LU, MC, NL, PT, SE, SK,

**Published:**

— with international search report

*For two-letter codes and other abbreviations, refer to the "Guidance Notes on Codes and Abbreviations" appearing at the beginning of each regular issue of the PCT Gazette.*

## BLOOD PRODUCT TRANSFER SYSTEM

5           This application claims benefit under 35 U.S.C. § 119(e) of U.S. Provisional Application No. 60/322,387, filed on September 14, 2001, the entire contents of which are incorporated herein by reference.

### BACKGROUND OF THE INVENTION

#### Field Of The Invention

10           The present invention relates in general to a fluid product transfer system, and pertains, more particularly, to a system for transferring blood product between a blood storage bag and a processing bag, or vice versa. The principles of the present invention may be applied in a centrifuge processing system or other extracorporeal blood processing systems.

#### 15    The Prior Art

          In current blood processing systems there are generally two techniques for moving blood product from a flexible blood storage bag to a processing device such as a centrifuge. These two techniques include gravity and peristaltic pumps currently used to create blood flow in the coupling tubing.

20           Regarding the gravity technique, the blood storage bag is typically disposed at a position higher than the processing bag and blood flows from the bag to the lower disposed centrifuge by gravitational force. The gravitational technique is adequate if the bag is high enough, the tubing diameter large enough, and the tubing length is short enough to expedite fluid flow. For some applications in which the tubing inside diameter  
25    is narrow, the length of tubing is relatively long. Thus, the required height to provide a reasonable drain time would make the gravity technique impractical. The deficiency of

the gravity technique is that the tubing size has to be of sufficient inside diameter to allow adequate flow or otherwise the fluid may clot, particularly if platelets are part of the fluid, and thus impede flow. In addition, if the inside diameter of the tubing is not sufficient this may cause the blood product to flow very slowly because of the relatively  
5 high viscosity of the blood related components. Another drawback to the gravity technique is that it only allows blood to flow in one direction, essentially from the blood storage bag to the processing device, unless positions are reversed.

The second technique for moving blood products to a processing device such as a centrifuge is with the use of a pump such as a peristaltic pump. These pumps are  
10 functional in terms of flow but their drawback is that they can cause damage to the blood product, particularly red blood cells. The roller wheels on peri-pumps tends to put a significant amount of pressure in a very small area of a tube where the blood is flowing, thereby destroying some of the red blood cells that come into contact with the roller wheels.

## 15 SUMMARY OF THE INVENTION

Accordingly, it is an object of the present invention to provide an improved blood product transfer system that enables the blood product to readily flow through smaller diameter tubes with great efficiency and speed.

Another object of the present invention is to provide a blood product transfer  
20 system that operates so as to keep the red blood cells or any other components of the blood product free from any damaging effects and in a sterile, closed environment.

To accomplish the foregoing and other objects, features and advantages of the invention there is provided a system for transferring blood product between a blood storage bag and a processing bag, usually a centrifuge processing bag. The system is  
25 comprised of an airtight containment chamber that is provided with means supported within the chamber, preferably at the top thereof, for supporting at least one blood storage bag, and usually a plurality of such bags. In a preferred orientation, the blood storage bag is supported in an upright position with a tubing end of the blood storage bag at the bottom thereof. The airtight containment chamber is provided with a door including an

airtight fixture that allows tubing from the blood storage bag to exit the chamber, such as for coupling by way of a distribution module to a processing module. A fluid pump is coupled to the airtight containment chamber for establishing either pressure within the chamber or drawing a vacuum in the chamber so as to transfer blood product, in one instance under pressure from the blood storage bag to the processing bag, and in the other instance, using vacuum for transferring fluid from the processing bag back to a blood storage bag. A controller is used for controlling at least the fluid pump to, in turn, control this transfer of blood product.

As indicated previously, the airtight containment chamber may be for supporting a plurality of storage bags. These bags are disposed in a position that allows the blood product to flow due to pressure or vacuum without allowing a blockage to occur via a collapsed tube or blood storage bag. The fluid pump may comprise an air pump having a compressor for delivering either a pressure to the chamber or drawing a vacuum on the chamber. A control solenoid circuit may be provided for selecting, in one state, pressure operation, and in another state, vacuum operation. These one and another states are mutually exclusive.

In accordance with other aspects of the present invention the airtight containment chamber may include a fluid control circuit that couples either pressure or vacuum to the chamber. In this embodiment some of the bags in the chamber are subjected to pressure during a first time interval and others of the bags are subjected to vacuum during a second time interval.

In accordance with another embodiment of the present invention there may be a pair of airtight containment chambers, one for coupling to a vacuum source and the other for coupling to a pressure source. This may comprise an air control circuit coupled between the pump and the chambers for directing only pressure to one chamber and only vacuum to the other chamber. Each of chambers may include a door. The chambers may be separated by a common dividing wall.

In accordance with still another embodiment of the present invention there may be provided a pair of pumps and an associated pair of chambers with a pump associated with each respective chamber. In this embodiment only vacuum is coupled to one chamber

and only pressure is coupled to the other chamber. The chambers may be separated and each have its own access door.

### BRIEF DESCRIPTIONS OF THE DRAWINGS

5 Numerous other objects, features and advantages of the invention should now become apparent upon a reading of the following detailed description when taken in conjunction with the accompanying drawings, in which:

Fig. 1 is a system block diagram illustrating a system in which the blood product transfer apparatus of the present invention may be employed;

Fig. 2 is a perspective view of the air chamber of the present invention;

10 Fig. 3 is a schematic diagram illustrating the fluid pump, chamber and air supply indicating alternate operation for respective pressure and vacuum;

Fig. 4 is a system block diagram illustrating an embodiment of the invention employing a single pump with multiple blood product storage bags;

15 Fig. 5 is a system block diagram of another embodiment of the present invention employing a single pump but in which the chamber can contain blood storage bags that can be alternately emptied and filled;

Fig. 6 is a system block diagram of still another embodiment of the present invention in which the airtight containment chamber is separated into two separate chambers with a single pump; and

20 Fig. 7 is a system block diagram for still another embodiment of the present invention employing separate containment chambers and separate pumps.

### DETAILED DESCRIPTION OF THE INVENTION

The drawings, that are to be discussed hereinafter, illustrate a chamber for storing blood product bags or any other fluid bags in which the fluid is to be driven or transferred  
25 without requiring the use of peri-pumps or gravity. In accordance with one embodiment of the invention only pressure may be applied within the containment chamber for the

purpose of expressing the blood product to, for example, a centrifuge, such as to a centrifuge processing bag. In another embodiment in accordance with the invention the chamber may be operated under vacuum so as to transfer blood products say from a blood processing bag to a blood product storage bag within the chamber.

5           Thus, the present invention describes, in essence, a mechanical device that is a pressure and/or vacuum chamber that facilitates the flow of blood or blood related product fluids to and/or from a centrifuge for blood related processing. The blood product may be contained in medical industry standard blood or transfer bags with attached sealed tubing. The blood related product may include platelets, plasma, red blood cells, in any  
10 combination or separately, and in any quantity up to the capacity of the bags in which they are contained. For the purpose of this invention, the term "blood product" may include, but is not necessarily limited to, treated or untreated fluid associated with blood, warm or cold blood, stored or fresh blood, blood diluted with a physiological solution, including but not limited to saline, nutrient, and/or anticoagulant solutions, one or more blood  
15 components, such as platelet concentrate, platelet rich plasma, fresh frozen plasma, plasma, plasma derivatives such as cryoprecipitate, packed red blood cells, or buffy coat, and analogous products derived from blood or blood components.

One objective of the present invention is to generate flow of blood product fluids say from one sterile flexible blood bag or multiple sterile flexible blood bags, to a  
20 centrifuge sterile processing bag or multiple centrifuge sterile processing bags. For this aspect of the invention air pressure is used within a chamber containing the blood product bags. A second objective is to generate flow of blood product fluids from a centrifuge sterile processing bag or multiple centrifuge sterile processing bags, to one sterile flexible blood bag or multiple sterile flexible blood bags. To accomplish this a vacuum is used  
25 within the chamber containing the blood product bags.

Reference is now made to Fig. 1 which is a system block diagram of a cell processing system embodying the device for enabling transfer of blood product between at least one blood storage bag and a centrifuge processing bag. Many of the components illustrated in Fig. 1 are not described in detail herein. However, reference is made to U.S.  
30 Patent No. 6,175,420 to Barry et al., granted January 16, 2001 for a more comprehensive

description of fluid management portions of the system. Reference may also be made to U.S. Patent No. 5,665,048 to Jorgensen, granted September 9, 1997 for further descriptions relating to the centrifuge itself. Both U.S. patent 5,665,048 and 6,175,420 are incorporated herein by reference, in their entirety.

5           Fig. 1 illustrates the vacuum/pressure chamber 10 in accordance with the present invention and the associated pump 12 that couples to the airtight containment chamber 10 by way of the tubing 14. Fig. 1 also illustrates the air supply at 16. Schematically illustrated within the chamber 10 are a series of blood product storage bags 20. Each of these bags is supported from a hanger 22 by means of a securing loop 24 associated with  
10 each bag. Individual lines or tubing from each bag couples through the wall of the chamber by way an airtight fixture 26. Fig. 1 illustrates this fixture at the bottom of the chamber 10. However, in embodiments to be described in further detail hereinafter, the fixture is usually provided on the door end and at about a mid-level position in the door, such as in, for example, Fig. 2. Fig. 1 also illustrates the door 28 to the chamber 10.

15           In Fig. 1 there is also illustrated a centrifuge 30 that may have associated therewith centrifuge processing bags 32. Also illustrated is the distribution section 40 comprising a plurality of fluid management cassettes 42 and a peristaltic pump 44. Also coupling to the cassettes 42 is a saline supply or bag 45 and reagent compartment 46. Also illustrated is a waste bag 48 relating to the fluid management cassettes.

20           Not specifically illustrated in Fig. 1, but considered as part of the system, is a computer controller. This is illustrated, however, in other embodiments of the present invention described hereinafter. This is described as a processor control 50 that controls, inter alia, operation of the air pump in accordance with the present invention.

25           Reference may now be made to Fig. 2 of the application for further details of the pressure/vacuum chamber of the present invention. As indicated previously, the concepts of the present invention can be practiced even with the use of only a single bag within the storage chamber. However, a number of bags may be placed in the device chamber, the quantity of which depends on the processing capabilities of the centrifuge, such as whether it is a single or N unit device. The chamber 10 contains an airtight door 28 that  
30 allows access and placement of the bags inside the chamber for processing. The airtight



door 28 also has an adjoining airtight fixture 26 for allowing the tubing from the blood bags to exit the chamber, so that those tube endings can be sterilely docked to the centrifuge processing tubing. This is illustrated in Fig. 2 and 4 by various lengths of tubing 26A within the chamber and tubing 26B outside the chamber. The airtight tubing fixture 26 allows for the maximum number of tubes related to the bag capacity of the chamber. Because the blood bags and tubing are not separated or cut, there is no concern for the device to provide a sterile environment. Inside the chamber are one or more hangers, schematically illustrated in Fig. 1 by the hanger 22 for mounting a single bag or a plurality of bags. These bags 20 are preferably mounted vertically so that under pressure, the tubing does not collapse or pinch until the blood product has been removed to the centrifuge, in the pressure application.

The device of the present invention, including the chamber 10 has the capability to provide a gradient level of pressure or vacuum, essentially from no pressure or vacuum to positive pressure or vacuum and over any time interval. The device chamber 10 preferably has a release valve 21 such as depicted in Fig. 2 that may be controlled by the user or by the centrifuge process to release pressure or vacuum to atmospheric conditions. Also, the airtight door 28 to the chamber preferably has a safety mechanism such as safety latch to ensure that the door cannot be opened unless the chamber contains no pressure or vacuum.

The chamber 10 of the device in accordance with the present invention may also have a pressure release valve that may be mounted in the wall of the chamber. This pressure release valve ensures that a pressure or vacuum does not exceed the device chamber limit. The device of the present invention, such as illustrated in Fig. 2 can be constructed as a stand-alone unit with manual control by an operator, or it can be driven automatically by a system that drives an entire process.

The airtight containment chamber is constructed of a material that can withstand large pressures and vacuums. The volumetric capacity of the chamber is great enough to contain one or more flexible blood bags (or blood transfer bags) hung vertically by the bag hanger that runs across the top of the chamber. The door of the chamber is preferably in the form of a clear window, made of lexan or some other strong clear material to allow

visibility into the chamber. As indicated previously the door to the chamber is airtight and provides access to place the flexible blood bags inside the chamber. The door has a fixture such as fixture 26 that allows the tubing from the flexible or transfer bags to exit the chamber to the outside of the chamber where the tubing can be attached with a  
5 sterilized dock to the processing bags of the centrifuge.

As also illustrated in the drawings, the chamber 10 has associated therewith an air hose 14 that is connected to the exterior pump 12. The pump 12 provides either air pressure or vacuum to the chamber. The chamber has a pressure/vacuum transducer that allows pressure and vacuum readings to be taken and to be preferably processed by the  
10 computer processor. Associated with the pump is a switch mechanism that allows it to pump air to the chamber to create pressure, or, alternatively, withdraw air to create a vacuum.

The chamber interlock, the chamber release valve, chamber transducer, air pump and other solenoids needed to control air flow, are all controlled by a computer processor  
15 that is itself part of a larger computer system that controls the entire process. This centrifuge system has a user interface that facilitates the process of loading and unloading the pressure and/or vacuum chamber.

Now, and with further reference to the drawings, Fig. 2 illustrates the door 28 to the chamber 10. Also illustrated in Fig. 2 is the hanger 22, showing at least one blood  
20 product storage bag 20 supported from the hanger 22. The amount of tubing illustrated in Fig. 2 indicates that there may be up to three bags in the chamber with associated tubing from all three bags. Also illustrated is the tubing fixture 26 that enables tubing 26A associated with the bag, to be coupled to the outside of the chamber to tubing 26B. Tubings 26A and 26B may be the same uninterrupted tubing.

25 Also, with reference to Fig. 2, there is shown there the chamber 10 and the tubing 14 that couples from the chamber 10 to the air pump 12. Also illustrated in Fig. 2 are the solenoids 80A and 80B that are controlled, to be described in further detail hereinafter, for selecting either vacuum or pressure operation. Also illustrated in Fig. 2 are the vacuum and pressure control valves 82A and 82B.

In Fig. 2, the chamber release valve 21 is also illustrated. Also illustrated is a gauge 15 for reading the pressure or vacuum that occurs in the chamber.

Fig. 3 is a schematic diagram illustrating the pump 12, chamber 10 and air supply 16, along with the solenoids 80A and 80B. Associated with the solenoid 80A are coupling tubing lines 83A, 84A and 85A. Associated with the solenoid 80B are coupling tubing lines 83B, 84B and 85B.

For pressure operation the solenoid 80A is operated so that there is a path between tubing lines 83A and 85A. Similarly, the solenoid 80B is operated so that there is a fluid path between the tubings 83B and 85B. This state of the solenoids is controlled by the switch 11. With the solenoids in this position, there is a direct path from the air intake 16 by way of solenoid 80A, via pump 12, and by way of solenoid 80B to chamber 10. This causes a pressurizing in the chamber 10. In this mode of operation the tubings 84A and 84B are essentially disconnected.

For vacuum operation the solenoids 80A and 80B are switched to their alternate position, under control of the switch 11. The switch 11 may be operated manually or may be an electronic switch controlled from the overall processing system. In the vacuum state of operation, the tubings 83A and 83B are blocked and the input side of the pump couples to the chamber 10 by way of solenoid 80B and tubings 84B and 85B. Similarly, the output side of the pump couples to the air source 16 by way of solenoid 80A and the tubings 84A and 85A.

To deliver blood product from the flexible blood product bag, or bags, to the centrifuge for some centrifugation process, the user opens the door to the chamber, hangs the bag(s) on the bag hanger, routes the tubing from the bags to the special tubing fixture that is part of the chamber door, closes the door, attaches the tubing ends to the centrifuge processing bag(s) tubing with sterilized docks, and then starts the computer system which controls the pump and centrifuge process. The computer system is responsible for maintaining the correct pressure level in the chamber derived either from the user, or by some established software protocol. Once the blood products have been completely delivered to the centrifuge, the pump is stopped and the release valve is activated to allow the pressure to escape.

To deliver blood product from centrifuge processing bag or bags, to a flexible blood product bag or bags, the user opens the door to the chamber, hangs the bag(s) on the bag hanger, routes the tubing from the bags to the special tubing fixture that is part of the chamber door, closes the door, attaches the tubing ends to the centrifuge processing bag(s) tubing with sterilized docks, and then starts the computer system which controls the pump and centrifuge process, if it is not already active or running. The computer system is responsible for maintaining the correct vacuum level in the chamber derived either from the user, or by some established software protocol. Once the blood product has been delivered to the flexible blood product bag(s) in the chamber, the pump is stopped and the release valve is activated to allow the vacuum to escape.

Now, reference may be made to separate embodiments of the present invention, such as illustrated in Figs. 4-7. In one embodiment there may be provided a single pressure/vacuum chamber and a single pump device. Another embodiment may include two pressure/vacuum chamber devices. In still another embodiment there may also be provided separate pumps.

Now, with reference to Fig. 4, there is shown a single pump 12 and a single chamber 10. Fig. 4 also shows the processor control 50 with the control line 52 coupling to the pump 12. Associated with the processor control 50, may be a solenoid arrangement such as that depicted in Fig. 3 with a switch that is either manually controlled or a computer control switch for selecting either pressure or vacuum operation. Fig. 4 illustrates a series of blood product bags 20 hung within the chamber 10. Also illustrated is the door 28 and the airtight fixture 26. For the pressure application, the chamber is essentially used to empty the contents of the sterile blood bags using pressure that is distributed evenly about the entire outer surfaces of each bag. It is noted in Fig. 4 that the bags are preferably hung vertically but also may be hung in other positions so that there are no air bubbles that would tend to get into the outlet tubing from each of the bags. The applied pressure provides an efficient and accurate way of dispensing blood product from the bags.

Reference is now made to another embodiment of the invention illustrated in Fig. 5. In this embodiment it is noted that there are provided two separate series of bags. This

includes three bags 20A and three bags 20B. The bags 20A are emptied with the application of pressure and the bags 20B may be filled with the use of vacuum. Again, there is illustrated in Fig. 5 the processor control 50 and control line 52 to the pump 12 for controlling the pump to apply either pressure or vacuum to the chamber 10.

- 5           In the sequence of operation in accordance with the embodiment of Fig. 5, blood product in bags 20A may be transferred with the use of pressure to the centrifuge. Thereafter, with the application of vacuum to the chamber 10 some predetermined blood products from the processing bags may be transferred to the bags 20B.

- Reference is now made to Fig. 6 for still a further embodiment of the present invention. This embodiment includes airtight containment chambers 10A and 10B within one single chamber 10. These chambers 10A and 10B are separated by a barrier or dividing wall 17. It is noted that, within each chamber, there are hangers. Within chamber 20A a series of bags 60 are hung from one hanger. On the other side, in chamber 10B there are a series of bags 62 that are hung from a hanger within that chamber. There are also illustrated in Fig. 6 separate doors 28A and 28B and respective airtight fixtures 26A and 26B.

- In Fig. 6 there is illustrated a single pump 12 that may have associated therewith a solenoid 64 for separating the output of the pump into two lines or tubings 14A and 14B. This arrangement may provide pressure in one chamber, such as chamber 10A and vacuum in the second chamber, such as chamber 10B.

- In accordance with one version of the embodiment of Fig. 6, there solenoid 64 may be operated to provide, during a first sequence of operation, pressure into chamber 10A, and during a second sequence of operation, vacuum into chamber 10B. Alternatively, the connections at the solenoid 64 may be provided so that both the input and output ends of the pump connect to tubings 14A and 14B so that pressure and vacuum occur sequentially in the respective chambers 10A and 10B. In this way, one chamber contains bags that are to be emptied using pressure, and a second chamber contains bags that are to be filled using a vacuum.

Now, reference is also made to still a further embodiment of the present invention illustrated in Fig. 7. This embodiment now uses two separate chambers 10C and 110D. Each of these have respective doors 28A and 28B and airtight fixtures 26A and 26B. The chamber 10C is for housing bags 70 and is considered as the pressure chamber. The  
5 chamber 10D houses bags 72 and is considered as the vacuum chamber. In Fig. 7 the pump 12A is operated so as to provide pressure by way of tubing 13A to the chamber 10C. Alternatively, the pump 12B is operated to draw vacuum through the tubing 13B so that the chamber 10D is under vacuum. It is also noted in Fig. 7 that the processor control 50 includes a control line 52 that is considered coupling to both of the pumps 12A and  
10 12B. The control is more simplified in the version of Fig. 7 in that there is a pump associated with each chamber. The previous embodiments described in Figs. 4-7, require a switching mechanism so that switching can occur between vacuum and pressure within the chamber. No such switch between the pump and chamber is required in the version of Fig. 7.

15 Having now described a few embodiments of the invention, it should be apparent to those skilled in the art that the foregoing is merely illustrative and not limiting, having been presented by way of example only. Numerous modifications and other embodiments are within the scope of ordinary skill in the art and are contemplated as falling within the scope of the invention as defined by the appended claims and equivalents thereto. The  
20 contents of all references, issued patents, and published patent applications cited throughout this application are hereby incorporated by reference. The appropriate components, processes, and methods of those patents, applications and other documents may be selected for the present invention and embodiments thereof.

## WHAT IS CLAIMED IS:

1. A system for transferring blood product in either direction between a blood storage bag and a processing bag, said system comprising:
  - an airtight containment chamber;
  - a hanger within the chamber for supporting at least one blood storage bag in an upright position with a tubing end of the blood storage bag at the bottom thereof;
  - a door to the airtight containment chamber including an airtight fixture that allows tubing from the blood storage bag to exit the chamber;
  - a fluid pump coupled to the airtight containment chamber for establishing one of pressure and vacuum within the airtight containment chamber to transfer blood product in either direction between the blood storage bag and processing bag; and
  - a controller for controlling at least said air pump to, in turn, control the transfer of blood product.
2. A system as in claim 1 wherein said hanger supports a plurality of blood storage bags.
3. A system as in claim 2 wherein said processing bag is a centrifuge processing bag.
4. A system as in claim 3 wherein the bags are disposed in a position that allows for blood product flow due to pressure or vacuum without allowing a blockage to occur via a collapsed tube or blood storage bag.
5. A system as in claim 1 wherein said fluid pump comprises an air pump having a compressor for delivering either a pressure to the chamber or drawing a vacuum on the chamber.
6. A system as in claim 5 including a control solenoid circuit for selecting, in one state, pressure operation and in another state, vacuum operation.

7. A system as in claim 6 wherein said one and another states are mutually exclusive.
8. A system as in claim 1 wherein the chamber contains multiple blood product bags and further including a fluid control circuit that coupled only one at a time of either pressure or vacuum to the chamber.
9. A system as in claim 8 wherein some of the bags in the chamber are subjected to pressure during a first time interval and other of the bags are subjected to vacuum during a second time interval.
10. A system as in claim 1 including a pair of airtight containment chambers one for receiving a vacuum source and the other for receiving a pressure source.
11. A system as in claim 10 including an air control circuit coupled between the pump and the chambers for directing only pressure to one chamber and only vacuum to the other chamber.
12. A system as in claim 11 including a door on each chamber.
13. A system as in claim 12 wherein said chambers are separated by a dividing wall.
14. A system as in claim 10 including a pair of pumps, one for each chamber.
15. A system as in claim 14 wherein only vacuum is coupled to one chamber and only pressure is coupled to the other chamber.
16. A system as in claim 15 wherein the chambers are separated and each has its own access door.
17. A centrifuge processing system for handling blood products, said system comprising:

a processing module including at least one processing bag;

a storage module including an airtight containment chamber for supporting at least one blood product storage bag in an upright position with a tubing end of the blood storage bag at the bottom thereof, an access



door to the chamber, and a fluid pump coupled to the airtight containment chamber for establishing one of pressure and vacuum within the chamber to transfer blood product in either direction between the blood storage bag and the processing bag; and

a control module for controlling the transfer of blood product.

18. A system as in claim 17 wherein said processing bag is a centrifuge processing bag.
19. A system as in claim 18 wherein the bags are disposed in a position that allows for blood product flow due to pressure or vacuum without allowing a blockage to occur via a collapsed tube or blood storage bag.
20. A system as in claim 17 wherein said fluid pump comprises an air pump having a compressor for delivering either a pressure to the chamber or drawing a vacuum on the chamber.
21. A system as in claim 20 including a control solenoid circuit for selecting, in one state, pressure operation and in another state, vacuum operation.
22. A system as in claim 17 wherein the chamber contains multiple blood product bags and further including a fluid control circuit that coupled only one at a time of either pressure or vacuum to the chamber.
23. A system as in claim 22 wherein some of the bags in the chamber are subjected to pressure during a first time interval and other of the bags are subjected to vacuum during a second time interval.
24. A system as in claim 17 including a pair of airtight containment chambers one for receiving a vacuum source and the other for receiving a pressure source.
25. A system as in claim 24 including an air control circuit coupled between the pump and the chambers for directing only pressure to one chamber and only vacuum to the other chamber.

26. A system as in claim 24 including a pair of pumps, one for each chamber.
27. A system as in claim 26 wherein only vacuum is coupled to one chamber and only pressure is coupled to the other chamber.
28. A system as in claim 27 wherein the chambers are separated and each has its own access door.
29. A method of transferring blood product in either direction between a blood storage bag and a processing bag, said method comprising the steps of:
  - disposing the blood storage bag in an airtight containment chamber with the blood storage bag hanging in an upright position;
  - coupling a pump to the airtight containment chamber;
  - providing either vacuum or pressure by means of the pump to the airtight containment to permit transfer of blood product in either direction between the blood storage bag and the processing bag.
30. A method as in claim 29 wherein the bags are disposed in a position that allows for blood product flow due to pressure or vacuum without allowing a blockage to occur via a collapsed tube or blood storage bag.
31. A method as in claim 29 including controlling the pump to select, in one state, pressure operation, and in another state, vacuum operation.
32. A method as in claim 31 wherein said one and another states are mutually exclusive.
33. A method as in claim 29 including disposing a plurality of storage bags in the chamber and providing a fluid control circuit that coupled only one at a time of either pressure or vacuum to the chamber.
34. A method as in claim 33 wherein some of the bags in the chamber are subjected to pressure during a first time interval and other of the bags are subjected to vacuum during a second time interval.

35. A method as in claim 29 including a pair of airtight containment chambers one for receiving a vacuum source and the other for receiving a pressure source.
36. A method as in claim 35 including an air control circuit coupled between the pump and the chambers for directing only pressure to one chamber and only vacuum to the other chamber.
37. A method as in claim 36 wherein said chambers are separated by a dividing wall.
38. A method as in claim 36 including a pair of pumps, one for each chamber.

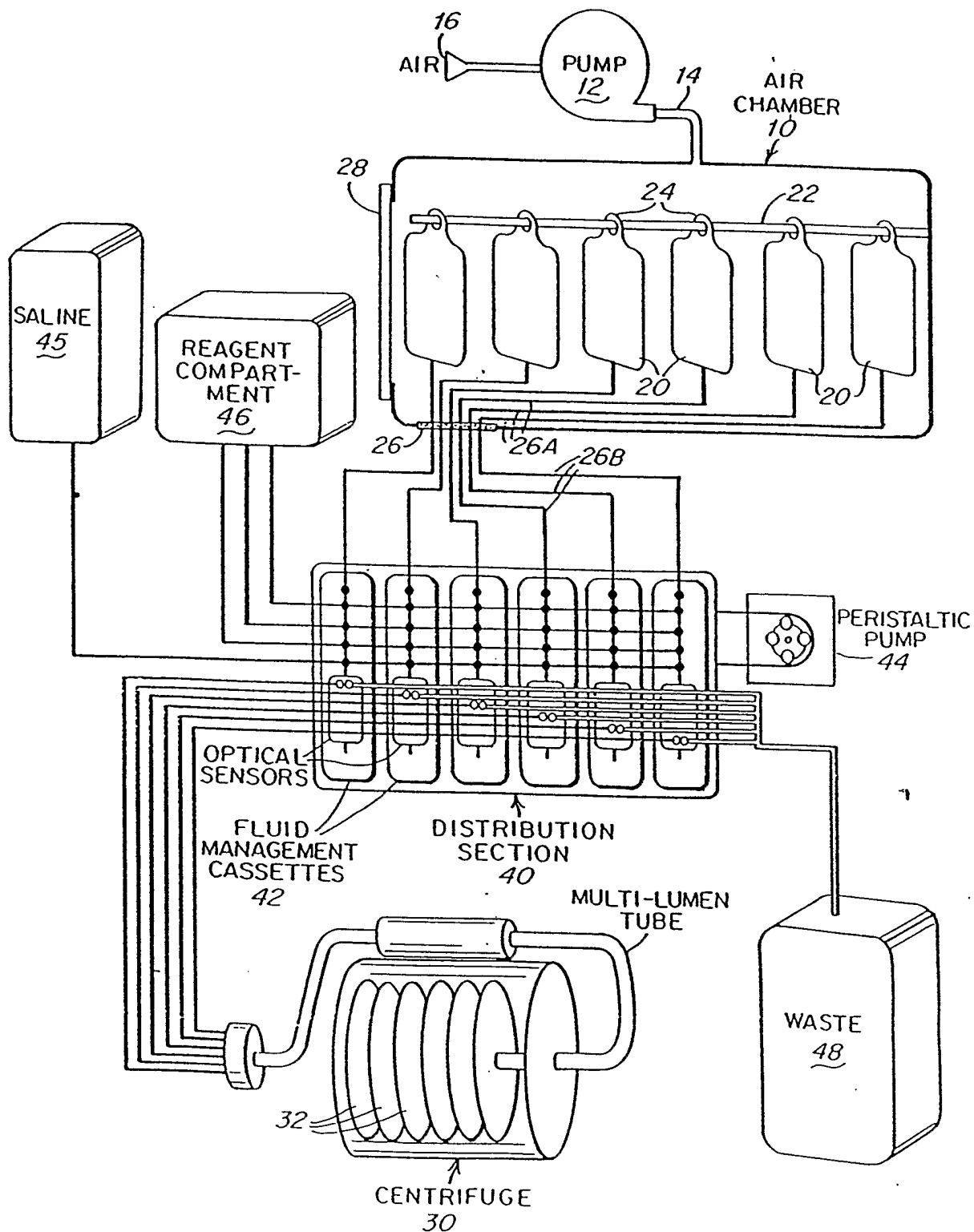
*Fig. 1*

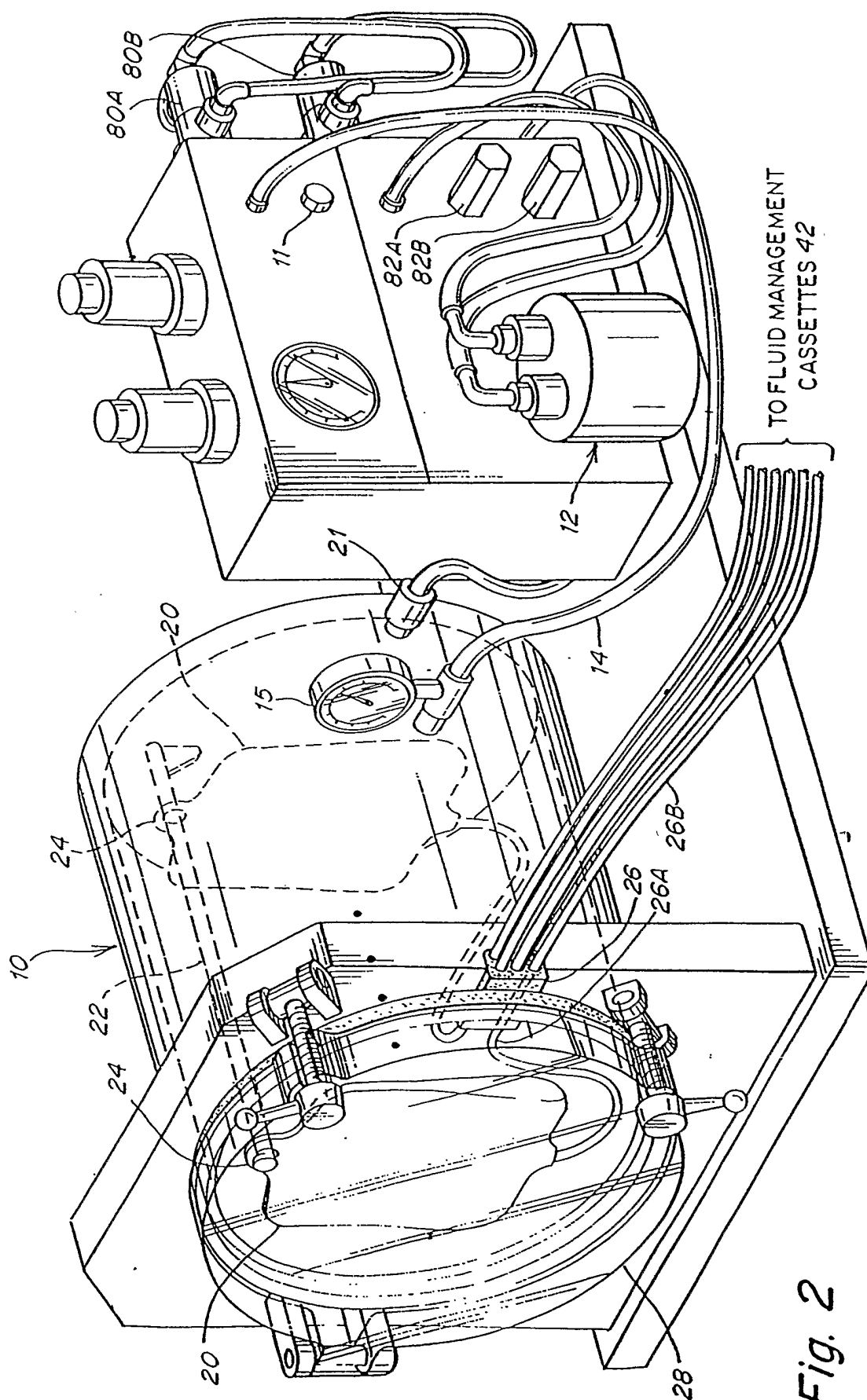

Fig. 2

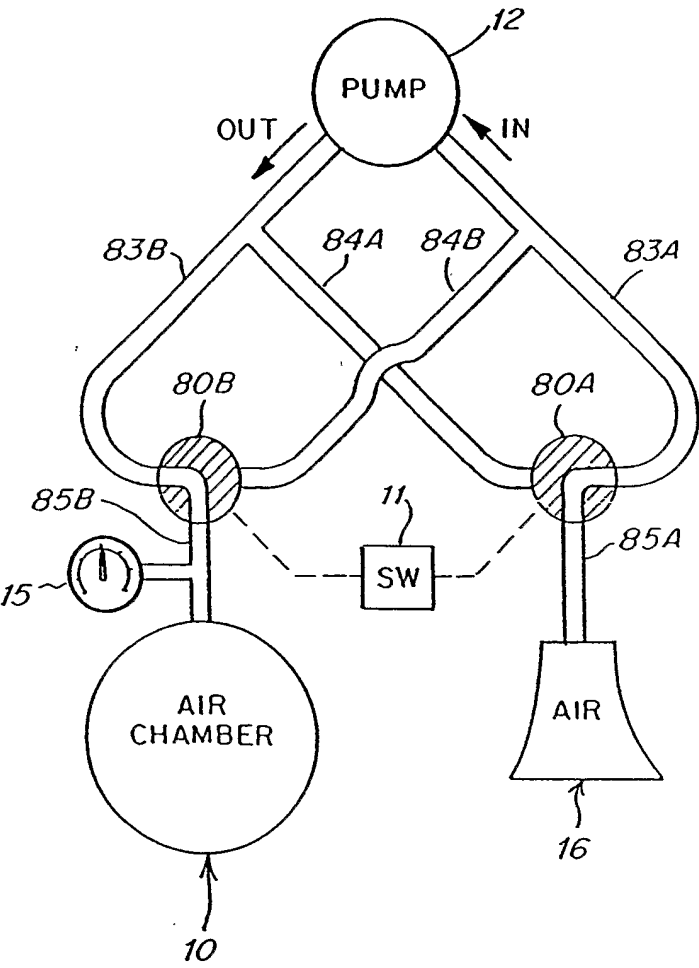
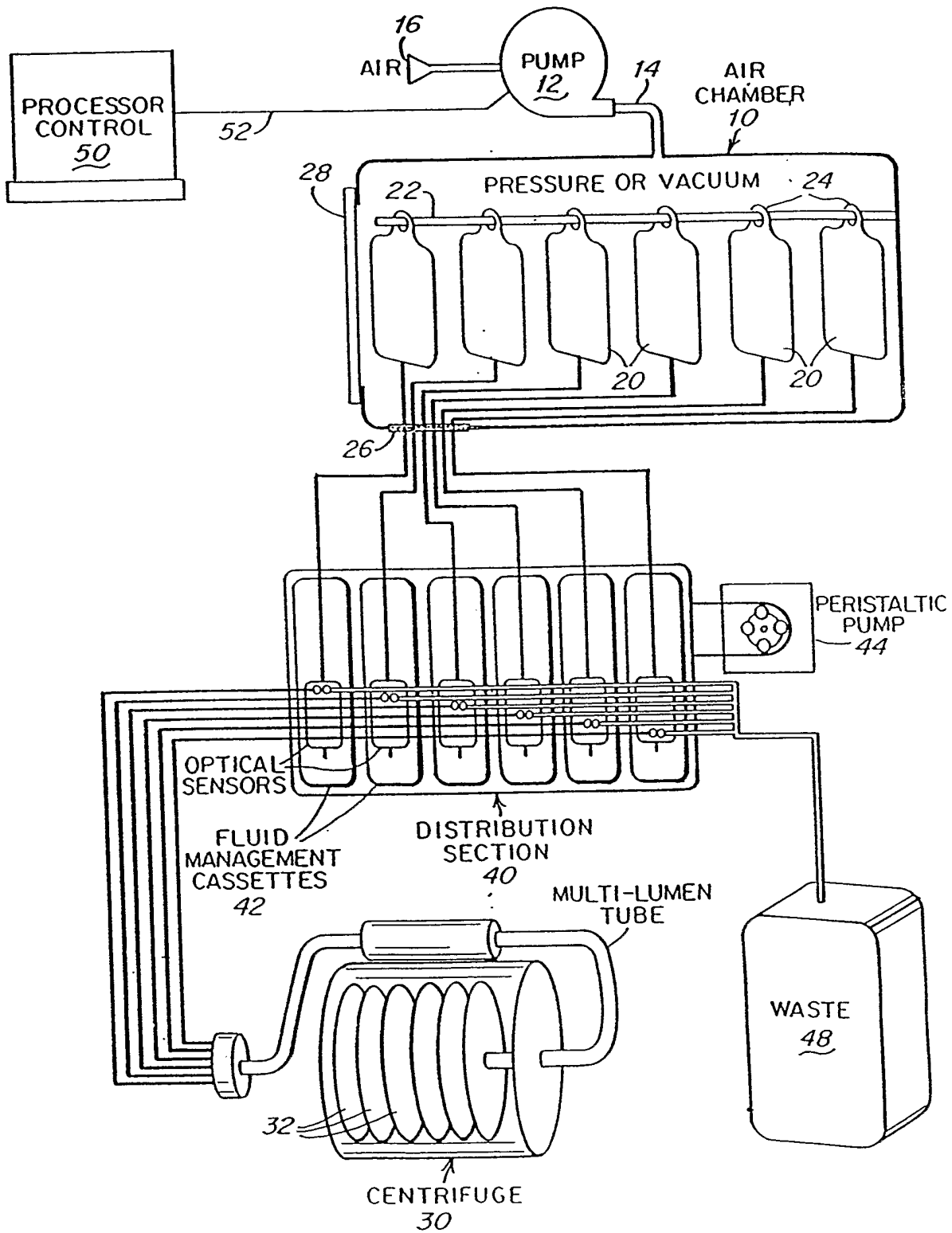
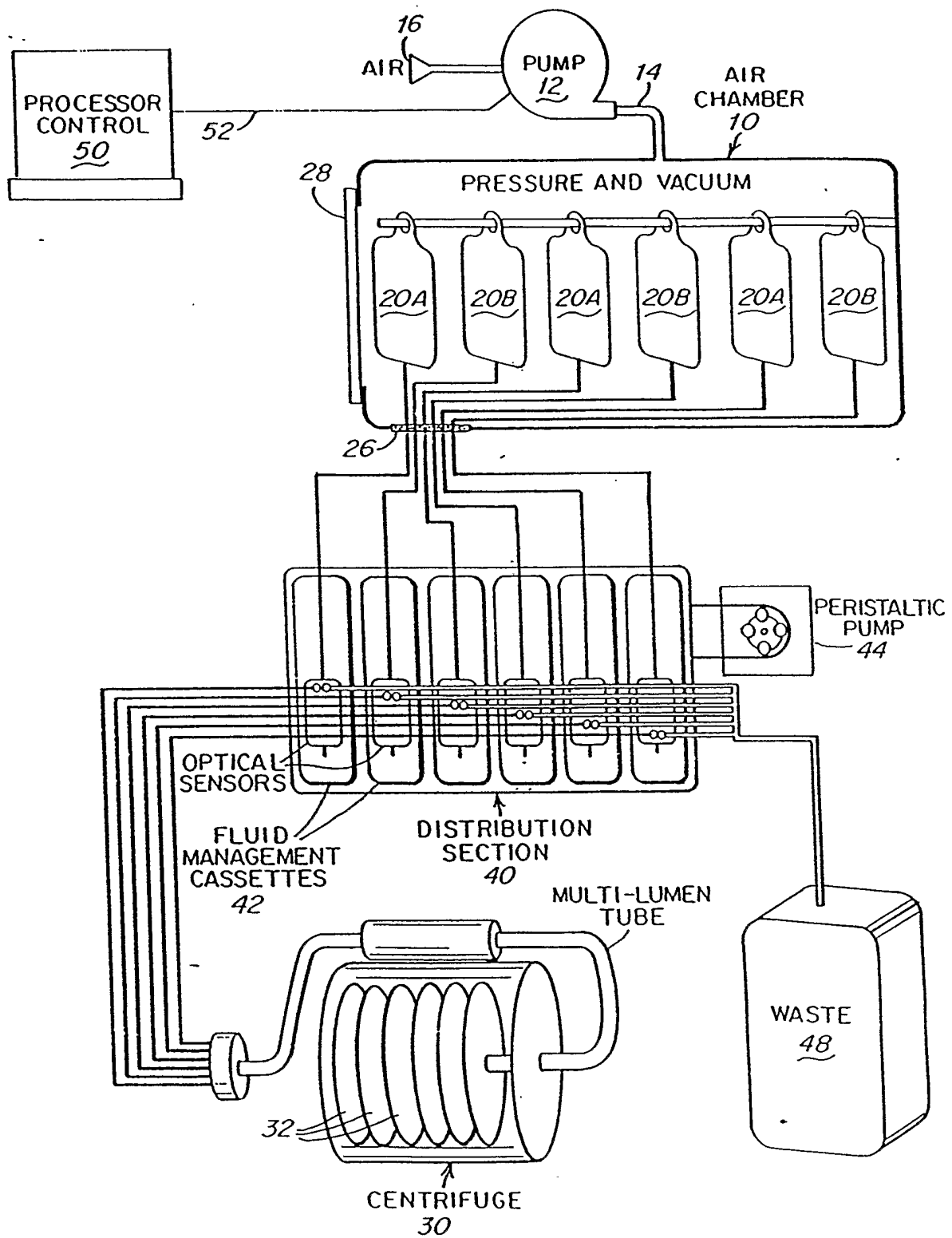
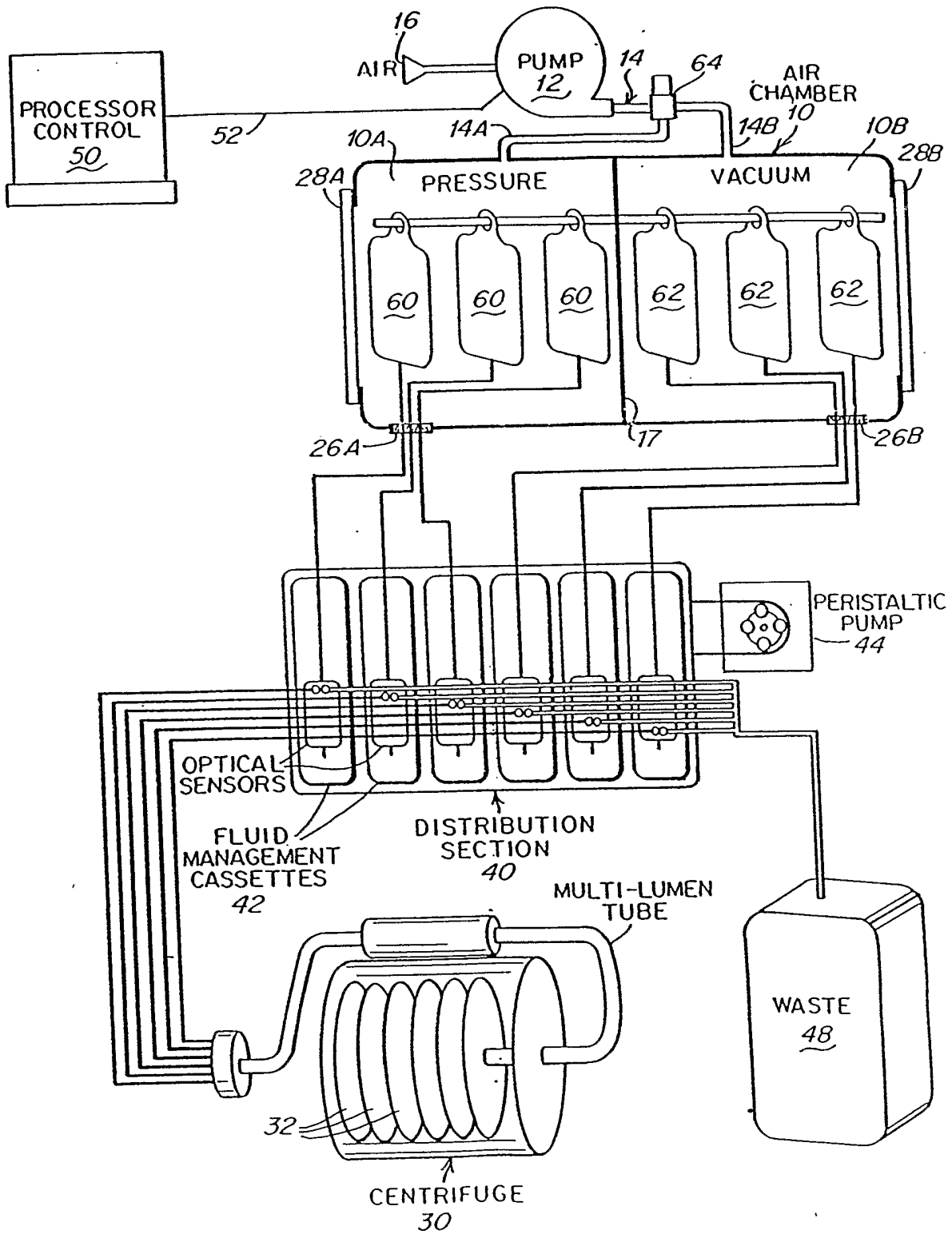

Fig. 3

*Fig. 4*

*Fig. 5*



*Fig. 6*

7/7

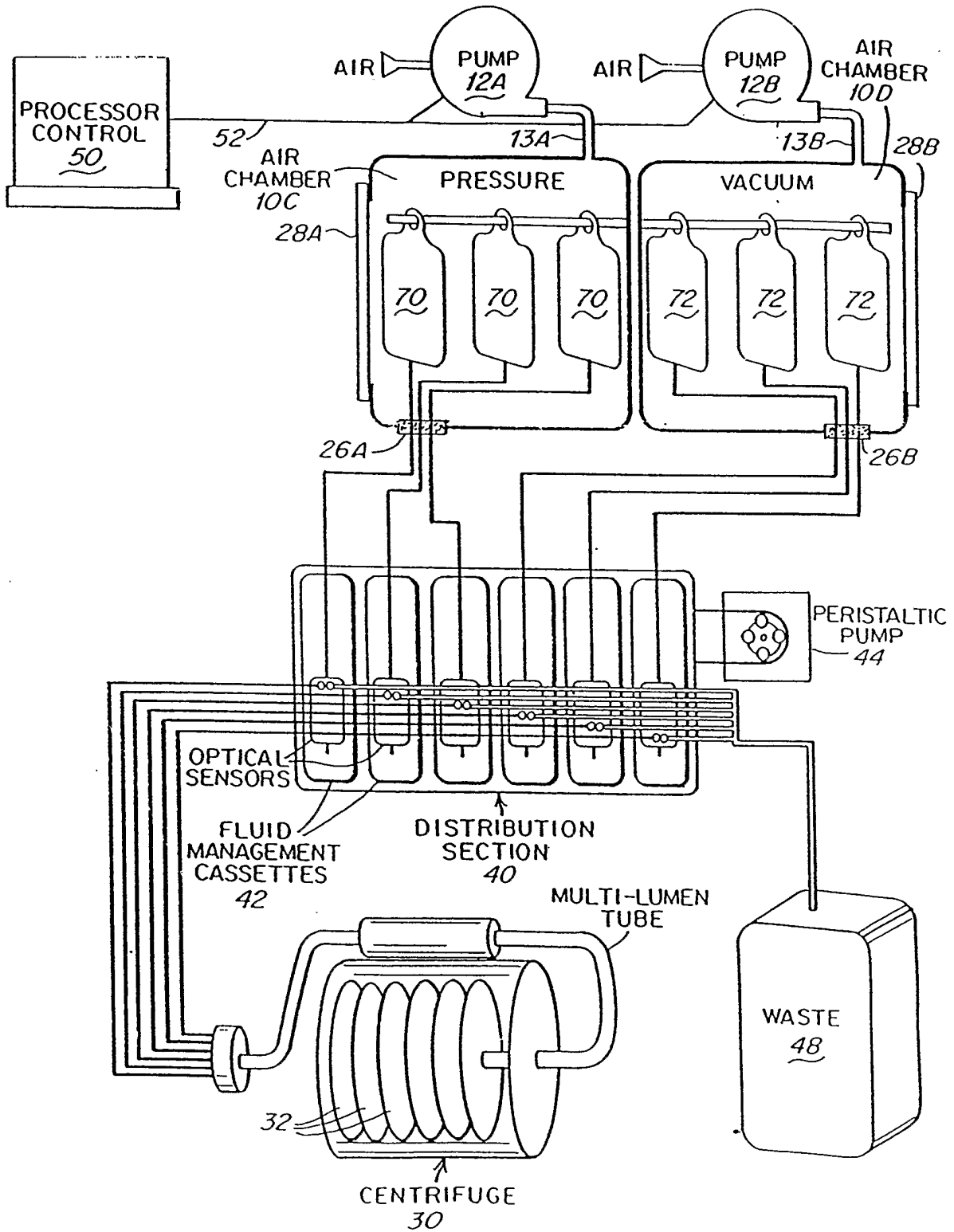

Fig. 7

## INTERNATIONAL SEARCH REPORT

International Application No

PCT/US 02/27696

A. CLASSIFICATION OF SUBJECT MATTER  
 IPC 7 A61M1/02 A61M5/148

According to International Patent Classification (IPC) or to both national classification and IPC

## B. FIELDS SEARCHED

Minimum documentation searched (classification system followed by classification symbols)

IPC 7 A61M

Documentation searched other than minimum documentation to the extent that such documents are included in the fields searched

Electronic data base consulted during the international search (name of data base and, where practical, search terms used)

EPO-Internal

## C. DOCUMENTS CONSIDERED TO BE RELEVANT

Category *	Citation of document, with indication, where appropriate, of the relevant passages	Relevant to claim No.
X	EP 0 405 094 A (TERUMO CORP) 2 January 1991 (1991-01-02) page 4, line 43 -page 9, line 24; figures 1, 4A	1-38
X	US 5 690 815 A (MATKOVICH VLADO I ET AL) 25 November 1997 (1997-11-25) column 5, line 48 -column 28, line 10; figures 1, 2, 12, 30	1-38
A	US 6 175 420 B1 (BARRY DONALD ET AL) 16 January 2001 (2001-01-16) cited in the application column 5, line 49 -column 6, line 59; figure 3	1-38
	--- -/--	

☒ Further documents are listed in the continuation of box C.

☒ Patent family members are listed in annex.

## \* Special categories of cited documents :

- \*A\* document defining the general state of the art which is not considered to be of particular relevance
- \*E\* earlier document but published on or after the international filing date
- \*L\* document which may throw doubts on priority claim(s) or which is cited to establish the publication date of another citation or other special reason (as specified)
- \*O\* document referring to an oral disclosure, use, exhibition or other means
- \*P\* document published prior to the international filing date but later than the priority date claimed

- \*T\* later document published after the international filing date or priority date and not in conflict with the application but cited to understand the principle or theory underlying the invention
- \*X\* document of particular relevance; the claimed invention cannot be considered novel or cannot be considered to involve an inventive step when the document is taken alone
- \*Y\* document of particular relevance; the claimed invention cannot be considered to involve an inventive step when the document is combined with one or more other such documents, such combination being obvious to a person skilled in the art.
- \*&\* document member of the same patent family

Date of the actual completion of the international search

29 November 2002

Date of mailing of the international search report

06/12/2002

Name and mailing address of the ISA

European Patent Office, P.B. 5818 Patentlaan 2  
 NL - 2280 HV Rijswijk  
 Tel. (+31-70) 340-2040, Tx. 31 651 epo nl,  
 Fax: (+31-70) 340-3016

Authorized officer

Kroeders, M

## INTERNATIONAL SEARCH REPORT

International Application No  
PCT/US 02/27696

## C.(Continuation) DOCUMENTS CONSIDERED TO BE RELEVANT

Category *	Citation of document, with indication, where appropriate, of the relevant passages	Relevant to claim No.
A	US 4 564 359 A (RUEHLAND DIETER) 14 January 1986 (1986-01-14) column 5, line 58 -column 8, line 6; figure 2 -----	1, 17, 29

## FURTHER INFORMATION CONTINUED FROM PCT/ISA/ 210

This International Searching Authority found multiple (groups of) inventions in this international application, as follows:

## 1. Claims: 1-16

A system for transferring blood product in either direction between a blood storage bag and a processing bag, said system comprising:

- A) an airtight containment chamber
- B) a hanger within the chamber
- C) a door to the airtight chamber and an airtight fixture
- D) a fluid pump coupled to the airtight containment chamber
- E) a controller

## 2. Claims: 17-28

A centrifuge processing system for handling blood products, said system comprising:

- F) a processing module
- A) an airtight containment chamber
- C) a door
- D) a fluid pump
- E) a controller

## 3. Claims: 29-38

A method of transferring blood product, said method comprising the steps of:

- G) disposing a bloodstorage bag in
- A) an airtight containment chamber
- D) coupling a fluid pump
- E) controlling the providing either vacuum or pressure

## INTERNATIONAL SEARCH REPORT

International application No.  
PCT/US 02/27696

### Box I Observations where certain claims were found unsearchable (Continuation of item 1 of first sheet)

This International Search Report has not been established in respect of certain claims under Article 17(2)(a) for the following reasons:

1. ☐ Claims Nos.:  
because they relate to subject matter not required to be searched by this Authority, namely:
  
2. ☐ Claims Nos.:  
because they relate to parts of the International Application that do not comply with the prescribed requirements to such an extent that no meaningful International Search can be carried out, specifically:
  
3. ☐ Claims Nos.:  
because they are dependent claims and are not drafted in accordance with the second and third sentences of Rule 6.4(a).

### Box II Observations where unity of invention is lacking (Continuation of item 2 of first sheet)

This International Searching Authority found multiple inventions in this international application, as follows:

see additional sheet

1. ☐ As all required additional search fees were timely paid by the applicant, this International Search Report covers all searchable claims.
2. ☒ As all searchable claims could be searched without effort justifying an additional fee, this Authority did not invite payment of any additional fee.
3. ☐ As only some of the required additional search fees were timely paid by the applicant, this International Search Report covers only those claims for which fees were paid, specifically claims Nos.:
4. ☐ No required additional search fees were timely paid by the applicant. Consequently, this International Search Report is restricted to the invention first mentioned in the claims; it is covered by claims Nos.:

#### Remark on Protest

- ☐ The additional search fees were accompanied by the applicant's protest.
- ☐ No protest accompanied the payment of additional search fees.

## INTERNATIONAL SEARCH REPORT

Information on patent family members

International Application No

PCT/US 02/27696

Patent document cited in search report		Publication date	Patent family member(s)	Publication date
EP 0405094	A	02-01-1991	DE 69023172 D1 DE 69023172 T2 EP 0405094 A2 US 5141490 A	30-11-1995 28-03-1996 02-01-1991 25-08-1992
US 5690815	A	25-11-1997	US 6106727 A AT 406638 B AT 904293 A AU 674692 B2 AU 4674493 A BE 1006620 A5 CA 2083544 A1 CA 2140141 A1 CH 685922 A5 DE 4393316 T0 DK 3695 A FI 950128 A FR 2696551 A1 GB 2284909 A ,B GB 2298933 A ,B GR 93100299 A IT 1270457 B JP 7509153 T NL 9320039 T PL 307164 A1 SE 514880 C2 SE 9500080 A WO 9401193 A1 US 6322709 B1 CA 2083543 A1 CN 1084426 A	22-08-2000 25-07-2000 15-12-1999 09-01-1997 31-01-1994 03-11-1994 14-01-1994 20-01-1994 15-11-1995 11-05-1995 13-01-1995 11-01-1995 08-04-1994 21-06-1995 18-09-1996 31-03-1994 05-05-1997 12-10-1995 03-04-1995 02-05-1995 07-05-2001 11-01-1995 20-01-1994 27-11-2001 14-01-1994 30-03-1994
US 6175420	B1	16-01-2001	NONE	
US 4564359	A	14-01-1986	DE 3304486 A1 AT 54569 T AT 70192 T AT 105715 T AU 558777 B2 AU 2447784 A BR 8400569 A DE 3429298 A1 DE 3482711 D1 DE 3485347 D1 DE 3485347 T DE 3486311 D1 EP 0116352 A1 EP 0345831 A1 EP 0454178 A1 JP 1686962 C JP 3048828 B JP 59155256 A MX 156522 A	16-08-1984 15-08-1990 15-12-1991 15-06-1994 05-02-1987 16-08-1984 18-09-1984 20-02-1986 23-08-1990 23-01-1992 23-01-1992 23-06-1994 22-08-1984 13-12-1989 30-10-1991 11-08-1992 25-07-1991 04-09-1984 06-09-1988