

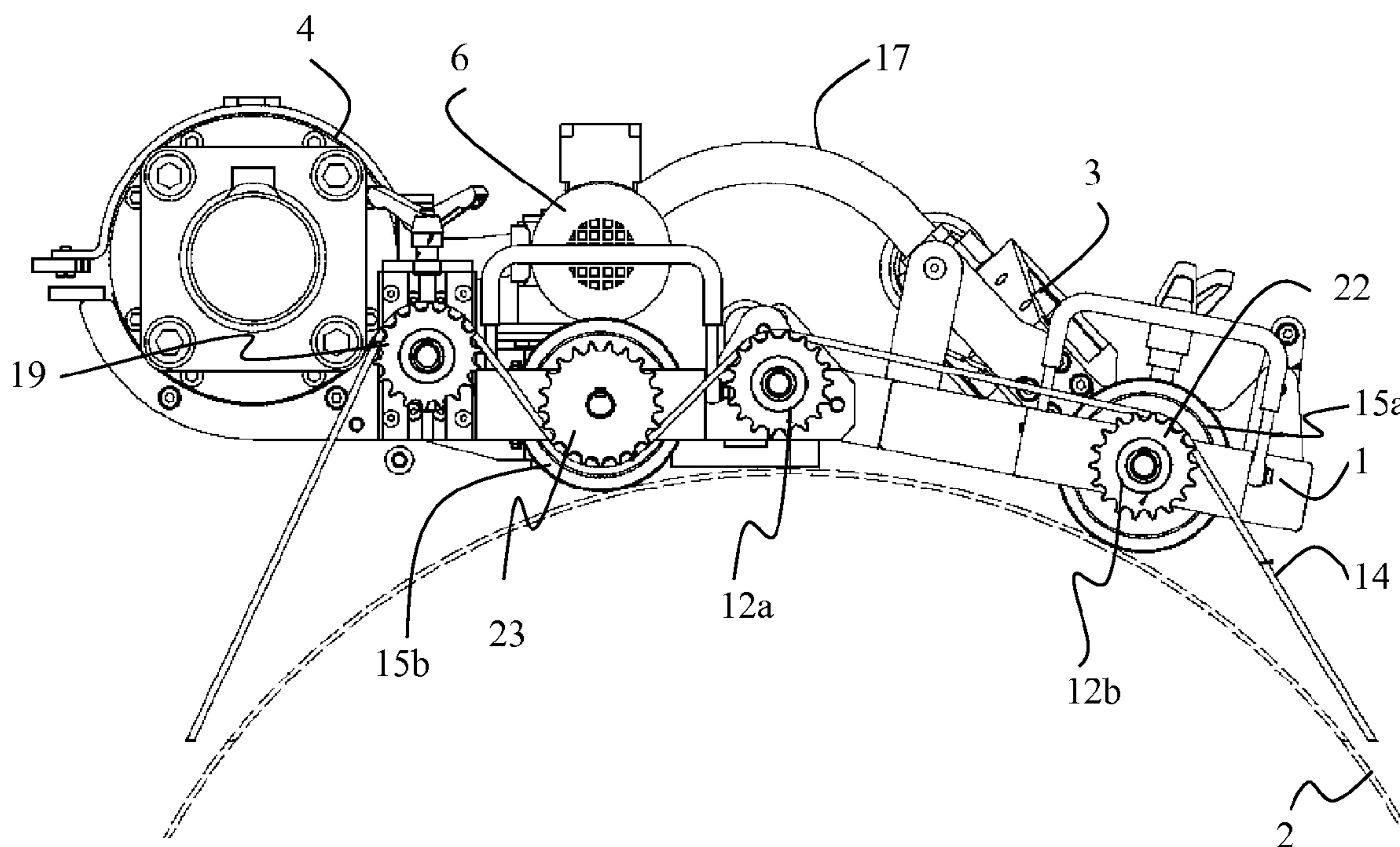

(86) Date de dépôt PCT/PCT Filing Date: 2008/04/24  
 (87) Date publication PCT/PCT Publication Date: 2008/11/06  
 (45) Date de délivrance/Issue Date: 2015/04/21  
 (85) Entrée phase nationale/National Entry: 2009/10/13  
 (86) N° demande PCT/PCT Application No.: FI 2008/050223  
 (87) N° publication PCT/PCT Publication No.: 2008/132279  
 (30) Priorité/Priority: 2007/04/25 (EP07397011.3)

(51) Cl.Int./Int.Cl. *F16L 58/18* (2006.01),  
*B29C 63/06* (2006.01), *F16L 13/02* (2006.01),  
*F16L 58/10* (2006.01)  
 (72) Inventeurs/Inventors:  
LEIDEN, LEIF, FI;  
SJOBERG, SVEN, FI;  
SMATT, RAUNO, FI  
 (73) Propriétaires/Owners:  
BOREALIS TECHNOLOGY OY, FI;  
UPONOR INFRA OY, FI  
 (74) Agent: NORTON ROSE FULBRIGHT CANADA  
LLP/S.E.N.C.R.L., S.R.L.

(54) Titre : PROCÉDE ET APPAREIL POUR REVETIR DES TUYAUX  
 (54) Title: METHOD AND APPARATUS FOR COATING PIPES



(57) Abrégé/Abstract:

Method and apparatus for coating a pipe (2) or a pipe section with a layer of at least one polymer. The method comprises providing a pipe (2) or a pipe section having an outer surface defining the periphery of the pipe or pipe section; applying on the outer surface of the pipe or pipe section a layer of at least one polymer material in melt stage using a nozzle (3), which is mounted on a carriage capable of travelling along the periphery of the pipe (2) or pipe section; and moving the carriage along at least a part of the periphery during the application of the polymer material to form a layer on the surface of the pipe (2) or pipe section. The present invention is particularly useful for coating field joints in pipelines.

(12) INTERNATIONAL APPLICATION PUBLISHED UNDER THE PATENT COOPERATION TREATY (PCT)

(19) World Intellectual Property Organization  
International Bureau(43) International Publication Date  
6 November 2008 (06.11.2008)

PCT

(10) International Publication Number  
**WO 2008/132279 A1**

## (51) International Patent Classification:

*F16L 58/18* (2006.01)      *F16L 13/02* (2006.01)  
*F16L 58/10* (2006.01)      *B29C 63/06* (2006.01)

## (21) International Application Number:

PCT/FI2008/050223

(22) International Filing Date: 24 April 2008 (24.04.2008)

(25) Filing Language: English

(26) Publication Language: English

## (30) Priority Data:

07397011.3      25 April 2007 (25.04.2007)      EP

(71) Applicants (for all designated States except US): **OY KWH PIPE AB** [FI/FI]; P.O. Box 21, FI-65101 Vaasa (FI). **BOREALIS TECHNOLOGY OY** [FI/FI]; P.O. Box 330, FI-06201 Porvoo (FI).

## (72) Inventors; and

(75) Inventors/Applicants (for US only): **LEIDÉN, Leif** [FI/FI]; Hemängsvägen 28, FI-07130 Andersböle (FI). **SJÖBERG, Sven** [FI/FI]; Stallkarlsgatan 6, FI-65370 Vasa (FI). **SMÅTT, Rauno** [FI/FI]; Sontulantie 426, FI-37800 Toijala (FI).(74) Agent: **SEPPO LAINE OY**; Itämerenkatu 3 B, FI-00180 Helsinki (FI).

(81) Designated States (unless otherwise indicated, for every kind of national protection available): AE, AG, AL, AM, AO, AT, AU, AZ, BA, BB, BG, BH, BR, BW, BY, BZ, CA, CH, CN, CO, CR, CU, CZ, DE, DK, DM, DO, DZ, EC, EE, EG, ES, FI, GB, GD, GE, GH, GM, GT, HN, HR, HU, ID, IL, IN, IS, JP, KE, KG, KM, KN, KP, KR, KZ, LA, LC, LK, LR, LS, LT, LU, LY, MA, MD, ME, MG, MK, MN, MW, MX, MY, MZ, NA, NG, NI, NO, NZ, OM, PG, PH, PL, PT, RO, RS, RU, SC, SD, SE, SG, SK, SL, SM, SV, SY, TJ, TM, TN, TR, TT, TZ, UA, UG, US, UZ, VC, VN, ZA, ZM, ZW.

(84) Designated States (unless otherwise indicated, for every kind of regional protection available): ARIPO (BW, GH, GM, KE, LS, MW, MZ, NA, SD, SL, SZ, TZ, UG, ZM, ZW), Eurasian (AM, AZ, BY, KG, KZ, MD, RU, TJ, TM), European (AT, BE, BG, CH, CY, CZ, DE, DK, EE, ES, FI, FR, GB, GR, HR, HU, IE, IS, IT, LT, LU, LV, MC, MT, NL, NO, PL, PT, RO, SE, SI, SK, TR), OAPI (BF, BJ, CF, CG, CI, CM, GA, GN, GQ, GW, ML, MR, NE, SN, TD, TG).

## Published:

- with international search report
- before the expiration of the time limit for amending the claims and to be republished in the event of receipt of amendments

(54) Title: METHOD AND APPARATUS FOR COATING PIPES

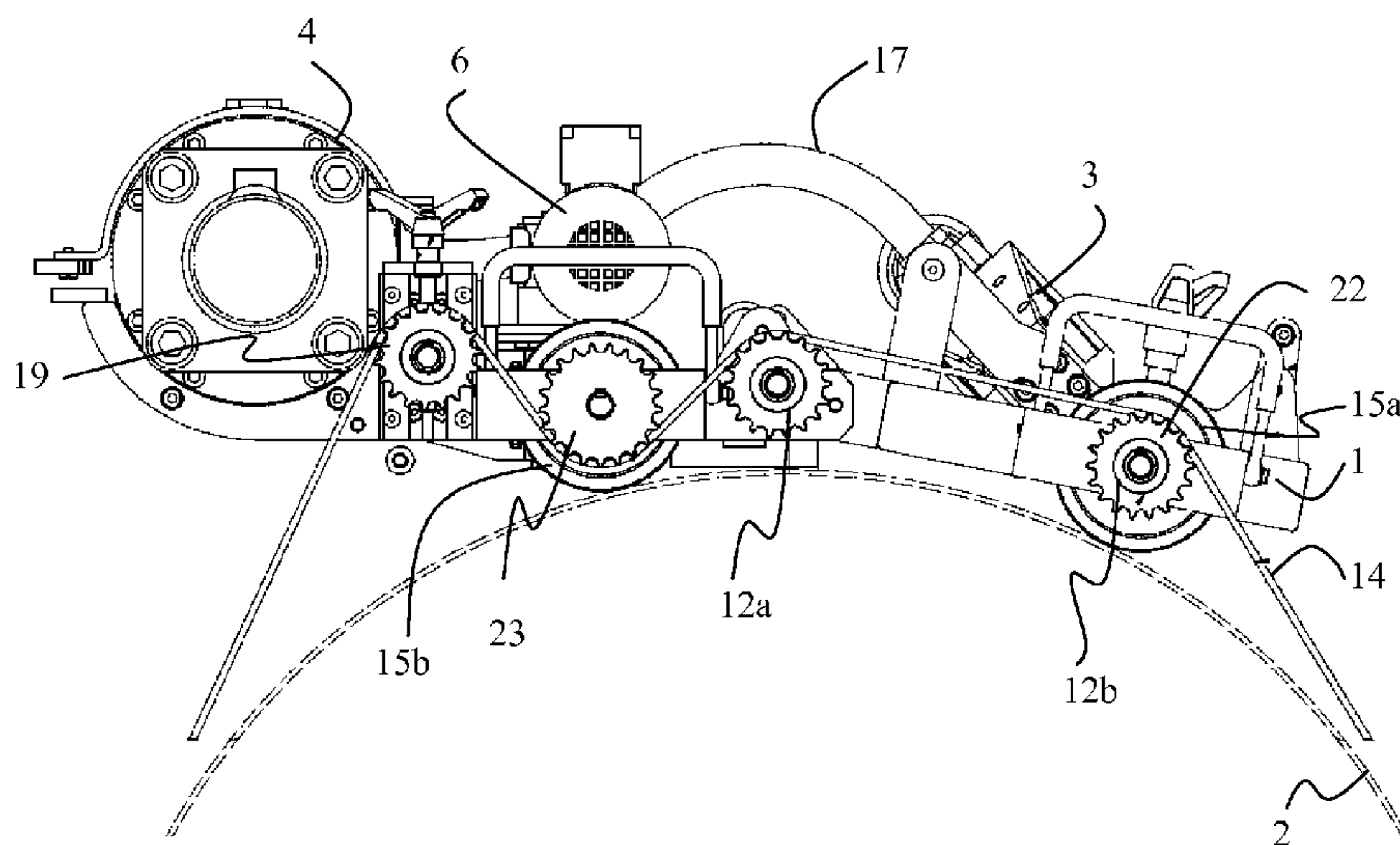

Fig. 1

(57) **Abstract:** Method and apparatus for coating a pipe (2) or a pipe section with a layer of at least one polymer. The method comprises providing a pipe (2) or a pipe section having an outer surface defining the periphery of the pipe or pipe section; applying on the outer surface of the pipe or pipe section a layer of at least one polymer material in melt stage using a nozzle (3), which is mounted on a carriage capable of travelling along the periphery of the pipe (2) or pipe section; and moving the carriage along at least a part of the periphery during the application of the polymer material to form a layer on the surface of the pipe (2) or pipe section. The present invention is particularly useful for coating field joints in pipelines.

WO 2008/132279 A1

### Method and apparatus for coating pipes

The present invention concerns a method according to the preamble of claim 1 for coating a pipe or a pipe section.

5

According to a method of this kind, a layer of at least one polymer material is applied on the surface of the pipe or pipe section at least along a part of the periphery thereof.

The present invention also comprises an apparatus according to the preamble of claim 33  
10 for applying a polymer coating on the surface of a pipe.

Steel pipes coated with layers of polymers, such as polyethylene or polypropylene, have been used in oil and gas pipelines for a long time. These kinds of pipes are mechanically strong and have good corrosion resistance along the coated part of the pipe. They are  
15 generally welded together using the SAW technique (Submerged Arc Welding) to form a pipeline. To facilitate weld-joining of the pipes at the construction site, a length of the pipe is usually left uncoated at both ends at the factory where the polymer coating is otherwise applied on the surface of the pipe.

20 Field-welded joints, i.e. the joints formed at the construction sites, are sensitive to corrosion. For this reason, a coating layer has to be spread upon the girth weld and on the adjacent, uncoated portions of the pipes so as to completely cover the welded joint and to shield it from moisture and water in the ambience.

25 A number of ways of producing protective coatings of field-welded joints are known in the art. Conventionally, the welded joints are covered in a film of polyethylene film (shrink-sleeve), which can be shrink-wrapped around the joint to cover the weld. This method accounts for about 65 % of the field-joint coatings in case of polyethylene-coated steel pipes. Another option is to provide the girth weld with a cover of urethane or epoxy resins.

30 Such coatings can be sprayed on the pipe using spray guns. Further alternatives are represented by machine taping, surface molten tape, manual taping and injection moulding. Some of these techniques give rise to good coating results but are difficult, if not impossible, to use in field conditions; some fail to give adequate protection against corrosion.

It is an aim of the present invention to eliminate at least a part of the problems related to the prior art and to provide a novel method of coating pipes.

- 5 It is another aim of the present invention to provide a novel kind of apparatus for coating pipes.

The present invention is based on the idea of applying at least one polymer material in the form of a melt film or sheet on the surface of the pipe or pipe section from a moving die or  
10 nozzle. In particular, the melt polymer film or sheet is applied on the pipe from a die which is mounted on a carriage, which can be moved along the periphery of the pipe or pipe section.

An apparatus according to the invention comprises

- 15 – a movable carriage, which is capable of travelling around the periphery of the pipe or pipe section; and  
– a flat die connected to a source of a polymer melt and mounted on the moveable carriage for applying a polymer layer in melt form on the surface of a pipe or pipe section.

20

Further, the apparatus comprises, in combination with the above features, a levelling means for levelling the melt polymer layer formed on the surface of the pipe or pipe section.

- 25 More specifically, the present method is mainly characterized by what is stated in the characterizing part of claim 1.

The apparatus according to the invention is characterized by what is stated in the characterizing part of claim 33.

30

Considerable advantages are obtained by means of the invention. Thus, the method and apparatus according to the invention can be used for coating field joints of pipelines, but it can also be used for other coating applications, where a layer of polymer material needs to be applied upon the surface of a pipe or a similar substrate. Therefore, the invention can

also be used for repairing various polymer coatings. The apparatus is light-weight, operator friendly and easy to use in field conditions. The equipment described below can be moved and operated with a tractor with trailer and a log-lift – all equipment being placed on the trailer. The log-lift can be used for moving a tent for shielding off the coating area and the die and platform from one joint to next. Cooling is mostly not needed, but can be effected with e.g. blowing of air or with a wet cloth. The coated area can be readily repaired, if needed with a portable welding machine.

Importantly, when used for producing a field-joint coating, the result of the present method and apparatus will be as good as a factory coating and the invention is fully operational in field conditions, all weather conditions taken into account. The invention can be used for coating sections of pipes or whole pipes. It can also be used for coating the area surrounding a welded or otherwise accomplished joint between two pipes, as will be discussed below.

15

Next the invention will be examined more closely with the aid of a detailed description and with reference to the attached drawings.

Figure 1 shows in side view the structure of a coating device according to one embodiment of the invention, wherein the movable die is arranged on a carriage which is provided with an intermediate container for melt polymer;

20

Figure 2 shows the same embodiment in perspective view; and

Figure 3a to 3c show the process of extruding a polymer film on the surface with the aid of one embodiment of the present invention, wherein melt polymer film is extruded on the surface of a pipe using a movable die directly connected to an extruder.

25

The method according to the present invention for coating a pipe or a section of a pipe with a polymer layer generally comprises, in combination, the steps of

30

- providing a pipe or a pipe section having an outer surface defining the periphery of the pipe or pipe section;
- applying on the outer surface of the pipe or pipe section a layer of at least one polymer material in the melt state with a nozzle or die, which is mounted on a carriage capable of travelling along the periphery of the pipe or pipe section; and

- moving the carriage along at least a part of the periphery for applying the material onto at least a part of the pipe or pipe section.

According to an embodiment, the method according to the present invention is used for  
5 producing a polymer layer having a predetermined breadth, whereby the material is applied on the surface of the pipe or pipe section using a flat die having a width of the slit gap essentially corresponding to the predetermined breadth of the layer.

In practice, the melt polymer film applied on the surface of the pipe or pipe section, is  
10 levelled after application. By levelling the polymer material, it is possible to some extent to adjust the thickness of the layer so that it corresponds to a pre-selected thickness of the coating. Importantly, however, by levelling any air pockets between the polymer layer and the coated surface can be removed and a tight and hermetic coating is achieved.

Levelling can be carried out manually or using a separate tool. However, according to a  
15 particularly preferred embodiment, the movable carriage is provided with a levelling means, as will be explained below in more detail.

According to a preferred embodiment, the carriage is moved along the periphery of the pipe or pipe section a distance essentially corresponding to a pre-selected length of the  
20 polymer coating. It is preferred to have the carriage travel at least 180 degrees and in particular at least 360 degrees along the periphery of the pipe or pipe section to provide a polymer layer covering half or all the outer surface along the periphery. One embodiment allows for several consecutive wrapping layers, e.g. by moving the carriage along a spiral-shaped path along the periphery of the pipe or pipe section to provide a polymer layer. In  
25 such a case, it is particularly advantageous to have each following layer partially overlap the proceeding layer whereby a hermetic and tight sealing layer can be produced. For achieving a spiral-shape path, the pipe can be axially transferred during coating.

The polymer film can have any desired dimensions, but typically it has a thickness in the  
30 range of 0.01 to 10 mm, preferably about 0.1 to 7 mm, in particular about 0.5 to 5 mm. The breadth of the film is about 1 to 1500 mm, preferably about 5 to 1250 mm, in particular about 10 to 1000 mm. The length is advantageously about  $\frac{1}{4}$  of the periphery to about 20 times the periphery, although this is no limit. In general, for example for covering a field joint/weld about 1 to 10 succeeding layers of partly overlapping polymer films suffices.

The coating may comprise a film of only one polymer material, but it can also be formed of a multilayer structure, where there are films of two or more polymer materials.

At least one of the films can be a foamed polymer. Typically, the surface or skin layer of the coating is composed of a solid polymer layer.

As already indicated above, the polymer material is applied in the form of a melt film. The film is preferably produced with an "extrusion nozzle" or "extrusion die" which is capable of forming a melt polymer material into a polymer film having a breadth essentially corresponding to the pre-selected breadth of the coating layer. Any die, such as a flat die, capable of producing a melt film or sheet of the polymer material used, can be applied and is included in the definition of "extrusion die" and "extrusion nozzle". I.e. said term is to be construed to stand for any die or nozzle capable of forming a film from the feed of a polymer melt. Naturally, multilayer film dies or nozzles can also be used.

15

As known in the art, the cross-section of the flow channel at the entrance of a flat die is typically a circle or a rectangle with a small aspect ratio. In the die, this initial cross-section is gradually transformed to a large aspect ratio rectangle required for sheet extrusion. The channel geometry in a flat die is designed so as to provide for uniform velocity at the exit of the die.

20

The die is connected to at least one source of melt polymer material. This source is typically selected from the group of extruders, heated screw mixers and storage containers. For producing multilayered film, it is possible to connect the die to two or more sources of polymer material.

25

One typical source of melt polymer is a conventional extruder, where the starting material comprising polymer pellets is heated before feeding with a feed screw to the extrusion tool. It is possible to connect the die to the extruder to provide for direct feed of melt polymer to the die. The extruder can be replaced with a heated screw mixer which can be filled with polymer pellets and where the polymer can be molten. Such a screw mixer can be mounted on the carriage.

30

In lieu of direct feed, the heated polymer melt can be intermediately stored on the carriage. This intermediate storage can be formed by, for example, a cylinder which is filled with the melt polymer mass and from which it can be pressed out through the die onto the pipe. The cylinder is heated and/or well-insulated, and it can be mounted on the same frame as  
5 the die. The cylinder can be heated with electrical resistance heaters placed about the cylinder. For emptying the intermediate storage container it is preferably provided with a piston, which is hydraulically or pneumatically operated, i.e. generally with any pressure means, or it is electrically operated. Instead of a piston, a conveyor screw can be used. According to one preferred embodiment, the intermediate storage container is replaceable  
10 as a cartridge, which makes facilitates a change of polymer during operation.

The thickness of the polymer coating can be controlled by adjusting the thickness of the polymer film extruded from the die. The lip distance (thickness of gap) is generally 0.1 to 50 mm, preferably about 1 to 10 mm, in particular about 1,5 to 5 mm. Alternatively, by  
15 using a carriage capable of travelling at an adjustable velocity it is also possible to control the thickness of the film extruded from the nozzle by the velocity of the carriage. In that case, the polymer material typically is extruded from a flat die at an essentially constant extrusion rate. Naturally, a combination of the two alternatives can be used.

20 The velocity of the carriage can be freely regulated. Depending on the thickness of the film and the consumption of the polymer material it is typically in the range of about 0.01 to 20 m/min, for example about 0.1 to 5 m/min, in particular about 0.3 to 2 m/min.

The thickness of the polymer layer – and the adherence of the layer to the pipe or pipe  
25 section – is also influenced by the levelling means used for smoothening and flattening out the polymer layer deposited on the surface. The levelling means typically applies a force generally perpendicular to the polymer material. This levelling means can be, for example, a roller or a blade.

30 In one embodiment, the roller has a central axis and an elastic surface. The surface is adjustable in the direction of the central axis to fit the surface profile of the pipe or pipe section at the part which is to be coated. For that purpose the roller may comprise an integral roller/cylinder or it can be formed by several cylindrical sections of the same or

even somewhat different diameters. The elastic surface can be achieved by using silicon or rubbery materials. Generally, the hardness of the elastic surface is about Shore A 10 to 30.

A levelling means in the form of a blade can also be stiff or elastic, preferably elastic.

5

Generally it is preferred that the surface of the levelling means is capable of following the upper surface of the pipe or pipe section in such a way that it smoothens the polymer layer against the surface tightly. The surface of the levelling means is also adapted to the adhesive properties of the melt polymer to provide for easy release.

10

According to one particularly preferred embodiment already mentioned above, the levelling means is mounted on the same movable carriage as the extrusion nozzle/flat die. One way of carrying out this embodiment comprises extruding from the flat die a film onto the levelling means and transferring from the levelling means onto the outer surface of the pipe or pipe section. In this case, the levelling means operates as an applicator and it smoothens and levels the film while transferring it against the surface of the pipe or pipe section.

15

It is, however, possible to spread the polymer film onto the outer surface of the pipe also directly from the flat die, e.g. by non-contact coating (curtain coating), whereby a flat levelling means is used for smoothing the polymer layer deposited on the surface.

20

In a preferred embodiment, the polymer material is applied on a surface comprising at least partially an uncoated part of a polymer coated steel pipe. The pipe section may comprise the girth weld between two adjacent pipes, which are welded to each other. The girth weld and the adjacent parts of the uncoated steel pipe, including the abutting ends of the polymer coating, are coated for tightly sealing off the girth weld against air, moisture and water.

25

Other applications of the present method include repair of polymer coatings, coating of generally any polymer pipes and also of materials different from polymers are metals.

30

According to a preferred embodiment, the movable carriage can be guided for movement around the periphery of the pipe or pipe section with strapping and guiding means. Such

means are exemplified below by chains for traction drive, but various belts and wires can also be used. The carriage can, naturally, be pressed against and moved along the periphery also manually.

5 In all above applications, the pipe or pipe section is coated with at least one thermoplastic polymer, for example one selected from the group consisting of polyolefins, in particular polyethylene and polypropylene, and modified polyolefins. One class of particularly interesting polymers is formed by stand alone polyolefins, disclosed in more detail in our  
10 co-pending patent application EP 06010822, titled "Structure comprising Polyolefin Layer or Profile with Enhanced Adhesion", filed 26.5.2006, the contents of which are herewith incorporated by reference. Such polyolefins comprise adhesion promoting groups, in particular polar groups, e.g. groups selected from the group of acrylates, such as methylacrylates, methacrylates, propylacrylates, butylacrylates, carboxylic acids, such as maleic acid, and amines.

15

Polyolefins with adhesion promoting, preferably polar, groups may e.g. be prepared by copolymerisation of olefin monomers with comonomer compounds bearing such groups or by grafting of appropriate compounds onto the polyolefin backbone after the polyolefin has been produced. If copolymerisation is used for the production of the polyolefin with  
20 adhesion promoting groups, it is preferred that a polar copolymer is produced which comprises a copolymer of ethylene with one or more comonomers selected from C1- to C6-alkyl acrylates, C1- to C6-alkyl methacrylates, hydroxy functional monomers, anhydride functional monomers, e.g. 2-hydroxyethyl (meth-)acrylate, acrylic acids, methacrylic acids, vinyl acetate and vinyl silanes. For example, the polar copolymer  
25 may also be a terpolymer of ethylene, one of the above mentioned monomers and a vinyl silane. The copolymer may also contain ionomeric structures (like in e.g. DuPont's Surlyn types).

If grafting is used to obtain the polyolefin with adhesion promoting groups, as grafting  
30 agent, any such agent can be used which is known to be suitable for this purpose by the person skilled in the art.

Preferably, the acid grafting agent is an unsaturated carboxylic acid or a derivative thereof such as anhydrides, esters and salts (both metallic or non-metallic). Preferably, the

unsaturated group is in conjugation with the carboxylic group. Examples of such grafting agents include vinyl silanes, acrylic acid, methacrylic acid, fumaric acid, maleic acid, nadic acid, citraconic acid, itaconic acid, crotonic acid, and their anhydrides, metal salts, 5 esters amides or imides.

5

The preferred grafting agents are maleic acid, its derivatives such as maleic acid anhydride, and in particular maleic acid anhydride.

10 Grafting can be carried out by any process known in the art such as grafting in an melt without a solvent or in solution or dispersion or in a fluidised bed. Preferably, grafting is performed in a heated extruder or mixer as e.g. described in US 3,236,917, US 4,639,495, US 4,950,541 or US 5,194,509. Preferably, grafting is carried out in a twin screw extruder such as described in US 4,950,541.

15 Grafting may be carried out in the presence or absence of a radical initiator but is preferably carried out in the presence of a radical initiator such as an organic peroxide, organic perester or organic hydroperoxide.

20 As mentioned, preferably, the polar groups in the polyolefin are selected from acrylates, e.g. methylacrylates, methylmethacrylates, propylacrylates, butylacrylates, carboxylic acids such as maleic acid and amines.

25 The base resin is composed of either one type of polyolefin or a mixture of two or more types of polyolefins. Preferably, the polyolefin of the base resin is composed of an ethylene homo- or copolymer and/or a propylene homo- or copolymer or a mixture thereof. The concentration of adhesion promoting groups in the polyolefin is typically from 0.01 to 5.0 mol-%, preferably about 0.02 to 1.0 mol-%, calculated from the total amount of olefin monomers in the polyolefin composition.

30 The methods as discussed above, are preferably carried out by first heating the outer surface of the pipe or pipe section. By heating the surface, better adherence of the film to the outer surface can be reached. The temperature is selected depending on the properties of the polymer and on the heating time. Generally, it is not necessary to heat up the surface

to the melting temperature of the polymer. Preferably the pipe surface is heated at a temperature in the range of 80 to 300 °C before coating. The heating can be carried out manually. One preferred embodiment comprises heating the surface with a heating means mounted on the carriage. This heating means is preferably mounted before the levelling means and the die in the progression direction of the carriage.

Before the surface is coated, it is possible to modify the surface of the pipe or pipe section by contacting it with a priming agent for improving adherence between the polymer layer and the surface. Naturally, the surface is preferably cleaned before any other treatment. Cleaning can be carried out for instance by shot or grit blasting or by sand blasting.

Next, some embodiments of the present invention will be examined more closely with the aid of the attached drawings for illustrating the use of the invention for coating of field-welded joints. In Figures 1 and 2 the following reference numerals are used:

15

	1	frame
	2	pipe
	3	nozzle assembly
	4	feed cylinder
20	5	levelling roll
	6	motor
	12a, 12b	retaining rings for shaft
	14	chain
	15a, 15b	wheels
25	19	chain tightener
	22, 23	chain wheels
	27	pressure hose

As shown in Figures 1 and 2, the present moveable coating device comprises a frame 1 supported upon two sets of wheels 15 for travelling along the surface of a pipe 2. The carriage 1, 15a, 15b is strapped onto the pipe 2 with the aid of at least one chain 14 – in the embodiment according to the drawing, there are two chains – arranged in a loop around the pipe and having a length greater than circumference of the pipe 2. The traction chain 14 engages chain wheels 22, 23 on the frame, at least some of which are rigidly mounted on the same axis (shaft) as the wheels 15 and kept in place with retaining rings 12a, 12b. A chain tightener 19 is provided for keeping the tension of the chain suitable for keeping the carriage 1, 15a, 15b pressed against the surface.

- In the moving direction, the carriage 1, 15a, 15b comprises a heating means (not shown) in the form of a radiation heater, such as an IR radiator. Next to the heating means there is a flat die 3, which is fed by polymer melt from a cylinder 4, which can be filled with the calculated amount of polymer melt needed for covering a predetermined surface of a pipe. The cylinder 4 and the die 3 are connected with a pressure hose 27. The cylinder is provided with an emptying means, e.g. a piston, which pushes melt polymer out of the cylinder 4 and through the hose 27 to the die 3. As mentioned above, it is also possible to feed melt polymer directly from an extruder into the die, as illustrated in Figures 3a to 3c.
- Close to the front wheels 15a, there is an applicator/levelling roll 5, which transfers a polymer film extruded from the die 3 onto the surface of the pipe 2. The roll 5 is stressed with a spring (not shown) so that it presses against the surface of the pipe.
- The carriage is driven by an electric motor 6 which is connected to the driving wheels 15a, 15b. Normally, the die travels one lap around the pipe, however, in special cases several laps can be done, depending on desired layer thickness or material combination. During this operation the field-joint will be extruded with molten polymers.
- In Figures 1 and 2, the die is fed from an intermediate container mounted on the movable carriage. In one embodiment, a coated steel pipe was coated with a 3 mm thick polyolefin film having a breadth of 500 mm at a velocity of 0.7 m/min with a total polymer consumption of 60 kg/h.
- Figure 3a to 3c show the operation of a moving die 36 which is fed directly from an extruder 32 via pressure hose 34. The pipe to be coated is given reference numeral 30 and the applicator roll numeral 38. The figures show how the pipe is coated by the carriage travelling around the pipe.
- The coating method according to the invention can be carried out in the following way:
- First, the surface of the pipe or pipe section – e.g. a field joint between two polyolefin coated steel pipes – is cleaned. This can be made with abrasive tools, e.g. shot or grit blasting or by sand blasting.

After the cleaning step, the surface is pre-heated. It is possible to utilize the heat from the pipes weld-together operation (pre- and post-heating of weld-zone). However, as indicated above, the carriage may also be provided with separate heating means, such as IR heating elements, or there can be separate for example manually operated IR heating means.

In stationary coating applications, typically in factories and barges, inductive heating can be used. Also gas flame heating is possible. Preferably the heating is carried out such that only the surface of the pipe is heated up.

The cleaned and heated surface is then treated with suitable materials. The materials are chosen for a project depends on the specification; it is possible to passivate the steel surface, for example with a chromate or sulphate treatment. Various primers can alternatively or additionally be spread on the surface. They can be selected from compositions comprising

- liquid epoxy one component;
- liquid epoxy two components (base + hardener);
- powder epoxy spray;
- organosilicon materials alone; and
- organosilicon materials + passivation

After a pre-treatment/priming step, the adhesives and top-coats (e.g. the polymer coating layer) are applied.

Typical polymer coatings are based on polyolefins or other thermoplastic polymers.

Exemplifying embodiments comprise polyethylene, polypropylene, adhesives in powder form or molten, SAPO (stand alone polyolefins, i.e. materials which can be used without separate adhesives). Also multilayer coatings are possible, where two or more layers are deposited on the surface simultaneously or consecutively.

In field, the operators (coaters) typically need the following equipments:

- a small extruder, preferably as simple and light as possible, for producing a melt polymer;
- preferably two cylinders for molten polymers (one in use, the other for filling);

- a blasting unit for cleaning of the field joint section;
  - preheating equipment, radiators (IR), inductive or gas flame;
  - an air compressor for blasting or pneumatic piston movement;
  - the above-described coating device, which is strapped to the pipe with preferably
  - 5 two chains or equivalent strapping means; an electrical power source for pipe heating and overlap area are preferably mounted to the die;
  - a generator for electricity; and
  - hydraulic system for the cylinder piston operation.
- 10 In operation, the FJ application area can be placed inside a tent.

As discussed above, the present invention can be used for coating different pipes. The pipe diameters can vary generally in the range from about 200 mm to 3500 mm. Typically in the particularly preferred embodiment, where the invention is used for coating field joints

15 between polyolefin coated pipes, the diameters of the pipes are in the range of about 250 to 1500 mm.

It should still be pointed out that according to one embodiment, the relative motion between the carriage and the pipe can also be achieved by rotating the pipe which

20 maintaining the carriage in stationary position. Such an embodiment can be applied for example indoors, in factories.

**Claims:**

1. A method of coating a pipe or a pipe section with a layer of at least one polymer, comprising the steps of
  - providing a pipe or a pipe section having an outer surface defining the periphery of the pipe or pipe section;
  - applying on the outer surface of the pipe or pipe section a layer of at least one polymer material in melt stage using a nozzle, which is mounted on a carriage capable of travelling along the periphery of the pipe or pipe section; and
  - moving the carriage along at least a part of the periphery during the application of the polymer material to form a layer on the surface of the pipe or pipe section,  
**characterized by**
    - levelling the polymer material with a levelling means mounted on the carriage.
2. The method according to claim 1, comprising using a flat die which is mounted on the carriage and connected to a source of melt polymer material.
3. The method according to any one of claims 1 and 2, wherein the flat die has a gap slit with a width at least essentially corresponding to a pre-selected breadth of the layer.
4. The method according to any one of claims 1 to 3, wherein the carriage is moved along the periphery a distance essentially corresponding to a pre-selected length of the polymer material.
5. The method according to any one of claims 1 to 4, wherein the carriage is capable of travelling at least 180 degrees, preferably 360 degrees or more along the periphery of the pipe or pipe section to provide a polymer layer covering the outer surface along the periphery.
6. The method according to claim 5, wherein the carriage is moved along a spiral-shaped path along the periphery of the pipe or pipe section to provide a polymer layer, where each following layer partially overlaps the proceeding layer.

7. The method according to any one of claims 1 to 6, wherein the polymer material is formed into a polymer film having a breadth essentially corresponding to the pre-selected breadth of the coating layer.
8. The method according to any one of claims 1 to 7, wherein a polymer layer comprising at least two overlapping films is applied on the surface.
9. The method according to any one of claims 7 and 8, wherein each polymer film has a thickness in the range of 0.01 to 10 mm, preferably about 0.1 to 5 mm, in particular about 0.1 to 3 mm.
10. The method according to any one of claims 1 to 9, wherein the levelling means applies a force generally perpendicular to the polymer material for smoothening the polymer layer against the outer surface of the pipe or pipe section.
11. The method according to any one of claim 1 to 10, wherein the polymer material is levelled with a roller or a blade.
12. The method according to claim 11, wherein the roller or the blade forms the levelling means mounted on the carriage.
13. The method according to claim 10, wherein the polymer material is levelled with a roller having an elastic surface.
14. The method according to claim 13, wherein the surface of the roller exhibits a Shore A hardness of about 10 to 30.
15. The method according to any one of claims 7 to 10, wherein the polymer film is withdrawn from the flat die onto the levelling means and transferred from the levelling means onto the outer surface of the pipe or pipe section.
16. The method according to claim 15, wherein the levelling means smoothenes and levels the film while transferring it against the surface.

17. The method according to any one of claims 1 to 16, wherein the thickness of the layer of polymer obtained from the flat die can be adjusted.
18. The method according to any one of claims 1 to 17, wherein the carriage is capable of travelling at an adjustable velocity.
19. The method according to claim 18, wherein the polymer material is extruded from said flat die at an essentially fixed extrusion rate, and the thickness of the film is controlled by adjusting the velocity of the travelling carriage.
20. The method according to any one of claims 1 to 19, wherein the polymer material is applied on a surface at least partially comprising an uncoated part of a polymer coated steel pipe.
21. The method according to claim 20, wherein the pipe section comprises the girth weld between two adjacent pipes, which are welded to each other.
22. The method according to claim 21, wherein the girth weld and the adjacent parts of the uncoated steel pipe, including the abutting ends of the polymer coating are coated for tightly sealing off the girth weld against air, moisture and water.
23. The method according to any one of claims 1 to 19, wherein the polymer material is applied on the outer surface of a polymer pipe or section of a polymer pipe.
24. The method according to any one of claims 1 to 19, wherein the polymer material is applied on a bitumen coated pipe or pipe section.
25. The method according to any one of claims 1 to 24, wherein the pipe or pipe section is coated with at least one thermoplastic polymer.
26. The method according to claim 25, wherein the thermoplastic polymer is selected from the group consisting of polyolefins, in particular polyethylene and polypropylene, including a stand-alone polyolefins, and substituted polyolefins.

27. The method according to claim 26, wherein the stand alone polyolefin comprises adhesion promoting groups selected from the group of acrylates, carboxylic acids and amines.

28. The method according to any one of claims 1 to 27, wherein the outer surface of the pipe or pipe section is heated to a temperature in the range of 80 to 300°C before coating.

29. The method according to claim 28, wherein the surface is heated using heating means mounted on the carriage.

30. The method according to any one of claims 1 to 29, wherein the outer surface of the pipe or pipe section is contacted with a priming agent to achieve a modified surface for improving adherence between the polymer layer and the surface.

31. The method according to claim 29, wherein the priming agent is selected from the group of liquid epoxy one component compositions, liquid epoxy two component compositions, epoxy spray powders, and organosilicons.

32. A method of joining pipes, in particular polyolefin coated steel pipes, wherein

- the ends of two coated steel pipes are fitted against each other;
- the steel pipes are welded together to form a joint and
- the joint is coated with at least one layer of a material capable of sealing off the joint against air and moisture,

characterized by providing the joint with a coating by using a method according to any one of claims 1 to 31.

33. An apparatus for coating of a pipe or pipe section having an outer surface defining the periphery of the pipe or pipe section, comprising

- a movable carriage, which is capable of travelling around the periphery of the pipe or pipe section; and
- a die connected to a source of a polymer melt for forming a polymer film, said die being mounted on the movable carriage;

characterized by

- a levelling means capable of levelling and smoothing the polymer film against the outer surface of the pipe or pipe section, wherein the levelling means is mounted on the movable carriage.

34. The apparatus according to claim 33, wherein the carriage is capable of travelling at least 360 degrees along the periphery of the pipe or pipe section for providing a polymer layer covering the outer surface along the periphery.

35. The apparatus according to any one of claims 33 or 34, wherein the die comprises a flat die capable of forming the polymer material into the polymer film having a breadth essentially corresponding to the pre-selected breadth of the coating layer.

36. The apparatus according to any one of claims 33 to 35, wherein the die is connected to a source of melt polymer material selected from the group of extruders, heated screw mixers or intermediate storage containers.

37. The apparatus according to claim 36, wherein the intermediate storage containers can be emptied using a hydraulically, pneumatically or electrically operated purging means.

38. The apparatus according to any one of claims 36 and 37, wherein the intermediate storage containers are replaceable as cartridges.

39. The apparatus according to any one of claims 33 to 38, wherein the levelling means is selected from the group of rollers and blades, adapted to apply a force generally perpendicular to the polymer material for smoothing the polymer layer against the outer surface of the pipe or pipe section.

40. The apparatus according to claim 39, wherein the roller has a central axis and wherein the profile of an elastic surface of the roller is adjustable in the direction of the central axis to fit the surface profile of the pipe or pipe section at the part which is to be coated.

41. The apparatus according to any one of claims 39 and 40, wherein the surface of the roller has a Shore A hardness of about 10 to 30.
42. The apparatus according to any one of claims 33 to 41, wherein the die is adapted to form the polymer film onto the levelling means and the levelling means is capable of transferring the polymer film onto the outer surface of the pipe or pipe section.
43. The apparatus according to any one of claims 33 to 42, wherein the carriage comprises a heating means, placed in front of the levelling means in the propagation direction of the carriage.
44. The apparatus according to any one of claims 33 to 43, wherein the carriage is capable of travelling at an adjustable velocity.
45. The apparatus according to any one of claims 33 to 44, wherein the carriage can be strapped onto the pipe or pipe section with at least one traction chain, which can be fitted about the pipe or pipe section.

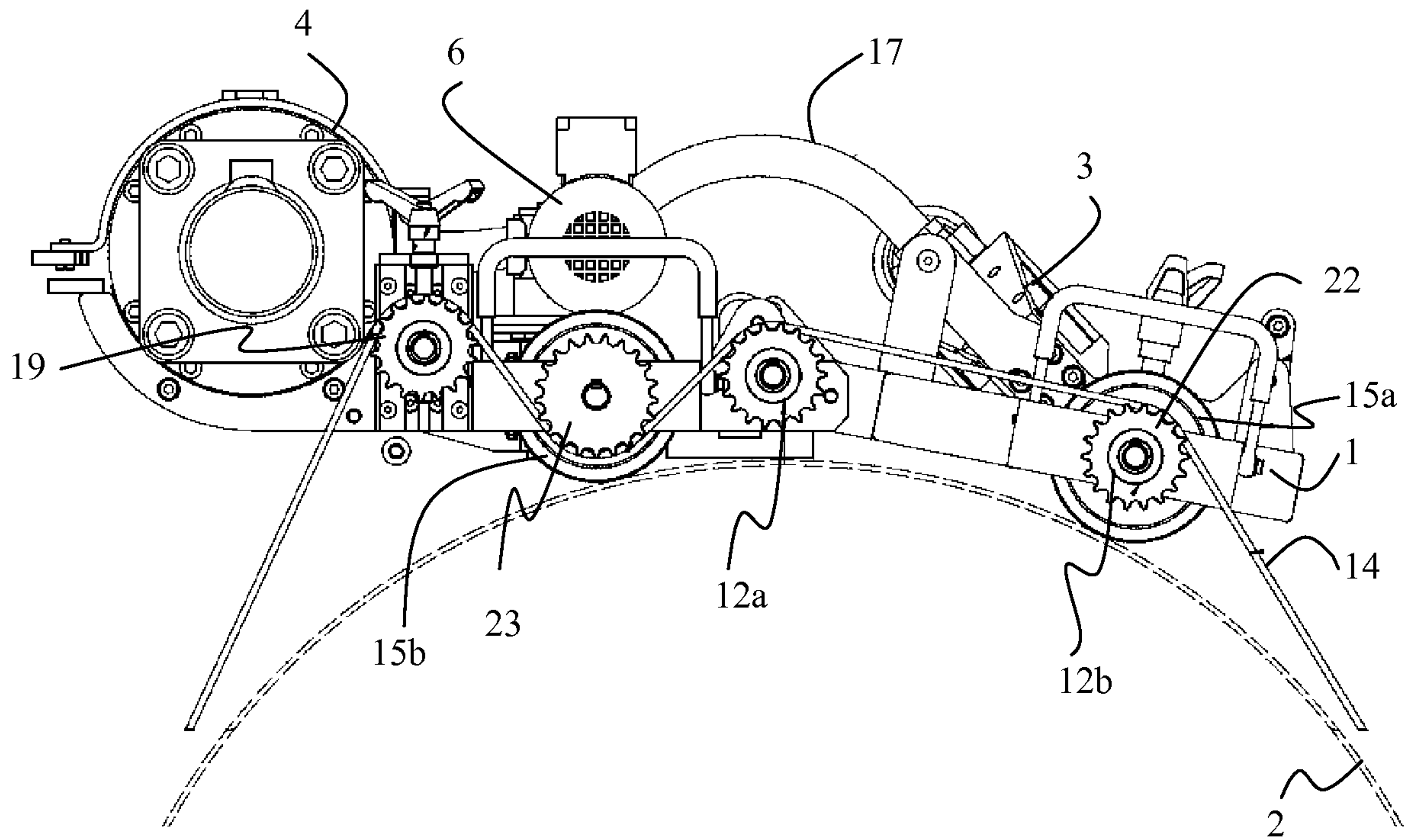

Fig. 1

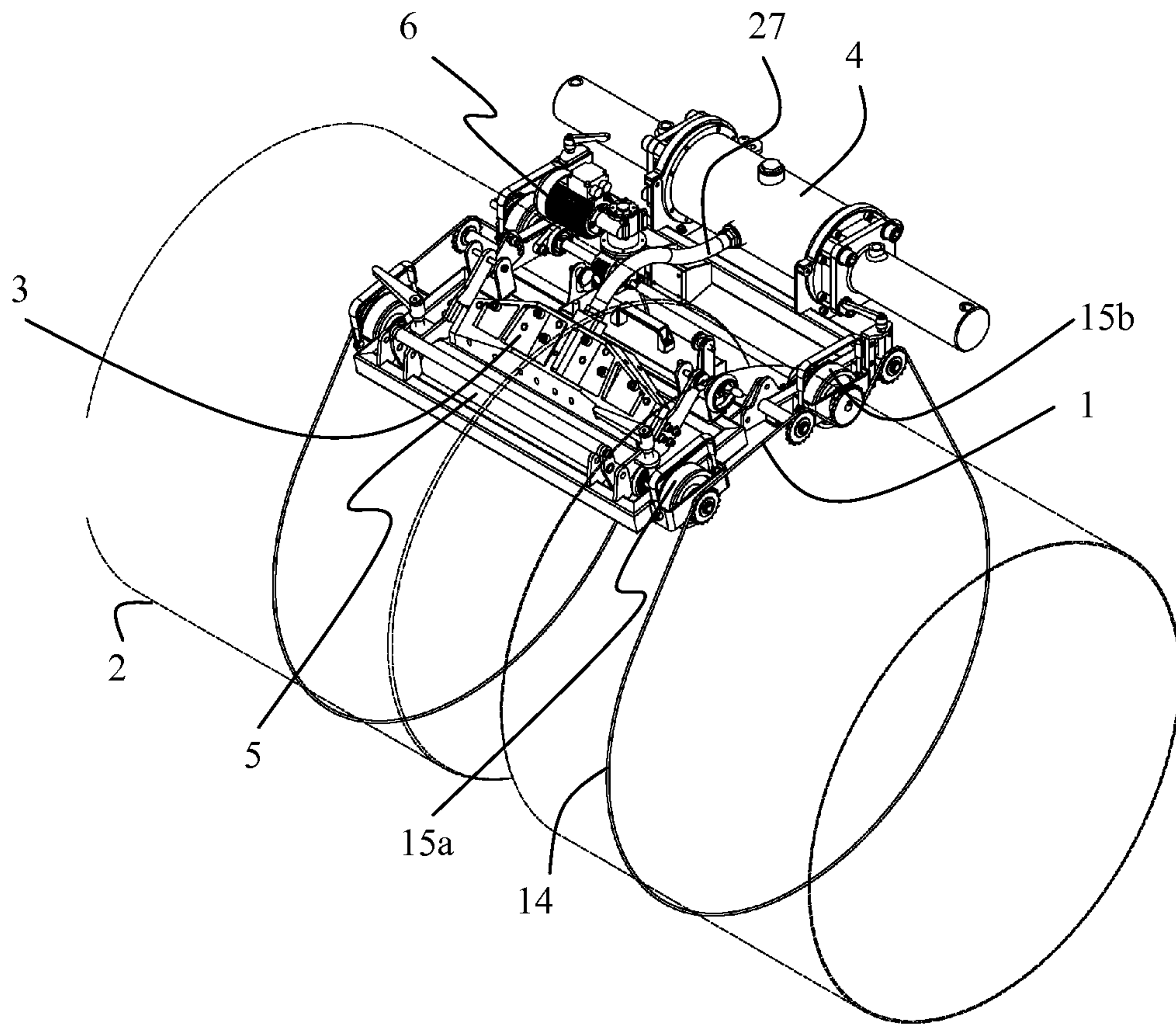

Fig. 2

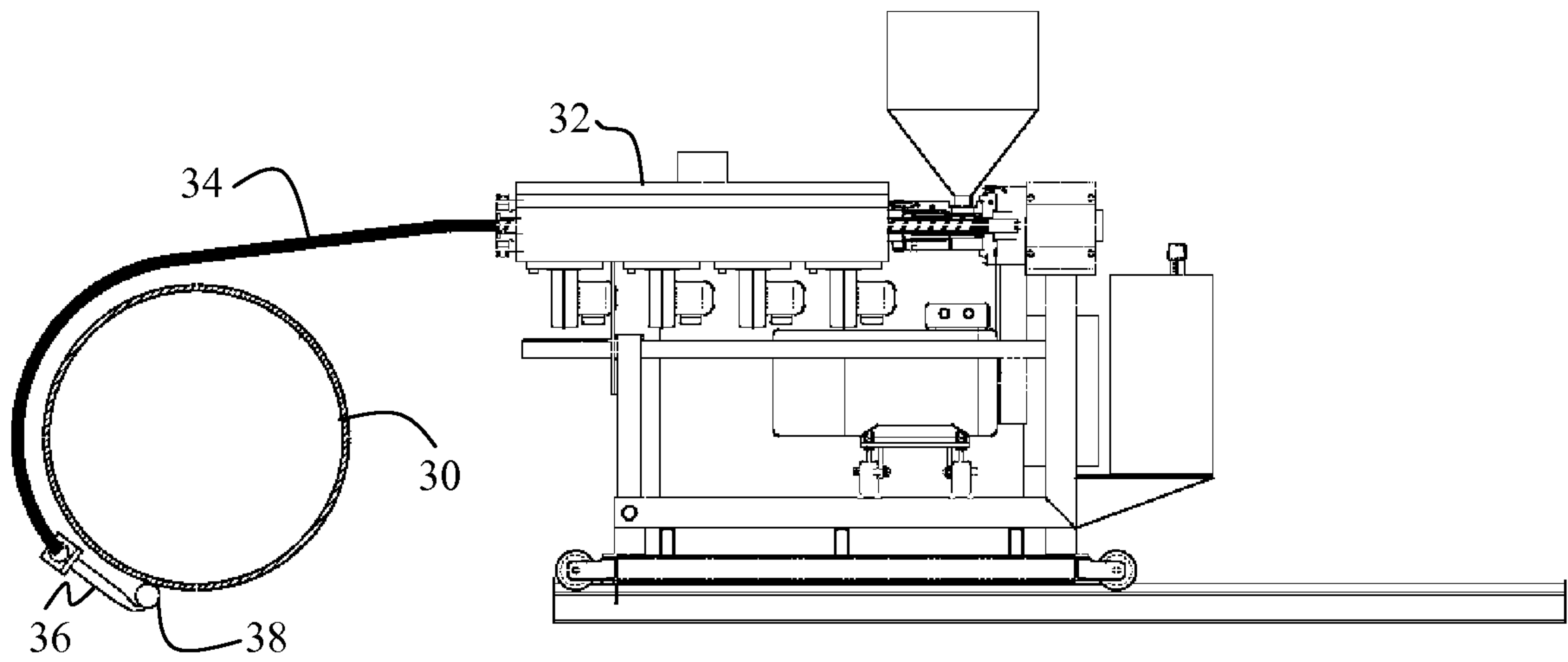

Fig. 3a

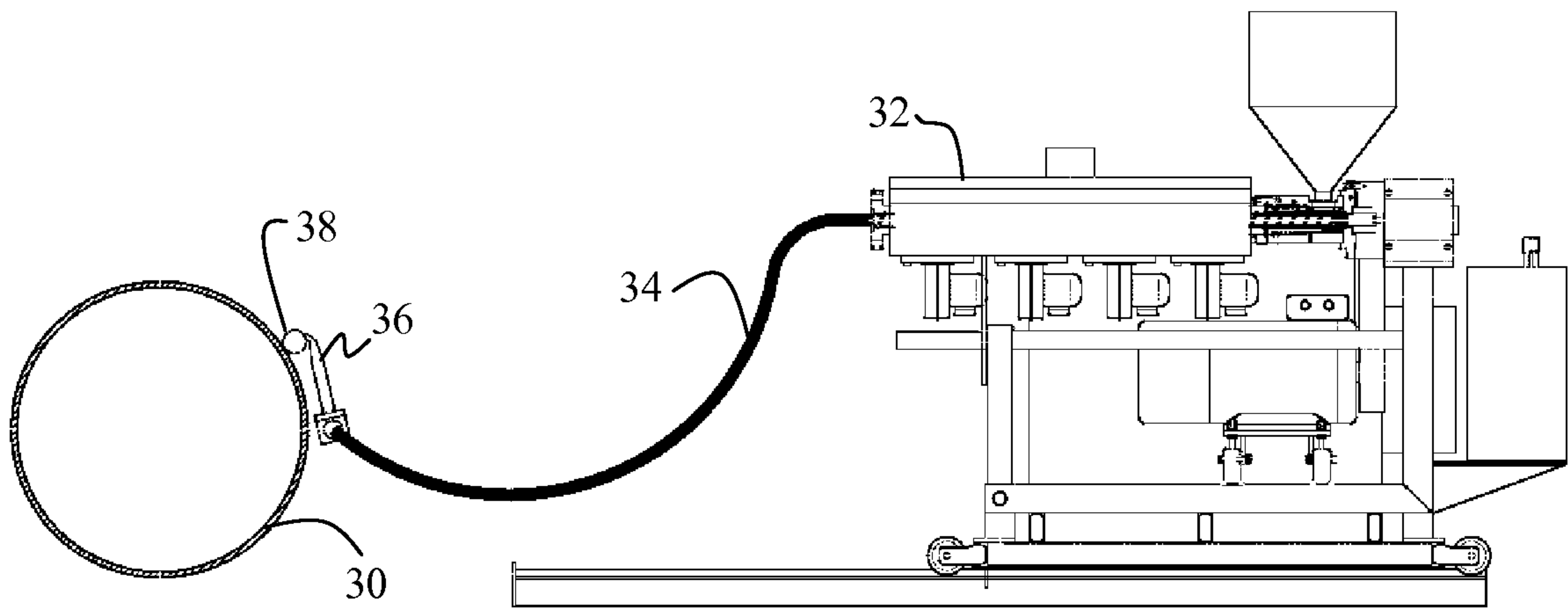

Fig. 3b

3/3

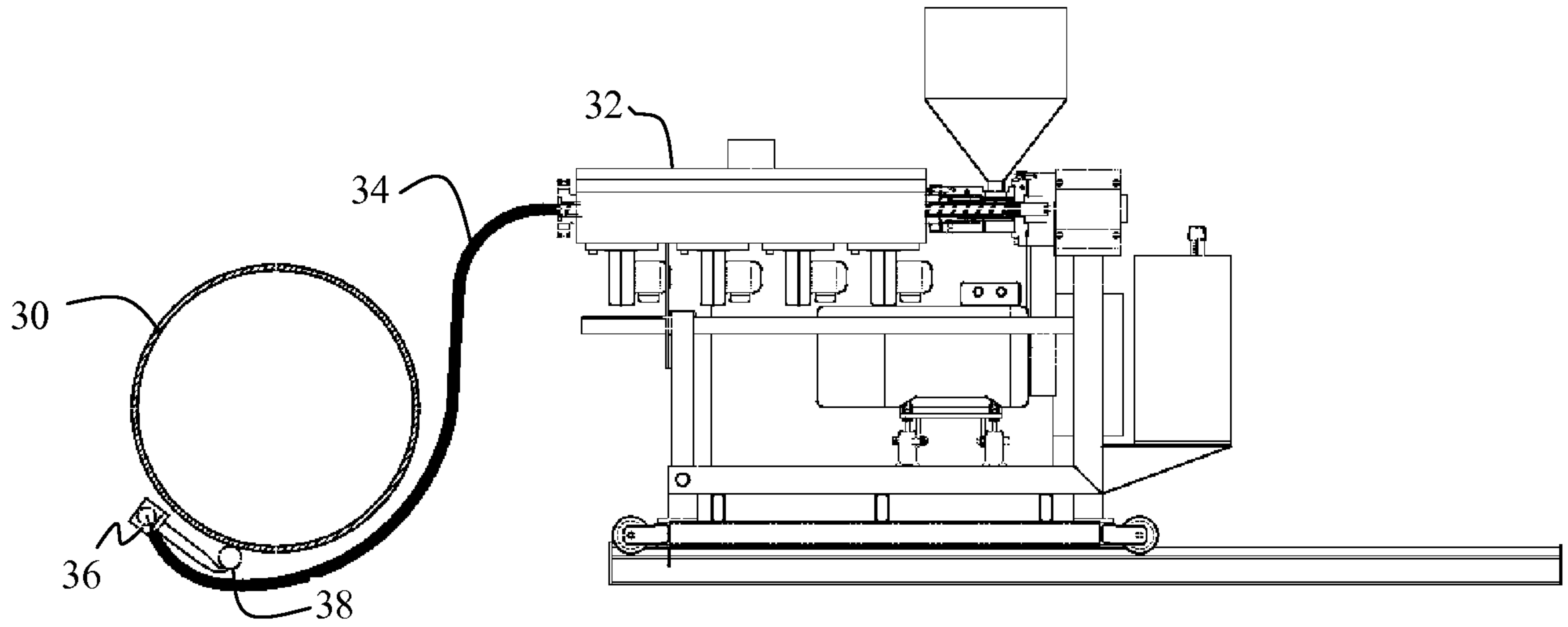

Fig. 3c

