

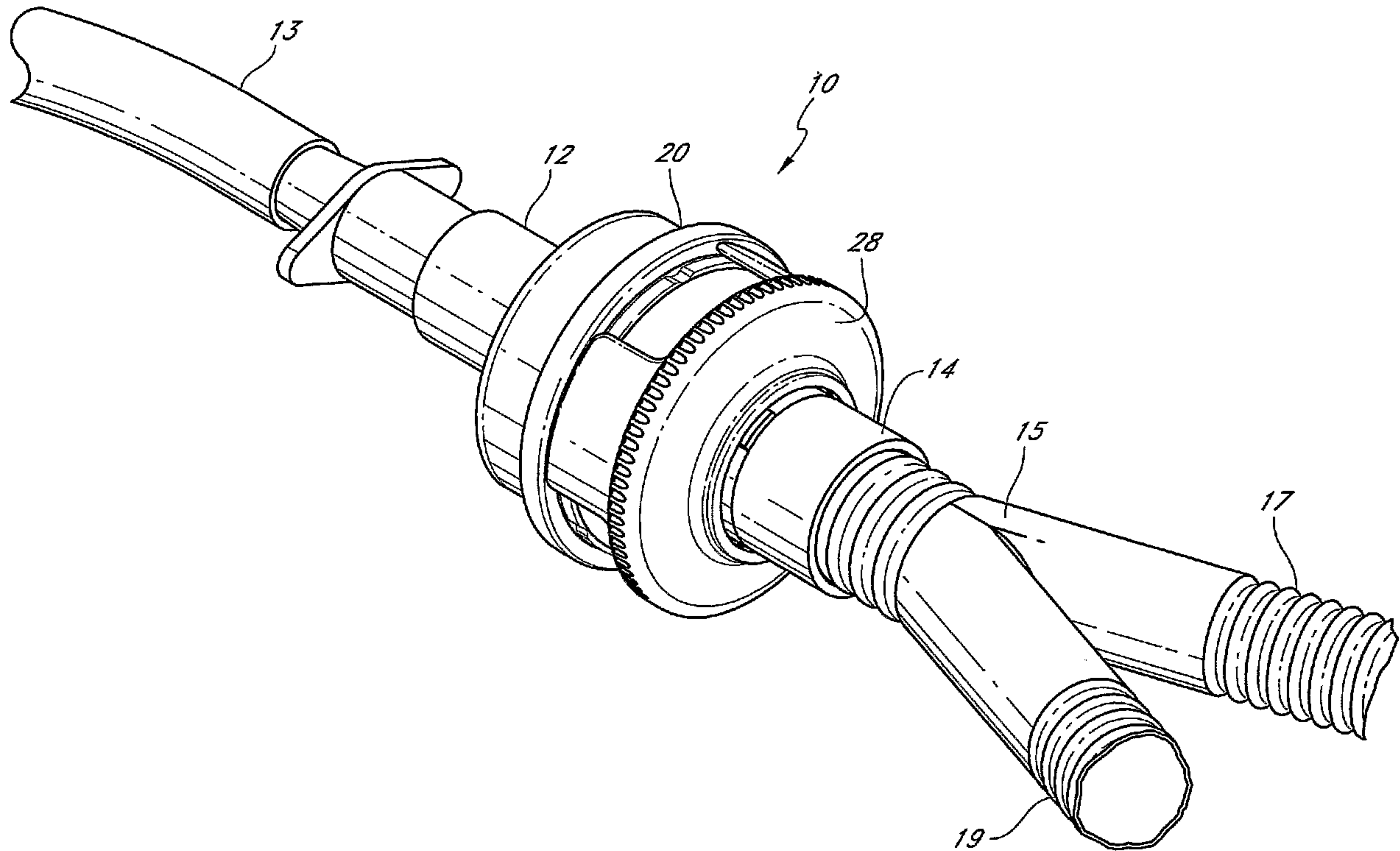

(86) Date de dépôt PCT/PCT Filing Date: 2006/01/18
 (87) Date publication PCT/PCT Publication Date: 2006/07/27
 (85) Entrée phase nationale/National Entry: 2007/07/17
 (86) N° demande PCT/PCT Application No.: US 2006/001645
 (87) N° publication PCT/PCT Publication No.: 2006/078667
 (30) Priorité/Priority: 2005/01/18 (US11/038,347)

(51) Cl.Int./Int.Cl. *A61M 16/10* (2006.01)
 (71) Demandeur/Applicant:
 TELEFLEX MEDICAL INCORPORATED, US
 (72) Inventeur/Inventor:
 BURK, MARK ALAN, US
 (74) Agent: ROBIC

(54) Titre : DISPOSITIF D'ECHANGE DE CHALEUR ET D'HUMIDITE POUR UNE THERAPIE RESPIRATOIRE
 (54) Title: HEAT AND MOISTURE EXCHANGE DEVICE FOR RESPIRATORY THERAPY



(57) **Abrégé/Abstract:**

A heat and moisture exchange (HME) device (10) for being selectively operated between HME mode and bypass mode comprises a rotatable valve and valve selector (28) configured to be rotated without transferring rotational movement to tubing (13, 17, 19) attached to the device.

(12) INTERNATIONAL APPLICATION PUBLISHED UNDER THE PATENT COOPERATION TREATY (PCT)

(19) World Intellectual Property Organization
International Bureau(43) International Publication Date
27 July 2006 (27.07.2006)

PCT

(10) International Publication Number
WO 2006/078667 A1

(51) International Patent Classification:

A61M 16/10 (2006.01)

(21) International Application Number:

PCT/US2006/001645

(22) International Filing Date: 18 January 2006 (18.01.2006)

(25) Filing Language:

English

(26) Publication Language:

English

(30) Priority Data:

11/038,347 18 January 2005 (18.01.2005) US

(71) Applicant (for all designated States except US): HUDSON RESPIRATORY CARE INC. [US/US]; 27711 Diaz Road, Temecula, California 92589 (US).

(72) Inventor; and

(75) Inventor/Applicant (for US only): BURK, Mark Alan [US/US]; 34490 Briggs Road, Murrieta, California 92563 (US).

(74) Agents: DERVIS, Erdal R. et al.; Baker & Hostetler, LLP, Washington Square, Ste 1100, 1050 Connecticut Ave., N.W., Washington, District Of Columbia 20036 (US).

(81) Designated States (unless otherwise indicated, for every kind of national protection available): AE, AG, AL, AM,

AT, AU, AZ, BA, BB, BG, BR, BW, BY, BZ, CA, CH, CN, CO, CR, CU, CZ, DE, DK, DM, DZ, EC, EE, EG, ES, FI, GB, GD, GE, GH, GM, HR, HU, ID, IL, IN, IS, JP, KE, KG, KM, KN, KP, KR, KZ, LC, LK, LR, LS, LT, LU, LV, LY, MA, MD, MG, MK, MN, MW, MX, MZ, NA, NG, NI, NO, NZ, OM, PG, PH, PL, PT, RO, RU, SC, SD, SE, SG, SK, SL, SM, SY, TJ, TM, TN, TR, TT, TZ, UA, UG, US, UZ, VC, VN, YU, ZA, ZM, ZW.

(84) Designated States (unless otherwise indicated, for every kind of regional protection available): ARIPO (BW, GH, GM, KE, LS, MW, MZ, NA, SD, SL, SZ, TZ, UG, ZM, ZW), Eurasian (AM, AZ, BY, KG, KZ, MD, RU, TJ, TM), European (AT, BE, BG, CH, CY, CZ, DE, DK, EE, ES, FI, FR, GB, GR, HU, IE, IS, IT, LT, LU, LV, MC, NL, PL, PT, RO, SE, SI, SK, TR), OAPI (BF, BJ, CF, CG, CI, CM, GA, GN, GQ, GW, ML, MR, NE, SN, TD, TG).

Declarations under Rule 4.17:

- as to applicant's entitlement to apply for and be granted a patent (Rule 4.17(ii))
- as to the applicant's entitlement to claim the priority of the earlier application (Rule 4.17(iii))

Published:

- with international search report

For two-letter codes and other abbreviations, refer to the "Guidance Notes on Codes and Abbreviations" appearing at the beginning of each regular issue of the PCT Gazette.

(54) Title: HEAT AND MOISTURE EXCHANGE DEVICE FOR RESPIRATORY THERAPY

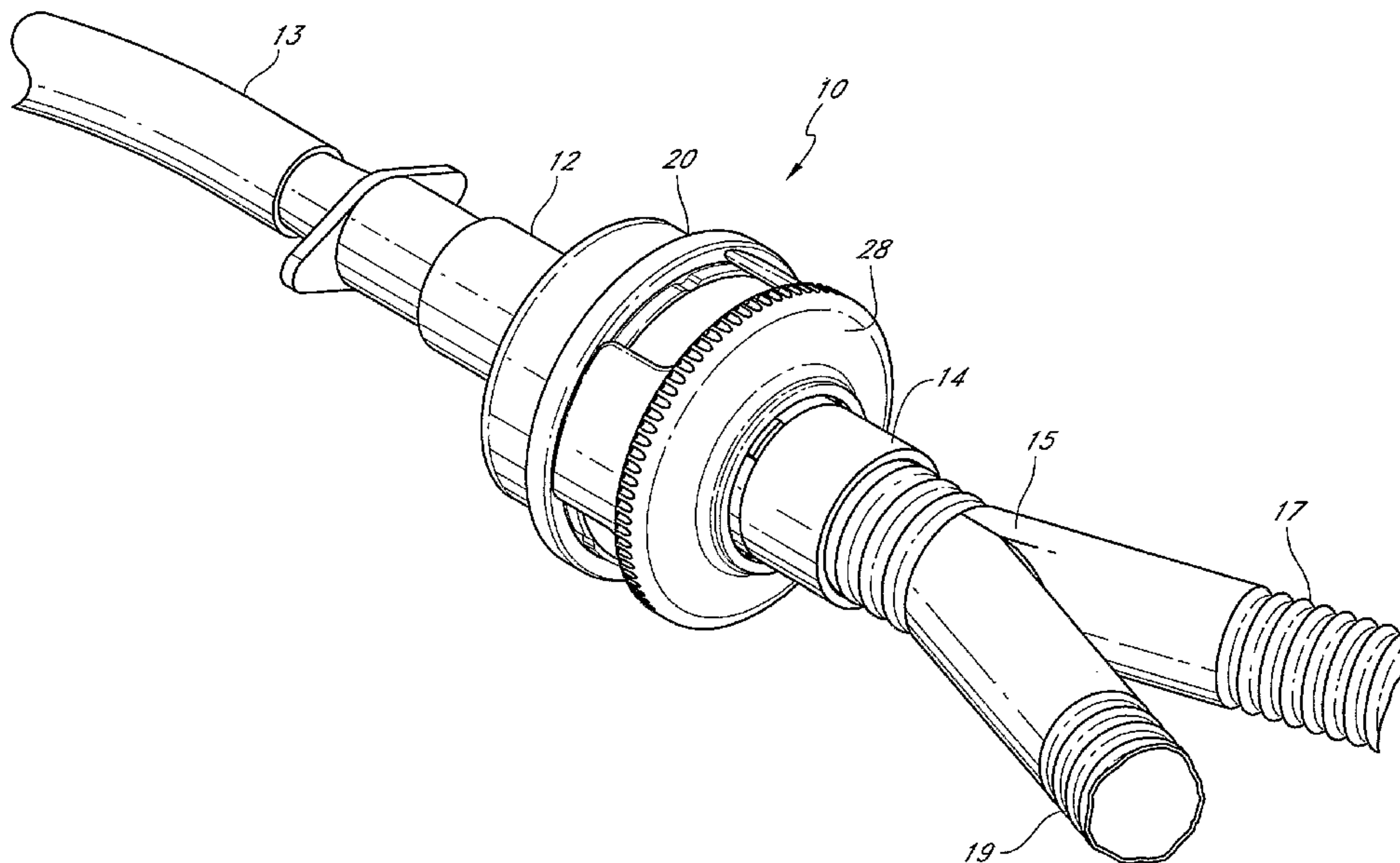

(57) Abstract: A heat and moisture exchange (HME) device (10) for being selectively operated between HME mode and bypass mode comprises a rotatable valve and valve selector (28) configured to be rotated without transferring rotational movement to tubing (13, 17, 19) attached to the device.

WO 2006/078667 A1

HEAT AND MOISTURE EXCHANGE DEVICE FOR RESPIRATORY THERAPY

Background of the Invention

[0001] Heat and moisture exchange devices are often used to provide moisture to gases from a ventilator for respiratory therapy. To this end, a heat-moisture exchanger (HME) is positioned in the respiratory circuit, such a device containing a material or composition capable of absorbing heat/moisture from patient exhaled gas and desorbing the heat/moisture into the cool/dry respiratory gas stream from the ventilator for patient inhalation.

[0002] For treating some respiratory conditions, it is desirable to introduce an aerosol generated by a nebulizer to the gas delivered to a patient. When such treatment is provided, it is desirable to bypass the HME to avoid absorption of the aerosol in the HME material. To avoid the inconvenience and inefficiency of removing the HME device each time aerosol treatment is to be administered, HME bypass devices have been designed, such as described in U.S. Patent Application Publication No. 2004/0084046. However, operating the prior art device between HME and bypass functions requires rotation of the housing portions causing rotation of the pipes at each end of the housing portions. Such housing and pipe rotation is transferred to the attached patient circuit tubing resulting in disturbing or loosening the pipe connections and contributes to inadvertent tubing disconnects affecting patient ventilation or necessitates repositioning of the patient ventilator circuit to relieve the added torque along the tubing.

Summary of the Invention

[0003] The heat and moisture exchange device described herein is provided with a mechanism that allows an operator to select and change the mode of operation between HME and aerosol treatment, but does not transfer rotation and torque to the patient respiratory circuit tubing. The device comprises a housing wall structure defining an interior chamber in which is positioned a heat and moisture exchange (HME) material or composition capable of absorbing moisture and heat from a patient exhaled gas and thereafter releasing the absorbed heat and moisture into a dry respiratory gas for patient inhalation. Within the

walled housing are a heat and moisture exchange passageway and a bypass passageway. Stationary pipes secured on opposite ends of the housing communicate with the interior chamber. A valve adjacent to the distal pipe end is configured to provide selective fluid communication through the HME passageway or the bypass passageway, the valve including a valve selector providing such selective communication without moving the wall structure or either of the end pipes relative to one another. The selectively operated valve comprises a first apertured wall and a second apertured wall. One wall is stationary, and the other is moved by the valve selector to align apertures for selectively directing fluid flow through the HME passageway or the bypass passageway. In a preferred embodiment, the valve selector is rotatably mounted on the device housing whereby an operator can conveniently rotate the valve selector, causing rotation of the movable apertured member for selectively aligning apertures to direct fluid flow for HME or bypass operation.

Brief Description of the Drawings

[0004] Fig. 1 is a perspective view of the heat and moisture exchange device with ventilator circuit tubing attached at one end and a patient gas delivery tube attached at the opposite end;

[0005] Fig. 2 is an exploded view of the device illustrating the major components in disassembled relationship;

[0006] Fig. 3 is a perspective view of a rotatable apertured member;

[0007] Fig. 4 is an end view of the member shown in Fig. 3;

[0008] Fig. 5 is a perspective view of a housing member and attached stationary apertured member;

[0009] Fig. 6 is an end view of an assembly shown in Fig. 5; and

[0010] Fig. 7 is a sectional view of the assembled device.

Detailed Description of the Preferred Embodiment

[0011] Fig. 1 shows an exterior view of the heat and moisture exchange device (HME) 10 with housing wall 20 having pipes 12 and 14 secured on the housing at opposite ends. Proximal end pipe 12 is secured to a tracheal tube 13 or to an endotracheal tube or

other patient airway interface. At the opposite end of the housing is distal end pipe 14 to which is secured a ventilator circuit wye 15 and tubing assembly including inspiratory and expiratory circuit tubes 17 and 19. Such respiratory or ventilator circuit tubing and assemblies and patient gas delivery tubing, such as tracheal tube or endotracheal tubes or other patient gas delivery tubes, are not a part of the heat and moisture exchange device, are well understood by those skilled in the art and will not be described in further detail. Also shown is a valve selector 28 rotatably mounted relatively to the housing adjacent to pipe 14. Other tubing configurations may be secured to respective ends of the HME device. The tubing assembly includes a nebulizer or metered dose inhaler (not shown) for generating a medicated aerosol to be delivered to the patient through the HME device in a bypass mode, as will be described further hereinafter.

[0012] Major components of the HME device assembly are illustrated in Fig. 2 showing the components disassembled but in relationship when assembled. The housing defining an interior chamber comprises a housing assembly having a first housing wall 16 and second housing wall 18 which are bonded or locked together or otherwise secured in a fixed or stationary position relative to one another. Conveniently the facing or mating edges of the housing members are secured as also shown in Fig. 7 with the mating edges glued or otherwise substantially permanently bonded with an adhesive or ultrasonically welded or the like. Alternatively, the housing components may be snap locked or in threaded engagement to provide access to interior components.

[0014] Referring again to Figs. 2-7, the valve for selectively directing fluid through the heat and moisture exchange device comprises two apertured members, one of which is fixed or stationary relative to the housing, and the other is movable, preferably rotatable, relative to the housing. Both of the apertured members comprise a plurality of apertures which are selectively aligned for directing a fluid through the device, between the opposite end pipes, in either HME mode or bypass mode. In the preferred embodiment illustrated in the drawings, apertured member 25 is formed as a unitary component with housing wall 16. The apertured member 25 comprises a wall having a plurality of fluid directing apertures 27 formed in the wall. In the preferred embodiment shown in Figs. 2-4, a plurality of first apertures 21 and a plurality of second apertures 23 are formed on the

rotational apertured member 22; a plurality of third apertures 27 are formed on stationary apertured member 25. Third apertures 27 are larger than apertures 21 or apertures 23. As apertured member 22 is rotated relative to apertured member 25, in a first valve position, first apertures 21 are aligned with apertures 27 of second apertured member 25 to provide a first fluid passage. In a second valve position, apertured member 22 is rotated so that the second apertures 23 are aligned with apertures 27 to provide a second fluid passage. In the valve position with apertures 21 and 27 aligned, apertures 23 are not aligned with any apertures in apertured member 25 whereby there is no passageway for gas flow through apertures 23. In a second valve position, with apertures 23 aligned with apertures 27, there is no alignment of apertures 21 with aperture 27 so that apertures 21 are closed to fluid flow. It is also to be understood that the apertured members as shown may be reversed, e.g., with the stationary member having first and second apertures and the rotatable member provided with third apertures. Moreover, the size and shape of the apertures shown, although preferred, are not limiting, and other relative sizes and shapes of apertures may be used to achieve the same performance.

[0016] The interior space or chamber defined by the housing walls between opposite pipes 12 and 14 is configured to provide a heat and moisture exchange passageway 34 and an elongated bypass passageway 32. As particularly illustrated in Fig. 7, bypass passageway 32 comprises an elongated generally circular conduit that is coaxial with pipes 12 and 14. The heat and moisture exchange passageway 34 is a generally annular space that is coaxial with the bypass passageway. As shown by arrows in Fig. 7, in one valve position, fluid flows through bypass passageway 32, and in another position through heat and moisture exchange passageway 34. Thus, fluid flow will be through one or the other of these two passageways, but not both, when the valve is positioned with rotatable apertured member 22 rotated so that either apertures 21 or 23 are further aligned with aperture 27 of apertured member 25. However, it will be understood that there will be intermediate positions where apertured member 22 is not fully rotated to the first or second valve positions whereby both of the apertures 21 and 23 will be partially aligned with apertures 27.

[0017] Positioned within the heat and moisture exchange passageway 34 is a heat and moisture exchange (HME) cartridge 30, as illustrated in the embodiment of Fig. 7. The

HME cartridge is formed of a material and composition capable of absorbing moisture and heat from patient exhaled gas, and thereafter capable of releasing absorbed heat and moisture into dry respiratory gas flowing through the passageway. Such material is sometimes referred to as regenerative heat-moisture exchanger material. Examples of suitable material are disclosed in U.S. Patent No. 5,042,468 and 5,592,933, the descriptions of which are incorporated herein by reference. Such material may be made of paper or other cellulosic material, for example, in the form of a honeycomb structure or helically wound strips of a corrugated mini-cardboard or cellulosic material to form an annular cartridge. Such material may be treated or impregnated with hygroscopic salts or compositions which will provide for good heat and moisture absorption and desorption. Other HME materials well known to those skilled in the art may also be used.

[0013] Prior to bonding the housing wall components together, the rotatable apertured member 22 is installed as is the HME material. As shown in Fig. 7, the rotatable apertured member 22 is assembled with apertured wall 37 of first apertured member 22 rotatably positioned adjacent to apertured wall 25. In the embodiment illustrated, pipe 14 at the opposite end of the housing from pipe 12 is unitary with first housing wall 16 and which housing is also provided with channels 35 through which components of valve selector 28 extend. Observing Figs. 2 and 7, valve selector 28 is provided with valve selector pins 31 which extend through channels 35 and are inserted through slots 33 in rotatable apertured member 22. As so mounted, when valve selector 28 is rotated, the rotation is transferred to rotatable member 22 via the movement of the valve selector pins.

[0018] In the embodiment illustrated, a cylindrical tube or conduit is provided along at least a portion of the length of bypass passageway 32. The cylindrical tube provides a coaxial spool for supporting an annular cartridge or roll of the HME material which may be wrapped around the cylindrical conduit. In a preferred embodiment, the cylindrical tube is formed as an integral part of rotatable apertured member 22. The tube is preferably long enough so that the end opposite the valve is received in or otherwise supported by a spacer 26 formed as a component of housing wall member 18. A plurality of notches 29 are illustrated in Fig. 2 into which the end of the cylindrical tube 24 is rotatably received. In the preferred embodiment illustrated, tube 24 is also provided with slots 36 which allow a thermoplastic

cylindrical material to be compressed because of the space of the slots whereby the cylinder acts as a biasing member for urging rotatable apertured member 22 against stationary apertured member 25 when the housing wall members 16 and 18 are sealed together in the fully assembled condition illustrated in Figs. 1 and 7. The plurality of slots 36 may also be substituted with one or more spiral slots along the thermoplastic cylindrical material which will also create a yield or compressible feature to form the bias as described. Alternatively, a cylindrical tube need not be used, in which case it may be preferred to coat or seal the inner surface of the HME material exposed along the bypass passageway to reduce or prevent substantial aerosol absorption.

[0019] In operating the HME devices, when aerosol is to be delivered to a patient, the valve selector is rotated to a HME bypass or nebulizer position whereby the rotatable apertured member 22 is rotated to align apertures 21 with apertures 27 on apertured member 25 so that substantially all gas directed through the device bypasses the HME passageway. In the bypass mode, the HME device operates to direct the aerosol-gas mixture from pipe 14 through the elongated passageway 32 to pipe 12. When aerosol delivery to the patient is eliminated or terminated, the valve selector is rotated to align apertures 23 in apertured member 22 with apertures 27, and whereby apertures 21 are not in alignment. In this HME mode of operation, substantially all of the gas is delivered between pipes 12 and 14 through HME passageway 34. When the valve selector is rotated, there is no rotational movement of the housing wall structure or housing wall components 16 and 18 relative to one another nor rotational movement of pipes 12 and 14 relative to one another. Thus, the HME mode and bypass mode can be selected by an operator without transferring rotation to a patient circuit. The device may be operated by holding the housing with one hand and rotating the valve selector with the other hand without transferring rotational movement to either the patient, proximal pipe 12 side, or ventilator, distal pipe 14 side, so that the connections to the tubing on both sides of the device are not disturbed, loosened or otherwise disconnected.

WHAT IS CLAIMED IS:

1. A heat and moisture exchange device for respiratory therapy comprising:

a housing comprising a wall structure defining an interior chamber, said wall structure having a first pipe formed at one end thereof and a second pipe formed at an opposite end thereof, said pipes communicating with said interior chamber, and wherein said wall structure and said first and second pipes are configured to be stationary relative to one another;

an elongated conduit along said interior chamber and configured to direct fluid flow between said first and second pipes;

an absorbent material configured to alternatively absorb and desorb heat and moisture therefrom positioned in said interior chamber between said elongated conduit and said housing; and

a valve operatively secured to said housing adjacent to said second pipe and configured to provide selective fluid communication between said second pipe and said conduit and between said second pipe and said fibrous material, said valve including a valve selector configured to provide said selective fluid communication without moving said wall structure or said first and second pipes relative to one another.

2. A device of Claim 1 wherein said elongated conduit and said interior chamber cooperate with said absorbent material to define a heat and moisture exchange passageway, and wherein said valve is configured to selectively operate in a first valve position for directing fluid between said first and second pipes along said elongated conduit, and in a second valve position for directing fluid between said first and second pipes along said heat and moisture exchange passageway.

3. A device of Claim 2 wherein said valve comprises a first apertured member having a plurality of apertures therein and a second apertured member having a plurality of apertures therein, and wherein in said first valve position said apertures are aligned to open fluid flow passage along said heat and moisture exchange passageway and close fluid flow passage along said elongated conduit, and wherein in said second valve position said

apertures are aligned to close fluid flow passage along said heat and moisture exchange passageway and open fluid flow passage along said elongated conduit.

4. A device of Claim 2 wherein said valve comprises a first apertured member having a plurality of first apertures and a plurality of second apertures therein and wherein said second apertured member has a plurality of third apertures therein, and wherein in said first valve position said valve provides fluid flow through said first and third apertures and in said second valve position said valve provides fluid flows through said second apertures.

5. A device of Claim 3 wherein said first apertured member is movable relative to said housing and said second apertured member is stationary relative to said housing, and wherein said valve selector is configured to move said first apertured member relative to said second apertured member between said first and second valve positions.

6. A device of Claim 5 wherein said first apertured member is configured to be rotated relative to said second apertured member, and wherein said valve selector is configured to rotate said first apertured member.

7. A device of Claim 6 wherein said valve selector is movably mounted on said housing in a configuration for rotating said first apertured member without moving said housing or said first and second pipes relative to one another.

8. A device of Claim 6 wherein said valve selector is rotatably mounted on said housing in a configuration for rotating said first apertured member without moving said housing or said first and second pipes relative to one another.

9. A device of Claim 6 wherein said second apertured member comprises an apertured wall secured at an end of said second pipe adjacent to said interior chamber.

10. A device of Claim 9 wherein said first apertured member comprises an apertured wall rotatably secured in said housing between said second apertured wall and said interior chamber.

11. A device of Claim 10 wherein said elongated conduit is secured to said first apertured wall.

12. A device of Claim 9 wherein said second apertured wall is concentric with said second pipe.

13. A device of Claim 12 wherein said first apertured member comprises an apertured wall rotatably secured in said housing between said second apertured wall and said interior chamber.

14. A device of Claim 12 wherein said elongated conduit comprises a cylindrical tube secured to said first apertured wall coaxially to said second pipe.

15. A device of Claim 3 wherein said second apertured member is movable relative to said housing and said first apertured member is stationary relative to said housing, and wherein said valve selector is configured to move said second apertured member relative to said first apertured member between said first and second valve positions.

16. A device of Claim 15 wherein said second apertured member is configured to be rotated relative to said first apertured member, and wherein said valve selector is configured to rotate said second apertured member.

17. A device of Claim 16 wherein said valve selector is movably mounted on said housing in a configuration for rotating said second apertured member without moving said housing or said first and second pipe relative to one another.

18. A device of Claim 16 wherein said valve selector is rotatably mounted on said housing in a configuration for rotating said second apertured member without moving said housing or said first and second pipes relative to one another.

19. A device of Claim 16 wherein said first apertured member comprises an apertured wall secured at an end of said second pipe adjacent to said interior chamber.

20. A device of Claim 19 wherein said second apertured member comprises an apertured wall rotatably secured in said housing between said first apertured wall and said interior chamber.

21. A device of Claim 20 wherein said elongated conduit comprises a tube secured to said second apertured wall.

22. A device of Claim 19 wherein said first apertured wall is concentric with said second pipe.

23. A device of Claim 22 wherein said second apertured member comprises an apertured wall rotatably secured in said housing between said first apertured wall and said interior chamber.

24. A device of Claim 22 wherein said elongated conduit comprises a cylindrical tube secured to said second apertured wall coaxially to said second pipe.

25. A heat and moisture exchange device for respiratory therapy comprising:

a walled housing having a first pipe secured at a first end thereof, and a second pipe secured at a second end thereof, opposite said first end, said first and second pipes and said walled housing configured to be stationary relative to one another, said walled housing having a chamber therein in fluid communication with said first and second pipes;

a moisture absorbing and desorbing composition positioned in said chamber and configured therein to form a first fluid passageway for directing fluid flows through said chamber between said first and second pipes in moisture absorption or desorption communication with said composition, and a second fluid passageway for directing fluid flows through said chamber between said first and second pipes substantially bypassing said moisture absorption or desorption communication;

a bypass valve comprising a first apertured component rigidly secured in said walled housing adjacent to a first or second end thereof, and a second apertured component movably secured in said walled housing and cooperating with said first apertured component to selectively direct a fluid flow through said chamber along said first fluid passageway, or along said second fluid passageway; and

a valve selector movably secured on said walled housing and configured for selectively moving said second apertured component.

26. A device of Claim 25 wherein said second fluid passageway comprises a conduit.

27. A device of Claim 25 wherein said second fluid passageway comprises a cylindrical tube.

28. A device of Claim 25 wherein said first fluid passageway is annular and concentric with said second fluid passageway.

29. A device of Claim 27 wherein said first fluid passageway is annular and concentric with said second fluid passageway.

30. A device of Claim 28 wherein said first and second pipes are coaxial with said second fluid passageway.

31. A device of Claim 25 wherein said second apertured component is rotatable and wherein said valve selector is configured to rotate said second apertured component relative to said first apertured component.

32. A device of Claim 30 wherein said second apertured component is rotatable and wherein said valve selector is configured to rotate said second apertured component relative to said first apertured component, and wherein said second apertured component is configured for being rotated coaxially to said first and second pipes.

33. A device of Claim 25 wherein said valve selector is rotatably mounted on said valve housing.

34. A device of Claim 31 wherein said valve selector is rotatably mounted on said valve housing.

35. A device of Claim 34 wherein said second apertured component is rotatable and wherein said valve selector is configured to rotate said second apertured component relative to said first apertured component, and wherein said second apertured component is configured for being rotated coaxially to said first and second pipes, and wherein said valve selector rotation is coaxial with said second apertured component.

36. A device of Claim 25 wherein said first apertured component comprises a wall having a plurality of apertures therein and wherein said second apertured component comprises a wall having a plurality of apertures therein, and wherein in a first valve position said apertures are aligned to open said first fluid passageway and close said second fluid passageway and in a second valve position said apertures are aligned to close said first fluid passageway and open said second fluid passageway.

37. A device of Claim 32 wherein said first apertured component comprises a wall having a plurality of apertures therein and wherein said second apertured component comprises a wall having a plurality of apertures therein, and wherein in a first valve position said apertures are aligned to open said first fluid passageway and close said second fluid passageway and in a second valve position said apertures are aligned to close said first fluid passageway and open said second fluid passageway.

38. A device of Claim 35 wherein said first apertured component comprises a wall having a plurality of apertures therein and wherein said second apertured component comprises a wall having a plurality of apertures therein, and wherein in a first valve position said apertures are aligned to open said first fluid passageway and close said second fluid passageway and in a second valve position said apertures are aligned to close said first fluid passageway and open said second fluid passageway.

39. A device of Claim 27 wherein said cylindrical tube includes one or more slots along the wall thereof.

1/5

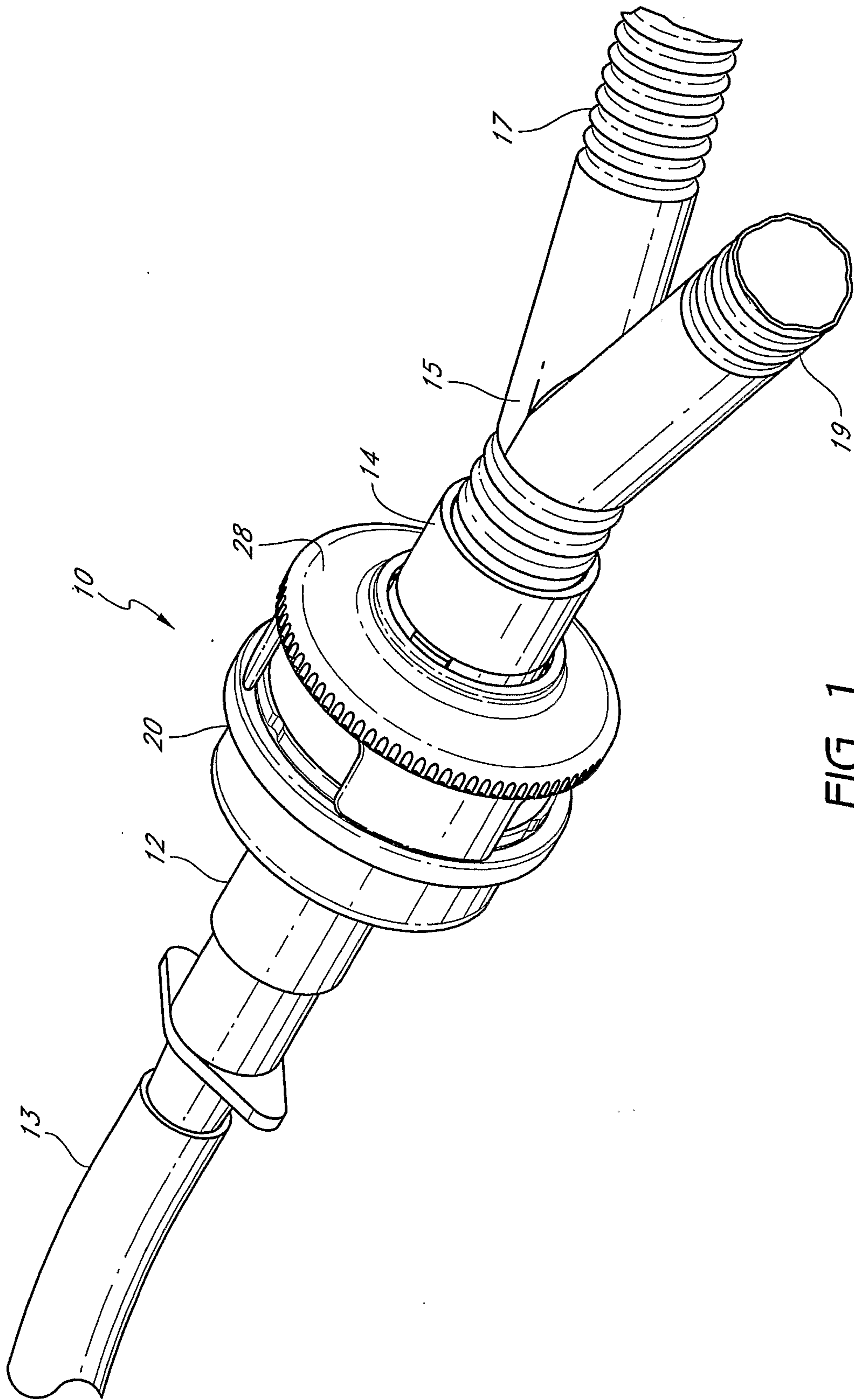

FIG. 1

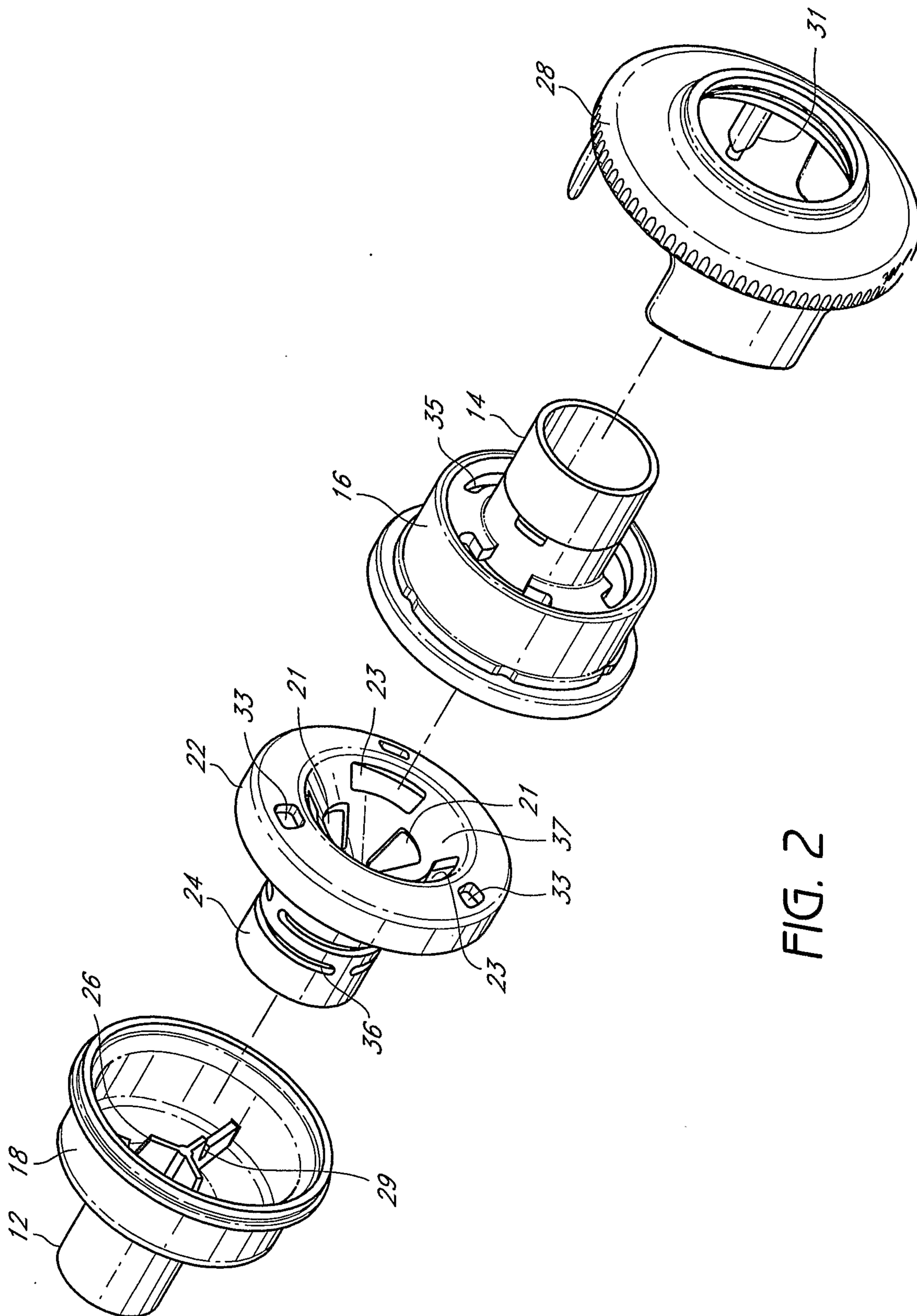

FIG. 2

3/5

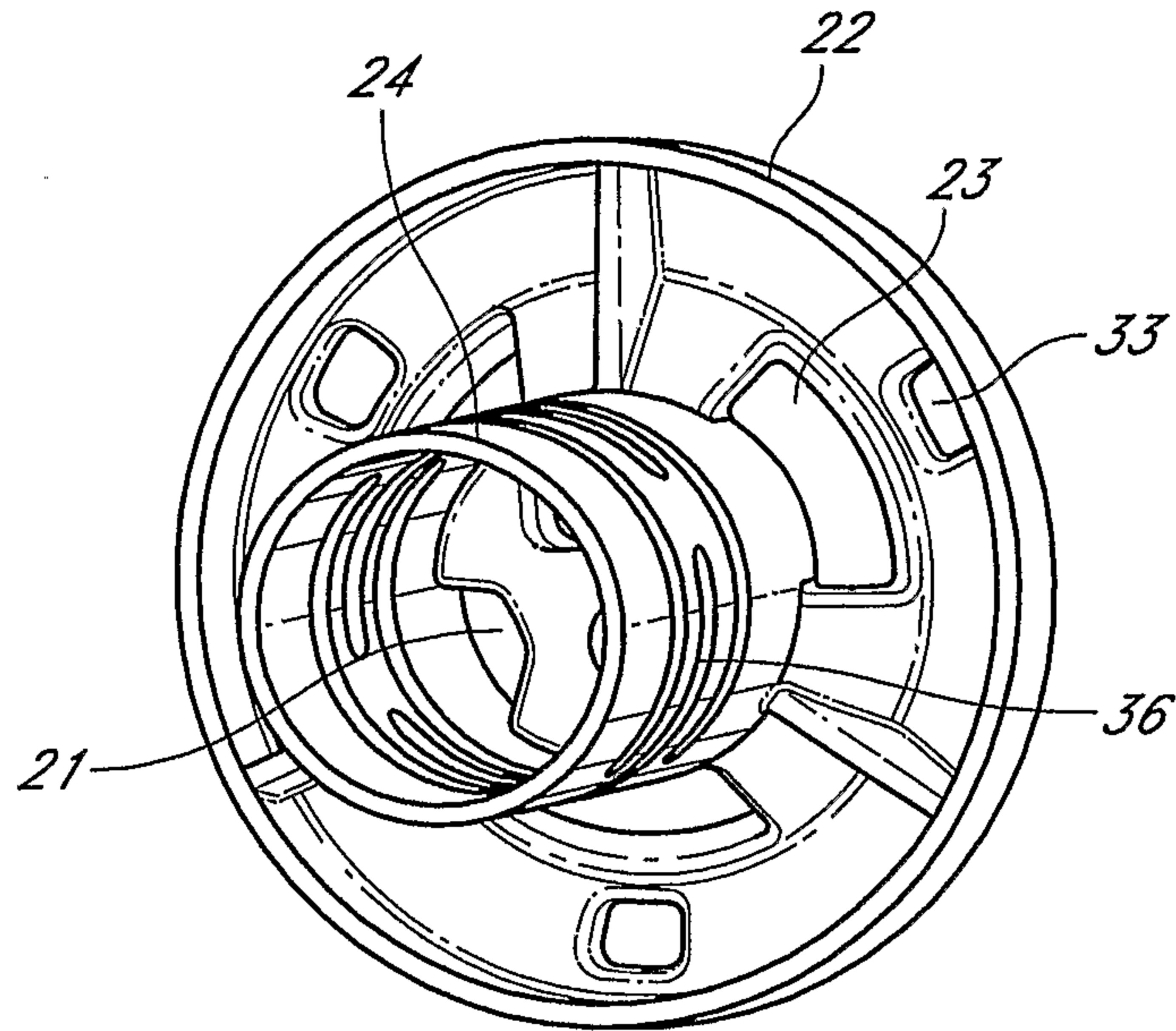

FIG. 3

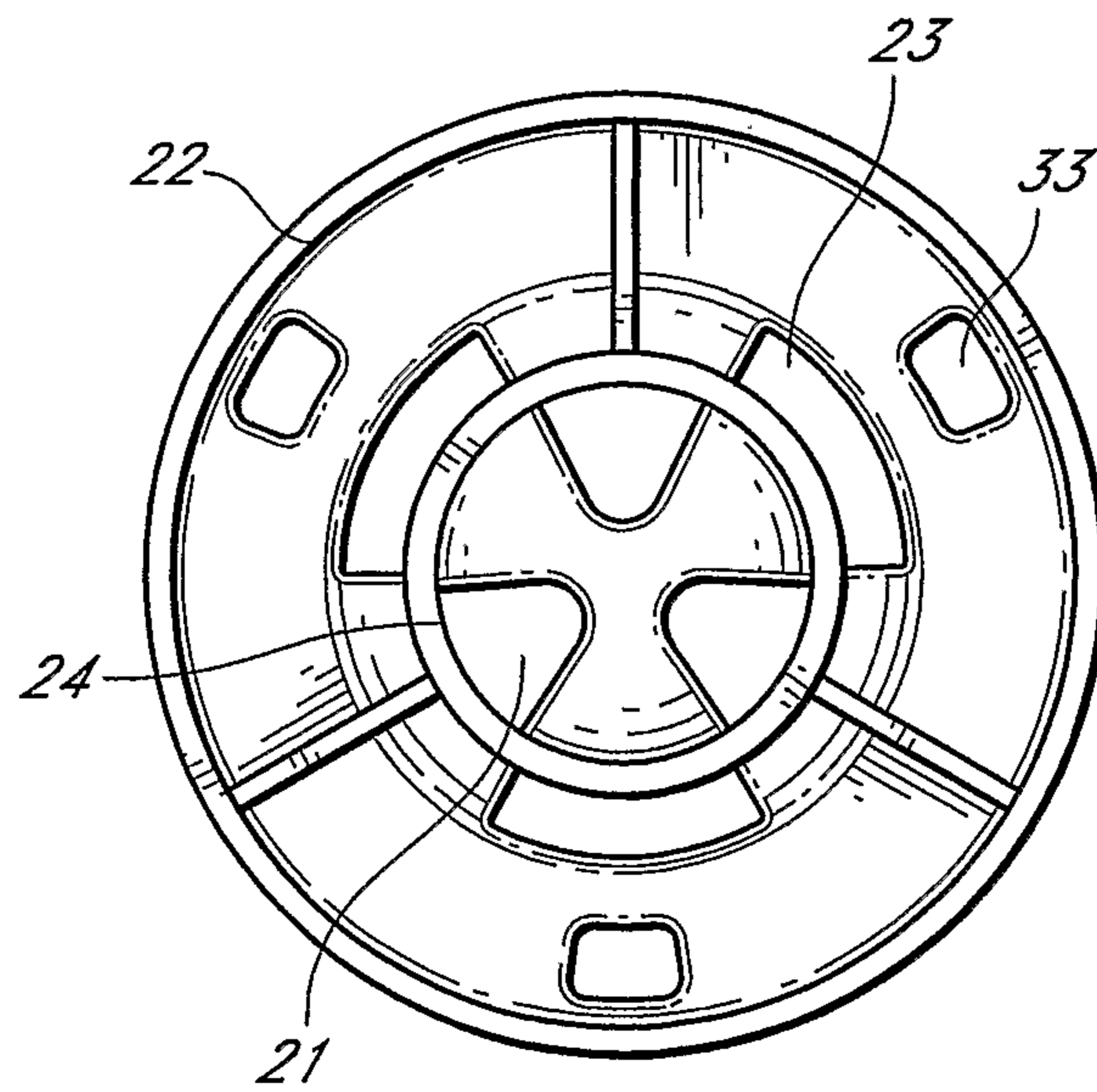

FIG. 4

4/5

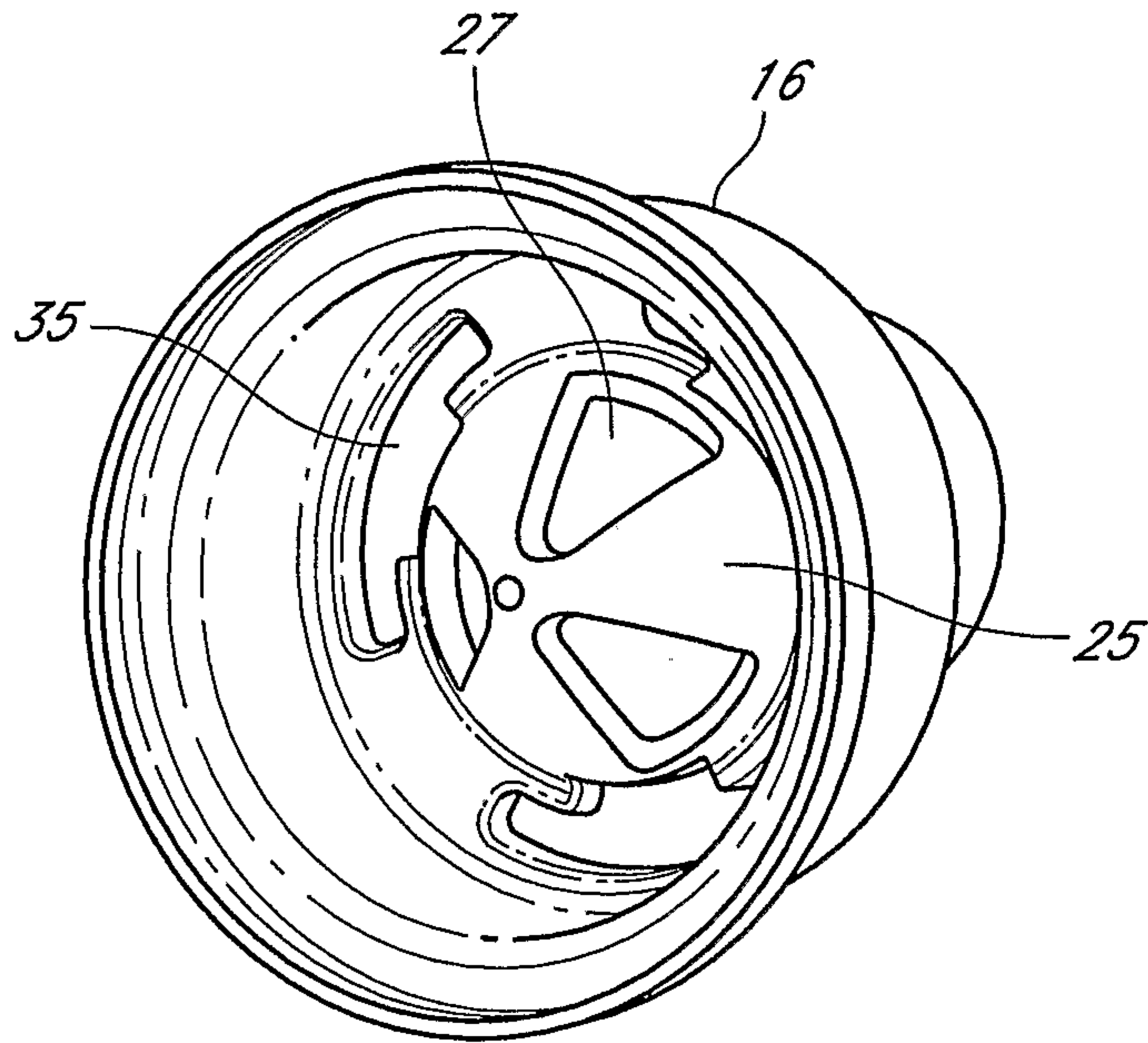

FIG. 5

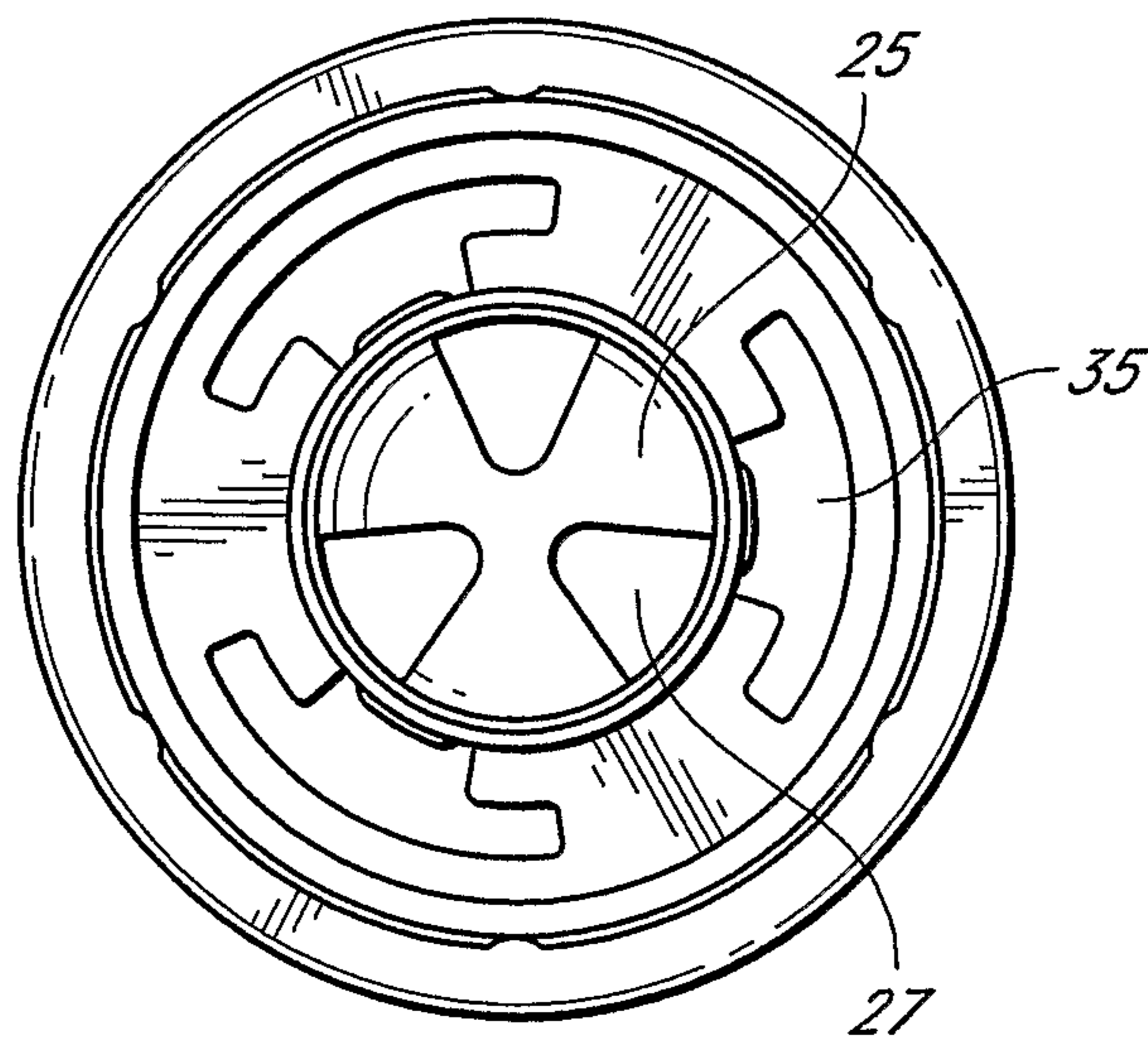

FIG. 6

5/5

