



INTERNATIONAL APPLICATION PUBLISHED UNDER THE PATENT COOPERATION TREATY (PCT)

<p>(51) International Patent Classification <sup>6</sup> : <b>G06F 17/60, H04L 29/06, G09F 27/00</b></p>	<p><b>A1</b></p>	<p>(11) International Publication Number: <b>WO 98/47090</b> (43) International Publication Date: 22 October 1998 (22.10.98)</p>
<p>(21) International Application Number: PCT/US98/07844 (22) International Filing Date: 14 April 1998 (14.04.98) (30) Priority Data: 08/839,883 16 April 1997 (16.04.97) US (71) Applicant: SONY ELECTRONICS, INC. [US/US]; 1 Sony Drive, Park Ridge, NJ 07656-8003 (US). (72) Inventors: SERVAN-SCHREIBER, Franklin; 305 West 13th Street #5D, New York, NY 10014 (US). CATAUDELLA, Salvatore; 50 Plaza Street #4C, Brooklyn, NY 11238 (US). (74) Agent: FROMMER, William, S.; Frommer Lawrence &amp; Haug LLP, 745 Fifth Avenue, New York, NY 10151 (US).</p>	<p>(81) Designated States: AL, AM, AT, AU, AZ, BA, BB, BG, BR, BY, CA, CH, CN, CU, CZ, DE, DK, EE, ES, FI, GB, GE, GH, GM, GW, HU, ID, IL, IS, JP, KE, KG, KP, KR, KZ, LC, LK, LR, LS, LT, LU, LV, MD, MG, MK, MN, MW, MX, NO, NZ, PL, PT, RO, RU, SD, SE, SG, SI, SK, SL, TJ, TM, TR, TT, UA, UG, UZ, VN, YU, ZW, ARIPO patent (GH, GM, KE, LS, MW, SD, SZ, UG, ZW), Eurasian patent (AM, AZ, BY, KG, KZ, MD, RU, TJ, TM), European patent (AT, BE, CH, CY, DE, DK, ES, FI, FR, GB, GR, IE, IT, LU, MC, NL, PT, SE), OAPI patent (BF, BJ, CF, CG, CI, CM, GA, GN, ML, MR, NE, SN, TD, TG).</p> <p><b>Published</b> <i>With international search report.</i></p>	

(54) Title: METHOD OF ADVERTISING ON-LINE

(57) Abstract

Method of advertising on-line during, for example, a world wide web session is provided by downloading full page advertisements from a predetermined site (e.g., remote server 26) to a user's computer (24) during a communication link idle time. The downloaded advertising data (AD) are stored and then displayed when the user makes a request to retrieve new data, for example, a hyperlink request to a selected remote server (26). The advertisement remains displayed while the connection to the selected remote server (26) is made and at least until a portion of new content data is transmitted to the user terminal (24).

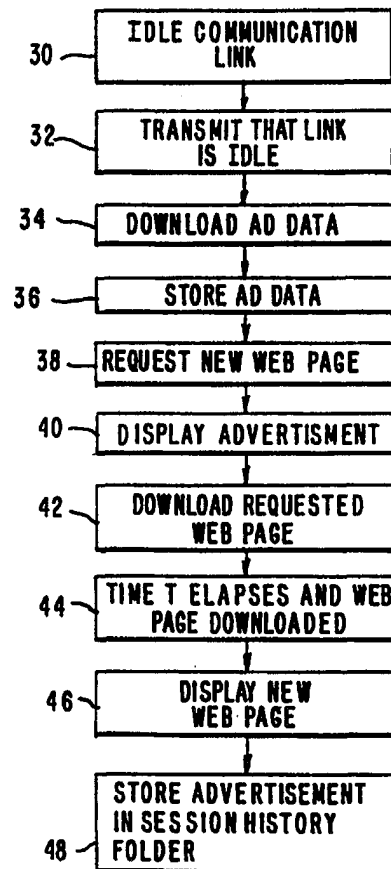

**FOR THE PURPOSES OF INFORMATION ONLY**

Codes used to identify States party to the PCT on the front pages of pamphlets publishing international applications under the PCT.

<b>AL</b>	Albania	<b>ES</b>	Spain	<b>LS</b>	Lesotho	<b>SI</b>	Slovenia
<b>AM</b>	Armenia	<b>FI</b>	Finland	<b>LT</b>	Lithuania	<b>SK</b>	Slovakia
<b>AT</b>	Austria	<b>FR</b>	France	<b>LU</b>	Luxembourg	<b>SN</b>	Senegal
<b>AU</b>	Australia	<b>GA</b>	Gabon	<b>LV</b>	Latvia	<b>SZ</b>	Swaziland
<b>AZ</b>	Azerbaijan	<b>GB</b>	United Kingdom	<b>MC</b>	Monaco	<b>TD</b>	Chad
<b>BA</b>	Bosnia and Herzegovina	<b>GE</b>	Georgia	<b>MD</b>	Republic of Moldova	<b>TG</b>	Togo
<b>BB</b>	Barbados	<b>GH</b>	Ghana	<b>MG</b>	Madagascar	<b>TJ</b>	Tajikistan
<b>BE</b>	Belgium	<b>GN</b>	Guinea	<b>MK</b>	The former Yugoslav Republic of Macedonia	<b>TM</b>	Turkmenistan
<b>BF</b>	Burkina Faso	<b>GR</b>	Greece	<b>ML</b>	Mali	<b>TR</b>	Turkey
<b>BG</b>	Bulgaria	<b>HU</b>	Hungary	<b>MN</b>	Mongolia	<b>TT</b>	Trinidad and Tobago
<b>BJ</b>	Benin	<b>IE</b>	Ireland	<b>MR</b>	Mauritania	<b>UA</b>	Ukraine
<b>BR</b>	Brazil	<b>IL</b>	Israel	<b>MW</b>	Malawi	<b>UG</b>	Uganda
<b>BY</b>	Belarus	<b>IS</b>	Iceland	<b>MX</b>	Mexico	<b>US</b>	United States of America
<b>CA</b>	Canada	<b>IT</b>	Italy	<b>NE</b>	Niger	<b>UZ</b>	Uzbekistan
<b>CF</b>	Central African Republic	<b>JP</b>	Japan	<b>NL</b>	Netherlands	<b>VN</b>	Viet Nam
<b>CG</b>	Congo	<b>KE</b>	Kenya	<b>NO</b>	Norway	<b>YU</b>	Yugoslavia
<b>CH</b>	Switzerland	<b>KG</b>	Kyrgyzstan	<b>NZ</b>	New Zealand	<b>ZW</b>	Zimbabwe
<b>CI</b>	Côte d'Ivoire	<b>KP</b>	Democratic People's Republic of Korea	<b>PL</b>	Poland		
<b>CM</b>	Cameroon	<b>KR</b>	Republic of Korea	<b>PT</b>	Portugal		
<b>CN</b>	China	<b>KZ</b>	Kazakstan	<b>RO</b>	Romania		
<b>CU</b>	Cuba	<b>LC</b>	Saint Lucia	<b>RU</b>	Russian Federation		
<b>CZ</b>	Czech Republic	<b>LI</b>	Liechtenstein	<b>SD</b>	Sudan		
<b>DE</b>	Germany	<b>LK</b>	Sri Lanka	<b>SE</b>	Sweden		
<b>DK</b>	Denmark	<b>LR</b>	Liberia	<b>SG</b>	Singapore		
<b>EE</b>	Estonia						

METHOD OF ADVERTISING ON-LINEBACKGROUND OF THE INVENTION

The present invention relates to method of advertising on-line and, more particularly, to a method for providing advertisements during a computer on-line session.

Currently, advertising during computer on-line sessions (e.g., "world-wide web" or simply "web" sessions) is accomplished by displaying so-called "banners" on the top of a "web" page. Advertisements also are provided as "buttons" or small square banners in particular areas of a web page currently being displayed. Such banner or button advertisements provide relatively little information to the user due to their small size, but operate to "hyperlink" to the advertiser's home web page when the advertisement is "clicked" on by means of a mouse.

One problem with these types of on-line advertisements is that they convey very little information, as previously mentioned. Another problem with such advertisements is that they must be included within the particular web pages that are viewed by users and, thus, advertisements included in web pages that are viewed rarely have little advertising value.

OBJECTS OF THE INVENTION

Therefore, it is an object of the present invention to provide method of advertising on-line which overcomes the shortcomings of current advertising techniques.

Another object of the present invention is to provide a technique for advertising on-line which provides for the display of full page advertisements.

A further object of the present invention is to provide a technique for providing advertisements to users of internet services regardless of the particular web pages that are viewed by those users.

Various other objects, advantages and features of the present invention will become readily apparent to those of ordinary skill in the art, and the novel features will be particularly pointed out in the appended  
5 claims.

#### SUMMARY OF THE INVENTION

In accordance with one embodiment of the present invention, method is provided for ascertaining when the communication link between a user terminal and a  
10 service provider is idle, transmitting to the user terminal advertising data (e.g., an advertising page) representing an advertisement during the ascertained communication idle time, and displaying at the user terminal the advertisement that is represented by the  
15 transmitted advertising data when a request to display different information (e.g., to receive a new content page) is made at the user terminal.

As one aspect of the present invention, the advertisement is displayed when a request to download new  
20 information (e.g., a new content page) is made, the request is transmitted to the service provider, and the requested information is transmitted from, for example, a remote server to the user terminal, all occurring while the advertisement is displayed.

As another aspect of the present invention, the advertisement that is transmitted to the user terminal  
25 corresponds to that information (i.e., content pages) that was previously displayed at the user terminal.

As a further aspect of the present invention,  
30 data indicating that the user terminal communication link is idle is transmitted from the user terminal to a remote server, and that remote server transmits the advertising data to the user terminal.

As yet another aspect of the present invention,  
35 the transmitted advertisement is displayed when a connection to a selected remote server is requested at

the user terminal, and remains displayed while the connection is being made.

#### BRIEF DESCRIPTION OF THE DRAWINGS

The following detailed description, given by way of example and not intended to limit the present invention solely thereto, will best be appreciated in conjunction with the accompanying drawings, wherein like reference numerals denote like elements and parts, in which:

10 Fig. 1 is a schematic illustration used to explain how individual users access the Internet;

Fig. 2 is a flow chart of method of advertising on-line in accordance with the present invention;

15 Fig. 3 is a schematic illustration of a full-screen display of an active web page;

Fig. 4 is a schematic illustration of an advertisement that is displayed in accordance with the present invention;

20 Fig. 5A - 5D are schematic illustrations of a display showing partially the advertisement of Fig. 4 in accordance with the present invention;

25 Fig. 6 is a schematic illustration of a new web page that is fully downloaded and fully displayed after the display of an advertisement in accordance with the present invention; and

Fig. 7 is a schematic illustration of a view of an overall web session illustrating the advertisements that are displayed in accordance with the present invention.

#### 30 DETAILED DESCRIPTION OF CERTAIN PREFERRED EMBODIMENTS

Referring now to the drawings, Fig. 1 is a schematic illustration showing the relationship between the Internet 20, an Internet service provider (ISP) 22 and users 24 that are serviced by ISP 22. During a typical on-line session, a user 24 (also identified herein as "user terminal") accesses via a computer modem the particular ISP 22 to which the user subscribes, and

the ISP operates to allow user 24 to communicate with a desired web site, for example, the Sony home page web site 26, which is considered to be a part of the world-wide web of the Internet 20.

5           In accordance with the present invention, full page advertisements are downloaded from a particular web site to user terminal 24 after a "content" page has been downloaded and is currently being displayed to the user, such content page being, for example, the home page of a  
10 selected web site. Upon downloading of the advertisement, the advertisement is stored in the memory of the user's computer and remains un-displayed until the user creates a so-called http connection. In other words, the advertisement (also identified herein as  
15 "advertising page") is downloaded (or pushed) in the background while the user is reading a content page (i.e., while the user's computer is idle). When the user "clicks" on a hyperlink or manually enters the address of the web site to be accessed, the downloaded advertising  
20 page immediately is displayed and remains displayed until the http connection is established with the hyperlinked page and that hyperlinked page begins to download.

Fig. 2 is a flow chart of method of advertising on-line in accordance with the present invention. When  
25 it is determined that the user's communication link is idle, at instruction 30, the user's computer communicates to ISP 22 that its communication link is idle at instruction 32, at which time, an advertising page (AD data) is supplied from a particular web site (e.g., web  
30 site 26) via ISP 22 to user 24 at instruction 34. In a preferred embodiment of the present invention, the user's web browser includes software that carries out the functions of determining whether its communication link is idle and communicating to a remote server the fact  
35 that its communication link is idle. During such idle time, the user's web browser accesses (i.e., links to) a preprogrammed web site (e.g., remote server 26), and upon

accessing the remote server, appropriate transmissions are supplied from user 24 thereto, at which time, the remote server transmits to user 24 the advertising page that is to be displayed. The received advertising page is stored (cached) in the computer's memory or hard disk at instruction 36. An exemplary content page that a user may be viewing during such idle time is shown in Fig. 3. Of course, the user may be viewing any content page supplied from any remote server, not necessarily and, in actuality, most likely not the same remote server that supplied the advertising page.

When the user clicks on a link from the currently displayed web page in order to request that a new web page be downloaded and displayed (from any particular remote server), as indicated at instruction 38, the new http connection then is established, and simultaneously, the cached advertising page, for example, such as shown in Fig. 4, is displayed for a minimum predetermined amount of time T or until the new web page "sufficiently" is downloaded, whichever is greater, at instruction 40. At this time, the requested web page is downloaded at instruction 42, and when it is determined that the new web page is "sufficiently" downloaded after the predetermined time T has elapsed, as determined at instruction 44, the new web page is displayed at instruction 46. As shown successively in Figs. 5A - 5D, after the new page is sufficiently downloaded, the new page replaces the displayed advertising page in the manner shown. When the new web page is fully downloaded, it is fully displayed, such as shown in Fig. 6. The advertising page then is saved in the web session history folder, along with the other saved web pages, at instruction 48, such as schematically shown in the web session zooming page shown in Fig. 7.

As previously discussed, a request to download a new web page is made by the user at instruction 38, at which time, the new http connection is established. If

such a request was made prior to the transmission of all of the data of the advertising page (from, for example, web site 26), then the advertising page is not displayed (at instruction 40) when the request to receive a new content web page is made by the user (at instruction 38).  
5 Instead, the remainder of the advertising page is transmitted to user 24 (and then stored therein) at the next instance the transmission link becomes idle (i.e., at instructions 32-36). However, to prevent the non-  
10 display of an advertising page between the display of content web pages, two or more advertising pages are downloaded to user 24 at instruction 34, assuming there is adequate time prior to a user request to receive a new content web page. Then, one or more downloaded  
15 advertising pages are displayed until the new content web page is "sufficiently" downloaded, and the not yet displayed downloaded advertising pages remain stored in user terminal 24's memory (RAM, hard-drive, etc.) and remain undisplayed until the next user request to  
20 retrieve a new content web page. Thus, there is reserve of advertising pages for display in the event there is an http request before an entire advertising page is downloaded.

In a preferred embodiment of the present  
25 invention, the advertising technique described herein is implemented by means of a zooming web browser which essentially "slips" each advertising page between two web content pages as the user hyperlinks from one page to another and, thus, the advertising pages remain as part  
30 of the session history. The session history may be displayed in the form of a tree, a spiral, a timeline, a circle or any other representation of a web session that may be provided using a zooming function. These zooming web browsers allow the user to view selected pages from  
35 the web session history folder, such selected pages being either content pages or advertising pages.



From the foregoing discussion, it is seen that the present invention provides a process of "pushing" advertising data to a client (or user) when client communication activity is idle, and then displaying that advertising data on the client's monitor during the down  
5 time that immediately follows a new network connection request. Hence, neither the advertising data download time nor the advertisement display time utilizes any of the client's communication time. Often, such advertising  
10 data is displayed during a time when the client's monitor would otherwise be blank.

The present invention may be applied to a web session, such as previously discussed, wherein an advertising page is downloaded to a user over the  
15 Internet while the user is reading a downloaded page, and the downloaded advertising page then is displayed when the user hyperlinks to another page. Also, as previously discussed, the advertising page is displayed for a minimum time T or until a new page is sufficiently  
20 downloaded, whichever is greater. Such minimum time can be preset to any amount of time, for example, two seconds, five seconds, ten seconds, etc. In an alternative embodiment of the present invention, two (or more) advertising pages are downloaded during the idle  
25 time, wherein each downloaded advertising page is displayed successively for a period of at least, for example, four seconds, for a minimum advertising display time of 8 seconds. Still further, additional advertising pages may be displayed during the web page download time  
30 if such download time is unusually long. Of course, any variation of the above also is possible.

Each advertising page that is downloaded to a user's computer is downloaded from a predetermined web site, such web site generally having no relationship with  
35 the particular content pages that are retrieved and displayed to the user. This advertising data web site may supply to users selected advertising pages in a

manner similar to that of television and radio. That is, "advertising time" is purchased by sponsors and the sponsors' advertisements are downloaded to the users during the above-discussed idle times. In an alternative  
5 embodiment of the present invention, the specific advertising pages that are downloaded to a particular user are a function of that user's preferences as determined by, for example, the particular content pages that are retrieved and viewed by the user. Thus,  
10 advertisements directed to, for example, food items are downloaded to users viewing cooking-related content pages. Of course, other information including statistical profiles of users, what items are searched for in search engines, etc., may be used to determine  
15 which advertising pages are to be downloaded.

In a further alternative embodiment of the present invention, advertising data is downloaded during idle times in the manner previously discussed, but the advertising data is displayed when the user clicks or  
20 zooms to a specific content space of the displayed web page. Thus, advertisements "pop up" in between any type of request for information, whether such request is a hyperlink request, a zoom request, etc. Such may be applied during whether a connection is made to the  
25 Internet or to a local area network. Further, advertising data could be provided to the user in this manner when data is being downloaded from a CD-ROM or other record medium. Thus, advertising pages downloaded during idle times may be displayed to a user during any  
30 type of action that requires at least a short amount of "wait" time.

While the present invention has been particularly shown and described in conjunction with preferred embodiments thereof, it will be readily  
35 appreciated by those of ordinary skill in the art that various changes may be made without departing from the spirit and scope of the invention. For example, while

the present invention has been described as downloading full page advertisements during communication idle time, the present invention is not limited to full page advertisements and may be applied to the downloading of  
5 partial pages of advertisements or any other form thereof, including, for example, advertising pages having more than one advertisement thereon.

As another example, although the present discussion is directed to a web browser that communicates  
10 to a remote server when it is idle, the present invention is not limited solely to providing the means for carrying out the present invention at the user's computer and may be provided at the internet service provider wherein the internet service provider ascertains when a user's  
15 communication link is idle and it is the internet service provider that automatically accesses (without the user's knowledge) the particular remote terminal that will download advertising data to the user.

Still further, although the present invention  
20 has been described as accessing a remote server which then downloads to the user advertising data, the present invention is not limited solely to the downloading of advertising data from a remote server and may be applied to the case when the internet service provider itself  
25 downloads to the user advertising data without the need to access a remote server on the internet.

Therefore, it is intended that the appended claims be interpreted as including the embodiments described herein, the alternatives mentioned above, and  
30 all equivalents thereto.

**WHAT IS CLAIMED IS:**

1. Method of advertising on-line, comprising the steps of:
  - ascertaining a time when a communication link  
5 between a user terminal (24) and a service provider (22) is idle;
  - transmitting to said user terminal (24) advertising data (AD) representing an advertisement during the ascertained communication idle time; and  
10 displaying at said user terminal (24) said advertisement represented by the transmitted advertising data (AD) when a request to display different information is made at said user terminal (24).
2. The method of claim 1, further comprising  
15 the step of storing the transmitted advertising data (AD) in a memory of said user terminal (24); and wherein said step of displaying is carried out by retrieving from the memory the stored advertising data (AD) and displaying the advertisement represented by the retrieved  
20 advertising data when said request is made.
3. The method of claim 1, wherein said step of displaying is carried for a predetermined time (T).
4. The method of claim 1, wherein said step of displaying is carried out when a request to download new  
25 information is made; said method further comprising the step of transmitting to said service provider (22), during a time when said advertisement is being displayed, a request to receive the requested information.
5. The method of claim 4, further comprising  
30 the steps of transmitting to said user terminal (24), during said time when said advertisement is being displayed, the requested information in response to the transmission of the request by said user terminal (24).
6. The method of claim 5, further comprising  
35 the step of displaying the transmitted requested information simultaneously with the advertisement as said requested information is transmitted.

7. The method of claim 4, wherein the step of displaying said advertisement is carried out until a substantial portion of the requested information is transmitted.

5           8. The method of claim 7, wherein the step of displaying said advertisement is carried out until a substantial portion of the requested information is transmitted and a predetermined amount of display time (T) of said advertisement has passed.

10           9. The method of claim 1, wherein said advertising data (AD) transmitted to said user terminal (24) represents an advertisement that corresponds to information previously displayed at said user terminal (24).

15           10. The method of claim 1, further comprising the step of transmitting from said user terminal (24) to a predetermined remote server (26) data indicating that the communication link of said user terminal is idle; and wherein said step of transmitting the advertising data  
20 (AD) is carried out by said predetermined remote server (26).

          11. The method of claim 10, further comprising the step of requesting at said user terminal (24) a connection to a selected remote server (26); and wherein  
25 said step of displaying said advertisement is carried out in response to the connection request.

          12. The method of claim 11, further comprising the steps of transmitting to said service provider (22) the connection request; and connecting said user terminal  
30 (24) with said selected remote server(26); and wherein said advertisement remains displayed while the connection request is transmitted and the connection between said user terminal (24) and said selected remote server (26) is made.

35           13. The method of claim 12, further comprising the step of transmitting from said selected remote server (26) to said user terminal (24) content data representing

a content page to be displayed; and wherein said step of displaying said advertisement is carried out at least until a displayable portion of said content data is transmitted.

5                   14. The method of claim 13, wherein said step of displaying said advertisement is carried out by displaying said transmitted content data simultaneously with a portion of said advertisement when a substantial amount of said content data is transmitted to said user  
10 terminal (24).

                  15. The method of claim 13, wherein said predetermined remote server (26) transmits to said user terminal (24) advertising data representing an advertisement corresponding to contents of content pages  
15 previously displayed at said user terminal (24).

                  16. The method of claim 10, wherein said predetermined remote server (26) that transmitted to said user terminal said advertising data (AD) is different from said selected remote server (26).

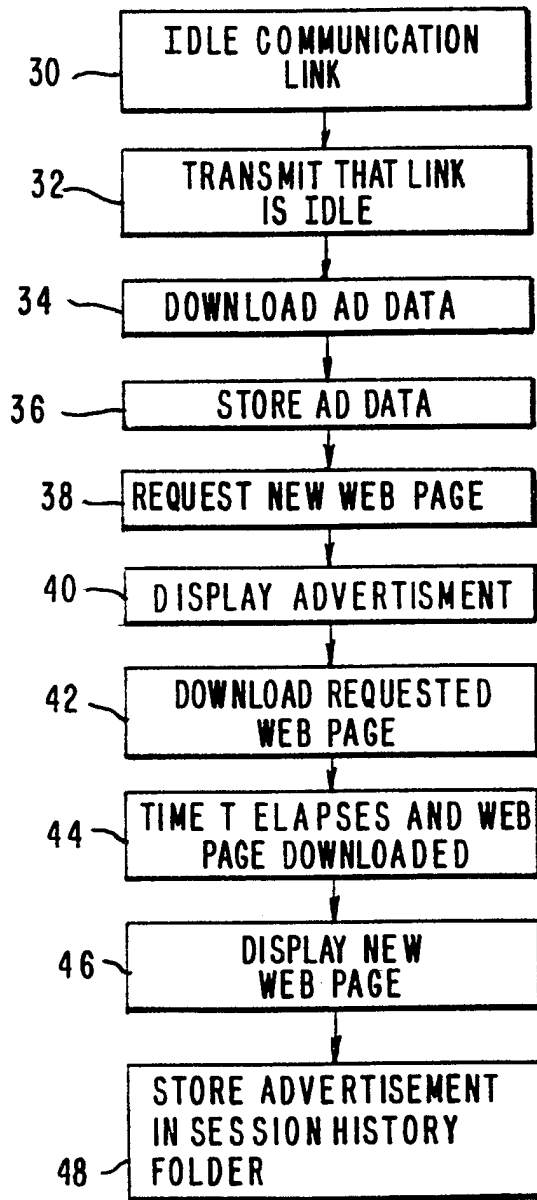
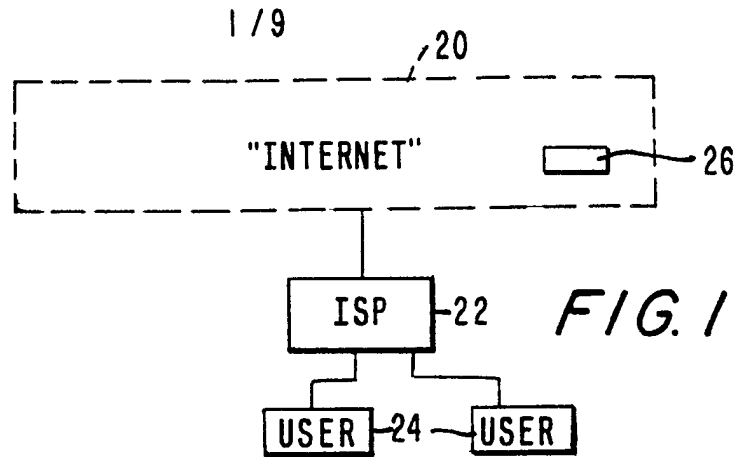

FIG. 2

FIG. 3

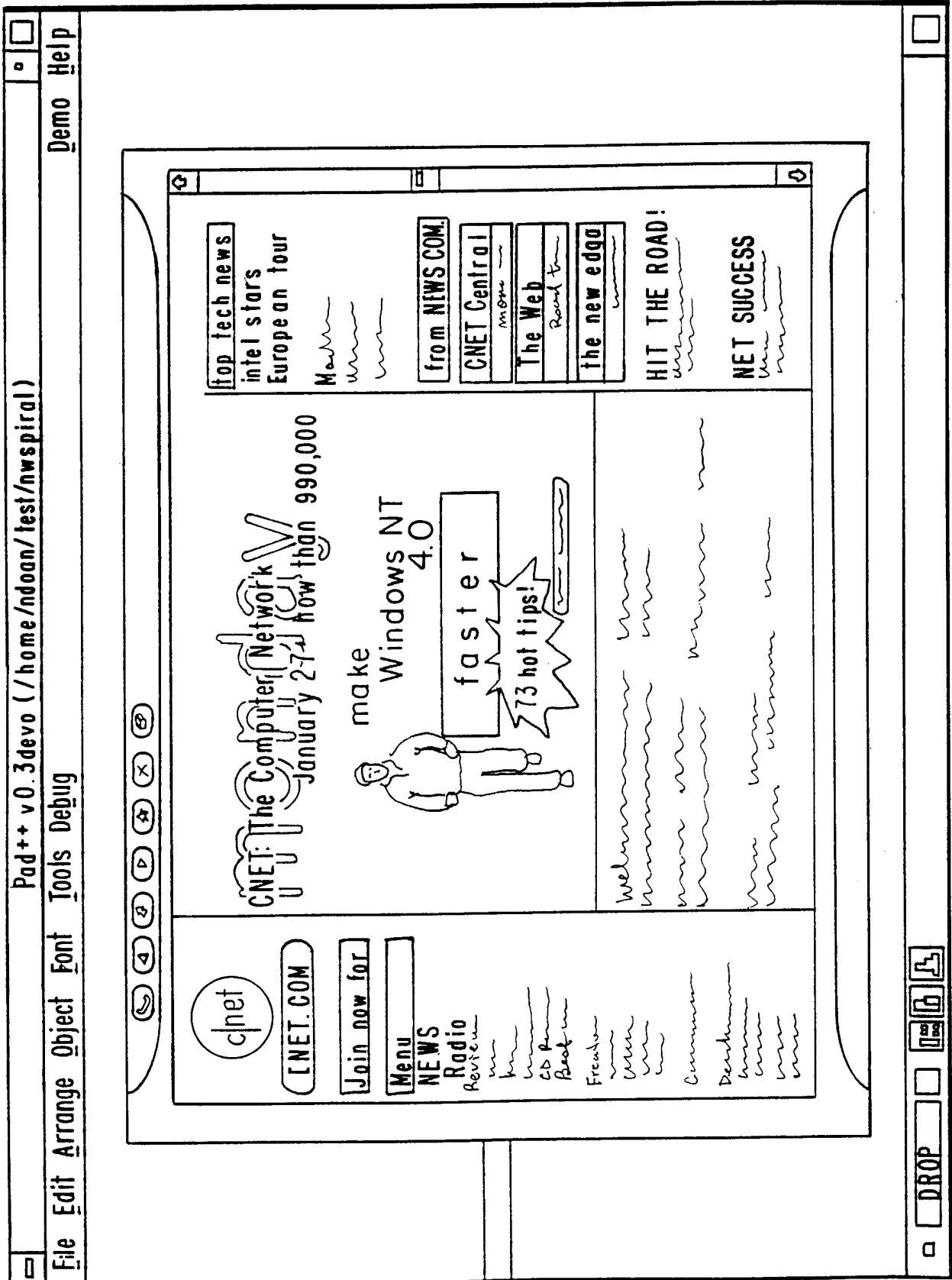



FIG. 4

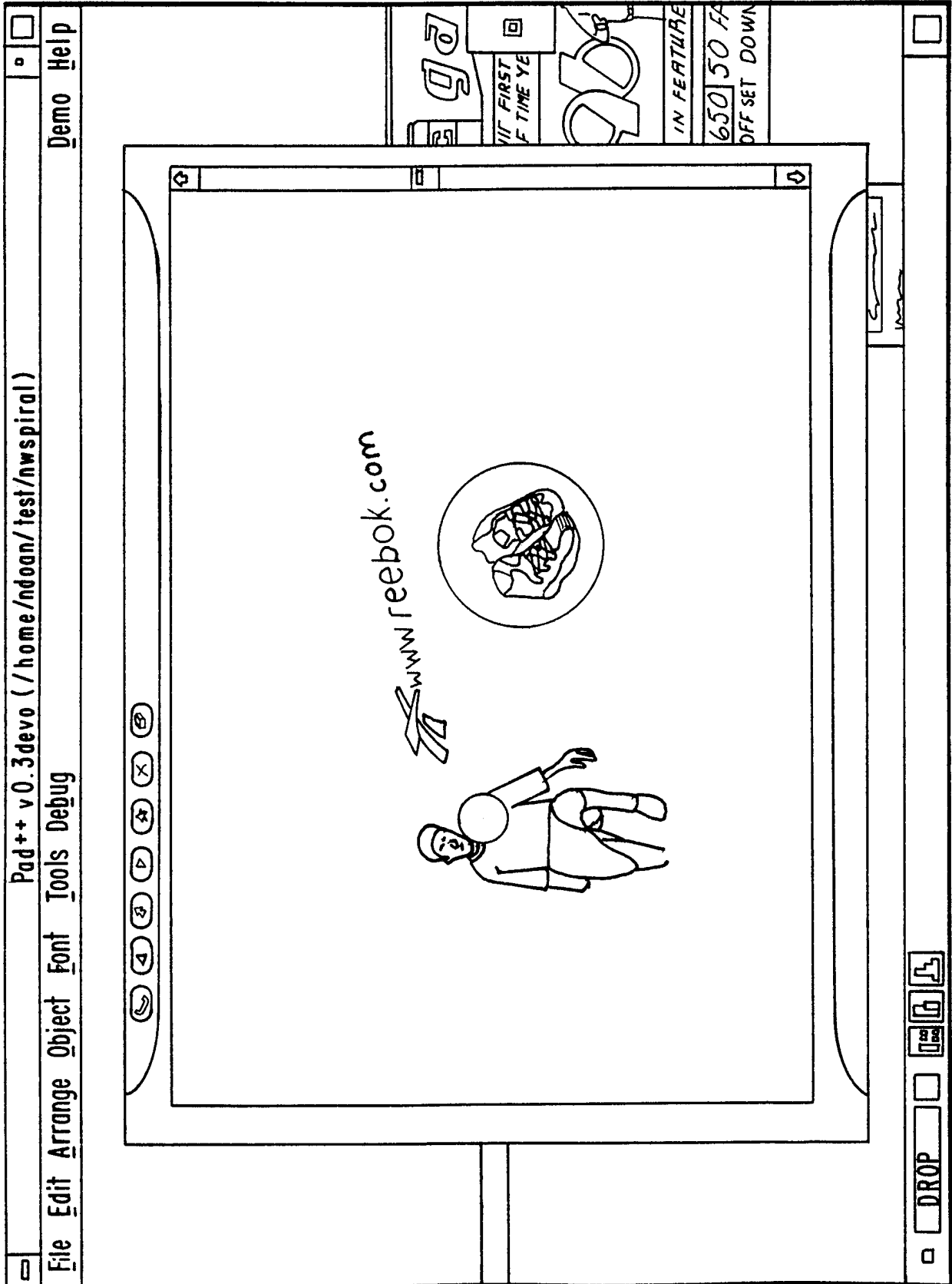

FIG. 5A

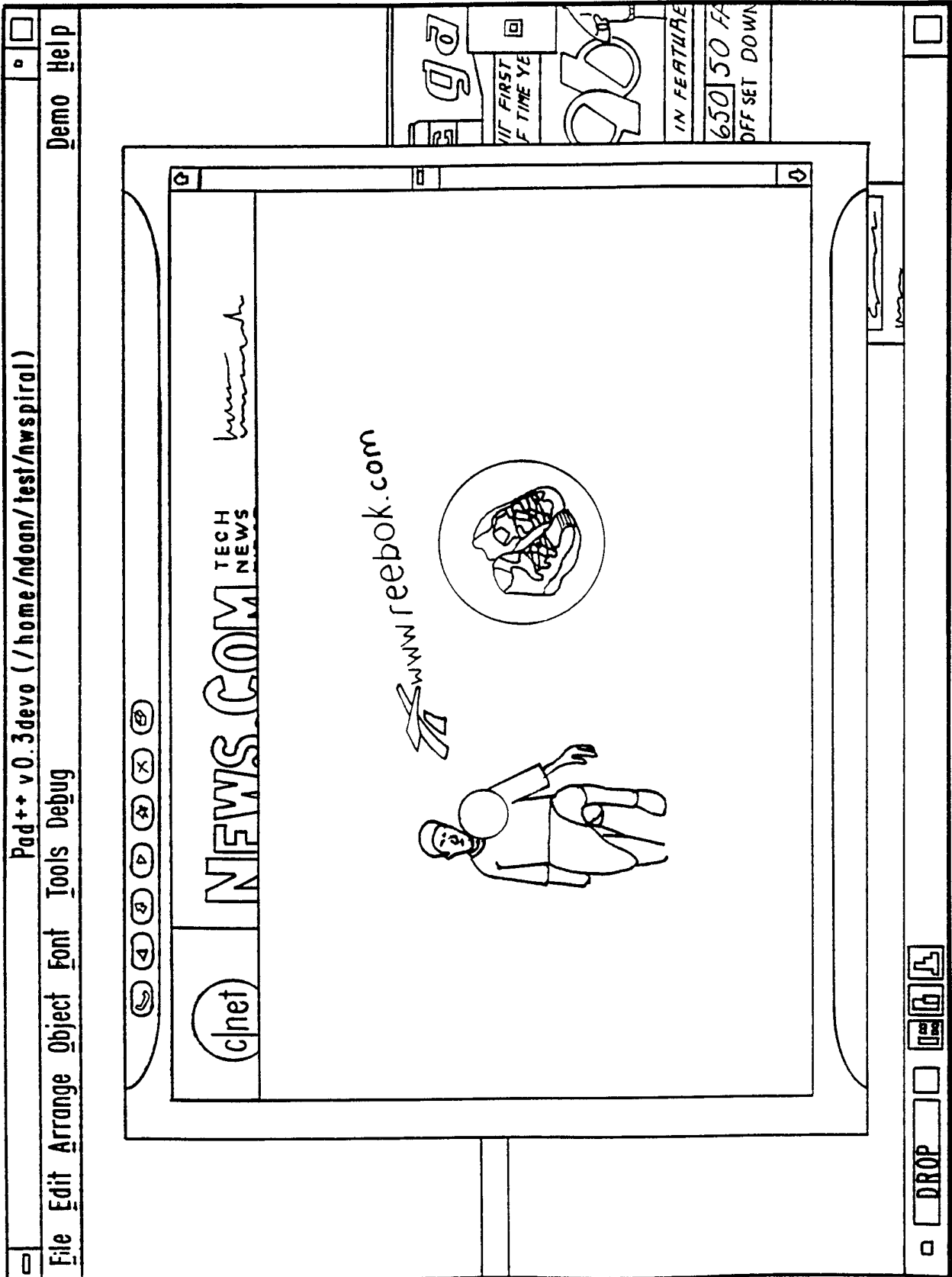

FIG. 5B

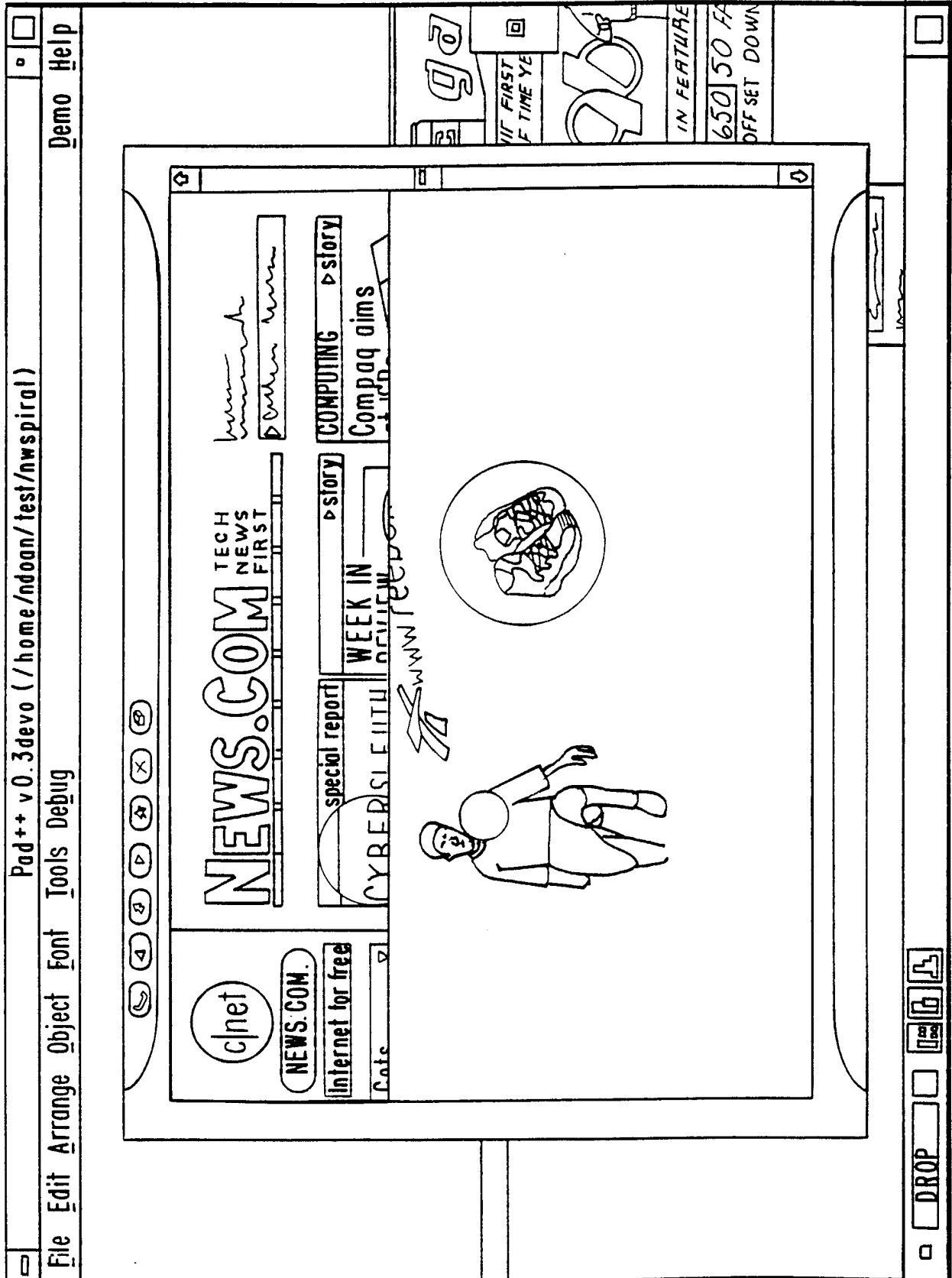
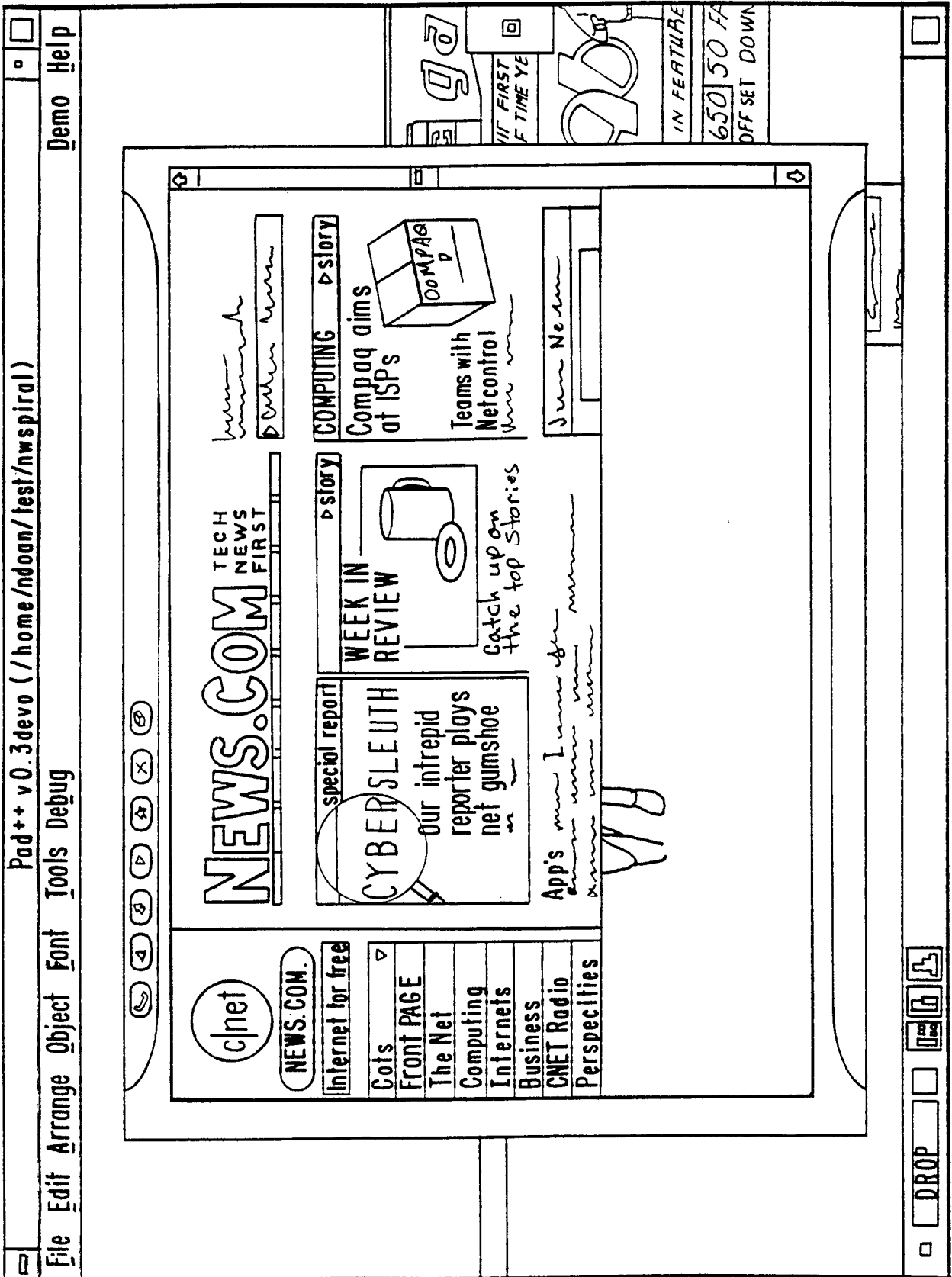

FIG. 5C 6/9



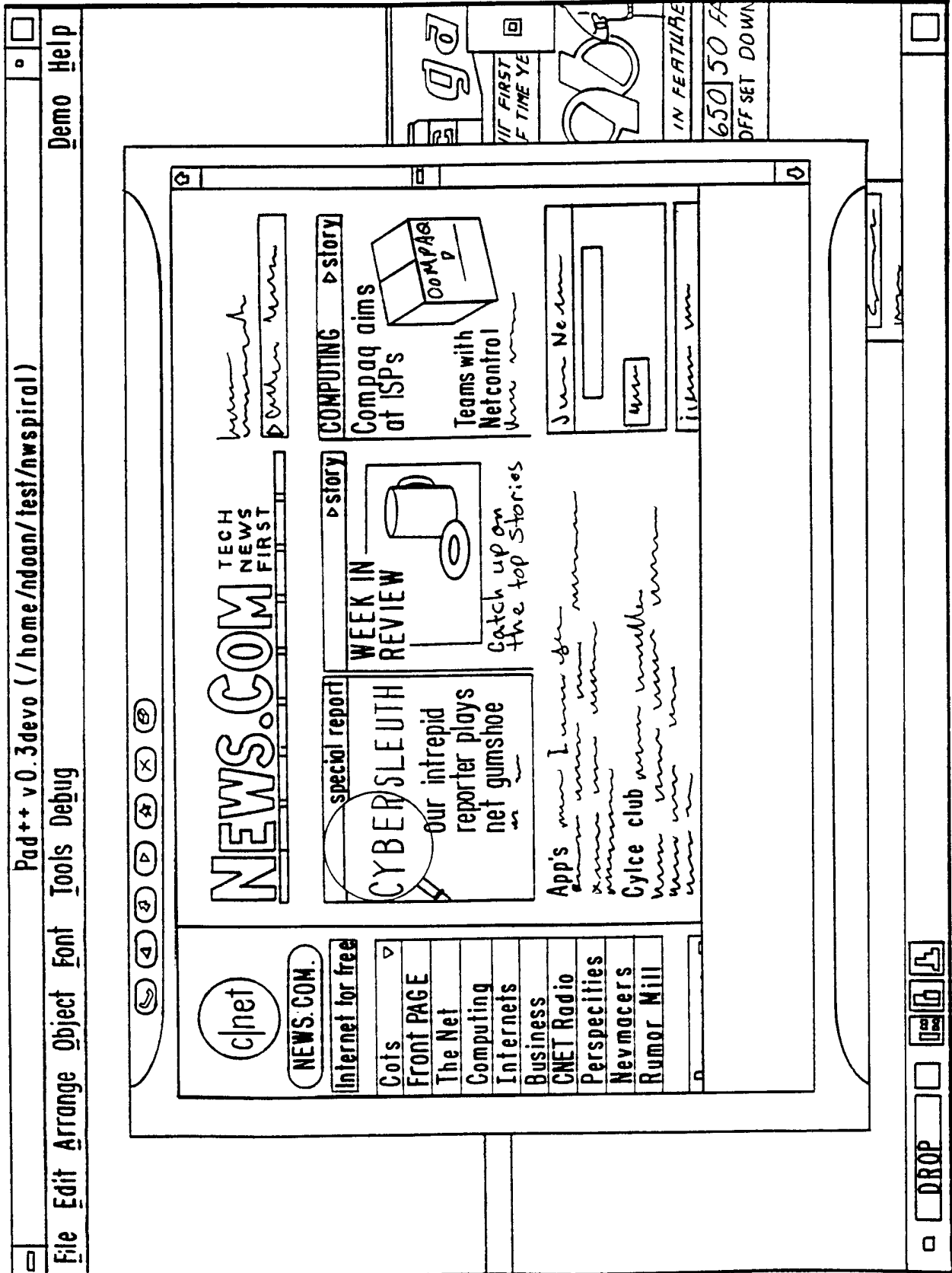
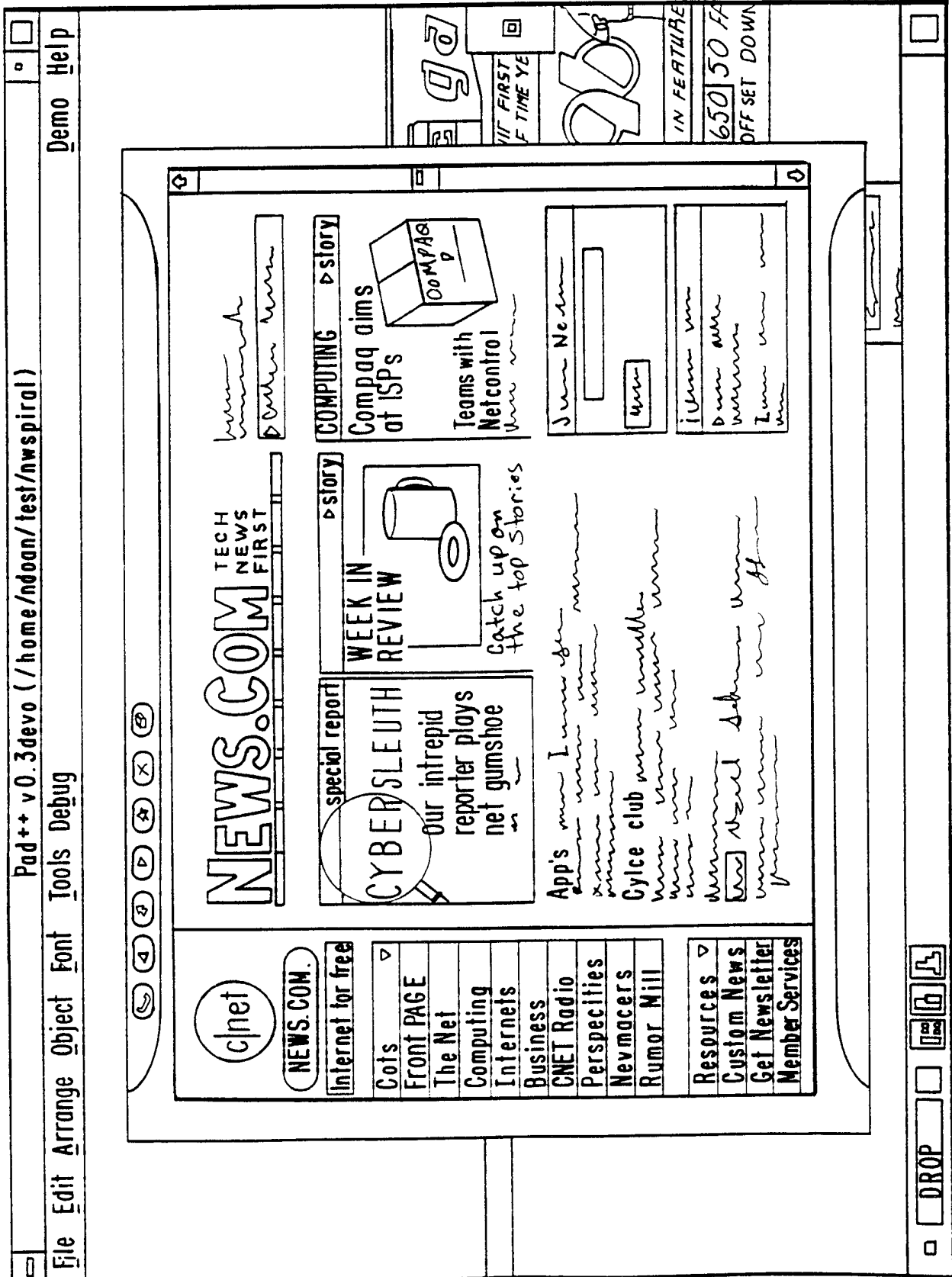
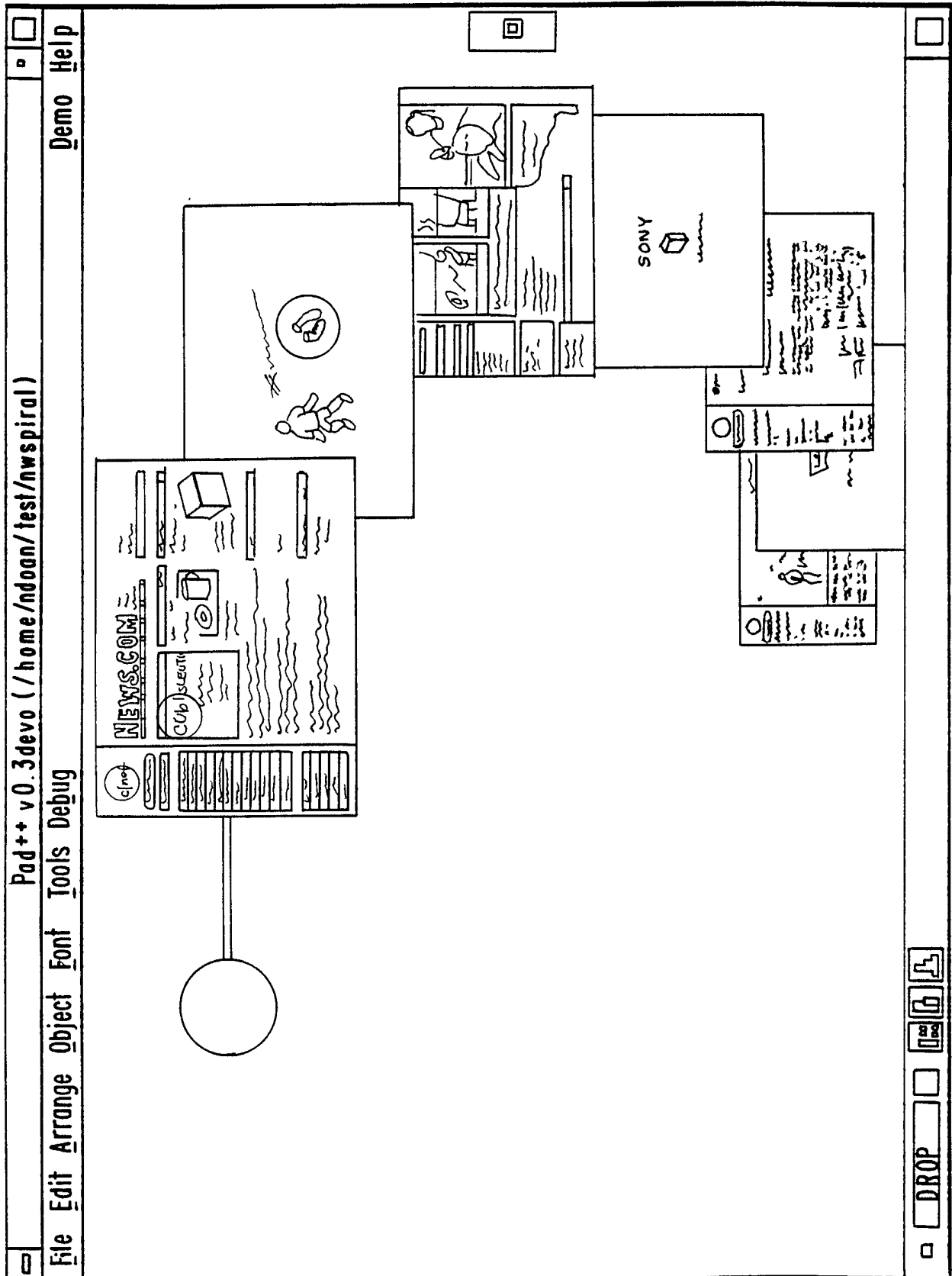

FIG. 6





# INTERNATIONAL SEARCH REPORT

International Application No  
PCT/US 98/07844

**A. CLASSIFICATION OF SUBJECT MATTER**  
IPC 6 G06F17/60 H04L29/06 G09F27/00

According to International Patent Classification (IPC) or to both national classification and IPC

**B. FIELDS SEARCHED**

Minimum documentation searched (classification system followed by classification symbols)  
IPC 6 G06F G09F H04L

Documentation searched other than minimum documentation to the extent that such documents are included in the fields searched

Electronic data base consulted during the international search (name of data base and, where practical, search terms used)

**C. DOCUMENTS CONSIDERED TO BE RELEVANT**

Category	Citation of document, with indication, where appropriate, of the relevant passages	Relevant to claim No.
X	PATENT ABSTRACTS OF JAPAN vol. 015, no. 476 (E-1140), 4 December 1991 -& JP 03 204259 A (NIPPON TELEGR & TELEPH CORP), 5 September 1991, see abstract ---	1
X	US 5 572 643 A (JUDSON DAVID H) 5 November 1996 see column 5, last paragraph - column 6, paragraph 3 see column 6, last paragraph - column 7, paragraph 3 --- -/--	1,2,4-6

Further documents are listed in the continuation of box C.

Patent family members are listed in annex.

Special categories of cited documents:

"A" document defining the general state of the art which is not considered to be of particular relevance

"E" earlier document but published on or after the international filing date

"L" document which may throw doubts on priority claim(s) or which is cited to establish the publication date of another citation or other special reason (as specified)

"O" document referring to an oral disclosure, use, exhibition or other means

"P" document published prior to the international filing date but later than the priority date claimed

"T" later document published after the international filing date or priority date and not in conflict with the application but cited to understand the principle or theory underlying the invention

"X" document of particular relevance; the claimed invention cannot be considered novel or cannot be considered to involve an inventive step when the document is taken alone

"Y" document of particular relevance; the claimed invention cannot be considered to involve an inventive step when the document is combined with one or more other such documents, such combination being obvious to a person skilled in the art.

"&" document member of the same patent family

Date of the actual completion of the international search

29 June 1998

Date of mailing of the international search report

06/07/1998

Name and mailing address of the ISA

European Patent Office, P.B. 5818 Patentlaan 2  
NL - 2280 HV Rijswijk  
Tel. (+31-70) 340-2040, Tx. 31 651 epo nl.  
Fax: (+31-70) 340-3016

Authorized officer

Wongel, H



# INTERNATIONAL SEARCH REPORT

International Application No  
PCT/US 98/07844

C.(Continuation) DOCUMENTS CONSIDERED TO BE RELEVANT		
Category	Citation of document, with indication, where appropriate, of the relevant passages	Relevant to claim No.
X	WO 93 19427 A (SINGER GERALD ;MURPHY ARTHUR J (US)) 30 September 1993 see page 3, paragraph 2 - page 4, paragraph 3 see page 5, last paragraph - page 6, paragraph 2 <p style="text-align: center;">---</p>	1-5
A	EP 0 749 081 A (POINTCAST INC) 18 December 1996 see page 3, line 15 - line 29 see page 10, line 46 - line 55 <p style="text-align: center;">-----</p>	1-6,9-11

# INTERNATIONAL SEARCH REPORT

Information on patent family members

In tional Application No PCT/US 98/07844
------------------------------------------------

Patent document cited in search report	Publication date	Patent family member(s)	Publication date
US 5572643    A	05-11-1996	AU 7458896 A WO 9715020 A US 5737619 A	07-05-1997 24-04-1997 07-04-1998
WO 9319427    A	30-09-1993	US 5305195 A AU 3937293 A CA 2132719 A EP 0638186 A JP 7507169 T MX 9301687 A	19-04-1994 21-10-1993 26-09-1993 15-02-1995 03-08-1995 31-01-1994
EP 0749081    A	18-12-1996	US 5740549 A CA 2177441 A JP 9269923 A	14-04-1998 13-12-1996 14-10-1997