



(12) Patent specification

(10) SE 539 173 C2

(21) Patent application number:	1451638-9	(51) Int.Cl.:	
(45) Grant of patent:	2017-05-02	B30B 15/30	(2006.01)
(41) Available to the public:	2016-06-23	B02C 18/00	(2006.01)
(22) Filing date:	2014-12-22	D21C 7/06	(2006.01)
(24) Effective date:	2014-12-22	<i>C12P 7/10</i>	(2006.01)
(30) Priority data:	---	<i>C12P 19/02</i>	(2006.01)

- (73) Patentee: Valmet AB, ., 851 94 SUNDSVALL SE
 (72) Inventor: Patrik Petterson, Alnö SE
 Johan Carlsson, Alnö SE
 (74) Agent: GROTH & CO. KB, P.O. Box 6107, 102 32, STOCKHOLM SE
 (54) Title: A system for feeding lignocellulosic biomass material to a hydrolysis or pre-hydrolysis process
 (56) Cited documents: US 5637836 A · FR 2362668 A · US 5302102 A · SU 1388481 A2 · US 20090221814 A1 · SU 914670 A
 (57) Abstract:

According to the present invention, a feeding arrangement (20; 40) for feeding lignocellulosic biomass material such as annual plant material to a hydrolysis process comprises at least one transportation device (24, 25; 41) for transporting the biomass material towards the treatment process; and at least one tearing roll (27; 47; 47a, 47b; 77; 87) arranged at a predetermined distance from the at least one transportation device (24, 25; 41) and being provided with tearing protrusions, the at least one tearing roll (27; 47; 47a, 47b; 77; 87) being arranged with a predetermined distance to the at least one transportation device (24, 25; 41) to tear off parts of the transported material to provide a substantially continuous flow of material.

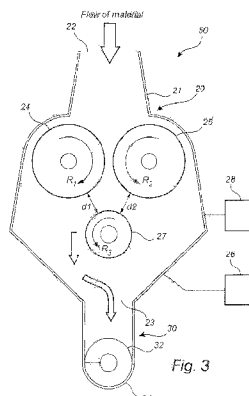

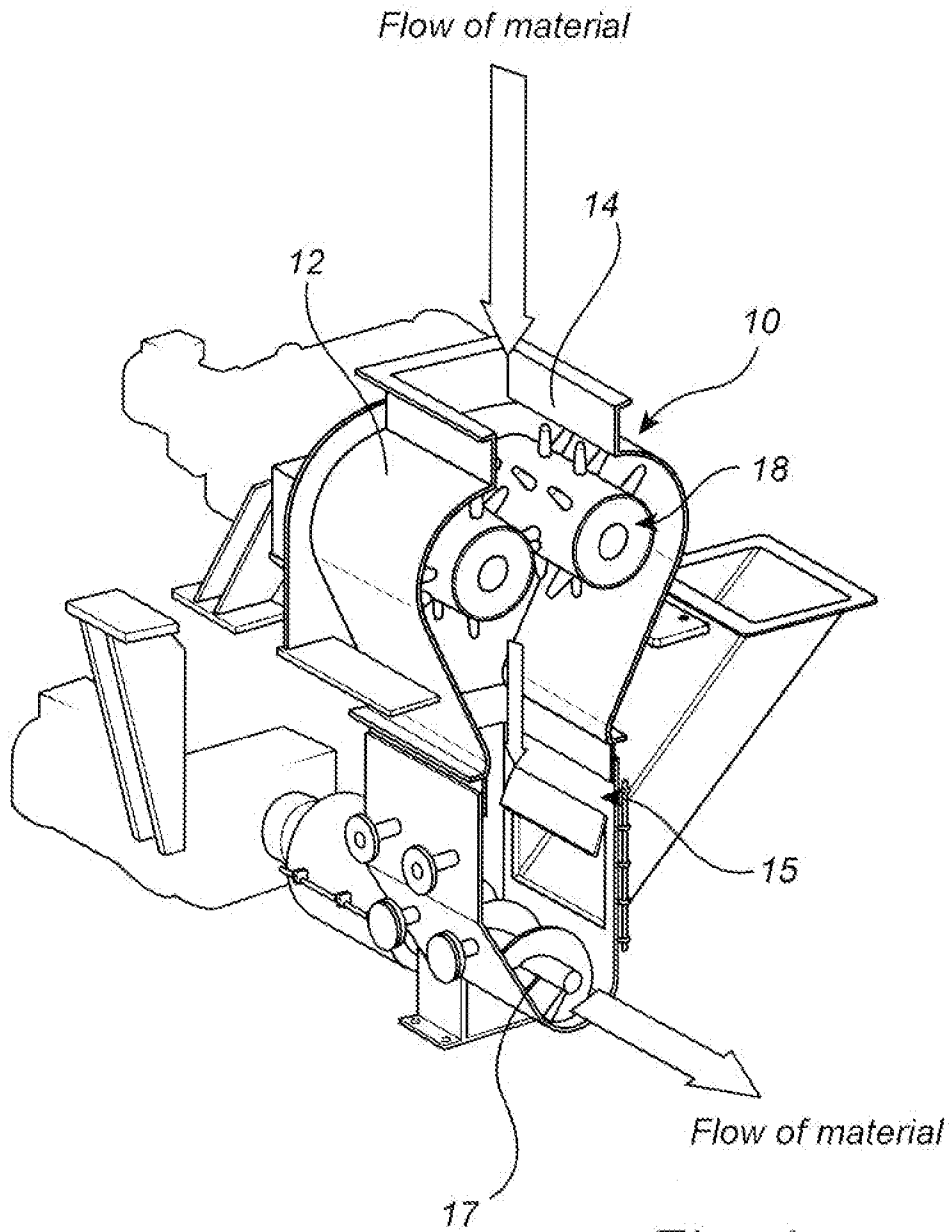

Fig. 1

2/7

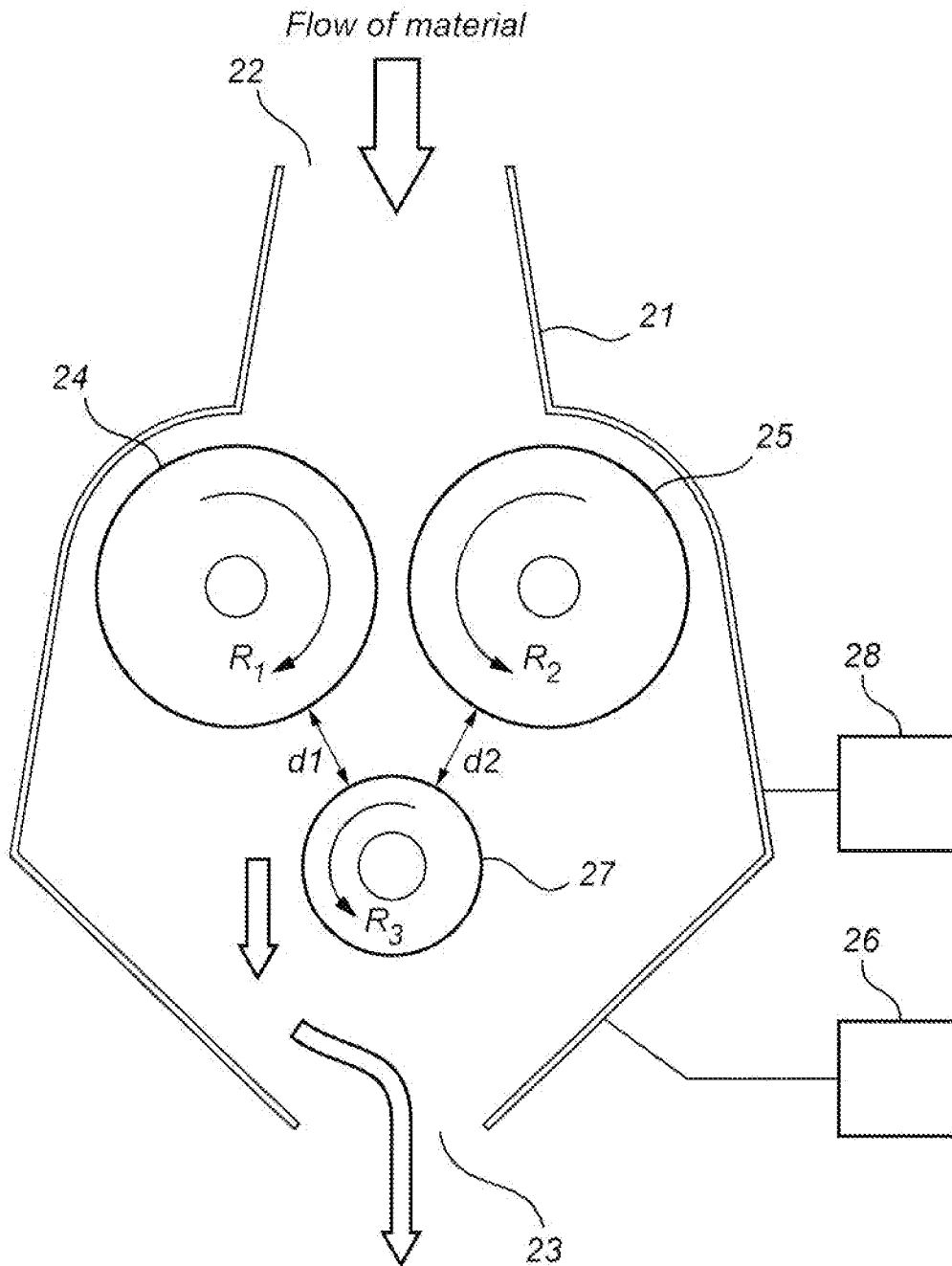
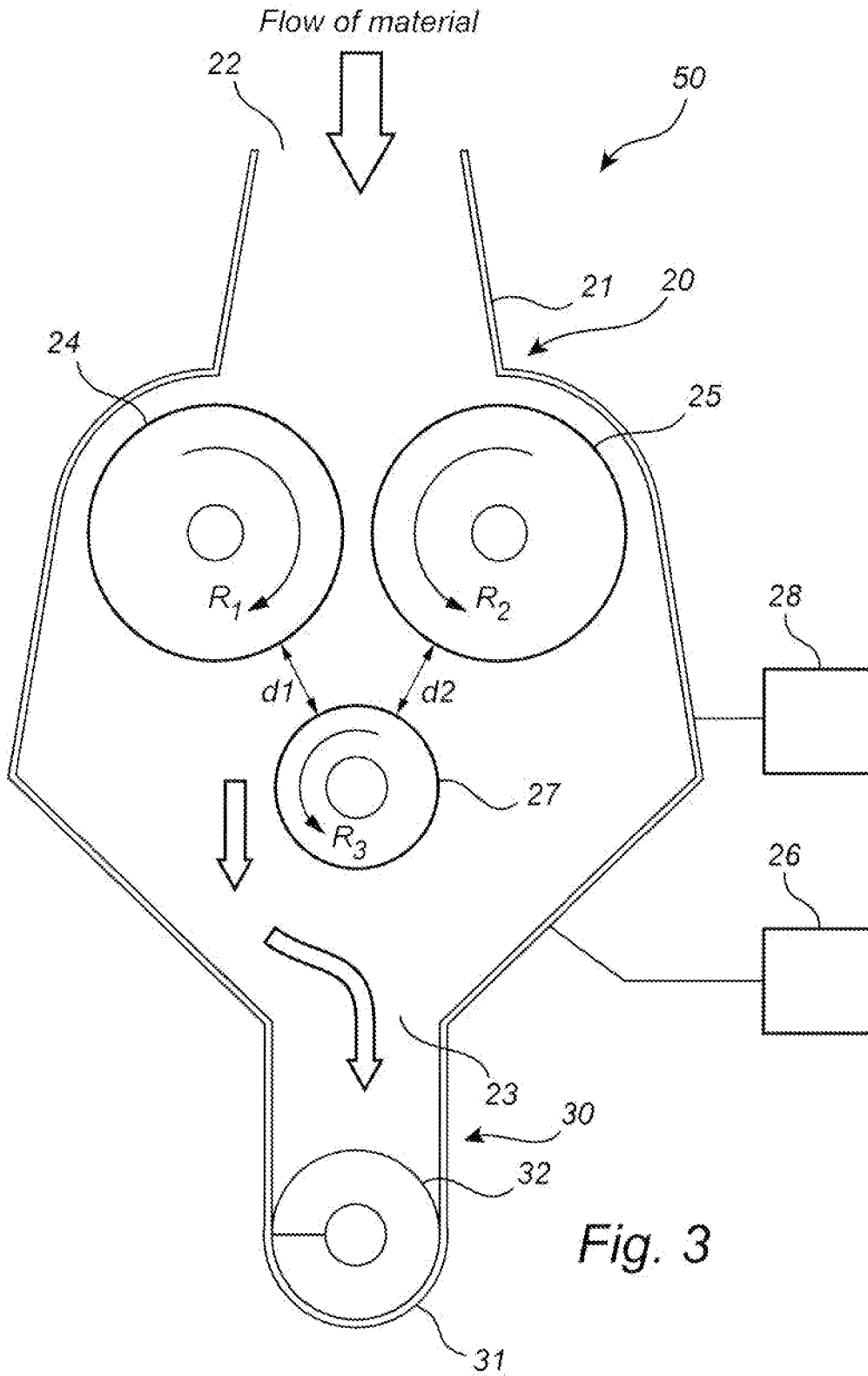

Fig. 2



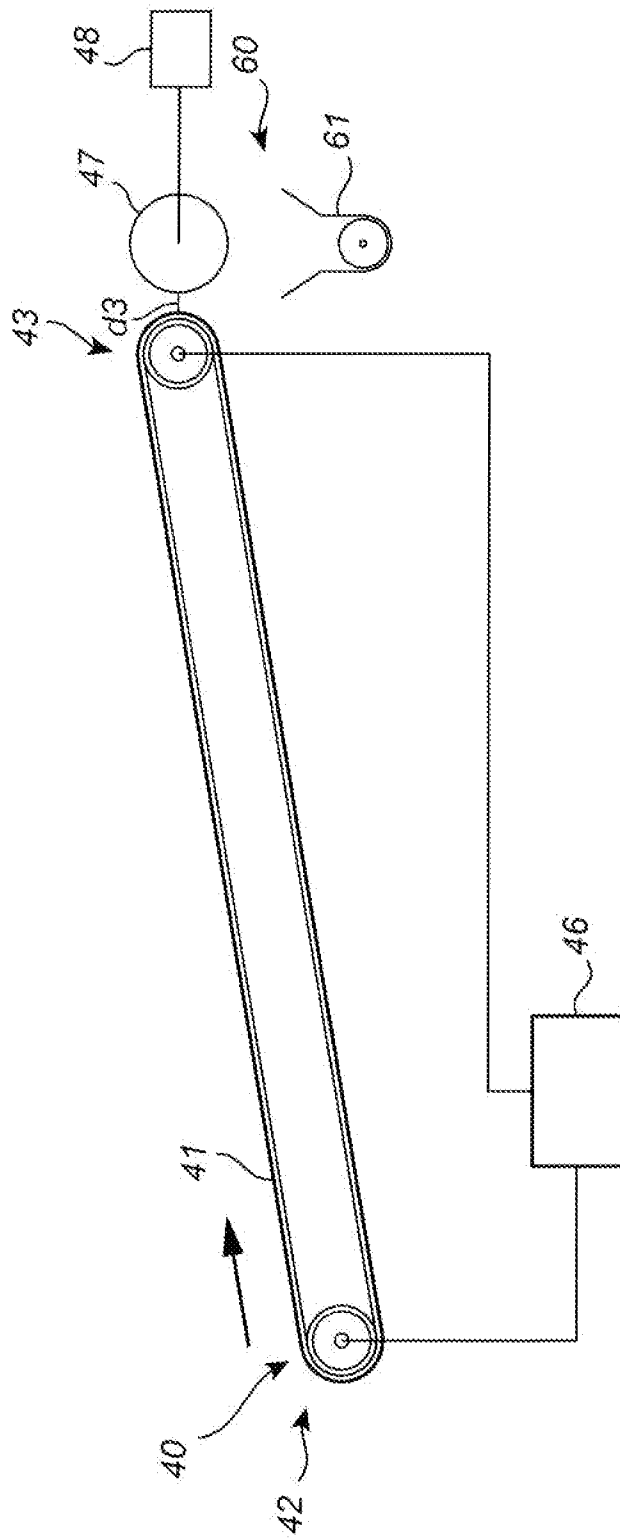

Fig. 4

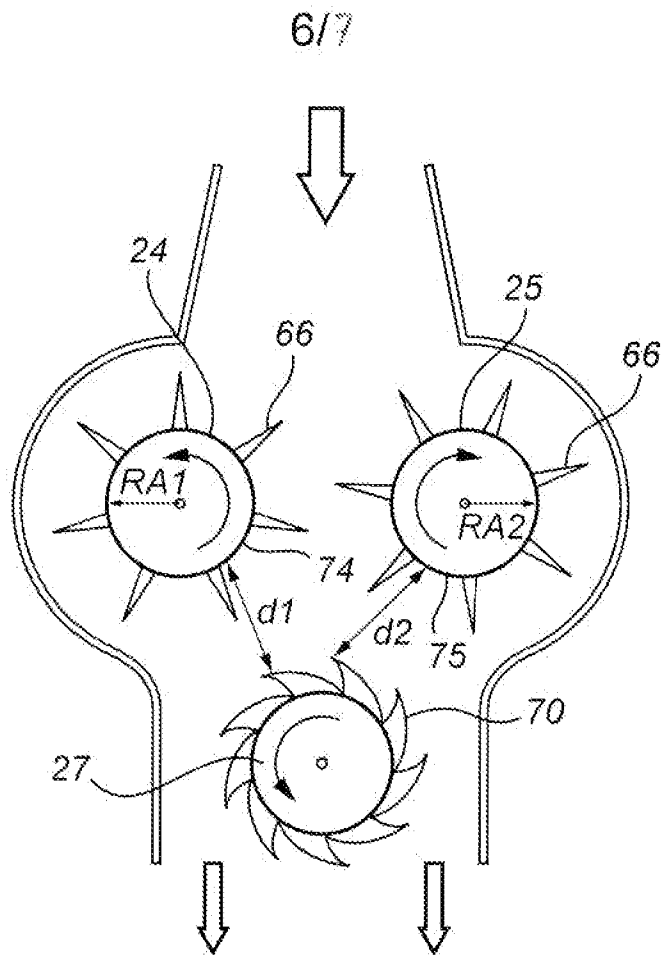

Fig. 6

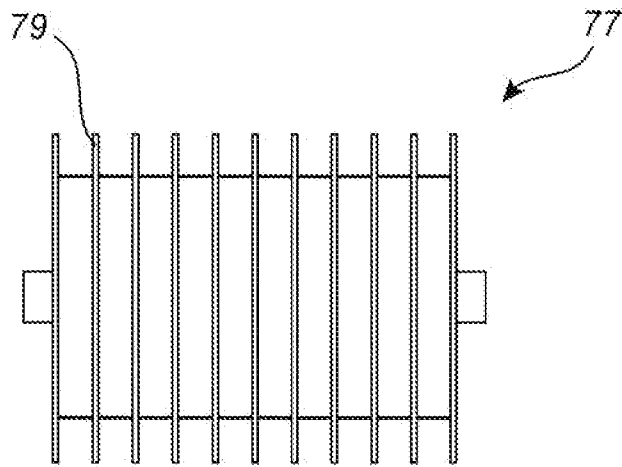

Fig. 7

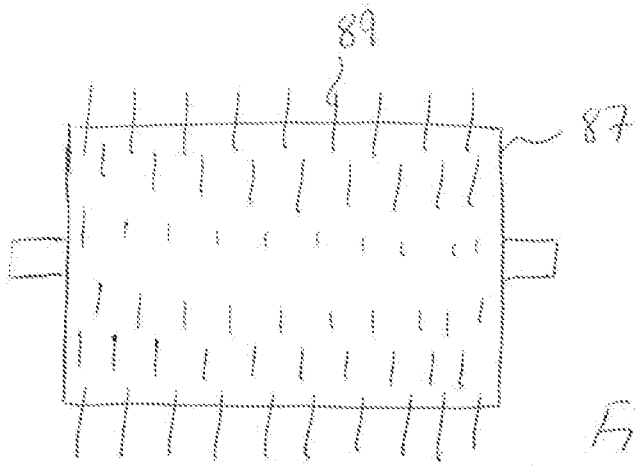

Fig. 8a

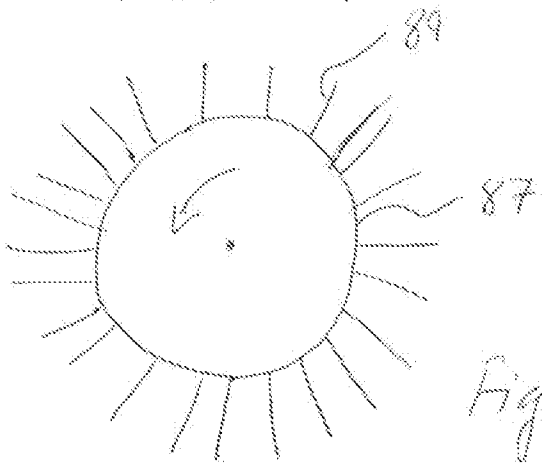

Fig. 8b