



(11) **EP 2 573 224 A3**

(12) **EUROPEAN PATENT APPLICATION**

(88) Date of publication A3:
17.06.2015 Bulletin 2015/25

(51) Int Cl.:
B65H 51/22 (2006.01) D01H 13/04 (2006.01)

(43) Date of publication A2:
27.03.2013 Bulletin 2013/13

(21) Application number: **12173362.0**

(22) Date of filing: **25.06.2012**

(84) Designated Contracting States:
AL AT BE BG CH CY CZ DE DK EE ES FI FR GB GR HR HU IE IS IT LI LT LU LV MC MK MT NL NO PL PT RO RS SE SI SK SM TR
Designated Extension States:
BA ME

(72) Inventors:
• **Akimoto, Masahiro**
Kyoto 612-8686 (JP)
• **Oka, Masaki**
Kyoto 612-8686 (JP)

(30) Priority: **20.09.2011 JP 2011205331**

(74) Representative: **Stöckeler, Ferdinand et al**
Schoppe, Zimmermann, Stöckeler
Zinkler, Schenk & Partner mbB
Patentanwälte
Radtkoferstrasse 2
81373 München (DE)

(71) Applicant: **Murata Machinery, Ltd.**
Minami-ku
Kyoto-shi
Kyoto 601-8326 (JP)

(54) **Spinning unit and spinning device**

(57) A spinning unit includes a yarn supplying device that supplies a spun yarn (Y), a winding device that winds the spun yarn (Y) into a package, a yarn accumulating device (50) that accumulates the spun yarn (Y) between the yarn supplying device and the winding device, and a yarn movement control member (75) arranged between the yarn supplying device and the yarn accumulating device (50), and adapted to guide the spun yarn (Y) to the yarn accumulating device (50) while applying tension to the spun yarn (Y), and to restrict movement of the spun yarn (Y) upon disconnection of the spun yarn (Y) at the yarn supplying device such that a yarn end of the spun yarn (Y) is prevented from being displaced from a yarn path of the spun yarn (Y) guided to the yarn accumulating device (50).

FIG. 3

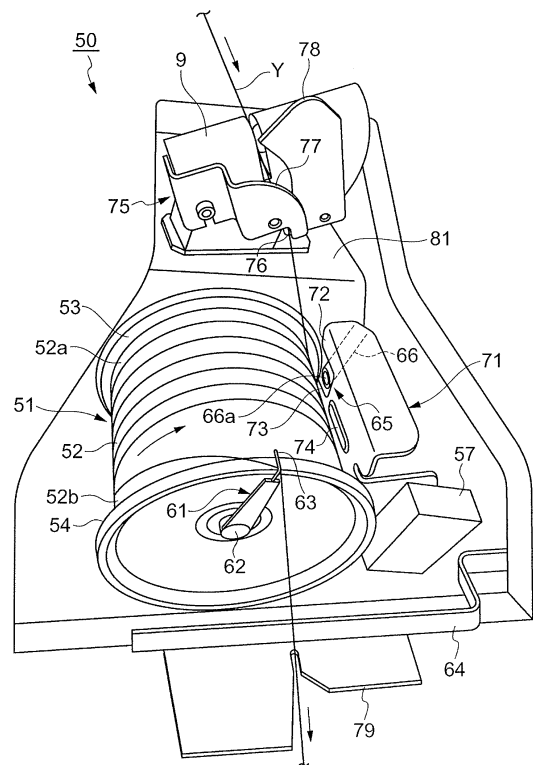

EP 2 573 224 A3



EUROPEAN SEARCH REPORT

Application Number
EP 12 17 3362

5

10

15

20

25

30

35

40

45

50

55

DOCUMENTS CONSIDERED TO BE RELEVANT			
Category	Citation of document with indication, where appropriate, of relevant passages	Relevant to claim	CLASSIFICATION OF THE APPLICATION (IPC)
X A	EP 1 407 995 A2 (MURATA MACHINERY LTD [JP]) 14 April 2004 (2004-04-14) * paragraph [0018] - paragraph [0022] * * figures 3-6 *	1,8,9, 12-14 2-7,10	INV. B65H51/22 D01H13/04
X A	EP 1 457 448 A2 (MURATA MACHINERY LTD [JP]) 15 September 2004 (2004-09-15) * paragraph [0041] - paragraph [0042] * * paragraph [0071] - paragraph [0072] * * figures 1, 8 *	1,8,9, 11-14 2-7,10	
Y Y,D	EP 2 298 971 A1 (MURATA MACHINERY LTD [JP]) 23 March 2011 (2011-03-23) * paragraph [0022] - paragraph [0029] * * figures 4, 5 * & JP 2011 037572 A (MURATA MACHINERY LTD) 24 February 2011 (2011-02-24) * abstract; figures 4, 5 *	1-14 1-14	
Y	JP 2001 159039 A (MURATA MACHINERY LTD) 12 June 2001 (2001-06-12) * paragraph [0037] * * figures 1-6 *	1-14	
The present search report has been drawn up for all claims			TECHNICAL FIELDS SEARCHED (IPC) D01H B65H
Place of search Munich		Date of completion of the search 11 May 2015	Examiner Hausding, Jan
CATEGORY OF CITED DOCUMENTS X : particularly relevant if taken alone Y : particularly relevant if combined with another document of the same category A : technological background O : non-written disclosure P : intermediate document		T : theory or principle underlying the invention E : earlier patent document, but published on, or after the filing date D : document cited in the application L : document cited for other reasons & : member of the same patent family, corresponding document	

1
EPO FORM 1503 03.82 (P04C01)

ANNEX TO THE EUROPEAN SEARCH REPORT
ON EUROPEAN PATENT APPLICATION NO.

EP 12 17 3362

5

This annex lists the patent family members relating to the patent documents cited in the above-mentioned European search report. The members are as contained in the European Patent Office EDP file on
The European Patent Office is in no way liable for these particulars which are merely given for the purpose of information.

11-05-2015

10

Patent document cited in search report	Publication date	Patent family member(s)	Publication date
EP 1407995 A2	14-04-2004	CN 1497075 A	19-05-2004
		CN 101033566 A	12-09-2007
		EP 1407995 A2	14-04-2004
		JP 4048902 B2	20-02-2008
		JP 2004124333 A	22-04-2004

EP 1457448 A2	15-09-2004	CN 1530478 A	22-09-2004
		EP 1457448 A2	15-09-2004
		JP 3700706 B2	28-09-2005
		JP 2004277031 A	07-10-2004

EP 2298971 A1	23-03-2011	CN 101994174 A	30-03-2011
		EP 2298971 A1	23-03-2011
		JP 2011037572 A	24-02-2011

JP 2001159039 A	12-06-2001	NONE	

15

20

25

30

35

40

45

50

55

EPO FORM P0459

For more details about this annex : see Official Journal of the European Patent Office, No. 12/82