

# HENRY BAKER'S

## COMBINED BOLT and LATCH.

Assignor to Self and C. G. Herr.

73491

PATENTED  
JAN 21 1868

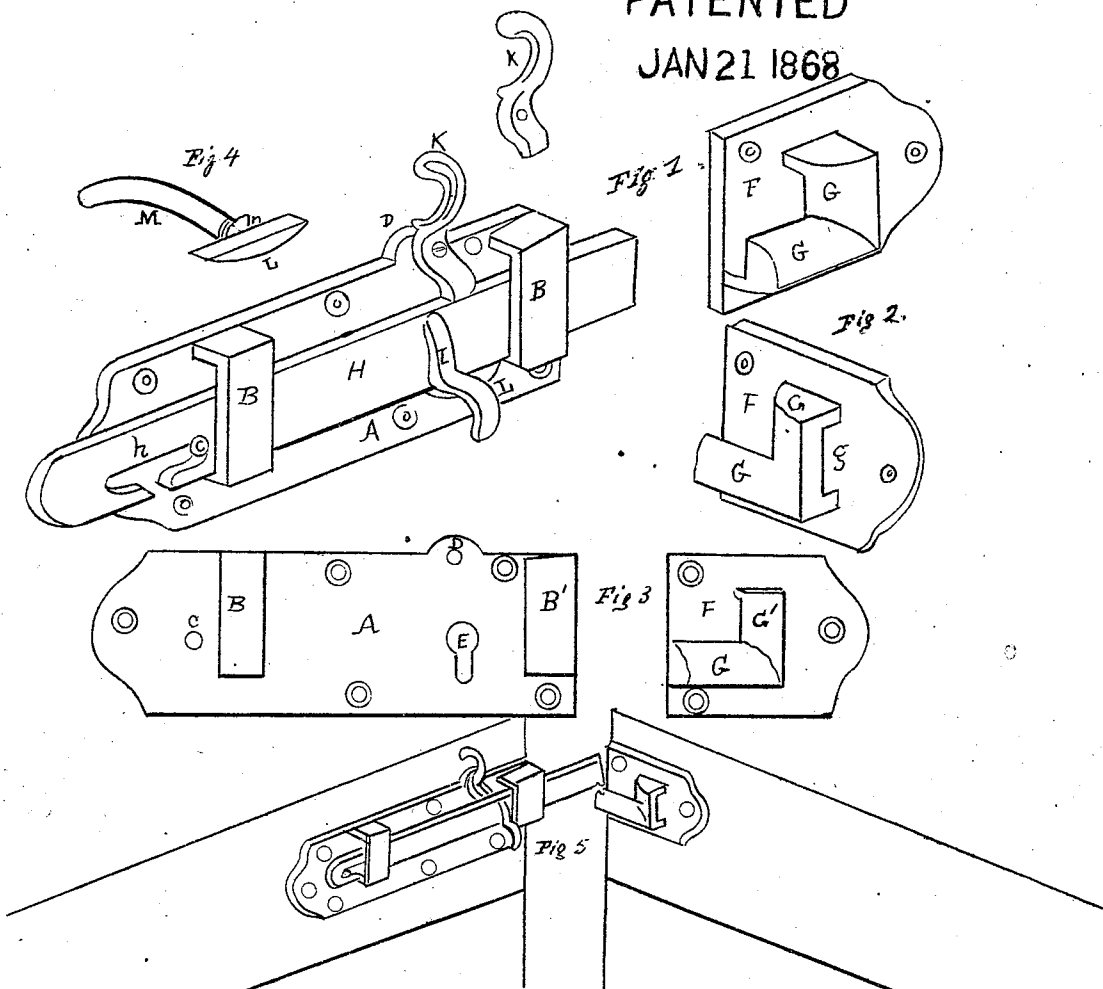

Witness at Signing  
*Wm B. Wiley*  
*Jacob Hanfer*

Signed by.  
*Henry Baker.*

# United States Patent Office.

HENRY BAKER, OF LANCASTER, PENNSYLVANIA, ASSIGNOR TO HIMSELF  
AND CHRISTIAN G. HERR, OF SAME PLACE.

Letters Patent No. 73,491, dated January 21, 1868.

## IMPROVED BOLT-LATCH.

The Schedule referred to in these Letters Patent and making part of the same.

### TO ALL WHOM IT MAY CONCERN:

Be it known that I, HENRY BAKER, of Lancaster, in the county of Lancaster, and State of Pennsylvania, have invented a new and improved Combined Bolt and Latch; and I do hereby declare that the following is a full and exact description thereof, reference being had to the accompanying drawings, making a part of this specification, in which—

Figure 1 is a perspective view of the bolt and counterpart.

Figure 2 a back view of right-angled slide and socket-chamber or counterpart, to show the vertical lock-portion, G', with the open slot *g*, and the horizontal slide-portion G, forming the latching inclined plane and slide-guide for bolting.

Figure 3 shows the single castings of the surface-plates A F, the other parts removed.

Figure 4 the outside latch-lever or turn-handle M L, when used for a gate or door-bolt and latch.

Figure 5 illustrates how to hold shutters bowed or partly open.

The nature of my invention consists in the construction and arrangement of the parts, to admit casting and putting together without labor in fitting up, and to put into market a strong, secure shutter-bolt, which can be simply closed by latching, or firmly bolted, and the bolt locked, at the same time, by the application of a single piece, fig. 4, to make a superior bolt and latch combined, for doors and gates.

To enable others skilled in the art to make and use my invention, I will proceed to describe its construction and operation

The surface-plates A F are cast each in a single piece, with the parts shown, A with the bridge-plates B B, through which the bolt H slides, the round pin C, rounded ear D, for the lock-lever K. When intended for a gate or door to be opened from the outside as a latch, then the hole E, with its lower elongation, may be made in the casting, (or drilled out afterwards,) as also the places for the screws. The receiving-section of the bolt F, provided with the horizontal open slot G, and the vertical perforated catch or lock G', as clearly shown, a combined at right angles with a rounded bevel face. The bolt H has a handle, I, and an open slot, *h*, with a recess for the pin *c*, on the surface-plate A. The lock-lever K is a separate piece, as is also the latch-lever M, with the rocker L and narrowed neck *m*. To fit it up for a door-latch, the bolt H, with its slotted end, is thrust through the keeper or bridge B, and the pin *c* entered through the opening in the slot *h*, below, when the forward end (being also previously slid forward under the keeper B') can be raised up, so as to allow the round end of the latch-lever to be passed outwards through the upper large hole of E, and the neck *m* slid down in the prolongation, with the straight side of the rocker L, so as to come under the edge of the bolt, face to face, in a line with the lower inner sides of the keepers B B' in which the bolt slides. The recess in the slot *h* of the bolt is sufficient to keep the bolt in place as a latch, which now only rests in the horizontal portion G of section F. By turning the latch-lever M either way on the outside, it raises the bolt on its pivot *c*, in the recess aforesaid, and the door or gate opens. By simply pushing it against the rounded bevelled edge, the bolt rises in closing the door, and drops in place. As a bolt and latch to a shutter not to be operated from the outside, the latch-lever can be dispensed with. If it is desirable to bow the shutters and retain them so, it is only necessary to file a notch into the forward lower side of the bolt, and make a corresponding groove or notch in the forward portion of G, and pushing the bolt out the entire length, and putting down the lock-lever K, (which lever also effectually locks the bolt when thrust into the lock-slot in G', and affords additional security.)

Altogether, it forms a strong, simple, and desirable combination, and when introduced to the trade, cannot fail to be appreciated.

I am aware that, separately considered, most of its features may be met with in some other bolts; but I am not aware that any combination of a bolt and latch, substantially the same, was ever before in use, arranged and operated as herein set forth and shown.

What I claim as my invention, and desire to secure by Letters Patent, is—

The arrangement and combination of a shutter-bolt, with its open slot *h*, and recess for the pin *c*, with its handle I, and horizontal and vertical bevelled latch and lock-catch G G', with or without the lock-lever K, all arranged and operated in the manner and for the purpose specified.

In combination with the foregoing arrangement, I also claim the latch-lever M, with its neck *m*, and rocker L, when applied in the manner and for the purpose shown and set forth.

HENRY BAKER.

Witnesses:

WM. B. WILEY,  
JACOB STAUFFER.