



US00RE45710E

(19) **United States**  
(12) **Reissued Patent**  
**Guimaraes**

(10) **Patent Number:** **US RE45,710 E**  
(45) **Date of Reissued Patent:** **Oct. 6, 2015**

(54) **LOCKING PIN ASSEMBLY FOR AN EXCAVATOR WEAR MEMBER**  
(71) Applicant: **CQMS Pty Ltd**, Mackay (AU)  
(72) Inventor: **Miguel Guimaraes**, Mackay (AU)  
(73) Assignee: **CQMS Pty Limited**, Queensland (AU)  
(21) Appl. No.: **29/463,598**  
(22) Filed: **Nov. 22, 2013**

#### Related U.S. Patent Documents

Reissue of:

(64) Patent No.: **Des. 634,605**  
Issued: **Mar. 22, 2011**  
Appl. No.: **29/362,308**  
Filed: **May 24, 2010**

#### Foreign Application Priority Data

(30) Dec. 11, 2009 (AU) ..... 14862/2009  
(51) **LOC (10) Cl.** ..... **08-07**  
(52) **U.S. Cl.**  
USPC ..... **D8/343**  
(58) **Field of Classification Search**  
USPC ..... D15/28; D8/343, 330, 331, 339;  
403/220, 154, 156; 37/446, 455, 456,  
37/459; 70/14, 51, 52, 57, 262, 431;  
299/102; 172/713  
See application file for complete search history.

#### References Cited

##### U.S. PATENT DOCUMENTS

3,526,435 A \* 9/1970 Krekeler ..... 299/109  
5,074,062 A \* 12/1991 Hahn et al. .... 37/456  
5,617,655 A \* 4/1997 Launder et al. .... 37/457  
5,937,550 A \* 8/1999 Emrich ..... 37/458  
5,992,063 A \* 11/1999 Mack ..... 37/450  
6,439,796 B1 \* 8/2002 Ruvang et al. .... 403/157  
6,735,890 B2 \* 5/2004 Carpenter et al. .... 37/456  
6,757,995 B2 \* 7/2004 Pippins ..... 37/468

7,162,818 B2 \* 1/2007 Ruvang et al. .... 37/456  
7,313,877 B2 \* 1/2008 Clendenning et al. .... 37/456  
D581,248 S \* 11/2008 Wu et al. .... D8/343  
7,603,799 B2 \* 10/2009 Campomanes ..... 37/456  
D614,476 S \* 4/2010 Buhse ..... D8/343  
2002/0023375 A1 \* 2/2002 Pippins ..... 37/457  
2006/0037219 A1 \* 2/2006 Robinson et al. .... 37/456  
2006/0236567 A1 \* 10/2006 Adamic ..... 37/452  
2008/0209772 A1 \* 9/2008 Cui ..... 37/456  
2009/0205228 A1 \* 8/2009 Ruvang ..... 37/456  
2010/0162595 A1 \* 7/2010 Leslie et al. .... 37/456  
2010/0170119 A1 \* 7/2010 Lopez Almendros et al. .. 37/452  
2010/0229433 A1 \* 9/2010 Leslie et al. .... 37/456

\* cited by examiner

Primary Examiner — Phillip S Hyder

(74) Attorney, Agent, or Firm — Blank Rome LLP

#### (57) CLAIM

The ornamental design for a locking pin assembly for an excavator wear member, as shown and described.

#### DESCRIPTION

FIG. 1 is a top view of a locking pin assembly for an excavator wear member showing my new design;  
FIG. 2 is a left side view thereof;  
FIG. 3 is a front view thereof;  
FIG. 4 is a right side view thereof;  
FIG. 5 is a rear view thereof;  
FIG. 6 is a bottom view thereof;  
FIG. 7 is a front perspective view thereof;  
FIG. 8 is an exploded left side view thereof;  
FIG. 9 is an exploded front lower perspective view thereof; and,  
FIG. 10 is an exploded front upper perspective view thereof.  
*The broken lines depict portions of the pocket cutter in which the design is embodied that are not considered part of the claimed design.*

#### 1 Claim, 3 Drawing Sheets

Matter enclosed in heavy brackets [ ] appears in the original patent but forms no part of this reissue; matter printed in italics indicates the additions made by reissue.

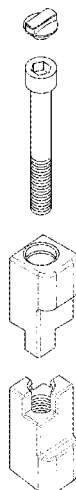

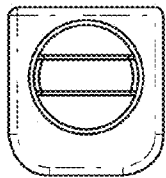

FIG. 1

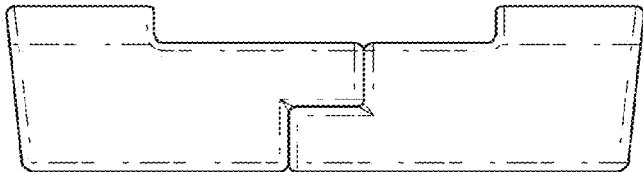

FIG. 2

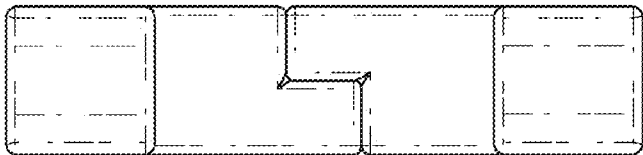

FIG. 3

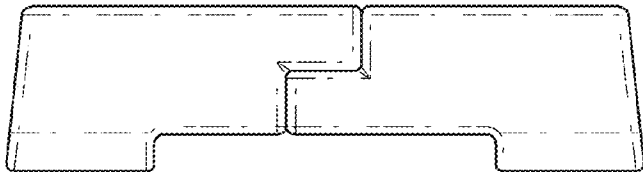

FIG. 4

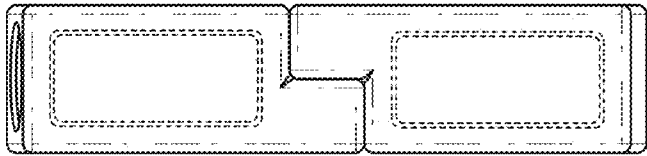
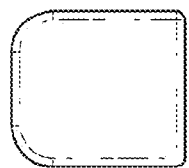
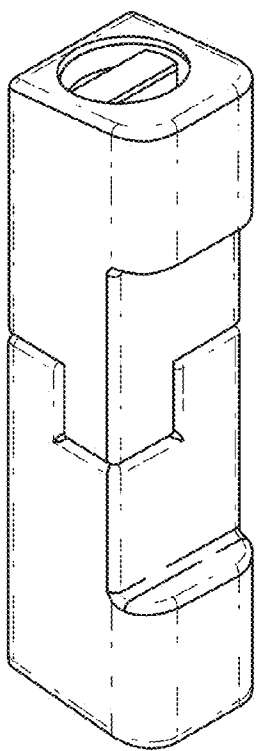

FIG. 5



**FIG. 6**



**FIG. 7**

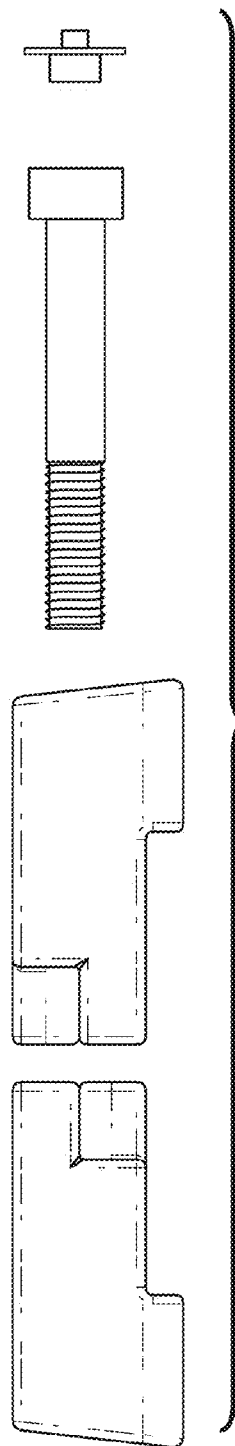

**FIG. 8**

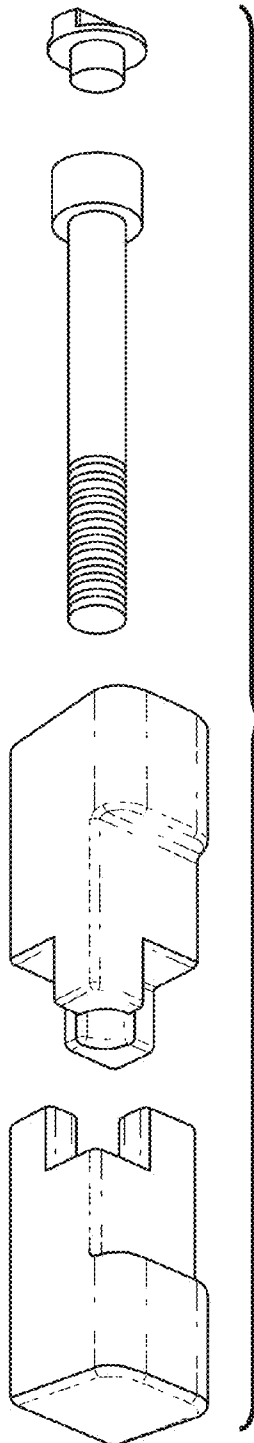

**FIG. 9**

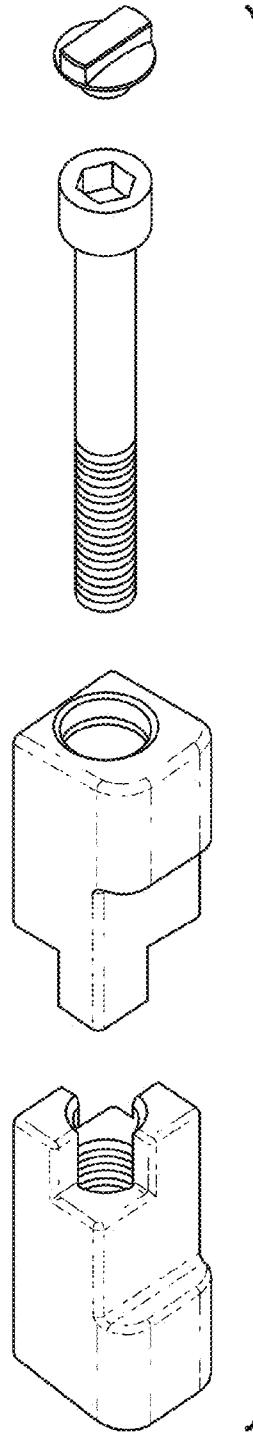

**FIG. 10**