

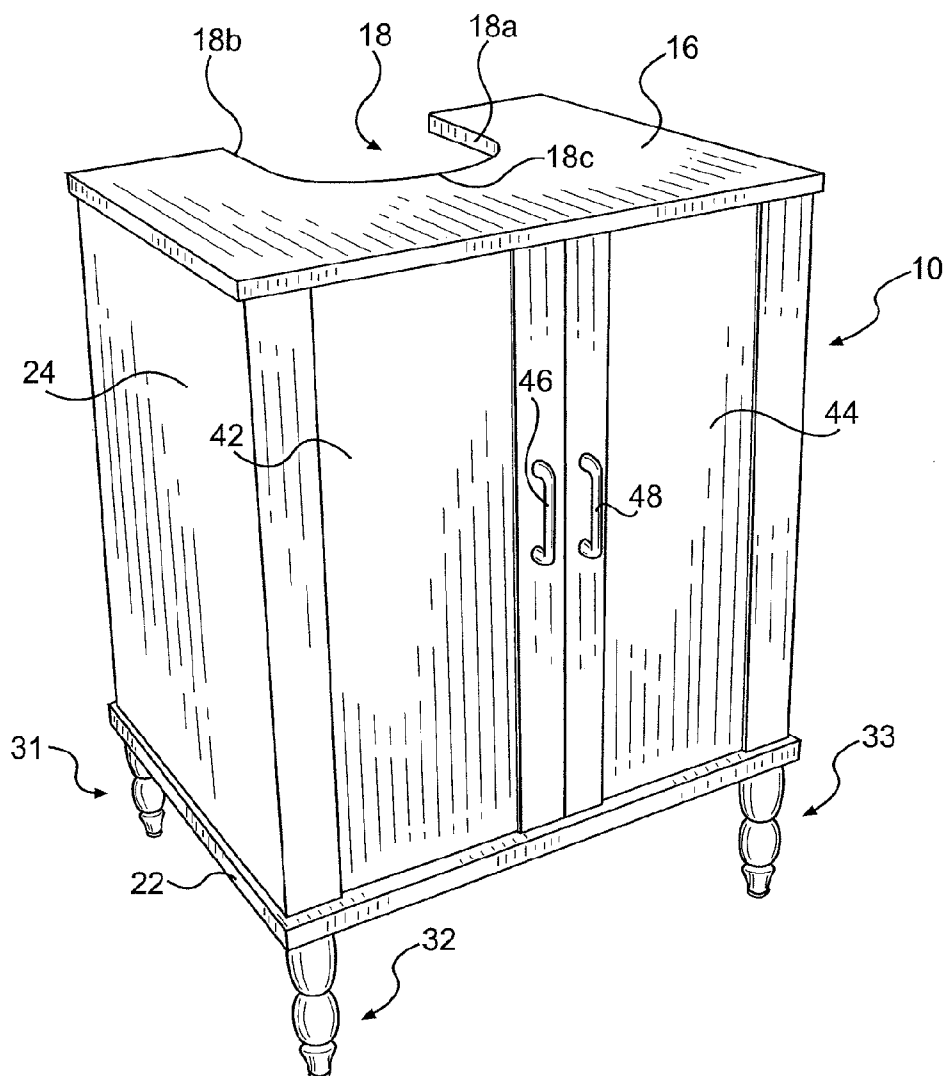

US 20100237756A1

(19) **United States**(12) **Patent Application Publication**
Weinstein(10) **Pub. No.: US 2010/0237756 A1**(43) **Pub. Date: Sep. 23, 2010**(54) **PEDESTAL VANITY****Publication Classification**(76) Inventor: **Hal Weinstein**, Alpharetta, GA
(US)(51) **Int. Cl.**
A47B 96/00 (2006.01)
A47K 1/04 (2006.01)(52) **U.S. Cl.** **312/228.1; 312/228**Correspondence Address:
BIRCH STEWART KOLASCH & BIRCH
PO BOX 747
FALLS CHURCH, VA 22040-0747 (US)(57) **ABSTRACT**(21) Appl. No.: **12/729,904**(22) Filed: **Mar. 23, 2010****Related U.S. Application Data**(60) Provisional application No. 61/162,509, filed on Mar.
23, 2009.

A pedestal vanity includes a cabinet including a base member, an upwardly projecting left side wall, an upwardly projecting right side wall and a front opening. The upwardly projecting left side wall and upwardly projecting right side wall extend upwardly from the base member and are connected to an upper surface of the cabinet. An aperture is formed in the upper surface for accommodating a pedestal of an existing sink. A storage space is formed below the upper surface by the base member, the upwardly projecting left side wall and the upwardly projecting right side wall with an open rear surface for mounting adjacent to a wall surface.



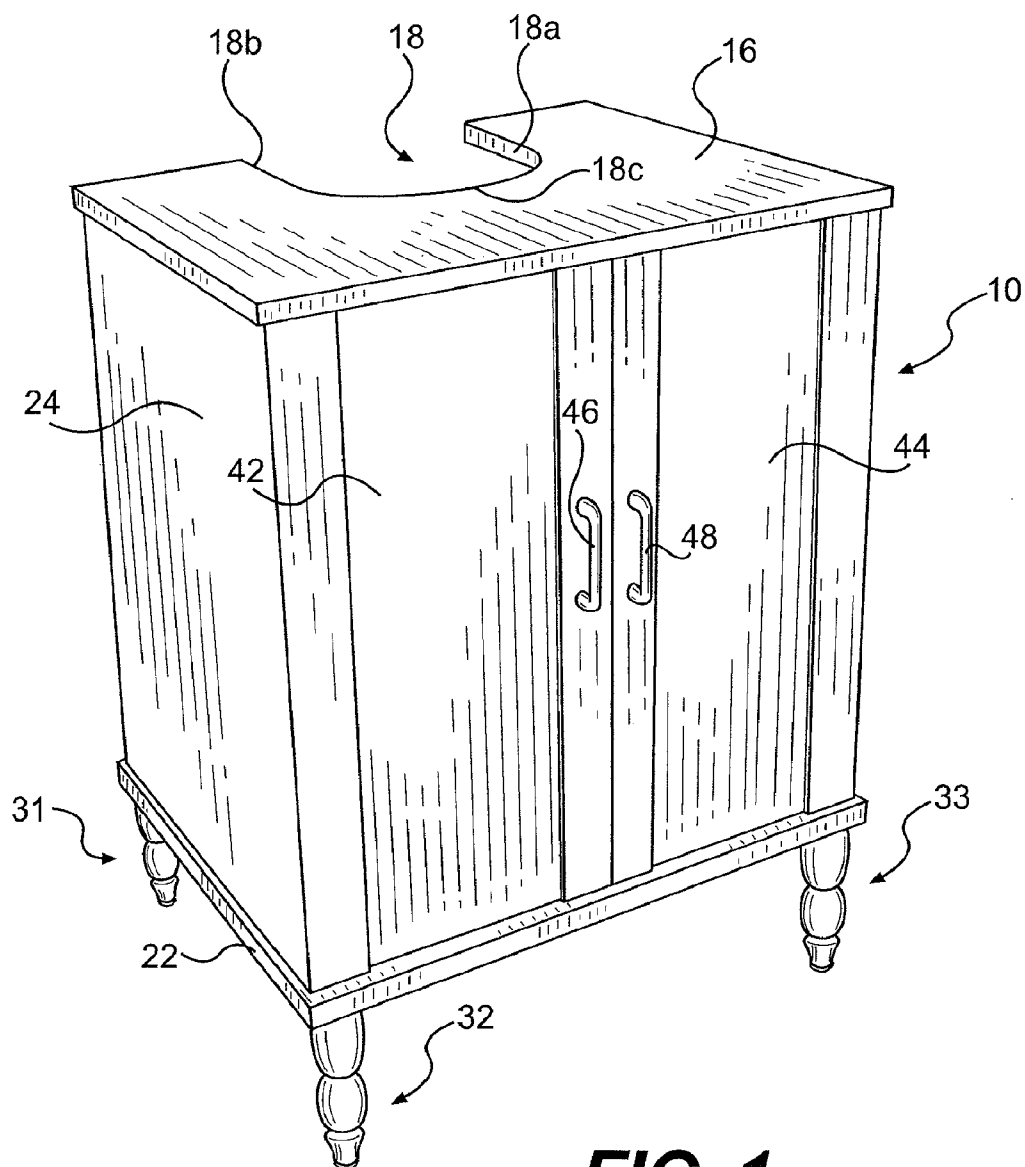

FIG. 1

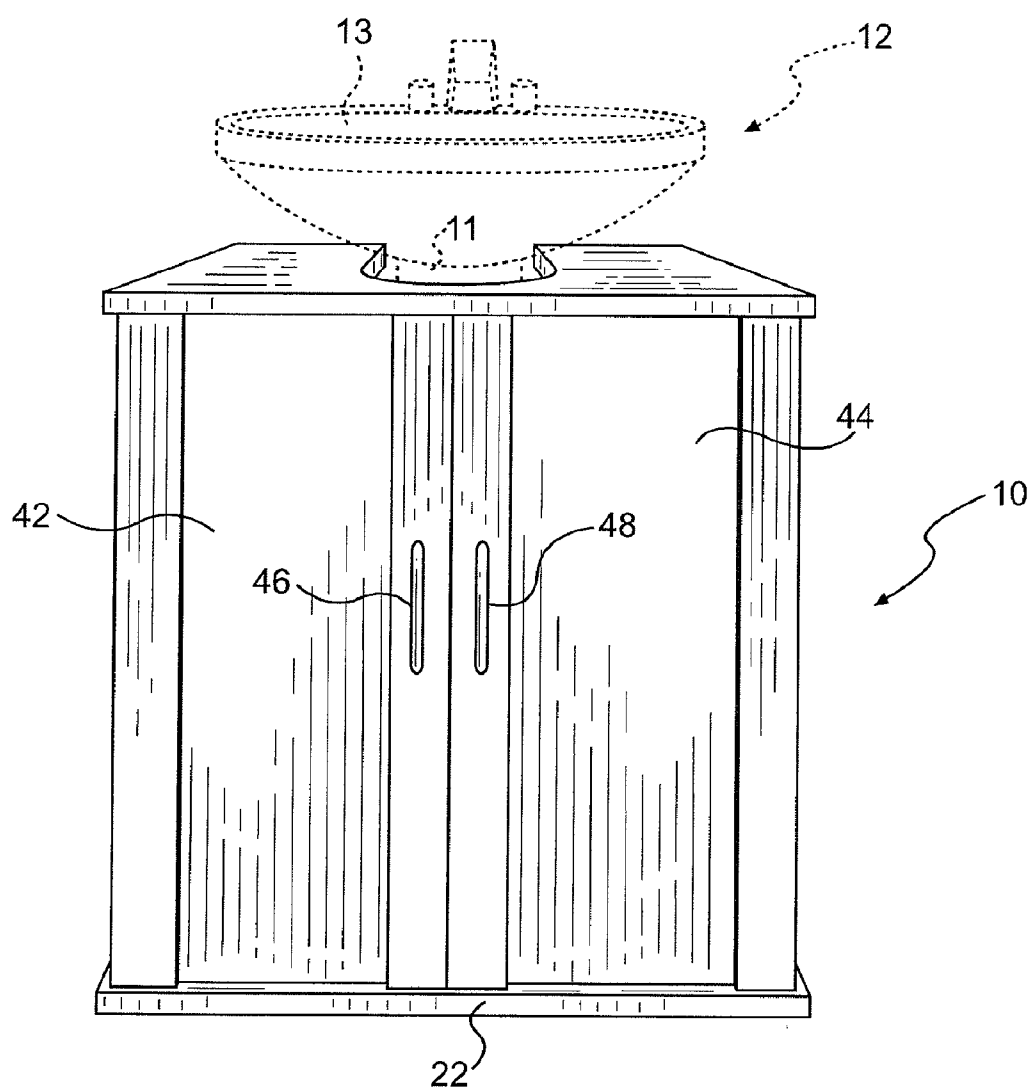

FIG. 2

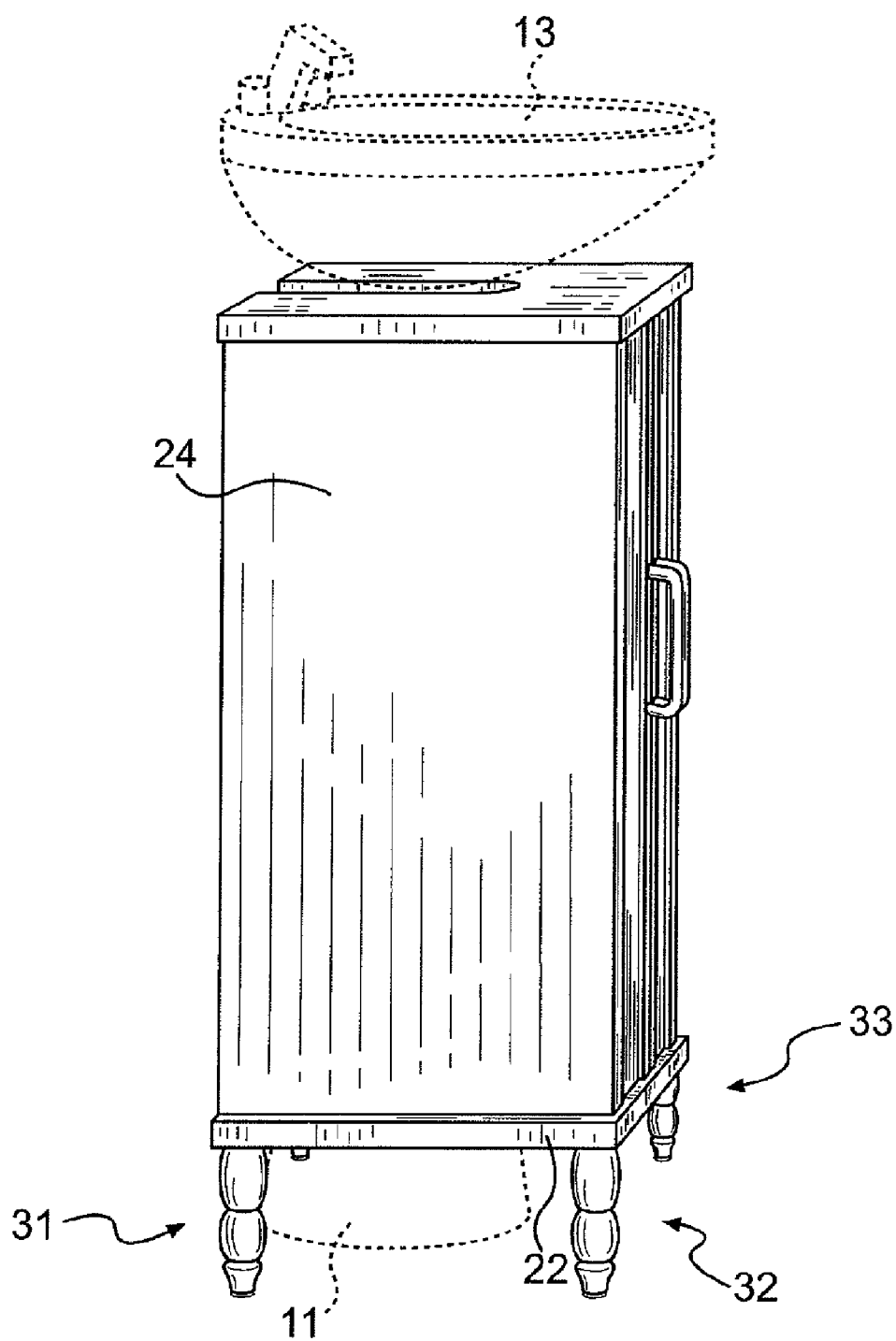

FIG. 3

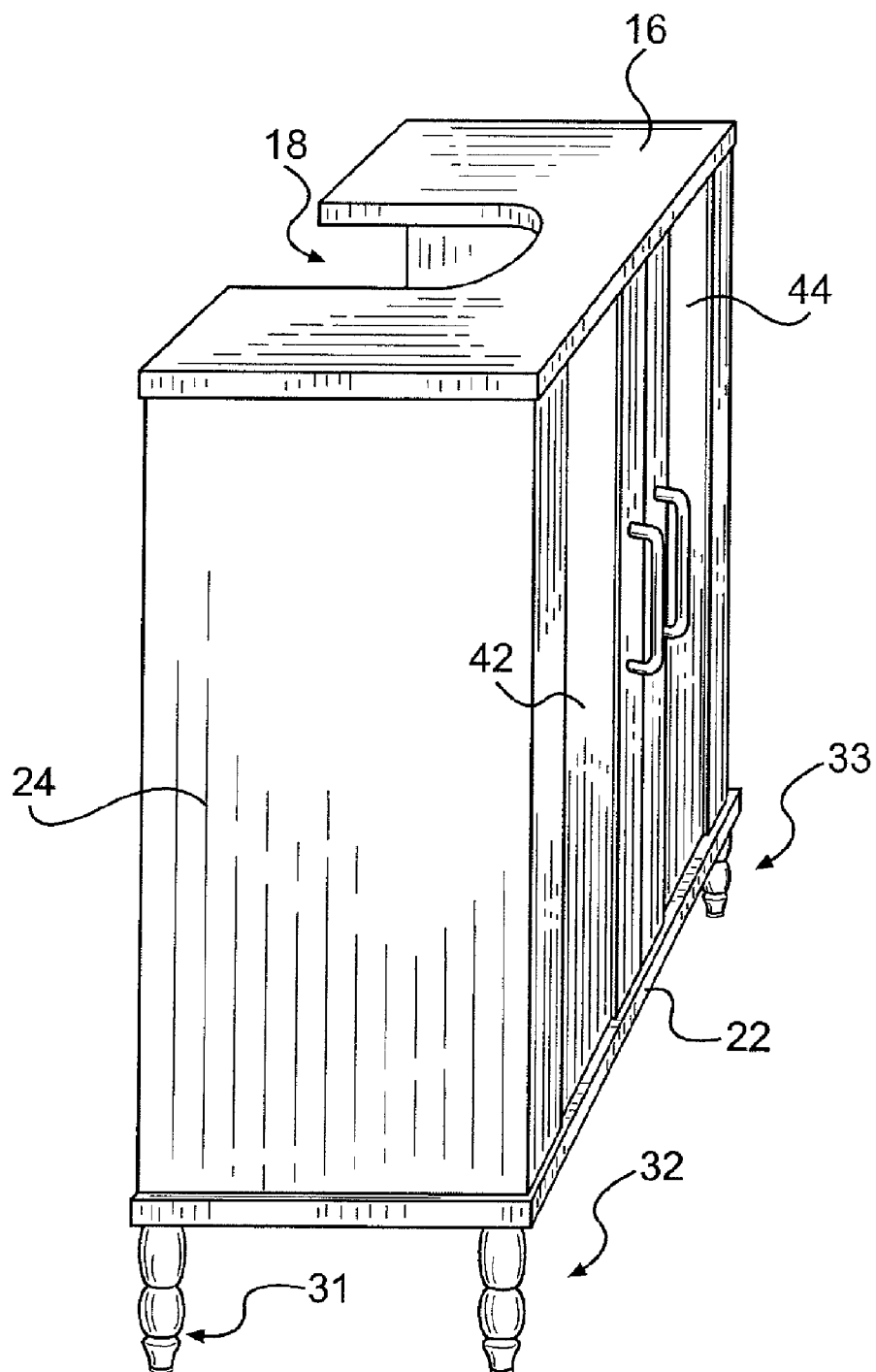

FIG. 4

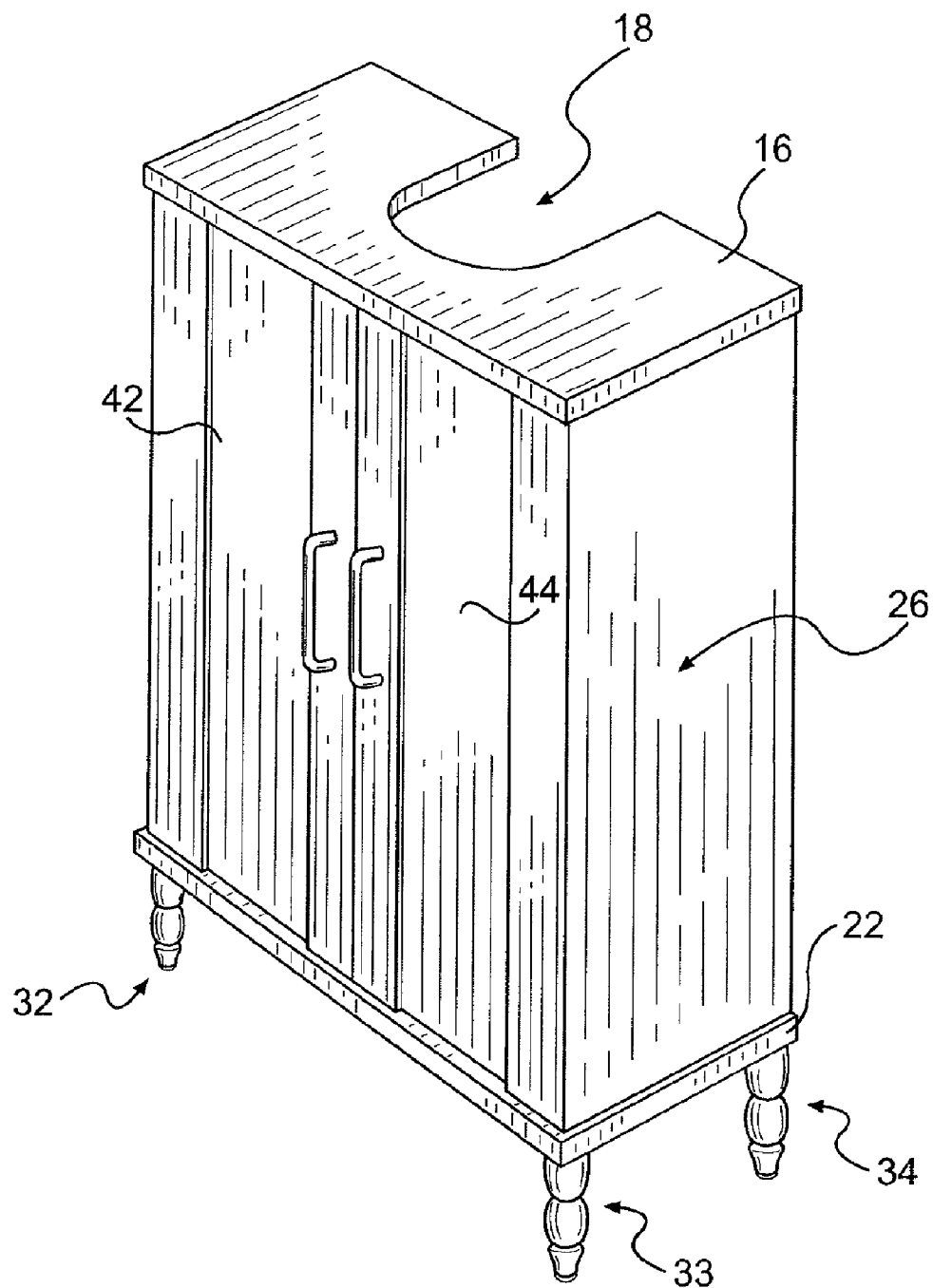

FIG. 5

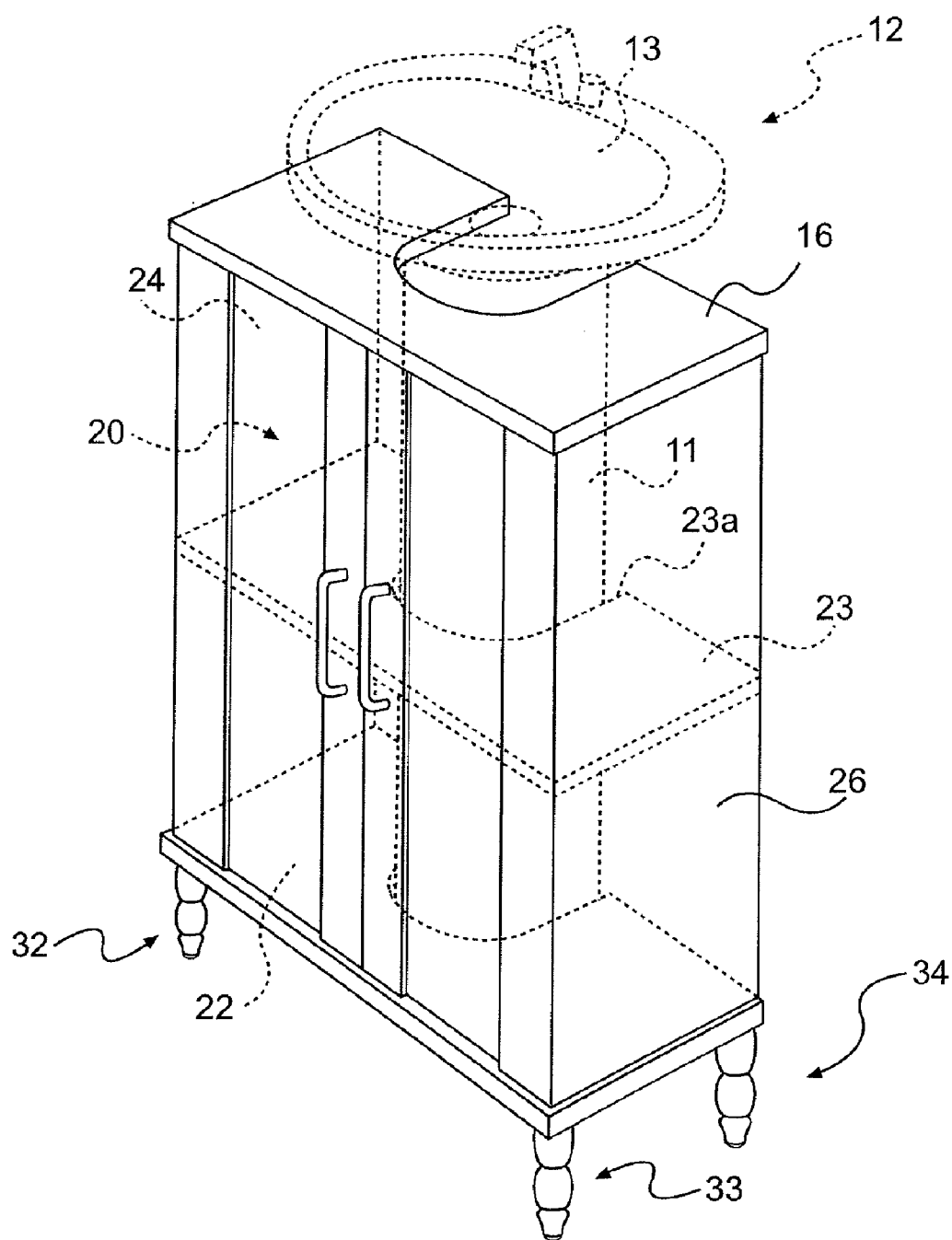

FIG. 6

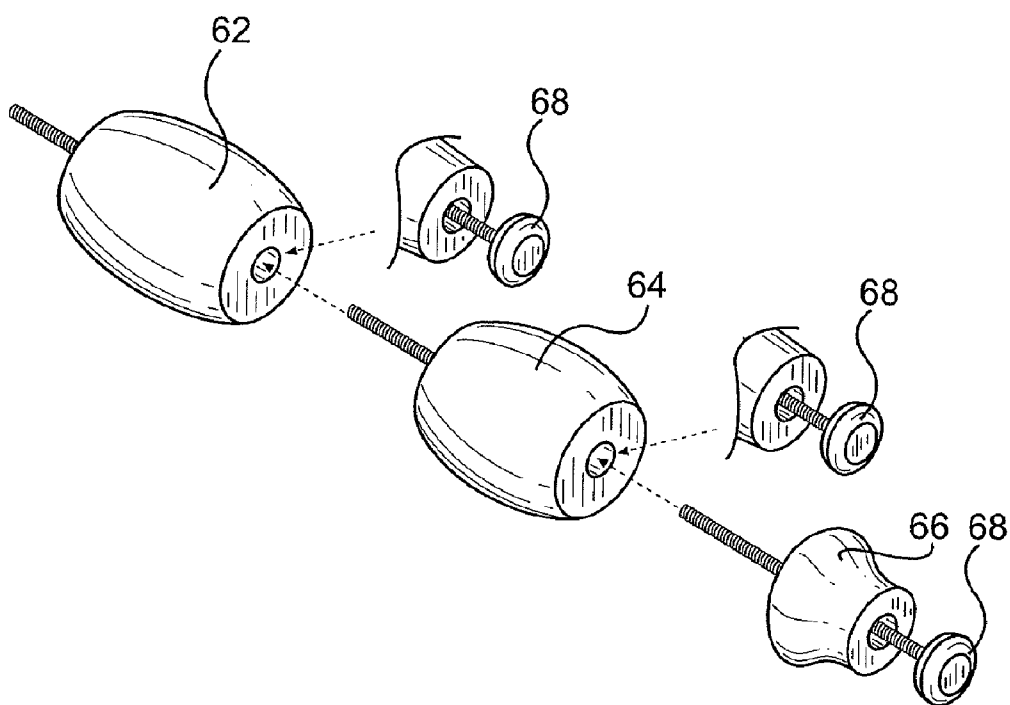

FIG. 7

PEDESTAL VANITY

CROSS-REFERENCE TO RELATED APPLICATIONS

[0001] The present application claims priority under 35 USC 119(e) to Provisional Patent Application No. 61/162,509 filed on Mar. 23, 2009 the entire contents of which are hereby incorporated by reference.

BACKGROUND OF THE INVENTION

[0002] 1. Field of the Invention

[0003] A pedestal vanity for mounting adjacent to an existing pedestal sink for providing a home owner with additional space for accommodating storage.

[0004] 2. Description of Background Art

[0005] Many half baths (powder rooms) and bathrooms have one or more pedestal lavatories which limit the amount of storage capacity in the bathroom.

SUMMARY AND OBJECTS OF THE INVENTION

[0006] In order to alleviate the inconvenience caused by the use of a pedestal in a half bath or bathroom, the present invention was conceived and developed for a pedestal vanity cabinet.

[0007] According to an embodiment of the present invention, a pedestal vanity includes a cabinet having an upper surface with an aperture in the upper surface for accommodating a pedestal of an existing sink. A storage space is disposed below the upper surface.

[0008] According to an embodiment of the present invention, the cabinet includes a base member with an upwardly projecting left side wall and an upwardly projecting right side wall that form a front opening. The upwardly projecting left side wall and upwardly projecting right side wall extending upwardly from the base member and are connected to the upper surface.

[0009] According to an embodiment of the present invention, at least one door is positioned to close the front opening for providing a closure for the storage space.

[0010] According to an embodiment of the present invention, the aperture is a substantially semi-circular aperture for accommodating the pedestal of an existing sink to provide a predetermined space for enabling the upper surface to be disposed directly below a bowl of the pedestal of an existing sink.

[0011] According to an embodiment of the present invention, a rearwardly extending opening is formed to mate with the substantially semi-circular aperture for extending the aperture in the upper surface to project rearwardly for enabling the upper surface to engage a wall surface while the aperture accommodates the pedestal of an existing sink.

[0012] According to an embodiment of the present invention, the base member is designed to be seated directly on a floor surface.

[0013] According to an embodiment of the present invention, the base member includes four corners and further includes adjusting members disposed adjacent to each of the four corners for leveling the pedestal vanity relative to a floor surface.

[0014] According to an embodiment of the present invention, the base member includes four corners and further

includes legs disposed adjacent to each of the four corners for adjusting a height of the pedestal vanity relative to a bowl of an existing sink.

[0015] Further scope of applicability of the present invention will become apparent from the detailed description given hereinafter. However, it should be understood that the detailed description and specific examples, while indicating preferred embodiments of the invention, are given by way of illustration only, since various changes and modifications within the spirit and scope of the invention will become apparent to those skilled in the art from this detailed description.

BRIEF DESCRIPTION OF THE DRAWINGS

[0016] The present invention will become more fully understood from the detailed description given hereinbelow and the accompanying drawings which are given by way of illustration only, and thus are not limitative of the present invention, and wherein:

[0017] FIG. 1 is a front elevational view of an embodiment of the present invention wherein the pedestal vanity is positioned on legs;

[0018] FIG. 2 is a front elevational view of an embodiment of the present invention wherein the pedestal vanity is positioned directly on the floor of a half bath or bathroom;

[0019] FIG. 3 is a side elevational view of the embodiment of the present invention wherein the pedestal vanity is positioned on legs with the pedestal sink being illustrated in broken lines;

[0020] FIG. 4 is a left front perspective view of the present invention wherein the pedestal vanity is positioned on legs;

[0021] FIG. 5 is a front right perspective view of the present invention wherein the pedestal vanity is positioned on legs;

[0022] FIG. 6 is a front right perspective view of the present invention wherein internal shelves of the pedestal vanity and the pedestal sink are illustrated in broken lines; and

[0023] FIG. 7 is an exploded view of the legs members illustrating that various heights of the pedestal vanity may be achieved by utilizing the leg members and the adjustment foot in various arrangements.

DETAILED DESCRIPTION OF THE PREFERRED EMBODIMENTS

[0024] FIGS. 1-6 are various views of the present invention wherein a pedestal vanity 10 may be positioned on legs 31-34 for adjusting the height of an upper surface 16 of the pedestal vanity 10 relative to the pedestal 11 of an existing sink 12. As illustrated in FIG. 2, the pedestal vanity 10 may be positioned directly on a floor surface of a half bath or bathroom.

[0025] The pedestal vanity 10 includes a cabinet having an upper surface 16 with an aperture 18 cut into the upper surface 16 for accommodating a pedestal 11 portion of an existing sink 12 that includes a sink bowl 13.

[0026] A storage space 20 is disposed below the upper surface 16 and is formed by a base member 22, an upwardly projecting left side wall 24 and an upwardly projecting right side wall 26. A front opening is formed by the base member 22, the upwardly projecting left side wall 24 and upwardly projecting right side wall 26 that is closed by doors 42, 44. The upwardly projecting left side wall 24 and upwardly projecting right side wall 26 extending upwardly from the base member 22 and are connected to the upper surface 16.

[0027] The doors 42, 44 include handles 46, 48 for permitting an individual to open the front of the pedestal vanity 10 to gain access to and to provide a closure for the storage space 20.

[0028] As illustrated in FIGS. 1 and 3-5, the aperture 18 is a substantially semi-circular aperture 18c for accommodating the pedestal 11 of an existing sink 12 to provide a predetermined space for enabling the upper surface 16 to be disposed directly below a bowl 13 of the pedestal 11 of an existing sink 12. The aperture 18 includes a rearwardly extending sections 18a, 18b that form an enlarged opening. The rearwardly extending sections 18a, 18b are formed to mate with the substantially semi-circular aperture 18c for extending the aperture 18 in the upper surface 16 to project rearwardly for enabling the upper surface 16 to engage a wall surface while the aperture accommodates the pedestal 11 of an existing sink 12.

[0029] As illustrated in FIG. 2, the base member 22 of the pedestal vanity 10 may be seated directly on a floor surface. The base member includes four corners and may further including adjusting members, similar to the adjusting member 68 illustrated in FIG. 7, disposed adjacent to each of the four corners for leveling the pedestal vanity relative to a floor surface.

[0030] As illustrated in FIGS. 1 and 3-6, the pedestal vanity 10 may include the base member 22 with four corners and further including legs 31-34 disposed adjacent to each of the four corners for adjusting a height of the pedestal vanity relative to a bowl 13 of an existing sink 12. As illustrated in FIG. 7, each of said legs 31-34 may include one member 62, or two members 62, 64 or three member 62, 64, 66 secured to each other for enabling an adjustment in the height of the pedestal vanity 10 relative to a bowl 13 of an existing sink 12. An infinite adjustment in the height of the pedestal vanity 10 relative to the bowl 13 can be achieved by changing the assortment of the members 62, 64, 66 to be either one member, two members or three members. In addition the adjusting member 68 for leveling the pedestal vanity 10 may be used separately or together with any combination of the members 62, 64, 66 to adjust the height of the pedestal vanity 10 relative to the bowl 13.

[0031] As illustrated in FIGS. 1 and 3-6, the pedestal vanity may include at least three members adapted to be attached to each other for enabling an adjustment in the height of the pedestal vanity 10 relative to a bowl 13 of an existing sink 12.

[0032] As illustrated in broken lines in FIG. 6, a shelf 23 may be provided within the space 20 wherein the shelf 23 would extend between the upwardly projecting left wall 24 and said upwardly projecting right wall 26. The shelf 23 is displaced upwardly a predetermined distance relative to the base member 22. In addition, the shelf 23 includes an aperture 23a for accommodating a pedestal 11 of an existing sink 13.

[0033] The present invention is directed to a pedestal vanity 10 for mounting adjacent to an pedestal 11 of an existing sink 12 for accommodating various sizes and shapes of a variety of pedestal lavatories. As illustrated in FIG. 7, the height of the pedestal vanity 10 can be adjusted by using a three piece leg extension or a two piece leg extensions or a one leg piece extension. The size of the pedestal 11 can be accommodated by an aperture 18 or cut-out in a predetermined size and shape for accommodating almost any size pedestal 11 sold today. With the adjustable height and the cut-out for the pedestal 11, the pedestal vanity 10 can be easily installed by placing the vanity on the floor in front of the pedestal sink 13, eyeing up

the proper height, adjusting the legs 31-34 to ensure a proper height adjustment and sliding the pedestal vanity 10 in place against the wall.

[0034] The pedestal vanity 10 can be made with a single or with multiple doors 42, 44 or drawers and may include an adjustable interior shelf 23. The pedestal vanity 10 may be constructed with either an interior panel to hide the pedestal leg 11. In the alternative, for more storage the interior of the pedestal vanity 10 may be open to reveal the pedestal leg 11.

[0035] The pedestal vanity 10 has been developed to be shipped to the customer in one of two configurations:

[0036] 1. Ready to assemble (RTA); or

[0037] 2. Shipped assembled.

[0038] While the overall design and configuration of the pedestal vanity 10 remains virtually the same in all configurations, the door panel/panels 42, 44 and colors can be altered to give the homeowner the look and appearance that matches their bathroom and house décor.

[0039] The pedestal vanity 10 can be manufactured in a myriad of widths to accommodate almost any bathroom size but the height and depth have been carefully calibrated to work in unison with most pedestal lavatories on the market.

[0040] The invention being thus described, it will be obvious that the same may be varied in many ways. Such variations are not to be regarded as a departure from the spirit and scope of the invention, and all such modifications as would be obvious to one skilled in the art are intended to be included within the scope of the following claims.

What is claimed is:

1. A pedestal vanity comprising:

a cabinet having an upper surface;

an aperture in said upper surface for accommodating a pedestal of an existing sink; and

storage space disposed below the upper surface.

2. The pedestal vanity according to claim 1, wherein said cabinet includes a base member, an upwardly projecting left side wall, an upwardly projecting right side wall and a front opening, said upwardly projecting left side wall and upwardly projecting right side wall extending upwardly from the base member and being connected to the upper surface.

3. The pedestal vanity according to claim 2, and further including at least one door being positioned to close said front opening for providing a closure for said storage space.

4. The pedestal vanity according to claim 1, wherein said aperture is a substantially semi-circular aperture for accommodating the pedestal of an existing sink to provide a predetermined space for enabling the upper surface to be disposed directly below a bowl of the pedestal of an existing sink.

5. The pedestal vanity according to claim 4, and further including a rearwardly extending opening formed to mate with the substantially semi-circular aperture for extending the aperture in the upper surface to project rearwardly for enabling the upper surface to engage a wall surface while the aperture accommodates the pedestal of an existing sink.

6. The pedestal vanity according to claim 2, wherein the base member is designed to be seated directly on a floor surface.

7. The pedestal vanity according to claim 6, wherein said base member includes four corners and further including adjusting members disposed adjacent to each of the four corners for leveling the pedestal vanity relative to a floor surface.

8. The pedestal vanity according to claim 2, wherein said base member includes four corners and further including legs

disposed adjacent to each of the four corners for adjusting a height of the pedestal vanity relative to a bowl of an existing sink.

9. The pedestal vanity according to claim 8, wherein each of said legs includes at least two members adapted to be attached to each other for enabling an adjustment in the height of the pedestal vanity relative to a bowl of an existing sink.

10. The pedestal vanity according to claim 8, wherein each of said legs includes at least three members adapted to be attached to each other for enabling an adjustment in the height of the pedestal vanity relative to a bowl of an existing sink.

11. The pedestal vanity according to claim 8, wherein each of said legs includes at least three members adapted to be attached to each other for enabling an adjustment in the height of the pedestal vanity relative to a bowl of an existing sink and an adjusting member attached to each of the legs for leveling the pedestal vanity relative to a floor surface.

12. The pedestal vanity according to claim 2, and further including a shelf extending between said upwardly projecting left wall and said upwardly projecting right wall and being displaced upwardly a predetermined distance relative to the base member.

13. The pedestal vanity according to claim 12, wherein said shelf includes an aperture for accommodating a pedestal of an existing sink.

14. A pedestal vanity comprising:

a cabinet including a base member, an upwardly projecting left side wall, an upwardly projecting right side wall and a front opening, said upwardly projecting left side wall and upwardly projecting right side wall extending upwardly from the base member and being connected to an upper surface of the cabinet;

an aperture in said upper surface for accommodating a pedestal of an existing sink; and

storage space is formed below the upper surface by the base member, the upwardly projecting left side wall and the upwardly projecting right side wall with an open rear surface for mounting adjacent to a wall surface.

15. The pedestal vanity according to claim 14, and further including at least one door being positioned to close said front opening for providing a closure for said storage space.

16. The pedestal vanity according to claim 14, wherein said aperture is a substantially semi-circular aperture for accommodating the pedestal of an existing sink to provide a predetermined space for enabling the upper surface to be disposed directly below a bowl of the pedestal of an existing sink.

17. The pedestal vanity according to claim 16, and further including a rearwardly extending opening formed to mate with the substantially semi-circular aperture for extending the aperture in the upper surface to project rearwardly for enabling the upper surface to engage a wall surface while the aperture accommodates the pedestal of an existing sink.

18. The pedestal vanity according to claim 14, wherein the base member is designed to be seated directly on a floor surface.

19. The pedestal vanity according to claim 14, wherein said base member includes four corners and further including adjusting members disposed adjacent to each of the four corners for leveling the pedestal vanity relative to a floor surface.

20. The pedestal vanity according to claim 14, wherein said base member includes four corners and further including legs disposed adjacent to each of the four corners for adjusting a height of the pedestal vanity relative to a bowl of an existing sink, wherein each of said legs includes at least two members adapted to be attached to each other for enabling an adjustment in the height of the pedestal vanity relative to a bowl of an existing sink.

* * * * *