



US 20130006378A1

(19) **United States**

(12) **Patent Application Publication**
Wogoman

(10) **Pub. No.: US 2013/0006378 A1**

(43) **Pub. Date: Jan. 3, 2013**

(54) **POLYMER FEMORAL TRIAL COMPONENT**

Publication Classification

(76) Inventor: **Thomas E. Wogoman**, Warsaw, IN (US)

(51) **Int. Cl.**
A61F 2/38 (2006.01)

(21) Appl. No.: **13/530,239**

(52) **U.S. Cl.** **623/20.35**

(22) Filed: **Jun. 22, 2012**

(57) **ABSTRACT**

Related U.S. Application Data

(60) Provisional application No. 61/503,237, filed on Jun. 30, 2011.

An orthopedic surgical instrument including a femoral trial component configured to be coupled to a surgically-prepared distal end of a patient's femur. The femoral trial component has a fixation side configured to engage a posterior aspect of the surgically-prepared distal femur.

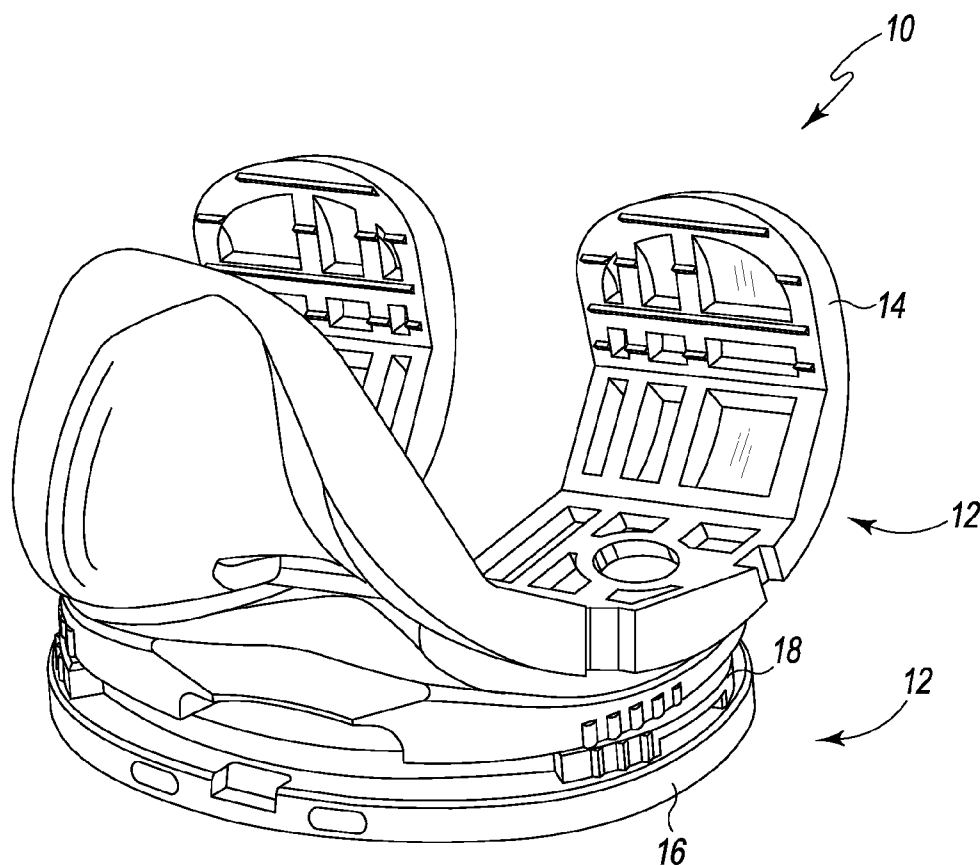

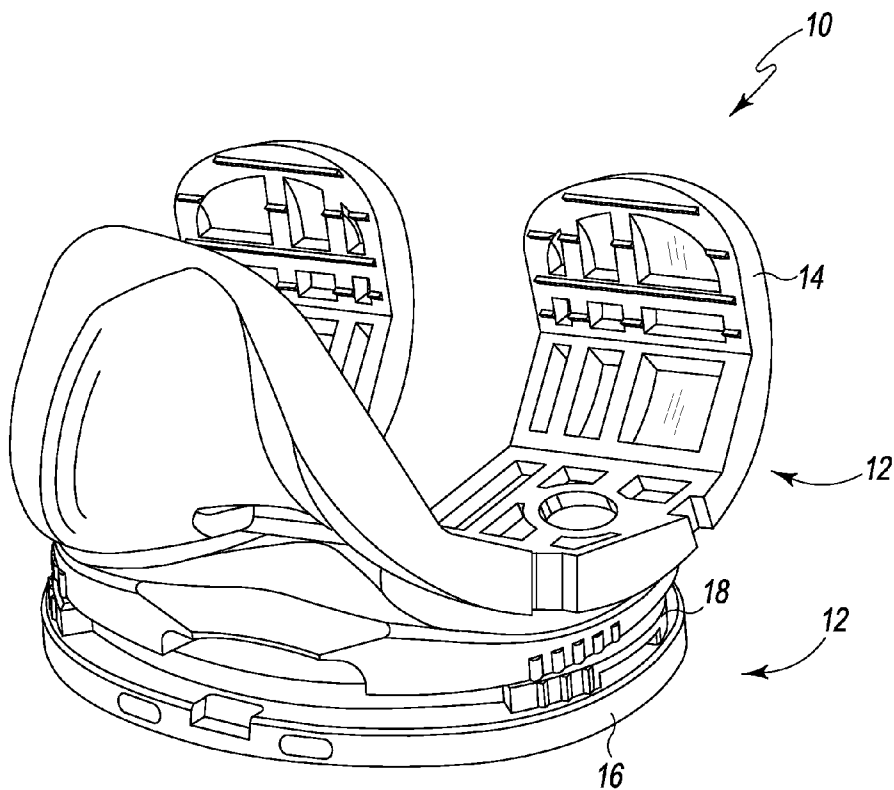

Fig. 1

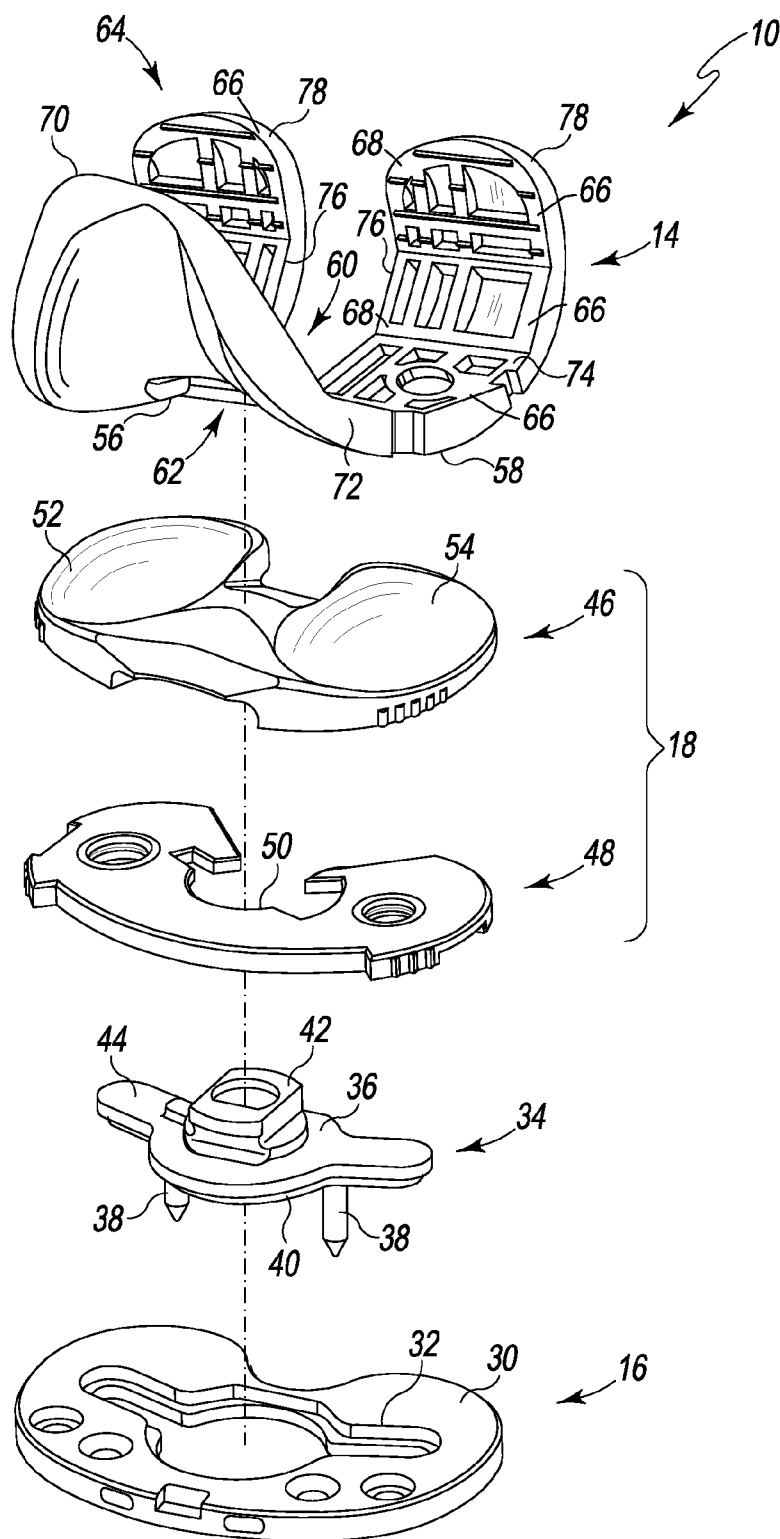

Fig. 2

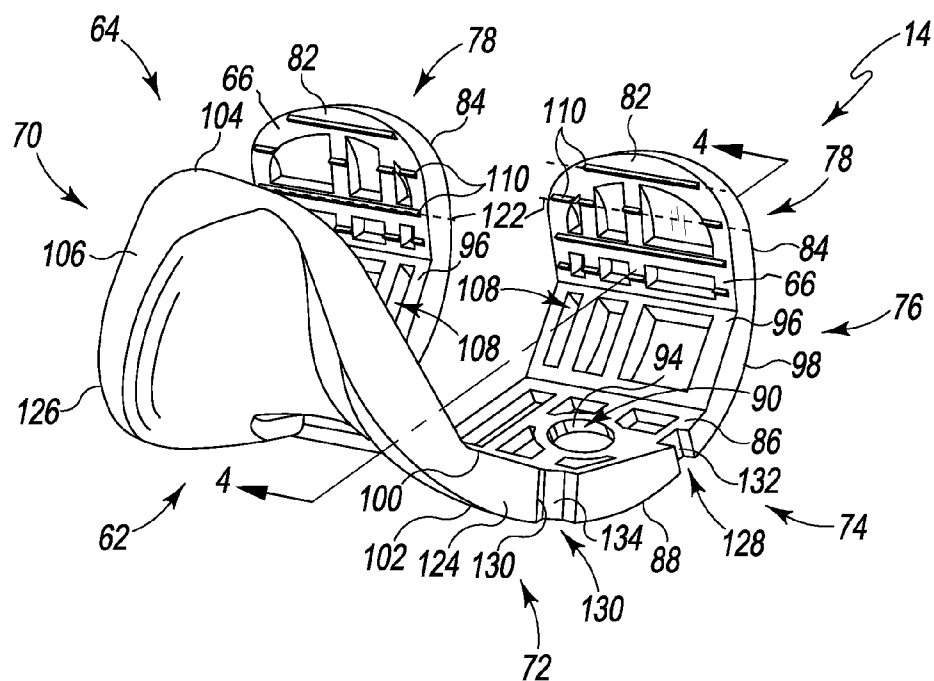

Fig. 3

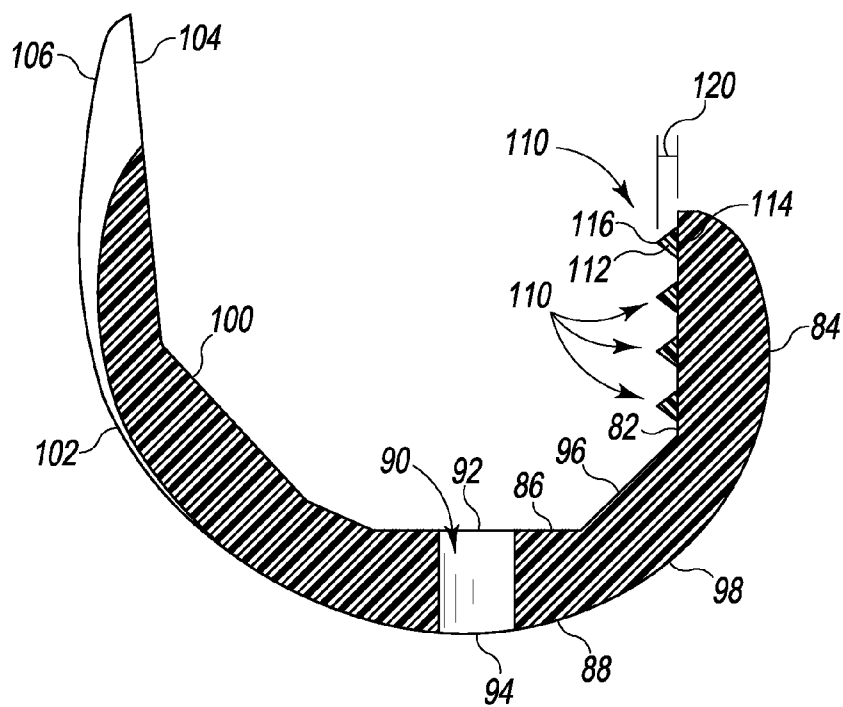

Fig. 4

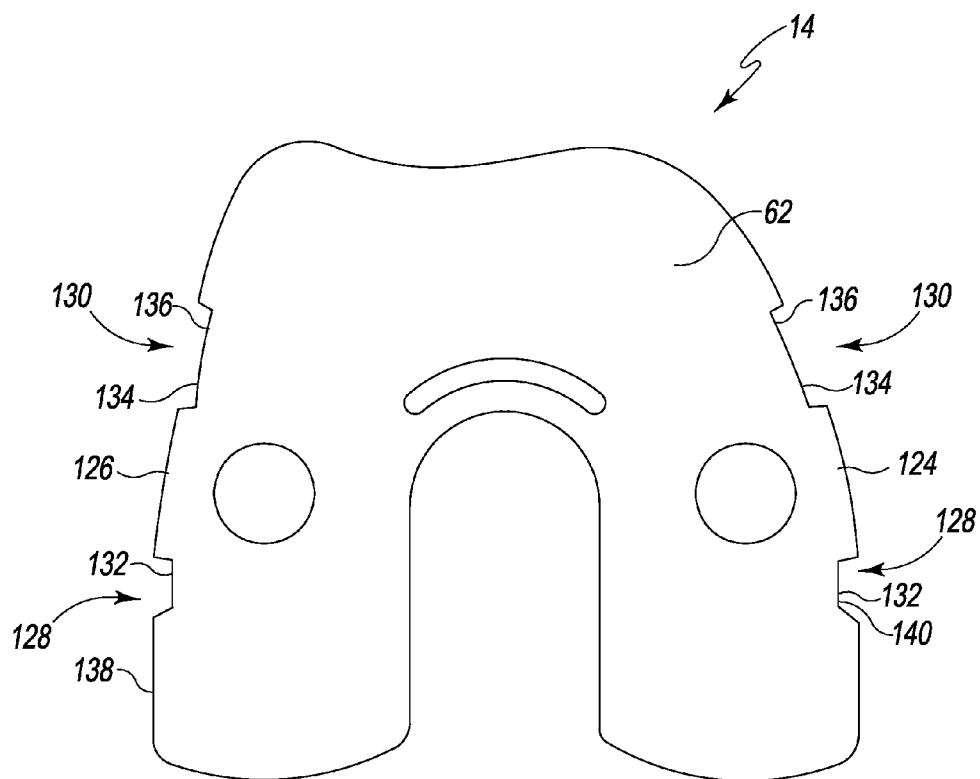

Fig. 5

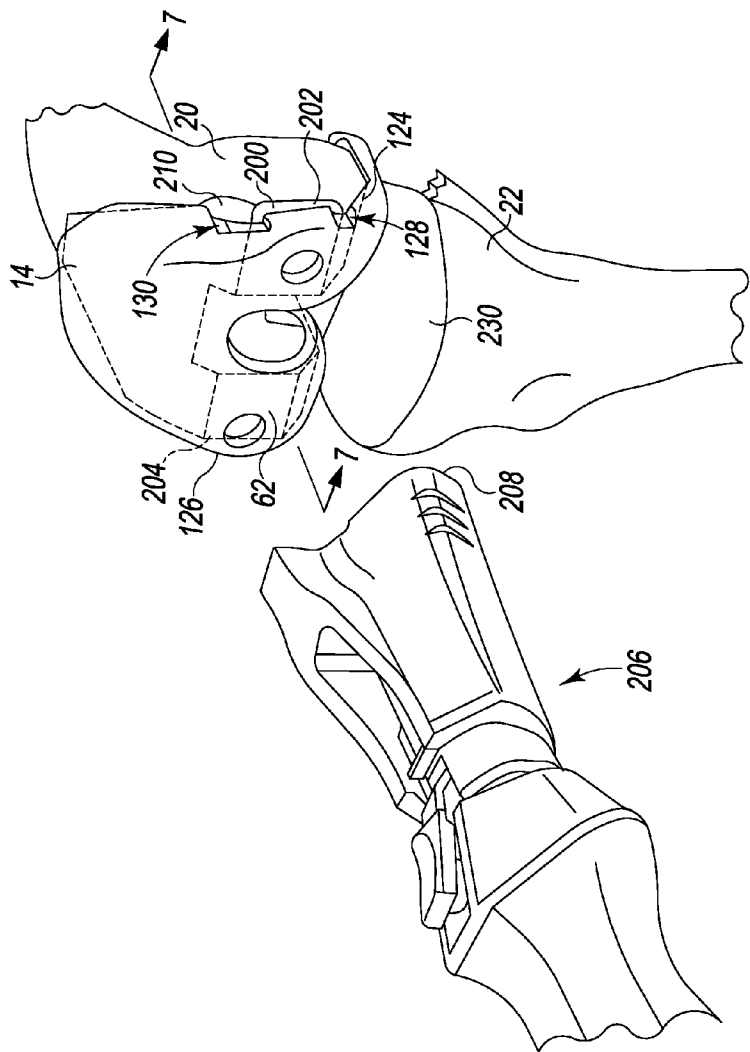
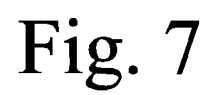

Fig. 6



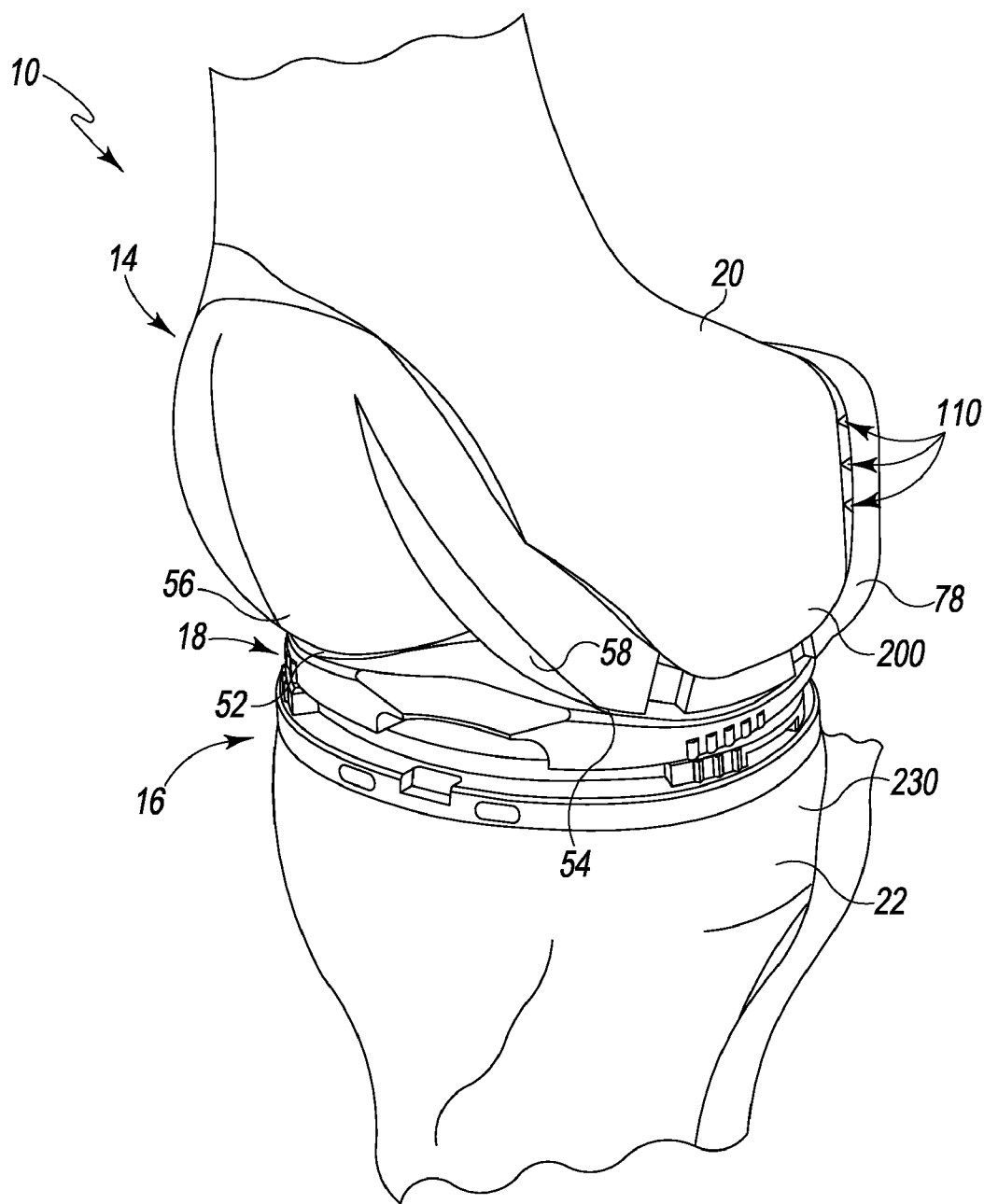

Fig. 8

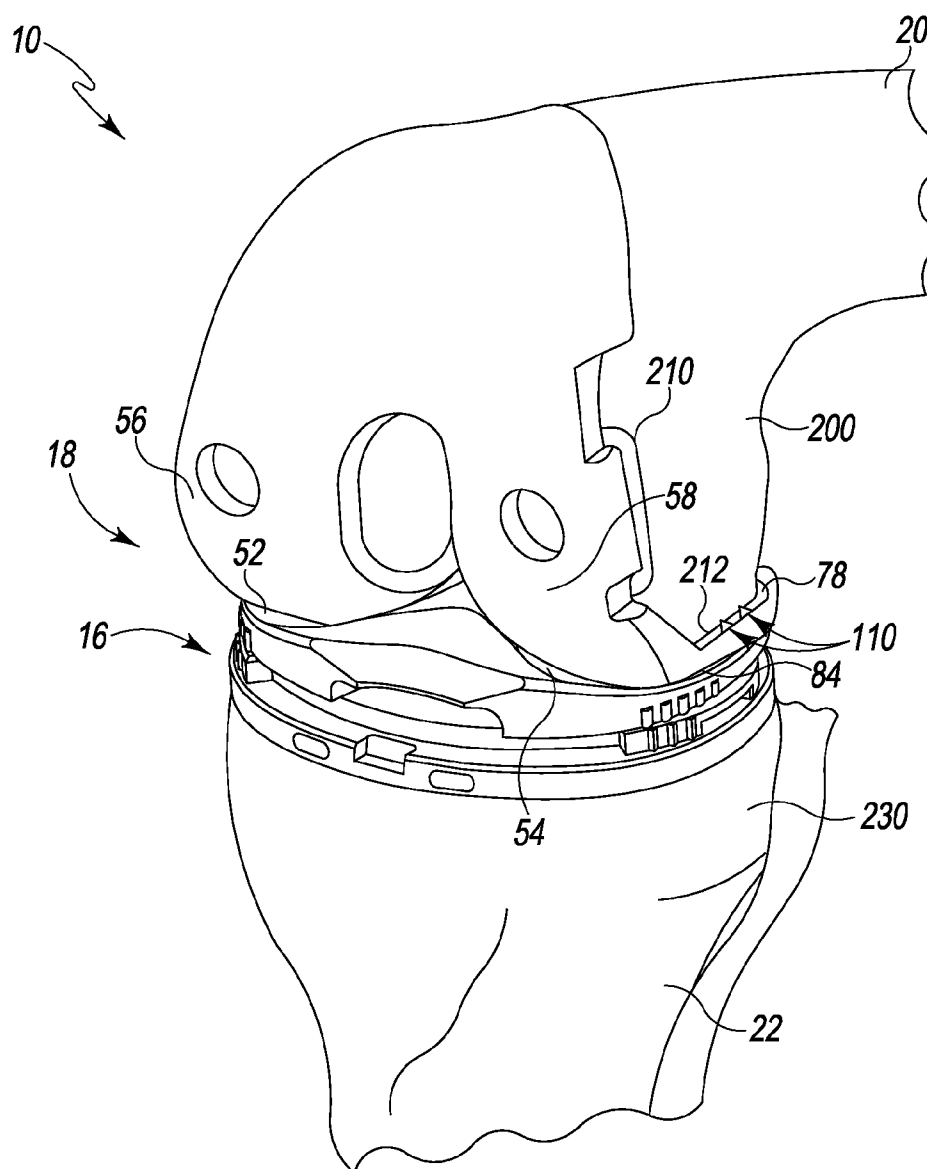

Fig. 9

POLYMER FEMORAL TRIAL COMPONENT

[0001] This application claims priority under 35 U.S.C. §119 to U.S. Patent Application No. 61/503,237, which was filed on Jun. 30, 2011 and is incorporated herein by reference.

TECHNICAL FIELD

[0002] The present disclosure relates generally to orthopedic surgical instruments and, more particularly, to surgical instruments used on a patient's femur.

BACKGROUND

[0003] Joint arthroplasty is a well-known surgical procedure by which a diseased and/or damaged natural joint is replaced by a prosthetic joint. A typical knee prosthesis includes a tibial tray, a femoral component, and a polymer insert or bearing positioned between the tibial tray and the femoral component. Femoral components are designed to be attached to a surgically-prepared distal end of a patient's femur. Tibial trays are designed to be attached to a surgically-prepared proximal end of a patient's tibia.

[0004] To facilitate the replacement of the natural joint with the knee prosthesis, orthopedic surgeons use a variety of orthopedic surgical instruments such as, for example, prosthetic trial components, cutting blocks, drill guides, milling guides, and other surgical instruments. Prosthetic trial components, such as, for example, a femoral trial component and a tibial bearing trial component, are used to size and select the components of the knee prosthesis that will replace the patient's natural joint. A procedure that utilizes the trial components to size and select the components of the knee prosthesis is often referred to as a trial reduction.

SUMMARY

[0005] According to one aspect of the disclosure, an orthopedic surgical instrument includes a polymeric femoral trial component configured to be coupled to a surgically-prepared distal end of a patient's femur. The femoral trial component includes an articular side having a posterior femoral condyle surface and a fixation side that is opposite the articular side. The fixation side has a plurality of ribs that extend in a direction away from the articular side so as to define a plurality of pockets therebetween. Each rib has an outer surface, and the outer surfaces of the ribs define a posterior fixation surface that extends generally in the superior/inferior direction and is configured to match the surgically-prepared distal end of the patient's femur. The femoral trial component also includes a plurality of teeth extending from the posterior fixation surface in a direction away from the articular side. Each tooth of the plurality of teeth has a pointed tip that defines a longitudinal axis of the tooth extending in the medial/lateral direction.

[0006] In some embodiments, each tooth of the plurality of teeth may have a triangular cross-section. In some embodiments, the plurality of teeth may include at least four teeth.

[0007] Additionally, in some embodiments, the polymeric femoral trial component may be formed as a molded integral component. In some embodiments, the outer surfaces of a number of the plurality of ribs may further define a distal fixation surface extending generally in the anterior/posterior direction and a posterior-chamfer fixation surface extending superiorly and posteriorly from the distal fixation surface to the posterior fixation surface.

[0008] In some embodiments, a second plurality of pockets may be defined in each of the distal fixation surface and the posterior-chamfer fixation surface between the plurality of ribs. In some embodiments, the femoral trial component may have an aperture defined in the distal fixation surface, and the aperture may extend from the fixation side to the articular side.

[0009] Additionally, in some embodiments, the femoral trial component may further include a lateral posterior condyle including the articular side and the fixation side that is opposite the articular side, and a medial posterior condyle. The medial posterior condyle may include a second articular side including a second posterior femoral condyle surface and a second fixation side that is opposite the second articular side. The second fixation side may have a second plurality of ribs that extend in a direction away from the second articular side so as to define a second plurality of pockets therebetween. Each rib may have an outer surface and the outer surfaces of the ribs may define a second posterior fixation surface that extends generally in the superior/inferior direction and is configured to match the surgically-prepared distal end of the patient's femur. The medial posterior condyle may also include a second plurality of teeth extending from the posterior fixation surface in a direction away from the second articular side.

[0010] In some embodiments, the femoral trial component may further have a medial side and a lateral side. The medial side may have at least one notch defined therein extending from the fixation side to the articular side, and the lateral side may have at least one notch defined therein extending from the fixation side to the articular side.

[0011] In some embodiments, the medial side may include two notches, and the lateral side may include two notches.

[0012] According to another aspect, an orthopedic surgical instrument includes a polymeric femoral trial component configured to be coupled to a surgically-prepared distal end of a patient's femur. The femoral trial component includes an articular side having a posterior femoral condyle surface and a fixation side that is opposite the articular side. The fixation side has a planar posterior fixation surface that extends generally in the superior/inferior direction and is configured to match the surgically-prepared distal end of the patient's femur. A plurality of teeth extend from the planar posterior fixation surface in a direction away from the articular side. Each tooth has a pointed tip that defines a longitudinal axis of the tooth extending in the medial/lateral direction.

[0013] In some embodiments, a plurality of pockets may be defined in the planar posterior fixation surface between the plurality of teeth.

[0014] According to another aspect, an orthopedic surgical instrument includes a polymeric femoral trial component configured to be coupled to a surgically-prepared distal end of a patient's femur. The femoral trial component has a medial side, a lateral side, an articular side including a posterior femoral condyle surface, and a fixation side that is opposite the articular side. The fixation side is configured to engage a posterior aspect of the surgically-prepared distal femur. The polymeric femoral trial component also includes a first notch extending from the fixation side to the articular side that is defined in the medial side, and a second notch extending from the fixation side to the articular side that is defined in the lateral side.

[0015] In some embodiments, the fixation side may include a plurality of ribs. Each rib may have an outer surface and the

outer surfaces may define a posterior fixation surface extending generally in the superior/inferior direction that is configured to match the surgically-prepared distal end of the patient's femur. A plurality of teeth may extend from the posterior fixation surface in a direction away from the articular side. In some embodiments, the plurality of teeth may include at least four teeth.

[0016] Additionally, in some embodiments, each tooth of the plurality of teeth may have a pointed tip that defines a longitudinal axis of the tooth extending in the medial/lateral direction. In some embodiments, the femoral trial component may be formed as a molded integral component. In some embodiments, each tooth of the plurality of teeth may have a triangular cross-section.

BRIEF DESCRIPTION OF THE DRAWINGS

[0017] The detailed description particularly refers to the following figures, in which:

[0018] FIG. 1 is a perspective view of an orthopedic surgical instrument assembly;

[0019] FIG. 2 is an exploded perspective view of the orthopedic surgical instrument assembly of FIG. 1;

[0020] FIG. 3 is a perspective view of the femoral trial component of the orthopedic surgical instrument assembly of FIG. 1;

[0021] FIG. 4 is a sagittal cross sectional view of the femoral trial component of FIGS. 1-3;

[0022] FIG. 5 is a bottom plan view of the femoral trial component of FIGS. 1-4;

[0023] FIG. 6 is a perspective view of the femoral trial component of FIGS. 1-5 positioned on a surgically-prepared distal end of a patient's femur;

[0024] FIG. 7 is a sagittal cross sectional view of the femoral trial component of FIGS. 1-6 on the surgically-prepared distal end of the patient's femur;

[0025] FIG. 8 is a perspective view of the orthopedic surgical instrument assembly of FIG. 1 positioned on surgically-prepared ends of the patient's femur and tibia with the patient's knee in extension; and

[0026] FIG. 9 is a perspective view of the orthopedic surgical instrument assembly of FIG. 8 with the patient's knee in flexion.

DETAILED DESCRIPTION OF THE DRAWINGS

[0027] While the concepts of the present disclosure are susceptible to various modifications and alternative forms, specific exemplary embodiments thereof have been shown by way of example in the drawings and will herein be described in detail. It should be understood, however, that there is no intent to limit the concepts of the present disclosure to the particular forms disclosed, but on the contrary, the intention is to cover all modifications, equivalents, and alternatives falling within the spirit and scope of the invention as defined by the appended claims.

[0028] Terms representing anatomical references, such as anterior, posterior, medial, lateral, superior, inferior, etcetera, may be used throughout the specification in reference to the orthopedic implants and surgical instruments described herein as well as in reference to the patient's natural anatomy. Such terms have well-understood meanings in both the study of anatomy and the field of orthopedics. Use of such anatomi-

cal reference terms in the written description and claims is intended to be consistent with their well-understood meanings unless noted otherwise.

[0029] Referring to FIGS. 1-4, an orthopedic surgical instrument assembly 10 is shown. The orthopedic surgical instrument assembly 10 has a number of trial components 12, including a femoral trial 14, a tibial base trial 16, and a tibial bearing trial 18. The femoral trial 14 is configured to be secured to a surgically-prepared end of a patient's distal femur 20 (see FIG. 6), whereas the tibial base trial 16 is configured to be secured to a surgically-prepared end of a patient's proximal tibia 22 (see FIG. 8).

[0030] As shown in FIG. 2, the tibial base trial 16 includes a plate 30 having an opening 32 defined therein sized to receive a base insert 34. The base insert 34 includes a body 36 having a number of fixation pins 38 extending away from a lower surface 40 of the body 36. The base insert 34 also includes a post 42 extending away from an upper surface 44 of the body 36. It should be appreciated that in other embodiments the fixation pins 38 may be omitted from base insert 34 or additional fixation pins 38 may be added.

[0031] The tibial bearing trial 18 is configured to assist the surgeon in selecting a prosthetic tibial bearing component of a typical knee prosthesis. The tibial bearing trial 18 is a multi-piece assembly that includes a bearing surface trial 46 and a shim 48. The post 42 of the base insert 34 is received in an opening 50 defined in the shim 48 and an opening (not shown) defined in the lower surface of the bearing surface trial 46. The bearing surface trial 46 includes a lateral articular surface 52 and a medial articular surface 54 positioned opposite the lower surface. In the illustrative embodiment, the bearing surface trial 46 is embodied as a fixed bearing trial and is fixed relative to the tibial base trial 16 (i.e., it is configured to not substantially rotate or move in the anterior/posterior direction or medial/lateral direction). In other embodiments, the bearing surface trial 46 may be a mobile bearing trial configured to rotate relative to the tibial base trial 16. As shown in the illustrative embodiment, the tibial bearing trial 18 is a multi-piece assembly, but it should be appreciated that in other embodiments the tibial bearing trial 18 may be a single monolithic component. One example of a tibial bearing trial 18 is shown and described in co-pending U.S. Patent Application Ser. No. 61/503,300, entitled "TRIALING SYSTEM FOR A KNEE PROSTHESIS AND METHOD OF USE" by Thomas E. Wogoman et al. (Attorney Docket No. 265280-210420, DEP6286USPSP), which is incorporated herein by reference.

[0032] The femoral trial 14 of the orthopedic surgical instrument assembly 10 is configured to assist the surgeon in selecting a femoral prosthetic component, which will emulate the configuration of the patient's natural femoral condyles. As such, the femoral trial 14 includes a lateral condyle surface 56 and a medial condyle surface 58, which may be shaped (i.e., curved) in a manner that approximates the condyles of the natural femur. The lateral condyle surface 56 and the medial condyle surface 58 are spaced apart from one another, thereby defining an intercondylar notch 60 therebetween. The articular surfaces 52, 54 of the tibial bearing trial 18 are configured to rotate with the lateral condyle surface 56 and the medial condyle surface 58, respectively, of the femoral trial 14.

[0033] As shown in FIG. 3, the lateral condyle surface 56 and the medial condyle surface 58 are formed in an articular side 62 of the femoral trial 14. A fixation side 64, which is the side of the femoral trial 14 that contacts the surgically-pre-

pared distal femur of the patient, is opposite the articular side **62**. The fixation side **64** includes a plurality of ribs **66** that extend in a direction away from the articular side **62**. Each of the ribs **66** includes an outer surface **68**, and the outer surfaces **68** of the ribs **66** cooperate to define multiple surfaces of the fixation side **64**. Those surfaces, identified below as “fixation surfaces,” mate or match with planar surfaces surgically cut into the patient’s femur, as discussed in greater detail below.

[0034] Although the femoral trial **14** is illustratively shown as a single integral or monolithic component, the trial **14** is characterized herein by a number of “regions” or “structures.” For example, the anterior structure of the femoral trial **14** is referred to herein as an anterior flange **70**. Moving along the femoral trial **14** from an anterior to posterior, the anterior flange **70** transitions to an anterior-chamfer region **72**, which transitions to a distal condylar region **74**. The distal condylar region **74** transitions to a posterior-chamfer region **76**. A pair of femoral condyles **78** forms the posterior structure of the femoral trial **14**. One of the femoral condyles **78** is medially positioned and the other laterally positioned when the femoral trial **14** is attached to the distal end of the patient’s resected femur **20** depending on which knee is being replaced.

[0035] The outer surfaces **68** of the ribs **66** of each of the posterior femoral condyles **78** define a planar posterior fixation surface **82** on the fixation side **64**, with one of the posterior fixation surfaces **82** being the lateral fixation surface and the other medial fixation surface. Each posterior fixation surface **82** is positioned opposite a posterior condyle surface **84** on the articulation side **60**. As shown in FIG. 4, the posterior fixation surfaces **82** and the posterior condyle surfaces **84** extend generally in the superior/inferior direction.

[0036] The outer surfaces **68** of the ribs **66** of the distal condylar region **74** define a pair of planar distal fixation surfaces **86** (one being medially positioned, the other laterally positioned). Each of the distal fixation surfaces **86** is opposite a distal condyle surface **88**. As shown in FIG. 3, the distal fixation surfaces **86** extend generally in the anterior/posterior direction.

[0037] The distal condylar region **74** also includes a pair of apertures or through-holes **90**, one of which is positioned laterally while the other is positioned medially. Each through-hole **90** extends from an opening **92** defined in one of the distal fixation surfaces **86** to an opening **94** defined in the corresponding distal condyle surface **88**. Each through-hole **90** is sized to receive a surgical drill, as described in greater detail below.

[0038] The posterior-chamfer region **76** of the femoral trial **14** includes a pair of planar posterior-chamfer fixation surfaces **96** defined by the outer surfaces **68** of the ribs **66**, with one being medially positioned and the other laterally positioned. The lateral and medial posterior-chamfer fixation surfaces **96** extend superiorly and posteriorly from their respective lateral and medial distal fixation surfaces **86** to their respective posterior fixation surfaces **82**. Each of the posterior-chamfer fixation surfaces **96** is positioned opposite a posterior-chamfer condyle surface **98**.

[0039] Similarly, the anterior-chamfer region **72** includes a pair of planar anterior-chamfer fixation surfaces **100**. Each anterior-chamfer fixation surface **100** is positioned opposite an anterior-chamfer condyle surface **102**. The anterior-chamfer fixation surfaces **100** extend superiorly and anteriorly away from their respective lateral and medial distal fixation surfaces **86** to a planar anterior fixation surface **104** of the anterior flange **70**. The anterior fixation surface **104** is oppo-

site an anterior condyle surface **106**, and, like the posterior fixation surfaces **82**, the anterior fixation surface **104** extends generally in the superior/inferior direction.

[0040] The plurality of ribs **66** define a plurality of pockets **108** in each of the fixation surfaces **82**, **86**, **96**, **100**, and **104**. In the illustrative embodiment, the pockets **108** are separated such that none of the pockets are in fluid communication with each other. It should be appreciated that in other embodiments two or more pockets may be in communication with one another such that a single, continuous pocket is formed in the fixation side **72** of the femoral trial **14**. It will be appreciated that in other embodiments the pockets **108** may be omitted from one or more of the fixation surfaces.

[0041] The femoral trial **14** of the orthopedic surgical instrument assembly **10** includes a plurality of teeth **110** that extend from each of the posterior fixation surfaces **82** in a direction away from the articular side **62**. The teeth **110** are configured to engage or grip the surgically-prepared distal end of the patient’s femur **20** when the femoral trial **14** is coupled thereto. The illustrative teeth **110** extend parallel to each other in the medial/lateral direction. It should be appreciated that in other embodiments the teeth **110** may be angled relative to each other or arranged in various patterns on the posterior fixation surfaces **82**. Additionally, one or more of the teeth **110** may extend inferiorly/superiorly along the posterior fixation surface **82** in addition to, or instead of, extending medially/laterally as shown in FIGS. 3-4. It should also be appreciated that in other embodiments one or more teeth may be formed on any of the other surfaces **82**, **86**, **96**, **100**, and **104** of the fixation side **64** of the femoral trial **14**.

[0042] As shown in FIG. 4, each tooth **110** has a triangular cross section when viewed in the sagittal plane. It should be appreciated that in other embodiments the teeth **110** may have a square cross section, rectangular cross section, dome-shaped cross section, or any other cross section suitable to engage the surgically-prepared distal end of the patient’s femur **20**. Additionally, while the teeth **110** have the same cross section in the illustrative embodiment, it should be appreciated that in other embodiments each tooth **110** may have a unique cross section.

[0043] Each tooth **110** has a body **112** including a base **114** fixed to the posterior fixation surface **82** between one or more of the pockets **108**. The body **112** extends outwardly from the posterior fixation surface **82** to a tip **116**. The tip **116** defines a longitudinal axis **122** of each tooth **110** extending in the medial/lateral direction. The tip **116** of each body **112** is spaced apart from the posterior fixation surface **82** such that each tooth **110** has a height **120**. In the illustrative embodiment, the height **120** is approximately 0.38 millimeters. However, in other embodiments, the height **120** may be greater than that shown in the illustrative embodiment. Additionally, while each tooth **110** has the same height **120** in the illustrative embodiment, it should be appreciated that in other embodiments the height **120** of each tooth **110** may vary.

[0044] The femoral trial **14** also includes a pair of sidewalls **124**, **126** that extend between the articular side **62** and the fixation side **64**, with one sidewall being medially positioned and the other laterally positioned depending on which knee is being replaced. As shown in FIG. 5, each of the sidewalls **124**, **126** has a pair of notches **128**, **130** defined therein. The notch **128** extends between the articular side **62** and the fixation side **64** of the distal condylar region **74** and has a base surface **132** that connects the distal fixation surface **86** to the distal condyle surface **88**. Similarly, the notch **130** extends between

the articular side **62** and the fixation side **64** of the distal condylar region **74** and the anterior-chamfer region **72**. The notch **130** includes a base surface **134** that connects the distal fixation surface **86** to the distal condyle surface **88**, and a base surface **136** that connects the anterior-chamfer fixation surface **100** and the anterior-chamfer condyle surface **102**. In the illustrative embodiment, the notches **128**, **130** extend inwardly approximately 1.75 millimeters from the sidewalls **124**, **126**, respectively, to the base surfaces **132**, **134**, **136**.

[0045] The sidewalls **124**, **126** define an outer edge **138** of the femoral trial **14** corresponding to a standard femoral prosthetic component size. The base surfaces **132**, **134**, **136** of the notches **128**, **130** define another edge **140** of the femoral trial **14** corresponding to a standard, but more narrow, femoral prosthetic component size. As such, a single femoral trial **14** may be used to size multiple femoral prosthetic component sizes. It should be appreciated that in other embodiments one or more of the notches **128**, **130** may be omitted from the femoral trial **14**. It should also be appreciated that in other embodiments the position of the notches **128**, **130** along the sidewalls **124**, **126** may vary such that, for example, the notches **130** are formed entirely in the distal condylar region **74**.

[0046] The femoral trial **14** is constructed from a polymeric material. In the illustrative embodiment, the polymeric material is a fifty percent glass-reinforced nylon. Another polymeric material that may be used is thirty percent glass-filled polyether ether ketone (PEEK) or polyethylene, such as ultra-high molecular weight polyethylene (UHMWPE), although other biocompatible polymers may be used. The tibial bearing trial **18** may be constructed from a material, such as, for example, any of the polymeric materials described above, which permits smooth articulation between the tibial bearing trial **18** and the femoral trial **14**. The tibial base trial **16** and the base insert **34** may be constructed from a biocompatible metal, such as a cobalt chrome alloy; other materials, such as ceramics, may also be used.

[0047] Referring now to FIGS. 6-9, the orthopedic surgical instrument assembly **10** is shown in use with the patient's bony anatomy. As shown in FIG. 6, a surgically-prepared distal end **200** of the patient's femur **20** includes a resected medial condyle **202** and a resected lateral condyle **204**. In use, the surgeon positions the femoral trial **14** over the distal end **200** of the patient's femur **20**. An impactor assembly **206** may be used to impact the femoral trial **14** into the distal end **200**.

[0048] To do so, an engagement end **208** of the impactor assembly **206** is positioned in contact with the articular side **62** of the femoral trial **14**, and force is applied to the impactor assembly **206** until the fixation side **64** of the femoral trial **14** contacts the resected medial condyle **202** and the resected lateral condyle **204**. Once the femoral trial **14** is properly positioned on the distal end **200** of the patient's femur **20**, the surgeon may remove the impactor assembly **206**. It should be appreciated that in other embodiments the surgeon may position the femoral trial **14** on the distal end **200** of the patient's femur **20** by hand without using the impactor assembly **206**.

[0049] When the femoral trial **14** is positioned on the distal end **200** of the patient's femur **20**, the sidewalls **124**, **126** indicate where the outer edge of the standard femoral prosthetic component would be located on the resected medial condyle **202** and the resected lateral condyle **204**. Conversely, the base surfaces **132**, **134**, **136** of the notches **128**, **130** in the femoral trial **14** indicate where the outer edge of the narrow femoral prosthetic component would be located. If the side-

walls **124**, **126** extend beyond the resected medial condyle **202** and the resected lateral condyle **204** of the distal end **200** of the patient's femur **20**, the surgeon may select the narrow femoral prosthetic component for implantation.

[0050] The resected medial condyle **202** and the resected lateral condyle **204** of the patient's femur **20** include a number of resected surfaces **210**. As shown in FIG. 7, the resected surfaces **210** of each condyle **202**, **204** include a posterior planar surface **212**, a distal planar surface **214**, and an anterior planar surface **216**. The resected surfaces **210** also include a posterior-chamfer planar surface **218** that extends superiorly and posteriorly from the distal planar surface **214** to the posterior planar surface **212** and an anterior-chamfer planar surface **220** that extends superiorly and anteriorly from the distal planar surface **214** to the anterior planar surface **216**.

[0051] When the femoral trial **14** is positioned on the distal end **200** of the patient's femur **20**, the anterior fixation surface **104** of the femoral trial **14** contacts the anterior planar surfaces **216** of the patient's femur **20** and the distal fixation surfaces **86** of the femoral trial **14** contacts the distal planar surfaces **214** of the patient's femur **20**. Similarly, posterior-chamfer fixation surface **96** of the femoral trial **14** contacts the posterior-chamfer planar surface **218** of the patient's femur **20**. The anterior-chamfer fixation surfaces **98** of the femoral trial **14** contacts the anterior-chamfer planar surfaces **220** of the patient's femur **20**.

[0052] Further, the posterior fixation surfaces **82** of the femoral trial **14** grip the posterior planar surfaces **212** of the patient's femur **20** when the femoral trial **14** is positioned thereon. As shown in FIG. 7, one or more of the teeth **110** of the lateral posterior fixation surface **82** engages with, or grips, the posterior planar surface **212** of the resected lateral condyle **204**. The engagement of the teeth **110** with the posterior planar surfaces **212** secures the femoral trial **14** to the distal end **200** of the patient's femur **20**.

[0053] In addition to positioning the femoral trial **14** on the distal end **200** of the patient's femur **20**, the surgeon may also position the tibial base trial **16** on a surgically-prepared proximal end **230** of the patient's tibia **22**. When the surgical instrument assembly **10** is fully installed, the tibial base trial **16** is secured to the surgically-prepared proximal end **230** of the patient's tibia **22**, as shown in FIG. 8. The tibial bearing trial **18**, including the bearing surface trial **46** and the shim **48**, are positioned over the post **42** of the base insert **34**. The lateral condyle surface **56** of the femoral trial **14** contacts the lateral articular surface **52** of the tibial bearing trial **18**, while the medial condyle surface **58** contacts the medial articular surface **54**. The surgeon may then evaluate the range of motion and stability of the knee with the surgical instrument assembly **10**.

[0054] As the range of motion is evaluated, the load on the femoral trial **14** translates posteriorly as the knee is moved from extension (see FIG. 8) to flexion (see FIG. 9). As the load moves posteriorly, the force normal to the posterior condyle surfaces **84** of the femoral trial **14** increases, thereby causing the teeth **110** of the posterior fixation surfaces **82** of the femoral trial **14** to further engage, or grip, the posterior planar surfaces **212** of the surgically-prepared distal end **200** of the patient's femur **20**. The engagement of one or more of the teeth **110** of the femoral trial **14** with the distal end **200** of the patient's femur **20** retains the femoral trial **14** on the patient's femur **20**. It should be appreciated that in other embodiments

screws or other fasteners may be inserted through the through-holes **90** into the femur **20** to provide additional fixation.

[0055] While the disclosure has been illustrated and described in detail in the drawings and foregoing description, such an illustration and description is to be considered as exemplary and not restrictive in character, it being understood that only illustrative embodiments have been shown and described and that all changes and modifications that come within the spirit of the disclosure are desired to be protected.

[0056] There are a plurality of advantages of the present disclosure arising from the various features of the method, apparatus, and system described herein. It will be noted that alternative embodiments of the method, apparatus, and system of the present disclosure may not include all of the features described yet still benefit from at least some of the advantages of such features. Those of ordinary skill in the art may readily devise their own implementations of the method, apparatus, and system that incorporate one or more of the features of the present invention and fall within the spirit and scope of the present disclosure as defined by the appended claims.

1. An orthopedic surgical instrument, comprising:

a polymeric femoral trial component configured to be coupled to a surgically-prepared distal end of a patient's femur, the femoral trial component comprising

- (i) an articular side comprising a posterior femoral condyle surface,
- (ii) a fixation side that is opposite the articular side, the fixation side comprising a plurality of ribs that extend in a direction away from the articular side so as to define a plurality of pockets therebetween, each rib having an outer surface, and the outer surfaces of the ribs defining a posterior fixation surface that extends generally in the superior/inferior direction and is configured to match the surgically-prepared distal end of the patient's femur, and
- (iii) a plurality of teeth extending from the posterior fixation surface in a direction away from the articular side, each tooth of the plurality of teeth having a pointed tip that defines a longitudinal axis of the tooth extending in the medial/lateral direction.

2. The orthopedic surgical instrument of claim **1**, wherein each tooth of the plurality of teeth has a triangular cross-section.

3. The orthopedic surgical instrument of claim **1**, wherein the plurality of teeth include at least four teeth.

4. The orthopedic surgical instrument of claim **1**, wherein the polymeric femoral trial component is formed as a molded integral component.

5. The orthopedic surgical instrument of claim **1**, wherein the outer surfaces of a number of the plurality of ribs further define (i) a distal fixation surface extending generally in the anterior/posterior direction, and (ii) a posterior-chamfer fixation surface extending superiorly and posteriorly from the distal fixation surface to the posterior fixation surface.

6. The orthopedic surgical instrument of claim **5**, wherein a second plurality of pockets are defined in each of the distal fixation surface and the posterior-chamfer fixation surface between the plurality of ribs.

7. The orthopedic surgical instrument of claim **5**, wherein the femoral trial component has an aperture defined in the distal fixation surface, the aperture extending from the fixation side to the articular side.

8. The orthopedic surgical instrument of claim **1**, wherein the femoral trial component further includes:

a lateral posterior condyle including the articular side and the fixation side that is opposite the articular side, and a medial posterior condyle including

- (i) a second articular side comprising a second posterior femoral condyle surface,
- (ii) a second fixation side that is opposite the second articular side, the second fixation side comprising a second plurality of ribs that extend in a direction away from the second articular side so as to define a second plurality of pockets therebetween, each rib having an outer surface and the outer surfaces of the ribs defining a second posterior fixation surface that extends generally in the superior/inferior direction and is configured to match the surgically-prepared distal end of the patient's femur, and
- (iii) a second plurality of teeth extending from the posterior fixation surface in a direction away from the second articular side.

9. The orthopedic surgical instrument of claim **1**, wherein the femoral trial component further has a medial side and a lateral side, the medial side having at least one notch defined therein extending from the fixation side to the articular side, and the lateral side having at least one notch defined therein extending from the fixation side to the articular side.

10. The orthopedic surgical instrument of claim **9**, wherein the medial side includes two notches, and the lateral side includes two notches.

11. An orthopedic surgical instrument, comprising:

a polymeric femoral trial component configured to be coupled to a surgically-prepared distal end of a patient's femur, the femoral trial component comprising

- (i) an articular side comprising a posterior femoral condyle surface,
- (ii) a fixation side that is opposite the articular side, the fixation side comprising a planar posterior fixation surface that extends generally in the superior/inferior direction and is configured to match the surgically-prepared distal end of the patient's femur, and
- (iii) a plurality of teeth extending from the planar posterior fixation surface in a direction away from the articular side, each tooth having a pointed tip that defines a longitudinal axis of the tooth extending in the medial/lateral direction.

12. The orthopedic surgical instrument of claim **11**, wherein the femoral trial component further has a medial side and a lateral side, the medial side having at least one notch defined therein extending from the fixation side to the articular side, and the lateral side having at least one notch defined therein extending from the fixation side to the articular side.

13. The orthopedic surgical instrument of claim **12**, wherein the medial side includes two notches, and the lateral side includes two notches.

14. The orthopedic surgical instrument of claim **13**, wherein a plurality of pockets are defined in the planar posterior fixation surface between the plurality of teeth.

15. An orthopedic surgical instrument, comprising:

a polymeric femoral trial component configured to be coupled to a surgically-prepared distal end of a patient's femur, the femoral trial component comprising (i) a medial side, (ii) a lateral side, (iii) an articular side comprising a posterior femoral condyle surface, and (iv) a fixation side that is opposite the articular side, the

fixation side being configured to engage a posterior aspect of the surgically-prepared distal femur,

wherein (i) a first notch extending from the fixation side to the articular side is defined in the medial side, and (ii) a second notch extending from the fixation side to the articular side is defined in the lateral side.

16. The orthopedic surgical instrument of claim **15**, wherein (i) the fixation side comprises a plurality of ribs, each rib having an outer surface and the outer surfaces defining a posterior fixation surface extending generally in the superior/inferior direction that is configured to match the surgically-prepared distal end of the patient's femur, and (ii) a plurality of teeth extend from the posterior fixation surface in a direction away from the articular side.

17. The orthopedic surgical instrument of claim **16**, wherein the plurality of teeth includes at least four teeth.

18. The orthopedic surgical instrument of claim **16**, wherein each tooth of the plurality of teeth has a pointed tip that defines a longitudinal axis of the tooth extending in the medial/lateral direction.

19. The orthopedic surgical instrument of claim **15**, wherein the femoral trial component is formed as a molded integral component.

20. The orthopedic surgical instrument of claim **16**, wherein each tooth of the plurality of teeth has a triangular cross-section.

* * * * *