

(19) World Intellectual Property Organization
International Bureau



(10) International Publication Number
WO 2009/153773 A1

(43) International Publication Date
23 December 2009 (23.12.2009)

(51) International Patent Classification:
H04W 72/00 (2009.01)

(21) International Application Number:
PCT/IL2008/001649

(22) International Filing Date:
21 December 2008 (21.12.2008)

(25) Filing Language: English

(26) Publication Language: English

(30) Priority Data:
61/074,016 19 June 2008 (19.06.2008) US

(71) Applicant (for all designated States except US): **MARVELL ISRAEL (MISL) LTD.** [IL/IL]; 6 Hamada Street, Mordot HaCarmel Industrial Park, 20692 Yokneam (IL).

(72) Inventors; and

(75) Inventors/Applicants (for US only): **YELLIN, Daniel** [IL/IL]; 71 Herzl Street, 43353 Raanana (IL). **PERETS, Yona** [IL/IL]; 12 Asher Street, 43553 Raanana (IL). **BERGEL, Itsik** [IL/IL]; 3/10 Modai Street, 54424 Givat Shmuel (IL).

(74) Agent: **D. KLIGLER I.P. SERVICES LTD.**; P.O. Box 33111, 61330 Tel Aviv (IL).

(81) Designated States (unless otherwise indicated, for every kind of national protection available): AE, AG, AL, AM, AO, AT, AU, AZ, BA, BB, BG, BH, BR, BW, BY, BZ, CA, CH, CN, CO, CR, CU, CZ, DE, DK, DM, DO, DZ, EC, EE, EG, ES, FI, GB, GD, GE, GH, GM, GT, HN, HR, HU, ID, IL, IN, IS, JP, KE, KG, KM, KN, KP, KR, KZ, LA, LC, LK, LR, LS, LT, LU, LY, MA, MD, ME, MG, MK, MN, MW, MX, MY, MZ, NA, NG, NI, NO, NZ, OM, PG, PH, PL, PT, RO, RS, RU, SC, SD, SE, SG, SK, SL, SM, ST, SV, SY, TJ, TM, TN, TR, TT, TZ, UA, UG, US, UZ, VC, VN, ZA, ZM, ZW.

(84) Designated States (unless otherwise indicated, for every kind of regional protection available): ARIPO (BW, GH, GM, KE, LS, MW, MZ, NA, SD, SL, SZ, TZ, UG, ZM, ZW), Eurasian (AM, AZ, BY, KG, KZ, MD, RU, TJ, TM), European (AT, BE, BG, CH, CY, CZ, DE, DK, EE, ES, FI, FR, GB, GR, HR, HU, IE, IS, IT, LT, LU, LV, MC, MT, NL, NO, PL, PT, RO, SE, SI, SK, TR), OAPI (BF, BJ, CF, CG, CI, CM, GA, GN, GQ, GW, ML, MR, NE, SN, TD, TG).

Published:

— with international search report (Art. 21(3))

(54) Title: BALANCING CAPACITY BETWEEN LINK DIRECTIONS USING VARIABLE FEEDBACK RATES

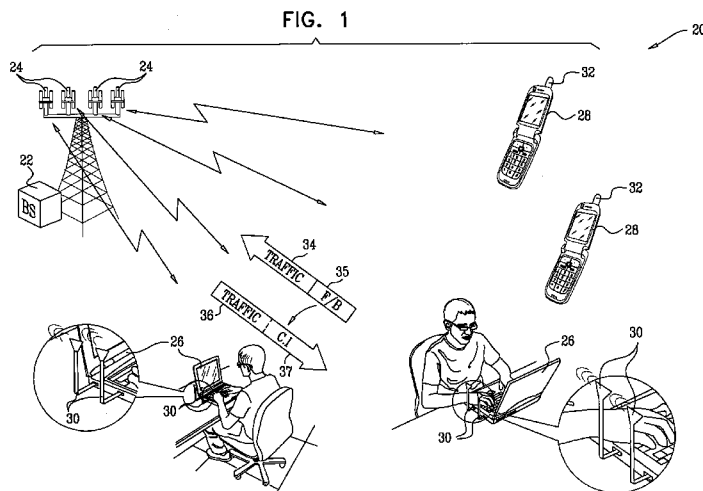

(57) Abstract: A method for communication includes providing a first transceiver (26, 28) configured to communicate with a second transceiver (22) over a bi-directional link having a first aggregation of frequencies that are assigned to carry first communication traffic (34) in a first link direction from the first transceiver to the second transceiver and a second aggregation of frequencies that are assigned to carry second communication traffic (36) in a second link direction from the second transceiver to the first transceiver. Communication feedback (35) is transmitted from the first transceiver to the second transceiver at an adaptive feedback rate. The feedback rate is determined so as to achieve a desired balance between the information carrying capacities of the first and second aggregations. An information carrying capacity of the second aggregation is controlled responsively to the communication feedback.

WO 2009/153773 A1

BALANCING CAPACITY BETWEEN LINK DIRECTIONS USING VARIABLE
FEEDBACK RATES

FIELD OF THE INVENTION

[0001] The present invention relates generally to communication systems,
5 and specifically to enhancing the traffic capacity of bidirectional communication
links.

BACKGROUND OF THE INVENTION

[0002] In many modern wireless communication applications, such as
cellular networks (and particularly advanced cellular standards, such as LTE), the
10 required traffic capacities in the uplink and downlink directions are not identical. For
example, Internet browsing typically requires much higher traffic capacity on the
downlink than on the uplink. (In the context of the present patent application and in
the claims, the term "traffic capacity" refers to the amount of information that is
conveyed over a communication link per unit time.) It has been estimated that the
15 overall downlink traffic demand in wireless networks is between three and ten times
larger than the corresponding uplink demand. In commercial wireless networks that
use frequency-domain duplexing (FDD), however, the available frequency spectrum
is usually partitioned in a fixed manner (typically equal) between downlink and
uplink.

20 [0003] Because of the mismatch between traffic demand and frequency
allocation, wireless networks fail to make full use of the available traffic capacity of
both the uplink and the downlink simultaneously, and are therefore limited by the
capacity of one of the link directions. As a result, FDD networks make sub-optimal
use of their available transmission spectrum. Furthermore, even if the frequency
25 spectrum were to be divided unequally between uplink and downlink, to achieve a
better match to the traffic demand, some inefficiency would still remain, as traffic
loads in the uplink and downlink directions may change over time.

SUMMARY

[0004] An embodiment disclosed herein provides a method for
30 communication, including providing a first transceiver configured to communicate

with a second transceiver over a bi-directional link having a first aggregation of frequencies that are assigned to carry first communication traffic in a first link direction from the first transceiver to the second transceiver and a second aggregation of frequencies that are assigned to carry second communication traffic in a second link direction from the second transceiver to the first transceiver. Communication feedback is transmitted from the first transceiver to the second transceiver at an adaptive feedback rate. An information carrying capacity of the second aggregation is controlled responsively to the communication feedback.

[0005] Another embodiment provides a method for communication that includes configuring a base station to communicate with one or more mobile terminals over a bi-directional link having a first aggregation of frequencies that are assigned to carry uplink communication traffic from the mobile terminals to the base station and a second aggregation of frequencies that are assigned to carry downlink communication traffic from the base station to the mobile terminals. Communication feedback is received at the base station from at least one of the mobile terminals at an adaptive feedback rate. An information carrying capacity of the second aggregation is controlled responsively to the communication feedback.

[0006] Yet another embodiment provide a method for communication, including configuring a mobile terminal to communicate with a base station over a bi-directional link having a first aggregation of frequencies that are assigned to carry uplink communication traffic from the mobile terminal to the base station and a second aggregation of frequencies that are assigned to carry downlink communication traffic from the base station to the mobile terminal. Communication feedback is transmitted from the mobile terminal to the base station at an adaptive feedback rate so as to cause the base station to control an information carrying capacity of the second aggregation responsively to the communication feedback.

[0007] In another embodiment, control (feedback) data is transmitted from the base station to the mobile terminal in order to increase uplink capacity.

[0008] There is additionally provided, in accordance with another embodiment, apparatus for communication, including a first transceiver, which is configured to communicate with a second transceiver over a bi-directional link having

a first aggregation of frequencies that are assigned to carry first communication traffic in a first link direction from the first transceiver to the second transceiver and a second aggregation of frequencies that are assigned to carry second communication traffic in a second link direction from the second transceiver to the first transceiver.

5 The first transceiver is configured to transmit communication feedback at an adaptive feedback rate to the second transceiver, and to receive data that is transmitted from the second transceiver over the second aggregation at an information carrying capacity that is responsive to the communication feedback.

[0009] A further embodiment provides apparatus for communication,
10 including a base station and one or more antennas coupled to the base station. The base station is configured to communicate, via the one or more antennas, with one or more mobile terminals over a bi-directional link having a first aggregation of frequencies that are assigned to carry uplink communication traffic from the mobile terminals to the base station and a second aggregation of frequencies that are assigned
15 to carry downlink communication traffic from the base station to the mobile terminals, and to receive communication feedback from at least one of the mobile terminals at an adaptive feedback rate, and to control an information carrying capacity of the second aggregation responsively to the communication feedback.

[0010] Another embodiment provides apparatus for communication,
20 including a mobile terminal and one or more antennas coupled to the mobile terminal. The mobile terminal is configured to communicate, via the one or more antennas, with a base station over a bi-directional link having a first aggregation of frequencies that are assigned to carry uplink communication traffic from the mobile terminal to the base station and a second aggregation of frequencies that are assigned to carry
25 downlink communication traffic from the base station to the mobile terminal, and to transmit communication feedback to the base station at an adaptive feedback rate so as to control an information carrying capacity of the second aggregation responsively to the communication feedback.

[0011] There is moreover provided, in accordance with yet another
30 embodiment, apparatus for communication, including first and second transceivers, which are configured to communicate over a bi-directional link having a first

aggregation of frequencies that are assigned to carry first communication traffic in a first link direction from the first transceiver to the second transceiver and a second aggregation of frequencies that are assigned to carry second communication traffic in a second link direction from the second transceiver to the first transceiver. The first
5 transceiver is configured to transmit communication feedback at an adaptive feedback rate to the second transceiver, so as to control an information carrying capacity of the second aggregation responsively to the communication feedback.

[0012] The present invention will be more fully understood from the following detailed description of the embodiments thereof, taken together with the
10 drawings in which:

BRIEF DESCRIPTION OF THE DRAWINGS

[0013] Fig. 1 is a schematic, pictorial illustration of a wireless communication network, in accordance with an embodiment of the present invention;

[0014] Fig. 2 is a flow chart that schematically illustrates a method for
15 controlling communications using feedback, in accordance with an embodiment of the present invention; and

[0015] Fig. 3 is a plot that schematically illustrates a variable quantization scheme, in accordance with an embodiment of the present invention.

DETAILED DESCRIPTION OF EMBODIMENTS

[0016] Embodiments that are described hereinbelow address and mitigate
20 the mismatch between the frequency spectra (i.e., the bandwidths) that are allocated to the two link directions in a bidirectional link and the demand for traffic capacity in the two directions. These embodiments are useful, for example, in wireless FDD systems, in which the spectra are fixed while the mismatch between bandwidth and
25 traffic demand can be large and variable. Therefore, the embodiments described hereinbelow relate to downlink and uplink communications between a base station and mobile terminals in such a system. The principles described herein, however, may also be applied in enhancing the traffic capacity of other sorts of bidirectional links.

[0017] Embodiments that are described herein variably balance the traffic
30 capacities of two link directions, such as the uplink (UL) and downlink (DL)

capacities in FDD systems based on feedback. This approach enables dynamic balancing of the DL/UL capacities relative to the instantaneous traffic load, by adaptively tuning a feedback rate on one of the link directions to meet the capacity requirements in the other link direction. In one embodiment, first and second
5 transceivers are assigned respective first and second aggregations of frequencies, which may or may not be in contiguous ranges, for carrying communication traffic over a bi-directional link. One (or both) of the transceivers transmits communication feedback at an adaptive rate (thus occupying a non-uniform part of the available bandwidth) to the other transceiver. The information carrying capacity of the other
10 link direction is controlled responsively to the communication feedback.

[0018] The idea behind this approach is that many modern communication techniques can significantly increase the system traffic throughput when a transmitter has good information regarding the state of the transmission channel. This information can be provided in the form of feedback from the receiver to the
15 transmitter, which then sets transmission parameters accordingly. The higher the feedback rate (up to some limit), the more accurately will the transmitter be able to adjust the transmission parameters, and thus increase the amount of information that it transmits over a given bandwidth. The higher feedback rate may be applied, for example, to increasing the frequency granularity at which carrier quality feedback is
20 provided (i.e., feedback is provided regarding more carriers with smaller intervals between reported carriers). When an increased granularity of feedback is provided, the transmitter may adaptively apply better transmission parameters for each of a greater number of carriers. Conversely, when a reduced granularity of feedback is available, the transmitter may apply more generalized and less optimal transmission
25 parameters to transmitted data.

[0019] Some parameters may reduce bit errors due to noise and interference at the receiver, for example, but their application comes at the cost of reduced traffic capacity. This point may be seen, for instance, in the application of encoding schemes. Stronger encoding schemes may reduce bit errors, but they may
30 correspondingly require greater bandwidth. Conversely, weaker encoding schemes

can also result in reduced traffic capacity by necessitating retransmission of data that is received in error.

[0020] The increased granularity of feedback may facilitate adaptively applying more optimal transmission parameters to ranges of carrier frequencies that are defined with increased precision. The concept of applying transmission parameters according to greater frequency resolution in response to feedback may also be valid for other transmission parameters such as MIMO transmission parameters, for example.

[0021] In accordance with an embodiment, excess uplink capacity, when available, is employed to provide quality feedback at a greater granularity, which results in a greater feedback rate on the uplink. Different encoding schemes, for example, or other transmission parameters, may be applied to carriers with a greater range of frequency precision, thereby facilitating an increase in traffic capacity on the downlink. The quantity of feedback is adapted to the available uplink capacity, and the granularity of encoding applied to downlink data may be correspondingly adapted to the granularity of the feedback. Multiple-input-multiple-output (MIMO) transmission schemes, for example, are well suited to this type of feedback-based adjustment.

[0022] Embodiments that are described herein may be useful in exploiting unused traffic capacity in one link direction to enhance the available capacity in the other direction. For example, in an FDD system in which the uplink traffic does not use the entire available bandwidth, the feedback rate on the uplink can be increased in order to increase the traffic capacity on the downlink, so as to better exploit the available bandwidth and improve balance and efficiency of the network. The feedback rate, for example, can be dynamically varied, thus allowing the network operator to alter the DL/UL capacities in the system based on the desired relation between uplink and downlink traffic capacities at different times, and possibly in different locations and/or for different subscribers.

[0023] Fig. 1 is a schematic, pictorial illustration of a wireless communication network 20, in accordance with an embodiment of the present invention. In this example, network 20 is assumed to be a FDD cellular

communication network, with MIMO capabilities. Such a network may be compliant with LTE standards promulgated by the 3rd Generation Partnership Program (3GPP), for instance. A base station 22 communicates with mobile terminals 26, 28 using a certain aggregation of frequencies for downlink communications to the mobile terminals and another aggregation of frequencies for uplink communications from the mobile terminals to the base station. In accordance with classical cellular network convention, the term "mobile terminal" is used generally, for convenience, to refer to any and all user equipment in network 20, including user equipment that may be stationary. The base station and mobile terminals in this example are specific types of wireless transceivers, but the principles described in the present disclosure are similarly applicable to transceivers and networks of other types.

[0024] Base station 22 and mobile terminals 26, 28 exchange uplink and downlink traffic, indicated in the figure by arrows 34 and 36, respectively, over their respective frequency aggregations. Base station 22 has multiple antennas 24, which it drives using suitable MIMO techniques, as are known in the art. The base station applies MIMO transmission parameters, in the form of complex (amplitude/phase) coefficients, to control the phases and amplitudes of the signals transmitted by the different antennas 24 (possibly with different coefficients for different frequencies). The base station computes these parameters on the basis of feedback 35 received from mobile terminals 26, 28. The rate of feedback is adaptive, i.e., it may be varied, typically under control of the network operator, over time and even among different mobile terminals 26, 28. Increasing the feedback rate on the uplink gives a capacity increase (C.I.) 37 on the downlink. Details of the techniques that may be used for this purpose are described hereinbelow.

[0025] Additionally or alternatively, a similar sort of adaptive feedback can be transmitted from base station 22 to mobile terminals 26 and/or 28, for use in controlling uplink transmission parameters. Some mobile terminals (such as terminals 26 in Fig. 1) have multiple antennas 30, which can transmit and receive in a MIMO configuration with transmission parameters based on feedback from the base station. As another alternative, the mobile terminals (even terminals 28, with only a

single antenna 32) can operate cooperatively in a "virtual-MIMO" configuration with feedback-based transmission parameters.

[0026] Fig. 2 is a flow chart that schematically illustrates a method for controlling communications using feedback, in accordance with an embodiment of the present invention. The method is described hereinbelow, for the sake of clarity, with specific reference to enhancing the information carrying capacity of downlink transmissions in system 20 (Fig. 1), but the principles of this method may be suitably adapted and similarly applied on the uplink, as well as in other systems.

[0027] Typically, particularly in FDD networks, the bandwidths that are allocated for uplink and downlink communications are pre-assigned and fixed by the applicable standard and/or allocated by relevant governing bodies. The present method, however, allows the network operator to adjust the traffic capacities (i.e., the amounts of information that are carried by the uplink and downlink) of the allocated bandwidths in order to make more optimal use of the available bandwidth.

[0028] For this purpose, the network operator determines the required traffic capacity on the uplink and downlink, at a requirement determination step 40. This determination may be made by a human administrator, based on reports of traffic statistics, for example, or it may be carried out automatically, by a suitable processor associated with the network. In general, the determination of the required traffic capacity looks to the desired relation between uplink and downlink traffic capacities. The desired relation is determined according to the instantaneous demand for communication traffic in each direction, as well as the specific user types and priorities. The determination of required capacity typically varies over time and so may be reevaluated and changed periodically. Furthermore, the capacity requirements may change at different times of day or under different network conditions and may even vary among different mobile terminals.

[0029] As explained above, base station 22 sets MIMO transmission parameters for antennas 24 on the basis of feedback provided by mobile terminals 26, 28 regarding downlink channel conditions. The data rate of this feedback determines how accurately the channel conditions are reported to the base station; but the feedback takes up a portion of the uplink bandwidth, possibly a portion of the data

channel, at the expense of uplink traffic capacity. The network operator therefore sets the feedback rate based on the relation between the desired downlink capacity and the available uplink capacity, at a rate setting step 42.

5 [0030] Various measures may be used for finding and implementing the desired balance between uplink and downlink. For instance, measures of total network throughput, edge cell user throughput, coverage, interference among cells, etc., may be used in capacity balancing. If there is available uplink capacity that is not used for carrying communication traffic, the network may set an even higher feedback rate in order to maximize the downlink capacity. The feedback rate need
10 not be uniform over the entire network and may vary, for example, among different geographical regions and/or different mobile terminals.

[0031] Base station 22 transmits signals to mobile terminals 26, 28, at a signal transmission step 44. The signals are typically pilot signals, which are transmitted from each of antennas 24 individually, and may also be divided into
15 different frequency bins or groups if network 20 uses frequency division multiplexing (FDM). Mobile terminals 26, 28 measure the power and phase of each of these signals. At a feedback transmission step 46, the mobile terminals return the measured values to base station 22 as feedback at the appropriate rate, such as the feedback rate that was set at step 42. The feedback may be transmitted by the mobile terminals over
20 traffic channels, which are otherwise used for carrying user data, or over control (signaling) channels, or both. For example, the feedback may be carried by a control channel as long as the control channel has available capacity, and then the excess part of the feedback may be carried by the traffic (data) channel when the capacity of the control channel is exceeded.

25 [0032] The feedback rate that is used at step 46 may determine, for example, the resolution, in bits, of the measurement data that are transmitted to the base station by the mobile stations. (A variable-resolution scheme of this sort is described hereinbelow with reference to Fig. 3.) In FDM schemes, the increase in feedback rate may be exploited, alternatively or additionally, to provide finer
30 frequency granularity, so that each measurement reported by the mobile terminals

covers a relatively small number of frequency bins, and therefore improves the performance of downlink data transmission over each group of frequency bins.

[0033] Base station 22 computes MIMO coefficients for downlink transmission to mobile terminal 26, 28 based on the feedback that it has received, at a coefficient computation step 48. Typically, the coefficients are computed for each mobile terminal based on the channel conditions that it has reported and possibly, in multi-user schemes, based on feedback from other mobile terminals, as well. The base station then transmits information to mobile terminals 26, 28 via antennas 24, using these MIMO coefficients. The precision of the MIMO coefficients, and hence the downlink traffic throughput, generally increases with the resolution of the feedback.

[0034] Various different types of MIMO schemes may be used in system 20 and benefit from the method described above. The following are some examples:

- MIMO techniques can be applied by the base station in transmitting several data streams simultaneously to a mobile terminal, using spatial multiplexing and multiple antennas both at the base station and the mobile terminal. Basic MIMO operation can be achieved with a very low feedback rate, but higher-rate feedback can increase the achievable traffic capacity of the link by providing better decomposition of the channel and optimal power allocation for each data stream.
- In multi-user MIMO, the base station transmits several data streams to several mobile terminals simultaneously using spatial multiplexing and multiple antennas at least at the base station. The MIMO coefficients are calculated so as to reduce the interference at each mobile terminal due to the signals transmitted to the other mobile terminals. (One example of this sort of technique is transmit zero-forcing, which aims to completely zero the interference caused by the signals transmitted to other terminals.) The interference between the different signals is dependent mainly on the quality of the channel estimates available to the base station. Therefore, a large reduction in the interference can be achieved by improving the quality of the channel estimates, i.e., by increasing the feedback rate. Reduced interference can result in a large increase in the achievable downlink traffic

capacity by reducing the bit-error rate, thereby reducing the need for retransmission and enabling the use of weaker encoding.

- Multi-cell MIMO techniques use the antennas of multiple base stations to transmit several data streams to mobile terminals. One technique in this family is multi-user-multi-cell-MIMO, in which multiple base stations transmit data simultaneously to multiple mobile terminals. The cooperative operation of several base stations both increases the signal power in each of the data streams and reduces interference from neighboring base stations. Efficient use of multi-cell-MIMO requires higher feedback rates, because the mobile terminals are required to send channel state information with respect to each of the base stations. The level of interference depends strongly on the quality of the channel estimates, and there is therefore a strong trade-off between channel capacity and feedback rate.

[0035] Although the examples described above relate to the use of uplink feedback in enhancing downlink traffic capacity, downlink feedback can be used, by the same token, to increase the uplink traffic capacity using downlink resources. In cellular communication systems that are known in the art, the base station is typically the coordinator of the network, and therefore generally transmits little, if any, explicit channel information to the mobile terminal. The base station may, however, increase its feedback rate to the mobile terminals in the form of more detailed control commands, which tell the mobile terminals how to compose the signals that they transmit in order to make best use the channel.

[0036] A number of MIMO schemes may be used for uplink transmission and may benefit from increased feedback on the downlink. Examples include the following:

- MIMO operates similarly on the uplink to the downlink operation described above, but uses a different sort of feedback mechanism. The base station estimates the uplink channel conditions and decides on the best transmission strategy. It then transmits a downlink control message, which tells the mobile terminal how to compose its uplink transmission, including the codebook and weights that should be used. To make best use of the channel state information, it is desirable that the base station be able to choose among many possible

codebooks and weights, and therefore requires a large control message to specify the choice it has made. The larger the control message, the more downlink traffic capacity is used by the base station in transmitting the message, and the greater is the enhancement achieved accordingly in the uplink traffic capacity.

- 5 • Virtual-MIMO is a form of multi-user MIMO in which a number of mobile terminals transmit data signals simultaneously to the base station (which receives the signals using multiple antennas). The interference between the different mobile terminals depends strongly on the proper choice of codebook and weights that are used by each mobile terminal, in order to achieve optimal transmission for
- 10 given channel conditions. A large increase in the uplink traffic capacity can be achieved by increasing the size of the downlink control messages in order to improve the quality of the selection of codebook and weights. A variant of this technique can be used in multi-cell virtual MIMO, in which several base stations jointly receive data from multiple mobile terminals.

15 [0037] Although the above examples relate specifically to MIMO transmission schemes, feedback may also be used to increase traffic capacity in other ways. For example, the transmitter may use feedback-based “water-filling” methods to better allocate the transmitted power across the allocated bandwidth. Increasing the feedback rate can improve water-filling performance, especially on links with low

20 signal/noise ratio. As another example, in incremental redundancy (IR) schemes, when a packet transmission failure occurs, additional redundancy bits are transmitted and used together with the previously-received bits for packet decoding at the receiver. Feedback from the receiver may be used by the transmitter in selecting the best IR version to use in order to optimize packet reception. An increased feedback

25 rate allows a larger selection of IR versions and hence enhanced effectiveness in retransmission. Fig. 3 is a plot that schematically illustrates a variable quantization scheme, in accordance with an embodiment of the present invention. This scheme illustrates the effect of quantization in increasing or decreasing the resolution of channel estimation feedback, and shows how finer quantization can be used, in

30 conjunction with an increased uplink feedback rate, to enhance downlink traffic capacity.

[0038] As noted earlier, channel estimation by mobile terminals is typically based on pilot symbols transmitted by the base station. The mobile terminal receives these pilot symbols and then filters them over time and frequency in order to generate a channel estimate for each frequency bin (or over all frequencies if frequency-discrimination is not used). This channel estimate can be represented as a complex number for each frequency bin. To convey the channel estimate back to the base station, the mobile terminal first quantizes the complex numbers to a predetermined number of bits, and then transmits the quantized numbers to the base station in a predefined transmission format.

10 **[0039]** At the most basic level of channel quantization, the feedback may consist only of the signal level (power) indication. Four bits may be used, for example, to describe the mean received signal over all antennas and all frequencies. At finer resolution, the feedback may include information about the frequency variation of the channel characteristics and/or the phase difference between the
15 different antennas.

[0040] The scheme shown in Fig. 3, for example, shows the effect of a uniform quantizer operating on the measurements made by a mobile terminal for a given antenna and frequency bin (although joint quantization of measurements from different antennas and/or different frequency bins may also be used). The quantizer
20 outputs a single complex number representing the amplitude and phase of the received signal in the frequency bin in question by first truncating the measured signal value and then finding the nearest value – represented by x-marks 50 - in the quantization scheme. Lines 52 mark the boundaries between decision areas. In the example shown in the figure, the quantizer output is a four-bit number with uniform
25 quantization, although non-uniform quantization schemes may alternatively be used.

[0041] The number of bits that are required to represent a set of quantized values is determined by the quantization limit V_m and the quantization step size Δ . Specifically, the number of bits required for uniform quantization is twice the smallest integer that is larger than $\log_2(V_m/\Delta)$. A larger quantization limit and/or smaller
30 quantization step will provide finer resolution but require more bits.

[0042] A similar sort of quantization may be required for several frequency bins and/or several antennas: If the total bandwidth sampled by the mobile terminal is W [Hz], and the mobile terminal transmits feedback with respect to frequency bins that are B [Hz] apart, the feedback from the mobile terminal to the base station will include the above quantized data for W/B frequency bins. If the mobile terminal reports the channel measured from N antennas at the base station, then the report size is further multiplied by N .

[0043] The base station can control the feedback rate over a large range by setting the values of the quantization limit (V_m), the quantization step (Δ) and the reporting frequency interval (B). The feedback data size, in bits, for the example of uniform quantization described above is approximately $(NW/B)\log_2(V_m/\Delta)$, which can vary from a minimum of four bits up to hundreds of bits per feedback message.

[0044] It will be appreciated that the embodiments described above are cited by way of example, and that the present invention is not limited to what has been particularly shown and described hereinabove. Rather, the scope of the present invention includes both combinations and subcombinations of the various features described hereinabove, as well as variations and modifications thereof which would occur to persons skilled in the art upon reading the foregoing description and which are not disclosed in the prior art.

20

CLAIMS

1. A method for communication, comprising:
providing a first transceiver configured to communicate with a second transceiver over a bi-directional link having a first aggregation of frequencies that are
5 assigned to carry first communication traffic in a first link direction from the first transceiver to the second transceiver and a second aggregation of frequencies that are assigned to carry second communication traffic in a second link direction from the second transceiver to the first transceiver;
transmitting from the first transceiver to the second transceiver
10 communication feedback at an adaptive feedback rate; and
controlling an information carrying capacity of the second aggregation responsively to the communication feedback.
2. The method according to claim 1, wherein controlling the information carrying capacity comprises defining a desired relation for allocation of the
15 information carrying capacity between the first aggregation and the second aggregation, and setting the feedback rate responsively to the desired relation.
3. The method according to claim 1, wherein controlling the information carrying capacity comprises identifying an excess bandwidth, not required by the first communication traffic, in the first link direction, and using the excess bandwidth to
20 increase the feedback rate in the first link direction so as to increase the information carrying capacity of the second aggregation.
4. The method according to claim 1, wherein providing the first and second transceivers comprises configuring the transceivers to operate in a frequency-domain duplexing (FDD) mode.
- 25 5. The method according to claim 1, wherein the communication feedback comprises channel information, and wherein controlling the information carrying capacity comprises adjusting transmission parameters of the second transceiver responsively to the channel information.

6. The method according to claim 5, wherein transmitting the communication feedback comprises varying a resolution of the channel information so as to set the feedback rate to a desired level.
7. The method according to claim 6, wherein varying the resolution comprises
5 adjusting a frequency granularity of measurement of the channel information.
8. The method according to any of claims 1-7, wherein controlling the information carrying capacity comprises setting selected transmission parameters of a multiple-input-multiple-output (MIMO) transmission scheme responsively to the communication feedback.
- 10 9. The method according to any of claims 1-7, wherein transmitting the communication feedback comprises adjusting a number of bits used to quantize a measure of a pilot signal received by the first transceiver from the second transceiver.
10. The method according to any of claims 1-7, wherein a first part of the communication feedback is transmitted over a control channel that is separate from a
15 data channel.
11. The method according to claim 10, wherein a second part of the communication feedback is transmitted over the data channel.
12. The method according to claim 11, wherein the second part of the communication feedback is transmitted over the data channel when a communication
20 feedback message exceeds a capacity of the control channel.
13. The method according to any of claims 1-7, wherein transmitting the communication feedback comprises increasing the feedback rate while reducing the information carrying capacity available in the first link direction so as to increase the information carrying capacity in the second link direction.
- 25 14. The method according to any of claims 1-7, wherein transmitting the communication feedback at the adaptive feedback rate comprises adjusting a frequency granularity for the communication feedback and providing communication feedback for different quantities of frequency ranges based on the frequency granularity.

15. The method according to claim 14, wherein controlling the information carrying capacity comprises selecting an encoding strength for encoding data to be transmitted over carriers in each of the different frequency ranges based on the communication feedback for the range.

5 16. A method for communication, comprising:

configuring a base station to communicate with one or more mobile terminals over a bi-directional link having a first aggregation of frequencies that are assigned to carry uplink communication traffic from the mobile terminals to the base station and a second aggregation of frequencies that are assigned to carry downlink communication traffic from the base station to the mobile terminals;

10 receiving communication feedback at the base station from at least one of the mobile terminals at an adaptive feedback rate; and

controlling an information carrying capacity of the second aggregation responsively to the communication feedback.

15 17. The method according to claim 16, wherein receiving the communication feedback comprises increasing the feedback rate while reducing the information carrying capacity available in the first link direction so as to increase the information carrying capacity in the second link direction.

18. A method for communication, comprising:

20 configuring a mobile terminal to communicate with a base station over a bi-directional link having a first aggregation of frequencies that are assigned to carry uplink communication traffic from the mobile terminal to the base station and a second aggregation of frequencies that are assigned to carry downlink communication traffic from the base station to the mobile terminal; and

25 transmitting communication feedback from the mobile terminal to the base station at an adaptive feedback rate so as to cause the base station to control an information carrying capacity of the second aggregation responsively to the communication feedback.

30 19. Apparatus for communication, comprising a first transceiver, which is configured to communicate with a second transceiver over a bi-directional link having

a first aggregation of frequencies that are assigned to carry first communication traffic in a first link direction from the first transceiver to the second transceiver and a second aggregation of frequencies that are assigned to carry second communication traffic in a second link direction from the second transceiver to the first transceiver,

5 wherein the first transceiver is configured to transmit communication feedback at an adaptive feedback rate to the second transceiver, and to receive data that is transmitted from the second transceiver over the second aggregation at an information carrying capacity that is responsive to the communication feedback.

10 20. The apparatus according to claim 19, wherein the feedback rate is set responsively to a desired relation for allocation of the information carrying capacity between the first aggregation and the second aggregation.

15 21. The apparatus according to claim 19, wherein the feedback rate is set by identifying an excess bandwidth, not required by the first communication traffic, in the first link direction, and using the excess bandwidth to increase the feedback rate in the first link direction so as to cause the second transceiver to increase the information carrying capacity of the second aggregation.

22. The apparatus according to claim 19, wherein the first and second transceivers are configured to operate in a frequency-domain duplexing (FDD) mode.

20 23. The apparatus according to any of claims 19-22, wherein the communication feedback comprises channel information, which causes the second transceiver to adjust transmission parameters used in transmitting the second communication traffic.

24. The apparatus according to claim 23, wherein the first transceiver is configured to vary a resolution of the channel information so as to set the feedback rate to a desired level.

25 25. The apparatus according to claim 24, wherein the resolution is varied by adjusting a number of bits used to quantize a measure of a pilot signal received by the first transceiver from the second transceiver.

26. The apparatus according to claim 24, wherein the resolution is varied by adjusting a frequency granularity of measurement of the channel information.

27. The apparatus according to claim 23, wherein the second communication traffic is transmitted using a multiple-input-multiple-output (MIMO) transmission scheme, and wherein the first transceiver is configured to transmit the communication feedback so as to cause the second transceiver to adjust the transmission parameters
5 of the MIMO transmission scheme.

28. The apparatus according to any of claims 19-22, wherein a first part of the communication feedback is transmitted over a control channel that is separate from a data channel.

29. The apparatus according to claim 28, wherein a second part of the communication feedback is transmitted over the data channel.
10

30. The apparatus according to claim 29, wherein the second part of the communication feedback is transmitted over the data channel when a communication feedback message exceeds a capacity of the control channel.

31. The apparatus according to claim 19, wherein the communication feedback is transmitted over a data channel.
15

32. Apparatus for communication, comprising:

a base station; and

one or more antennas coupled to the base station,

wherein the base station is configured to communicate, via the one or more
20 antennas, with one or more mobile terminals over a bi-directional link having a first aggregation of frequencies that are assigned to carry uplink communication traffic from the mobile terminals to the base station and a second aggregation of frequencies that are assigned to carry downlink communication traffic from the base station to the mobile terminals, and to receive communication feedback from at least one of the
25 mobile terminals at an adaptive feedback rate, and to control an information carrying capacity of the second aggregation responsively to the communication feedback.

33. The apparatus according to claim 32, wherein the feedback rate is set by identifying an excess bandwidth, not required by the first communication traffic, in the first link direction, and using the excess bandwidth to increase the feedback rate in

the first link direction so as to increase the information carrying capacity of the second aggregation.

34. Apparatus for communication, comprising:

a mobile terminal; and

5 one or more antennas coupled to the mobile terminal,

wherein the mobile terminal is configured to communicate, via the one or more antennas, with a base station over a bi-directional link having a first aggregation of frequencies that are assigned to carry uplink communication traffic from the mobile terminal to the base station and a second aggregation of frequencies that are assigned to carry downlink communication traffic from the base station to the mobile terminal, and to transmit communication feedback to the base station at an adaptive feedback rate so as to control an information carrying capacity of the second aggregation responsively to the communication feedback.

35. The apparatus according to claim 34, wherein the feedback rate is set by identifying an excess bandwidth, not required by the first communication traffic, in the first link direction, and using the excess bandwidth to increase the feedback rate in the first link direction so as to increase the information carrying capacity of the second aggregation.

36. Apparatus for communication, comprising first transceiver and second transceivers, which are configured to communicate over a bi-directional link having a first aggregation of frequencies that are assigned to carry first communication traffic in a first link direction from the first transceiver to the second transceiver and a second aggregation of frequencies that are assigned to carry second communication traffic in a second link direction from the second transceiver to the first transceiver,

25 wherein the first transceiver is configured to transmit communication feedback at an adaptive feedback rate to the second transceiver, so as to control an information carrying capacity of the second aggregation responsively to the communication feedback.

FIG. 1

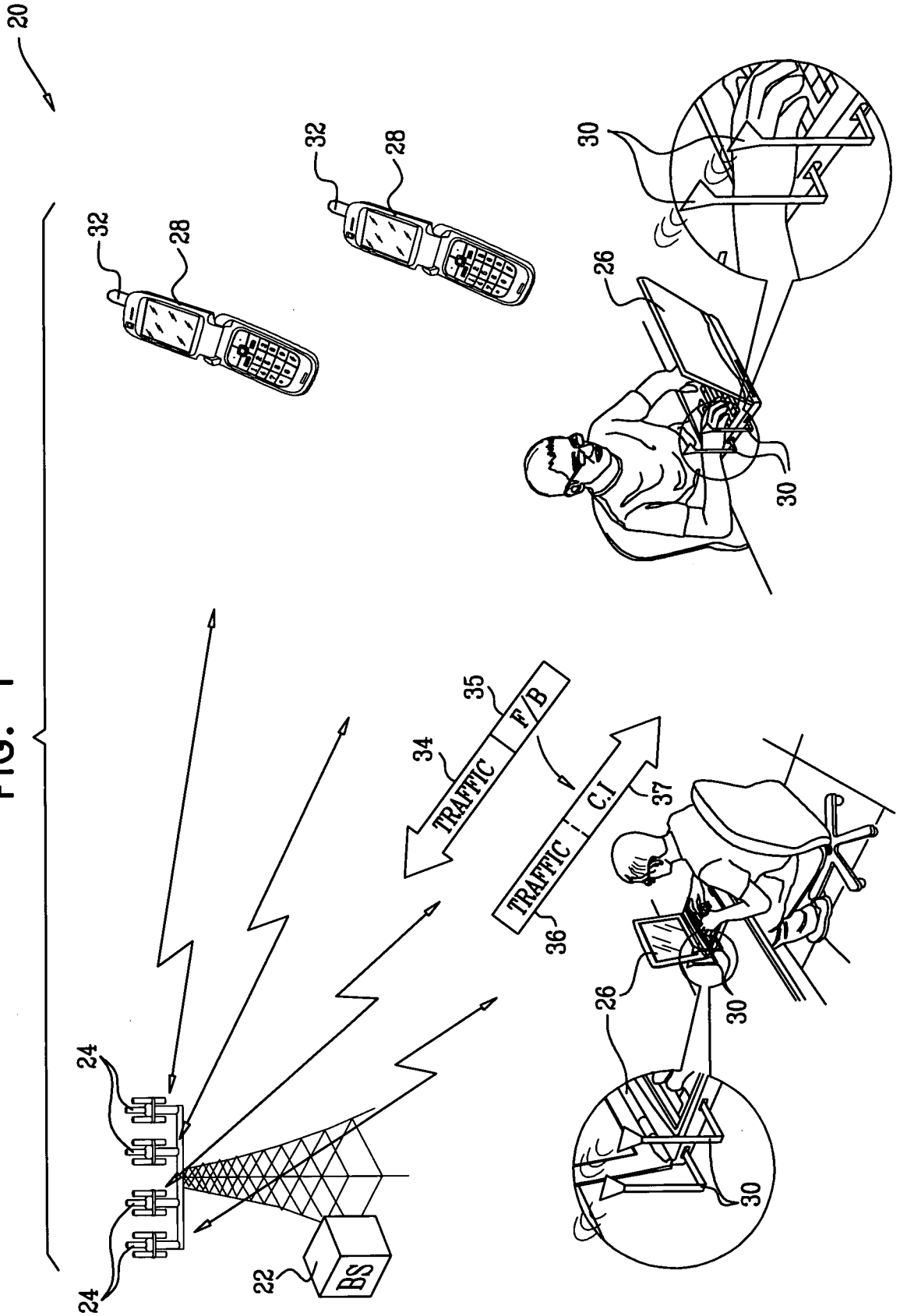

FIG. 2

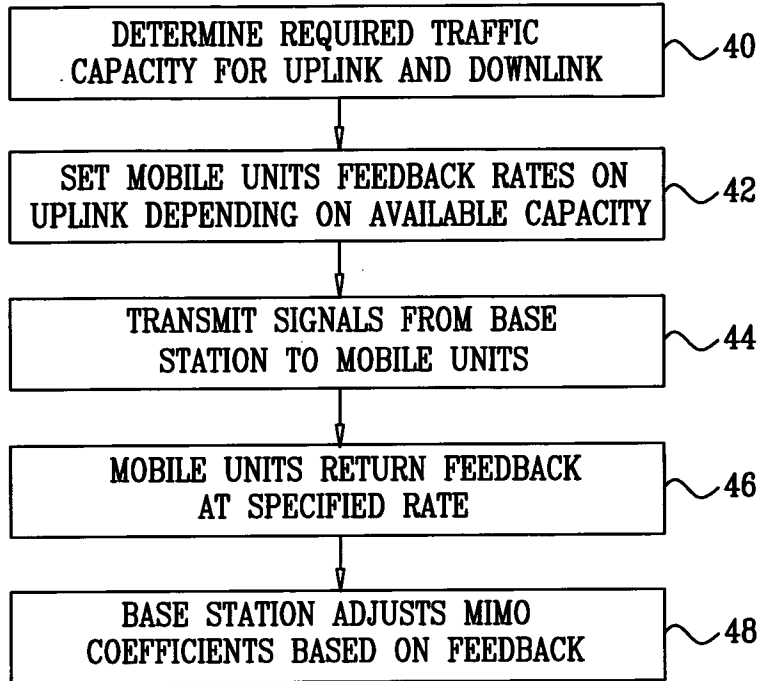
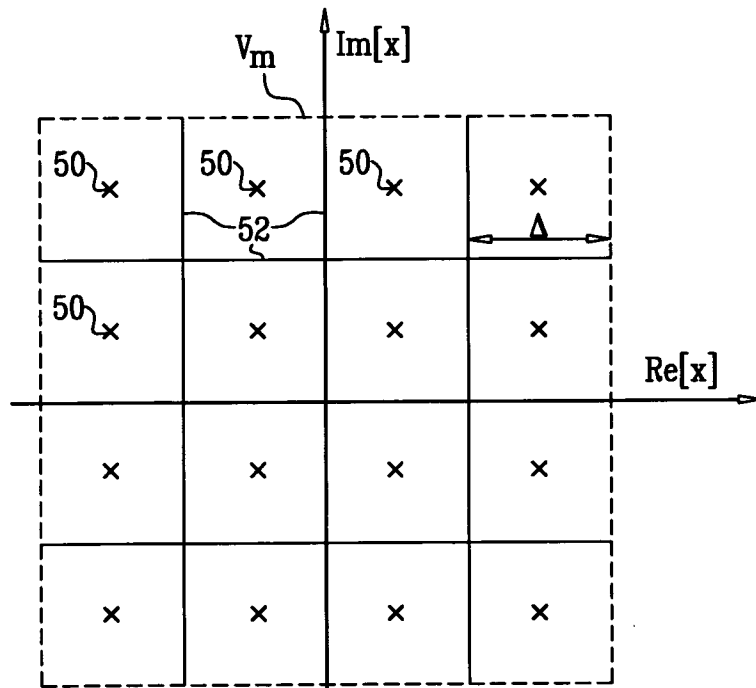

FIG. 3



INTERNATIONAL SEARCH REPORT

International application No.

PCT/IL 08/01649

A. CLASSIFICATION OF SUBJECT MATTER IPC(8) - H04W 72/00 (2009.01) USPC - 455/453 According to International Patent Classification (IPC) or to both national classification and IPC		
B. FIELDS SEARCHED Minimum documentation searched (classification system followed by classification symbols) IPC(8): H04W 72/00 (2009.01) USPC: 455/453 Documentation searched other than minimum documentation to the extent that such documents are included in the fields searched USPC: 455/403, 450, 452.2, 453, 464; 370/230.1, 232, 329, 330 (keyword limited - see terms below) Electronic data base consulted during the international search (name of data base and, where practicable, search terms used) PubWEST(PGPB, USPT, EPAB, JPAB); GoogleScholar Search Terms: communication, transceiver, frequency division duplex, FDD, bidirectional link, traffic, frequencies, transmitting, transmission, rate, feedback, control, information, carry, first transceiver, second transceiver, carry, adaptive etc.		
C. DOCUMENTS CONSIDERED TO BE RELEVANT		
Category*	Citation of document, with indication, where appropriate, of the relevant passages	Relevant to claim No.
X	US 2004/0095907 A1 (AGEE et al.) 20 May 2004 (20.05.2004), entire document, especially abstract, para. [0008], [0018], [0023], [0025]-[0026], [0029]-[0030], [0047], [0056], [0062], [0065], [0067], [0069], [0071], [0073]-[0074], [0078], [0081], [0085], [0090]-[0091], [0093], [0096]-[0097], [0099]-[0101], [0107], [0109], [0143], [0150], [0186], [0204], [0206], [0215]-[0217], [0222], [0235], [0243]-[0244], [0246]-[0247], [0265], [0271], [0375], [0386], [0389], [0397], [0474], [0476], [0482]-[0485], [0492], [0507], [0521], [0523], [0525], and [0528].	1-36
A	US 6,853,629 B2 (ALAMOUTI et al.) 08 February 2005 (08.02.2005), entire document	1-36
A	US 2005/0025093 A1 (YUN et al.) 03 February 2005 (03.02.2005), entire document	1-36
A	US 2007/0207730 A1 (NGUYEN et al.) 06 September 2007 (06.09.2007), entire document	1-36
A	US 2007/0281642 A1 (GOROKHOV) 06 December 2007 (06.12.2007), entire document	1-36
<input type="checkbox"/> Further documents are listed in the continuation of Box C. <input type="checkbox"/>		
* Special categories of cited documents: "A" document defining the general state of the art which is not considered to be of particular relevance "E" earlier application or patent but published on or after the international filing date "L" document which may throw doubts on priority claim(s) or which is cited to establish the publication date of another citation or other special reason (as specified) "O" document referring to an oral disclosure, use, exhibition or other means "P" document published prior to the international filing date but later than the priority date claimed "T" later document published after the international filing date or priority date and not in conflict with the application but cited to understand the principle or theory underlying the invention "X" document of particular relevance; the claimed invention cannot be considered novel or cannot be considered to involve an inventive step when the document is taken alone "Y" document of particular relevance; the claimed invention cannot be considered to involve an inventive step when the document is combined with one or more other such documents, such combination being obvious to a person skilled in the art "&" document member of the same patent family		
Date of the actual completion of the international search 16 March 2009 (16.03.09)		Date of mailing of the international search report 25 MAR 2009
Name and mailing address of the ISA/US Mail Stop PCT, Attn: ISA/US, Commissioner for Patents P.O. Box 1450, Alexandria, Virginia 22313-1450 Facsimile No. 571-273-3201		Authorized officer: Lee W. Young PCT Helpdesk: 571-272-4300 PCT OSP: 571-272-7774