



- (51) **International Patent Classification:**  
G01B 11/00 (2006.01) G01N 21/00 (2006.01)
- (21) **International Application Number:**  
PCT/US2013/065667
- (22) **International Filing Date:**  
18 October 2013 (18.10.2013)
- (25) **Filing Language:** English
- (26) **Publication Language:** English
- (30) **Priority Data:**  
61/716,153 19 October 2012 (19.10.2012) US  
61/829,002 30 May 2013 (30.05.2013) US
- (71) **Applicant: MILWAUKEE ELECTRIC TOOL CORPORATION** [US/US]; 13 135 West Lisbon Road, Brookfield, WI 53005 (US).
- (72) **Inventors: MUECKL, Gareth;** 2927 N. 70th Street, Milwaukee, WI 53210 (US). **CROWE, Jason, R.;** 1453 N. 50th Place, Milwaukee, WI 53208 (US).
- (74) **Agent: EVANS, Edward, J.;** Michael Best & Friedrich LLP, 100 East Wisconsin Avenue, Suite 3300, Milwaukee, WI 53202-4108 (US).

(81) **Designated States** (unless otherwise indicated, for every kind of national protection available): AE, AG, AL, AM, AO, AT, AU, AZ, BA, BB, BG, BH, BN, BR, BW, BY, BZ, CA, CH, CL, CN, CO, CR, CU, CZ, DE, DK, DM, DO, DZ, EC, EE, EG, ES, FI, GB, GD, GE, GH, GM, GT, HN, HR, HU, ID, IL, IN, IR, IS, JP, KE, KG, KN, KP, KR, KZ, LA, LC, LK, LR, LS, LT, LU, LY, MA, MD, ME, MG, MK, MN, MW, MX, MY, MZ, NA, NG, NI, NO, NZ, OM, PA, PE, PG, PH, PL, PT, QA, RO, RS, RU, RW, SA, SC, SD, SE, SG, SK, SL, SM, ST, SV, SY, TH, TJ, TM, TN, TR, TT, TZ, UA, UG, US, UZ, VC, VN, ZA, ZM, ZW.

(84) **Designated States** (unless otherwise indicated, for every kind of regional protection available): ARIPO (BW, GH, GM, KE, LR, LS, MW, MZ, NA, RW, SD, SL, SZ, TZ, UG, ZM, ZW), Eurasian (AM, AZ, BY, KG, KZ, RU, TJ, TM), European (AL, AT, BE, BG, CH, CY, CZ, DE, DK, EE, ES, FI, FR, GB, GR, HR, HU, IE, IS, IT, LT, LU, LV, MC, MK, MT, NL, NO, PL, PT, RO, RS, SE, SI, SK, SM, TR), OAPI (BF, BJ, CF, CG, CI, CM, GA, GN, GQ, GW, KM, ML, MR, NE, SN, TD, TG).

**Published:**

— with international search report (Art. 21(3))

(54) **Title:** VISUAL INSPECTION DEVICE

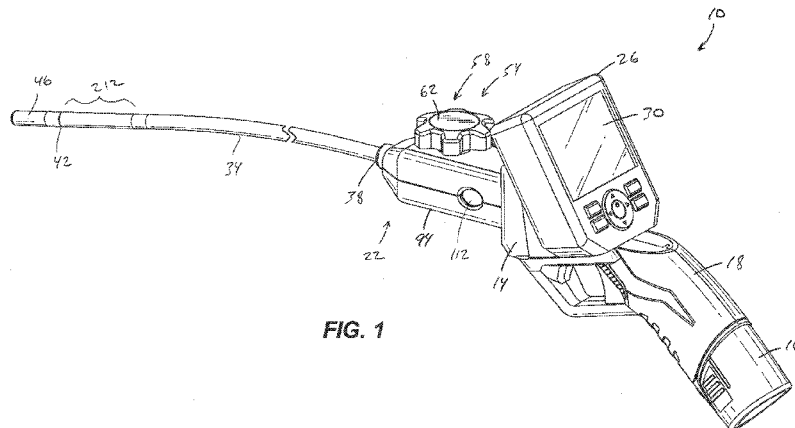

**FIG. 1**

(57) **Abstract:** A visual inspection device includes a housing, a handle coupled to the housing that is grasped by a user while the device is in use, an articulating camera unit coupled to the housing, and a display unit coupled to the housing to display an image transmitted by the articulating camera unit.

WO 2014/063042 A1

## VISUAL INSPECTION DEVICE

### CROSS-REFERENCE TO RELATED APPLICATIONS

[0001] This application claims priority to co-pending U.S. Provisional Patent Application No. 61/716,153 filed on October 19, 2012 and U.S. Provisional Patent Application No. 61/829,002 filed on May 30, 2013, the entire contents of both of which are incorporated herein by reference.

### FIELD OF THE INVENTION

[0002] The present invention relates to a visual inspection device and, more particularly, to a hand-held visual inspection device for viewing confined or otherwise difficult to access locations.

### BACKGROUND OF THE INVENTION

[0003] Visual inspection devices (e.g., borescopes, endoscopes, or the like) provide tradespeople, such as plumbers, electricians, mechanics, HVAC (heating, ventilation, and air conditioning) professionals, welders, carpenters, MRO (maintenance, repair, and operations) professionals, or the like, with means to view locations that are inaccessible without dismantling or removing surrounding structures. For example, visual inspection devices are used to inspect inside pipes, walls, floors, aircraft or automobile engines, or other equipment that include narrow, small, and/or dark passageways.

### SUMMARY OF THE INVENTION

[0004] The invention provides, in one aspect, a visual inspection device including a housing, a handle coupled to the housing that is grasped by a user while the device is in use, an articulating camera unit coupled to the housing, and a display unit coupled to the housing to display an image transmitted by the articulating camera unit.

[0005] Other features and aspects of the invention will become apparent by consideration of the following detailed description and accompanying drawings.

## BRIEF DESCRIPTION OF THE DRAWINGS

[0006] FIG. 1 is a front perspective view of a visual inspection device of the invention.

[0007] FIG. 2 is a partial cutaway view of an articulating camera unit exploded from a housing of the visual inspection device of FIG. 1.

[0008] FIG. 3 is a front perspective view of the visual inspection device with the articulating camera unit installed in an alternate orientation.

[0009] FIG. 4 is a front perspective view of the visual inspection device of FIG. 1 with a thermal imaging unit installed rather than the articulating camera unit.

[0010] FIG. 5 is an exploded, rear perspective view of the visual inspection device of FIG. 1 with an intermediate module coupling the housing to a display unit.

[0011] FIG. 6 is a cross-sectional view of a portion of the articulating camera unit installed to the housing of the visual inspection device.

[0012] FIG. 7 is a perspective view of an articulating section of a flexible cable of the articulating camera unit, illustrating a camera oriented coaxially with the articulating section.

[0013] FIG. 8 is a plan view of the articulating section and camera of FIG. 7, illustrating the camera oriented transversely to the remainder of the flexible cable.

[0014] FIG. 9 is an enlarged, perspective view of another articulating section incorporated in an articulating camera unit for use with the visual inspection device of FIG. 1.

[0015] FIG. 10 is a front perspective view of a disc of the articulating section shown in FIG. 9.

[0016] FIG. 11 is a front perspective view of another disc for use in the articulating section of FIG. 9.

[0017] Before any embodiments of the invention are explained in detail, it is to be understood that the invention is not limited in its application to the details of construction and the

arrangement of components set forth in the following description or illustrated in the following drawings. The invention is capable of other embodiments and of being practiced or of being carried out in various ways. Also, it is to be understood that the phraseology and terminology used herein is for the purpose of description and should not be regarded as limiting.

#### DETAILED DESCRIPTION

**[0018]** FIG. 1 illustrates a visual inspection device 10 configured as a hand-held unit for a user (e.g., a plumber, an electrician, a mechanic, an HVAC professional, a welder, a carpenter, an MRO professional, or the like) to view the interior of a confined space (e.g., a pipe, a wall, a floor, an engine, or the like). The visual inspection device 10 includes a housing 14 and a handle 18 extending from the housing 14 that is grasped by a user while the device is in use. The visual inspection device 10 also includes a battery pack 16 supported by the handle 18 for powering the device. Particularly, the handle 18 includes a cavity (not shown) in which the battery pack 16 is removably received. Such a battery pack 16 may be configured as a rechargeable power tool battery pack 16 that is usable with a variety of power tools (e.g., drills, screwdrivers, saws, or the like). The battery pack 16 may be a twelve-volt (12V) battery pack. The battery pack 16 may also include three battery cells having, for example, a lithium (Li), lithium-ion (Li-ion), or other lithium-based chemistry. For example, the battery cells may have a chemistry of lithium-cobalt (Li~Co), lithium-manganese (Li~Mn) spinel, or Li~Mn nickel. In such embodiments, each battery cell may have a nominal voltage of about, for example, 3.6V, 4.0V, or 4.2V. In other embodiments, the battery cells may have a nickel-cadmium, nickel-metal hydride, or lead acid battery chemistry. In further embodiments, the battery pack 16 may include fewer or more battery cells, and/or each battery cell may have a different nominal voltage.

**[0019]** The visual inspection device 10 further includes an articulating camera unit 22 coupled to the housing 14 and a display unit 26 having a screen 30 for displaying an image transmitted by the articulating camera unit 22. With continued reference to FIG. 1, the articulating camera unit 22 includes a flexible cable 34 having a first or proximal end 38 coupled to the housing 14 and a second or distal end 42. The articulating camera unit 22 further includes a camera 46 coupled to the distal end 42 of the flexible cable 34. The camera 46 transmits image data through the flexible cable 34, though other forms of data may also be transmitted through

the flexible cable 34 (e.g., sound, etc.). Such a camera is described and shown in U.S. Patent No. 8,189,043, the entire content of which is incorporated herein by reference.

**[0020]** With reference to FIGS. 1, 2, and 6, the articulating camera unit 22 also includes an articulation mechanism 54 for articulating and maneuvering the camera 46 relative to the flexible cable 34. The articulation mechanism 54 includes an actuator 58 (FIGS. 1 and 2) that is manipulatable by a user of the visual inspection device 10 to articulate the camera 46 relative to the flexible cable 34. In the illustrated embodiment of the device as shown in FIGS. 1 and 2, the actuator 58 is a dial 62 that is rotatable in a first direction (e.g., counter-clockwise) for articulating the camera 46 in a first direction (e.g., left) relative to the flexible cable 34. Likewise, the dial 62 is rotatable in a second direction (e.g., clockwise) for articulating the camera 46 in a second direction (e.g., right) relative to the flexible cable 34. As such, the user of the visual inspection device 10 may selectively articulate or maneuver the camera 46 in a certain direction by rotating the dial 62. Alternatively, the actuator 58 may be configured differently to provide an alternative user interface (e.g. a slider, a lever, etc.).

**[0021]** With reference to FIGS. 6 and 7, the articulating mechanism 54 also includes a continuous wire 66 disposed within and routed through the flexible cable 34. A first end 70 of the wire 66 is attached to the camera 46 at a first location radially offset from a longitudinal axis 78 of the camera 46, while a second end 82 of the wire 66 is attached to the camera 46 at a second location radially offset from the longitudinal axis 78 of the camera 46 (FIG. 7). In the illustrated embodiment of the visual inspection device 10, the first and second ends 70, 82 of the wire 66 are attached to the camera 46 on opposite sides of the longitudinal axis 78. Alternatively, the ends of the wire 70, 82 may be attached to the camera 46 at other locations.

**[0022]** A middle portion 90 of the wire 66 is wrapped around a pulley 84 which, in turn, is coupled for co-rotation with the dial 62 such that tension may be developed in the wire 66 proximate one of the first and second ends 70, 82 in response to rotation of the dial 62 (FIG. 6). Moreover, rotation of the dial 62 in a first direction (e.g., counter-clockwise) develops tension in the wire 66 proximate the first end 70, and rotation of the dial 62 in a second direction (e.g., clockwise) develops tension in the wire 66 proximate the second end 82. As such, the user may rotate the dial 62 to turn the camera 46 to the left or right as shown in FIG. 8 to obtain an

additional degree of freedom of movement for the camera 46. Alternatively, individual or separate wires may be utilized rather than the single continuous wire 66 wrapped around the pulley 84. The articulation mechanism 22 may further include two additional pulleys 92 (FIG. 6) in contact with respective lengths of the continuous wire 66 to reduce friction on the wire 66 as it is redirected into the flexible cable 34 and toward the camera 46.

[0023] With reference to FIGS. 1-3, the articulating camera unit 22 includes a mount 94 upon which the dial 62 is rotatably coupled. The mount 94, in turn, is removably coupled to the housing 14 in multiple orientations (FIGS. 1 and 3) to allow a user of the visual inspection device 10 to orient the dial 62 in a position that is either more comfortable or accessible for the user. In the illustrated embodiment of the device 10 as shown in FIG. 2, the housing 14 includes a boss 98 having a square cross-sectional shape, and the mount 94 includes a receptacle 102 having a corresponding square cross-sectional shape in which the boss 98 is received. Alternatively, the boss 98 and the receptacle 102 may be configured having any of a number of different non-circular cross-sectional shapes to inhibit relative rotation between the mount 94 and the housing 14.

[0024] With reference to FIG. 2, the mount 94 includes a detent or quick-release latch mechanism 104 for positively securing the mount 94 to the housing 14 in each of the different orientations shown in FIGS. 1 and 3. In the illustrated embodiment, the latch mechanism 104 includes pivotable arms 108 and corresponding buttons 112 for actuating the arms 108 between a spring-biased, radially inward position (shown in FIG. 2) and a radially outward position. As shown in FIG. 6, distal ends of the arms 108 are received within an annular groove 116 of an electrical connector 106, described in more detail below, for securing the mount 94 to the housing 14 in each of the different orientations shown in FIGS. 1 and 3. The detent or quick-release latch mechanism 104 allows the user of the visual inspection device 10 to quickly attach the articulating camera unit 22 to the housing 14 and remove the articulating camera unit 22 from the housing 14. Alternatively, the quick-release latch mechanism 104 may be omitted, and a snug fit may be employed between the boss 98 and the receptacle 102 for retaining the mount 94 to the housing 14.

[0025] With reference to FIG. 2, the visual inspection device 10 includes an electrical connector 106 extending from the housing 14, and the articulating camera unit 22 includes a mating electrical connector 110 within the mount 94. In the illustrated embodiment of the device 10, the electrical connector 106 is a multi-conductor cylindrical jack 114 and the electrical connector 110 is a corresponding cylindrical socket 118 located adjacent the receptacle 102 of the mount 94. Particularly, the electrical connector 106 is a four-conductor jack with an insulator (not shown) surrounding the jack 114, and the electrical connector 110 is a mating four-conductor socket 118. Such an electrical connector 106 is otherwise known as a Tip Ring Ring Sleeve (TRRS) connector. Alternatively, the electrical connectors 106, 110 may be configured in different ways, and may employ any of a number of different conductors depending upon the number of signals or channels of data that must be transmitted by the camera 46.

[0026] The cylindrical configuration of the jack 114 and the corresponding socket 118 enables the articulating camera unit 22 to be mounted to the housing 14 in multiple orientations to position the dial 62 in accordance with the user's comfort or ease of accessibility. Although the articulating camera unit 22 is capable of being mounted to the housing 14 in four different orientations corresponding to the square cross-sectional shape of the boss 98 and the mount receptacle 102 (FIG. 2), the boss 98 and the mount receptacle 102 may be configured in any of a number of non-circular cross-sectional shapes to permit more mounting orientations of the articulating camera unit 22 to accommodate additional placements of the dial 62 relative to the housing 14. As shown in FIG. 2, the electrical connector 106 extends from a rear side of the housing 14 but it is not limited to that location.

[0027] With reference to FIG. 4, a thermal imager unit 134 may be coupled to the electrical connector 106 and interchangeable with the articulating camera unit 22. The thermal imager unit 134 includes a thermal camera (not shown), an interface module 138, and a flexible cable 142 interconnecting the thermal camera and the module 138. Like the mount 94 of the articulating camera unit 22, the interface module 138 includes a receptacle (not shown) having a square cross-sectional shape and an electrical connector (e.g., a TRRS-style electrical socket, not shown) accessible through the receptacle that is electrically connectable to the electrical connector 106 on the housing 14. As such, the interface module 138 may be supported upon the housing 14 in four different orientations, one of which is shown in FIG. 4. The module 138 may

also include a similar detent mechanism or quick-release latch mechanism as that used in the articulating camera unit 22 so the module 138 may be secured to the boss 98 on the housing 14 in a similar manner. The module 138 includes a user interface 154 including buttons 158 for selecting options associated with the thermal imager unit 134 (e.g. temperature range, color schemes, etc.).

**[0028]** An adapter (not shown) may be coupled to the electrical connector 106 and interchangeable with either of the articulating camera unit 22 or the thermal imager unit 134 for using the visual inspection device 10 with a conventional sewer camera reel (not shown). Such a sewer camera reel includes a reel having an extended length (e.g., upwards of 200 feet) of flexible cable and a camera attached to a distal end of the flexible cable. The adapter includes a mount similar to the mount 94 of the articulating camera unit 22, an electrical connector (not shown) of a particular style for connection to the sewer camera reel, and an electrical cable interconnecting the electrical connector and the mount. Like the articulating camera unit 22, the adapter includes an electrical connector (e.g., a TRRS-style electrical socket) within the mount for connecting to the electrical connector 106 on the housing 14.

**[0029]** With reference to FIG. 5, the display unit 26 is removably coupled to the housing 14 to allow a user to hold the display unit 26 separately from the remainder of the visual inspection device 10 during use. As such, the user may hold the display unit 26 steady, or place the display unit 26 on a stationary support surface, while maneuvering the remainder of the visual inspection device 10 during an inspection. In the illustrated embodiment of the device 10, the display unit 26 is slidably coupled to the housing 14 using a tongue and groove arrangement, with the housing 14 including parallel grooves 174 in which respective tongues or ribs 176 on the display unit 26 are slidably received. Alternatively, the display unit 26 may be removably coupled to the housing 14 using any of a number of different physical connections.

**[0030]** The visual inspection device 10 includes a wireless transmitter (e.g., a frequency modulated radio transmitter) positioned in the housing 14 for transmitting the image from either the camera unit 22 or the thermal imager unit 134 and a corresponding wireless receiver positioned in the display unit 26 for viewing the image on the screen 30. Although not shown, the visual inspection device 10 includes corresponding electrical contacts on the housing 14 and



the display unit 26 that are engaged when the display unit 26 is attached to the housing 14 such that transmission of the image from either the camera unit 22 or the thermal imager unit 134 to the display unit 26 occurs through the electrical contacts. In operation of the visual inspection device 10, when the display unit 26 is detached from the housing 14, the wireless transmitter and receiver are automatically activated to provide a seamless transition from transmitting the image through the engaged electrical contacts to transmitting the image wirelessly using the wireless transmitter and receiver. Likewise, when the display unit 26 is re-attached to the housing 14, the wireless transmitter and receiver are automatically deactivated to provide a seamless transition back to transmitting the image through the engaged electrical contacts.

**[0031]** With continued reference to FIG. 5, the visual inspection device 10 may also include a module 178 selectively interconnecting the display unit 26 and the housing 14 and another wireless transmitter positioned in the module 178 for transmitting the image from either the camera unit 22 or the thermal imager unit 134 to a mobile electronic device (e.g., a smart phone, a tablet, etc.). As such, the image viewed by either the camera unit 22 or the thermal imager unit 134 can be remotely viewed by others using their mobile electronic devices, thereby enabling multiple users to view the same image that the operator of the visual inspection device 10 sees on the screen 30. The wireless transmitter in the module 178 may be a short-wavelength radio transmitter using Wi-Fi technology. Alternatively, other transmitters (e.g., a BLUETOOTH transmitter) may be utilized.

**[0032]** Although not shown, the module 178 includes pass-through electrical contacts that electrically interconnect the respective electrical contacts on the housing 14 and the display unit 26 when the module 178 interconnects the housing 14 and the display unit 26. The wireless transmitter in the module 178 also receives the image from the engaged electrical contacts on the housing 14 and the pass-through electrical contacts on the module 178. The module 178 may be utilized for transmitting the image to remote users' mobile devices, regardless of whether the display unit 26 is attached to the module 178.

**[0033]** With reference to FIG. 7, the flexible cable 34 includes an articulating section 212 for articulating or adjusting the position of the camera 46 relative to the remainder of the cable 34. The articulating section 212 includes spaced discs 216 interconnected by parallel coil

springs 220. As such, the coil springs 220 maintain the discs 216 in a biased, linear orientation in which the articulating section 212 of the cable 34 is substantially coaxial with the camera 46. Lengths of the continuous wire 66 are disposed within respective sheaths 228 for protecting the lengths of wire 66 between the articulating section 212 and the mount 94.

**[0034]** With continued reference to FIG. 7, respective lengths of the wire 66, routed through the sheaths 228, are spiral-wound around a plurality of electrical wires 232 leading to the camera 46. A distal end of the sheaths 228 terminates in a first 216a of the discs 216, while respective lengths of the wire 66 are routed through apertures 236 in the individual discs 216, with the respective ends 70, 82 of the wire 66 being attached to the camera 46 in the manner described above. The sheaths 228 and corresponding lengths of wire 66 are twisted or spiral-wound around the electrical wires 232 along the length of the flexible cable 34, excluding the articulating section 212, to prevent pre-tensioning the wire 66 when the flexible cable 34 is adjusted or manipulated by the user. Accordingly, adjusting the flexible cable 34 does not impart any unwanted movement to the articulating section 212 or the camera 46.

**[0035]** In operation of the remote inspection device 10 with the articulating camera unit 22, the user may grasp and manipulate the flexible cable 34 to position the camera 46, and may also actuate the wire 66 to turn the camera 46 and obtain an additional degree of freedom. Particularly, by tensioning one length of the wire 66, the coil springs 220 bend and the individual discs 216 in the articulating section 212 skew to thereby turn the camera 46 in a first direction (FIG. 8). Likewise, by tensioning the other length of the wire 66, the coil springs 220 bend and the individual discs 216 in the articulating section 212 skew to thereby turn the camera 46 in an opposite, second direction (shown in phantom in FIG. 8). The lengths of wire 66 are tensioned by rotating the dial 62 in the manner described above.

**[0036]** FIG. 9 illustrates another articulating camera unit 300 for use with the visual inspection device 10 of FIG. 1. The articulating camera unit 300 includes an articulating section 302 having a series of spaced discs 304 interconnected by parallel resilient cables 308 (e.g., high-strand count stainless steel cable) that behave as springs for biasing the discs 304 in a linear orientation in which the articulating section 302 is substantially coaxial with a camera 306. With reference to FIG. 10, the discs 304 include a center aperture 312 for electrical wires (e.g., wires

232; FIG. 7) to pass through, and two apertures 316 for respective lengths of a continuous wire 320 to pass through (FIG. 9). In addition, each of the discs 304 includes two slots 324 (FIG. 10) formed within respective tabs 328 on opposite sides of the disc 304, and the resilient cables 308 are received within the slots 324 (FIG. 9). The resilient cables 308 are positioned within the slots 324 and the tabs 328 are crimped to mechanically deform the slots 324, thereby securing the resilient cables 308 to each of the discs 304. The articulating camera unit 300 operates in an identical manner as the unit 22 described above and shown in FIGS. 1-8.

**[0037]** FIG. 11 illustrates an alternative construction of a disc 400 for use in the articulating camera unit 300 of FIG. 9. The disc 400 includes a center aperture 404 for electrical wires (e.g., wires 232; FIG. 7) to pass through, and two apertures 408 (FIG. 11) for respective lengths of the continuous wire 320 to pass through, similar to the disc 304. In addition, the disc 400 includes two slots 412 formed on opposite sides of the disc 400 in which the resilient cables 308 are received. The resilient cables 308 are welded (i.e., electrically welded) or soldered to the disc 400 to interconnect a plurality of the discs 400. The disc 400 can be made of different materials. For example, for electrically welding the resilient cables 308 to the disc 400, the disc 400 may be made from stainless steel, and for soldering the resilient cables 308 to the disc 400 (e.g., using silver solder), the disc 400 may be made from brass or stainless steel.

**[0038]** Various features of the invention are set forth in the following claims.

## CLAIMS

What is claimed is:

1. A visual inspection device comprising:  
a housing;  
a handle coupled to the housing that is grasped by a user while the device is in use;  
an articulating camera unit coupled to the housing; and  
a display unit coupled to the housing to display an image transmitted by the articulating camera unit.
2. The visual inspection device of claim 1, wherein the articulating camera unit includes  
a flexible cable including a first end coupled to the housing and a second end,  
a camera coupled to the second end of the flexible cable and operable to transmit image data through the flexible cable, and  
an articulation mechanism operable to articulate the camera relative to the flexible cable.
3. The visual inspection device of claim 2, wherein the articulation mechanism includes an actuator coupled to the housing, and wherein the actuator is manipulatable to articulate the camera relative to the flexible cable.
4. The visual inspection device of claim 3, wherein the actuator is a dial that is rotatably coupled to the housing.
5. The visual inspection device of claim 4, wherein the dial is rotatable in a first direction for articulating the camera in a first direction relative to the flexible cable, and wherein the dial is rotatable in a second direction for articulating the camera in a second direction relative to the flexible cable.

6. The visual inspection device of claim 3, wherein the articulation mechanism includes a continuous wire at least partially disposed within the flexible cable, wherein a first end of the wire is attached to the camera at a first location radially offset from a longitudinal axis of the camera, and wherein a second end of the wire is attached to the camera at a second location radially offset from the longitudinal axis of the camera.

7. The visual inspection device of claim 6, wherein the first and second locations are on opposite sides of the longitudinal axis.

8. The visual inspection device of claim 6, wherein a middle portion of the wire is coupled to the actuator, and wherein tension is developed in the wire proximate one of the first and second ends in response to movement of the actuator.

9. The visual inspection device of claim 8, wherein the actuator is a dial, and wherein the middle portion of the wire is wrapped around the dial such that rotation of the dial in a first direction develops tension in the wire proximate the first end, and rotation of the dial in a second direction develops tension in the wire proximate the second end.

10. The visual inspection device of claim 9, wherein the articulation mechanism further includes a pulley positioned between the dial and the flexible cable, and wherein the pulley is engaged with the wire for guiding the wire between the dial and the flexible cable.

11. The visual inspection device of claim 3, wherein the articulating camera unit further includes a mount to which the actuator is coupled, and wherein the mount is removably coupled to the housing.

12. The visual inspection device of claim 11, further comprising:  
a first electrical connector extending from the housing; and  
a second electrical connector extending from an end of the flexible cable opposite the camera, the mount at least partially surrounding the second electrical connector.

13. The visual inspection device of claim 12, wherein the first electrical connector is one of a multi-conductor, cylindrical jack and a cylindrical socket, and wherein the second electrical connector is the other of the jack and the socket.

14. The visual inspection device of claim 13, wherein the mount is removably coupled to the housing in a plurality of different orientations relative to the housing.

15. The visual inspection device of claim 14, further comprising one of a detent mechanism and a quick-release latch mechanism for alternately securing the mount to the housing in each of the different orientations.

16. The visual inspection device of claim 14, further comprising:  
a boss having a square cross-sectional shape coupled to one of the housing and the mount; and  
a receptacle having a corresponding square cross-sectional shape defined by the other of the housing and the mount, wherein the boss is received within the receptacle in four different orientations to alternately position the actuator in each of the different orientations relative to the housing.

17. The visual inspection device of claim 2, wherein the flexible cable includes an articulating section having a plurality of interconnected discs.

18. The visual inspection device of claim 17, wherein the articulating section of the flexible cable includes a biasing member interconnecting the discs and biasing the discs to a linear orientation.

19. The visual inspection device of claim 18, wherein the biasing member is one of a coil spring and a cable.

20. The visual inspection device of claim 17, wherein the discs are one of crimped, welded, and soldered to the biasing member.

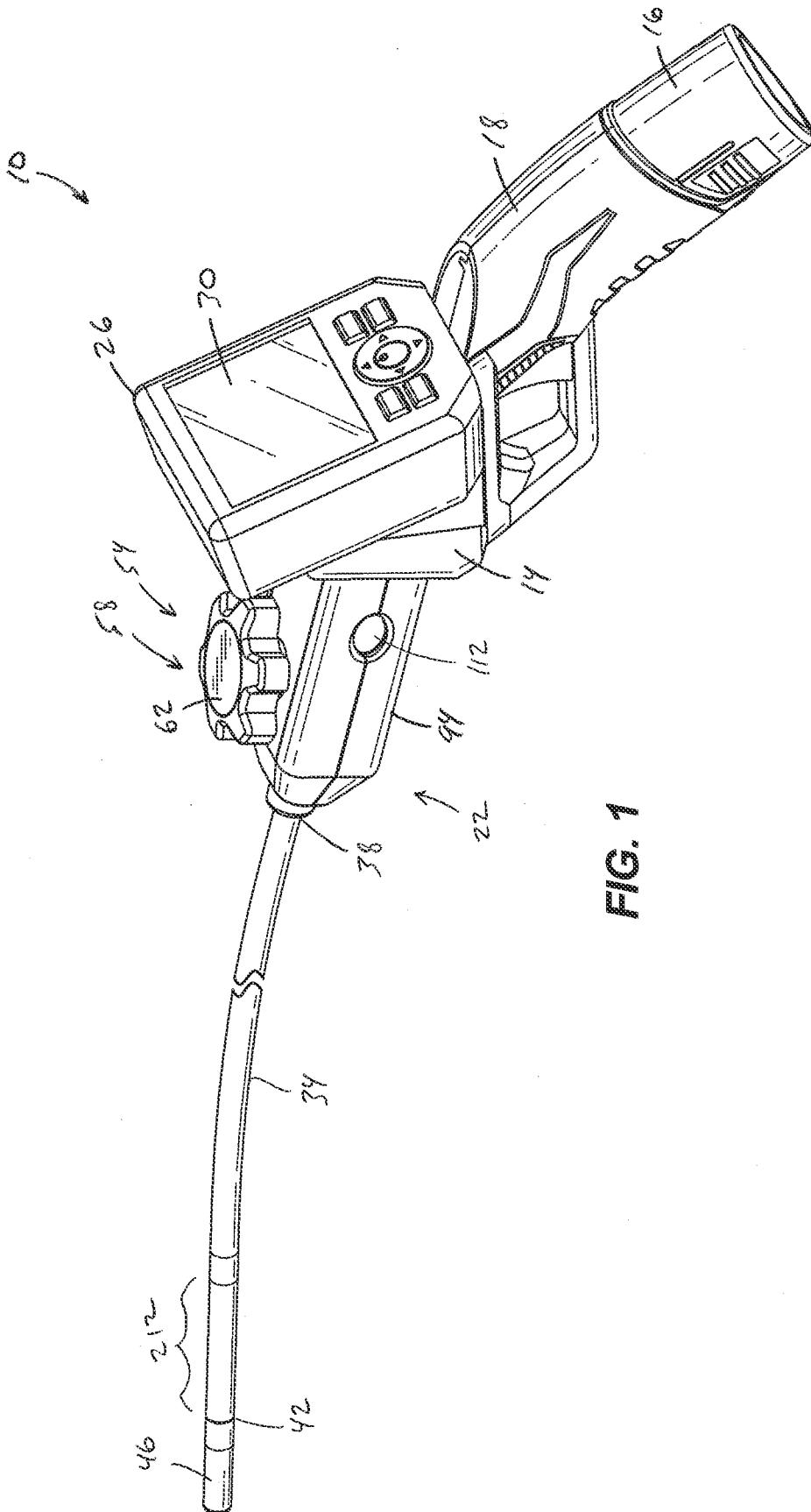

FIG. 1

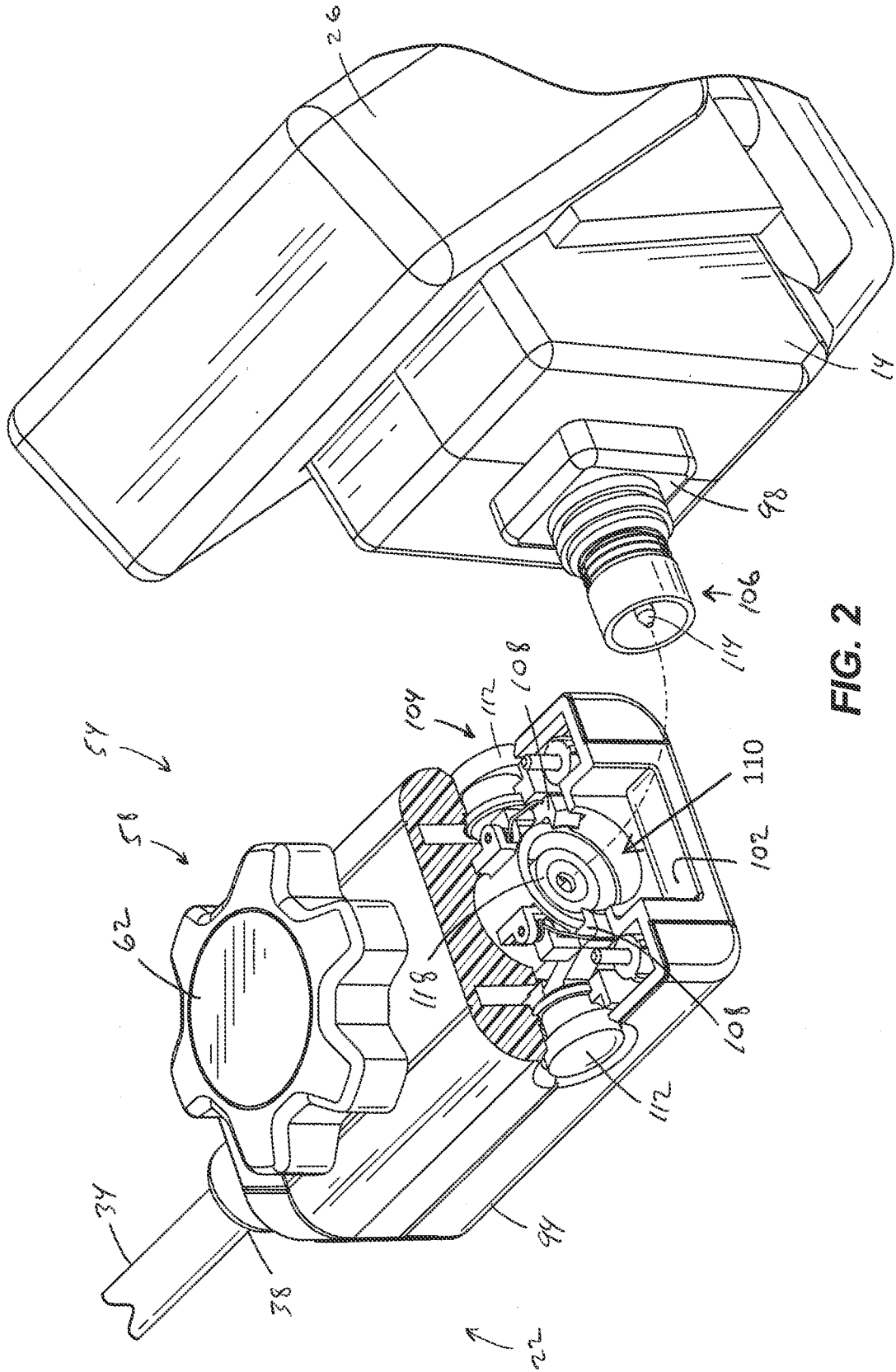

FIG. 2



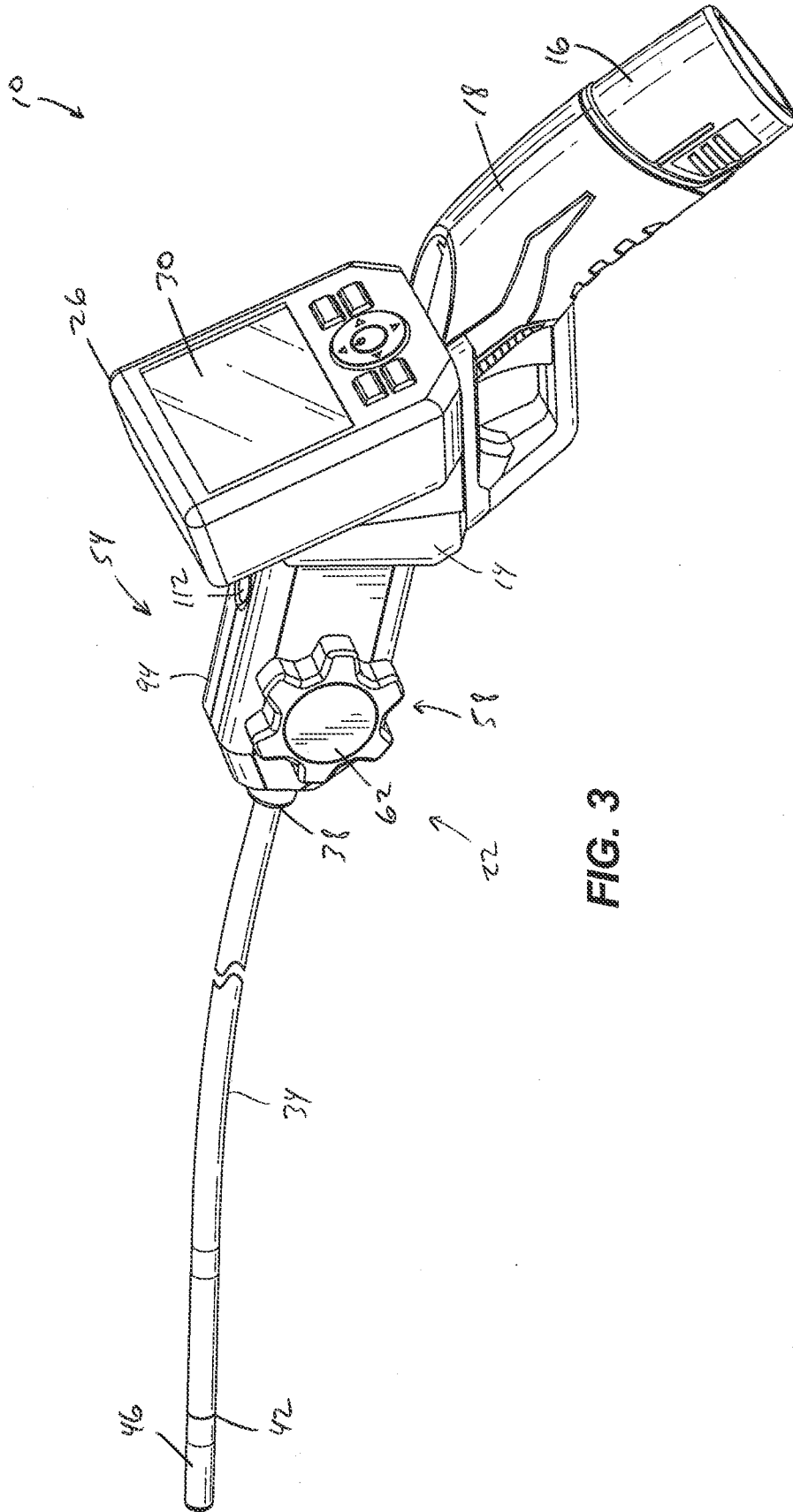

FIG. 3

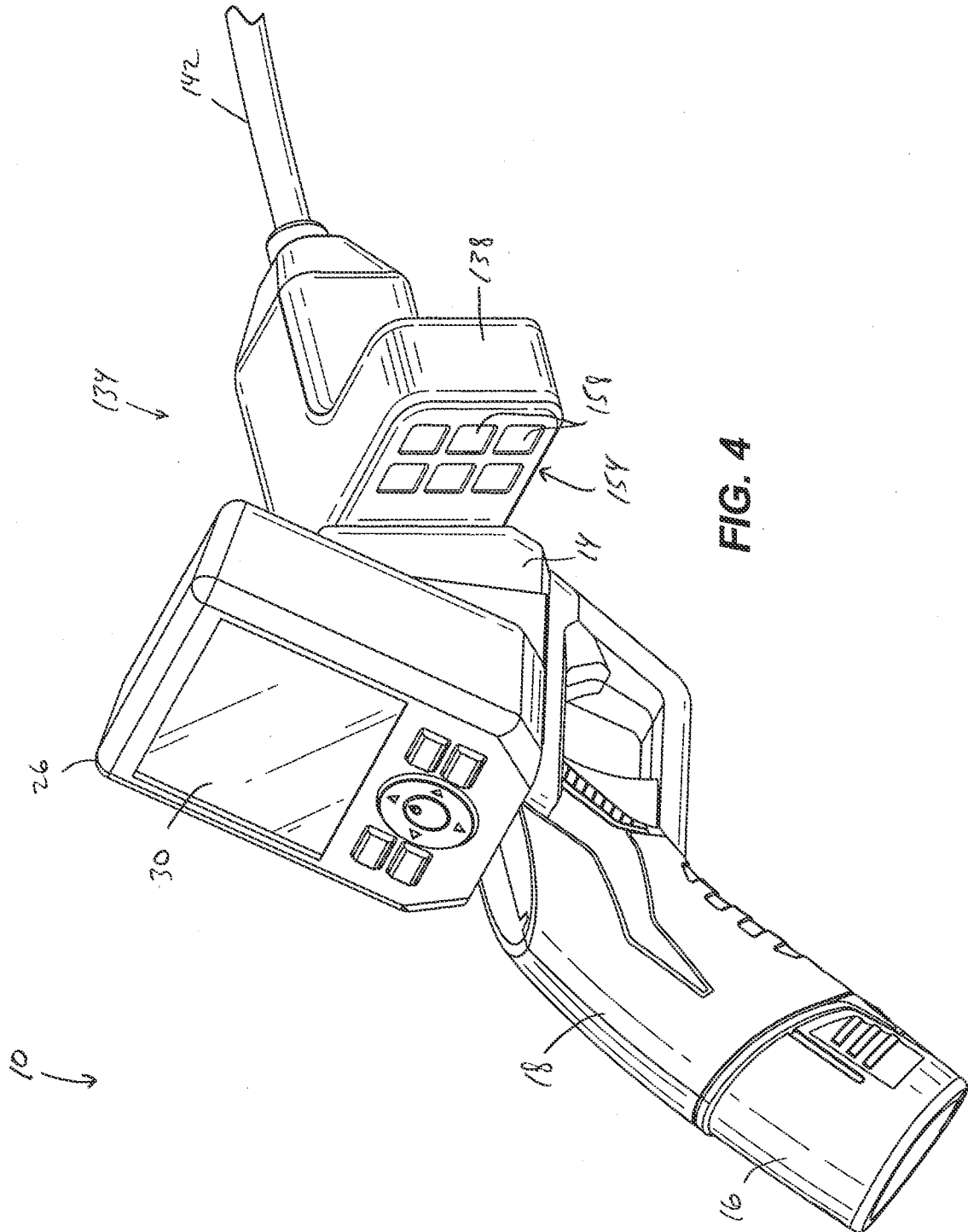
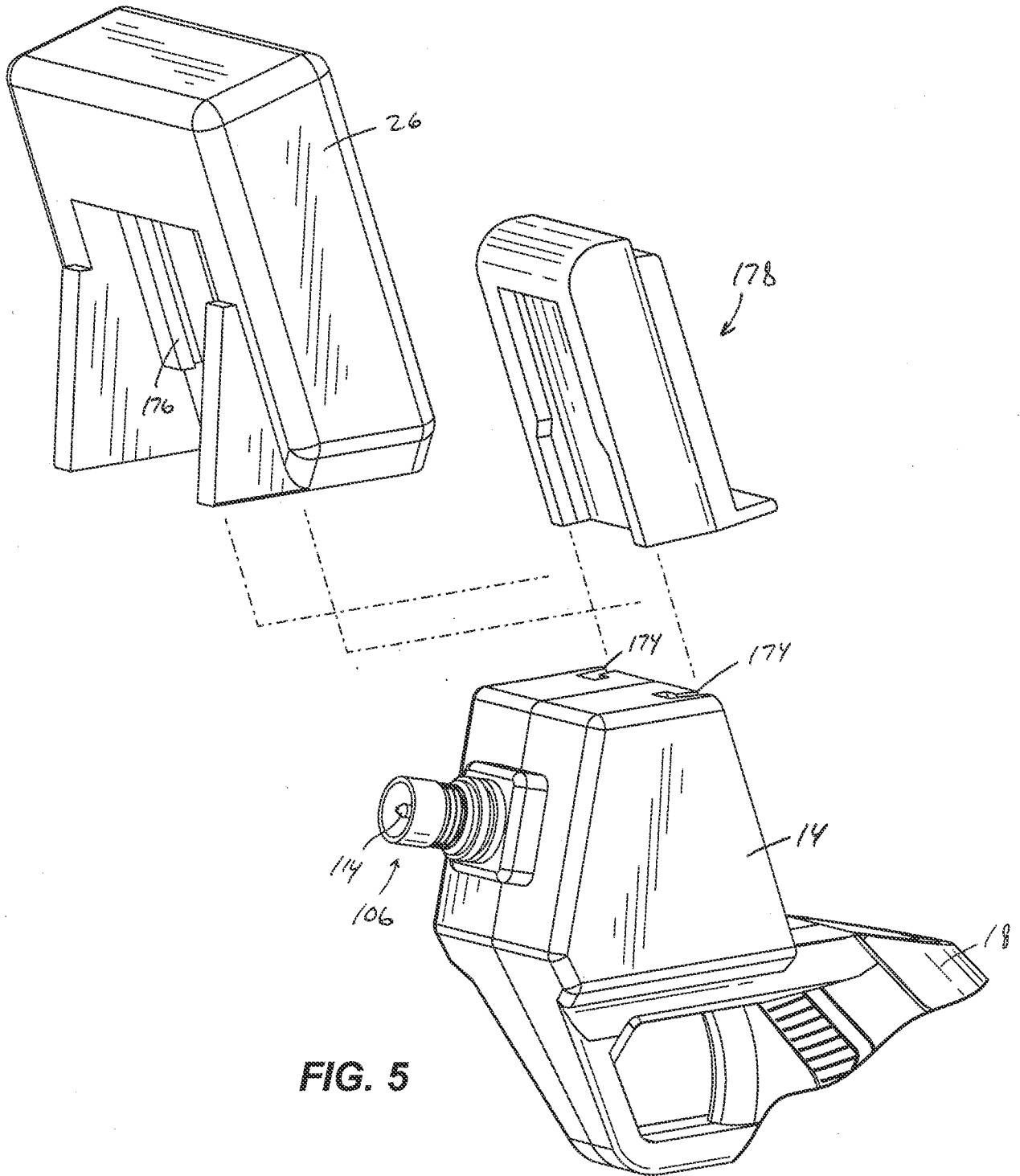

FIG. 4



**FIG. 5**

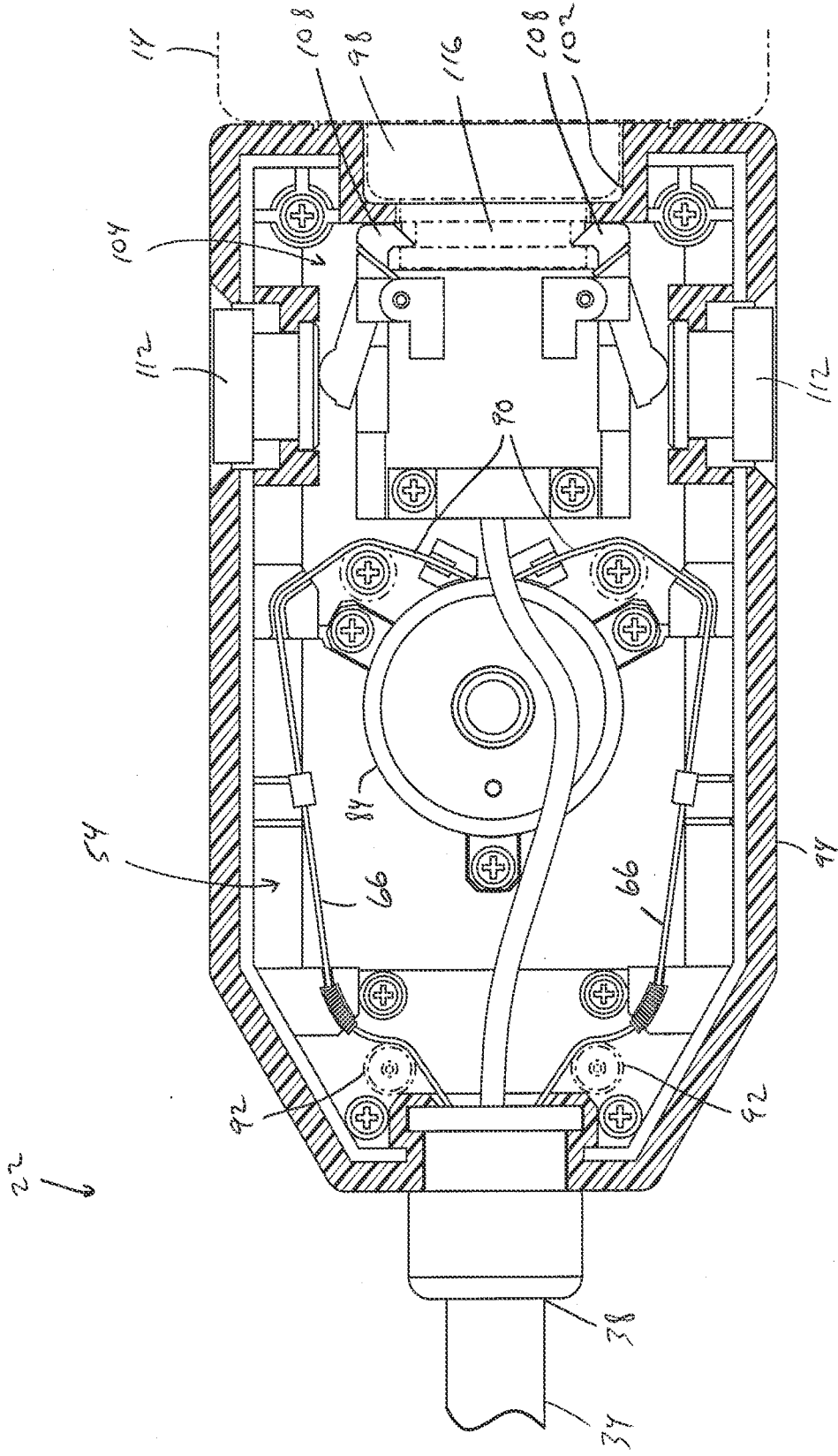

FIG. 6

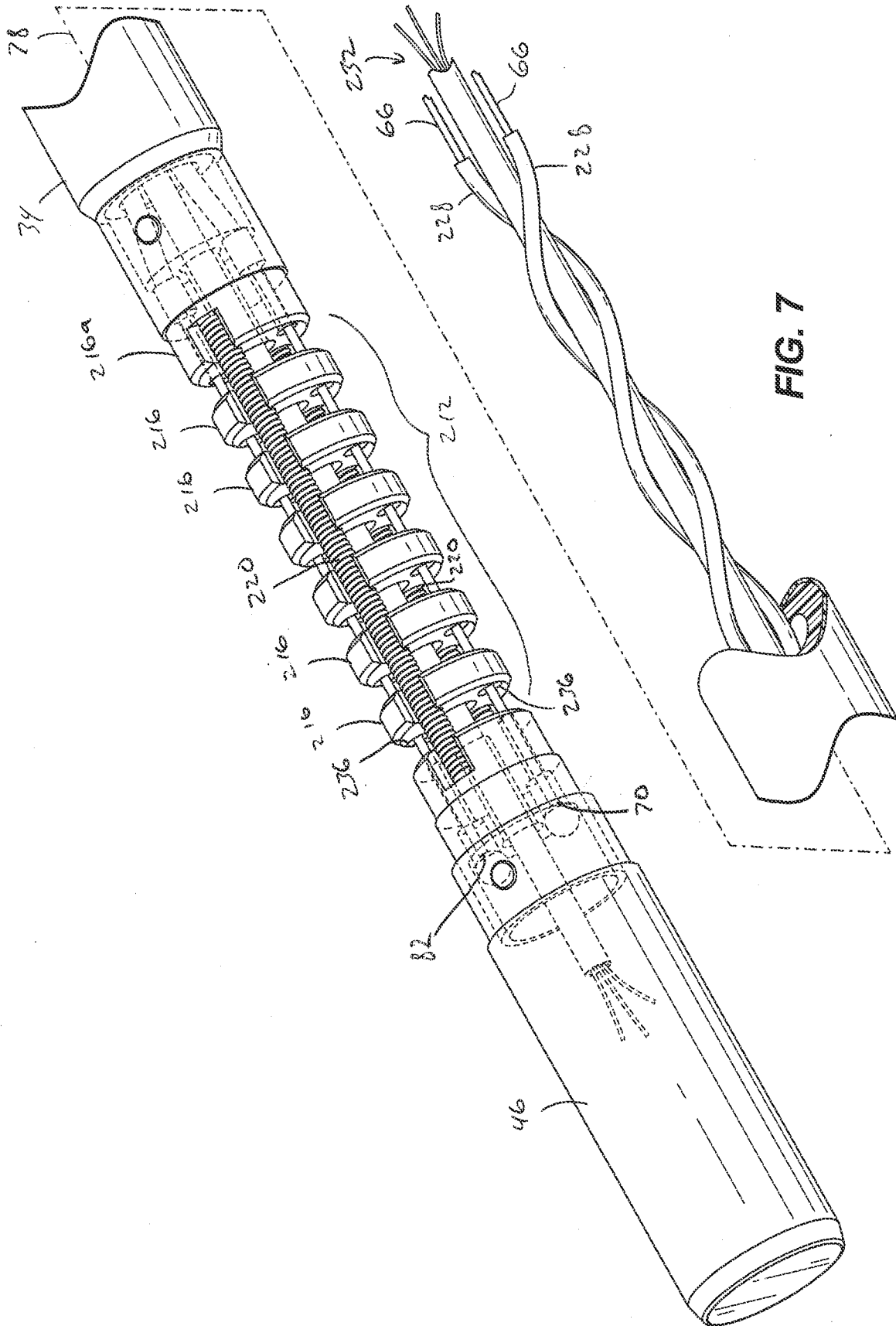
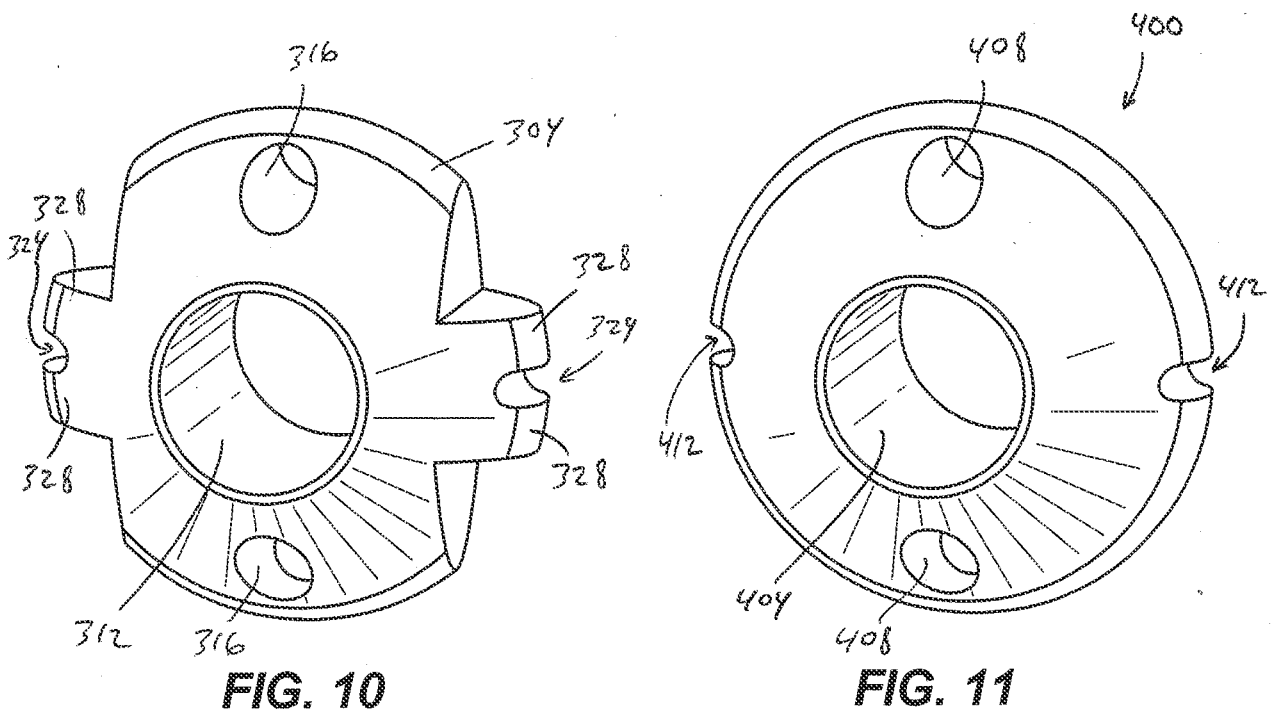
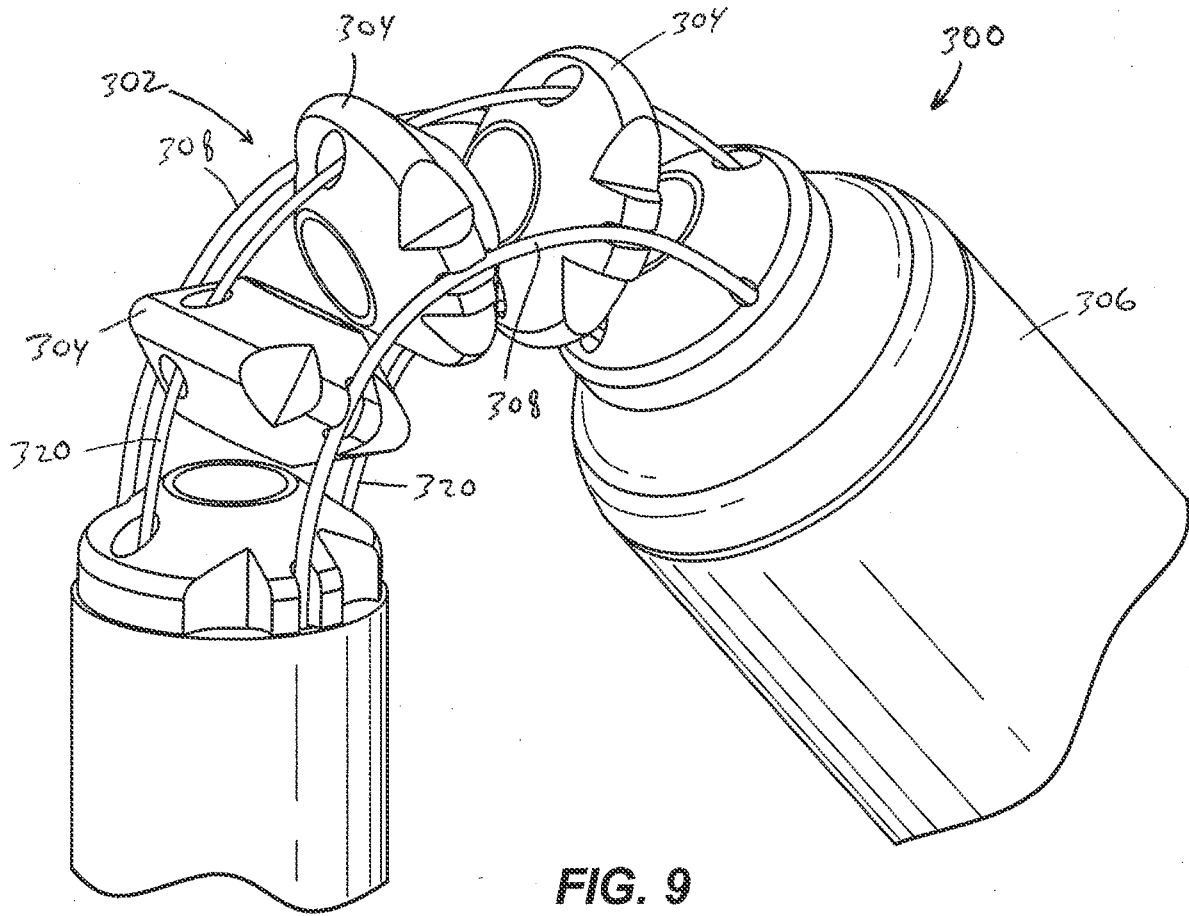

FIG. 7





**INTERNATIONAL SEARCH REPORT**

International application No.  
**PCT/US2013/065667**

**A. CLASSIFICATION OF SUBJECT MATTER**

GOIB 11/00(2006.01)i, G01N 21/00(2006.01)i

According to International Patent Classification (IPC) or to both national classification and IPC

**B. FIELDS SEARCHED**

Minimum documentation searched (classification system followed by classification symbols)

G01B 11/00; A61B 1/05; H04N 7/18; A61B 1/267; B23Q 17/00; B23Q 5/00; A61B 1/04; A61B 1/06; G01N 21/00

Documentation searched other than minimum documentation to the extent that such documents are included in the fields searched  
Korean utility models and applications for utility models  
Japanese utility models and applications for utility models

Electronic data base consulted during the international search (name of data base and, where practicable, search terms used)  
eKOMPASS(KIPO internal) & keywords: visual, inspection, articulate, disc, flexible, cable, camera and rotatable

**C. DOCUMENTS CONSIDERED TO BE RELEVANT**

Category *	Citation of document, with indication, where appropriate, of the relevant passages	Relevant to claim No.
X	US 2009-0225159 AI (SCHNEIDER et al.) 10 September 2009 See abst ract ; paragraphs 30-46 and figures 1-13 .	1-16
A		17-20
A	US 2005-0143626 AI (PRESCOTT, JAMES T.) 30 June 2005 See abst ract ; paragraphs 37-44 and figures 1-10 .	1-20
A	US 2009-0229842 AI (GRAY et al.) 17 Sept ember 2009 See abst ract ; paragraphs 25-34 and figures 1-8 .	1-20
A	US 6221007 BI (GREEN, PHILIPS S.) 24 April 2001 See abst ract ; column 6, line 29 - column 8, line 64 and figures 1-5 .	1-20
A	US 2012-0016197 AI (TURNBULL, CHRISTOPHER STRATTON) 19 January 2012 See abst ract ; paragraphs 14-19 and figures 1-4 .	1-20

I Further documents are listed in the continuation of Box C.

See patent family annex.

\* Special categories of cited documents:

"A" document defining the general state of the art which is not considered to be of particular relevance  
"E" earlier application or patent but published on or after the international filing date  
"L" document which may throw doubts on priority claim(s) or which is cited to establish the publication date of another citation or other special reason (as specified)  
"O" document referring to an oral disclosure, use, exhibition or other means  
"P" document published prior to the international filing date but later than the priority date claimed

"T" later document published after the international filing date or priority date and not in conflict with the application but cited to understand the principle or theory underlying the invention  
"X" document of particular relevance; the claimed invention cannot be considered novel or cannot be considered to involve an inventive step when the document is taken alone  
"Y" document of particular relevance; the claimed invention cannot be considered to involve an inventive step when the document is combined with one or more other such documents, such combination being obvious to a person skilled in the art  
"&" document member of the same patent family

Date of the actual completion of the international search

15 January 2014 (15.01.2014)

Date of mailing of the international search report

**16 January 2014 (16.01.2014)**

Name and mailing address of the ISA/KR

 Korean Intellectual Property Office  
189 Cheongsu-ro, Seo-gu, Daejeon Metropolitan City,  
302-701, Republic of Korea  
Facsimile No. +82-42-472-7140

Authorized officer

AHN, Jae Yul  
Telephone No. **+82-42-481-8525**





## INTERNATIONAL SEARCH REPORT

Information on patent family members

International application No.

**PCT/US2013/065667**

Patent document cited in search report	Publication date	Patent family member(s)	Publication date
us 2009-0225159 AI	10/09/2009	AU 2009-221762 AI	11/09/2009
		AU 2009-221762 A8	21/10/2010
		AU 2009-221762 B2	27/06/2013
		AU 2009-234158 AI	15/10/2009
		CA 2717776 AI	11/09/2009
		CA 2717860 AI	11/09/2009
		CA 2720996 AI	15/10/2009
		CN 102017622 A	13/04/2011
		CN 102066953 A	18/05/2011
		EP 2250720 AI	17/11/2010
		GB 201014984 DO	20/10/2010
		GB 201121678 DO	25/01/2012
		GB 201212510 DO	29/08/2012
		GB 2470327 A	17/11/2010
		GB 2470327 B	21/03/2012
		GB 2471248 A	22/12/2010
		GB 2488720 A	05/09/2012
		GB 2493606 A	13/02/2013
		GB 2493606 B	27/03/2013
		GB 2494584 A	13/03/2013
		GB 2494723 A	20/03/2013
		GB 2494723 B	08/05/2013
		US 2009-0229842 AI	17/09/2009
		US 2009-0257469 AI	15/10/2009
		<b>us</b> 2010-0225299 AI	09/09/2010
		<b>us</b> 2011-0169481 AI	14/07/2011
		<b>us</b> 2012-224047 AI	06/09/2012
		<b>us</b> 8189043 B2	29/05/2012
		<b>us</b> 8251157 B2	28/08/2012
		<b>us</b> 8274273 B2	25/09/2012
		<b>wo</b> 2009-111740 A2	11/09/2009
		<b>wo</b> 2009-111740 A3	30/12/2009
<b>wo</b> 2009-111743 AI	11/09/2009		
<b>wo</b> 2009-126824 AI	15/10/2009		
us 2005-0143626 AI	30/06/2005	<b>us</b> 2005-0222494 AI	06/10/2005
		<b>us</b> 7901351 B2	08/03/2011
		<b>wo</b> 2006-095245 A2	14/09/2006
us 2009-0229842 AI	17/09/2009	AU 2009-221762 AI	11/09/2009
		AU 2009-234158 AI	15/10/2009
		CA 2717776 AI	11/09/2009
		CA 2717860 AI	11/09/2009
		CA 2720996 AI	15/10/2009
		CN 102017622 A	13/04/2011
		CN 102066953 A	18/05/2011
		EP 2250720 AI	17/11/2010
		EP 2250720 A4	19/09/2012
		GB 2470327 A	17/11/2010

**INTERNATIONAL SEARCH REPORT**

Information on patent family members

International application No.

**PCT/US2013/065667**

Patent document cited in search report	Publication date	Patent family member(s)	Publication date
		GB 2471248 A	22/12/2010
		GB 2488720 A	05/09/2012
		GB 2493606 A	13/02/2013
		GB 2494584 A	13/03/2013
		GB 2494723 A	20/03/2013
		US 2009-0225159 AI	10/09/2009
		US 2009-0257469 AI	15/10/2009
		<b>us</b> 2010-0225299 AI	09/09/2010
		<b>us</b> 2011-0169481 AI	14/07/2011
		<b>us</b> 2012-318546 AI	20/12/2012
		<b>us</b> 2013-021036 AI	24/01/2013
		<b>us</b> 8189043 B2	29/05/2012
		<b>us</b> 8251157 B2	28/08/2012
		<b>us</b> 8274273 B2	25/09/2012
		<b>wo</b> 2009-111740 A2	11/09/2009
		<b>wo</b> 2009-111743 AI	11/09/2009
		<b>wo</b> 2009-126824 AI	15/10/2009
us 6221007 B1	24/04/2001	<b>us</b> 05928137 A	27/07/1999
us 2012-0016197 AI	19/01/2012	EP 2434941 AI	04/04/2012
		GB 0909168 DO	08/07/2009
		JP 2012-527927 A	12/11/2012
		wo 2010-136748 AI	02/12/2010