



Europäisches Patentamt
European Patent Office
Office européen des brevets



(11) **EP 0 961 016 A3**

(12) **EUROPEAN PATENT APPLICATION**

(88) Date of publication A3:
20.09.2000 Bulletin 2000/38

(51) Int Cl.7: **F02B 75/24**

(43) Date of publication A2:
01.12.1999 Bulletin 1999/48

(21) Application number: **99600006.3**

(22) Date of filing: **26.05.1999**

(84) Designated Contracting States:
**AT BE CH CY DE DK ES FI FR GB GR IE IT LI LU
MC NL PT SE**
Designated Extension States:
AL LT LV MK RO SI

(71) Applicant: **Parathiras, Antonios
N. Halkidikis P.B. 63077 (GR)**

(72) Inventor: **Parathiras, Antonios
N. Halkidikis P.B. 63077 (GR)**

(30) Priority: **29.05.1998 GR 98100191**

(54) **Internal combustion engine**

(57) It is a thermal engine that can be placed on any vehicle, it is piston-bearing, retrogressive, four-stroke, four-cylinder, over-quadrangular and uses gasoline as

principal combustible. It accepts lubrication and is water cooled. Finally, it produces work with the cylinders only in level disposition.

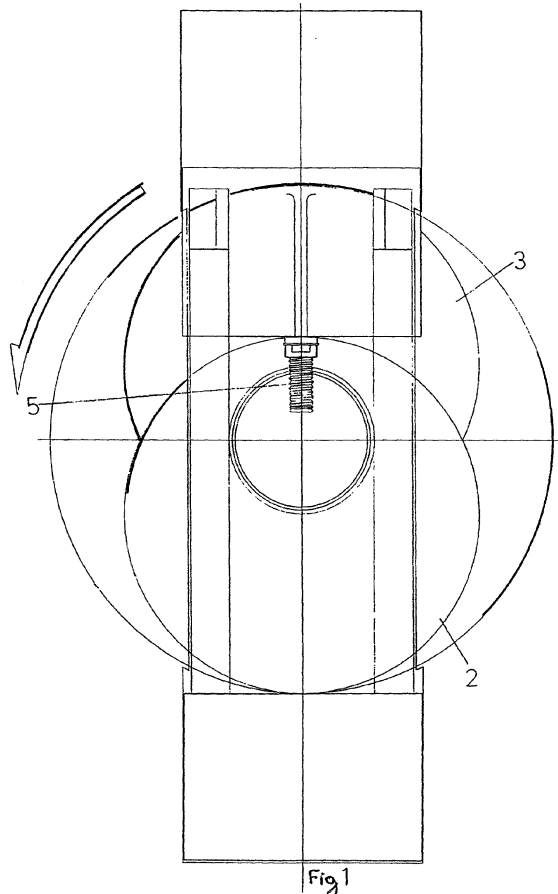

Fig 1

EP 0 961 016 A3



European Patent
Office

EUROPEAN SEARCH REPORT

Application Number
EP 99 60 0006

DOCUMENTS CONSIDERED TO BE RELEVANT			
Category	Citation of document with indication, where appropriate, of relevant passages	Relevant to claim	CLASSIFICATION OF THE APPLICATION (Int.Cl.6)
X	US 3 195 420 A (JOHANNSEN) 20 July 1965 (1965-07-20) * column 1, line 64 - column 3, line 19; figures 1-3 *	1	F02B75/24 F01B1/08 F01B9/04
X	US 5 402 755 A (WAISSI GARY R) 4 April 1995 (1995-04-04) * column 2, line 12 - column 4, line 8; figures *	1	
X	EP 0 025 071 A (SCHWARZ FRIEDHELM) 18 March 1981 (1981-03-18) * page 3, line 1 - line 15; figures *	1	
			TECHNICAL FIELDS SEARCHED (Int.Cl.6)
			F01B F02B
The present search report has been drawn up for all claims			
Place of search THE HAGUE		Date of completion of the search 2 August 2000	Examiner von Arx, H
CATEGORY OF CITED DOCUMENTS		T : theory or principle underlying the invention E : earlier patent document, but published on, or after the filing date D : document cited in the application L : document cited for other reasons & : member of the same patent family, corresponding document	
X : particularly relevant if taken alone Y : particularly relevant if combined with another document of the same category A : technological background O : non-written disclosure P : intermediate document			

EPO FORM 1603 03/92 (P04C01)

**ANNEX TO THE EUROPEAN SEARCH REPORT
ON EUROPEAN PATENT APPLICATION NO.**

EP 99 60 0006

This annex lists the patent family members relating to the patent documents cited in the above-mentioned European search report. The members are as contained in the European Patent Office EDP file on The European Patent Office is in no way liable for these particulars which are merely given for the purpose of information.

02-08-2000

Patent document cited in search report	Publication date	Patent family member(s)	Publication date
US 3195420 A	20-07-1965	NONE	
US 5402755 A	04-04-1995	NONE	
EP 0025071 A	18-03-1981	NONE	

EPO FORM P0469

For more details about this annex : see Official Journal of the European Patent Office, No. 12/82