



INTERNATIONAL APPLICATION PUBLISHED UNDER THE PATENT COOPERATION TREATY (PCT)

(51) International Patent Classification ⁶ : B62K 27/00	A1	(11) International Publication Number: WO 99/35029 (43) International Publication Date: 15 July 1999 (15.07.99)
(21) International Application Number: PCT/US98/00378 (22) International Filing Date: 12 January 1998 (12.01.98) (30) Priority Data: 08/780,831 10 January 1998 (10.01.98) US (71) Applicant: BRUNSWICK CORPORATION [US/US]; P.O. Box 270, Tulsa, OK 74101 (US). (72) Inventor: KOTLIER, Bernard, M.; 5401 Greenside Drive, San Jose, CA 95127 (US). (74) Agent: MACCORD, Howard, A., Jr.; Rhodes, Coates & Bennett, P.O. Box 2974, Greensboro, NC 27402 (US).	(81) Designated States: CA, CN, European patent (AT, BE, CH, DE, DK, ES, FI, FR, GB, GR, IE, IT, LU, MC, NL, PT, SE). Published <i>With international search report.</i>	

(54) Title: FOLDING TRAILER GOOSENECK**(57) Abstract**

A trailer (18) of the type for securing to and following a bicycle. The trailer (18) includes a frame, a wheel (12) rotatably mounted on the frame, and an extension member (20) having first and second ends. The first end is hingedly connected to the frame such that the extension member (20) is selectively positionable between an extended position (30) wherein the extension member extends outwardly from the frame and a folded position wherein the extension member is disposed adjacent the frame for compactness of storage and transport.

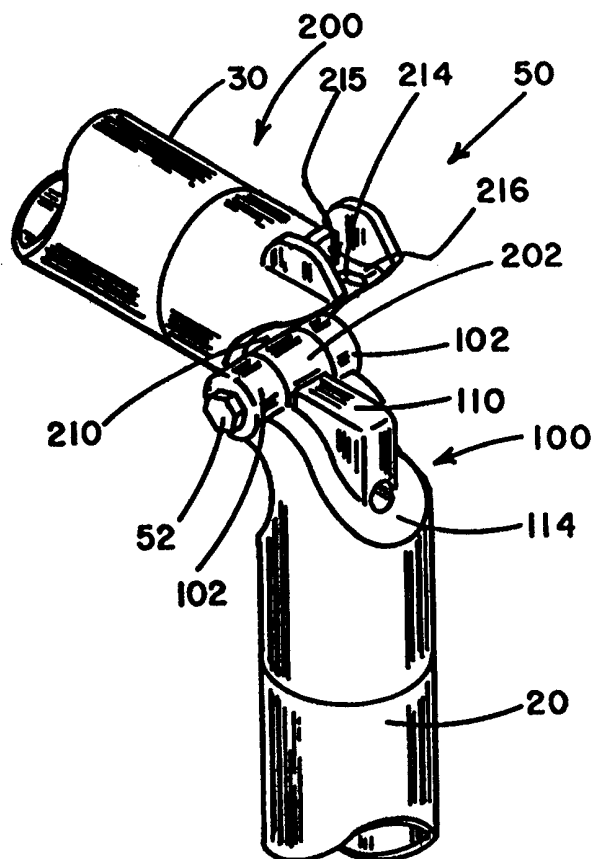

FOR THE PURPOSES OF INFORMATION ONLY

Codes used to identify States party to the PCT on the front pages of pamphlets publishing international applications under the PCT.

AL	Albania	ES	Spain	LS	Lesotho	SI	Slovenia
AM	Armenia	FI	Finland	LT	Lithuania	SK	Slovakia
AT	Austria	FR	France	LU	Luxembourg	SN	Senegal
AU	Australia	GA	Gabon	LV	Latvia	SZ	Swaziland
AZ	Azerbaijan	GB	United Kingdom	MC	Monaco	TD	Chad
BA	Bosnia and Herzegovina	GE	Georgia	MD	Republic of Moldova	TG	Togo
BB	Barbados	GH	Ghana	MG	Madagascar	TJ	Tajikistan
BE	Belgium	GN	Guinea	MK	The former Yugoslav Republic of Macedonia	TM	Turkmenistan
BF	Burkina Faso	GR	Greece	ML	Mali	TR	Turkey
BG	Bulgaria	HU	Hungary	MN	Mongolia	TT	Trinidad and Tobago
BJ	Benin	IE	Ireland	MR	Mauritania	UA	Ukraine
BR	Brazil	IL	Israel	MW	Malawi	UG	Uganda
BY	Belarus	IS	Iceland	MX	Mexico	US	United States of America
CA	Canada	IT	Italy	NE	Niger	UZ	Uzbekistan
CF	Central African Republic	JP	Japan	NL	Netherlands	VN	Viet Nam
CG	Congo	KE	Kenya	NO	Norway	YU	Yugoslavia
CH	Switzerland	KG	Kyrgyzstan	NZ	New Zealand	ZW	Zimbabwe
CI	Côte d'Ivoire	KP	Democratic People's Republic of Korea	PL	Poland		
CM	Cameroon	KR	Republic of Korea	PT	Portugal		
CN	China	KZ	Kazakstan	RO	Romania		
CU	Cuba	LC	Saint Lucia	RU	Russian Federation		
CZ	Czech Republic	LI	Liechtenstein	SD	Sudan		
DE	Germany	LK	Sri Lanka	SE	Sweden		
DK	Denmark	LR	Liberia	SG	Singapore		
EE	Estonia						

FOLDING TRAILER GOOSENECK

Field of the Invention

5 The present invention is directed to trailers of the type for detachably securing to bicycles and the like, and, more particularly, to a folding trailer hitch for such trailers and to a trailer incorporating the same.

Background of the Invention

10 Detachable tandem bicycle trailers have recently become a popular means for converting a conventional bicycle to a tandem bicycle. Typically, the trailer takes the form of a conventional bicycle except that the front wheel, steering head, fork, and related hardware are replaced with a gooseneck. The gooseneck extends over the rear wheel of an associated bicycle and has a clamp or other suitable means for securing the end of the gooseneck to the conventional bicycle's frame, typically at the seatpost.

15 While the tandem bike trailer as described above may be conveniently attached to the leading bicycle, its configuration necessarily makes it cumbersome and inconvenient to transport and store. Because the front wheel is replaced with a gooseneck which must extend all the way over the wheel of the leading bicycle, the overall length of the trailer is somewhat greater than that of a conventional bicycle. 20 Whereas conventional bicycles can be reduced in length for storage or transport by removing the front wheel, this cannot be done with the trailer.

Thus, there exists a need for a means for converting a detachable tandem bike trailer to a configuration which is more compact and thus more suitable for storage and transport. There exists a need for such a means which is easily and conveniently 25 operated. However, such capability should not be provided at the expense of the strength and stability of the tandem trailer when the tandem trailer is in use. In particular, at least a minimum degree of resistance to torsion and overbending of the gooseneck must be provided.

30

Summary of the Invention

The present invention is directed to a trailer of the type for securing to and following a bicycle which overcomes the shortcomings of the tandem bicycle trailer as described above, particularly with regard to transport and storage. The trailer includes a frame and a wheel rotatably mounted on the frame. The trailer further includes an extension member having first and second ends. The first end is hingedly connected to the frame such that the extension member is selectively positionable between an extended position and a folded position. In the extended position, the extension member extends outwardly from the frame. In the folded position, the extension member is disposed adjacent the frame for compactness of storage and transport.

The trailer may further include a connector formed on the second end of the extension member and adapted to secure the trailer to the bicycle. Moreover, a seat may be mounted on the frame. Also, handle bars may be mounted on the frame. A pedal assembly may be interconnected with and operable to drive the wheel.

In a preferred embodiment, the extension member is hingedly connected to the frame by a foldable connector assembly. The foldable connector assembly includes a first hinge member which has first and second ends, and a second hinge member which has first and second ends. Each of the first ends of the first and second hinge members have at least one knuckle formed thereon. Each of the knuckles have a respective bore formed therethrough. A pin extends through each of the bores, whereby the first and second hinge members are relatively pivotable about the pin between a closed position and an open position. When the first and second hinge members are in the closed position, a longitudinal axis is defined between the second end of the first hinge member and the second end of the second hinge member. The connector assembly further includes a quick release mechanism operable to selectively secure the first and second hinge members in the closed position and to release the first and second hinge members into the open position. Each of the second ends of the first and second hinge members may have a reduced diameter portion adapted to securely fit into a tube of a prescribed size and shape.

In the trailer as just described, the quick release mechanism preferably includes a shank, a bearing surface movably mounted on the shank, and a tightening mechanism for selectively positioning the bearing surface between an upper position and a lower position. A tab is formed on the first end of the first hinge member. The shank is attached to the second hinge member and extends substantially transverse to the longitudinal axis and substantially transverse to the pin. The first hinge member, the second hinge member, the tab, and the bearing surface are relatively arranged and configured such that when the first and second hinge members are in the closed position, the tab is disposed between the bearing surface and the second hinge member. Further, when the bearing surface is in the upper position, the first and second hinge members may be transitioned between the closed and open positions. When the bearing surface is in the lower position and the first and second hinge members are in the closed position, the bearing surface prevents relative rotation of the first and second hinge members about the pin.

Preferably, the tab has a recess defined therein. The recess is relatively configured such that when the first and second hinge members are in the closed position, a portion of the shank is disposed in the recess.

Preferably, the tightening mechanism includes a cam member rotatably secured to the shank and has a cam lobe adjacent the bearing surface. The bearing surface is a bearing member slidably mounted on the shank and transitionable from the upper position to the lower position by rotating the cam member into a first position wherein the cam lobe forces the bearing member along the shank toward the second hinge member. The bearing member is transitionable from the lower position to the upper position by rotating the cam member into a second position wherein the cam lobe allows the bearing member to move away from the second hinge member.

Preferably, a spring is provided operative to bias the bearing surface away from the second hinge member.

In a connector assembly as described above, several additional features may be incorporated to minimize or eliminate relative twist of the hinge members and, accordingly, of the extension member and the frame. A first face may be formed on the first end of the first hinge member, the first face disposed at an angle of less than

90° with respect to the longitudinal axis when the first and second hinge members are in the closed position. A second face is formed on the first end of the second hinge member, the second face complementary to the first face. Preferably, the first face has a curved profile, the curved profile including a concave portion and a convex portion.

5 Alternatively, or in addition to the preceding feature, one of the first and second hinge members may have a projection formed on the first end thereof and extending in the direction of the longitudinal axis. The other of the first and second hinge members has a recess formed in the first end thereof. When the first and second hinge members are in the closed position, the projection is received within the recess.

10 The present invention is further directed to a foldable connector assembly as described above.

The present invention is further directed to a bicycle trailer including a frame, a wheel rotatably mounted on the frame, and a trailer hitch extending from the frame. The trailer hitch is formed in two sections joined by a hinge connection so as to be
15 able to be folded together to conserve space or extended and locked to make an extended hitch. The hinge connection includes first and second bosses which are mounted to the sections and formed of sufficient bulk to provide for a rigid, extended hitch when locked.

The present invention is directed to a tandem bicycle including a trailer and a
20 bicycle having a rear wheel and a first frame. The trailer includes a second frame, a wheel rotatably mounted on the frame, and an extension member extending over the rear wheel of the bicycle. The extension member has first and second ends. The first end of the extension member is hingedly connected to the second frame such that the extension member is selectively positionable between an extended position wherein
25 the extension member extends outwardly from the second frame and a folded position wherein the extension member is disposed adjacent the second frame. A connector is formed on the second end of the extension member. The connector is detachably secured to the first frame of the bicycle.

The present invention is also directed to a method of shipping a bicycle trailer
30 having a frame, a wheel rotatably mounted on the frame, and a trailer hitch, the trailer hitch formed in first and second sections joined by a hinge connection. The method

includes folding the first and second sections together about the hinge connection to provide a more compact configuration.

Brief Description of the Drawings

5 The invention will be better understood after a reading of the Detailed Description of the Preferred Embodiments and a review of the drawings in which:

FIGURE 1 is a side elevational, schematic view of a trailer incorporating the folding gooseneck according to the present invention, a folded configuration of the gooseneck being shown in dotted lines, and a towing bicycle also being shown in
10 dotted lines;

FIGURE 2 is a perspective view of the hinged connection of the folding gooseneck according to the present invention shown in a folded position with the quick release mechanism removed;

FIGURE 3 is a side, cross sectional view of the connector assembly in an
15 extended position; and

FIGURE 4 is a side, elevational view of the connector assembly in a folded position.

Detailed Description of the Preferred Embodiment

20 With reference to Figure 1, a tandem bike trailer according to the present invention, generally denoted by the numeral 10, is shown therein secured to a conventional bicycle 5 (shown in dotted lines) to form a tandem bicycle. As shown in solid lines, extension member or gooseneck 30 is in an extended position such that it extends over the rear wheel of bicycle 5. A suitable securement means 35, such as a
25 releasable clamp, is attached to seat post 7 of bicycle 5. Various connectors or clamping mechanisms can be used. As discussed in more detail below, extension member 30 may be pivoted about connector assembly 50 as indicated by the arrow to place gooseneck 30 in a folded position, as shown in dotted lines.

Trailer 10 includes frame 18 to which rear wheel 12 is rotatably mounted.
30 Rear wheel 12 may be driven by pedals 17 via chain 15. The rider sits on seat 14 which is secured to frame 18. The rider balances with handlebars 16, which are also mounted on frame 18. Horizontal frame member 20 is connected to extension

member 30 by connector assembly 50. It will be appreciated that frame 18 may be otherwise configured. For example, extension member 30 may be connected to the diagonal frame member by connector assembly 50 with horizontal frame member 20 serving only as a brace.

5 Connector assembly 50 is shown in greater detail in Figures 2-4. (Quick release mechanism 60, as discussed below, is omitted from Figure 2 for clarity.) Connector assembly 50 includes, generally, first hinge member 100 and second hinge member 200 joined by pin 52. As best seen in Figure 3, hinge member 100 has reduced diameter portion 104 sized to fit within tubular frame member 20. Likewise,
10 second hinge member 200 includes reduced diameter portion 204 sized to fit within tubular extension member 30. The tube inner dimensions and the reduced portions are relatively sized to provide interference fits therebetween which may be supplemented with adhesive, welding or other bonding techniques.

 As best seen in Figure 2, hinge member 100 has a pair of spaced apart
15 knuckles 102 with aligned bores formed therethrough. The bores are oriented such that their axes are substantially transverse to longitudinal axis L-L (see Figure 3) and substantially parallel to the ground. Hinge member 200 has a centrally located knuckle 202. Knuckle 202 has a bore formed therethrough which is aligned with the bores of knuckles 102. Pin 52 extends through the bores of each of knuckles 102 and
20 202. Knuckle 202 spans substantially the entire gap between knuckles 102 with a small clearance provided to allow relative rotation of knuckles 102 and knuckle 202 about pin 52. From the foregoing, it will be appreciated that the arrangement of knuckles 102, knuckle 202, and pin 52 provides for the hinged connection of hinge members 100 and 200, as well as frame member 20 and extension member 30.
25 Preferably, knuckles 102 extend the width of extension member 30 or greater.

 With reference to Figures 3 and 4, quick release mechanism 60 and tab 215 formed on hinge member 200 allow the user to selectively lock and unlock connecting assembly 50 in the closed position shown in Figure 3 (and, thus lock extension member 30 in the extended position). Quick release mechanism 60 includes shank 66,
30 bearing member or washer 64, spring 65, lever 62, pin 63, and end cap 68. Shank 66 extends through bore 114 formed in first hinge member 100. End cap 68 is secured to

the lower end of shank 66 and nests in cavity 120 formed in hinge member 100. End cap 68 thereby limits the upward movement of shank 66 with respect to hinge member 100. Moreover, end cap threadedly engages shank 66 and is turnable with respect thereto so that the position of end cap 68 may be adjusted to compensate for wear and variations in fabrication. Spring 65 is held between an upper surface of hinge member 100 and the lower surface of bearing member 64 and thereby urges bearing member 64 upward and into contact with lever 62. Lever 62 is pivotable about pin 63 between a locked position as shown in Figure 3 and an unlocked position as shown in Figure 4. Upwardly extending ears 220 (one on either side of lever 62) are provided to prevent rotation of lever 62 about shank 66 so that the lever remains aligned along the length of the gooseneck.

When lever 62 is in the locked position of Figure 3, cam lobe 62A forces bearing member 64 downward into a lower position. When lever 62 is in the unlocked position of Figure 4, the displacement of cam lobe 62A allows spring 65 to urge bearing member 64 into an upper position. In doing so, spring 65 causes lever 62 to assume the fully open position of Figure 4, thereby giving a visual indication that the lock mechanism is unlocked. It will be appreciated from the foregoing that unless quick release mechanism 60 is disassembled, it will remain secured within bore 114 of hinge member 100 whether it is in the locked position or the unlocked position.

Second hinge member 200 has tab 215 with recess or cutout 214 formed therein to define fingers 216 on either side of the cutout. Cutout 214, tab 215, shank 66, spring 65, and bearing member 64 are each relatively configured so that when connecting assembly 50 is placed in the closed position as shown in Figure 3, spring 65 and shank 66 are received within cutout 214 while bearing member 64 extends beyond cutout 214 to overlap at least a portion of tab 215. Preferably, bearing member 64 extends sidewardly to overlap fingers 216 and rearwardly to overlap a portion of tab 215 adjacent the apex of cutout 214, as shown in Figure 3. In this way, when hinge members 100, 200 are in the closed position and lever 62 is in the locked position, as shown in Figure 3, relative rotation of hinge members 100 and 200 about pin 52 is prevented by the interface of bearing member 64 against tab 215 including fingers 216, and the interface of end cap 68 against cavity 120. Preferably, shank 66

extends transverse to pin 52.

When the user desires to open connecting assembly 50 to fold extension member 30 into the folded position, he or she need only rotate lever 62 into the open position of Figure 4. Bearing member 64 is forced upwardly by spring 65, providing clearance for tab 215 as hinge member 200 rotates about pin 52.

As noted in the Background of the Invention, it is important that relative torsion or twisting between frame member 20 and extension member 30 be minimized. It will be appreciated that the arrangement of knuckles 102, knuckle 202, and pin 52 serves this purpose to a great extent. To further minimize twisting, rigid projection 110 is formed on hinge member 100 and complementary recess 210 is formed in hinge member 200 (see Figures 2 and 3). When connector assembly 50 is in the closed position, projection 110 nests within recess 210 to present sideways bending.

As best seen in Figure 4, the respective profiles of hinge members 100 and 200 are selectively configured to further reduce the tendency for twist between the hinge members. Face 140 of hinge member 100 and face 240 of hinge member 200 each have a side profile which defines a general angle of less than 90°, and preferably about 45°, with respect to the longitudinal axis L-L (see Figure 3) defined along the length of trailer 10. Faces 140 and 240 are complementary. Further, face 140 as viewed in side profile has convex portion 140A and concave portion 140B while face 240 has concave portion 240A and convex portion 240B which complement portions 140A and 140B, respectively. Each of these features serve to further minimize the ability of the hinge members to rotate with respect to each other about the longitudinal axis.

Notably, bearing member 64 is not essential to operation of the locking mechanism and may be omitted if the size and shape of cam lobe 62A are appropriately modified. Bearing member 64 serves primarily to prevent wear on cam lobe 62A. Thus, the bearing surface which bears against tab 215 in the locked position may be cam lobe 62A rather than the lower surface of bearing member 64.

While the quick release mechanism as disclosed provides for certain distinct advantages, it will be appreciated that other means for locking and unlocking the

connecting assembly in the closed position may be employed. For example, a simple nut and bolt combination may be used. Alternatively, other pivoted and secured joints may be substituted.

5 While a preferred embodiment of the present invention has been described, it will be appreciated by those of skill in the art that certain modifications may be made without departing from the scope of the present invention. All such modifications are intended to come within the scope of the claims which follow.

WHAT IS CLAIMED IS:

1. A trailer of the type for securing to and following a bicycle comprising:
a frame;
a wheel rotatably mounted on said frame; and
5 an extension member having first and second ends, said first end
hingedly connected to said frame such that said extension member is
selectively positionable between an extended position wherein said extension
member extends outwardly from said frame and a folded position wherein said
extension member is disposed adjacent said frame for compactness of storage
10 and transport.
2. The trailer of Claim 1 including a connector formed on said second end
of said extension member and adapted to secure said trailer to the bicycle.
- 15 3. The trailer of Claim 1 including a seat mounted on said frame.
4. The trailer of Claim 3 including handle bars mounted on said frame.
5. The trailer of Claim 1 including a pedal assembly interconnected with
20 and operable to drive the wheel.
6. The trailer of Claim 1 wherein said extension member is hingedly
connected to said frame by a foldable connector assembly, said foldable connector
assembly comprising:
25 a first hinge member having first and second ends;
a second hinge member having first and second ends;
each of said first ends of said first and second hinge members having at
least one knuckle formed thereon;
each of said knuckles having a respective bore formed therethrough;
30 a pin extending through each of said bores, whereby said first and
second hinge members are relatively pivotable about said pin between a closed

position and an open position, and wherein, when said first and second hinge members are in said closed position, a longitudinal axis is defined between said second end of said first hinge member and said second end of said second hinge member; and

5 a quick release mechanism operable to selectively secure said first and second hinge members in said closed position and to release said first and second hinge members into said open position.

7. The trailer of Claim 6 wherein:

- 10 a) said quick release mechanism includes:
- i) a shank;
 - ii) a bearing surface movably mounted on said shank; and
 - 15 iii) a tightening mechanism for selectively positioning said bearing surface between an upper position and a lower position;
- b) a tab is formed on said first end of said first hinge member;
- c) said shank is attached to said second hinge member and extends substantially transverse to said longitudinal axis and substantially transverse to said pin; and
- 20 d) said first hinge member, said second hinge member, said tab, and said bearing surface are relatively arranged and configured such that:
- i) when said first and second hinge members are in said closed position, said tab is disposed between said bearing surface and said second hinge member;
 - 25 ii) when said bearing surface is in said upper position, said first and second hinge members may be transitioned between said closed and open positions; and
 - 30 iii) when said bearing surface is in said lower position and said first and second hinge members are in said closed position, said bearing surface prevents relative rotation

of said first and second hinge members about said pin.

8. The trailer of Claim 7 wherein said tab has a recess defined therein, said recess relatively configured such that, when said first and second hinge members are in said closed position, a portion of said shank is disposed in said recess.

9. The trailer of Claim 7 wherein:

said tightening mechanism includes a cam member rotatably secured to said shank and having a cam lobe adjacent said bearing surface;

said bearing surface is a bearing member slidably mounted on said shank and transitionable from said upper position to said lower position by rotating said cam member into a first position wherein said cam lobe forces said bearing member along said shank toward said second hinge member; and

said bearing member is transitionable from said lower position to said upper position by rotating said cam member into a second position wherein said cam lobe allows said bearing member to move away from said second hinge member.

10. The trailer of Claim 7 including a spring operative to bias said bearing surface away from said second hinge member.

11. The trailer of Claim 6 wherein each of said second ends of said first and second hinge members has a reduced diameter portion adapted to securely fit into a tube of a prescribed size and shape.

12. The trailer of Claim 6 including a first face formed on said first end of said first hinge member, said first face disposed at an angle of less than 90° with respect to said longitudinal axis when said first and second hinge members are in said closed position, and a second face formed on said first end of said second hinge member, said second face complementary to said first face.

13. The trailer of Claim 12 wherein said first face has a curved profile, said curved profile including a concave portion and a convex portion.

14. The trailer of Claim 6 wherein one of said first and second hinge members has a projection formed on said first end thereof and extending in the direction of said longitudinal axis, the other of said first and second hinge members having a recess formed in said first end thereof, and wherein, when said first and second hinge members are in said closed position, said projection is received within said recess.

15. A tandem bicycle, comprising:

- a) a bicycle having a rear wheel and a first frame;
- b) a trailer including:
 - i) a second frame;
 - ii) a wheel rotatably mounted on said frame; and
 - iii) an extension member extending over said rear wheel of said bicycle, said extension member having first and second ends, said first end hingedly connected to said second frame such that said extension member is selectively positionable between an extended position wherein said extension member extends outwardly from said second frame and a folded position wherein said extension member is disposed adjacent said second frame; and
- c) a connector formed on said second end of said extension member, said connector detachably secured to said first frame of said bicycle.

16. A bicycle trailer comprising:

- a frame;
- a wheel rotatably mounted on said frame; and

a trailer hitch extending from said frame, said trailer hitch being formed in two sections joined by a hinge connection so as to be able to be folded together to conserve space or extended and locked to make an extended hitch, said hinge connection including first and second bosses which are mounted to said sections and formed of sufficient bulk to provide for a rigid, extended hitch when locked.

17. A foldable connector assembly comprising:

a first hinge member having first and second ends;

a second hinge member having first and second ends;

each of said first ends of said first and second hinge members having at least one knuckle formed thereon;

each of said knuckles having a respective bore formed therethrough;

a pin extending through each of said bores, whereby said first and second hinge members are relatively pivotable about said pin between a closed position and an open position, and wherein, when said first and second hinge members are in said closed position, a longitudinal axis is defined between said second end of said first hinge member and said second end of said second hinge member; and

a quick release mechanism operable to selectively secure said first and second hinge members in said closed position and to release said first and second hinge members into said open position.

18. The connector assembly of Claim 17 wherein:

a) said quick release mechanism includes:

i) a shank;

ii) a bearing surface movably mounted on said shank; and

iii) a tightening mechanism for selectively positioning said bearing surface between an upper position and a lower position;

b) a tab is formed on said first end of said first hinge member;

- 5 c) said shank is attached to said second hinge member and extends substantially transverse to said longitudinal axis and substantially transverse to said pin; and
- d) said first hinge member, said second hinge member, said tab, and said bearing surface are relatively arranged and configured such that:
- 10 i) when said first and second hinge members are in said closed position, said tab is disposed between said bearing surface and said second hinge member;
- ii) when said bearing surface is in said upper position, said first and second hinge members may be transitioned between said closed and open positions; and
- 15 iii) when said bearing surface is in said lower position and said first and second hinge members are in said closed position, said bearing surface prevents relative rotation of said first and second hinge members about said pin.

20 19. The trailer of Claim 18 wherein said tab has a recess defined therein, said recess relatively configured such that, when said first and second hinge members are in said closed position, a portion of said shank is disposed in said recess.

 20. The connector assembly of Claim 18 wherein:

 said tightening mechanism includes a cam member rotatably secured to said shank and having a cam lobe adjacent said bearing member;

25 said bearing surface is a bearing member slidably mounted on said shank and transitionable from said upper position to said lower position by rotating said cam member into a first position wherein said cam lobe forces said bearing member along said shank toward said second hinge member; and

 said bearing surface is transitionable from said lower position to said upper position by rotating said cam member into a second position wherein

30 said cam lobe allows said bearing member to move away from said second

hinge member.

21. The connector assembly of Claim 18 including a spring operative to bias said bearing surface away from said second hinge member.

22. The connector assembly of Claim 17 wherein each of said second ends of said first and second hinge members has a reduced diameter portion adapted to securely fit into a tube of a prescribed size and shape.

23. The connector assembly of Claim 17 including a first face formed on said first end of said first hinge member, said first face disposed at an angle of less than 90° with respect to said longitudinal axis when said first and second hinge members are in said closed position, and a second face formed on said first end of said second hinge member, said second face complementary to said first face.

24. The connector assembly of Claim 23 wherein said first face has a curved profile, said curved profile including a concave portion and a convex portion.

25. The connector assembly of Claim 17 wherein one of said first and second hinge members has a projection formed on said first end thereof and extending in the direction of said longitudinal axis, the other of said first and second hinge members having a recess formed in said first end thereof, and wherein, when said first and second hinge members are in said closed position, said projection is received within said recess.

26. A method of shipping a bicycle trailer having a frame, a wheel rotatably mounted on the frame, and a trailer hitch, the trailer hitch formed in first and second sections joined by a hinge connection, said method comprising the step of folding the first and second sections together about the hinge connection to provide a more compact configuration.

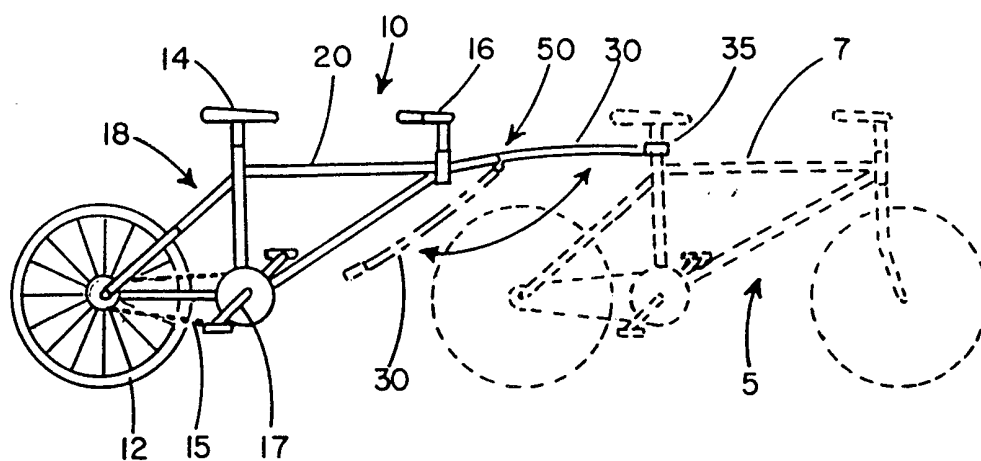

FIG. 1

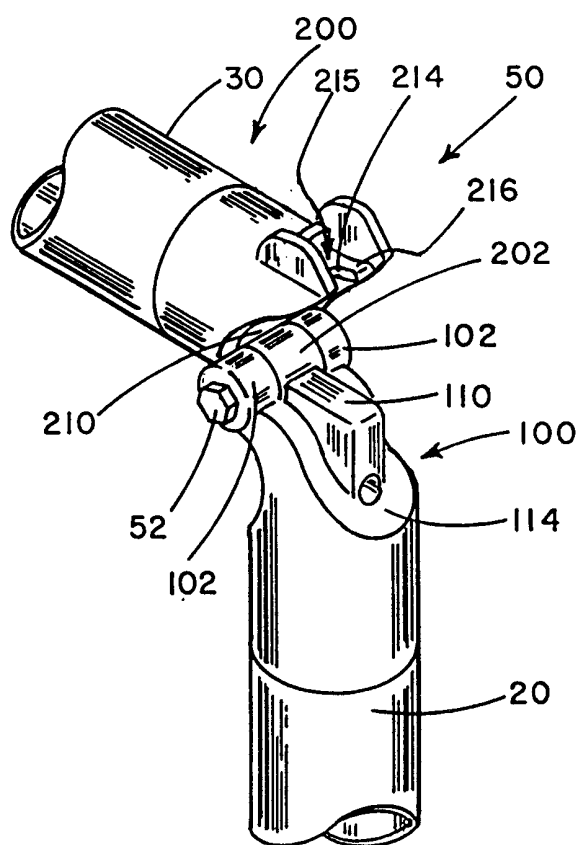

FIG. 2

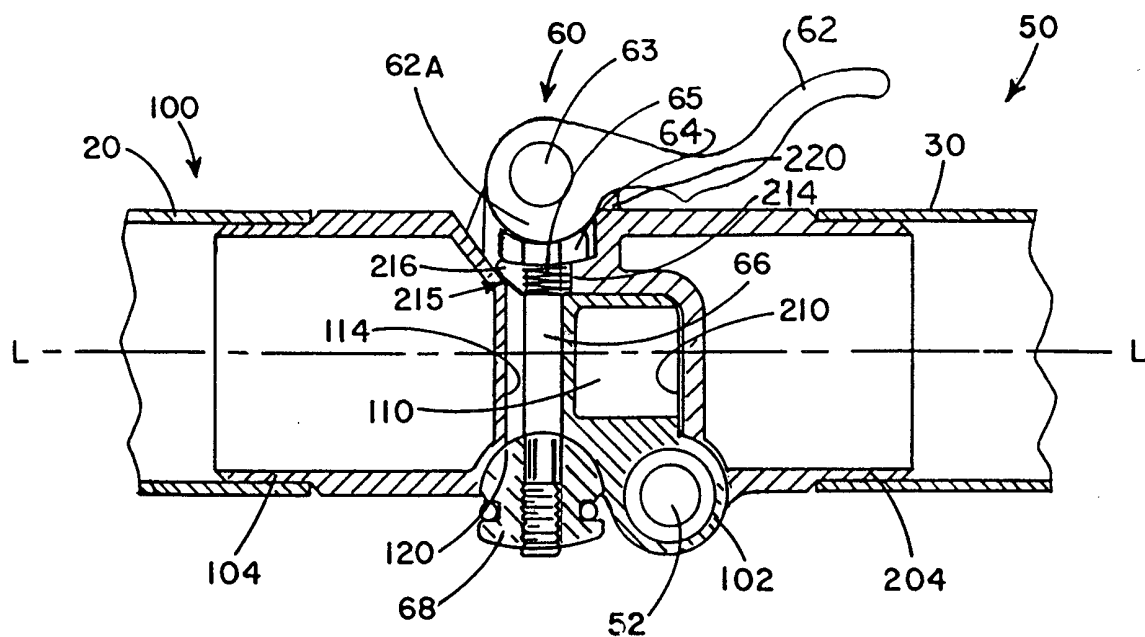

FIG. 3

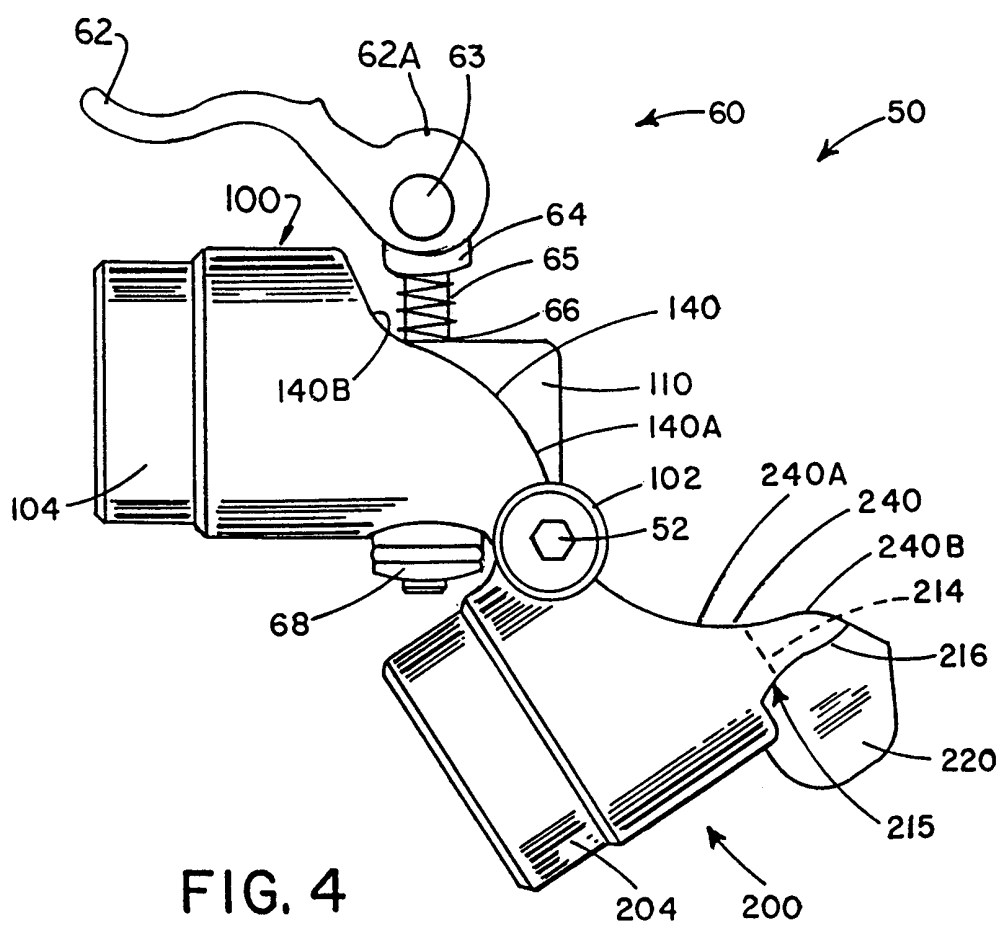

FIG. 4

INTERNATIONAL SEARCH REPORT

International application No.
PCT/US98/00378**A. CLASSIFICATION OF SUBJECT MATTER**

IPC(6) : B62K 27/00

US CL : 280/204

According to International Patent Classification (IPC) or to both national classification and IPC

B. FIELDS SEARCHED

Minimum documentation searched (classification system followed by classification symbols)

U.S. : 280/204, 202, 230, 231, 239; 403/84, 102

Documentation searched other than minimum documentation to the extent that such documents are included in the fields searched

Electronic data base consulted during the international search (name of data base and, where practicable, search terms used)

C. DOCUMENTS CONSIDERED TO BE RELEVANT

Category*	Citation of document, with indication, where appropriate, of the relevant passages	Relevant to claim No.
X	US 5,251,359 A (FINKL) 12 October 1993 (12/10/93), col. 4, lines 38-61.	17, 22, 25 23, 24
X	US 3,791,672 A (PERA) 12 February 1974 (12/02/74), col. 2, lines 15-56.	26
X	US 5,067,738 A (O'CONNOR) 26 November 1991 (26/11/91), col. 2, lines 23-61.	1-6, 11-16



Further documents are listed in the continuation of Box C.



See patent family annex.

* Special categories of cited documents:

"A" document defining the general state of the art which is not considered to be of particular relevance

"E" earlier document published on or after the international filing date

"L" document which may throw doubts on priority claim(s) or which is cited to establish the publication date of another citation or other special reason (as specified)

"O" document referring to an oral disclosure, use, exhibition or other means

"P" document published prior to the international filing date but later than the priority date claimed

"T"

later document published after the international filing date or priority date and not in conflict with the application but cited to understand the principle or theory underlying the invention

"X"

document of particular relevance; the claimed invention cannot be considered novel or cannot be considered to involve an inventive step when the document is taken alone

"Y"

document of particular relevance; the claimed invention cannot be considered to involve an inventive step when the document is combined with one or more other such documents, such combination being obvious to a person skilled in the art

"&"

document member of the same patent family

Date of the actual completion of the international search

02 APRIL 1998

Date of mailing of the international search report

04 JUN 1998

Name and mailing address of the ISA/US
Commissioner of Patents and Trademarks
Box PCT
Washington, D.C. 20231

Facsimile No. (703) 305-3230

Authorized officer

R. OBERLEITNER

Telephone No. (703) 308-1113