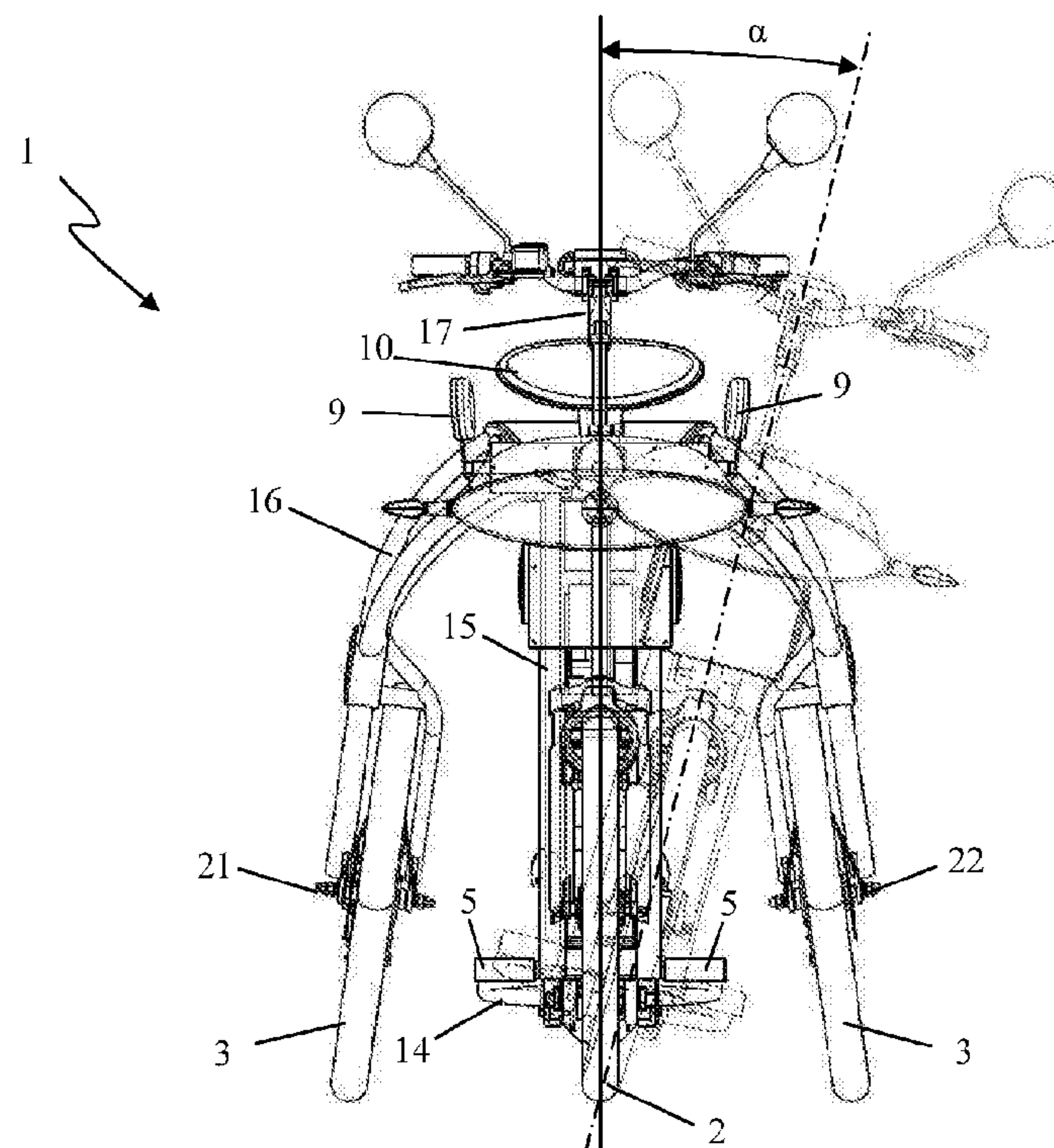




(86) Date de dépôt PCT/PCT Filing Date: 2014/03/10  
(87) Date publication PCT/PCT Publication Date: 2014/09/18  
(85) Entrée phase nationale/National Entry: 2015/07/30  
(86) N° demande PCT/PCT Application No.: IB 2014/059583  
(87) N° publication PCT/PCT Publication No.: 2014/141036  
(30) Priorité/Priority: 2013/03/11 (BEBE2013/0158)

(51) Cl.Int./Int.Cl. *B62K 5/02* (2013.01),  
*B62J 1/28* (2006.01), *B62J 25/00* (2006.01),  
*B62K 3/00* (2006.01), *B62K 5/06* (2006.01),  
*B62K 5/10* (2013.01)  
(71) Demandeur/Applicant:  
N.G.M. SPRL, BE  
(72) Inventeur/Inventor:  
NEERMAN, JOHAN, BE  
(74) Agent: KIRBY EADES GALE BAKER

(54) Titre : TRICYCLE  
(54) Title: TRICYCLE



**FIG. 3**

(57) Abrégé/Abstract:

The invention relates to a tricycle (1), designed to move a user, that is more ergonomic and easier to operate, to carry a person, comprising a front wheel (2), two rear wheels (3), a frame (4), joining the wheels (2, 3), substantially comprising a stationary rear section (4a) relative to the support plane of the three wheels (2, 3) and a front section (4b) being able to pivot laterally, relative to the substantially stationary section (4a), about a tilting axis (19) substantially in the longitudinal direction of the tricycle (1), a footrest (5) located on the pivoting section (4b) and an ischiatic support (6) located on the essentially stationary section (4a).



(12) INTERNATIONAL APPLICATION PUBLISHED UNDER THE PATENT COOPERATION TREATY (PCT)

(19) World Intellectual Property

Organization

International Bureau

(43) International Publication Date

18 September 2014 (18.09.2014)



(10) International Publication Number

WO 2014/141036 A1

## (51) International Patent Classification:

B62K 5/02 (2013.01) B62J 1/28 (2006.01)

B62K 5/10 (2013.01) B62K 5/06 (2006.01)

B62J 25/00 (2006.01) B62K 3/00 (2006.01)

## (21) International Application Number:

PCT/IB2014/059583

## (22) International Filing Date:

10 March 2014 (10.03.2014)

## (25) Filing Language:

English

## (26) Publication Language:

English

## (30) Priority Data:

BE2013/0158 11 March 2013 (11.03.2013) BE

(71) Applicant: N.G.M. SPRL [BE/BE]; Rue de la Loi 25 Bte 21, B-7100 La Louvière (BE).

(72) Inventor: NEERMAN, Johan; Beverlaai 73, B-8500 Kortrijk (BE).

(74) Agents: HOSTENS, Veerle et al.; President Kennedypark 31 C, B-8500 Kortrijk (BE).

(81) Designated States (unless otherwise indicated, for every kind of national protection available): AE, AG, AL, AM,

AO, AT, AU, AZ, BA, BB, BG, BH, BN, BR, BW, BY, BZ, CA, CH, CL, CN, CO, CR, CU, CZ, DE, DK, DM, DO, DZ, EC, EE, EG, ES, FI, GB, GD, GE, GH, GM, GT, HN, HR, HU, ID, IL, IN, IR, IS, JP, KE, KG, KN, KP, KR, KZ, LA, LC, LK, LR, LS, LT, LU, LY, MA, MD, ME, MG, MK, MN, MW, MX, MY, MZ, NA, NG, NI, NO, NZ, OM, PA, PE, PG, PH, PL, PT, QA, RO, RS, RU, RW, SA, SC, SD, SE, SG, SK, SL, SM, ST, SV, SY, TH, TJ, TM, TN, TR, TT, TZ, UA, UG, US, UZ, VC, VN, ZA, ZM, ZW.

(84) Designated States (unless otherwise indicated, for every kind of regional protection available): ARIPO (BW, GH, GM, KE, LR, LS, MW, MZ, NA, RW, SD, SL, SZ, TZ, UG, ZM, ZW), Eurasian (AM, AZ, BY, KG, KZ, RU, TJ, TM), European (AL, AT, BE, BG, CH, CY, CZ, DE, DK, EE, ES, FI, FR, GB, GR, HR, HU, IE, IS, IT, LT, LU, LV, MC, MK, MT, NL, NO, PL, PT, RO, RS, SE, SI, SK, SM, TR), OAPI (BF, BJ, CF, CG, CI, CM, GA, GN, GQ, GW, KM, ML, MR, NE, SN, TD, TG).

## Declarations under Rule 4.17:

— of inventorship (Rule 4.17(iv))

## Published:

— with international search report (Art. 21(3))

## (54) Title: TRICYCLE

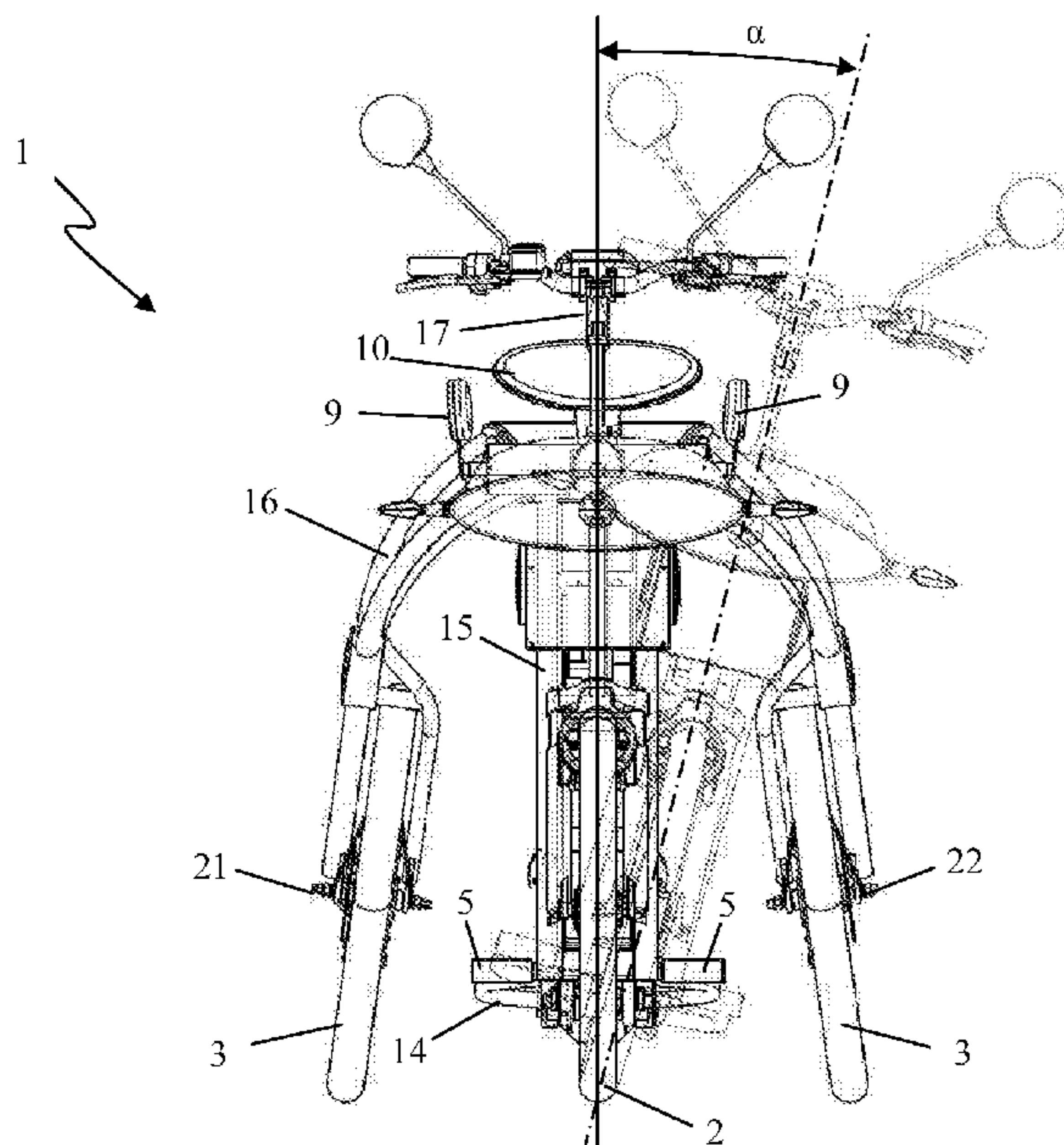


FIG. 3

(57) Abstract: The invention relates to a tricycle (1), designed to move a user, that is more ergonomic and easier to operate, to carry a person, comprising a front wheel (2), two rear wheels (3), a frame (4), joining the wheels (2, 3), substantially comprising a stationary rear section (4a) relative to the support plane of the three wheels (2, 3) and a front section (4b) being able to pivot laterally, relative to the substantially stationary section (4a), about a tilting axis (19) substantially in the longitudinal direction of the tricycle (1), a footrest (5) located on the pivoting section (4b) and an ischiatic support (6) located on the essentially stationary section (4a).



**TRICYCLE**

The present invention relates to a tricycle for carrying a person, comprising:

- a front wheel arranged substantially in the longitudinal axis of the tricycle;
- 5     - two rear wheels arranged laterally on opposite sides with respect to the longitudinal axis of the tricycle;
- a frame, connecting the wheels, comprising a pivoting section that can pivot laterally about a tilting axis positioned substantially in the longitudinal direction of the tricycle;
- 10    - a footrest which is part of or is mounted on the frame;
- a second user support which is part of or is mounted on the frame.

The tricycle according to the present invention is more particularly a tricycle powered either by pushing off the ground with the foot, or by a motor.

15

The longitudinal axis of the tricycle is the axis of the conventional direction of movement of the tricycle. The longitudinal direction of the tricycle is the direction in the conventional direction of movement of the tricycle.

20    The tricycle comprises a front wheel and two rear wheels to ensure better stability.

The prior art of vehicles having a frame, comprising a pivoting section, provides that the vehicle can adapt itself when taking curves, such that the axis of the vehicle moves transversely relative to the direction of movement to facilitate taking curves.

25    On these vehicles, the seat is mounted on the pivoting section to adjust the inclination of this part. Document WO 2005/077683 A1 specifically describes an improved tricycle of this type wherein the seat is mounted on the pivoting section with means for detecting a lateral force that a user applies on the seat. These detecting means are in functional relation with the tilting means of the pivoting  
30    section. The tilting means actively controls the inclination of the pivoting section according to said measured force.

Such a control system that uses a seat is not ergonomically ideal.

The aim of the invention is therefore to provide an alternative to the tricycle  
5 comprising a frame provided with a pivoting section that ensures optimal ergonomics for the driver.

This objective can be achieved by producing a tricycle for carrying a person, comprising:

- 10 - a front wheel, arranged substantially in the longitudinal axis of the tricycle;
- two rear wheels, arranged laterally on opposite sides with respect to the longitudinal axis of the tricycle;
- a frame, connecting the wheels, comprising a pivoting section that can pivot laterally about a tilting axis located substantially in the longitudinal direction  
15 of the tricycle;
- a footrest which is part of or is mounted on the frame;
- a second user support which is part of or is mounted on the frame;

wherein the frame comprises a substantially stationary section relative to the support plane of the three wheels, the pivoting section of the frame being able to pivot  
20 relative to the substantially stationary section being located at the front of the tricycle, joining the front wheel and being provided with the footrest of the tricycle, and the substantially stationary section of the frame being located at the rear of the tricycle, joining the rear wheels and being provided with the second support of the tricycle which is designed as an ischiatic support.

25

According to the invention, the seat of the tricycle in sitting position is replaced by a ischiatic support that provides optimal ergonomics for the driver. This ischiatic support is additionally located on the substantially stationary section of the frame and not on the pivoting section of the frame. The inclination of the pivoting section can  
30 therefore be directly adjusted with the feet of the user and not by using the seat which is mounted on the substantially stationary section. Such an adjustment is much

more ergonomic. In addition, an adjustment made using the feet facilitates driving and is more ergonomic. The system acts directly, without intermediary, and ensures greater reaction speed. With such a configuration, the tricycle according to the invention is more manoeuvrable than tricycles of the prior art.

5

The tricycle of the invention is even more easily manoeuvrable in an embodiment wherein the tilting axis is located in a plane comprising the longitudinal axis of the tricycle and substantially perpendicular to the support plane of the three wheels, this axis being inclined  $1^{\circ}$  to  $10^{\circ}$  with respect to the support plane of the three wheels, the  
10 inclination tending to vary when the tricycle is loaded.

The tilting axis is preferably substantially inclined  $5^{\circ}$  to  $8^{\circ}$  and, more preferably, is substantially inclined  $6^{\circ}$  with respect to the support plane of the three wheels.

15 The maximum inclination of the pivoting section about its tilting axis is preferably substantially  $15^{\circ}$ .

According to a preferred embodiment, the tricycle comprises means for centring the pivoting section, so as to return the pivoting section of the frame to its initial  
20 position. More specifically, these centring means may comprise cylinders. The pressure of such cylinders is preferably adjustable so that they can be adjusted, for example, relative to the weight or the preferred sensation of the user.

Preferably, the footrest of a tricycle according to the invention is arranged in such a  
25 way that it ensures that the feet of the user are inclined relative to the support plane of the three wheels. The position of a user with such an inclination provides the user an ideal ergonomic posture, such that the user can stand upright for a much longer duration.



According to an even more preferred embodiment, the footrest is in the form of one or more bar(s) for placing one's feet. The use of footrest bars provides the system an ideal ergonomic tilt. The footrest bars are preferably round bars.

- 5 In a preferred embodiment, the ischiatic support can pivot relative to the frame about a tilting axis which is substantially located in a plane comprising the longitudinal axis of the tricycle and which is substantially inclined  $45^{\circ}$  to  $90^{\circ}$  relative to the support plane of the three wheels. Preferably, the tilting axis is, in this case, substantially inclined from  $65^{\circ}$  to  $70^{\circ}$ .

10

The maximum inclination of the ischiatic support about its tilting axis is preferably substantially  $15^{\circ}$ .

- 15 According to a preferred embodiment of a tricycle according to the invention comprising such a pivoting ischiatic support, the tricycle comprises means for centring the ischiatic support so as to return the ischiatic support to its initial position. More specifically, these centring means can comprise a torsion spring.

- 20 According to a particular variant of embodiment, the ischiatic support is mounted to the frame in an adjustable heightwise manner, so that the height can be adjusted according to the morphology of the user.

- 25 According to a particular embodiment of the invention, the tricycle comprises lateral supports which are mounted substantially on either side of the ischiatic support and at least partially above the ischiatic support so as to support the user laterally. Preferably, such lateral supports are laterally adjustable relative to the ischiatic support, which allows the width of the buttock support to be adjusted. Furthermore, such lateral supports can preferably pivot, relative to the ischiatic support, about a tilting axis substantially perpendicular to the longitudinal axis of the tricycle and
- 30 substantially parallel to the support plane of the three wheels, so that they can be lowered in such a way that the user can get on or off the tricycle more easily.

The present invention will now be explained in greater depth based on the following description of several preferred tricycles according to the invention. The purpose of this description is exclusively to give an illustrative example of the invention and to indicate further advantages and details of these tricycles according to the invention, and may thus in no way be interpreted as a limitation of the scope of application of the invention or of the patent rights requested in the claims.

This detailed description will use reference numerals to refer to the appended drawings, wherein:

- 10 Figure 1 is a rear view of an embodiment of a tricycle according to the invention;  
Figure 2 is a side view of the tricycle that is shown in Figure 1;  
Figure 3 is a front view of the tricycle shown in Figure 1, which shows the two positions of the tricycle between pivoting section of the tricycle pivots 15°;  
Figure 4 is a perspective view from behind of a part of the tricycle shown in Figure 1, at the connection between the substantially stationary section and the pivoting section of the frame of the tricycle, which shows two positions between which the pivoting section of the tricycle pivots 15°;  
15 Figure 5 is a front perspective view of part of the tricycle shown in Figure 1, at the ischiatic support, showing the two positions between which the ischiatic support pivots 15°;  
20 Figure 6 is a top view of part of the tricycle shown in Figure 1, at the ischiatic support, which shows two positions of the ischiatic support between which the ischiatic support pivots 15°;  
Figure 7 is a perspective view from the front of the tricycle shown in Figure 1, which shows two positions of the tricycle between which the pivoting section of the tricycle pivots 15° and the handlebar pivots;  
25 Figure 8 is a detailed view of zone A of Figure 7;  
Figure 9 is a perspective view from the front of a section of the tricycle shown in Figure 1, at the ischiatic support, which shows two positions of the ischiatic support between which the ischiatic support is moved upward;  
30



Figure 10 is a front view of the ischiatic support, with the lumbar backrest, the lateral supports and the seat support, which shows two positions of the lateral supports between which the distance between the lateral supports is set; and

Figure 11 is a side view of the ischiatic support, with the lumbar backrest, the lateral supports and the seat support, which shows three positions of the lateral supports between which the inclination of the lateral supports relative to the ischiatic support is changed, and which shows two positions of the seat support between which the seat support is retracted.

10 The Figures show a tricycle (1) comprising a front wheel (2) and two rear wheels (3), as shown in Figures 1 to 3 and 7. The front wheel (2) is arranged substantially in the longitudinal axis of the tricycle (1). The two rear wheels (3) are arranged laterally on opposite sides relative to the longitudinal axis of the tricycle (1), such that the tricycle (1) is substantially symmetrical to the longitudinal axis of the tricycle (1).

15

A frame (4) (see Figure 2) connects the wheels (2, 3). This frame (4) comprises a front section (4b) and a rear section (4a). The front section (4b) of the frame (4) comprises a platform (14) and a post (13) and seal the front wheel (2) with a handlebar (17) that can pivot relative to the post (13) in a well-known manner. The inclination of the handlebar (17) relative to the post (13) is limited and is in the order of 40°. The handlebar (17) is connected to a first end of the post (13). The other end of the post (13) is connected to a first end of the platform (14). The platform (14) allows the driver to place one foot on it and propel the tricycle (1) by pushing off the ground with the other foot. The platform (14) is, for example, of perforated anti-slip sheeting for better adhesion of the feet. In front of the platform (14) at the two lateral faces, a cylindrical bar (5) is mounted as a footrest (5) to provide support when the tricycle is powered by the motors (12). Owing to the footrests (5) made in the form of cylindrical bars, the inclination of the feet automatically adapts to the best ergonomic position. A roller (20) is mounted below the platform (14) and allows an obstacle to be easily crossed whose height is greater than or equal to the clearance height of the platform (14). The platform (14) is slightly inclined relative to the

20

25

30



support plane of the three wheels (2, 3); this angle being between  $5^{\circ}$  and  $15^{\circ}$ , thereby allowing better support of the feet. The second end of the platform (14) is connected to the rear section (4a) of the tricycle (1). The rear section (4a) comprises an arcade (15) and an arch (16) supporting the rear wheels (3). A first end of the arcade (15) is connected to the second end of the platform (14), and the second end of the arcade (15) is connected in the middle of the arch (16). On the gantry (15) is mounted an ischiatic support (6) with its lateral supports (9), its lumbar backrest (10) and the retractable seat support (23). The section of the arcade (15), where the ischiatic support (6) is mounted, is substantially inclined  $66.5^{\circ}$  with respect to the support plane of the three wheels (2, 3), this inclination being such that the user can position himself/herself with the feet on the footrests (5) and the back against the ischiatic support (9), assuming an ideal ergonomic posture. The arch (16) supporting the rear wheels (16) comprises two arms extending laterally from the middle of the arch (16) to the rear wheels (3). The rear wheels (3) have an independent axis of rotation (21, 22) which frees up the space between the wheels (3) required for the user to propel himself/herself by muscular effort.

The front section (4b) is connected to the rear section (4a) via a pivot which ensures the lateral inclination of the front section (4b). The rear section (4a) is substantially stationary relative to the support plane of the three wheels (2, 3). Thus, when the front section (4b) is inclined relative to the rear section (4b), the rear section (4a) and rear wheels (3) remain immobile as a result of this rotation, and the front section (4b) and the front wheel (2) pivot relative to the support plane of the three wheels (2), as illustrated in Figure 3 and Figure 7. The tilting axis (19) of the front portion (4b) is situated in a plane comprising the longitudinal axis of the tricycle (1) and essentially perpendicular to the support plane of the three wheels (2, 3). This axis (19) is substantially inclined  $6^{\circ}$  relative to the support plane of the three wheels (2, 3), the inclination tending to vary when the tricycle (1) is loaded. Figures 3, 7 and 8 show the maximum inclination ( $\alpha$ ) of the pivoting part (4b) which is substantially  $15^{\circ}$ . The front section (4b) and the rear section (4a) are connected by with a force transfer plate (18) which is fixedly mounted on the shaft (19) of the front section (4b), as

shown in Figure 1. On each side of the force transfer plate (18), a cylinder (7) is provided that is fixed to the arcade (15) on the rear section (4a). Through these elements, the front section (4b) is able to pivot relative to the rear section. The cylinders (7) are used as means for centring the front section (4b) so as to automatically recentre the front section (4b) in its initial position. The cylinders (7) are adjustable so that the recentring pressure can be adjusted relative to the weight of the user or depending on user preference.

Such a configuration allows the user to adjust the pivoting section using his/her feet.

10

The ischiatic support (6) of the tricycle (1) is adjustable in height on the arcade (15), as illustrated in Figure 9, so that the height can be adjusted according to the morphology of the user. Numerous means of attachment that allow such movement already exist and are known in the prior art.

15

The ischiatic support (6) is further pivotally mounted laterally relative to the arcade (15) about an axis substantially inclined  $66.5^\circ$  relative to the support plane of the three wheels (2, 3). The inclination of the axis about which the support can rotate is the same as that of the arcade (15), as illustrated in Figures 5 to 8. This allows the user to monitor the movement of the tricycle (1) via the ischiatic support (6). The maximum inclination ( $\beta$ ) of the ischiatic support (6) about its tilting axis is substantially  $15^\circ$ . Numerous solutions are known in the prior art for making this type of connection.

20

Two springs (8), as shown in Figure 6, acting in opposite directions, constitute means for centring the ischiatic support (6) to ensure that the ischiatic support (6) returns to its initial position.

25

A lumbar backrest (10), provided to support the lower back of the user, is mounted above and in connection with the ischiatic support (6), such that the backrest (10) follows all the movements of the ischiatic support (6) (see Figures 5 to 8).

30



Two lateral supports (9) support the movements user laterally at the pelvis and are substantially mounted on either side of the ischiatic support (6), and in connection with the ischiatic support (6), such that they follow all the movements of the ischiatic support (see Figures 5 to 8).

The lateral supports (9) for the pelvis are adjustable in width relative to the ischiatic support (6), as illustrated in figure 10, so that the distance between the supports (9) can be adjusted relative to the width of the user's pelvis. The lateral supports (9) can pivot relative to the ischiatic support (6) about a tilting axis that is substantially perpendicular to the longitudinal axis of the tricycle (1) and substantially parallel to the support plane of the three wheels (2, 3), so that it can be lowered in such a way that the user can get on and off the tricycle more easily. In Figure 11, three positions of the lateral supports (9) are shown, with a inclination ( $\gamma$ ) of  $15^\circ$  between the various positions. Many systems for adjusting the lateral supports (9) are possible.

The tricycle (1) as illustrated further comprises a seat support (23). As a seat support (23) gives riders the opportunity to opt for a support between the legs without necessarily having to use the lateral supports (9). This seat support (23) is retractable, so that it can be lowered ( $\delta$ )  $60^\circ$ , as illustrated in Figure 11.

The tricycle (1) as shown is powered either by pushing off on the ground with the foot, or by motors (12). The motors (12) are mounted in the axis of the rear wheels, as shown in Figure 2, so as not to impede the movements of the user. The batteries (11) for the motors (12) are mounted either inside the post (13) of the front frame (4), or at the base of the arcade (15) of the rear frame (4). It is also possible to equip the tricycle with a motor that is mounted on or in the frame (4), or in a single wheel (2, 3), or to mount a motor in or on each wheel (2, 3). It is also possible to mount the batteries (11) only on the post (13), or only on the arcade (15). Numerous positions are possible without the motor preventing this tricycle (1) from being propelled with the feet.

## CLAIMS

1. A tricycle (1) for carrying a person, comprising:
  - 5           – a front wheel (2) arranged substantially in the longitudinal axis of the tricycle (1);
  - two rear wheels (3), arranged laterally on opposite sides with respect to the longitudinal axis of the tricycle (1);
  - a frame (4), connecting the wheels (2, 3) comprising a pivoting  
10           section (4b) that can pivot laterally about a tilting axis (19) positioned substantially in the longitudinal direction of the tricycle (1);
  - a footrest (5) which is part of or is mounted on the frame (4);
  - a second user support (6) which is part of or is mounted on the frame (4);
- 15           characterised in that the frame (4) comprises a section (4a) substantially stationary relative to the support plane of the three wheels (2, 3), in that the pivoting section (4b) of the frame (4) can pivot relative to the substantially stationary section (4a), is located at the front of the tricycle (1), joining the front wheel (2), and is provided with the footrest (5) of the tricycle (1), and in  
20           that the substantially stationary section (4a) of the frame (4) is located at the rear of the tricycle (1), joining the rear wheels (3), and is provided with the second support (6) of the tricycle (1) which is designed as an ischiatic support (6).
- 25           2. The tricycle (1) according to claim 1, characterised in that the tilting axis (19) is located in a plane comprising the longitudinal axis of the tricycle (1) and substantially perpendicular to the support plane of the three wheels (2, 3), this axis (19) being inclined 1° to 10° with respect to the support plane of the three wheels (2, 3), the inclination tending to vary when the tricycle (1) is  
30           loaded.

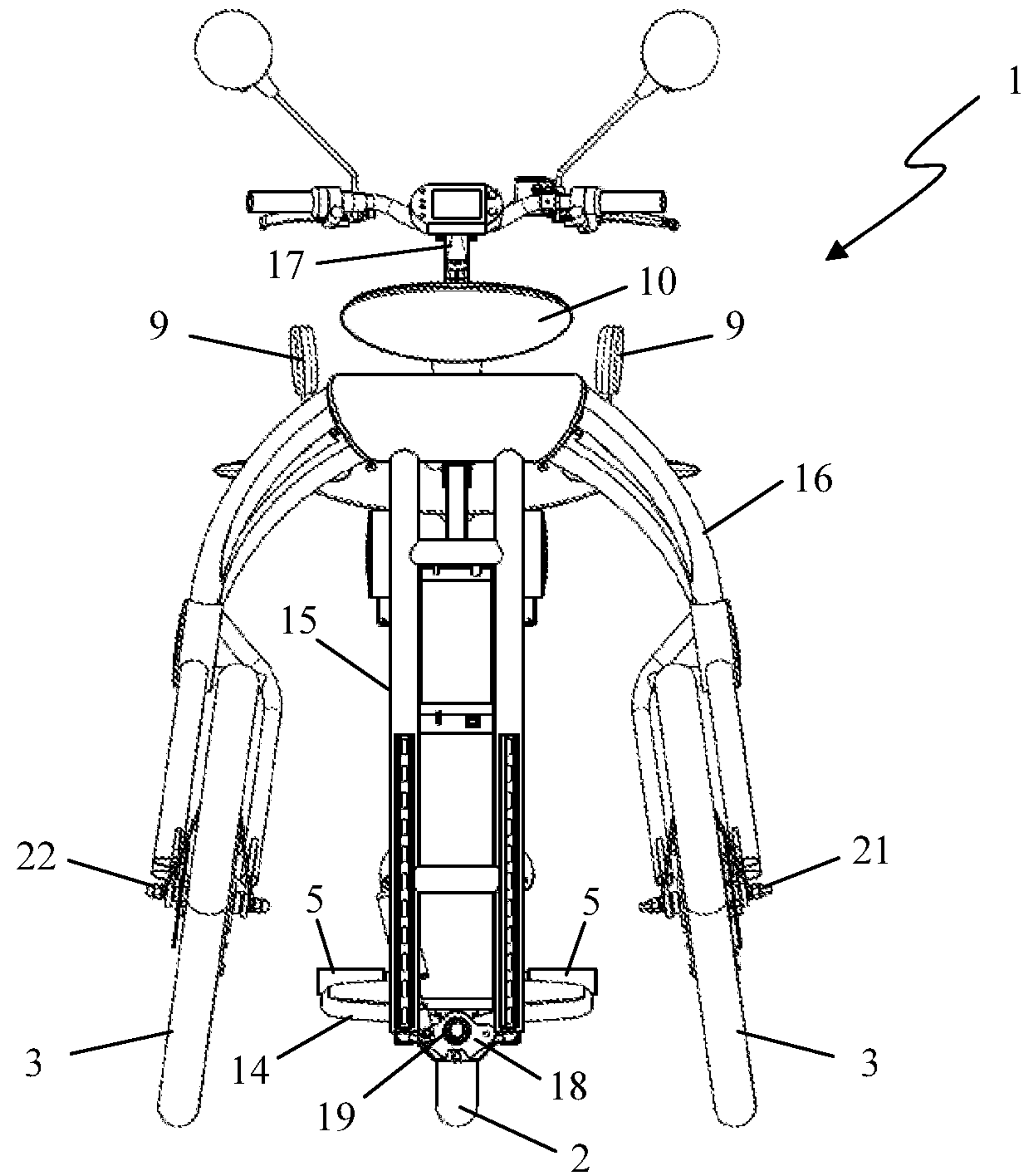
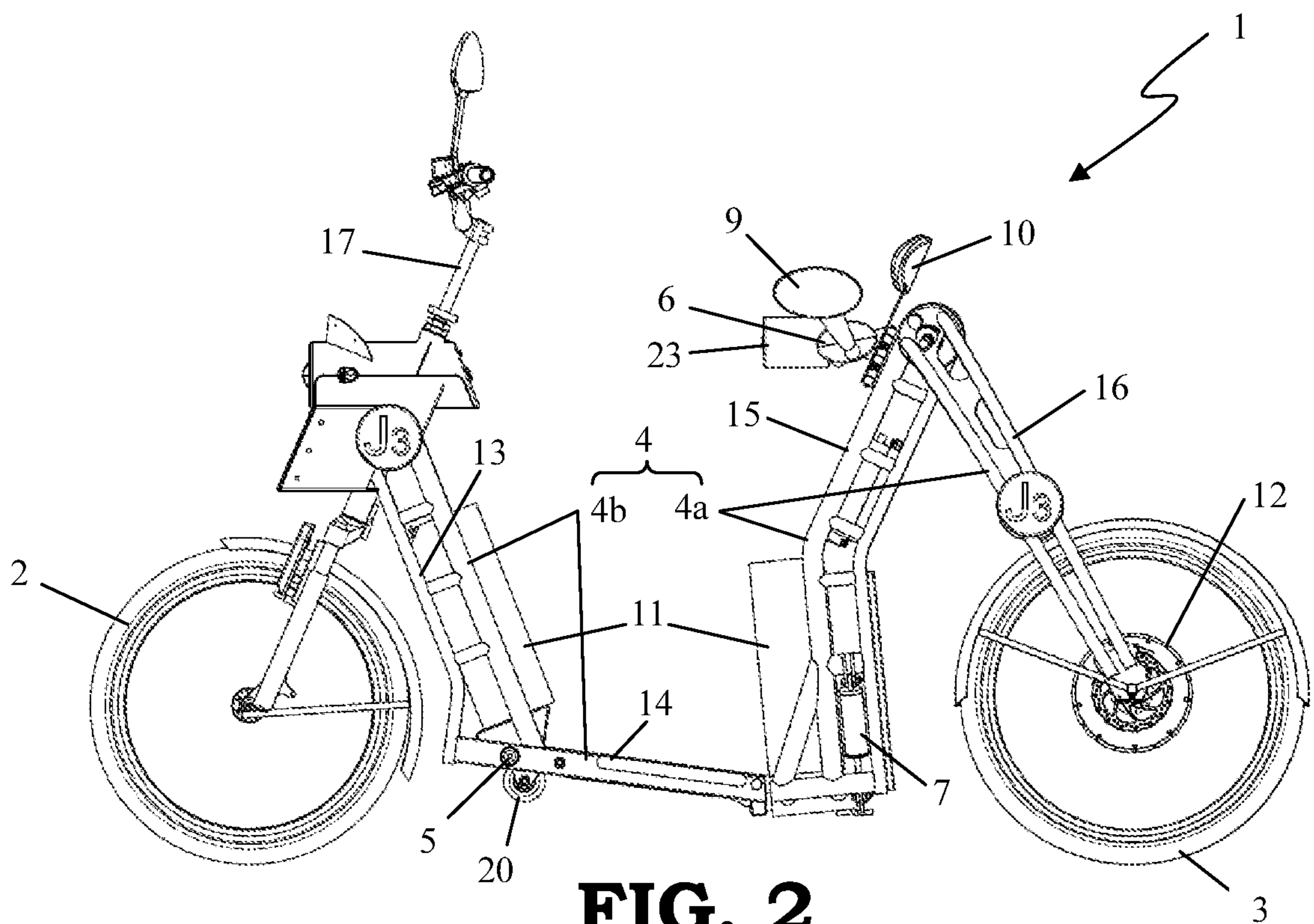


3. The tricycle (1) according to claim 2, characterised in that the tilting axis is substantially inclined  $6^\circ$  with respect to the support plane of the three wheels (2, 3).
- 5 4. The tricycle (1) according to any one of the preceding claims, characterised in that the maximum inclination ( $\alpha$ ) of the pivoting section (4b) around its tilting axis (19) is substantially  $15^\circ$ .
- 10 5. The tricycle (1) according to any one of the preceding claims, characterised in that the tricycle (1) comprises means (7) for centring the pivoting section (4b) so as to return the pivoting section (4b) of the frame (4) to its initial position.
6. The tricycle (1) according to claim 5, characterised in that the means (7) for centring the pivoting section (4b) comprise cylinders (7).
- 15 7. The tricycle (1) according to claim 6, characterised in that the pressure of the cylinders (7) is adjustable.
8. The tricycle (1) according to any one of the preceding claims, characterised in that the footrest (5) is arranged in such a way that it ensures that the feet of the user are inclined relative to the support plane of the three wheels (2, 3).
- 20 9. The tricycle (1) according to claim 8, characterised in that the footrest (5) is built in the form of one or more bar(s) (5) for placing one's feet.
- 25 10. The tricycle (1) according to any one of the preceding claims, characterised in that the ischiatic support (6) can pivot relative to the frame (4) about a tilting axis which is substantially located in a plane comprising the longitudinal axis of the tricycle and which is substantially inclined  $60^\circ$  to  $90^\circ$  relative to the support plane of the three wheels (2, 3).
- 30

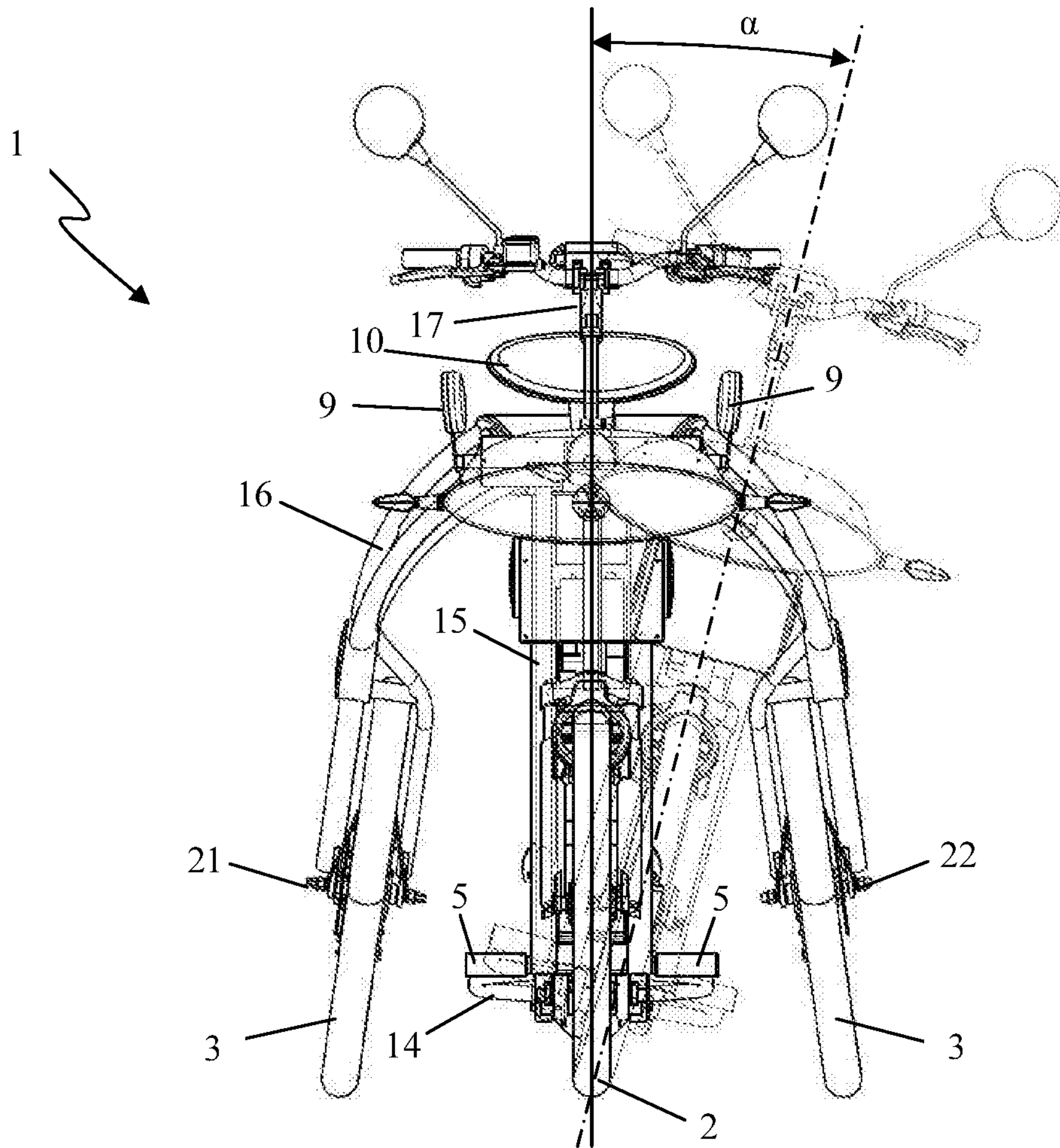
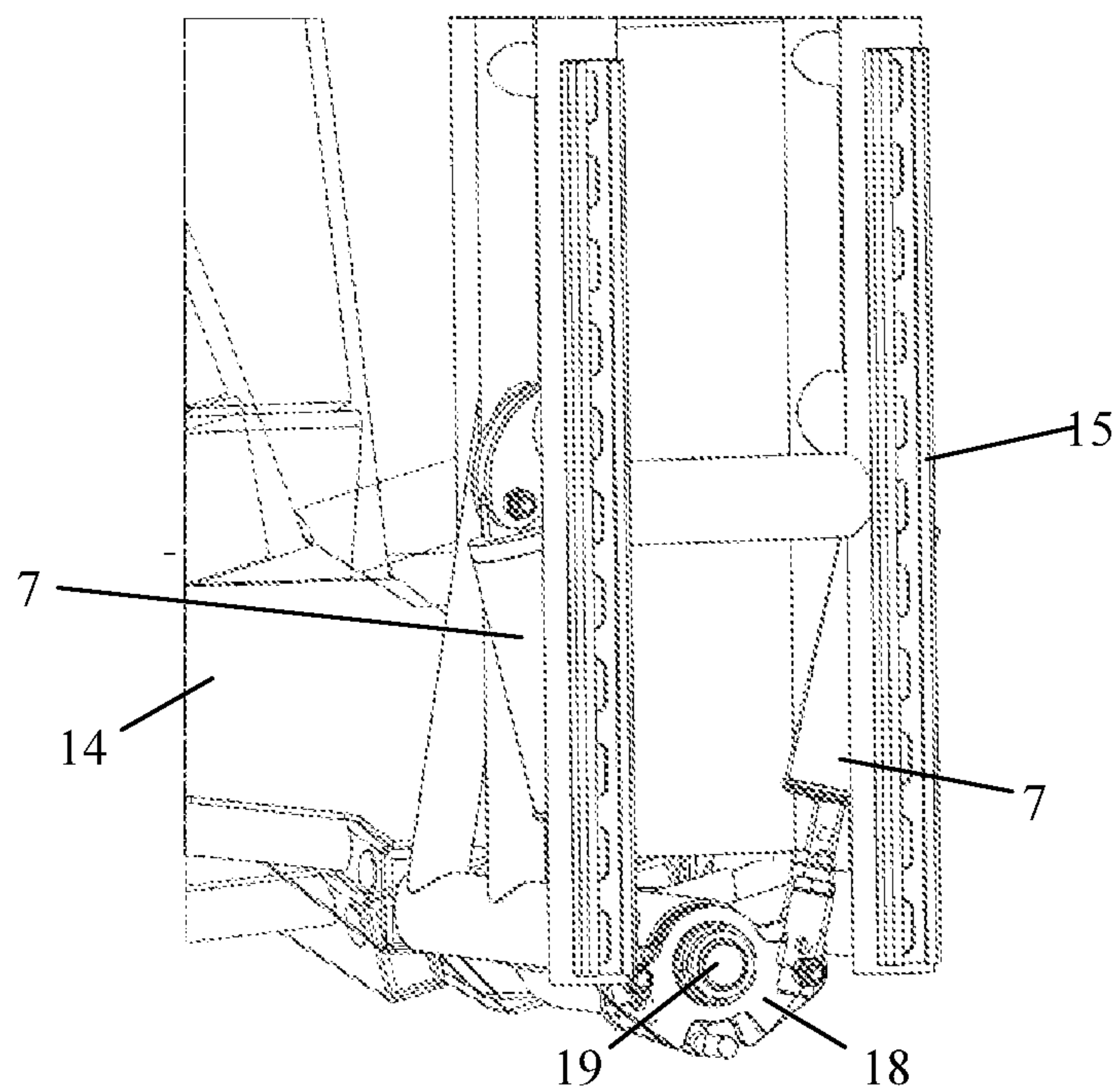
11. The tricycle (1) according to claim 10, characterised in that the maximum inclination ( $\beta$ ) of the ischiatic support (6) about its tilting axis is substantially 15°.
- 5 12. The tricycle (1) according to claim 10 or 11, characterised in that the tricycle (1) comprises means (8) for centring the ischiatic support (6) so as to return the ischiatic support (6) to its initial position.
- 10 13. The tricycle (1) according to claim 12, characterised in that the means (8) for centring the ischiatic support (6) comprise a torsion spring (8).
14. The tricycle (1) according to any one of the preceding claims, characterised in that the ischiatic support (6) is mounted to the frame (4) in an adjustable heightwise manner (4).
- 15 15. The tricycle (1) according to any one of the preceding claims, characterised in that the tricycle (1) comprises lateral supports (9) which are mounted substantially on either side of the ischiatic support (6) and at least partially above the ischiatic support (6) so as to support the user laterally.
- 20 16. The tricycle (1) according to claim 15, characterised in that the lateral supports (9) are adjustable laterally relative to the ischiatic support (6).
- 25 17. The tricycle (1) according to claim 15 or 16, characterised in that the lateral supports (9) can pivot relative to the ischiatic support (6) about a tilting axis substantially perpendicular to the longitudinal axis of the tricycle (1) and substantially parallel to the support plane of the three wheels (2, 3).



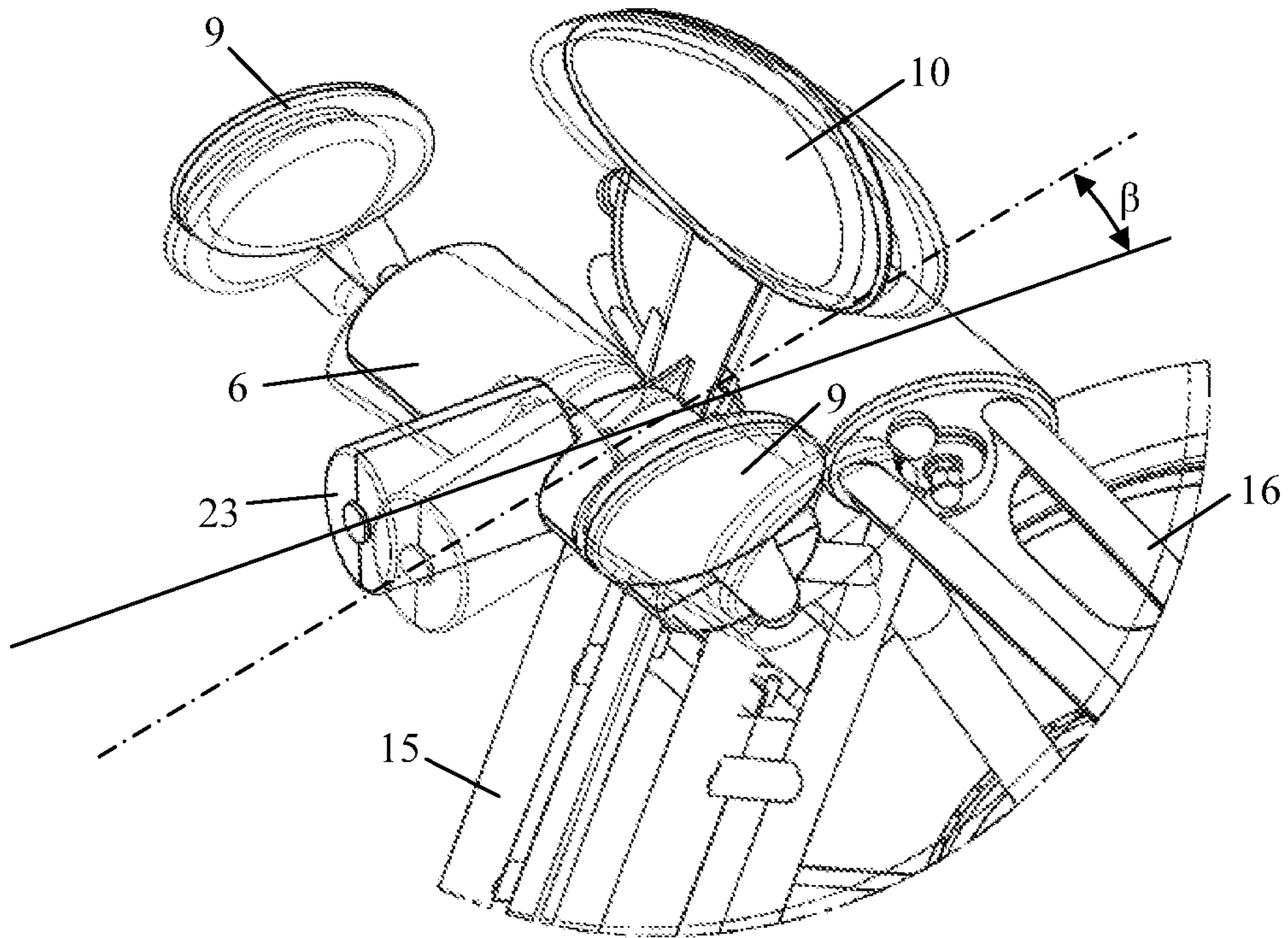
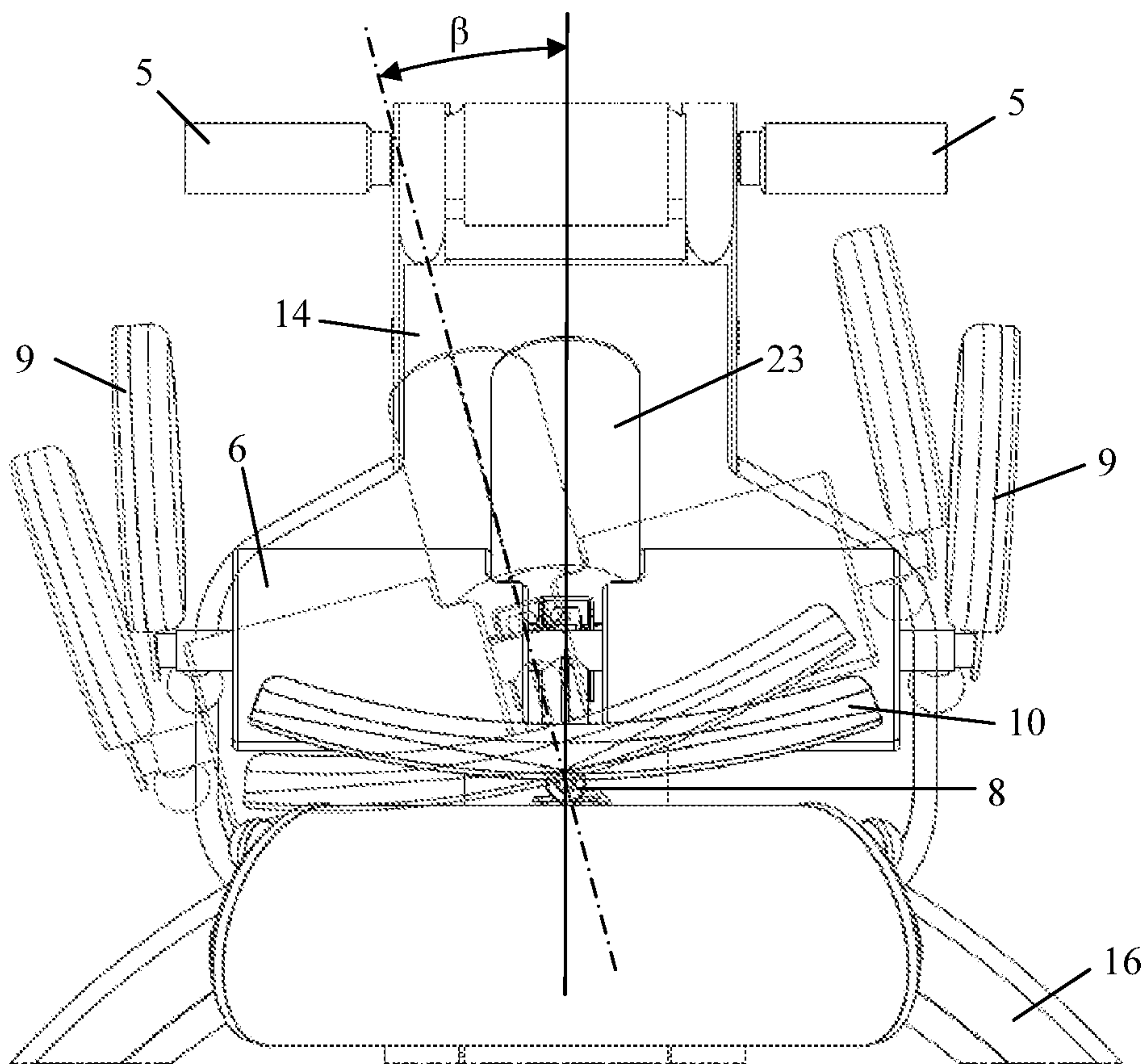
1/6

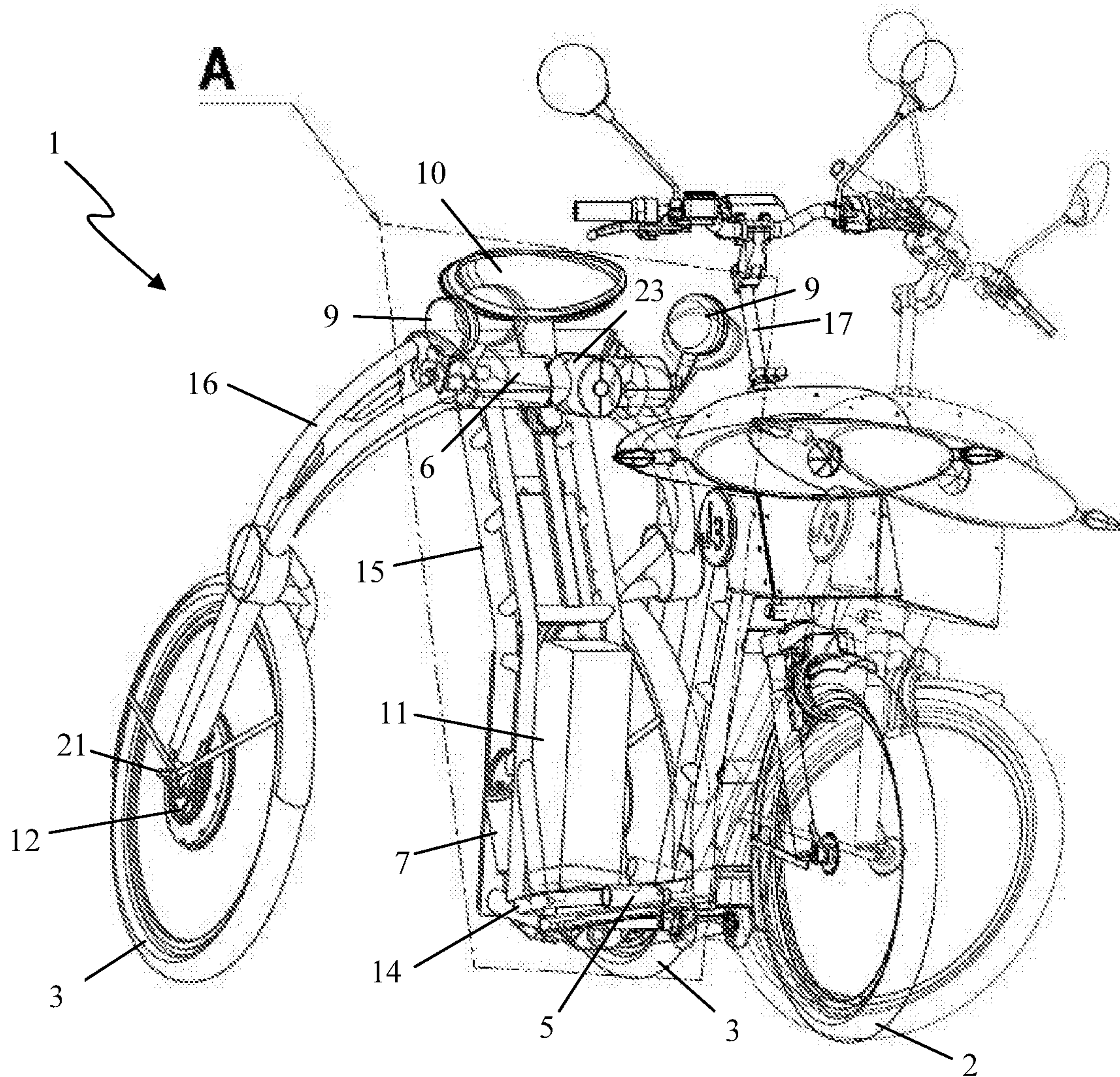
**FIG. 1****FIG. 2**

2/6

**FIG. 3****FIG. 4**

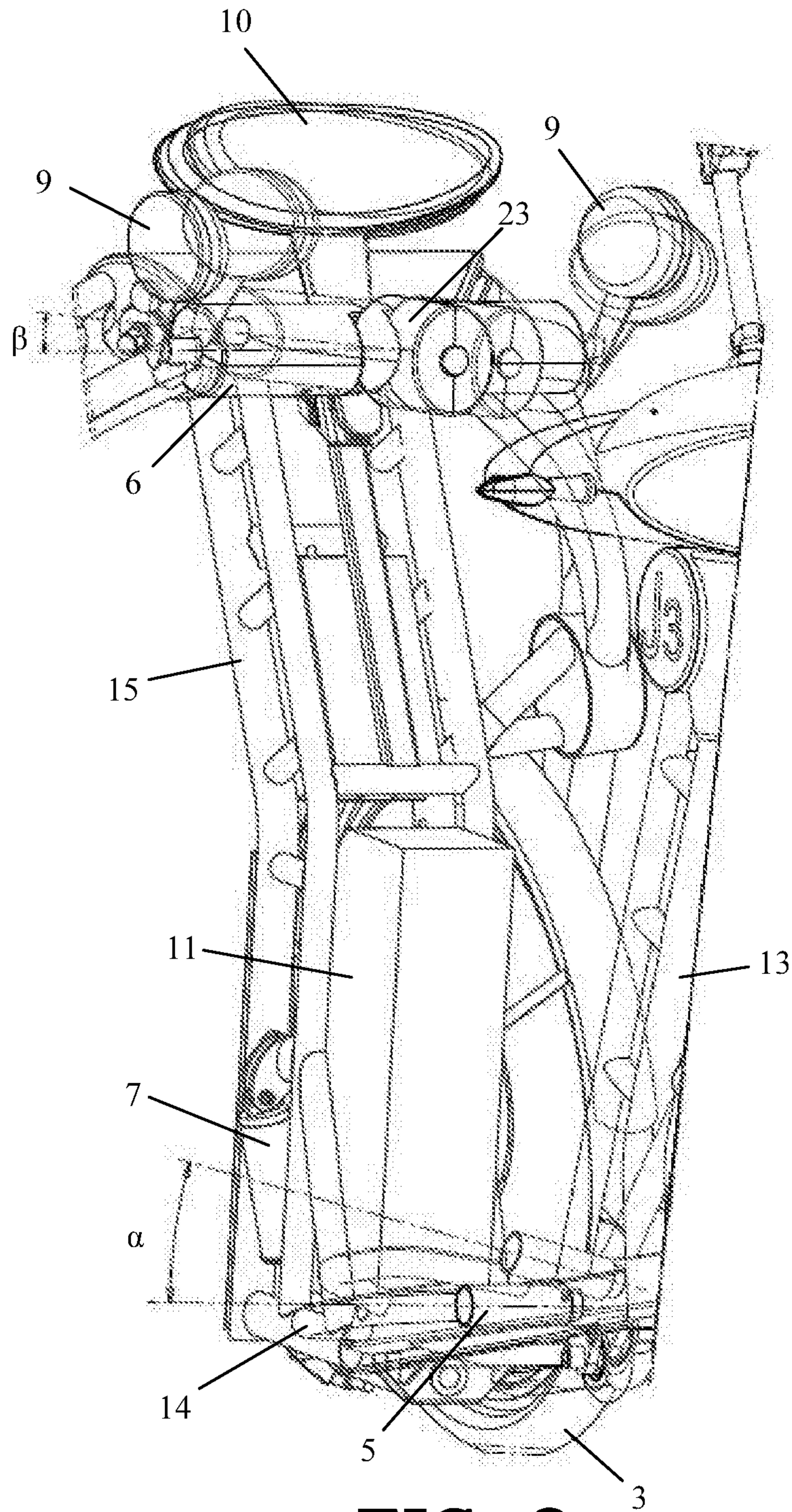


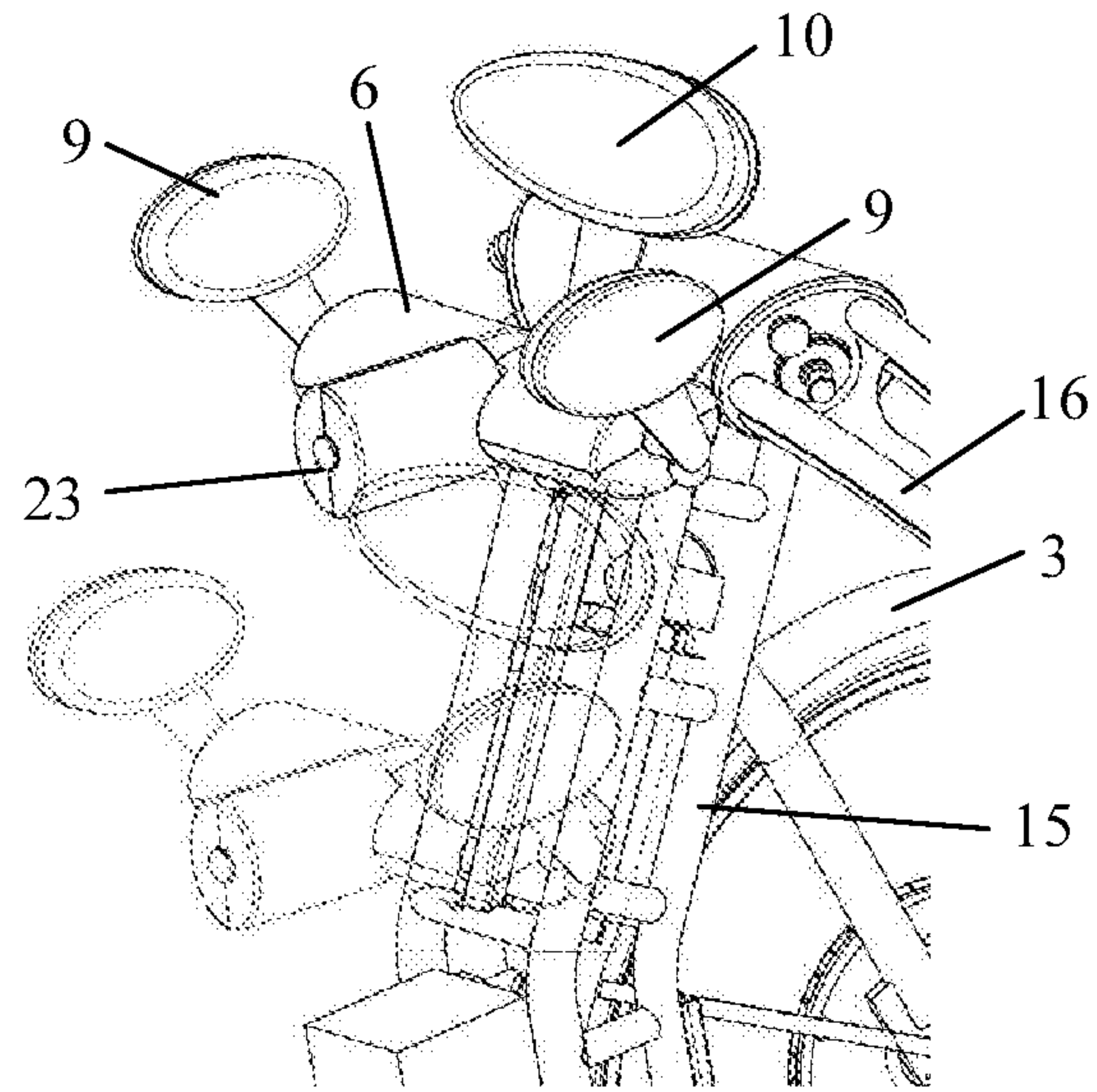
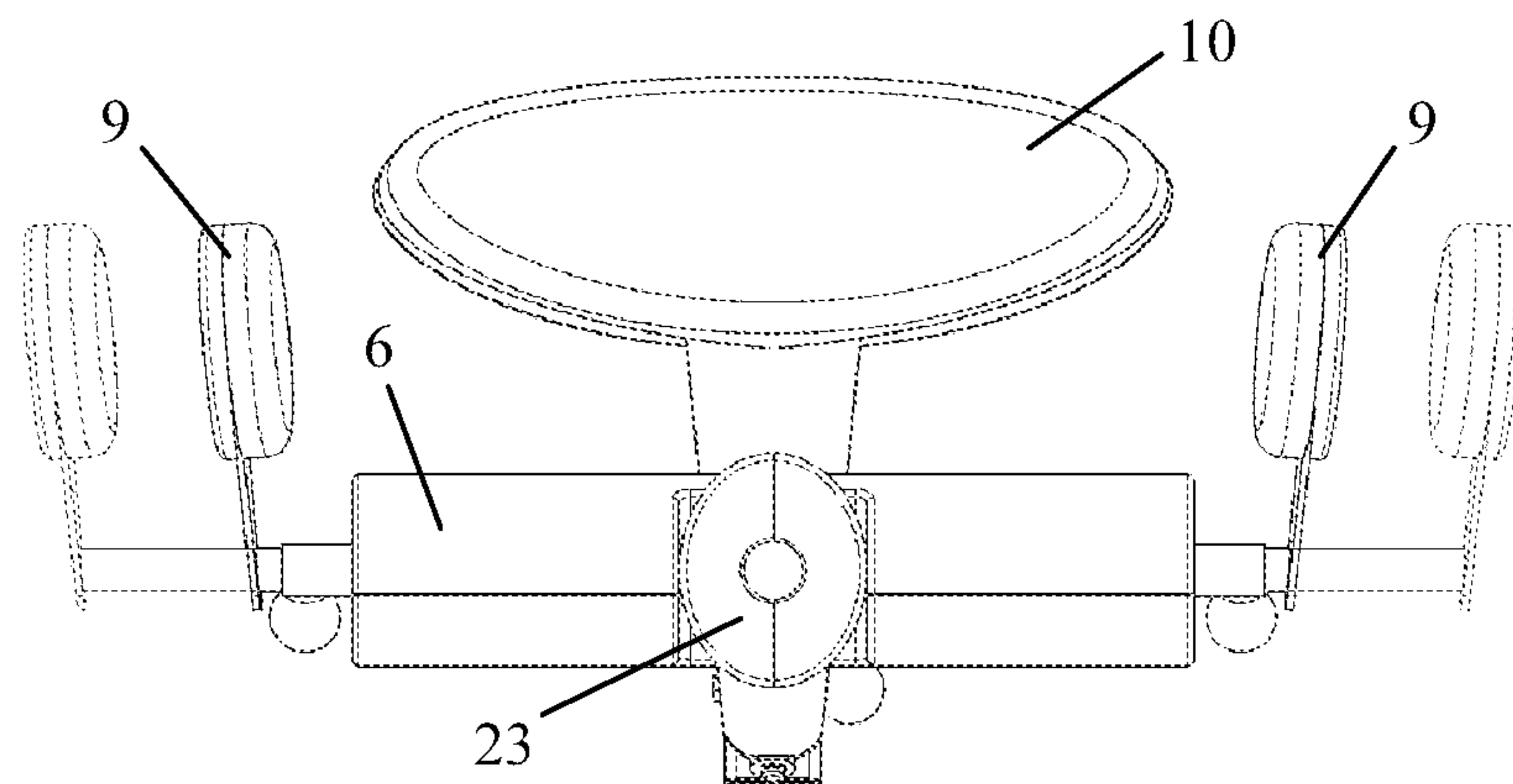
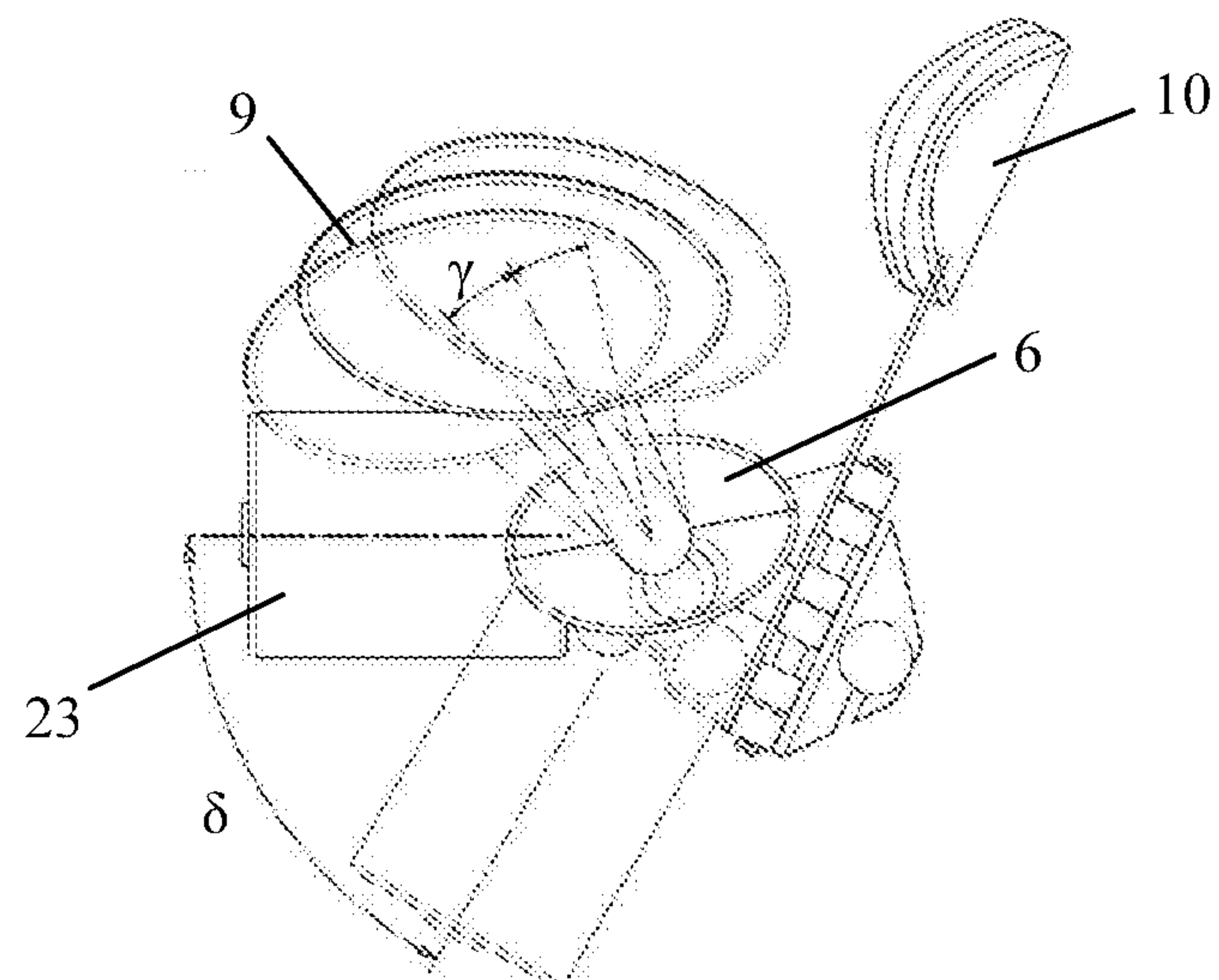
**FIG. 5****FIG. 6**



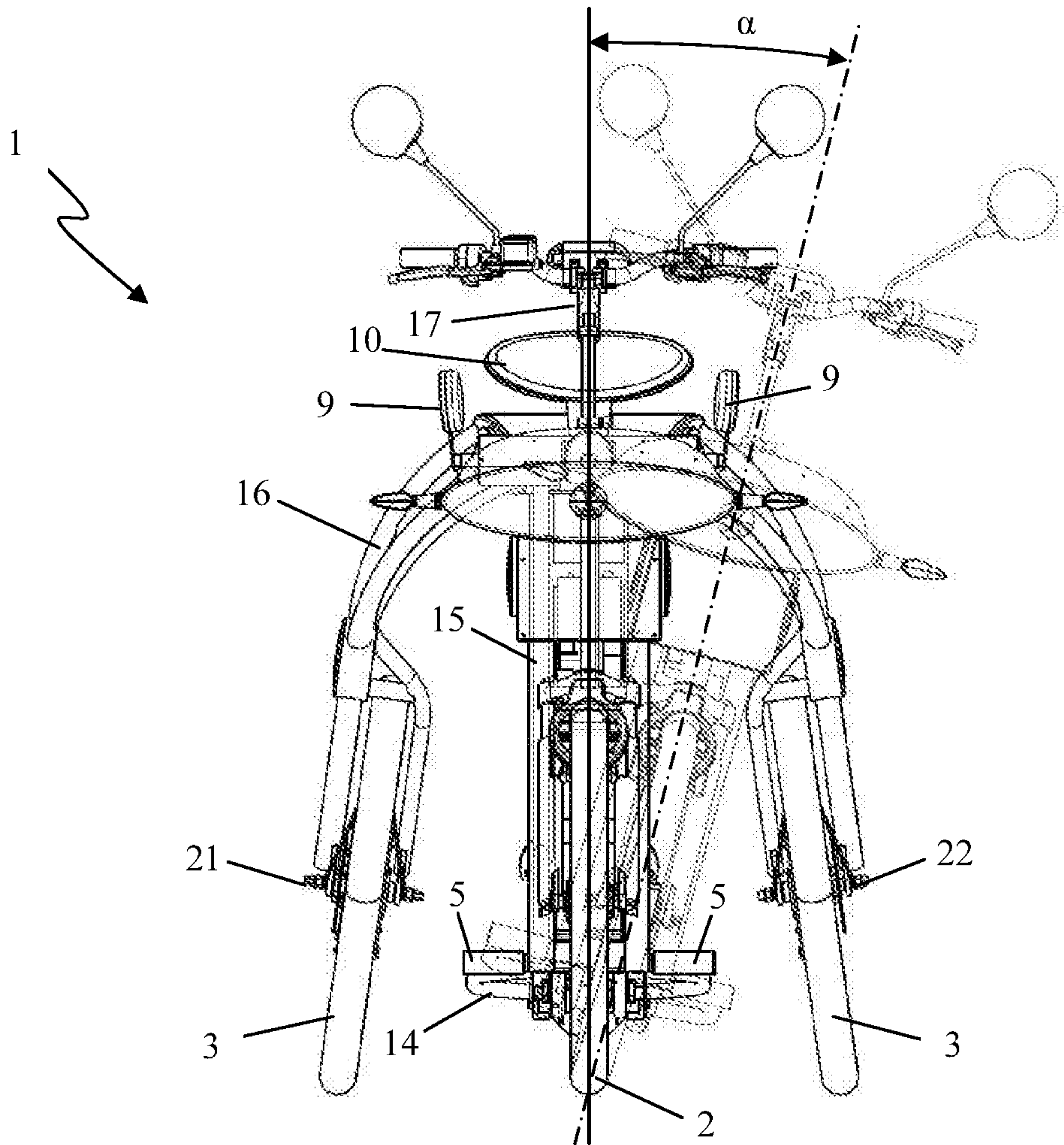
**FIG. 7**



**FIG. 8**

**FIG. 9****FIG. 10****FIG. 11**





**FIG. 3**