

(19) World Intellectual Property Organization
International Bureau



(43) International Publication Date
27 June 2002 (27.06.2002)

PCT

(10) International Publication Number
WO 02/49916 A1

(51) International Patent Classification⁷: **B64D 47/04**,
F21S 8/10, H01S 5/40

(74) Agents: **CRISS, Roger, H.** et al.; Honeywell International
Inc., 101 Columbia Avenue, P.O. Box 2245, Morristown,
NJ 07960 (US).

(21) International Application Number: PCT/US01/49730

(81) Designated States (*national*): CA, JP, KR.

(22) International Filing Date:
20 December 2001 (20.12.2001)

(84) Designated States (*regional*): European patent (AT, BE,
CH, CY, DE, DK, ES, FI, FR, GB, GR, IE, IT, LU, MC,
NL, PT, SE, TR).

(25) Filing Language: English

(26) Publication Language: English

Published:
— with international search report
— before the expiration of the time limit for amending the
claims and to be republished in the event of receipt of
amendments

(30) Priority Data:
60/257,203 20 December 2000 (20.12.2000) US
09/975,162 20 December 2001 (20.12.2001) US

(71) Applicant: **HONEYWELL INTERNATIONAL INC.**
[US/US]; 101 Columbia Road, P.O. Box 2245, Morris-
town, NJ 07960 (US).

For two-letter codes and other abbreviations, refer to the "Guid-
ance Notes on Codes and Abbreviations" appearing at the begin-
ning of each regular issue of the PCT Gazette.

(72) Inventors: **MACHI, Nicolo, F.**; 3176 Windy Ridge Drive,
Springfield, OH 45502 (US). **VO NAM, H.**; 1508 Village
Drive, Marysville, OH 43040 (US).

(54) Title: IR LASER DIODE BASED HIGH INTENSITY LIGHT

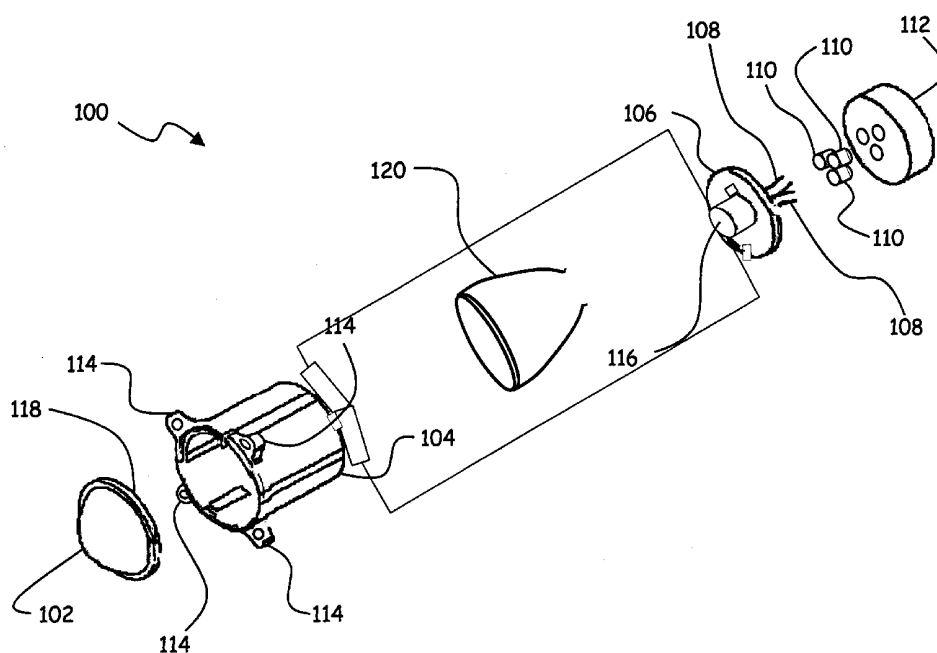

(57) **Abstract:** An infrared LASER diode based high intensity light (100) for use as an aircraft landing light or searchlight in conjunction with night vision imaging systems. The high intensity light (100) uses infrared LASER diodes (110) installed into a heat sink (112) for temperature stability. The infrared light emitted from the LASER diodes (110) is transmitted to an optical positioning plate (106) by optical transmission means (108). The optical positioning plate (106) combines the emissions of the individual LASER diodes (110) to a single infrared light beam, which is collimated by an aspheric lens (102).

IR LASER DIODE BASED HIGH INTENSITY LIGHT

BACKGROUND OF THE INVENTION

[0001] This application claims the benefit of U.S. Provisional
5 Application No. 60/257,203 filed December 20, 2000 entitled IR LASER
DIODE BASED HIGH INTENSITY LIGHT.

Field of the invention.

[0002] This invention relates to an infrared light designed for use
with infrared imaging equipment. Specifically, this invention relates to a
10 high intensity light for use on aircraft or other vehicles and utilizes infrared
("IR") LASER diodes.

Description of the related art.

[0002] Military and law enforcement personnel regularly use night
vision imaging systems ("NVIS") to support covert operations. NVIS
15 systems utilize infrared light amplification techniques to allow the user to
see terrain, objects, people, and targets in conditions of near total
darkness. NVIS equipment is frequently augmented by infrared lighting.
The IR lights cast a bright beam of infrared light that extends the viewing
area of the NVIS system but cannot be detected by the unaided eye,
20 preserving the covert nature of night vision operations.

[0003] Aircraft commonly use landing lights to provide illumination
during taxi, take-off, and landing when visibility is reduced by darkness or
adverse weather conditions. Similarly, helicopters use searchlights to aim
a beam of light in a desired direction to illuminate areas of interest or
25 targets. High intensity IR lights have previously been installed on aircraft
for this purpose in conjunction with NVIS equipment, but they suffer from
several disadvantages. Prior high intensity IR lights typically use sealed
beam or halogen incandescent lamps coupled with a "black glass" filter
that blocks visible light while passing infrared light. Such high intensity IR
30 lights generate a substantial amount of heat due to the low efficacy of
incandescent lamps and the visible light energy trapped in the lamp
housing by the infrared light filter. This condition is made worse by the

-2-

need to use high-wattage lamps to overcome the inefficiencies of the lamp and filter to achieve the high infrared light output needed for landing lights and searchlights.

[0004] The high temperatures generated by prior infrared high
5 intensity lights may have many detrimental effects. For example, the operating life of the incandescent lamps is considerably reduced. In fact, the lab-rated lamp life of some prior incandescent lamp-filter IR high intensity lighting systems may be as low as 50 hours, with an even lower life expectancy in the harsh aircraft environment. This increases the risk
10 of a lamp failure at a critical time during covert operations. The high temperatures can also cause premature failure of other materials, such as cracking of the filter due to thermal stress and accelerated weathering of filter sealing materials. If either the filter or the seal were to fail, high intensity visible light could escape, compromising covertness.

15 [0005] A limitation of incandescent lamp-filter IR high intensity lighting systems is that the high operating temperature increases the thermal signature of the light. If the light's thermal signature is too high, the light may be visible to thermal imaging systems and equipment used by opposing personnel. It should be further noted that the black glass
20 NVIS filter does not filter out all visible frequencies of light. As a result, the prior high intensity IR light may have a visible red glow, also compromising covertness.

[0006] As previously noted, the low efficacy of incandescent lamps combined with the low efficiency of IR filters has necessitated the use of
25 high-wattage lamps to overcome these drawbacks. As a result, 200-watt incandescent lamps are commonly used for aircraft landing lights and searchlights, burdening the aircraft's electrical system. Since the prior landing and searchlights are so prone to failure it is common to install two or more lighting systems on the aircraft, further taxing the aircraft's
30 electrical system.

-3-

Alternative lighting systems have been devised to overcome some of these obstacles. For example, Meyers U.S. Patent No. Re. 33,572 discloses an infrared light beam projector for use with a night vision system. However, infrared high intensity lights such as those used for aircraft landing lights and searchlights require a much higher level of light than can be achieved through the teachings of Meyers. Laser diodes have been previously used in vehicular applications, such as Scifres U.S. Patent No. 5,713,654 which discloses a centralized lighting system for vehicular instrument lights, marker lights, and brake lights. However, the high intensity light requirements of landing lights and searchlights obviate use of the teachings of Scifres. A co-owned and pending patent application, U.S. patent application number 09/217,221, "IR Diode Based High Intensity Light," offers an alternate means for generating high intensity infrared light. However, application number 09/217,221 differs significantly from the present invention. The present invention uses LASER infrared diodes rather than infrared light emitting diodes, resulting in coherent infrared light as opposed to non-coherent infrared light, and includes means for combining infrared light emissions from two or more infrared light sources.

[0007] There is a need for a light which provides a beam of high intensity infrared light, has a long operating life, does not generate high temperatures, has a low thermal signature, and operates with reduced power requirements compared to prior IR high intensity lighting systems.

SUMMARY OF THE INVENTION

[0008] This invention is directed to a light which provides a beam of high intensity infrared light without the need for resorting to inefficient and power-hungry incandescent lights and "black glass filters."

[0009] Specifically, the present invention includes two or more LASER infrared light emitting diodes. "LASER" is an acronym for "light amplification by stimulated emission of radiation." Lasers are used in the creation, amplification, and transmission of a narrow, intense beam of

-4-

coherent light. The coherent light produced by a laser differs from ordinary light in that it is made up of waves all of the same wavelength and all in phase, whereas ordinary light contains many different wavelengths and phase relations.

5 [0010] If an array of LASER infrared light emitting diodes ("LIDs") is employed, the IR light's intensity will be greater. An array also carries an inherent benefit of redundancy in that the remaining LIDs will continue to operate if one LID should fail, reducing the risk of total failure of the high intensity IR light at a critical time during a covert operation.

10 [0011] The LIDs are mounted to a heat sink for temperature stabilization. The heat sink serves to extend LID life by maintaining the LID's operating temperature within the manufacturer's specification. The infrared light emitted by the LIDs is coupled to an optical transmission means, such as machined or molded light pipes, or preferably optical
15 fibers. An optical positioning plate receives the infrared radiation from the optical transmission means and concentrates the radiation of the individual LIDs into a single beam, providing a "point" source of infrared light. An aspheric lens is situated such that its focal plane is placed at the light emitting surface of the optical positioning plate. The aspheric
20 lens receives the beam of light emitted by the optical positioning plate and collimates the radiation, resulting in a radiant intensity greater than six. A conical reflector, such as a polished aluminum reflector, may optionally be placed between the optical positioning plate and the aspheric lens to further direct the infrared light emitted by the optical positioning plate,
25 resulting in increased light-collection efficiency.

[0012] Electrical power is connected to a control circuit that conditions the voltage and current to a level compatible with the LIDs. The control circuit may be mounted inside the housing, or may be located remotely. The control circuit provides sufficient electrical power to
30 activate the LIDs while preventing over-driving of the LIDs.

-5-

[0013] The high intensity IR light may include a housing to contain internal components of the light. The housing may include mounting points to facilitate installation and mounting of the infrared high intensity light.

5 [0014] The present invention comprises a high intensity infrared light, comprising: a housing; two or more LASER infrared diodes arranged inside said housing; means comprising a heat sink for receiving heat from said LASER infrared diodes; means for collecting and transmitting the infrared light radiated by said LASER infrared diodes; means for receiving
10 and combining the infrared light from said transmitting means into a single beam of infrared light and to radiate the beam of light from a light emitting surface; and an aspheric lens situated such that the focal plane of said aspheric lens is placed at the light emitting surface of said combining means, wherein said aspheric lens is adapted to receive the
15 beam of infrared light emitted by the combining means and to collimate said beam of infrared light.

[0015] These and other features will become better understood with reference to the following description, appended claims, and accompanying drawings.

20

BRIEF DESCRIPTION OF THE DRAWINGS

[0016] Figure 1 is a view of the general arrangement of the high intensity IR light; and

Figure 2 is an electrical schematic of the high intensity IR light.

25

DETAILED DESCRIPTION OF THE INVENTION

[0017] The general arrangement of the high intensity infrared light 100 is illustrated in Figure 1. Two or more LASER infrared diodes (LIDs) 110 are mounted to a heat sink 112 to maintain a stabilized operating
30 temperature for the LIDs 110. The infrared light emitted by LIDs 110 is coupled to a set of optical transmission means such as light pipes or preferably optical fibers 108. The light received by the optical fibers 108

-6-

is transmitted to the optical positioning plate 106, and is combined in optical positioning plate 106 to form a single beam of infrared light. An aspheric lens 102 is situated such that its focal plane 118 is placed at the light emitting surface 116 of the optical positioning plate 106. The
5 aspheric lens 102 receives the single beam of light emitted by the optical positioning plate 106 and collimates the beam, providing an NVIS radiant intensity greater than six. A conical reflector 120, such as a polished aluminum reflector, may optionally be placed between the optical positioning plate 106 and the aspheric lens 102 to further direct the
10 infrared light emitted by the optical positioning plate 106.

[0018] The components of the high intensity infrared light 100 may be assembled into a housing 104 for protection from the elements. The housing 104 may optionally include mounting points 114 to facilitate mounting of the high intensity infrared light 100 to a landing light or
15 searchlight assembly.

[0019] A schematic diagram of the electrical circuit for the high intensity IR light 100 is shown in Figure 2. Electrical power for the high intensity IR light 100 is supplied by the power input lines 202, 204. *Electrical power is controlled by a switch 206. When switch 206 is*
20 *closed, voltage is supplied to the high voltage filter 208, which isolates electrical noise between the power source and the control circuit 200.* The power supply 210, such as a voltage regulator, conditions the electrical power from the power source to a level suitable for the components in control circuit 200. The driver control 212, upon receiving
25 conditioned power from the power supply 210, activates the driver 214. The driver 214, such as an electrical current limiter, supplies a controlled amount of electrical current to the infrared light sources 110, causing the infrared light sources 110 to emit infrared light.

[0020] In operation, the high intensity IR light 100 is mounted to an
30 aircraft for use as a landing light or searchlight. A control switch 206, typically mounted in the cockpit, is initially placed in the "open" position

-7-

causing electrical power to be removed the infrared light sources 110. When the operator sets control switch 206 to the "closed" position, driver 214 is activated, causing the infrared light sources 110 to emit infrared light to facilitate takeoff, landing, searching, targeting, and
5 maneuvering during covert operations.

[0021] Although the present invention has been shown and described herein with reference to a particular embodiment for a particular application, the present invention is not limited to aviation uses. Indeed, the present invention is immediately applicable to hand-held and
10 stationary fixtures as well as all types of vehicular traffic, including automotive, marine, and railroad.

WHAT IS CLAIMED IS:

1. A high intensity infrared light, comprising:
a housing (104);
two or more LASER infrared diodes (110) arranged inside said
5 housing (104);
means comprising a heat sink (112) for receiving heat from said
LASER infrared diodes (110);
means (108) for collecting and transmitting the infrared light
radiated by said LASER infrared diodes (110);
10 means (106) for receiving and combining the infrared light from
said optical transmitting means into a single beam of infrared light and to
radiate the beam of light from a light emitting surface (116); and
an aspheric lens (102) situated such that the focal plane (118) of
said aspheric lens (102) is placed at the light emitting surface (116) of
15 said combining means (106), wherein said aspheric lens (102) is adapted
to receive the beam of infrared light emitted by the combining means
(106) and to collimate said beam of infrared light.
2. The high intensity infrared light of claim 1, further including
means (200) for controlling the electrical power applied to said LASER
20 infrared diodes (110).
3. The high intensity infrared light of claim 2 wherein said control
means (200) is one of located inside said housing (104) and located
remotely from said housing (104).
4. The high intensity infrared light of claim 1, further including
25 mounting points (114) on said housing (104) to facilitate installation.
5. The high intensity infrared light of claim 1, further including a
conical reflector (120) positioned between said means for receiving and
combining infrared light (106) and said aspheric lens (102) to further
collect and direct the infrared light emitted by said means for receiving
30 and combining infrared light (106).

6. A high intensity infrared light, comprising:
- a housing (104), said housing (104) including mounting points (114) to facilitate installation;
 - two or more LASER infrared diodes (110) arranged inside said housing (104);
 - means comprising a heat sink (112) for receiving heat from said LASER infrared diodes (110);
 - at least two optical transmission means (108) coupled to said LASER infrared diodes (110) and adapted to collect and transmit the infrared light radiated by said LASER infrared diodes (110);
 - an optical positioning plate (106) adapted to receive and combine said optical transmissions into a single beam of light and to radiate the beam of light from a light emitting surface (116);
 - an aspheric lens (102) situated such that the focal plane (118) of said aspheric lens (102) is placed at the light emitting surface (116) of said optical positioning plate (106), said aspheric lens (102) adapted to receive the beam of infrared light emitted by the optical positioning plate (106) and to collimate said beam of infrared light; and
 - means (200) for controlling the electrical power applied to said LASER infrared diodes (110), said means (200) being one of located inside said housing (104) and located remotely from said housing (104).
7. A process for providing high intensity infrared light, comprising:
- providing at least two LASER infrared diodes (110);
 - removing heat from said LASER infrared diodes (110);
 - transmitting infrared light emitted from said LASER infrared diodes (110) through an optical transmission means (108);
 - combining the output of said optical transmission means (108) into a single beam of infrared light;
 - radiating said beam of light from a light emitting surface (116);

positioning an aspheric lens (102) such that the focal plane (118) of said aspheric lens (102) is situated at said light emitting surface (116); and

transmitting the beam of light through said aspheric lens (102).

5 8. A process according to claim 7, further including the step of collecting the infrared light emitted by said light emitting surface (116) and directing the infrared light toward said aspheric lens (102).

9. A process according to claim 7 wherein the LASER infrared diodes (110) are conformed within a housing (104).

10 10. A process according to claim 9 wherein said housing (104) includes mounting points (114) to facilitate installation.

11. A process according to claim 7 wherein an optical positioning plate (106) is used to combine the output of said optical transmission means (108).

15 12. A process according to claim 7 wherein a heat sink (112) is used to remove the heat from said LASER infrared diodes (110).

13. A process for providing high intensity infrared light, comprising:

providing at least two LASER infrared diodes (110);

20 limiting the electrical power applied to said LASER infrared diodes (110);

removing heat from said LASER infrared diodes (110);

transmitting infrared light emitted from said LASER infrared diodes (110) to optical transmission means (108);

25 combining the output of said optical transmission means (108) into a single beam of infrared light;

radiating said beam of light from a light emitting surface (116);

positioning an aspheric lens (102) such that the focal plane (118) of said aspheric lens (102) is situated at said light emitting surface (116);

30 and

transmitting the beam of light through said aspheric lens (102).

14. A process according to claim 13 wherein a control circuit (200) is used to limit the electrical power applied to said LASER infrared diodes (110).

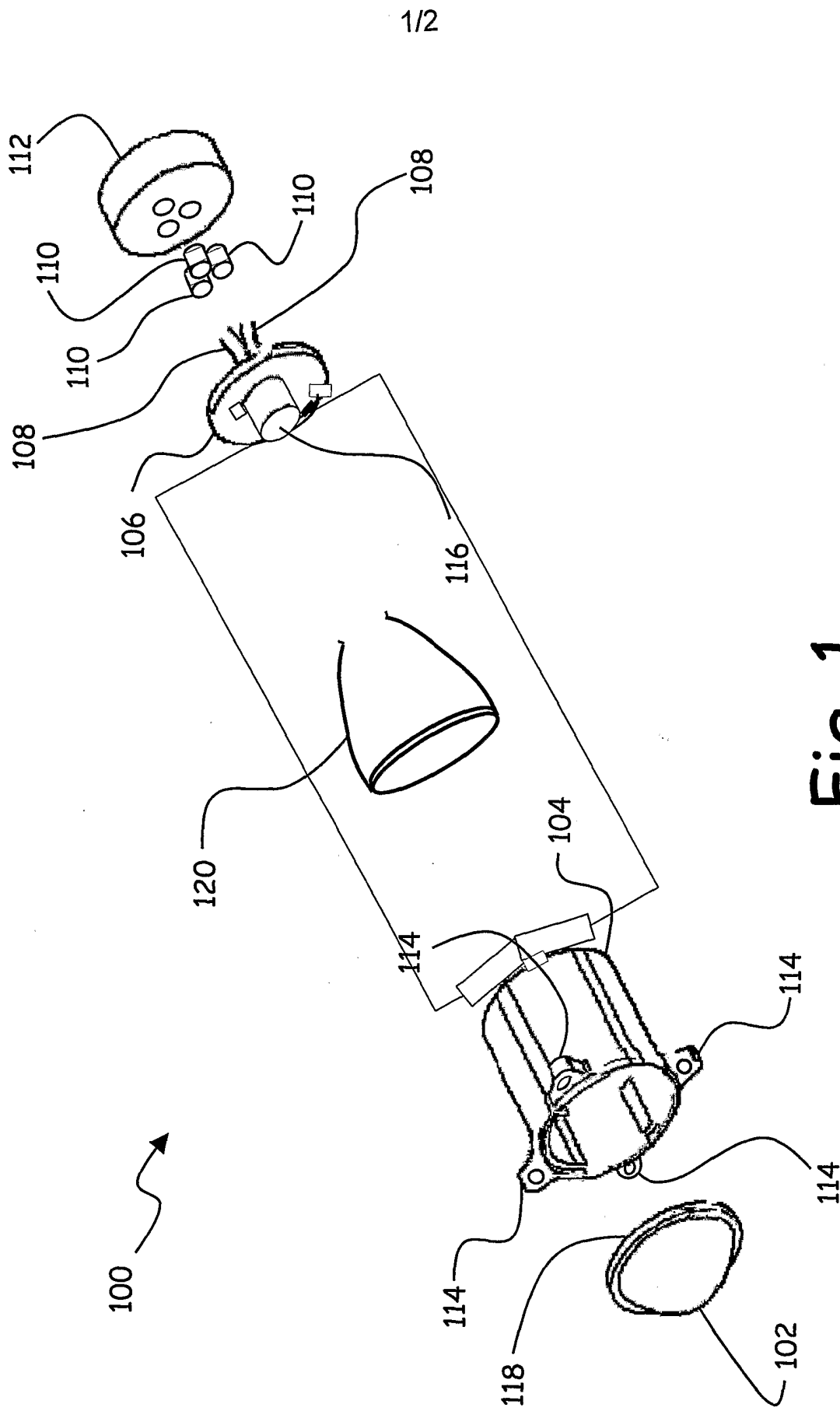

Fig. 1

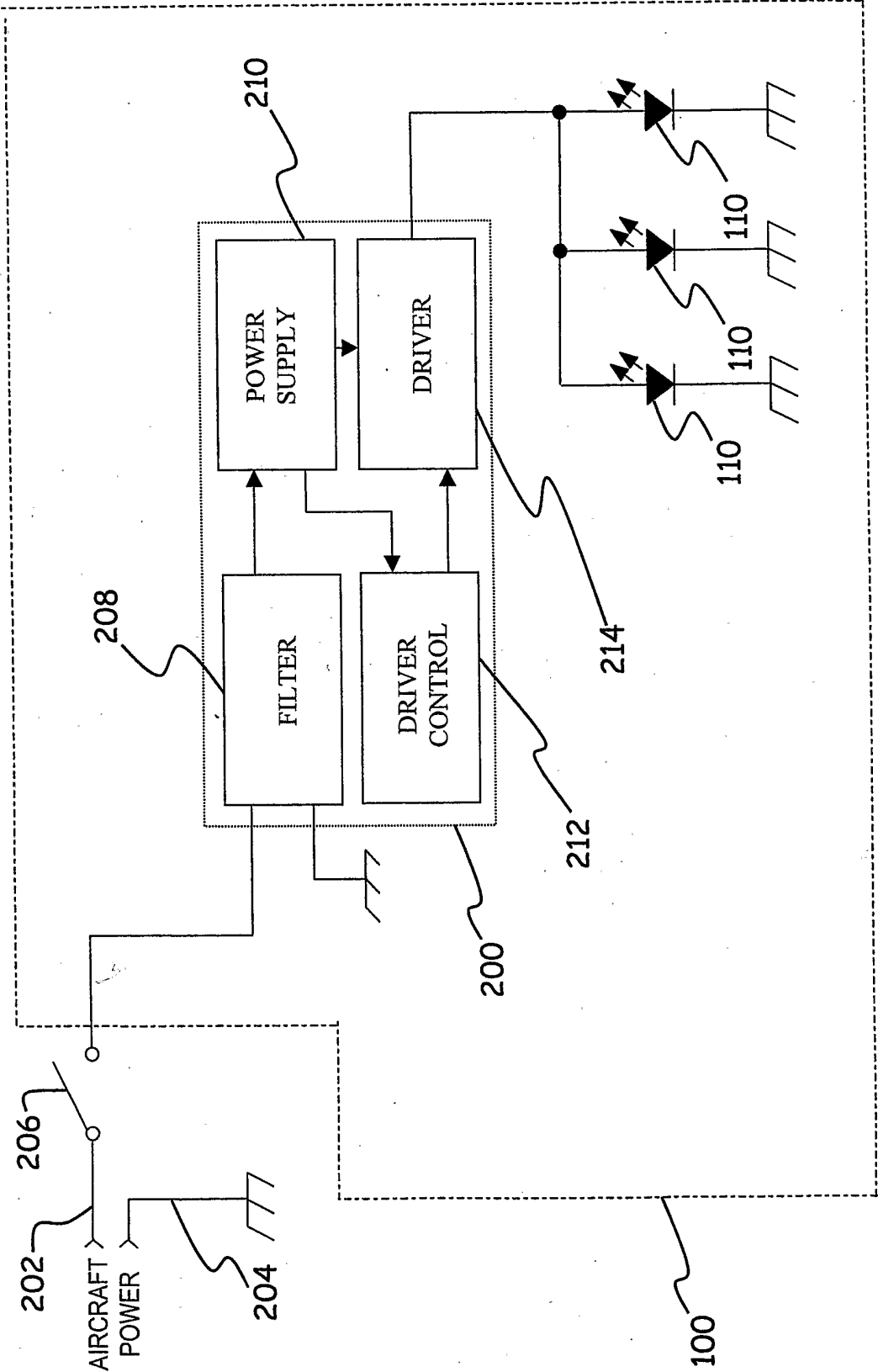

Fig. 2

INTERNATIONAL SEARCH REPORT

Intel ^{nal} Application No

PCT/US 01/49730

A. CLASSIFICATION OF SUBJECT MATTER

IPC 7 B64D47/04 F21S8/10 H01S5/40

According to International Patent Classification (IPC) or to both national classification and IPC

B. FIELDS SEARCHED

Minimum documentation searched (classification system followed by classification symbols)

IPC 7 B64D F21S H01L H01S

Documentation searched other than minimum documentation to the extent that such documents are included in the fields searched

Electronic data base consulted during the international search (name of data base and, where practical, search terms used)

EPO-Internal, WPI Data, PAJ

C. DOCUMENTS CONSIDERED TO BE RELEVANT

Category *	Citation of document, with indication, where appropriate, of the relevant passages	Relevant to claim No.
A	WO 00 37314 A (ALLIED SIGNAL INC) 29 June 2000 (2000-06-29) abstract page 4, line 9 -page 6, line 6 figures 1,2,6 ---	1-14
A	US 5 685 637 A (BLOXHAM LAURENCE HASTINGS ET AL) 11 November 1997 (1997-11-11) abstract column 1, line 37 -column 1, line 41 column 2, line 8 -column 2, line 22 column 3, line 11 -column 3, line 26 figures 1,8 -----	1-14

☐ Further documents are listed in the continuation of box C.☒ Patent family members are listed in annex.

* Special categories of cited documents :

A document defining the general state of the art which is not considered to be of particular relevance

E earlier document but published on or after the international filing date

L document which may throw doubts on priority claim(s) or which is cited to establish the publication date of another citation or other special reason (as specified)

O document referring to an oral disclosure, use, exhibition or other means

P document published prior to the international filing date but later than the priority date claimed

T later document published after the international filing date or priority date and not in conflict with the application but cited to understand the principle or theory underlying the invention

X document of particular relevance; the claimed invention cannot be considered novel or cannot be considered to involve an inventive step when the document is taken alone

Y document of particular relevance; the claimed invention cannot be considered to involve an inventive step when the document is combined with one or more other such documents, such combination being obvious to a person skilled in the art.

& document member of the same patent family

Date of the actual completion of the international search

13 May 2002

Date of mailing of the international search report

27/05/2002

Name and mailing address of the ISA

European Patent Office, P.B. 5818 Patentlaan 2
NL - 2280 HV Rijswijk
Tel. (+31-70) 340-2040, Tx. 31 651 epo nl,
Fax: (+31-70) 340-3016

Authorized officer

Bagge Af Berga, H

INTERNATIONAL SEARCH REPORT

International Application No
PCT/US 01/49730

Patent document cited in search report		Publication date		Patent family member(s)	Publication date
WO 0037314	A	29-06-2000	EP	1140626 A1	10-10-2001
			WO	0037314 A1	29-06-2000
US 5685637	A	11-11-1997	GB	2307977 A	11-06-1997
			US	5984494 A	16-11-1999