

(19) World Intellectual Property  
Organization  
International Bureau



(43) International Publication Date  
12 February 2004 (12.02.2004)

PCT

(10) International Publication Number  
**WO 2004/013710 A3**

(51) International Patent Classification<sup>7</sup>: **B65G 29/00**

(21) International Application Number:  
PCT/IB2003/002968

(22) International Filing Date: 25 July 2003 (25.07.2003)

(25) Filing Language: English

(26) Publication Language: English

(30) Priority Data:  
60/398,893 26 July 2002 (26.07.2002) US

(71) Applicant: **LAB-INTERLINK** [US/US]; 1011 South  
Saddle Creek Road, Omaha, NE 68106 (US).

(72) Inventors: **BARRY, Douglas**; 5120 Patmore, Lincoln, NE  
68516 (US). **SIMMS, Don**; 46 Horizon Drive, Council  
Bluffs, IA 51503 (US). **ZEVAKINA, Inna**; 2224 South  
164th Avenue, Omaha, NE 68130 (US).

(81) Designated States (*national*): AE, AG, AL, AM, AT, AU,  
AZ, BA, BB, BG, BR, BY, BZ, CA, CH, CN, CO, CR, CU,  
CZ, DE, DK, DM, DZ, EC, EE, ES, FI, GB, GD, GE, GH,  
GM, HR, HU, ID, IL, IN, IS, JP, KE, KG, KP, KR, KZ, LC,  
LK, LR, LS, LT, LU, LV, MA, MD, MG, MK, MN, MW,  
MX, MZ, NI, NO, NZ, OM, PG, PH, PL, PT, RO, RU, SC,  
SD, SE, SG, SK, SL, SY, TJ, TM, TN, TR, TT, TZ, UA,  
UG, UZ, VC, VN, YU, ZA, ZM, ZW.

(84) Designated States (*regional*): ARIPO patent (GH, GM,  
KE, LS, MW, MZ, SD, SL, SZ, TZ, UG, ZM, ZW),  
Eurasian patent (AM, AZ, BY, KG, KZ, MD, RU, TJ, TM),  
European patent (AT, BE, BG, CH, CY, CZ, DE, DK, EE,  
ES, FI, FR, GB, GR, HU, IE, IT, LU, MC, NL, PT, RO,  
SE, SI, SK, TR), OAPI patent (BF, BJ, CF, CG, CI, CM,  
GA, GN, GQ, GW, ML, MR, NE, SN, TD, TG).

Published:  
— with international search report

[Continued on next page]

(54) Title: PASSIVE TRANSFER GUIDE FOR CONVEYOR TRACK

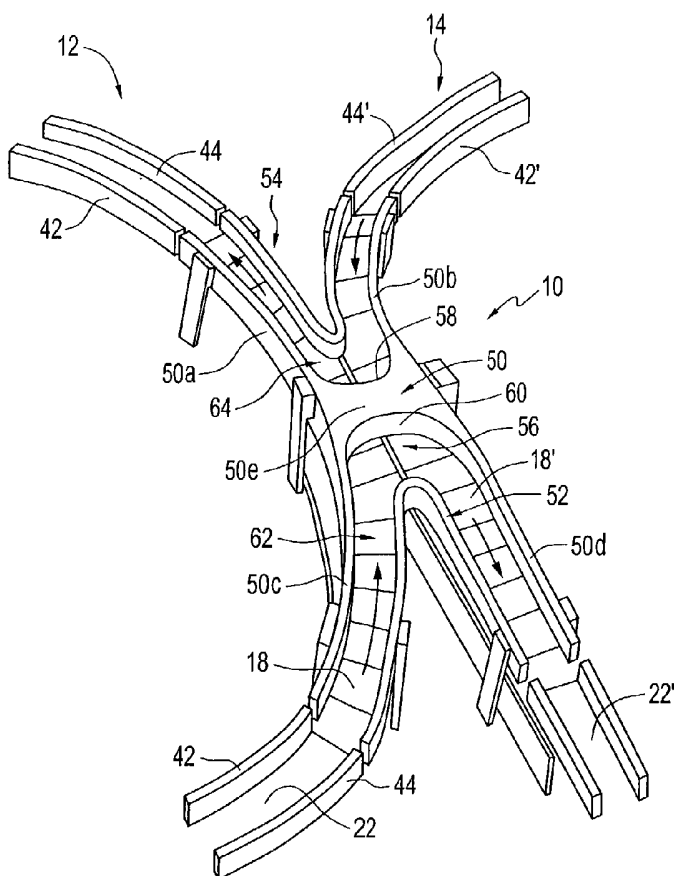

(57) Abstract: A passive guide (50) positioned in a section of tangency between a first continuous loop conveyor (12) and a second continuous loop conveyor (14) for directing a specimen carrier (24) from the first conveyor to the second conveyor and from the second conveyor to the first conveyor. The guide has a horizontally oriented "H" shape with the upper legs (50a, 50b) and an upper portion of the cross-member (50e) forming one specimen carrier directing lane and the lower legs (50c, 50d) and lower portion of the cross member forming the second specimen carrier directing lane.

WO 2004/013710 A3



— *before the expiration of the time limit for amending the claims and to be republished in the event of receipt of amendments*

*For two-letter codes and other abbreviations, refer to the "Guidance Notes on Codes and Abbreviations" appearing at the beginning of each regular issue of the PCT Gazette.*

**(88) Date of publication of the international search report:**  
19 August 2004

# INTERNATIONAL SEARCH REPORT

International application No.

PCT/IB03/02968

**A. CLASSIFICATION OF SUBJECT MATTER**

IPC(7) : B65G 29/00  
 US CL : 198/465.1

According to International Patent Classification (IPC) or to both national classification and IPC

**B. FIELDS SEARCHED**

Minimum documentation searched (classification system followed by classification symbols)  
 U.S. : 198/465.1, 465.2, 599, 637

Documentation searched other than minimum documentation to the extent that such documents are included in the fields searched

Electronic data base consulted during the international search (name of data base and, where practicable, search terms used)

**C. DOCUMENTS CONSIDERED TO BE RELEVANT**

Category *	Citation of document, with indication, where appropriate, of the relevant passages	Relevant to claim No.
A	US 1,762,129 A (COLBERT) 03 June 1930, see entire document	1-19
A	US 4,718,560 A (KIRIAKE) 12 January 1988, see entire document	1-19
A	US 5,158,168 A (BEDIN) 27 October 1992, see entire document	1-19
A	US 5,377,813 A (MARKIN ET AL) 03 January 1995, see entire document.	1-19

Further documents are listed in the continuation of Box C.

See patent family annex.

\* Special categories of cited documents:

"A" document defining the general state of the art which is not considered to be of particular relevance

"E" earlier application or patent published on or after the international filing date

"L" document which may throw doubts on priority claim(s) or which is cited to establish the publication date of another citation or other special reason (as specified)

"O" document referring to an oral disclosure, use, exhibition or other means

"P" document published prior to the international filing date but later than the priority date claimed

"T" later document published after the international filing date or priority date and not in conflict with the application but cited to understand the principle or theory underlying the invention

"X" document of particular relevance; the claimed invention cannot be considered novel or cannot be considered to involve an inventive step when the document is taken alone

"Y" document of particular relevance; the claimed invention cannot be considered to involve an inventive step when the document is combined with one or more other such documents, such combination being obvious to a person skilled in the art

"&" document member of the same patent family

Date of the actual completion of the international search

09 June 2004 (09.06.2004)

Date of mailing of the international search report

21 JUN 2004

Name and mailing address of the ISA/US

Mail Stop PCT, Attn: ISA/US  
 Commissioner for Patents  
 P.O. Box 1450  
 Alexandria, Virginia 22313-1450

Facsimile No. (703)305-3230

Authorized officer

Joseph Valenza

Telephone No. 703-308-2577