



(43) International Publication Date
12 June 2014 (12.06.2014)

- (51) International Patent Classification:
A61B 17/11 (2006.01) *A61B 17/115* (2006.01)
- (21) International Application Number:
PCT/US2013/073097
- (22) International Filing Date:
4 December 2013 (04.12.2013)
- (25) Filing Language: English
- (26) Publication Language: English
- (30) Priority Data:
13/693,430 4 December 2012 (04.12.2012) US
- (71) Applicant: **ETHICON ENDO-SURGERY, INC.**
[US/US]; 4545 Creek Road, Cincinnati, Ohio 45242 (US).
- (72) Inventors: **SCHEIB, Charles J.**; 11329 Donwiddle Drive, Loveland, Ohio 45140 (US). **MEASAMER, John P.**; 8780 Weller Station Drive, Cincinnati, Ohio 45249 (US). **SHELTON IV, Frederick E.**; 245 East Main Street, Hillsboro, Ohio 45133 (US).
- (74) Agents: **JOHNSON, Philip S.** et al.; JOHNSON & JOHNSON, One Johnson & Johnson Plaza, New Brunswick, New Jersey 08933 (US).
- (81) Designated States (*unless otherwise indicated, for every kind of national protection available*): AE, AG, AL, AM, AO, AT, AU, AZ, BA, BB, BG, BH, BN, BR, BW, BY, BZ, CA, CH, CL, CN, CO, CR, CU, CZ, DE, DK, DM, DO, DZ, EC, EE, EG, ES, FI, GB, GD, GE, GH, GM, GT, HN, HR, HU, ID, IL, IN, IR, IS, JP, KE, KG, KN, KP, KR, KZ, LA, LC, LK, LR, LS, LT, LU, LY, MA, MD, ME, MG, MK, MN, MW, MX, MY, MZ, NA, NG, NI, NO, NZ, OM, PA, PE, PG, PH, PL, PT, QA, RO, RS, RU, RW, SA, SC, SD, SE, SG, SK, SL, SM, ST, SV, SY, TH, TJ, TM, TN, TR, TT, TZ, UA, UG, US, UZ, VC, VN, ZA, ZM, ZW.
- (84) Designated States (*unless otherwise indicated, for every kind of regional protection available*): ARIPO (BW, GH, GM, KE, LR, LS, MW, MZ, NA, RW, SD, SL, SZ, TZ, UG, ZM, ZW), Eurasian (AM, AZ, BY, KG, KZ, RU, TJ, TM), European (AL, AT, BE, BG, CH, CY, CZ, DE, DK, EE, ES, FI, FR, GB, GR, HR, HU, IE, IS, IT, LT, LU, LV,

[Continued on next page]

(54) Title: TRANS-ORAL CIRCULAR ANVIL INTRODUCTION SYSTEM WITH DILATION FEATURE

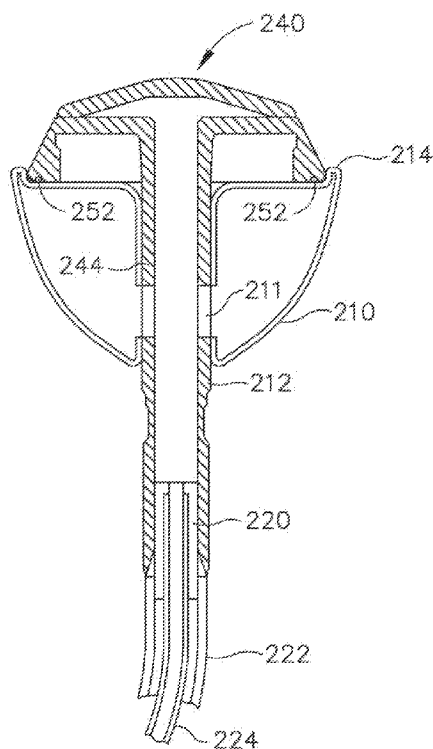

Fig. 9B

(57) Abstract: An anvil introduction system is operable to provide smooth insertion of an anvil (240) of a surgical stapling device (10) through a bodily lumen such as the esophagus. The anvil introduction system is coupled to the anvil (240) and includes a dilation feature (210). The dilation feature (210) has a collapsed position and an expanded position. The dilation feature (210) may cover staple pockets (252) and an outer edge of the anvil (240) with the dilation feature (210) is in the expanded position. The anvil (240) may be inserted through the bodily lumen with the dilation feature (210) in the expanded position. The dilation feature (210) may then be collapsed in order to complete an end-to-end anastomosis of the bodily lumen.



MC, MK, MT, NL, NO, PL, PT, RO, RS, SE, SI, SK,
SM, TR), OAPI (BF, BJ, CF, CG, CI, CM, GA, GN, GQ,
GW, KM, ML, MR, NE, SN, TD, TG).

— as to the applicant's entitlement to claim the priority of
the earlier application (Rule 4.17(iii))

Declarations under Rule 4.17:

- as to the identity of the inventor (Rule 4.17(i))
- as to applicant's entitlement to apply for and be granted
a patent (Rule 4.17(ii))

Published:

- with international search report (Art. 21(3))
- before the expiration of the time limit for amending the
claims and to be republished in the event of receipt of
amendments (Rule 48.2(h))

TRANS-ORAL CIRCULAR ANVIL INTRODUCTION SYSTEM WITH DILATION FEATURE

BACKGROUND

[0001] In some settings, a surgeon may want to position a surgical instrument through an orifice of the patient and use the instrument to adjust, position, attach, and/or otherwise interact with tissue within the patient. For instance, in some surgical procedures, portions of the gastrointestinal tract may be cut and removed to eliminate undesirable tissue or for other reasons. Once the desired tissue is removed, the remaining portions may need to be recoupled together. One such tool for accomplishing these anastomotic procedures is a circular stapler that is inserted through a patient's orifice.

[0002] Examples of circular surgical staplers are described in U.S. Pat. No. 5,205,459, entitled "Surgical Anastomosis Stapling Instrument," issued April 27, 1993; U.S. Pat. No. 5,271,544, entitled "Surgical Anastomosis Stapling Instrument," issued December 21, 1993; U.S. Pat. No. 5,275,322, entitled "Surgical Anastomosis Stapling Instrument," issued January 4, 1994; U.S. Pat. No. 5,285,945, entitled "Surgical Anastomosis Stapling Instrument," issued February 15, 1994; U.S. Pat. No. 5,292,053, entitled "Surgical Anastomosis Stapling Instrument," issued March 8, 1994; U.S. Pat. No. 5,333,773, entitled "Surgical Anastomosis Stapling Instrument," issued August 2, 1994; U.S. Pat. No. 5,350,104, entitled "Surgical Anastomosis Stapling Instrument," issued September 27, 1994; and U.S. Pat. No. 5,533,661, entitled "Surgical Anastomosis Stapling Instrument," issued July 9, 1996. The disclosure of each of the above-cited U.S. Patents is incorporated by reference herein. Some such staplers are operable to clamp down on layers of tissue, cut through the clamped layers of tissue, and drive staples through the layers of tissue to substantially seal the severed layers of tissue together near the severed ends of the tissue layers, thereby joining two severed ends of an anatomical lumen.

[0003] Merely additional other exemplary surgical staplers are disclosed in U.S. Pat. No. 4,805,823, entitled "Pocket Configuration for Internal Organ Staplers," issued February 21, 1989; U.S. Pat. No. 5,415,334, entitled "Surgical Stapler and Staple Cartridge," issued May 16, 1995; U.S. Pat. No. 5,465,895, entitled "Surgical Stapler Instrument," issued November 14, 1995; U.S. Pat. No. 5,597,107, entitled "Surgical Stapler Instrument," issued January 28, 1997; U.S. Pat. No. 5,632,432, entitled "Surgical Instrument," issued May 27, 1997; U.S. Pat. No. 5,673,840, entitled "Surgical Instrument," issued October 7, 1997; U.S. Pat. No. 5,704,534, entitled "Articulation Assembly for Surgical Instruments," issued January 6, 1998; U.S. Pat. No. 5,814,055, entitled "Surgical Clamping Mechanism," issued September 29, 1998; U.S. Pat. No. 6,978,921, entitled "Surgical Stapling Instrument Incorporating an E-Beam Firing Mechanism," issued December 27, 2005; U.S. Pat. No. 7,000,818, entitled "Surgical Stapling Instrument Having Separate Distinct Closing and Firing Systems," issued February 21, 2006; U.S. Pat. No. 7,143,923, entitled "Surgical Stapling Instrument Having a Firing Lockout for an Unclosed Anvil," issued December 5, 2006; U.S. Pat. No. 7,303,108, entitled "Surgical Stapling Instrument Incorporating a Multi-Stroke Firing Mechanism with a Flexible Rack," issued December 4, 2007; U.S. Pat. No. 7,367,485, entitled "Surgical Stapling Instrument Incorporating a Multistroke Firing Mechanism Having a Rotary Transmission," issued May 6, 2008; U.S. Pat. No. 7,380,695, entitled "Surgical Stapling Instrument Having a Single Lockout Mechanism for Prevention of Firing," issued June 3, 2008; U.S. Pat. No. 7,380,696, entitled "Articulating Surgical Stapling Instrument Incorporating a Two-Piece E-Beam Firing Mechanism," issued June 3, 2008; U.S. Pat. No. 7,404,508, entitled "Surgical Stapling and Cutting Device," issued July 29, 2008; U.S. Pat. No. 7,434,715, entitled "Surgical Stapling Instrument Having Multistroke Firing with Opening Lockout," issued October 14, 2008; and U.S. Pat. No. 7,721,930, entitled "Disposable Cartridge with Adhesive for Use with a Stapling Device," issued May 25, 2010. The disclosure of each of the above-cited U.S. Patents is incorporated by reference herein. While the surgical staplers referred to above are described as being used in endoscopic procedures, it should be understood that such surgical staplers may also be used in open procedures and/or other non-endoscopic procedures.

[0004] While various kinds of surgical stapling instruments and associated components have been made and used, it is believed that no one prior to the inventor(s) has made or used the invention described in the appended claims.

BRIEF DESCRIPTION OF THE DRAWINGS

[0005] While the specification concludes with claims which particularly point out and distinctly claim this technology, it is believed this technology will be better understood from the following description of certain examples taken in conjunction with the accompanying drawings, in which like reference numerals identify the same elements and in which:

[0006] FIG. 1 depicts a side elevation view of an exemplary circular stapling surgical instrument;

[0007] FIG. 2A depicts an enlarged longitudinal cross-section view of an exemplary stapling head assembly of the instrument of FIG. 1 showing an exemplary anvil in an open position;

[0008] FIG. 2B depicts an enlarged longitudinal cross-sectional view of the stapling head assembly of FIG. 2A showing the anvil in a closed position;

[0009] FIG. 2C depicts an enlarged longitudinal cross-sectional view of the stapling head assembly of FIG. 2A showing an exemplary staple driver and blade in a fired position;

[0010] FIG. 3 depicts an enlarged partial cross-sectional view of an exemplary staple formed against the anvil;

[0011] FIG. 4A depicts an enlarged side elevation view of an exemplary actuator handle assembly of the surgical instrument of FIG. 1 with a portion of the body removed, showing a trigger in an unfired position and a lockout feature in a locked position;

[0012] FIG. 4B depicts an enlarged side elevation view of the actuator handle assembly of FIG. 4A, showing the trigger in a fired position and the lockout feature in an unlocked position;

- [0013] FIG. 5 depicts an enlarged partial perspective view of an exemplary indicator assembly of the surgical instrument of FIG. 1 showing an indicator window and indicator lever;
- [0014] FIG. 6 depicts a diagrammatic view of the indicator window of FIG. 5 showing an exemplary indicator bar and exemplary corresponding staple representations;
- [0015] FIG. 7 depicts a schematic view of an exemplary circular stapler system being used in an esophagectomy procedure;
- [0016] FIG. 8 depicts an enlarged partial perspective view of an exemplary trans-oral circular anvil introduction system showing a dilation feature in a deflated state;
- [0017] FIG. 9A depicts a cross sectional view of the anvil introduction system of FIG. 7 showing the dilation feature in the deflated state;
- [0018] FIG. 9B depicts a cross sectional view of the anvil introduction system of FIG. 7 showing the dilation feature in an inflated state;
- [0019] FIG. 10 depicts an enlarged partial perspective view of the anvil introduction system of FIG. 7 showing the dilation feature in the inflated state passing through a lumen;
- [0020] FIG. 11 depicts an enlarged partial perspective view of another exemplary trans-oral circular anvil introduction system showing a dilation feature in an expanded state;
- [0021] FIG. 12 depicts a cross sectional view of the anvil introduction system of FIG. 11 taken along the line 12-12 of FIG. 11;
- [0022] FIG. 13 depicts an enlarged partial perspective view of the anvil introduction system of FIG. 11 showing the dilation feature in the expanded state with a mesh covering;
- [0023] FIG. 14 depicts a cross sectional view of the anvil introduction system of FIG. 13;

- [0024] FIG. 15 depicts an enlarged partial perspective view of the anvil introduction system of FIG. 11 showing the dilation feature in a collapsed state with a mesh covering;
- [0025] FIG. 16 depicts a cross sectional view of the anvil introduction system of FIG. 15;
- [0026] FIG. 17A depicts an enlarged partial perspective view of the anvil introduction system of FIG. 11 passing through a lumen;
- [0027] FIG. 17B depicts an enlarged partial perspective view of the anvil introduction system of FIG. 11, showing the anvil introduction system removed from the anvil;
- [0028] FIG. 18 depicts an enlarged bottom perspective view of an exemplary anvil with a grasping feature;
- [0029] FIG. 19A depicts an enlarged partial perspective view of the anvil of FIG. 18, showing the anvil in an introduction position within a lumen;
- [0030] FIG. 19B depicts an enlarged partial perspective view of the anvil of FIG. 18, showing rotation of the anvil within the lumen;
- [0031] FIG. 19C depicts an enlarged partial perspective view of the anvil of FIG. 18, showing the anvil approaching a stapling position within the lumen;
- [0032] FIG. 20 depicts an enlarged top perspective view of another exemplary anvil with a grasping feature;
- [0033] FIG. 21A depicts a cross sectional view of the anvil of FIG. 20, showing an anvil locking feature in a collapsed state;
- [0034] FIG. 21B depicts a cross sectional view of the anvil of FIG. 20, showing the anvil locking feature in an expanded state;
- [0035] FIG. 22A depicts an enlarged partial perspective view of an exemplary anvil securing feature within a lumen, showing the lumen being sutured in a purse-string configuration; and

[0036] FIG. 22B depicts an enlarged partial perspective view of the anvil securing feature of FIG. 22A showing the lumen in a cinched position and secured to the anvil by the suture.

[0037] The drawings are not intended to be limiting in any way, and it is contemplated that various embodiments of the technology may be carried out in a variety of other ways, including those not necessarily depicted in the drawings. The accompanying drawings incorporated in and forming a part of the specification illustrate several aspects of the present technology, and together with the description serve to explain the principles of the technology; it being understood, however, that this technology is not limited to the precise arrangements shown.

DETAILED DESCRIPTION

[0038] The following description of certain examples of the technology should not be used to limit its scope. Other examples, features, aspects, embodiments, and advantages of the technology will become apparent to those skilled in the art from the following description, which is by way of illustration, one of the best modes contemplated for carrying out the technology. As will be realized, the technology described herein is capable of other different and obvious aspects, all without departing from the technology. Accordingly, the drawings and descriptions should be regarded as illustrative in nature and not restrictive.

[0039] I. Overview of Exemplary Circular Stapling Surgical Instrument

[0040] FIGS. 1-6 depict an exemplary circular surgical stapling instrument (10) having a stapling head assembly (20), a shaft assembly (60), and an actuator handle assembly (70), each of which will be described in more detail below. Shaft assembly (60) extends distally from actuator handle assembly (70) and stapling head assembly (20) is coupled to a distal end of shaft assembly (60). In brief, actuator handle assembly (70) is operable to actuate a staple driver (24) of stapling head assembly (20) to drive a plurality of staples (66) out of stapling head assembly (20). Staples (66) are bent to form completed staples

by an anvil (40) that is attached at the distal end of instrument (10). Accordingly, tissue (2), shown in FIGS. 2A-2C, may be stapled utilizing instrument (10).

[0041] In the present example, instrument (10) comprises a closure system and a firing system. The closure system comprises a trocar (38), a trocar actuator (39), and a rotating knob (98). An anvil (40) may be coupled to a distal end of trocar (38). Rotating knob (98) is operable to longitudinally translate trocar (38) relative to stapling head assembly (20), thereby translating anvil (40) when anvil (40) is coupled to trocar (38), to clamp tissue between anvil (40) and stapling head assembly (20). The firing system comprises a trigger (74), a trigger actuation assembly (84), a driver actuator (64), and a staple driver (24). Staple driver (24) includes a knife (36) configured to sever tissue when staple driver (24) is actuated longitudinally. In addition, staples (66) are positioned distal to a plurality of staple driving members (30) of staple driver (24) such that staple driver (24) also drives staples (66) distally when staple driver (24) is actuated longitudinally. Thus, when trigger (74) is actuated and trigger actuation assembly (84) actuates staple driver (24) via driver actuator (64), knife (36) and members (30) substantially simultaneously sever tissue (2) and drive staples (66) distally relative to stapling head assembly (20) into tissue. The components and functionalities of the closure system and firing system will now be described in greater detail.

[0042] A. Exemplary Anvil

[0043] As shown in FIGS. 1-2C, anvil (40) is selectively coupleable to instrument (10) to provide a surface against which staples (66) may be bent to staple material contained between stapling head assembly (20) and anvil (40). Anvil (40) of the present example is selectively coupleable to a trocar or pointed rod (38) that extends distally relative to stapling head assembly (20). Referring to FIGS. 2A-2C, anvil (40) is selectively coupleable via the coupling of a proximal shaft (42) of anvil (40) to a distal tip of trocar (38). Anvil (40) comprises a generally circular anvil head (48) and a proximal shaft (42) extending proximally from anvil head (48). In the example shown, proximal shaft (42) comprises a tubular member (44) having resiliently biased retaining clips (46) to selectively couple anvil (40) to trocar (38), though this is merely optional, and it should

be understood that other retention features for coupling anvil (40) to trocar (38) may be used as well. For example, C-clips, clamps, threading, pins, adhesives, etc. may be employed to couple anvil (40) to trocar (38). In addition, while anvil (40) is described as selectively coupleable to trocar (38), in some versions proximal shaft (42) may include a one-way coupling feature such that anvil (40) cannot be removed from trocar (38) once anvil (40) is attached. Merely exemplary one-way features include barbs, one way snaps, collets, collars, tabs, bands, etc. Of course still other configurations for coupling anvil (40) to trocar (38) will be apparent to one of ordinary skill in the art in view of the teachings herein. For instance, trocar (38) may instead be a hollow shaft and proximal shaft (42) may comprise a sharpened rod that is insertable into the hollow shaft.

[0044] Anvil head (48) of the present example comprises a plurality of staple forming pockets (52) formed in a proximal face (50) of anvil head (48). Accordingly, when anvil (40) is in the closed position and staples (66) are driven out of stapling head assembly (20) into staple forming pockets (52), as shown in FIG. 2C, legs (68) of staples (66) are bent to form completed staples.

[0045] With anvil (40) as a separate component, it should be understood that anvil (40) may be inserted and secured to a portion of tissue (2) prior to being coupled to stapling head assembly (20). By way of example only, anvil (40) may be inserted into and secured to a first tubular portion of tissue (2) while instrument (10) is inserted into and secured to a second tubular portion of tissue (2). For instance, the first tubular portion of tissue (2) may be sutured to or about a portion of anvil (40), and the second tubular portion of tissue (2) may be sutured to or about trocar (38).

[0046] As shown in FIG. 2A, anvil (40) is then coupled to trocar (38). Trocar (38) of the present example is shown in a distal most actuated position. Such an extended position for trocar (38) may provide a larger area to which tissue (2) may be coupled prior to attachment of anvil (40). In addition, the extended position of trocar (38) may also provide for easier attachment of anvil (40) to trocar (38). Trocar (38) further includes a tapered distal tip. Such a tip may be capable of piercing through tissue and/or aiding the insertion of anvil (40) on to trocar (38), though the tapered distal tip is merely optional.

For instance, in other versions trocar (38) may have a blunt tip. In addition, or in the alternative, trocar (38) may include a magnetic portion (not shown) which may attract anvil (40) towards trocar (38). Of course still further configurations and arrangements for anvil (40) and trocar (38) will be apparent to one of ordinary skill in the art in view of the teachings herein.

[0047] When anvil (40) is coupled to trocar (38), the distance between a proximal face of the anvil (40) and a distal face of stapling head assembly (20) defines a gap distance d . Trocar (38) of the present example is translatable longitudinally relative to stapling head assembly (20) via an adjusting knob (98) located at a proximal end of actuator handle assembly (70), as will be described in greater detail below. Accordingly, when anvil (40) is coupled to trocar (38), rotation of adjusting knob (98) enlarges or reduces gap distance d by actuating anvil (40) relative to stapling head assembly (20). For instance, as shown sequentially in FIGS. 2A-2B, anvil (40) is shown actuating proximally relative to actuator handle assembly (70) from an initial, open position to a closed position, thereby reducing the gap distance d and the distance between the two portions of tissue (2) to be joined. Once the gap distance d is brought within a predetermined range, stapling head assembly (20) may be fired, as shown in FIG. 2C, to staple and sever tissue (2) between anvil (40) and stapling head assembly (20). Stapling head assembly (20) is operable to staple and sever tissue (2) by a user pivoting a trigger (74) of actuator handle assembly (70), as will be described in greater detail below. In some other versions, stapling head assembly (20) is actuated via motor or is otherwise powered.

[0048] As noted above, gap distance d corresponds to the distance between anvil (40) and stapling head assembly (20). When instrument (10) is inserted into a patient, this gap distance d may not be easily viewable. Accordingly, a moveable indicator bar (110), shown in FIGS. 5-6, is provided to be visible through an indicator window (120) positioned opposite to trigger (74). Indicator bar (110) is operable to move in response to rotation of adjusting knob (98) such that the position of indicator bar (110) is representative of the gap distance d . As shown in FIG. 6, indicator window (120) further comprises a scale (130) which indicates that the anvil gap is within a desired operating range (e.g., a green colored region or “green zone”) and a corresponding staple

compression representation at each end of scale (130). By way of example only, as shown in FIG. 6, a first staple image (132) depicts a large staple height while a second staple image (134) depicts a small staple height. Accordingly, a user can view the position of the coupled anvil (40) relative to the stapling head assembly (20) via indicator bar (110) and scale (130). The user may then adjust the positioning of anvil (40) via adjusting knob (98) accordingly.

[0049] Referring back to FIGS. 2A-2C, a user sutures a portion of tissue (2) about tubular member (44) such that anvil head (48) is located within a portion of the tissue (2) to be stapled. When tissue (2) is attached to anvil (40), retaining clips (46) and a portion of tubular member (44) protrude out from tissue (2) such that the user may couple anvil (40) to trocar (38). With tissue (2) coupled to trocar (38) and/or another portion of stapling head assembly (20), the user attaches anvil (40) to trocar (38) and actuates anvil (40) proximally towards stapling head assembly (20) to reduce the gap distance d . Once instrument (10) is within the operating range, the user then staples together the ends of tissue (2), thereby forming a substantially contiguous tubular portion of tissue (2).

[0050] Anvil (40) may be further constructed in accordance with at least some of the teachings of U.S. Pat. No. 5,205,459; U.S. Pat. No. 5,271,544; U.S. Pat. No. 5,275,322; U.S. Pat. No. 5,285,945; U.S. Pat. No. 5,292,053; U.S. Pat. No. 5,333,773; U.S. Pat. No. 5,350,104; U.S. Pat. No. 5,533,661, the disclosures of which are incorporated by reference herein; and/or in accordance with other configurations as will be apparent to one of ordinary skill in the art in view of the teachings herein.

[0051] B. Exemplary Stapling Head Assembly

[0052] Stapling head assembly (20) of the present example is coupled to a distal end of shaft assembly (60) and comprises a tubular casing (22) housing a slidable staple driver (24) and a plurality of staples (66) contained within staple pockets (32). Staples (66) and staple pockets (32) are disposed in a circular array about tubular casing (22). In the present example, staples (66) and staple pockets (32) are disposed in a pair of concentric annular rows of staples (66) and staple pockets (32). Staple driver (24) is operable to actuate longitudinally within tubular casing (22) in response to rotation of trigger (74) of

actuator handle assembly (70). As shown in FIGS. 2A-2C, staple driver (24) comprises a flared cylindrical member having a trocar opening (26), a central recess (28), and a plurality of members (30) disposed circumferentially about central recess (28) and extending distally relative to shaft assembly (60). Each member (30) is configured to contact and engage a corresponding staple (66) of the plurality of staples (66) within staple pockets (32). Accordingly, when staple driver (24) is actuated distally relative to actuator handle assembly (70), each member (30) drives a corresponding staple (66) out of its staple pocket (32) through a staple aperture (34) formed in a distal end of tubular casing (22). Because each member (30) extends from staple driver (24), the plurality of staples (66) are driven out of stapling head assembly (20) at substantially the same time. When anvil (40) is in the closed position, staples (66) are driven into staple forming pockets (52) to bend legs (68) of the staples (66), thereby stapling the material located between anvil (40) and stapling head assembly (20). FIG. 3 depicts one merely exemplary staple (66) driven by a member (30) into a staple forming pocket (32) of anvil (40) to bend legs (68).

[0053] Staple driver (24) further includes a cylindrical knife (36) that is coaxial to trocar opening (26) and inset from staple pockets (32). In the present example, cylindrical knife (36) is disposed within central recess (28) to translate distally with staple driver (24). When anvil (40) is secured to trocar (38), as described above, anvil head (48) provides a surface against which cylindrical knife (36) cuts the material contained between anvil (40) and stapling head assembly (20). In some versions, anvil head (48) may include a recess (not shown) for cylindrical knife (36) to aid in cutting the material (e.g., by providing a cooperative shearing edge). In addition, or in the alternative, anvil head (48) may include one or more opposing cylindrical knives (not shown) offset from cylindrical knife (36) such that a scissor-type cutting action may be provided. Still other configurations will be apparent to one of ordinary skill in the art in view of the teachings herein. Stapling head assembly (20) is thus operable to both staple and cut tissue (2) substantially simultaneously in response to actuation by actuator handle assembly (70).

[0054] Of course stapling head assembly (20) may be further constructed in accordance with at least some of the teachings of U.S. Pat. No. 5,205,459; U.S. Pat. No. 5,271,544;

U.S. Pat. No. 5,275,322; U.S. Pat. No. 5,285,945; U.S. Pat. No. 5,292,053; U.S. Pat. No. 5,333,773; U.S. Pat. No. 5,350,104; U.S. Pat. No. 5,533,661, the disclosures of which are incorporated by reference herein; and/or in accordance with other configurations as will be apparent to one of ordinary skill in the art in view of the teachings herein.

[0055] As noted previously, staple driver (24) includes a trocar opening (26). Trocar opening (26) is configured to permit trocar (38) to longitudinally slide relative to stapling head assembly (20) and/or shaft assembly (60). As shown in FIGS. 2A-2C, trocar (38) is coupled to a trocar actuator (39) such that trocar (38) can be actuated longitudinally via rotation of rotating knob (98), as will be described in greater detail below in reference to actuator handle assembly (70). In the present example, trocar actuator (39) comprises an elongated, relatively stiff shaft coupled to trocar (38), though this is merely optional. In some versions, actuator (39) may comprise a longitudinally stiff material while permitting lateral bending such that portions of instrument (10) may be selectively bent or curved during use; or instrument (10) may include a preset bent shaft assembly (60). One merely exemplary material is nitinol. When anvil (40) is coupled to trocar (38), trocar (38) and anvil (40) are translatable via actuator (39) to adjust the gap distance *d* between anvil (40) and stapling head assembly (20). Still further configurations for actuator (39) to longitudinally actuate trocar (38) will be apparent to one of ordinary skill in the art in view of the teachings herein.

[0056] C. Exemplary Shaft Assembly

[0057] Stapling head assembly (20) and trocar (38) are positioned at a distal end of shaft assembly (60), as shown in FIGS. 2A-2C. Shaft assembly (60) of the present example comprises an outer tubular member (62) and a driver actuator (64). Outer tubular member (62) is coupled to tubular casing (22) of stapling head assembly (20) and to a body (72) of actuator handle assembly (70), thereby providing a mechanical ground for the actuating components therein. The proximal end of driver actuator (64) is coupled to a trigger actuation assembly (84) of actuator handle assembly (70), described below. The distal end of driver actuator (64) is coupled to staple driver (24) such that the rotation of trigger (74) longitudinally actuates staple driver (24). As shown in FIGS. 2A-2C, driver

actuator (64) comprises a tubular member having an open longitudinal axis such that actuator (39) coupled to trocar (38) may actuate longitudinally within and relative to driver actuator (64). Of course it should be understood that other components may be disposed within driver actuator (64) as will be apparent to one of ordinary skill in the art in view of the teachings herein.

[0058] Shaft assembly (60) may be further constructed in accordance with at least some of the teachings of U.S. Pat. No. 5,205,459; U.S. Pat. No. 5,271,544; U.S. Pat. No. 5,275,322; U.S. Pat. No. 5,285,945; U.S. Pat. No. 5,292,053; U.S. Pat. No. 5,333,773; U.S. Pat. No. 5,350,104; U.S. Pat. No. 5,533,661, the disclosures of which are incorporated by reference herein; and/or in accordance with other configurations as will be apparent to one of ordinary skill in the art in view of the teachings herein.

[0059] D. Exemplary Actuator Handle Assembly

[0060] Referring now to FIGS. 4A-5, actuator handle assembly (70) comprises a body (72), a trigger (74), a lockout feature (82), a trigger actuation assembly (84), and a trocar actuation assembly (90). Trigger (74) of the present example is pivotably mounted to body (72) and is coupled to trigger actuation assembly (84) such that rotation of trigger (74) from an unfired position (shown in FIG. 4A) to a fired position (shown in FIG. 4B) actuates driver actuator (64) described above. A spring (78) is coupled to body (72) and trigger (74) to bias trigger (74) towards the unfired position. Lockout feature (82) is a pivotable member that is coupled to body (72). In a first, locked position, lockout feature (82) is pivoted upwards and away from body (72) such that lockout feature (82) engages trigger (74) and mechanically resists actuation of trigger (74) by a user. In a second, unlocked position, such as that shown in FIGS. 1 and 4B, lockout feature (82) is pivoted downward such that trigger (74) may be actuated by the user. Accordingly, with lockout feature (82) in the second position, trigger (74) can engage a trigger actuation assembly (84) to fire instrument (10).

[0061] As shown in FIGS. 4A-4B, trigger actuation assembly (84) of the present example comprises a slidable trigger carriage (86) engaged with a proximal end of driver actuator (64). Carriage (86) includes a set of tabs (88) on a proximal end of carriage (86) to retain

and engage a pair of trigger arms (76) extending from trigger (74). Accordingly, when trigger (74) is pivoted, carriage (86) is actuated longitudinally and transfers the longitudinal motion to driver actuator (64). In the example shown, carriage (86) is fixedly coupled to the proximal end of driver actuator (64), though this is merely optional. Indeed, in one merely exemplary alternative, carriage (86) may simply abut driver actuator (64) while a distal spring (not shown) biases driver actuator (64) proximally relative to actuator handle assembly (70).

[0062] Trigger actuation assembly (84) may be further constructed in accordance with at least some of the teachings of U.S. Pat. No. 5,205,459; U.S. Pat. No. 5,271,544; U.S. Pat. No. 5,275,322; U.S. Pat. No. 5,285,945; U.S. Pat. No. 5,292,053; U.S. Pat. No. 5,333,773; U.S. Pat. No. 5,350,104; U.S. Pat. No. 5,533,661, the disclosures of which are incorporated by reference herein; and/or in accordance with other configurations as will be apparent to one of ordinary skill in the art in view of the teachings herein.

[0063] Body (72) also houses a trocar actuation assembly (90) configured to actuate trocar (38) longitudinally in response to rotation of adjusting knob (98). As best shown in FIGS. 4A-5, trocar actuation assembly (90) of the present example comprises adjusting knob (98), a grooved shank (94), and a sleeve (92). Grooved shank (94) of the present example is located at a distal end of trocar actuator (39), though it should be understood that grooved shank (94) and trocar actuator (39) may alternatively be separate components that engage to transmit longitudinal movement. Adjusting knob (98) is rotatably supported by the proximal end of body (72) and is operable to rotate sleeve (92) that is engaged with grooved shank (94) via an internal tab (not shown). Grooved shank (94) of the present example comprises a continuous groove (96) formed in the outer surface of grooved shank (94). Accordingly, when adjusting knob (98) is rotated, the internal tab rides within groove (96) and grooved shank (94) is longitudinally actuated relative to sleeve (92). Since grooved shank (94) is located at the distal end of trocar actuator (39), rotating adjusting knob (98) in a first direction advances trocar actuator (39) distally relative to actuator handle assembly (70). Accordingly, the gap distance *d* between anvil (40) and stapling head assembly (20) is increased. By rotating adjusting knob (98) in the opposite direction, trocar actuator (39) is actuated proximally relative to

actuator handle assembly (70) to reduce the gap distance d between anvil (40) and stapling head assembly (20). Thus, trocar actuation assembly (90) is operable to actuate trocar (38) in response to rotating adjustment knob (98). Of course other configurations for trocar actuation assembly (90) will be apparent to one of ordinary skill in the art in view of the teachings herein.

[0064] Groove (96) of the present example comprises a plurality of different portions (96A, 96B, 96C) that have a varying pitch or number of grooves per axial distance. The present groove (96) is divided into a distal portion (96A), a middle portion (96B) and a proximal portion (96C). As shown in FIG. 5, distal portion (96A) comprises a fine pitch or a high number of grooves over a short axial distance of grooved shank (94) such that a large number of rotations of adjusting knob (98) are required to traverse the short axial distance. Middle portion (96B) comprises a section with comparably coarser pitch or fewer grooves per axial distance such that relatively few rotations are required to traverse a long axial distance. Accordingly, the gap distance d may be quickly reduced through relatively few rotations of adjusting knob (98). Proximal portion (96C) of the present example is substantially similar to distal portion (96A) and comprises a fine pitch or a high number of grooves over a short axial distance of grooved shank (94) such that a large number of rotations are required to traverse the short axial distance. Proximal portion (96C) of the present example is positioned within sleeve (92) when anvil (40) is substantially near to stapling head assembly (20) such that indicator bar (110) moves within indicator window (120) along scale (130) to indicate that the anvil gap is within a desired operating range, as will be described in more detail below. Accordingly, when the tab is within proximal portion (96C) of groove (96), each rotation of adjusting knob (98) may reduce the gap distance d by a small amount to provide for fine tuning.

[0065] Trocar actuation assembly (90) may be further constructed in accordance with at least some of the teachings of U.S. Pat. No. 5,205,459; U.S. Pat. No. 5,271,544; U.S. Pat. No. 5,275,322; U.S. Pat. No. 5,285,945; U.S. Pat. No. 5,292,053; U.S. Pat. No. 5,333,773; U.S. Pat. No. 5,350,104; U.S. Pat. No. 5,533,661, the disclosures of which are incorporated by reference herein; and/or in accordance with other configurations as will be apparent to one of ordinary skill in the art in view of the teachings herein.

[0066] In the example shown in FIGS. 4A-4B, a U-shaped clip (100) is attached to an intermediate portion of trocar actuator (39) located distally of grooved shank (94). In the present example, an extension of trocar actuator (39) engages a slot in the housing of handle assembly (70) to prevent trocar actuator (39) from rotating about its axis when adjusting knob (98) is rotated. In some other versions, U-shaped clip (100) engages with a portion of body (72) to substantially prevent trocar actuator (39) from rotating about its axis when adjusting knob (98) is rotated. U-shaped clip (100) of the present example further includes an elongated slot (102) on each of its opposite sides for receiving an attachment member, such as a screw, bolt, pin, clip, etc., to selectively adjust the longitudinal position of elongated slot (102) of U-shaped clip (100) relative to trocar actuator (39) for purposes of calibrating indicator bar (110) relative to scale (130).

[0067] As shown in FIG. 5, actuator handle assembly (70) further includes an indicator bracket (140) configured to engage and pivot an indicator (104). Indicator bracket (140) of the present example is slidable relative to body (72) along a pair of slots formed on body (72). Indicator bracket (140) comprises a rectangular plate (144), an indicator arm (146), and an angled flange (142). Angled flange (142) is formed at the proximal end of rectangular plate (144) and includes an aperture (not shown) to slidable mount onto trocar actuator (39) and/or grooved shank (94). A coil spring (150) is interposed between flange (142) and a boss (152) to bias flange (142) against U-shaped clip (100). Accordingly, when U-shaped clip (100) actuates distally with trocar actuator (39) and/or grooved shank (94), coil spring (150) urges indicator bracket (140) to travel distally with U-shaped clip (100). In addition, U-shaped clip (100) urges indicator bracket (140) proximally relative to boss (152) when trocar actuator (39) and/or grooved shank (94) translate proximally, thereby compressing coil spring (150). Of course, it should be understood that in some versions indicator bracket (140) may be fixedly attached to trocar actuator (39) and/or grooved shank (94).

[0068] In the present example, a portion of lockout feature (82) abuts a surface (141) of indicator bracket (140) when indicator bracket (140) is in a longitudinal position that does not correspond to when the anvil gap is within a desired operating range (e.g., a green colored region or “green zone”). When the anvil gap is within a desired operating

range (e.g., a green colored region or “green zone”), indicator bracket (140) narrows to provide a pair of gaps (145) on either side of an indicator arm (146) that permits lockout feature (82) to pivot, thereby releasing trigger (74). Accordingly, lockout feature (82) and indicator bracket (140) can substantially prevent a user from releasing and operating trigger (74) until anvil (40) is in a predetermined operating range. Of course it should be understood that lockout feature (82) may be omitted entirely in some versions.

[0069] This operating range may be visually communicated to the user via an indicator bar (110) of an indicator (104) shown against a scale (130), described briefly above. At the distal end of indicator bracket (140) is a distally projecting indicator arm (146) which terminates at a laterally projecting finger (148) for controlling the movement of indicator (104). Indicator arm (146) and finger (148), best shown in FIG. 5, are configured to engage a tab (106) of indicator (104) such that indicator (104) is pivoted when indicator bracket (140) is actuated longitudinally. In the present example, indicator (104) is pivotably coupled to body (72) at a first end of indicator (104), though this is merely optional and other pivot points for indicator (104) will be apparent to one of ordinary skill in the art in view of the teachings herein. An indicator bar (110) is positioned on the second end of indicator (104) such that indicator bar (110) moves in response to the actuation of indicator bracket (140). Accordingly, as discussed above, indicator bar (110) is displayed through an indicator window (120) against a scale (130) (shown in FIG. 6) to show the relative gap distance d between anvil (40) and stapling head assembly (20).

[0070] Of course indicator bracket (140), indicator (104), and/or actuator handle assembly (70) may be further constructed in accordance with at least some of the teachings of U.S. Pat. No. 5,205,459; U.S. Pat. No. 5,271,544; U.S. Pat. No. 5,275,322; U.S. Pat. No. 5,285,945; U.S. Pat. No. 5,292,053; U.S. Pat. No. 5,333,773; U.S. Pat. No. 5,350,104; U.S. Pat. No. 5,533,661, the disclosures of which are incorporated by reference herein; and/or in accordance with other configurations as will be apparent to one of ordinary skill in the art in view of the teachings herein.

[0071] II. Exemplary Trans-Oral Circular Anvil Introduction System

[0072] As described above, anvil (40) may be provided as a separate component such that anvil (40) may be inserted and secured to a portion of tissue (2) prior to being coupled to stapling head assembly (20). For instance, it may be desirable to introduce anvil (40) trans-orally for procedures within a patient's gastro-intestinal tract (e.g., an esophagectomy). FIG. 7 depicts an initial stage of an anastomosis procedure to couple severed esophagus sections (2, 4) following an esophagectomy. Anvil (40) is inserted trans-orally through the esophagus using an endoscope (6) and is positioned within a first severed section (2) of the esophagus. Instrument (10) is inserted through the stomach and positioned within a second severed section (4) of the esophagus. Anvil (40) is then coupled to trocar (38) of instrument (10) to staple and seal severed sections (2, 4) of the esophagus in an anastomosis. Anvil (40) may also be inserted within other bodily lumens or regions of the gastro-intestinal tract to perform an anastomosis as will be apparent to one with ordinary skill in the art in view of the teachings herein. Because improper introduction of anvil (40) may irritate the esophagus, it may be desirable to provide a trans-oral circular anvil introduction system to smoothly insert anvil (40) through the bodily lumen. An anvil introduction system may comprise dilation features to cover at least the proximal side of anvil (40) during insertion, if not the entire anvil (40) during insertion; or the system may comprise anvil grasping features to insert anvil (40) upside-down such that the proximal side of anvil (40) faces away from tissue. Various examples of such features will be described in greater detail below, while other examples will be apparent to one with ordinary skill in the art in view of the teachings herein.

[0073] A. Exemplary Dilation Features

[0074] An anvil introduction system may comprise anvil dilation features that either inflate or expand to cover the proximal side of anvil (40) during insertion. Such dilation features may prevent an outer perimeter edge at the proximal side of anvil (40) from dragging along the inner wall of the esophagus as anvil (40) is transported through the esophagus to reach the desired anastomosis site. Various examples of such features will be described in greater detail below, while other examples will be apparent to one with ordinary skill in the art in view of the teachings herein.

[0075] 1. Exemplary Inflatable Feature

[0076] An exemplary trans-oral circular anvil introduction system (200) is shown in FIGS. 8-10. Anvil introduction system (200) of the present example comprises a dilation feature, such as inflatable bladder (210), which is expandable around anvil (240) to cover any sharp edges of anvil (240) during the introduction of anvil (240) through a naturally occurring bodily lumen (e.g. the esophagus). For example, anvil introduction system (200) comprises an anvil (240), an inflatable bladder (210), and a flexible tube (222), as shown in FIG. 8. Anvil (240) is similar to anvil (40) described above. Anvil (240) comprises staple pockets (252) aligned on proximal surface (250) of anvil (240). Anvil (240) also comprises a proximally extending shaft (244). Shaft (244) is coupled to inflatable bladder (210). Inflatable bladder (210) comprises a flexible membrane that wraps around shaft (244) and inflates to cover staple pockets (252) and the edge of proximal surface (250) of anvil (240), as shown in FIG. 9B. In the inflated state, bladder (210) defines a tapered shape from anvil (240). Apertures (211) are provided in shaft (244) to allow air, saline, or other fluid to pass through shaft (244) to inflate bladder (210). Tubular member (212) extends from bladder (210) to selectively couple bladder (210) to flexible tube (222). Shaft (244) is similar to proximal shaft (42) of anvil (40) such that shaft (244) is configured to couple with trocar (38) once anvil (240) is positioned for stapling.

[0077] Flexible tube (222) comprises a snap feature (220) and an inflation tube (224). Snap feature (220) extends from the distal end of flexible tube (222). Snap feature (220) comprises a smaller diameter than tubular member (212) such that snap feature (220) slides or snaps into tubular member (212) to couple flexible tube (222) to tubular member (212), as shown in FIG. 9A. Snap feature (220) may also have a larger diameter than tubular member (212) such that snap feature (220) slides around tubular member (212). Snap feature (220) may also be sutured to tubular member (212). Other suitable methods to couple flexible tube (222) to tubular member (212) will be apparent to one with ordinary skill in the art based on the teachings herein. Inflation tube (224) is positioned within flexible tube (222). Inflation tube may be used to inject fluid into bladder (210) to inflate bladder (210). However, inflation tube (224) is merely optional and flexible tube

(222) may be used to inject fluid into bladder (210). Flexible tube (222) may comprise a conventional NG (nasogastric) tube or any other suitable structure.

[0078] As shown in FIG. 9A, snap feature (200) is inserted into tubular member (212) to couple flexible tube (222) to tubular member (212). Once coupled, inflation tube (224) introduces fluid into bladder (210) to inflate bladder (210), as shown in FIG. 9B. With bladder (210) inflated, bladder (210) covers staple pockets (252). Bladder (210) also extends past anvil (240) to form an annular protrusion (214) to cover the edge of proximal surface (250) of anvil (240). In the inflated state, flexible tube (222) is used to pull anvil (240) smoothly through a naturally occurring bodily lumen (e.g., the esophagus), as shown in FIG. 10. Once anvil (240) is positioned by anvil introduction system (200), bladder (210) is deflated by passing the fluid back through inflation tube (224). Flexible tube (222) is then removed from anvil (240), and anvil (240) is coupled to trocar (38) of circular surgical stapling instrument (10) for operation.

[0079] 2. Exemplary Expandable Mesh Feature

[0080] Another exemplary trans-oral circular anvil introduction system (300) comprising a dilation feature is shown in FIGS. 11-17B. Anvil introduction system (300) comprises an anvil (340), a flexible tube (322), a sliding feature (360), and a dilation feature (361). Anvil (340) is similar to anvil (40) described above. Anvil (340) comprises staple pockets (352) aligned on proximal surface (350) of anvil (340), as shown in FIG. 15. Anvil (340) also comprises a shaft (344) extending from proximal surface (350) of anvil (340). Shaft (344) is similar to proximal shaft (42) of anvil (40) such that shaft (344) is configured to couple with trocar (38) once anvil (340) is positioned for stapling. Shaft (344) is coupled to flexible tube (322) as anvil (340) is being moved into a position for stapling. Shaft (344) comprises a smaller diameter than flexible tube (322) such that shaft (344) slides into flexible tube (322) to couple flexible tube (322) to anvil (340). Shaft (344) may also have a larger diameter than flexible tube (322) such that shaft (344) may slide around flexible tube (322). Shaft (344) may also be sutured to flexible tube (322) through corresponding apertures (312, 320) in shaft (344) and flexible tube (322). Other suitable methods to couple flexible tube (322) to shaft (344) will be apparent to one

with ordinary skill in the art based on the teachings herein. Flexible tube (322) may comprise a conventional NG (nasogastric) tube or any other suitable structure.

[0081] Sliding feature (360) is coupled to flexible tube (322). Sliding feature (360) comprises a sliding collar (368), connecting members (367), and a cam collar (366), as shown in FIG. 11. Sliding collar (368) wraps around flexible tube (322) such that sliding collar (368) slides proximally and/or distally along flexible tube (322). A cam collar (366) is positioned distal to sliding collar (368) and cam collar (366) also wraps around flexible tube (322) such that cam collar (366) slides proximally and/or distally along flexible tube (322). Cam collar (366) defines a tapered configuration. One or more connecting members (367) extend between sliding collar (368) and cam collar (366) to connect sliding collar (368) to cam collar (366).

[0082] Dilation feature (361) is also coupled to flexible tube (322), as shown in FIGS. 13-14. Dilation feature (361) comprises expanding members (362) and a washer (363). Washer (363) wraps around flexible tube (322) such that washer (363) is positioned between cam collar (366) and sliding collar (368). Washer (363) is fixed relative to flexible tube (322) such that sliding feature (360) also slides relative to washer (363). A plurality of expanding members (362) extend distally from washer (363) to anvil (340). Expanding members (362) are positioned to extend from underneath sliding collar (368) and over cam collar (366), as shown in FIG. 11. A mesh (364) is applied to dilation feature (361) to cover expanding members (362). Mesh (364) is configured to taper from anvil (340) to washer (363). Mesh (364) expands and contracts with expanding members (362). In the present example, mesh (364) extends up to the bottom of the head of anvil (340). In some other versions, mesh (364) fully encompasses the head of anvil (340). In addition or in the alternative, mesh (364) may fully encompass the shaft of anvil (340).

[0083] As shown in FIGS. 15-16, flexible tube (322) is coupled to anvil (340) via shaft (344), with dilation feature (361) in a collapsed state. Expanding members (362) and/or mesh (364) may be resiliently biased to assume the collapsed configuration of FIGS. 15-16. In the collapsed state, sliding feature (360) is in a distal position such that cam collar

(366) is distal to washer (363). A user grasps sliding collar (368) to translate sliding feature (360) to a proximal position, as shown in FIGS. 13-14. A conventional grasper or any other device may be used to translate sliding collar (368). As sliding collar (368) translates proximally, cam collar (366) also translates proximally to engage washer (363). The tapered configuration of cam collar (366) underneath expanding members (362) acts as a cam, pushing expanding members (362) outwardly to an expanded state. In the expanded state, expanding members (362) contact the edge of proximal surface (350) of anvil (340). Mesh (364) also expands with expanding members (362). In the expanded state, dilation feature (361) covers the edge and staple pockets (352) of anvil (340). With proximal surface (350) of anvil (340) covered by dilation feature (361), anvil (240) is introduced trans-orally by pulling flexible tube (322) of anvil introduction system (300) through the esophagus, as shown in FIG. 17A. When dilation feature (362) is in the expanded position, dilation feature (362) prevents the edge of anvil (340) from dragging along the inner wall of the esophagus. Once anvil (340) is in a desired position within the esophagus, suture (380) connecting flexible tube (322) and anvil shaft (344) is cut. Sliding collar (368) is then advanced distally to allow dilation feature (361) to collapse. As shown in FIG. 17B, flexible tube (322) is then pulled to remove flexible tube (322), sliding feature (360), and dilation feature (361) from anvil (340). Anvil (340) is then coupled to trocar (38) of circular surgical stapling instrument (10) for operation.

[0084] B. Exemplary Anvil Grasping Features

[0085] An anvil (40) may comprise an anvil grasping features to facilitate pulling anvil (40) upside-down through the esophagus such that the proximal side of anvil (40) faces away from tissue. This may enable a tapered or curved upper surface of anvil (40) to engage tissue as anvil (40) is pulled through the esophagus. A flexible or rigid anvil grasping feature may be used. Various examples of such features will be described in greater detail below, while other examples will be apparent to one with ordinary skill in the art in view of the teachings herein.

[0086] 1. Exemplary Flexible Grasping Feature

[0087] FIGS. 18-19C show an exemplary anvil assembly (400) comprising an anvil grasping feature (448). Grasping feature (448) is used to grasp anvil (440) at an orientation with top surface (442) leading through a naturally occurring bodily lumen (e.g. the esophagus). Anvil assembly (400) comprises an anvil (440), an anvil grasping feature (448), and an anvil shaft (444), as shown in FIG. 18. Anvil (440) is similar to anvil (40) described above. Anvil (440) comprises staple pockets (452) on lower surface (450) of anvil (440). Shaft (444) extends from lower surface (450) of anvil (440). Shaft (444) is coupleable to trocar (38). Anvil (440) defines a tapered configuration such that top surface (442) comprises a smaller diameter than lower surface (450). Grasping feature (448) extends from top surface (442) of anvil (440). Grasping feature (448) may be flexible. As shown in FIG. 18, grasping feature (448) is configured as a rounded tab. Grasping feature (448) may also be configured as a long, round cylindrical tab, or a flat fin shaped tab. Other suitable grasping configurations will be apparent to one with ordinary skill in the art in view of the teachings herein.

[0088] In an exemplary use, as shown in FIGS. 19A-19C, anvil (440) is introduced by leading top surface (442) trans-orally through the esophagus. The tapered configuration defined by anvil (440) provides a smooth transit for anvil (440) through the esophagus. A suture (450) is coupled around shaft (444) of anvil (440). A conventional surgical grasper (460) is used to grab grasping feature (448) with grasping end effector jaws (462), as shown in FIG. 19A. Grasper (460) is then pulled through the esophagus to trans-orally introduce anvil (440) to the intended anastomosis site. Once anvil (440) is close to a desired position within the esophagus, grasper (460) releases grasping feature (448). As shown in FIG. 19B, grasper (460) then grabs suture (450) to pull anvil shaft (444) to thereby flip anvil (440) to align lower surface (450) with the desired tissue (2) to be stapled. After anvil (440) is flipped, grasper (460) continues to pull anvil (440) into position, as shown in FIG. 19C. Suture (350) is then cut and grasper (460) is removed. Anvil (440) is then coupled to trocar (38) of circular surgical stapling instrument (10) for operation.

[0089] 2. Exemplary Rigid Grasping Feature

[0090] FIGS. 20-21B show another exemplary anvil assembly (700) comprising an anvil grasping feature (748). Anvil assembly (700) comprises an anvil (740) and an anvil grasping feature (748), as shown in FIG. 20. Anvil (740) is similar to anvil (40) described above. Anvil (740) comprises staple pockets (752) on lower surface (750) of anvil (740). A shaft (746) extends from top surface (742) of anvil (740) to connect anvil grasping feature (748) to anvil (740). Anvil grasping feature (748) comprises a convex shaped top. An opening (744) is formed on lower surface (750) of anvil (740) to receive trocar (738), as shown in FIG. 21A. Opening (744) comprises an inwardly extending annular protrusion (743).

[0091] Trocar (738) is similar to trocar (38). Trocar (738) comprises a pointed distal end (730), a cam portion (732), a shaft (733), and expanding members (736), as shown in FIG. 21A. The distal portion of shaft (733) is angled to form cam portion (732). Pointed distal end (730) is positioned distal to cam portion (732). Shaft (733) extends through expanding members (736). Expanding members (736) comprise inwardly extending recesses (734) that correspond to protrusion (743).

[0092] In an exemplary use, anvil (740) is introduced by leading top surface (742) through a naturally occurring bodily lumen (e.g. the esophagus). A grasper is used to grab grasping feature (748) with jaws to pull anvil (740) trans-orally through the esophagus. Anvil (740) is flipped to align lower surface (750) with tissue (2) to be stapled. Once anvil (740) is positioned within the esophagus, anvil (740) is coupled to trocar (738) for operation. In particular, trocar (738) is inserted into opening (744) of anvil (740) until recesses (734) align with protrusion (743), as shown in FIG. 21A. Shaft (733) is pulled proximally to slide shaft (733) through expanding members (736). As shaft (733) translates proximally, cam portion (732) pushes expanding members (736) outwardly, as shown in FIG. 21B. This causes recesses (734) to engage protrusion (743). The longitudinal position of shaft (733) relative to expanding members (736) is secured in order to cause recesses (734) of trocar (738) to lock anvil (740) to trocar (738) during operation of circular surgical stapling instrument (10). After operation of instrument (10), shaft (733) may be translated distally to allow expanding members (736) to bend inwardly. This removes recesses (734) from protrusion (743) to unlock anvil (740) from

trocar (738). Instrument (10) and anvil (740) may then be removed separately from the anastomosis site. Alternatively, instrument (10) may be removed from the anastomosis site with anvil (740) still coupled to trocar (738).

[0093] C. Exemplary Anvil Securing Feature

[0094] An anvil securing feature (848) may be applied to the various anvils, including those described above, to hold anvil (840) in place relative to tissue while coupling anvil (840) to a trocar (38). An exemplary anvil assembly (800) comprising an anvil securing feature (848) is shown in FIGS. 22A-22B. Anvil assembly (800) comprises an anvil (840) and an anvil securing feature (820). Anvil (840) is similar to anvil (40) described above. Anvil (840) comprises staple pockets (852) on lower surface (850) of anvil (840). A shaft (844) extends from lower surface (850) of anvil (840). Anvil securing feature (848) is fixedly coupled to shaft (844). Anvil grasping feature (848) comprises a collar (822) and a flange (820) extending from collar (822), as shown in FIG. 22A. Collar (822) is configured to wrap around shaft (844) to couple anvil securing feature (848) to anvil (840). An opening (824) is formed in flange (820) such that a suture may pass through opening (824). Alternatively, flange (820) may be formed of a compliant material to enable needle (832) to pierce flange (820) at any desired location on flange (820).

[0095] Once anvil (840) is positioned within through the esophagus using any of the features described above, anvil securing feature (848) allows for retention of anvil (840) relative to tissue after a grasper is removed from anvil (840). As shown in FIGS. 22A-22B, tissue (2) is sutured in a purse-string configuration. Suture (830) then passes through opening (824) of anvil securing feature (848) by needle (832). A loop is formed through opening (824) around flange (820) with suture (830). As suture (830) is drawn around tissue (2) and flange (820), anvil (840) is held in position by suture (830). With anvil (840) secured to tissue (2), anvil (840) is held in place when anvil (840) is coupled to a trocar (38). Other suitable suturing methods to retain anvil (840) will be apparent to one with ordinary skill in the art in view of the teachings herein.

[0096] III. Miscellaneous

[0097] It should be understood that any one or more of the teachings, expressions, embodiments, examples, etc. described herein may be combined with any one or more of the other teachings, expressions, embodiments, examples, etc. that are described herein. The above-described teachings, expressions, embodiments, examples, etc. should therefore not be viewed in isolation relative to each other. Various suitable ways in which the teachings herein may be combined will be readily apparent to those of ordinary skill in the art in view of the teachings herein. Such modifications and variations are intended to be included within the scope of the claims.

[0098] It should be appreciated that any patent, publication, or other disclosure material, in whole or in part, that is said to be incorporated by reference herein is incorporated herein only to the extent that the incorporated material does not conflict with existing definitions, statements, or other disclosure material set forth in this disclosure. As such, and to the extent necessary, the disclosure as explicitly set forth herein supersedes any conflicting material incorporated herein by reference. Any material, or portion thereof, that is said to be incorporated by reference herein, but which conflicts with existing definitions, statements, or other disclosure material set forth herein will only be incorporated to the extent that no conflict arises between that incorporated material and the existing disclosure material.

[0099] Versions of the devices described above may have application in conventional medical treatments and procedures conducted by a medical professional, as well as application in robotic-assisted medical treatments and procedures. By way of example only, various teachings herein may be readily incorporated into a robotic surgical system such as the DAVINCI™ system by Intuitive Surgical, Inc., of Sunnyvale, California. Similarly, those of ordinary skill in the art will recognize that various teachings herein may be readily combined with various teachings of U.S. Pat. No. 6,783,524, entitled “Robotic Surgical Tool with Ultrasound Cauterizing and Cutting Instrument,” published August 31, 2004, the disclosure of which is incorporated by reference herein.

[00100] Versions described above may be designed to be disposed of after a single use, or they can be designed to be used multiple times. Versions may, in either or both cases, be

reconditioned for reuse after at least one use. Reconditioning may include any combination of the steps of disassembly of the device, followed by cleaning or replacement of particular pieces, and subsequent reassembly. In particular, some versions of the device may be disassembled, and any number of the particular pieces or parts of the device may be selectively replaced or removed in any combination. Upon cleaning and/or replacement of particular parts, some versions of the device may be reassembled for subsequent use either at a reconditioning facility, or by a user immediately prior to a procedure. Those skilled in the art will appreciate that reconditioning of a device may utilize a variety of techniques for disassembly, cleaning/replacement, and reassembly. Use of such techniques, and the resulting reconditioned device, are all within the scope of the present application.

[00101] By way of example only, versions described herein may be sterilized before and/or after a procedure. In one sterilization technique, the device is placed in a closed and sealed container, such as a plastic or TYVEK bag. The container and device may then be placed in a field of radiation that can penetrate the container, such as gamma radiation, x-rays, or high-energy electrons. The radiation may kill bacteria on the device and in the container. The sterilized device may then be stored in the sterile container for later use. A device may also be sterilized using any other technique known in the art, including but not limited to beta or gamma radiation, ethylene oxide, or steam.

[00102] Having shown and described various embodiments of the present invention, further adaptations of the methods and systems described herein may be accomplished by appropriate modifications by one of ordinary skill in the art without departing from the scope of the present invention. Several of such potential modifications have been mentioned, and others will be apparent to those skilled in the art. For instance, the examples, embodiments, geometrics, materials, dimensions, ratios, steps, and the like discussed above are illustrative and are not required. Accordingly, the scope of the present invention should be considered in terms of the following claims and is understood not to be limited to the details of structure and operation shown and described in the specification and drawings.

I/We claim:

1. An apparatus for stapling tissue, the apparatus comprising:
 - (a) an anvil, wherein the anvil comprises:
 - (i) a distal surface,
 - (ii) a proximal surface, and
 - (iii) a plurality of staple pockets, wherein the plurality of staple pockets are formed on the proximal surface of the anvil;wherein the anvil is configured to be inserted through a bodily lumen; and
 - (b) an anvil introduction system coupled with the anvil, wherein the anvil introduction system comprises an dilation feature, wherein the dilation feature is configured to transition between:
 - (i) a collapsed position, and
 - (ii) an expanded position, wherein the dilation feature covers the staple pockets of the anvil in the expanded position;wherein the dilation feature is configured to be in the expanded position when the anvil is inserted through the bodily lumen.
2. The apparatus of claim 1, wherein the anvil is configured to be inserted trans-orally.
3. The apparatus of claim 1, wherein the anvil introduction system is removeably coupled with the anvil.
4. The apparatus of claim 1, wherein the anvil further comprises a shaft.
5. The apparatus of claim 4, further comprising an anvil securing feature coupled to the shaft of the anvil, wherein the anvil securing feature is operable to secure the anvil to the bodily lumen.
6. The apparatus of claim 5, wherein the anvil securing feature comprises a collar

wrapped around at least a portion of the shaft of the anvil and a flange protruding outwardly from the collar.

7. The apparatus of claim 4, wherein the anvil introduction system further comprises a tube coupled to the anvil shaft, wherein the tube is configured to pull the anvil through the bodily lumen.

8. The apparatus of claim 1, wherein the dilation feature defines a tapered configuration.

9. The apparatus of claim 1, wherein the dilation feature comprises a bladder.

10. The apparatus of claim 9, wherein the bladder is configured to receive a fluid to transition the bladder from the collapsed position to the expanded position.

11. The apparatus of claim 10, wherein the fluid is either air or saline.

12. The apparatus of claim 1, wherein the dilation feature comprises a plurality of expanding members.

13. The apparatus of claim 12, wherein the anvil introduction system further comprises a sliding feature, wherein the sliding feature is operable to transition the dilation feature from the collapsed position to the expanded position in response to translation of the sliding feature.

14. The apparatus of claim 13, wherein the sliding feature comprises a sliding collar, a cam collar positioned distal to the sliding collar, and at least one connecting member coupling the sliding collar to the cam collar.

15. The apparatus of claim 13, wherein the dilation feature further comprises a mesh wrapped around the plurality of expanding members.

16. An apparatus for stapling tissue, the apparatus comprising:
- (a) an anvil, wherein the anvil comprises:
 - (i) a top surface,
 - (ii) a lower surface, and
 - (iii) a plurality of staple pockets, wherein the plurality of staple pockets are formed on the lower surface of the anvil;wherein the anvil is configured to be inserted through a bodily lumen; and
 - (b) an anvil grasping feature secured to the anvil, wherein the anvil grasping feature extends outwardly from the top surface of the anvil, wherein the grasping feature is operable to be grasped to pull the anvil through the bodily lumen such that the top surface leads as the anvil is pulled through the bodily lumen.
17. The apparatus of claim 16, wherein the grasping feature comprises a flexible tab.
18. The apparatus of claim 16, wherein the grasping feature comprises a shaft extending from the top surface of the anvil and a convex shaped top extending outwardly from the shaft.
19. A method for introducing an apparatus for stapling tissue into tissue, the apparatus comprising an anvil and an anvil introduction system coupled with the anvil, wherein the anvil introduction system comprises a dilation feature, the method comprising:
- (a) coupling the anvil introduction system to the anvil;
 - (b) expanding the dilation feature of the anvil introduction system to an expanded position; and
 - (c) pulling the anvil through tissue to a desired position with the dilation feature in the expanded position.
20. The method of claim 19, further comprising coupling a trocar of a surgical stapling instrument to the anvil.

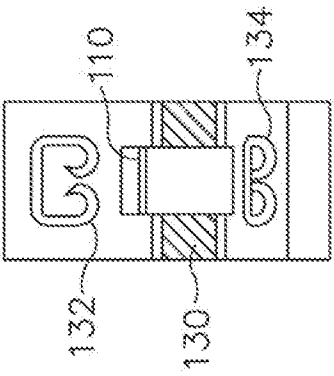

Fig. 6

1/21

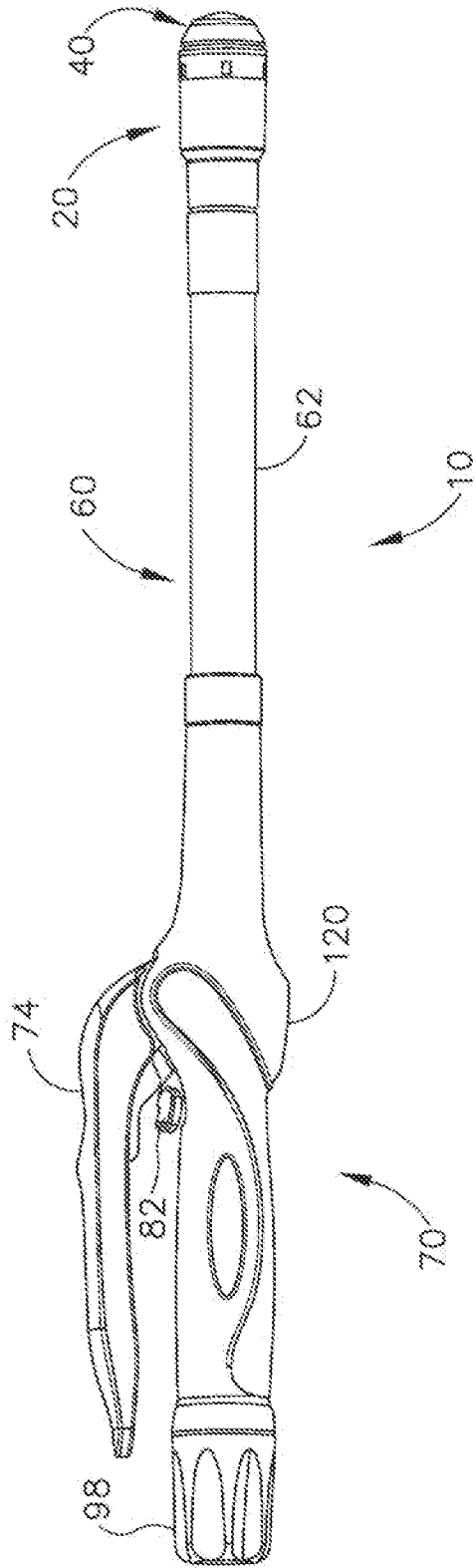
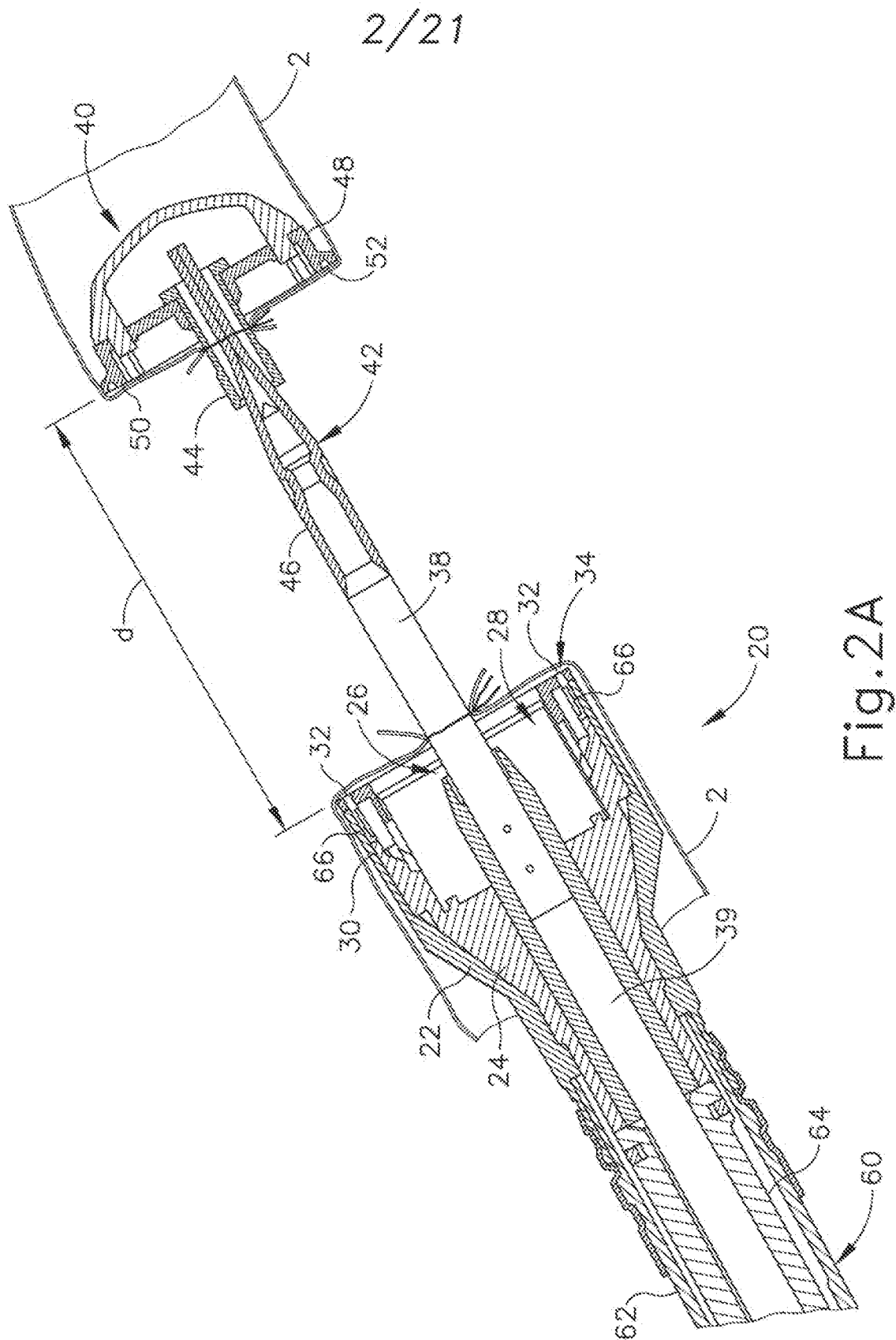

Fig. 1



3/21

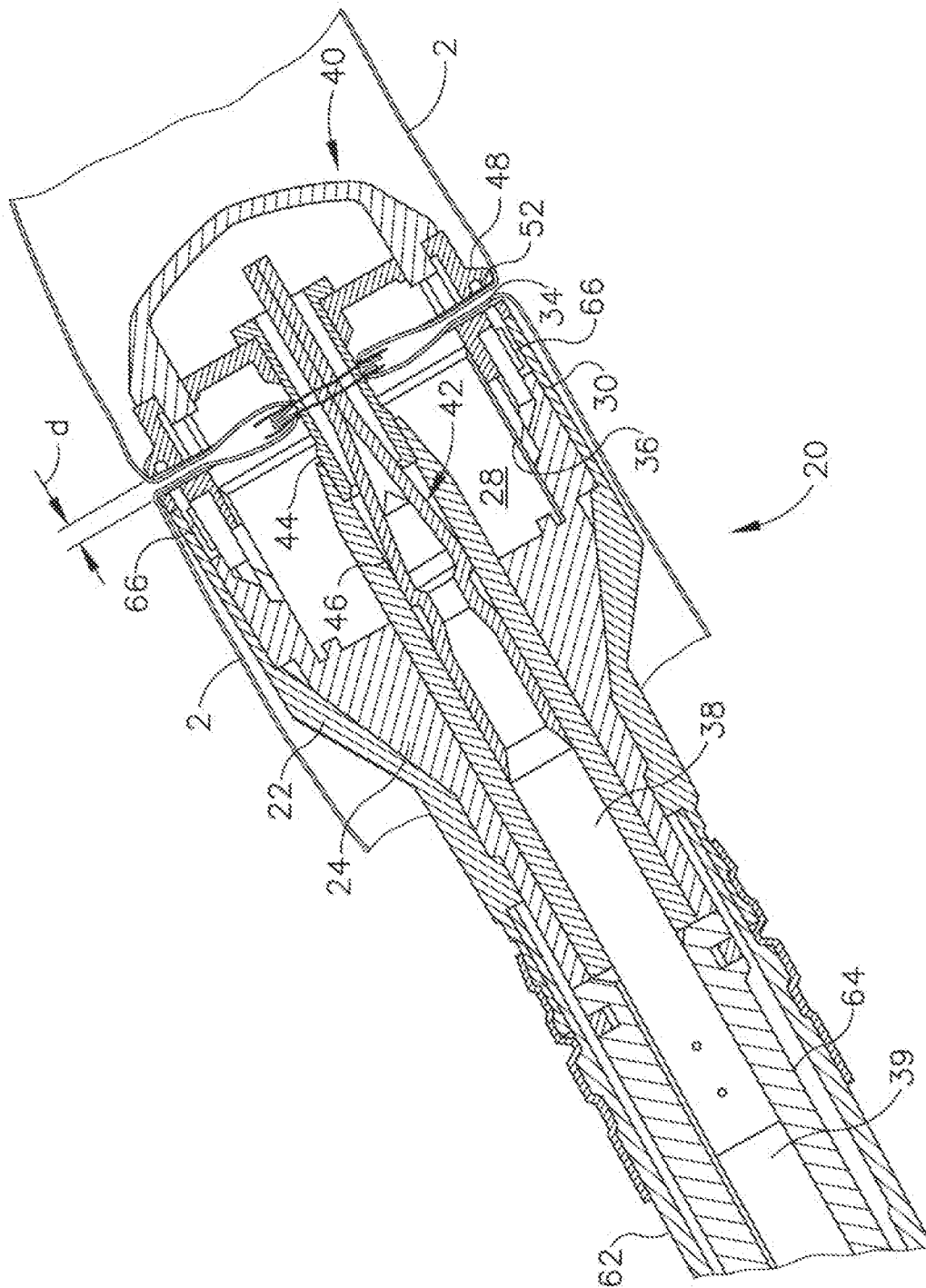

Fig. 2B

4/21

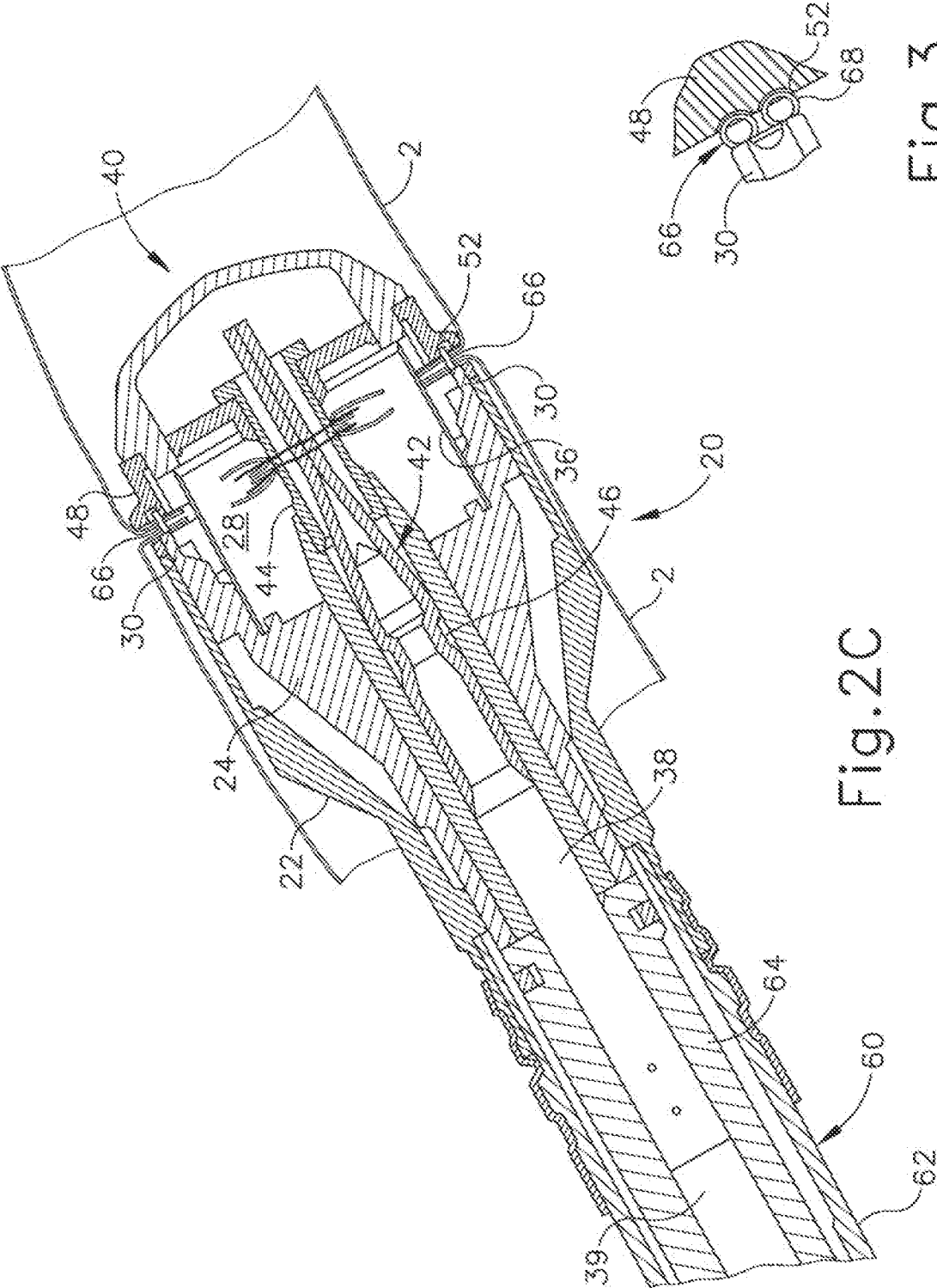

Fig. 2C

Fig. 3

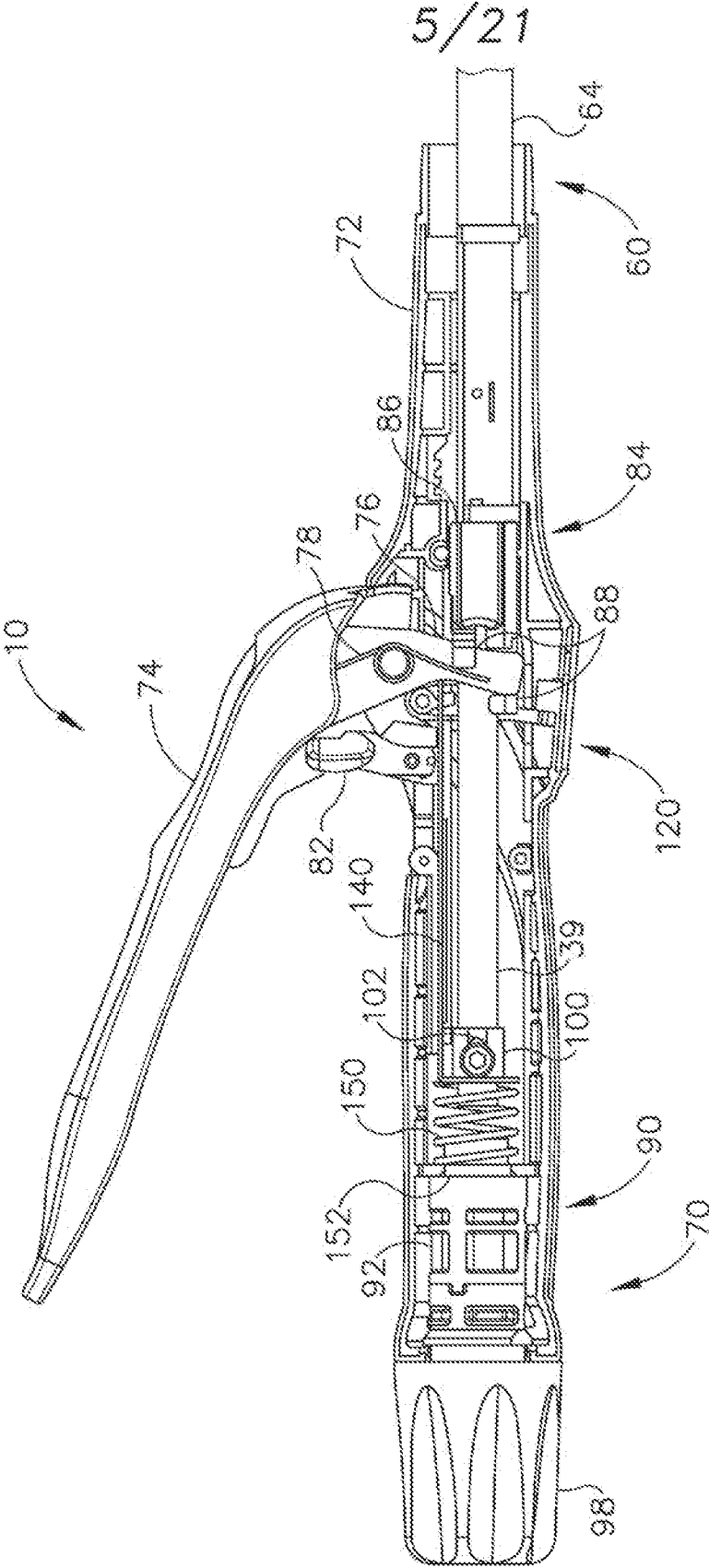

Fig. 4A

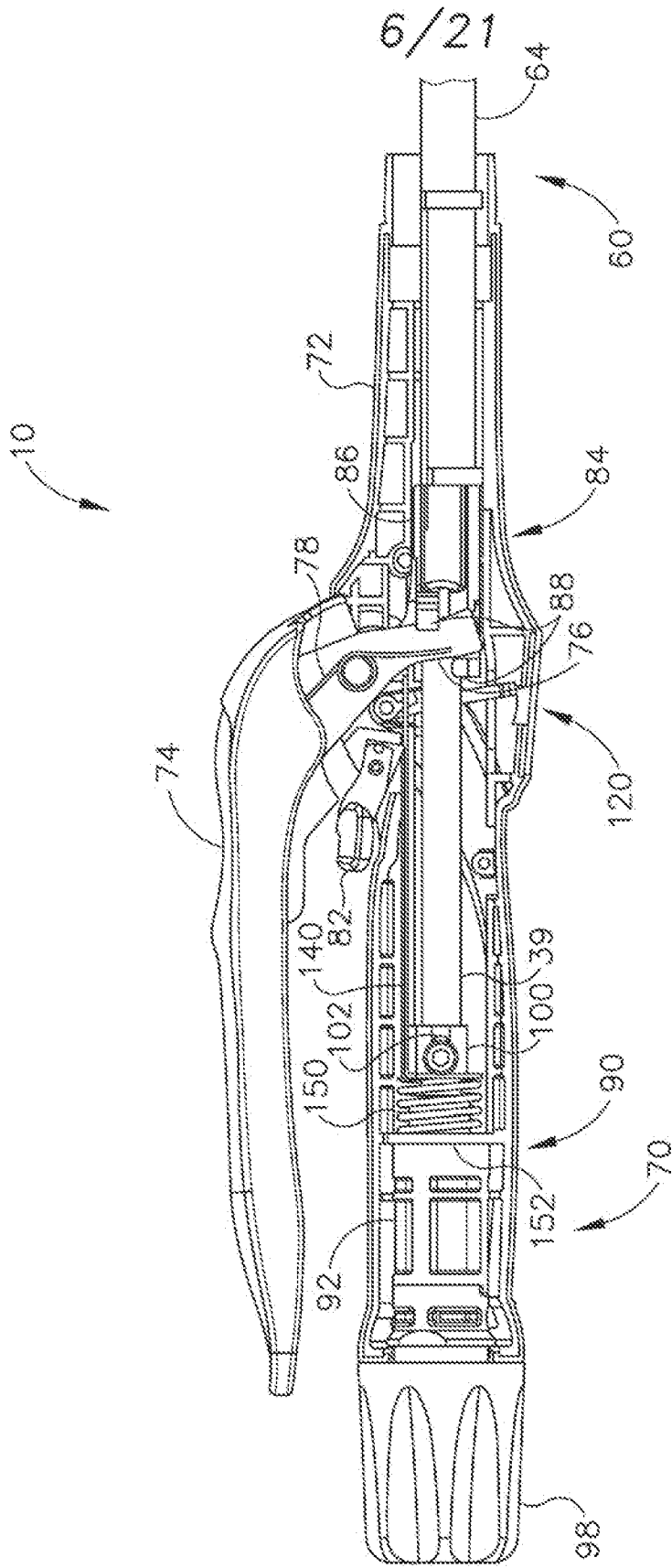
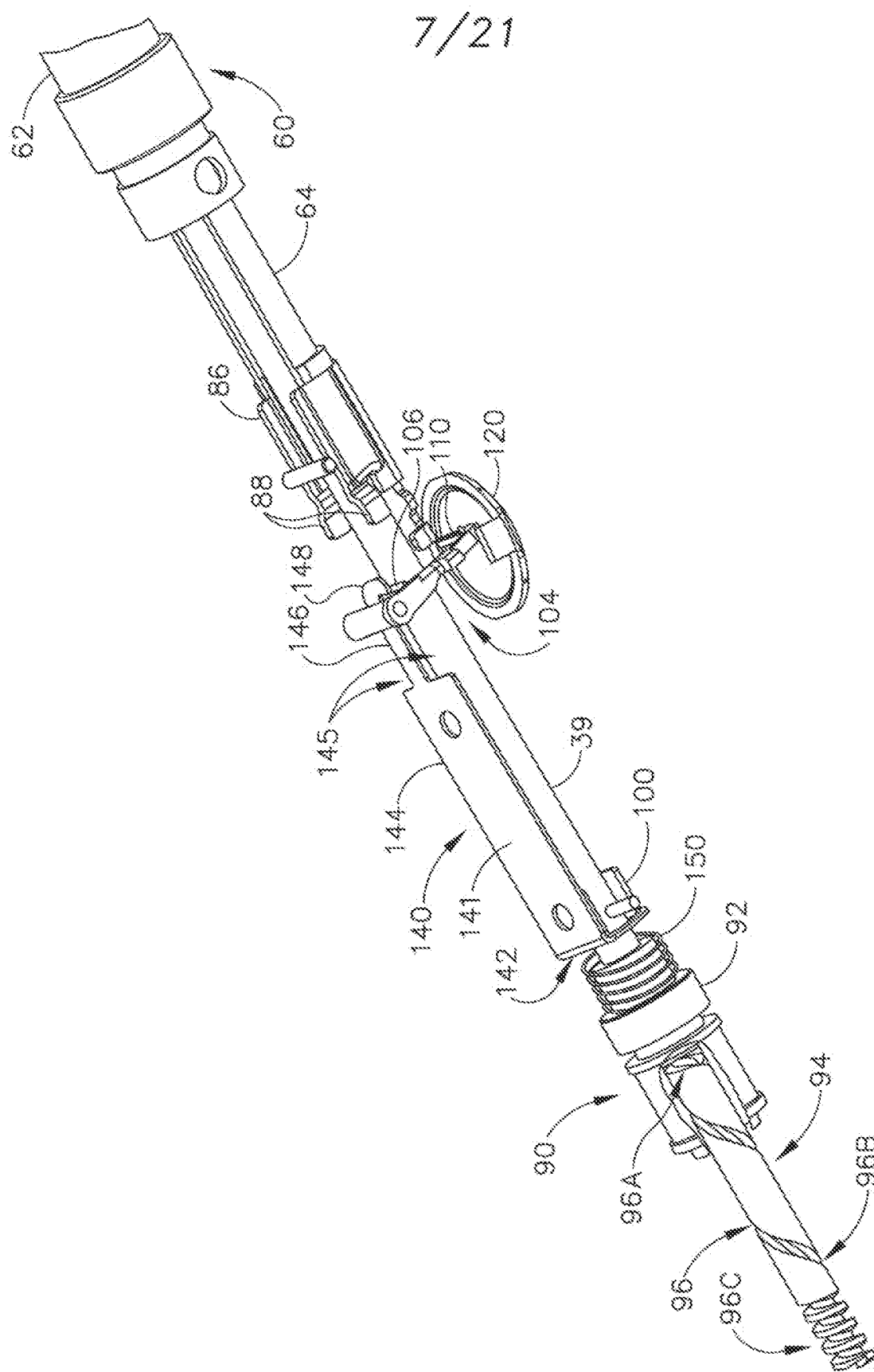

Fig. 4B



504

8/21

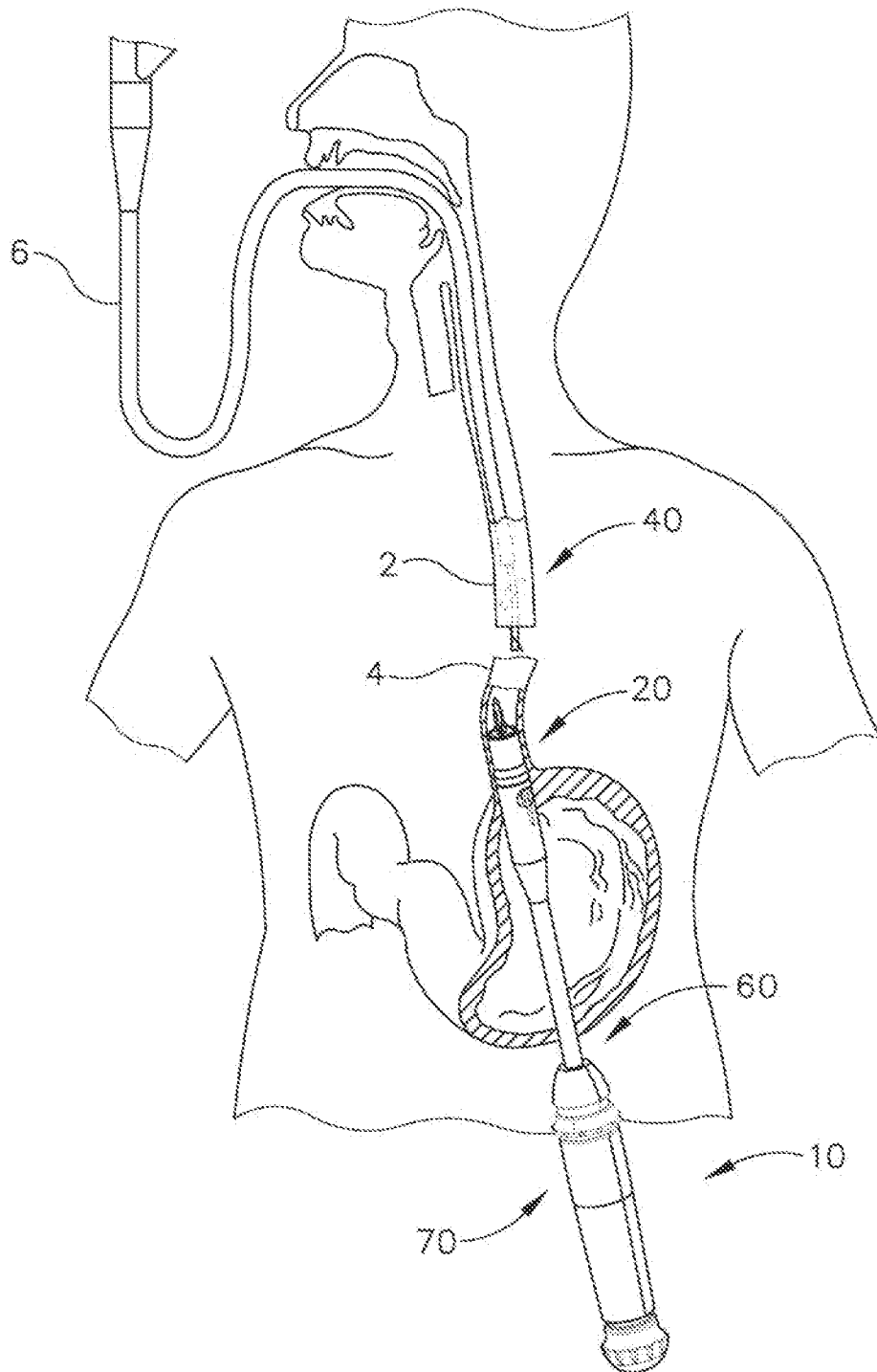

Fig.7

9/21

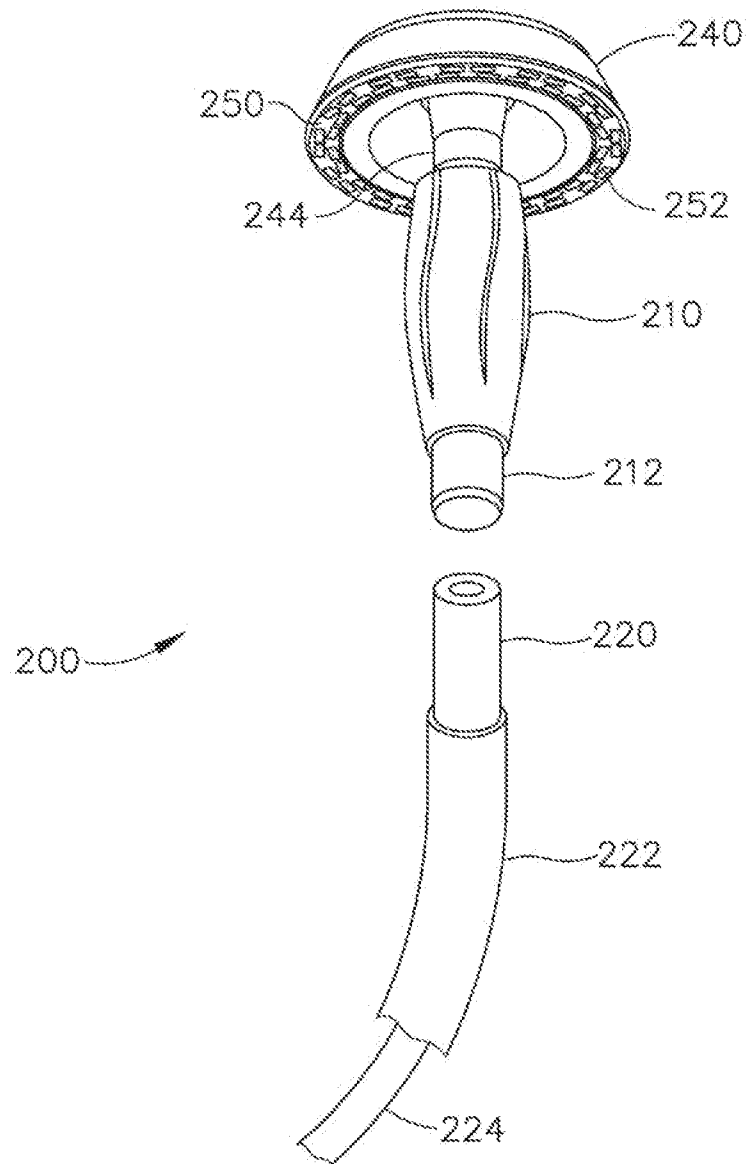

Fig.8

10/21

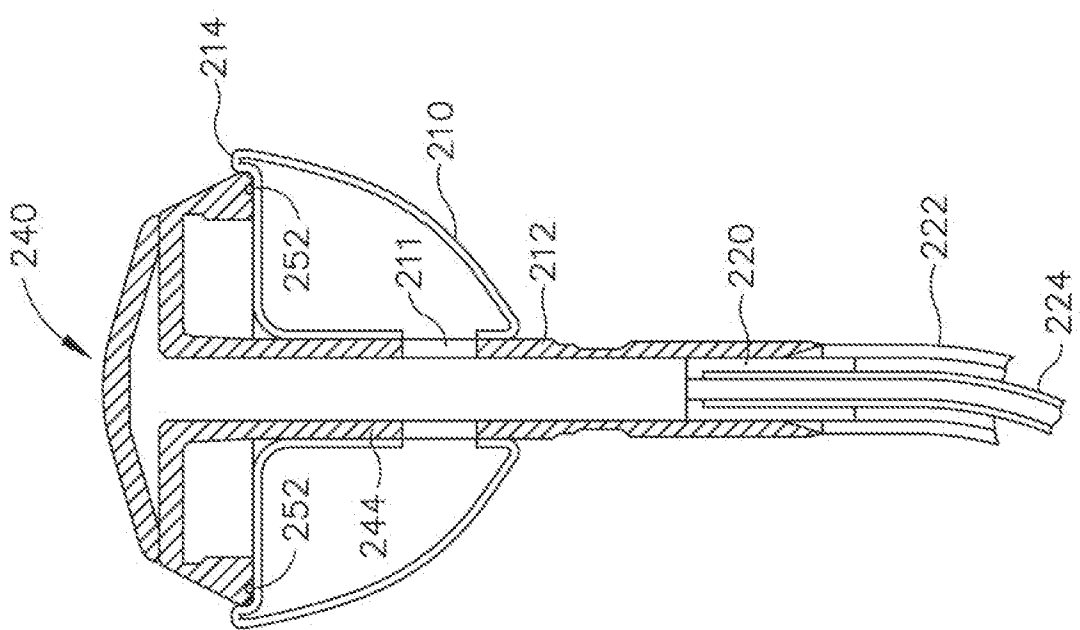

Fig. 9B

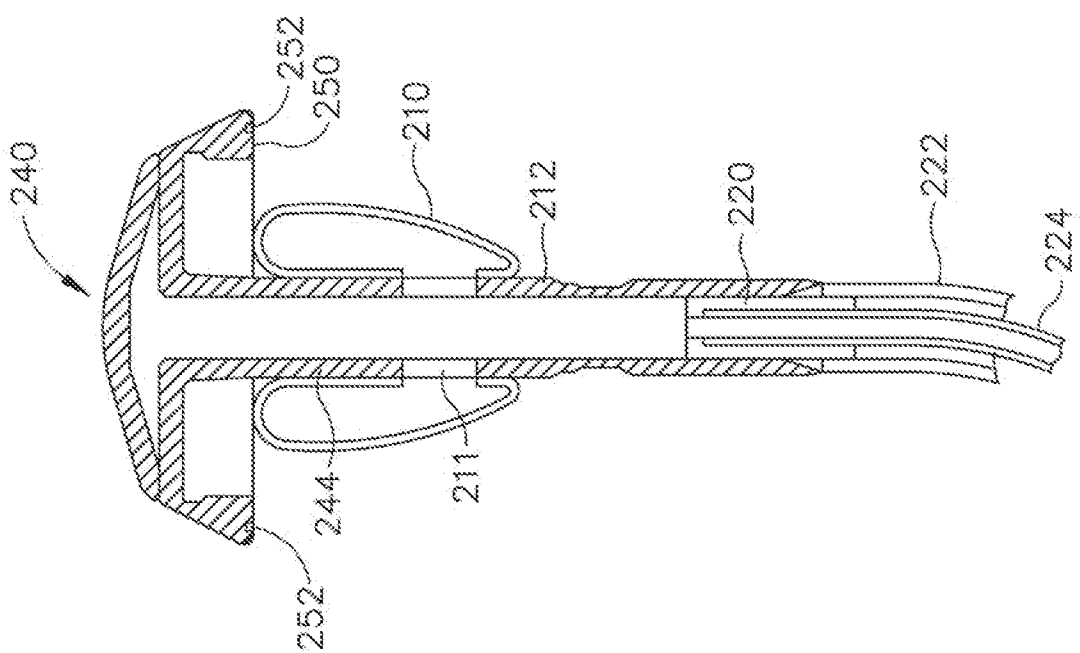

Fig. 9A

11/21

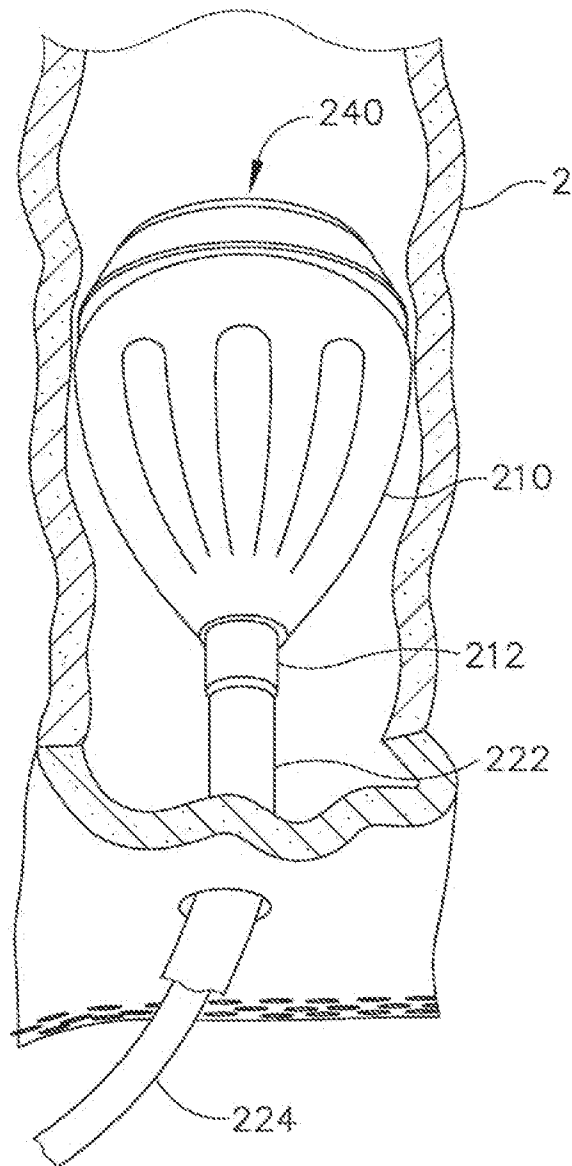

Fig.10

12/21

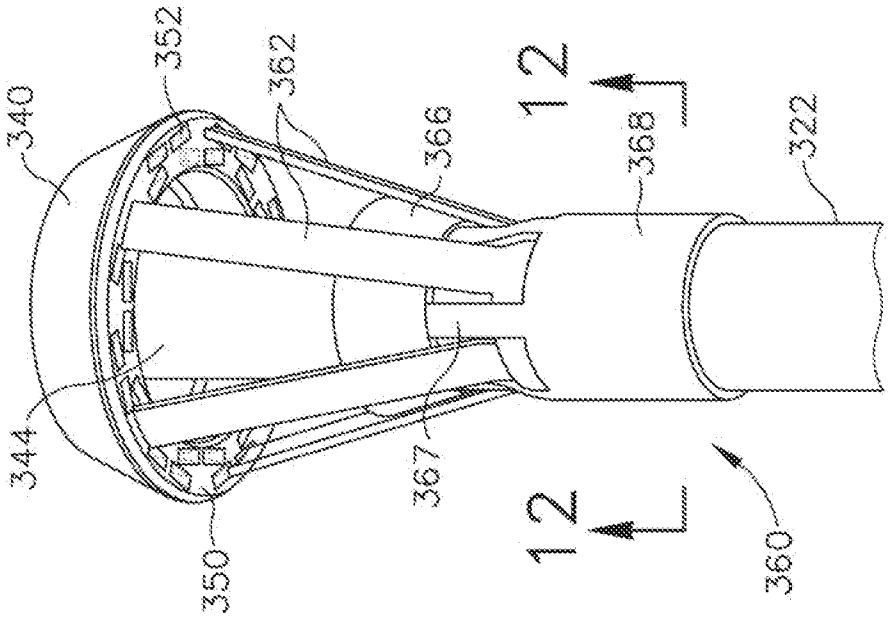

Fig. 11

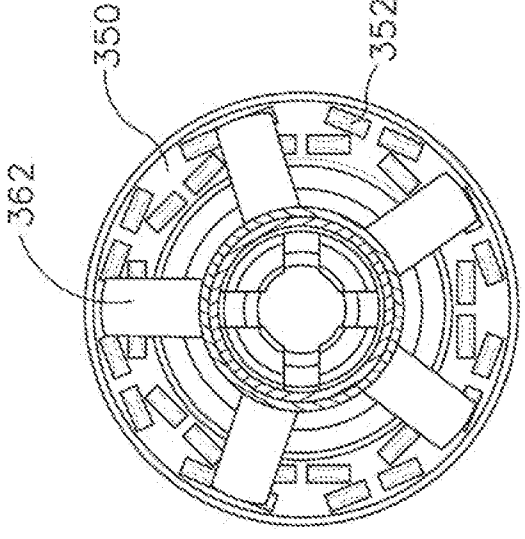

Fig. 12

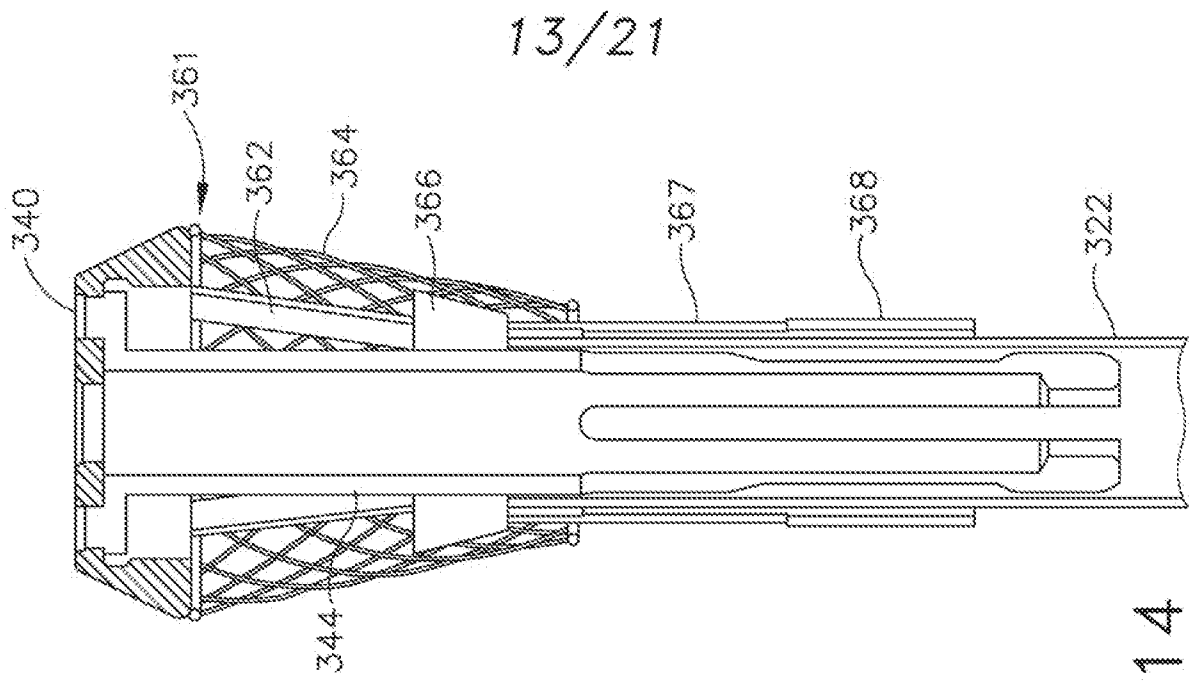

Fig. 14

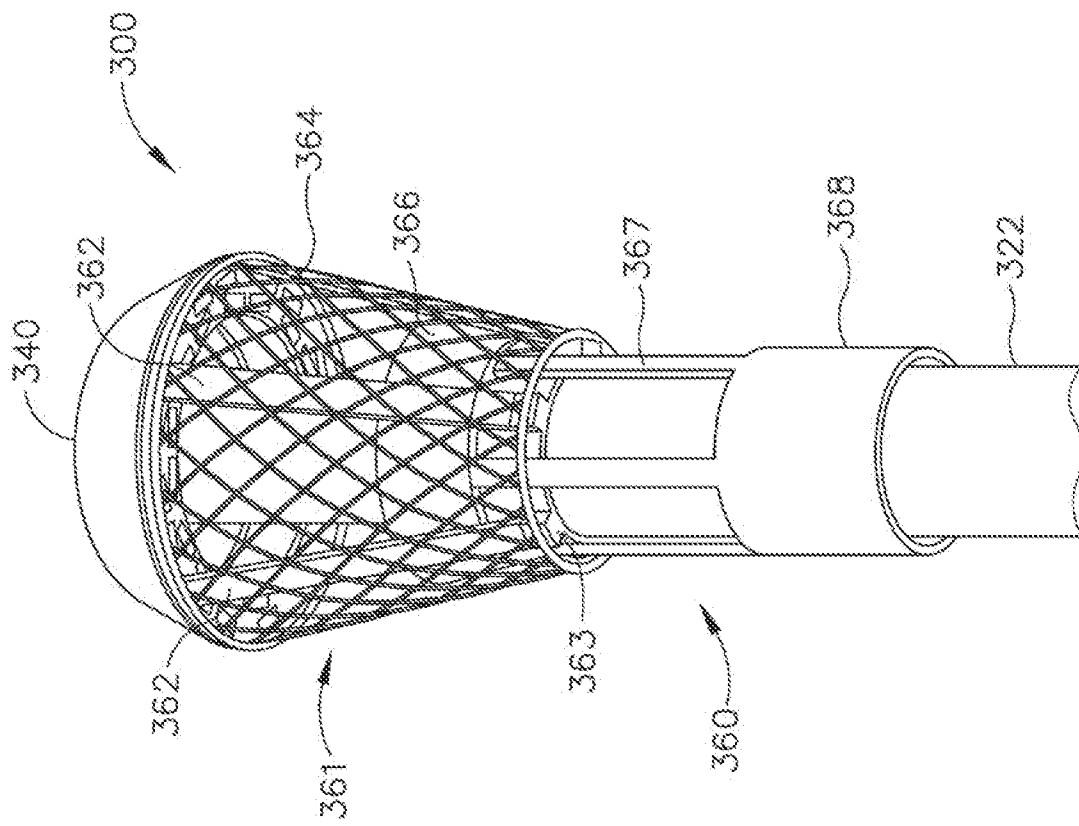

Fig. 13

14/21

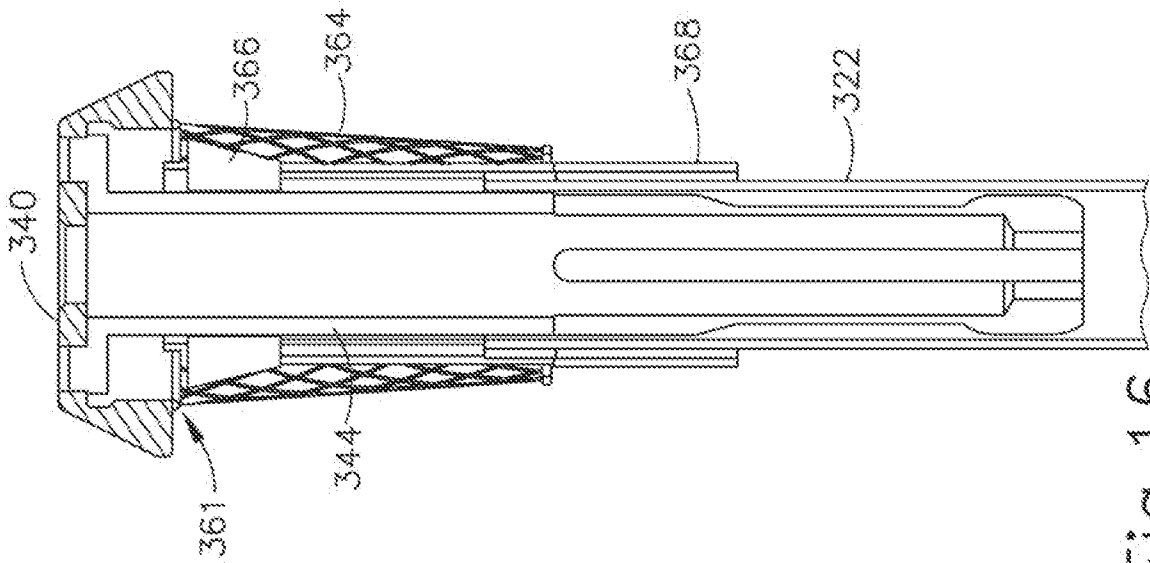

Fig. 15

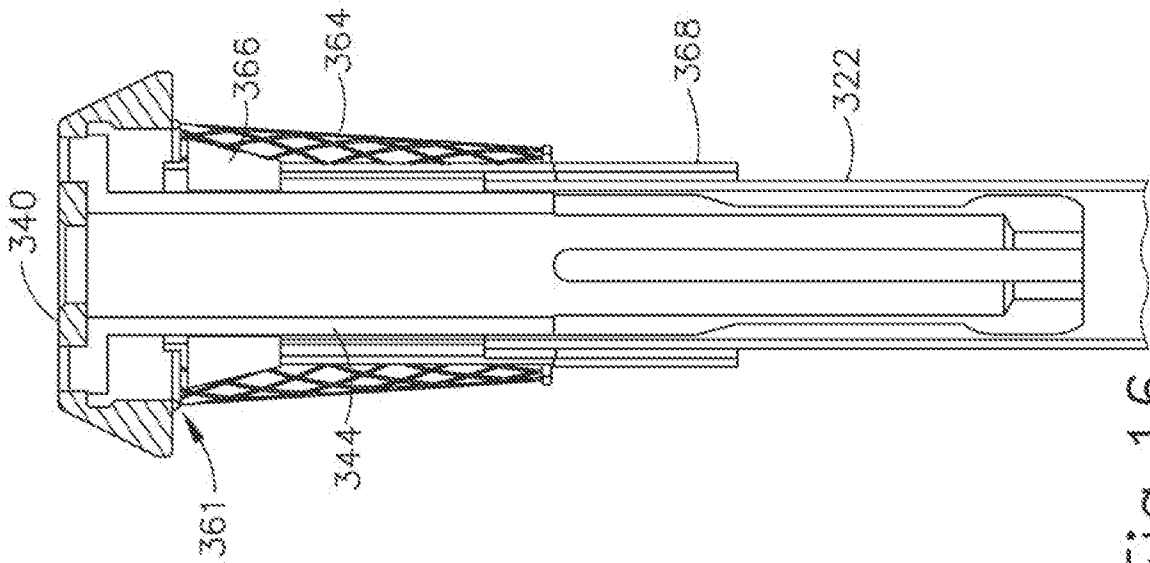

Fig. 16

15/21

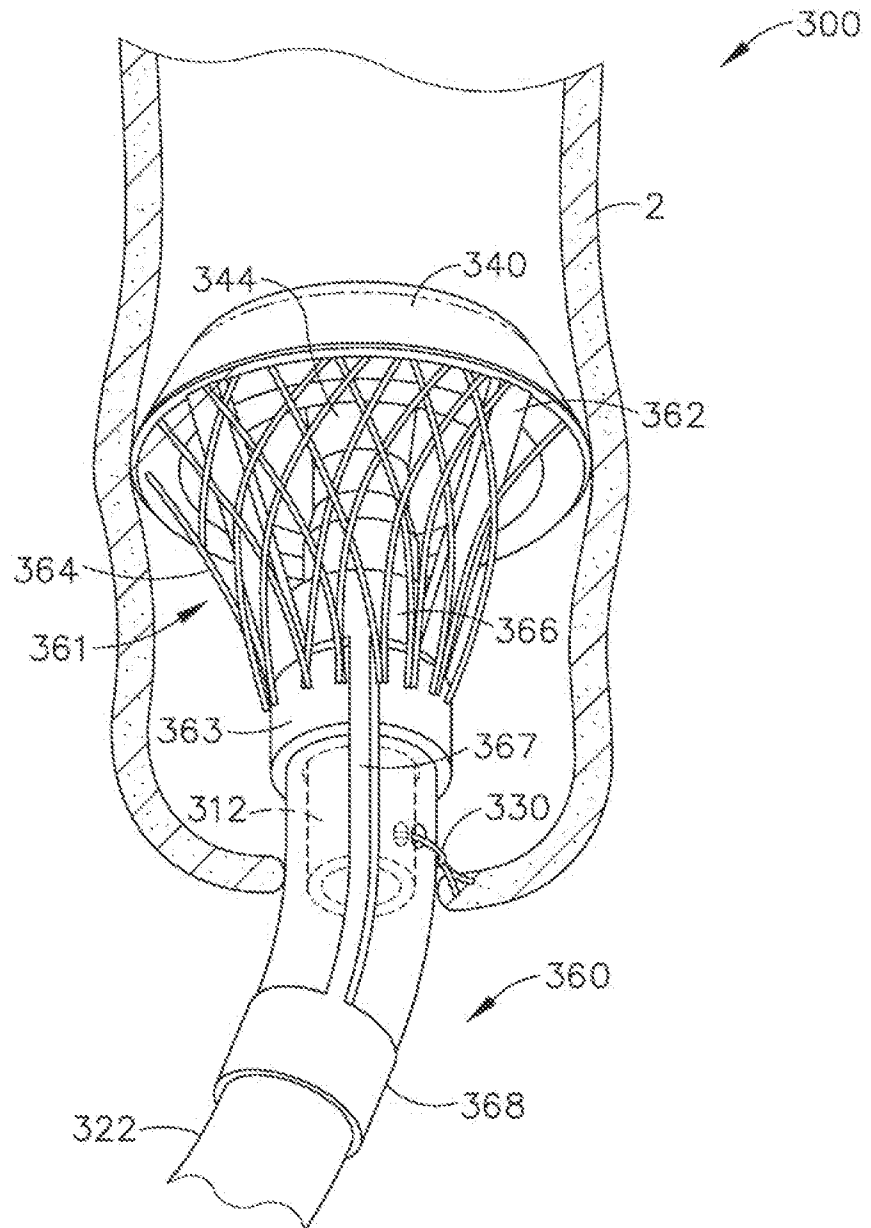

Fig.17A

16/21

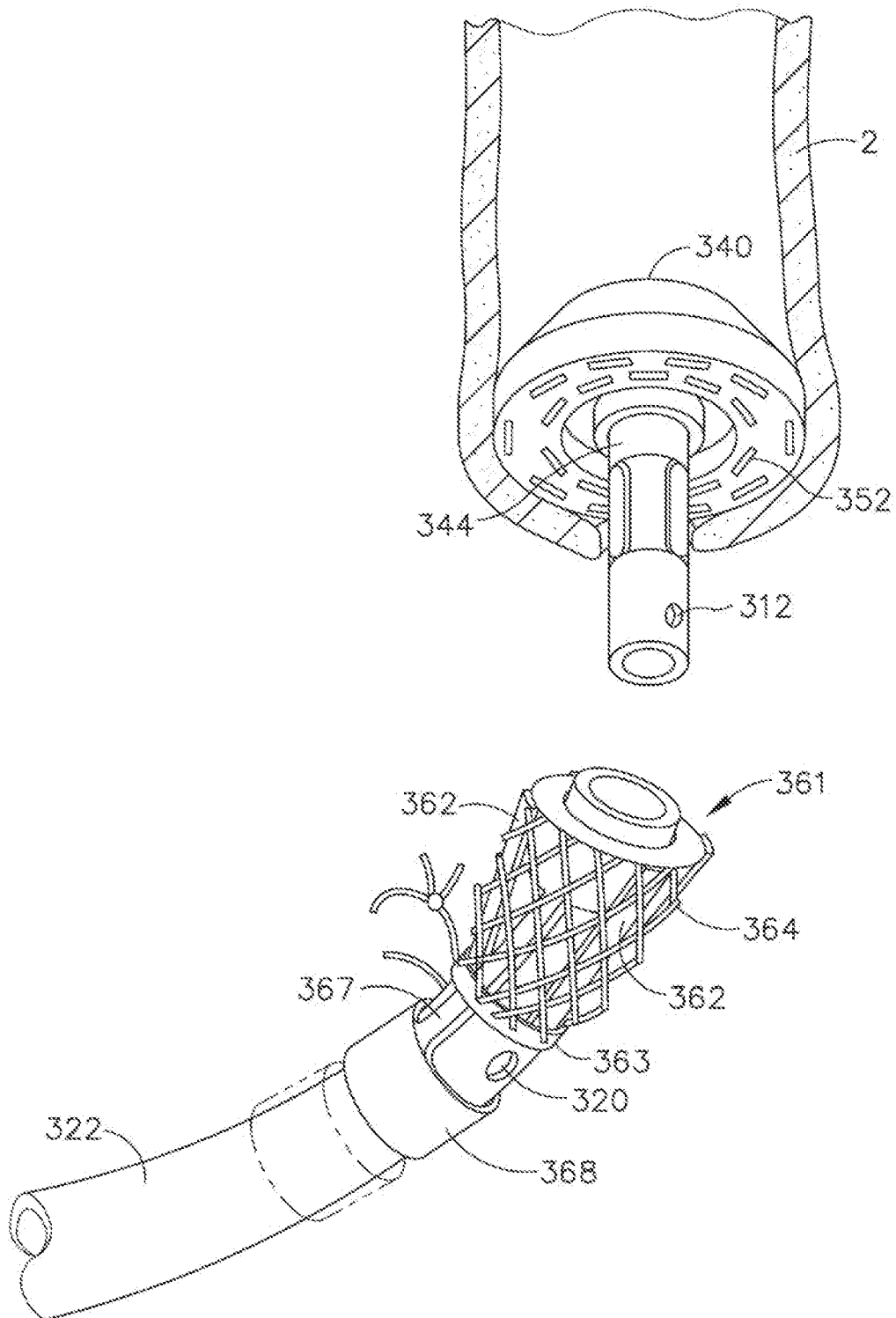

Fig.17B

17/21

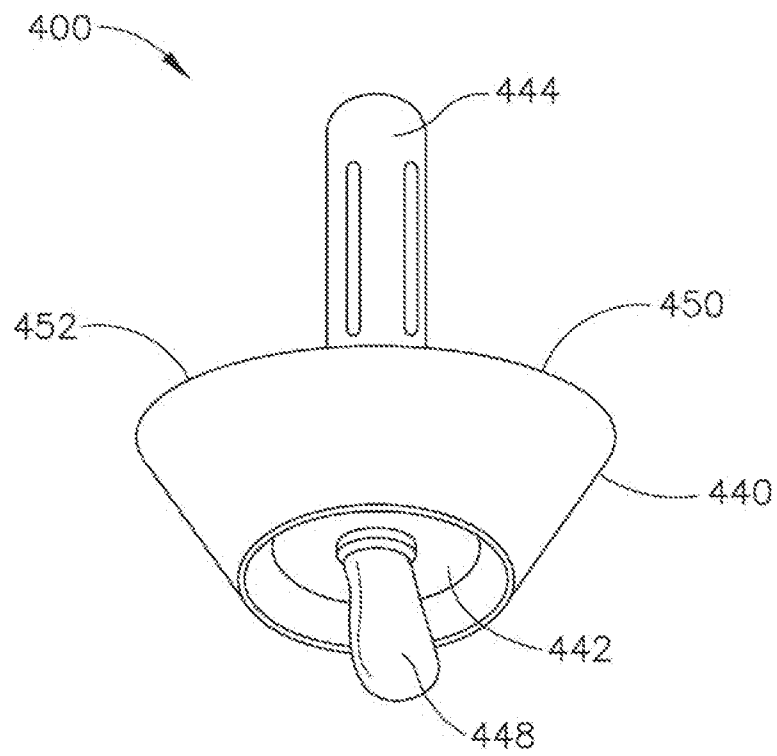

Fig. 18

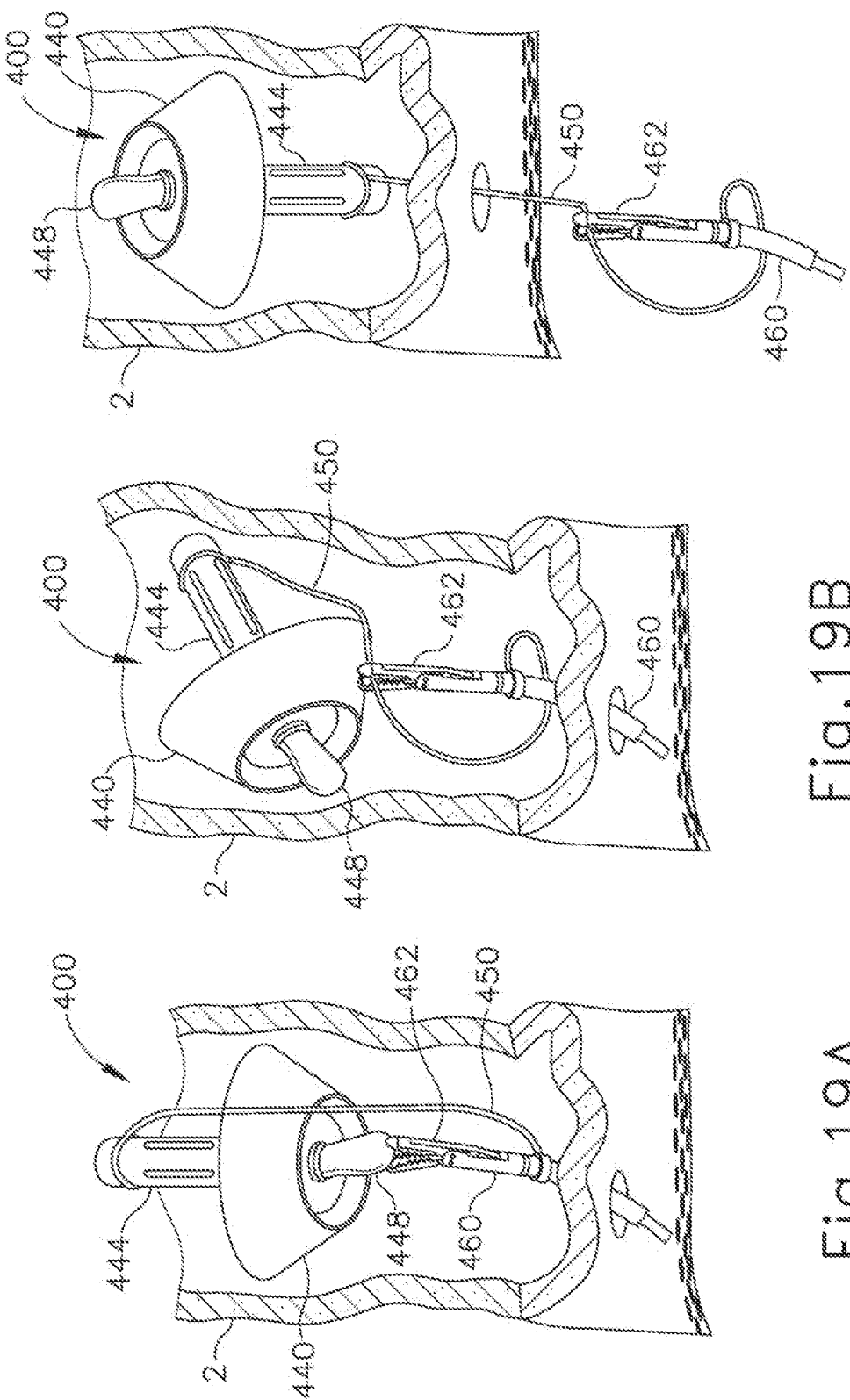

Fig.19C

Fig.19B

Fig.19A

19/21

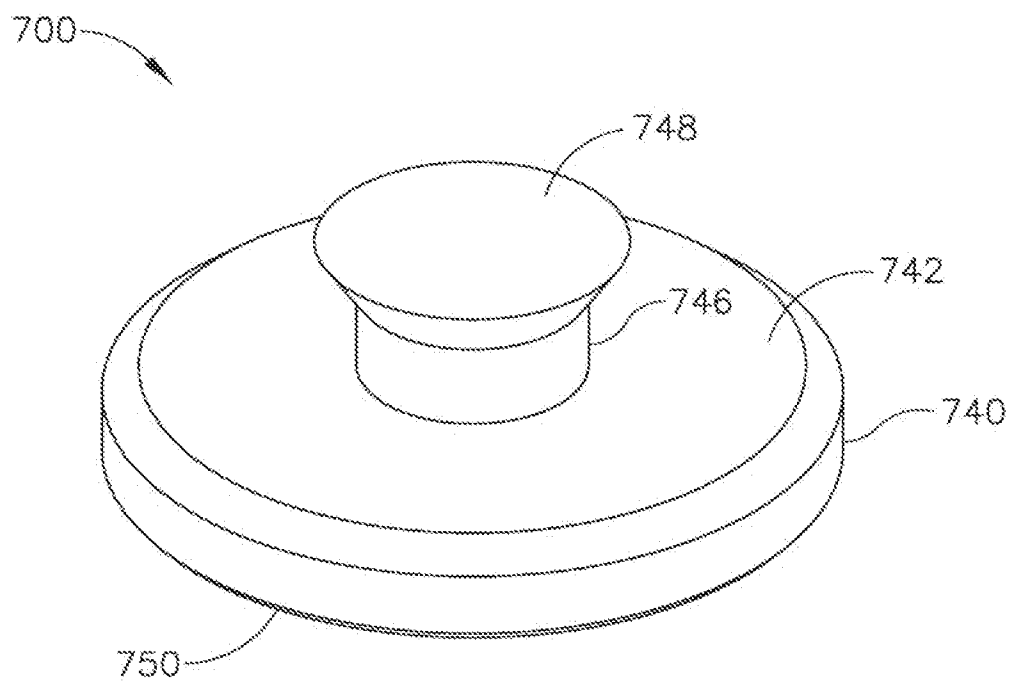

Fig.20

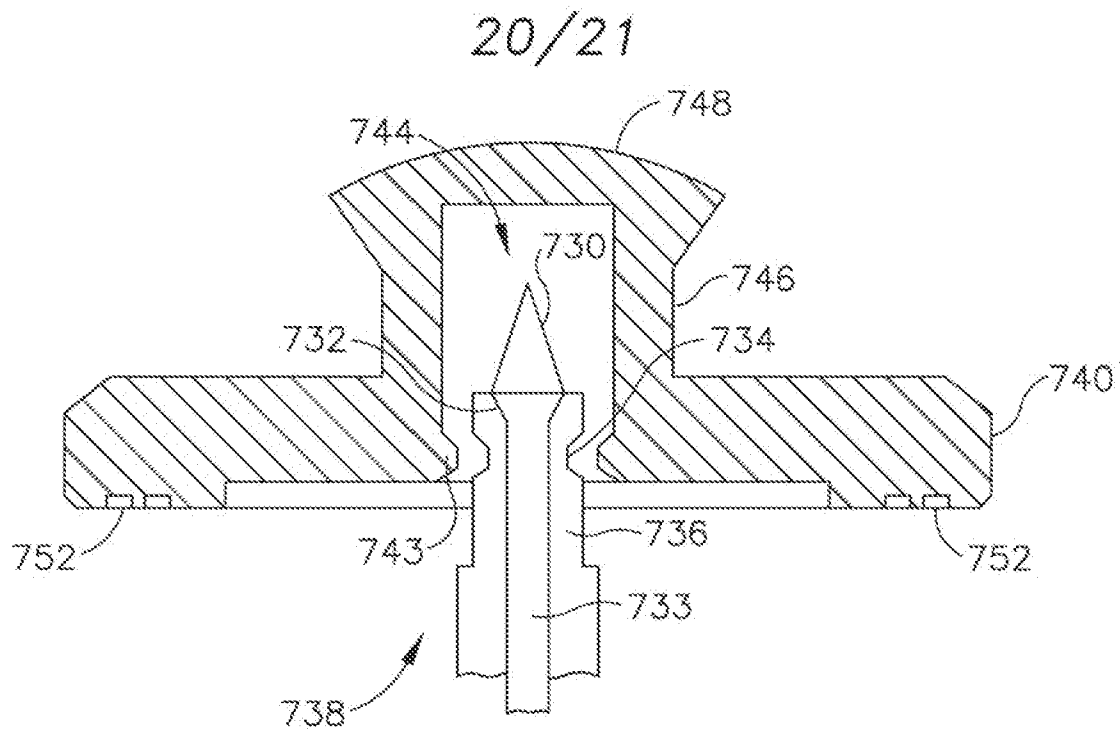

Fig.21A

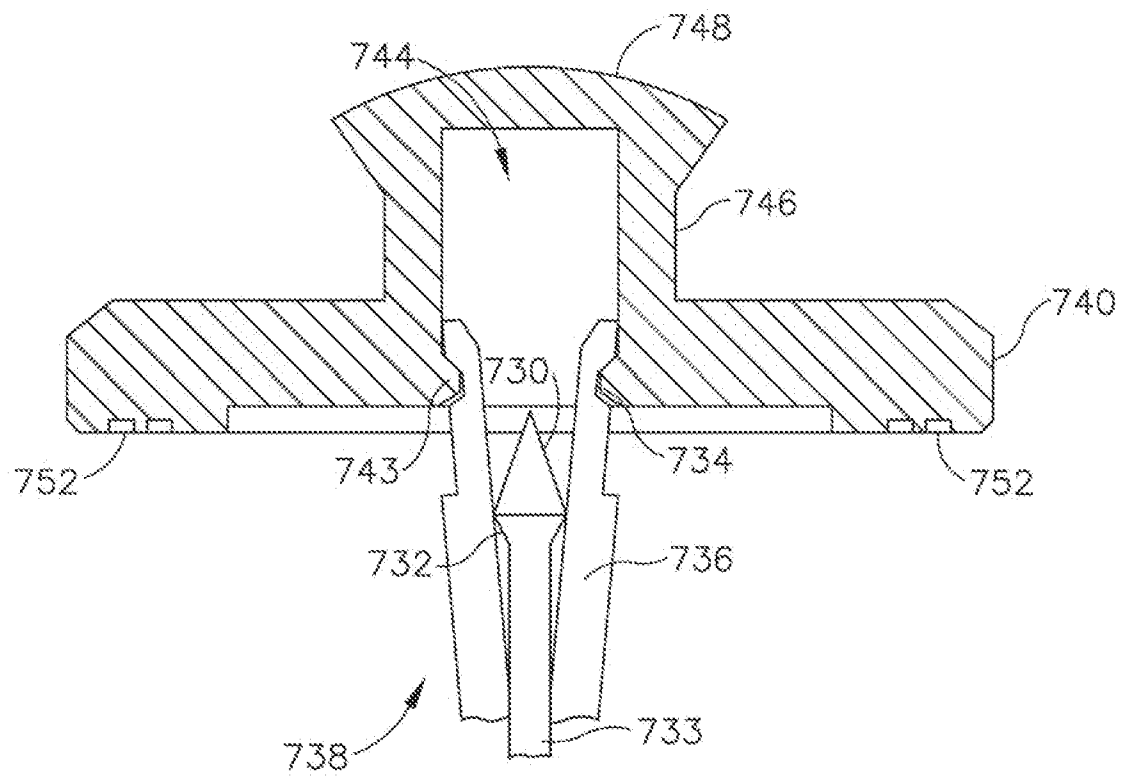

Fig.21B

21/21

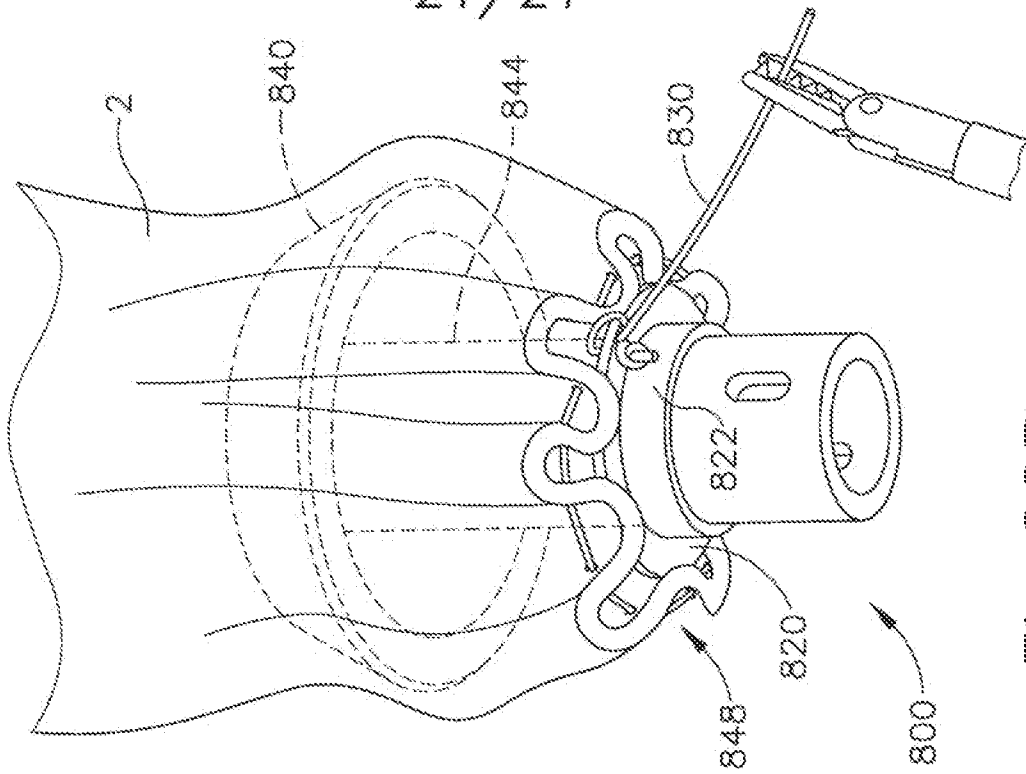

Fig. 22B

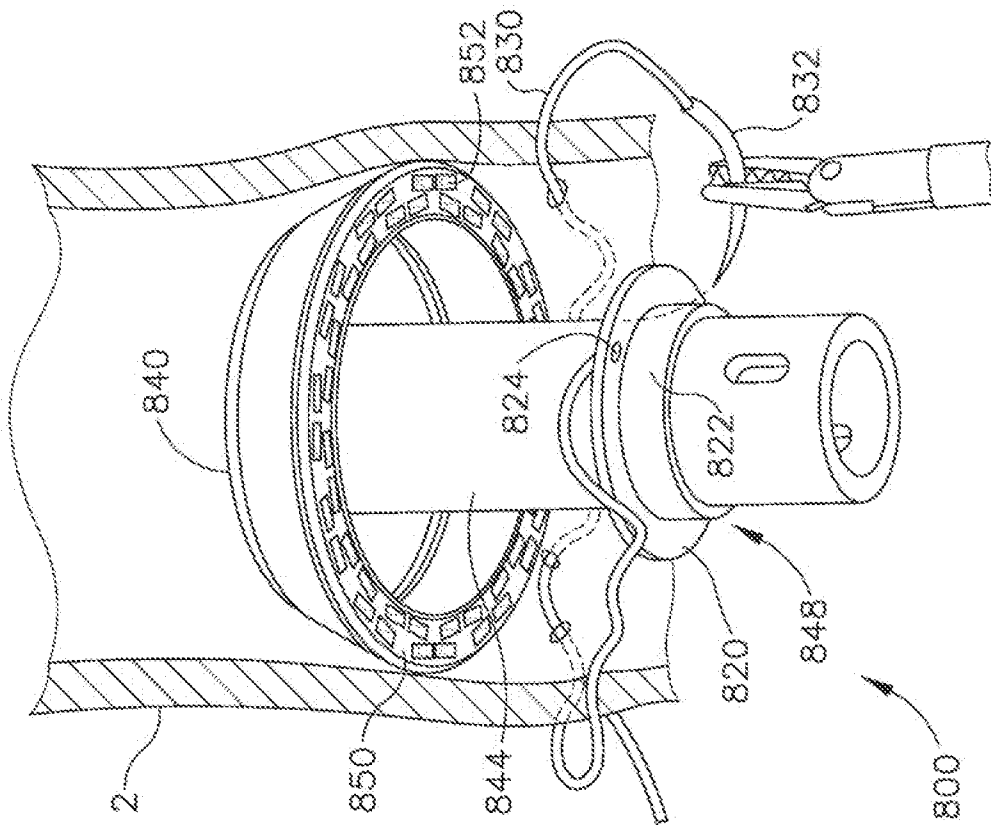

Fig. 22A

INTERNATIONAL SEARCH REPORT

International application No

PCT/US2013/073097

A. CLASSIFICATION OF SUBJECT MATTER

INV. A61B17/11 A61B17/115
ADD.

According to International Patent Classification (IPC) or to both national classification and IPC

B. FIELDS SEARCHED

Minimum documentation searched (classification system followed by classification symbols)

A61B

Documentation searched other than minimum documentation to the extent that such documents are included in the fields searched

Electronic data base consulted during the international search (name of data base and, where practicable, search terms used)

EPO-Internal, WPI Data

C. DOCUMENTS CONSIDERED TO BE RELEVANT

Category*	Citation of document, with indication, where appropriate, of the relevant passages	Relevant to claim No.
X	WO 2008/089404 A2 (SYNOVIS LIFE TECHNOLOGIES INC [US]; KUESTER WILLIAM F [US]) 24 July 2008 (2008-07-24)	1-4,7,8, 12-14
A	figure 2 page 1, lines 11-15 page 2, lines 15-25 page 5, lines 3-14 page 8, lines 9,32-33	9-11,15
X	WO 01/66020 A2 (US SURGICAL [US]; NOLAN TIM [US]; ARANYI ERNIE [US]; KLINGER JOHN [US]) 13 September 2001 (2001-09-13)	1-8,12, 13
A	figures 1,2,4,5,8 page 10, paragraph 3 page 9, line 5 - page 10, line 1 page 10, line 3 page 11, line 2	9-11,15
	----- -/--	



Further documents are listed in the continuation of Box C.



See patent family annex.

* Special categories of cited documents :

"A" document defining the general state of the art which is not considered to be of particular relevance

"E" earlier application or patent but published on or after the international filing date

"L" document which may throw doubts on priority claim(s) or which is cited to establish the publication date of another citation or other special reason (as specified)

"O" document referring to an oral disclosure, use, exhibition or other means

"P" document published prior to the international filing date but later than the priority date claimed

"T" later document published after the international filing date or priority date and not in conflict with the application but cited to understand the principle or theory underlying the invention

"X" document of particular relevance; the claimed invention cannot be considered novel or cannot be considered to involve an inventive step when the document is taken alone

"Y" document of particular relevance; the claimed invention cannot be considered to involve an inventive step when the document is combined with one or more other such documents, such combination being obvious to a person skilled in the art

"&" document member of the same patent family

Date of the actual completion of the international search

23 April 2014

Date of mailing of the international search report

06/05/2014

Name and mailing address of the ISA/

European Patent Office, P.B. 5818 Patentlaan 2
NL - 2280 HV Rijswijk
Tel. (+31-70) 340-2040,
Fax: (+31-70) 340-3016

Authorized officer

Erbel, Stephan

INTERNATIONAL SEARCH REPORT

International application No

PCT/US2013/073097

C(Continuation). DOCUMENTS CONSIDERED TO BE RELEVANT		
Category*	Citation of document, with indication, where appropriate, of the relevant passages	Relevant to claim No.
A	US 4 817 847 A (REDTENBACHER MICHAEL [AT] ET AL) 4 April 1989 (1989-04-04) figures 1-12 abstract column 7, line 43 -----	1-15
X	GB 2 038 692 A (UNITED STATES SURGICAL CORP) 30 July 1980 (1980-07-30) figures 1,34 -----	16,18
A		17
X	DE 87 14 082 U1 (UNITED STATES SURGICAL CORPORATION) 18 February 1988 (1988-02-18) figures 1-4 -----	16,18
A		17

INTERNATIONAL SEARCH REPORT

International application No.
PCT/US2013/073097

Box No. II Observations where certain claims were found unsearchable (Continuation of item 2 of first sheet)

This international search report has not been established in respect of certain claims under Article 17(2)(a) for the following reasons:

1. ☒ Claims Nos.: 19, 20
because they relate to subject matter not required to be searched by this Authority, namely:
see FURTHER INFORMATION sheet PCT/ISA/210
2. ☐ Claims Nos.:
because they relate to parts of the international application that do not comply with the prescribed requirements to such an extent that no meaningful international search can be carried out, specifically:
3. ☐ Claims Nos.:
because they are dependent claims and are not drafted in accordance with the second and third sentences of Rule 6.4(a).

Box No. III Observations where unity of invention is lacking (Continuation of item 3 of first sheet)

This International Searching Authority found multiple inventions in this international application, as follows:

see additional sheet

1. ☒ As all required additional search fees were timely paid by the applicant, this international search report covers all searchable claims.
2. ☐ As all searchable claims could be searched without effort justifying an additional fees, this Authority did not invite payment of additional fees.
3. ☐ As only some of the required additional search fees were timely paid by the applicant, this international search report covers only those claims for which fees were paid, specifically claims Nos.:
4. ☐ No required additional search fees were timely paid by the applicant. Consequently, this international search report is restricted to the invention first mentioned in the claims; it is covered by claims Nos.:

Remark on Protest

- ☐ The additional search fees were accompanied by the applicant's protest and, where applicable, the payment of a protest fee.
- ☐ The additional search fees were accompanied by the applicant's protest but the applicable protest fee was not paid within the time limit specified in the invitation.
- ☒ No protest accompanied the payment of additional search fees.

FURTHER INFORMATION CONTINUED FROM PCT/ISA/ 210

This International Searching Authority found multiple (groups of) inventions in this international application, as follows:

1. claims: 1-15

An apparatus for stapling tissue, directed at a dilation feature to partially cover the anvil.

2. claims: 16-18

An apparatus for stapling tissue, directed at an anvil grasping feature located on the anvil.

FURTHER INFORMATION CONTINUED FROM PCT/ISA/ 210

Continuation of Box II.1

Claims Nos.: 19, 20

Rule 39.1(iv) PCT - Method for treatment of the human or animal body by surgery

Claims 19 and 20 relate to a method for treating the human body by surgery. According to Rule 39.1 (iv) PCT the international search authority is not required to search subject matter falling under this category.

INTERNATIONAL SEARCH REPORT

Information on patent family members

International application No

PCT/US2013/073097

Patent document cited in search report	Publication date	Patent family member(s)	Publication date
WO 2008089404	A2	24-07-2008	NONE
WO 0166020	A2	13-09-2001	AU 4729201 A 17-09-2001
		AU 2001247292 B2 06-04-2006	
		CA 2402313 A1 13-09-2001	
		CA 2646518 A1 13-09-2001	
		CA 2718633 A1 13-09-2001	
		EP 1416861 A2 12-05-2004	
		ES 2316441 T3 16-04-2009	
		JP 4675538 B2 27-04-2011	
		JP 5215371 B2 19-06-2013	
		JP 2004515258 A 27-05-2004	
		JP 2011067662 A 07-04-2011	
		US 2004087977 A1 06-05-2004	
		WO 0166020 A2 13-09-2001	
US 4817847	A	04-04-1989	AT 96633 T 15-11-1993
		AU 6680790 A 14-02-1991	
		AU 7286587 A 24-11-1987	
		DE 3788037 D1 09-12-1993	
		EP 0267202 A1 18-05-1988	
		FI 875584 A 18-12-1987	
		JP H01500966 A 06-04-1989	
		US 4817847 A 04-04-1989	
		WO 8706448 A1 05-11-1987	
GB 2038692	A	30-07-1980	CA 1136020 A1 23-11-1982
		DE 2947107 A1 26-06-1980	
		FR 2443239 A1 04-07-1980	
		GB 2038692 A 30-07-1980	
		IT 1193867 B 31-08-1988	
		JP S5757135 B2 03-12-1982	
		JP S55108347 A 20-08-1980	
DE 8714082	U1	18-02-1988	NONE