

(12) INTERNATIONAL APPLICATION PUBLISHED UNDER THE PATENT COOPERATION TREATY (PCT)

(19) World Intellectual Property  
Organization  
International Bureau



(10) International Publication Number  
**WO 2020/168415 A1**

(43) International Publication Date  
27 August 2020 (27.08.2020)

(51) International Patent Classification:

A47L 9/28 (2006.01) A47L 5/28 (2006.01)  
A47L 5/24 (2006.01)

(21) International Application Number:

PCT/CA2020/050158

(22) International Filing Date:

07 February 2020 (07.02.2020)

(25) Filing Language:

English

(26) Publication Language:

English

(30) Priority Data:

16/280,930	20 February 2019 (20.02.2019)	US
16/280,951	20 February 2019 (20.02.2019)	US
16/280,978	20 February 2019 (20.02.2019)	US
16/281,023	20 February 2019 (20.02.2019)	US

(63) Related by continuation (CON) or continuation-in-part (CIP) to earlier applications:

US	16/280,930 (CON)
Filed on	20 February 2019 (20.02.2019)
US	16/280,951 (CON)
Filed on	20 February 2019 (20.02.2019)
US	16/280,978 (CON)
Filed on	20 February 2019 (20.02.2019)
US	16/281,023 (CON)
Filed on	20 February 2019 (20.02.2019)

(71) Applicant: **OMACHRON INTELLECTUAL PROPERTY INC.** [CA/CA]; 9 King Lane, Hampton, Ontario L0B 1J0 (CA).

(72) Inventor: **CONRAD, Wayne Ernest**; 9 King Lane, Hampton, Ontario L0B 1J0 (CA).

(54) Title: SURFACE CLEANING APPARATUS HAVING AN ENERGY STORAGE MEMBER AND A CHARGER FOR AN ENERGY STORAGE MEMBER

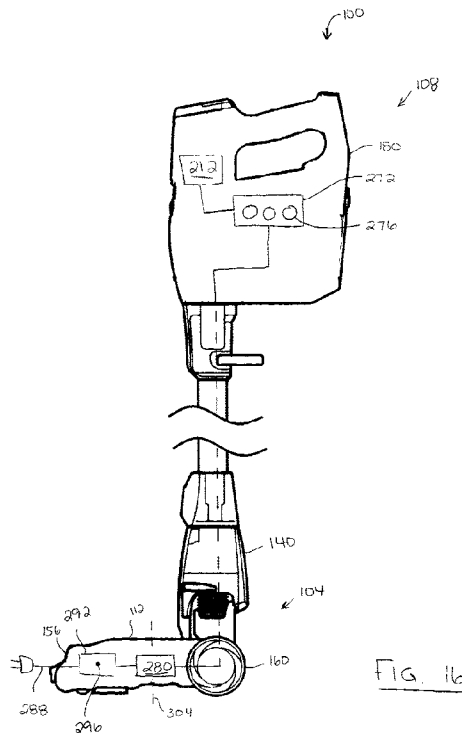

FIG. 16

(57) Abstract: A surface cleaning apparatus includes a floor cleaning unit and a portable surface cleaning unit. The floor cleaning unit includes a surface cleaning head, an upper section moveably mounted to the surface cleaning head between an upright storage position and a rearwardly inclined floor cleaning position, a charger having an energy storage member, and an air flow path extending from the dirty air inlet to a floor cleaning unit air outlet. The portable surface cleaning unit is connectable to the floor cleaning unit, and includes a portable surface cleaning unit air inlet connectable in air flow communication with the floor cleaning unit air outlet, a main body, an air treatment member, a suction motor, a handle and a capacitor. When fully charged, the energy storage member stores sufficient stored power to recharge the capacitor at least twice.



WO 2020/168415 A1

(74) **Agent: BERESKIN & PARR LLP/S.E.N.C.R.L., S.R.L.:**  
Scotia Plaza, 40 King Street West, 40th Floor, Toronto, Ontario M5H 3Y2 (CA).

(81) **Designated States** (*unless otherwise indicated, for every kind of national protection available*): AE, AG, AL, AM, AO, AT, AU, AZ, BA, BB, BG, BH, BN, BR, BW, BY, BZ, CA, CH, CL, CN, CO, CR, CU, CZ, DE, DJ, DK, DM, DO, DZ, EC, EE, EG, ES, FI, GB, GD, GE, GH, GM, GT, HN, HR, HU, ID, IL, IN, IR, IS, JO, JP, KE, KG, KH, KN, KP, KR, KW, KZ, LA, LC, LK, LR, LS, LU, LY, MA, MD, ME, MG, MK, MN, MW, MX, MY, MZ, NA, NG, NI, NO, NZ, OM, PA, PE, PG, PH, PL, PT, QA, RO, RS, RU, RW, SA, SC, SD, SE, SG, SK, SL, ST, SV, SY, TH, TJ, TM, TN, TR, TT, TZ, UA, UG, US, UZ, VC, VN, WS, ZA, ZM, ZW.

(84) **Designated States** (*unless otherwise indicated, for every kind of regional protection available*): ARIPO (BW, GH, GM, KE, LR, LS, MW, MZ, NA, RW, SD, SL, ST, SZ, TZ, UG, ZM, ZW), Eurasian (AM, AZ, BY, KG, KZ, RU, TJ, TM), European (AL, AT, BE, BG, CH, CY, CZ, DE, DK, EE, ES, FI, FR, GB, GR, HR, HU, IE, IS, IT, LT, LU, LV, MC, MK, MT, NL, NO, PL, PT, RO, RS, SE, SI, SK, SM, TR), OAPI (BF, BJ, CF, CG, CI, CM, GA, GN, GQ, GW, KM, ML, MR, NE, SN, TD, TG).

**Published:**

- with international search report (Art. 21(3))
- in black and white; the international application as filed contained color or greyscale and is available for download from PATENTSCOPE

## **SURFACE CLEANING APPARATUS HAVING AN ENERGY STORAGE MEMBER AND A CHARGER FOR AN ENERGY STORAGE MEMBER**

### **FIELD**

[0001] This application relates to the field of surface cleaning apparatus operable on an energy storage member, chargers for an energy storage member and a surface cleaning apparatus having an on board charger for an energy storage member.

### **INTRODUCTION**

[0002] The following is not an admission that anything discussed below is part of the prior art or part of the common general knowledge of a person skilled in the art.

[0003] Various types of surface cleaning apparatus are known, including upright surface cleaning apparatus, canister surface cleaning apparatus, stick surface cleaning apparatus, central vacuum systems, and hand carryable surface cleaning apparatus such as hand vacuums. Further, various designs for cyclonic hand vacuum cleaners, including battery operated cyclonic hand vacuum cleaners, are known in the art.

[0004] Battery operated vacuum cleaners are known. For Example, Best (US 7,377,007) discloses an upright vacuum cleaner having a detachable vacuum module wherein the detachable vacuum module may have an on board battery. A charger may be provided in the surface cleaning head or the detachable vacuum module. Accordingly, when the on board battery requires recharging, the on board charger may be used to recharge the battery. Alternately, the battery charger may be provided in a docking station and the battery recharged when the upright vacuum cleaner is placed in the docking station.

### **SUMMARY**

[0005] This summary is intended to introduce the reader to the more detailed description that follows and not to limit or define any claimed or as yet unclaimed invention. One or more inventions may reside in any combination or sub-combination of the elements or process steps disclosed in any part of this document including its claims and figures.

[0006] In accordance with a first aspect, which may be used by itself or with any one or more other aspects set out herein, an energy storage member charger, such as a battery charger, may have its own on board energy storage member. Accordingly, when another energy storage member that is external to the charger (e.g., an energy storage member for a surface cleaning apparatus) needs charging, the energy storage member in the charger may be used to charge the energy storage member of the surface cleaning apparatus by itself or concurrently with power drawn, e.g., from a stationary source of power such as a household electrical outlet. The energy storage member of the energy storage member charger may hold sufficient charge to charge the external energy storage member at least twice and optionally 3, 4, 5, 6 or more times. Using a charger having an on board energy storage member, a user may be able to recharge an energy storage member of a surface cleaning apparatus at a rate of 2C, 3C, 4C, 5C, 6C or more.

[0007] In a particular embodiment of this aspect, the energy storage member of the portable surface cleaning apparatus comprises or consists of one or more capacitors such as an ultra-capacitor.

[0008] An advantage of this design is that a user may be able to clean an entire household without any breaks or with fewer and/or shorter breaks. For example, current domestic upright or stick type vacuum cleaners may need 6 – 8 or more hours to fully recharge a battery pack. Accordingly, once a battery pack is depleted, a user may have to wait overnight to finish cleaning a household. In contrast, in accordance with this design, a surface cleaning apparatus comprises a floor cleaning module and a portable surface cleaning unit (e.g., a lift away module or a hand vac) that has an on board energy storage member. A user may use the portable surface cleaning unit to clean part of a household (e.g., furniture). Once that part is cleaned or when the on board energy storage member is depleted, the portable surface cleaning unit may be mounted on the floor cleaning unit. The floor cleaning unit may then be operated on power drawn from a household electrical outlet (e.g., the surface cleaning apparatus may have an electric cord). While the user is cleaning the floor, the energy storage member of the portable surface cleaning unit may be recharged in, e.g., 1 – 15 minutes, 2 - 12 minutes, 3 – 10 minutes 4 – 7 minutes, about 5 minutes or any desired time frame less than 15 minutes. Accordingly, by the time a user needs to again use the portable surface

cleaning unit, the energy storage member of the portable surface cleaning unit may be fully charged. Accordingly, this aspect allows a user to continuously use the surface cleaning apparatus in a floor cleaning and an above floor cleaning mode.

[0009] In accordance with this aspect, there is provide a surface cleaning apparatus comprising:

- (a) a floor cleaning unit comprising:
  - (i) a surface cleaning head having a front end having a dirty air inlet, a rear end and a center positioned midway between the front and rear ends;
  - (ii) an upper section moveably mounted to the surface cleaning head between an upright storage position and a rearwardly inclined floor cleaning position;
  - (iii) a charger having an energy storage member; and,
  - (iv) an air flow path extending from the dirty air inlet to a floor cleaning unit air outlet; and,
- (b) a portable surface cleaning unit connectable to the floor cleaning unit, the portable surface cleaning unit comprising a portable surface cleaning unit air inlet connectable in air flow communication with the floor cleaning unit air outlet, a main body, an air treatment member, a suction motor, a handle and a capacitor,

wherein, when fully charged, the energy storage member stores sufficient stored power to recharge the capacitor at least twice.

[0010] In any embodiment, the suction motor may not be operable directly on power supplied by the energy storage member.

[0011] In any embodiment, the suction motor may be operable only from:

- (a) power supplied from the capacitor, or
- (b) the surface cleaning apparatus may further comprise an electrical cord connectable with a stationary source of power and the suction motor is operable from power supplied from the capacitor and power supplied from a stationary power supply.

[0012] In any embodiment, the energy storage member may be provided in the surface cleaning head and, optionally, in a forward portion of the surface cleaning head (e.g., at a location forward of the portable surface cleaning unit such as adjacent the dirty air inlet).

[0013] In any embodiment, the energy storage member may have a center of gravity and the center of gravity may be positioned forward of the center of the surface cleaning head.

[0014] In any embodiment, the floor cleaning unit may further comprise a thermal cooling unit thermally connected to the charger.

[0015] In any embodiment, the charger may be operable to recharge the capacitor at a rate of at least 4C or at least 6C.

[0016] In any embodiment, the capacitor may comprise an ultra-capacitor.

[0017] In any embodiment, the surface cleaning apparatus may further comprise an electrical cord connectable with a stationary source of power.

[0018] In any embodiment, the portable cleaning unit may further comprise an electrical cord connectable with a stationary source of power. The electrical cord may be removably connectable with the portable cleaning unit.

[0019] In any embodiment, the capacitor may be removably mounted in the portable surface cleaning unit.

[0020] In any embodiment, the portable surface cleaning unit may comprise a hand vacuum cleaner and the upper section may comprise a rigid air flow conduit having an upper end and a lower end,

wherein the lower end of the rigid air flow conduit is moveably mounted to the surface cleaning head between the upright storage position and the rearwardly inclined floor cleaning position, and

wherein the hand vacuum cleaner is connectable to the upper end of the rigid air flow conduit,

whereby, when the hand vacuum cleaner is connected to the upper end of the rigid air flow conduit the handle is a steering handle for the vacuum cleaner.

[0021] In accordance with another aspect, which may be used by itself or with any one or more other aspects set out herein, a surface cleaning apparatus comprises a floor cleaning module and a portable surface cleaning unit that has an on board energy storage member that optionally comprises or consists of one or more capacitors such as an ultra-capacitor. The surface cleaning head is provided with a charger whereby the on board energy storage member may be charged at a rate of 2C, 3C, 4C, 5C, 6C or more. As discussed previously, an advantage of this aspect is that a user may be able to continuously, or more continuously clean a household without downtime while an on board energy storage member is recharged.

[0022] In accordance with this aspect, there is provided a vacuum cleaner comprising:

- (a) a floor cleaning unit comprising:
  - (i) a surface cleaning head having a front end having a dirty air inlet, a rear end, a center positioned midway between the front and rear ends and a charger;
  - (ii) an upper section moveably mounted to the surface cleaning head between an upright storage position and a rearwardly inclined floor cleaning position; and,
  - (iii) an air flow path extending from the dirty air inlet to a floor cleaning unit air outlet; and,
- (b) a portable surface cleaning unit removably mounted to the upper section, the portable surface cleaning unit comprising a main body, an air treatment member, a suction motor, a handle and a capacitor, wherein, the portable surface cleaning unit is rechargeable when mounted to the floor cleaning unit and, wherein the capacitor is rechargeable at a rate of at least 4C.

[0023] In any embodiment, the suction motor may be operable only from:

- (a) power supplied from the capacitor, or
- (b) the surface cleaning apparatus may further comprise an electrical cord connectable with a stationary source of power and the suction motor is

operable from power supplied from the capacitor and power supplied from a stationary power supply.

In any embodiment, the energy storage member may have a center of gravity and the center of gravity is positioned forward of the center of the surface cleaning head. The center of gravity may be positioned at the front end of the surface cleaning head.

[0024] In any embodiment, the capacitor may comprise an ultra-capacitor.

[0025] In any embodiment, the portable surface cleaning unit may comprise a hand vacuum cleaner and the upper section may comprise a rigid air flow conduit having an upper end and a lower end,

wherein the lower end of the rigid air flow conduit is moveably mounted to the surface cleaning head between the upright storage position and the rearwardly inclined floor cleaning position, and

wherein the hand vacuum cleaner is connectable to the upper end of the rigid air flow conduit,

whereby, when the hand vacuum cleaner is connected to the upper end of the rigid air flow conduit the handle is a steering handle for the vacuum cleaner.

[0026] In any embodiment, the portable cleaning unit may further comprise an electrical cord connectable with a stationary source of power.

[0027] In any embodiment, the energy storage member may store sufficient stored power to recharge the capacitor at least twice.

[0028] In any embodiment, the floor cleaning unit may further comprise a thermal cooling unit thermally connected to the charger.

[0029] In accordance with this aspect, there is also provided a vacuum cleaner comprising:

(a) a floor cleaning unit comprising:

- (i) a surface cleaning head having a front end having a dirty air inlet, a rear end, a center positioned midway between the front and rear ends and a charger;

- (ii) an upper section moveably mounted to the surface cleaning head between an upright storage position and a rearwardly inclined floor cleaning position; and,
  - (iii) an air flow path extending from the dirty air inlet to a floor cleaning unit air outlet; and,
- (b) a portable surface cleaning unit removably mounted to the upper section, the portable surface cleaning unit comprising a main body, an air treatment member, a suction motor, a handle and a capacitor, wherein, the portable surface cleaning unit is rechargeable when mounted to the floor cleaning unit, and wherein the energy storage member has a center of gravity and the center of gravity is positioned forward of the center of the surface cleaning head.

[0030] In any embodiment, the suction motor may be operable only from:

- (c) power supplied from the capacitor, or
- (d) the surface cleaning apparatus may further comprise an electrical cord connectable with a stationary source of power and the suction motor is operable from power supplied from the capacitor and power supplied from a stationary power supply.

[0031] In any embodiment, the center of gravity may be positioned at the front end of the surface cleaning head.

[0032] In any embodiment, the capacitor may comprise an ultra-capacitor.

[0033] In any embodiment, the portable surface cleaning unit may comprise a hand vacuum cleaner and the upper section may comprise a rigid air flow conduit having an upper end and a lower end,

wherein the lower end of the rigid air flow conduit is moveably mounted to the surface cleaning head between the upright storage position and the rearwardly inclined floor cleaning position, and

wherein the hand vacuum cleaner is connectable to the upper end of the rigid air flow conduit,

whereby, when the hand vacuum cleaner is connected to the upper end of the rigid air flow conduit the handle is a steering handle for the vacuum cleaner.

In such a surface cleaning apparatus, the portable cleaning unit may further comprise an electrical cord connectable with a stationary source of power. The suction motor may be operable only from:

- (a) power supplied from the capacitor, or
- (b) the surface cleaning apparatus may further comprise an electrical cord connectable with a stationary source of power and the suction motor is operable from power supplied from the capacitor and power supplied from a stationary power supply.

[0034] In any embodiment, the energy storage member may store sufficient stored power to recharge the capacitor at least twice or at least three times.

[0035] In any embodiment, the floor cleaning unit may further comprise a thermal cooling unit thermally connected to the charger.

[0036] In accordance with another aspect, which may be used by itself or with any one or more other aspects set out herein, the charger may be remote from the surface cleaning apparatus. An advantage of this design is that the surface cleaning apparatus may be lighter. This may be preferred for the elderly or those with a physical disability. In particular, such a design may be used for embodiments wherein the charger includes a thermal cooling member.

[0037] In accordance with this aspect, there is provided a surface cleaning apparatus kit comprising:

- (a) a surface cleaning apparatus comprising:
  - (i) floor cleaning unit comprising a surface cleaning head and a rigid air flow conduit having an upper end and a lower end moveably mounted to the surface cleaning head between an upright storage position and a rearwardly inclined floor cleaning position; and,
  - (ii) a portable surface cleaning unit removably mounted to the rigid air flow conduit, the portable surface cleaning unit comprising a main

body, an air treatment member, a suction motor, a handle and a capacitor; and,

- (b) a charger positionable remote from the surface cleaning apparatus and electrically connectable to a stationary power supply, wherein, when the capacitor is electrically connected to the charger, the capacitor is recharged at a rate of at least 4C.

[0038] In any embodiment, the capacitor may comprise an ultra-capacitor.

[0039] In any embodiment, the charger may be operable to recharge the capacitor at a rate of at least 6C.

[0040] In any embodiment, the surface cleaning apparatus kit may further comprise a thermal cooling unit thermally connected to the charger.

[0041] In any embodiment, the capacitor may be removably mounted to the portable surface cleaning unit.

[0042] In any embodiment, the portable cleaning unit may further comprise an electrical cord connectable with a stationary source of power.

[0043] In any embodiment, the electrical cord may be removably connectable with the portable surface cleaning unit.

[0044] In any embodiment, the portable cleaning unit may further comprise an electrical cord connectable with the charger. The electrical cord may be removably connectable with the portable surface cleaning unit.

[0045] In accordance with this aspect, there is also provided a surface cleaning apparatus kit comprising:

(a) a surface cleaning apparatus comprising:

- (i) floor cleaning unit comprising a surface cleaning head and a rigid air flow conduit having an upper end and a lower end moveably mounted to the surface cleaning head between an upright storage position and a rearwardly inclined floor cleaning position; and,
- (ii) a portable surface cleaning unit removably mounted to the rigid air flow conduit, the portable surface cleaning unit comprising a main

body, an air treatment member, a suction motor, a handle and a capacitor;

- (b) a charger positionable remote from the surface cleaning apparatus and electrically connectable to a stationary power supply; and,
- (c) a thermal cooling unit thermally connected to the charger.

[0046] In any embodiment, the capacitor may comprise an ultra-capacitor.

[0047] In any embodiment, the charger may be operable to recharge the capacitor at a rate of at least 6C.

[0048] In any embodiment, the thermal cooling unit may comprise a liquid heat sink.

[0049] In any embodiment, the capacitor may be removably mounted to the portable surface cleaning unit.

[0050] In any embodiment, the portable cleaning unit may further comprise an electrical cord connectable with a stationary source of power. The electrical cord may be removably connectable with the portable surface cleaning unit.

[0051] In any embodiment, the portable cleaning unit may further comprise an electrical cord connectable with the charger. The electrical cord may be removably connectable with the portable surface cleaning unit.

[0052] As discussed with respect to previous aspects, a user may be able to clean continuously or more continuously using any of the aspects set out herein. Accordingly, there is provided a method of cleaning a surface using a stick vacuum cleaner, the stick vacuum cleaner comprising:

- (a) a floor cleaning unit comprising:
  - (i) a surface cleaning head having a front end having a dirty air inlet and a rear end;
  - (ii) a rigid air flow conduit having an upper end and a lower end moveably mounted to the surface cleaning head between an upright storage position and a rearwardly inclined floor cleaning position; and,
  - (iii) an air flow path extending from the dirty air inlet to a rigid air flow conduit air outlet; and,

(b) a hand vacuum cleaner removably mounted to the upper end of the rigid air flow conduit, the hand vacuum cleaner comprising a main body, an air treatment member, a suction motor, a handle and a capacitor,

the method comprising:

- (a) removing the hand vacuum cleaner from the upper end of the rigid air flow conduit and using the portable cleaning unit to clean a surface;
- (b) subsequently mounting the hand vacuum cleaner on the upper end of the rigid air flow conduit and using the stick vacuum cleaner to clean a floor for up to 15 minutes while the capacitor at least substantially recharges; and,
- (c) subsequently removing the hand vacuum cleaner from the upper end of the rigid air flow conduit and using the hand vacuum cleaner to clean a surface.

[0053] In any embodiment, step (b) may comprise using the stick vacuum cleaner to clean the floor for up to 5, 6, 7, 8, 9, 12, 11, 12, 13, 14 or 15 minutes while the capacitor substantially or fully recharges.

[0054] In any embodiment, the floor cleaning unit may further comprise a charger having an energy storage member, wherein, when fully charged, the energy storage member stores sufficient stored power to recharge the capacitor at least twice, and step (b) may comprise using the energy storage member to recharge the capacitor.

[0055] There is also provided a method of cleaning a surface using a surface cleaning apparatus, the surface cleaning apparatus comprising:

(a) a floor cleaning unit comprising a surface cleaning head and a rigid air flow conduit having an upper end and a lower end moveably mounted to the surface cleaning head between an upright storage position and a rearwardly inclined floor cleaning position; and,

(b) a portable surface cleaning unit removably mounted to the rigid air flow conduit, the portable surface cleaning unit comprising a main body, an air treatment member, a suction motor, a handle and a capacitor,

the method comprising:

- (a) removing the portable cleaning unit from the floor cleaning unit and using the portable cleaning unit to clean a surface;

- (b) subsequently mounting the portable cleaning unit on the floor cleaning unit and using the surface cleaning apparatus to clean a floor for up to 15 minutes while the capacitor at least substantially recharges; and,
- (c) subsequently removing the portable cleaning unit from the floor cleaning unit and using the portable cleaning unit to clean a surface.

[0056] In any embodiment, step (b) may comprise using the stick vacuum cleaner to clean the floor for up to 5, 6, 7, 8, 9, 10, 11, 12, 13, 14 or 15 minutes while the capacitor substantially or fully recharges.

[0057] In any embodiment, the floor cleaning unit may further comprise a charger having an energy storage member, wherein, when fully charged, the energy storage member stores sufficient stored power to recharge the capacitor at least twice, and step (b) may comprise using the energy storage member to recharge the capacitor.

[0058] The method may be conducted using a stick vacuum cleaner comprising:

- (a) a surface cleaning head;
  - (b) a rigid air flow conduit having an upper end and a lower end moveably mounted to the surface cleaning head between an upright storage position and a rearwardly inclined floor cleaning position; and,
  - (c) a hand vacuum cleaner removably mounted to the upper end of the rigid air flow conduit, the hand vacuum cleaner comprising a main body, an air treatment member, a suction motor, a handle, a capacitor and an electrical cord connectable with a stationary source of power,
- wherein, when the portable surface cleaning unit is mounted to the upper end of the rigid air flow conduit, the handle is a steering handle for the vacuum cleaner.

[0059] In any embodiment, the electrical cord may be removably connectable with the hand vacuum cleaner.

[0060] In any embodiment, the capacitor may be removably mounted to the hand vacuum cleaner.

[0061] In any embodiment, the capacitor may be an ultra-capacitor.

[0062] It will be appreciated that one or more of these aspects may be used with outer household self-powered appliances such as power tools, kitchen appliances, personal appliances and the like.

## **DRAWINGS**

[0063] For a better understanding of the described embodiments and to show more clearly how they may be carried into effect, reference will now be made, by way of example, to the accompanying drawings in which:

[0064] FIG. 1 is a perspective view of a surface cleaning apparatus in accordance with an embodiment;

[0065] FIG. 2 is an exploded view of the surface cleaning apparatus of FIG. 1;

[0066] FIG. 3 is a perspective view of a portable surface cleaning unit of the surface cleaning apparatus of FIG. 1;

[0067] FIG. 4 is a cross-sectional view taken along line 4-4 in FIG. 3;

[0068] FIG. 5 is a perspective view of a surface cleaning apparatus in accordance with another embodiment;

[0069] FIG. 6 is an exploded view of the surface cleaning apparatus of FIG. 5;

[0070] FIG. 7 is a side elevation view of the portable surface cleaning unit of FIG. 3 with an energy storage member removed;

[0071] FIG. 8 is a perspective view of the energy storage member of FIG. 7 and a charger;

[0072] FIG. 9 is a schematic illustration of a surface cleaning apparatus in accordance with an embodiment;

[0073] FIG. 10 is a perspective view of a portable surface cleaning unit connected by a power cable to a stationary power supply, in accordance with an embodiment;

[0074] FIG. 11 is a schematic illustration of a surface cleaning apparatus in accordance with an embodiment;

[0075] FIG. 12 is a perspective view of a portable surface cleaning unit disconnected from a power cable, in accordance with an embodiment;

[0076] FIG. 13 is a perspective view of a surface cleaning apparatus with a floor cleaning unit connected by a power cable to a stationary power supply, in accordance with an embodiment;

[0077] FIG. 14 is a schematic illustration of a surface cleaning apparatus in accordance with an embodiment;

[0078] FIG. 15 is a perspective view of a surface cleaning apparatus with a floor cleaning unit connected by a power cable to a charger, in accordance with an embodiment;

[0079] FIG. 16 is a schematic illustration of a surface cleaning apparatus in accordance with an embodiment;

[0080] FIG. 17 is a schematic illustration of a surface cleaning apparatus in accordance with an embodiment;

[0081] FIGS. 18-20 are schematic illustrations of an energy storage member, a thermal cooling unit, and a charger, in accordance with various embodiments;

[0082] FIG. 21 is a flowchart illustrating a method of cleaning with a surface cleaning apparatus, in accordance with an embodiment;

[0083] FIG. 22 is a schematic illustration of a surface cleaning apparatus in accordance with an embodiment;

[0084] FIG. 23 is a schematic illustration of a surface cleaning apparatus in accordance with an embodiment; and,

[0085] FIG. 24 is a schematic illustration of a surface cleaning apparatus in accordance with an embodiment.

#### **DESCRIPTION OF VARIOUS EMBODIMENTS**

[0086] Numerous embodiments are described in this application, and are presented for illustrative purposes only. The described embodiments are not intended to be limiting in any sense. The invention is widely applicable to numerous embodiments, as is readily apparent from the disclosure herein. Those skilled in the art will recognize that the present invention may be practiced with modification and alteration without departing from the teachings disclosed herein. Although particular features of the present invention may be described with reference to one or more

particular embodiments or figures, it should be understood that such features are not limited to usage in the one or more particular embodiments or figures with reference to which they are described.

[0087] The terms "an embodiment," "embodiment," "embodiments," "the embodiment," "the embodiments," "one or more embodiments," "some embodiments," and "one embodiment" mean "one or more (but not all) embodiments of the present invention(s)," unless expressly specified otherwise.

[0088] The terms "including," "comprising" and variations thereof mean "including but not limited to," unless expressly specified otherwise. A listing of items does not imply that any or all of the items are mutually exclusive, unless expressly specified otherwise. The terms "a," "an" and "the" mean "one or more," unless expressly specified otherwise.

[0089] As used herein and in the claims, two or more parts are said to be "coupled", "connected", "attached", "joined", "affixed", or "fastened" where the parts are joined or operate together either directly or indirectly (i.e., through one or more intermediate parts), so long as a link occurs. As used herein and in the claims, two or more parts are said to be "directly coupled", "directly connected", "directly attached", "directly joined", "directly affixed", or "directly fastened" where the parts are connected in physical contact with each other. As used herein, two or more parts are said to be "rigidly coupled", "rigidly connected", "rigidly attached", "rigidly joined", "rigidly affixed", or "rigidly fastened" where the parts are coupled so as to move as one while maintaining a constant orientation relative to each other. None of the terms "coupled", "connected", "attached", "joined", "affixed", and "fastened" distinguish the manner in which two or more parts are joined together.

[0090] Further, although method steps may be described (in the disclosure and / or in the claims) in a sequential order, such methods may be configured to work in alternate orders. In other words, any sequence or order of steps that may be described does not necessarily indicate a requirement that the steps be performed in that order. The steps of methods described herein may be performed in any order that is practical. Further, some steps may be performed simultaneously.

[0091] Some elements herein may be identified by a part number, which is composed of a base number followed by an alphabetical or subscript-numerical

suffix (e.g. 112a, or 112<sub>1</sub>). Multiple elements herein may be identified by part numbers that share a base number in common and that differ by their suffixes (e.g. 112<sub>1</sub>, 112<sub>2</sub>, and 112<sub>3</sub>). All elements with a common base number may be referred to collectively or generically using the base number without a suffix (e.g. 112).

### **General Description Of A Hand Vacuum Cleaner**

[0092] Referring to FIGS. 1-6, exemplary embodiments of a surface cleaning apparatus are shown generally as 100. The following is a general discussion of apparatus 100 which provides a basis for understanding several of the features which are discussed herein. As discussed subsequently, each of the features may be used individually or in any particular combination or sub-combination in this or in other embodiments disclosed herein.

[0093] Surface cleaning apparatus 100 may be any type of surface cleaning apparatus, including for example a stick vacuum cleaner as shown in FIG. 1, an upright vacuum cleaner as shown in FIG. 5, a canister vacuum cleaner, an extractor or a wet/dry type vacuum cleaner. Optionally, the surface cleaning apparatus 100 may use one or more cyclones and may therefore be a cyclonic surface cleaning apparatus.

[0094] In FIGS. 1-6, surface cleaning apparatus 100 is illustrated as including a floor cleaning unit 104, and a portable surface cleaning unit 108 that is connectable to the floor cleaning unit 104. The floor cleaning unit 104 may include a surface cleaning head 112 adapted to clean floors. Portable surface cleaning unit 108 may include an air treatment member 116. Surface cleaning apparatus 100 may include an upright configuration (also referred to as a 'floor cleaning configuration', see FIGS. 1 and 5) in which portable surface cleaning unit 108 is mounted to floor cleaning unit 104, and dirty air that enters the surface cleaning head 112 flows downstream to portable surface cleaning unit 108 where the dirty air is cleaned by air treatment member 116. Surface cleaning apparatus 100 may also include a 'portable cleaning configuration' (also referred to as a 'hand carryable configuration', or 'above-floor cleaning configuration', see FIGS. 3 and 6), in which portable surface cleaning unit 108 is separated from floor cleaning unit 104, such as to clean above-floor surfaces and surfaces generally inaccessible to or unsuitable for cleaning with surface cleaning head 112 for example.

[0095] In the embodiment of FIGS. 1-4, surface cleaning apparatus 100 is illustrated as a stick vacuum cleaner, which may also be referred to as a “stickvac”. As used herein and in the claims, a stick vacuum cleaner is one in which portable surface cleaning unit 108 is a hand vacuum cleaner, which may also be referred to also as a “handvac” or “hand-held vacuum cleaner”. As used herein and in the claims, a hand vacuum cleaner is a vacuum cleaner that can be operated to clean a surface generally one-handedly. That is, the entire weight of the hand vacuum cleaner may be held by the same one hand used to direct a dirty air inlet of the hand vacuum cleaner with respect to a surface to be cleaned. For example, handle 120 and dirty air inlet 124 may be rigidly coupled to each other (directly or indirectly), such as being integrally formed or separately molded and then non-removably secured together such as by an adhesive or welding, so as to move as one while maintaining a constant orientation relative to each other. This is to be contrasted with canister and upright vacuum cleaners, whose weight is typically supported by a surface (e.g. a floor) during use.

[0096] In the embodiment of FIGS. 5-6, surface cleaning apparatus 100 is illustrated as a convertible upright vacuum, in which portable surface cleaning unit 108 is a ‘lift away’ pod that, in the portable cleaning configuration, can be hand carried by handle 120. As opposed to a hand vacuum cleaner, a lift-away pod typically uses a flexible hose to deliver air for treatment to the air inlet provided in the casing of the lift-away pod. As shown, portable surface cleaning unit 108 may include a dirty air inlet 124 upstream of a flexible hose 128. For example, dirty air inlet 124 may be located at an upstream end of a rigid conduit 132 (e.g. a wand). The user may manipulate rigid conduit 132 to position dirty air inlet 124 on or adjacent a surface (e.g. above-floor surface) to be cleaned. Optionally, rigid conduit 132 may include a handle 136 for the user to grasp while manipulating rigid conduit 132.

[0097] Referring again to FIGS. 1-6, floor cleaning unit 104 may include surface cleaning head 112, an upper section 140, a dirty air inlet 144, an air outlet 148, and an air flow path 152 extending from dirty air inlet 144 to air outlet 148. As shown, surface cleaning head 112 may include a front end 156 opposed to a rear end 160, opposed sides 164 and 168, and a lower end 172 opposed to an upper end 176. Dirty air inlet 144 may be located on lower end 172. For example, dirty air inlet

144 may be provide at front end 156. Alternatively or in addition, dirty air inlet may be provided at rear end 160, or intermediate front and rear ends 156, 160.

[0098] Upper section 140 may be movably mounted to surface cleaning head 112 in a manner that allows upper section 140 to move between an upright storage position (e.g. FIG. 1), and an inclined floor cleaning position (e.g. FIG. 5). For example, upper section 140 may have a rotating connection to surface cleaning head 112 that allows upper section 140 to rotate between the upright storage and inclined floor cleaning positions.

[0099] As shown in FIGS. 1-4, the portable surface cleaning unit 108 is a hand vacuum cleaner and in FIGS. 5-6, the portable surface cleaning unit 108 is a lift-away pod. Accordingly, the description of apparatus 100 and portable surface cleaning unit 108 below makes frequent reference to figures showing embodiments in which portable surface cleaning unit 108 is illustrated as a hand vacuum, similar to FIGS. 1-4. To be clear and concise and avoid duplication, the description may not reference a lift-way pod version which has an appearance similar to the embodiment of FIGS. 5-6. However, it is expressly contemplated, and will be readily understood by persons skilled in the art, that the features described with reference to hand vacuum cleaners similar to the embodiment of FIGS. 1-4 also apply *mutatis mutandis* to embodiments with a lift-away pod similar to FIGS. 5-6, unless expressly stated otherwise.

[00100] Referring to FIGS. 3-4, portable surface cleaning unit 108 includes a main body 180 having an air treatment member 116 (which may be permanently affixed to the main body or may be removable therefrom for emptying), a dirty air inlet 124, a clean air outlet 184, and an air flow path 188 extending between the dirty air inlet 124 and the clean air outlet 184.

[00101] Portable surface cleaning unit 108 has a front end 192, a rear end 196, an upper end (also referred to as the top) 204, and a lower end (also referred to as the bottom) 208. In the embodiment shown, dirty air inlet 124 is at an upper portion of front end 192 and clean air outlet 184 is at rear end 196. It will be appreciated that dirty air inlet 124 and clean air outlet 184 may be positioned in different locations of portable surface cleaning unit 108. For example, FIG. 6 illustrates an embodiment in which clean air outlet 184 is located at front end 192.

[00102] Turning to FIG. 4, portable surface cleaning unit 108 may include a suction motor 212 to generate vacuum suction through air flow path 188. Suction motor 212 may be positioned within a motor housing 216. Suction motor 212 may be a fan-motor assembly including an electric motor and impeller blade(s). In the illustrated embodiment, suction motor 212 is positioned in the air flow path 188 downstream of air treatment member 116. In this configuration, suction motor 212 may be referred to as a “clean air motor”. Alternatively, suction motor 212 may be positioned upstream of air treatment member 116, and referred to as a “dirty air motor”.

[00103] Air treatment member 116 is configured to remove particles of dirt and other debris from the air flow. In the illustrated example, air treatment member 116 includes a cyclone assembly (also referred to as a “cyclone bin assembly”) having a single cyclonic cleaning stage with a single cyclone 220 and a dirt collection chamber 224 (also referred to as a “dirt collection region”, “dirt collection bin”, “dirt bin”, or “dirt chamber”). Cyclone 220 has a cyclone chamber 228, a cyclone air inlet 232, and a cyclone air outlet 236. Dirt collection chamber 224 may be external to the cyclone chamber 228 (i.e. dirt collection chamber 224 may have a discrete volume from that of cyclone chamber 228). Cyclone 220 and dirt collection chamber 224 may be of any configuration suitable for separating dirt from an air stream and collecting the separated dirt respectively and may be in communication by a dirt outlet of the cyclone chamber.

[00104] In alternate embodiments, air treatment member 116 may include a cyclone assembly having two or more cyclonic cleaning stages arranged in series with each other. Each cyclonic cleaning stage may include one or more cyclones arranged in parallel with each other and one or more dirt collection chambers, of any suitable configuration. The dirt collection chamber(s) may be external to the cyclone chambers of the cyclones. Alternatively, one or more (or all) of the dirt collection chamber(s) may be internal to one or more (or all) of the cyclone chambers. For example, the internal dirt collection chamber(s) may be configured as a dirt collection area within the cyclone chamber.

[00105] In other embodiments, air treatment member 116 may not include a cyclonic cleaning stage. For example, air treatment member 116 may include a bag,

a porous physical filter media (such as, for example foam or felt), one or more screens, or other air treating means.

[00106] Referring to FIG. 4, portable surface cleaning unit 108 may include a pre-motor filter 240 provided in the air flow path 188 downstream of air treatment member 116 and upstream of suction motor 212. Pre-motor filter 240 may be formed from any suitable physical, porous filter media (also referred to as “porous filter material”). For example, pre-motor filter 240 may be one or more of a foam filter, felt filter, HEPA filter, or other physical filter media. In some embodiments, pre-motor filter 240 may include an electrostatic filter, or the like. As shown, pre-motor filter 240 may be located in a pre-motor filter housing 244 that is external to the air treatment member 116.

[00107] In the illustrated embodiment, dirty air inlet 124 is the inlet end 252 of an air inlet conduit 248. Optionally, inlet end 252 of air inlet conduit 248 can be used as a nozzle to directly clean a surface. Alternatively, or in addition to functioning as a nozzle, air inlet conduit 248 may be connected (e.g. directly connected) to the downstream end of any suitable accessory tool such as a rigid air flow conduit (e.g., an above floor cleaning wand), a crevice tool, a mini brush, and the like. As shown, dirty air inlet 124 may be positioned forward of air treatment member 116, although this need not be the case.

[00108] In the embodiment of FIG. 4, the air treatment member comprises a cyclone 220, the air treatment air inlet is a cyclone air inlet 232, and the air treatment member air outlet is a cyclone air outlet 236. Accordingly, when operated in the portable cleaning configuration, suction motor 212 may be activated to draw dirty air into portable surface cleaning unit 108 through dirty air inlet 124. The dirty air is directed along air inlet conduit 248 to the cyclone air inlet 232. As shown, cyclone air inlet 232 may direct the dirty air flow to enter cyclone chamber 228 in a tangential direction so as to promote cyclonic action. Dirt particles and other debris may be disentrained (i.e. separated) from the dirty air flow as the dirty air flow travels from cyclone air inlet 232 to cyclone air outlet 236. The disentrained dirt particles and debris may discharge from cyclone chamber 228 through a dirt outlet into dirt collection chamber 224 external to the cyclone chamber 228, where the dirt particles and debris may be collected and stored until dirt collection chamber 224 is emptied.

[00109] Air exiting cyclone chamber 228 may pass through an outlet passage 256 located upstream of cyclone air outlet 236. Cyclone chamber outlet passage 256 may also act as a vortex finder to promote cyclonic flow within cyclone chamber 228. In some embodiments, cyclone outlet passage 256 may include a screen 260 (also referred to as a shroud) (e.g. a fine mesh screen) in the air flow path 188 to remove large dirt particles and debris, such as hair, remaining in the exiting air flow.

[00110] From cyclone air outlet 236, the air flow may be directed into pre-motor filter housing 244. The air flow may pass through pre-motor filter 240, and then exit pre-motor filter housing 244 into motor housing 216. At motor housing 216, the clean air flow may be drawn into suction motor 212 and then discharged from portable surface cleaning unit 108 through clean air outlet 184. Prior to exiting the clean air outlet 184, the treated air may pass through a post-motor filter, which may be one or more layers of filter media.

[00111] Referring to FIGS. 1-4, in the upright configuration (FIG. 1), dirty air inlet 124 of portable surface cleaning unit 108 is fluidly connected to air outlet 148 of floor cleaning unit 104, whereby air flow path 188 of portable surface cleaning unit 108 is located downstream of air flow path 152 of floor cleaning unit 104. In operation, dirty air enters dirty air inlet 144 of floor cleaning unit 104, travels along air flow path 152 to air outlet 148, and then enters portable surface cleaning unit 108 at dirty air inlet 124. From dirty air inlet 124, the dirty air flow moves through portable surface cleaning unit 108 as described above in connection with the portable cleaning configuration.

[00112] Referring to FIGS. 1-2, upper section 140 of floor cleaning unit 104 may include a rigid air flow conduit 132. Rigid air flow conduit 132 includes a conduit upper end 264 downstream of a conduit lower end 268. Conduit lower end 268 may be movably mounted to the surface cleaning apparatus between the upright storage position and the rearwardly inclined floor cleaning position. Portable surface cleaning unit 108 may be connected to conduit upper end 264. As shown, this allows handle 120 of handvac 108 to be used as a steering handle for stickvac 100.

### **Fast Charging Capacitor**

[00113] A trend in cordless vacuum cleaners is to provide longer runtime in a single charge. For example, some cordless vacuum cleaners can run continuously

for 30 minutes or more before recharging. However, such vacuum cleaners require large, expensive, heavy batteries. In use, this can make these vacuum cleaners unwieldy to carry, in both size and weight. Moreover, it can take a long time to fully recharge high capacity batteries, and batteries often degrade and require replacement during the working life of a vacuum cleaner. The battery replacement cost is a significant expense for the user.

[00114] In some embodiments disclosed herein, a surface cleaning apparatus includes a portable surface cleaning unit equipped with an energy storage member having one or more capacitors. As compared with rechargeable batteries (e.g. lead-acid, Ni-Cad, NiMH, or lithium), a capacitor can be recharged much faster, and have a much longer lifespan (measured in charge cycles). With battery powered vacuums, traditional design philosophy is that it is important to have a long runtime to mitigate having to recharge in the middle of a cleaning session, since the recharge could take several hours (e.g., 4-8), which would be disruptive to the user who wishes to finish their cleaning session in a timely manner. In contrast, with a capacitor powered portable cleaning unit, the need to recharge mid-session may be minimally disruptive as it may only require a few seconds to a few minutes to recharge. Therefore, a capacitor powered portable surface cleaning unit may include comparatively less energy storage capacity because avoiding a recharge mid-session is not a priority. As a result, a capacitor powered portable surface cleaning unit may have a relatively smaller and lighter on board energy storage member (one or more capacitors), as compared with a high capacity battery pack. This can make a capacitor powered portable surface cleaning unit smaller and lighter overall, without compromising performance or user experience. Moreover, the long lifespan of capacitors (often 1 million charge cycles or more) means that the capacitors will not generally require replacement during the working life of the portable surface cleaning unit.

[00115] The features in this section may be used by itself in any surface cleaning apparatus or in any combination or sub-combination with any other feature or features described herein.

[00116] For convenience, reference to “a capacitor” herein means “one or more capacitors”, unless expressly stated otherwise (e.g. “a single capacitor”). Similarly,

reference to “a battery” herein means “one or more batteries”, unless expressly stated otherwise (e.g. “a single battery”).

[00117] Referring to FIG. 4, portable surface cleaning unit 108 is shown including an energy storage member 272. Energy storage member 272 may include a capacitor 276. For example, capacitor 276 may be the only significant energy storage in energy storage member 272, or energy storage member 272 may further include a battery. Some or all of the power consuming elements of portable surface cleaning unit 108 may be powered by capacitor 276. For example, at least suction motor 212 may be powered by capacitor 276. In some embodiments, some or all power consuming elements of portable surface cleaning unit 108 may be exclusively powered by capacitor 276. For example, at least suction motor 212 may be exclusively powered by capacitor 276 in some embodiments.

[00118] Capacitor 276 may be any capacitor suitable for supplying power required to operate at least suction motor 212. For example, capacitor 276 may be an ultracapacitor (also referred to as a supercapacitor or Goldcap). As compared to an electrolytic capacitor, ultracapacitors have dramatically higher energy density (per unit mass and per unit volume). Types of ultracapacitors include electrostatic double-layer capacitors (EDLCs), electrochemical pseudocapacitors, and hybrid capacitors that store charge both electrostatically and electrochemically. Accordingly, it will be appreciated that a portable surface cleaning unit 108 may use only a single capacitor 276 or optionally, for example, 2, 3 or 4 capacitors 276.

[00119] Capacitor 276 may be recharged by power from a power source external to portable surface cleaning unit 108. FIGS. 7-8 show an example in which energy storage member 272 is removable from portable surface cleaning unit 108 for electrically connecting to an external charger 280. External charger 280 may be powered by an electrical connection to a stationary power supply 284 (e.g. mains power). An advantage of this design is that the external charger 280 also reduces the size and weight of portable surface cleaning unit 108 as compared with including charger 280 within portable surface cleaning unit 108. Further, this design may not require portable surface cleaning unit 108 to have a power cord or power cord connector, which may also reduce the size and weight of portable surface cleaning unit 108 all else being equal. It will be appreciated that, if the capacitor is charged

rapidly (e.g., 1, 2, 3, 4, or 5 minutes), then the user may be able to make a cup of coffee or make a quick call and then return to continue the cleaning operation with a fuller recharged capacitor 276.

[00120] A further advantage of this design is that it can allow the user to swap a discharged energy storage member 272 for a charged energy storage member 272 that has been stored on the charger 280.

[00121] Alternatively or in addition to energy storage member 272 being removable for recharging, energy storage member 272 may be rechargeable in-situ without removal from portable surface cleaning unit 108. For example, FIGS. 9-10 show an embodiment in which portable surface cleaning unit 108 includes a power cable 288 for transmitting power from stationary power supply 284 towards energy storage member 272. An advantage of a non-removable energy storage member 272 is that it may not require a discrete outer shell for user handling and transportation since it is permanently held within main body 180. Further, a non-removable energy storage member 272 may not require hardware to support easy user removal and insertion of energy storage member 272. This may make energy storage member 272 smaller and lighter, all else being equal.

[00122] In accordance with the alternate exemplified embodiment of FIGS. 9-10, portable surface cleaning unit 108 includes charger 280 within main body 180. An advantage of this design is that it may make connecting portable surface cleaning unit 108 to a stationary power supply 284 more convenient, in that an external charger does not need to be relocated to the selected stationary power supply 284.

[00123] FIG. 11 shows an alternative embodiment in which energy storage member 272 is rechargeable in-situ without removal from portable surface cleaning unit 108, by a corded connection to an external charger 280. An advantage of this design is that it may reduce the size and weight of portable surface cleaning unit 108 as compared with including charger 280 within portable surface cleaning unit 108, all else being equal.

[00124] In an alternate embodiment in which energy storage member 272 is rechargeable in-situ without removal from portable surface cleaning unit 108, the portable surface cleaning unit 108 may itself be plugged into the charger 280.

[00125] Energy storage member 272 may have sufficient energy capacity to power at least suction motor 212 (or all power consuming parts of portable surface cleaning unit 108) for at least 3 minutes (e.g. 3 minutes to 15 minutes). For example, an energy storage member 272 with a capacity of at least 5Wh can provide 100W of power to a suction motor 212 for at least 3 minutes. As mentioned above, all of the energy storage may be provided by capacitor 276 in some embodiments. A 3 to 5 minute runtime may be sufficient for short cleaning sessions, such as to clean crumbs off a couch, to clean dirt around a planter, or to clean cereal spilled by a child for example.

[00126] If a task is larger, and requires more runtime than energy storage member 272 can provide, then energy storage member 272 can be quickly recharged. For example, charger 280 (whether external or internal to portable surface cleaning unit 108) may be configured to recharge capacitor 276 at a rate of at least 2C, 3C or 4C (e.g. at least 6C, such as 4C to 10C, or 6C to 10C). This can allow capacitor 276 to be fully recharged in a matter of seconds or minutes, as compared with hours in the case of many batteries.

[00127] Returning to FIG. 10, in some embodiments power cable 288 may be permanently connected to portable surface cleaning unit 108. An advantage of this design is that it may not require portable surface cleaning unit 108 to have hardware to support a removable connection, and it may make connecting portable surface cleaning unit 108 to a stationary power supply 284 more convenient to the extent that a separate power cable 288 does not need to be relocated to the selected power supply 284. FIG. 12 shows an alternative embodiment in which power cable 288 is removably connected to portable surface cleaning unit 108. For example, power cable 288 may be connected to portable surface cleaning unit 108 only to recharge energy storage member 272. An advantage of this design is that it does not require the user to carry the weight of power cable 288 when portable surface cleaning unit 108 does not require a connection to a stationary power supply 284 (e.g. when not recharging).

#### **Capacitor Rechargeable In Upright Configuration**

[00128] In some embodiments, the floor cleaning unit charges the capacitor of the portable surface cleaning unit when the portable surface cleaning unit is

connected to the floor cleaning unit. For example, the capacitor of the portable surface cleaning unit may be recharged while the surface cleaning apparatus is operated in the upright configuration. Several advantages flow from this design. First, this design can mitigate the capacitor of the portable surface cleaning unit being dead when disconnected from the floor cleaning unit for use in the portable cleaning configuration. Second, this design can allow cleaning to continue in the upright configuration if the portable surface cleaning unit runs out of power in the portable surface cleaning mode. For example, if the capacitor of the portable surface cleaning unit runs out of power while cleaning an above-floor surface, the user may connect the portable surface cleaning unit to the floor cleaning unit and resume cleaning floor surfaces while the capacitor recharges. Third, this design can allow the capacitor to recharge while the portable surface cleaning unit is connected to the floor cleaning unit in the storage mode. This mitigates misplacing the floor cleaning unit, as compared to a design that requires the portable surface cleaning unit to be disconnected from the floor cleaning unit to recharge.

[00129] The features in this section may be used by itself in any surface cleaning apparatus or in any combination or sub-combination with any other feature or features described herein.

[00130] Reference is now made to FIGS. 13-14. As shown, floor cleaning unit 104 may include a charger 280. For example, charger 280 may be located in surface cleaning head 112 as shown, or in upper section 140. When charger 280 is connected to a source of power, and portable surface cleaning unit 108 is connected to floor cleaning unit 104, charger 280 may recharge energy storage member 272 (including at least capacitor 276). In the illustrated example, portable surface cleaning unit 108 is connected to floor cleaning unit 104 in an upright configuration. Thus, energy storage member 272 may be recharged while surface cleaning apparatus 100 is in a storage position and/or an inclined floor cleaning position.

[00131] Embodiments that can recharge energy storage member 272 while apparatus 100 is in the inclined floor cleaning position can allow the user to continue cleaning without interruption when portable surface cleaning unit 108 runs out of power in a portable cleaning configuration. The rapid charging rate of capacitor 276 means that capacitor 276 may be fully recharged in a short period of time, and

therefore allow the user to return to the portable cleaning configuration after only a short time in the upright configuration.

[00132] In some embodiments, suction motor 212 may be powered only (i.e. exclusively) by (i) energy storage member 272 (e.g. when in the portable cleaning configuration), or (ii) by a stationary power supply (e.g. mains power, when in the upright cleaning configuration). As shown, when in the upright cleaning configuration, charger 280 may be electrically connected by power cable 288 to stationary power supply 284. Power cable 288 may have a length suitable to allow surface cleaning apparatus 100 to be used for cleaning floors in the upright configuration while connected to stationary power supply 284. For example, power cable 288 may be at least 10-15 feet long.

[00133] Power cable 288 may be permanently connected to floor cleaning unit 104. For example, surface cleaning apparatus 100 may require an electrical connection to a stationary power supply 284 when in the upright configuration. This may encourage users to arrange their cleaning routine to allow energy storage member 272 to recharge between short periods of use in the portable cleaning configuration.

[00134] Alternatively, power cable 288 may be removably connected to floor cleaning unit 104. This allows surface cleaning apparatus 100 to operate in a cordless manner while in the upright configuration, even if only for a short duration subject to the power capacity of energy storage member 272. For example, this can allow surface cleaning apparatus 100 to be used in an upright configuration to clean floors (e.g. in an unfinished basement) where there is not an electrical outlet within range.

[00135] FIG. 15 shows an embodiment in which charger 280 is located external to floor cleaning unit 104. This can reduce the size and weight of floor cleaning unit 104 as compared with a design having charger 280 inside floor cleaning unit 104.

#### **Floor Cleaning Unit Including An Energy Storage Member**

[00136] In some embodiments, the floor cleaning unit may include an energy storage member. The energy storage member may have sufficient power capacity to fully recharge the capacitor of the portable surface cleaning unit several times.

This allows a continuous cordless cleaning session with the surface cleaning apparatus wherein the cleaning session includes two or more iterations of (i) cleaning with the portable cleaning unit in the portable cleaning configuration, and (ii) recharging the portable cleaning unit while cleaning in the upright cleaning configuration. The floor cleaning unit may include a relatively inexpensive, rechargeable energy storage member (e.g. a lead acid, NiCad, NiMH, or lithium) with an energy storage capacity that is several times greater than the capacitor of the portable surface cleaning unit. While providing a rechargeable energy storage member in the floor cleaning unit (optionally the surface cleaning head) increases the weight of the floor cleaning unit, this added weight is supported by the floor being cleaned, and may also help stabilize the surface cleaning apparatus 100 when in the storage configuration by lowering the center of gravity. Alternately, or in addition, it can provide needed weight to help maintain the dirty air inlet of the surface cleaning head a desired distance from the floor being cleaned.

[00137] The features in this section may be used by itself in any surface cleaning apparatus or in any combination or sub-combination with any other feature or features described herein.

[00138] Referring to FIG. 16, floor cleaning unit 104 may include an energy storage member 292. Floor cleaning unit 104 may also include a charger 280 as shown. Charger 280 may include one or more charging circuits for one or more of :

- (i) supplying power from a stationary power supply (i.e. via power cable 288) to energy storage member 292;
- (ii) supplying power from the floor cleaning unit energy storage member 292 to the portable surface cleaning unit energy storage member 272; and,
- (iii) supplying power from a stationary power supply (i.e. via power cable 288) to energy storage member 272.

[00139] Energy storage member 292 can be any device suitable to supply power for fully recharging energy storage member 272 one or several times. For example, energy storage member 292 may include a battery and/or a capacitor that collectively have an energy storage capacity sufficient to recharge energy storage

member 272 (or at least capacitor 276) two or more times (e.g. three or more times, or six or more times).

[00140] In some embodiments, when portable surface cleaning unit 108 is connected to floor cleaning unit 104, and floor cleaning unit 104 is disconnected from an external power supply (e.g. power cable 288 is disconnected from mains power, and/or disconnected from floor cleaning unit 104), energy storage member 272 is charged by charger 280 with power from energy storage member 292. In this situation, surface cleaning apparatus 100 may be operated in the inclined floor cleaning position to clean floors while energy storage member 272 is charging. After a short period (e.g. 15 minutes or less), energy storage member 272 will have been substantially or fully recharged, and portable surface cleaning unit 108 can be removed for use again in the portable cleaning configuration.

[00141] While energy storage member 272 is being charged by charger 280 from power supplied by energy storage member 292, suction motor 212 may be powered exclusively by energy storage member 272. An advantage of this design is that it does not require portable surface cleaning unit 108 to include circuitry that can electrically reconfigure suction motor 212 to receive power directly from energy storage member 292 and/or enable suction motor 212 to receive power directly from energy storage member 292. Further, this design does not require energy storage member 292 to be capable of discharging at a rate sufficient to supply both (i) recharging of energy storage member 272, and (ii) powering suction motor 212.

[00142] Alternatively, while energy storage member 272 is being charged by charger 280 from power supplied by energy storage member 292, suction motor 212 may be powered exclusively by energy storage member 292. An advantage of this design is that it may reduce or stop the discharge of energy storage member 272, so that energy storage member 272 can sooner attain a substantially or full charge for use in the portable cleaning configuration.

[00143] Alternatively, while energy storage member 272 is being charged by charger 280 from power supplied by energy storage member 292, suction motor 212 may be powered by energy storage members 272, 292 together.

[00144] In some embodiments, when portable surface cleaning unit 108 is connected to floor cleaning unit 104, and floor cleaning unit 104 is connected to an

external power supply (e.g. power cable 288 is connected to mains power and floor cleaning unit 104) one or more of the following may occur concurrently:

- (i) energy storage member 272 may be charged by charger 280 with power from energy storage member 292 and/or power from the external power supply;
- (ii) energy storage member 292 may be charged by charger 280 with power from the external power supply; and,
- (iii) suction motor 212 may be powered by energy from energy storage member 272, and/or energy storage member 292, and/or the external power supply.

An advantage of partially or completely powering suction motor 212 from the external power supply in this situation is that it can reduce or stop the discharge of energy due to energy storage members 272, 292 powering the suction motor 212 so that energy storage members 272, 292 can sooner attain be substantially or fully recharged. Once energy storage members 272, 292 have attained a substantial or full charge, surface cleaning apparatus 100 can again be used in a cordless configuration (e.g. power cable 288 can be disconnected from mains power and/or disconnected from floor cleaning unit 104).

[00145] Reference is now made to FIG. 17. Alternatively or in addition to providing a charger 280<sub>1</sub> in floor cleaning unit 104, floor cleaning unit 104 may be connectable to an external charger 280<sub>2</sub>. For example, internal charger 280<sub>1</sub> may be configured with a charging circuit for transferring power from energy storage member 292 to energy storage member 272, and external charger 280<sub>2</sub> may be configured with a charging circuit for transferring power from an external power supply (e.g. mains power) to energy storage member 292. This design may reduce the size and/or weight of floor cleaning unit 104 as compared with a design that includes both chargers 280<sub>1</sub> and 280<sub>2</sub> (or a single charger with the functionality of both chargers) inside floor cleaning unit 104.

[00146] Referring to FIGS. 16-17, energy storage member 292 may be located anywhere inside floor cleaning unit 104. For example, energy storage member 292 may be located at (e.g. inside, part of, or attached to) surface cleaning head 112 as

shown, or upper section 140. In the illustrated embodiment, surface cleaning head 112 has a center 304 located midway between front and rear ends 156, 160, and energy storage member 292 has a center of gravity 296 located forward of cleaning head center 304. An advantage of this design is that energy storage member 292 may help move the center of gravity of surface cleaning apparatus 100 forwards, and thereby help stabilize surface cleaning apparatus 100 when in the storage position. For example, a more forward center of gravity of apparatus 100 may mitigate surface cleaning apparatus tipping over rearwardly when in the storage position.

### **Thermal Cooling During Charging and/or Discharging**

[00147] The rate at which an energy storage member can be charged, without suffering damage or substantial degradation, may be limited by heat generated during charging. When an energy storage member for an appliance is charged, the generated heat can raise the temperature of the energy storage member to dangerous or damaging levels. In some embodiments, a thermal cooling unit that, directly or indirectly, cools an appliance energy storage member during charging is provided. This can help keep the temperature of the energy storage member within safe limits when the energy storage member is charged rapidly (e.g. at a rate of 4C or faster). If the charger is in a surface cleaning unit, then the surface cleaning apparatus may include the charger and the thermal cooling unit. Alternately, if the charger is remote, then the charger may include the thermal cooling unit. Such a thermal cooling unit may be referred to as an appliance energy storage member thermal cooling unit.

[00148] As discussed herein, a charger which is used to charge an energy storage member may itself have an onboard energy storage member. The rate at which such an on board energy storage member can be discharged, without suffering damage or substantial degradation, may also be limited by heat generated during discharge. When an energy storage member is rapidly discharged, the generated heat can raise the temperature of the energy storage member to dangerous or damaging levels. In some embodiments, a thermal cooling unit that, directly or indirectly, cools an charger energy storage member during discharging is provided. This can help keep the temperature of the energy storage member of the charger within safe limits when the charger is rapidly charging an energy storage

member (e.g. at a rate of 4C or faster). If the charger is in a surface cleaning unit, then the surface cleaning apparatus may include the charger and the thermal cooling unit. Alternately, if the charger is remote, then the charger may include the thermal cooling unit. Such a thermal cooling unit may be referred to as an charger energy storage member thermal cooling unit.

[00149] It will be appreciated that, in some embodiments, the appliance energy storage member thermal cooling unit and the charger energy storage member thermal cooling unit may be the same thermal cooling unit.

[00150] The features in this section may be used by itself in any surface cleaning apparatus or in any combination or sub-combination with any other feature or features described herein.

[00151] FIGS. 18-20 illustrate various embodiments of a charger 280 electrically connected to an energy storage member 272 or 292, and a thermal cooling unit 308 thermally connected to the energy storage member 272, 292 to remove heat generated during recharging of energy storage member 272 or 292 or the discharge of energy storage member 292, and thereby keep the temperature of the energy storage member 272, 292 within safe limits when the energy storage member is charged rapidly or the energy storage member 292 is discharged rapidly.

[00152] It will be appreciated that the arrangements described herein including a thermal cooling unit 308 can be used in combination with energy storage member 272 and/or 292 in any embodiment of surface cleaning apparatus 100, floor cleaning unit 104, or portable surface cleaning unit 108 described elsewhere or illustrated in any figure. Further, a thermal cooling unit 308 may be included at a location at which the energy storage member is used (e.g., in the portable surface cleaning unit 108) or where the energy storage member is recharged (e.g., in the portable surface cleaning unit 108 if recharged in situ or in charger 280 if recharged exterior to appliance 100). For example, referring to FIGS. 22 and 23, the portable surface cleaning unit 108 may include a thermal cooling unit 308 as energy storage member 272 may be recharged in situ. Alternately, or in addition, as exemplified in FIG. 23, surface cleaning head 112 may include a thermal cooling unit 308 to cool energy storage member 292 when energy storage member 292 is charged and/or discharged. In the alternate embodiment exemplified in FIG 24., energy storage

member 272 is recharged external to the apparatus 100. Accordingly, remote charger 280 is provided with a thermal cooling unit 308 that may be used to cool energy storage member 272 and/or 292 during charging and/or to cool energy storage member 292 during discharge. It will be appreciated that charger 280 may have a single thermal cooling unit 308 that is thermally connected to each of energy storage members 272, 292 when energy storage members 272, 292 are installed in the charger 280. Alternately, a first thermal cooling unit 308 may be provided that is thermally connected to energy storage members 272 when energy storage member 272 is installed in the charger 280 and a second thermal cooling unit 308 may be provided that is thermally connected to energy storage members 292 when energy storage member 292 is installed in the charger 280.

[00153] Referring to FIG. 18, in some embodiments, thermal cooling unit 308 may include active cooling. Any active cooling means known in the art may be used. That is, thermal cooling unit 308 may include a powered cooling element 312. An advantage of this design is that the rate of cooling can be controlled by regulating the power supplied to cooling element 312. This may provide better control over the temperature of energy storage member 272, 292. Powered cooling element 312 may be any powered device that can be operated to remove heat from energy storage member 272, 292. For example, powered cooling element 312 may be a fan as shown, a coolant circulating pump (e.g., the energy storage member or a casing in which the energy storage member is received) may include flow channels through which a cooling fluid may flow due to operation of the coolant circulating pump), or a Peltier cooler. As shown, charger 280 may be configured to control the operation of powered cooling element 312. For example, charger 280 may include a temperature sensor that provides a signal to a controller that, in turn, controls the speed of fan 312 according to a signal from the sensor that represents the temperature of energy storage member 272, 292.

[00154] Alternatively or in addition to a powered cooling element 312, thermal cooling unit 308 may include a passive cooling element 316. A passive cooling element 316 may be an unpowered device that is effective for removing heat from energy storage member 272, 292 during charging. FIG. 19 shows an example in which passive cooling element 316 is a heat sink (e.g. a metal heat sink, such as an

aluminum heat sink). FIG. 20 shows an example in which passive cooling element 316 is a liquid heat sink.

[00155] In some embodiments, passive cooling element 316 may be configured to provide an enlarged surface area to promote natural convective cooling with the ambient air. For example, heat sink 316 in FIG. 19 includes a plurality of fins 320 that collectively provide a large surface area for convective cooling. In use, energy storage member 272, 292 is positioned in thermal (e.g., abutting) contact with heat sink 316 whereby heat from energy storage member 272, 292 is transferred into heat sink 316 by conduction, and heat from heat sink 316 is lost by convection into the ambient air.

[00156] Alternatively or in addition to promoting convective heat loss, passive cooling element 316 may have a heat capacity sufficient to absorb the heat generated by one or several charges of energy storage member 272, 292 (e.g. at least 2 charge cycles, at least 3 charge cycles, or at least 4 charge cycles) and/or the rapid discharge of energy storage member 292. For example, passive cooling element 316 may include a volume of material that after absorbing one or several charges of energy storage member 272, 292, maintains the energy storage member 272, 292 below a target temperature. In the exemplary embodiment of FIG. 19, heat sink 316 may be composed of a sufficient volume of metal (e.g. aluminum) to achieve this effect. In FIG. 20, thermal cooling unit 308 is shown including a housing 324 that holds energy storage member 272, 292 in a volume of liquid 328 (e.g. mineral oil, or other coolant). The liquid 328 may have sufficient volume to maintain the temperature of energy storage member 272, 292 within safe limits after several charging cycles.

[00157] After passive cooling element 316 has absorbed the heat generated by a number of charge cycles, and the user has finished their cleaning session, passive cooling element 316 will passively cool back to room temperature while surface cleaning apparatus 100 rests in storage (e.g. overnight). Once at room temperature, passive cooling element 316 will again be capable of absorbing heat generated by a number of charge cycles.

[00158] In an alternate embodiment, it will be appreciated that passive cooling element 319 may also be provided with active cooling using any technique disclosed herein.

#### **Method of Cleaning With A Capacitor-Powered Portable Surface Cleaning Unit**

[00159] A surface cleaning apparatus operable in both upright and portable cleaning configurations, and having a portable surface cleaning unit that may be powered by a rapidly rechargeable energy storage member (e.g. a capacitor-powered portable surface cleaning unit) may be operated according to a new paradigm. Whereas conventional philosophy has been that a handvac should have a maximized runtime so that all surfaces requiring use of the handvac can be cleaned at in one continuous operation without recharging the handvac, embodiments disclosed herein promote a cleaning session that includes several iterations of: (i) cleaning in an upright configuration while the portable surface cleaning unit charges, and (ii) cleaning in a portable cleaning configuration with the portable surface cleaning unit powered by its, e.g., capacitor. This method of alternating between upright and portable cleaning configurations, lowers the required energy storage capacity of the portable surface cleaning unit. This means the portable surface cleaning unit can have a smaller, lighter, and possibly less expensive energy storage member. In order to achieve several full charges of the portable surface cleaning unit within a single uninterrupted cleaning session, the energy storage member preferably uses a capacitor which enables very fast charging.

[00160] It will be appreciated that, in other embodiments, a battery or battery pack that is rapidly chargeable may also be used. For example, if the handvac may have a short run time (e.g., 3, 5, 7 or 10 minutes), then the handvac may have only one or a few (e.g., 2 or 3) batteries. In such a case, the amount of energy required to fully charge the batteries is reduced compared to traditional battery packs that may have 6-7 batteries. Accordingly less heat will be generated during rapid recharging and the handvac may accordingly include a thermal cooling unit 308 that does not add excessive weight to the handvac.

[00161] The features in this section may be used by itself in any surface cleaning apparatus or in any combination or sub-combination with any other feature or features described herein.

[00162] Referring to FIGS. 2 and 21, a method 400 of cleaning a surface using surface cleaning apparatus 100 (e.g. a stickvac) is shown.

[00163] At 404, portable surface cleaning unit 108 (e.g. handvac 108) is removed from floor cleaning unit 104. For example, portable cleaning unit 108 may be disconnected from rigid conduit upper end 264 to reconfigure surface cleaning apparatus 100 into a portable cleaning configuration.

[00164] At 408, portable surface cleaning unit 108 is used to clean surface(s) in the portable cleaning configuration. For example, portable surface cleaning unit 108 may be used to clean surfaces unsuitable for surface cleaning head 112, such as seat cushions, counters, drapes, and ceilings. Portable surface cleaning unit 108 may be powered by a capacitor 276 (FIG. 4).

[00165] At 412, portable surface cleaning unit 108 is remounted to floor cleaning unit 104. For example, portable cleaning unit 108 may be reconnected to rigid conduit upper end 264 to reconfigure surface cleaning apparatus 100 into an upright configuration.

[00166] At 416, surface cleaning apparatus 100 is used in the upright configuration to clean a floor, simultaneously while portable surface cleaning unit 108 recharges. Capacitor 276 (FIG. 4) may be recharged by an internal or external charger 280 with power from an external power supply and/or another energy storage member 292, as described above in connection with FIGS. 9-17. Cleaning and recharging in step 416 may continue for a period sufficient to substantially or fully recharge capacitor 276 (FIG. 4). For example, step 416 may continue for up to 15 minutes or for up to 10 minutes or for up to 5 minutes or for up to 3 minutes, during which capacitor 276 (FIG. 4) may be substantially recharged or fully recharged.

[00167] As shown, after step 416, method 400 may return to step 404 and continue until the cleaning session is completed. Accordingly, a user may remove the portable cleaning unit 108 and use it in the portable cleaning unit configuration

until portable cleaning unit 108 requires recharging or until the cleaning job is finished.

[00168] While the above description provides examples of the embodiments, it will be appreciated that some features and/or functions of the described embodiments are susceptible to modification without departing from the spirit and principles of operation of the described embodiments. Accordingly, what has been described above has been intended to be illustrative of the invention and non-limiting and it will be understood by persons skilled in the art that other variants and modifications may be made without departing from the scope of the invention as defined in the claims appended hereto. The scope of the claims should not be limited by the preferred embodiments and examples, but should be given the broadest interpretation consistent with the description as a whole.

[00169] This specification also includes the subject matter of the following clause sets:

**Clause Set A:**

1. A vacuum cleaner comprising:
  - (a) a floor cleaning unit comprising:
    - (i) a surface cleaning head having a front end having a dirty air inlet, a rear end, a center positioned midway between the front and rear ends and a charger;
    - (ii) an upper section moveably mounted to the surface cleaning head between an upright storage position and a rearwardly inclined floor cleaning position; and,
    - (iii) an air flow path extending from the dirty air inlet to a floor cleaning unit air outlet; and,
  - (b) a portable surface cleaning unit removably mounted to the upper section, the portable surface cleaning unit comprising a main body, an air treatment member, a suction motor, a handle and a capacitor, wherein, the portable surface cleaning unit is rechargeable when mounted to the floor cleaning unit and, wherein the capacitor is rechargeable at a rate of at least 4C.

2. The surface cleaning apparatus of clause 1 wherein the suction motor is operable only from:
  - (a) power supplied from the capacitor, or
  - (b) the surface cleaning apparatus further comprises an electrical cord connectable with a stationary source of power and the suction motor is operable from power supplied from the capacitor and power supplied from a stationary power supply.
3. The surface cleaning apparatus of clause 1 wherein the energy storage member has a center of gravity and the center of gravity is positioned forward of the center of the surface cleaning head.
4. The surface cleaning apparatus of clause 3 wherein the center of gravity is positioned at the front end of the surface cleaning head.
5. The surface cleaning apparatus of clause 1 wherein the capacitor comprises an ultra-capacitor.
6. The surface cleaning apparatus of clause 1 wherein the portable surface cleaning unit comprises a hand vacuum cleaner and the upper section comprises a rigid air flow conduit having an upper end and a lower end,

wherein the lower end of the rigid air flow conduit is moveably mounted to the surface cleaning head between the upright storage position and the rearwardly inclined floor cleaning position, and

wherein the hand vacuum cleaner is connectable to the upper end of the rigid air flow conduit,

whereby, when the hand vacuum cleaner is connected to the upper end of the rigid air flow conduit the handle is a steering handle for the vacuum cleaner.
7. The surface cleaning apparatus of clause 6 wherein the portable cleaning unit further comprises an electrical cord connectable with a stationary source of power.

8. The surface cleaning apparatus of clause 7 wherein the suction motor is operable only from:
  - (a) power supplied from the capacitor, or
  - (b) the surface cleaning apparatus further comprises an electrical cord connectable with a stationary source of power and the suction motor is operable from power supplied from the capacitor and power supplied from the stationary power supply.
  
9. The surface cleaning apparatus of clause 1 wherein the energy storage member stores sufficient stored power to recharge the capacitor at least twice.
  
10. The surface cleaning apparatus of clause 1 wherein the floor cleaning unit further comprises a thermal cooling unit thermally connected to the charger.
  
11. A surface cleaning apparatus comprising:
  - (a) a floor cleaning unit comprising:
    - (i) a surface cleaning head having a front end having a dirty air inlet, a rear end, a center positioned midway between the front and rear ends and a charger;
    - (ii) an upper section moveably mounted to the surface cleaning head between an upright storage position and a rearwardly inclined floor cleaning position; and,
    - (iii) an air flow path extending from the dirty air inlet to a floor cleaning unit air outlet; and,
  - (b) a portable surface cleaning unit removably mounted to the upper section, the portable surface cleaning unit comprising a main body, an air treatment member, a suction motor, a handle and a capacitor, wherein, the portable surface cleaning unit is rechargeable when mounted to the floor cleaning unit, and wherein the energy storage member has a center of gravity and the center of gravity is positioned forward of the center of the surface cleaning head.

12. The surface cleaning apparatus of clause 11 wherein the suction motor is operable only from:
- (a) power supplied from the capacitor, or
  - (b) the surface cleaning apparatus further comprises an electrical cord connectable with a stationary source of power and the suction motor is operable from power supplied from the capacitor and power supplied from a stationary power supply.
13. The surface cleaning apparatus of clause 11 wherein the center of gravity is positioned at the front end of the surface cleaning head.
14. The surface cleaning apparatus of clause 11 wherein the capacitor comprises an ultra-capacitor.
15. The surface cleaning apparatus of clause 11 wherein the portable surface cleaning unit comprises a hand vacuum cleaner and the upper section comprises a rigid air flow conduit having an upper end and a lower end,
- wherein the lower end of the rigid air flow conduit is moveably mounted to the surface cleaning head between the upright storage position and the rearwardly inclined floor cleaning position, and
- wherein the hand vacuum cleaner is connectable to the upper end of the rigid air flow conduit,
- whereby, when the hand vacuum cleaner is connected to the upper end of the rigid air flow conduit the handle is a steering handle for the vacuum cleaner.
16. The surface cleaning apparatus of clause 15 wherein the portable cleaning unit further comprises an electrical cord connectable with a stationary source of power.
17. The surface cleaning apparatus of clause 16 wherein the suction motor is operable only from:

- (a) power supplied from the capacitor, or
- (b) the surface cleaning apparatus further comprises an electrical cord connectable with a stationary source of power and the suction motor is operable from power supplied from the capacitor and power supplied from a stationary power supply.

18. The surface cleaning apparatus of clause 11 wherein the energy storage member stores sufficient stored power to recharge the capacitor at least twice.

19. The surface cleaning apparatus of clause 11 wherein the energy storage member stores sufficient stored power to recharge the capacitor at least three times.

20. The surface cleaning apparatus of clause 11 wherein the floor cleaning unit further comprises a thermal cooling unit thermally connected to the charger.

**Clause Set B:**

1. A surface cleaning apparatus kit comprising:
  - (a) a surface cleaning apparatus comprising:
    - (i) floor cleaning unit comprising a surface cleaning head and a rigid air flow conduit having an upper end and a lower end moveably mounted to the surface cleaning head between an upright storage position and a rearwardly inclined floor cleaning position; and,
    - (ii) a portable surface cleaning unit removably mounted to the rigid air flow conduit, the portable surface cleaning unit comprising a main body, an air treatment member, a suction motor, a handle and a capacitor; and,
  - (b) a charger positionable remote from the surface cleaning apparatus and electrically connectable to a stationary power supply,wherein, when the capacitor is electrically connected to the charger, the capacitor is recharged at a rate of at least 4C.

2. The surface cleaning apparatus kit of clause 1 wherein the capacitor comprises an ultra-capacitor.
3. The surface cleaning apparatus kit of clause 1 wherein the charger is operable to recharge the capacitor at a rate of at least 6C.
4. The surface cleaning apparatus kit of clause 1 further comprising a thermal cooling unit thermally connected to the charger.
5. The surface cleaning apparatus kit of clause 1 wherein the capacitor is removably mounted to the portable surface cleaning unit.
6. The surface cleaning apparatus kit of clause 1 wherein the portable cleaning unit further comprises an electrical cord connectable with a stationary source of power.
7. The surface cleaning apparatus kit of clause 6 wherein the electrical cord is removably connectable with the portable surface cleaning unit.
8. The surface cleaning apparatus kit of clause 1 wherein the portable cleaning unit further comprises an electrical cord connectable with the charger.
9. The surface cleaning apparatus kit of clause 8 wherein the electrical cord is removably connectable with the portable surface cleaning unit.
10. A surface cleaning apparatus kit comprising:
  - (a) a surface cleaning apparatus comprising:
    - (i) floor cleaning unit comprising a surface cleaning head and a rigid air flow conduit having an upper end and a lower end moveably mounted to the surface cleaning head between an upright storage position and a rearwardly inclined floor cleaning position; and,
    - (ii) a portable surface cleaning unit removably mounted to the rigid air flow conduit, the portable surface cleaning unit comprising a main

- body, an air treatment member, a suction motor, a handle and an energy storage member;
- (b) a charger positionable remote from the surface cleaning apparatus and electrically connectable to a stationary power supply; and,
  - (c) a thermal cooling unit thermally connected to the charger.
11. The surface cleaning apparatus kit of clause 10 wherein the energy storage member comprises a capacitor.
12. The surface cleaning apparatus kit of clause 11 wherein the capacitor comprises an ultra-capacitor.
13. The surface cleaning apparatus kit of clause 10 wherein the charger is operable to recharge the capacitor at a rate of at least 6C.
14. The surface cleaning apparatus kit of clause 10 wherein the thermal cooling unit comprises a liquid heat sink.
15. The surface cleaning apparatus kit of clause 10 wherein the capacitor is removably mounted to the portable surface cleaning unit.
16. The surface cleaning apparatus kit of clause 10 wherein the portable cleaning unit further comprises an electrical cord connectable with a stationary source of power.
17. The surface cleaning apparatus kit of clause 16 wherein the electrical cord is removably connectable with the portable surface cleaning unit.
18. The surface cleaning apparatus kit of clause 10 wherein the portable cleaning unit further comprises an electrical cord connectable with the charger.
19. The surface cleaning apparatus kit of clause 18 wherein the electrical cord is removably connectable with the portable surface cleaning unit.

**Clause Set C:**

1. A method of cleaning a surface using a stick vacuum cleaner, the stick vacuum cleaner comprising:
  - (a) a floor cleaning unit comprising:
    - (i) a surface cleaning head having a front end having a dirty air inlet and a rear end;
    - (ii) a rigid air flow conduit having an upper end and a lower end moveably mounted to the surface cleaning head between an upright storage position and a rearwardly inclined floor cleaning position; and,
    - (iii) an air flow path extending from the dirty air inlet to a rigid air flow conduit air outlet; and,
  - (b) a hand vacuum cleaner removably mounted to the upper end of the rigid air flow conduit, the hand vacuum cleaner comprising a main body, an air treatment member, a suction motor, a handle and a capacitor, the method comprising:
    - (a) removing the hand vacuum cleaner from the upper end of the rigid air flow conduit and using the portable cleaning unit to clean a surface;
    - (b) subsequently mounting the hand vacuum cleaner on the upper end of the rigid air flow conduit and using the stick vacuum cleaner to clean a floor for up to 15 minutes while the capacitor at least substantially recharges; and,
    - (c) subsequently removing the hand vacuum cleaner from the upper end of the rigid air flow conduit and using the hand vacuum cleaner to clean a surface.
2. The method of clause 1 wherein step (b) comprises using the stick vacuum cleaner to clean the floor for up to 15 minutes while the capacitor fully recharges.

3. The method of clause 1 wherein step (b) comprises using the stick vacuum cleaner to clean a floor for up to 10 minutes while the capacitor at least substantially recharges.
4. The method of clause 1 wherein step (b) comprises using the stick vacuum cleaner to clean a floor for up to 10 minutes while the capacitor fully recharges.
5. The method of clause 1 wherein the floor cleaning unit further comprises a charger having an energy storage member, wherein, when fully charged, the energy storage member stores sufficient stored power to recharge the capacitor at least twice, and step (b) comprises using the energy storage member to recharge the capacitor.
6. A method of cleaning a surface using a surface cleaning apparatus, the surface cleaning apparatus comprising:
  - (a) a floor cleaning unit comprising a surface cleaning head and a rigid air flow conduit having an upper end and a lower end moveably mounted to the surface cleaning head between an upright storage position and a rearwardly inclined floor cleaning position; and,
  - (b) a portable surface cleaning unit removably mounted to the rigid air flow conduit, the portable surface cleaning unit comprising a main body, an air treatment member, a suction motor, a handle and a capacitor,the method comprising:
  - (a) removing the portable cleaning unit from the floor cleaning unit and using the portable cleaning unit to clean a surface;
  - (b) subsequently mounting the portable cleaning unit on the floor cleaning unit and using the surface cleaning apparatus to clean a floor for up to 15 minutes while the capacitor at least substantially recharges; and,
  - (c) subsequently removing the portable cleaning unit from the floor cleaning unit and using the portable cleaning unit to clean a surface.

7. The method of clause 6 wherein step (b) comprises using the surface cleaning apparatus to clean the floor for up to 15 minutes while the capacitor fully recharges.
8. The method of clause 6 wherein step (b) comprises using the surface cleaning apparatus to clean a floor for up to 10 minutes while the capacitor at least substantially recharges.
9. The method of clause 6 wherein step (b) comprises using the surface cleaning apparatus to clean a floor for up to 10 minutes while the capacitor fully recharges.
10. The method of clause 6 wherein the floor cleaning unit further comprises a charger having an energy storage member, wherein, when fully charged, the energy storage member stores sufficient stored power to recharge the capacitor at least twice, and step (b) comprises using the energy storage member to recharge the capacitor.
11. A stick vacuum cleaner comprising:
  - (a) a surface cleaning head;
  - (b) a rigid air flow conduit having an upper end and a lower end moveably mounted to the surface cleaning head between an upright storage position and a rearwardly inclined floor cleaning position; and,
  - (c) a hand vacuum cleaner removably mounted to the upper end of the rigid air flow conduit, the hand vacuum cleaner comprising a main body, an air treatment member, a suction motor, a handle, a capacitor and an electrical cord connectable with a stationary source of power,wherein, when the portable surface cleaning unit is mounted to the upper end of the rigid air flow conduit, the handle is a steering handle for the vacuum cleaner.
12. The stick vacuum cleaner of clause 11 wherein the electrical cord is removably connectable with the hand vacuum cleaner.

13. The stick vacuum cleaner of clause 11 wherein the capacitor is removably mounted to the hand vacuum cleaner.

14. The stick vacuum cleaner of clause 11 wherein the capacitor is an ultra-capacitor.

**CLAIMS:**

1. A surface cleaning apparatus comprising:
  - (a) a floor cleaning unit comprising:
    - (i) a surface cleaning head having a front end having a dirty air inlet, a rear end and a center positioned midway between the front and rear ends;
    - (ii) an upper section moveably mounted to the surface cleaning head between an upright storage position and a rearwardly inclined floor cleaning position;
    - (iii) a charger having an energy storage member; and,
    - (iv) an air flow path extending from the dirty air inlet to a floor cleaning unit air outlet; and,
  - (b) a portable surface cleaning unit connectable to the floor cleaning unit, the portable surface cleaning unit comprising a portable surface cleaning unit air inlet connectable in air flow communication with the floor cleaning unit air outlet, a main body, an air treatment member, a suction motor, a handle and a capacitor,  
wherein, when fully charged, the energy storage member stores sufficient stored power to recharge the capacitor at least twice.
2. The surface cleaning apparatus of claim 1 wherein the suction motor is not operable directly on power supplied by the energy storage member.
3. The surface cleaning apparatus of claim 1 wherein the suction motor is operable only from:
  - (a) power supplied from the capacitor, or
  - (b) the surface cleaning apparatus further comprises an electrical cord connectable with a stationary source of power and the suction motor is operable from power supplied from the capacitor and power supplied from a stationary power supply.
4. The surface cleaning apparatus of claim 1 wherein the energy storage member is provided in the surface cleaning head.

5. The surface cleaning apparatus of claim 4 wherein the energy storage member has a center of gravity and the center of gravity is positioned forward of the center of the surface cleaning head.
6. The surface cleaning apparatus of claim 1 wherein the floor cleaning unit further comprises a thermal cooling unit thermally connected to the charger.
7. The surface cleaning apparatus of claim 6 wherein the charger is operable to recharge the capacitor at a rate of at least 4C.
8. The surface cleaning apparatus of claim 6 wherein the charger is operable to recharge the capacitor at a rate of at least 6C.
9. The surface cleaning apparatus of claim 1 wherein the capacitor comprises an ultra-capacitor.
10. The surface cleaning apparatus of claim 1 further comprising an electrical cord connectable with a stationary source of power.
11. The surface cleaning apparatus of claim 1 wherein the portable cleaning unit further comprises an electrical cord connectable with a stationary source of power.
12. The surface cleaning apparatus of claim 11 wherein the electrical cord is removably connectable with the portable cleaning unit.
13. The surface cleaning apparatus of claim 1 wherein the capacitor is removably mounted in the portable surface cleaning unit.
14. The surface cleaning apparatus of claim 1 wherein the portable surface cleaning unit comprises a hand vacuum cleaner and the upper section comprises a rigid air flow conduit having an upper end and a lower end,

wherein the lower end of the rigid air flow conduit is moveably mounted to the surface cleaning head between the upright storage position and the rearwardly inclined floor cleaning position, and

wherein the hand vacuum cleaner is connectable to the upper end of the rigid air flow conduit,

whereby, when the hand vacuum cleaner is connected to the upper end of the rigid air flow conduit the handle is a steering handle for the vacuum cleaner.

15. The surface cleaning apparatus of claim 14 wherein the portable cleaning unit further comprises an electrical cord connectable with a stationary source of power.
16. The surface cleaning apparatus of claim 15 wherein the suction motor is operable only from:
  - (a) power supplied from the capacitor, or
  - (b) the surface cleaning apparatus further comprises an electrical cord connectable with a stationary source of power and the suction motor is operable from power supplied from the capacitor and power supplied from a stationary power supply.
17. The surface cleaning apparatus of claim 14 wherein the energy storage member is provided in the surface cleaning head.
18. The surface cleaning apparatus of claim 17 wherein the energy storage member has a center of gravity and the center of gravity is positioned forward of the center of the surface cleaning head.
19. The surface cleaning apparatus of claim 1 wherein the charger is operable to recharge the capacitor at a rate of at least 4C.
20. The surface cleaning apparatus of claim 1 wherein the energy storage member stores sufficient stored power to recharge the capacitor at least three times.

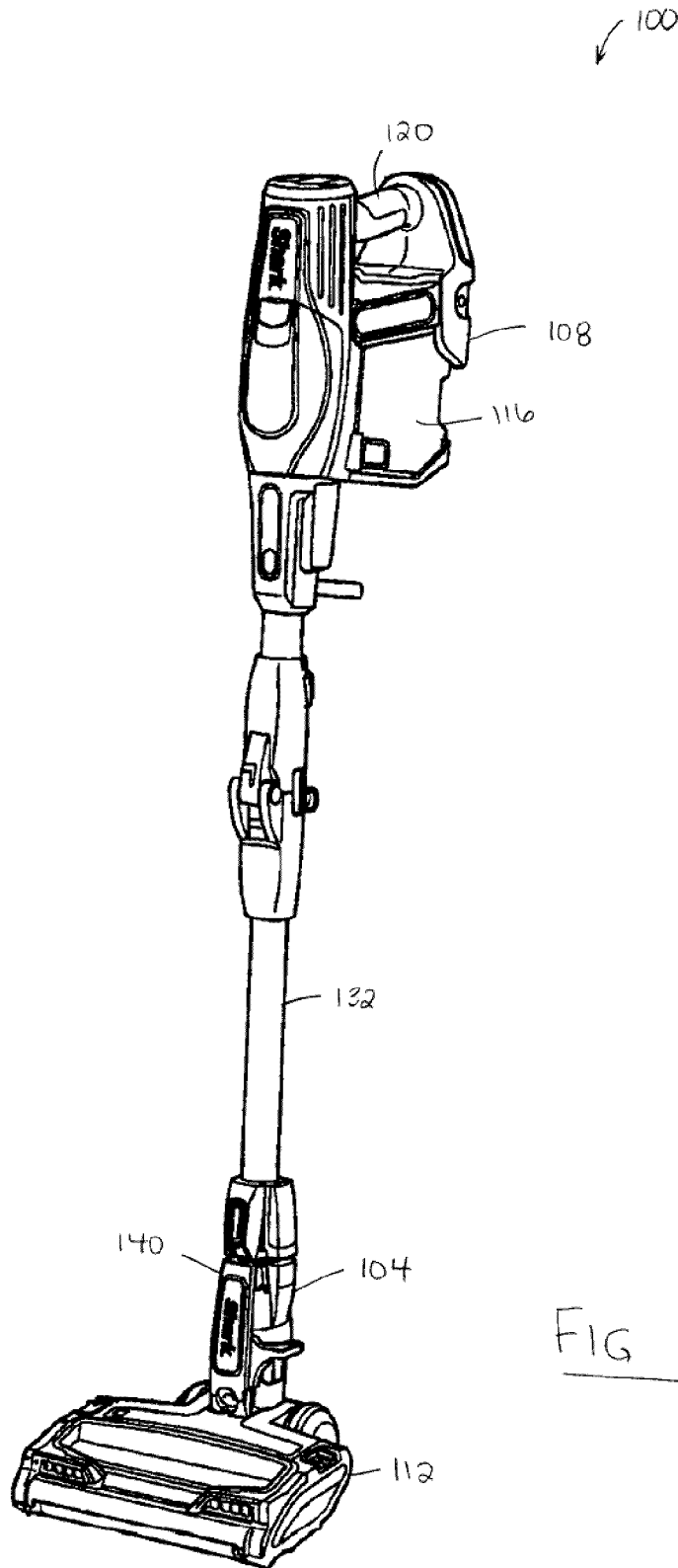

FIG 1

2/22

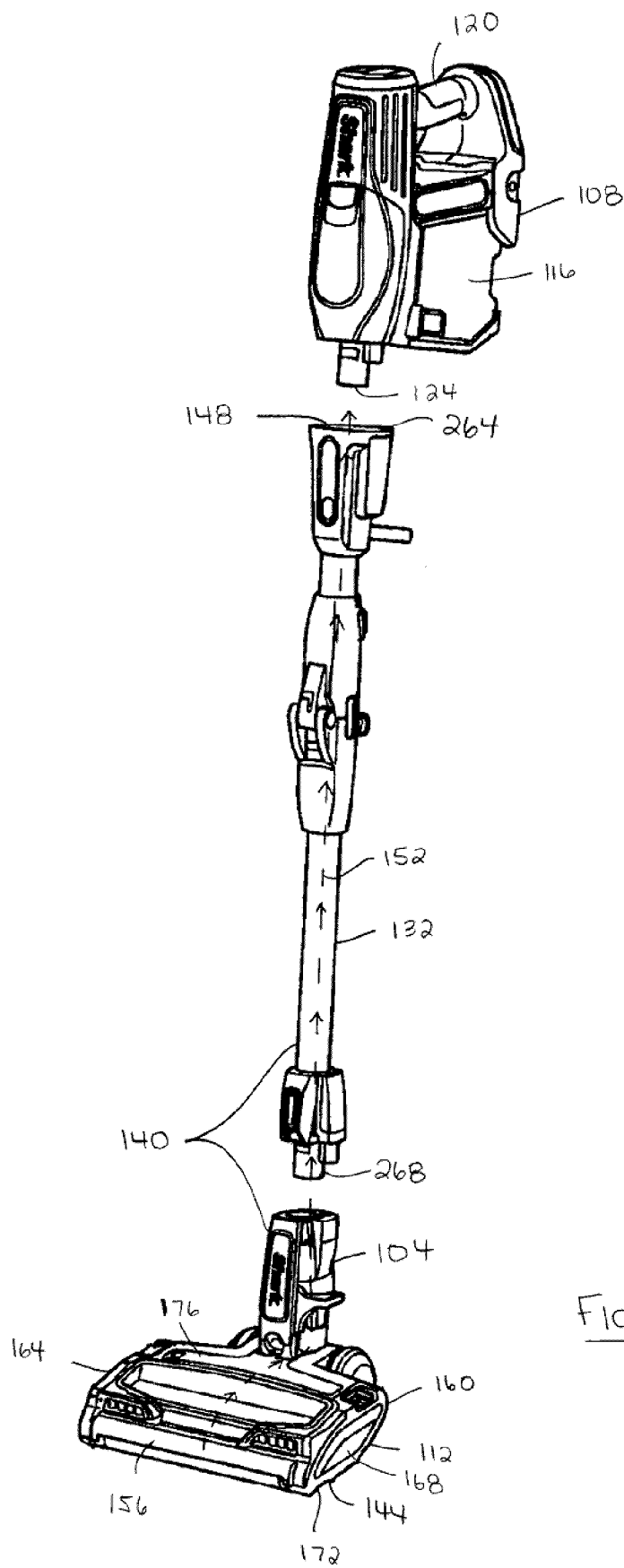

Fig. 2

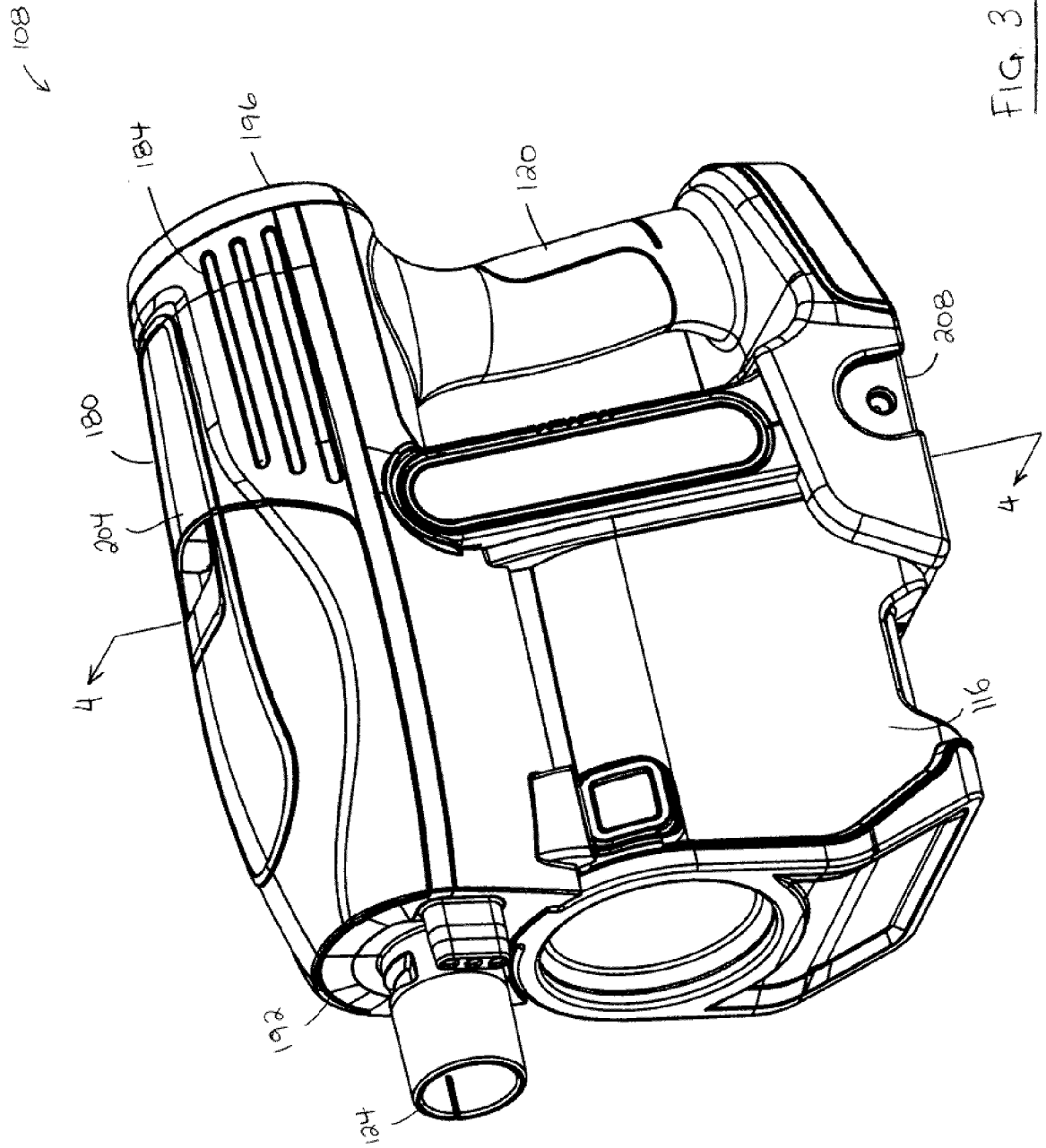

FIG. 3

108 ↙

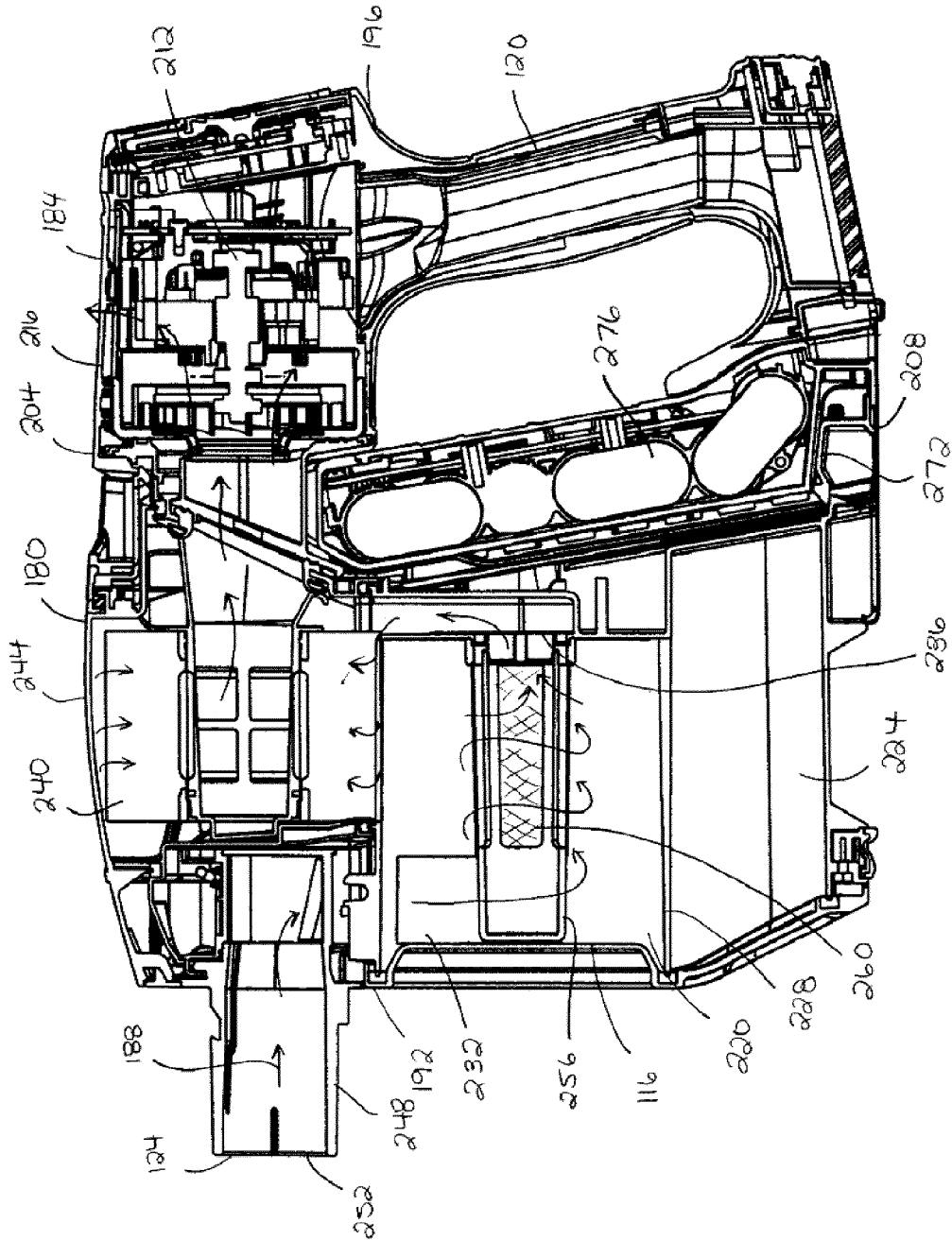

FIG. 4

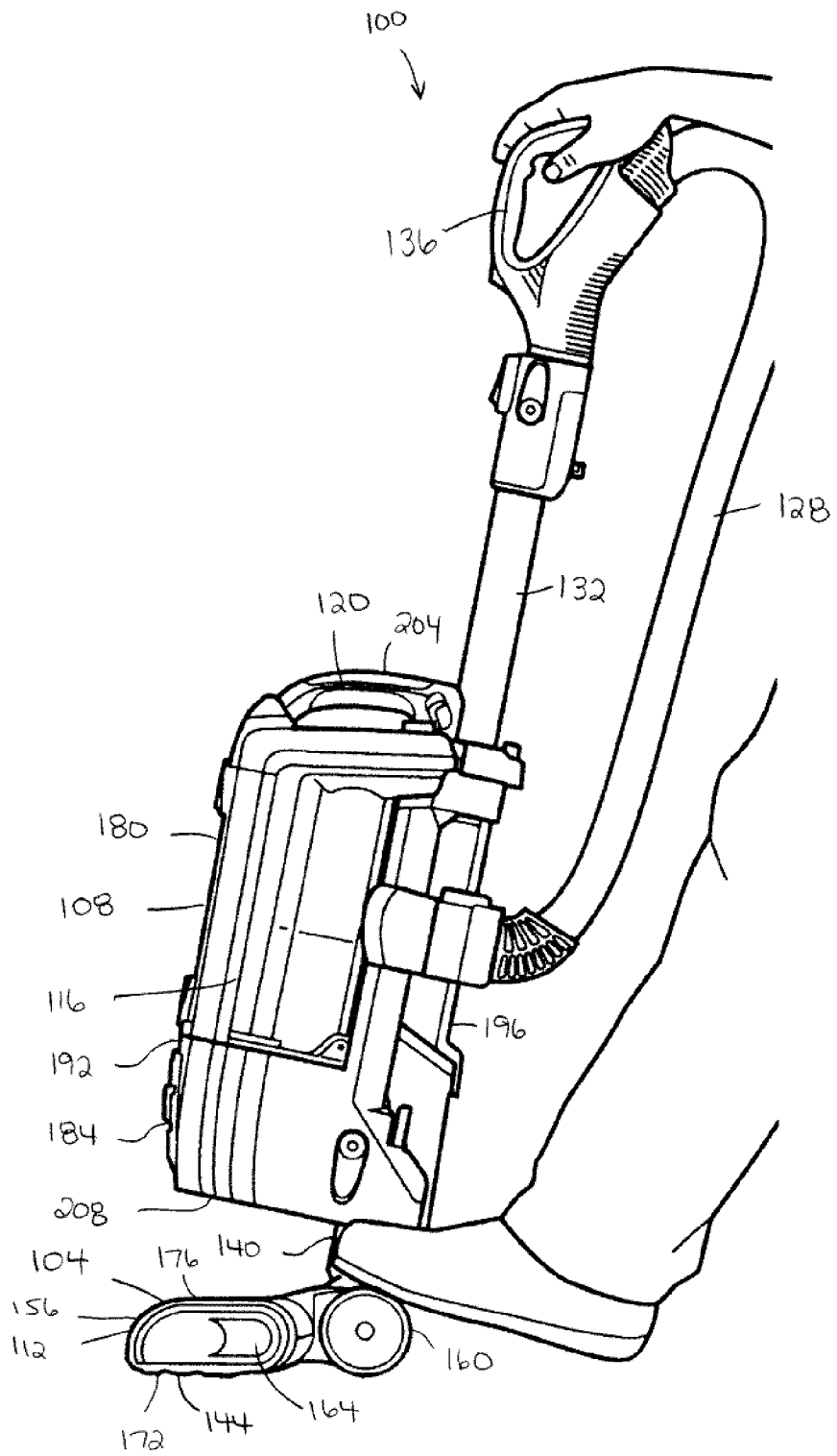

FIG 5

6/22

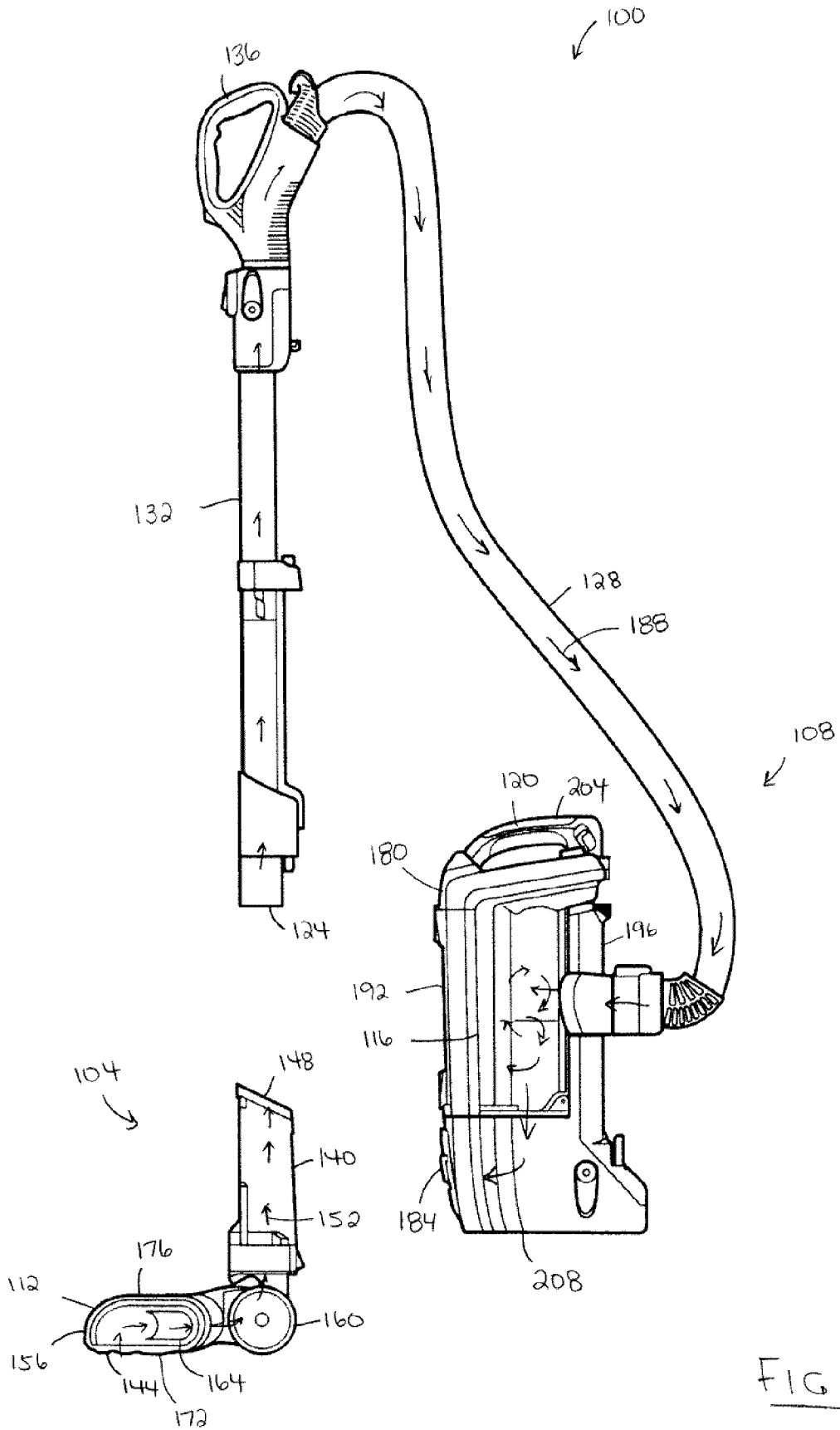
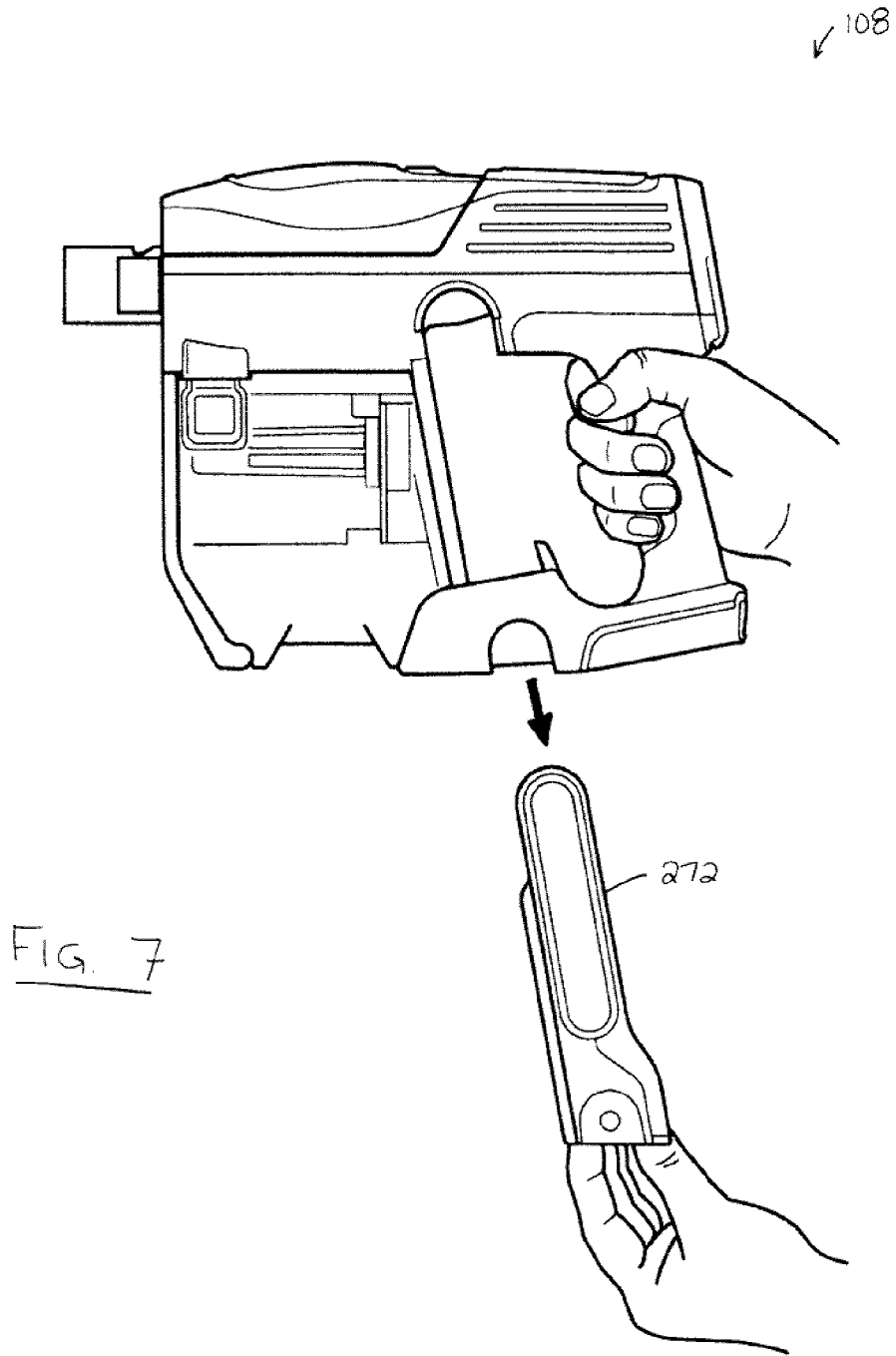

FIG 6



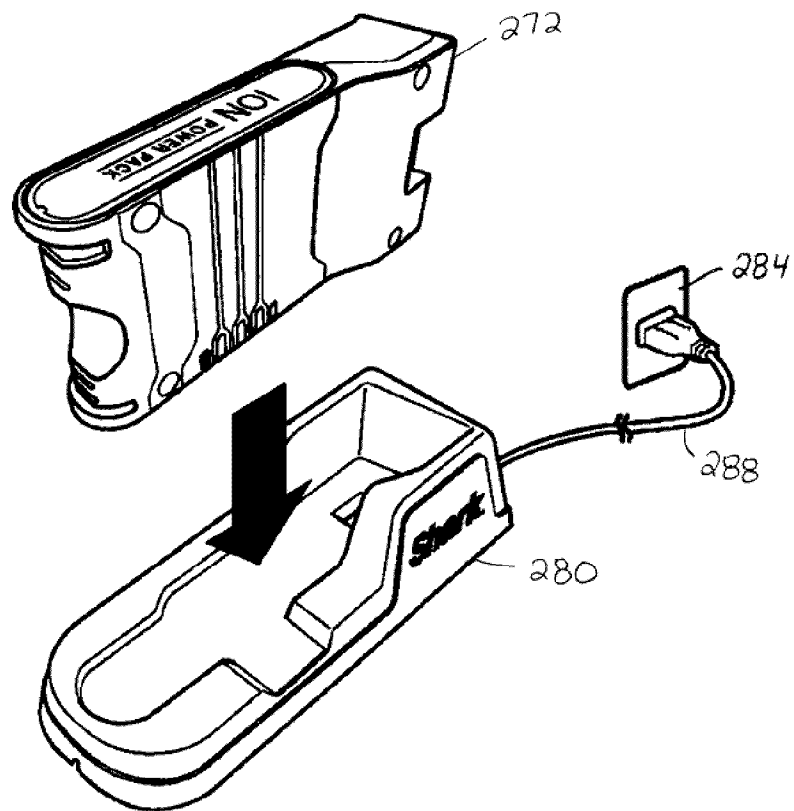

FIG. 8

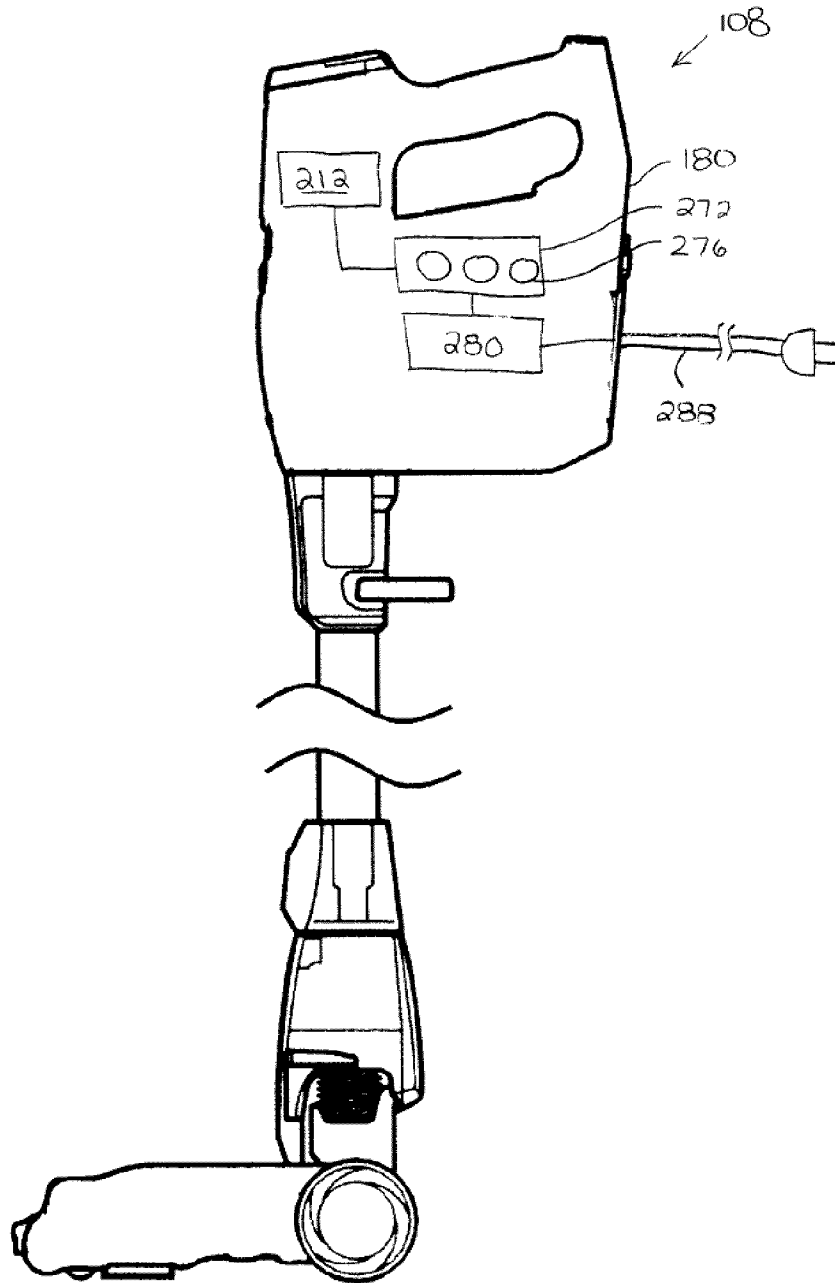

FIG 9

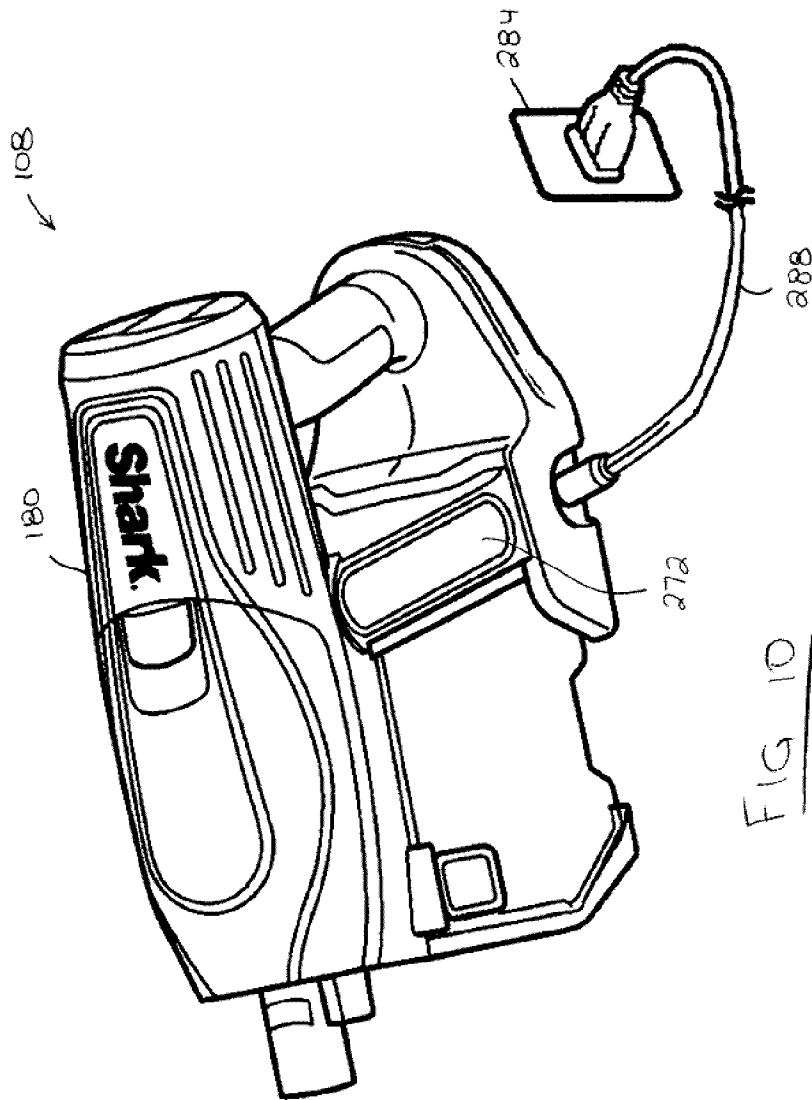
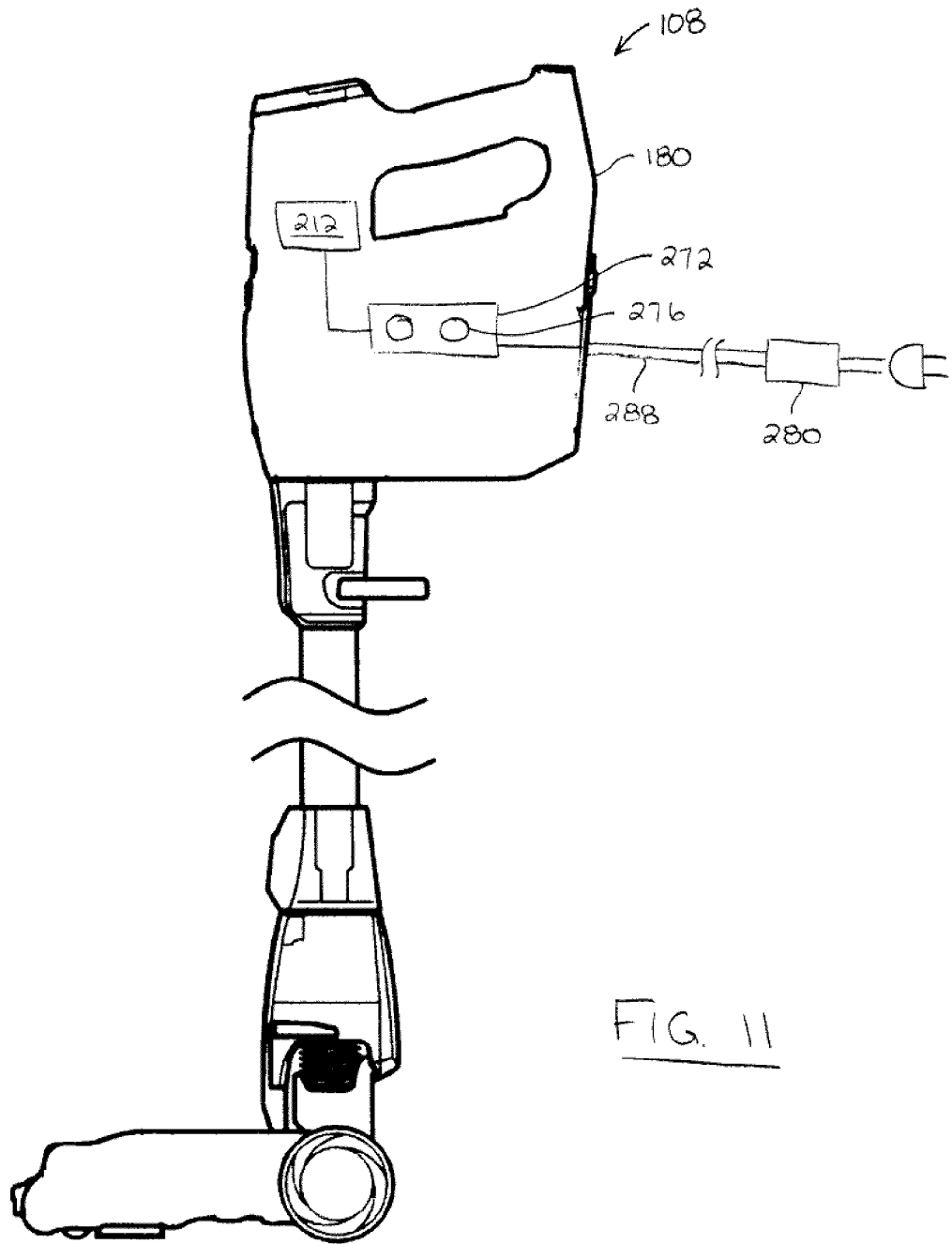

FIG 10

11/22



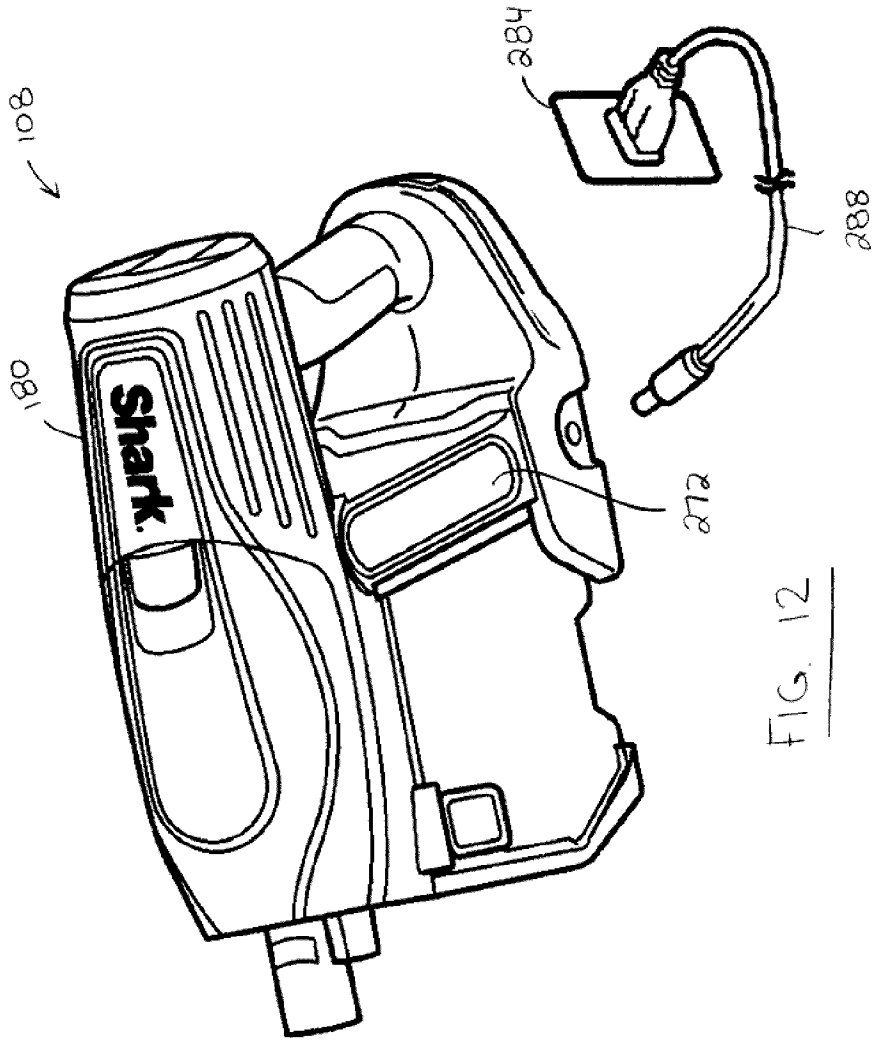

FIG. 12

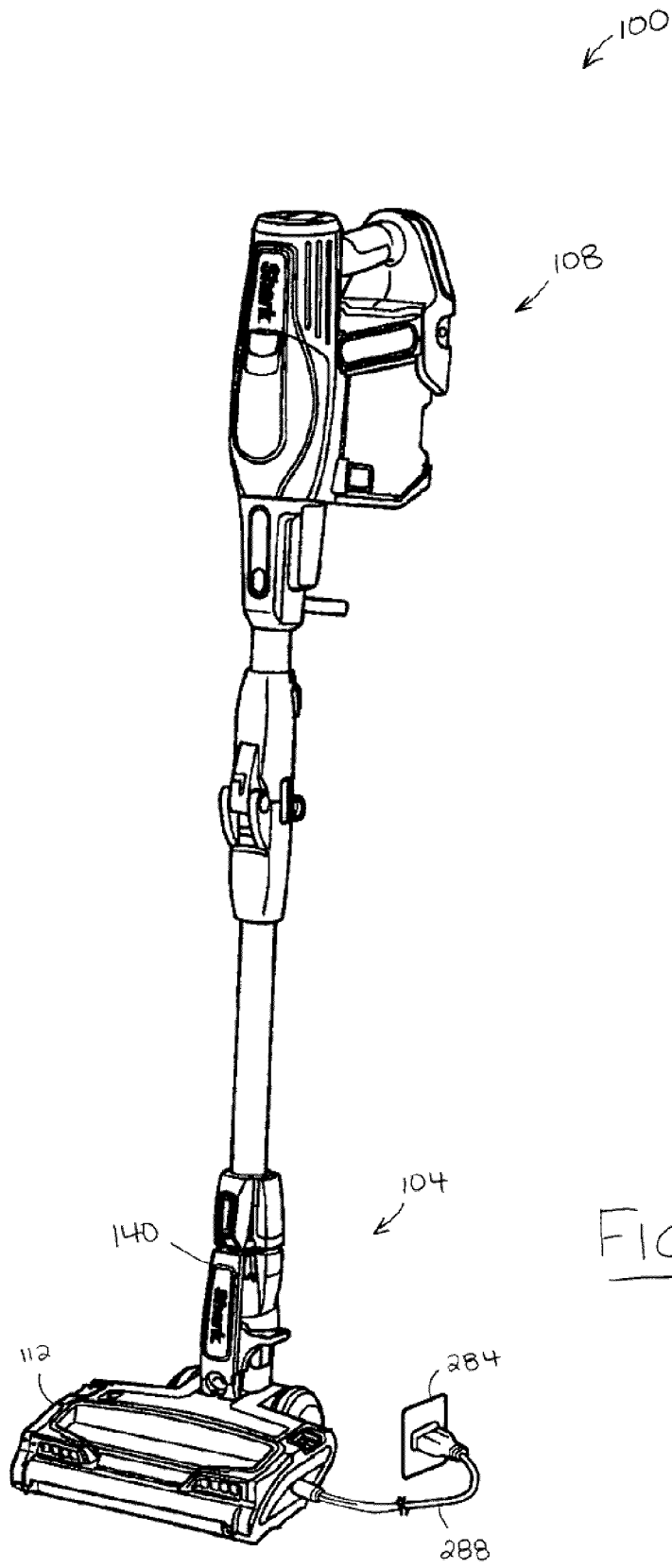

FIG. 13

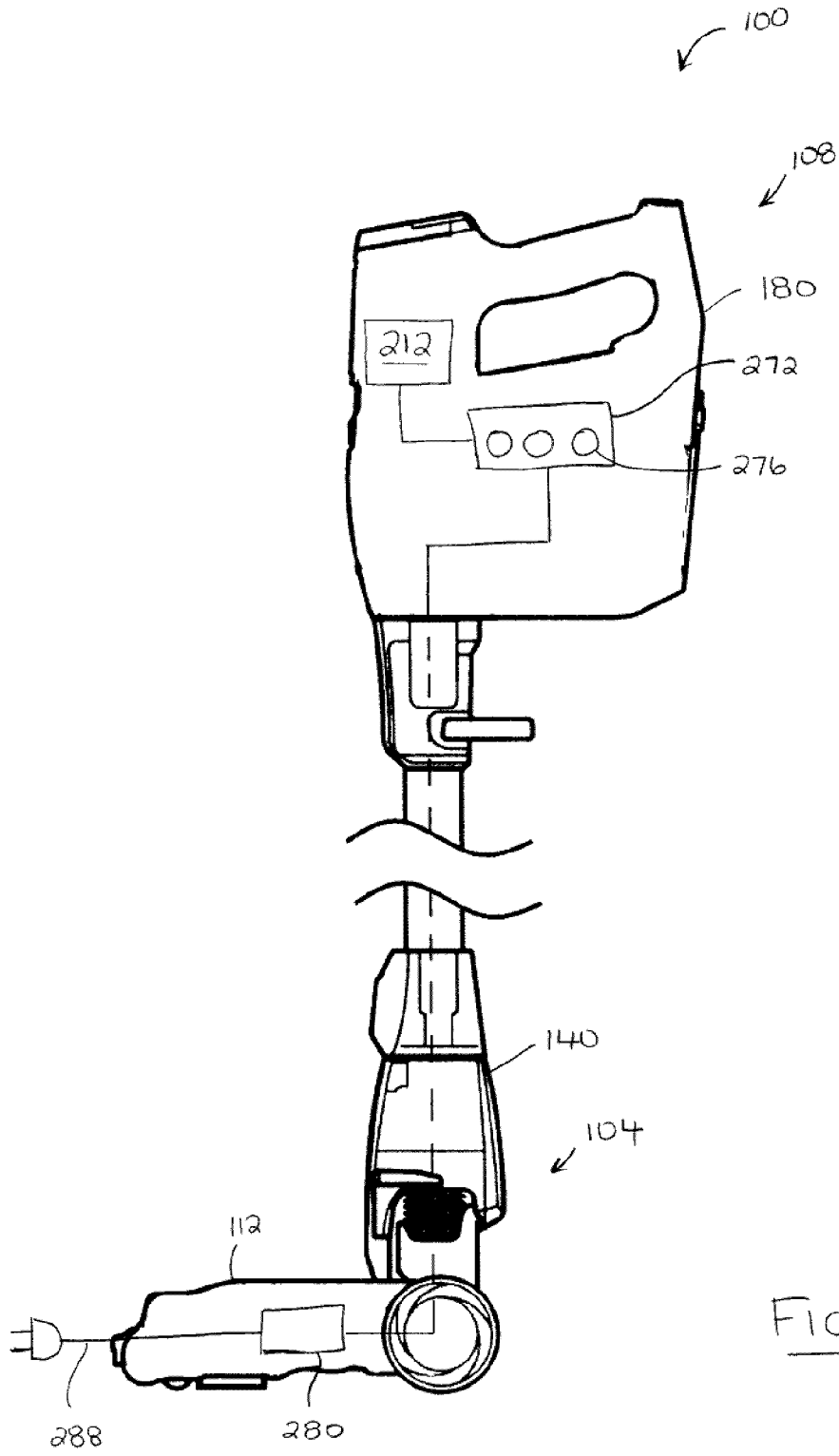

FIG. 14

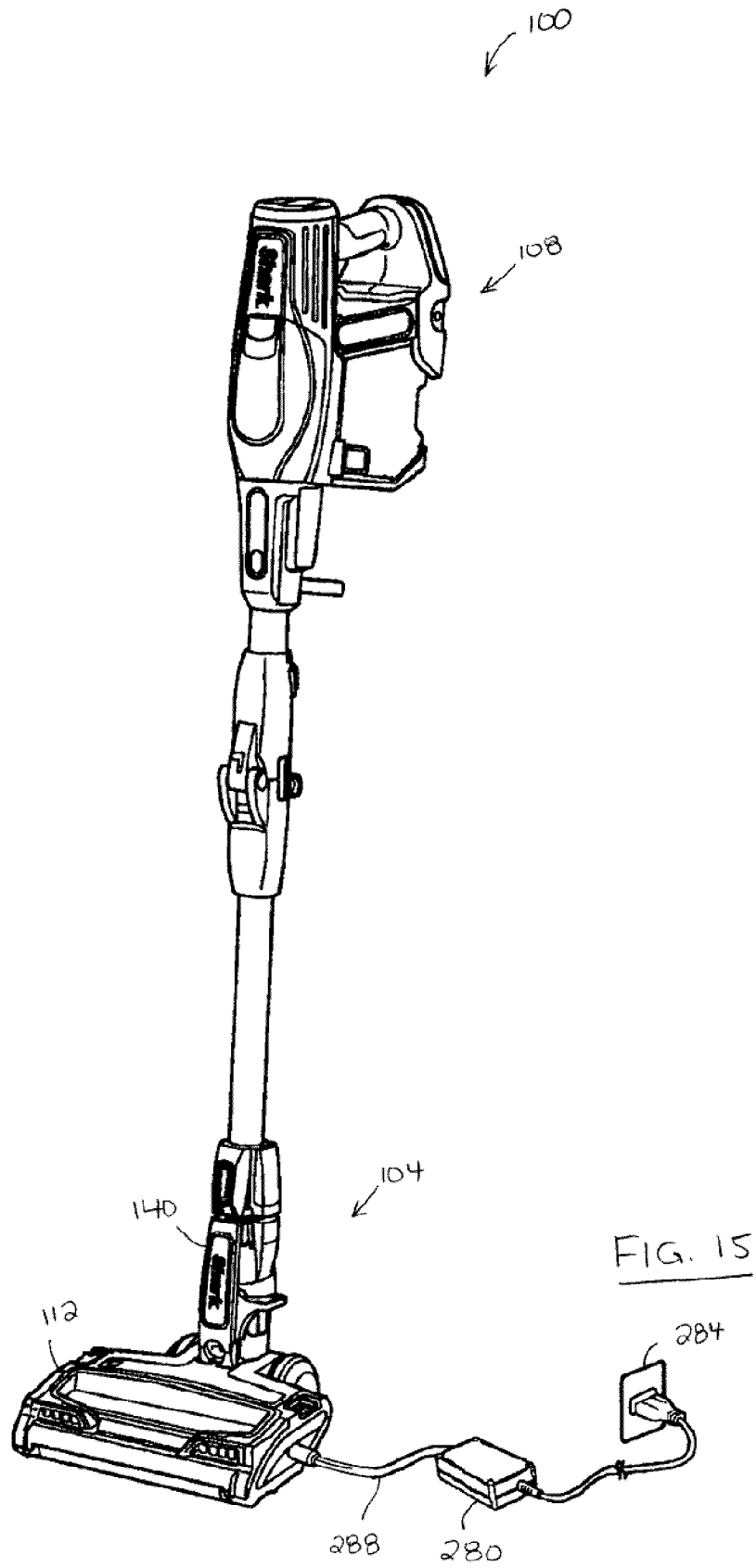

FIG. 15

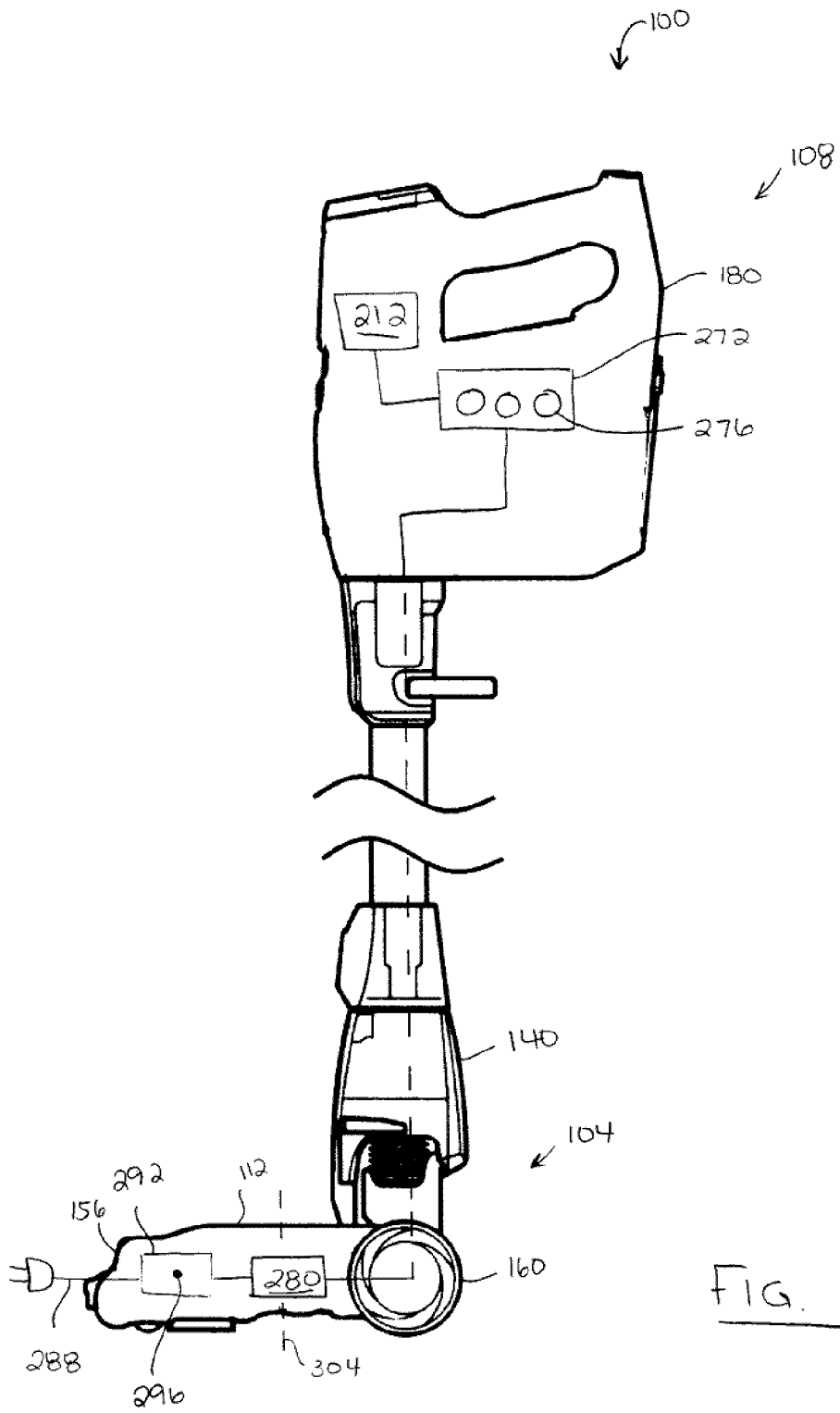

FIG. 16

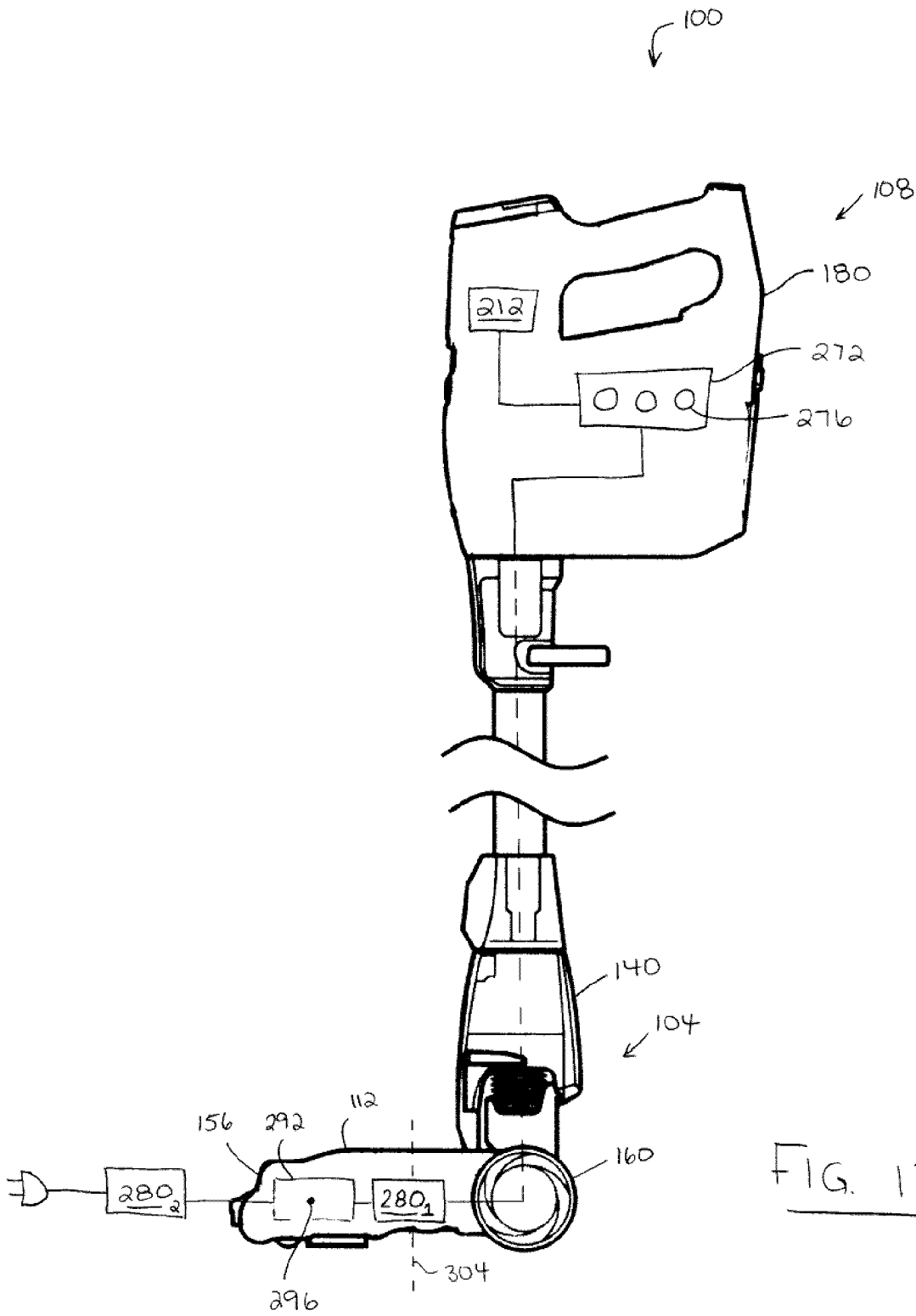

FIG. 17

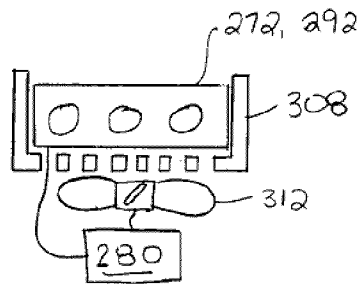

FIG. 18

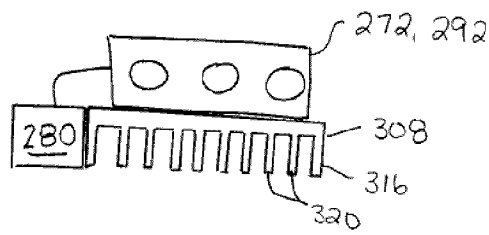

FIG. 19

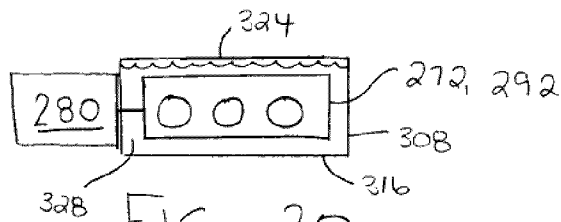

FIG. 20

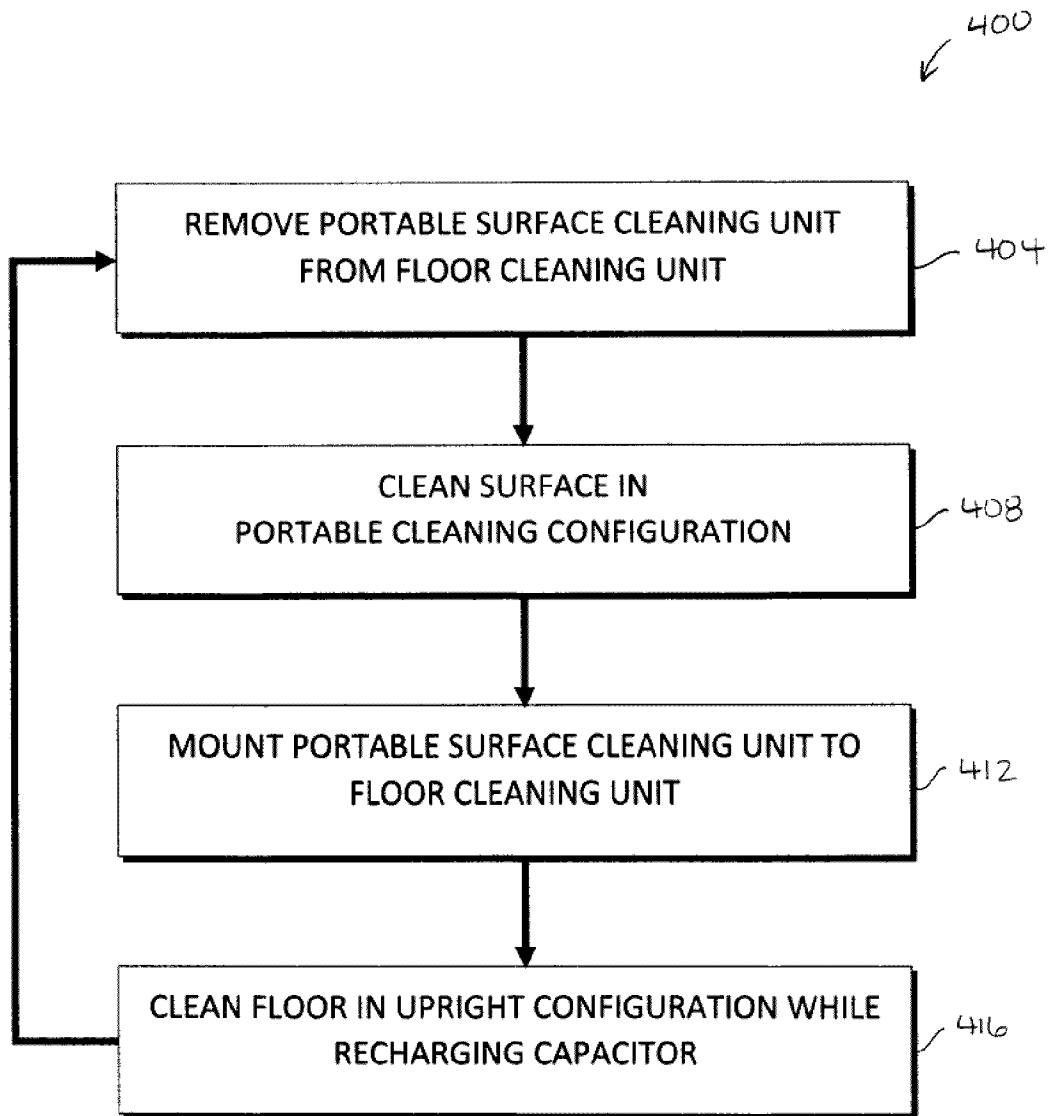

FIG. 21

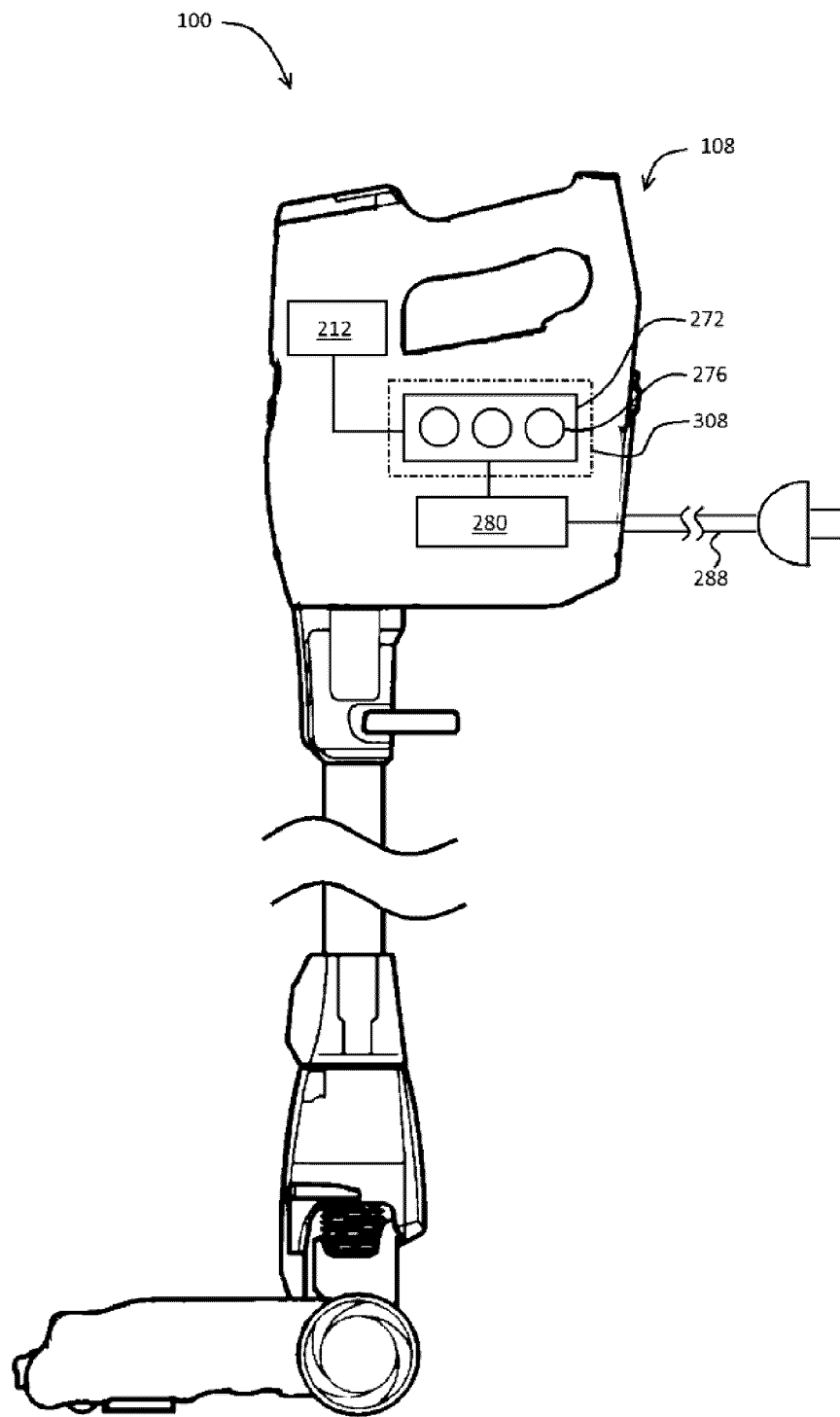
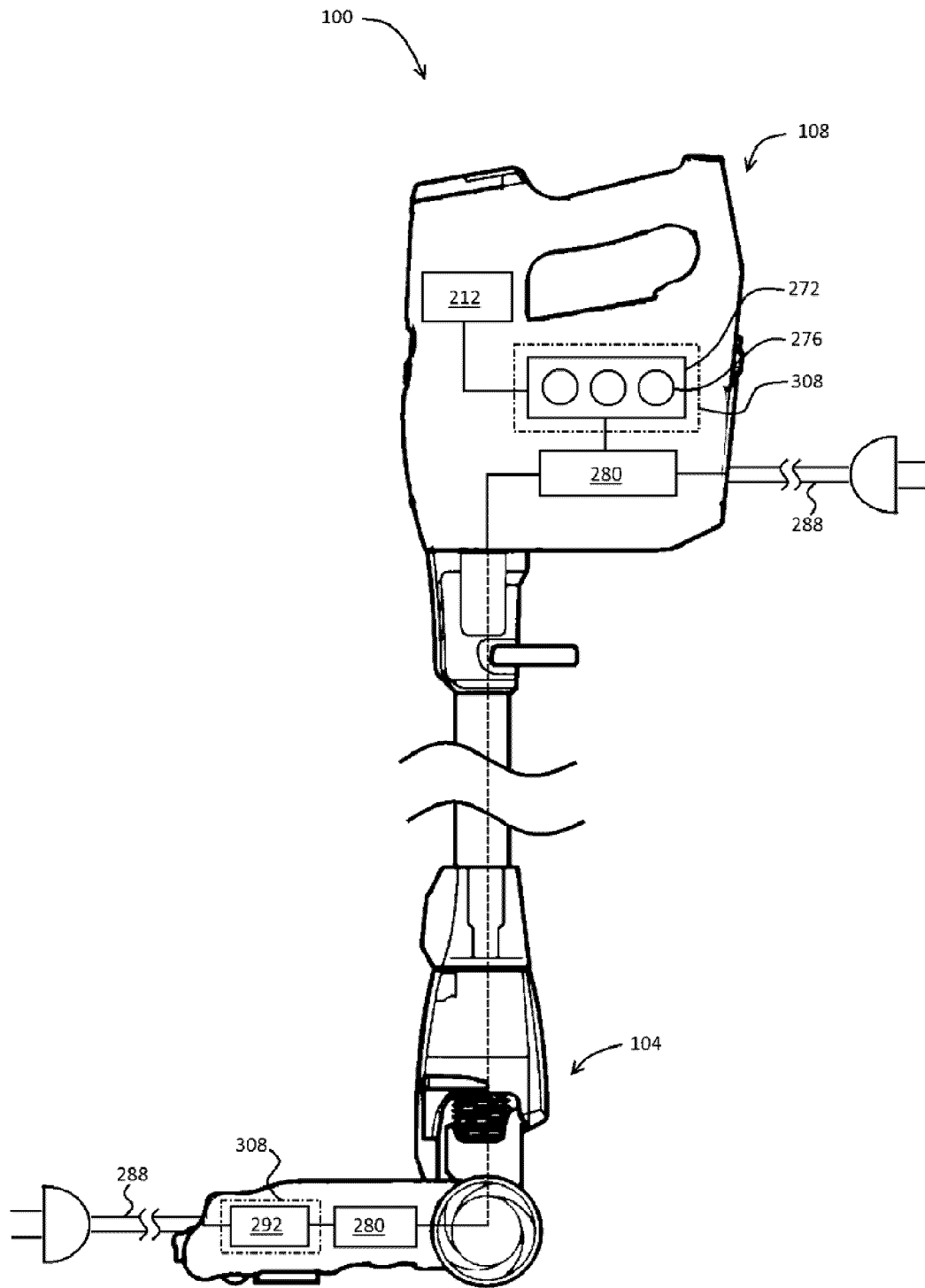
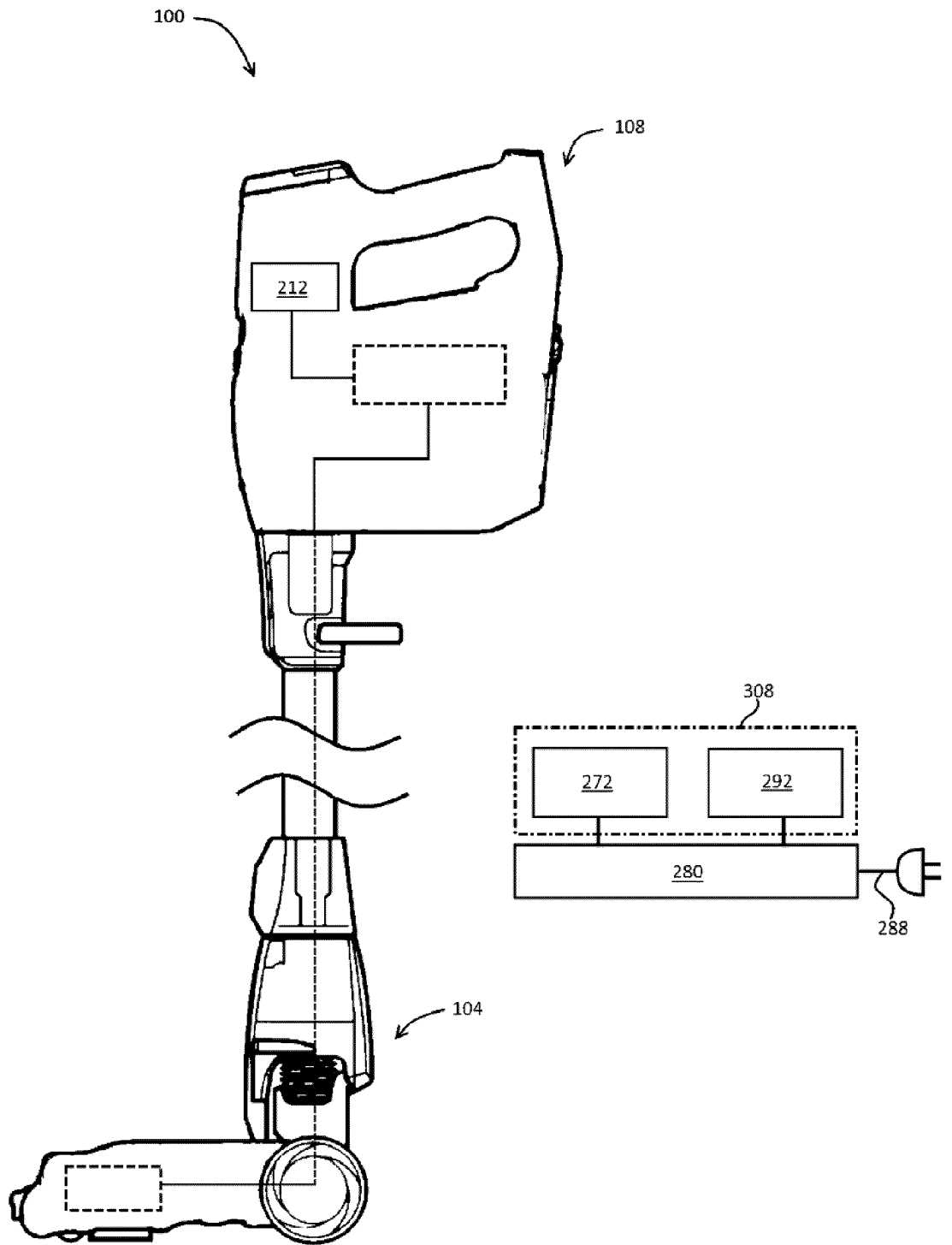

FIG. 22



**FIG. 23**



**FIG. 24**

## INTERNATIONAL SEARCH REPORT

International application No.  
**PCT/CA2020/050158**A. CLASSIFICATION OF SUBJECT MATTER  
IPC: *A47L 9/28* (2006.01), *A47L 5/24* (2006.01), *A47L 5/28* (2006.01)

According to International Patent Classification (IPC) or to both national classification and IPC

## B. FIELDS SEARCHED

Minimum documentation searched (classification system followed by classification symbols)  
IPC (2006.01): A47L

Documentation searched other than minimum documentation to the extent that such documents are included in the fields searched

Electronic database(s) consulted during the international search (name of database(s) and, where practicable, search terms used)

Questel Orbit, Canadian Patent Office Database (Intellect), IEEE Xplore.

Keywords: surface, clean, head, air, stor\*, position, communicat\*, energy, flow, capacitor, portable.

## C. DOCUMENTS CONSIDERED TO BE RELEVANT

Category*	Citation of document, with indication, where appropriate, of the relevant passages	Relevant to claim No.
A	US 2008/0196745 A1 (Conrad) – 21 August 2008 (21-08-2008) *See Abstract, Paragraphs [0003] – [0005], [0051] – [0053], Figures 1 – 11B	1-20
A	US 2019/0014963 A1 (Barabeisch et al.), 17 January 2019 (17-01-2019) *See whole document	1-20
A	US 2005/0000054 A1 (Ninomiya et al.), 06 January 2005 (06-01-2005) *See whole document	1-20

 Further documents are listed in the continuation of Box C. See patent family annex.

* Special categories of cited documents:	“T” later document published after the international filing date or priority date and not in conflict with the application but cited to understand the principle or theory underlying the invention
“A” document defining the general state of the art which is not considered to be of particular relevance	“X” document of particular relevance; the claimed invention cannot be considered novel or cannot be considered to involve an inventive step when the document is taken alone
“D” document cited by the applicant in the international application	“Y” document of particular relevance; the claimed invention cannot be considered to involve an inventive step when the document is combined with one or more other such documents, such combination being obvious to a person skilled in the art
“E” earlier application or patent but published on or after the international filing date	“&” document member of the same patent family
“L” document which may throw doubts on priority claim(s) or which is cited to establish the publication date of another citation or other special reason (as specified)	
“O” document referring to an oral disclosure, use, exhibition or other means	
“P” document published prior to the international filing date but later than the priority date claimed	

Date of the actual completion of the international search  
16 March 2020 (16-03-2020)Date of mailing of the international search report  
15 April 2020 (15-04-2020)Name and mailing address of the ISA/CA  
Canadian Intellectual Property Office  
Place du Portage I, C114 - 1st Floor, Box PCT  
50 Victoria Street  
Gatineau, Quebec K1A 0C9  
Facsimile No.: 819-953-2476Authorized officer  
  
Sajith Bandaranayake (819) 639-5760

**INTERNATIONAL SEARCH REPORT**  
Information on patent family members

International application No.  
**PCT/CA2020/050158**

Patent Document Cited in Search Report	Publication Date	Publication Family Member(s)	Publication Date
US2008196745A1	21 August 2008 (21-08-2008)	US2008196745A1	21 August 2008 (21-08-2008)
		US8713751B2	06 May 2014 (06-05-2014)
		AU2007332043A1	19 June 2008 (19-06-2008)
		AU2007332048A1	19 June 2008 (19-06-2008)
		AU2007332115A1	19 June 2008 (19-06-2008)
		AU2007332116A1	19 June 2008 (19-06-2008)
		CA2593950A1	12 June 2008 (12-06-2008)
		CA2593950C	15 January 2013 (15-01-2013)
		CA2599303A1	28 February 2009 (28-02-2009)
		CA2658005A1	11 September 2010 (11-09-2010)
		CN101657134A	24 February 2010 (24-02-2010)
		CN101657134B	08 May 2013 (08-05-2013)
		CN101662975A	03 March 2010 (03-03-2010)
		CN109310254A	05 February 2019 (05-02-2019)
		DE112007003039T5	29 October 2009 (29-10-2009)
		DE112007003052T5	14 January 2010 (14-01-2010)
		EP2101622A1	23 September 2009 (23-09-2009)
		EP2101622A4	23 June 2010 (23-06-2010)
		EP2106233A1	07 October 2009 (07-10-2009)
		EP2106233A4	26 May 2010 (26-05-2010)
		EP2114231A1	11 November 2009 (11-11-2009)
		EP2114231A4	23 June 2010 (23-06-2010)
		GB2535604A	24 August 2016 (24-08-2016)
		GB2535604B	07 June 2017 (07-06-2017)
		GB2535604C	27 June 2018 (27-06-2018)
		GB201706875D0	14 June 2017 (14-06-2017)
		GB2546923A	02 August 2017 (02-08-2017)
		GB2546923A9	20 June 2018 (20-06-2018)
		JP2010512196A	22 April 2010 (22-04-2010)
		JP2010512197A	22 April 2010 (22-04-2010)
		JP2017537743A	21 December 2017 (21-12-2017)
		KR20090106515A	09 October 2009 (09-10-2009)
		KR20090106516A	09 October 2009 (09-10-2009)
		KR20090112649A	28 October 2009 (28-10-2009)
		US2008172995A1	24 July 2008 (24-07-2008)
		US2008216282A1	11 September 2008 (11-09-2008)
		US8151407B2	10 April 2012 (10-04-2012)
		US2008178420A1	31 July 2008 (31-07-2008)
		US8166607B2	01 May 2012 (01-05-2012)
		US2008196195A1	21 August 2008 (21-08-2008)
		US8176596B2	15 May 2012 (15-05-2012)
		US2010243158A1	30 September 2010 (30-09-2010)
		US8349428B2	08 January 2013 (08-01-2013)
		US2015000076A1	01 January 2015 (01-01-2015)
		US9949601B2	24 April 2018 (24-04-2018)
		US2017290476A1	12 October 2017 (12-10-2017)
		US9986880B2	05 June 2018 (05-06-2018)
		US2019328188A1	31 October 2019 (31-10-2019)
		US2019374079A1	12 December 2019 (12-12-2019)
		US2020029759A1	30 January 2020 (30-01-2020)
		US2020046182A1	13 February 2020 (13-02-2020)
		WO2008070962A1	19 June 2008 (19-06-2008)
		WO2008070980A1	19 June 2008 (19-06-2008)
		WO2008109984A1	18 September 2008 (18-09-2008)
		WO2009026700A1	05 March 2009 (05-03-2009)
		WO2009026708A1	05 March 2009 (05-03-2009)
		WO2016095041A1	23 June 2016 (23-06-2016)
		WO2017177318A1	19 October 2017 (19-10-2017)

## INTERNATIONAL SEARCH REPORT

International application No.

**PCT/CA2020/050158**

Patent Document Cited in Search Report	Publication Date	Publication Family Member(s)	Publication Date
US2019014963A1	17 January 2019 (17-01-2019)	US2019014963A1	17 January 2019 (17-01-2019)
		CN108697287A	23 October 2018 (23-10-2018)
		DE102016100780A1	20 July 2017 (20-07-2017)
		EP3405089A1	28 November 2018 (28-11-2018)
		EP3405089B1	01 January 2020 (01-01-2020)
		WO2017125298A1	27 July 2017 (27-07-2017)
US2005000054A1	06 January 2005 (06-01-2005)	US2005000054A1	06 January 2005 (06-01-2005)
		US7591043B2	22 September 2009 (22-09-2009)
		CN1578638A	09 February 2005 (09-02-2005)
		CN1283202C	08 November 2006 (08-11-2006)
		CN2801057Y	02 August 2006 (02-08-2006)
		DE60220683D1	26 July 2007 (26-07-2007)
		DE60220683T2	06 March 2008 (06-03-2008)
		EP1424032A1	02 June 2004 (02-06-2004)
		EP1424032A4	14 September 2005 (14-09-2005)
		EP1424032B1	13 June 2007 (13-06-2007)
		JP2003153831A	27 May 2003 (27-05-2003)
		JP4159298B2	01 October 2008 (01-10-2008)
		US2009211052A1	27 August 2009 (27-08-2009)
		US8627531B2	14 January 2014 (14-01-2014)
		WO03022118A1	20 March 2003 (20-03-2003)
		WO03022119A1	20 March 2003 (20-03-2003)