



- (51) **International Patent Classification:**
C03B 17/06 (2006.01) *C03B 23/037* (2006.01)
C03B 18/04 (2006.01)
- (21) **International Application Number:**
PCT/US2013/067714
- (22) **International Filing Date:**
31 October 2013 (31.10.2013)
- (25) **Filing Language:** English
- (26) **Publication Language:** English
- (30) **Priority Data:**
13/669,994 6 November 2012 (06.11.2012) US
- (71) **Applicant:** CORNING INCORPORATED [US/US]; 1 Riverfront Plaza, Corning, NY 14831 (US).
- (72) **Inventors; and**
- (71) **Applicants :** LEBLANC, Philip, Robert [CA/US]; 29 West Fourth Street, Corning, NY14830 (US). USTANIK, Correy, Robert [US/US]; 41 Hemlock Lane, Painted Post, NY 14870 (US).
- (74) **Agent:** ABLE, Kevin, M; Corning Incorporated, Intellectual Property Department, SP-Ti-03-01, Corning, NY 14831 (US).

(81) **Designated States** (unless otherwise indicated, for every kind of national protection available): AE, AG, AL, AM, AO, AT, AU, AZ, BA, BB, BG, BH, BN, BR, BW, BY, BZ, CA, CH, CL, CN, CO, CR, CU, CZ, DE, DK, DM, DO, DZ, EC, EE, EG, ES, FI, GB, GD, GE, GH, GM, GT, HN, HR, HU, ID, IL, IN, IR, IS, JP, KE, KG, KN, KP, KR, KZ, LA, LC, LK, LR, LS, LT, LU, LY, MA, MD, ME, MG, MK, MN, MW, MX, MY, MZ, NA, NG, NI, NO, NZ, OM, PA, PE, PG, PH, PL, PT, QA, RO, RS, RU, RW, SA, SC, SD, SE, SG, SK, SL, SM, ST, SV, SY, TH, TJ, TM, TN, TR, TT, TZ, UA, UG, US, UZ, VC, VN, ZA, ZM, ZW.

(84) **Designated States** (unless otherwise indicated, for every kind of regional protection available): ARIPO (BW, GH, GM, KE, LR, LS, MW, MZ, NA, RW, SD, SL, SZ, TZ, UG, ZM, ZW), Eurasian (AM, AZ, BY, KG, KZ, RU, TJ, TM), European (AL, AT, BE, BG, CH, CY, CZ, DE, DK, EE, ES, FI, FR, GB, GR, HR, HU, IE, IS, IT, LT, LU, LV, MC, MK, MT, NL, NO, PL, PT, RO, RS, SE, SI, SK, SM, TR), OAPI (BF, BJ, CF, CG, CI, CM, GA, GN, GQ, GW, KM, ML, MR, NE, SN, TD, TG).

Published:

— with international search report (Art. 21(3))

(54) **Title:** THICKNESS CONTROL OF SUBSTRATES

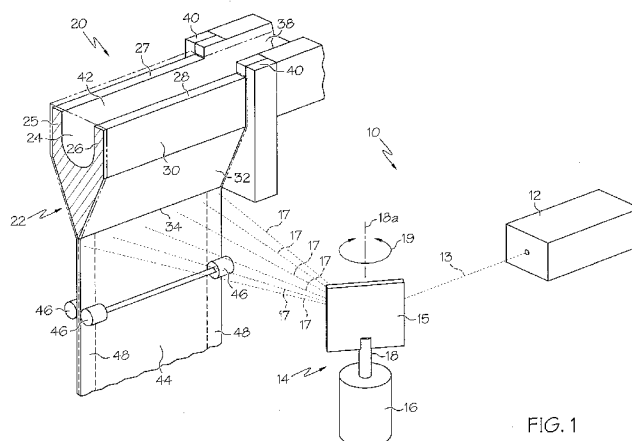

FIG. 1

(57) **Abstract:** A thickness of at least one preselected portion of a substrate, such as a glass substrate for example, is controlled. A laser beam is directed to the at least one preselected portion of the substrate in a viscous state, thereby increasing a temperature and reducing a viscosity of the at least one preselected portion of the substrate in a viscous state sufficiently to cause the at least one preselected portion of the glass substrate to attain a desired thickness. The laser beam after it is generated can be directed to a reflecting surface from which the laser beam is reflected to the at least one preselected portion of the substrate in the viscous state. The substrate can comprise a glass ribbon produced in a downdraw glass forming process for example, and the laser beam can be directed onto a plurality of preselected portions of the glass ribbon.



THICKNESS CONTROL OF SUBSTRATES

[0001] This application claim the benefit of priority to U.S. Patent Application No. 13/669,994 filed November 6, 2012, the content of which is incorporated herein by reference in its entirety.

TECHNICAL FIELD

[0002] The present disclosure relates to methods and apparatus relating to the control of the thickness of substrates and, more particularly, to methods and apparatus relating to controlling the thickness of preselected portions of glass substrates in glass making processes. |

BACKGROUND

[0003] For a variety of applications, the close control of the thickness of manufactured substrates can be important if not critical. For example, diverse procedures have been implemented and proposed for controlling thickness variations that can occur in liquid crystal display (LCD) glass manufactured by a fusion downdraw method causing variations in the thickness of the glass ribbon. Thermo-mechanical and glass flow conditions can be uneven across the entirety or portions of a width of a glass ribbon as it is being formed in the fusion downdraw method. Typically, the surface tension at the glass ribbon as it is being formed is inadequate to entirely obviate the variations that can occur in the thickness of the glass ribbon. Although the variations may be only a few microns in size, the consequences of such variations can be significant with respect to LCD glass for example. One technique for controlling thickness variations is disclosed in United States Patent No. 8,196,431 to Steven R. Burdette.

SUMMARY

[0004] According to a first aspect, a method is provided of controlling a thickness of at least one preselected portion of a substrate. The method comprises generating a laser beam and directing the laser beam onto the at least one preselected portion of the substrate in a viscous state, wherein the thickness of the at least one portion of the substrate is

not fixed, the laser beam possessing adequate energy to increase a temperature and reduce a viscosity of the at least one preselected portion of the substrate in a viscous state sufficiently to alter the thickness of the at least one preselected portion of the substrate, whereby the at least one preselected portion of the substrate attains a desired thickness.

[0005] In a first embodiment of the first aspect, the substrate comprises a glass substrate.

[0006] In a second embodiment of the first aspect, the substrate comprises a glass ribbon produced in a downdraw glass forming process.

[0007] In a first example of the second embodiment of the first aspect, the step of directing the laser beam onto the at least one preselected portion of the glass ribbon in a viscous state includes directing the laser beam from a laser beam generator at which the laser beam is generated to a reflecting surface from which the laser beam is reflected to the at least one preselected portion of the glass ribbon in a viscous state. According to one expression of this first example, the laser beam can be reflected onto a plurality of preselected portions of the glass ribbon in a viscous state and the plurality of preselected portions of the glass ribbon can be arranged across substantially an entire width of the glass ribbon. In the case in which the laser beam is directed onto a plurality of preselected portions of the glass ribbon in a viscous state, a respective residence time of the laser beam at each of the plurality of preselected portions of the glass ribbon in a viscous state can be selectively controlled.

[0008] In a second example of the second embodiment of the first aspect, the glass substrate comprises at least two glass layers, at least one of the two glass layers including the at least one preselected portion of the glass ribbon in a viscous state. According to one expression of this second example, the at least one preselected portion of the glass ribbon can be present at each of at least two of the at least two glass layers. A wavelength of the laser beam can be employed such that a respective amount of energy absorbed at the at least one preselected portion of the glass ribbon in a viscous state that is present at each of the at least two glass layers is adequate to increase the temperature and decrease the viscosity at the at least one preselected portion of the glass ribbon in a viscous state that is present at each of the at least two glass layers sufficiently to cause the at least one preselected portion

of the glass ribbon in a viscous state that is present at each of the at least two glass layers to attain a respective desired thickness.

[0009] The first aspect can be provided alone or in combination with any one or any combination of the embodiments and examples of the first aspect discussed above.

[0010] According to a second aspect, a control apparatus is configured to control the thickness of at least one preselected portion of a substrate. The control apparatus includes a laser generator configured to generate and emit a laser beam having adequate energy to increase the temperature and decrease the viscosity of the at least one preselected portion of the substrate in a viscous state when directed onto the at least one preselected portion of the substrate in a viscous state and thereby alter the thickness of the at least one preselected portion of the substrate. The control apparatus also includes a reflecting apparatus including a reflecting surface configured to receive from the laser generator and reflect onto the at least one preselected portion of the substrate in a viscous state the laser beam generated and emitted by the laser generator. The laser generator and the reflecting apparatus are arranged in relation to the substrate such that the laser beam generated and emitted by the laser generator and reflected by the reflecting surface of the reflecting apparatus is reflected onto the at least one preselected portion of the substrate in a viscous state.

[0011] In a first embodiment of the second aspect, the control apparatus is operatively associated with a downdraw glass forming apparatus configured to produce a glass ribbon that comprises the substrate.

[0012] In a first example of the first embodiment of the second aspect, the reflecting apparatus includes a regulating mechanism configured to adjust an attitude of the reflecting surface of the reflecting apparatus with respect to receipt of the laser beam and a location of the at least one preselected portion of the glass ribbon in a viscous state, whereby the laser beam can be reflected from the reflecting surface onto the at least one preselected portion of the glass ribbon in a viscous state. According to one expression of this first example, the regulating mechanism can comprise a galvanometer. According to a second expression of this first example, the regulating mechanism can be configured to adjust, for preselected time periods, the reflecting surface of the reflecting apparatus in a plurality of

varying attitudes with respect to the receipt of the laser beam and reflection of the laser beam at the reflecting surface of the reflecting apparatus. As a result, the laser beam can be directed onto a plurality of preselected portions of the glass ribbon in a viscous state for respective preselected time periods, thereby controlling the thickness of the glass ribbon at each of the preselected portions of the glass ribbon.

[0013] In a second example of the first embodiment of the second aspect, the control apparatus is located with respect to the downdraw glass forming apparatus such that the laser beam can be directed from the reflecting surface of the reflecting apparatus onto the glass ribbon at the at least one preselected portion of the glass ribbon in a viscous state adjacent to a root of a glass forming wedge of the downdraw glass forming apparatus.

[0014] The second aspect can be provided alone or in combination with any one or any combination of the embodiments and examples of the second aspect discussed above.

BRIEF DESCRIPTION OF THE DRAWINGS

[0015] The foregoing and other aspects, embodiments and examples are better understood when the following detailed description is read with reference to the accompanying drawings, in which:

[0016] **FIG. 1** is a schematic perspective view of an apparatus configured to control a thickness of at least one preselected portion of a glass substrate; and

[0017] **FIG. 2** is a block diagram that illustrates an aspect of apparatus applied to methods and apparatus of controlling a thickness of at least one preselected portion of a glass substrate.

DETAILED DESCRIPTION

[0018] Aspects, embodiments and examples will now be described more fully hereinafter with reference to the accompanying drawings in which certain of the aspects, embodiments and examples are shown. Whenever possible, the same reference numerals are used throughout the drawings to refer to the same or like parts. It should be understood that aspects, embodiments and examples may be represented in many different forms and should not be construed as limited to the specific aspects, embodiments and examples set forth herein.

[0019] It can be the case in the production of a substrate such as a plastic or glass substrate for example that the thickness of the substrate that is produced is non-uniform. The non-uniformity can be localized, in which case the non-uniformity would be present only at a somewhat discrete portion of the substrate as viewed across the width of the substrate. On the other hand, a plurality of non-uniformities can exist, even in some cases across the entire width of the substrate.

[0020] It usually is the case in the production of a substrate, such as a plastic or glass substrate for example, that particular thickness non-uniformities in the substrate, if not corrected, will continue to be manifested as the substrate is continued to be produced. According to one aspect of the present invention, these thickness non-uniformities are identified and preselected for attention so that the non-uniformities can be essentially eliminated in the subsequently produced substrate. The correction of the thickness non-uniformities is accomplished by increasing the temperature and decreasing the viscosity of the portions of the substrate at which the non-uniformities are present, while the substrate is in a viscous state. As a result, the respective thickness of each non-uniform portion of the substrate is made uniform in the subsequently produced substrate as described in greater detail below.

[0021] A substrate is considered to be in a viscous state so long as its viscosity is such that the response of the substrate to the application of a stress is intermediate the behavior of a pure liquid and an elastic solid. Whenever the response of the substrate is that of an elastic solid, the thickness of the substrate is considered to be “fixed” as that term is used and applied herein.

[0022] The disclosures contained herein are applicable to various substrates, such as plastic and glass substrates for example, the thicknesses of which are controlled by applying corrective measures to the substrates when the substrates are in a viscous state. The drawings illustrate an aspect of apparatus and methods that can be employed for the purpose of such thickness control with respect to glass substrates. Referring to **FIG. 1** of the drawings, an embodiment of a control apparatus, indicated generally at **10**, that is configured to control the thickness of at least one preselected portion of a substrate is schematically illustrated. In the aspect of **FIG. 1**, the control apparatus **10** is shown operatively associated

with an embodiment of a downdraw glass forming apparatus, indicated generally at **20**, that is configured to produce a glass ribbon **44**. Downdraw glass forming processes for manufacturing glass substrates such as the glass ribbon **44** and employing equipment such as the downdraw glass forming apparatus **20** are sometimes referred to as fusion processes, overflow processes or overflow downdraw processes. The schematic representations of the control apparatus **10** and the downdraw glass forming apparatus **20** are referred to herein with respect to the descriptions to follow of aspects, embodiments and examples of methods and apparatus that concern the control of the thickness of a glass substrate such as the glass ribbon **44** for example.

[0023] Included in the embodiment of the downdraw glass forming apparatus **20** illustrated in **FIG. 1** is a forming wedge **22** that includes an open channel **24** that is bounded on its longitudinal sides by walls **25** and **26**. The walls **25** and **26** terminate at their upper extent in opposed longitudinally-extending overflow weirs **27** and **28**, respectively. The overflow weirs **27** and **28** are integral with a pair of opposed substantially vertical forming surfaces **30** that, in turn, are integral with a pair of opposed downwardly inclined converging forming surfaces **32**. The pair of downwardly inclined converging surfaces **32** terminate at a substantially horizontal lower apex that comprises a root **34** of the forming wedge **22**. Molten glass is delivered into open channel **24** by means of a delivery passage **38** that is in fluid communication with the open channel **24**. A pair of dams **40** are provided above overflow weirs **27** and **28** adjacent each end of open channel **24** to direct the overflow of the free surface **42** of molten glass over overflow weirs **27** and **28** as separate flows of molten glass. Only the pair of dams **40** that are located at the end of the open channel **24** that is adjacent the delivery passage **38** are shown in **FIG. 1**. The separate flows of molten glass flow down over the pair of opposed substantially vertical forming surfaces **30** and the pair of opposed downwardly inclined converging forming surfaces **32** to the root **34** where the separate flows of molten glass, shown in broken lines in **FIG. 1**, converge to form the glass ribbon **44**. At approximately this point the glass ribbon is in a viscous state and the thickness of the glass ribbon **44** has not become fixed so that the thickness of the glass ribbon can be altered according to the aspects described herein.

[0024] Pulling rolls **46** are located downstream of the root **34** of the forming wedge **22** and engage side edges **48** at both sides of the glass ribbon **44** so as to apply tension to the glass ribbon. The pulling rolls **46** are positioned sufficiently below the root **34** that the thickness of the glass ribbon **44** is essentially fixed at that location. The pulling rolls **46** draw the glass ribbon **44** downwardly at a prescribed rate that establishes the thickness of the glass ribbon as it is formed at the root **34**.

[0025] In the aspect illustrated in **FIG. 1**, the control apparatus **10** includes a laser generator **12** that is configured to generate and emit a laser beam **13** adequate to increase the temperature and decrease the viscosity of at least one preselected portion of a glass substrate in a viscous state, such as the glass ribbon **44** in a viscous state for example, when the laser beam **13** is directed onto the at least one preselected portion of the glass substrate in a viscous state and thereby alter the thickness of the at least one preselected portion of the glass substrate. As illustrated in the aspect of **FIG. 1**, the laser beam **13** is directed to the glass ribbon **44** at a location adjacent the root **34** of the forming wedge **22** where the glass ribbon is in a viscous state. However, the laser beam **13** can be directed to the glass ribbon **44** at other locations where the glass ribbon is in a viscous state.

[0026] In one aspect, and depending on the characteristics of the glass substrate, the viscosity of the glass substrate in a viscous state would be greater than approximately 100,000 poise but not so great that the thickness of the substrate would be fixed. At viscosities greater than approximately 100,000 poise but less than the viscosity of the glass substrate when the thickness is fixed, the application of heat to the glass substrate effectively decreases the viscosity of the glass substrate at the point at which the heat is applied, and the heat is not dissipated in the glass substrate as would occur at lower substrate viscosities.

[0027] The adequacy of a laser beam for the purpose of increasing the temperature and decreasing the viscosity of at least one preselected portion of a glass ribbon is a function primarily of the characteristics of the glass ribbon in a viscous state, the wavelength and the power level of the laser beam and whether an objective is to alter the thickness of a limited or a large number of preselected portions of the glass substrate. For example, according to one aspect, where the glass substrate comprises a single layer, the

wave length of the laser beam is selected so that the laser beam is substantially absorbed by the glass substrate and does not readily pass through the glass substrate. According to another aspect, for example, if the thickness of only a single portion of a few millimeters of a single layer of the glass substrate is to be controlled and the laser beam is relatively stationary and fixed on the single portion of the glass substrate in a viscous state, the power of the laser beam can be lower than the power used if the thicknesses of a plurality of portions of the glass substrate are to be controlled and the laser beam must continuously and rapidly sweep over the plurality of portions. Additionally, if the cycle rate of the laser is greater than approximately 50Hz or so, the laser can be pulsed or continuous.

[0028] The laser generator **12**, as an example, can comprise a high-intensity infrared laser generator such as a carbon dioxide (CO₂) laser generator of a type that is available from numerous commercial sources. The wavelengths of the light produced and the power generated by CO₂ laser generators are variable and can be selected so that the laser beam generated is adequate to increase the temperature and decrease the viscosity of at least one preselected portion of a glass substrate in a viscous state, such as the glass ribbon **44**, sufficiently to correct thickness variations present in the glass substrate. For example, a laser beam with a wavelength of between approximately 9.4 micrometers and approximately 10.6 micrometers and a power output of thousands of watts can be suitable for increasing the temperature and decreasing the viscosity of at least one preselected portion of a glass substrate in a viscous state such as the glass ribbon **44**. However, because differing glass substrates will absorb laser beams to differing degrees at differing wavelengths, wavelengths outside the range of approximately 9.4 micrometers to approximately 10.6 micrometers can be employed.

[0029] The control apparatus **10** in the aspect illustrated in **FIG. 1** can also include a reflecting apparatus, indicated generally at **14**, including a reflecting surface **15** that is configured to receive from the laser generator **12** and reflect onto at least one preselected portion of the glass substrate, such as the glass ribbon **44** for example, the laser beam **13** generated and emitted by the laser generator **12**. The reflecting apparatus can therefore function as a beam-steering and/or scanning device. In **FIG. 1**, the laser beam **13** is illustrated as being advanced as reflected laser beams **17** to a plurality of preselected portions

of the glass ribbon **44** in a viscous state as a result of incremental adjustments of the attitude of the reflecting surface **15** made with respect to the receipt of the laser beam **13** by the reflecting surface **15** and the locations of the preselected portions of the glass ribbon **44** in a viscous state as described in greater detail below. It is noted here, however, that thickness variations that can occur with respect to glass substrates, such as a glass substrate that is suitable for use as LCD glass, can exist in only a very small area and, therefore, be localized. Because the laser beam spot striking the glass substrate also is very small, localized thickness variations can be addressed without affecting immediately adjacent portions of the glass substrate. Thus, the laser beams can provide localized heating at high spatial resolutions.

[0030] The reflecting surface **15** in one example can comprise a gold-coated mirror although other types of mirrors may be used in other examples. Gold-coated mirrors may be desirable under certain applications for the purpose of providing superior and consistent reflectivity with respect to infrared lasers. In addition, the reflectivity of the gold-coated mirrors is virtually independent of the angle of incidence, and, therefore, the gold-coated mirrors are particularly useful as scanning or laser beam-steering mirrors.

[0031] The reflecting apparatus **14** in the embodiment illustrated in **FIG. 1** also includes a regulating mechanism **16** configured to adjust an attitude of the reflecting surface **15** of the reflecting apparatus **14** with respect to the receipt of the laser beam **13** and a location of the at least one preselected portion of the glass substrate in a viscous state, such as the glass ribbon **44** for example. Thereby, the laser beam **13** can be reflected as reflected laser beams **17** from the reflecting surface **15** onto the at least one preselected portion of the glass substrate. According to one example, the regulating mechanism **16** can comprise a galvanometer that is operatively associated with the reflecting surface **15** so that the reflecting surface **15** can be rotated by the galvanometer along an axis in relation to the glass ribbon **44**. For example, the reflecting surface **15** can be mounted on a rotating shaft **18** that is driven by a galvanometer motor and rotated about axis **18a** as shown by double arrow **19**.

[0032] As illustrated in the embodiment of **FIG. 1**, the reflecting apparatus **14** is located with respect to the downdraw glass forming apparatus **20** such that the laser beam **13** can be directed from the reflecting surface **15** of the reflecting apparatus **14** onto at least one preselected portion of the glass ribbon **44** in a viscous state prior to the thickness of the at

least one preselected portion of the glass ribbon becoming fixed. In the embodiment of **FIG. 1**, the reflected laser beams **17** are directed to the glass substrate substantially adjacent the root **34** of the forming wedge **22**, at which location the separate flows of molten glass have converged to form the glass ribbon **44** in a viscous state, but at which location the thickness of the glass ribbon has not yet been fixed. However, the reflected laser beams **17** need not be directed to the glass ribbon **44** substantially adjacent the root **34** and can be directed to the glass ribbon at any location at which the glass ribbon is in a viscous state. By increasing the temperature and reducing the viscosity of a preselected portion of the glass substrate at a location at which the preselected portion of the glass substrate is in a viscous state and its thickness has not been fixed, the preselected portion of the glass substrate will tend to flow, under the influence, for example, of thermo-mechanical and other forces present at the preselected portion of the glass substrate, so that the thickness of the preselected portion of the glass substrate will become substantially uniform at that preselected portion of the glass substrate.

[0033] As will be understood by those having ordinary skill in the art, the downdraw glass forming apparatus **20** illustrated in **FIG. 1** is typically contained within enclosures, not shown, to control the thermal environment of the glass ribbon **44**. There also will be enclosures, not shown, provided at the location of the pulling rolls **46** also for controlling the thermal environment of the glass ribbon. However, the control apparatus **20** can be located just below the enclosures for the downdraw glass forming apparatus **20** and above the enclosures for the pulling rolls **46**. In any event, the laser generator **12** and the reflecting apparatus **14** are arranged in relation to the substrate or glass ribbon **44** such that the laser beam **13** generated and emitted by the laser generator **12** and reflected by the reflecting surface **15** of the reflecting apparatus **14** is reflected onto the at least one preselected portion of the glass ribbon **44** at a location at which the glass ribbon is in a viscous state.

[0034] Based on the foregoing description, it will be understood that, according to one aspect, a method is provided of controlling a thickness of at least one preselected portion of a substrate, such as a glass ribbon **44** for example. The method can comprise generating a laser beam and directing the laser beam onto the at least one

preselected portion of the substrate in a viscous state, wherein the thickness of the at least one portion of the substrate is not fixed. The laser beam would possess adequate energy to increase a temperature and reduce a viscosity of the at least one preselected portion of the substrate in a viscous state sufficiently to alter the thickness of the at least one preselected portion of the substrate. Consequently, the at least one preselected portion of the substrate can be caused to attain a desired thickness.

[0035] According to another aspect, the step of directing the laser beam onto the at least one preselected portion of the substrate in a viscous state includes directing the laser beam from a laser beam generator, at which the laser beam is generated, to a reflecting surface from which the laser beam is reflected to the at least one preselected portion of the substrate in a viscous state. In both these aspects, the laser beam can be directed onto a plurality of preselected portions of the substrate in the viscous state and the plurality of preselected portions of the substrate can be arranged across an entire width of the substrate as shown in **FIG. 1** for example with respect to the glass ribbon **44**. In addition, as described below in greater detail, in an example embodiment, the residence time of the laser beam at each of the plurality of preselected portions of the substrate in a viscous state can be selectively controlled. In examples of all these aspects, the substrate can comprise a glass ribbon produced in a downdraw glass forming process such as the glass ribbon **44**.

[0036] **FIG. 2** comprises a block diagram that illustrates an aspect of an operating apparatus that functions in cooperation with the control apparatus **10**, wherein solid lines with an arrow represent laser beams and dashed lines represent electrical control signals. A laser power control unit **50** controls the operation of the laser generator **12** so that the wavelength and the power of the laser beam **13** generated at the laser generator **12** will comprise preselected values. In addition, the laser power control unit **50** can control the time intervals during which the laser generator **12** generates the laser beam **13**. In turn, a control computer **52** is provided to appropriately control the operation of the laser power control unit **50** whereby the laser power control unit **50** will cause the laser generator **12** to generate during preselected time intervals a laser beam **13** having preselected wavelength and power characteristics. At the same time, the control computer **52** is operatively associated with the reflecting apparatus **14** so as to control the functioning of the regulating mechanism **16**, and

in a particular example where a galvanometer is employed, the motor of the galvanometer. Accordingly, the control computer **52** is capable of adjusting the attitude and positioning of the reflecting surface **15** with respect to the receipt of the laser beam **13** by the reflecting surface and the locations of the preselected portions of the glass substrate in a viscous state for which the thicknesses are to be controlled.

[0037] It will be understood based on the aspects, embodiments and examples described above with reference to **FIG. 1** and **FIG. 2** that, according to an example embodiment, the regulating mechanism **16** can be configured to adjust for preselected time periods the reflecting surface **15** of the reflecting apparatus **14** in a plurality of varying attitudes with respect to the receipt of the laser beam **13** and the reflection of the laser beam at the reflecting surface **15** of the reflecting apparatus **14**. As a consequence, the laser beam **13** can be directed onto a plurality of preselected portions of the glass ribbon **44** in a viscous state across a width of the glass substrate for respective preselected time periods, as illustrated by the reflected laser beams **17** in **FIG. 1** for example, thereby controlling the thickness of the glass substrate at each of the preselected portions. More particularly, with reference to the aspect illustrated in **FIG. 2**, the control computer **52** can be programmed so as to cause the regulating mechanism **16** to control the attitude of the reflecting surface **15** in a manner such that the reflected laser beams **17** are directed to preselected portions of the glass ribbon **44** for preselected time periods that can vary in the event, for example, that it has been determined based on experience or otherwise that the thicknesses of the preselected portions of the glass ribbon are required to be controlled to varying extents.

[0038] The non-uniformities in thickness that can occur in connection with the production of substrates such as the glass ribbon **44** for example can arise in various contexts. For example, a non-uniformity can be present at a single localized portion of the substrate and that non-uniformity can exist with respect to the thicknesses of adjacent portions of the substrate or with respect to the single localized portion of the substrate itself. In either event, it is only necessary to provide for the reflecting apparatus **14** to continuously reflect to that single portion of the substrate in a viscous state the laser beam **13** at a suitable energy level and wavelength for the purpose of causing the thickness of the single portion of the substrate to attain a desired thickness in the finally produced substrate. This is

accomplished by programming the computer **52** to cause the regulating mechanism **16** of the reflecting apparatus **14** to control the attitude and positioning of the reflecting surface **15** of the regulating mechanism **16** and to cause the power control unit **50** to control the energy level and wavelength of the laser beam **13** produced by the laser generator **12**. By way of further example, there can exist in the substrate two or more distinct portions in which thickness non-uniformities exist. In that case, the computer **52** can be programmed so as to cause the regulating mechanism **16** of the reflecting apparatus **14** to control the attitude and positioning of the reflecting surface **15** such that the reflected beam **17** continuously is placed in contact with the two or more portions of the substrate at which the non-uniformities exist. Also, the computer is programmed to cause the power control unit **50** to control the energy level and wavelength of the laser beam **13** produced by the laser generator **12** so that the thicknesses at those two or more portions are caused to be altered whereby they attain respective desired thicknesses in the finally produced substrate. In addition, the computer **52** can be programmed so as to cause the reflected beam **17**, through the operation of the regulating mechanism **16**, to reside at each of the two or more non-uniform portions of the substrate for the necessary periods of time to adequately decrease the viscosity of each of the portions so that the thicknesses of the non-uniform portions can be suitably altered. Also by way of example, the non-uniformities in thickness that are present in the substrate can range across the entirety of the substrate, including any beads that are present at the side edges **48** of the glass ribbon **44**. Again, the computer **52** can be programmed appropriately to cause the laser generator **12**, through the control of the power control unit **50**, to provide a laser beam **13** of an appropriate strength and wavelength and to cause the laser beam **13**, through the instrumentality of the reflecting apparatus **14**, to continuously sweep back and forth across the substrate while residing at the portions of the substrate at which the thickness corrections are to be made for the periods of time required to decrease the viscosities of these portions of substrate to levels that result in the attainment of the respective desired thicknesses at these portions of the substrate as the substrate is produced.

[0039] The development of the information and data required to appropriately program the computer **52** can be accomplished in various ways. For example, a thickness measurement trace can be carried out on the substrate that has been produced for the purpose

of identifying thickness non-uniformities that are present in the substrate. The computer **52** can then be programmed appropriately based on that measurement trace. Also by way of example, the thickness profile of the substrate can be monitored in real time as the substrate is produced and the information developed by that monitoring can be fed back to the computer **52** so that the computer, pursuant to an appropriate closed-loop control algorithm, can cause adjustments to the reflecting apparatus **14** and the laser power control unit **50** to cause the portions of the substrate that exhibit thickness non-uniformities to attain the desired thicknesses.

[0040] According to an additional aspect, a glass substrate, such as the glass ribbon **44**, can comprise at least two glass layers, with at least one of the glass layers including at least one preselected portion of the glass substrate in a viscous state. In the case in which the at least one preselected portion is present at each of at least two of the at least two glass layers, the wavelength of the laser beam employed is such that a respective amount of energy absorbed at the at least one preselected portion of the glass substrate in a viscous state that is present at each of the at least two glass layers is adequate to increase the temperature and decrease the viscosity at the at least one preselected portion of the glass substrate that is present at each of the at least two glass layers sufficiently to cause the at least one preselected portion of the glass ribbon that is present at each of the at least two glass layers to attain a respective desired thickness. The extent to which the laser beam is absorbed and transmitted at each of the glass layers depends, and consequently the extents to which the preselected portions of the glass substrate in a viscous state are heated and their viscosities decreased depend, not only on the characteristics of the glass layers but also on the wavelength of the laser beam. Therefore, laser beam wavelengths can be selected that, depending on the characteristics of the glass layers, will allow the laser beams to reach all preselected portions of the two or more glass layers, the thicknesses of which are to be altered. The result will be that the preselected portions of the substrate will be differentially heated as required to decrease the viscosities of the preselected portions of the glass substrate sufficiently to alter the thicknesses of the preselected portions, whereby they attain the desired thicknesses.

[0041] It will be apparent to those skilled in the art that various modifications and variations can be made without departing from the spirit and scope of the claims set forth below. For example, the various aspects, embodiments and examples described herein can be applied to glass substrates produced by other glass forming processes such as slot draw, updraw and float processes for example.

CLAIMS

What is claimed is:

1. A method of controlling a thickness of at least one preselected portion of a glass substrate comprising:

generating a laser beam; and

directing the laser beam onto the at least one preselected portion of the glass substrate in a viscous state, wherein the thickness of the at least one preselected portion of the glass substrate is not fixed, the laser beam possessing adequate energy to increase a temperature and reduce a viscosity of the at least one preselected portion of the glass substrate in a viscous state sufficiently to alter the thickness of the at least one preselected portion of the glass substrate, whereby the at least one preselected portion of the glass substrate attains a predetermined thickness.

2. The method of claim 1, wherein the glass substrate comprises a glass ribbon produced in a downdraw glass forming process.

3. The method of claim 1, wherein the step of directing the laser beam onto the at least one preselected portion of the glass substrate in a viscous state includes directing the laser beam to a reflecting surface from which the laser beam is reflected to the at least one preselected portion of the glass substrate in a viscous state.

4. The method of claim 1, wherein the laser beam is directed onto a plurality of preselected portions of the glass substrate in a viscous state.

5. The method of claim 4, wherein the plurality of preselected portions of the glass substrate are arranged across substantially an entire width of the glass substrate.
6. The method of claim 4, including selectively controlling a respective residence time of the laser beam at each of the plurality of preselected portions of the glass substrate in a viscous state.
7. The method of claim 1, wherein the glass substrate comprises at least two glass layers, at least one of the two glass layers including the at least one preselected portion of the glass substrate in a viscous state.
8. The method of claim 7, wherein the at least one preselected portion of the glass substrate in a viscous state is present at each of at least two of the at least two glass layers and a wavelength of the laser beam is such that a respective amount of energy absorbed at the at least one preselected portion of the glass substrate in a viscous state that is present at each of the at least two glass layers is adequate to increase the temperature and decrease the viscosity at the at least one preselected portion of the glass substrate in a viscous state that is present at each of the at least two glass layers sufficiently to cause the at least one preselected portion of the glass substrate in a viscous state that is present at each of the at least two glass layers to attain a respective desired thickness.
9. A control apparatus configured to control a thickness of at least one preselected portion of a glass substrate, including:
 - a laser generator configured to generate and emit a laser beam having adequate energy to increase a temperature and decrease a viscosity of the at least one preselected portion of the glass substrate in a viscous state when directed onto the at least one preselected portion of the glass substrate in a viscous state and thereby alter the thickness of the at least one preselected portion of the glass substrate; and
 - a reflecting apparatus including a reflecting surface configured to receive from the laser generator and reflect onto the at least one preselected portion of the glass substrate in a viscous state the laser beam generated and emitted by the laser generator, wherein

the laser generator and the reflecting apparatus are arranged in relation to the glass substrate such that the laser beam reflected by the reflecting surface is reflected onto the at least one preselected portion of the glass substrate in a viscous state.

10. The control apparatus of claim 9, wherein the control apparatus is operatively associated with a downdraw glass forming apparatus configured to produce a glass ribbon that comprises the glass substrate.

11. The control apparatus of claim 9, wherein the reflecting apparatus includes a regulating mechanism configured to adjust an attitude of the reflecting surface of the reflecting apparatus with respect to receipt of the laser beam and a location of the at least one preselected portion of the glass substrate in a viscous state, whereby the laser beam can be reflected from the reflecting surface onto the at least one preselected portion of the glass substrate in a viscous state.

12. The control apparatus of claim 11, wherein the regulating mechanism comprises a galvanometer.

13. The control apparatus of claim 11, wherein the regulating mechanism is configured to adjust, for preselected time periods, the reflecting surface of the reflecting apparatus in a plurality of varying attitudes with respect to receipt of the laser beam and reflection of the laser beam at the reflecting surface of the reflecting apparatus, whereby the laser beam can be directed onto a plurality of preselected portions of the glass substrate in a viscous state for respective preselected time periods, thereby controlling the thickness of the glass substrate at each of the preselected portions of the glass substrate.

14. The control apparatus of claim 10, wherein the control apparatus is located with respect to the downdraw glass forming apparatus such that the laser beam can be directed from the reflecting surface of the reflecting apparatus onto the glass substrate at the at least one preselected portion of the glass substrate in a viscous state adjacent to a root of a glass forming wedge of a downdraw glass forming apparatus.

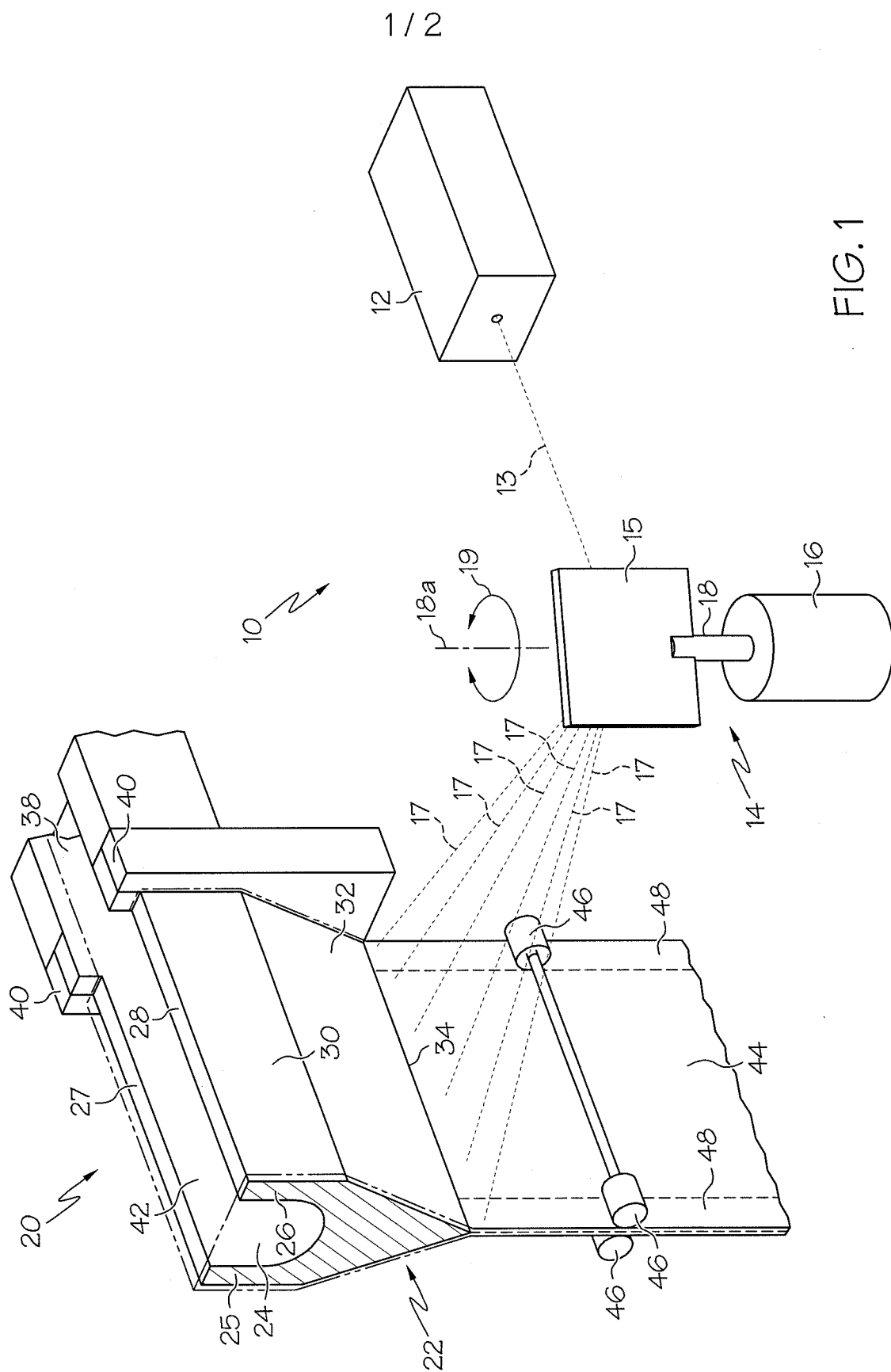

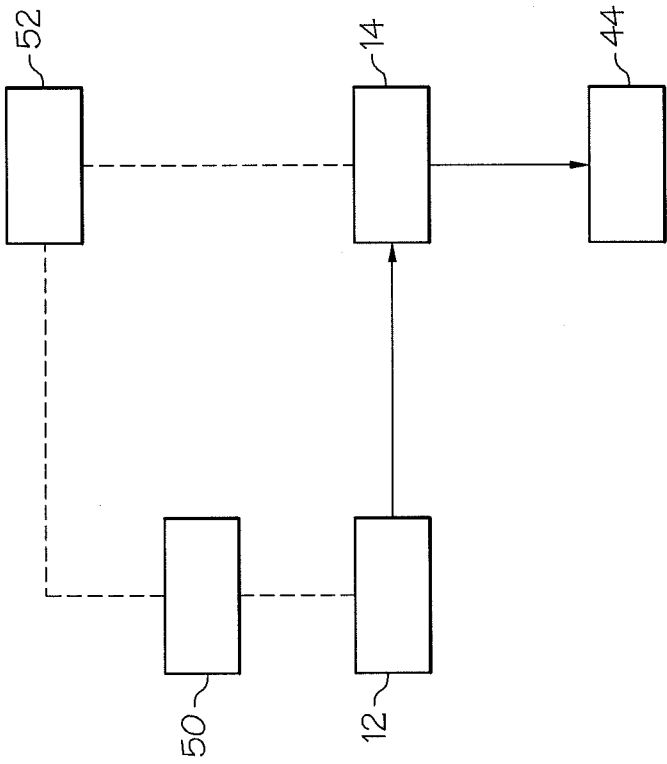

FIG. 2

INTERNATIONAL SEARCH REPORT

International application No.
PCT/US2013/067714**A. CLASSIFICATION OF SUBJECT MATTER****C03B 17/06(2006.01)i, C03B 18/04(2006.01)i, C03B 23/037(2006.01)i**

According to International Patent Classification (IPC) or to both national classification and IPC

B. FIELDS SEARCHED

Minimum documentation searched (classification system followed by classification symbols)

C03B 17/06; C03B 23/00; C03B 18/02; G02B 5/18; B23K 26/38; B32B 17/00; C03B 18/04; C03B 23/037

Documentation searched other than minimum documentation to the extent that such documents are included in the fields searched

Korean utility models and applications for utility models

Japanese utility models and applications for utility models

Electronic data base consulted during the international search (name of data base and, where practicable, search terms used)

eKOMPASS(KIPO internal) & Keywords: glass, substrate, control, thickness, laser, reflector

C. DOCUMENTS CONSIDERED TO BE RELEVANT

Category*	Citation of document, with indication, where appropriate, of the relevant passages	Relevant to claim No.
X	KR 10-2004-0008215 A (CARL-ZEISS-STIFTUNG TRAD. AS SCHOTT GLAS) 28 January 2004 See pages 1 and 2; and claims 1-6.	1,4-6
Y		2,7,8
A		3,9-14
Y	WO 2011-066064 A2 (CORNING INCORPORATED) 03 June 2011 See paragraphs [0008]-[0013], [0027]-[0030], [0044]-[0046], [0048]-[0062]; claims 1-28; and figures 1-5.	2,7,8
A	US 2010-0326138 A1 (KUMATANI et al.) 30 December 2010 See paragraphs [0010]-[0037], [0053]-[0113]; and claims 1-15.	1-14
A	US 2009-0226733 A1 (KATO et al.) 10 September 2009 See paragraphs [0010]-[0162]; and claims 1-24.	1-14
A	US 2002-0040892 A1 (KOYAMA et al.) 11 April 2002 See paragraphs [0024]-[0037], [0055]-[0133]; and claims 1-12.	1-14



Further documents are listed in the continuation of Box C.



See patent family annex.

* Special categories of cited documents:

"A" document defining the general state of the art which is not considered to be of particular relevance

"E" earlier application or patent but published on or after the international filing date

"L" document which may throw doubts on priority claim(s) or which is cited to establish the publication date of another citation or other special reason (as specified)

"O" document referring to an oral disclosure, use, exhibition or other means

"P" document published prior to the international filing date but later than the priority date claimed

"T" later document published after the international filing date or priority date and not in conflict with the application but cited to understand the principle or theory underlying the invention

"X" document of particular relevance; the claimed invention cannot be considered novel or cannot be considered to involve an inventive step when the document is taken alone

"Y" document of particular relevance; the claimed invention cannot be considered to involve an inventive step when the document is combined with one or more other such documents, such combination being obvious to a person skilled in the art

"&" document member of the same patent family

Date of the actual completion of the international search

27 January 2014 (27.01.2014)

Date of mailing of the international search report

28 January 2014 (28.01.2014)

Name and mailing address of the ISA/KR

Korean Intellectual Property Office
189 Cheongsa-ro, Seo-gu, Daejeon Metropolitan City,
302-701, Republic of Korea

Facsimile No. +82-42-472-7140

Authorized officer

CHANG, Bong Ho

Telephone No. +82-42-481-3353



INTERNATIONAL SEARCH REPORT

Information on patent family members

International application No.

PCT/US2013/067714

Patent document cited in search report	Publication date	Patent family member(s)	Publication date
KR 10-2004-0008215 A	28/01/2004	JP 2004-528264 A WO 02-100787 A1	16/09/2004 19/12/2002
WO 2011-066064 A2	03/06/2011	CN 102725238 A JP 2013-512171 A KR 10-2012-0102720 A TW 201125828 A WO 2011-066064 A3	10/10/2012 11/04/2013 18/09/2012 01/08/2011 03/11/2011
US 2010-0326138 A1	30/12/2010	CN 101935156 A EP 2275223 A1 EP 2275223 B1 JP 2011-011212 A JP 2011-011917 A KR 10-1226200 B1 KR 10-2011-0001948 A TW 201105445 A US 8448471 B2	05/01/2011 19/01/2011 19/06/2013 20/01/2011 20/01/2011 28/01/2013 06/01/2011 16/02/2011 28/05/2013
US 2009-0226733 A1	10/09/2009	CN 101925546 A CN 101925546 B CN 103121791 A CN 103121792 A JP 2009-196879 A JP 5327702 B2 KR 10-2010-0115739 A TW 200940459 A US 2011-0177287 A1 US 8136371 B2 WO 2009-093550 A1	22/12/2010 12/06/2013 29/05/2013 29/05/2013 03/09/2009 30/10/2013 28/10/2010 01/10/2009 21/07/2011 20/03/2012 30/07/2009
US 2002-0040892 A1	11/04/2002	EP 0959051 A1 EP 0959051 A4 JP 10-059743 A JP 10-059746 A JP 3452733 B2 JP 3960643 B2 US 2004-0031778 A1 US 6291797 B1 US 6645603 B2 US 6924457 B2 WO 98-06676 A1	24/11/1999 15/12/1999 03/03/1998 03/03/1998 29/09/2003 15/08/2007 19/02/2004 18/09/2001 11/11/2003 02/08/2005 19/02/1998