



US 20040210239A1

(19) **United States**(12) **Patent Application Publication****Nash et al.**(10) **Pub. No.: US 2004/0210239 A1**(43) **Pub. Date: Oct. 21, 2004**(54) **SYSTEM AND METHOD OF USE FOR TREATING OCCLUDED VESSELS AND DISEASED TISSUE**(76) Inventors: **John E. Nash**, Chester Springs, PA (US); **Douglas G. Evans**, Downingtown, PA (US); **David M. Hoganson**, Philadelphia, PA (US)

Correspondence Address:

**KENSEY NASH CORPORATION
MARSH CREEK CORPORATE CENTER
55 EAST UWCHLAN AVENUE
EXTON, PA 19341 (US)**(21) Appl. No.: **10/847,932**(22) Filed: **May 18, 2004****Related U.S. Application Data**

(63) Continuation of application No. 10/058,556, filed on Jan. 28, 2002, which is a continuation-in-part of application No. 09/594,131, filed on Jun. 14, 2000, now Pat. No. 6,524,323, which is a continuation of application No. 09/233,712, filed on Jan. 19, 1999, now Pat. No. 6,080,170, which is a continuation-in-

part of application No. 08/900,598, filed on Jul. 25, 1997, now Pat. No. 5,879,361, which is a continuation-in-part of application No. 08/690,438, filed on Jul. 26, 1996, now Pat. No. 5,779,721.

Publication Classification(51) **Int. Cl.⁷** **A61B 17/22; A61F 2/06**(52) **U.S. Cl.** **606/127; 623/1.11**(57) **ABSTRACT**

A system and method for treating diseased target tissue of a living being. The system comprises a working head, e.g., a rotary impacting impeller, a stent delivery catheter, a flush catheter, or liquid jets, a debris extraction sub-system, and may have barrier means in certain embodiments. The working head is arranged to treat diseased tissue, e.g., at least partially occluded with atherosclerotic plaque, or surrounding tissue being compromised by a disease such as cancer, in vessels or lumens, whereupon some debris may be produced. The debris extraction sub-system introduces an infusate liquid adjacent the working head and withdraws that liquid and debris adjacent the working head. The introduction of the infusate liquid may also be used to deliver drugs and other therapies systemically or locally, between the working head and the distal protection barrier.

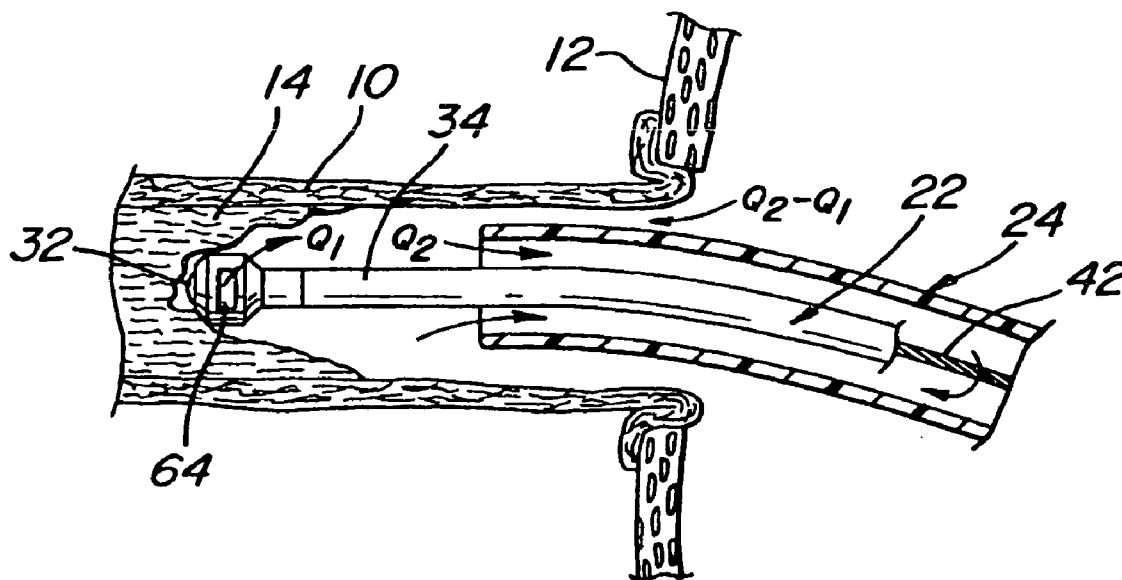

FIG. 2

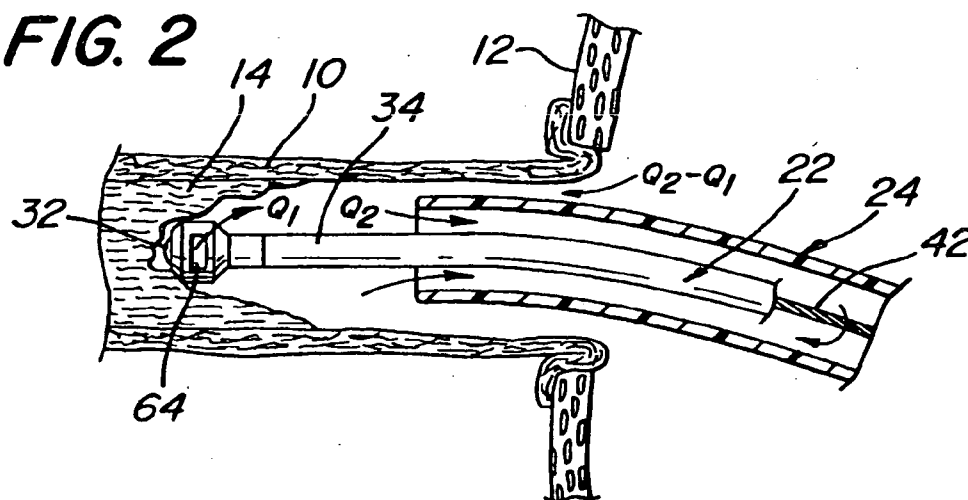

FIG. 3

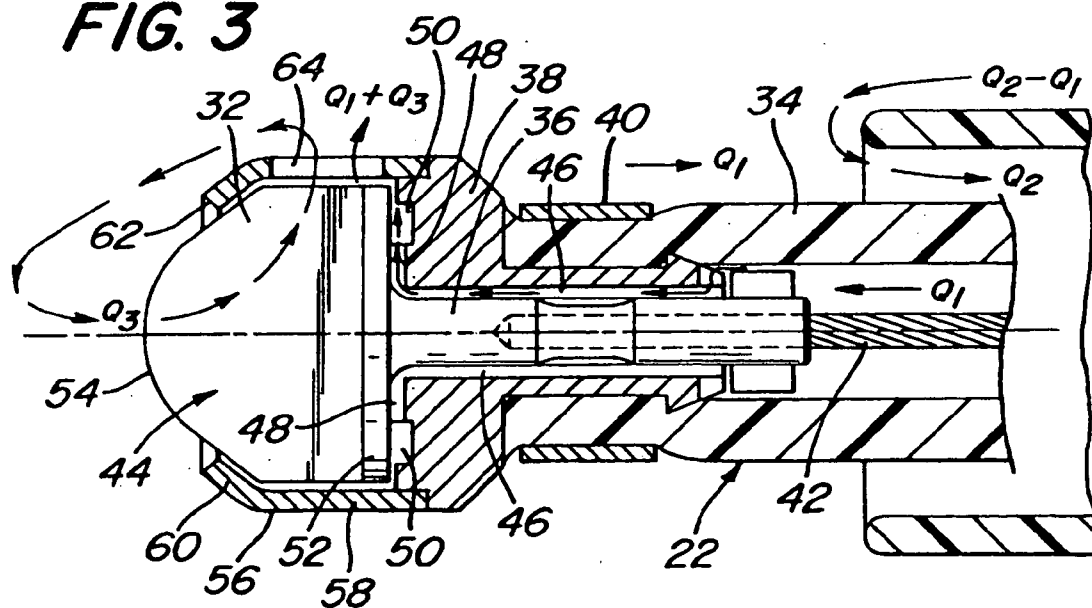

FIG. 4

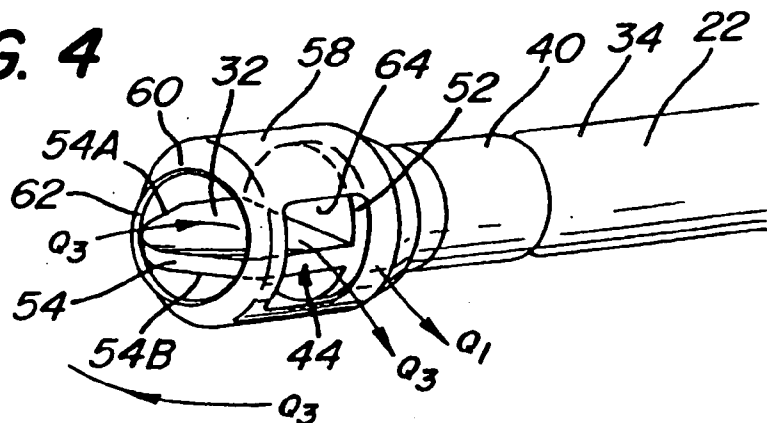

FIG. 5

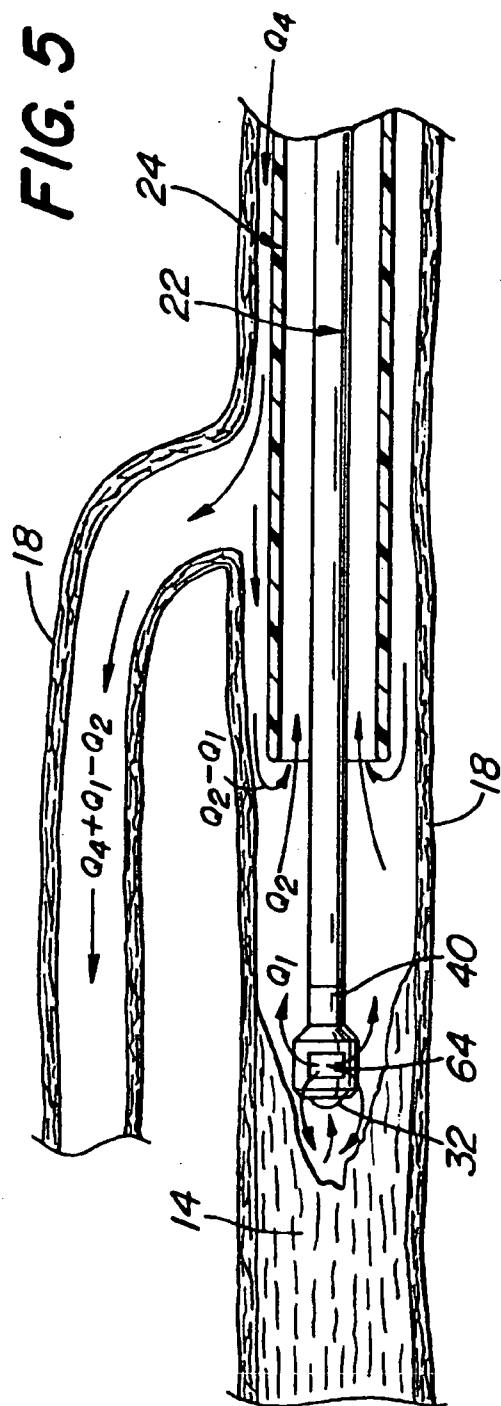

FIG. 6B

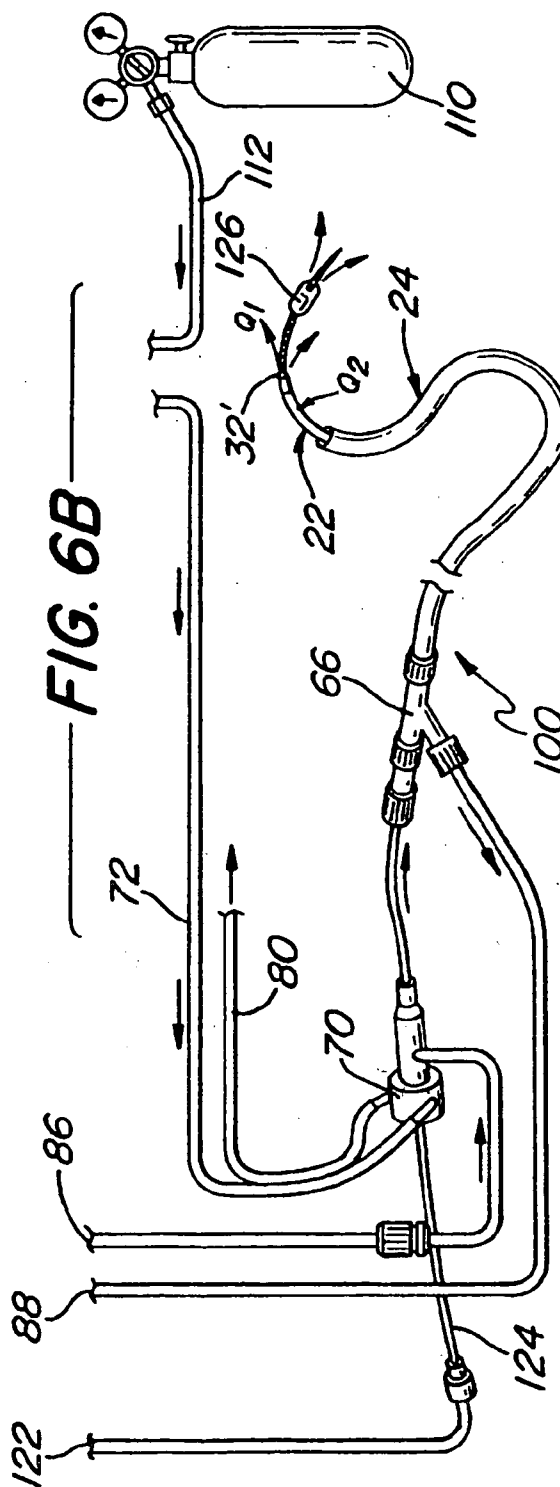

FIG. 6A

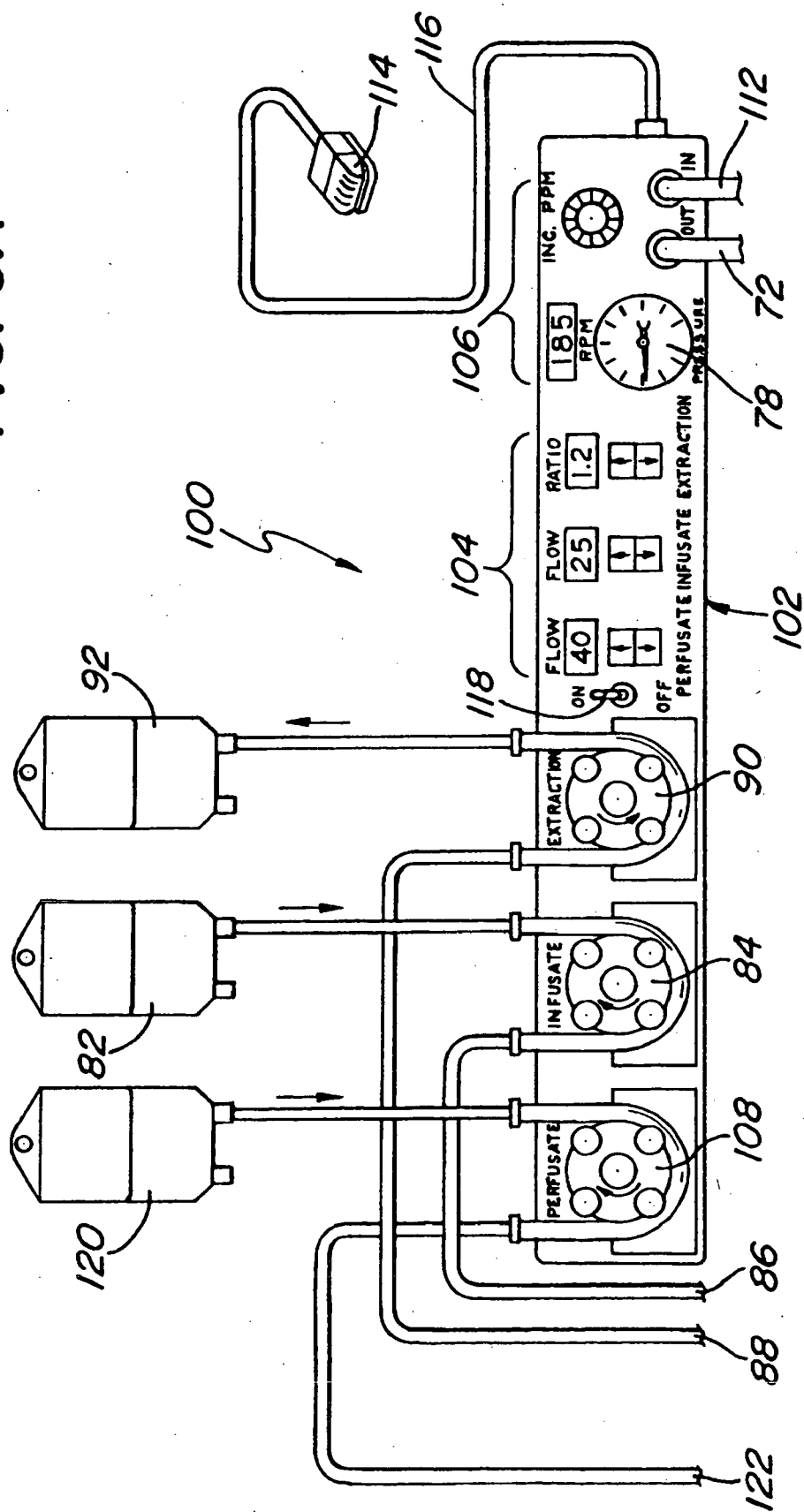

FIG. 7

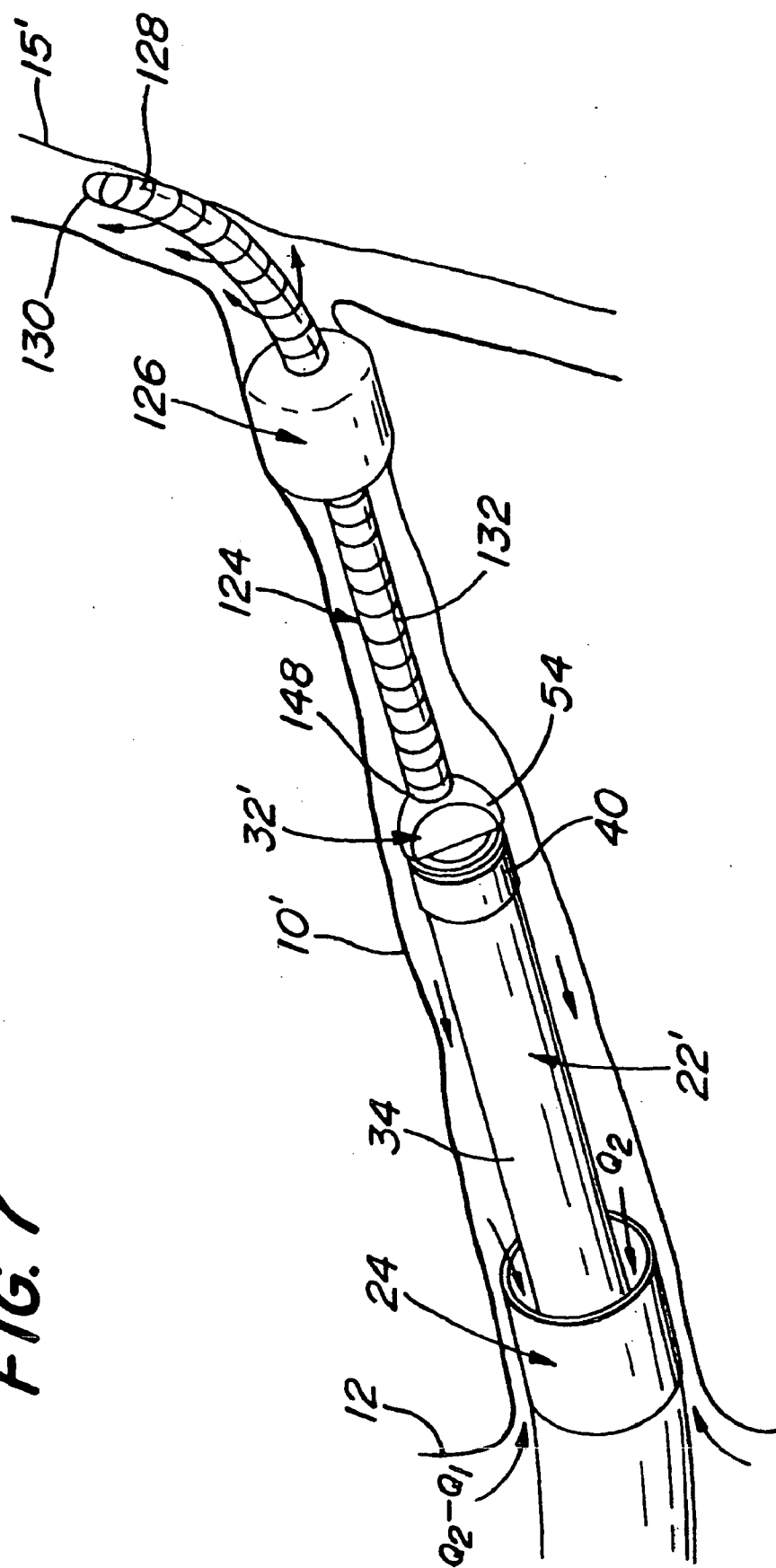
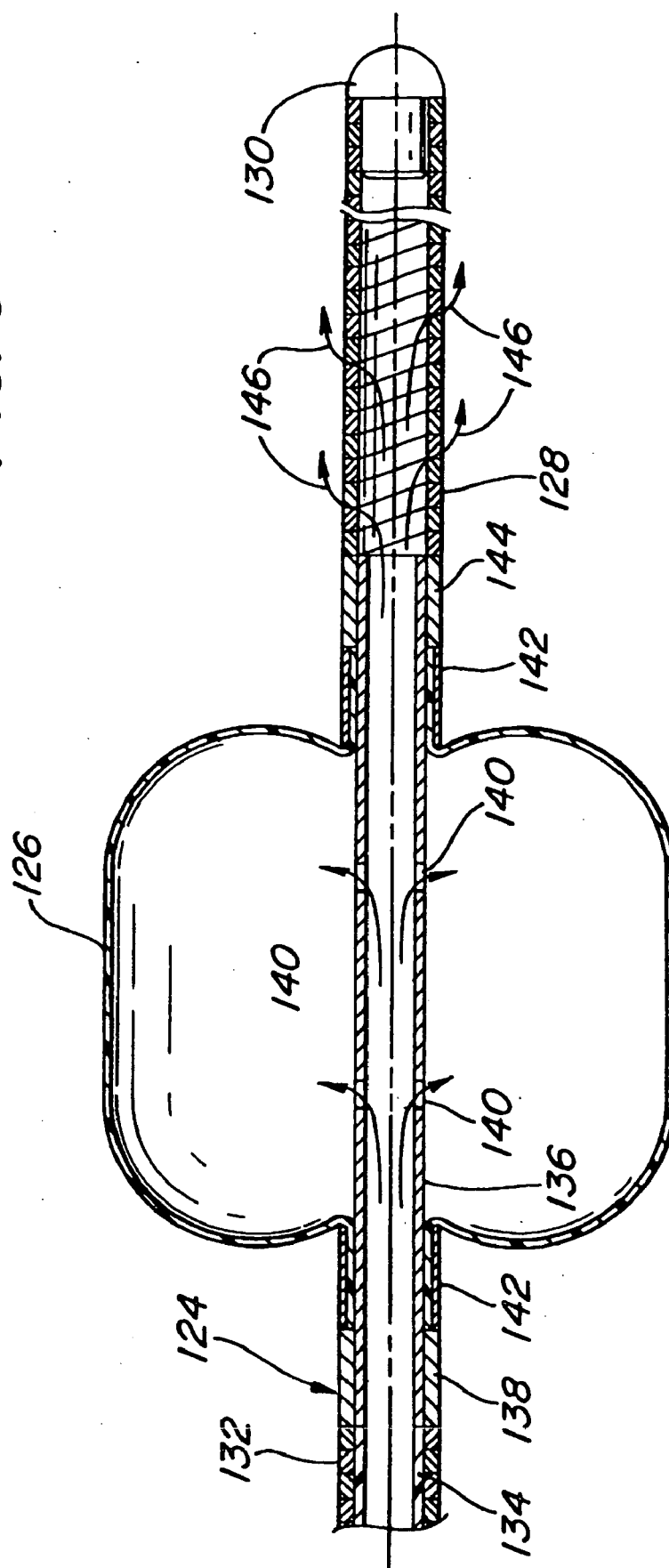

FIG. 8



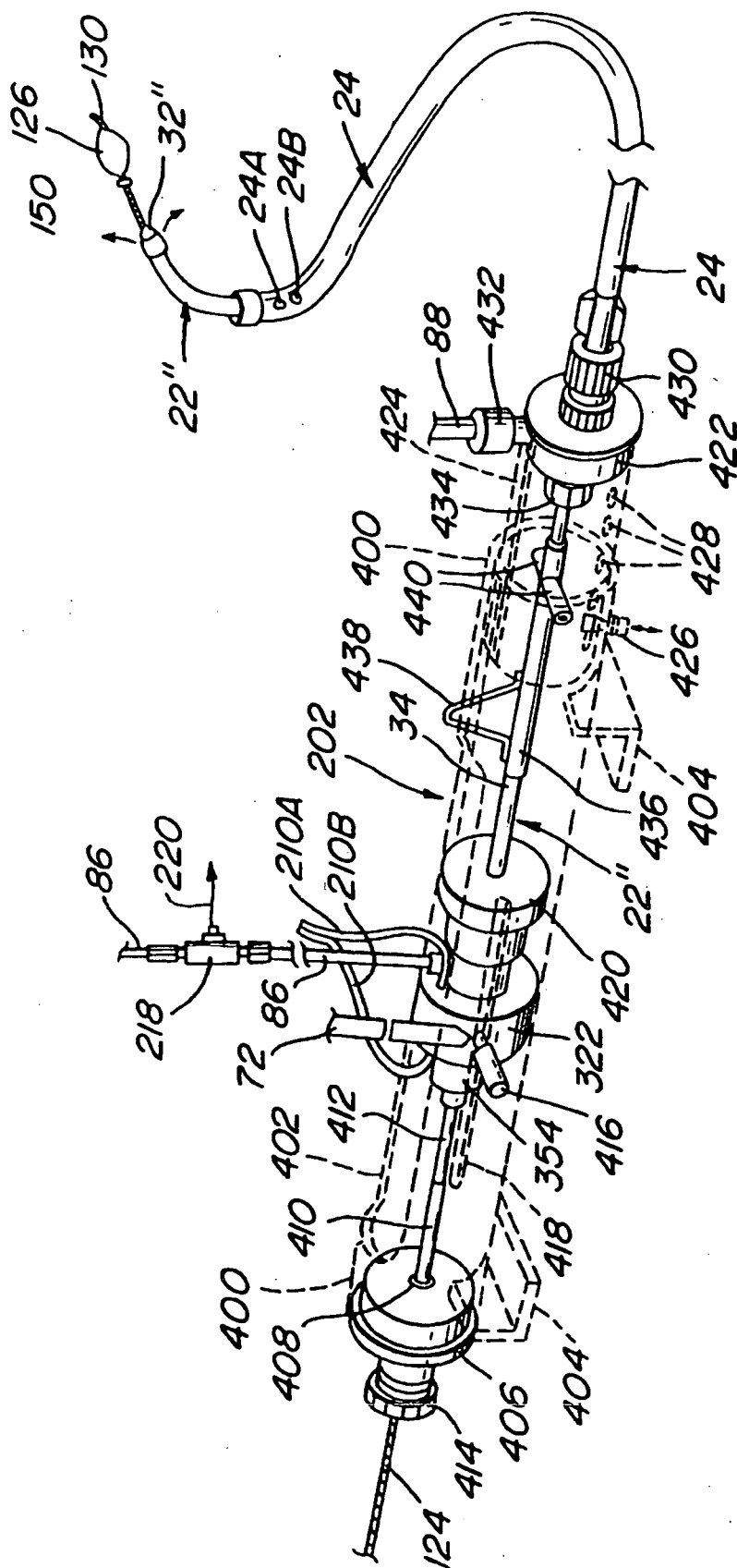

FIG. 9A

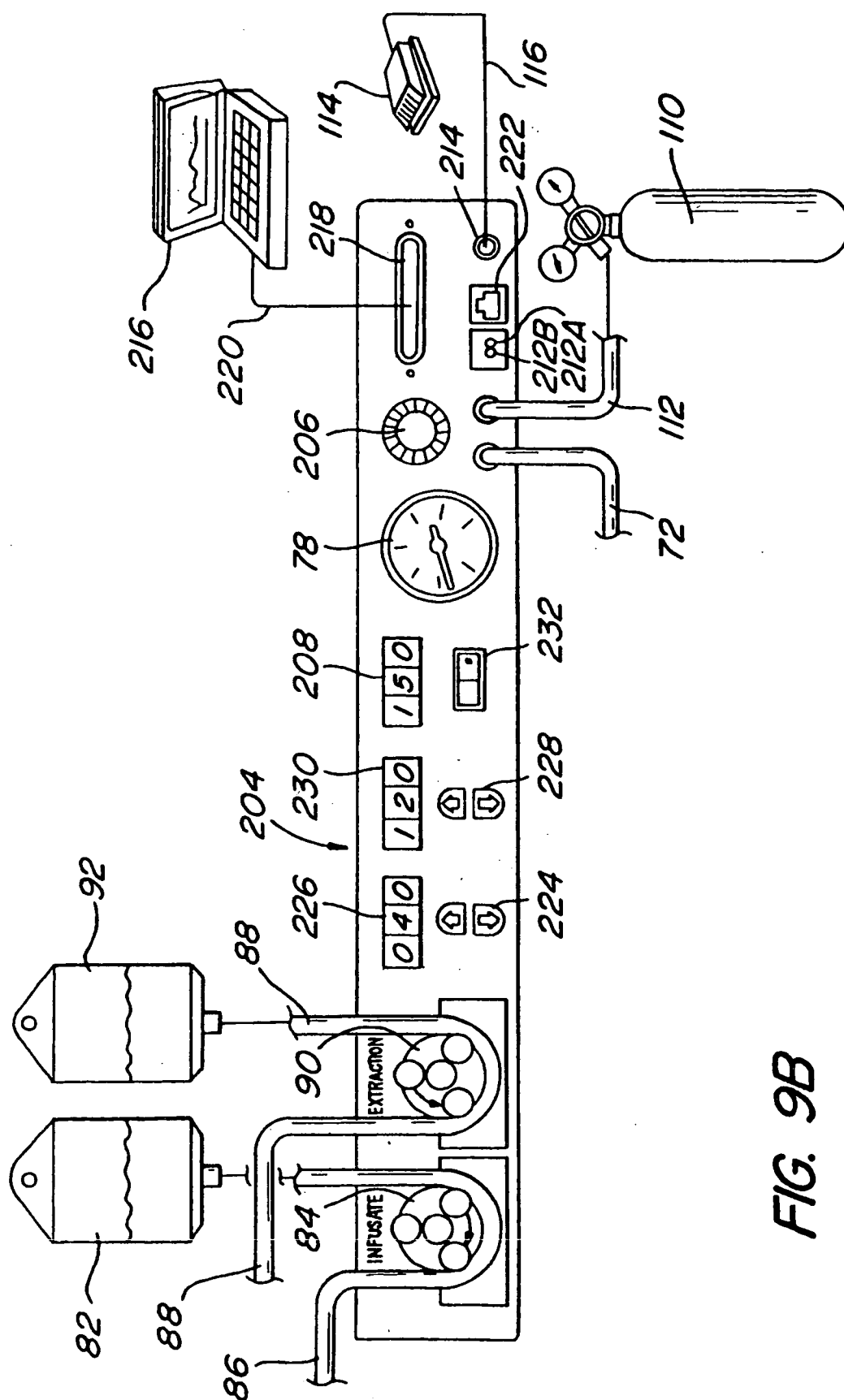

FIG. 9B

FIG. 10

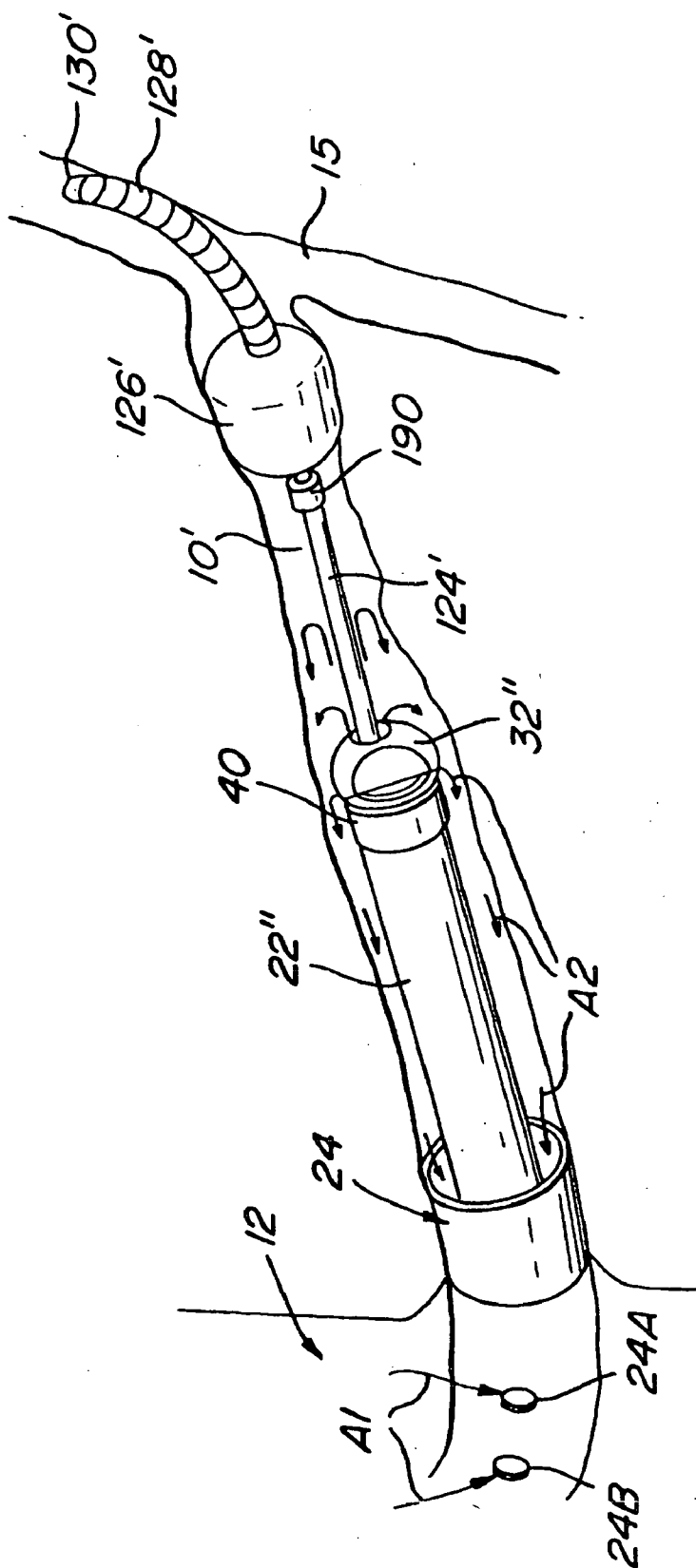

FIG. 11

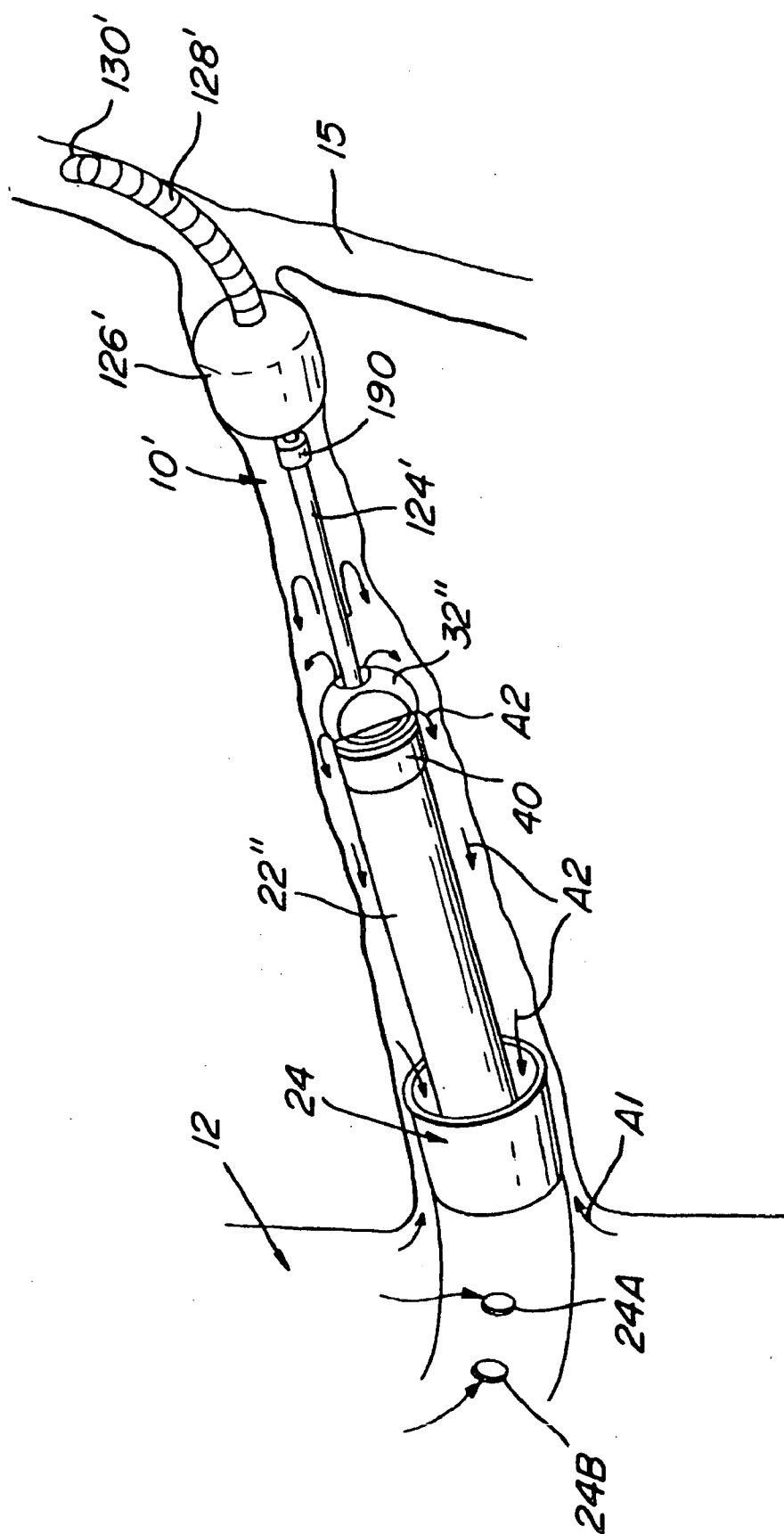
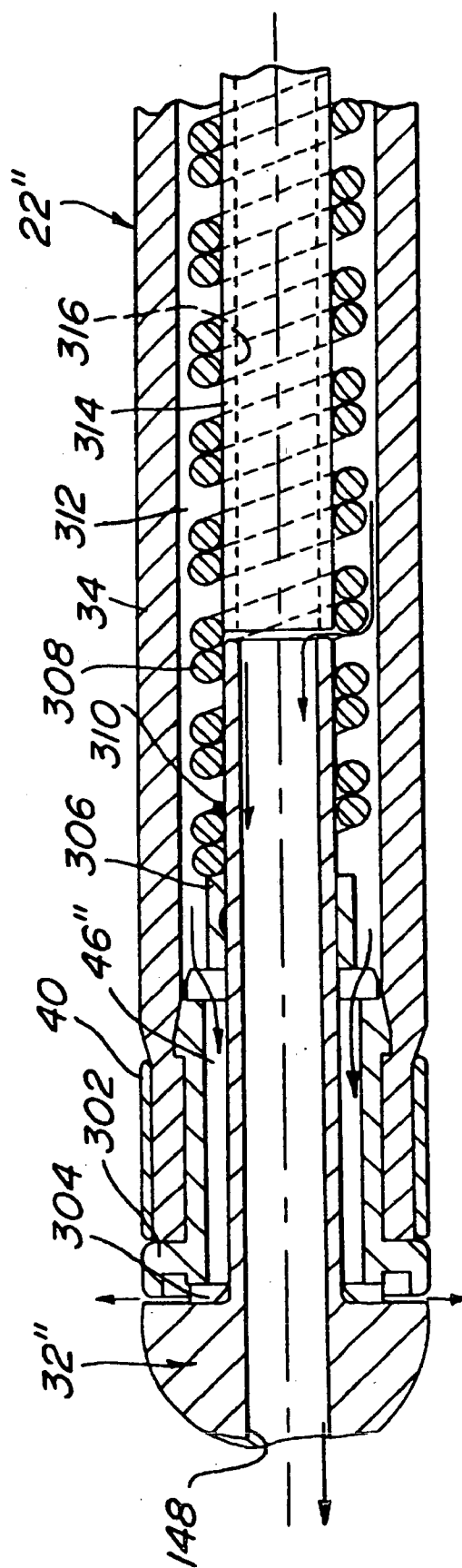
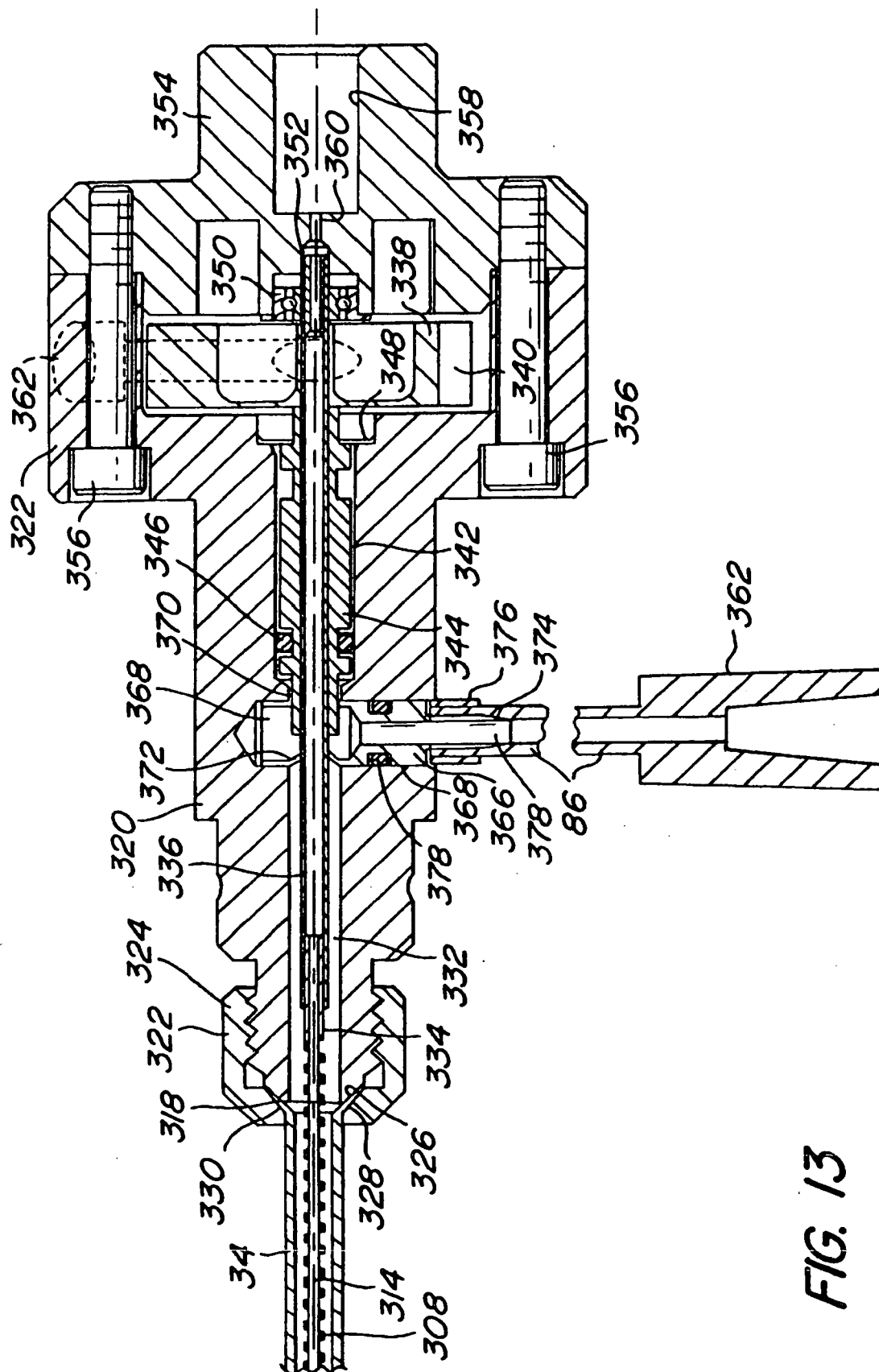

FIG. 12





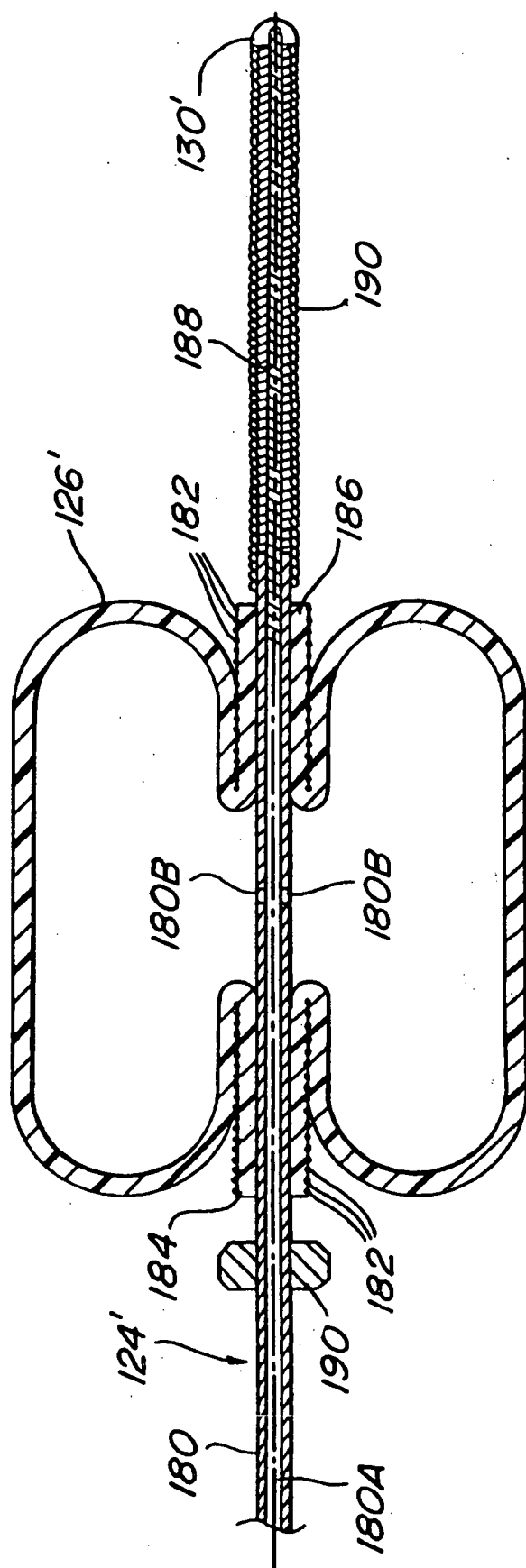

FIG. 14

FIG. 15

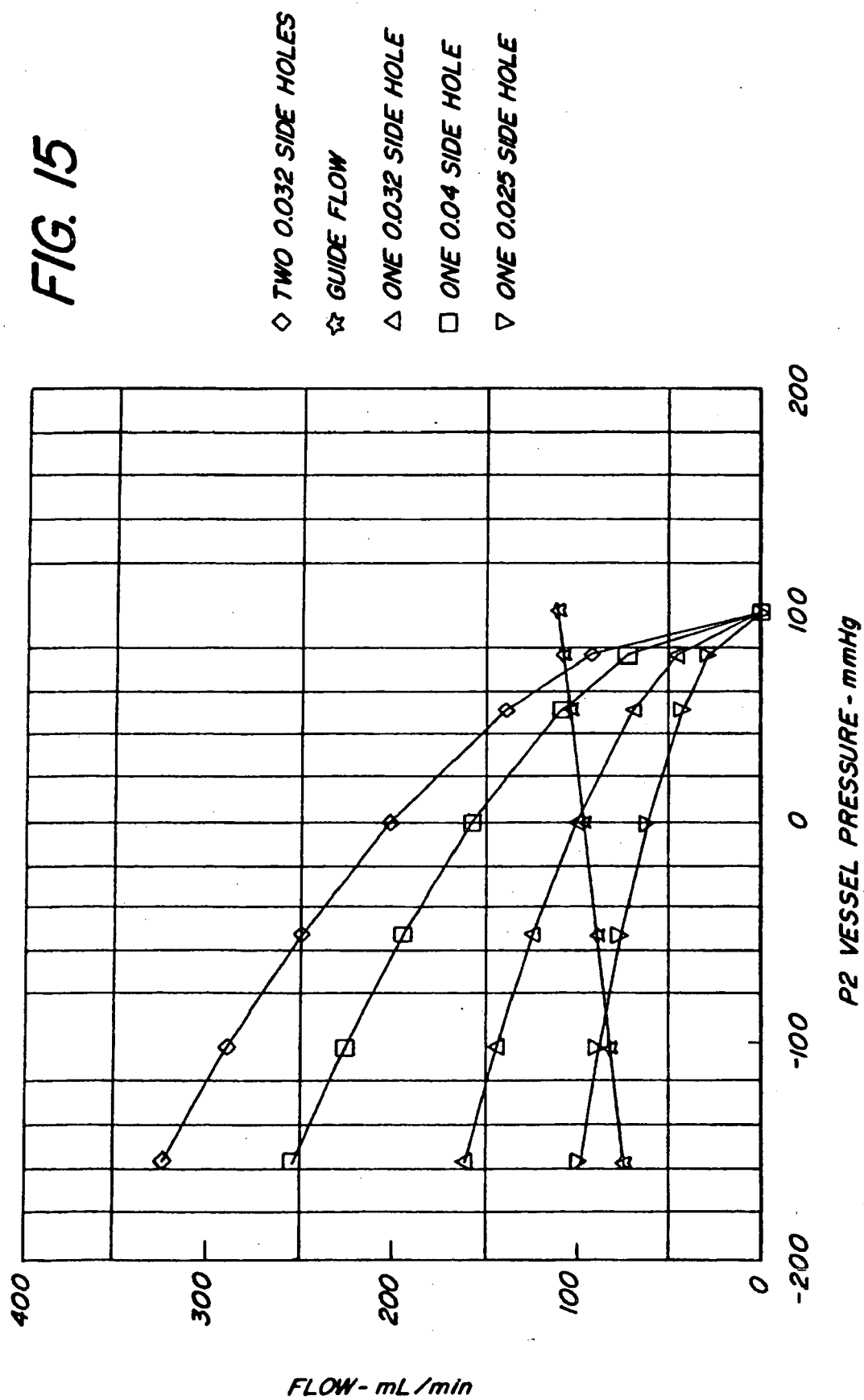
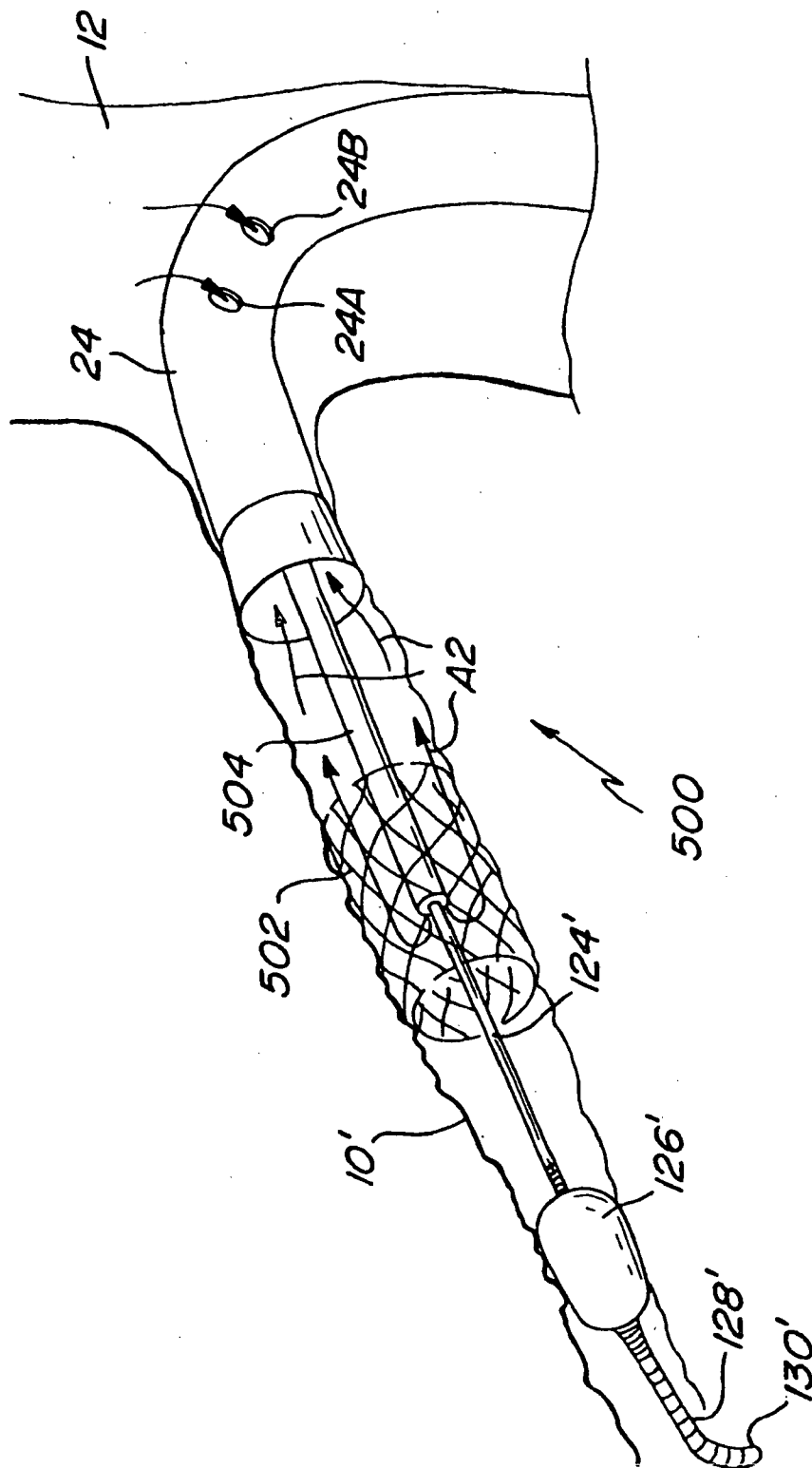

FIG. 16



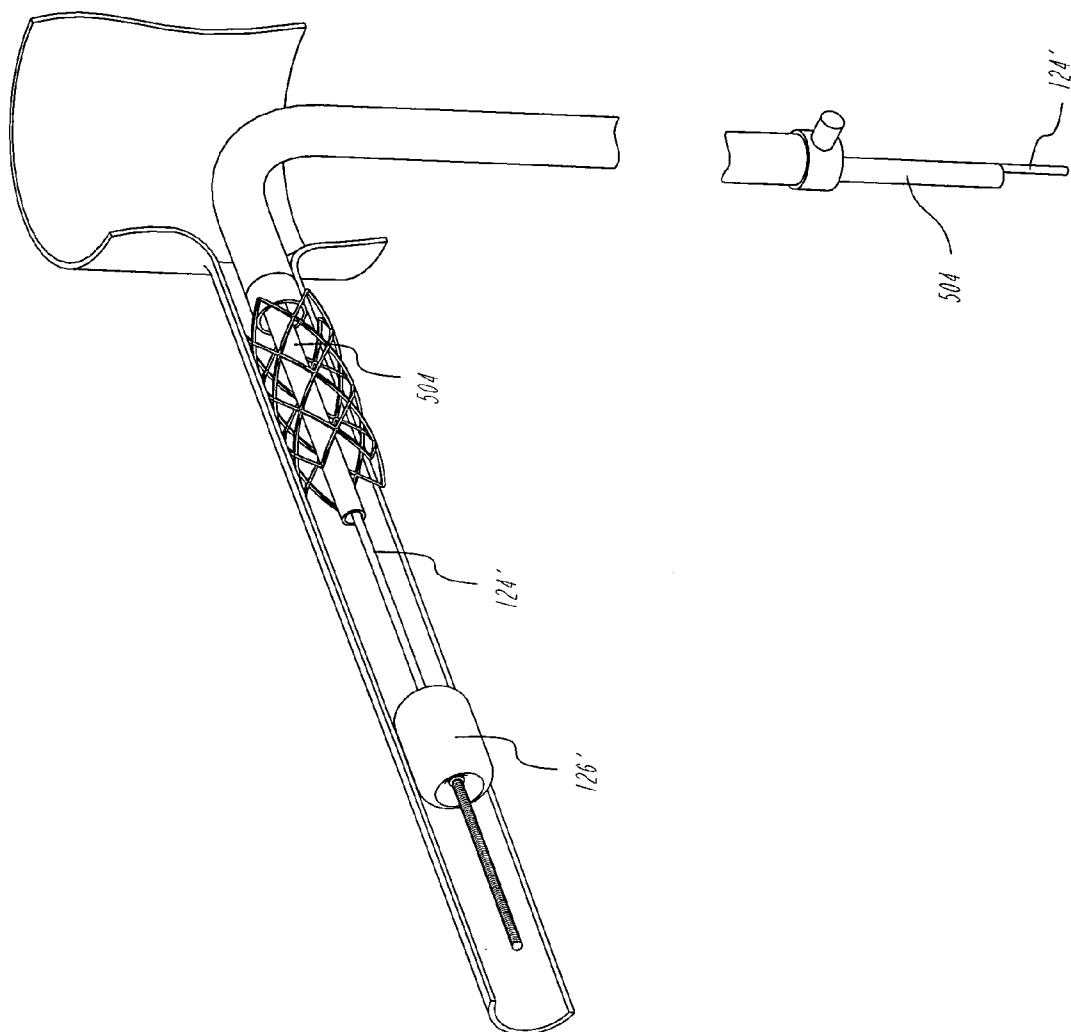

FIG. 18

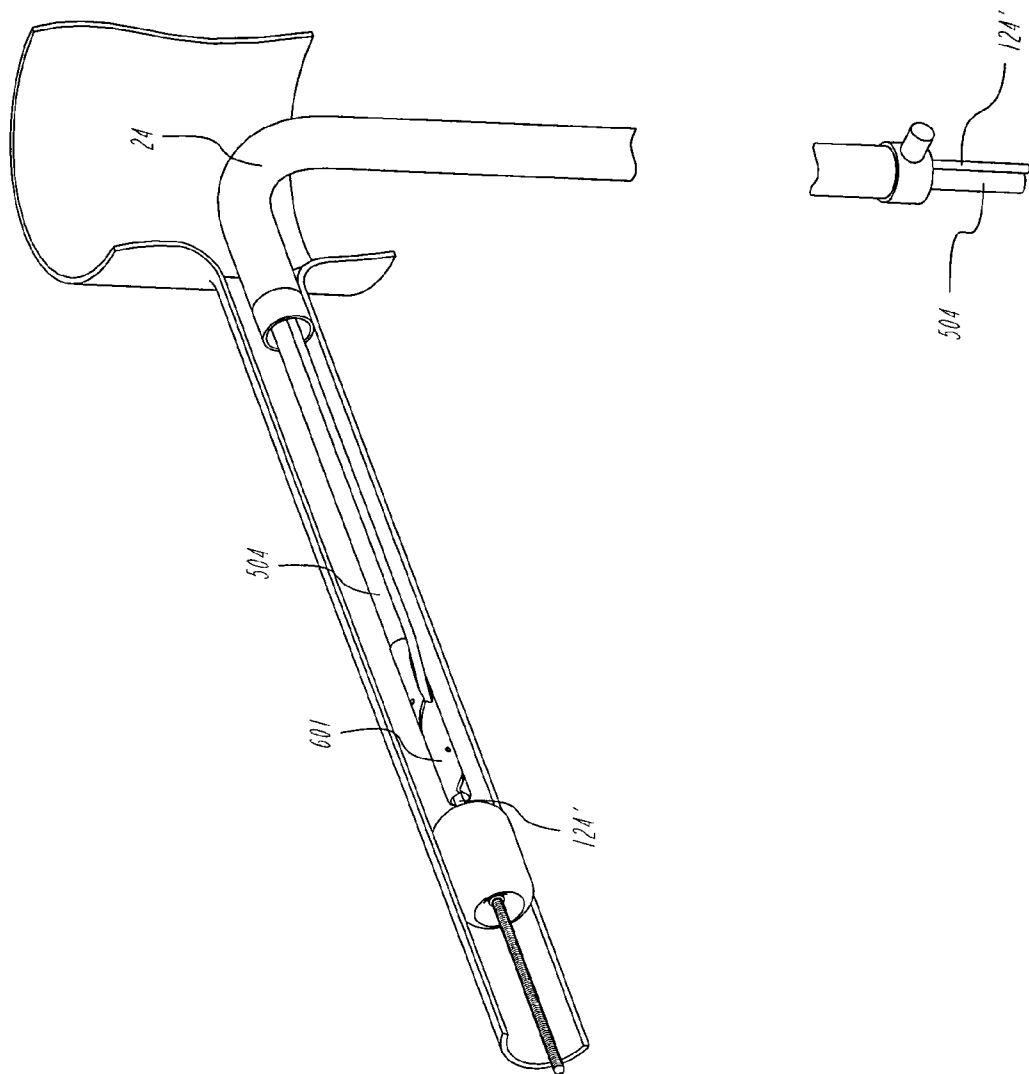

FIG. 19

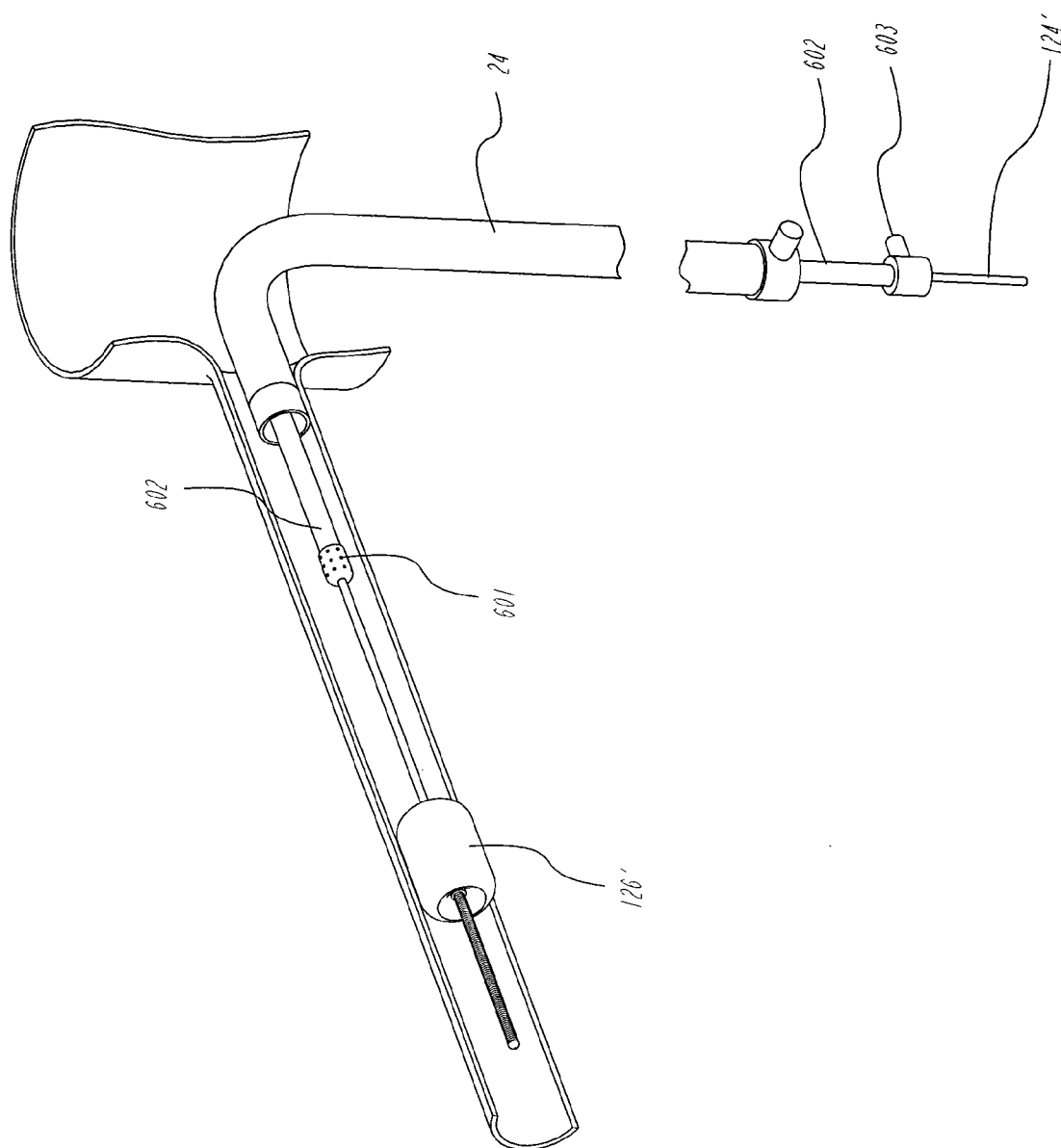

FIG. 20

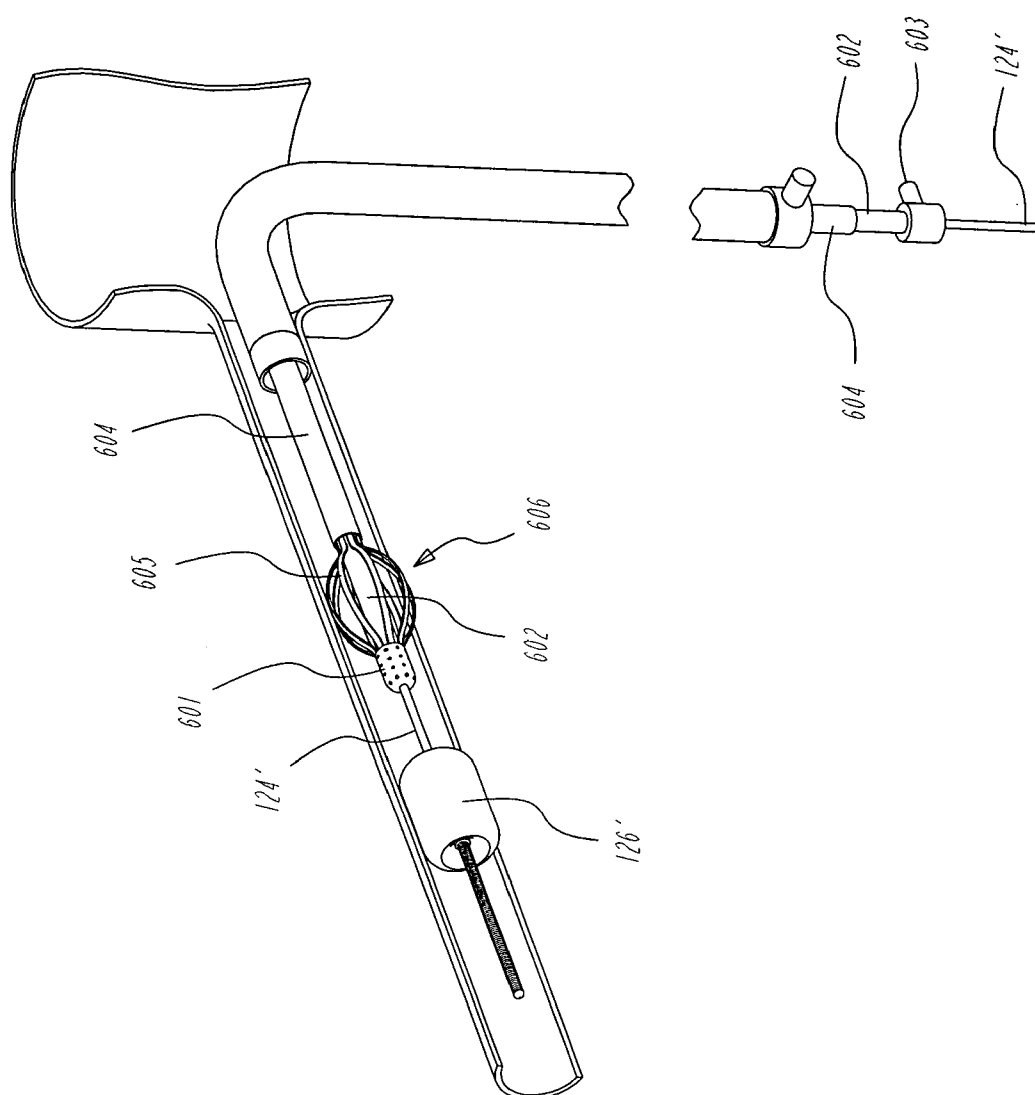

FIG. 21

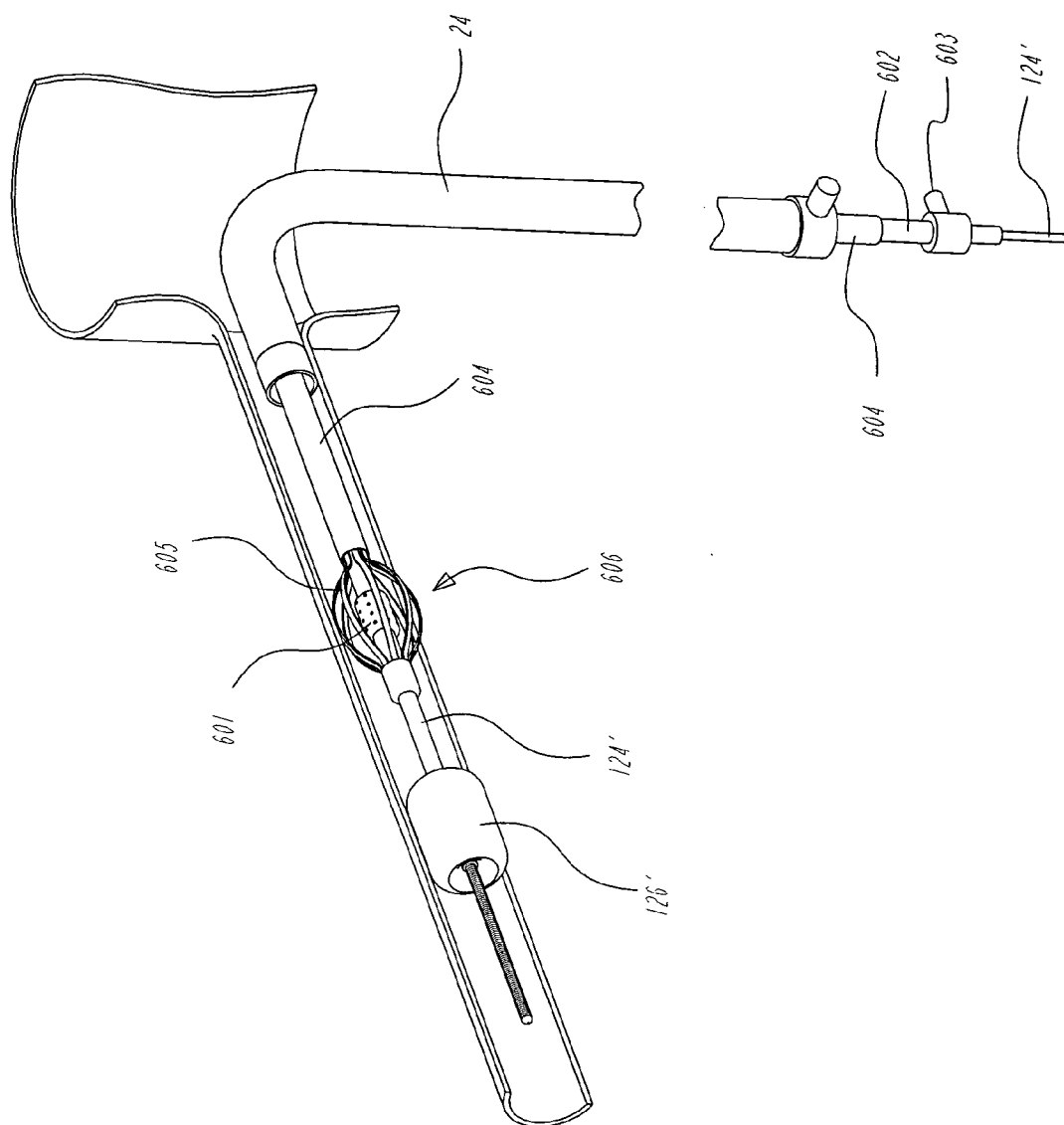

FIG. 22

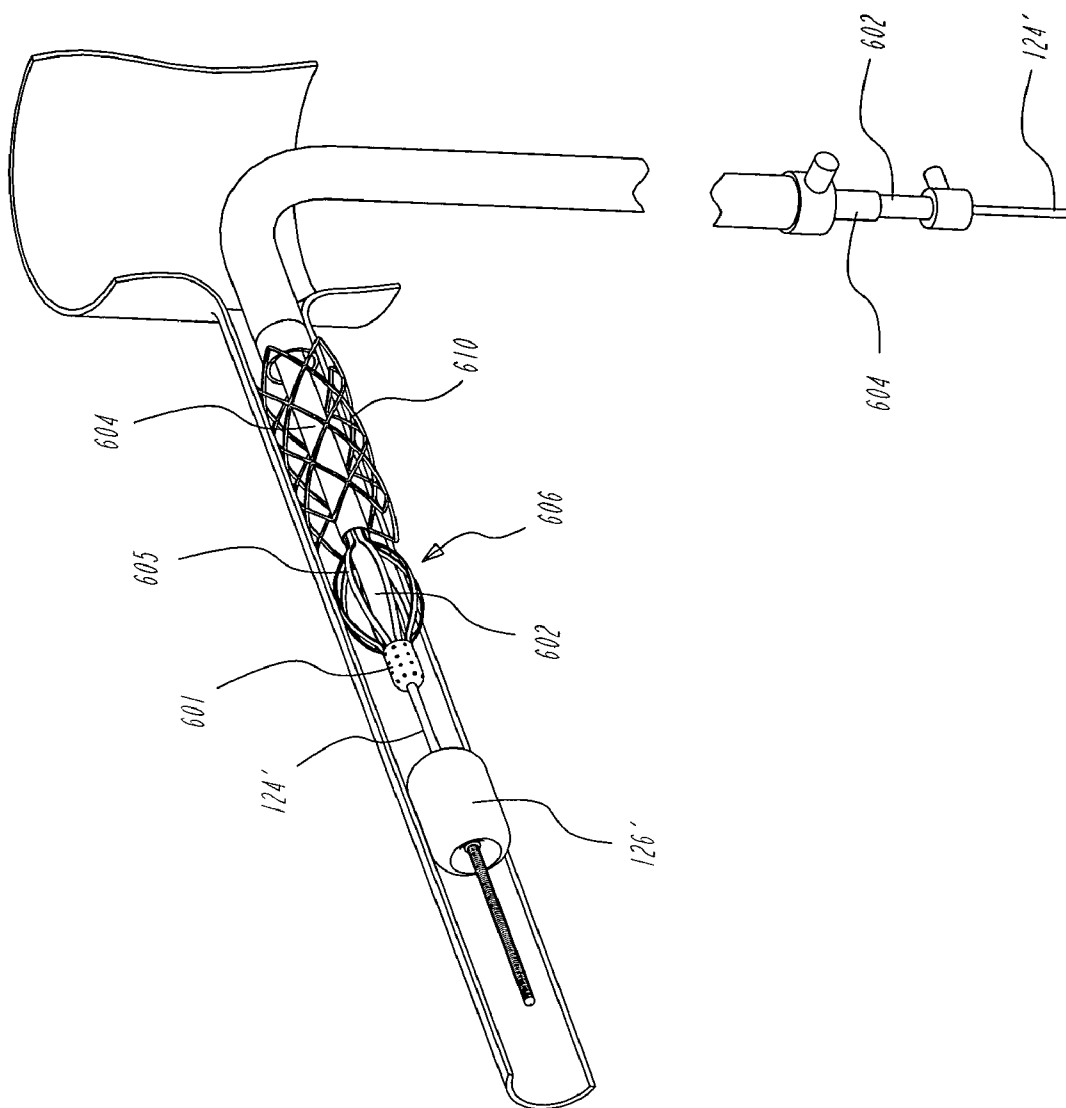

FIG. 24

SYSTEM AND METHOD OF USE FOR TREATING OCCLUDED VESSELS AND DISEASED TISSUE

RELATED APPLICATION

[0001] This application is a Continuation of U.S. patent application Ser. No. 10/058,556, filed on Jan. 28, 2002 entitled System and Method of Use for Treating Occluded Vessels And Diseased Tissue, which is a Continuation-In-Part of U.S. patent application Ser. No. 09/594,131, filed on Jun. 14, 2000, entitled System and Method of Use for Revascularizing Stenotic Bypass Grafts and Other Occluded Blood Vessels, now U.S. Pat. No. 6,524,323, which is a Continuation of U.S. patent application Ser. No. 09/233,712, filed on Jan. 19, 1999, entitled Improved System And Method Of Use For Revascularizing Stenotic Bypass Grafts And Other Occluded Blood Vessels, now U.S. Pat. No. 6,080,170, which in turn is a Continuation-In-Part of U.S. patent application Ser. No. 08/900,598, filed on Jul. 25, 1997, entitled System And Method Of Use For Revascularizing Stenotic Bypass Grafts And Other Blood Vessels, now U.S. Pat. No. 5,879,361, which in turn is a Continuation-In-Part of U.S. application Ser. No. 08/690,438, filed on Jul. 26, 1996, entitled System And Method Of Use For Revascularizing Stenotic Bypass Grafts And Other Blood Vessels, now U.S. Pat. No. 5,779,721, all of which are assigned to the same assignee as this invention, and whose disclosures are incorporated by reference herein.

BACKGROUND OF THE INVENTION

[0002] This application relates generally to medical instruments and methods of use to remove occlusive material from a vessel, duct or lumen within the body of a living being.

[0003] Catheter instruments have been suggested or disclosed in the patent literature for effecting non-invasive or minimally invasive revascularization of occluded arteries. For example, in U.S. Pat. No. 4,445,509 there is disclosed a recanalization catheter designed specifically for cutting away hard, abnormal deposits, such as atherosclerotic plaque, from the inside of an artery, while supposedly preserving the soft arterial tissue. That recanalizing catheter includes a sharp-edged, multi-fluted, rotating cutting tip mounted at the distal end of the catheter and arranged to be rotated by a flexible drive shaft extending down the center of the catheter. The rotation of the cutting head is stated as producing a "differential cutting" effect, whereupon relatively hard deposits are cut away from relatively soft tissue. Suction ports are provided to pull the hard particles produced by the cutting action into the catheter for removal at the proximal end thereof so that such particles do not flow distally of the catheter where they could have an adverse effect on the patients' body.

[0004] In U.S. Pat. No. 4,700,705, which is assigned to the same assignee as this invention and whose disclosure is incorporated by reference herein, there are disclosed and claimed catheters and methods of use for effecting the opening of a vessel, duct or lumen, such as the opening of a atherosclerotic restriction (partial or total occlusion) in an artery. These catheters are elongated flexible members of sufficient flexibility to enable them to be readily passed through the body of the patient to the situs of the atherosclerotic plaque in the artery to be opened. A working head is mounted at the distal end of the catheter and is arranged

for high-speed rotation about the longitudinal axis of the catheter. In some embodiments the catheter may eject fluid at the working head to expedite the restriction-opening procedure.

[0005] In U.S. Pat. No. 4,747,821, which is also assigned to the same assignee as this invention and whose disclosure is incorporated by reference herein, there is disclosed and claimed other catheters particularly suited for revascularization of arteries. Each of those catheters includes a rotary working head having at least one non-sharp impacting surface to effect material removal without cutting. Moreover, those catheters are arranged to eject fluid adjacent the working head to expedite the revascularization procedure. In particular, the rotation of the working head produces a powerful, toroidal shaped vortex contiguous with the working head which has the effect of recirculating any particles that may have been broken off from the material forming the arterial restriction so that the working head repeatedly impacts those particles to reduce their size.

[0006] In U.S. Pat. No. 5,042,984, which is also assigned to the same assignee as this invention and whose disclosure is incorporated by reference herein, there are disclosed and claimed catheters whose working heads include impacting surfaces of differing aggressiveness which may be selectively brought into engagement with the restriction to be opened. Such catheters also make use of exiting jets of liquid as described above.

[0007] Other atherectomy devices for enlarging an opening in a blood vessel have been disclosed and claimed in the following U.S. Pat. No. 4,589,412 (which is assigned to the same assignee as this invention and whose disclosure is incorporated by reference herein); U.S. Pat. Nos. 4,631,052; 4,686,982 (which is assigned to the same assignee as this invention and whose disclosure is incorporated by reference herein); U.S. Pat. No. 4,749,376 (which is assigned to the same assignee as this invention and whose disclosure is incorporated by reference herein); U.S. Pat. Nos. 4,790,813; 5,009,659; 5,074,841; 5,282,484; 5,366,463; 5,368,603; 5,402,790; 5,423,742; and 5,429,136.

[0008] Some rotary atherectomy devices are in use in this country for revascularizing occluded arteries. However, their use is limited to some very selected applications. Thus, in many instances a vascular occlusion of a coronary artery can only be treated by coronary bypass surgery wherein a graft, e.g., a saphenous vein section and/or mammary artery section, is surgically shunted across the occluded coronary artery. Unfortunately a significant percentage of bypass surgical grafts become re-occluded over time. Thus, the re-occluded graft has to be either bypassed by another graft (i.e., second bypass surgery), or the re-occluded graft has to be revascularized (i.e., its lumen reopened) by some intravascular procedure. If the occluded graft is not totally occluded, balloon angioplasty may be indicated to reopen the graft. Where, however, the graft is totally occluded or heavily occluded by frangible deposits balloon angioplasty is unavailable. Thus, if revascularization of such a graft is desired, resort may be to rotary atherectomy.

[0009] One currently available rotary atherectomy device is the ROTOBULATOR® System of Heart Technology, Inc. That system utilizes a catheter having a diamond coated elliptical burr which is rotated at a high rate of speed, e.g., up to 190,000 rpm. The burr serves to break the atheroscle-

rotic plaque into fine particles which are allowed to remain in the patient's body for disposal by the patient's reticuloendothelial system.

[0010] As is known to those skilled in the art, one problem with a rotary atherectomy device is that unless the debris produced is so small and benign that it can be left within the patient's vascular system there must be some means to ensure that the debris does not flow upstream into the aorta during the procedure or into the downstream artery graft at the break-through point when the device comes out the distal side of a total occlusion, since either action could present a significant hazard to the patient. In particular, the former route risks stroke, the later route risks local ischemia of heart muscle when debris blocks off small arteries.

[0011] Thus, the collection and/or aspiration of debris produced during the revascularization of occluded arterial bypass grafts or other blood vessels is getting considerable attention in the medical arts. For example, Possis Medical, Inc., the assignee of U.S. Pat. Nos. 5,370,609 and 5,496,267, provides catheter devices designated as the ANGIOJET Rapid Thrombolectomy System and the ANGIOJET Rheolytic Thrombolectomy System. These devices are presumably constructed in accordance with those patents and are believed to be presently undergoing clinical trials. The catheter devices disclosed in those patents utilize high velocity jets of saline to abrade the blockage. In particular, the patents disclose utilizing the momentum of the saline jets to create a local vacuum to entrain any particulate material produced by the revascularization procedure, with the momentum and the local positive pressure being sufficient to carry the saline and debris to a return collection bag.

[0012] Another atherectomy device which is currently undergoing clinical trials is the Coronary TEC® System of Interventional Technologies, Inc. That device is believed to be the subject of U.S. Pat. No. 5,224,945, and basically comprises a catheter having a working head with microtome sharp blades for cutting plaque circumferentially. The excised plaque is extracted by suction through a central lumen in the catheter into an exteriorly-located vacuum bottle. No control of the quantity of flow of the debris-carrying fluid from the catheter is disclosed.

[0013] U.S. Pat. No. 5,030,201 (Palestran) discloses a system including an expandable atherectomy catheter arranged to be rotated to cut through an occluded artery to revascularize it. The atherectomy catheter includes an expandable cutting head having plural elongated cutting members which are mounted on a flexible torque tube incorporating a vacuum or aspiration system for retrieval of excised material. The cutting head is arranged to be rotated to cause the elongated members to cut away atheromatous material or blood clots. The atherectomy catheter is arranged to be inserted into the blood vessel through a coaxial delivery catheter, also forming a part of the system. The mechanism for aspirating particles of atheromatous material or blood clots removed by the elongated cutting members is disclosed as being in the form of a vacuum port provided at the proximal end of either the delivery catheter, the atherectomy catheter or a "retracting catheter" which also constitutes a part of the system. Saline solution or some other irrigant is infused through one of the catheters of the device that is not being used for aspiration. The infusion rate of the saline solution is balanced with the aspiration rate to avoid

any net removal of fluid from the vessel. In particular, the patent teaches that by balancing the infusion rate of the saline solution to the aspiration rate, the net removal of fluid from the vessel can be brought close to zero, thereby minimizing blood loss.

[0014] While the balancing of the infusion and aspiration flow rates to minimize blood loss may be desirable, such action does not insure positive removal of all debris produced during the revascularization procedure.

[0015] Accordingly, a need exists for apparatus and a method of use to revascularize partially or totally occluded blood vessels, while positively assuring that any particles produced during the revascularization procedure are removed from the patient's body. In the case of partially or totally occluded coronary bypass grafts, a need exists for intravascular atherectomy apparatus and methods of use for effectively producing a lumen through the occlusion for the free flow of blood, without the risk that any debris produced during the lumen opening procedure will enter into the aorta or downstream of the occlusion once it has been crossed or opened.

[0016] Additionally, there exists a need for a single device to revascularize and/or treat occlusive or diseased tissue and/or deliver a therapy to a lumen or artery and the surrounding tissue.

OBJECTS OF THE INVENTION

[0017] Accordingly, it is a general object of this invention to provide systems and methods which address those needs.

[0018] It is another object of this invention to provide a system and methods for effectively revascularizing partially or totally occluded blood vessels and for removing any debris produced during the procedure from the patient's body.

[0019] It is another object of this invention to provide a system and methods for safely revascularizing partially or totally occluded blood vessels.

[0020] It is still another object of this invention to provide a system and methods for effectively opening a lumen in a partially or totally occluded arterial bypass graft, without the risk of debris produced during the procedure entering the aorta or from flowing downstream once the lumen through the occlusion has been opened.

[0021] It is yet another object of this invention to provide a system and methods for effectively opening a lumen in a partially or totally occluded portion of an artery, e.g., the femoral artery, downstream of a junction with another vessel, e.g., the profunda femoris, without the risk of debris produced during the procedure entering the other vessel or from flowing downstream in the artery once the lumen through the occlusion has been opened.

[0022] It is yet a further object of this invention to provide a system and methods for revascularizing partially or totally occluded blood vessels utilizing liquid infusion and aspiration means for establishing a differential flow to positively ensure the aspiration of debris produced during the revascularization procedure.

[0023] It is yet a further object of this invention to provide a system and methods for revascularizing partially or totally

occluded blood vessels utilizing liquid infusion and aspiration means which is easy to operate to effect the positive removal of debris produced during the revascularization procedure.

[0024] It is yet a further object of this invention to provide a system and methods for revascularizing partially or totally occluded blood vessels utilizing liquid infusion and aspiration means which is adjustable for effectuating the positive removal of debris produced during the revascularization procedure.

[0025] It is yet a further object of this invention to provide a system and methods for revascularizing partially or totally occluded blood vessels utilizing liquid infusion and aspiration (extraction) subsystems which effect positive removal of debris produced during the revascularization procedure but which precludes collapse of the vessel being revascularized.

[0026] It is yet a further object of this invention to provide a system and methods to diagnose or treat diseased tissue (e.g., vessels or lumens at least partially occluded with atherosclerotic plaque, or cancerous tissue, etc.), via the use of catheters, working heads and drug delivery means.

[0027] It is yet a further object of this invention to provide a low profile device to reach small vessels and lumens, perhaps in difficult regions, to treat diseased tissue (e.g., deep venous thromboses (DVT) located in the lower leg regions, etc.), where the system of the present invention may be used to support, replace, or augment existing treatment modalities (e.g., thrombolysis, chemotherapy, etc.) in a way that is less tortuous than existing technologies (e.g., the Rotoblator™ atherectomy system manufactured by Boston Scientific, Natick, Mass.).

SUMMARY OF THE INVENTION

[0028] These and other objects of this invention may be achieved by providing a system for opening a lumen in an occluded blood vessel, e.g., a coronary bypass graft, of a living being's vascular system located downstream of another blood vessel, e.g., the aorta, from which blood will flow to the occluded blood vessel. The system basically comprises a guide catheter, a lumen-opening catheter, a debris blocking member, and a fluid flow system.

[0029] The guide catheter has a distal end portion and at least one blood entrance port located proximally of the distal end portion. The lumen-opening catheter extends through the guide catheter to establish a fluid flow passageway therebetween and has a working head, e.g., a rotatable impacting member, for location immediately adjacent the occlusive material within the occluded blood vessel portion. The working head is arranged for operating on the occlusive material, e.g., repeatedly impacting it, to open a lumen for the freer flow of blood therethrough. Some debris may be produced by the operation of the working head.

[0030] The debris blocking member is located distally of the working head to prevent debris from flowing distally thereof.

[0031] The fluid flow system is arranged to introduce an infusate liquid at a first flow rate adjacent the working head and to withdraw that liquid through the passageway between the guide catheter and the lumen opening catheter at a

second and higher flow rate to create a differential flow adjacent the working head, whereupon debris produced by the operation of the working head is withdrawn by the differential flow and flows with the liquid proximally through the passageway for extraction.

[0032] The blood entrance port in the distal end portion of the guide catheter is in communication with the passageway between the guide catheter and the lumen opening catheter, whereupon blood from the patent blood vessel portion may enter for merger with the liquid and debris flowing through that passageway.

[0033] In accordance with one preferred embodiment of this invention the debris blocking member is an inflatable balloon is provided at the distal end of the instrument to physically block the egress of any debris downstream of the apparatus. Perfusion means is preferably provided to inflate the balloon and to oxygenate downstream tissue when the balloon is inflated.

[0034] In yet another embodiment the system of the current invention allows for a working head to eject infusate liquid (e.g., through liquid jets), where said infusate may comprise a therapy or additional material (e.g., drugs, biologically active agents, microspheres, etc.). The working head may be arranged to be spaced a certain distance from the lumen's interior surface, such that said infusate may penetrate into the lumen or surrounding tissue.

[0035] In yet another embodiment, the working head may be arranged to eject infusate in opposing or impeding directions to cause turbulent flow, which may facilitate diffusion or penetration into tissue. The working head may comprise a complicated fluid jet system, or may comprise simple irrigation catheters (as will be discussed in more detail later).

[0036] In yet another embodiment, pump means operates to independently introduce liquid infusate and/or therapy, and after some dwell time, withdraw the liquid. This dwell time will allow said infusate and/or therapy more time to diffuse or penetrate into tissue. The liquid withdraw may use the differential flow arrangement of pumping means, as previously described, or may use only the aspiration portion. In a similar embodiment, the differential flow system may remain active during the infusing of drugs (whether they are delivered solely or via infusate). This would allow continuous flow against the artery or lumen wall, which may facilitate diffusion of the drug or therapy into the tissue.

[0037] In yet another embodiment the working head is arranged to contact the interior wall of the lumen, during operation (e.g., ejection of liquid) such that infusate and/or therapy are forced into the interior wall and/or the surrounding tissue.

[0038] In yet another embodiment, working heads may comprise irrigation catheters, diagnostic instruments (e.g., biopsy devices, etc.) or imaging devices (e.g., laser, infra-red optical or ultrasound, etc.)

[0039] In these various embodiments, vessels and/or lumens are the location of the treatment to be performed; while blood vessels are designated in some embodiments, that is meant to be exemplary, and not limiting.

BRIEF DESCRIPTION OF THE DRAWINGS

[0040] Other objects and many of the attendant advantages of this invention will readily be appreciated as the same

becomes better understood by reference to the following detailed description when considered in connection with the accompanying drawings wherein:

[0041] **FIG. 1** is a schematic diagram, partially in section, of a system of the subject invention shown during the process of opening a lumen in a totally occluded coronary bypass graft so that blood can flow therethrough;

[0042] **FIG. 2** is an enlarged view, partially in section, of a portion of the system of **FIG. 1** shown during the process of opening a lumen in the occluded coronary bypass graft;

[0043] **FIG. 3** is an even more greatly enlarged view, partially in section, of a portion of the system shown in **FIG. 2**;

[0044] **FIG. 4** is a reduced isometric view of the portion of the system shown in **FIG. 3**;

[0045] **FIG. 5** is an illustration showing the apparatus of **FIG. 1**, partially in section, during the process of revascularizing a totally occluded femoral artery downstream of the profunda femoris;

[0046] **FIGS. 6A and 6B** together are an illustration of another embodiment of the system of this invention for revascularizing or opening a lumen in a coronary bypass graft;

[0047] **FIG. 7** is an enlarged isometric illustration of a portion of an instrument forming a component of the system shown in **FIGS. 6A and 6B** during the process of revascularizing a diseased bypass graft;

[0048] **FIG. 8** is an enlarged longitudinal sectional view of the distal end of the instrument shown in **FIG. 7**;

[0049] **FIG. 9A** is an isometric view of a portion of another preferred embodiment of this invention making use of a guide catheter having at least one flow regulation port to ensure that the vessel being revascularized does not collapse during the extraction of the debris produced by the revascularization;

[0050] **FIG. 9B** is an isometric view of another portion of the embodiment of the system shown in **FIG. 9**;

[0051] **FIG. 10** is an enlarged isometric view of the distal end of the atherectomy catheter, guide catheter and guide wire of the embodiment of **FIG. 9A** shown during revascularization of a coronary bypass graft, where the guide catheter tightly fits within the bypass graft;

[0052] **FIG. 11** is a view similar to **FIG. 10** but where the guide catheter fits loosely within the bypass graft;

[0053] **FIG. 12** is a greatly enlarged longitudinal sectional view of the distal end of an atherectomy catheter forming a part of the embodiment of the system of **FIG. 9A**;

[0054] **FIG. 13** is an enlarged longitudinal sectional view of the proximal end of the atherectomy catheter of the system of **FIG. 9A**;

[0055] **FIG. 14** is an enlarged longitudinal sectional view similar to **FIG. 8**, but showing a modified guide wire and distally located balloon for use with the systems of this invention;

[0056] **FIG. 15** is a graph showing the four potential sizes and numbers of flow regulation ports for the guide catheter and their potential for precluding collapse of the vessel being revascularized;

[0057] **FIG. 16** is a view similar to that of **FIG. 10** but showing a method of providing a stent in an occluded blood vessel section, e.g., a bypass graft, to revascularize it, and with the debris extraction system making use of a guide catheter tightly engaging the wall of the blood vessel section;

[0058] **FIG. 17** is a view similar to that of **FIG. 11** but showing a method of providing a stent in an occluded blood vessel section, e.g., a bypass graft, to revascularize it, and with the debris extraction system making use of a guide catheter not engaging the wall of the blood vessel section;

[0059] **FIG. 18** is an isometric view of a portion of one embodiment of the treatment and therapy delivery system shown positioned within a partially sectioned blood vessel which contains a stent;

[0060] **FIG. 19** is a view similar to that of **FIG. 18** but showing another embodiment of the treatment system that includes a rapid exchange catheter;

[0061] **FIG. 20** is a view similar to that of **FIG. 19** but showing another embodiment of the treatment system that includes a high velocity agent delivery catheter with a fluid distribution working head;

[0062] **FIG. 21** is a view similar to that of **FIG. 20** but showing another embodiment of the treatment system that includes a high velocity agent delivery catheter with a centralizing basket positioned proximal of the distribution head;

[0063] **FIG. 22** is a view similar to that of **FIG. 21** but showing another embodiment of the treatment system that includes a high velocity agent delivery catheter with a distribution head positioned within a centralizing basket;

[0064] **FIG. 23** is an isometric view of a portion of one embodiment of the treatment and therapy delivery system containing two distal protection components and a therapy delivery catheter with a distribution head shown positioned within a partially sectioned branched vessel or lumen; and

[0065] **FIG. 24** is a view similar to that of **FIG. 21** but showing the treatment system that includes an agent delivery catheter with centralizing basket positioned to treat a portion of a blood vessel containing a stent.

DETAILED DESCRIPTION OF THE PREFERRED EMBODIMENT

[0066] Referring now in greater detail to the various figures of the drawings wherein like reference characters refer to like parts, there is shown at **20** in **FIG. 1** a system for revascularizing or opening a lumen through a coronary bypass graft which has become occluded, such as by the formation of a stenotic lesion or the build-up of plaque therein. As used herein the term "occluded" is given its broadest interpretation. Thus, an "occluded" graft or blood vessel may be either totally blocked or only partially blocked (i.e., there is a passageway or lumen through which some blood may flow).

[0067] The system **20** is arranged to be used for forming or enlarging a lumen through any blood vessel within the body of a living being, e.g., an occluded femoral artery downstream of the profunda femoris, not necessarily an occluded coronary bypass graft or an occluded coronary

artery. In particular, the system **20** is arranged to produce a channel or lumen or to enlarge a lumen through the occlusive material within the vessel and to ensure that any particles of that material which are removed or broken away, during the revascularization procedure are prevented from flowing into the contiguous vascular system. When the system **20** is used for revascularization of occluded coronary bypass grafts, a primary application for the system **20**, the debris produced is drawn into the system for extracorporeal removal and is thus prevented from entering the aorta.

[0068] As can be seen in **FIG. 1**, the system **20** basically comprises an "atherectomy" catheter **22**, a guide catheter **24**, an introducer sheath **26**, a drive sub-system **28**, and a debris removal sub-system **30**. The atherectomy catheter **22** is in the form of an elongated flexible tubular body member or jacket at the free or distal end of which is located a rotatable working head **32**. The working head **32** is generally similar to that described in U.S. Pat. No. 4,747,821. Alternatively, the working head may be constructed in accordance with the teachings of U.S. Pat. Nos. 4,679,558, 4,686,982, 4,749,376, 5,042,984, and 5,097,849, all of which are also assigned to the same assignee as this invention, and whose disclosures are also incorporated by reference herein. In fact, the working head may be any device for opening a lumen through at least partially occlusive material.

[0069] In use the atherectomy catheter **22** is guided through the vascular system of the patient by the guide catheter **24** (which is conventionally placed) to the site of the vascular occlusion that has been determined to exist, so that the rotary working head is located immediately adjacent the upstream end of the occlusion. In the embodiment shown in **FIG. 1**, the atherectomy catheter is located within a coronary bypass graft **10** having an upstream end in fluid communication with the aorta **12**. The downstream end of the graft is not shown and is in fluid communication with the coronary artery being bypassed or with smaller arteries of the heart. In the example shown herein the graft **10** is totally occluded by an atherosclerotic lesion or plaque or some other occlusive material **14** (**FIG. 2**) within the interior of the graft.

[0070] The atherectomy catheter **22** is introduced into the patient's vascular system in a conventional manner, e.g., via the use of the introducer sheath and guide catheter. As shown, this is accomplished via a percutaneous puncture **16** in the femoral artery **18**. The sheath **26** and guide catheter **24** are each of conventional construction and thus their details will not be described in the interest of brevity.

[0071] The working head **32** is arranged to rotate about the longitudinal axis of the catheter at a high rate of speed, e.g., from 10,000 rpm to 200,000 rpm to repeatedly mechanically impact the occlusive material. At the same time, an infusate liquid (to be described later) is pumped through the atherectomy catheter by a pump (to be described later and forming a portion of the debris removal sub-system **30**) and out of distal end of the atherectomy catheter adjacent the working head. The opening of the occlusion to allow freer flow of blood therethrough is effected by impacting surfaces of the rotating working head impacting the occlusive material **14**, whereupon portions thereof are removed, e.g., broken away. In addition, as will be described later, the rotation of the working head produces a powerful, toroidal shaped vortex contiguous with the working head. This vortex flow has the

effect of recirculating particles that are broken off from the occlusive material by the impact of the rotary working head's impacting surfaces back into contact with such surfaces. Accordingly, those particles are repeatedly impacted, with each impaction reducing the size of the particles further until the majority of resulting particle sizes are very small, e.g., less than 200 microns. At the same time another pump (also to be described later) of the debris removal sub-system **30** is operated to aspirate the particles produced during the revascularization procedure along with the infusate liquid and some blood.

[0072] Thus, as will be described in detail later, the debris removal subsystem **30** utilizing a downstream balloon, as will be described later, is operative to ensure that debris produced as the working head opens a lumen through the occlusion is not able to flow upstream into the upstream vessel, e.g., the aorta **12**, during the lumen opening procedure, and once the working head breaks through or exits the occlusion on the downstream side, that the debris is not able to flow downstream into the downstream blood vessel(s).

[0073] As best seen in **FIG. 4** the atherectomy catheter includes a jacket **34** which is formed of any suitable material, e.g., plastic, and has a small outside diameter. In the preferred embodiment shown herein, the outside diameter of the jacket **34** is approximately 1.5 mm (5 French). This size catheter is merely exemplary. The means for effecting the rotation of the working head is the heretofore identified drive sub-system **28**. That sub-system is similar to the drives disclosed in the aforementioned U.S. Pat. Nos. 4,686,982, and 4,747,821 and basically comprises an air-turbine motor and associated rotary drive cable (to be described later). Other drive systems can be utilized, as well.

[0074] Irrespective of the construction of the drive system, it is coupled to the working head **32** so that the working head is rotated about its longitudinal axis at the high rate of speed. Many of the details of the working head embodiments will be described later. Suffice it for now to say that the working head **32** of this embodiment includes an impeller portion **44** and a central shank portion or axle **36** (**FIG. 4**) projecting proximally therefrom. The axle **36** is supported in a central bore of a bushing **38** fixedly mounted at the distal end of the catheter's jacket **34** by an encircling mounting band **40**. The shank **36** is fixedly secured to the distal end of a flexible drive cable **42** forming a portion of the drive sub-system **28**.

[0075] The impeller **44** forms the distal portion of the working head and is fixedly secured to the shank **36** so that it will be rotated at a high rate of speed about its longitudinal axis by the concomitant rotation of the drive cable. The impeller portion **44** comprises a circular disk or base **52** from which a generally planar tip **54** projects. The tip **54** has a pair of generally planar diametrically disposed relieved side surfaces or faces which merge with an arcuate front or distal surface to form a pair of arcuate impacting surfaces **54A** and **54B**. Each of the impacting surfaces is radiused in a plane perpendicular to the axis of rotation of the working head so that each is not sharp, e.g., is in the range of approximately 0.001 inch to approximately 0.008 inch, although in the scale of the figures of the drawing they appear to be a sharp line. The working head is located within a cylindrical shroud **56** (**FIGS. 3 and 4**) fixedly mounted on the front of the bushing **38**. The shroud **56** includes a cylindrical sidewall portion **58** and a generally conical distal wall portion **60**

terminating in a circular opening 62 in the distal end thereof. The shroud may be of any suitable outside diameter, e.g., 7 to 8 French. The distal arcuate portion of the impeller tip 54 projects out of the central or front opening 62. A side port or open window 64 is located in the sidewall 58.

[0076] As mentioned earlier the system 20 utilizes an infusate liquid to expedite the revascularization of the vessel. In particular, the infusate liquid is pumped at a flow rate Q_1 (to be described later) down through the interior of the catheter jacket 34 through four equidistantly spaced grooves 46 extending down the central bore of the bushing 38 and via radial ports 48 to an annular recess 50 in the front wall of the bushing. The annular recess is in fluid communication with the side port or window 64 in the shroud so that the infusate liquid can exit therefrom. The direction of flow of the infusate liquid down the atherectomy catheter and out the shroud at its working head is shown clearly in FIG. 4.

[0077] The rotation of the working head about its longitudinal axis produces a powerful toroidal shaped vortex flow Q_3 in the fluid contiguous with the working head. This flow Q_3 circulates by entering into the shroud through the central or front opening 62 and exits out through the side window 64 as shown in FIG. 3. Thus, the flow exiting through window 64 is $Q_1 + Q_3$. As will be appreciated by those skilled in the art the vortex flow Q_3 has the effect of recirculating any particles that are broken off from the occlusive material 14 by the action of the rotating working head back into contact with the working head's impacting surfaces. Thus, the occlusive material particles which are broken away are progressively reduced in size until they are aspirated by aspiration means forming a portion of the debris removal sub-system 30. That means will be described later. Suffice it for now to state that the aspiration means withdraws the infusate liquid, the debris particles and some blood at an aspiration flow rate of Q_2 .

[0078] As should be appreciated by those skilled in the art the liquid exiting from the window 64 of the shroud will tend to push the atherectomy catheter's distal end sideways or laterally in the direction opposite to the direction of the liquid exiting that window. This hydrodynamic action may be used to aid in steering the catheter to a desired position with respect to an occlusion to be revascularized. In this regard, for example, when negotiating a branch in the artery system to reach the occlusion to be revascularized, the atherectomy catheter can be rotated or twisted about its longitudinal axis so that the shroud's window is facing in the opposite direction to the branch to be entered. This action will cause the side directed liquid exiting the window 64 to push the catheter's distal end sideways, whereupon it can enter the desired arterial branch. Such "hydrodynamic steering" of the atherectomy catheter can be accomplished in other manners and by other means than by the use of a shroud having a single side window or port. Thus, this invention contemplates an intravascular catheter instrument, of any type, including any means for producing an asymmetric, e.g., side directed, fluid flow adjacent the distal end of the catheter so that it can be steered into a desired position by appropriate rotation of the catheter about its longitudinal axis.

[0079] As mentioned earlier, the guide catheter 24 is of any conventional construction. In the preferred embodiment shown in FIG. 1 it is a 10F to 12F catheter having a

conventional Y connector 66 at its proximal end. The Y connector 66 has one input leg including a Touhy-Borst adjustable hemostasis valve 66A through which the atherectomy catheter 22 passes. The other input leg, i.e., the angled leg 68, is connected to the aspiration portion of the debris removal sub-system 30 (to be described later).

[0080] Power for operating the atherectomy catheter is provided by the drive sub-system 28. That system includes an air turbine motor 70 which is coupled to the proximal end of the flexible drive cable 42. The air turbine 70 is provided with compressed air via an input line or conduit 72. Air for the line 72 is provided from a source (not shown) via an associated regulator 74, and the conventional control valve 76. The control valve is coupled to the input line 72 of the air turbine. A pressure gauge 78 is connected between the regulator 74 and the control valve 76. The regulator 74, the control valve 76, the pressure gauge 78 and the associated lines or conduits and the air source make up the drive sub-system 28. The control valve 76 is of any conventional construction, be it mechanical or electrical. The air turbine motor 70 is also of any conventional construction, as is the regulator 74 and the pressure gauge 78. The air turbine includes an outlet port in communication with the ambient atmosphere, via a line 80. It must be pointed out at this juncture that the atherectomy catheter 22 need not utilize an air turbine motor to rotate the working head. For example, an electric motor can be provided to replace the air turbine to drive the rotating cable and the associated working head.

[0081] The debris removal sub-system 30 basically comprises a source 82 of the infusate liquid "S", e.g., saline plus a 30% contrast media, a first positive displacement pump 84, an input line or conduit 86, an outlet line or conduit 88, a second positive displacement pump 90, and a debris collection vessel 92. The input line 86 and its associated components, i.e., the pump 84 and infusate source 82 serve as the "infusion" means for the system 20. To that end the input line 86 is coupled via a connector to the interior of the atherectomy catheter, i.e., to the annular space within the catheter's jacket between it and the drive cable. The infusate liquid S is pumped at the flow rate Q_1 by the positive displacement pump 84 through line 86 from the supply or source 82. Thus, the infusate liquid S exits the catheter's working head and circulates as described earlier.

[0082] The rate of flow Q_1 of the infusate liquid is established by the positive displacement pump 84 under control of some automatic or manual controller (not shown). In accordance with one exemplary method of use the pump is operated to produce a flow rate Q_1 the range of 5-80 ml. per minute.

[0083] The output line 88 and its associated components, i.e., the pump 90 and debris collector vessel 92 serve as the "aspirating" means for the debris removal sub-system 30. To that end, the aspiration line 88 is connected to the leg 68 of the Y connector 66. The pump 90 is arranged to be operated to pump the infusate liquid, the debris produced by the revascularization, and some small amount of blood at the flow rate Q_2 in the proximal direction through the annular space between the atherectomy catheter 22 and the guide catheter 24 and out through the connector leg 68 into the outlet line 88, and from there to the collector vessel 92.

[0084] The flow rate Q_2 is selected to be greater than Q_1 . For example, in one exemplary method of use the flow rate

is selected to be in the range of 5-100 ml. per minute, with the differential between Q_2 and Q_1 being between 5 and 50 percent. The use of an aspiration flow rate Q_2 which is higher than the infusion flow rate Q_1 insures that any debris, e.g., particles of the occlusive material making up the graft's lesion, produced from debriding that material is positively prevented from flowing into adjacent vessel portions. In this regard, as will be appreciated by those skilled in the art, since the aspiration flow rate Q_2 is greater than the infusion flow rate Q_1 , some blood equal to $Q_2 - Q_1$ will also be withdrawn from the upstream vessel, e.g., the aorta as shown in **FIGS. 1 and 3**. The withdrawal of some blood from that vessel insures that the debris produced cannot flow upstream to enter into it. Instead the debris particles will be entrained within the infusate liquid and blood which is withdrawn through the aspiration line. The rate of blood withdrawn is preferably be kept to a minimum, e.g., 40 ml. per minute in the interests of patient safety.

[0085] In accordance with a preferred aspect of this invention the operation of the pumps **84** and **90** are coordinated so that Q_2 is equal to some variable times Q_1 , where that variable is greater than 1 and is adjustable to accommodate the needs of the patient. Moreover, the coordination of the flow rates is preferably accomplished automatically, so that a change in one flow rate automatically results in a proportional change in the other flow rate. This coordinated action may be accomplished by a mechanical linkage between the pumps, or by a common electrical controller for the pumps. Manual control of the pumps is also envisioned for some applications.

[0086] In any case, any suitable positive displacement pumps can be utilized, e.g., peristaltic pumps or piston pumps, in the system.

[0087] In order to expedite the revascularization of the bypass graft, the infusate liquid may be provided with a contrast medium, e.g., 30% contrast medium, so that the revascularization procedure can be viewed using conventional imaging techniques. Moreover, the infusate liquid can, if desired, be oxygenated to eliminate distal ischemia when the catheter is used for arterial restriction opening procedures. Also, if desired, small amounts of heparin, urokinase, etc., or other drugs can be added to the infusate liquid for the procedure.

[0088] As should be appreciated from the foregoing the subject invention provides a viable means for effecting the revascularization of partially or totally occluded coronary bypass grafts, while assuring that any debris particles produced during the revascularization procedure is removed from the patient's body. In addition, the subject invention is suitable for revascularizing other occluded vessels, as well. For example, in **FIG. 5** the system is shown in use revascularizing a totally occluded femoral artery **18** downstream of the profunda femoris **18A**. In this application the system functions to capture the debris created during the lumen opening procedure by preventing it from going along side the catheter and exiting down the profunda to end up in the distal capillary beds. In this application, a portion $Q_1 + Q_2 - Q_2$ of the blood flowing down the femoral artery **18** to the situs of the occlusion will be permitted to flow into the profunda femoris, while the portion $Q_2 - Q_1$ of the blood and infusate liquid is diverted and/or withdrawn into the guide catheter to ensure positive debris removal in the same

manner as described earlier. For some persons, e.g., diabetics with severely compromised distal capillary beds, a femoral artery revascularization procedure is likely to prove beneficial.

[0089] Turning now to **FIGS. 6A and 6B**, an alternative embodiment **100** of the system of the subject invention is shown. The system **100** is similar in most respects to system **20** described heretofore. One major difference, however, is that the atherectomy catheter is arranged for use over a guide wire (to be described later). The guide wire includes a debris blocking member, e.g., an inflatable balloon (also to be described later). When the atherectomy catheter is in place on the guide wire the balloon is located distally of the working head of the atherectomy catheter and the balloon serves to physically block any debris produced by the system **100** which may tend to escape extraction from flowing distally. The atherectomy catheter used in the system **100** is designated by the reference numeral **22'** and is identical in most respects to the catheter **22** described heretofore. In the interests of brevity, the features common to catheters **22** and **22'** will not be reiterated. So too, the features common to systems **100** and **20** will also not be reiterated. Moreover, in the interests of drawing simplicity common components will be given the same reference numerals.

[0090] As can be seen in **FIGS. 6A and 6B**, the system **100** includes a controller or console **102** housing the heretofore identified infusate pump **84** and the extraction pump **90**. Each of these pumps is a peristaltic pump. The console **102** also includes a flow control section **104** for establishing the various fluid flows of the system, as will be described later, and a speed control section **106** for establishing the operational speed of the working head of the atherectomy catheter. The details of the speed control section **106** will also be described later. A perfusate pump **108** is also provided in the console **102**. The perfusate pump **108** is also a peristaltic pump and its operation will be described later. Suffice it for now to state that the pump **108** is arranged to provide a perfusion liquid, e.g., blood or a suitable synthetic oxygenation liquid, downstream of the inflatable balloon to perfuse downstream (distally) located tissue. The pump **108** also serves to effect the inflation of the balloon.

[0091] Compressed gas (e.g., air or nitrogen) is provided via line **72** from the console **102** to the catheter's turbine **70**. The console, in turn, receives the compressed gas from a tank **110** via an input line **112**. The rotational speed of the turbine is controlled by the speed control section **106** of the console **102**. On/off operation of the turbine is controlled by a turbine foot control pedal **114** and an associated gas line **116** connected to the console. This pedal also initiates operation of the infusate pump **84**.

[0092] The speed control section **106** of the console includes a rotary knob for establishing the desired rotational speed of the turbine and an associated digital display for displaying the turbine's speed. The console also includes an on/off switch **118** for enabling electrical power to be provided to the system's electrical components when the switch is in the "on" position.

[0093] The foot pedal **114** is used by the operator of the system **100** to initiate operation of the infusate pump to cause the infusate liquid to flow down the guide wire and out its distal end and to start the atherectomy catheter's

turbine **70** a short time, e.g., 2 seconds, after the infusate liquid begins to flow. The use of the foot pedal frees the operator's hands for other purposes.

[0094] The perfusate pump **108** is connected via an input line to a bag **120** containing the perfusion liquid. The output of the perfusate pump **108** is provided via a line **122** to the guide wire of the system **100**. The guide wire is designated by the reference numeral **124** and includes the heretofore identified balloon. That balloon is designated by the reference number **126** and, as seen clearly in FIGS. 6B, 7 and 8, is located adjacent the distal end of the guide wire **124**.

[0095] The atherectomy catheter **22'** is an "over-the-wire" type of device. Thus, it includes a central lumen for receipt of the guide wire **124** so that the catheter **22'** can be threaded over the guide wire **124**. The guide wire **124** serves to perfuse distally located tissue and to inflate its balloon **126** so that the balloon blocks any particulate material (debris) from flowing distally. To accomplish these functions, the perfusate liquid in the bag **120** is pumped by the perfusate pump **108** through the line **122** and through the interior of the guide catheter **124** where some of it fills or inflates the balloon and the remainder exits at the distal end of the catheter to perfuse downstream tissue, as will be described later.

[0096] The rate of flow of the infusate, extraction and perfusate liquids is established by the flow control section **104** of the console via its various up/down switches and associated digital displays. As discussed earlier, the ratio of the infusate flow rate to the extraction flow rate is adjustable. This is accomplished by the appropriate setting of the "infusate flow" and "ratio" up/down switches of the flow control section of the console. The desired ratio and the infusate flow rate are displayed by the associated digital displays.

[0097] In FIG. 7 there is shown in greater detail the distal end of the atherectomy catheter **22'** located within a diseased bypass graft, e.g., a re-occluded mammary artery **10'**. The diseased artery leads to a distal blood vessel **15**, i.e., the vessel to be fed by the graft **10'**. The guide wire **124** is in the form of an elongated flexible member, whose construction will be described later with reference to FIG. 8. The distal end of the guide wire **124** is in the form of a somewhat soft or flexible, precurved tip **128**. The free end of the catheter's tip is a hemispherical dome **130**. The balloon **126** is disposed slightly proximally of the free end **130** of the guide wire **124**.

[0098] In FIG. 8 the details of the distal end of the guide wire **124** and balloon are shown (although the tip **128** is shown being linear in the interest of drawing simplicity). Most of the length of the guide wire, i.e., from its proximal end to the location of the balloon **126**, is in the form of a two start helical spring **132** (see FIG. 8) whose convolutions are in close engagement (abutment) with one another. The spring **132** enables the guide wire to be bent through a small radius of curvature to facilitate its intravascular placement via the conventional guide catheter **24**. Inside the helical spring **132** is a liquid impervious, e.g., rubber or plastic, flexible liner tube **134**. This tube prevents the egress of the perfusate liquid through the interface between successive convolutions of the helical spring **132** as that liquid is pumped down the guide wire **124**.

[0099] A perforated support tube **136** is mounted within a distal end helix termination **138** of the spring **132**. The

support tube **136** is arranged to mount the balloon **126** thereon and includes a plurality of radially located apertures or ports **140**. The balloon **136** is an annular member of any conventional construction, e.g., rubber, and is mounted on and is disposed about opposite ends of the perforated support tube **136**. In particular, the balloon **136** is held in place and sealed to the periphery of the support tube at each end thereof via respective bands **142**. Each band **142** extends about one cylindrical end of the balloon. Thus, when the perfusion liquid is pumped down the guide wire **124** by the pump **108** it passes through the apertures or ports **140** (as shown by the arrows in FIG. 8) to fill up, i.e., inflate, the balloon **126**.

[0100] The distal end of the perforated support tube is located within a spring helix termination **144** forming the proximal end of the guide wire tip portion **128**. The portion **128** is also formed as a two start helix, like portion **132**. However, no fluid-impervious sleeve is located within the tip portion **128** so that the interface between successive convolutions of the spring forming the tip portion **128** serve as passageways through which the portion of the perfusion liquid which doesn't enter the balloon exits the guide wire as shown by the arrows **146** in FIG. 8.

[0101] Since the atherectomy catheter **22'** is designed for over-the-wire use, the drive cable for rotating its working head is in the form of a spiral spring helix having a central lumen extending down its center. The proximal end of the drive cable is connected to the output of the turbine **70** while the distal end is connected to the working head. That working head is designated by the reference number **32'** and is shown in FIGS. 6A and 7. The central lumen of the spiral helix drive cable forms the passageway for receipt of the guide wire **124**. If desired an anti-friction sleeve or some other anti-friction bearing can be provided at the interface between the inner surface of the spiral drive cable and the outer surface of the guide wire. The working head **32'** is similar in construction to the working head **32** of system **20** except that the working head **32'** includes a central bore **148** through which the guide wire **124** extends. As can be seen clearly in FIG. 7, the working head **32'** is unshrouded, i.e., is not located within a shroud like the working head **32** of the atherectomy catheter **22**.

[0102] Operation of the system **100** is as follows:

[0103] The guide wire **124** with its balloon **126** deflated and with the atherectomy catheter **22'** mounted thereon so that the balloon **126** and tip portion **128** extend beyond the working head **32'** is threaded through a preplaced guide catheter **24** in the patient's vascular system until it is at a desired situs, such as at the arch of the aorta. At this point the guide wire **124** is advanced with respect to the atherectomy catheter **22'** so that the guide catheter crosses the lesion or atherosclerotic deposits in the bypass graft **10'**. The precurved tip of the guide wire **124** facilitates the placement of the guide wire. In this regard, the guide wire can be rotated about its longitudinal axis to point the tip **130** in the desired direction.

[0104] Once the guide wire **124** is at the desired position, such as shown in FIG. 7, the balloon **126** can be inflated and the distally located tissue perfused. The exiting perfusion liquid is shown by the arrows in FIG. 7. In particular, the perfusate liquid is pumped by pump **108** and associated conduit **122** through the hollow interior of the guide wire

124, so that it passes through the apertures or ports 140 in the support tube 136 to inflate the balloon 126 to the state shown in FIG. 7, while the remainder of that liquid flows out of the open distal end of the support tube 136, into the hollow interior of guide wire's tip 128, and out through the interface between the immediately adjacent convolutions of the tip. Accordingly, distally located tissue is oxygenated, notwithstanding the fact that the balloon is inflated and thus blocking the flow of blood through the bypass graft 10'.

[0105] If no perfusion or oxygenation of distally located tissue is desired, the system may utilize an alternative guide-wire mounted debris-blocking balloon. That alternative embodiment of the guide-wire is designated by the reference number 124', is shown clearly in FIG. 14, and will be described in detail later.

[0106] The rate of flow of the infusate liquid is set by the flow control section switch and the ratio of that flow to the extraction flow rate is established by the ratio control switch of the flow control section. Accordingly, when ready the operator presses the foot pedal 114 to start the infusate pump. This action provides the infusate liquid through line 86 and through the associated components of the catheter 22', whereupon the infusate liquid exits from the catheter at the working tip 32' as described earlier. The rate of extraction of liquid through the annular space between the inner surface of the guide catheter 24 and the outer surface of the atherectomy catheter 22' is established by the extraction pump 90 under control of the associated flow controls of the console. The turbine 70 is arranged to commence operation on a fixed time delay, e.g., 2 seconds, after the infusate pump commences operation in response to the depression of the foot pedal 114. This action causes the working head to begin rotating at a high rate of speed. The desired speed setting for the turbine is established by setting of the rotary knob of the speed control section of the console. Preferably some restraining means (not shown but like the cradle assembly of the system 200 to be described later) is used to hold or clamp the guide wire in position when the atherectomy catheter is operated to prevent the rotation of the working head 32' from causing the guide wire to rotate. The compressed gas e.g., nitrogen or air, powering the turbine 70 of the atherectomy catheter 22' vents to the atmosphere via line 80. The debris particles produced by the rotary working head repeatedly impacting the plaque or other deposit within the diseased graft are withdrawn by the extraction pumps into the collection bag 92, in the same manner as discussed earlier. Any debris particles which may have otherwise escaped being withdrawn from the patient's body by the extraction subsystem are positively prevented from flowing distally by the barrier established by the inflated balloon 126. Thus, such particles will eventually be extracted. After the diseased bypass graft has been opened, the balloon 136 can be deflated by turning off the infusion pump. Then, the atherectomy catheter 22' and the guide wire 124 can be removed through the guide catheter 24.

[0107] It must be reiterated that the atherectomy catheter for producing the lumen through the vascular occlusion need not be a rotary impacting device, like described above. Thus, a system constructed in accordance with any embodiment of this invention may make use of any instrument having any type of working head, e.g., a reciprocating impacting working head, a combined rotary and reciprocating impacting working head, a rotary cutting head, a reciprocating cutting

head, a rotary abrasive head, etc., to open the lumen in the occlusive material in the blood vessel. Moreover, the working head need not be shrouded. In fact, any of the heretofore identified prior art atherectomy devices can be utilized as part of the system 20 or 100. Some thrombectomy devices may also be utilized as part of the system 20 or 100 (or even as part of the systems 200 and 500, to be described later). One such potential device is the Amplatz Thrombectomy Device designated by the trademark CLOT BUSTER by Microvena Corporation. It should also be pointed out that the working head of the device for forming the lumen need not even engage the occlusive material, so long as its lumen-opening operation produces debris particles to be removed. Thus, devices making use of liquid jets, laser beams, etc., can be utilized to open the lumen as part of the system of this invention. In short, any type of instrument for opening a lumen through the occlusive material and which produces debris can benefit from use in the system of this invention, i.e., a system which establishes a differential flow, wherein the infusate flow is less than the aspiration flow so that particles or pieces of occlusive material removed are positively precluded from flowing into adjacent vessels. Moreover, while the production of a local vortex flow adjacent the working head is desirable to effectuate the lumen opening process and to reduce debris particle size, it is not crucial to this invention.

[0108] In the embodiments described in FIGS. 1-8, it has been assumed that there will be some blood flow from the patent upstream blood vessel, e.g., the aorta in the case of a revascularization of a bypass graft, which may flow about the exterior of the distal end of the guide catheter 24 to merge with the flow being drawn into the passageway between the guide catheter 24 and the atherectomy catheter 22. See for example, FIG. 7 wherein blood flow Q_2-Q_1 from the aorta flows around the outer surface of the distal end of the guide catheter 24 between the guide catheter and the inner wall of the bypass graft 10'. In the event that blood flow from the upstream, patent artery, e.g., the aorta 12, is precluded from entering the guide catheter 24, such as by the outer peripheral surface of the distal end of the guide catheter 24 tightly engaging the inner periphery of the bypass graft 10' to be revascularized, care must be taken to control the ingress and egress flow rates with respect to each other to ensure that the bypass graft does not collapse since the extraction or aspiration rate will exceed the infusion rate. As will be appreciated by those skilled in the art, if the bypass graft does collapse, the rotating working head 32 will be forced against the inner surface of the bypass graft wall, which is now in a flatulent state, and the risk of vascular damage will increase.

[0109] In prior art devices, such as the Clement et al. U.S. Pat. No. 5,681,336 the potential for vessel collapse is even more acute. In this regard, the Clement et al. patent positively seals off a space in the vessel to be revascularized between a pair of balloons. In particular, one balloon is located on the distal end of a guide wire distally of the restriction to be opened and the other balloon is located on the distal end of a guide catheter through which a rotary ablation catheter extends. Thus, when suction is applied to that space to evacuate the particles produced by the revascularization process, if the extraction rate is not precisely controlled and coordinated to the infusion rate, vessel collapse may occur to bring the vessel wall into the rotating burr.

[0110] This embodiment overcomes this potential vascular collapse problem. In particular, in **FIGS. 9-13** there is shown another alternative embodiment of a system **200** constructed in accordance with this invention utilizing an atherectomy catheter **22"** for revascularizing occluded vessels, e.g., coronary bypass grafts. The system **200** obviates the problem of potential vessel collapse by providing automatic access to blood flow from a patent, upstream vessel, e.g., the aorta **12**, via use of at least one flow control or regulation port in the wall of the guide catheter **24** (or any other tubular member through which the atherectomy catheter **22"** extends and through which the infusate liquid, blood and debris will be aspirated). The flow control or regulation port(s) extend(s) through the wall of the guide catheter **24** close to its distal end, yet is(are) located sufficient proximally from the distal end of the guide catheter so that when the guide catheter is in its normal position for enabling an atherectomy catheter **22"** (to be described later) to revascularize the restricted vessel, e.g., a coronary bypass graft **10'**, the side port(s) is(are) in direct fluid communication with the blood flowing in the patent upstream vessel, e.g., the aorta **12**. In the exemplary embodiment of the system **200** shown in **FIGS. 9-13** two such side flow regulation ports **24A** and **24B** are provided near the distal end of the guide catheter **24**. As will become apparent later the size, location and number of flow regulation side ports used is a matter of choice, depending upon various system parameters. For example, for a system making use of a guide catheter of 9 French (one suitable size for effecting the revascularization of coronary bypass grafts), two side ports **24A** and **24B**, each of 0.032 inch, may be used. Alternatively, only one side port **24A** of 0.04 inch may be used. Other number(s) and sizes of side port(s) can be used as well.

[0111] Since the two side ports **24A** and **24B** extend through the wall of the guide catheter **24**, they are in fluid communication with the interior of the guide catheter, and hence with the annular space or passageway between the inner surface of the guide catheter **24** and the outer surface of the atherectomy catheter **22"** which extends through the guide catheter. As described earlier it is through this annular space or passageway that the infusate liquid, blood and any debris, e.g., atherosclerotic plaque produced by the revascularization procedure, is extracted by the extraction sub-system.

[0112] The use of at least one flow regulation or control port ensures that the vessel being revascularized does not collapse as the debris is extracted, even if the guide catheter **24** is tightly fit within the bypass graft **10**, such as shown in **FIG. 10**, and even if the extraction pump **90** is operating at a much higher rate than the infusate pump **84**. This automatic control or regulation provided by the at least one side port(s) will be described after a brief background discussion. To that end, as will be appreciated by those skilled in the art, if the guide catheter **24** (or other tubular member through which the atherectomy catheter extends) does not tightly fit in the bypass graft (such as shown in **FIG. 11**), blood from within the aorta **12** may flow around the outside of the guide catheter **24** (see the arrows **A1**) to join with the blood, debris particles and infusate fluid flowing into the open end of the guide catheter (see the arrows **A2**). Accordingly, the action of the extraction pump to remove liquid from the space in the bypass graft section between the end of the guide tube and the distally located blocking balloon **126'** (forming a portion of the guide-wire **124'** to be described later), will not

collapse that vessel section, even if the guide catheter does not make use of any flow control or regulation side port(s). If however, a guide catheter without any flow control or regulation side ports is tightly fit within the bypass graft, the possibility for vessel collapse exists if the extraction rate is not controlled precisely with respect to the infusion rate as discussed earlier.

[0113] By utilizing at least one flow control or regulation side port this potential hazard can be eliminated since such port(s) will provide automatic access to blood flow in the upstream, patent vessel. In this regard, as can be seen in **FIG. 10**, with the guide catheter **24** in place tightly engaging the periphery of the bypass graft section **10'** blood from the aorta **12** is enabled to flow into the flow control regulation ports **24A** and **24B** as shown by the arrows **A1**. This blood then merges with the flow (shown by arrows **A2**) of blood, infusion liquid and debris particles produced by the action of the rotary working head **32"** in the bypass graft section between the distally located blocking balloon **126'** of the guide wire **124'** (a variant of guide-wire **124** and which will be described later with reference to **FIG. 14**) and the distal end of the guide catheter **24**. By appropriate sizing of the flow control side port(s) one can ensure that the pressure within the vessel being revascularized, e.g., the bypass graft, is positive, thus ensuring that the vessel section will not collapse.

[0114] The foregoing automatic flow control feature of this invention renders it useful with other revascularization systems than those of the systems disclosed herein. For example, a guide catheter **24** having at least one flow control port (or any other tubular member through which an atherectomy catheter is extended) can be used with any prior art atherectomy catheter system, e.g., the atherectomy system of the heretofore identified Clement et al. U.S. Pat. No. 5,681, 336.

[0115] As discussed previously, it is desirable to operate the extraction pump at a rate to pull more fluid out of the vessel section being revascularized than the rate at which infusion liquid is introduced by the infusion pump to ensure that debris is removed even. By the use of a guide catheter **24** having at least one flow regulation port, like that described above, one can accept a significant mismatch in flow between the infusate flow and the extraction flow and still not risk collapse of the vessel being revascularized. This factor considerably simplifies the amount of coordination between the extraction pump and the infusion pump.

[0116] In **FIGS. 9A, 9B, 12** and **13** there are shown the details of system **200**. That system basically comprises the same system as the system **100** shown in **FIGS. 6-8** described heretofore, with some slight minor modifications (as will be described later). Thus, in the interest of brevity, the common components of those systems will be given the same reference numbers and their construction and operation will not be reiterated.

[0117] The system **200** basically comprises a guide catheter **24**, a modified guide wire **124'** with a distally located inflatable balloon **126**, an atherectomy catheter **22"** with a distally located rotary working head **32"** disposed over the guide wire and within the guide catheter to be moved longitudinally with respect thereto, a drive sub-system **28** for rotating the working head **32"**, a cradle assembly **202** (**FIG. 9A**) for supporting the turbine and associated portion

of the drive sub-system, for fixing the position of the guide wire **124** and guide catheter **24** and for enabling the atherectomy catheter **22** to be moved longitudinally with respect to the guide catheter and the guide wire, a source **110** of compressed gas, e.g., nitrogen or air, to power the drive sub-system, a debris removal sub-system **30** made up of an extraction pump **90** and associated components, and a control console **204**.

[0118] The guide wire **124'** is shown clearly in **FIG. 14** and is similar to the guide wire **124** in that it includes an inflatable balloon **126'** located immediately adjacent the distal end of the guide wire **124'**, a flexible distal end portion **128'** immediately distally of the balloon **126'** and terminating in an atraumatic tip **130'** at the distal end of the guide-wire **124'**. However, the guide wire **124'** is not arranged to perfuse downstream tissue, as is the case of the guide wire **124**. Thus, as can be seen in **FIG. 14** the guide wire **124'** basically comprises an elongated small diameter, flexible, hollow wire or tube **180**, e.g., a "hypo" tube formed of type **304** stainless steel having a 0.010 inch outside diameter and a 0.005 inch inside diameter. A central passageway or bore **180A** extends the full length of the guide-wire tube **180**.

[0119] The balloon **126'** is formed of any suitable material, e.g., latex of a thickness of approximately 0.006 inch, and is fixedly secured slightly proximally of the distal end portion of the tube **180** via a plurality of loops or lashes of a filament **182**, e.g., polypropylene, wrapped about the tubular proximal end portion **184** of the balloon **126'** and similar loops or lashes **182** wrapped about the tubular distal end portion **186** of the balloon **126'**. This creates a confined space within the balloon and into which an inflation gas, e.g., carbon dioxide, is to be provided via the guide-wire tube **180** to inflate the balloon. To that end plural gas ports **180B** extend through the wall of the guide-wire tube **180** in communication with the interior of the balloon and with the central passageway **180A** in the guide-wire tube **180**. The balloon can be any suitable size, depending upon the application. For example, for revascularizing a typical bypass graft, the outside diameter of the balloon when deflated may be approximately 0.03 inch, and may be inflated to an outside diameter of up to 0.2 inch (5 mm).

[0120] A tapered, flexible, core wire **188**, e.g., type **304** stainless steel, is soldered by any suitable lead-free solder into the distal end of the central passageway **180A** of the guide-wire tube **180** to seal its distal end. A tight helix or coil **128'** is also soldered by a lead-free solder to the outer surface of the distal end of the tube **180**. The coil **128'** forms the curved, flexible distal end of the guide-wire and can be fabricated of any suitable radiopaque material, e.g., platinum wire of 0.003 inch diameter. The coil **190** extends for a short distance, e.g., approximately 1 inch, from the end of the tube **180** and is of a suitably small outside diameter, e.g., 0.018 inch. The distal end of the core **188** extends into a small bore in the atraumatic tip **130'** and is soldered in place by a lead-free solder. The distal end of the coil **128'** is also soldered to the atraumatic tip by a lead-free solder. The atraumatic tip **130'** is in the form of a hemisphere of any suitable material, e.g., type **300** stainless steel.

[0121] A small sleeve or ring **190** formed of any suitable material, e.g., plastic or stainless steel, is located on the guide wire **124'** immediately proximally of the balloon **126'**. This ring serves as a stop member for the atherectomy

catheter **22**". In particular, as the atherectomy catheter **22**" is advanced along the guide wire **124'**, with the guide wire **124'** and the guide catheter **24** being held in a fixed position with respect to each other and to the patient's vascular system by a cradle assembly (to be described later), the rotating working head **32**" will be prevented from engaging and perforating the distally located balloon by the ring or stop **190**. Thus, the advancement of the working head along the guide wire to remove the plaque or other restriction-forming material in the vessel will not present any danger of perforating the balloon.

[0122] The console **204** is similar to console **102** described heretofore and includes various electrical and electronic components, e.g., a microprocessor and associated circuitry to accomplish the various functions of the system and to display various system parameters. Thus, as can be seen clearly in **FIG. 9B**, the console **204** includes the heretofore identified peristaltic infusion pump **84** and the peristaltic extraction pump **90**. Compressed gas, e.g., nitrogen, is provided via line **112** from the tank **110**. The tank provides the compressed nitrogen via heretofore identified regulator **74** and associated valve **76** into line **112** and from there to line **72**. The gas pressure is displayed on a dial or meter **78** on the front of the console. Control of the turbine's rotational speed is effected by a turbine speed adjustment knob **206** on the front console. The turbine's speed is displayed on a digital display panel **208**. An optical signal indicative of the turbine's speed is provided via a fiber optic line **210A**. This line is connected to a connector **212A** on the console. Another fiber optic line **210B** is connected to another connector **212B** on the console, whereupon a beam of light from the console is carried down line **212B** to the turbine rotor where it is broken or chopped up by the rotating blades. The chopped up light beam which is indicative of rotor speed is carried back to the console via line **210A** and connector **212A**. Control of the turbine is effected via a turbine foot control (or hand control, not shown) **114** connected via line **116** to a connector **214** on the console.

[0123] A pressure transducer **218** (**FIG. 9A**) is connected in the line **86** coupled from the infusate pump **84** to the atherectomy catheter **22**". The pressure transducer provides an output signal via a line **220** to a connector **222** (**FIG. 9B**) on the console. The rate of infusion liquid flow into the atherectomy catheter **22**" is effected by the heretofore identified peristaltic pump **84**. The speed of that pump is controlled via an up/down switch **224** on the console. The pump's speed in RPM is displayed on a digital readout panel **226**. The speed of the extraction pump is controlled by an up/down switch **228** on the console and that pump's speed is displayed on an associated digital readout panel **230**. The console also includes an on/off switch **232** for providing electrical power to the system when the switch is in the on position.

[0124] Data from the console, e.g., operating parameters, etc., is arranged to be downloaded to any suitable device, e.g., a laptop computer **216**, via conventional multipin electrical connector **218**, e.g., an RS **232** serial port, and associated cable **220**.

[0125] If desired, the console **204** may also include various alarm devices to warn operating personnel of certain abnormal conditions. For example, the console may include a low battery power warning lamp on the front of the console

to warn operating personnel that the battery is low. An infusate high pressure warning lamp may also be provided on the console along with an associated audible annunciator to produce respective visible and audible warning signals when a high pressure infusate condition exists.

[0126] Referring now to **FIGS. 12 and 13**, the details of the atherectomy catheter **22"** will now be described. As can be seen that the catheter **22"** is similar to catheter **22'** in that it includes a jacket **34** having a distal end. A rotary working head or tip **32"** is located at the distal end of the jacket. The tip **32** is preferably constructed in accordance with the teachings of U.S. Pat. No. 4,747,821. However, tip **32"** unlike the tip of the aforementioned patent includes a central passageway or bore **148** through it (like tip **32'**). It is through this bore that the guide wire **124** extends.

[0127] The working head **32"** is mounted for rotation within a bushing **302** secured to the distal end of the jacket. The bushing **302** is similar in construction to the bushing of the U.S. Pat. No. 4,747,821 and it includes plural passages **46"** extending along its length through which the infusate liquid passes to exit out of the tip. In addition it includes plural radial passageways **304** in the thrust pad portion forming the distal end of the bushing and which are in communication with the passages **46"** through which the liquid exits radially. The radial passages are constructed similarly to those of U.S. Pat. No. 5,049,124 (Bayles) whose disclosure is incorporated by reference herein. Thus, the exiting liquid from those passages is impacted by the flattened sides of the tip to create a vortex flow in a manner similar to that as shown in **FIG. 12**. The rotary working head **32"** also includes a tubular shank portion through which the central bore **148** extends. Infusate liquid from the passageway **312** is enabled to flow into the open proximal end of the bore **148** and through the annular space or clearance between the inner surface of that bore and the outer surface of the guide wire extending through the bore as shown by the arrows in **FIG. 12**. A sleeve **306** is located immediately proximally of the bushing **302** and extends about the shank portion of the rotary working head **32"**. The sleeve **306** is welded to the shank portion of the rotary working head. The rotary working head **32"** is arranged to be rotated at a high rate of speed within the bushing by a drive cable **308**. As best seen in **FIG. 12**, the cable **308** is a bifilar or double helix formed of any suitable material, e.g., 304 stainless steel or Nitinol, and is flexible so that the atherectomy catheter can be readily bent to follow tortuous paths to the revascularization site, i.e., the coronary bypass graft. The distal end helices of the drive cable **308** are welded at **310** to the shank portion of the rotary working head **32"**. The outer diameter of the drive cable is less than the inner diameter of the catheter jacket **34** to form an annular passageway **312** therebetween. This passageway extends the full length of the atherectomy catheter and serves to carry the infusion liquid to the working head **34"**.

[0128] A flexible plastic tube or sleeve **314** is located within the central passageway of the bifilar drive cable **308** and extends for the full length thereof. The tube **314** includes a central passageway **316** which is of approximately the same internal diameter as the bore **148** extending through the working head **32"** and is coaxial therewith in order to accommodate the guide wire **124** therethrough. The sleeve **314** serves to form a barrier between the metal helices of the

drive cable **308** and metal guide wire extending through it, while preventing the helices of the cable **308** from closing up as the drive cable is rotated.

[0129] In **FIG. 13**, there is shown the details of the proximal end of the atherectomy catheter **22"**. Thus, it can be seen that the proximal end of the jacket **34** is flared outward at **318**. The flared proximal end of the jacket is connected to the distal end of a turbine housing or body **320** via a capture nut **322**. The capture nut **322** includes internal threads **324** which mate with corresponding external threads on the distal end of the turbine housing **320**. The free end of the turbine housing is tapered at **326**. The capture nut **322** also includes a tapered inner surface **328** merging into a central bore **330** through which the catheter jacket **34** extends. Thus, when the nut **322** is tightened, the flared end **318** of the jacket is tightly interposed between the surface **330** of the nut and the tapered surface **326** of the turbine housing **320**. The distal end portion of the turbine housing **320** also includes a central bore **332** into which the infusate fluid will be injected for flow into the annular passageway **312** in the atherectomy catheter, as will be described later.

[0130] The proximal end of the bifilar drive cable **308** is connected, e.g., welded, to an adaptor sleeve **334**. The adaptor is a tubular member which is in turn welded to the turbine rotor drive shaft **336**. The turbine drive shaft **336** is an elongated tubular member. Being tubular the turbine drive shaft **336** includes a central passageway. It is through this central passageway that the guide wire is arranged to be extended. The turbine rotor drive shaft **336** extends through the central bore **332** in the turbine housing and terminates at its proximal end in a seven-bladed turbine rotor **338**. The rotor is located in an enlarged proximally located flanged portion **322** of the turbine housing **320**. In particular, the flanged portion **322** includes a hollow interior chamber **340** in which the turbine blade **338** is located. An enlarged central bore **342** extends distally of the chamber **340** and is axially aligned with the central bore **332** in the distal portion of the turbine housing **320**. A sleeve bearing **344** is located within the central bore **342**. The turbine rotor shaft **336** extends through a central bore in the bearing with a slight clearance or leakage passageway, e.g., 0.0005 inch, to form a fluid leakage path to facilitate the cooling of the bearing. An O-ring **346** is located within an annular recess in the distal portion of the sleeve bearing **344** to form a fluid-tight seal. A star washer **348** is located within an enlarged portion of the bore **342** to hold the sleeve bearing in place.

[0131] The proximal end of the turbine drive shaft **336** extends into a ball bearing assembly **350** to center the turbine shaft on the longitudinal axis of the housing. A guide-wire centerer and leakage control restrictor member **352** is located within the hollow proximal end of the turbine drive shaft **336**. The guide wire **124** is arranged to pass through the restrictor where it is centered and then through the turbine drive shaft, the adaptor **334**, the sleeve **314**, and out through bore **148** in the working head **32"**. Moreover, air can pass through the interface of the restrictor **352** to cool and lubricate the adjacent surfaces. The ball bearing assembly **350** is held in place via a cap or cover **354**. The cap **354** serves to close off the hollow interior of the turbine housing. To that end, the cap is releasably secured to the flanged proximal portion **322** of the turbine housing **320** via plural threaded bolts **356**. An enlarged bore hole **358** is located within the cap **354** and is coaxially aligned with the central

longitudinal axis of the drive shaft **336**. A smaller diameter bore **360** communicates with the bore **358** and with the restrictor **352**.

[0132] The compressed gas, e.g., nitrogen, to effect the rotation of the turbine is provided from the tank **110** via an inlet port **362**. The pressurized gas enters the turbine housing portion **322** somewhat tangentially and impinges on the angled rotor blades **338** to cause the turbine rotor to rotate about its longitudinal axis at a high rate of speed. This effects the concomitant rotation of the drive shaft **336**, the bifilar cable **308** and hence the rotary working head **32"**.

[0133] The infusate fluid, e.g., saline and a contrast medium (plus anything else which is desired to be introduced into the vascular system, such as heparin, growth factors, microspheres carrying chemicals, pharmaceuticals or other biologically active materials, etc.) is introduced into the turbine housing **320** so that it gains ingress into the passageway **332**. From that passageway, it flows through the communicating passageway **312** extending within the jacket of the catheter to exit at the distal end of the jacket where the working head **32"** is located. The means for introducing infusate liquid into the turbine housing comprises the tubing **86** on which a connector **362** is mounted. The connector **362** is arranged to be connected to the output of the infusate pump.

[0134] An interlock member **366** is located in a transverse bore **368** in the turbine housing **320** so that it perpendicularly intersects the longitudinally extending bore **332**. The interlock member is a generally plug-like, tubular body having a thin walled upper end **368** defining an enlarged hollow interior space. An opening **370** is provided in the thin walled upper end of the interlock member communicating with the enlarged hollow interior space and into which the distal portion of the sleeve bearing **344** extends. Another opening **372** is provided diametrically opposed from the opening **370** so that the turbine drive shaft **336** can extend through the interlock member via the openings **370** and **372**. The lower end of the interlock member **366** includes a barb-like tubular projection **374** which extends into the interior of the plastic tube **86**. A ring-like ferrule **376** extends about the outer surface of the tube at the upper end thereof to capture the tube on the barb. A sealing O-ring **378** is disposed within an annular recess extending about the periphery of the interlock member **366**. The barb portion of the interlock member **366** includes a passageway **378** extending through it in communication with the hollow interior at the upper end of the interlock member. Thus, the infusion liquid introduced into the tube **86** will pass through the communicating passageway **378** in the barb member into the hollow upper interior **368** of the interlock member and out through opening **372** into the passageway or bore **332**. From passageway **332**, the infusate liquid will flow through the hollow annular passageway **312** in the catheter's jacket **34** and out through its distal end at the working head **32"**.

[0135] As will be appreciated by those skilled in the art, the rotation of the drive cable **308** creates an Archimedes-like pumping action to aid the infusate pump in carrying the infusate liquid down the annular passageway **312** in the jacket **34**. In particular, the ability of the helical drive cable **308** to deliver flow is a function of: (1) the rotation speed of the helix, (2) the swept volume of the helix (the swept volume of the helix being the volume of fluid entrapped

between the coils of one pitch of the helix), and (3) the leakage of flow back along the helix due to the clearance between the helix and the jacket and the clearance between the helix and the liner. If the clearances are reduced to zero (leakage reduced to zero) the pump can act as a very stiff positive displacement pump, that is, it can deliver flow at a large range of output pressures regardless of the inlet pressure. For example, with a 5F diameter catheter having bifilar drive cable with 0.008 inch wire diameter and pitch of 0.040 inch running at speeds between 100,000 and 160,000 RPM, the helix design suitable for transmitting suitable torque, with adequate flexibility for navigating the bends of the coronary vasculature, also has the correct swept volume to deliver an appropriate flow, e.g., 30-40 mL/minute, required to keep the catheter and tip abrasion site at a temperature compatible with tissue viability (e.g., not more than 98 deg F.). These facts make it possible for a 5F catheter system to use the helical drive cable **308** as the infusate metering pump while the peristaltic infusate pump **84** serves as a priming pump. This arrangement, can deliver pressure rather than flow by the use of soft pump tubing, i.e., tubing, that leaks back under the pump **84** rollers, if the delivery pressure becomes excessive, e.g., approximately 30 psi or greater. If different size catheters are used, such as 8F or 4F, the helical drive cable design may not provide the ideal flow, and the peristaltic infusate pump **84** characteristics might well have to be changed to obtain the correct flow. This can be accomplished by changing the peristaltic pump speeds, changing the stiffness of the peristaltic pumps by using tubing of different softness, and partially disabling the helix drive cable pump by increasing the clearances around the helix. Thus, if the console provides for independently adjustable peristaltic pump speeds for the infusate and extraction pumps, the system can provide for any catheter design. The operator can be instructed to select the appropriate pump speed and the appropriate pump tubing for whatever catheter is in use. In some instances it may be advisable to use operator adjustable peristaltic pumps linked electronically that provide for fixed ratios between the infusate and extraction pumps, and in other designs it may be best to provide for the pumps to be preset and not user adjustable.

[0136] It has also been found that there is an advantage to having a variable pitch helix for the drive cable **308**. Thus, the cable **308** is preferably so constructed. As will be appreciated if the drive cable **308** is to act as a pump in addition to the means for effecting the rotation of the working head, the helices of the cable have to have a certain pitch (e.g., 25 coils to the inch) to provide the required swept volume. If the bending stiffness of the atherectomy catheter is to be minimized (e.g., to enable the catheter to freely negotiate tortuous paths to the site of the occluded vessel section) the helices of the cable needs to be approximately of closed coil configuration (e.g., 40 coils to the inch), but not quite closed, because it is best if the coils do not touch each other as the catheter bends since the friction between the abutting coils may cause excessive heat to be generated. It has been found that if the distal end portion of the helical drive cable **308** is almost close wound for a short distance (e.g., 0.5 to 4.0 inches), as is the case in the embodiment shown herein, the remainder of the cable, (i.e., the portion located proximally of the distal end portion and which may be approximately 50 inches or longer) can force the infusate liquid past the close coils at the distal end and out of the catheter. The variable pitch of the drive cable thus provides

for the optimum pumping action, while maintaining optimum flexibility. As will also be appreciated the helix pitch of the drive cable also has an affect on vibration of the catheter, with the coarser or greater spacing between helices resulting in lower vibration. Thus, the variable pitch drive cable 308 will also help to reduce the vibration level by minimizing the length of closed coil helices at the distal end of the drive cable.

[0137] As mentioned earlier, the system 200 includes a cradle assembly 202 for holding the guide catheter 24 and the guide wire 124 fixed with respect to each other and with respect to the patient's vascular system, while supporting a portion of the atherectomy catheter to enable it to be moved longitudinally with respect to the guide catheter and guide wire in order to advance the working head through the vessel section to be revascularized. The cradle assembly 202 will now be described with reference to FIG. 9A. As can be seen therein, the cradle assembly basically comprises a cradle member 400 (shown by phantom lines in the interest of drawing simplicity) and other associated components (some shown by solid lines and others by phantom lines), all to be described later. The cradle member 400 itself is a generally tubular member which is arranged to support the turbine body therein and to allow the turbine body to slide longitudinally with respect to the cradle member 400 while fixing the position of the guide catheter 24 and guide wire 124 relative to each other.

[0138] The tubular cradle 400 includes a loading slot 402 extending from its front or distal end to a point close to its rear or proximal end. A pair of support feet 404, also shown by phantom lines, are provided on the underside of the cradle tube to support it on any horizontal surface. A cup-shaped plug member 406 is mounted in the open rear end of the cradle tube. The plug member includes a central passageway 408 extending through it. A pair of telescoping tubes 410 and 412, are mounted between the central passageway in the plug member and the proximally located cap 354 of the turbine housing 320 via a ferrule (not shown). The central passageway 408 in the plug member and the associated telescoping tubes 410 and 412 provide a passageway through which the guide wire 124 may be extended into the turbine housing and from there through the atherectomy catheter 22" as described earlier. The telescoping tubes are formed of any stiff material, e.g., type 304 stainless steel, to prevent buckling of the guide wire.

[0139] In order to fix or clamp the longitudinal position of the guide wire with respect to the cradle assembly while also forming a fluid tight seal about the guide wire where it enters the plug member 406, a conventional hemostasis valve, e.g., a Tuohy Borst valve 412, is mounted on the rear side of the plug member via a wing nut mount (not shown).

[0140] The turbine housing assembly is mounted within the cradle tube for sliding movement therealong in order to adjust the distance that the working head 34" extends from the distal end of the guide tube 24. This feature enables the rotary working head to be advanced in the distal direction to open a lumen through the plaque or other material forming the restriction in the bypass graft to be revascularized. To achieve that end, a handle 416 is provided for the turbine housing and projects radially outward from the turbine housing portion 322. The handle extends through a longitudinally extending linear slot 418 in the cradle tube 400. It

should be pointed out at this juncture that the handle and the associated slot are shown on the facing side of the turbine tube (i.e., the visible side in FIG. 9), when in reality they are located on the opposite side. The showing of the handle and slot on the facing side of the cradle tube is merely done for drawing convenience.

[0141] In order to increase the "wheel base" of turbine housing so that it slides easily within the cradle tube 400 in a longitudinal direction without tilting or canting, a turbine tube housing extension member 420 is mounted, i.e., snap-fit, on the distal portion of the turbine housing. The extension member 420 includes a central opening through which the atherectomy catheter 22" exits the turbine housing.

[0142] A manifold member 422 is mounted within an extension adjustment tube 424 at the front end of the cradle tube 400. The extension adjustment tube is a slotted tube which telescopes within the front end of the cradle tube 400 and whose position can be adjusted so that the manifold 422 can be moved closer or further away from the cradle tube. This feature enables the system 200 to be used with guide catheters of varying lengths. In order to fix the position of the extension adjustment tube with respect to the cradle tube 400, a tube extension latch 426 is provided to extend through any selected one of plural longitudinally spaced holes 428 in the extension tube and a single aligned hole not shown in the front end of the cradle tube.

[0143] The manifold 422 is a disk-like member having a longitudinal passageway (not shown) extending there-through and to which the proximal end of the guide catheter 24 is connected via a swivel connector 430. The swivel connector permits one to adjust the angular orientation of the guide catheter with respect to the cradle tube so that the guide catheter can be revolved to any rotary position necessary to obtain compatibility with the patient's vascular anatomy. The longitudinal passageway of the manifold is in fluid communication with the proximal end of the annular passageway 312 extending down the interior of the atherectomy catheter's jacket. The manifold also includes a radially extending side port (not shown) in communication with the longitudinal passageway at the proximal end of the guide catheter. The extraction (vacuum) tube 88 is arranged to be connected to the radial side port of the manifold via conventional connector 432 to withdraw blood, infusate liquid and debris which has been drawn down the passageway between the guide catheter and the atherectomy catheter by the action of the extraction pump 90.

[0144] Since the atherectomy catheter 22" extends through the guide catheter 24, a conventional hemostasis valve 434 is mounted on the rear (proximal) side of the manifold 422 to enable to the atherectomy catheter to extend through the longitudinal passageway in the manifold and into and through the guide catheter 24.

[0145] A stiffener tube 436 is provided on the atherectomy catheter between the turbine housing and the manifold to prevent the atherectomy catheter's jacket 34 from buckling under axial loads. The stiffener tube also facilitates the assembly and loading of the atherectomy catheter into the cradle tube. To that end, a hook wire 438 is mounted on the stiffener tube 436 to facilitate movement of the stiffener tube. A pair of pivotable trunnions 440 project outward from the distal end portion of the stiffener tube for connection to diametrically opposed portions of the extension tube 424 to

center the stiffener tube so that it can be lifted to enable loading of the atherectomy catheter.

[0146] In accordance with one preferred embodiment of the invention, the longitudinally extending slot **402** is of sufficient length to enable the turbine housing and hence the atherectomy catheter **22**" to be reciprocated through a 4-5 inch range.

[0147] It must be pointed out again that the subject invention is not limited to atherectomy catheters, and particularly rotary head catheters. In particular, the subject invention may incorporate an instrument having any other type of working head, e.g., a balloon angioplasty catheter, a catheter for injecting a restriction-removing or dissolving liquid, an ultrasonic catheter, a laser catheter, a stent-delivery catheter, etc., for opening a lumen in an occluded vessel. To that end the term "working head" as used herein is meant to include any type of device for operating on an occluded vessel to open a lumen in that vessel to the free flow of blood therethrough.

[0148] In **FIGS. 16 and 17** there are shown yet another alternative embodiment of a revascularization system **500** of this invention. The system **500** is arranged to revascularize an occluded blood vessel, e.g., a bypass graft **10**', by introducing a conventional expandable stent **502** into a lumen formed in the restrictive material of the occluded blood vessel section, e.g., the bypass graft. If desired, the system **500** may also employ the atherectomy catheter and some associated components of the system **200** described heretofore to effect the opening of a lumen through the material forming the restriction, followed by the introduction of a stent-delivery catheter (not shown) for carrying the stent **502** in a collapsed state into the lumen created by the atherectomy catheter, and then to expand the stent **502** in that lumen to the state shown in **FIGS. 16 and 17** to ensure that the lumen stays open. The stent-delivery catheter used in such an application may be of any conventional type, e.g., a balloon catheter.

[0149] It must be pointed out at this juncture that the system **500** may be used without an atherectomy catheter, like the catheters described above or any prior art restriction-opening device, for initially forming the lumen through the material forming the restriction. In such an alternative application, as will be described later, the system **500** makes use of any suitable conventional stent-delivery catheter to carry the collapsed stent **502** over a guide wire, like guide-wire **124**' or any other suitable balloon bearing guide-wire, through the restriction in the occluded blood vessel to an operative position, whereupon the stent-delivery catheter is operated, e.g., its balloon inflated, to expand and place the stent in position (like shown in **FIGS. 16 and 17**).

[0150] Irrespective of the manner in which the lumen is created into which the stent **502** is placed, the system **500** of this invention makes use of a debris removal sub-system to remove any particles or other debris produced during the revascularization/stenting procedure. That debris removal system may be similar to that described earlier, or any other suitable type. As shown in the embodiments of **FIGS. 16 and 17**, the debris removal sub-system used to remove any particles or debris produced during the revascularization/stenting procedure basically comprises a guide catheter **24** having at least one control port, like that described above, and another catheter **504** (to be described later) for delivery

of an infusate or irrigation liquid from some pumping means, e.g., an infusate pump **84**, into the occluded vessel section, and some pumping means, e.g., an extraction pump **90**, coupled to the interior of the guide catheter **24** to effect the removal of blood, the infusion liquid and any debris created during the restriction opening procedure from the patient. It should be noted that the "other catheter **504**" for delivery of the infusate or irrigation liquid to the situs of the vessel portion being revascularized, may comprise an atherectomy catheter **22**" like that described with respect to system **200** when such a system is used to form the lumen into which the stent will be placed, or may comprise a separate catheter, tube, or conduit, or may comprise a lumen or passageway in the guide catheter **24** separate and apart from the central passageway through which the debris, blood and infusate liquid is removed. In the embodiment shown the catheter **504** for carrying the infusion or irrigation liquid into the situs where the stent is to be placed basically comprises a simple irrigation tube or catheter formed of a flexible material, e.g., a plastic, and having a central passageway or lumen extending fully therethrough for carrying the infusate or irrigation liquid from a pump, like pump **84** or any other suitable source of irrigation liquid, down the lumen and out of its open end to the operative situs like shown in **FIGS. 16 and 17**.

[0151] If it is desired to utilize a system **500** to apply the stent **502** into a lumen formed by an atherectomy catheter, e.g., atherectomy catheter **22**", the procedure to be followed basically comprises the following steps. First the guide catheter **24** is placed in position so that its distal end is located proximally of the restriction to be opened and its control or regulation port(s) **24A/B** is(are) in fluid communication with an upstream patent vessel, e.g., the aorta, like shown in **FIGS. 10, 11, 16 and 17**. The guide wire **124**' is then extended through the guide catheter **24** and through the restriction to be opened so that the distally located balloon (obturator) **126** on the guide wire is downstream of the restriction. The balloon **126** is then inflated to block the vessel to be revascularized downstream of its restriction. The extraction pump **90** is then operated to evacuate any debris particles which may have been produced by the passage of the guide wire **124** and balloon **126** through the restriction and by the inflation of the balloon **126**. The atherectomy catheter **22**" is then passed over the guide wire through the guide catheter so that its working head **32**" extends out of the open end of the guide catheter and is at the situs of the restriction to be opened.

[0152] The atherectomy catheter **22**" (or any other catheter having a restriction opening working head) is then operated in a manner like described above to enable the working head to open a lumen through the restriction, while the debris removal sub-system removes the debris created by that operation along with blood and the infusate liquid through the guide catheter. The control or regulation ports in the guide catheter ensure that the vessel being revascularized does not collapse during the procedure.

[0153] Once the lumen has been created through the restriction, the atherectomy catheter can be removed, while maintaining the vacuum, i.e., keeping the extraction pump **90** operating. After removal of the atherectomy catheter the extraction pump **90** can be stopped. If it is desired to give the patient some recovery time before deployment of the stent **502**, the distal balloon on the guide wire may be deflated,

thereby enabling blood to flow through the newly formed lumen in the revascularized vessel to the downstream vessel, e.g., a coronary artery **15**. Once sufficient time for the patient to recover has elapsed (assuming that any recovery time is desired) the distally located balloon **126** is then re-inflated.

[0154] The stent-delivery catheter (not shown) is then introduced through the guide catheter and over the guide wire until its working head, e.g., the balloon on which the collapsed stent **502** is located, is within the lumen created by the atherectomy catheter **22"**. The stent-delivery catheter is then operated, e.g., its balloon inflated, to expand the stent **502** radially outward and into seating engagement with the revascularized vessel section, like that shown in **FIGS. 16 and 17**. If desired, the debris removal system may be operated to withdraw any debris particles created by the deployment of the stent. Once the stent has been deployed the stent-delivery catheter can be removed, e.g., its balloon deflated and then the catheter withdrawn proximally along the guide wire. The guide catheter can then be removed.

[0155] In some applications it may be desirable to provide an irrigation or infusate liquid into the lumen in which the stent is to be deployed during or immediately after the stent deployment the procedure. To that end, an irrigation tube **504** (like that shown in **FIGS. 16 and 17**) may be introduced over and along the guide wire **124'** and through the guide catheter **24** so that its open distal end is in communication with the situs of the stent while the distally located balloon (obturator) **126'** remains inflated. An irrigant liquid can then be introduced via the irrigation tube to flush out any debris via the passageway between it and the guide catheter under the action of the extraction pump **90** or any other suitable pump or vacuum source. Once this has been accomplished the irrigation tube **504** can then be withdrawn over the guide wire, while the vacuum is maintained, e.g., the pump **90** operates, to remove any debris which may be produced by the removal of the irrigation tube. The vacuum (e.g., pump **90**) can then be stopped, the balloon **126'** on the distal end of the guide-wire **124'** can then be deflated and the guide wire can then be withdrawn through the guide catheter **24**. Then the guide catheter can be removed.

[0156] If it is desired to place a stent **502** within an occluded blood vessel section, without having first opened a lumen through it with an atherectomy catheter, like catheter **22"** or any other lumen-opening catheter, the procedure to be followed using the system **500** basically comprises the following steps. First the guide catheter **24** is placed in position so that its distal end is located proximally of the restriction to be opened and its control or regulation port(s) **24A/B** is(are) in fluid communication with an upstream patent vessel, e.g., the aorta, like shown in **FIGS. 10, 11, 16 and 17**. The guide wire **124'** is then extended through the guide catheter **24** and through the restriction to be opened so that the distally located balloon (obturator) **126'** on the guide wire is downstream of the restriction. The balloon **126'** is then inflated to block the vessel to be revascularized downstream of its restriction. The stent-delivery catheter (not shown) is then introduced through the guide catheter **24** and over the guide-wire **124'** until its working head, e.g., the balloon on which the collapsed stent **502** is located is at the desired position within the vessel to be revascularized. The debris removal sub-system, or any other extraction or vacuum system, is then operated to withdraw any debris or particles created when the stent is deployed. Thus, once the

debris removal sub-system is operating the stent-delivery catheter can then be operated, e.g., its balloon inflated, to expand the stent **502** radially outward thereby enlarging the lumen through the restriction seating the stent in place against accidental dislodgement within the blood vessel section, like that shown in **FIGS. 16 and 17**. Once the stent has been deployed the stent-delivery catheter can be removed, e.g., its balloon deflated, and then the catheter withdrawn, e.g., slid proximally along the guide-wire **124'** until it is out of the being's body. An irrigation or infusate liquid is then provided into the operative situs, i.e., the situs of the stent, to flush away any debris created during the stent deployment procedure. To that end, an irrigation tube **504** is introduced along the guide wire **124'** and through the guide catheter **24** so that its open distal end is in communication with the situs of the stent, while the distally located balloon (obturator) **126** remains inflated. An irrigant liquid can then be introduced via the irrigation tube **504** to flush out any debris via the passageway between it and the guide catheter **24** under the action of the extraction pump **90** or any other suitable pump or vacuum source.

[0157] Once the stent is deployed and all debris removed, the irrigation tube can then be withdrawn from the being by sliding it out over the guide-wire **124'**, while the vacuum is maintained, e.g., the pump **90** operates, to remove any debris which may be produced by the removal of the irrigation tube. As described earlier, the control or regulation port(s) **24A/B** ensure that the vessel section being revascularized does not collapse during the revascularization procedure.

[0158] After removal of all remaining debris, the vacuum (e.g., pump **90**) can then be stopped, the balloon **126** on the distal end of the guide-wire can then be deflated and the guide wire can then be withdrawn through the guide catheter. Then the guide catheter can be removed.

[0159] Irrespective of the type of revascularization procedure utilized, it may be desirable before removal of the guide catheter **24** to inject a dye through it to the operative situs to enable one to fluoroscope or otherwise visualize the bypass vessel to ensure that it has been properly revascularized.

[0160] In yet another embodiment the system of the current invention allows for a working head to eject infusate liquid (e.g., through liquid jets), where said infusate may comprise a therapy (e.g., drugs, biologically active agents, microspheres, etc.). The working head may be arranged to be spaced a certain distance from the lumen's interior surface, such that said infusate may penetrate into the lumen tissue.

[0161] To this end, further embodiments of the device shown in **FIG. 17** are illustrated in **FIGS. 18 to 24**. The objective with these devices includes the delivery drugs or biologically active agents (together "therapy") to the lumen wall, either statically or dynamically. Such therapy may be used to restore or to help maintain the flow of blood, or other bodily fluid, through the vessel. One such treatment would include the delivery of anti-spasm agents, which would prevent closure of the vessel resulting from vascular spasm for a period of time after the vascular intervention. Another such treatment would include the delivery of anti-restenosis, or other therapies, that prevent or minimize the future formation of occlusive material. Such therapy can be designed to not only reduce or eliminate restenosis of the vessel locally within a stent, but to eliminate restenosis

adjacent (e.g., proximally and distally) to the stent and/or to prevent further stenosis anywhere along the vessel walls. Such aforementioned therapies might include, but are not limited to, those therapies listed in Table 1. In all the devices shown in **FIGS. 17 through 24**, it is to be understood that the system permits the delivery of therapy at very high doses that could likely not be tolerated systemically.

TABLE 1

Examples of Biological, Pharmaceutical, and other Therapies Deliverable via the Present Invention

Adenovirus with or without genetic material
 Angiogenic agents
 Angiotensin Converting Enzyme Inhibitors (ACE inhibitors)
 Angiotensin II antagonists
 Anti-angiogenic agents
 Antiarrhythmics
 Anti-bacterial agents
 Antibiotics
 Erythromycin
 Penicillin
 Anti-coagulants
 Heparin
 Anti-growth factors
 Anti-inflammatory agents
 Dexamethasone
 Aspirin
 Hydrocortisone
 Antioxidants
 Anti-platelet agents
 Forskolin
 Anti-proliferation agents
 Anti-rejection agents
 Rapamycin
 Anti-restenosis agents
 Antisense
 Antispasm agents
 Lidocaine
 Nitroglycerin
 Anti-thrombogenic agents
 Argatroban
 Hirudin
 GP IIb/IIIa inhibitors
 Anti-virus drugs
 Arteriogenesis agents
 acidic fibroblast growth factor (aFGF)
 angiogenin
 angiotropin
 basic fibroblast growth factor (bFGF)
 Bone morphogenic proteins (BMP)
 epidermal growth factor (EGF)
 fibrin
 granulocyte-macrophage colony stimulating factor (GM-CSF)
 hepatocyte growth factor (HGF)
 HIF-1
 insulin growth factor-1 (IGF-1)
 interleukin-8 (IL-8)
 MAC-1
 nicotinamide
 platelet-derived endothelial cell growth factor (PD-ECGF)
 platelet-derived growth factor (PDGF)
 transforming growth factors alpha & beta (TGF-.alpha., TGF-beta.)
 tumor necrosis factor alpha (TNF-.alpha.)
 vascular endothelial growth factor (VEGF)
 vascular permeability factor (VPF)
 Bacteria
 Beta blocker
 Blood clotting factor
 Bone morphogenic proteins (BMP)
 Calcium channel blockers
 Carcinogens
 Cells
 Chemotherapeutic agents (e.g., Ceramide, Taxol, Cisplatin)
 Cholesterol reducers
 Chondroitin

TABLE 1-continued

Examples of Biological, Pharmaceutical, and other Therapies Deliverable via the Present Invention

Collagen Inhibitors
 Colony stimulating factors
 Coumadin
 Cytokines prostaglandins
 Dentin
 Etretinate
 Genetic material
 Glucosamine
 Glycosaminoglycans
 GP IIb/IIIa inhibitors
 L-703,081
 Granulocyte-macrophage colony stimulating factor (GM-CSF)
 Growth factor antagonists or inhibitors
 Growth factors
 Bone morphogenic proteins (BMPs)
 Endothelial Cell Growth Factor (ECGF)
 Epidermal growth factor (EGF)
 Fibroblast Growth Factors (FGF)
 Hepatocyte growth factor (HGF)
 Insulin-like Growth Factors (e.g., IGF-I)
 Nerve growth factor (NGF)
 Platelet Derived Growth Factor (PDGF)
 Recombinant NGF (rhNGF)
 Tissue necrosis factor (TNF)
 Transforming growth factors alpha (TGF-.alpha.)
 Transforming growth factors beta (TGF-.beta.)
 Vascular Endothelial Growth Factor (VEGF)
 Vascular permeability factor (VPF)
 Acidic fibroblast growth factor (aFGF)
 Basic fibroblast growth factor (bFGF)
 Epidermal growth factor (EGF)
 Hepatocyte growth factor (HGF)
 Insulin growth factor-1 (IGF-1)
 Platelet-derived endothelial cell growth factor (PD-ECGF)
 Tumor necrosis factor alpha (TNF-.alpha.)
 Growth hormones
 Heparin sulfate proteoglycan
 HMC-CoA reductase inhibitors (statins)
 Hormones
 Erythropoietin
 Immoxdal
 Immunosuppressant agents
 inflammatory mediator
 Insulin
 Interleukins
 Interlukin-8 (IL-8)
 Interlukins
 Lipid lowering agents
 Lipo-proteins
 Low-molecular weight heparin
 Lymphocytes
 Lysine
 MAC-1
 Morphogens
 Nitric oxide (NO)
 Nucleotides
 Peptides
 Polyphenol
 PR39
 Proteins
 Prostaglandins
 Proteoglycans
 Perlecan
 Radioactive materials
 Iodine - 125
 Iodine - 131
 Iridium - 192
 Palladium 103
 Radio-pharmaceuticals
 Secondary Messengers
 Ceramide
 Somatomedins
 Statins

TABLE 1-continued

Examples of Biological, Pharmaceutical, and other Therapies Deliverable via the Present Invention
Stem Cells
Steroids
Thrombin
Thrombin inhibitor
Thrombolytics
Ticlopid
Tyrosine kinase Inhibitors
ST638
AG-17
Vasodilator
Histamine
Forskolin
Nitroglycerin
Vitamins
E
C
Yeast

[0162] The inclusion of groups and subgroups in Table 2 is for convenience only. The grouping does not indicate the preferred use or limited use of any drug therein. That is, the groupings are for reference only and not meant to be limiting in any way (e.g., it is recognized that the Taxol formulations are used for chemotherapeutic applications as well as for anti-restenotic coatings).

[0163] In yet another embodiment, the working head may be arranged to eject infusate in opposing or impeding directions to cause turbulent flow, which may facilitate diffusion or penetration into tissue.

[0164] It should be noted that the effects of drugs and contrast are highlighted herein, but water is also realized to have a material removing, or flushing, effect (e.g., devices such as the Hydrolyzer, manufactured by Cordis Corporation).

[0165] In yet another embodiment, pump means operates to independently introduce infusate and after some dwell time withdraw the infusate. This dwell time will allow infusate and/or therapy more time to diffuse or penetrate into tissue.

[0166] FIG. 18 is similar to FIG. 17 but the components are used differently. In one mode the therapy is delivered (infused) via catheter 504 to remain as a bolus in the lumen for a significant period of time (i.e., dwell time) with the balloon inflated but with the extraction system turned off. During this time the drug permeates the lumen wall, and, at the end of the predetermined period, the debris extraction means may be operated normally, i.e., extraction is turned on and an infusate is delivered through the catheter 504 to flush the therapy from the vessel. The initial pressure of the bolus can also be adjusted to help deliver the therapy to the target tissue. For example, a high-pressure bolus could locally stretch the lumen and thereby increase the local permeability of the tissue. In an alternative embodiment, the fluid containing the therapy flows continuously from catheter 504 and is continuously extracted through the guide catheter 24. This alternative mode has the advantage that the fluid containing the therapy is in motion, which could aid in increasing the rate at which the therapy permeates the vessel wall. It is also contemplated that the temperature of the fluid could be

adjusted (e.g., increased) to enhance the delivery of the therapy. The catheter 504 is shown as a tube running over a guide wire in FIGS. 17 and 18, but, in another embodiment, the catheter could also be of the rapid exchange type. FIG. 19 shows one kind of rapid exchange catheter at 601, this embodiment includes a helical cut in the end of the tube, which permits the attachment of the catheter 504 onto a wire without access to the wire ends (this concept is fully described in co-pending application Ser. No. 523,077, which is assigned to the assignee of the present invention, which is incorporated herein by reference). A more common rapid exchange concept (not shown) is utilizing a short lumen at the end of the catheter that has a distal port at the distal end of the catheter and a proximal port close to the distal end of the catheter. Such rapid exchange concepts reduce the required length of guide wires but still require access to one end of the guide wire to permit attachment of the catheter to the guide wire. Therefore, the delivery of therapy is not limited to the tube-over-wire approach shown in FIG. 18.

[0167] In yet another embodiment of the present invention, the distal protection component (e.g., balloon, filter, etc.) may be collapsed or avoided entirely. This would allow the concentrated treatment to contact the targeted tissues and then naturally disperse and become more diffuse, for easy systemic toleration.

[0168] In yet another embodiment the working head is arranged to contact the interior wall of the lumen, during operation (e.g., ejection of liquid) such that infusate and/or therapy are forced into the interior wall and/or the surrounding tissue. In one such embodiment, the distal protection device (e.g., balloon, filter, expandable member, etc.) comprises an offset (i.e., the centerline of the distal protection device is offset from the centerline of the working head), wherein the offset causes the working head to contact the interior wall of the lumen.

[0169] The therapy delivery concepts discussed thus far might be classified as static or low velocity delivery systems. FIGS. 20, 21, and 22 however show delivery devices, which should be classified as high velocity delivery devices. Several high-pressure therapy delivery devices for delivery of therapy to the myocardium, vessels, and tissue surrounding a lumen are disclosed in a co-pending patent application Ser. No. 09/368,410, which is assigned to the same entity as the present application, and which is incorporated herein by reference. The devices of FIGS. 20, 20', and 21 utilize the guide catheter 24 and distal balloon 126' illustrated in FIG. 16, but additionally provide a medication distribution head 601 (i.e., working head) mounted on the distal portion of catheter 602. The medication distribution type of working head 601 (see FIG. 20) passes through the guide catheter 24 along the balloon guide wire and can be positioned anywhere between the balloon 126' and the distal end of the guide catheter 24. A high-pressure source 603 (not shown) drives the therapy through the catheter 602 to the distribution head 601 where the therapy is emitted at sufficiently high velocity to traverse the liquid filled gap between the head and the vessel wall, and impact and penetrate the vessel wall and may go into surrounding tissue (all being referred to as "target tissue"). In one preferred embodiment, the distribution head is of the order 1 mm in diameter and the multiple distribution jets are each expected to be in the range 0.002 to 0.015 inch diameter. Drive pressures are expected

to be approximately 100 psi to 3000 psi. Other embodiments are envisioned, where the size and number of jets will dictate the pressures required.

[0170] In one embodiment, catheter **602** is fed over the guide wire, through guide catheter **24** to a point close to the un-inflated distal balloon **126'**. The balloon is then inflated, the therapy delivered through the head **601** and the aspiration activated. The catheter **602** is traversed along the vessel to distribute the therapy. Additional components might be necessary to better centralize the distribution head **601** (i.e., working head locating members) (See **FIGS. 21 and 22**) in the vessel once the head is some distance away from the balloon **126**.

[0171] In one embodiment, the centralizing device is a multi filament basket **606** of the type often used in urology. The basket is formed from several pre-bent wires **605** (e.g., nitinol), or ribbons, which form a football shaped basket in their relaxed condition as a result of a shape memory property. A thin control tube **604** is used to capture and compress the wires **605** to reduce the effective diameter of the basket, although thin pull ribbons (not shown) are also used to control basket shapes in other applications. In use, the combined medication distribution head **601**, catheter **602**, and basket and control tube **604** concentric with the catheter **602**, are moved through the guide catheter **24** on guide wire **124** (together, the "assembly head") to a position close to the un-inflated balloon **126'**. The balloon **126'** is inflated, axial movement of the control tube **604** adjusts the basket, the high-pressure source **603** is activated and the aspiration commenced. The entire assembly head is traversed along the vessel to distribute the therapy. The traversing of the assembly head along the vessel length (or at least well beyond the ends of the stent, if any) could be automated, such as by a linear actuated drive motor, to provide a uniform, or alternatively variable, distribution of the therapy to the targeted tissue. The only difference between **FIGS. 21 and 22** is that the medication delivery head **601** is shown distal of the basket in **FIG. 21** and within the basket in **FIG. 22**. The in-basket construction may give better centralization and closer action to the guide catheter **24** on reverse travel of the head **601**.

[0172] Previous embodiments herein have shown use of the devices in single un-branched vessels, however, applications of the embodiments may be used in a branched vessel (See **FIG. 23**), in this example the internal and external carotid arteries, but other hollow organs and lumens could benefit from these embodiments as well. A working head, in this example a medication distribution head **601**, is shown on the balloon guide wire **124** in the internal carotid, and a second balloon guide wire **124** is shown in the external carotid. This arrangement allows the isolation of the two branches and the use of a strong dose of therapy to be introduced via a medication distribution head **601** to one of the branches at a time. The dose can be allowed to act as a bolus, which rests for a given time before aspiration or as a continuous delivery with aspiration via a guide or other catheter (referred to as "through-flow"). The through-flow rate may be different than either of the infusate or aspiration rates used in the differential flow sequence. The location of the aspiration catheter with respect to the location of the working head (e.g., separation distance) could be adjusted to determine the effective treatment area in the vessel.

[0173] Additionally, the normal differential flow system or through-flow system may be used with an infusate (with or without additional material) and the through-flow stage may employ a different infusate or added material.

[0174] In these various embodiments, the therapy delivery devices can be used in vessels prior to, or post, angioplasty, stent delivery or use of other working heads. **FIG. 24** shows the use of the medication distribution head in a situation identical to that shown in **FIG. 21** with the addition of a stent **610**. Clearly any of the devices and embodiments disclosed can operate through a stent or other intraluminal prosthesis. They can also be used prior to or post the application of any other working heads such as atherectomy devices, angioplasty balloons, radiation catheters, intravascular ultrasound, infra-red intravascular imaging, or any other diagnostic or imaging head. In short, the disclosed drug delivery concepts can be used with any other kind of intravascular therapy where a therapy needs to be delivered onto, into, or through the wall of the vessel.

[0175] Therapy delivery devices (e.g., working heads) are used to deliver therapy to the artery or lumen, or to the interior surface of same. This delivery, which may be through liquid jets or irrigation-type catheters, may be normal to said interior surface or may be tangential; all of which directions are said to result in therapy ultimately directed toward the vessel's or lumen's interior surface.

[0176] Additionally, it is self evident that the embodiments disclosed can function in vessels or lumens that are not occluded at all but would benefit from the features of drug delivery in conjunction with (or without) the disclosed barriers and pumping systems. Thus, these embodiments can be used to treat target tissue, where the target tissue comprises vessels or lumens that contain at least partial occlusions or where the vessel or lumen has surrounding tissue (i.e., tissue in the vicinity of the vessel or lumen, but not necessarily encompassing the vessel or lumen), which is diseased in some fashion. Notwithstanding the above, it is also recognized that this form of drug delivery may be useful as a prophylactic measure, which may be used alone or in conjunction with other treatments and/or devices, to treat vessels, lumens or other targeted tissues.

[0177] Without further elaboration the foregoing will so fully illustrate our invention that others may, by applying current or future knowledge, adopt the same for use under various conditions of service.

What is claimed is:

1. An intravascular system for opening a lumen in an occluded blood vessel portion of a living being's vascular system, the occluded blood vessel portion being occluded by an occlusive material, said system comprising a stent, an instrument for deploying said stent and a debris extraction system, said debris extraction system being arranged for introducing an infusate liquid comprising at least one material, said instrument being arranged to be extended into the living being's vascular system to deploy said stent to the interior of the occluded blood vessel portion to open a lumen therein for the flow of blood therethrough, whereupon some debris may be produced, said debris extraction system being arranged for removing debris.

2. The system of claim 1, wherein said at least one material comprises at least one of saline, contrast, a drug, pharmaceutical, a biologically active material, or microspheres carrying chemicals.

3. The system of claim 2, wherein said biologically active material comprises a growth factor.

4. The intravascular system of claim 1, wherein said system additionally comprises a working head.

5. The intravascular system of claim 4, wherein said working head is arranged to remove occlusive material from the occluded blood vessel portion.

6. The intravascular system of claim 5, additionally comprising a debris blocking member for preventing the debris from flowing into downstream blood vessels.

7. The intravascular system of claim 6, wherein said debris blocking member comprises a balloon.

8. The intravascular system of claim 4, wherein said working head is rotatable.

9. The intravascular system of claim 4, wherein debris may be produced during the operation of said working head, and wherein said debris extraction system is arranged for removing said debris.

10. The intravascular system of claim 1, additionally comprising a catheter through which said instrument extends to form a passageway therebetween, the debris being withdrawn through said passageway for collection remote from the occluded blood vessel.

11. The intravascular system of claim 10, additionally comprising a debris blocking member for preventing the debris from flowing into downstream blood vessels.

12. The intravascular system of claim 11, wherein said debris blocking member comprises a balloon.

13. An intravascular system for opening a lumen in an occluded blood vessel portion of a living being's vascular system and for handling debris that may be produced thereby, the occluded blood vessel portion being occluded by an occlusive material, said system comprising a stent, an instrument for deploying said stent, a debris extraction system, and a debris blocking member, said instrument being arranged to be extended into the living being's vascular system to deploy said stent to the interior of the

occluded blood vessel portion to open a lumen therein for the flow of blood therethrough, said debris extraction system being arranged for introducing an infusate liquid comprising at least one material, and said debris extraction system being further arranged for removing the debris, said debris blocking member being arranged for preventing the debris from flowing into a downstream blood vessel during deployment of said stent.

14. The system of claim 13 wherein said at least one material comprises at least one of saline, contrast, a drug, pharmaceutical, a biologically active material, or microspheres carrying chemicals.

15. The system of claim 14 wherein said biologically active material comprises a growth factor.

16. The intravascular system of claim 13 wherein said debris blocking member comprises a balloon.

17. The intravascular system of claim 13 wherein said system additionally comprises a working head.

18. The intravascular system of claim 17 wherein said working head is rotatable.

19. The intravascular system of claim 17 wherein debris may be produced during the operation of said working head, and wherein said debris extraction system is arranged for removing the debris produced by the operation of said working head.

20. An intravascular system for opening a lumen in an occluded blood vessel portion of a living being's vascular system, the occluded blood vessel portion being occluded by an occlusive material, said system comprising a stent, an instrument for deploying said stent and a debris extraction system, said debris extraction system being arranged for introducing an infusate liquid comprising at least one material, said instrument being arranged to be extended into the lumen to deploy said stent to the occlusive material in the interior of the occluded blood vessel portion to open a lumen therein for the flow of blood therethrough, whereupon some debris may be produced, said debris extraction system being arranged for removing debris produced during the deployment of said stent.

* * * * *