



(51) International Patent Classification:  
A61F 2/44 (2006.01)

(21) International Application Number:  
PCT/US2010/032491

(22) International Filing Date:  
27 April 2010 (27.04.2010)

(25) Filing Language: English

(26) Publication Language: English

(30) Priority Data:  
12/432,117 29 April 2009 (29.04.2009) US

(71) Applicant (for all designated States except US): **DEPUY SPINE, INC.** [US/US]; 325 Paramount Drive, Raynham, MA 02767-0350 (US).

(72) Inventor; and

(75) Inventor/Applicant (for US only): **FRASIER, William** [US/US]; 834 Tarkiln Hill Road, New Bedford, MA 02745 (US).

(74) Agents: **JOHNSON, Philip, S.** et al.; Johnson & Johnson, One Johnson & Johnson Plaza, New Brunswick, NJ 08933 (US).

(81) Designated States (unless otherwise indicated, for every kind of national protection available): AE, AG, AL, AM, AO, AT, AU, AZ, BA, BB, BG, BH, BR, BW, BY, BZ, CA, CH, CL, CN, CO, CR, CU, CZ, DE, DK, DM, DO, DZ, EC, EE, EG, ES, FI, GB, GD, GE, GH, GM, GT, HN, HR, HU, ID, IL, IN, IS, JP, KE, KG, KM, KN, KP, KR, KZ, LA, LC, LK, LR, LS, LT, LU, LY, MA, MD, ME, MG, MK, MN, MW, MX, MY, MZ, NA, NG, NI, NO, NZ, OM, PE, PG, PH, PL, PT, RO, RS, RU, SC, SD, SE, SG, SK, SL, SM, ST, SV, SY, TH, TJ, TM, TN, TR, TT, TZ, UA, UG, US, UZ, VC, VN, ZA, ZM, ZW.

(84) Designated States (unless otherwise indicated, for every kind of regional protection available): ARIPO (BW, GH, GM, KE, LR, LS, MW, MZ, NA, SD, SL, SZ, TZ, UG, ZM, ZW), Eurasian (AM, AZ, BY, KG, KZ, MD, RU, TJ, TM), European (AT, BE, BG, CH, CY, CZ, DE, DK, EE, ES, FI, FR, GB, GR, HR, HU, IE, IS, IT, LT, LU, LV, MC, MK, MT, NL, NO, PL, PT, RO, SE, SI, SK, SM,

[Continued on next page]

(54) Title: MINIMALLY INVASIVE CORPECTOMY CAGE AND INSTRUMENTS

**FIG. 1**

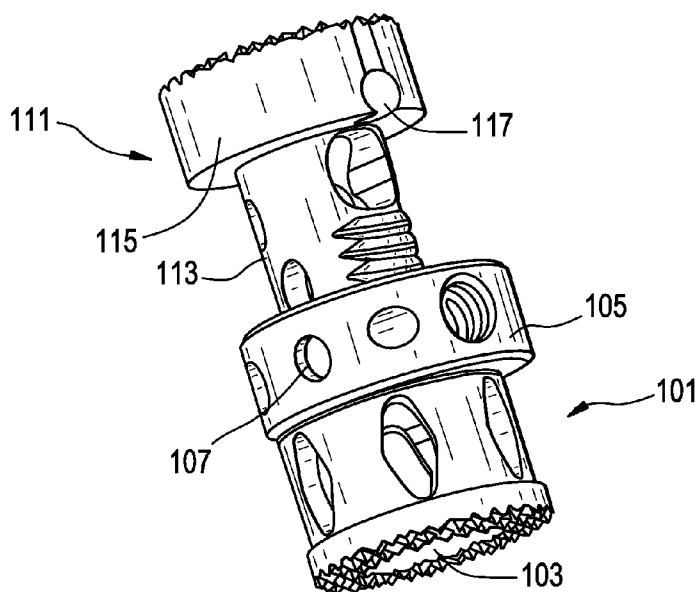

(57) Abstract: An assembly comprising an expandable corpectomy cage and an insertion instrument, wherein the expandable cage comprises an instrument attachment features, including mating holes on the sides of the outer sleeve, and a ball-shaped pocket on the endplate of the inner sleeve, and the insertion instrument features a tuning-fork shaped holder, which attaches to the mating holes on the implant's outer sleeve using small bosses which mate with the holes under the spring tension of the fork, and a lever with a spherical end that mates with the ball-shaped pocket in the inner sleeve endplate.





TR), OAPI (BF, BJ, CF, CG, CI, CM, GA, GN, GQ, GW, ML, MR, NE, SN, TD, TG).

— *as to the applicant's entitlement to claim the priority of the earlier application (Rule 4.17(iii))*

**Declarations under Rule 4.17:**

- *as to the identity of the inventor (Rule 4.17(i))*
- *as to applicant's entitlement to apply for and be granted a patent (Rule 4.17(ii))*

**Published:**

- *without international search report and to be republished upon receipt of that report (Rule 48.2(g))*

## Minimally Invasive Corpectomy Cage and Instrument

### BACKGROUND OF THE INVENTION

5 A spinal corpectomy procedure seeks to remove a diseased vertebral body from the patient, and is commonly performed through an anterior approach using a large, open incision and general retractors. Increasingly, however, surgeons are utilizing smaller access portals for all types of surgeries, including spinal corpectomies. They also are more often using a posterior approach when the corpectomy involves the thoracic spine. However, this approach  
10 provides a more limited access to the spine, and often requires the surgeon to take a nerve root in order to use existing corpectomy cages and instruments. Surgeons who strive to keep their access windows small often resort to manipulating the corpectomy cage into position using sutures and small instruments, by first inserting the cage orthogonal to the axis of the spinal column, then and rotating it into place so that the endplates of the cage face the  
15 opposing vertebral bodies. A corpectomy implant and instrument designed for use through a small incision or port would make this cage placement easier and faster for the surgeon, and safer for the patient.

US Patent Publication No. 20080114467 (Capote) discloses an expandable medical implant for supporting bone structures. The implant may include an outer member and an  
20 inner member receivable in the outer member. One of the outer and inner members includes a tapered surface and the other of the outer and inner members includes a scalloped surface. The implant may also include a locking element disposed between the tapered surface and the scalloped surface. The tapered surface may be movable relative to the locking element to transversely shift the locking element into engagement with the scalloped surface to inhibit a  
25 decrease in the overall implant height.

US Patent Publication No. 20080167720 (Melkent) discloses an expandable vertebral replacement device and method of using the same that allows surgeons to support two adjacent vertebrae after an intermediate vertebra or a portion of an intermediate vertebra has been removed for the spine. The expandable vertebral replacement device includes a first  
30 replacement body, a second replacement body and a collar. The second replacement body

includes a projecting portion that is telescopically received within an axial passage defined by the first replacement body. The collar is used to force the collet of the first replacement body into clamping engagement with the projecting portion of the second replacement body to lock the expandable vertebral replacement device at a select height.

5 PCT Patent Publication No. WO2006116052 (Rhoda) discloses an expandable prosthetic implant device for engagement between vertebrae generally comprising an inner member, outer member, and gear member positioned coaxial with respect to each other such that the inner and outer members are moveable relative to each other along an axis. The gear member is axially fixed to the outer member and freely rotatable with respect to the outer  
10 member and the gear member threadedly engages a threaded portion of the inner member to translate inner member along the axis. The implant is configured to engage the vertebrae in a predetermined alignment and the gear member includes gear teeth exposed to the exterior and configured to be accessible by a tool member at a plurality of angular positions around the perimeter of the implant device.

15 PCT Patent Publication No. WO2008065450 (Parry) discloses an implant for repairing a damaged body structure that comprises or is associated with bone parts. In one aspect a spinal implant includes an inferior member having an inferior end surface for engaging a superior face of an inferior vertebral body and a longitudinal portion; a superior member having a superior end surface for engaging an opposing inferior surface of a second  
20 vertebral body, and a portion adapted to cooperate with the longitudinal portion of the inferior member such that the superior member is moveable relative to the inferior member by sliding in the longitudinal direction; and fixating means for securing the superior member to the inferior member. Also described are instruments and methods used in the repair of such damaged body structures.

## 25 SUMMARY OF THE INVENTION

The present invention is directed to implants, instruments and methods of delivering a corpectomy implant into a spinal defect space and then rotating the corpectomy implant in the defect space without disconnecting it from its delivery instruments. In preferred  
30 embodiments, the instruments of the present invention are designed to work through a minimally invasive port. This minimally invasive approach thereby eliminates the need for the surgeon to take the local nerve root during the corpectomy procedure.

The present invention is further advantageous in that it also eliminates the need for a parallel expansion insertion device (which would require an open surgery), while maintaining a sufficient external expansion mechanism and a large graft volume inside the implant.

Preferred embodiments of the present invention feature an expandable corpectomy cage and  
5 an insertion instrument designed to both rotate and expand the cage.

In preferred embodiments, the expandable cage comprises an instrument attachment features, these feature including i) mating holes on the sides of the outer sleeve, and ii) a ball-shaped pocket on the endplate of the inner sleeve.

In preferred embodiments, the insertion instrument features:

- 10 a) a tuning-fork shaped holder, which attaches to the mating holes on the implant's outer sleeve using small bosses which mate with the holes under the spring tension of the fork, and
- b) a lever with a spherical end that mates with the ball-shaped pocket in the inner sleeve endplate.

In other embodiments, the mating provided by the spring tension of the fork can be  
15 accomplished with a pivot and lock.

Therefore, in accordance with the present invention, there is provided a spacer for insertion between two vertebrae, the spacer having a variable axial height and comprising:

- 20 a) an outer member comprising an inner wall and an outer wall having a pair of attachment features thereon adapted for mating with an insertion instrument,
- b) an inner member comprising an outer wall and an end plate having a pocket having a substantially curved bottom thereon adapted for mating with the instrument,

wherein the outer wall of the inner member is received within the inner wall of the  
25 outer member and is axially adjustable relative thereto in an axial direction thereof for adjusting the variable axial height of the spacer.

Also in accordance with the present invention, there is provided a spacer for insertion between two vertebrae by an insertion instrument, the spacer having a variable axial height  
30 and comprising:

a) an outer member comprising an inner wall and an outer wall having a pocket having a substantially curved bottom thereon adapted for mating with a first portion of the instrument,

5 b) an inner member comprising an outer wall and an end plate having a pair of attachment features thereon adapted for mating with a second portion of the instrument,

wherein the outer wall of the inner member is received within the inner wall of the outer member and is axially adjustable relative thereto in an axial direction thereof for adjusting the variable axial height of the spacer.

10

Also in accordance with the present invention, there is provided an assembly for inserting a spacer between two vertebrae, the assembly comprising:

i) the spacer having a variable axial height and comprising:

15 a) an outer member comprises an inner wall and an outer wall having a pair of attachment features thereon adapted for mating with an instrument,

b) an inner member comprises an outer wall and an end plate having a pocket having a substantially curved bottom thereon adapted for mating with the instrument,

20 wherein the outer wall of the inner member is guided within the inner wall of the outer member to be adjustable relative thereto in an axial direction thereof for adjusting an overall height, and

ii) an insertion instrument comprising:

25 a) a fork comprising a proximal shaft comprising a handle, an intermediate crossbar, and a distal portion comprising a pair of extensions, the extensions having a pair of opposing bosses,

b) a lever having a proximal shaft comprising a handle, an intermediate portion and a substantially curved distal end,

wherein the intermediate portion of the lever pivots upon the crossbar,

wherein the opposing bosses mate with the pair of attachment features, and

30 wherein the substantially curved distal end of the lever pivotally mates with the substantially curved bottom of the pocket.

Also in accordance with the present invention, there is provided a method of inserting an expandable spinal corpectomy cage into a defect space between a pair of vertebral bodies, the cage comprising i) an outer member having a first endplate and opposing attachment features defining a rotation axis, and ii) an inner member having a second endplate, wherein  
5 the inner member is received within the outer member and is axially adjustable relative thereto in an axial direction thereof for adjusting the variable axial height of the cage, the method comprising the steps of:

- a) attaching the attachment features of the expandable cage to an insertion instrument,
- b) inserting the expandable cage into the defect space in an orientation in which the  
10 axis of the cage is substantially orthogonal to an axis of the spine, and
- c) manipulating the insertion instrument to rotate the expandable cage about the rotation axis so that the axis of the cage is substantially parallel to the axis of the spine.

#### DESCRIPTION OF THE FIGURES

FIG.1 discloses an expandable cage of the present invention comprising instrument attachment  
15 features, including mating holes on the sides of the outer sleeve, and a ball-shaped pocket on the endplate of the inner sleeve.

FIG. 2 discloses a first instrument component of the present invention, namely, a tuning-fork shaped holder, which attaches to the mating holes on the implant's outer sleeve using small bosses which mate with the holes under the spring tension of the fork.

20 FIG. 3 discloses a second instrument component of the present invention, namely, a lever with a spherical end that mates with the ball-shaped pocket in the inner sleeve endplate.

FIG. 4a discloses the cage of the present invention attached to the instrument of the present invention.

FIGS. 4b and 4c disclose insertion of the cage into a defect space in a minimally invasive orientation.

FIG. 4d discloses rotating the cage 90 ninety degrees.

25 FIG. 4e discloses expansion of the rotated cage.

FIG. 4f discloses rotation of the instrument to allow access to the set screw.

FIGS.5a-5j disclose a series of steps performed by the surgeon in order to insert and expand the cage of the present invention.

FIGS. 6a and 6b disclose front and back views of a cage of the present invention.

FIG. 6c discloses a cage of the present invention having windows in both annuluses.

FIG. 7a discloses a cage of the present invention in which the teeth of the pressure plate mate  
5 with the notches on the inner annulus.

FIG. 7b discloses details of the engagement mechanism of the present invention.

FIG. 8a discloses a perspective view of the engagement member of the present invention.  
10

FIG. 8b discloses a cross-section of the engagement mechanism of the present invention  
having a pressure plate.

#### DETAILED DESCRIPTION OF THE INVENTION

15 Now referring to FIG. 1, there is provided a spacer 150 for insertion between two vertebrae, the spacer having a variable axial height and comprising:

- a) an outer member 101 comprising an inner wall 103 and an outer wall 105 having a pair of recesses 107 thereon adapted for mating with an instrument,
- b) an inner member 111 comprising an outer wall 113 and an end plate 115 having a  
20 substantially spherical pocket 117 thereon adapted for mating with the instrument, wherein the outer wall of the inner member is received within the inner wall of the outer member and is axially adjustable relative thereto in an axial direction thereof for adjusting the variable axial height of the spacer.

Now referring to FIG. 2 , there is provided a first component of the delivery  
25 instrument, comprising a fork 122 comprising a proximal shaft 123 comprising a handle 125, an intermediate crossbar 127 (fulcrum), and a distal portion 129 comprising a pair of extensions 131, each extension having a pair of opposing bosses 133.

Now referring to FIG. 3, there is provided a second component of the delivery  
instrument, comprising a lever 141 having a proximal shaft 143 comprising a handle 145, an  
30 intermediate portion 147 and a substantially spherical distal end 149.



In preferred embodiments, the cage of the present invention is inserted into the defect space in the following manner:

First, the surgeon accesses the spinal level of interest by removing the target vertebral body through a small incision or portal.

5       Next, and now referring to FIG. 4a, an appropriately-sized cage 150 is selected and attached to the fork 122 by snapping the fork's bosses 133 over the recesses 7 on the outer member of the cage. Next, the lever 141 is attached to the inner sleeve pocket 117 by sliding its spherical end 149 into the pocket from under the inferior side of the superior endplate. Next, the cage is collapsed, and the handles of the fork 125 and lever 145 are oriented to be  
10       parallel to the main axis of the cage.

Next, and now referring to FIGS. 4b and 4c, the surgeon holds the handles 125,145 together, and inserts the cage 150 through an access portal (not shown).

Now referring to FIG. 4d, once the cage 150 is in the defect at the desired location (but not orientation), the surgeon manipulates the two handles 125,145 to flip the cage ninety  
15       degrees, thereby making it parallel to the axis of the spine.

Now referring to FIG. 4e, expansion of the cage 150 is then initiated by placing the intermediate portion 147 of the lever against the horizontal crossbar 127 of the fork, and squeezing the handles together.

Now referring to FIG. 4f, the fork 122 and lever 141 can be rotated slightly while still  
20       under tension, allowing access to a set screw on the cage with a straight, thin driver. Once the set screw is locked, the fork is removed by pulling it straight up to overcome the spring tension in the fork. The lever is removed by sliding it out from under the superior endplate.

A more detailed presentation of the procedure for inserting the present invention is provided in FIGS. 5a-5j and is presented below:

25       Now referring to FIG. 5a, the fork extensions 131 are attached to the implant, with the extension bosses 133 resting in the recesses 107 on the wall 105 of the outer member of the implant. This attachment configuration allows rotation of the implant about the bosses. The spring-loaded nature of the extensions of the fork allow them to snap over the implant body.

30       Now referring to FIG. 5b, the spherical distal end 149 of the lever is mounted in the spherical pocket 117 located on the implant. This spherical distal end is mounted in the pocket through an underside 199 of the endplate portion 115 of the inner member. Slot 153

provided above the spherical pocket on the endplate allows the lever to rotate into an insertion position

Now referring to FIG. 5c, the fork 122 and the lever 141 are held together in-line with the longitudinal axis of the implant as the implant 150 is inserted between the vertebrae.

5 Now referring to FIG. 5d, the fork 122 is held steady while the lever 141 is manipulated to begin rotation of the implant 150.

Now referring to FIG. 5e, rotation of the implant 150 about the bosses 133 continues by continued manipulation of the lever 141.

10 Now referring to FIG. 5f, rotation of the implant 150 to its final orientation is accomplished by pushing the lever 141 down while holding onto the fork 122.

Now referring to FIG. 5g, once the implant 150 has been rotated to its final orientation and the implant endplates seat against the endplates of the vertebral bodies, the proximal shaft 143 of the lever is swung upwards to more substantially align with the proximal shaft 123 of the fork.

15 Now referring to FIGS. 5h and 5i, to begin expansion of the implant, the shafts 143, 123 of the lever and fork are squeezed together. In this configuration, the lever mates with a slot 155 on the cross-bar of the fork so that the crossbar 127 behaves as a fulcrum in order to expand the implant.

20 Now referring to FIG. 5j, to complete expansion of the implant 150, the shaft 143 of the lever is typically pushed past the shaft 123 of the fork, depending upon the amount of expansion needed.

25 Generally, the attachment features of the cage can be any conventional feature that is used to attach an implant to an insertion instrument. Preferably, the attachment feature is a recess having a shape corresponding to the bosses of the insertion instrument. Also preferably, the cage has a pair of attachment features that are located on diametrically opposite sides of a cage wall. Although the attachment features are shown in the FIGS. as recesses, in other embodiments, the attachment features can also be projections (in which case, the insertion instrument possesses corresponding recesses).

30 Generally, the pocket has a curved bottom that facilitates the pivoting of the cage. Preferably, the curved surface has a circular cross section in the axial direction. More preferably, the pocket has a substantially spherical shape. In other embodiments, the pocket

has a cylindrical shape. In general, the distal end of the lever component possesses a feature that matingly corresponds to the pocket shape on the cage. For example, when the cage's pocket is substantially spherical, the lever's distal end is likewise substantially spherical.

Now referring to FIGS. 6a-6c there is provided a spacer for insertion between two  
5 vertebrae, the spacer having a variable axial height and comprising a sleeve-shaped first member 1 and a second member 2 guided within the first member to be slidable relative thereto in an axial direction thereof for adjusting an overall height,

wherein the second member comprises an outer wall 3 and ratchet notches 5 provided at its outer wall facing the first member and extending in the axial direction, and

10 wherein the first member comprises a wall 7 having an engagement member 9, which cooperates with the ratchet notches for adjusting the overall height of the spacer,

wherein the first member has a window 10 therein for inserting graft material therethrough, and

wherein the engagement member 9 comprises i) a set screw 11 and ii) a pressure plate  
15 13 having an outer face 15 contacting the set screw and an inner face 17 having teeth 19 adapted to mate with the ratchet notches of the second member.

The first member generally has a tubular shape comprising a first annulus 21. The outer end of the first member should be adapted to seat upon a lower vertebral endplate, and  
20 so a substantially flat endplate 25 is generally attached to the outer end 27 of the first annulus. This endplate generally has a hole in its center and extends outwardly substantially radially from the outer end of the annulus. The outer face 28 of the endplate should be adapted to grip the lower vertebral endplate and so is generally provided with roughened features 29. These roughened features may be a plurality of uniformly distributed, pointed teeth 31 that  
25 bite into the adjacent endplate. In other embodiments, the teeth may be non-uniformly distributed. For further insuring that the endplate will be stably seated into the vertebral endplate, the outer face of the endplate may also have a few long spikes 33 extending therefrom. In some embodiments, the endplate has an overall convex shape in order to suitably conform to the overall concave shape of the natural vertebral endplate in which it  
30 seats. In some embodiments (as in FIG. 6), the endplate has a wedge cross-section in order to conform to the lordosis adopted by the natural spine in the region of the implant. Typically, the wedge is designed to provided a lordotic angle of between about 0 and about 24 degrees,

more typically between about 6 and about 12 degrees . The wedge may also be designed to provided a kyphotic angle of between about 0 and about -12 degrees,

In general, the outer dimensions of the endplates of the present invention are between about 16 mm and about 30 mm (e.g., 16 x 20; 20x23 and 24x30).

5       The annular portion of the first member also comprises a plurality of uniformly distributed, transverse, through-holes 35. These throughholes are generally about 2-8 mm in diameter, and provide a means for bone growth therethrough. The holes are preferably of diamond shape, although other shapes such as triangles may be used. When in a diamond shape, suitable sizes include 2.5 mm x 3.5 mm shapes to 5 mm x 7 mm shapes. In the  
10 particular FIGS. 6a and 6b, the throughholes have a diamond shape. The diamond shape allows the annulus material to make a mesh pattern in the wall that has structural advantages. However, any conventional shape may be used for the through-hole pattern. In some embodiments, the plurality of throughholes occupy only the distal portion 37 of the annulus. In such an embodiment, graft windows may be placed both on the proximal 39 and lateral 41  
15 portions of the annulus. This has the advantage of allowing the surgeon to place bone graft into the cage from a variety of angles. In some embodiments, the plurality of throughholes occupy not only the distal portion of the first annulus, but also the lateral portions as well. In such an embodiment, graft windows may be placed only through the proximal portion of the annulus, but the cage has the structural advantage of extra strength.

20       The first member generally has at least one graft window 10 therein. The graft window functions both as a path through which the surgeon can place bone graft into the cage, but also as a means for bone growth therethrough. In other embodiments, the first member has a plurality of graft windows therein. When a face of the annulus has been selected for graft windows, in preferred embodiments, two graft windows 43 are placed one  
25 on top of the other, being separated by a bar 45. This bar enhances the strength of the cage. In the particular cage shown in FIG. 6, there are two graft windows on the proximal face of the annulus, two graft windows on the left lateral face of the annulus and two graft windows on the right lateral face of the annulus. This configuration represents a balance between providing surgeon flexibility (through the inclusion of multiple faces with graft windows) and  
30 cage strength (through the use of a lateral bar between windows on any face). Each window typically has a diameter of between about 5 mm and about 20 mm. Typical windows measure 5.5 mm x 5.6 mm to 12 mm x 15.75 mm to 17.5 mm x 12 mm.

The first member may preferably include a reinforcing collar 47 surrounding the inner (upper) end portion 48 of the first annulus. The function of the reinforcing collar is to strengthen the first member and reduce deflection when the screw is tightened. The reinforcing collar also generally has a threaded screw hole extending radially therethrough. This threaded screw hole is adapted for threadable passage of a threaded locking set screw therethrough.

Now referring to FIG. 7a, the first member comprises a collar 47 having an engagement member 9 therein, and the engagement member cooperates with the ratchet notches of the second member for adjusting a desired overall height of the spacer.

Now referring to FIG. 7b, there is provided a more detailed understanding of the engagement member. The engagement member 9 comprises i) a set screw 11 and ii) a pressure plate 13 having an outer face 15 contacting the set screw and an inner face 17 having teeth 19 adapted to mate with the ratchet notches of the second member.

In some embodiments, as in FIG. 7b, a cylindrical outer surface 20 of the set screw is threaded to allow its advance toward the second member. In some embodiments, as in FIGS. 8a and 8b, the set screw is tubular with internal axial recesses 22 therein extending along its axis. These axial recesses mate with a screwdriver, thus allowing the screw to be rotated and thereby advanced towards the second member.

The set screw further has a neck and head extension 49 extending from its distal end 50, wherein the extension is shaped so as to both provide engagement with a corresponding recess 51 of the pressure plate and allow its rotation during that engagement.

Now referring to FIGS. 8a and 8b, the pressure plate 13 has an outer face 15 contacting the set screw and an inner face 17 having teeth 19 adapted to mate with the ratchet notches of the second member. The outer face has a neck and head recess 51 therein that corresponds with the head and neck extension of the set screw so as to both provide engagement with a corresponding extension of the set screw and allow rotation of the set screw during that engagement. The pressure plate is seated on the inside face of the collar.

The inner face of the pressure plate has at least two elongated teeth 19 thereon forming at least one notch therebetween. The tips of the teeth are preferably spaced apart a distance of between about 1 mm and 2 mm, generally about 1.5 mm. The spacing can be larger or smaller than these values, with smaller being preferable.

Now referring to FIG. 6b, the distal 37 portion of the first member also has an assembly pin 53 extending radially inward from the collar. This assembly pin slidably mates

with a corresponding assembly groove 54 of the second member in order to maintain the second member in a slidable orientation within the first member, and to retain the first member to the second member.

Still referring to FIG. 6b, the second member generally has a tubular shape  
5 comprising a second annulus 55. The outer diameter of the second annulus should be slightly smaller than the inner diameter of the first annulus of the first member, in order to provide slidable reception of the second annulus within the first member.

The outer end of the second member should be adapted to seat upon an upper vertebral endplate, and so a substantially flat endplate 57 is generally attached to the outer  
10 end 59 of the second annulus 55. This endplate generally has a hole in its center and extends outward substantially radially from the upper end of the annulus. The outer face of the endplate should be adapted to grip the upper vertebral endplate and so is generally provided with roughened features 29. These roughened features may be a plurality of uniformly (or non-uniformly) distributed, pointed teeth 31 that bite into the adjacent endplate. For further  
15 insuring that the endplate will be stably seated into the vertebral endplate, the outer face of the endplate may also have a few long spikes 33 extending therefrom. In some embodiments, the endplate has an overall convex shape in order to suitably conform to the overall concave shape of the natural vertebral endplate in which it seats.

The annular portion of the second member also comprises a plurality of uniformly  
20 distributed, transverse, through-holes 35. These throughholes are generally of the throughhole size discussed above, , and provide a means for bone growth therethrough. In this particular FIG. 6a, the throughholes have a diamond shape. The diamond shape allows the second annulus material to make a mesh pattern that has structural advantages. However, any conventional shape may be used for the through-hole pattern. In some embodiments, the  
25 plurality of throughholes occupy each of the lateral faces of the posterior portion of the second annulus.

The second member may preferably include a reinforcing collar 61 surrounding the outer (upper) end portion 59 of the second annulus. The function of this reinforcing collar is to allow for instrument attachment. The reinforcing collar also generally has a plurality of  
30 through-holes 63 extending radially therethrough. These throughholes function as areas for instrument attachment, and as areas for bone growth and vascularization.

The proximal portion 65 of the second annulus has a plurality of elongated teeth 67 thereon forming at least one notch 69 therebetween. These teeth and notches form a row

extending up the outside of the annulus. Typically, the annulus of the second member has at least ten elongated notches thereon. These notches are formed to compliment the teeth of the pressure plate. The apices of the notches on the second member are generally spaced apart a distance of between about 1 mm and 2 mm, generally about 1.5 mm. The spacing can be  
5 larger or smaller than these values, with smaller being preferable.

The distal 70 portion of the second annulus of the second member also has an assembly groove 54 extending inwardly and axially along the outside 68 of the second annulus. This assembly groove mates with the corresponding assembly pin of the first member in order to maintain the second member in a slidable orientation within the first  
10 member.

Once the overall height of the cage has been determined by the surgeon and the relative disposition of the first and second members set accordingly, the set screw is then rotated by the surgeon using a screwdriver. The set screw acts to advance the pressure plate so that the teeth on the pressure plate contact the ratchet notches of the second member,  
15 thereby locking the desired overall height of the cage.

Typically, the cages of the present invention are designed to occupy either one, two or three levels of a thoracolumbar corpectomy. In some embodiments having either 16 mm or 20 mm endplate dimensions, the height of the cage can be between 22 mm and 72 mm. In some embodiments having 24 mm endplate dimensions, the height of the cage can be  
20 between 22 mm and 110 mm. In general, the cage is designed to expand its height in an increment of between about 8.5 mm to about 25 mm. Cages can be designed to overlap in height ranges with their adjacent sizes. For example a first cage can range in height from 25 to 33.5 mm, while a second cage can range in height from 28.5 mm to 38.5 mm in height.

25

I claim:

1. A spacer for insertion between two vertebrae, the spacer having a variable axial height and comprising:

- 5                   a) an outer member comprising an inner wall and an outer wall having a pair of attachment features thereon adapted for mating with an insertion instrument,
- b) an inner member comprising an outer wall and an end plate having a pocket having a substantially curved bottom thereon adapted for
- 10                   mating with the instrument,

wherein the outer wall of the inner member is received within the inner wall of the outer member and is axially adjustable relative thereto in an axial direction thereof for adjusting the variable axial height of the spacer.

- 15           2. The spacer of claim 1 wherein the attachment features are selected from the group consisting of a recess and a projection.
3. The spacer of claim 1 wherein the substantially curved bottom of the pocket has a substantially spherical portion.

- 20   4. A spacer for insertion between two vertebrae by an insertion instrument, the spacer having a variable axial height and comprising:

- a) an outer member comprising an inner wall and an outer wall having a pocket having a substantially curved bottom thereon adapted for mating with a first portion of the instrument,
- 25                b) an inner member comprising an outer wall and an end plate having a pair of attachment features thereon adapted for mating with a second portion of the instrument,

wherein the outer wall of the inner member is received within the inner wall of the outer member and is axially adjustable relative thereto in an axial direction thereof for adjusting the

30   variable axial height of the spacer.



5. The spacer of claim 4 wherein the attachment features are selected from the group consisting of a recess and a projection.

6. The spacer of claim 4 wherein the substantially curved bottom of the pocket has a substantially spherical portion.

5

**(Assembly)**

7. An assembly for inserting a spacer between two vertebrae, the assembly comprising:

i) the spacer having a variable axial height and comprising:

10 a) an outer member comprises an inner wall and an outer wall having a pair of attachment features thereon adapted for mating with an instrument,

b) an inner member comprises an outer wall and an end plate having a pocket having a substantially curved bottom thereon adapted for mating with the instrument,

15 wherein the outer wall of the inner member is guided within the inner wall of the outer member to be adjustable relative thereto in an axial direction thereof for adjusting an overall height, and

ii) an insertion instrument comprising:

20 a) a fork comprising a proximal shaft comprising a handle, an intermediate crossbar, and a distal portion comprising a pair of extensions, the extensions having a pair of opposing bosses,

b) a lever having a proximal shaft comprising a handle, an intermediate portion and a substantially curved distal end,

wherein the intermediate portion of the lever pivots upon the crossbar,

25 wherein the opposing bosses mate with the pair of attachment features, and

wherein the substantially curved distal end of the lever pivotally mates with the substantially curved bottom of the pocket.

8. The spacer of claim 7 wherein the attachment features are selected from the group consisting of a recess and a projection.

30 9. The spacer of claim 7 wherein the pocket has a substantially spherical portion.

10. A method of inserting an expandable spinal corpectomy cage into a defect space between a pair of vertebral bodies, the cage comprising i) an outer member having a first endplate and

opposing attachment features defining a rotation axis, and ii) an inner member having a second endplate, wherein the inner member is received within the outer member and is axially adjustable relative thereto in an axial direction thereof for adjusting the variable axial height of the cage, the method comprising the steps of:

- 5           a) attaching the attachment features of the expandable cage to an insertion instrument,  
          b) inserting the expandable cage into the defect space in an orientation in which the axis of the cage is substantially orthogonal to an axis of the spine, and  
          c) manipulating the insertion instrument to rotate the expandable cage about the rotation axis so that the axis of the cage is substantially parallel to the axis of the  
10       spine.

11. The method of claim 10 wherein each of the outer and inner members are sleeves.

12. The method of claim 11 wherein the outer sleeve comprises an inner wall and an outer wall having a pair of recesses thereon adapted for mating with the instrument.

- 15       13. The method of claim 12 wherein the inner sleeve comprises an outer wall and an end plate having a substantially spherical pocket thereon adapted for mating with the instrument.

14. The method of claim 11 wherein the outer sleeve comprises an inner wall and an outer wall having a substantially spherical pocket thereon adapted for mating with a first portion of  
20       the instrument.

15. The method of claim 14 wherein the inner sleeve comprises an outer wall and an end plate having a pair of recesses thereon adapted for mating with a second portion of the instrument.

- 25       16. The method of claim 11 wherein the instrument comprises a fork comprising a proximal shaft, an intermediate crossbar, and a distal portion comprising a pair of extensions, each extension having a pair of opposing bosses.

17. The method of claim 16 wherein the instrument comprises a lever having a proximal shaft, an intermediate portion and a spherical distal end.

- 30       18. The method of claim 17 wherein the intermediate portion of the lever pivots upon the fulcrum.

19. The method of claim 18 wherein the outer member comprises an inner wall and an outer wall having a pair of recesses thereon adapted for mating with an instrument, wherein the opposing bosses mate with the pair of recesses.

5 20. The method of claim 19 wherein the inner member comprises an outer wall and an end plate having a substantially spherical pocket thereon adapted for mating with the instrument, and wherein the spherical distal end of the lever pivotally mates with the spherical pocket.

10 21. The method of claim 10 wherein the cage has a closed configuration in step a), and further comprising the step of:  
d) expanding the cage to an expanded configuration.

1/14

FIG. 1

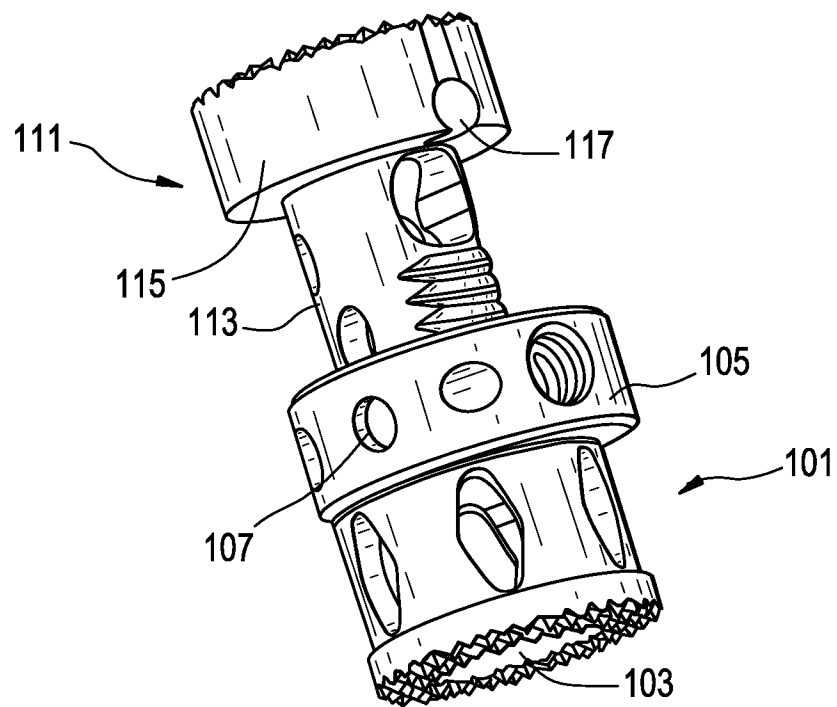

2/14

FIG. 2

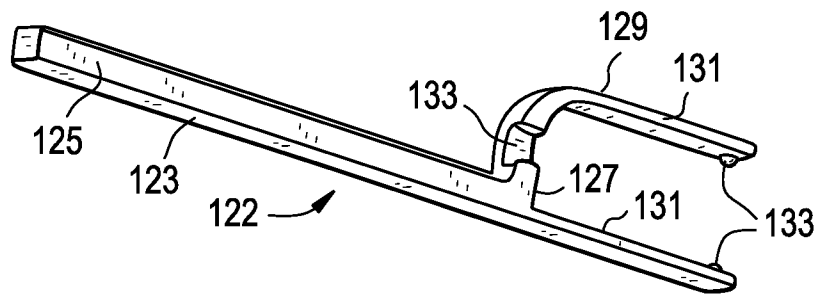

FIG. 3

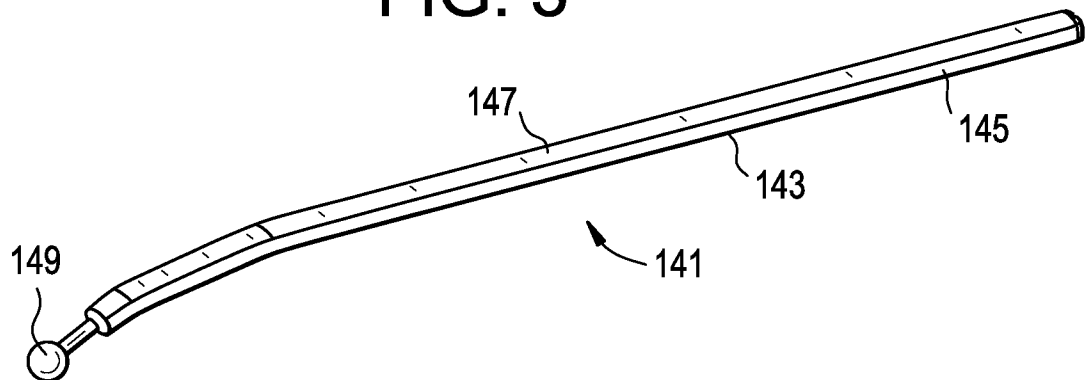
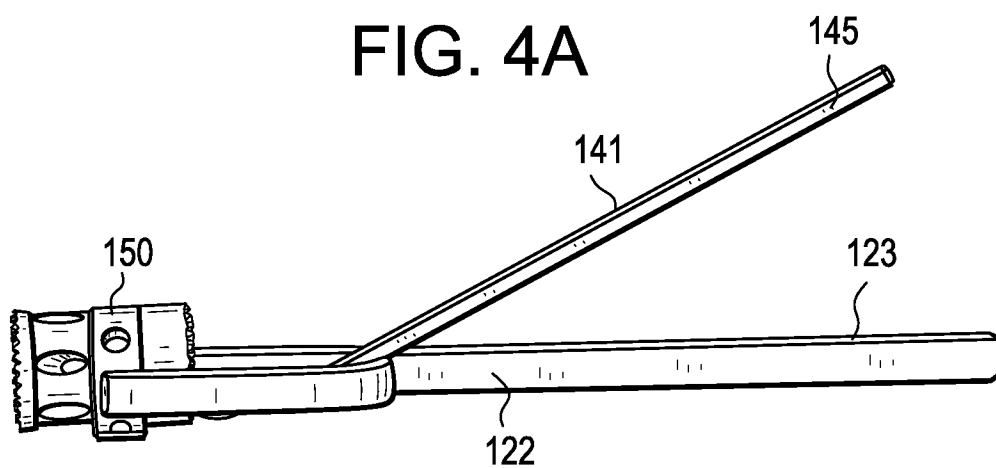

FIG. 4A



3/14

FIG. 4B

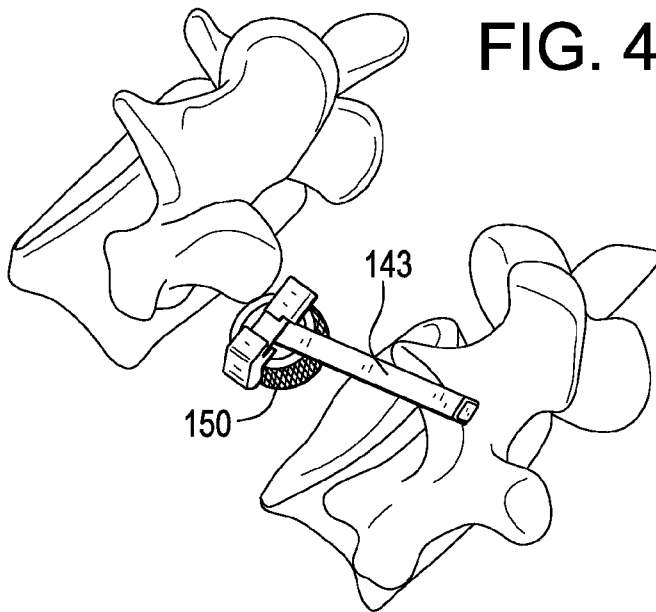

FIG. 4C

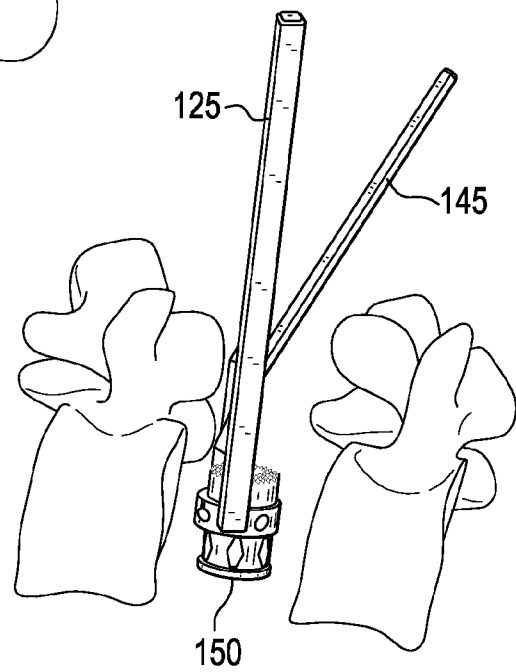
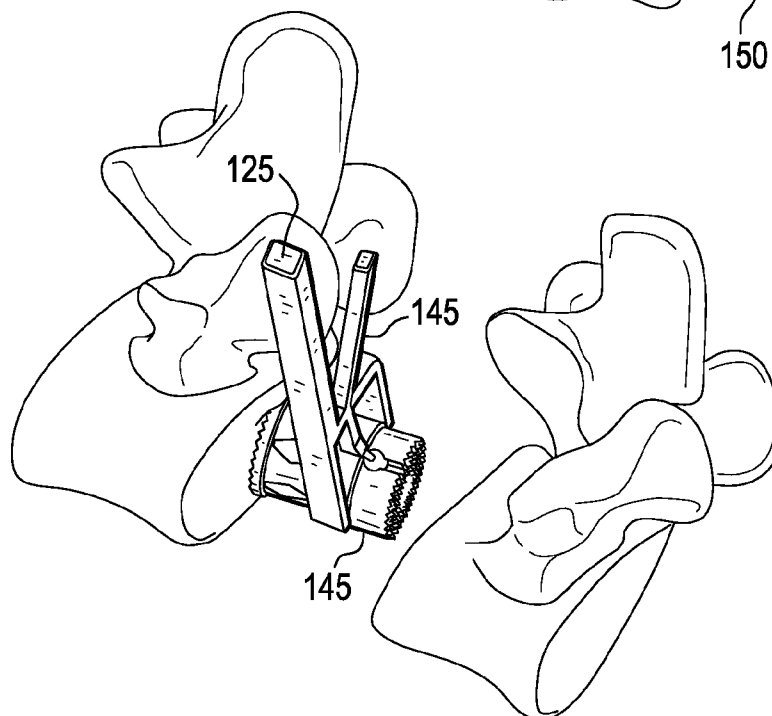

FIG. 4D



4/14

FIG. 4E

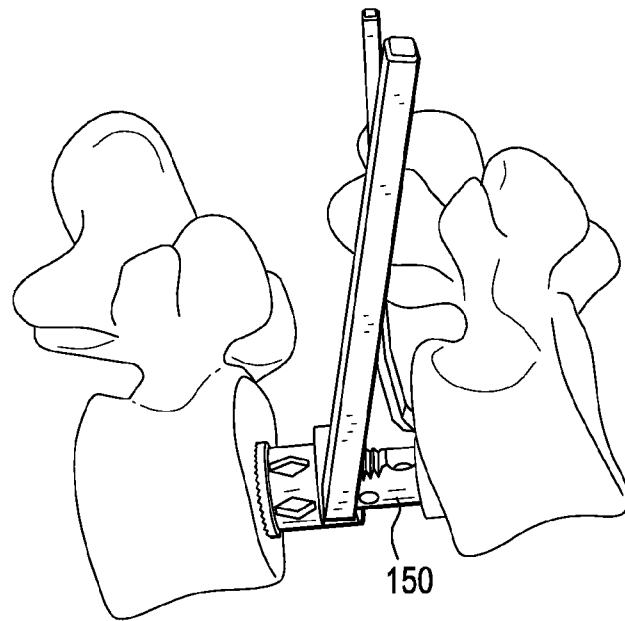
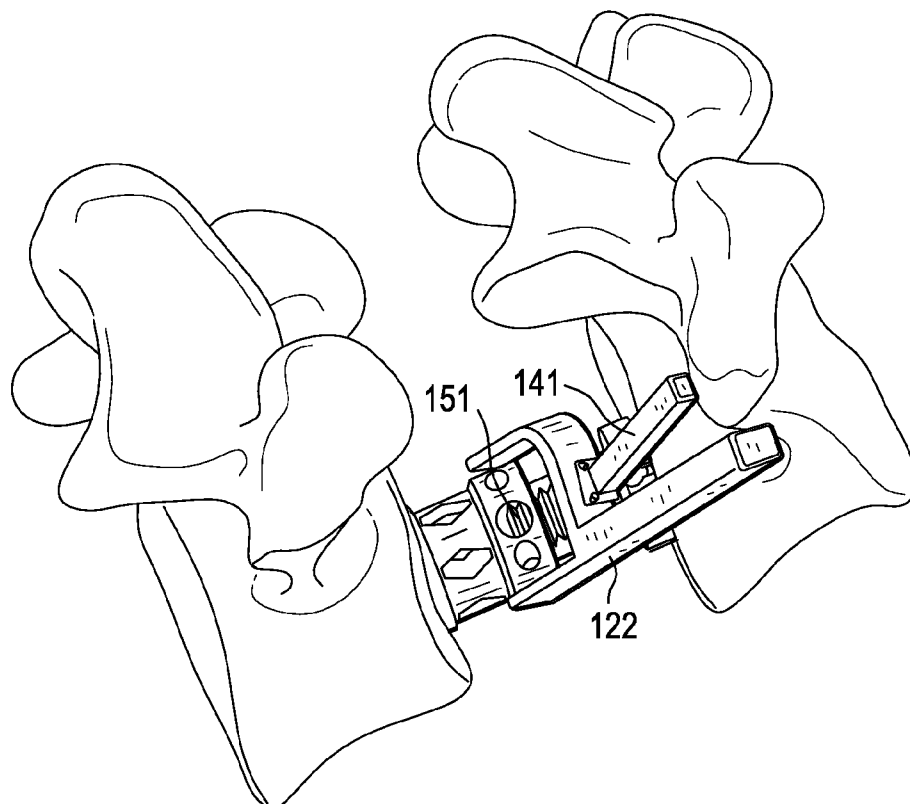

FIG. 4F



5/14

FIG. 5A

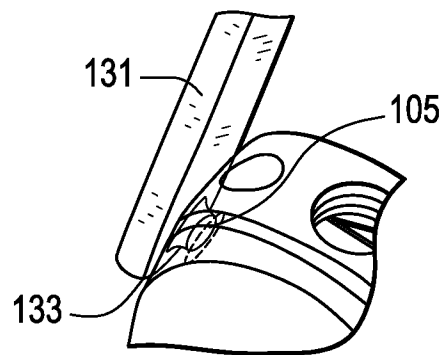
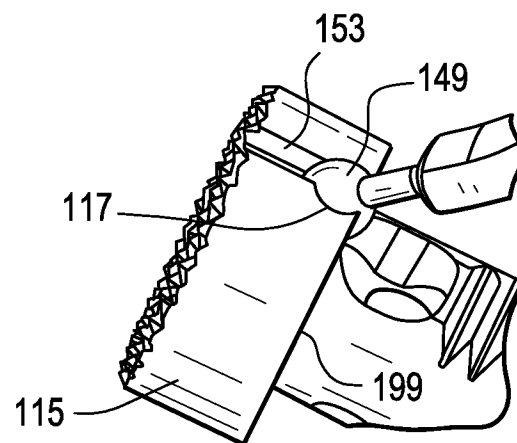

FIG. 5B





6/14

FIG. 5C

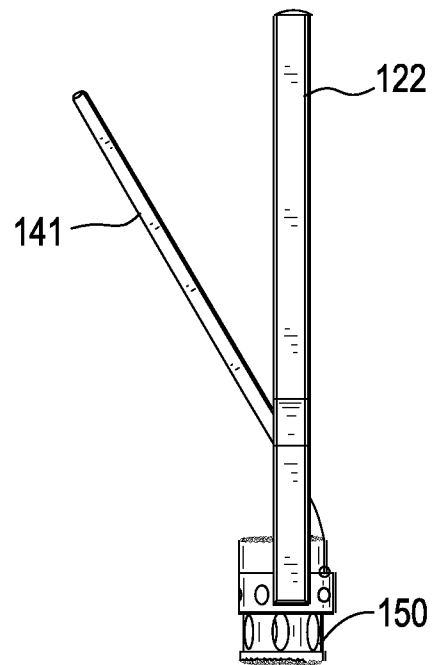
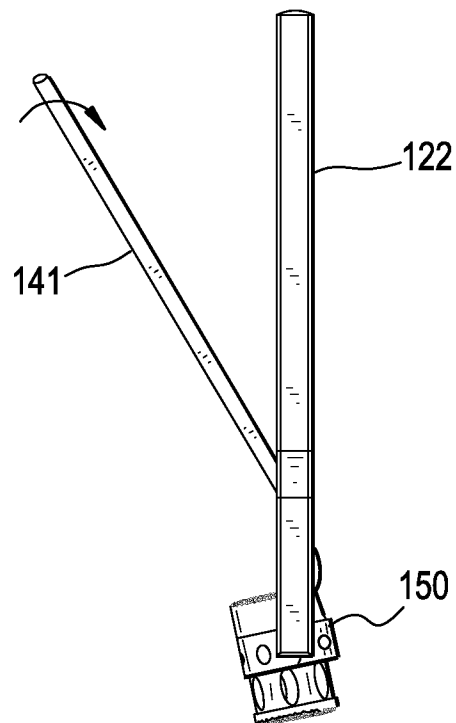

FIG. 5D



7/14

FIG. 5E

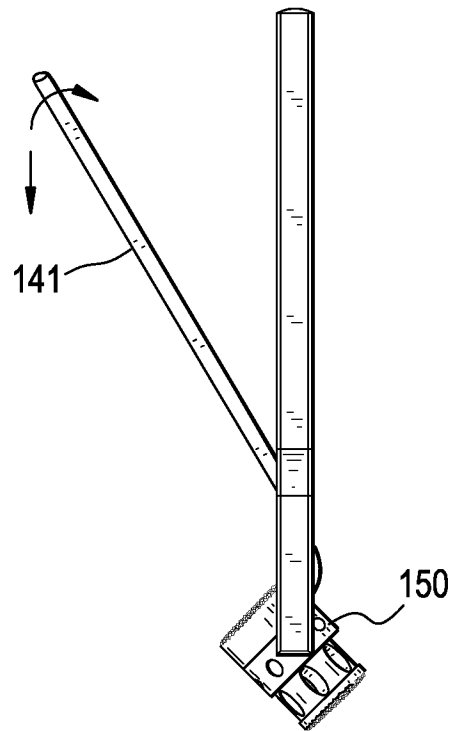
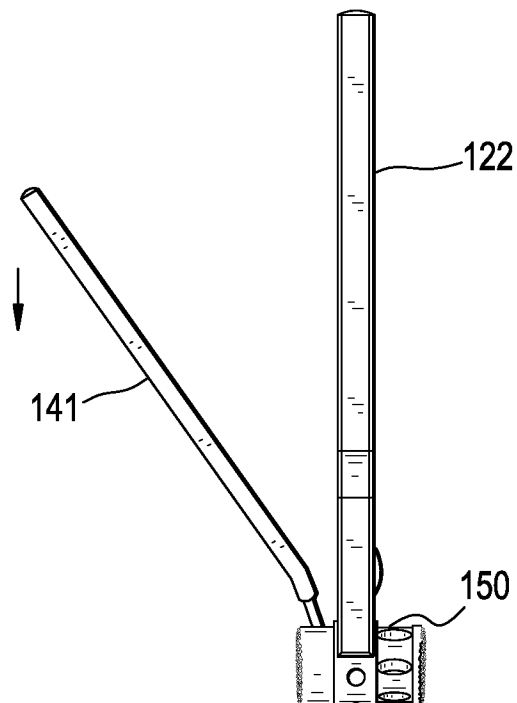

FIG. 5F



8/14

FIG. 5G

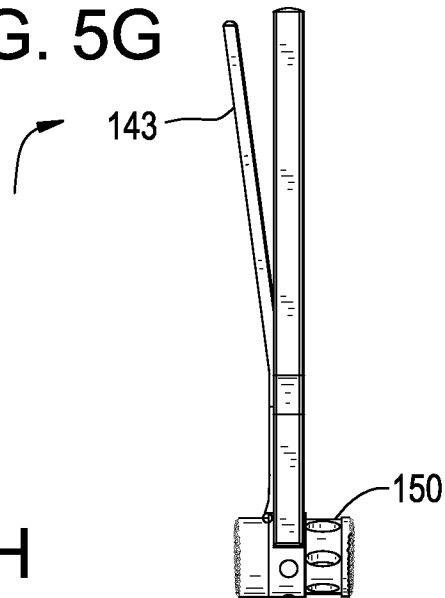

FIG. 5H

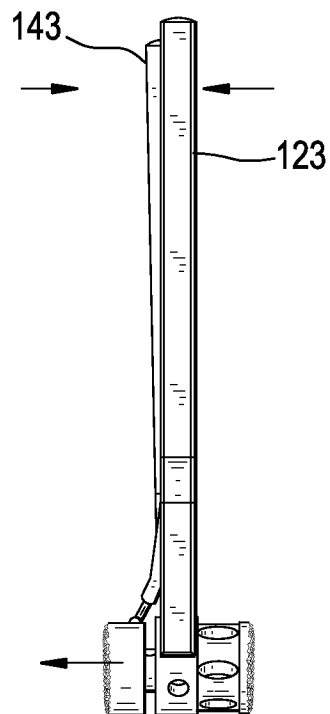
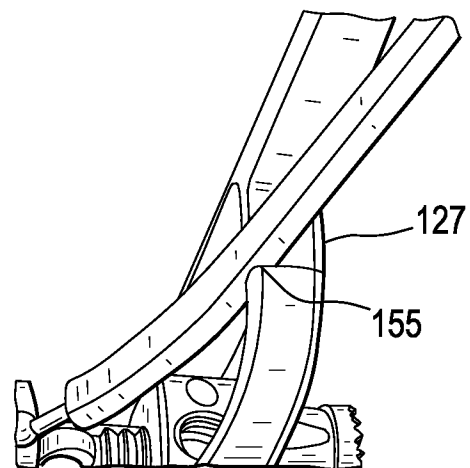
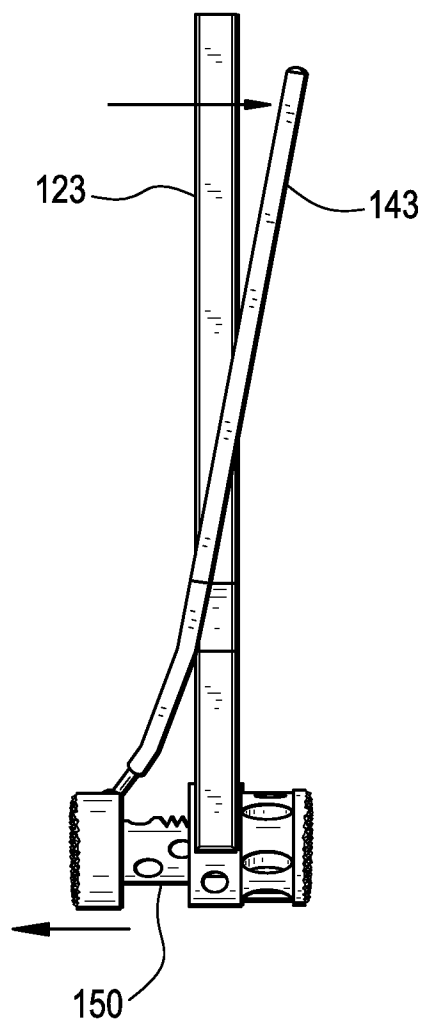

FIG. 5I



9/14

FIG. 5J



10/14

FIG. 6A

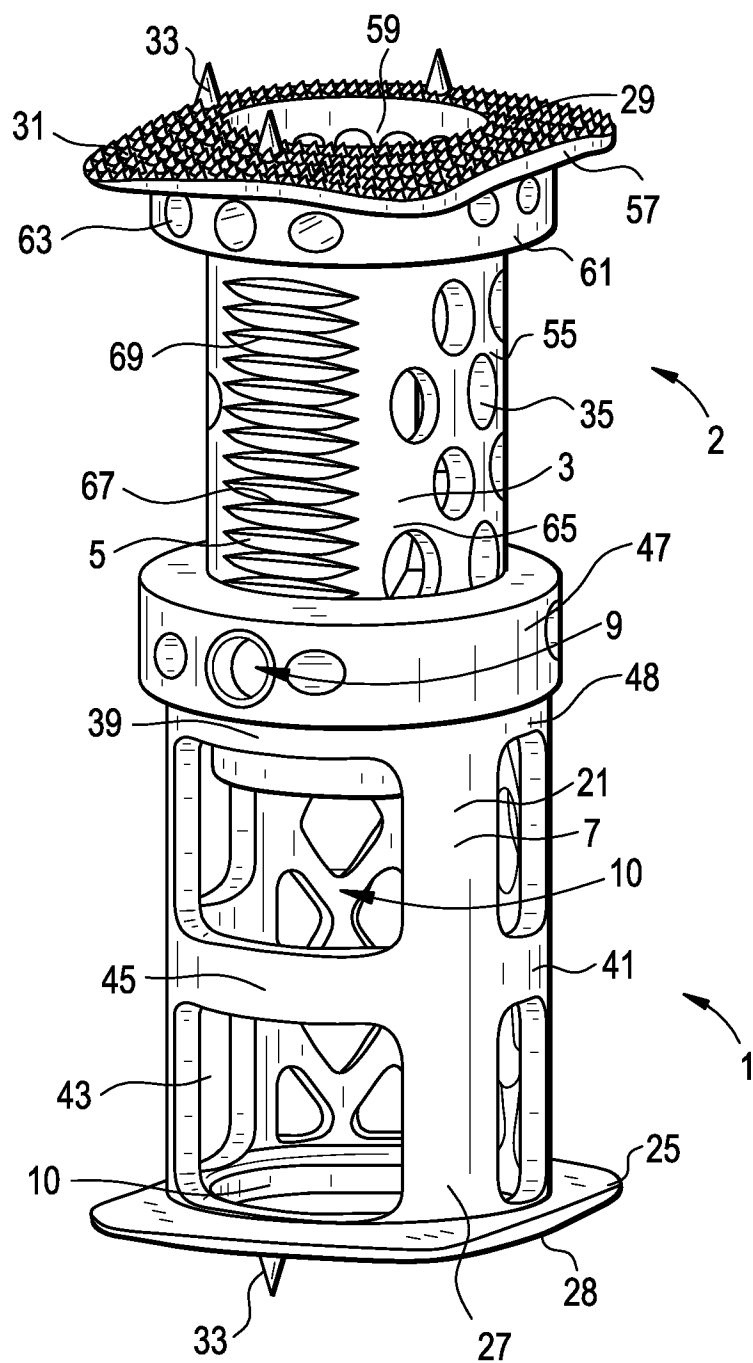

11/14

FIG. 6B

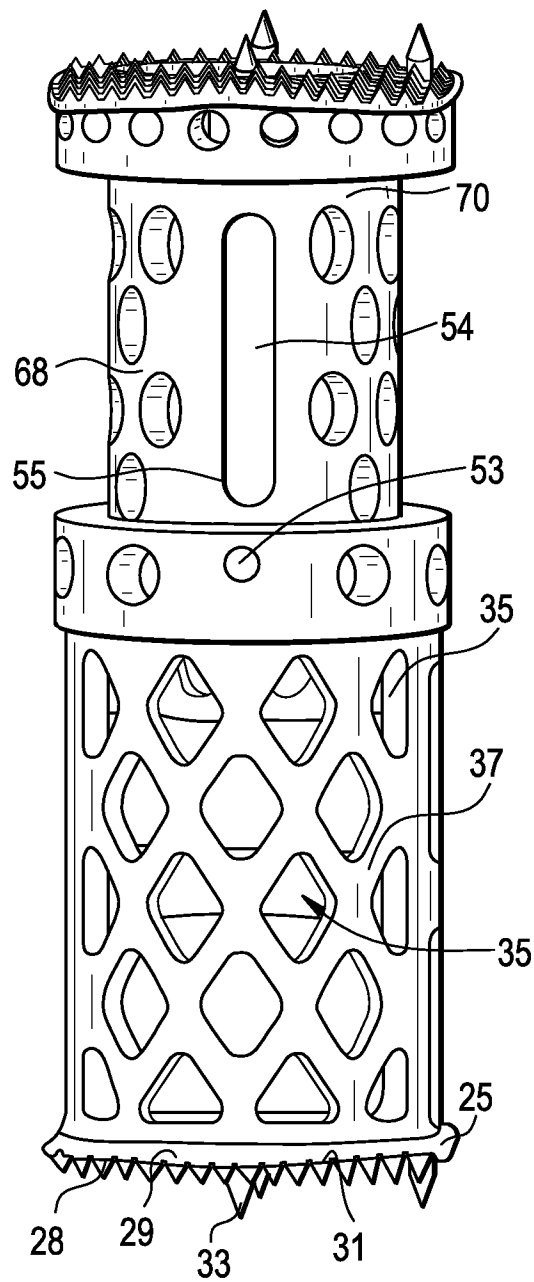

12/14

FIG. 6C

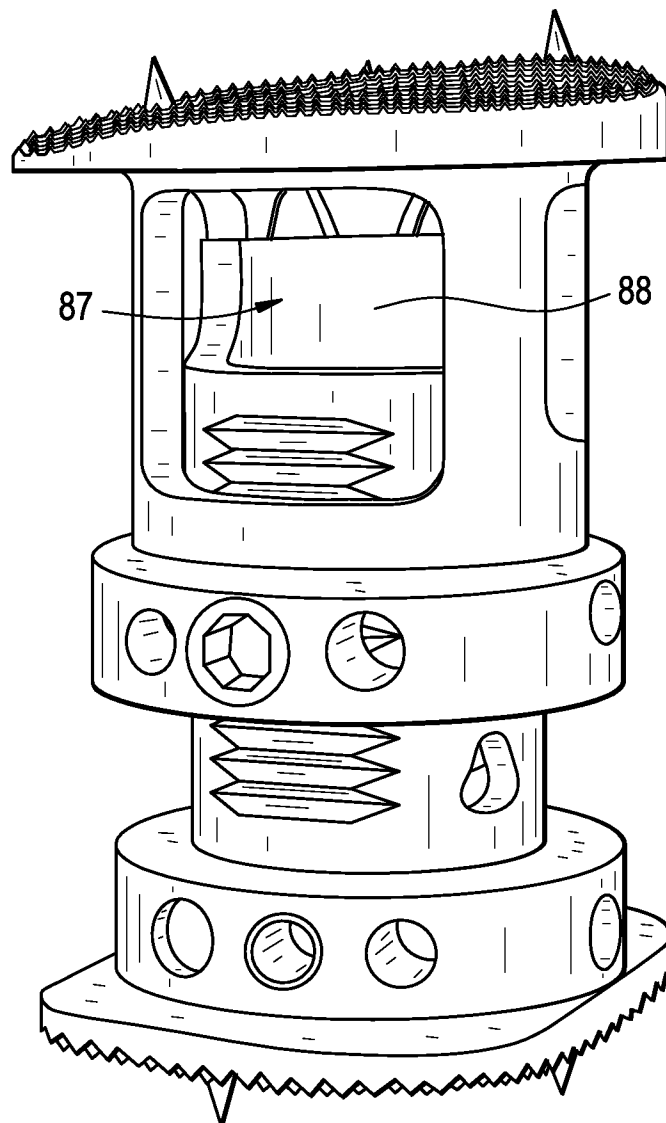

13/14

FIG. 7A

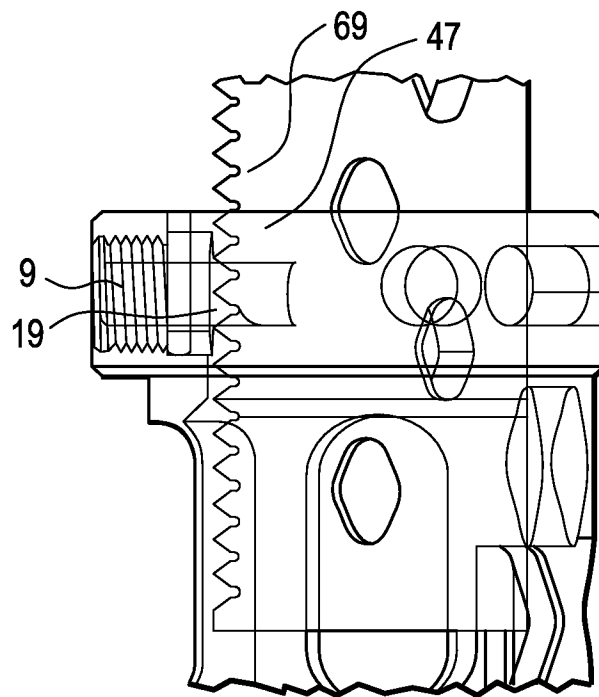
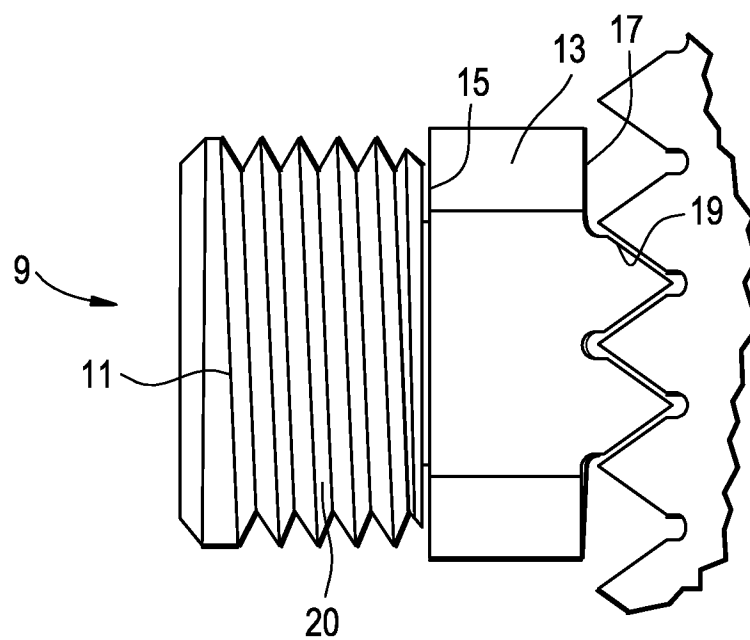

FIG. 7B





14/14

FIG. 8A

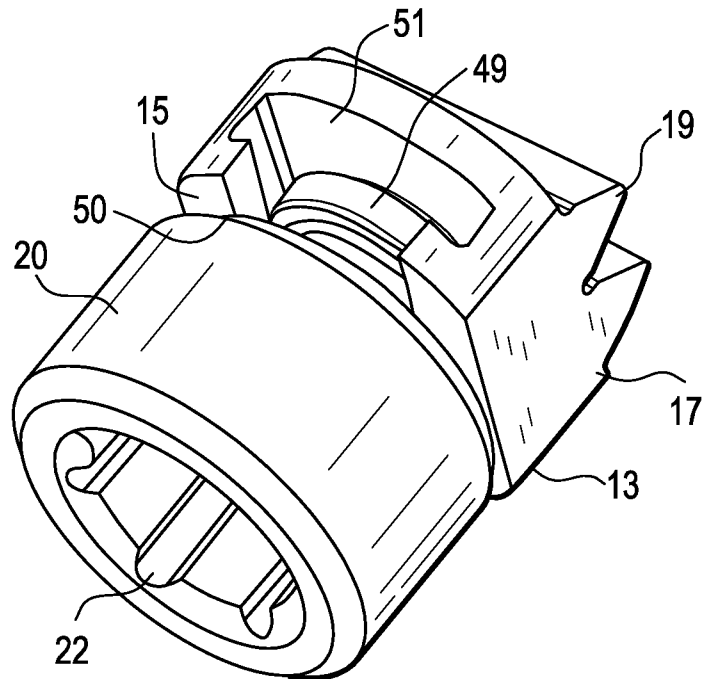

FIG. 8B

