



(43) International Publication Date
7 February 2013 (07.02.2013)

- (51) International Patent Classification:
B60W 30/00 (2006.01) *B60W 50/00* (2006.01)
B60C 23/20 (2006.01)
- (21) International Application Number:
PCT/IB2012/001985
- (22) International Filing Date:
3 August 2012 (03.08.2012)
- (25) Filing Language: English
- (26) Publication Language: English
- (30) Priority Data:
61/515,148 4 August 2011 (04.08.2011) US
13/561,749 30 July 2012 (30.07.2012) US
- (71) Applicant (for all designated States except US): **MOTOR COACH INDUSTRIES LIMITED** [CA/CA]; 1475 Clarence Avenue, Winnipeg, MB R3T 1T5 (CA).
- (72) Inventors; and
- (75) Inventors/Applicants (for US only): **COUCH, Bryan** [CA/CA]; Box 204, Balmoral, MB R0C 0H0 (CA). **OLSON, Daniel, Edward** [CA/CA]; 755 Harstone Rd., Winnipeg, MB R3R 1E1 (CA).

- (74) Agent: **SMART & BIGGAR**; 1000 De La Gauchetiere Street West, Suite 3300, Montreal, Quebec, H3B 4W5 (CA).
- (81) Designated States (unless otherwise indicated, for every kind of national protection available): AE, AG, AL, AM, AO, AT, AU, AZ, BA, BB, BG, BH, BN, BR, BW, BY, BZ, CA, CH, CL, CN, CO, CR, CU, CZ, DE, DK, DM, DO, DZ, EC, EE, EG, ES, FI, GB, GD, GE, GH, GM, GT, HN, HR, HU, ID, IL, IN, IS, JP, KE, KG, KM, KN, KP, KR, KZ, LA, LC, LK, LR, LS, LT, LU, LY, MA, MD, ME, MG, MK, MN, MW, MX, MY, MZ, NA, NG, NI, NO, NZ, OM, PE, PG, PH, PL, PT, QA, RO, RS, RU, RW, SC, SD, SE, SG, SK, SL, SM, ST, SV, SY, TH, TJ, TM, TN, TR, TT, TZ, UA, UG, US, UZ, VC, VN, ZA, ZM, ZW.
- (84) Designated States (unless otherwise indicated, for every kind of regional protection available): ARIPO (BW, GH, GM, KE, LR, LS, MW, MZ, NA, RW, SD, SL, SZ, TZ, UG, ZM, ZW), Eurasian (AM, AZ, BY, KG, KZ, RU, TJ, TM), European (AL, AT, BE, BG, CH, CY, CZ, DE, DK, EE, ES, FI, FR, GB, GR, HR, HU, IE, IS, IT, LT, LU, LV, MC, MK, MT, NL, NO, PL, PT, RO, RS, SE, SI, SK, SM, TR), OAPI (BF, BJ, CF, CG, CI, CM, GA, GN, GQ, GW, ML, MR, NE, SN, TD, TG).

[Continued on next page]

(54) Title: WHEEL END CONDITION DETECTION

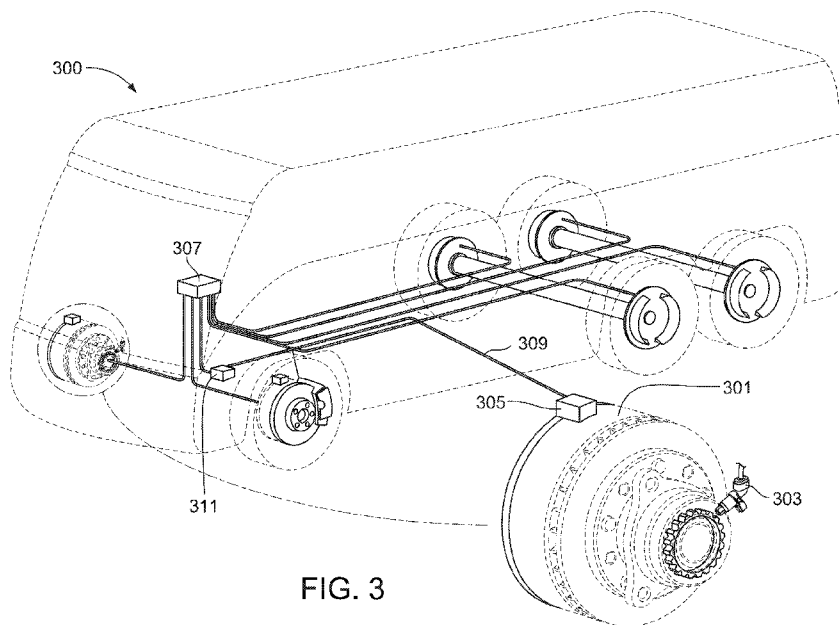
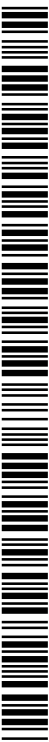

FIG. 3

(57) Abstract: An enhanced wheel data processing unit may analyze tire air temperature data from a tire pressure monitoring system (TPMS) and antilock brake system (ABS) wheel speed sensor fault codes from an ABS controller within a vehicle. When the enhanced wheel data processing unit determines that the tire air temperature is above a predetermined threshold for a given tire and that an ABS wheel speed sensor fault code exists for the wheel end corresponding to the same tire, the enhanced wheel data processing unit may initiate a vehicle shutdown or derate procedure. The vehicle shutdown or derate procedure may include instructions to give an operator of the vehicle a warning indicator for a predetermined time period before shutting down or derating the engine power to the vehicle.





Published:

(88) Date of publication of the international search report:

11 April 2013

- *with international search report (Art. 21(3))*
- *before the expiration of the time limit for amending the claims and to be republished in the event of receipt of amendments (Rule 48.2(h))*

INTERNATIONAL SEARCH REPORT

International application No.
PCT/IB2012/001985

<p>A. CLASSIFICATION OF SUBJECT MATTER IPC: B60W 30/00 (2006.01) , B60C 23/20 (2006.01) , B60W 50/00 (2006.01) According to International Patent Classification (IPC) or to both national classification and IPC</p>																				
<p>B. FIELDS SEARCHED</p> <p>Minimum documentation searched (classification system followed by classification symbols) IPC: B60W 30/00 , B60C 23/20 , B60W 50/00</p> <p>Documentation searched other than minimum documentation to the extent that such documents are included in the fields searched</p> <p>Electronic database(s) consulted during the international search (name of database(s) and, where practicable, search terms used) Epodoc using Epoque and Canadian Patents Database using Intellect. Search terms: tire, air, temperature, TPMS, ABS, fault, code, derate, anti, lock, brakes, wheel, speed, sensor.</p>																				
<p>C. DOCUMENTS CONSIDERED TO BE RELEVANT</p> <table border="1" style="width:100%; border-collapse: collapse;"> <thead> <tr> <th style="width:10%;">Category*</th> <th style="width:60%;">Citation of document, with indication, where appropriate, of the relevant passages</th> <th style="width:30%;">Relevant to claim No.</th> </tr> </thead> <tbody> <tr> <td align="center">A</td> <td>US2010/0292898A1 (STOEHR) 18 November 2010 (18-11-2010) *description*</td> <td align="center">1-20</td> </tr> <tr> <td align="center">A</td> <td>WO2004/007235A2 (GRONEAU et al.) 22 January 2004 (22-01-2004) *Fig 1 , abstract*</td> <td align="center">1-20</td> </tr> <tr> <td align="center">A</td> <td>US7391308B2 (IWAZUMI) 24 June 2008 (24-06-2008) *abstract*</td> <td align="center">1-20</td> </tr> <tr> <td align="center">A</td> <td>US2007/0100531A1 (KIM) 3 May 2007 (03-05-2007) *Fig 1*</td> <td align="center">1-20</td> </tr> <tr> <td align="center">A</td> <td>US7202777B2 (TSUJI et al.) 10 April 2007 (10-04-2007) *description*</td> <td align="center">1-20</td> </tr> </tbody> </table>			Category*	Citation of document, with indication, where appropriate, of the relevant passages	Relevant to claim No.	A	US2010/0292898A1 (STOEHR) 18 November 2010 (18-11-2010) *description*	1-20	A	WO2004/007235A2 (GRONEAU et al.) 22 January 2004 (22-01-2004) *Fig 1 , abstract*	1-20	A	US7391308B2 (IWAZUMI) 24 June 2008 (24-06-2008) *abstract*	1-20	A	US2007/0100531A1 (KIM) 3 May 2007 (03-05-2007) *Fig 1*	1-20	A	US7202777B2 (TSUJI et al.) 10 April 2007 (10-04-2007) *description*	1-20
Category*	Citation of document, with indication, where appropriate, of the relevant passages	Relevant to claim No.																		
A	US2010/0292898A1 (STOEHR) 18 November 2010 (18-11-2010) *description*	1-20																		
A	WO2004/007235A2 (GRONEAU et al.) 22 January 2004 (22-01-2004) *Fig 1 , abstract*	1-20																		
A	US7391308B2 (IWAZUMI) 24 June 2008 (24-06-2008) *abstract*	1-20																		
A	US2007/0100531A1 (KIM) 3 May 2007 (03-05-2007) *Fig 1*	1-20																		
A	US7202777B2 (TSUJI et al.) 10 April 2007 (10-04-2007) *description*	1-20																		
<p><input type="checkbox"/> Further documents are listed in the continuation of Box C. <input checked="" type="checkbox"/> See patent family annex.</p> <table border="1" style="width:100%; border-collapse: collapse;"> <tr> <td style="width:50%; vertical-align: top;"> * Special categories of cited documents : "A" document defining the general state of the art which is not considered to be of particular relevance "E" earlier application or patent but published on or after the international filing date "L" document which may throw doubts on priority claim(s) or which is cited to establish the publication date of another citation or other special reason (as specified) "O" document referring to an oral disclosure, use, exhibition or other means "P" document published prior to the international filing date but later than the priority date claimed </td> <td style="width:50%; vertical-align: top;"> "T" later document published after the international filing date or priority date and not in conflict with the application but cited to understand the principle or theory underlying the invention "X" document of particular relevance; the claimed invention cannot be considered novel or cannot be considered to involve an inventive step when the document is taken alone "Y" document of particular relevance; the claimed invention cannot be considered to involve an inventive step when the document is combined with one or more other such documents, such combination being obvious to a person skilled in the art "&" document member of the same patent family </td> </tr> </table>			* Special categories of cited documents : "A" document defining the general state of the art which is not considered to be of particular relevance "E" earlier application or patent but published on or after the international filing date "L" document which may throw doubts on priority claim(s) or which is cited to establish the publication date of another citation or other special reason (as specified) "O" document referring to an oral disclosure, use, exhibition or other means "P" document published prior to the international filing date but later than the priority date claimed	"T" later document published after the international filing date or priority date and not in conflict with the application but cited to understand the principle or theory underlying the invention "X" document of particular relevance; the claimed invention cannot be considered novel or cannot be considered to involve an inventive step when the document is taken alone "Y" document of particular relevance; the claimed invention cannot be considered to involve an inventive step when the document is combined with one or more other such documents, such combination being obvious to a person skilled in the art "&" document member of the same patent family																
* Special categories of cited documents : "A" document defining the general state of the art which is not considered to be of particular relevance "E" earlier application or patent but published on or after the international filing date "L" document which may throw doubts on priority claim(s) or which is cited to establish the publication date of another citation or other special reason (as specified) "O" document referring to an oral disclosure, use, exhibition or other means "P" document published prior to the international filing date but later than the priority date claimed	"T" later document published after the international filing date or priority date and not in conflict with the application but cited to understand the principle or theory underlying the invention "X" document of particular relevance; the claimed invention cannot be considered novel or cannot be considered to involve an inventive step when the document is taken alone "Y" document of particular relevance; the claimed invention cannot be considered to involve an inventive step when the document is combined with one or more other such documents, such combination being obvious to a person skilled in the art "&" document member of the same patent family																			
Date of the actual completion of the international search 09 January 2013 (09-01-2013)		Date of mailing of the international search report 04 February 2013 (04-02-2013)																		
Name and mailing address of the ISA/CA Canadian Intellectual Property Office Place du Portage I, C114 - 1st Floor, Box PCT 50 Victoria Street Gatineau, Quebec K1A 0C9 Facsimile No.: 001-819-953-2476		Authorized officer Arthur Gary Grant (819) 953-9698																		

INTERNATIONAL SEARCH REPORT
Information on patent family members

International application No.
PCT/IB2012/001985

Patent Document Cited in Search Report	Publication Date	Patent Family Member(s)	Publication Date
US2010292898A1	18 November 2010 (18-11-2010)	DE102009008342A1	02 September 2010 (02-09-2010)
WO2004007235A2	22 January 2004 (22-01-2004)	DE10230967A1 EP1521688A2 EP1521688B1 JP2005532229A US2006108863A1 WO2004007235A3	22 January 2004 (22-01-2004) 13 April 2005 (13-04-2005) 14 September 2011 (14-09-2011) 27 October 2005 (27-10-2005) 25 May 2006 (25-05-2006) 06 May 2004 (06-05-2004)
US7391308B2	24 June 2008 (24-06-2008)	JP2005329856A US2005258949A1	02 December 2005 (02-12-2005) 24 November 2005 (24-11-2005)
US2007100531A1	03 May 2007 (03-05-2007)	KR100680341B1	01 February 2007 (01-02-2007)
US7202777B2	10 April 2007 (10-04-2007)	CN1636772A CN100354150C DE102005001129A1 JP2005193861A JP4192789B2 JP2005199977A KR20050073408A KR100644963B1 US2005151634A1	13 July 2005 (13-07-2005) 12 December 2007 (12-12-2007) 04 August 2005 (04-08-2005) 21 July 2005 (21-07-2005) 10 December 2008 (10-12-2008) 28 July 2005 (28-07-2005) 13 July 2005 (13-07-2005) 14 November 2006 (14-11-2006) 14 July 2005 (14-07-2005)