



(86) Date de dépôt PCT/PCT Filing Date: 2014/04/23
 (87) Date publication PCT/PCT Publication Date: 2014/10/30
 (45) Date de délivrance/Issue Date: 2021/06/15
 (85) Entrée phase nationale/National Entry: 2015/10/22
 (86) N° demande PCT/PCT Application No.: US 2014/035081
 (87) N° publication PCT/PCT Publication No.: 2014/176308
 (30) Priorité/Priority: 2013/04/23 (US61/815,125)

(51) Cl.Int./Int.Cl. *B05B 17/00* (2006.01)
 (72) Inventeurs/Inventors:
 HUFFMAN, DAVID C., US;
 FRECHETTE, RUSSELL R., US;
 SZCZAP, JOSEPH P., US;
 BUHL, BO R., US
 (73) Propriétaire/Owner:
 SPRAYING SYSTEMS CO., US
 (74) Agent: MACRAE & CO.

(54) Titre : COLLECTEUR DE PULVERISATION POURVU DE PISTOLETS PULVERISATEURS A ALIMENTATION EN LIQUIDE INDIVIDUELLE

(54) Title: SPRAY MANIFOLD WITH INDIVIDUAL LIQUID FEED SPRAY GUNS

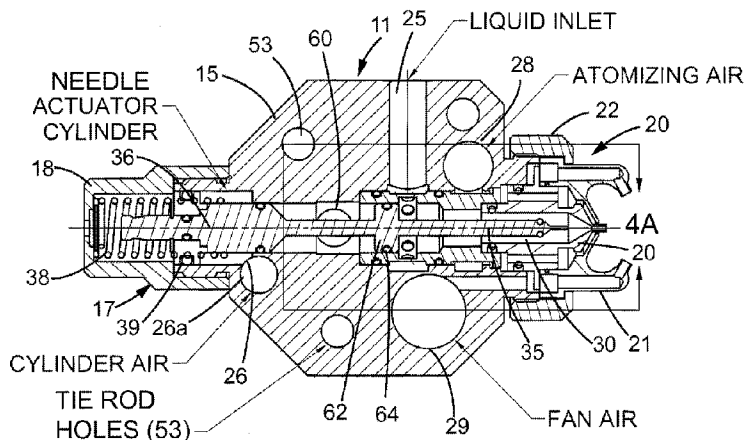

VALVE NEEDLE IN OPEN POSITION

(57) **Abrégé/Abstract:**

A modular spray gun manifold having a plurality of spray gun modules arranged in a lateral array each separated by an adjacent support assembly. Each spray gun module has a central liquid passage communicating with a spray nozzle and a transversely oriented liquid inlet port communicating through an outer side of the spray gun module for connection with an independently controllable liquid supply. The spray gun modules further include a recirculation port communicating between the central passageway and a recirculation conduit in an adjacent support assembly. A control valve of each module is operable when in open spraying position for blocking communication of liquid from the central passageway to the circulation port and when in a valve closing position blocking the liquid flow to the spray nozzle while redirecting liquid from the liquid inlet to the recirculation port for recirculation through the manifold array.

(12) INTERNATIONAL APPLICATION PUBLISHED UNDER THE PATENT COOPERATION TREATY (PCT)

(19) World Intellectual Property
Organization
International Bureau(10) International Publication Number
WO 2014/176308 A1(43) International Publication Date
30 October 2014 (30.10.2014)(51) International Patent Classification:
B05B 17/00 (2006.01)(21) International Application Number:
PCT/US2014/035081(22) International Filing Date:
23 April 2014 (23.04.2014)

(25) Filing Language: English

(26) Publication Language: English

(30) Priority Data:
61/815,125 23 April 2013 (23.04.2013) US(71) Applicant: **SPRAYING SYSTEMS CO.** [US/US]; North Avenue and Schmale Road, P.O. Box 7900, Wheaton, Illinois 60187-7901 (US).(72) Inventors: **HUFFMAN, David C.**; 60 Amherst Road, Merrimack, New Hampshire 03054 (US). **FRECHETTE, Russell R.**; 51 Pelham Road, Pelham, New Hampshire 03076 (US). **SZCZAP, Joseph P.**; 1428 Duquesne Avenue, Naperville, Illinois 60565 (US). **BUHL, Bo R.**; 3656 Perada Drive, Walnut Creek, California 94598 (US).(74) Agents: **SCHLEMMER, Dennis R.** et al.; Leydig, Voit & Mayer, LTD., 180 North Stetson Avenue, Suite 4900, Chicago, Illinois 60601-6731 (US).

(81) Designated States (unless otherwise indicated, for every kind of national protection available): AE, AG, AL, AM, AO, AT, AU, AZ, BA, BB, BG, BH, BN, BR, BW, BY, BZ, CA, CH, CL, CN, CO, CR, CU, CZ, DE, DK, DM, DO, DZ, EC, EE, EG, ES, FI, GB, GD, GE, GH, GM, GT, HN, HR, HU, ID, IL, IN, IR, IS, JP, KE, KG, KN, KP, KR, KZ, LA, LC, LK, LR, LS, LT, LU, LY, MA, MD, ME, MG, MK, MN, MW, MX, MY, MZ, NA, NG, NI, NO, NZ, OM, PA, PE, PG, PH, PL, PT, QA, RO, RS, RU, RW, SA, SC, SD, SE, SG, SK, SL, SM, ST, SV, SY, TH, TJ, TM, TN, TR, TT, TZ, UA, UG, US, UZ, VC, VN, ZA, ZM, ZW.

(84) Designated States (unless otherwise indicated, for every kind of regional protection available): ARIPO (BW, GH, GM, KE, LR, LS, MW, MZ, NA, RW, SD, SL, SZ, TZ, UG, ZM, ZW), Eurasian (AM, AZ, BY, KG, KZ, RU, TJ, TM), European (AL, AT, BE, BG, CH, CY, CZ, DE, DK, EE, ES, FI, FR, GB, GR, HR, HU, IE, IS, IT, LT, LU, LV, MC, MK, MT, NL, NO, PL, PT, RO, RS, SE, SI, SK, SM, TR), OAPI (BF, BJ, CF, CG, CI, CM, GA, GN, GQ, GW, KM, ML, MR, NE, SN, TD, TG).

Published:

— with international search report (Art. 21(3))

[Continued on next page]

(54) Title: SPRAY MANIFOLD WITH INDIVIDUAL LIQUID FEED SPRAY GUNS

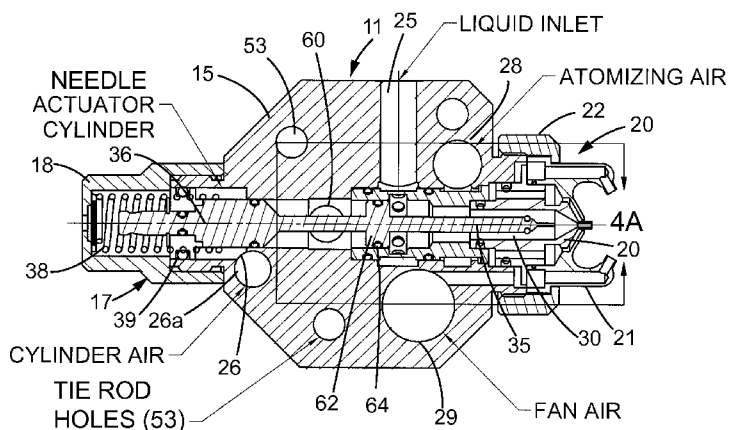

VALVE NEEDLE IN OPEN POSITION

FIG. 4

(57) Abstract: A modular spray gun manifold having a plurality of spray gun modules arranged in a lateral array each separated by an adjacent support assembly. Each spray gun module has a central liquid passage communicating with a spray nozzle and a transversely oriented liquid inlet port communicating through an outer side of the spray gun module for connection with an independently controllable liquid supply. The spray gun modules further include a recirculation port communicating between the central passageway and a recirculation conduit in an adjacent support assembly. A control valve of each module is operable when in open spraying position for blocking communication of liquid from the central passageway to the circulation port and when in a valve closing position blocking the liquid flow to the spray nozzle while redirecting liquid from the liquid inlet to the recirculation port for recirculation through the manifold array.

WO 2014/176308 A1 

- *before the expiration of the time limit for amending the claims and to be republished in the event of receipt of amendments (Rule 48.2(h))*

SPRAY MANIFOLD WITH INDIVIDUAL LIQUID FEED SPRAY GUNS

[0001] Continue to [0002]

FIELD OF THE INVENTION

[0002] The present invention relates generally to spray gun type liquid spray devices, and more particularly, to a spray gun manifold having a modular construction.

BACKGROUND OF THE INVENTION

[0003] Modular spray gun manifold assemblies that include a plurality of laterally spaced spray guns supported in a row for discharging an elongated spray pattern are known. Such manifolds are used, for example, in pill coating machines in the pharmaceutical industry. Spray gun manifolds, such as shown in U.S. Patent 7,083,121 B2 assigned to the same assignee as the present application, comprise spray gun modules disposed between respective support assemblies through which pressurized air and liquid are directed for supplying the plurality of spray gun modules. Liquid directed through the manifold also is recirculated back to the liquid supply.

[0004] In some spray applications, it is desirable to monitor the liquid supply to each individual spray gun module in order to detect possible blockage in the spray discharge. For this purpose, it has been necessary to individually supply pressurized liquid to the spray gun modules, rather than through the manifold system, in order to more reliably detect the interruption of discharge of the individual spray gun. While it is also desirable that the liquid be continuously recirculated through the system, when pressurized liquid is individually supplied to the spray gun modules, rather than through the manifold system, this has presented problems.

OBJECTS AND SUMMARY OF THE INVENTION

[0005] It is an object of the present invention to provide a modular spray gun manifold in which the plurality of spray gun modules have individual pressurized liquid feeds and which facilitates efficient recirculation of the liquid.

[0006] Another object is to provide a novel spray gun module for use in such a manifold system.

[0007] A further object is to provide a spray gun module of the foregoing type which is relatively simple in construction and lends itself to economical manufacture and reliable usage.

[0008] Other objects and advantages of the invention will become apparent upon reading the following detailed description and upon reference to the drawings, in which:

BRIEF DESCRIPTION OF THE DRAWINGS

[0009] Figure 1 is a perspective of an illustrative modular spray gun manifold in accordance with the invention mounted on a support structure;

[0010] Fig. 2 is a partially diagrammatic depiction of the spray gun manifold shown in Fig. 1;

[0011] Fig. 3 is an enlarged, partially exploded, perspective of the modular spray gun manifold shown in Fig. 2, showing one of the spray gun modules and the adjacent support assemblies in separated relation to each other;

[0012] Fig. 4 is a vertical section of one of the spray gun modules of the illustrated manifold showing a flow control valve thereof in an open position;

[0013] Fig. 4A is an enlarged fragmentary section of the discharge end of the spray gun module shown in Fig. 4;

[0014] Fig. 5 is an end view of the discharge end of the spray gun module shown in Fig. 4;

[0015] Fig. 6 is a vertical section of the spray gun module, similar to Fig. 4, showing the flow control valve end of the module in an closed position; and

[0016] Fig. 6A is an enlarged fragmentary section of the discharge end of the spray gun module shown in Fig. 6

[0017] While the invention is susceptible of various modifications and alternative constructions, a certain illustrative embodiment thereof has been shown in the drawings and will be described below in detail. It should be understood, however, that there is no intention to limit the invention to the specific form disclosed, but on the contrary, the invention is to cover all modifications, alternative constructions, and equivalents falling within the spirit and scope of the invention.

DESCRIPTION OF THE PREFERRED EMBODIMENT

[0018] Referring now more particularly to the drawings, there is shown an illustrative modular spray gun manifold 10 which includes a plurality of spray gun modules 11 in accordance with the invention. The spray gun modules 11 each are interposed between support assemblies 12, and the manifold 10 in this case is mounted on a support pipe 14 by laterally spaced brackets 15.

[0019] Each spray gun module 11 includes a generally blocked shaped body 15, a spray nozzle assembly 16 supported at one end of the module body 15, and a valve actuator 17, and end cap 18 supported at the opposite end of the modular body 15, as depicted in Figs. 2 and 4. The illustrated spray nozzle assembly 16 includes a spray tip or nozzle insert 20 and an air cap 21 mounted in overlying surrounding relation to the spray tip 20 (Fig. 4A) and retained on the nozzle body 15 by a retaining nut 22. The nozzle body 15 has a liquid inlet 25, a cylinder air inlet 26, an atomizing air inlet 28, and a fan air inlet 29 (Fig. 4). Liquid is supplied to the inlet 25 communicates with a central longitudinal passageway 30 in the nozzle body 15 and spray tip 20 and through a liquid discharge orifice 31 defined by a forwardly extending nose portion 32 of the spray tip 20 (Fig. 4A).

[0020] For controlling the discharge of liquid from the spray gun module 11, a valve needle 35 coaxially extends through the housing body 15 for reciprocating movement between a valve closing position in seated engagement with a downstream tapered entry section of the spray tip passageway 30 and an unseated valve open position. The valve needle 35 in this case has a tapered seating section and an axially extending clean out nose portion that is positionable into and through the discharge orifice 31 when in a closed position (Fig. 6A) for maintaining the passage free of buildup during usage.

[0021] For operating the valve needle 35, a piston 36 is mounted at an upstream end of the needle 35 which is biased in a valve closing **direction** by a compression spring 38 interposed between the piston 36 and the upstream actuator cap 18 (Fig. 4). The piston 36 carries an annular sealing ring 39 in sealing engagement with a cylindrical bore in the housing body 15. The compression spring 38 biases the piston 36, and hence the valve needle 35, forwardly to a fully seated, *i.e.*, valve closed position, depicted in Fig. 6. The valve needle 35 is moveable axially in the opposite direction (to the left in Fig. 6) against the force of the spring 38 by pressurized air (*i.e.* "cylinder air") selectively directed into the cylinder air inlet 26, which

communicates through the housing body 15 with an air chamber on the downstream side of the piston 36 in a known manner.

[0022] For atomizing the liquid discharging from the spray tip 20, the spray tip nose portion 32 and a central orifice of the air cap 21 define an annular atomizing air discharge orifice 40 which communicates with angled atomizing air passages 41 and an annular air passage 42 defined between the spray tip 20 and air cap 21, which in turn communicates through nozzle body 15 with the atomizing air inlet 28. Pressurized air directed through the annular discharge orifice 40 communicates outwardly in surrounding relation to the liquid discharge orifice 31 for interaction with the discharging liquid flow stream.

[0023] For forming and directing the discharging liquid spray into a flat fan spray pattern for wider lateral application, each spray gun module 11 is operable for impinging pressurized air (*i.e.*, “fan air”) on opposite sides of the liquid spray. Pressurized air from the fan air inlet 29 of the spray gun module 11 communicates through the nozzle body 15 with an annular chamber 44 adjacent an upstream end of the air cap 21. The annular chamber 44 communicates pressurized air to a pair of longitudinal passages 45, which terminate in opposed angled discharge passages 46 that direct pressurized air streams at an acute angle on opposite sides of the discharging liquid spray for spreading the liquid spray into a relatively flat narrow spray pattern.

[0024] For communicating atomizing air, fan air, and control air to the spray gun modules 11, the cylinder air inlet 26, atomizing air inlet 28, and fan air inlet 29 each is defined by a respective fluid passage 26a, 28a and 29a that extend transversely through opposite sides of the module body and which communicate with fluid conduits 50 in the adjacent support assemblies 12 which supply atomizing air, cylinder and control air through the manifold 10, as best shown in Fig. 3. The support assemblies 12 in this case are blocks 51 within which the fluid conduits 50 are supported. The fluid conduits 50 each preferably extend outwardly a small distance beyond the respective ends of the blocks 51 for insertion into the passages of the spray gun manifold, with a threadless union therebetween (see. e.g., Fig. 3). Threaded retaining rods 52 in this instance extend through aligned holes 53 in the spray gun modules 11 and support assemblies 12 for retaining the modules and support assemblies in assembled relation to each other.

[0025] In accordance with one aspect of the invention, each spray gun module has a respective individual pressurized liquid feed or supply, which lends itself to reliable monitoring of the spray discharge while permitting circulation of the supply liquid through the manifold for

return to the liquid supply. To this end, the liquid inlet 25 of each spray gun module housing block 15 is connected to a respective liquid supply 54. In the illustrated embodiment, each nozzle body 15 has a liquid inlet fitting 55 (Fig. 1) protruding outwardly of the spray gun module for easy connection to a supply line 57 coupled to the liquid supply. It will be understood by a person skilled in the art that the inlet fittings 55 and respective supply lines may be coupled to individual liquid supply pumps, or alternatively to a multiple feed pump operable for selectively directing pressurized liquid individually to the inlet fittings 55 and the respective spray gun modules 11.

[0026] In keeping with the illustrated embodiment, when the valve needle 35 is moved to the off or closed position, as depicted in Fig. 6, the liquid inlet 25 is enabled to communicate with a recirculation port 60 extending transversely to the block housing 15 of the spray gun module 11 for permitting continued recirculation of the liquid through the manifold 10 via passages in the spray gun modules 11 and support assemblies 15. To this end, the valve needle 35 carries a plunger 62 intermediate its end which is movable within an enlarged passage section 6 upstream of the central fluid passageway 30 (Fig. 4A). The plunger 62 includes an outer annular seal 64 for sealing slide-able contact with the enlarged passageway section 6.

[0027] When the valve needle 35 is in the open position during spraying (Fig. 4A), the plunger 62 is disposed at a location between the liquid inlet 25 and the recirculation port 60 preventing the communication of liquid from the liquid inlet 25 to the recirculation port 60. As an incident to movement of the valve needle 35 to the shutoff position, as shown in Fig. 6A under the force of the spring 38 upon discontinuation of the actuating air, the plunger 62 is moved with the valve needle 35 to a position downstream of the liquid inlet 25 for permitting the continuous communication of liquid from the liquid inlet 25 to the recirculation port 60 for recirculation through the manifold 10. For this purpose, the recirculation port 60 extends transversely through the block housing 15 for communicating with recirculation tubes 64 in the adjacent support assemblies 12, which thereby enable the liquid to be recirculated through the manifold and return to the liquid supply regardless of whether the valve needles in the other spray gun modules 11 are in open or closed positions.

[0028] Hence, it can be seen that a spray gun manifold is provided in which the spray gun modules have individual liquid feeds or supplies that enables more reliable monitoring of interruptions or changes in liquid pressure and spray discharge. Yet, the spray gun modules

enable automatic recirculation of the supply liquid through the manifold system when any of the valve needles of any of the spray gun modules are in their shutoff positions.

THE EMBODIMENTS OF THE INVENTION IN WHICH AN EXCLUSIVE PROPERTY OR PRIVILEGE IS CLAIMED ARE DEFINED AS FOLLOWS:

1. A modular spray gun manifold (10) comprising:
 - a plurality of spray gun modules (11) arranged in a lateral array, a plurality of support assemblies (12), said each spray gun module (11) being arranged between pairs of individual support assemblies (12) of said plurality of support assemblies (12) for supporting the plurality of spray gun modules (11) in laterally spaced relation to each other;
 - said plurality of spray gun modules (11) each including a nozzle body (15) and a spray nozzle (20) having a liquid discharge orifice (31);
 - said plurality of spray gun modules (11) each defining a central liquid passageway (30) communicating with the discharge orifice (31) of the respective spray nozzle (16);
 - said nozzle body (15) having lateral sides disposed in abutting side by side relation to lateral sides of the adjacent pairs of the individual support assemblies (12);
 - said nozzle body (15) each having outer exposed sides between the lateral sides;
 - a valve needle (35) disposed within said central liquid passageway (30) of the nozzle body (15) for reciprocating movement between a valve closing position for preventing discharge of liquid from said spray nozzle discharge orifice (31) and a valve open position for enabling liquid passage through said central liquid passageway (30) and liquid discharge orifice (31);
 - said plurality of support assemblies (12) each having a respective fluid conduit (50) for communicating pressurized air from a pressurized air source successively through said plurality of support assemblies (12) and plurality of spray gun modules (11) for atomizing, shaping, or controlling liquid discharge from the plurality of spray gun modules (11);
 - said plurality of support assemblies (12) each having a liquid recirculation conduit (64) for communicating liquid successively through said plurality of support assemblies (12) and plurality of spray gun modules (11) for return to the liquid supply (54), said plurality of spray gun modules (11) each having a liquid recirculation port (60) communicating between the central liquid passageway (30) of the spray gun module (11) and the recirculation conduit (64) of an adjacent support assembly (12);

said valve needle (35) of each spray gun module being operable when in the open position for enabling communication of liquid from the respective inlet (25) of the spray gun module through the central liquid passageway (30) for discharge from the spray nozzle discharge orifice (31) while blocking the communication of liquid from the central liquid passageway (30) to the recirculation port of the spray gun module, and said valve needle (35) of each spray gun module being operable when in the valve closing position for blocking the flow of liquid from the central liquid passageway (30) to the spray nozzle discharge orifice (31) and redirecting liquid from the liquid inlet (25) to the recirculation port (60) for communication to the recirculation conduit (64) of an adjacent support assembly (12) for recirculation to the liquid supply source (25), characterized by;

said plurality of spray gun modules (11) each having a respective liquid inlet (25) in one of the outer exposed sides of the nozzle body (15) of the respective spray gun module (11) communicating with the central liquid passageway (30) of the spray gun module (11) for directing liquid from a liquid supply (54) remote from the spray gun module (11) to the central liquid passageway thereof (30).

2. The spray gun manifold of claim 1, in which the plurality of spray gun modules (11) each have an independently controllable liquid supply to the liquid inlet (25).

3. The spray gun manifold of claim 1, in which the liquid inlet (25) communicates with said central liquid passageway (30) at a first location, said liquid recirculation port (60) communicates with said central liquid passageway (30) at a second location spaced from the first location, said valve needle (35) having a spool (62) disposed at a location intermediate said liquid inlet port (25) and said liquid recirculation port (60) when said valve needle (35) is in said valve open position for enabling the flow of liquid through said central liquid passageway (30) and liquid discharge orifice (31) while blocking the flow of liquid from said liquid inlet (25) to said recirculation port (60).

4. The spray gun manifold of claim 3, in which each of the valve needles (35) are independently controllable so that when the valve needle (35) is in said valve closing position

liquid communicates from the liquid inlet (25) to the recirculation port (60) of the spray gun module and the recirculation conduit (64) of an adjacent support assembly 12).

5. The spray gun manifold of claim 3, in which said spool (62) of the valve needle (35) when the valve needle (35) is in said closing position being disposed at a location for permitting communication of liquid from said liquid inlet port (25) to said central liquid passageway (30) and recirculation port (60) to the recirculation conduit (64) of the adjacent support assembly.

6. The spray gun manifold of claim 3, in which the liquid inlet (25) of each spray gun module communicates with the central liquid passageway (30) at a location along the central liquid passageway (30) intermediate the spray nozzle discharge orifice (31) and the recirculation port (60).

7. The spray gun manifold of claim 1, in which each spray gun module (11) of said plurality of spray gun modules (11) has a respective liquid supply line (57) externally of said spray gun module (11) coupled to the liquid inlet (25) of the spray gun module (11).

8. The spray gun manifold of claim 1, including an actuator (17) for selectively moving the valve needle (35) of each spray gun module (11) of said plurality of spray gun modules (11) between said open and closing positions.

9. The spray gun manifold of claim 1, in which the spray nozzle (20) of each spray gun module (11) of said plurality of spray gun modules (11) includes an air cap (21) and one of the fluid conduits (50) in each of the plurality of support assemblies (12) communicates pressurized air to the respective air caps (21) of the plurality of spray gun modules (11).

10. The spray gun manifold of claim 1 in which said spray nozzle (20) of each spray gun module is disposed in a forward exposed side of the module body (15) thereof, and said liquid inlet (25) of each spray gun module is in an upper exposed side of the module body (15).

11. The spray gun manifold of claim 1 in which said spray nozzle (20) of each spray gun module is disposed in a forward exposed side of the module body (15) thereof, and said liquid inlet (25) of each spray gun module is in a lower exposed side of the module body (15).

12. A modular spray gun (10) manifold comprising:

a plurality of spray gun modules (11) arranged in a lateral array, a plurality of support assemblies (12), each spray gun module (11) being arranged between pairs of individual support assemblies (12) of said plurality of said plurality of support assemblies (12) for supporting the plurality of spray gun modules (11) in laterally spaced relation to each other;

said plurality of said spray gun modules (11) each including a nozzle body (15) and a spray nozzle (20) having a liquid discharge orifice (31);

said nozzle body (15) of each spray gun modules (11) each defining a central liquid passageway (30) communicating with said spray nozzle discharge orifice (31) of the respective spray nozzle (20);

said nozzle body (15) having lateral sides disposed in abutting side by side relation to lateral sides of the adjacent pairs of the plurality of support assemblies (12);

said nozzle body (15) each having outer exposed sides between the lateral sides;

a valve needle (35) disposed within said central liquid passageway (30) of the nozzle body (15) for reciprocating movement between a valve closing position for preventing discharge of liquid from said spray nozzle discharge orifice (31) and a valve open position for enabling liquid passage through said central passageway (30) and liquid discharge orifice (31);

said plurality of support assemblies (12) each having a liquid recirculation conduit (64) for communicating liquid successively through said plurality of support assemblies (12) and plurality of spray gun modules (11) for return to a liquid supply (54);

said plurality of spray gun modules (11) each having a recirculation port (60) communicating between the central liquid passageway (30) of the spray gun module and the liquid recirculation conduit (64) of an adjacent support assembly (12);

said valve needle (35) of each spray gun module (11) being operable when in the open position for enabling communication of liquid from the respective inlet (25) of the spray gun

module through the central liquid passageway (30) for discharge from the spray nozzle discharge orifice (31) while blocking the communication of liquid from the central liquid passage (30) to the recirculation port (60); and

said valve needle (35) of each spray gun module being operable when in the valve closing position for blocking the flow of liquid from the central liquid passage (30) of the spray gun module to the spray nozzle discharge orifice (31) and redirecting liquid from the liquid inlet to the recirculation port (60) of the spray gun module for communication to the recirculation conduit (64) of an adjacent support assembly (12) for recirculation to the liquid supply source (54), characterized by;

said plurality of spray gun modules (11) each having a respective liquid inlet (25) in one of the outer exposed sides of the nozzle body (15) of the respective spray gun module (11) communicating with the central liquid passageway (30) of the nozzle body (15) of the spray gun module (11) for directing liquid from a liquid supply (54) remote from the spray gun module (11) to the central liquid passageway (30) of the nozzle body (15); and

said plurality spray gun modules (11) each having an independently controllable liquid supply communicating with the liquid inlet (25) thereof.

13. The spray gun manifold of claim 10, in which the liquid inlet (25) of each said spray gun module communicates with the central liquid passageway (30) of the spray gun module at a first location, said liquid recirculation port (60) of each spray gun module communicating with said central liquid passageway (30) at a second location spaced from the first location, said valve needle (35) having a spool (62) disposed at a location intermediate said liquid inlet port (25) and said liquid recirculation port (60) when said valve is in said valve open position for enabling the flow of liquid through said central liquid passageway (30) and spray nozzle discharge orifice (31) while blocking the flow of liquid from said liquid inlet (25) to said recirculation port of the spray gun module (60).

14. The spray gun manifold of claim 11, in which said spool (62) of the valve needle (35) of each spray gun module when in said valve closing position being disposed at a location for permitting communication of liquid from said liquid inlet port (25) and said central liquid

passageway (30) to the recirculation port (60) of the spray gun module and recirculation conduit (64) of the adjacent support assembly (12).

15. The spray gun manifold of claim 12, in which the liquid inlet (25) communicates with the central liquid passageway (30) at a location along the central liquid passageway (30) intermediate the spray nozzle discharge orifice (31) and the recirculation port (60).

16. The spray gun manifold of claim 10, in which the liquid inlet (25) extends transversely between the central longitudinal passageway (30) and one of the outer exposed sides.

17. The spray gun manifold of claim 10 in which said spray nozzle (20) is disposed in a forward exposed side of the module body (15) thereof, and said liquid inlet (25) of each spray gun module is in an upper exposed side of the module (15) body.

18. The spray gun manifold of claim 10 in which said spray nozzle (20) is disposed in a forward exposed side of the module (15) body thereof, and said liquid inlet (25) of each spray gun module is in a lower exposed side of the module body (15).

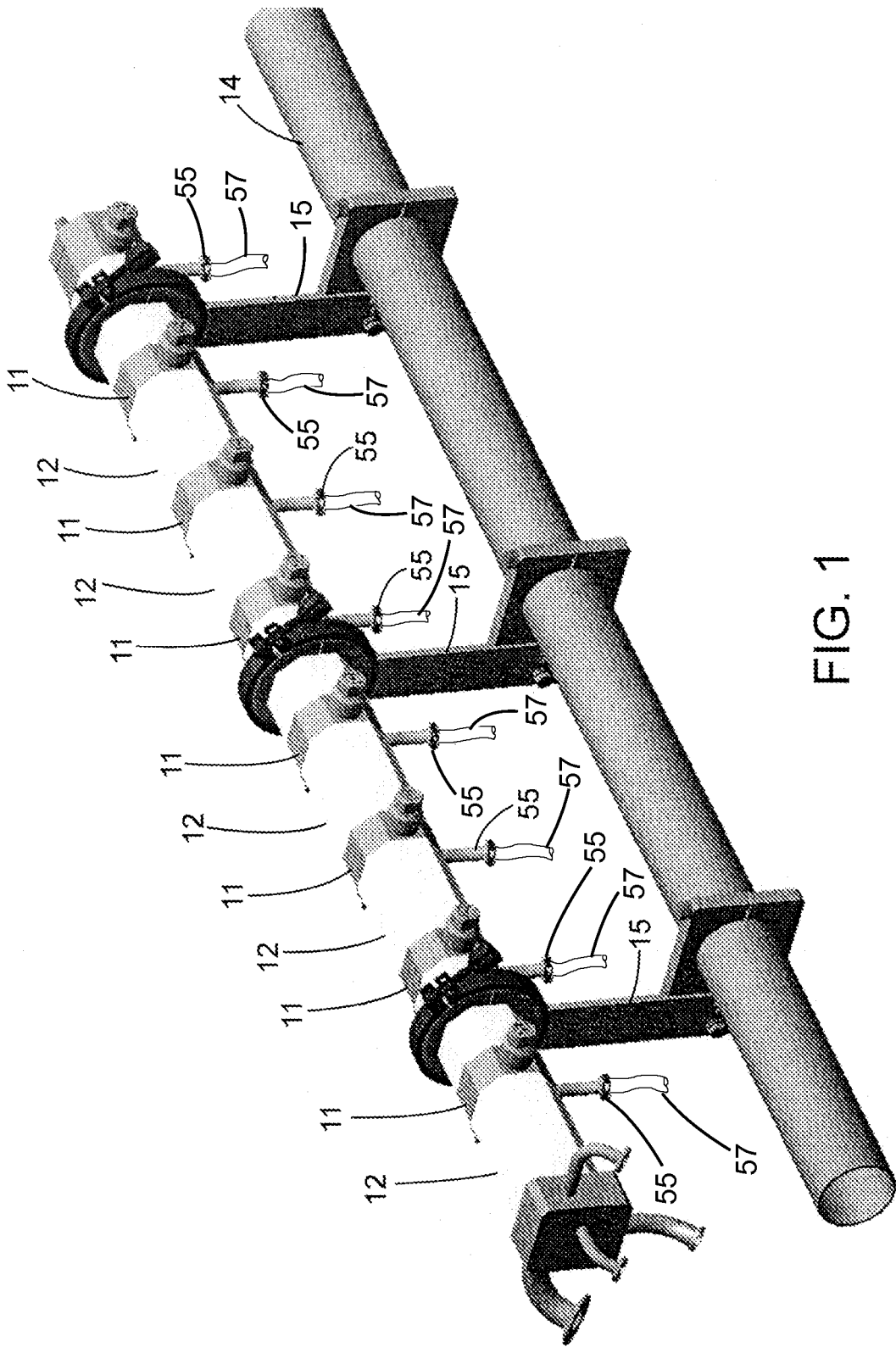

FIG. 1

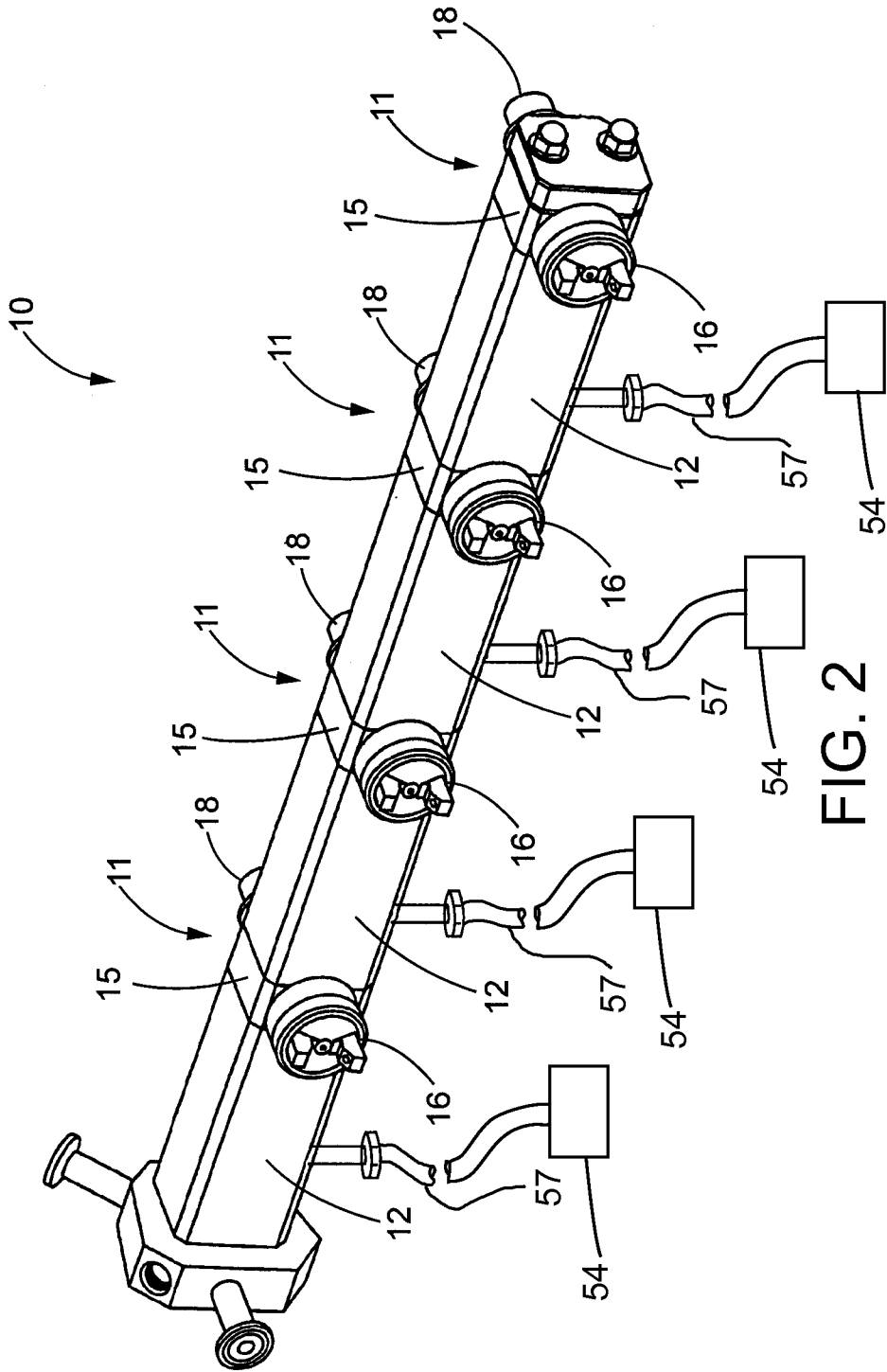
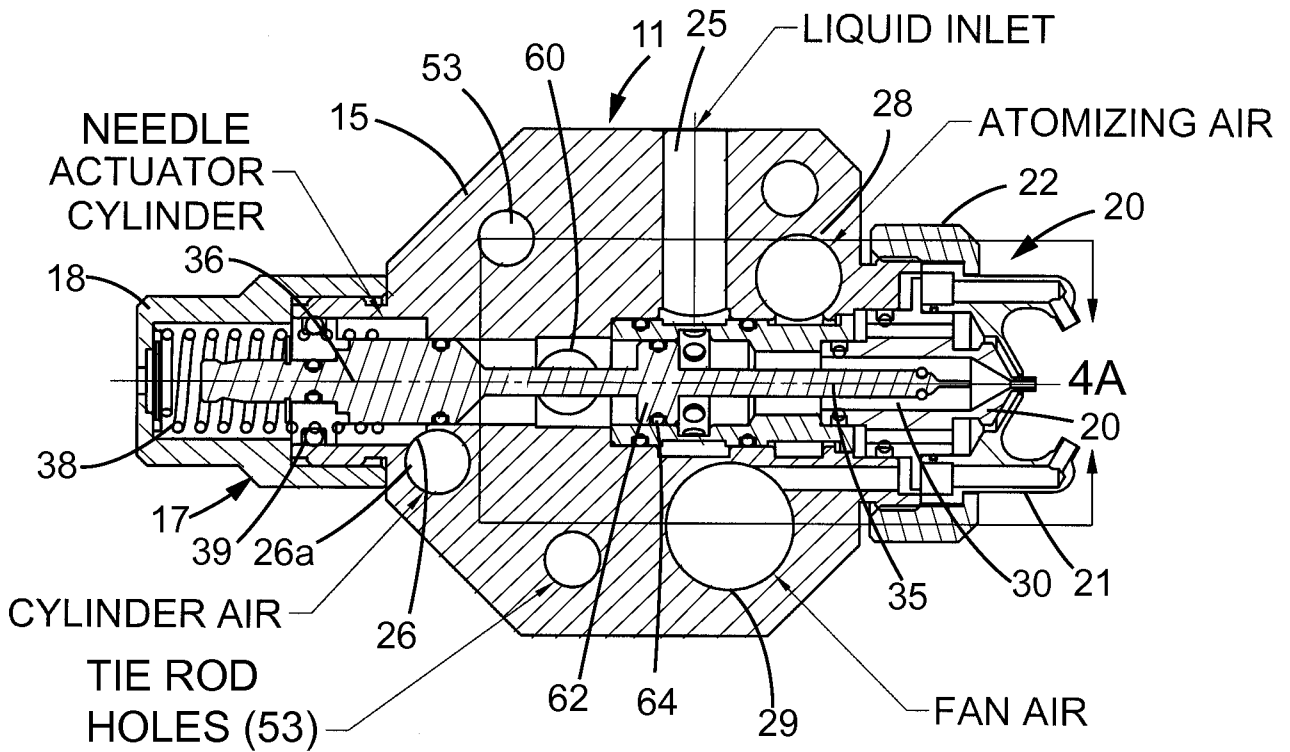

FIG. 2



VALVE NEEDLE IN OPEN POSITION

FIG. 4

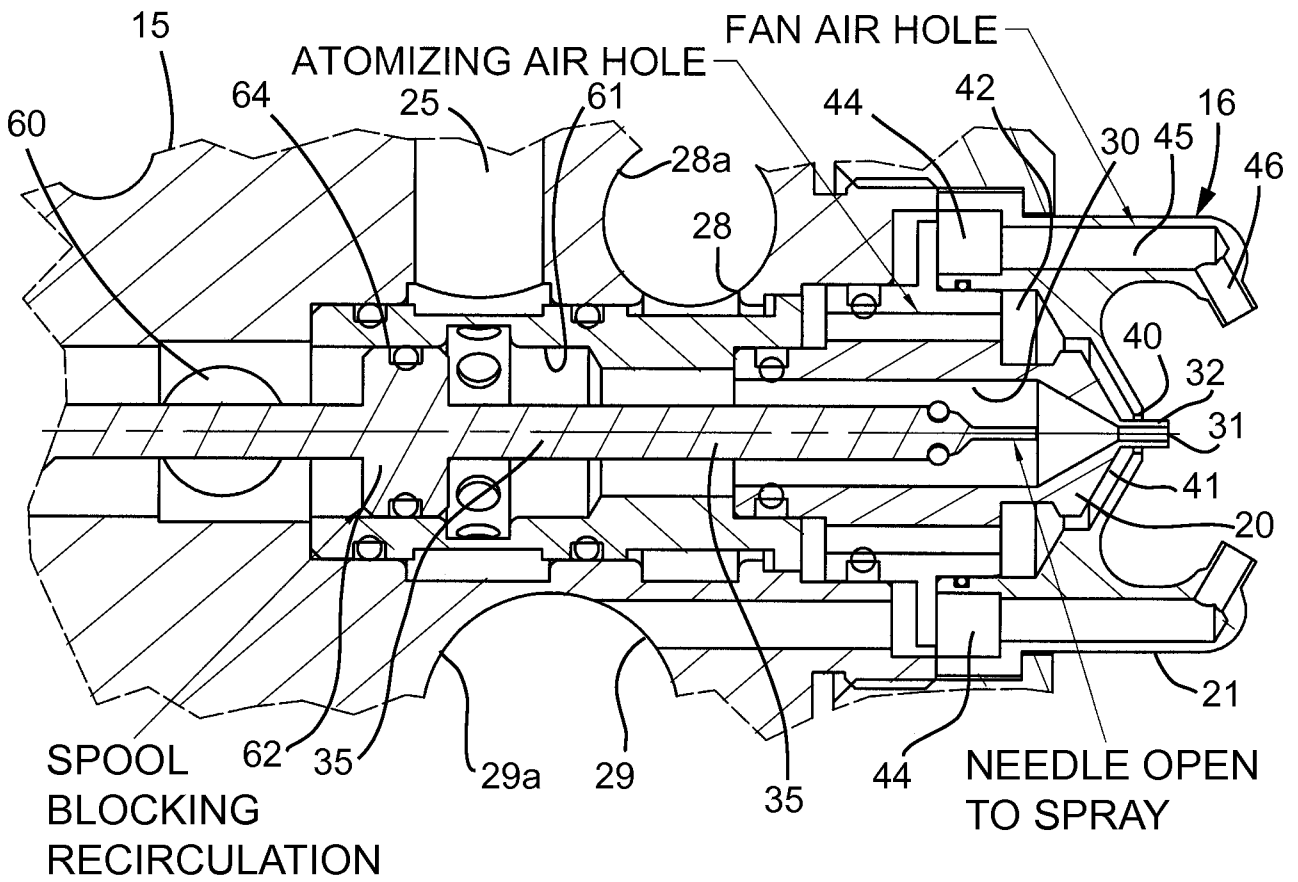

FIG. 4A

6/8

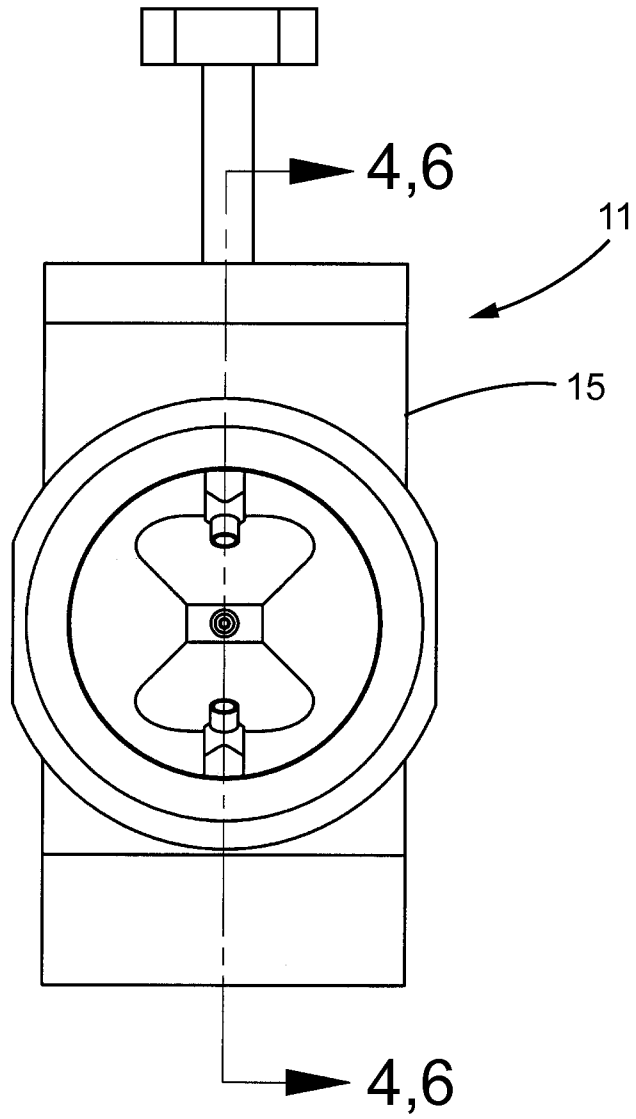
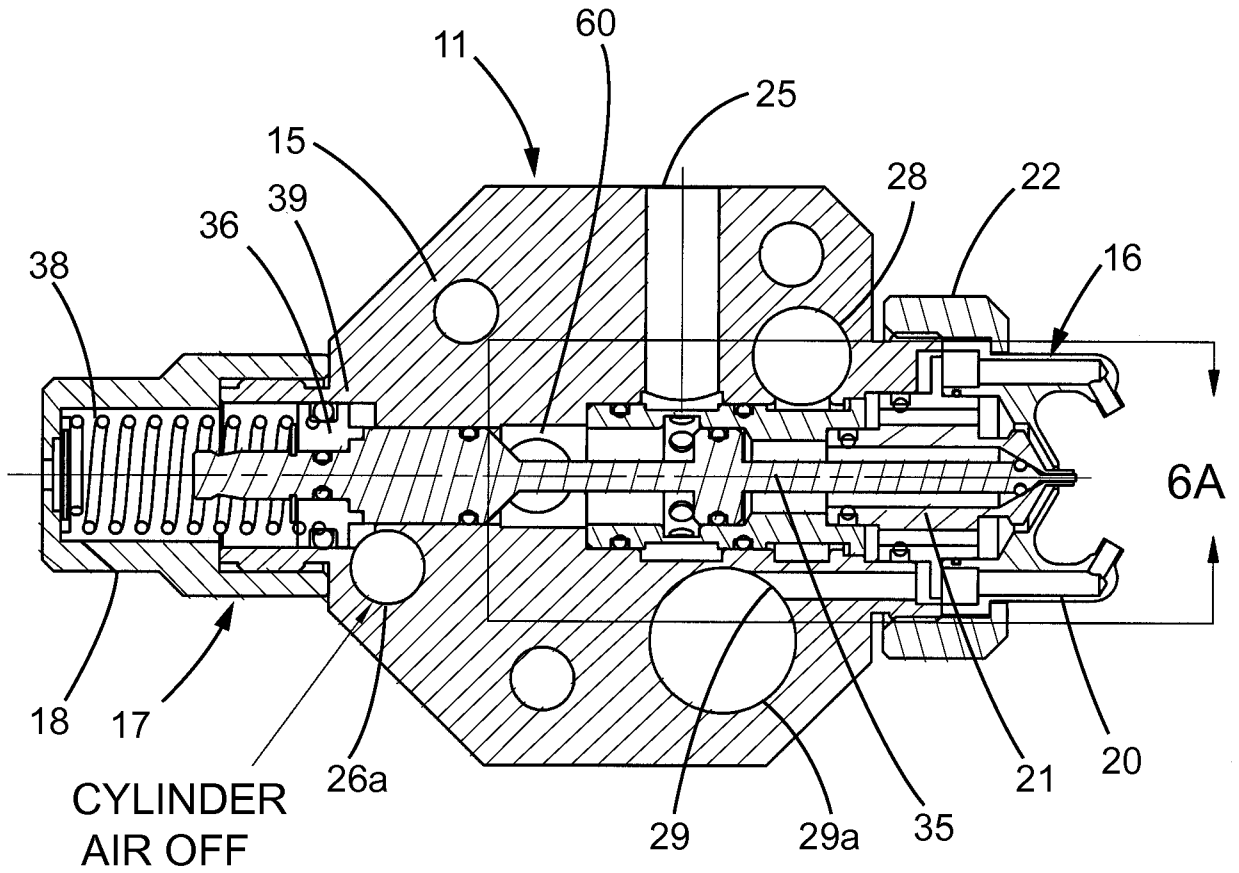

FIG. 5

7/8



VALVE NEEDLE IN CLOSED POSITION

FIG. 6

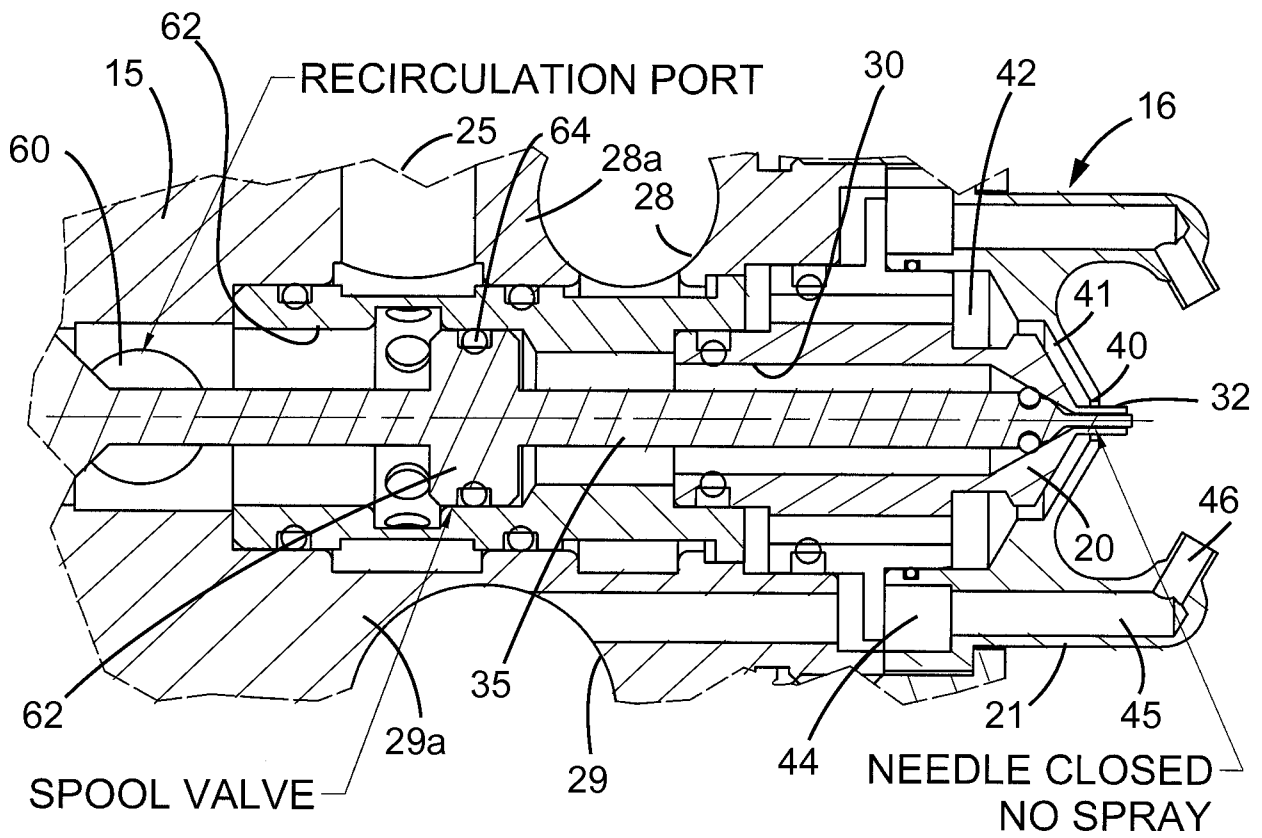
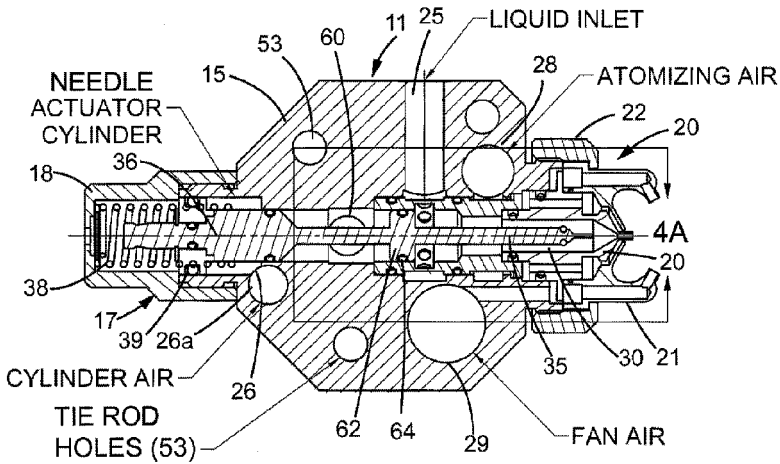

FIG. 6A



VALVE NEEDLE IN OPEN POSITION