

(19)



(11)

EP 3 225 843 B1

(12)

EUROPEAN PATENT SPECIFICATION

(45) Date of publication and mention of the grant of the patent:
08.05.2019 Bulletin 2019/19

(51) Int Cl.:
F04B 15/02 ^(2006.01) **F04D 7/04** ^(2006.01)
F04B 53/16 ^(2006.01) **F04D 29/42** ^(2006.01)

(21) Application number: **16162861.5**

(22) Date of filing: **30.03.2016**

(54) **A SLURRY PUMP**

SCHLAMMPUMPE

POMPE À BOUE

(84) Designated Contracting States:
AL AT BE BG CH CY CZ DE DK EE ES FI FR GB GR HR HU IE IS IT LI LT LU LV MC MK MT NL NO PL PT RO RS SE SI SK SM TR

(43) Date of publication of application:
04.10.2017 Bulletin 2017/40

(73) Proprietor: **Damen Dredging Equipment B.V.**
3861 NE Nijkerk (NL)

(72) Inventors:
 • **Tijssen, Marc**
3861 NE Nijkerk (NL)

• **van Duursen, Ewout Arjen**
3861 NE Nijkerk (NL)

(74) Representative: **De Vries & Metman**
Overschiestraat 180
1062 XK Amsterdam (NL)

(56) References cited:
EP-A1- 1 906 029 **EP-A1- 1 972 788**
EP-A2- 1 584 797 **CN-A- 101 149 066**
JP-A- 2002 096 413 **JP-A- 2013 092 049**
US-A- 5 437 538

EP 3 225 843 B1

Note: Within nine months of the publication of the mention of the grant of the European patent in the European Patent Bulletin, any person may give notice to the European Patent Office of opposition to that patent, in accordance with the Implementing Regulations. Notice of opposition shall not be deemed to have been filed until the opposition fee has been paid. (Art. 99(1) European Patent Convention).

Description

[0001] The present invention pertains to a slurry pump for pumping a liquid and solid particle material, comprising a casing which accommodates a drivable impeller and includes a suction inlet and an outlet, and protection means for protecting the environment against leakage of liquid or ejection of fragments of the casing in case of damage thereof.

[0002] A slurry pump in the form of a dredge pump including protection means is known in the field of dredging vessels with on-board dredge pumps which are used for sucking slurry of sand, gravel and so forth from the bottom of the sea, lake, river or the like. Such a dredging vessel often has a suction tube and a cutting mechanism located nearby an inlet of the suction tube. The cutting mechanism loosens the bed material, after which it is transported to the inlet of the suction tube. The dredging vessel may also have a suction tube and drag head with or without jet water which loosens the bed material, like a Trailing Suction Hopper Dredger.

[0003] The dredged material is sucked up by the dredge pump and discharged to a barge, for example. Dredged material may comprise solid abrasive pieces such as sand, stones or the like. When such materials are thrown against the inner surfaces of the casing by the impeller, they cause considerable wear to the inner parts of the pump. This may result in weak areas of the casing at a certain moment the casing may be worn such that it starts leaking liquid. Consequently, the casing must be replaced. Furthermore, the dredged material may also contain unexploded ordnance like grenades, bombs, shells and mines that did not explode when they were employed, but may detonate upon entering the dredge pump or when hitting the impeller or after being accelerated by the impeller. If this happens, the casing, which is generally made of cast iron, will be damaged and fragments of the casing may be ejected. When the dredge pump is placed in a closed room or a box this functions as a protection means for reducing the risk of damage to personnel and equipment in the environment of the pump.

[0004] JP 2013 092049 is related to a slurry pump including a casing having an inlet and an outlet of slurry and covering an impeller rotating in an inner chamber to which the inlet and the outlet are connected; and a waterproof film coating the outer surface of the casing. The waterproof film is constituted of a net-like first film for covering a surface of the casing and a waterproof second film for coating the film on the first film, and discharges leaked water in the casing to the outside from a gap between the casing and the first film.

[0005] EP 1 972 788 is related to a centrifugal pump, comprising an outer casing, an inner casing contained in the outer casing, an impeller rotatably supported within the inner casing, an outer casing inlet concentrically arranged with respect to the impeller as well as a tangential outlet, said outer casing comprising a cup shaped part

as well as a cover part mounted onto the cup shaped part. The cover part comprises a single element which extends as a unity continuously between the cup shaped part and the outer casing inlet.

[0006] US 5,437,538 is related to an improved blade containment structure including a projectile shield having a braided ballistic fabric. The braided fabric includes ballistic strands arranged in a preferred orientation and is effective for increasing the ability of the fabric to contain projectiles and absorb energy therefrom. The braided ballistic fabric provides substantial improvement in performance over conventional woven ballistic fabrics.

[0007] It is an object of the present invention to provide a safe slurry pump which requires minimum space.

[0008] This is achieved by the slurry pump according to claim 1.

[0009] The fact that the cover is wrapped around the casing, or enfolds the casing, provides the opportunity to create a close fitting of the cover about the casing. Any empty and unused space such as in case of a conventional protective box of solid plates around the pump can be omitted. Furthermore, a relatively small or no distance between the casing and the protective cover may improve the absorption characteristics of the impact of ejected fragments. Besides, the slurry pump including the protective cover can be assembled before transporting the pump to a dredging vessel, which reduces installation work on board. On the other hand, some space between the casing and the protective cover may be desired in order to receive gas from an explosion. It is noted that the wrapped protective cover minimizes additional weight. Since the protective cover can protect the environment against leakage of liquid the cover is preferably made of a watertight material. An advantage of the invention is that the pump can be used until it starts leaking instead of replacing the casing preventively.

[0010] The cover may comprise a flexible fabric. This means that the cover is flexible under operating conditions. Since the cover is wrapped around the casing it is always flexible upon wrapping it around the casing, but in an alternative embodiment the cover may be cured such that it is solid or semi-solid under operating conditions.

[0011] The cover may comprise a textile or a woven fabric. The tenacity of these materials provide a great resistance against impact of ejected fragments of the casing. Due to the woven structure of filaments, fibres, yarns or the like, energy absorption of an impact is distributed in width direction of the cover. Therefore, similar materials are applied in the field of bulletproof vests, for example.

[0012] The fabric may comprise fibres, for example plastic fibres made of polyethylene or the like. It is conceivable that the fabric comprises a plurality of layers of woven or laminated fibres, but three-dimensional weaving with fibres connecting flat wovens together into a 3D system is also possible.

[0013] The cover may comprise a plurality of layers

wherein the outer layer may be made of a fire-resistant and/or waterproof material. For example, a part of the plurality of layers may be waterproof PVC sheets. The layers may be adhered to each other, but it is also possible that the layers are separate from each other and are only fixed to each other at their side edges.

[0014] The impeller is coupled to an impeller drive shaft which leaves the casing at a drive shaft side as seen from the impeller, and the protective cover is attached to the casing through holding members at the suction inlet, at the outlet and the drive shaft side. It is conceivable that the protective cover is attached to the casing through holding members which are only located at the suction inlet, at the outlet and the drive shaft side, whereas the remainder of the protective cover is free from the casing or only contacting the casing.

[0015] At least one of the holding members comprises a flange and a clamp for clamping the protective cover between the clamp and the flange.

[0016] The clamp is formed of a plurality of blocks which are mountable to the flange in circumferential direction thereof. The blocks may be wedge-shaped such that the space between two neighbouring blocks is minimized. Nevertheless, some space between the blocks may be desired in order to provide room for creases in the protective cover. The blocks may be separate units in order to make installation relatively simply.

[0017] Each of the blocks is provided with a cavity at its side facing the flange which may be arranged such that after mounting the blocks on the flange the cavities form a ring-shaped channel between the blocks and the flange for receiving a thickened end portion of the cover.

[0018] In an advantageous embodiment the protective cover at the flange is folded about a string hence forming a hem with the string therein, wherein at least a part of the hem including the distance between the pressure elements reduces and the crease will automatically be held stronger between the neighbouring blocks.

[0019] In an embodiment where the crease flattener and the pressure elements are present, the pressure elements may be movable outside the crease flattener, for example along opposite sides thereof.

[0020] The invention will hereafter be elucidated with reference to drawings illustrating embodiments of the invention very schematically.

Fig. 1 is a perspective view of a part of an embodiment of the slurry pump according to the invention, showing the pump without a protective cover.

Fig. 2 is a similar view as Fig. 1, but showing the opposite side of the slurry pump.

Figs. 3-7 are a top view and four side views, respectively, of the embodiment of Fig. 1 on a smaller scale.

Figs. 8-12 are similar views as Figs. 3-7, but showing the slurry pump including the protective cover according to the invention.

Figs. 13 and 14 are similar views as Figs. 1 and 2, but showing the slurry pump without holding mem-

bers for holding the protective cover.

Figs. 15 and 16 are similar views as Figs. 13 and 14, but showing the slurry pump including parts of the holding members for holding the protective cover.

Figs. 17 and 18 are perspective views of wedge-shaped blocks for fixing the protective cover.

Fig. 19 is a perspective view of a part of a counter outlet flange for fixing the protective cover.

Fig. 20 is a sectional view of the holding member at the suction inlet.

Fig. 21 is a sectional view of the holding member at the outlet.

Fig. 22 is a perspective view of an alternative embodiment of the slurry pump according to the invention, showing the pump without a protective cover.

Fig. 23 is a frontal view of a part of the embodiment of Fig. 22 on a larger scale.

Fig. 24 is a top view, a perspective view, a side view and a front view of a holding member of the embodiment of Fig. 22 on a larger scale.

Fig. 25 is a top view and a side view of a crease flattener of the embodiment of Fig. 22 on a larger scale.

Fig. 26 is a top view and a side view of a fitting plate of the embodiment of Fig. 22 on a larger scale.

Figs. 27 and 28 are cross-sectional views at a holding member and a crease flattener, respectively, of the embodiment of Fig. 22 on a larger scale.

Fig. 29 is a top view, a side view and a perspective view of a pressure element of the embodiment of Fig. 22 on a larger scale.

[0021] Figs. 1-7 show different views of a slurry pump 1 without a protective cover, and Figs. 8-11 show different views of an embodiment of the slurry pump 1 including a protective cover 2 according to the invention. In particular Figs. 3-7 and Figs. 8-12 are views from the same respective sides, showing the embodiment of the slurry pump 1 without and with the protective cover 2, respectively. The slurry pump 1 including the cover 2 can be installed on board of a dredging vessel (not shown). Such a dredging vessel is provided with a suction tube and a cutting mechanism located nearby an inlet of the suction tube. The cutting mechanism loosens the bed material of a sea bed, a river bed or a lake bed, for example, and a mixture of solids and water is then sucked up by the slurry pump 1 via the suction tube. The slurry pump 1 according to the invention is not limited to dredging applications, but is also suitable for pumping liquid and solid particle mixtures in other fields, for example in the mining industry.

[0022] The slurry pump 1 as shown in the figures is a centrifugal pump and has a casing 3 which accommodates an impeller (not shown). The impeller has an impeller shaft which is supported by bearings, located in a bearing housing. The impeller shaft is driven by an electric motor 4. Alternatively, the impeller shaft may be driven by alternative driving means such as an internal com-

bustion engine, hydraulic motor or the like, possibly via a transmission. The casing 3 has a suction inlet 5 and a tangentially oriented outlet 6. The casing 3 comprises a volute or cup shaped part 3a and a substantially flat impeller lid 3b which is bolted to the cup shaped part 3a at the side of the pump 1 where the suction inlet 5 is located. The impeller lid 3b is removable in order to easily reach the impeller in case of maintenance or replacement of a worn impeller. At a side of the casing 3 opposite to the side where the impeller lid 3b is located, the impeller shaft leaves the casing 3.

[0023] In practice, the slurry or dredged material may also contain unexploded ordnance like grenades and bombs which may detonate upon entering the slurry pump 1 such that the casing 3 will be damaged and fragments of the casing 3 will be ejected. In order to avoid a dangerous situation for operators and equipment the casing 3 is enveloped by the protective cover 2. The cover 2 in the embodiment as shown in Figs. 8-12 comprises a flexible fabric which is wrapped around the casing 3. The cover 2 is made of a woven fabric and comprises plastic fibres, for example para-aramid synthetic fibre known under the registered trademarks Kevlar or Twaron or polyethylene fibre under the registered trademarks Dyneema or Spectra. Such fibres are also used for manufacturing bulletproof vests, for example. Nevertheless, alternative fibres are possible.

[0024] The protective cover as shown in Figs. 8-12 forms a bag which surrounds the casing 3 and which comprises three holes at the suction inlet 5, the outlet 6 and the side of the casing 3 where the electric motor 4 is located. At these locations the protective cover 2 is attached to the casing 3. In the embodiment as shown in the figures the casing 3 is provided with an outlet flange 7 at the outlet 6, see Fig. 14. The protective cover 2 is clamped to the outlet flange 7 by a counter outlet flange 8, as illustrated in Figs. 8-12. The counter outlet flange 8 comprises three portions which are bolted to each other. One of the three portions is shown in Fig. 19. Fig. 21 shows in cross-section how the protective cover 2 is clamped between the outlet flange 7 and the counter outlet flange 8. It is noted that there are numerous alternative means for fixing the protective cover 2 to the outlet 6.

[0025] At the suction inlet 5 and the opposite side of the casing 3 facing the electric motor 4, the protective cover 2 is fixed in more or less the same manner. Figs. 15 and 16 show that an inlet flange 9 is mounted at the suction inlet 5 and an impeller shaft flange 10 is mounted at the side of the casing 3 facing the electric motor 4. For clarity reasons, it is referred to Figs. 13 and 14 which are similar views as Figs. 15 and 16, but in which the inlet flange 9 and the impeller shaft flange 10 are not shown. The inlet flange 9 is mounted to the casing 3 by means of welding whereas the impeller shaft flange 10 is bolted to the casing 3.

[0026] The protective cover 2 can be fixed at the inlet flange 9 and at the impeller shaft flange 10 by means of wedge-shaped blocks 13 which are bolted to the respec-

tive flanges 9, 10. Each of the blocks 13 is provided with a cavity 14, see Figs. 17 and 18. After installing all blocks 13 the cavities 14 form a ring-shaped channel between the blocks 13 and the respective flanges 9, 10.

[0027] Fig. 20 shows how the protective cover 2 is fixed at the inlet flange 9. The protective cover 2 is fixed to the impeller shaft flange 10 in the same way. It can be seen in Fig. 20 that the protective cover 2 at its end edge is provided with a hem 11 with a string 12 therein which is accommodated in the mating cavity 14 of the wedge-shaped blocks 13. The string 12 and a portion of the hem 11 are clamped between the blocks 13 and the respective flanges 9, 10. The hem can be made by means of sewing or gluing or the like.

[0028] Figs. 11 and 12 illustrate that creases 15 in the protective cover 2 are present at the inlet flange 9 and the impeller shaft flange 10. The creases 15 arise since the surface for fixing the protective cover 2 at the inlet flange 9 is smaller than the surface of the protective cover 2 at that location. The creases 15 may protrude outwardly and clamped between respective neighbouring wedge-shaped blocks 13.

[0029] In case of maintenance or replacement of a worn impeller the blocks 13 at the inlet flange 9 can be loosened and the protective cover 2 can be folded backwards in order to provide access to the bolts of the impeller lid 3b so as to be able to remove the lid 3b.

[0030] Fig. 22 shows an alternative slurry pump 1 and Fig. 23 shows a part of the pump 1 at the suction inlet 5. For explanatory reasons the pump 1 is depicted without the protective cover 2. This embodiment has different holding members or blocks 13 than the embodiment as described above. In this embodiment the suction inlet 5 is provided with twelve blocks 13. Fig. 24 shows different views of one of the blocks 13. The block 13 has also a wedge-shape as seen from above and comprises a cavity 14, as well. After installing all blocks 13 on the cooperating inlet flange 9 the cavities 14 form a ring-shaped channel between the blocks 13 and the inlet flange 9 for receiving the string 12 enveloped by the protective cover 2. Each of the blocks 13 is mounted to the inlet flange 9 via a threaded pin 16 running through a through-hole 17 in the block 13 and fixed thereto by a nut, in a similar way as the blocks 13 in the previous embodiment.

[0031] After clamping the protective cover 2 including the string 12 between the blocks 13 and the inlet flange 9, creases 15 of the protective cover 2 are present between neighbouring blocks 13. The creases 15 are flattened by means of crease flatteners 18 such that the protective cover 2 forms a watertight sealing. Figs. 22 and 23 show that the crease flatteners 18 are located between each two neighbouring blocks 13. As shown in Fig. 25 the crease flattener 18 has a wedge shape and fits between two neighbouring blocks 13 which can be observed in Fig. 23. Each of the crease flatteners 18 is pressed onto a crease 15 by means of a crease flattener bolt 19 which is screwed in a tapped hole 20 of a fitting plate 21, see Fig. 26, and ends in a recess 22 of the

crease flattener 18. The fitting plate 21 is mounted on two neighbouring blocks 13 by means of fitting plate bolts 23, see Figs. 22 and 23. The fitting plate bolts 23 are screwed in mating holes 29 in the blocks 12.

[0032] In order to avoid a bending force on the crease flattener bolt 19 in case of a pulling force on the protective cover 2, the crease flattener 18 is provided with lateral protrusions 24 which fit in mating recesses 25 of the adjacent blocks 13 such that the crease flatteners 18 are locked with respect to the blocks 13 in radial outward direction of the inlet flange 9.

[0033] Figs. 27 and 28 illustrate an assembled situation by cross-sectional views taken along a plane through the block 13 at the threaded pin 16 and the through-hole 17 and taken along a plane through the crease flattener 18, respectively.

[0034] Fig. 29 shows different views of a pressure element 26, which has a semi-circular cross-section. Each block 13 is provided with two pressure elements 26 of which the curved portions face away from each other. In assembled condition a crease 15 between two adjacent blocks 13 is flattened and clamped to the inlet flange 9 by the crease flattener 18, whereas the pressure elements 26 of two neighbouring blocks 13 prevent the protective cover 2 from moving out of the space between the blocks 13, the inlet flange 9 and the crease flattener 18 upon exerting a pulling force on the protective cover 2. This is caused by the fact that the amount of material of the protective cover 2 in radial inward direction of the inlet flange 9 beyond the pressure elements 26 increases which increases resistance during displacement of the protective cover 2 in outward direction. Besides, the pressure elements 26 are freely movable in radial outward direction of the inlet flange 9, since protrusions 27 at the back side of the pressure elements 26 slidably fit in cooperating rails 28 of the blocks 13. The rails 28 of a block 13 are diverging in radial outward direction of the inlet flange 9. This means that upon a sudden pulling force on the protective cover 2, the cover 2 may pull the pressure elements 26 in radial outward direction such that the distance between neighbouring pressure elements 26 decreases. Consequently, it becomes still more difficult to move the crease 15 of the cover 2 in radial outward direction of the inlet flange 9.

[0035] Figs. 22-29 show the manner of fixing the protective cover 2 at the suction inlet 5, but a similar manner can be used for fixing the protective cover 2 at the impeller shaft flange 10.

[0036] The invention is not limited to the embodiments as shown in the drawings and described hereinbefore, which may be varied in different manners within the scope of the claims. For example, alternative holding members are conceivable for fixing the protective cover to the casing.

Claims

1. A slurry pump (1) for pumping a liquid and solid particle mixture, comprising a casing (3) which accommodates a drivable impeller and includes a suction inlet (5) and an outlet (6), and protection means (2) for protecting the environment against leakage of liquid or ejection of fragments of the casing (3) in case of damage thereof, wherein the protection means comprises a protective cover (2) which is wrapped around the casing (3) wherein the impeller is coupled to an impeller drive shaft which leaves the casing (3) at a drive shaft side (10) as seen from the impeller, **characterized in that** the protective cover (2) is attached to the casing (3) through holding members (7, 8, 9, 10, 13) at the suction inlet (5), at the outlet (6) and the drive shaft side (10), wherein at least one of the holding members comprises a flange (7, 9, 10) and a clamp (8, 13) for clamping the protective cover (2) between the clamp (8, 13) and the flange (7, 9, 10), wherein the clamp is formed of a plurality of blocks (13) which are mountable to the flange (9, 10) in circumferential direction thereof, wherein each of the blocks (13) is provided with a cavity (14) at its side facing the flange (9, 10) which is arranged such that after mounting the blocks (13) on the flange (9, 10) the cavities (14) form a ring-shaped channel between the blocks (13) and the flange (9, 10) for receiving a thickened end portion of the cover (2).
2. A slurry pump (1) according to claim 1, wherein the cover (2) comprises a flexible fabric.
3. A slurry pump (1) according to claim 1 or 2, wherein the cover (2) comprises a textile.
4. A slurry pump (1) according to one of the preceding claims, wherein the cover (2) comprises a woven fabric.
5. A slurry pump (1) according to claim 4, wherein the fabric comprises plastic fibres.
6. A slurry pump (1) according to one of the preceding claims, wherein the protective cover (2) at the flange (9, 10) is folded about a string (12) hence forming a hem (11) with the string (12) therein, wherein at least a part of the hem (11) including the string (12) is accommodated in said ring-shaped channel.
7. A slurry pump (1) according to one of the preceding claims, wherein a crease flattener (18) is fixed between two neighbouring blocks (13), which crease flattener (18) presses a crease (15) of the protective cover (2) against the flange (9, 10).
8. A slurry pump (1) according to claim 7, wherein the crease flattener (18) and the blocks (13) are provided

with cooperating locking members (24, 25) for locking the crease flattener (18) between the blocks (13) in a radial direction of the flange (9, 10).

9. A slurry pump (1) according to one of the claims 7-8, wherein each of the blocks (13) are provided with at least two pressure elements (26), which are freely movable with respect to the flange (9, 10) in radial outward direction thereof, wherein the pressure elements (26) of two neighbouring blocks (13) face each other and a crease (15) of the protective cover (2) extends between the pressure elements (26), wherein the pressure elements (26) in circumferential direction of the flange (9, 10) and the blocks (13) are adapted such that the distance between the pressure elements (26) decreases upon moving the pressure elements (26) in radial outward direction thereof.
10. A slurry pump (1) according to claims 7 and 9, wherein the pressure elements (26) are movable outside the crease flattener (18).

Patentansprüche

1. Schlammpumpe (1) zum Pumpen einer Flüssigkeits-Feststoffteilchen-Mischung mit einem Gehäuse (3), das ein antriebsfähiges Laufrad unterbringt und einen Ansaug einlass (5) und einen Auslass (6) aufweist, und einer Schutzeinrichtung (2) zum Schützen der Umgebung vor Austritt von Flüssigkeit oder Ausstoß von Bruchstücken des Gehäuses (3) bei dessen Beschädigung, wobei die Schutzeinrichtung eine Schutzabdeckung (2) aufweist, mit der das Gehäuse (3) umhüllt ist, wobei das Laufrad mit einer Laufrad-antriebswelle gekoppelt ist, die das Gehäuse (3) an einer Antriebswellenseite (10) mit Blick vom Laufrad verlässt, **dadurch gekennzeichnet, dass** die Schutzabdeckung (2) am Gehäuse (3) über Halteteile (7, 8, 9, 10, 13) am Ansaug einlass (5), am Auslass (6) und an der Antriebswellenseite (10) angebracht ist, wobei mindestens eines der Halteteile einen Flansch (7, 9, 10) und eine Klemme (8, 13) zum Klemmen der Schutzabdeckung (2) zwischen der Klemme (8, 13) und dem Flansch (7, 9, 10) aufweist, wobei die Klemme aus mehreren Blöcken (13) gebildet ist, die am Flansch (9, 10) in dessen Umfangsrichtung anbaubar sind, wobei jeder der Blöcke (13) mit einem Hohlraum (14) an seiner zum Flansch (9, 10) weisenden Seite versehen ist, der so angeordnet ist, dass nach Anbauen der Blöcke (13) an dem Flansch (9, 10) die Hohlräume (14) einen ringförmigen Kanal zwischen den Blöcken (13) und dem Flansch (9, 10) zum Aufnehmen eines verdickten Endabschnitts der Abdeckung (2) bilden.
2. Schlammpumpe (1) nach Anspruch 1, wobei die Ab-

deckung (2) einen flexiblen Stoff aufweist.

3. Schlammpumpe (1) nach Anspruch 1 oder 2, wobei die Abdeckung (2) ein Textil aufweist.
4. Schlammpumpe (1) nach einem der vorstehenden Ansprüche, wobei die Abdeckung (2) einen Webstoff aufweist.
5. Schlammpumpe (1) nach Anspruch 4, wobei der Stoff Kunststofffasern aufweist.
6. Schlammpumpe (1) nach einem der vorstehenden Ansprüche, wobei die Schutzabdeckung (2) am Flansch (9, 10) um eine Schnur (12) gefaltet ist, was eine Einfassung (11) mit der Schnur (12) darin bildet, wobei mindestens ein Teil der Einfassung (11) mit der Schnur (12) im ringförmigen Kanal untergebracht ist.
7. Schlammpumpe (1) nach einem der vorstehenden Ansprüche, wobei ein Falten glätter (18) zwischen zwei benachbarten Blöcken (13) befestigt ist, wobei der Falten glätter (18) eine Falte (15) der Schutzabdeckung (2) an den Flansch (9, 10) drückt.
8. Schlammpumpe (1) nach Anspruch 7, wobei der Falten glätter (18) und die Blöcke (13) mit zusammenwirkenden Verriegelungsteilen (24, 25) zum Verriegeln des Falten glätters (18) zwischen den Blöcken (13) in Radialrichtung des Flanschs (9, 10) versehen sind.
9. Schlammpumpe (1) nach einem der Ansprüche 7-8, wobei jeder der Blöcke (13) mit mindestens zwei Druckelementen (26) versehen ist, die im Hinblick auf den Flansch (9, 10) in ihrer Radialauswärtsrichtung frei beweglich sind, wobei die Druckelemente (26) zweier benachbarter Blöcke (13) zueinander weisen und sich eine Falte (15) der Schutzabdeckung (2) zwischen den Druckelementen (26) erstreckt, wobei die Druckelemente (26) in Umfangsrichtung des Flanschs (9, 10) und die Blöcke (13) so angepasst sind, dass der Abstand zwischen den Druckelementen (26) bei Bewegung der Druckelemente (26) in ihre Radialauswärtsrichtung abnimmt.
10. Schlammpumpe (1) nach Anspruch 7 und 9, wobei die Druckelemente (26) außerhalb des Falten glätters (18) beweglich sind.

Revendications

1. Pompe à boue (1) pour pomper un mélange de particules liquides et solides, comprenant un corps (3) qui loge une turbine pouvant être entraînée et comporte un orifice d'entrée d'aspiration (5) et un orifice

- de sortie (6), et un moyen de protection (2) pour protéger l'environnement contre une fuite de liquide ou une éjection de fragments du corps (3) dans le cas où il est endommagé, dans laquelle le moyen de protection comprend un couvercle protecteur (2) qui est enroulé autour du corps (3), dans laquelle la turbine est accouplée à un arbre d'entraînement de turbine qui sort du corps (3) d'un côté arbre d'entraînement (10) vu depuis la turbine, **caractérisée en ce que** le couvercle protecteur (2) est attaché au corps (3) par le biais d'organes de maintien (7, 8, 9, 10, 13) au niveau de l'orifice d'entrée d'aspiration (5), au niveau de l'orifice de sortie (6) et du côté arbre d'entraînement (10), dans laquelle au moins l'un des organes de maintien comprend une bride (7, 9, 10) et une pince (8, 13) pour serrer le couvercle protecteur (2) entre la pince (8, 13) et la bride (7, 9, 10), dans laquelle la pince est formée d'une pluralité de blocs (13) qui peuvent être montés sur la bride (9, 10) en direction circonférentielle de celle-ci, dans laquelle chacun des blocs (13) est pourvu d'une cavité (14) de son côté en regard de la bride (9, 10) qui est agencée de sorte qu'après montage des blocs (13) sur la bride (9, 10), les cavités (14) forment un canal en forme d'anneau entre les blocs (13) et la bride (9, 10) pour recevoir une portion d'extrémité épaissie du couvercle (2).
2. Pompe à boue (1) selon la revendication 1, dans laquelle le couvercle (2) comprend une étoffe flexible.
3. Pompe à boue (1) selon la revendication 1 ou 2, dans laquelle le couvercle (2) comprend un textile.
4. Pompe à boue (1) selon l'une des revendications précédentes, dans laquelle le couvercle (2) comprend une étoffe tissée.
5. Pompe à boue (1) selon la revendication 4, dans laquelle l'étoffe comprend des fibres de plastique.
6. Pompe à boue (1) selon l'une des revendications précédentes, dans laquelle le couvercle protecteur (2) au niveau de la bride (9, 10) est plié autour d'une ficelle (12) formant ainsi un bord rabattu (11) avec la ficelle (12) à l'intérieur, dans laquelle au moins une partie du bord rabattu (11) comportant la ficelle (12) est logée dans ledit canal en forme d'anneau.
7. Pompe à boue (1) selon l'une des revendications précédentes, dans laquelle un aplatisseur de pli (18) est fixé entre deux blocs voisins (13), lequel aplatisseur de pli (18) appuie un pli (15) du couvercle protecteur (2) contre la bride (9, 10).
8. Pompe à boue (1) selon la revendication 7, dans laquelle l'aplatisseur de pli (18) et les blocs (13) sont pourvus d'organes de blocage coopérants (24, 25) pour bloquer l'aplatisseur de pli (18) entre les blocs (13) dans une direction radiale de la bride (9, 10).
9. Pompe à boue (1) selon l'une des revendications 7 et 8, dans laquelle chacun des blocs (13) est pourvu d'au moins deux éléments de pression (26), qui sont mobiles librement par rapport à la bride (9, 10) en direction extérieure radiale de celle-ci, dans laquelle les éléments de pression (26) de deux blocs voisins (13) sont en regard l'un de l'autre et un pli (15) du couvercle protecteur (2) s'étend entre les éléments de pression (26), dans laquelle les éléments de pression (26) en direction circonférentielle de la bride (9, 10) et des blocs (13) sont adaptés de sorte que la distance entre les éléments de pression (26) diminue lorsqu'on déplace les éléments de pression (26) en direction extérieure radiale de ceux-ci.
10. Pompe à boue (1) selon les revendications 7 et 9, dans laquelle les éléments de pression (26) sont mobiles en dehors de l'aplatisseur de pli (18).

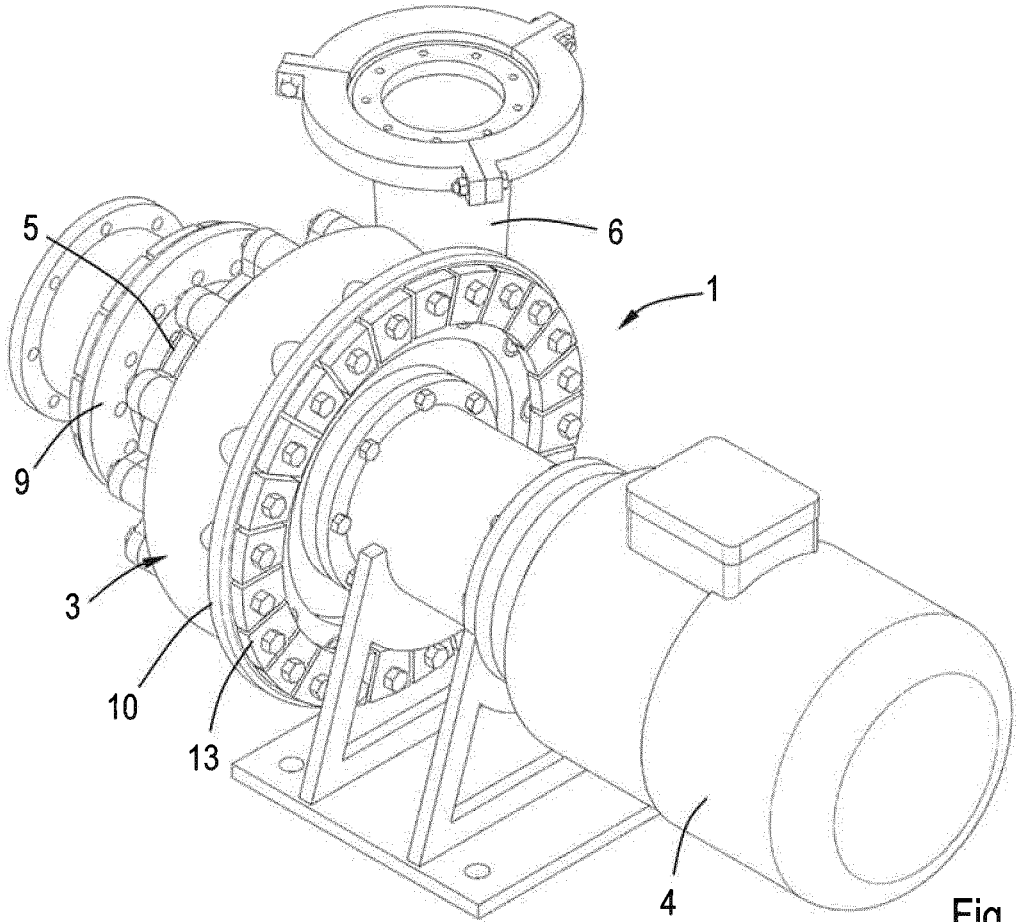

Fig.1

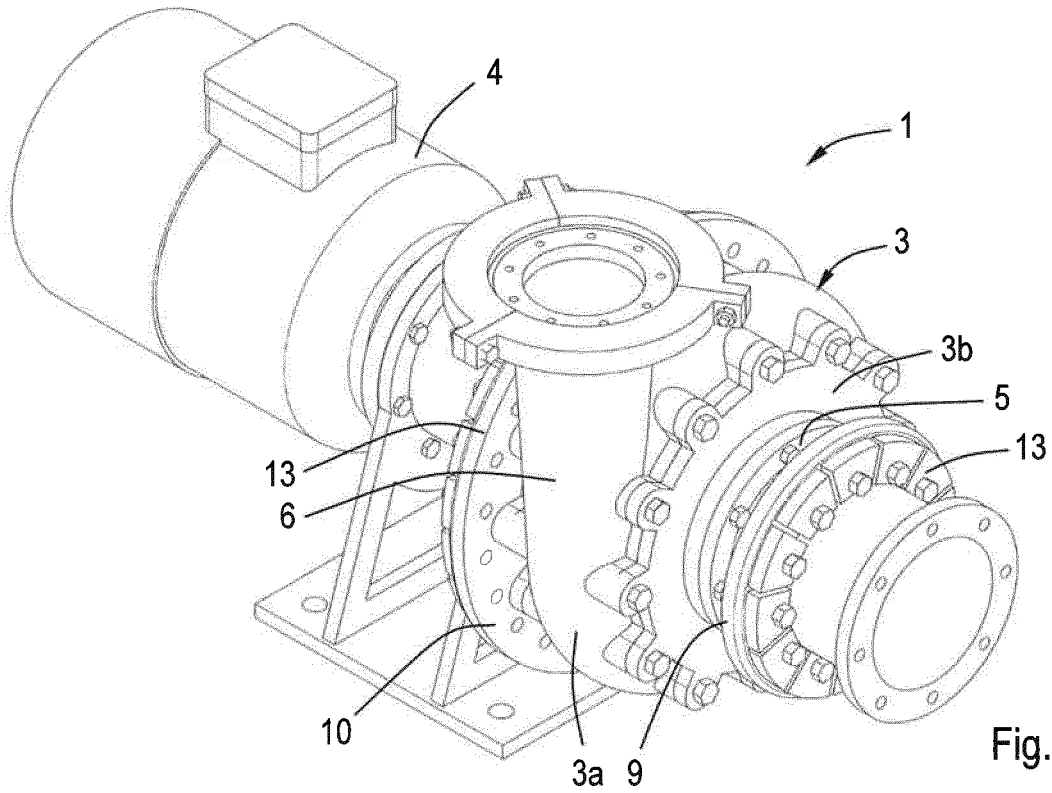

Fig.2

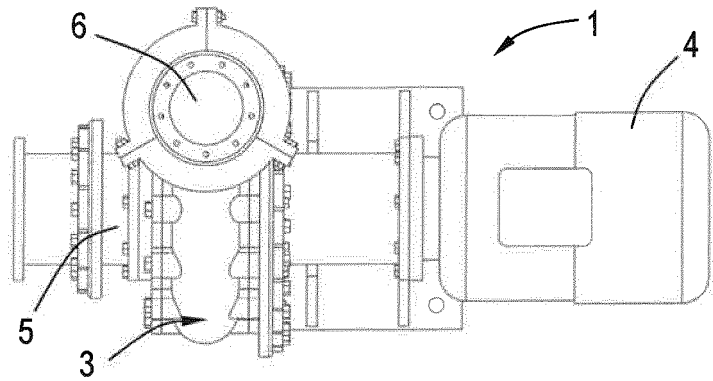

Fig.3

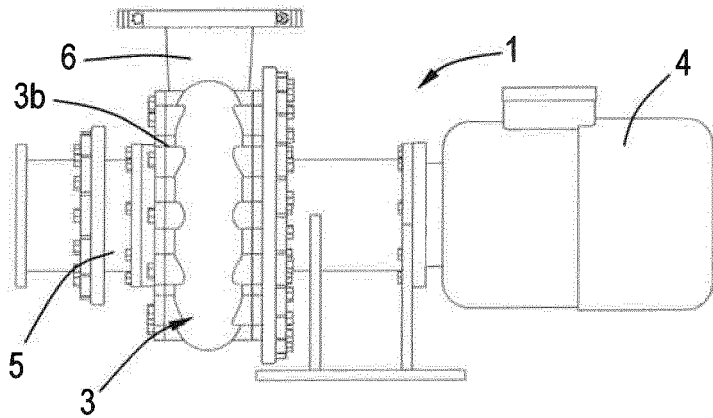

Fig.4

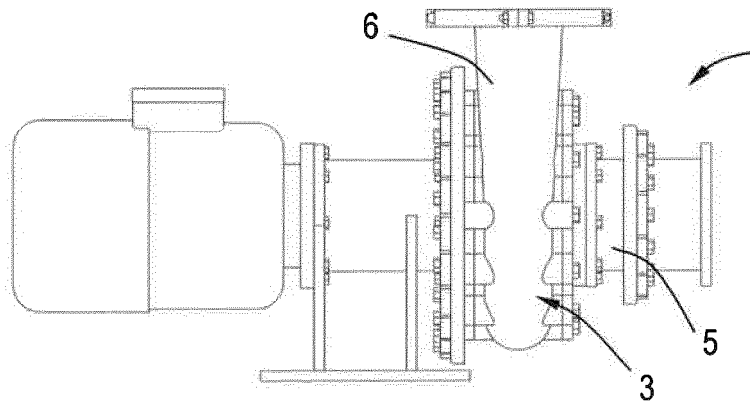

Fig.5

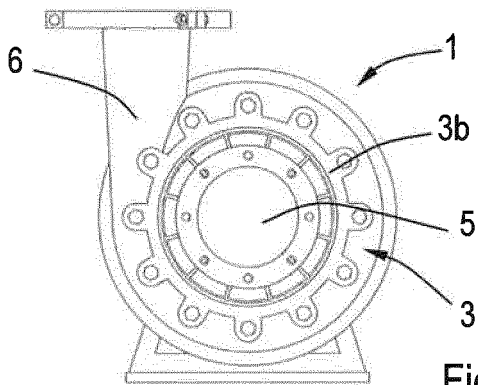

Fig.6

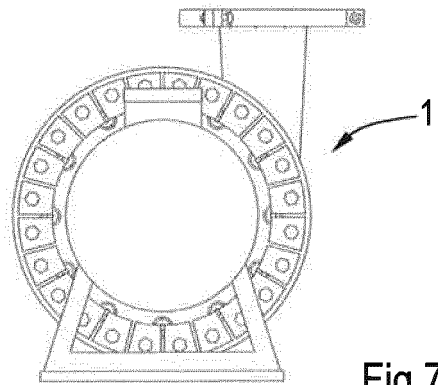

Fig.7

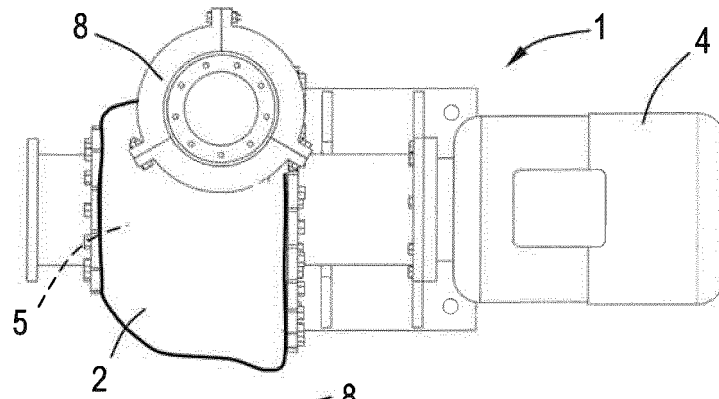

Fig.8

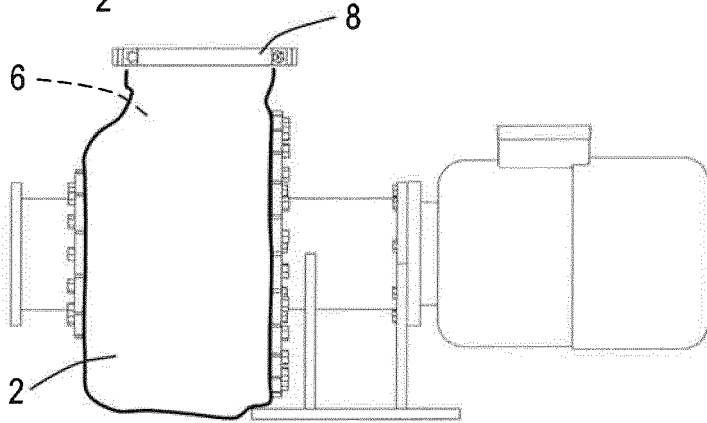

Fig.9

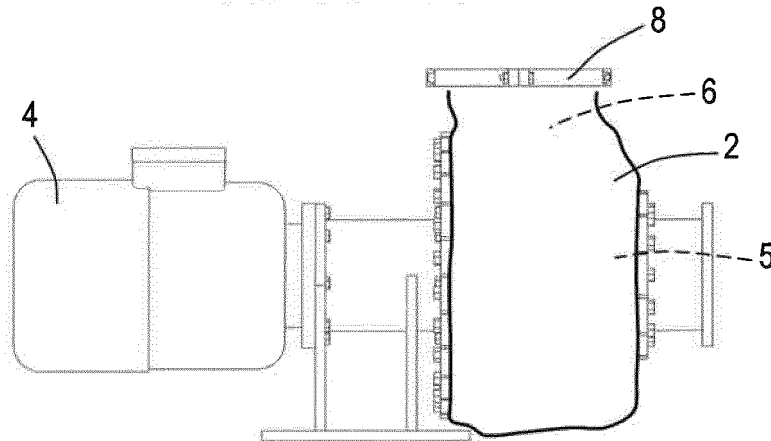

Fig.10

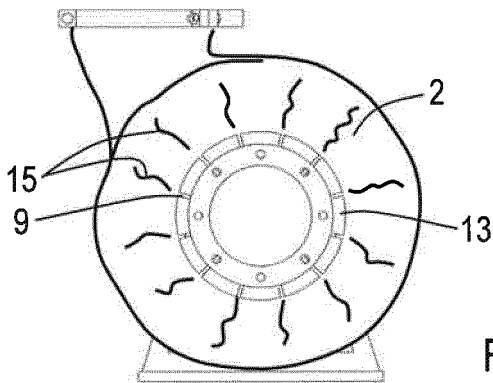

Fig.11

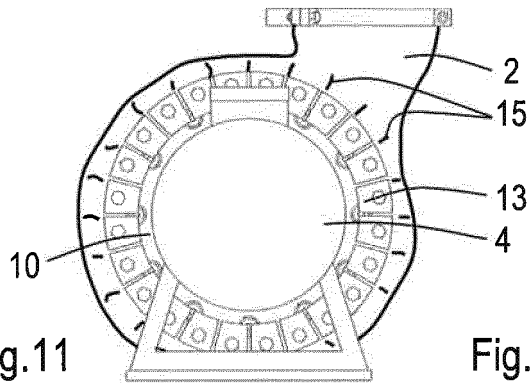

Fig.12

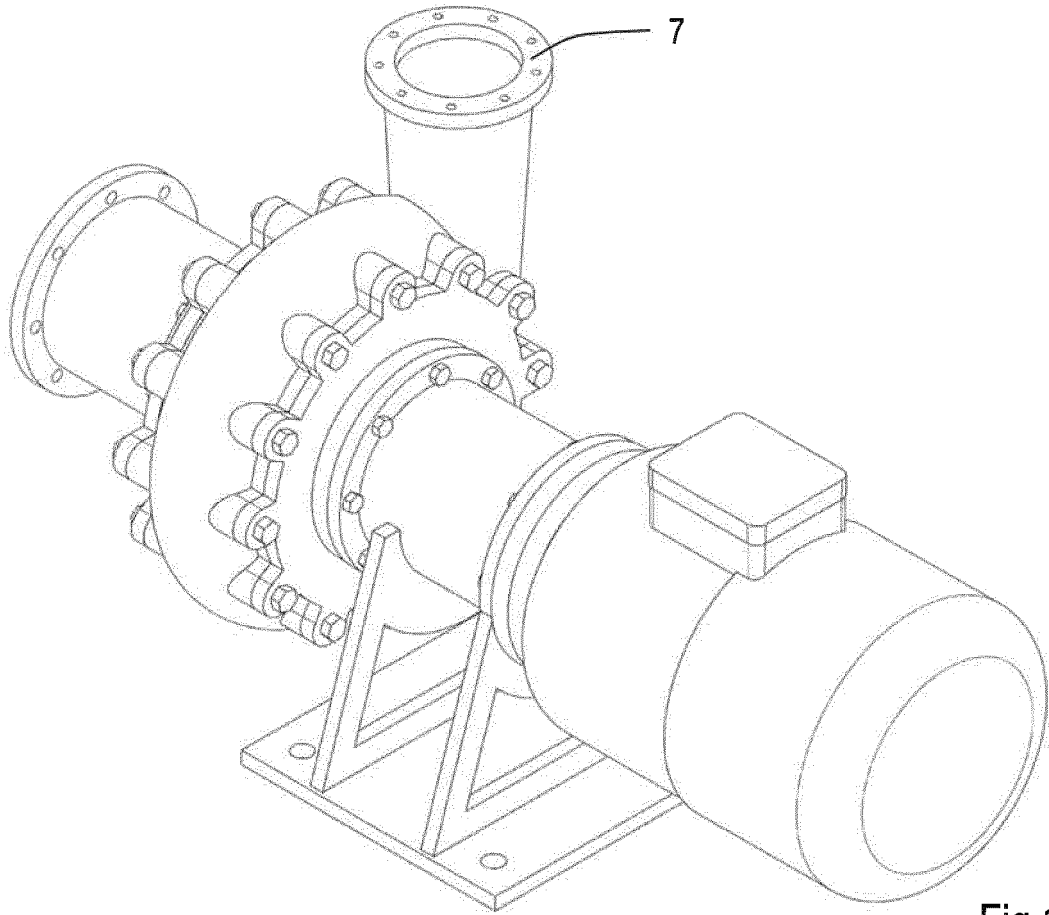

Fig.13

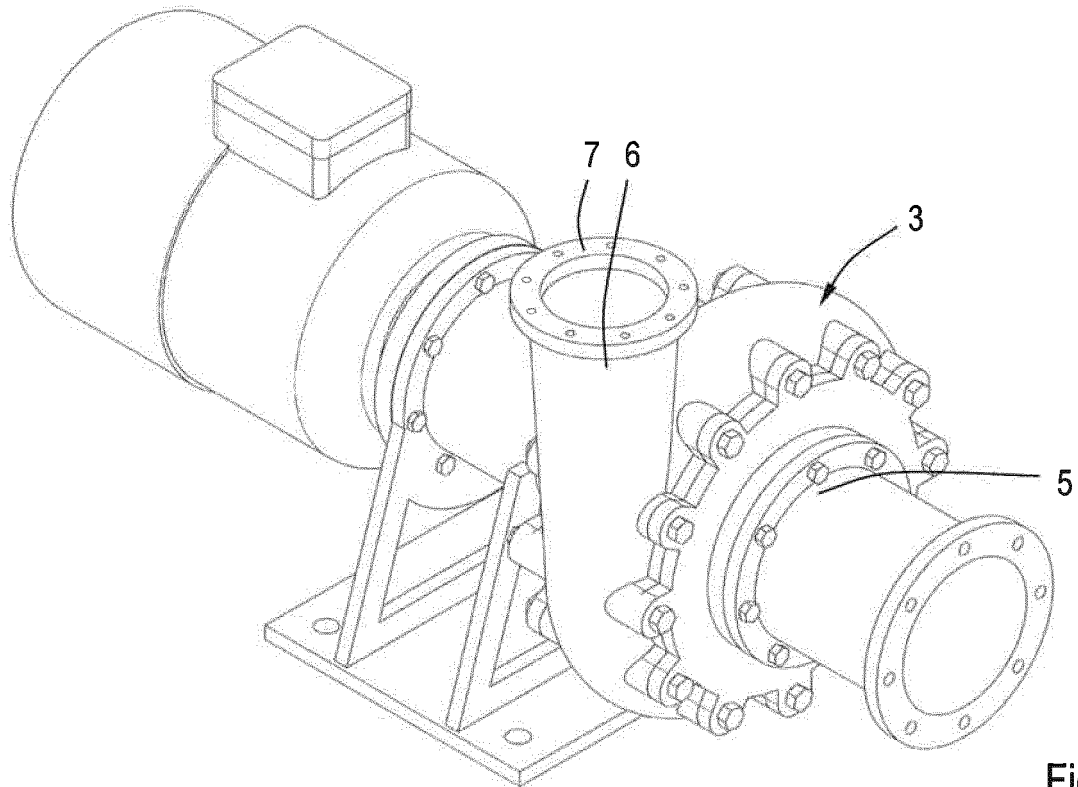

Fig.14

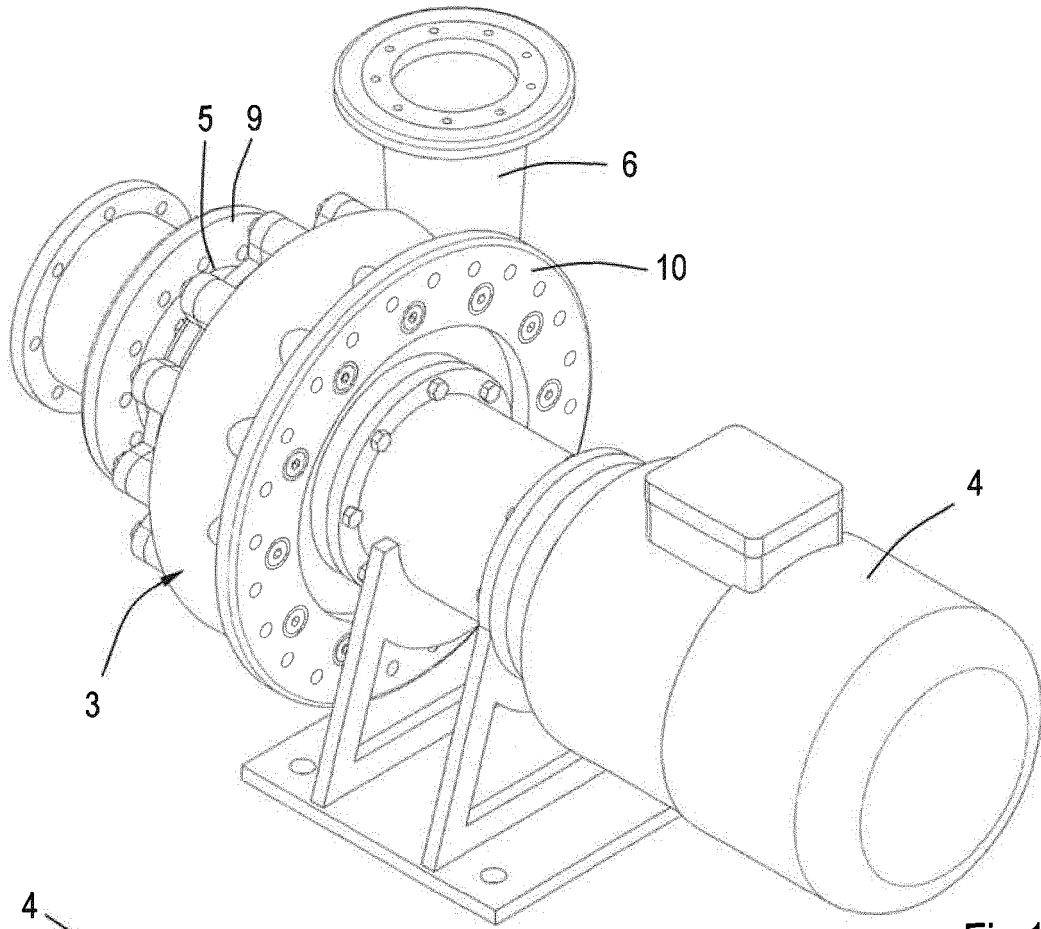

Fig.15

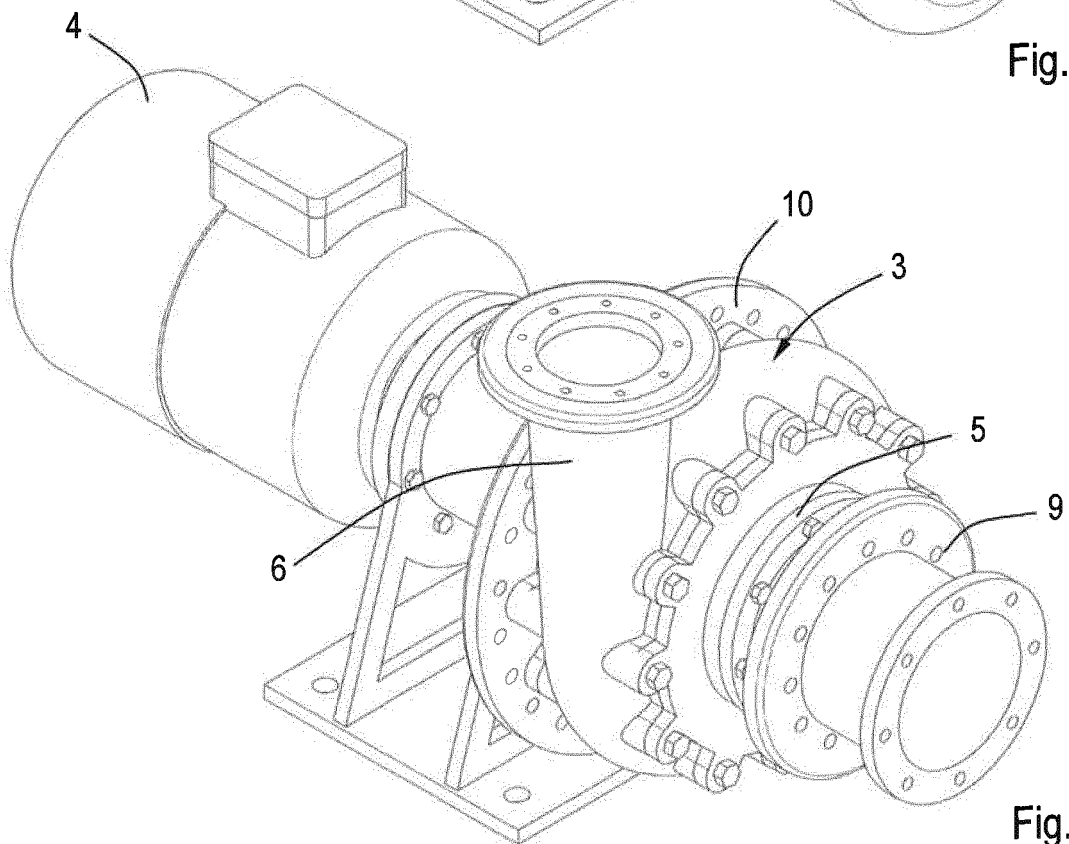

Fig.16

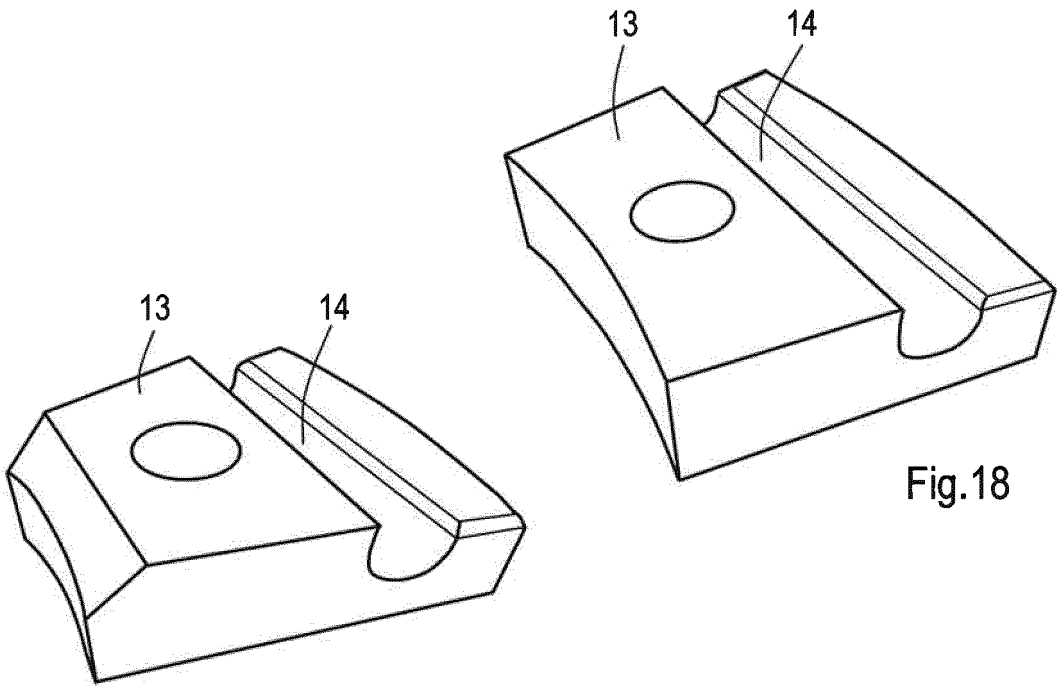

Fig.17

Fig.18

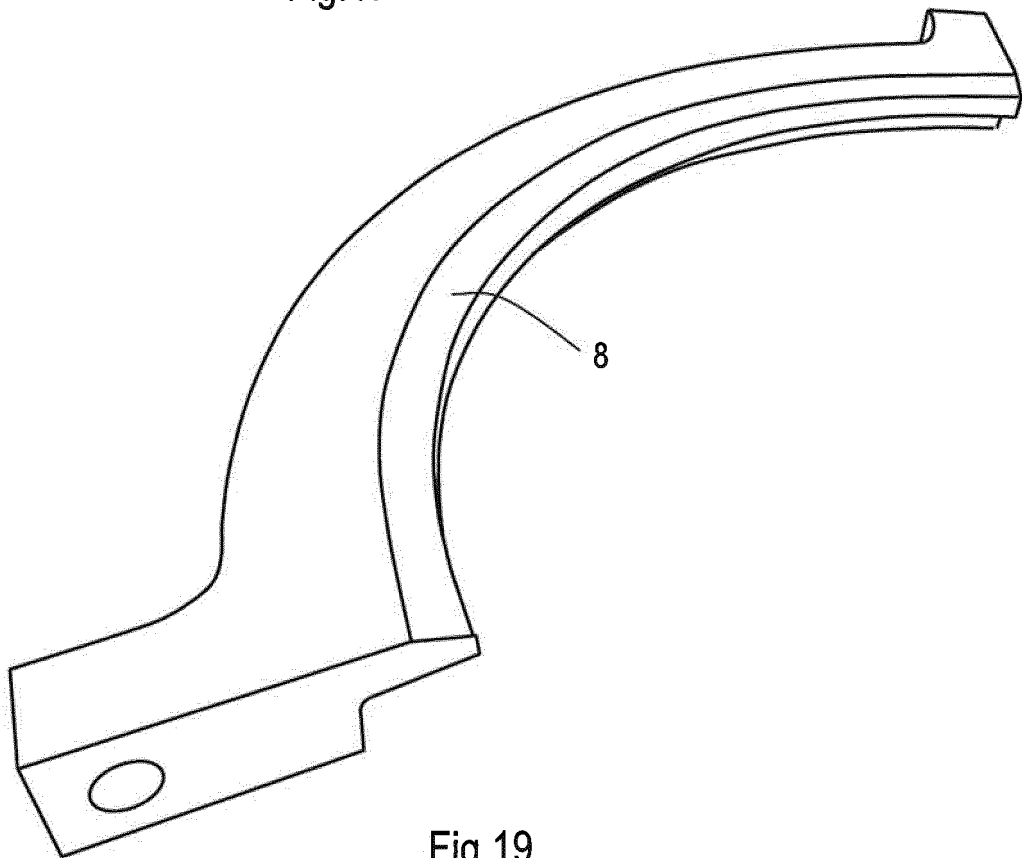

Fig.19

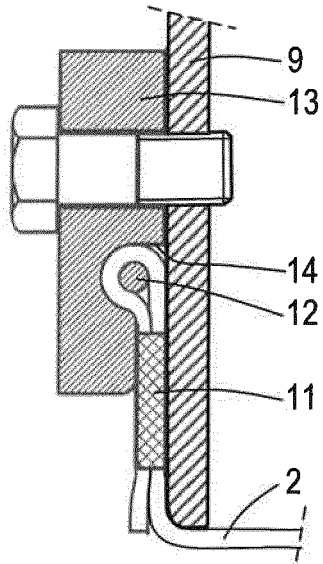

Fig.20

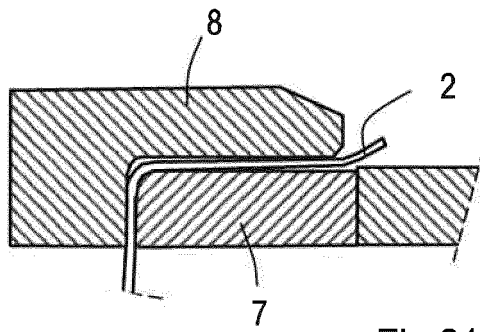

Fig.21

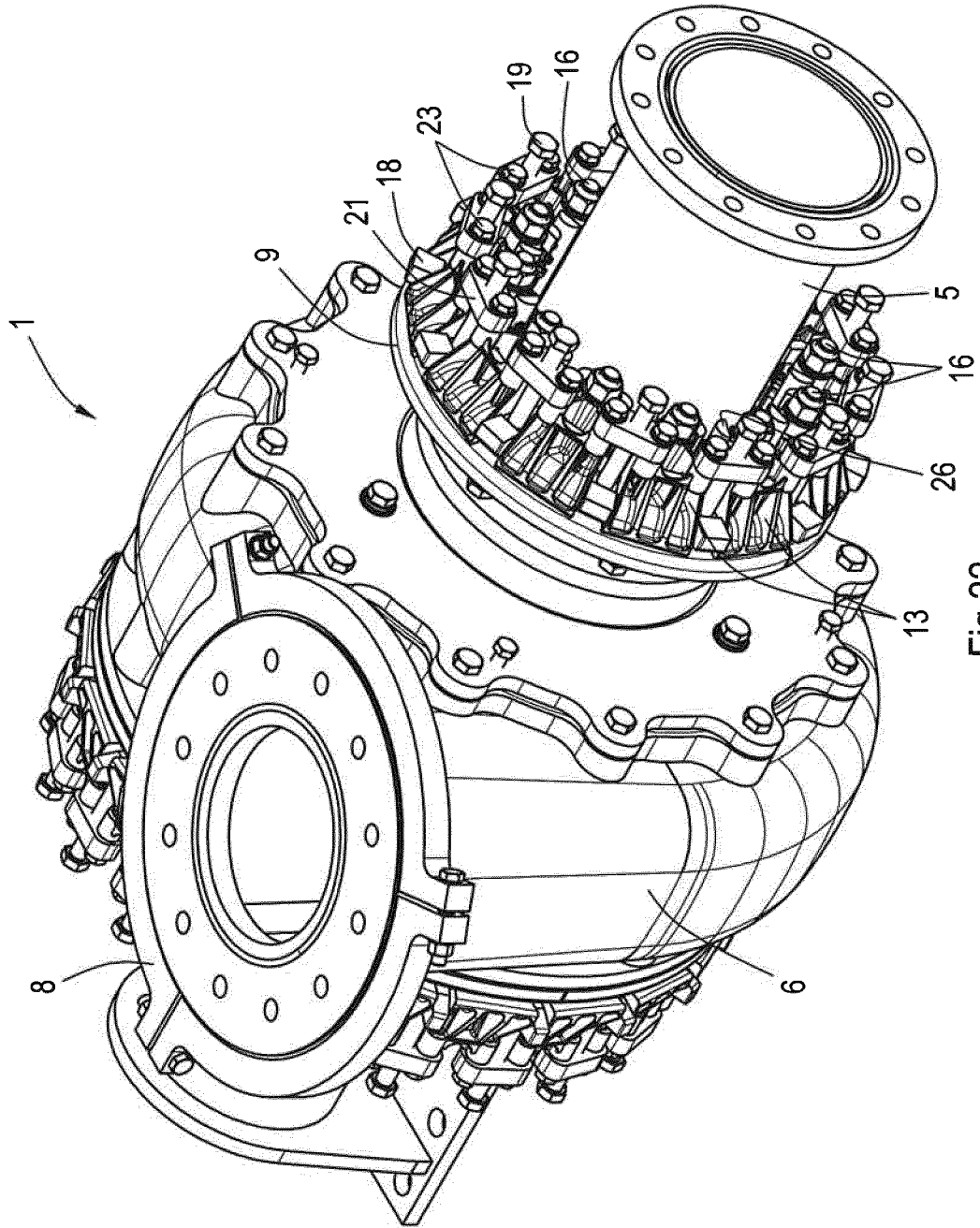

Fig.22

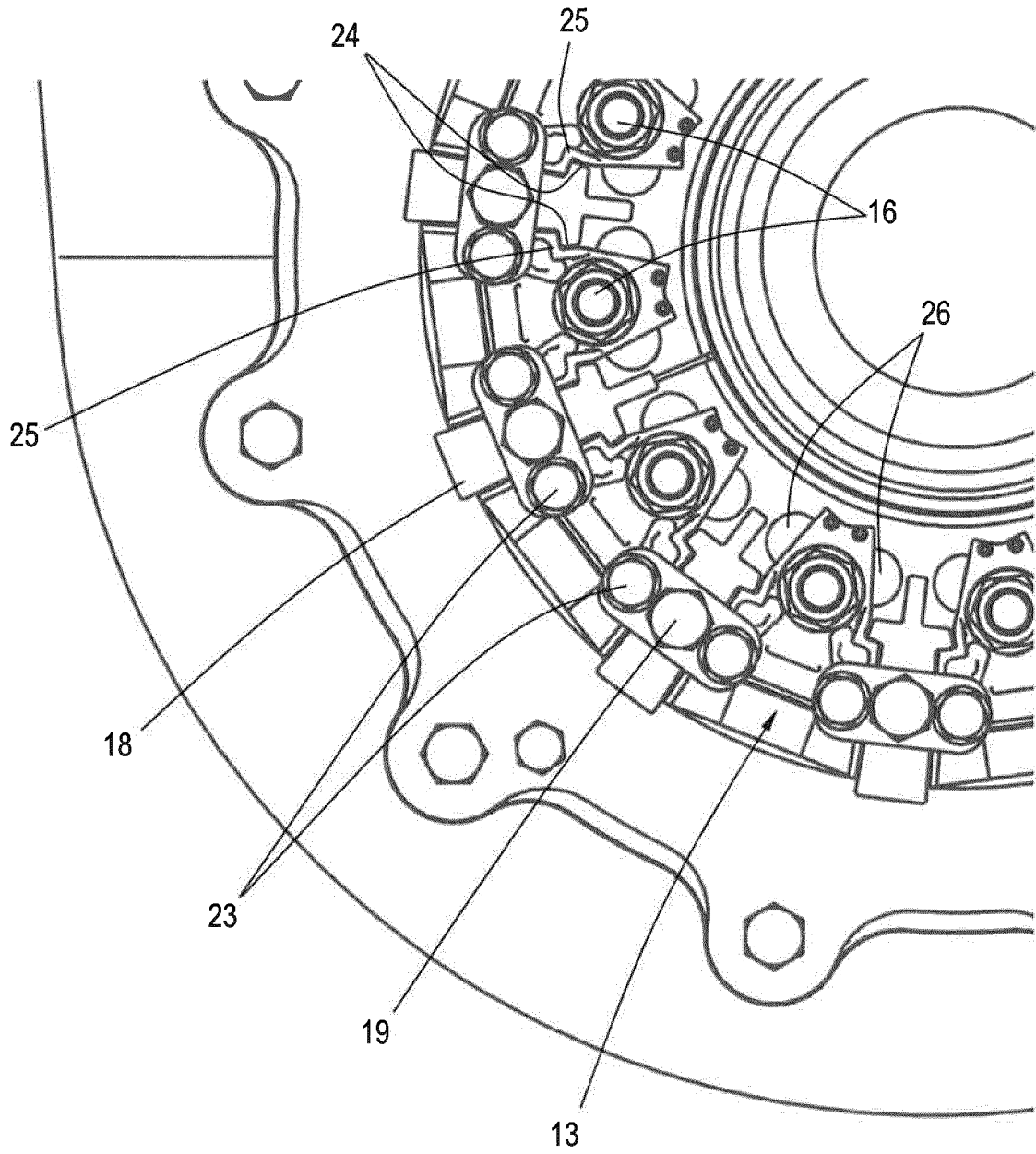

Fig.23

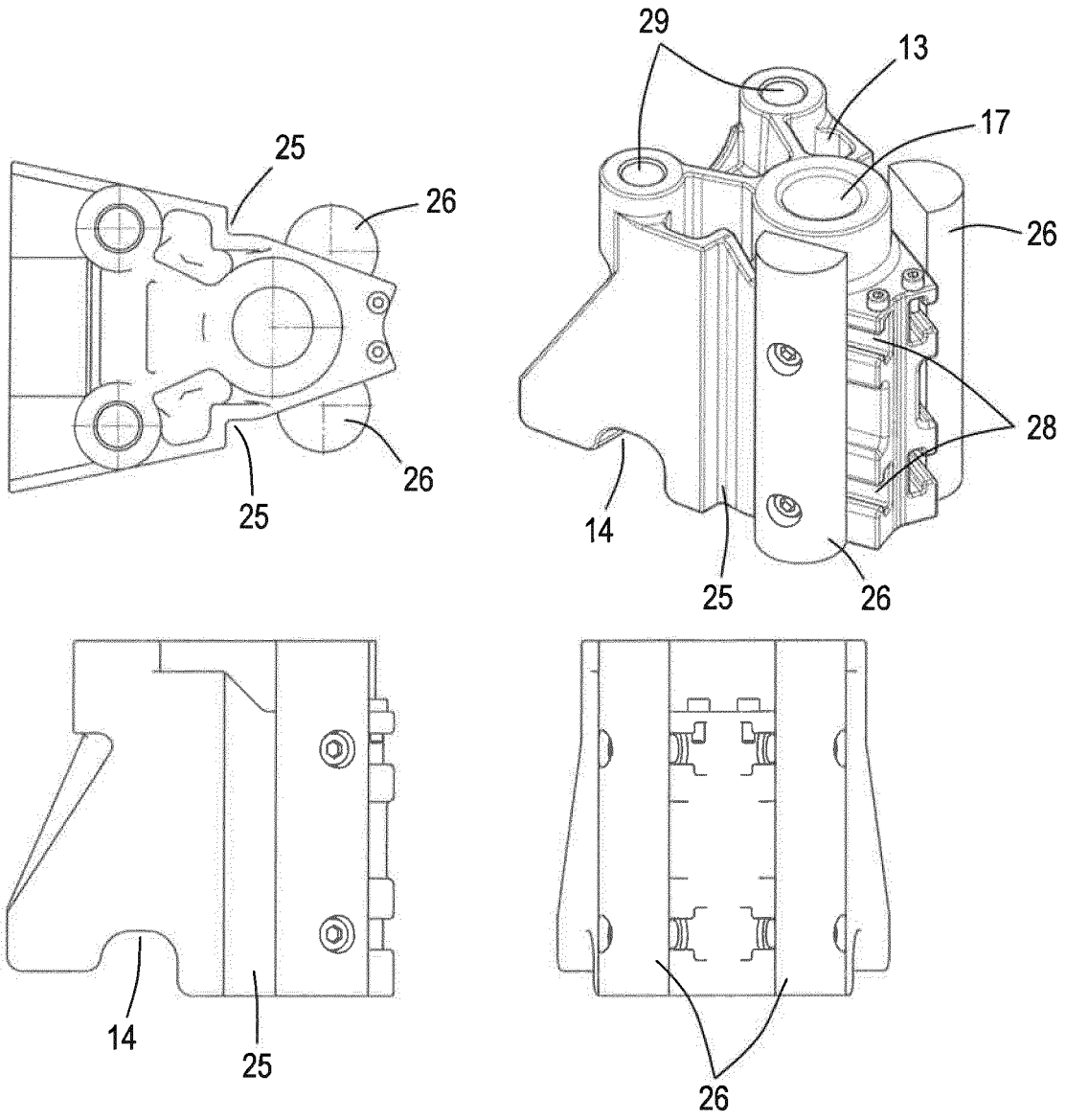

Fig.24

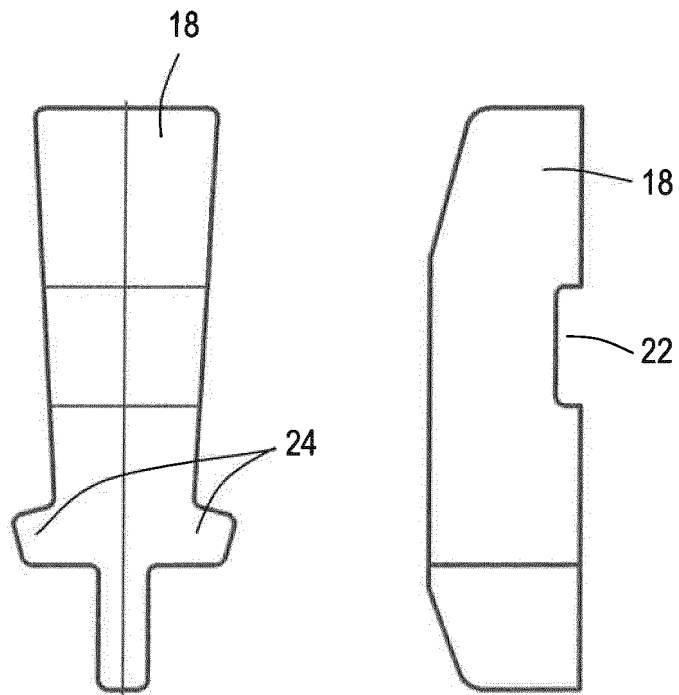

Fig.25

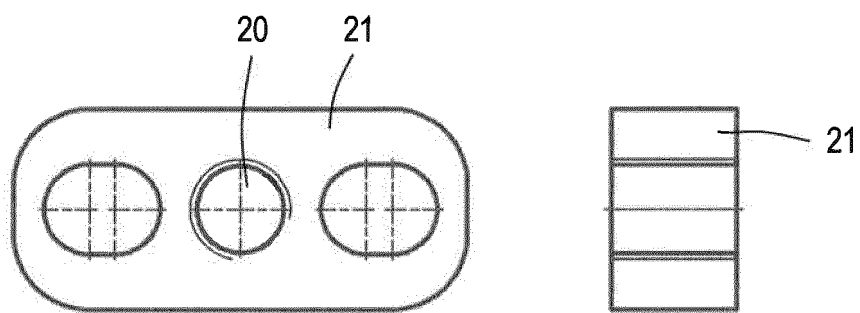

Fig.26

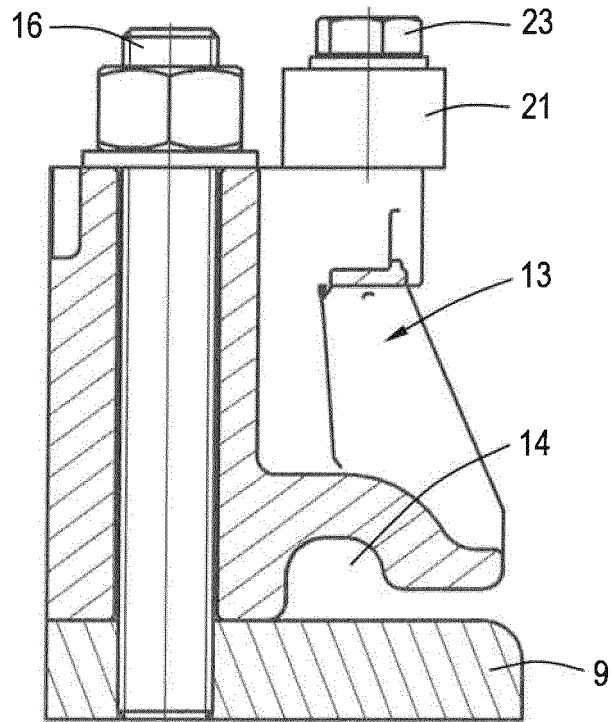

Fig.27

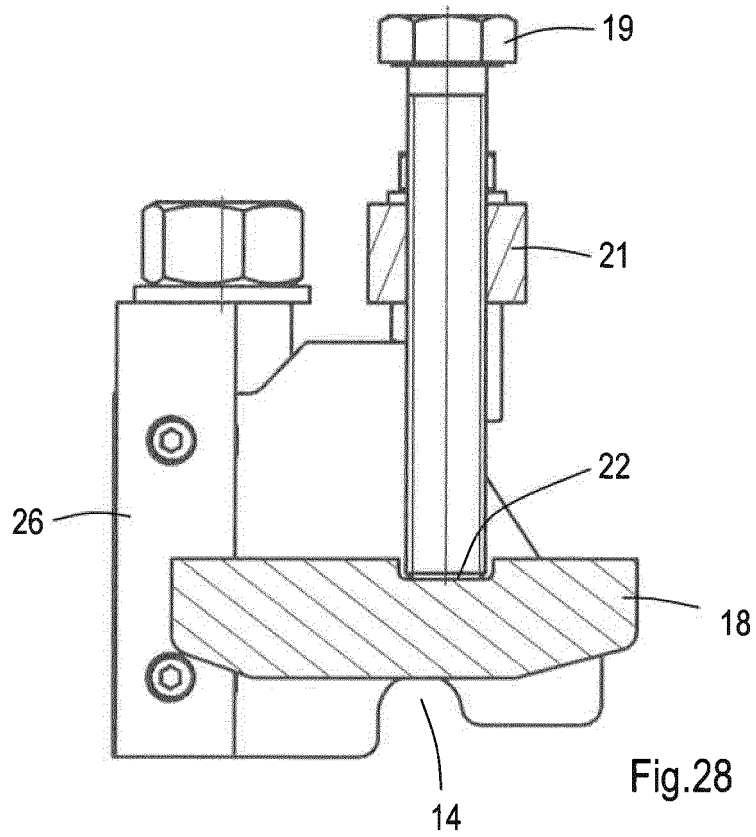

Fig.28

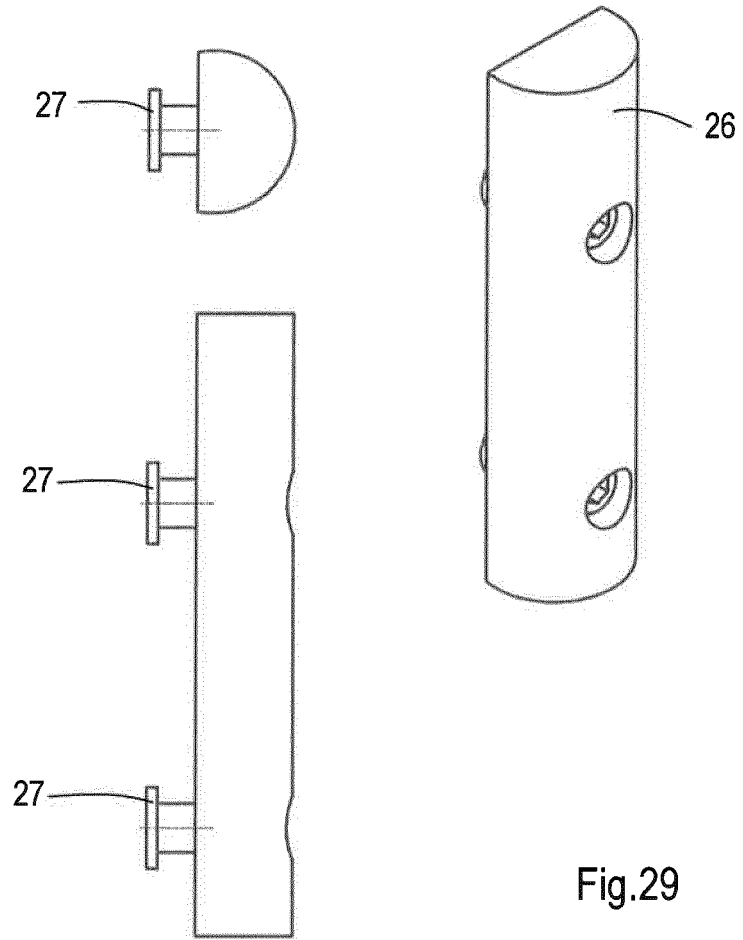

Fig.29

REFERENCES CITED IN THE DESCRIPTION

This list of references cited by the applicant is for the reader's convenience only. It does not form part of the European patent document. Even though great care has been taken in compiling the references, errors or omissions cannot be excluded and the EPO disclaims all liability in this regard.

Patent documents cited in the description

- JP 2013092049 A [0004]
- EP 1972788 A [0005]
- US 5437538 A [0006]