

(19)



(11)

EP 2 757 329 B1

(12)

EUROPEAN PATENT SPECIFICATION

(45) Date of publication and mention
of the grant of the patent:
05.06.2019 Bulletin 2019/23

(51) Int Cl.:
F24F 13/22 ^(2006.01) **F24F 1/36** ^(2011.01)

(21) Application number: **13191682.7**

(22) Date of filing: **05.11.2013**

(54) **Outdoor unit of air-conditioning apparatus**

Außeneinheit einer Klimaanlage

Unité extérieure de climatiseur

(84) Designated Contracting States:
**AL AT BE BG CH CY CZ DE DK EE ES FI FR GB
GR HR HU IE IS IT LI LT LU LV MC MK MT NL NO
PL PT RO RS SE SI SK SM TR**

(30) Priority: **18.01.2013 JP 2013007261**
10.07.2013 JP 2013144549

(43) Date of publication of application:
23.07.2014 Bulletin 2014/30

(73) Proprietor: **Mitsubishi Electric Corporation**
Chiyoda-ku
Tokyo 100-8310 (JP)

(72) Inventors:
• **Jinnai, Hiroyuki**
Tokyo, 102-0073 (JP)
• **Kubono, Toshiyuki**
Tokyo, 102-0073 (JP)
• **Takatsuka, Yoichi**
Tokyo, 102-0073 (JP)

(74) Representative: **Pfenning, Meinig & Partner mbB**
Patent- und Rechtsanwälte
Theresienhöhe 11a
80339 München (DE)

(56) References cited:
JP-A- 2007 064 507 JP-A- 2010 101 537

Note: Within nine months of the publication of the mention of the grant of the European patent in the European Patent Bulletin, any person may give notice to the European Patent Office of opposition to that patent, in accordance with the Implementing Regulations. Notice of opposition shall not be deemed to have been filed until the opposition fee has been paid. (Art. 99(1) European Patent Convention).

EP 2 757 329 B1

Description

[Technical Field]

[0001] The present invention relates to an outdoor unit of an air-conditioning apparatus, the outdoor unit including a drain water drainage hose connection socket (hereinafter, simply referred to as a "socket") for connection of a drainage hose for drain water.

[Background Art]

[0002] There have been recently developed air-conditioning-apparatus outdoor units each provided with a drainage device including a socket for connecting a body of the outdoor unit and a drainage hose to allow drain water generated in the outdoor unit to be drained out of the outdoor unit (refer to Patent Literature 1, for example).

[Citation List]

[Patent Literature]

[0003] [Patent Literature 1] Japanese Unexamined Patent Application Publication No. 2007-64507 (Fig. 4, for example)

[Summary of Invention]

[Technical Problem]

[0004] When such a socket disclosed in Patent Literature 1 is used in a cold climate area in the winter, drain water may freeze in a drainage hose connected to the socket. If drain water is additionally generated while the frozen drain water, or ice is left in the drainage hose, the ice would grow in a backflow direction, causing the ice to intrude into the outdoor unit eventually. If the ice intrudes into the outdoor unit and grows in the outdoor unit, the outdoor unit may be damaged, for example, outer parts of the outdoor unit may be deformed due to the weight of the ice and a heat exchanger disposed in the outdoor unit may be damaged. The use of such a socket for connection of a drain water drainage hose is therefore prohibited in cold climate areas.

[0005] In a typical air-conditioning-apparatus outdoor unit, a base plate of the outdoor unit has a drainage hole for drainage of drain water. In cases where the outdoor unit is mounted on a wall or is suspended from a ceiling or the like, a bird or another small animal may intrude into the outdoor unit through the hole and build a nest. Unfortunately, the nest would interfere with drainage of drain water. If the use of a socket is not prohibited, the socket may be disposed to close the hole of the base plate. Such a problem can be solved. In cold climate areas where the use of the socket is prohibited, the intrusion of birds and small animals cannot be prevented. Disadvantageously, there are no effective countermeasures.

[0006] To install the outdoor unit, typically, a drainage hose that functions as a drain water drainage path may be prepared by an installation worker. In cold climate areas, since the use of a socket is prohibited there, the installation worker may independently make, for example, a drainage-hose catch to achieve drainage in order to install the outdoor unit in a place that requires drainage, for example, above a passage through which people pass.

[0007] In such a case, a thick rubber tube may be used as a drainage hose so that drain water does not tend to freeze. In many cases, a vinyl chloride pipe having a diameter of ϕ 32 or more may be used as a drainage hose. Assuming that a hose connection portion of the socket is connectable to only one of a rubber tube and a vinyl chloride pipe, if a drainage hose prepared by the installation worker is not connectable to the socket, the installation worker has to yet again prepare a connectable drainage hose. Unfortunately, ease of installation is reduced.

[0008] The present invention has been made to solve the above-described disadvantages and provides an air-conditioning-apparatus outdoor unit including a socket that can be used in cold climate areas.

[Solution to Problem]

[0009] This invention provides an outdoor unit for an air-conditioning apparatus as defined in claim 1. Preferred embodiments are defined in the dependent claims. The outdoor unit including a base plate having at least one hole and a socket attached to the base plate with a clearance provided between the socket and a lower surface of the base plate, the socket communicating with the hole to provide a first drainage path. The clearance is provided so as to function as a second drainage path that allows drain water from the hole to be guided out of the outdoor unit when the first drainage path is blocked.

[Advantageous Effects of Invention]

[0010] In the outdoor unit according to the invention, if the first drainage path is blocked with frozen drain water, the clearance functions as the second drainage path. Advantageously, the outdoor unit can be used in cold climate areas.

[Brief Description of Drawings]

[0011]

Fig. 1 is a perspective view of an exemplary appearance of an outdoor unit of an air-conditioning apparatus according to Embodiment 1 of the invention.

Fig. 2 is a perspective view of an exemplary internal configuration of the outdoor unit of the air-conditioning apparatus according to Embodiment 1 of the invention.

Fig. 3 is a perspective view of the outdoor unit of the air-conditioning apparatus according to Embodiment 1 of the invention as seen from below.

Fig. 4 is a perspective view of a configuration of a drain water drainage hose connection socket of the outdoor unit of the air-conditioning apparatus according to Embodiment 1 of the invention.

Fig. 5 is an enlarged view of a hose connection portion of the socket of the outdoor unit of the air-conditioning apparatus according to Embodiment 1 of the invention.

Fig. 6 is a side elevational view of the socket attached to a base plate of the outdoor unit of the air-conditioning apparatus according to Embodiment 1 of the invention.

Fig. 7 is a top plan view of the socket of the outdoor unit of the air-conditioning apparatus according to Embodiment 1 of the invention.

Fig. 8 is a rear view of an outdoor unit of an air-conditioning apparatus according to Embodiment 2 of the invention, lower part of the outdoor unit being illustrated in enlarged view.

Fig. 9 is a perspective view of a base plate of an outdoor unit of an air-conditioning apparatus according to Embodiment 3 of the invention as seen from above.

Fig. 10 is a side elevational view of another configuration of the socket of the outdoor unit of the air-conditioning apparatus according to Embodiment 1 of the invention.

Fig. 11 is a side elevational view of still another configuration of the socket of the outdoor unit of the air-conditioning apparatus according to Embodiment 1 of the invention.

Fig. 12 is a perspective view of the socket of the outdoor unit of the air-conditioning apparatus according to Embodiment 1 of the invention.

Fig. 13 is a front view of the outdoor unit of the air-conditioning apparatus according to Embodiment 1 of the invention in an exemplary installed state.

[Description of Embodiments]

[0012] Embodiments of the invention will be described below with reference to the drawings. Note that the dimensional relationship among components in Fig. 1 and the following figures may be different from the actual one. Furthermore, note that components designated by the same reference numerals in Fig. 1 and the following figures are the same components or equivalents. The above notes are intended to be common throughout this specification. Furthermore, note that the forms of components described in the specification are intended to be illustrative only and are not intended to be limited to the descriptions.

Embodiment 1

[0013] Fig. 1 is a perspective view of an exemplary appearance of an outdoor unit (hereinafter, referred to as an "outdoor unit 100") of an air-conditioning apparatus according to Embodiment 1 of the invention. Fig. 2 is a perspective view of an exemplary internal configuration of the outdoor unit 100. A schematic configuration and operation of the outdoor unit 100 will be described with reference to Figs. 1 and 2. In the air-conditioning apparatus according to Embodiment 1, components (a compressor 6, a heat exchanger 1, a pressure reducing device, and another heat exchanger) mounted in the outdoor unit 100 and an indoor unit (not illustrated) are connected by pipes to achieve a refrigeration cycle operation.

(Schematic Configuration of Outdoor Unit 100)

[0014] As illustrated in Fig. 1, the outdoor unit 100 includes a top panel 31 defining an upper surface, a front panel 32 defining a front surface, side panels 33 each defining a side surface, and a base plate 12 defining a bottom surface so as to be surrounded by the panels and the plate. The base plate 12 is provided with legs 11 for securing the outdoor unit 100 in an installation site. The base plate 12 is further provided with a drain water drainage hose connection socket, which will be described in detail later, such that the socket is disposed in back part of the base plate 12 close to the rear surface of the outdoor unit 100.

[0015] Referring to Fig. 2, the outdoor unit 100 has an interior space partitioned by a separator 10 into an air-sending device chamber 5 and a machine chamber 9. The machine chamber 9 accommodates an electric component (control box) 8 or the like in which, for example, the compressor 6, a refrigerant pipe 7, and a controller are mounted. The air-sending device chamber 5 accommodates the heat exchanger 1 having a plurality of inlets and outlets, a propeller fan 2, a motor 3 to which the propeller fan 2 is attached, and a motor support 4 that supports the motor 3. The components (e.g., the compressor 6, the heat exchanger 1, and the motor support 4) arranged in the outdoor unit 100 are held on the base plate 12.

[0016] The compressor 6 is configured to suck a refrigerant, compress the refrigerant into a high-temperature high-pressure state, and discharge the resultant refrigerant through the refrigerant pipe 7 to a refrigerant circuit. The electric component 8 is configured to accommodate the components, such as the controller for controlling the operation of the outdoor unit 100, and supply power to the components.

[0017] The heat exchanger 1 is configured to exchange heat between outside air and the refrigerant, function as an evaporator in a heating operation, and function as a condenser in a cooling operation. The heat exchanger 1 includes heat transfer pipes through which the refrigerant

is allowed to pass and fins for increasing the area of heat transfer between the refrigerant flowing through the heat transfer pipes and the outside air. The heat exchanger 1 includes a side flat portion 1a, a corner portion 1b, and a rear flat portion 1c and is accordingly L-shaped. Although the L-shaped heat exchanger 1 is illustrated, the heat exchanger 1 may be of a flat type or a U-shaped type that has bent end portions.

[0018] The propeller fan 2 is rotated and driven by the motor 3 and is configured to send air to the heat exchanger 1. The propeller fan 2 operates to allow the air to flow through the side flat portion 1a, the corner portion 1b, and the rear flat portion 1c of the heat exchanger 1 into the outdoor unit 100. The air passes through the propeller fan 2 and flows toward the front of the outdoor unit 100.

[0019] The motor 3 is connected through a rotary shaft to the propeller fan 2 and is configured to rotate and drive the propeller fan 2 in accordance with an instruction from the electric component 8. Furthermore, the motor 3 is supported by the motor support 4. The motor support 4 includes a pillar that extends vertically (in a direction indicated by arrows Z). An upper end of the motor support 4 is connected to upper part of the heat exchanger 1 and a lower end thereof is fastened to the base plate 12 by a bolt or the like.

(Operation of Outdoor Unit 100)

[0020] The refrigerant sent from the indoor unit (not illustrated) is sucked into the compressor 6. The sucked refrigerant is compressed by the compressor 6 and is then discharged from the compressor 6. The refrigerant discharged from the compressor 6 is sent through the refrigerant pipe 7 to the heat exchanger 1. The heat exchanger 1 is supplied with air by the propeller fan 2. For example, since the heat exchanger 1 functions as a condenser in the cooling operation, the refrigerant which has flowed into the heat exchanger 1 is cooled by the air from the propeller fan 2. The air passing through the heat exchanger 1 exchanges heat with the refrigerant flowing through the heat exchanger 1, so that the air is heated.

[0021] The refrigerant cooled in the heat exchanger 1 is discharged from the heat exchanger 1 and is then sent to the pressure reducing device (not illustrated). The refrigerant is expanded and pressure-reduced by the pressure reducing device. The pressure-reduced refrigerant flows into the heat exchanger in the indoor unit. The refrigerant which has flowed into the heat exchanger in the indoor unit cools air supplied through an indoor fan (not illustrated). The cooled air is sent to an air-conditioned space, such as a room, thus achieving the cooling operation. The refrigerant which has cooled the air flows out of the heat exchanger in the indoor unit and is then again sucked into the compressor 6.

(Detailed Configuration of Bottom of Outdoor Unit 100)

[0022] Fig. 3 is a perspective view of the outdoor unit

100 as seen from below. A configuration of the bottom of the outdoor unit 100 will be described in detail with reference to Fig. 3.

[0023] As illustrated in Fig. 3, typically, the base plate 12 of the outdoor unit 100 has a hole 13. Furthermore, the base plate 12 has a slope downwardly extending to the hole 13. The slope allows drain water generated in the outdoor unit 100 and rain water in the air-sending device chamber 5 to be drained through the hole 13. Since the base plate 12 has the slope downwardly extending to the hole 13, water is prevented from remaining on the base plate 12 for a long time. Thus, water can be prevented from freezing on the base plate 12 and rust can be prevented from being formed on the base plate 12. Furthermore, in the outdoor unit 100, the base plate 12 has the single hole 13 to facilitate concentrated drainage.

(Detailed Configuration of Socket 50)

[0024] Fig. 4 is a perspective view of a configuration of the drain water drainage hose connection socket (hereinafter, referred to as a "socket 50") of the outdoor unit 100. Fig. 5 is an enlarged view of a hose connection portion 51 of the socket 50 of the outdoor unit 100. Fig. 6 is a side elevational view of the socket 50 attached to the base plate 12 of the outdoor unit 100. Fig. 7 is a top plan view of the socket 50 of the outdoor unit 100. The socket 50 will be described below with reference to Figs. 4 to 7. In the following description, a lower end of any part or component in a state in which the socket 50 is attached to the base plate 12 will be referred to as a "first end" and an upper end thereof will be referred to as a "second end."

[0025] The socket 50 is disposed in the back part of the base plate 12. Specifically, the socket 50 is attached to the hole 13 of the base plate 12, so that the socket 50 is disposed on the base plate 12. Since the base plate 12 has the single hole 13 as described above with reference to Fig. 3, the number of sockets 50 may also be one. This results in lower cost. Furthermore, drainage arrangement may be performed at a single position in installation of the outdoor unit 100, thus improving the ease of installation.

[0026] The socket 50 includes the hose connection portion 51 to which a drainage hose is connected and a base plate connection portion 52 attached to the base plate 12. The socket 50 is made of resin, for example. Furthermore, the socket 50 and the hole 13 constitute a first drainage path.

[0027] The hose connection portion 51 is a hollow cylinder which has an inlet 51a and an outlet 51b and through which water flows. Specifically, the hose connection portion 51 includes a corrugated part 19 and a cylindrical straight part 20 which are connected in series as illustrated in Fig. 5. While the socket 50 is attached to the base plate 12, the corrugated part 19 is upper part of the socket 50 and the cylindrical straight part 20 is

lower part thereof.

[0028] The corrugated part 19 includes a plurality of downwardly tapered sections and is therefore corrugated. When a rubber tube, serving as a drainage hose, is connected to the corrugated part 19, the rubber tube is easily fitted over the corrugated part 19 because a small lower end of each tapered section of the corrugated part 19 facilitates insertion of the rubber tube on the tapered sections. On the other hand, when the rubber tube is disconnected from the corrugated part 19, it is difficult to detach the rubber tube because a large upper end of each tapered section of the corrugated part 19 acts as a drag. The corrugated part 19 may include any number of tapered sections and each section may have any taper angle.

[0029] Hoses used in installation sites include rubber tubes and vinyl chloride pipes. In the use of a rubber tube as a drainage hose, the rubber tube may be fitted over the corrugated part 19 as described above. In the use of a vinyl chloride pipe as a drainage hose, the vinyl chloride pipe may be fitted over the cylindrical straight part 20. Accordingly, if an installation worker prepares either of the two types of hose, the hose can be connected to the socket 50. Thus, the ease of installation can be improved.

[0030] The cylindrical straight part 20 may be tapered from the outlet 51b to the inlet 51a. Thus, ease of insertion of a pipe to be connected can be improved.

[0031] Fig. 10 is a side elevational view of another configuration of the socket 50 of the outdoor unit 100. Fig. 11 is a side elevational view of still another configuration of the socket 50 of the outdoor unit 100. The other configurations of the socket 50 will be described below with reference to Figs. 10 and 11. Note that the terms "upper" or "top" and "lower" or "bottom" are intended to indicate "upper" or "top" and "lower" or "bottom" in a state in which the socket 50 is attached to the outdoor unit 100.

[0032] Although the hose connection portion 51 illustrated in Fig. 4 includes the corrugated part 19 and the cylindrical straight part 20 connected in series such that the corrugated part 19 is the upper part (on an inlet side) and the cylindrical straight part 20 is the lower part, the hose connection portion 51 may include a cylindrical straight part 20a having a different outside diameter from the cylindrical straight part 20 instead of the corrugated part 19 as illustrated in Fig. 10 such that the cylindrical straight parts 20a and 20 are connected in series. In this case, the cylindrical straight part 20a having a larger outside diameter may be disposed on the upper side (the inlet side). The hose connection portion 51 with this configuration is connectable to vinyl chloride pipes of two different diameters. Thus, the ease of installation can be further improved.

[0033] Although the hose connection portion 51 illustrated in Fig. 10 is stepped to provide two different outside diameters and is connectable to vinyl chloride pipes of two different diameters, the hose connection portion 51 may be stepped to provide three or more different outside diameters and be connectable to vinyl chloride pipes of

three or more different diameters. In such a configuration, each cylindrical straight part may be tapered from the outlet 51a to the inlet 51b, thus improving the ease of insertion of a pipe to be connected.

[0034] Furthermore, as illustrated in Fig. 11, the hose connection portion 51 may include the corrugated part 19, the cylindrical straight part 20, and the cylindrical straight part 20a having a different outside diameter from the cylindrical straight part 20 such that the parts are connected in series. In this case, the corrugated part 19, the cylindrical straight part 20a, and the cylindrical straight part 20 may be connected in that order from the top (the inlet side).

[0035] The base plate connection portion 52 includes an outer wall part 52a, lugs 14, and catches 17. The outer wall part 52a is hollow and defines an outer wall of the base plate connection portion 52. The outer wall part 52a is an isosceles trapezoid in side view such that the diameter of the outer wall part 52a is reduced toward the hose connection portion 51 (in other words, the diameter thereof is increased toward the base plate 12) as illustrated in Fig. 6. Furthermore, the outer wall part 52a has a first end connected to a second end of the hose connection portion 51, namely, the periphery of the inlet 51a. In other words, the base plate connection portion 52 and the hose connection portion 51 are in communication to provide the first drainage path through which water flows. The outer wall part 52a has a second end that is open.

[0036] The lugs 14 each have a first end connected to an inner surface of the outer wall part 52a and a second end projecting toward the base plate 12. The lugs 14 are arranged at regular intervals around the inlet 51a. The second ends of the lugs 14 project beyond the second end of the outer wall part 52a. Specifically, while the socket 50 is attached to the base plate 12, the second end of the outer wall part 52a is not in contact with a lower surface of base-plate back part 15 of the base plate 12 but the second ends of the lugs 14 are in contact with the lower surface of the base-plate back part 15 of the base plate 12. Consequently, a clearance 16 can be provided between the lower surface of the base-plate back part 15 of the base plate 12 and the second end of the outer wall part 52a of the socket 50. This clearance 16 functions as a second drainage path.

[0037] Although each lug 14 is a single-piece flat plate and the lugs 14 are radially arranged in Fig. 4, the lugs 14 may have any shape and be arranged in any pattern. For example, each lug 14 may be V-shaped, cross-shaped, or W-shaped when viewed from above. Furthermore, the lugs 14 may be arranged orthogonal to a radial direction of the socket 50. In other words, the lugs 14 may have any shape and be arranged in any pattern unless the clearance 16 can be provided and drain water can be drained through the clearance 16.

[0038] Each of the catches 17 has a first end connected to the inner surface of the outer wall part 52a and a second end projecting toward the base plate 12. The catch 17 includes a support 17a and a protrusion 17b and is

configured to fasten the socket 50 to the base plate 12 such that when the catch 17 is inserted into the hole 13, the protrusion 17b is engaged with a peripheral edge of the hole 13 inside the outdoor unit 100. Accordingly, the support 17a of the catch 17 is longer than the lug 14. The protrusion 17b protrudes outwardly from a free end of the support 17a.

[0039] Attachment of the socket 50 will be described in brief below. When parts of the supports 17a of the catches 17 are inserted together with the protrusions 17b into the hole 13, the protrusions 17b are pressed inward by the hole 13, so that the supports 17a are elastically deformed. After that, when pressure applied to the protrusions 17b by the hole 13 is released, the supports 17a are restored. At this time, the protrusions 17b are engaged with the peripheral edge of the hole 13 inside the outdoor unit 100. Thus, the socket 50 is attached to the base plate 12. It is only required that at least two catches 17 be arranged.

[0040] Fig. 12 is a perspective view of the socket 50 of the outdoor unit 100. Another configuration of the catch 17 will be described with reference to Fig. 12. The support 17a of each catch 17 has an elongated hole 17c as illustrated in Fig. 12. Accordingly, the catch 17 is easy to deform, thus improving ease of attachment of the socket 50. Although it is preferred that the elongated hole 17c be a slit, the dimensions of the elongated hole 17c may be determined relative to the lugs 14. The elongated hole 17c may have any shape and size.

[0041] To attach the socket 50 to the base plate 12, upper ends (on an inflow side) of the lugs 14 are come into contact with an outer surface of the base plate 12 and the catches 17 are then engaged with an inner surface of the base plate 12, so that the socket 50 is stably fastened to the base plate 12. Arrangement of the upper ends (on the inflow side) of the lugs 14 under the protrusions 17b enables more stable fastening. In this arrangement, if the support 17a of each catch 17 has no elongated hole 17c, water would not be drained at a position (hereinafter, referred to as an "intersection") in which the support 17a of the catch 17 intersects the corresponding lug 14, thus facilitating growth of ice. The support 17a therefore has the elongated hole 17c.

[0042] Specifically, each catch 17 straddles the lug 14 such that the lug 14 extends through the elongated hole 17c of the catch 17. Accordingly, if water is accumulated at the intersection, the water can be drained through the elongated hole 17c. Advantageously, ice does not tend to grow at the intersection.

[0043] The clearance 16 is intentionally provided so as to be greater than or equal to 5 mm by arranging the lugs 14 around the inlet 51a of the socket 50 and bringing the second ends of the lugs 14 into contact with the lower surface of the base-plate back part 15. If drain water freezes in a connected hose or the drain water drainage path in the socket 50 such that ice grows in the backflow direction, the clearance 16 allows drain water to flow out of the outdoor unit 100 before the ice intrudes into the

outdoor unit 100. In other words, if the first drainage path is blocked with ice, the clearance 16 can function as the second drainage path such that drain water is continuously drained. Advantageously, the likelihood of the outdoor unit 100 being damaged due to frozen drain water can be significantly reduced.

[0044] Fig. 13 is a front view of the outdoor unit 100 in an exemplary installed state. The clearance 16 will be described with reference to Fig. 13. The outdoor unit 100 of the air-conditioning apparatus is typically installed such that the legs 11 are fixed to mounts 101 as illustrated in Fig. 13. Furthermore, the socket 50 has to be disposed in a placement space provided between the base plate 12 and a lower surface of each mount 101.

[0045] The clearance 16 greater than or equal to 5 mm is provided as described above. As the clearance 16 is larger, the drainage is more effectively enhanced. Since the socket 50 has to be disposed in the placement space, however, the length or height of the socket 50 is preferably short as much as possible. Increasing the clearance 16 causes the length of the socket 50 to be increased. Considering the placement space for the socket 50 and the length of the hose connection portion 51, it is therefore preferred that the clearance 16 be up to 15 mm.

[0046] Upon fastening the socket 50 to the base plate 12, the second ends of the lugs 14 are in contact with the lower surface of the base-plate back part 15. Accordingly, at least two catches 17 enable the socket 50 to be stably attached to the base plate 12 with no inclination. The at least two catches 17 are preferably arranged so as to be opposed to each other.

[0047] Although a clearance is illustrated in Fig. 4 of Patent Literature 1 described as related art, this clearance illustrated in Fig. 4 of Patent Literature 1 is a very small clearance provided for engagement between a socket and a base plate and has a completely different function from the clearance 16 illustrated in Fig. 6. Specifically, the clearance 16 is provided not for engagement between the socket 50 and the base plate 12 but for drainage of drain water, flowing from the inside of the outdoor unit 100, out of the outdoor unit 100 without using the drainage hose while the drain water drainage path (first drainage path) is blocked with frozen drain water.

[0048] Furthermore, the socket 50 includes a rib 18 as illustrated in Fig. 7. The rib 18 may be disposed in the drain water drainage path (first drainage path) and may be provided for at least one of the hose connection portion 51 and the base plate connection portion 52. The rib 18 is provided so as to extend across a cross-section of the drain water drainage path.

[0049] A bird or another small animal can intrude into a typical related-art outdoor unit through a hole in a base plate of the outdoor unit and build a nest inside the outdoor unit, thus damaging the outdoor unit. This is a common occurrence. In normal climate areas, a drain water drainage hose connection socket can be attached to the base plate in order to close the hole, thereby considerably preventing the intrusion of a bird or another small animal

into the outdoor unit. In cold climate areas, however, the use of the drain water drainage hose connection socket has been prohibited. Unfortunately, there have been no effective countermeasures against the intrusion of a bird or another small animal through the hole of the base plate under present circumstances.

[0050] The socket 50 includes the rib 18 disposed in the drain water drainage path such that the rib 18 extends across a cross-section of the drainage path, thus partly closing the hole 13 of the base plate 12. This eliminates an intrusion space for birds and small animals and therefore considerably prevents birds and small animals from building a nest in the outdoor unit 100. The rib 18 may have any shape and size and any number of ribs 18 may be arranged. The shape and size of the rib 18 and the number of ribs 18 may be determined on the basis of the diameter of the hole 13 and the sizes of birds and small animals likely to intrude. Furthermore, the rib 18 may be separate from the socket 50 and be attachable to the socket 50. The rib 18 may be made of any material.

[0051] As described above, since the outdoor unit 100 includes the socket 50 capable of providing the clearance 16 when attached to the base plate 12, the outdoor unit 100 can be used in cold climate areas. In addition, since the hose connection portion 51 of the socket 50 is configured such that any of a rubber tube and a vinyl chloride pipe can be fitted on the hose connection portion 51, the ease of installation can be improved.

Embodiment 2

[0052] Fig. 8 is a rear view of an outdoor unit (hereinafter, referred to as an "outdoor unit 100A") of an air-conditioning apparatus according to Embodiment 2 of the invention, lower part of the outdoor unit 100A being illustrated in enlarged view. A configuration of the outdoor unit 100A will be described with reference to Fig. 8. In the air-conditioning apparatus according to Embodiment 2, components (a compressor 6, a heat exchanger 1, a pressure reducing device, and another heat exchanger) mounted in the outdoor unit 100A and an indoor unit (not illustrated) are connected by pipes to achieve a refrigeration cycle operation. In Embodiment 2, the difference from Embodiment 1 described above will be mainly described. The same functional components as those in Embodiment 1 are designated by the same reference numerals and description thereof is omitted.

[0053] In Embodiment 1, the base plate 12 has the single hole 13 and the single socket 50 is disposed. In Embodiment 2, a base plate 12 has a plurality of holes 13 and multiple sockets 50 are arranged as illustrated in Fig. 8. If any one of the holes 13 is completely blocked with frozen drain water, therefore, drainage can be achieved through the other holes 13, thus leading to more certainty of preventing freezing. In the use of multiple sockets 50, if the base plate 12 has slopes each downwardly extending to the hole 13, water does not remain on the base plate 12 for a long time, thus preventing water

from freezing. Advantageously, this leads to further improved certainty of preventing freezing.

[0054] Like the outdoor unit 100 of the air-conditioning apparatus according to Embodiment 1, the outdoor unit 100A is provided with the sockets 50 capable of providing a clearance 16 when attached to the base plate 12, as described above. Accordingly, the outdoor unit 100A can be used in cold climate areas. Furthermore, since each socket 50 includes a hose connection portion 51 configured such that any of a rubber tube and a vinyl chloride pipe can be fitted on the hose connection portion 51, the ease of installation can be improved. In addition, since the multiple holes 13 are arranged, the certainty of preventing freezing is increased.

Embodiment 3

[0055] Fig. 9 is a perspective view of a base plate of an outdoor unit (hereinafter, referred to as an "outdoor unit 100B") of an air-conditioning apparatus according to Embodiment 3 of the invention when viewed from above. A configuration of the outdoor unit 100B will be described with reference to Fig. 9. In the air-conditioning apparatus according to Embodiment 3, components (a compressor 6, a heat exchanger 1, a pressure reducing device, and another heat exchanger) mounted in the outdoor unit 100B and an indoor unit (not illustrated) are connected by pipes to achieve a refrigeration cycle operation. In Embodiment 3, the difference from Embodiment 1 described above will be mainly described. The same functional components as those in Embodiment 1 are designated by the same reference numerals and description thereof is omitted.

[0056] In Embodiment 3, a heater 21 is disposed on a base plate 12. Consequently, heat generated by the heater 21 is transferred to the base plate 12, thereby preventing drain water from freezing. Accordingly, the outdoor unit 100B achieves drainage through a hole 13 of the base plate 12, a socket 50, and a drainage hose in that order with high certainty.

[0057] Like the outdoor unit 100 of the air-conditioning apparatus according to Embodiment 1, the outdoor unit 100B includes the socket 50 capable of providing a clearance 16 when attached to the base plate 12, as described above. Accordingly, the outdoor unit 100B can be used in cold climate areas. Additionally, since the socket 50 includes a hose connection portion 51 configured such that any of a rubber tube and a vinyl chloride pipe can be fitted on the hose connection portion 51, the ease of installation can be improved. Furthermore, since the heater 21 is provided, the certainty of normal drainage is increased. Note that the heater 21 may be disposed in Embodiment 2.

[Reference Signs List]

[0058] 1, heat exchanger; 1a, side flat portion; 1b, corner portion; 1c, rear flat portion; 2, propeller fan; 3, motor;

4, motor support; 5, air-sending device chamber; 6, compressor; 7, refrigerant pipe; 8, electric component; 9, machine chamber; 10, separator; 11, leg; 12, base plate; 13, hole; 14, lug; 15, base-plate back part; 16, clearance; 17, catch; 17a, support; 17b, protrusion; 17c, elongated hole; 18, rib; 19, corrugated part; 20, cylindrical straight part; 20a, cylindrical straight part; 21, heater; 31, top panel; 32, front panel; 33, side panel; 50, socket; 51, hose connection portion; 51a, inlet; 51b, outlet; 52, base plate connection portion; 52a, outer wall part; 100, outdoor unit; 100A, outdoor unit; 100B, outdoor unit; and 101, mount.

Claims

1. An outdoor unit (100, 100A, 100B) for an air-conditioning apparatus, the outdoor unit (100, 100A, 100B) comprising:

a base plate (12) having at least one hole (13) for drainage; and
a socket (50) attached to the base plate (12) with a clearance (16) provided between the socket (50) and a lower surface of the base plate (12), the socket (50) communicating with the hole (13) to form a first drainage path,
wherein the clearance (16) is provided so as to function as a second drainage path that allows drain water from the hole (13) to be guided out of the outdoor unit (100, 100A, 100B) when the first drainage path is blocked,
wherein the socket (50) includes a base plate connection portion (52) attached to the base plate (12),
wherein the base plate connection portion (52) includes

an outer wall part (52a) that is hollow and serves as an outer wall of the base plate connection portion (52), the outer wall part (52a) being shaped so as to expand toward the base plate (12) in side view,
a lug (14) having a first end connected to an inner surface of the outer wall part (52a) and a second end projecting beyond a top end of the outer wall part (52a), and
a catch (17) having a first end connected to the inner surface of the outer wall part (52a) and a second end projecting beyond the second end of the lug (14), and

wherein the catch (17) extends through the hole (13) and the second end of the lug (14) is in contact with the lower surface of the base plate (12) such that the clearance (16) is provided between the top end of the outer wall part (52a) and the lower surface of the base plate (12).

2. The outdoor unit (100, 100A, 100B) of claim 1 or 2, wherein the clearance (16) is greater than or equal to 5 mm.

3. The outdoor unit (100, 100A, 100B) of claim 1 or claim 2, wherein the catch (17) has a slit-shaped elongated hole (17c).

4. The outdoor unit (100, 100A, 100B) of any one of claims 1 to 3, further comprising:
a rib (18) disposed in the first drainage path so as to extend across a cross-section of the first drainage path.

5. The outdoor unit (100, 100A, 100B) of any one of claims 1 to 4, wherein the socket (50) includes a hose connection portion (51) including a corrugated part (19) and a cylindrical straight part (20) connected in series.

6. The outdoor unit (100, 100A, 100B) of any one of claims 1 to 4,
wherein the socket (50) includes a hose connection portion (51) including a plurality of cylindrical straight parts (20, 20a) having different outside diameters connected in series, and
wherein a cylindrical straight part (20) having a larger outside diameter is disposed closer to the base plate (12).

7. The outdoor unit (100, 100A, 100B) of any one of claims 1 to 4,
wherein the socket (50) includes a hose connection portion (51) including a corrugated part (19) and a plurality of cylindrical straight parts (20, 20a) having different outside diameters connected in series, and
wherein the corrugated part (19), a cylindrical straight part (20a) having a larger outside diameter of the plurality of cylindrical straight parts (20, 20a), and a cylindrical straight part (20) having a smaller outside diameter of the plurality of cylindrical straight parts (20) are arranged in order from a side close to the base plate (12).

8. The outdoor unit (100A) of any one of claims 1 to 7, wherein the at least one hole (13) of the base plate (12) includes a plurality of holes (13).

9. The outdoor unit (100B) of any one of claims 1 to 8, further comprising
a heater (21) disposed on the base plate (12).

Patentansprüche

1. Außeneinheit (100, 100A, 100B) für eine Klimaanlage, wobei die Außeneinheit (100, 100A, 100B) umfasst:

eine Grundplatte (12) mit mindestens einer Öffnung (13) zur Drainage; und einen Stutzen (50), der an der Grundplatte (12) befestigt ist, mit einem Freiraum (16), der zwischen dem Stutzen (50) und einer unteren Oberfläche der Grundplatte (12) vorgesehen ist, wobei der Stutzen (50) mit der Öffnung (13) kommuniziert, um einen ersten Ablaufpfad zu bilden, wobei der Freiraum (16) vorgesehen ist, um als ein zweiter Ablaufpfad zu wirken, der es ermöglicht, dass Ablaufwasser aus der Öffnung (13) aus der Außeneinheit (100, 100A, 100B) heraus geleitet werden kann, wenn der erste Ablaufpfad blockiert ist, wobei der Stutzen (50) einen Grundplattenverbindungsabschnitt (52) aufweist, der an der Grundplatte (12) befestigt ist, wobei der Grundplattenverbindungsabschnitt (52) aufweist:

einen Außenwandteil (52a), der hohl ist und als eine Außenwand des Grundplattenverbindungsabschnitts (52) dient, wobei der Außenwandteil (52a) geformt ist, um in Seitenansicht sich zur Grundplatte (12) zu erweitern, einen Distanzstück (14) mit einem ersten Ende, das mit einer inneren Oberfläche des Außenwandteils (52a) verbunden ist, und einem zweiten Ende, das über ein oberes Ende des Außenwandteils (52a) hinausragt, und eine Arretierung (17) mit einem ersten Ende, das mit der inneren Oberfläche des Außenwandteils (52a) verbunden ist, und einem zweiten Ende, das über das zweite Ende des Distanzstückes (14) hinausragt, und

wobei sich die Arretierung (17) durch die Öffnung (13) erstreckt und das zweite Ende des Distanzstückes (14) mit der unteren Oberfläche der Grundplatte (12) derart in Kontakt ist, dass der Freiraum (16) zwischen dem oberen Ende des Außenwandteils (52a) und der unteren Oberfläche der Grundplatte (12) bereitgestellt wird.

2. Außeneinheit (100, 100A, 100B) nach Anspruch 1 oder 2, wobei der Freiraum (16) größer als oder gleich 5 mm ist.
3. Außeneinheit (100, 100A, 100B) nach Anspruch 1 oder Anspruch 2, wobei die Arretierung (17) ein schlitzförmiges längliches Loch (17c) aufweist.
4. Außeneinheit (100, 100A, 100B) nach einem der Ansprüche 1 bis 3, ferner umfassend: eine Rippe (18), die im ersten Ablaufpfad angeordnet

ist, um sich über einen Querschnitt des ersten Ablaufpfades zu erstrecken.

5. Außeneinheit (100, 100A, 100B) nach einem der Ansprüche 1 bis 4, wobei der Stutzen (50) einen Schlauchverbindungsabschnitt (51) mit einem gewellten Teil (19) und einem zylinderförmigen geraden Teil (20) aufweist, die in Reihe verbunden sind.
6. Außeneinheit (100, 100A, 100B) nach einem der Ansprüche 1 bis 4, wobei der Stutzen (50) einen Schlauchverbindungsabschnitt (51) mit einer Vielzahl von zylinderförmigen geraden Teilen (20, 20a) mit unterschiedlichen Außendurchmessern aufweist, die in Reihe verbunden sind, und wobei ein zylinderförmiger gerader Teil (20) mit einem größeren Außendurchmesser näher an der Grundplatte (12) angeordnet ist.
7. Außeneinheit (100, 100A, 100B) nach einem der Ansprüche 1 bis 4, wobei der Stutzen (50) einen Schlauchverbindungsabschnitt (51) mit einem gewellten Teil (19) und einer Vielzahl von zylinderförmigen geraden Teilen (20, 20a) mit unterschiedlichen Außendurchmessern aufweist, die in Reihe verbunden sind, und wobei der gewellte (19), ein zylinderförmiger gerader Teil (20a) mit einem größeren Außendurchmesser der Vielzahl von zylinderförmigen geraden Teilen (20, 20a) und ein zylinderförmiger gerader Teil (20) mit einem kleineren Außendurchmesser der Vielzahl von zylinderförmigen geraden Teilen (20) in Reihenfolge von einer Seite nahe der Grundplatte (12) angeordnet sind.
8. Außeneinheit (100A) nach einem der Ansprüche 1 bis 7, wobei die mindestens eine Öffnung (13) der Grundplatte (12) eine Vielzahl von Öffnungen (13) aufweist.
9. Außeneinheit (100B) nach einem der Ansprüche 1 bis 8, ferner umfassend einen Heizer (21), der auf der Grundplatte (12) angeordnet ist.

Revendications

1. Unité extérieure (100, 100A, 100B) pour un climatiseur, l'unité extérieure (100, 100A, 100B) comprenant :

une plaque de base (12) ayant au moins un trou (13) pour le drainage ; et
une douille (50) fixée à la plaque de base (12) avec un jeu (16) prévu entre la douille (50) et une surface inférieure de la plaque de base (12),

la douille (50) communiquant avec le trou (13) afin de former une première trajectoire de drainage, dans laquelle le jeu (16) est prévu afin de servir de seconde trajectoire de drainage qui permet à l'eau de drain provenant du trou (13) d'être guidée à l'extérieur de l'unité extérieure (100, 100A, 100B) lorsque la première trajectoire de drainage est bloquée, dans laquelle la douille (50) comprend une partie de raccordement de plaque de base (52) fixée à la plaque de base (12), dans laquelle la partie de raccordement de plaque de base (52) comprend :

une partie de paroi externe (52a) qui est creuse et sert de paroi externe de la partie de raccordement de plaque de base (52), la partie de paroi externe (52a) étant formée afin de subir une expansion vers la plaque de base (12) sur une vue latérale, une patte (14) ayant une première extrémité raccordée à une surface interne de la partie de paroi externe (52a) et une seconde extrémité faisant saillie au-delà d'une extrémité supérieure de la partie de paroi externe (52a), et un loquet (17) ayant une première extrémité raccordée à la surface interne de la partie de paroi externe (52a) et une seconde extrémité faisant saillie au-delà de la seconde extrémité de la patte (14), et

le loquet (17) s'étendant à travers le trou (13) et la seconde extrémité de la patte (14) étant en contact avec la surface inférieure de la plaque de base (12) de sorte que le jeu (16) est prévu entre l'extrémité supérieure de la partie de paroi externe (52a) et la surface inférieure de la plaque de base (12).

2. Unité extérieure (100, 100A, 100B) selon la revendication 1 ou 2, dans laquelle le jeu (16) est supérieur ou égal à 5 mm.

3. Unité extérieure (100, 100A, 100B) selon la revendication 1 ou la revendication 2, dans laquelle le loquet (17) a un trou allongé en forme de fente (17c).

4. Unité extérieure (100, 100A, 100B) selon l'une quelconque des revendications 1 à 3, comprenant en outre : une nervure (18) disposée dans la première trajectoire de drainage afin de s'étendre sur une section transversale de la première trajectoire de drainage.

5. Unité extérieure (100, 100A, 100B) selon l'une quelconque des revendications 1 à 4, dans laquelle la

douille (50) comprend une partie de raccordement de tuyau flexible (51) comprenant une partie ondulée (19) et une partie droite cylindrique (20) raccordées en série.

6. Unité extérieure (100, 100A, 100B) selon l'une quelconque des revendications 1 à 4, dans laquelle la douille (50) comprend une partie de raccordement de tuyau flexible (51) comprenant une pluralité de parties droites cylindriques (20, 20a) ayant différents diamètres extérieurs raccordés en série, et dans laquelle une partie droite cylindrique (20) ayant un plus grand diamètre extérieur est disposée plus à proximité de la plaque de base (12).

7. Unité extérieure (100, 100A, 100B) selon l'une quelconque des revendications 1 à 4, dans laquelle la douille (50) comprend une partie de raccordement de tuyau flexible (51) comprenant une partie ondulée (19) et une pluralité de parties droites cylindriques (20, 20a) ayant des diamètres externes différents, raccordés en série, et dans laquelle la partie ondulée (19), une partie droite cylindrique (20a) ayant un plus grand diamètre extérieur de la pluralité de parties droites cylindriques (20, 20a) et une partie droite cylindrique (20) ayant un plus petit diamètre extérieur de la pluralité de parties droites cylindriques (20) sont agencées dans l'ordre à partir d'un côté à proximité de la plaque de base (12).

8. Unité extérieure (100A) selon l'une quelconque des revendications 1 à 7, dans laquelle l'au moins un trou (13) de la plaque de base (12) comprend une pluralité de trous (13).

9. Unité extérieure (100B) selon l'une quelconque des revendications 1 à 8, comprenant en outre : un dispositif de chauffage (21) disposé sur la plaque de base (12).

FIG. 1

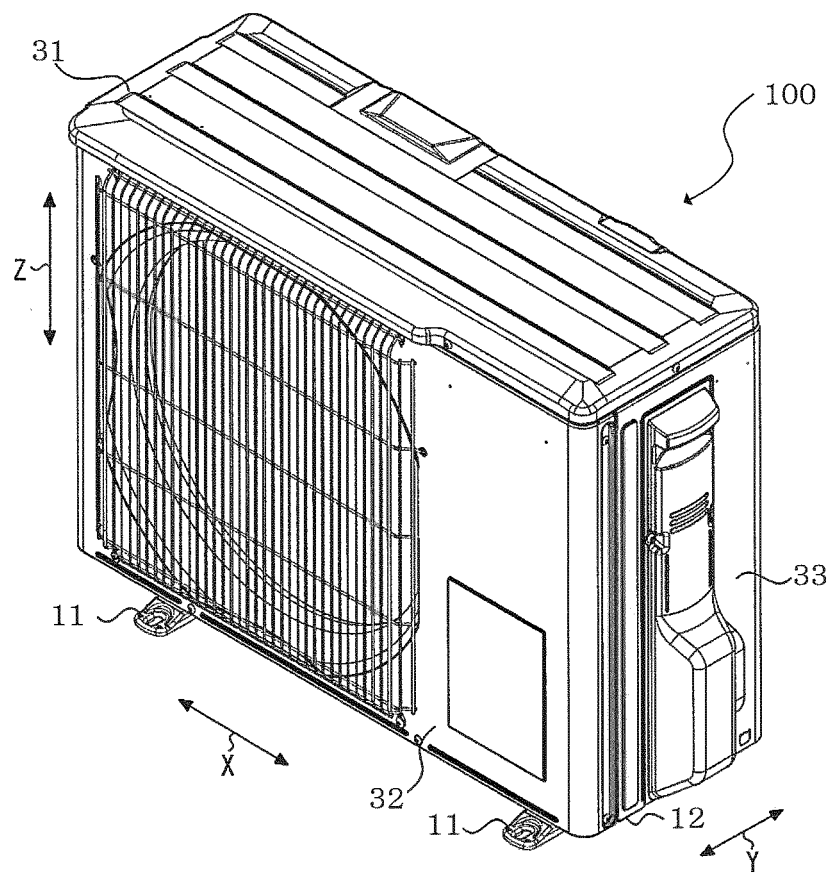

FIG. 2

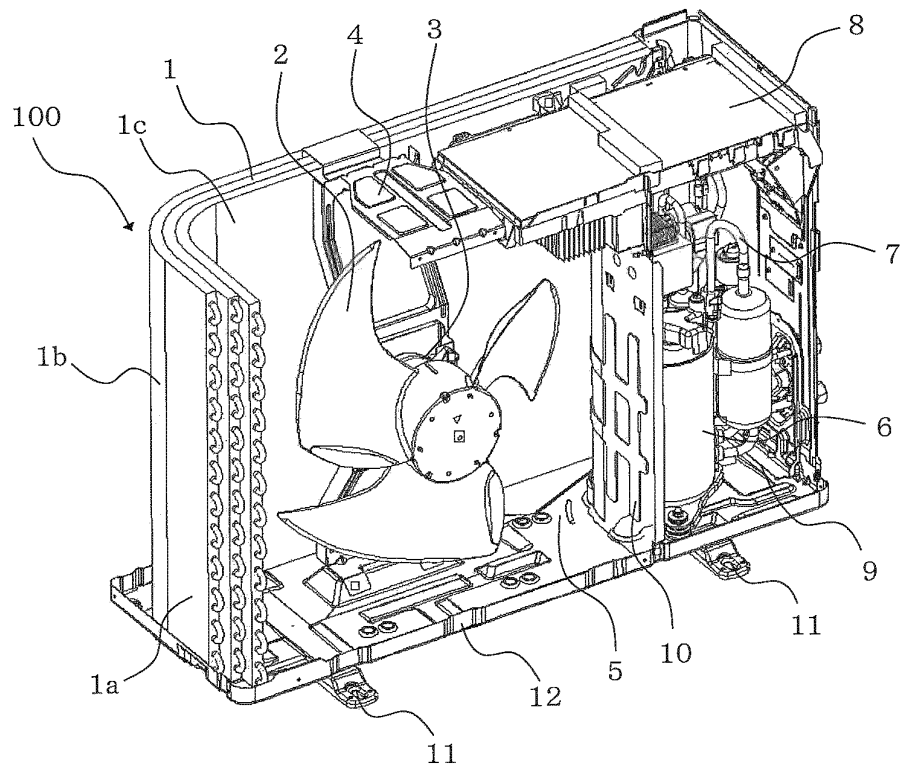

FIG. 3

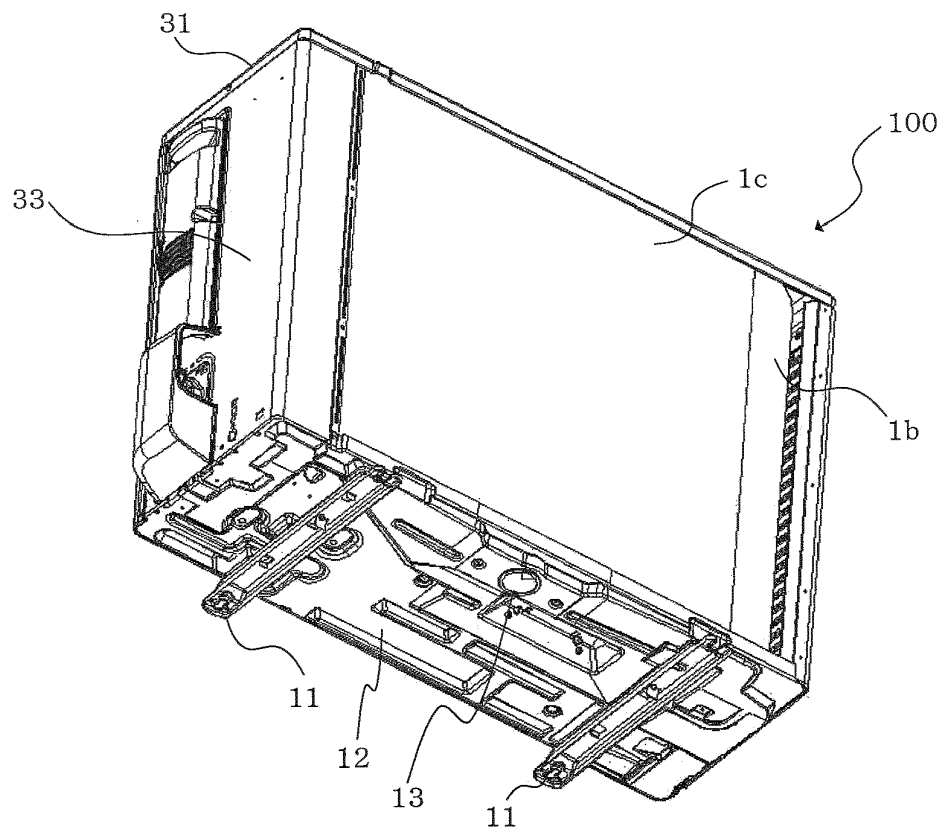

FIG. 4

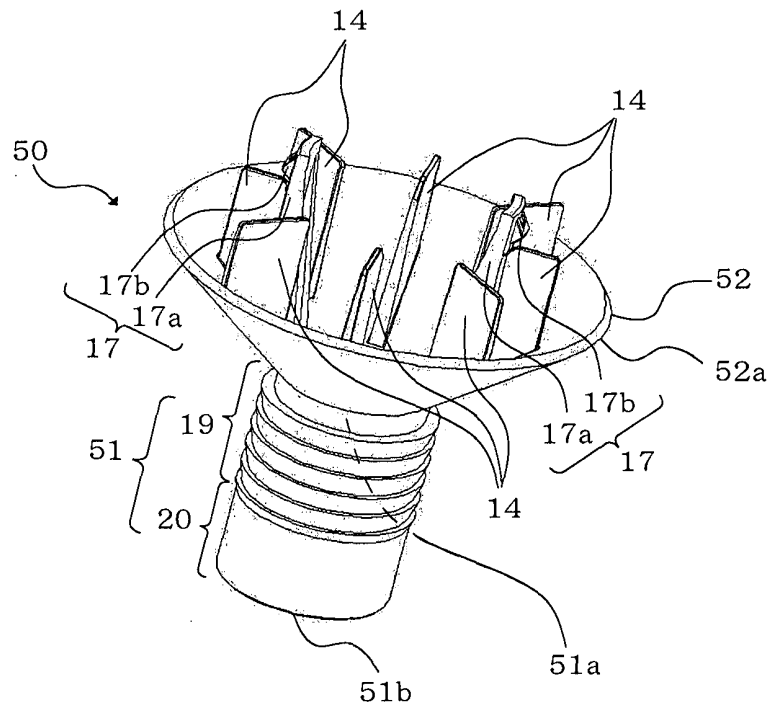
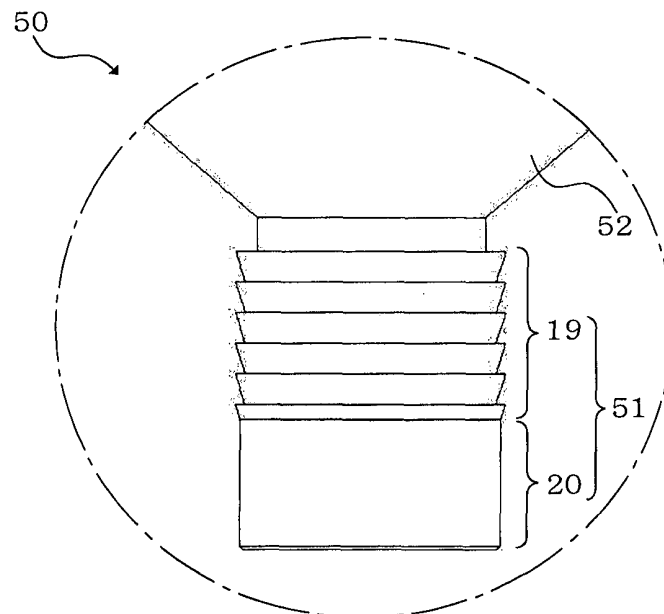

FIG. 5

BASE-PLATE BACK PART CONNECTION SIDE



DRAINAGE HOSE CONNECTION SIDE

FIG. 6

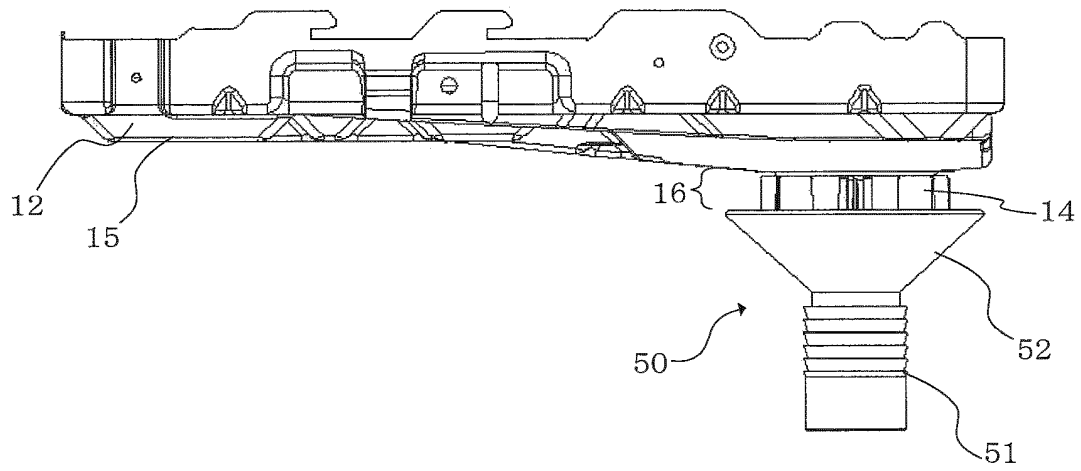

FIG. 7

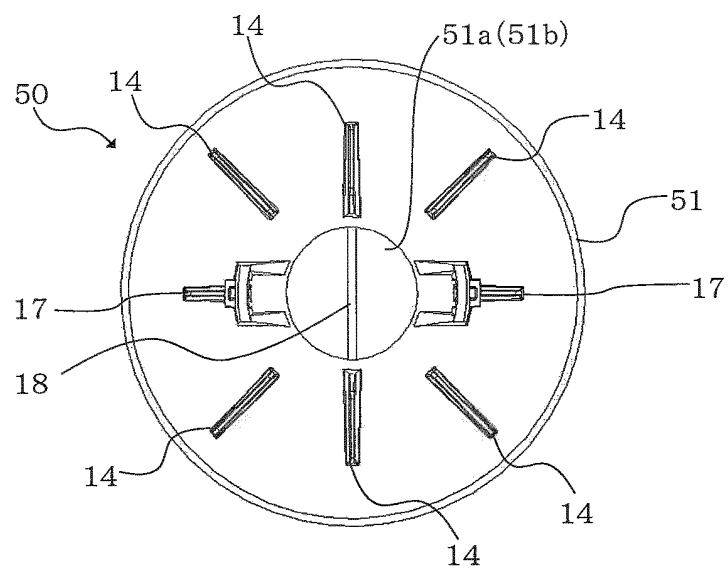

FIG. 8

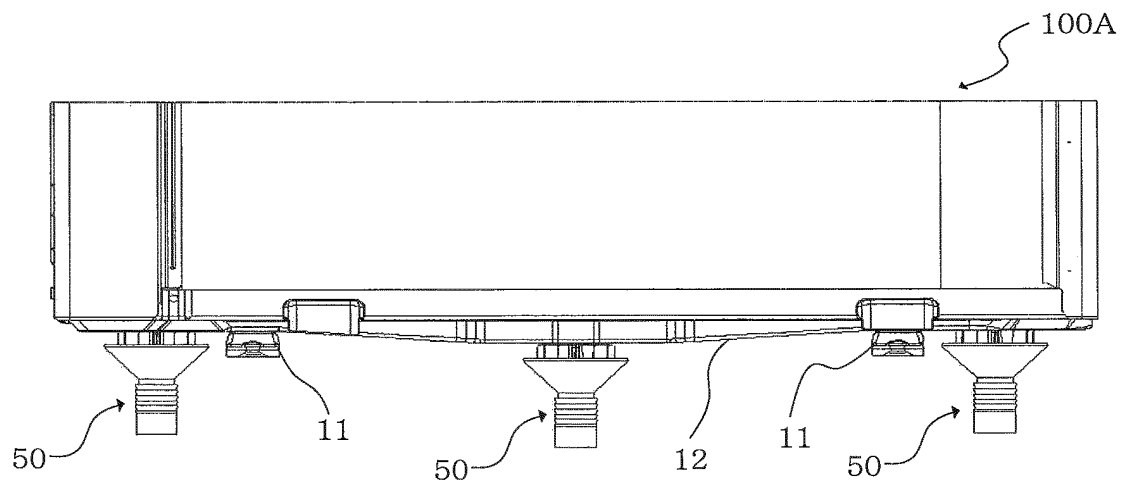

FIG. 9

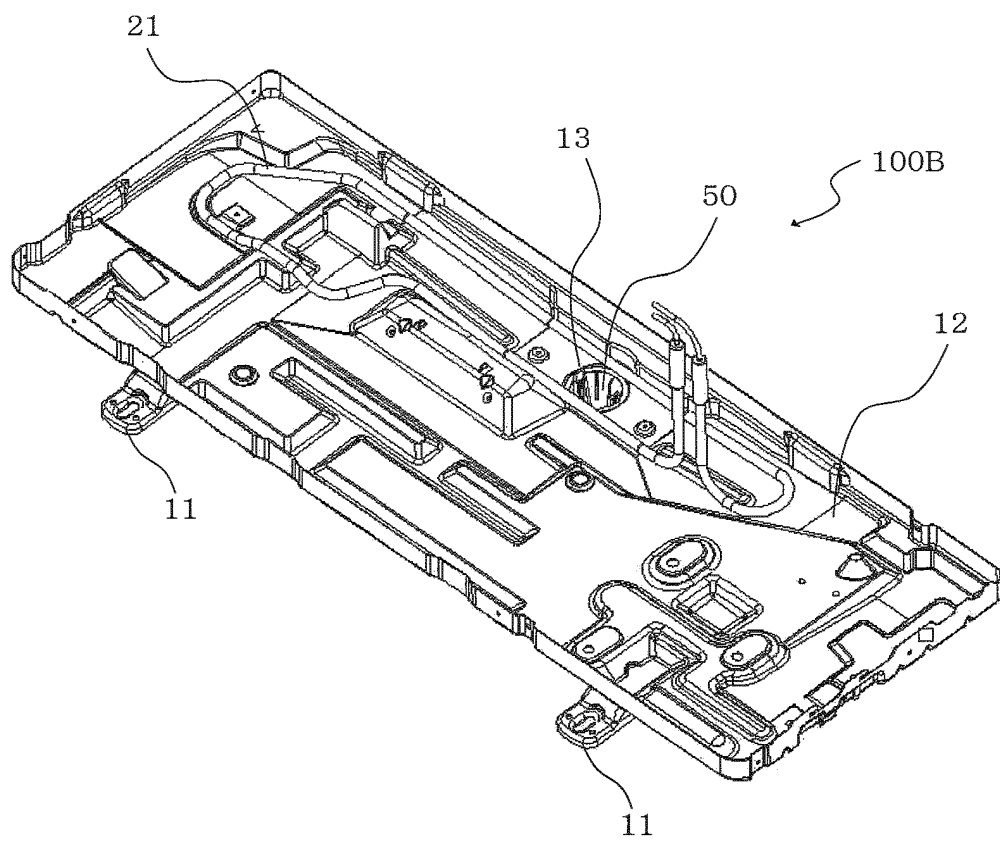

FIG. 10

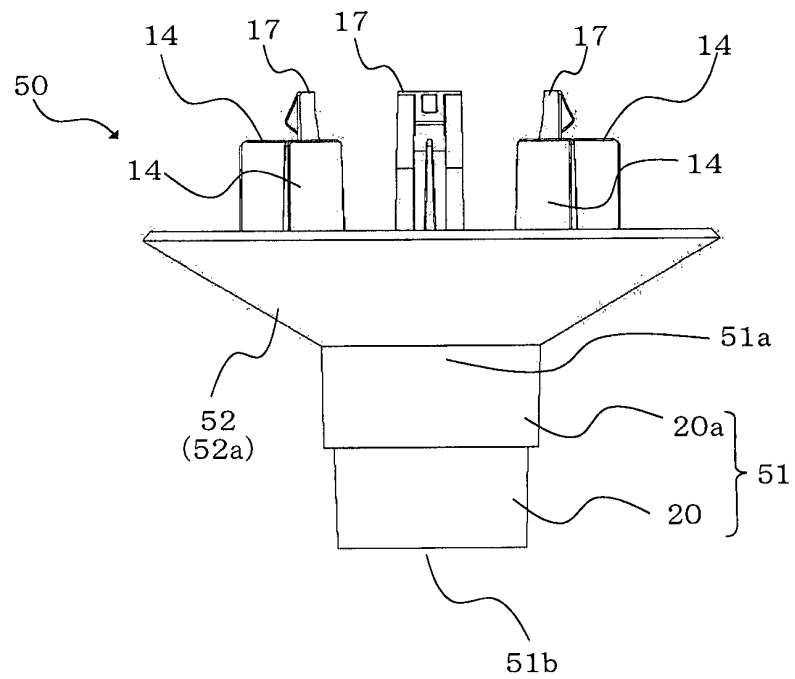

FIG. 11

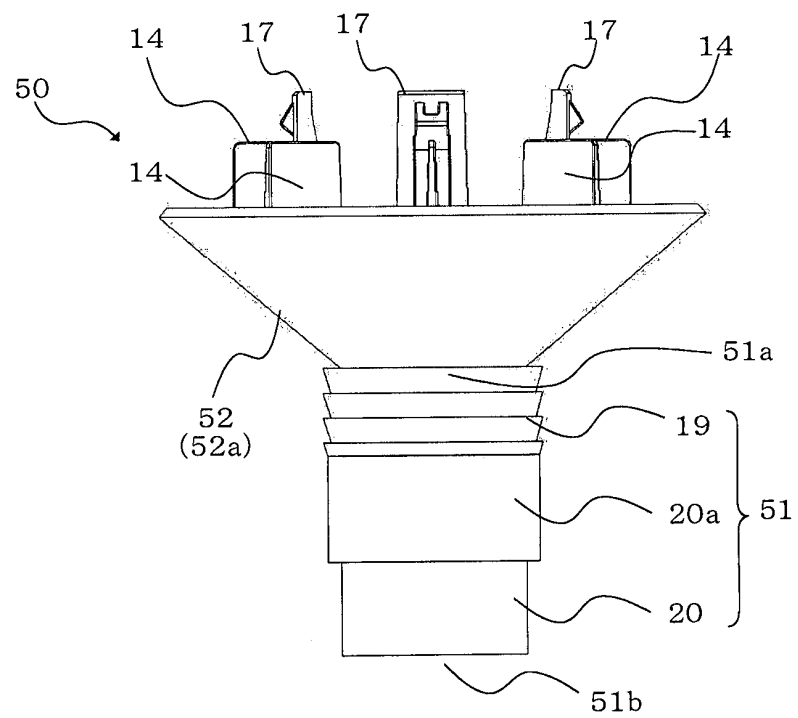

FIG. 12

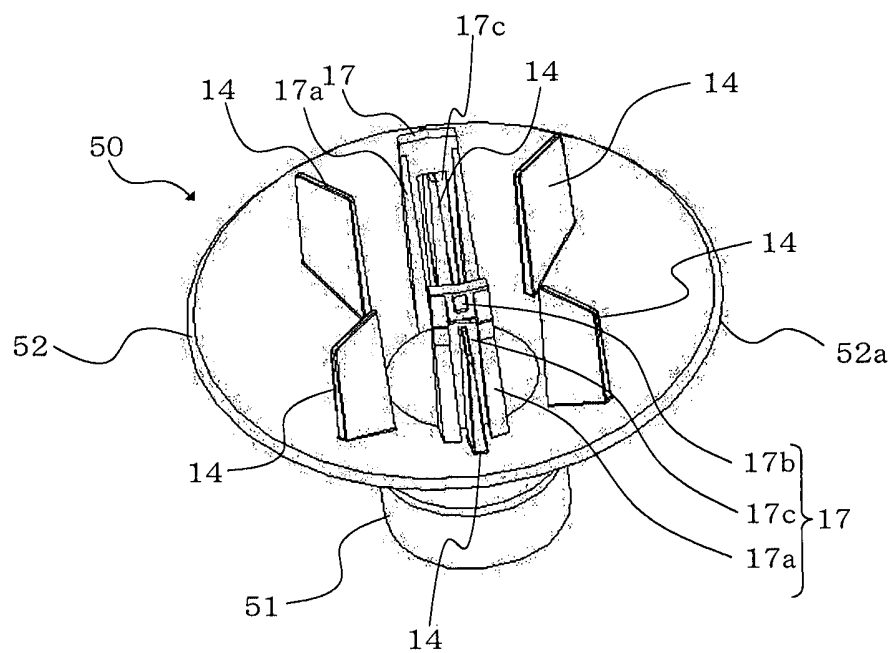
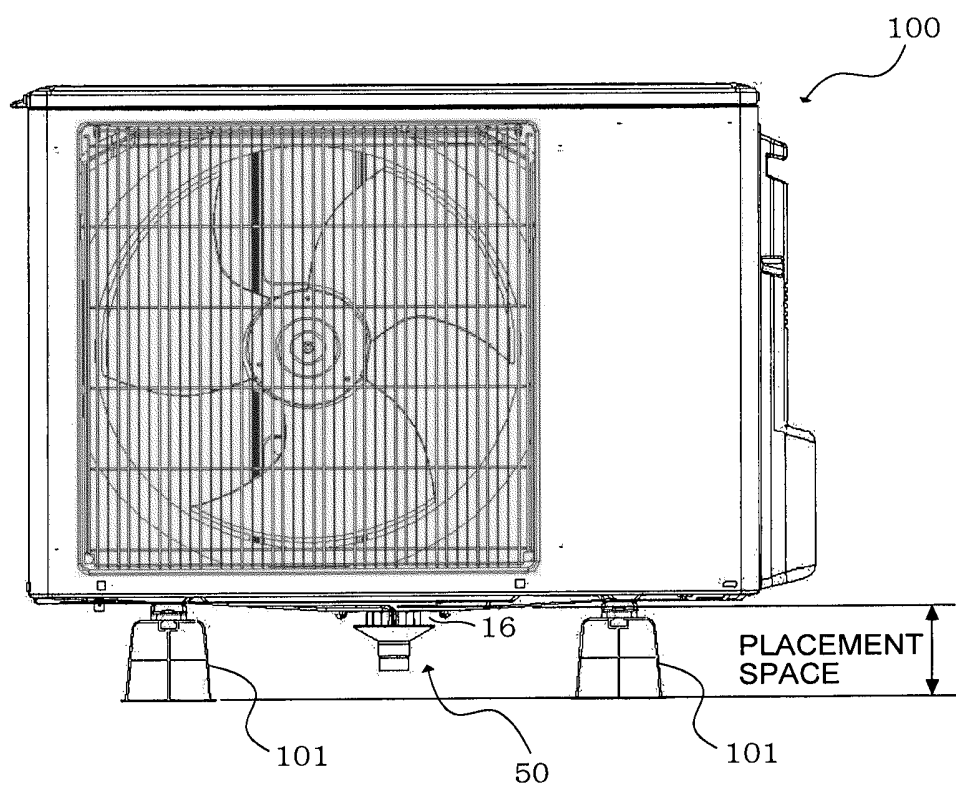

FIG. 13



REFERENCES CITED IN THE DESCRIPTION

This list of references cited by the applicant is for the reader's convenience only. It does not form part of the European patent document. Even though great care has been taken in compiling the references, errors or omissions cannot be excluded and the EPO disclaims all liability in this regard.

Patent documents cited in the description

- JP 2007064507 A [0003]