



(12) **DEMANDE DE BREVET CANADIEN**
CANADIAN PATENT APPLICATION

(13) **A1**

(86) Date de dépôt PCT/PCT Filing Date: 2018/12/13
(87) Date publication PCT/PCT Publication Date: 2019/06/20
(85) Entrée phase nationale/National Entry: 2020/06/10
(86) N° demande PCT/PCT Application No.: US 2018/065447
(87) N° publication PCT/PCT Publication No.: 2019/118725
(30) Priorité/Priority: 2017/12/13 (US62/598,369)

(51) Cl.Int./Int.Cl. *A61N 1/05* (2006.01)
(71) Demandeur/Applicant:
NEUROS MEDICAL, INC., US
(72) Inventeur/Inventor:
SNYDER, JON JOSEPH, US
(74) Agent: MACRAE & CO.

(54) Titre : DISPOSITIFS DE DEPLOIEMENT DE MANCHONS POUR LES NERFS
(54) Title: NERVE CUFF DEPLOYMENT DEVICES

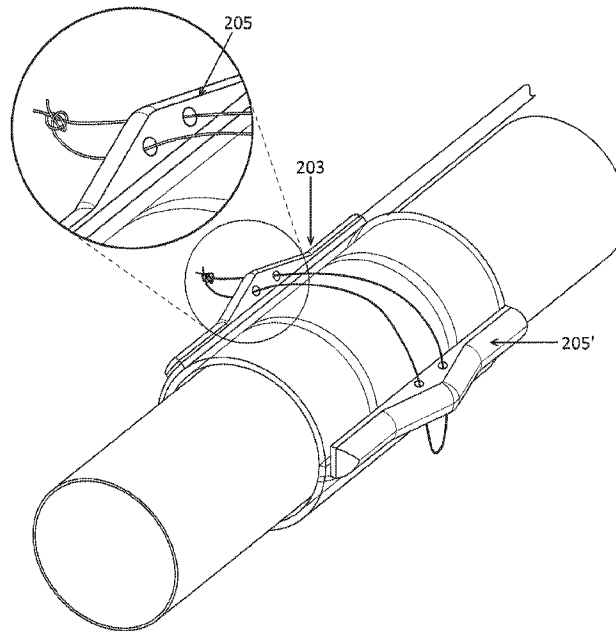

FIG. 2B

(57) **Abrégé/Abstract:**

Nerve cuff deployment apparatuses and methods of using them to deliver a nerve cuff electrode to a target nerve trunk.

(12) INTERNATIONAL APPLICATION PUBLISHED UNDER THE PATENT COOPERATION TREATY (PCT)

(19) World Intellectual Property
Organization
International Bureau

(43) International Publication Date
20 June 2019 (20.06.2019)



(10) International Publication Number
WO 2019/118725 A1

(51) International Patent Classification:

A61N 1/05 (2006.01)

(21) International Application Number:

PCT/US2018/065447

(22) International Filing Date:

13 December 2018 (13.12.2018)

(25) Filing Language:

English

(26) Publication Language:

English

(30) Priority Data:

62/598,369 13 December 2017 (13.12.2017) US

(71) Applicant: **NEUROS MEDICAL, INC.** [US/US]; 35010 Chardon Road, #210, Willoughby Hills, OH 44094 (US).

(72) Inventor: **SNYDER, Jon, Joseph**; 35010 Chardon Road, #210, Willoughby Hills, OH 44094 (US).

(74) Agent: **SHOOP, Richard, D.** et al.; Shay Glenn LLP, 2755 Campus Drive, Suite 210, San Mateo, CA 94403 (US).

(81) Designated States (*unless otherwise indicated, for every kind of national protection available*): AE, AG, AL, AM, AO, AT, AU, AZ, BA, BB, BG, BH, BN, BR, BW, BY, BZ, CA, CH, CL, CN, CO, CR, CU, CZ, DE, DJ, DK, DM, DO, DZ, EC, EE, EG, ES, FI, GB, GD, GE, GH, GM, GT, HN, HR, HU, ID, IL, IN, IR, IS, JO, JP, KE, KG, KH, KN, KP, KR, KW, KZ, LA, LC, LK, LR, LS, LU, LY, MA, MD, ME,

MG, MK, MN, MW, MX, MY, MZ, NA, NG, NI, NO, NZ, OM, PA, PE, PG, PH, PL, PT, QA, RO, RS, RU, RW, SA, SC, SD, SE, SG, SK, SL, SM, ST, SV, SY, TH, TJ, TM, TN, TR, TT, TZ, UA, UG, US, UZ, VC, VN, ZA, ZM, ZW.

(84) Designated States (*unless otherwise indicated, for every kind of regional protection available*): ARIPO (BW, GH, GM, KE, LR, LS, MW, MZ, NA, RW, SD, SL, ST, SZ, TZ, UG, ZM, ZW), Eurasian (AM, AZ, BY, KG, KZ, RU, TJ, TM), European (AL, AT, BE, BG, CH, CY, CZ, DE, DK, EE, ES, FI, FR, GB, GR, HR, HU, IE, IS, IT, LT, LU, LV, MC, MK, MT, NL, NO, PL, PT, RO, RS, SE, SI, SK, SM, TR), OAPI (BF, BJ, CF, CG, CI, CM, GA, GN, GQ, GW, KM, ML, MR, NE, SN, TD, TG).

Published:

— with international search report (Art. 21(3))

(54) Title: NERVE CUFF DEPLOYMENT DEVICES

(57) Abstract: Nerve cuff deployment apparatuses and methods of using them to deliver a nerve cuff electrode to a target nerve trunk.

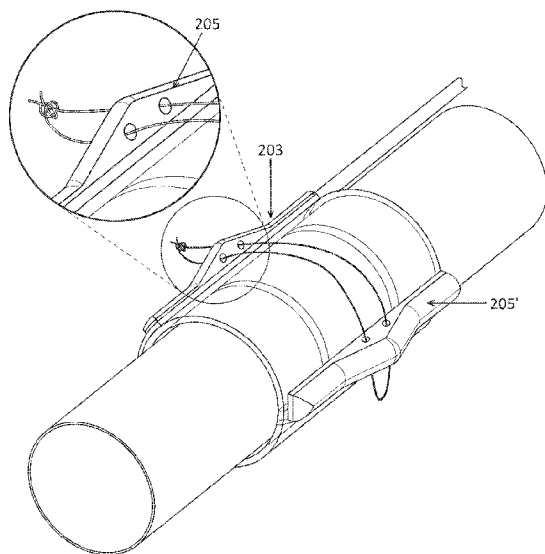

FIG. 2B

WO 2019/118725 A1

NERVE CUFF DEPLOYMENT DEVICES

CROSS REFERENCE TO RELATED APPLICATIONS

[0001] This patent claims priority to U.S. provisional patent application no. 62/598,369,
5 titled ("NERVE CUFF DEPLOYMENT DEVICES") filed on 12/13/2017.

[0002] This patent may also be related to pending U.S. Patent Application No. 15/510,824,
filed on 3/14/2017, and herein incorporated by reference in its entirety.

INCORPORATION BY REFERENCE

10 [0003] All publications and patent applications mentioned in this specification are herein
incorporated by reference in their entirety to the same extent as if each individual publication or
patent application was specifically and individually indicated to be incorporated by reference.

FIELD

15 [0004] The inventions described herein relate to the field of implantable neurostimulators.

BACKGROUND

[0005] Nerve cuffs (e.g., nerve cuff electrodes) may be used to apply energy to a nerve. For
example, a nerve cuff electrode may have a plurality of segmented platinum contacts connected
20 by at least one wire made of durable and biocompatible conductive material fashioned in a
helical configuration. The nerve cuff electrode may include a plurality of conductive nerve
contact segments, with the segments having an inner surface contacting a nerve trunk and an
outer surface not contacting the nerve trunk; at least a single wire of a conductive biocompatible
material operatively connecting the plurality of conductive nerve contact segments thus forming
25 a segmented strip, the wire configured as helical portions separated by non-helical portions
where the non-helical portions are secured to the surface of the conductive nerve contact
segments not contacting the nerve trunk; and a conductive lead capable of operatively connecting
a waveform generator to at least one of the plurality of nerve contact segments. FIGS. 1-3D
illustrate an example of such a nerve cuff electrode.

30 [0006] For example, the nerve cuffs described herein may be applied to relatively large
nerve, i.e., a nerve with a diameter exceeding about 3 mm and up to 12 mm. The nerve cuff may
include a self-curling sheet of non-conductive material that includes a first layer, which is pre-
tensioned, and a second layer, which is not pre-tensioned. The two layers are configured to form
a cuff containing or holding strips of conductive material there between. The device may have

one, two, three, four or more segmented strips of a conductive material that are disposed adjacent, but not transverse, to one longitudinally extending edge of the self-curling sheet, each of these strips of conductive material may be connected to an electrically conductive lead. The nerve cuff may contain one strip of a conductive material, termed a monopolar configuration, or at least two segmented strips, connected by an electrically conductive lead, of a conductive material, termed a bipolar configuration. The nerve cuff may contain three segmented strips, connected by an electrically conductive lead, of a conductive material, termed a tripolar configuration, or at least four segmented strips, connected by an electrically conductive lead, of a conductive material. Multiple apertures, typically circular but not necessarily so limited in shape, may be disposed at periodic intervals of the inner nerve-contacting surface along the curling length of one of the two non-conductive sheets or layers of the self-curling sheet/cuff. This may provide contact to the nerve by exposing and providing continuous multiple conductive contact points. The exposure may be at any interval that exposes as much of the conductive material as possible or desirable, and exceeds the contact surface area of conventional electrodes. Each of the first or top non-conductive sheet or layer and the second or bottom non-conductive sheet or layer may still retain and contain the conductive material therebetween, i.e., sandwiched inside the sheets or layers, so that the conductive material is in fact retained and does not pop out or come out while providing efficient current delivery. The non-conductive material may be silicone, the electrically conductive lead may be stainless steel, and the conductive material may be platinum. Other materials for each of the non-conductive material, the electrically conductive lead or wire, and the conductive material are known in the art. In use, the device may be operatively connected, e.g., by an external lead or wire, to a waveform generator that provides the regulated waveform.

[0007] The wire helical portions may be arranged along the wire length between the conductive nerve contact segments, and the wire non-helical portions may be secured to the conductive nerve contact segments by a plurality of spot welds. The wire helical portions may be embedded in a non-conductive material. The helical portions may be separated by non-helical portions that connect the conductive nerve contact segments. A second wire may operatively connect the plurality of nerve contact segments, with the second wire generally parallel with the first wire. The conductive nerve contact segments may be platinum, the wires may be stainless steel, and the non-conductive material may be silicone.

[0008] For example, FIG. 1 illustrates an implantable system including a nerve cuff 101, a lead 103 connecting the nerve cuff to a controller (e.g., waveform generator, control circuitry, power source, communications circuitry and/or antenna, etc.) 105. Systems including a nerve cuff such as those described herein, including those shown in FIGS. 1-3D, may be used to apply

a high frequency nerve block to acutely treat pain, either acute pain or chronic pain (more than 6 months in duration), in humans by blocking nerve conduction on an action potential. Acute treatment may refer to on-demand treatment with substantially immediate pain relief effect. The nerve cuff may be applied onto a moderate and relatively large diameter nerves such as the sciatic nerve. One therapy involves reversibly blocking peripheral nerves by applying high frequency alternating current directly on a nerve trunk. Specifically, a current ranging from 5 kHz to 50 kHz may be applied; this may be referred to as a high frequency stimulation, compared to a current of less than 1 kHz applied in the conventional electrical stimulation described above. Efficacy of the high frequency alternating current therapy in acute non-human animal experiments (frog, cat) has been reported. U.S. Pat. Nos. 7,389,145 and 8,060,208 describe in general this electrical stimulation technology.

[0009] The nerve cuffs described herein may encircle a particular segment of a targeted peripheral nerve, e.g., a sciatic nerve, a tibial nerve. Using a patient-implanted electrode connected to an electrical waveform generator, an electrical waveform may be applied for a time interval, e.g., 10 min, sufficient to effect substantially immediate patient pain relief, e.g., within 10 min, and an extended period of pain relief up to several hours. The current may range, for example, from 4 mApp to 26 mApp. In general, electrical nerve block or activation in patients for pain management or other conditions may require a direct interfacing device with peripheral nerves in the form of a cuff wrapping around a nerve trunk. For example, U.S. Pat. No. 8,731,676 discloses a bipolar nerve cuff electrode with two continuous platinum strips embedded in a silicone substrate used to wrap around a nerve trunk. However, breakage of the platinum strips was found where a larger nerve trunk and/or certain anatomical characteristics (such as short stumps in above-knee amputees) were encountered. Inspections of explanted electrodes revealed that the platinum strips situated around the nerve trunk were wrinkled/creased or broken along their length due to repeated bending when the nerve trunk was compressed and flattened during daily activities. Platinum has a low mechanical strength despite its superior biocompatibility and electrical characteristics for charge delivery, thus, it may be beneficial to use multiple segmented platinum contacts, each segment connected with wires made of a durable and biocompatible conductive material, e.g., stainless steel (SS). The total surface area of all of the platinum contacts may be equivalent to that of a continuous strip by increasing the width to compensate for the gaps between the contacts. The configuration of the wire interconnection may establish the durability and flexibility of the cuff electrode. For example, a 7-strand of 316LVM wire may be wound into a helix. A gap may be created along the helix wherever it overlaps with a platinum contact. Conventional spot welding may be used for connecting the wire to the platinum contact. Two wire helices lying in parallel may be employed to provide redundancy.

The helices may be entirely embedded in the silicone sheeting and only the outer side of the platinum contacts was exposed to the surface of the nerve trunk.

[00010] In use, the application of 10 kHz alternating current generated by a custom generator via a custom implanted nerve electrode may significantly reduce pain in the majority of patients treated. For example, an implantable electrode operatively connected to an external or implanted waveform generator may be used. The electrode may be a spiral cuff electrode similar to that described in U.S. Pat. No. 4,602,624. The electrode may be implanted in a human mammal on a desired peripheral nerve trunk proximal to the pain source (e.g., a neuroma), such that the cuff encircled the desired peripheral nerve in which the action potential was to be blocked. The cuff inner diameter may range from about 5 mm to about 12 mm. The sciatic nerve is known to have a relatively large nerve trunk; the diameter of the proximal part of the sciatic nerve in a human adult is about 12 mm. In one embodiment, the apparatus and method was used on the sciatic nerve to treat limb pain in above knee amputees. In one embodiment, the apparatus and method was used on the tibial nerve to treat limb pain in below knee amputees.

[00011] For example, FIG. 2A illustrates the use of a system including a cuff electrode applied to the sciatic nerve of an amputee patient. In this example, the amputee 107 has been implanted with a nerve cuff 101 around the sciatic nerve (nerve trunk), and is connected, via a lead 103, to the controller including the waveform generator 105. This procedure may be done, for example, by first dissecting to expose the nerve in an open procedure, then wrapping the nerve with the flexible (self-closing) cuff. Once implanted the controller/waveform generator may be placed in a pocket in the anterolateral abdominal wall, and a tunneling electrode cable may be positioned along the midaxillary line (including transversely across the abdomen) to connect the controller/waveform generator to the nerve cuff electrode. Once the impedance of the nerve cuff is checked (e.g., by the controller) the incisions may be closed. The incision for implanting the nerve cuff is typically larger than about 1.5 inches (e.g., between 1.5 and 3 inches), so that sufficient visualization and access may be achieved.

[00012] Any reduction in the size of this access incision would be highly desirable. However, to date, because of the difficulty in accessing the nerve trunk of the amputee, only open procedures have been used. Described herein are methods and apparatuses (including systems and devices, which may specifically include access tools) for minimally invasively attaching a nerve cuff, and specifically nerve cuffs such as those described, e.g., in U.S. patent application no. US20170246453A1.

SUMMARY OF THE DISCLOSURE

[00013] Described herein is a deployment device to introduce a nerve cuff electrode via minimal surgical incision, including a cannula accommodating, e.g., a 13mm diameter. The nerve cuff electrode may be deployed via an apparatus such as an introducer tool which
5 encapsulates the electrode (e.g., in some variations via a two-part compartment) and provides support for visualizing and positioning the nerve cuff, protecting the nerve cuff electrode, so that it can be implanted in the desired location in a minimally invasive manner.

[00014] In some variations, the introducer capsule is delivered and pushed through the cannula (e.g., trocar), once the nerve target is identified and exposed via the cannula. In any of
10 these variations, endoscopic visualization may be used as part of the deployment; the delivery tool may couple with or integrate with an endoscope, or may be used separately from the endoscope. In some variations, the delivery tool may then be detached; for example, in variations including a two-part capsule, the capsule may be detached, and the electrode remains may be implanted near the target nerve site; the delivery tool (e.g., capsule) may then be
15 removed from the cannula. The electrode may be unrolled via forceps, placed around the targeted nerve and sutured closed via two suture loops.

[00015] For example, described herein are methods of minimally-invasively attaching a nerve cuff electrode to a patient's nerve (e.g., nerve root). Any of these methods may include: minimally invasively inserting a cannula (which may be part of a trocar) into the patient's body
20 (e.g., tissue) to a nerve root region; inserting a nerve cuff deployment tool into the cannula, wherein the nerve cuff electrode is attached at a distal end of an elongated body of the nerve cuff deployment tool, further wherein the elongated body of the nerve cuff deployment tool has a column strength sufficient to resist buckling at compressive forces of at least a predetermined amount (e.g., 2 N, 5 N, 10 N, 15 N, 20 N, 25 N, 30 N, etc.); advancing the nerve cuff
25 deployment tool distally through the cannula into the nerve root region; and disengaging the nerve cuff from the nerve cuff deployment tool and coupling the nerve cuff to the patient's nerve root.

[00016] Any of these methods may also include visualizing the nerve root region. For example any of these methods may include inserting a visualization tool into the nerve root
30 region and visualizing the nerve root region. The visualization tool (e.g., a scope) may be separate from the cannula, or it may be combined with/coupled to the cannula. For example, the visualization tool may include a cannula and may visualize the distal end of the cannula, e.g., near the nerve root region. The scope may include illumination. The scope may include a camera.

[00017] The cannula may be inserted as part of a trocar. For example, a trocar having a cutting portion (e.g., an obturator) and a cannula may also include a seal and may be minimally invasively inserted into the body as part of any of these methods. For example, minimally invasively inserting the cannula may include inserting a trocar through the patient's tissue to the nerve region, wherein the cannula forms a part of the trocar.

[00018] In general, the nerve root region includes a region around the nerve root onto which the nerve cuff electrode is to be positioned. The nerve root region may be proximal to neuroma (e.g., in an amputated region) and may include the nerve root and any surrounding tissues; alternatively or additionally the surrounding tissues may be removed (e.g., through the cannula) or retracted to create a clearing for insertion of the nerve cuff electrode.

[00019] Any of these methods may include removably attaching the nerve cuff electrode to the distal end of the elongated body of the nerve cuff deployment tool. For example, the nerve cuff electrode may be held within a chamber (e.g., capsule) of the nerve cuff deployment tool. Alternatively or additionally, the nerve cuff deployment tool may be connected by a clip, clamp, etc. to the nerve cuff electrode. The nerve cuff deployment tool may be configured to attach to a predetermined portion of the nerve cuff electrode; alternatively, the nerve cuff deployment tool may be configured to connected and hold to any region of the nerve cuff electrode. In some variations the nerve cuff deployment tool includes a nerve cuff engagement region that is configured to removably attach to the nerve cuff electrode. Examples of nerve cuff attachment or engagement regions are described below.

[00020] Any of the methods of operation described herein may include removably attaching the nerve cuff to the distal end of the nerve cuff deployment tool. This may include least partially enclosing the nerve cuff within a chamber of the nerve cuff deployment tool (e.g., within a sleeve, opening, cup, chamber, etc. of the nerve cuff deployment tool distal end, forming part of the nerve cuff engagement region. Alternatively, removably attaching the nerve cuff may comprise fully enclosing the nerve cuff, e.g., within a capsule region at a distal end of the nerve cuff deployment tool.

[00021] Inserting the nerve cuff deployment tool may include inserting the nerve cuff deployment tool with the nerve cuff attached wherein the nerve cuff is a self-rolling nerve cuff electrode. Self-rolling nerve cuffs as described, for example, in U.S. patent application no. 15/510824, filed on 3/14/2017, herein incorporated by reference in its entirety. The nerve cuff electrode may be held in a constrained (e.g., collapsed, constricted, etc.) configuration by the nerve cuff deployment tool.

[00022] The elongated body of the nerve cuff deployment tool may be flexible or rigid. In some variations, the nerve cuff deployment tool has a flexible elongated body (which still

maintains sufficient column strength as indicated above), so as to navigate a bent or curved cannula for delivery.

[00023] Advancing the nerve cuff deployment tool distally through the cannula into the nerve root region may include positioning a distal end of the nerve cuff deployment tool adjacent to the nerve root within the nerve root region. For example, the distal end of the cannula may be positioned immediately adjacent to the nerve (e.g., within about 1 mm) or closely adjacent (e.g., within about 10 mm).

[00024] Disengaging the nerve cuff electrode from the nerve cuff deployment tool may include activating a detachment mechanism at the proximal end of the nerve cuff deployment tool. In some variations the nerve cuff electrode is disengaged by separating or opening two parts (e.g., halves) of a capsule to release the nerve cuff electrode; this may be done by proximally manipulating the nerve cuff deployment tool to separate the two portions forming the capsule, releasing the nerve cuff electrode and removing the portion of the nerve cuff deployment tool forming the capsule back into the catheter. For example, disengaging the nerve cuff from the nerve cuff deployment tool may include separating two halves of a nerve cuff capsule at the distal end of the nerve cuff deployment tool. In some variations a separate pusher is included having a distal end configured to apply distal force to the nerve cuff electrode. Thus, any of these methods may include pushing or holding the nerve cuff electrode using the pusher to separate or disengage the nerve cuff electrode from the rest of the nerve cuff deployment tool.

[00025] Either before, during or after disengaging the nerve cuff electrode from the nerve cuff deployment tool, the nerve cuff may be wrapped (e.g., rolled) around the nerve. For example, in some variations, the nerve cuff electrode may be wrapped around the nerve root when released from the nerve cuff deployment tool. The nerve cuff electrode may be held in an inverted configuration within the nerve cuff deployment tool, so that, when released from the nerve cuff deployment tool, it is biased to wrap itself around the nerve root; thus, the nerve cuff deployment tool may position the nerve cuff sufficiently near or adjacent to the nerve root so that it may automatically wrap itself around the nerve root. Alternatively or additionally, the nerve cuff electrode may be manipulated by, e.g., a laparoscopic or other tool (e.g., forceps, etc.) to position or wrap around the nerve root. For example, any of these methods may include extending one or more manipulators (e.g., pairs of manipulators) through the cannula to wrap the nerve cuff around the nerve root.

[00026] For example, a method of minimally-invasively attaching a nerve cuff electrode to a patient's nerve root may include: minimally invasively inserting a cannula the patient's tissue to a nerve root region; inserting a nerve cuff deployment tool into the cannula, wherein the nerve cuff electrode comprises a self-curling nerve cuff electrode that is removably attached at a distal

end of an elongated body of the nerve cuff deployment tool, further wherein the elongated body of the nerve cuff deployment tool has a column strength sufficient to resist buckling at compressive forces of at least 10 N; advancing the nerve cuff deployment tool distally through the cannula into the nerve root region; and disengaging the nerve cuff from the nerve cuff deployment tool and wrapping the nerve cuff to the patient's nerve root.

[00027] In general, a nerve cuff deployment apparatus for minimally invasively attaching a nerve cuff electrode to a patient's nerve root may include: an elongated body having a column strength sufficient to resist buckling at compressive forces of at least some predetermined amount of force (e.g., 2 N, 3 N, 4 N, 5 N, 6 N, 7 N, 8 N, 9 N, 10 N, 12 N, 15 N, 20 N, 25 N, 30 N, etc.); and a nerve cuff engagement region at a distal end of elongated body, configured to releasably secure to a nerve cuff electrode.

[00028] Any of these systems may include the nerve cuff electrode as part of the system, which may be pre-loaded. For example, any of these systems may include a self-curling nerve cuff electrode, as described herein. Thus, the system may include a self-curling nerve cuff releasably coupled to the nerve cuff engagement region.

[00029] The elongated body may be flexible. In some variation, the elongated body is rigid.

[00030] In some variations the apparatus is configured to form an enclosure to hold the nerve cuff electrode. For example, the elongated body may include a first half and a second half, wherein the nerve cuff engagement region comprises a first capsule portion at the distal end of the first half and a second capsule portion at the distal end of the second half, wherein the first and second capsule portions are configured to couple to form a capsule to enclose and protect the nerve cuff electrode.

[00031] In some variation, the nerve cuff engagement region includes a flared-open distal-facing region chamber configured to at least partially enclose the nerve cuff electrode.

Alternatively or additionally, the nerve cuff engagement region may include a hook or fork configured to releasably engage with the nerve cuff electrode. The nerve cuff engagement region may hold the expandable (curling) wings of the nerve cuff electrode or to the base of the nerve cuff electrode, e.g., where the wire(s) extending from the nerve cuff electrode extend proximally. In some variations, the nerve cuff engagement region comprises a rounded distal end configured to engage with the nerve cuff electrode. The rounded distal end may be configured to support against the nerve cuff electrode without damaging the nerve cuff electrode, e.g., by pushing against it. In some variations nerve cuff engagement region includes a passage for holding the lead extending from the nerve cuff.

[00032] As mentioned, any of these apparatuses may include a pusher (e.g., a nerve cuff pusher) extending adjacent to the elongated body and having a distal end configured to apply

WO 2019/118725

PCT/US2018/065447

distal force to the nerve cuff electrode. The pusher may extend within the elongated body of the nerve cuff deployment apparatus. The distal-facing end of the pusher (the distal end) may be configured to engage with the nerve cuff electrode. For example, the distal-facing end of the pusher may include a forked distal end that is configured to engage with the nerve cuff electrode.

5 [00033] In any of these variations, the nerve cuff deployment apparatus may include a proximal control coupled to the elongated body configured to disengage the nerve cuff engagement region from the nerve cuff electrode. The proximal control may include a handle, grip, button, switch, slider, or the like. For example, the proximal control may be a handle coupled to a slider that allows the apparatus to engage with the pusher, for example, and/or the
10 halves of the elongated body that can be (in some variations) separated to release the nerve cuff electrode.

[00034] For example, a nerve cuff deployment apparatus for minimally invasively attaching a nerve cuff electrode to a patient's nerve root may include: an elongated body having a column strength sufficient to resist buckling at compressive forces of at least 10 N, wherein the
15 elongated body comprises a first half and a second half, each extending distally to proximally; and a nerve cuff engagement region at a distal end of elongated body, configured to releasably secure to a nerve cuff electrode, wherein the nerve cuff engagement region further comprises a first capsule portion at the distal end of the first half and a second capsule portion at the distal end of the second half, wherein the first and second capsule portions are configured to form a
20 capsule to enclose and protect the nerve cuff electrode.

BRIEF DESCRIPTION OF THE DRAWINGS

[00035] The novel features of the invention are set forth with particularity in the claims that follow. A better understanding of the features and advantages of the present invention will be
25 obtained by reference to the following detailed description that sets forth illustrative embodiments, in which the principles of the invention are utilized, and the accompanying drawings of which:

[00036] FIG. 1 shows one example of a nerve cuff system (including nerve cuff, lead and implantable controller/waveform generator).

30 [00037] FIG. 2A shows an example of the system of FIG. 1 implanted into a patient.

[00038] FIG. 2B schematically illustrates the attachment of and nerve cuff such as the one shown in FIGS. 1-2A onto a nerve trunk.

[00039] FIGS. 3A-3D illustrate application of a self-curling nerve cuff onto a model of a nerve trunk.

[00040] FIGS. 4A-4B illustrate one example of a method for minimally-invasively applying a self-rolling nerve cuff onto a nerve trunk as described herein. In FIG. 4A, access to the nerve trunk onto which the nerve cuff is to be applied is achieved using a trocar or cannula; a visualization tool (e.g., an endoscope for endoscopic visualization) is also shown allowing the physician to view the application directly. In FIG. 4B, a nerve cuff deployment device (tool) is used to support and protect the nerve cuff (e.g., self-rolling nerve cuff) so that it may be minimally invasively delivered to the nerve root and deployed for attachment over the nerve root.

[00041] FIGS. 5A-5G illustrate a method of minimally invasively applying a self-rolling nerve cuff onto a nerve trunk using one variations of a nerve trunk deployment tool, in greater detail.

[00042] FIGS. 6A and 6B illustrate the nerve cuff deployment tool shown in FIGS. 5A-5E. FIG. 6A shows the tool assembled to form a capsule that surrounds and protects the nerve cuff electrode. FIG. 6B shows an exploded view of the nerve cuff deployment tool of FIG. 6A, which may be assembled to fully enclose the nerve cuff electrode.

[00043] FIGS. 6C and 6D illustrate a nerve cuff deployment tool similar to that shown in FIG. 6A-6B. In FIG. 6C the nerve cuff deployment tool forms a capsule at the distal end to fully enclose the nerve cuff electrode; a pusher extends adjacent to and within the elongated body to apply distal force to the nerve cuff electrode. FIG. 6D shows an exploded view of the nerve cuff deployment tool of FIG. 6C.

[00044] FIGS. 7A1-7A2 show another example of a nerve cuff deployment tool that includes a flexible deployment tool having high column strength that may be releasably attached to the self-curling nerve cuff (as shown in FIG. 7A1) and used to push or pull the nerve cuff within a delivery cannula or trocar. FIG. 7A2 shows the tool unconnected to a nerve cuff.

[00045] FIG. 7B shows another example of a flexible deployment tool having a high column strength that may be used to push (or in some variations, pull) the self-curling nerve cuff distally through a delivery cannula or trocar for minimally invasive insertion, as described herein.

[00046] FIG. 7C shows another example of a flexible deployment tool having a high column strength that may be used to push (or in some variations, pull) the self-curling nerve cuff distally through a delivery cannula or trocar for minimally invasive insertion, as described herein.

[00047] FIGS. 7D1 and 7D2 show another example of a nerve cuff deployment tool that includes a flexible deployment tool having high column strength that may be releasably attached to the self-curling nerve cuff (as shown in FIG. 7) and used to push or pull the nerve cuff within a delivery cannula or trocar.

[00048] FIGS. 8A-8C illustrate alternative examples of nerve cuffs that may be used with any of the methods and apparatuses described herein. In FIG. 8A, the nerve cuff is hinged (e.g., two-part) nerve cuff. FIG. 8B shows the hinged nerve cuff of FIG. 8A wrapped around a nerve in an end view and FIG. 8C shows the hinged nerve cuff of FIG. 8A in an external perspective view on the nerve trunk.

DETAILED DESCRIPTION

[00049] In general, described herein are methods and apparatuses, including in particular tools such as nerve cuff deployment tools and methods of using them, for minimally invasively attaching a nerve cuff to a nerve trunk. In particular, described herein are methods and apparatuses for delivering nerve cuff electrode (particularly self-rolling nerve cuff electrodes) through an elongated cannula or other elongated, minimally invasive channel for deployment at, near or on a nerve root. In general, a nerve cuff deployment apparatus for minimally invasively attaching a nerve cuff electrode to a patient's nerve root may have a sufficient column strength (e.g., a column strength sufficient to resist buckling at compressive forces of at least 2 N, 5 N, 7 N, 8 N, 9 N, 10 N, 15 N, etc.) so that it may support and protect the generally flexible and loose nerve cuff electrode prior to placing it on the nerve root. The nerve cuff deployment device generally includes a nerve cuff engagement region at a distal end of elongated body that is configured to releasably secure to a nerve cuff electrode to be delivered.

[00050] As already discussed above, FIGS. 1-2A illustrate current methods for positioning or placing a nerve cuff onto a nerve root. For example, in an above-the-knee amputee, a nerve cuff may be placed approximately 5 cm proximal to the neuroma on the sciatic nerve; prior to the inventions described herein, this required a long incision (e.g., 8-10 cm in length), e.g., between the biceps femoris and semimembranosus/semitendinosus region of the body. The nerve cuff (e.g., such as shown in FIG. 2B and 3A-3D) would then be positioned over and around the exposed nerve root. FIG. 3A-3D illustrates one example of this technique. For example, by exposing the nerve, e.g., by dissecting away material around the nerve, including in some cases cauterizing the tissue around the nerve, the nerve cuff electrode 303 may be pulled, e.g., by use of forceps 305 under and around the nerve. The cuff may be initially bathed in an antibiotic solution. Forceps (e.g., right angle forceps) may be used to gently pull the cuff underneath the nerve (FIG. 3B), and the cuff may be wrapped around the nerve, as shown in FIGS. 3C-3D. The electrode cable runs superiorly away from the cuff (e.g., distally).

[00051] Although any appropriate nerve cuff may be used, in particular, the nerve cuff may be a self-wrapping nerve cuff, such as illustrated in FIG. 2B. In this example, the nerve cuff 203 includes two proud regions 205 that each include suture holes through which a suture to secure

the two regions together around the nerve may be positioned. The proud region extend up (e.g., 90 degrees) from the curved/curling plane of the arms forming the nerve cuff electrode. The first proud region is separated from the second proud region by less than the expected circumference of the nerve root onto which the nerve cuff is to be applied (e.g., +/-50% of the average expected circumference, or within 50% of the expected circumference), on one side of the wings, so that one “wing” may wrap against the nerve root and the other wing (with the two proud regions) may extend from the other wing and wrap over the first wing, as shown.

[00052] Described herein are methods of less invasively applying a nerve cuff electrode onto a nerve root, including methods of minimally invasively applying the nerve cuff electrode that do not require a large incision. For example, FIGS. 4A-4B illustrate a general method of less invasively applying a nerve cuff, including the use of a nerve cuff deployment tool as described herein. In FIG. 4A, a trocar 403 (including a cannula) is first inserted into the body to the region of the nerve root region 407 onto which the nerve cuff electrode is to be positioned. In this example, the nerve root region is just proximal to a neuroma 411. Prior to inserting the trocar/cannula, a visualization tool such as an endoscope 409 may be inserted into the body to visualize the nerve root region. In this example, the endoscope is a rigid endoscope; any appropriate endoscope may be used. Once the trocar is used to position the cannula with a distal end opening into the nerve root region, the nerve cuff electrode may be inserted through the cannula and onto the nerve root. In general the nerve cuff electrode is loose, and overly flexible, so that it cannot be easily inserted through a cannula. Instead, as shown in FIG. 4B, a nerve cuff deployment device 415 may be used to deliver the nerve cuff electrode through the cannula and into position.

[00053] In FIG. 4B, the nerve cuff deployment device 415 includes a two-part elongated body that ends in a pair of halves that form a capsule 413 which may hold a nerve cuff electrode 417, as shown. In this example, the nerve cuff deployment device therefore include an elongated region that can be pushed to drive the capsule and therefore the nerve cuff electrode distally through the cannula.

[00054] FIGS. 5A-5G illustrate this method in additional detail. For example, in FIG. 5A, the nerve cuff electrode 517 is held within a nerve cuff engagement region forming a capsule 521; the lead coupled to the nerve cuff electrode is either also held within the capsule or extends proximally through the nerve cuff deployment device. In FIG. 5A, the nerve cuff deployment device is already loaded with the nerve cuff electrode; once the catheter 503 is positioned, the nerve cuff deployment device may be driven distally (e.g., by pushing on the proximal end 525) and extended out of the distal end of the catheter, as shown in FIGS. 5B-5C. Thereafter, the nerve cuff electrode may be disengaged from the nerve cuff deployment tool by separating the

two halves 527, 527' of the nerve cuff capsule; this may be done at the distal end of the nerve cuff deployment tool, as shown in FIG. 5D. These separated halves may then be withdrawn back into the catheter and/or fully removed, as shown in FIG. 5E. In some variations, an additional step of using a tool such as an endoscope manipulator 535 may be used to help wrap the nerve cuff electrode around the nerve root ("nerve") as shown in FIG. 5G. In some variations the nerve cuff electrode may be held inverted within the capsule, so that the arms of the nerve cuff electrode are wrapped in the opposite direction. In this case, a self-wrapping nerve cuff may be biased to automatically wrap around the nerve root, or wrap around with assistance, e.g., from a minimally invasive manipulator.

[00055] FIGS. 6A and 6B illustrate the nerve cuff deployment tool variations shown in FIGS. 5A-5G, which includes a capsule region that encloses and protects (and may constrain) a nerve cuff electrode. In FIG. 6A the nerve cuff deployment tool is pre-loaded to include the nerve cuff electrode. FIG. 6B shows an exploded view in which a left half 603 and a right half 603' of the nerve cuff engagement region forming the enclosed capsule is shown. In FIG. 6B, the two halves may be closed over the nerve cuff electrode and either coupled together or held together within the cannula. The nerve cuff electrode 617 includes a highly flexible lead 618 that may also be held within the capsule, or it may be within the elongated body of the nerve cuff deployment tool. FIGS. 6C and 6D illustrate a similar variation of the nerve cuff deployment tool that also includes an inner pusher 621. The pusher may be coupled to the nerve cuff electrode (in FIG. 6C-6D, the pusher is shown to include a forked distal end 623 to engage with the rolled nerve cuff electrode within the capsule. In this example, the pusher is a high-column strength member that can either hold the nerve cuff electrode in position when disengaging from the nerve cuff deployment tool or may drive the nerve cuff electrode distally (e.g., towards the nerve root) when deploying.

[00056] FIGS. 7A1-7D2 illustrate other variations of nerve cuff deployment tools that may be used with any of the methods described herein. Elements from any of the nerve cuff deployment tools shown in any of the variations and embodiments described may be used with any of other variation or embodiment of a nerve cuff deployment tool. For example, a pusher such as the one shown in FIG. 6C-6D may be used with any of the nerve cuff deployment tools shown in FIG. 7A1-7D2.

[00057] FIG. 7A1 shows a nerve cuff deployment tool 715 releasably coupled to a nerve cuff electrode 717. In this example, the nerve cuff deployment tool has a bifurcated end 716 (e.g., forked or split) that may couple and engage with the nerve cuff electrode, and particularly the wrapping arms of the nerve cuff electrode. In some variations one or both arms may be hinged so as to close (e.g., clamp) onto each other to releasably secure the nerve cuff assembly between

them; a control (e.g., handle, etc. on the distal end of the nerve cuff deployment tool may be operated to release the arms of the nerve cuff deployment tool. FIG. 7A2 shows a perspective view of the nerve cuff deployment tool not coupled to the nerve cuff.

[00058] FIG. 7B shows another variation of a nerve cuff deployment tool 719 having a distal end that is rounded 720 to apply force to a portion of the nerve cuff electrode 717 without damaging it. In this example the nerve cuff deployment tool is a hollow member that receives the lead connected to the nerve cuff assembly and provide structural support to drive the nerve cuff electrode distally. The lead may be held within the nerve cuff deployment tool in tension, so that the nerve cuff assembly is secured to the distal end of the nerve cuff deployment tool.

[00059] FIG. 7C shows another example of a nerve cuff deployment tool 723 that includes a partial capsule that is distally open. The distal-facing end region may hold (and constrain expansion of) the nerve cuff electrode 717 until it is deployed; for example by withdrawing the nerve cuff deployment tool elongated body 733 proximally while holding a pusher (not shown) in place relative to the patient's body, or advancing it slightly distally.

[00060] FIGS. 7D1 and 7D2 show another example of a nerve cuff deployment tool 725 in which the nerve cuff engagement region 736 at the distal end of the nerve cuff deployment tool is configured to releasably couple with the nerve cuff electrode 717. This variation is similar to that shown in FIGS. 7A1-7A2, but may extend over the distal side of the nerve cuff electrode, allowing it to be both pulled and pushed robustly. This variations may also include a release, e.g., at the proximal end, and the distal end region may be hinged in one or more positions to remove the connection to the nerve cuff electrode. Alternatively, in some variations a pusher such as that shown in FIG. 6C-6D may be used to disengage the nerve cuff electrode from the nerve cuff deployment tool.

[00061] Although in general, the nerve cuff electrodes described herein are similar to those shown in FIGS. 2B-3D, any appropriate nerve cuff electrode may be used. FIGS. 8A-8C illustrate another variation of a nerve cuff electrode in which two halve or sides of the nerve cuff electrode are hinged together and may be coupled over and around a nerve root. For example, in FIG. 8A, the nerve cuff electrode shows a left side 803 and a right side 803' that are joined initially by hinge region 805. The electrodes within the nerve cuff electrode may be similar to those described above, and each half may be connected to a lead 807, 807'. FIG. 8B shows the nerve cuff electrode of FIG. 8A extended over a nerve, and secured on the opposite side by, e.g., a suture. FIG. 8C shows the nerve cuff electrode of FIG. 8A in a perspective view over a nerve.

[00062] Any of the methods (including user interfaces) described herein may be implemented as software, hardware or firmware, and may be described as a non-transitory computer-readable storage medium storing a set of instructions capable of being executed by a processor (e.g.,

computer, tablet, smartphone, etc.), that when executed by the processor causes the processor to control perform any of the steps, including but not limited to: displaying, communicating with the user, analyzing, modifying parameters (including timing, frequency, intensity, etc.), determining, alerting, or the like.

5 **[00063]** When a feature or element is herein referred to as being "on" another feature or element, it can be directly on the other feature or element or intervening features and/or elements may also be present. In contrast, when a feature or element is referred to as being "directly on" another feature or element, there are no intervening features or elements present. It will also be understood that, when a feature or element is referred to as being "connected", "attached" or
10 "coupled" to another feature or element, it can be directly connected, attached or coupled to the other feature or element or intervening features or elements may be present. In contrast, when a feature or element is referred to as being "directly connected", "directly attached" or "directly coupled" to another feature or element, there are no intervening features or elements present. Although described or shown with respect to one embodiment, the features and elements so
15 described or shown can apply to other embodiments. It will also be appreciated by those of skill in the art that references to a structure or feature that is disposed "adjacent" another feature may have portions that overlap or underlie the adjacent feature.

[00064] Terminology used herein is for the purpose of describing particular embodiments only and is not intended to be limiting of the invention. For example, as used herein, the singular
20 forms "a", "an" and "the" are intended to include the plural forms as well, unless the context clearly indicates otherwise. It will be further understood that the terms "comprises" and/or "comprising," when used in this specification, specify the presence of stated features, steps, operations, elements, and/or components, but do not preclude the presence or addition of one or more other features, steps, operations, elements, components, and/or groups thereof. As used
25 herein, the term "and/or" includes any and all combinations of one or more of the associated listed items and may be abbreviated as "/".

[00065] Spatially relative terms, such as "under", "below", "lower", "over", "upper" and the like, may be used herein for ease of description to describe one element or feature's relationship to another element(s) or feature(s) as illustrated in the figures. It will be understood that the
30 spatially relative terms are intended to encompass different orientations of the device in use or operation in addition to the orientation depicted in the figures. For example, if a device in the figures is inverted, elements described as "under" or "beneath" other elements or features would then be oriented "over" the other elements or features. Thus, the exemplary term "under" can encompass both an orientation of over and under. The device may be otherwise oriented (rotated
35 90 degrees or at other orientations) and the spatially relative descriptors used herein interpreted

accordingly. Similarly, the terms "upwardly", "downwardly", "vertical", "horizontal" and the like are used herein for the purpose of explanation only unless specifically indicated otherwise.

[00066] Although the terms "first" and "second" may be used herein to describe various features/elements (including steps), these features/elements should not be limited by these terms, unless the context indicates otherwise. These terms may be used to distinguish one feature/element from another feature/element. Thus, a first feature/element discussed below could be termed a second feature/element, and similarly, a second feature/element discussed below could be termed a first feature/element without departing from the teachings of the present invention.

[00067] Throughout this specification and the claims which follow, unless the context requires otherwise, the word "comprise", and variations such as "comprises" and "comprising" means various components can be co-jointly employed in the methods and articles (e.g., compositions and apparatuses including device and methods). For example, the term "comprising" will be understood to imply the inclusion of any stated elements or steps but not the exclusion of any other elements or steps.

[00068] In general, any of the apparatuses and methods described herein should be understood to be inclusive, but all or a sub-set of the components and/or steps may alternatively be exclusive, and may be expressed as "consisting of" or alternatively "consisting essentially of" the various components, steps, sub-components or sub-steps.

[00069] As used herein in the specification and claims, including as used in the examples and unless otherwise expressly specified, all numbers may be read as if prefaced by the word "about" or "approximately," even if the term does not expressly appear. The phrase "about" or "approximately" may be used when describing magnitude and/or position to indicate that the value and/or position described is within a reasonable expected range of values and/or positions. For example, a numeric value may have a value that is +/- 0.1% of the stated value (or range of values), +/- 1% of the stated value (or range of values), +/- 2% of the stated value (or range of values), +/- 5% of the stated value (or range of values), +/- 10% of the stated value (or range of values), etc. Any numerical values given herein should also be understood to include about or approximately that value, unless the context indicates otherwise. For example, if the value "10" is disclosed, then "about 10" is also disclosed. Any numerical range recited herein is intended to include all sub-ranges subsumed therein. It is also understood that when a value is disclosed that "less than or equal to" the value, "greater than or equal to the value" and possible ranges between values are also disclosed, as appropriately understood by the skilled artisan. For example, if the value "X" is disclosed the "less than or equal to X" as well as "greater than or equal to X" (e.g., where X is a numerical value) is also disclosed. It is also understood that the throughout the

application, data is provided in a number of different formats, and that this data, represents endpoints and starting points, and ranges for any combination of the data points. For example, if a particular data point “10” and a particular data point “15” are disclosed, it is understood that greater than, greater than or equal to, less than, less than or equal to, and equal to 10 and 15 are considered disclosed as well as between 10 and 15. It is also understood that each unit between two particular units are also disclosed. For example, if 10 and 15 are disclosed, then 11, 12, 13, and 14 are also disclosed.

[00070] Although various illustrative embodiments are described above, any of a number of changes may be made to various embodiments without departing from the scope of the invention as described by the claims. For example, the order in which various described method steps are performed may often be changed in alternative embodiments, and in other alternative embodiments one or more method steps may be skipped altogether. Optional features of various device and system embodiments may be included in some embodiments and not in others. Therefore, the foregoing description is provided primarily for exemplary purposes and should not be interpreted to limit the scope of the invention as it is set forth in the claims.

[00071] The examples and illustrations included herein show, by way of illustration and not of limitation, specific embodiments in which the subject matter may be practiced. As mentioned, other embodiments may be utilized and derived there from, such that structural and logical substitutions and changes may be made without departing from the scope of this disclosure. Such embodiments of the inventive subject matter may be referred to herein individually or collectively by the term “invention” merely for convenience and without intending to voluntarily limit the scope of this application to any single invention or inventive concept, if more than one is, in fact, disclosed. Thus, although specific embodiments have been illustrated and described herein, any arrangement calculated to achieve the same purpose may be substituted for the specific embodiments shown. This disclosure is intended to cover any and all adaptations or variations of various embodiments. Combinations of the above embodiments, and other embodiments not specifically described herein, will be apparent to those of skill in the art upon reviewing the above description.

CLAIMS

What is claimed is:

1. A method of minimally-invasively attaching a nerve cuff electrode to a patient's nerve root, the method comprising:

minimally invasively inserting a cannula into the patient's body to a nerve root region;

inserting a nerve cuff deployment tool into the cannula, wherein the nerve cuff electrode is attached at a distal end of an elongated body of the nerve cuff deployment tool, further wherein the elongated body of the nerve cuff deployment tool has a column strength sufficient to resist buckling at compressive forces of at least 10 N;

advancing the nerve cuff deployment tool distally through the cannula into the nerve root region; and

disengaging the nerve cuff from the nerve cuff deployment tool and coupling the nerve cuff electrode to the patient's nerve root.
2. The method of claim 1, further comprising inserting a visualization tool into the nerve root region and visualizing the nerve root region.
3. The method of claim 1, wherein minimally invasively inserting the cannula comprises inserting a trocar through the patient's tissue to the nerve region, wherein the cannula forms a part of the trocar.
4. The method of claim 1, further comprising removably attaching the nerve cuff electrode to the distal end of the elongated body of the nerve cuff deployment tool.
5. The method of claim 4, wherein removably attaching the nerve cuff electrode comprises at least partially enclosing the nerve cuff electrode within a chamber of the nerve cuff deployment tool.
6. The method of claim 4, wherein removably attaching the nerve cuff electrode comprises fully enclosing the nerve cuff electrode within a capsule region at a distal end of the nerve cuff deployment tool.
7. The method of claim 1, wherein inserting the nerve cuff deployment tool comprises inserting the nerve cuff deployment tool with the nerve cuff electrode attached wherein the nerve cuff electrode is a self-rolling nerve cuff electrode.

8. The method of claim 1, wherein inserting the nerve cuff deployment tool comprises inserting the nerve cuff deployment tool wherein the elongated body of the nerve cuff deployment tool is flexible.
- 5 9. The method of claim 1, wherein advancing the nerve cuff deployment tool distally through the cannula into the nerve root region comprises positioning a distal end of the nerve cuff deployment tool adjacent to the nerve root within the nerve root region.
10. The method of claim 1, wherein disengaging the nerve cuff electrode from the nerve cuff deployment tool comprises activating a detachment mechanism at the proximal end of the nerve cuff deployment tool.
- 10 11. The method of claim 1, wherein disengaging the nerve cuff electrode from the nerve cuff deployment tool comprises separating two halves of a nerve cuff capsule at the distal end of the nerve cuff deployment tool.
12. The method of claim 1, wherein the nerve cuff electrode forms around the nerve when released from the nerve cuff deployment tool.
- 15 13. The method of claim 1, further comprising extending one or more manipulators through the cannula to wrap the nerve cuff electrode around the nerve root.
14. A method of minimally-invasively attaching a nerve cuff electrode to a patient's nerve root, the method comprising:
- 20 minimally invasively inserting a cannula into the patient's tissue to a nerve root region;
- inserting a nerve cuff deployment tool into the cannula, wherein the nerve cuff electrode comprises a self-curling nerve cuff electrode that is removably attached at a distal end of an elongated body of the nerve cuff deployment tool, further wherein the elongated body of the nerve cuff deployment tool has a column
- 25 strength sufficient to resist buckling at compressive forces of at least 10 N;
- advancing the nerve cuff deployment tool distally through the cannula into the nerve root region; and
- disengaging the nerve cuff electrode from the nerve cuff deployment tool and wrapping the nerve cuff electrode to the patient's nerve root.
- 30 15. A nerve cuff deployment apparatus for minimally invasively attaching a nerve cuff electrode to a patient's nerve root, the apparatus comprising:

an elongated body having a column strength sufficient to resist buckling at compressive forces of at least 10 N; and
a nerve cuff engagement region at a distal end of elongated body, configured to releasably secure to a nerve cuff electrode.

- 5 16. The system of claim 15, further comprising a self-curling nerve cuff electrode.
17. The system of claim 15 further comprising a self-curling nerve cuff electrode releasably coupled to the nerve cuff engagement region.
18. The system of claim 15, wherein the elongated body is flexible.
- 10 19. The system of claim 15, wherein the elongated body comprises a first half and a second half, further wherein the nerve cuff engagement region comprises a first capsule portion at the distal end of the first half and a second capsule portion at the distal end of the second half, wherein the first and second capsule portions are configured to couple to form a capsule to enclose and protect the nerve cuff electrode.
- 15 20. The system of claim 15, wherein the nerve cuff engagement region comprises a flared-open distal-facing region chamber configured to at least partially enclose the nerve cuff electrode.
21. The system of claim 15, wherein the nerve cuff engagement region comprises a hook or fork configured to releasably engage with the nerve cuff electrode.
- 20 22. The system of claim 15, wherein the nerve cuff engagement region comprises a rounded distal end configured to engage with the nerve cuff electrode.
23. The system of claim 15, further comprising a pusher extending adjacent to the elongated body having a distal end configured to apply distal force to the nerve cuff electrode.
24. The system of claim 23, wherein the pusher extends within the elongated body.
- 25 25. The system of claim 23, wherein the pusher comprises a forked distal end configured to engage with the nerve cuff electrode.
26. The system of claim 23, further comprising a proximal control coupled to the elongated body configured to disengage the nerve cuff engagement region from the nerve cuff electrode.

27. A nerve cuff deployment apparatus for minimally invasively attaching a nerve cuff electrode to a patient's nerve root, the apparatus comprising:

an elongated body having a column strength sufficient to resist buckling at compressive forces of at least 10 N, wherein the elongated body comprises a first half and a second half, each extending distally to proximally; and a nerve cuff engagement region at a distal end of elongated body, configured to releasably secure to a nerve cuff electrode, wherein the nerve cuff engagement region further comprises a first capsule portion at the distal end of the first half and a second capsule portion at the distal end of the second half, wherein the first and second capsule portions are configured to form a capsule to enclose and protect the nerve cuff electrode.

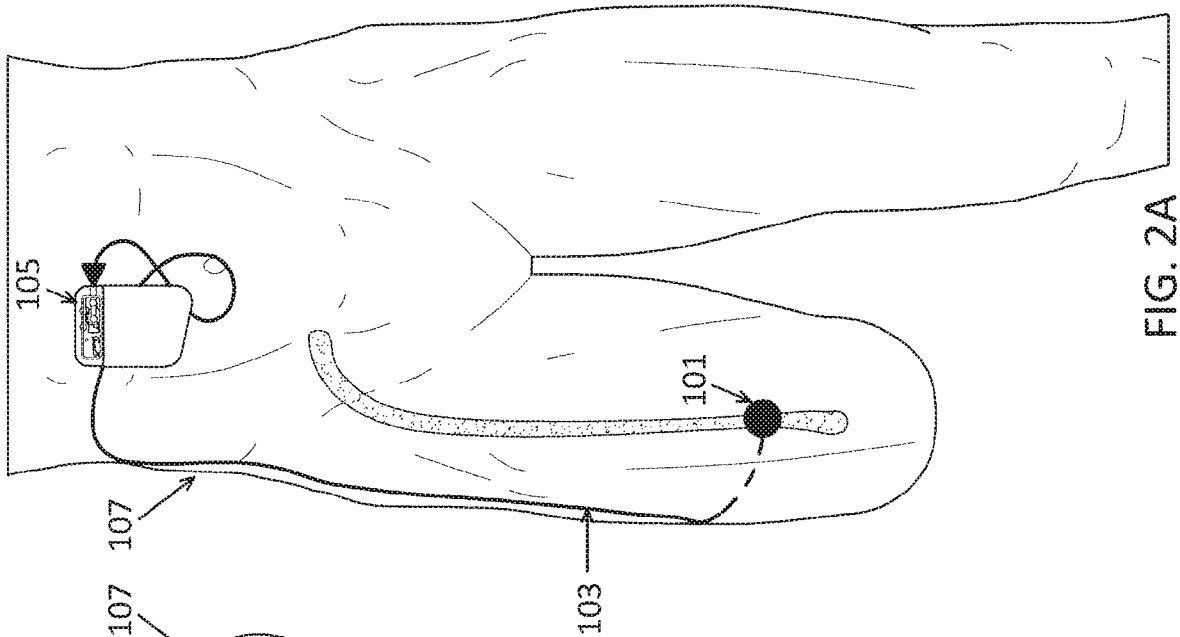

FIG. 2A

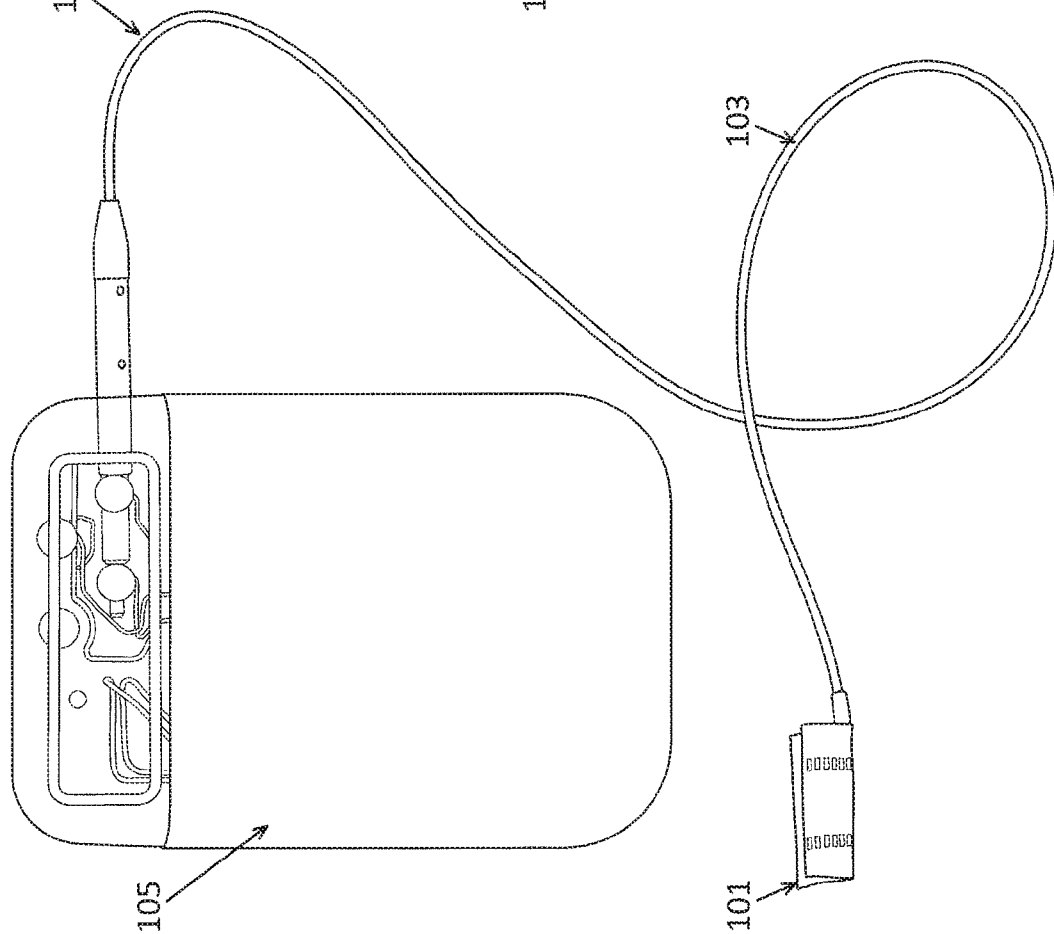

FIG. 1

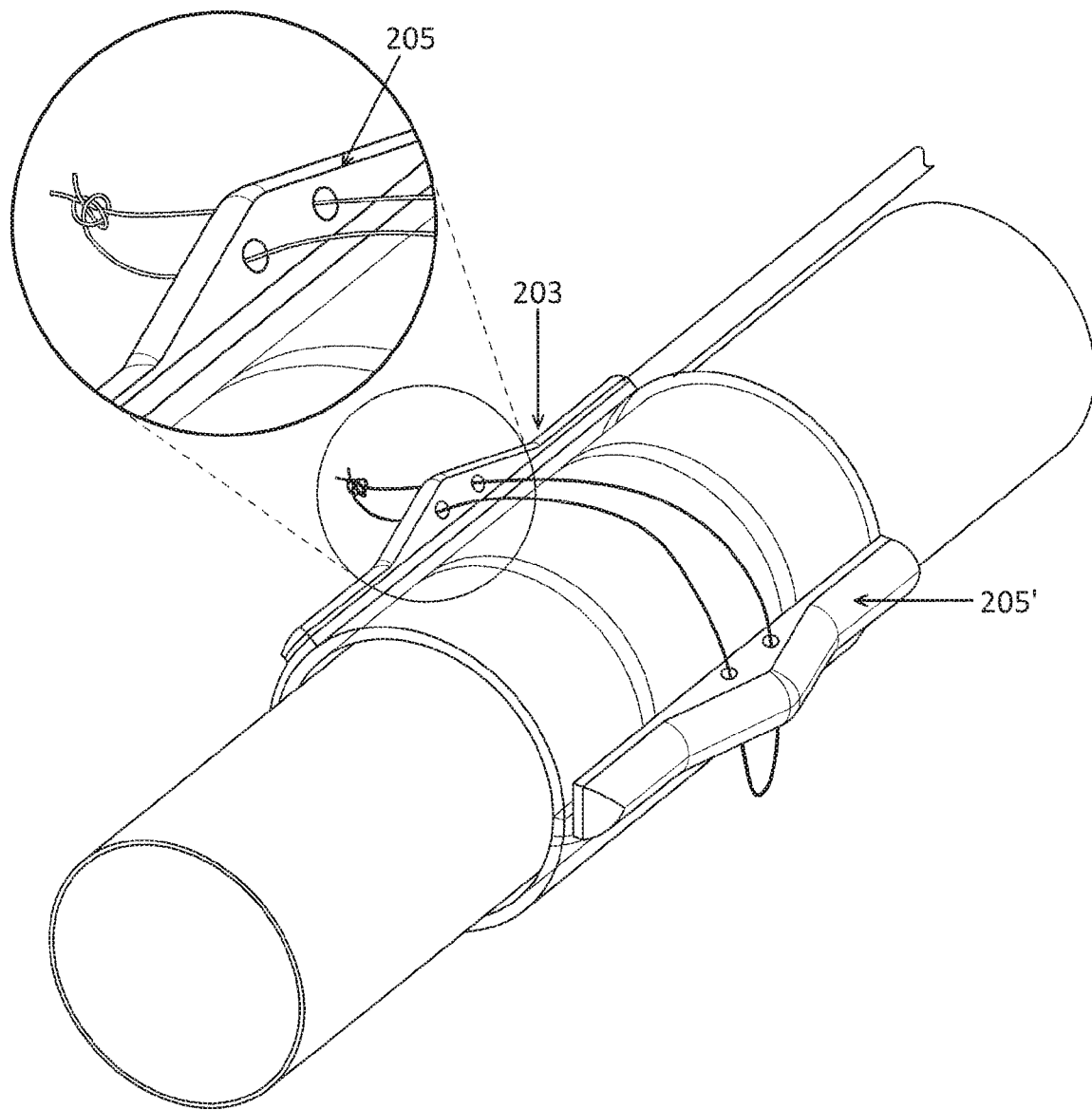

FIG. 2B

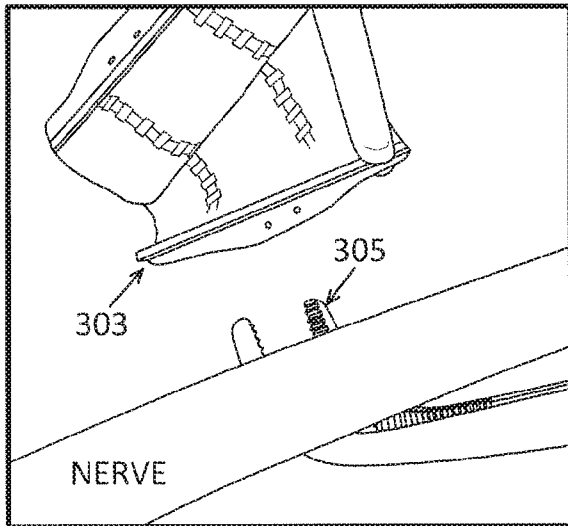

FIG. 3A

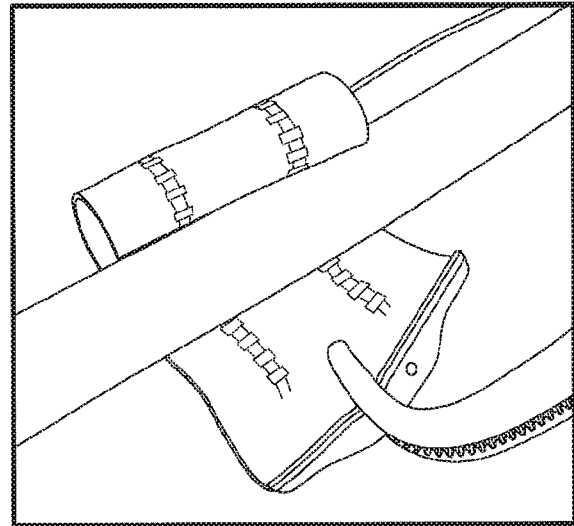

FIG. 3B

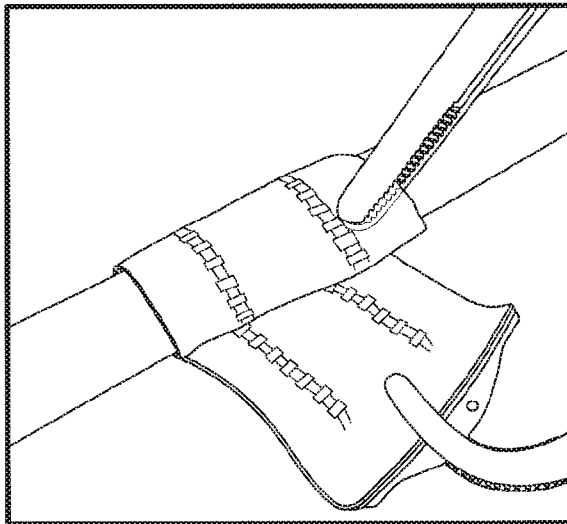

FIG. 3C

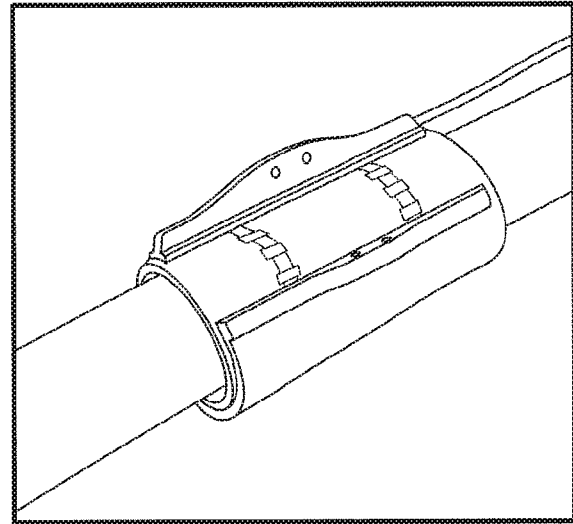

FIG. 3D

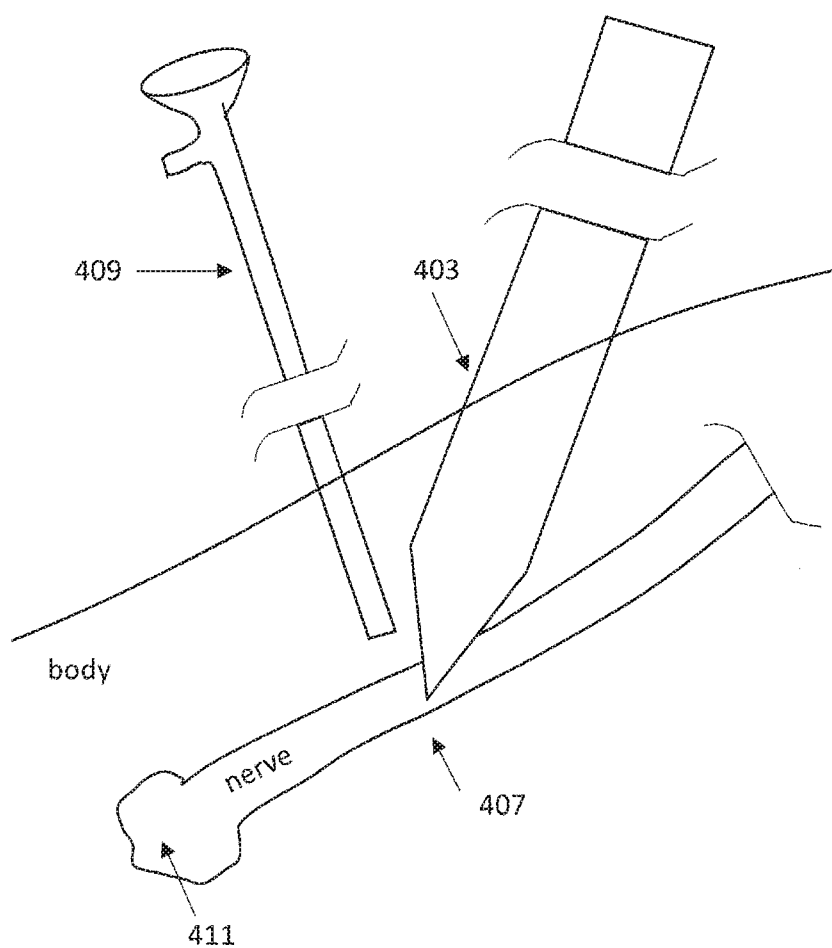

FIG. 4A
(not to scale)

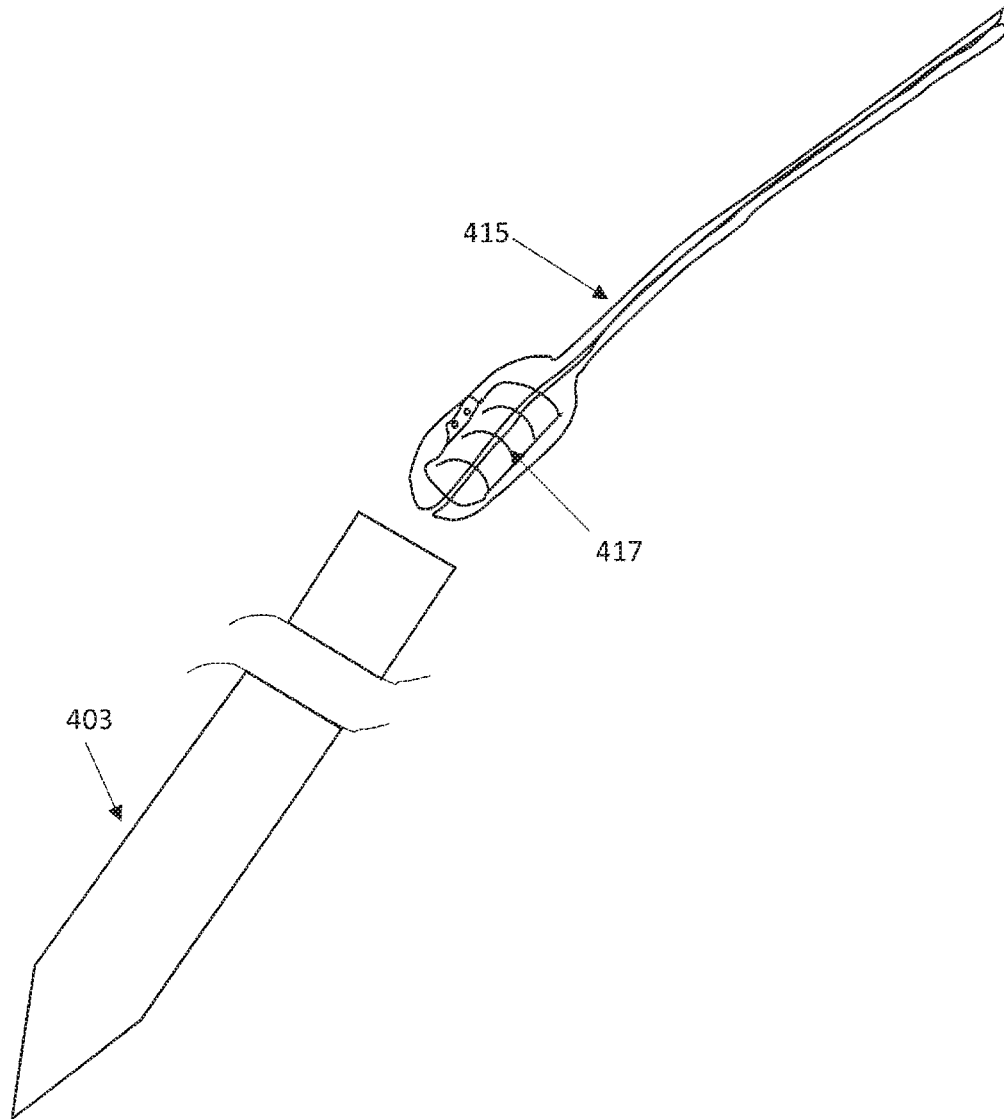
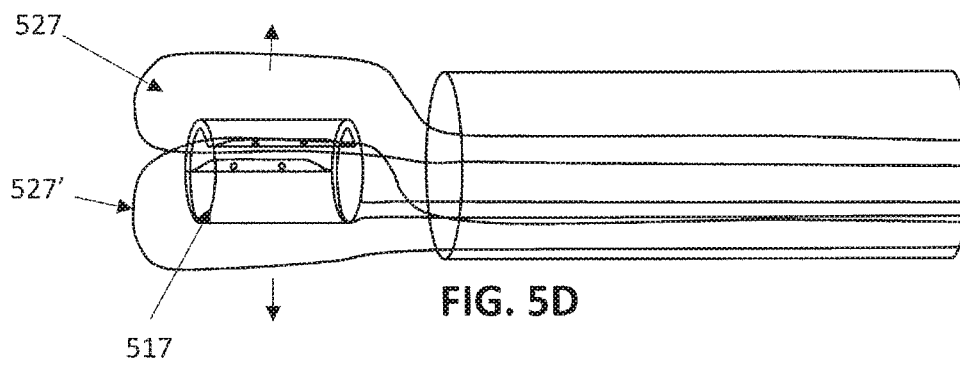
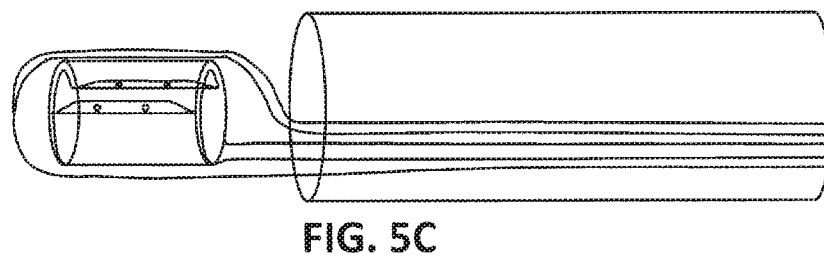
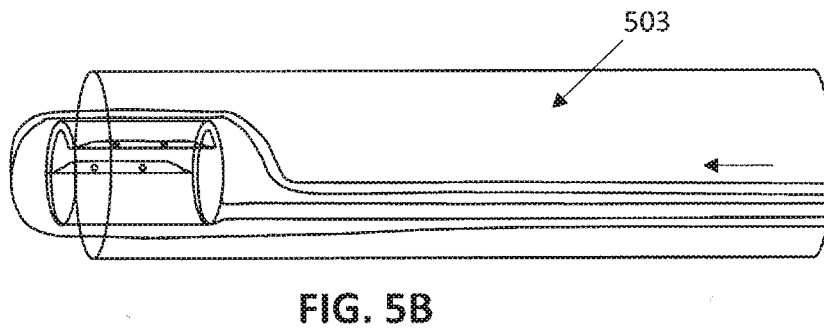
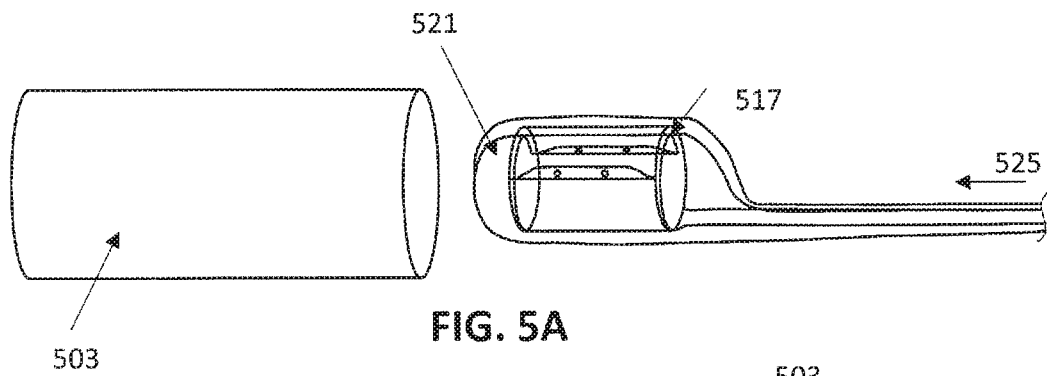

FIG. 4B



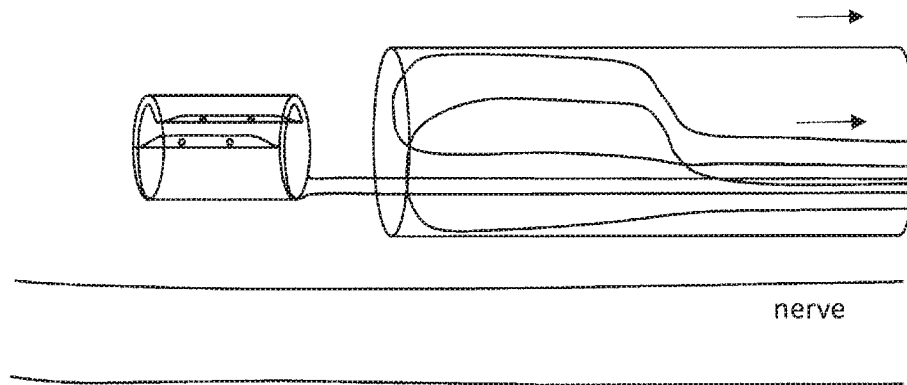

FIG. 5E

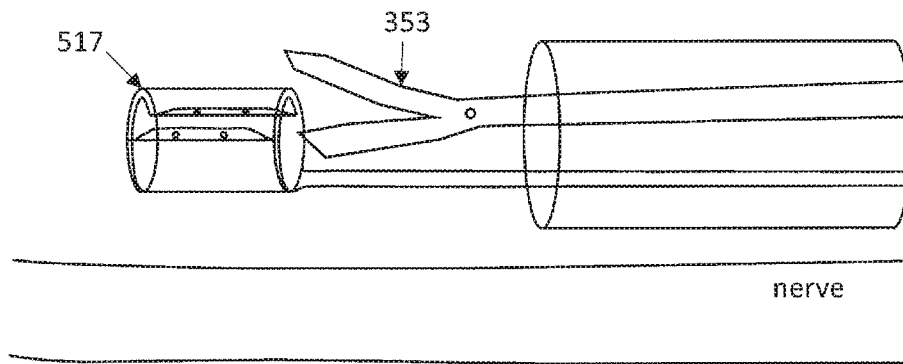

FIG. 5F

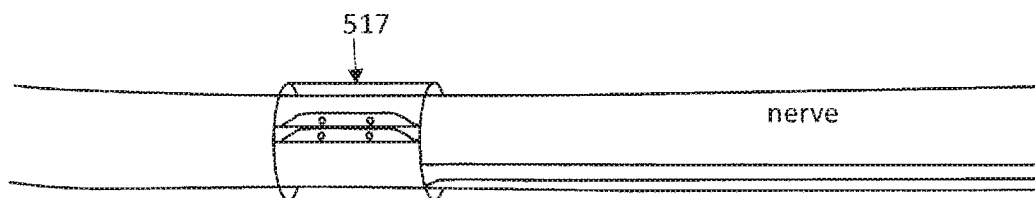

FIG. 5G

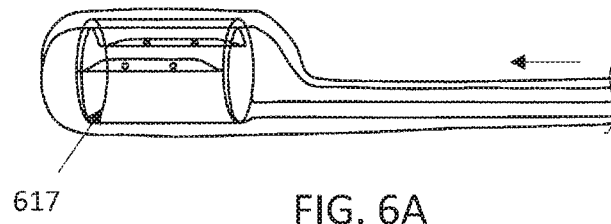

FIG. 6A

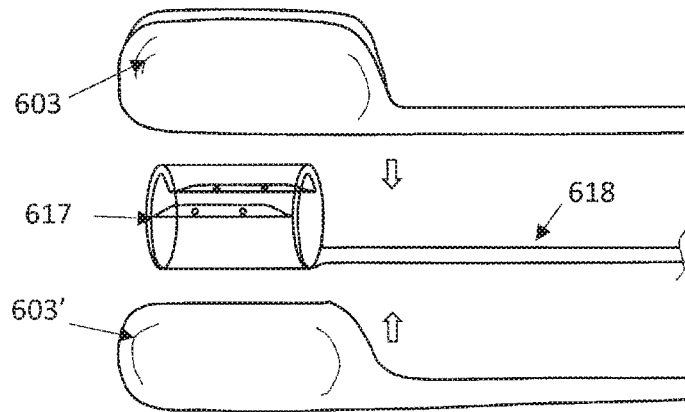

FIG. 6B

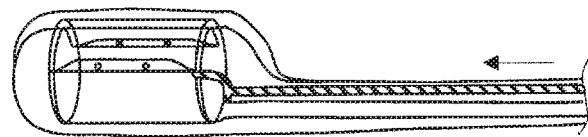

FIG. 6C

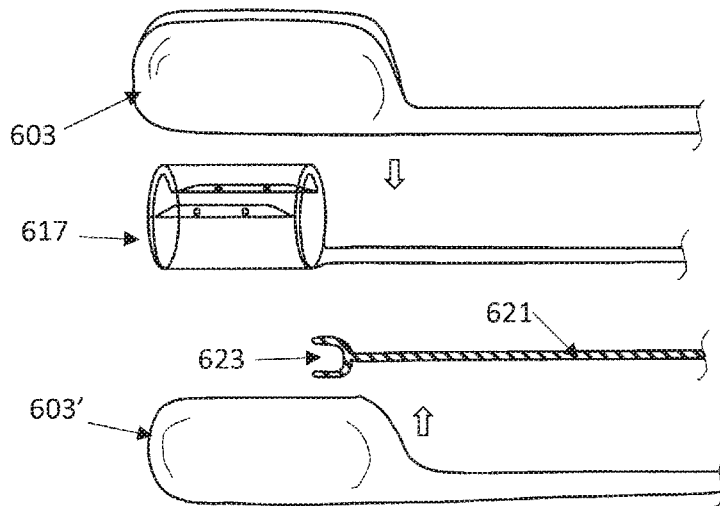

FIG. 6D

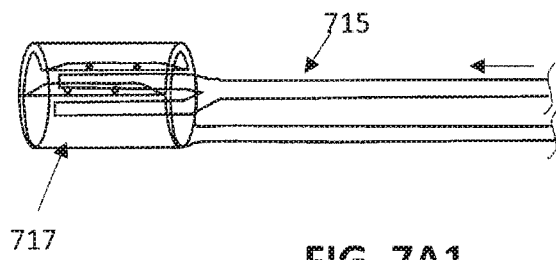

FIG. 7A1

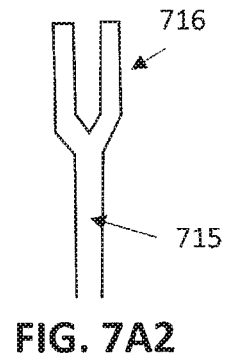

FIG. 7A2

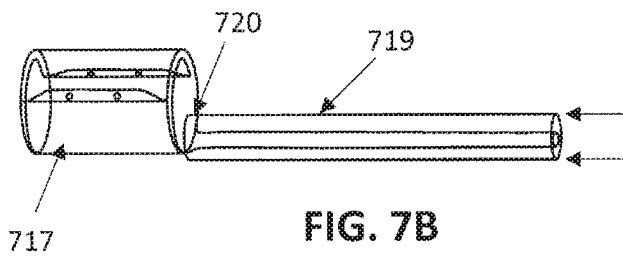

FIG. 7B

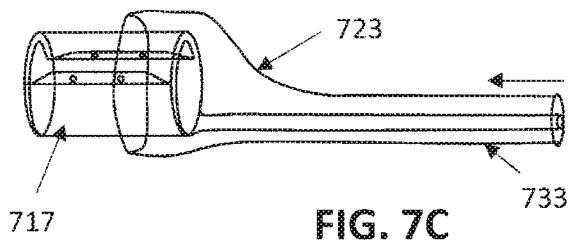

FIG. 7C

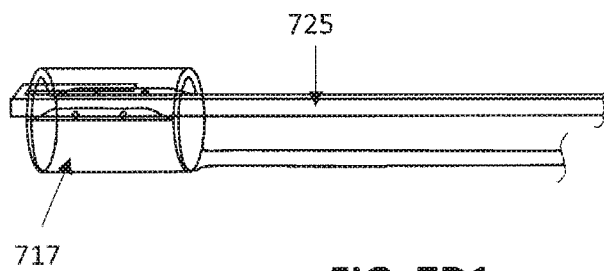

FIG. 7D1

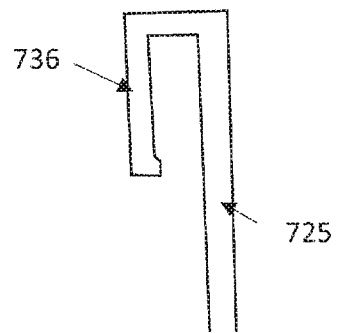
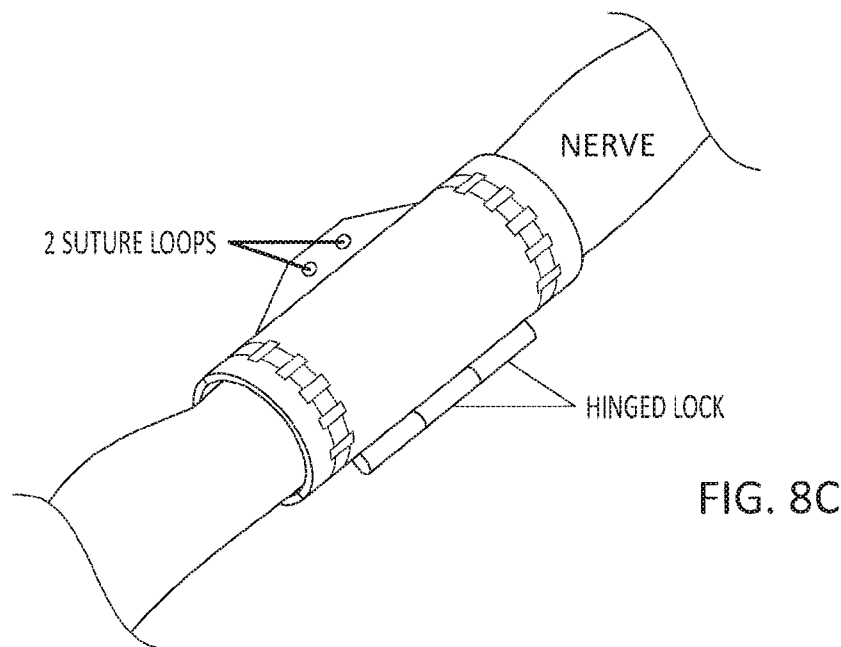
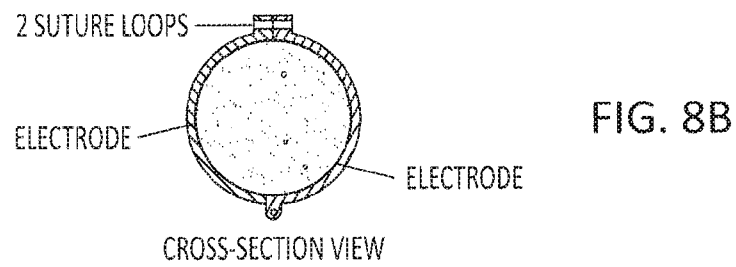
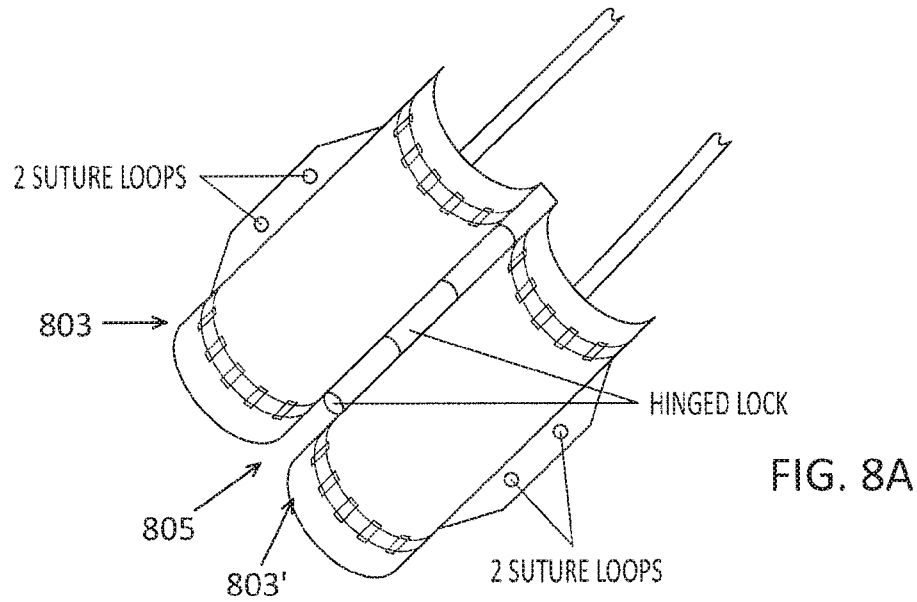

FIG. 7D2



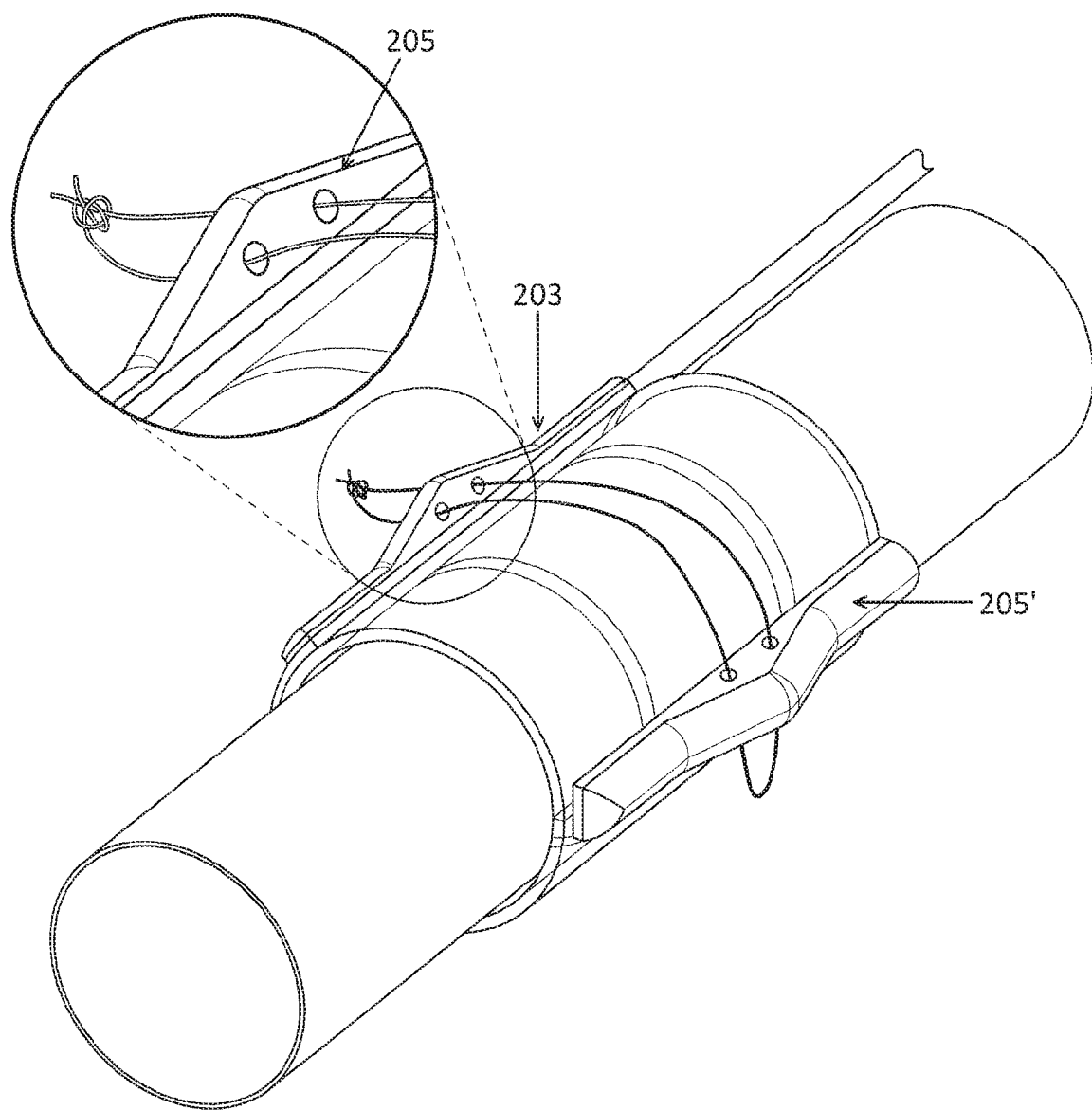

FIG. 2B