

(19) World Intellectual Property Organization
International Bureau



(43) International Publication Date
28 September 2006 (28.09.2006)

PCT

(10) International Publication Number
WO 2006/100579 A1

(51) International Patent Classification:
B62J 7/04 (2006.01)

(21) International Application Number:

PCT/IB2006/000666

(22) International Filing Date: 23 March 2006 (23.03.2006)

(25) Filing Language: English

(26) Publication Language: English

(30) Priority Data:

05006609.1 24 March 2005 (24.03.2005) EP

(71) Applicant (for all designated States except US): **HAMAX AS** [NO/NO]; Makeveien 4, N-1679 Krakerøy (NO).

(72) Inventor; and

(75) Inventor/Applicant (for US only): **HOIDAL, Dag** [NO/NO]; Holmelia 19, N-1675 Krakerøy (NO).

(81) Designated States (unless otherwise indicated, for every kind of national protection available): AE, AG, AL, AM, AT, AU, AZ, BA, BB, BG, BR, BW, BY, BZ, CA, CH, CN,

CO, CR, CU, CZ, DE, DK, DM, DZ, EC, EE, EG, ES, FI, GB, GD, GE, GH, GM, HR, HU, ID, IL, IN, IS, JP, KE, KG, KM, KN, KP, KR, KZ, LC, LK, LR, LS, LT, LU, LV, LY, MA, MD, MG, MK, MN, MW, MX, MZ, NA, NG, NI, NO, NZ, OM, PG, PH, PL, PT, RO, RU, SC, SD, SE, SG, SK, SL, SM, SY, TJ, TM, TN, TR, TT, TZ, UA, UG, US, UZ, VC, VN, YU, ZA, ZM, ZW.

(84) Designated States (unless otherwise indicated, for every kind of regional protection available): ARIPO (BW, GH, GM, KE, LS, MW, MZ, NA, SD, SL, SZ, TZ, UG, ZM, ZW), Eurasian (AM, AZ, BY, KG, KZ, MD, RU, TJ, TM), European (AT, BE, BG, CH, CY, CZ, DE, DK, EE, ES, FI, FR, GB, GR, HU, IE, IS, IT, LT, LU, LV, MC, NL, PL, PT, RO, SE, SI, SK, TR), OAPI (BF, BJ, CF, CG, CI, CM, GA, GN, GQ, GW, ML, MR, NE, SN, TD, TG).

Published:

- with international search report
- before the expiration of the time limit for amending the claims and to be republished in the event of receipt of amendments

For two-letter codes and other abbreviations, refer to the "Guidance Notes on Codes and Abbreviations" appearing at the beginning of each regular issue of the PCT Gazette.

(54) Title: CARRIER RACK FOR A BICYCLE

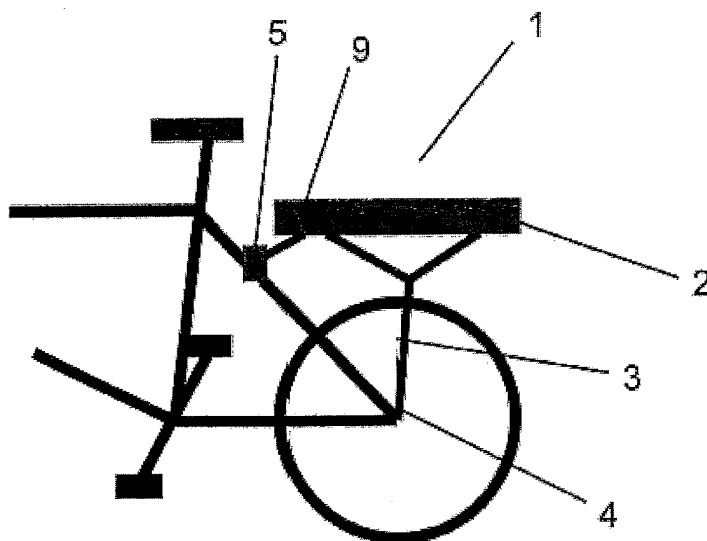

(57) Abstract: Users of cycles are limited in the amount that they can carry with them as luggage, owing to the need of having both hands to ride the cycle. Cycle carriers, therefore, provide a convenient way of allowing items to be carried by a cyclist, with the cycle and not the rider bearing the weight of the items. Many carriers, however, are designed for permanent attachment to cycles, this is not always appropriate if the cycle is to be used for other types of riding, where the carrier could be cumbersome or provide a hazard. To overcome such problems, a carrier (1) is presented which is readily attachable and detachable from the frame of a cycle without the need of tools. Furthermore, the carrier (1) is highly adjustable and can easily be fitted to a range of cycles with only minimal and straightforward modifications.

WO 2006/100579 A1

MEISSNER, BOLTE & PARTNER GBR

Postfach 860624
81633 München

5

HAMAX AS
P.O. Box 1408
1602 Fredrikstad
Norway

21. März 2006
M/HAX-052-PC
MB/PO/PA/kl

10

"Carrier rack for a bicycle"

15

Description

The current invention relates to a carrier rack which is provided for a two wheeled vehicle, in particular a bicycle.

Background to the Invention

20

25

Carrying racks, or simply carriers, for cycles are well known in the art for attachment to the cycle frame so as to allow the user of the bike to carry items of luggage without having to use their hands. Further, it is known for such carriers to be adapted so that further specific carrying elements, such as a child's seat for instance, can be attached to the base carrier. Most carriers that are adapted for attachment to the cycle over the rear wheel are possessed of three supports: two which extend to a fixing point either side of the rear wheel, and which are designed to take the weight of the carrier and items in transit, with a third which is provided for stabilising motion of the carrier around these two fixing points. These supports attach the actual carrier top to the frame of the cycle, wherein the carrier top is commonly of the form of a base made from a rigid plastic or a tubular frame, to which elements of luggage can be attached using ropes, straps, string or the like.

30

35

Most designs of carrier, however, are directed toward permanent fixture to the cycle. Whilst this can be acceptable to some users, there are occasions where it is desirable to remove the carrier from the bike. This is perhaps the case when the carrier is to be used with a so called mountain bike, wherein many users enjoy using the cycle in "off

road" conditions, for instance on dirt tracks in the countryside or through woodland. In such situations, it is desirable to remove the carrier from the cycle as it adds unnecessary weight and also poses the risk of being caught on vegetation which could lead to either carrier damage or in more serious situations, the user crashing the cycle.

5

It is an object of the current invention, therefore, to provide a carrier for attachment to the frame of a cycle in such a manner that it can readily be removed without the requirement of general or specialised tools. Furthermore, it is desired that such a carrier be quickly and easily attachable to or detachable from the cycle. Finally, it is preferable that the carrier be readily adjustable, such that it can easily be adapted for a wide range of cycle designs, again without the use of tools.

10

US 5,803,329 discusses a carrier which is intended for use on a cycle, and which is possessed of a fixing mechanism which does not require the use of tools. Herein, the mounting points either side of the rear wheel are provided by nuts permanently affixed to the cycle frame. These nuts are possessed of two partial shoulders which extend radially outward at the side of the nut removed from the cycle frame, to provide two lugs. These are designed to interact with appropriately shaped cut outs at the bottom end of the carrier supports, such that the carrier is rotated 90° back from its normal position and the provided cut outs are guided over the nuts and lugs. The carrier is then rotated into its normal position so that the cut outs in the carrier supports and the lugs on the nuts are out of alignment and the carrier is fixed in position. Finally, the carrier is fixed to the seat stem by use of a third connector which fixes around the tubing.

15

20

25

Summary of the Invention

The above detailed problems are solved by the carrier according to claim 1, with the dependent claims thereof giving preferred embodiments to the invention.

30

A carrier for a bicycle is disclosed which comprises a carrier top and rear axle mounts. The carrier top is connectable to one or more supporting members which are attachable to the carrier and extend from the carrier toward the rear axle mounts.

These axle mounts are fixed to the frame of the bicycle. Further, a front connector is provided, which is fixed to the frame of the bicycle in a position forward of the rear axle. This connector is for attaching the front of the carrier to the bicycle to give support and to stop the carrier from rotating about the rear axle mount. The carrier and front connector are interconnected by means of an adjustable securing rod, which is secured in a removable manner to the carrier top. This rod extends from the carrier top, such that its second end can be positioned and held within a channel provided in the front connector to secure the carrier, with the channel lying in a direction which is perpendicular to the direction of motion of the bicycle. This further means, that the carrier can be fitted to a variety of bicycle designs.

Description of the Figures

Figure 1 demonstrates a carrier according to the present invention attached to the frame of a bicycle.

Figure 2 details an expanded view of the mounting members and rear axle connector.

Figure 3 shows the front connector in expanded form.

Figure 4 is an exploded diagram of the carrier, showing the carrier top.

Figure 5 shows a carrier top with an integrated wire frame.

Figure 6 details the carrier top with seat base adapter.

Figure 7 illustrates the seat base with wedge securing pieces and a hand operated cam wheel.

Figure 8 is a cross section through the seat base engaged with the carrier top.

Figure 9 shows the seat base and cradle with suspension, in exploded form.

Figure 10 is an exploded diagram of a further rear axle mounting mechanism.

Figure 11 details a carrier showing a seat base, in which the seat base is held to the carrier by means of a moveable joint piece.

Figure 12 shows the integration of a tyre pump with a carrier.

Figure 13 details a removable light affixable to the rear of a carrier

Figure 14 is an exploded diagram showing a further front connecting mechanism for a cycle carrier.

Description of the Preferred Embodiment

With reference to figure 1, a carrier (1) for a bicycle according to the present invention is shown attached over the rear wheel of a bicycle. The bicycle carrier (1) comprises a carrier top (2), which can either be used as it appears in the figure as a simple bicycle carrier (1), or it can be integrated with further components which are described in detail below. Attached to this carrier top (2) in a removable manner, are one or more supporting members (3) which extend from the carrier top (2) to mounting points (4) provided on the cycle frame for supporting the carrier (1) and load. The mounting points (4) are positioned in the close vicinity of the rear axle of the bicycle, as is shown in figure 1, and are designed to be fixed to the bicycle and left in place when the carrier (1) is not being used.

It is envisioned, that the mounting points (4) will be fixed to the frame of the bicycle using either a screw or a nut and bolt arrangement, utilising an eyelet in the bicycle frame provided for the connection of cycle carriers. Should no such connection point exist, it is a straightforward matter to drill a hole of suitable size in the frame of the bicycle, at the point which extends around the rear wheel axle to fix the wheel to the frame. It is further possible, that the mounting point (4) be integrated with the axle of the rear wheel, and be positioned around the axle between the hub of the rear wheel and the inner side of the frame.

In order for the cycle carrier (1) to be readily attached and removed from the cycle frame, the rear mounting points (4) provide a pin for interacting with the lower end of the supporting members (3), this is best seen in figure 2. The lower end of the supporting members (3), are provided with slots (19) which are designed to accommodate the pin of the mounting points (4). When fitting the carrier (1) to the bicycle, all that is required to ensure a secure load bearing connection, is to slide the slots (19) at the end of the supporting members (3) over the pins provided by the mounting points (4). As a modification to the mounting points (4), and so as to stop sideways movement of the supporting members (3) from disengagement with the pin, the mounting points (4) can be provided by mushroom connectors. These mushroom connectors are cylindrical in shape, and are provided with a bore which extends

through the central axis of the connector to be used for fixing to the bicycle. The outer surface of the connector varies in diameter along its length in a step wise manner, so that at either end of the connector the diameter is greater than in the middle. This, therefore, provides a connector which has an "H" profile, wherein the slots (19) at the end of the supporting members (3) are designed to fit within the region of reduced diameter and thereby be prevented from slipping off the mounting point (4).

To further fix the carrier (1) to the frame of the cycle, there is provided a front connector (5) which is positioned at a point forward of the mounting points (4). This front fixing point is designed and provided to stop rotation of the carrier (1) around the rear axle mounting points (4). One possible design for the front connector (5) can be most clearly seen in figure 3, which shows an expanded view of the key components of the connector (5). As with the rear axle mounting points (4), this front connector (5) is intended to be semi-permanently fitted to the frame of the cycle, and left in place when the rest of the carrier (1) has been removed. Shown in figure 3, are two brackets (6) which are provided to fix the front connector (5) to carrier fixing points provided on the rear wheel forks of most cycles. Shown in the diagram are L-shaped brackets, although it is to be understood that the brackets (6) are not limited to these, and can be changed for simple plate brackets depending upon the fixing points on the cycle. The fixing brackets (6) are adjustably attached to the front connector (5) to accommodate a variety of widths in the bicycle side fixing points. As can be seen in figure 3, two slots (7) are provided passing through the body of the front connector (5) through which bolts (8) are passed for engaging with the fixing brackets (6) at the desired spacing.

As shown in figure 1, the carrier (1) is attached to the front connector (5) by means of an adjustable securing rod (9). This rod (9) is fixable at one end to the carrier top (2) in a removable and adjustable manner, so that the carrier can be used with a variety of bicycle designs and shapes. At the carrier top (2) the securing rod (9) either engages with one of a plurality of fixing points which allow it to be rotationally secured, or with a track which runs along the length of the carrier top (2) to which the rod (9) is clamped, again allowing for rotation of the rod (9) to accommodate different cycle

frame designs. The securing rod (9) is engaged with the front connector (5) via a bore (10), which passes through the body of the connector (5). This bore (10) passes through the connector (5) in a direction which is substantially perpendicular to that between the carrier (1) and the front connector (5). In this manner, it is only required
5 for the rod (9) to be bent into a configuration that will allow one end to slide into the bore (10) with the other being attached to the carrier top (2), so as to fully secure the carrier (1) and stop it from rotating around the rear axle mounting points (4).

For increased security in the above described fixing between the rod (9) and the front
10 connector (5), a locking mechanism is provided. As is shown in figure 3, this locking mechanism is in the form of a button (11), which is biased by means of a spring (12). The actual locking mechanism is formed by a plate (13) which has 2 right angle bends in it, wherein the two opposing faces of this plate (13) are positioned within the connector and cross the path of the bore (10). Two holes are provided in these
15 opposing faces in appropriate positions, so that when the plate (13) is fully engaged within the front connector (5) these holes align with the bore (10). Under the influence of the spring (12), however, the plate (13) is pushed out of the connector (5) body, and the holes on the plate become misaligned with the bore (10). As is shown in the figures, if the end of the rod (9) engaging with the front connector (5) is provided
20 with a groove (14) toward its end, the edge of one of the holes in the biased plate will slot into this groove (14), when the rod is fully within the connector. Indeed, as the bore (10) is accessible from both sides, it is necessary to provide the locking mechanism working with both orientations of the rod (9); this is achieved by use of the plate (13) crossing the bore (10) in two positions. This provides an additional
25 security feature in that, whilst the rod (9) is being inserted into the bore (10), the groove (14) will engage with the first side of the plate (13) and will therefore be stopped from slipping out again. Pressing of the button (11), will then allow the groove (14) to be disengaged from the holes in the plate (13) and the end of the rod (9) can be fully inserted within the bore (10). Clearly, the above double locking
30 mechanism works in reverse: should the rod (9) become dislodged from the hole in the first side of the plate (13) and slide outward of the front connector (5), the groove (14) will be engaged with the second side of the plate, and will therefore be retained.

In order to facilitate sliding the rod (9) into the bore (10) for engagement, it is possible to chamfer the relevant end, or even provide it with a point.

As can be seen in figure 3, the front connector further includes a safety strap (15).
5 This strap (15) is attached to the front connector (5) via the bolts (8), and is designed to pass around the back of the frame of the bicycle to which the connector (5) is attached. In this way, should the fixing mechanism holding the front connector (5) to the frame fail, the front connector (5) will still remain fixed to the frame and will not allow the carrier (1) to rotate or become unattached. Whilst the diagram has shown
10 this safety strap (15) connected through the bolts (8) used for adjusting the width of the fixing brackets (6), any other method of securing the strap (15) to the front connector (5) around the frame is believed as being considered obvious by the skilled man and falling within the scope of the design. For instance, the strap (15) could be attached to the connector (5), and when the connector (5) is fixed to the frame the
15 strap (15) is passed around the frame and the two ends are connected together, by means of a buckle or a clip, for instance.

As can be seen from figure 3, a modification to the design of the fixing rod (9), includes it having multiple bends. This design is particularly useful, as it further allows
20 for the carrier (1) to be fastened to a wider range of cycles. The rod (9) is fashioned in such a manner, that the direction of the central axis at each end of the rod (9) lies perpendicular to each other, which therefore allows one end to fasten to the carrier top (2) with the other being engaged in the front connector (5). Secondly, these two axes do not lie in the same plane as each other and are separated by a chosen distance.
25 In this manner, when the rod (9) is inserted into the bore (10) of the front connector (5), by choosing which side to insert from, the height of the rod (9) can be adjusted. This adjustment is designed to allow for different frame designs, wherein the relationship between the front connector (5) frame attachment points and the height of the carrier top (2) above the rear wheel differs.

30

Figure 14, shows another front fixing mechanism (5) for securing the front of the carrier (1) to the cycle. As in the above case, there is provided a unit for semi-permanent fixture to the cycle. As is detailed above, the figure shows "L-shaped"

fixing brackets (6) for attachment to relevant points of the cycle frame. The same connectors as those detailed in relation to figure 3 can be used, and so no further discussion will be presented. Attachable to the brackets (6) is a fixing plate (67), made from a rigid and durable material, preferably steel. This plate has two elongate slots, through which screws or bolts (not shown) are intended to pass in order to affix this plate to the brackets (6). The slots are provided, so as to allow the connector to be fixed to a plurality of cycles, wherein the fixing points on the cycle can be a variety of widths apart. Attached to the fixing plate (67), is a rigid hook assembly (68), preferably formed from metal. It is this hook (68) which provides a securing channel (10) and interacts with the securing rod (9) attached to the carrier (1), and which attaches the front of the carrier (1) to the frame of the cycle.

Shown in figure 14, is a securing rod (9) which is shaped in a continuous loop. Whilst this is a preferred shape for interacting with this embodiment of the front securing mechanism, the bent rod as disclosed above and in figure 3 could work equally well. It is clear that the loop end of the rod (9) slots into the hook or channel (10) region of the hook assembly (68), and thereby secures the front of the carrier (1) to the frame of the cycle. In order to further increase the security of this attachment, a safety knob (69) is provided within the fixing assembly. Preferably, this safety knob (69) is biased via a spring (70), to block the exit path from the hooks in the hook assembly (68). The safety knob (69) is rotatable around an axis point, the axle being provided by the pin (71). In use, the securing rod (9) is pressed into an appropriately shaped slot recess in the top of the safety knob (69), such that the knob (69) rotates about its axis point. In rotating, the knob (69) allows access to the hook regions of the hook assembly (68), and the end or loop of the rod (9) can pass and become secured. With removal of the force from the rod (9), the safety knob (69) rotates under the spring bias to close off the access way from the hooks portion of the assembly (68). In order to remove the securing rod (9), the safety knob (69) must be rotated, such that the open portions of the hooks is freed.

As a further security feature, the operation of the safety knob (69) may be locked in the closed position, such that there is no chance of the mechanism accidentally opening if the cycle is on rough terrain. This additional locking method is by way of a

5 snap extension which is positioned at the bottom of a push surface (72), which clips over the fixing plate (67). The spring (70) is chosen, such that it possesses the strength to achieve this. In order to open the safety knob (69), the user must squeeze the push surface (72) and a release lever (73) which is formed on the carrier side of the safety knob (69). Squeezing these two together, creates enough lift for the snap clip to disengage from behind the fixing plate (67) and allow the rotation and opening of the safety knob (69). In order to protect the workings of the above mentioned securing mechanism, there may be provided a cover piece (74), made from a rigid, preferably plastic, material. A safety strap (15) could be utilised with this front connector, as is described in relation to the design in figure 3.

15 In order to allow the carrier (1) to be fixed to a variety of cycles, the length of the supporting members (3) attached to the carrier top (2) can be varied. This is most simply achieved by the system as shown in figure 2. Herein, two sets of rods (16) are shown which extend from the carrier top (2) to a height adjusting block (17), to be held within. Whilst the diagram shows four rods grouped in pairs, it is to be understood that this is by way of example only, and that more or fewer can be used if so required. Furthermore, whilst it is envisioned that these rods be made from aluminium for both lightness and strength, it is clearly possible to fabricate them out of a different metal or indeed a rigid plastic. The rods (16) are designed to interact with the carrier top (2) and fasten thereto in a removable manner, and are shown in the figures attached to the underside of the top (2). Other designs, however, which fulfil the same function are clearly possible, and that shown in the figure is intended as one possible solution.

25

The height adjusting block (17), to which the lower end of the support rods (16) are attached, further interacts with a height plate (18), which has at its lower end the slot (19) for sliding over the rear mounting point (4). The height plate (18) comprises a rigid plate of metal which has a series of holes spaced out along its length, such that when the slot (19) is in position around the rear mounting point (4) the holes extend in an upward direction. The height adjusting block (17) is possessed of a slot which is sized to accept the height plate (18); further, the block (17) is provided with a fixing

30

pin which engages with the desired hole, and thus positions the adjusting block (17) at the desired height.

Whilst the engagement of the slot (19) in the height plate (18) over the rear mounting point (4) is a straightforward method of attaching the rear of the carrier (1) to the frame of the bike, it requires a locking mechanism to stop the motion of the bike from bouncing the carrier (1) out of the mount (4). This is most readily achieved by providing a clip (20) at the end of the height plate (18), for sliding underneath and around the rear mounting pin (4), and in this way securing the plate (18). Such a clip (20) would be affixed in a rotatable manner to the end of the height plate (18), on one of the arms either side of the slot (19). Once the height plate (18) is engaged with the rear mounting point (4), the clip (20) can be rotated from its open position allowing access to the slot (19) to the closed position, wherein it passes under the rear mount (4) and stops the height plate (18) from disengaging as a result of the motion of the cycle. As an additional feature, it is possible to bias this clip (20) by means of a spring (21), thereby ensuring that the clip is always engaged with the rear mounting point (4), and as such increasing the security of the locking mechanism. Moreover, to maintain this clip (20) assembly in good working order, and avoid its degradation from either physical knocks or from dirt and/or oil, a protective cap (22) can be provided to cover the clip (20) and spring (21).

An additional mechanism for securing the slot (19) associated with the support rods (16) with the rear axle mounts (4), is shown in figure 10. This figure also shows a further mechanism for attaching the support rods (16) to a height plate (18a). In this figure the rear axle mount (4a) is constructed in a slightly different manner from that disclosed above. Here, the mounting to the cycle is performed by 2 pieces: a bolt (76) and a mushroom pin (75). The mushroom pin (75) has a central extending cylinder with a flat head at one end. The cylindrical section is hollow in construction, and possessed of a thread on the inner side, this thread is designed to interact with the external thread of the bolt, and fix the mounting to the frame of the cycle. The exterior surface of the cylindrical section of the mushroom pin (75), also possesses a thread as will be described below.

The height plate (18a) of this embodiment, is constructed of a durable, rigid material, preferably metallic in nature. Unlike in the previous embodiment, wherein the support rods (16) interact with the height plate (18) via an adjusting block (17), here they are shown attaching directly with the height plate (18a) via the use of fixing means (46).

5 Of course, it is to be understood, that the further fixing features of the design shown in figure 10, can be implemented using the height plate (18) and block (17) described in figure 2. The fixing means (46) can comprise any suitable means, such as a bolt or screw, and they pass through fixing holes (47) positioned at the bottom of the support rods, to fasten with the height adjustment holes provided on the height adjustment
10 plate (18a). In the figure, two support rods (16) are shown attaching to a substantially "V" shaped plate (18a), however, it is to be understood that this system works equally well with a carrier (1) provided with only one support rod (16)

As with the previous height adjustment plate (18), the plate (18a) of this embodiment
15 may be provided with a slot (19) for sliding over and fixing with the rear axle mount (4), or the slot (19) may be replaced by a hole. In this embodiment, the mechanism of securing the height adjustment plate (18a) with the rear axle mount (4) differs from that of the clip (20) disclosed above. As can be seen in figure 10, also provided in the reduced diameter region of the rear axle mount (4) is a barbed knob (48). This knob
20 (48) has a hole running through its rotational centre in which there is a screw thread. This hole and thread are designed to threadably engage with the external surface thread of the cylindrical part of the mushroom pin (75) of the rear axle mount (4a). When the slot (19) of the height plate (18a) is positioned over the cylindrical portion of the rear mount (4a), the barbed knob (48) is rotated so as to grip the height plate
25 (18a) with the flat head of the mushroom pin (75) by means of the interacting screw threads. If the height plate (18a) is possessed of a hole, the cylindrical part of the mushroom pin (75) is passed through the hole, and the barbed knob (48) is then threadably engaged with the mushroom pin (75).

30 As a further security measure, to stop the knob (48) from unscrewing during motion of the cycle, there may be provided a push button (49). This push button (49) has a lower edge (50) which is sized and shaped so as to receive a portion of the outer surface of the barbed knob (48) which lies between adjacent barbs (51). This push

button interlocks with the knob (48), such that the lower edge (50) stops the rotation of the knob (48) by blocking the passage of the barbs (51). Preferably, the push button (49) is biased by a spring, which keeps it in the locking position. In order to rotate the knob (48) to both tighten and loosen the grip on the height plate (18a), the
5 button (49) must be pushed and the lower edge (50) removed from the path of the barbs (51).

Additionally shown in figure 10 is a cover (52), preferably made from an appropriate plastic, which may be provided to fit over the ends of the support rods (16) and is
10 releasably fixed to the height plate (18a). This cover (52), is preferably provided with holes through it, which allow external access to the fixing means (46). A further optional feature which is shown in figure 10, is that of the fastening clip (53) for attachment of a strap (not shown). This strap, preferably elastic in nature, is intended for positioning over the top of the carrier (1) and attaching to a similar clip (53) on
15 the other mounting apparatus on the other side of the cycle axle. Such a strap, is optionally provided for securing items to the carrier (1) during transit.

Whilst the two rear axle fixing mechanisms have been described separately, it is to be understood that features from each of figures 2 and 10 can readily be interchanged to
20 provide a rear axle fixing system for the bike carrier (1).

The above disclosed arrangements for attaching the carrier (1) to a cycle, means that one carrier (1) can be used with a range of cycles. This is particularly desirable when multiple users, say within a family, wish to use just one carrier (1). Provision of
25 multiple front connectors (5) and rear axle mounts (4) attached to several cycles, in addition to the above disclosed adjustable support members (3) and securing rod (9), leads to a carrier (1) which can readily be moved from one cycle to another.

Figure 4 is an exploded diagram detailing how the carrier top (2), the front connector
30 (5) and the supporting members (3) are disposed to make the basis of the carrier (1). As shown in this figure, the preferred number of supporting members (3), each of which comprises a pair of rods (16), is two, that is: one either side of the rear wheel. Further provided on the carrier top (2) is one half of a dovetail joint (23), for the

secure connection of further carrier elements as detailed below. Shown in figure 4, is a carrier top (2) which is fully formed as a single unit, preferably out of a rigid plastic material, in which the half dovetail joint (23) is positioned toward the outer edge of the top (2). Another possible method of providing one half of a joint for attachment
5 of further carrier elements, is shown in figure 5, wherein a rigid wire (24) is situated above the carrier top (2) upper surface in a loop. This rigid wire loop (24) provides a fixing point which can be treated as one half of a dovetail joint, as in the case where the carrier top (2) is formulated from a single unit. The loop can also be used for attaching items to the carrier in the same way as the slots (25), which can be seen in
10 figures 4 and 5, passing through the carrier top (2), securing the items by means of straps, rope, string or the like.

The half dovetail joint in the carrier top (23), is specifically intended for interfacing the carrier top (2) with further elements of the carrier (1); figure 6 shows one such
15 element in the form of a seat base (26). Further elements which could interface with the carrier top (2) in the manner described below, include a basket or box or the like. The term seat base (26) is merely used throughout for simplicity and is intended to cover each of the above options. This seat base (26) is designed such that its underside has a half dovetail joint (27) which is the matching half of the carrier top
20 dovetail joint (23). Attachment of the seat base (26) to the carrier (1), is by the simple sliding of the seat base (26) over the carrier top (2) such that the two halves of the joint engage. In the case that the carrier top (2) has a wire loop for the attachment of the seat base (26), the seat base (26) slides over this for attachment. Whilst the figures show the carrier top (2) being possessed of the tenon to the joint, in the case of the
25 wire loop carrier (24) the seat base (26) has the mortise which slides over and around the loop, it is equally possible for these to be reversed. In this situation, the carrier top (2) has a dovetail shaped recess into which a tenon on the seat base (26) can slide; the wire loop carrier (24) is adapted so that the seat base tenon slides between the two sides of the loop to engage therewith.

30

The dovetail joint between the carrier top (2, 24) and seat base (26) clearly stops the two elements from disengaging vertically, but there remains the possibility of the base (26) sliding off from the carrier (2). In order to obviate this problem, the seat base

(26) can be fitted with at least one hand operable locking mechanism. Two solutions for this locking system are presented: a mechanism for causing the two halves of the dovetail joint to be gripped together so as to remove any play from the joint and stop the sliding disengagement; and a rotatable safety lock (28) which is connected to the seat base (26), and has projections that extend below the bottom of the seat base (26) to interact with the carrier top (2, 24). It is conceived that one or both of the above locking systems be fitted to the carrier (1) of the present invention, although with a well fitting dovetail joint (23, 27) it is possible that neither would be necessary.

Several solutions exist for removing the play from the dovetail joint, either the two halves are forced apart vertically, so that the tenon is forced into tight engagement with the mortise, or the seat base (26) is formed such that it can be deformed slightly and act so as to grip the carrier top (2, 24), or the rods of the loop carrier (24) can be moved to grip the seat base (26). The method of forcing the two halves of the joint apart, is best achieved by providing 2 wedges (29), see figure 7, which fit within the dovetail joint in between the seat base (26) and the carrier top (2). These wedges (29) are biased, with the aid of springs (30), pulling them together toward the centre of the carrier top (26). The wedges (29) are oriented so that the narrow portions face each other, and when they are pulled together by the biasing springs (30), thicker and thicker portions are introduced into the gap between the two halves of the joint and thus it is pushed apart and more securely held. In order to remove the wedges (29) from the joint, and allow the seat base (26) to be removed from the carrier top (2), a cam wheel (31) is mounted within the seat base (26) such when it is rotated, it acts upon linear extensions of the wedges (29) and pushes them apart. This cam wheel is provided with a grip and is intended to be hand operated. Clearly, the cam wheel (31) must be in the position that forces the two wedges (29) apart for mounting or removal of the seat base (26) onto the carrier top (2). As the wedges act upon the carrier top (2), this method is particularly suited to the solid carrier top (2), rather than the wire loop top (24).

30

Secure fixing of the seat base (26) by deformation, requires that this base (26) is formed from a piece of plastic in the shape of a "U"; that is, it has two extending arms which are separated by a small gap. When the seat base (26) is positioned in the

carrier top dovetail joint (23), these two arms are either squeezed together or pushed apart by hand operated means and therefore secure the dovetail joint. Shown in figure 6 is a locking lever (32), which has an extension passing through one of the seat base (26) arms to be secured in the other. This design is appropriate for when the carrier top (2) has the tenon of the dovetail joint, whether provided in the moulded plastic carrier top (2) or the carrier top possessing the rod loop (24), and the seat base (26) the mortise. As the lever (32) has an eccentric mounting point at one end of the extension, when it is rotated it acts upon the side of the seat base (26) and pushes the first arm toward the second, and in so doing grips the carrier top tenon (23). Whilst in the figure a lever (32) is shown, it is clear that other systems exist, such as a hand operated screw thread, which upon rotation pushes the two arms of the seat base (26) together. Additionally, in the system which employs a wire loop carrier top (24), it is possible to bias the rods outward so as to engage more tightly with the mortise of the seat base (26) and so secure the joint. This could be achieved by means of a hand operated screw thread, which upon rotation acts to force the rods apart.

When the converse system to that above is utilised, that is where the seat base (26) presents the tenon of the dovetail joint, to either fit within a moulded mortise in the carrier top (2), or within the rods of the carrier (24), a different locking mechanism is required. In this case, it is possible to still utilise the seat base (26) formed as a "U", as detailed above, however, instead of using a system to push the two arms together, the biasing is required to pull the two arms apart and so engage the two halves of the dovetail joint in tight connection. The simplest method of performing this task, is by providing a screw thread which passes through one of the arms and impinges upon the other. Rotation of the screw in the appropriate direction, will drive the end of the screw into the second arm of the seat base (26) and force the two apart and into tight engagement within the joint. It is also possible, to have a screw thread engaged with both arms, wherein each half has a thread of opposite thread direction, such that rotation will cause both arms to be forced apart. An additional method of gripping the tenon on the seat base (26) is possible, if the carrier top (24) has the rigid wire loop configuration. Here, when the tenon is engaged between the rods, application of a force to move the rods together will grip the seat base (26) firmly to the carrier top

(24). This gripping force could most readily be achieved by means of screw thread operated clamps attached to each of the rods.

A further mechanism of securing the seat base (26) with the carrier top (2) and removing the play within the dovetail type joint can be seen in exploded form in figure 11. In this figure, the carrier (1) is shown to be a wire carrier (1) and the seat base interacts directly with this. This is purely by way of example, and the fixing system works equally well with the solid carrier top (2) in figure 4, and the carrier top (2) with rigid wire fixing means (24), as detailed above in relation to figure 5. In this fixing mechanism, the play in the joint between the seat base (26) and carrier top (2), is removed by means of joint piece (54). This joint piece (54) forms a separate section which interacts with the underside of the seat base (26), and fits within a recess formed therein.

As can be seen in figure 11, the joint piece (54) is designed such that it can move in and out of the recess formed in the seat base (26). Flanges extending along either side of the joint piece (54) are designed to fit within the mortise of the seat base (26). If a wire frame is being used as the carrier (1), or the carrier top (2) has the rigid wire (24) construction, then the flanges are designed to fit underneath the wire when the seat base (26) is in position. Furthermore, the solid carrier top (2) could be provided with a track comprising two rails running along the length of the top, which provide a gap between their underside and the carrier top (2) top surface, into which the flanges can slide.

The seat base (26) is slid into position with the flanges of the joint piece (54) engaging with whichever fixing mechanism is formed on the carrier top (2). Once in position, the joint piece (54) is brought further within the recess of the seat base (26) and thus the flanges grip the carrier top (2). As seen in figure 11, the joint piece (54) is moved within the seat base recess by means of the wedge screw (55). Wedge screw (55) is formed from an elongate rigid material, which fits within the seat base (26) and has a substantially flat lower base. The upper surface has a varying profile, such that the vertical width of the screw (55), vertical being defined when viewing the carrier (1) from the side, increases and decreases a number of times along the length of the screw

(55). The wedge screw (55) is contained within a hole running along the length of the seat base (26) and is free to move in the horizontal plane, in particular in and out of this hole. The flat bottom of the wedge screw (55) resting on a corresponding flat lower side of the hole extending through the seat base (26).

5

In operation, the joint piece (54) is further possessed of a plurality of extensions on its upper side, which fit with the recess of the seat base (26). These extensions further pass within the region of the longitudinal hole provided for the wedge screw (55). The extensions are provided with holes therein, such that when the joint piece (54) is placed within the recess of the seat base (26) the holes within the extension line up with the hole through the seat base (26) to create a longitudinal passageway for the wedge screw (55).

When in the initial position, the narrow sections of the wedge screw (55) align with the holes in the extensions of the joint piece (54). It is clear then, that movement of the wedge screw (55) in the longitudinal direction, will bring the regions of increased thickness within the holes in the extensions and in so doing cause the joint piece (54) to be brought further within the recess in the seat base (26). This will clearly cause the gap between the flanges of the joint piece (54) and the underside of the seat base (26) to narrow, which will in turn grip the relevant section on the carrier top (2). In this manner, the seat base (26) can be firmly attached to the carrier top (2).

As can be seen in figure 11, the method of moving the wedge screw (55) in and out of the hole in the seat base, is by means of a screw thread portion at one end of the screw (55). This screw thread interacts with a matching nut (56) which has the appropriate internal screw thread. The nut (56) is held within the seat base (26) and is free to rotate within this mounting. The screw thread at the end of the wedge screw (55) is threadably engaged with this nut (56), and therefore rotation of the nut (56) causes the wedge screw (55) to move in and out of the hole through the seat base (26), thereby tightening the grip of the joint piece (54) with the seat base (26). So that the nut can be rotated more easily, a hand operable screw knob (57) may be attached thereto.

An additional, and optional, security feature can be integrated within this design, for ensuring that the seat base (26) is fully engaged with the carrier top (2) prior to allowing the rotation of the screw knob (57). The security device (58) is provided at the rear end of the seat base (26), that is the end that slides within the carrier top joint last. One or a plurality of tabs protrude from the underside of the seat base (26) when the base (26) is not fully engaged within the carrier top joint. Additional optional tabs can also protrude from the upper side of the seat base (26), so as to provide a visual indication to the operator that the seat base (26) is not fully engaged. Once the seat base (26) is positioned fully within the carrier top joint, the lower tabs are pushed within the base (26) which further causes the visual tabs on the upper side to be retracted. A further feature of this, is that until the lower tabs are retracted, the safety device (58) can stop the rotation of the nut (56) and thereby ensure that the seat base (26) is fully within the carrier top joint prior to attempting to lock the two together.

15

Whilst the security device (58) is described only in conjunction with seat base (26) according to figure 11, it is clear that a similar feature could be included in designs disclosed above. Each of the seat base (26) designs, could be fitted with the security device (58) so as to alert users of the system when the seat base (26) is not fully engaged with the carrier top joint.

20

Figure 6 shows the relative positioning of the safety lock (28), if present, within the seat base (26) for further ensuring that it does not accidentally disengage from the carrier top (2, 24). Figure 8, shows a cross section through the engaged carrier top (2) and seat base (26) taken along the line A-A in figure 6. Clearly visible is the projection from the safety lock (28) which extends below the bottom surface of the seat base (26) to engage with a resilient side of a recess (33) in the carrier top (2). This recess (33) can be more clearly seen in figure 6. As the seat base (26) is slid into engagement with the carrier top (2), the safety lock (28) rotates around the pivot point (34) and the projection end rises out of the dovetail joint region, until the recess (33) is reached. At this point, the projection drops down to engage the locking mechanism and prevents the seat base (26) from sliding back and disengaging from the carrier top (2). Whilst it is possible to allow this lock to work under the force of gravity alone, it

30

is preferable to spring bias the rotation of the member to ensure that the lock (28) properly engages, and further prevent the motion of the cycle from bouncing it out of position.

5 The safety lock (28), if present, can also be positioned to the side of the seat base (26) as shown in figure 11. In this case, the safety lock (28) is provided with a downward facing protrusion, which interacts with a block positioned on the carrier top (2), or wire carrier. Once again, the safety lock (28) is rotatably held within the seat base (26), such that the protrusion can be moved upward and over the block in the carrier
10 top (2) when the seat base (26) is slid in and out of the joint. Whilst gravity can be utilised to keep the safety lock engaged, it is preferred to provide the lock (28) with a spring bias to ensure it remains in position. Preferably also, the protrusion is provided with a front curved edge so that when the seat base (26) is being engaged with the carrier top joint, the sliding motion automatically moves the safety lock (28) up and
15 over the block. Further, the back edge of the protrusion may have a straight profile such that it forms a resilient locking assembly with the block when engaged. If this lock (28) is also integrated with the safety device (58) as shown in figure 11, it is possible to ensure that the lock (28) engages at the same point that the safety device (58) is disengaged by the carrier top (2).

20

Figure 9 shows the seat base (26) of figure 6 with additional elements of the seat for integration with the carrier (1). As can be seen in the figure, the seat base (26) is possessed of a series of projections (35) extending upward at one end of the base (26). Preferably, these projections (35) are formed such that they are positioned at the front
25 of the carrier (1) when it is fixed to the cycle, although this is not necessary. These projections (35) provide one half of a rotatable hinge for integration of further seat elements, such as the cradle (36) shown in figure 9. Through the projections (35) in the seat base (26) are a series of holes (37) which each align along a central axis in a direction perpendicular to the direction of motion of the cycle. As can be seen in
30 figure 9, the underside of the cradle (36) is provided with a second set of projections (38) with holes (39) through. The two sets of projections (35, 38) are so designed as to interdigitate with each other such that the sets of holes (37, 39) align and with insertion of a split pin (40) form a hinge. This pin (40) can be formed in many ways,

as two halves of a single pin (40) which after insertion into the holes (37, 39) are joined together; or as two shorter pins (40) which fit through half of the interdigitated projections (35, 38) only, and which form into the hinge in this manner. If the two separate pin (40) option is utilised, the inserted end is provided with a deformable section which after insertion through the holes (37, 39), stops the accidental removal of the pin (40) from the hinge.

The provision of a hinge section between the seat base (26) and the cradle (36) is so that a suspension system can be incorporated between these two elements. It is desirable, however, that the cradle (36) cannot rotate too far forward away from the seat base (26), as this could lead to a further element attached to the cradle (36) tipping too far forward, which could prove dangerous. In order to stop this from occurring, the cradle (36) has formed shoulders (41) which match the contour of the seat base projections (35). These shoulders (41) are positioned around the seat base projections (35) and will only allow the cradle (36) to rotate so far away from the seat base (26). As can be seen in figure 9, the cradle unit (40) is provided with attachment points on its upper surface which are used for attachment of further carrier elements. Such elements could be, but are not limited to, a child's seat (42) or other carrying units, such as a box.

20

In order to improve the ride comfort for a child using the child's seat (42), or for reducing the number of potentially content damaging bounces the carrier unit suffers during the use of the cycle, suspension blocks (43) can be placed between the rotateably interconnected seat base (26) and cradle (36). These suspension blocks (43) are preferably made from rubber, as this is a naturally deforming substance with long durability, however, any appropriate elastomeric substance could be used. As a further option, the positioning of these blocks (43) with respect to the hinge point, can be altered so as to adjust the suspension effect. These suspension blocks (43) are either held within specific fixing points provided on the top surface of the seat base (26) and corresponding points on the lower surface of the cradle (36), or a fixing track is provided on each of these carrier elements so as to allow the positioning of the block in a range of places to give a truly variable suspension effect.

Further shown within figure 9, is an adjustment spindle (44), which can further be used to alter the level of travel available between the cradle (36) and the seat base (26). The spindle (44) shown, has a screw thread which is in threaded engagement with a nut (45); this nut (45) being held within the cradle (36). At one end of the spindle (44) is a hand operated grip for rotation of the thread to adjust the position of the spindle (44) with respect to the nut (45), with the other end of the spindle (44) resting on the seat base (26). Clearly, with this arrangement, rotation of the spindle (44) will drive the one end into the seat base (26) and thereby adjust the amount of rotation which is possible between the cradle (36) and the seat base (26). Whilst a nut (45) is shown in the figure, it is also possible that the cradle (36) be possessed of a threaded section for attachment of the spindle (44), thereby removing the need for a separate nut (45).

A further requirement of the spindle (44), is to integrate with the further elements which are attached to the cradle (36), be these the child's seat (42), storage boxes or the like. The hand operated end of the spindle (44) is required to be accessible when the further elements are attached, whilst additionally not getting in the way of the functioning of the elements. A further function that the spindle can perform, is to provide another fixing point between the seat (42) or storage element, and the cradle (36). In order to achieve this, the spindle is housed within the seat (42) or storage element, such that it can be rotated to allow adjustment of the suspension, whilst still connecting the element to the cradle (36).

Further features which can optionally be included within the numerous carrier embodiments detailed above, are shown in figures 12 and 13. Figure 12 shows a method of incorporating a bicycle tyre pump (59) with the carrier top (2). Whilst the figure shows that the carrier top (2) is that of the solid design, such a feature can equally well be incorporated within any of the carrier (1) designs detailed above. The pump (59) is shown integrating with a pump housing (60) which is designed to fit within a recess formed in the top of the carrier top (2). As is shown in the figure, the housing (60) is possessed of a removably attachable lid portion. The pump (59) and housing (60) are designed to allow the pump (59) to be held securely within the housing (60), and further for the housing (60) to held securely within the carrier top

(2) in a removable manner. It is anticipated that the housing (60) will interact with the carrier top (2) by means of simple clips and slots to hold the housing (60) securely in place. Clearly, it is also possible for the pump (59) to be housed within the carrier top (2) itself, without the need for a full housing module (60). Additionally, the carrier top
5 (2) could have a recess which will securely hold the pump (59), and further an optional lid portion which fits directly on top of the carrier top (2) to cover the pump recess.

Also shown in figure 12, and more clearly seen in figure 13, is an optional light
10 module (61) attachable to the back of the carrier top (2). Figure 13 shows the light module (61) in exploded form, so that each element is visible. This light (61) is designed to integrate fully with the carrier top (2) and be positioned at the rear of the carrier, providing the necessary rear cycle light for when the cycle is used at night or in poor light conditions. Within this unit can be seen a clip (62) for removably
15 attaching the light (61) to the back of the carrier, with this clip (62) interacting with a matching housing (63) in the carrier top (2). Whilst the light here is shown as being battery powered via the battery module (64) and housing (65), the light could be run from a dynamo (not shown). The provision of electrical connectors for connection to
20 a dynamo already integrated with a cycle, could readily be provided. The light is shown powered by multiple LEDs (66), although it is clear that a conventional bulb light could also be provided.

While various features and embodiments of the invention are described above, they
25 can readily be combined with each other resulting in further embodiments of the invention.

Claims

1. A carrier (1) for a bicycle comprising:

5

a carrier top (2);

rear axle mounts (4);

10

wherein the carrier top (2) is connectable to one or more supporting members (3) which are attachable to the carrier top (2) and extend from the carrier top (2) toward the rear axle mounts (4), these axle mounts (4) being fixed to the frame of the bicycle;

15

a front connector (5) is provided, which is fixed to the frame of the bicycle in a position forward of the rear axle, for attaching the front of the carrier top (2) to the bicycle to give support and to stop the carrier (1) from rotating about the rear axle mount (4); wherein,

20

the carrier top (2) and front connector (5) are interconnected by means of an adjustable securing rod or loop (9) which is secured in a removable manner to the carrier top (2), the rod or loop (9) extending from the carrier top (2) such that its second end can be positioned and held within a channel (10) provided in the front connector (5) to secure the carrier (1) whilst further meaning that it can be fitted to a variety of bicycle designs, the channel (10) lying in a direction which is perpendicular to the direction of motion of the bicycle.

25

2. The carrier (1) of claim 1, wherein the front connector (5) further comprises:

30

brackets (6) for attaching the connector (5) to the carrier connection points on the frame of the bicycle via screws or bolts, wherein the distance between the

two brackets (6) can be adjusted to accommodate a variety of widths of connection points.

5 3. The carrier (1) of claim 1, wherein the front connector (5) further comprises:

a bracket for extending around one or more of the tubes of a bicycle in order to grip the tube between the bracket and the main body of the front connector (5) to attach it to the frame;

10

the fixing bracket being attached to the connector (5) via a hinge at one side, and being connectable to the connector (5) on its other side via means of a hand operable mechanism.

15

4. The carrier (1) of claims 1 to 3, wherein the channel (10) of the front connector (5) comprises:

20

a bore (10) extending through the full length of the body of the connector (5) with a diameter that is large enough to accommodate the securing rod (9), whilst further allowing the end of the rod (9) to be inserted into either end of the bore (10).

25

5. The carrier (1) of claims 1 to 4, wherein the front connector (5) further comprises:

30

a safety lock disposed along the length of the bore (10), such that when the securing rod (9) is fully inserted within the connector (5) it is locked in place and cannot slide out.

6. The carrier (1) of claim 5, wherein the safety lock comprises:

a plate (13) with two right-angle bends in it to form a "U" shape, with holes of the same size as the bore (10) drilled through the opposing portions of the plate (13),

5

slots (7) in the connector (5) which are shaped and positioned to accept the opposing portions of the locking plate (13), and which extend perpendicular to the axis of the bore (10) and cross its path, wherein,

10

the holes in the locking plate (13) are positioned such that when the opposed portions of the plate (13) are inserted into the slots (7), the holes align with the bore (10),

15

the plate (13) further being biased by means of a spring (12) to push the holes out of alignment with the bore (10),

20

the end of the securing rod (9) for inserting into the connector (5), being provided with a groove (14) at the appropriate position so that it can interact with the biased plate (13) such that the inside edge of the hole will be pushed into the groove (14) and the rod (9) will be secured in place.

25

7. The carrier (1) of claims 1 to 6, wherein the front connector (5) is further provided with a safety strap (15), this safety strap (15) being secured to the body of the connector (5) in a removable fashion, and being positioned such that it extends around the back of the connector (5) for encircling the section of frame to which the connector (5) is fixed, thereby ensuring that if the primary fastening mechanism fails, the connector (5) remains connected to the bicycle and the carrier (1) remains secure.

30

8. The carrier (1) of claim 1 to 7, wherein the securing rod (9) is secured to the carrier top (2) either at one of a plurality of integrated fixing points, or to a fixing track which is provided with a hand operable clamping mechanism.
- 5
9. The carrier (1) of claims 1 to 8, wherein one end of the securing rod (9) is provided with a fastening mechanism for removable connection to one of the integrated fixing points on the carrier top (2), wherein the fastening mechanism provides a means for allowing the rod (9) to rotate around the fixing point in a vertical direction, as defined when the carrier top (2) is attached to the bicycle, thereby allowing the carrier (1) to be secured to a variety of bicycle designs.
- 10
10. The carrier (1) of claims 1 to 9, wherein the securing rod (9) is fashioned such that the central axis of the rod (9) at each of the ends lie at 90° with respect to each other, wherein the two axes do not cross each other and are separated by a preset distance.
- 15
11. The carrier (1) of claims 1 to 10, wherein the securing rod (9) has a chamfered end to ease insertion into the front connector (5) and integration through the holes in the locking plate (13).
- 20
12. The carrier (1) of claims 1 to 11, wherein the rear axle mount (4) comprises a mushroom connector fastened to the frame of the bicycle, this mushroom connector being cylindrical in shape and possessing an outer diameter which varies in a stepwise fashion along its length, from a larger diameter to a smaller and then back to the first diameter to resemble an "H", thereby providing a fixing means for the support members (3) of the carrier (1).
- 25
- 30

13. The carrier (1) of claim 12, wherein the mushroom connector comprises a longitudinal bore running the length of the connector and along the central axis, the bore being used to secure the connector to the frame by means of a screw or bolt.

5

14. The carrier (1) of claim 12, wherein the mushroom connector comprises a longitudinal bore running the length of the connector and along the central axis, the bore being wide enough to be positioned on the rear wheel axle, between the frame of the bicycle and the hub of the rear wheel so as to secure the connector to the bicycle.

10

15. The carrier (1) of claims 12 to 14, wherein the width of the reduced diameter region of the mushroom connector is wider than the width of the support members (3) in the slot (19) region.

15

16. The carrier (1) of claims 1 to 15, wherein the supporting members (3) include a height plate (18) and an associated adjustment block (17) for adjusting the height of the carrier top (2) above the rear axle mount (4).

20

17. The carrier (1) of claim 16, wherein the height plate (18) is formed from a rigid strip, at one end of which is the slot (19) for integrating with the pin of the rear axle mount (4) and along its length the plate is provided with a series of holes for adjusting the fastening point between the plate (18) and the height adjustment block (17).

25

30

18. The carrier (1) of claims 16 or 17, wherein the height adjustment block (17) comprises a slot for accepting the height plate (18) and for facilitating the slideable positioning of the block (17) at the desired point on the height plate (18),

the height adjustment block (17) being kept in place by means of a pin which passes through the chosen hole of the height plate (18).

- 5 19. The carrier (1) of claims 16 to 18, wherein the height adjustment block (17) is attached to one or more support rods which extend from the carrier top (2).
- 10 20. The carrier (1) of claim 19, wherein the number of support rods per supporting member (3) is two.
- 15 21. The carrier (1) of claims 16 to 20, wherein the height plate (18) further includes a fastening clip (20) attached in a rotatable manner to the end of the plate (18) with the slot (19), the clip (20) being positioned and shaped such that when the slot (19) in the height plate (18) is engaged with the pin, the clip (20) passes around the underside of the pin to restrain the height plate (18) and prevent accidental disengagement.
- 20 22. The carrier (1) of claim 21, wherein the fastening clip (20) is spring biased into the locking position.
- 25 23. The carrier (1) of claims 21 and 22, wherein the fastening clip (20) is provided with a protective cap (22) to prevent damage to the clip (20) and further to keep the mechanism and spring (21) clean.
- 30 24. The carrier (1) of claims 1 to 23, wherein the carrier top (2) comprises a solid base, the underside of which is provided with means for the removable attachment of both the support members (3) and the adjustment rod (9).

25. The carrier (1) of claims 1 to 24, wherein the topside of the carrier top (2) is fashioned to present either the tenon or mortise of a dovetail joint (23) for the slide-able engagement of a seat base (26) which is provided with an appropriately sized counterpart tenon or mortise (27).
26. The carrier (1) of claim 25, wherein a locking mechanism is provided between the carrier top (2) and the seat base (26) to remove any play which might exist in the dovetail joint (23, 27) as a result of manufacturing tolerances.
27. The carrier (1) of claim 26, wherein the locking mechanism takes the form of a pair of wedge shaped blocks (29) which are integrated with the seat base (26) in the region of the dovetail joint (23, 27), the wedge shaped blocks (29) being positioned at either end of the dovetail joint track and biased toward the centre of the seat base (26) with the narrower sections of the wedges (29) oriented in the direction of this bias;
- the wedge shaped blocks (29) further positioned such that the sloped face interacts with the seat base (26) body when they are biased inward, and that the wedges (29) are forced within the dovetail joint (23, 27) region to provide a means of separating the seat base (26) from the carrier top (2), thereby forcing the two parts of the dovetail joint (23, 27) together and removing any play between the two sections.
28. The carrier (1) of claim 27, wherein a hand operable rotatable cam wheel (31) is provided in the seat base (26) which interacts with the wedges (29), and provides a means for moving them in the direction opposing the bias so as to remove the wedges (29) from the joint region and allow the slide-able engagement or disengagement of the seat base (26) and carrier top (2).

29. The carrier (1) of claims 1 to 24, wherein the carrier top (2) comprises a series of rods, wherein two of the rods making up the carrier top (2) are positioned parallel with each other, such that a seat base (26) provided with either the mortise or tenon of a dovetail joint (27) can be slide-ably attached either around or between the parallel rods respectively, to create a dovetail joint.
30. The carrier (1) of claims 25 or 29, wherein the seat base (26) is fashioned in the shape of a "U" with the two arms running parallel with dovetail track in the carrier top (2), a locking mechanism being provided which by means of a hand operable apparatus moves the two arms of the seat base (26) so as to more tightly engage the two parts of the dovetail joint (23, 27) and remove any play from the joint.
31. The carrier (1) of claim 30, wherein the carrier top (2) is provided with the tenon of the dovetail joint and the seat base (26) the mortise, and the locking mechanism acts to force the two arms together so as to more tightly grip the tenon on the carrier top (2).
32. The carrier (1) of claim 30, wherein the carrier top (2) is provided with the mortise of the dovetail joint and the seat base (26) the tenon, and the locking mechanism acts to force the two arms apart so that each half of the tenon of the seat base (26) is more tightly engaged with the mortise of the carrier top (2).
33. The carrier (1) of claims 31 and 32, wherein the locking mechanism is provided by a screw thread and screw through the seat base (26) which, by means of a hand operable rotatable handle, moves the arms of the seat base (26).

34. The carrier (1) of claim 31, wherein the locking mechanism is provided by a rotatable lever (32) which has an eccentric axle point of its rotating member, this lever (32) is mounted on a connector which passes through one arm of the seat base (26) and is fastened to the other; wherein

5

the locking mechanism is so designed that, upon rotation of the lever (32) and by virtue of the eccentric mounting, one arm is pulled toward the other whilst the other is pushed in the opposite direction so as to bring the two arms together to increase the grip of the seat base mortise on the tenon of the carrier top (2).

10

35. The carrier (1) of claim 29, wherein the seat base (26) is provided with the mortise of a dovetail joint and means are provided for pushing the parallel rods apart so as to more tightly engage with the seat base (26) and secure it in position.

15

36. The carrier (1) of claim 29, wherein the seat base (26) is provided with the tenon of a dovetail joint and means are provided for forcing the parallel rods together to more tightly grip the tenon on the seat base (26), securing it in position.

20

37. The carrier (1) of claims 25 to 36, wherein the seat base (26) is provided with a safety lock (28) which is mounted to the base (26) in a rotatable manner, the safety lock (28) being provided with extensions which pass through the seat base (26) to engage with resilient features on the carrier top (26) underneath, in such a manner that the seat base (26) is prevented from sliding off the carrier top (2) without first rotating the safety lock (28) and disengaging the extensions from the resilient features in the carrier top (2).

25

30

38. The carrier (1) of claim 37, wherein the safety lock (28) engages with the carrier top (2) by means of gravity pulling it into position.

39. The carrier (1) of claim 37, wherein the safety lock (28) is biased into the engagement position with the carrier top (2), by means of a spring.

5

40. The carrier (1) of claims 25 to 39, wherein a plurality of protrusions (35) are provided extending upward from the top side of the seat base (26), these protrusions (35) being shaped and arranged at one end of the seat base (26) so as to form one half of a hinge for attachment of a cradle (36).

10

41. The carrier (1) of claim 40, wherein each of the plurality of protrusions (35) has a hole (37) passing through it of the same size and sharing the same central axis, this hole (37) being provided for accepting a separable axle pin (40) for the removable attachment of the cradle (36).

15

42. The carrier (1) of claims 40 and 41, wherein the underside of the cradle (36) is provided with a series of protrusions (38) which integrate and interdigitate with those provided on the top side of the seat base (26), the cradle protrusions (38) being provided with holes (39) through them of the same size and sharing the same axis such that the two sets of protrusions (35, 38) can be interlocked and the separable axle pin (40) passed through each of the holes (37, 39) to secure the cradle (36) to the seat base (26) via a rotatable hinge engagement.

20

25

43. The carrier (1) of claims 40 to 42, wherein the cradle (36) is provided with a shoulder (41) which extends between the protrusions (38) and follows the same contour as the base seat hinge protrusions (35), the shoulder (41) being provided in such a manner as to limit the amount of opening of the hinge between the seat base (26) and the cradle (36), thereby stopping the cradle (36) from tipping too far forward.

30

44. The carrier (1) of claims 40 to 43, wherein the top surface of the cradle (36) is provided with fittings for the attachment of further carrier elements.
- 5
45. The carrier (1) of claim 44, wherein the further element is a child's seat (42).
- 10 46. The carrier (1) of claim 44, wherein the further element is a carrying unit, such as a box.
47. The carrier (1) of claims 25 to 46, wherein suspension blocks (43) are provided
15 between the cradle (36) and the seat base (26), so as to dampen the motion of the cradle (36) and any further attached elements, whilst the bicycle is in motion.
48. The carrier (1) of claim 47, wherein the top surface of the seat base (26) and the
20 lower surface of the cradle (36) are further provided with features and fixing points for incorporating the suspension blocks (43).
49. The carrier (1) of claim 48, wherein the features and fixing points allow for the
25 suspension blocks (43) to be positioned in a range of positions with respect to the hinge, so that the effect and extent of the suspension can be adjusted.
50. The carrier (1) of claims 47 to 49, wherein there is further provided an
30 adjustment spindle (44) which has a hand operable grip on one end with the other end resting against the seat base (26), in such a manner that the spindle (44) passes through the cradle (36),

an associated screw thread is provided in the cradle (36) with which the spindle (44) is threadably engaged, the spindle (44) being oriented such that upon rotation the spindle (44) provides a means for fixing the relative positions of the cradle (36) and seat base (26) and removing the suspension effects of the hinge and blocks, or for altering the amount of travel possible between the cradle (36) and the seat base (26) so as to adjust the suspension effect.

51. The carrier (1) of claim 50, wherein the screw thread in the cradle (36) is provided by a removable nut (45) housed within the cradle (36).
52. The carrier (1) of claims 50 and 51, wherein the spindle (44) is further adapted such that it will pass through the body of a child's seat (42) if integrated with the cradle (36) in such a manner that it does not interfere with the seating position of the child, whilst providing a further method of securing the seat (42) to the cradle (36).
53. The carrier (1), in particular according to any of the preceding claims, comprising a front fixing mechanism (5) for removeably attaching to the frame of a cycle in a position forward of the rear axle of the cycle, for securing the front section of the cycle carrier (1) to the cycle by means of a securing rod or loop (9) attached to the carrier (1), the fixing mechanism (5) comprising:
- a hook assembly (68) extending toward the cycle carrier (1), wherein one or a plurality of hooks are provided in the assembly (68) for accepting the securing rod (9) of the cycle carrier (1).
54. The carrier of claim 53, wherein the front fixing mechanism (5) further comprises brackets (6) for attaching the connector (5) to carrier connection points on the frame of the bicycle via screws or bolts, wherein the distance between the two brackets (6) can be adjusted to accommodate a variety of widths of connection points.

55. The carrier of claim 54, wherein the hook assembly (68) is attached to a fixing plate (67) which is further attached to the fixing brackets (6).

5 56. The carrier of any of claims 53 to 55, wherein the front fixing mechanism (5) further comprises a safety knob (69) rotatably provided within the region of the hook assembly (68), and wherein the safety knob (69) is positioned such that in one orientation it obscures the access way to the hook regions in the hook assembly (68), and in a second rotatably accessed orientation, the safety knob
10 (69) does not obscure the access way to the hook regions in the hook assembly (68).

57. The carrier of claim 56, wherein the safety knob (69) is biased by means of a spring (70) into the orientation whereby it obscures the access way to the hooks.

15

58. The carrier of either of claims 56 or 57, wherein the safety knob (69) further comprises a push surface (72) at a side opposing the hooks in the hook assembly (68), a release lever (73) on a side opposing the push surface (72) and a snap extension which is located beneath the push surface (72), wherein

20

the snap extension is adapted to clip over the fixing plate (67) and thereby stop rotation of the safety knob (69) until the release lever (73) and push surface (72) are squeezed together by a user, thereby disengaging the snap from the fixing plate (67).

25

59. The carrier (1) of any of claims 56 to 58, wherein the safety knob (69) further comprises a slot recess on an upper surface, shaped to accept the securing rod (9) of the carrier (1) as the rod (9) is engaged with the hook assembly (68).

30 60. The carrier (1) of any of claims 53 to 59, wherein the front fixing mechanism (5) further comprises a cover (74).

61. The carrier (1) of any of claims 53 to 60, wherein the front fixing mechanism (5) further comprises a safety strap (15) for positioning around the frame of the cycle.

5 62. The carrier (1), in particular according to any of the preceding claims, comprising a rear axle mount (4a) for removeably attaching to the frame of a cycle in the region of the rear axle of the cycle, the rear axle mount (4a) comprising a bolt (76) and mushroom pin (75) for attachment to the frame of the cycle, wherein

10 the mushroom pin (75) has a central extending cylindrical section with a flat head of increased diameter positioned at one end of this section, the cylindrical section comprising a hollow bore with an internal screw thread, which is adapted to threadably engage with an external screw thread on the pin to thereby allow attachment of the mount (4a) to a convenient point on the cycle frame,

15

the cylindrical section further comprising a screw thread on its outer surface, which threadably engages with a barbed knob (48) providable on the cylindrical section of the mount (4a), wherein the knob (48) is adapted to grip the lower section of the supporting members (3) of the carrier (1).

20

63. The carrier of claim 62, wherein the rear axle mount (4a) further comprises a height plate (18a) for attachment to support rods (16) of the carrier (1), wherein

25 the height plate (18a) further comprises a slot or hole (19) in a lower portion thereof for positioning over the cylindrical section of the mushroom pin (75).

25

64. The carrier (1) of claim 63, wherein the height plate (18a) further comprises a series of holes therethrough for allowing the fastening of support rods (16) from the carrier (1), wherein the holes extend upward from the slot (19) in the plate (18a) to allow height adjustment in the fixing.

30

65. The carrier (1) of any of claims 63 to 64, wherein a push button (49) is further provided attachable to the height plate (18a), the push button (49) having a lower

edge (50) which has a profile matching the external surface of the barbed knob (48) in a region between adjacent barbs (51) on the knob (48), wherein

5 the push button (49) has an extended and pressed in position, and is located such that it contacts the barbed knob (48) when it is in its extended position thereby blocking the rotation of the knob (48) by virtue of the barbs (51), and is located out of the rotational path of the knob (48) when in the pressed in position.

10 66. The carrier (1) of claim 65, wherein the push button (49) is spring biased to the extended position.

15 67. The carrier (1) of any of claims 62 to 66, wherein the rear axle mount (4a) further comprises a fastening clip (53) adapted for fastening a strap for interaction with the carrier (1).

20 68. The carrier (1), in particular according to any of the preceding claims, comprising a mounting base, in particular a seat base (26), for removable attachment of a seat, basket, box or the like to a cycle carrier (1), wherein the seat base (26) comprises a joint piece (54) which is moveably attached to the underside of the seat base (26), the joint piece (54) comprising flanges extending along two opposing sides, and being adapted to slideably engage with rails or rods forming part of the carrier (1), wherein

25 the joint piece (54) is moveably held in the seat base (26) such that it can be moved closer to the seat base (26) to reduce the gap between the flanges and the underside of the base (26).

30 69. The carrier (1) of claim 68, wherein the joint piece (54) comprises a plurality of extensions on an upper surface thereof, which are adapted to fit within a recess provided on the underside of the seat base (26), further

a longitudinal hole passes through the seat base (26) in a direction parallel with the flanges on the joint piece (54), and the extensions on the joint piece (54)

further pass through the region of this longitudinal hole when the joint piece (54) is located within the underside recess, and the extensions have holes which align with the longitudinal hole.

5 70. The carrier (1) of claim 69, wherein the seat base (26) further comprises a longitudinal wedge screw (55) which is positioned within the longitudinal hole in the seat base (26), and aligned holes through the joint piece extensions, wherein
10 the wedge screw (55) has a substantially flat lower base and a varying profile upper surface, such that the depth of the screw (55) increases and decreases a number of times along the length of the screw (55).

15 71. The carrier (1) of claim 70, wherein the wedge screw (55) further comprises a screw thread at one end, which threadably engages with a nut (56), wherein the nut is rotatably held within the seat base (26) at the entrance to the longitudinal hole, and wherein

20 the upper surface of the wedge screw (55) is profiled such that when the screw (55) is within the longitudinal hole and threaded through the holes in the extensions of the joint piece (54), the regions of narrower depth align with each of the holes through the extensions of the joint piece (54), and further

25 when the wedge screw (55) is moved in the longitudinal hole in a direction parallel with the central axis of the hole, by rotation of the nut, regions of thicker depth move within the holes in the extensions of the joint piece (54) and cause the joint piece (54) to move further within the recess on the underside of the seat base (26).

30 72. The carrier (1) of claim 71, wherein a screw knob (57) is attached to the nut (56).

73. The carrier of any of claims 68 to 72, wherein the seat base (26) further comprises a security device (58) at the rear end of the seat base (26), the security device (58) having a plurality of tabs protruding from the underside of the seat

base (26), wherein the tabs are fastened within the base (26) in a moveable manner, wherein

the security device (58) is adapted to stop the movement of the joint piece (54) within the seat base (26) whilst the tabs protrude, and to allow the movement of the seat base (26) when the tabs are within the seat base (26).

74. The carrier (1) of claim 73, wherein the security device (58) stops the rotation of the nut (56) threadably engaged with the wedge screw (55).

75. The carrier (1) of either of claims 73 or 74, wherein the security device (58) further has tabs which protrude from the upper surface of the seat base (26) when the lower tabs protrude, and the upper tabs are adapted to be held within the seat base (26) when the lower tabs are within the seat base (26).

76. The carrier (1) of any of claims 68 to 75, wherein the seat base (26) is provided with a safety lock (28) which is mounted to the base (26) in a rotatable manner, the safety lock (28) being provided with an extension which passes by the side of the seat base (26) to engage with a resilient feature on the carrier (1) underneath, in such a manner that the seat base (26) is prevented from sliding off the carrier (1) without first rotating the safety lock (28) and disengaging the extension from the resilient feature in the carrier (1).

77. The carrier (1) of claim 76, wherein the safety lock (28) engages with the carrier top (2) by means of gravity pulling it into position.

78. The carrier (1) of claim 76, wherein the safety lock (28) is biased into the engagement position with the carrier top (2), by means of a spring.

79. The carrier (1) of any of claims 68 to 78, wherein a plurality of protrusions (35) are provided extending upward from the top side of the seat base (26), these protrusions (35) being shaped and arranged at one end of the seat base (26) so as to form one half of a hinge for attachment of a cradle (36).

80. The carrier (1) of claim 79, wherein each of the plurality of protrusions (35) has a hole (37) passing through it of the same size and sharing the same central axis, this hole (37) being provided for accepting a separable axle pin (40) for the removable attachment of the cradle (36).

5

81. The carrier (1) according to any of claims 68 to 80, wherein the mounting base forms an integral part of the box, basket or the like for fixing to the carrier top (2).

10 82. The carrier (1), in particular according to any of the preceding claims, comprising a recess formed therein shaped and sized to receive a pump (54).

15 83. The carrier top (2) of claim 82, wherein the pump (54) is further housed within a pump housing (60), which in turn is housed within the recess in the carrier top (2).

84. The carrier (1), in particular according to any of the preceding claims, wherein a light module (61) is removeably attachable to the rear of the carrier top (2).

20

FIG. 2

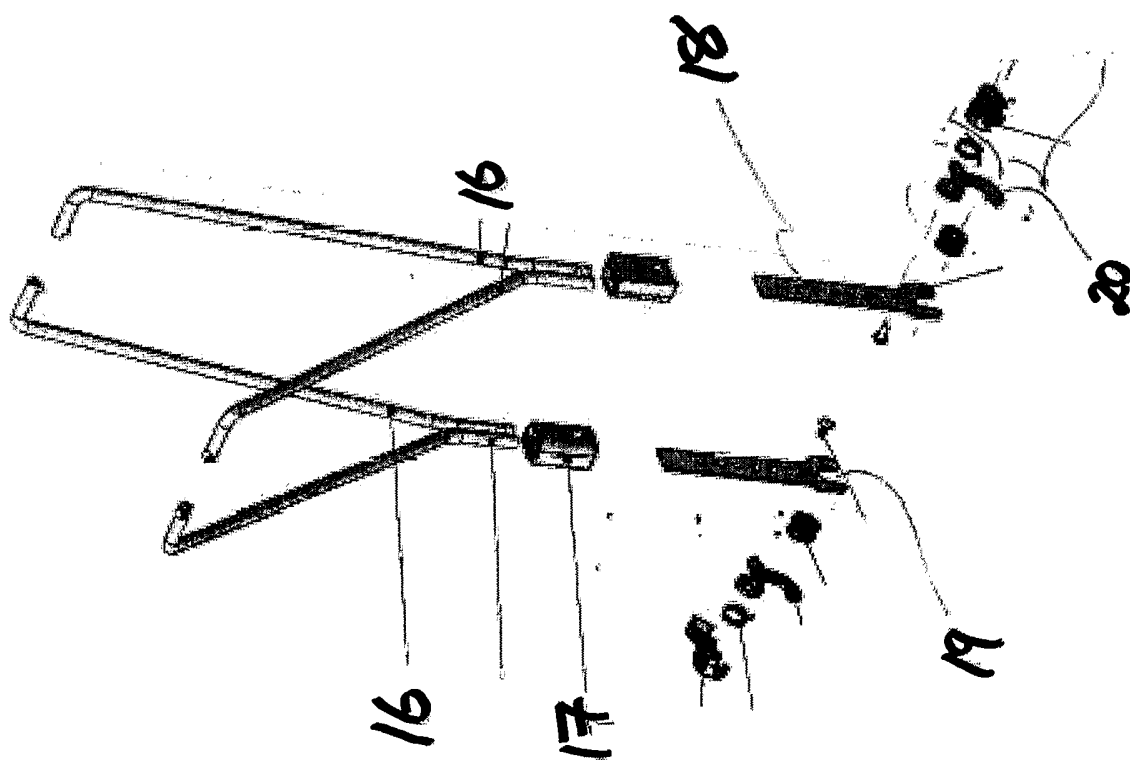
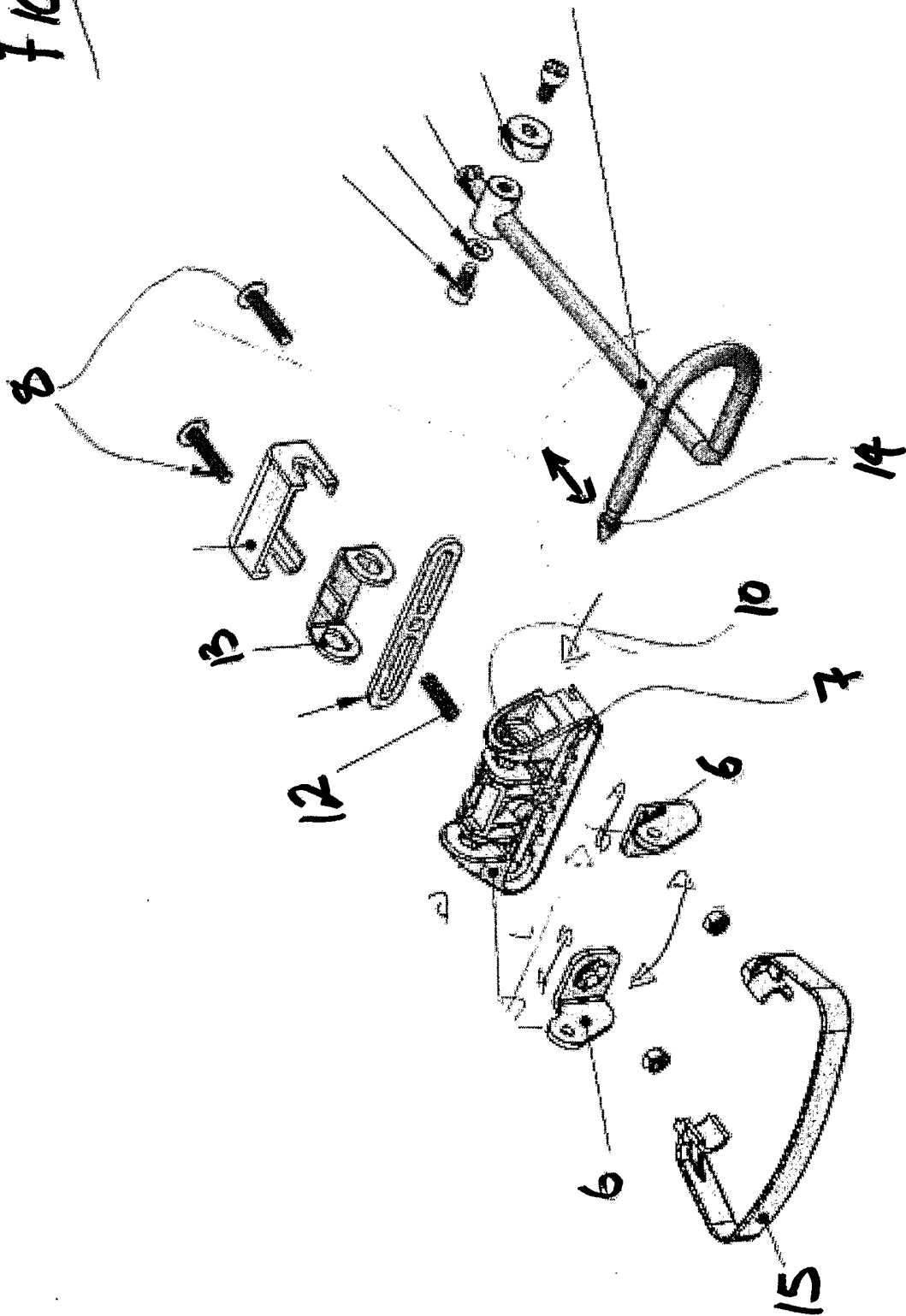

FIG. 3



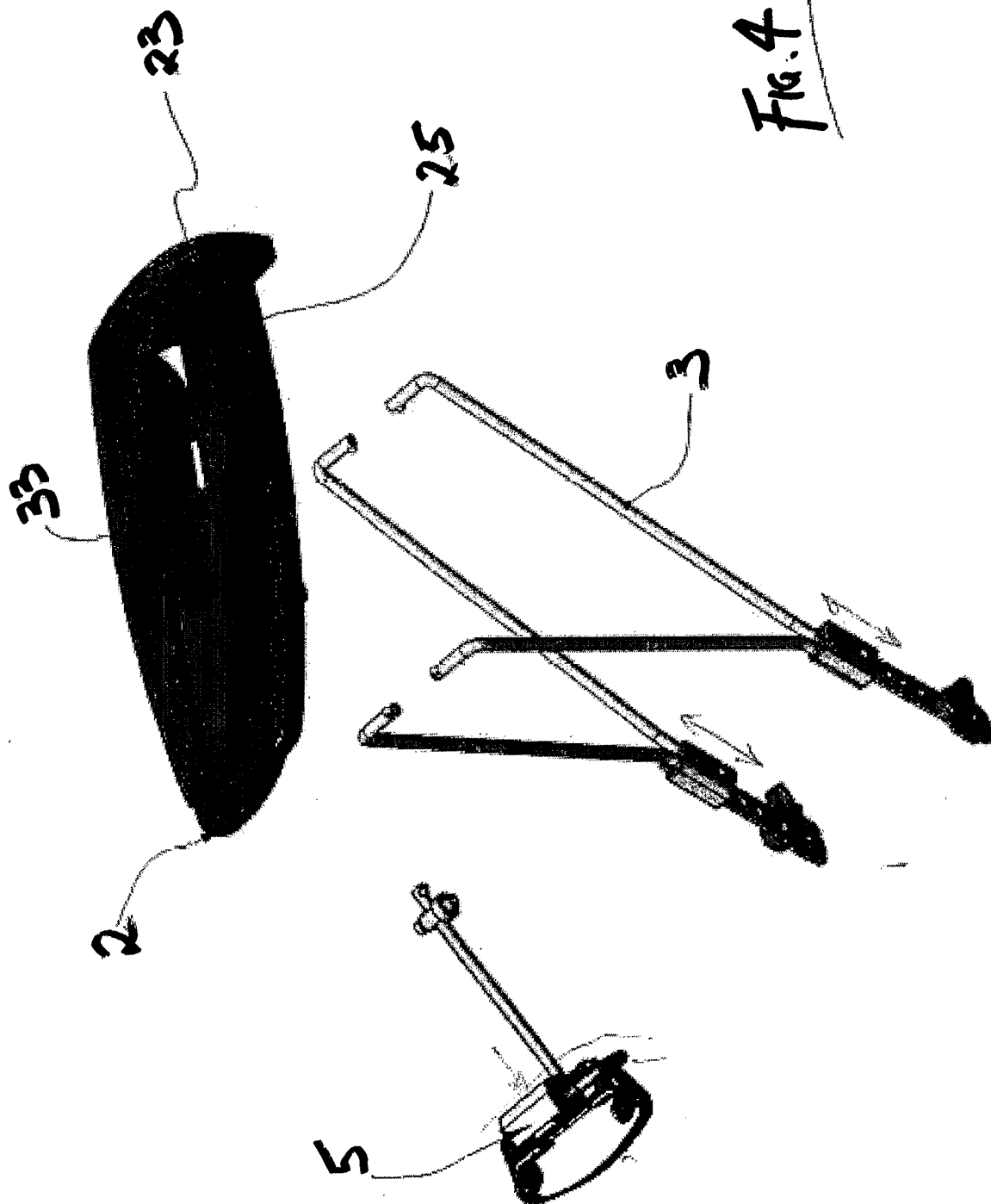
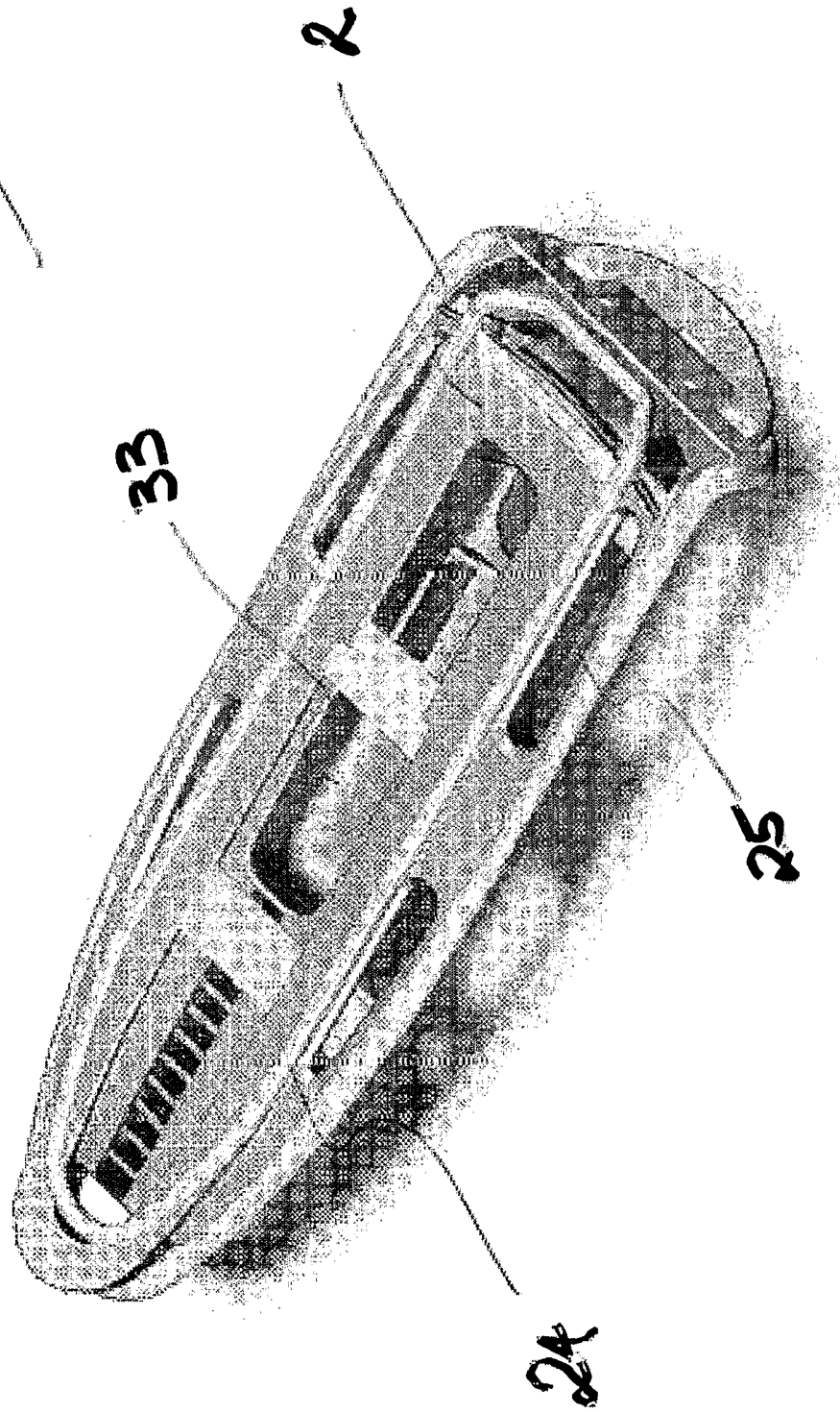

FIG. 4

Fig. 5



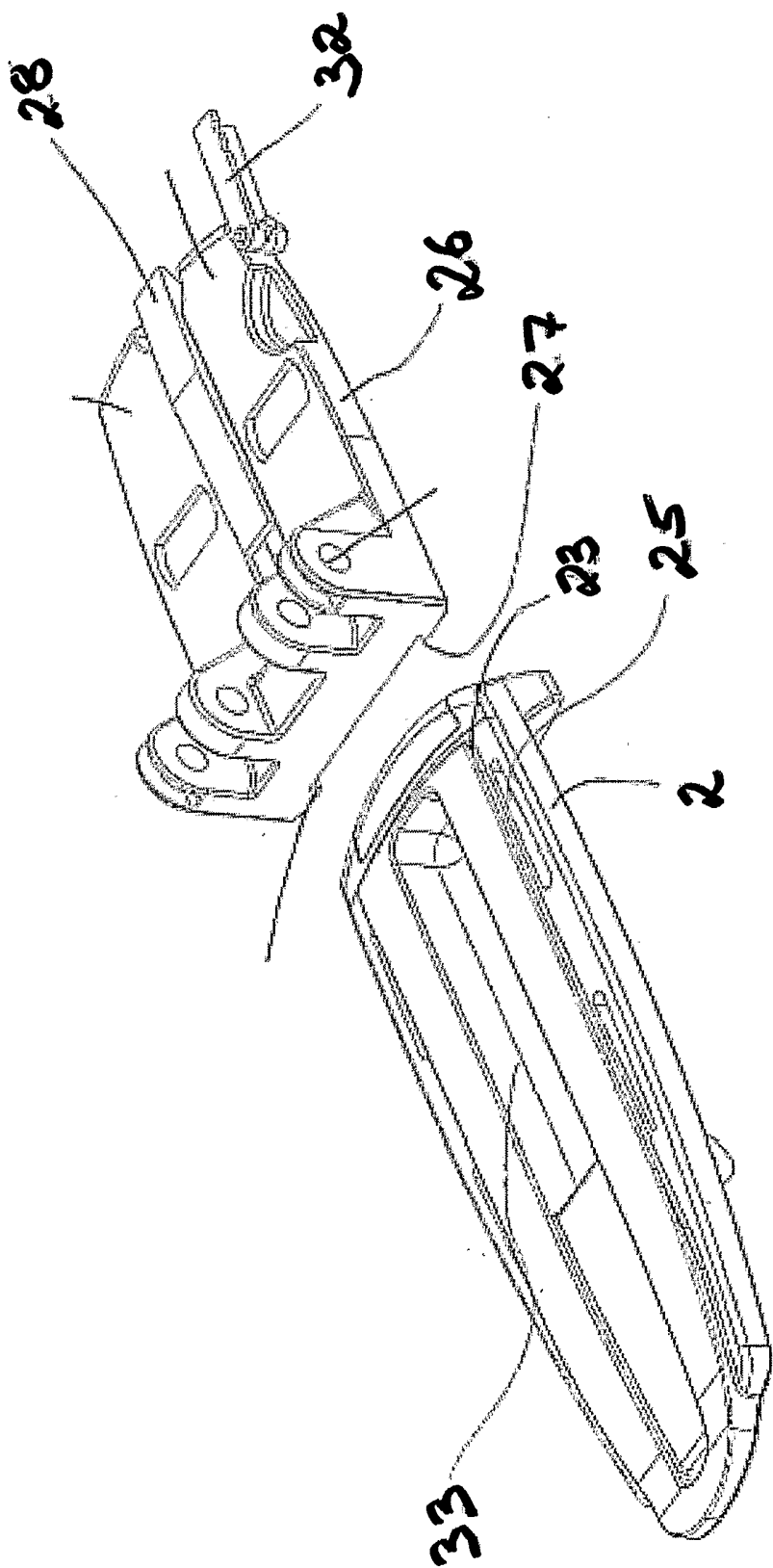

FIG. 6

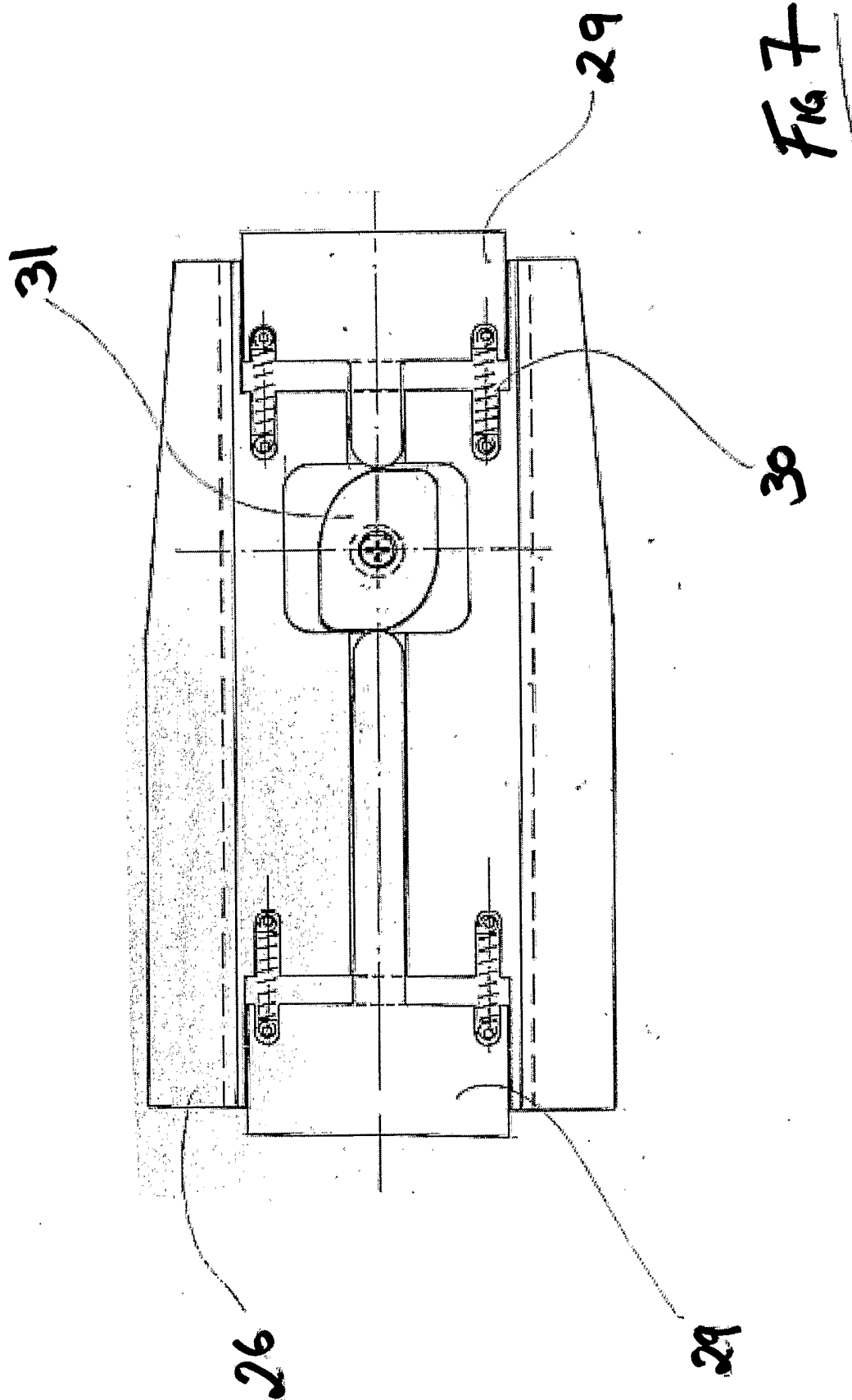

FIG 7

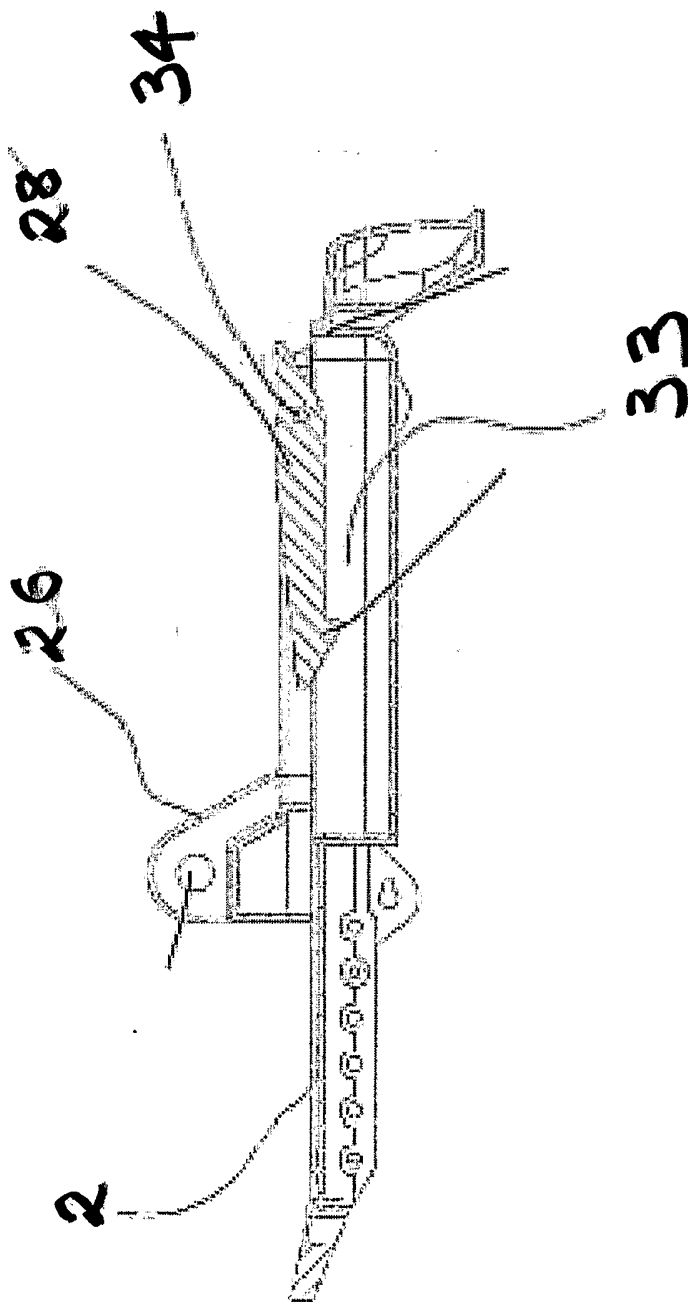

Fig 8

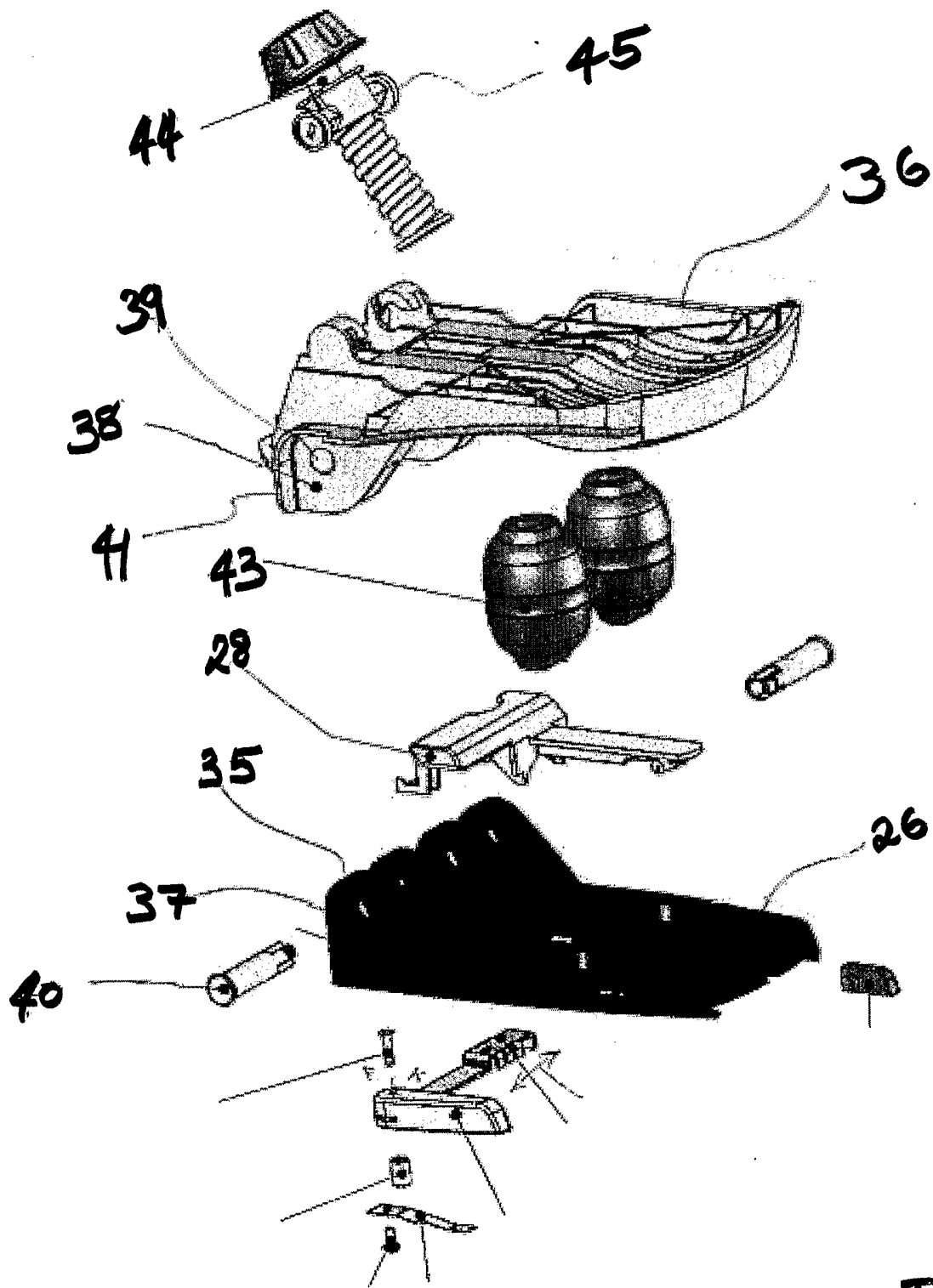

FIG. 9

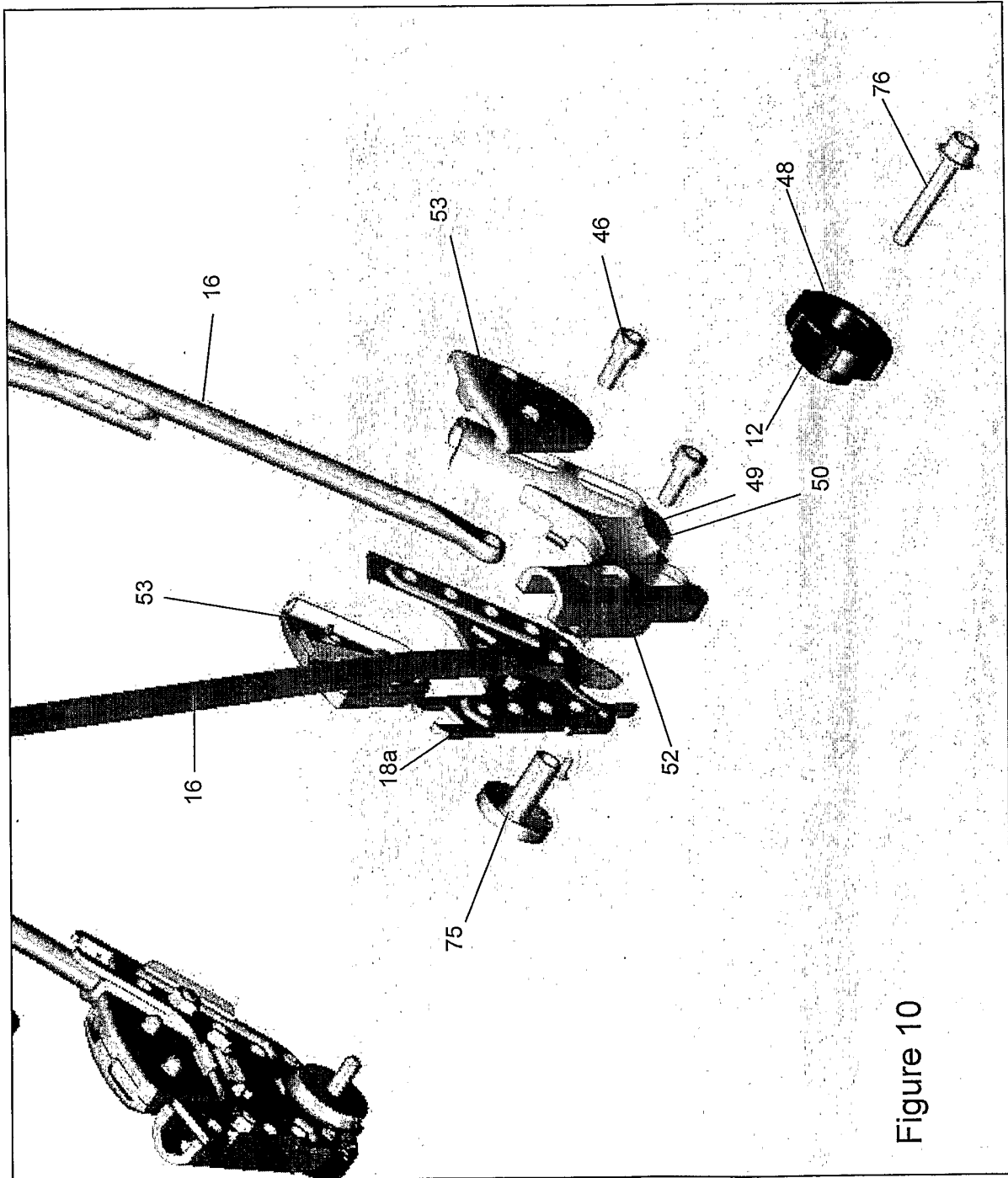

Figure 10

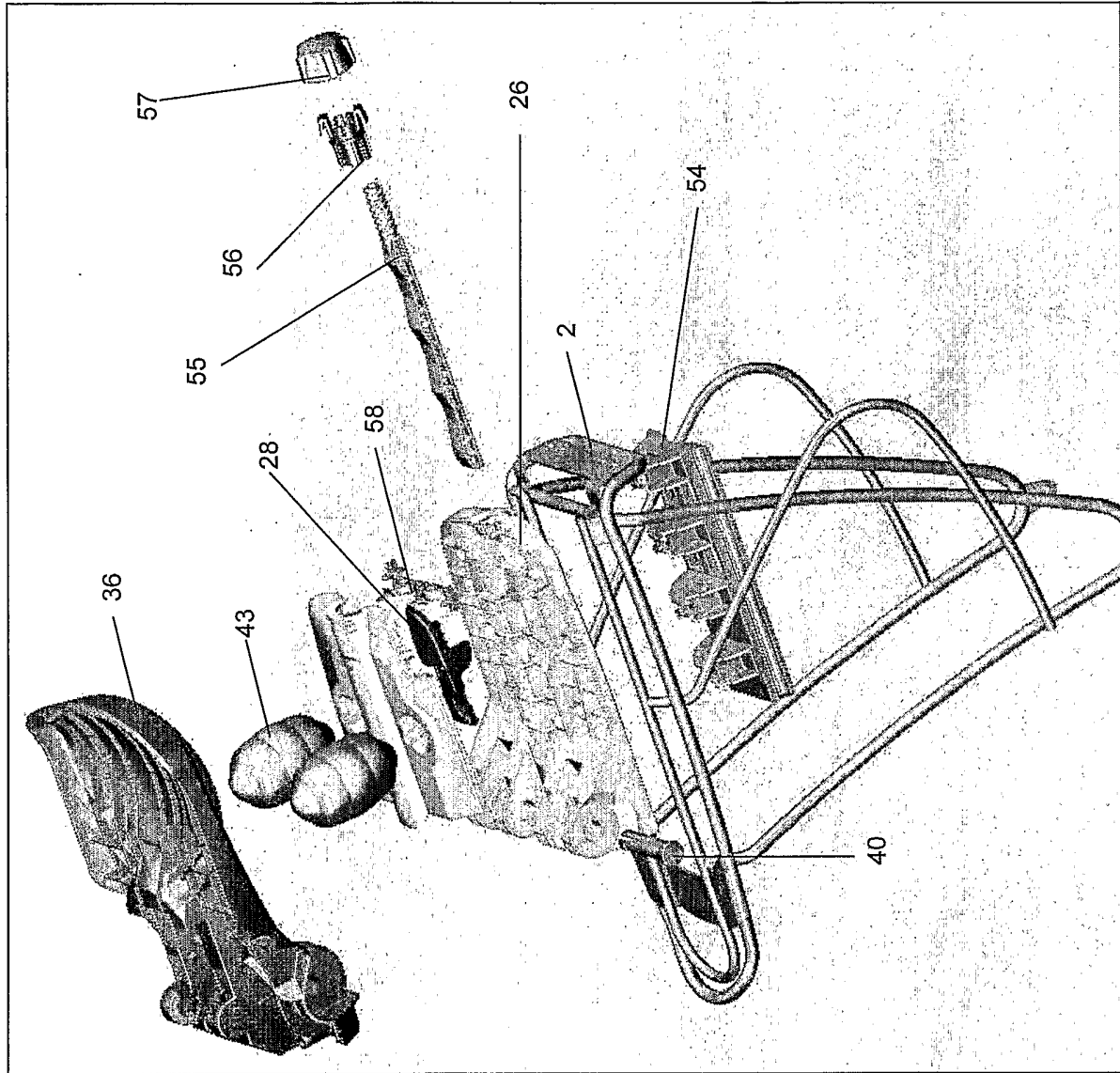

Figure 11

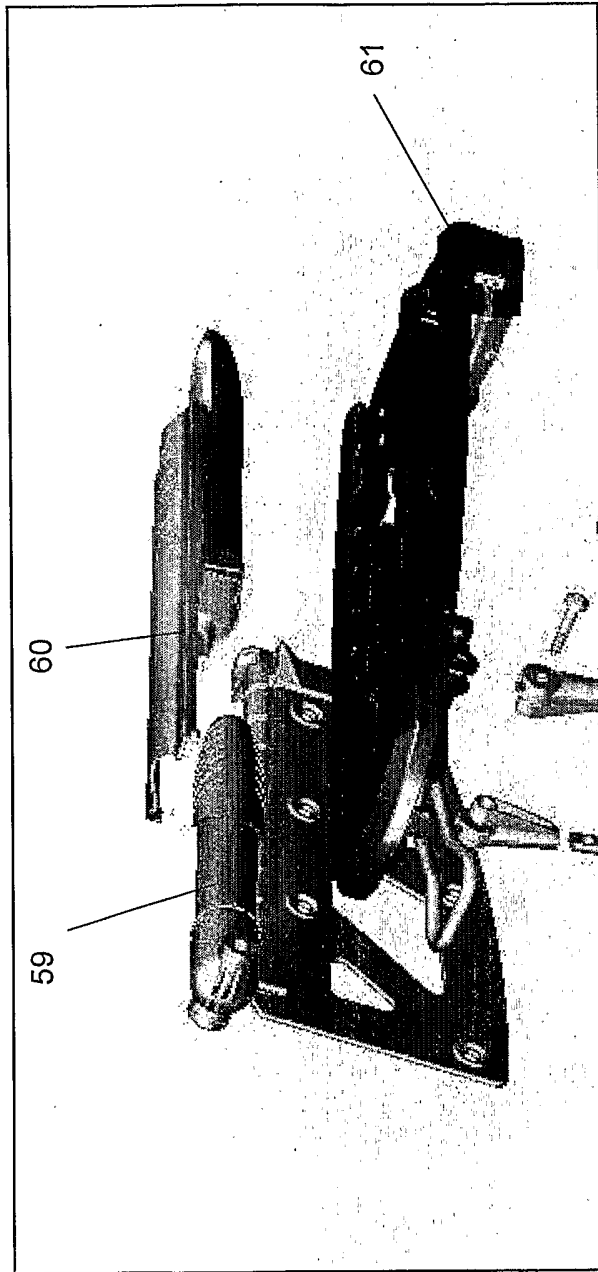

Figure 12

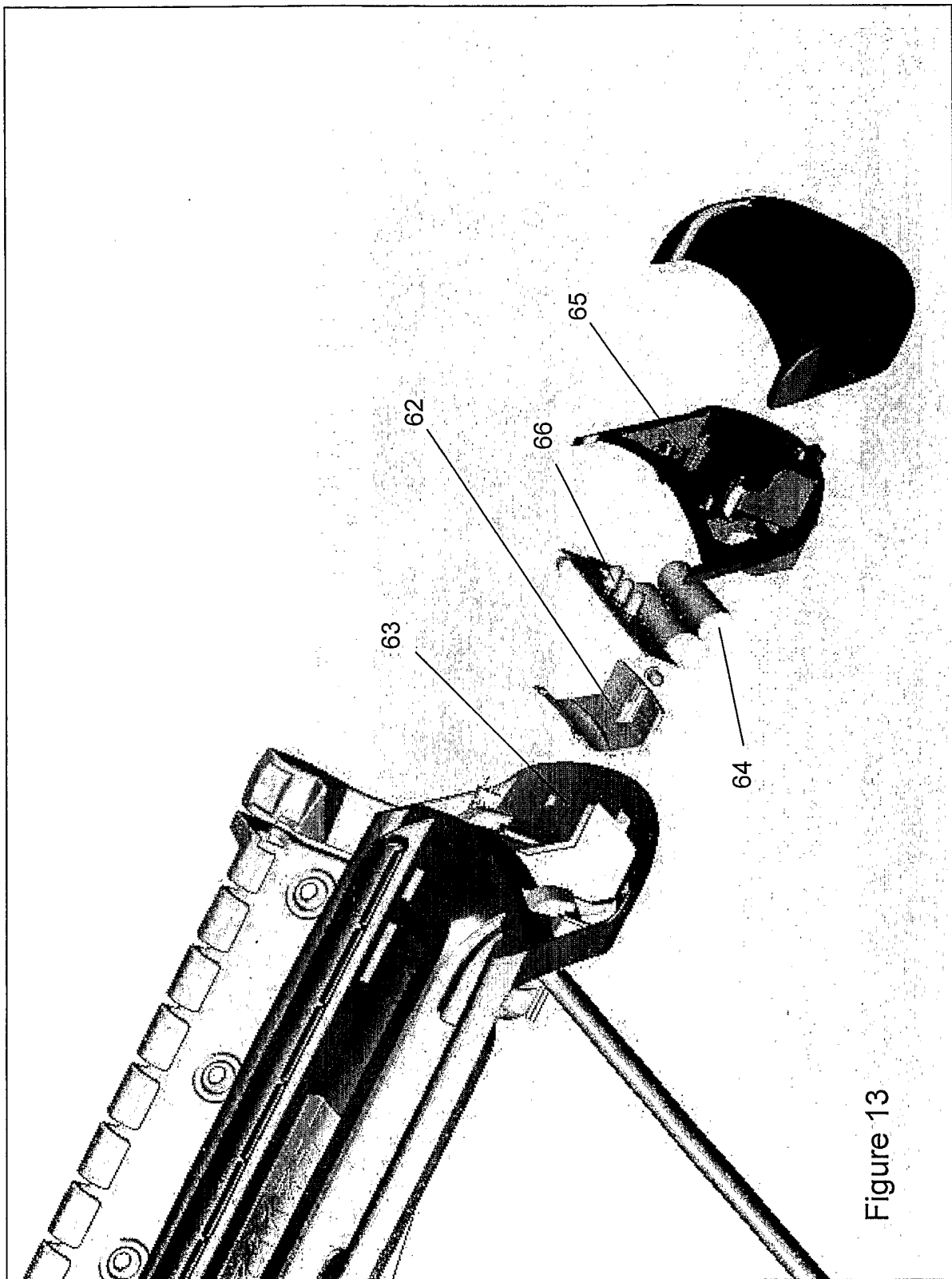

Figure 13

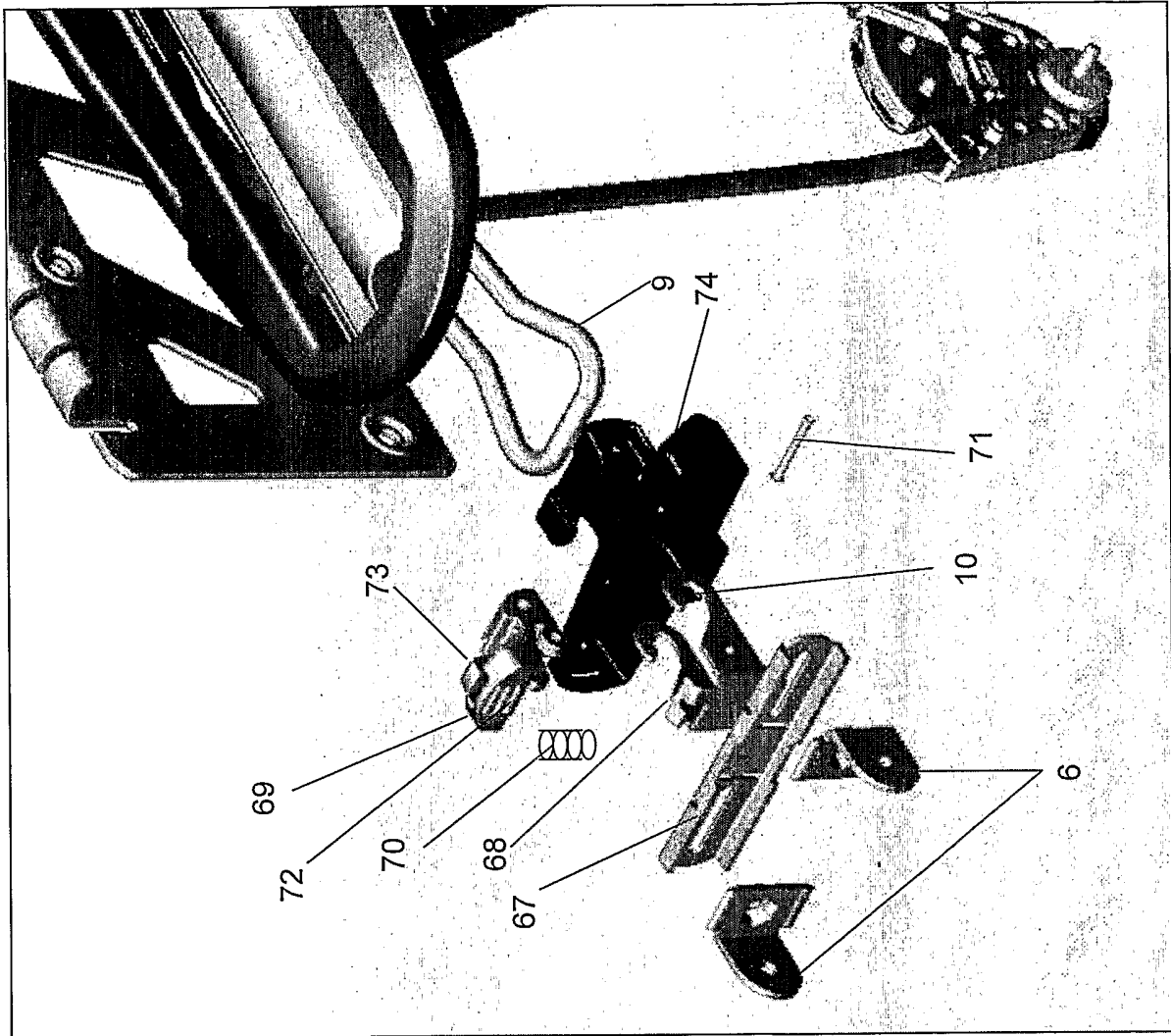

Figure 14

INTERNATIONAL SEARCH REPORT

International application No
PCT/IB2006/000666

A. CLASSIFICATION OF SUBJECT MATTER INV. B62J7/04				
According to International Patent Classification (IPC) or to both national classification and IPC				
B. FIELDS SEARCHED				
Minimum documentation searched (classification system followed by classification symbols) B62J				
Documentation searched other than minimum documentation to the extent that such documents are included in the fields searched				
Electronic data base consulted during the international search (name of data base and, where practical, search terms used) EPO-Internal				
C. DOCUMENTS CONSIDERED TO BE RELEVANT				
Category*	Citation of document, with indication, where appropriate, of the relevant passages	Relevant to claim No.		
A	US 4 666 071 A (IRWIN ET AL) 19 May 1987 (1987-05-19) the whole document	1		
A	US 4 350 361 A (FUJII ET AL) 21 September 1982 (1982-09-21) the whole document	1		
A	DE 43 39 761 C1 (WEGER, WOLFGANG, 82008 UNTERHACHING, DE) 13 April 1995 (1995-04-13) the whole document	1		
<input type="checkbox"/> Further documents are listed in the continuation of Box C. <input checked="" type="checkbox"/> See patent family annex.				
* Special categories of cited documents :				
<table style="width: 100%; border: none;"> <tr> <td style="width: 50%; border: none; vertical-align: top;"> *A* document defining the general state of the art which is not considered to be of particular relevance *E* earlier document but published on or after the international filing date *L* document which may throw doubts on priority claim(s) or which is cited to establish the publication date of another citation or other special reason (as specified) *O* document referring to an oral disclosure, use, exhibition or other means *P* document published prior to the international filing date but later than the priority date claimed </td> <td style="width: 50%; border: none; vertical-align: top;"> *T* later document published after the international filing date or priority date and not in conflict with the application but cited to understand the principle or theory underlying the invention *X* document of particular relevance; the claimed invention cannot be considered novel or cannot be considered to involve an inventive step when the document is taken alone *Y* document of particular relevance; the claimed invention cannot be considered to involve an inventive step when the document is combined with one or more other such documents, such combination being obvious to a person skilled in the art. *&* document member of the same patent family </td> </tr> </table>			*A* document defining the general state of the art which is not considered to be of particular relevance *E* earlier document but published on or after the international filing date *L* document which may throw doubts on priority claim(s) or which is cited to establish the publication date of another citation or other special reason (as specified) *O* document referring to an oral disclosure, use, exhibition or other means *P* document published prior to the international filing date but later than the priority date claimed	*T* later document published after the international filing date or priority date and not in conflict with the application but cited to understand the principle or theory underlying the invention *X* document of particular relevance; the claimed invention cannot be considered novel or cannot be considered to involve an inventive step when the document is taken alone *Y* document of particular relevance; the claimed invention cannot be considered to involve an inventive step when the document is combined with one or more other such documents, such combination being obvious to a person skilled in the art. *&* document member of the same patent family
A document defining the general state of the art which is not considered to be of particular relevance *E* earlier document but published on or after the international filing date *L* document which may throw doubts on priority claim(s) or which is cited to establish the publication date of another citation or other special reason (as specified) *O* document referring to an oral disclosure, use, exhibition or other means *P* document published prior to the international filing date but later than the priority date claimed	*T* later document published after the international filing date or priority date and not in conflict with the application but cited to understand the principle or theory underlying the invention *X* document of particular relevance; the claimed invention cannot be considered novel or cannot be considered to involve an inventive step when the document is taken alone *Y* document of particular relevance; the claimed invention cannot be considered to involve an inventive step when the document is combined with one or more other such documents, such combination being obvious to a person skilled in the art. *&* document member of the same patent family			
Date of the actual completion of the international search		Date of mailing of the international search report		
26 July 2006		03/08/2006		
Name and mailing address of the ISA/ European Patent Office, P.B. 5818 Patentlaan 2 NL - 2280 HV Rijswijk Tel. (+31-70) 340-2040, Tx. 31 651 epo nl, Fax: (+31-70) 340-3016		Authorized officer Denicolai, G		

INTERNATIONAL SEARCH REPORT

International application No
PCT/IB2006/000666

Patent document cited in search report	Publication date	Patent family member(s)	Publication date
US 4666071	A	19-05-1987	NONE
US 4350361	A	21-09-1982	JP 1142531 C 13-04-1983 JP 56082676 A 06-07-1981 JP 57034146 B 21-07-1982
DE 4339761	C1	13-04-1995	NONE