



(51) International Patent Classification:
B62K 1/00 (2006.01)

(21) International Application Number:

PCT/US2013/056282

(22) International Filing Date:

22 August 2013 (22.08.2013)

(25) Filing Language:

English

(26) Publication Language:

English

(30) Priority Data:

61/692,131	22 August 2012 (22.08.2012)	US
61/709,924	4 October 2012 (04.10.2012)	US
61/817,817	30 April 2013 (30.04.2013)	US
61/863,064	7 August 2013 (07.08.2013)	US

(71) Applicant: **RYNO MOTORS, INC.** [US/US]; 8219 S.W. Cirrus Drive, Beaverton, OR 97008 (US).

(72) Inventors: **OZRELIC, Anthony, J.**; 1242 N.W. City Heights Drive, Bend, OR 97701 (US). **HOFFMANN, Christopher, J.**; c/o Ryno Motors, Inc., 8219 S.W. Cirrus Drive, Beaverton, OR 97008 (US).

(74) Agent: **ROMANO, Thomas, J.**; Kolisch Hartwell, P.C., 520 S.w. Yamhill Street, Suite 200, Portland, OR 97204 (US).

(81) Designated States (*unless otherwise indicated, for every kind of national protection available*): AE, AG, AL, AM, AO, AT, AU, AZ, BA, BB, BG, BH, BN, BR, BW, BY, BZ, CA, CH, CL, CN, CO, CR, CU, CZ, DE, DK, DM, DO, DZ, EC, EE, EG, ES, FI, GB, GD, GE, GH, GM, GT, HN, HR, HU, ID, IL, IN, IS, JP, KE, KG, KN, KP, KR, KZ, LA, LC, LK, LR, LS, LT, LU, LY, MA, MD, ME, MG, MK, MN, MW, MX, MY, MZ, NA, NG, NI, NO, NZ, OM, PA, PE, PG, PH, PL, PT, QA, RO, RS, RU, RW, SA, SC, SD, SE, SG, SK, SL, SM, ST, SV, SY, TH, TJ, TM, TN, TR, TT, TZ, UA, UG, US, UZ, VC, VN, ZA, ZM, ZW.

(84) Designated States (*unless otherwise indicated, for every kind of regional protection available*): ARIPO (BW, GH, GM, KE, LR, LS, MW, MZ, NA, RW, SD, SL, SZ, TZ, UG, ZM, ZW), Eurasian (AM, AZ, BY, KG, KZ, RU, TJ, TM), European (AL, AT, BE, BG, CH, CY, CZ, DE, DK, EE, ES, FI, FR, GB, GR, HR, HU, IE, IS, IT, LT, LU, LV, MC, MK, MT, NL, NO, PL, PT, RO, RS, SE, SI, SK, SM,

[Continued on next page]

(54) Title: ELECTRIC-POWERED SELF-BALANCING UNICYCLE

Fig. 2

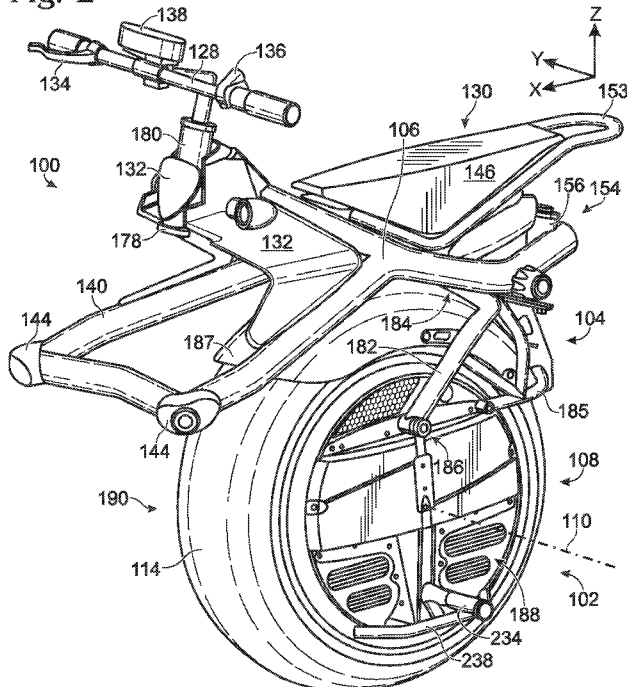

(57) Abstract: An electric powered self-balancing unicycle may include a single wheel assembly having a drive system substantially contained within the inner circumference of a rim of the wheel, a frame generally oriented perpendicular to the axis of rotation of the wheel, and handlebars including a four-bar linkage mechanism pivotably connected to the wheel assembly by a fork.

WO 2014/031904 A3



TR), OAPI (BF, BJ, CF, CG, CI, CM, GA, GN, GQ, GW, (88) Date of publication of the international search report:
KM, ML, MR, NE, SN, TD, TG). 16 July 2015

Published:

— *with international search report (Art. 21(3))*

INTERNATIONAL SEARCH REPORT

International application No.

PCT/US2013/056282

A. CLASSIFICATION OF SUBJECT MATTER

IPC(8) - B62K 1/00 (2013.01)

USPC - 280/205

According to International Patent Classification (IPC) or to both national classification and IPC

B. FIELDS SEARCHED

Minimum documentation searched (classification system followed by classification symbols)

IPC(8) - B62K 1/00 (2013.01)

USPC - 74/5R; 180/54.1, 65.1, 65.51; 280/47.3, 47.32, 78, 92, 205, 210, 220, 263, 270, 293; 301/5.1; 700/275, 279; 701/22, 82, 124

Documentation searched other than minimum documentation to the extent that such documents are included in the fields searched

CPC - B62K 1/00 (2013.01)

Electronic data base consulted during the international search (name of data base and, where practicable, search terms used)

PatBase, Google Scholar

C. DOCUMENTS CONSIDERED TO BE RELEVANT

Category*	Citation of document, with indication, where appropriate, of the relevant passages	Relevant to claim No.
X	US 2011/0056757 A1 (POLUTNIK) 10 March 2011 (10.03.2011) entire document	1-6, 8-11
Y		7, 23-31
X	US 2011/0191013 A1 (LEESER) 04 August 2011 (04.08.2011) entire document	12, 16, 17
Y	US 2004/0150187 A1 (CHEN) 05 August 2004 (05.08.2004) entire document	7
Y	EP 2 409 905 A1 (VERDURON) 25 January 2012 (25.01.2012) entire document	23-31
Y	US 2011/0220427 A1 (CHEN) 15 September 2011 (15.09.2011) entire document	23-31
A	US 2007/0158117 A1 (ALEXANDER) 12 July 2007 (12.07.2007) entire document	1-31
A	US 3,399,742 A (MALICK) 03 September 1968 (03.09.1968) entire document	1-31

☐ Further documents are listed in the continuation of Box C.

* Special categories of cited documents:

"A" document defining the general state of the art which is not considered to be of particular relevance

"E" earlier application or patent but published on or after the international filing date

"L" document which may throw doubts on priority claim(s) or which is cited to establish the publication date of another citation or other special reason (as specified)

"O" document referring to an oral disclosure, use, exhibition or other means

"P" document published prior to the international filing date but later than the priority date claimed

"T"

later document published after the international filing date or priority date and not in conflict with the application but cited to understand the principle or theory underlying the invention

"X"

document of particular relevance; the claimed invention cannot be considered novel or cannot be considered to involve an inventive step when the document is taken alone

"Y"

document of particular relevance; the claimed invention cannot be considered to involve an inventive step when the document is combined with one or more other such documents, such combination being obvious to a person skilled in the art

"&"

document member of the same patent family

Date of the actual completion of the international search

17 December 2013

Date of mailing of the international search report

10 JAN 2014

Name and mailing address of the ISA/US

Mail Stop PCT, Attn: ISA/US, Commissioner for Patents
P.O. Box 1450, Alexandria, Virginia 22313-1450

Facsimile No. 571-273-3201

Authorized officer:

Blaine R. Copenheaver

PCT Helpdesk: 571-272-4300

PCT OSP: 571-272-7774